

**SUBMITTAL TO THE BOARD OF SUPERVISORS
COUNTY OF RIVERSIDE, STATE OF CALIFORNIA**



101B

SUBMITTAL DATE:
August 19, 2010

FROM: TLMA - Transportation Department

SUBJECT: Accepting a portion of Vista Del Sol in the Thousand Palms area, Fourth Supervisorial District.

RECOMMENDED MOTION: Adopt Resolution No. 2010-251, accepting a portion of Vista Del Sol.

BACKGROUND: The applicant of FPM 34772 has requested the acceptance of a portion of Vista Del Sol. Conditions of Approval for the Parcel Map require public access from a publicly maintained road to the land division. This action of accepting Vista Del Sol will satisfy this requirement for Parcel Map 34772

REVIEWED BY EXECUTIVE OFFICE

DATE

02/23/10
Tina Grande

FORM APPROVED COUNTY COUNSEL

BY: *Synthia M. Gunzel* DATE: *8-20-10*

SYNTHIA M. GUNZEL Departmental Concurrence

Juan C. Perez
Director of Transportation

WJH
Attachments: Resolution No. 2010-251
Exhibit "A"

MINUTES OF THE BOARD OF SUPERVISORS

On motion of Supervisor Ashley, seconded by Supervisor Buster and duly carried by unanimous vote, IT WAS ORDERED that the above matter is approved as recommended.

Ayes: Buster, Tavaglione, Stone, Benoit and Ashley
Nays: None
Absent: None
Date: September 14, 2010
xc: Transp., Recorder

Kecia Harper-Ihem
Clerk of the Board
By: *[Signature]*
Deputy

Dep't Recomm.: Consent Policy
Per Exec. Ofc.: Consent Policy

Prev. Agn. Ref. District: 4 Agenda Number:

ATTACHMENTS FILED WITH
THE CLERK OF THE BOARD

2.10



N.T.S.

T. 4S, R. 6E
SECTION 17
S.B.M.

VICINITY MAP

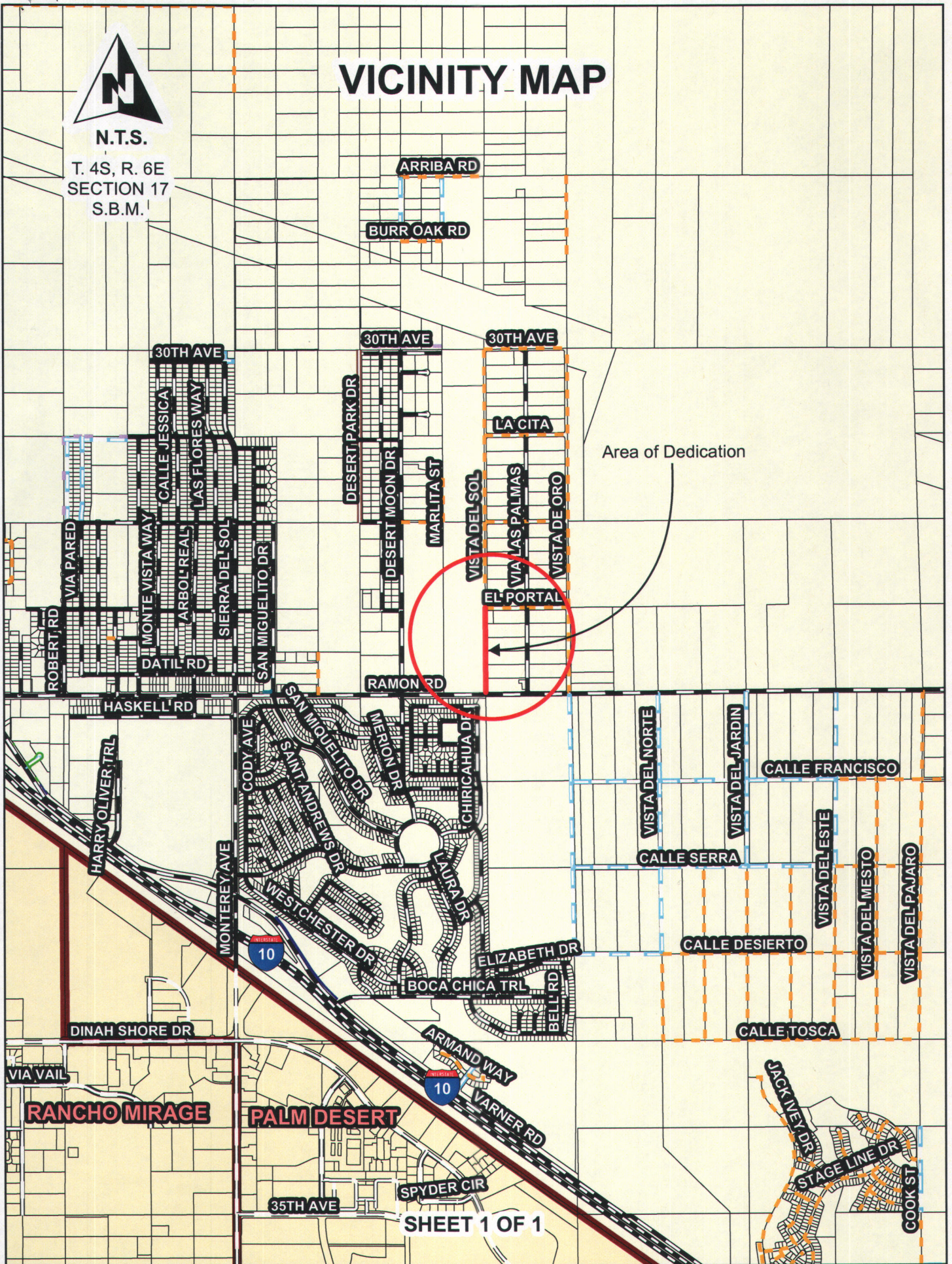

SHEET 1 OF 1

To be removed before recording

PLEASE COMPLETE THIS INFORMATION

RECORDING REQUESTED BY:

KECIA HARPER-IHEM, CLERK OF THE BOARD
RIVERSIDE CO. CLERK OF THE BOARD
4080 LEMON STREET, 1ST FLOOR CAC
P O BOX 1147 - RIVERSIDE, CA 92502

MAIL STOP # 1010

AND WHEN RECORDED MAIL TO:

RETURN TO: STOP #1010
RIVERSIDE COUNTY CLERK OF THE BOARD
P. O. BOX 1147 - RIVERSIDE, CA 92502

DOC # 2010-0442771

09/15/2010 08:00A Fee:NC

Page 1 of 5

Recorded in Official Records
County of Riverside

Larry W. Ward
Assessor, County Clerk & Recorder



S	R	U	PAGE	SIZE	DA	MISC	LONG	RFD	COPY
1			5						
M	A	L	465	426	PCOR	NCOR	SMF	NCHG	EXAM
<i>no fee</i>						T:	CTY	UNI	513



RESOLUTION NO. 2010-251

Title of Document

ACCEPTING A PORTION OF VISTA DEL SOL IN THE THOUSAND PALMS AREA

(FOURTH SUPERVISORIAL DISTRICT)

(Transportation Department ~ Item 2.10 of 09/14/10)

THIS PAGE ADDED TO PROVIDE ADEQUATE SPACE
FOR RECORDING INFORMATION

2010-09-103384

RECEIVED RIVERSIDE COUNTY
CLERK/BOARD OF SUPERVISORS
2010 SEP 27 PM 3:05

2
3 **RESOLUTION NO 2010-251**

4
5 **ACCEPTING A PORTION OF VISTA DEL SOL IN THE THOUSAND PALMS AREA**
6 **(Fourth Supervisorial District)**

7
8 **WHEREAS**, the hereinafter described road was offered for dedication for road
9 and public utility purposes by the documents hereinafter-referred to, which offer of
10 dedication has not been previously accepted for public use by the County of Riverside,
11 now, therefore;

12
13 **BE IT RESOLVED, DETERMINED AND ORDERED** by the Board of Supervisors of
14 the County of Riverside, State of California, in regular session assembled on
15 September 14, 2010, that this Board accepts the offer of dedication
16 and recognizes that said road is a public road open for use by the general public;

17
18 **BE IT FURTHER RESOLVED, DETERMINED, AND ORDERED** that this
19 acceptance is for the purpose of vesting title in the County of Riverside on behalf of the
20 public for public road and utility uses, but will not be an acceptance of the road into the
21 County Maintained Road System, pursuant to Section 941 of the Streets and Highways
22 Code;

FORM APPROVED COUNTY COUNSEL
BY: *Cynthia M. Gunzel* 8-20-10
SYNTHIA M. GUNZEL DATE



1
2
3
4
5
6
7
8
9
10
11
12
13
14
15
16
17
18
19
20
21
22
23
24
25

Resolution No. 2010-251

Said road is in the County of Riverside, State of California, and is described as follows:

Vista Del Sol (See Exhibit "A")

That portion of Vista Del Sol (30.00 feet wide) between Ramon Road and El Portal, as shown on Record of Survey, filed in Book 14, Page 72 of Records of Survey, Records of the County of Riverside, California.

BE IT FURTHER RESOLVED, DETERMINED AND ORDERED that the Clerk of the Board is directed to cause a certified copy of this resolution to be recorded in the office of the Recorder of the County of Riverside, California.

ROLL CALL:

Ayes: Buster, Tavaglione, Stone, Benoit, and Ashley
Nays: None
Absent: None

The foregoing is certified to be a true copy of a resolution duly adopted by said Board of Supervisors on the date therein set forth.

KECIA HARPER-IHEM, Clerk of said Board

By: *Karen Burton*
Deputy

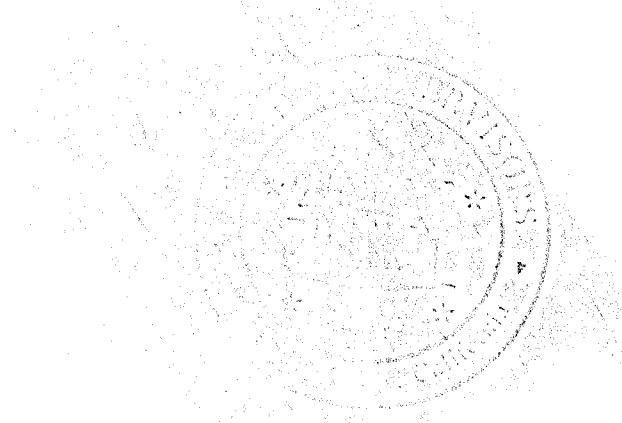

WJH

W.O. FPM34772





N.T.S.
 T. 4S, R. 6E
 SECTION 17
 S.B.M.

EXHIBIT "A"

18

31

Acceptance of a portion of Vista Del Sol

EL PORTAL

19

30

60 feet per Instrument No.270467
 recorded 8/17/1995

30 Feet per
 RS 17/42

20

29

RS 14/72

21

28

VISTA DEL SOL

VIA LAS PALMAS

22

27

Parcel 1

PM 34772

Parcel 2

23

26

24

25

RAMON RD

SHEET 1 OF 1





LARRY W. WARD
COUNTY OF RIVERSIDE
ASSESSOR-COUNTY CLERK-RECORDER

Recorder
P.O. Box 751
Riverside, CA 92502-0751
(951) 486-7000

<http://riverside.asrclrec.com>

CERTIFICATION

Pursuant to the provisions of Government Code 27361.7, I certify under the penalty of perjury that the following is a true copy of illegible wording found in the attached document:

(Print or type the page number(s) and wording below):

CLARIFICATION OF THE SEAL for the Riverside County Board of Supervisors
(embossed on document)

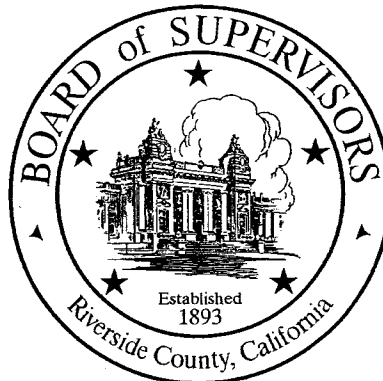

Date:

09-14-10

Signature:

Karen Barton

Print Name:

Karen Barton, Board Assistant, Riverside County Clerk of the Board

