

**SUBMITTAL TO THE BOARD OF SUPERVISORS
COUNTY OF RIVERSIDE, STATE OF CALIFORNIA**

206B



FROM: County Counsel/TLMA
Code Enforcement Department

SUBJECT: Abatement of Public Nuisance [Accumulation of Rubbish]
Case No.: CV 10-01852 (ROACH)
Subject Property: 61785 Crest Street, Desert Hot Springs
APN: 667-211-043
District Five

SUBMITTAL DATE:
Sept. 16, 2010

RECOMMENDED MOTION: Move that:

- (1) The accumulation of rubbish on the real property located at 61785 Crest Street, Desert Hot Springs, Riverside County, California, APN: 667-211-043, be declared a public nuisance and a violation of Riverside County Ordinance No. 541 which does not permit the accumulation of rubbish on the property.
- (2) Owners Eddie Lee Roach and Charles Roach, or whoever has possession and control of the subject real property, be directed to abate the accumulation of rubbish on the property by removing and disposing of the same from the real property within ninety (90) days.

[Signature]
L. ALEXANDRA FONG, Deputy County Counsel
for PAMELA J. WALLS, County Counsel

(Continued)

FINANCIAL DATA	Current F.Y. Total Cost:	\$ N/A	In Current Year Budget:	N/A
	Current F.Y. Net County Cost:	\$ N/A	Budget Adjustment:	N/A
	Annual Net County Cost:	\$ N/A	For Fiscal Year:	N/A

SOURCE OF FUNDS:	Positions To Be Deleted Per A-30	<input type="checkbox"/>
	Requires 4/5 Vote	<input type="checkbox"/>

C.E.O. RECOMMENDATION:

APPROVE
[Signature]
BY: Tina Grande
County Executive Office Signature

- Policy
- Consent

MINUTES OF THE BOARD OF SUPERVISORS

On motion of Supervisor Ashley, seconded by Supervisor Benoit and duly carried, IT WAS ORDERED that the above matter is approved as recommended.

Ayes: Buster, Stone, Benoit and Ashley
Nays: None
Absent: Tavaglione
Date: September 28, 2010
xc: Co. Co., CED, Prop. Owner, Sheriff

Kecia Harper-Ihem
Clerk of the Board
By: *[Signature]*
Deputy

Prev. Agn. Ref.: _____ District: 5 Agenda Number: _____

9.9

- (3) If the owners or whoever has possession or control of the real property does not take the above described action within ninety (90) days of the date of the Board's Order to Abate, that representatives of the Code Enforcement Department, Sheriff's Department, and/or a contractor, upon consent of the owner or receipt of a Court Order authorizing entry onto the real property, when necessary under applicable law, shall abate the accumulation of rubbish by removing and disposing of the same from the real property.
- (4) The reasonable cost of abatement, after notice and an opportunity for hearing, shall be imposed as a lien on the real property, which may be collected as a special assessment against the real property pursuant to Government Code Section 25845 and Riverside County Ordinance No. 725.
- (5) County Counsel be directed to prepare the necessary Findings of Facts and Conclusions that the accumulation of rubbish on the real property is declared to be in violation of Riverside County Ordinance No. 541, and a public nuisance, and further, to prepare an Order to Abate for approval by the Board.

JUSTIFICATION:

1. An initial inspection was made of the subject real property by the Code Enforcement Officers on March 5, 2010. The inspection revealed the accumulation of rubbish on the subject property in violation of Riverside County Ordinance No. 541. The rubbish consisted of, but was not limited to: wood, trash, debris, furniture, barrels, televisions, 15 tires and other miscellaneous items.
2. Subsequent inspections of the above-described real property on March 8, 2010 May 11, 2010 and August 3, 2010, revealed the property continues to be in violation of Riverside County Ordinance No. 541.
3. Staff and the Code Enforcement Department have complied with the requirements set forth in the appropriate laws of this jurisdiction pertaining to the administrative abatement proceedings for the removal of accumulated rubbish.

**BOARD OF SUPERVISORS
COUNTY OF RIVERSIDE**

IN RE ABATEMENT OF PUBLIC NUISANCE) CASE NO. CV 10-01852
[ACCUMULATION OF RUBBISH] APN: 667-)
211-043, 61785 CREST STREET, DESERT HOT)
SPRINGS, COUNTY OF RIVERSIDE, STATE) DECLARATION OF CODE
OF CALIFORNIA; EDDIE LEE ROACH AND) ENFORCEMENT OFFICER
CHARLES ROACH, OWNERS.) REGINA KEYES
[R.C.O. No. 541 (RCC Title 8.120)]

I, Regina Keyes, declare that the facts set forth below are personally known to me except to the extent that certain information is based on information and belief which I believe to be true, and if called as a witness, I could and would competently testify thereto under oath:

1. I am currently employed by the Riverside County Code Enforcement Department as a Senior Code Enforcement Officer. My current official duties as a Senior Code Enforcement Officer include inspecting property for violations and enforcement of the provisions of Riverside County Ordinances.

2. On March 5, 2010, Code Enforcement Officer Herrera and I conducted an initial inspection of the real property described as 61785 Crest Street, Desert Hot Springs, Riverside County, California and further described as Assessor's Parcel Number 667-211-043 (hereinafter referred to as "THE PROPERTY"). A true and correct copy of a Thomas Brothers map indicating the location of THE PROPERTY is attached hereto as Exhibit "A" and incorporated herein by reference.

3. A review of County records and documents disclosed that THE PROPERTY was owned by Eddie Lee Roach and Charles Roach (hereinafter referred to as the "OWNERS"). A certified copy of the County Equalized Assessment Roll for the year 2009-2010 and a copy of the County Geographic Information System ("GIS") report are attached hereto as Exhibit "B" and incorporated herein by reference.

4. Based on the Lot Book Report from RZ Title Service on March 11, 2010, it is determined that no other parties potentially hold a legal interest in THE PROPERTY. A true and correct copy of the Lot Book Report is attached hereto as Exhibit "C" and incorporated herein by reference.

///

///

1 5. On March 8, 2010, Officer Herrera and I conducted a follow up inspection of THE
2 PROPERTY. We met OWNER at THE PROPERTY and observed accumulation of rubbish throughout
3 THE PROPERTY consisting of but not limited to: wood, trash, debris, furniture, barrels, televisions, 15
4 tires and other miscellaneous items. Based on my training and experience I visually estimated the amount
5 of rubbish to be fifteen hundred (1500) square feet. I posted a Notice of Violation on THE PROPERTY.

6 6. As a result of the accumulation of rubbish, THE PROPERTY constituted a public nuisance in
7 violation of the provisions set forth in Riverside County Ordinance No. 541, as codified in Riverside
8 County Code Title 8.120.

9 7. A site plan and photographs of THE PROPERTY are attached hereto and incorporated
10 herein by reference as Exhibit "D."

11 8. True and correct copies of each Notice issued in this matter and other supporting
12 documentation are attached hereto as Exhibit "E" and incorporated herein by reference.

13 9. On March 31, 2010, a Notice of Violation was mailed to OWNERS by certified mail,
14 return receipt requested.

15 10. I am informed and believe and based thereon allege that on May 11, 2010, Senior Code
16 Enforcement Officer Bowles and Officer Green conducted a follow-up inspection of THE PROPERTY.
17 They met OWNER at THE PROPERTY and were granted permission to inspect. Using a measuring
18 wheel Officer Bowles quantified the amount of rubbish on THE PROPERTY as six thousand two hundred
19 (6200) square feet. THE PROPERTY remained in violation of Riverside County Ordinance No. 541.

20 11. Based upon my experience, knowledge and visual observations, it is my determination that
21 the conditions on THE PROPERTY are dangerous to the neighboring property owners and the general
22 public.

23 12. A Notice of Noncompliance regarding the accumulation of rubbish was recorded in the
24 Office of the Assessor, County Clerk & Recorder, County of Riverside, State of California, on March 17,
25 2010, as Instrument Number 2010-0123088. A true and correct copy of the notice is attached hereto and
26 incorporated herein by reference as Exhibit "F".

27 ///

28 ///

1 13. On August 2, 2010 the second notice, "Notice to Abate Public Nuisance" providing
2 notification of the Board of Supervisors' hearing scheduled for September 28, 2010, was mailed to
3 OWNERS by certified mail, return receipt requested and on August 3, 2010 was posted on THE
4 PROPERTY. True and correct copies of the notice and supporting documentation are attached hereto as
5 Exhibit "G" and incorporated herein by reference.

6 14. A follow-up inspection on August 3, 2010 revealed that THE PROPERTY remains in
7 violation.

8 15. Removal of the accumulation of rubbish on THE PROPERTY is required to bring THE
9 PROPERTY into compliance with Riverside County Ordinance No. 541 (RCC Chapter 8.120) and the
10 Health and Safety Code. Under RCO No. 541, no amount of rubbish is allowed to accumulate on THE
11 PROPERTY.

12 16. The Board of Supervisors is requested to issue an Order to Abate the Nuisance described
13 herein. Accordingly, the following findings and conclusions are recommended:

14 (a) the accumulation of rubbish on THE PROPERTY to be deemed and declared a
15 public nuisance;

16 (b) the OWNERS and person(s) in possession of THE PROPERTY be required to
17 remove all accumulated rubbish within ninety (90) days of the date of the posting and mailing of the
18 Board's Order to Abate Nuisance, in accordance with all Riverside County Ordinances, including but not
19 limited to the provisions of County Ordinance No. 541;

20 (c) in the event the rubbish is not removed and disposed of according to the above
21 referenced ninety (90) day time period in strict accordance with all Riverside County Ordinances,
22 including but not limited to Riverside County Ordinance No. 541 (RCC Chapter 8.120), the rubbish shall
23 be abated by representatives of the Riverside County Code Enforcement Department, a contractor or the
24 Sheriff's Department; and

25 ///

26 ///

27 ///

28 ///

1 (d) reasonable costs of abatement, after notice and opportunity for hearing, shall be
2 imposed as a lien on THE PROPERTY, which may be collected as a special assessment against THE
3 PROPERTY pursuant to Government Code Section 25845 and Riverside County Ordinance Nos. 541
4 (RCC Title 8.120) and 725 (RCC Title 1).

5 I declare under penalty of perjury under the laws of the State of California that the foregoing is
6 true and correct.

7 Executed this 4th day of August, 2010. at Riverside, California.

8
9
10 Regina Keyes
11 REGINA KEYES
12 Senior Code Enforcement Officer
13 Code Enforcement Department
14
15
16
17
18
19
20
21
22
23
24
25
26
27
28

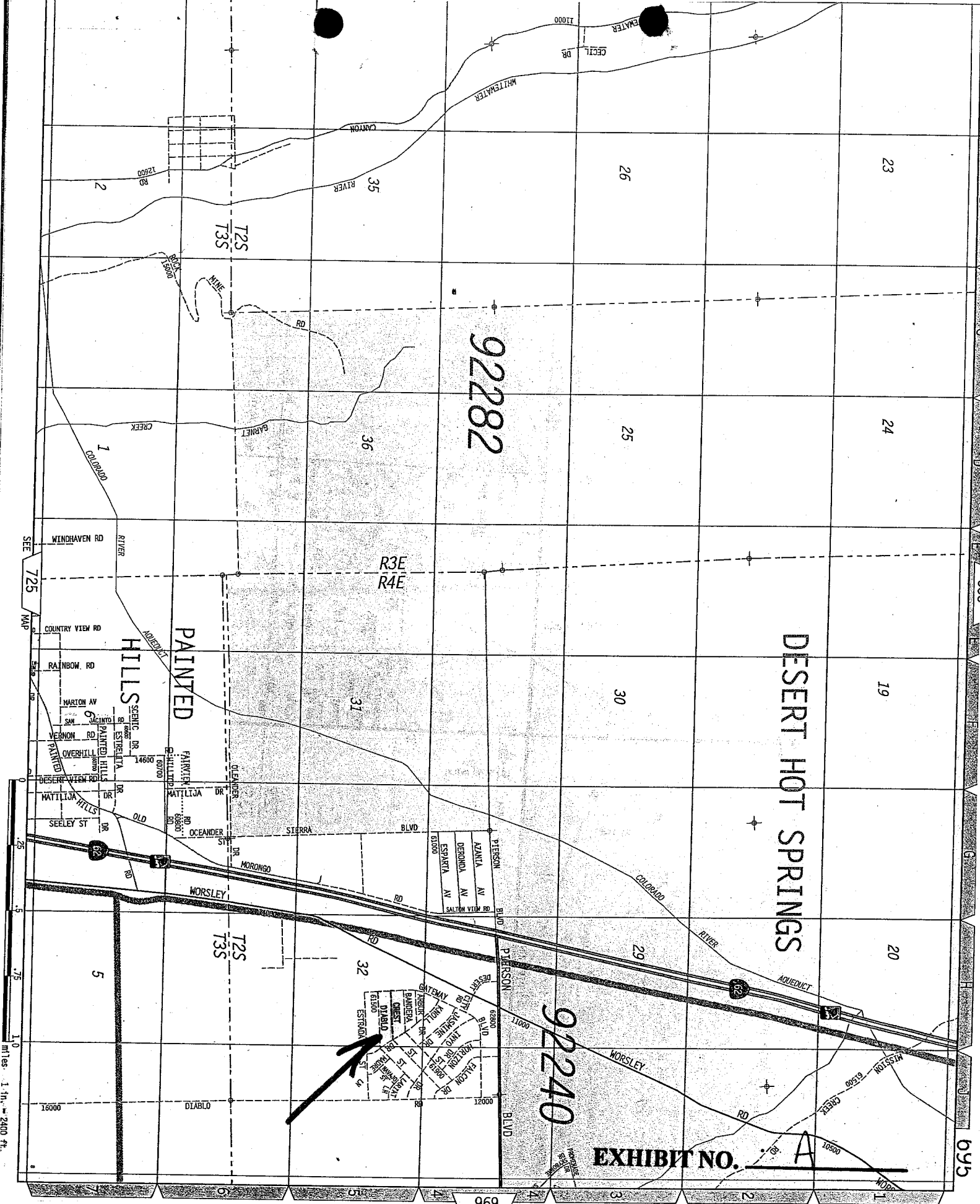

92282

92240

DESERT HOT SPRINGS

PAINTED HILLS

EXHIBIT NO. A

RIVERSIDE CO.

SEE MAP 696

SEE MAP 725

1.0
0.75
0.5
0.25
0
miles 1 in. = 2400 ft.

695

Assessment Roll For the 2009-2010 Tax Year as of January 1, 2009

Assessment #667211043-4		Parcel # 667211043-4	
Assessee:	ROACH EDDIE LEE	Land	3,113
Assessee:	ROACH CHARLES	Structure	2,471
Mail Address:	P O BOX 1158	Full Value	5,584
City, State Zip:	DESERT HOT SPRINGS CA 92240	Total Net	5,584
Real Property Use Code:	YS	<div style="border: 1px solid black; padding: 5px; display: inline-block;">View Parcel Map</div>	
Base Year	1986		
Conveyance Number:	0412509		
Conveyance (mm/yy):	10/1994		
PUI:	Y010000		
TRA:	61-040		
Taxability Code:	0-00		
ID Data:	Lot 57 RS 025/053		

EXHIBIT NO. B

RIVERSIDE COUNTY GIS

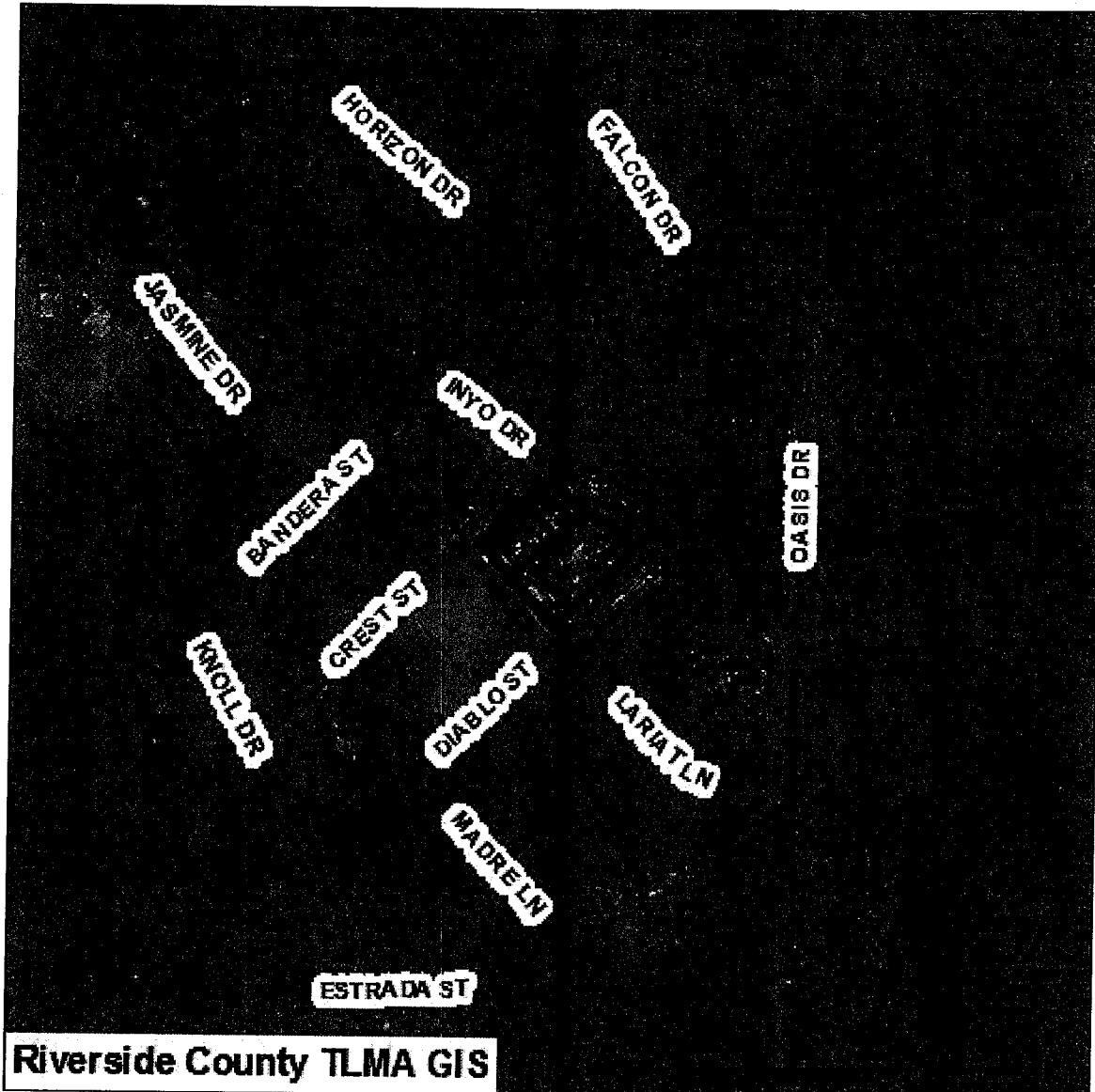

Selected parcel(s):
667-211-043

IMPORTANT

Maps and data are to be used for reference purposes only. Map features are approximate, and are not necessarily accurate to surveying or engineering standards. The County of Riverside makes no warranty or guarantee as to the content (the source is often third party), accuracy, timeliness, or completeness of any of the data provided, and assumes no legal responsibility for the information contained on this map. Any use of this product with respect to accuracy and precision shall be the sole responsibility of the user.

STANDARD REPORT

APNs

667-211-043-4

OWNER NAME / ADDRESS

EDDIE LEE ROACH
CHARLES ROACH
ADDRESS NOT AVAILABLE

MAILING ADDRESS

(SEE OWNER)
P O BOX 1158
DESERT HOT SPRINGS CA. 92240

EXHIBIT NO. B²

LEGAL DESCRIPTION

RECORDED BOOK/PAGE: RS 25/53
SUBDIVISION NAME: DESERT CITY
LOT/PARCEL: 57, BLOCK: NOT AVAILABLE
TRACT NUMBER: NOT AVAILABLE

LOT SIZE

RECORDED LOT SIZE IS 1.4 ACRES

PROPERTY CHARACTERISTICS

NO PROPERTY DESCRIPTION AVAILABLE

THOMAS BROS. MAPS PAGE/GRID

PAGE 695

CITY BOUNDARY/SPHERE

NOT WITHIN A CITY
CITY SPHERE: DESERT HOT SPRINGS
ANNEXATION DATE: FEB. 22, 2007
LAFCO CASE #: 2006-25-4&5
NO PROPOSALS

MARCH JOINT POWERS AUTHORITY

NOT IN THE JURISDICTION OF THE MARCH JOINT POWERS AUTHORITY

INDIAN TRIBAL LAND

NOT IN A TRIBAL LAND

SUPERVISORIAL DISTRICT (ORD. 813)

MARION ASHLEY, DISTRICT 5

TOWNSHIP/RANGE

T2SR4E SEC 32

ELEVATION RANGE

1380/1384 FEET

PREVIOUS APN

667-210-043

PLANNING

LAND USE DESIGNATIONS

Zoning not consistent with the General Plan.
LDR

AREA PLAN (RCIP)

WESTERN COACHELLA VALLEY

GENERAL PLAN POLICY OVERLAYS

NOT IN A GENERAL PLAN POLICY OVERLAY AREA

GENERAL PLAN POLICY AREAS

SAN GORGONIO PASS WIND ENERGY POLICY AREA

ZONING CLASSIFICATIONS (ORD. 348)

R-1

ZONING DISTRICTS AND ZONING AREAS

PASS & DESERT DISTRICT

ZONING OVERLAYS

NOT IN A ZONING OVERLAY

SPECIFIC PLANS

NOT WITHIN A SPECIFIC PLAN

AGRICULTURAL PRESERVE

NOT IN AN AGRICULTURAL PRESERVE

REDEVELOPMENT AREAS

NOT IN A REDEVELOPMENT AREA

AIRPORT INFLUENCE AREAS

NOT IN AN AIRPORT INFLUENCE AREA

NOT IN AN AIRPORT COMPATIBILITY ZONE

ENVIRONMENTAL

CVMSHCP (COACHELLA VALLEY MULTI-SPECIES HABITAT CONSERVATION PLAN) CONSERVATION AREA
NOT IN A CONSERVATION AREA

CVMSHCP FLUVIAL SAND TRANSPORT SPECIAL PROVISION AREAS
NOT IN A FLUVIAL SAND TRANSPORT SPECIAL PROVISION AREA

WRMSHCP (WESTERN RIVERSIDE COUNTY MULTI-SPECIES HABITAT CONSERVATION PLAN) CELL GROUP
NOT IN A CELL GROUP

WRMSHCP CELL NUMBER
NOT IN A CELL

HANS/ERP (HABITAT ACQUISITION AND NEGOTIATION STRATEGY/EXPEDITED REVIEW PROCESS)
NONE

VEGETATION (2005)
NO DATA AVAILABLE

FIRE

HIGH FIRE AREA (ORD. 787)
NOT IN A HIGH FIRE AREA

FIRE RESPONSIBILITY AREA
NOT IN A FIRE RESPONSIBILITY AREA

DEVELOPMENT FEES

CVMSHCP FEE AREA (ORD. 875)
WITHIN THE COACHELLA VALLEY MSHCP FEE AREA

WRMSHCP FEE AREA (ORD. 810)
NOT WITHIN THE WESTERN RIVERSIDE COUNTY MSHCP FEE AREA

ROAD & BRIDGE DISTRICT
NOT IN A DISTRICT

EASTERN TUMF (TRANSPORTATION UNIFORM MITIGATION FEE ORD. 673)
IN OR PARTIALLY WITHIN A TUMF FEE AREA. SEE MAP FOR MORE INFORMATION.
In EAST

WESTERN TUMF (TRANSPORTATION UNIFORM MITIGATION FEE ORD. 824)
NOT WITHIN THE WESTERN TUMF FEE AREA

DIF (DEVELOPMENT IMPACT FEE AREA ORD. 659)
WESTERN COACHELLA VALLEY

SKR FEE AREA (STEPHEN'S KANGAROO RAT ORD. 663.10)
NOT WITHIN AN SKR FEE AREA.

DEVELOPMENT AGREEMENTS
NOT IN A DEVELOPMENT AGREEMENT AREA

TRANSPORTATION

CIRCULATION ELEMENT ULTIMATE RIGHT-OF-WAY
NOT IN A CIRCULATION ELEMENT RIGHT-OF-WAY

ROAD BOOK PAGE
166

TRANSPORTATION AGREEMENTS
NOT IN A TRANSPORTATION AGREEMENT

CETAP (COMMUNITY AND ENVIRONMENTAL TRANSPORTATION ACCEPTABILITY PROCESS) CORRIDORS

NOT IN A CETAP CORRIDOR.

HYDROLOGY

FLOOD PLAIN REVIEW

FLOOD PLAIN MANAGEMENT REVIEW IS REQUIRED. CONTACT THE FLOOD PLAIN MANAGEMENT SECTION AT (951) 955-1200 FOR INFORMATION.

WATER DISTRICT

DWA

FLOOD CONTROL DISTRICT

RIVERSIDE COUNTY FLOOD CONTROL DISTRICT

WATERSHED

WHITEWATER

GEOLOGIC

FAULT ZONE

NOT IN A FAULT ZONE

FAULTS

NOT WITHIN A 1/2 MILE OF A FAULT

LIQUEFACTION POTENTIAL

MODERATE

SUBSIDENCE

SUSCEPTIBLE

PALEONTOLOGICAL SENSITIVITY

LOW POTENTIAL.

FOLLOWING A LITERATURE SEARCH, RECORDS CHECK AND A FIELD SURVEY, AREAS MAY BE DETERMINED BY A QUALIFIED VERTEBRATE PALEONTOLOGIST AS HAVING LOW POTENTIAL FOR CONTAINING SIGNIFICANT PALEONTOLOGICAL RESOURCES SUBJECT TO ADVERSE IMPACTS.

MISCELLANEOUS

SCHOOL DISTRICT

PALM SPRINGS UNIFIED

COMMUNITIES

NORTH PALM SPRINGS

COUNTY SERVICE AREA

NOT IN A COUNTY SERVICE AREA.

LIGHTING (ORD. 655)

ZONE B, 44.44 MILES FROM MT. PALOMAR OBSERVATORY

2000 CENSUS TRACT

044503

FARMLAND

OTHER LANDS

TAX RATE AREAS

061-040

- CITRUS PEST CONTROL 2
- COACHELLA VALLEY RESOURCE CONSER
- COUNTY FREE LIBRARY
- COUNTY STRUCTURE FIRE PROTECTION
- COUNTY WASTE RESOURCE MGMT DIST
- CSA 152
- CV MOSQ & VECTOR CONTROL
- DESERT COMMUNITY COLLEGE
- DESERT HOSPITAL
- DESERT WATER AGENCY 1ST FRINGE
- FLOOD CONTROL ADMINISTRATION
- FLOOD CONTROL ZONE 6
- GENERAL

- GENERAL PURPOSE
- MISSION SPRINGS IMP F
- MISSION SPRINGS WATER DISTRICT
- PALM SPRINGS PUBLIC CEMETERY
- PALM SPRINGS UNIF B & I 1992-A
- PALM SPRINGS UNIFIED SCHOOL
- RIV CO REG PARK & OPEN SPACE
- RIV. CO. OFFICE OF EDUCATION

SPECIAL NOTES

NO SPECIAL NOTES

CODE COMPLAINTS

Case #	Description	Start Date
CV0904325	ABATEMENT	Jun. 17, 2009
CV1001852	ABATEMENT	Mar. 8, 2010
CV1004412	VEHICLE ABATEMENT	May. 27, 2010

REPORT PRINTED ON...Fri Jun 04 10:49:10 2010
Version 100412



P.O. Box 1193
 Whittier, CA 90609
 Tel # (562) 325-8351
 Fax # (714) 783-3038

Lot Book Report

Order Number: **21343**

Customer:

RIVERSIDE COUNTY TLMA-CODE INFORCEMENT

4080 Lemon Street

Riverside

CA 92501

Attn: Brent Steele

Reference: CV10-01852/ Regina Keyes

IN RE: ROACH, EDDIE LEE

Order Date: 3/11/2010

Dated as of: 3/9/2010

County Name: Riverside

FEE(s):

Report: \$114.00

Property Address: 61785 Crest Street

Desert Hot Springs

CA

Assessor's Parcel No. : 667-211-043-4

Assessments:

Land Value:	\$3,113.00
Improvement Value:	\$2,471.00
Exemption Value:	\$0.00
Total Value:	\$5,584.00

Tax Information

Property Taxes for the Fiscal Year	2009-2010
Total Annual Tax	\$73.68
Status: Paid through	06/30/2010

Property Vesting

The last recorded document transferring title of said property

Dated 09/16/1994

Recorded 10/27/1994

EXHIBIT NO. C



P.O. Box 1193
Whittier, CA 90609
Tel # (562) 325-8351
Fax # (714) 783-3038

Order Number: 21343

Reference: CV10-01852/ Regi

Document No.	412509
D.T.T.	\$0.00
Grantor	Charles Roach, a widower
Grantee	Eddie Lee Roach, a single man and Charles Roach, a widower as joint tenants

Deeds of Trust

No Deeds of Trust of Record

Additional Information

A Declaration of Homestead executed by	Charles Roach
Recorded	01/19/1996
Document No	020337

Notice of Non-Compliance filed by	Department of Building and Safety
In the matter of the property of	Eddie Lee Roach and Charles Roach
Case No.	CV97-0141
Recorded	01/07/1998
Document No.	004248

Notice of Non-Compliance filed by	Department of Building and Safety
In the matter of the property of	Charles Roach and Eddie Lee Roach
Case No.	VAI-086-97
Recorded	07/02/1998
Document No.	273117

Notice of Non-Compliance filed by	County of Riverside Department of Building and Safety
In the matter of the property of	Eddie Lee Roach and Charles Roach
Case No.	CV06-3133, CV06-2435, CV06-2870, CV06-2434, CV06-2868 AND CV06-3133
Recorded	06/23/2006
Document No.	2006-0454264



P.O. Box 1193
Whittier, CA 90609
Tel # (562) 325-8351
Fax # (714) 783-3038

Order Number: 21343
Reference: CV10-01852/ Regi

Document Type	Findings of Fact, Conclusions and Order to Abate Nuisance
Document No.	2006-0932581
Recorded	12/21/2006
Document Type	Findings of Fact, Conclusions and Order to Abate Nuisance
Document No.	2008-0390223
Recorded	07/17/2008
Notice of Non-Compliance filed by	County of Riverside Code Enforcement Department
In the matter of the property of	Eddie Lee Roach and Charles Roach
Case No.	CV09-04057 & CV09-04325
Recorded	06/30/2009
Document No.	2009-0336832
Notice of Non-Compliance filed by	County of Riverside Code Enforcement Department
In the matter of the property of	Eddie Lee Roach and Charles Roach
Case No.	CV09-04056
Recorded	10/09/2009
Document No.	2009-0526935
Document Type	Finding of Fact, Conclusions and Order to Abate Nuisance
Document No.	2010-0035272
Recorded	01/27/2010
Abstract of Judgment Filed in the	Los Angeles Municipal, Central
Case No.	00K12585
Recorded	10/02/2000
Document No.	2000-388238
Amount	\$29,451.60
Debtor	Camille Shapiro and Ed Roach
Creditor	The Saxe Dobrin Trust

Legal Description

THE LAND REFERRED TO IN THIS REPORT IS LOCATED IN AND IS DESCRIBED AS FOLLOWS:



P.O. Box 1193
Whittier, CA 90609
Tel # (562) 325-8351
Fax # (714) 783-3038

Order Number: 21343

Reference: CV10-01852/ Regi

PARCEL 57 IN THE COUNTY OF RIVERSIDE, STATE OF CALIFORNIA, AS PER MAP FILED IN BOOK 25, PAGE 53 OF RECORDS OF SURVEY IN OFFICE OF COUNTY RECORDER OF SAID COUNTY.

662-42
667-21

T.C.A. 6140, 6156
POR. NE⁴ SEC. 32 T.2S. R.4E.

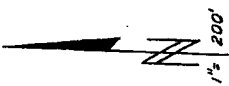

DATE	OLD NO.	NEW NO.
4/17/55	561-57	
8/24/55	571-1	
"	571-2-4	
"	570-57	571-5
"	570-6	571-6
"	570-58	571-58

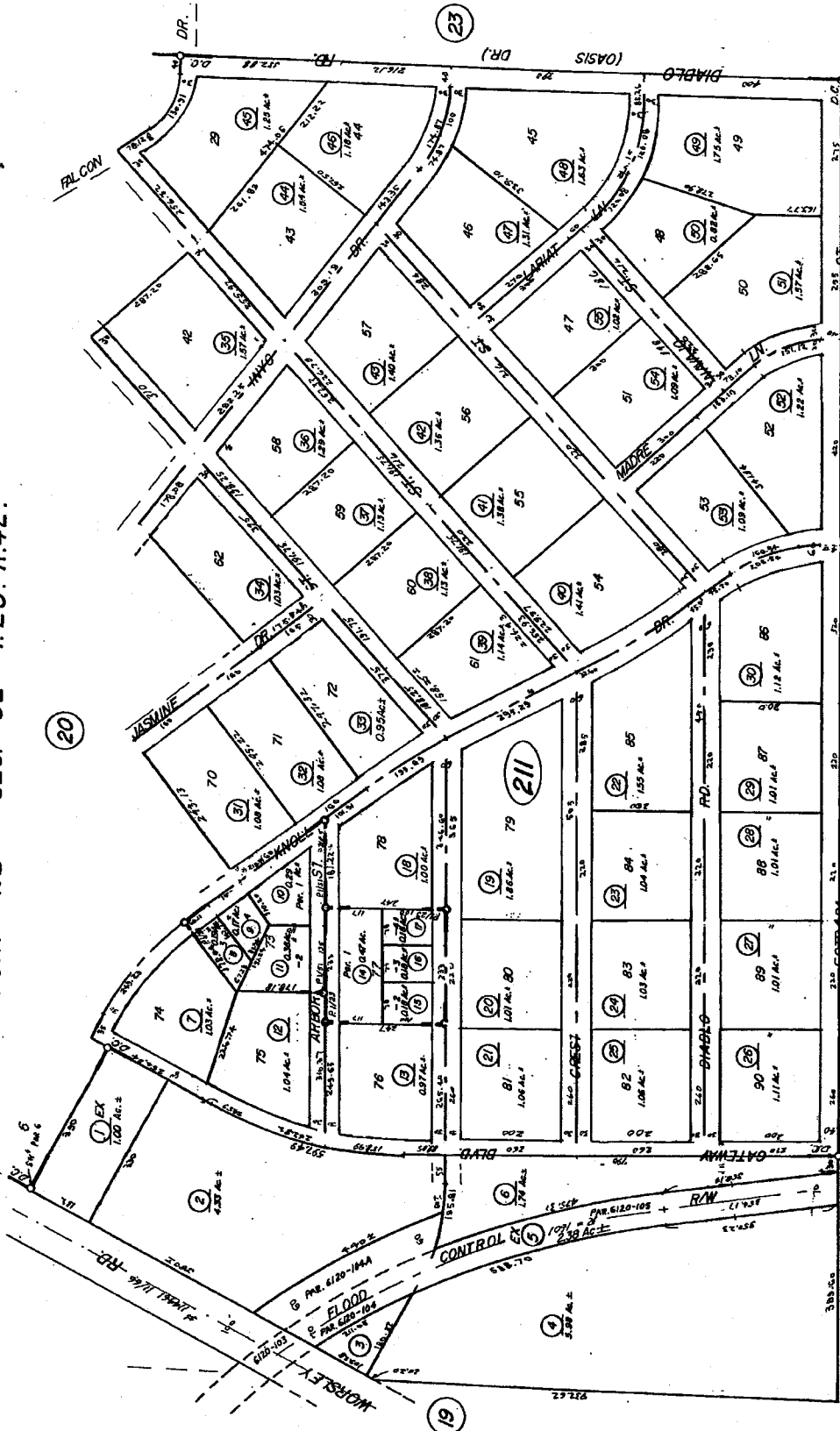

Record of Survey 25/53 (Desert City)
Parcel Map 1/23
11/51

DATA: RS. 47/39

ASSESSOR'S MAP BK. 667 PG. 21
RIVERSIDE COUNTY, CALIF.

668

AUG 1970

509

RECORDING REQUESTED BY

J. W. Samuel
WHEN RECORDED MAIL THIS DEED AND,
UNLESS OTHERWISE SHOWN BELOW,
MAIL TAX STATEMENTS TO:

CHARLES ROACH
P.O. BOX 115B
DESERT HOT SPRINGS,
CALIF 92240

RECEIVED FOR RECORD
AT 8:00 O'CLOCK

OCT 27 1994

9
Recorder
Fee \$

SPACE ABOVE THIS LINE FOR RECORDER'S USE

Grant Deed

A.P.N. 667-211-043

The undersigned grantor(s) declare(s):

Documentary transfer tax is \$ (CONSIDERATION UNDER \$100.00)

() computed on full value of property conveyed, or
() computed on full value less value of liens and encumbrances remaining at time of sale.

() Unincorporated area: () City of _____, and

FOR A VALUABLE CONSIDERATION, receipt of which is hereby acknowledged,
CHARLES ROACH, A WIDOWER,

hereby GRANT(S) to EDDIE LEE ROACH A SINGLE MAN AND
CHARLES ROACH A WIDOWER AS JOINT
TENANTS.

the real property in the City of _____, County of RIVERSIDE, State of California, described as

PARCEL 57, IN COUNTY OF RIVERSIDE, STATE
OF CALIFORNIA, AS PER MAP FILED IN
BOOK 25 PAGE 53 OF RECORDS OF
SURVEY IN OFFICE OF COUNTY RECORDER
OF SAID COUNTY,

Dated September 16, 1994

State of California _____
County of Riverside) s.s.

On Sept. 16, 1994 before me, J. W. Samuel

Charles Roach, personally appeared

Signature of Grantor

Charles Roach

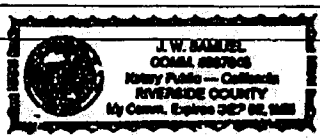

personally known to me (or proved to me on the basis of satisfactory evidence) to be the person(s) whose name(s) is / are subscribed to the within instrument and acknowledged to me that he / she / they executed the same in his / her / their authorized capacity(ies), and that by his / her / their signature(s) on the instrument the person(s), or the entity upon behalf of which the person(s) acted, executed the instrument.

WITNESS my hand and official seal.

Signature J. W. Samuel

(This area for official notarial seal)

J. W. Samuel, my commission expires Sept. 2, 1995

MAIL TAX STATEMENTS TO:

Form 3185-4 (Rev. 5-94)

This Document provided by Commonwealth Land Title Insurance Company

RECORDED

10 27 94

THIS MICROFILM COPYRIGHTED 1994
BY SECURITY UNION TITLE INSURANCE COMPANY, OREGON MICRO-GRAPHICS DIVISION.

Public Record

Land 1
COM

ING REQUESTED BY

J. W. Samuel
RECORDED MAIL THIS DEED AND,
LESS OTHERWISE SHOWN BELOW,
MAIL TAX STATEMENTS TO:

CHARLES ROACH
PO. BOX 1158
DESERT HOT SPRINGS,
CALIF 92240

SPACE ABOVE THIS LINE FOR RECORDER'S USE

Grant Deed

A.P.N. 667-211-043

The undersigned grantor(s) declare(s):
Documentary transfer tax is \$ 0 (CONSIDERATION UNDER \$100.00)
() computed on full value of property conveyed, or
() computed on full value less value of liens and encumbrances remaining at time of sale.
() Unincorporated area: () City of _____, and

FOR A VALUABLE CONSIDERATION, receipt of which is hereby acknowledged,
CHARLES ROACH, A WIDOWER,

hereby GRANT(S) to EDDIE LEE ROACH A SINGLE MAN AND
CHARLES ROACH A WIDOWER AS JOINT
TENANTS.

the real property in the City of _____, County of RIVERSIDE, State of California, described as

PARCEL 57, IN COUNTY OF RIVERSIDE, STATE
OF CALIFORNIA, AS PER MAP FILED IN
BOOK 25 PAGE 53 OF RECORDS OF
SURVEY IN OFFICE OF COUNTY RECORDER
OF SAID COUNTY.

Dated September 16, 1994

State of California _____)
County of Riverside _____) s.s.

On Sept. 16, 1994 before me, J. W. Samuel

Charles Roach, personally appeared

Signature of Grantor

Charles Roach

personally known to me (or proved to me on the basis of satisfactory evidence) to be the person(s) whose name(s) is / are subscribed to the within instrument and acknowledged to me that he / she / they executed the same in his / her / their authorized capacity(ies), and that by his / her / their signature(s) on the instrument the person(s), or the entity upon behalf of which the person(s) acted, executed the instrument.

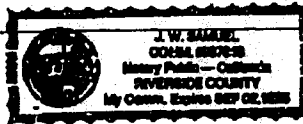

WITNESS my hand and official seal.

Signature

J. W. Samuel

(This area for official notarial seal)

J. W. Samuel, my commission expires Sept. 2, 1995

MAIL TAX STATEMENTS TO:

Form 3195-4 (Rev. 6-84)

This Document provided by Commonwealth Land Title Insurance Company

1994

27 94

THIS MICROFILM COPYRIGHTED 1994
BY SECURITY UNION TITLE INSURANCE COMPANY, ORANGE MICRO-GRAPHICS DIVISION.

Public Record

RECORDING REQUESTED BY:

020337

RECEIVED FOR RECORD
AT 8:00 O'CLOCK

JAN 10 1996

Notarized in Office records
of Riverside County, California

Recorder

Page 8

AND WHEN RECORDED MAIL TO:
NAME CHARLES ROACH
STREET ADDRESS P.O. BOX 1158
CITY DESERT HOT SPRINGS, CA
STATE ZIP 92240

THIS SPACE FOR RECORDER'S USE ONLY

DECLARATION of HOMESTEAD

I, CHARLES ROACH (Individual as Declared owner)

do hereby certify and declare as follows:

1. I hereby claim as a declared homestead the premises located in the City of UNINCORPORATED AREA

County of RIVERSIDE State of California, commonly known as

61785 CREST ST. DESERT HOT SPRINGS

and more particularly described as follows: (Give complete legal description)

PARCEL 57, IN COUNTY OF RIVERSIDE, STATE OF CALIFORNIA, AS PER
MAP FILED IN BOOK 25, PAGE 53 OF RECORDS OF COUNTY RECORDER OF
SAID COUNTY.

2. I am the declared homestead owner of the above declared homestead.
3. I own the following interest in the above declared homestead: 1/2 %

4. The above declared homestead is (strike inapplicable clause) my principal dwelling and
(strike inapplicable clause) I am currently residing on that declared homestead

5. The facts stated in this Declaration are true as of my personal knowledge.

Dated January 2, 1996

Charles Roach
Charles Roach

STATE OF CALIFORNIA)
COUNTY OF RIVERSIDE) ss

On Jan 2, 1996 before me

personally appeared CHARLES ROACH

personally known to me (or proved to me on the basis of satisfactory evidence) to be the person(s) whose name(s) is/are subscribed to the within instrument, and acknowledged to me that he/she/they executed the same in his/her/their authorized capacity(ies), and that by his/her/their signature(s) on the instrument the person(s) or the entity upon behalf of which the person(s) acted, executed the instrument.

WITNESS my hand and official seal.

Signature *Stephanie Ann Bodde*



(This area for official notary seal)

RS/00-441 000

THIS FORM FURNISHED COURTESY OF ORANGE COAST TITLE COMPANIES

EXEMPT § 6103
When recorded please mail to:
Mail Stop # 4036

004248
RECEIVED FOR RECORD
AT 8:00 O'CLOCK



JAN - 7 1998

Recorded in Official Records
of Riverside County, California
Recorder
Fees \$

NOTICE OF NONCOMPLIANCE

In the matter of the Property of)

Eddie Lee Roach)
Charles Roach)

CASE NO. CV97-0141

NOTICE IS HEREBY GIVEN to all persons, pursuant to Section 10 of Ordinance Number 725 of the County of Riverside, State of California, that proceedings have commenced with respect to violations of Riverside County Ordinance No. 348, Section 6.1, described as Junkyard. Such proceedings are based upon the noncompliance of such real property, located at 61785 Crest St, Desert Hot Springs CA and more particularly described as Assessor's Parcel No. 667-211-043 and having a legal description of Lot 57, Desert City, Recorded in Mapbook 25, Page 53, Records of Survey, with the requirements of Ordinance No. 348.

The owner has been advised to immediately correct the above-referenced violations to avoid further action by the County of Riverside which may include demolition, removal, razing, etc., to abate the public nuisance. Any costs incurred by the County, including, but not limited to investigative, administrative and abatement costs and attorneys' fees, may become a lien on the property. Further details regarding this notice may be obtained by addressing an inquiry to the Building and Safety Department, 46209 Oasis St., Rm. 209, Indio, CA 92201, Attention Code Enforcement Officer Garry Shopshear.

NOTICE IS FURTHER GIVEN in accordance with §§ 17274 and 24436.5 of the California Revenue and Taxation Code, that a tax deduction may not be allowed for interest, taxes, depreciation, or amortization paid or incurred in the taxable year affected by these proceedings.

DEPARTMENT OF BUILDING AND SAFETY

By Scott Barber
Scott Barber, Deputy Director
Code Enforcement Division

ACKNOWLEDGEMENT

State of California)
County of Riverside)

On Jan 5, 1998 before me, David H.K. Huff, Deputy County Counsel, on behalf of William C. Katzenstein, Riverside County Counsel, personally appeared Scott Barber, personally known to me to be the person whose name is subscribed to the within instrument and acknowledged to me that he executed the same in his authorized capacity as Deputy Director of Code Enforcement Division of the Riverside County Department of Building and Safety, and that by his signature on the instrument the person, or the County of Riverside executed the instrument.

WITNESS my hand pursuant to California Civil Code Section 1181.

David H.K. Huff

(SEAL)
None Required

004248

1798

RIVERSIDE

EXEMPT § 6103
When recorded please mail to:

Mail Stop # 2715

273117

RECEIVED FOR RECORD
AT 8:00AM

JUL - 2 1998

Recorded in Official Records
of Riverside County, California
Recorder

Fee \$ 0 C
TM

NOTICE OF NONCOMPLIANCE

In the matter of the Property of)
Charles Roach)
Eddie Lee Roach)
CASE NO. VAI-086-97

NOTICE IS HEREBY GIVEN to all persons, pursuant to Section 10 of Ordinance Number 725 of the County of Riverside, State of California, that proceedings have commenced with respect to violations of Riverside County Ordinance No. 520, described as the storage in inoperable vehicles. Such proceedings are based upon the noncompliance of such real property, located at 61785 Crest Street, Desert Hot Springs, CA and more particularly described as Assessor's Parcel No. 667-211-043-4 and having a legal description of Parcel 57, Record of Survey (Desert City) recorded in Book 25, Page 53, records of Riverside County, with the requirements of Ordinance No. 520.

The owner has been advised to immediately correct the above-referenced violations to avoid further action by the County of Riverside which may include demolition, removal, razing, etc., to abate the public nuisance. Any costs incurred by the County, including, but not limited to investigative, administrative and abatement costs and attorneys' fees, may become a lien on the property. Further details regarding this notice may be obtained by addressing an inquiry to the Building and Safety Department, P.O. Box 1440, Riverside, CA 92502-1440, Attention Senior Code Enforcement Officer Jim. Monroe.

NOTICE IS FURTHER GIVEN in accordance with §§ 17274 and 24436.5 of the California Revenue and Taxation Code, that a tax deduction may not be allowed for interest, taxes, depreciation, or amortization paid or incurred in the taxable year affected by these proceedings.

DEPARTMENT OF BUILDING AND SAFETY

By *Jim Monroe*
Jim. Monroe, Senior Code Enforcement Officer
Code Enforcement Division

ACKNOWLEDGEMENT

State of California)
County of Riverside)

On July 2, 1998 before me, Theresa L. Towner, Notary Public, personally appeared Jim Monroe, personally known to me to be the person whose name is subscribed to the within instrument and acknowledged to me that he executed the same in his authorized capacity, and that by his signature on the instrument the person, or the entity upon behalf of which the person acted, executed the instrument.

WITNESS my hand and official seal.

Theresa L. Towner

(seal of Notary)

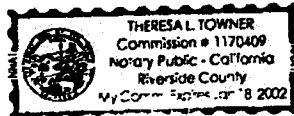

RIVERSIDE
7 2 98
NON TITLE INS. CO.
1011 JIMMIE JONES DIVISION
1814 Inland Boulevard, Suite 200
Desert Hot Springs, CA 92570

When recorded please mail to:
5002

DOC # 2006-0454264
06/23/2006 08:00A Fee:NC
Page 1 of 1
Recorded in Official Records
County of Riverside
Larry W. Ward
Assessor, County Clerk & Recorder



M	S	U	PAGE	SIZE	CH	FOUR	INCUR	SMP	MISC.
A	R	L			COPY	LONG	REFUND	NCHG	EXAM

①
M
L

NOTICE OF NONCOMPLIANCE

In the matter of the Property of
EDDIE LEE ROACH &
CHARLES ROACH

Case No. CV06-3133, CV06-2435, CV06-2870,
CV06-2434, CV06-2868. & CV06-3133

NOTICE IS HEREBY GIVEN to all persons, pursuant to Section 10 of Ordinance Number 725 of the County of Riverside, State of California, that proceedings have been commenced with respect to violations of Riverside County Ordinance No.520, (RCC Title 10.04) described as VEHICLE ABATEMENT, Riverside County Ordinance No.348, (RCC Title 17.24.010) described as EXCESSIVE OUTSIDE STORAGE, Riverside County Ordinance No.541, (RCC Title 8.120.010) described as ACCUMULATED RUBBUSH, Riverside County Ordinance No.457, (RCC Title 15.16.020) described as SUBSTANDARD STRUCTURE, Riverside County Ordinance No.457, (RCC Title 15.48.010) described as SUBSTANDARD MOBILEHOMES (3) & SUBSTANDARD RECREATIONAL VEHICLE, and Riverside County Ordinance No.457, (RCC Title 15.08) described as CONSTRUCTION WITHOUT A PERMIT (WORKSHOPS / SHEDS, CARPOSRT / STORAGE AREA, AND ROOM ADDITIONS). Such Proceedings are based upon the noncompliance of such real property, located at 61875 CREST STREET, DESERT HOT SPRINGS, CA, and more particularly described as Assessor's Parcel Number 667-211-043 and having a legal description of SECTION 32 TOWNSHIP 2 SOUTH RANGE 4 EAST, LOT 57, DESERT CITY, RECORD SURVEY 25, PAGE 53, Records of Riverside County, with the requirements of Ordinance No. 520, 348, & 457 (RCC Title 10.04, 17.24.010, 8.120.010, 15.16.020, 15.48.010, & 15.08.010).

The owner has been advised to immediately correct the above-referenced violations to avoid further action by the County of Riverside which may include demolition, removal, razing, etc., to abate the public nuisance. Any costs incurred by the County, including, but not limited to investigative, administrative and abatement costs and attorneys' fees, may become a lien on the property. Further details regarding this notice may be obtained by addressing an inquiry to the Building and Safety Department, 24318 Hemlock Ave., Suite C-1, Moreno Valley, CA 92553, Attention Code Enforcement Officer MICHELE KOMPIER.

NOTICE IS FURTHER GIVEN in accordance with §17274 and §24436.5 of the California Revenue and Taxation Code, that a tax deduction may not be allowed for interest, taxes, depreciation, or amortization paid or incurred in the taxable year affected by these proceedings.

COUNTY OF RIVERSIDE
DEPARTMENT OF BUILDING AND SAFETY

By Mickey Parmele
MICKEY PARMELE
Code Enforcement Division

ACKNOWLEDGMENT

State of California)
County of Riverside)

On 6/14/2006 before me, Amanda Rodriguez, Notary Public, personally appeared Mickey Parmele, personally known to me (or proved to me on the basis of satisfactory evidence) to be the person(s) whose name(s) is/are subscribed to the within instrument and acknowledged to me that he/she/they executed the same in his/her/their authorized capacity(ies), and that by his/her/their signature(s) on the instrument the person(s), or the entity upon behalf of which the person(s) acted, executed the instrument.

WITNESS my hand and official seal.

[Signature]

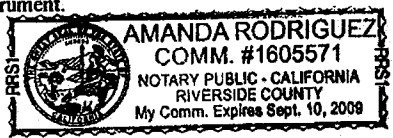

DOC # 2006-0932581

12/21/2006 08:00A Fee:NC

Page 1 of 12

Recorded in Official Records
County of Riverside

Larry W. Ward
Assessor, County Clerk & Recorder



1
2
3
4
5
6
7
8
9
10
11
12
13
14
15
16
17
18
19
20
21
22
23
24
25
26
27
28

WHEN RECORDED PLEASE MAIL TO:
Tiffany N. North, Deputy County Counsel
County of Riverside
OFFICE OF COUNTY COUNSEL
3535 Tenth Street, Suite 300 (Stop #1350)
Riverside, CA 92501

S	R	U	PAGE	SIZE	DA	MISC	LONG	RFD	COPY
1			12						1
M	A	L	465	426	PCOR	NCOR	SMF	NCHG	EXAM 505

EXEMPT 6103

**BOARD OF SUPERVISORS
COUNTY OF RIVERSIDE**



IN RE APPEAL OF ADMINISTRATIVE) CASE NO. CV 06-2433
 HEARING DECISION RE: THE ABATEMENT)
 OF PUBLIC NUISANCE: [INOPERABLE) FINDINGS OF FACT,
 VEHICLES]; APN: 667-211-043, 61875 CREST) CONCLUSIONS AND ORDER TO
 STREET, DESERT HOT SPRINGS, COUNTY OF) ABATE NUISANCE
 RIVERSIDE, STATE OF CALIFORNIA;)
 CHARLES ROACH AND EDDIE LEE ROACH,) [R.C.O. No. 520 (RCC Title 10)]
 OWNERS AND APPELLANTS.)

The above-captioned matter came on regularly for hearing on December 5, 2006, before the Board of Supervisors of the County of Riverside, State of California in the Board Room, First Floor Annex, County Administrative Center, 4080 Lemon Street, Riverside, California regarding the appeal of an administrative hearing officer's decision on the abatement of abandoned, wrecked, dismantled or inoperable vehicles and vehicle parts on the real property described as 61875 Crest Street, Desert Hot Springs, APN 667-211-043 and referred to hereinafter as "The Property."

Tiffany N. North, Deputy County Counsel, appeared along with Jim Monroe, Code Enforcement Division Manager, on behalf of the Director of the Code Enforcement Department.

Rodell Hinshaw, representative of Charles Roach, appeared and addressed the Board. Owner, Charles Roach, was present at the hearing but did not testify.

The Board of Supervisors received the Declaration of the Code Enforcement Officer together with attached Exhibits, evidencing the abandoned, wrecked, dismantled, or inoperable vehicles and

FINDINGS OF FACT, CONCLUSIONS
AND ORDER TO ABATE NUISANCE

DEC 19 2006 2.8

1 vehicle parts on The Property as violations of Riverside County Ordinance No. 520 as codified in
2 Riverside County Code Chapter 10.04, and as a public nuisance.

3 **SUMMARY OF EVIDENCE**

4 1. Documents of record in the Riverside County Recorder's Office identify the owners
5 of The Property as Charles Roach and Eddie Lee Roach ("Owners").

6 2. As the result of a complaint from a member of the public, the Code Enforcement
7 Officer conducted an inspection of The Property on May 18, 2006. During this inspection, the Code
8 Enforcement Officer inventoried fifty (50) abandoned, wrecked, dismantled or inoperable vehicles
9 and miscellaneous vehicle parts on The Property.

10 3. The Property was determined to be in violation of Riverside County Ordinance No.
11 520 (RCC Title 10) by the Code Enforcement Officer. A Notice of Violation was posted on The
12 Property on May 18, 2006.

13 4. On May 26, 2006, a Notice of Intention to Abate and Remove the Vehicles or Parts
14 was mailed via certified mail, return receipt requested, to the Owners and identifiable registered
15 owners of the vehicles at the addresses as listed with the Department of Motor Vehicles. This notice
16 advised Owners of their right to request a hearing.

17 5. At Owners' request, an administrative hearing was held on July 17, 2006.

18 6. On August 7, 2006, the Hearing Officer issued a Decision/Order that the vehicles and
19 parts as set forth on the inventory constitute a violation of Ordinance No. 520 and a public nuisance
20 subject to abatement and that the County shall be allowed to remove all fifty-one (51) vehicles in
21 accordance Riverside County Code Title 10 and related statues, regulations and ordinances.

22 7. On or about August 10, 2006, Owner requested an appeal to the Board of Supervisors.
23 On November 7, 2006, a "Notice of Hearing on the Appeal of Administrative Order to Abate Public
24 Nuisance" providing notification of the Board hearing scheduled for December 5, 2006 was mailed
25 to the Owner and Interested Parties.

26 **FINDINGS AND CONCLUSIONS**

27 WHEREFORE, the Board of Supervisors of the County of Riverside, State of California, in
28 regular session assembled on December 5, 2006 finds and concludes that:

FINDINGS OF FACT, CONCLUSIONS
AND ORDER TO ABATE NUISANCE

2006-0932581
12/21/2006 08:08A
2 of 12



2006-0932581
12/21/2006 08:00A
3 of 12



1 1. WHEREAS, the fifty-one (51) abandoned, wrecked, dismantled or inoperative
2 vehicles and parts thereof on the real property described as 61875 Crest Street, Desert Hot Springs,
3 Riverside County, Assessor's Parcel Numbers 667-211-043 as set forth in the vehicle inventory list
4 attached hereto, violate Riverside County Ordinance No. 520 (RCC Title 10) and constitute a public
5 nuisance subject to abatement by removal.

6 2. WHEREAS, all due process requirements were satisfied by the Code Enforcement
7 Department. The Administrative Hearing Order/Decision, exhibits and testimony have been
8 considered. The testimony of Rodell Hinshaw, representative for Owners, was also considered.

9 3. WHEREAS, the Administrative Hearing Order/Decision is affirmed;

10 4. WHEREAS, the Owners, or anyone having possession or control of the vehicles or
11 vehicle parts be required to abate the public nuisance by removing all the vehicles and vehicle parts
12 set forth in the vehicle inventory list, making them operable or completely enclosing them within a
13 building in a lawful manner where they are not visible from the street or other public or private
14 property within seventy-five (75) days of the posting and mailing of this Board order in accordance
15 with all Riverside County Ordinances and Codes, including but not limited to Riverside County
16 Ordinance No. 520 (RCC Title 10).

17 5. WHEREAS, if the above described nuisance is not abated within seventy-five (75)
18 days of issuance of the Board order, a designated representative of the Code Enforcement
19 Department, a towing contractor and/or Sheriff's Department representative shall abate the nuisance
20 by removal and destruction pursuant to Riverside County Code Title 10 and applicable laws.

21 6. WHEREAS, the Owners, Appellants and Interested Parties are hereby further noticed
22 that the time within which judicial review of the administrative determinations made herein must
23 be sought is ninety (90) days from the posting and mailing of the Findings of Fact, Conclusions and
24 Order To Abate Nuisance, and is governed by California Code of Civil Procedure Section 1094.6.

ORDER TO ABATE NUISANCE

26 IT IS THEREFORE ORDERED that the abandoned, wrecked, dismantled or inoperable
27 vehicles and vehicle parts on the real property described as 61875 Crest Street, Desert Hot Springs,
28 Riverside County, and further identified as Assessor's Parcel Number 667-211-043 violates

1 Riverside County Ordinance No. 520 and constitutes a public nuisance subject to abatement by
2 removal.

3 The Administrative Hearing Order/Decision issued on August 7, 2006, is affirmed.

4 Charles Roach and Eddie Lee Roach, or anyone having possession or control of the vehicles
5 and vehicle part are required to abate the public nuisance by removing the vehicles and vehicle parts
6 as set forth in the vehicle inventory list attached hereto, making them operable or completely
7 enclosing them within a building in a lawful manner where they are not visible from the street or
8 other public or private property within seventy-five (75) days of the posting and mailing of the Board
9 order in accordance with all Riverside County Ordinances and Codes, including but not limited to
10 Riverside County Ordinance No. 520 (RCC Title 10).

11 If Charles Roach and Eddie Lee Roach or anyone having possession or control of the vehicles
12 and vehicle parts do not properly abate the public nuisance within seventy-five (75) days of posting
13 and mailing of the Board order, a designated representative of the Code Enforcement Department, a
14 towing contractor and/or Sheriff's Department representative shall abate the public nuisance by
15 removal and destruction pursuant to Riverside County Code Title 10 and applicable laws.

16 \\\

17 \\\

18 \\\

19 \\\

20 \\\

21 \\\

22 \\\

23 \\\

24 \\\

25 \\\

26 \\\

27 \\\

28 \\\



2006-0932581
12/21/2006 09:00A
4 of 12

FINDINGS OF FACT, CONCLUSIONS
AND ORDER TO ABATE NUISANCE

1
2
3
4
5
6
7
8
9
10
11
12
13
14
15
16
17
18
19
20
21
22
23
24
25
26
27
28

IT IS FURTHER ORDERED that reasonable costs of abatement, after notice and opportunity for hearing, shall be imposed as a lien on the property which may be collected as a special assessment against the property pursuant to Government Code Section 25845 and Riverside County Ordinance Nos. 520 and 725 (RCC Titles 10 and 1).

Dated: DEC 19 2006

COUNTY OF RIVERSIDE

By Bob Buster
Bob Buster
Chairman, Board of Supervisors

ATTEST:

NANCY ROMERO
Clerk to the Board

By Janice Thummet
Deputy

(SEAL)

g:\property\01-code\bs\abatement\roach2433\fof.doc



2006-0932581
12/21/2006 08:09A
5 of 12

FINDINGS OF FACT, CONCLUSIONS
AND ORDER TO ABATE NUISANCE

DEC 19 2006 2.8



**COUNTY OF RIVERSIDE
CODE ENFORCEMENT ADMINISTRATION
VEHICLE INVESTIGATION INVENTORY AND ABATEMENT REPORT**



Officer's Name: M. Kompier / M. Overholt I.D. #: 44 / 41 Case Number: CV062433 Map Coordinates: 695 J-5
 Date of Initial Investigation: 05/18/06 Location of Vehicle(s) & Paris: 61851 Crest St., Desert Hot Springs, CA (s/e corner of Crest & Invo)
 A-P-N: 667-211-043 Property Owner's Name: Eddie Lee Roach, Charles Roach
 Supervisor Dist: 5 Property Owner's Address: P. O. Box 1158, Desert Hot Springs, CA 92240

ITEM NO.	VEHICLE CONDITION	YR	MAKE STYLE/COLOR	VIN	LICENSE NO. STATE	REGISTERED OWNER AND ADDRESS	LEGAL OWNER AND ADDRESS	AB/ CODE
1	Inoperative, Dismantled (low/flat/deteriorated tires, engine dismantled, rodent nesting & droppings in engine compartment)	'75	Ford Maverick, Green	5K92L170117	828MPD (CA)	NOT ON FILE		
2	Inoperative, Dismantled (low/flat tires, wiring to dash dismantled, engine dismantled, no battery)	'79	Dodge Pickup Truck, White/Primer	D14AP9S170656	4X23667 (CA)	CHARLES ROACH 61785 CREST ST P O BOX 1158 DESERT HOT SPRINGS CA 92240		
3	Inoperative, Dismantled (engine dismantled, no battery, interior deteriorated)		Toyota Pick up truck, white		1HBP652 (CA) (plate comes back to Veh. # 11 - Datsun Sedan)	CHARLES ROACH 61785 CREST ST DESERT HOT SPRINGS CA 92240		
4	Inoperative, Dismantled (no hood, engine dismantled, interior deteriorated, cobwebs to interior)	'70	Datsun Pick up truck, lt. blue	PL521470266		NOT ON FILE		
5	Inoperative, Dismantled (low/flat tires, engine dismantled, interior dismantled/stripped)	'73	Dodge Van, White	B25AF3X088469	4K24960 (CA)	JOAQUIN HERRERA SIORDIA 38175 JEFFERSON ST INDIO CA 92203		

EXHIBIT NO.



2066-0932581
12/21/2006 08:09A
6 of 12



Case No.: CV062433

ITEM NO.	VEHICLE CONDITION	YR	MAKE STYLE/COLOR	VIN	LICENSE NO. STATE	REGISTERED OWNER AND ADDRESS	LEGAL OWNER AND ADDRESS	ABATE CODE
6	Inoperative, Dismantled (engine & grill dismantled; no hood, missing rear windshield, interior deteriorated)	'73	GM Pick up truck, White & Beige	CCY245F430583	V794885 (CA)	CHARLES WILLIAM ROACH 61785 CREST ST P O BOX 1158 DESERT HOT SPRINGS CA 92240		
7	Inoperative, Dismantled (low/flat tires, interior stripped, engine dismantled with weeds growing throughout)	'78	Ford, 2 door, white	8X91T191195	2ZYX279 (CA)	ARTHUR CECIL GANN 61785 CREST ST P O BOX 10 DESERT HOT SPRINGS CA 92240		
8	Inoperative, Dismantled (Engine dismantled, no battery, interior deteriorated, bed filled w/debris, tires flat/deteriorated)	'84	Dodge Ram Pick up truck, Brown & Tan	1B7HW14T4ES314497	6U60780 (CA)	CHARLES W ROACH 61785 CREST ST P O BOX 1158 DESERT HOT SPRINGS CA 92240		
9	Inoperative, dismantled (broken/missing tail lights, flat tires)		Zieman Utility trailer, yellow/rust		VN1683 (CA)	NOT ON FILE		
10	Inoperative, Dismantled (engine dismantled, low/flat tires)	'69	Chevy Commercial Truck, orange	CS539P837459	46942Y (CA)	CHARLES W ROACH P O BOX 1158 DESERT HOT SPRINGS CA 92240		
11	Inoperative, Dismantled (low/flat tires, no battery, broken rear windshield)	'83	Datsun, 4 door, gray	JN1HU01S3DT097919	1HBP652 (CA)	WILLIAM CHARLES ROACH P O BOX 1158 DESERT HOT SPRINGS CA 92240		
12	Dismantled		Unknown pick up truck bed, orange		UNKNOWN	UNKNOWN	UNKNOWN	
13	Inoperative, Dismantled (low/flat/det tires, interior deteriorated, rodent nest in engine, no battery)	'81	Subaru, 2 door, black	1F1AW44B6BB314352	1CRN614 (CA)	NOT OF FILE		
14	Dismantled		Datsun pick up truck (bed only), silver		UNKNOWN	UNKNOWN	UNKNOWN	

2896-0932581
12/21/2006 09:06A
8 of 12



Case No.: CV062433

ITEM NO.	VEHICLE CONDITION	YR	MAKE STYLE/COLOR	VIN	LICENSE NO. STATE	REGISTERED OWNER AND ADDRESS	LEGAL OWNER AND ADDRESS	ABATE CODE
15	Inoperative, Dismantled (4 flat tires, no battery, engine dismantled, interior deteriorated)	'82	Ford Thunderbird, 2 door, white & black	1FABP4236CH133215	IFCF694 (CA)	CHARLES WILLIAM ROACH P O BOX 1158 DESERT HOT SPRINGS CA 92240		
16	Inoperative, Dismantled (missing tail light, 4 flat tires, no battery, engine dismantled)	'78	Dodge Cordova, 2 door, primer/rust	SS22K8R182573	477WOJ (CA) Came back: 1FTU342 (CA)	BRIAN MERCEDES GIANNUNZIO 1616 OCEAN AVE SANTA MONICA CA 90401		
17	Inoperative, Dismantled (4 flat tires, no headlights, engine dismantled)	'78	Cadillac, 2 door, gray/rust	SS22H8R191304	2BMK128 (CA)	RAMON C BAEZ 2387 E FINLEY RD PALM SPRINGS CA 92262		
18	Inoperative, Dismantled (missing rear tires, flat front tires)		Ford, 4 door, green		437NPI (CA)	NOT ON FILE		
19	Inoperative, Dismantled (Engine dismantled, no battery, filled with debris, interior deteriorated)		Dodge Coronelle, yellow/rust	WHA41G2A114183	IDND959 (CA)	NOT ON FILE		
20	Inoperative, Dismantled (4 flat tires, engine dismantled, no battery, interior deteriorated)	'77	Honda Civic, 2 door/hatchback, red	SGC3535540		NOT ON FILE		
21	Inoperative, Dismantled (4 flat/deteriorated tires, no engine)	'83	Chrysler, 4 door, gray	1C3BC56G2DC256540	2ATP809 (CA)	NOT ON FILE		
22	Inoperative, Dismantled (4 flat/deteriorated tires, engine dismantled)	'66	Chrysler Imperial, 4 door, white	YM43163295503	084WHX (CA)	EDWARD S CLARK JR 448 LAGUNA RD PASADENA CA 91105	TIMOTHY REGAN 222 S PARK SIERRA MADRA CA 91024-2353	
23	Inoperative (low/flat/deteriorated tires, cobwebs and deterioration to interior)	'78	Cadillac, 4 door, gray	6S69B8Q433094	629WDB (CA)	NOT ON FILE		



Case No.: CV062433

ITEM NO.	VEHICLE CONDITION	YR	MAKE STYLE/COLOR	VIN	LICENSE NO. STATE	REGISTERED OWNER AND ADDRESS	LEGAL OWNER AND ADDRESS	ABATE CODE
24	Inoperative, Wrecked, Dismantled (low/flat/deteriorated tires, engine dismantled, broken tail lights, body damage to front passenger side panel)			0YD065 (CA)		NOT ON FILE		
25	Inoperative, Dismantled	'80	Chevy Van, Brown & Tan	CGL25A7127660	1T67112 (CA)	NOT ON FILE		
26	Inoperative, Dismantled (flat/deteriorated tires, no headlight, brake broken)	'79	Gryoner Moped, White	SA10627		NOT ON FILE		
27	Inoperative, Dismantled (broken rear tail light, flat/deteriorated tires, dash dismantled, interior filled with bedding)	'76	Mercedes, 4 door, gray	11511412052316	4MDM444 (CA)	CHARLES W ROACH P O BOX 1158 DESERT HOT SPRINGS CA 92240		
28	Inoperative, Dismantled (flat/deteriorated tires, broken tail lights, no battery, interior door panels dismantled)	'86	Ford Escort, 4 Door, blue	1FABP3696GW299860	2XDW474 (CA)	CHARLES W ROACH P O BOX 1158 DESERT HOT SPRINGS CA 92240		
29	Inoperative, Dismantled (interior door panel dismantled, missing engine parts, interior deteriorated, tires flat/deteriorated)	'79	Continental, 2 Door, Beige	9Y89S691253	2CQA911 (CA)	NOT ON FILE		
30	Inoperative, Wrecked (missing front side panel and portion of front of frame, remaining frame bent, engine missing parts, no hood, no grill or front bumper)	'87	Ford, 2 door/hatchback, gray	1FAPP2194HW302909	2FFL999 (CA)	CHARLES W ROACH P O BOX 1158 DESERT HOT SPRINGS CA 92240		
31	Inoperative, Dismantled (engine dismantled, flat/deteriorated tires)		Chrysler, 4 door, green & rust	8343231159	734CHR (CA)	NOT ON FILE		



Case No.: CV062433

ITEM NO.	VEHICLE CONDITION	YR	MAKE STYLE/COLOR	VIN	LICENSE NO. STATE	REGISTERED OWNER AND ADDRESS	LEGAL OWNER AND ADDRESS	ABATE CODE
32	Inoperative, Dismantled (Engine dismantled, flat/deteriorated tires, interior dismantled)		Ford Van, Brown & Beige	E22GHI64354 OR 123WME22034G0876	A E 75202 (WT)	NOT ON FILE		
33	Inoperative, Dismantled (no windows, engine missing parts, interior deteriorated)		Unknown Tractor Trailer Truck, white	7373289		NOT ON FILE		
34	Inoperative, Dismantled (4 flat/deteriorated tires, no hood, engine compartment filled with tires & misc. debris)	'88	Ford Escort, 4 door, silver	IFAPP2599JW230203	2LSB607 (CA)	NOT ON FILE		
35	Inoperative (flat tires)	'89	Ford Escort, 2 door, blue	IFAPP93J2KW336354	4BDP360 (CA)	ALLEN DUANE LOZANO 32501 MERION DR THOUSAND PALMS CA 92276		
36	Inoperative (flat tires, deteriorated seat, rust to chain)		Honda Motorcycle, Black & Orange	CB001		NOT ON FILE		
37	Inoperative (wiring deteriorated, tires flat/deteriorated, rear tail light broken, seat deteriorated)	'90	Honda moped, Red-orange	CT90182397		NOT ON FILE		
38	Inoperative, Dismantled (no front tire, headlight dismantled, seat missing)	'79	Gryner moped, Orange	CA00395		NOT ON FILE		
39	Inoperative, Dismantled, Wrecked (flat/deteriorated tires, no rear seat, broken/missing tail lights, passenger side rear door dented)		Plymouth, 3 door, white	12187002223112FF1	BGC835 (CA)	NOT ON FILE		
40	Inoperative, Dismantled (4 flat/deteriorated tires, no battery, engine dismantled, rodent nest in engine)		Ford Fairlane, white		SBR445 (CA)	NOT ON FILE		



Case No.: CV062433

ITEM NO.	VEHICLE CONDITION	YR	MAKE STYLE/COLOR	VIN	LICENSE NO. STATE	REGISTERED OWNER AND ADDRESS	LEGAL OWNER AND ADDRESS	ABATE CODE
41	Inoperative, Dismantled (flat/deteriorated tires, dash dismantled, interior filled with bedding)	'82	Mercury, 2 door/hatchback, red	1MEBF6327CR600419	IRAE404 (CA) On file as: 1ESR209 (CA)	MIKENICK'S AUTO DISM 14803 WHITTAM AVE FONTANA CA 92335		
42	Inoperative (missing rear window, flat/deteriorated tires, interior deteriorated - exposed to elements)		Chrysler Le Baron, 2 door/convertible, blue	1C3BC55GAF8123727 (VIN plate defaced; difficult to read)	ZYRZ815 (CA)	NOT ON FILE		
43	Inoperative, Dismantled (up on blocks, dash dismantled)	'04	Honda Accord, 4 door, black	JHMCA5633JC080739	2KHG222 (CA)	ADELITA CIFUENTESORTIZ GABRIEL ADEL R 656 WILSON PERRIS CA 92571	CHARLES W ROACH 61785 CREST DR P O BOX 1158 DESERT HOT SPRINGS CA 92240	
44	Inoperative, Dismantled (flat/deteriorated tires, engine dismantled)		Chevy, 4 door, black	1G1AN69A3CX103549	1EPR404 (CA)	PASCUALA L BERMUDEZ 16139 CHAPIN ST MADERA CA 93638		
45	Inoperative (no battery, flat/deteriorated tires, interior deteriorated)		Pontiac, 2 door/hatchback, blue	1G2A108C7EY200543		NOT ON FILE		
46	Inoperative, Dismantled (dash dismantled, no bed, interior deteriorated, weeds growing throughout)		Chevrolet Truck, no bed, white	1C363L119637	3VNG782 (CA)	NOT ON FILE		
47	Inoperative, Dismantled (no battery, flat/deteriorated tires, engine dismantled, seats missing)	'88	Honda Accord, 4 door, white	JHMCA5637JC064530	4HFF980 (CA)	KATHRYN J RUSSELL 1155 EL ALAMEDA PALM SPRINGS CA 92262	DENNIS CRAIG BELL 255 S AVE CABALLEROS # 211 PALM SPRINGS CA 92262	
48	Inoperative (flat/deteriorated tires; hundreds of dead insects in rear window)	'89	Honda, 4 door, blue	1HGCAS544KA128212	461V696 (CA) On file as: 4NTV696 (CA)	JEFFREY FLOYD AHRENS 66241 ESTRELLA APT A DESERT HOT SPRINGS CA 92262		

2006-0932581
12/21/2006 08:00A
12 of 12



Case No.: CV062433

ITEM NO.	VEHICLE CONDITION	YR	MAKE STYLE/COLOR	VIN	LICENSE NO. STATE	REGISTERED OWNER AND ADDRESS	LEGAL OWNER AND ADDRESS	ABATE CODE
49	Inoperative, Dismantled (no battery, engine dismantled, interior filled with bedding & misc., evidence of rodent nesting)	'84	Toyota, 4 door, gray	JT2SV12H7E0110451	2ZXF092 (CA)	JOSE & PETRA PORTILLO 61555 ARBOR DESERT HOT SPRINGS CA 92240		
50	Inoperative, Dismantled (4 flat/deteriorated tires, interior deteriorated)	'86	Toyota, 4 Door, Gray	JT2SV16E9G0504455	2ZXF092 (CA) On File as: 4ZDJ341 (CA)	MARIO W STEWART OR MICHELL BERRY P O BOX 10 DESERT HOT SPRINGS CA 92240		
51	Dismantled		Miscellaneous parts	UNKNOWN	UNKNOWN	UNKNOWN	UNKNOWN	

Public Record

When recorded please mail to:
 Riverside County Code Enforcement Department
 (District 5 Office)
 24318 Hemlock Avenue, Suite C-1
 Moreno Valley, CA 92557
 Mail Stop No. 5002

DOC # 2009-0336832
 06/30/2009 08:00A Fee:NC
 Page 1 of 1
 Recorded in Official Records
 County of Riverside
 Larry W. Ward
 Assessor, County Clerk & Recorder



S	R	U	PAGE	SIZE	DA	MISC	LONG	RFD	COPY
1			1						
M	A	L	465	426	PCOR	NCOR	SMF	NCHG	EXAM
NCHG CC						T:	CTY	UNI	002

NOTICE OF NONCOMPLIANCE

In the matter of the Property of
 Eddie Lee Roach
 Charles Roach

Case No. CV09-04057 & CV09-04325



NOTICE IS HEREBY GIVEN to all persons, pursuant to Section 10 of Ordinance Number 725 of the County of Riverside, State of California, that proceedings have been commenced with respect to violations of Riverside County Ordinance No.457, (RCC Title 15.48.040) described as substandard mobile home (quality lower than prescribed by law) & Riverside County Ordinance No. 457, (RCC Title 15.16.020) described as substandard structure. Such Proceedings are based upon the noncompliance of such real property, located at 61785 Crest Street, Desert Hot Springs, CA, and more particularly described as Assessor's Parcel Number 667-211-043 and having a legal description of 1.40 ACRES M/L IN PAR 57 RS 025/053 DESERT CITY, Records of Riverside County, with the requirements of Ordinance No. 457 (RCC Title 15.48.040 & 15.16.020).

The owner has been advised to immediately correct the above-referenced violations to avoid further action by the County of Riverside which may include demolition, removal, razing, etc., to abate the public nuisance. Any costs incurred by the County, including, but not limited to investigative, administrative and abatement costs and attorneys' fees, may become a lien on the property. Further details regarding this notice may be obtained by addressing an inquiry to the Code Enforcement Department, 24318 Hemlock Avenue, Suite C-1, Moreno Valley, California, Attention Code Enforcement Officer Regina Keyes.

NOTICE IS FURTHER GIVEN in accordance with §17274 and §24436.5 of the California Revenue and Taxation Code, that a tax deduction may not be allowed for interest, taxes, depreciation, or amortization paid or incurred in the taxable year affected by these proceedings.

COUNTY OF RIVERSIDE
 CODE ENFORCEMENT DEPARTMENT

By Mary Overholt
 Mary Overholt
 Code Enforcement Department

ACKNOWLEDGMENT

State of California)
 County of Riverside)

On 06/18/09 before me, Ana E. Carrillo, Notary Public, personally appeared Mary Overholt, who proved to me on the basis of satisfactory evidence to be the person(s) whose name(s) are subscribed to the within instrument and acknowledged to me that he/she/they executed the same in his/her/their authorized capacity(ies), and that by his/her/their signature(s) on the instrument the person(s), or the entity upon behalf of which the person(s) acted, executed the instrument.

I certify under PENALTY OF PERJURY under the laws of the State of California that the foregoing paragraph is true and correct.

WITNESS my hand and official seal.

Ana E. Carrillo
 Commission # 1767676 Comm. Expires Sep. 14, 2011

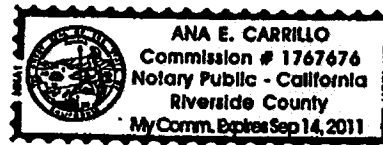

When recorded please mail to:
 Riverside County Code Enforcement Department
 (District 5 Office)
 24318 Hemlock Avenue, Suite C-1
 Moreno Valley, CA 92557
 Mail Stop No. 5002

DOC # 2009-0526935
 10/09/2009 08:00A Fee:NC
 Page 1 of 1
 Recorded in Official Records
 County of Riverside
 Larry U. Ward
 Assessor, County Clerk & Recorder



S	R	U	PAGE	SIZE	DA	MISC	LONG	RFD	COPY
/			/						
M	A	L	465	426	PCOR	NCOR	SMF	NCHG	EXAM
NCHG CC						T:	CTY	UNI	062

NOTICE OF NONCOMPLIANCE



In the matter of the Property of
 Eddie Lee Roach
 Charles Roach

Case No.: CV09-04056

NOTICE IS HEREBY GIVEN to all persons, pursuant to Section 10 of Ordinance Number 725 of the County of Riverside, State of California, that proceedings have been commenced with respect to violations of Riverside County Ordinance No. 520, (RCC Title 10.04) described as Vehicle Abatement (inoperative, dismantled, wrecked vehicles). Such Proceedings are based upon the noncompliance of such real property, located at 61785 Crest Street, Desert Hot Springs, CA, and more particularly described as Assessor's Parcel Number 667-211-043 and having a legal description of 1.40 ACRES M/L IN PAR 57 RS 025/053 DESERT CITY, Records of Riverside County, with the requirements of Ordinance No. 520 (RCC Title 10.04).

The owner has been advised to immediately correct the above-referenced violation to avoid further action by the County of Riverside, which may include remediation or restoration to abate the public nuisance or other remedies available to the department by a court of competent jurisdiction. Any costs incurred by the County, including, but not limited to investigative, administrative and abatement costs and attorneys' fees, may become a lien on the property. Further details regarding this notice may be obtained by addressing an inquiry to the Code Enforcement Department, 24318 Hemlock Avenue, Suite C-1, Moreno Valley, California 92557, Attention Senior Code Enforcement Officer Regina Keyes 951-485-5840.

NOTICE IS FURTHER GIVEN in accordance with §17274 and §24436.5 of the California Revenue and Taxation Code, that a tax deduction may not be allowed for interest, taxes, depreciation, or amortization paid or incurred in the taxable year affected by these proceedings.

COUNTY OF RIVERSIDE
 CODE ENFORCEMENT DEPARTMENT

By Mary Overholt
 Mary Overholt
 Code Enforcement Department

ACKNOWLEDGMENT

State of California)
 County of Riverside)

On 09/28/09 before me, Ana E. Carrillo, Notary Public, personally appeared Mary Overholt, who proved to me on the basis of satisfactory evidence to be the person(s) whose name(s) is/are subscribed to the within instrument and acknowledged to me that he/she/they executed the same in his/hers/their authorized capacity(ies), and that by his/hers/their signature(s) on the instrument the person(s), or the entity upon behalf of which the person(s) acted, executed the instrument.

I certify under PENALTY OF PERJURY under the laws of the State of California that the foregoing paragraph is true and correct.

WITNESS my hand and official seal.

Ana E. Carrillo
 Commission # 1767676 Comm. Expires Sep. 14, 2011

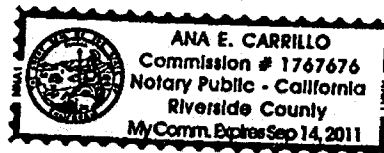

Public Record

DOC # 2010-0035272

01/27/2010 08:00R Fee:NC

Page 1 of 6

Recorded in Official Records

County of Riverside

Larry W. Ward

Assessor, County Clerk & Recorder

1 RECORDING REQUESTED BY:
2 Kecia Harper-Ihem, Clerk of the
3 Board of Supervisors
4 (Stop #1010)



5 WHEN RECORDED PLEASE MAIL TO:
6 Julie Jarvi, Deputy County Counsel
7 County of Riverside
8 OFFICE OF COUNTY COUNSEL
9 3960 Orange Street, Fifth Floor (Stop #1350,
10 Riverside, CA 92501

S	R	U	PAGE	SIZE	DA	MISC	LONG	RFD	COPY
1			6						
M	A	L	465	426	PCOR	NCOR	SMF	NCHG	EXAM
NCL6CC.							T:	CTY	UNI

[EXEMPT '6103]

C
513

11 **BOARD OF SUPERVISORS**
12 **COUNTY OF RIVERSIDE**

13 IN RE ABATEMENT OF PUBLIC NUISANCE:) CASE NO. CV 09-04325
14 [SUBSTANDARD STRUCTURES]; APN: 667-)
15 211-043, 61785 CREST STREET, DESERT HOT)
16 SPRINGS, RIVERSIDE COUNTY,) FINDINGS OF FACT,
17 CALIFORNIA; EDDIE LEE ROACH AND) CONCLUSIONS AND ORDER TO
18 CHARLES ROACH, OWNERS.) ABATE NUISANCE
19) [R.C.O. Nos. 457 (RCC Title 15) and
20) 725 (RCC Title 1)]

21 The above-captioned matter came on regularly for hearing on December 22, 2009 before the
22 Board of Supervisors of the County of Riverside, State of California in the Board Room, First Floor
23 Annex, County Administrative Center, 4080 Lemon Street, Riverside, California regarding the real
24 property described as 61785 Crest Street, Desert Hot Springs, Riverside County, APN: 667-211-043,
25 and referred to hereinafter as "THE PROPERTY."

26 Julie Jarvi, Deputy County Counsel, appeared along with Brian Black, Supervising Code
27 Enforcement Officer, on behalf of the Director of the Code Enforcement Department.

28 Owner, Eddie Roach, appeared and addressed the Board of Supervisors.

The Board of Supervisors received the Declaration of the Code Enforcement Officer together
with the attached Exhibits, evidencing the substandard structures on THE PROPERTY as a public
nuisance and violation of Riverside County Ordinance No. 457 as codified in Riverside County Code
Title 15.

///

FINDINGS OF FACT, CONCLUSIONS
AND ORDER TO ABATE NUISANCE

1 **SUMMARY OF EVIDENCE**

2 1. Documents of record in the Riverside County Recorder's Office identify the Owners
3 of THE PROPERTY as Eddie Lee Roach and Charles Roach ("OWNERS").

4 2. Documents of title indicate that other parties potentially hold a legal interest in THE
5 PROPERTY, to wit: The Saxe Dobrin Trust (hereinafter "INTERESTED PARTY").

6 3. THE PROPERTY was inspected by Code Enforcement Officers on June 17, 2009,
7 July 28, 2009, August 18, 2009, August 19, 2009, November 25, 2009 and December 21, 2009.

8 4. During each inspection, three substandard structures (48' x 21' wood structure, 12' x
9 24' patio and perimeter fence) were observed on THE PROPERTY. The structures were described
10 as abandoned, dilapidated and vacant. The structures contained numerous deficiencies, including but
11 not limited to: deteriorated or inadequate foundation; defective or deteriorated flooring and floor
12 supports; members of walls, partitions or other vertical supports that split, lean, list or buckle due to
13 defective material or deterioration; members of ceilings, roofs, ceiling and roof supports or other
14 horizontal members which sag, split or buckle due to defective material or deterioration; dampness of
15 habitable rooms; faulty weather protection; general dilapidation or improper maintenance;
16 abandoned/vacant, public and attractive nuisance.

17 5. THE PROPERTY was determined to be in violation of Riverside County Ordinance
18 No. 457 (RCC Title 15) by the Code Enforcement Officer.

19 6. A Notice of Noncompliance was recorded on June 30, 2009 as Document Number
20 2009-0336832 in the Office of the County Recorder, County of Riverside.

21 7. June 17, 2009, Notices of Violation, Notice of Defects and "Danger Do Not Enter"
22 signs were posted on THE PROPERTY for two of the structures. On June 19, 2009, a Notice of
23 Violation and Notice of Defects for the perimeter fence was posted on THE PROPERTY. On July 1,
24 2009, Notices of Violation and Notice of Defects were mailed by certified mail, return receipt
25 requested to the OWNERS and INTERSTED PARTY. On August 19, 2009, a Notice of Violation
26 and Notice of Defects were mailed by certified mail, return receipt requested to the INTERESTED
27 PARTY.

28 ///

FINDINGS OF FACT, CONCLUSIONS
AND ORDER TO ABATE NUISANCE

2010-0035272
01/27/2010 08:08A
2 of 6



1 reconstruction of said structures provided such reconstruction can be accomplished in strict
2 accordance with all Riverside County Ordinances, including but not limited to Riverside County
3 Ordinance No. 457 within ninety (90) days of the posting and mailing of this Order to Abate
4 Nuisance.

5 IT IS FURTHER ORDERED that if the substandard structures are not razed, removed and
6 disposed of, or reconstructed in strict accordance with all Riverside County Ordinances, including but
7 not limited to Riverside County Ordinance No. 457, within ninety (90) days of the posting and
8 mailing of this Order to Abate Nuisance, the substandard structures, contents therein, and structural
9 debris and materials, shall be abated by representatives of the Riverside County Code Enforcement
10 Department, a contractor, or the Sheriff's Department upon receipt of the owner's consent or a Court
11 Order, where necessary, under, applicable law authorizing entry onto THE PROPERTY.

12 FURTHERMORE, THE OWNERS are ordered to ascertain the existence or non-existence of
13 asbestos containing materials in said structure by survey and materials sample testing by a duly
14 licensed and certified asbestos consultant; and, prior to the abatement ordered hereinabove, to secure
15 the removal of all asbestos containing materials discovered through such survey and testing by
16 contract with a duly certified and licensed contractor for the handling of such materials to avoid
17 citations and/or fines by South Coast Air Quality Management District (SCAQMD).

18 IT IS FURTHER ORDERED that reasonable abatement costs, after notice and opportunity
19 for hearing, shall be imposed as a lien on THE PROPERTY, which may be collected as a special
20 assessment against THE PROPERTY pursuant to Government Code section 25845 and Riverside
21 County Ordinance Nos. 457 and 725. Under Riverside County Ordinance 725, "abatement costs"
22 means "any costs or expenses reasonably related to the abatement of conditions which violate County
23 Land Use Ordinances, and shall include, but not be limited to, enforcement, investigation, collection
24 and administrative costs, attorneys fees, and the costs associated with the removal or correction of the
25 violation." Reasonable abatement costs accrued by the Code Enforcement Department will be

26 ///

27 ///

28 ///

FINDINGS OF FACT, CONCLUSIONS
AND ORDER TO ABATE NUISANCE

2010-0035272
01/27/2010 08:00A
4 of 6



1 recoverable from the property owner(s) even if THE PROPERTY is brought into compliance within
2 ninety (90) days of the date of this Order to Abate Nuisance.

4 Dated: January 26, 2010

COUNTY OF RIVERSIDE

By Marion Ashley
Marion Ashley
Chairman, Board of Supervisors

7 ATTEST:

8 KECIA HARPER-IHEM

9 Clerk to the Board

12 By Julie A. Koons Jarvi

13 Deputy

14 (SEAL)

FORM APPROVED COUNTY COUNSEL
BY: Julie A. Koons Jarvi 1/26/10
DATE



2010-0035272
01/27/2010 09:00A
5 of 6

FINDINGS OF FACT, CONCLUSIONS
AND ORDER TO ABATE NUISANCE



LARRY W. WARD
COUNTY OF RIVERSIDE
ASSESSOR-COUNTY CLERK-RECORDER

Recorder
P.O. Box 751
Riverside, CA 92502-0751
(951) 486-7000

<http://riverside.asclerc.com>

CERTIFICATION

Pursuant to the provisions of Government Code 27361.7, I certify under the penalty of perjury that the following is a true copy of illegible wording found in the attached document:

(Print or type the page number(s) and wording below):

CLARIFICATION OF THE SEAL for the Riverside County Board of Supervisors
(embossed on document)

2010-0035272
01/27/2010 08:00A
6 of 6



Date:

1-26-10

Signature:

Sandi Schlemmer

Print Name:

Sandi Schlemmer, Deputy Clerk - Riverside County Clerk of the Board

ACR 601P-AS4RE0 (Rev. 01/2005)

Public Record

RECORDING REQUEST BY

THE SAKS DOBRIN TRUST
judgment creditor
WHEN RECORDED MAIL TO

NAME Brian L. Dobrin, Esq.

MAILING ADDRESS 11600 WASHINGTON Pl. Ste. 116A

CITY, STATE Los Angeles, CA 9006
ZIP CODE

Attorney for judgment creditor

DOC # 2000-388238

10/02/2000 08:00A Fee:17.00

Page 1 of 3

Recorded in Official Records
County of Riverside

Gary L. Orso
Assessor, County Clerk & Recorder



M	S	U	PAGE	SIZE	DA	PCOR	NOCOR	IMP	MSC
			3						
A	R	L				COPY	LONG	REFUND	INDX

18

TITLE(S)

M
SC

ABSTRACT OF JUDGMENT

RV00007700

10 2 00

THIS MICROFILM COPYRIGHTED
1987 BY SECURITY UNION TITLE
INSURANCE COMPANY
MICROFILM DIVISION

RIVERSIDE

PAGE 1/34

1700007700

10 2 00

1987 BY SECURITY UNION TITLE INSURANCE COMPANY MICROGRAPHICS DIVISION

RIVERSIDE

KEY OR PARTY WITHOUT ATTORNEY (Name of) TELEPHONE NO

Recording requested by and return to:
BRIAN L. DOBRIN, SBN: 159552 (310)915-1978
 11800 Washington Pl. Ste. 116A
 Los Angeles, CA 90088

ATTORNEY FOR JUDGMENT CREDITOR ASSIGNEE OF RECORD

NAME OF COURT: Los Angeles Municipal
 STREET ADDRESS: 110 North Grand Avenue
 MAILING ADDRESS:
 CITY AND ZIP CODE: Los Angeles, CA 90012
 BRANCH NAME: Central

PLAINTIFF: THE SAXE DOBRIN TRUST
 DEFENDANT: CAMILLE SHAPIRO et. al.

CASE NUMBER: 00K12585

5 20 2
2000-080208
19/08/01

ABSTRACT OF JUDGMENT

1. The judgment creditor assignee of record applies for an abstract of judgment and represents the following:
- a. Judgment debtor's Name and last known address:
CAMILLE SHAPIRO
 825 Vernon Avenue
 Venice, California 90291
- b. Driver's license No. and state: C4601945 CA Unknown
 Social Security No.: 573-84-0262 Unknown
- c. Summons or notice of entry of sister-state judgment was personally served or mailed to (name and address): Same as above

NOTIFICATION MAILED USA POSTAL SERVICE

e. 3 Additional judgment debtors are shown on reverse.
Date: Sept. 8, 2000

BRIAN L. DOBRIN _____
(TYPE OR PRINT NAME) (SIGNATURE OF APPLICANT OR ATTORNEY)

2. a. I certify that the following is a true and correct abstract of the judgment entered in this action.
 b. A certified copy of the judgment is attached.
3. Judgment creditor (name): **THE SAXE DOBRIN TRUST**
 whose address appears on this form above the court's name.
4. Judgment debtor (full name as it appears in judgment):
CAMILLE SHAPIRO; ED ROACH
5. a. Judgment entered on (date): **March 25, 1991**
 b. Renewal entered on (date): **June 10, 2000**
 c. Renewal entered on (date):
6. Total amount of judgment as entered or last renewed: **\$29,451.60**
7. An execution attachment lien is endorsed on the judgment as follows:
 a. Amount: \$
 b. In favor of (name and address):
8. A stay of enforcement has
 a. not been ordered by the court.
 b. been ordered by the court effective until (date):
9. This judgment is an installment judgment.
- This abstract issued on (date): **SEP 14 2000**
 Clerk, by **John A. Zahn** Deputy **KARA ZAHN**

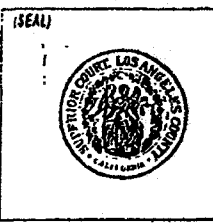

Form Adopted by Rule 962 Judicial Council of California 5/23/91 (Rev. January 1, 1991)

ABSTRACT OF JUDGMENT (CIVIL)

Code of Civil Procedure, § 488.480, 674.700-190

PLAINTIFF: THE SAXE DOBRIN TRUST	CASE NUMBER
DEFENDANT: CAMILLE SHAPIRO et. al.	00K12585

INFORMATION ON ADDITIONAL JUDGMENT DEBTORS:

10. Name and last known address

ED ROACH
825 Vernon Ave.
Venice, CA 90291

14. Name and last known address

Driver's license No. & state: Unknown
Social Security No.: Unknown
Summons was personally served at or mailed to (address):
Same as above

Driver's license No. & state: Unknown
Social Security No.: Unknown
Summons was personally served at or mailed to (address):

NOTIFICATION MAILED
USA POSTAL SERVICE

11. Name and last known address

Driver's license No. & state: Unknown
Social Security No.: Unknown
Summons was personally served at or mailed to (address):

15. Name and last known address

Driver's license No. & state: Unknown
Social Security No.: Unknown
Summons was personally served at or mailed to (address):

12. Name and last known address

Driver's license No. & state: Unknown
Social Security No.: Unknown
Summons was personally served at or mailed to (address):

16. Name and last known address

Driver's license No. & state: Unknown
Social Security No.: Unknown
Summons was personally served at or mailed to (address):

13. Name and last known address

Driver's license No. & state: Unknown
Social Security No.: Unknown
Summons was personally served at or mailed to (address):

17. Name and last known address

Driver's license No. & state: Unknown
Social Security No.: Unknown
Summons was personally served at or mailed to (address):

18. Continued on attachment 18.



2000-388238
10/02/2000 08:00A
3 of 3

ABSTRACT OF JUDGMENT (CIVIL) Page two
2000 (C) American LegalNet, Inc.

THIS MICROFILM COPYRIGHTED
 1997 BY SECURITY UNION TITLE
 INSURANCE COMPANY
 MICROGRAPHICS DIVISION

RIVERSIDE

SITE PLAN: Case # CV-1001852

OWNER(S): EDDIE LEE ROACH / CHARLES ROACH
 ADDRESS: P O BOX 1158, DESERT HOT SPRINGS, CA 92240
 ASSESSOR'S PARCEL: 667-211-043
 ACREAGE: 1.399999

NORTH ARROW: 

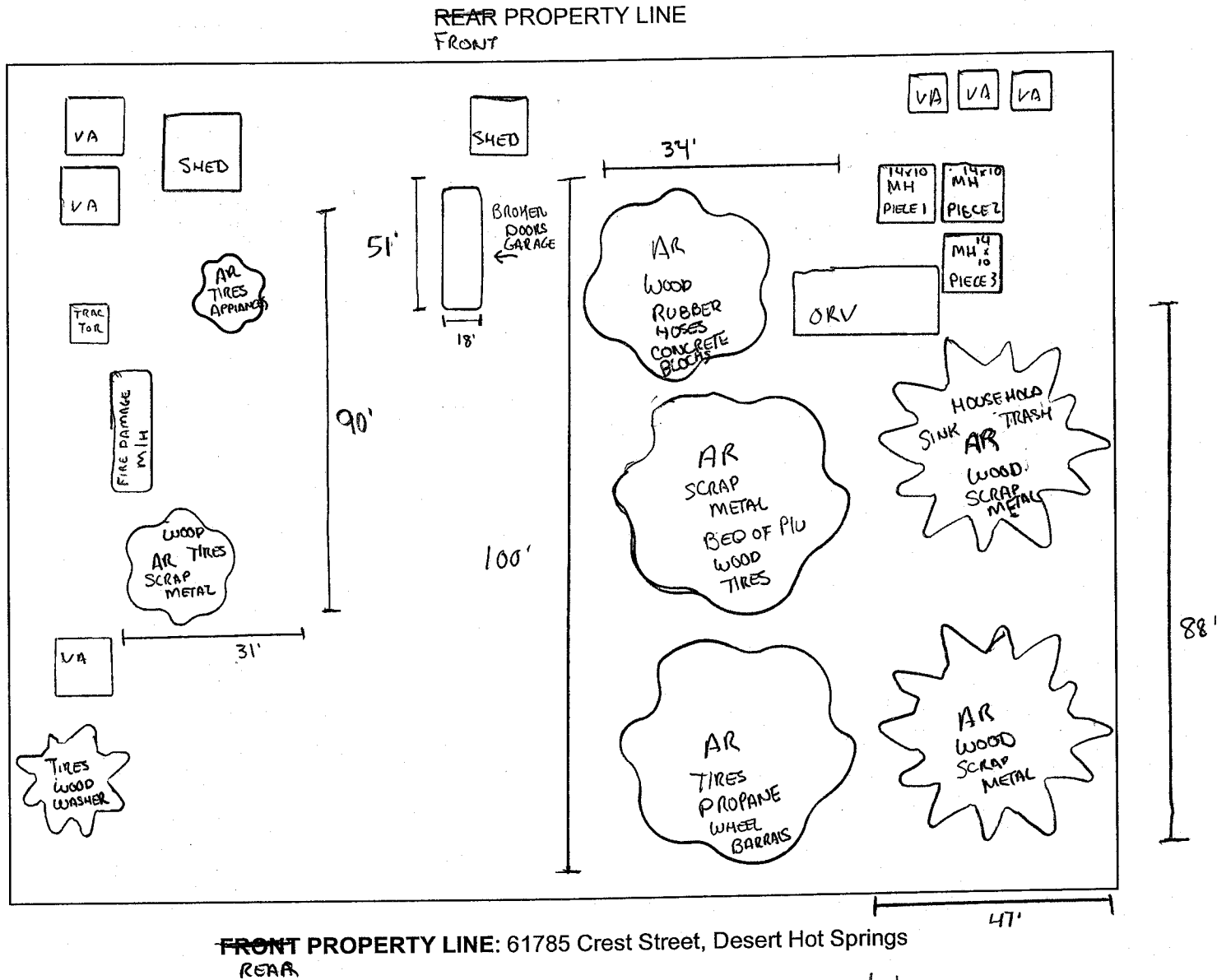

PREPARED BY: M. BOWLES #14 DATE: 5/11/2010

EXHIBIT NO. D

Code Enforcement Case: CV1001852

Printed on: 06/04/2010

Photographs



Picture2.jpg - 03/05/2010

EXHIBIT NO. D²



Picture1.jpg - 03/05/2010

EXHIBIT NO. D³



IMG_7434.JPG - 03/09/2010

EXHIBIT NO. D⁴



IMG_7432.JPG - 03/09/2010

EXHIBIT NO. D⁵



IMG_7433.JPG - 03/09/2010

EXHIBIT NO. _____

D6



Accumulated Rubbish. (Overview) MB 5/11/2010 - 05/05/2010

EXHIBIT NO. D⁷



Accumulated Rubbish.(scrap Metal, appliances) MB 5/11/2010 - 05/05/2010

EXHIBIT NO. _____

D8



Accumulated Rubbish. (tires, scrap wood) MB 5/11/2010 - 05/05/2010

EXHIBIT NO. D⁹



Accumulated Rubbish. (scrap metal, appliances, wood) MB 5/5/2010 - 05/05/2010

EXHIBIT NO. D¹⁰



Accumulated Rubbish. (propane tanks, tires, etc.) MB 5/11/2010 - 05/05/2010

EXHIBIT NO. D¹¹



Accumulated Rubbish. (auto parts,tires,wood,etc.) MB 5/11/2010 - 05/05/2010

EXHIBIT NO. D¹²



Accumulated Rubbish. (wood, concrete) MB 5/11/2010 - 05/05/2010

EXHIBIT NO. D¹³



Accumulated Rubbish. (scrap wood) MB 5/11/2010 - 05/05/2010

EXHIBIT NO. D/A



Accumulated Rubbish. (household Items, wood,etc.) MB 5/11/2010 - 05/05/2010

EXHIBIT NO. D¹⁵



Accumulated Rubbish. (scrap wood) MB 5/11/2010 - 05/05/2010

EXHIBIT NO. D¹⁶



Accumulated Rubbish. (barrels, appliances, etc.) MB 5/11/2010 - 05/05/2010

EXHIBIT NO. D¹⁷



EXHIBIT NO. 5



Accumulated Rubbish. 9household trash, carpets, wood) MB 5/11/2010 - 05/05/2010

EXHIBIT NO. D¹⁸



COUNTY OF RIVERSIDE
CODE ENFORCEMENT DEPARTMENT

NOTICE OF VIOLATION

CASE No.: CV TBA [] [] [] [] [] [] [] [] [] []

THE PROPERTY AT 101745 CHST

APN: 1007-211-043

WAS INSPECTED BY OFFICER: R. K. K. S.

ID# 104

ON 3/8/2010 AT 9:35 am/pm

AND FOUND TO BE IN VIOLATION OF RIVERSIDE COUNTY CODE(S) AS FOLLOWS:

<input type="checkbox"/>	5.28.040 (RCO 593)	Excessive Yard Sales - Cease yard sale. Limit of 3 yard sale events, not over 3 consecutive days, per year.	<input type="checkbox"/>	17.252.030 (RCO 348)	Unpermitted Outdoor Advertising Display - Obtain a permit from the Planning Dept. or remove display.
<input type="checkbox"/>	8.28.030 (RCO 821)	Unfenced Pool - Install or provide adequate fencing to secure the pool.	<input type="checkbox"/>	17.172.205 (RCO 348)	Prohibited Fencing - Remove fence. Fences shall not be constructed of garage doors, tires, pallets or other materials not typically used for the construction of fences.
<input checked="" type="checkbox"/>	8.120.010 (RCO 541)	Accumulated Rubbish - Remove all rubbish & dispose of in an approved legal landfill.	<input type="checkbox"/>	17. (RCO 348)	Excessive Outside Storage: Storage of Unpermitted Mobile Home(s) Not Allowed - Remove unpermitted mobile home(s) from the property.
<input type="checkbox"/>	15.08.010 (RCO 457)	Unpermitted Construction - Cease construction. Obtain the appropriate permits from the Bldg. & Safety and Planning Departments or demolish the	<input type="checkbox"/>	17. (RCO 348)	Occupied RV/Trailer - Cease occupancy & disconnect all utilities to RV/Trailer.
<input type="checkbox"/>	15.12.020(J)(2) (RCO 457)	Unapproved Grading/Clearing - Cease grading/clearing/stockpiling/importing fill. Obtain a Restoration Assessment from the Dept. of Building & Safety. Perform complete restoration and remediation of the property affected by the unapproved grading in accordance with the Restoration Assessment.	<input type="checkbox"/>	17. (RCO 348)	Excessive Animals - Remove or reduce the number of _____ to less than _____.
<input type="checkbox"/>	15.16.020 (RCO 457)	Substandard Structure - Obtain a permit from the Bldg. & Safety Dept. to rehabilitate per Notice of Defects or demolish the structure.	<input type="checkbox"/>	17. (RCO 348)	Unpermitted Land Use: _____ Cease all business activities. Obtain Planning Dept. approval prior to resuming business operations.
<input type="checkbox"/>	15.48.010 (RCO 457)	Unpermitted Mobile Home—Vacate mobile home. Obtain the appropriate permits from the Planning Dept. & Dept. of Bldg. & Safety prior to occupancy or remove Mobile Home.	<input type="checkbox"/>	17. (RCO 348)	Excessive Outside Storage - Remove or reduce all outside storage to less than _____ square feet at the rear of the property.
<input type="checkbox"/>	15.48.040 (RCO 457)	Substandard Mobile Home/Trailer/RV - Obtain a permit from the Bldg. & Safety Dept. to rehabilitate per Notice of Defects and Title 25 or demolish the Mobile Home/Trailer/RV.	<input type="checkbox"/>		

COMMENTS: _____

IMPORTANT! CORRECTION(S) MUST BE COMPLETED BY: 4/1/2010. FAILURE TO COMPLY BY THIS DATE, MAY RESULT IN THE ISSUANCE OF AN ADMINISTRATIVE CITATION WITH FINES UP TO \$500.00 PER DAY, FOR EACH VIOLATION. YOU MAY BE CITED EACH DAY THAT THE VIOLATION(S) EXIST BEYOND THE CORRECTION DATE. IN ADDITION, OTHER ENFORCEMENT ACTION, PENALTIES AND THE IMPOSITION OF A LIEN ON THE PROPERTY FOR THE ABATEMENT AND ENFORCEMENT COSTS MAY RESULT IF COMPLIANCE IS NOT ACHIEVED BY THE CORRECTION DATE.

NOTICE IS HEREBY GIVEN THAT AT THE CONCLUSION OF THIS CASE YOU WILL RECEIVE A SUMMARY OF ADMINISTRATIVE COSTS ASSOCIATED WITH THE PROCESSING OF SUCH VIOLATION(S), AT AN HOURLY RATE OF \$50 AS DETERMINED BY THE BOARD OF SUPERVISORS. YOU WILL HAVE THE RIGHT TO OBJECT TO THESE CHARGES BY FILING A REQUEST FOR HEARING WITH THE DEPARTMENT OF CODE ENFORCEMENT WITHIN TEN (10) DAYS OF SERVICE OF THE SUMMARY OF CHARGES, PURSUANT TO RIVERSIDE COUNTY ORDINANCE 725 AND RIVERSIDE COUNTY CODE I.16.

_____ SIGNATURE _____ PRINT NAME _____ DATE _____ PROPERTY OWNER TENANT
 _____ CDL/CID# _____ D.O.B. _____ EXHIBIT NO. E POSTED



**CODE ENFORCEMENT DEPARTMENT
COUNTY OF RIVERSIDE**

JOHN BOYD
Director

AFFIDAVIT OF POSTING OF NOTICES

March 9, 2010

RE CASE NO: CV1001852

I, Regina Keyes, hereby declare:

I am employed by the Riverside County Code Enforcement Department; that my business address is 24318 Hemlock, Ave., Suite C-1, Moreno Valley, California 92557 .

That on 3/8/2010 at 9:05 a.m., I securely and conspicuously posted Notice of Violation for RCC 8.120.010 Accumulation of Rubbish at the property described as:

Property Address: 61785 Crest Street, Desert Hot Springs

Assessor's Parcel Number: 667-211-043

I declare under the penalty of perjury that the foregoing is true and correct.

Executed on March 9, 2010 in the County of Riverside, California.

CODE ENFORCEMENT DEPARTMENT

Regina Keyes
By: Regina Keyes, Sr. Code Enforcement Officer

EXHIBIT NO. E²

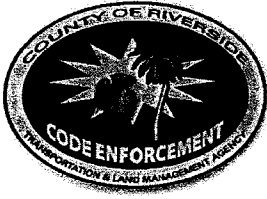

**CODE ENFORCEMENT DEPARTMENT
COUNTY OF RIVERSIDE**

JOHN BOYD
Director

NOTICE OF VIOLATION

March 31, 2010

EDDIE LEE ROACH / CHARLES ROACH
P O BOX 1158
DESERT HOT SPRINGS, CA 92240

RE CASE NO: CV10-01852 at 61785 Crest Street, Desert Hot Springs, California,
Assessor's Parcel Number 667-211-043

NOTICE IS HEREBY GIVEN that property owned or controlled by you at 61785 Crest Street, Desert Hot Springs California, Assessor's Parcel Number 667-211-043, is in violation of Section(s) RCC Section No. 8.120.010 (Ord. 541), of the Riverside County Code.

Said violation is described as:

- 1) 8.120.010 (Ord. 541) - No person or entity shall permit the accumulation of rubbish or other material, dangerous or injurious to the health and welfare of persons or the environment, on any real property in the unincorporated area of Riverside County owned by them or under their control.

YOU ARE HEREBY REQUIRED TO COMPLY with the provisions of the ordinance by:

- 1) Remove all rubbish and dispose of it in an approved, legal landfill.

COMPLIANCE MUST BE COMPLETED BY April 30, 2010. FAILURE TO COMPLY WILL RESULT IN LEGAL ACTION BEING BROUGHT AGAINST YOU.

NOTICE IS HEREBY GIVEN THAT AT THE CONCLUSION OF THIS CASE YOU WILL RECEIVE A SUMMARY OF ADMINISTRATIVE COSTS ASSOCIATED WITH THE PROCESSING OF SUCH VIOLATION(S), AT AN HOURLY RATE OF \$109.00 AS DETERMINED BY THE BOARD OF SUPERVISORS.

YOU WILL HAVE THE RIGHT TO OBJECT TO THESE CHARGES BY FILING A REQUEST FOR HEARING WITH THE DEPARTMENT OF CODE ENFORCEMENT WITHIN TEN (10) DAYS OF SERVICE OF THE SUMMARY OF CHARGES, PURSUANT TO SECTION 1.16.080 OF RIVERSIDE COUNTY CODE.

CODE ENFORCEMENT DEPARTMENT

By: Regina Keyes, Sr. Code Enforcement Officer

EXHIBIT NO. E³



**CODE ENFORCEMENT DEPARTMENT
COUNTY OF RIVERSIDE**

JOHN BOYD
Director

NOTICE OF VIOLATION

March 31, 2010

Occupant
61785 Crest Street
Desert Hot Springs, CA 92240

RE CASE NO: CV10-01852 at 61785 Crest Street, Desert Hot Springs, California,
Assessor's Parcel Number 667-211-043

NOTICE IS HEREBY GIVEN that property owned or controlled by you at 61785 Crest Street, Desert Hot Springs California, Assessor's Parcel Number 667-211-043, is in violation of Section(s) RCC Section No. 8.120.010 (Ord. 541), of the Riverside County Code.

Said violation is described as:

- 1) 8.120.010 (Ord. 541) - No person or entity shall permit the accumulation of rubbish or other material, dangerous or injurious to the health and welfare of persons or the environment, on any real property in the unincorporated area of Riverside County owned by them or under their control.

YOU ARE HEREBY REQUIRED TO COMPLY with the provisions of the ordinance by:

- 1) Remove all rubbish and dispose of it in an approved, legal landfill.

COMPLIANCE MUST BE COMPLETED BY April 30, 2010. FAILURE TO COMPLY WILL RESULT IN LEGAL ACTION BEING BROUGHT AGAINST YOU.

NOTICE IS HEREBY GIVEN THAT AT THE CONCLUSION OF THIS CASE YOU WILL RECEIVE A SUMMARY OF ADMINISTRATIVE COSTS ASSOCIATED WITH THE PROCESSING OF SUCH VIOLATION(S), AT AN HOURLY RATE OF \$109.00 AS DETERMINED BY THE BOARD OF SUPERVISORS.

YOU WILL HAVE THE RIGHT TO OBJECT TO THESE CHARGES BY FILING A REQUEST FOR HEARING WITH THE DEPARTMENT OF CODE ENFORCEMENT WITHIN TEN (10) DAYS OF SERVICE OF THE SUMMARY OF CHARGES, PURSUANT TO SECTION 1.16.080 OF RIVERSIDE COUNTY CODE.

CODE ENFORCEMENT DEPARTMENT

By: Regina Keyes, Sr. Code Enforcement Officer

EXHIBIT NO. _____

E⁴



**CODE ENFORCEMENT DEPARTMENT
COUNTY OF RIVERSIDE**

JOHN BOYD
Director

NOTICE OF VIOLATION

March 31, 2010

Brian L. Dobrin, ESQ.
11600 Washington Pl.
Los Angeles, CA 9006

RE CASE NO: CV10-01852 at 61785 Crest Street, Desert Hot Springs, California,
Assessor's Parcel Number 667-211-043

NOTICE IS HEREBY GIVEN that property owned or controlled by you at 61785 Crest Street, Desert Hot Springs California, Assessor's Parcel Number 667-211-043, is in violation of Section(s) RCC Section No. 8.120.010 (Ord. 541), of the Riverside County Code.

Said violation is described as:

- 1) 8.120.010 (Ord. 541) - No person or entity shall permit the accumulation of rubbish or other material, dangerous or injurious to the health and welfare of persons or the environment, on any real property in the unincorporated area of Riverside County owned by them or under their control.

YOU ARE HEREBY REQUIRED TO COMPLY with the provisions of the ordinance by:

- 1) Remove all rubbish and dispose of it in an approved, legal landfill.

COMPLIANCE MUST BE COMPLETED BY April 30, 2010. FAILURE TO COMPLY WILL RESULT IN LEGAL ACTION BEING BROUGHT AGAINST YOU.

NOTICE IS HEREBY GIVEN THAT AT THE CONCLUSION OF THIS CASE YOU WILL RECEIVE A SUMMARY OF ADMINISTRATIVE COSTS ASSOCIATED WITH THE PROCESSING OF SUCH VIOLATION(S), AT AN HOURLY RATE OF \$109.00 AS DETERMINED BY THE BOARD OF SUPERVISORS.

YOU WILL HAVE THE RIGHT TO OBJECT TO THESE CHARGES BY FILING A REQUEST FOR HEARING WITH THE DEPARTMENT OF CODE ENFORCEMENT WITHIN TEN (10) DAYS OF SERVICE OF THE SUMMARY OF CHARGES, PURSUANT TO SECTION 1.16.080 OF RIVERSIDE COUNTY CODE.

CODE ENFORCEMENT DEPARTMENT

By: Regina Keyes, Sr. Code Enforcement Officer

EXHIBIT NO. ES



**CODE ENFORCEMENT DEPARTMENT
COUNTY OF RIVERSIDE**

JOHN BOYD
Director

NOTICE OF VIOLATION

March 31, 2010

Ed Roach
825 Vermon Ave.
Venice, Ca 90291

RE CASE NO: CV10-01852 at 61785 Crest Street, Desert Hot Springs, California,
Assessor's Parcel Number 667-211-043

NOTICE IS HEREBY GIVEN that property owned or controlled by you at 61785 Crest Street, Desert Hot Springs California, Assessor's Parcel Number 667-211-043, is in violation of Section(s) RCC Section No. 8.120.010 (Ord. 541), of the Riverside County Code.

Said violation is described as:

- 1) 8.120.010 (Ord. 541) - No person or entity shall permit the accumulation of rubbish or other material, dangerous or injurious to the health and welfare of persons or the environment, on any real property in the unincorporated area of Riverside County owned by them or under their control.

YOU ARE HEREBY REQUIRED TO COMPLY with the provisions of the ordinance by:

- 1) Remove all rubbish and dispose of it in an approved, legal landfill.

COMPLIANCE MUST BE COMPLETED BY April 30, 2010. FAILURE TO COMPLY WILL RESULT IN LEGAL ACTION BEING BROUGHT AGAINST YOU.

NOTICE IS HEREBY GIVEN THAT AT THE CONCLUSION OF THIS CASE YOU WILL RECEIVE A SUMMARY OF ADMINISTRATIVE COSTS ASSOCIATED WITH THE PROCESSING OF SUCH VIOLATION(S), AT AN HOURLY RATE OF \$109.00 AS DETERMINED BY THE BOARD OF SUPERVISORS.

YOU WILL HAVE THE RIGHT TO OBJECT TO THESE CHARGES BY FILING A REQUEST FOR HEARING WITH THE DEPARTMENT OF CODE ENFORCEMENT WITHIN TEN (10) DAYS OF SERVICE OF THE SUMMARY OF CHARGES, PURSUANT TO SECTION 1.16.080 OF RIVERSIDE COUNTY CODE.

CODE ENFORCEMENT DEPARTMENT

By: Regina Keyes, Sr. Code Enforcement Officer

EXHIBIT NO. _____

E6



**CODE ENFORCEMENT DEPARTMENT
COUNTY OF RIVERSIDE**

JOHN BOYD
Director

PROOF OF SERVICE

Case No. CV10-01852

STATE OF CALIFORNIA, COUNTY OF RIVERSIDE

I, Jennifer Miller, declare that I am a citizen of the United States and am employed in the County of Riverside, over the age of 18 years and not a party to the within action or proceeding; that my business address is at the footer of this notice.

That on March 31, 2010, I served the following documents(s):

**NOTICE RE: Notice of Violation (RCC 8.120.010)
Summary of Costs Notification**

by placing a true copy thereof enclosed in a sealed envelope(s) **BY CERTIFIED MAIL, RETURN RECEIPT REQUESTED** addressed as follows:

1. EDDIE LEE ROACH / CHARLES ROACH P O BOX 1158, DESERT HOT SPRINGS, CA 92240
2. Occupant 61785 Crest Street, Desert Hot Springs, CA 92240
3. Brian L. Dobrin, ESQ. 11600 Washington Pl., Los Angeles, CA 9006
4. Ed Roach 825 Vermon Ave., Venice, Ca 90291

XX **By First Class Mail.** I am readily familiar with the office's practice of collection and processing correspondence for mailing. Under that practice it would be deposited with the U.S. Postal Service with postage thereon fully prepaid in the County of Riverside, California, in the ordinary course of business.

XX **STATE.** I declare under the penalty of perjury under the laws of the State of California that the above is true and correct.

EXECUTED ON March 31, 2010 in the County of Riverside, California.

CODE ENFORCEMENT DEPARTMENT



By: Jennifer Miller, Code Enforcement Aide

EXHIBIT NO. E⁷

7009 3410 0000 1203 1997

U.S. Postal Service™
CERTIFIED MAIL™ RECEIPT
(Domestic Mail Only; No Insurance Coverage Provided)

For delivery information visit our website at www.usps.com

OFFICIAL USE

Postage	\$	Postmark Here
Certified Fee		
Return Receipt Fee (Endorsement Required)		
Restricted Delivery Fee (Endorsement Required)		

Eddie Lee Roach
 Charles Roach
 P.O. Box 1158
 Desert Hot Springs, CA 92240
 CV10-01852 / RK 667-211-043 (4)

PS Form 3800, August 2006 See Reverse for Instructions

SENDER: COMPLETE THIS SECTION	COMPLETE THIS SECTION ON DELIVERY
<ul style="list-style-type: none"> Complete items 1, 2, and 3. Also complete item 4 if Restricted Delivery is desired. Print your name and address on the reverse so that we can return the card to you. Attach this card to the back of the mailpiece, or on the front if space permits. 	<p>A. Signature <input checked="" type="checkbox"/> Charles Roach <input type="checkbox"/> Agent <input type="checkbox"/> Addressee</p> <p>B. Received by (Printed Name) _____ C. Date of Delivery 04/2/10</p> <p>D. Is delivery address different from item 1? <input type="checkbox"/> Yes If YES, enter delivery address below: <input type="checkbox"/> No</p>
<p>1. Article Addressed to: Eddie Lee Roach Charles Roach P.O. Box 1158 Desert Hot Springs, CA 92240 CV10-01852 / RK 667-211-043 (4)</p> <p style="text-align: center; font-size: 1.2em;">REC'D APR 05 2010</p>	<p>3. Service Type <input checked="" type="checkbox"/> Certified Mail <input type="checkbox"/> Express Mail <input type="checkbox"/> Registered <input checked="" type="checkbox"/> Return Receipt for Merchandise <input type="checkbox"/> Insured Mail <input type="checkbox"/> C.O.D.</p> <p>4. Restricted Delivery? (Extra Fee) <input type="checkbox"/> Yes</p>
<p>2. Article Number (Transfer from service label)</p>	<p>7009 3410 0000 1203 1997</p>
PS Form 3811, February 2004	Domestic Return Receipt 102595-02-M-1540

EXHIBIT NO. E8

U.S. Postal Service™
CERTIFIED MAIL™ RECEIPT
 (Domestic Mail Only; No Insurance Coverage Provided)

For delivery information visit our website at www.usps.com

OFFICIAL USE

Postage	\$
Certified Fee	
Return Receipt Fee (Endorsement Required)	
Restricted Delivery Fee (Endorsement Required)	

Postmark
Here

Occupant
 61785 Crest Street
 Desert Hot Springs, CA 92240
 CV10-01852 / RK 667-211-043 (4)

PS Form 3800, August 2006

See Reverse for Instr

0002 002T 0000 014E 6002

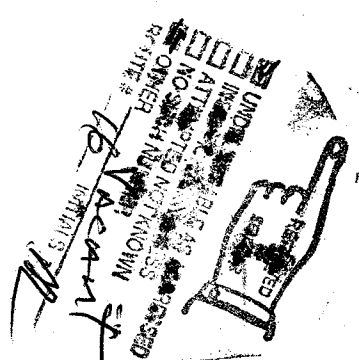

COUNTY OF RIVERSIDE
 Code Enforcement Department
 24318 Hemlock Avenue, Suite C-1
 Moreno Valley, CA 92557

RETURN RECEIPT REQUESTED
 RETURN RECEIPT REQUESTED

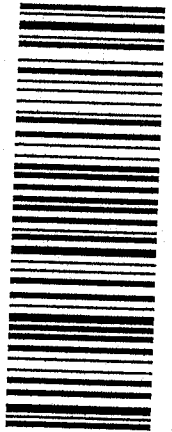

7009 3410 0000 1203 2000

CERTIFIED MAIL™

Occupant
 61785 Crest Street
 Desert Hot Springs, CA 92240
 CV10-01852 / RK 667-211-043 (4)

FIRST CLASS



UNITED STATES POSTAGE
 \$ 05.540
 02 1M
 0004234315
 MAR 31 2010
 MAILED FROM ZIP CODE 92504
 PRIMEY BOWES

NIXIE

923 DE 1 00 04/01/10

RETURN TO SENDER
 VACANT
 UNABLE TO FORWARD

BC: 92557722431

*0804-00791-31-40

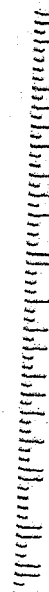

EXHIBIT NO. _____

79

U.S. Postal Service
CERTIFIED MAIL RECEIPT
(Domestic Mail Only; No Insurance Coverage Provided)

For delivery information visit our website at www.usps.com

OFFICIAL USE

7009 3410 0000 1203 2017

Postage	\$	Postmark Here
Certified Fee		
Return Receipt Fee (Endorsement Required)		
Restricted Delivery Fee (Endorsement Required)		

Brian L. Dobrin, ESQ
 11600 Washington Place
 Los Angeles, CA 90006
 CV10-01852 / RK 667-211-043 (4)

PS Form 3800, August 2006 See Reverse for Instructions

SENDER: COMPLETE THIS SECTION

- Complete items 1, 2, and 3. Also complete item 4 if Restricted Delivery is desired.
- Print your name and address on the reverse so that we can return the card to you.
- Attach this card to the back of the mailpiece, or on the front if space permits.

1. Article Addressed to:

Brian L. Dobrin, ESQ
 11600 Washington Place
 Los Angeles, CA 90006
 CV10-01852 / RK 667-211-043 (4)

REC'D APR 07 2010

2. Article Number
 (Transfer from service label)

7009 3410 0000 1203 2017

PS Form 3811, February 2004

Domestic Return Receipt

102595-02-M-1540

COMPLETE THIS SECTION ON DELIVERY

A. Signature *R. D.* Agent
 Addressee

B. Received by (Printed Name) *R. Destache* C. Date of Delivery *4-5-10*

D. Is delivery address different from item 1? Yes
 If YES, enter delivery address below: No

3. Service Type
 Certified Mail Express Mail
 Registered Return Receipt for Merchandise
 Insured Mail C.O.D.

4. Restricted Delivery? (Extra Fee) Yes

EXHIBIT NO. _____

E¹⁰

U.S. Postal Service™
CERTIFIED MAIL™ RECEIPT
(Domestic Mail Only; No Insurance Coverage Provided)

For delivery information visit our website at www.usps.com

OFFICIAL USE

7009 3410 0000 1203 2024

Postage	\$
Certified Fee	
Return Receipt Fee (Endorsement Required)	
Restricted Delivery Fee (Endorsement Required)	

Postmark
Here

Ed Roach
825 Vernon Avenue
Venice, CA 90291
CV10-01852 / RK 667-211-043 (4)

for Instructions

USPS - Track & Confirm

Page 1 of 1



[Home](#) | [Help](#) | [Sign In](#)

[Track & Confirm](#)

[FAQs](#)

Track & Confirm

Search Results

Label/Receipt Number: 7009 3410 0000 1203 2024
Service(s): **Certified Mail™**
Status: **Notice Left**

We attempted to deliver your item at 2:46 PM on April 2, 2010 in VENICE, CA 90291 and a notice was left. No further information is available for this item.

Track & Confirm

Enter Label/Receipt Number.

[Go >](#)

Notification Options

Track & Confirm by email

Get current event information or updates for your item sent to you or others by email.

[Go >](#)

EXHIBIT NO. _____

E11

When recorded please mail to
Riverside County Code Enforcement Department
(District 5 Office)
24318 Hemlock Avenue, Suite C-1
Moreno Valley, CA 92557
Mail Stop No. 5002

DOC # 2010-0123088
03/17/2010 08:00A Fee:NC

Page 1 of 1
Recorded in Official Records
County of Riverside
Larry W. Ward
Assessor, County Clerk & Recorder

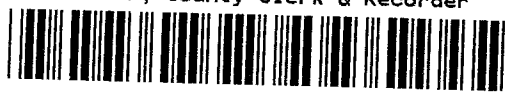

M
030

NOTICE OF NONCOMPLIANCE

In the matter of the Property of
Eddie Lee Roach)
Charles Roach)

Case No. CV10-01852

NOTICE IS HEREBY GIVEN to all persons, pursuant to Section 10 of Ordinance Number 725 of the County of Riverside, State of California, that proceedings have been commenced with respect to violations of Riverside County Ordinance No.541, (RCC Title 8.120.010) described as accumulation of rubbish. Such Proceedings are based upon the noncompliance of such real property, located at 1 parcel North of (61850 Crest Street) also known as 61785 Crest Street, Desert Hot Springs, CA, and more particularly described as Assessor's Parcel Number 667-211-043 and having a legal description of 1.40 ACRES M/L IN PAR 57 RS 025/053 DESERT CITY, Records of Riverside County, with the requirements of Ordinance No. 541 (RCC Title 8.120.010).

The owner has been advised to immediately correct the above-referenced violations to avoid further action by the County of Riverside which may include demolition, removal, razing, etc., to abate the public nuisance. Any costs incurred by the County, including, but not limited to investigative, administrative and abatement costs and attorneys' fees, may become a lien on the property. Further details regarding this notice may be obtained by addressing an inquiry to the Code Enforcement Department, 24318 Hemlock Avenue, Suite C-1, Moreno Valley, California, Attention Code Enforcement Officer Regina Keyes.

NOTICE IS FURTHER GIVEN in accordance with §17274 and §24436.5 of the California Revenue and Taxation Code, that a tax deduction may not be allowed for interest, taxes, depreciation, or amortization paid or incurred in the taxable year affected by these proceedings.

COUNTY OF RIVERSIDE
CODE ENFORCEMENT DEPARTMENT

By Mary Overholt
Mary Overholt
Code Enforcement Department

ACKNOWLEDGMENT

State of California)
County of Riverside)

On 03/12/10 before me, Ana E. Carrillo, Notary Public, personally appeared Mary Overholt, who proved to me on the basis of satisfactory evidence to be the person(s) whose name(s) is are subscribed to the within instrument and acknowledged to me that he/she they executed the same in his/her their authorized capacity(ies), and that by his/her their signature(s) on the instrument the person(s), or the entity upon behalf of which the person(s) acted, executed the instrument.

I certify under PENALTY OF PERJURY under the laws of the State of California that the foregoing paragraph is true and correct.

WITNESS my hand and official seal.
Ana E. Carrillo

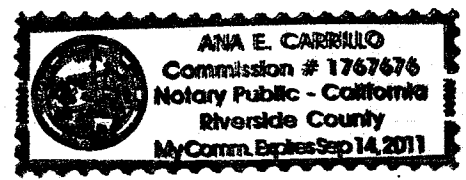

Commission # 1767676 Comm. Expires 9 14, 2011 **EXHIBIT NO.** F

PAMELA J. WALLS
County Counsel

Assistant County Counsel
KATHERINE A. LIND

OFFICE OF COUNTY COUNSEL
COUNTY OF RIVERSIDE

3960 ORANGE STREET, 5TH FLOOR
RIVERSIDE, CA 92501
TELEPHONE: 951/955-6300
FAX: 951/955-6322 & 955-6363

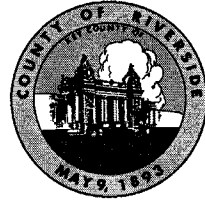

August 2, 2010

**NOTICE TO CORRECT COUNTY ORDINANCE VIOLATIONS
AND ABATE PUBLIC NUISANCE**

TO: Owners and Interested Parties
(See Attached Proof of Service
and Attached Notice List)

Case No.: CV 10-01852
APN: 667-211-043; ROACH
Property: 61785 Crest Street, Desert Hot Springs

NOTICE IS HEREBY GIVEN that a hearing will be held before the Riverside County Board of Supervisors pursuant to Riverside County Ordinance Nos. 541 (RCC Title 8) and 725 (RCC Title 1) to consider the abatement of the accumulated rubbish located on the SUBJECT PROPERTY described as 61785 Crest Street, Desert Hot Springs, **Riverside County, California**, and more particularly described as Assessor's Parcel Number 667-211-043.

YOU ARE HEREBY DIRECTED as owner of the SUBJECT PROPERTY, to appear at this hearing to show cause why the SUBJECT PROPERTY should not be condemned as a public nuisance and be abated by removing the accumulated rubbish from the real property.

SAID HEARING will be held on **Tuesday, September 28, 2010, at 9:30 a.m.** in the Board of Supervisors Room, County Administrative Center, 4080 Lemon Street, 1st Floor Annex, Riverside, California at which time and place pertinent evidence will be received and/or testimony from all concerned parties will be heard. Failure to appear on your behalf will result in the exclusion of your testimony, and facts as known to the Code Enforcement Department ("Department") will be presented to the Board of Supervisors for consideration and deliberation in this matter.

Please be advised that the costs already accrued in this case, including but not limited to, enforcement and investigation costs, are recoverable by the Department, as allowed under Riverside County Ordinance No. 725. The Department may seek recovery of such costs from the property owner(s) which may result in a special assessment lien against the SUBJECT PROPERTY. Additionally, should the Department abate the property, the costs associated therewith, as well as all abatement costs allowed under Riverside County Ordinance No. 725 (RCC Title 1), will be sought from the property owner(s) and/or may result in a special assessment lien against the property.

You are encouraged to contact Supervising Code Enforcement Officer Mary Overholt at (951) 485-5840 or the undersigned prior to the hearing. Please meet the undersigned and Brian Black, Supervising Code Enforcement Officer, at 8:30 a.m. on the day of the hearing in the lobby of the 1st floor annex in front of the Clerk of the Board's Office to discuss the case.

PAMELA J. WALLS
Riverside County Counsel



L. ALEXANDRA FONG
Deputy County Counsel

EXHIBIT NO. 6

NOTICE LIST

Subject Property: 61785 Crest Street, Desert Hot Springs
Case No.: CV 10-01852 APN: 667-211-043; District 5

EDDIE LEE ROACH
CHARLES ROACH
PO BOX 1158
DESERT HOT SPRINGS, CA 92240

SENDER, COMPLETE THIS SECTION	COMPLETE THIS SECTION ON DELIVERY
<ul style="list-style-type: none">■ Complete items 1, 2, and 3. Also complete item 4 if Restricted Delivery is desired.■ Print your name and address on the reverse so that we can return the card to you.■ Attach this card to the back of the mailpiece, or on the front if space permits.	A. Signature <i>x Charles Roach</i> <input type="checkbox"/> Agent <input type="checkbox"/> Addressee
1. Article Addressed to: EDDIE LEE ROACH CHARLES ROACH PO BOX 1158 DESERT HOT SPRINGS, CA 92240	B. Received by (Printed Name) <i>Charles Roach</i> C. Date of Delivery
2. Article Number (Transfer from service label) <i>CV 10-01852 (ROACH) ABT 1</i>	D. Is delivery address different from item 1? <input type="checkbox"/> Yes If YES, enter delivery address below: <input type="checkbox"/> No
2. Article Number (Transfer from service label)	3. Service Type <input checked="" type="checkbox"/> Certified Mail <input type="checkbox"/> Express Mail <input type="checkbox"/> Registered <input checked="" type="checkbox"/> Return Receipt for Merchandise <input type="checkbox"/> Insured Mail <input type="checkbox"/> C.O.D.
PS Form 3811, February 2004	4. Restricted Delivery? (Extra Fee) <input type="checkbox"/> Yes 7009 3410 0000 1318 1905 <i>[Signature]</i> Domestic Return Receipt 102595-02-M-1548

EXHIBIT NO. 62

PROOF OF SERVICE

Case No. CV 10-01852

1
2
3
4
5
6
7
8
9
10
11
12
13
14
15
16
17
18
19
20
21
22
23
24
25
26
27
28

STATE OF CALIFORNIA, COUNTY OF RIVERSIDE

I, Brenda Peeler, declare that I am a citizen of the United States and am employed in the County of Riverside, over the age of 18 years and not a party to the within action or proceeding; that my business address is 3960 Orange Street, 5th Floor, Riverside, California 92501.

That on August 2, 2010, I served the following document(s):

**NOTICE TO CORRECT COUNTY ORDINANCE VIOLATIONS
AND ABATE PUBLIC NUISANCE**

by placing a true copy thereof enclosed in a sealed envelope(s) addressed as follows:

**Owners or Interested Parties
(see attached notice list)**

XX **BY CERTIFIED MAIL, RETURN RECEIPT REQUESTED.** I am "readily familiar" with the office's practice of collection and processing correspondence for mailing. Under that practice it would be deposited with the U.S. Postal Service on that same day with postage thereon fully prepaid at Riverside, California, in the ordinary course of business.

 BY PERSONAL SERVICE: I caused to be delivered such envelope(s) by hand to the offices of the addressee(s).

XX **STATE - I declare under penalty of perjury under the laws of the State of California that the above is true and correct.**

 FEDERAL - I declare that I am employed in the office of a member of the bar of this court at whose direction the service was made.

EXECUTED ON August 2, 2010, at Riverside, California.

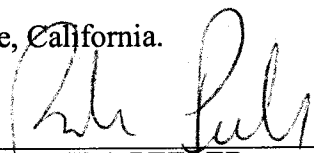

BRENDA PEELER

EXHIBIT NO. 6³

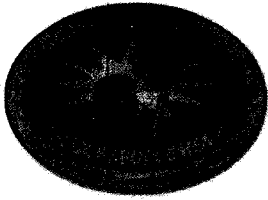

**CODE ENFORCEMENT DEPARTMENT
COUNTY OF RIVERSIDE**

GLENN BAUDE
Director

AFFIDAVIT OF POSTING OF NOTICES

August 4, 2010

RE CASE NO: CV1001852

I, Mike Bowles, hereby declare:

I am employed by the Riverside County Code Enforcement Department; that my business address is 24318 Hemlock, Ave., Suite C-1, Moreno Valley, California 92557 .

That on 8/3/2010 at 10:05 am, I securely and conspicuously posted Hearing Notice to Correct County Ordinance and Abate Public Nuisance. at the property described as:

Property Address: 61785 Crest Street, Desert Hot Springs

Assessor's Parcel Number: 667-211-043

I declare under the penalty of perjury that the foregoing is true and correct.

Executed on August 4, 2010 in the County of Riverside, California.

CODE ENFORCEMENT DEPARTMENT

By: Mike Bowles, Sr. Code Enforcement Officer

EXHIBIT NO. 64