

**SUBMITTAL TO THE FLOOD CONTROL AND
WATER CONSERVATION DISTRICT BOARD
COUNTY OF RIVERSIDE, STATE OF CALIFORNIA**

217B



FROM: General Manager-Chief Engineer

SUBMITTAL DATE:
September 28, 2010

SUBJECT: Public Hearing for Day Creek – Frank Avenue Storm Drain
Project No. 2-0-00274

RECOMMENDED MOTION:

Adopt Resolution No. F2010-23 which

1. Finds that the Project will not have a significant adverse effect upon the environment and is in compliance with the Western Riverside County Multiple Species Habitat Conservation Plan;
2. Adopts a Mitigated Negative Declaration;
3. Approves the Project and authorizes the District to proceed with the Project; and
4. Directs the Clerk of the Board to deliver the Mitigated Negative Declaration and the Notice of Determination to the office of the County Clerk for filing within 5 working days of this Board hearing.

BACKGROUND:

The hearing is in accordance with the requirements for CEQA and Section 18 of the District Act.

[Signature]

HAE:cw
P8/132053

WARREN D. WILLIAMS
General Manager-Chief Engineer

FINANCIAL DATA	Current F.Y. District Cost:	\$	In Current Year Budget:
	Current F.Y. County Cost:	\$	Budget Adjustment:
	Annual Net District Cost:	\$	For Fiscal Year:

SOURCE OF FUNDS:	Positions To Be Deleted Per A-30	<input type="checkbox"/>
	Requires 4/5 Vote	<input type="checkbox"/>

C.E.O. RECOMMENDATION:

APPROVE

BY: *[Signature]*
Alex Gann

County Executive Office Signature

FORM APPROVED COUNTY COUNSEL
BY: *[Signature]* 7/26/10
KARIN L. WATTS-BAZAN DATE

- Dept't Recomm.: Policy
- Per Exec. Ofc.: Policy
- Consent
- Consent

MINUTES OF THE FLOOD CONTROL AND WATER CONSERVATION DISTRICT

On motion of Supervisor Ashley, seconded by Supervisor Stone and duly carried, IT WAS ORDERED that the above matter is approved as recommended.

Ayes: Buster, Stone, Benoit and Ashley
Nays: None
Absent: Tavaglione
Date: October 5, 2010
xc: Flood, Recorder

Kecia Harper-Ihem
Clerk of the Board
By: *[Signature]*
Deputy

Prev. Agn. Ref.: 11.2 of 8/10/10 | **District:** 2nd | **Agenda Number:**

11.12

ATTACHMENTS FILED
WITH THE CLERK OF THE BOARD

BOARD OF SUPERVISORS

RIVERSIDE COUNTY FLOOD CONTROL
AND WATER CONSERVATION DISTRICT

RESOLUTION NO. F2010-23
APPROVING DAY CREEK - FRANK AVENUE STORM DRAIN PROJECT

WHEREAS, on August 10, 2010, the Board adopted Resolution No. F2010-22 pursuant to Section 18 of the District Act giving notice of its intention to construct a project in Zone 2, within the unincorporated Mira Loma community of Riverside County, designated as Day Creek - Frank Avenue Storm Drain Project and giving further notice that the Project would be considered at a public hearing on September 28, 2010; and

WHEREAS, notice of the public hearing was properly made by publication and posting as required by law, and all persons desiring to be heard on the matter were given the opportunity to appear and present testimony, both oral and written; and

WHEREAS, all requirements of the California Environmental Quality Act and the District Rules to Implement the Act have been met and the General Manager-Chief Engineer of the District has found that the Project will not have a significant adverse effect upon the environment and has completed a Mitigated Negative Declaration; now, therefore,

BE IT RESOLVED, DETERMINED AND ORDERED by the Board of Supervisors of the Riverside County Flood Control and Water Conservation District in regular session assembled on September 28, 2010 based upon the evidence and testimony presented on the matter, both written and oral, that:

1. The Project is **not** within the Criteria Area set forth in and established by the Western Riverside County Multiple Species Habitat Conservation Plan (MSHCP).

2. The Project is consistent with the Riparian/Riverine Area and Vernal Pool requirements of the MSHCP. Pursuant to Section 6.1.2 of the MSHCP, Riparian/Riverine areas are lands which contain habitat dominated by trees, shrubs, persistent emergents, or emergent mosses and lichens, which occur close to or which depend upon soil moisture from a nearby

FOR APPROVAL
BY: *Karin L. Watts* DATE: *7/26/10*
BY: *KARIN L. WATTS* DATE: _____

1 fresh water source, or areas with freshwater flow during all or a portion of the year. Vernal
2 Pools are seasonal wetlands that occur in depression areas that have wetlands indicators of all
3 three parameters (soils, vegetation, and hydrology) during the wetter portion of the growing
4 season. It has been determined that the Project area does not contain any vernal pools, nor does
5 it include Riparian/Riverine Areas as defined by the MSHCP. In addition, the proposed storm
6 drain alignment does not contain suitable habitat for least Bell's vireo, Southwestern Willow
7 Flycatcher, Yellow-breasted chat, or Yellow Warbler. Therefore, no further surveys or
8 conservation measures are required.
9

10 3. The Project is consistent with the Narrow Endemic Plant Species
11 requirements of the MSHCP. Pursuant to Section 6.1.3 of the MSHCP, habitat assessments
12 and/or focused surveys for certain narrow endemic plant species are required for properties
13 within mapped survey areas. The survey area maps have been reviewed and the Project is not
14 within a mapped survey area for Narrow Endemic Plant Species. Therefore, no further surveys
15 or conservation measures are required.
16

17 4. The Project is consistent with the Urban-Wildlands Interface requirements
18 of the MSHCP. Section 6.1.4 of the MSHCP presents guidelines to minimize indirect effects of
19 a project in proximity to the MSHCP Conservation Area. This section provides mitigation
20 measures for impacts associated with: Drainage, Toxics, Lighting, Noise, Invasives, Barriers,
21 and Grading/Land Development. The Project has been reviewed and it has been determined
22 the Project does not occur within or adjacent to the Criteria Area or MSHCP-designated
23 Public/Quasi-Public conservation lands. Therefore, no further analysis or implementation of
24 any conservation measures is required.
25

26 5. The Project is consistent with the Database Updates/Additional Surveys
27 requirements of the MSHCP. Pursuant to Section 6.3.2 of the MSHCP, habitat assessments
28 and/or focused surveys for certain additional plant and animal species are required for

1 properties within mapped survey areas. The survey area maps have been reviewed and the
2 Project is not within a mapped survey area. Therefore, no further surveys or conservation
3 measures are required.

4 6. The Project is consistent with the Public/Quasi-Public Land provisions
5 contained in Section 3.2.1 of the MSHCP. Section 3.2.1 describes lands within the MSHCP
6 conservation area including those designated as Public/Quasi-Public (PQP) lands. Section
7 3.2.1 states that if a Permittee elects to use property currently depicted as PQP Lands in a way
8 that alters the land use such that it would not contribute to Reserve Assembly, the Permittee
9 shall locate and acquire or otherwise encumber replacement acreage at a minimum ratio of 1:1.
10 The Permittee must make findings that the replacement acreage is biologically equivalent or
11 superior to the existing property. The Project has been reviewed and it has been determined the
12 Project does not occur within MSHCP-designated PQP conservation lands. Therefore, no
13 further analysis is required.

14
15
16 7. The project designated as Day Creek – Frank Avenue Storm Drain Project
17 is approved and the District is hereby authorized to proceed with the project.

18 8. The project will not have a significant adverse effect upon the environment
19 and a Mitigated Negative Declaration is adopted.

20 **BE IT FURTHER RESOLVED** that, within 5 working days of this Board
21 hearing, the Clerk of the Board is directed to deliver the adopted Mitigated Negative
22 Declaration and the Notice of Determination to the Office of the County Clerk and Recorder,
23 who are thereby directed to file same, all as required by law.

24
25 ROLL CALL:

26 Ayes: Buster, Stone, Benoit, and Ashley
27 Nays: None
28 Absent: Tavaglione

The foregoing is certified to be a true copy of a resolution duly adopted by said Board of Supervisors on the date therein set forth.

KECIA HARPER-IHEM, Clerk of said Board

-3-

By: _____

Deputy

MITIGATED NEGATIVE DECLARATION

10/27/10
Date

KB
Initial

State Clearinghouse Number: None Contact Person: Kris Flanigan Telephone Number: 951.955.8581 Email: kflaniga@rcflood.org

Lead Agency and Project Sponsor: Riverside County Flood Control and Water Conservation District

Address: 1995 Market Street City: Riverside Zip: 92501

Project Title and Description: **Day Creek-Frank Avenue Storm Drain.**
Day Creek-Frank Avenue Storm Drain includes the construction, operation and maintenance of approximately 1,100 lineal feet of 18 inch underground storm drain. The proposed project will be located within 65th Street and Frank Avenue. The project starts in Wineville Avenue at 65th Street and proceeds easterly for approximately 660 feet in 65th Street to Frank Avenue where it will turn north and continue for approximately 450 feet to an existing sump station. The project will be located entirely within existing street right of way. The construction will be managed by the District and the maintenance of this facility will be turned over to the County Transportation Department.

Project Location:
The proposed project is located within the unincorporated community of Mira Loma in Riverside County. The alignment for this project is generally bounded by Wineville Avenue to the west, Frank Avenue to the east, 64th Street to the north, and 65th Street to the south (please refer to the vicinity map and location map on Pages 3, 4 and 5). The proposed project is located within Township 6 South, Range 3 West, Section 29 of the Corona North, California 7.5 Minute USGS Quadrangle.

The General Manager-Chief Engineer of the Riverside County Flood Control and Water Conservation District has made a finding that the proposed Day Creek – Frank Avenue Storm Drain project will not have a significant adverse effect on the environment. An Initial Study/Environmental Assessment supporting this finding is attached. This finding will become final upon adoption of this Mitigated Negative Declaration by the Board of Supervisors of the Riverside County Flood Control and Water Conservation District. For mitigation measures refer to attached Mitigation Monitoring Program Table.

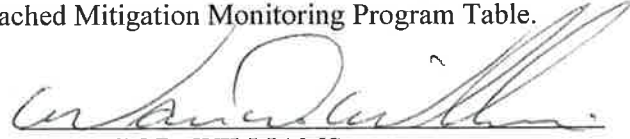
Signature: 
WARREN D. WILLIAMS
General Manager-Chief Engineer

Dated: 9/27/10

The Board of Supervisors of the Riverside County Flood Control and Water Conservation District, assembled in regular session on October 5, 2010, has determined that the Day Creek-Frank Avenue Storm Drain project will not have a significant adverse effect on the environment and has adopted this Mitigated Negative Declaration.

Signature:  for
KECIA HARPER-HEM
Clerk of the Board

Dated: October 5, 2010

- Attachments
Copies to: 1) County Clerk
 2) Flood Control

P8\131952

Notice of Determination

To: Office of Planning and Research

For U.S. Mail:
P.O. Box 3044
Sacramento, CA 95812-3044

Street Address:
1400 Tenth Street
Sacramento, CA 95814

From: Riverside County Flood Control
1995 Market Street
Riverside, CA 92501
Contact: Kris Flanigan
Phone: 951.955.8581

Lead Agency (if different from above):

County Clerk
County of Riverside
2724 Gateway Drive
Riverside, CA 92507

SUBJECT:

Filing of Notice of Determination in compliance with Section 21108 or 21152 of the Public Resources Code.

State Clearinghouse Number (if submitted to State Clearinghouse): N/A

Project Title:

Day Creek – Frank Avenue Storm Drain Project

Project Location (include county)

The proposed project is located within the unincorporated community of Mira Loma in Riverside County. The alignment for this project is generally bounded by Wineville Avenue to the west, Frank Avenue to the east, 64th Street to the north, and 65th Street to the south. The proposed project is located within Township 6 South, Range 3 West, Section 29 of the Corona North, California 7.5 Minute USGS Quadrangle.

Project Description

The proposed project consists of the construction, operation and maintenance of approximately 1,100 lineal feet of an 18 inch diameter reinforced concrete pipe.

This is to advise that the Riverside County Flood Control and Water Conservation District has approved the above described project on October 5, 2010 and has made the following determinations regarding the above described project:
(Date)

(Lead Agency or Responsible Agency)

1. The project will not have a significant effect on the environment.
2. A Mitigated Negative Declaration was prepared for this project pursuant to the provisions of CEQA.
3. Mitigation measures were made a condition of the approval of the project.
4. A mitigation reporting or monitoring program table was adopted for this project.
5. A statement of Overriding Considerations was not adopted for this project.
6. Findings were not made pursuant to the provisions of CEQA.

This is to certify that the Mitigated Negative Declaration, is available to the General Public at: The office of the Clerk of the Board, County Administrative Center, 4080 Lemon Street, Riverside, CA 92501.



Signature (Public Agency)

Board Assistant
Title

Karen Barton, Board Assistant to Kecia Harper-Ihem, Clerk of the Board of Supervisors

October 5, 2010
Date

Date

Date received for filing at OPR:

Revised 2004

Authority cited: Sections 21083 and 21087, Public Resources Code.

Reference: Sections 21000-21174, Public Resources Code.

HAE:cw
P8\132168

10.05.10 11.12

MINUTES OF THE FLOOD CONTROL AND WATER
CONSERVATION DISTRICT COUNTY OF
RIVERSIDE, STATE OF CALIFORNIA



11.1

The Chairman announced due to lack of quorum that the public hearing on the Adoption of Resolution F2010-23 Adoption of a Mitigated Negative Declaration for the Day Creek – Frank Avenue Storm Drain Project, 5th District is continued to Tuesday, October 5, 2010 at 1:30 p.m.

I hereby certify that the foregoing is a full true, and correct copy of an order made and entered on _____ September 28, 2010 _____ of Supervisors Minutes.

(seal)

WITNESS my hand and the seal of the Board of Supervisors
Dated: September 28, 2010
Kecia Harper-Ihem, Clerk of the Board of Supervisors, in
and for the County of Riverside, State of California.

By: *Kecia Harper-Ihem* Deputy

AGENDA NO.
11.1

xc: Flood, COB

**SUBMITTAL TO THE FLOOD CONTROL AND
WATER CONSERVATION DISTRICT BOARD
COUNTY OF RIVERSIDE, STATE OF CALIFORNIA**

706B



FROM: General Manager-Chief Engineer

SUBMITTAL DATE:
August 10, 2010

SUBJECT: Day Creek – Frank Avenue Storm Drain
Project No. 2-0-00274

RECOMMENDED MOTION:

Adopt Resolution No. F2010-22 which

1. Sets September 28, 2010 as the date for holding a Public Hearing concerning the Notice of Intent to Adopt California Environmental Quality Act (CEQA) Mitigated Negative Declaration; and
2. Sets September 28, 2010 as the date for holding a Public Hearing concerning the intent to approve the construction of the above referenced project in accordance with Section 18 of the District Act; and
3. Directs the Clerk of the Board to advertise and post said public hearing in accordance with Section 18 of the District Act and CEQA.

Continued on Page 2

HAE:cw
P8/132044

WARREN D. WILLIAMS
General Manager-Chief Engineer

FINANCIAL DATA	Current F.Y. District Cost:	\$	In Current Year Budget:
	Current F.Y. County Cost:	\$	Budget Adjustment:
	Annual Net District Cost:	\$	For Fiscal Year:

SOURCE OF FUNDS:

Positions To Be Deleted Per A-30	<input type="checkbox"/>
Requires 4/5 Vote	<input type="checkbox"/>

APPROVE

C.E.O. RECOMMENDATION:

BY:
Jerry Norris

County Executive Office Signature

MINUTES OF THE FLOOD CONTROL AND WATER CONSERVATION DISTRICT

On motion of Supervisor Buster, seconded by Supervisor Stone and duly carried by unanimous vote, IT WAS ORDERED that the above matter is approved as recommended and is set for public hearing Tuesday, September 28, 2010 at 1:30 p.m.

Ayes: Buster, Tavaglione, Stone, Benoit and Ashley
Nays: None
Absent: None
Date: August 10, 2010
xc: Flood, COB, Recorder

Kecia Harper-Ihem
Clerk of the Board
By:
Deputy

Prev. Agn. Ref.:

District: 2nd

Agenda Number:

11.4

FORM APPROVED COUNTY COUNSEL
BY:
KARIN L. WATTS-BAZAN
DATE: 7/14/10
Departmental Concurrence

Policy
 Consent
 Dept't Recomm.:
 Consent
 Per Exec. Ofc.:

**FLOOD CONTROL AND WATER CONSERVATION DISTRICT BOARD SUBMITTAL
COUNTY OF RIVERSIDE, STATE OF CALIFORNIA**

SUBJECT: Day Creek – Frank Avenue Storm Drain
Project No. 2-0-00274

SUBMITTAL DATE: August 10, 2010

Page 2

BACKGROUND:

Section 18 of the District's Enabling Act requires the Board to hold a Public Hearing for the purpose of considering all comments regarding any proposed facilities before authorizing the construction of such facilities.

In accordance with the State guidelines implementing the CEQA, the General Manager-Chief Engineer of the District has found that the proposed project will not have a significant adverse effect on the environment and has completed a Mitigated Negative Declaration which will not be final until approved and adopted by this Board.

HAE:cw
P8/132044

BOARD OF SUPERVISORS

RIVERSIDE COUNTY FLOOD CONTROL
AND WATER CONSERVATION DISTRICT

**RESOLUTION NO. F2010-22
SETTING A PUBLIC HEARING DATE FOR
DAY CREEK – FRANK AVENUE STORM DRAIN PROJECT
AND GIVING NOTICE OF INTENT TO ADOPT A
MITIGATED NEGATIVE DECLARATION THEREFOR
IN ACCORDANCE WITH SECTION 18 OF THE DISTRICT ACT
AND THE CALIFORNIA ENVIRONMENTAL QUALITY ACT (CEQA)**

WHEREAS, the District proposes to undertake a project within the unincorporated Mira Loma Community of Riverside County, designated as Day Creek – Frank Avenue Storm Drain Project; and

WHEREAS, the proposed Project is located in 65th Street between Wineville Avenue and Frank Avenue and in Frank Avenue between 64th Street and 65th Street; and

WHEREAS, the proposed Project consists of the construction and subsequent operation and maintenance of approximately 1,110 lineal feet of underground storm drain system; and

WHEREAS, reference is made to the engineering estimate of the cost of the proposed project, entitled "Engineer's Statement" on file with the Clerk of the Board; and

WHEREAS, reference is made to a map dated March 2010, bearing the name and showing the general location and typical section of the proposed Project which is also on file with the Clerk of the Board; and

WHEREAS, the General Manager-Chief Engineer of the District has found that the proposed Project will not have a significant adverse effect on the environment and has prepared a Mitigated Negative Declaration which will not become final until adopted by this Board; and

WHEREAS, any person wishing to comment on the proposed project or the Mitigated Negative Declaration may do so in writing between the date of this notice and the public hearing, or may appear and be heard at the time and place noted below; and

WHEREAS, in a subsequent legal challenge any person may be limited to raising only those issues he, she or someone else raised at the public hearing described in this notice, or in written comments delivered before or at the public hearing; and

FORM APPROVED COUNTY COUNSEL
BY: *Karin L. Watts-Bazan* 7/26/10
KARIN L. WATTS-BAZAN DATE

1 WHEREAS, prior to making a decision on the proposed project or the Mitigated
2 Negative Declaration, this Board will consider all written and oral comments; and

3 WHEREAS, the above-listed documents can be inspected at the District office, 1995
4 Market Street, Riverside, California 92501 and written comments will be received at the above
5 address.

6 NOW, THEREFORE, BE IT RESOLVED, DETERMINED AND ORDERED by the
7 Board of Supervisors of the Riverside County Flood Control and Water Conservation District
8 in regular session assembled on August 10, 2010 that:

9 1. A public hearing concerning the proposed project and the Mitigated Negative
10 Declaration will be held at 1:30 p.m. on September 28, 2010, at the meeting room of this
11 Board, 1st Floor, County Administrative Center, 4080 Lemon Street, Riverside, California, at
12 which time all public comment shall be heard.

13 2. A copy of this resolution and copies of the above-listed documents shall be posted
14 at least 30 days before said hearing at the Eastvale Library, 7447 Cleveland Avenue, Corona,
15 California 92880.

16 3. A copy of this resolution shall be posted at least 30 days before said hearing at the
17 Riverside County Clerk and Recorder's Office, 2724 Gateway Drive, Riverside, California
18 92507.

19 4. The Clerk of this Board is directed to cause a copy of this resolution to be
20 published twice, once at least 30 days before said hearing, and once 7 days following the initial
21 publication, in a newspaper of general circulation in accordance with Section 18 of the District
22 Act and CEQA.

23

24 ROLL CALL:

25 Ayes: Buster, Tavaglione, Stone, Benoit, and Ashley
26 Nays: None
Absent: None

27 The foregoing is certified to be a true copy of a resolution duly
28 adopted by said Board of Supervisors on the date therein set forth.

KECIA HARPER-IHEM, Clerk of said Board

By: 
Deputy

SECTION 18 PUBLIC HEARING MAP



DAY CREEK - FRANK AVENUE STORM DRAIN

PROJECT NO. 2-0-00274

MARCH 2010

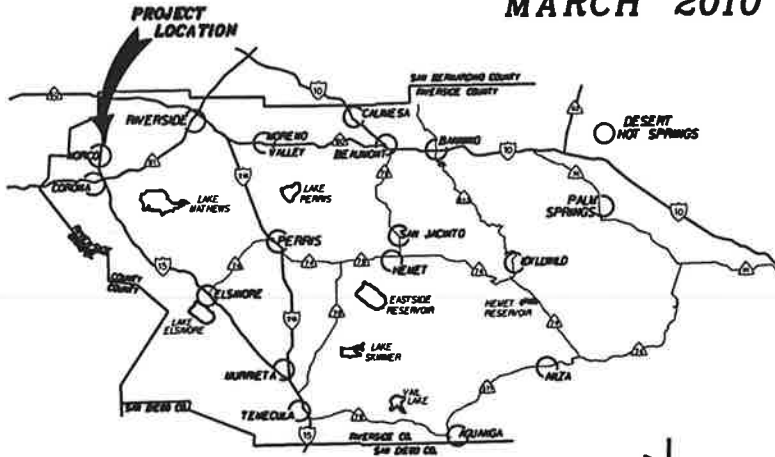

VICINITY MAP
N.T.S.

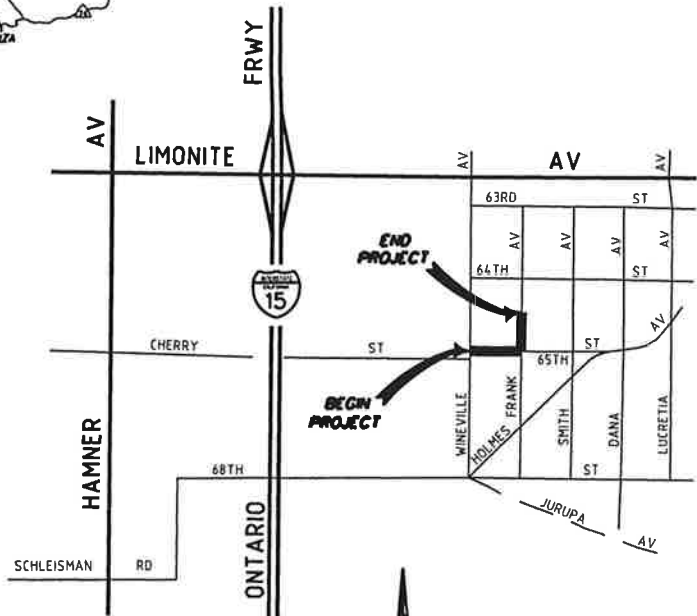

INDEX MAP
N.T.S.

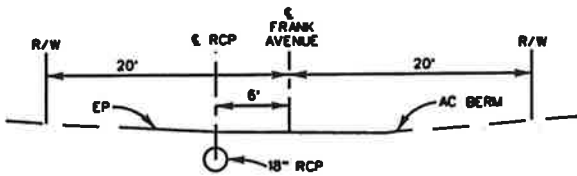

TYPICAL SECTION
N.T.S.

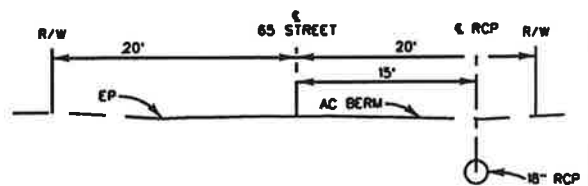

TYPICAL SECTION
N.T.S.

RIVERSIDE COUNTY CLERK-RECORDER

AUTHORIZATION TO BILL

TO BE FILLED OUT BY SUBMITTING AGENCY

DATE: 8/25/2010 BUSINESS UNIT/AGENCY: FLOOD CONTROL - FCARC

ACCOUNTING STRING:

ACCOUNT: 523220 FUND: 25120
DEPT ID: 947420 PROGRAM: _____

AMOUNT: \$ 2,010.25 - Mitigation Negative Declaration (MND)
\$ 64.00 - Doc Handling Fee
\$2,074.25

REF: CEQA Notice of Determination Posting, Day Creek - FRANK AVE STORM DRAIN

THIS AUTHORIZES THE COUNTY CLERK & RECORDER TO ISSUE AN INVOICE FOR PAYMENT OF ALL FEES FOR THE ACCOMPANYING DOCUMENTS.

NUMBER OF DOCUMENTS INCLUDED: 1

AUTHORIZED BY: Lisa McFarland 

PRESENTED BY: Kris Flanigan

CONTACT: Lisa McFarland (951) 955-8454

TO BE FILLED OUT BY COUNTY CLERK

ACCEPTED BY: _____

DATE: _____

DOCUMENT NO(S)/INVOICE NO(S): _____

BOARD OF SUPERVISORS

RIVERSIDE COUNTY FLOOD CONTROL
AND WATER CONSERVATION DISTRICT

**RESOLUTION NO. F2010-22
SETTING A PUBLIC HEARING DATE FOR
DAY CREEK – FRANK AVENUE STORM DRAIN PROJECT
AND GIVING NOTICE OF INTENT TO ADOPT A
MITIGATED NEGATIVE DECLARATION THEREFOR
IN ACCORDANCE WITH SECTION 18 OF THE DISTRICT ACT
AND THE CALIFORNIA ENVIRONMENTAL QUALITY ACT (CEQA)**

FILED
RIVERSIDE COUNTY
AUG 25 2010
COURT CLERK
BY: [Signature]

COUNTY CLERK
Neg Declaration/Ntc Determination
Filed per P.R.C. 21152
POSTED

AUG 25 2010

Removed: _____
By: _____
County of Riverside

WHEREAS, the District proposes to undertake a project within the unincorporated Mira Loma Community of Riverside County, designated as Day Creek – Frank Avenue Storm Drain Project; and

WHEREAS, the proposed Project is located in 65th Street between Wineville Avenue and Frank Avenue and in Frank Avenue between 64th Street and 65th Street; and

WHEREAS, the proposed Project consists of the construction and subsequent operation and maintenance of approximately 1,110 lineal feet of underground storm drain system; and

WHEREAS, reference is made to the engineering estimate of the cost of the proposed project, entitled "Engineer's Statement" on file with the Clerk of the Board; and

WHEREAS, reference is made to a map dated March 2010, bearing the name and showing the general location and typical section of the proposed Project which is also on file with the Clerk of the Board; and

WHEREAS, the General Manager-Chief Engineer of the District has found that the proposed Project will not have a significant adverse effect on the environment and has prepared a Mitigated Negative Declaration which will not become final until adopted by this Board; and

WHEREAS, any person wishing to comment on the proposed project or the Mitigated Negative Declaration may do so in writing between the date of this notice and the public hearing, or may appear and be heard at the time and place noted below; and

WHEREAS, in a subsequent legal challenge any person may be limited to raising only those issues he, she or someone else raised at the public hearing described in this notice, or in written comments delivered before or at the public hearing; and

FORM APPROVED COUNTY COUNSEL
BY: [Signature] DATE 7/26/10
KARIN L. WATTS-BAZAN

1 WHEREAS, prior to making a decision on the proposed project or the Mitigated
2 Negative Declaration, this Board will consider all written and oral comments; and

3 WHEREAS, the above-listed documents can be inspected at the District office, 1995
4 Market Street, Riverside, California 92501 and written comments will be received at the above
5 address.

6 NOW, THEREFORE, BE IT RESOLVED, DETERMINED AND ORDERED by the
7 Board of Supervisors of the Riverside County Flood Control and Water Conservation District
8 in regular session assembled on August 10, 2010 that:

9 1. A public hearing concerning the proposed project and the Mitigated Negative
10 Declaration will be held at 1:30 p.m. on September 28, 2010, at the meeting room of this
11 Board, 1st Floor, County Administrative Center, 4080 Lemon Street, Riverside, California, at
12 which time all public comment shall be heard.

13 2. A copy of this resolution and copies of the above-listed documents shall be posted
14 at least 30 days before said hearing at the Eastvale Library, 7447 Cleveland Avenue, Corona,
15 California 92880.

16 3. A copy of this resolution shall be posted at least 30 days before said hearing at the
17 Riverside County Clerk and Recorder's Office, 2724 Gateway Drive, Riverside, California
18 92507.

19 4. The Clerk of this Board is directed to cause a copy of this resolution to be
20 published twice, once at least 30 days before said hearing, and once 7 days following the initial
21 publication, in a newspaper of general circulation in accordance with Section 18 of the District
22 Act and CEQA.

23

24

25

26

27

28

Day Creek – Frank Avenue Storm Drain

Project No. 2-0-00274

Engineer's Statement

This proposed project is located within the unincorporated community of Mira Loma, Riverside County, California. The project is an underground system designed to drain the existing sump area located on the west side of Frank Avenue between 64th and 65th Streets.

The proposed project consists of approximately 1,100 linear feet of an 18 inch diameter reinforced concrete pipe (RCP) that will connect to an existing 18 inch RCP located on the east side of the intersection of Wineville Avenue and 65th Street, it will then extend easterly in 65th Street and turn northerly in Frank Avenue until it reaches the sump location. The cost of the proposed project is approximately \$258,000.

Riverside County Flood Control and Water Conservation District
1995 Market Street
Riverside, CA 92501

FINAL

CEQA INITIAL STUDY

DAY CREEK – FRANK AVENUE STORM DRAIN

ZONE 2

September 2010

Warren D. Williams
General Manager-Chief Engineer

MITIGATED NEGATIVE DECLARATION

State Clearinghouse Number:	Contact Person:	Telephone Number:	Email:
None	Kris Flanigan	951.955.8581	kflaniga@rcflood.org

Lead Agency and Project Sponsor:
Riverside County Flood Control and Water Conservation District

Address:	City:	Zip:
1995 Market Street	Riverside	92501

Project Title and Description: **Day Creek–Frank Avenue Storm Drain.**
Day Creek–Frank Avenue Storm Drain includes the construction, operation and maintenance of approximately 1,100 lineal feet of 18 inch underground storm drain. The proposed project will be located within 65th Street and Frank Avenue. The project starts in Wineville Avenue at 65th Street and proceeds easterly for approximately 660 feet in 65th Street to Frank Avenue where it will turn north and continue for approximately 450 feet to an existing sump station. The project will be located entirely within existing street right of way. The construction will be managed by the District and the maintenance of this facility will be turned over to the County Transportation Department.

Project Location:
The proposed project is located within the unincorporated community of Mira Loma in Riverside County. The alignment for this project is generally bounded by Wineville Avenue to the west, Frank Avenue to the east, 64th Street to the north, and 65th Street to the south (please refer to the vicinity map and location map on Pages 3, 4 and 5). The proposed project is located within Township 6 South, Range 3 West, Section 29 of the Corona North, California 7.5 Minute USGS Quadrangle.

The General Manager-Chief Engineer of the Riverside County Flood Control and Water Conservation District has made a finding that the proposed Day Creek – Frank Avenue Storm Drain project will not have a significant adverse effect on the environment. An Initial Study/Environmental Assessment supporting this finding is attached. This finding will become final upon adoption of this Mitigated Negative Declaration by the Board of Supervisors of the Riverside County Flood Control and Water Conservation District. For mitigation measures refer to attached Mitigation Monitoring Program Table.

Signature: _____ Dated: _____
WARREN D. WILLIAMS
General Manager-Chief Engineer

The Board of Supervisors of the Riverside County Flood Control and Water Conservation District, assembled in regular session on September 28, 2010, has determined that the Day Creek–Frank Avenue Storm Drain project will not have a significant adverse effect on the environment and has adopted this Mitigated Negative Declaration.

Signature: _____ Dated: _____
KECIA HARPER-IHEM
Clerk of the Board

Attachments
Copies to: 1) County Clerk
 2) Flood Control

P8\131952

RIVERSIDE COUNTY FLOOD CONTROL AND WATER CONSERVATION DISTRICT

**DAY CREEK - FRANK AVENUE STORM DRAIN PROJECT
MITIGATION MONITORING PROGRAM TABLE**

TABLE 1

Issue	Potential Impact	Mitigation Measures	Action	Implementing Agency	Governing Agency	Implementation Timing	Monitoring Frequency
III. Air Quality	During construction, there is potential for temporary increases in air pollution.	<u>MM III-1:</u> The construction contractor shall be required to comply with applicable provisions of the AQMD Rule 403 and implement appropriate fugitive dust control measures including watering, stabilized construction access to reduce tracking of mud or dirt onto public roads, covering trucks hauling loose material offsite and street sweeping of track-out.	Implement applicable dust control measures.	RCFC & WCD (Design and Construction Division)	SCAQMD	During the construction period	Daily monitoring during project construction
V. Cultural Resources	During construction, there is potential to impact cultural resources.	<u>MM V-1:</u> If historical resources are accidentally discovered during construction, ground disturbance activities in the vicinity of the find shall cease until a qualified historical resources specialist can assess the significance of the find and, if necessary, develop appropriate treatment measures. Any discovered resources that merit long term consideration shall be collected and reported in accordance with current protocols.	Excavation activities will cease if potential historical resources are encountered. A qualified historical resources specialist will be retained to evaluate the resources.	RCFC & WCD (Design and Construction Division)	State Historic Preservation Officer	During excavation activities	Monitoring as needed during ground disturbance activities
V. Cultural Resources (continued)	During construction, there is potential to impact cultural resources.	<u>MM V-2:</u> If any archaeological resources are exposed during ground excavation disturbance, ground disturbance activities in the vicinity of the discovery will be terminated immediately and a qualified archaeological resources specialist will evaluate the resources. If any discovered archaeological resources merit long-term consideration, adequate funding will be provided to collect, curate and report these resources in accordance with standard archaeological management requirements.	Excavation activities will cease if potential historical resources are encountered. A qualified archaeologist specialist will be retained to evaluate the resources.	RCFC & WCD (Design and Construction Division)	None	During excavation activities	Monitoring as needed during ground disturbance activities

Issue	Potential Impact	Mitigation Measures	Action	Implementing Agency	Governing Agency	Implementation Timing	Monitoring Frequency
V. Cultural Resources (continued)	During construction, there is potential to impact cultural resources.	<u>MM V-3:</u> If any paleontological resources are exposed during ground excavation disturbance, ground disturbance activities in the vicinity of the discovery will be terminated immediately until a qualified paleontological resources specialist can evaluate the significance of the find and, if necessary, develop appropriate treatment measures.	Excavation activities will cease if potential paleontological resources are encountered. A qualified paleontologist will be retained to evaluate the resources.	RCFC & WCD (Design and Construction Division)	None	During excavation activities	Monitoring as needed during excavation activities
V. Cultural Resources (continued)	During construction, there is potential to encounter human remains.	<u>MM V-4:</u> Pursuant to State Health and Safety Code Section 7050.5, if human remains are encountered during construction, ground disturbance activities in the vicinity of the find shall cease until the Riverside County Coroner has made a determination of origin and disposition pursuant to Public Resources Code Section 5097.98. The Riverside County Coroner must be notified within 24 hours. If the County Coroner determines that the remains are not Native American, the County Coroner will decide the disposition of the remains. If the County Coroner determines that the remains are Native American, the County Coroner will notify the Native American Heritage Commission (NAHC). The NAHC will determine and notify the Most Likely Descent (MLD). The MLD will then recommend the treatment and disposition of the remains pursuant to California Public Resources Code Section 5097.98. The NAHC may become involved with decisions concerning the treatment and disposition of the remains.	Halt construction and notify the County Coroner's Office for proper identification of any human remains found onsite. Contact NAHC to assist, if possible, in disposition of the burial for any human remains found onsite.	RCFC & WCD (Design and Construction Division)	Riverside County Coroner and NAHC	During excavation activities	Daily monitoring during excavation activities
VII. Hazards	Construction activity may uncover potentially hazardous materials.	<u>MM VII-1:</u> If previously unknown hazardous wastes/materials are encountered in the field during construction, ground disturbance activities in the vicinity of the discovery shall cease until a qualified hazardous materials management specialist can assess the potentially hazardous substances and, if necessary, develop appropriate management measures for the treatment and disposal of the materials in accordance with applicable laws and regulation set by the appropriate regulatory agencies.	If potentially hazardous materials are uncovered, cease ground disturbance near the material until a qualified hazardous materials specialist assesses the materials and provides recommendation for their treatment and disposal.	RCFC & WCD (Design and Construction Division)	To be determined by hazardous material specialist	During excavation activities	Daily monitoring during excavation activities

Issue	Potential Impact	Mitigation Measures	Action	Implementing Agency	Governing Agency	Implementation Timing	Monitoring Frequency
XI. Noise	The use of heavy equipment during project construction may temporarily increase noise levels within nearby residential areas.	MM XI-1: Heavy equipment use that may impact adjacent residential structures shall be limited from 7 a.m. to 5 p.m. Monday through Friday, except under special circumstances approved by the District's General Manager-Chief Engineer.	Construction will occur between 7 a.m. and 5 p.m.	RCFC & WCD (Design and Construction Division)	None	During construction	During construction
XI. Noise (continued)	The use of heavy equipment during project construction may temporarily increase noise levels within nearby residential areas.	MM XI-2: Each resident adjacent to the storm drain construction site shall be notified in writing three days prior to operating heavy construction equipment near the residences. The notice shall include the expected work schedule and the District's contact information. The District shall alert the construction contractor of any noise complaints and incorporate any feasible and practical techniques which minimize the noise impacts on adjacent residences.	Ensure that the described notices are provided to each resident adjacent to the storm drain construction site and inform the construction contractor of any complaints and feasible corrective measures.	RCFC & WCD (Design and Construction Division)	None	During construction	During construction
XV. Traffic	Construction activities may impact the routes of emergency service vehicles.	MM XV-1: At all times during construction, emergency fire or medical vehicles shall have access through the project site.	Contractor will ensure emergency access through construction areas at all times.	RCFC & WCD (Design and Construction Division)	None	During construction	During construction

TABLE OF CONTENTS

INITIAL STUDY FORM.....	1
1. PROJECT TITLE.....	1
2. LEAD AGENCY NAME AND ADDRESS	1
3. CONTACT PERSON AND PHONE NUMBER	1
4. PROJECT LOCATION.....	1
5. PROJECT SPONSOR'S NAME AND ADDRESS.....	1
6. GENERAL PLAN DESIGNATION	1
7. ZONING	1
8. PROJECT DESCRIPTION	1
9. PROJECT OBJECTIVES	1
10. SURROUNDING LAND USES AND SETTING.....	1-2
11. OTHER PUBLIC AGENCIES WHOSE APPROVAL IS REQUIRED	2
ENVIRONMENTAL FACTORS POTENTIALLY AFFECTED.....	8
EVALUATION OF ENVIRONMENTAL IMPACTS	8
ENVIRONMENTAL CHECKLIST	10
I. AESTHETICS	10
II. AGRICULTURAL AND FOREST RESOURCES.....	11
III. AIR QUALITY	12
IV. BIOLOGICAL RESOURCES	16
V. CULTURAL RESOURCES	20
VI. GEOLOGY AND SOILS.....	23
VII. HAZARDS AND HAZARDOUS MATERIALS	25
VIII. HYDROLOGY AND WATER QUALITY	28
IX. LAND USE PLANNING.....	32
X. MINERAL RESOURCES	33
XI. NOISE	33
XII. POPULATION AND HOUSING	36
XIII. PUBLIC SERVICES	37
XIV. RECREATION	38
XV. TRANSPORTATION AND TRAFFIC	38
XVI. UTILITIES AND SERVICE SYSTEMS	41
XVII. MANDATORY FINDINGS OF SIGNIFICANCE.....	43
EARLIER ANALYSES.....	44
DETERMINATION	45
REFERENCES AND BIBLIOGRAPHY.....	46

LIST OF FIGURES

- Figure 1 Vicinity and Location Map**
- Figure 2 Site Location**
- Figure 3 USGS Map**
- Figure 4 Aerial View of Project Area**
- Figure 5 Photos of Project Area**
- Figure 6 Photos of Project Area**
- Figure 7 Photos of Project Area**

LIST OF TABLES

- Table 1 Mitigation Monitoring Program Table**
- Table 2 Air Quality Summary**

APPENDICES

- Appendix A: URBEMIS Summary Report**
- Appendix B: Comments from Reviewing Agencies**

SECTION 18
PUBLIC HEARING
MAP



DAY CREEK -
FRANK AVENUE
STORM DRAIN

PROJECT NO. 2-0-00274

MARCH 2010

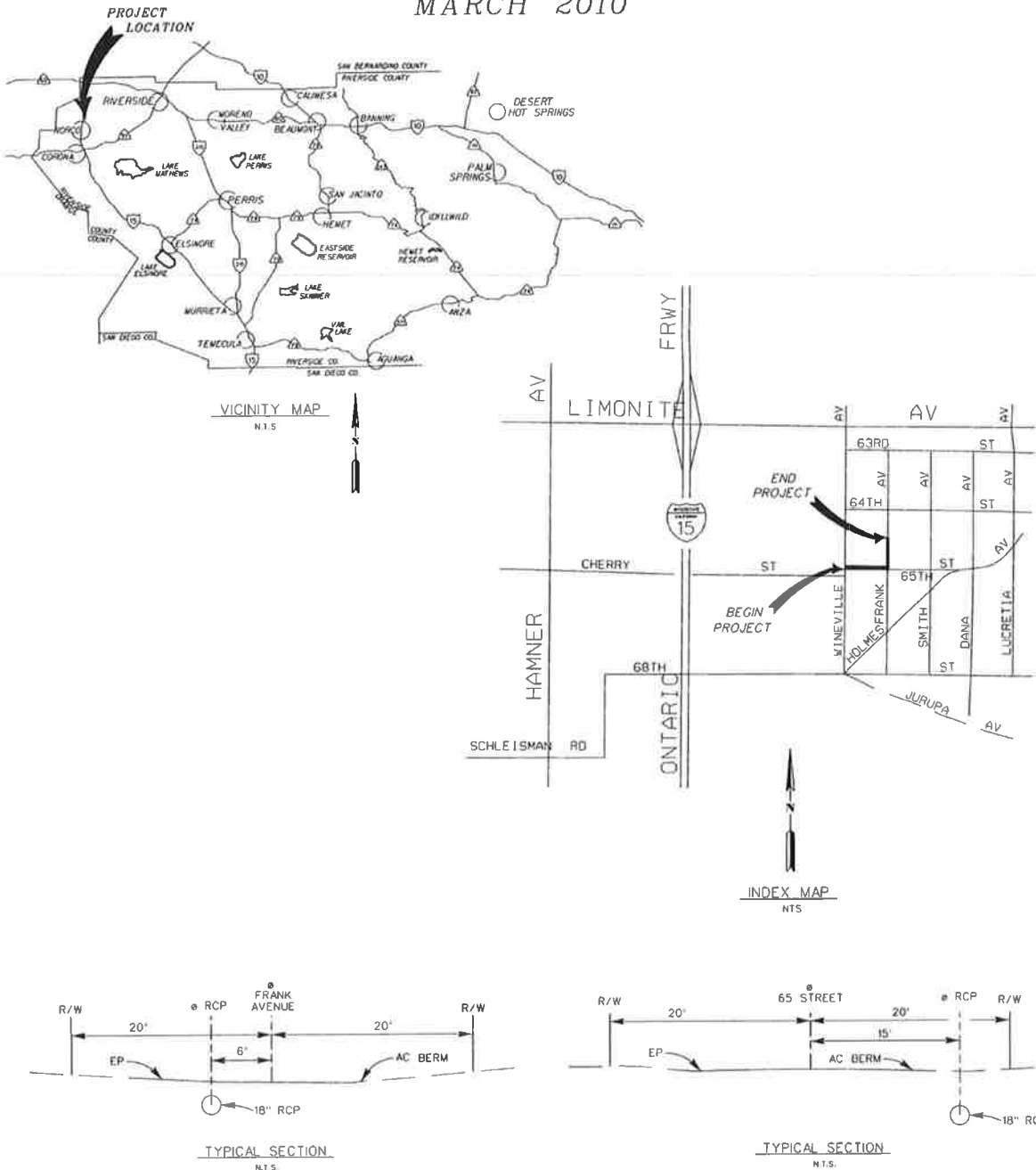

Figure 1. Day Creek - Frank Avenue Storm Drain: Vicinity and Location Map

RIVERSIDE COUNTY FLOOD CONTROL AND WATER CONSERVATION DISTRICT

Initial Study Form

1. **Project title:** Day Creek – Frank Avenue Storm Drain
Project No. 2-0-00274-01
2. **Lead agency name and address:** Riverside County Flood Control and Water Conservation District
1995 Market Street
Riverside, California 92501
3. **Contact person and phone number:** Kris Flanigan: kflaniga@rcflood.org
951.955.8581
4. **Project Location:** The proposed project is an underground storm drain located within the unincorporated Mira Loma community of Riverside County. The alignment for this project is generally bounded by Wineville Avenue to the west, Frank Avenue to the east, 64th Street to the north, and 65th Street to the south (please refer to the vicinity map and location map on Pages 3, 4 and 5). The proposed project is located within Township 6 South, Range 3 West, Section 29 of the Corona North, California 7.5 Minute USGS Quadrangle.
5. **Project sponsor's name and address:** N/A
6. **General plan designation:** The County of Riverside General Plan designates the project site and its adjacent areas as low density residential (single-family detached residences on large parcels of ½ to 1 acre).
7. **Zoning:** Refer to response No. 6 above.
8. **Project Description:** Day Creek - Frank Avenue Storm Drain includes the construction, operation and maintenance of approximately 1,100 lineal feet of 18" underground storm drain. The proposed project will be located within 65th Street and Frank Avenue. The project starts in Wineville Avenue at 65th Street and proceeds easterly for approximately 660 feet in 65th Street to Frank Avenue where it will turn north and continue for approximately 450 feet to an existing sump station. The project will be located entirely within existing street right of way. The construction will be managed by the District and the maintenance of this facility will be turned over to the County Transportation Department.

The project consists of two alternative alignments: i) the pipe is located within the travelled way on 65th Street; or ii) a portion of the pipe is located within the shoulder lane of 65th Street. No known resources will be impacted by either alternative.
9. **Project Objectives:** The residences in the area experience periodic local flooding problems. When the sump pump at the upstream portion of the project stops working, portions of Frank Avenue become inundated during storm events. The project is needed to drain the existing sump area on Frank Avenue located between 64th and 65th Streets. When implemented, the project will improve local drainage and safely convey stormwater to an adequate outlet. The project will alleviate an ongoing nuisance and provide flood protection to the surrounding residences.
10. **Surrounding land uses and setting:** (brief description of the project's surroundings)
The proposed underground storm drain system will be constructed within the existing street right-of-way. The existing surrounding land uses are generally characterized by low density residential (single-family

detached residences on large parcels of ½ to 1 acre). There are no businesses along Frank Avenue or along 65th Street. Surrounding land uses include private homes and vacant lands.

Frank Avenue and 65th Street are both paved two-lane roadways with dirt shoulders along both sides of the streets. The road shoulders located along the project alignment are highly disturbed. The project site is generally flat and vegetation, outside of the traveled way, is limited to ornamental landscaping and rural (weedy) species. The entire project site is heavily disturbed. Thus, the area of impact does not contain any known biological, ecological, archeological, etc. resources of significance.

11. Other public agencies whose approval is required:

County/Local Agencies

County of Riverside Transportation Department - Approval of Storm Drain for Maintenance
Santa Ana River Water Company



Figure 2. Day Creek - Frank Avenue Storm Drain: Site Location

**FRANK AVENUE STORM DRAIN
PROJ. No. 2-0-00274**

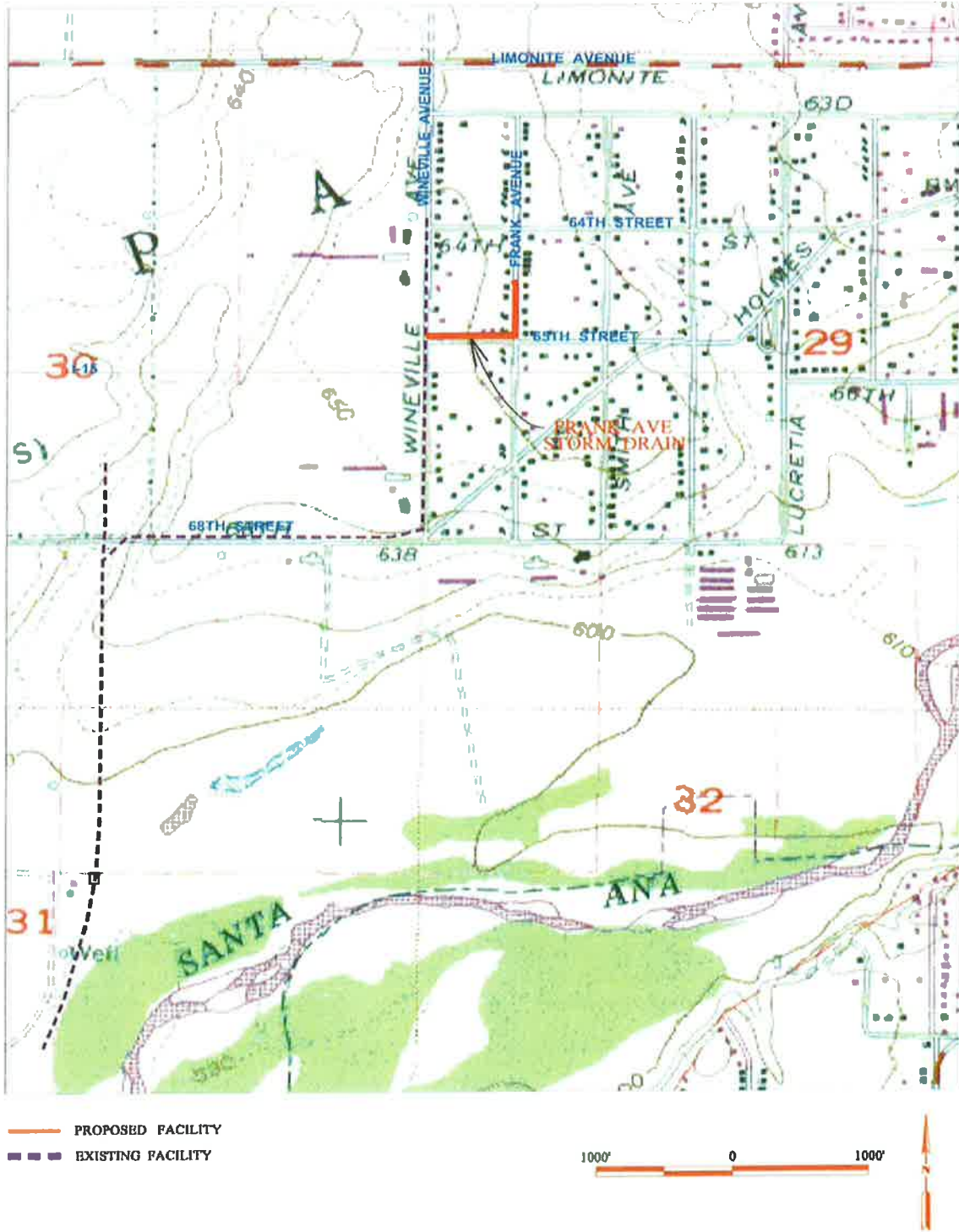

Figure 3. Day Creek - Frank Avenue Storm Drain: USGS Map

**FRANK AVENUE STORM DRAIN
PROJ. No. 2-0-00274**



- PROPOSED FACILITY
- - - EXISTING FACILITY

1000' 0 1000'



Copyright 2007 AirPhoto USA™ L.L.C. All Rights Reserved

Figure 4. Day Creek - Frank Avenue Storm Drain: Aerial View of Project Area



Figure 5. Day Creek - Frank Ave Storm Drain: Frank Avenue looking south (just north of 65th Street)



Figure 6. Day Creek – Frank Avenue Storm Drain: Intersection of 65th Street and Frank Avenue (65th Street looking west)



Figure 7. Day Creek – Frank Avenue: Intersection of Wineville Avenue and 65th Street (65th Street looking East)

ENVIRONMENTAL FACTORS POTENTIALLY AFFECTED:

The environmental factors, as checked below, would potentially be affected by this project.

<input type="checkbox"/> Aesthetics	<input type="checkbox"/> Mineral Resources
<input type="checkbox"/> Agriculture Resources	<input checked="" type="checkbox"/> Noise
<input type="checkbox"/> Air Quality and Greenhouse Gas Emissions	<input type="checkbox"/> Population/Housing
<input checked="" type="checkbox"/> Biological Resources	<input type="checkbox"/> Public Services
<input checked="" type="checkbox"/> Cultural Resources	<input type="checkbox"/> Recreation
<input type="checkbox"/> Geology/Soils	<input checked="" type="checkbox"/> Transportation/Traffic
<input checked="" type="checkbox"/> Hazards & Hazardous Materials	<input type="checkbox"/> Utilities/Service Systems
<input type="checkbox"/> Hydrology/Water Quality	<input type="checkbox"/> Mandatory Findings of Significance
<input type="checkbox"/> Land Use/Planning	

Evaluation of Environmental Impacts:

- 1) A brief explanation is required for all answers except "No Impact" answers that are adequately supported by the information sources a lead agency cites in the parentheses following each question. A "No Impact" answer is adequately supported if the referenced information sources show that the impact simply does not apply to projects like the one involved (*e.g., the project falls outside a fault rupture zone*). A "No Impact" answer should be explained where it is based on project-specific factors as well as general standards (*e.g., the project will not expose sensitive receptors to pollutants, based on a project-specific screening analysis*).
- 2) All answers must take account of the whole action involved, including off-site as well as on-site, cumulative as well as project-level, indirect as well as direct, and construction as well as operational impacts.
- 3) Once the lead agency has determined that a particular physical impact may occur, then the checklist answers must indicate whether the impact is potentially significant, less than significant with mitigation, or less than significant. "Potentially Significant Impact" is appropriate if there is substantial evidence that an effect may be significant. If there are one or more "Potentially Significant Impact" entries when the determination is made, an EIR is required.
- 4) "Negative Declaration: Less Than Significant With Mitigation Incorporated" applies where the incorporation of mitigation measures has reduced any effect from "Potentially Significant Impact" to a "Less Than Significant Impact." The lead agency must describe the mitigation measures, and briefly explain how they reduce the effect to a less than significant level (mitigation measures from "Earlier Analyses," as described in (5) below, may be cross-referenced).
- 5) Earlier analyses may be used where, pursuant to the tiering, program EIR, or other CEQA process, an effect has been adequately analyzed in an earlier EIR or negative declaration. (CEQA Guidelines Section 15063(c)(3)(D)). The use of an earlier analysis as a reference should include a brief discussion that identifies the following:
 - a) Earlier Analysis Used. Identify and state where they are available for review.
 - b) Impacts Adequately Addressed. Identify which effects from the above checklist were within the scope of and adequately analyzed in an earlier document pursuant to applicable legal standards, and state whether such effects were addressed by mitigation measures based on the earlier analysis.

- c) Mitigation Measures. For effects that are "Less than Significant with Mitigation Measures Incorporated", describe the mitigation measures which were incorporated or refined from the earlier document and the extent to which they address site-specific conditions for the project.
 - 6) Lead agencies are encouraged to incorporate into the checklist references to information sources for potential impacts (*e.g., general plans, zoning ordinances*). Reference to a previously prepared or outside document should, where appropriate, include a reference to the page or pages where the statement is substantiated.
 - 7) Supporting Information Sources: A source list should be attached, and other sources used or individuals contacted should be cited in the discussion.
 - 8) The explanation of each issue should identify:
 - a) The significance criteria or threshold, if any, used to evaluate each question; and
 - b) The mitigation measure identified, if any, to reduce the impact to less than significance.
-

ENVIRONMENTAL CHECKLIST

	<i>Potentially Significant Unless Mitigation Incorporated</i>	<i>Potentially Significant Unless Mitigation Incorporated</i>	<i>Less than Significant Impact</i>	<i>No Impact</i>
--	---	---	---	----------------------

I. AESTHETICS. Would the project:

- | | | | | |
|---|--------------------------|--------------------------|-------------------------------------|-------------------------------------|
| a) Have a substantial adverse effect on a scenic vista? | <input type="checkbox"/> | <input type="checkbox"/> | <input type="checkbox"/> | <input checked="" type="checkbox"/> |
| b) Substantially damage scenic resources, including, but not limited to trees, rock outcroppings, and historic buildings within a state scenic highway? | <input type="checkbox"/> | <input type="checkbox"/> | <input type="checkbox"/> | <input checked="" type="checkbox"/> |
| c) Substantially degrade the existing visual character or quality of the site and its surroundings? | <input type="checkbox"/> | <input type="checkbox"/> | <input checked="" type="checkbox"/> | <input type="checkbox"/> |
| d) Create a new source of substantial light or glare, which would adversely affect day or nighttime views in the area? | <input type="checkbox"/> | <input type="checkbox"/> | <input type="checkbox"/> | <input checked="" type="checkbox"/> |

Aesthetics Discussion:

a) *Would the project have a substantial adverse effect on a scenic vista?*

No Impact. The proposed project is located within a low-density residential zoned area (single-family detached residences on large parcels of 1/2 to 1 acre), as described and shown in the County of Riverside General Plan. The proposed storm drain system will be constructed underground within street rights-of-way. Thus, the project will not have a substantial adverse effect on a scenic vista.

Source: Project Design, RCIP

b) *Would the project substantially damage scenic resources, including, but not limited to, trees, rock outcroppings, and historic buildings within a state scenic highway?*

No Impact. Refer to response I. a). Major trees, rocks outcroppings or historic buildings are not located within the proposed project alignment nor is there a State scenic highway located within the project area.

The proposed project area does not contain any known scenic resources. There are some large trees along Frank Avenue and 65th Street but they will not be impacted by the proposed project.

Source: Project Design, RCIP, Google Earth

c) *Would the project substantially degrade the existing visual character or quality of the site and its surroundings?*

Less than Significant Impact. The visual character of the project site and its surroundings could be affected in the short-term by construction activities. The potential construction-related visual impacts could result from excavating, stockpiling and construction materials/equipment storage. Visual disturbance during construction is short-term and would cease once construction is completed. The long term visual character of the site and surrounding areas will not be significantly degraded as a result of the project.

Source: Project Design

- d) *Would the project create a new source of substantial light or glare which would adversely affect day or nighttime views in the area?*

No Impact. The proposed project is an underground storm drain that does not create new or additional light or glare, either during construction or operation and maintenance. The only artificial lighting that may be expected to be used on the project site would be under emergency conditions; however, any impacts would be temporary and insignificant.

Source: Project Design

	<i>Potentially Significant Unless Mitigation Incorporated</i>	<i>Potential Significant Impact</i>	<i>Less than Significant Impact</i>	<i>No Impact</i>
--	---	---	---	----------------------

II. AGRICULTURAL AND FOREST RESOURCES.

In determining whether impacts to agricultural resources are significant environmental effects, lead agencies may refer to the California Agricultural Land Evaluation and Site Assessment Model (1997) prepared by the California Department of Conservation as an optional model to use in assessing impacts on agriculture and farmland. Would the project:

- | | | | | |
|--|--------------------------|--------------------------|--------------------------|-------------------------------------|
| a) Convert Prime Farmland, Unique Farmland, or Farmland of Statewide Importance (Farmland), as shown on the maps prepared pursuant to the Farmland Mapping and Monitoring Program of the California Resources Agency, to non-agricultural use? | <input type="checkbox"/> | <input type="checkbox"/> | <input type="checkbox"/> | <input checked="" type="checkbox"/> |
| b) Conflict with existing agriculture zoning, agricultural use, or land subject to a Williamson Act contract or land within a Riverside County agriculture preserve? | <input type="checkbox"/> | <input type="checkbox"/> | <input type="checkbox"/> | <input checked="" type="checkbox"/> |
| c) Involve other changes in the existing environment which, due to their location or nature, could result in conversion of Farmland, to non-agricultural use? | <input type="checkbox"/> | <input type="checkbox"/> | <input type="checkbox"/> | <input checked="" type="checkbox"/> |
| d) Conflict with existing zoning for, or cause rezoning of, forest land (as defined in Public Resources Code Section 12220(g)), timberland (as defined by Public Resources Code Section 4526), or timberland zoned Timberland Production (as defined by Government Code Section 51104(g))? | <input type="checkbox"/> | <input type="checkbox"/> | <input type="checkbox"/> | <input checked="" type="checkbox"/> |
| e) Result in the loss of forest land or conversion of forest land to non-forest use? | <input type="checkbox"/> | <input type="checkbox"/> | <input type="checkbox"/> | <input checked="" type="checkbox"/> |

Agricultural Resources Discussion:

- a) *Would the project convert Prime Farmland, Unique Farmland, or Farmland of Statewide Importance (Farmland), as shown on the maps prepared pursuant to the Farmland Mapping and Monitoring Program of the California Resources Agency, to non-agricultural use?*

No Impact. According to Figure OS-2 of the Riverside County General Plan, the proposed

project site is not located within areas designated as Prime Farmland, Unique Farmland, or Farmland of Statewide Importance.

Source: County GIS, RCIP, Project Design

- b) **Would the project conflict with existing agriculture zoning, agricultural use, or land subject to Williamson Act contract or land within a Riverside County Agriculture Preserve?**

No Impact. The proposed project would not conflict with existing zoning due to the fact that it will not involve any changes to current General Plan land use or zoning destinations. Additionally, the proposed project site does not contain areas zoned for agriculture land use, areas subject to a Williamson Act Contract, or land within a Riverside County Agriculture Preserve. The proposed underground storm drain system will be constructed within existing street rights-of-way.

Source: Department of Conservation, County GIS, Project Design

- c) **Would the project involve other changes in the existing environment, which due to their location or nature, could result in conversion of Farmland to non-agricultural use?**

No Impact. Farmland will not be directly or indirectly impacted as a result of the construction, operation and subsequent maintenance of the proposed project.

Source: Department of Conservation, County GIS, Project Design

- d) **Conflict with existing zoning for, or cause rezoning of, forest land (as defined in Public Resources Code Section 12220(g)), timberland (as defined by Public Resources Code Section 4526), or timberland zoned Timberland Production (as defined by Government Code Section 51104(g))?**

No Impact. The project does not conflict with existing zoning, or cause rezoning of forest land, timberland or timberland zoned Timberland Production. Please refer to response I. a).

- e) **Result in the loss of forest land or conversion of forest land to non-forest use?**

No Impact. The project does not result in the loss of forest or conversion of forest to non-forest use. The project is not located within an area considered as forest land. Please refer to the project description on Page 3 of this document.

Potentially Significant Unless Mitigation Incorporated Less than Significant Impact No Impact

III. AIR QUALITY.

Where available, the significance criteria established by the applicable air quality management or air pollution control district may be relied upon to make the following determinations. Would the project:

- a) Conflict with or obstruct implementation of the applicable air quality plan?

	Potential Significant Impact	Potentially Significant Unless Mitigation Incorporated	Less than Significant Impact	No Impact
b) Violate any air quality standard or contribute substantially to an existing or projected air quality violation?	<input type="checkbox"/>	<input checked="" type="checkbox"/>	<input type="checkbox"/>	<input type="checkbox"/>
c) Result in cumulatively considerable net increase of any criteria pollutant for which the project region is non-attainment under an applicable federal or state ambient air quality standard (including releasing emissions which exceed quantitative thresholds for ozone precursors)?	<input type="checkbox"/>	<input type="checkbox"/>	<input checked="" type="checkbox"/>	<input type="checkbox"/>
d) Expose sensitive receptors to substantial pollutant concentrations?	<input type="checkbox"/>	<input type="checkbox"/>	<input checked="" type="checkbox"/>	<input type="checkbox"/>
e) Create objectionable odors affecting a substantial number or people?	<input type="checkbox"/>	<input type="checkbox"/>	<input checked="" type="checkbox"/>	<input type="checkbox"/>
f) Generate greenhouse gas emissions, either directly or indirectly, that may have a significant impact on the environment?	<input type="checkbox"/>	<input type="checkbox"/>	<input checked="" type="checkbox"/>	<input type="checkbox"/>
g) Conflict with an applicable plan, policy or regulation adopted for the purpose of reducing the emissions of greenhouse gases?	<input type="checkbox"/>	<input type="checkbox"/>	<input checked="" type="checkbox"/>	<input type="checkbox"/>

Air Quality Discussion:

a) *Would the project conflict with or obstruct implementation of the applicable air quality plan?*

Less than Significant Impact. The proposed project is located within the South Coast Air Basin (SCAB). The South Coast Air Quality Management District (SCAQMD) regulates air quality emission within the SCAB and has prepared a series of Air Quality Management Plan (AQMP), the most recent of which was adopted by the Governing Board of the SCAQMD on June 1, 2007 (2007 AQMP). The 2007 AQMP identifies emission reduction from existing sources and air pollution control measures that are necessary to comply with applicable state and federal ambient air quality standards. To achieve compliance with these standards, AQMP establishes control measures and emission reductions based upon future development scenarios derived from land use, population, and employment characteristics defined in consultation with local governments. In addition, to assess the impacts of project-related construction and operational emissions to the air quality, the SCAQMD has established regional significance thresholds.

As described in Section III. b), construction and subsequent maintenance emissions from the proposed project will only result in temporary air emissions from heavy equipment exhaust, construction-related trips by workers and associated fugitive dust generation. The proposed project will be consistent with the existing AQMP rules and will not exceed air quality significance thresholds.

In addition, the proposed project is a storm drain that in and of itself will not result in any changes to the existing land use patterns in the project area, and the construction of the project accommodates present and future development within the Jurupa area.

Therefore, the proposed project will not conflict with the AQMP or obstruct its implementation.

Source: AQMP, SCAQMD

- b) *Would the project violate any air quality standard or contribute substantially to an existing or projected air quality violation?*

Potentially Significant Unless Mitigation Incorporated. The proposed project consists of the construction, operation and maintenance of flood control facilities. The maintenance of the proposed storm drains will not result in any significant air quality impacts. The construction of the project will create minimal, temporary short term air quality impacts that are considered less than significant with the implementation of the MM III-1. Construction activities related to the proposed project consist of excavating, hauling, pipe laying, backfilling, compacting, and paving. Construction emission thresholds as recommended by the SCAQMD and estimated construction emissions for the proposed project are noted in Table 2.

Table 2. Day Creek - Frank Avenue Storm Drain. Air Quality Impact.

Air Pollutant	SCAQMD Significance Criteria for Construction (lbs/day)	Project Estimated Construction Emissions (lbs/day)
Nitrogen Oxides	100	41.06
Reactive Organic Compounds	75	5.89
Sulfur Oxides	150	0.01
Carbon Monoxide	550	25.99
PM10	150	3.36
PM2.5	55	2.65

The estimated construction emissions shown above are based on data derived from URBEMIS 2007 (Version 9.2.4) air pollution emissions model. The URBEMIS Summary Report is included as Appendix 'A' of this document. For purposes of running the model, it was assumed that the construction of Day Creek – Frank Avenue storm drain project would occur simultaneously over a 2 month period resulting in the most significant air quality impact. It was also assumed that the total disturbance area would be 1.04 acres and that 580 cubic yards of soil would be exported. The equipment to be used during the construction was assumed to consist of one concrete/industrial saw, one grader, one piece of paving equipment, one roller, two rubber tired loaders, two signal boards, one backhoe loader, one loader, and two dump trucks. The above emission estimates are also based on every piece of equipment operating a full 8 hours per day; whereas some equipment will actually sit idle during the construction process. The estimate includes the use of at least one water truck as needed to reduce PM10 emissions.

Based on the values shown in Table 2, the estimated short-term emissions from construction equipment are not expected to exceed daily air emissions thresholds as established by SCAQMD. Carbon dioxide has been identified as a contributor to global climate change. However, significance criteria thresholds for carbon dioxide have not been established. Since construction emissions will be low-level and temporary, the proposed project will not have a significant effect on regional or global carbon dioxide levels. Although the project is not anticipated to exceed any of the thresholds noted above nor to cause or contribute to regional or cumulative air quality impacts, the project will comply with SCAQMD Rule 403 regarding the implementation of appropriate fugitive dust control measures and the following mitigation measure will be implemented to ensure compliance with SCAQMD Rule 403:

MM III-1: The construction contractor shall be required to comply with applicable provisions of the AQMD Rule 403 and implement appropriate fugitive dust control measures including watering, stabilized construction access to reduce tracking of mud or dirt onto public roads, covering trucks hauling loose material offsite and street sweeping of track-out.

Source: Project Design, CARB, SCAQMD, URBEMIS

- c) *Would the project result in a cumulatively considerable net increase of any criteria pollutant for which the project region is in non-attainment under an applicable federal or state ambient air quality standard (including releasing emissions which exceed quantitative thresholds for ozone precursors)?*

Less than Significant Impact. As mentioned previously in response III. a) and b), the SCAB is a non-attainment area for several criteria pollutants. Although the URBEMIS modeling software does not estimate ozone emissions, NO_x and ROG are considered precursors to ozone formation. According to Table 2 above, NO_x, CO and ROG emissions will remain below daily emissions thresholds set by SCAQMD and, therefore, will not cause a cumulatively considerable net increase of any criteria pollutant.

Source: Project Design, CARB, SCAQMD, URBEMIS

- d) *Would the project expose sensitive receptors to substantial pollutant concentrations?*

Less than Significant Impact. Since the project's emissions have been shown to be below all applicable SCAQMD thresholds and there are no significant operational emissions associated with the proposed project, the project will not expose sensitive receptors to substantial point source pollutant concentrations. The project site is located in the immediate vicinity of a residential neighborhood. Residences located in the project area would be considered the most sensitive land uses (sensitive receptors) in the project area. However, construction activities associated with the installation of the storm drains would result in an increase in dust and some vehicle and equipment emissions during the construction period. While impacts during the construction period are not potentially significant, implementation of mitigation measure MM III-1 will reduce potential impacts associated with this issue to a less than significant level.

Source: SCAQMD

- e) *Would the project create objectionable odors affecting a substantial number of people?*

Less than Significant Impact. The proposed project site is located primarily within an existing residential neighborhood. Construction and maintenance activities may produce odors associated with the operation of heavy equipment (diesel exhaust); however, the generation of any odors would be transitory and would not create objectionable odors affecting the residents. The operation and maintenance proposed project will not create any long-term objectionable odors.

Source: Project Design

- f) *Generate greenhouse gas emissions, either directly or indirectly, that may have a significant impact on the environment?*

Less than Significant Impact. Greenhouse gas (GHG) emissions have been associated with global warming and the resulting potential impacts. On June 1, 2005, Governor Arnold Schwarzenegger signed Executive Order S-3-05 which sets forth a series of target dates by which

statewide GHG emissions would be reduced to, as follows: 1) 2000 levels by the year 2010; 2) 1990 levels by the year 2020; and 3) eighty percent (80%) below the 1990 levels by the year 2050. In 2006, the California State Legislature adopted AB 32 (Global Warming Solutions Act of 2006) and the Governor signed it into law. AB 32 requires the California Air Resources Board (ARB), the State agency charged with regulating statewide air quality, to adopt rules and regulations that would achieve GHG emissions equivalent to statewide levels in 1990 by the year 2020. GHG as defined under AB 32 includes carbon dioxide (CO₂), methane, nitrous oxide, sulfur hexafluoride, hydrofluorocarbons, and perfluorocarbons. CO₂ has been identified as the most important anthropogenic GHG because it comprises the majority of total GHG emissions per year and it is very long-lived in the atmosphere. The main source of potential GHG emissions associated with the project is the previously described temporary emissions related to the use of heavy equipment during project construction process. URBEMIS 2007 (version 9.2.4) provides an estimated total CO₂ quantity of 41.48 tons/year (i.e., 37.75 metric tons of CO₂ equivalents per year – MTCO₂ eq/yr) in year 2010 for the temporary project construction emissions. The 2011 project construction emissions and subsequent emissions associated with maintenance activities will be 34.11 tons/year. Subsequent operation and maintenance of the proposed project is expected to release infrequent and minor GHG emissions far less than the expected 2010 and 2011 construction emission of 37.75 MTCO₂ eq/yr.

Currently, there are no established significance thresholds from federal or state agencies. However, in October 2008, the ARB and AQMD issued the draft “Recommended Approaches for Setting Interim Significance Thresholds for Greenhouse Gases under the California Environmental Quality Act” and the “Draft Guidance Document – Interim CEQA Greenhouse Gas (GHG) Significance Threshold”, respectively. In general, interim GHG threshold of 7,000 ton/year and 25,000 MTCO₂eq/yr is recommended by ARB and AQMD, respectively. The estimated project construction GHG emission of 37.75 MTCO₂ eq/yr is well below the available interim threshold recommended by the ARB and AQMD. Thus, the proposed project will not generate GHG emissions that would cause significant direct or indirect impacts on the environment.

g) Conflict with an applicable plan, policy or regulation adopted for the purpose of reducing the emissions of greenhouse gases?

Less than Significant Impact. As described above, the GHG emissions caused by the proposed project are temporary and insignificant. Thus, the proposed project would not conflict with any currently adopted plans, policies, or regulations established for the purpose of reducing the greenhouse gases. Refer to Section III (f) above.

	<i>Potentially Significant Unless Mitigation Incorporated</i>	<i>Potential Significant Impact</i>	<i>Less than Significant Impact</i>	<i>No Impact</i>
--	---	---	---	----------------------

IV. BIOLOGICAL RESOURCES. Would the project:

- a) Have a substantial adverse effect, either directly or through habitat modifications, on any species identified as a candidate, sensitive, or special status species in local or regional plans, policies, or regulations, or by the California Department of Fish and Game or U.S. Fish and Wildlife Service?

	Potential Significant Impact	Potentially Significant Unless Mitigation Incorporated	Less than Significant Impact	No Impact
b) Have a substantial adverse effect on any riparian habitat or other sensitive natural community identified in local or regional plans, policies, and regulations, or by the California Department of Fish and Game or U.S. Fish and Wildlife Service?	<input type="checkbox"/>	<input type="checkbox"/>	<input type="checkbox"/>	<input checked="" type="checkbox"/>
c) Have a substantial adverse effect on biological resources involved within a jurisdictional water feature as defined by federal, state or local regulations (e.g., Section 404 of the Clean Water Act, Section 401 of the Clean Water Act, Section 1602 of California Fish and Game Code, Porter-Cologne Water Quality Control Act, etc.) through direct removal, filing, hydrological interruption, or other means?	<input type="checkbox"/>	<input type="checkbox"/>	<input type="checkbox"/>	<input checked="" type="checkbox"/>
d) Interfere substantially with the movement of any native resident or migratory fish or wildlife species or with established native resident or migratory wildlife corridors, or impede the use of native wildlife nursery sites?	<input type="checkbox"/>	<input type="checkbox"/>	<input type="checkbox"/>	<input checked="" type="checkbox"/>
e) Conflict with any local policies or ordinances protecting biological resources, such as a tree preservation policy or ordinance?	<input type="checkbox"/>	<input type="checkbox"/>	<input type="checkbox"/>	<input checked="" type="checkbox"/>
f) Conflict with the provisions of an adopted Habitat Conservation Plan, Natural Community Conservation Plan, or other approved local, regional, or state habitat conservation plan?	<input type="checkbox"/>	<input type="checkbox"/>	<input type="checkbox"/>	<input checked="" type="checkbox"/>

Biological Resources Discussion:

- a) *Would the project have a substantial adverse effect, either directly or through habitat modifications, on any species identified as a candidate, sensitive, or special status species in local or regional plans, policies, or regulations, or by the California Department of Fish and Game or the U.S. Fish and Wildlife Service?*

No Impact. The proposed underground storm drain project will be constructed within street right of way, adjacent to urbanized/disturbed lands. Potential habitat for species identified as candidate, sensitive or special status does not exist within the project footprint.

In general, species have specific habitat requirements that do not exist in the project area, such as riparian areas and wetlands associated with creeks and lakes: chaparral or coastal sage scrub communities; rocky areas with dense vegetation; and coniferous forests and woodlands. Furthermore, due to the disturbed nature of the project area, asphalt street paving, continual disturbance and compaction of dirt shoulders, and the close proximity of residences, suitable habitat does not appear to exist in the project area for any of the sensitive species listed in the database.

In addition, the District has adopted the provisions of the Western Riverside County Multiple Species Habitat Conservation Plan (MSHCP). As defined by the MSHCP, the project site is

located within the Jurupa Area Plan. The RCIP online Conservation Summary Report Generator was used to determine biological survey requirements under the MSHCP. According to the RCIP Report Generator, the project area is not within a criteria cell and is outside any special survey assessment area such as Burrowing Owl, Narrow Endemics and Criteria Area plant species.

Source: MSHCP, RCIP

- b) *Would the project have a substantial adverse effect on any riparian habitat or other sensitive natural community identified in local or regional plans, policies, and regulations, or by the California Department of Fish and Game or the U.S. Fish and Wildlife Service?*

No Impact. Sensitive habitats are those that are considered rare or declining in the region or support sensitive plant and/or wildlife species. Such areas typically include riparian or wetland areas regulated by the U.S. Army Corps of Engineers (ACOE), the California Department of Fish and Game (CDFG) and the Regional Water Quality Control Board (RWQCB). The proposed underground storm drain project will be constructed within street right of way and adjacent urbanized/disturbed lands. The project area does not contain Riparian habitat. Therefore, no impacts are anticipated and no mitigation is required.

Source: GIS

- c) *Would the project have a substantial adverse effect on biological resources involved within a jurisdictional water feature as defined by federal, state or local regulations (e.g., Section 404 of the Clean Water Act, Section 401 of the Clean Water Act, Section 1602 of California Fish and Game Code, Porter-Cologne Water Quality Control Act, etc.) through direct removal, filing, hydrological interruption, or other means?*

No Impact. As defined by Section 404 of the Clean Water Act, wetlands are “those areas that are inundated or saturated by surface or groundwater at a frequency and duration sufficient to support, and that under normal circumstances do support, a prevalence of vegetation typically adapted for life in saturated soil conditions.” Wetlands do not currently exist on the project site. The proposed project area along 65th Street and Frank Avenue does not meet the definition of WUS or Water of the State.

Fish and Game Code Section 1602 requires any person, state or local governmental agency, or public utility to notify the Department before beginning any activity that will do one or more of the following:

1. Substantially divert or obstruct the natural flow of any river, stream or lake;
2. Substantially change or use any material from the bed, channel, or bank of, any river, stream, or lake; or
3. Deposit or dispose of debris, waste, or other material containing crumbled, flaked, or ground pavement where it may pass into any river, stream, or lake.

Fish and Game Code section 1602 applies to all perennial, intermittent, and ephemeral rivers, streams, and lakes in the state. These conditions do not currently exist on the project site. The proposed project does not require a 1602 permit.

Refer to response IV. b) above.

Source: GIS, ACOE, CDFG

- d) *Would the project interfere substantially with the movement of any native resident or migratory fish or wildlife species or with established native resident or migratory wildlife corridors, or impede the use of native wildlife nursery sites?*

No Impact. Migratory fish or wildlife species do not currently exist on the project site. Please refer to response IV. a) and IV. c) above.

Source: Project Design

- e) *Would the project conflict with any local policies or ordinance protecting biological resources, such as a tree preservation policy or ordinance?*

No Impact. The proposed project will not conflict with any local policies or ordinances protecting biological resources, such as a tree preservation policy or ordinance. The District implements the provision of the adopted MSHCP, which is addressed in Section IV (f) below.

Source: Project Design, RCIP

- f) *Would the project conflict with the provisions of an adopted Habitat Conservation Plan, Natural Community Conservation Plan, or other approved local, regional, or state habitat conservation plan?*

No Impact. On June 17, 2003, the Riverside County Board of Supervisors adopted the Western Riverside County Multiple Species Habitat Conservation Plan (MSHCP). The U.S. Fish and Wildlife Service (USFWS) and California Department of Fish and Game (CDFG) issued "take" permits on June 22, 2004 for the implementation of the MSHCP. The MSHCP is a comprehensive, multi-jurisdictional habitat conservation plan focusing on the conservation of species and their associated habitats in Western Riverside County. The Riverside County Flood Control and Water Conservation District (District) is a MSHCP permittee and the proposed project must fulfill all applicable MSHCP requirements.

The proposed underground storm drain project will be constructed within street right of way.

The proposed project area does not meet the MSHCP definition of riparian/riverine areas or vernal pools. In addition, the proposed project area lacks suitable habitat for the species listed in **Sections 6.1.2 of the MSHCP**. Therefore, no analysis or survey is required.

Habitat assessments and/or focused surveys for certain narrow endemic plant species are required for projects within MSHCP mapped survey areas. The proposed project is not located within a mapped survey area for the Narrow Endemic Plant Species. Therefore, no habitat assessment or survey is required under **Section 6.1.3 of the MSHCP**.

Section 6.1.4 of the MSHCP provides guidelines to minimize indirect effects of a project in proximity to a MSHCP conservation area. The proposed project is not located within the Criteria Area or Public/Quasi Public Lands as designated in the MSHCP, and is therefore not subject to further analysis or implementation of any conservation measures as shown in the guidelines.

Habitat assessments and/or focused surveys for certain additional plant and animal species are required for projects within MSHCP mapped survey areas. The proposed project is not located within a mapped survey area for plant, amphibian, mammal species or Burrowing Owl. Therefore, no habitat assessment or survey is required under **Section 6.3.2 of the MSHCP**.

The District will consider and implement all appropriate Standard Best Management Practices (BMP) as listed in Appendix C of the MSHCP. Additionally, the District will pay the MSHCP mitigation fee in accordance with **Section 13.4 Provision B of the MSHCP** Implementing Agreement. The District will contribute to MSHCP mitigation through a payment of 3% of the total project capital cost. Such payment may be offset through acquisition of replacement habitat or creation of new habitat for the benefit of covered species.

The proposed project is not located within a Criteria Area as established by the MSHCP.

The proposed project is not located within Public/Quasi-Public (P/QP) Lands as designated in the MSHCP.

Based on the above discussion, the proposed project is consistent with the MSHCP.

Source: MSHCP

	<i>Potentially Significant Unless Mitigation Incorporated</i>	<i>Potential Significant Impact</i>	<i>Less than Significant Impact</i>	<i>No Impact</i>
--	---	---	---	----------------------

V. CULTURAL RESOURCES. Would the project:

- | | | | | |
|---|--------------------------|-------------------------------------|--------------------------|--------------------------|
| a) Cause a substantial adverse change in the significance of a historical resource as defined in §15064.5? | <input type="checkbox"/> | <input checked="" type="checkbox"/> | <input type="checkbox"/> | <input type="checkbox"/> |
| b) Cause a substantial adverse change in the significance of an archaeological resource pursuant to §15064.5? | <input type="checkbox"/> | <input checked="" type="checkbox"/> | <input type="checkbox"/> | <input type="checkbox"/> |
| c) Directly or indirectly destroy a unique paleontological resource or site or unique geologic feature? | <input type="checkbox"/> | <input checked="" type="checkbox"/> | <input type="checkbox"/> | <input type="checkbox"/> |
| d) Disturb any human remains, including those interred outside of formal cemeteries? | <input type="checkbox"/> | <input checked="" type="checkbox"/> | <input type="checkbox"/> | <input type="checkbox"/> |

Cultural Resources Discussion:

- a) *Would the project cause a substantial adverse change in the significance of a historical resource as defined in Section 15064.5?*

Potentially Significant Unless Mitigation Incorporated. The Riverside County General Plan Historical Resources Map (Figure OS-7) indicates that the proposed project site is not marked as a historical site and is not located within an area of known historical resources. A cultural resource records search by the Eastern Information Center (EIC) was received on December 15, 2009 (see Appendix B). The EIC records search indicates that seven cultural resources studies have been conducted within a quarter-mile radius of the project area. No cultural resources properties are recorded within the boundaries of the project area. The EIC also consulted the National Register of Historic Places (NRHP), California Office of Historical Preservation (OHP), the Archeological Determination of Eligibility (ADOE), the Historic Prop Entry Directory (HPD), and the 1947 USGS Corona topographic maps. NRHP, OHP, ADOE, and HPD indicated that there is no listed historical property within the boundaries of the project area.

Additionally, the proposed storm drain is located within existing road right of way. Based on the available information, no listed historical property is likely to be impacted by the project and

therefore, no avoidance, minimization, and/or mitigation measures are required. However, in the event of the accidental discovery of historical resources during construction, the following measure shall be implemented:

MM V-1: If historical resources are accidentally discovered during construction, ground disturbance activities in the vicinity of the find shall cease until a qualified historical resources specialist can assess the significance of the find and, if necessary, develop appropriate treatment measures. Any discovered resources that merit long term consideration shall be collected and reported in accordance with current protocols.

Source: Project Design, RCIP, EIC.

- b) *Would the project cause a substantial adverse change in the significance of an archaeological resource pursuant to Section 15064.5?*

Potentially Significant Unless Mitigation Incorporated. The proposed storm drain project would be located within existing street right of way. The Riverside County General Plan Archeological Record Map (Figure OS-7) indicates that the project site is not located within an area of known Archaeological resources and is not marked as an archaeological/historical resource site. A record search conducted by the Eastern Information Center (EIC) and the Native American Heritage Commission (NAHC) failed to indicate the presence of any known cultural resources or archaeological resources within the project area. However, according to the EIC, Archaeological resources may be present within the boundaries of the project area.

In addition, a Sacred Lands File (SLF) search conducted by the Native American Heritage Commission (NAHC) failed to indicate the presence of Native American cultural resources in the immediate project area.

As recommended by the NAHC, the following Native American Tribes were consulted via letter: Pechanga Band of Mission Indians, Ramona Band of Cahuilla Mission Indians, Gabrieleno/Tongva San Gabriel Band of Mission Indians, Santa Rosa Band of Mission Indians, Morongo Band of Mission Indians, Juaneno Band of Mission Indians, Kupa Cultural center (Pala Band), Soboba Band of Luiseño Indians, Cahuilla Band of Indians, Pechanga Cultural Resources Department, and Luiseno Band (Mr. Willie Pink). Letter responses dated February 3, 2010 and February 4, 2010 were received from the Soboba Band of Luiseño Indians and the Pala Band of Mission Indians, respectively. No other responses have been received.

The response letter from the Soboba Band of Luiseno Indians states that the proposed project is not within its existing tribal reservation and the project does not fall within the bounds of the tribal traditional use areas. In addition, the Soboba Band did not have any specific concerns regarding this project.

The response letter from the Pala Band of Mission Indians states that the proposed project is not within the boundaries of the recognized Pala Band Reservation of the recognized Pala Indian Reservation. In addition, the Pala Band states that the project is also beyond the territory that the tribe considers its Traditional Use Area (TUA). The Pala Band states that they have no objection to the continuation of project activities as currently planned.

It is unlikely that any archaeological resources will be impacted during construction. However, in the event of accidental discovery of archaeological resources during construction, the following mitigation measure will be incorporated into the proposed project:

MM V-2: If any archaeological resources are exposed during ground excavation

disturbance, ground disturbance activities in the vicinity of the discovery will be terminated immediately and a qualified archaeological resources specialist will evaluate the resources.

If any discovered archaeological resources merit long-term consideration, adequate funding will be provided to collect, curate and report these resources in accordance with standard archaeological management requirements.

Source: Project Design, RCIP, EIC, NAHC

- c) *Directly or indirectly destroy a unique paleontological resource or site or unique geologic feature?*

Potentially Significant Unless Mitigation Incorporated. The Riverside County General Plan Paleontological Sensitivity Map (Figure OS-8) and the Riverside County GIS mapping indicate that the project is located within an area of high potential for paleontological resources. Thus, there is potential that buried paleontological resources could be uncovered during construction. However, the proposed storm drain project is located within existing street right of way and the project site consists of previously disturbed streets including the installation of utilities. To ensure that potential impacts to paleontological resources are avoided or reduced to a less than significant level, the following mitigation measure will be incorporated into the proposed project:

MM V-3: If any paleontological resources are exposed during ground excavation disturbance, ground disturbance activities in the vicinity of the discovery will be terminated immediately until a qualified paleontological resources specialist can evaluate the significance of the find and, if necessary, develop appropriate treatment measures.

Source: Project Design, RCIP

- d) *Would the project disturb any human remains, including those interred outside of formal cemeteries?*

Potentially Significant Unless Mitigation Incorporated. It is unlikely that human remains are located within the proposed project area. The Native American Heritage Commission (NAHC) Sacred Lands File search failed to indicate the presence of known Native American cultural resources or sacred sites in the immediate project area. Despite the absence of known resources, the potential exists for discovery of unknown human remains during soil disturbance. In the unlikely event that human remains are encountered on the project site during construction of the project, the following mitigation measure will be incorporated into the project to ensure that impacts remain less than significant.

MM V-4: Pursuant to State Health and Safety Code Section 7050.5, if human remains are encountered during construction, ground disturbance activities in the vicinity of the find shall cease until the Riverside County Coroner has made a determination of origin and disposition pursuant to Public Resources Code Section 5097.98. The Riverside County Coroner must be notified within 24 hours. If the County Coroner determines that the remains are not Native American, the County Coroner will decide the disposition of the remains. If the County Coroner determines that the remains are Native American, the County Coroner will notify the Native American Heritage Commission (NAHC). The NAHC will determine and notify the Most Likely Descent (MLD). The MLD will then recommend the treatment and disposition of the remains pursuant to California Public Resources Code Section 5097.98. The NAHC may become involved with decisions concerning the treatment and disposition of the remains.

Source: Project Design, NAHC

	<i>Potentially Significant Unless Mitigation Incorporated</i>	<i>Potentially Significant Unless Mitigation Incorporated</i>	<i>Less than Significant Impact</i>	<i>No Impact</i>
--	---	---	---	----------------------

VI. GEOLOGY AND SOILS. Would the project:

- | | | | | |
|--|--------------------------|--------------------------|-------------------------------------|-------------------------------------|
| a) Expose people or structures to potential substantial adverse effects, including the risk of loss, injury or death involving: | | | | |
| i) Rupture of a known earthquake fault, as delineated on the most recent Alquist-Priolo Earthquake Fault Zoning Map issued by the State Geologist for the area or based on other substantial evidence of a Known fault? Refer to Division of Mines and Geology Special Publication 42. | <input type="checkbox"/> | <input type="checkbox"/> | <input checked="" type="checkbox"/> | <input type="checkbox"/> |
| ii) Strong seismic ground shaking? | <input type="checkbox"/> | <input type="checkbox"/> | <input checked="" type="checkbox"/> | <input type="checkbox"/> |
| iii) Seismic-related ground failure, including liquefaction? | <input type="checkbox"/> | <input type="checkbox"/> | <input type="checkbox"/> | <input checked="" type="checkbox"/> |
| iv) Landslides or mudflows? | <input type="checkbox"/> | <input type="checkbox"/> | <input checked="" type="checkbox"/> | <input type="checkbox"/> |
| b) Result in substantial changes in topography, unstable soil conditions from excavation, grading or fill, or soil erosion or the loss of topsoil? | <input type="checkbox"/> | <input type="checkbox"/> | <input checked="" type="checkbox"/> | <input type="checkbox"/> |
| c) Be located on a geologic unit or soil that is unstable, or that would become unstable as a result of the project, and potentially result in on- or off-site landslide, lateral spreading, subsidence, liquefaction or collapse? | <input type="checkbox"/> | <input type="checkbox"/> | <input type="checkbox"/> | <input checked="" type="checkbox"/> |
| d) Be located on expansive soil, as defined in Table 18-1-B of the Uniform Building Code (1994), creating substantial risks to life or property? | <input type="checkbox"/> | <input type="checkbox"/> | <input type="checkbox"/> | <input checked="" type="checkbox"/> |
| e) Have soils incapable of adequately supporting any structures, fill or other improvement associated with the project? | <input type="checkbox"/> | <input type="checkbox"/> | <input type="checkbox"/> | <input checked="" type="checkbox"/> |

Geology and Soils Discussion:

- a) *Would the project expose people or structures to potential substantial adverse effects, including the risk of loss, injury or death involving:*
- i) *Rupture of a known earthquake fault, as delineated on the most recent Alquist-Priolo Earthquake Fault Zoning Map issued by the State Geologist for the area or based on other substantial evidence of a known fault? Refer to Division of Mines and Geology Special Publication 42.*

No Impact. According to Figure S-2 of the Riverside County General Plan, the project site is not located within or near a currently delineated State of California Alquist-Priolo Earthquake Fault Zone. In addition, Figure S-1 of the Riverside County General Plan does not show any known faults mapped within the project area. Furthermore, the Riverside County Land Information System indicates that the proposed project is not located within a Fault Zone or within one half mile of any known fault. The proposed project is an

underground storm drain facility located mostly within existing right-of-way. Therefore, the proposed project will not expose people or structures to potential substantial adverse effects resulting from seismic activity.

Source: RCIP, GIS, CGS

ii) ***Strong seismic ground shaking?***

Less than Significant Impact. Most of southern California is subject to strong seismic ground shaking due to the sheer number of faults traversing the region. According to Figure S-12 of the Riverside County General Plan, the project area is located within an area of "extremely high" risk for seismic ground shaking. However, the District's routine inspection and maintenance activities will ensure that the storm drain system is repaired if damage does occur during a seismic event. Consequently, the project would not expose people or structures to potential substantial adverse effects involving seismic ground shaking.

Source: RCIP, GIS, CGS

iii) ***Seismic-related ground failure, including liquefaction?***

Less than Significant Impact. According to Figure S-3 of the Riverside County General Plan, the project is located within an area of "high" susceptibility for liquefaction due to the shallow depth to groundwater within the area. However, the proposed project is a storm drain facility located within existing street rights-of-way and, furthermore, will be designed in accordance with the applicable recommendations of the geotechnical engineer. The District's routine inspection and maintenance activities will ensure that the storm drain system is repaired if damage does occur during a seismic-related ground failure, including liquefaction. Consequently, the project would not expose people or structures to potential substantial adverse effects involving seismic-related ground failure.

Source: RCIP, GIS

iv) ***Landslides or mudflows?***

No Impact. According to Figure S-4 of the Riverside County General Plan, the project area is not mapped as having susceptibility to seismically-induced landslides or mudflows. The project area is relatively flat terrain and is not located on a hillside. Therefore, the proposed project would not expose people or structures to potential substantial adverse effects involving landslides or mudflows.

Source: RCIP

b) ***Would the project result in substantial changes in topography, unstable soil conditions from excavation, grading or fill, or soil erosion or the loss of topsoil?***

Less than Significant Impact. The construction of the proposed storm drain facility will involve excavation and backfill activities. The excavation operation will be conducted in accordance with the Division of Occupational Safety and Health (CAL/OSHA) standards to ensure that unstable soil conditions do not occur. The backfill operation will be conducted in accordance with the applicable recommendations of the Geotechnical Investigation Report. (During the construction phase, appropriate Best Management Practices (BMPs) will be implemented by the construction contractor to minimize erosion.

Compliance with the existing NPDES Municipal Separate Storm Sewer System permit issued by the Santa Ana Regional Water Quality Control Board is also required.

Source: Project Design, NPDES

- c) *Would the project be located on a geologic unit or soil that is unstable, or that would become unstable as a result of the project, and potentially result in, on or offsite landslide, lateral spreading, subsidence, liquefaction or collapse?*

Less than Significant Impact. According to Figure 4.10.5 of the County of Riverside General Plan Final Program Environmental Impact Report, the proposed project is located in an area that may be susceptible to subsidence. The proposed project will be designed and constructed in accordance with the applicable recommendations in the geotechnical analysis prepared for the project. See also response to VI. a) and VI. b).

Source: RCIP

- d) *Would the project be located on expansive soil, as defined in Table 18-1-B of the Uniform Building Code (1994), creating substantial risks of life or property?*

No Impact. Per the Geotechnical Report, the proposed project is located in an area classified to have low expansive soils. A geotechnical report will be prepared prior to the finalization of the project's design. Recommendations from the geotechnical report will be incorporated into the design and construction of the project. The proposed project is a small underground storm drain system located primarily within existing road rights-of-way. Thus, irrespective of soil type, the project does not pose a substantial risk to life or property.

Source: Project Design, Geotechnical Report

- e) *Would the project have soils incapable of adequately supporting any structures, fill or other improvement associated with the project?*

No Impact. The proposed project consists of the construction and maintenance of a storm drain system. There are no structures or businesses proposed as part of the project. See also response to VI. d)

Source: Project Design

	<i>Potentially Significant Unless Mitigation Incorporated</i>	<i>Potential Significant Impact</i>	<i>Potentially Significant Unless Mitigation Incorporated</i>	<i>Less than Significant Impact</i>	<i>No Impact</i>
--	---	---	---	---	----------------------

VII. HAZARDS AND HAZARDOUS MATERIALS. Would the project:

- | | | | | |
|---|--------------------------|-------------------------------------|-------------------------------------|--------------------------|
| a) Create a significant hazard to the public or the environment through the routine transport, use, or disposal of hazardous materials? | <input type="checkbox"/> | <input type="checkbox"/> | <input checked="" type="checkbox"/> | <input type="checkbox"/> |
| b) Create a significant hazard to the public or the environment through reasonably foreseeable upset and accident conditions involving the release of hazardous materials into the environment? | <input type="checkbox"/> | <input checked="" type="checkbox"/> | <input type="checkbox"/> | <input type="checkbox"/> |

	Potential Significant Impact	Potentially Significant Unless Mitigation Incorporated	Less than Significant Impact	No Impact
c) Emit hazardous emissions or handle hazardous or acutely hazardous materials, substances, or waste within one-quarter mile of an existing or proposed school?	<input type="checkbox"/>	<input type="checkbox"/>	<input type="checkbox"/>	<input checked="" type="checkbox"/>
d) Be located on a site, which is included on a list of hazardous materials sites compiled pursuant to Government Code Section 65962.5 and, as a result, would it create a significant hazard to the public or the environment?	<input type="checkbox"/>	<input checked="" type="checkbox"/>	<input type="checkbox"/>	<input type="checkbox"/>
e) For a project located within an airport land use plan or, where such a plan has not been adopted, within two miles of a public airport or public use airport, would the project result in a safety hazard for people residing or working in the project area?	<input type="checkbox"/>	<input type="checkbox"/>	<input type="checkbox"/>	<input checked="" type="checkbox"/>
f) For a project within the vicinity of a private airstrip, would the project result in a safety hazard for people residing or working in the project area?	<input type="checkbox"/>	<input type="checkbox"/>	<input type="checkbox"/>	<input checked="" type="checkbox"/>
g) Impair implementation of or physically interfere with an adopted emergency response plan or emergency evacuation plan?	<input type="checkbox"/>	<input type="checkbox"/>	<input checked="" type="checkbox"/>	<input type="checkbox"/>
h) Expose people or structures to a significant risk of loss, injury or death involving wildland fires, including where Wildlands are adjacent to urbanized areas or where residences are intermixed with wildlands?	<input type="checkbox"/>	<input type="checkbox"/>	<input checked="" type="checkbox"/>	<input type="checkbox"/>

Hazards and Hazardous Materials Discussion:

- a) *Would the project create a significant hazard to the public or the environment through the routine transport, use, or disposal of hazardous materials?*

Less than Significant Impact. Construction and subsequent maintenance of the proposed project does not involve the routine use or transport of hazardous materials beyond the short-term use of petroleum-based fuels, lubricants, pesticides and other similar materials during construction. The construction phase may include the transport of gasoline and diesel fuel to the project site and on-site storage for the sole purpose of fueling construction equipment. Best Management Practices (BMPs) stipulating proper storage of hazardous materials and vehicle fueling will be implemented during construction. All transport, handling, use and disposal of substances such as petroleum products, solvents and paints related to operation and maintenance of the proposed project will comply with all Federal, State and local laws regulating the management and use of hazardous materials. The proposed project will not create a significant hazard to the public or the environment.

Source: Project Design

- b) *Would the project create a significant hazard to the public or the environment through reasonably foreseeable upset and accident conditions involving the release of hazardous materials into the environment?*

Less than Significant Impact. The potential risk of an accidental explosion or the release of hazardous substances associated with the proposed project is minimal. However, there is a low potential that excavation activities during construction could uncover hazardous materials. In the event that hazardous waste is discovered during site preparation or construction, the identified hazardous waste and/or hazardous material shall be handled and disposed of in the manner specified by the State of California Hazardous Substances Control Law (Health and Safety Code, Division 20, Chapter 6.5) and according to the requirements of the California Administrative Code, Title 30, Chapter 22. BMPs will be implemented for the duration of project construction that will avoid and minimize the release of hazardous materials into the environment. In the unlikely event that hazardous waste is encountered on the project site during construction of the project, the following mitigation measure will be incorporated into the project to ensure that impacts remain less than significant.

MM VII-1: If previously unknown hazardous wastes/materials are encountered in the field during construction, ground disturbance activities in the vicinity of the discovery shall cease until a qualified hazardous materials management specialist can assess the potentially hazardous substances and, if necessary, develop appropriate management measures for the treatment and disposal of the materials in accordance with applicable laws and regulation set by the appropriate regulatory agencies.

Source: Project Design

- c) ***Would the project emit hazardous emissions or handle hazardous or acutely hazardous materials, substances, or waste within one-quarter mile of an existing or proposed school?***

No Impact. The project area is located within the Corona-Norco Unified School District. One school facility exists within ¼ mile of the proposed project area. The proposed project does not include any activities or uses that would pose a significant source for hazardous materials.

The District will comply or, in the case of its contractors, require compliance with all Federal, State and local laws regulation the use, storage and transport of hazardous materials

Source: Project Design, Google Earth

- d) ***Would the project be located on a site which is included on a list of hazardous materials sites compiled pursuant to Government Code Section 65962.5 and, as a result, would it create a significant hazard to the public or the environment?***

Less than Significant. A review of the Department of Toxic Substance Control's Hazardous Waste and Substances List (Cortese List) indicates that the proposed project is not located on any identified hazardous materials sites. In addition, a review of the State Water Resources Control Board's Leaking Underground Storage Tank (LUST) Geotracker database indicates that the nearest LUST site is over ½ mile away from the project site. The proposed underground storm drain facility is located within the street right of way and would not expose the public or the environment to such hazards. These are no listed hazardous materials site within the project area. However, in the unlikely event of the discovery of previously unknown hazardous materials during construction, the following measure shall be implemented. Refer to MM VII-1.

Source: DTSC, SWRCB, EPA

- e) ***For a project located within an airport land use plan or, where such a plan has not been adopted, within two miles of a public airport or public use airport, would the project result in a safety hazard for people residing or working in the project area?***

No Impact. The project is not located within an airport land use plan or within two miles of a public or public use airport (See Figure 2 and 4).

Source: Google Earth

- f) **For a project within the vicinity of a private airstrip, would the project result in a safety hazard for people residing or working in the project area?**

No Impact. The project is not located within the vicinity of a private airstrip.

Source: Google Earth

- g) **Would the project impair implementation of or physically interfere with an adopted emergency response plan or emergency evacuation plan?**

Less than Significant Impact. Neither the construction nor subsequent maintenance of the proposed project will impair implementation of or physically interfere with an adopted emergency response plan or emergency evacuation plan. Vehicular access will be maintained or detours will be provided during project construction. It is also standard practice for the District to notify public safety agencies prior to commencing project construction activity.

According to the Riverside County General Plan, an adopted emergency response plan or emergency plan does not exist within the proposed project area. The Traffic Control Plan prepared for the project will ensure that temporary construction impacts will not significantly interfere or impair traffic flow or access through the project area. Temporary traffic impacts associated with the proposed project are further addressed in Section XV of this document.

Source: Project Design, RCIP

- h) **Would the project expose people or structures to a significant risk of loss, injury or death involving wildland fires, including where wildlands are adjacent to urbanized areas or where residences are intermixed with wildlands?**

Less than Significant Impact. According to Figure S-11 in the Riverside County General Plan, the plan area is not subject to wildland fire hazards. In addition, the Jurupa Area Plan Wildfire Susceptibility Map (Figure 9) of the Riverside County General Plan indicates that the majority of the plan area is not subject to risk of wildland fire hazards. The proposed storm drain system would not expose people or structures to an increased risk of wildfire beyond current conditions.

Source: RCIP

	<i>Potentially Significant Unless Mitigation Incorporated</i>	<i>Potentially Significant Unless Mitigation Incorporated</i>	<i>Less than Significant Impact</i>	<i>No Impact</i>
--	---	---	---	----------------------

VIII. HYDROLOGY AND WATER QUALITY. Would the project:

- | | | | | |
|--|--------------------------|--------------------------|-------------------------------------|--------------------------|
| a) Violate or conflict with any adopted water quality standards or waste discharge requirements? | <input type="checkbox"/> | <input type="checkbox"/> | <input checked="" type="checkbox"/> | <input type="checkbox"/> |
| b) Result in substantial discharges of typical storm water pollutants (e.g. sediment from construction activities, hydrocarbons, and metals from motor vehicles, nutrients and pesticides from landscape maintenance activities, metals of | <input type="checkbox"/> | <input type="checkbox"/> | <input checked="" type="checkbox"/> | <input type="checkbox"/> |

	<i>Potentially Significant Unless Mitigation Incorporated</i>	<i>Potentially Significant Unless Mitigation Incorporated</i>	<i>Less than Significant Impact</i>	<i>No Impact</i>
--	---	---	---	----------------------

other pollutants from industrial operation,) or substantial changes to surface water quality including, but not limited to, temperature, dissolved oxygen, pH, or turbidity?

- | | | | | |
|---|--------------------------|--------------------------|-------------------------------------|-------------------------------------|
| c) Substantially deplete groundwater supplies or interfere substantially with groundwater recharge such that there would be a net deficit in aquifer volume or a lowering of the local groundwater table level (e.g., the production rate of pre-existing nearby wells would drop to a level which would not support existing land uses or planned uses for which permits have been granted)? | <input type="checkbox"/> | <input type="checkbox"/> | <input type="checkbox"/> | <input checked="" type="checkbox"/> |
| d) Substantially alter the existing drainage pattern of the site or area, including through the alteration of a watercourse or wetland, in a manner which would result in substantial erosion or siltation on- or off-site? | <input type="checkbox"/> | <input type="checkbox"/> | <input type="checkbox"/> | <input checked="" type="checkbox"/> |
| e) Substantially alter the existing drainage pattern of the site or area, including through the alteration of the course of a stream or river, or substantially increase the rate or amount of surface runoff in a manner which would result in flooding on- or off-site? | <input type="checkbox"/> | <input type="checkbox"/> | <input type="checkbox"/> | <input checked="" type="checkbox"/> |
| f) Create or contribute runoff water, which would exceed the capacity of existing or planned stormwater drainage systems? | <input type="checkbox"/> | <input type="checkbox"/> | <input type="checkbox"/> | <input checked="" type="checkbox"/> |
| g) Place housing within a 100-year flood hazard area as mapped on a Federal Flood Hazard boundary of Flood Insurance Rate Map or other flood hazard delineation map? | <input type="checkbox"/> | <input type="checkbox"/> | <input type="checkbox"/> | <input checked="" type="checkbox"/> |
| h) Place structures or fill within a 100-year flood hazard area, which would impede or redirect flood flows? | <input type="checkbox"/> | <input type="checkbox"/> | <input type="checkbox"/> | <input checked="" type="checkbox"/> |
| i) Expose people or structures to a significant risk of loss, injury or death involving flooding, including flooding as a result of the failure of a levee or dam? | <input type="checkbox"/> | <input type="checkbox"/> | <input type="checkbox"/> | <input checked="" type="checkbox"/> |
| j) Expose people or structures to a significant risk of loss, injury or death involving inundation by seiche, tsunami, or mudflow? | <input type="checkbox"/> | <input type="checkbox"/> | <input type="checkbox"/> | <input checked="" type="checkbox"/> |
| k) Involve the construction of a jurisdictional dam or other improvement as defined by Chapter 1 of Part 1 of Division 3 of the California Water Code? | <input type="checkbox"/> | <input type="checkbox"/> | <input checked="" type="checkbox"/> | <input type="checkbox"/> |

Hydrology and Water Quality Discussion:

- a) *Would the project violate or conflict with any adopted water quality standards or waste discharge requirements?*

Less than Significant Impact. The proposed project consists of the construction, operation and maintenance of a minor underground storm drain system. The proposed project will not create new sources of stormwater pollutants; however, it will collect, convey and discharge stormwater runoff emanating from developed areas that may already produce pollutants. During the construction phase, the potential for short-term discharges of sediment, hydrocarbons or other pollutant associated with stormwater runoff from the construction site may be increased. The District is also required to comply with the NPDES Municipal Separate Storm Sewer System (MS4) permit issued by the Santa Ana Regional Water Quality Control Board (SARWQCB). Implementing appropriate BMPs mentioned above will ensure that the project would not result in substantial discharges of typical storm water pollutants.

Source: Project Design, NPDES, SARWQCB

- b) ***Result in substantial discharges of typical storm water pollutants (e.g. sediment from construction activities, hydrocarbons, and metals from motor vehicles, nutrients and pesticides from landscape maintenance activities, metals of other pollutants from industrial operation,) or substantial changes to surface water quality including, but not limited to, temperature, dissolved oxygen, pH, or turbidity?***

Less than Significant Impact. The proposed project will not result in substantial changes to surface water quality including, but not limited to, temperature, dissolved oxygen, pH, or turbidity. Refer to response VIII. a) above.

Source: Project Design

- c) ***Would the project substantially deplete groundwater supplies or interfere substantially with groundwater recharge such that there would be a net deficit in aquifer volume or a lowering of a local groundwater table level (e.g., the production rate of pre-existing nearby wells would drop to a level which would not support existing land uses or planned uses for which permits have been granted)?***

No Impact. The proposed project will not result in the withdrawal or use of groundwater. The proposed project consists of a minor underground drainage system that will convey stormwater flow from the project area and outlet into an existing 18" storm drain located on Wineville Avenue. Thus, the project will not deplete groundwater supplies or interfere with groundwater recharge such that there would be a net deficit in aquifer volume or a lowering of the local groundwater table level.

Source: Project Design

- d) ***Would the project substantially alter the existing drainage pattern of the site or area, including through the alteration of a water course or wetland, in a manner which would result in substantial erosion or siltation on- or off-site?***

No Impact. The proposed project will not substantially alter a watercourse or wetland. The proposed project lies within an area that is already developed and the project does not alter the existing or proposed land-use within the project area; therefore, the project will not increase the quantity of surface water runoff. Implementation of the proposed project will result in the construction, operation and maintenance of a minor underground storm drain system that will outlet into existing facilities with sufficient capacity to convey the runoff from the proposed project site. The proposed project will not substantially alter the existing drainage pattern of the site or area in a manner which would result in substantial erosion or siltation on or offsite.

Source: Project Design

- e) *Would the project substantially alter the existing drainage pattern of the site or area, including through the alteration of the course of a stream or river, or substantially increase the rate or amount of surface runoff in a manner which would result in flooding on- or off-site?*

Less than Significant Impact. The proposed project consists of the construction, operation and maintenance of a minor underground storm drain system located within existing road rights-of-way. The proposed storm drain system will safely collect and convey storm water runoff through the project area and discharge to an existing 18" storm drain on Wineville Avenue. The project will not substantially alter the existing drainage pattern of the site or area in a manner which result in substantial flooding on or offsite. The proposed project will relieve local flooding problems by providing needed drainage facilities in the area.

The proposed project will not change existing land use or create any new impervious surfaces, therefore, the proposed project will not substantially increase the rate or the amount of surface runoff in a manner which result in flooding on or offsite. See response VIII. d) above.

Source: Project Design

- f) *Would the project create or contribute runoff water, which would exceed the capacity of existing or planned stormwater drainage systems?*

Less than Significant Impact. As previously discussed, the proposed storm drain project will not modify existing land-use or create any new impervious surfaces. The proposed storm drain will outlet into an existing interim storm drain in Wineville Avenue. Replacement of the existing storm drain is not a part of this project nor is it planned in the foreseeable future. The project will not create or contribute additional runoff water to the existing or planned stormwater drainage systems and therefore, the impact is less than significant.

Source: Project Design

- g) *Would the project place housing within a 100-year flood hazard area as mapped on a federal Flood Hazard Boundary or Flood Insurance Rate Map or other flood hazard delineation map?*

No Impact. The proposed project will not place housing within a 100-year flood hazard area. In addition, the proposed project is not within the 100-year flood hazard area as mapped on a Federal Flood Hazard Boundary or Flood Insurance Rate Map. The proposed project consists of the construction of a minor underground storm drain system that will alleviate local flooding for nearby existing development and will reduce the exposure of people and property to local flood hazards.

Source: Project Design

- h) *Would the project place structures or fill within a 100-year flood hazard area, which would impede or redirect flood flows?*

No Impact. The proposed project is not located within a 100-year flood hazard area as mapped on a Federal Flood Hazard Boundary or Flood Insurance Rate Map or other flood hazard delineation map. In addition, the proposed facilities will reduce the exposure of people and property to local nuisance flooding. See Response VIII. g).

Source: Project Design

- i) **Would the project expose people or structures to a significant risk of loss, injury or death involving flooding, including flooding as a result of the failure of a levee or dam?**

No Impact. The proposed underground storm drain system will not expose people or structures to a significant risk involving flooding including failure of a levee or dam.

Source: Project Design

- j) **Would the project expose people or structures to a significant risk of loss, injury or death involving inundation by seiche, tsunami, or mudflow?**

No Impact. The proposed project site is not subject to inundation by a seiche or tsunami. In addition, the proposed project will not increase the potential for mudflows.

Source: Project Design

	<i>Potentially Significant Unless Mitigation Incorporated</i>	<i>Potential Significant Impact</i>	<i>Less than Significant Impact</i>	<i>No Impact</i>
--	---	---	---	----------------------

IX. LAND USE PLANNING. Would the project:

- | | | | | |
|---|--------------------------|--------------------------|--------------------------|-------------------------------------|
| a) Physically divide an established community? | <input type="checkbox"/> | <input type="checkbox"/> | <input type="checkbox"/> | <input checked="" type="checkbox"/> |
| b) Conflict with any applicable land use plan, policy, or regulation of an agency with jurisdiction over the project (Including, but not limited to the general plan, specific plan, local coastal program, or zoning ordinance) adopted for the purpose of avoiding or mitigating an environmental effect? | <input type="checkbox"/> | <input type="checkbox"/> | <input type="checkbox"/> | <input checked="" type="checkbox"/> |

Land Use Planning Discussion:

- a) **Would the project physically divide an established community?**

No Impact. The project consists of the construction, operation, and maintenance of an underground storm drain system within existing road right of way. Thus, the proposed project would not physically divide an established community.

Source: Project Design

- b) **Would the project conflict with any applicable land use plan, policy, or regulation of an agency with jurisdiction over the project (including, but not limited to the general plan, specific plan, local coastal program, or zoning ordinance) adopted for the purpose of avoiding or mitigating an environmental effect?**

No Impact. The proposed project is located in the unincorporated Riverside County and is generally subject to the land use policies of the County of Riverside. The project area lies within an area that is designated as low density residential and the proposed project site is located within street right-of-way. Thus, the proposed project will not conflict with any land use plans, policies or regulations adopted for the purpose of avoiding or mitigating an environmental effect.

Source: Project Design, RCIP

	<i>Potentially Significant Unless Mitigation Incorporated</i>	<i>Potentially Significant Unless Mitigation Incorporated</i>	<i>Less than Significant Impact</i>	<i>No Impact</i>
--	---	---	---	----------------------

X. MINERAL RESOURCES. Would the project:

- | | | | | |
|---|--------------------------|--------------------------|--------------------------|-------------------------------------|
| a) Result in the loss of availability of a known mineral resource that would be of value to the region and the residents of the state? | <input type="checkbox"/> | <input type="checkbox"/> | <input type="checkbox"/> | <input checked="" type="checkbox"/> |
| b) Result in the loss of availability of a locally-important mineral resource recovery site delineated on a local general plan, specific plan or other land use plan? | <input type="checkbox"/> | <input type="checkbox"/> | <input type="checkbox"/> | <input checked="" type="checkbox"/> |

Mineral Resources Discussion:

- a) *Would the project result in the loss of availability of a known mineral resource that would be of value to the region and the residents of the state?*

No Impact. Sections 2761(a) and (b) and 2790 of the State's Surface Mining and Reclamation Act (SMARA) provide for a mineral lands inventory process termed classification-designation. The California Division of Mines and Geology, and the State Mining and Geology Board are responsible for administering this process and have statutory authority. Areas are classified on the basis of geologic factors, without regard to existing land use and land ownership. The areas are categorized into four Mineral Resource Zones (MRZs). According to Figure OS-5 of the Riverside County General Plan, much of the project vicinity is classified by the State of California as a MRZ-3. This classification denotes mineral deposits are likely to exist; however, the significance of the deposit is undetermined. The proposed project is an underground storm drain system located within existing street right-of-way and would not affect known mineral resources. Moreover, the proposed project would not change any land uses within the project area that would affect known mineral resources. Therefore, the proposed project would not result in the loss of availability of a known mineral resource that would be of value to the region and the residents of the state.

Source: RCIP

- b) *Would the project result in the loss of availability of a locally-important mineral resource recovery site delineated on a local general plan, specific plan or other land use plan?*

No Impact. The project site is not within a delineated mineral resource recovery area. Refer to previous response in Section X. a).

Source: RCIP

	<i>Potentially Significant Unless Mitigation Incorporated</i>	<i>Potentially Significant Unless Mitigation Incorporated</i>	<i>Less than Significant Impact</i>	<i>No Impact</i>
--	---	---	---	----------------------

XI. NOISE. Would the project result in:

- | | | | | |
|---|--------------------------|--------------------------|-------------------------------------|--------------------------|
| a) Exposure of persons to or generation of noise levels in excess of standards established in the local general plan or noise ordinance, or applicable standards of other agencies? | <input type="checkbox"/> | <input type="checkbox"/> | <input checked="" type="checkbox"/> | <input type="checkbox"/> |
|---|--------------------------|--------------------------|-------------------------------------|--------------------------|

	Potential Significant Impact	Potentially Significant Unless Mitigation Incorporated	Less than Significant Impact	No Impact
b) Exposure of persons to or generation of excessive ground-borne vibration or ground-borne noise levels?	<input type="checkbox"/>	<input checked="" type="checkbox"/>	<input type="checkbox"/>	<input type="checkbox"/>
c) A substantial permanent increase in ambient noise levels in the project vicinity above levels existing without the project?	<input type="checkbox"/>	<input type="checkbox"/>	<input type="checkbox"/>	<input checked="" type="checkbox"/>
d) A substantial temporary or periodic increase in ambient noise levels in the project vicinity above levels existing without the project?	<input type="checkbox"/>	<input checked="" type="checkbox"/>	<input type="checkbox"/>	<input type="checkbox"/>
e) For a project located within an airport land use plan or, where such a plan has not been adopted, within two miles of a public airport or public use airport, would the project expose people residing or working in the project area to excessive noise levels?	<input type="checkbox"/>	<input type="checkbox"/>	<input type="checkbox"/>	<input checked="" type="checkbox"/>
f) For a project within the vicinity of a private airstrip, would the project expose people residing or working in the project area to excessive noise levels?	<input type="checkbox"/>	<input type="checkbox"/>	<input type="checkbox"/>	<input checked="" type="checkbox"/>

Noise Discussion:

- a) *Would the project result in exposure of persons to or generation of noise levels in excess of standards established in the local general plan or noise ordinance, or applicable standards of other agencies?*

Less than Significant Impact. The proposed flood control project will not generate long-term sources of noise levels in excess of standards established in the local general plan or noise ordinance. Temporary noise related to construction and subsequent maintenance activities is discussed below in Section XI (b).

Source: Project Design, RCIP

- b) *Would the project result in exposure of persons to or generation of excessive ground-borne vibration or ground-borne noise levels?*

Potentially Significant Unless Mitigation Incorporated. The proposed project would involve the temporary and intermittent use of construction equipment for various construction and maintenance activities over the life of the project. Construction and maintenance equipment may result in temporary increases above existing noise levels. Construction equipment noise generally ranges from 70 to 95 dBA at 50 feet from the source. At about 500 feet from the source, intermittent levels from the loudest construction equipment would be about 75 dBA. Maintenance activities would be infrequent and involve less equipment than the initial construction of the proposed project. Residential areas are located adjacent to the project site and could be temporarily affected by increased noise levels during construction. The long-term operation and maintenance of the proposed project would not cause a significant increase in noise levels. To ensure that potential short-term impacts are less than significant, the proposed project will comply with the Riverside County Ordinance Number 847 and incorporate the following

measures:

MM XI-1: Heavy equipment use that may impact adjacent residential structures shall be limited from 7 a.m. to 5 p.m. Monday through Friday, except under special circumstances approved by the District's General Manager-Chief Engineer.

MM XI-2: Each resident adjacent to the storm drain construction site shall be notified in writing three days prior to operating heavy construction equipment near the residences. The notice shall include the expected work schedule and the District's contact information. The District shall alert the construction contractor of any noise complaints and incorporate any feasible and practical techniques which minimize the noise impacts on adjacent residences.

Source: Project Design, RCIP, JCC

- c) *Would the project result in a substantial permanent increase in ambient noise levels in the project vicinity above levels existing without the project?*

No Impact. The construction, operation and maintenance of a flood control facility will not result in a substantial permanent increase in ambient noise levels. Potential noise impacts will be limited to the temporary construction impacts described above. Refer to Section XI. b)

Source: Project Design

- d) *Would the project result in a substantial temporary or periodic increase in ambient noise levels in the project vicinity above levels existing without the project?*

Potentially Significant Unless Mitigation Incorporated. The operation and maintenance of the proposed project will not result in a permanent substantial ambient noise increase. Potential impacts will be limited to the temporary impacts during construction described in Section XI. b).

Source: Project Design

- e) *For a project located within an airport land use plan or, where such a plan has not been adopted, within two miles of a public airport or public use airport, would the project expose people residing or working in the project area to excessive noise levels?*

No Impact. There are no airports located within two miles of the proposed project site. The proposed project will not expose people residing or working in the project area to excessive noise levels.

Source: Project Design, Google Earth

- f) *For a project within the vicinity of a private airstrip, would the project expose people residing or working in the project area to excessive noise levels?*

No Impact. The project is not located within two miles of a private airstrip.

Source: Project Design, Google Earth

	<i>Potentially Significant Unless Mitigation Incorporated</i>	<i>Potentially Significant Unless Mitigation Incorporated</i>	<i>Less than Significant Impact</i>	<i>No Impact</i>
--	---	---	---	----------------------

XII. POPULATION AND HOUSING. Would the project:

- | | | | | |
|---|--------------------------|--------------------------|--------------------------|-------------------------------------|
| a) Induce substantial population growth in an area, either directly (for example, by proposing new homes and businesses) or indirectly (for example, through extension of roads or other infrastructure) resulting in substantial adverse physical impacts or conflict with the adopted general plan, specific plan, or other applicable land use or regional plan? | <input type="checkbox"/> | <input type="checkbox"/> | <input type="checkbox"/> | <input checked="" type="checkbox"/> |
| b) Displace substantial numbers of existing housing, necessitating the construction of replacement housing elsewhere? | <input type="checkbox"/> | <input type="checkbox"/> | <input type="checkbox"/> | <input checked="" type="checkbox"/> |
| c) Displace substantial numbers of people, necessitating the construction of replacement housing elsewhere? | <input type="checkbox"/> | <input type="checkbox"/> | <input type="checkbox"/> | <input checked="" type="checkbox"/> |

Population and Housing Discussion:

- a) *Induce substantial population growth in an area, either directly (for example, by proposing new homes and businesses) or indirectly (for example, through extension of roads or other infrastructure) resulting in substantial adverse physical impacts or conflict with the adopted general plan, specific plan, or other applicable land use or regional plan?*

No Impact. The proposed underground storm drain system will alleviate local flooding in an area that, for the most part, is already developed. The purpose of the proposed project is to alleviate local nuisance flooding within the existing roadway and nearby residences. The proposed project does not include the construction of homes or businesses and is not expected to result in any change to existing land use patterns or trigger substantial growth in the area. Regardless, any development that may occur is subject to the policies of the Riverside County General Plan and to further review by the Community.

Source: Project Design

- b) *Would the project displace substantial numbers of existing housing, necessitating the construction of replacement housing elsewhere?*

No Impact. The proposed project will not displace any existing housing. Refer to response in Section XII. b).

Source: Project Design

- c) *Would the project displace substantial numbers of people, necessitating the construction of replacement housing elsewhere?*

No Impact. The proposed project will not displace people and, thus, will not necessitate the construction of replacement housing elsewhere. Refer to response in Section XII (b)

Source: Project Design

	<i>Potentially Significant Unless Mitigation Incorporated</i>	<i>Potentially Significant Unless Mitigation Incorporated</i>	<i>Less than Significant Impact</i>	<i>No Impact</i>
--	---	---	---	----------------------

XIII. PUBLIC SERVICES. Would the project:

a) Would the project result in substantial adverse physical impacts associated with the provision of new or physically altered governmental facilities, need for new or physically altered governmental facilities, the construction of which could cause significant environmental impacts, in order to maintain acceptable service ratios, response times or other performance objectives for any of the following public services:

- | | | | | |
|-----------------------------|--------------------------|--------------------------|--------------------------|-------------------------------------|
| i) Fire protection? | <input type="checkbox"/> | <input type="checkbox"/> | <input type="checkbox"/> | <input checked="" type="checkbox"/> |
| ii) Police protection? | <input type="checkbox"/> | <input type="checkbox"/> | <input type="checkbox"/> | <input checked="" type="checkbox"/> |
| iii) Schools? | <input type="checkbox"/> | <input type="checkbox"/> | <input type="checkbox"/> | <input checked="" type="checkbox"/> |
| iv) Parks? | <input type="checkbox"/> | <input type="checkbox"/> | <input type="checkbox"/> | <input checked="" type="checkbox"/> |
| v) Other public facilities? | <input type="checkbox"/> | <input type="checkbox"/> | <input type="checkbox"/> | <input checked="" type="checkbox"/> |

Public Services Discussion:

a) *Would the project result in substantial adverse physical impacts associated with the provision of new or physically altered governmental facilities, need for new or physically altered government facilities, the construction of which could cause significant environmental impacts, in order to maintain acceptable service rations, response times or other performance objectives for any of the following public services?*

i) Fire protection

No Impact. The proposed project would not require new fire protection services.

ii. Police protection?

No Impact. The proposed project would not require new police services.

iii) Schools?

No Impact. The proposed project would not affect existing schools within the area.

iv) Parks?

No Impact. Additional demands on existing public parks would not occur. New or improved park facilities would not be necessary as a result of the proposed project.

v. Other public facilities?

No Impact. Local roads are the only public facilities that may be impacted by the proposed project. Once constructed, the proposed project will reduce the potential for flood damage to

the public roads within the project area. Thus, the need to maintain and repair public roads due to flood damage will be reduced. No additional public facilities will be impacted by the proposed project.

Source: Project Design

	<i>Potentially Significant Unless Mitigation Incorporated</i>	<i>Potentially Significant Unless Mitigation Incorporated</i>	<i>Less than Significant Impact</i>	<i>No Impact</i>
--	---	---	---	----------------------

XIV. RECREATION. Would the project:

- | | | | | |
|--|--------------------------|--------------------------|--------------------------|-------------------------------------|
| a) Would the project increase the use of existing neighborhood and regional parks or other recreational facilities such that substantial physical deterioration of the facility would occur or be accelerated? | <input type="checkbox"/> | <input type="checkbox"/> | <input type="checkbox"/> | <input checked="" type="checkbox"/> |
| b) Does the project include recreational facilities or require the construction or expansion of recreational facilities which might have an adverse physical effect on the environment? | <input type="checkbox"/> | <input type="checkbox"/> | <input type="checkbox"/> | <input checked="" type="checkbox"/> |

Recreation Discussion:

- a) ***Would the project increase the use of existing neighborhood and regional parks or other recreational facilities such that substantial physical deterioration of the facility would occur or be accelerated?***

No Impact. The proposed project would not impact or increase the use of existing neighborhood parks, regional parks, or other recreational facilities.

Source: Project Design

- b) ***Does the project include recreational facilities or require the construction or expansion of recreational facilities which might have an adverse physical effect on the environment?***

No Impact. The proposed project does not include recreational facilities nor will it require the construction or expansion of such facilities.

Source: Project Design

	<i>Potentially Significant Unless Mitigation Incorporated</i>	<i>Potentially Significant Unless Mitigation Incorporated</i>	<i>Less than Significant Impact</i>	<i>No Impact</i>
--	---	---	---	----------------------

XV. TRANSPORTATION AND TRAFFIC. Would the project:

- | | | | | |
|--|--------------------------|--------------------------|-------------------------------------|--------------------------|
| a) Conflict with an adopted plan, ordinance or policy establishing measures of effectiveness for the performance of the circulation system, taking into account all modes of transportation including mass transit and non-motorized travel and relevant components of the circulation system, including but not limited to intersections, streets, highways and freeways, pedestrian and bicycle paths, and mass transit? | <input type="checkbox"/> | <input type="checkbox"/> | <input checked="" type="checkbox"/> | <input type="checkbox"/> |
|--|--------------------------|--------------------------|-------------------------------------|--------------------------|

	Potential Significant Impact	Potentially Significant Unless Mitigation Incorporated	Less than Significant Impact	No Impact
b) Conflict with an adopted congestion management program, including, but not limited to level of service standards and travel demand measures, or other standards established by the appropriate congestion management agency for designated roads or highways?	<input type="checkbox"/>	<input type="checkbox"/>	<input checked="" type="checkbox"/>	<input type="checkbox"/>
c) Substantially increase hazards due to a design feature (e.g., sharp curves or dangerous intersections) or incompatible uses (e.g., farm equipment)?	<input type="checkbox"/>	<input type="checkbox"/>	<input type="checkbox"/>	<input checked="" type="checkbox"/>
d) Would the project result in inadequate emergency access?	<input type="checkbox"/>	<input checked="" type="checkbox"/>	<input type="checkbox"/>	<input type="checkbox"/>
e) Would the project result in inadequate parking capacity?	<input type="checkbox"/>	<input type="checkbox"/>	<input type="checkbox"/>	<input checked="" type="checkbox"/>
f) Conflict with adopted policies, plans, or programs regarding public transit, bicycle, pedestrian facilities, or other alternate transportation or otherwise decrease the performance or safety of such facilities?	<input type="checkbox"/>	<input type="checkbox"/>	<input checked="" type="checkbox"/>	<input type="checkbox"/>

Transportation and Traffic Discussion:

- a) ***Conflict with an adopted plan, ordinance or policy establishing measures of effectiveness for the performance of the circulation system, taking into account all modes of transportation including mass transit and non-motorized travel and relevant components of the circulation system, including but not limited to intersections, streets, highways and freeways, pedestrian and bicycle paths, and mass transit?***

Less than Significant Impact. The proposed storm drain system will be constructed within existing roads. Any traffic impacts will be limited to the construction phase. Long-term traffic effects will not occur, as the project would not create uses that would increase trip generation to the site. The proposed project will include the implementation of a traffic control plan. Temporary street and lane closures during construction will be kept at minimum and will be coordinated with the Riverside County Transportation Department to ensure that adverse impact to traffic flow is less than significant. Construction workers and other construction related vehicles traveling to the project site may result in a minor increase in traffic volume in the vicinity of the project during the approximate 2-month construction period; however, the minor amount of increased traffic will not substantially change existing levels of traffic.

Source: Project Design

- b) ***Conflict with an adopted congestion management program, including, but not limited to level of service standards and travel demand measures, or other standards established by the appropriate congestion management agency for designated roads or highways?***

Less than Significant Impact. Although the project would result in temporary increases in short-term and limited construction-related traffic, it would not create a significant impact on traffic volumes or change traffic patterns in such a way as to affect the level of service or vehicle to congestion ratios on local roadways. See response XV. a).

Source: Project Design

- c) ***Would the project substantially increase hazards due to a design feature (e.g., sharp curves of dangerous intersections) or incompatible uses (e.g., farm equipment)?***

No Impact. The proposed project consists of underground storm drainage facilities that would not increase hazards due to design features or incompatible uses.

Source: Project Design

- d) ***Would the project result in inadequate emergency access?***

Potentially Significant Impact. Although the operation and maintenance of the proposed project would not result in inadequate emergency access, the construction of the proposed project is expected to result in temporary lane closures of local roads for approximately 8 hours per day. A Traffic Control Plan (TCP) that will detail and coordinate all traffic movement through the project area will be implemented throughout project construction. The proposed project will also be closely coordinated with the Riverside County Transportation Department, who will also review and approve the TCP. With the implementation of the TCP, combined with the short-term nature of lane closures and the inclusion of the following measure, impacts to emergency access will remain less than significant:

MM XV-1: At all times during construction, emergency fire or medical vehicles shall have access through the project site.

Source: Project Design

- e) ***Would the project result in inadequate parking capacity?***

No Impact. The proposed project site will not affect any existing parking facilities. The project site is expected to provide sufficient temporary parking areas for construction workers and equipment. Temporary parking related to construction activities is typically on or adjacent to the construction site. The project will not create long-term trip generation requiring parking.

Source: Project Design

- f) ***Conflict with adopted policies, plans, or programs regarding public transit, bicycle, pedestrian facilities, or other alternate transportation or otherwise decrease the performance or safety of such facilities?***

Less than Significant Impact. The proposed project would not conflict with adopted policies, plans, or programs regarding public transit, bicycle, pedestrian facilities, or other alternate transportation or otherwise decrease the performance or safety of such facilities.

	<i>Potentially Significant Unless Mitigation Incorporated</i>	<i>Potential Significant Impact</i>	<i>Less than Significant Impact</i>	<i>No Impact</i>
--	---	---	---	----------------------

XVI. UTILITIES AND SERVICE SYSTEMS. Would the project:

- | | | | | |
|---|--------------------------|--------------------------|-------------------------------------|-------------------------------------|
| a) Impact the following facilities requiring or resulting in the construction of new facilities or expansion of existing facilities, the construction of which could cause significant environmental effects? | | | | |
| i) Electricity | <input type="checkbox"/> | <input type="checkbox"/> | <input type="checkbox"/> | <input checked="" type="checkbox"/> |
| ii) Natural Gas | <input type="checkbox"/> | <input type="checkbox"/> | <input type="checkbox"/> | <input checked="" type="checkbox"/> |
| iii) Communication System | <input type="checkbox"/> | <input type="checkbox"/> | <input type="checkbox"/> | <input checked="" type="checkbox"/> |
| iv) Street lighting | <input type="checkbox"/> | <input type="checkbox"/> | <input type="checkbox"/> | <input checked="" type="checkbox"/> |
| v) Public facilities, including roads and bridges | <input type="checkbox"/> | <input type="checkbox"/> | <input type="checkbox"/> | <input checked="" type="checkbox"/> |
| b) Require or result in the construction of new storm water drainage facilities or expansion of existing facilities, the construction of which could cause significant environmental effects? | <input type="checkbox"/> | <input type="checkbox"/> | <input type="checkbox"/> | <input checked="" type="checkbox"/> |
| c) Have sufficient water supplies available to serve the project from existing entitlements and resources, or are new or expanded entitlements needed? | <input type="checkbox"/> | <input type="checkbox"/> | <input checked="" type="checkbox"/> | <input type="checkbox"/> |
| d) Result in a determination by the wastewater treatment provider which serves or may serve the project that it has adequate capacity to serve the project's projected demand in addition to the provider's existing commitments? | <input type="checkbox"/> | <input type="checkbox"/> | <input type="checkbox"/> | <input checked="" type="checkbox"/> |
| e) Be served by a landfill with sufficient permitted capacity to accommodate the project's solid waste disposal needs? | <input type="checkbox"/> | <input type="checkbox"/> | <input checked="" type="checkbox"/> | <input type="checkbox"/> |
| f) Comply with federal, state, and local statutes and regulations related to solid waste? | <input type="checkbox"/> | <input type="checkbox"/> | <input checked="" type="checkbox"/> | <input type="checkbox"/> |

Utilities and Service Systems Discussion:

a) *Impact the following facilities requiring or resulting in the construction of new facilities or expansion of existing facilities, the construction of which could cause significant environmental effects?*

i) *Electricity*

No impact. The proposed project does not require or result in the construction of new electrical facilities or expansion of existing electrical facilities.

ii) *Natural Gas*

No impact. The proposed project does not require or result in the construction of new natural gas facilities or expansion of existing natural gas facilities.

iii) *Communication System*

No impact. The proposed project does not require or result in the construction of new communication system facilities or expansion of existing communication system facilities.

iv) *Street lighting*

No impact. The proposed project does not require or result in the construction of new street lighting or expansion of existing street lighting.

v) *Public facilities, including roads and bridges*

No Impact. The proposed project would not require or result in the construction of new public facilities or the expansion of existing public facilities including roads and bridges.

Source: Project Design

- b) *Would the project require or result in the construction of new storm water drainage facilities or expansion of existing facilities, the construction of which could cause significant environmental effects?*

No Impact. The proposed project consists of the construction of new drainage facilities to alleviate nuisance flooding within the project area. Other drainage facilities will not be required as a result of the proposed project.

Source: Project Design

- c) *Would the project have sufficient water supplies available to serve the project from existing entitlements and resources, or are new or expanded entitlements needed?*

Less than Significant Impact. The proposed project does not require new or expanded water supplies. Construction of the proposed project will necessitate incidental short-term water use; for example dust control during construction. Existing water sources/supplies will be adequate. Impacts are less than significant.

Source: Project Design

- d) *Would the project result in determination by the wastewater treatment provider which serves or may serve the project that it has adequate capacity to serve the project's projected demand in addition to the provider's existing commitments?*

No Impact. The proposed project would not generate wastewater or require wastewater treatment services. No new wastewater facilities are required as a result of the proposed project.

Source: Project Design

- e) *Would the project be served by a landfill with sufficient permitted capacity to accommodate the project's solid waste disposal needs?*

Less than Significant Impact. The proposed project would generate a limited amount of solid waste during the construction phase. Construction waste will be limited to trash generated by construction crews plus minimal debris created during the clearing phase. The District estimates that the proposed project would require the removal of 133 tons of construction and demolition (C&D) debris, including asphalt concrete (AC) and aggregate base from roadway demolition. The limited amount of solid waste generated by construction of the project would not be substantial or interfere with the capacity of nearby landfills. See response XVI. f).

Source: Project Design

- f) **Would the project comply with federal, state, and local statutes and regulations related to solid waste?**

Less than Significant Impact. For District projects, all C&D materials become the property of the Contractor for disposal. However, the District requires that construction waste be disposed offsite in compliance with Federal, State and local statutes and regulations related to solid waste. A long-term solid waste source would not be created.

Source: Project Design

	<i>Potentially Significant Unless Mitigation Incorporated</i>	<i>Potential Significant Impact</i>	<i>Less than Significant Impact</i>	<i>No Impact</i>
--	---	---	---	----------------------

XVII. MANDATORY FINDINGS OF SIGNIFICANCE.

- | | | | | |
|--|--------------------------|--------------------------|-------------------------------------|--------------------------|
| a) Does the project have the potential to degrade the quality of the environment, substantially reduce the habitat of a fish or wildlife species, cause a fish or wildlife population to drop below self-sustaining levels, threaten to eliminate a plant or animal community, reduce the number or restrict the range of a rare or endangered plant or animal or eliminate important examples of the major periods of California history or prehistory? | <input type="checkbox"/> | <input type="checkbox"/> | <input checked="" type="checkbox"/> | <input type="checkbox"/> |
| b) Does the project have impacts that are individually limited, but cumulatively considerable? (<i>"Cumulatively considerable" means that the incremental effects of a project are considerable when viewed in connection with the effects of past projects, the effects of other current projects, and the effects of probable future projects.</i>)? | <input type="checkbox"/> | <input type="checkbox"/> | <input checked="" type="checkbox"/> | <input type="checkbox"/> |
| c) Does the project have environmental effects, which will cause substantial adverse effects on human beings, either directly or indirectly? | <input type="checkbox"/> | <input type="checkbox"/> | <input checked="" type="checkbox"/> | <input type="checkbox"/> |

Mandatory Findings of Significance Discussion:

- a) **Does the project have the potential to degrade the quality of the environment, substantially reduce the habitat of a fish or wildlife species, cause a fish or wildlife population to drop below self-sustaining levels, threaten to eliminate a plant or animal community, reduce the number or restrict the range of a rare or endangered plant or animal or eliminate important examples**

of the major periods of California history or prehistory?

Less than Significant Impact. As demonstrated by this Initial Study, potential impacts to the environment, wildlife species, plant community and cultural resources will not occur, will be less than significant or will be mitigated to a level of insignificance. Refer to Section IV (a).

- b) ***Does the project have impacts that are individually limited, but cumulatively considerable? ("Cumulatively considerable" means that the incremental effects of a project are considerable when viewed in connection with the effects of past projects, the effects of other current projects, and the effects of probable future projects)?***

Less than Significant Impact. As discussed in this document, most of the potential adverse impacts such as noise and air quality are temporary and will cease upon construction completion. Due to the relatively small area of impact and the relatively short construction period, potential impacts would not be cumulatively considerable. Further, the proposed project will serve to efficiently convey storm flows through the project area that otherwise traverse existing residential areas, thereby decreasing the amount of pollutants directly reaching the SAR and reducing flooding to surrounding properties.

- c) ***Does the project have environmental effects which will cause substantial adverse effects on human beings, either directly or indirectly?***

Less than Significant Impact. As discussed in this document, the project would result in very minimal environmental impacts such as air quality and noise due to construction related activities. With the incorporation of the mitigation measures described in Sections III and XI, potential air quality and noise impacts will be less than significant and would not cause substantial adverse effects on human beings. Other potential adverse impacts to human beings are not expected to occur.

EARLIER ANALYSES

No earlier analysis was used pursuant to the tiering, program EIR or other CEQA process, nor does the analysis rely on an earlier EIR or negative declaration pursuant to California Code of Regulations, Section 15063(c)(3)(D).

DETERMINATION: (To be completed by the Lead Agency)

On the basis of this initial evaluation:

- I find that the proposed project COULD NOT have a significant effect on the environment, and a NEGATIVE DECLARATION will be prepared.
- I find that although the proposed project could have a significant effect on the environment, there will not be a significant effect in this case because the mitigation measures described on an attached sheet have been added to the project. A MITIGATED NEGATIVE DECLARATION will be prepared.
- I find that the proposed project MAY have a significant effect on the environment, and an ENVIRONMENTAL IMPACT REPORT is required.
- I find that the proposed project MAY have a "potentially significant impact" or "potentially significant unless mitigated" impact on the environment, but at least one effect 1) has been adequately analyzed in an earlier document pursuant to applicable legal standards, and 2) has been addressed by mitigation measures based on the earlier analysis as described on attached sheets, if the effect is a "potentially significant impact" or "potentially significant unless mitigated." An ENVIRONMENTAL IMPACT REPORT is required, but it must analyze only the effects that remain to be addressed.
- I find that although the proposed project could have a significant effect on the environment, there WILL NOT be a significant effect in this case because all potentially significant effects (a) have been analyzed adequately in an earlier EIR pursuant to applicable standards, and (b) have been avoided or mitigated pursuant to that earlier EIR, including revisions or mitigation measures that are imposed upon the proposed project.

Steve Thomas

Signature

July 7, 2010

Date

FOR WARREN D. WILLIAMS, General Manager-Chief Engineer
Printed Name

REFERENCES AND BIBLIOGRAPHY

The following documents were referred to as information sources during preparation of this document. They are available for public review at the locations abbreviated after each listing and spelled out at the end of this section. Some of these documents may also be available at the Riverside City and County Public Library, 3581 Seventh Street, Riverside CA 92502-0468, and or branches of the library.

<u>Cited As:</u>	<u>Source:</u>
AQMP	South Coast Air Quality Management District, <i>Air Quality Management Plan 2007</i> , June 2007. (Available at SCAQMD)
Basin Plan	The 1995 Water Quality Control Plan for the Santa Ana River Basin (Region 8), updated in February 2008. (Available at http://www.swrcb.ca.gov/rwqcb8/water_issues/programs/basin_plan/index.shtml)
CARB	California Air Resources Board, <i>Area Designation Maps / State and National</i> , 2006. (Available at http://www.arb.ca.gov/desig/adm/adm.htm)
Conservation	California Department of Conservation, Farmland Mapping and Monitoring Program, Important Farmland Map, Western Riverside County, 2004. (ftp://ftp.consrv.ca.gov/pub/dlrp/FMMP/pdf/2006/riv06_west.pdf)
CGS	California Department of Conservation, California Geological Survey, Alquist-Priolo Earthquake Fault Zones. (Available ftp://ftp.consrv.ca.gov/pub/dmg/pubs/sp/Sp42.pdf)
CNNDDB	California Natural Diversity Database, 2008. (Available at http://www.dfg.ca.gov/biogeodata/cnnddb/)
CNPSEI	California Native Plant Society Electronic Inventory of Rare and Endangered Vascular Plants of California (Available at http://cnps.web.aplus.net/cgi-bin/inv/inventory.cgi)
DTSC	California Department of Toxic Substances Control, Hazardous Waste and Substance Site List (Cortese List), website accessed September 27, 2005. (Available at http://www.calepa.ca.gov/SiteCleanup/CorteseList/default.htm)
EIC	Eastern Information Center, Department of Anthropology, University of California Riverside (UCR), letter dated July 6, 1998. (Available UCR)
GIS	County of Riverside, Geographic Information System Database. (Available at http://www3.tlma.co.riverside.ca.us/pa/rclis/index.html)
GE	Google Earth 4.3, 2008. (Available at http://www.earth.google.com/)
MSHCP	Western Riverside County, Multiple Species Habitat Conservation Plan, Final Version, Adopted June 17, 2003. (Available at Riverside County Planning and at http://www.rctlma.org/mshcp/index.html)
NRCS	U.S. Department of Agriculture, Soil Conservation Service, Soil Survey, Western Riverside Area, California, November 1971. (Available at USDA or at http://websoilsurvey.nrcs.usda.gov/app/)
RCIP	Riverside County Integrated Project, County of Riverside General Plan, Final Version, Adopted October 7, 2003. (Available at Riverside County Planning and at www.rctlma.org)
Section 53091	California Government Code Section 53091. (Available at http://www.leginfo.ca.gov/calaw.html)
SCAQMD	South Coast Air Quality Management District, CEQA Air Quality Handbook, April 1993, with November 1993 Update. (Available at SCAQMD)

- SureVoid "Swelling Clays Map of the Conterminous United States" published in 1989 as Map I-1940 in the USGS Miscellaneous Investigations Series. (Available at http://www.surevoid.com/surevoid_web/soil_maps/intro1.html)
- Thomas Guide Riverside County and San Bernardino County Street Guide, Thomas Brother's, 2008. (Available at District)
- URBEMIS The URBan EMISsions (URBEMIS) 2007 model (version 9.2.4), released February 2008. (Available on the SCAQMD Website at: www.urbemis.com)

APPENDIX A

URBEMIS Summary Report

Page: 1

4/19/2010 11:05:43 AM

Urbems 2007 Version 9 2 4

Combined Summer Emissions Reports (Pounds/Day)

File Name: C:\Documents and Settings\shaelhadd\Desktop\Day Creek- Frank Avenue.urb924

Project Name: Day Creek - Frank Avenue Storm Drain

Project Location: Riverside County

On-Road Vehicle Emissions Based on: Version : Emfac2007 V2.3 Nov 1 2006

Off-Road Vehicle Emissions Based on: OFFROAD2007

Summary Report:

CONSTRUCTION EMISSION ESTIMATES

	ROG	NOx	CO	SO2	PM10 Dust	PM10 Exhaust	PM10	PM2.5 Dust	PM2.5 Exhaust	PM2.5	CO2
2010 TOTALS (lbs/day unmitigated)	5.89	41.06	25.99	0.01	0.62	2.73	3.36	0.13	2.51	2.65	4260.05
2011 TOTALS (lbs/day unmitigated)	3.76	28.09	18.27	0.00	0.62	1.67	2.29	0.13	1.54	1.67	3249.26

Construction Unmitigated Detail Report:

CONSTRUCTION EMISSION ESTIMATES Summer: Pounds Per Day, Unmitigated

ROG	NOx	CO	SO2	PM10 Dust	PM10 Exhaust	PM10	PM2.5 Dust	PM2.5 Exhaust	PM2.5	CO2
-----	-----	----	-----	-----------	--------------	------	------------	---------------	-------	-----

Page: 2

4/19/2010 11:06:43 AM

Time Slice 12/1/2010-12/19/2010 Active Days: 8	<u>5.88</u>	<u>41.06</u>	<u>26.99</u>	<u>0.01</u>	<u>0.62</u>	<u>2.73</u>	<u>3.36</u>	<u>0.13</u>	<u>2.51</u>	<u>2.65</u>	<u>4,280.25</u>
Asphalt 12/01/2010-12/12/2010	1.85	11.06	7.35	0.00	0.01	0.98	0.96	0.00	0.88	0.88	1,031.73
Paving Off-Gas	0.02	0.00	0.00	0.00	0.00	0.00	0.00	0.00	0.00	0.00	0.00
Paving Off Road Diesel	1.79	10.91	6.27	0.00	0.00	0.95	0.95	0.00	0.87	0.87	894.03
Paving On Road Diesel	0.01	0.09	0.03	0.00	0.00	0.00	0.00	0.00	0.00	0.00	13.31
Paving Worker Trips	0.03	0.06	1.04	0.00	0.01	0.00	0.01	0.00	0.00	0.01	124.39
Mass Grading 12/01/2010- 01/31/2011	4.04	29.99	18.64	0.00	0.62	1.77	2.39	0.13	1.63	1.76	3,248.31
Mass Grading Dust	0.00	0.00	0.00	0.00	0.60	0.00	0.60	0.13	0.00	0.13	0.00
Mass Grading Off Road Diesel	3.92	29.43	15.62	0.00	0.00	1.75	1.75	0.00	1.61	1.61	2,850.36
Mass Grading On Road Diesel	0.03	0.40	0.14	0.00	0.00	0.02	0.02	0.00	0.01	0.01	56.87
Mass Grading Worker Trips	0.09	0.17	2.87	0.00	0.02	0.01	0.03	0.01	0.01	0.01	342.98
Time Slice 12/13/2010-12/31/2010 Active Days: 15	4.04	29.99	18.64	0.00	0.62	1.77	2.39	0.13	1.63	1.76	3,248.31
Mass Grading 12/01/2010- 01/31/2011	4.04	29.99	18.64	0.00	0.62	1.77	2.39	0.13	1.63	1.76	3,248.31
Mass Grading Dust	0.00	0.00	0.00	0.00	0.60	0.00	0.60	0.13	0.00	0.13	0.00
Mass Grading Off Road Diesel	3.92	29.43	15.62	0.00	0.00	1.75	1.75	0.00	1.61	1.61	2,850.36
Mass Grading On Road Diesel	0.03	0.40	0.14	0.00	0.00	0.02	0.02	0.00	0.01	0.01	56.87
Mass Grading Worker Trips	0.09	0.17	2.87	0.00	0.02	0.01	0.03	0.01	0.01	0.01	342.98

Page: 3

4/19/2010 11:05:43 AM

Time Slice 1/3/2011-1/31/2011	<u>3.76</u>	<u>28.09</u>	<u>18.27</u>	<u>0.00</u>	<u>0.62</u>	<u>1.67</u>	<u>2.29</u>	<u>0.13</u>	<u>1.54</u>	<u>1.67</u>	<u>3,248.26</u>
Active Days: 21											
Mass Grading 12/01/2010-01/31/2011	3.76	28.09	18.27	0.00	0.62	1.67	2.29	0.13	1.54	1.67	3,248.26
Mass Grading Dust	0.00	0.00	0.00	0.00	0.60	0.00	0.60	0.13	0.00	0.13	0.00
Mass Grading Off Road Diesel	3.66	27.58	15.49	0.00	0.00	1.65	1.65	0.00	1.52	1.52	2,850.36
Mass Grading On Road Diesel	0.03	0.36	0.13	0.00	0.00	0.01	0.02	0.00	0.01	0.01	55.87
Mass Grading Worker Trips	0.08	0.15	2.65	0.00	0.02	0.01	0.03	0.01	0.01	0.01	342.03

Phase Assumptions

Phase: Mass Grading 12/1/2010 - 1/31/2011 - Trenching and storm drain installation

Total Acres Disturbed: 1.04

Maximum Daily Acreage Disturbed: 0.03

Fugitive Dust Level of Detail: Default

20 lbs per acre-day

On Road Truck Travel (VMT): 13.18

Off-Road Equipment:

1 Concrete/Industrial Saws (10 hp) operating at a 0.73 load factor for 8 hours per day

2 Dumpers/Tenders (16 hp) operating at a 0.38 load factor for 8 hours per day

1 Graders (174 hp) operating at a 0.61 load factor for 6 hours per day

2 Rubber Tired Loaders (164 hp) operating at a 0.54 load factor for 8 hours per day

2 Signal Boards (15 hp) operating at a 0.78 load factor for 8 hours per day

2 Tractors/Loaders/Backhoes (108 hp) operating at a 0.55 load factor for 7 hours per day

1 Water Trucks (189 hp) operating at a 0.5 load factor for 8 hours per day

Phase: Paving 12/1/2010 - 12/12/2010 - Paving after connection to Wineville Ave

Acres to be Paved: 0.07

Off-Road Equipment:

1 Concrete/Industrial Saws (10 hp) operating at a 0.73 load factor for 8 hours per day

1 Paving Equipment (104 hp) operating at a 0.53 load factor for 8 hours per day

Page: 4

4/19/2010 11:05:43 AM

1 Rollers (95 hp) operating at a 0.56 load factor for 7 hours per day

1 Tractors/Loaders/Backhoes (108 hp) operating at a 0.55 load factor for 7 hours per day

Page: 1

4/19/2010 11:07:57 AM

Urbanis 2007 Version 9.2.4

Combined Winter Emissions Reports (Pounds/Day)

File Name: C:\Documents and Settings\haelhad\Deskto\Day Creek- Frank Avenue.urb924

Project Name: Day Creek - Frank Avenue Storm Drain

Project Location: Riverside County

On-Road Vehicle Emissions Based on: Version : Emfac2007 V2.3 Nov 1 2006

Off-Road Vehicle Emissions Based on: OFFROAD2007

Summary Report:

CONSTRUCTION EMISSION ESTIMATES

	<u>ROG</u>	<u>NOx</u>	<u>CO</u>	<u>SO2</u>	<u>PM10 Dust</u>	<u>PM10 Exhaust</u>	<u>PM10</u>	<u>PM2.5 Dust</u>	<u>PM2.5 Exhaust</u>	<u>PM2.5</u>	<u>CO2</u>
2010 TOTALS (lbs/day unmitigated)	5.89	41.06	25.99	0.01	0.62	2.73	3.36	0.13	2.51	2.65	4,280.05
2011 TOTALS (lbs/day unmitigated)	3.76	28.09	18.27	0.00	0.62	1.67	2.29	0.13	1.54	1.67	3,248.26

Construction Unmitigated Detail Report:

CONSTRUCTION EMISSION ESTIMATES Winter Pounds Per Day Unmitigated

<u>ROG</u>	<u>NOx</u>	<u>CO</u>	<u>SO2</u>	<u>PM10 Dust</u>	<u>PM10 Exhaust</u>	<u>PM10</u>	<u>PM2.5 Dust</u>	<u>PM2.5 Exhaust</u>	<u>PM2.5</u>	<u>CO2</u>
------------	------------	-----------	------------	------------------	---------------------	-------------	-------------------	----------------------	--------------	------------

Page: 2

4/19/2010 11:07:57 AM

Time Slice 12/1/2010-12/10/2010 Active Days: 8	<u>5.89</u>	<u>41.06</u>	<u>25.99</u>	<u>0.01</u>	<u>0.62</u>	<u>2.73</u>	<u>3.36</u>	<u>0.13</u>	<u>2.51</u>	<u>2.65</u>	<u>4,280.05</u>
Asphalt 12/01/2010-12/12/2010	1.85	11.06	7.35	0.00	0.01	0.96	0.96	0.00	0.88	0.88	1,031.73
Paving Off-Gas	0.02	0.00	0.00	0.00	0.00	0.00	0.00	0.00	0.00	0.00	0.00
Paving Off Road Diesel	1.79	10.91	6.27	0.00	0.00	0.95	0.95	0.00	0.87	0.87	894.03
Paving On Road Diesel	0.01	0.09	0.03	0.00	0.00	0.00	0.00	0.00	0.00	0.00	13.31
Paving Worker Trips	0.03	0.06	1.04	0.00	0.01	0.00	0.01	0.00	0.00	0.01	124.39
Mass Grading 12/01/2010-01/31/2011	4.04	29.99	18.64	0.00	0.62	1.77	2.39	0.13	1.63	1.76	3,248.31
Mass Grading Dust	0.00	0.00	0.00	0.00	0.60	0.00	0.60	0.13	0.00	0.13	0.00
Mass Grading Off Road Diesel	3.92	29.43	15.62	0.00	0.00	1.75	1.75	0.00	1.61	1.61	2,850.36
Mass Grading On Road Diesel	0.03	0.40	0.14	0.00	0.00	0.02	0.02	0.00	0.01	0.01	55.87
Mass Grading Worker Trips	0.09	0.17	2.87	0.00	0.02	0.01	0.03	0.01	0.01	0.01	342.08
Time Slice 12/13/2010-12/31/2010 Active Days: 15	4.04	29.99	18.64	0.00	0.62	1.77	2.39	0.13	1.63	1.76	3,248.31
Mass Grading 12/01/2010-01/31/2011	4.04	29.99	18.64	0.00	0.62	1.77	2.39	0.13	1.63	1.76	3,248.31
Mass Grading Dust	0.00	0.00	0.00	0.00	0.60	0.00	0.60	0.13	0.00	0.13	0.00
Mass Grading Off Road Diesel	3.92	29.43	15.62	0.00	0.00	1.75	1.75	0.00	1.61	1.61	2,850.36
Mass Grading On Road Diesel	0.03	0.40	0.14	0.00	0.00	0.02	0.02	0.00	0.01	0.01	55.87
Mass Grading Worker Trips	0.09	0.17	2.87	0.00	0.02	0.01	0.03	0.01	0.01	0.01	342.08

Page: 3

4/19/2010 11:07:57 AM

Time Slice 1/3/2011-1/31/2011	<u>3.76</u>	<u>28.09</u>	<u>18.27</u>	<u>0.00</u>	<u>0.62</u>	<u>1.67</u>	<u>2.29</u>	<u>0.13</u>	<u>1.54</u>	<u>1.67</u>	<u>3,248.26</u>
Active Days: 21											
Mass Grading 12/01/2010-01/31/2011	3.76	28.09	18.27	0.00	0.62	1.67	2.29	0.13	1.54	1.67	3,248.26
Mass Grading Dust	0.00	0.00	0.00	0.00	0.60	0.00	0.60	0.13	0.00	0.13	0.00
Mass Grading Off Road Diesel	3.66	27.58	15.49	0.00	0.00	1.65	1.65	0.00	1.52	1.52	2,850.36
Mass Grading On Road Diesel	0.03	0.36	0.13	0.00	0.00	0.01	0.02	0.00	0.01	0.01	55.87
Mass Grading Worker Trips	0.08	0.15	2.65	0.00	0.02	0.01	0.03	0.01	0.01	0.01	342.03

Phase Assumptions

Phase: Mass Grading 12/1/2010 - 1/31/2011 - Trenching and storm drain installation

Total Acres Disturbed: 1.04

Maximum Daily Acreage Disturbed: 0.03

Fugitive Dust Level of Detail: Default

20 lbs per acre-day

On Road Truck Travel (VMT): 13.18

Off-Road Equipment:

- 1 Concrete/Industrial Saws (10 hp) operating at a 0.73 load factor for 8 hours per day
- 2 Dumpers/Tenders (16 hp) operating at a 0.38 load factor for 8 hours per day
- 1 Graders (174 hp) operating at a 0.61 load factor for 8 hours per day
- 2 Rubber Tired Loaders (164 hp) operating at a 0.54 load factor for 8 hours per day
- 2 Signal Boards (15 hp) operating at a 0.78 load factor for 8 hours per day
- 2 Tractors/Loaders/Backhoes (108 hp) operating at a 0.55 load factor for 7 hours per day
- 1 Water Trucks (189 hp) operating at a 0.5 load factor for 8 hours per day

Phase: Paving 12/1/2010 - 12/12/2010 - Paving after connection to Wineville Ave

Acres to be Paved: 0.07

Off-Road Equipment:

- 1 Concrete/Industrial Saws (10 hp) operating at a 0.73 load factor for 8 hours per day
- 1 Paving Equipment (104 hp) operating at a 0.53 load factor for 8 hours per day

Page: 4

4/19/2010 11:07:57 AM

1 Rollers (95 hp) operating at a 0.56 load factor for 7 hours per day

1 Tractors/Loaders/Backhoes (108 hp) operating at a 0.55 load factor for 7 hours per day

Page: 1

4/19/2010 11:08:04 AM

Urbemis 2007 Version 9.2.4

Combined Annual Emissions Reports (Tons/Year)

File Name: C:\Documents and Settings\haelhadd\Desktop\Day Creek - Frank Avenue.urb924

Project Name: Day Creek - Frank Avenue Storm Drain

Project Location: Riverside County

On-Road Vehicle Emissions Based on: Version : Emfac2007 V2.3 Nov 1 2006

Off-Road Vehicle Emissions Based on: OFFROAD2007

Summary Report:

CONSTRUCTION EMISSION ESTIMATES

	<u>ROG</u>	<u>NOx</u>	<u>CO</u>	<u>SO2</u>	<u>PM10 Dust</u>	<u>PM10 Exhaust</u>	<u>PM10</u>	<u>PM2.5 Dust</u>	<u>PM2.5 Exhaust</u>	<u>PM2.5</u>	<u>CO2</u>
2010 TOTALS (tons/year unmitigated)	0.05	0.39	0.24	0.00	0.01	0.02	0.03	0.00	0.02	0.02	41.48
2011 TOTALS (tons/year unmitigated)	0.04	0.29	0.19	0.00	0.01	0.02	0.02	0.00	0.02	0.02	34.11

Construction Unmitigated Detail Report:

CONSTRUCTION EMISSION ESTIMATES Annual Tons Per Year, Unmitigated

<u>ROG</u>	<u>NOx</u>	<u>CO</u>	<u>SO2</u>	<u>PM10 Dust</u>	<u>PM10 Exhaust</u>	<u>PM10</u>	<u>PM2.5 Dust</u>	<u>PM2.5 Exhaust</u>	<u>PM2.5</u>	<u>CO2</u>
------------	------------	-----------	------------	------------------	---------------------	-------------	-------------------	----------------------	--------------	------------

Page: 2

4/19/2010 11:08:04 AM

2010	0.05	0.39	0.24	0.00	0.01	0.02	0.03	0.00	0.02	0.02	41.48
Asphalt 12/01/2010-12/12/2010	0.01	0.04	0.03	0.00	0.00	0.00	0.00	0.00	0.00	0.00	4.13
Paving Off-Gas	0.00	0.00	0.00	0.00	0.00	0.00	0.00	0.00	0.00	0.00	0.00
Paving Off Road Diesel	0.01	0.04	0.03	0.00	0.00	0.00	0.00	0.00	0.00	0.00	3.58
Paving On Road Diesel	0.00	0.00	0.00	0.00	0.00	0.00	0.00	0.00	0.00	0.00	0.05
Paving Worker Trips	0.00	0.00	0.00	0.00	0.00	0.00	0.00	0.00	0.00	0.00	0.50
Mass Grading 12/01/2010-01/31/2011	0.05	0.34	0.21	0.00	0.01	0.02	0.03	0.00	0.02	0.02	37.36
Mass Grading Dust	0.00	0.00	0.00	0.00	0.01	0.00	0.01	0.00	0.00	0.00	0.00
Mass Grading Off Road Diesel	0.05	0.34	0.18	0.00	0.00	0.02	0.02	0.00	0.02	0.02	32.78
Mass Grading On Road Diesel	0.00	0.00	0.00	0.00	0.00	0.00	0.00	0.00	0.00	0.00	0.64
Mass Grading Worker Trips	0.00	0.00	0.03	0.00	0.00	0.00	0.00	0.00	0.00	0.00	3.93
2011	0.04	0.29	0.19	0.00	0.01	0.02	0.02	0.00	0.02	0.02	34.11
Mass Grading 12/01/2010-01/31/2011	0.04	0.29	0.19	0.00	0.01	0.02	0.02	0.00	0.02	0.02	34.11
Mass Grading Dust	0.00	0.00	0.00	0.00	0.01	0.00	0.01	0.00	0.00	0.00	0.00
Mass Grading Off Road Diesel	0.04	0.29	0.16	0.00	0.00	0.02	0.02	0.00	0.02	0.02	29.93
Mass Grading On Road Diesel	0.00	0.00	0.00	0.00	0.00	0.00	0.00	0.00	0.00	0.00	0.59
Mass Grading Worker Trips	0.00	0.00	0.03	0.00	0.00	0.00	0.00	0.00	0.00	0.00	3.59

Phase Assumptions

Phase: Mass Grading 12/1/2010 - 1/31/2011 - Trenching and storm drain installation

Total Acres Disturbed: 1.04

Maximum Daily Acreage Disturbed: 0.03

Fugitive Dust Level of Detail: Default

20 lbs per acre-day

On Road Truck Travel (VMT): 13.18

Page: 3

4/19/2010 11:08:04 AM

Off-Road Equipment:

- 1 Concrete/Industrial Saws (10 hp) operating at a 0.73 load factor for 8 hours per day
- 2 Dumpers/Tenders (16 hp) operating at a 0.38 load factor for 8 hours per day
- 1 Graders (174 hp) operating at a 0.61 load factor for 6 hours per day
- 2 Rubber Tired Loaders (164 hp) operating at a 0.54 load factor for 8 hours per day
- 2 Signal Boards (15 hp) operating at a 0.78 load factor for 8 hours per day
- 2 Tractors/Loaders/Backhoes (108 hp) operating at a 0.55 load factor for 7 hours per day
- 1 Water Trucks (189 hp) operating at a 0.5 load factor for 8 hours per day

Phase: Paving 12/1/2010 - 12/12/2010 - Paving after connection to Wineville Ave

Acres to be Paved: 0.07

Off-Road Equipment:

- 1 Concrete/Industrial Saws (10 hp) operating at a 0.73 load factor for 8 hours per day
- 1 Paving Equipment (104 hp) operating at a 0.53 load factor for 8 hours per day
- 1 Rollers (95 hp) operating at a 0.56 load factor for 7 hours per day
- 1 Tractors/Loaders/Backhoes (108 hp) operating at a 0.55 load factor for 7 hours per day

APPENDIX B

Comments from Reviewing Agencies

EASTERN INFORMATION CENTER

CALIFORNIA HISTORICAL RESOURCES INFORMATION SYSTEM
Department of Anthropology, University of California, Riverside, CA 92521-0418
(951) 827-5745 - Fax (951) 827-5409 - eickw@ucr.edu
Inyo, Mono, and Riverside Counties

RECEIVED
DEC 15 2009

December 14, 2009
EIC-RIV-ST-713

Kris Flanigan
Riverside County Flood Control
and Water Conservation District
1995 Market Street
Riverside, CA 92501

RIVERSIDE COUNTY FLOOD CONTROL
AND WATER CONSERVATION DISTRICT

Re: Cultural Resources Records Search for Day Creek-Frank Avenue Storm Drain
Project (Project No. 2-0-00274)

Dear Mr. Flanigan,

We received your request on December 10, 2009, and correct scale map on December 14, 2009, for a cultural resources records search for the Day Creek-Frank Avenue Storm Drain project, located in Section 29, T.2S, R.6W, SBBM, in the Mira Loma area of Riverside County. We have reviewed our maps, records, and reports against the project area defined on the map you provided.

Our records indicate that seven cultural resources studies have been conducted within a quarter-mile radius of your project area. No studies involved the project area.

No cultural resources properties are recorded within the boundaries of the project area. Our records indicate that four properties have been recorded within a quarter-mile radius of the project area.

Additional sources of information consulted are identified below.

National Register of Historic Places (NRHP): no listed properties are located within the boundaries of the project area.

California Office of Historic Preservation (OHP), Archaeological Determinations of Eligibility (ADOE): no listed sites are located within the boundaries of the project area.

Kris Flanigan
December 14, 2009
Page 2

California Office of Historic Preservation (OHP), Historic Property Directory (HPD): no listed properties are located within the boundaries of the project area.

Note: not all properties in the California Historical Resources Information System are listed in the OHP ADOE and HPD; the ADOE and HPD comprise lists of properties submitted to the OHP for review.

The 1947 USGS Corona 15' topographic map does not indicate the presence of possible historical structures or features within the boundaries of the project area.

Based on the information reviewed, cultural resources may be present within the boundaries of the project area. The property has never been surveyed for cultural resources, therefore, it is recommended that the project area be surveyed systematically by a cultural resources professional to identify all cultural resources and provide recommendations regarding their significance and management prior to any development of the property. A statewide list of cultural resources consultants can be found online at <http://chrisinfo.org>.

Sincerely,

Michael P. Loyd
Information Officer

Enclosure

12/23/2009 14:37 FAX 916 657 5390

NAHC

001/004

STATE OF CALIFORNIA

Arnold Schwarzenegger, Governor

NATIVE AMERICAN HERITAGE COMMISSION

915 CAPITOL MALL, ROOM 364
SACRAMENTO, CA 95814
(916) 655-6261
Fax (916) 657-5390
Web Site www.nahc.ca.gov
e-mail na_hc@pacbell.net



December 23, 2009

RECEIVED
DEC 23 2009

Mr. Kris Flanigan, Senior Civil Engineer
**RIVERSIDE COUNTY FLOOD CONTROL AND WATER
CONSERVATION DISTRICT**
1995 Market Street
Riverside, CA 92501

RIVERSIDE COUNTY FLOOD CONTROL
AND WATER CONSERVATION DISTRICT

Sent by FAX to: 951-788-9965
Number of pages: 4

Re: Request for a Sacred Lands File Search and Native American Contacts List for a Proposed "Day Creek - Frank Avenue Storm Drain Project No. 2-0-00274 Project"; located north of Corona, Riverside County, California

Dear Mr. Flanigan:

The Native American Heritage Commission (NAHC), the State of California 'Trustee Agency' for the protection and preservation of Native American cultural resources (c.f. CA Public Resources Code §21070; also c.f. *Environmental Protection Information Center v. Johnson* (1985) 170 Cal App. 3rd 604), was able to perform a record search of its Sacred Lands File (SLF) for the affected project area (APE) requested. The California Environmental Quality Act (CEQA; CA Public Resources Code Section 21000 - 21177) requires that any project that causes a substantial adverse change in the significance of an historical resource, that includes archaeological resources, is a 'significant effect' requiring the preparation of an Environmental Impact Report (EIR) per the California Code of Regulations §15064.5(b)(c)(f) CEQA guidelines). Section 15382 of the 2007 CEQA Guidelines defines a significant impact on the environment as "a substantial, or potentially substantial, adverse change in any of physical conditions within an area affected by the proposed project, including ...objects of historic or aesthetic significance." The NAHC SLF search **did not indicate** the presence of Native American cultural resources within one-half - mile radius of the proposed project (APE).

This letter includes state and federal statutes relating to Native American historic properties of religious and cultural significance to American Indian tribes and individuals as 'consulting parties' under both state and federal law.

Early consultation with Native American tribes in your area is the best way to avoid unanticipated discoveries once a project is underway. Enclosed are the names of the nearest tribes and interested Native American individuals that the NAHC recommends as 'consulting parties,' for this purpose, that may have knowledge of the religious and cultural significance of the historic properties in the project area (e.g. APE). We recommend that you contact persons on the attached list of Native American contacts. Furthermore we suggest that you contact the California Historic Resources Information System (CHRIS) at the Office of Historic Preservation Coordinator's office (at (916) 653-7278, for referral to the nearest Information Center of which there are 10.

Consultation with tribes and interested Native American consulting parties, on the NAHC list, should be conducted in compliance with the requirements of federal NEPA (42 U.S.C. 4321-43351) and Section 106 and 4(f) of federal NHPA (16 U.S.C. 470 (f) et seq), 36 CFR Part 800.3, the President's Council on Environmental Quality (CSQ; 42 U.S.C. 4371 et seq) and NAGPRA (25 U.S.C. 3001-3013), as appropriate.

12/23/2009 14:38 FAX 016 657 5390

NAHC

002/004

Lead agencies should consider avoidance, as defined in Section 15370 of the California Environmental Quality Act (CEQA) when significant cultural resources could be affected by a project. Also, Public Resources Code Section 5097.98 and Health & Safety Code Section 7050.5 provide for provisions for accidentally discovered archeological resources during construction and mandate the processes to be followed in the event of an accidental discovery of any human remains in a project location other than a 'dedicated cemetery. Discussion of these should be included in your environmental documents, as appropriate.

The response to this search for Native American cultural resources is conducted in the NAHC Sacred Lands Inventory, established by the California Legislature (CA Public Resources Code §5097.94(a) and is exempt from the CA Public Records Act (c.f. California Government Code §6254.10) although Native Americans on the attached contact list may wish to reveal the nature of identified cultural resources/historic properties. Confidentiality of 'historic properties of religious and cultural significance' may also be protected the under Section 304 of the NHPA or at the Secretary of the Interior' discretion if not eligible for listing on the National Register of Historic Places. The Secretary may also be advised by the federal Indian Religious Freedom Act (cf. 42 U.S.C. 1996) in issuing a decision on whether or not to disclose items of religious and/or cultural significance identified in or near the APE and possibly threatened by proposed project activity.

If you have any questions about this response to your request, please do not hesitate to contact me at (916) 653-6251.

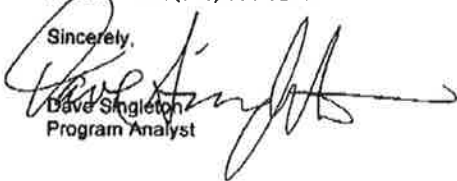
Sincerely,

Dave Singleton
Program Analyst

Attachment: Native American Contacts List (NOTE: we further recommend that other forms of 'proof of mailing or proof of contact be utilized instead of 'Return Receipt Requested' Certified or Registered Mail) Further, we suggest a follow-up telephone call to the contacts if the replies are not received or need clarification.

12/23/2009 14:38 FAX 016 057 5390

NAHC

003/004

**Native American Contacts
Riverside County
December 23, 2009**

Pechanga Band of Mission Indians
Paul Macarro, Cultural Resource Center
P.O. Box 1477 Luiseno
Temecula , CA 92593
pmacarro@pechanga-nsn.
(951) 308-9295 Ext 8106
(951) 676-2768
(951) 506-9491 Fax

Morongo Band of Mission Indians
Michael Contreras, Cultural Heritage Prog.
12700 Pumarra Road Cahuilla
Banning , CA 92220 Serrano
mcontreras@monongo-nsn.
(951) 755-5025
(951)201-1866 - cell
(951) 922-0105 Fax

Ramona Band of Cahuilla Mission Indians
Joseph Hamilton, Chairman
P.O. Box 391670 Cahuilla
Anza , CA 92539
admin@ramonatribe.com
(951) 763-4105
(951) 763-4325 Fax

Juaneno Band of Mission Indians
Alfred Cruz, Cultural Resources Coordinator
P.O. Box 25628 Juaneno
Santa Ana , CA 92799
alfredgcruz@sbcglobal.net
714-998-0721
714-998-0721 - FAX
714-321-1944 - cell

Tongva Ancestral Territorial Tribal Nation
John Tommy Rosas, Tribal Admin.
.itnlaw@gmail.com Gabrielino Tongva
310-570-6567

Kupa Cultural Center (Pala Band)
Shasta Gaughen, Assistant Director
35008 Pala-Temecula Rd.PMB Box Luiseno
Pala , CA 92059
cupa@palatribe.com
(760) 891-3590
(760) 742-4543 - FAX

Santa Rosa Band of Mission Indians
John Marcus, Chairman
P.O. Box 609 Cahuilla
Hemet , CA 92546
srtribaloffice@aol.com
(951) 658-5311
(951) 658-6733 Fax

Willie Pink
48310 Pechanga Road Luiseno
Temecula , CA 92592
wjpink@hotmail.com
(909) 936-1216
Prefers e-mail contact

This list is current only as of the date of this document.

tribution of this list does not relieve any person of statutory responsibility as defined in Section 7050.6 of the Health and Safety Code, Section 5097.94 of the Public Resources Code and Section 5097.98 of the Public Resources Code. Also, federal National Environmental Policy Act (NEPA), National Historic Preservation Act, Section 106, and federal NAGPRA.

This list is only applicable for contacting local Native Americans with regard to cultural resources for the proposed Day Creek - Frank Avenue Storm Drain Project No. 2-0-00274, of the Riverside County Flood Control and Water Conservation District, located in the Corona area; Riverside County, California for which a Sacred Lands File search and Native American Contacts list were requested.

12/23/2009 14:38 FAX 916 857 5390

NAHC

004/004

**Native American Contacts
Riverside County
December 23, 2009**

**Soboba Band of Luiseno Indians
Joseph Ontiveros, Cultural Resources Manager
P.O. Box 487 Luiseno
San Jacinto , CA 92581
jontiveros@soboba-nsn.gov
(951) 654-2765
FAX: (951) 654-4198**

**Cahuilla Band of Indians
Luther Salgado, Sr.
PO Box 391760 Cahuilla
Anza , CA 92539
tribalcouncil@cahuilla.net
915-763-5549**

**Anna Hoover, Cultural Analyst
Pechanga Cultural Resources Department
P.O. Box 2183 Luiseño
Imperial , CA 92593
(951-770-8104
(951) 694-0446 - FAX
ahoover@pechanga-nsn.gov**

This list is current only as of the date of this document.

Distribution of this list does not relieve any person of statutory responsibility as defined in Section 7080.9 of the Health and Safety Code, Section 5007.94 of the Public Resources Code and Section 5097.98 of the Public Resources Code. Also, federal National Environmental Policy Act (NEPA), National Historic Preservation Act, Section 106, and federal NAGPRA.

This list is only applicable for contacting local Native Americans with regard to cultural resources for the proposed Day Creek - Frank Avenue Storm Drain Project No. 2-0-00274, of the Riverside County Flood Control and Water Conservation District; located in the Corona area; Riverside County, California for which a Sacred Lands File search and Native American Contacts list were requested.



Ph: (760) 891-3591
Fax: (760) 742-4543

PALA BAND OF MISSION INDIANS
Tribal Historic Preservation Office
35008 Pala Temecula Rd. PMB 445
Pala, CA 92059

RECEIVED
FEB 10 2010

RIVERSIDE COUNTY FLOOD CONTROL
AND WATER CONSERVATION DISTRICT

February 4, 2010

Warren D Williams
Riverside County Flood Control and Water Conservation District
1995 Market Street
Riverside, CA 92501

Re: Day Creek- Frank Avenue Storm Drain; Project No. 2-0-00274

Dear Mr. Williams:

The Pala Band of Mission Indians Tribal Historic Preservation Office has received your notification of the project referenced above. This letter constitutes our response on behalf of Robert Smith, Tribal Chairman.

We have consulted our maps and determined that the project as described is not within the boundaries of the recognized Pala Indian Reservation. The project is also beyond the boundaries of the territory that the tribe considers its Traditional Use Area (TUA). Therefore, we have no objection to the continuation of project activities as currently planned and we defer to the wishes of Tribes in closer proximity to the project area.

We appreciate involvement with your initiative and look forward to working with you on future efforts. If you have questions or need additional information, please do not hesitate to contact me by telephone at 760-891-3591 or by e-mail at sgaughen@palatribe.com.

Sincerely,

Shasta C. Gaughen, MA
Tribal Historic Preservation Officer
Pala Band of Mission Indians

ATTENTION: THE PALA TRIBAL HISTORIC PRESERVATION OFFICE IS RESPONSIBLE FOR ALL REQUESTS FOR CONSULTATION. PLEASE ADDRESS CORRESPONDENCE TO SHASTA C. GAUGHEN AT THE ABOVE ADDRESS. IT IS NOT NECESSARY TO ALSO SEND NOTICES TO PALA TRIBAL CHAIRMAN ROBERT SMITH. PLEASE ALSO NOTE THAT JOE NIXON NO LONGER WORKS FOR THE PALA THPO.

RECEIVED
FEB 03 2010

February 3, 2010

Attn: Kris Flanigan, Senior Civil Engineer
1995 Market Street
Riverside, CA 92501

RIVERSIDE COUNTY FLOOD CONTROL
AND WATER CONSERVATION DISTRICT



**Re: Day Creek - Frank Avenue Storm Drain
Project No. 2-0-00274**

The Soboba Band of Luiseño Indians appreciates your observance of Tribal Cultural Resources and their preservation in your project. The information provided to us on said project(s) has been assessed through our Cultural Resource Department, where it was concluded that although it is outside the existing reservation, the project area does fall within the bounds of our Tribal Traditional Use Areas. At this time the Soboba Band does not have any specific concerns regarding this project.

[SPECIAL NOTE: (for projects other than cell towers): If this project is associated with a city or county specific plan or general plan action it is subject to the provisions of SB18-Traditional Tribal Cultural Places (law became effective January 1, 2005) and will require the city or county to participate in formal, government-to-government consultation with the Tribe. If the city or county are your client, you may wish to make them aware of this requirement. By law, they are required to contact the Tribe.

Sincerely,

A handwritten signature in black ink, appearing to read "Joe", written over a horizontal line.

Joseph Ontiveros
Soboba Cultural Resource Department
P.O. Box 487
San Jacinto, CA 92581
Phone (951) 654-5544 ext. 4137
Cell (951) 663-5279
jontiveros@soboba-nsn.gov



RIVERSIDE COUNTY FIRE DEPARTMENT
IN COOPERATION WITH
THE CALIFORNIA DEPARTMENT OF FORESTRY AND FIRE PROTECTION

John R. Hawkins ~ Fire Chief
210 West San Jacinto Avenue ~ Perris, CA 92570
(951) 940-6900 ~ www.rvcfire.org

PROUDLY SERVING THE
UNINCORPORATED AREAS
OF RIVERSIDE COUNTY
AND THE CITIES OF:

- BANKING
- BEAUMONT
- CAJONERA
- CANYON LAKE
- COACHELLA
- DESERT HOT SPRINGS
- INDIAN WELLS
- KNOX
- LAREDO
- LA GUNTA
- MENFICE
- MORENO VALLEY
- PALM DESERT
- PERRIS
- RANCHO MIRAGE
- RIVERSIDE
- SAN JACINTO
- TEMICULA
- WILDOMAN

BOARD OF
SUPERVISORS:

- BOB BUSTER
DISTRICT 1
- JOHN TAMASIONE
DISTRICT 2
- JEFF STONE
DISTRICT 3
- JOHN BUNDT
DISTRICT 4
- MARION ASHLEY
DISTRICT 5

August 4, 2010

Riverside County Flood Control and Water Conservation District
Kris Flanigan
1995 Market Street
Riverside, CA 92501

RE: Day Creek-Frank Avenue Storm Drain, Initial Study for a Mitigated Negative Deceleration

Dear Ms. Flanigan,

Thank you for providing the Riverside County Fire Department the opportunity to review the Initial Study for the Day Creek-Frank Avenue Storm Drain project in Mira Loma.

With respect to the referenced project, the Riverside County Fire Department has no further comments.

If I can be of further assistance, please feel free to contact me at (951) 940-6349 or e-mail at jason.neumann@fire.ca.gov

Sincerely,

Jason Neuman
Fire Captain
Strategic Planning Bureau



OFFICE OF
CLERK OF THE BOARD OF SUPERVISORS
1st FLOOR, COUNTY ADMINISTRATIVE CENTER
P.O. BOX 1147, 4080 LEMON STREET
RIVERSIDE, CA 92502-1147
PHONE: (951) 955-1060
FAX: (951) 955-1071

KECIA HARPER-IHEM
Clerk of the Board of Supervisors

KIMBERLY A. RECTOR
Assistant Clerk of the Board

August 24, 2010

RIVERSIDE COUNTY RECORD
ATTN: LEGALS
P.O. BOX 3187
RIVERSIDE, CA 92519

FAX (951) 685-2961
E-MAIL: recordmde@aol.com

RE: NOTICE OF PUBLIC HEARING: RESOLUTION NO. F2010-22

To Whom It May Concern:

Attached is a copy for publication in your newspaper for **TWO (2) TIMES** on **Thursdays: August 26 and September 2, 2010.**

We require your affidavit of publication immediately upon completion of the last publication.

Your invoice must be submitted to this office in duplicate, **WITH TWO CLIPPINGS OF THE PUBLICATION.**

NOTE: PLEASE COMPOSE THIS PUBLICATION INTO A SINGLE COLUMN FORMAT.

Thank you in advance for your assistance and expertise.

Sincerely,

Mcgil

Cecilia Gil, Board Assistant to
KECIA HARPER-IHEM, CLERK OF THE BOARD

Gil, Cecilia

From: recordmde@aol.com
Sent: Monday, August 23, 2010 4:52 PM
To: Gil, Cecilia
Subject: Re: FOR PUBLICATION: RES. NO F2010-22

Hello Cecilia,
I have received the publication. I will publish it twice.
Thanks, Mike

-----Original Message-----

From: Gil, Cecilia <CCGIL@rcbos.org>
To: recordmde@aol.com
Sent: Mon, Aug 23, 2010 4:26 pm
Subject: FOR PUBLICATION: RES. NO F2010-22

Good afternoon! Attached is a Notice of Public Hearing, for publication on 2 Thursdays: Aug. 26 and Sept. 2, 2010.
Please confirm. THANK YOU!

Cecilia Gil

Board Assistant to the
Clerk of the Board of Supervisors
951-955-8464

THE COUNTY ADMINISTRATIVE CENTER IS CLOSED EVERY FRIDAY UNTIL FURTHER NOTICE.
PLEASE CONSIDER THE ENVIRONMENT BEFORE PRINTING.

NOTICE OF PUBLIC HEARING BEFORE THE BOARD OF SUPERVISORS OF THE RIVERSIDE COUNTY FLOOD CONTROL AND WATER CONSERVATION DISTRICT

RESOLUTION NO. F2010-22

SETTING A PUBLIC HEARING DATE FOR DAY CREEK – FRANK AVENUE STORM DRAIN PROJECT AND GIVING NOTICE OF INTENT TO ADOPT A MITIGATED NEGATIVE DECLARATION THEREFOR IN ACCORDANCE WITH SECTION 18 OF THE DISTRICT ACT AND THE CALIFORNIA ENVIRONMENTAL QUALITY ACT (CEQA)

WHEREAS, the District proposes to undertake a project within the unincorporated Mira Loma Community of Riverside County, designated as Day Creek – Frank Avenue Storm Drain Project; and

WHEREAS, the proposed Project is located in 65th Street between Wineville Avenue and Frank Avenue and in Frank Avenue between 64th Street and 65th Street; and

WHEREAS, the proposed Project consists of the construction and subsequent operation and maintenance of approximately 1,110 lineal feet of underground storm drain system; and

WHEREAS, reference is made to the engineering estimate of the cost of the proposed project, entitled "Engineer's Statement" on file with the Clerk of the Board; and

WHEREAS, reference is made to a map dated March 2010, bearing the name and showing the general location and typical section of the proposed Project which is also on file with the Clerk of the Board; and

WHEREAS, the General Manager-Chief Engineer of the District has found that the proposed Project will not have a significant adverse effect on the environment and has prepared a Mitigated Negative Declaration which will not become final until adopted by this Board; and

WHEREAS, any person wishing to comment on the proposed project or the Mitigated Negative Declaration may do so in writing between the date of this notice and the public hearing, or may appear and be heard at the time and place noted below; and

WHEREAS, in a subsequent legal challenge any person may be limited to raising only those issues he, she or someone else raised at the public hearing described in this notice, or in written comments delivered before or at the public hearing; and

WHEREAS, prior to making a decision on the proposed project or the Mitigated Negative Declaration, this Board will consider all written and oral comments; and

WHEREAS, the above-listed documents can be inspected at the District office, 1995 Market Street, Riverside, California 92501 and written comments will be received at the above address.

NOW, THEREFORE, BE IT RESOLVED, DETERMINED AND ORDERED by the Board of Supervisors of the Riverside County Flood Control and Water Conservation District in regular session assembled on August 10, 2010 that:

1. A public hearing concerning the proposed project and the Mitigated Negative Declaration will be held at 1:30 p.m. on September 28, 2010, at the meeting room of this Board, 1st Floor, County Administrative Center, 4080 Lemon Street, Riverside, California, at which time all public comment shall be heard.

2. A copy of this resolution and copies of the above-listed documents shall be posted at least 30 days before said hearing at the Eastvale Library, 7447 Cleveland Avenue, Corona, California 92880.

3. A copy of this resolution shall be posted at least 30 days before said hearing at the Riverside County Clerk and Recorder's Office, 2724 Gateway Drive, Riverside, California 92507.

4. The Clerk of this Board is directed to cause a copy of this resolution to be published twice, once at least 30 days before said hearing, and once 7 days following the initial publication, in a newspaper of general circulation in accordance with Section 18 of the District Act and CEQA.

ROLL CALL:

Ayes: Buster, Tavaglione, Stone, Benoit and Ashley
Nays: None
Absent: None

The foregoing is certified to be a true copy of a resolution duly adopted by said Board of Supervisors on August 10, 2010.

KECIA HARPER-IHEM, Clerk of said Board
By: Cecilia Gil, Board Assistant

Any person affected by the above matter(s) may submit written comments to the Clerk of the Board before the public hearing or may appear and be heard in support of or opposition to the project at the time of the hearing. If you challenge the above item(s) in court, you may be limited to raising only those issues you or someone else raised at the public hearing described in this notice, or in written correspondence, to the Board of Supervisors at, or prior to, the public hearing.

Please send all written correspondence to: Clerk of the Board, 4080 Lemon Street, 1st Floor, Post Office Box 1147, Riverside, CA 92502-1147

Dated: August 24, 2010

Kecia Harper-Ihem
Clerk of the Board
By: Cecilia Gil, Board Assistant



The Riverside County Record Newspaper

Western Riverside County's Only Hometown Newspaper

Since 1955

Post Office Box 3187 • Riverside, California 92519

⁹⁵¹685-6191 • FAX ⁹⁵¹685-2961

e-mail: recorddhb@aol.com

INVOICE

August 26, 2010

Riverside County
Clerk of the Board
4080 Lemon Street, 1st Floor
P.O. Box 1147
Riverside, CA 92502- 1147

Legal Advertising

Notice of Public Hearing

Your: Resolution No. F2010-22
Our #0697

19.00 column inches x \$8.94 = \$169.86 x 2 = \$339.72

Publish two (2) week: August 26, 2010; September 2, 2010

Amount Due: \$339.72

Thank You,

Cathy Sypin-Barnes

Flood
11.4 of 08/10/10
Phv

2010 SEP - 2 PM 3: 04

RECEIVED RIVERSIDE COUNTY
CLERK/BOARD OF SUPERVISORS

Affidavit of Publication

(2015.5 C.C.P.)

County of Riverside

State of California

Catherine Sypin-Barnes, being first duly sworn, deposes and says: That at all times hereinafter, mentioned that she was a citizen of the United States, over the age of eighteen years, and a resident of said County, and was at and during all said times the principal clerk of the printer and publisher of The Riverside County Record-News, a newspaper of general circulation, adjudicated by court decree, printed and published weekly in said County of Riverside, State of California, that said Riverside County Record-News is and was at all times herein mentioned, a newspaper of general circulation as that term is defined in section 4460 of the Political Code, and, as provided by that section, is published for the dissemination of local and telegraphic news and intelligence of a general character, having a bona fide subscription list of paying subscribers, and is not devoted to nor published for the interest, entertainment or instruction of a particular class, profession, trade, calling, race or denominations; that at all said time said newspaper has been established, printed and published in said County and State at regular intervals for more than one year preceding the date of publication of the notice hereinafter mentioned; that said notice was set in type not smaller than nonpareil and was preceded with words printed in black face type not smaller than nonpareil describing and expressing in general terms the purport and character of the notice intended to be given; that the

RIVERSIDE COUNTY RECORD NEWSPAPER

of which the annexed is a printed copy, published and printed in said newspaper in at least 2 weekly issues, as follows:

August 26, 2010;
September 2, 2010

I certify (or declare) under penalty of perjury that the foregoing is true and correct.



Signature

NOTICE OF PUBLIC HEARING BEFORE THE BOARD OF SUPERVISORS OF THE RIVERSIDE COUNTY FLOOD CONTROL AND WATER CONSERVATION DISTRICT RESOLUTION NO. F2010-22

SETTING A PUBLIC HEARING DATE FOR DAY CREEK - FRANK AVENUE STORM DRAIN PROJECT AND GIVING NOTICE OF INTENT TO ADOPT A MITIGATED NEGATIVE DECLARATION THEREFOR IN ACCORDANCE WITH SECTION 18 OF THE DISTRICT ACT AND THE CALIFORNIA ENVIRONMENTAL QUALITY ACT (CEQA)

WHEREAS, the District proposes to undertake a project within the unincorporated Mira Loma Community of Riverside County, designated as Day Creek - Frank Avenue Storm Drain Project; and

WHEREAS, the proposed Project is located in 65th Street between Wineville Avenue and Frank Avenue and in Frank Avenue between 64th Street and 65th Street; and

WHEREAS, the proposed Project consists of the construction and subsequent operation and maintenance of approximately 1,110 lineal feet of underground storm drain system; and

WHEREAS, reference is made to the engineering estimate of the cost of the proposed project, entitled "Engineer's Statement" on file with the Clerk of the Board; and

WHEREAS, reference is made to a map dated March 2010, bearing the name and showing the general location and typical section of the proposed Project which is also on file with the Clerk of the Board; and

WHEREAS, the General Manager-Chief Engineer of the District has found that the proposed Project will not have a significant adverse effect on the environment and has prepared a Mitigated Negative Declaration which will not become final until adopted by this Board; and

WHEREAS, any person wishing to comment on the proposed project or the Mitigated Negative Declaration may do so in writing between the date of this notice and the public hearing, or may appear and be heard at the time and place noted below; and

WHEREAS, in a subsequent legal challenge any person may be limited to raising only those issues he, she or someone else raised at the public hearing described in this notice, or in written comments delivered before or at the public hearing; and

WHEREAS, prior to making a decision on the proposed project or the Mitigated Negative Declaration, this Board will consider all written and oral comments; and

WHEREAS, the above-listed documents can be inspected at the District office, 1995 Market Street, Riverside, California 92501 and written comments will be received at the above address.

NOW, THEREFORE, BE IT RESOLVED, DETERMINED AND ORDERED by the Board of Supervisors of the Riverside County Flood Control and Water Conservation District in regular session assembled on August 10, 2010 that:

1. A public hearing concerning the proposed project and the Mitigated Negative Declaration will be held at 1:30 p.m. on September 28, 2010, at the meeting room of this Board, 1st Floor, County Administrative Center, 4080 Lemon Street, Riverside, California, at which time all public comment shall be heard.

2. A copy of this resolution and copies of the above-listed documents shall be posted at least 30 days before said hearing at the Eastvale Library, 7447 Cleveland Avenue, Corona, California 92880.

3. A copy of this resolution shall be posted at least 30 days before said hearing at the Riverside County Clerk and Recorder's Office, 2724 Gateway Drive, Riverside, California 92507.

4. The Clerk of this Board is directed to cause a copy of this resolution to be published twice, once at least 30 days before said hearing, and once 7 days following the initial publication, in a newspaper of general circulation in accordance with Section 18 of the District Act and CEQA.

ROLL CALL:

Ayes: Buster, Tavaglione, Stone, Benoit and Ashley

Nays: None

Absent: None

The foregoing is certified to be a true copy of a resolution duly adopted by said Board of Supervisors on August 10, 2010.

KECIA HARPER-IHEM, Clerk of said Board

By: Cecilia Gil, Board Assistant

Any person affected by the above matter(s) may submit written comments to the Clerk of the Board before the public hearing or may appear and be heard in support of or opposition to the project at the time of the hearing. If you challenge the above item(s) in court, you may be limited to raising only those issues you or someone else raised at the public hearing described in this notice, or in written correspondence, to the Board of Supervisors at, or prior to, the public hearing. Please send all written correspondence to: Clerk of the Board, 4080 Lemon Street, 1st Floor, Post Office Box 1147, Riverside, CA 92502-1147

Dated: August 24, 2010

Kecia Harper-Ihem

Clerk of the Board

By: Cecilia Gil, Board Assistant

Published: August 26, 2010; September 2, 2010

RCR0697