

**SUBMITTAL TO THE BOARD OF SUPERVISORS
COUNTY OF RIVERSIDE, STATE OF CALIFORNIA**

369 A



FROM: TLMA – Planning Department

SUBMITTAL DATE:
June 29, 2011

SUBJECT: Establishment of the Idyllwild Historic Downtown District

RECOMMENDED MOTION: That the Board of Supervisors:

- 1) Vacate, set aside and rescind its adoption of Resolution No. 2011-178 Establishing the Idyllwild Historic Downtown District.
- 2) Adopt Resolution No. 2011-206 Establishing the Idyllwild Historic Downtown District and finding it exempt from the California Environmental Quality Act (CEQA) pursuant to CEQA Guidelines Section 15061(b)(3); and
- 3) Direct the Clerk of the Board to file a Notice of Exemption with the County Clerk for posting.

BACKGROUND: continued on next page

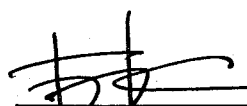
Frank Coyle

Carolyn Syms Luna
Planning Director

FINANCIAL DATA	Current F.Y. Total Cost:	\$ 45,000	In Current Year Budget:	Yes
	Current F.Y. Net County Cost:	\$ 45,000	Budget Adjustment:	No
	Annual Net County Cost:	\$0	For Fiscal Year:	10/11

SOURCE OF FUNDS: 100% General Fund (Third District CID)	Positions To Be Deleted Per A-30	<input type="checkbox"/>
	Requires 4/5 Vote	<input type="checkbox"/>

C.E.O. RECOMMENDATION:

APPROVE

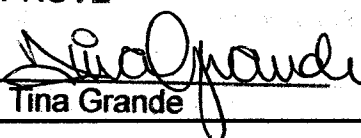
BY: 
Tina Grande

County Executive Office Signature

Departmental Concurrence
 FORM APPROVED COUNTY COUNSEL
 BY: Michelle Clack
 DATE: 6/30/11
 MICHELLE CLACK

Consent Policy
 Consent Policy

MINUTES OF THE BOARD OF SUPERVISORS

On motion of Supervisor Stone, seconded by Supervisor Ashley and duly carried, IT WAS ORDERED that the above matter is approved as recommended with the exclusion of Mr. Canfield's property.

Ayes: Buster, Stone, Benoit, and Ashley
Nays: None
Absent: Tavaglione
Date: July 12, 2011
xc: Planning, Applicant, Parks, Building & Safety, Recorder, Code Enfr

Kecia Harper-Ihem
 Clerk of the Board
 By: 
 Deputy

Prev. Agn. Ref.: 7/27/10, Item 3.2 | **District:** Third | **Agenda Number:**

16.4

Dep't Recomm.:
 Per Exec. Ofc.:

BACKGROUND (continued from page 1):

The establishment of the Idyllwild Historic Downtown District (District) was presented at the June 28, 2011 Board of Supervisors meeting (Agenda Item No. 3.102). The Board adopted the resolution to establish the District and directed the Clerk of the Board to file a Notice of Exemption. A public hearing needed to be conducted before the Board adopted the resolution establishing the District. After the meeting, it was discovered that the public hearing did not take place. Therefore, the item is being brought back to the Board in order to rescind the previous action and conduct the public hearing before consideration of Resolution 2011-206.

Historic preservation districts offer many benefits to the County including safeguarding our historic heritage; improving property values; enhancing the County's attractiveness to residents, tourists and visitors; and providing flexibility when applying building codes to historical resources.

On March 7, 2011, an application for the establishment of the District was submitted by Keith Herron, Historic Preservation Officer of the Riverside County Park and Open Space District.

On March 17, 2011, the Historical Commission evaluated the proposal for the District and recommended that the District application be approved. The application was subsequently forwarded to the Planning Director to be placed on the Board's agenda for a public hearing.

The District generally encompasses 152 properties located in the downtown area of Idyllwild—of which 65 properties have distinct historic value. The boundaries of the District are depicted in the map attached as Exhibit B to Resolution No. 2011-206. The proposed District is considered significant because it represents important aspects of the social and economic history of Riverside County through the development of Idyllwild as one of the County's earliest and most distinctive mountain resort communities.

Ordinance No. 578 provides that a Historic Preservation District may be established only upon the Board adopting a resolution that includes the boundaries of the District and specific findings. Resolution No. 2011-206 is attached for this purpose.

If the District is established, the following actions will occur: noticing all property owners within the District, convening a Local Review Board, developing District Guidelines, hosting several community meetings, and integrating new Historic District Alteration Permit procedures within TLMA's existing permit processing system. Funding for the aforementioned activities will be covered by Third District CID funds originally provided for this purpose to the Planning Department via Board action on July 27, 2010, Agenda Item No. 3.2.

2
3 **RESOLUTION NO. 2011- 206**
4 **ESTABLISHING THE IDYLLWILD**
5 **HISTORIC DOWNTOWN DISTRICT**

6 **WHEREAS**, Riverside County Ordinance No. 578 ("RCO No. 578") sets forth the
7 procedures to establish Historic Preservation Districts in the County of Riverside; and,

8 **WHEREAS**, on March 7, 2011, the General Manager of the Riverside County Regional
9 Park and Open-Space District received a Riverside County Historic Preservation District Application
10 ("Application") to establish the Idyllwild Historic Downtown District ("District"); and,

11 **WHEREAS**, the Application included that certain survey titled "Historic Resources
12 Survey: Idyllwild Commercial Corridor/Survey Results & Historic Context Statement", attached as
13 Exhibit A and incorporated herein by this reference; and

14 **WHEREAS**, the Application was placed on the Riverside Historical Commission's regular
15 agenda on March 17, 2011, and it recommended that the Application be approved; and,

16 **WHEREAS**, a public hearing was held before the Board of Supervisors in Riverside,
17 California on July 12, 2011, to consider the establishment of the District; and,

18 **WHEREAS**, all provisions of RCO No. 578 to establish a Historic Preservation District
19 have been met and the matter was discussed fully with testimony and documentation presented by the
20 public; now, therefore,

21 **BE IT RESOLVED, FOUND, DETERMINED, AND ORDERED**, by the Board of
22 Supervisors of the County of Riverside, in regular session assembled on July 12, 2011, that:

23 A. Open-Space Policy 19.1 of the Riverside County General Plan provides that
24 cultural resources (both prehistoric and historic) are a valued part of the history of the County of
25 Riverside ("County"). Cultural resources are evidence of past human activity that becomes important for
26 scientific, historic and/or religious reasons to communities, descendant groups and individuals. They may
27 include objects, buildings, structures, sites, areas or places associated with history.

DATE 07/29/11
BY MICHELLE CLACK

1 B. Idyllwild is significant because it reflects important aspects of the social and
2 economic history of the County through its development as one of the County's earliest and most
3 significant mountain resort communities.

4 C. The District contains 65 properties that reflect the cultural, social and economic
5 history of the County. In particular, the District consists of important properties that represent the post-
6 World War II commercial era that helped to establish Idyllwild as a permanent community and widely
7 popular tourist destination.

8 D. Establishing the District is consistent with the Cultural and Paleontological Section
9 of the Multipurpose Open Space Element of the County General Plan because it will ensure that the
10 District's cultural resources are protected and preserved for the County's residents, tourists and visitors.

11 **BE IT FURTHER RESOLVED** by the Board of Supervisors that the establishment of the
12 District is exempt from the California Environmental Quality Act (CEQA) pursuant to CEQA Guidelines
13 Section 15061(b)(3) as it can be seen with certainty that there is no possibility that it may have a
14 significant effect on the environment because the establishment of the District does not grant a land use
15 entitlement, building permit or any other entitlement to demolish or construct a building, structure or
16 façade. Establishing the District merely sets forth the boundaries of the District.

17 **BE IT FURTHER RESOLVED** by the Board of Supervisors that the boundaries of the
18 District are hereby approved as shown on the map attached as Exhibit B, which is incorporated herein by
19 this reference.

20 **BE IT FURTHER RESOLVED** by the Board of Supervisors that copies of Resolution
21 No. 2011- 206 and the District's boundary map shall be placed on file in the offices of the Planning
22 Director, Riverside County Regional Park and Open-Space District General Manager, Code Enforcement
23 Director and the Director of Building and Safety.

24 ROLL CALL:

25 Ayes: Buster, Stone, Benoit, and Ashley
26 Nays: None
27 Absent: Tavaglione

The foregoing is certified to be a true copy of a
resolution duly adopted by said Board of Super-
visors on the date therein set forth.

KECIA HARPER-IHEM Clerk of said Board

By _____ Deputy

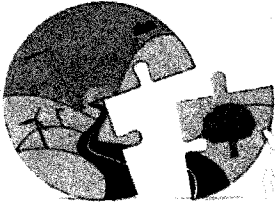

RIVERSIDE COUNTY PLANNING DEPARTMENT

Original Negative Declaration No. _____
Determination was routed to County _____

NOTICE OF EXEMPTION

7/18/11

KD

TO: Office of Planning and Research (OPR) FROM: Riverside County Planning Department
 P.O. Box 3044 4080 Lemon Street, 12th Floor Initial
 Sacramento, CA 95812-3044 P. O. Box 1409 38686 El Cerrito Road
 County of Riverside County Clerk Riverside, CA 92502-1409 Palm Desert, CA 92201

Project Title/Case No.: Formation of the Idyllwild Historic Downtown District

Project Location: Idyllwild downtown area located in the San Jacinto mountains within the unincorporated area of Riverside County. The boundaries of the district extend along North Circle Drive from the intersection of Ridgeview Drive northerly to the intersection with Circle Drive.

Project Description: The proposed project is the establishment of a historic district within the downtown area of the mountain village of Idyllwild in accordance with County Ordinance 578. The Idyllwild Historic Downtown District would encompass 152 properties which are currently zoned either Scenic Highway Commercial (CPS) or Village Tourist Residential (R-3A). Each of the subject properties are identified and categorized by their contribution to the unique historical character of the downtown area. Creation of a historic district provides for the development of guidelines and procedures to follow when constructing, altering, or demolishing a building, structure, or facade. A historic district would allow the Idyllwild Downtown area to retain much of the important aspects of its social and economic history while preserving the village's unique character as one of the County's earliest and most distinctive mountain resort communities.

Name of Public Agency Approving Project: Riverside County

Project Sponsor: Riverside County Planning Department

Exempt Status: (Check one)

- Ministerial (Sec. 21080(b)(1); 15268)
- Declared Emergency (Sec. 21080(b)(3); 15269(a))
- Emergency Project (Sec. 21080(b)(4); 15269 (b)(c))
- Categorical Exemption (15061(b)(3))
- Statutory Exemption (_____)
- Other: _____

Reasons why project is exempt: Creation of the Idyllwild Historic Downtown District is exempt from CEQA pursuant to CEQA Guidelines Section 15061(b)(3) as it can be seen with certainty that there is no possibility that the activity in question may have a significant effect on the environment. The proposed project merely establishes the Idyllwild Historic Downtown District and provides for the development of guidelines and procedures to follow when constructing, altering, or demolishing a building, structure, or facade.

Kristi Lovelady County Contact Person 951-955-0781 Phone Number
Kristi Lovelady Signature Principal Planner Title _____ Date _____

Date Received for Filing and Posting at OPR: _____

Revised: 3/15/10: Y:\Planning Master Forms\Templates\CEQA Forms\NOE Form.docx

JUL 12 2011 16.4

Please charge deposit fee case#: N/A

ZCFG No. N/A - FREE POSTING per Govt. Code 6103 and 27383

FOR COUNTY CLERK'S USE ONLY

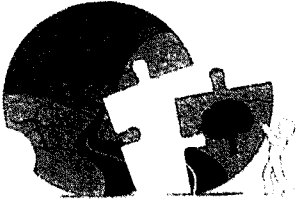

RIVERSIDE COUNTY
PLANNING DEPARTMENT

file

Carolyn Syms Luna
Director

DATE: June 8, 2011

TO: Clerk of the Board of Supervisors

FROM: Planning Department - Riverside Office

SUBJECT: Establishment of the Idyllwild Historic Downtown District
(Charge your time to these case numbers)

The attached item(s) require the following action(s) by the Board of Supervisors:

- Place on Administrative Action (Receive & File; EOT)
 - Labels provided If Set For Hearing
 - 10 Day 20 Day 30 day
 - Place on Consent Calendar
 - Place on Policy Calendar (Resolutions; Ordinances; PNC)
 - Place on Section Initiation Proceeding (GPIP)
 - Set for Hearing (Legislative Action Required, CZ, GPA, SP, SPA)
 - Publish in Newspaper:
 - (3rd Dist-M) Press Enterprise+Idyllwild Town Crier
 - CEQA Exempt
 - 10 Day 20 Day 30 day
 - Notify Property Owners (app/agencies/property owner labels provided)
- Controversial: YES NO

Designate Newspaper used by Planning Department for Notice of Hearing:
(3rd Dist-M) Press Enterprise+Idyllwild Town Crier

Need Director's signature by 6/15/11
Please schedule on the July 12, 2011 BOS Agenda

Documents to be sent to County Clerk's Office for Posting within five days:
Notice of Exemption
Fish & Game Receipt (CFG FREE POSTING PER GOVT. CODE 6103 AND 27383)

Do not send these documents to the County Clerk for posting until the Board has taken final action on the subject cases.

PWS sent 6/14/11
16.4 7/12/11

(21)

Riverside Office · 4080 Lemon Street, 12th Floor
P.O. Box 1409, Riverside, California 92502-1409
(951) 955-3200 · Fax (951) 955-1811

Desert Office · 38686 El Cerrito Road
Palm Desert, California 92211
(760) 863-8277 · Fax (760) 863-7555

"Planning Our Future... Preserving Our Past"

**NOTICE OF PUBLIC HEARING
BEFORE THE RIVERSIDE COUNTY BOARD OF SUPERVISORS**

A PUBLIC HEARING has been scheduled before the RIVERSIDE COUNTY BOARD OF SUPERVISORS to consider the establishment of the Idyllwild Historic Downtown District (Historic District) described below. The Planning Department has tentatively determined that the project will not have a significant effect on the environment. Therefore, the Department has prepared a Notice of Exemption (NOE). The Board of Supervisors will consider the NOE in conjunction with their consideration of the proposed Historic District at the public hearing referenced herein.

BOARD OF SUPERVISORS HEARING

DATE OF HEARING: **July 12, 2011**
TIME OF HEARING: **1:30 P.M. or as soon as possible thereafter**
PLACE OF HEARING: **Board Hearing Room
First Floor
4080 Lemon Street
Riverside CA 92501**

BACKGROUND: The Idyllwild Historic Downtown District is a County initiated proposal that is the result of a collaborative process between property and business owners within the Idyllwild community, the County Historian, Third Supervisorial District staff, and the Planning Department. During this time a historic resources survey was performed to identify the boundaries of the Historic District and determine the contributive historic value of various properties.

PROJECT DESCRIPTION AND IDENTIFICATION:

Idyllwild Historic Downtown District – County Initiated – Third Supervisorial District – PROPOSAL: The County of Riverside proposes to establish a historic preservation district within the downtown area of the mountain village of Idyllwild in accordance with County Ordinance 578. The boundaries of the Historic District would extend along North Circle Drive from the intersection of Ridgeview Drive northerly to the intersection with Circle Drive (see attached map). The district would encompass approximately 152 properties which are currently zoned either Scenic Highway Commercial (CPS) or Village Tourist Residential (R-3A). Each of the subject properties are identified and categorized by their contribution to the unique historical character of the downtown area. Creation of a Historic District provides for the development of guidelines and procedures to follow when constructing, altering, or demolishing a building, structure, or façade. A historic district would allow the Idyllwild Downtown area to retain much of the important aspects of its social and economic history while preserving the village's unique character as one of the County's earliest and most distinctive mountain resort communities.

ANTICIPATED ENVIRONMENTAL EFFECTS:

The Planning Department has tentatively determined that the establishment of the Historic District will not have a significant effect on the environment. Therefore the Department has prepared a Notice of Exemption (NOE).

YOUR RIGHT TO COMMENT:

Any person wishing to comment on or testify in support of, or in opposition to, the proposed Historic District may do so in writing prior to the hearing (between the date of this notice and the public hearing) or may appear and be heard at the dates, times, and places noted above. All comments received prior to the public hearing will be submitted to the Board of Supervisors. The Board of Supervisors will consider such comments, in addition to any oral testimony, before making a decision on the proposed Historic District. If you challenge this project (Historic District and/or NOE) in court, you may be limited to raising only those issues you or someone else raised at the public hearings described in this notice, or in written correspondence delivered to the Board of Supervisors at, or prior to, the date of the Board hearing.

Please send all written correspondence to the following address:

Riverside County Planning Department
Attention: Kristi Lovelady
P. O. Box 1409
Riverside, CA 92502-1409

Correspondence may also be sent by FAX to (951) 955-1811 or by e-mail to klovelad@rctlma.org

BE ADVISED that, as a result of public hearings and comment, the Board of Supervisors may amend, in whole or in part, the proposed Historic District project and/or the environmental documents associated therewith.

FOR ADDITIONAL INFORMATION:

The proposed Historic District maps, survey, resolution, and environmental findings to be considered by the Board of Supervisors (and any documents referenced in the environmental assessment) are available for review beginning June 28, 2011, Monday through Thursday, from 8:00 a.m. to 5:00 p.m., at the County of Riverside Planning Department office located at 4080 Lemon Street, Twelfth Floor, Riverside, CA. This information may also be reviewed at the Riverside County Public Library in Idyllwild located at 54185 Pinecrest Avenue, Idyllwild, CA 92549 during normal business hours. For further information regarding the proposed Historic District, please contact Mr. Keith Herron at (951) 955-4558 or Ms. Kristi Lovelady at (951) 955-0781.

Carolyn Syms Luna
Planning Director

ASMT: 565062003, APN: 565062003
DELOBO ENTERPRISES INC
P O BOX 2423
IDYLLWILD CA 92549

ASMT: 565062008, APN: 565062008
TINDLE NEWSPAPERS INC
P O BOX 157
IDYLLWILD CA 92549

ASMT: 565062010, APN: 565062010
GEERTRUIDA TWARDOWSKI
C/O TRUDY TWARDOWSKI
P O BOX 2143
IDYLLWILD CA 92549

ASMT: 565062015, APN: 565062015
RICHARD MILLER, ETAL
P O BOX 101
IDYLLWILD CA 92549

ASMT: 565062017, APN: 565062017
WILLIAM WAGSTAFF
P O BOX 69
IDYLLWILD CA 92549

ASMT: 563300039, APN: 563300039
JOSE HUIZAR
P O BOX 1288
IDYLLWILD CA 92549

ASMT: 563300045, APN: 563300045
NELSON ROWEN
P O BOX 317
PALM DESERT CA 92261

ASMT: 563312030, APN: 563312030
WARREN LIPSON, ETAL
79 DAILY DR STE 508
CAMARILLO CA 93010

ASMT: 563300046, APN: 563300046
BONNIE WOLF
P O BOX V
IDYLLWILD CA 92549

ASMT: 563313001, APN: 563313001
SANDEN & ETAL
P O BOX 72
MOUNTAIN CENTER CA 92561

ASMT: 563300048, APN: 563300048
LLOYD WOOD, ETAL
P O BOX 12
IDYLLWILD CA 92549

ASMT: 563313006, APN: 563313006
RICHARD KRUPP
101 STATE PL STE I
ESCONDIDO CA 92029

ASMT: 563313007, APN: 563313007
VILLAGE CENTER PARTNERS
P O BOX 165
IDYLLWILD CA 92549

ASMT: 565061036, APN: 565061036
IDYLLWILD INN INC
C/O JOSHUA B WHITE
P O BOX 515
IDYLLWILD CA 92549

ASMT: 563312028, APN: 563312028
JOHN FRIEMOTH, ETAL
P O BOX 567
IDYLLWILD CA 92549

ASMT: 565062001, APN: 565062001
SUBURBAN PROPANE
240 RTE 10 WEST
WHIPPANY NJ 7981



ASMT: 563300024, APN: 563300024
STERLING TRUST CO IRA, ETAL
P O BOX 786
IDYLLWILD CA 92549

ASMT: 563300032, APN: 563300032
JAMES JOHNSON
P O BOX 147
IDYLLWILD CA 92549

ASMT: 563300026, APN: 563300026
PATRICK LIPPERT
P O BOX 3502
IDYLLWILD CA 92549

ASMT: 563300034, APN: 563300034
FAUX EVER AFTER
P O BOX 1212
IDYLLWILD CA 92549

ASMT: 563300028, APN: 563300028
IDYLLWILD ALL YEAR RESORT
BOX 147
IDYLLWILD CA 92549

ASMT: 563300035, APN: 563300035
JAMES CROSS, ETAL
45500 STONEBROOK CT
LA QUINTA CA 92253

ASMT: 563300029, APN: 563300029
CHARLES KRETSINGER, ETAL
P O BOX 911
IDYLLWILD CA 92549

ASMT: 563300038, APN: 563300038
IDYLLWILD COMMUNITY PRESBYTERIAN CHURCH
P O BOX 537
IDYLLWILD CA 92549

ASMT: 563283020, APN: 563283020
PHILIP THOMPSON, ETAL
P O BOX 1130
IDYLLWILD CA 92549

ASMT: 563292009, APN: 563292009
IDYLLWILD INN INC
C/O JOSHUA B WHITE
P O BOX 515
IDYLLWILD CA 92549

ASMT: 563283022, APN: 563283022
NOMAD VENTURES INC
405 W GRAND AVE
ESCONDIDO CA 92025

ASMT: 563292011, APN: 563292011
GERALD VANZANTEN, ETAL
P O BOX 2332
IDYLLWILD CA 92549

ASMT: 563283024, APN: 563283024
ZHI YE, ETAL
762 SANDGLASS DR
HUNTINGTON BEACH CA 92648

ASMT: 563292012, APN: 563292012
SHANE STEWART
P O BOX 243
IDYLLWILD CA 92549

ASMT: 563283025, APN: 563283025
JIT
P O BOX 2184
IDYLLWILD CA 92549

ASMT: 563292015, APN: 563292015
SHATTO PLACE MANAGEMENT
5914 PACIFIC BLV
HUNTINGTON PARK CA 90255

ASMT: 563283028, APN: 563283028
PETER CAPPARELLI, ETAL
P O BOX 3599
IDYLLWILD CA 92549

ASMT: 563300012, APN: 563300012
ROBERT MUIR, ETAL
P O BOX 369
IDYLLWILD CA 92549

ASMT: 563291001, APN: 563291001
BETTY LACKEY
P O BOX 1905
IDYLLWILD CA 92549

ASMT: 563292003, APN: 563292003
MILE HI PLAZA
C/O JIM ENGLE
79785 WESTWARD HO DR
LA QUINTA CA 92253

ASMT: 563300021, APN: 563300021
KEN GIOELI, ETAL
P O BOX 878
IDYLLWILD CA 92549



ASMT: 563271004, APN: 563271004
JACK COOPER, ETAL
5200 IRVINE BLV 18
IRVINE CA 92620

ASMT: 563273016, APN: 563273016
ARTURO ALVARADO, ETAL
P O BOX 833
IDYLLWILD CA 92549

ASMT: 563273004, APN: 563273004
DAVID FOSTER, ETAL
P O BOX 1386
IDYLLWILD CA 92549

ASMT: 563274005, APN: 563274005
LEONA EGELAND
434 MONTECITO BLV
NAPA CA 94559

ASMT: 563273005, APN: 563273005
MARY ZACHAR
P O BOX 1685
IDYLLWILD CA 92549

ASMT: 563274008, APN: 563274008
ROMAN CATHOLIC BISHOP OF SB
1201 E HIGHLAND AVE
SAN BERNARDINO CA 92404

ASMT: 563273006, APN: 563273006
M ZACHAR, ETAL
P O BOX 1685
IDYLLWILD CA 92549

ASMT: 563281001, APN: 563281001
ROMAN CATHOLIC BISHOP OF SB
1201 E HIGHLAND AVE
SAN BERNARDINO CA 92404

ASMT: 563273013, APN: 563273013
PETER DALY, ETAL
3560 TOMAHAWK LN
SAN DIEGO CA 92117

ASMT: 563281002, APN: 563281002
RUTH BOND, ETAL
109 BALTIMORE RD
HOLLY SPRINGS NC 27540

ASMT: 563273014, APN: 563273014
JAMES JENNISON, ETAL
P O BOX 571
IDYLLWILD CA 92549

ASMT: 563283002, APN: 563283002
SAMUEL KOTYCK, ETAL
P O BOX 2950
PALM SPRINGS CA 92263

ASMT: 563273015, APN: 563273015
SANDERS CHASE, ETAL
4445 VICTORIA TARK DR
LOS ANGELES CA 90019

ASMT: 563283003, APN: 563283003
LANCE HECK, ETAL
33262 MESA VISTA DR
DANA POINT CA 92629

ASMT: 563263010, APN: 563263010
MARK GRADY
P O BOX 1984
IDYLLWILD CA 92549

ASMT: 563263015, APN: 563263015
IDYLLWILD AREA HISTORICAL SOCIETY
P O BOX 3320
IDYLLWILD CA 92549

ASMT: 563265010, APN: 563265010
THOMAS SMITH, ETAL
26565 CHESTNUT DR
HEMET CA 92544

ASMT: 563263016, APN: 563263016
MARK GRADY
P O BOX 00917287
SIOUX FALLS SD 57186

ASMT: 563264007, APN: 563264007
JON KIBBY, ETAL
P O BOX 1411
IDYLLWILD CA 92549

ASMT: 563265015, APN: 563265015
MANUEL GARCIA, ETAL
460 N SOBOBA
HEMET CA 92544

ASMT: 563264008, APN: 563264008
JACK NEWORTH
2700 NEILSON WAY NO 322
SANTA MONICA CA 90405

ASMT: 563271001, APN: 563271001
REGUR FRANK P & ETAL
68 SILVER SADDLE LN
RLLNG HLS EST CA 90274

ASMT: 563264012, APN: 563264012
WILLIAM SEFFEL
1355 BARNARD DR
LAS VEGAS NV 89102

ASMT: 563271002, APN: 563271002
JAMES POMEROY
P O BOX 459
IDYLLWILD CA 92549

ASMT: 563265008, APN: 563265008
REX BURKE
P O BOX 1316
OJAI CA 93024

ASMT: 563271003, APN: 563271003
CHE FANG WU
P O BOX 51072
IRVINE CA 92619



ASMT: 563222026, APN: 563222026
CLARK CANFIELD
4118 N LOST SPRINGS DR
CALABASAS CA 91301

ASMT: 563223004, APN: 563223004
DAVID FLYNN, ETAL
1101 W NORTH ST
ANAHEIM CA 92801

ASMT: 563223005, APN: 563223005
MANHAR PATEL, ETAL
12641 WOODGREEN AVE
LOS ANGELES CA 90066

ASMT: 563234005, APN: 563234005
SANDERS CHASE
7809 MELROSE AVE
LOS ANGELES CA 90046

ASMT: 563223002, APN: 563223002
GLENN PRAISS
43996 E STREET
HEMET CA 92544

ASMT: 563223003, APN: 563223003
HERMAN SMITH, ETAL
24672 DEVONPORT CIR
LAGUNA HILLS CA 92653

ASMT: 563263009, APN: 563263009
LARRY ALLEN, ETAL
P O BOX 313
IDYLLWILD CA 92549





ASMT: 563100013, APN: 563100013
SHANE STEWART
P O BOX 243
IDYLLWILD CA 92549

ASMT: 563222016, APN: 563222016
STEVEN MOULTON
P O BOX 3286
IDYLLWILD CA 92549

ASMT: 563222017, APN: 563222017
RICHARD BOETTCHER, ETAL
C/O ERIC BOETTCHER
P O BOX 896
IDYLLWILD CA 92549

ASMT: 563222018, APN: 563222018
HEBER DUNN, ETAL
2985 VISTA WAY
HEMET CA 92544

ASMT: 563123016, APN: 563123016
MARY PRICE, ETAL
P O BOX 1773
IDYLLWILD CA 92549

ASMT: 563222022, APN: 563222022
BARNABY FINCH, ETAL
P O BOX 1702
IDYLLWILD CA 92549

ASMT: 563123021, APN: 563123021
ALPENGLow
P O BOX 1171
IDYLLWILD CA 92549

ASMT: 563222023, APN: 563222023
SHARON SMITH
28279 PANORAMA HILLS DR
MENIFEE CA 92584

ASMT: 563125001, APN: 563125001
KENNETH RUGGLES, ETAL
78753 ALLIANCE WAY
PALM DESERT CA 92211

ASMT: 563222024, APN: 563222024
ERIC JORDAN
P O BOX 4370
IDYLLWILD CA 92549

ASMT: 563125002, APN: 563125002
WILLIAM WAGSTAFF
P O BOX 1680
IDYLLWILD CA 92549

Idyllwild Historic Downtown (81)

Gil, Cecilia

From: Meyer, Mary Ann <MaMeyer@asrclkrec.com>
Sent: Wednesday, June 29, 2011 4:33 PM
To: Gil, Cecilia
Subject: RE: FOR POSTING: Idyllwild Historic Downtown District

received and posted

From: Gil, Cecilia
Sent: Wednesday, June 29, 2011 2:36 PM
To: Meyer, Mary Ann
Subject: FOR POSTING: Idyllwild Historic Downtown District

Maryann,

One more for posting please...and also need confirmation. thank you!

Cecilia Gil

Board Assistant to the
Clerk of the Board of Supervisors
951-955-8464

**THE COUNTY ADMINISTRATIVE CENTER IS CLOSED EVERY FRIDAY UNTIL FURTHER NOTICE.
PLEASE CONSIDER THE ENVIRONMENT BEFORE PRINTING.**

CERTIFICATE OF POSTING

(Original copy, duly executed, must be attached to the original document at the time of filing)

I, Cecilia Gil, Board Assistant to Kecia Harper-Ihem, Clerk of the Board of Supervisors, for the County of Riverside, do hereby certify that I am not a party to the within action or proceeding; that on June 29, 2011, I forwarded to Riverside County Clerk & Recorder's Office a copy of the following document:

NOTICE OF PUBLIC HEARING

Idyllwild Historic Downtown District

to be posted, pursuant to Government Code Section 21092 et seq, in the office of the County Clerk at 2724 Gateway Drive, Riverside, California 92507. Upon completion of posting, the County Clerk will provide the required certification of posting.

Board Agenda Date: July 12, 2011 @ 1:30 PM

SIGNATURE: Mcgil DATE: June 29, 2011
Cecilia Gil

**NOTICE OF PUBLIC HEARING BEFORE THE BOARD OF SUPERVISORS OF RIVERSIDE COUNTY
ON A COUNTY-INITIATED PROPOSAL TO ESTABLISH A HISTORIC PRESERVATION DISTRICT
WITHIN THE DOWN AREA OF IDYLLWILD, THIRD SUPERVISORIAL DISTRICT AND INTENT TO
FILE NOTICE OF EXEMPTION**

NOTICE IS HEREBY GIVEN that a public hearing at which all interested persons will be heard, will be held before the Board of Supervisors of Riverside County, California, on the 1st Floor Board Chambers, County Administrative Center, 4080 Lemon Street, Riverside, on **Tuesday, July 12, 2011 at 1:30 P.M.** to consider a County-Initiated proposal to establish a historic preservation district within the downtown area of the mountain village of Idyllwild, Third Supervisorial District, in accordance with County Ordinance 578. The boundaries of the Historic District would extend along North Circle Drive from the intersection of Ridgeview Drive northerly to the intersection with Circle Drive. The district would encompass approximately 152 properties which are currently zoned either Scenic Highway Commercial (CPS) or Village Tourist Residential (R-3A). Each of the subject properties are identified and categorized by their contribution to the unique historical character of the downtown area. Creation of a Historic District provides for the development of guidelines and procedures to follow when constructing, altering, or demolishing a building, structure, or façade. A historic district would allow the Idyllwild Downtown area to retain much of the important aspects of its social and economic history while preserving the village's unique character as one of the County's earliest and most distinctive mountain resort communities.

The Planning Department has tentatively determined that the project will not have a significant effect on the environment and therefore, has prepared a Notice of Exemption (NOE), which the Board of Supervisors will consider in conjunction with the proposed project.

The project case file may be viewed from the date of this notice until the public hearing, Monday through Thursday, from 7:30 a.m. to 5:30 p.m. at the Clerk of the Board of Supervisors at 4080 Lemon Street, 1st Floor, Riverside, California 92501, and at the Central Files Division of Riverside County Planning Department at 4080 Lemon Street, 12th Floor, Riverside, California 92501.

FOR FURTHER INFORMATION REGARDING THIS PROJECT, PLEASE CONTACT KRISTI LOVELADY, PROJECT PLANNER, AT (951) 955-1811 or EMAIL at klovelad@rctlma.org.

Any person wishing to testify in support of or in opposition to the project may do so in writing between the date of this notice and the public hearing, or may appear and be heard at the time and place noted above. All written comments received prior to the public hearing will be submitted to the Board of Supervisors and the Board of Supervisors will consider such comments, in addition to any oral testimony, before making a decision on the project.

If you challenge the above item in court, you may be limited to raising only those issues you or someone else raised at the public hearing described in this notice, or in written correspondence to the Planning Commission or Board of Supervisors at, or prior to, the public hearing. Be advised that as a result of the public hearing and the consideration of all public comment, written and oral, the Board of Supervisors may amend, in whole or in part, the project and/or the related environmental document. Accordingly, the designations, development standards, design or improvements, or any properties or lands within the boundaries of the project, may be changed in a way other than specifically proposed.

Please send all written correspondence to:

Clerk of the Board
4080 Lemon Street, 1st Floor
Post Office Box 1147
Riverside, CA 92502-1147

Kecia Harper-Ihem
Clerk of the Board
By: Cecilia Gil, Board Assistant

Dated: June 29, 2011

Gil, Cecilia

From: Sandy Burns <sandy@towncrier.com>
Sent: Wednesday, June 29, 2011 3:06 PM
To: Gil, Cecilia
Subject: Re: FOR PUBLICATION: Idyllwild Historic District

Thank you Cecilia.

It will run in the paper 7/7/11.

I will mail you an Proof of Publication and the invoice.

Sandy

On Jun 29, 2011, at 2:35 PM, Gil, Cecilia wrote:

Hello Sandy,

Attached is a Notice of Public Hearing, for publication on Thursday, July 7, 2011. Please confirm receipt of this Notice. Thank you!

Cecilia Gil

Board Assistant to the
Clerk of the Board of Supervisors
951-955-8464

*THE COUNTY ADMINISTRATIVE CENTER IS CLOSED EVERY FRIDAY UNTIL FURTHER NOTICE.
PLEASE CONSIDER THE ENVIRONMENT BEFORE PRINTING.*

<image001.jpg><ID TWN-Idyllwild Historic Downtown.doc>

Sandy Burns
Classifieds & Legals
Idyllwild Town Crier
P.O. Box 157
54295 Village Center Dr.
Idyllwild, CA 92549
(951) 659-2145
sandy@towncrier.com



OFFICE OF
CLERK OF THE BOARD OF SUPERVISORS
1st FLOOR, COUNTY ADMINISTRATIVE CENTER
P.O. BOX 1147, 4080 LEMON STREET
RIVERSIDE, CA 92502-1147
PHONE: (951) 955-1060
FAX: (951) 955-1071

KECIA HARPER-IHEM
Clerk of the Board of Supervisors

KIMBERLY A. RECTOR
Assistant Clerk of the Board

June 29, 2011

IDYLLWILD TOWN CRIER
ATTN: LEGALS
PO BOX 157
IDYLLWILD, CA 92549

E-MAIL: sandy@towncrier.com
PH: (951) 659-2145 ext. 10
FAX: (951) 659-2071

RE: NOTICE OF PUBLIC HEARING: IDYLLWILD HISTORIC DOWNTOWN DISTRICT

To Whom It May Concern:

Attached is a copy for publication in your newspaper for **One (1) Time on Saturday, July 2, 2011.**

We require your affidavit of publication immediately upon completion of the last publication.

Your invoice must be submitted to this office in duplicate, WITH TWO CLIPPINGS OF THE PUBLICATION.

NOTE: PLEASE COMPOSE THIS PUBLICATION INTO A SINGLE COLUMN FORMAT.

Thank you in advance for your assistance and expertise.

Sincerely,

McGil

Cecilia Gil, Board Assistant to
KECIA HARPER-IHEM, CLERK OF THE BOARD

Gil, Cecilia

From: PE Legals <legals@pe.com>
Sent: Wednesday, June 29, 2011 3:21 PM
To: Gil, Cecilia
Subject: RE: FOR PUBLICATION: Idyllwild Historic Downtown District

Received for publication on July 2

Please Note: The Press-Enterprise offices will be closed on Monday, July 4th in observance of Independence day. Below are our Independence Day Holiday Deadlines.

Deadlines:

- Wed., June 29th at 10:30 am for all ads publishing on Fri. July 1st or Sat. July 2nd
- Thurs. June 30th at 10:30 am for all ads publishing on Sun. July 3, Mon. July 4, Tues. July 5
- Fri. July 1st at 10:30 am for all ads publishing on Wed. July 6

From: Gil, Cecilia [<mailto:CCGIL@rcbos.org>]
Sent: Wednesday, June 29, 2011 2:34 PM
To: PE Legals
Subject: FOR PUBLICATION: Idyllwild Historic Downtown District

Maria,

Here's the last one for today, a Notice of Hearing, for publication on Saturday, July 2, 2011. Please confirm. THANK YOU!

Cecilia Gil

Board Assistant to the
Clerk of the Board of Supervisors
951-955-8464

**THE COUNTY ADMINISTRATIVE CENTER IS CLOSED EVERY FRIDAY UNTIL FURTHER NOTICE.
PLEASE CONSIDER THE ENVIRONMENT BEFORE PRINTING.**



OFFICE OF
CLERK OF THE BOARD OF SUPERVISORS
1st FLOOR, COUNTY ADMINISTRATIVE CENTER
P.O. BOX 1147, 4080 LEMON STREET
RIVERSIDE, CA 92502-1147
PHONE: (951) 955-1060
FAX: (951) 955-1071

KECIA HARPER-IHEM
Clerk of the Board of Supervisors

KIMBERLY A. RECTOR
Assistant Clerk of the Board

June 29, 2011

THE PRESS ENTERPRISE
ATTN: LEGALS
P.O. BOX 792
RIVERSIDE, CA 92501

E-MAIL: legals@pe.com
FAX: (951) 368-9018

RE: NOTICE OF PUBLIC HEARING: IDYLLWILD HISTORIC DOWNTOWN DISTRICT

To Whom It May Concern:

Attached is a copy for publication in your newspaper for **One (1) Time on Saturday, July 2, 2011.**

We require your affidavit of publication immediately upon completion of the last publication.

Your invoice must be submitted to this office in duplicate, WITH TWO CLIPPINGS OF THE PUBLICATION.

NOTE: PLEASE COMPOSE THIS PUBLICATION INTO A SINGLE COLUMN FORMAT.

Thank you in advance for your assistance and expertise.

Sincerely,

McGil

Cecilia Gil, Board Assistant to
KECIA HARPER-IHEM, CLERK OF THE BOARD

June 29, 2011

Dear Ms. Lovelady:

Per the options to comment on the attached public hearing notice, I am submitting the enclosed materials and my position on this matter. As of this date, I still have never heard ANY response to my previously submitted correspondence on this matter. I would appreciate a follow-up to my position on this matter, preferably prior to the scheduled hearing on this issue. I also hope my position on this matter is made know to the Riverside Board of Supervisors at the appropriate time.

Thank you,

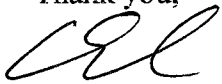

Clark Canfield
(818) 880-1628

Cc: Carolyn Syms Luna – Planning Director
Supervisor Bob Buster – District #1
Supervisor John Tavaglione – District #2
Supervisor Jeff Stone – District #3
Supervisor John J. Benoit – District #4
Supervisor Marion Ashley – District #5
Ms. Pamela J. Walls – County Council

Submitted by Clark Canfield
7/12/11 Item 16.4
(date)

Clark Canfield

From: "Clark Canfield" <clarkcanfield@earthlink.net>
To: <district3@rcbos.org>
Cc: <rrchaves@rivcoparks.org>
Sent: Tuesday, March 29, 2011 5:46 PM
Subject: Idyllwild Historic District Opposition
March 29, 2011

Dear Supervisor Stone:

I am a homeowner (a secondary home) in the Idyllwild area (parcel #563222026-4). In the March 21st Press-Enterprise Newspaper I read an article which stated during a recent meeting regarding the Idyllwild Historic District issue, (I'm paraphrasing) I believe you posed a question to Mr. Herron, if there had been any opposition voiced about this Historic District issue or proceedings. As I understood, Mr. Herron indicated something to the fact that there basically had been none. In my case, that is not the situation.

As per my many previous conversations with Mr. Herron, I would like to go on the official record *again* as opposing the Idyllwild Historic District, *only* as it effects my property. Although all of the buildings on my property have been personally verified by Mr. Herron as not the type, age, etc (non-contributing) that would be regulated by the Historic District guidelines, my opposition still is present due to my parcel itself being projected to fall within the proposed boundaries of this Historic District – thus my property would be effected by this possible Historic District and I'd like my position heard and put on the official record as such! There are many reasons as to why I do not think or desire my property (which is located on the very far N. end of the projected Historic District zone) to be included inside the proposed Historic District boundaries, all of which I have previously shared with Mr. Herron. I believe one criteria why my property should be eliminated from the projected Historic District is that nothing around or adjacent to my property is considered Historic, in any respect of the word/concept. On all four sides of my residential property there are either streets, non-historic zones/parcels or vacant lots and open space. Furthermore, the exclusion of my property would not have any effect on the remainder of the proposed Historical District elements or boundaries.

Although Mr. Herron has been very responsive to my previous questions and has assisted me with some of my associated issues in the past, the inclusion issue of my property within the proposed Idyllwild Historic District has yet to be resolved. I am requesting that my opposition position be heard, put on the official record and preferably resolved, by having my property removed from within this possible Historical District zone when and if the final boundaries are finally established.

Thank you for your time, consideration and assistance with this matter...I look forward to hearing from you soon,

Clark Canfield
(818) 880-1628

Area Under Consideration for Potential Idyllwild Commercial Core Historic Preservation District

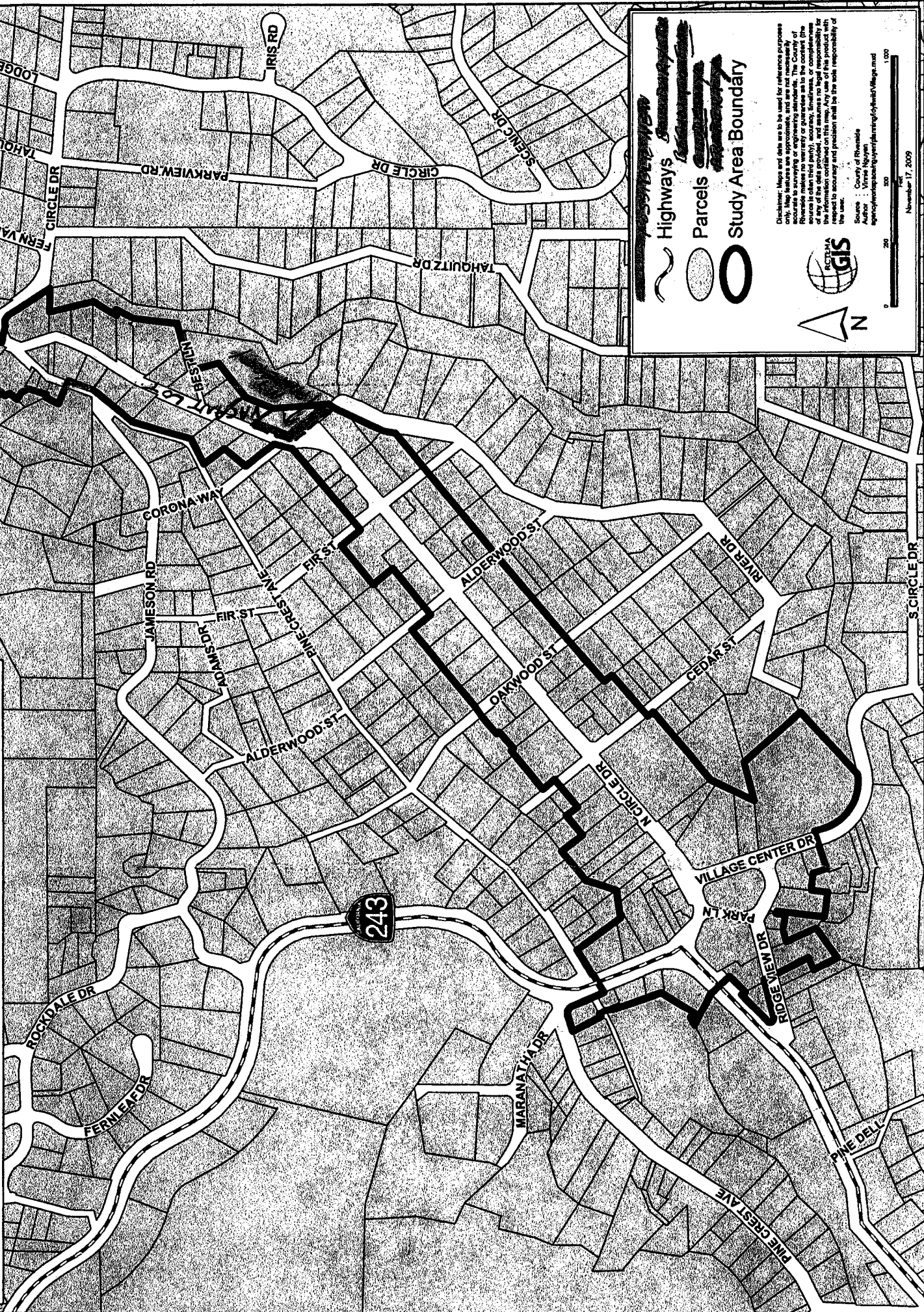

Legend

- Highways
- Parcels
- Study Area Boundary

Disclaimer: Maps and data are to be used for reference purposes only. Map features are approximate, and are not necessarily of Riverside. Riverside makes no warranty or guarantee as to the content, the source, the date, the accuracy, timeliness, or completeness of any of the data provided, and assumes no legal responsibility for respect to accuracy and precision shall be the sole responsibility of the user.
 Source: County of Riverside
 Author: Virens Nguyen
 Agency: <http://www.mapping.idyllwild.com>

 November 17, 2009

**NOTICE OF PUBLIC HEARING
BEFORE THE RIVERSIDE COUNTY BOARD OF SUPERVISORS**

A PUBLIC HEARING has been scheduled before the RIVERSIDE COUNTY BOARD OF SUPERVISORS to consider the establishment of the Idyllwild Historic Downtown District (Historic District) described below. The Planning Department has tentatively determined that the project will not have a significant effect on the environment. Therefore, the Department has prepared a Notice of Exemption (NOE). The Board of Supervisors will consider the NOE in conjunction with their consideration of the proposed Historic District at the public hearing referenced herein.

BOARD OF SUPERVISORS HEARING

DATE OF HEARING: **July 12, 2011**
TIME OF HEARING: **1:30 P.M. or as soon as possible thereafter**
PLACE OF HEARING: **Board Hearing Room**
 First Floor
 4080 Lemon Street
 Riverside CA 92501

BACKGROUND: The Idyllwild Historic Downtown District is a County initiated proposal that is the result of a collaborative process between property and business owners within the Idyllwild community, the County Historian, Third Supervisorial District staff, and the Planning Department. During this time a historic resources survey was performed to identify the boundaries of the Historic District and determine the contributive historic value of various properties.

PROJECT DESCRIPTION AND IDENTIFICATION:

Idyllwild Historic Downtown District – County Initiated – Third Supervisorial District – PROPOSAL: The County of Riverside proposes to establish a historic preservation district within the downtown area of the mountain village of Idyllwild in accordance with County Ordinance 578. The boundaries of the Historic District would extend along North Circle Drive from the intersection of Ridgeview Drive northerly to the intersection with Circle Drive (see attached map). The district would encompass approximately 152 properties which are currently zoned either Scenic Highway Commercial (CPS) or Village Tourist Residential (R-3A). Each of the subject properties are identified and categorized by their contribution to the unique historical character of the downtown area. Creation of a Historic District provides for the development of guidelines and procedures to follow when constructing, altering, or demolishing a building, structure, or façade. A historic district would allow the Idyllwild Downtown area to retain much of the important aspects of its social and economic history while preserving the village's unique character as one of the County's earliest and most distinctive mountain resort communities.

ANTICIPATED ENVIRONMENTAL EFFECTS:

The Planning Department has tentatively determined that the establishment of the Historic District will not have a significant effect on the environment. Therefore the Department has prepared a Notice of Exemption (NOE).

YOUR RIGHT TO COMMENT:

Any person wishing to comment on or testify in support of, or in opposition to, the proposed Historic District may do so in writing prior to the hearing (between the date of this notice and the public hearing) or may appear and be heard at the dates, times, and places noted above. All comments received prior to the public hearing will be submitted to the Board of Supervisors. The Board of Supervisors will consider such comments, in addition to any oral testimony, before making a decision on the proposed Historic District. If you challenge this project (Historic District and/or NOE) in court, you may be limited to raising only those issues you or someone else raised at the public hearings described in this notice, or in written correspondence delivered to the Board of Supervisors at, or prior to, the date of the Board hearing.

Primary Owner: CANFIELD CLARK

Secondary Owner:

Mail Address: 4118 LOST SPRINGS DR
CALABASAS CA 91301

Site Address: 54735 NORTH CIRCLE DR
IDYLLWILD CA 92549

County: RIVERSIDE

Assessor Parcel Number: 563-222-026

Housing Tract Number:

Lot Number: 10

Page Grid:

Legal Description: Lot: 10 Abbreviated Description: LOT:10 LOT 10 MB
010/044 IDYLLWILD MOUNTAIN PARK SUB NO 5

enterprise media

Legal Advertising Invoice

THE PRESS-ENTERPRISE PE.com

THE BUSINESS PRESS SoCal

LA PRENSA WEEKLY

9-MEDIA waves LANDSOCAL LA.PRESSONLINE.COM **HS**

① BILLING PERIOD 07/02/11 - 07/02/11 ② ADVERTISING/CLIENT NAME BOARD OF SUPERVISORS
 ③ BILLING DATE 07/02/11 | FOR BILLING INFORMATION CALL (951) 368-9713 ④ PAGE NO 1
 ⑤ TOTAL AMOUNT DUE 247.00 ⑥ UNAPPLIED AMOUNT ⑦ TERMS OF PAYMENT Due Upon Receipt

⑧ REMITTANCE ADDRESS
 POST OFFICE BOX 12009
 RIVERSIDE, CA 92502-2209

⑨ BILLED ACCOUNT NAME AND ADDRESS
 BOARD OF SUPERVISORS
 COUNTY OF RIVERSIDE
 P.O. BOX 1147
 RIVERSIDE CA 92502

⑩ BILLED ACCOUNT NUMBER 045202 | REP NO LE04

Statement #: 56603074 Amount Paid \$ _____ Your Check # _____

PLEASE DETACH AND RETURN UPPER PORTION WITH YOUR REMITTANCE

① DATE	① REFERENCE	② ③ ④ DESCRIPTION-OTHER COMMENTS/CHARGES	⑤ SAU SIZE ⑥ BILLED UNITS	⑦ RATE	⑧ GROSS AMOUNT	⑨ NET AMOUNT
07/02	4311666 CO	PH - IDYLLWILD HISTORIC DT DIS Class : 10 Ctext Ad# 10715080 Placed By : Cecilia Gil	190 L	1.30		247.00

*Planning
1604 of 07/12/11*

2011 JUL 12 PM 12:49
 RECEIVED BY: [unclear]
 CLERK/BOARD OF SUPERVISORS

⑩ CURRENT NET AMOUNT DUE	⑪ 30 DAYS	⑫ 60 DAYS	⑬ OVER 90 DAYS	⑭ UNAPPLIED AMOUNT	⑮ PLEASE PAY THIS AMOUNT 247.00
--------------------------	-----------	-----------	----------------	--------------------	------------------------------------

enterprise media THE PRESS-ENTERPRISE PE.com P.O. BOX 12009 RIVERSIDE, CA 92502-2209 FAX (951) 368-9026

ADVERTISING STATEMENT/INVOICE



* UNAPPLIED AMOUNTS ARE INCLUDED IN TOTAL AMOUNT DUE

⑯ STATEMENT NUMBER 56603074	⑰ BILLING PERIOD 07/02/11 - 07/02/11	⑱ BILLED ACCOUNT NUMBER 045202	⑲ ADVERTISER/CLIENT NUMBER	⑳ ADVERTISER/CLIENT NAME BOARD OF SUPERVISORS
--------------------------------	---	-----------------------------------	----------------------------	--

THE PRESS-ENTERPRISE

3450 Fourteenth Street
Riverside CA 92501-3878
951-684-1200
951-368-9018 FAX

**PROOF OF PUBLICATION
(2010, 2015.5 C.C.P.)**

Press-Enterprise

PROOF OF PUBLICATION OF

Ad Desc.: PH - Idyllwild Historic DT district

I am a citizen of the United States. I am over the age of eighteen years and not a party to or interested in the above entitled matter. I am an authorized representative of THE PRESS-ENTERPRISE, a newspaper of general circulation, printed and published daily in the County of Riverside, and which newspaper has been adjudicated a newspaper of general circulation by the Superior Court of the County of Riverside, State of California, under date of April 25, 1952, Case Number 54446, under date of March 29, 1957, Case Number 65673 and under date of August 25, 1995, Case Number 267864; that the notice, of which the annexed is a printed copy, has been published in said newspaper in accordance with the instructions of the person(s) requesting publication, and not in any supplement thereof on the following dates, to wit:

07-02-11

I Certify (or declare) under penalty of perjury that the foregoing is true and correct.

Date: Jul. 2, 2011
At: Riverside, California



BOARD OF SUPERVISORS

P.O. BOX 1147
COUNTY OF RIVERSIDE
RIVERSIDE CA 92502

Ad #: 10715080

PO #:

Agency #: _____

Ad Copy:

NOTICE OF PUBLIC HEARING BEFORE THE BOARD OF SUPERVISORS OF RIVERSIDE COUNTY ON A COUNTY-INITIATED PROPOSAL TO ESTABLISH A HISTORIC PRESERVATION DISTRICT WITHIN THE DOWN AREA OF IDYLLWILD, THIRD SUPERVISORIAL DISTRICT AND INTENT TO FILE NOTICE OF EXEMPTION

NOTICE IS HEREBY GIVEN that a public hearing at which all interested persons will be heard, will be held before the Board of Supervisors of Riverside County, California, on the 1st Floor Board Chambers, County Administrative Center, 4080 Lemon Street, Riverside, on **Tuesday, July 12, 2011 at 1:30 P.M.** to consider a County-Initiated proposal to establish a historic preservation district within the downtown area of the mountain village of Idyllwild, Third Supervisorial District, in accordance with County Ordinance 578. The boundaries of the Historic District would extend along North Circle Drive from the intersection of Ridgeview Drive northerly to the intersection with Circle Drive. The district would encompass approximately 152 properties which are currently zoned either Scenic Highway Commercial (CPS) or Village Tourist Residential (R-3A). Each of the subject properties are identified and categorized by their contribution to the unique historical character of the downtown area. Creation of a Historic District provides for the development of guidelines and procedures to follow when constructing, altering, or demolishing a building, structure, or facade. A historic district would allow the Idyllwild Downtown area to retain much of the important aspects of its social and economic history while preserving the village's unique character as one of the County's earliest and most distinctive mountain resort communities.

The Planning Department has tentatively determined that the project will not have a significant effect on the environment and therefore, has prepared a Notice of Exemption (NOE), which the Board of Supervisors will consider in conjunction with the proposed project.

The project case file may be viewed from the date of this notice until the public hearing, Monday through Thursday, from 7:30 a.m. to 5:30 p.m. at the Clerk of the Board of Supervisors at 4080 Lemon Street, 1st Floor, Riverside, California 92501, and at the Central Files Division of Riverside County Planning Department at 4080 Lemon Street, 12th Floor, Riverside, California 92501.

FOR FURTHER INFORMATION REGARDING THIS PROJECT, PLEASE CONTACT KRISTI LOVELADY, PROJECT PLANNER, AT (951) 955-1811 or EMAIL klovelad@rctlma.org.

Any person wishing to testify in support of or in opposition to the project may do so in writing between the date of this notice and the public hearing, or may appear and be heard at the time and place noted above. All written comments received prior to the

public hearing will be submitted to the Board of Supervisors and the Board of Supervisors will consider such comments, in addition to any oral testimony, before making a decision on the project.

If you challenge the above item in court, you may be limited to raising only those issues you or someone else raised at the public hearing described in this notice, or in written correspondence to the Planning Commission or Board of Supervisors at, or prior to, the public hearing. Be advised that as a result of the public hearing and the consideration of all public comment, written and oral, the Board of Supervisors may amend, in whole or in part, the project and/or the related environmental document. Accordingly, the designations, development standards, design or improvements, or any properties or lands within the boundaries of the project, may be changed in a way other than specifically proposed.

Please send all written correspondence to: Clerk of the Board, 4080 Lemon Street, 1st Floor, Post Office Box 1147, Riverside, CA 92502-1147

Kecia Harper-Ihem
Clerk of the Board

By: Cecilia Gil, Board Assistant

Dated: June 29, 2011 7/2

IDYLLWILD TOWN CRIER

54295 VILLAGE CENTER DR.
P.O. BOX 157
IDYLLWILD, CA 92549
(951) 659-2145

Statement

Date: 07/07/11

AMOUNT DUE: \$ 114.00

AMOUNT ENCL: \$

TO:

Office of Clerk of the Board of Supervisors
1st Floor, County Administrative Center
P.O. Box 1147, 4080 Lemon Street
Riverside, CA 92502-1147

PLEASE DETACH AND RETURN THIS UPPER PORTION WITH PAYMENT

DATE	TRANSACTION	AMOUNT	BALANCE
07/07/11	1 X 9.5 Public Notice	114.00	114.00

Notice of Public hearing efore the Board of Supervisors of Riverside County on a County-Initiated proposal to establish a Historic Preservation District within the Downtown area of Idyllwild.

RECEIVED RIVERSIDE COUNTY
CLERK / BOARD OF SUPERVISORS
2012 MAY - 8 PM 5:06

1st run is \$12.00 per inch

*Planning
6.4 of 07/12/11*

CURRENT	1-30 DAYS PAST DUE	31-60 DAYS PAST DUE	61-90 DAYS PAST DUE	OVER 90 DAYS PAST DUE	AMOUNT DUE
\$114.00	0000	0000	0000	0000	\$114.00

**PROOF OF PUBLICATION
(2015.5 C.C.P.)**

STATE OF CALIFORNIA
County of Riverside

I am a citizen of the United States and a resident of the County aforesaid; I am over the age of eighteen years, and not a party to or interested in the above-entitled matter. I am the principal clerk of the printer of the IDYLLWILD TOWN CRIER, a newspaper of general circulation, printed and published in Riverside County, State of California; that the notice in the above entitled matter, of which the annexed is not a printed copy, was published in said newspaper on the following dates, to wit:

July 7, 2011

all in the year 2011.

I certify (or declare) under penalty of perjury that the foregoing is true and correct.

Dated at Idyllwild, California this 7th day of July, 2011.

SIGNATURE

Proof of Publication of

[The following text is extremely faint and largely illegible due to heavy scanning artifacts and noise. It appears to be a detailed notice or legal document.]

[The following text is also extremely faint and illegible due to scanning artifacts. It appears to be a notice or legal document.]

CERTIFICATE OF MAILING

(Original copy, duly executed, must be attached to
the original document at the time of filing)

I, Cecilia Gil, Board Assistant, for the
(NAME and TITLE)

County of Riverside, do hereby certify that I am not a party to the within action or proceeding; that on June 30, 2011, I mailed a copy of the following document:

NOTICE OF PUBLIC HEARING

Idyllwild Historic Downtown District

to the parties listed in the attached labels, by depositing said copy with postage thereon fully prepaid, in the United States Post Office, 3890 Orange St., Riverside, California, 92501.

Board Agenda Date: July 12, 2011 @ 1:30 PM

SIGNATURE: Mcgil
Cecilia Gil

DATE: June 30, 2011