

**SUBMITTAL TO THE BOARD OF SUPERVISORS
COUNTY OF RIVERSIDE, STATE OF CALIFORNIA**

170



FROM: TLMA - Transportation Department

SUBMITTAL DATE:
December 29, 2010

SUBJECT: Notice of Completion - Construction of pedestrian sidewalk and associated improvements on Krameria Avenue in the Woodcrest area and on Mayberry Avenue in the Valle Vista area.

RECOMMENDED MOTION: That the Board execute and file the attached "Notice of Completion".

BACKGROUND: By Minute Order 3.67 of June 8, 2010, the Board entered into an agreement with Mamco, Inc. of Riverside, CA for the construction of pedestrian sidewalk and associated improvements on Krameria Avenue in the Woodcrest area and on Mayberry Avenue in the Valle Vista area. The originally authorized amount of the contract was \$264,277.

Juan C. Perez
Director of Transportation

dj
(Continued On Attached Page)

FINANCIAL DATA	Current F.Y. Total Cost:	\$276,316	In Current Year Budget:	Yes
	Current F.Y. Net County Cost:	\$ 0	Budget Adjustment:	No
	Annual Net County Cost:	\$ 0	For Fiscal Year:	2010/2011

SOURCE OF FUNDS: Measure A / Western (52%), SB 821 Bicycle and Pedestrian Facilities Program (48%)	Positions To Be Deleted Per A-30	<input type="checkbox"/>
	Requires 4/5 Vote	<input type="checkbox"/>

C.E.O. RECOMMENDATION:

APPROVE
BY:
Jennifer L. Sargent

County Executive Office Signature

MINUTES OF THE BOARD OF SUPERVISORS

On motion of Supervisor Buster, seconded by Supervisor Benoit and duly carried by unanimous vote, IT WAS ORDERED that the above matter is approved as recommended.

Ayes: Buster, Tavaglione, Stone, Benoit and Ashley
Nays: None
Absent: None
Date: January 11, 2011
xc: Transp., Recorder

Kecia Harper-Ihem
Clerk of the Board
By:
Deputy

Prev. Agn. Ref. 6/8/10, Item 3.67 | **District:** 1,3 | **Agenda Number:**

3.78

Departmental Circulation

Dept's Recomm.: Consent Policy
Per Exec. Ofc.: Consent Policy

The Honorable Board of Supervisors

RE: Notice of Completion - Construction of pedestrian sidewalk and associated improvements on Krameria Avenue in the Woodcrest area and on Mayberry Avenue in the Valle Vista area.

December 29, 2010

Page 2 of 2

The total amended contract amount (including quantity adjustments) is \$276,315.77 which is 4.6% more than the originally authorized amount.

This work was completed in conformance with the plans and specifications on November 17, 2010. The work was inspected by the Construction Engineering Section of the Transportation Department. Work Order B8-0672, B9-0941.

Budget

Original Contract Amount		\$264,276.76
Tot. Chg Orders Authorized -	0.0%	\$0.00
Est. Pending Change Orders	0.0%	\$0.00
Amended Contract Amount		\$264,276.76
* Quantity Adjustments	4.6%	\$12,039.01
+ CCO FA Adjustments	0.0%	\$0.00
Total Amended Contract Amount	104.6%	\$276,315.77

Expenditures

Total Progress Payments -	\$276,315.77
Estimated Pending Payments	
Total Expenditures	\$276,315.77

(Over)\Under Contract Amount \$0.00

+ Change Orders using the Force Account method of payment issued prior to the work being completed generally do not use the total authorized amount.

* CAL-Trans Standard Specifications 4-1.03B. Increases or decreases in the quantity of a contract item of work will be determined by comparing the total pay quantity of such item of work with the Engineer's Estimate. If the total pay quantity of any item of work required under the contract varies from the Engineers Estimate by 25 percent or less, payment will be made for the quantity of work of said item performed at contract unit price, unless eligible for adjustment pursuant to Section 4-1.03C, "Changes in Character of Work."

PLEASE COMPLETE THIS INFORMATION
RECORDING REQUESTED BY:

**KECIA HARPER-IHEM, CLERK OF THE BOARD
RIVERSIDE CO. CLERK OF THE BOARD
4080 LEMON STREET, 1ST FLOOR CAC
P O BOX 1147 – RIVERSIDE, CA 92502
MAIL STOP # 1010**

AND WHEN RECORDED MAIL TO:
RETURN TO: STOP #1010
RIVERSIDE COUNTY CLERK OF THE BOARD
P. O. BOX 1147 – RIVERSIDE, CA 92502

DOC # 2011-0027299

01/19/2011 09:08A Fee:NC

Page 1 of 2

Recorded in Official Records

County of Riverside

Larry W. Ward

Assessor, County Clerk & Recorder



S	R	U	PAGE	SIZE	DA	MISC	LONG	RFD	COPY
1			2						
M	A	L	465	426	PCOR	NCOR	SMF	NCHG	EXAM
nchg cc						T:	CTY	UNI	509

NOTICE OF COMPLETION

To be recorded with County Recorder
within 10 days after completion.
No recording fee.



Notice is hereby given by the undersigned owner, a public entity of the State of California, that a public work of improvement has been completed, as follows:

Project title or description of work: Pedestrian sidewalk construction and associated improvements

Date of Completion: Date of this notice 01/11/11

Nature of owner: County of Riverside, public entity

Interest or estate of owner: Public Roadway

Address of owner: 4080 Lemon Street, 8th Floor, Riverside, CA 92501

Name of contractor: Mamco, Inc.

Street or legal description of site: Mayberry Avenue & Krameria Avenue

Dated: January 11, 2011

Owner: County of Riverside
(Name of Public Entity)

By: Bob Buster
Bob Buster, Chairman, Board of Supervisors

STATE OF CALIFORNIA)

ss

COUNTY OF RIVERSIDE)

I am the Chairman of the governing board of the County of Riverside, the public entity which executed the foregoing notice and on whose behalf I make this verification; I have read this notice, know its contents, and the same is true. I certify under penalty of perjury that the foregoing is true and correct.

Executed at Riverside, California on 01/11/11 (Date)

Bob Buster,
Bob Buster, Chairman of the Board of Supervisors

ATTEST:

KECIA HARPER-IHEM, Clerk of the Board

By: Karen [Signature]
Deputy



**LARRY W. WARD
COUNTY OF RIVERSIDE
ASSESSOR-COUNTY CLERK-RECORDER**

Recorder
P.O. Box 751
Riverside, CA 92502-0751
(951) 486-7000

<http://riverside.asrelkrec.com>

CERTIFICATION

Pursuant to the provisions of Government Code 27361.7, I certify under the penalty of perjury that the following is a true copy of illegible wording found in the attached document:

(Print or type the page number(s) and wording below):

CLARIFICATION OF THE SEAL for the Riverside County Board of Supervisors
(embossed on document)



Date:

01-11-11

Signature:

Karen Barton

Print Name:

Karen Barton, Board Assistant, Riverside County Clerk of the Board



**COUNTY OF RIVERSIDE
DEPARTMENT OF TRANSPORTATION**

**KRAMERIA AVENUE
SIDEWALK PROJECT
WASHINGTON ST. TO LOIS LN.**

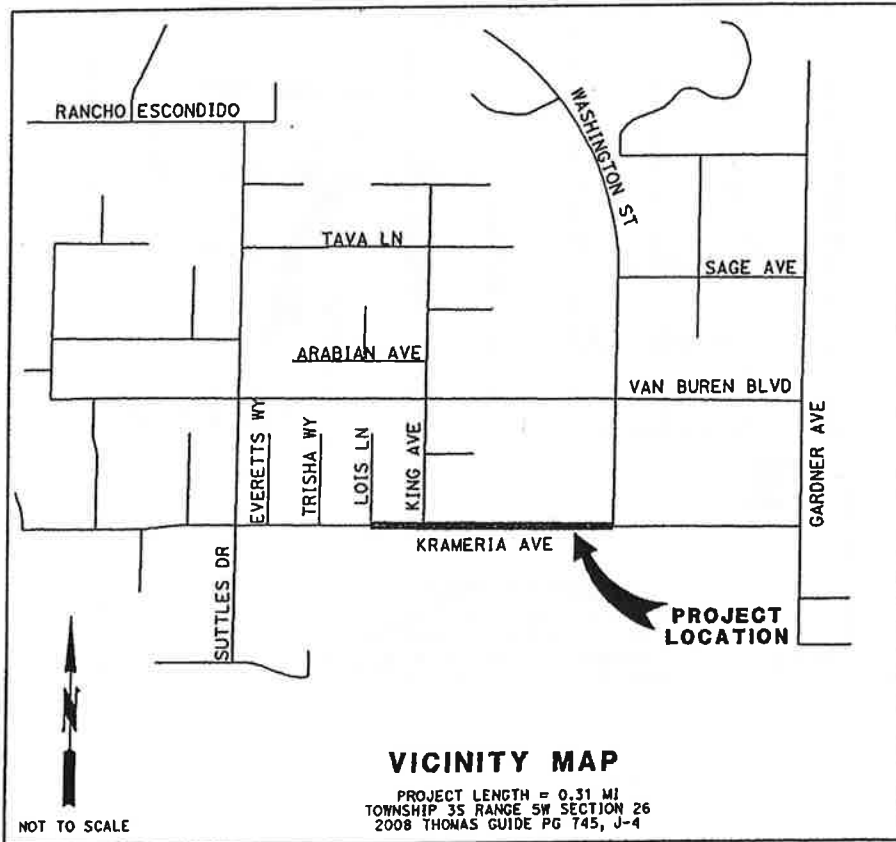
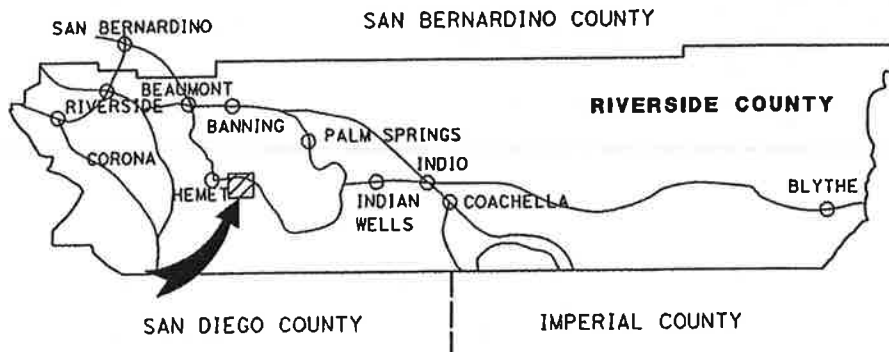

PROJECT LENGTH = 0.31 MI
TOWNSHIP 35 RANGE SW SECTION 26
2008 THOMAS GUIDE PG 745, J-4

VICINITY MAP	KRAMERIA AVENUE SIDEWALK PROJECT WASHINGTON ST. TO LOIS LN.
SCALE NONE	
EXHIBIT "A"	

USERNAME => ohwyhh
DCN FILE => 88-0672 VICINITY MAP.dgn

WO 88-0672

6/1/2008 11:33:00 AM ohwyhh P:\88-0672-KRAMERIA AVE\3 CAD\SDR\01-TITLE-0811-VICINITY MAP.dgn

MAYBERRY AVENUE CONSTRUCT SIDEWALK PROJECT

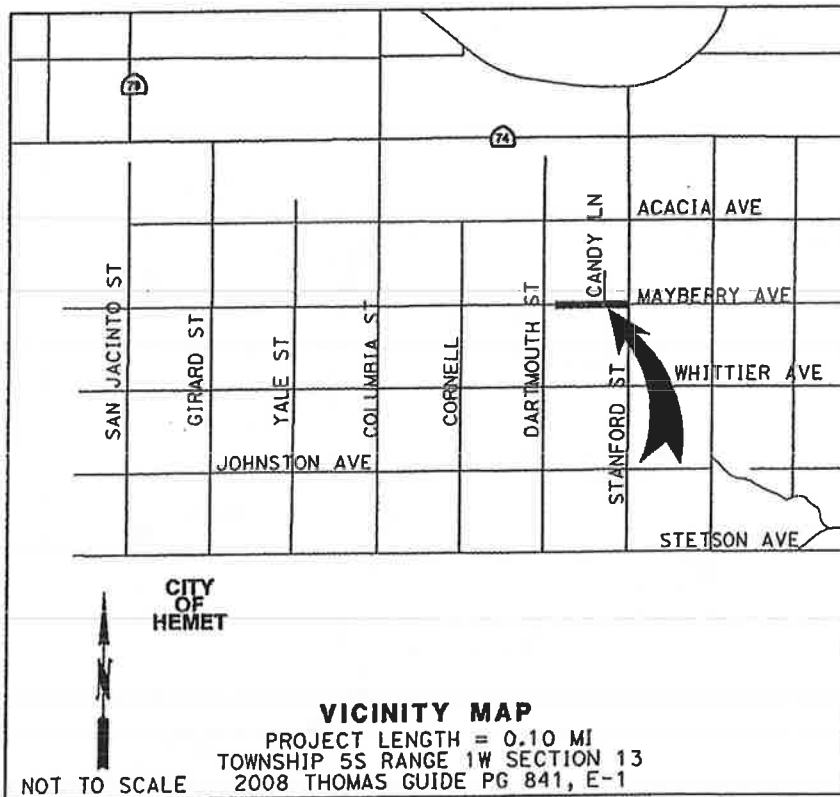
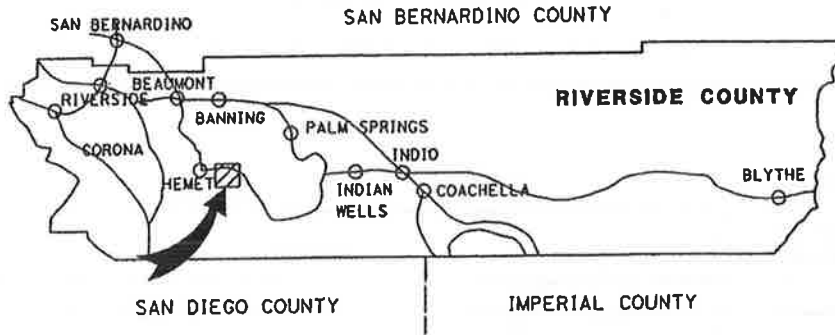

VICINITY MAP

SCALE NONE

EXHIBIT "A"

MAYBERRY AVENUE CONSTRUCT SIDEWALK PROJECT

DARTMOUTH MIDDLE SCHOOL TO STANFORD ST.



Contractor: Mamco, Inc.
 Address: 16610 Van Buren Blvd. #200
 City, State, Zip: Riverside, CA 92504

Estimate No. 2 Final
 From: October 28, 2010
 To: November 25, 2010

Item No.	Item Description	Units	Quantity	Unit Price	Original Contract Amount	Change Authorized Quantity	Amount	Total Authorized		This Estimate		Previous		Total Estimate To Date		% Auth.
								Quantity	Amount	Quantity	Amount	Quantity	Amount	Quantity	Amount	
Project Subtotals																
	SCHEDULE A - KRAMERIA AVENUE - 88-0672				179,788.38		179,788.38				179,788.38		86,565.48		183,870.41	
	SCHEDULE B - MAYBERRY AVENUE - 89-0491				84,488.38		84,488.38				84,488.38		92,445.36		92,445.36	
	PROJECT TOTAL				264,276.76	0.00	264,276.76				264,276.76		179,010.84		276,315.77	

Made by: Keith B. Smith
 Checked by: [Signature]
 OK Const. Supv. [Signature]

Working Days: 20 Start Date: 10-15-10
 Days Added: 2 End Date: 11-17-10
 Subtotal: 22 % \$ Complete: 105%
 Days Used: 21 Original Contract: \$264,276.76
 % Time Elapsed: 95% Amended Contract: \$264,276.76

TOTAL VALUE OF WORK TO DATE: \$276,315.77
 LESS RETENTION: 10% 27,631.58
 TOTAL DUE TO DATE: \$248,684.19
 LESS PREVIOUSLY INVOICED: 87,574.45
 LESS LABOR NON COMPLIANCE: 0.00
 TOTAL DUE THIS PAYMENT: \$161,109.74

This Estimate Approved _____ Date: _____ for: _____
 Juan C. Perez, Director of Transportation
 Mamco, Inc.

Received by Accounts Payable: _____
 By: _____

PAYMENT APPROVAL
 Fund 20000
 Dept ID 31305

Account 527980
 Project Z-08-0672E, Z-09-0941E
 Activity ID Z3500
 Resource Type CNT
 Signature [Signature]
 Date 12/7/10

Quantities on This Estimate Approved _____ Date: 12/6/10

PROJECT: Krameria Avenue and Mayberry Avenue Sidewalk Improvement Projects

County Project No.: B8-0672 & B9-0491

Contract No.: 16-05-008

Contractor: Mamco, Inc.

Address: 16810 Van Buren Blvd. #200

City, State, Zip: Riverside, CA 92504



Estimate No.

2 Final

From: October 28, 2010

To: November 25, 2010

SCHEDULE A - KRAMERIA AVENUE - B8-0672

ESTIMATE TO DATE:	\$183,870.41
LESS RETENTION:	10% 18,387.04
LESS PREVIOUSLY INVOICED:	87,574.45
LESS LABOR NON COMPLIANCE:	0.00
TOTAL DUE THIS PAYMENT:	<u>\$77,908.92</u>

SCHEDULE B - MAYBERRY AVENUE - B9-0491

ESTIMATE TO DATE:	\$92,445.36
LESS RETENTION:	10% 9,244.54
LESS PREVIOUSLY INVOICED:	0.00
LESS LABOR NON COMPLIANCE:	0.00
TOTAL DUE THIS PAYMENT:	<u>\$83,200.82</u>

TOTAL DUE THIS PAYMENT: **\$161,109.74**

PROGRESS ESTIMATE RECORD - COUNTY OF RIVERSIDE

PROJECT: Krameria Avenue and Maryberry Avenue Sidewalk Improvement Projects
 County Project No.: BB-0672 & 99-0941
 Contract No.: 10-05-008

Contractor: Mamco, Inc.
 Address: 16810 Van Buren Blvd. #200
 City, State, Zip: Riverside, CA 92504

SHEET 1 of 4

Processed Construction Inspection 12/6/2010



Estimate No. 2 Final
 From: October 28, 2010
 To: November 25, 2010

Item No.	Item Description	Units	Quantity	Unit Price	Original Contract Amount	Change Authorized Quantity	Change Authorized Amount	Total Authorized Quantity	Total Authorized Amount	This Estimate Quantity	This Estimate Amount	Previous Quantity	Total Estimate To Date Quantity	Total Estimate To Date Amount	% Auth.
SCHEDULE A - KRAMERIA AVENUE - BB-0672															
1	DUST ABATEMENT	LS	1	1,500.00	1,500.00			1.00	1,500.00	0.25	375.00	0.75	1.00	1,500.00	100%
2	WATER POLLUTION CONTROL	LS	1	2,000.00	2,000.00			1.00	2,000.00	0.25	500.00	0.75	1.00	2,000.00	100%
3	TRAFFIC CONTROL SYSTEMS	LS	1	2,818.38	2,818.38			1.00	2,818.38	0.25	704.60	0.75	1.00	2,818.38	100%
4	RELOCATE MAILBOX	EA	12	450.00	5,400.00			12.00	5,400.00	5.00	2,250.00	8.00	13.00	5,850.00	108%
5	RELOCATE FENCE	LF	450	20.00	9,000.00			450.00	9,000.00	156.25	3,125.00	240.00	396.25	7,925.00	88%
6	RELOCATE ROADSIDE SIGN-ONE POST	EA	10	125.00	1,250.00			10.00	1,250.00	12.00	1,500.00		12.00	1,500.00	120%
6.A.	RELOCATE IRRIGATION SYSTEM	LS	1	2,000.00	2,000.00			1.00	2,000.00	1.00	2,000.00		1.00	2,000.00	100%
7	CLEARING AND GRUBBING	LS	1	3,000.00	3,000.00			1.00	3,000.00			1.00	1.00	3,000.00	100%
8	DEVELOP WATER SUPPLY	LS	1	1,000.00	1,000.00			1.00	1,000.00			1.00	1.00	1,000.00	100%
9	ROADWAY EXCAVATION	CY	450	35.00	15,750.00			450.00	15,750.00	62.52	2,188.20	388.40	430.92	15,082.20	96%
10	FINISHING ROADWAY	LS	1	1,000.00	1,000.00			1.00	1,000.00	1.00	1,000.00		1.00	1,000.00	100%
11	CLASS 2 AGGREGATE BASE	CY	260	39.00	10,140.00			260.00	10,140.00	262.17	10,224.63		262.17	10,224.63	101%
12	HOT MIX ASPHALT	TON	360	90.00	32,400.00			360.00	32,400.00	404.23	36,380.70		404.23	36,380.70	112%
13	MINOR CONCRETE (CURB AND GUTTER) (CRS 201)	LF	1,650	15.00	24,750.00			1,650.00	24,750.00	172.00	2,580.00	1,580.00	1,752.00	26,280.00	106%
14	MINOR CONCRETE (DRIVEWAY APPROACH) (CRS 207)	EA	20	750.00	15,000.00			20.00	15,000.00	8.00	6,000.00	14.00	22.00	16,500.00	110%
15	MINOR CONCRETE (CURB RAMP) (CRS 403 - CASE A)	EA	1	1,900.00	1,900.00			1.00	1,900.00			1.00	1.00	1,900.00	100%
15.A	MINOR CONCRETE (CURB RAMP) (CRS 403 - CASE B) [MODIFIED]	EA	2	1,800.00	3,600.00			2.00	3,600.00	2.00	3,600.00		2.00	3,600.00	100%
16	MINOR CONCRETE (CROSS-GUTTER AND SPANDREL)	SOFT	350	6.00	2,100.00			350.00	2,100.00	180.00	1,080.00	238.00	418.00	2,508.00	119%
17	MINOR CONCRETE (DRIVEWAY)	SOFT	1,500	4.00	6,000.00			1,500.00	6,000.00	443.00	1,772.00	1,432.00	1,875.00	7,500.00	125%
18	MINOR CONCRETE (SIDEWALK)	SOFT	7,600	2.95	22,420.00			7,600.00	22,420.00	2,453.00	7,236.35	4,697.00	7,150.00	21,092.50	94%
19	PLACE ASPHALT CONCRETE DIKE (CRS 212) (8')	LF	90	14.00	1,260.00			90.00	1,260.00	40.00	560.00		40.00	560.00	44%
20	CATCH BASIN (CURB INLET)(CRS 300)	EA	1	6,800.00	6,800.00			1.00	6,800.00			1.20	1.20	8,160.00	120%

PROGRESS ESTIMATE RECORD - COUNTY OF RIVERSIDE

PROJECT: Kramedia Avenue and Mayberry Avenue Sidewalk Improvement Projects

County Project No.: B9-0672 & B9-0941

Contract No.: 10-05-008

SHEET 2 of 4

Processed Construction Inspection 12/6/2010

Estimate No. 2 Final

From: October 26, 2010

To: November 25, 2010



Contractor: Mamco, Inc.

Address: 16810 Van Buren Blvd. #200

City, State, Zip: Riverside, CA 92504

Item No.	Item Description	Units	Quantity	Unit Price	Original Contract Amount	Change Authorized Quantity	Change Authorized Amount	Total Authorized Quantity	Total Authorized Amount	This Estimate Quantity	This Estimate Amount	Previous Quantity	Previous Amount	Total Estimate To Date Quantity	Total Estimate To Date Amount	% Auth.
21	RETAINING WALL	SOFT	60	30.00	1,800.00			60.00	1,800.00	37.50	1,125.00			37.50	1,125.00	63%
22	UNDER SIDEWALK CURB DRAIN (CRS 310)	EA	6	400.00	2,400.00			6.00	2,400.00							
23	THERMOPLASTIC PAVEMENT MARKING	SOFT	350	6.00	2,100.00			350.00	2,100.00	394.00	2,364.00	5.00		394.00	2,364.00	83%
23.A	INSTALL 24" BOX TREE (SCHINUS MOLLE CALIFORNIA PEPPER TREE)	EA	3	800.00	2,400.00			3.00	2,400.00							113%
	ALTERNATE BID ITEMS - WESTERN MUNICIPAL WATER DISTRICT															
24	ADJUST WATER METER TO GRADE (Not awarded)	EA	2	0.00	0.00											0%
25	RELOCATE WATER METER (Not awarded)	EA	8	0.00	0.00											N/A
26	ADJUST FIRE HYDRANT (Not awarded)	EA	1	0.00	0.00											N/A
27	RELOCATE HYDRANT (Not awarded)	EA	1	0.00	0.00											N/A
	SCHEDULE B - MAYBERRY AVENUE - B9-0491															
28	DUST ABATEMENT	LS	1	1,500.00	1,500.00			1.00	1,500.00	1.00	1,500.00			1.00	1,500.00	100%
29	WATER POLLUTION CONTROL	LS	1	2,000.00	2,000.00			1.00	2,000.00	1.00	2,000.00			1.00	2,000.00	100%
30	TRAFFIC CONTROL SYSTEMS	LS	1	1,718.38	1,718.38			1.00	1,718.38	1.00	1,718.38			1.00	1,718.38	100%
31	RELOCATE MAILBOX	EA	5	450.00	2,250.00			5.00	2,250.00	5.00	2,250.00			5.00	2,250.00	100%
32	RELOCATE FENCE	LF	210	20.00	4,200.00			210.00	4,200.00	261.00	5,220.00			261.00	5,220.00	124%
33	RELOCATE ROADSIDE SIGN-ONE POST	EA	2	125.00	250.00			2.00	250.00	2.00	250.00			2.00	250.00	100%
33.A	RELOCATE IRRIGATION SYSTEM	LS	1	2,000.00	2,000.00			1.00	2,000.00	1.00	2,000.00			1.00	2,000.00	100%
34	CLEARING AND GRUBBING	LS	1	8,000.00	8,000.00			1.00	8,000.00	1.00	8,000.00			1.00	8,000.00	100%
35	DEVELOP WATER SUPPLY	LS	1	1,000.00	1,000.00			1.00	1,000.00	1.00	1,000.00			1.00	1,000.00	100%
36	ROADWAY EXCAVATION	CY	50	35.00	1,750.00			50.00	1,750.00	49.92	1,747.20			49.92	1,747.20	100%
37	FINISHING ROADWAY	LS	1	1,000.00	1,000.00			1.00	1,000.00	1.00	1,000.00			1.00	1,000.00	100%
38	CLASS 2 AGGREGATE BASE	CY	15	39.00	585.00			15.00	585.00	17.25	672.75			17.25	672.75	115%
39	HOT MIX ASPHALT	TON	35	200.00	7,000.00			35.00	7,000.00	43.75	8,750.00			43.75	8,750.00	125%
40	MINOR CONCRETE (CURB AND GUTTER) (CRS 201)	LF	370	15.00	5,550.00			370.00	5,550.00	376.00	5,640.00			376.00	5,640.00	102%

PROGRESS ESTIMATE RECORD - COUNTY OF RIVERSIDE

PROJECT: Krameria Avenue and Mayberry Avenue Sidewalk Improvement Projects
 County Project No.: 89-0672 & 89-0941
 Contract No.: 10-06-008

Contractor: Mameco, Inc.
 Address: 16810 Van Buren Blvd. #200
 City, State, Zip: Riverside, CA 92504

SHEET 3 of 4

Processed Construction Inspection 12/6/2010



Estimate No. 2 Final

From: October 26, 2010
 To: November 25, 2010

Item No.	Item Description	Units	Quantity	Unit Price	Original Contract Amount	Change Authorized Quantity	Change Authorized Amount	Total Authorized Quantity	Total Authorized Amount	This Estimate		Previous Quantity	Total Estimate To Date		% Auth.
										Quantity	Amount		Quantity	Amount	
41	MINOR CONCRETE (DRIVEWAY APPROACH) (CRS 207)	EA	6	750.00	4,500.00			6.00	4,500.00	6.00	4,500.00		6.00	4,500.00	100%
42	MINOR CONCRETE (CURB RAMP) (CRS 403 - CASE A)	EA	2	1,800.00	3,600.00			2.00	3,600.00	2.00	3,600.00		2.00	3,600.00	100%
43	MINOR CONCRETE (CROSS-GUTTER AND SPANDREL)	SQFT	1,300	6.00	7,800.00			1,300.00	7,800.00	1,625.00	9,750.00		1,625.00	9,750.00	125%
44	MINOR CONCRETE (DRIVEWAY)	SQFT	1,400	4.00	5,600.00			1,400.00	5,600.00	1,741.50	6,966.00		1,741.50	6,966.00	124%
45	MINOR CONCRETE (SIDEWALK)	SQFT	2,700	2.95	7,965.00			2,700.00	7,965.00	2,840.37	8,379.09		2,840.37	8,379.09	105%
46	MINOR CONCRETE (TYPE 'D' CURB)(CRS204) [MODIFIED]	LF	140	14.00	1,960.00			140.00	1,960.00	152.71	2,137.94		152.71	2,137.94	109%
47	REMOVE AND RECONSTRUCT RR TIE RETAINING CURB	LF	80	13.00	1,040.00			80.00	1,040.00	80.00	1,040.00		80.00	1,040.00	100%
48	WEDGE PLANE ASPHALT CONCRETE	LF	360	17.00	6,120.00			360.00	6,120.00	372.00	6,324.00		372.00	6,324.00	103%
49	RECONSTRUCT STEEL UNDERWALK DRAIN FRAME & COVER	LS	1	1,000.00	1,000.00			1.00	1,000.00	1.00	1,000.00		1.00	1,000.00	100%
50	UNDER SIDEWALK CURB DRAIN (CRS 310)	EA	4	400.00	1,600.00			4.00	1,600.00	4.00	1,600.00		4.00	1,600.00	100%
51	ALTERNATE BID ITEMS - LAKE HEMET MUNICIPAL WATER DISTRICT RELOCATE WATER METER	EA	5	900.00	4,500.00			5.00	4,500.00	6.00	5,400.00		6.00	5,400.00	120%