

**SUBMITTAL TO THE BOARD OF SUPERVISORS
COUNTY OF RIVERSIDE, STATE OF CALIFORNIA**

114B



FROM: County Counsel
Code Enforcement Department

SUBMITTAL DATE:
December 23, 2010

SUBJECT: Statement of Expense [Case No. CV09-03714]
Subject Property: 22708 Carter Drive, Perris; VIOLANTI FAMILY TRUST
APN: 326-062-014
District: Five

RECOMMENDED MOTION: Move that the Board of Supervisors:

- (1) assess the reasonable costs of abatement of a public nuisance (substandard mobile home) in the above-referenced matter to be **ten thousand, eight hundred, twelve dollars and thirteen cents (US \$10,812.13)**;
- (2) assess the costs of abatement against the above-described subject property;
- (3) authorize the recordation of a notice of abatement lien; and
- (4) authorize the abatement costs to be added to the tax roll as a special assessment
- (5) authorize and direct the Code Enforcement Department to take any reasonable actions to collect the amount owed.

L. Alexandra Fong
L. ALEXANDRA FONG, Deputy County Counsel
for PAMELA J. WALLS, County Counsel

FINANCIAL DATA	Current F.Y. Total Cost:	\$ N/A	In Current Year Budget:	N/A
	Current F.Y. Net County Cost:	\$ N/A	Budget Adjustment:	N/A
	Annual Net County Cost:	\$ N/A	For Fiscal Year:	N/A

SOURCE OF FUNDS:	Positions To Be Deleted Per A-30	<input type="checkbox"/>
	Requires 4/5 Vote	<input type="checkbox"/>

C.E.O. RECOMMENDATION: APPROVE
BY: *Jennifer V. Sargent*
County Executive Office Signature

Consent
 Policy
 Consent
 Policy

MINUTES OF THE BOARD OF SUPERVISORS

On motion of Supervisor Benoit, seconded by Supervisor Stone and duly carried by unanimous vote, IT WAS ORDERED that the above matter is approved as recommended.

Ayes: Buster, Tavaglione, Stone, Benoit and Ashley
Nays: None
Absent: None
Date: January 11, 2011
xc: Co. Co., CED, Prop. Owner

Kecia Harper-Ihem
 Clerk of the Board
 By: *Kecia Harper-Ihem*
 Den/iv

Prev. Agn. Ref.: _____ | District: 5 | Agenda Number: _____

9.21

Statement of Expense [Case No. CV09-03714]

Subject Property: 22708 Carter Drive, Perris; VIOLANTI FAMILY TRUST

APN: 326-062-014

District: Five

Page 2

BACKGROUND: Government Code § 25845, Riverside County Ordinance Nos. 457 (RCC Title 15) and 725 (RCC Chapter 1.16) and Section 1618, Article 10, Title 25 of the California Code of Regulations, provide authority for the recovery of abatement costs in public nuisance cases, the recordation of a notice of abatement lien and inclusion of abatement costs on the tax roll as a special assessment upon approval of the Board of Supervisors.

In 2009, the Code Enforcement Department issued a Ten-Day Notice of Intent to Abate in a substandard mobile home on the subject property, which was deemed to be an imminent hazard. On or about June 17, 2010, the substandard mobile home was abated from the subject property under the direction of the Riverside Code Enforcement Department pursuant to seizure warrant **MISC2010-055**.

The property has a delinquent tax status as of 2005.

The Notice of Hearing re Statement of Expense has been posted on the property and mailed to the property owner and all interested parties, as required by law. Copies of all relevant notices issued in this matter together with proof of service and posting have been separately filed with the Clerk of the Board and are made a part of the record herein, pursuant to Riverside County Ordinance 725.

PAMELA J. WALLS
County Counsel

OFFICE OF COUNTY COUNSEL
COUNTY OF RIVERSIDE



KATHERINE A. LIND
Assistant County Counsel

3960 ORANGE STREET, SUITE 500
RIVERSIDE, CA 92501-3674
TELEPHONE: 951/955-6300
FAX: 951/955-6322 & 951/955-6363

December 14, 2010

NOTICE OF HEARING RE: STATEMENT OF EXPENSE

To: Owners and Interested Parties
(See attached Proof of Service
and Notice List)

Subject Property: 22708 Carter Drive, Perris
Case No.: CV 09-03714; VIOLANTI
APN: 326-062-014

NOTICE IS HEREBY GIVEN that a hearing will be held before the Riverside County Board of Supervisors on **Tuesday, January 11, 2011 at 9:30 a.m.** in the Board of Supervisors Room, 4080 Lemon Street, 1st Floor Annex, Riverside, California, at which time and place pertinent testimony will be heard regarding the expenses incurred by the County of Riverside, Code Enforcement Department ("DEPARTMENT") for the above-referenced abatement proceeding. Said abatement proceeding involved the removal of a substandard mobile home located on your real property commonly described as 22708 Carter Drive, Perris and more particularly described as Assessor's Parcel Number 326-062-014.

The total expense due, including all other fees and costs, for the removal of the above-described dangerous or injurious condition is **ten thousand, eight hundred, twelve dollars and thirteen cents (US \$10,812.13)**. This amount is immediately due and payable. If you have any objections to the Statement of Expense attached hereto, you must address your objections to the Board of Supervisors at the hearing. If you have any questions about the attached Statement of Expense or would like to see additional documents in support of costs set forth on the Statement of Expense Worksheet, please contact the undersigned at (951) 955-6300. In the event the total amount due is not paid to the DEPARTMENT prior to the Board Hearing, the DEPARTMENT shall seek an order from the Board of Supervisors to place a lien against your property and collect the amount due as a special tax assessment.

Failure to appear at the hearing will result in the exclusion of your testimony. Facts as known to the DEPARTMENT will be presented to the Board of Supervisors for their final consideration and deliberation of this matter.

You are encouraged to contact Supervising Code Enforcement Officer, Brian Black at (951) 955-2004 prior to the hearing. Please meet with the undersigned or Brian Black at 8:30 a.m. on the day of the hearing in the lobby of the 1st floor annex to discuss the case.

PAMELA J. WALLS
County Counsel

L. ALEXANDRA FONG
Deputy County Counsel

Enclosure: Statement of Expense

JAN 11 2011 9.21



COUNTY OF RIVERSIDE

Code Enforcement Administration

STATEMENT OF EXPENSE WORKSHEET



CASE NUMBER: CV0903714
OWNER: VIOLANTI FAMILY TRUST
SITUS: 22708 CARTER DR, PERRIS, CA. 92570
APN: 326-062-014
SUPERVISORIAL DISTRICT: 5
AUTHORITY: RIVERSIDE COUNTY ORDINANCE NO(s).
 457 (RCC Title 15) & 725 (RCC Chapter 1.16)

Code Enforcement Department Billable Rates: Effective June 21, 2007 (Riverside County Ordinance 725.12)

SUPER-SUPERVISING CODE ENFORCEMENT OFFICER \$130.00/HR
 SENIOR-SENIOR CODE ENFORCEMENT OFFICER \$129.00/HR
 OFFICER- CODE ENFORCEMENT OFFICER II \$109.00/HR
 TECH- CODE ENFORCEMENT TECHNICIAN \$82.00/HR

<u>DATE</u>	<u>DESCRIPTION</u>	<u>HOURS</u>	<u>AMOUNT</u>
05/26/09 - 06/17/10	CV09-03714: Officers- Morris - Field Investigation/File Maintenance	6.20	\$675.80
12/08/10	Prepare/Attend Statement of Expense Hearing	0.50	\$65.00
SUBTOTAL CODE ENFORCEMENT COSTS		6.70	\$740.80
11/30/09 - 06/25/10	COUNTY COUNSEL- CV09-03714: LEGAL CONSULTATION SERVICES-Includes Administrative Costs	13.65	\$1,377.68
12/01/10	CONTRACTOR SERVICES- Lot/Title Report - RZ Title Services Inc.		\$120.00
02/04/10	Lot/Title Report - RZ Title Services Inc.		\$114.00
06/17/10	All Commercial Towing - Mobile Home Abatement		\$8,459.65
TOTAL COSTS DUE			\$10,812.13

I affirm and declare under penalty of perjury under the laws of the State of California that the foregoing is true and correct.

Executed this 8th day of December, 2010, at Riverside, California.



 Cuong Pham
 Code Enforcement Department

NOTICE LIST

Subject Property: 22708 Carter Drive, Perris; Case No.: CV09-03714;
 APN: 326-062-014; District 5

VIOLANTI FAMILY TRUST
 PHYLLIS VIOLANTI
 13761 BOEING STREET
 MORENO VALLEY CA 92553

VIOLANTI FAMILY TRUST
 PHYLLIS VIOLANTI
 22708 CARTER DRIVE
 PERRIS CA 92570

RICHARD P WELDON
 PO BOX 366
 SANTA MARIA CA 934540

PHYLLIS VIOLANTI
 290 WILSON AVENUE
 PERRIS CA 92571

<p>SENDER: COMPLETE THIS SECTION</p> <p>■ Complete items 1, 2, and 3. Also complete item 4 if Restricted Delivery is desired. ■ Print your name and address on the reverse so that we can return the card to you. ■ Attach this card to the back of the mailpiece, or on the front if space permits.</p> <p>1. Article Addressed to: RICHARD P WELDON PO BOX 366 SANTA MARIA CA 934540</p>	<p>COMPLETE THIS SECTION ON DELIVERY</p> <p>A. Signature <input checked="" type="checkbox"/> Agent <i>Phyllis Violanti</i> <input type="checkbox"/></p> <p>B. Received by (Printed Name) <input type="checkbox"/> Addressee <i>Phyllis Violanti</i> <input type="checkbox"/></p> <p>C. Date of Delivery <i>12-17</i></p> <p>D. Is delivery address different from item 1? <input type="checkbox"/> Yes If YES, enter delivery address below: <input type="checkbox"/> No</p>
<p>2. Article Number <i>CV09-03714 (Violanti Trust) S/F 4</i></p> <p>(Transfer from service label)</p> <p>PS Form 3811, February 2004</p>	<p>3. Service Type</p> <p><input checked="" type="checkbox"/> Certified Mail <input type="checkbox"/> Express Mail <input type="checkbox"/> Registered <input checked="" type="checkbox"/> Return Receipt for Merchandise <input type="checkbox"/> Insured Mail <input type="checkbox"/> C.O.D.</p> <p>4. Restricted Delivery? (Extra Fee) <input type="checkbox"/> Yes</p>
<p>Domestic Return Receipt</p> <p>7010 1670 0001 7232 5754</p> <p>102595-02-M-1540</p>	



Track & Confirm

Search Results

Label/Receipt Number: **7010 1670 0001 7232 5747**
Service(s): **Certified Mail™**
Status: **Notice Left**

We attempted to deliver your item at 4:14 pm on December 16, 2010 in PERRIS, CA 92570 and a notice was left. You may pick up the item at the Post Office indicated on the notice, go to www.usps.com/redelivery, or call 800-ASK-USPS to arrange for redelivery. If this item is unclaimed after 15 days then it will be returned to the sender. Information, if available, is updated periodically throughout the day. Please check again later.

Detailed Results:

- Notice Left, December 16, 2010, 4:14 pm, PERRIS, CA 92570
- Arrival at Unit, December 16, 2010, 8:05 am, PERRIS, CA 92570

Notification Options

Track & Confirm by email

Get current event information or updates for your item sent to you or others by email. [Go >](#)

Track & Confirm

Enter Label/Receipt Number.

[Go >](#)

7010 1670 0001 7232 5747

U.S. Postal Service™
CERTIFIED MAIL™ RECEIPT
(Domestic Mail Only; No Insurance Coverage Provided)

For delivery information visit our website at www.usps.com.

OFFICIAL USE

Postage	\$.44	Mailed 12/14/10 Postmark Here
Certified Fee	2.80	
Return Receipt Fee (Endorsement Required)	2.30	
Restricted Delivery Fee (Endorsement Required)		
Total Postage & Fees	\$ 5.54	

Sent To: VIOLANTI FAMILY TRUST
Street, Ap or PO Box: PHYLLIS VIOLANTI
City, State: 22708 CARTER DRIVE
PERRIS CA 92570

PS Form 3800, August 2006 See Reverse for Instructions



Home | Help | Sign In

Track & Confirm | FAQs

Track & Confirm

Search Results

Label/Receipt Number: **7010 1670 0001 7232 5730**
Service(s): **Certified Mail™**
Status: **Notice Left**

We attempted to deliver your item at 10:03 am on December 16, 2010 in MORENO VALLEY, CA 92553 and a notice was left. You may pick up the item at the Post Office indicated on the notice, go to www.usps.com/redelivery, or call 800-ASK-USPS to arrange for redelivery. If this item is unclaimed after 15 days then it will be returned to the sender. Information, if available, is updated periodically throughout the day. Please check again later.

Track & Confirm

Enter Label/Receipt Number.

Go >

Notification Options

Track & Confirm by email

Get current event information or updates for your item sent to you or others by email. [Go >](#)

[Site Map](#) | [Customer Service](#) | [Forms](#) | [Gov't Services](#) | [Careers](#) | [Privacy Policy](#) | [Terms of Use](#) | [Business Customer Gateway](#)

Copyright© 2010 USPS. All Rights Reserved. No FEAR Act EEO Data FOIA

7010 1670 0001 7232 5730

U.S. Postal Service™		
CERTIFIED MAIL™ RECEIPT		
<i>(Domestic Mail Only; No Insurance Coverage Provided)</i>		
For delivery information visit our website at www.usps.com		
OFFICIAL USE		
Postage	\$ 1.44	Mailed 12/14/10 Postmark Here
Certified Fee	2.80	
Return Receipt Fee (Endorsement Required)	2.30	
Restricted Delivery Fee (Endorsement Required)		
Total Postage & Fees	\$ 5.54	
Sent To		
Street, Apt. or PO Box	VIOLANTI FAMILY TRUST	
City, State, ZIP	PHYLLIS VIOLANTI	
	13761 BOEING STREET	
	MORENO VALLEY CA 92553	
PS Form 3800, August 2008 See Reverse for Instructions		



Track & Confirm

Search Results

Label/Receipt Number: **7010 1670 0001 7232 5723**
Service(s): **Certified Mail™**
Status: **Undeliverable as Addressed**

Your item was undeliverable as addressed at 10:24 am on December 16, 2010 in PERRIS, CA 92571. It is being returned if appropriate information is available.

Detailed Results:

- **Undeliverable as Addressed, December 16, 2010, 10:24 am, PERRIS, CA 92571**
- **Arrival at Unit, December 16, 2010, 8:05 am, PERRIS, CA 92570**

Notification Options

Track & Confirm by email

Get current event information or updates for your item sent to you or others by email. [Go >](#)

Track & Confirm

Enter Label/Receipt Number.

[Go >](#)

7010 1670 0001 7232 5723

U.S. Postal Service™
CERTIFIED MAIL™ RECEIPT
(Domestic Mail Only; No Insurance Coverage Provided)

For delivery information visit our website at www.usps.com

OFFICIAL USE

Postage	\$ 1.44	Mailed 12/14/10 Postmark Here
Certified Fee	2.80	
Return Receipt Fee (Endorsement Required)	2.30	
Restricted Delivery Fee (Endorsement Required)		
Total Postage & Fees	\$ 5.54	

Sent To
 Street, A or PO Box PHYLIS VIOLANTI
 City, State City, State 290 WILSON AVENUE
 PERRIS CA 92571

1 **PROOF OF SERVICE**

2 Case No. CV09-03714

3 STATE OF CALIFORNIA, COUNTY OF RIVERSIDE

4 I, Brenda G. Peeler, declare that I am a citizen of the United States and am employed in the County
5 of Riverside, over the age of 18 years and not a party to the within action or proceeding; that my
6 business address is 3960 Orange Street, Suite 500, Riverside, California 92501.

7 That on December 14, 2010, I served the following document(s):

- 8 - **NOTICE OF HEARING RE: STATEMENT OF EXPENSE**
9 - **STATEMENT OF EXPENSE WORKSHEET**

10 by placing a true copy thereof enclosed in a sealed envelope(s) addressed as follows:

11 **OWNERS OR INTERESTED PARTIES**
12 **(SEE NOTICE LIST ATTACHED TO NOTICE OF HEARING)**

13 XX **BY CERTIFIED MAIL, RETURN RECEIPT REQUESTED.** I am "readily familiar"
14 with the office's practice of collection and processing correspondence for mailing. Under
15 that practice it would be deposited with the U.S. Postal Service on that same day with
16 postage thereon fully prepaid at Riverside, California, in the ordinary course of business.

17 **BY PERSONAL SERVICE:** I caused to be delivered such envelope(s) by hand to the offices
18 of the addressee(s).

19 XX **STATE - I declare under penalty of perjury under the laws of the State of California that the**
20 **above is true and correct.**

21 **FEDERAL - I declare that I am employed in the office of a member of the bar of this court at**
22 **whose direction the service was made.**

23 EXECUTED ON December 14, 2010, at Riverside, California.

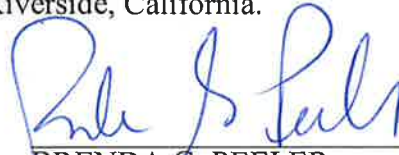
24 
25 _____
26 BRENDA G. PEELER
27
28



**CODE ENFORCEMENT DEPARTMENT
COUNTY OF RIVERSIDE**

GLENN BAUDE
Director

AFFIDAVIT OF POSTING OF NOTICES

December 15, 2010

RE CASE NO: CV0903714

I, Ryan Dolan, hereby declare:

I am employed by the Riverside County Code Enforcement Department; that my business address is 24318 Hemlock, Ave., Suite C-1, Moreno Valley, California 92557 .

That on 12/15/2010 at 1132 hours, I securely and conspicuously posted Notice of Hearing, Statement of Expense at the property described as:

Property Address: 22708 CARTER DR, PERRIS

Assessor's Parcel Number: 326-062-014

I declare under the penalty of perjury that the foregoing is true and correct.

Executed on December 15, 2010 in the County of Riverside, California.

CODE ENFORCEMENT DEPARTMENT

By: Ryan Dolan, Code Enforcement Officer

**SUBMITTAL TO THE BOARD OF SUPERVISORS
COUNTY OF RIVERSIDE, STATE OF CALIFORNIA**

FROM: County Counsel
Code Enforcement Department
SUBJECT: Statement of Expense [Case No. CV09-03714]
Subject Property: 22708 Carter Drive; Perris; VIOLANTI FAMILY TRUST
APN: 326-062-014
District Five

**TABLE OF SUPPLEMENTAL DOCUMENTS
FILED WITH THE CLERK OF THE BOARD**

Hearing Date: JANUARY 11, 2011

Statement of Expense with Supporting Documents.....	Exhibit A
Notice of Noncompliance	Exhibit B
Assessment-Roll For The Year 10-11 And Geographic Information System, November 30, 2010.....	Exhibit C



COUNTY OF RIVERSIDE

Code Enforcement Administration

STATEMENT OF EXPENSE WORKSHEET



CASE NUMBER: CV0903714
OWNER: VIOLANTI FAMILY TRUST
SITUS: 22708 CARTER DR, PERRIS, CA. 92570
APN: 326-062-014
SUPERVISORIAL DISTRICT: 5
AUTHORITY: RIVERSIDE COUNTY ORDINANCE NO(s).
 457 (RCC Title 15) & 725 (RCC Chapter 1.16)

Code Enforcement Department Billable Rates: Effective June 21, 2007 (Riverside County Ordinance 725.12)

SUPER-SUPERVISING CODE ENFORCEMENT OFFICER \$130.00/HR
 SENIOR-SENIOR CODE ENFORCEMENT OFFICER \$129.00/HR
 OFFICER- CODE ENFORCEMENT OFFICER II \$109.00/HR
 TECH- CODE ENFORCEMENT TECHNICIAN \$82.00/HR

DATE	DESCRIPTION	HOURS	AMOUNT
05/26/09 - 06/17/10	CV09-03714: Officers- Morris - Field Investigation/File Maintenance	6.20	\$675.80
12/08/10	Prepare/Attend Statement of Expense Hearing	0.50	\$65.00
SUBTOTAL CODE ENFORCEMENT COSTS		6.70	\$740.80
COUNTY COUNSEL-			
11/30/09 - 06/25/10	CV09-03714: LEGAL CONSULTATION SERVICES-Includes Administrative Costs	13.65	\$1,377.68
CONTRACTOR SERVICES-			
12/01/10	Lot/Title Report - RZ Title Services Inc.		\$120.00
02/04/10	Lot/Title Report - RZ Title Services Inc.		\$114.00
06/17/10	All Commercial Towing - Mobile Home Abatement		\$8,459.65
TOTAL COSTS DUE			\$10,812.13

I affirm and declare under penalty of perjury under the laws of the State of California that the foregoing is true and correct.

Executed this 8th day of December, 2010, at Riverside, California.



 Cuong Pham
 Code Enforcement Department

EXHIBIT NO. A



INVOICE

Order Number: 22973 **Order Date:** 12/1/2010

Customer Information:

Acct No. 1044

RIVERSIDE COUNTY TLMA-CODE ENFORCEMENT
4080 Lemon Street
Riverside, CA 92501

Attn: Brent Steele
REF: CV09-03714/Brenda Peeler
IN RE: VIOLANTI, PHYLLIS E.; TRUST

Product and/or Service ordered for Property known as: 22708 Carter Drive	
DESCRIPTION: Lot Book Report	FEE: \$120.00
TOTAL DUE:	\$120.00

Payment due upon receipt. Please remit to:

RZ Title Services, Inc.
P.O. Box 1193
Whittier, CA 90609

EXHIBIT NO. _____

A4



P.O. Box 1193
 Whittier, CA 90609
 Tel # (562) 325-8351
 Fax # (714) 783-3038

Lot Book Report

Order Number: **20128**

Customer:

RIVERSIDE COUNTY TLMA-CODE INFORCEMENT

4080 Lemon Street

Riverside

CA 92501

Attn: Brent Steele

Reference: CV09-03714/Jennifer Morris

IN RE: VIOLANTI, PHYLLIS E.; TRUST

Order Date: 9/23/2009

Dated as of: 1/11/2010

County Name: Riverside

FEE(s):

Report: \$114.00

Property Address: 22708 Carter Drive

Perris

CA 92570

Assessor's Parcel No. : 326-062-014-6

Assessments:

Land Value:	\$13,968.00
Improvement Value:	\$14,591.00
Exemption Value:	\$7,000.00
Total Value:	\$21,559.00

Tax Information

Property Taxes for the Fiscal Year	2009-2010
First Installment	\$124.67
Penalty	\$12.45
Status	NOT PAID-DELINQUENT
Second Installment	\$124.67
Penalty	\$0.00
Status	OPEN NOT-PAID (DUE DATE 04/10/2010)

EXHIBIT NO. _____

A⁵

Invoice

us
50799

Invoice #	Date	Call #	Ticket #
15842	17-Jun-2010	4645	15842

All Commercial Towing Services

P.O. Box 40970
Bakersfield, California 93384-0970
Phone: (661) 832-7080
Fax: (661) 832-7773

Customer

Code Enforcement Admin Services
SYLVIA
PO Box 1469
Riverside, California 92502
Voucher No 253231
Jose Gutierrez (5-3254)

JUL 14 2010

TLARC

Summary	
Location:	22708 CARTER DR. PERRIS
Destination:	** SINGLE WIDE MOBILE HOME **
Reason:	Riverside County Abatement
Zone:	5-ACTS
Vehicle:	SINGLE WIDE MOBILE
Owner:	PHYLLIS E. VIOLANTI
VIN:	
Plate/Tag:	Truck: R-7;B-4
Mileage:	Driver: 129;138

Terms:

Date	Incident #	Club/PO #	Service	Quantity	Rate	Amount
17-Jun-2010	CV09-03714	D2250	1 - Mileage (R - 70)	150.00	2.25	337.50
			Riverside - Dump Fees (R - 70)	1.00	1,782.15	1,782.15
			Riverside - Extra Load Per Load (R - 70)	2.00	550.00	1,100.00
			Riverside - Extra Rooms (R - 70)	1.00	550.00	550.00
			Riverside - Landoll Transport To & From (R - 70)	2.00	115.00	230.00
			Riverside - Landoll Transport To & From (R - 4)	4.00	115.00	460.00
			Riverside - Porch (R - 70)	1.00	550.00	550.00
			Riverside - Single Wide (R - 70)	1.00	2,900.00	2,900.00
			Riverside County Abatement (R - 70)	1.00	550.00	550.00

RECEIVED JUN 30 2010

PAYMENT APPROVAL	
Fund	<u>10000</u>
DeptID	<u>3140/00000</u>
Account	<u>626440</u>
Project	<u>7 CV0903714</u>
Amount Paid	<u>\$ 8,459.65</u>
Signature	<u>[Signature]</u>
Date	<u>7/11/10</u>

TLMA

JUL 14 2010

Approved

Robert Brooks (5-3243)

RECEIVED
JUL 06 2010

TLMA - PURCHASING

PLEASE PAY UPON RECEIPT OF INVOICE.

Thank you for choosing ALL COMMERCIAL TOWING SERVICES

Sub Total	8,459.65
TOTAL Payments	8,459.65 0.00
Balance Owing	8,459.65

Ab

EXHIBIT NO. _____

RECEIVED JUN 30 2010

When recorded please mail to:
Riverside County Code Enforcement Department
(District 5 Office)
24318 Hemlock Avenue, Suite C-1
Moreno Valley, CA 92557
Mail Stop No. 5002

DOC # 2009-0299289

06/11/2009 08:00A Fee:NC

Page 1 of 1

Recorded in Official Records

County of Riverside

Larry W. Ward

Assessor, County Clerk & Recorder



059 M 059

NOTICE OF NONCOMPLIANCE

In the matter of the Property of
Phyllis E. Violanti, Trust

Case No. CV09-03714

NOTICE IS HEREBY GIVEN to all persons, pursuant to Section 10 of Ordinance Number 725 of the County of Riverside, State of California, that proceedings have been commenced with respect to violations of Riverside County Ordinance No.457, (RCC Title 15.48.040) described as Substandard Mobile Home (quality lower than prescribed by law). Such Proceedings are based upon the noncompliance of such real property, located at 22708 Carter Drive, Perris, CA, and more particularly described as Assessor's Parcel Number 326-062-014 and having a legal description of LOT 14 BLK E MB 017/051 ALTURA ENCANTADA, Records of Riverside County, with the requirements of Ordinance No. 457 (RCC Title 15.48.040).

The owner has been advised to immediately correct the above-referenced violations to avoid further action by the County of Riverside which may include demolition, removal, razing, etc., to abate the public nuisance. Any costs incurred by the County, including, but not limited to investigative, administrative and abatement costs and attorneys' fees, may become a lien on the property. Further details regarding this notice may be obtained by addressing an inquiry to the Code Enforcement Department, 24318 Hemlock Avenue, Suite C-1, Moreno Valley, California, Attention Code Enforcement Officer Jennifer Morris.

NOTICE IS FURTHER GIVEN in accordance with §17274 and §24436.5 of the California Revenue and Taxation Code, that a tax deduction may not be allowed for interest, taxes, depreciation, or amortization paid or incurred in the taxable year affected by these proceedings.

COUNTY OF RIVERSIDE
CODE ENFORCEMENT DEPARTMENT

By Mary Overholt
Mary Overholt
Code Enforcement Department

ACKNOWLEDGMENT

State of California)
County of Riverside)

On 06/03/09 before me, Ana E. Carrillo, Notary Public, personally appeared Mary Overholt, who proved to me on the basis of satisfactory evidence to be the person(s) whose name(s) is/are subscribed to the within instrument and acknowledged to me that he/she/they executed the same in his/her/their authorized capacity(ies), and that by his/her/their signature(s) on the instrument the person(s), or the entity upon behalf of which the person(s) acted, executed the instrument.

I certify under PENALTY OF PERJURY under the laws of the State of California that the foregoing paragraph is true and correct.

WITNESS my hand and official seal.

Ana E. Carrillo

Commission # 1767676 Comm. Expires Sep. 14, 2011

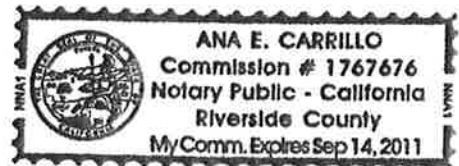

EXHIBIT NO. B

Assessment Roll For the 2010-2011 Tax Year as of January 1,2010

Assessment #326062014-6		Parcel # 326062014-6	
Assessee:	VIOLANTI FAMILY TRUST	Land	13,934
Mail Address:	13761 BOEING ST	Structure	14,555
City, State Zip:	MORENO VALLEY CA 92553	Full Value	28,489
Real Property Use Code:	MO	Total Net	28,489
Base Year	2003		
Conveyance Number:	9800114		
Conveyance (mm/yy):	7/2004		
PUI:	M030012		
TRA:	87-014		
Taxability Code:	0-00		
ID Data:	Lot 14 MB 017/051 ALTURA ENCANTADA		
Situs Address:	22708 CARTER DR PERRIS CA 92570		

View Parcel Map

EXHIBIT NO. _____

C

RIVERSIDE COUNTY GIS

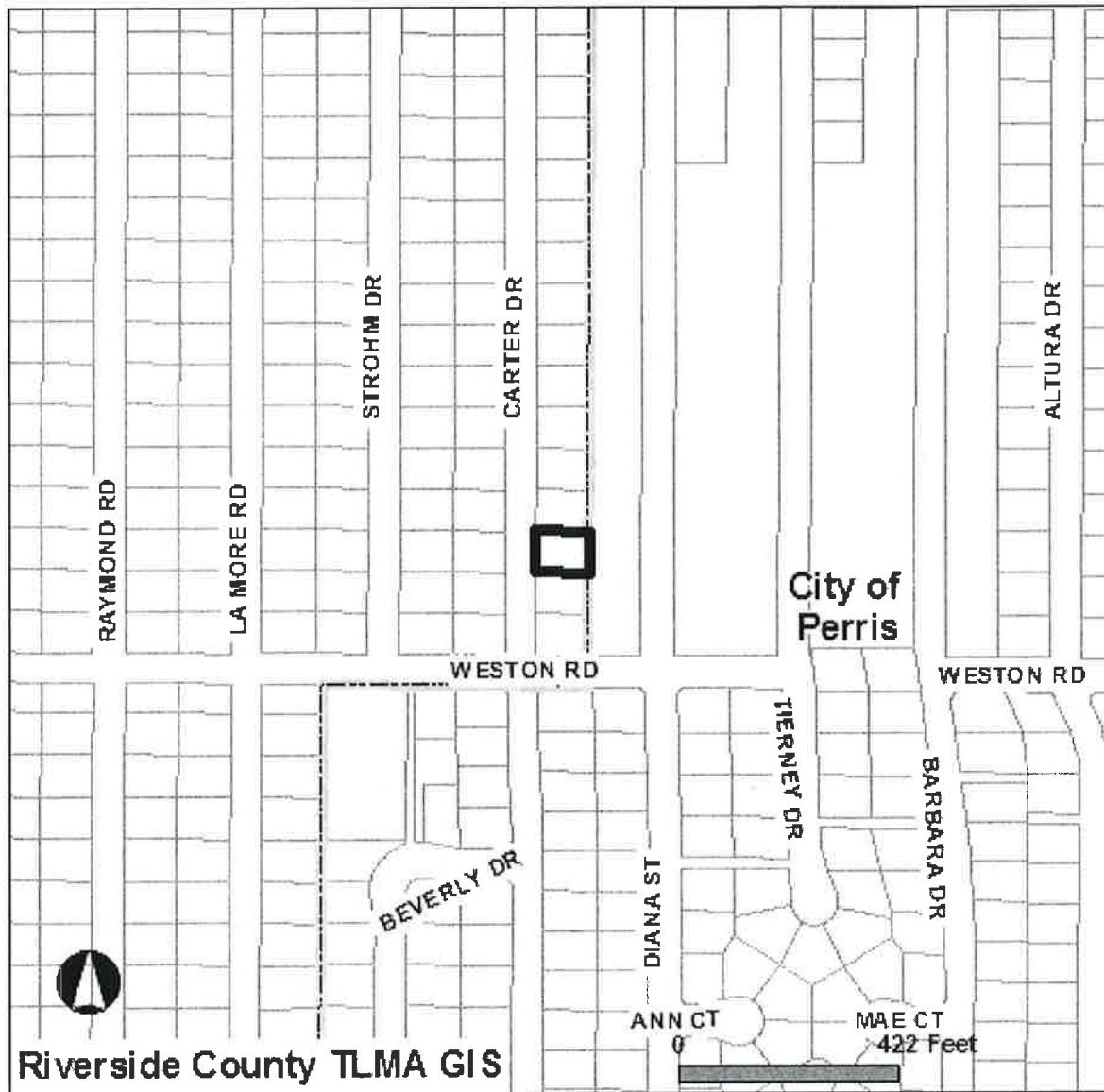

Selected parcel(s):
326-062-014

IMPORTANT

Maps and data are to be used for reference purposes only. Map features are approximate, and are not necessarily accurate to surveying or engineering standards. The County of Riverside makes no warranty or guarantee as to the content (the source is often third party), accuracy, timeliness, or completeness of any of the data provided, and assumes no legal responsibility for the information contained on this map. Any use of this product with respect to accuracy and precision shall be the sole responsibility of the user.

STANDARD REPORT

APNs

326-062-014-6

OWNER NAME / ADDRESS

VIOLANTI FAMILY TRUST
22708 CARTER DR
PERRIS, CA. 92570

MAILING ADDRESS

(SEE OWNER)
13761 BOEING ST
MORENO VALLEY CA. 92553

EXHIBIT NO. _____ *C²*

LEGAL DESCRIPTION

RECORDED BOOK/PAGE: MB 17/51
SUBDIVISION NAME: ALTURA ENCANTADA
LOT/PARCEL: 14, BLOCK:
TRACT NUMBER: NOT AVAILABLE

LOT SIZE

RECORDED LOT SIZE IS 0.18 ACRES

PROPERTY CHARACTERISTICS

WOOD FRAME, 720 SQFT., 2 BDRM/ 1 BATH, 1 STORY, CONST'D 1973 COMPOSITION, ROOF, CENTRAL HEATING, CENTRAL COOLING

THOMAS BROS. MAPS PAGE/GRID

PAGE: 807 GRID: D2

CITY BOUNDARY/SPHERE

NOT WITHIN A CITY
CITY SPHERE: PERRIS
NO ANNEXATION DATE AVAILABLE
NO LAFCO CASE # AVAILABLE
NO PROPOSALS

MARCH JOINT POWERS AUTHORITY

NOT IN THE JURISDICTION OF THE MARCH JOINT POWERS AUTHORITY

INDIAN TRIBAL LAND

NOT IN A TRIBAL LAND

SUPERVISORIAL DISTRICT (ORD. 813)

MARION ASHLEY, DISTRICT 5

TOWNSHIP/RANGE

T4SR4W SEC 25

ELEVATION RANGE

1700/1700 FEET

PREVIOUS APN

NO DATA AVAILABLE

PLANNING

LAND USE DESIGNATIONS

Zoning not consistent with the General Plan.
MDR

AREA PLAN (RCIP)

MEAD VALLEY

GENERAL PLAN POLICY OVERLAYS

NOT IN A GENERAL PLAN POLICY OVERLAY AREA

GENERAL PLAN POLICY AREAS

NONE

ZONING CLASSIFICATIONS (ORD. 348)

R-R

ZONING DISTRICTS AND ZONING AREAS

GOOD HOPE AREA

ZONING OVERLAYS

NOT IN A ZONING OVERLAY

SPECIFIC PLANS

NOT WITHIN A SPECIFIC PLAN

AGRICULTURAL PRESERVE

NOT IN AN AGRICULTURAL PRESERVE

REDEVELOPMENT AREAS

PROJECT AREA NAME: I-215 CORRIDOR
SUBAREA NAME: SOUTH MEAD VALLEY
AMENDMENT NUMBER: 0
ADOPTION DATE: FEB. 6, 2009
ACREAGE: 5013 ACRES

AIRPORT INFLUENCE AREAS

NOT IN AN AIRPORT INFLUENCE AREA

AIRPORT COMPATIBILITY ZONES

NOT IN AN AIRPORT COMPATIBILITY ZONE

ENVIRONMENTAL

CVMSHCP (COACHELLA VALLEY MULTI-SPECIES HABITAT CONSERVATION PLAN) CONSERVATION AREA

NOT IN A CONSERVATION AREA

CVMSHCP FLUVIAL SAND TRANSPORT SPECIAL PROVISION AREAS

NOT IN A FLUVIAL SAND TRANSPORT SPECIAL PROVISION AREA

WRMSHCP (WESTERN RIVERSIDE COUNTY MULTI-SPECIES HABITAT CONSERVATION PLAN) CELL GROUP

NOT IN A CELL GROUP

WRMSHCP CELL NUMBER

NOT IN A CELL

HANS/ERP (HABITAT ACQUISITION AND NEGOTIATION STRATEGY/EXPEDITED REVIEW PROCESS)

NONE

VEGETATION (2005)

Developed/Disturbed Land

FIRE

HIGH FIRE AREA (ORD. 787)

NOT IN A HIGH FIRE AREA

FIRE RESPONSIBILITY AREA

STATE RESPONSIBILITY AREA

DEVELOPMENT FEES

CVMSHCP FEE AREA (ORD. 875)

NOT WITHIN THE COACHELLA VALLEY MSHCP FEE AREA

WRMSHCP FEE AREA (ORD. 810)

IN OR PARTIALLY WITHIN THE WESTERN RIVERSIDE MSHCP FEE AREA. SEE MAP FOR MORE INFORMATION.

ROAD & BRIDGE DISTRICT

NOT IN A DISTRICT

EASTERN TUMF (TRANSPORTATION UNIFORM MITIGATION FEE ORD. 673)

NOT WITHIN THE EASTERN TUMF FEE AREA

WESTERN TUMF (TRANSPORTATION UNIFORM MITIGATION FEE ORD. 824)

IN OR PARTIALLY WITHIN A TUMF FEE AREA. SEE MAP FOR MORE INFORMATION. CENTRAL

DIF (DEVELOPMENT IMPACT FEE AREA ORD. 659)

MEAD VALLEY

SKR FEE AREA (STEPHEN'S KANGAROO RAT ORD. 663.10)

IN OR PARTIALLY WITHIN AN SKR FEE AREA. SEE MAP FOR MORE INFORMATION.

DEVELOPMENT AGREEMENTS

NOT IN A DEVELOPMENT AGREEMENT AREA

TRANSPORTATION

CIRCULATION ELEMENT ULTIMATE RIGHT-OF-WAY

NOT IN A CIRCULATION ELEMENT RIGHT-OF-WAY

ROAD BOOK PAGE

61

TRANSPORTATION AGREEMENTS

NOT IN A TRANSPORTATION AGREEMENT

CETAP (COMMUNITY AND ENVIRONMENTAL TRANSPORTATION ACCEPTABILITY PROCESS) CORRIDORS
NOT IN A CETAP CORRIDOR.

HYDROLOGY

FLOOD PLAIN REVIEW

NOT REQUIRED.

WATER DISTRICT

EMWD

FLOOD CONTROL DISTRICT

RIVERSIDE COUNTY FLOOD CONTROL DISTRICT

WATERSHED

SAN JACINTO VALLEY

GEOLOGIC

FAULT ZONE

NOT IN A FAULT ZONE

FAULTS

NOT WITHIN A 1/2 MILE OF A FAULT

LIQUEFACTION POTENTIAL

NO POTENTIAL FOR LIQUEFACTION EXISTS

SUBSIDENCE

NOT IN A SUBSIDENCE AREA

PALEONTOLOGICAL SENSITIVITY

LOW POTENTIAL.

FOLLOWING A LITERATURE SEARCH, RECORDS CHECK AND A FIELD SURVEY, AREAS MAY BE DETERMINED BY A QUALIFIED VERTEBRATE PALEONTOLOGIST AS HAVING LOW POTENTIAL FOR CONTAINING SIGNIFICANT PALEONTOLOGICAL RESOURCES SUBJECT TO ADVERSE IMPACTS.

MISCELLANEOUS

SCHOOL DISTRICT

PERRIS & PERRIS UNION HIGH

COMMUNITIES

MEAD VALLEY

COUNTY SERVICE AREA

NOT IN A COUNTY SERVICE AREA.

LIGHTING (ORD. 655)

ZONE B, 37.54 MILES FROM MT. PALOMAR OBSERVATORY

2000 CENSUS TRACT

042904

FARMLAND

URBAN-BUILT UP LAND

TAX RATE AREAS

087-014

- COUNTY FREE LIBRARY
- COUNTY STRUCTURE FIRE PROTECTION
- COUNTY WASTE RESOURCE MGMT DIST
- CSA 152
- EASTERN MUN WATER IMP DIST 8
- EASTERN MUNICIPAL WATER
- FLOOD CONTROL ADMINISTRATION
- FLOOD CONTROL ZONE 4
- GENERAL
- GENERAL PURPOSE
- METRO WATER EAST 1301999

- MT SAN JACINTO JUNIOR COLLEGE
- PERRIS AREA ELEM SCHOOL FUND
- PERRIS JR HIGH AREA FUND
- PERRIS SCHOOL
- PERRIS UNION HIGH SCHOOL
- PERRIS VALLEY CEMETERY
- RIV CO REG PARK & OPEN SPACE
- RIV. CO. OFFICE OF EDUCATION
- SAN JACINTO BASIN RESOURCE CONS

SPECIAL NOTES

NO SPECIAL NOTES

CODE COMPLAINTS

NO CODE COMPLAINTS

REPORT PRINTED ON...Tue Nov 30 10:51:33 2010
Version 101124