

**SUBMITTAL TO THE BOARD OF SUPERVISORS
COUNTY OF RIVERSIDE, STATE OF CALIFORNIA**

210B



FROM: County Counsel
Code Enforcement Department

SUBMITTAL DATE:
January 12, 2011

SUBJECT: Statement of Expense [Case No. CV 08-10576]
Subject Property: 1 Parcel S/O 16700 Avenida Merced Desert Hot Springs; BURTON FAMILY TRUST
APN: 657-202-023
District Five

RECOMMENDED MOTION: Move that the Board of Supervisors:

- (1) assess the reasonable costs of abatement of a public nuisance (accumulated rubbish) in the above-referenced matter to be **one thousand, one hundred two dollars and twenty-three cents (US \$1,102.23)**;
- (2) assess the costs of abatement against the above-described subject property;
- (3) authorize the recordation of a notice of abatement lien; and
- (4) authorize the abatement costs to be added to the tax roll as a special assessment
- (5) authorize and direct the Code Enforcement Department to take any reasonable actions to collect the amount owed.

L. Fong
L. ALEXANDRA FONG, Deputy County Counsel
for PAMELA J. WALLS, County Counsel

FINANCIAL DATA	Current F.Y. Total Cost:	\$ N/A	In Current Year Budget:	N/A
	Current F.Y. Net County Cost:	\$ N/A	Budget Adjustment:	N/A
	Annual Net County Cost:	\$ N/A	For Fiscal Year:	N/A

SOURCE OF FUNDS:	Positions To Be Deleted Per A-30	<input type="checkbox"/>
	Requires 4/5 Vote	<input type="checkbox"/>

C.E.O. RECOMMENDATION: APPROVE
BY: *Jennifer Sargent*
County Executive Office Signature
Jennifer Sargent

Consent
 Policy
 Consent
 Policy

MINUTES OF THE BOARD OF SUPERVISORS

On motion of Supervisor-Buster, seconded by Supervisor Benoit and duly carried, IT WAS ORDERED that the above matter is approved as recommended.

Ayes: Buster, Stone, Benoit and Ashley
Nays: None
Absent: Tavaglione
Date: January 25, 2011
xc: Co. Co., CED, Prop. Owner

Kecia Harper-Ihem
 Clerk of the Board
 By: *Kecia Harper-Ihem*
 Deputy

Prev. Agn. Ref.: | District: 5 | Agenda Number:

ATTACHMENTS FILED
WITH THE CLERK OF THE BOARD

9.14

Dept's Recomm.:
 Per Exec. Ofc.:

Statement of Expense [Case No. CV CV 08-10576]

Subject Property: 1 Parcel S/O 16700 Avenida Merced Desert Hot Springs; BURTON FAMILY TRUST

APN: 657-202-023

District Five

The Riverside County Code Enforcement Department issued Notices of Violation and Orders to Remove Rubbish on Feb. 24, 2009 and Oct. 6, 2009. On or about August 20, 2010, the accumulated rubbish was abated from the subject property under the direction of the Riverside County Code Enforcement Department.

The Notice of Hearing re Statement of Expense has been posted on the property and mailed to the property owner and all interested parties, as required by law. Copies of all relevant notices issued in this matter together with proof of service and posting have been separately filed with the Clerk of the Board and are made a part of the record herein, pursuant to Riverside County Ordinance 725.

**SUBMITTAL TO THE BOARD OF SUPERVISORS
COUNTY OF RIVERSIDE, STATE OF CALIFORNIA**

FROM: County Counsel
Code Enforcement Department
SUBJECT: Statement of Expense [Case No. CV08-10576]
Subject Property: 1 Parcel S/O 16700 Avenida Merced DHS; BURTON FAMILY TRUST
APN: 657-202-023
District Five

**TABLE OF SUPPLEMENTAL DOCUMENTS
FILED WITH THE CLERK OF THE BOARD**

Hearing Date: JANUARY 25, 2011

Notice of Statement Expense Hearing (including Proofs of Service, Affidavits of Posting and Return Receipts)	Exhibit A
Statement of Expense Worksheet With Supporting Documents.....	Exhibit B
Assessment-Roll For The Year 10-11 And Geographic Information System, December 30, 2010	Exhibit C

JAN 25 2011 9.14

PAMELA J. WALLS
County Counsel

OFFICE OF COUNTY COUNSEL
COUNTY OF RIVERSIDE



KATHERINE A. LIND
Assistant County Counsel

3960 ORANGE STREET, SUITE 500
RIVERSIDE, CA 92501-3674
TELEPHONE: 951/955-6300
FAX: 951/955-6322 & 951/955-6363

January 6, 2011

**NOTICE OF HEARING
RE: STATEMENT OF EXPENSE**

To: Owner(s) or Interested Parties
(See Attached Proof of Service
and Notice List)

Subject Property: 1 Parcel S/O 16700 Avenida Merced, DHS
Case No.: CV08-10576; BURTON FAMILY TRUST
APN: 657-202-023

NOTICE IS HEREBY GIVEN that a hearing will be held before the Riverside County Board of Supervisors on **Tuesday, January 25, 2011, at 9:30 a.m.** in the Board of Supervisors Room, 4080 Lemon Street, 1st Floor Annex, Riverside, California, at which time and place pertinent testimony will be heard regarding the expenses incurred by the County of Riverside, Code Enforcement Department ("DEPARTMENT") for the above-referenced abatement case. Said abatement case involved accumulated rubbish located on your real property commonly described as 1 Parcel S/O 16700 Avenida Merced, DHS, Riverside County, California and more particularly described as Assessor's Parcel Number 657-202-023.

The total expense due, including all other fees and costs, for the abatement of the above-described dangerous or injurious condition is **one thousand, one hundred two dollars and twenty-three cents, (US \$1,102.23)**. This amount is immediately due and payable. If you have any objections to the Statement of Expense attached hereto, you must address your objections to the Board of Supervisors at the hearing. If you have any questions about the attached Statement of Expense or would like to see additional documents in support of costs set forth on the Statement of Expense Worksheet, please contact the undersigned at (951) 955-6300. In the event the total amount due is not paid to the DEPARTMENT prior to the Board Hearing, the DEPARTMENT shall seek an order from the Board of Supervisors to place a lien against your property and collect the amount due as a special tax/assessment.

Failure to appear at the hearing will result in the exclusion of your testimony. Facts as known to the DEPARTMENT will be presented to the Board of Supervisors for their final consideration and deliberation of this matter.

You are encouraged to contact Supervising Code Enforcement Officer, Brian Black (951) 955-2004 prior to the hearing. Please meet with the undersigned or Brian Black at 7:30 a.m. on the day of the hearing in Conference Room 2A located on the 1st floor in front of the Human Resources Office to discuss the case.

PAMELA J. WALLS
County Counsel

L. ALEXANDRA FONG
Deputy County Counsel

Enclosure: Statement of Expense

EXHIBIT NO. A



COUNTY OF RIVERSIDE

Code Enforcement Administration

STATEMENT OF EXPENSE WORKSHEET



CASE NUMBER: CV08-10576

OWNER: GENE E BURTON & PHYLLIS BURTON

SITUS: 1 PARCEL SOUTH OF 16700 AVENIDA MERCED, DESERT HOT SPRINGS, CA

APN: 657-202-023-5

SUPERVISORIAL DISTRICT: 5

AUTHORITY: RIVERSIDE COUNTY ORDINANCE NO(s).
541 (RCC Chapter 8.120) & 725 (RCC Chapter 1.16)

Code Enforcement Department Billable Rates: Effective June 21, 2007 (Riverside County Ordinance 725.12)

SUPER-SUPERVISING CODE ENFORCEMENT OFFICER	\$130.00/HR
SENIOR-SENIOR CODE ENFORCEMENT OFFICER	\$129.00/HR
OFFICER- CODE ENFORCEMENT OFFICER II	\$109.00/HR
TECH- CODE ENFORCEMENT TECHNICIAN	\$82.00/HR

<u>DATE</u>	<u>DESCRIPTION</u>	<u>HOURS</u>	<u>AMOUNT</u>
02/04/09 - 08/20/10	CV08-10576: Officers- Cervantes/ Herrera/ Jurden - Field Investigation/File Maintenance	3.30	\$348.10
01/06/11	Prepare/Attend Statement of Expense Hearing	0.50	\$65.00
SUBTOTAL CODE ENFORCEMENT COSTS		3.80	\$413.10
	COUNTY COUNSEL- LEGAL CONSULTATION SERVICES-Includes Administrative Costs		\$195.30
	CONTRACTOR SERVICES-		
12/23/10	Lot/Title Report - RZ Title Services Inc.		\$120.00
08/19/10	Lanik Enterprises - Demolition & Disposal Services		\$373.83
TOTAL COSTS DUE			\$1,102.23

I affirm and declare under penalty of perjury under the laws of the State of California that the foregoing is true and correct.

Executed this 6th day of January, 2010, at Riverside, California.



 Cuong Pham
 Code Enforcement Department

EXHIBIT NO. A²

NOTICE LIST

Subject Property: 1 Parcel S/O 16700 Avenida Merced, Desert Hot Springs;
Case No.: CV08-10576; APN: 657-202-023; District Five

GENE E BURTON
PHYLLIS C BURTON
TRUSTEES OF THE BURTON FAMILY
REVOCABLE TRUST DATED DEC 30, 1991
21385 AUBERRY ROAD
CLOVIS CA 93611

JAMES E SHEKOYAN
BAKER, MANOCK & JENSEN
5260 N PALM STE 421
FRESNO CA 93704

EXHIBIT NO. _____

A³



Track & Confirm

Search Results

Label/Receipt Number: 7010 1670 0001 7232 6096
Service(s): **Certified Mail™**
Status: **Delivered**

Your item was delivered at 9:40 am on January 10, 2011 in FRESNO, CA 93704.

Track & Confirm

Enter Label/Receipt Number.

Go >

Notification Options

Track & Confirm by email

Get current event information or updates for your item sent to you or others by email. Go >

7010 1670 0001 7232 6096

U.S. Postal Service™
CERTIFIED MAIL™ RECEIPT
(Domestic Mail Only; No Insurance Coverage Provided)

For delivery information visit our website at www.usps.com

OFFICIAL USE

Postage	\$.44	MAILED 1/6/11 Postmark Here
Certified Fee	2.80	
Return Receipt Fee (Endorsement Required)	2.30	
Restricted Delivery Fee (Endorsement Required)		
Total Postage & Fees	\$ 5.54	

Sent To
Street, or PO E: JAMES E SHEKOYAN
BAKER, MANOCK & JENSEN
City, St: 5260 N PALM STE 421
FRESNO CA 93704

PS Form 3800, August 2006 See Reverse for Instructions

EXHIBIT NO.

A4



Track & Confirm

Search Results

Label/Receipt Number: **7010 1670 0001 7232 6089**
Service(s): **Certified Mail™**
Status: **Delivered**

Your item was delivered at 11:05 am on January 10, 2011 in CLOVIS, CA 93619.

Track & Confirm

Enter Label/Receipt Number.

Go >

Detailed Results:

- **Delivered, January 10, 2011, 11:05 am, CLOVIS, CA 93619**
- **Arrival at Unit, January 10, 2011, 7:01 am, CLOVIS, CA 93612**

Notification Options

Track & Confirm by email

Get current event information or updates for your item sent to you or others by email. [Go >](#)

7010 1670 0001 7232 6089

U.S. Postal Service™
CERTIFIED MAIL™ RECEIPT
(Domestic Mail Only; No Insurance Coverage Provided)

For delivery information visit our website at www.usps.com

OFFICIAL USE

Postage	\$.44	MAILED 1/6/11 Postmark Here
Certified Fee	2.80	
Return Receipt Fee (Endorsement Required)	2.30	
Restricted Delivery Fee (Endorsement Required)		
Total Postage & Fees	\$ 5.54	

Sent To GENE E BURTON
PHYLLIS C BURTON
Street, or PO E TRUSTEES OF THE BURTON FAM ILY
21385 AUBERRY ROAD
City, St CLOVIS CA 93611

PS Form 3800, August 2006

EXHIBIT NO. A5

PROOF OF SERVICE

Case No. CV08-10576

1
2
3
4
5
6
7
8
9
10
11
12
13
14
15
16
17
18
19
20
21
22
23
24
25
26
27
28

STATE OF CALIFORNIA, COUNTY OF RIVERSIDE

I, Brenda G. Peeler, declare that I am a citizen of the United States and am employed in the County of Riverside, over the age of 18 years and not a party to the within action or proceeding; that my business address is 3960 Orange Street, Suite 500, Riverside, California 92501.

That on January 6, 2011, I served the following document(s):

- NOTICE OF HEARING RE: STATEMENT OF EXPENSE
- STATEMENT OF EXPENSE WORKSHEET

by placing a true copy thereof enclosed in a sealed envelope(s) addressed as follows:

**OWNERS OR INTERESTED PARTIES
(SEE NOTICE LIST ATTACHED TO NOTICE OF HEARING)**

XX **BY CERTIFIED MAIL, RETURN RECEIPT REQUESTED.** I am "readily familiar" with the office's practice of collection and processing correspondence for mailing. Under that practice it would be deposited with the U.S. Postal Service on that same day with postage thereon fully prepaid at Riverside, California, in the ordinary course of business.

___ **BY PERSONAL SERVICE:** I caused to be delivered such envelope(s) by hand to the offices of the addressee(s).

XX **STATE - I declare under penalty of perjury under the laws of the State of California that the above is true and correct.**

___ **FEDERAL - I declare that I am employed in the office of a member of the bar of this court at whose direction the service was made.**

EXECUTED ON January 6, 2011, at Riverside, California.



BRENDA G. PEELER

EXHIBIT NO. Ab



**CODE ENFORCEMENT DEPARTMENT
COUNTY OF RIVERSIDE**

GLENN BAUDE
Director

AFFIDAVIT OF POSTING OF NOTICES

January 7, 2011

RE CASE NO: CV0810576

I, Thomas Cervantes, hereby declare:

I am employed by the Riverside County Code Enforcement Department; that my business address is 31-290 Plantation Drive, Thousand Palms, California 92276 .

That on 01/07/2011 at 9:12 AM, I securely and conspicuously posted Notice of Hearing RE: Statement of Expense at the property described as:

Property Address: 1 Par S/O 16700 Avenida Merced, Desert Hot Springs

Assessor's Parcel Number: 657-202-023

I declare under the penalty of perjury that the foregoing is true and correct.

Executed on January 7, 2011 in the County of Riverside, California.

CODE ENFORCEMENT DEPARTMENT

By: Thomas Cervantes, Code Enforcement Officer

EXHIBIT NO. A7



COUNTY OF RIVERSIDE

Code Enforcement Administration

STATEMENT OF EXPENSE WORKSHEET



CASE NUMBER: CV08-10576
OWNER: GENE E BURTON & PHYLLIS BURTON
SITUS: 1 PARCEL SOUTH OF 16700 AVENIDA MERCED, DESERT HOT SPRINGS, CA
APN: 657-202-023-5
SUPERVISORIAL DISTRICT: 5
AUTHORITY: RIVERSIDE COUNTY ORDINANCE NO(s).
 541 (RCC Chapter 8.120) & 725 (RCC Chapter 1.16)

Code Enforcement Department Billable Rates: Effective June 21, 2007 (Riverside County Ordinance 725.12)

SUPER-SUPERVISING CODE ENFORCEMENT OFFICER \$130.00/HR
 SENIOR-SENIOR CODE ENFORCEMENT OFFICER \$129.00/HR
 OFFICER- CODE ENFORCEMENT OFFICER II \$109.00/HR
 TECH- CODE ENFORCEMENT TECHNICIAN \$82.00/HR

<u>DATE</u>	<u>DESCRIPTION</u>	<u>HOURS</u>	<u>AMOUNT</u>
02/04/09 - 08/20/10	CV08-10576: Officers- Cervantes/ Herrera/ Jurden - Field Investigation/File Maintenance	3.30	\$348.10
01/06/11	Prepare/Attend Statement of Expense Hearing	0.50	\$65.00
SUBTOTAL CODE ENFORCEMENT COSTS		3.80	\$413.10
	COUNTY COUNSEL- LEGAL CONSULTATION SERVICES-Includes Administrative Costs		\$195.30
12/23/10	CONTRACTOR SERVICES- Lot/Title Report - RZ Title Services Inc.		\$120.00
08/19/10	Lanik Enterprises - Demolition & Disposal Services		\$373.83
TOTAL COSTS DUE			\$1,102.23

I affirm and declare under penalty of perjury under the laws of the State of California that the foregoing is true and correct.

Executed this 6th day of January, 2010, at Riverside, California.



 Cuong Pham
 Code Enforcement Department

BILL DATE	BILL CLIENT / MATTER	BILL HOURS	BILL AMOUNT	ATTY	DESCRIPTION
	CV0810576				
	CV0810576				
	CV0810576				
	CV0810576				
	CV0810576				
	CV0810576				
Subtotal		0	0		
Add					
	CV0810576	0	0		Mailing Expense
	CV0810576	0.9	125.55		Prepare case for SOE Hearing
	CV0810576	0.5	69.75		Attend SOE Hearing
Total		1.4	195.3		

EXHIBIT NO. B²

Case Labor Audit

APN: 657-202-023-5
Property Owner: GENE E BURTON
PHYLLIS BURTON
Property address: 1 PARCEL SOUTH OF AVENIDA MERCED
DESERT HOT SPRINGS CA 92240
Date Prepared: 11/30/2010

CASE TYPE

Table with 11 columns: Case Name, LaborDate, CaseNumber, Name, Work Performed, Time, Rate, Charge, Unsupported Time, Charges, Adjusted Time, Charge. Includes rows for various dates from 2/4/2009 to 8/20/2010.

ZCV0810576

Summary table for ZCV0810576 with categories: Labor, Additional Fees, County Counsel, Citations, Expenses. Totals: Case Total \$1,102.23

PROPERTY TOTALS

Summary table for PROPERTY TOTALS showing Total Charged Labor \$348.10, Total Additional Fees \$65.00, Total County Counsel \$195.30, Total Citations \$0.00, Total Expenses \$493.83, Cumulative Total \$1,102.23

Handwritten signature or initials

Handwritten 'B3' in blue ink

USE AS ORIGINAL

Lanik Enterprises Inc.

PO Box 891416
Temecula, CA 92589

RECEIVED
AUG 31 2010

TH 51266

Invoice

Date	Invoice #
8/19/2010	1607

TLMA - PURCHASING

Bill To
Riverside County TLMA PO #TLA0051266 Case # CV0810576
TLMA SEP 03 2010 Approved

Job Address
APN# 657-202-023 1 Parcel S. of 16700 Avenida Merced Desert Hot Springs, Ca
TLARC SEP 08 2010 Voucher No. 257171 Colleen Braswell (5-2719)

Quantity	Description	Price Each	Est Amt	Amount	Terms
1	Abatement services per PO #TLA0051266	373.83		373.83	
				RECEIVED AUG 30 2010 TLMA - PURCHASING	
				Total	\$373.83
				Payments/Credits	\$0.00
				Balance Due	\$373.83

EXHIBIT NO. BA

RECEIVED AUG 30 2010

RECEIVED AUG 30 2010

PAYMENT APPROVAL	
Fund	10000
DeptID	3140100000
Account	525440
Project	2 CV0810576
Amount Paid	\$373.83
Signature	
Date	8/31/10



INVOICE

Order Number: 23016 **Order Date:** 12/23/2010

Customer Information:

Acct No. 1044

RIVERSIDE COUNTY TLMA-CODE ENFORCEMENT
4080 Lemon Street
Riverside, CA 92501

Attn: Brent Steele
REF: CV08-10576 / Brenda Peeler
IN RE: BURTON, GENE E.

Product and/or Service ordered for Property known as:	
Vacant Land	
DESCRIPTION: Lot Book Report	FEE: \$120.00
TOTAL DUE:	\$120.00

Payment due upon receipt. Please remit to:

RZ Title Services, Inc.
P.O. Box 1193
Whittier, CA 90609

EXHIBIT NO. B⁵

Assessment Roll For the 2010-2011 Tax Year as of January 1,2010

Assessment #657202023-5		Parcel # 657202023-5	
Assessee:	BURTON GENE E	Land	1,068
Assessee:	BURTON PHYLLIS C	Full Value	1,068
Mail Address:	21385 AUBERRY RD	Total Net	1,068
City, State Zip:	CLOVIS CA 93611		
Real Property Use Code:	YR		
Base Year	1975		
Conveyance Number:	0004806		
Conveyance (mm/yy):	1/1992		
PUI:	R070000		
TRA:	61-074		
Taxability Code:	0-00		
ID Data:	Lot 1225 MB 032/077 DOS PALMAS TR UNIT 11		

[View Parcel Map](#)

EXHIBIT NO. Q

RIVERSIDE COUNTY GIS

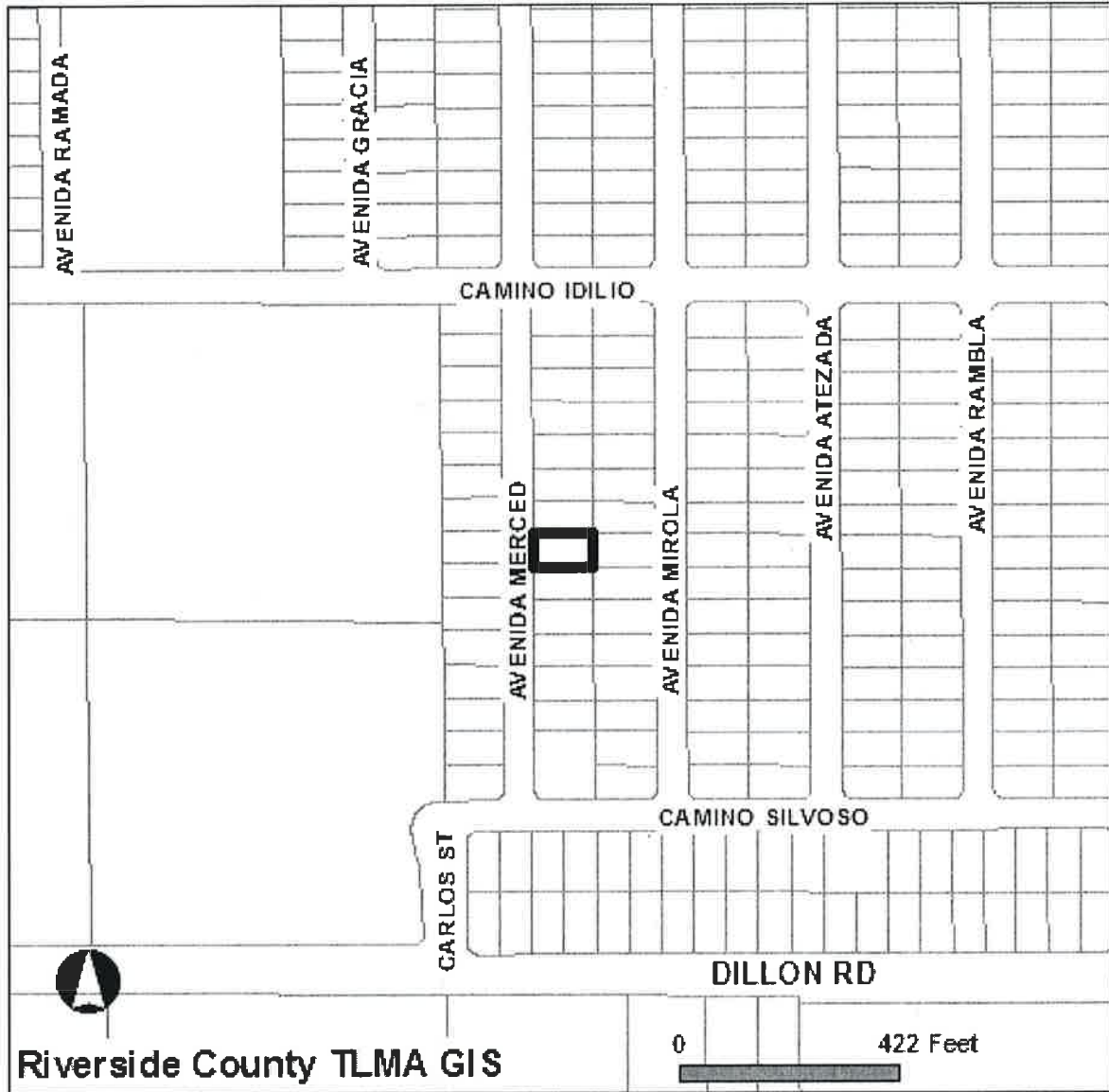

Selected parcel(s):
657-202-023

IMPORTANT

Maps and data are to be used for reference purposes only. Map features are approximate, and are not necessarily accurate to surveying or engineering standards. The County of Riverside makes no warranty or guarantee as to the content (the source is often third party), accuracy, timeliness, or completeness of any of the data provided, and assumes no legal responsibility for the information contained on this map. Any use of this product with respect to accuracy and precision shall be the sole responsibility of the user.

STANDARD REPORT

APNs

657-202-023-5

OWNER NAME / ADDRESS

GENE E BURTON
PHYLLIS BURTON
ADDRESS NOT AVAILABLE

MAILING ADDRESS

(SEE OWNER)
21385 AUBERRY RD
CLOVIS CA. 93611

EXHIBIT NO. _____

C2

LEGAL DESCRIPTION

RECORDED BOOK/PAGE: MB 32/77
SUBDIVISION NAME: DOS PALMAS TR UNIT 11
LOT/PARCEL: 1225, BLOCK: NOT AVAILABLE
TRACT NUMBER: NOT AVAILABLE

LOT SIZE

RECORDED LOT SIZE IS 0.17 ACRES

PROPERTY CHARACTERISTICS

NO PROPERTY DESCRIPTION AVAILABLE

THOMAS BROS. MAPS PAGE/GRID

PAGE: 727 GRID: B1

CITY BOUNDARY/SPHERE

NOT WITHIN A CITY
CITY SPHERE: DESERT HOT SPRINGS
ANNEXATION DATE: FEB. 22, 2007
LAFCO CASE #: 2006-25-4&5
NO PROPOSALS

MARCH JOINT POWERS AUTHORITY

NOT IN THE JURISDICTION OF THE MARCH JOINT POWERS AUTHORITY

INDIAN TRIBAL LAND

NOT IN A TRIBAL LAND

SUPERVISORIAL DISTRICT (ORD. 813)

MARION ASHLEY, DISTRICT 5

TOWNSHIP/RANGE

T3SR5E SEC 8

ELEVATION RANGE

836/836 FEET

PREVIOUS APN

NO DATA AVAILABLE

PLANNING

LAND USE DESIGNATIONS

Zoning not consistent with the General Plan.
MDR

AREA PLAN (RCIP)

WESTERN COACHELLA VALLEY

GENERAL PLAN POLICY OVERLAYS

NOT IN A GENERAL PLAN POLICY OVERLAY AREA

GENERAL PLAN POLICY AREAS

NONE

ZONING CLASSIFICATIONS (ORD. 348)

W-2

ZONING DISTRICTS AND ZONING AREAS

PASS & DESERT DISTRICT

ZONING OVERLAYS

NOT IN A ZONING OVERLAY

SPECIFIC PLANS

NOT WITHIN A SPECIFIC PLAN

AGRICULTURAL PRESERVE

NOT IN AN AGRICULTURAL PRESERVE

REDEVELOPMENT AREAS

PROJECT AREA NAME: MCPA
SUBAREA NAME: GARNET - SUB AREA
AMENDMENT NUMBER: 0
ADOPTION DATE: MAY. 13, 2010
ACREAGE: 2588 ACRES

AIRPORT INFLUENCE AREAS
NOT IN AN AIRPORT INFLUENCE AREA

AIRPORT COMPATIBILITY ZONES
NOT IN AN AIRPORT COMPATIBILITY ZONE

ENVIRONMENTAL

CVMSHCP (COACHELLA VALLEY MULTI-SPECIES HABITAT CONSERVATION PLAN) CONSERVATION AREA
NOT IN A CONSERVATION AREA

CVMSHCP FLUVIAL SAND TRANSPORT SPECIAL PROVISION AREAS
NOT IN A FLUVIAL SAND TRANSPORT SPECIAL PROVISION AREA

WRMSHCP (WESTERN RIVERSIDE COUNTY MULTI-SPECIES HABITAT CONSERVATION PLAN) CELL GROUP
NOT IN A CELL GROUP

WRMSHCP CELL NUMBER
NOT IN A CELL

HANS/ERP (HABITAT ACQUISITION AND NEGOTIATION STRATEGY/EXPEDITED REVIEW PROCESS)
NONE

VEGETATION (2005)
NO DATA AVAILABLE

FIRE

HIGH FIRE AREA (ORD. 787)
NOT IN A HIGH FIRE AREA

FIRE RESPONSIBILITY AREA
NOT IN A FIRE RESPONSIBILITY AREA

DEVELOPMENT FEES

CVMSHCP FEE AREA (ORD. 875)
WITHIN THE COACHELLA VALLEY MSHCP FEE AREA

WRMSHCP FEE AREA (ORD. 810)
NOT WITHIN THE WESTERN RIVERSIDE COUNTY MSHCP FEE AREA

ROAD & BRIDGE DISTRICT
NOT IN A DISTRICT

EASTERN TUMF (TRANSPORTATION UNIFORM MITIGATION FEE ORD. 673)
IN OR PARTIALLY WITHIN A TUMF FEE AREA. SEE MAP FOR MORE INFORMATION.
In EAST

WESTERN TUMF (TRANSPORTATION UNIFORM MITIGATION FEE ORD. 824)
NOT WITHIN THE WESTERN TUMF FEE AREA

DIF (DEVELOPMENT IMPACT FEE AREA ORD. 659)
WESTERN COACHELLA VALLEY

SKR FEE AREA (STEPHEN'S KANGAROO RAT ORD. 663.10)
NOT WITHIN AN SKR FEE AREA.

DEVELOPMENT AGREEMENTS
NOT IN A DEVELOPMENT AGREEMENT AREA

TRANSPORTATION

CIRCULATION ELEMENT ULTIMATE RIGHT-OF-WAY
NOT IN A CIRCULATION ELEMENT RIGHT-OF-WAY

ROAD BOOK PAGE
171

TRANSPORTATION AGREEMENTS
NOT IN A TRANSPORTATION AGREEMENT**CETAP (COMMUNITY AND ENVIRONMENTAL TRANSPORTATION ACCEPTABILITY PROCESS) CORRIDORS**
NOT IN A CETAP CORRIDOR.

HYDROLOGY

FLOOD PLAIN REVIEW

FLOOD PLAIN MANAGEMENT REVIEW IS REQUIRED. CONTACT THE FLOOD PLAIN MANAGEMENT SECTION AT (951) 955-1200 FOR INFORMATION.

WATER DISTRICT

DWA

FLOOD CONTROL DISTRICT

RIVERSIDE COUNTY FLOOD CONTROL DISTRICT

WATERSHED

WHITewater

GEOLOGIC

FAULT ZONE

NOT IN A FAULT ZONE

FAULTS

NOT WITHIN A 1/2 MILE OF A FAULT

LIQUEFACTION POTENTIAL

MODERATE

SUBSIDENCE

SUSCEPTIBLE

PALEONTOLOGICAL SENSITIVITY

LOW POTENTIAL.

FOLLOWING A LITERATURE SEARCH, RECORDS CHECK AND A FIELD SURVEY, AREAS MAY BE DETERMINED BY A QUALIFIED VERTEBRATE PALEONTOLOGIST AS HAVING LOW POTENTIAL FOR CONTAINING SIGNIFICANT PALEONTOLOGICAL RESOURCES SUBJECT TO ADVERSE IMPACTS.

MISCELLANEOUS

SCHOOL DISTRICT

PALM SPRINGS UNIFIED

COMMUNITIES

SOUTHEAST DESERT HOT SPRINGS

COUNTY SERVICE AREA

NOT IN A COUNTY SERVICE AREA.

LIGHTING (ORD. 655)

ZONE B, 44.93 MILES FROM MT. PALOMAR OBSERVATORY

2000 CENSUS TRACT

044506

FARMLAND

URBAN-BUILT UP LAND

TAX RATE AREAS

061-074

- CITRUS PEST CONTROL 2
- COACHELLA VALLEY RESOURCE CONSER
- COUNTY FREE LIBRARY
- COUNTY STRUCTURE FIRE PROTECTION
- COUNTY WASTE RESOURCE MGMT DIST
- CSA 152
- CV MOSQ & VECTOR CONTROL
- DESERT COMMUNITY COLLEGE
- DESERT HOSPITAL

- DESERT WATER AGENCY 5TH FRINGE
- FLOOD CONTROL ADMINISTRATION
- FLOOD CONTROL ZONE 6
- GENERAL
- GENERAL PURPOSE
- MISSION SPRINGS IMP G
- MISSION SPRINGS WATER DISTRICT
- PALM SPRINGS PUBLIC CEMETERY
- PALM SPRINGS UNIF B & I 1992-A
- PALM SPRINGS UNIFIED SCHOOL
- RIV CO REG PARK & OPEN SPACE
- RIV. CO. OFFICE OF EDUCATION

SPECIAL NOTES

NO SPECIAL NOTES

CODE COMPLAINTS

NO CODE COMPLAINTS

REPORT PRINTED ON...Thu Dec 30 14:04:11 2010
Version 101221