

**SUBMITTAL TO THE BOARD OF SUPERVISORS
COUNTY OF RIVERSIDE, STATE OF CALIFORNIA**

204B



FROM: County Counsel
Code Enforcement Department

SUBMITTAL DATE:
January 12, 2011

SUBJECT: Statement of Expense [Case Nos. CV 09-03133, CV09-10068 & CV09-11549]
Subject Property: 508 Toulouse Ave., Riverside; RAJI
APN: 246-181-012
District Five

RECOMMENDED MOTION: Move that the Board of Supervisors:

- (1) assess the reasonable costs of abatement of a public nuisance (substandard structures) in the above-referenced matter to be nine thousand, three hundred six dollars and eighty cents (US \$9,306.80);
- (2) assess the costs of abatement against the above-described subject property;
- (3) authorize the recordation of a notice of abatement lien; and
- (4) authorize the abatement costs to be added to the tax roll as a special assessment.
- (5) authorize and direct the Code Enforcement Department to take any reasonable actions to collect the amount owed.

L. A. Fong
L. ALEXANDA FONG, Deputy County Counsel
for PAMELA J. WALLS, County Counsel

(Continued)

FINANCIAL DATA	Current F.Y. Total Cost:	\$ N/A	In Current Year Budget:	N/A
	Current F.Y. Net County Cost:	\$ N/A	Budget Adjustment:	N/A
	Annual Net County Cost:	\$ N/A	For Fiscal Year:	N/A

SOURCE OF FUNDS:	Positions To Be Deleted Per A-30	<input type="checkbox"/>
	Requires 4/5 Vote	<input type="checkbox"/>

C.E.O. RECOMMENDATION:

APPROVE

County Executive Office Signature

BY: *Jennifer U. Sargent*

Jennifer U. Sargent

Consent X Policy
 Consent Policy

MINUTES OF THE BOARD OF SUPERVISORS

On motion of Supervisor Buster, seconded by Supervisor Benoit and duly carried, IT WAS ORDERED that the above matter is approved as recommended.

Ayes: Buster, Stone, Benoit and Ashley
Nays: None
Absent: Tavaglione
Date: January 25, 2011
xc: Co. Co., CED, Prop. Owner

Kecia Harper-Ihem
 Clerk of the Board
 By: *Kecia Harper-Ihem*
 Deputy

Prev. Agn. Ref.: | **District:** 5 | **Agenda Number:**

9.15

Statement of Expense [Case Nos. CV 09-03133, CV09-10068 & CV09-11549]
Subject Property: 508 Toulouse Ave., Riverside; RAJI
APN: 246-181-012
District One: Five
Page 2

BACKGROUND: Government Code § 25845, Riverside County Ordinance Nos. 457 (RCC Title 15) and 725 (RCC Chapter 1.16) authorize for the recovery of abatement costs in public nuisance cases, the recordation of a notice of abatement lien and inclusion of abatement costs on the tax roll as a special assessment upon approval of the Board of Supervisors.

The Code Enforcement Department issued Notices of Summary Abatement of Nuisance in the aforementioned cases. On Sept. 19, 2009 and Oct. 29, 2009, the violations were summarily abated under the direction of the Riverside County Code Enforcement.

The Notice of Hearing re Statement of Expense has been posted on the property and mailed to the property owner and all interested parties, as required by law. Copies of all relevant notices issued in this matter together with proof of service and posting have been separately filed with the Clerk of the Board and are made a part of the record herein, pursuant to Riverside County Ordinance 725.

**SUBMITTAL TO THE BOARD OF SUPERVISORS
COUNTY OF RIVERSIDE, STATE OF CALIFORNIA**

FROM: County Counsel
Code Enforcement Department
SUBJECT: Statement of Expense [Case Nos. CV09-03133, CV09-10068 & CV09-11549]
Subject Property: 508 Tolouse Ave., Riverside; RAJI
APN: 246-181-012
District Five

**TABLE OF SUPPLEMENTAL DOCUMENTS
FILED WITH THE CLERK OF THE BOARD**

Hearing Date: JANUARY 25, 2011

Notice of Statement of Expense Hearing (including Proofs of Service, Affidavits of Posting and Return Receipts)	Exhibit A
Statement of Expense Worksheet With Supporting Documents.....	Exhibit B
Assessment-Roll For The Year 10-11 And Geographic Information System, January 6, 2011	Exhibit C

PAMELA J. WALLS
County Counsel

OFFICE OF COUNTY COUNSEL
COUNTY OF RIVERSIDE



KATHERINE A. LIND
Assistant County Counsel

3960 ORANGE STREET, SUITE 500
RIVERSIDE, CA 92501-3674
TELEPHONE: 951/955-6300
FAX: 951/955-6322 & 951/955-6363

January 6, 2011

NOTICE OF HEARING RE: STATEMENT OF EXPENSE

To: Owner(s) or Interested Parties
(See Attached Notice List)

Subject Property: 508 Tolouse Ave., Riverside
Case Nos.: CV09-03133, CV09-10068 & CV09-11549
APN: 246-181-012; RAJI

NOTICE IS HEREBY GIVEN that a hearing will be held before the Riverside County Board of Supervisors on **Tuesday, January 25, 2011, at 9:30 a.m.** in the Board of Supervisors Room, 4080 Lemon Street, 1st Floor Annex, Riverside, California, at which time and place pertinent testimony will be heard regarding the expenses incurred by the County of Riverside, Code Enforcement Department ("DEPARTMENT") for the above-referenced abatement case. Said abatement case involved summary abatement of substandard structures located on your real property commonly described as 508 Tolouse Ave., Riverside, Riverside County, California and more particularly described as Assessor's Parcel Number 246-181-012.

The total expense due, including all other fees and costs, for the abatement of the above-described dangerous or injurious condition is **nine thousand, three hundred six dollars and eighty cents, (US \$9,306.80)**. This amount is immediately due and payable. If you have any objections to the Statement of Expense attached hereto, you must address your objections to the Board of Supervisors at the hearing. If you have any questions about the attached Statement of Expense or would like to see additional documents in support of costs set forth on the Statement of Expense Worksheet, please contact the undersigned at (951) 955-6300. In the event the total amount due is not paid to the DEPARTMENT prior to the Board Hearing, the DEPARTMENT shall seek an order from the Board of Supervisors to place a lien against your property and collect the amount due as a special tax assessment.

Failure to appear at the hearing will result in the exclusion of your testimony. Facts as known to the DEPARTMENT will be presented to the Board of Supervisors for their final consideration and deliberation of this matter.

You are encouraged to contact Supervising Code Enforcement Officer, Brian Black (951) 955-2004 prior to the hearing. Please meet with the undersigned or Brian Black at 7:30 a.m. on the day of the hearing in Conference Room 2A located on the 1st floor in front of the Human Resources Office to discuss the case.

PAMELA J. WALLS
County Counsel

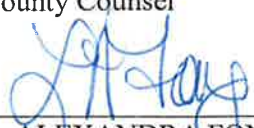
L. ALEXANDRA FONG
Deputy County Counsel

Enclosure: Statement of Expense

EXHIBIT NO. A



COUNTY OF RIVERSIDE

Code Enforcement Administration

STATEMENT OF EXPENSE WORKSHEET



CASE NUMBER: CV09-03133, CV09-10068 & CV09-11549

OWNER: IYABO O RAJI

SITUS: 508 TOLOUSE AVE, RIVERSIDE CA 92501

APN: 246-181-012-7

SUPERVISORIAL DISTRICT: 5

AUTHORITY: RIVERSIDE COUNTY ORDINANCE NO(s).
457 (RCC Title 15) & 725 (RCC Chapter 1.16)

Code Enforcement Department Billable Rates: Effective June 21, 2007 (Riverside County Ordinance 725.12)

SUPER-SUPERVISING CODE ENFORCEMENT OFFICER	\$130.00/HR
SENIOR-SENIOR CODE ENFORCEMENT OFFICER	\$129.00/HR
OFFICER- CODE ENFORCEMENT OFFICER II	\$109.00/HR
TECH- CODE ENFORCEMENT TECHNICIAN	\$82.00/HR

<u>DATE</u>	<u>DESCRIPTION</u>	<u>HOURS</u>	<u>AMOUNT</u>
9/29/2009 - 10/13/09	CV09-03133: Officers- Padilla/ Bowles II - Field Investigation/File Maintenance	9.10	\$991.90
09/15/09 - 09/17/09	CV09-10068: Officers- Bowles II/ Padilla/ Pike/ Torres - Field Investigation/File Maintenance	0.20	\$281.60
10/28/09 - 10/30/09	CV09-11549: Officers- Bowles II/ Padilla - Field Investigation/File Maintenance	11.00	\$1,339.00
01/06/11	Prepare/Attend Statement of Expense Hearing	0.50	\$65.00
SUBTOTAL CODE ENFORCEMENT COSTS		20.80	\$2,677.50
	COUNTY COUNSEL- CV09-03133: LEGAL CONSULTATION SERVICES-Includes Administrative Costs	1.40	\$195.30
	CONTRACTOR SERVICES- 12/23/10 Lot/Title Report - RZ Title Services Inc.		\$120.00
	10/29/09 CV09-03133: All Commercial Towing - Demolition & Disposal Services		\$5,000.00
	10/14/09 CV09-03133: Lot/Title Report - RZ Title Services Inc.		\$114.00
	09/22/09 CV09-10068: Fence Repair/Install		\$1,200.00
TOTAL COSTS DUE			\$9,306.80

I affirm and declare under penalty of perjury under the laws of the State of California that the foregoing is true and correct.

Executed this 6th day of January, 2011, at Riverside, California.



 Cuong Pham
 Code Enforcement Department

EXHIBIT NO. A²

NOTICE LIST

Subject Property: 508 Toulouse Ave., Riverside; Case Nos.: CV09-03133;
CV09-10068 & CV09-11549; APN: 246-181-012; District Five

IYABO O RAJI
508 TOLOUSE AVE
RIVERSIDE CA 92501

NOVASTAR MORT INC
25520 COMMERCENTRE DR
LAKE FOREST CA 92630

QUALITY LOAN SERVICE CORP
2141 5TH AVE
SAN DIEGO CA 92101

EXHIBIT NO. _____

A³



Track & Confirm

Search Results

Label/Receipt Number: **7010 1670 0001 7232 6126**
Service(s): **Certified Mail™**
Status: **Undeliverable as Addressed**

Your item was undeliverable as addressed at 8:57 am on January 08, 2011 in RIVERSIDE, CA 92501. It is being returned if appropriate information is available.

Detailed Results:

- **Undeliverable as Addressed, January 08, 2011, 8:57 am, RIVERSIDE, CA 92501**
- **Arrival at Unit, January 08, 2011, 8:24 am, RIVERSIDE, CA 92501**

Notification Options

Track & Confirm by email

Get current event information or updates for your item sent to you or others by email. [Go >](#)

Track & Confirm

Enter Label/Receipt Number.

[Go >](#)

7010 1670 0001 7232 6126

U.S. Postal Service™
CERTIFIED MAIL™ RECEIPT
(Domestic Mail Only; No Insurance Coverage Provided)

For delivery information visit our website at www.usps.com

OFFICIAL USE

Postage	\$.44	MAILED 1/6/11 Postmark Here
Certified Fee	2.80	
Return Receipt Fee (Endorsement Required)	2.30	
Restricted Delivery Fee (Endorsement Required)		
Total Postage & Fees	\$ 5.54	

Sent To

Street, Apt or PO Box: IYABO O RAJI
City, State: 508 TOLOUSE AVE RIVERSIDE CA 92501

PS Form 3800, August 2006 See Reverse for Instructions

EXHIBIT NO. A⁴



Track & Confirm

Search Results

Label/Receipt Number: **7010 1670 0001 7232 6119**
Service(s): **Certified Mail™**
Status: **Undeliverable as Addressed**

Your item was undeliverable as addressed at 9:49 am on January 08, 2011 in LAKE FOREST, CA 92630. It is being returned if appropriate information is available.

Track & Confirm

Enter Label/Receipt Number.

[Go >](#)

Notification Options

Track & Confirm by email

Get current event information or updates for your item sent to you or others by email. [Go >](#)

7010 1670 0001 7232 6119

U.S. Postal Service™	
CERTIFIED MAIL™ RECEIPT	
<i>(Domestic Mail Only; No Insurance Coverage Provided)</i>	
For delivery information visit our website at www.usps.com	
OFFICIAL USE	
Postage	\$.44
Certified Fee	2.80
Return Receipt Fee (Endorsement Required)	2.30
Restricted Delivery Fee (Endorsement Required)	
Total Postage & Fees	\$ 5.54
Postmark Here	
MAILED 1/6/11	
Sent To	
Street, Apt. or PO Box	NOVASTAR MORT INC
City, State	25520 COMMERCENTRE DR
	LAKE FOREST CA 92630
PS Form 3800, August 2006 See Reverse for Instructions	

EXHIBIT NO. A⁵



[Track & Confirm](#)

[FAQs](#)

Track & Confirm

Search Results

Label/Receipt Number: **7010 1670 0001 7232 6102**
 Service(s): **Certified Mail™**
 Status: **Delivered**

Your item was delivered at 11:40 am on January 10, 2011 in SAN DIEGO, CA 92101.

Track & Confirm

Enter Label/Receipt Number.

[Go >](#)

Notification Options

Track & Confirm by email

Get current event information or updates for your item sent to you or others by email. [Go >](#)

[Site Map](#) [Customer Service](#) [Forms](#) [Gov't Services](#) [Careers](#) [Privacy Policy](#) [Terms of Use](#) [Business Customer Gateway](#)

Copyright© 2010 USPS. All Rights Reserved. No FEAR Act EEO Data FOIA

7010 1670 0001 7232 6102

U.S. Postal Service™									
CERTIFIED MAIL™ RECEIPT									
<i>(Domestic Mail Only; No Insurance Coverage Provided)</i>									
For delivery information visit our website at www.usps.com									
OFFICIAL USE									
Postage	\$.44 <i>Mailed 1/6/11</i>								
Certified Fee	2.80								
Return Receipt Fee (Endorsement Required)	2.30								
Restricted Delivery Fee (Endorsement Required)									
Total Postage & Fees	\$ 5.54								
<small>Postmark Here</small>									
<table border="1"> <tr> <th colspan="2">Sent to</th> </tr> <tr> <td><i>Street, A</i></td> <td>QUALITY LOAN SERVICE CORP</td> </tr> <tr> <td><i>or PO Box</i></td> <td>2141 5TH AVE</td> </tr> <tr> <td><i>City, State</i></td> <td>SAN DIEGO CA 92101</td> </tr> </table>		Sent to		<i>Street, A</i>	QUALITY LOAN SERVICE CORP	<i>or PO Box</i>	2141 5 TH AVE	<i>City, State</i>	SAN DIEGO CA 92101
Sent to									
<i>Street, A</i>	QUALITY LOAN SERVICE CORP								
<i>or PO Box</i>	2141 5 TH AVE								
<i>City, State</i>	SAN DIEGO CA 92101								
<small>PS Form 3800, August 2006 See Reverse for Instructions</small>									

EXHIBIT NO.

A6

PROOF OF SERVICE

Case Nos. CV09-03133, CV09-10068 & CV09-11549

STATE OF CALIFORNIA, COUNTY OF RIVERSIDE

I, Brenda G. Peeler, declare that I am a citizen of the United States and am employed in the County of Riverside, over the age of 18 years and not a party to the within action or proceeding; that my business address is 3960 Orange Street, Suite 500, Riverside, California 92501.

That on January 6, 2011, I served the following document(s):

- NOTICE OF HEARING RE: STATEMENT OF EXPENSE
- STATEMENT OF EXPENSE WORKSHEET

by placing a true copy thereof enclosed in a sealed envelope(s) addressed as follows:

**OWNERS OR INTERESTED PARTIES
(SEE NOTICE LIST ATTACHED TO NOTICE OF HEARING)**

XX BY CERTIFIED MAIL, RETURN RECEIPT REQUESTED. I am "readily familiar" with the office's practice of collection and processing correspondence for mailing. Under that practice it would be deposited with the U.S. Postal Service on that same day with postage thereon fully prepaid at Riverside, California, in the ordinary course of business.

___ BY PERSONAL SERVICE: I caused to be delivered such envelope(s) by hand to the offices of the addressee(s).

XX STATE - I declare under penalty of perjury under the laws of the State of California that the above is true and correct.

___ FEDERAL - I declare that I am employed in the office of a member of the bar of this court at whose direction the service was made.

EXECUTED ON January 6, 2011, at Riverside, California.

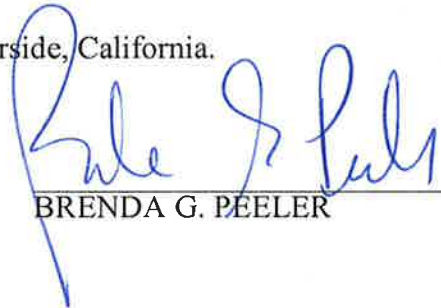

BRENDA G. PEELER

EXHIBIT NO. _____

A7

CO OF RIVERSIDE

Fax:951-485-4938

Jan 11 2011 02:39pm P001/007



**CODE ENFORCEMENT DEPARTMENT
COUNTY OF RIVERSIDE**

**GLENN BAUDE
Director**

AFFIDAVIT OF POSTING OF NOTICES

January 8, 2011

RE CASE NO: CV0903133, CV09-10068 & CV09-11549

I, Lance Padilla, hereby declare:

I am employed by the Riverside County Code Enforcement Department; that my business address is 24318 Hemlock, Ave., Suite C-1, Moreno Valley, California 92557.

That on 1/8/2011 at 12:00PM, I securely and conspicuously posted Statement of Expense Hearing Notification at the property described as:

Property Address: 508 TOLOUSE AVE, RIVERSIDE

Assessor's Parcel Number: 246-181-012

I declare under the penalty of perjury that the foregoing is true and correct.

Executed on January 8, 2011 in the County of Riverside, California.

CODE ENFORCEMENT DEPARTMENT

Lance Padilla #70
By: Lance Padilla, Code Enforcement Officer

EXHIBIT NO. A8



COUNTY OF RIVERSIDE

Code Enforcement Administration

STATEMENT OF EXPENSE WORKSHEET



CASE NUMBER: CV09-03133, CV09-10068 & CV09-11549

OWNER: IYABO O RAJI

SITUS: 508 TOLOUSE AVE, RIVERSIDE CA 92501

APN: 246-181-012-7

SUPERVISORIAL DISTRICT: 5

AUTHORITY: RIVERSIDE COUNTY ORDINANCE NO(s).
457 (RCC Title 15) & 725 (RCC Chapter 1.16)

Code Enforcement Department Billable Rates: Effective June 21, 2007 (Riverside County Ordinance 725.12)

SUPER-SUPERVISING CODE ENFORCEMENT OFFICER	\$130.00/HR
SENIOR-SENIOR CODE ENFORCEMENT OFFICER	\$129.00/HR
OFFICER- CODE ENFORCEMENT OFFICER II	\$109.00/HR
TECH- CODE ENFORCEMENT TECHNICIAN	\$82.00/HR

<u>DATE</u>	<u>DESCRIPTION</u>	<u>HOURS</u>	<u>AMOUNT</u>
9/29/2009 - 10/13/09	CV09-03133: Officers- Padilla/ Bowles II - Field Investigation/File Maintenance	9.10	\$991.90
09/15/09 - 09/17/09	CV09-10068: Officers- Bowles II/ Padilla/ Pike/ Torres - Field Investigation/File Maintenance	0.20	\$281.60
10/28/09 - 10/30/09	CV09-11549: Officers- Bowles II/ Padilla - Field Investigation/File Maintenance	11.00	\$1,339.00
01/06/11	Prepare/Attend Statement of Expense Hearing	0.50	\$65.00
SUBTOTAL CODE ENFORCEMENT COSTS		20.80	\$2,677.50
	COUNTY COUNSEL- CV09-03133: LEGAL CONSULTATION SERVICES-Includes Administrative Costs	1.40	\$195.30
	CONTRACTOR SERVICES- 12/23/10 Lot/Title Report - RZ Title Services Inc.		\$120.00
10/29/09	CV09-03133: All Commercial Towing - Demolition & Disposal Services		\$5,000.00
10/14/09	CV09-03133: Lot/Title Report - RZ Title Services Inc.		\$114.00
09/22/09	CV09-10068: Fence Repair/Install		\$1,200.00
TOTAL COSTS DUE			\$9,306.80

I affirm and declare under penalty of perjury under the laws of the State of California that the foregoing is true and correct.

Executed this 6th day of January, 2011, at Riverside, California.



 Cuong Pham
 Code Enforcement Department

EXHIBIT NO. B

BILL DATE	BILL CLIENT / MATTER	BILL HOURS	BILL AMOUNT	ATTY	DESCRIPTION
-----------	----------------------	------------	-------------	------	-------------

Subtotal		0	0		
Add					
	CV0903133	0	0		Mailing Expense
	CV0903133	0.9	125.55		Prepare case for SOE Hearing
	CV0903133	0.5	69.75		Attand SOE Hearing
Total		1.4	195.3		

EXHIBIT NO. B²

Case Labor Audit

APN: 246-181-012-7
 Property Owner: IYABO O RAJI
 Property address: 508 TOLOUSE AVE
 RIVERSIDE, CA. 92501
 Date Prepared: 11/30/2010

457

Case Name	LaborDate	CaseNumber	Name	Work Performed	SSST ZCV0903133			SSST ZCV0910068			SSST ZCV0911549			Unsupported		Adjusted	
					Time	Rate	Charge	Time	Rate	Charge	Time	Rate	Charge	Time	Charges	Time	Charge
5/1/2009	ZCV0903133	Padilla, Lanee A		Initial Site Visit	0	\$0.00	\$0.00									0	\$0.00
9/15/2009	ZCV0903133	Padilla, Lanee A		Site Visit Follow up	0	\$0.00	\$0.00									0	\$0.00
9/29/2009	ZCV0903133	Padilla, Lanee A		Admin Work	9	109	\$981.00									9	\$981.00
10/13/2009	ZCV0903133	Padilla, Lanee A		Site Visit Follow up	0.1	109	\$10.90									0.1	\$10.90
10/28/2009	ZCV0903133	Bowles II, Michael E		Site Visit Follow up	0	\$0.00	\$0.00									0	\$0.00
10/29/2009	ZCV0903133	Bowles II, Michael E		Site Visit Follow up	0	\$0.00	\$0.00									0	\$0.00
9/15/2009	ZCV0910068	Padilla, Lanee A		Initial Site Visit				1.20	109	\$130.80						1.2	\$130.80
9/15/2009	ZCV0910068	Bowles II, Michael E		Initial Site Visit				1.00	129	\$129.00						1	\$129.00
9/19/2009	ZCV0910068	Torres, Edward F		Not in narrative				0.20	109	\$21.80			0.2	\$21.80			
9/19/2009	ZCV0910068	Pike, James D		Site Visit Follow up				0.20	109	\$21.80						0.2	\$21.80
9/17/2009	ZCV0910068	Bowles II, Michael E		Site Visit Follow up				0.00	\$0.00	\$0.00						0	\$0.00
10/28/2009	ZCV0911549	Padilla, Lanee A		Initial Site Visit							2.00	109	\$218.00			2	\$218.00
10/28/2009	ZCV0911549	Bowles II, Michael E		Initial Site Visit							3.00	129	\$387.00			3	\$387.00
10/29/2009	ZCV0911549	Padilla, Lanee A		Site Visit Follow up							2.00	109	\$218.00			2	\$218.00
10/29/2009	ZCV0911549	Bowles II, Michael E		Site Visit Follow up							2.00	129	\$258.00			2	\$258.00
10/30/2009	ZCV0911549	Bowles II, Michael E		Admin Work							2.00	129	\$258.00			2	\$258.00
					9.10		\$991.80	2.60		\$303.40	11.00		\$1,339.00	0.20	\$21.80	22.50	\$2,612.50

	ZCV0903133	ZCV0910068	ZCV0911549
Labor			
Labor	9.10	2.60	11.00
Less: Unsupported Charge	0.00	0.20	0.00
Adjusted Labor	9.10	0.20	11.00
	\$991.90	\$281.60	\$1,339.00
Additional Fees			
Prepare/Attend SOE Hearing	0.5		
	\$65.00		
County Counsel			
CV09-03133	1.4		
	\$195.30		
Citations			
N/A			
Expenses			
10/29/2009 CV09-03133: All Commercial Towing - Demolition & Disposal Serv		\$5,000.00	
10/14/2009 CV09-03133: Lot/Title Report - RZ Title Services Inc.		\$114.00	
00/00/0000 Lot/Title Report		\$120.00	
9/22/2009 CV09-10068: Fence Repair/Install			\$1,200.00
Case Total		\$6,486.20	\$1,481.60
			\$1,339.00

PROPERTY TOTALS	
Total Charged Labor	\$2,612.50
Total Additional Fees	\$65.00
Total County Counsel	\$195.30
Total Citations	\$0.00
Total Expenses	\$6,434.00
Cumulative Total	\$9,306.80

B³

EXHIBIT NO. _____

Invoice

Invoice #	Date	Call #	Ticket #
15714	29-Oct-2009	2512	15714

TA47122

All Commercial Towing Services

P.O. Box 40970
 Bakersfield, California 93384-0970
 Phone: (661) 832-7080
 Fax: (661) 832-7773

Customer

Code Enforcement Admin Services
 SYLVIA
 PO Box 1469
 Riverside, California 92502

DEC 14 2009

TLARC
 Voucher No. 235961
 Jose Gutierrez (5-3254)

Summary	
Location:	508 TOLOUSE AVE. HIGHGROVE
Destination:	** BURNED STRUCTURE **
Reason:	Riverside County Abatement
Zone:	5-ACTS
Vehicle:	Structure
Owner:	
VIN:	
Plate/Tag:	Truck: RL120
Mileage:	Driver: 129;139

Terms:

Date	Incident #	Club/PO #	Service	Quantity	Rate	Amount
29-Oct-2009		301A	Riverside County Abatement (RL - 120)	1.00	5,000.00	5,000.00

PAYMENT APPROVAL

DeptID 3140/00000

Account 525440

Project 2C00903133

Signature [Signature]

Date 12/3/09

TLMA
 DEC 15 2009
 Approved

DEC 15 2009

RECEIVED
 DEC 14 2009
 TLMA - ACCOUNTS PAYABLE

RECEIVED
 DEC - 7 2009
 TLMA - PURCHASING

PLEASE PAY UPON RECEIPT OF INVOICE.

Thank you for choosing ALL COMMERCIAL TOWING SERVICES

Sub Total	5,000.00
TOTAL Payments	5,000.00 0.00
Balance Owing	5,000.00

B⁴
B

EXHIBIT NO. _____



P.O. Box 1193
 Whittier, CA 90609
 Tel # (562) 325-8351
 Fax # (714) 783-3038

Lot Book Report

Order Number: **19728**

Customer:

RIVERSIDE COUNTY TLMA-CODE INFORCEMENT
 4080 Lemon Street
 Riverside CA 92501

Order Date: 9/15/2009

Dated as of: 9/17/2009

County Name: Riverside

Attn: Brent Steele
 Reference: CV09-03133 / Lanee Padilla
 IN RE: RAJI, IYABO O.

FEE(s):
 Report: \$114.00

Property Address: 508 Toulouse Avenue
 Riverside CA 92501

Assessor's Parcel No. : 246-181-012-7

Assessments:

Land Value:	\$45,884.00
Improvement Value:	\$74,565.00
Exemption Value:	\$7,000.00
Total Value:	\$113,449.00

Tax Information

Property Taxes for the Fiscal Year	2008-2009
Total Annual Tax	\$1,221.18
Status: Paid through	PAID (PAID THRU 06/30/2009)

Property Vesting

The last recorded document transferring title of said property

Dated	06/16/2004
Recorded	01/26/2004

EXHIBIT NO. B⁵



INVOICE

Order Number: 23011	Order Date: 12/23/2010
----------------------------	-------------------------------

Customer Information:

Acct No. 1044

RIVERSIDE COUNTY TLMA-CODE INFORCEMENT
4080 Lemon Street
Riverside, CA 92501

Attn: Brent Steele
REF: CV09-03133, CV09-10068 & CV09-11549
IN RE: RAJI, IYABO O.

Product and/or Service ordered for Property known as:	
508 Toulouse Avenue Riverside, CA 92501	
DESCRIPTION: Lot Book Report	FEE: \$120.00
TOTAL DUE:	\$120.00

Payment due upon receipt. Please remit to:

RZ Title Services, Inc.
P.O. Box 1193
Whittier, CA 90609

EXHIBIT NO. B6

TL446258

Invoice

C R GANN DEMOLITION INC

31521 PARK BLVD
NUEVO, CA 92567

Date	Invoice #
9/22/2009	09-99

TLARC OCT 22 2009
Voucher No. 231389
Carolyn Hannibal (5-6859)

Bill To
The County of Riverside, TLMA Charlene Mc nair 4080 Lemon Street, Floor 14 Riverside, Ca 92501

RECEIVED
OCT 14 2009

TLMA - PURCHASING

TLMA
OCT 22 2009
Approved [Signature]

Terms

Due on receipt

Description	Rate	Amount
Site Work (Fencing and board replacement) located at 508 Toulouse Avenue, Highgrove, CA.	1,200.00	1,200.00

PAYMENT APPROVAL

DeptID 3140100000

Account 525440

Project 2200910068

Signature [Signature]

Date 10/14/09

Thank you for your business.

Total \$1,200.00

Payments/Credits \$0.00

Balance Due \$1,200.00

EXHIBIT NO. B7

Assessment Roll For the 2010-2011 Tax Year as of January 1,2010

Assessment #246181012-7		Parcel # 246181012-7	
Assessee:	RAJI IYABO O	Land	46,000
Mail Address:	508 TOLOUSE AVE RIVERSIDE CA 92501	Structure	74,000
Real Property Use Code:	R1	Full Value	120,000
Base Year	2001	Homeowners' Exemption	7,000
Conveyance Number:	0053413	Total Net	113,000
Conveyance (mm/yy):	9/2004		
PUI:	R010010		
TRA:	88-080		
Taxability Code:	0-00		
ID Data:	Lot 29 MB 035/018 RIVERSIDE RIVIERA		
Situs Address:	508 TOLOUSE AVE RIVERSIDE CA 92501		

View Parcel Map

EXHIBIT NO. c

RIVERSIDE COUNTY GIS

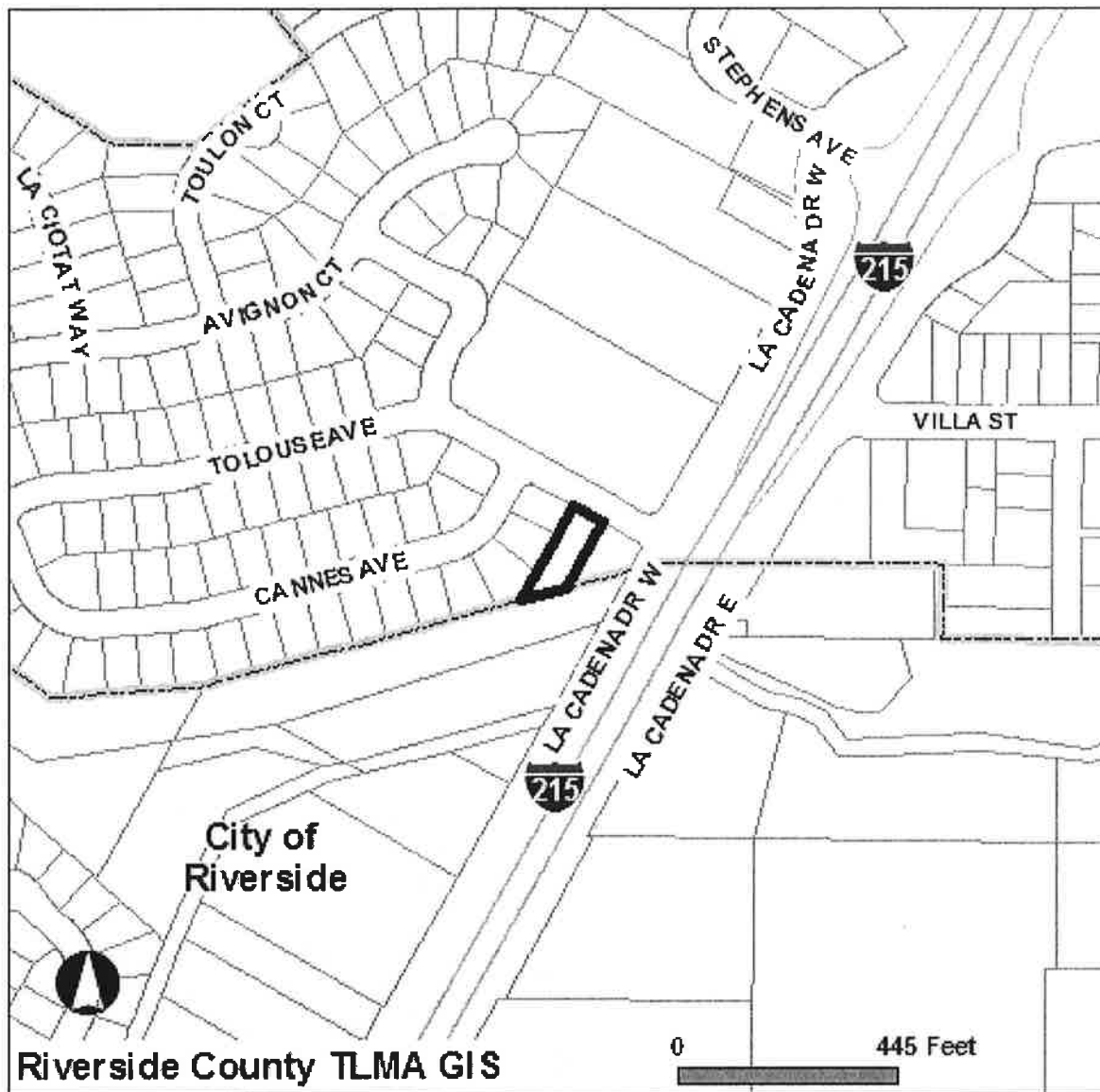

Selected parcel(s):
246-181-012

IMPORTANT

Maps and data are to be used for reference purposes only. Map features are approximate, and are not necessarily accurate to surveying or engineering standards. The County of Riverside makes no warranty or guarantee as to the content (the source is often third party), accuracy, timeliness, or completeness of any of the data provided, and assumes no legal responsibility for the information contained on this map. Any use of this product with respect to accuracy and precision shall be the sole responsibility of the user.

STANDARD REPORT

APNs

246-181-012-7

OWNER NAME / ADDRESS

IYABO O RAJI
508 TOLOUSE AVE
RIVERSIDE, CA. 92501

MAILING ADDRESS

(SEE OWNER)
508 TOLOUSE AVE
RIVERSIDE CA.. 92501

EXHIBIT NO. C²

LEGAL DESCRIPTION

RECORDED BOOK/PAGE: MB 35/18
SUBDIVISION NAME: RIVERSIDE RIVIERA
LOT/PARCEL: 29, BLOCK: NOT AVAILABLE
TRACT NUMBER: NOT AVAILABLE

LOT SIZE

RECORDED LOT SIZE IS 0.27 ACRES

PROPERTY CHARACTERISTICS

WOOD FRAME, 1500 SQFT., 3 BDRM/ 1.75 BATH, 1 STORY, CONST'D 1958COMPOSITION, ROOF

THOMAS BROS. MAPS PAGE/GRID

PAGE: 646 GRID: B7

CITY BOUNDARY/SPHERE

NOT WITHIN A CITY
CITY SPHERE: RIVERSIDE
NO ANNEXATION DATE AVAILABLE
NO LAFCO CASE # AVAILABLE
NO PROPOSALS

MARCH JOINT POWERS AUTHORITY

NOT IN THE JURISDICTION OF THE MARCH JOINT POWERS AUTHORITY

INDIAN TRIBAL LAND

NOT IN A TRIBAL LAND

SUPERVISORIAL DISTRICT (ORD. 813)

MARION ASHLEY, DISTRICT 5

TOWNSHIP/RANGE

T2SR4W SEC 7

ELEVATION RANGE

884/888 FEET

PREVIOUS APN

120-500-268

PLANNING

LAND USE DESIGNATIONS

Zoning not consistent with the General Plan.
MDR

AREA PLAN (RCIP)

HIGHGROVE

GENERAL PLAN POLICY OVERLAYS

NOT IN A GENERAL PLAN POLICY OVERLAY AREA

GENERAL PLAN POLICY AREAS

HIGHGROVE COMMUNITY POLICY AREA

ZONING CLASSIFICATIONS (ORD. 348)

R-1

ZONING DISTRICTS AND ZONING AREAS

NORTH RIVERSIDE DISTRICT

ZONING OVERLAYS

NOT IN A ZONING OVERLAY

SPECIFIC PLANS

NOT WITHIN A SPECIFIC PLAN

AGRICULTURAL PRESERVE

NOT IN AN AGRICULTURAL PRESERVE

REDEVELOPMENT AREAS

PROJECT AREA NAME: I-215 CORRIDOR
SUBAREA NAME: HIGHGROVE
AMENDMENT NUMBER: 1
ADOPTION DATE: NOV. 24, 1998
ACREAGE: 878 ACRES

AIRPORT INFLUENCE AREAS
NOT IN AN AIRPORT INFLUENCE AREA

AIRPORT COMPATIBILITY ZONES
NOT IN AN AIRPORT COMPATIBILITY ZONE

ENVIRONMENTAL

CVMSHCP (COACHELLA VALLEY MULTI-SPECIES HABITAT CONSERVATION PLAN) CONSERVATION AREA
NOT IN A CONSERVATION AREA

CVMSHCP FLUVIAL SAND TRANSPORT SPECIAL PROVISION AREAS
NOT IN A FLUVIAL SAND TRANSPORT SPECIAL PROVISION AREA

WRMSHCP (WESTERN RIVERSIDE COUNTY MULTI-SPECIES HABITAT CONSERVATION PLAN) CELL GROUP
NOT IN A CELL GROUP

WRMSHCP CELL NUMBER
NOT IN A CELL

HANS/ERP (HABITAT ACQUISITION AND NEGOTIATION STRATEGY/EXPEDITED REVIEW PROCESS)
NONE

VEGETATION (2005)
Developed/Disturbed Land

FIRE

HIGH FIRE AREA (ORD. 787)
NOT IN A HIGH FIRE AREA

FIRE RESPONSIBILITY AREA
NOT IN A FIRE RESPONSIBILITY AREA

DEVELOPMENT FEES

CVMSHCP FEE AREA (ORD. 875)
NOT WITHIN THE COACHELLA VALLEY MSHCP FEE AREA

WRMSHCP FEE AREA (ORD. 810)
IN OR PARTIALLY WITHIN THE WESTERN RIVERSIDE MSHCP FEE AREA. SEE MAP FOR MORE INFORMATION.

ROAD & BRIDGE DISTRICT
NOT IN A DISTRICT

EASTERN TUMF (TRANSPORTATION UNIFORM MITIGATION FEE ORD. 673)
NOT WITHIN THE EASTERN TUMF FEE AREA

WESTERN TUMF (TRANSPORTATION UNIFORM MITIGATION FEE ORD. 824)
IN OR PARTIALLY WITHIN A TUMF FEE AREA. SEE MAP FOR MORE INFORMATION. NORTHWEST

DIF (DEVELOPMENT IMPACT FEE AREA ORD. 659)
HIGHGROVE/NORTHSIDE

SKR FEE AREA (STEPHEN'S KANGAROO RAT ORD. 663.10)
IN OR PARTIALLY WITHIN AN SKR FEE AREA. SEE MAP FOR MORE INFORMATION.

DEVELOPMENT AGREEMENTS
NOT IN A DEVELOPMENT AGREEMENT AREA

TRANSPORTATION

CIRCULATION ELEMENT ULTIMATE RIGHT-OF-WAY
NOT IN A CIRCULATION ELEMENT RIGHT-OF-WAY

ROAD BOOK PAGE
44A

TRANSPORTATION AGREEMENTS

NOT IN A TRANSPORTATION AGREEMENT

CETAP (COMMUNITY AND ENVIRONMENTAL TRANSPORTATION ACCEPTABILITY PROCESS) CORRIDORS
NOT IN A CETAP CORRIDOR.

HYDROLOGY

FLOOD PLAIN REVIEW

THIS PARCEL MAY BE SUBJECT TO A FLOOD MANAGEMENT REVIEW. CONTACT THE FLOOD PLAIN MANAGEMENT SECTION AT (951) 955-1200.

WATER DISTRICT

WMWD

FLOOD CONTROL DISTRICT

RIVERSIDE COUNTY FLOOD CONTROL DISTRICT

WATERSHED

SANTA ANA RIVER

GEOLOGIC

FAULT ZONE

NOT IN A FAULT ZONE

FAULTS

NOT WITHIN A 1/2 MILE OF A FAULT

LIQUEFACTION POTENTIAL

LOW
MODERATE

SUBSIDENCE

SUSCEPTIBLE

PALEONTOLOGICAL SENSITIVITY

HIGH SENSITIVITY (HIGH A).
BASED ON GEOLOGIC FORMATIONS OR MAPPABLE ROCK UNITS THAT ARE ROCKS THAT CONTAIN FOSSILIZED BODY ELEMENTS, AND TRACE FOSSILS SUCH AS TRACKS, NESTS AND EGGS. THESE FOSSILS OCCUR ON OR BELOW THE SURFACE.

MISCELLANEOUS

SCHOOL DISTRICT

RIVERSIDE UNIFIED

COMMUNITIES

HIGH GROVE

COUNTY SERVICE AREA

IN OR PARTIALLY WITHIN
HIGHGROVE #126 -
LANDSCAPING

LIGHTING (ORD. 655)

NOT APPLICABLE, 53.01 MILES FROM MT. PALOMAR OBSERVATORY

2000 CENSUS TRACT

042300

FARMLAND

URBAN-BUILT UP LAND

TAX RATE AREAS

088-080
• COUNTY FREE LIBRARY
• COUNTY SERVICE AREA 126 *
• COUNTY STRUCTURE FIRE PROTECTION
• COUNTY WASTE RESOURCE MGMT DIST
• CSA 152
• ERAF RDV
• FLOOD CONTROL ADMINISTRATION
• FLOOD CONTROL ZONE 1

- FLOOD CONTROL ZONE 1 DEBT SERV
- GENERAL
- GENERAL PURPOSE
- METRO WATER WEST 1302999
- N.W. MOSQUITO & VECTOR CONT DIST
- PROJECT 5-HIGHGROVE RDV AB1290
- RIV CO REG PARK & OPEN SPACE
- RIV. CO. OFFICE OF EDUCATION
- RIVERSIDE CITY COMMUNITY COLLEGE
- RIVERSIDE CORONA RESOURCE CONSER
- RIVERSIDE UNIFIED SCHOOL
- WESTERN MUNICIPAL WATER

SPECIAL NOTES

NO SPECIAL NOTES

CODE COMPLAINTS

NO CODE COMPLAINTS

REPORT PRINTED ON...Thu Jan 06 13:18:12 2011
Version 101221