

**SUBMITTAL TO THE BOARD OF SUPERVISORS
COUNTY OF RIVERSIDE, STATE OF CALIFORNIA**

424B



FROM: County Counsel/TLMA
Code Enforcement Department

SUBMITTAL DATE:
January 27, 2011

SUBJECT: Abatement of Public Nuisance [Excess Outside Storage & Accumulated Rubbish]
Case Nos.: CV 08-00025 and CV08-00026 [DORN]
Subject Property: 32235 Morris Ranch Rd., Hemet; APN: 568-110-029
District: 3

RECOMMENDED MOTION: Move that:

Departmental Concurrence

1. The excess outside storage of materials and accumulation of rubbish on the real property located at 32235 Morris Ranch Rd., Hemet, County of Riverside, State of California, APN: 568-110-029 be declared a public nuisance and a violation of Riverside County Ordinance Nos. 348 and 541 (Riverside County Code Chapters 17.152 and 8.120).
2. Clifford G. Dorn, the owner of the subject real property, be directed to abate the excess outside storage and accumulation of rubbish on the property by removing the same from the real property within ninety (90) days.

(Continued)

L. Fong
L. ALEXANDRA FONG, Deputy County Counsel
for PAMELA J. WALLS, County Counsel

FINANCIAL DATA	Current F.Y. Total Cost:	\$ N/A	In Current Year Budget:	N/A
	Current F.Y. Net County Cost:	\$ N/A	Budget Adjustment:	N/A
	Annual Net County Cost:	\$ N/A	For Fiscal Year:	N/A

SOURCE OF FUNDS:	Positions To Be Deleted Per A-30	<input type="checkbox"/>
	Requires 4/5 Vote	<input type="checkbox"/>

C.E.O. RECOMMENDATION:

APPROVE

BY:

Jennifer L. Sargent
Jennifer L. Sargent

County Executive Office Signature

- Policy
- Policy
- Consent
- Consent

MINUTES OF THE BOARD OF SUPERVISORS

On motion of Supervisor Stone, seconded by Supervisor Benoit and duly carried by unanimous vote, IT WAS ORDERED that the above matter is approved as recommended.

Ayes: Buster, Tavaglione, Stone, Benoit and Ashley
Nays: None
Absent: None
Date: February 8, 2011
xc: Co. Co., CED, Prop. Owner, Sheriff

Kecia Harper-Ihem
Clerk of the Board

By: *Kecia Harper-Ihem*
Deputy

9.3

Dep't Recomm.:
Per Exec. Ofc.:

3. If the owner of the real property do not take the above described action within ninety (90) days of the date of the Board's Order to Abate, that representatives of the Code Enforcement Department, Sheriff's Department, and/or a contractor, upon consent or receipt of a Court Order authorizing entry onto the real property when necessary under applicable law, shall abate the excess outside storage and accumulation of rubbish by removing and disposing of the same from the real property.
4. The reasonable costs of abatement, after notice and an opportunity for hearing, shall be imposed as a lien on the real property, which may be collected as a special assessment against the real property pursuant to Government Code Section 25845 and Riverside County Ordinance No. 725.
5. County Counsel be directed to prepare the necessary Findings of Fact and Conclusions that the excess outside storage of materials and accumulation of rubbish on the real property is declared to be in violation of Riverside County Ordinance Nos. 348 and 541, and a public nuisance, and further, to prepare an Order to Abate for approval by the Board.

BACKGROUND:

1. An initial inspection was made of the subject property by the Code Enforcement Officer on January 7, 2008.
2. The inspection revealed the excess outside storage of materials and an accumulation of rubbish on the subject property in violation of Riverside County Ordinance Nos. 348 and 541. The items included but were not limited to: broken tile, old wiring, scrap lumber, piping, car parts, tires, buckets, tools, equipment and other miscellaneous items.
3. Subsequent follow up inspections of the above-described real property on May 20, 2009, May 20, 2010, July 1, 2010, August 10, 2010, September 30, 2010 and January 20, 2011, revealed that the property continued to be in violation of Riverside County Ordinance Nos. 348 and 541.
4. Staff and the Code Enforcement Department have complied with the notice requirements set forth in the appropriate laws of this jurisdiction pertaining to the administrative abatement proceedings for the removal of excess outside storage and accumulated rubbish.

1 **BOARD OF SUPERVISORS**
2 **COUNTY OF RIVERSIDE**

3 IN RE ABATEMENT OF PUBLIC NUISANCE) CASE NO. CV 08-00025 and CV08-
4 [EXCESS OUTSIDE STORAGE AND) 00026
5 ACCUMULATED RUBBISH] APN: 568-110-029,)
6 32235 MORRIS RANCH RD., HEMET, COUNTY) DECLARATION OF OFFICER
7 OF RIVERSIDE, STATE OF CALIFORNIA;) CAROL FORREY
8 CLIFFORD G. DORN, OWNER.)
9) [R.C.O. NO. 348, R.C.C. Chapter 17,
10) R.C.O. NO. 541, R.C.C. Chapter
11) 8.120].

12 I, Carol Forrey, declare that the facts set forth below are personally known to me except to the
13 extent that certain information is based on information and belief which I believe to be true, and if called
14 as a witness, I could and would competently testify thereto under oath:

15 1. I am currently employed by the Riverside County Code Enforcement Department as a
16 Code Enforcement Officer. My current official duties as a Code Enforcement Officer include inspecting
17 property for violations and enforcement of the provisions of Riverside County Ordinances.

18 2. On January 7, 2008, Senior Code Enforcement Officer Wayne O’Gara, Code
19 Enforcement Brian Noone and I conducted an initial inspection of the real property described as 32235
20 Morris Ranch Rd., Hemet, County of Riverside, State of California and further described as Assessor’s
21 Parcel Number 568-110-029 (hereinafter referred to as “THE PROPERTY”). A true and correct copy of
22 a Thomas Brothers map indicating the location of THE PROPERTY is attached hereto as Exhibit “A.”

23 3. A review of County records and documents disclosed that THE PROPERTY is owned by
24 Clifford G. Dorn (hereinafter referred to as “OWNER”). A certified copy of the County Equalized
25 Assessment Roll for the year 2010-2011 and a copy of the report generated from the County Geographic
26 Information System (“GIS”) is attached hereto and incorporated herein by reference as Exhibit “B.”
27 THE PROPERTY is located within the N-A-40 (Natural Assets -40 acres) zone classification. This zone
28 classification allows outside storage on an improved parcel with the amount of storage to be two
hundred (200) square feet for properties that are minimum of one acre or more in size. THE
PROPERTY is approximately 20 acres.

4. Based upon the Lot Book Reports issued by RZ Title Service on May 21, 2010 and
updated on September 27, 2010, it is determined that no other party potentially holds a legal interest

1 in THE PROPERTY. A true and correct copy of the Lot Book Report is attached hereto as Exhibit "C"
2 and is incorporated herein by reference.

3 5. On January 7, 2008, Senior Code Enforcement Officer Wayne O'Gara, Code
4 Enforcement Brian Noone and I drove to THE PROPERTY to conduct an inspection and were granted
5 consent to inspect THE PROPERTY. Senior Code Enforcement Wayne O'Gara and I observed excess
6 outside storage in violation of Riverside County Ordinance ("RCO") No. 348, as codified in Riverside
7 County Code ("RCC") Chapter 17.152 and accumulated rubbish in violation of RCO No. 541, as
8 codified in RCC Chapter 8.120 on THE PROPERTY. Excess outside storage and accumulated rubbish
9 was approximately four thousand two hundred ninety (4,290) square feet comprising of such items as
10 broken tile, old wiring, scrap lumber, piping, car parts, tires, buckets, tools, equipment and other
11 miscellaneous items.

12 6. On April 15, 2009, Code Enforcement Officers executed Inspection Warrant No.
13 MISC2009-028 on THE PROPERTY and found that the excess outside storage and accumulated rubbish
14 remained.

15 7. Based on information and belief which I believe to be true, on May 20, 2009, Code
16 Enforcement Officers Wayne Durant and Roy Ryder went to THE PROPERTY for a follow-up
17 inspection. THE PROPERTY was open and accessible. They met the OWNER, explained the reason
18 for their visit and was granted consent to inspect. Officers Durant and Ryder observed that violations
19 remained.

20 8. On June 9, 2009, Notices of Violation were sent to OWNER via certified mail with return
21 receipt requested.

22 9. As a result of the excess outside storage of materials and accumulated rubbish, THE
23 PROPERTY constituted a public nuisance in violation of the provisions set forth in Riverside County
24 Ordinance ("RCO") No. 348 as codified in Riverside County Code ("RCC") Chapter 17.152 and RCO
25 No. 541, as codified in RCC Chapter 8.120.

26 10. Based on information and belief which I believe to be true, on May 20, 2010, Code
27 Enforcement Officer Jason Heagstedt went to THE PROPERTY to conduct a follow-up inspection.
28 Tenant/caretaker, Albert J. Guanche, granted consent to inspect THE PROPERTY. Mr. Guanche

1 explained that the OWNER had recently died. Officer Heagstedt observed that THE PROPERTY
2 remained in violation of RCO Nos. 348 and 541.

3 11. Based on information and belief which I believe to be true, on July 1, 2010 and August
4 10, 2010, Code Enforcement Officer Jason Heagstedt conducted follow-up inspections on THE
5 PROPERTY. Officer Heagstedt met tenant/caretaker, Albert J. Guanche, who granted consent to
6 inspect THE PROPERTY. Officer Heagstedt observed some compliance with the accumulated rubbish.

7 12. On September 30, 2010, Code Enforcement Officer Roy Ryder and I went to THE
8 PROPERTY for a follow-up inspection. We met the tenant/caretaker, Albert Guanche. We were
9 informed by him that Mr. Dorn, OWNER, passed away and Mr. Dorn's sister appointed him to be THE
10 PROPERTY's caretaker. Mr. Guanche told us that he had been cleaning THE PROPERTY. We
11 observed that violations remained although the accumulated rubbish reduced by approximately twenty
12 (20) percent.

13 13. A site plan and photographs depicting the condition of THE PROPERTY during the
14 above referenced inspections are attached hereto as Exhibit "D" and are incorporated herein by
15 reference.

16 14. True and correct copies of each Notice issued in this matter and other supporting
17 documentation are attached hereto as Exhibit "E" and incorporated herein by reference.

18 15. Based upon my experience, knowledge and visual observations, it is my determination
19 that the conditions on THE PROPERTY are dangerous to the neighboring property owner and the
20 general public.

21 16. I am informed and believe and based upon said information and belief allege that the
22 OWNER does not have legal authority or permission to store or accumulate the above described
23 materials on THE PROPERTY.

24 17. Notices of Non-Compliance were recorded in the Office of the County Recorder, County
25 of Riverside, State of California, on June 1, 2010 as Instrument Numbers 2010-0251764 and 2010-
26 0251765, true and correct copies of which are attached hereto and incorporated herein by reference as
27 Exhibit "F".

28 18. On January 20, 2011, I conducted a follow-up inspection on THE PROPERTY that

1 revealed the excess outside storage and accumulated rubbish remained on THE PROPERTY in violation
2 of RCO 348 (RCC Chapter 17.152) and 541 (RCC Chapter 8.120).

3 19. On January 19, 2011, the second notice – “Notice to Correct County Ordinance
4 Violations and Abate Public Nuisance” providing notification of the Board of Supervisors’ hearing
5 scheduled for February 8, 2011; as required by Riverside County Ordinance No. 725, was mailed to
6 OWNER by certified mail, return receipt requested and on January 19, 2011, was posted on THE
7 PROPERTY. True and correct copies of the notice, returned receipt cards, together with the proof of
8 service, and the affidavit of posting of notices are attached hereto as Exhibit “G” and incorporated
9 herein by reference.

10 20. The removal of all outside storage of materials and the removal of accumulated rubbish
11 currently on THE PROPERTY is required to bring THE PROPERTY into compliance with Riverside
12 County Ordinance Nos. 348, 541 and the Health and Safety Code. Given the size of the parcel and the
13 zoning classification, no amount of outside storage is allowed on THE PROPERTY under RCO No.
14 348. Under RCO No. 541, no amount of rubbish is allowed to be accumulated on THE PROPERTY.

15 21. Accordingly, the following findings and conclusions are recommended:

16 (a) the outside storage of materials and accumulated rubbish on THE PROPERTY be,
17 deemed and declared a public nuisance; and

18 (b) the OWNER or whoever have possession or control of THE PROPERTY be
19 required to remove all outside storage of materials and accumulated rubbish on THE PROPERTY in
20 accordance with the provisions of RCO Nos. 348 and 541.

21 (c) that if the materials and rubbish are not removed and disposed of in strict
22 accordance with all Riverside County Ordinances, including but not limited to Riverside County
23 Ordinance Nos. 348 and 541, within ninety (90) days of the date of the Order to Abate Nuisance, the
24 outside storage of materials and accumulated rubbish shall be abated and disposed of by representatives
25 of the Riverside County Code Enforcement Department, a contractor or the Sheriff’s Department upon
26 receipt of an owner’s consent or a Court Order when necessary under applicable law.

27 (d) that reasonable costs of abatement, after notice and opportunity for hearing,
28 shall be imposed as a lien on THE PROPERTY, which may be collected as a special assessment

1 against THE PROPERTY pursuant to Government Code Section 25845 and Riverside County
2 Ordinance Nos. 348 and 725.

3 I declare under penalty of perjury under the laws of the State of California that the foregoing is
4 true and correct.

5 Executed this 20th day of January, 2011 at Riverside, California.

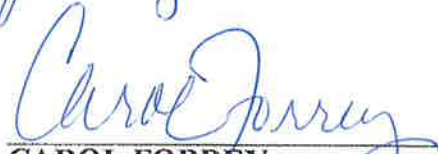
6
7
8 
9 **CAROL FORREY**
Code Enforcement Officer
Code Enforcement Department

10
11
12
13 L:\Code Enforcement\Abatements\2010\2008\CV08-00025 and CV08-00026\348 & 541 Dec.DOC

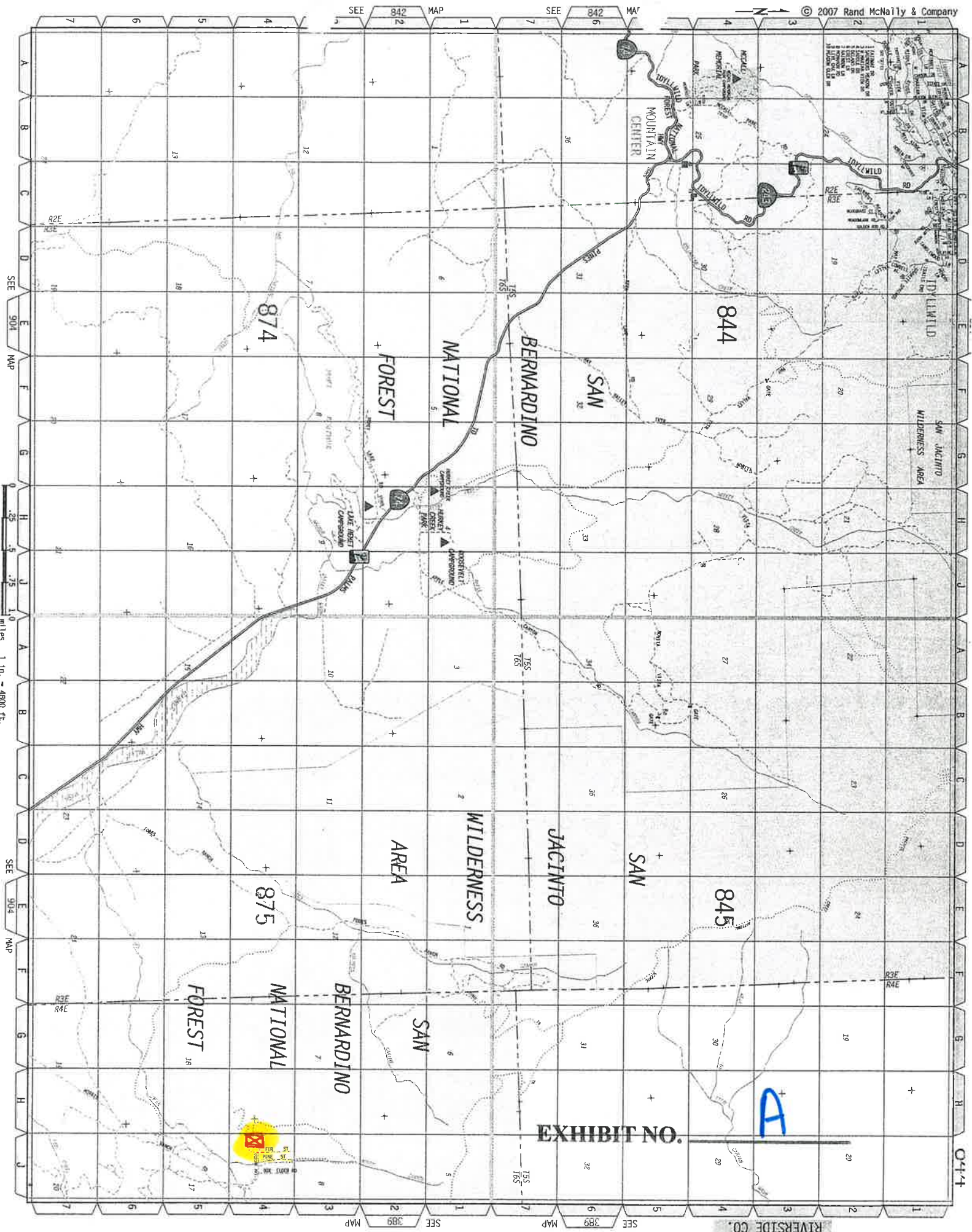

0 .25 .5 .75 1.0
miles 1 in. = 4800 ft.

RIVERSIDE CO.

EXHIBIT NO.

A

044

Assessment Roll For the 2010-2011 Tax Year as of January 1,2010

Assessment #568110029-6		Parcel # 568110029-6	
Assessee:	DORN CLIFFORD G	Land	42,151
Mail Address:	32235 MORRIS RANCH RD	Full Value	42,151
City, State Zip:	MOUNTAIN CENTER, CA 92561	Total Net	42,151
Real Property Use Code:	YY	<div style="border: 1px solid black; padding: 5px; display: inline-block;">View Parcel Map</div>	
Base Year	1980		
Conveyance Number:	0012906		
Conveyance (mm/yy):	7/1984		
PUI:	Y040000		
TRA:	71-306		
Taxability Code:	0-00		
ID Data:	SEE ASSESSOR MAPS		
Situs Address:	32235 MORRIS RANCH RD HEMET CA 92543		

EXHIBIT NO. B

RIVERSIDE COUNTY GIS

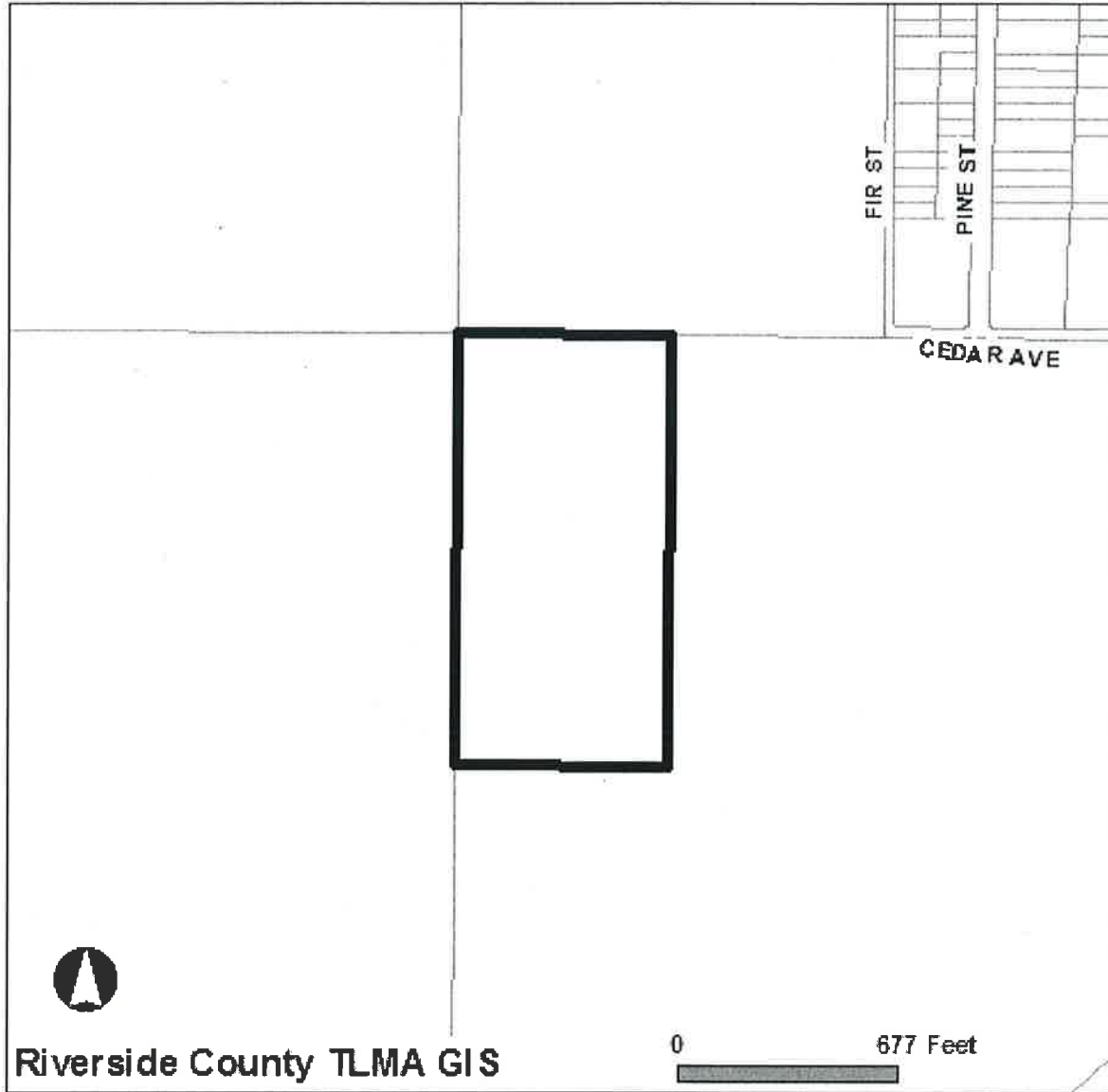

Selected parcel(s):
568-110-029

IMPORTANT

Maps and data are to be used for reference purposes only. Map features are approximate, and are not necessarily accurate to surveying or engineering standards. The County of Riverside makes no warranty or guarantee as to the content (the source is often third party), accuracy, timeliness, or completeness of any of the data provided, and assumes no legal responsibility for the information contained on this map. Any use of this product with respect to accuracy and precision shall be the sole responsibility of the user.

STANDARD REPORT

APNs

568-110-029-6

OWNER NAME / ADDRESS

CLIFFORD G DORN
32235 MORRIS RANCH RD
HEMET, CA. 92543

MAILING ADDRESS

(SEE OWNER)
32235 MORRIS RANCH RD
MOUNTAIN CENTER CA. 92561

EXHIBIT NO. _____

B²

LEGAL DESCRIPTION

LEGAL DESCRIPTION IS NOT AVAILABLE

LOT SIZE

RECORDED LOT SIZE IS 20 ACRES

PROPERTY CHARACTERISTICS

NO PROPERTY DESCRIPTION AVAILABLE

THOMAS BROS. MAPS PAGE/GRID

PAGE: 875 GRID: H4, H5, J4, J5

CITY BOUNDARY/SPHERE

NOT WITHIN A CITY
NOT WITHIN A CITY SPHERE
NO ANNEXATION DATE AVAILABLE
NO LAFCO CASE # AVAILABLE
NO PROPOSALS

MARCH JOINT POWERS AUTHORITY

NOT IN THE JURISDICTION OF THE MARCH JOINT POWERS AUTHORITY

INDIAN TRIBAL LAND

NOT IN A TRIBAL LAND

SUPERVISORIAL DISTRICT (ORD. 813)

JEFF STONE, DISTRICT 3

TOWNSHIP/RANGE

T6SR4E SEC 17

ELEVATION RANGE

5468/5752 FEET

PREVIOUS APN

568-110-019

PLANNING

LAND USE DESIGNATIONS

Zoning not consistent with the General Plan.
OS-RUR

AREA PLAN (RCIP)

REMAP

GENERAL PLAN POLICY OVERLAYS

NOT IN A GENERAL PLAN POLICY OVERLAY AREA

GENERAL PLAN POLICY AREAS

NONE

ZONING CLASSIFICATIONS (ORD. 348)

N-A-40

ZONING DISTRICTS AND ZONING AREAS

PYRAMID PEAK AREA

ZONING OVERLAYS

NOT IN A ZONING OVERLAY

SPECIFIC PLANS

NOT WITHIN A SPECIFIC PLAN

AGRICULTURAL PRESERVE

NOT IN AN AGRICULTURAL PRESERVE

REDEVELOPMENT AREAS

NOT IN A REDEVELOPMENT AREA

AIRPORT INFLUENCE AREAS

NOT IN AN AIRPORT INFLUENCE AREA

AIRPORT COMPATIBILITY ZONES

NOT IN AN AIRPORT COMPATIBILITY ZONE

ENVIRONMENTAL

CVMSHCP (COACHELLA VALLEY MULTI-SPECIES HABITAT CONSERVATION PLAN) CONSERVATION AREA
NOT IN A CONSERVATION AREA

CVMSHCP FLUVIAL SAND TRANSPORT SPECIAL PROVISION AREAS
NOT IN A FLUVIAL SAND TRANSPORT SPECIAL PROVISION AREA

WRMSHCP (WESTERN RIVERSIDE COUNTY MULTI-SPECIES HABITAT CONSERVATION PLAN) CELL GROUP
NOT IN A CELL GROUP

WRMSHCP CELL NUMBER
NOT IN A CELL

HANS/ERP (HABITAT ACQUISITION AND NEGOTIATION STRATEGY/EXPEDITED REVIEW PROCESS)
NONE

VEGETATION (2005)
Chaparral
Montane Coniferous Forest

FIRE

HIGH FIRE AREA (ORD. 787)
IN HIGH FIRE AREA - Grading And Building Permit Applications Require Fire Dept Clearance Prior To Permit Issuance.

FIRE RESPONSIBILITY AREA
STATE RESPONSIBILITY AREA

DEVELOPMENT FEES

CVMSHCP FEE AREA (ORD. 875)
NOT WITHIN THE COACHELLA VALLEY MSHCP FEE AREA

WRMSHCP FEE AREA (ORD. 810)
IN OR PARTIALLY WITHIN THE WESTERN RIVERSIDE MSHCP FEE AREA. SEE MAP FOR MORE INFORMATION.

ROAD & BRIDGE DISTRICT
NOT IN A DISTRICT

EASTERN TUMF (TRANSPORTATION UNIFORM MITIGATION FEE ORD. 673)
NOT WITHIN THE EASTERN TUMF FEE AREA

WESTERN TUMF (TRANSPORTATION UNIFORM MITIGATION FEE ORD. 824)
NOT WITHIN THE WESTERN TUMF FEE AREA

DIF (DEVELOPMENT IMPACT FEE AREA ORD. 659)
REMAP

SKR FEE AREA (STEPHEN'S KANGAROO RAT ORD. 663.10)
NOT WITHIN AN SKR FEE AREA.

DEVELOPMENT AGREEMENTS
NOT IN A DEVELOPMENT AGREEMENT AREA

TRANSPORTATION

CIRCULATION ELEMENT ULTIMATE RIGHT-OF-WAY
NOT IN A CIRCULATION ELEMENT RIGHT-OF-WAY

ROAD BOOK PAGE
193

TRANSPORTATION AGREEMENTS
NOT IN A TRANSPORTATION AGREEMENT

CETAP (COMMUNITY AND ENVIRONMENTAL TRANSPORTATION ACCEPTABILITY PROCESS) CORRIDORS
NOT IN A CETAP CORRIDOR.

HYDROLOGY

FLOOD PLAIN REVIEW

NOT REQUIRED.

WATER DISTRICT

DATA NOT AVAILABLE

FLOOD CONTROL DISTRICT

RIVERSIDE COUNTY FLOOD CONTROL DISTRICT

WATERSHED

SAN JACINTO VALLEY

GEOLOGIC

FAULT ZONE

NOT IN A FAULT ZONE

FAULTS

WITHIN A 1/2 MILE OF

GOFF FLAT FAULT

CONTACT THE COUNTY'S CHIEF ENGINEERING GEOLOGIST AT (951)955-6863.

LIQUEFACTION POTENTIAL

NO POTENTIAL FOR LIQUEFACTION EXISTS

SUBSIDENCE

NOT IN A SUBSIDENCE AREA

PALEONTOLOGICAL SENSITIVITY

LOW POTENTIAL.

FOLLOWING A LITERATURE SEARCH, RECORDS CHECK AND A FIELD SURVEY, AREAS MAY BE DETERMINED BY A QUALIFIED VERTEBRATE PALEONTOLOGIST AS HAVING LOW POTENTIAL FOR CONTAINING SIGNIFICANT PALEONTOLOGICAL RESOURCES SUBJECT TO ADVERSE IMPACTS.

MISCELLANEOUS

SCHOOL DISTRICT

HEMET UNIFIED

COMMUNITIES

NOT IN A COMMUNITY

COUNTY SERVICE AREA

NOT IN A COUNTY SERVICE AREA.

LIGHTING (ORD. 655)

ZONE B, 25.56 MILES FROM MT. PALOMAR OBSERVATORY

2000 CENSUS TRACT

044402

FARMLAND

NOT MAPPED

TAX RATE AREAS

071-306

- CITRUS PEST CONTROL 2
- COACHELLA VALLEY RESOURCE CONSER
- COUNTY FREE LIBRARY
- COUNTY STRUCTURE FIRE PROTECTION
- COUNTY WASTE RESOURCE MGMT DIST
- CSA 152
- CSA 153
- FLOOD CONTROL ADMINISTRATION
- FLOOD CONTROL ZONE 6
- GENERAL
- GENERAL PURPOSE
- HEMET UNIFIED SCHOOL
- MT SAN JACINTO JUNIOR COLLEGE
- RIV CO REG PARK & OPEN SPACE
- RIV. CO. OFFICE OF EDUCATION

SPECIAL NOTES

NO SPECIAL NOTES

CODE COMPLAINTS

Case #	Description	Start Date
CV0800022	ABATEMENT	Jan. 3, 2008
CV0800023	NEIGHBORHOOD ENFORCEMENT	Jan. 3, 2008
CV0800024	VEHICLE ABATEMENT	Jan. 3, 2008
CV0800025	ABATEMENT	Jan. 3, 2008
CV0800026	NEIGHBORHOOD ENFORCEMENT	Jan. 3, 2008

REPORT PRINTED ON...Tue Nov 30 10:55:49 2010
Version 101124



INVOICE

Order Number: 21562 **Order Date:** 5/25/2010

Customer Information:

Acct No. 1044

RIVERSIDE COUNTY TLMA-CODE ENFORCEMENT
4080 Lemon Street
Riverside, CA 92501

Attn: Brent Steele
REF: CV08-00026 & CV08-00025 / Anna Vasquez
IN RE: DORN, CLIFFORD G.

Product and/or Service ordered for Property known as:	
32235 Morris Ranch Rd. Hemet, CA 92543	
DESCRIPTION:	FEE:
Updated Lot Book	\$57.00
TOTAL DUE:	\$57.00

Payment due upon receipt. Please remit to:

RZ Title Services, Inc.
P.O. Box 1193
Whittier, CA 90609

EXHIBIT NO. C



P.O. Box 1193
 Whittier, CA 90609
 Tel # (562) 325-8351
 Fax # (714) 783-3038

Updated Lot Book

Customer:

RIVERSIDE COUNTY TLMA-CODE INFORCEMENT

4080 Lemon Street
 Riverside CA 92501

Attn: Brent Steele
 Reference: CV08-00026 & CV08-00025 / Anna Vasquez
 IN RE: DORN, CLIFFORD G.

Order Number: **21562**

Order Date: 5/25/2010
 Dated as of: 5/21/2010

County Name: Riverside

FEE(s):
 Report: \$57.00

Property Address: 32235 Morris Ranch Rd.
 Hemet CA 92543

RZ Title Reporting Service hereby reports, as disclosed by the Official Records of the Recorder of said County as of the date shown above, that subsequent to the date of the original report that (i) No document in the chain of title to said land has been recorded purporting to convey the fee title to said land, and (ii) No encumbrances affecting said land have been recorded nor has a homestead been executed on said land, and (iii) No encumbrances affecting said land on the date of the original report have been released or reconveyed.

All exceptions are as follows:

Assessor's Parcel No. : 568-110-029-6

Assessments:	Land Value:	\$42,252.00
	Improvement Value:	\$0.00
	Exemption Value:	\$0.00
	Total Value:	\$42,252.00

Property Taxes for the Fiscal Year	2009-2010
Total Annual Tax	\$462.54
Status: Paid through	06/30/2010

NO OTHER EXCEPTIONS



INVOICE

Order Number: 19204	Order Date: 5/26/2009
----------------------------	------------------------------

Customer Information:

Acct No. 1044

RIVERSIDE COUNTY TLMA-CODE INFORCEMENT
4080 Lemon Street
Riverside, CA 92501

Attn: Brent Steele
REF: CV08-00022 / Anna Vasquez
IN RE: DORN, CLIFFORD G.

Product and/or Service ordered for Property known as: 32235 Morris Ranch Rd. Hemet, CA 92543	
DESCRIPTION:	FEE:
Lot Book Report	\$120.00
TOTAL DUE:	\$120.00

Payment due upon receipt. Please remit to:

RZ Title Services, Inc.
P.O. Box 1193
Whittier, CA 90609



P.O. Box 1193
 Whittier, CA 90609
 Tel # (562) 325-8351
 Fax # (714) 783-3038

Lot Book Report

Order Number: **19204**

Customer:

RIVERSIDE COUNTY TLMA-CODE ENFORCEMENT
 4080 Lemon Street
 Riverside CA 92501

Order Date: 5/26/2009
 Dated as of: 5/25/2009
 County Name: Riverside

Attn: Brent Steele
 Reference: CV08-00022 / Anna Vasquez
 IN RE: DORN, CLIFFORD G.

FEE(s):
 Report: \$120.00

Property Address: 32235 Morris Ranch Rd.
 Hemet CA 92543

Assessor's Parcel No. : 568-110-029-6

Assessments:

Land Value:	\$41,424.00
Improvement Value:	\$0.00
Exemption Value:	\$0.00
Total Value:	\$41,424.00

Tax Information

Property Taxes for the Fiscal Year	2008-2009
Total Annual Tax	\$459.64
Status: Paid through	06/30/2009

Property Vesting

The last recorded document transferring title of said property

Dated	01/16/1984
Recorded	01/20/1984



P.O. Box 1193
Whittier, CA 90609
Tel # (562) 325-8351
Fax # (714) 783-3038

Order Number: 19204

Reference: CV08-00022 / Ann

Document No.	12906
D.T.T.	\$27.50
Grantor	Estelle G. Wellman
Grantee	Clifford G. Dorn

Deeds of Trust

No Deeds of Trust of Record

Additional Information

A Declaration of Homestead executed by	Clifford G. Dorn and Daphne N. Dorn
Recorded	03/15/1993
Document No	93680
Notice of Non-Compliance filed by	County of Riverside Department of Code Enforcement
In the matter of the property of	Clifford G. Dorn
Case No.	CV08-00023
Recorded	12/26/2008
Document No.	2008-0671640
Notice of Non-Compliance filed by	County of Riverside Department of Code Enforcement
In the matter of the property of	Clifford G. Dorn
Case No.	CV08-00022
Recorded	12/26/2008
Document No.	2008-0671641

Legal Description

THE LAND REFERRED TO IN THIS REPORT IS LOCATED IN AND IS DESCRIBED AS FOLLOWS:

THE WEST HALF OF THE WEST HALF OF THE NORTH HALF OF THE NORTHWEST QUARTER OF SECTION 17, TOWNSHIP 6 SOUTH, RANGE 4 EAST, SAN BERNARDINO BASE AND MERIDIAN, IN THE COUNTY OF RIVERSIDE, STATE OF CALIFORNIA.

T.R.A. 7166, 071-303
7171, 071-306
7127

NI/2 T. 6S, R. 4E

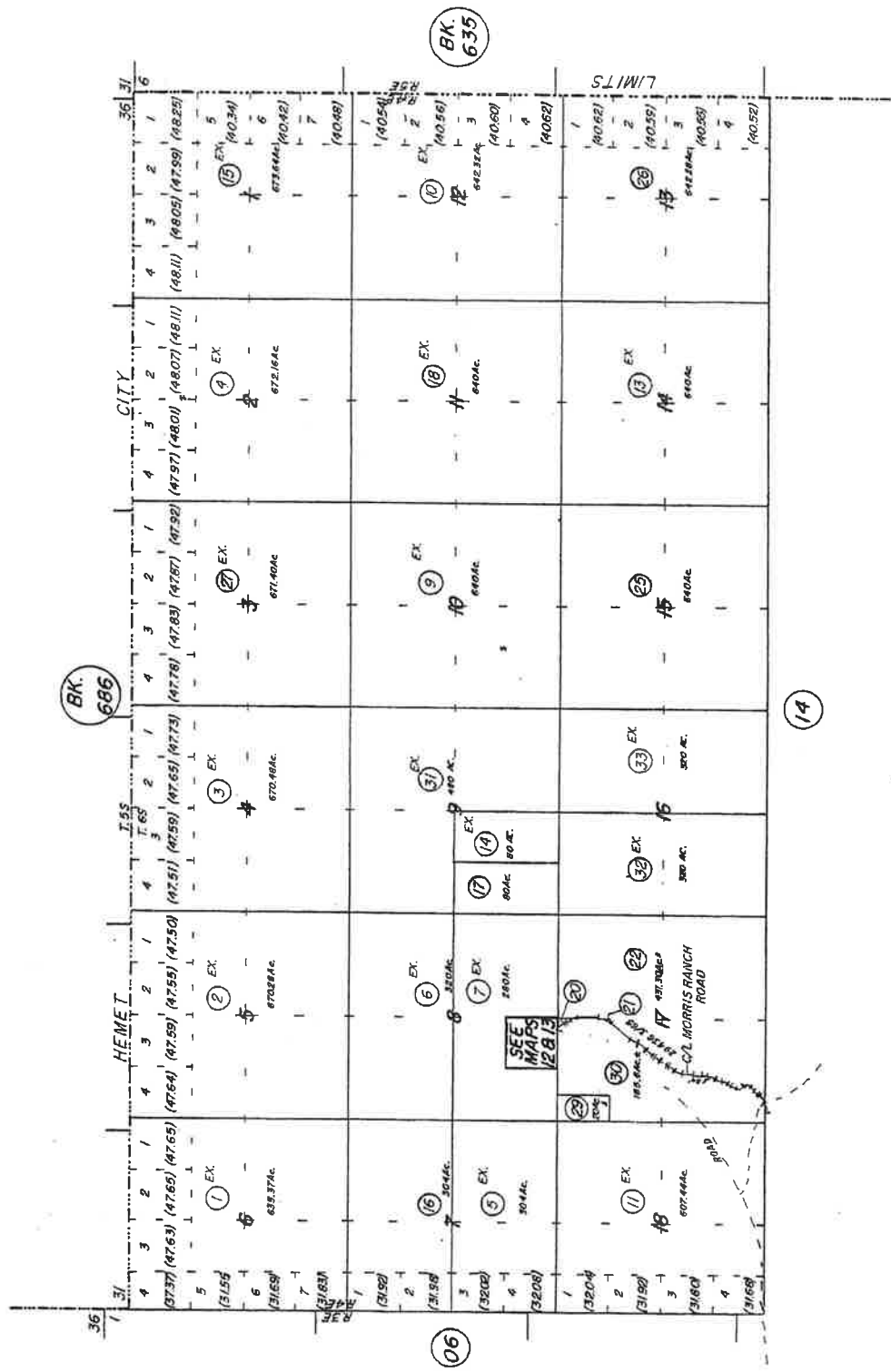

DATE	OLD PAR. NO.	NEW NO.
2/77	853	595, 596
7/77	871	597, 598
1/78	877	599, 600
2/78	887, 888	601, 602
	889, 890	603, 604
	891, 892	605, 606
	893, 894	607, 608
	895, 896	609, 610
	897, 898	611, 612
	899, 900	613, 614
	901, 902	615, 616
	903, 904	617, 618
	905, 906	619, 620
	907, 908	621, 622
	909, 910	623, 624
	911, 912	625, 626
	913, 914	627, 628
	915, 916	629, 630
	917, 918	631, 632
	919, 920	633, 634
	921, 922	635, 636
	923, 924	637, 638
	925, 926	639, 640
	927, 928	641, 642
	929, 930	643, 644
	931, 932	645, 646
	933, 934	647, 648
	935, 936	649, 650
	937, 938	651, 652
	939, 940	653, 654
	941, 942	655, 656
	943, 944	657, 658
	945, 946	659, 660
	947, 948	661, 662
	949, 950	663, 664
	951, 952	665, 666
	953, 954	667, 668
	955, 956	669, 670
	957, 958	671, 672
	959, 960	673, 674
	961, 962	675, 676
	963, 964	677, 678
	965, 966	679, 680
	967, 968	681, 682
	969, 970	683, 684
	971, 972	685, 686
	973, 974	687, 688
	975, 976	689, 690
	977, 978	691, 692
	979, 980	693, 694
	981, 982	695, 696
	983, 984	697, 698
	985, 986	699, 700
	987, 988	701, 702
	989, 990	703, 704
	991, 992	705, 706
	993, 994	707, 708
	995, 996	709, 710
	997, 998	711, 712
	999, 1000	713, 714

DATA: G.L.O. PLAT. M.B. 18/12, NS 6671.2
Co. Rec. 754-S

NOV. 1969

ASSESSOR'S MAP BK. 568 P. 11
RIVERSIDE COUNTY, CALIF. 92

12906

RECORDING REQUESTED BY
Clifford G. Dorn
AND WHEN RECORDED MAIL TO

Name Clifford G. Dorn
Street Address 9395 Corbie Ct.
City & State Calimesa, CA 92320

PAID
DOC. TRANSFER TAX
WILLIAM E. CUNRELY
Riv. Co. Recorder

RECEIVED FOR RECORDING
Mr. Fred C. [unclear]
C. DORN
Notary Public

Book 1984, Page 12906

JAN 20 1984

Recorded in Official Records
of Riverside County, California

William E. Cunrely
Recorder

SURVEYORS
Monument Fund
\$10.00

SPACE ABOVE THIS LINE FOR RECORDER'S USE

GRANT DEED

DOCUMENTARY TRANSFER TAX: 27.50
COMPUTED ON FULL VALUE OF PROPERTY CONVEYED,
OR COMPUTED ON FULL VALUE LESS LIENS AND
ENCUMBRANCES REMAINING AT TIME OF SALE.
Signature of Declarant or Agent determining tax. Firm Name

THIS INDENTURE, made the 16th day of January 1984
BETWEEN
Estelle G. Wellman
and Clifford G. Dorn

the party of the first part
the party of the second part
WITNESSETH: That the said party of the first part, for and in consideration of the sum of Twenty Five Thousand (25,000) Dollars,
lawful money of the United States of America, to be in hand paid by the said party of the second part, the receipt whereof is hereby acknowledged, do hereby by these presents, GRANT free of all liens and encumbrances unto the said party of the second part, and to his heirs and assigns forever, all the certain lot, piece or parcel of land, situate, lying and being in the unincorporated area in the County of Riverside and State of California and bounded and particularly described as follows, to-wit:

The west 1/2 of the west 1/2 of the north 1/2 of the northwest 1/4 of Section 17, Township 6 south, Range 4 East, San Bernardino Base and Meridian, Consisting of 20 acres.

TOGETHER with all and singular the tenements, hereditaments and appurtenances thereto belonging, or in anywise appertaining, and the reversion and reversions, remainder and remainders, rents, issues and profits thereof.
YO HAVE AND TO HOLD, all and singular the said premises, together with the appurtenances, unto the said party of the second part, and to his heirs and assigns forever.
IN WITNESS WHEREOF, the said party of the first part has hereunto set her hand and seal the day and year first above written.

Estelle G. Wellman
STATE OF CALIFORNIA, }
County of _____ } ss.

State of California }
County of Riverside } ss.
On this the 16th day of January 1984, before me,
Linda Cummings
the undersigned Notary Public, personally appeared
Estelle G. Wellman
 personally known to me
 proved to me on the basis of satisfactory evidence
to be the person (s) whose name (s) is subscribed to the
within instrument, and acknowledged that she executed it.
WITNESS my hand and official seal.
Linda Cummings
Notary's Signature

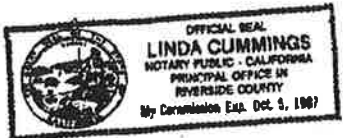

GENERAL ACKNOWLEDGMENT FORM M-16 12/82

Public Record

93650

RECORDING REQUESTED BY

AND WHEN RECORDED MAIL TO

Name Clifford Dorn
Street 25 Trails End
Address Mountain Center
City, State & Zip Code California 92561

RECEIVED FOR RECORDING
MAR 15 1993

MAR 15 1993

Notary Public
Riverside Co
Ron Kiskila

03 07 77 10 00 03 03 15 93

SPACE ABOVE THIS LINE FOR RECORDER'S USE

HOMESTEAD DECLARATION

(SPOUSES AS DECLARED OWNERS)

We CLIFFORD G. DORN and DAPHNE N. DORN
(Full Name of Declarant) (Full Name of Declarant)

do hereby certify and declare as follows:

(1) We are married to each other.

(2) We hereby claim as a homestead, and make ourselves declared homestead owners of, the premises located in the City of Mountain Center County of Riverside State of California, commonly known as 32235 Morris Ranch Road Mt. Center CA 92561

and more particularly described as follows: (Street Address) [Give complete legal description]

The West 1/2 of the West 1/2 of the North 1/2 of the Northwest 1/4 of Section 17, Township 6 South, Range 4 East, San Bernardino Base and Meridian, consisting of 20 acres. Records of Riverside County.

(3) I, CLIFFORD G. DORN
(Name of First Spouse)
own the following interest in the above declared homestead:
50%

(4) I, DAPHNE N. DORN
(Name of Second Spouse)
own the following interest in the above declared homestead:
50%

(5) The above declared homestead is the principal dwelling of CLIFFORD & DAPHNE DORN
(Name of one or both spouses, whichever is applicable)
and we currently reside(s) in that declared homestead.
(He, She, or We)

(6) The facts stated in this Declaration are true as of our personal knowledge.
Dated: March 12, 1993 19 93
Clifford G. Dorn
(Signature of Declarant)
Daphne N. Dorn
(Signature of Declarant)

STATE OF CALIFORNIA }
COUNTY OF Riverside } ss.

On this 12th day of March, in the year 19 93, before me, the undersigned, a Notary Public in and for said State, personally appeared CLIFFORD G. DORN and DAPHNE N. DORN

personally appearing
(or proved to me on the basis of satisfactory evidence) to be the persons whose names are subscribed to the within instrument, and acknowledged to me that they executed it.
WITNESS my hand and official seal.

Ron Kiskila
Notary Public in and for said State.



WOLCOTT'S FORM 732 - HOMESTEAD DECLARATION (Spouses As Declared Owners) - Nov. 12, 82a (Please check 7)

© 1982 WOLCOTT'S, INC.

When recorded please mail to:
Mail Stop# 5155
Code Enforcement Department
39493 Los Alamos Rd.
Murrieta, CA 92563

DOC # 2008-0671640

12/26/2008 08:00A Fee:NC

Page 1 of 1

Recorded in Official Records

County of Riverside

Larry W. Ward

Assessor, County Clerk & Recorder



024
M
026

NOTICE OF NONCOMPLIANCE

In the matter of the Property of)

Case No.: CV08-00023

Clifford G. Dorn)

NOTICE IS HEREBY GIVEN to all persons, pursuant to Section 10 of Ordinance Number 725 of the County of Riverside, State of California, that proceedings have been commenced with respect to violations of Riverside County Ordinance No.457, (RCC Title 15.08.010) described as Construction without Permit. Such Proceedings are based upon the noncompliance of such real property, located at 32235 Morris Ranch Road, Hemet, CA, and more particularly described as Assessor's Parcel Number 568-110-029 and having a legal description of 20.00 ACRES M/L IN POR NW 1/4 OF SEC 17 T6S R4E. Records of Riverside County, with the requirements of Ordinance No. 457 (RCC Title 15.08.010).

The owner has been advised to immediately correct the above-referenced violation to avoid further action by the County of Riverside, which may include remediation or restoration to abate the public nuisance or other remedies available to the department by a court of competent jurisdiction. Any costs incurred by the County, including, but not limited to investigative, administrative and abatement costs and attorneys' fees, may become a lien on the property. Further details regarding this notice may be obtained by addressing an inquiry to the Code Enforcement Department, 39493 Los Alamos Road, Murrieta, CA.; Attention Code Enforcement Officer Roy Ryder (951) 600-6140.

NOTICE IS FURTHER GIVEN in accordance with §17274 and §24436.5 of the California Revenue and Taxation Code, that a tax deduction may not be allowed for interest, taxes, depreciation, or amortization paid or incurred in the taxable year affected by these proceedings.

COUNTY OF RIVERSIDE
DEPARTMENT OF CODE ENFORCEMENT

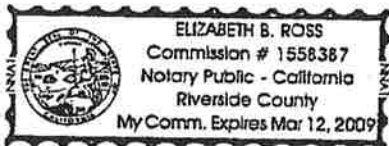

By: 
Mark Slocum
Code Enforcement Department

ACKNOWLEDGEMENT

State of California)
County of Riverside)

On 12/18/08 before me, Elizabeth B. Ross, Notary Public, personally appeared Mark Slocum, who proved to me on the basis of satisfactory evidence to be the person(s) whose name(s) is/are subscribed to the within instrument and acknowledged to me that he/she/they executed the same in his/her/their authorized capacity(ies), and that by his/her/their signature(s) on the instrument the person(s), or the entity upon behalf of which the person(s) acted, executed the instrument.

I certify under PENALTY OF PERJURY under the laws of the State of California that the foregoing paragraph is true and correct.

WITNESS my hand and official seal.

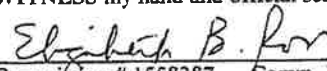
Commission # 1558387 Comm. Expires March 12, 2009

When recorded please mail to:
Mail Stop# 5155
Code Enforcement Department
39493 Los Alamos Rd.
Murrieta, CA 92563

DOC # 2008-0671641

12/26/2008 08:00A Fee:NC

Page 1 of 1

Recorded in Official Records
County of Riverside

Larry W. Ward

Assessor, County Clerk & Recorder



NOTICE OF NONCOMPLIANCE

026
M
026
Ⓞ

In the matter of the Property of)

Case No.: CV08-00022

Clifford G. Dorn)

NOTICE IS HEREBY GIVEN to all persons, pursuant to Section 10 of Ordinance Number 725 of the County of Riverside, State of California, that proceedings have been commenced with respect to violations of Riverside County Ordinance No.457, (RCC Title 15.48.040) described as Substandard Mobile Home. Such Proceedings are based upon the noncompliance of such real property, located at 32235 Morris Ranch Road, Hemet, CA, and more particularly described as Assessor's Parcel Number 568-110-029 and having a legal description of 20.00 ACRES M/L IN POR NW 1/4 OF SEC 17 T6S R4E. Records of Riverside County, with the requirements of Ordinance No 457 (RCC Title 15.48.040).

The owner has been advised to immediately correct the above-referenced violation to avoid further action by the County of Riverside, which may include remediation or restoration to abate the public nuisance or other remedies available to the department by a court of competent jurisdiction. Any costs incurred by the County, including, but not limited to investigative, administrative and abatement costs and attorneys' fees, may become a lien on the property. Further details regarding this notice may be obtained by addressing an inquiry to the Code Enforcement Department, 39493 Los Alamos Road, Murrieta, CA.; Attention Code Enforcement Officer Roy Ryder (951) 600-6140.

NOTICE IS FURTHER GIVEN in accordance with §17274 and §24436.5 of the California Revenue and Taxation Code, that a tax deduction may not be allowed for interest, taxes, depreciation, or amortization paid or incurred in the taxable year affected by these proceedings.

COUNTY OF RIVERSIDE
DEPARTMENT OF CODE ENFORCEMENT



By: [Signature]
Mark Slocum
Code Enforcement Department

ACKNOWLEDGEMENT

State of California)
County of Riverside)

On 12/18/08 before me, Elizabeth B. Ross, Notary Public, personally appeared Mark Slocum, who proved to me on the basis of satisfactory evidence to be the person(s) whose name(s) is/are subscribed to the within instrument and acknowledged to me that he/she/they executed the same in his/her/their authorized capacity(ies), and that by his/her/their signature(s) on the instrument the person(s), or the entity upon behalf of which the person(s) acted, executed the instrument.

I certify under PENALTY OF PERJURY under the laws of the State of California that the foregoing paragraph is true and correct.
WITNESS my hand and official seal.

[Signature]
Commission # 1558387 Comm. Expires March 12, 2009



JAY E. ORR
DIRECTOR

CODE ENFORCEMENT DEPARTMENT COUNTY OF RIVERSIDE

4080 LEMON STREET, 12TH FLOOR
RIVERSIDE, CALIFORNIA 92501
(951) 955-2004 • FAX (951) 955-2023

C1080025
CASES#: _____ PROPERTY SITUS: 32235 MORRIS RANCH R.D
A.P.N.: 569-110-029 DRAWN ON (date) 1-7-09 DRAWN BY: W. Durkin

Provide North Arrow



REAR PROPERTY LINE

NOT TO SCALE

S
I
D
E

P
R
O
P
E
R
T
Y

L
I
N
E

S
I
D
E

P
R
O
P
E
R
T
Y

L
I
N
E

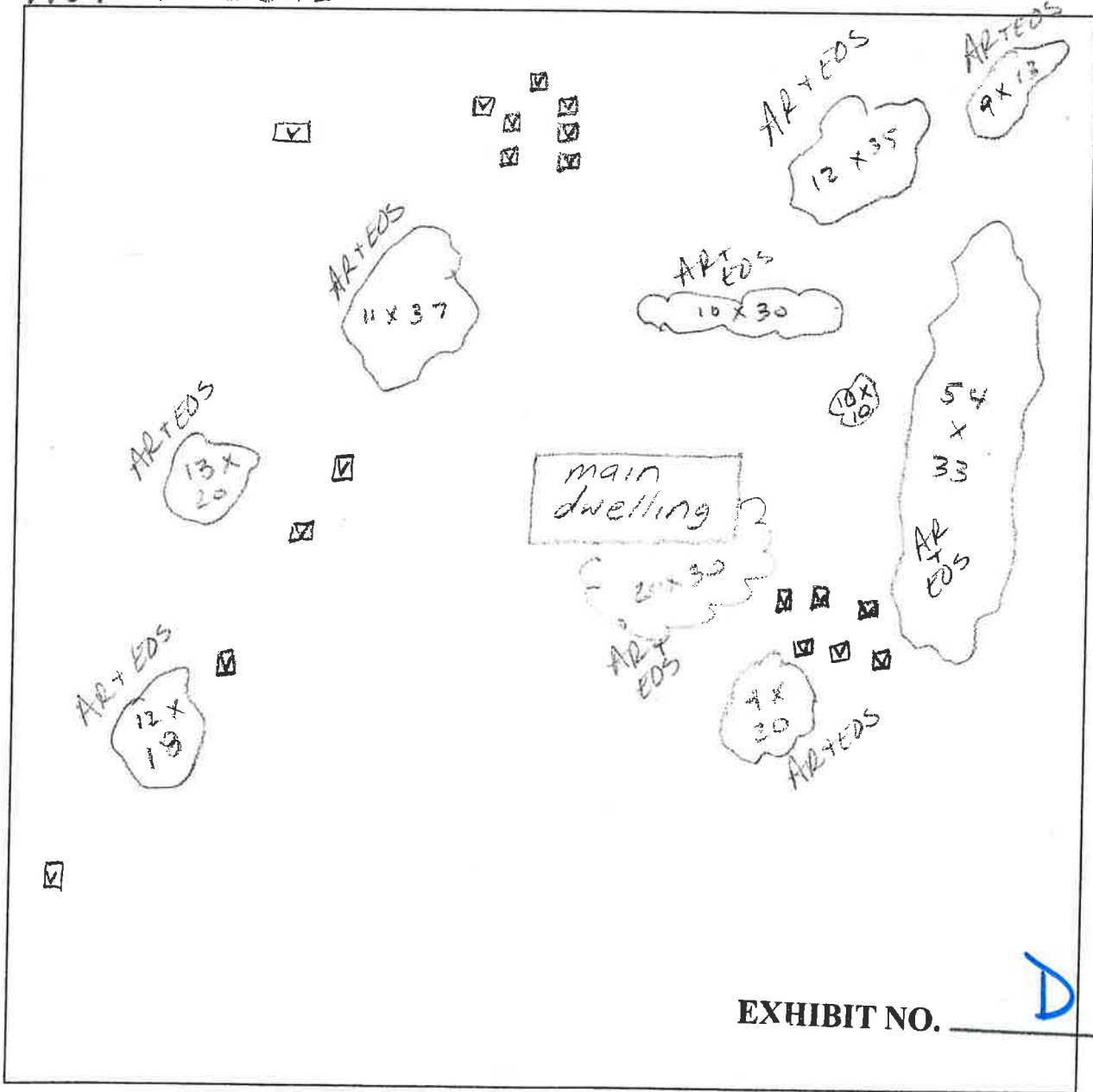

EXHIBIT NO. D

NOT TO SCALE

FRONT PROPERTY LINE

☑ = VEHICLE

32235 MORRIS RANCH ST./AV./DR

Code Enforcement Case: CV0800026

Printed on: 10/13/2010

Photographs



CForrey / AR/EOS remains - 09/29/2010

EXHIBIT NO. D²



CForrey / AR/EOS remains - 09/29/2010

EXHIBIT NO. D³



CForrey / AR/EOS remains - 09/29/2010

EXHIBIT NO. D⁴



CForrey / AR/EOS remains - 09/29/2010

EXHIBIT NO. D^s



EOS remains. JHeagstedt - 08/10/2010

EXHIBIT NO. Dk



EOS remains. JHeagstedt - 08/10/2010

EXHIBIT NO. D7



EOS remains. JHeagstedt - 08/10/2010

EXHIBIT NO. D₈



EOS remains. JHeagstedt - 08/10/2010

EXHIBIT NO. D⁹



EOS remains. JHeagstedt - 08/10/2010

EXHIBIT NO. D²



AR remains. JHeagstedt - 08/10/2010

EXHIBIT NO. D¹¹



AR remains. JHeagstedt - 08/10/2010

EXHIBIT NO. D¹²



AR remains. JHeagstedt - 08/10/2010

EXHIBIT NO. D¹³



EOS remains. JHeagstedt - 07/01/2010

EXHIBIT NO. D¹⁴



EOS remains. JHeagstedt - 07/01/2010

EXHIBIT NO. D¹⁵



EOS remains. JHeagstedt - 07/01/2010

EXHIBIT NO. D¹⁶



AR remains. JHeagstedt - 07/01/2010

EXHIBIT NO. D¹⁷



AR remains. JHeagstedt - 07/01/2010

EXHIBIT NO. D¹⁸

Code Enforcement Case: CV0800026

Printed on: 11/03/2010

Photographs



EOS remains. JHeagstedt - 05/20/2010

EXHIBIT NO. D¹⁹



EOS remains. JHeagstedt - 05/20/2010

EXHIBIT NO. D²⁰



EOS remains. JHeagstedt - 05/20/2010

EXHIBIT NO. D²¹



AR remains. JHeagstedt - 05/20/2010

EXHIBIT NO. _____

D²²



AR remains. JHeagstedt - 05/20/2010

EXHIBIT NO. D²³



AR remains. JHeagstedt - 05/20/2010

EXHIBIT NO. D²⁴

PHOTOGRAPHIC EVIDENCE

TAKEN BY: R.Ryder

CASE # 08 00025 & 08 00026

DATE: 052009

Location: 32235 Morris Ranch Rd. Mtn. Center

568.110.029



PHOTO # 1 NOTES: AR & EOS – Remain on the property



PHOTO # 2 NOTES: AR & EOS – Remain on the property

EXHIBIT NO. _____

D25

PHOTOGRAPHIC EVIDENCE

TAKEN BY: RRyder

CASE # 08 00025 & 08 00026

DATE: 052009

Location: 32235 Morris Ranch Rd. Mtn. Center

568.110.029



PHOTO # 3 NOTES: AR & EOS – Remain on the property



PHOTO # 4 NOTES: AR & EOS – Remain on the property

EXHIBIT NO. _____

D26

PHOTOGRAPHIC EVIDENCE

TAKEN BY: RRyder

CASE # 08 00025 & 08 00026

DATE: 052009

Location: 32235 Morris Ranch Rd. Mtn. Center

568.110.029



PHOTO # 5 NOTES: AR & EOS – Remain on the property



PHOTO # 6 NOTES: AR & EOS – Remain on the property

EXHIBIT NO. _____

D²⁷

PHOTOGRAPHIC EVIDENCE

TAKEN BY: RRyder

CASE # 08 00025 & 08 00026

DATE: 052009

Location: 32235 Morris Ranch Rd. Mtn. Center

568.110.029



PHOTO # 7 NOTES: AR & EOS – Remain on the property



PHOTO # 8 NOTES: AR & EOS – Remain on the property

EXHIBIT NO. _____

D²⁸

PHOTOGRAPHIC EVIDENCE

TAKEN BY: RRyder

CASE # 08 00025 & 08 00026

DATE: 052009

Location: 32235 Morris Ranch Rd. Mtn. Center

568.110.029



PHOTO # 9 NOTES: AR & EOS – Remain on the property



PHOTO # 10 NOTES: AR & EOS – Remain on the property

EXHIBIT NO. _____

D^{2A}

PHOTOGRAPHIC EVIDENCE

TAKEN BY: RRyder

CASE # 08 00025 & 08 00026

DATE: 052009

Location: 32235 Morris Ranch Rd. Mtn. Center

568.110.029



PHOTO # 11 NOTES: AR & EOS – Remain on the property



PHOTO # 12 NOTES: AR & EOS – Remain on the property

EXHIBIT NO. _____

D³⁰

PHOTOGRAPHIC EVIDENCE

TAKEN BY: RRyder

CASE # 08 00025 & 08 00026

DATE: 052009

Location: 32235 Morris Ranch Rd. Mtn. Center

568.110.029



PHOTO # 13 NOTES: AR & EOS – Remain on the property



PHOTO # 14 NOTES: AR & EOS – Remain on the property

EXHIBIT NO. _____

D³¹

PHOTOGRAPHIC EVIDENCE

TAKEN BY: RRyder

CASE # 08 00025 & 08 00026

DATE: 052009

Location: 32235 Morris Ranch Rd. Mtn. Center

568.110.029



PHOTO # 15 NOTES: AR & EOS – Remain on the property



PHOTO # 16 NOTES: AR & EOS – Remain on the property

EXHIBIT NO. _____

D³²



INVOICE

Order Number: 22810	Order Date: 10/5/2010
----------------------------	------------------------------

Customer Information:

Acct No. 1044

RIVERSIDE COUNTY TLMA-CODE ENFORCEMENT
4080 Lemon Street
Riverside, CA 92501

Attn: Brent Steele
REF: CV08-00026/Liz Ross
IN RE: DORN, CLIFFORD G.

Product and/or Service ordered for Property known as:	
32235 Morris Ranch Rd. Hemet, CA 92543	
DESCRIPTION:	FEE:
Updated Lot Book	\$60.00
TOTAL DUE:	\$60.00

Payment due upon receipt. Please remit to:

RZ Title Services, Inc.
P.O. Box 1193
Whittier, CA 90609



P.O. Box 1193
 Whittier, CA 90609
 Tel # (562) 325-8351
 Fax # (714) 783-3038

Updated Lot Book

Customer:

RIVERSIDE COUNTY TLMA-CODE ENFORCEMENT

4080 Lemon Street
 Riverside CA 92501

Attn: Brent Steele
 Reference: CV08-00026/Liz Ross
 IN RE: DORN, CLIFFORD G.

Order Number: **22810**

Order Date: 10/5/2010
 Dated as of: 9/27/2010

County Name: Riverside

FEE(s):
 Report: \$60.00

Property Address: 32235 Morris Ranch Rd.
 Hemet CA 92543

RZ Title Reporting Service hereby reports, as disclosed by the Official Records of the Recorder of said County as of the date shown above, that subsequent to the date of the original report that (i) No document in the chain of title to said land has been recorded purporting to convey the fee title to said land, and (ii) No encumbrances affecting said land have been recorded nor has a homestead been executed on said land, and (iii) No encumbrances affecting said land on the date of the original report have been released or reconveyed.

All exceptions are as follows:

Assessor's Parcel No. : 568-110-029-6

Assessments:	Land Value:	\$42,151.00
	Improvement Value:	\$0.00
	Exemption Value:	\$0.00
	Total Value:	\$42,151.00

Property Taxes for the Fiscal Year	2010-2011
First Installment	\$234.31
Penalty	\$0.00
Status	OPEN NOT-PAID (DUE DATE 12/10/2010)
Second Installment	\$234.31
Penalty	\$0.00
Status	OPEN NOT-PAID (DUE DATE 04/10/2011)

Notice of Non-Compliance filed by	County of Riverside Department of Code Enforcement
In the matter of the property of	Clifford G. Dorn
Case No.	CV08-00026
Recorded	06/01/2010



P.O. Box 1193
Whittier, CA 90609
Tel # (562) 325-8351
Fax # (714) 783-3038

Order Number: 22810

Reference: CV08-00026/Liz R

Document No.	2010-0251764
Notice of Non-Compliance filed by	County of Riverside Department of Code Enforcement
In the matter of the property of	Clifford G. Dorn
Case No.	CV08-00025
Recorded	06/01/2010
Document No.	2010-0251765

When recorded please mail to:
Mail Stop# 5155
Riverside County
Code Enforcement Department
39493 Los Alamos Rd.
Murrieta, CA 92563

DOC # 2010-0251764
06/01/2010 08:00A Fee:NC
Page 1 of 1
Recorded in Official Records
County of Riverside
Larry W. Ward
Assessor, County Clerk & Recorder



0
JA
M
059

NOTICE OF NONCOMPLIANCE

In the matter of the Property of

Case No.: CV08-00026

CLIFFORD G. DORN

NOTICE IS HEREBY GIVEN to all persons, pursuant to Section 10 of Ordinance Number 725 of the County of Riverside, State of California, that proceedings have been commenced with respect to violations of Riverside County Ordinance No.348,(RCC Title 17.16.010), described as EXCESSIVE OUTSIDE STORAGE. Such Proceedings are based upon the noncompliance of such real property, located at 32235 MORRIS RANCH ROAD, HEMET, CA, and more particularly described as Assessor's Parcel Number 568-110-029 and having a legal description of 20.00 ACRES M/L IN POR NW 1/4 OF SEC 17 T6S R4E FOR TOTAL DESCRIPTION SEE ASSESSORS MAPS. Records of Riverside County, with the requirements of Ordinance No. 348 (RCC Title 17.16.010)

The owner has been advised to immediately correct the above-referenced violation to avoid further action by the County of Riverside, which may include remediation or restoration to abate the public nuisance or other remedies available to the department by a court of competent jurisdiction. Any costs incurred by the County, including, but not limited to investigative, administrative and abatement costs and attorneys' fees, may become a lien on the property. Further details regarding this notice may be obtained by addressing an inquiry to the Code Enforcement Department, 39493 Los Alamos Road, Murrieta, CA,; Attention Code Enforcement Officer Jason Heagstedt (951) 600-6140.

NOTICE IS FURTHER GIVEN in accordance with §17274 and §24436.5 of the California Revenue and Taxation Code, that a tax deduction may not be allowed for interest, taxes, depreciation, or amortization paid or incurred in the taxable year affected by these proceedings.

COUNTY OF RIVERSIDE
DEPARTMENT OF CODE ENFORCEMENT

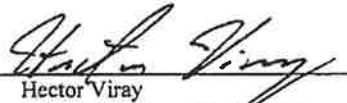
By: 
Hector Viray
Code Enforcement Department

ACKNOWLEDGEMENT

State of California)
County of Riverside)

On 05/26/10 before me, Elizabeth B. Ross, Notary Public, personally appeared Hector Viray, who proved to me on the basis of satisfactory evidence to be the person(s) whose name(s) is/are subscribed to the within instrument and acknowledged to me that he/~~she~~/they executed the same in his/~~her~~/their authorized capacity(ies), and that by his/~~her~~/their signature(s) on the instrument the person(s), or the entity upon behalf of which the person(s) acted, executed the instrument.

I certify under PENALTY OF PERJURY under the laws of the State of California that the foregoing paragraph is true and correct.
WITNESS my hand and official seal.

Commission # 1838743 Comm. Expires March 12, 2013

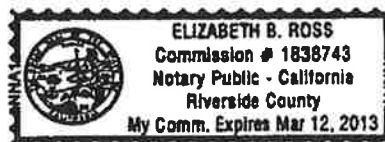

When recorded please mail to:
Mail Stop# 5155
Riverside County
Code Enforcement Department
39493 Los Alamos Rd.
Murrieta, CA 92563

DOC # 2010-0251765
06/01/2010 08:00A Fee:NC
Page 1 of 1
Recorded in Official Records
County of Riverside
Larry W. Ward
Assessor, County Clerk & Recorder

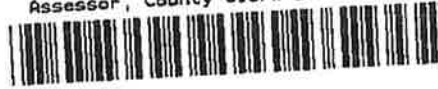

0
M
059

NOTICE OF NONCOMPLIANCE

In the matter of the Property of

Case No.: CV08-00025

CLIFFORD G. DORN

NOTICE IS HEREBY GIVEN to all persons, pursuant to Section 10 of Ordinance Number 725 of the County of Riverside, State of California, that proceedings have been commenced with respect to violations of Riverside County Ordinance No.541,(RCC Title 8.120.010), described as ACCUMULATED RUBBISH. Such Proceedings are based upon the noncompliance of such real property, located at 32235 MORRIS RANCH ROAD, HEMET, CA, and more particularly described as Assessor's Parcel Number 568-110-029 and having a legal description of 20.00 ACRES M/L IN POR NW 1/4 OF SEC 17 T6S R4E FOR TOTAL DESCRIPTION SEE ASSESSORS MAPS. Records of Riverside County, with the requirements of Ordinance No. 541 (RCC Title 8.120.010)

The owner has been advised to immediately correct the above-referenced violation to avoid further action by the County of Riverside, which may include remediation or restoration to abate the public nuisance or other remedies available to the department by a court of competent jurisdiction. Any costs incurred by the County, including, but not limited to investigative, administrative and abatement costs and attorneys' fees, may become a lien on the property. Further details regarding this notice may be obtained by addressing an inquiry to the Code Enforcement Department, 39493 Los Alamos Road, Murrieta, CA,; Attention Code Enforcement Officer Jason Heagstedt (951) 600-6140.

NOTICE IS FURTHER GIVEN in accordance with §17274 and §24436.5 of the California Revenue and Taxation Code, that a tax deduction may not be allowed for interest, taxes, depreciation, or amortization paid or incurred in the taxable year affected by these proceedings.

COUNTY OF RIVERSIDE
DEPARTMENT OF CODE ENFORCEMENT

By: 
Hector Viray
Code Enforcement Department

ACKNOWLEDGEMENT

State of California)
County of Riverside)

On 05/26/10 before me, Elizabeth B. Ross, Notary Public, personally appeared Hector Viray, who proved to me on the basis of satisfactory evidence to be the person(s) whose name(s) is/are subscribed to the within instrument and acknowledged to me that he/she/they executed the same in his/her/their authorized capacity(ies), and that by his/her/their signature(s) on the instrument the person(s), or the entity upon behalf of which the person(s) acted, executed the instrument.

I certify under PENALTY OF PERJURY under the laws of the State of California that the foregoing paragraph is true and correct.
WITNESS my hand and official seal.

Commission # 1838743 Comm. Expires March 12, 2013

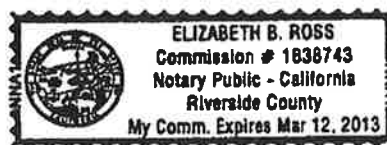

Public Record



John Boyd
DIRECTOR

Code Enforcement Department
County Of Riverside
Murrieta District Office
39493 Los Alamos Road, Suite A
Murrieta, California 92563
(951) 600-6140 – Fax (951) 600-6190

NOTICE OF VIOLATION

June 9, 2009

Clifford Dorn
32235 Morris Ranch Rd.
Hemet, CA 92543

Re: Case No.: CV08-00026

NOTICE IS HEREBY GIVEN that property owned or controlled by you at 32235 Morris Ranch Rd. Hemet, California, Assessor's Parcel Number 568-110-029, is in violation of Riverside County Code Section(s) 17.152.010, an Ordinance of the County of Riverside providing for land use planning and zoning regulations and related functions. **Such violation(s) are described as:**

1. Excessive outside storage.

YOU ARE HEREBY REQUIRED TO COMPLY with the provisions of Riverside County Code by:

1. Remove all outside storage. None allowed.

COMPLIANCE MUST BE COMPLETED BY 7/9/09. FAILURE TO COMPLY WILL RESULT IN LEGAL ACTION BEING BROUGHT AGAINST YOU.

NOTICE IS HEREBY GIVEN that at the conclusion of this case you will receive a Summary of Administrative Costs associated with the processing of such violation(s), at an hourly rate of **\$109.00** as determined by the Board of Supervisors.

You will have the right to object to these charges by filing a request for hearing with the Department of Building and Safety within 10 days of service of the Summary of Administrative Costs, pursuant to section 1.16.080 of Riverside County Code.



R. Ryder, Code Enforcement Officer III

EXHIBIT NO. E

PROOF OF SERVICE BY MAIL

Case No: CV08-00026

I, the undersigned, say I am a citizen of the United States and am employed in the County of Riverside, over the age of 18 years and not a party to the within action or proceeding; that my business address is 39493 Los Alamos Road, Ste A, Murrieta, CA.

I am readily familiar with our department's practice for collection and processing of correspondence for mailing with the United States Postal Service. Correspondence is deposited with the United States Postal Service on the same day in the ordinary course of business.

That on June 9, 2009, I served a copy of the papers to which this proof of service is attached, entitled:

NOTICE OF VIOLATION (RCC 17.152.010)

By depositing a copy thereof in an envelope for deposit in the United States Postal Service & Certified Mail, return receipt requested, and addressed as follows:

Address:

See attached: NOTICE LIST / INTERESTED PARTIES

The envelope was sealed and placed for collection and mailing at Murrieta, California, on the same date following the ordinary business practices.

I certify under penalty of perjury according to the laws of the State of California that the foregoing is true and correct.

Executed on June 9, 2009 at Murrieta District Office.

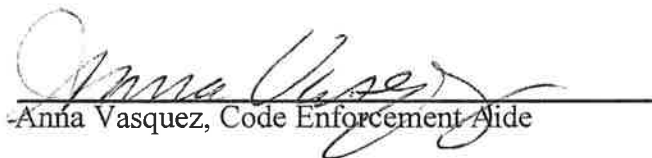

Anna Vasquez, Code Enforcement Aide

Article # 7006276000005737088
70062760000005737064 - 70062760000005737071

EXHIBIT NO. E²



**CODE ENFORCEMENT DEPARTMENT
COUNTY OF RIVERSIDE**

JOHN BOYD
Director

NOTICE LIST / INTERESTED PARTIES

RE: Case No.: 08 00026
APN No.: 568-110-029
Address: 32235 Morris Ranch Rd., Hemet 92543

1. Clifford Dorn
32235 Morris Ranch Rd.
Hemet, CA 92543
2. Clifford Dorn
9395 Corbie Ct.
Calimesa, CA 92320
3. Clifford Dorn
25 Trails End
Mountian Center, CA 92561

EXHIBIT NO. _____

E³

County of Riverside
Code Enforcement Department
39493 Los Alamos Road
Murrieta, CA 92563

RECD JUN 15 2009

Clifford Dorn
32235 Morris Ranch Rd.
Hemet, CA 92543

150



7006 2760 0000 0573 7088



02 1M
0004277091 JUN 10 2009
MAILED FROM ZIP CODE 92504



NIXIE 929 SE 1 08 06/11/09
RETURN TO SENDER
NO SUCH STREET
UNABLE TO FORWARD

BC: 9254999999 *2577-07449-10-99

9254999999

bbbbb

7006 2760 0000 0573 7088

U.S. Postal ServiceTM
CERTIFIED MAILTM RECEIPT
(Domestic Mail Only; No Insurance Coverage Provided)
For delivery information visit our website at www.usps.com

OFFICIAL USE

Postage	\$	
Certified Fee		
Return Receipt Fee (Endorsement Required)		
Restricted Delivery Fee (Endorsement Required)		

Total **Clifford Dorn**
Sent To **32235 Morris Ranch Rd.**
Street, or PO E **Hemet, CA 92543**
City, St **CV08-00026 RR**

Postmark Here

PS Form 3800, August 2006 See Reverse for Instructions

EXHIBIT NO. _____

150

7006 2760 0000 0573 7064

U.S. Postal Service TM
CERTIFIED MAILTM RECEIPT
 (Domestic Mail Only; No Insurance Coverage Provided)

For delivery information visit our website at www.usps.com

OFFICIAL USE

Postage	\$	Postmark Here
Certified Fee		
Return Receipt Fee (Endorsement Required)		
Restricted Delivery Fee (Endo		
Total		

Sent to
 Street or PO
 City, State

Clifford Dorn
9395 Corbie Ct.
Calimesa, CA 92320
CV08-00026 RR

PS Form 3800, August 2006 See Reverse for Instructions

UNITED STATES POSTAGE
 EAGLE
\$ 05.54⁰
 JUL 10 2009
 02 1M
 0004277091
 MAILED FROM ZIP CODE 92504

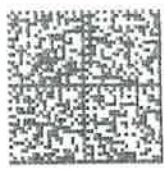

7006 2760 0000 0573 7064

CERTIFIED MAILTM

County of Riverside
Code Enforcement Department
39493 Los Alamos Road
Murrieta, CA 92563

NA 6-11-09

Clifford Dorn
9395 Corbie Ct.
Calimesa, CA 92320

ANK

NIXIE 923 SE 1 06 06/13/09
 RETURN TO SENDER
 ATTEMPTED - NOT KNOWN
 UNABLE TO FORWARD

EC: 92563050393
 *1977-00332-13-32



9256305039

EXHIBIT NO. 57

County of Riverside
Code Enforcement Department
39493 Los Alamos Road
Murrieta, CA 92563

REC'D JUL 06 2009

Clifford Dorn
25 Trails End
Mountain Center, CA 92561

CERTIFIED MAIL™

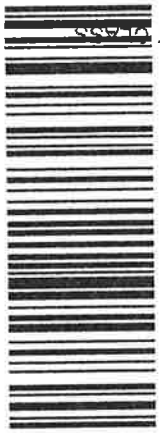

7006 2760 0000 0573 7071



NAME Ab
1st Notice 6/11
2nd Notice 6/16
Return 6/26

NIXIE 923 SE 1 06 07/01/09

RETURN TO SENDER
UNCLAIMED
UNABLE TO FORWARD

BC: 925553503999 *2577-07444-10-99

9255535039



7006 2760 0000 0573 7071

U.S. Postal Service™
CERTIFIED MAIL™ RECEIPT
(Domestic Mail Only; No Insurance Coverage Provided)

For delivery information visit our website at www.usps.com

OFFICIAL USE

Postage	\$	
Certified Fee		
Return Receipt Fee (Endorsement Required)		
Restricted Delivery Fee (Endorsement Required)		

Postmark Here

Clifford Dorn
25 Trails End
Mountain Center, CA 92561
CV08-00026 RR

PS Form 3800, August 2006 See Reverse for Instructions

EXHIBIT NO. 76



John Boyd
DIRECTOR

Code Enforcement Department
County Of Riverside
Murrieta District Office
39493 Los Alamos Road, Suite A
Murrieta, California 92563
(951) 600-6140 – Fax (951) 600-6190

NOTICE OF VIOLATION

June 9, 2009

Clifford Dorn
32235 Morris Ranch Rd.
Hemet, CA 92543

RE CASE NO.: CV08-00025

NOTICE IS HEREBY GIVEN that properties owned or controlled by you described as 32235 Morris Ranch Rd. Hemet, California, Assessor's Parcel Number 568-110-029, are in violation of Riverside County Code Chapter 8.120 and constitutes a public nuisance. The subject properties are dangerous or injurious to the public because of the unauthorized accumulation of rubbish, trash and/or debris, specifically including but not limited to the following: VEGETATION WASTE, APPLIANCES, FURNITURE, HOUSEHOLD WASTE, ETC.

AS OWNER OF RECORD, you are required to abate the public nuisance by removal of all rubbish, trash, or debris from the subject properties within thirty (30) days of the date of this notice. ANY OTHER PARTY WITH INTEREST IN THE SUBJECT PROPERTY may thereafter abate the public nuisance within (15) days after expiration of the thirty (30) day period.

NOTICE IS HEREBY GIVEN THAT YOUR FAILURE TO COMPLY TO THIS NOTICE WILL RESULT IN FURTHER CIVIL, CRIMINAL OR ADMINISTRATIVE PROCEEDINGS FOR THE ABATEMENT OF THE PUBLIC NUISANCE AND COULD RESULT IN THE IMPOSITION OF A LIEN ON THE SUBJECT PROPERTIES FOR COSTS, INCLUDING ATTORNEYS' FEES, RELATED TO THE ENFORCEMENT OF THE ORDINANCES AND ABATEMENT OF THE VIOLATIVE CONDITIONS. A "NOTICE OF NONCOMPLIANCE" HAS BEEN RECORDED AGAINST THE SUBJECT PROPERTIES.

PLEASE BE ADVISED that the costs already accrued in this case, including but not limited to, enforcement and investigation costs, are recoverable by the Department, as allowed under Riverside County Ordinance number 725. The Department may seek recovery of such costs from the property owner(s) which may result in a special assessment lien against the property. Additionally, should Code Enforcement abate the property, the costs associated therewith, as well as all abatement costs allowed under Riverside County Ordinance 725, will be sought from the property owner(s) and/or may result in a special assessment lien against the property.

NOTICE IS ADDITIONALLY GIVEN that in accordance with § § 17274 and 24426.5 of the Revenue and Tax Code, a tax deduction may not be allowed for interest, taxes, depreciation, or amortization paid or incurred in the taxable year affected by these proceedings.

CODE ENFORCEMENT DEPARTMENT



R. Ryder, Code Enforcement Officer III

PROOF OF SERVICE BY MAIL

Case No: CV08-00025

I, the undersigned, say I am a citizen of the United States and am employed in the County of Riverside, over the age of 18 years and not a party to the within action or proceeding; that my business address is 39493 Los Alamos Road, Ste A, Murrieta, CA.

I am readily familiar with our department's practice for collection and processing of correspondence for mailing with the United States Postal Service. Correspondence is deposited with the United States Postal Service on the same day in the ordinary course of business.

That on June 9, 2009, I served a copy of the papers to which this proof of service is attached, entitled:

NOTICE OF VIOLATION (RCC 8.120.010)

By depositing a copy thereof in an envelope for deposit in the United States Postal Service & Certified Mail, return receipt requested, and addressed as follows:

Address:

See attached: NOTICE LIST / INTERESTED PARTIES

The envelope was sealed and placed for collection and mailing at Murrieta, California, on the same date following the ordinary business practices.

I certify under penalty of perjury according to the laws of the State of California that the foregoing is true and correct.

Executed on June 9, 2009 at Murrieta District Office.



Anna Vasquez, Code Enforcement Aide

Article # 7006276000005737118
7006276000005737125 - 7006276000005737101

EXHIBIT NO. _____

E⁸



**CODE ENFORCEMENT DEPARTMENT
COUNTY OF RIVERSIDE**

JOHN BOYD
Director

NOTICE LIST / INTERESTED PARTIES

RE: Case No.: 08 00025
APN No.: 568-110-029
Address: 32235 Morris Ranch Rd., Hemet 92543

1. Clifford Dorn
32235 Morris Ranch Rd.
Hemet, CA 92543
2. Clifford Dorn
9395 Corbie Ct.
Calimesa, CA 92320
3. Clifford Dorn
25 Trails End
Mountain Center, CA 92561

EXHIBIT NO. _____

E9

County of Riverside
Code Enforcement Department
39493 Los Alamos Road
Murrieta, CA 92563

CERTIFIED MAIL™



1ST CLASS

7006 2760 0000 0573 7116

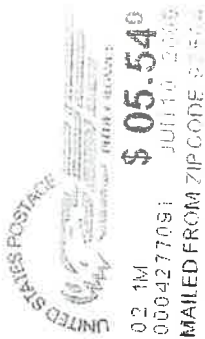

UNCLAIMED

NAME AKB
1st Notice 4/11
2nd Notice 6/16
Return 6/26

Clifford Dorn
25 Trails End
Mountain Center, CA 92561

UNC

RECD JUL 06 2009

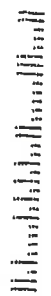

U.S. Postal Service™
CERTIFIED MAIL™ RECEIPT
(Domestic Mail Only; No Insurance Coverage Provided)
For delivery information visit our website at www.usps.com

OFFICIAL USE

Postage	\$	
Certified Fee		
Return Receipt Fee (Endorsement Required)		
Restricted Delivery Fee (Endorsement Required)		

Total: **Clifford Dorn**
25 Trails End
Mountain Center, CA 92561
CV08-00025 RR

PS Form 3800, August 2006 See Reverse for Instructions

EXHIBIT NO. E 10

County of Riverside
Code Enforcement Department
39493 Los Alamos Road
Murrieta, CA 92563

CERTIFIED MAIL™



7006 2760 0000 0573 7125



N/S

Clifford Dorn
32235 Morris Ranch Rd.
Hemet, CA 92543

REC'D JUN 15 2009

NIXIE

829 SE 1 05 05/11/09

RETURN TO SENDER
NO SUCH STREET
UNABLE TO FORWARD

EC: 9256300000 *2577-07447-10-99



7006 2760 0000 0573 7125

U.S. Postal Service™		CERTIFIED MAIL™ RECEIPT	
<i>(Domestic Mail Only; No Insurance Coverage Provided)</i>			
For delivery information visit our website at www.usps.com			
OFFICIAL USE			
Postage	\$	Postmark Here	
Certified Fee			
Return Receipt Fee (Endorsement Required)			
Registered Mail Fee			
Res. (End)			
To	Clifford Dorn		
City	32235 Morris Ranch Rd.		
State or P	Hemet, CA 92543		
Zip	CV08-0025 RR		
PS Form 3800, August 2006		See Reverse for Instructions	

EXHIBIT NO. _____

E''

County of Riverside
Code Enforcement Department
39493 Los Alamos Road
Murrieta, CA 92563

ANK

Clifford Dorn
9395 Corbie Ct.
Calimesa, CA 92320

NL 6-11-09

CERTIFIED MAIL™



7006 2760 0000 0573 7101



NIXIE 923 SE 1 05 06/13/09

RETURN TO SENDER
ATTEMPTED - NOT KNOWN
UNABLE TO FORWARD

BC: 9256305039 9256305039 *1977-00331-13-52

9256305039



7006 2760 0000 0573 7101

U.S. Postal Service™
CERTIFIED MAIL™ RECEIPT
(Domestic Mail Only; No Insurance Coverage Provided)

For delivery information visit our website at www.usps.com

OFFICIAL USE

Postage	\$	
Certified Fee		
Return Receipt Fee (Endorsement Required)		
Restricted Delivery Fee (Endorsement)		

Total Po: **Clifford Dorn**

Sent To: **9395 Corbie Ct.**

Street, Apt or PO Box: **Calimesa, CA 92320**

City, State: **CV08-00025 RR**

PS Form 3800, August 2006 See Reverse for Instructions

Postmark Here

EXHIBIT NO. E12

When recorded please mail to:
Mail Stop# 5155
Riverside County
Code Enforcement Department
39493 Los Alamos Rd.
Murrieta, CA 92563

DOC # 2010-0251765
06/01/2010 08:00A Fee:NC
Page 1 of 1
Recorded in Official Records
County of Riverside
Larry W. Ward
Assessor, County Clerk & Recorder



059
M
059

NOTICE OF NONCOMPLIANCE

In the matter of the Property of

Case No.: CV08-00025

CLIFFORD G. DORN

NOTICE IS HEREBY GIVEN to all persons, pursuant to Section 10 of Ordinance Number 725 of the County of Riverside, State of California, that proceedings have been commenced with respect to violations of Riverside County Ordinance No.541,(RCC Title 8.120.010), described as ACCUMULATED RUBBISH Such Proceedings are based upon the noncompliance of such real property, located at 32235 MORRIS RANCH ROAD, HEMET, CA, and more particularly described as Assessor's Parcel Number 568-110-029 and having a legal description of 20.00 ACRES M/L IN POR NW 1/4 OF SEC 17 T6S R4E FOR TOTAL DESCRIPTION SEE ASSESSORS MAPS. Records of Riverside County, with the requirements of Ordinance No. 541 (RCC Title 8.120.010)

The owner has been advised to immediately correct the above-referenced violation to avoid further action by the County of Riverside, which may include remediation or restoration to abate the public nuisance or other remedies available to the department by a court of competent jurisdiction. Any costs incurred by the County, including, but not limited to investigative, administrative and abatement costs and attorneys' fees, may become a lien on the property. Further details regarding this notice may be obtained by addressing an inquiry to the Code Enforcement Department, 39493 Los Alamos Road, Murrieta, CA,; Attention Code Enforcement Officer Jason Heagstedt (951) 600-6140.

NOTICE IS FURTHER GIVEN in accordance with §17274 and §24436.5 of the California Revenue and Taxation Code, that a tax deduction may not be allowed for interest, taxes, depreciation, or amortization paid or incurred in the taxable year affected by these proceedings.

COUNTY OF RIVERSIDE
DEPARTMENT OF CODE ENFORCEMENT

By: Hector Viray
Hector Viray
Code Enforcement Department

ACKNOWLEDGEMENT

State of California)
County of Riverside)

On 05/26/10 before me, Elizabeth B. Ross, Notary Public, personally appeared Hector Viray, who proved to me on the basis of satisfactory evidence to be the person(s) whose name(s) is/are subscribed to the within instrument and acknowledged to me that he/she/they executed the same in his/her/their authorized capacity(ies), and that by his/her/their signature(s) on the instrument the person(s), or the entity upon behalf of which the person(s) acted, executed the instrument.

I certify under PENALTY OF PERJURY under the laws of the State of California that the foregoing paragraph is true and correct.
WITNESS my hand and official seal.

Elizabeth B. Ross
Commission # 1838743 Comm. Expires March 12, 2013

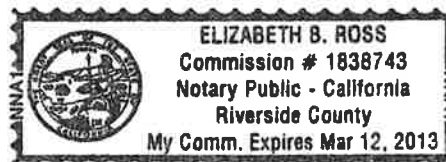

EXHIBIT NO. 4

When recorded please mail to:
Mail Stop# 5155
Riverside County
Code Enforcement Department
39493 Los Alamos Rd.
Murrieta, CA 92563

DOC # 2010-0251764

06/01/2010 08:00A Fee:NC

Page 1 of 1

Recorded in Official Records

County of Riverside

Larry W. Ward

Assessor, County Clerk & Recorder



0
059
M
059

NOTICE OF NONCOMPLIANCE

In the matter of the Property of

Case No.: CV08-00026

CLIFFORD G. DORN

NOTICE IS HEREBY GIVEN to all persons, pursuant to Section 10 of Ordinance Number 725 of the County of Riverside, State of California, that proceedings have been commenced with respect to violations of Riverside County Ordinance No.348,(RCC Title 17.16.010), described as EXCESSIVE OUTSIDE STORAGE Such Proceedings are based upon the noncompliance of such real property, located at 32235 MORRIS RANCH ROAD, HEMET, CA, and more particularly described as Assessor's Parcel Number 568-110-029 and having a legal description of 20.00 ACRES M/L IN POR NW 1/4 OF SEC 17 T6S R4E FOR TOTAL DESCRIPTION SEE ASSESSORS MAPS. Records of Riverside County, with the requirements of Ordinance No. 348 (RCC Title 17.16.010)

The owner has been advised to immediately correct the above-referenced violation to avoid further action by the County of Riverside, which may include remediation or restoration to abate the public nuisance or other remedies available to the department by a court of competent jurisdiction. Any costs incurred by the County, including, but not limited to investigative, administrative and abatement costs and attorneys' fees, may become a lien on the property. Further details regarding this notice may be obtained by addressing an inquiry to the Code Enforcement Department, 39493 Los Alamos Road, Murrieta, CA,; Attention Code Enforcement Officer Jason Heagstedt (951) 600-6140.

NOTICE IS FURTHER GIVEN in accordance with §17274 and §24436.5 of the California Revenue and Taxation Code, that a tax deduction may not be allowed for interest, taxes, depreciation, or amortization paid or incurred in the taxable year affected by these proceedings.

COUNTY OF RIVERSIDE
DEPARTMENT OF CODE ENFORCEMENT

By: *Hector Viray*
Hector Viray
Code Enforcement Department

ACKNOWLEDGEMENT

State of California)
County of Riverside)

On 05/26/10 before me, Elizabeth B. Ross, Notary Public, personally appeared Hector Viray, who proved to me on the basis of satisfactory evidence to be the person(s) whose name(s) is/are subscribed to the within instrument and acknowledged to me that he/she/they executed the same in his/her/their authorized capacity(ies), and that by his/her/their signature(s) on the instrument the person(s), or the entity upon behalf of which the person(s) acted, executed the instrument.

I certify under PENALTY OF PERJURY under the laws of the State of California that the foregoing paragraph is true and correct.
WITNESS my hand and official seal.

Elizabeth B-Ross
Commission # 1838743 Comm. Expires March 12, 2013

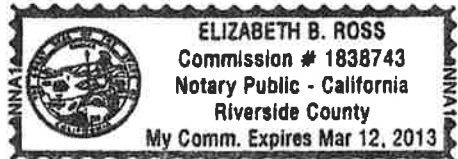

F-2
EXHIBIT NO.

PAMELA J. WALLS
County Counsel

OFFICE OF COUNTY COUNSEL
COUNTY OF RIVERSIDE



KATHERINE A. LIND
Assistant County Counsel

3960 ORANGE STREET, SUITE 500
RIVERSIDE, CA 92501-3674
TELEPHONE: 951/955-6300
FAX: 951/955-6322 & 951/955-6363

January 19, 2011

**NOTICE TO CORRECT COUNTY ORDINANCE VIOLATIONS
AND ABATE PUBLIC NUISANCE**

TO: Owners and Interested Parties
(See Attached Proof of Service
and Attached Notice List)

Case Nos.: CV08-00025 & CV08-00026
APN: 568-110-029; DORN
Property: 32235 Morris Ranch Rd., Hemet

NOTICE IS HEREBY GIVEN that a hearing will be held before the Riverside County Board of Supervisors pursuant to Riverside County Ordinance Nos. 348 and 541 (RCC Titles 17 & 8.120) and 725 (RCC Title 1) to consider the abatement of the accumulated rubbish and excessive outside storage located on the SUBJECT PROPERTY described as 32235 Morris Ranch Rd., Hemet, **Riverside County, California**, and more particularly described as Assessor's Parcel Number 568-110-029.

YOU ARE HEREBY DIRECTED as owner of the SUBJECT PROPERTY, to appear at this hearing to show cause why the SUBJECT PROPERTY should not be condemned as a public nuisance and be abated by removing the accumulated rubbish and excessive outside storage from the real property.

SAID HEARING will be held on **Tuesday, February 8, 2011, at 9:30 a.m.** in the Board of Supervisors Room, County Administrative Center, 4080 Lemon Street, 1st Floor Annex, Riverside, California at which time and place pertinent evidence will be received and/or testimony from all concerned parties will be heard. Failure to appear on your behalf will result in the exclusion of your testimony, and facts as known to the Code Enforcement Department ("Department") will be presented to the Board of Supervisors for consideration and deliberation in this matter.

Please be advised that the costs already accrued in this case, including but not limited to, enforcement and investigation costs, are recoverable by the Department, as allowed under Riverside County Ordinance No. 725. The Department may seek recovery of such costs from the property owner(s) which may result in a special assessment lien against the SUBJECT PROPERTY. Additionally, should the Department abate the property, the costs associated therewith, as well as all abatement costs allowed under Riverside County Ordinance No. 725 (RCC Title 1), will be sought from the property owner(s) and/or may result in a special assessment lien against the property.

You are encouraged to contact Supervising Code Enforcement Hector Viray at (951) 600-6140 or the undersigned prior to the hearing. Please meet the undersigned and Brian Black, Supervising Code Enforcement Officer, at 8:30 a.m. on the day of the hearing in Conference Room 2A located on the 1st floor in front of the Human Resources Office to discuss the case.

PAMELA J. WALLS
Riverside County Counsel



L. Alexandra Fong
Deputy County Counsel

EXHIBIT NO. 6

NOTICE LIST

Subject Property: 32235 Morris Ranch Rd., Hemet
Case No.: CV 08-00025 and CV08-00026; APN: 568-110-029; District 3

CLIFFORD G. DORN
32235 MORRIS RANCH RD.
HEMET, CA 92543

CLIFFORD G. DORN
9395 CORBIE CT.
CALIMESA, CA 92320

CLIFFORD G. DORN
25 TRAILS END
MOUNTAIN CENTER, CA 92561

ALBERT J. GUANCHE
32235 MORRIS RANCH RD.
HEMET, CA 92543

EXHIBIT NO. _____

G²

NOTICE LIST

Subject Property: 32235 Morris Ranch Rd., Hemet
Case No. CV 08-00025 and CV08-00026; APN: 568-110-029; District 3

Office of County Counsel
3960 Orange Street, Suite 500
Riverside, CA 92501

CERTIFIED MAIL™



7010 1670 0001 7232 6843

CLIFFORD G DORN
32235 MORRIS RANCH RD
HEMET CA 92543

TH 2/5/11



UNITED STATES POSTAGE
PITNEY BOWES
02 1P
0003958246 JAN 19 2011
MAILED FROM ZIP CODE 92501
\$ 005.540

NIXIE 923 DE 1 00 01/21/11

RETURN TO SENDER
INSUFFICIENT ADDRESS
UNABLE TO FORWARD

BC: 92501364425 *0704-06295-19-45



7010 1670 0001 7232 6836



PITNEY BOWES
02 1P
0003958246 JAN 19 2011
MAILED FROM ZIP CODE 92501
\$ 005.540

Riverside, CA 92501

ALBERT J GUANCHE
32235 MORRIS RANCH RD
HEMET CA 92543

NIXIE 923 SE 1 00 01/21/11

RETURN TO SENDER
NO SUCH STREET
UNABLE TO FORWARD

BC: 92501364425 *0904-15412-19-42

92501364425



93 EXHIBIT NO.

NOTICE LIST

Subject Property: 32235 Morris Ranch Rd., Hemet
Case No.: CV 08-00025 and CV08-00026; APN: 568-110-029; District 3

11/12/10 00 1 32 625 SIXIN
RETURN TO SENDER
NO SUCH NUMBER
UNABLE TO FORWARD
BC: 92501364425 *1977-04277-21-34

92501364425
32 6812

02 1P \$ 005.540
0003958246 JAN 19 2011
MAILED FROM ZIP CODE 92501
UNITED STATES POSTAGE
PITNEY BOWES

NSN
CLIFFORD G DORN
25 TRAILS END
MOUNTAIN CENTER CA 92561

EXHIBIT NO. 54

701D 167D 0001 7232 6829

02 1P \$ 005.540
0003958246 JAN 19 2011
MAILED FROM ZIP CODE 92501

CLIFFORD G. DORN
9395 CORBIE CT
CALIMESA CA 92320

UNK

NIXIE 923 SE 1 05 01/22/11

RETURN TO SENDER
UNDELIVERABLE AS ADDRESSED
UNABLE TO FORWARD

BC: 92501364425 *2604-00620-19-38

523209895203644

|||||

1
2
3
4
5
6
7
8
9
10
11
12
13
14
15
16
17
18
19
20
21
22
23
24
25
26
27
28

PROOF OF SERVICE
Case Nos. CV08-00025 & CV08-00026

STATE OF CALIFORNIA, COUNTY OF RIVERSIDE

I, Brenda Peeler, declare that I am a citizen of the United States and am employed in the County of Riverside, over the age of 18 years and not a party to the within action or proceeding; that my business address is 3960 Orange Street, Suite 500, Riverside, California 92501.

That on January 19, 2011, I served the following document(s):

**NOTICE TO CORRECT COUNTY ORDINANCE VIOLATIONS
AND ABATE PUBLIC NUISANCE**

by placing a true copy thereof enclosed in a sealed envelope(s) addressed as follows:

**Owners or Interested Parties
(see attached notice list)**

XX **BY CERTIFIED MAIL, RETURN RECEIPT REQUESTED.** I am "readily familiar" with the office's practice of collection and processing correspondence for mailing. Under that practice it would be deposited with the U.S. Postal Service on that same day with postage thereon fully prepaid at Riverside, California, in the ordinary course of business.

— **BY PERSONAL SERVICE:** I caused to be delivered such envelope(s) by hand to the offices of the addressee(s).

XX **STATE - I declare under penalty of perjury under the laws of the State of California that the above is true and correct.**

— **FEDERAL - I declare that I am employed in the office of a member of the bar of this court at whose direction the service was made.**

EXECUTED ON January 19, 2011, at Riverside, California.

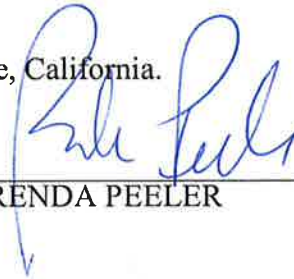

BRENDA PEELER

EXHIBIT NO. 65



**CODE ENFORCEMENT DEPARTMENT
COUNTY OF RIVERSIDE**

GLENN BAUDE
Director

AFFIDAVIT OF POSTING OF NOTICES

January 20, 2011

RE CASE NO: CV0800025

I, Carol Forrey, hereby declare:

I am employed by the Riverside County Code Enforcement Department; that my business address is 39493 Los Alamos Road, Suite #A, Murrieta, California 92563 .

That on 01/20/11 at 10:05AM, I securely and conspicuously posted NOTICE OF ABATEMENT HEARING at the property described as:

Property Address: 32235 MORRIS RANCH RD, HEMET

Assessor's Parcel Number: 568-110-029

I declare under the penalty of perjury that the foregoing is true and correct.

Executed on January 20, 2011 in the County of Riverside, California.

CODE ENFORCEMENT DEPARTMENT



By: Carol Forrey, Code Enforcement Officer

EXHIBIT NO. 56

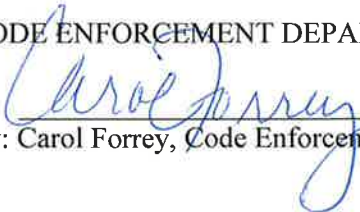

**CODE ENFORCEMENT DEPARTMENT
COUNTY OF RIVERSIDE**

GLENN BAUDE
Director

AFFIDAVIT OF POSTING OF NOTICES

January 20, 2011

RE CASE NO: CV0800026

I, Carol Forrey, hereby declare:

I am employed by the Riverside County Code Enforcement Department; that my business address is 39493 Los Alamos Road, Suite #A, Murrieta, California 92563 .

That on 01/20/11 at 10:05AM, I securely and conspicuously posted NOTICE OF ABATEMENT HEARING at the property described as:

Property Address: 32235 MORRIS RANCH RD, HEMET

Assessor's Parcel Number: 568-110-029

I declare under the penalty of perjury that the foregoing is true and correct.

Executed on January 20, 2011 in the County of Riverside, California.

CODE ENFORCEMENT DEPARTMENT

By: Carol Forrey, Code Enforcement Officer

EXHIBIT NO. _____

G⁷