

**SUBMITTAL TO THE BOARD OF SUPERVISORS  
COUNTY OF RIVERSIDE, STATE OF CALIFORNIA**

420B



**FROM:** County Counsel  
Code Enforcement Department

**SUBMITTAL DATE:**  
January 27, 2011

**SUBJECT:** Statement of Expense [Case No. CV 08-01744]  
Subject Property: 1 Parcel E/O 21676 Bonham St., Perris; ZAMORA / VELASQUEZ  
APN: 315-171-019  
District One

Departmental Concurrence

**RECOMMENDED MOTION:** Move that the Board of Supervisors:

- (1) assess the reasonable costs of abatement of a public nuisance (accumulated rubbish) in the above-referenced matter to be **one thousand, five hundred eighty-nine dollars and ten cents (US \$1,589.10)**;
- (2) assess the costs of abatement against the above-described subject property;
- (3) authorize the recordation of a notice of abatement lien; and
- (4) authorize the abatement costs to be added to the tax roll as a special assessment
- (5) authorize and direct the Code Enforcement Department to take any reasonable actions to collect the amount owed.

*L. Alexandra Fong*  
\_\_\_\_\_  
L. ALEXANDRA FONG, Deputy County Counsel  
for PAMELA J. WALLS, County Counsel

<b>FINANCIAL DATA</b>	Current F.Y. Total Cost:	\$ N/A	In Current Year Budget:	N/A
	Current F.Y. Net County Cost:	\$ N/A	Budget Adjustment:	N/A
	Annual Net County Cost:	\$ N/A	For Fiscal Year:	N/A

<b>SOURCE OF FUNDS:</b>	<b>Positions To Be Deleted Per A-30</b>	<input type="checkbox"/>
	<b>Requires 4/5 Vote</b>	<input type="checkbox"/>

**C.E.O. RECOMMENDATION:** APPROVE  
BY: *Jennifer L. Sargent*  
\_\_\_\_\_  
Jennifer L. Sargent  
County Executive Office Signature

Consent  
 Policy  
 Consent  
 Policy

Dept's Recomm.:  
 Per Exec. Ofc.:

**MINUTES OF THE BOARD OF SUPERVISORS**

On motion of Supervisor Stone, seconded by Supervisor Benoit and duly carried by unanimous vote, IT WAS ORDERED that the above matter is approved as recommended.

Ayes: Buster, Tavaglione, Stone, Benoit and Ashley  
 Nays: None  
 Absent: None  
 Date: February 8, 2011  
 xc: Co. Co., CED, Prop. Owner

Kecia Harper-Ihem  
Clerk of the Board  
By: *Kecia Harper-Ihem*  
\_\_\_\_\_  
Deputy

**Prev. Agn. Ref.:** | **District:** 1 | **Agenda Number:**

9.9

Statement of Expense [Case No. CV08-01744]

Subject Property: 1 Parcel E/O 21676 Bonham St., Perris; ZAMORA / VELASQUEZ

APN: 315-171-019

District One

Page 2

**BACKGROUND:** Government Code § 25845, Riverside County Ordinance Nos. 541(RCC Chapter 8.120) and 725 (RCC Chapter 1.16) authorize the recovery of abatement costs in public nuisance cases, the recordation of a notice of abatement lien and inclusion of abatement costs on the tax roll as a special assessment upon approval of the Board of Supervisors.

On March 7, 2008 a Notice Violation and Order to Remove Rubbish was issued on the subject property. On or about May 27, 2010, the accumulated rubbish was abated from the subject property under the direction of the Riverside County Code Enforcement Department.

The property has a delinquent tax status as of 2008.

The Notice of Hearing re Statement of Expense has been posted on the property and mailed to the property owner and all interested parties, as required by law. Copies of all relevant notices issued in this matter together with proof of service and posting have been separately filed with the Clerk of the Board and are made a part of the record herein, pursuant to Riverside County Ordinance 725.

**SUBMITTAL TO THE BOARD OF SUPERVISORS  
COUNTY OF RIVERSIDE, STATE OF CALIFORNIA**

**FROM:** County Counsel  
Code Enforcement Department  
**SUBJECT:** Statement of Expense [Case No. CV08-01744]  
Subject Property: 1 Parcel E/O 21676 Bonham Street, Perris  
APN: 315-171-019; ZAMORA / VELASQUEZ  
District One

**TABLE OF SUPPLEMENTAL DOCUMENTS  
FILED WITH THE CLERK OF THE BOARD**

**Hearing Date: FEBRUARY 8, 2011**

Notice of Statement Expense Hearing (including Proofs of Service, Affidavits of Posting and Return Receipts) .....	Exhibit A
Statement of Expense Worksheet with Supporting Documents .....	Exhibit B
Assessment-Roll For The Year 10/11 And Geographic Information System, Jan. 20, 2011.....	Exhibit C

PAMELA J. WALLS  
County Counsel

OFFICE OF COUNTY COUNSEL  
COUNTY OF RIVERSIDE



KATHERINE A. LIND  
Assistant County Counsel

3960 ORANGE STREET, SUITE 500  
RIVERSIDE, CA 92501-3674  
TELEPHONE: 951/955-6300  
FAX: 951/955-6322 & 951/955-6363

January 20, 2011

## NOTICE OF HEARING RE: STATEMENT OF EXPENSE

To: Owner(s) or Interested Parties  
(See Attached Proof of Service  
and Notice List)

Subject Property: 1 Parcel E/O 21676 Bonham St., Perris  
Case Nos.: CV08-01744; ZAMORA / VELASQUEZ  
APN: 315-171-019

**NOTICE IS HEREBY GIVEN** that a hearing will be held before the Riverside County Board of Supervisors on **Tuesday, February 8, 2011, at 9:30 a.m.** in the Board of Supervisors Room, 4080 Lemon Street, 1st Floor Annex, Riverside, California, at which time and place pertinent testimony will be heard regarding the expenses incurred by the County of Riverside, Code Enforcement Department ("DEPARTMENT") for the above-referenced abatement case. Said abatement case involved accumulated rubbish located on your real property commonly described as 1 Parcel E/O 21676 Bonham St., Perris, Riverside County, California and more particularly described as Assessor's Parcel Number 315-171-019.

The total expense due, including all other fees and costs, for the abatement of the above-described dangerous or injurious condition is **one thousand, five hundred eighty-nine dollars and ten cents, (US \$1,589.10)**. This amount is immediately due and payable. If you have any objections to the Statement of Expense attached hereto, you must address your objections to the Board of Supervisors at the hearing. If you have any questions about the attached Statement of Expense or would like to see additional documents in support of costs set forth on the Statement of Expense Worksheet, please contact the undersigned at (951) 955-6300. In the event the total amount due is not paid to the DEPARTMENT prior to the Board Hearing, the DEPARTMENT shall seek an order from the Board of Supervisors to place a lien against your property and collect the amount due as a special tax assessment.

Failure to appear at the hearing will result in the exclusion of your testimony. Facts as known to the DEPARTMENT will be presented to the Board of Supervisors for their final consideration and deliberation of this matter.

**You are encouraged to contact Supervising Code Enforcement Officer, Brian Black (951) 955-2004 prior to the hearing. Please meet with the undersigned or Brian Black at 8:30 a.m. on the day of the hearing in Conference Room 2A located on the 1st floor in front of the Human Resources Office to discuss the case.**

PAMELA J. WALLS  
County Counsel

  
\_\_\_\_\_  
L. ALEXANDRA FONG  
Deputy County Counsel

Enclosure: Statement of Expense

EXHIBIT NO.     A



# County of Riverside Code Enforcement Department

P.O. Box 1469, Riverside, CA 92502  
Phone: (951) 955-2004 Fax: (951) 955-8680  
demands@rctlma.org

## Statement of Expense

315171019  
RAFAEL ZAMORA  
MARIA VELASQUEZ  
16144 MILLER AVE  
FONTANA CA. 92336

Date	Invoice #
12/28/2010	100108

Case Number	District	Class
CV0801744	1	SOE

Property Address
315171019 RAFAEL ZAMORA & MARIA VELASQUEZ 1 P/E OF 21676 BONHAM ST PERRIS, CA

Date	Item	Description	Hours/Qty	Rate	Amount
3/6/2008	Officer Hours	Labor Charges - Officer Time	0.2	82.00	16.40
3/7/2008	Officer Hours	Labor Charges - Officer Time	0.3	82.00	24.60
3/11/2008	Officer Hours	Labor Charges - Officer Time	0.6	82.00	49.20
3/10/2010	Officer Hours	Labor Charges - Officer Time	0.2	129.00	25.80
4/16/2010	Officer Hours	Labor Charges - Officer Time	0.3	109.00	32.70
5/27/2010	Officer Hours	Labor Charges - Officer Time	1.1	82.00	90.20
5/27/2010	Officer Hours	Labor Charges - Officer Time	1.1	109.00	119.90
	SOE Preparation	Prepare Statement of Expense		65.00	65.00
		Subtotal Code Enforcement Costs			423.80
	Prepare Case for SOE He...			125.55	125.55
	Attend SOE Hearing			69.75	69.75
		Subtotal County Counsel Costs			195.30
5/27/2010	Demolition & Disposal	Demolition & Disposal	1	850.00	850.00
12/28/2010	Lot/Title Report	Lot/Title Report		120.00	120.00
		Subtotal Contractor Costs			970.00
<b>Subtotal</b>					<b>\$1,589.10</b>
<b>Payments/Credits</b>					<b>\$0.00</b>
<b>Total</b>					<b>\$1,589.10</b>

I affirm and declare under penalty of perjury under the laws of the State of California that the foregoing is true and correct.

  
 Code Enforcement Department

EXHIBIT NO.     A2

# NOTICE LIST

Subject Property: 1 Parcel E/O 21676 Bonham St., Perris; Case No.: CV08-01744;  
APN: 315-171-019; District One

RAFAEL ZAMORA  
MARIA VICTORIA VELASQUEZ  
16144 MILLER AVE  
FONTANA CA 92336

SPECIAL PROCEDURES SECTION  
PO BOX 2952  
SACTO CA 95812-2952

EXHIBIT NO. \_\_\_\_\_

A<sup>3</sup>



# Track & Confirm

## Search Results

Label/Receipt Number: **7010 1670 0001 7232 7086**  
Service(s): **Certified Mail™**  
Status: **Delivered**

Your item was delivered at 8:46 am on January 25, 2011 in SACRAMENTO, CA 95812.

Track & Confirm

Enter Label/Receipt Number.

### Detailed Results:

- **Delivered, January 25, 2011, 8:46 am, SACRAMENTO, CA 95812**
- **Notice Left (No Authorized Recipient Available), January 25, 2011, 7:33 am, SACRAMENTO, CA 95812**
- **Arrival at Unit, January 25, 2011, 7:15 am, SACRAMENTO, CA 95814**

### Notification Options

#### Track & Confirm by email

Get current event information or updates for your item sent to you or others by email.

7010 1670 0001 7232 7086

<b>U.S. Postal Service™</b> <b>CERTIFIED MAIL™ RECEIPT</b> <i>(Domestic Mail Only; No Insurance Coverage Provided)</i>	
For delivery information visit our website at <a href="http://www.usps.com">www.usps.com</a>	
<b>OFFICIAL USE</b>	
Postage	\$ 44
Certified Fee	2.80
Return Receipt Fee (Endorsement Required)	2.30
Restricted Delivery Fee (Endorsement Required)	
<b>Total Postage &amp; Fees</b>	<b>\$ 5.54</b>
Postmark Here	
Mailed 1/20/11	
<b>Sent To</b> SPECIAL PROCEDURES SECTION PO BOX 2952 SACTO CA 95812-2952	
PS Form 3800, August 2006 See Reverse for Instructions	

EXHIBIT NO. A4



# Track & Confirm

## Search Results

Label/Receipt Number: **7010 1670 0001 7232 7499**  
Service(s): **Certified Mail™**  
Status: **Notice Left**

We attempted to deliver your item at 11:27 am on January 24, 2011 in FONTANA, CA 92336 and a notice was left. You may arrange redelivery by visiting [www.usps.com/redelivery](http://www.usps.com/redelivery) or calling 800-ASK-USPS, or may pick up the item at the Post Office indicated on the notice. If this item is unclaimed after 15 days then it will be returned to the sender. Information, if available, is updated periodically throughout the day. Please check again later.

### Detailed Results:

- Notice Left, January 24, 2011, 11:27 am, FONTANA, CA 92336
- Arrival at Unit, January 22, 2011, 6:09 am, FONTANA, CA 92335

### Notification Options

#### Track & Confirm by email

Get current event information or updates for your item sent to you or others by email. [Go >](#)

### Track & Confirm

Enter Label/Receipt Number.

[Go >](#)

7010 1670 0001 7232 7499

**U.S. Postal Service™**  
**CERTIFIED MAIL™ RECEIPT**  
(Domestic Mail Only; No Insurance Coverage Provided)

For delivery information visit our website at [www.usps.com](http://www.usps.com)

**OFFICIAL USE**

Postage	\$ 1.44	Mailed 1/20/11  Postmark Here
Certified Fee	2.80	
Return Receipt Fee (Endorsement Required)	2.30	
Restricted Delivery Fee (Endorsement Required)		
<b>Total Postage &amp; Fees</b>	<b>\$ 5.54</b>	

Sent To: RAFAEL ZAMORA  
Street, Apt or PO Box: MARIA VICTORIA VELASQUEZ  
City, State: 16144 MILLER AVE  
FONTANA CA 92336

PS Form 3800, August 2006

A5

EXHIBIT NO. \_\_\_\_\_







**CODE ENFORCEMENT DEPARTMENT  
COUNTY OF RIVERSIDE**

GLENN BAUDE  
Director

**AFFIDAVIT OF POSTING OF NOTICES**

January 24, 2011

RE CASE NO: CV0801744

I, Marco Diaz, hereby declare:

I am employed by the Riverside County Code Enforcement Department; that my business address is 19450 Clark Street, Perris, California 92570 .

That on 01/24/2011 at 12:41pm, I securely and conspicuously posted a NOTICE OF HEARING RE: STATEMENT OF EXPENSE at the property described as:

**Property Address:** 1 Parcel East of (21676 Bonham St), Perris

**Assessor's Parcel Number:** 315-171-019

I declare under the penalty of perjury that the foregoing is true and correct.

Executed on January 24, 2011 in the County of Riverside, California.

CODE ENFORCEMENT DEPARTMENT

  
By: Marco Diaz, Code Enforcement Technician

EXHIBIT NO.     A<sup>7</sup>



# County of Riverside Code Enforcement Department

P.O. Box 1469, Riverside, CA 92502  
Phone: (951) 955-2004 Fax: (951) 955-8680  
demands@rctlma.org

## Statement of Expense

315171019  
RAFAEL ZAMORA  
MARIA VELASQUEZ  
16144 MILLER AVE  
FONTANA CA. 92336

Date	Invoice #
12/28/2010	100108

Case Number	District	Class
CV0801744	1	SOE

Property Address
315171019 RAFAEL ZAMORA & MARIA VELASQUEZ 1 P/E OF 21676 BONHAM ST PERRIS, CA

Date	Item	Description	Hours/Qty	Rate	Amount
3/6/2008	Officer Hours	Labor Charges - Officer Time	0.2	82.00	16.40
3/7/2008	Officer Hours	Labor Charges - Officer Time	0.3	82.00	24.60
3/11/2008	Officer Hours	Labor Charges - Officer Time	0.6	82.00	49.20
3/10/2010	Officer Hours	Labor Charges - Officer Time	0.2	129.00	25.80
4/16/2010	Officer Hours	Labor Charges - Officer Time	0.3	109.00	32.70
5/27/2010	Officer Hours	Labor Charges - Officer Time	1.1	82.00	90.20
5/27/2010	Officer Hours	Labor Charges - Officer Time	1.1	109.00	119.90
	SOE Preparation	Prepare Statement of Expense		65.00	65.00
		Subtotal Code Enforcement Costs			423.80
	Prepare Case for SOE He...			125.55	125.55
	Attend SOE Hearing			69.75	69.75
		Subtotal County Counsel Costs			195.30
5/27/2010	Demolition & Disposal	Demolition & Disposal	1	850.00	850.00
12/28/2010	Lot/Title Report	Lot/Title Report		120.00	120.00
		Subtotal Contractor Costs			970.00
<b>Subtotal</b>					<b>\$1,589.10</b>
<b>Payments/Credits</b>					<b>\$0.00</b>
<b>Total</b>					<b>\$1,589.10</b>

I affirm and declare under penalty of perjury under the laws of the State of California that the foregoing is true and correct.

\_\_\_\_\_  
 Code Enforcement Department

EXHIBIT NO.     B

# F.E. Services, Inc.

8891 Mission Blvd - Riverside CA 92509

Job Name 21676 Bonham, Perris, Ca 92570

## PAYMENT REQUEST

P.O.# TLA0049333  
Job No. FEASB20101010

### GENERAL INFORMATION

Customer Name County of Riverside TLMA Administration  
Address P.O. Box 1605  
City, State and Zip Code Riverside, Ca 92502  
Phone No. 951-955-1858

Date 27-May-10  
Invoice No. 193  
Due On Upon Receipt

FAX No. 951-955-1859

### ORIGINAL CONTRACT

Contract Description	Contract Amount	Previous %	Progress%	Total %	Requested Amount
1) <u>Oringal Contract</u>	\$650.00			100%	\$650.00
2) <u>Removal of Black Sheeting</u>	\$200.00			100%	\$200.00
3)					
4)					
5)					
6)					
7)					
8)					
9)					
10)					
Totals From 2nd Page					
<b>Original Contract Totals</b>	<b>\$850.00</b>				<b>\$850.00</b>

**FAXED**  
05/27/2010

**MAILED**  
05-27-2010

#### NOTES:

Case # CP09-11178  
APN: 315 171-019

6/18/10  
\$850

### APPROVED CHANGE ORDERS

C.O. #	Amount	Total %	Requested Amount
1			
2			
3			
4			
5			
6			
7			
8			
9			
10			
2nd Page			
Total C.O.'s			

### PAYMENT REQUEST SUMMARY

Total Current Contract Amount	\$850.00
Work Completed To Date	\$850.00
Less Retention %	0%
Subtotal	\$850.00
Less Previous Payment Requests	\$0.00
Amount Due This Payment Request	\$850.00

EXHIBIT NO. **B<sup>2</sup>**

### F.E. Services, Inc. OFFICE USE ONLY

Vendor No. \_\_\_\_\_ Job No. FEASB20101010  
Item SUB Code \_\_\_\_\_ Type \_\_\_\_\_ Clean Up \_\_\_\_\_  
Extension \_\_\_\_\_ Entered 6/18/10  
Approved \_\_\_\_\_ Date Paid 6/18/10  
App. No. \_\_\_\_\_ Check No. 0502040610

Tel: (951) 332-0174

Fax: (951) 332-6230



# INVOICE

**Order Number:** 23061 **Order Date:** 1/11/2011

**Customer Information:**

Acct No. 1044

RIVERSIDE COUNTY TLMA-CODE ENFORCEMENT  
4080 Lemon Street  
Riverside, CA 92501

Attn: Brent Steele  
REF: CV08-01744 / Brenda Peeler  
IN RE: ZAMORA, RAFAEL

Product and/or Service ordered for Property known as:	
<b>Vacant Land</b>	
<b>DESCRIPTION:</b>	<b>FEE:</b>
Lot Book Report	\$120.00
<b>TOTAL DUE:</b>	\$120.00

Payment due upon receipt. Please remit to:

RZ Title Services, Inc.  
P.O. Box 1193  
Whittier, CA 90609

EXHIBIT NO. \_\_\_\_\_

B<sup>3</sup>

Assessment Roll For the 2010-2011 Tax Year as of January 1,2010

Assessment #315171019-8		Parcel # 315171019-8	
<b>Assessee:</b>	ZAMORA RAFAEL	<b>Land</b>	89,988
<b>Assessee:</b>	VELASQUEZ MARIA	<b>Full Value</b>	89,988
	VICTORIA	<b>Total Net</b>	89,988
<b>Mail Address:</b>	16144 MILLER AVE		
<b>City, State Zip:</b>	FONTANA CA 92336		
<b>Real Property Use Code:</b>	YY	<b>View Parcel Map</b>	
<b>Base Year</b>	2007		
<b>Conveyance Number:</b>	0513155		
<b>Conveyance (mm/yy):</b>	1/2007		
<b>PUI:</b>	Y040000		
<b>TRA:</b>	98-044		
<b>Taxability Code:</b>	0-00		
<b>ID Data:</b>	Lot 120 MB 014/099 UPTON ACRES 6		

EXHIBIT NO.           c

RIVERSIDE COUNTY GIS

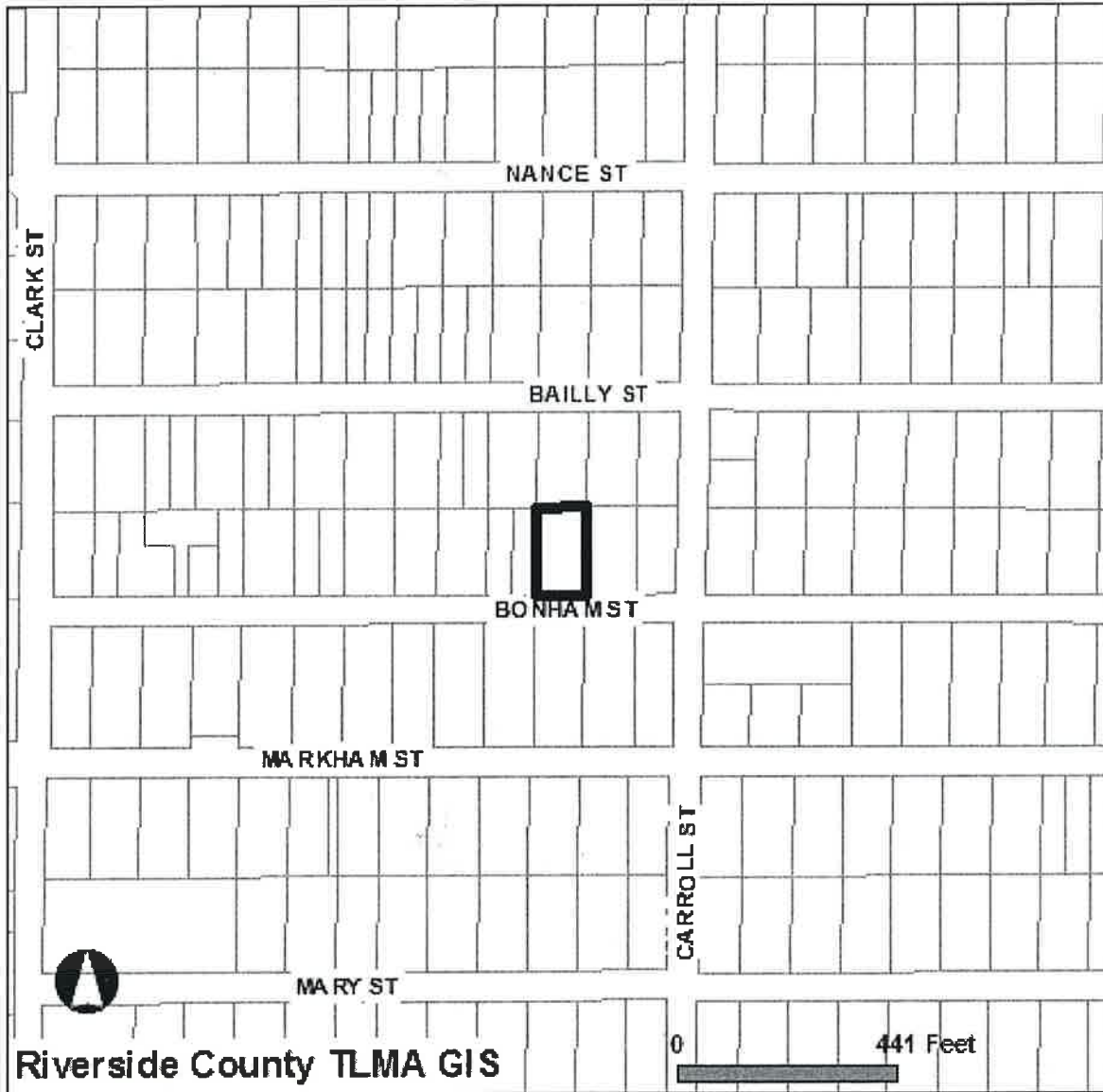

Selected parcel(s):  
315-171-019

**\*IMPORTANT\***

Maps and data are to be used for reference purposes only. Map features are approximate, and are not necessarily accurate to surveying or engineering standards. The County of Riverside makes no warranty or guarantee as to the content (the source is often third party), accuracy, timeliness, or completeness of any of the data provided, and assumes no legal responsibility for the information contained on this map. Any use of this product with respect to accuracy and precision shall be the sole responsibility of the user.

STANDARD REPORT

**APNs**

315-171-019-8

**OWNER NAME / ADDRESS**

RAFAEL ZAMORA  
MARIA VELASQUEZ  
ADDRESS NOT AVAILABLE

**MAILING ADDRESS**

(SEE OWNER)  
16144 MILLER AVE  
FONTANA CA. 92336

EXHIBIT NO.           C<sup>2</sup>

**LEGAL DESCRIPTION**

RECORDED BOOK/PAGE: MB 14/99  
SUBDIVISION NAME: UPTON ACRES 6  
LOT/PARCEL: 120, BLOCK: NOT AVAILABLE  
TRACT NUMBER: NOT AVAILABLE

**LOT SIZE**

RECORDED LOT SIZE IS 0.44 ACRES

**PROPERTY CHARACTERISTICS**

NO PROPERTY DESCRIPTION AVAILABLE

**THOMAS BROS. MAPS PAGE/GRID**

PAGE: 776 GRID: J1

**CITY BOUNDARY/SPHERE**

NOT WITHIN A CITY  
CITY SPHERE: PERRIS  
NO ANNEXATION DATE AVAILABLE  
NO LAFCO CASE # AVAILABLE  
NO PROPOSALS

**MARCH JOINT POWERS AUTHORITY**

NOT IN THE JURISDICTION OF THE MARCH JOINT POWERS AUTHORITY

**INDIAN TRIBAL LAND**

NOT IN A TRIBAL LAND

**SUPERVISORIAL DISTRICT (ORD. 813)**

BOB BUSTER, DISTRICT 1

**TOWNSHIP/RANGE**

T4SR4W SEC 3

**ELEVATION RANGE**

1703 FEET

**PREVIOUS APN**

NO DATA AVAILABLE

---

**PLANNING**

---

**LAND USE DESIGNATIONS**

Zoning not consistent with the General Plan.  
RC-LDR

**AREA PLAN (RCIP)**

MEAD VALLEY

**GENERAL PLAN POLICY OVERLAYS**

NOT IN A GENERAL PLAN POLICY OVERLAY AREA

**GENERAL PLAN POLICY AREAS**

NONE

**ZONING CLASSIFICATIONS (ORD. 348)**

R-R-1/2 (CZ 6312)

**ZONING DISTRICTS AND ZONING AREAS**

MEAD VALLEY DISTRICT

**ZONING OVERLAYS**

NOT IN A ZONING OVERLAY

**SPECIFIC PLANS**

NOT WITHIN A SPECIFIC PLAN

**AGRICULTURAL PRESERVE**

NOT IN AN AGRICULTURAL PRESERVE

**REDEVELOPMENT AREAS**

PROJECT AREA NAME: I-215 CORRIDOR  
SUBAREA NAME: MEAD VALLEY  
AMENDMENT NUMBER: 0  
ADOPTION DATE: DEC. 23, 1986  
ACREAGE: 2580 ACRES



**AIRPORT INFLUENCE AREAS**

MARCH AIR RESERVE BASE

**AIRPORT COMPATIBILITY ZONES**

NOT IN AN AIRPORT COMPATIBILITY ZONE

***ENVIRONMENTAL*****CVMSHCP (COACHELLA VALLEY MULTI-SPECIES HABITAT CONSERVATION PLAN) CONSERVATION AREA**

NOT IN A CONSERVATION AREA

**CVMSHCP FLUVIAL SAND TRANSPORT SPECIAL PROVISION AREAS**

NOT IN A FLUVIAL SAND TRANSPORT SPECIAL PROVISION AREA

**WRMSHCP (WESTERN RIVERSIDE COUNTY MULTI-SPECIES HABITAT CONSERVATION PLAN) CELL GROUP**

NOT IN A CELL GROUP

**WRMSHCP CELL NUMBER**

NOT IN A CELL

**HANS/ERP (HABITAT ACQUISITION AND NEGOTIATION STRATEGY/EXPEDITED REVIEW PROCESS)**

NONE

**VEGETATION (2005)**

Developed/Disturbed Land

***FIRE*****HIGH FIRE AREA (ORD. 787)**

NOT IN A HIGH FIRE AREA

**FIRE RESPONSIBILITY AREA**

NOT IN A FIRE RESPONSIBILITY AREA

***DEVELOPMENT FEES*****CVMSHCP FEE AREA (ORD. 875)**

NOT WITHIN THE COACHELLA VALLEY MSHCP FEE AREA

**WRMSHCP FEE AREA (ORD. 810)**

IN OR PARTIALLY WITHIN THE WESTERN RIVERSIDE MSHCP FEE AREA. SEE MAP FOR MORE INFORMATION.

**ROAD & BRIDGE DISTRICT**

NOT IN A DISTRICT

**EASTERN TUMF (TRANSPORTATION UNIFORM MITIGATION FEE ORD. 673)**

NOT WITHIN THE EASTERN TUMF FEE AREA

**WESTERN TUMF (TRANSPORTATION UNIFORM MITIGATION FEE ORD. 824)**

IN OR PARTIALLY WITHIN A TUMF FEE AREA. SEE MAP FOR MORE INFORMATION. CENTRAL

**DIF (DEVELOPMENT IMPACT FEE AREA ORD. 659)**

MEAD VALLEY

**SKR FEE AREA (STEPHEN'S KANGAROO RAT ORD. 663.10)**

IN OR PARTIALLY WITHIN AN SKR FEE AREA. SEE MAP FOR MORE INFORMATION.

**DEVELOPMENT AGREEMENTS**

NOT IN A DEVELOPMENT AGREEMENT AREA

***TRANSPORTATION*****CIRCULATION ELEMENT ULTIMATE RIGHT-OF-WAY**

NOT IN A CIRCULATION ELEMENT RIGHT-OF-WAY

**ROAD BOOK PAGE**

58A

**TRANSPORTATION AGREEMENTS**

NOT IN A TRANSPORTATION AGREEMENT

**CETAP (COMMUNITY AND ENVIRONMENTAL TRANSPORTATION ACCEPTABILITY PROCESS) CORRIDORS**  
NOT IN A CETAP CORRIDOR.

---

## **HYDROLOGY**

---

**FLOOD PLAIN REVIEW**  
NOT REQUIRED.

**WATER DISTRICT**  
EMWD

**FLOOD CONTROL DISTRICT**  
RIVERSIDE COUNTY FLOOD CONTROL DISTRICT

**WATERSHED**  
SANTA ANA RIVER

---

## **GEOLOGIC**

---

**FAULT ZONE**  
NOT IN A FAULT ZONE

**FAULTS**  
NOT WITHIN A 1/2 MILE OF A FAULT

**LIQUEFACTION POTENTIAL**  
NO POTENTIAL FOR LIQUEFACTION EXISTS

**SUBSIDENCE**  
NOT IN A SUBSIDENCE AREA

**PALEONTOLOGICAL SENSITIVITY**  
LOW POTENTIAL.  
FOLLOWING A LITERATURE SEARCH, RECORDS CHECK AND A FIELD SURVEY, AREAS MAY BE DETERMINED BY A QUALIFIED VERTEBRATE PALEONTOLOGIST AS HAVING LOW POTENTIAL FOR CONTAINING SIGNIFICANT PALEONTOLOGICAL RESOURCES SUBJECT TO ADVERSE IMPACTS.

---

## **MISCELLANEOUS**

---

**SCHOOL DISTRICT**  
VAL VERDE UNIFIED

**COMMUNITIES**  
MEAD VALLEY

**COUNTY SERVICE AREA**  
IN OR PARTIALLY WITHIN  
MEAD VALLEY #117 -  
STREET LIGHTING

**LIGHTING (ORD. 655)**  
ZONE B, 41.89 MILES FROM MT. PALOMAR OBSERVATORY

**2000 CENSUS TRACT**  
042010

**FARMLAND**  
URBAN-BUILT UP LAND

**TAX RATE AREAS**  
098-044  
• COUNTY FREE LIBRARY  
• COUNTY SERVICES AREA 117  
• COUNTY STRUCTURE FIRE PROTECTION  
• COUNTY WASTE RESOURCE MGMT DIST  
• CSA 152  
• EASTERN MUNICIPAL WATER  
• FLOOD CONTROL ADMINISTRATION  
• FLOOD CONTROL ZONE 4  
• GENERAL

- GENERAL PURPOSE
- METRO WATER EAST 1301999
- PERRIS AREA ELEM SCHOOL FUND
- PERRIS JR HIGH AREA FUND
- PERRIS VALLEY CEMETERY
- PROJECT 5-MEAD VALLEY
- RIV CO REG PARK & OPEN SPACE
- RIV. CO. OFFICE OF EDUCATION
- RIVERSIDE CITY COMMUNITY COLLEGE
- SAN JACINTO BASIN RESOURCE CONS
- VAL VERDE UNIF
- WATER

**SPECIAL NOTES**

NO SPECIAL NOTES

**CODE COMPLAINTS**

NO CODE COMPLAINTS

REPORT PRINTED ON...Thu Jan 20 08:10:58 2011  
Version 101221