

**SUBMITTAL TO THE BOARD OF SUPERVISORS  
COUNTY OF RIVERSIDE, STATE OF CALIFORNIA**

621B



**FROM:** County Counsel  
Code Enforcement Department

**SUBMITTAL DATE:**  
Feb. 16, 2011

**SUBJECT:** Statement of Expense [CV07-8338]  
Subject Property: 1 Parcel W/O 22113 Cajalco Road, Perris; RODRIGUEZ / BAHENA  
APN: 317-060-010  
District One

Departmental Concurrence

**RECOMMENDED MOTION:** Move that the Board of Supervisors:

- (1) assess the reasonable costs of abatement of a public nuisance [substandard mobile homes (x4)] in the above-referenced matter to be **one thousand, eight hundred fifty-nine dollars and sixty cents (US \$1,859.60)**;
- (2) assess the costs of abatement against the above-described subject property;
- (3) authorize the recordation of a notice of abatement lien; and
- (4) authorize the abatement costs to be added to the tax roll as a special assessment
- (5) authorize and direct the Code Enforcement Department to take any reasonable actions to collect the amount owed.

*L. Alexandra Fong*  
L. ALEXANDRA FONG, Deputy County Counsel  
for PAMELA J. WALLS, County Counsel

<b>FINANCIAL DATA</b>	Current F.Y. Total Cost:	\$ N/A	In Current Year Budget:	N/A
	Current F.Y. Net County Cost:	\$ N/A	Budget Adjustment:	N/A
	Annual Net County Cost:	\$ N/A	For Fiscal Year:	N/A

<b>SOURCE OF FUNDS:</b>	Positions To Be Deleted Per A-30	<input type="checkbox"/>
	Requires 4/5 Vote	<input type="checkbox"/>

**C.E.O. RECOMMENDATION:** APPROVE

BY: *Jennifer L. Sargent*  
County Executive Office Signature: Jennifer L. Sargent

- Consent
- Policy
- Consent
- Policy

**MINUTES OF THE BOARD OF SUPERVISORS**

On motion of Supervisor Tavaglione, seconded by Supervisor Ashley and duly carried, IT WAS ORDERED that the above matter is approved as recommended.

Ayes: Buster, Tavaglione, Stone and Ashley  
Nays: None  
Absent: Benoit  
Date: March 1, 2011  
xc: Co. Co., CED, Prop. Owner

Kecia Harper-Ihem  
Clerk of the Board  
By: *Kecia Harper-Ihem*  
Deputy

Dep't Recomm.:  
Per Exec. Ofc.:

Prev. Agn. Ref.: | District: 1 | Agenda Number: | 9.7

Statement of Expense [Case No. CV07-8338]

Subject Property: 1 Parcel W/O 22113 Cajalco Road, Perris; RODRIGUEZ / BAHENA

APN: 317-060-010

District One

Page 2

**BACKGROUND:** Government Code § 25845, Riverside County Ordinance Nos. 457 (RCC Title 15) and 725 (RCC Title 1.16) authorize the recovery of abatement costs in public nuisance cases, the recordation of a notice of abatement lien and inclusion of abatement costs on the tax roll as a special assessment upon approval of the Board of Supervisors.

Notices of Violation were issued. Subsequently, on or about Aug. 29, 2008, the substandard mobile homes were demolished by the property owners. However, this Statement of Expense does not address any other violations and/or costs associated with other case numbers regarding the subject property.

The Notice of Hearing re Statement of Expense has been posted on the property and mailed to the property owner and all interested parties, as required by law. Copies of all relevant notices issued in this matter together with proof of service and posting have been separately filed with the Clerk of the Board and are made a part of the record herein, pursuant to Riverside County Ordinance 725.

**SUBMITTAL TO THE BOARD OF SUPERVISORS  
COUNTY OF RIVERSIDE, STATE OF CALIFORNIA**

**FROM:** County Counsel  
Code Enforcement Department  
**SUBJECT:** Statement of Expense [Case No. CV07-8338]  
Subject Property: 1Parcel W/O 2213 Cajalco Rd., Perris; RODRIGUEZ/BAHENA  
APN: 317-060-010  
District One

**TABLE OF SUPPLEMENTAL DOCUMENTS  
FILED WITH THE CLERK OF THE BOARD**

**Hearing Date: MARCH 1, 2011**

Notice of Statement Expense Hearing (including Proofs of Service, Affidavits of Posting and Return Receipts) .....	Exhibit A
Statement of Expense Worksheet with Supporting Documents .....	Exhibit B
Assessment-Roll For The Year 10/11 And Geographic Information System, Feb. 8, 2011 .....	Exhibit C

PAMELA J. WALLS  
County Counsel

OFFICE OF COUNTY COUNSEL  
COUNTY OF RIVERSIDE



KATHERINE A. LIND  
Assistant County Counsel

3960 ORANGE STREET, SUITE 500  
RIVERSIDE, CA 92501-3674  
TELEPHONE: 951/955-6300  
FAX: 951/955-6322 & 951/955-6363

February 8, 2011

## NOTICE OF HEARING RE: STATEMENT OF EXPENSE

To: Owners and Interested Parties  
(See attached Proof of Service  
and Notice List)

Subject Property: 1 Parcel W/O 22113 Cajalco Rd., Perris  
Case No.: CV07-8338; RODRIGUEZ / BAHENA  
APN: 317-060-010

**NOTICE IS HEREBY GIVEN** that a hearing will be held before the Riverside County Board of Supervisors on **Tuesday, March 1, 2011 at 9:30 a.m.** in the Board of Supervisors Room, 4080 Lemon Street, 1st Floor Annex, Riverside, California, at which time and place pertinent testimony will be heard regarding the expenses incurred by the County of Riverside, Code Enforcement Department ("DEPARTMENT") for the above-referenced abatement proceeding. Said abatement proceeding involved the removal of substandard mobile homes (x4) located on your real property commonly described as 1 Parcel W/O 22113 Cajalco Rd., Perris and more particularly described as Assessor's Parcel Number 317-060-010.

The total expense due, including all other fees and costs, for the removal of the above-described dangerous or injurious condition is **one thousand, eight hundred fifty-nine dollars and sixty cents, (US \$1,859.60)**. This amount is immediately due and payable. If you have any objections to the Statement of Expense attached hereto, you must address your objections to the Board of Supervisors at the hearing. If you have any questions about the attached Statement of Expense or would like to see additional documents in support of costs set forth on the Statement of Expense Worksheet, please contact the undersigned at (951) 955-6300. In the event the total amount due is not paid to the DEPARTMENT prior to the Board Hearing, the DEPARTMENT shall seek an order from the Board of Supervisors to place a lien against your property and collect the amount due as a special tax assessment.

Failure to appear at the hearing will result in the exclusion of your testimony. Facts as known to the DEPARTMENT will be presented to the Board of Supervisors for their final consideration and deliberation of this matter.

**You are encouraged to contact Supervising Code Enforcement Officer, Brian Black (951) 955-2004 prior to the hearing. Please meet with the undersigned or Brian Black at 8:30 a.m. on the day of the hearing in Conference Room 2A located on the 1st floor in front of the Human Resources Office to discuss the case.**

PAMELA J. WALLS  
County Counsel

  
L. ALEXANDRA FONG  
Deputy County Counsel

Enclosure: Statement of Expense

EXHIBIT NO.     A

# NOTICE LIST

Subject Property: 1 Parcel W/O 22113 Cajalco Rd., Perris; Case No.: CV07-8338;  
APN: 317-060-010; District One

EVENCIO RODRIGUEZ  
VICTORIA BAHENA  
511 S HILL STREET NO B  
ORANGE CA 92869

EXHIBIT NO. \_\_\_\_\_

A<sup>2</sup>



# County of Riverside Code Enforcement Department

P.O. Box 1469, Riverside, CA 92502  
Phone: (951) 955-2004 Fax: (951) 955-8680  
demands@rctlma.org

## Statement of Expense

317060010  
EVENCIO RODRIGUEZ  
VICTORIA BAHENA  
511 S HILL ST NO B  
ORANGE CA. 92869

Date	Invoice #
12/30/2010	100120

Property Address
317060010 1 PARCEL W OF 22113 CAJALCO RD PERRIS CA

Case Number	District	Class
CV078338	1	SOE

Date	Item	Description	Hours/Qty	Rate	Amount
10/3/2007	Officer Hours	Labor Charges - Officer Time	1.1	109.00	119.90
10/23/2007	Officer Hours	Labor Charges - Officer Time	0.4	82.00	32.80
11/5/2007	Officer Hours	Labor Charges - Officer Time	0.2	109.00	21.80
11/6/2007	Officer Hours	Labor Charges - Officer Time	0.2	109.00	21.80
11/27/2007	Officer Hours	Labor Charges - Officer Time	0.2	109.00	21.80
12/6/2007	Officer Hours	Labor Charges - Officer Time	0.3	109.00	32.70
1/15/2008	Officer Hours	Labor Charges - Officer Time	1	109.00	109.00
2/26/2008	Officer Hours	Labor Charges - Officer Time	0.5	109.00	54.50
3/3/2008	Officer Hours	Labor Charges - Officer Time	0.5	109.00	54.50
3/6/2008	Officer Hours	Labor Charges - Officer Time	0.2	109.00	21.80
3/13/2008	Officer Hours	Labor Charges - Officer Time	0.1	129.00	12.90
4/15/2008	Officer Hours	Labor Charges - Officer Time	2.2	109.00	239.80
4/16/2008	Officer Hours	Labor Charges - Officer Time	3	109.00	327.00
8/12/2008	Officer Hours	Labor Charges - Officer Time	0.3	109.00	32.70
8/15/2008	Officer Hours	Labor Charges - Officer Time	0.6	109.00	65.40
8/29/2008	Officer Hours	Labor Charges - Officer Time	0.1	109.00	10.90
12/30/2010	SOE Preparation	Prepare Statement of Expense		65.00	65.00
		Subtotal Code Enforcement Costs			1,244.30
12/30/2010	Prepare Case for SOE He...			125.55	125.55
	Attend SOE Hearing			69.75	69.75
		Subtotal County Counsel Costs			195.30
<b>Subtotal</b>					
<b>Payments/Credits</b>					
<b>Total</b>					

I affirm and declare under penalty of perjury under the laws of the State of California that the foregoing is true and correct.

Code Enforcement Department

**EXHIBIT NO**           A<sup>3</sup>



# County of Riverside Code Enforcement Department

P.O. Box 1469, Riverside, CA 92502  
Phone: (951) 955-2004 Fax: (951) 955-8680  
demands@rctlma.org

## Statement of Expense

317060010  
EVENCIO RODRIGUEZ  
VICTORIA BAHENA  
511 S HILL ST NO B  
ORANGE CA. 92869

Date	Invoice #
12/30/2010	100120

Property Address
317060010 1 PARCEL W OF 22113 CAJALCO RD PERRIS CA

Case Number	District	Class
CV078338	1	SOE

Date	Item	Description	Hours/Qty	Rate	Amount
11/28/2007	Lot/Title Report	Lot/Title Report	1	150.00	150.00
5/1/2008	Lot/Title Report	Lot/Title Report	1	150.00	150.00
12/30/2010	Lot/Title Report	Lot/Title Report		120.00	120.00
		Subtotal Contractor Costs			420.00
<b>Subtotal</b>					\$1,859.60
<b>Payments/Credits</b>					\$0.00
<b>Total</b>					\$1,859.60

I affirm and declare under penalty of perjury under the laws of the State of California that the foregoing is true and correct.

  
Code Enforcement Department

A4

**PROOF OF SERVICE**

Case No. CV07-8338

1  
2  
3  
4  
5  
6  
7  
8  
9  
10  
11  
12  
13  
14  
15  
16  
17  
18  
19  
20  
21  
22  
23  
24  
25  
26  
27  
28

STATE OF CALIFORNIA, COUNTY OF RIVERSIDE

I, Brenda G. Peeler, declare that I am a citizen of the United States and am employed in the County of Riverside, over the age of 18 years and not a party to the within action or proceeding; that my business address is 3960 Orange Street, Suite 500, Riverside, California 92501.

That on Feb. 8, 2011, I served the following document(s):

- NOTICE OF HEARING RE: STATEMENT OF EXPENSE
- STATEMENT OF EXPENSE WORKSHEET

by placing a true copy thereof enclosed in a sealed envelope(s) addressed as follows:

**OWNERS OR INTERESTED PARTIES  
(SEE NOTICE LIST ATTACHED TO NOTICE OF HEARING)**

XX BY CERTIFIED MAIL, RETURN RECEIPT REQUESTED. I am "readily familiar" with the office's practice of collection and processing correspondence for mailing. Under that practice it would be deposited with the U.S. Postal Service on that same day with postage thereon fully prepaid at Riverside, California, in the ordinary course of business.

\_\_\_ BY PERSONAL SERVICE: I caused to be delivered such envelope(s) by hand to the offices of the addressee(s).

XX STATE - I declare under penalty of perjury under the laws of the State of California that the above is true and correct.

\_\_\_ FEDERAL - I declare that I am employed in the office of a member of the bar of this court at whose direction the service was made.

EXECUTED ON Feb. 8, 2011, at Riverside, California.

  
\_\_\_\_\_  
BRENDA G. PEELER

EXHIBIT NO. AS





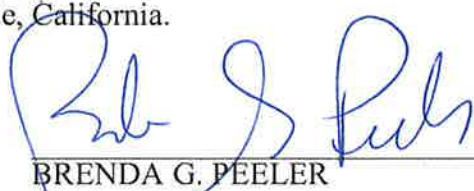

**CODE ENFORCEMENT DEPARTMENT  
COUNTY OF RIVERSIDE**

GLENN BAUDE  
Director

**AFFIDAVIT OF POSTING OF NOTICES**

February 10, 2011

RE CASE NO: CV078338

I, Jon Kirchoff, hereby declare:

I am employed by the Riverside County Code Enforcement Department; that my business address is 19450 Clark Street, Perris, California 92570 .

That on 02/10/2011 at 1140 hours, I securely and conspicuously posted the \"Notice of Hearing\" re: Statement of Expense, at the property described as:

**Property Address:** ,

**Assessor's Parcel Number:** 317-060-010

I declare under the penalty of perjury that the foregoing is true and correct.

Executed on February 10, 2011 in the County of Riverside, California.

CODE ENFORCEMENT DEPARTMENT

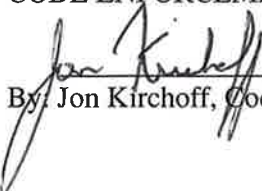
  
By: Jon Kirchoff, Code Enforcement Officer

**EXHIBIT NO.**     A<sup>7</sup>



# County of Riverside Code Enforcement Department

P.O. Box 1469, Riverside, CA 92502  
Phone: (951) 955-2004 Fax: (951) 955-8680  
demands@rctlma.org

## Statement of Expense

317060010  
EVENCIO RODRIGUEZ  
VICTORIA BAHENA  
511 S HILL ST NO B  
ORANGE CA. 92869

Date	Invoice #
12/30/2010	100120

Case Number	District	Class
CV078338	1	SOE

Property Address
317060010 1 PARCEL W OF 22113 CAJALCO RD PERRIS CA

Date	Item	Description	Hours/Qty	Rate	Amount
10/3/2007	Officer Hours	Labor Charges - Officer Time	1.1	109.00	119.90
10/23/2007	Officer Hours	Labor Charges - Officer Time	0.4	82.00	32.80
11/5/2007	Officer Hours	Labor Charges - Officer Time	0.2	109.00	21.80
11/6/2007	Officer Hours	Labor Charges - Officer Time	0.2	109.00	21.80
11/27/2007	Officer Hours	Labor Charges - Officer Time	0.2	109.00	21.80
12/6/2007	Officer Hours	Labor Charges - Officer Time	0.3	109.00	32.70
1/15/2008	Officer Hours	Labor Charges - Officer Time	1	109.00	109.00
2/26/2008	Officer Hours	Labor Charges - Officer Time	0.5	109.00	54.50
3/3/2008	Officer Hours	Labor Charges - Officer Time	0.5	109.00	54.50
3/6/2008	Officer Hours	Labor Charges - Officer Time	0.2	109.00	21.80
3/13/2008	Officer Hours	Labor Charges - Officer Time	0.1	129.00	12.90
4/15/2008	Officer Hours	Labor Charges - Officer Time	2.2	109.00	239.80
4/16/2008	Officer Hours	Labor Charges - Officer Time	3	109.00	327.00
8/12/2008	Officer Hours	Labor Charges - Officer Time	0.3	109.00	32.70
8/15/2008	Officer Hours	Labor Charges - Officer Time	0.6	109.00	65.40
8/29/2008	Officer Hours	Labor Charges - Officer Time	0.1	109.00	10.90
12/30/2010	SOE Preparation	Prepare Statement of Expense		65.00	65.00
		Subtotal Code Enforcement Costs			1,244.30
12/30/2010	Prepare Case for SOE He...			125.55	125.55
	Attend SOE Hearing			69.75	69.75
		Subtotal County Counsel Costs			195.30
				<b>Subtotal</b>	
				<b>Payments/Credits</b>	
				<b>Total</b>	

I affirm and declare under penalty of perjury under the laws of the State of California that the foregoing is true and correct.

EXHIBIT NO.     B    

\_\_\_\_\_  
Code Enforcement Department



# County of Riverside Code Enforcement Department

P.O. Box 1469, Riverside, CA 92502  
Phone: (951) 955-2004 Fax: (951) 955-8680  
demands@rctlma.org

## Statement of Expense

317060010  
EVENCIO RODRIGUEZ  
VICTORIA BAHENA  
511 S HILL ST NO B  
ORANGE CA. 92869

Date	Invoice #
12/30/2010	100120

Property Address
317060010 1 PARCEL W OF 22113 CAJALCO RD PERRIS CA

Case Number	District	Class
CV078338	1	SOE

Date	Item	Description	Hours/Qty	Rate	Amount
11/28/2007	Lot/Title Report	Lot/Title Report	1	150.00	150.00
5/1/2008	Lot/Title Report	Lot/Title Report	1	150.00	150.00
12/30/2010	Lot/Title Report	Lot/Title Report		120.00	120.00
		Subtotal Contractor Costs			420.00
				<b>Subtotal</b>	\$1,859.60
				<b>Payments/Credits</b>	\$0.00
				<b>Total</b>	\$1,859.60

I affirm and declare under penalty of perjury under the laws of the State of California that the foregoing is true and correct.

Code Enforcement Department





# INVOICE

**Order Number:** 23092 **Order Date:** 1/25/2011

**Customer Information:**

Acct No. 1044

RIVERSIDE COUNTY TLMA-CODE ENFORCEMENT  
4080 Lemon Street  
Riverside, CA 92501

Attn: Brent Steele  
REF: CV07-8338 / Brenda Peeler  
IN RE: RODRIGUEZ, EVENCIO

Product and/or Service ordered for Property known as:	
<b>Vacant Land</b>	
<b>DESCRIPTION:</b> Lot Book Report	<b>FEE:</b> \$120.00
<b>TOTAL DUE:</b>	\$120.00

Payment due upon receipt. Please remit to:

RZ Title Services, Inc.  
P.O. Box 1193  
Whittier, CA 90609

EXHIBIT NO. B4

Assessment Roll For the 2010-2011 Tax Year as of January 1,2010

Assessment #317060010-0		Parcel # 317060010-0	
<b>Assessee:</b>	RODRIGUEZ EVENCIO	<b>Land</b>	103,792
<b>Assessee:</b>	BAHENA VICTORIA	<b>Full Value</b>	103,792
<b>Mail Address:</b>	511 S HILL ST NO B	<b>Total Net</b>	103,792
<b>City, State Zip:</b>	ORANGE CA 92869		
<b>Real Property Use Code:</b>	YY		
<b>Base Year</b>	2007		
<b>Conveyance Number:</b>	0906435		
<b>Conveyance (mm/yy):</b>	12/2006		
<b>PUI:</b>	Y040000		
<b>TRA:</b>	98-110		
<b>Taxability Code:</b>	0-00		
<b>ID Data:</b>	Lot 12 RS 052/049		

[View Parcel Map](#)

**EXHIBIT NO.**     C

RIVERSIDE COUNTY GIS

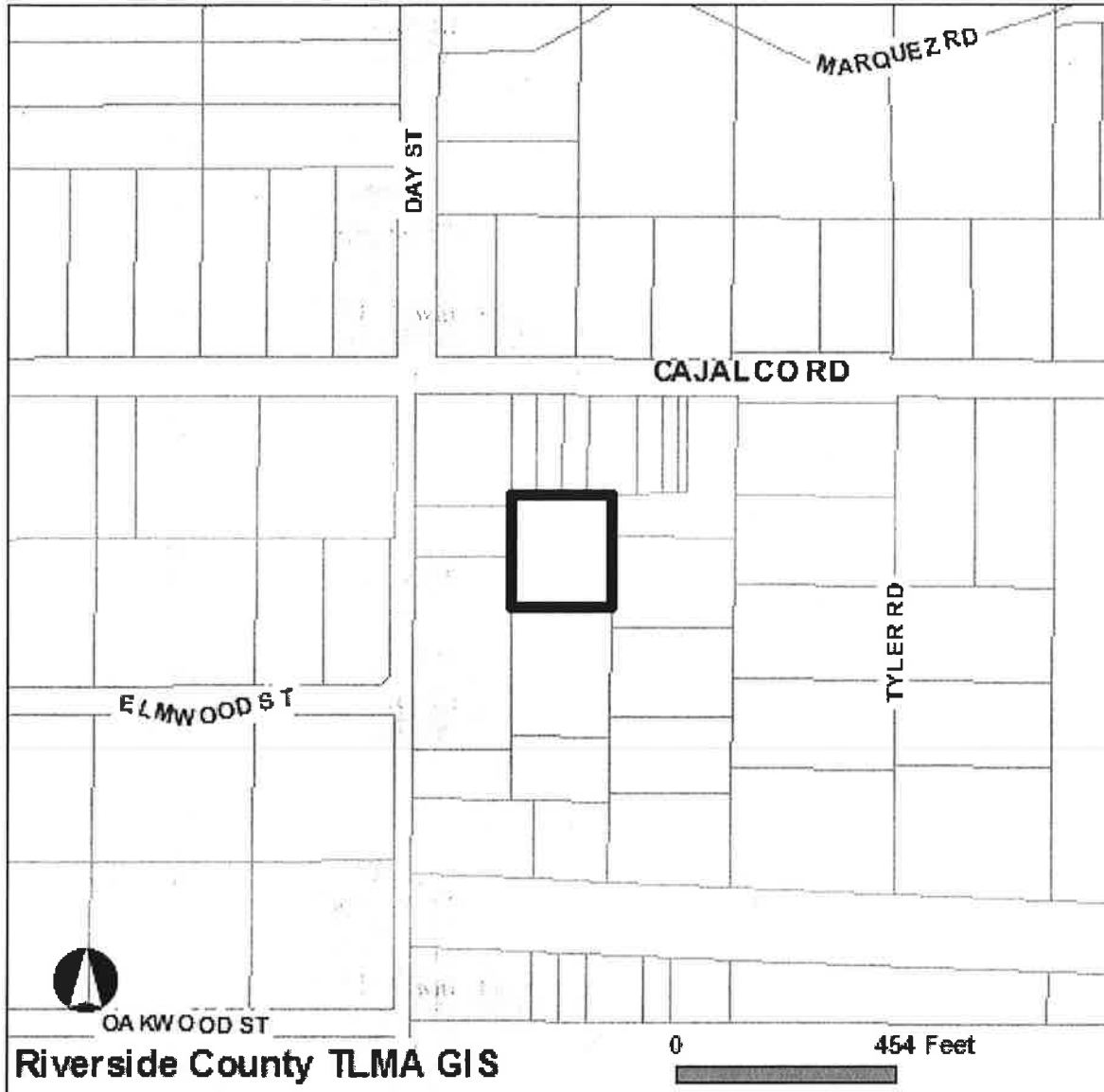

Selected parcel(s):  
317-060-010

**\*IMPORTANT\***

Maps and data are to be used for reference purposes only. Map features are approximate, and are not necessarily accurate to surveying or engineering standards. The County of Riverside makes no warranty or guarantee as to the content (the source is often third party), accuracy, timeliness, or completeness of any of the data provided, and assumes no legal responsibility for the information contained on this map. Any use of this product with respect to accuracy and precision shall be the sole responsibility of the user.

STANDARD REPORT

**APNs**

317-060-010-0

**OWNER NAME / ADDRESS**

EVENCIO RODRIGUEZ  
VICTORIA BAHENA  
ADDRESS NOT AVAILABLE

**MAILING ADDRESS**

(SEE OWNER)  
511 S HILL ST NO B  
ORANGE CA. 92869

EXHIBIT NO.           C<sup>2</sup>



**LEGAL DESCRIPTION**

RECORDED BOOK/PAGE: RS 52/49  
SUBDIVISION NAME: NOT AVAILABLE  
LOT/PARCEL: 12, BLOCK: NOT AVAILABLE  
TRACT NUMBER: NOT AVAILABLE

**LOT SIZE**

RECORDED LOT SIZE IS 1.12 ACRES

**PROPERTY CHARACTERISTICS**

NO PROPERTY DESCRIPTION AVAILABLE

**THOMAS BROS. MAPS PAGE/GRID**

PAGE: 777 GRID: A3

**CITY BOUNDARY/SPHERE**

NOT WITHIN A CITY  
CITY SPHERE: PERRIS  
NO ANNEXATION DATE AVAILABLE  
NO LAFCO CASE # AVAILABLE  
NO PROPOSALS

**MARCH JOINT POWERS AUTHORITY**

NOT IN THE JURISDICTION OF THE MARCH JOINT POWERS AUTHORITY

**INDIAN TRIBAL LAND**

NOT IN A TRIBAL LAND

**SUPERVISORIAL DISTRICT (ORD. 813)**

BOB BUSTER, DISTRICT 1

**TOWNSHIP/RANGE**

T4SR4W SEC 11

**ELEVATION RANGE**

1688/1692 FEET

**PREVIOUS APN**

NO DATA AVAILABLE

---

**PLANNING**

---

**LAND USE DESIGNATIONS**

Zoning not consistent with the General Plan.  
RC-VLDR

**AREA PLAN (RCIP)**

MEAD VALLEY

**GENERAL PLAN POLICY OVERLAYS**

NOT IN A GENERAL PLAN POLICY OVERLAY AREA

**GENERAL PLAN POLICY AREAS**

NONE

**ZONING CLASSIFICATIONS (ORD. 348)**

A-1-1

**ZONING DISTRICTS AND ZONING AREAS**

MEAD VALLEY DISTRICT

**ZONING OVERLAYS**

NOT IN A ZONING OVERLAY

**SPECIFIC PLANS**

NOT WITHIN A SPECIFIC PLAN

**AGRICULTURAL PRESERVE**

NOT IN AN AGRICULTURAL PRESERVE

**REDEVELOPMENT AREAS**

PROJECT AREA NAME: I-215 CORRIDOR  
SUBAREA NAME: MEAD VALLEY  
AMENDMENT NUMBER: 2  
ADOPTION DATE: JUL. 16, 2002  
ACREAGE: 3444 ACRES

**AIRPORT INFLUENCE AREAS**

MARCH AIR RESERVE BASE

**AIRPORT COMPATIBILITY ZONES**

NOT IN AN AIRPORT COMPATIBILITY ZONE

**ENVIRONMENTAL**

**CVMSHCP (COACHELLA VALLEY MULTI-SPECIES HABITAT CONSERVATION PLAN) CONSERVATION AREA**

NOT IN A CONSERVATION AREA

**CVMSHCP FLUVIAL SAND TRANSPORT SPECIAL PROVISION AREAS**

NOT IN A FLUVIAL SAND TRANSPORT SPECIAL PROVISION AREA

**WRMSHCP (WESTERN RIVERSIDE COUNTY MULTI-SPECIES HABITAT CONSERVATION PLAN) CELL GROUP**

NOT IN A CELL GROUP

**WRMSHCP CELL NUMBER**

NOT IN A CELL

**HANS/ERP (HABITAT ACQUISITION AND NEGOTIATION STRATEGY/EXPEDITED REVIEW PROCESS)**

NONE

**VEGETATION (2005)**

Developed/Disturbed Land

**FIRE**

**HIGH FIRE AREA (ORD. 787)**

NOT IN A HIGH FIRE AREA

**FIRE RESPONSIBILITY AREA**

NOT IN A FIRE RESPONSIBILITY AREA

**DEVELOPMENT FEES**

**CVMSHCP FEE AREA (ORD. 875)**

NOT WITHIN THE COACHELLA VALLEY MSHCP FEE AREA

**WRMSHCP FEE AREA (ORD. 810)**

IN OR PARTIALLY WITHIN THE WESTERN RIVERSIDE MSHCP FEE AREA. SEE MAP FOR MORE INFORMATION.

**ROAD & BRIDGE DISTRICT**

NOT IN A DISTRICT

**EASTERN TUMF (TRANSPORTATION UNIFORM MITIGATION FEE ORD. 673)**

NOT WITHIN THE EASTERN TUMF FEE AREA

**WESTERN TUMF (TRANSPORTATION UNIFORM MITIGATION FEE ORD. 824)**

IN OR PARTIALLY WITHIN A TUMF FEE AREA. SEE MAP FOR MORE INFORMATION. CENTRAL

**DIF (DEVELOPMENT IMPACT FEE AREA ORD. 659)**

MEAD VALLEY

**SKR FEE AREA (STEPHEN'S KANGAROO RAT ORD. 663.10)**

IN OR PARTIALLY WITHIN AN SKR FEE AREA. SEE MAP FOR MORE INFORMATION.

**DEVELOPMENT AGREEMENTS**

NOT IN A DEVELOPMENT AGREEMENT AREA

**TRANSPORTATION**

**CIRCULATION ELEMENT ULTIMATE RIGHT-OF-WAY**

NOT IN A CIRCULATION ELEMENT RIGHT-OF-WAY

**ROAD BOOK PAGE**

58

**TRANSPORTATION AGREEMENTS**

NOT IN A TRANSPORTATION AGREEMENT

**CETAP (COMMUNITY AND ENVIRONMENTAL TRANSPORTATION ACCEPTABILITY PROCESS) CORRIDORS**  
CONTACT FARAH KHORASHADI IN THE TRANSPORTATION DEPARTMENT AT (951)955-2091.

---

## ***HYDROLOGY***

---

### **FLOOD PLAIN REVIEW**

NOT REQUIRED.

### **WATER DISTRICT**

EMWD

### **FLOOD CONTROL DISTRICT**

RIVERSIDE COUNTY FLOOD CONTROL DISTRICT

### **WATERSHED**

SAN JACINTO VALLEY

---

## ***GEOLOGIC***

---

### **FAULT ZONE**

NOT IN A FAULT ZONE

### **FAULTS**

NOT WITHIN A 1/2 MILE OF A FAULT

### **LIQUEFACTION POTENTIAL**

NO POTENTIAL FOR LIQUEFACTION EXISTS

### **SUBSIDENCE**

NOT IN A SUBSIDENCE AREA

### **PALEONTOLOGICAL SENSITIVITY**

LOW POTENTIAL.

FOLLOWING A LITERATURE SEARCH, RECORDS CHECK AND A FIELD SURVEY, AREAS MAY BE DETERMINED BY A QUALIFIED VERTEBRATE PALEONTOLOGIST AS HAVING LOW POTENTIAL FOR CONTAINING SIGNIFICANT PALEONTOLOGICAL RESOURCES SUBJECT TO ADVERSE IMPACTS.

---

## ***MISCELLANEOUS***

---

### **SCHOOL DISTRICT**

VAL VERDE UNIFIED

### **COMMUNITIES**

MEAD VALLEY

### **COUNTY SERVICE AREA**

IN OR PARTIALLY WITHIN  
MEAD VALLEY #117 -  
STREET LIGHTING

### **LIGHTING (ORD. 655)**

ZONE B, 40.74 MILES FROM MT. PALOMAR OBSERVATORY

### **2000 CENSUS TRACT**

042904

### **FARMLAND**

OTHER LANDS

### **TAX RATE AREAS**

098-110

- COUNTY FREE LIBRARY
- COUNTY SERVICES AREA 117
- COUNTY STRUCTURE FIRE PROTECTION
- COUNTY WASTE RESOURCE MGMT DIST
- CSA 152
- EASTERN MUNICIPAL WATER
- ERAF RDV
- FLOOD CONTROL ADMINISTRATION
- FLOOD CONTROL ZONE 4

- GENERAL
- GENERAL PURPOSE
- METRO WATER EAST 1301999
- PERRIS AREA ELEM SCHOOL FUND
- PERRIS JR HIGH AREA FUND
- PERRIS VALLEY CEMETERY
- PROJ 5 MEAD VAL 03 ANX AB1290
- RIV CO REG PARK & OPEN SPACE
- RIV. CO. OFFICE OF EDUCATION
- RIVERSIDE CITY COMMUNITY COLLEGE
- SAN JACINTO BASIN RESOURCE CONS
- VAL VERDE UNIF
- WATER

**SPECIAL NOTES**

NO SPECIAL NOTES

**CODE COMPLAINTS**

NO CODE COMPLAINTS

REPORT PRINTED ON...Tue Feb 08 11:44:27 2011  
Version 101221