

**SUBMITTAL TO THE BOARD OF SUPERVISORS
COUNTY OF RIVERSIDE, STATE OF CALIFORNIA**

615B



FROM: County Counsel
Code Enforcement Department

SUBMITTAL DATE:
February 16, 2011

SUBJECT: Statement of Expense [Case No. CV 09-06388]
Subject Property: 1 Parcel E/O 20420 Sawgo Rd., Perris; GONZALEZ, REFUGIO
APN: 322-090-021
District One

RECOMMENDED MOTION: Move that the Board of Supervisors:

- (1) assess the reasonable costs of abatement of a public nuisance (accumulated rubbish) in the above-referenced matter to be **twenty thousand, thirty-six dollars and thirty cents (US \$20,036.30)**;
- (2) assess the costs of abatement against the above-described subject property;
- (3) authorize the recordation of a notice of abatement lien; and
- (4) authorize the abatement costs to be added to the tax roll as a special assessment
- (5) authorize and direct the Code Enforcement Department to take any reasonable actions to collect the amount owed.

[Signature]
L. ALEXANDRA FONG, Deputy County Counsel
for PAMELA J. WALLS, County Counsel

FINANCIAL DATA	Current F.Y. Total Cost:	\$ N/A	In Current Year Budget:	N/A
	Current F.Y. Net County Cost:	\$ N/A	Budget Adjustment:	N/A
	Annual Net County Cost:	\$ N/A	For Fiscal Year:	N/A

SOURCE OF FUNDS:

Positions To Be Deleted Per A-30
Requires 4/5 Vote

C.E.O. RECOMMENDATION: APPROVE

County Executive Office Signature BY: *[Signature]*
Jennifer L. Sargent

Consent
 Policy
 Consent
 Policy

MINUTES OF THE BOARD OF SUPERVISORS

On motion of Supervisor Tavaglione, seconded by Supervisor Ashley and duly carried, IT WAS ORDERED that the above matter is approved as recommended.

Ayes: Buster, Tavaglione, Stone and Ashley
Nays: None
Absent: Benoit
Date: March 1, 2011
xc: Co. Co., CED, Prop. Owner

Kecia Harper-Ihem
 Clerk of the Board
 By: *[Signature]*
 Deputy

Prev. Agn. Ref.: | **District:** 1 | **Agenda Number:**

9.8

Statement of Expense [Case No. CV 09-06388]

Subject Property: 1 Parcel W/O 20420 Sawgo Rd., Perris; GONZALEZ, REFUGIO

APN: 322-090-021

District One

Page 2

BACKGROUND: Government Code § 25845, Riverside County Ordinance Nos. 541(RCC Chapter 8.120) and 725 (RCC Chapter 1.16) authorize the recovery of abatement costs in public nuisance cases, the recordation of a notice of abatement lien and inclusion of abatement costs on the tax roll as a special assessment upon approval of the Board of Supervisors.

Notices of Violation were issued. Additionally, a Notice of Violation and Order to Remove Rubbish was issued on or about June 8, 2010. Subsequently, on or about September 22, 2010, the accumulated rubbish was abated from the subject property under the direction of the Riverside County Code Enforcement Department.

The property has a delinquent tax status as of 2006.

The Notice of Hearing re Statement of Expense has been posted on the property and mailed to the property owner and all interested parties, as required by law. Copies of all relevant notices issued in this matter together with proof of service and posting have been separately filed with the Clerk of the Board and are made a part of the record herein, pursuant to Riverside County Ordinance 725.

**SUBMITTAL TO THE BOARD OF SUPERVISORS
COUNTY OF RIVERSIDE, STATE OF CALIFORNIA**

FROM: County Counsel
Code Enforcement Department
SUBJECT: Statement of Expense [Case No. CV09-06388]
Subject Property: 1 Parcel W/O 20588 Sawgo Road, Perris; GONZALEZ, REFUGIO
APN: 322-090-021
District One

**TABLE OF SUPPLEMENTAL DOCUMENTS
FILED WITH THE CLERK OF THE BOARD**

Hearing Date: MARCH 1, 2011

Notice of Statement Expense Hearing (including Proofs of Service, Affidavits of Posting and Return Receipts)	Exhibit A
Statement of Expense Worksheet with Supporting Documents	Exhibit B
Assessment-Roll For The Year 10/11 And Geographic Information System, Feb. 8, 2011	Exhibit C

PAMELA J. WALLS
County Counsel

OFFICE OF COUNTY COUNSEL
COUNTY OF RIVERSIDE



KATHERINE A. LIND
Assistant County Counsel

3960 ORANGE STREET, SUITE 500
RIVERSIDE, CA 92501-3674
TELEPHONE: 951/955-6300
FAX: 951/955-6322 & 951/955-6363

February 8, 2011

NOTICE OF HEARING RE: STATEMENT OF EXPENSE

To: Owner(s) or Interested Parties
(See Attached Proof of Service
and Notice List)

Subject Property: 1 Parcel W/O 20588 Sawgo Rd., Perris
Case No.: CV09-06388; GONZALEZ, REFUGIO
APN: 322-090-021

NOTICE IS HEREBY GIVEN that a hearing will be held before the Riverside County Board of Supervisors on **Tuesday, March 1, 2011, at 9:30 a.m.** in the Board of Supervisors Room, 4080 Lemon Street, 1st Floor Annex, Riverside, California, at which time and place pertinent testimony will be heard regarding the expenses incurred by the County of Riverside, Code Enforcement Department ("DEPARTMENT") for the above-referenced abatement case. Said abatement case involved accumulated rubbish located on your real property commonly described as 1 Parcel W/O 20588 Sawgo Rd., Perris, Riverside County, California and more particularly described as Assessor's Parcel Number 322-090-021.

The total expense due, including all other fees and costs, for the abatement of the above-described dangerous or injurious condition is **twenty thousand, thirty-six dollars and thirty cents, (US \$20,036.30)**. This amount is immediately due and payable. If you have any objections to the Statement of Expense attached hereto, you must address your objections to the Board of Supervisors at the hearing. If you have any questions about the attached Statement of Expense or would like to see additional documents in support of costs set forth on the Statement of Expense Worksheet, please contact the undersigned at (951) 955-6300. In the event the total amount due is not paid to the DEPARTMENT prior to the Board Hearing, the DEPARTMENT shall seek an order from the Board of Supervisors to place a lien against your property and collect the amount due as a special tax assessment.

Failure to appear at the hearing will result in the exclusion of your testimony. Facts as known to the DEPARTMENT will be presented to the Board of Supervisors for their final consideration and deliberation of this matter.

You are encouraged to contact Supervising Code Enforcement Officer, Brian Black (951) 955-2004 prior to the hearing. Please meet with the undersigned or Brian Black at 8:30 a.m. on the day of the hearing in the lobby of the 1st floor annex in front of the Clerk of the Board's Office to discuss the case.

PAMELA J. WALLS
County Counsel

L. ALEXANDRA FONG
Deputy County Counsel

Enclosure: Statement of Expense

EXHIBIT NO. A



County of Riverside Code Enforcement Department

P.O. Box 1469, Riverside, CA 92502
Phone: (951) 955-2004 Fax: (951) 955-8680
demands@rctlma.org

322090021
REFUGIO A GONZALEZ
P O BOX 801898
CALEXICO CA. 92231

Statement of Expense

Date	Invoice #
1/11/2011	100204

Case Number	District	Class
CV0906388	1	SOE

Property Address
322090021 1 P/W OF 20588 SAWGO RD PERRIS, CA

Date	Item	Description	Hours/Qty	Rate	Amount
12/28/2009	Officer Hours	Labor Charges - Officer Time	0.2	109.00	21.80
3/30/2010	Officer Hours	Labor Charges - Officer Time	0.1	109.00	10.90
4/7/2010	Officer Hours	Labor Charges - Officer Time	0.1	109.00	10.90
5/24/2010	Officer Hours	Labor Charges - Officer Time	0.2	82.00	16.40
7/8/2010	Officer Hours	Labor Charges - Officer Time	0.2	82.00	16.40
8/17/2010	Officer Hours	Labor Charges - Officer Time	0.5	82.00	41.00
9/20/2010	Officer Hours	Labor Charges - Officer Time	0.8	82.00	65.60
9/22/2010	Officer Hours	Labor Charges - Officer Time	0.5	82.00	41.00
1/11/2011	SOE Preparation	Prepare Statement of Expense		65.00	65.00
		Subtotal Code Enforcement Costs			289.00
1/11/2011	Prepare Case for SOE He...			125.55	125.55
	Attend SOE Hearing			69.75	69.75
		Subtotal County Counsel Costs			195.30
9/23/2010	Demolition & Disposal	Demolition & Disposal	1	19,432.00	19,432.00
1/11/2011	Lot/Title Report	Lot/Title Report		120.00	120.00
		Subtotal Contractor Costs			19,552.00

Subtotal	\$20,036.30
Payments/Credits	\$0.00
Total	\$20,036.30

affirm and declare under penalty of perjury under the laws of the State of California that the foregoing is true and correct.

Code Enforcement Department

EXHIBIT NO. A²

NOTICE LIST

Subject Property: 1 Parcel W/O 20588 Sawgo Rd., Perris; Case No.: CV09-06388;
 APN: 322-090-021: District One

REFUGIO A GONZALEZ
 PO BOX 801898
 CALEXICO CA 92231

REFUGIO A GONZALEZ
 C/O CENTURY 21 EMPIRE
 12220 PIGEON PASS ROAD STE O
 MORENO VALLEY CA 92557

BETTY S TEE
 PO BOX 1646
 SANDY OR 97055

Office of County Counsel
 3960 Orange Street, Suite 500
 Riverside, CA 92501

CERTIFIED MAIL™



7010 1670 0001 7232 7955



REFUGIO A GONZALEZ
 PO BOX 801898
 CALEXICO CA 92231

NIXIE 923 DE 1 00 02/12/11

RETURN TO SENDER
 NO SUCH NUMBER
 UNABLE TO FORWARD

EC: 92501364425 *0704-07695-09-44

3220136444 09644

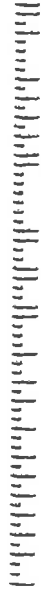

102595-02-M-1640

Domestic Return Receipt

PS Form 3811, February 2004

6462 2222 1000 0297 0102

322-06388 (607413, Refugio) 5063

2. Article Number
 (Transfer from service label)

REFUGIO A GONZALEZ
 C/O CENTURY 21 EMPIRE
 12220 PIGEON PASS ROAD STE O
 MORENO VALLEY CA 92557

1. Article Addressed to:

- Complete items 1, 2, and 3. Also complete item 4 if Restricted Delivery is desired.
- Print your name and address on the reverse so that we can return the card to you.
- Attach this card to the back of the mailpiece, or on the front if space permits.

COMPLETE THIS SECTION ON DELIVERY

A. Signature Agent
 Addressee
 B. Received by (Printed Name) C. Date of Delivery
 2-10
 D. Is delivery address different from item 1? Yes
 If YES, enter delivery address below: No

3. Service Type
 Certified Mail
 Registered
 Insured Mail
 Express Mail
 Return Receipt for Merchandise
 C.O.D.

4. Restricted Delivery? (Extra Fee) Yes

EXHIBIT NO.

A3

UNITED STATES POSTAGE
 PITNEY BOWES
 02 1P
 0003958246 FEB 08 2011
 MAILED FROM ZIP CODE 92501
\$ 005.540



Track & Confirm

Search Results

Label/Receipt Number: **7010 1670 0001 7232 7932**
Service(s): **Certified Mail™**
Status: **Arrival at Unit**

Your item arrived at 8:44 am on February 12, 2011 in SANDY, OR 97055.

Track & Confirm

Enter Label/Receipt Number.

[Go >](#)

Notification Options

Track & Confirm by email

Get current event information or updates for your item sent to you or others by email. [Go >](#)

7010 1670 0001 7232 7932

U.S. Postal Service™	
CERTIFIED MAIL™ RECEIPT	
<i>(Domestic Mail Only; No Insurance Coverage Provided)</i>	
For delivery information visit our website at www.usps.com	
OFFICIAL USE	
Postage	\$.44
Certified Fee	2.80
Return Receipt Fee (Endorsement Required)	2.30
Restricted Delivery Fee (Endorsement Required)	
Total Postage & Fees	\$ 5.54
MAILED 2/8/11	
Postmark Here	
Sent To	
Street, Apt., or PO Box #	BETTY S TEE
City, State, ZIP	PO BOX 1646
	SANDY OR 97055
PS Form 3800, August 2006 See Reverse for Instructions	

EXHIBIT NO.

A⁴

PROOF OF SERVICE

Case No. CV09-06388

1
2
3
4
5
6
7
8
9
10
11
12
13
14
15
16
17
18
19
20
21
22
23
24
25
26
27
28

STATE OF CALIFORNIA, COUNTY OF RIVERSIDE

I, Brenda G. Peeler, declare that I am a citizen of the United States and am employed in the County of Riverside, over the age of 18 years and not a party to the within action or proceeding; that my business address is 3960 Orange Street, Suite 500, Riverside, California 92501.

That on Feb. 8, 2011, I served the following document(s):

- NOTICE OF HEARING RE: STATEMENT OF EXPENSE
- STATEMENT OF EXPENSE WORKSHEET

by placing a true copy thereof enclosed in a sealed envelope(s) addressed as follows:

**OWNERS OR INTERESTED PARTIES
(SEE NOTICE LIST ATTACHED TO NOTICE OF HEARING)**

XX **BY CERTIFIED MAIL, RETURN RECEIPT REQUESTED.** I am "readily familiar" with the office's practice of collection and processing correspondence for mailing. Under that practice it would be deposited with the U.S. Postal Service on that same day with postage thereon fully prepaid at Riverside, California, in the ordinary course of business.

___ **BY PERSONAL SERVICE:** I caused to be delivered such envelope(s) by hand to the offices of the addressee(s).

XX **STATE - I declare under penalty of perjury under the laws of the State of California that the above is true and correct.**

___ **FEDERAL - I declare that I am employed in the office of a member of the bar of this court at whose direction the service was made.**

EXECUTED ON Feb. 8, 2011, at Riverside, California.



BRENDA G. PEELER

EXHIBIT NO. AS



**CODE ENFORCEMENT DEPARTMENT
COUNTY OF RIVERSIDE**

GLENN BAUDE
Director

AFFIDAVIT OF POSTING OF NOTICES

February 10, 2011

RE CASE NO: CV0906388

I, Marco Diaz, hereby declare:

I am employed by the Riverside County Code Enforcement Department; that my business address is 19450 Clark Street, Perris, California 92570 .

That on 02/09/2011 at 2:32pm, I securely and conspicuously posted a NOTICE OF HEARING RE: STATEMENT OF EXPENSE at the property described as:

Property Address: 1 P/E OF 20420 SAWGO RD, PERRIS

Assessor's Parcel Number: 322-090-021

I declare under the penalty of perjury that the foregoing is true and correct.

Executed on February 10, 2011 in the County of Riverside, California.

CODE ENFORCEMENT DEPARTMENT

By: Marco Diaz, Code Enforcement Technician

EXHIBIT NO. AG



County of Riverside Code Enforcement Department

P.O. Box 1469, Riverside, CA 92502
Phone: (951) 955-2004 Fax: (951) 955-8680
demands@rctlma.org

Statement of Expense

322090021
REFUGIO A GONZALEZ
P O BOX 801898
CALEXICO CA. 92231

Date	Invoice #
1/11/2011	100204

Property Address
322090021 1 P/W OF 20588 SAWGO RD PERRIS, CA

Case Number	District	Class
CV0906388	1	SOE

Date	Item	Description	Hours/Qty	Rate	Amount
12/28/2009	Officer Hours	Labor Charges - Officer Time	0.2	109.00	21.80
3/30/2010	Officer Hours	Labor Charges - Officer Time	0.1	109.00	10.90
4/7/2010	Officer Hours	Labor Charges - Officer Time	0.1	109.00	10.90
5/24/2010	Officer Hours	Labor Charges - Officer Time	0.2	82.00	16.40
7/8/2010	Officer Hours	Labor Charges - Officer Time	0.2	82.00	16.40
8/17/2010	Officer Hours	Labor Charges - Officer Time	0.5	82.00	41.00
9/20/2010	Officer Hours	Labor Charges - Officer Time	0.8	82.00	65.60
9/22/2010	Officer Hours	Labor Charges - Officer Time	0.5	82.00	41.00
1/11/2011	SOE Preparation	Prepare Statement of Expense		65.00	65.00
		Subtotal Code Enforcement Costs			289.00
1/11/2011	Prepare Case for SOE He...			125.55	125.55
	Attend SOE Hearing			69.75	69.75
		Subtotal County Counsel Costs			195.30
9/23/2010	Demolition & Disposal	Demolition & Disposal	1	19,432.00	19,432.00
1/11/2011	Lot/Title Report	Lot/Title Report		120.00	120.00
		Subtotal Contractor Costs			19,552.00
				Subtotal	\$20,036.30
				Payments/Credits	\$0.00
				Total	\$20,036.30

I affirm and declare under penalty of perjury under the laws of the State of California that the foregoing is true and correct.

 Code Enforcement Department

EXHIBIT NO. B



INVOICE

Order Number: 23091 **Order Date:** 1/25/2011

Customer Information:

Acct No. 1044

RIVERSIDE COUNTY TLMA-CODE ENFORCEMENT
4080 Lemon Street
Riverside, CA 92501

Attn: Brent Steele
REF: CV09-06388 / Brenda Peeler
IN RE: **GONZALEZ, REFUGIO**

Product and/or Service ordered for Property known as: Vacant Land	
DESCRIPTION: Lot Book Report	FEE: \$120.00
TOTAL DUE:	\$120.00

Payment due upon receipt. Please remit to:

RZ Title Services, Inc.
P.O. Box 1193
Whittier, CA 90609

EXHIBIT NO. B³

Assessment Roll For the 2010-2011 Tax Year as of January 1,2010

Assessment #322090021-1		Parcel # 322090021-1	
Assessee:	GONZALEZ REFUGIO A	Land	151,180
Mail Address:	P O BOX 801898	Full Value	151,180
City, State Zip:	CALEXICO CA 92231	Total Net	151,180
Real Property Use Code:	YY		
Base Year	2006		
Conveyance Number:	0299398	View Parcel Map	
Conveyance (mm/yy):	4/2005		
PUI:	Y040000		
TRA:	98-033		
Taxability Code:	0-00		
ID Data:	Lot 88 RS 034/089		

EXHIBIT NO. C

RIVERSIDE COUNTY GIS

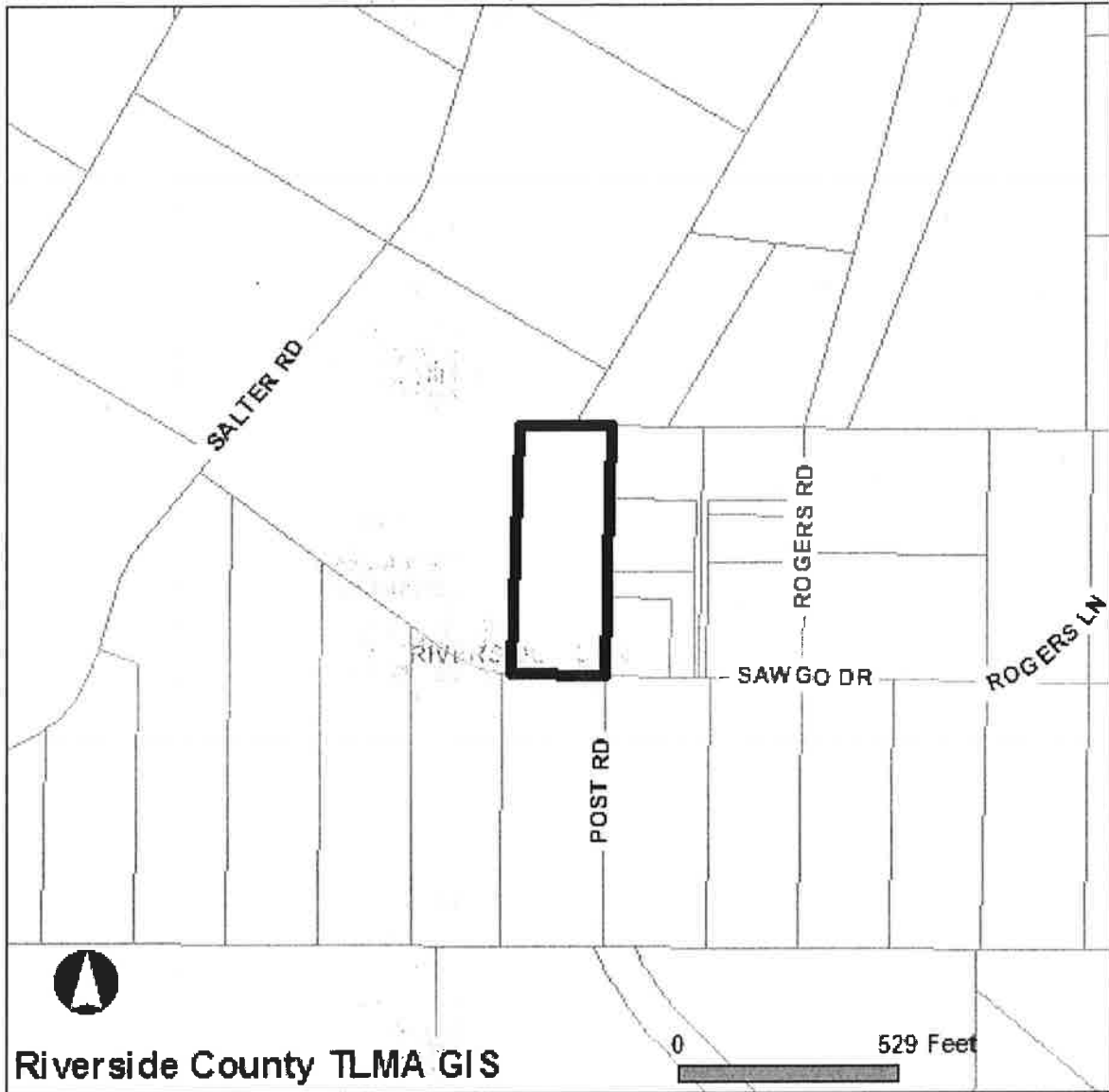

Selected parcel(s):
322-090-021

IMPORTANT

Maps and data are to be used for reference purposes only. Map features are approximate, and are not necessarily accurate to surveying or engineering standards. The County of Riverside makes no warranty or guarantee as to the content (the source is often third party), accuracy, timeliness, or completeness of any of the data provided, and assumes no legal responsibility for the information contained on this map. Any use of this product with respect to accuracy and precision shall be the sole responsibility of the user.

STANDARD REPORT

APNs

322-090-021-1

OWNER NAME / ADDRESS

REFUGIO A GONZALEZ
ADDRESS NOT AVAILABLE

MAILING ADDRESS

(SEE OWNER)
P O BOX 801898
CALEXICO CA. 92231

EXHIBIT NO. C²

LEGAL DESCRIPTION

RECORDED BOOK/PAGE: RS 34/89
SUBDIVISION NAME: NOT AVAILABLE
LOT/PARCEL: 88, BLOCK: NOT AVAILABLE
TRACT NUMBER: NOT AVAILABLE

LOT SIZE

RECORDED LOT SIZE IS 3.03 ACRES

PROPERTY CHARACTERISTICS

NO PROPERTY DESCRIPTION AVAILABLE

THOMAS BROS. MAPS PAGE/GRID

PAGE: 776 GRID: G7

CITY BOUNDARY/SPHERE

NOT WITHIN A CITY
CITY SPHERE: PERRIS
NO ANNEXATION DATE AVAILABLE
NO LAFCO CASE # AVAILABLE
NO PROPOSALS

MARCH JOINT POWERS AUTHORITY

NOT IN THE JURISDICTION OF THE MARCH JOINT POWERS AUTHORITY

INDIAN TRIBAL LAND

NOT IN A TRIBAL LAND

SUPERVISORIAL DISTRICT (ORD. 813)

BOB BUSTER, DISTRICT 1

TOWNSHIP/RANGE

T4SR4W SEC 21

ELEVATION RANGE

2048/2092 FEET

PREVIOUS APN

NO DATA AVAILABLE

PLANNING

LAND USE DESIGNATIONS

Zoning not consistent with the General Plan.
RR

AREA PLAN (RCIP)

MEAD VALLEY

GENERAL PLAN POLICY OVERLAYS

NOT IN A GENERAL PLAN POLICY OVERLAY AREA

GENERAL PLAN POLICY AREAS

NONE

ZONING CLASSIFICATIONS (ORD. 348)

R-A-5 (CZ 5086)

ZONING DISTRICTS AND ZONING AREAS

MEAD VALLEY DISTRICT

ZONING OVERLAYS

NOT IN A ZONING OVERLAY

SPECIFIC PLANS

NOT WITHIN A SPECIFIC PLAN

AGRICULTURAL PRESERVE

NOT IN AN AGRICULTURAL PRESERVE

REDEVELOPMENT AREAS

NOT IN A REDEVELOPMENT AREA

AIRPORT INFLUENCE AREAS

NOT IN AN AIRPORT INFLUENCE AREA

AIRPORT COMPATIBILITY ZONES
NOT IN AN AIRPORT COMPATIBILITY ZONE

ENVIRONMENTAL

CVMSHCP (COACHELLA VALLEY MULTI-SPECIES HABITAT CONSERVATION PLAN) CONSERVATION AREA
NOT IN A CONSERVATION AREA

CVMSHCP FLUVIAL SAND TRANSPORT SPECIAL PROVISION AREAS
NOT IN A FLUVIAL SAND TRANSPORT SPECIAL PROVISION AREA

WRMSHCP (WESTERN RIVERSIDE COUNTY MULTI-SPECIES HABITAT CONSERVATION PLAN) CELL GROUP
D

WRMSHCP CELL NUMBER
2741

HANS/ERP (HABITAT ACQUISITION AND NEGOTIATION STRATEGY/EXPEDITED REVIEW PROCESS)
NONE

VEGETATION (2005)
Coastal Sage Scrub
Developed/Disturbed Land
Grassland

FIRE

HIGH FIRE AREA (ORD. 787)
IN HIGH FIRE AREA - Grading And Building Permit Applications Require Fire Dept Clearance Prior To Permit Issuance.

FIRE RESPONSIBILITY AREA
STATE RESPONSIBILITY AREA

DEVELOPMENT FEES

CVMSHCP FEE AREA (ORD. 875)
NOT WITHIN THE COACHELLA VALLEY MSHCP FEE AREA

WRMSHCP FEE AREA (ORD. 810)
IN OR PARTIALLY WITHIN THE WESTERN RIVERSIDE MSHCP FEE AREA. SEE MAP FOR MORE INFORMATION.

ROAD & BRIDGE DISTRICT
NOT IN A DISTRICT

EASTERN TUMF (TRANSPORTATION UNIFORM MITIGATION FEE ORD. 673)
NOT WITHIN THE EASTERN TUMF FEE AREA

WESTERN TUMF (TRANSPORTATION UNIFORM MITIGATION FEE ORD. 824)
IN OR PARTIALLY WITHIN A TUMF FEE AREA. SEE MAP FOR MORE INFORMATION. NORTHWEST

DIF (DEVELOPMENT IMPACT FEE AREA ORD. 659)
MEAD VALLEY

SKR FEE AREA (STEPHEN'S KANGAROO RAT ORD. 663.10)
IN OR PARTIALLY WITHIN AN SKR FEE AREA. SEE MAP FOR MORE INFORMATION.

DEVELOPMENT AGREEMENTS
NOT IN A DEVELOPMENT AGREEMENT AREA

TRANSPORTATION

CIRCULATION ELEMENT ULTIMATE RIGHT-OF-WAY
NOT IN A CIRCULATION ELEMENT RIGHT-OF-WAY

ROAD BOOK PAGE
61

TRANSPORTATION AGREEMENTS
NOT IN A TRANSPORTATION AGREEMENT

CETAP (COMMUNITY AND ENVIRONMENTAL TRANSPORTATION ACCEPTABILITY PROCESS) CORRIDORS
NOT IN A CETAP CORRIDOR.

HYDROLOGY

FLOOD PLAIN REVIEW
NOT REQUIRED.**WATER DISTRICT**
EMWD**FLOOD CONTROL DISTRICT**
RIVERSIDE COUNTY FLOOD CONTROL DISTRICT**WATERSHED**
SAN JACINTO VALLEY

GEOLOGIC

FAULT ZONE
NOT IN A FAULT ZONE**FAULTS**
NOT WITHIN A 1/2 MILE OF A FAULT**LIQUEFACTION POTENTIAL**
NO POTENTIAL FOR LIQUEFACTION EXISTS**SUBSIDENCE**
NOT IN A SUBSIDENCE AREA**PALEONTOLOGICAL SENSITIVITY**
LOW POTENTIAL.
FOLLOWING A LITERATURE SEARCH, RECORDS CHECK AND A FIELD SURVEY, AREAS MAY BE DETERMINED BY A QUALIFIED VERTEBRATE PALEONTOLOGIST AS HAVING LOW POTENTIAL FOR CONTAINING SIGNIFICANT PALEONTOLOGICAL RESOURCES SUBJECT TO ADVERSE IMPACTS.

MISCELLANEOUS

SCHOOL DISTRICT
VAL VERDE UNIFIED**COMMUNITIES**
MEAD VALLEY**COUNTY SERVICE AREA**
NOT IN A COUNTY SERVICE AREA.**LIGHTING (ORD. 655)**
ZONE B, 39.82 MILES FROM MT. PALOMAR OBSERVATORY**2000 CENSUS TRACT**
042903**FARMLAND**
OTHER LANDS**TAX RATE AREAS**
098-033

- COUNTY FREE LIBRARY
- COUNTY STRUCTURE FIRE PROTECTION
- COUNTY WASTE RESOURCE MGMT DIST
- CSA 152
- EASTERN MUNICIPAL WATER
- FLOOD CONTROL ADMINISTRATION
- FLOOD CONTROL ZONE 4
- GENERAL
- GENERAL PURPOSE
- METRO WATER EAST 1301999
- PERRIS AREA ELEM SCHOOL FUND
- PERRIS JR HIGH AREA FUND
- PERRIS VALLEY CEMETERY

- RIV CO REG PARK & OPEN SPACE
- RIV. CO. OFFICE OF EDUCATION
- RIVERSIDE CITY COMMUNITY COLLEGE
- SAN JACINTO BASIN RESOURCE CONS
- VAL VERDE UNIF

SPECIAL NOTES

NO SPECIAL NOTES

CODE COMPLAINTS

NO CODE COMPLAINTS

REPORT PRINTED ON...Tue Feb 08 13:58:52 2011
Version 101221