

MINUTES OF THE BOARD OF SUPERVISORS
COUNTY OF RIVERSIDE, STATE OF CALIFORNIA



9.12

9:30 a.m. being the time set for public hearing on the recommendation from County Counsel/Code Enforcement regarding Public Hearing on Statement of Expense Case No. CV 08-05300 located at 7080 Sumner Ave., Corona; APN: 152-040-001, 2nd District.

Alexandra Fong, Deputy County Counsel, presented the matter.

On motion of Supervisor Stone, seconded by Supervisor Tavaglione and duly carried, IT WAS ORDERED that the above matter is taken *off calendar*.

Roll Call:

Ayes: Buster, Tavaglione, Stone and Ashley
Nays: None
Absent: Benoit

I hereby certify that the foregoing is a full true, and correct copy of an order made and entered on March 1, 2011 of Supervisors Minutes.

(seal)

WITNESS my hand and the seal of the Board of Supervisors
Dated: March 1, 2011
Kecia Harper-Ihem, Clerk of the Board of Supervisors, in
and for the County of Riverside, State of California.

By: Karen [Signature] Deputy

AGENDA NO.
9.12

xc: Co. Co.

**SUBMITTAL TO THE BOARD OF SUPERVISORS
COUNTY OF RIVERSIDE, STATE OF CALIFORNIA**

617B



FROM: County Counsel
Code Enforcement Department

SUBMITTAL DATE:
February 16, 2011

SUBJECT: Statement of Expense [Case No. CV 08-05300]
Subject Property: 7080 Sumner Ave., Corona; MARTIN
APN: 152-040-001
District Two

RECOMMENDED MOTION: Move that the Board of Supervisors:

- 1) assess the reasonable costs of abatement of a public nuisance (unpermitted land use – feed [processing facility) in the above-referenced matter to be **one thousand, one hundred thirty-three dollars and sixty cents (US \$1,133.60)**;
- (2) assess the costs of abatement against the above-described subject property;
- (3) authorize the recordation of a notice of abatement lien; and
- (4) authorize the abatement costs to be added to the tax roll as a special assessment
- (5) authorize and direct the Code Enforcement Department to take any reasonable actions to collect the amount owed.

BACKGROUND: Government Code § 25845, Riverside County Ordinance Nos. 348 (RCC Title 17) and 725 (RCC Title 1.16) authorize the recovery of abatement costs in public nuisance cases, the recordation of a notice of abatement lien and inclusion of abatement costs on the tax roll as a special assessment upon approval of the Board of Supervisors.

L. Alexandra Fong
L. ALEXANDRA FONG, Deputy County Counsel
for PAMELA J. WALLS, County Counsel

FINANCIAL DATA	Current F.Y. Total Cost:	\$ N/A	In Current Year Budget:	N/A
	Current F.Y. Net County Cost:	\$ N/A	Budget Adjustment:	N/A
	Annual Net County Cost:	\$ N/A	For Fiscal Year:	N/A

SOURCE OF FUNDS:	Positions To Be Deleted Per A-30	<input type="checkbox"/>
	Requires 4/5 Vote	<input type="checkbox"/>

C.E.O. RECOMMENDATION: APPROVE

BY: *Jennifer L. Sargent*
Jennifer L. Sargent

County Executive Office Signature

Dept't Recomm.: Consent Policy Policy

Per Exec. Ofc.: Consent Policy

[Faint background text: recovery, inclusion of costs...]

Prev. Agn. Ref.: _____ District: 2 Agenda Number: _____

9.12

Statement of Expense [Case No. CV 08-05300]
Subject Property: 7080 Sumner Ave., Corona; MARTIN
APN: 152-040-001
District: Two
Page 2

Multiple Notices of Violation were issued. Subsequently, the property owner brought the subject property into compliance.

The Notice of Hearing re Statement of Expense has been posted on the property and mailed to the property owner and all interested parties, as required by law. Copies of all relevant notices issued in this matter together with proof of service and posting have been separately filed with the Clerk of the Board and are made a part of the record herein, pursuant to Riverside County Ordinance 725.

**SUBMITTAL TO THE BOARD OF SUPERVISORS
COUNTY OF RIVERSIDE, STATE OF CALIFORNIA**

FROM: County Counsel
Code Enforcement Department
SUBJECT: Statement of Expense [Case No. CV08-05300]
Subject Property: 7080 Sumner Ave., Corona; MARTIN
APN: 152-040-001
District Two

**TABLE OF SUPPLEMENTAL DOCUMENTS
FILED WITH THE CLERK OF THE BOARD**

Hearing Date: MARCH 1, 2011

Notice of Statement Expense Hearing (including Proofs of Service, Affidavits of Posting and Return Receipts)	Exhibit A
Statement of Expense Worksheet with Supporting Documents	Exhibit B
Assessment-Roll For The Year 10/11 And Geographic Information System, Feb. 7, 2011	Exhibit C

PAMELA J. WALLS
County Counsel

OFFICE OF COUNTY COUNSEL
COUNTY OF RIVERSIDE



KATHERINE A. LIND
Assistant County Counsel

3960 ORANGE STREET, SUITE 500
RIVERSIDE, CA 92501-3674
TELEPHONE: 951/955-6300
FAX: 951/955-6322 & 951/955-6363

February 9, 2011

**NOTICE OF HEARING
RE: STATEMENT OF EXPENSE**

To: Owner(s) or Interested Parties
(See Attached Proof of Service
and Notice List)

Subject Property: 7080 Sumner Ave., Corona
Case No.: CV08-05300; MARTIN
APN: 152-040-001

NOTICE IS HEREBY GIVEN that a hearing will be held before the Riverside County Board of Supervisors on **Tuesday, March 1, 2011, at 9:30 a.m.** in the Board of Supervisors Room, 4080 Lemon Street, 1st Floor Annex, Riverside, California, at which time and place pertinent testimony will be heard regarding the expenses incurred by the County of Riverside, Code Enforcement Department ("DEPARTMENT") for the above-referenced abatement case. Said abatement case involved construction without permits located on your real property commonly described as 7080 Sumner Ave., Corona, Riverside County, California and more particularly described as Assessor's Parcel Number 152-040-001.

The total expense due, including all other fees and costs, for the abatement of the above-described dangerous or injurious condition is **one thousand, one hundred thirty-three dollars and sixty cents, (US \$1,133.60)**. This amount is immediately due and payable. If you have any objections to the Statement of Expense attached hereto, you must address your objections to the Board of Supervisors at the hearing. If you have any questions about the attached Statement of Expense or would like to see additional documents in support of costs set forth on the Statement of Expense Worksheet, please contact the undersigned at (951) 955-6300. In the event the total amount due is not paid to the DEPARTMENT prior to the Board Hearing, the DEPARTMENT shall seek an order from the Board of Supervisors to place a lien against your property and collect the amount due as a special tax assessment.

Failure to appear at the hearing will result in the exclusion of your testimony. Facts as known to the DEPARTMENT will be presented to the Board of Supervisors for their final consideration and deliberation of this matter.

You are encouraged to contact Supervising Code Enforcement Officer, Briar hearing. Please meet with the undersigned or Brian Black at 7:30 a.m. on tl Room 2A located on the 1st floor in front of the Human Resources Office to disc

9.12 311/11

to the
erence

PAMELA J. WALLS
County Counsel

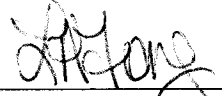
L. ALEXANDRA FONG
Deputy County Counsel

(11)

Enclosure: Statement of Expense

EXHIBIT NO. A



County of Riverside Code Enforcement Department

P.O. Box 1469, Riverside, CA 92502
Phone: (951) 955-2004 Fax: (951) 955-8680
demands@rectlma.org

152040001
FRANK E MARTIN
2616 CORYDON AVE
NORCO, CA. 92860

Statement of Expense

Date	Invoice #
12/16/2010	100033

Case Number	District	Class
CV0805300	2	SOE

Property Address
152040001 7080 SUMNER AVE CORONA, CA 92880

Date	Item	Description	Hours/Qty	Rate	Amount
8/27/2008	Officer Hours	Labor Charges - Officer Time	3	70.00	210.00
8/27/2008	Officer Hours	Labor Charges - Officer Time	1	109.00	109.00
8/27/2008	Officer Hours	Labor Charges - Officer Time	1.2	109.00	130.80
9/16/2008	Officer Hours	Labor Charges - Officer Time	0.5	109.00	54.50
2/11/2009	Officer Hours	Labor Charges - Officer Time	1	129.00	129.00
	SOE Preparation	Prepare Statement of Expense		65.00	65.00
		Subtotal Code Enforcement Costs			698.30
	Prepare Case for SOE He...			125.55	125.55
	Attend SOE Hearing			69.75	69.75
		Subtotal County Counsel Costs			195.30
3/10/2009	Lot/Title Report	Lot/Title Report	1	120.00	120.00
	Lot/Title Report	Lot/Title Report		120.00	120.00
		Subtotal Contractor Costs			240.00
Subtotal					\$1,133.60
Payments/Credits					\$0.00
Total					\$1,133.60

I affirm and declare under penalty of perjury under the laws of the State of California that the foregoing is true and correct.



 Code Enforcement Department

EXHIBIT NO. A²

NOTICE LIST

Subject Property: 7080 Sumner Ave., Corona; Case No.: CV08-05300;
APN: 152-040-001; District Two

FRANK E MARTIN, TRUSTEE
2616 CORYDON AVE
NORCO CA 92860

FRANK E MARTIN, TRUSTEE
7080 SUMNER AVE
CORONA CA 92880

INTERNAL REVENUE SERVICE
PO BOX 145585 - STOP 8420G
CINCINNATI OH 45250-5585

SPECIAL PROCEDURES SECTION
PO BOX 2952
SACRAMENTO CA 95812-2952

EXHIBIT NO. _____

A³



Home | Help | Sign In

Track & Confirm

FAQs

Track & Confirm

Search Results

Label/Receipt Number: 7010 1670 0001 7232 8151

Service(s): **Certified Mail™**

Status: **Delivered**

Your item was delivered at 8:18 am on February 14, 2011 in SACRAMENTO, CA 95812.

Track & Confirm

Enter Label/Receipt Number.

[Go >](#)

Detailed Results:

- **Delivered, February 14, 2011, 8:18 am, SACRAMENTO, CA 95812**
- **Notice Left (No Authorized Recipient Available), February 14, 2011, 7:23 am, SACRAMENTO, CA 95812**
- **Arrival at Unit, February 14, 2011, 6:35 am, SACRAMENTO, CA 95814**

Notification Options

Track & Confirm by email

Get current event information or updates for your item sent to you or others by email. [Go >](#)

[Site Map](#)

[Customer Service](#)

[Forms](#)

[Gov't Services](#)

[Careers](#)

[Privacy Policy](#)

[Terms of Use](#)

[Business Customer Gateway](#)

Copyright© 2010 USPS. All Rights Reserved.

No FEAR Act EEO Data

FOIA



The 4th Amendment
Protects you, the individual



Integrity & Transparency
Freedom of Information Act

7010 1670 0001 7232 8151

U.S. Postal Service™ CERTIFIED MAIL™ RECEIPT *(Domestic Mail Only; No Insurance Coverage Provided)*

For delivery information visit our website at www.usps.com®

OFFICIAL USE

Postage	\$.49	MAILED 2/14/11 Postmark Here
Certified Fee	2.80	
Return Receipt Fee (Endorsement Required)	2.30	
Restricted Delivery Fee (Endorsement Required)		
Total Postage & Fees	\$ 5.59	

Sent To

Street, Apt. or PO Box: SPECIAL PROCEDURES SECTION
 City, State: SACRAMENTO CA 95812-2952

PS Form 3800, August 2006 See Reverse for Instructions

EXHIBIT NO.

A⁴



[Home](#) | [Help](#) | [Sign In](#)

[Track & Confirm](#) [FAQs](#)

Track & Confirm

Search Results

Label/Receipt Number: 7010 1670 0001 7232 8120
 Service(s): **Certified Mail™**
 Status: **Delivered**

Track & Confirm

Enter Label/Receipt Number.

[Go >](#)

Your item was delivered at 7:44 am on February 15, 2011 in CINCINNATI, OH 45250.

Detailed Results:

- **Delivered, February 15, 2011, 7:44 am, CINCINNATI, OH 45250**
- **Notice Left (No Authorized Recipient Available), February 14, 2011, 12:15 pm, CINCINNATI, OH 45250**
- **Arrival at Unit, February 14, 2011, 11:53 am, CINCINNATI, OH 45250**

Notification Options

Track & Confirm by email

Get current event information or updates for your item sent to you or others by email. [Go >](#)

[Site Map](#) [Customer Service](#) [Forms](#) [Gov't Services](#) [Careers](#) [Privacy Policy](#) [Terms of Use](#) [Business Customer Gateway](#)

Copyright © 2010 USPS. All Rights Reserved. No FEAR Act EEO Data FOIA

7010 1670 0001 7232 8120

U.S. Postal Service™	
CERTIFIED MAIL™ RECEIPT	
<i>(Domestic Mail Only; No Insurance Coverage Provided)</i>	
For delivery information visit our website at www.usps.com	
OFFICIAL USE	
Postage	\$ 1.44
Certified Fee	2.80
Return Receipt Fee (Endorsement Required)	2.30
Restricted Delivery Fee (Endorsement Required)	
Total Postage & Fees	\$ 5.54
Sent To Street, or PO E INTERNAL REVENUE SERVICE City, St. PO BOX 145585 - STOP 8420G CINCINNATI OH 45250-5585	
PS Form 3800, August 2007 See Reverse for Instructions	

MAILED 2/19/11

Postmark Here

EXHIBIT NO. A5



[Home](#) | [Help](#) | [Sign In](#)

[Track & Confirm](#) [FAQs](#)

Track & Confirm

Search Results

Label/Receipt Number: **7010 1670 0001 7232 8144**
 Service(s): **Certified Mail™**
 Status: **Arrival at Unit**

Your item arrived at 6:46 am on February 16, 2011 in RIVERSIDE, CA 92501.

Track & Confirm

Enter Label/Receipt Number.

Go >

Detailed Results:

- **Arrival at Unit, February 16, 2011, 6:46 am, RIVERSIDE, CA 92501**
- **Undeliverable as Addressed, February 11, 2011, 1:41 pm, CORONA, CA 92880**

Notification Options

Track & Confirm by email

Get current event information or updates for your item sent to you or others by email. **Go >**

[Site Map](#) [Customer Service](#) [Forms](#) [Gov't Services](#) [Careers](#) [Privacy Policy](#) [Terms of Use](#) [Business Customer Gateway](#)

Copyright© 2010 USPS. All Rights Reserved. No FEAR Act EEO Data FOIA

U.S. Postal Service™ CERTIFIED MAIL™ RECEIPT <i>(Domestic Mail Only; No Insurance Coverage Provided)</i>		
For delivery information visit our website at www.usps.com		
OFFICIAL USE		
Postage \$.44	M266D 2/19/11 Postmark Here
Certified Fee	2.80	
Return Receipt Fee (Endorsement Required)	2.30	
Restricted Delivery Fee (Endorsement Required)	[Blank]	
Total Postage & Fees	\$ 5.54	
Sent To		
Street, Apt. or PO Box: FRANK E MARTIN 7080 SUMNER AVE City, State: CORONA CA 92880		
PS Form 3800, August 2006 See Reverse for Instructions		

7010 1670 0001 7232 8144

EXHIBIT NO. A6

NOTICE LIST

Subject Property: 7080 Sumner Ave., Corona; Case No.: CV08-05300;
APN: 152-040-001; District Two

SENDER: COMPLETE THIS SECTION	COMPLETE THIS SECTION ON DELIVERY
<ul style="list-style-type: none">■ Complete items 1, 2, and 3. Also complete item 4 if Restricted Delivery is desired.■ Print your name and address on the reverse so that we can return the card to you.■ Attach this card to the back of the mailpiece, or on the front if space permits.	A. Signature <i>Tina Nichols</i> <input type="checkbox"/> Agent <input type="checkbox"/> Addressee B. Received by (Printed Name) <i>Tina Nichols</i> C. Date of Delivery
1. Article Addressed to: FRANK E MARTIN 2616 CORYDON AVE NORCO CA 92860 <i>CV08-05300 (MARTIN) SOE 4</i>	D. Is delivery address different from item 1? <input type="checkbox"/> Yes If YES, enter delivery address below: <input type="checkbox"/> No 3. Service Type <input checked="" type="checkbox"/> Certified Mail <input type="checkbox"/> Express Mail <input type="checkbox"/> Registered <input checked="" type="checkbox"/> Return Receipt for Merchandise <input type="checkbox"/> Insured Mail <input type="checkbox"/> C.O.D. 4. Restricted Delivery? (Extra Fee) <input type="checkbox"/> Yes
2. Article Number (Transfer from service label)	7010 1670 0001 7232 8137

PS Form 3811, February 2004

Domestic Return Receipt

102595-02-M-1540

EXHIBIT NO. _____

A7

PROOF OF SERVICE

Case No. CV08-05300

1
2
3
4
5
6
7
8
9
10
11
12
13
14
15
16
17
18
19
20
21
22
23
24
25
26
27
28

STATE OF CALIFORNIA, COUNTY OF RIVERSIDE

I, Brenda G. Peeler, declare that I am a citizen of the United States and am employed in the County of Riverside, over the age of 18 years and not a party to the within action or proceeding; that my business address is 3960 Orange Street, Suite 500, Riverside, California 92501.

That on Feb. 9, 2011, I served the following document(s):

- NOTICE OF HEARING RE: STATEMENT OF EXPENSE
- STATEMENT OF EXPENSE

by placing a true copy thereof enclosed in a sealed envelope(s) addressed as follows:

**OWNERS OR INTERESTED PARTIES
(SEE NOTICE LIST ATTACHED TO NOTICE OF HEARING)**

XX **BY CERTIFIED MAIL, RETURN RECEIPT REQUESTED.** I am "readily familiar" with the office's practice of collection and processing correspondence for mailing. Under that practice it would be deposited with the U.S. Postal Service on that same day with postage thereon fully prepaid at Riverside, California, in the ordinary course of business.

 BY PERSONAL SERVICE: I caused to be delivered such envelope(s) by hand to the offices of the addressee(s).

XX **STATE - I declare under penalty of perjury under the laws of the State of California that the above is true and correct.**

 FEDERAL - I declare that I am employed in the office of a member of the bar of this court at whose direction the service was made.

EXECUTED ON Feb. 9, 2011, at Riverside, California.

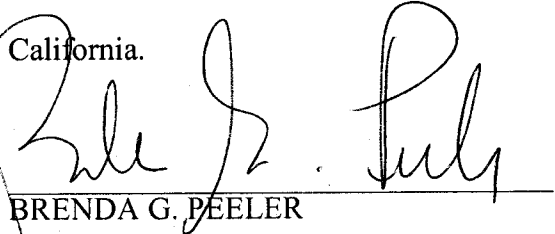

BREND A G. PEELER

EXHIBIT NO. A8



**CODE ENFORCEMENT DEPARTMENT
COUNTY OF RIVERSIDE**

GLENN BAUDE
Director

AFFIDAVIT OF POSTING OF NOTICES

February 10, 2011

RE CASE NO: CV0805300

I, Jonathan Lance, hereby declare:

I am employed by the Riverside County Code Enforcement Department; that my business address is 13575 Magnolia Ave, Corona, California 92879 .

That on 2/10/11 at 9:32 a.m., I securely and conspicuously posted a Statement of Expense hearing notice at the property described as:

Property Address: 7080 SUMNER AVE, CORONA

Assessor's Parcel Number: 152-040-001

I declare under the penalty of perjury that the foregoing is true and correct.

Executed on February 10, 2011 in the County of Riverside, California.

CODE ENFORCEMENT DEPARTMENT

By: Jonathan Lance, Code Enforcement Officer

EXHIBIT NO. A⁹



County of Riverside Code Enforcement Department

P.O. Box 1469, Riverside, CA 92502
Phone: (951) 955-2004 Fax: (951) 955-8680
demands@rctlma.org

Statement of Expense

152040001
FRANK E MARTIN
2616 CORYDON AVE
NORCO, CA. 92860

Date	Invoice #
12/16/2010	100033

Property Address
152040001 7080 SUMNER AVE CORONA, CA 92880

Case Number	District	Class
CV0805300	2	SOE

Date	Item	Description	Hours/Qty	Rate	Amount
8/27/2008	Officer Hours	Labor Charges - Officer Time	3	70.00	210.00
8/27/2008	Officer Hours	Labor Charges - Officer Time	1	109.00	109.00
8/27/2008	Officer Hours	Labor Charges - Officer Time	1.2	109.00	130.80
9/16/2008	Officer Hours	Labor Charges - Officer Time	0.5	109.00	54.50
2/11/2009	Officer Hours	Labor Charges - Officer Time	1	129.00	129.00
	SOE Preparation	Prepare Statement of Expense		65.00	65.00
		Subtotal Code Enforcement Costs			698.30
	Prepare Case for SOE He...			125.55	125.55
	Attend SOE Hearing			69.75	69.75
		Subtotal County Counsel Costs			195.30
3/10/2009	Lot/Title Report	Lot/Title Report	1	120.00	120.00
	Lot/Title Report	Lot/Title Report		120.00	120.00
		Subtotal Contractor Costs			240.00
			Subtotal		\$1,133.60
			Payments/Credits		\$0.00
			Total		\$1,133.60

I affirm and declare under penalty of perjury under the laws of the State of California that the foregoing is true and correct.



 Code Enforcement Department

EXHIBIT NO. B

Transaction Details

Transaction Details

Journal ID: AP01301135
Journal Date: 4/22/2009
Fiscal Period: 2009-10
Process Date: 4/29/2009
Ledger: ACTUALS
Line: 484 of 553
Journal Desc.:
Amount: 120.00
Debit/Credit: Debit
Line Desc.:
Operator: MAESTRO -- Maestro

Accounting

Department: 3140100000 -- Code Enforcement
Fund: 10000 -- General Fund
Account: 525440 -- Professional Services
Program: --
Project: ZCV0805300 -- ZONING VIOLATION
Class: --

Voucher

Voucher: MSARC -- 00334766
Invoice ID: 100911807520868
Invoice Date: 5/5/2009
Vendor: RIVCO -- 0000028923
Operator ID: MAESTRO -- Maestro
Accounting Date: 5/5/2009
Due Date: 5/5/2009

EXHIBIT NO.

B²



INVOICE

Order Number: 23028 **Order Date:** 12/28/2010

Customer Information:

Acct No. 1044

RIVERSIDE COUNTY TLMA-CODE ENFORCEMENT
4080 Lemon Street
Riverside, CA 92501

Attn: Brent Steele
REF: CV08-05300 / Brenda Peeler
IN RE: MARTIN, FRANK

Product and/or Service ordered for Property known as:	
7080 Sumner Avenue Corona, CA 92880	
DESCRIPTION:	FEE:
Lot Book Report	\$120.00
TOTAL DUE:	\$120.00

Payment due upon receipt. Please remit to:

RZ Title Services, Inc.
P.O. Box 1193
Whittier, CA 90609

EXHIBIT NO. B³

Assessment Roll For the 2010-2011 Tax Year as of January 1,2010

Assessment #152040001-5

Parcel # 152040001-5

Assessee:	MARTIN FRANK E	Land	2,200,000
Mail Address:	2616 CORYDON AVE	Structure	420,750
City, State Zip:	NORCO CA 92860	Full Value	2,620,750
Real Property Use Code:	AR	Total Net	2,620,750
Base Year	2009		
Conveyance Number:	0495921		
Conveyance (mm/yy):	9/2008		
PUI:	A210000		
TRA:	59-005		
Taxability Code:	0-00		
ID Data:	Lot 45 MB 012/006 KINGSTON TR		
Situs Address:	7080 SUMNER AVE CORONA CA 92880		

[View Parcel Map](#)EXHIBIT NO. C

RIVERSIDE COUNTY GIS

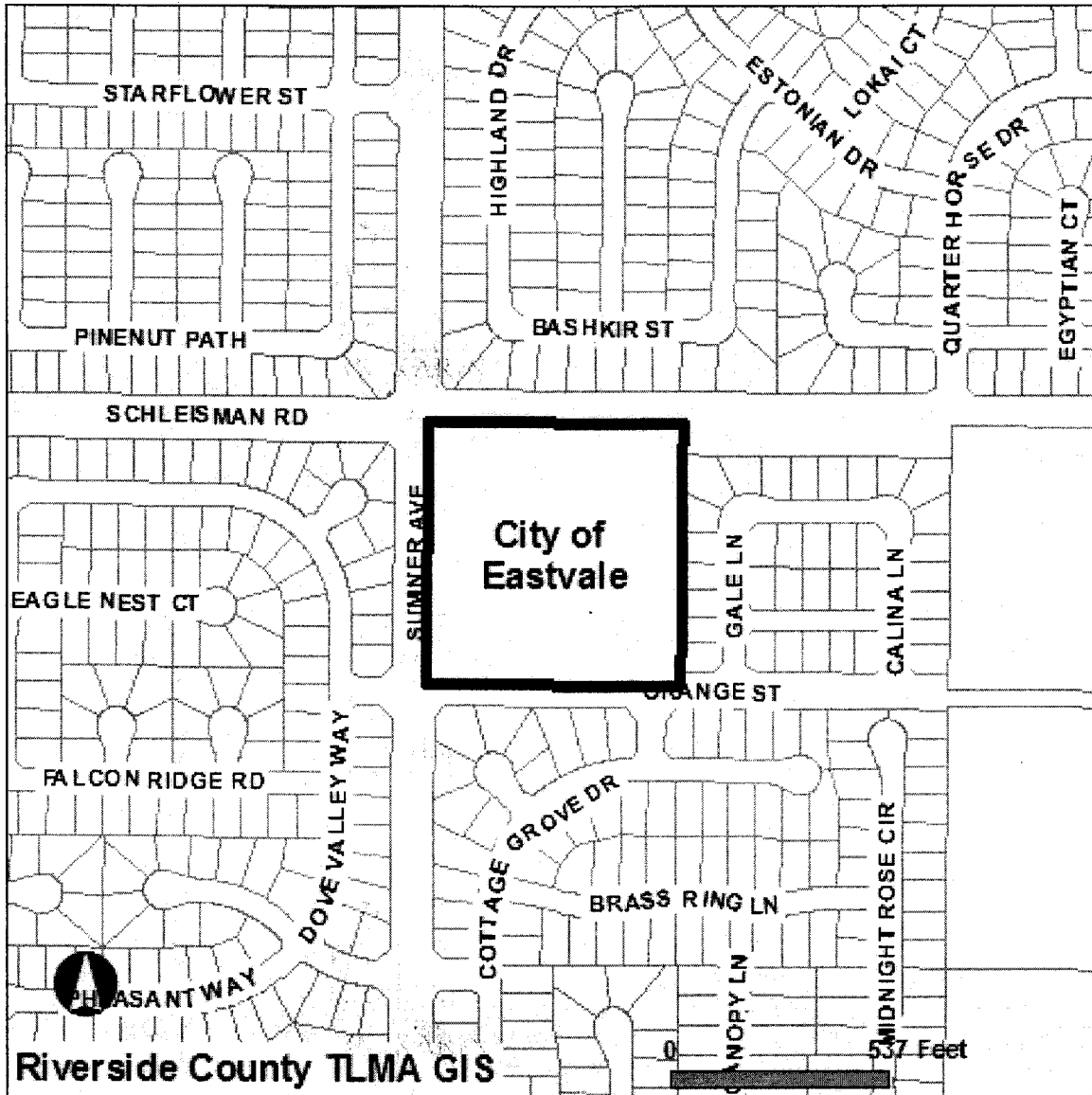

Selected parcel(s):
152-040-001

IMPORTANT

Maps and data are to be used for reference purposes only. Map features are approximate, and are not necessarily accurate to surveying or engineering standards. The County of Riverside makes no warranty or guarantee as to the content (the source is often third party), accuracy, timeliness, or completeness of any of the data provided, and assumes no legal responsibility for the information contained on this map. Any use of this product with respect to accuracy and precision shall be the sole responsibility of the user.

STANDARD REPORT

APNs

152-040-001-5

OWNER NAME / ADDRESS

FRANK E MARTIN
7080 SUMNER AVE
CORONA, CA. 92880

MAILING ADDRESS

(SEE OWNER)
2616 CORYDON AVE
NORCO CA. 92860

EXHIBIT NO. _____

C²

LEGAL DESCRIPTION

RECORDED BOOK/PAGE: MB 12/6 SB
SUBDIVISION NAME: KINGSTON TR
LOT/PARCEL: 45, BLOCK: NOT AVAILABLE
TRACT NUMBER: NOT AVAILABLE

LOT SIZE

RECORDED LOT SIZE IS 10 ACRES

PROPERTY CHARACTERISTICS

152-040-001
NO PROPERTY DESCRIPTION AVAILABLE

152-040-001

NO PROPERTY DESCRIPTION AVAILABLE

THOMAS BROS. MAPS PAGE/GRID

PAGE: 713 GRID: C1

CITY BOUNDARY/SPHERE

CITY OF EASTVALE
NOT WITHIN A CITY SPHERE
NO ANNEXATION DATE AVAILABLE
NO LAFCO CASE # AVAILABLE
NO PROPOSALS

MARCH JOINT POWERS AUTHORITY

NOT IN THE JURISDICTION OF THE MARCH JOINT POWERS AUTHORITY

INDIAN TRIBAL LAND

NOT IN A TRIBAL LAND

SUPERVISORIAL DISTRICT (ORD. 813)

JOHN TAVAGLIONE, DISTRICT 2

TOWNSHIP/RANGE

T2SR7W SEC 36

ELEVATION RANGE

612/612 FEET

PREVIOUS APN

134-240-001

PLANNING

LAND USE DESIGNATIONS

Consult with the city for land use information.

AREA PLAN (RCIP)

EASTVALE

GENERAL PLAN POLICY OVERLAYS

NOT IN A GENERAL PLAN POLICY OVERLAY AREA

GENERAL PLAN POLICY AREAS

NONE

ZONING CLASSIFICATIONS (ORD. 348)

See the city for more information

ZONING DISTRICTS AND ZONING AREAS

PRADO-MIRA LOMA DISTRICT

ZONING OVERLAYS

IN OR PARTIALLY WITHIN THE EASTVALE NEIGHBORHOOD PRESERVATION OVERLAY

SPECIFIC PLANS

NOT WITHIN A SPECIFIC PLAN

AGRICULTURAL PRESERVE

NOT IN AN AGRICULTURAL PRESERVE

REDEVELOPMENT AREAS

NOT IN A REDEVELOPMENT AREA

AIRPORT INFLUENCE AREAS
NOT IN AN AIRPORT INFLUENCE AREA

AIRPORT COMPATIBILITY ZONES
NOT IN AN AIRPORT COMPATIBILITY ZONE

ENVIRONMENTAL

CVMSHCP (COACHELLA VALLEY MULTI-SPECIES HABITAT CONSERVATION PLAN) CONSERVATION AREA
NOT IN A CONSERVATION AREA

CVMSHCP FLUVIAL SAND TRANSPORT SPECIAL PROVISION AREAS
NOT IN A FLUVIAL SAND TRANSPORT SPECIAL PROVISION AREA

WRMSHCP (WESTERN RIVERSIDE COUNTY MULTI-SPECIES HABITAT CONSERVATION PLAN) CELL GROUP
NOT IN A CELL GROUP

WRMSHCP CELL NUMBER
NOT IN A CELL

HANS/ERP (HABITAT ACQUISITION AND NEGOTIATION STRATEGY/EXPEDITED REVIEW PROCESS)
NONE

VEGETATION (2005)
Developed/Disturbed Land

FIRE

HIGH FIRE AREA (ORD. 787)
NOT IN A HIGH FIRE AREA

FIRE RESPONSIBILITY AREA
NOT IN A FIRE RESPONSIBILITY AREA

DEVELOPMENT FEES

CVMSHCP FEE AREA (ORD. 875)
NOT WITHIN THE COACHELLA VALLEY MSHCP FEE AREA

WRMSHCP FEE AREA (ORD. 810)
IN OR PARTIALLY WITHIN THE WESTERN RIVERSIDE MSHCP FEE AREA. SEE MAP FOR MORE INFORMATION.

ROAD & BRIDGE DISTRICT
MIRA LOMA D

EASTERN TUMF (TRANSPORTATION UNIFORM MITIGATION FEE ORD. 673)
NOT WITHIN THE EASTERN TUMF FEE AREA

WESTERN TUMF (TRANSPORTATION UNIFORM MITIGATION FEE ORD. 824)
IN OR PARTIALLY WITHIN A TUMF FEE AREA. SEE MAP FOR MORE INFORMATION. NORTHWEST

DIF (DEVELOPMENT IMPACT FEE AREA ORD. 659)
EASTVALE

SKR FEE AREA (STEPHEN'S KANGAROO RAT ORD. 663.10)
NOT WITHIN AN SKR FEE AREA.

DEVELOPMENT AGREEMENTS
NOT IN A DEVELOPMENT AGREEMENT AREA

TRANSPORTATION

CIRCULATION ELEMENT ULTIMATE RIGHT-OF-WAY
IN OR PARTIALLY WITHIN A CIRCULATION ELEMENT RIGHT-OF-WAY. SEE MAP FOR MORE INFORMATION. CONTACT THE TRANSPORTATION DEPT. PERMITS SECTION AT (951) 955-6790 FOR INFORMATION REGARDING THIS PARCEL IF IT IS IN AN UNINCORPORATED AREA.

ROAD BOOK PAGE
14C

TRANSPORTATION AGREEMENTS

NOT IN A TRANSPORTATION AGREEMENT

CETAP (COMMUNITY AND ENVIRONMENTAL TRANSPORTATION ACCEPTABILITY PROCESS) CORRIDORS

NOT IN A CETAP CORRIDOR.

HYDROLOGY**FLOOD PLAIN REVIEW**

FLOOD PLAIN MANAGEMENT REVIEW IS REQUIRED. CONTACT THE FLOOD PLAIN MANAGEMENT SECTION AT (951) 955-1200 FOR INFORMATION.

WATER DISTRICT

WMWD

FLOOD CONTROL DISTRICT

RIVERSIDE COUNTY FLOOD CONTROL DISTRICT

WATERSHED

SANTA ANA RIVER

GEOLOGIC**FAULT ZONE**

NOT IN A FAULT ZONE

FAULTS

NOT WITHIN A 1/2 MILE OF A FAULT

LIQUEFACTION POTENTIAL

HIGH

VERY HIGH

SUBSIDENCE

SUSCEPTIBLE

PALEONTOLOGICAL SENSITIVITY

HIGH SENSITIVITY (HIGH B).

SENSITIVITY EQUIVALENT TO HIGH A, BUT IS BASED ON THE OCCURRENCE OF FOSSILS AT A SPECIFIED DEPTH BELOW THE SURFACE. THE CATEGORY HIGH B INDICATES THAT FOSSILS ARE LIKELY TO BE ENCOUNTERED AT OR BELOW FOUR FEET OF DEPTH, AND MAY BE IMPACTED DURING EXCAVATION BY CONSTRUCTION ACTIVITIES.

MISCELLANEOUS**SCHOOL DISTRICT**

CORONA-NORCO UNIFIED

COMMUNITIES

EASTVALE

COUNTY SERVICE AREA

NOT IN A COUNTY SERVICE AREA.

LIGHTING (ORD. 655)

NOT APPLICABLE, 58.26 MILES FROM MT. PALOMAR OBSERVATORY

2000 CENSUS TRACT

040602

FARMLAND

OTHER LANDS

URBAN-BUILT UP LAND

TAX RATE AREAS

059-005

- CORONA NORCO UNIFIED SCHOOL
- COUNTY FREE LIBRARY
- COUNTY STRUCTURE FIRE PROTECTION
- COUNTY WASTE RESOURCE MGMT DIST
- CSA 152
- FLOOD CONTROL ADMINISTRATION
- FLOOD CONTROL ZONE 2

- GENERAL
- GENERAL PURPOSE
- INLAND EMPIRE RCD
- JURUPA COMMUNITY SERVICES
- METRO WATER WEST 1302999
- N.W. MOSQUITO & VECTOR CONT DIST
- RIV CO REG PARK & OPEN SPACE
- RIV. CO. OFFICE OF EDUCATION
- RIVERSIDE CITY COMMUNITY COLLEGE
- WESTERN MUNICIPAL WATER

SPECIAL NOTES

NO SPECIAL NOTES

CODE COMPLAINTS

NO CODE COMPLAINTS

REPORT PRINTED ON...Mon Feb 07 09:31:52 2011
Version 101221