

**SUBMITTAL TO THE BOARD OF SUPERVISORS
COUNTY OF RIVERSIDE, STATE OF CALIFORNIA**

419 B



SUBMITTAL DATE:
January 27, 2011

FROM: County Counsel
Code Enforcement Department

SUBJECT: Statement of Expense [Case No. CV03-1316]
Subject Property: 1 Parcel N/O 61610 El Dorado Road, N. Palm Springs; RENNICK
APN: 668-390-083
District: Five

RECOMMENDED MOTION: Move that the Board of Supervisors:

- (1) assess the reasonable costs of abatement of a public nuisance (unpermitted land use (storage of mobile home, accumulated rubbish, excess outside storage and unpermitted fencing) in the above-referenced matter to be **three thousand, eight hundred thirteen dollars and thirty cents (US \$3,813.30)**;
- (2) assess the costs of abatement against the above-described subject property;
- (3) authorize the recordation of a notice of abatement lien; and
- (4) authorize the abatement costs to be added to the tax roll as a special assessment
- (5) authorize and direct the Code Enforcement Department to take any reasonable actions to collect the amount owed.

L. Alexandra Fong
L. ALEXANDRA FONG, Deputy County Counsel
for PAMELA J. WALLS, County Counsel

FINANCIAL DATA

Current F.Y. Total Cost:	\$ N/A	In Current Year Budget:	N/A
Current F.Y. Net County Cost:	\$ N/A	Budget Adjustment:	N/A
Annual Net County Cost:	\$ N/A	For Fiscal Year:	N/A

SOURCE OF FUNDS:

Positions To Be Deleted Per A-30	<input type="checkbox"/>
Requires 4/5 Vote	<input type="checkbox"/>

C.E.O. RECOMMENDATION:

APPROVE

BY:

Jennifer L. Sargent
Jennifer L. Sargent

County Executive Office Signature

MINUTES OF THE BOARD OF SUPERVISORS

On motion of Supervisor Ashley, seconded by Supervisor Buster and duly carried, IT WAS ORDERED that the above matter is approved as recommended with 6 months to pay a revised amount of costs to \$3,000.00.

Ayes: Buster, Stone and Ashley
Nays: None
Absent: Tavaglione and Benoit
Date: March 1, 2011
xc: Co. Co., CED, Prop. Owner

Kecia Harper-Ihem
Clerk of the Board

By: *Kecia Harper-Ihem*
Deputy

Prev. Agn. Ref.:

District: 5

Agenda Number:

ATTACHMENTS FILED
WITH THE CLERK OF THE BOARD

9.16

Departmental Concurrence

Consent
 Policy
 Consent
 Policy
 Dept't Recomm.:
 Per Exec. Ofc.:

Statement of Expense [Case No. CV03-1316]

Subject Property: 1 Parcel N/O 61610 El Dorado Road, N. Palm Springs; RENNICK

APN: 668-390-083

District: Five

Page 2

BACKGROUND: Government Code § 25845, Riverside County Ordinance Nos. 541 (RCC Title 8), 348 (RCC Title 17), and 725 (RCC Chapter 1.16) and Section 1618, Article 10, Title 25 of the California Code of Regulations, provide authority for the recovery of abatement costs in public nuisance cases, the recordation of a notice of abatement lien and inclusion of abatement costs on the tax roll as a special assessment upon approval of the Board of Supervisors.

Multiple Notices of Violation and Administrative Citations were issued. Subsequently, the property owner brought the property into compliance on or about February 24, 2004.

The Notice of Hearing re Statement of Expense has been posted on the property and mailed to the property owner and all interested parties, as required by law. Copies of all relevant notices issued in this matter together with proof of service and posting have been separately filed with the Clerk of the Board and are made a part of the record herein, pursuant to Riverside County Ordinance 725.

MINUTES OF THE BOARD OF SUPERVISORS
COUNTY OF RIVERSIDE, STATE OF CALIFORNIA



9.21

9:30 a.m. being the time set for public hearing on the recommendation from County Counsel/Code Enforcement regarding Public Hearing on Statement of Expense Case No. CV 03-1316, located 1 Parcel N/O 61610 El Dorado Road, N. Palm Springs; APN: 668-390-083, 5th District, the chairman called the matter for hearing.

Alexandra Fong, Deputy County Counsel, presented the matter.

On motion of Supervisor Ashley, seconded by Supervisor Buster and duly carried by unanimous vote, IT WAS ORDERED that the above matter is continued to Tuesday, March 1, 2011 at 9:30 a.m.

I hereby certify that the foregoing is a full true, and correct copy of an order made and entered on February 8, 2011 of Supervisors Minutes.

(seal)

WITNESS my hand and the seal of the Board of Supervisors
Dated: February 8, 2011
Kecia Harper-Ihem, Clerk of the Board of Supervisors, in
and for the County of Riverside, State of California.

By: *Kecia Harper-Ihem* Deputy

AGENDA NO.
9.21

xc: Co. Co., CED, Prop. Owner, COB

**SUBMITTAL TO THE BOARD OF SUPERVISORS
COUNTY OF RIVERSIDE, STATE OF CALIFORNIA**

FROM: County Counsel
Code Enforcement Department
SUBJECT: Statement of Expense [Case No. CV03-1316]
Subject Property: 1 Parcel N/O 61610 El Dorado Road, N. Palm Springs;
APN: 668-390-083; RENNICK
District Five

**TABLE OF SUPPLEMENTAL DOCUMENTS
FILED WITH THE CLERK OF THE BOARD**

Hearing Date: FEBRUARY 8, 2011

Notice of Statement Expense Hearing (including Proofs of Service, Affidavits of Posting and Return Receipts)	Exhibit A
Statement of Expense Worksheet with Supporting Documents	Exhibit B
Assessment-Roll For The Year 10/11 And Geographic Information System, Jan. 20, 2011.....	Exhibit C

PAMELA J. WALLS
County Counsel

OFFICE OF COUNTY COUNSEL
COUNTY OF RIVERSIDE



KATHERINE A. LIND
Assistant County Counsel

3960 ORANGE STREET, SUITE 500
RIVERSIDE, CA 92501-3674
TELEPHONE: 951/955-6300
FAX: 951/955-6322 & 951/955-6363

January 20, 2011

**NOTICE OF HEARING
RE: STATEMENT OF EXPENSE**

To: Owner(s) or Interested Parties
(See Attached Proof of Service
and Notice List)

Subject Property: 1 Parcel N/O 61610 El Dorado Rd., N. Palm Springs
Case No.: CV03-1316; RENNICK
APN: 668-390-083

NOTICE IS HEREBY GIVEN that a hearing will be held before the Riverside County Board of Supervisors on **Tuesday, February 8, 2011, at 9:30 a.m.** in the Board of Supervisors Room, 4080 Lemon Street, 1st Floor Annex, Riverside, California, at which time and place pertinent testimony will be heard regarding the expenses incurred by the County of Riverside, Code Enforcement Department ("DEPARTMENT") for the above-referenced abatement case. Said abatement case involved unpermitted land use (storage of mobile home, accumulated rubbish, excess outside storage and unpermitted fencing) located on your real property commonly described as 1 Parcel N/O 61610 El Dorado Rd., N. Palm Springs, Riverside County, California and more particularly described as Assessor's Parcel Number 668-390-083.

The total expense due, including all other fees and costs, for the abatement of the above-described dangerous or injurious condition is **three thousand, eight hundred thirteen dollars and thirty cents, (US \$3,813.30)**. This amount is immediately due and payable. If you have any objections to the Statement of Expense attached hereto, you must address your objections to the Board of Supervisors at the hearing. If you have any questions about the attached Statement of Expense or would like to see additional documents in support of costs set forth on the Statement of Expense Worksheet, please contact the undersigned at (951) 955-6300. In the event the total amount due is not paid to the DEPARTMENT prior to the Board Hearing, the DEPARTMENT shall seek an order from the Board of Supervisors to place a lien against your property and collect the amount due as a special tax assessment.

Failure to appear at the hearing will result in the exclusion of your testimony. Facts as known to the DEPARTMENT will be presented to the Board of Supervisors for their final consideration and deliberation of this matter.

You are encouraged to contact Supervising Code Enforcement Officer, Brian Black (951) 955-2004 prior to the hearing. Please meet with the undersigned or Brian Black at 8:30 a.m. on the day of the hearing in Conference Room 2A located on the 1st floor in front of the Human Resources Office to discuss the case.

PAMELA J. WALLS
County Counsel

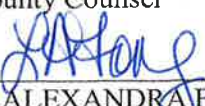
L. ALEXANDRA FONG
Deputy County Counsel

Enclosure: Statement of Expense

EXHIBIT NO. A



COUNTY OF RIVERSIDE CODE ENFORCEMENT

P.O. Box 1469, Riverside, CA 92502
Phone: 951-955-2004 Fax: 951-955-8680

Property Reference/Mailing Address

668390083
ETHEL E RENNICK
C/O ETHEL E RENNICK LIVING TRUST
PO BOX 580081
NORTH PALM SPRINGS CA 92258

Summary Statement

As of: 1/12/2011

Date	Invoice Number & Amount	Amount	Balance
12/23/2010	CV031316- INV #100071. Orig. Amount \$2,313.30.	2,313.30	2,313.30
10/07/2003	CV031316:A03384- INV #11310. Orig. Amount \$200.00. A03384	200.00	2,513.30
10/29/2003	CV031316:A03396- INV #11311. Orig. Amount \$500.00. A03396	500.00	3,013.30
08/26/2003	CV031316:A03600- INV #11312. Orig. Amount \$200.00. A03600	200.00	3,213.30
06/10/2003	CV031316:A07265- INV #11313. Orig. Amount \$200.00. A07265	200.00	3,413.30
07/01/2003	CV031316:A07273- INV #11314. Orig. Amount \$400.00. A07273	400.00	3,813.30
		Balance Due	\$3,813.30

I affirm and declare under penalty of perjury under the laws of the State of California that the foregoing is true and correct.

Sue Rush

Code Enforcement Department

EXHIBIT NO.

A2

NOTICE LIST

Subject Property: 1 Parcel N/O 61610 El Dorado Rd., N. Palm Springs; Case No.: CV03-1316;
 APN: 668-390-083; District Five

ETHEL E RENNICK
 C/O ETHEL E RENNICK LIVING TRUST
 PO BOX 580081
 N PALM SPRINGS CA 92258

JOLLIE STUART
 PEARLIE STUART
 61610 EL DORADO RD
 N PALM SPRINGS CA 92258

HOUSEHOLD FINANCE CORP
 961 WEIGEL DRIVE
 ELMHURST IL 60126

THE ETHEL E RENNICK
 LIVING TRUST
 2138 CAMBRIDGE F
 DEERFIELD FL 33442

<p>1. Article Addressed to: ETHEL E RENNICK C/O ETHEL E RENNICK LIVING TRUST PO BOX 580081 N PALM SPRINGS CA 92258</p>	<p>SENDER: COMPLETE THIS SECTION</p> <ul style="list-style-type: none"> ■ Complete items 1, 2, and 3. Also complete item 4 if Restricted Delivery is desired. ■ Print your name and address on the reverse so that we can return the card to you. ■ Attach this card to the back of the mailpiece, or on the front if space permits.
<p>2. Article Number (Transfer from service label) PS Form 3811, February 2004</p>	<p>COMPLETE THIS SECTION ON DELIVERY</p> <p>A. Signature <input checked="" type="checkbox"/> Recipient <input type="checkbox"/> Agent</p> <p>B. Received by (Printed Name) Ethel E Rennick <input type="checkbox"/> Addressee</p> <p>C. Date of Delivery 1/22/11 <input type="checkbox"/> Yes <input type="checkbox"/> No</p> <p>D. Is delivery address different from item 1? If YES, enter delivery address below: <input type="checkbox"/> Yes <input type="checkbox"/> No</p>
<p>3. Service Type <input checked="" type="checkbox"/> Certified Mail <input type="checkbox"/> Express Mail <input type="checkbox"/> Registered <input checked="" type="checkbox"/> Return Receipt for Merchandise <input type="checkbox"/> Insured Mail <input type="checkbox"/> C.O.D.</p>	<p>4. Restricted Delivery? (Extra Fee) <input type="checkbox"/> Yes</p>
<p>7010 1670 0001 7232 7123 Domestic Return Receipt 102595-02-M-1540</p>	<p><i>W03-1316 (Rennick) SOE 4</i></p>

<p>SENDER: COMPLETE THIS SECTION</p> <ul style="list-style-type: none"> ■ Complete items 1, 2, and 3. Also complete item 4 if Restricted Delivery is desired. ■ Print your name and address on the reverse so that we can return the card to you. ■ Attach this card to the back of the mailpiece, or on the front if space permits. <p>1. Article Addressed to: JOLLIE STUART PEARLIE STUART 61610 EL DORADO RD N PALM SPRINGS CA 92258</p>	<p>COMPLETE THIS SECTION ON DELIVERY</p> <p>A. Signature <input checked="" type="checkbox"/> Recipient <input type="checkbox"/> Agent <input type="checkbox"/> Addressee</p> <p>B. Received by (Printed Name) C. Date of Delivery</p> <p>D. Is delivery address different from item 1? If YES, enter delivery address below: <input type="checkbox"/> Yes <input type="checkbox"/> No</p> <p>3. Service Type <input checked="" type="checkbox"/> Certified Mail <input type="checkbox"/> Express Mail <input type="checkbox"/> Registered <input checked="" type="checkbox"/> Return Receipt for Merchandise <input type="checkbox"/> Insured Mail <input type="checkbox"/> C.O.D.</p> <p>4. Restricted Delivery? (Extra Fee) <input type="checkbox"/> Yes</p>
<p>2. Article Number (Transfer from service label) PS Form 3811, February 2004</p>	<p>7010 1670 0001 7232 7116 Domestic Return Receipt 102595-02-M-1540</p>

W03-1316 (Rennick) SOE 4

A³

EXHIBIT NO. _____



Track & Confirm

Search Results

Label/Receipt Number: **7010 1670 0001 7232 7109**
Service(s): **Certified Mail™**
Status: **Delivered**

Your item was delivered at 8:07 am on January 25, 2011 in ELMHURST, IL 60126.

Detailed Results:

- **Delivered, January 25, 2011, 8:07 am, ELMHURST, IL 60126**
- **Arrival at Unit, January 25, 2011, 7:39 am, ELMHURST, IL 60126**

Notification Options

Track & Confirm by email

Get current event information or updates for your item sent to you or others by email. [Go >](#)

Track & Confirm

Enter Label/Receipt Number.

[Go >](#)

7010 1670 0001 7232 7109

U.S. Postal Service™		
CERTIFIED MAIL™ RECEIPT		
<i>(Domestic Mail Only; No Insurance Coverage Provided)</i>		
For delivery information visit our website at www.usps.com		
OFFICIAL USE		
Postage	\$.44	MAILED 1/20/11 Postmark Here
Certified Fee	2.80	
Return Receipt Fee (Endorsement Required)	2.30	
Restricted Delivery Fee (Endorsement Required)		
Total Postage & Fees	\$ 5.54	
Sent To		
Street, Apt or PO Box	HOUSEHOLD FINANCE CORP	
City, State	961 WEIGEL DRIVE ELMHURST IL 60126	
PS Form 3800, August 2006		See Reverse for Instructions

EXHIBIT NO.

A9



Track & Confirm

Search Results

Label/Receipt Number: **7010 1670 0001 7232 7093**
Service(s): **Certified Mail™**
Status: **Undeliverable as Addressed**

Your item was undeliverable as addressed at 10:47 am on January 24, 2011 in DEERFIELD BEACH, FL 33442. It is being returned if appropriate information is available.

Track & Confirm

Enter Label/Receipt Number.

Go >

Notification Options

Track & Confirm by email

Get current event information or updates for your item sent to you or others by email. [Go >](#)

7010 1670 0001 7232 7093

U.S. Postal Service™	
CERTIFIED MAIL™ RECEIPT	
<i>(Domestic Mail Only; No Insurance Coverage Provided)</i>	
For delivery information visit our website at www.usps.com	
OFFICIAL USE	
Postage	\$.44
Certified Fee	2.80
Return Receipt Fee (Endorsement Required)	2.30
Restricted Delivery Fee (Endorsement Required)	
Total Postage & Fees	\$ 5.54
Mailed 1/20/11	
Postmark Here	
Sent To	THE ETHEL E RENNICK
Street, or PO Box	LIVING TRUST
City, St	2138 CAMBRIDGE F
	DEERFIELD FL 33442
PS Form 3800, August 2006	

EXHIBIT NO. _____

AS

PROOF OF SERVICE

Case No. CV03-1316

1
2
3
4
5
6
7
8
9
10
11
12
13
14
15
16
17
18
19
20
21
22
23
24
25
26
27
28

STATE OF CALIFORNIA, COUNTY OF RIVERSIDE

I, Brenda G. Peeler, declare that I am a citizen of the United States and am employed in the County of Riverside, over the age of 18 years and not a party to the within action or proceeding; that my business address is 3960 Orange Street, Suite 500, Riverside, California 92501.

That on January 20, 2011, I served the following document(s):

- NOTICE OF HEARING RE: STATEMENT OF EXPENSE
- STATEMENT OF EXPENSE WORKSHEET

by placing a true copy thereof enclosed in a sealed envelope(s) addressed as follows:

**OWNERS OR INTERESTED PARTIES
(SEE NOTICE LIST ATTACHED TO NOTICE OF HEARING)**

XX **BY CERTIFIED MAIL, RETURN RECEIPT REQUESTED.** I am "readily familiar" with the office's practice of collection and processing correspondence for mailing. Under that practice it would be deposited with the U.S. Postal Service on that same day with postage thereon fully prepaid at Riverside, California, in the ordinary course of business.

 BY PERSONAL SERVICE: I caused to be delivered such envelope(s) by hand to the offices of the addressee(s).

XX **STATE - I declare under penalty of perjury under the laws of the State of California that the above is true and correct.**

 FEDERAL - I declare that I am employed in the office of a member of the bar of this court at whose direction the service was made.

EXECUTED ON January 20, 2011, at Riverside, California.



BRENDA G. PEELER

EXHIBIT NO. A.6

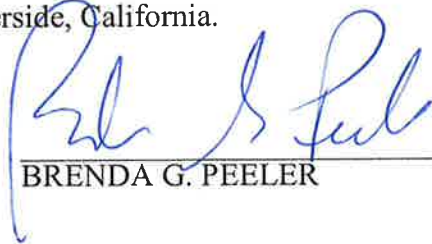

**CODE ENFORCEMENT DEPARTMENT
COUNTY OF RIVERSIDE**

GLENN BAUDE
Director

AFFIDAVIT OF POSTING OF NOTICES

January 21, 2011

RE CASE NO: CV031316

I, Hector Herrera, hereby declare:

I am employed by the Riverside County Code Enforcement Department; that my business address is 24318 Hemlock, Ave., Suite C-1, Moreno Valley, California 92557 .

That on 01/21/2011 at 12:45 pm, I securely and conspicuously posted Notice of hearing Re: Statement of expense at the property described as:

Property Address: 1 LOT BEHIND 61610 EL DORADO RD., GARNET

Assessor's Parcel Number: 668-390-083

I declare under the penalty of perjury that the foregoing is true and correct.

Executed on January 21, 2011 in the County of Riverside, California.

CODE ENFORCEMENT DEPARTMENT

Hector Herrera
By: Hector Herrera, Sr. Code Enforcement Officer

EXHIBIT NO. A⁷



COUNTY OF RIVERSIDE CODE ENFORCEMENT

P.O. Box 1469, Riverside, CA 92502
Phone: 951-955-2004 Fax: 951-955-8680

Property Reference/Mailing Address
668390083 ETHEL E RENNICK C/O ETHEL E RENNICK LIVING TRUST PO BOX 580081 NORTH PALM SPRINGS CA 92258

Summary Statement
As of: 1/12/2011

Date	Invoice Number & Amount	Amount	Balance
12/23/2010	CV031316- INV #100071. Orig. Amount \$2,313.30.	2,313.30	2,313.30
10/07/2003	CV031316:A03384- INV #11310. Orig. Amount \$200.00. A03384	200.00	2,513.30
10/29/2003	CV031316:A03396- INV #11311. Orig. Amount \$500.00. A03396	500.00	3,013.30
08/26/2003	CV031316:A03600- INV #11312. Orig. Amount \$200.00. A03600	200.00	3,213.30
06/10/2003	CV031316:A07265- INV #11313. Orig. Amount \$200.00. A07265	200.00	3,413.30
07/01/2003	CV031316:A07273- INV #11314. Orig. Amount \$400.00. A07273	400.00	3,813.30
		Balance Due	\$3,813.30

I affirm and declare under penalty of perjury under the laws of the State of California that the foregoing is true and correct.

Sue Rush
Code Enforcement Department

EXHIBIT NO. 3



County of Riverside Code Enforcement Department

P.O. Box 1469, Riverside, CA 92502
Phone: (951) 955-2004 Fax: (951) 955-8680
demands@rctlma.org

Statement of Expense

668390083
ETHEL E RENNICK
C/O ETHEL E RENNICK LIVING TRUST
PO BOX 580081
NORTH PALM SPRINGS CA 92258

Date	Invoice #
12/23/2010	100071

Case Number	District	Class
CV031316	5	SOE

Property Address
668390083 ETHEL E RENNICK C/O ETHEL E RENNICK LIVING TRUST N/O 61610 EL DORADO NORTH PALM SPRINGS CA 92258

Date	Item	Description	Hours/Qty	Rate	Amount
1/14/2004	Officer Hours	Labor Charges - Officer Time	1	100.00	100.00
1/15/2004	Officer Hours	Labor Charges - Officer Time	0.1	100.00	10.00
1/16/2004	Officer Hours	Labor Charges - Officer Time	0.5	100.00	50.00
1/21/2004	Officer Hours	Labor Charges - Officer Time	1	100.00	100.00
2/2/2004	Officer Hours	Labor Charges - Officer Time	0.5	100.00	50.00
2/17/2004	Officer Hours	Labor Charges - Officer Time	0.5	100.00	50.00
2/24/2004	Officer Hours	Labor Charges - Officer Time	0.5	100.00	50.00
2/25/2004	Officer Hours	Labor Charges - Officer Time	1	100.00	100.00
12/23/2010	SOE Preparation	Prepare Statement of Expense		65.00	65.00
		Subtotal Code Enforcement Costs			1,933.00
12/23/2010	Prepare Case for SOE He...			125.55	125.55
	Attend Hearing	Attend Statement of Expense hearing with Board of Supervisors		69.75	69.75
		Subtotal County Counsel Costs			195.30
12/23/2010	Lot/Title Report	Lot/Title Report		120.00	120.00
11/26/2003	Lot/Title Report	Lot/Title Report	1	65.00	65.00
		Subtotal Contractor Costs			185.00
				Subtotal	\$2,313.30
				Payments/Credits	\$0.00
				Total	\$2,313.30

I affirm and declare under penalty of perjury under the laws of the State of California that the foregoing is true and correct.

Sean Rush
Code Enforcement Department

EXHIBIT NO. B²



County of Riverside Code Enforcement Department

P.O. Box 1469, Riverside, CA 92502
Phone: (951) 955-2004 Fax: (951) 955-8680
demands@rctlma.org

Administrative Citation

668390083
ETHEL E RENNICK
C/O ETHEL E RENNICK LIVING TRUST
PO BOX 580081
NORTH PALM SPRINGS CA 92258

Citation Issue Date	Billing Date
10/7/2003	1/6/2011

Citation Number	District	Class
A03384	5	SOE

Property Address
668390083 N/O 61610 EL DORADO NORTH PALM SPRINGS CA 92258

Item	Description	Hours/Qty	Rate	Amount
Admiaistrative Citations	A03384	1	200.00	200.00
			Subtotal	\$200.00
			Payments/Credits	\$0.00
			Total	\$200.00

EXHIBIT NO. B³



County of Riverside Code Enforcement Department

P.O. Box 1469, Riverside, CA 92502
Phone: (951) 955-2004 Fax: (951) 955-8680
demands@rctlma.org

Administrative Citation

668390083
ETHEL E RENNICK
C/O ETHEL E RENNICK LIVING TRUST
PO BOX 580081
NORTH PALM SPRINGS CA 92258

Citation Issue Date	Billing Date
10/29/2003	1/6/2011

Citation Number	District	Class
A03396	5	SOE

Property Address
668390083 N/O 61610 EL DORADO NORTH PALM SPRINGS CA 92258

Item	Description	Hours/Qty	Rate	Amount
Administrative Citations	A03396	1	500.00	500.00
			Subtotal	\$500.00
			Payments/Credits	\$0.00
			Total	\$500.00

EXHIBIT NO. B⁴



County of Riverside Code Enforcement Department

P.O. Box 1469, Riverside, CA 92502
Phone: (951) 955-2004 Fax: (951) 955-8680
demands@rctlma.org

Administrative Citation

668390083
ETHEL E RENNICK
C/O ETHEL E RENNICK LIVING TRUST
PO BOX 580081
NORTH PALM SPRINGS CA 92258

Citation Issue Date	Billing Date
8/26/2003	1/6/2011

Citation Number	District	Class
A03600	5	SOE

Property Address
668390083 N/O 61610 EL DORADO NORTH PALM SPRINGS CA 92258

Item	Description	Hours/Qty	Rate	Amount
Administrative Citations	A03600	1	200.00	200.00

Subtotal	\$200.00
Payments/Credits	\$0.00
Total	\$200.00

EXHIBIT NO. B⁵



County of Riverside Code Enforcement Department

P.O. Box 1469, Riverside, CA 92502
Phone: (951) 955-2004 Fax: (951) 955-8680
demands@rctlma.org

Administrative Citation

668390083
ETHEL E RENNICK
C/O ETHEL E RENNICK LIVING TRUST
PO BOX 580081
NORTH PALM SPRINGS CA 92258

Citation Issue Date	Billing Date
6/10/2003	1/6/2011

Citation Number	District	Class
A07265	5	SOE

Property Address
668390083 N/O 61610 EL DORADO NORTH PALM SPRINGS CA 92258

Item	Description	Hours/Qty	Rate	Amount
Administrative Citations	A07265	1	200.00	200.00

Subtotal	\$200.00
Payments/Credits	\$0.00
Total	\$200.00

EXHIBIT NO. B6



County of Riverside Code Enforcement Department

P.O. Box 1469, Riverside, CA 92502
Phone: (951) 955-2004 Fax: (951) 955-8680
demands@rctlma.org

Administrative Citation

668390083
ETHEL E RENNICK
C/O ETHEL E RENNICK LIVING TRUST
PO BOX 580081
NORTH PALM SPRINGS CA 92258

Citation Issue Date	Billing Date
7/1/2003	1/6/2011

Citation Number	District	Class
A07273	5	SOE

Property Address
668390083 N/O 61610 EL DORADO NORTH PALM SPRINGS CA 92258

Item	Description	Hours/Qty	Rate	Amount
Administrative Citations	A07273	1	400.00	400.00

Subtotal	\$400.00
Payments/Credits	\$0.00
Total	\$400.00

EXHIBIT NO. B1

General Ledger Transactions

Criteria: Post On = 7/1/2002..12/31/2010

Journal Date	Journal ID	Fund	Department	Account	Program	Project	Class	Amount	Description	Operator
Fund 10000 -- General Fund										
Account 525440 -- Professional Services										
3/1/2004	AP00627900	10000	3110200000	525440		ZCV031316		65.00	LOT BOOK REPORT	E206543
Total Professional Services								65.00		
Total General Fund								65.00		

EXHIBIT NO.

B⁸



INVOICE

Order Number: 23039 **Order Date:** 12/30/2010

Customer Information:

Acct No. 1044

RIVERSIDE COUNTY TLMA-CODE INFORCEMENT
4080 Lemon Street
Riverside, CA 92501

Attn: Brent Steele
REF: CV03-1316 / Brenda Peeler
IN RE: RENNICK, ETHEL E.

Product and/or Service ordered for Property known as:	
Vacant Land	
DESCRIPTION:	FEE:
Lot Book Report	\$120.00
TOTAL DUE:	\$120.00

Payment due upon receipt. Please remit to:

RZ Title Services, Inc.
P.O. Box 1193
Whittier, CA 90609

EXHIBIT NO.

B9

Assessment Roll For the 2010-2011 Tax Year as of January 1,2010

Assessment #668390083-1

Parcel # 668390083-1

Assessee:	RENNICK ETHEL E	Land	4,757
Mail Name:	C/O ETHEL E RENNIC LIVING TRUST	Full Value	4,757
Mail Address:	P O BOX 580081	Total Net	4,757
City, State Zip:	N PALM SPRINGS CA 92258		
Real Property Use Code:	YD		
Base Year	2000		
Conveyance Number:	0546274		
Conveyance (mm/yy):	12/1999		
PUI:	Y020000		
TRA:	61-082		
Taxability Code:	0-00		
ID Data:	SEE ASSESSOR MAPS		

[View Parcel Map](#)

RIVERSIDE COUNTY GIS

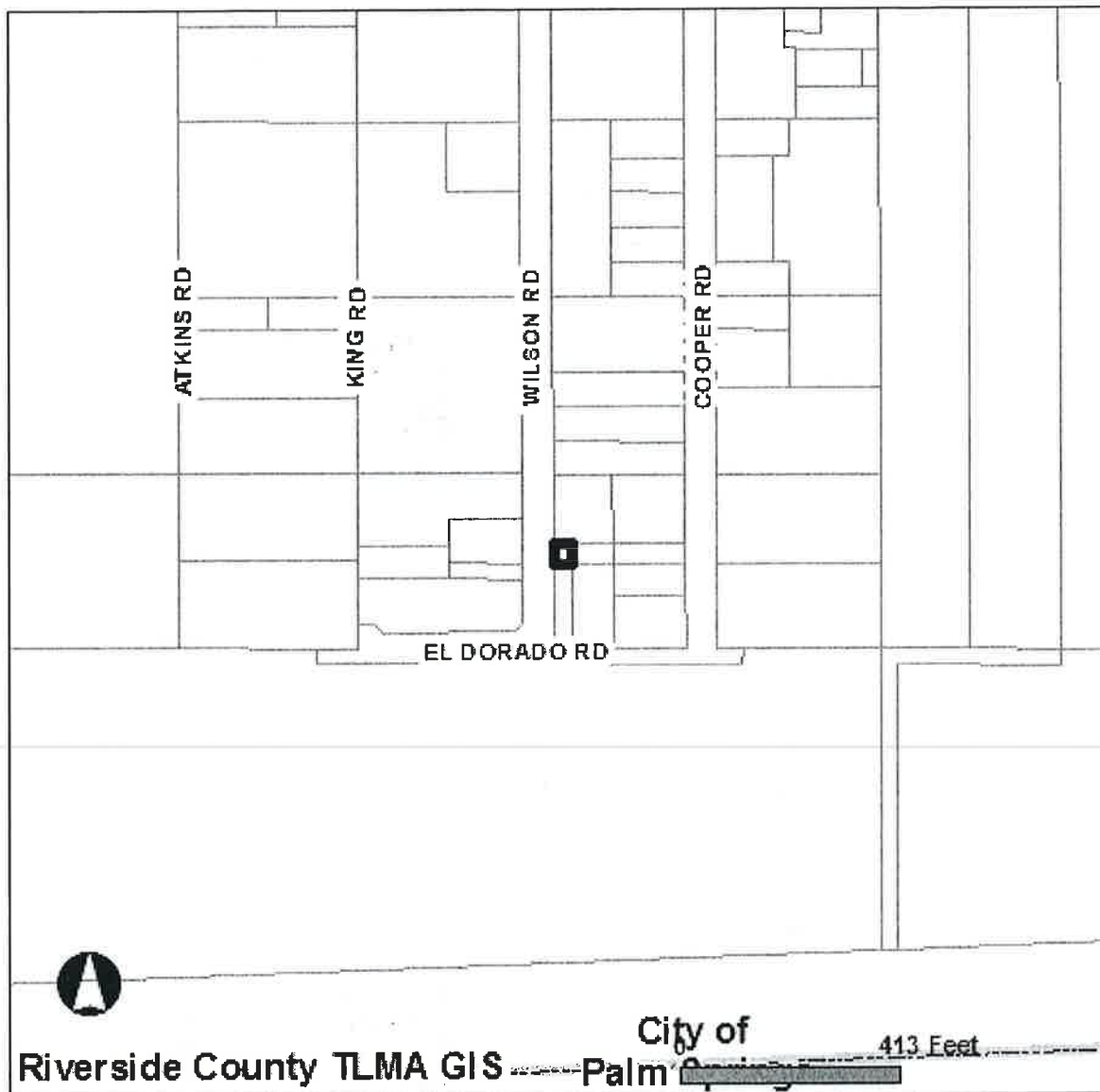

Riverside County TLMA GIS City of Palm Springs

Selected parcel(s):
668-390-083

IMPORTANT

Maps and data are to be used for reference purposes only. Map features are approximate, and are not necessarily accurate to surveying or engineering standards. The County of Riverside makes no warranty or guarantee as to the content (the source is often third party), accuracy, timeliness, or completeness of any of the data provided, and assumes no legal responsibility for the information contained on this map. Any use of this product with respect to accuracy and precision shall be the sole responsibility of the user.

STANDARD REPORT

APNs

668-390-083-1

OWNER NAME / ADDRESS

ETHEL E RENNICK
ADDRESS NOT AVAILABLE

MAILING ADDRESS

C/O ETHEL E RENNICK LIVING TRUST
P O BOX 580081
N PALM SPRINGS CA. 92258

LEGAL DESCRIPTION

EXHIBIT NO. _____

C²

LEGAL DESCRIPTION IS NOT AVAILABLE

LOT SIZE

RECORDED LOT SIZE IS 0.03 ACRES

PROPERTY CHARACTERISTICS

NO PROPERTY DESCRIPTION AVAILABLE

THOMAS BROS. MAPS PAGE/GRID

PAGE: 725 GRID: H5

CITY BOUNDARY/SPHERE

NOT WITHIN A CITY
CITY SPHERE: PALM SPRINGS
ANNEXATION DATE: FEB. 22, 2007
LAFCO CASE #: 2006-26-4&5
NO PROPOSALS

MARCH JOINT POWERS AUTHORITY

NOT IN THE JURISDICTION OF THE MARCH JOINT POWERS AUTHORITY

INDIAN TRIBAL LAND

NOT IN A TRIBAL LAND

SUPERVISORIAL DISTRICT (ORD. 813)

MARION ASHLEY, DISTRICT 5

TOWNSHIP/RANGE

T3SR4E SEC 17

ELEVATION RANGE

873 FEET

PREVIOUS APN

NO DATA AVAILABLE

PLANNING

LAND USE DESIGNATIONS

Zoning not consistent with the General Plan.
LDR

AREA PLAN (RCIP)

WESTERN COACHELLA VALLEY

GENERAL PLAN POLICY OVERLAYS

NOT IN A GENERAL PLAN POLICY OVERLAY AREA

GENERAL PLAN POLICY AREAS

SAN GORGONIO PASS WIND ENERGY POLICY AREA

ZONING CLASSIFICATIONS (ORD. 348)

W-2

ZONING DISTRICTS AND ZONING AREAS

PASS & DESERT DISTRICT

ZONING OVERLAYS

NOT IN A ZONING OVERLAY

SPECIFIC PLANS

NOT WITHIN A SPECIFIC PLAN

AGRICULTURAL PRESERVE

NOT IN AN AGRICULTURAL PRESERVE

REDEVELOPMENT AREAS

PROJECT AREA NAME: MCPA
SUBAREA NAME: WEST GARNET
AMENDMENT NUMBER: 0
ADOPTION DATE: DEC. 23, 1986
ACREAGE: 119 ACRES

AIRPORT INFLUENCE AREAS

NOT IN AN AIRPORT INFLUENCE AREA

AIRPORT COMPATIBILITY ZONES
NOT IN AN AIRPORT COMPATIBILITY ZONE

ENVIRONMENTAL

CVMSHCP (COACHELLA VALLEY MULTI-SPECIES HABITAT CONSERVATION PLAN) CONSERVATION AREA
NOT IN A CONSERVATION AREA**CVMSHCP FLUVIAL SAND TRANSPORT SPECIAL PROVISION AREAS**
NOT IN A FLUVIAL SAND TRANSPORT SPECIAL PROVISION AREA**WRMSHCP (WESTERN RIVERSIDE COUNTY MULTI-SPECIES HABITAT CONSERVATION PLAN) CELL GROUP**
NOT IN A CELL GROUP**WRMSHCP CELL NUMBER**
NOT IN A CELL**HANS/ERP (HABITAT ACQUISITION AND NEGOTIATION STRATEGY/EXPEDITED REVIEW PROCESS)**
NONE**VEGETATION (2005)**
NO DATA AVAILABLE

FIRE

HIGH FIRE AREA (ORD. 787)
NOT IN A HIGH FIRE AREA**FIRE RESPONSIBILITY AREA**
NOT IN A FIRE RESPONSIBILITY AREA

DEVELOPMENT FEES

CVMSHCP FEE AREA (ORD. 875)
WITHIN THE COACHELLA VALLEY MSHCP FEE AREA**WRMSHCP FEE AREA (ORD. 810)**
NOT WITHIN THE WESTERN RIVERSIDE COUNTY MSHCP FEE AREA**ROAD & BRIDGE DISTRICT**
NOT IN A DISTRICT**EASTERN TUMF (TRANSPORTATION UNIFORM MITIGATION FEE ORD. 673)**
IN OR PARTIALLY WITHIN A TUMF FEE AREA. SEE MAP FOR MORE INFORMATION.
IN EAST**WESTERN TUMF (TRANSPORTATION UNIFORM MITIGATION FEE ORD. 824)**
NOT WITHIN THE WESTERN TUMF FEE AREA**DIF (DEVELOPMENT IMPACT FEE AREA ORD. 659)**
WESTERN COACHELLA VALLEY**SKR FEE AREA (STEPHEN'S KANGAROO RAT ORD. 663.10)**
NOT WITHIN AN SKR FEE AREA.**DEVELOPMENT AGREEMENTS**
NOT IN A DEVELOPMENT AGREEMENT AREA

TRANSPORTATION

CIRCULATION ELEMENT ULTIMATE RIGHT-OF-WAY
NOT IN A CIRCULATION ELEMENT RIGHT-OF-WAY**ROAD BOOK PAGE**
169**TRANSPORTATION AGREEMENTS**
NOT IN A TRANSPORTATION AGREEMENT

CETAP (COMMUNITY AND ENVIRONMENTAL TRANSPORTATION ACCEPTABILITY PROCESS) CORRIDORS
NOT IN A CETAP CORRIDOR.

HYDROLOGY

FLOOD PLAIN REVIEW
NOT REQUIRED.

WATER DISTRICT
DWA

FLOOD CONTROL DISTRICT
RIVERSIDE COUNTY FLOOD CONTROL DISTRICT

WATERSHED
WHITEWATER

GEOLOGIC

FAULT ZONE
NOT IN A FAULT ZONE

FAULTS
WITHIN A 1/2 MILE OF
GARNET HILL FAULT
CONTACT THE COUNTY'S CHIEF ENGINEERING GEOLOGIST AT (951)955-6863.

LIQUEFACTION POTENTIAL
MODERATE

SUBSIDENCE
SUSCEPTIBLE

PALEONTOLOGICAL SENSITIVITY
LOW POTENTIAL.
FOLLOWING A LITERATURE SEARCH, RECORDS CHECK AND A FIELD SURVEY, AREAS MAY BE DETERMINED BY A QUALIFIED VERTEBRATE PALEONTOLOGIST AS HAVING LOW POTENTIAL FOR CONTAINING SIGNIFICANT PALEONTOLOGICAL RESOURCES SUBJECT TO ADVERSE IMPACTS.

MISCELLANEOUS

SCHOOL DISTRICT
PALM SPRINGS UNIFIED

COMMUNITIES
GARNET

COUNTY SERVICE AREA
NOT IN A COUNTY SERVICE AREA.

LIGHTING (ORD. 655)
ZONE B, 40.98 MILES FROM MT. PALOMAR OBSERVATORY

2000 CENSUS TRACT
044503

FARMLAND
OTHER LANDS

TAX RATE AREAS
061-082

- CITRUS PEST CONTROL 2
- COACHELLA VALLEY RESOURCE CONSER
- COUNTY FREE LIBRARY
- COUNTY STRUCTURE FIRE PROTECTION
- COUNTY WASTE RESOURCE MGMT DIST
- CSA 152
- CV MOSQ & VECTOR CONTROL
- DESERT COMMUNITY COLLEGE
- DESERT HOSPITAL
- DESERT WATER AGENCY 6TH FRINGE
- FLOOD CONTROL ADMINISTRATION

- FLOOD CONTROL ZONE 6
- GENERAL
- GENERAL PURPOSE
- MISSION SPRINGS IMP 2
- MISSION SPRINGS WATER DISTRICT
- PALM SPRINGS PUBLIC CEMETERY
- PALM SPRINGS UNIF B & I 1992-A
- PALM SPRINGS UNIFIED SCHOOL
- RIV CO REG PARK & OPEN SPACE
- RIV. CO. OFFICE OF EDUCATION

SPECIAL NOTES

NO SPECIAL NOTES

CODE COMPLAINTS

NO CODE COMPLAINTS

REPORT PRINTED ON...Thu Jan 20 07:52:32 2011
Version 101221

**BOARD OF SUPERVISORS
PUBLIC HEARING**

**March 1, 2011
(Continued 9.21 of Feb. 8, 2011)**

AGENDA ITEM NO. 9.16

Supplemental Documents

Statement of Expense

1 Parcel N/O 61610 El Dorado Rd., N. Palm Springs
Case No. CV03-1316

DISTRICT Five

2011-3-105890

OFFICE OF COUNTY COUNSEL
COUNTY OF RIVERSIDE



PAMELA J. WALLS
County Counsel

Assistant County Counsel
KATHERINE A. LIND

3960 ORANGE STREET, SUITE 500
RIVERSIDE, CA 92501
TELEPHONE: 951/955-6300
FAX: 951/955-6322 & 955-6363

Feb. 15, 2011

CONTINUATION NOTICE OF HEARING RE: STATEMENT OF EXPENSE

To: Owner(s) or Interested Parties
(See Attached Proof of Service
and Notice List)

Subject Property: 1 Parcel N/O 61610 El Dorado Rd., N. Palm Springs
Case No.: CV03-1316; RENNICK
APN: 668-390-083

NOTICE IS HEREBY GIVEN that a hearing that was held before the Riverside County Board of Supervisors on **Tuesday, February 8, 2011, at 9:30 a.m.** in the Board of Supervisors Room, 4080 Lemon Street, 1st Floor Annex, Riverside, California, and **has been continued to Tuesday, March 1, 2011, at 9:30 a.m.** at which time and place pertinent testimony will be heard regarding the expenses incurred by the County of Riverside, Code Enforcement Department ("DEPARTMENT") for the above-referenced abatement case. Said abatement case involved unpermitted land use (storage of mobile home, accumulated rubbish, excess outside storage and unpermitted fencing) located on your real property commonly described as 1 Parcel N/O 61610 El Dorado Rd., N. Palm Springs, Riverside County, California and more particularly described as Assessor's Parcel Number 668-390-083.

The total expense due, including all other fees and costs, for the abatement of the above-described dangerous or injurious condition is **three thousand, eight hundred thirteen dollars and thirty cents, (US \$3,813.30)**. This amount is immediately due and payable. If you have any objections to the Statement of Expense attached hereto, you must address your objections to the Board of Supervisors at the hearing. If you have any questions about the attached Statement of Expense, please contact the undersigned at (951) 955-6300. In the event the total amount due is not paid to the DEPARTMENT prior to the Board Hearing, the DEPARTMENT shall seek an order from the Board of Supervisors to place a lien against your property and collect the amount due as a special tax assessment.

Failure to appear at the hearing will result in the exclusion of your testimony. Facts as known to the DEPARTMENT will be presented to the Board of Supervisors for their final consideration and deliberation of this matter.

You are encouraged to contact Supervising Code Enforcement Officer, Brian Black (951) 955-2004 prior to the hearing. Please meet with the undersigned or Brian Black at 8:30 a.m. on the day of the hearing in Conference Room 2A located on the 1st floor in front of the Human Resources Office to discuss the case.

PAMELA J. WALLS
County Counsel



L. ALEXANDRA FONG
Deputy County Counsel

Enclosure: Statement of Expense



COUNTY OF RIVERSIDE CODE ENFORCEMENT

P.O. Box 1469, Riverside, CA 92502
Phone: 951-955-2004 Fax: 951-955-8680

Property Reference/Mailing Address
668390083 ETHEL E RENNICK C/O ETHEL E RENNICK LIVING TRUST PO BOX 580081 NORTH PALM SPRINGS CA 92258

Summary Statement
As of: 1/12/2011

Date	Invoice Number & Amount	Amount	Balance
12/23/2010	CV031316- INV #100071. Orig. Amount \$2,313.30.	2,313.30	2,313.30
10/07/2003	CV031316:A03384- INV #11310. Orig. Amount \$200.00. A03384	200.00	2,513.30
10/29/2003	CV031316:A03396- INV #11311. Orig. Amount \$500.00. A03396	500.00	3,013.30
08/26/2003	CV031316:A03600- INV #11312. Orig. Amount \$200.00. A03600	200.00	3,213.30
06/10/2003	CV031316:A07265- INV #11313. Orig. Amount \$200.00. A07265	200.00	3,413.30
07/01/2003	CV031316:A07273- INV #11314. Orig. Amount \$400.00. A07273	400.00	3,813.30
		Balance Due	\$3,813.30

I affirm and declare under penalty of perjury under the laws of the State of California that the foregoing is true and correct.

Sue Rush
Code Enforcement Department

EXHIBIT NO. B



County of Riverside Code Enforcement Department

P.O. Box 1469, Riverside, CA 92502
Phone: (951) 955-2004 Fax: (951) 955-8680
demands@rctlma.org

Statement of Expense

668390083
ETHEL E RENNICK
C/O ETHEL E RENNICK LIVING TRUST
PO BOX 580081
NORTH PALM SPRINGS CA 92258

Date	Invoice #
12/23/2010	100071

Property Address
668390083 ETHEL E RENNICK C/O ETHEL E RENNICK LIVING TRUST N/O 61610 EL DORADO NORTH PALM SPRINGS CA 92258

Case Number	District	Class
CV031316	5	SOE

Date	Item	Description	Hours/Qty	Rate	Amount
1/14/2004	Officer Hours	Labor Charges - Officer Time	1	100.00	100.00
1/15/2004	Officer Hours	Labor Charges - Officer Time	0.1	100.00	10.00
1/16/2004	Officer Hours	Labor Charges - Officer Time	0.5	100.00	50.00
1/21/2004	Officer Hours	Labor Charges - Officer Time	1	100.00	100.00
2/2/2004	Officer Hours	Labor Charges - Officer Time	0.5	100.00	50.00
2/17/2004	Officer Hours	Labor Charges - Officer Time	0.5	100.00	50.00
2/24/2004	Officer Hours	Labor Charges - Officer Time	0.5	100.00	50.00
2/25/2004	Officer Hours	Labor Charges - Officer Time	1	100.00	100.00
12/23/2010	SOE Preparation	Prepare Statement of Expense		65.00	65.00
		Subtotal Code Enforcement Costs			1,933.00
12/23/2010	Prepare Case for SOE He...			125.55	125.55
	Attend Hearing	Attend Statement of Expense hearing with Board of Supervisors		69.75	69.75
		Subtotal County Counsel Costs			195.30
12/23/2010	Lot/Title Report	Lot/Title Report		120.00	120.00
11/26/2003	Lot/Title Report	Lot/Title Report	1	65.00	65.00
		Subtotal Contractor Costs			185.00
Subtotal					\$2,313.30
Payments/Credits					\$0.00
Total					\$2,313.30

affirm and declare under penalty of perjury under the laws of the State of California that the foregoing is true and correct.

Sue Rush
Code Enforcement Department

EXHIBIT NO. B²



County of Riverside Code Enforcement Department

P.O. Box 1469, Riverside, CA 92502
Phone: (951) 955-2004 Fax: (951) 955-8680
demands@rctlma.org

Administrative Citation

668390083
ETHEL E RENNICK
C/O ETHEL E RENNICK LIVING TRUST
PO BOX 580081
NORTH PALM SPRINGS CA 92258

Citation Issue Date	Billing Date
10/7/2003	1/6/2011

Citation Number	District	Class
A03384	5	SOE

Property Address
668390083 N/O 61610 EL DORADO NORTH PALM SPRINGS CA 92258

Item	Description	Hours/Qty	Rate	Amount
Administrative Citations	A03384	1	200.00	200.00
			Subtotal	\$200.00
			Payments/Credits	\$0.00
			Total	\$200.00

EXHIBIT NO. 133



County of Riverside Code Enforcement Department

P.O. Box 1469, Riverside, CA 92502
Phone: (951) 955-2004 Fax: (951) 955-8680
demands@rctlma.org

Administrative Citation

668390083
ETHEL E RENNICK
C/O ETHEL E RENNICK LIVING TRUST
PO BOX 580081
NORTH PALM SPRINGS CA 92258

Citation Issue Date	Billing Date
10/29/2003	1/6/2011

Property Address
668390083 N/O 61610 EL DORADO NORTH PALM SPRINGS CA 92258

Citation Number	District	Class
A03396	5	SOE

Item	Description	Hours/Qty	Rate	Amount
Administrative Citations	A03396	1	500.00	500.00

Subtotal	\$500.00
Payments/Credits	\$0.00
Total	\$500.00

EXHIBIT NO. B4



County of Riverside

Code Enforcement Department

P.O. Box 1469, Riverside, CA 92502
 Phone: (951) 955-2004 Fax: (951) 955-8680
 demands@rctlma.org

Administrative Citation

668390083
 ETHEL E RENNICK
 C/O ETHEL E RENNICK LIVING TRUST
 PO BOX 580081
 NORTH PALM SPRINGS CA 92258

Citation Issue Date	Billing Date
8/26/2003	1/6/2011

Property Address
668390083 N/O 61610 EL DORADO NORTH PALM SPRINGS CA 92258

Citation Number	District	Class
A03600	5	SOE

Item	Description	Hours/Qty	Rate	Amount
Administrative Citations	A03600	1	200.00	200.00
			Subtotal	\$200.00

Payments/Credits	\$0.00
Total	\$200.00

EXHIBIT NO. B⁵



County of Riverside Code Enforcement Department

P.O. Box 1469, Riverside, CA 92502
Phone: (951) 955-2004 Fax: (951) 955-8680
demands@rctlma.org

Administrative Citation

668390083
ETHEL E RENNICK
C/O ETHEL E RENNICK LIVING TRUST
PO BOX 580081
NORTH PALM SPRINGS CA 92258

Citation Issue Date	Billing Date
6/10/2003	1/6/2011

Citation Number	District	Class
A07265	5	SOE

Property Address
668390083 N/O 61610 EL DORADO NORTH PALM SPRINGS CA 92258

Item	Description	Hours/Qty	Rate	Amount
Administrative Citations	A07265	1	200.00	200.00

Subtotal	\$200.00
Payments/Credits	\$0.00
Total	\$200.00

EXHIBIT NO. 84



County of Riverside

Code Enforcement Department

P.O. Box 1469, Riverside, CA 92502
 Phone: (951) 955-2004 Fax: (951) 955-8680
 demands@rctlma.org

668390083
 ETHEL E RENNICK
 C/O ETHEL E RENNICK LIVING TRUST
 PO BOX 580081
 NORTH PALM SPRINGS CA 92258

Administrative Citation

Citation Issue Date	Billing Date
7/1/2003	1/6/2011

Citation Number	District	Class
A07273	5	SOE

Property Address
668390083 N/O 61610 EL DORADO NORTH PALM SPRINGS CA 92258

Item	Description	Hours/Qty	Rate	Amount
Administrative Citations	A07273	1	400.00	400.00
			Subtotal	\$400.00
			Payments/Credits	\$0.00
			Total	\$400.00

EXHIBIT NO. B7

NOTICE LIST

Subject Property: 1 Parcel N/O 61610 El Dorado Rd., N. Palm Springs; Case No.: CV03-1316;
 APN: 668-390-083; District Five

ETHEL E RENNICK
 C/O ETHEL E RENNICK LIVING TRUST
 PO BOX 580081
 N PALM SPRINGS CA 92258

JOLLIE STUART
 PEARLIE STUART
 61610 EL DORADO RD
 N PALM SPRINGS CA 92258

HOUSEHOLD FINANCE CORP
 961 WEIGEL DRIVE
 ELMHURST IL 60126

THE ETHEL E RENNICK
 LIVING TRUST
 2138 CAMBRIDGE F
 DEERFIELD FL 33442

SENDER: COMPLETE THIS SECTION	
1. Article Addressed to: ETHEL E RENNICK C/O ETHEL E RENNICK LIVING TRUST PO BOX 580081 N PALM SPRINGS CA 92258	
2. Article Number (Transfer from service label) 7010 1670 0001 7232 8472 PS Form 3811, February 2004 Domestic Return Receipt	
3. Service Type <input checked="" type="checkbox"/> Certified Mail <input type="checkbox"/> Registered <input type="checkbox"/> Insured Mail <input type="checkbox"/> Express Mail <input checked="" type="checkbox"/> Return Receipt for Merchandise <input type="checkbox"/> C.O.D.	
4. Restricted Delivery? (Extra Fee) <input type="checkbox"/> Yes	
5. Article Description CV03-1316 (Rennick) Site 4	
COMPLETE THIS SECTION ON DELIVERY	
A. Signature <input checked="" type="checkbox"/> <i>Ethel E Rennick</i> <input type="checkbox"/> Agent	
B. Received by (Printed Name) <input checked="" type="checkbox"/> <i>Ethel E Rennick</i> <input type="checkbox"/> Addressee	
C. Date of Delivery <input type="checkbox"/>	
D. Is delivery address different from item 1? <input type="checkbox"/> Yes If YES, enter delivery address below: <input type="checkbox"/> No	
102595-02-M-1540	

U.S. Postal Service™
CERTIFIED MAIL™ RECEIPT
 (Domestic Mail Only; No Insurance Coverage Provided)

For delivery information visit our website at www.usps.com

OFFICIAL USE

Postage \$ *2.50*
 Certified Fee *2.30*
 Return Receipt Fee (Endorsement Required)
 Restricted Delivery Fee (Endorsement Required)
 Total Postage & Fees \$

Mailed 2/15/11

Postmark Here

Sent To
 Street, or PO E HOUSEHOLD FINANCE CORP
 City, St 961 WEIGEL DRIVE
 ELMHURST IL 60126

PS Form 3800, August 2006 See Reverse for Instructions

9549 2E22 T000 029T 0T02

NOTICE LIST

Subject Property: 1 Parcel N/O 61610 El Dorado Rd., N. Palm Springs; Case No.: CV03-1316;
APN: 668-390-002, District Five

Office of County Counsel
3960 Orange Street, Suite 500
Riverside, CA 92501

CERTIFIED MAIL™



7010 1670 0001 7232 8465

THE ETHEL E RENNICK
LIVING TRUST
2138 CAMBRIDGE F
DEERFIELD I

NIXIE

334 DE 1

00 02/18/11

RETURN TO SENDER
NOT DELIVERABLE AS ADDRESSED
UNABLE TO FORWARD

BC: 92501964425

*1004-01000-15-43



02 1P
\$ 005.710
0003958246 FEB 15 2011
MAILED FROM ZIP CODE 92501

Handwritten signature

Office of County Counsel
3960 Orange Street, Suite 500
Riverside, CA 92501

CERTIFIED MAIL™



7010 1670 0001 7232 8489

NO STREET DELIVERY
PO BOXES ONLY

No PO BOX HERE SINCE 2006

JOLLIE STUART
PEARLIE STUART
61610-EL DORADO RD
N PALM SPRI

NIXIE

923 DE 1

00 02/16/11

RETURN TO SENDER
NOT DELIVERABLE AS ADDRESSED
UNABLE TO FORWARD

BC: 92501964425

*1004-00311-15-40



02 1P
\$ 005.710
0003958246 FEB 15 2011
MAILED FROM ZIP CODE 92501



925019644



1 **PROOF OF SERVICE**

2 Case No. CV03-1316

3 STATE OF CALIFORNIA, COUNTY OF RIVERSIDE

4 I, Brenda G. Peeler, declare that I am a citizen of the United States and am employed in the County
5 of Riverside, over the age of 18 years and not a party to the within action or proceeding; that my
6 business address is 3960 Orange Street, Suite 500, Riverside, California 92501.

7 That on Feb. 15, 2011, I served the following document(s):

- 8 - **CONTINUED NOTICE OF HEARING RE: STATEMENT OF**
9 **EXPENSE**
- 10 - **SUMMARY STATEMENT, STATEMENT OF EXPENSE &**
11 **ADMINISTRATIVE CITATIONS (A03384, A03396, A03600, A07265**
12 **& A07273)**

13 by placing a true copy thereof enclosed in a sealed envelope(s) addressed as follows:

14 **OWNERS OR INTERESTED PARTIES**
15 **(SEE NOTICE LIST ATTACHED TO NOTICE OF HEARING)**

16 XX **BY CERTIFIED MAIL, RETURN RECEIPT REQUESTED.** I am "readily familiar"
17 with the office's practice of collection and processing correspondence for mailing. Under
18 that practice it would be deposited with the U.S. Postal Service on that same day with
19 postage thereon fully prepaid at Riverside, California, in the ordinary course of business.

20 **BY PERSONAL SERVICE:** I caused to be delivered such envelope(s) by hand to the offices
21 of the addressee(s).

22 XX **STATE - I declare under penalty of perjury under the laws of the State of California that the**
23 **above is true and correct.**

24 **FEDERAL - I declare that I am employed in the office of a member of the bar of this court at**
25 **whose direction the service was made.**

26 EXECUTED ON Feb. 15, 2011, at Riverside, California.

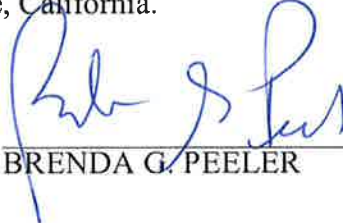
27 
28 _____
BRENDA G. PEELER



**CODE ENFORCEMENT DEPARTMENT
COUNTY OF RIVERSIDE**

GLENN BAUDE
Director

AFFIDAVIT OF POSTING OF NOTICES

February 17, 2011

RE CASE NO: CV031316

I, Mike Bowles, hereby declare:

I am employed by the Riverside County Code Enforcement Department; that my business address is 24318 Hemlock, Ave., Suite C-1, Moreno Valley, California 92557 .

That on 2/16/2011 at 10:00, I securely and conspicuously posted Continuation Notice of Statement of Expense Hearing at the property described as:

Property Address: 1 LOT BEHIND 61610 EL DORADO RD., GARNET

Assessor's Parcel Number: 668-390-083

I declare under the penalty of perjury that the foregoing is true and correct.

Executed on February 17, 2011 in the County of Riverside, California.

CODE ENFORCEMENT DEPARTMENT



By: Mike Bowles, Sr. Code Enforcement Officer

Riverside County Board of Supervisors
Request to Speak

Submit request to Clerk of Board (right of podium),
Speakers are entitled to three (3) minutes, subject
Board Rules listed on the reverse side of this form.

SPEAKER'S NAME: LEE VINOCUR

Address: _____
(only if follow-up mail response requested)

City: _____ Zip: _____

Phone #: _____

Date: 3/1/11 Agenda # 9.16

PLEASE STATE YOUR POSITION BELOW:

Position on "Regular" (non-appealed) Agenda Item:
_____ Support Oppose _____ Neutral

Note: If you are here for an agenda item that is filed
for "Appeal", please state separately your position on
the appeal below:

_____ Support _____ Oppose _____ Neutral

I give my 3 minutes to: _____

Riverside County Board of Supervisors
Request to Speak

Submit request to Clerk of Board (right of podium),
Speakers are entitled to three (3) minutes, subject
Board Rules listed on the reverse side of this form.

SPEAKER'S NAME: LEE VINOCUR

Address: _____
(only if follow-up mail response requested)

City: N.P.S. Zip: 92258

Phone #: 760/3299813

Date: 2/8/11 Agenda # 9.21

PLEASE STATE YOUR POSITION BELOW:

Position on "Regular" (non-appealed) Agenda Item:
_____ Support Oppose _____ Neutral

Note: If you are here for an agenda item that is filed
for "Appeal", please state separately your position on
the appeal below:

_____ Support _____ Oppose _____ Neutral

I give my 3 minutes to: _____