

**SUBMITTAL TO THE FLOOD CONTROL AND
WATER CONSERVATION DISTRICT BOARD
COUNTY OF RIVERSIDE, STATE OF CALIFORNIA**

623B



FROM: General Manager-Chief Engineer

SUBMITTAL DATE:
March 1, 2011

SUBJECT: Notice of Completion
Belltown Market Street Storm Drain, Stage 1 Line A, Line B and Line B1
Project No. 1-0-00148-01

RECOMMENDED MOTION:

The Board accept the referenced project as constructed; authorize the Chairman to execute the attached Notice of Completion; and direct the Clerk of the Board to record the executed Notice of Completion with the Riverside County Clerk and Recorder's Office.

BACKGROUND:

Continued on Page 2.

FINANCIAL:

N/A

HO:mcv

WARREN D. WILLIAMS
General Manager-Chief Engineer

FINANCIAL DATA	Current F.Y. District Cost:	N/A	In Current Year Budget:	N/A
	Current F.Y. County Cost:	N/A	Budget Adjustment:	N/A
	Annual Net District Cost:	N/A	For Fiscal Year:	N/A

SOURCE OF FUNDS: N/A

Positions To Be Deleted Per A-30	<input type="checkbox"/>
Requires 4/5 Vote	<input type="checkbox"/>

C.E.O. RECOMMENDATION:

APPROVE

BY:
Michael R. Shetler

County Executive Office Signature

MINUTES OF THE FLOOD CONTROL AND WATER CONSERVATION DISTRICT

On motion of Supervisor Buster, seconded by Supervisor Stone and duly carried, IT WAS ORDERED that the above matter is approved as recommended.

Ayes: Buster, Stone and Ashley
Nays: None
Absent: Tavaglione and Benoit
Date: March 1, 2011
xc: Flood, Recorder

Kecia Harper-Ihem
Clerk of the Board
By:
Deputy

Prev. Agn. Ref.: 11.5 of 09/01/09

District: 2nd

Agenda Number:

11.2

FORM APPROVED BY COUNTY COUNSEL
BY: NEAL R. KIPNIS DATE

ATTACHMENTS FILED WITH THE CLERK OF THE BOARD
Dep't Recomm.: Consent Policy
Per Exec. Ofc.: Consent Policy

**FLOOD CONTROL AND WATER CONSERVATION DISTRICT BOARD SUBMITTAL
COUNTY OF RIVERSIDE, STATE OF CALIFORNIA**

SUBJECT: Notice of Completion
Belltown Market Street Storm Drain, Stage 1 Line A, Line B and Line B1
Project No. 1-0-00148-01

SUBMITTAL DATE: March 1, 2011

Page 2

The Board approved a contract with H & H General Contractors, Inc., in the amount of \$5,959,054.00 as Agenda Item Number 11.5 on September 1, 2009. The total payment of the contract, including contract overages and change orders, is \$6,099,926.64. This amount is 2.4% over the original contract amount.

Final inspection of the above referenced project was made, and the project was found to be complete according to plans and specifications. A brief project description and location map are attached.

To be recorded with County Recorder
No recording fee.

Recording requested by:
Kecia Harper-Ihem, Clerk of the Board
Riverside County Clerk of the Board
Stop No. 1010
Post Office Box 1147, Riverside, CA 92502-1147

When recorded return to:
CLERK OF THE BOARD
Stop No. 1010
Post Office Box 1147, Riverside, CA 92502-1147

NOTICE OF COMPLETION
(Civil Code § 3093 – Public Works)

DOC # 2011-0098423
03/03/2011

Customer Copy Label
The paper to which this label is
affixed has not been compared
with the recorded document
Larry W Ward
County of Riverside
Assessor, County Clerk & Recorder

Notice is hereby given by the undersigned owner, a public entity of the State of California, that a public work or improvement has been completed, as follows:

Project title or description of work: **Belltown Market Street Storm Drain, Stage 1 Line A, Line B and Line B1**
Project No. 1-0-00148-01

Date of completion: **Date this document is recorded** 03/01/11

Nature of owner: **Public Agency**

Interest or estate of owner: **Easement and Street Right-of-Way**

Address of owner: **1995 Market Street, Riverside, CA 92501**

Name of contractor: **H & H General Contractors, Inc.**

Street address or legal description of site: **Located along Rubidoux Boulevard, Agua Mansa Road, Avalon, 20th and Market Streets within the Belltown community and connecting to the Santa Ana River Channel. Consisting of approximately 4,900 lineal feet of 11' W x 7' H RCB approximately 3,000 lineal feet of mainline storm drain ranging from 36" to 84" diameter, approximately 1,000 lineal feet of connector pipe storm drain ranging from 18" to 48" diameter, two major inlet structures, a porous landscape detention water quality feature and a major outlet structure adjacent to and outletting into the Santa Ana River Channel.**

Dated: March 1, 2011

Owner: RIVERSIDE COUNTY FLOOD CONTROL AND WATER CONSERVATION DISTRICT
(Name of public entity)

ATTEST:
Kecia Harper-Ihem, Clerk

By: Marion Ashley

By: _____ Deputy

Title: Chairman, Board of Supervisors
Marion Ashley

STATE OF CALIFORNIA)
COUNTY OF RIVERSIDE)

I am the Chairman of the governing board of the Riverside County Flood Control and Water Conservation District, the public entity which executed the foregoing notice and on whose behalf I make this verification; I have read and notice, know its contents, and the same is true. I certify under penalty of perjury that the foregoing is true and correct.

Executed at Riverside, California on 03/01/11 (Date)

COPY

Marion Ashley

DEPOSED COUNTY COUNSEL
 BY NEAL R. KIPNIS DATE

**LARRY W. WARD
COUNTY OF RIVERSIDE
ASSESSOR-COUNTY CLERK-RECORDER**

Recorder
P.O. Box 751
(951) 486-7000

www.riversideacr.com

CERTIFICATION

Pursuant to the provisions of Government Code 27361.7, I certify under the penalty of perjury that the following is a true copy of illegible wording found in the attached document:

(Print or type the page number(s) and wording below):

CLARIFICATION FOR SEAL for the Riverside County Flood Control and Water Conservation District (EMBOSED ON DOCUMENT)

RIVERSIDE COUNTY FLOOD CONTROL AND
WATER CONSERVATION DISTRICT

1945

CALIFORNIA

Date:

3-1-11

Signature:

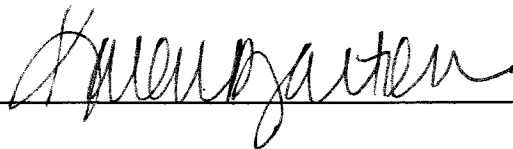

Print Name: Karen Barton, Board Assistant

BELLTOWN MARKET STREET STORM DRAIN STAGE 1 LINE A, LINE B, LINE B-1

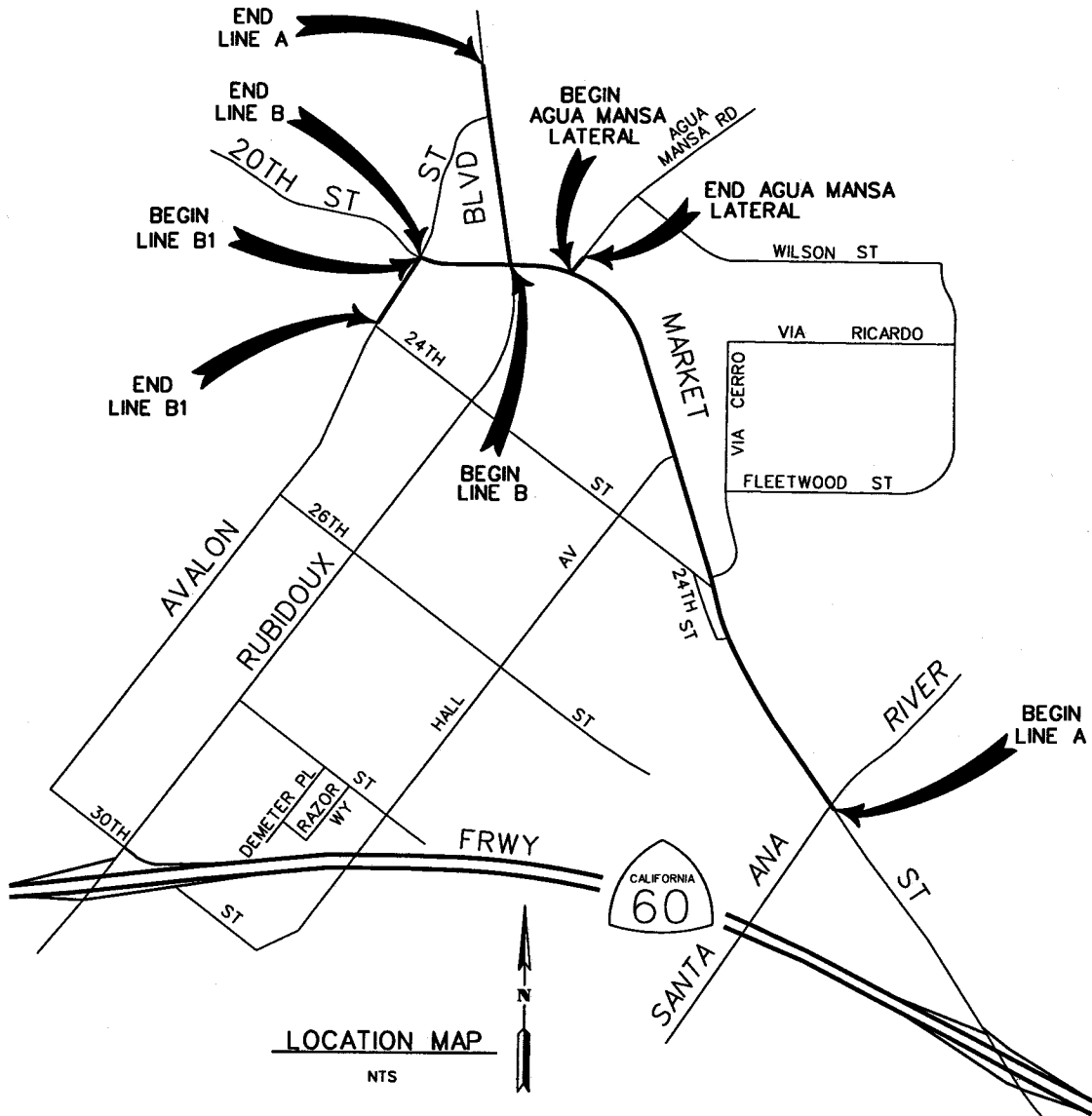

The proposed project is located within the unincorporated Belltown community of Riverside County northerly of the City of Riverside. The alignment of the drainage facilities will specifically be located along Rubidoux Boulevard, Agua Mansa Road, Avalon, 20th and Market Streets, and connecting to the Santa Ana River Channel. The project consists of the construction of approximately 4,900 lineal feet of 11 feet wide by 7 feet high reinforced concrete box (RCB), approximately 3,000 lineal feet of mainline storm drain ranging from 36 inch to 84 inch diameter, approximately 1,000 lineal feet of connector pipe storm drain ranging from 18 inch to 48 inch diameter, two major inlet structures, a porous landscape detention water quality feature and a major outlet structure adjacent to and outletting into the Santa Ana River Channel.