

**SUBMITTAL TO THE BOARD OF SUPERVISORS
COUNTY OF RIVERSIDE, STATE OF CALIFORNIA**

8103



FROM: County Counsel
Code Enforcement Department

SUBMITTAL DATE:
March 10, 2011

SUBJECT: Statement of Expense [Case No. CV08-02344]
Subject Property: 6641 Morab Street, Corona; BARTHOLOMEW
APN: 164-090-005
District Two

RECOMMENDED MOTION: Move that the Board of Supervisors:

- (1) assess the reasonable costs of abatement of a public nuisance (unmaintained landscaping) in the above-referenced matter to be **four thousand, two hundred thirty-six dollars and seventy cents (US \$4,236.70)**;
- (2) assess the costs of abatement against the above-described subject property;
- (3) authorize the recordation of a notice of abatement lien; and
- (4) authorize the abatement costs to be added to the tax roll as a special assessment
- (5) authorize and direct the Code Enforcement Department to take any reasonable actions to collect the amount owed.

Raymond M. Mistica
RAYMOND M. MISTICA, Deputy County Counsel
for PAMELA J. WALLS, County Counsel

**FINANCIAL
DATA**

Current F.Y. Total Cost:	\$ N/A	In Current Year Budget:	N/A
Current F.Y. Net County Cost:	\$ N/A	Budget Adjustment:	N/A
Annual Net County Cost:	\$ N/A	For Fiscal Year:	N/A

SOURCE OF FUNDS:

Positions To Be Deleted Per A-30	<input type="checkbox"/>
Requires 4/5 Vote	<input type="checkbox"/>

C.E.O. RECOMMENDATION:

APPROVE

BY *Tina Grande*
Tina Grande

County Executive Office Signature

☐ Consent
☒ Policy
☐ Consent
☒ Policy

MINUTES OF THE BOARD OF SUPERVISORS

On motion of Supervisor Ashley, seconded by Supervisor Stone and duly carried by unanimous vote, IT WAS ORDERED that the above matter is approved as recommended.

Ayes: Buster, Tavaglione, Stone, Benoit and Ashley
Nays: None
Absent: None
Date: March 22, 2011
xc: Co. Co., CED, Prop. Owner

Kecia Harper-Ihem
 Clerk of the Board
 By: *[Signature]*
 Deputy

Prev. Agn. Ref.:

District: 2

Agenda Number:

9.2

Statement of Expense [Case No. CV08-02344]
Subject Property: 6641 Morab Street, Corona; BARTHOLOMEW
APN: 164-090-005
District Two
Page 2

BACKGROUND: Government Code § 25845, Riverside County Ordinance Nos. 348 (Title 4.3.1) and 725 (RCC Chapter 1.16) authorize the recovery of abatement costs in public nuisance cases, the recordation of a notice of abatement lien and inclusion of abatement costs on the tax roll as a special assessment upon approval of the Board of Supervisors.

Multiple Notices of Violation and Administrative Citations were issued. Subsequently, the property brought the subject property into compliance.

The Notice of Hearing re Statement of Expense has been posted on the property and mailed to the property owner and all interested parties, as required by law. Copies of all relevant notices issued in this matter together with proof of service and posting have been separately filed with the Clerk of the Board and are made a part of the record herein, pursuant to Riverside County Ordinance 725.

**SUBMITTAL TO THE BOARD OF SUPERVISORS
COUNTY OF RIVERSIDE, STATE OF CALIFORNIA**

FROM: County Counsel
Code Enforcement Department
SUBJECT: Statement of Expense [Case No. CV08-02344]
Subject Property: 6641 Morab Street, Corona; BARTHOLOMEW
APN: 164-090-005
District Two

**TABLE OF SUPPLEMENTAL DOCUMENTS
FILED WITH THE CLERK OF THE BOARD**

Hearing Date: MARCH 22, 2011

Notice of Statement Expense Hearing (including Proofs of Service, Affidavits of Posting and Return Receipts)	Exhibit A
Statement of Expense Worksheet with Supporting Documents	Exhibit B
Assessment-Roll For The Year 10/11 And Geographic Information System, February 8, 2011	Exhibit C
Lot Book Report	Exhibit D

PAMELA J. WALLS
County Counsel

OFFICE OF COUNTY COUNSEL
COUNTY OF RIVERSIDE



KATHERINE A. LIND
Assistant County Counsel

3960 ORANGE STREET, SUITE 500
RIVERSIDE, CA 92501-3674
TELEPHONE: 951/955-6300
FAX: 951/955-6322 & 951/955-6363

March 2, 2011

NOTICE OF HEARING RE: STATEMENT OF EXPENSE

To: Owner(s) or Interested Parties
(See Attached Proof of Service
and Notice List)

Subject Property: 6641 Morab Street, Corona
Case No.: CV08-02344; BARTHOLOMEW
APN: 164-090-005

NOTICE IS HEREBY GIVEN that a hearing will be held before the Riverside County Board of Supervisors on **Tuesday, March 22, 2011, at 9:30 a.m.** in the Board of Supervisors Room, 4080 Lemon Street, 1st Floor Annex, Riverside, California, at which time and place pertinent testimony will be heard regarding the expenses incurred by the County of Riverside, Code Enforcement Department ("DEPARTMENT") for the above-referenced abatement case. Said abatement case involved unmaintained landscaping located on your real property commonly described as 6641 Morab Street, Corona, Perris, Riverside County, California and more particularly described as Assessor's Parcel Number 164-090-005.

The total expense due, including all other fees and costs, for the abatement of the above-described dangerous or injurious condition is **four thousand, two hundred thirty-six dollars and seventy cents (US \$4,236.70)**. This amount is immediately due and payable. If you have any objections to the Statement of Expense attached hereto, you must address your objections to the Board of Supervisors at the hearing. If you have any questions about the attached Statement of Expense, please contact the undersigned at (951) 955-6300. In the event the total amount due is not paid to the DEPARTMENT prior to the Board Hearing, the DEPARTMENT shall seek an order from the Board of Supervisors to place a lien against your property and collect the amount due as a special tax assessment.

Failure to appear at the hearing will result in the exclusion of your testimony. Facts as known to the DEPARTMENT will be presented to the Board of Supervisors for their final consideration and deliberation of this matter.

You are encouraged to contact Supervising Code Enforcement Officer, Brian Black (951) 955-2004 prior to the hearing. Please meet with the undersigned or Brian Black at 7:30 a.m. on the day of the hearing in Conference Room 2A located on the 1st floor in front of the Human Resources Office to discuss the case.

PAMELA J. WALLS
County Counsel

L. ALEXANDRA FONG
Deputy County Counsel

Enclosure: Statement of Expense

EXHIBIT NO. A



COUNTY OF RIVERSIDE CODE ENFORCEMENT

P.O. Box 1469, Riverside, CA 92502
Phone: 951-955-2004 Fax: 951-955-8680

Property Reference/Mailing Address

164090005
KIMBERLY MICHELE BARTHOLOMEW
C/O MARK BARTHOLOMEW
6641 MORAB ST
CORONA, CA. 92880

Summary Statement

As of: 1/31/2011

Date	Invoice Number & Amount	Amount	Balance
01/31/2011	CV0802344- INV #100331. Orig. Amount \$636.70.	636.70	636.70
12/16/2009	CV0802344:A27596- INV #3830. Orig. Amount \$500.00. A27596	400.00	1,036.70
02/05/2010	CV0802344:A27766- INV #12675. Orig. Amount \$500.00. A27766	500.00	1,536.70
03/11/2009	CV0802344:A29131- INV #3831. Orig. Amount \$700.00. A29131	700.00	2,236.70
12/02/2008	CV0802344:A29307- INV #3832. Orig. Amount \$200.00. A29307	200.00	2,436.70
05/13/2009	CV0802344:A29427- INV #3833. Orig. Amount \$500.00. A29427	500.00	2,936.70
08/04/2009	CV0802344:A29483- INV #3834. Orig. Amount \$500.00. A29483	500.00	3,436.70
09/30/2009	CV0802344:A29567- INV #3835. Orig. Amount \$500.00. A29567	300.00	3,736.70
03/12/2010	CV0802344:A31482- INV #12676. Orig. Amount \$500.00. A31482	500.00	4,236.70
		Balance Due	\$4,236.70

I affirm and declare under penalty of perjury under the laws of the State of California that the foregoing is true and correct.

Code Enforcement Department

EXHIBIT NO. A²



County of Riverside Code Enforcement Department

P.O. Box 1469, Riverside, CA 92502
Phone: (951) 955-2004 Fax: (951) 955-8680
demands@rctlma.org

Statement of Expense

164090005
KIMBERLY MICHELE BARTHOLOMEW
C/O MARK BARTHOLOMEW
6641 MORAB ST
CORONA, CA. 92880

Date	Invoice #
1/31/2011	100331

Property Address

164090005
KIMBERLY MICHELE BARTHOLOMEW
C/O MARK BARTHOLOMEW
6641 MORAB ST
CORONA, CA 92880

Case Number	District	Class
CV0802344	2	SOE

Date	Item	Description	Hours/Qty	Rate	Amount
3/17/2008	Officer Hours	Labor Charges - Officer Time	1	82.00	82.00
6/17/2008	Officer Hours	Labor Charges - Officer Time	0.1	109.00	10.90
9/5/2008	Officer Hours	Labor Charges - Officer Time	0.2	109.00	21.80
12/2/2008	Officer Hours	Labor Charges - Officer Time	0.2	109.00	21.80
3/11/2009	Officer Hours	Labor Charges - Officer Time	0.2	109.00	21.80
5/13/2009	Officer Hours	Labor Charges - Officer Time	0.2	109.00	21.80
8/4/2009	Officer Hours	Labor Charges - Officer Time	0.2	109.00	21.80
9/30/2009	Officer Hours	Labor Charges - Officer Time	0.1	109.00	10.90
12/16/2009	Officer Hours	Labor Charges - Officer Time	0.1	109.00	10.90
2/5/2010	Officer Hours	Labor Charges - Officer Time	0.1	109.00	10.90
3/12/2010	Officer Hours	Labor Charges - Officer Time	0.1	109.00	10.90
4/15/2010	Officer Hours	Labor Charges - Officer Time	0.1	109.00	10.90
1/31/2011	SOE Preparation	Prepare Statement of Expense		65.00	65.00
		Subtotal Code Enforcement Costs			321.40
1/31/2011	Prepare Case for SOE He...			125.55	125.55
	Attend SOE Hearing			69.75	69.75
		Subtotal County Counsel Costs			195.30
1/31/2011	Lot/Title Report	Lot/Title Report		120.00	120.00
		Subtotal Contractor Costs			120.00
			Subtotal		\$636.70
			Payments/Credits		\$0.00
			Total		\$636.70

I affirm and declare under penalty of perjury under the laws of the State of California that the foregoing is true and correct.



Code Enforcement Department

EXHIBIT NO. A³

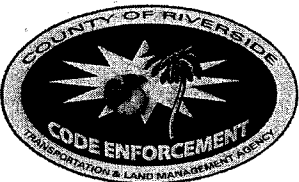

County of Riverside

Code Enforcement Department

P.O. Box 1469, Riverside, CA 92502
Phone: (951) 955-2004 Fax: (951) 955-8680
demands@rctlma.org

Administrative Citation

164090005
KIMBERLY MICHELE BARTHOLOMEW
C/O MARK BARTHOLOMEW
6641 MORAB ST
CORONA, CA. 92880

Citation Issue Date	Billing Date
12/16/2009	1/31/2011

Property Address
164090005 KIMBERLY MICHELE BARTHOLOMEW C/O MARK BARTHOLOMEW 6641 MORAB ST CORONA, CA. 92880

Citation Number	District	Class
A27596	2	SOE

Item	Description	Hours/Qty	Rate	Amount
Administrative Citations	A27596--CV08-02344	1	500.00	500.00
			Subtotal	\$500.00
			Payments/Credits	\$-100.00
			Total	\$400.00

EXHIBIT NO. A⁴



County of Riverside

Code Enforcement Department

P.O. Box 1469, Riverside, CA 92502
Phone: (951) 955-2004 Fax: (951) 955-8680
demands@rctlma.org

Administrative Citation

164090005
KIMBERLY MICHELE BARTHOLOMEW
C/O MARK BARTHOLOMEW
6641 MORAB ST
CORONA, CA. 92880

Citation Issue Date	Billing Date
2/5/2010	1/31/2011

Property Address
164090005 KIMBERLY MICHELE BARTHOLOMEW C/O MARK BARTHOLOMEW 6641 MORAB ST CORONA, CA. 92880

Citation Number	District	Class
A27766	2	SOE

Item	Description	Hours/Qty	Rate	Amount
Administrative Citations	A27766--CV0802344	1	500.00	500.00
			Subtotal	\$500.00
			Payments/Credits	\$0.00
			Total	\$500.00

EXHIBIT NO. A⁵



County of Riverside Code Enforcement Department

P.O. Box 1469, Riverside, CA 92502
Phone: (951) 955-2004 Fax: (951) 955-8680
demands@rctlma.org

Administrative Citation

164090005
KIMBERLY MICHELE BARTHOLOMEW
C/O MARK BARTHOLOMEW
6641 MORAB ST
CORONA, CA. 92880

Citation Issue Date	Billing Date
3/11/2009	1/31/2011

Property Address

164090005
KIMBERLY MICHELE BARTHOLOMEW
C/O MARK BARTHOLOMEW
6641 MORAB ST
CORONA, CA. 92880

Citation Number	District	Class
A29131	2	SOE

Item	Description	Hours/Qty	Rate	Amount
Administrative Citations	A29131--CV0802344	1	700.00	700.00

Subtotal	\$700.00
Payments/Credits	\$0.00
Total	\$700.00

EXHIBIT NO. AL



County of Riverside Code Enforcement Department

P.O. Box 1469, Riverside, CA 92502
Phone: (951) 955-2004 Fax: (951) 955-8680
demands@rctlma.org

Administrative Citation

164090005
KIMBERLY MICHELE BARTHOLOMEW
C/O MARK BARTHOLOMEW
6641 MORAB ST
CORONA, CA. 92880

Citation Issue Date	Billing Date
12/2/2008	1/31/2011

Property Address
164090005 KIMBERLY MICHELE BARTHOLOMEW C/O MARK BARTHOLOMEW 6641 MORAB ST CORONA, CA. 92880

Citation Number	District	Class
A29307	2	SOE

Item	Description	Hours/Qty	Rate	Amount
Administrative Citations	A29307--CV0802344	1	200.00	200.00

Subtotal	\$200.00
Payments/Credits	\$0.00
Total	\$200.00

EXHIBIT NO. A7



County of Riverside Code Enforcement Department

P.O. Box 1469, Riverside, CA 92502
Phone: (951) 955-2004 Fax: (951) 955-8680
demands@rctlma.org

Administrative Citation

164090005
KIMBERLY MICHELE BARTHOLOMEW
C/O MARK BARTHOLOMEW
6641 MORAB ST
CORONA, CA. 92880

Citation Issue Date	Billing Date
5/13/2009	1/31/2011

Property Address
164090005 KIMBERLY MICHELE BARTHOLOMEW C/O MARK BARTHOLOMEW 6641 MORAB ST CORONA, CA. 92880

Citation Number	District	Class
A29427	2	SOE

Item	Description	Hours/Qty	Rate	Amount
Administrative Citations	A29427--CV0802344	1	500.00	500.00
			Subtotal	\$500.00
			Payments/Credits	\$0.00
			Total	\$500.00

EXHIBIT NO. A⁸



County of Riverside

Code Enforcement Department

P.O. Box 1469, Riverside, CA 92502
Phone: (951) 955-2004 Fax: (951) 955-8680
demands@rctlma.org

Administrative Citation

164090005
KIMBERLY MICHELE BARTHOLOMEW
C/O MARK BARTHOLOMEW
6641 MORAB ST
CORONA, CA. 92880

Citation Issue Date	Billing Date
8/4/2009	1/31/2011

Property Address
164090005 KIMBERLY MICHELE BARTHOLOMEW C/O MARK BARTHOLOMEW 6641 MORAB ST CORONA, CA. 92880

Citation Number	District	Class
A29483	2	SOE

Item	Description	Hours/Qty	Rate	Amount
Administrative Citations	A29483--CV0802344	1	500.00	500.00

Subtotal	\$500.00
Payments/Credits	\$0.00
Total	\$500.00

EXHIBIT NO. A9



County of Riverside Code Enforcement Department

P.O. Box 1469, Riverside, CA 92502
Phone: (951) 955-2004 Fax: (951) 955-8680
demands@rctlma.org

Administrative Citation

164090005
KIMBERLY MICHELE BARTHOLOMEW
C/O MARK BARTHOLOMEW
6641 MORAB ST
CORONA, CA. 92880

Citation Issue Date	Billing Date
9/30/2009	1/31/2011

Property Address
164090005 KIMBERLY MICHELE BARTHOLOMEW C/O MARK BARTHOLOMEW 6641 MORAB ST CORONA, CA. 92880

Citation Number	District	Class
A29567	2	SOE

Item	Description	Hours/Qty	Rate	Amount
Administrative Citations	A29567--CV0802344	1	500.00	500.00
			Subtotal	\$500.00
			Payments/Credits	\$-200.00
			Total	\$300.00

EXHIBIT NO. A¹⁰



County of Riverside Code Enforcement Department

P.O. Box 1469, Riverside, CA 92502
Phone: (951) 955-2004 Fax: (951) 955-8680
demands@rctlma.org

Administrative Citation

164090005
KIMBERLY MICHELE BARTHOLOMEW
C/O MARK BARTHOLOMEW
6641 MORAB ST
CORONA, CA. 92880

Citation Issue Date	Billing Date
3/12/2010	1/31/2011

Property Address
164090005 KIMBERLY MICHELE BARTHOLOMEW C/O MARK BARTHOLOMEW 6641 MORAB ST CORONA, CA. 92880

Citation Number	District	Class
A31482	2	SOE

Item	Description	Hours/Qty	Rate	Amount
Administrative Citations	A31482--CV0802344	1	500.00	500.00
			Subtotal	\$500.00
			Payments/Credits	\$0.00
			Total	\$500.00

EXHIBIT NO. A"

NOTICE LIST

Subject Property: 6641 Morab Street, Corona; Case No.: CV08-02344;
APN: 164-090-005; District Two

KIMBERLY M. BARTHOLOMEW
MARK BARTHOLOMEW
6641 MORAB STREET
CORONA CA 92880

WORLD SAVINGS BANK FSB
CLOSING DEPARTMENT
PO BOX 65948
SAN ANTONIO TX 78265-9548

7010 1670 0001 7232 8786

U.S. Postal Service™	
CERTIFIED MAIL™ RECEIPT	
(Domestic Mail Only; No Insurance Coverage Provided)	
For delivery information visit our website at www.usps.com ®	
OFFICIAL USE	
Postage	\$.78
Certified Fee	2.80
Return Receipt Fee (Endorsement Required)	2.30
Restricted Delivery Fee (Endorsement Required)	
Total Postage & Fees	\$ 5.88
Mailed 3/2/11	
Postmark Here	
Ser. _____	
Street or P.O. Box _____	
City, State, ZIP+4® _____	
PS Form 3800, August 2006 See Reverse for Instructions	

7010 1670 0001 7232 8779

U.S. Postal Service™	
CERTIFIED MAIL™ RECEIPT	
(Domestic Mail Only; No Insurance Coverage Provided)	
For delivery information visit our website at www.usps.com ®	
OFFICIAL USE	
Postage	\$.78
Certified Fee	2.80
Return Receipt Fee (Endorsement Required)	2.30
Restricted Delivery Fee (Endorsement Required)	
Total Postage & Fees	\$ 5.88
Mailed 3/2/11	
Postmark Here	
Sent To _____	
World Savings Bank FSB	
CLOSING DEPARTMENT	
PO BOX 65948	
SAN ANTONIO TX 78265-9548	
PS Form 3800, August 2006 See Reverse for Instructions	

EXHIBIT NO. _____

A12

PROOF OF SERVICE

Case No. CV08-02344

STATE OF CALIFORNIA, COUNTY OF RIVERSIDE

I, Brenda G. Peeler, declare that I am a citizen of the United States and am employed in the County of Riverside, over the age of 18 years and not a party to the within action or proceeding; that my business address is 3960 Orange Street, Suite 500, Riverside, California 92501.

That on March 2, 2011, I served the following document(s):

- NOTICE OF HEARING RE: STATEMENT OF EXPENSE
- STATEMENT OF EXPENSE

by placing a true copy thereof enclosed in a sealed envelope(s) addressed as follows:

**OWNERS OR INTERESTED PARTIES
(SEE NOTICE LIST ATTACHED TO NOTICE OF HEARING)**

XX **BY CERTIFIED MAIL, RETURN RECEIPT REQUESTED.** I am "readily familiar" with the office's practice of collection and processing correspondence for mailing. Under that practice it would be deposited with the U.S. Postal Service on that same day with postage thereon fully prepaid at Riverside, California, in the ordinary course of business.

___ **BY PERSONAL SERVICE:** I caused to be delivered such envelope(s) by hand to the offices of the addressee(s).

XX **STATE - I declare under penalty of perjury under the laws of the State of California that the above is true and correct.**

___ **FEDERAL - I declare that I am employed in the office of a member of the bar of this court at whose direction the service was made.**

EXECUTED ON March 2, 2011, at Riverside, California.

BRENDA G. PEELER

EXHIBIT NO. AB

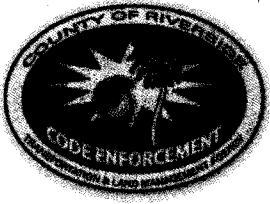

**CODE ENFORCEMENT DEPARTMENT
COUNTY OF RIVERSIDE**

GLENN BAUDE
Director

AFFIDAVIT OF POSTING OF NOTICES

March 3, 2011

RE CASE NO: CV0802344

I, Jonathan Lance, hereby declare:

I am employed by the Riverside County Code Enforcement Department; that my business address is 13575 Magnolia Ave, Corona, California 92879 .

That on 3/3/11 at 10:36 a.m., I securely and conspicuously posted a copy of the Statment of Expense hearing notice at the property described as:

Property Address: 6641 MORAB ST, CORONA

Assessor's Parcel Number: 164-090-005

I declare under the penalty of perjury that the foregoing is true and correct.

Executed on March 3, 2011 in the County of Riverside, California.

CODE ENFORCEMENT DEPARTMENT

By: Jonathan Lance, Code Enforcement Officer

EXHIBIT NO. A14



COUNTY OF RIVERSIDE CODE ENFORCEMENT

P.O. Box 1469, Riverside, CA 92502
Phone: 951-955-2004 Fax: 951-955-8680

Summary Statement As of: 1/31/2011

Property Reference/Mailing Address

164090005
KIMBERLY MICHELE BARTHOLOMEW
C/O MARK BARTHOLOMEW
6641 MORAB ST
CORONA, CA. 92880

Date	Invoice Number & Amount	Amount	Balance
01/31/2011	CV0802344- INV #100331. Orig. Amount \$636.70.	636.70	636.70
12/16/2009	CV0802344:A27596- INV #3830. Orig. Amount \$500.00. A27596	400.00	1,036.70
02/05/2010	CV0802344:A27766- INV #12675. Orig. Amount \$500.00. A27766	500.00	1,536.70
03/11/2009	CV0802344:A29131- INV #3831. Orig. Amount \$700.00. A29131	700.00	2,236.70
12/02/2008	CV0802344:A29307- INV #3832. Orig. Amount \$200.00. A29307	200.00	2,436.70
05/13/2009	CV0802344:A29427- INV #3833. Orig. Amount \$500.00. A29427	500.00	2,936.70
08/04/2009	CV0802344:A29483- INV #3834. Orig. Amount \$500.00. A29483	500.00	3,436.70
09/30/2009	CV0802344:A29567- INV #3835. Orig. Amount \$500.00. A29567	300.00	3,736.70
03/12/2010	CV0802344:A31482- INV #12676. Orig. Amount \$500.00. A31482	500.00	4,236.70
		Balance Due	\$4,236.70

I affirm and declare under penalty of perjury under the laws of the State of California that the foregoing is true and correct.

Code Enforcement Department

EXHIBIT NO. B

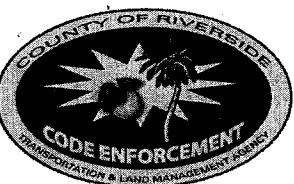

County of Riverside Code Enforcement Department

P.O. Box 1469, Riverside, CA 92502
Phone: (951) 955-2004 Fax: (951) 955-8680
demands@rctlma.org

Statement of Expense

164090005
KIMBERLY MICHELE BARTHOLOMEW
C/O MARK BARTHOLOMEW
6641 MORAB ST
CORONA, CA. 92880

Date	Invoice #
1/31/2011	100331

Case Number	District	Class
CV0802344	2	SOE

Property Address
164090005 KIMBERLY MICHELE BARTHOLOMEW C/O MARK BARTHOLOMEW 6641 MORAB ST CORONA, CA 92880

Date	Item	Description	Hours/Qty	Rate	Amount
3/17/2008	Officer Hours	Labor Charges - Officer Time	1	82.00	82.00
6/17/2008	Officer Hours	Labor Charges - Officer Time	0.1	109.00	10.90
9/5/2008	Officer Hours	Labor Charges - Officer Time	0.2	109.00	21.80
12/2/2008	Officer Hours	Labor Charges - Officer Time	0.2	109.00	21.80
3/11/2009	Officer Hours	Labor Charges - Officer Time	0.2	109.00	21.80
5/13/2009	Officer Hours	Labor Charges - Officer Time	0.2	109.00	21.80
8/4/2009	Officer Hours	Labor Charges - Officer Time	0.2	109.00	21.80
9/30/2009	Officer Hours	Labor Charges - Officer Time	0.1	109.00	10.90
12/16/2009	Officer Hours	Labor Charges - Officer Time	0.1	109.00	10.90
2/5/2010	Officer Hours	Labor Charges - Officer Time	0.1	109.00	10.90
3/12/2010	Officer Hours	Labor Charges - Officer Time	0.1	109.00	10.90
4/15/2010	Officer Hours	Labor Charges - Officer Time	0.1	109.00	10.90
1/31/2011	SOE Preparation	Prepare Statement of Expense		65.00	65.00
		Subtotal Code Enforcement Costs			321.40
1/31/2011	Prepare Case for SOE He...			125.55	125.55
	Attend SOE Hearing			69.75	69.75
		Subtotal County Counsel Costs			195.30
1/31/2011	Lot/Title Report	Lot/Title Report		120.00	120.00
		Subtotal Contractor Costs			120.00
			Subtotal		\$636.70
			Payments/Credits		\$0.00
			Total		\$636.70

affirm and declare under penalty of perjury under the laws of the State of California that the foregoing is true and correct.

Code Enforcement Department

EXHIBIT NO. B²

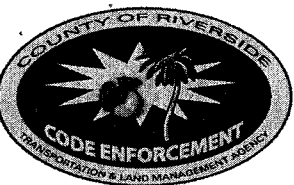

County of Riverside Code Enforcement Department

P.O. Box 1469, Riverside, CA 92502
Phone: (951) 955-2004 Fax: (951) 955-8680
demands@rctlma.org

Administrative Citation

164090005

KIMBERLY MICHELE BARTHOLOMEW
C/O MARK BARTHOLOMEW
6641 MORAB ST
CORONA, CA. 92880

Citation Issue Date	Billing Date
12/16/2009	1/31/2011

Citation Number	District	Class
A27596	2	SOE

Property Address
164090005 KIMBERLY MICHELE BARTHOLOMEW C/O MARK BARTHOLOMEW 6641 MORAB ST CORONA, CA. 92880

Item	Description	Hours/Qty	Rate	Amount
Administrative Citations	A27596--CV08-02344	1	500.00	500.00
			Subtotal	\$500.00
			Payments/Credits	\$-100.00
			Total	\$400.00

EXHIBIT NO. B³

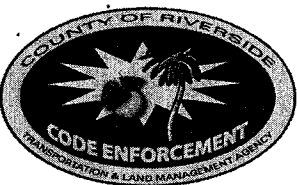

County of Riverside Code Enforcement Department

P.O. Box 1469, Riverside, CA 92502
Phone: (951) 955-2004 Fax: (951) 955-8680
demands@rctlma.org

Administrative Citation

164090005
KIMBERLY MICHELE BARTHOLOMEW
C/O MARK BARTHOLOMEW
6641 MORAB ST
CORONA, CA. 92880

Citation Issue Date	Billing Date
2/5/2010	1/31/2011

Citation Number	District	Class
A27766	2	SOE

Property Address
164090005 KIMBERLY MICHELE BARTHOLOMEW C/O MARK BARTHOLOMEW 6641 MORAB ST CORONA, CA. 92880

Item	Description	Hours/Qty	Rate	Amount
Administrative Citations	A27766--CV0802344	1	500.00	500.00
			Subtotal	\$500.00
			Payments/Credits	\$0.00
			Total	\$500.00

EXHIBIT NO. B^A



County of Riverside Code Enforcement Department

P.O. Box 1469, Riverside, CA 92502
Phone: (951) 955-2004 Fax: (951) 955-8680
demands@rctlma.org

Administrative Citation

164090005
KIMBERLY MICHELE BARTHOLOMEW
C/O MARK BARTHOLOMEW
6641 MORAB ST
CORONA, CA. 92880

Citation Issue Date	Billing Date
3/11/2009	1/31/2011

Citation Number	District	Class
A29131	2	SOE

Property Address
164090005 KIMBERLY MICHELE BARTHOLOMEW C/O MARK BARTHOLOMEW 6641 MORAB ST CORONA, CA. 92880

Item	Description	Hours/Qty	Rate	Amount
Administrative Citations	A29131--CV0802344	1	700.00	700.00
			Subtotal	\$700.00
			Payments/Credits	\$0.00
			Total	\$700.00

EXHIBIT NO. B⁵

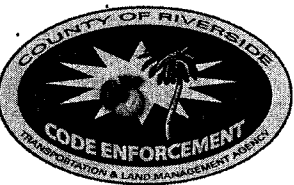

County of Riverside

Code Enforcement Department

P.O. Box 1469, Riverside, CA 92502
Phone: (951) 955-2004 Fax: (951) 955-8680
demands@rctlma.org

Administrative Citation

164090005

KIMBERLY MICHELE BARTHOLOMEW

C/O MARK BARTHOLOMEW

6641 MORAB ST

CORONA, CA. 92880

Citation Issue Date	Billing Date
12/2/2008	1/31/2011

Citation Number	District	Class
A29307	2	SOE

Property Address
164090005 KIMBERLY MICHELE BARTHOLOMEW C/O MARK BARTHOLOMEW 6641 MORAB ST CORONA, CA. 92880

Item	Description	Hours/Qty	Rate	Amount
Administrative Citations	A29307--CV0802344	1	200.00	200.00
			Subtotal	\$200.00
			Payments/Credits	\$0.00
			Total	\$200.00

EXHIBIT NO. B⁶



County of Riverside

Code Enforcement Department

P.O. Box 1469, Riverside, CA 92502
Phone: (951) 955-2004 Fax: (951) 955-8680
demands@rctlma.org

Administrative Citation

164090005
KIMBERLY MICHELE BARTHOLOMEW
C/O MARK BARTHOLOMEW
6641 MORAB ST
CORONA, CA. 92880

Citation Issue Date	Billing Date
5/13/2009	1/31/2011

Citation Number	District	Class
A29427	2	SOE

Property Address
164090005 KIMBERLY MICHELE BARTHOLOMEW C/O MARK BARTHOLOMEW 6641 MORAB ST CORONA, CA. 92880

Item	Description	Hours/Qty	Rate	Amount
Administrative Citations	A29427--CV0802344	1	500.00	500.00
			Subtotal	\$500.00
			Payments/Credits	\$0.00
			Total	\$500.00

EXHIBIT NO. B7



County of Riverside Code Enforcement Department

P.O. Box 1469, Riverside, CA 92502
Phone: (951) 955-2004 Fax: (951) 955-8680
demands@rctlma.org

Administrative Citation

164090005
KIMBERLY MICHELE BARTHOLOMEW
C/O MARK BARTHOLOMEW
6641 MORAB ST
CORONA, CA. 92880

Citation Issue Date	Billing Date
8/4/2009	1/31/2011

Citation Number	District	Class
A29483	2	SOE

Property Address
164090005 KIMBERLY MICHELE BARTHOLOMEW C/O MARK BARTHOLOMEW 6641 MORAB ST CORONA, CA. 92880

Item	Description	Hours/Qty	Rate	Amount
Administrative Citations	A29483--CV0802344	1	500.00	500.00
			Subtotal	\$500.00
			Payments/Credits	\$0.00
			Total	\$500.00

EXHIBIT NO. B8



County of Riverside Code Enforcement Department

P.O. Box 1469, Riverside, CA 92502
Phone: (951) 955-2004 Fax: (951) 955-8680
demands@rctlma.org

Administrative Citation

164090005
KIMBERLY MICHELE BARTHOLOMEW
C/O MARK BARTHOLOMEW
6641 MORAB ST
CORONA, CA. 92880

Citation Issue Date	Billing Date
9/30/2009	1/31/2011

Citation Number	District	Class
A29567	2	SOE

Property Address
164090005 KIMBERLY MICHELE BARTHOLOMEW C/O MARK BARTHOLOMEW 6641 MORAB ST CORONA, CA. 92880

Item	Description	Hours/Qty	Rate	Amount
Administrative Citations	A29567--CV0802344	1	500.00	500.00
			Subtotal	\$500.00
			Payments/Credits	\$-200.00
			Total	\$300.00

EXHIBIT NO. B⁹



County of Riverside

Code Enforcement Department

P.O. Box 1469, Riverside, CA 92502
Phone: (951) 955-2004 Fax: (951) 955-8680
demands@rctlma.org

Administrative Citation

164090005
KIMBERLY MICHELE BARTHOLOMEW
C/O MARK BARTHOLOMEW
6641 MORAB ST
CORONA, CA. 92880

Citation Issue Date	Billing Date
3/12/2010	1/31/2011

Citation Number	District	Class
A31482	2	SOE

Property Address
164090005 KIMBERLY MICHELE BARTHOLOMEW C/O MARK BARTHOLOMEW 6641 MORAB ST CORONA, CA. 92880

Item	Description	Hours/Qty	Rate	Amount
Administrative Citations	A31482--CV0802344	1	500.00	500.00
			Subtotal	\$500.00
			Payments/Credits	\$0.00
			Total	\$500.00

EXHIBIT NO. B¹⁰



INVOICE

Order Number: 23148

Order Date: 2/17/2011

Customer Information:

Acct No. 1044

RIVERSIDE COUNTY TLMA-CODE ENFORCEMENT
4080 Lemon Street
Riverside, CA 92501

Attn: Brent Steele
REF: CV08-02344 / Angela Sarmiento
IN RE: BARTHOLOMEW, KIMBERLY MICHELE

Product and/or Service ordered for Property known as:

6641 Morab Street
Corona, CA 92880

DESCRIPTION:	FEE:
Lot Book Report	\$120.00
TOTAL DUE:	\$120.00

Payment due upon receipt. Please remit to:

RZ Title Services, Inc.
P.O. Box 1193
Whittier, CA 90609

EXHIBIT NO. _____

B¹¹

Assessment Roll For the 2010-2011 Tax Year as of January 1,2010

Assessment #164090005-1		Parcel # 164090005-1	
Assessee:	BARTHOLOMEW KIMBERLY MICHELE	Land	75,875
Mail Address:	6641 MORAB ST CORONA CA 92880	Structure	277,751
Real Property Use Code:	R1	Full Value	353,626
Base Year	2001	Total Net	353,626
Conveyance Number:	0172856		
Conveyance (mm/yy):	1/2003		
PUI:	R010010		
TRA:	59-005		
Taxability Code:	0-00		
ID Data:	Lot 47 MB 288/012 TR 28945		
Situs Address:	6641 MORAB ST CORONA CA 92880		

EXHIBIT NO. C

RIVERSIDE COUNTY GIS

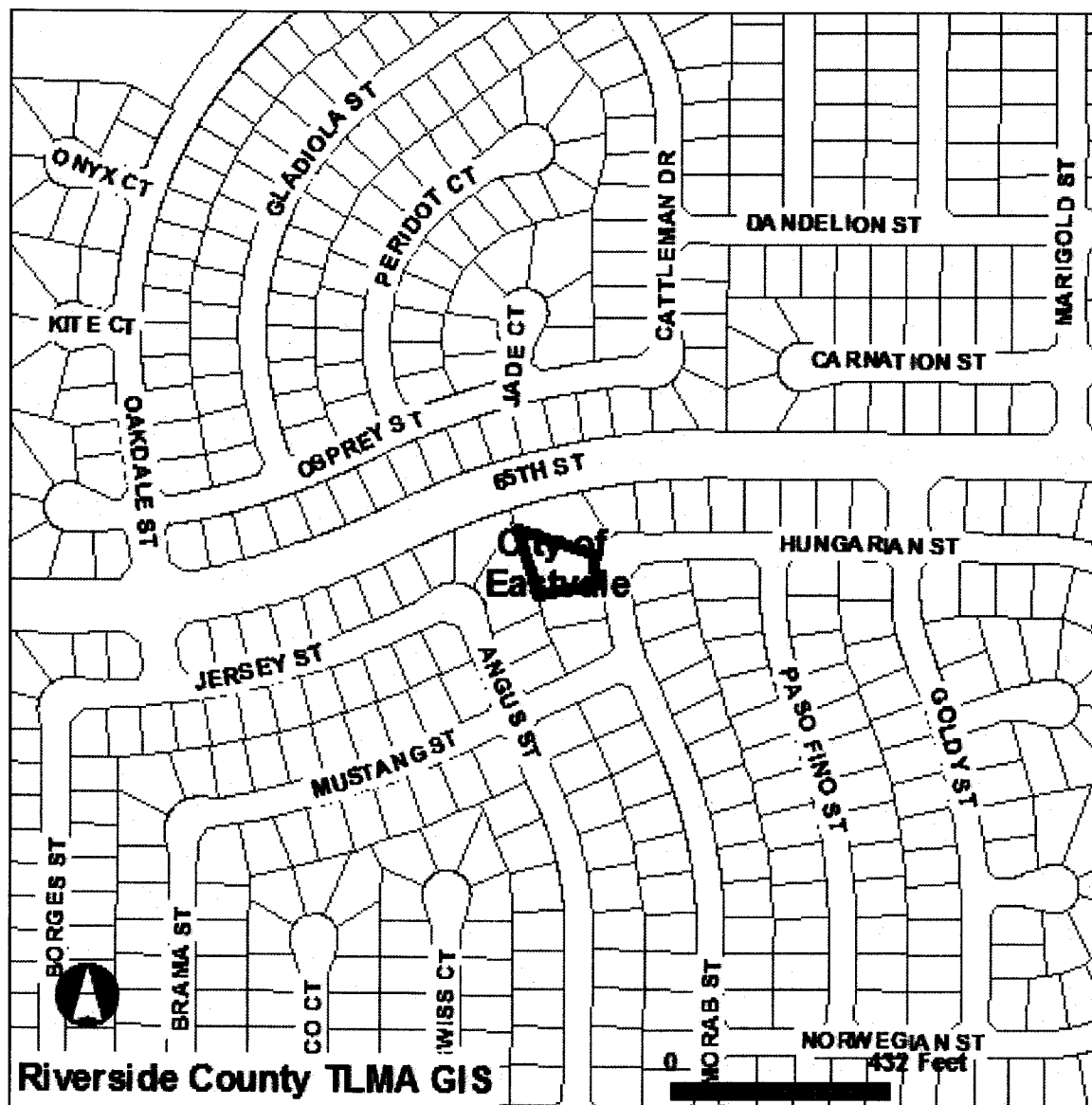

Selected parcel(s):
164-090-005

IMPORTANT

Maps and data are to be used for reference purposes only. Map features are approximate, and are not necessarily accurate to surveying or engineering standards. The County of Riverside makes no warranty or guarantee as to the content (the source is often third party), accuracy, timeliness, or completeness of any of the data provided, and assumes no legal responsibility for the information contained on this map. Any use of this product with respect to accuracy and precision shall be the sole responsibility of the user.

STANDARD REPORT**APNs**

164-090-005-1

OWNER NAME / ADDRESS

KIMBERLY MICHELE BARTHOLOMEW
6641 MORAB ST
CORONA, CA. 92880

MAILING ADDRESS

C/O MARK BARTHOLOMEW
6641 MORAB ST
CORONA CA. 92880

EXHIBIT NO. C²

LEGAL DESCRIPTION

RECORDED BOOK/PAGE: MB 288/12
SUBDIVISION NAME: TR 28945
LOT/PARCEL: 47, BLOCK: NOT AVAILABLE
TRACT NUMBER: 28945

LOT SIZE

RECORDED LOT SIZE IS 0.29 ACRES

PROPERTY CHARACTERISTICS

WOOD FRAME, 3099 SQFT., 4 BDRM/ 2.5 BATH, 2 STORY, ATTACHED GARAGE(644 SQ. FT), CONST'D 2000TILE, ROOF, CENTRAL HEATING, CENTRAL COOLING, POOL

THOMAS BROS. MAPS PAGE/GRID

PAGE: 683 GRID: D7

CITY BOUNDARY/SPHERE

CITY OF EASTVALE
NOT WITHIN A CITY SPHERE
NO ANNEXATION DATE AVAILABLE
NO LAFCO CASE # AVAILABLE
NO PROPOSALS

MARCH JOINT POWERS AUTHORITY

NOT IN THE JURISDICTION OF THE MARCH JOINT POWERS AUTHORITY

INDIAN TRIBAL LAND

NOT IN A TRIBAL LAND

SUPERVISORIAL DISTRICT (ORD. 813)

JOHN TAVAGLIONE, DISTRICT 2

TOWNSHIP/RANGE

T2SR7W SEC 25

ELEVATION RANGE

633 FEET

PREVIOUS APN

134-401-006

PLANNING

LAND USE DESIGNATIONS

Consult with the city for land use information.

AREA PLAN (RCIP)

EASTVALE

GENERAL PLAN POLICY OVERLAYS

NOT IN A GENERAL PLAN POLICY OVERLAY AREA

GENERAL PLAN POLICY AREAS

NONE

ZONING CLASSIFICATIONS (ORD. 348)

See the city for more information

ZONING DISTRICTS AND ZONING AREAS

PRADO-MIRA LOMA DISTRICT

ZONING OVERLAYS

IN OR PARTIALLY WITHIN THE EASTVALE NEIGHBORHOOD PRESERVATION OVERLAY

SPECIFIC PLANS

NOT WITHIN A SPECIFIC PLAN

AGRICULTURAL PRESERVE

NOT IN AN AGRICULTURAL PRESERVE

REDEVELOPMENT AREAS

NOT IN A REDEVELOPMENT AREA

AIRPORT INFLUENCE AREAS

NOT IN AN AIRPORT INFLUENCE AREA

NOT IN AN AIRPORT COMPATIBILITY ZONE

ENVIRONMENTAL

CVMSHCP (COACHELLA VALLEY MULTI-SPECIES HABITAT CONSERVATION PLAN) CONSERVATION AREA
NOT IN A CONSERVATION AREA

CVMSHCP FLUVIAL SAND TRANSPORT SPECIAL PROVISION AREAS
NOT IN A FLUVIAL SAND TRANSPORT SPECIAL PROVISION AREA

WRMSHCP (WESTERN RIVERSIDE COUNTY MULTI-SPECIES HABITAT CONSERVATION PLAN) CELL GROUP
NOT IN A CELL GROUP

WRMSHCP CELL NUMBER
NOT IN A CELL

HANS/ERP (HABITAT ACQUISITION AND NEGOTIATION STRATEGY/EXPEDITED REVIEW PROCESS)
NONE

VEGETATION (2005)
Agricultural Land

FIRE

HIGH FIRE AREA (ORD. 787)
NOT IN A HIGH FIRE AREA

FIRE RESPONSIBILITY AREA
NOT IN A FIRE RESPONSIBILITY AREA

DEVELOPMENT FEES

CVMSHCP FEE AREA (ORD. 875)
NOT WITHIN THE COACHELLA VALLEY MSHCP FEE AREA

WRMSHCP FEE AREA (ORD. 810)
IN OR PARTIALLY WITHIN THE WESTERN RIVERSIDE MSHCP FEE AREA. SEE MAP FOR MORE INFORMATION.

ROAD & BRIDGE DISTRICT
MIRA LOMA D

EASTERN TUMF (TRANSPORTATION UNIFORM MITIGATION FEE ORD. 673)
NOT WITHIN THE EASTERN TUMF FEE AREA

WESTERN TUMF (TRANSPORTATION UNIFORM MITIGATION FEE ORD. 824)
IN OR PARTIALLY WITHIN A TUMF FEE AREA. SEE MAP FOR MORE INFORMATION. NORTHWEST

DIF (DEVELOPMENT IMPACT FEE AREA ORD. 659)
EASTVALE

SKR FEE AREA (STEPHEN'S KANGAROO RAT ORD. 663.10)
NOT WITHIN AN SKR FEE AREA.

DEVELOPMENT AGREEMENTS
NOT IN A DEVELOPMENT AGREEMENT AREA

TRANSPORTATION

CIRCULATION ELEMENT ULTIMATE RIGHT-OF-WAY
NOT IN A CIRCULATION ELEMENT RIGHT-OF-WAY

ROAD BOOK PAGE
14C

TRANSPORTATION AGREEMENTS
NOT IN A TRANSPORTATION AGREEMENT

CETAP (COMMUNITY AND ENVIRONMENTAL TRANSPORTATION ACCEPTABILITY PROCESS) CORRIDORS
NOT IN A CETAP CORRIDOR.

HYDROLOGY

FLOOD PLAIN REVIEW

FLOOD PLAIN MANAGEMENT REVIEW IS REQUIRED. CONTACT THE FLOOD PLAIN MANAGEMENT SECTION AT (951) 955-1200 FOR INFORMATION.

WATER DISTRICT

WMWD

FLOOD CONTROL DISTRICT

RIVERSIDE COUNTY FLOOD CONTROL DISTRICT

WATERSHED

SANTA ANA RIVER

GEOLOGIC

FAULT ZONE

NOT IN A FAULT ZONE

FAULTS

NOT WITHIN A 1/2 MILE OF A FAULT

LIQUEFACTION POTENTIAL

HIGH
MODERATE

SUBSIDENCE

SUSCEPTIBLE

PALEONTOLOGICAL SENSITIVITY

HIGH SENSITIVITY (HIGH B).
SENSITIVITY EQUIVALENT TO HIGH A, BUT IS BASED ON THE OCCURRENCE OF FOSSILS AT A SPECIFIED DEPTH BELOW THE SURFACE. THE CATEGORY HIGH B INDICATES THAT FOSSILS ARE LIKELY TO BE ENCOUNTERED AT OR BELOW FOUR FEET OF DEPTH, AND MAY BE IMPACTED DURING EXCAVATION BY CONSTRUCTION ACTIVITIES.

MISCELLANEOUS

SCHOOL DISTRICT

CORONA-NORCO UNIFIED

COMMUNITIES

EASTVALE

COUNTY SERVICE AREA

NOT IN A COUNTY SERVICE AREA.

LIGHTING (ORD. 655)

NOT APPLICABLE, 58.24 MILES FROM MT. PALOMAR OBSERVATORY

2000 CENSUS TRACT

040602

FARMLAND

URBAN-BUILT UP LAND

TAX RATE AREAS

059-005

- CORONA NORCO UNIFIED SCHOOL
- COUNTY FREE LIBRARY
- COUNTY STRUCTURE FIRE PROTECTION
- COUNTY WASTE RESOURCE MGMT DIST
- CSA 152
- FLOOD CONTROL ADMINISTRATION
- FLOOD CONTROL ZONE 2
- GENERAL
- GENERAL PURPOSE
- INLAND EMPIRE RCD
- JURUPA COMMUNITY SERVICES
- METRO WATER WEST 1302999
- N.W. MOSQUITO & VECTOR CONT DIST
- RIV CO REG PARK & OPEN SPACE
- RIV. CO. OFFICE OF EDUCATION

- RIVERSIDE CITY COMMUNITY COLLEGE
- WESTERN MUNICIPAL WATER

SPECIAL NOTES

NO SPECIAL NOTES

CODE COMPLAINTS

NO CODE COMPLAINTS

REPORT PRINTED ON...Tue Feb 08 10:29:58 2011
Version 101221



P.O. Box 1193
Whittier, CA 90609
Tel # (562) 325-8351
Fax # (714) 783-3038

Lot Book Report

Order Number: **23148**

Customer:

RIVERSIDE COUNTY TLMA-CODE INFORCEMENT
4080 Lemon Street
Riverside CA 92501

Order Date: 2/17/2011

Dated as of: 2/9/2011

County Name: Riverside

Attn: Brent Steele
Reference: CV08-02344 / Angela Sarmiento
IN RE: BARTHOLOMEW, KIMBERLY MICHELE

FEE(s):
Report: \$120.00

Property Address: 6641 Morab Street
Corona CA 92880

Assessor's Parcel No. : 164-090-005-1

Assessments:

Land Value:	\$75,875.00
Improvement Value:	\$277,751.00
Exemption Value:	\$0.00
Total Value:	\$353,626.00

Tax Information

Property Taxes for the Fiscal Year	2010-2011
First Installment	\$3,038.07
Penalty	\$0.00
Status	PAID (PAID THRU 01/31/2011)
Second Installment	\$3,038.07
Penalty	\$0.00
Status	OPEN NOT-PAID (DUE DATE 04/10/2011)

EXHIBIT NO. D



P.O. Box 1193
Whittier, CA 90609
Tel # (562) 325-8351
Fax # (714) 783-3038

Order Number: 23148

Reference: CV08-02344 / Ang

Property Vesting

The last recorded documents transferring title of said property

Dated	06/06/2000
Recorded	08/31/2000
Document No.	2000-343281
D.T.T.	\$317.90
Grantor	Kaufman and Broad of Southern California Inc., a California Corporation
Grantee	Mark Jeffrey Bartholomew and Kimberly Michele Bartholomew, husband and wife, as joint tenants
Dated	08/29/2000
Recorded	08/31/2000
Document No.	2000-343282
D.T.T.	\$0.00
Grantor	Mark Jeffrey Bartholomew, a married man (husband of the grantee)
Grantee	Kimberly Michele Bartholomew, a married woman, as her sole and separate property
Property Now Vested as	Kimberly Michele Bartholomew, a married woman, as her sole and separate property

Deeds of Trust

Position No.	1st
A Deed of Trust Dated	03/02/2005
Recorded	03/09/2005
Document No.	2005-0187441
Amount	\$450,000.00
Trustor	Kimberly Michele Bartholomew, a married woman
Trustee	Golden West Savings Association Service Co., a California Corporation
Beneficiary	World Savings Bank, FSB



P.O. Box 1193
Whittier, CA 90609
Tel # (562) 325-8351
Fax # (714) 783-3038

Order Number: 23148

Reference: CV08-02344 / Ang

Notice of Default Recorded	04/29/2010
Document No.	2010-0197263
Substitution of Trustee Recorded	08/12/2010
Document No.	2010-0379045
Trustee	Executive Trustee Services, LLC dba ETS Services, LLC

Additional Information

Notice of Non-Compliance filed by	County of Riverside Department of Code Enforcement
In the matter of the property of	Kimberly Michele Bartholomew
Case No.	CV08-02344
Recorded	06/09/2009
Document No.	2009-0292799

Abstract of Judgment Filed in the	Superior Court of California, County of Riverside - Riverside Branch
Case No.	RIC473422
Recorded	05/28/2008
Document No.	2008-0287018
Amount	\$12,916.13
Debtor	Kimberly M. Bartholomew
Creditor	Discover Bank, Issuer of The Discover Card

Abstract of Judgment Filed in the	Superior Court of California, County of Riverside - Riverside Division-Limited Civil
Case No.	RIC488671
Recorded	07/02/2008
Document No.	2008-0362462
Amount	\$39,750.55
Debtor	Kimberly M Bartholomew
Creditor	Daimlerchrysler Financial Services America LLC

Abstract of Judgment Filed in the	Superior Court of California, Riverside County - Central District
Case No.	RIC502584



P.O. Box 1193
Whittier, CA 90609
Tel # (562) 325-8351
Fax # (714) 783-3038

Order Number: 23148

Reference: CV08-02344 / Ang

Recorded	12/26/2008
Document No.	2008-0671847
Amount	\$12,326.17
Debtor	Kimberly M Bartholomew
Creditor	Capital One Bank
Abstract of Judgment Filed in the	Superior Court of California, County of Riverside - Riverside
Case No.	RIC528124
Recorded	06/02/2010
Document No.	2010-0254440
Amount	\$11,941.10
Debtor	Kimberly M Bartholomew
Creditor	Cavalry Portfolio Services, LLC, as assignee of Cavalry SPV I, LLC, as assignee of FIA Card Services, N.A.
A Bankruptcy filed by	Kimberly Michele Bartholomew
Social Security Number(s)	None Shown
Date filed	10/18/2010
Case No.	43730

Legal Description

THE LAND REFERRED TO IN THIS REPORT IS LOCATED IN AND IS DESCRIBED AS FOLLOWS:

LOT 47 OF TRACT NO. 28945, IN THE COUNTY OF RIVERSIDE, STATE OF CALIFORNIA, AS SHOWN BY MAP ON FILE IN BOOK 288 PAGE(S) 12 THROUGH 17 OF MAPS, RECORDS OF THE COUNTY RECORDER OF SAID COUNTY.