

**SUBMITTAL TO THE BOARD OF SUPERVISORS  
COUNTY OF RIVERSIDE, STATE OF CALIFORNIA**

806B



**FROM:** County Counsel  
Code Enforcement Department

**SUBMITTAL DATE:**  
March 10, 2011

**SUBJECT:** Statement of Expense [Case No. CV08-03500]  
Subject Property: 1 Parcel W/O 13950 Avenida De Las Familias, Desert Hot Springs  
APN: 663-140-010; GONZALES  
District Five

**RECOMMENDED MOTION:** Move that the Board of Supervisors:

- (1) assess the reasonable costs of abatement of a public nuisance (accumulated rubbish) in the above-referenced matter to be **six thousand, two hundred eighty-four dollars and nine cents (US \$6,284.09)**;
- (2) assess the costs of abatement against the above-described subject property;
- (3) authorize the recordation of a notice of abatement lien; and
- (4) authorize the abatement costs to be added to the tax roll as a special assessment
- (5) authorize and direct the Code Enforcement Department to take any reasonable actions to collect the amount owed.

*[Signature]*  
L. ALEXANDRA FONG, Deputy County Counsel  
for PAMELA J. WALLS, County Counsel

<b>FINANCIAL DATA</b>	Current F.Y. Total Cost:	\$ N/A	In Current Year Budget:	N/A
	Current F.Y. Net County Cost:	\$ N/A	Budget Adjustment:	N/A
	Annual Net County Cost:	\$ N/A	For Fiscal Year:	N/A

**SOURCE OF FUNDS:**

<b>Positions To Be Deleted Per A-30</b>	<input type="checkbox"/>
<b>Requires 4/5 Vote</b>	<input type="checkbox"/>

**C.E.O. RECOMMENDATION:**

APPROVE

BY: *[Signature]*  
Tina Grande

**County Executive Office Signature**

☐ Consent  
☒ Policy  
☐ Consent  
☒ Policy

**MINUTES OF THE BOARD OF SUPERVISORS**

On motion of Supervisor Ashley, seconded by Supervisor Stone and duly carried by unanimous vote, IT WAS ORDERED that the above matter is approved as recommended.

**Ayes:** Buster, Tavaglione, Stone, Benoit and Ashley  
**Nays:** None  
**Absent:** None  
**Date:** March 22, 2011  
**xc:** Co. Co., CED, Prop. Owner

Kecia Harper-Ihem  
 Clerk of the Board  
 By: *[Signature]*  
 Deputy

**Prev. Agn. Ref.:** **District: 5** **Agenda Number:**

Statement of Expense [Case No. CV08-03500]

Subject Property: 1 Parcel W/O 13950 Avenida De Las Familias, Desert Hot Springs

APN: 663-140-010; GONZALES

District Five

Page 2

**BACKGROUND:** Government Code § 25845, Riverside County Ordinance Nos. 541(RCC Chapter 8.120) and 725 (RCC Chapter 1.16) authorize the recovery of abatement costs in public nuisance cases, the recordation of a notice of abatement lien and inclusion of abatement costs on the tax roll as a special assessment upon approval of the Board of Supervisors.

On June 4, 2008, a Notice of Violation and Order to Remove Accumulated Rubbish was issued. Subsequently, on or about Dec. 2, 2008, the accumulated rubbish was abated from the subject property under the direction of the Riverside County Code Enforcement Department.

The Notice of Hearing re Statement of Expense has been posted on the property and mailed to the property owner and all interested parties, as required by law. Copies of all relevant notices issued in this matter together with proof of service and posting have been separately filed with the Clerk of the Board and are made a part of the record herein, pursuant to Riverside County Ordinance 725.

**SUBMITTAL TO THE BOARD OF SUPERVISORS  
COUNTY OF RIVERSIDE, STATE OF CALIFORNIA**

**FROM:** County Counsel  
Code Enforcement Department  
**SUBJECT:** Statement of Expense [Case No. CV08-03500]  
Subject Property: 1 Parcel W/O 13950 Avenida De Las Familias, Desert Hot Springs  
APN: 663-140-010  
District Five

**TABLE OF SUPPLEMENTAL DOCUMENTS  
FILED WITH THE CLERK OF THE BOARD**

**Hearing Date: MARCH 22, 2011**

Notice of Statement Expense Hearing (including Proofs of Service, Affidavits of Posting and Return Receipts) .....	Exhibit A
Statement of Expense Worksheet with Supporting Documents .....	Exhibit B
Assessment-Roll For The Year 10/11 And Geographic Information System, February 8, 2011 .....	Exhibit C
Lot Book Report .....	Exhibit D

PAMELA J. WALLS  
County Counsel

KATHERINE A. LIND  
Assistant County Counsel

OFFICE OF COUNTY COUNSEL  
COUNTY OF RIVERSIDE

3960 ORANGE STREET, SUITE 500  
RIVERSIDE, CA 92501-3674  
TELEPHONE: 951/955-6300  
FAX: 951/955-6322 & 951/955-6363



March 3, 2011

**NOTICE OF HEARING  
RE: STATEMENT OF EXPENSE**

To: Owner(s) or Interested Parties  
(See Attached Proof of Service  
and Notice List)

Subject Property: 1 Parcel W/O 13950 Avenida De Las Familias  
Desert Hot Springs  
Case No.: CV08-03500; GONZALES  
APN: 663-140-010

**NOTICE IS HEREBY GIVEN** that a hearing will be held before the Riverside County Board of Supervisors on **Tuesday, March 15, 2011, at 9:30 a.m.** in the Board of Supervisors Room, 4080 Lemon Street, 1st Floor Annex, Riverside, California, at which time and place pertinent testimony will be heard regarding the expenses incurred by the County of Riverside, Code Enforcement Department ("DEPARTMENT") for the above-referenced abatement case. Said abatement case involved accumulated rubbish located on your real property commonly described as 1 Parcel W/O 13950 Avenida De Las Familias, Desert Hot Springs, Riverside County, California and more particularly described as Assessor's Parcel Number 663-140-010.

The total expense due, including all other fees and costs, for the abatement of the above-described dangerous or injurious condition is **six thousand, two hundred eighty-four dollars and nine cents (US \$6,284.09)**. This amount is immediately due and payable. If you have any objections to the Statement of Expense attached hereto, you must address your objections to the Board of Supervisors at the hearing. If you have any questions about the attached Statement of Expense, please contact the undersigned at (951) 955-6300. In the event the total amount due is not paid to the DEPARTMENT prior to the Board Hearing, the DEPARTMENT shall seek an order from the Board of Supervisors to place a lien against your property and collect the amount due as a special tax assessment.

Failure to appear at the hearing will result in the exclusion of your testimony. Facts as known to the DEPARTMENT will be presented to the Board of Supervisors for their final consideration and deliberation of this matter.

**You are encouraged to contact Supervising Code Enforcement Officer, Brian Black (951) 955-2004 prior to the hearing. Please meet with the undersigned or Brian Black at 8:30 a.m. on the day of the hearing in Conference Room 2A located on the 1st floor in front of the Human Resources Office to discuss the case.**

PAMELA J. WALLS  
County Counsel

L. ALEXANDRA FONG  
Deputy County Counsel

Enclosure: Statement of Expense

EXHIBIT NO. A

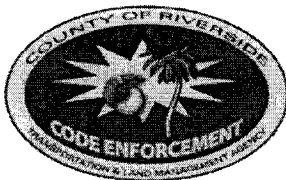

# County of Riverside Code Enforcement Department

P.O. Box 1469, Riverside, CA 92502  
Phone: (951) 955-2004 Fax: (951) 955-8680  
demands@rctlma.org

## Statement of Expense

663140010  
VINCENT & MONICA GONZALES  
620 S CAMINO REAL  
PALM SPRINGS CA. 92264

Date	Invoice #
1/27/2011	100320

Case Number	District	Class
CV0803500	5	SOE

Property Address
663140010 VINCENT & MONICA GONZALES 1 PAR W/O (13950 AVENIDA DE LAS FAMILIAS DESERT HOT SPRINGS, CA

Date	Item	Description	Hours/Qty	Rate	Amount
6/11/2008	Officer Hours	Labor Charges - Officer Time	0.2	82.00	16.40
9/15/2008	Officer Hours	Labor Charges - Officer Time	0.8	82.00	65.60
11/18/2008	Officer Hours	Labor Charges - Officer Time	1.1	82.00	90.20
11/19/2008	Officer Hours	Labor Charges - Officer Time	0.3	82.00	24.60
11/20/2008	Officer Hours	Labor Charges - Officer Time	0.3	82.00	24.60
11/24/2008	Officer Hours	Labor Charges - Officer Time	0.1	82.00	8.20
12/1/2008	Officer Hours	Labor Charges - Officer Time	0.3	82.00	24.60
12/2/2008	Officer Hours	Labor Charges - Officer Time	0.5	82.00	41.00
1/27/2011	SOE Preparation	Prepare Statement of Expense		65.00	65.00
		Subtotal Code Enforcement Costs			360.20
8/20/2008	Lot/Title Report	Lot/Title Report	1	150.00	150.00
11/20/2008	Demolition & Disposal	Demolition & Disposal	1	4,400.00	4,400.00
11/25/2008	Other Services	Other Services	1	250.00	250.00
6/23/2009	Asbestos Survey & Abate...	Asbestos Survey & Abatement	1	808.59	808.59
1/27/2011	Lot/Title Report	Lot/Title Report		120.00	120.00
		Subtotal Contractor Costs			5,728.59
1/27/2011	Prepare Case for SOE He...			125.55	125.55
	Attend SOE Hearing			69.75	69.75
		Subtotal County Counsel Costs			195.30

<b>Subtotal</b>	\$6,284.09
<b>Payments/Credits</b>	\$0.00
<b>Total</b>	\$6,284.09

I affirm and declare under penalty of perjury under the laws of the State of California that the foregoing is true and correct.

  
Code Enforcement Department

EXHIBIT NO. A<sup>2</sup>

# NOTICE LIST

Subject Property: 1 Parcel W/O 13950 Avenida De Las Familias, Desert Hot Springs;  
Case No.: CV08-03500; APN: 663-140-010;  
District Five

VINCENT GONZALES SR  
MONICA ANN GONZALES  
620 SOUTH CAMINO REAL  
PALM SPRINGS CA 92264

7010 1670 0001 7232 8915

U.S. Postal Service™	
CERTIFIED MAIL™ RECEIPT	
(Domestic Mail Only; No Insurance Coverage Provided)	
For delivery information visit our website at <a href="http://www.usps.com">www.usps.com</a> ®	
OFFICIAL USE	
Postage	\$ 1.44
Certified Fee	2.80
Return Receipt Fee (Endorsement Required)	2.30
Restricted Delivery Fee (Endorsement Required)	
Total Postage & Fees	\$ 5.54
MAILED 3/3/11	
Postmark Here	
Sent To	
VINCENT GONZALES SR	
MONICA ANN GONZALES	
620 SOUTH CAMINO REAL	
PALM SPRINGS CA 92264	
PS Form 3800, August 2005	

EXHIBIT NO. A<sup>3</sup>

**PROOF OF SERVICE**

Case No. CV08-03500

STATE OF CALIFORNIA, COUNTY OF RIVERSIDE

I, Brenda G. Peeler, declare that I am a citizen of the United States and am employed in the County of Riverside, over the age of 18 years and not a party to the within action or proceeding; that my business address is 3960 Orange Street, Suite 500, Riverside, California 92501.

That on March 3, 2011, I served the following document(s):

- NOTICE OF HEARING RE: STATEMENT OF EXPENSE
- STATEMENT OF EXPENSE

by placing a true copy thereof enclosed in a sealed envelope(s) addressed as follows:

**OWNERS OR INTERESTED PARTIES  
(SEE NOTICE LIST ATTACHED TO NOTICE OF HEARING)**

XX **BY CERTIFIED MAIL, RETURN RECEIPT REQUESTED.** I am "readily familiar" with the office's practice of collection and processing correspondence for mailing. Under that practice it would be deposited with the U.S. Postal Service on that same day with postage thereon fully prepaid at Riverside, California, in the ordinary course of business.

\_\_\_ **BY PERSONAL SERVICE:** I caused to be delivered such envelope(s) by hand to the offices of the addressee(s).

XX **STATE - I declare under penalty of perjury under the laws of the State of California that the above is true and correct.**

\_\_\_ **FEDERAL - I declare that I am employed in the office of a member of the bar of this court at whose direction the service was made.**

EXECUTED ON March 3, 2011, at Riverside, California.

  
BRENDA G. PEELER

EXHIBIT NO. A4

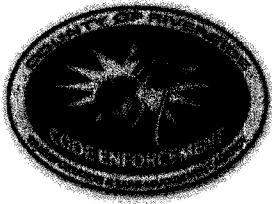

**CODE ENFORCEMENT DEPARTMENT  
COUNTY OF RIVERSIDE**

GLENN BAUDE  
Director

**AFFIDAVIT OF POSTING OF NOTICES**

March 4, 2011

RE CASE NO: CV0803500

I, Hector Herrera, hereby declare:

I am employed by the Riverside County Code Enforcement Department; that my business address is 4080 Lemon Street, 12th Floor, Riverside, California 92501 .

That on 03/04/2011 at 10:10 am, I securely and conspicuously posted Notice of hearing Re: statement of expense. at the property described as:

**Property Address:** Across from 13950 Avenida de la familia, North Palm Springs Ca

**Assessor's Parcel Number:** 663-140-010

I declare under the penalty of perjury that the foregoing is true and correct.

Executed on March 4, 2011 in the County of Riverside, California.

CODE ENFORCEMENT DEPARTMENT

Ht Herrera  
By: Hector Herrera, Sr. Code Enforcement Officer

EXHIBIT NO. AS

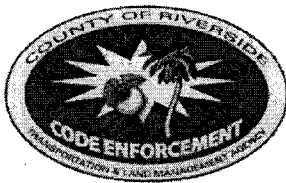

# County of Riverside Code Enforcement Department

P.O. Box 1469, Riverside, CA 92502  
Phone: (951) 955-2004 Fax: (951) 955-8680  
demands@rctlma.org

## Statement of Expense

663140010  
VINCENT & MONICA GONZALES  
620 S CAMINO REAL  
PALM SPRINGS CA. 92264

Date	Invoice #
1/27/2011	100320

### Property Address

663140010  
VINCENT & MONICA GONZALES  
1 PAR W/O (13950 AVENIDA DE LAS FAMILIAS  
DESERT HOT SPRINGS, CA

Case Number	District	Class
CV0803500	5	SOE

Date	Item	Description	Hours/Qty	Rate	Amount
6/11/2008	Officer Hours	Labor Charges - Officer Time	0.2	82.00	16.40
9/15/2008	Officer Hours	Labor Charges - Officer Time	0.8	82.00	65.60
11/18/2008	Officer Hours	Labor Charges - Officer Time	1.1	82.00	90.20
11/19/2008	Officer Hours	Labor Charges - Officer Time	0.3	82.00	24.60
11/20/2008	Officer Hours	Labor Charges - Officer Time	0.3	82.00	24.60
11/24/2008	Officer Hours	Labor Charges - Officer Time	0.1	82.00	8.20
12/1/2008	Officer Hours	Labor Charges - Officer Time	0.3	82.00	24.60
12/2/2008	Officer Hours	Labor Charges - Officer Time	0.5	82.00	41.00
1/27/2011	SOE Preparation	Prepare Statement of Expense		65.00	65.00
		Subtotal Code Enforcement Costs			360.20
8/20/2008	Lot/Title Report	Lot/Title Report	1	150.00	150.00
11/20/2008	Demolition & Disposal	Demolition & Disposal	1	4,400.00	4,400.00
11/25/2008	Other Services	Other Services	1	250.00	250.00
6/23/2009	Asbestos Survey & Abate...	Asbestos Survey & Abatement	1	808.59	808.59
1/27/2011	Lot/Title Report	Lot/Title Report		120.00	120.00
		Subtotal Contractor Costs			5,728.59
1/27/2011	Prepare Case for SOE He...			125.55	125.55
	Attend SOE Hearing			69.75	69.75
		Subtotal County Counsel Costs			195.30
				<b>Subtotal</b>	<b>\$6,284.09</b>
				<b>Payments/Credits</b>	<b>\$0.00</b>
				<b>Total</b>	<b>\$6,284.09</b>

I affirm and declare under penalty of perjury under the laws of the State of California that the foregoing is true and correct.

Code Enforcement Department

EXHIBIT NO. B

# Expenditure Transactions

Criteria: Post On = 7/1/2002..1/31/2011

Page 1 of 1

Journal Date	Journal ID	Fund	Department	Account	Program	Project	Class	Amount	Description	Operator
<b>Fund 10000 -- General Fund</b>										
<b>Account 525440 -- Professional Services</b>										
10/14/2008	AP01258892	10000	3140100000	525440		ZCV0803500		150.00	REPORTS ON PARCELS/LOTS: INV 4	E221241
12/15/2008	AP01272507	10000	3140100000	525440		ZCV0803500		4,400.00	DEMOLITION SERVICES, REMOVE AL	E216294
1/5/2009	AP01276574	10000	3140100000	525440		ZCV0803500		250.00	EMERGENCY BEE REMOVAL SERVICE	E216294
6/23/2009	0001314676	10000	3140100000	525440		ZCV0803500		808.59	IH Invoice #96535	E205333
<b>Total Professional Services</b>								5,608.59		
<b>Total General Fund</b>								5,608.59		

EXHIBIT NO. B<sup>2</sup>

Criteria: Account = 525440; Project = zcv0803500; Transaction Type = Actual

Run: 1/27/2011 12:28 PM Data Last Updated: 1/27/2011 6:28:22 AM



## INVOICE

Order Number: 23149

Order Date: 2/17/2011

**Customer Information:**

Acct No. 1044

RIVERSIDE COUNTY TLMA-CODE ENFORCEMENT  
4080 Lemon Street  
Riverside, CA 92501

Attn: Brent Steele  
REF: CV08-03500 / Angela Sarmiento  
IN RE: GONZALES, VINCENT

Product and/or Service ordered for Property known as:

**Vacant Land**

DESCRIPTION:	FEE:
Lot Book Report	\$120.00
<b>TOTAL DUE:</b>	<b>\$120.00</b>

Payment due upon receipt. Please remit to:

RZ Title Services, Inc.  
P.O. Box 1193  
Whittier, CA 90609

EXHIBIT NO. B<sup>3</sup>

## Assessment Roll For the 2010-2011 Tax Year as of January 1, 2010

Assessment #663140010-7		Parcel # 663140010-7	
Assessee:	GONZALES VINCENT	Land	13,003
Assessee:	GONZALES MONICA ANN	Full Value	13,003
Mail Address:	620 S CAMINO REAL	Total Net	13,003
City, State Zip:	PALM SPRINGS CA 92264		
Real Property Use Code:	YR		
Base Year	1995		
Conveyance Number:	0327528		
Conveyance (mm/yy):	8/1994		
PUI:	R070000		
TRA:	61-207		
Taxability Code:	0-00		
ID Data:	Lot 4 RS 025/035		

[View Parcel Map](#)EXHIBIT NO. C

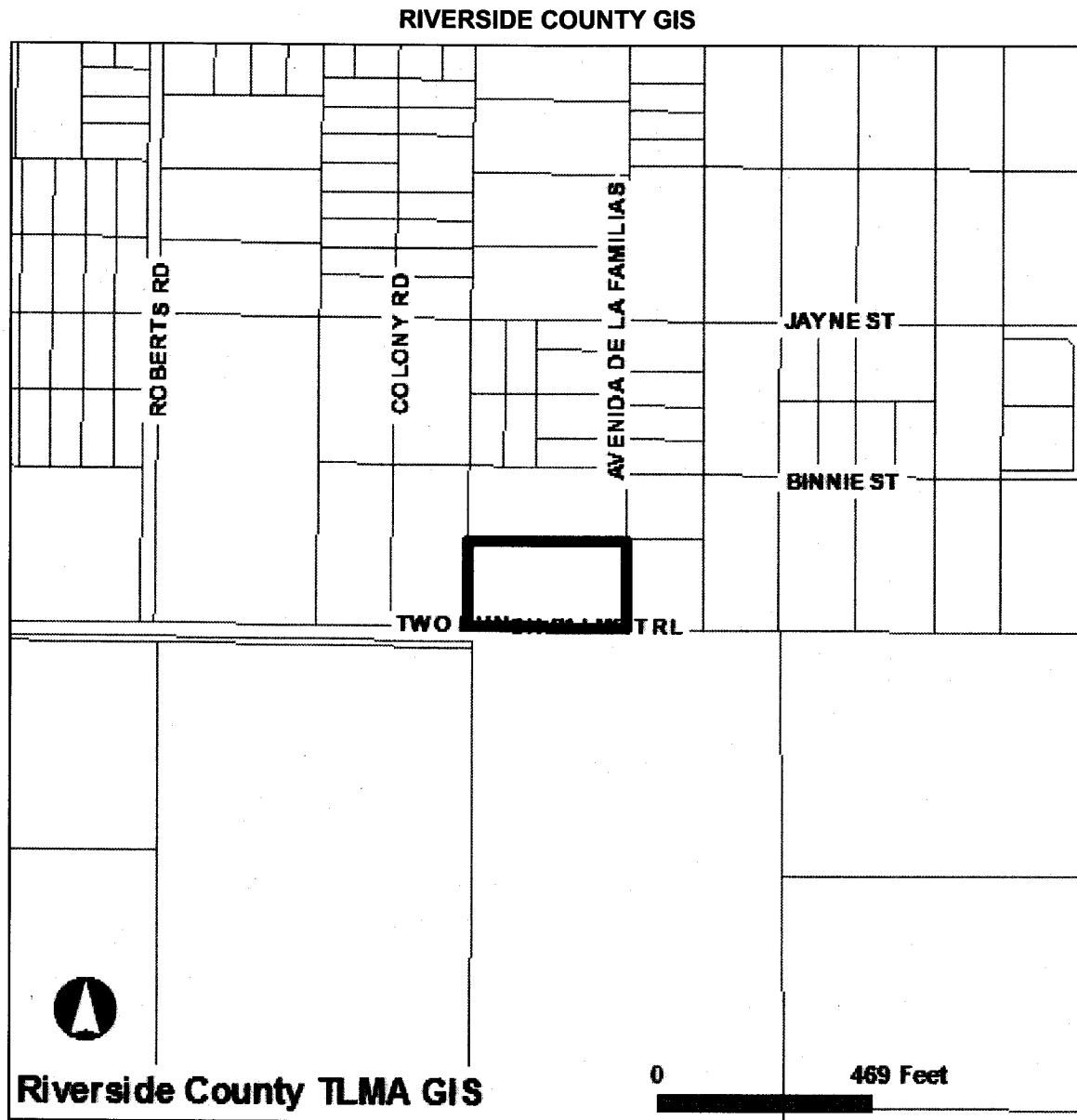

**Selected parcel(s):**  
663-140-010

**\*IMPORTANT\***

Maps and data are to be used for reference purposes only. Map features are approximate, and are not necessarily accurate to surveying or engineering standards. The County of Riverside makes no warranty or guarantee as to the content (the source is often third party), accuracy, timeliness, or completeness of any of the data provided, and assumes no legal responsibility for the information contained on this map. Any use of this product with respect to accuracy and precision shall be the sole responsibility of the user.

**STANDARD REPORT**

**APNs**

663-140-010-7

**OWNER NAME / ADDRESS**

VINCENT GONZALES  
MONICA GONZALES  
ADDRESS NOT AVAILABLE

**MAILING ADDRESS**

(SEE OWNER)  
620 S CAMINO REAL  
PALM SPRINGS CA. 92264

**EXHIBIT NO.** C<sup>2</sup>

**LEGAL DESCRIPTION**

RECORDED BOOK/PAGE: RS 25/35  
SUBDIVISION NAME: NOT AVAILABLE  
LOT/PARCEL: 4, BLOCK: NOT AVAILABLE  
TRACT NUMBER: NOT AVAILABLE

**LOT SIZE**

RECORDED LOT SIZE IS 1.46 ACRES

**PROPERTY CHARACTERISTICS**

NO PROPERTY DESCRIPTION AVAILABLE

**THOMAS BROS. MAPS PAGE/GRID**

PAGE: 696 GRID: D6

**CITY BOUNDARY/SPHERE**

NOT WITHIN A CITY  
CITY SPHERE: DESERT HOT SPRINGS  
ANNEXATION DATE: FEB. 22, 2007  
LAFCO CASE #: 2006-25-4&5  
NO PROPOSALS

**MARCH JOINT POWERS AUTHORITY**

NOT IN THE JURISDICTION OF THE MARCH JOINT POWERS AUTHORITY

**INDIAN TRIBAL LAND**

NOT IN A TRIBAL LAND

**SUPERVISORIAL DISTRICT (ORD. 813)**

MARION ASHLEY, DISTRICT 5

**TOWNSHIP/RANGE**

T2SR4E SEC 35

**ELEVATION RANGE**

1048/1048 FEET

**PREVIOUS APN**

NO DATA AVAILABLE

---

***PLANNING***

---

**LAND USE DESIGNATIONS**

Zoning not consistent with the General Plan.  
MDR

**AREA PLAN (RCIP)**

WESTERN COACHELLA VALLEY

**GENERAL PLAN POLICY OVERLAYS**

NOT IN A GENERAL PLAN POLICY OVERLAY AREA

**GENERAL PLAN POLICY AREAS**

NONE

**ZONING CLASSIFICATIONS (ORD. 348)**

W-2-M

**ZONING DISTRICTS AND ZONING AREAS**

PASS & DESERT DISTRICT

**ZONING OVERLAYS**

NOT IN A ZONING OVERLAY

**SPECIFIC PLANS**

NOT WITHIN A SPECIFIC PLAN

**AGRICULTURAL PRESERVE**

NOT IN AN AGRICULTURAL PRESERVE

**REDEVELOPMENT AREAS**

PROJECT AREA NAME: MCPA  
SUBAREA NAME: GARNET - SUB AREA  
AMENDMENT NUMBER: 0  
ADOPTION DATE: MAY. 13, 2010  
ACREAGE: 2588 ACRES

NOT IN AN AIRPORT INFLUENCE AREA

**AIRPORT COMPATIBILITY ZONES**  
NOT IN AN AIRPORT COMPATIBILITY ZONE

---

## **ENVIRONMENTAL**

---

**CVMSHCP (COACHELLA VALLEY MULTI-SPECIES HABITAT CONSERVATION PLAN) CONSERVATION AREA**  
NOT IN A CONSERVATION AREA

**CVMSHCP FLUVIAL SAND TRANSPORT SPECIAL PROVISION AREAS**  
NOT IN A FLUVIAL SAND TRANSPORT SPECIAL PROVISION AREA

**WRMSHCP (WESTERN RIVERSIDE COUNTY MULTI-SPECIES HABITAT CONSERVATION PLAN) CELL GROUP**  
NOT IN A CELL GROUP

**WRMSHCP CELL NUMBER**  
NOT IN A CELL

**HANS/ERP (HABITAT ACQUISITION AND NEGOTIATION STRATEGY/EXPEDITED REVIEW PROCESS)**  
NONE

**VEGETATION (2005)**  
NO DATA AVAILABLE

---

## **FIRE**

---

**HIGH FIRE AREA (ORD. 787)**  
NOT IN A HIGH FIRE AREA

**FIRE RESPONSIBILITY AREA**  
NOT IN A FIRE RESPONSIBILITY AREA

---

## **DEVELOPMENT FEES**

---

**CVMSHCP FEE AREA (ORD. 875)**  
WITHIN THE COACHELLA VALLEY MSHCP FEE AREA

**WRMSHCP FEE AREA (ORD. 810)**  
NOT WITHIN THE WESTERN RIVERSIDE COUNTY MSHCP FEE AREA

**ROAD & BRIDGE DISTRICT**  
NOT IN A DISTRICT

**EASTERN TUMF (TRANSPORTATION UNIFORM MITIGATION FEE ORD. 673)**  
IN OR PARTIALLY WITHIN A TUMF FEE AREA. SEE MAP FOR MORE INFORMATION.  
In EAST

**WESTERN TUMF (TRANSPORTATION UNIFORM MITIGATION FEE ORD. 824)**  
NOT WITHIN THE WESTERN TUMF FEE AREA

**DIF (DEVELOPMENT IMPACT FEE AREA ORD. 659)**  
WESTERN COACHELLA VALLEY

**SKR FEE AREA (STEPHEN'S KANGAROO RAT ORD. 663.10)**  
NOT WITHIN AN SKR FEE AREA.

**DEVELOPMENT AGREEMENTS**  
NOT IN A DEVELOPMENT AGREEMENT AREA

---

## **TRANSPORTATION**

---

**CIRCULATION ELEMENT ULTIMATE RIGHT-OF-WAY**  
IN OR PARTIALLY WITHIN A CIRCULATION ELEMENT RIGHT-OF-WAY. SEE MAP FOR MORE INFORMATION. CONTACT MAJEED FARSHED AT (760)863-8267 FOR INFORMATION REGARDING THIS PARCEL IF IT IS IN AN UNINCORPORATED AREA.

**ROAD BOOK PAGE**  
167B

**TRANSPORTATION AGREEMENTS**  
NOT IN A TRANSPORTATION AGREEMENT**CETAP (COMMUNITY AND ENVIRONMENTAL TRANSPORTATION ACCEPTABILITY PROCESS) CORRIDORS**  
NOT IN A CETAP CORRIDOR.

---

**HYDROLOGY**

---

**FLOOD PLAIN REVIEW**

FLOOD PLAIN MANAGEMENT REVIEW IS REQUIRED. CONTACT THE FLOOD PLAIN MANAGEMENT SECTION AT (951) 955-1200 FOR INFORMATION.

**WATER DISTRICT**

DWA

**FLOOD CONTROL DISTRICT**

RIVERSIDE COUNTY FLOOD CONTROL DISTRICT

**WATERSHED**

WHITEWATER

---

**GEOLOGIC**

---

**FAULT ZONE**

NOT IN A FAULT ZONE

**FAULTS**

NOT WITHIN A 1/2 MILE OF A FAULT

**LIQUEFACTION POTENTIAL**

MODERATE

**SUBSIDENCE**

SUSCEPTIBLE

**PALEONTOLOGICAL SENSITIVITY**

LOW POTENTIAL.

FOLLOWING A LITERATURE SEARCH, RECORDS CHECK AND A FIELD SURVEY, AREAS MAY BE DETERMINED BY A QUALIFIED VERTEBRATE PALEONTOLOGIST AS HAVING LOW POTENTIAL FOR CONTAINING SIGNIFICANT PALEONTOLOGICAL RESOURCES SUBJECT TO ADVERSE IMPACTS.

---

**MISCELLANEOUS**

---

**SCHOOL DISTRICT**

PALM SPRINGS UNIFIED

**COMMUNITIES**

NORTH PALM SPRINGS

**COUNTY SERVICE AREA**

NOT IN A COUNTY SERVICE AREA.

**LIGHTING (ORD. 655)**

ZONE B, 44.78 MILES FROM MT. PALOMAR OBSERVATORY

**2000 CENSUS TRACT**

044507

**FARMLAND**

OTHER LANDS

URBAN-BUILT UP LAND

**TAX RATE AREAS**

NOT AVAILABLE

**SPECIAL NOTES**

NO SPECIAL NOTES

**CODE COMPLAINTS**

NO CODE COMPLAINTS

REPORT PRINTED ON...Tue Feb 08 10:26:33 2011  
Version 101221



P.O. Box 1193  
Whittier, CA 90609  
Tel # (562) 325-8351  
Fax # (714) 783-3038

## Lot Book Report

Order Number: **23149**

**Customer:**

RIVERSIDE COUNTY TLMA-CODE INFORCEMENT  
4080 Lemon Street  
Riverside CA 92501

Order Date: 2/17/2011

Dated as of: 2/9/2011

County Name: Riverside

Attn: Brent Steele  
Reference: CV08-03500 / Angela Sarmiento  
IN RE: GONZALES, VINCENT

FEE(s):  
Report: \$120.00

Property Address: Vacant Land

CA

Assessor's Parcel No. : 663-140-010-7

**Assessments:**

Land Value:	\$13,003.00
Improvement Value:	\$0.00
Exemption Value:	\$0.00
Total Value:	\$13,003.00

## Tax Information

Property Taxes for the Fiscal Year	2010-2011
First Installment	\$100.05
Penalty	\$0.00
Status	PAID (PAID THRU 01/31/2011)
Second Installment	\$100.05
Penalty	\$0.00
Status	OPEN NOT-PAID (DUE DATE 04/10/2011)

EXHIBIT NO. D



P.O. Box 1193  
Whittier, CA 90609  
Tel # (562) 325-8351  
Fax # (714) 783-3038

Order Number: 23149

Reference: CV08-03500 / Ang

## Property Vesting

The last recorded document transferring title of said property

Dated	02/25/1993
Recorded	08/23/1994
Document No.	327528
D.T.T.	\$11.00
Grantor	Joe Macias, an unmarried man
Grantee	Vincent Gonzales, Sr. and Monica Ann Gonzales, husband and wife as joint tenants

## Deeds of Trust

No Deeds of Trust of Record

## Additional Information

Notice of Non-Compliance filed by	County of Riverside Code Enforcement Department
In the matter of the property of	Vincent Gonzales and Monica Ann Gonzales
Case No.	CV08-03500
Recorded	06/11/2008
Document No.	2008-0319766

JUDGMENT AND/OR LIEN DOCUMENTS LISTED  
AS FOLLOWS:

Document Type	Abstract of Judgment
Document No.	2008-0275470
Recorded	05/22/2008
Document Type	Abstract of Judgment
Document No.	2009-0052471



P.O. Box 1193  
Whittier, CA 90609  
Tel # (562) 325-8351  
Fax # (714) 783-3038

Order Number: 23149

Reference: CV08-03500 / Ang

---

Recorded	02/03/2009
Document Type	Abstract of Judgment
Document No.	2010-0002051
Recorded	01/05/2010
Document Type	Abstract of Judgment
Document No.	2010-0113590
Recorded	03/11/2010
Document Type	Notice of State Tax Lien
Document No.	2010-0171327
Recorded	04/14/2010
Document Type	Abstract of Judgment
Document No.	2010-0421271
Recorded	09/01/2010
Document Type	Certificate of Lien
Document No.	2003-834507
Recorded	10/23/2003
Document Type	Certificate of Lien
Document No.	2004-0918700
Recorded	11/17/2004
Document Type	Notice of Federal Tax Lien
Document No.	2005-0146423
Recorded	02/23/2005
Document Type	Certificate of Lien
Document No.	2005-0928374
Recorded	11/08/2005
A Bankruptcy filed by	Monica Gonsales
Social Security Number(s)	None Shown
Date filed	02/16/2006
Case No.	DN10290
A Bankruptcy filed by	Monica Gonzalez
Social Security Number(s)	None Shown
Date filed	08/01/2006

---



P.O. Box 1193  
Whittier, CA 90609  
Tel # (562) 325-8351  
Fax # (714) 783-3038

Order Number: 23149

Reference: CV08-03500 / Ang

---

Case No.	MG11994
A Bankruptcy filed by	Monica Gonzalez
Social Security Number(s)	None Shown
Date filed	08/04/2008
Case No.	19831
A Bankruptcy filed by	Monica Gonzalez
Social Security Number(s)	None Shown
Date filed	05/19/2009
Case No.	20633
A Bankruptcy filed by	Monica Gonzalez
Social Security Number(s)	None Shown
Date filed	06/10/2009
Case No.	22710
A Bankruptcy filed by	Monica Gonzalez
Social Security Number(s)	None Shown
Date filed	02/02/2011
Case No.	13604
A Bankruptcy filed by	Vincent M. Gonzales
Social Security Number(s)	None Shown
Date filed	08/02/2006
Case No.	MJ12024
A Bankruptcy filed by	Vincent M. Gonzales
Social Security Number(s)	None Shown
Date filed	09/05/2006
Case No.	MJ12460
A Bankruptcy filed by	Vicente M. Gonzalez
Social Security Number(s)	None Shown
Date filed	06/25/2009
Case No.	24315

---



P.O. Box 1193  
Whittier, CA 90609  
Tel # (562) 325-8351  
Fax # (714) 783-3038

Order Number: 23149

Reference: CV08-03500 / Ang

A Bankruptcy filed by	Vincent Luis Gonzalez
Social Security Number(s)	None Shown
Date filed	05/03/2010
Case No.	23417

### Legal Description

THE LAND REFERRED TO IN THIS REPORT IS LOCATED IN AND IS DESCRIBED AS FOLLOWS:

LOT 4 OF RECORD SURVEY BEING A SURVEY OF A PORTION OF THE SOUTHEAST 1/2 OF THE SOUTHWEST 1/2 OF SECTION 35, TOWNSHIP 2 SOUTH, RANGE 4 EAST, SAN BERNARDINO BASE AND MERIDIAN, ACCORDING TO THE OFFICIAL PLAT THEREOF FILED IN BOOK 25, PAGES 35 OF MAPS, RECORDS OF RIVERSIDE COUNTY, STATE OF CALIFORNIA.