

**SUBMITTAL TO THE BOARD OF SUPERVISORS
COUNTY OF RIVERSIDE, STATE OF CALIFORNIA**

809B



FROM: County Counsel
Code Enforcement Department

SUBMITTAL DATE:
March 10, 2011

SUBJECT: Statement of Expense [Case No. CV09-00792]
Subject Property: 1 Parcel N/O 16264 Avenida Atezada, Desert Hot Springs; MARENTES
APN: 657-182-030
District Five

RECOMMENDED MOTION: Move that the Board of Supervisors:

- (1) assess the reasonable costs of abatement of a public nuisance (accumulated rubbish) in the above-referenced matter to be **one thousand, nine hundred seventy-nine dollars and ten cents (US \$1,979.10)**;
- (2) assess the costs of abatement against the above-described subject property;
- (3) authorize the recordation of a notice of abatement lien; and
- (4) authorize the abatement costs to be added to the tax roll as a special assessment
- (5) authorize and direct the Code Enforcement Department to take any reasonable actions to collect the amount owed.

Raymond M. Mistica

RAYMOND M. MISTICA, Deputy County Counsel
for PAMELA J. WALLS, County Counsel

**FINANCIAL
DATA**

Current F.Y. Total Cost:	\$ N/A	In Current Year Budget:	N/A
Current F.Y. Net County Cost:	\$ N/A	Budget Adjustment:	N/A
Annual Net County Cost:	\$ N/A	For Fiscal Year:	N/A

SOURCE OF FUNDS:

Positions To Be Deleted Per A-30	<input type="checkbox"/>
Requires 4/5 Vote	<input type="checkbox"/>

C.E.O. RECOMMENDATION:

APPROVE

BY:

Tina Grande
Tina Grande

County Executive Office Signature

MINUTES OF THE BOARD OF SUPERVISORS

On motion of Supervisor Ashley, seconded by Supervisor Stone and duly carried by unanimous vote, IT WAS ORDERED that the above matter is approved as recommended.

Ayes: Buster, Tavaglione, Stone, Benoit and Ashley
Nays: None
Absent: None
Date: March 22, 2011
xc: Co. Co., CED, Prop. Owner

Kecia Harper-Ihem
Clerk of the Board
By: *Kecia Harper-Ihem*
Deputy

Prev. Agn. Ref.:

District: 5

Agenda Number:

9.8

ATTACHMENTS FILED
WITH THE CLERK OF THE BOARD

Departmental Concurrence

Dep't Recomm.: ☐ Policy
Per Exec. Ofc.: ☒ Policy
☐ Consent
☐ Consent

Statement of Expense [Case No. CV09-00792]

Subject Property: 1 Parcel N/O 16264 Avenida Atezada, Desert Hot Springs; MARENTES

APN: 657-182-030

District Five

Page 2

BACKGROUND: Government Code § 25845, Riverside County Ordinance Nos. 541(RCC Chapter 8.120) and 725 (RCC Chapter 1.16) authorize the recovery of abatement costs in public nuisance cases, the recordation of a notice of abatement lien and inclusion of abatement costs on the tax roll as a special assessment upon approval of the Board of Supervisors.

On May 21, 2009, a Notice of Violation and Order to Remove Accumulated Rubbish was issued. Subsequently, on or about April 13, 2010, the accumulated rubbish was abated from the subject property under the direction of the Riverside County Code Enforcement Department.

The property has a delinquent tax status as of 2008.

The Notice of Hearing re Statement of Expense has been posted on the property and mailed to the property owner and all interested parties, as required by law. Copies of all relevant notices issued in this matter together with proof of service and posting have been separately filed with the Clerk of the Board and are made a part of the record herein, pursuant to Riverside County Ordinance 725.

**SUBMITTAL TO THE BOARD OF SUPERVISORS
COUNTY OF RIVERSIDE, STATE OF CALIFORNIA**

FROM: County Counsel
Code Enforcement Department
SUBJECT: Statement of Expense [Case No. CV09-00792]
Subject Property: 1 Parcel N/O 16264 Avenida Atezada, Desert Hot Springs
APN: 657-182-030; MARENTES
District Five

**TABLE OF SUPPLEMENTAL DOCUMENTS
FILED WITH THE CLERK OF THE BOARD**

Hearing Date: MARCH 22, 2011

Notice of Statement Expense Hearing (including Proofs of Service, Affidavits of Posting and Return Receipts)	Exhibit A
Statement of Expense Worksheet with Supporting Documents	Exhibit B
Assessment-Roll For The Year 10/11 And Geographic Information System, February 8, 2011	Exhibit C
Lot Book Report	Exhibit D

PAMELA J. WALLS
County Counsel

OFFICE OF COUNTY COUNSEL
COUNTY OF RIVERSIDE

KATHERINE A. LIND
Assistant County Counsel

3960 ORANGE STREET, SUITE 500
RIVERSIDE, CA 92501-3674
TELEPHONE: 951/955-6300
FAX: 951/955-6322 & 951/955-6363



March 2, 2011

**NOTICE OF HEARING
RE: STATEMENT OF EXPENSE**

To: Owner(s) or Interested Parties
(See Attached Proof of Service
and Notice List)

Subject Property: 1 Parcel N/O 16264 Avenida Atezada, Desert Hot Springs
Case No.: CV09-00792; MARENTES
APN: 657-182-030

NOTICE IS HEREBY GIVEN that a hearing will be held before the Riverside County Board of Supervisors on **Tuesday, March 22, 2011, at 9:30 a.m.** in the Board of Supervisors Room, 4080 Lemon Street, 1st Floor Annex, Riverside, California, at which time and place pertinent testimony will be heard regarding the expenses incurred by the County of Riverside, Code Enforcement Department ("DEPARTMENT") for the above-referenced abatement case. Said abatement case involved accumulated rubbish located on your real property commonly described as 1 Parcel N/O 16264 Avenida Atezada, Desert Hot Springs, Riverside County, California and more particularly described as Assessor's Parcel Number 657-182-030.

The total expense due, including all other fees and costs, for the abatement of the above-described dangerous or injurious condition is **one thousand, nine hundred seventy-nine dollars and ten cents (US \$1,979.10)**. This amount is immediately due and payable. If you have any objections to the Statement of Expense attached hereto, you must address your objections to the Board of Supervisors at the hearing. If you have any questions about the attached Statement of Expense, please contact the undersigned at (951) 955-6300. In the event the total amount due is not paid to the DEPARTMENT prior to the Board Hearing, the DEPARTMENT shall seek an order from the Board of Supervisors to place a lien against your property and collect the amount due as a special tax assessment.

Failure to appear at the hearing will result in the exclusion of your testimony. Facts as known to the DEPARTMENT will be presented to the Board of Supervisors for their final consideration and deliberation of this matter.

You are encouraged to contact Supervising Code Enforcement Officer, Brian Black (951) 955-2004 prior to the hearing. Please meet with the undersigned or Brian Black at 7:30 a.m. on the day of the hearing in Conference Room 2A located on the 1st floor in front of the Human Resources Office to discuss the case.

PAMELA J. WALLS
County Counsel

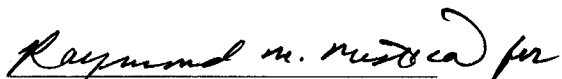
L. ALEXANDRA FONG
Deputy County Counsel

Enclosure: Statement of Expense

EXHIBIT NO. A

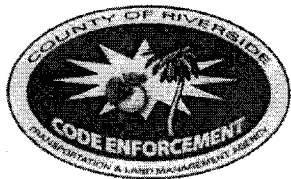

County of Riverside Code Enforcement Department

P.O. Box 1469, Riverside, CA 92502
Phone: (951) 955-2004 Fax: (951) 955-8680
demands@rctlma.org

Statement of Expense

657182030
GABRIEL R MARENTES
MARIA MARENTES
68355 TACHEVAH DR
CATHEDRAL CY CA. 92234

Date	Invoice #
1/27/2011	100321

Case Number	District	Class
CV0900792	5	SOE

Property Address

657182030
GABRIEL R MARENTES
MARIA MARENTES
1 PAR N/O (16264 AVENIDA ATEZADA)
DESERT HOT SPRINGS, CA

Date	Item	Description	Hours/Qty	Rate	Amount
4/28/2009	Officer Hours	Labor Charges - Officer Time	0.3	82.00	24.60
5/21/2009	Officer Hours	Labor Charges - Officer Time	0.1	82.00	8.20
6/24/2009	Officer Hours	Labor Charges - Officer Time	0.2	82.00	16.40
3/8/2010	Officer Hours	Labor Charges - Officer Time	0.1	109.00	10.90
3/18/2010	Officer Hours	Labor Charges - Officer Time	0.3	129.00	38.70
1/27/2011	SOE Preparation	Prepare Statement of Expense		65.00	65.00
		Subtotal Code Enforcement Costs			163.80
1/27/2011	Prepare Case for SOE He...			125.55	125.55
	Attend SOE Hearing			69.75	69.75
		Subtotal County Counsel Costs			195.30
4/15/2010	Demolition & Disposal	Demolition & Disposal	1	1,500.00	1,500.00
1/27/2011	Lot/Title Report	Lot/Title Report		120.00	120.00
		Subtotal Contractor Costs			1,620.00
			Subtotal		\$1,979.10
			Payments/Credits		\$0.00
			Total		\$1,979.10

I affirm and declare under penalty of perjury under the laws of the State of California that the foregoing is true and correct.

Code Enforcement Department

EXHIBIT NO. A²

NOTICE LIST

Subject Property: 1 Parcel N/O 16264 Avenida Atezada, Desert Hot Springs;
Case No.: CV09-00792; APN: 657-182-030;
District Five

GABRIEL R MARENTES
MARIA MARENTES
68355TACHEVAH DRIVE
CATHEDRAL CITY CA 92234

7010 1670 0001 7232 8823

U.S. Postal Service™	
CERTIFIED MAIL™ RECEIPT	
(Domestic Mail Only; No Insurance Coverage Provided)	
For delivery information visit our website at www.usps.com	
OFFICIAL USE	
Postage	\$.44
Certified Fee	2.80
Return Receipt Fee (Endorsement Required)	2.30
Restricted Delivery Fee (Endorsement Required)	
Total Postage & Fees	\$ 5.54
MAILED 3/2/11	
Postmark Here	
Se	GABRIEL R MARENTES
Si	MARIA MARENTES
or	
Ci	68355 TACHEVAH DRIVE
	CATHEDRAL CITY CA 92234
PS Form 3800, August 2006	
Instructions	

EXHIBIT NO. A3

NOTICE LIST

Subject Property: 1 Parcel N/O 16264 Avenida Atezada, Desert Hot Springs;
Case No.: CV09-00792; APN: 657-182-030;
District Five

GABRIEL R MARENTES
MARIA MARENTES
67685 BROKEN ARROW LANE
DESERT HOT SPRINGS CA 92241-7308

7010 1670 0001 7232 9134

U.S. Postal Service™	
CERTIFIED MAIL™ RECEIPT	
(Domestic Mail Only; No Insurance Coverage Provided)	
For delivery information visit our website at www.usps.com	
OFFICIAL USE	
Postage	\$.44
Certified Fee	2.80
Return Receipt Fee (Endorsement Required)	2.30
Restricted Delivery Fee (Endorsement Required)	
Total Postage & Fees	\$ 5.54
Mailed 3/10/11	
Postmark Here	
Sent To	
Street or PO	GABRIEL R MARENTES
City, S	MARIA MARENTES
	67685 BROKEN ARROW LANE
	DESERT HOT SPRINGS CA 92241-7308

PS Form 3800, August 2006 See Reverse for Instructions

EXHIBIT NO. A4

PROOF OF SERVICE

Case No. CV09-00792

STATE OF CALIFORNIA, COUNTY OF RIVERSIDE

I, Brenda G. Peeler, declare that I am a citizen of the United States and am employed in the County of Riverside, over the age of 18 years and not a party to the within action or proceeding; that my business address is 3960 Orange Street, Suite 500, Riverside, California 92501.

That on March 2, 2011, I served the following document(s):

- NOTICE OF HEARING RE: STATEMENT OF EXPENSE
- STATEMENT OF EXPENSE

by placing a true copy thereof enclosed in a sealed envelope(s) addressed as follows:

**OWNERS OR INTERESTED PARTIES
(SEE NOTICE LIST ATTACHED TO NOTICE OF HEARING)**

XX **BY CERTIFIED MAIL, RETURN RECEIPT REQUESTED.** I am "readily familiar" with the office's practice of collection and processing correspondence for mailing. Under that practice it would be deposited with the U.S. Postal Service on that same day with postage thereon fully prepaid at Riverside, California, in the ordinary course of business.

___ **BY PERSONAL SERVICE:** I caused to be delivered such envelope(s) by hand to the offices of the addressee(s).

XX **STATE - I declare under penalty of perjury under the laws of the State of California that the above is true and correct.**

___ **FEDERAL - I declare that I am employed in the office of a member of the bar of this court at whose direction the service was made.**

EXECUTED ON March 2, 2011, at Riverside, California.

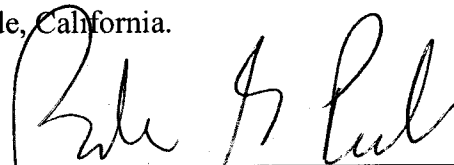

BRENDA G. PEELER

EXHIBIT NO. AS

PROOF OF SERVICE

Case No. CV09-00792

STATE OF CALIFORNIA, COUNTY OF RIVERSIDE

I, Brenda G. Peeler, declare that I am a citizen of the United States and am employed in the County of Riverside, over the age of 18 years and not a party to the within action or proceeding; that my business address is 3960 Orange Street, Suite 500, Riverside, California 92501.

That on March 10, 2011, I served the following document(s):

- NOTICE OF HEARING RE: STATEMENT OF EXPENSE
- STATEMENT OF EXPENSE

by placing a true copy thereof enclosed in a sealed envelope(s) addressed as follows:

**OWNERS OR INTERESTED PARTIES
(SEE NOTICE LIST ATTACHED TO NOTICE OF HEARING)**

XX **BY CERTIFIED MAIL, RETURN RECEIPT REQUESTED.** I am "readily familiar" with the office's practice of collection and processing correspondence for mailing. Under that practice it would be deposited with the U.S. Postal Service on that same day with postage thereon fully prepaid at Riverside, California, in the ordinary course of business.

___ **BY PERSONAL SERVICE:** I caused to be delivered such envelope(s) by hand to the offices of the addressee(s).

XX **STATE - I declare under penalty of perjury under the laws of the State of California that the above is true and correct.**

___ **FEDERAL - I declare that I am employed in the office of a member of the bar of this court at whose direction the service was made.**

EXECUTED ON March 10, 2011, at Riverside, California.

BRENDA G. PEELER

EXHIBIT NO. A6

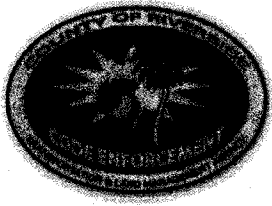

**CODE ENFORCEMENT DEPARTMENT
COUNTY OF RIVERSIDE**

GLENN BAUDE
Director

AFFIDAVIT OF POSTING OF NOTICES

March 4, 2011

RE CASE NO: CV0900792

I, Hector Herrera, hereby declare:

I am employed by the Riverside County Code Enforcement Department; that my business address is 31-290 Plantation Drive, Thousand Palms, California 92276 .

That on 03/04/2011 at 9:30 am, I securely and conspicuously posted Notice of hearing Re: statement of expense. at the property described as:

Property Address: 1 Parcel Norht of (16264 Avenida Atezada), Desert Hot Springs

Assessor's Parcel Number: 657-182-030

I declare under the penalty of perjury that the foregoing is true and correct.

Executed on March 4, 2011 in the County of Riverside, California.

CODE ENFORCEMENT DEPARTMENT



By: Hector Herrera, Sr. Code Enforcement Officer

EXHIBIT NO. A7

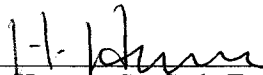
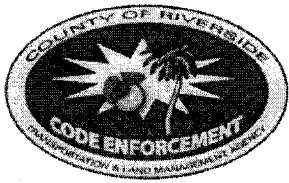

County of Riverside Code Enforcement Department

P.O. Box 1469, Riverside, CA 92502
Phone: (951) 955-2004 Fax: (951) 955-8680
demands@rctlma.org

Statement of Expense

657182030
GABRIEL R MARENTES
MARIA MARENTES
68355 TACHEVAH DR
CATHEDRAL CY CA. 92234

Date	Invoice #
1/27/2011	100321

Case Number	District	Class
CV0900792	5	SOE

Property Address
657182030 GABRIEL R MARENTES MARIA MARENTES 1 PAR N/O (16264 AVENIDA ATEZADA) DESERT HOT SPRINGS, CA

Date	Item	Description	Hours/Qty	Rate	Amount
4/28/2009	Officer Hours	Labor Charges - Officer Time	0.3	82.00	24.60
5/21/2009	Officer Hours	Labor Charges - Officer Time	0.1	82.00	8.20
6/24/2009	Officer Hours	Labor Charges - Officer Time	0.2	82.00	16.40
3/8/2010	Officer Hours	Labor Charges - Officer Time	0.1	109.00	10.90
3/18/2010	Officer Hours	Labor Charges - Officer Time	0.3	129.00	38.70
1/27/2011	SOE Preparation	Prepare Statement of Expense		65.00	65.00
		Subtotal Code Enforcement Costs			163.80
1/27/2011	Prepare Case for SOE He...			125.55	125.55
	Attend SOE Hearing			69.75	69.75
		Subtotal County Counsel Costs			195.30
4/15/2010	Demolition & Disposal	Demolition & Disposal	1	1,500.00	1,500.00
1/27/2011	Lot/Title Report	Lot/Title Report		120.00	120.00
		Subtotal Contractor Costs			1,620.00
			Subtotal		\$1,979.10
			Payments/Credits		\$0.00
			Total		\$1,979.10

I affirm and declare under penalty of perjury under the laws of the State of California that the foregoing is true and correct.

Code Enforcement Department

EXHIBIT NO. B

Transaction Details

Page 1 of 1

Transaction Details

Journal ID: AP01383218
Journal Date: 6/1/2010
Fiscal Period: 2010-12
Process Date: 6/7/2010
Ledger: ACTUALS
Line: 72 of 103
Journal Desc.:
Amount: 1,500.00
Debit/Credit: Debit
Line Desc.:
Operator: MAESTRO -- Maestro

Accounting

Department: 3140100000 -- Code Enforcement
Fund: 10000 -- General Fund
Account: 525440 -- Professional Services
Program: --
Project: ZCV0900792 -- ACCUMULATED RUBBISH
Class: --

EXHIBIT NO. B²



INVOICE

Order Number: 23157

Order Date: 2/17/2011

Customer Information:

Acct No. 1044

RIVERSIDE COUNTY TLMA-CODE ENFORCEMENT
4080 Lemon Street
Riverside, CA 92501

Attn: Brent Steele
REF: CV09-00792 / Angela Sarmiento
IN RE: MARENTES, GABRIEL R.

Product and/or Service ordered for Property known as: Vacant Land	
DESCRIPTION: Lot Book Report	FEE: \$120.00
TOTAL DUE:	\$120.00

Payment due upon receipt. Please remit to:

RZ Title Services, Inc.
P.O. Box 1193
Whittier, CA 90609

EXHIBIT NO. B³

Assessment Roll For the 2010-2011 Tax Year as of January 1, 2010

Assessment #657182030-0

Parcel # 657182030-0

Assessee:	MARENTES GABRIEL R	Land	72,654
Assessee:	MARENTES MARIA	Full Value	72,654
Mail Address:	68355 TACHEVAH DR	Total Net	72,654
City, State Zip:	CATHEDRAL CY CA 92234		
Real Property Use Code:	YR		
Base Year	2007		
Conveyance Number:	0725724		
Conveyance (mm/yy):	9/2006		
PUI:	R070000		
TRA:	61-074		
Taxability Code:	0-00		
ID Data:	Lot 1132 MB 032/015 DOS PALMAS TR UNIT 12		

[View Parcel Map](#)EXHIBIT NO. C

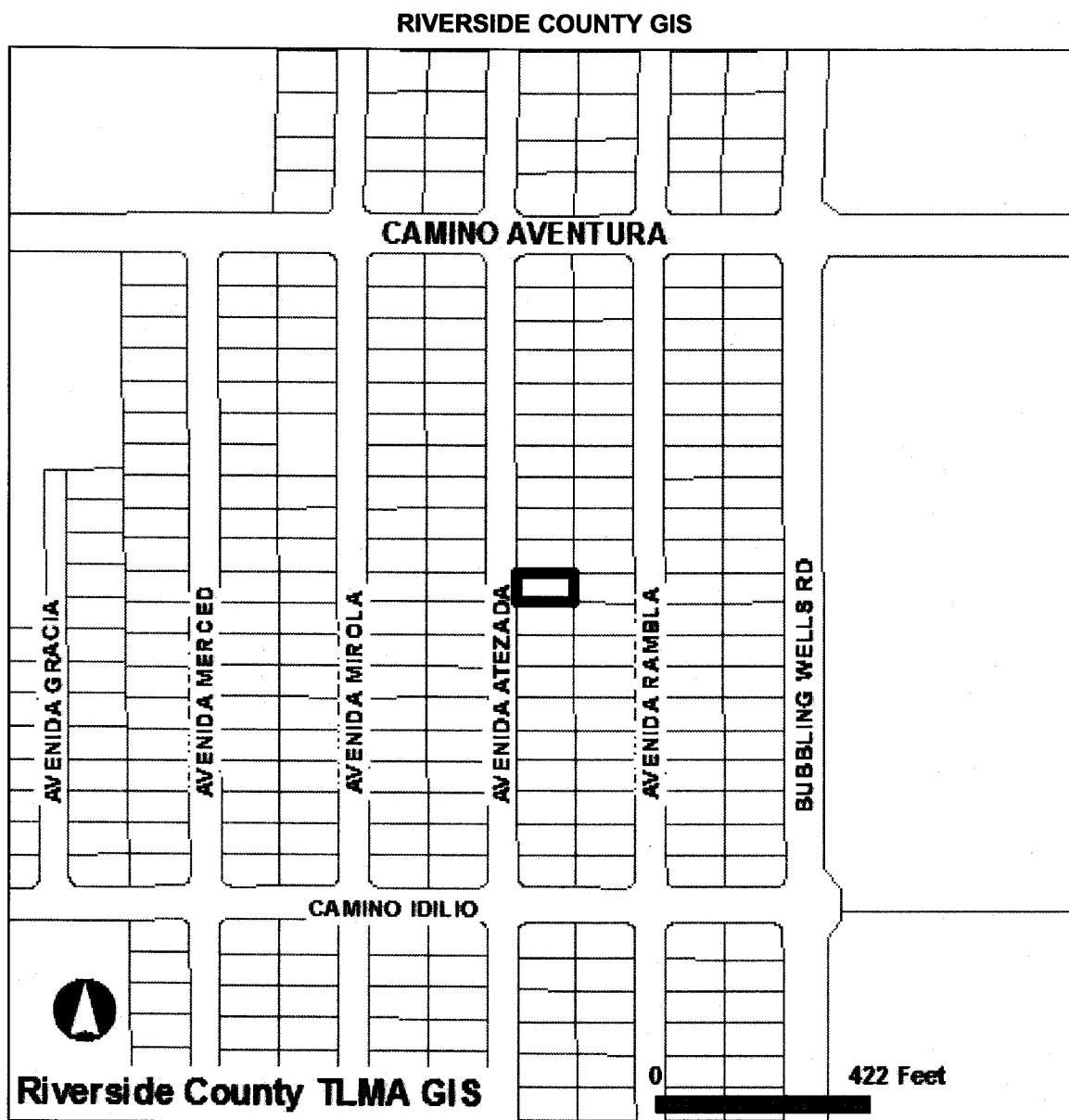

Selected parcel(s):
657-182-030

IMPORTANT

Maps and data are to be used for reference purposes only. Map features are approximate, and are not necessarily accurate to surveying or engineering standards. The County of Riverside makes no warranty or guarantee as to the content (the source is often third party), accuracy, timeliness, or completeness of any of the data provided, and assumes no legal responsibility for the information contained on this map. Any use of this product with respect to accuracy and precision shall be the sole responsibility of the user.

STANDARD REPORT

APNs

657-182-030-0

OWNER NAME / ADDRESS

GABRIEL R MARENTES
MARIA MARENTES
ADDRESS NOT AVAILABLE

MAILING ADDRESS

(SEE OWNER)
68355 TACHEVAH DR
CATHEDRAL CY CA. 92234

EXHIBIT NO. C²

LEGAL DESCRIPTION

RECORDED BOOK/PAGE: MB 32/15
SUBDIVISION NAME: DOS PALMAS TR UNIT 12
LOT/PARCEL: 1132, BLOCK: NOT AVAILABLE
TRACT NUMBER: NOT AVAILABLE

LOT SIZE

RECORDED LOT SIZE IS 0.17 ACRES

PROPERTY CHARACTERISTICS

NO PROPERTY DESCRIPTION AVAILABLE

THOMAS BROS. MAPS PAGE/GRID

PAGE: 727 GRID: B1

CITY BOUNDARY/SPHERE

NOT WITHIN A CITY
CITY SPHERE: DESERT HOT SPRINGS
ANNEXATION DATE: FEB. 22, 2007
LAFCO CASE #: 2006-25-4&5
NO PROPOSALS

MARCH JOINT POWERS AUTHORITY

NOT IN THE JURISDICTION OF THE MARCH JOINT POWERS AUTHORITY

INDIAN TRIBAL LAND

NOT IN A TRIBAL LAND

SUPERVISORIAL DISTRICT (ORD. 813)

MARION ASHLEY, DISTRICT 5

TOWNSHIP/RANGE

T3SR5E SEC 8

ELEVATION RANGE

852/856 FEET

PREVIOUS APN

NO DATA AVAILABLE

PLANNING

LAND USE DESIGNATIONS

Zoning not consistent with the General Plan.
MDR

AREA PLAN (RCIP)

WESTERN COACHELLA VALLEY

GENERAL PLAN POLICY OVERLAYS

NOT IN A GENERAL PLAN POLICY OVERLAY AREA

GENERAL PLAN POLICY AREAS

NONE

ZONING CLASSIFICATIONS (ORD. 348)

W-2

ZONING DISTRICTS AND ZONING AREAS

PASS & DESERT DISTRICT

ZONING OVERLAYS

NOT IN A ZONING OVERLAY

SPECIFIC PLANS

NOT WITHIN A SPECIFIC PLAN

AGRICULTURAL PRESERVE

NOT IN AN AGRICULTURAL PRESERVE

REDEVELOPMENT AREAS

PROJECT AREA NAME: MCPA
SUBAREA NAME: GARNET - SUB AREA
AMENDMENT NUMBER: 0
ADOPTION DATE: MAY. 13, 2010
ACREAGE: 2588 ACRES

NOT IN AN AIRPORT INFLUENCE AREA

AIRPORT COMPATIBILITY ZONES

NOT IN AN AIRPORT COMPATIBILITY ZONE

ENVIRONMENTAL

CVMSHCP (COACHELLA VALLEY MULTI-SPECIES HABITAT CONSERVATION PLAN) CONSERVATION AREA

NOT IN A CONSERVATION AREA

CVMSHCP FLUVIAL SAND TRANSPORT SPECIAL PROVISION AREAS

NOT IN A FLUVIAL SAND TRANSPORT SPECIAL PROVISION AREA

WRMSHCP (WESTERN RIVERSIDE COUNTY MULTI-SPECIES HABITAT CONSERVATION PLAN) CELL GROUP

NOT IN A CELL GROUP

WRMSHCP CELL NUMBER

NOT IN A CELL

HANS/ERP (HABITAT ACQUISITION AND NEGOTIATION STRATEGY/EXPEDITED REVIEW PROCESS)

NONE

VEGETATION (2005)

NO DATA AVAILABLE

FIRE

HIGH FIRE AREA (ORD. 787)

NOT IN A HIGH FIRE AREA

FIRE RESPONSIBILITY AREA

NOT IN A FIRE RESPONSIBILITY AREA

DEVELOPMENT FEES

CVMSHCP FEE AREA (ORD. 875)

WITHIN THE COACHELLA VALLEY MSHCP FEE AREA

WRMSHCP FEE AREA (ORD. 810)

NOT WITHIN THE WESTERN RIVERSIDE COUNTY MSHCP FEE AREA

ROAD & BRIDGE DISTRICT

NOT IN A DISTRICT

EASTERN TUMF (TRANSPORTATION UNIFORM MITIGATION FEE ORD. 673)

IN OR PARTIALLY WITHIN A TUMF FEE AREA. SEE MAP FOR MORE INFORMATION.
In EAST

WESTERN TUMF (TRANSPORTATION UNIFORM MITIGATION FEE ORD. 824)

NOT WITHIN THE WESTERN TUMF FEE AREA

DIF (DEVELOPMENT IMPACT FEE AREA ORD. 659)

WESTERN COACHELLA VALLEY

SKR FEE AREA (STEPHEN'S KANGAROO RAT ORD. 663.10)

NOT WITHIN AN SKR FEE AREA.

DEVELOPMENT AGREEMENTS

NOT IN A DEVELOPMENT AGREEMENT AREA

TRANSPORTATION

CIRCULATION ELEMENT ULTIMATE RIGHT-OF-WAY

NOT IN A CIRCULATION ELEMENT RIGHT-OF-WAY

ROAD BOOK PAGE

171

TRANSPORTATION AGREEMENTS
NOT IN A TRANSPORTATION AGREEMENT**CETAP (COMMUNITY AND ENVIRONMENTAL TRANSPORTATION ACCEPTABILITY PROCESS) CORRIDORS**
NOT IN A CETAP CORRIDOR.

HYDROLOGY

FLOOD PLAIN REVIEW

FLOOD PLAIN MANAGEMENT REVIEW IS REQUIRED. CONTACT THE FLOOD PLAIN MANAGEMENT SECTION AT (951) 955-1200 FOR INFORMATION.

WATER DISTRICT
DWA**FLOOD CONTROL DISTRICT**
RIVERSIDE COUNTY FLOOD CONTROL DISTRICT**WATERSHED**
WHITEWATER

GEOLOGIC

FAULT ZONE
NOT IN A FAULT ZONE**FAULTS**
NOT WITHIN A 1/2 MILE OF A FAULT**LIQUEFACTION POTENTIAL**
MODERATE**SUBSIDENCE**
SUSCEPTIBLE**PALEONTOLOGICAL SENSITIVITY**

LOW POTENTIAL.

FOLLOWING A LITERATURE SEARCH, RECORDS CHECK AND A FIELD SURVEY, AREAS MAY BE DETERMINED BY A QUALIFIED VERTEBRATE PALEONTOLOGIST AS HAVING LOW POTENTIAL FOR CONTAINING SIGNIFICANT PALEONTOLOGICAL RESOURCES SUBJECT TO ADVERSE IMPACTS.

MISCELLANEOUS

SCHOOL DISTRICT
PALM SPRINGS UNIFIED**COMMUNITIES**
SOUTHEAST DESERT HOT SPRINGS**COUNTY SERVICE AREA**
NOT IN A COUNTY SERVICE AREA.**LIGHTING (ORD. 655)**
NOT APPLICABLE, 45.17 MILES FROM MT. PALOMAR OBSERVATORY**2000 CENSUS TRACT**
044506**FARMLAND**
URBAN-BUILT UP LAND**TAX RATE AREAS**

061-074

- CITRUS PEST CONTROL 2
- COACHELLA VALLEY RESOURCE CONSER
- COUNTY FREE LIBRARY
- COUNTY STRUCTURE FIRE PROTECTION
- COUNTY WASTE RESOURCE MGMT DIST
- CSA 152
- CV MOSQ & VECTOR CONTROL
- DESERT COMMUNITY COLLEGE
- DESERT HOSPITAL

- DESERT WATER AGENCY 5TH FRINGE
- FLOOD CONTROL ADMINISTRATION
- FLOOD CONTROL ZONE 6
- GENERAL
- GENERAL PURPOSE
- MISSION SPRINGS IMP G
- MISSION SPRINGS WATER DISTRICT
- PALM SPRINGS PUBLIC CEMETERY
- PALM SPRINGS UNIF B & I 1992-A
- PALM SPRINGS UNIFIED SCHOOL
- RIV CO REG PARK & OPEN SPACE
- RIV. CO. OFFICE OF EDUCATION

SPECIAL NOTES

NO SPECIAL NOTES

CODE COMPLAINTS

NO CODE COMPLAINTS

REPORT PRINTED ON...Tue Feb 08 10:27:35 2011
Version 101221



P.O. Box 1193
Whittier, CA 90609
Tel # (562) 325-8351
Fax # (714) 783-3038

Lot Book Report

Order Number: **23157**

Customer:

RIVERSIDE COUNTY TLMA-CODE INFORCEMENT
4080 Lemon Street
Riverside CA 92501

Order Date: 2/17/2011

Dated as of: 2/9/2011

County Name: Riverside

Attn: Brent Steele
Reference: CV09-00792 / Angela Sarmiento
IN RE: MARENTES, GABRIEL R.

FEE(s):
Report: \$120.00

Property Address: Vacant Land

CA

Assessor's Parcel No. : 657-182-030-0

Assessments:

Land Value:	\$72,654.00
Improvement Value:	\$0.00
Exemption Value:	\$0.00
Total Value:	\$72,654.00

Tax Information

Property Taxes for the Fiscal Year	2010-2011
First Installment	\$461.39
Penalty	\$46.13
Status	NOT PAID-DELINQUENT
Second Installment	\$461.39
Penalty	\$0.00
Status	OPEN NOT-PAID (DUE DATE 04/10/2011)

Supplemental Property Tax Assessment for the

Fiscal Year 2003
Bill Number 052002511-0

EXHIBIT NO. D



P.O. Box 1193
Whittier, CA 90609
Tel # (562) 325-8351
Fax # (714) 783-3038

Order Number: 23157

Reference: CV09-00792 / Ang

First Installment	\$7.21
Penalty	\$0.72
Due Date	12/10/2004
Status	NOT PAID-DELINQUENT
Second Installment	\$0.00
Penalty	\$0.00
Due Date	04/10/2005
Status	NO TAXES DUE
Prior Delinquencies for tax defaulted year(s)	2007-2009 and 2006 (Supplemental Bill# 052516388-4)
Redemption Amount	\$4,159.13
If paid by	02/28/2011

Property Vesting

The last recorded document transferring title of said property

Dated	09/27/2006
Recorded	09/29/2006
Document No.	2006-0725724
D.T.T.	\$77.00
Grantor	Charly Lopez and Maria Leticia Lopez, husband and wife as joint tenants
Grantee	Gabriel R. Marentes and Maria Marentes, husband and wife as joint tenants

Deeds of Trust

No Deeds of Trust of Record



P.O. Box 1193
Whittier, CA 90609
Tel # (562) 325-8351
Fax # (714) 783-3038

Order Number: 23157
Reference: CV09-00792 / Ang

Additional Information

Document Type	Notice of Assessment
Document No.	2004-0559888
Recorded	07/20/2004
Notice of Non-Compliance filed by	County of Riverside Code Enforcement Department
In the matter of the property of	Gabriel R. Marentes and Maria Marentes
Case No.	CV09-00792
Recorded	05/20/2009
Document No.	2009-0255668

Legal Description

THE LAND REFERRED TO IN THIS REPORT IS LOCATED IN AND IS DESCRIBED AS FOLLOWS:

LOT NO. 1132 DOS PALMAS TRACT UNIT NO. 12, IN THE COUNTY OF RIVERSIDE, STATE OF CALIFORNIA, AS SHOWN BY MAP ON FILE IN BOOK 32, PAGES 15 AND 16 OF MAPS, RECORDS OF THE COUNTY RECORDER OF SAID COUNTY.