

**SUBMITTAL TO THE BOARD OF SUPERVISORS  
COUNTY OF RIVERSIDE, STATE OF CALIFORNIA**

912B



**FROM:** County Counsel  
Code Enforcement Department

**SUBMITTAL DATE:**  
March 17, 2011

**SUBJECT:** Statement of Expense [Case No. CV09-12161]  
Subject Property: 1 Parcel S/O 15468 Avenida Manzana, Desert Hot Springs; REYNOLDS  
APN: 656-171-042  
District Five

**RECOMMENDED MOTION:** Move that the Board of Supervisors:

- (1) assess the reasonable costs of abatement of a public nuisance (accumulated rubbish) in the above-referenced matter to be **one thousand, two hundred eighty dollars and fifty-five cents (US \$1,280.55)**;
- (2) assess the costs of abatement against the above-described subject property;
- (3) authorize the recordation of a notice of abatement lien; and
- (4) authorize the abatement costs to be added to the tax roll as a special assessment
- (5) authorize and direct the Code Enforcement Department to take any reasonable actions to collect the amount owed.

*Raymond M. Mistica*  
RAYMOND M. MISTICA, Deputy County Counsel  
for PAMELA J. WALLS, County Counsel

<b>FINANCIAL DATA</b>	Current F.Y. Total Cost:	\$ N/A	In Current Year Budget:	N/A
	Current F.Y. Net County Cost:	\$ N/A	Budget Adjustment:	N/A
	Annual Net County Cost:	\$ N/A	For Fiscal Year:	N/A

<b>SOURCE OF FUNDS:</b>	<b>Positions To Be Deleted Per A-30</b>	<input type="checkbox"/>
	<b>Requires 4/5 Vote</b>	<input type="checkbox"/>

**C.E.O. RECOMMENDATION:** APPROVE

BY: *Tina Grande*  
Tina Grande

**County Executive Office Signature**

Consent  
 Policy  
 Consent  
 Policy

**MINUTES OF THE BOARD OF SUPERVISORS**

On motion of Supervisor Buster, seconded by Supervisor Ashley and duly carried, IT WAS ORDERED that the above matter is approved as recommended.

**Ayes:** Buster, Stone, Benoit and Ashley  
**Nays:** None  
**Absent:** Tavaglione  
**Date:** March 29, 2011  
**xc:** Co. Co., CED, Prop. Owner

Kecia Harper-Ihem  
 Clerk of the Board  
 By: *Kecia Harper-Ihem*  
 Deputy

**Prev. Agn. Ref.:** | **District:** 5 | **Agenda Number:**

**9.11**

Statement of Expense [Case No. CV09-12161]

Subject Property: 1 Parcel S/O 15468 Avenida Manzana, Desert Hot Springs; REYNOLDS

APN: 656-171-042

District Five

Page 2

**BACKGROUND:** Government Code § 25845, Riverside County Ordinance Nos. 541(RCC Chapter 8.120) and 725 (RCC Chapter 1.16) authorize the recovery of abatement costs in public nuisance cases, the recordation of a notice of abatement lien and inclusion of abatement costs on the tax roll as a special assessment upon approval of the Board of Supervisors.

On Jan. 29, 2010, a Notice of Violation and Order to Remove Accumulated Rubbish was issued. Subsequently, on or about Aug. 26, 2010, the accumulated rubbish was abated from the subject property under the direction of the Riverside County Code Enforcement Department.

The Notice of Hearing re Statement of Expense has been posted on the property and mailed to the property owner and all interested parties, as required by law. Copies of all relevant notices issued in this matter together with proof of service and posting have been separately filed with the Clerk of the Board and are made a part of the record herein, pursuant to Riverside County Ordinance 725.

PAMELA J. WALLS  
County Counsel

OFFICE OF COUNTY COUNSEL  
COUNTY OF RIVERSIDE



KATHERINE A. LIND  
Assistant County Counsel

3960 ORANGE STREET, SUITE 500  
RIVERSIDE, CA 92501-3674  
TELEPHONE: 951/955-6300  
FAX: 951/955-6322 & 951/955-6363

March 11, 2011

## NOTICE OF HEARING RE: STATEMENT OF EXPENSE

To: Owner(s) or Interested Parties  
(See Attached Proof of Service  
and Notice List)

Subject Property: 1 Parcel S/O 15468 Avenida Manzana,  
Desert Hot Springs  
Case No.: CV09-12161; ESTATE OF REYNOLDS  
APN: 656-171-042

**NOTICE IS HEREBY GIVEN** that a hearing will be held before the Riverside County Board of Supervisors on **Tuesday, March 29, 2011, at 9:30 a.m.** in the Board of Supervisors Room, 4080 Lemon Street, 1st Floor Annex, Riverside, California, at which time and place pertinent testimony will be heard regarding the expenses incurred by the County of Riverside, Code Enforcement Department ("DEPARTMENT") for the above-referenced abatement case. Said abatement case involved accumulated rubbish located on your real property commonly described as 1 Parcel S/O 15468 Avenida Manzana, Desert Hot Springs, Riverside County, California and more particularly described as Assessor's Parcel Number 656-171-042.

The total expense due, including all other fees and costs, for the abatement of the above-described dangerous or injurious condition is **one thousand, two hundred eighty dollars and fifty-five cents (US \$1,280.55)**. This amount is immediately due and payable. If you have any objections to the Statement of Expense attached hereto, you must address your objections to the Board of Supervisors at the hearing. If you have any questions about the attached Statement of Expense, please contact the undersigned at (951) 955-6300. In the event the total amount due is not paid to the DEPARTMENT prior to the Board Hearing, the DEPARTMENT shall seek an order from the Board of Supervisors to place a lien against your property and collect the amount due as a special tax assessment.

Failure to appear at the hearing will result in the exclusion of your testimony. Facts as known to the DEPARTMENT will be presented to the Board of Supervisors for their final consideration and deliberation of this matter.

**You are encouraged to contact Supervising Code Enforcement Officer, Brian Black (951) 955-2004 prior to the hearing. Please meet with the undersigned or Brian Black at 8:30 a.m. on the day of the hearing in Conference Room 2A located on the 1st floor in front of the Human Resources Office to discuss the case.**

PAMELA J. WALLS  
County Counsel

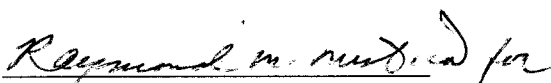
  
L. ALEXANDRA FONG  
Deputy County Counsel

Enclosure: Statement of Expense

EXHIBIT NO.     A



# County of Riverside Code Enforcement Department

P.O. Box 1469, Riverside, CA 92502  
Phone: (951) 955-2004 Fax: (951) 955-8680  
demands@rctlma.org

## Statement of Expense

656171042  
REYNOLDS ELLA ESTATE OF  
C/O H A TADOLINI  
9744 E WOOLLEY ST  
TEMPLE CITY CA. 91780

Date	Invoice #
1/27/2011	100324

Property Address
656171042 REYNOLDS ELLA ESTATE OF C/O H A TADOLINI 1 PAR S/O (15468 AVENIDA MANZANA) DESERT HOT SPRINGS, CA

Case Number	District	Class
CV0912161	5	SOE

Date	Item	Description	Hours/Qty	Rate	Amount
1/20/2010	Officer Hours	Labor Charges - Officer Time	0.3	82.00	24.60
1/29/2010	Officer Hours	Labor Charges - Officer Time	0.1	82.00	8.20
3/24/2010	Officer Hours	Labor Charges - Officer Time	0.2	129.00	25.80
6/15/2010	Officer Hours	Labor Charges - Officer Time	0.2	129.00	25.80
7/27/2010	Officer Hours	Labor Charges - Officer Time	0.3	129.00	38.70
8/26/2010	Officer Hours	Labor Charges - Officer Time	3.5	109.00	381.50
1/27/2011	SOE Preparation	Prepare Statement of Expense		65.00	65.00
		Subtotal Code Enforcement Costs			569.60
8/19/2010	Demolition & Disposal	Demolition & Disposal	1	395.65	395.65
	Lot/Title Report	Lot/Title Report		120.00	120.00
		Subtotal Contractor Costs			515.65
1/27/2011	Prepare Case for SOE He...			125.55	125.55
	Attend SOE Hearing			69.75	69.75
		Subtotal County Counsel Costs			195.30

<b>Subtotal</b>	\$1,280.55
<b>Payments/Credits</b>	\$0.00
<b>Total</b>	\$1,280.55

affirm and declare under penalty of perjury under the laws of the State of California that the foregoing is true and correct.

Code Enforcement Department

EXHIBIT NO.     A2

# NOTICE LIST

Subject Property: 1 Parcel S/O 15468 Avenida Manzana, Desert Hot Springs;  
 Case No.: CV09-12161; APN: 656-171-042;  
 District Five

ELLA REYNOLDS  
 ESTATE OF ELLA REYNOLDS  
 5483 NORWICH  
 LOS ANGELES CA 90032

ESTATE OF ELLA REYNOLDS  
 C/O H A TADOLINI  
 9744 E WOOLLEY STREET  
 TEMPLE CITY CA 91780

**U.S. Postal Service™**  
**CERTIFIED MAIL™ RECEIPT**  
 (Domestic Mail Only; No Insurance Coverage Provided)

For delivery information visit our website at [www.usps.com](http://www.usps.com)®

OFFICIAL USE

Postage	\$ .44	Mailed 3/11/11  Postmark Here
Certified Fee	2.80	
Return Receipt Fee (Endorsement Required)	2.30	
Restricted Delivery Fee (Endorsement Required)		
<b>Total Postage &amp; Fees</b>	<b>\$ 5.54</b>	

*Sent To* ESTATE OF ELLA REYNOLDS

*Street, or PO B* C/O H A TADOLINI

*City, St* 9744 E WOOLLEY STREET

TEMPLE CITY CA 91780

PS Form 3800, August 2006 See Reverse for Instructions

7010 1670 0001 7232 9226

**U.S. Postal Service™**  
**CERTIFIED MAIL™ RECEIPT**  
 (Domestic Mail Only; No Insurance Coverage Provided)

For delivery information visit our website at [www.usps.com](http://www.usps.com)®

OFFICIAL USE

Postage	\$ .44	3/11/11  Postmark Here
Certified Fee	2.80	
Return Receipt Fee (Endorsement Required)	2.30	
Restricted Delivery Fee (Endorsement Required)		
<b>Total Postage &amp; Fees</b>	<b>\$ 5.54</b>	

*Sent To* ELLA REYNOLDS

*Street, or PO* ESTATE OF ELLA REYNOLDS

*City, St* 5483 NORWICH

LOS ANGELES CA 90032

PS Form 3800, August 2006 See Reverse for Instructions

7010 1670 0001 7232 9226

EXHIBIT NO.                      A3

1 **PROOF OF SERVICE**

2 Case No. CV09-12161

3 STATE OF CALIFORNIA, COUNTY OF RIVERSIDE

4 I, Brenda G. Peeler, declare that I am a citizen of the United States and am employed in the County  
5 of Riverside, over the age of 18 years and not a party to the within action or proceeding; that my  
6 business address is 3960 Orange Street, Suite 500, Riverside, California 92501.

7 That on March 11, 2011, I served the following document(s):

- 8 - NOTICE OF HEARING RE: STATEMENT OF EXPENSE
- 9 - STATEMENT OF EXPENSE

10 by placing a true copy thereof enclosed in a sealed envelope(s) addressed as follows:

11 **OWNERS OR INTERESTED PARTIES**  
12 **(SEE NOTICE LIST ATTACHED TO NOTICE OF HEARING)**

13 XX **BY CERTIFIED MAIL, RETURN RECEIPT REQUESTED.** I am "readily familiar"  
14 with the office's practice of collection and processing correspondence for mailing. Under  
15 that practice it would be deposited with the U.S. Postal Service on that same day with  
16 postage thereon fully prepaid at Riverside, California, in the ordinary course of business.

17      **BY PERSONAL SERVICE:** I caused to be delivered such envelope(s) by hand to the offices  
18 of the addressee(s).

19 XX **STATE - I declare under penalty of perjury under the laws of the State of California that the**  
20 **above is true and correct.**

21      **FEDERAL - I declare that I am employed in the office of a member of the bar of this court at**  
22 **whose direction the service was made.**

23 EXECUTED ON March 11, 2011, at Riverside, California.

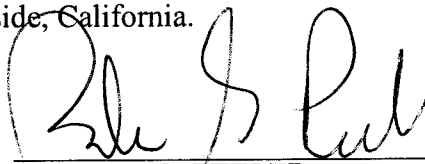
24   
25 \_\_\_\_\_  
26 BRENDA G. PEELER

27  
28  
EXHIBIT NO.     A4



**CODE ENFORCEMENT DEPARTMENT  
COUNTY OF RIVERSIDE**

GLENN BAUDE  
Director

**AFFIDAVIT OF POSTING OF NOTICES**

March 11, 2011

RE CASE NO: CV0912161

I, Hector Herrera, hereby declare:

I am employed by the Riverside County Code Enforcement Department; that my business address is 31-290 Plantation Drive, Thousand Palms, California 92276 .

That on 03/11/2011 at 10:49 AM, I securely and conspicuously posted Notice of Hearing RE: Statement of Expense at the property described as:

**Property Address:** 1 Parcel South of (15468 Avenida Manzana), Desert Hot Springs

**Assessor's Parcel Number:** 656-171-042

I declare under the penalty of perjury that the foregoing is true and correct.

Executed on March 11, 2011 in the County of Riverside, California.

CODE ENFORCEMENT DEPARTMENT

  
By: Thomas Cervantes, Code Enforcement Officer

EXHIBIT NO. AS



# County of Riverside Code Enforcement Department

P.O. Box 1469, Riverside, CA 92502  
Phone: (951) 955-2004 Fax: (951) 955-8680  
demands@rcetlma.org

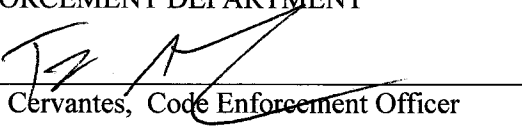
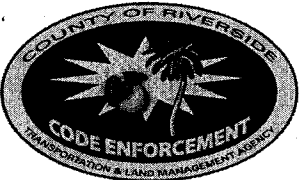
## Statement of Expense

656171042  
REYNOLDS ELLA ESTATE OF  
C/O H A TADOLINI  
9744 E WOOLLEY ST  
TEMPLE CITY CA. 91780

Date	Invoice #
1/27/2011	100324

Property Address
656171042 REYNOLDS ELLA ESTATE OF C/O H A TADOLINI 1 PAR S/O (15468 AVENIDA MANZANA) DESERT HOT SPRINGS, CA

Case Number	District	Class
CV0912161	5	SOE

Date	Item	Description	Hours/Qty	Rate	Amount
1/20/2010	Officer Hours	Labor Charges - Officer Time	0.3	82.00	24.60
1/29/2010	Officer Hours	Labor Charges - Officer Time	0.1	82.00	8.20
3/24/2010	Officer Hours	Labor Charges - Officer Time	0.2	129.00	25.80
6/15/2010	Officer Hours	Labor Charges - Officer Time	0.2	129.00	25.80
7/27/2010	Officer Hours	Labor Charges - Officer Time	0.3	129.00	38.70
8/26/2010	Officer Hours	Labor Charges - Officer Time	3.5	109.00	381.50
1/27/2011	SOE Preparation	Prepare Statement of Expense		65.00	65.00
		Subtotal Code Enforcement Costs			569.60
8/19/2010	Demolition & Disposal Lot/Title Report	Demolition & Disposal Lot/Title Report	1	395.65	395.65
		Subtotal Contractor Costs		120.00	120.00
					515.65
1/27/2011	Prepare Case for SOE He... Attend SOE Hearing			125.55	125.55
				69.75	69.75
		Subtotal County Counsel Costs			195.30
			<b>Subtotal</b>		<b>\$1,280.55</b>
			<b>Payments/Credits</b>		<b>\$0.00</b>
			<b>Total</b>		<b>\$1,280.55</b>

I affirm and declare under penalty of perjury under the laws of the State of California that the foregoing is true and correct.

Code Enforcement Department

EXHIBIT NO.     B



**Vouchers**

Criteria: Accounting Date = 7/1/2002..1/31/2011

Accounting Date	Voucher ID	Invoice ID	Vendor ID	Vendor Name	Amount Invoiced	Amount Paid	Amount Due
<b>Fund 10000 -- General Fund</b>							
9/8/2010	TLARC-00257169	1608	RIVCO-0000082893	Lanik Enterprises Inc	395.65	395.65	0.00
<b>Total General Fund</b>					<b>395.65</b>	<b>395.65</b>	<b>0.00</b>

EXHIBIT NO. \_\_\_\_\_

B<sup>2</sup>



# INVOICE

Order Number: 23160 Order Date: 2/17/2011

**Customer Information:**

Acct No. 1044

RIVERSIDE COUNTY TLMA-CODE ENFORCEMENT  
4080 Lemon Street  
Riverside, CA 92501

Attn: Brent Steele  
REF: CV09-12161 / Angela Sarmiento  
IN RE: REYNOLDS, ELLA ESTATE OF

Product and/or Service ordered for Property known as:	
<b>Vacant Land</b>	
<b>DESCRIPTION:</b>	<b>FEE:</b>
Lot Book Report	\$120.00
<b>TOTAL DUE:</b>	<b>\$120.00</b>

Payment due upon receipt. Please remit to:

RZ Title Services, Inc.  
P.O. Box 1193  
Whittier, CA 90609

EXHIBIT NO.     B<sup>3</sup>

Assessment Roll For the 2010-2011 Tax Year as of January 1,2010

Assessment #656171042-0		Parcel # 656171042-0	
<b>Assessee:</b>	REYNOLDS ELLA ESTATE OF	<b>Land</b>	984
<b>Mail Name:</b>	C/O H A TADOLINI	<b>Full Value</b>	984
<b>Mail Address:</b>	9744 E WOOLLEY ST	<b>Total Net</b>	984
<b>City, State Zip:</b>	TEMPLE CITY CA 91780		
<b>Real Property Use Code:</b>	YR		
<b>Base Year</b>	1975		
<b>Conveyance Number:</b>	9981099		
<b>Conveyance (mm/yy):</b>	8/1997		
<b>PUI:</b>	R070000		
<b>TRA:</b>	61-074		
<b>Taxability Code:</b>	0-00		
<b>ID Data:</b>	Lot 897 MB 031/074 DOS PALMAS TR UNIT 10		

**View Parcel Map**

EXHIBIT NO.     C

RIVERSIDE COUNTY GIS

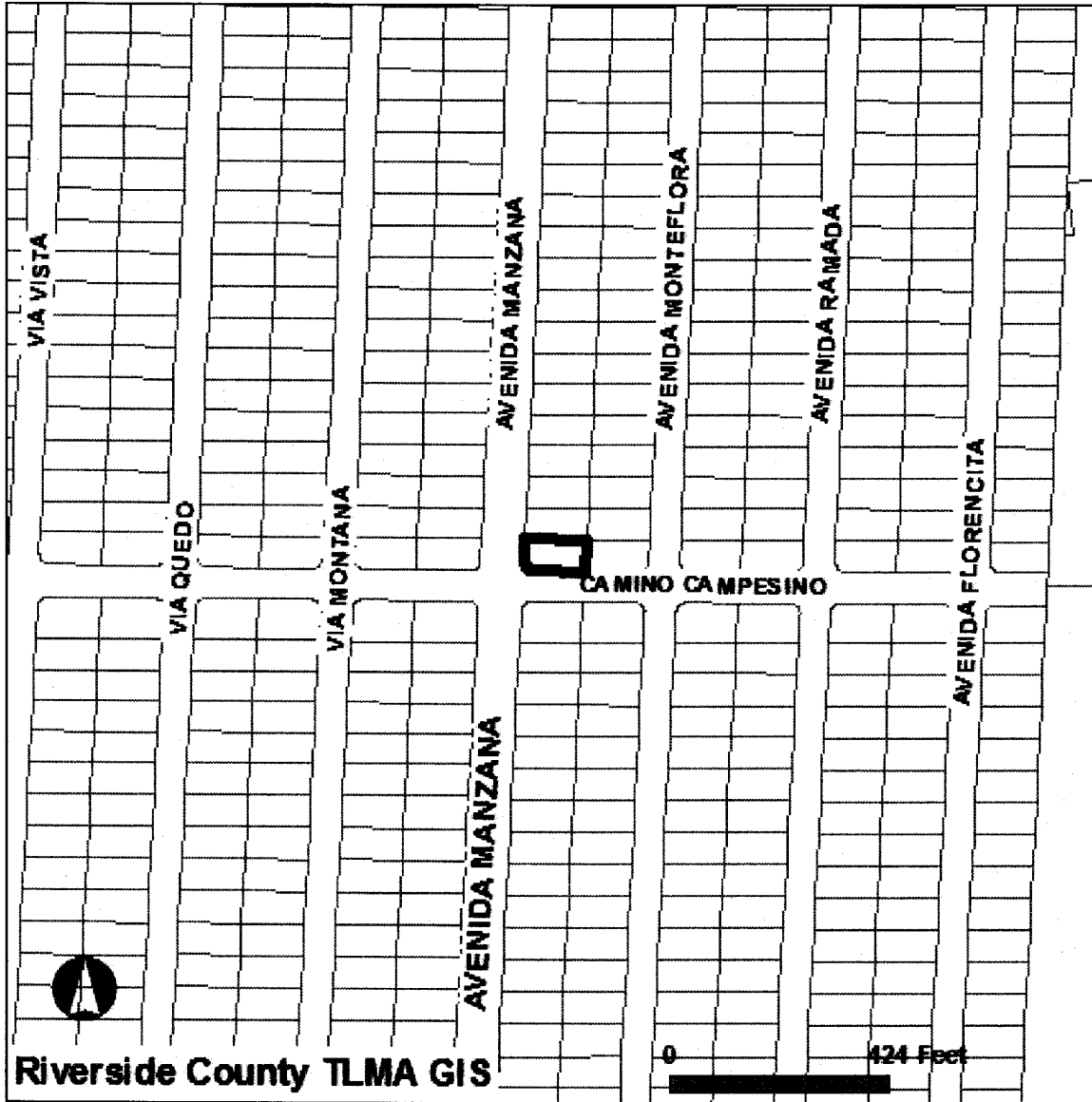

Selected parcel(s):  
656-171-042

**\*IMPORTANT\***

Maps and data are to be used for reference purposes only. Map features are approximate, and are not necessarily accurate to surveying or engineering standards. The County of Riverside makes no warranty or guarantee as to the content (the source is often third party), accuracy, timeliness, or completeness of any of the data provided, and assumes no legal responsibility for the information contained on this map. Any use of this product with respect to accuracy and precision shall be the sole responsibility of the user.

STANDARD REPORT

**APNs**  
656-171-042-0

**OWNER NAME / ADDRESS**  
REYNOLDS ELLA ESTATE OF  
ADDRESS NOT AVAILABLE

**MAILING ADDRESS**  
C/O H A TADOLINI  
9744 E WOOLLEY ST  
TEMPLE CITY CA. 91780

**LEGAL DESCRIPTION**

EXHIBIT NO.     C2

RECORDED BOOK/PAGE: MB 31/74  
SUBDIVISION NAME: DOS PALMAS TR UNIT 10  
LOT/PARCEL: 897, BLOCK: NOT AVAILABLE  
TRACT NUMBER: NOT AVAILABLE

**LOT SIZE**

RECORDED LOT SIZE IS 0.17 ACRES

**PROPERTY CHARACTERISTICS**

NO PROPERTY DESCRIPTION AVAILABLE

**THOMAS BROS. MAPS PAGE/GRID**

PAGE: 697 GRID: A7

**CITY BOUNDARY/SPHERE**

NOT WITHIN A CITY  
CITY SPHERE: DESERT HOT SPRINGS  
ANNEXATION DATE: FEB. 22, 2007  
LAFCO CASE #: 2006-25-4&5  
NO PROPOSALS

**MARCH JOINT POWERS AUTHORITY**

NOT IN THE JURISDICTION OF THE MARCH JOINT POWERS AUTHORITY

**INDIAN TRIBAL LAND**

NOT IN A TRIBAL LAND

**SUPERVISORIAL DISTRICT (ORD. 813)**

MARION ASHLEY, DISTRICT 5

**TOWNSHIP/RANGE**

T3SR5E SEC 5

**ELEVATION RANGE**

861 FEET

**PREVIOUS APN**

NO DATA AVAILABLE

---

**PLANNING**

---

**LAND USE DESIGNATIONS**

Zoning not consistent with the General Plan.  
MDR

**AREA PLAN (RCIP)**

WESTERN COACHELLA VALLEY

**GENERAL PLAN POLICY OVERLAYS**

NOT IN A GENERAL PLAN POLICY OVERLAY AREA

**GENERAL PLAN POLICY AREAS**

NONE

**ZONING CLASSIFICATIONS (ORD. 348)**

W-2

**ZONING DISTRICTS AND ZONING AREAS**

PASS & DESERT DISTRICT

**ZONING OVERLAYS**

NOT IN A ZONING OVERLAY

**SPECIFIC PLANS**

NOT WITHIN A SPECIFIC PLAN

**AGRICULTURAL PRESERVE**

NOT IN AN AGRICULTURAL PRESERVE

**REDEVELOPMENT AREAS**

PROJECT AREA NAME: MCPA  
SUBAREA NAME: GARNET - SUB AREA  
AMENDMENT NUMBER: 0  
ADOPTION DATE: MAY. 13, 2010  
ACREAGE: 2588 ACRES

NOT IN AN AIRPORT INFLUENCE AREA

**AIRPORT COMPATIBILITY ZONES**  
NOT IN AN AIRPORT COMPATIBILITY ZONE

---

## **ENVIRONMENTAL**

---

**CVMSHCP (COACHELLA VALLEY MULTI-SPECIES HABITAT CONSERVATION PLAN) CONSERVATION AREA**  
NOT IN A CONSERVATION AREA

**CVMSHCP FLUVIAL SAND TRANSPORT SPECIAL PROVISION AREAS**  
NOT IN A FLUVIAL SAND TRANSPORT SPECIAL PROVISION AREA

**WRMSHCP (WESTERN RIVERSIDE COUNTY MULTI-SPECIES HABITAT CONSERVATION PLAN) CELL GROUP**  
NOT IN A CELL GROUP

**WRMSHCP CELL NUMBER**  
NOT IN A CELL

**HANS/ERP (HABITAT ACQUISITION AND NEGOTIATION STRATEGY/EXPEDITED REVIEW PROCESS)**  
NONE

**VEGETATION (2005)**  
NO DATA AVAILABLE

---

## **FIRE**

---

**HIGH FIRE AREA (ORD. 787)**  
NOT IN A HIGH FIRE AREA

**FIRE RESPONSIBILITY AREA**  
NOT IN A FIRE RESPONSIBILITY AREA

---

## **DEVELOPMENT FEES**

---

**CVMSHCP FEE AREA (ORD. 875)**  
WITHIN THE COACHELLA VALLEY MSHCP FEE AREA

**WRMSHCP FEE AREA (ORD. 810)**  
NOT WITHIN THE WESTERN RIVERSIDE COUNTY MSHCP FEE AREA

**ROAD & BRIDGE DISTRICT**  
NOT IN A DISTRICT

**EASTERN TUMF (TRANSPORTATION UNIFORM MITIGATION FEE ORD. 673)**  
IN OR PARTIALLY WITHIN A TUMF FEE AREA. SEE MAP FOR MORE INFORMATION.  
IN EAST

**WESTERN TUMF (TRANSPORTATION UNIFORM MITIGATION FEE ORD. 824)**  
NOT WITHIN THE WESTERN TUMF FEE AREA

**DIF (DEVELOPMENT IMPACT FEE AREA ORD. 659)**  
WESTERN COACHELLA VALLEY

**SKR FEE AREA (STEPHEN'S KANGAROO RAT ORD. 663.10)**  
NOT WITHIN AN SKR FEE AREA.

**DEVELOPMENT AGREEMENTS**  
NOT IN A DEVELOPMENT AGREEMENT AREA

---

## **TRANSPORTATION**

---

**CIRCULATION ELEMENT ULTIMATE RIGHT-OF-WAY**  
IN OR PARTIALLY WITHIN A CIRCULATION ELEMENT RIGHT-OF-WAY. SEE MAP FOR MORE INFORMATION. CONTACT MAJEED FARSHED AT (760)863-8267 FOR INFORMATION REGARDING THIS PARCEL IF IT IS IN AN UNINCORPORATED AREA.

**ROAD BOOK PAGE**  
171

NOT IN A TRANSPORTATION AGREEMENT

**CETAP (COMMUNITY AND ENVIRONMENTAL TRANSPORTATION ACCEPTABILITY PROCESS) CORRIDORS**  
NOT IN A CETAP CORRIDOR.

---

## **HYDROLOGY**

---

**FLOOD PLAIN REVIEW**  
NOT REQUIRED.

**WATER DISTRICT**  
DWA

**FLOOD CONTROL DISTRICT**  
RIVERSIDE COUNTY FLOOD CONTROL DISTRICT

**WATERSHED**  
WHITEWATER

---

## **GEOLOGIC**

---

**FAULT ZONE**  
NOT IN A FAULT ZONE

**FAULTS**  
NOT WITHIN A 1/2 MILE OF A FAULT

**LIQUEFACTION POTENTIAL**  
MODERATE

**SUBSIDENCE**  
SUSCEPTIBLE

**PALEONTOLOGICAL SENSITIVITY**  
LOW POTENTIAL.  
FOLLOWING A LITERATURE SEARCH, RECORDS CHECK AND A FIELD SURVEY, AREAS MAY BE DETERMINED BY A QUALIFIED VERTEBRATE PALEONTOLOGIST AS HAVING LOW POTENTIAL FOR CONTAINING SIGNIFICANT PALEONTOLOGICAL RESOURCES SUBJECT TO ADVERSE IMPACTS.

---

## **MISCELLANEOUS**

---

**SCHOOL DISTRICT**  
PALM SPRINGS UNIFIED

**COMMUNITIES**  
SOUTHEAST DESERT HOT SPRINGS

**COUNTY SERVICE AREA**  
NOT IN A COUNTY SERVICE AREA.

**LIGHTING (ORD. 655)**  
NOT APPLICABLE, 45.33 MILES FROM MT. PALOMAR OBSERVATORY

**2000 CENSUS TRACT**  
044506

**FARMLAND**  
URBAN-BUILT UP LAND

**TAX RATE AREAS**  
061-074

- CITRUS PEST CONTROL 2
- COACHELLA VALLEY RESOURCE CONSER
- COUNTY FREE LIBRARY
- COUNTY STRUCTURE FIRE PROTECTION
- COUNTY WASTE RESOURCE MGMT DIST
- CSA 152
- CV MOSQ & VECTOR CONTROL
- DESERT COMMUNITY COLLEGE
- DESERT HOSPITAL
- DESERT WATER AGENCY 5TH FRINGE
- FLOOD CONTROL ADMINISTRATION

- FLOOD CONTROL ZONE 6
- GENERAL
- GENERAL PURPOSE
- MISSION SPRINGS IMP G
- MISSION SPRINGS WATER DISTRICT
- PALM SPRINGS PUBLIC CEMETERY
- PALM SPRINGS UNIF B & I 1992-A
- PALM SPRINGS UNIFIED SCHOOL
- RIV CO REG PARK & OPEN SPACE
- RIV. CO. OFFICE OF EDUCATION

**SPECIAL NOTES**  
NO SPECIAL NOTES

**CODE COMPLAINTS**  
NO CODE COMPLAINTS

REPORT PRINTED ON...Tue Feb 08 10:18:36 2011  
Version 101221





P.O. Box 1193  
 Whittier, CA 90609  
 Tel # (562) 325-8351  
 Fax # (714) 783-3038

## Lot Book Report

Order Number: **23160**

**Customer:**

RIVERSIDE COUNTY TLMA-CODE ENFORCEMENT

4080 Lemon Street

Riverside

CA 92501

Attn: Brent Steele

Reference: CV09-12161 / Angela Sarmiento

IN RE: REYNOLDS, ELLA ESTATE OF

Order Date: 2/16/2011

Dated as of: 2/9/2011

County Name: Riverside

FEE(s):

Report: \$120.00

Property Address: Vacant Land

CA

Assessor's Parcel No. : 656-171-042-0

**Assessments:**

Land Value:	\$984.00
Improvement Value:	\$0.00
Exemption Value:	\$0.00
Total Value:	\$984.00

## Tax Information

Property Taxes for the Fiscal Year	2010-2011
First Installment	\$175.65
Penalty	\$0.00
Status	PAID (PAID THRU 01/31/2011)
Second Installment	\$175.65
Penalty	\$0.00
Status	OPEN NOT-PAID (DUE DATE 04/10/2011)

EXHIBIT NO. \_\_\_\_\_

D



P.O. Box 1193  
Whittier, CA 90609  
Tel # (562) 325-8351  
Fax # (714) 783-3038

Order Number: 23160

Reference: CV09-12161 / Ang

## Property Vesting

The last recorded document transferring title of said property

Dated	06/17/1969
Recorded	07/02/1969
Document No.	67305
D.T.T.	\$3.30
Grantor	Dos Palmas Estates Unit 10
Grantee	Ella Reynolds, a widow

## Deeds of Trust

No Deeds of Trust of Record

## Additional Information

Document Type	Notice of Assessment
Document No.	2004-0559888
Recorded	07/20/2004
Notice of Non-Compliance filed by	County of Riverside Code Enforcement Department
In the matter of the property of	Ella Reynolds
Case No.	CV09-12161
Recorded	02/04/2010
Document No.	2010-0051623

## Legal Description

THE LAND REFERRED TO IN THIS REPORT IS LOCATED IN AND IS DESCRIBED AS FOLLOWS:

LOT 897, DOS PALMAS TRACT UNIT NO. 10, IN THE COUNTY OF RIVERSIDE, STATE OF CALIFORNIA, AS SHOWN BY MAP ON FILE IN BOOK 31, PAGES 74 AND 75, OF MAPS, RECORDS OF THE COUNTY



P.O. Box 1193  
Whittier, CA 90609  
Tel # (562) 325-8351  
Fax # (714) 783-3038

Order Number: 23160

Reference: CV09-12161 / Ang

---

RECORDER OF SAID COUNTY.