

**SUBMITTAL TO THE BOARD OF SUPERVISORS
COUNTY OF RIVERSIDE, STATE OF CALIFORNIA**

906 B



FROM: County Counsel
Code Enforcement Department

SUBMITTAL DATE:
March 17, 2011

SUBJECT: Statement of Expense [Case Nos.: CV05-4324, CV05-4325 & CV06-6286]
Subject Property: 19770 Cooper Road, N. Palm Springs; DURAN
APN: 668-390-065
District Five

RECOMMENDED MOTION: Move that the Board of Supervisors:

- (1) assess the reasonable costs of abatement of a public nuisance (substandard structure, accumulated rubbish and unpermitted land use – storage of shipping container) in the above-referenced matter to be **seven thousand, five hundred twenty-three dollars and fourteen cents (US \$7,523.14)**;
- (2) assess the costs of abatement against the above-described subject property;
- (3) authorize the recordation of a notice of abatement lien; and
- (4) authorize the abatement costs to be added to the tax roll as a special assessment
- (5) authorize and direct the Code Enforcement Department to take any reasonable actions to collect the amount owed.

Raymond M. Mistica

RAYMOND M. MISTICA, Deputy County Counsel
for PAMELA J. WALLS, County Counsel

(Continued)

FINANCIAL DATA	Current F.Y. Total Cost:	\$ N/A	In Current Year Budget:	N/A
	Current F.Y. Net County Cost:	\$ N/A	Budget Adjustment:	N/A
	Annual Net County Cost:	\$ N/A	For Fiscal Year:	N/A

SOURCE OF FUNDS:

Positions To Be Deleted Per A-30	<input type="checkbox"/>
Requires 4/5 Vote	<input type="checkbox"/>

C.E.O. RECOMMENDATION:

APPROVE

BY: *Tina Grande*
Tina Grande

County Executive Office Signature

Consent
 Policy
 Consent
 Policy

MINUTES OF THE BOARD OF SUPERVISORS

On motion of Supervisor Buster, seconded by Supervisor Ashley and duly carried, IT WAS ORDERED that the above matter is approved as recommended.

Ayes: Buster, Stone, Benoit and Ashley
Nays: None
Absent: Tavaglione
Date: March 29, 2011
xc: Co. Co., CED, Prop. Owner

Kecia Harper-Ihem
 Clerk of the Board
 By: *Kecia Harper-Ihem*
 Deputy

Dep't Recomm.:
 Per Exec. Ofc.:

Prev. Agn. Ref.:

District: 5

Agenda Number:

9.5

Statement of Expense [Case Nos. CV05-4324, CV05-4325 & CV06-6286]

Subject Property: 19770 Cooper Road, N. Palm Springs; DURAN

APN: 668-390-065

District: Five

Page 2

BACKGROUND: Government Code § 25845, Riverside County Ordinance Nos. 457 (RCC Title 15), 541 (RCC Chapter 8.120), 348 (RCC Title 17) and 725 (RCC Chapter 1.16) authorize the recovery of abatement costs in public nuisance cases, the recordation of a notice of abatement lien and inclusion of abatement costs on the tax roll as a special assessment upon approval of the Board of Supervisors.

With regard to Case Nos. CV05-4324 & CV05-4325, the Board of Supervisors issued an Order to Abate on Sept. 1, 2009 and recorded on Sept. 2, 2009, as document number 2009-0458330. Subsequently, on or about May 20, 2010, the substandard structure and accumulated rubbish was voluntarily abated from the subject property. Additionally, with regard to Case No. CV06-6286, numerous Notices of Violation and Administrative Citations were issued. Subsequently, on or about May 14, 2010, the shipping container was voluntarily removed from the subject property.

The property has a delinquent tax status as of 2006.

The Notice of Hearing re Statement of Expense has been posted on the property and mailed to the property owner and all interested parties, as required by law. Copies of all relevant notices issued in this matter together with proof of service and posting have been separately filed with the Clerk of the Board and are made a part of the record herein, pursuant to Riverside County Ordinance 725.

**SUBMITTAL TO THE BOARD OF SUPERVISORS
COUNTY OF RIVERSIDE, STATE OF CALIFORNIA**

FROM: County Counsel
Code Enforcement Department
SUBJECT: Statement of Expense [Case Nos. CV05-4324, CV05-4324 & CV06-6286]
Subject Property: 19770 Cooper Road, N. Palm Springs; DURAN
APN: 668-390-065
District Five

**TABLE OF SUPPLEMENTAL DOCUMENTS
FILED WITH THE CLERK OF THE BOARD**

Hearing Date: MARCH 29, 2011

Notice of Statement Expense Hearing (including Proofs of Service, Affidavits of Posting and Return Receipts)	Exhibit A
Statement of Expense Worksheet with Supporting Documents	Exhibit B
Assessment-Roll For The Year 10/11 And Geographic Information System, Feb. 9, 2011	Exhibit C
Lot Book Report	Exhibit D

PAMELA J. WALLS
County Counsel

OFFICE OF COUNTY COUNSEL
COUNTY OF RIVERSIDE



KATHERINE A. LIND
Assistant County Counsel

3960 ORANGE STREET, SUITE 500
RIVERSIDE, CA 92501-3674
TELEPHONE: 951/955-6300
FAX: 951/955-6322 & 951/955-6363

March 9, 2011

NOTICE OF HEARING RE: STATEMENT OF EXPENSE

To: Owner(s) or Interested Parties
(See Attached Proof of Service
and Notice List)

Subject Property: 19770 Cooper Road, N. Palm Springs
Case Nos.: CV05-4324, CV05-4325 & CV06-6286; DURAN
APN: 668-390-065

NOTICE IS HEREBY GIVEN that a hearing will be held before the Riverside County Board of Supervisors on **Tuesday, March 29, 2011 at 9:30 a.m.** in the Board of Supervisors Room, 4080 Lemon Street, 1st Floor Annex, Riverside, California, at which time and place pertinent testimony will be heard regarding the expenses incurred by the County of Riverside, Code Enforcement Department ("DEPARTMENT") for the above-referenced abatement case. Said abatement case involved a substandard structure, accumulated rubbish and unpermitted land use – storage of shipping container located on your real property commonly described as 19770 Cooper Road, N. Palm Springs, Riverside County, California and more particularly described as Assessor's Parcel Number 668-390-065.

The total expense due, including all other fees and costs, for the abatement of the above-described dangerous or injurious condition is **seven thousand, five hundred twenty-three dollars and fourteen cents (US \$7,523.14)**. This amount is immediately due and payable. If you have any objections to the Statement of Expense attached hereto, you must address your objections to the Board of Supervisors at the hearing. If you have any questions about the attached Statement of Expense, please contact the undersigned at (951) 955-6300. In the event the total amount due is not paid to the DEPARTMENT prior to the Board Hearing, the DEPARTMENT shall seek an order from the Board of Supervisors to place a lien against your property and collect the amount due as a special tax assessment.

Failure to appear at the hearing will result in the exclusion of your testimony. Facts as known to the DEPARTMENT will be presented to the Board of Supervisors for their final consideration and deliberation of this matter.

You are encouraged to contact Supervising Code Enforcement Officer, Brian Black (951) 955-2004 prior to the hearing. Please meet with the undersigned or Brian Black at 7:30 a.m. on the day of the hearing in Conference Room 2A located on the 1st floor in front of the Human Resources Office to discuss the case.

PAMELA J. WALLS
County Counsel

Raymond M. Mistica for
L. ALEXANDRA FONG
Deputy County Counsel

Enclosure: Statement of Expense

EXHIBIT NO. A



COUNTY OF RIVERSIDE CODE ENFORCEMENT

P.O. Box 1469, Riverside, CA 92502
Phone: 951-955-2004 Fax: 951-955-8680

Property Reference/Mailing Address
668390065 JUAN G DURAN P O BOX 580941 N.PALM SPRINGS, CA 92255

Summary Statement
As of: 2/1/2011

Date	Invoice Number & Amount	Amount	Balance
01/31/2011	CV054324- INV #100336. Orig. Amount \$4,345.81.	4,345.81	4,345.81
01/31/2011	CV054325- INV #100337. Orig. Amount \$1,154.23.	1,154.23	5,500.04
01/31/2011	CV066286- INV #100339. Orig. Amount \$623.10.	623.10	6,123.14
01/23/2007	CV066286:A15870- INV #11305. Orig. Amount \$100.00. A15870	100.00	6,223.14
10/04/2007	CV066286:A20253- INV #11306. Orig. Amount \$500.00. A20253	500.00	6,723.14
03/12/2007	CV066286:A22153- INV #11307. Orig. Amount \$200.00. A22153	200.00	6,923.14
08/09/2007	CV066286:A23826- INV #11308. Orig. Amount \$500.00. A23826	500.00	7,423.14
06/10/2009	CV066286:A25944- INV #11309. Orig. Amount \$100.00. A25944	100.00	7,523.14
		Balance Due	\$7,523.14

I affirm and declare under penalty of perjury under the laws of the State of California that the foregoing is true and correct.

Code Enforcement Department

EXHIBIT NO. A2



County of Riverside Code Enforcement Department

P.O. Box 1469, Riverside, CA 92502
Phone: (951) 955-2004 Fax: (951) 955-8680
demands@rctlma.org

Statement of Expense

668390065
JUAN G DURAN
P O BOX 580941
N PALM SPRINGS CA. 92255

Date	Invoice #
1/31/2011	100336

Case Number	District	Class
CV054324	5	SOE

Property Address
668390065 JUAN G DURAN 19770 COOPER RD N PALM SPG, CA 92258

Date	Item	Description	Hours/Qty	Rate	Amount
9/19/2005	Officer Hours	Labor Charges - Officer Time	0.3	103.00	30.90
10/27/2005	Officer Hours	Labor Charges - Officer Time	0.4	103.00	41.20
11/29/2005	Officer Hours	Labor Charges - Officer Time	0.3	103.00	30.90
10/11/2006	Officer Hours	Labor Charges - Officer Time	0.1	103.00	10.30
10/11/2006	Officer Hours	Labor Charges - Officer Time	0.1	103.00	10.30
10/11/2006	Officer Hours	Labor Charges - Officer Time	0.1	103.00	10.30
10/26/2006	Officer Hours	Labor Charges - Officer Time	0.2	109.00	21.80
11/6/2006	Officer Hours	Labor Charges - Officer Time	0.3	109.00	32.70
1/23/2007	Officer Hours	Labor Charges - Officer Time	0.3	109.00	32.70
1/24/2007	Officer Hours	Labor Charges - Officer Time	0.6	109.00	65.40
3/12/2007	Officer Hours	Labor Charges - Officer Time	0.1	109.00	10.90
3/13/2007	Officer Hours	Labor Charges - Officer Time	2.5	109.00	272.50
4/10/2007	Officer Hours	Labor Charges - Officer Time	0.1	109.00	10.90
4/12/2007	Officer Hours	Labor Charges - Officer Time	0.4	109.00	43.60
8/2/2007	Officer Hours	Labor Charges - Officer Time	0.8	109.00	87.20
8/27/2007	Officer Hours	Labor Charges - Officer Time	0.2	129.00	25.80
10/2/2007	Officer Hours	Labor Charges - Officer Time	0.6	109.00	65.40
10/4/2007	Officer Hours	Labor Charges - Officer Time	1.8	109.00	196.20
10/4/2007	Officer Hours	Labor Charges - Officer Time	0.2	109.00	21.80
10/9/2007	Officer Hours	Labor Charges - Officer Time	0.5	109.00	54.50
8/21/2008	Officer Hours	Labor Charges - Officer Time	0.1	129.00	12.90
8/21/2008	Officer Hours	Labor Charges - Officer Time	0.1	109.00	10.90
			Subtotal		
			Payments/Credits		
			Total		

I affirm and declare under penalty of perjury under the laws of the State of California that the foregoing is true and correct.

Code Enforcement Department

EXHIBIT NO. A³

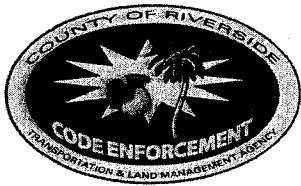

County of Riverside Code Enforcement Department

P.O. Box 1469, Riverside, CA 92502
Phone: (951) 955-2004 Fax: (951) 955-8680
demands@rctlma.org

Statement of Expense

668390065
JUAN G DURAN
P O BOX 580941
N PALM SPRINGS CA. 92255

Date	Invoice #
1/31/2011	100336

Property Address
668390065 JUAN G DURAN 19770 COOPER RD N PALM SPG, CA 92258

Case Number	District	Class
CV054324	5	SOE

Date	Item	Description	Hours/Qty	Rate	Amount
11/5/2008	Officer Hours	Labor Charges - Officer Time	0.2	109.00	21.80
4/1/2009	Officer Hours	Labor Charges - Officer Time	0.1	109.00	10.90
5/26/2009	Officer Hours	Labor Charges - Officer Time	0.1	82.00	8.20
6/19/2009	Officer Hours	Labor Charges - Officer Time	0.1	109.00	10.90
9/28/2009	Officer Hours	Labor Charges - Officer Time	0.1	109.00	10.90
12/11/2009	Officer Hours	Labor Charges - Officer Time	0.2	109.00	21.80
1/16/2010	Officer Hours	Labor Charges - Officer Time	0.1	129.00	12.90
3/16/2010	Officer Hours	Labor Charges - Officer Time	0.1	129.00	12.90
1/31/2011	SOE Preparation	Prepare Statement of Expense		65.00	65.00
		Subtotal Code Enforcement Costs			1,274.40
5/4/2007	Attorney Fees	Attorney Fees - County Counsel	1.1	64.00	70.40
5/7/2007	Attorney Fees	Attorney Fees - County Counsel	2.2	64.00	140.80
5/9/2007	Attorney Fees	Attorney Fees - County Counsel	0.1	64.00	6.40
5/29/2007	Attorney Fees	Attorney Fees - County Counsel	0.3	64.00	19.20
5/30/2007	Attorney Fees	Attorney Fees - County Counsel	0.3	64.00	19.20
7/17/2007	Attorney Fees	Attorney Fees - County Counsel	0.3	64.00	19.20
8/15/2007	Attorney Fees	Attorney Fees - County Counsel	0.4	64.00	25.60
9/5/2007	Attorney Fees	Attorney Fees - County Counsel	0.4	64.00	25.60
9/5/2007	Attorney Fees	Attorney Fees - County Counsel	0.5	128.00	64.00
9/6/2007	Attorney Fees	Attorney Fees - County Counsel	0.2	64.00	12.80
9/10/2007	Attorney Fees	Attorney Fees - County Counsel	1.5	128.00	192.00
				Subtotal	
				Payments/Credits	
				Total	

I affirm and declare under penalty of perjury under the laws of the State of California that the foregoing is true and correct.

 Code Enforcement Department



County of Riverside Code Enforcement Department

P.O. Box 1469, Riverside, CA 92502
Phone: (951) 955-2004 Fax: (951) 955-8680
demands@rctlma.org

Statement of Expense

668390065
JUAN G DURAN
P O BOX 580941
N PALM SPRINGS CA. 92255

Date	Invoice #
1/31/2011	100336

Property Address
668390065 JUAN G DURAN 19770 COOPER RD N PALM SPG, CA 92258

Case Number	District	Class
CV054324	5	SOE

Date	Item	Description	Hours/Qty	Rate	Amount
9/11/2007	Attorney Fees	Attorney Fees - County Counsel	0.4	128.00	51.20
9/18/2007	Attorney Fees	Attorney Fees - County Counsel	0.4	64.00	25.60
9/24/2007	Attorney Fees	Attorney Fees - County Counsel	0.5	64.00	32.00
9/27/2007	Attorney Fees	Attorney Fees - County Counsel	0.2	64.00	12.80
10/1/2007	Attorney Fees	Attorney Fees - County Counsel	0.75	64.00	48.00
10/2/2007	Attorney Fees	Attorney Fees - County Counsel	0.5	64.00	32.00
10/3/2007	Attorney Fees	Attorney Fees - County Counsel	0.3	64.00	19.20
10/4/2007	Attorney Fees	Attorney Fees - County Counsel	0.2	128.00	25.60
10/4/2007	Attorney Fees	Attorney Fees - County Counsel	1.2	64.00	76.80
10/5/2007	Attorney Fees	Attorney Fees - County Counsel	0.2	64.00	12.80
10/9/2007	Attorney Fees	Attorney Fees - County Counsel	0.6	64.00	38.40
1/29/2009	Attorney Fees	Attorney Fees - County Counsel	0.1	69.80	6.98
2/11/2009	Attorney Fees	Attorney Fees - County Counsel	1.8	69.76111	125.57
2/23/2009	Attorney Fees	Attorney Fees - County Counsel	1.3	69.76154	90.69
5/14/2009	Attorney Fees	Attorney Fees - County Counsel	1	139.51	139.51
5/19/2009	Mailing Fees - County Co...	Mailing Fees - County Counsel	10	5.34	53.40
6/10/2009	Attorney Fees	Attorney Fees - County Counsel	0.1	139.50	13.95
6/22/2009	Attorney Fees	Attorney Fees - County Counsel	0.1	139.50	13.95
6/22/2009	Attorney Fees	Attorney Fees - County Counsel	0.4	139.50	55.80
6/25/2009	Attorney Fees	Attorney Fees - County Counsel	0.1	139.50	13.95
7/28/2009	Attorney Fees	Attorney Fees - County Counsel	0.8	139.5125	111.61
9/15/2009	Mailing Fees - County Co...	Mailing Fees - County Counsel	10	5.76	57.60
			Subtotal		
			Payments/Credits		
			Total		

affirm and declare under penalty of perjury under the laws of the State of California that the foregoing is true and correct.

[Signature]

Code Enforcement Department

EXHIBIT NO. AS



County of Riverside Code Enforcement Department

P.O. Box 1469, Riverside, CA 92502
Phone: (951) 955-2004 Fax: (951) 955-8680
demands@rctlma.org

Statement of Expense

668390065
JUAN G DURAN
P O BOX 580941
N PALM SPRINGS CA. 92255

Date	Invoice #
1/31/2011	100336

Property Address
668390065 JUAN G DURAN 19770 COOPER RD N PALM SPG, CA 92258

Case Number	District	Class
CV054324	5	SOE

Date	Item	Description	Hours/Qty	Rate	Amount
1/31/2011	Prepare Case for SOE He... Attend SOE Hearing			125.55 69.75	125.55 69.75 1,847.91
		Subtotal County Counsel Costs			
11/30/2005	Lot/Title Report	Lot/Title Report	1	95.00	95.00
10/11/2007	Lot/Title Report	Lot/Title Report	1	150.00	150.00
10/20/2008	Lot/Title Report	Lot/Title Report	1	60.00	60.00
5/21/2009	Lot/Title Report	Lot/Title Report	1	120.00	120.00
6/17/2010	Asbestos Survey & Abate...	Asbestos Survey & Abatement	1	678.50	678.50
1/31/2011	Lot/Title Report	Lot/Title Report		120.00	120.00
		Subtotal Contractor Costs			1,223.50
				Subtotal	\$4,345.81
				Payments/Credits	\$0.00
				Total	\$4,345.81

I affirm and declare under penalty of perjury under the laws of the State of California that the foregoing is true and correct.

 Code Enforcement Department

EXHIBIT NO. A6



County of Riverside Code Enforcement Department

P.O. Box 1469, Riverside, CA 92502
Phone: (951) 955-2004 Fax: (951) 955-8680
demands@rctlma.org

Statement of Expense

668390065
JUAN G DURAN
P O BOX 580941
N PALM SPRINGS CA. 92255

Date	Invoice #
1/31/2011	100337

Property Address
668390065 JUAN G DURAN 19770 COOPER RD N PALM SPG, CA 92258

Case Number	District	Class
CV054325	5	SOE

Date	Item	Description	Hours/Qty	Rate	Amount
10/27/2005	Officer Hours	Labor Charges - Officer Time	0.4	103.00	41.20
11/29/2005	Officer Hours	Labor Charges - Officer Time	0.3	103.00	30.90
9/29/2006	Officer Hours	Labor Charges - Officer Time	0.6	103.00	61.80
10/11/2006	Officer Hours	Labor Charges - Officer Time	0.1	103.00	10.30
10/11/2006	Officer Hours	Labor Charges - Officer Time	0.1	103.00	10.30
10/11/2006	Officer Hours	Labor Charges - Officer Time	0.1	103.00	10.30
10/26/2006	Officer Hours	Labor Charges - Officer Time	0.2	109.00	21.80
1/23/2007	Officer Hours	Labor Charges - Officer Time	0.3	109.00	32.70
1/24/2007	Officer Hours	Labor Charges - Officer Time	0.6	109.00	65.40
3/12/2007	Officer Hours	Labor Charges - Officer Time	0.1	109.00	10.90
3/13/2007	Officer Hours	Labor Charges - Officer Time	0.4	109.00	43.60
10/4/2007	Officer Hours	Labor Charges - Officer Time	0.5	109.00	54.50
10/4/2007	Officer Hours	Labor Charges - Officer Time	0.2	109.00	21.80
10/9/2007	Officer Hours	Labor Charges - Officer Time	0.4	109.00	43.60
8/21/2008	Officer Hours	Labor Charges - Officer Time	0.1	129.00	12.90
8/21/2008	Officer Hours	Labor Charges - Officer Time	0.1	109.00	10.90
11/5/2008	Officer Hours	Labor Charges - Officer Time	0.2	109.00	21.80
5/26/2009	Officer Hours	Labor Charges - Officer Time	0.1	82.00	8.20
1/16/2010	Officer Hours	Labor Charges - Officer Time	0.1	129.00	12.90
3/24/2010	Officer Hours	Labor Charges - Officer Time	0.2	129.00	25.80
5/19/2010	Officer Hours	Labor Charges - Officer Time	0.1	129.00	12.90
1/31/2011	SOE Preparation	Prepare Statement of Expense		65.00	65.00
			Subtotal		
			Payments/Credits		
			Total		

I affirm and declare under penalty of perjury under the laws of the State of California that the foregoing is true and correct.

Code Enforcement Department

EXHIBIT NO. A7



County of Riverside Code Enforcement Department

P.O. Box 1469, Riverside, CA 92502
Phone: (951) 955-2004 Fax: (951) 955-8680
demands@rctlma.org

Statement of Expense

668390065
JUAN G DURAN
P O BOX 580941
N PALM SPRINGS CA. 92255

Date	Invoice #
1/31/2011	100337

Property Address
668390065 JUAN G DURAN 19770 COOPER RD N PALM SPG, CA 92258

Case Number	District	Class
CV054325	5	SOE

Date	Item	Description	Hours/Qty	Rate	Amount
		Subtotal Code Enforcement Costs			629.50
2/11/2009	Attorney Fees	Attorney Fees - County Counsel	1.6	69.7625	111.62
2/23/2009	Attorney Fees	Attorney Fees - County Counsel	1.1	69.76363	76.74
5/13/2009	Attorney Fees	Attorney Fees - County Counsel	1.4	69.75714	97.66
5/18/2009	Attorney Fees	Attorney Fees - County Counsel	0.1	139.50	13.95
5/18/2009	Attorney Fees	Attorney Fees - County Counsel	0.6	69.76667	41.86
5/20/2009	Attorney Fees	Attorney Fees - County Counsel	0.2	69.75	13.95
6/23/2009	Attorney Fees	Attorney Fees - County Counsel	0.1	139.50	13.95
		Subtotal County Counsel Costs			369.73
2/28/2007	Lot/Title Report	Lot/Title Report	1	95.00	95.00
10/20/2008	Lot/Title Report	Lot/Title Report	1	60.00	60.00
		Subtotal Contractor Costs			155.00
Subtotal					\$1,154.23
Payments/Credits					\$0.00
Total					\$1,154.23

I affirm and declare under penalty of perjury under the laws of the State of California that the foregoing is true and correct.

Code Enforcement Department

EXHIBIT NO. AS



County of Riverside Code Enforcement Department

P.O. Box 1469, Riverside, CA 92502
Phone: (951) 955-2004 Fax: (951) 955-8680
demands@rctlma.org

Statement of Expense

668390065
JUAN G DURAN
P O BOX 580941
N PALM SPRINGS CA. 92255

Date	Invoice #
1/31/2011	100339

Property Address
668390065 JUAN G DURAN 19770 COOPER RD N PALM SPG, CA 92258

Case Number	District	Class
CV066286	5	SOE

Date	Item	Description	Hours/Qty	Rate	Amount
10/11/2006	Officer Hours	Labor Charges - Officer Time	0.2	103.00	20.60
10/11/2006	Officer Hours	Labor Charges - Officer Time	0.2	103.00	20.60
10/11/2006	Officer Hours	Labor Charges - Officer Time	0.5	103.00	51.50
1/23/2007	Officer Hours	Labor Charges - Officer Time	0.3	109.00	32.70
1/24/2007	Officer Hours	Labor Charges - Officer Time	0.7	109.00	76.30
3/13/2007	Officer Hours	Labor Charges - Officer Time	0.4	109.00	43.60
8/9/2007	Officer Hours	Labor Charges - Officer Time	0.1	109.00	10.90
8/9/2007	Officer Hours	Labor Charges - Officer Time	0.1	82.00	8.20
8/13/2007	Officer Hours	Labor Charges - Officer Time	0.5	82.00	41.00
10/4/2007	Officer Hours	Labor Charges - Officer Time	0.2	109.00	21.80
10/4/2007	Officer Hours	Labor Charges - Officer Time	0.5	109.00	54.50
10/9/2007	Officer Hours	Labor Charges - Officer Time	0.3	109.00	32.70
8/21/2008	Officer Hours	Labor Charges - Officer Time	0.1	109.00	10.90
8/21/2008	Officer Hours	Labor Charges - Officer Time	0.1	129.00	12.90
5/27/2009	Officer Hours	Labor Charges - Officer Time	0.4	109.00	43.60
6/10/2009	Officer Hours	Labor Charges - Officer Time	0.3	109.00	32.70
1/8/2010	Officer Hours	Labor Charges - Officer Time	0.3	109.00	32.70
2/9/2010	Officer Hours	Labor Charges - Officer Time	0.1	109.00	10.90
1/31/2011	SOE Preparation	Prepare Statement of Expense		65.00	65.00
		Subtotal Code Enforcement Costs			623.10
Subtotal					\$623.10
Payments/Credits					\$0.00
Total					\$623.10

I affirm and declare under penalty of perjury under the laws of the State of California that the foregoing is true and correct.

 Code Enforcement Department

EXHIBIT NO. A9



County of Riverside Code Enforcement Department

P.O. Box 1469, Riverside, CA 92502
 Phone: (951) 955-2004 Fax: (951) 955-8680
 demands@rctlma.org

Administrative Citation

668390065
 JUAN G DURAN
 P O BOX 580941
 N PALM SPRINGS CA. 92255

Citation Issue Date	Billing Date
1/23/2007	1/31/2011

Property Address
668390065 JUAN G DURAN 19770 COOPER RD N PALM SPG, CA. 92258

Citation Number	District	Class
A15870	5	SOE

Item	Description	Hours/Qty	Rate	Amount
Administrative Citations	A15870--CV066286	1	100.00	100.00
			Subtotal	\$100.00
			Payments/Credits	\$0.00
			Total	\$100.00

EXHIBIT NO. A¹⁰



County of Riverside Code Enforcement Department

P.O. Box 1469, Riverside, CA 92502
Phone: (951) 955-2004 Fax: (951) 955-8680
demands@rctlma.org

Administrative Citation

668390065
JUAN G DURAN
P O BOX 580941
N PALM SPRINGS CA. 92255

Citation Issue Date	Billing Date
10/4/2007	1/31/2011

Property Address
668390065 JUAN G DURAN 19770 COOPER RD N PALM SPG, CA. 92258

Citation Number	District	Class
A20253	5	SOE

Item	Description	Hours/Qty	Rate	Amount
Administrative Citations	A20253--CV066286	1	500.00	500.00

Subtotal	\$500.00
Payments/Credits	\$0.00
Total	\$500.00

EXHIBIT NO. A"



County of Riverside Code Enforcement Department

P.O. Box 1469, Riverside, CA 92502
 Phone: (951) 955-2004 Fax: (951) 955-8680
 demands@rctlma.org

Administrative Citation

668390065
 JUAN DURAN
 P. O BOX 580941
 N PALM SPRINGS, CA 92258

Citation Issue Date	Billing Date
3/12/2007	1/31/2011

Property Address
668390065 JUAN DURAN 19770 COOPER RD N PALM SPG, CA. 92258

Citation Number	District	Class
A22153	5	SOE

Item	Description	Hours/Qty	Rate	Amount
Administrative Citations	A22153--CV066286	1	200.00	200.00

Subtotal	\$200.00
Payments/Credits	\$0.00
Total	\$200.00

EXHIBIT NO. A12



County of Riverside

Code Enforcement Department

P.O. Box 1469, Riverside, CA 92502
 Phone: (951) 955-2004 Fax: (951) 955-8680
 demands@rctlma.org

Administrative Citation

668390065
 JUAN DURAN
 P.O. BOX 580941
 N. PALM SPRINGS, CA 92258

Citation Issue Date	Billing Date
8/9/2007	1/31/2011

Property Address
668390065 JUAN DURAN 19770 COOPER RD N PALM SPG, CA. 92258

Citation Number	District	Class
A23826	5	SOE

Item	Description	Hours/Qty	Rate	Amount
Administrative Citations	A23826--CV066286	1	500.00	500.00
			Subtotal	\$500.00
			Payments/Credits	\$0.00
			Total	\$500.00

EXHIBIT NO. A¹³



County of Riverside Code Enforcement Department

P.O. Box 1469, Riverside, CA 92502
Phone: (951) 955-2004 Fax: (951) 955-8680
demands@rctlma.org

Administrative Citation

668390065
JUAN DURAN
PO Box 580941
N. Palm Springs CA 92255

Citation Issue Date	Billing Date
6/10/2009	1/31/2011

Citation Number	District	Class
A25944	5	SOE

Property Address
668390065 JUAN DURAN 19770 COOPER RD N. PALM SPRINGS, CA 92258

Item	Description	Hours/Qty	Rate	Amount
Administrative Citations	A25944--CV066286	1	100.00	100.00
			Subtotal	\$100.00
			Payments/Credits	\$0.00
			Total	\$100.00

EXHIBIT NO. A14

NOTICE LIST

Subject Property: 19770 Cooper Road, N. Palm Springs; Case Nos.: CV05-4324,
CV05-4325 & CV06-6289; APN: 668-390-065;
District Five

JUAN G DURAN
PO BOX 580941
N PALM SPRINGS CA 92255

JUAN G DURAN
19770 COOPER ROAD
N PALM SPRINGS CA 92258

7010 1670 0001 7232 9103

U.S. Postal Service™ CERTIFIED MAIL™ RECEIPT <small>(Domestic Mail Only; No Insurance Coverage Provided)</small>							
For delivery information visit our website at www.usps.com ®							
OFFICIAL USE							
Postage \$	Mailed 3/9/11						
Certified Fee	2.80						
Return Receipt Fee <small>(Endorsement Required)</small>	2.30						
Restricted Delivery Fee <small>(Endorsement Required)</small>							
Total Postage & Fees \$							
Postmark Here							
<table border="1" style="width: 100%; border-collapse: collapse;"> <tr> <td style="padding: 2px;"><small>Sent To</small></td> <td style="padding: 2px;">JUAN G DURAN</td> </tr> <tr> <td style="padding: 2px;"><small>Street, Ap. or PO Box</small></td> <td style="padding: 2px;">PO BOX 580941</td> </tr> <tr> <td style="padding: 2px;"><small>City, State</small></td> <td style="padding: 2px;">N PALM SPRINGS CA 92255</td> </tr> </table>		<small>Sent To</small>	JUAN G DURAN	<small>Street, Ap. or PO Box</small>	PO BOX 580941	<small>City, State</small>	N PALM SPRINGS CA 92255
<small>Sent To</small>	JUAN G DURAN						
<small>Street, Ap. or PO Box</small>	PO BOX 580941						
<small>City, State</small>	N PALM SPRINGS CA 92255						
PS Form 3800, August 2006 See Reverse for Instructions							

7010 1670 0001 7232 9110

U.S. Postal Service™ CERTIFIED MAIL™ RECEIPT <small>(Domestic Mail Only; No Insurance Coverage Provided)</small>							
For delivery information visit our website at www.usps.com ®							
OFFICIAL USE							
Postage \$	Mailed 3/9/11						
Certified Fee	2.80						
Return Receipt Fee <small>(Endorsement Required)</small>	2.30						
Restricted Delivery Fee <small>(Endorsement Required)</small>							
Total Postage & Fees \$							
Postmark Here							
<table border="1" style="width: 100%; border-collapse: collapse;"> <tr> <td style="padding: 2px;"><small>Sent To</small></td> <td style="padding: 2px;">JUAN G DURAN</td> </tr> <tr> <td style="padding: 2px;"><small>Street, Ap. or PO Box</small></td> <td style="padding: 2px;">19770 COOPER ROAD</td> </tr> <tr> <td style="padding: 2px;"><small>City, State</small></td> <td style="padding: 2px;">N PALM SPRINGS CA 92258</td> </tr> </table>		<small>Sent To</small>	JUAN G DURAN	<small>Street, Ap. or PO Box</small>	19770 COOPER ROAD	<small>City, State</small>	N PALM SPRINGS CA 92258
<small>Sent To</small>	JUAN G DURAN						
<small>Street, Ap. or PO Box</small>	19770 COOPER ROAD						
<small>City, State</small>	N PALM SPRINGS CA 92258						
PS Form 3800, August 2006 See Reverse for Instructions							

EXHIBIT NO. A15

PROOF OF SERVICE

Case Nos. CV05-4324, CV05-4325 & CV06-6286

1
2
3
4
5
6
7
8
9
10
11
12
13
14
15
16
17
18
19
20
21
22
23
24
25
26
27
28

STATE OF CALIFORNIA, COUNTY OF RIVERSIDE

I, Brenda G. Peeler, declare that I am a citizen of the United States and am employed in the County of Riverside, over the age of 18 years and not a party to the within action or proceeding; that my business address is 3960 Orange Street, Suite 500, Riverside, California 92501.

That on March 9, 2011, I served the following document(s):

- NOTICE OF HEARING RE: STATEMENT OF EXPENSE
- SUMMARY STATEMENT & STATEMENT OF EXPENSE

by placing a true copy thereof enclosed in a sealed envelope(s) addressed as follows:

**OWNERS OR INTERESTED PARTIES
(SEE NOTICE LIST ATTACHED TO NOTICE OF HEARING)**

XX **BY CERTIFIED MAIL, RETURN RECEIPT REQUESTED.** I am "readily familiar" with the office's practice of collection and processing correspondence for mailing. Under that practice it would be deposited with the U.S. Postal Service on that same day with postage thereon fully prepaid at Riverside, California, in the ordinary course of business.

___ **BY PERSONAL SERVICE:** I caused to be delivered such envelope(s) by hand to the offices of the addressee(s).

XX **STATE - I declare under penalty of perjury under the laws of the State of California that the above is true and correct.**

___ **FEDERAL - I declare that I am employed in the office of a member of the bar of this court at whose direction the service was made.**

EXECUTED ON March 9, 2011, at Riverside, California.

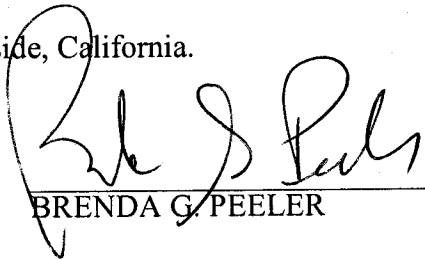

BRENDA G. PEELER

EXHIBIT NO. A16

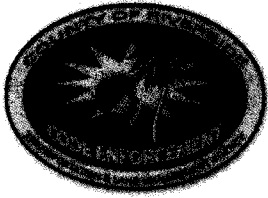

**CODE ENFORCEMENT DEPARTMENT
COUNTY OF RIVERSIDE**

GLENN BAUDE
Director

AFFIDAVIT OF POSTING OF NOTICES

March 11, 2011

RE CASE NO: CV054324

I, Hector Herrera, hereby declare:

I am employed by the Riverside County Code Enforcement Department; that my business address is 31-290 Plantation Drive, Thousand Palms, California 92276 .

That on 03/10/2011 at 1:31 PM, I securely and conspicuously posted Statement of Expense at the property described as:

Property Address: 19770 COOPER RD, N PALM SPG

Assessor's Parcel Number: 668-390-065

I declare under the penalty of perjury that the foregoing is true and correct.

Executed on March 11, 2011 in the County of Riverside, California.

CODE ENFORCEMENT DEPARTMENT

By: Pedro Hernandez for: Hector Herrera, Sr. Code Enforcement Officer

EXHIBIT NO. A17



**CODE ENFORCEMENT DEPARTMENT
COUNTY OF RIVERSIDE**

GLENN BAUDE
Director

AFFIDAVIT OF POSTING OF NOTICES

March 11, 2011

RE CASE NO: CV054325

I, Hector Herrera, hereby declare:

I am employed by the Riverside County Code Enforcement Department; that my business address is 31-290 Plantation Drive, Thousand Palms, California 92276 .

That on 03/10/11 at 1:31 PM, I securely and conspicuously posted Statement of Expense at the property described as:

Property Address: 19770 COOPER RD, N PALM SPG

Assessor's Parcel Number: 668-390-065

I declare under the penalty of perjury that the foregoing is true and correct.

Executed on March 11, 2011 in the County of Riverside, California.

CODE ENFORCEMENT DEPARTMENT

by: Pedro Hernandez for: Hector Herrera, Sr. Code Enforcement Officer

EXHIBIT NO. A18



**CODE ENFORCEMENT DEPARTMENT
COUNTY OF RIVERSIDE**

GLENN BAUDE
Director

AFFIDAVIT OF POSTING OF NOTICES

March 10, 2011

RE CASE NO: CV066286

I, Hector Herrera, hereby declare:

I am employed by the Riverside County Code Enforcement Department; that my business address is 31-290 Plantation Drive, Thousand Palms, California 92276 .

That on 3/10/2011 at 1:31 PM, I securely and conspicuously posted NOTICE OF HEARING RE: STATEMENT OF EXPENSE at the property described as:

Property Address: 19770 COOPER RD, N PALM SPG

Assessor's Parcel Number: 668-390-065

I declare under the penalty of perjury that the foregoing is true and correct.

Executed on March 10, 2011 in the County of Riverside, California.

CODE ENFORCEMENT DEPARTMENT



By: Hector Herrera, Sr. Code Enforcement Officer

EXHIBIT NO. A19



COUNTY OF RIVERSIDE CODE ENFORCEMENT

P.O. Box 1469, Riverside, CA 92502
Phone: 951-955-2004 Fax: 951-955-8680

Property Reference/Mailing Address
668390065 JUAN G DURAN P O BOX 580941 N.PALM SPRINGS, CA 92255

Summary Statement
As of: 2/1/2011

Date	Invoice Number & Amount	Amount	Balance
01/31/2011	CV054324- INV #100336. Orig. Amount \$4,345.81.	4,345.81	4,345.81
01/31/2011	CV054325- INV #100337. Orig. Amount \$1,154.23.	1,154.23	5,500.04
01/31/2011	CV066286- INV #100339. Orig. Amount \$623.10.	623.10	6,123.14
01/23/2007	CV066286:A15870- INV #11305. Orig. Amount \$100.00. A15870	100.00	6,223.14
10/04/2007	CV066286:A20253- INV #11306. Orig. Amount \$500.00. A20253	500.00	6,723.14
03/12/2007	CV066286:A22153- INV #11307. Orig. Amount \$200.00. A22153	200.00	6,923.14
08/09/2007	CV066286:A23826- INV #11308. Orig. Amount \$500.00. A23826	500.00	7,423.14
06/10/2009	CV066286:A25944- INV #11309. Orig. Amount \$100.00. A25944	100.00	7,523.14
		Balance Due	\$7,523.14

I affirm and declare under penalty of perjury under the laws of the State of California that the foregoing is true and correct.



Code Enforcement Department

EXHIBIT NO. B

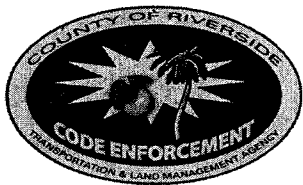

County of Riverside Code Enforcement Department

P.O. Box 1469, Riverside, CA 92502
Phone: (951) 955-2004 Fax: (951) 955-8680
demands@rctlma.org

Statement of Expense

668390065
JUAN G DURAN
P O BOX 580941
N PALM SPRINGS CA. 92255

Date	Invoice #
1/31/2011	100336

Property Address
668390065 JUAN G DURAN 19770 COOPER RD N PALM SPG, CA 92258

Case Number	District	Class
CV054324	5	SOE

Date	Item	Description	Hours/Qty	Rate	Amount
9/19/2005	Officer Hours	Labor Charges - Officer Time	0.3	103.00	30.90
10/27/2005	Officer Hours	Labor Charges - Officer Time	0.4	103.00	41.20
11/29/2005	Officer Hours	Labor Charges - Officer Time	0.3	103.00	30.90
10/11/2006	Officer Hours	Labor Charges - Officer Time	0.1	103.00	10.30
10/11/2006	Officer Hours	Labor Charges - Officer Time	0.1	103.00	10.30
10/11/2006	Officer Hours	Labor Charges - Officer Time	0.1	103.00	10.30
10/26/2006	Officer Hours	Labor Charges - Officer Time	0.2	109.00	21.80
11/6/2006	Officer Hours	Labor Charges - Officer Time	0.3	109.00	32.70
1/23/2007	Officer Hours	Labor Charges - Officer Time	0.3	109.00	32.70
1/24/2007	Officer Hours	Labor Charges - Officer Time	0.6	109.00	65.40
3/12/2007	Officer Hours	Labor Charges - Officer Time	0.1	109.00	10.90
3/13/2007	Officer Hours	Labor Charges - Officer Time	2.5	109.00	272.50
4/10/2007	Officer Hours	Labor Charges - Officer Time	0.1	109.00	10.90
4/12/2007	Officer Hours	Labor Charges - Officer Time	0.4	109.00	43.60
8/2/2007	Officer Hours	Labor Charges - Officer Time	0.8	109.00	87.20
8/27/2007	Officer Hours	Labor Charges - Officer Time	0.2	129.00	25.80
10/2/2007	Officer Hours	Labor Charges - Officer Time	0.6	109.00	65.40
10/4/2007	Officer Hours	Labor Charges - Officer Time	1.8	109.00	196.20
10/4/2007	Officer Hours	Labor Charges - Officer Time	0.2	109.00	21.80
10/9/2007	Officer Hours	Labor Charges - Officer Time	0.5	109.00	54.50
8/21/2008	Officer Hours	Labor Charges - Officer Time	0.1	129.00	12.90
8/21/2008	Officer Hours	Labor Charges - Officer Time	0.1	109.00	10.90
Subtotal					
Payments/Credits					
Total					

I affirm and declare under penalty of perjury under the laws of the State of California that the foregoing is true and correct.

Code Enforcement Department

EXHIBIT NO. B²



County of Riverside Code Enforcement Department

P.O. Box 1469, Riverside, CA 92502
Phone: (951) 955-2004 Fax: (951) 955-8680
demands@rctlma.org

Statement of Expense

668390065
JUAN G DURAN
P O BOX 580941
N PALM SPRINGS CA. 92255

Date	Invoice #
1/31/2011	100336

Property Address
668390065 JUAN G DURAN 19770 COOPER RD N PALM SPG, CA 92258

Case Number	District	Class
CV054324	5	SOE

Date	Item	Description	Hours/Qty	Rate	Amount
11/5/2008	Officer Hours	Labor Charges - Officer Time	0.2	109.00	21.80
4/1/2009	Officer Hours	Labor Charges - Officer Time	0.1	109.00	10.90
5/26/2009	Officer Hours	Labor Charges - Officer Time	0.1	82.00	8.20
6/19/2009	Officer Hours	Labor Charges - Officer Time	0.1	109.00	10.90
9/28/2009	Officer Hours	Labor Charges - Officer Time	0.1	109.00	10.90
12/11/2009	Officer Hours	Labor Charges - Officer Time	0.2	109.00	21.80
1/16/2010	Officer Hours	Labor Charges - Officer Time	0.1	129.00	12.90
3/16/2010	Officer Hours	Labor Charges - Officer Time	0.1	129.00	12.90
1/31/2011	SOE Preparation	Prepare Statement of Expense		65.00	65.00
		Subtotal Code Enforcement Costs			1,274.40
5/4/2007	Attorney Fees	Attorney Fees - County Counsel	1.1	64.00	70.40
5/7/2007	Attorney Fees	Attorney Fees - County Counsel	2.2	64.00	140.80
5/9/2007	Attorney Fees	Attorney Fees - County Counsel	0.1	64.00	6.40
5/29/2007	Attorney Fees	Attorney Fees - County Counsel	0.3	64.00	19.20
5/30/2007	Attorney Fees	Attorney Fees - County Counsel	0.3	64.00	19.20
7/17/2007	Attorney Fees	Attorney Fees - County Counsel	0.3	64.00	19.20
8/15/2007	Attorney Fees	Attorney Fees - County Counsel	0.4	64.00	25.60
9/5/2007	Attorney Fees	Attorney Fees - County Counsel	0.4	64.00	25.60
9/5/2007	Attorney Fees	Attorney Fees - County Counsel	0.5	128.00	64.00
9/6/2007	Attorney Fees	Attorney Fees - County Counsel	0.2	64.00	12.80
9/10/2007	Attorney Fees	Attorney Fees - County Counsel	1.5	128.00	192.00
Subtotal					
Payments/Credits					
Total					

I affirm and declare under penalty of perjury under the laws of the State of California that the foregoing is true and correct.

Code Enforcement Department

EXHIBIT NO. B³



County of Riverside Code Enforcement Department

P.O. Box 1469, Riverside, CA 92502
Phone: (951) 955-2004 Fax: (951) 955-8680
demands@rctlma.org

Statement of Expense

668390065
JUAN G DURAN
P O BOX 580941
N PALM SPRINGS CA. 92255

Date	Invoice #
1/31/2011	100336

Property Address
668390065 JUAN G DURAN 19770 COOPER RD N PALM SPG, CA 92258

Case Number	District	Class
CV054324	5	SOE

Date	Item	Description	Hours/Qty	Rate	Amount
9/11/2007	Attorney Fees	Attorney Fees - County Counsel	0.4	128.00	51.20
9/18/2007	Attorney Fees	Attorney Fees - County Counsel	0.4	64.00	25.60
9/24/2007	Attorney Fees	Attorney Fees - County Counsel	0.5	64.00	32.00
9/27/2007	Attorney Fees	Attorney Fees - County Counsel	0.2	64.00	12.80
10/1/2007	Attorney Fees	Attorney Fees - County Counsel	0.75	64.00	48.00
10/2/2007	Attorney Fees	Attorney Fees - County Counsel	0.5	64.00	32.00
10/3/2007	Attorney Fees	Attorney Fees - County Counsel	0.3	64.00	19.20
10/4/2007	Attorney Fees	Attorney Fees - County Counsel	0.2	128.00	25.60
10/4/2007	Attorney Fees	Attorney Fees - County Counsel	1.2	64.00	76.80
10/5/2007	Attorney Fees	Attorney Fees - County Counsel	0.2	64.00	12.80
10/9/2007	Attorney Fees	Attorney Fees - County Counsel	0.6	64.00	38.40
1/29/2009	Attorney Fees	Attorney Fees - County Counsel	0.1	69.80	6.98
2/11/2009	Attorney Fees	Attorney Fees - County Counsel	1.8	69.76111	125.57
2/23/2009	Attorney Fees	Attorney Fees - County Counsel	1.3	69.76154	90.69
5/14/2009	Attorney Fees	Attorney Fees - County Counsel	1	139.51	139.51
5/19/2009	Mailing Fees - County Co...	Mailing Fees - County Counsel	10	5.34	53.40
6/10/2009	Attorney Fees	Attorney Fees - County Counsel	0.1	139.50	13.95
6/22/2009	Attorney Fees	Attorney Fees - County Counsel	0.1	139.50	13.95
6/22/2009	Attorney Fees	Attorney Fees - County Counsel	0.4	139.50	55.80
6/25/2009	Attorney Fees	Attorney Fees - County Counsel	0.1	139.50	13.95
7/28/2009	Attorney Fees	Attorney Fees - County Counsel	0.8	139.5125	111.61
9/15/2009	Mailing Fees - County Co...	Mailing Fees - County Counsel	10	5.76	57.60
Subtotal					
Payments/Credits					
Total					

I affirm and declare under penalty of perjury under the laws of the State of California that the foregoing is true and correct.

 Code Enforcement Department

EXHIBIT NO. 34

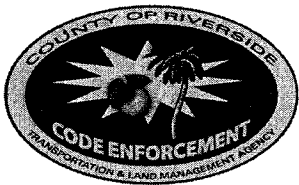

County of Riverside Code Enforcement Department

P.O. Box 1469, Riverside, CA 92502
Phone: (951) 955-2004 Fax: (951) 955-8680
demands@rctlma.org

Statement of Expense

668390065
JUAN G DURAN
P O BOX 580941
N PALM SPRINGS CA. 92255

Date	Invoice #
1/31/2011	100336

Property Address
668390065 JUAN G DURAN 19770 COOPER RD N PALM SPG, CA 92258

Case Number	District	Class
CV054324	5	SOE

Date	Item	Description	Hours/Qty	Rate	Amount
1/31/2011	Prepare Case for SOE He... Attend SOE Hearing			125.55 69.75	125.55 69.75
		Subtotal County Counsel Costs			1,847.91
11/30/2005	Lot/Title Report	Lot/Title Report	1	95.00	95.00
10/11/2007	Lot/Title Report	Lot/Title Report	1	150.00	150.00
10/20/2008	Lot/Title Report	Lot/Title Report	1	60.00	60.00
5/21/2009	Lot/Title Report	Lot/Title Report	1	120.00	120.00
6/17/2010	Asbestos Survey & Abate...	Asbestos Survey & Abatement	1	678.50	678.50
1/31/2011	Lot/Title Report	Lot/Title Report		120.00	120.00
		Subtotal Contractor Costs			1,223.50
			Subtotal		\$4,345.81
			Payments/Credits		\$0.00
			Total		\$4,345.81

I affirm and declare under penalty of perjury under the laws of the State of California that the foregoing is true and correct.

 Code Enforcement Department

EXHIBIT NO. B⁵

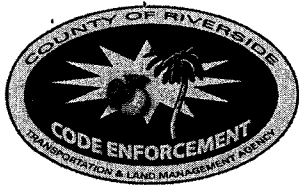

County of Riverside Code Enforcement Department

P.O. Box 1469, Riverside, CA 92502
Phone: (951) 955-2004 Fax: (951) 955-8680
demands@rctlma.org

Statement of Expense

668390065
JUAN G DURAN
P O BOX 580941
N PALM SPRINGS CA. 92255

Date	Invoice #
1/31/2011	100337

Property Address
668390065 JUAN G DURAN 19770 COOPER RD N PALM SPG, CA 92258

Case Number	District	Class
CV054325	5	SOE

Date	Item	Description	Hours/Qty	Rate	Amount
10/27/2005	Officer Hours	Labor Charges - Officer Time	0.4	103.00	41.20
11/29/2005	Officer Hours	Labor Charges - Officer Time	0.3	103.00	30.90
9/29/2006	Officer Hours	Labor Charges - Officer Time	0.6	103.00	61.80
10/11/2006	Officer Hours	Labor Charges - Officer Time	0.1	103.00	10.30
10/11/2006	Officer Hours	Labor Charges - Officer Time	0.1	103.00	10.30
10/11/2006	Officer Hours	Labor Charges - Officer Time	0.1	103.00	10.30
10/26/2006	Officer Hours	Labor Charges - Officer Time	0.2	109.00	21.80
1/23/2007	Officer Hours	Labor Charges - Officer Time	0.3	109.00	32.70
1/24/2007	Officer Hours	Labor Charges - Officer Time	0.6	109.00	65.40
3/12/2007	Officer Hours	Labor Charges - Officer Time	0.1	109.00	10.90
3/13/2007	Officer Hours	Labor Charges - Officer Time	0.4	109.00	43.60
10/4/2007	Officer Hours	Labor Charges - Officer Time	0.5	109.00	54.50
10/4/2007	Officer Hours	Labor Charges - Officer Time	0.2	109.00	21.80
10/9/2007	Officer Hours	Labor Charges - Officer Time	0.4	109.00	43.60
8/21/2008	Officer Hours	Labor Charges - Officer Time	0.1	129.00	12.90
8/21/2008	Officer Hours	Labor Charges - Officer Time	0.1	109.00	10.90
11/5/2008	Officer Hours	Labor Charges - Officer Time	0.2	109.00	21.80
5/26/2009	Officer Hours	Labor Charges - Officer Time	0.1	82.00	8.20
1/16/2010	Officer Hours	Labor Charges - Officer Time	0.1	129.00	12.90
3/24/2010	Officer Hours	Labor Charges - Officer Time	0.2	129.00	25.80
5/19/2010	Officer Hours	Labor Charges - Officer Time	0.1	129.00	12.90
1/31/2011	SOE Preparation	Prepare Statement of Expense		65.00	65.00

Subtotal
Payments/Credits
Total

I affirm and declare under penalty of perjury under the laws of the State of California that the foregoing is true and correct.

Code Enforcement Department

EXHIBIT NO. B⁶



County of Riverside Code Enforcement Department

P.O. Box 1469, Riverside, CA 92502
Phone: (951) 955-2004 Fax: (951) 955-8680
demands@rctlma.org

Statement of Expense

668390065
JUAN G DURAN
P O BOX 580941
N PALM SPRINGS CA. 92255

Date	Invoice #
1/31/2011	100337

Property Address
668390065 JUAN G DURAN 19770 COOPER RD N PALM SPG, CA 92258

Case Number	District	Class
CV054325	5	SOE

Date	Item	Description	Hours/Qty	Rate	Amount
		Subtotal Code Enforcement Costs			629.50
2/11/2009	Attorney Fees	Attorney Fees - County Counsel	1.6	69.7625	111.62
2/23/2009	Attorney Fees	Attorney Fees - County Counsel	1.1	69.76363	76.74
5/13/2009	Attorney Fees	Attorney Fees - County Counsel	1.4	69.75714	97.66
5/18/2009	Attorney Fees	Attorney Fees - County Counsel	0.1	139.50	13.95
5/18/2009	Attorney Fees	Attorney Fees - County Counsel	0.6	69.76667	41.86
5/20/2009	Attorney Fees	Attorney Fees - County Counsel	0.2	69.75	13.95
6/23/2009	Attorney Fees	Attorney Fees - County Counsel	0.1	139.50	13.95
		Subtotal County Counsel Costs			369.73
2/28/2007	Lot/Title Report	Lot/Title Report	1	95.00	95.00
10/20/2008	Lot/Title Report	Lot/Title Report	1	60.00	60.00
		Subtotal Contractor Costs			155.00
Subtotal					\$1,154.23
Payments/Credits					\$0.00
Total					\$1,154.23

I affirm and declare under penalty of perjury under the laws of the State of California that the foregoing is true and correct.

Code Enforcement Department

EXHIBIT NO. B⁷



County of Riverside Code Enforcement Department

P.O. Box 1469, Riverside, CA 92502
Phone: (951) 955-2004 Fax: (951) 955-8680
demands@rctlma.org

Statement of Expense

668390065
JUAN G DURAN
P O BOX 580941
N PALM SPRINGS CA. 92255

Date	Invoice #
1/31/2011	100339

Property Address
668390065 JUAN G DURAN 19770 COOPER RD N PALM SPG, CA 92258

Case Number	District	Class
CV066286	5	SOE

Date	Item	Description	Hours/Qty	Rate	Amount
10/11/2006	Officer Hours	Labor Charges - Officer Time	0.2	103.00	20.60
10/11/2006	Officer Hours	Labor Charges - Officer Time	0.2	103.00	20.60
10/11/2006	Officer Hours	Labor Charges - Officer Time	0.5	103.00	51.50
1/23/2007	Officer Hours	Labor Charges - Officer Time	0.3	109.00	32.70
1/24/2007	Officer Hours	Labor Charges - Officer Time	0.7	109.00	76.30
3/13/2007	Officer Hours	Labor Charges - Officer Time	0.4	109.00	43.60
8/9/2007	Officer Hours	Labor Charges - Officer Time	0.1	109.00	10.90
8/9/2007	Officer Hours	Labor Charges - Officer Time	0.1	82.00	8.20
8/13/2007	Officer Hours	Labor Charges - Officer Time	0.5	82.00	41.00
10/4/2007	Officer Hours	Labor Charges - Officer Time	0.2	109.00	21.80
10/4/2007	Officer Hours	Labor Charges - Officer Time	0.5	109.00	54.50
10/9/2007	Officer Hours	Labor Charges - Officer Time	0.3	109.00	32.70
8/21/2008	Officer Hours	Labor Charges - Officer Time	0.1	109.00	10.90
8/21/2008	Officer Hours	Labor Charges - Officer Time	0.1	129.00	12.90
5/27/2009	Officer Hours	Labor Charges - Officer Time	0.4	109.00	43.60
6/10/2009	Officer Hours	Labor Charges - Officer Time	0.3	109.00	32.70
1/8/2010	Officer Hours	Labor Charges - Officer Time	0.3	109.00	32.70
2/9/2010	Officer Hours	Labor Charges - Officer Time	0.1	109.00	10.90
1/31/2011	SOE Preparation	Prepare Statement of Expense		65.00	65.00
		Subtotal Code Enforcement Costs			623.10
Subtotal					\$623.10
Payments/Credits					\$0.00
Total					\$623.10

I affirm and declare under penalty of perjury under the laws of the State of California that the foregoing is true and correct.

Code Enforcement Department

EXHIBIT NO. B⁸



County of Riverside Code Enforcement Department

P.O. Box 1469, Riverside, CA 92502
Phone: (951) 955-2004 Fax: (951) 955-8680
demands@rctlma.org

Administrative Citation

668390065
JUAN G DURAN
P O BOX 580941
N PALM SPRINGS CA. 92255

Citation Issue Date	Billing Date
1/23/2007	1/31/2011

Citation Number	District	Class
A15870	5	SOE

Property Address
668390065 JUAN G DURAN 19770 COOPER RD N PALM SPG, CA. 92258

Item	Description	Hours/Qty	Rate	Amount
Administrative Citations	A15870--CV066286	1	100.00	100.00

Subtotal	\$100.00
Payments/Credits	\$0.00
Total	\$100.00

EXHIBIT NO. B⁹



County of Riverside Code Enforcement Department

P.O. Box 1469, Riverside, CA 92502
Phone: (951) 955-2004 Fax: (951) 955-8680
demands@rctlma.org

Administrative Citation

668390065
JUAN G DURAN
P O BOX 580941
N PALM SPRINGS CA. 92255

Citation Issue Date	Billing Date
10/4/2007	1/31/2011

Citation Number	District	Class
A20253	5	SOE

Property Address 668390065 JUAN G DURAN 19770 COOPER RD N PALM SPG, CA. 92258

Item	Description	Hours/Qty	Rate	Amount
Administrative Citations	A20253--CV066286	1	500.00	500.00

Subtotal	\$500.00
Payments/Credits	\$0.00
Total	\$500.00

EXHIBIT NO. B¹⁰



County of Riverside Code Enforcement Department

P.O. Box 1469, Riverside, CA 92502
Phone: (951) 955-2004 Fax: (951) 955-8680
demands@rctlma.org

Administrative Citation

668390065
JUAN DURAN
P. O BOX 580941
N PALM SPRINGS, CA 92258

Citation Issue Date	Billing Date
3/12/2007	1/31/2011

Citation Number	District	Class
A22153	5	SOE

Property Address
668390065 JUAN DURAN 19770 COOPER RD N PALM SPG, CA. 92258

Item	Description	Hours/Qty	Rate	Amount
Administrative Citations	A22153--CV066286	1	200.00	200.00
			Subtotal	\$200.00
			Payments/Credits	\$0.00
			Total	\$200.00

EXHIBIT NO. B''

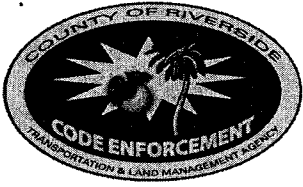

County of Riverside Code Enforcement Department

P.O. Box 1469, Riverside, CA 92502
Phone: (951) 955-2004 Fax: (951) 955-8680
demands@rctlma.org

Administrative Citation

668390065
JUAN DURAN
P.O. BOX 580941
N. PALM SPRINGS, CA 92258

Citation Issue Date	Billing Date
8/9/2007	1/31/2011

Citation Number	District	Class
A23826	5	SOE

Property Address
668390065 JUAN DURAN 19770 COOPER RD N PALM SPG, CA. 92258

Item	Description	Hours/Qty	Rate	Amount
Administrative Citations	A23826--CV066286	1	500.00	500.00
			Subtotal	\$500.00
			Payments/Credits	\$0.00
			Total	\$500.00

EXHIBIT NO. B¹²



County of Riverside Code Enforcement Department

P.O. Box 1469, Riverside, CA 92502
Phone: (951) 955-2004 Fax: (951) 955-8680
demands@rctlma.org

Administrative Citation

668390065
JUAN DURAN
PO Box 580941
N. Palm Springs CA 92255

Citation Issue Date	Billing Date
6/10/2009	1/31/2011

Citation Number	District	Class
A25944	5	SOE

Property Address
668390065 JUAN DURAN 19770 COOPER RD N. PALM SPRINGS, CA 92258

Item	Description	Hours/Qty	Rate	Amount
Administrative Citations	A25944--CV066286	1	100.00	100.00

Subtotal	\$100.00
Payments/Credits	\$0.00
Total	\$100.00

EXHIBIT NO. B¹³

Expenditure Transactions

Criteria: Post On = 7/1/2002...1/31/2011

Journal Date	Journal ID	Fund	Department	Account	Program	Project	Class	Amount	Description	Operator
Fund 10000 -- General Fund										
Account 525440 -- Professional Services										
5/1/2006	AP00953731	10000	3110200000	525440		ZCV054324		95.00	REPORTS ON PARCELS/LOTS	E213106
12/8/2007	AP01179930	10000	3140100000	525440		ZCV054324		150.00	REPORTS ON PARCELS/LOTS INV 44	E129381
1/17/2008	AP01188689	10000	3140100000	525440		ZCV054324		150.00	PROFESSIONAL SERVICES	E221244
11/17/2008	AP01266449	10000	3140100000	525440		ZCV054324		60.00	PARTIES OF INTEREST REPORTS	E148473
6/23/2009	AP01315924	10000	3140100000	525440		ZCV054324		120.00	PARTIES OF INTEREST REPORTS IN	E148473
6/17/2010	0001385634	10000	3140100000	525440		ZCV054324		678.50	IH INVOICE #96692	E205333
Total Professional Services								1,253.50		
Total General Fund								1,253.50		

B¹⁴

EXHIBIT NO. _____

Expenditure Transactions

Criteria: Post On = 7/1/2002..1/31/2011

Journal Date	Journal ID	Fund	Department	Account	Program	Project	Class	Amount	Description	Operator
Fund 10000 -- General Fund										
Account 525440 -- Professional Services										
4/6/2007	AP01112776	10000	3110200000	525440		ZCV054325		95.00	REPORTS ON PARCELS/LOTS	E129381
11/17/2008	AP01266449	10000	3140100000	525440		ZCV054325		60.00	PARTIES OF INTEREST REPORTS	E148473
Total Professional Services								155.00		
Total General Fund								155.00		

EXHIBIT NO. 315



INVOICE

Order Number: 23183 **Order Date:** 2/28/2011

Customer Information:

Acct No. 1044

RIVERSIDE COUNTY TLMA-CODE INFORCEMENT
4080 Lemon Street
Riverside, CA 92501

Attn: Brent Steele
REF: CV06-6286 & CV05-4325 & CV05-4324
IN RE: DURAN, JUAN G.

Product and/or Service ordered for Property known as:	
19770 Cooper Road North Palm Springs, CA 92258	
DESCRIPTION: Lot Book Report	FEE: \$120.00
TOTAL DUE:	\$120.00

Payment due upon receipt. Please remit to:

RZ Title Services, Inc.
P.O. Box 1193
Whittier, CA 90609

EXHIBIT NO. B¹⁶

Assessment Roll For the 2010-2011 Tax Year as of January 1,2010

Assessment #668390065-5		Parcel # 668390065-5	
Assessee:	DURAN JUAN G	Land	9,000
Mail Address:	P O BOX 580941	Structure	25,000
City, State Zip:	N PALM SPRINGS CA 92255	Full Value	34,000
Real Property Use Code:	R1	Total Net	34,000
Base Year	2006		
Conveyance Number:	0763035		
Conveyance (mm/yy):	9/2005		
PUI:	R010012		
TRA:	61-081		
Taxability Code:	0-00		
ID Data:	SEE ASSESSOR MAPS		
Situs Address:	19770 COOPER RD N PALM SPG CA 92258		

View Parcel Map

EXHIBIT NO. C

RIVERSIDE COUNTY GIS

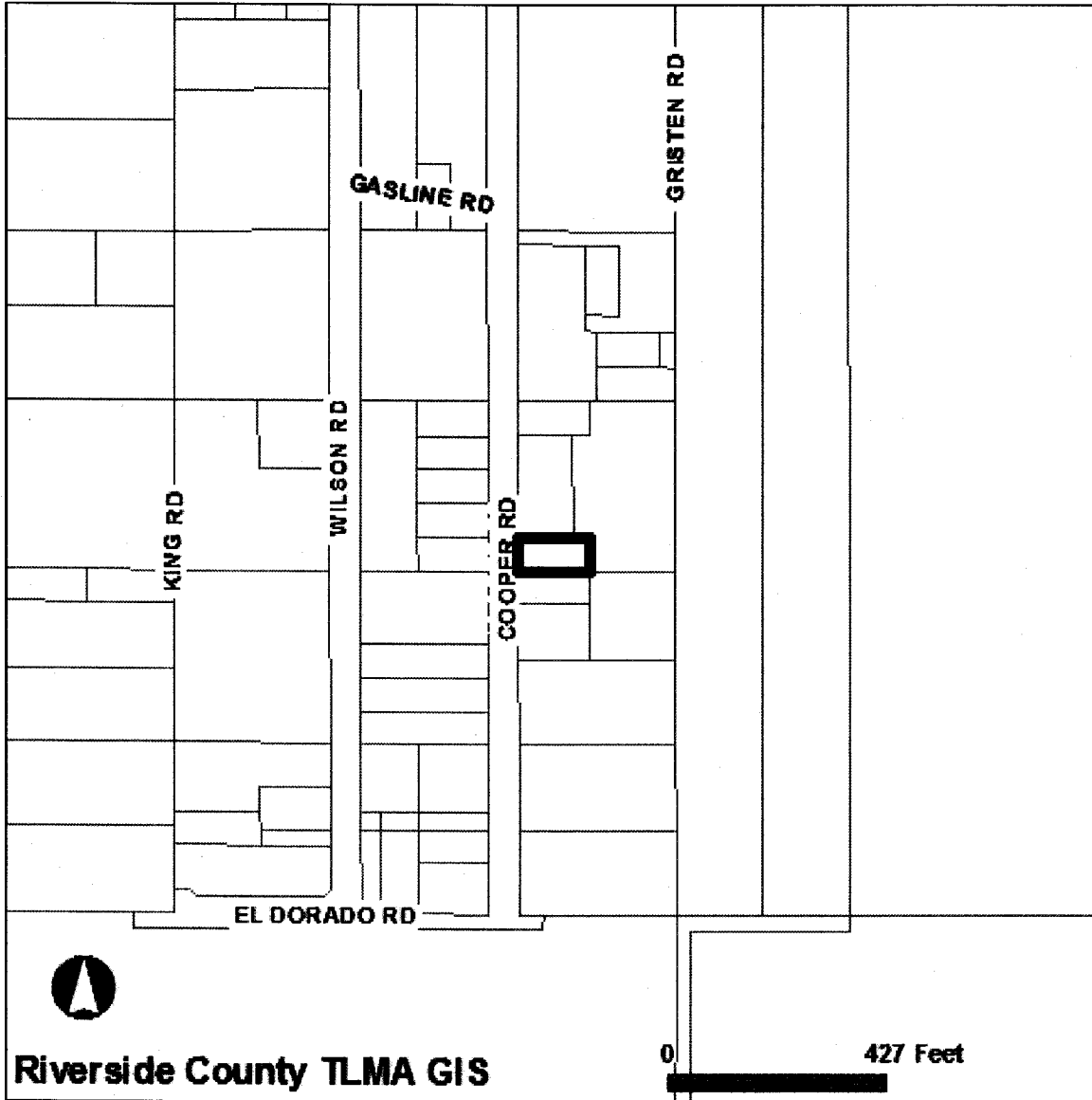

Selected parcel(s):
668-390-065

IMPORTANT

Maps and data are to be used for reference purposes only. Map features are approximate, and are not necessarily accurate to surveying or engineering standards. The County of Riverside makes no warranty or guarantee as to the content (the source is often third party), accuracy, timeliness, or completeness of any of the data provided, and assumes no legal responsibility for the information contained on this map. Any use of this product with respect to accuracy and precision shall be the sole responsibility of the user.

STANDARD REPORT

APNs

668-390-065-5

OWNER NAME / ADDRESS

JUAN G DURAN
19770 COOPER RD
N PALM SPG, CA. 92258

MAILING ADDRESS

(SEE OWNER)
P O BOX 580941
N PALM SPRINGS CA. 92255

EXHIBIT NO. _____ *C2*

LEGAL DESCRIPTION

LEGAL DESCRIPTION IS NOT AVAILABLE

LOT SIZE

RECORDED LOT SIZE IS 0.21 ACRES

PROPERTY CHARACTERISTICS

WOOD FRAME, 549 SQFT., 1 BDRM/ 0.75 BATH, 1 STORY, CONST'D 1946COMPOSITION, ROOF

THOMAS BROS. MAPS PAGE/GRID

PAGE: 725 GRID: J5

CITY BOUNDARY/SPHERE

NOT WITHIN A CITY

CITY SPHERE: PALM SPRINGS

ANNEXATION DATE: FEB. 22, 2007

LAFCO CASE #: 2006-26-4&5

NO PROPOSALS

MARCH JOINT POWERS AUTHORITY

NOT IN THE JURISDICTION OF THE MARCH JOINT POWERS AUTHORITY

INDIAN TRIBAL LAND

NOT IN A TRIBAL LAND

SUPERVISORIAL DISTRICT (ORD. 813)

MARION ASHLEY, DISTRICT 5

TOWNSHIP/RANGE

T3SR4E SEC 17

ELEVATION RANGE

868/868 FEET

PREVIOUS APN

668-390-009

PLANNING

LAND USE DESIGNATIONS

Zoning not consistent with the General Plan.

LDR

AREA PLAN (RCIP)

WESTERN COACHELLA VALLEY

GENERAL PLAN POLICY OVERLAYS

NOT IN A GENERAL PLAN POLICY OVERLAY AREA

GENERAL PLAN POLICY AREAS

SAN GORGONIO PASS WIND ENERGY POLICY AREA

ZONING CLASSIFICATIONS (ORD. 348)

W-2

ZONING DISTRICTS AND ZONING AREAS

PASS & DESERT DISTRICT

ZONING OVERLAYS

NOT IN A ZONING OVERLAY

SPECIFIC PLANS

NOT WITHIN A SPECIFIC PLAN

AGRICULTURAL PRESERVE

NOT IN AN AGRICULTURAL PRESERVE

REDEVELOPMENT AREAS

PROJECT AREA NAME: MCPA

SUBAREA NAME: WEST GARNET

AMENDMENT NUMBER: 0

ADOPTION DATE: DEC. 23, 1986

ACREAGE: 119 ACRES

AIRPORT INFLUENCE AREAS

NOT IN AN AIRPORT INFLUENCE AREA

AIRPORT COMPATIBILITY ZONES
NOT IN AN AIRPORT COMPATIBILITY ZONE

ENVIRONMENTAL

CVMSHCP (COACHELLA VALLEY MULTI-SPECIES HABITAT CONSERVATION PLAN) CONSERVATION AREA
NOT IN A CONSERVATION AREA

CVMSHCP FLUVIAL SAND TRANSPORT SPECIAL PROVISION AREAS
NOT IN A FLUVIAL SAND TRANSPORT SPECIAL PROVISION AREA

WRMSHCP (WESTERN RIVERSIDE COUNTY MULTI-SPECIES HABITAT CONSERVATION PLAN) CELL GROUP
NOT IN A CELL GROUP

WRMSHCP CELL NUMBER
NOT IN A CELL

HANS/ERP (HABITAT ACQUISITION AND NEGOTIATION STRATEGY/EXPEDITED REVIEW PROCESS)
NONE

VEGETATION (2005)
NO DATA AVAILABLE

FIRE

HIGH FIRE AREA (ORD. 787)
NOT IN A HIGH FIRE AREA

FIRE RESPONSIBILITY AREA
NOT IN A FIRE RESPONSIBILITY AREA

DEVELOPMENT FEES

CVMSHCP FEE AREA (ORD. 875)
WITHIN THE COACHELLA VALLEY MSHCP FEE AREA

WRMSHCP FEE AREA (ORD. 810)
NOT WITHIN THE WESTERN RIVERSIDE COUNTY MSHCP FEE AREA

ROAD & BRIDGE DISTRICT
NOT IN A DISTRICT

EASTERN TUMF (TRANSPORTATION UNIFORM MITIGATION FEE ORD. 673)
IN OR PARTIALLY WITHIN A TUMF FEE AREA. SEE MAP FOR MORE INFORMATION.
In EAST

WESTERN TUMF (TRANSPORTATION UNIFORM MITIGATION FEE ORD. 824)
NOT WITHIN THE WESTERN TUMF FEE AREA

DIF (DEVELOPMENT IMPACT FEE AREA ORD. 659)
WESTERN COACHELLA VALLEY

SKR FEE AREA (STEPHEN'S KANGAROO RAT ORD. 663.10)
NOT WITHIN AN SKR FEE AREA.

DEVELOPMENT AGREEMENTS
NOT IN A DEVELOPMENT AGREEMENT AREA

TRANSPORTATION

CIRCULATION ELEMENT ULTIMATE RIGHT-OF-WAY
NOT IN A CIRCULATION ELEMENT RIGHT-OF-WAY

ROAD BOOK PAGE
169

TRANSPORTATION AGREEMENTS

NOT IN A TRANSPORTATION AGREEMENT

CETAP (COMMUNITY AND ENVIRONMENTAL TRANSPORTATION ACCEPTABILITY PROCESS) CORRIDORS
NOT IN A CETAP CORRIDOR.

HYDROLOGY

FLOOD PLAIN REVIEW
NOT REQUIRED.

WATER DISTRICT
DWA

FLOOD CONTROL DISTRICT
RIVERSIDE COUNTY FLOOD CONTROL DISTRICT

WATERSHED
WHITEWATER

GEOLOGIC

FAULT ZONE
COUNTY FAULT ZONE
CONTACT THE COUNTY'S CHIEF ENGINEERING GEOLOGIST AT (951)955-6863.

FAULTS
WITHIN A 1/2 MILE OF
GARNET HILL FAULT
CONTACT THE COUNTY'S CHIEF ENGINEERING GEOLOGIST AT (951)955-6863.

LIQUEFACTION POTENTIAL
MODERATE

SUBSIDENCE
SUSCEPTIBLE

PALEONTOLOGICAL SENSITIVITY
LOW POTENTIAL.
FOLLOWING A LITERATURE SEARCH, RECORDS CHECK AND A FIELD SURVEY, AREAS MAY BE DETERMINED BY A QUALIFIED VERTEBRATE PALEONTOLOGIST AS HAVING LOW POTENTIAL FOR CONTAINING SIGNIFICANT PALEONTOLOGICAL RESOURCES SUBJECT TO ADVERSE IMPACTS.

MISCELLANEOUS

SCHOOL DISTRICT
PALM SPRINGS UNIFIED

COMMUNITIES
GARNET

COUNTY SERVICE AREA
NOT IN A COUNTY SERVICE AREA.

LIGHTING (ORD. 655)
ZONE B, 41.09 MILES FROM MT. PALOMAR OBSERVATORY

2000 CENSUS TRACT
044503

FARMLAND
OTHER LANDS

TAX RATE AREAS
061-081
• CITRUS PEST CONTROL 2
• COACHELLA VALLEY RESOURCE CONSER
• COUNTY FREE LIBRARY
• COUNTY STRUCTURE FIRE PROTECTION
• COUNTY WASTE RESOURCE MGMT DIST
• CSA 152
• CV MOSQ & VECTOR CONTROL
• DESERT COMMUNITY COLLEGE

- DESERT HOSPITAL
- DESERT WATER AGENCY 6TH FRINGE
- FLOOD CONTROL ADMINISTRATION
- FLOOD CONTROL ZONE 6
- GENERAL
- GENERAL PURPOSE
- MISSION SPRINGS IMP 2
- MISSION SPRINGS WATER DISTRICT
- PALM SPRINGS PUBLIC CEMETERY
- PALM SPRINGS UNIF B & I 1992-A
- PALM SPRINGS UNIFIED SCHOOL
- PROJECT 3-WEST GARNET
- RIV CO REG PARK & OPEN SPACE
- RIV. CO. OFFICE OF EDUCATION

SPECIAL NOTES

NO SPECIAL NOTES

CODE COMPLAINTS

NO CODE COMPLAINTS

REPORT PRINTED ON...Wed Feb 09 10:42:51 2011
Version 101221



P.O. Box 1193
 Whittier, CA 90609
 Tel # (562) 325-8351
 Fax # (714) 783-3038

Lot Book Report

Order Number: **23183**

Customer:

RIVERSIDE COUNTY TLMA-CODE INFORCEMENT
 4080 Lemon Street
 Riverside CA 92501

Order Date: 2/28/2011
 Dated as of: 2/18/2011
 County Name: Riverside

Attn: Brent Steele
 Reference: CV06-6286 & CV05-4325 & CV05-4324
 IN RE: DURAN, JUAN G.

FEE(s):
 Report: \$120.00

Property Address: 19770 Cooper Road
 North Palm Springs CA 92258

Assessor's Parcel No. : 668-390-065

Assessments:

Land Value:	\$9,000.00
Improvement Value:	\$25,000.00
Exemption Value:	\$0.00
Total Value:	\$34,000.00

Tax Information

Property Taxes for the Fiscal Year	2010-2011
First Installment	\$214.36
Penalty	\$21.43
Status	NOT PAID-DELINQUENT
Second Installment	\$214.36
Penalty	\$0.00
Status	OPEN NOT-PAID (DUE DATE 04/10/2011)

Supplemental Property Tax Assessment for the	
Fiscal Year	2004
Bill Number	052320285-9

EXHIBIT NO. D



P.O. Box 1193
Whittier, CA 90609
Tel # (562) 325-8351
Fax # (714) 783-3038

Order Number: 23183

Reference: CV06-6286 & CV0

First Installment	\$142.86
Penalty	\$14.29
Due Date	05/31/2006
Status	NOT PAID-DELINQUENT
Second Installment	\$0.00
Penalty	\$0.00
Due Date	09/30/2006
Status	NO TAXES DUE
Prior Delinquencies for tax defaulted year(s)	2005-2009 and 2005 Supplemental Bill # 052375884-0
Redemption Amount	\$5,328.95
If paid by	03/31/2011

Property Vesting

The last recorded document transferring title of said property

Dated	08/30/2005
Recorded	09/15/2005
Document No.	2005-0763035
D.T.T.	\$60.50
Grantor	Neighborhood Choice Dynamic Realty, Inc., a California Corporation
Grantee	Juan G. Duran, a single man

Deeds of Trust

No Deeds of Trust of Record



P.O. Box 1193
Whittier, CA 90609
Tel # (562) 325-8351
Fax # (714) 783-3038

Order Number: 23183

Reference: CV06-6286 & CV0

Additional Information

Notice of Non-Compliance filed by	County of Riverside Department of Building and Safety
In the matter of the property of	Juan G. Duran
Case No.	CV05-4324 and CV05-4325
Recorded	03/01/2006
Document No.	2006-0151166
A Notice of Lien Recorded	06/26/2006
Document No.	2006-0458874
Amount	\$50.08
Owner	Juan Duran
Claimant	Mission Springs Water District
Document Type	Finding of Fact, Conclusions and Order to Abate Nuisance
Document No.	2009-0458330
Recorded	09/02/2009
Abstract of Judgment Filed in the	Superior Court of California, County of Riverside, Civil Division Temecula Court
Case No.	RIC428201
Recorded	09/05/2006
Document No.	2006-0653685
Amount	\$8,199.31
Debtor	Joe Duran
Creditor	Daimlerchrysler Services North America, LLC
Abstract of Judgment Filed in the	Superior Court of California, County of Sacramento, Limited Civil
Case No.	06ED33173
Recorded	10/06/2006
Document No.	2006-0740600
Amount	\$2,328.20
Debtor	Juan G. Duran



P.O. Box 1193
Whittier, CA 90609
Tel # (562) 325-8351
Fax # (714) 783-3038

Order Number: 23183

Reference: CV06-6286 & CV0

Creditor	State of California Employment Development Department
Abstract of Judgment Filed in the	Superior Court of California, County of Riverside, Larson Justice Center
Case No.	INC086177
Recorded	08/12/2010
Document No.	2010-0380774
Amount	\$8,721.11
Debtor	Juan Duran
Creditor	GCFS, Inc., a California Corporation

Legal Description

THE LAND REFERRED TO IN THIS REPORT IS LOCATED IN AND IS DESCRIBED AS FOLLOWS:

THAT PORTION OF THE SOUTH HALF OF THE NORTH HALF OF THE EAST HALF OF THE EAST HALF OF THE SOUTHWEST QUARTER OF THE SOUTHEAST QUARTER OF SECTION 17, TOWNSHIP 5 SOUTH, RANGE 4 EAST, SAN BERNARDINO BASE AND MERIDIAN, ACCORDING TO THE OFFICIAL PLAT THEREOF, DESCRIBED AS FOLLOWS:

BEGINNING AT A POINT AT THE SOUTHWESTERLLY CORNER OF SAID SOUTH HALF; THENCE NORTH 66 FEET; THENCE EAST 165 FEET; THENCE SOUTH 66 FEET; THENCE WEST TO THE POINT OF BEGINNING.