

**SUBMITTAL TO THE BOARD OF SUPERVISORS
COUNTY OF RIVERSIDE, STATE OF CALIFORNIA**

9103



FROM: County Counsel
Code Enforcement Department

SUBMITTAL DATE:
March 17, 2011

SUBJECT: Statement of Expense [Case No. CV08-10056]
Subject Property: 17211 Covey Street, N. Palm Springs; SCHWARTZ
APN: 666-201-012
District Five

RECOMMENDED MOTION: Move that the Board of Supervisors:

- (1) assess the reasonable costs of abatement of a public nuisance (excess outside storage of materials and accumulated rubbish) in the above-referenced matter to be **one thousand, one hundred ninety-four dollars and forty cents (US \$1,194.40)**;
- (2) assess the costs of abatement against the above-described subject property;
- (3) authorize the recordation of a notice of abatement lien; and
- (4) authorize the abatement costs to be added to the tax roll as a special assessment
- (5) authorize and direct the Code Enforcement Department to take any reasonable actions to collect the amount owed.

Raymond M. Mistica

RAYMOND M. MISTICA, Deputy County Counsel
for PAMELA J. WALLS, County Counsel

(Continued)

FINANCIAL DATA	Current F.Y. Total Cost:	\$ N/A	In Current Year Budget:	N/A
	Current F.Y. Net County Cost:	\$ N/A	Budget Adjustment:	N/A
	Annual Net County Cost:	\$ N/A	For Fiscal Year:	N/A

SOURCE OF FUNDS:	Positions To Be Deleted Per A-30	<input type="checkbox"/>
	Requires 4/5 Vote	<input type="checkbox"/>

C.E.O. RECOMMENDATION: APPROVE

BY: *Tina Grande*
Tina Grande

County Executive Office Signature

- Consent
- Policy
- Consent
- Policy

MINUTES OF THE BOARD OF SUPERVISORS

On motion of Supervisor Buster, seconded by Supervisor Ashley and duly carried, IT WAS ORDERED that the above matter is approved as recommended.

Ayes: Buster, Stone, Benoit and Ashley
Nays: None
Absent: Tavaglione
Date: March 29, 2011
xc: Co. Co., CED, Prop. Owner

Kecia Harper-Ihem
Clerk of the Board
By: *[Signature]*
Deputy

Prev. Agn. Ref.: | **District:** 5 | **Agenda Number:**

9.7

Statement of Expense [Case No. CV08-10056]

Subject Property: 17211 Covey Street, N. Palm Springs; SCHWARTZ

APN: 666-201-012

District: Five

Page 2

BACKGROUND: Government Code § 25845, Riverside County Ordinance Nos. 348 (RCC Title 17), 541(RCC Chapter 8.120) and 725 (RCC Chapter 1.16) authorize the recovery of abatement costs in public nuisance cases, the recordation of a notice of abatement lien and inclusion of abatement costs on the tax roll as a special assessment upon approval of the Board of Supervisors.

Notice of Violation were issued regarding the above-referenced violations. Additionally, the Board of Supervisors issued an Order to Abate in this case on Feb. 9, 2010 and recorded on Feb. 11, 2011, as document number 2010-0065342. Subsequently, on or about July 26, 2010, the case was closed as significant compliance was achieved.

The Notice of Hearing re Statement of Expense has been posted on the property and mailed to the property owner and all interested parties, as required by law. Copies of all relevant notices issued in this matter together with proof of service and posting have been separately filed with the Clerk of the Board and are made a part of the record herein, pursuant to Riverside County Ordinance 725.

**SUBMITTAL TO THE BOARD OF SUPERVISORS
COUNTY OF RIVERSIDE, STATE OF CALIFORNIA**

FROM: County Counsel
Code Enforcement Department
SUBJECT: Statement of Expense [Case No. CV08-10056]
Subject Property: 17211 Covey St., N. Palm Springs; SCHWARTZ
APN: 666-201-012
District Five

**TABLE OF SUPPLEMENTAL DOCUMENTS
FILED WITH THE CLERK OF THE BOARD**

Hearing Date: MARCH 29, 2011

Notice of Statement Expense Hearing (including Proofs of Service, Affidavits of Posting and Return Receipts)	Exhibit A
Statement of Expense Worksheet with Supporting Documents	Exhibit B
Assessment-Roll For The Year 10/11 And Geographic Information System, Feb. 8, 2011	Exhibit C
Lot Book Report	Exhibit D

PAMELA J. WALLS
County Counsel

OFFICE OF COUNTY COUNSEL
COUNTY OF RIVERSIDE



KATHERINE A. LIND
Assistant County Counsel

3960 ORANGE STREET, SUITE 500
RIVERSIDE, CA 92501-3674
TELEPHONE: 951/955-6300
FAX: 951/955-6322 & 951/955-6363

March 9, 2011

NOTICE OF HEARING RE: STATEMENT OF EXPENSE

To: Owner(s) or Interested Parties
(See Attached Proof of Service
and Notice List)

Subject Property: 17211 Covey Street, N. Palm Springs
Case No.: CV08-10056; SCHWARTZ
APN: 666-201-012

NOTICE IS HEREBY GIVEN that a hearing will be held before the Riverside County Board of Supervisors on **Tuesday, March 29, 2011, at 9:30 a.m.** in the Board of Supervisors Room, 4080 Lemon Street, 1st Floor Annex, Riverside, California, at which time and place pertinent testimony will be heard regarding the expenses incurred by the County of Riverside, Code Enforcement Department ("DEPARTMENT") for the above-referenced abatement case. Said abatement case involved excessive outside storage and accumulated rubbish located on your real property commonly described as 17211 Covey Street, N. Palm Springs, Riverside County, California and more particularly described as Assessor's Parcel Number 666-201-012.

The total expense due, including all other fees and costs, for the abatement of the above-described dangerous or injurious condition is **one thousand, one hundred ninety-four dollars and forty cents (US \$1,194.40)**. This amount is immediately due and payable. If you have any objections to the Statement of Expense attached hereto, you must address your objections to the Board of Supervisors at the hearing. If you have any questions about the attached Statement of Expense, please contact the undersigned at (951) 955-6300. In the event the total amount due is not paid to the DEPARTMENT prior to the Board Hearing, the DEPARTMENT shall seek an order from the Board of Supervisors to place a lien against your property and collect the amount due as a special tax assessment.

Failure to appear at the hearing will result in the exclusion of your testimony. Facts as known to the DEPARTMENT will be presented to the Board of Supervisors for their final consideration and deliberation of this matter.

You are encouraged to contact Supervising Code Enforcement Officer, Brian Black (951) 955-2004 prior to the hearing. Please meet with the undersigned or Brian Black at 7:30 a.m. on the day of the hearing in Conference Room 2A located on the 1st floor in front of the Human Resources Office to discuss the case.

PAMELA J. WALLS
County Counsel

Raymond m. medical for

L. ALEXANDRA FONG
Deputy County Counsel

Enclosure: Statement of Expense

EXHIBIT NO. A



County of Riverside Code Enforcement Department

P.O. Box 1469, Riverside, CA 92502
Phone: (951) 955-2004 Fax: (951) 955-8680
demands@rctlma.org

Statement of Expense

666201012
ANNE MARIE SCHWARTZ
39846 CRICKET COVE
PALM DESERT CA. 92211

Date	Invoice #
1/31/2011	100334

Property Address
666201012 ANNE MARIE SCHWARTZ 17211 COVEY ST N PALM SPG, CA 92258

Case Number	District	Class
CV0810056	5	SOE

Date	Item	Description	Hours/Qty	Rate	Amount
11/25/2008	Officer Hours	Labor Charges - Officer Time	1	109.00	109.00
11/25/2008	Officer Hours	Labor Charges - Officer Time	1.5	109.00	163.50
5/6/2009	Officer Hours	Labor Charges - Officer Time	0.1	109.00	10.90
7/11/2009	Officer Hours	Labor Charges - Officer Time	0.1	129.00	12.90
9/1/2009	Officer Hours	Labor Charges - Officer Time	0.1	109.00	10.90
10/28/2009	Officer Hours	Labor Charges - Officer Time	0.1	109.00	10.90
12/14/2009	Officer Hours	Labor Charges - Officer Time	0.1	82.00	8.20
5/7/2010	Officer Hours	Labor Charges - Officer Time	0.1	129.00	12.90
6/25/2010	Officer Hours	Labor Charges - Officer Time	0.1	129.00	12.90
7/23/2010	Officer Hours	Labor Charges - Officer Time	0.2	129.00	25.80
1/31/2011	SOE Preparation	Prepare Statement of Expense		65.00	65.00
		Subtotal Code Enforcement Costs			442.90
8/11/2009	Attorney Fees	Attorney Fees - County Counsel	1	139.51	139.51
8/18/2009	Attorney Fees	Attorney Fees - County Counsel	0.2	139.50	27.90
8/31/2009	Mailing Fees - County Co...	Mailing Fees - County Counsel	6	5.54	33.24
10/27/2009	Mailing Fees - County Co...	Mailing Fees - County Counsel	6	5.54	33.24
12/2/2009	Attorney Fees	Attorney Fees - County Counsel	0.1	139.50	13.95
12/14/2009	Attorney Fees	Attorney Fees - County Counsel	0.4	139.50	55.80
12/15/2009	Attorney Fees	Attorney Fees - County Counsel	0.4	139.50	55.80
12/23/2009	Attorney Fees	Attorney Fees - County Counsel	2.5	69.76	174.40
12/24/2009	Attorney Fees	Attorney Fees - County Counsel	0.4	69.75	27.90
			Subtotal		
			Payments/Credits		
			Total		

affirm and declare under penalty of perjury under the laws of the State of California that the foregoing is true and correct.

EXHIBIT NO. A2

Code Enforcement Department



County of Riverside Code Enforcement Department

P.O. Box 1469, Riverside, CA 92502
Phone: (951) 955-2004 Fax: (951) 955-8680
demands@rctlma.org

Statement of Expense

666201012
ANNE MARIE SCHWARTZ
39846 CRICKET COVE
PALM DESERT CA. 92211

Date	Invoice #
1/31/2011	100334

Property Address
666201012 ANNE MARIE SCHWARTZ 17211 COVEY ST N PALM SPG, CA 92258

Case Number	District	Class
CV0810056	5	SOE

Date	Item	Description	Hours/Qty	Rate	Amount
1/20/2010 1/31/2011	Attorney Fees	Attorney Fees - County Counsel Subtotal County Counsel Costs	0.5	139.52	69.76 631.50
1/31/2011	Lot/Title Report	Lot/Title Report		120.00	120.00
Subtotal					\$1,194.40
Payments/Credits					\$0.00
Total					\$1,194.40

affirm and declare under penalty of perjury under the laws of the State of California that the foregoing is true and correct.

EXHIBIT NO. A3

Code Enforcement Department

NOTICE LIST

Subject Property: 17211 covey Street, N. Palm Springs;
 Case No.: CV08-10056; APN: 666-201-012;
 District Five

ANNE MARIE SCHWARTZ, AS TRUSTEE
 39846 CRICKET COVE
 PALM DESERT CA 92211

THE SECURITY TRUST
 C/O COUNTY RECORDS RESEARCH
 TRUSTEE DIVISION
 4952 WARNER AVE #105
 HUNTINGTON BEACH CA 92649

THE SECURITY TRUST
 C/O SOUTHWESTERN SERVS INC
 16285 AVENIDA RAMBLA
 DESERT HOT SPRINGS CA 92240
 ATTN HARVEY SCHWARTZ

MISSION SPRINGS WATER DISTRICT
 66575 SECOND STREET
 DESERT HOT SPRINGS CA 92240

7010 1670 0001 7232 9059

U.S. Postal Service™		
CERTIFIED MAIL™ RECEIPT		
(Domestic Mail Only; No Insurance Coverage Provided)		
For delivery information visit our website at www.usps.com ®		
OFFICIAL USE		
Postage	\$.61	Mailed 3/9/11 Postmark Here
Certified Fee	2.80	
Return Receipt Fee (Endorsement Required)	2.30	
Restricted Delivery Fee (Endorsement Required)		
Total Postage & Fees	\$ 5.71	
Sent To		
<small>Street, Apt. 1 or PO Box #</small>	ANNE MARIE SCHWARTZ, AS TRUSTEE	
<small>City, State, Z</small>	39846 CRICKET COVE PALM DESERT CA 92211	

7010 1670 0001 7232 9066

U.S. Postal Service™		
CERTIFIED MAIL™ RECEIPT		
(Domestic Mail Only; No Insurance Coverage Provided)		
For delivery information visit our website at www.usps.com ®		
OFFICIAL USE		
Postage	\$.61	Mailed 3/9/11 Postmark Here
Certified Fee	2.80	
Return Receipt Fee (Endorsement Required)	2.30	
Restricted Delivery Fee (Endorsement Required)		
Total Postage & Fees	\$ 5.71	
Sent To		
<small>Street, or PO #</small>	THE SECURITY TRUST C/O COUNTY RECORDS RESEARCH TRUSTEE DIVISION	
<small>City, St</small>	4952 WARNER AVE #105 HUNTINGTON BEACH CA 92649	

EXHIBIT NO. A4

NOTICE LIST

Subject Property: 17211 covey Street, N. Palm Springs;
 Case No.: CV08-10056; APN: 666-201-012;
 District Five

7010 1670 0001 7232 9060

U.S. Postal Service™	
CERTIFIED MAIL™ RECEIPT	
<i>(Domestic Mail Only; No Insurance Coverage Provided)</i>	
For delivery information visit our website at www.usps.com ®	
OFFICIAL USE	
Postage	\$.61
Certified Fee	2.80
Return Receipt Fee (Endorsement Required)	2.30
Restricted Delivery Fee (Endorsement Required)	
Total Postage & Fees	\$ 5.71

Mailed 3/9/11

Postmark Here

Sent To	THE SECURITY TRUST
Street, Ap or PO Box	C/O SOUTHWESTERN SERVS INC
City, State	16285 AVENIDA RAMBLA DESERT HOT SPRINGS CA 92240
	ATTN HARVEY SCHWARTZ

PS Form 3800, August 2006 See Reverse for Instructions

7010 1670 0001 7232 9073

U.S. Postal Service™	
CERTIFIED MAIL™ RECEIPT	
<i>(Domestic Mail Only; No Insurance Coverage Provided)</i>	
For delivery information visit our website at www.usps.com ®	
OFFICIAL USE	
Postage	\$.61
Certified Fee	2.80
Return Receipt Fee (Endorsement Required)	2.30
Restricted Delivery Fee (Endorsement Required)	
Total Postage & Fees	\$ 5.71

Mailed 3/9/11

Postmark Here

Sent To	MISSION SPRINGS WATER DISTRICT
Street, Ap or PO Box	66575 SECOND STREET
City, State	DESERT HOT SPRINGS CA 92240

PS Form 3800, August 2006 See Reverse for Instructions

EXHIBIT NO. AS

1 **PROOF OF SERVICE**

2 Case No. CV08-10056

3 STATE OF CALIFORNIA, COUNTY OF RIVERSIDE

4 I, Brenda G. Peeler, declare that I am a citizen of the United States and am employed in the County
5 of Riverside, over the age of 18 years and not a party to the within action or proceeding; that my
6 business address is 3960 Orange Street, Suite 500, Riverside, California 92501.

7 That on March 9, 2011, I served the following document(s):

- 8 - **NOTICE OF HEARING RE: STATEMENT OF EXPENSE**
9 - **STATEMENT OF EXPENSE**

10 by placing a true copy thereof enclosed in a sealed envelope(s) addressed as follows:

11 **OWNERS OR INTERESTED PARTIES**
12 **(SEE NOTICE LIST ATTACHED TO NOTICE OF HEARING)**

13 XX **BY CERTIFIED MAIL, RETURN RECEIPT REQUESTED.** I am "readily familiar"
14 with the office's practice of collection and processing correspondence for mailing. Under
15 that practice it would be deposited with the U.S. Postal Service on that same day with
16 postage thereon fully prepaid at Riverside, California, in the ordinary course of business.

17 **BY PERSONAL SERVICE:** I caused to be delivered such envelope(s) by hand to the offices
18 of the addressee(s).

19 XX **STATE - I declare under penalty of perjury under the laws of the State of California that the**
20 **above is true and correct.**

21 **FEDERAL - I declare that I am employed in the office of a member of the bar of this court at**
22 **whose direction the service was made.**

23 EXECUTED ON March 9, 2011, at Riverside, California.

24 
25 _____
26 BRENDA G. PEELER
27
28

EXHIBIT NO. A⁶



**CODE ENFORCEMENT DEPARTMENT
COUNTY OF RIVERSIDE**

GLENN BAUDE
Director

AFFIDAVIT OF POSTING OF NOTICES

March 10, 2011

RE CASE NO: CV0810056

I, Hector Herrera, hereby declare:

I am employed by the Riverside County Code Enforcement Department; that my business address is 31-290 Plantation Drive, Thousand Palms, California 92276 .

That on 03/10/2011 at 10:400 am, I securely and conspicuously posted Notice of violation Re: statement of expense at the property described as:

Property Address: 17211 COVEY ST, N PALM SPG

Assessor's Parcel Number: 666-201-012

I declare under the penalty of perjury that the foregoing is true and correct.

Executed on March 10, 2011 in the County of Riverside, California.

CODE ENFORCEMENT DEPARTMENT

A. Herrera
By: Hector Herrera, Sr. Code Enforcement Officer

EXHIBIT NO. A7



County of Riverside Code Enforcement Department

P.O. Box 1469, Riverside, CA 92502
Phone: (951) 955-2004 Fax: (951) 955-8680
demands@rctlma.org

Statement of Expense

666201012
ANNE MARIE SCHWARTZ
39846 CRICKET COVE
PALM DESERT CA. 92211

Date	Invoice #
1/31/2011	100334

Property Address
666201012 ANNE MARIE SCHWARTZ 17211 COVEY ST N PALM SPG, CA 92258

Case Number	District	Class
CV0810056	5	SOE

Date	Item	Description	Hours/Qty	Rate	Amount
11/25/2008	Officer Hours	Labor Charges - Officer Time	1	109.00	109.00
11/25/2008	Officer Hours	Labor Charges - Officer Time	1.5	109.00	163.50
5/6/2009	Officer Hours	Labor Charges - Officer Time	0.1	109.00	10.90
7/11/2009	Officer Hours	Labor Charges - Officer Time	0.1	129.00	12.90
9/1/2009	Officer Hours	Labor Charges - Officer Time	0.1	109.00	10.90
10/28/2009	Officer Hours	Labor Charges - Officer Time	0.1	109.00	10.90
12/14/2009	Officer Hours	Labor Charges - Officer Time	0.1	82.00	8.20
5/7/2010	Officer Hours	Labor Charges - Officer Time	0.1	129.00	12.90
6/25/2010	Officer Hours	Labor Charges - Officer Time	0.1	129.00	12.90
7/23/2010	Officer Hours	Labor Charges - Officer Time	0.2	129.00	25.80
1/31/2011	SOE Preparation	Prepare Statement of Expense		65.00	65.00
		Subtotal Code Enforcement Costs			442.90
8/11/2009	Attorney Fees	Attorney Fees - County Counsel	1	139.51	139.51
8/18/2009	Attorney Fees	Attorney Fees - County Counsel	0.2	139.50	27.90
8/31/2009	Mailing Fees - County Co...	Mailing Fees - County Counsel	6	5.54	33.24
10/27/2009	Mailing Fees - County Co...	Mailing Fees - County Counsel	6	5.54	33.24
12/2/2009	Attorney Fees	Attorney Fees - County Counsel	0.1	139.50	13.95
12/14/2009	Attorney Fees	Attorney Fees - County Counsel	0.4	139.50	55.80
12/15/2009	Attorney Fees	Attorney Fees - County Counsel	0.4	139.50	55.80
12/23/2009	Attorney Fees	Attorney Fees - County Counsel	2.5	69.76	174.40
12/24/2009	Attorney Fees	Attorney Fees - County Counsel	0.4	69.75	27.90
			Subtotal		
			Payments/Credits		
			Total		

I affirm and declare under penalty of perjury under the laws of the State of California that the foregoing is true and correct.

Code Enforcement Department

EXHIBIT NO. B



County of Riverside Code Enforcement Department

P.O. Box 1469, Riverside, CA 92502
Phone: (951) 955-2004 Fax: (951) 955-8680
demands@rctlma.org

Statement of Expense

666201012
ANNE MARIE SCHWARTZ
39846 CRICKET COVE
PALM DESERT CA. 92211

Date	Invoice #
1/31/2011	100334

Property Address
666201012 ANNE MARIE SCHWARTZ 17211 COVEY ST N PALM SPG, CA 92258

Case Number	District	Class
CV0810056	5	SOE

Date	Item	Description	Hours/Qty	Rate	Amount
1/20/2010	Attorney Fees	Attorney Fees - County Counsel	0.5	139.52	69.76
1/31/2011		Subtotal County Counsel Costs			631.50
1/31/2011	Lot/Title Report	Lot/Title Report		120.00	120.00
			Subtotal		\$1,194.40
			Payments/Credits		\$0.00
			Total		\$1,194.40

I affirm and declare under penalty of perjury under the laws of the State of California that the foregoing is true and correct.

Code Enforcement Department

EXHIBIT NO. B²



INVOICE

Order Number: 23151 **Order Date:** 2/16/2011

Customer Information:

Acct No. 1044

RIVERSIDE COUNTY TLMA-CODE ENFORCEMENT
4080 Lemon Street
Riverside, CA 92501

Attn: Brent Steele
REF: CV08-10056 / Angela Sarmiento
IN RE: SCHWARTZ, ANNE MARIE

Product and/or Service ordered for Property known as:	
17211 Covey Street North Palm Springs, CA 92258	
DESCRIPTION:	FEE:
Lot Book Report	\$120.00
TOTAL DUE:	\$120.00

Payment due upon receipt. Please remit to:

RZ Title Services, Inc.
P.O. Box 1193
Whittier, CA 90609

EXHIBIT NO. B³

Assessment Roll For the 2010-2011 Tax Year as of January 1,2010

Assessment #666201012-8		Parcel # 666201012-8	
Assessee:	SCHWARTZ ANNE MARIE	Land	5,000
Mail Address:	39846 CRICKET COVE	Structure	19,000
City, State Zip:	PALM DESERT CA 92211	Full Value	24,000
Real Property Use Code:	R1	Total Net	24,000
Base Year	2002		
Conveyance Number:	0280279		
Conveyance (mm/yy):	9/2007		
PUI:	R010012		
TRA:	61-215		
Taxability Code:	0-00		
ID Data:	Lot 12 MB 022/047 GARNET GARDENS 2		
Situs Address:	17211 COVEY ST N PALM SPG CA 92258		



EXHIBIT NO. C

RIVERSIDE COUNTY GIS

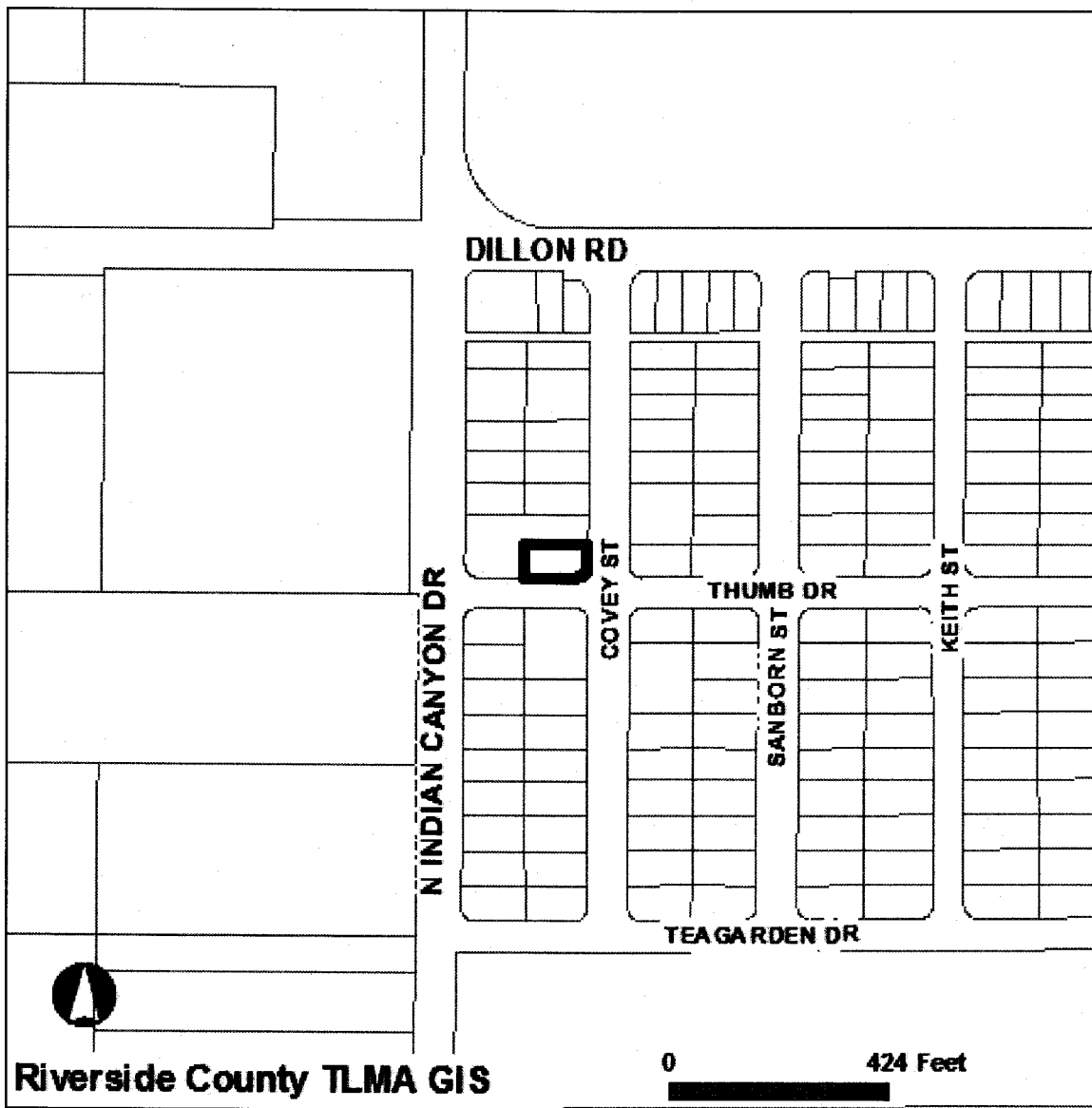

Selected parcel(s):
666-201-012

IMPORTANT

Maps and data are to be used for reference purposes only. Map features are approximate, and are not necessarily accurate to surveying or engineering standards. The County of Riverside makes no warranty or guarantee as to the content (the source is often third party), accuracy, timeliness, or completeness of any of the data provided, and assumes no legal responsibility for the information contained on this map. Any use of this product with respect to accuracy and precision shall be the sole responsibility of the user.

STANDARD REPORT

APNs

666-201-012-8

OWNER NAME / ADDRESS

ANNE MARIE SCHWARTZ
17211 COVEY ST
N PALM SPG, CA. 92258

MAILING ADDRESS

(SEE OWNER)
39846 CRICKET COVE
PALM DESERT CA. 92211

EXHIBIT NO. C²

LEGAL DESCRIPTION

RECORDED BOOK/PAGE: MB 22/47
SUBDIVISION NAME: GARNET GARDENS 2
LOT/PARCEL: 12, BLOCK:
TRACT NUMBER: NOT AVAILABLE

LOT SIZE

RECORDED LOT SIZE IS 0.17 ACRES

PROPERTY CHARACTERISTICS

CONCRETE BLOCK THROUGHOUT, 598 SQFT., 1 BDRM/ 0.75 BATH, 1 STORY, CONST'D 1953 COMPOSITION, ROOF

THOMAS BROS. MAPS PAGE/GRID

PAGE: 726 GRID: D2

CITY BOUNDARY/SPHERE

NOT WITHIN A CITY
CITY SPHERE: DESERT HOT SPRINGS
ANNEXATION DATE: FEB. 22, 2007
LAFCO CASE #: 2006-25-4&5
NO PROPOSALS

MARCH JOINT POWERS AUTHORITY

NOT IN THE JURISDICTION OF THE MARCH JOINT POWERS AUTHORITY

INDIAN TRIBAL LAND

NOT IN A TRIBAL LAND

SUPERVISORIAL DISTRICT (ORD. 813)

MARION ASHLEY, DISTRICT 5

TOWNSHIP/RANGE

T3SR4E SEC 11

ELEVATION RANGE

865 FEET

PREVIOUS APN

NO DATA AVAILABLE

PLANNING

LAND USE DESIGNATIONS

Zoning not consistent with the General Plan.
MDR

AREA PLAN (RCIP)

WESTERN COACHELLA VALLEY

GENERAL PLAN POLICY OVERLAYS

NOT IN A GENERAL PLAN POLICY OVERLAY AREA

GENERAL PLAN POLICY AREAS

NONE

ZONING CLASSIFICATIONS (ORD. 348)

W-2-M

ZONING DISTRICTS AND ZONING AREAS

PASS & DESERT DISTRICT

ZONING OVERLAYS

NOT IN A ZONING OVERLAY

SPECIFIC PLANS

NOT WITHIN A SPECIFIC PLAN

AGRICULTURAL PRESERVE

NOT IN AN AGRICULTURAL PRESERVE

REDEVELOPMENT AREAS

PROJECT AREA NAME: MCPA
SUBAREA NAME: GARNET - SUB AREA
AMENDMENT NUMBER: 0
ADOPTION DATE: MAY. 13, 2010
ACREAGE: 2588 ACRES

NOT IN AN AIRPORT INFLUENCE AREA

AIRPORT COMPATIBILITY ZONES
NOT IN AN AIRPORT COMPATIBILITY ZONE

ENVIRONMENTAL

CVMSHCP (COACHELLA VALLEY MULTI-SPECIES HABITAT CONSERVATION PLAN) CONSERVATION AREA
NOT IN A CONSERVATION AREA

CVMSHCP FLUVIAL SAND TRANSPORT SPECIAL PROVISION AREAS
NOT IN A FLUVIAL SAND TRANSPORT SPECIAL PROVISION AREA

WRMSHCP (WESTERN RIVERSIDE COUNTY MULTI-SPECIES HABITAT CONSERVATION PLAN) CELL GROUP
NOT IN A CELL GROUP

WRMSHCP CELL NUMBER
NOT IN A CELL

HANS/ERP (HABITAT ACQUISITION AND NEGOTIATION STRATEGY/EXPEDITED REVIEW PROCESS)
NONE

VEGETATION (2005)
NO DATA AVAILABLE

FIRE

HIGH FIRE AREA (ORD. 787)
NOT IN A HIGH FIRE AREA

FIRE RESPONSIBILITY AREA
NOT IN A FIRE RESPONSIBILITY AREA

DEVELOPMENT FEES

CVMSHCP FEE AREA (ORD. 875)
WITHIN THE COACHELLA VALLEY MSHCP FEE AREA

WRMSHCP FEE AREA (ORD. 810)
NOT WITHIN THE WESTERN RIVERSIDE COUNTY MSHCP FEE AREA

ROAD & BRIDGE DISTRICT
NOT IN A DISTRICT

EASTERN TUMF (TRANSPORTATION UNIFORM MITIGATION FEE ORD. 673)
IN OR PARTIALLY WITHIN A TUMF FEE AREA. SEE MAP FOR MORE INFORMATION.
In EAST

WESTERN TUMF (TRANSPORTATION UNIFORM MITIGATION FEE ORD. 824)
NOT WITHIN THE WESTERN TUMF FEE AREA

DIF (DEVELOPMENT IMPACT FEE AREA ORD. 659)
WESTERN COACHELLA VALLEY

SKR FEE AREA (STEPHEN'S KANGAROO RAT ORD. 663.10)
NOT WITHIN AN SKR FEE AREA.

DEVELOPMENT AGREEMENTS
NOT IN A DEVELOPMENT AGREEMENT AREA

TRANSPORTATION

CIRCULATION ELEMENT ULTIMATE RIGHT-OF-WAY
NOT IN A CIRCULATION ELEMENT RIGHT-OF-WAY

ROAD BOOK PAGE
172

TRANSPORTATION AGREEMENTS
NOT IN A TRANSPORTATION AGREEMENT**CETAP (COMMUNITY AND ENVIRONMENTAL TRANSPORTATION ACCEPTABILITY PROCESS) CORRIDORS**
NOT IN A CETAP CORRIDOR.

HYDROLOGY

FLOOD PLAIN REVIEW
NOT REQUIRED.**WATER DISTRICT**
DWA**FLOOD CONTROL DISTRICT**
RIVERSIDE COUNTY FLOOD CONTROL DISTRICT**WATERSHED**
WHITEWATER

GEOLOGIC

FAULT ZONE
NOT IN A FAULT ZONE**FAULTS**
WITHIN A 1/2 MILE OF
SAN ANDREAS FAULT
SAN ANDREAS FAULT SOUTH BRANCH
SAN ANDREAS FAULTS
CONTACT THE COUNTY'S CHIEF ENGINEERING GEOLOGIST AT (951)955-6863.**LIQUEFACTION POTENTIAL**
MODERATE**SUBSIDENCE**
SUSCEPTIBLE**PALEONTOLOGICAL SENSITIVITY**
LOW POTENTIAL.
FOLLOWING A LITERATURE SEARCH, RECORDS CHECK AND A FIELD SURVEY, AREAS MAY BE DETERMINED BY A QUALIFIED VERTEBRATE PALEONTOLOGIST AS HAVING LOW POTENTIAL FOR CONTAINING SIGNIFICANT PALEONTOLOGICAL RESOURCES SUBJECT TO ADVERSE IMPACTS.

MISCELLANEOUS

SCHOOL DISTRICT
PALM SPRINGS UNIFIED**COMMUNITIES**
NORTH PALM SPRINGS**COUNTY SERVICE AREA**
IN OR PARTIALLY WITHIN
N PALM SPRINGS #13 -
STREET LIGHTING**LIGHTING (ORD. 655)**
ZONE B, 43.21 MILES FROM MT. PALOMAR OBSERVATORY**2000 CENSUS TRACT**
044503**FARMLAND**
URBAN-BUILT UP LAND**TAX RATE AREAS**
NOT AVAILABLE**SPECIAL NOTES**
NO SPECIAL NOTES

Case #	Description	Start Date
CV0810057	NEIGHBORHOOD ENFORCEMENT	Nov. 25, 2008

REPORT PRINTED ON...Tue Feb 08 10:25:29 2011
Version 101221



P.O. Box 1193
 Whittier, CA 90609
 Tel # (562) 325-8351
 Fax # (714) 783-3038

Lot Book Report

Order Number: **23151**

Customer:

RIVERSIDE COUNTY TLMA-CODE ENFORCEMENT
 4080 Lemon Street
 Riverside CA 92501

Order Date: 2/16/2011
 Dated as of: 2/9/2011
 County Name: Riverside

Attn: Brent Steele
 Reference: CV08-10056 / Angela Sarmiento
 IN RE: SCHWARTZ, ANNE MARIE

FEE(s):
 Report: \$120.00

Property Address: 17211 Covey Street
 North Palm Springs CA 92258

Assessor's Parcel No. : 666-201-012-8

Assessments:

Land Value:	\$5,000.00
Improvement Value:	\$19,000.00
Exemption Value:	\$0.00
Total Value:	\$24,000.00

Tax Information

Property Taxes for the Fiscal Year	2010-2011
First Installment	\$157.32
Penalty	\$15.71
Status	NOT PAID-DELINQUENT
Second Installment	\$157.32
Penalty	\$0.00
Status	OPEN NOT-PAID (DUE DATE 04/10/2011)

EXHIBIT NO. D



P.O. Box 1193
Whittier, CA 90609
Tel # (562) 325-8351
Fax # (714) 783-3038

Order Number: 23151

Reference: CV08-10056 / Ang

Property Vesting

The last recorded document transferring title of said property

Dated	08/07/2007
Recorded	08/13/2007
Document No.	2007-0521915
D.T.T.	\$0.00
Grantor	Anne Marie Schwartz, aka A.M. Schwartz, an unmarried woman
Grantee	Anne Marie Schwartz, as Trustee of the Anne Marie Schwartz Living Trust, U/A dated August 7, 2007

Deeds of Trust

Position No.	1st
A Deed of Trust Dated	02/18/2000
Recorded	05/30/2001
Document No.	2001-238304
Amount	\$30,000.00
Trustor	The 17-211 Covey St. Trust, Ovando Morua Villarrel
Trustee	Chicago Title Company, a California corporation
Beneficiary	The Security Trust, by Southwestern Services, Inc., a Nevada corporation, as Trustee

Notice of Default Recorded	04/27/2010
Document No.	2010-0191150

Substitution of Trustee Recorded	08/06/2010
Document No.	2010-0369897
Trustee	County Records Research, Inc.

Position No.	2nd
A Deed of Trust Dated	02/18/2000



P.O. Box 1193
Whittier, CA 90609
Tel # (562) 325-8351
Fax # (714) 783-3038

Order Number: 23151

Reference: CV08-10056 / Ang

Recorded	05/30/2001
Document No.	2001-238305
Amount	\$22,000.00
Trustor	The 17-211 Covey St. Trust, Ovando Morua Villarrel, as Trustee
Trustee	Chicago Title Company, a California corporation
Beneficiary	The Security Trust, by Southwestern Services, Inc., a Nevada corporation, as Trustee

Assignment Dated	01/08/2008
Recorded	01/17/2008
Document No.	2008-0028722
Assigned to	The Anne Marie Schwartz Living Trust, U/A dated August 7, 2007, Anne Marie Schwartz, or her sucesor, as Trustee

Position No.	3rd
A Deed of Trust Dated	02/18/2000
Recorded	05/30/2001
Document No.	2001-238306
Amount	\$7,000.00
Trustor	The 17-211 Covey St. Trust, Ovando Morua Villarel, as Successor Trustee
Trustee	Chicago Title Company, a California corporation
Beneficiary	The Security Trust, by Southwestern Services, Inc., a Nevada corporation

Additional Information

A Notice of Lien Recorded	06/01/2006
Document No.	2006-0400801
Amount	\$366.05
Owner	Ovando Villarreal
Claimant	Mission Spring Water District

Notice of Non-Compliance filed by	County of Riverside Code Enforcement Department
In the matter of the property of	Anne Marie Schwartz, Trust



P.O. Box 1193
Whittier, CA 90609
Tel # (562) 325-8351
Fax # (714) 783-3038

Order Number: 23151

Reference: CV08-10056 / Ang

Case No.	CV08-10056
Recorded	01/20/2009
Document No.	2009-0025745
Notice of Non-Compliance filed by	County of Riverside Code Enforcement Department
In the matter of the property of	Anne Marie Schwartz, Trust
Case No.	CV08-10057
Recorded	01/20/2009
Document No.	2009-0025746
Notice of Non-Compliance filed by	County of Riverside Code Enforcement Department
In the matter of the property of	Anne Marie Schwartz, Trust
Case No.	CV08-10056 & CV09-03796
Recorded	06/25/2009
Document No.	2009-0325137
A Notice of Lien Recorded	10/13/2009
Document No.	2009-0529595
Amount	\$298.03
Owner	Ovando Villarreal and Anne Marie Scwartz
Claimant	Mission Springs Water District
Document Type	Findings of Fact, Conclusions and Order to Abate Nuisance
Document No.	2010-0065342
Recorded	02/11/2010

Legal Description

THE LAND REFERRED TO IN THIS REPORT IS LOCATED IN AND IS DESCRIBED AS FOLLOWS:

LOT 12 IN BLOCK A OF GARNET GARDENS UNIT NO. 2, IN THE COUNTY OF RIVERSIDE, STATE OF CALIFORNIA, AS SHOWN BY MAP ON FILE IN BOOK 22, PAGE 47 OF MAPS, RECORDS OF SAID COUNTY.