

SUBMITTAL TO THE BOARD OF SUPERVISORS
COUNTY OF RIVERSIDE, STATE OF CALIFORNIA

101B



FROM: TLMA - Transportation Department

SUBMITTAL DATE:
March 24, 2011

SUBJECT: Accepting Kerber Court in the Glen Ivy Hot Springs area, First Supervisorial District.

RECOMMENDED MOTION: Adopt Resolution No. 2011-066, accepting Kerber Court.

BACKGROUND: The applicant has improved Kerber Court within Parcel Map 13387 to county standards for acceptance into the County Maintained Road System.

REVIEWED BY EXECUTIVE OFFICE

DATE 3/24/11 TLMA
Tina Grande

FORM APPROVED COUNTY COUNSEL
BY: Synthia M. Gunzel
DATE 3-23-11
SYNTHIA M. GUNZEL
Departmental Concurrence

Juan C. Perez
Director of Transportation

WJH
Attachments: Resolution No. 2011-066
Exhibit "A"

Dept't Recomm.: Consent Policy
Per Exec. Ofc.: Consent Policy

MINUTES OF THE BOARD OF SUPERVISORS

On motion of Supervisor Buster, seconded by Supervisor Benoit and duly carried, IT WAS ORDERED that the above matter is approved as recommended.

Ayes: Buster, Tavaglione, Stone and Benoit
Nays: None
Absent: Ashley
Date: April 5, 2011
xc: Transp., Recorder

Kecia Harper-Ihem
Clerk of the Board
By: [Signature]
Deputy

Prev. Agn. Ref. | District: 1 | Agenda Number:

2.8

VICINITY MAP



N.T.S.
T. 5S, R. 6W
SECTION 3
SBM

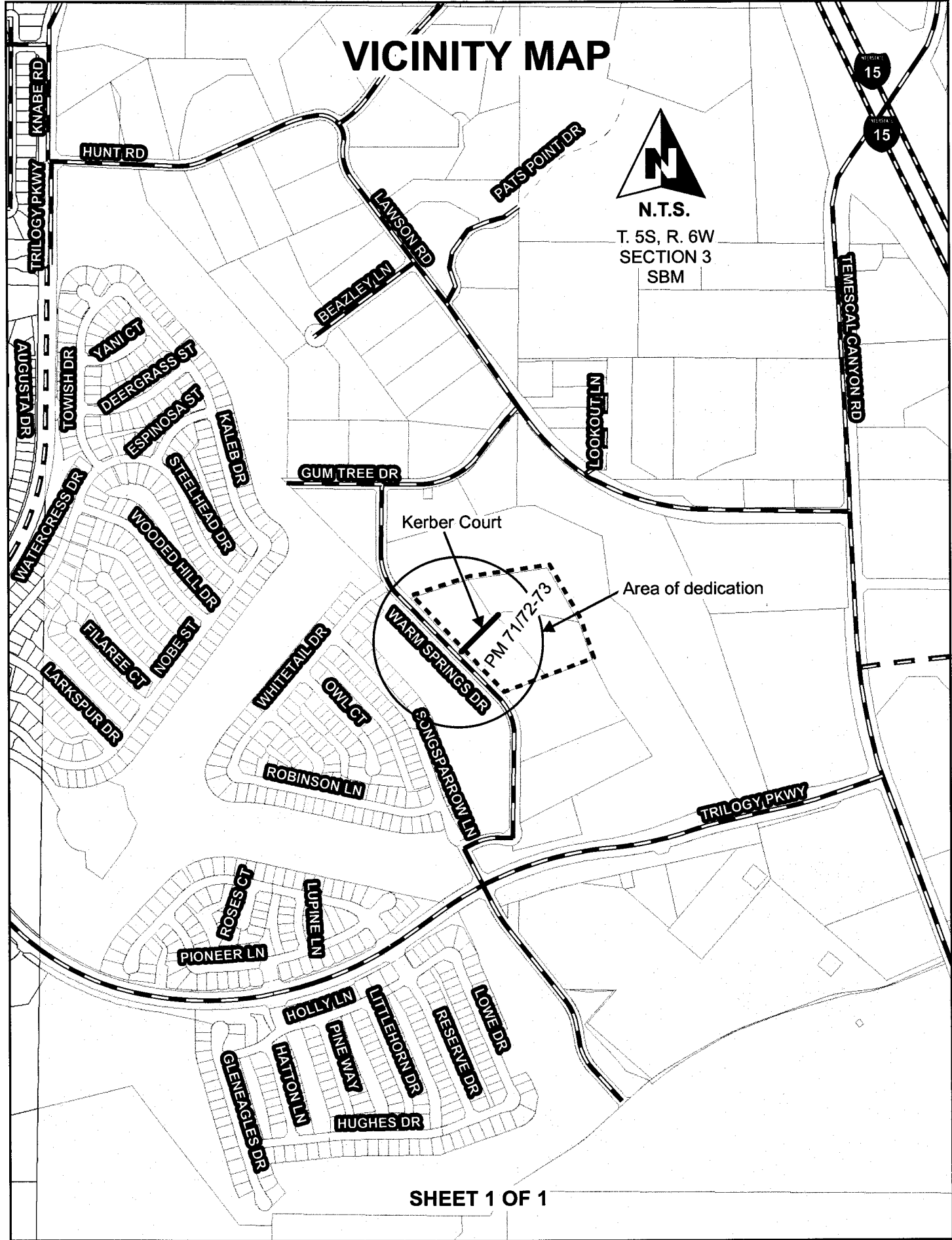

PLEASE COMPLETE THIS INFORMATION

RECORDING REQUESTED BY:

KECIA HARPER-IHEM, CLERK OF THE BOARD
RIVERSIDE CO. CLERK OF THE BOARD
4080 LEMON STREET, 1ST FLOOR CAC
P O BOX 1147 - RIVERSIDE, CA 92502

MAIL STOP # 1010

AND WHEN RECORDED MAIL TO:

RETURN TO: STOP #1010
RIVERSIDE COUNTY CLERK OF THE BOARD
P. O. BOX 1147 - RIVERSIDE, CA 92502

DOC # 2011-0160311
04/12/2011

Customer Copy Label

The paper to which this label is
affixed has not been compared
with the recorded document

Larry W Ward

County of Riverside
Assessor, County Clerk & Recorder

THIS SPACE FOR RECORDERS USE ONLY

RESOLUTION NO. 2011-066

Title of Document

ACCEPTING KERBER COURT IN THE GLEN IVY HOT SPRINGS AREA

(FIRST SUPERVISORIAL DISTRICT)

(Transportation Department ~ Item 2.8 of 04/05/11)

THIS PAGE ADDED TO PROVIDE ADEQUATE SPACE
FOR RECORDING INFORMATION

COPY

2
3 **RESOLUTION NO 2011-066**

4
5 **ACCEPTING KERBER COURT IN THE GLEN IVY HOT SPRINGS AREA**
6 **(First Supervisorial District)**

7
8 **WHEREAS**, the hereinafter described roads were offered for dedication for road
9 and public utility purposes by the documents hereinafter-referred to, which offer of
10 dedication has not been previously accepted for public use by the County of Riverside,
11 now, therefore;

12
13 **BE IT RESOLVED, DETERMINED AND ORDERED** by the Board of Supervisors of
14 the County of Riverside, State of California, in regular session assembled on
15 April 5, 2011, that this Board accepts the offer of dedication
16 and recognizes that said roads are public roads open for use by the general public;

17
18 **BE IT FURTHER RESOLVED, DETERMINED, AND ORDERED** that this
19 acceptance is for the purpose of vesting title in the County of Riverside on behalf of the
20 public for public road and utility purposes, and will be an acceptance of the road into the
21 County Maintained Road System, pursuant to Section 941 of the Streets and Highways
22 Code;

FORM APPROVED COUNTY COUNSEL
BY: *Sybil M. Gunzel* 3-22-11
SYBIL M. GUNZEL DATE

1 **Resolution No. 2011-066**

2

3 Said road is in Riverside County, California, and is described as follows:

4

5 **Kerber Court** (See Exhibit "A")

6 Kerber Court (50.00 feet wide) shown as Lot's "C" through "F", on Parcel Map No.
7 13387 filed in Book 71, Pages 72 and 73 of Parcel Maps, Records of Riverside
8 County, California

9

10 **BE IT FURTHER RESOLVED, DETERMINED AND ORDERED** that the Clerk of the
11 Board is directed to cause a certified copy of this resolution to be recorded in the office
12 of the Recorder of the County of Riverside, California.

13

14 **ROLL CALL:**

15 Ayes: Buster, Tavaglione, Stone, and Benoit
16 Nays: None
17 Absent: Ashley

18 The foregoing is certified to be a true copy of a resolution duly
19 adopted by said Board of Supervisors on the date therein set forth.

KECIA HARPER-IHEM, Clerk of said Board

By: 

Deputy

21

22

23

24 WJH

25 W.O. SUR09027

EXHIBIT "A"

Acceptance of Kerber Court



N.T.S.
T. 5S, R. 6W
SECTION 3
S.B.M.

MB306/60-86

Parcel Map 71/72-73

Parcel 1

Parcel 2

Lot "D"

Lot "E"

50.00 feet

Lot "C"

Lot "F"

KERBER COURT

Parcel 3

WARM SPRINGS DRIVE

Parcel 4

MB 306/60-86

PM 98/34

Parcel 1

SONGSPARROW LN

SHEET 1 OF 1

Parcel 2



LARRY W. WARD
COUNTY OF RIVERSIDE
ASSESSOR-COUNTY CLERK-RECORDER

Recorder
P.O. Box 751
Riverside, CA 92502-0751
(951) 486-7000

<http://riverside.asrclrec.com>

CERTIFICATION

Pursuant to the provisions of Government Code 27361.7, I certify under the penalty of perjury that the following is a true copy of illegible wording found in the attached document:

(Print or type the page number(s) and wording below):

CLARIFICATION OF THE SEAL for the Riverside County Board of Supervisors
(embossed on document)

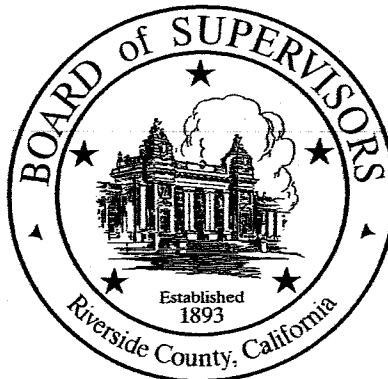

Date:

4-5-11

Signature:

Karen Barton

Print Name:

Karen Barton, Board Assistant, Riverside County Clerk of the Board