

**SUBMITTAL TO THE BOARD OF SUPERVISORS  
COUNTY OF RIVERSIDE, STATE OF CALIFORNIA**

113B



**FROM:** County Counsel  
Code Enforcement Department

**SUBMITTAL DATE:**  
March 24, 2011

**SUBJECT:** Statement of Expense [Case Nos. CV06-7213 & CV06-7365]  
Subject Property: 38875 Indian Road, Anza; BERTRAND  
APN: 572-100-030  
District: Three

Departmental Concurrence

**RECOMMENDED MOTION:** Move that the Board of Supervisors:

- (1) assess the reasonable costs of abatement of a public nuisance (substandard mobile home/recreational vehicles and excess outside storage) in the above-referenced matter to be **one thousand, four hundred eighty-six dollars and eighty cents (US \$1,486.80)**;
- (2) assess the costs of abatement against the above-described subject property;
- (3) authorize the recordation of a notice of abatement lien; and
- (4) authorize the abatement costs to be added to the tax roll as a special assessment
- (5) authorize and direct the Code Enforcement Department to take any reasonable actions to collect the amount owed.

*Raymond M. Mistica*  
RAYMOND M. MISTICA, Deputy County Counsel  
for PAMELA J. WALLS, County Counsel

<b>FINANCIAL DATA</b>	Current F.Y. Total Cost:	\$ N/A	In Current Year Budget:	N/A
	Current F.Y. Net County Cost:	\$ N/A	Budget Adjustment:	N/A
	Annual Net County Cost:	\$ N/A	For Fiscal Year:	N/A

<b>SOURCE OF FUNDS:</b>	Positions To Be Deleted Per A-30	<input type="checkbox"/>
	Requires 4/5 Vote	<input type="checkbox"/>

**C.E.O. RECOMMENDATION:** APPROVE

BY: *Tina Grande*  
Tina Grande

**County Executive Office Signature**

- Consent
- Policy
- Consent
- Policy

**MINUTES OF THE BOARD OF SUPERVISORS**

On motion of Supervisor Benoit, seconded by Supervisor Stone and duly carried, IT WAS ORDERED that the above matter is approved as recommended.

Ayes: Buster, Tavaglione, Stone and Benoit  
Nays: None  
Absent: Ashley  
Date: April 5, 2011  
xc: Co. Co., CED, Prop. Owner

Kecia Harper-Ihem  
Clerk of the Board  
By: *Kecia Harper-Ihem*  
Deputy

Dept's Recomm.:  
Per Exec. Ofc.:

Prev. Agn. Ref.:	District: 3	Agenda Number:	
------------------	-------------	----------------	--

9.9

Statement of Expense [Case Nos. CV06-7213 & CV06-7365]  
Subject Property: 38875 Indian Road, Anza; BERTRAND  
APN: 572-100-030  
District: Three  
Page 2

**BACKGROUND:** Government Code § 25845, Riverside County Ordinance Nos. 457 (RCC Title 15), 348 (RCC Title 17) and 725 (RCC Chapter 1.16) and Section 1618, Article 10, Title 25 of the California Code of Regulations, provide authority for the recovery of abatement costs in public nuisance cases, the recordation of a notice of abatement lien and inclusion of abatement costs on the tax roll as a special assessment upon approval of the Board of Supervisors.

The Code Enforcement Department issued Notices of Violations. Subsequently, the property was brought into compliance.

The Notice of Hearing re Statement of Expense has been posted on the property and mailed to the property owner and all interested parties, as required by law. Copies of all relevant notices issued in this matter together with proof of service and posting have been separately filed with the Clerk of the Board and are made a part of the record herein, pursuant to Riverside County Ordinance 725.

---

**SUBMITTAL TO THE BOARD OF SUPERVISORS  
COUNTY OF RIVERSIDE, STATE OF CALIFORNIA**

**FROM:** County Counsel  
Code Enforcement Department  
**SUBJECT:** Statement of Expense [Case Nos. CV06-7213 & CV06-7365]  
Subject Property: 38875 Indian Road, Anza; BERTRAND  
APN: 572-100-030  
District Three

**TABLE OF SUPPLEMENTAL DOCUMENTS  
FILED WITH THE CLERK OF THE BOARD**

**Hearing Date: APRIL 5, 2011**

Notice of Statement Expense Hearing (including Proofs of Service, Affidavits of Posting and Return Receipts).....	Exhibit A
Statement of Expense Worksheet with Supporting Documents .....	Exhibit B
Assessment-Roll For The Year 10/11 And Geographic Information System, Feb 22, 2011 .....	Exhibit C
Lot Book Report .....	Exhibit D

PAMELA J. WALLS  
County Counsel

OFFICE OF COUNTY COUNSEL  
COUNTY OF RIVERSIDE



KATHERINE A. LIND  
Assistant County Counsel

3960 ORANGE STREET, SUITE 500  
RIVERSIDE, CA 92501-3674  
TELEPHONE: 951/955-6300  
FAX: 951/955-6322 & 951/955-6363

March 22, 2011

## NOTICE OF HEARING RE: STATEMENT OF EXPENSE

To: Owners and Interested Parties  
(See attached Proof of Service  
and Notice List)

Subject Property: 38875 Indian Road, Anza  
Case Nos.: CV06-7213 & CV06-7365; BERTRAND  
APN: 572-100-030

**NOTICE IS HEREBY GIVEN** that a hearing will be held before the Riverside County Board of Supervisors on **Tuesday, April 5, 2011 at 9:30 a.m.** in the Board of Supervisors Room, 4080 Lemon Street, 1st Floor Annex, Riverside, California, at which time and place pertinent testimony will be heard regarding the expenses incurred by the County of Riverside, Code Enforcement Department ("DEPARTMENT") for the above-referenced abatement proceeding. Said abatement proceeding involved the removal of a excessive outside storage and substandard mobile home/recreational vehicle(s) located on your real property commonly described as 38875 Indian Road, Anza and more particularly described as Assessor's Parcel Number 572-100-030.

The total expense due, including all other fees and costs, for the removal of the above-described dangerous or injurious condition is **one thousand, four hundred eighty-six dollars and eighty cents, (US \$1,486.80)**. This amount is immediately due and payable. If you have any objections to the Statement of Expense attached hereto, you must address your objections to the Board of Supervisors at the hearing. If you have any questions about the attached Statement of Expense, please contact the undersigned at (951) 955-6300. In the event the total amount due is not paid to the DEPARTMENT prior to the Board Hearing, the DEPARTMENT shall seek an order from the Board of Supervisors to place a lien against your property and collect the amount due as a special tax assessment.

Failure to appear at the hearing will result in the exclusion of your testimony. Facts as known to the DEPARTMENT will be presented to the Board of Supervisors for their final consideration and deliberation of this matter.

**You are encouraged to contact Supervising Code Enforcement Officer, Brian Black (951) 955-2004 prior to the hearing. Please meet with the undersigned or Brian Black at 7:30 a.m. on the day of the hearing in Conference Room 2A located on the 1st floor in front of the Human Resources Office to discuss the case.**

PAMELA J. WALLS  
County Counsel

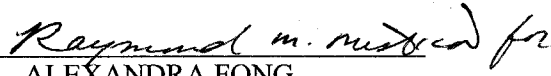
  
L. ALEXANDRA FONG  
Deputy County Counsel

Enclosure: Statement of Expense

EXHIBIT NO.           A



# COUNTY OF RIVERSIDE CODE ENFORCEMENT

P.O. Box 1469, Riverside, CA 92502  
Phone: 951-955-2004 Fax: 951-955-8680

Property Reference/Mailing Address
572100030 KENNETH D BERTRAND DARLENE BERTRAND 105 GERONIMO ST PALM SPRINGS CA. 92264

**Summary Statement**  
**As of: 2/22/2011**

Date	Invoice Number & Amount	Amount	Balance
02/22/2011	CV067213- INV #100454. Orig. Amount \$454.30.	454.30	454.30
02/22/2011	CV067365- INV #100453. Orig. Amount \$1,032.50.	1,032.50	1,486.80
<b>Balance Due</b>			<b>\$1,486.80</b>

I affirm and declare under penalty of perjury under the laws of the State of California that the foregoing is true and correct.

Code Enforcement Department

EXHIBIT NO. A<sup>2</sup>



# County of Riverside Code Enforcement Department

P.O. Box 1469, Riverside, CA 92502  
Phone: (951) 955-2004 Fax: (951) 955-8680  
demands@rctlma.org

## Statement of Expense

572100030  
KENNETH D BERTRAND  
DARLENE BERTRAND  
105 GERONIMO ST  
PALM SPRINGS CA. 92264

Date	Invoice #
2/22/2011	100454

Property Address
572100030 KENNETH D BERTRAND DARLENE BERTRAND 38875 INDIAN RD ANZA, CA 92539

Case Number	District	Class
CV067213	3	SOE

Date	Item	Description	Hours/Qty	Rate	Amount
11/28/2006	Officer Hours	Labor Charges - Officer Time	1.5	109.00	163.50
5/16/2008	Officer Hours	Labor Charges - Officer Time	0.3	109.00	32.70
7/2/2008	Officer Hours	Labor Charges - Officer Time	0.3	109.00	32.70
8/13/2008	Officer Hours	Labor Charges - Officer Time	0.3	109.00	32.70
10/15/2008	Officer Hours	Labor Charges - Officer Time	0.3	109.00	32.70
2/22/2011	SOE Preparation	Prepare Statement of Expense		65.00	65.00
		Subtotal Code Enforcement Costs			359.30
12/31/2006	Lot/Title Report	Lot/Title Report	1	95.00	95.00
		Subtotal Contractor Costs			95.00
<b>Subtotal</b>					\$454.30
<b>Payments/Credits</b>					\$0.00
<b>Total</b>					\$454.30

I hereby firm and declare under penalty of perjury under the laws of the State of California that the foregoing is true and correct.

*[Signature]*  
Code Enforcement Department

EXHIBIT NO.     A3



# County of Riverside Code Enforcement Department

P.O. Box 1469, Riverside, CA 92502  
Phone: (951) 955-2004 Fax: (951) 955-8680  
demands@rctlma.org

## Statement of Expense

572100030  
KENNETH D BERTRAND  
DARLENE BERTRAND  
105 GERONIMO ST  
PALM SPRINGS CA. 92264

Date	Invoice #
2/22/2011	100453

Property Address
572100030 KENNETH D BERTRAND DARLENE BERTRAND 38875 INDIAN RD ANZA, CA 92539

Case Number	District	Class
CV067365	3	SOE

Date	Item	Description	Hours/Qty	Rate	Amount
5/16/2008	Officer Hours	Labor Charges - Officer Time	0.3	109.00	32.70
7/2/2008	Officer Hours	Labor Charges - Officer Time	0.3	109.00	32.70
10/15/2008	Officer Hours	Labor Charges - Officer Time	0.3	109.00	32.70
3/6/2009	Officer Hours	Labor Charges - Officer Time	0.3	109.00	32.70
6/24/2009	Officer Hours	Labor Charges - Officer Time	0.3	109.00	32.70
6/24/2009	Officer Hours	Labor Charges - Officer Time	0.3	109.00	32.70
7/20/2009	Officer Hours	Labor Charges - Officer Time	0.3	109.00	32.70
9/8/2009	Officer Hours	Labor Charges - Officer Time	0.3	109.00	32.70
1/25/2010	Officer Hours	Labor Charges - Officer Time	0.2	109.00	21.80
1/28/2010	Officer Hours	Labor Charges - Officer Time	0.1	82.00	8.20
2/5/2010	Officer Hours	Labor Charges - Officer Time	0.3	109.00	32.70
2/22/2011	SOE Preparation	Prepare Statement of Expense		65.00	65.00
		Subtotal Code Enforcement Costs			389.30
8/11/2008	Attorney Fees	Attorney Fees - County Counsel	0.4	69.75	27.90
2/22/2011	Prepare Case for SOE He...			125.55	125.55
	Attend SOE Hearing			69.75	69.75
		Subtotal County Counsel Costs			223.20
10/18/2007	Lot/Title Report	Lot/Title Report	1	150.00	150.00
5/1/2008	Lot/Title Report	Lot/Title Report	1	150.00	150.00
2/22/2011	Lot Book Report			120.00	120.00
			<b>Subtotal</b>		
			<b>Payments/Credits</b>		
			<b>Total</b>		

I affirm and declare under penalty of perjury under the laws of the State of California that the foregoing is true and correct.

Code Enforcement Department

EXHIBIT NO.     A4



# County of Riverside Code Enforcement Department

P.O. Box 1469, Riverside, CA 92502  
Phone: (951) 955-2004 Fax: (951) 955-8680  
demands@rctlma.org

## Statement of Expense

572100030  
KENNETH D BERTRAND  
DARLENE BERTRAND  
105 GERONIMO ST  
PALM SPRINGS CA. 92264

Date	Invoice #
2/22/2011	100453

Property Address
572100030 KENNETH D BERTRAND DARLENE BERTRAND 38875 INDIAN RD ANZA, CA 92539

Case Number	District	Class
CV067365	3	SOE

Date	Item	Description	Hours/Qty	Rate	Amount
		Subtotal Contractor Costs			420.00
			<b>Subtotal</b>		\$1,032.50
			<b>Payments/Credits</b>		\$0.00
			<b>Total</b>		\$1,032.50

I affirm and declare under penalty of perjury under the laws of the State of California that the foregoing is true and correct.

*[Signature]*  
Code Enforcement Department

EXHIBIT NO.   A<sup>5</sup>





**PROOF OF SERVICE**  
Case Nos. CV06-7213 & CV06-7365

STATE OF CALIFORNIA, COUNTY OF RIVERSIDE

I, Brenda G. Peeler, declare that I am a citizen of the United States and am employed in the County of Riverside, over the age of 18 years and not a party to the within action or proceeding; that my business address is 3960 Orange Street, Suite 500, Riverside, California 92501.

That on March 22, 2011, I served the following document(s):

- NOTICE OF HEARING RE: STATEMENT OF EXPENSE
- STATEMENT OF EXPENSE

by placing a true copy thereof enclosed in a sealed envelope(s) addressed as follows:

**OWNERS OR INTERESTED PARTIES  
(SEE NOTICE LIST ATTACHED TO NOTICE OF HEARING)**

XX **BY CERTIFIED MAIL, RETURN RECEIPT REQUESTED.** I am "readily familiar" with the office's practice of collection and processing correspondence for mailing. Under that practice it would be deposited with the U.S. Postal Service on that same day with postage thereon fully prepaid at Riverside, California, in the ordinary course of business.

\_\_\_ **BY PERSONAL SERVICE:** I caused to be delivered such envelope(s) by hand to the offices of the addressee(s).

XX **STATE - I declare under penalty of perjury under the laws of the State of California that the above is true and correct.**

\_\_\_ **FEDERAL - I declare that I am employed in the office of a member of the bar of this court at whose direction the service was made.**

EXECUTED ON March 22, 2011, at Riverside, California.

  
\_\_\_\_\_  
BRENDA G. PEELER

EXHIBIT NO.                     A7



**CODE ENFORCEMENT DEPARTMENT  
COUNTY OF RIVERSIDE**

GLENN BAUDE  
Director

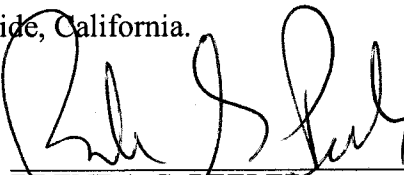
**AFFIDAVIT OF POSTING OF NOTICES**

March 23, 2011

RE CASE NO: CV067213

I, Ariana Meza, hereby declare:

I am employed by the Riverside County Code Enforcement Department; that my business address is 39493 Los Alamos Road, Suite #A, Murrieta, California 92563 .

That on 03/23/2011 at 10:37am, I securely and conspicuously posted SOE Packet (Notice of Hearing RE: Statement of Expense, Summary Statement, Statement of Expense x3, Notice List & Proof of Service) at the property described as:

**Property Address:** 38875 INDIAN RD, ANZA

**Assessor's Parcel Number:** 572-100-030

I declare under the penalty of perjury that the foregoing is true and correct.

Executed on March 23, 2011 in the County of Riverside, California.

CODE ENFORCEMENT DEPARTMENT

  
By: Ariana Meza, Code Enforcement Technician

EXHIBIT NO. AS



**CODE ENFORCEMENT DEPARTMENT  
COUNTY OF RIVERSIDE**

GLENN BAUDE  
Director

**AFFIDAVIT OF POSTING OF NOTICES**

March 23, 2011

RE CASE NO: CV067365

I, Ariana Meza, hereby declare:

I am employed by the Riverside County Code Enforcement Department; that my business address is 39493 Los Alamos Road, Suite #A, Murrieta, California 92563 .

That on 03/23/2011 at 10:37am, I securely and conspicuously posted SOE Packet (Notice of Hearing RE: Statement of Expense, Summary Statement, Statement of Expense x3, Notice List & Proof of Service) at the property described as:

**Property Address:** 38875 INDIAN RD, ANZA

**Assessor's Parcel Number:** 572-100-030

I declare under the penalty of perjury that the foregoing is true and correct.

Executed on March 23, 2011 in the County of Riverside, California.

CODE ENFORCEMENT DEPARTMENT

  
By: Ariana Meza, Code Enforcement Technician

EXHIBIT NO.     A<sup>9</sup>



# COUNTY OF RIVERSIDE CODE ENFORCEMENT

P.O. Box 1469, Riverside, CA 92502  
Phone: 951-955-2004 Fax: 951-955-8680

Property Reference/Mailing Address
572100030 KENNETH D BERTRAND DARLENE BERTRAND 105 GERONIMO ST PALM SPRINGS CA. 92264

## Summary Statement As of: 2/22/2011

Date	Invoice Number & Amount	Amount	Balance
02/22/2011	CV067213- INV #100454. Orig. Amount \$454.30.	454.30	454.30
02/22/2011	CV067365- INV #100453. Orig. Amount \$1,032.50.	1,032.50	1,486.80
<b>Balance Due</b>			<b>\$1,486.80</b>

I affirm and declare under penalty of perjury under the laws of the State of California that the foregoing is true and correct.

  
Code Enforcement Department

EXHIBIT NO. B

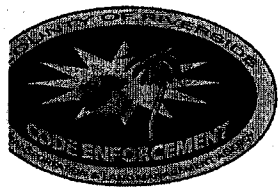

# County of Riverside Code Enforcement Department

P.O. Box 1469, Riverside, CA 92502  
Phone: (951) 955-2004 Fax: (951) 955-8680  
demands@rctlma.org

## Statement of Expense

572100030  
KENNETH D BERTRAND  
DARLENE BERTRAND  
105 GERONIMO ST  
PALM SPRINGS CA. 92264

Date	Invoice #
2/22/2011	100454

Property Address
572100030 KENNETH D BERTRAND DARLENE BERTRAND 38875 INDIAN RD ANZA, CA 92539

Case Number	District	Class
CV067213	3	SOE

Date	Item	Description	Hours/Qty	Rate	Amount
11/28/2006	Officer Hours	Labor Charges - Officer Time	1.5	109.00	163.50
5/16/2008	Officer Hours	Labor Charges - Officer Time	0.3	109.00	32.70
7/2/2008	Officer Hours	Labor Charges - Officer Time	0.3	109.00	32.70
8/13/2008	Officer Hours	Labor Charges - Officer Time	0.3	109.00	32.70
10/15/2008	Officer Hours	Labor Charges - Officer Time	0.3	109.00	32.70
2/22/2011	SOE Preparation	Prepare Statement of Expense		65.00	65.00
		Subtotal Code Enforcement Costs			359.30
12/31/2006	Lot/Title Report	Lot/Title Report	1	95.00	95.00
		Subtotal Contractor Costs			95.00
				<b>Subtotal</b>	\$454.30
				<b>Payments/Credits</b>	\$0.00
				<b>Total</b>	\$454.30

I hereby affirm and declare under penalty of perjury under the laws of the State of California that the foregoing is true and correct.

Code Enforcement Department

EXHIBIT NO. B<sup>2</sup>



# County of Riverside Code Enforcement Department

P.O. Box 1469, Riverside, CA 92502  
Phone: (951) 955-2004 Fax: (951) 955-8680  
demands@rctlma.org

## Statement of Expense

572100030  
KENNETH D BERTRAND  
DARLENE BERTRAND  
105 GERONIMO ST  
PALM SPRINGS CA. 92264

Date	Invoice #
2/22/2011	100453

Property Address
572100030 KENNETH D BERTRAND DARLENE BERTRAND 38875 INDIAN RD ANZA, CA 92539

Case Number	District	Class
CV067365	3	SOE

Date	Item	Description	Hours/Qty	Rate	Amount
5/16/2008	Officer Hours	Labor Charges - Officer Time	0.3	109.00	32.70
7/2/2008	Officer Hours	Labor Charges - Officer Time	0.3	109.00	32.70
10/15/2008	Officer Hours	Labor Charges - Officer Time	0.3	109.00	32.70
3/6/2009	Officer Hours	Labor Charges - Officer Time	0.3	109.00	32.70
6/24/2009	Officer Hours	Labor Charges - Officer Time	0.3	109.00	32.70
6/24/2009	Officer Hours	Labor Charges - Officer Time	0.3	109.00	32.70
7/20/2009	Officer Hours	Labor Charges - Officer Time	0.3	109.00	32.70
9/8/2009	Officer Hours	Labor Charges - Officer Time	0.3	109.00	32.70
1/25/2010	Officer Hours	Labor Charges - Officer Time	0.2	109.00	21.80
1/28/2010	Officer Hours	Labor Charges - Officer Time	0.1	82.00	8.20
2/5/2010	Officer Hours	Labor Charges - Officer Time	0.3	109.00	32.70
2/22/2011	SOE Preparation	Prepare Statement of Expense		65.00	65.00
		Subtotal Code Enforcement Costs			389.30
8/11/2008	Attorney Fees	Attorney Fees - County Counsel	0.4	69.75	27.90
2/22/2011	Prepare Case for SOE He...			125.55	125.55
	Attend SOE Hearing			69.75	69.75
		Subtotal County Counsel Costs			223.20
10/18/2007	Lot/Title Report	Lot/Title Report	1	150.00	150.00
5/1/2008	Lot/Title Report	Lot/Title Report	1	150.00	150.00
2/22/2011	Lot Book Report			120.00	120.00
<b>Subtotal</b>					
<b>Payments/Credits</b>					
<b>Total</b>					

I affirm and declare under penalty of perjury under the laws of the State of California that the foregoing is true and correct.

Code Enforcement Department



# County of Riverside Code Enforcement Department

P.O. Box 1469, Riverside, CA 92502  
Phone: (951) 955-2004 Fax: (951) 955-8680  
demands@rctlma.org

## Statement of Expense

572100030  
KENNETH D BERTRAND  
DARLENE BERTRAND  
105 GERONIMO ST  
PALM SPRINGS CA. 92264

Date	Invoice #
2/22/2011	100453

Case Number	District	Class
CV067365	3	SOE

Property Address
572100030 KENNETH D BERTRAND DARLENE BERTRAND 38875 INDIAN RD ANZA, CA 92539

Date	Item	Description	Hours/Qty	Rate	Amount
		Subtotal Contractor Costs			420.00

<b>Subtotal</b>	\$1,032.50
<b>Payments/Credits</b>	\$0.00
<b>Total</b>	\$1,032.50

I affirm and declare under penalty of perjury under the laws of the State of California that the foregoing is true and correct.

*Amey*  
Code Enforcement Department

EXHIBIT NO. BA



### Expenditure Transactions

Criteria: Post On = 7/1/2002..2/28/2011

Journal Date	Journal ID	Fund	Department	Account	Program	Project	Class	Amount	Description	Operator
<b>Fund 10000 -- General Fund</b>										
<b>Account 525440 -- Professional Services</b>										
2/14/2007	AP01100090	10000	3110200000	525440		ZCV067213		95.00	REPORTS ON PARCELS/LOTS	E129381
								95.00		
<b>Total Professional Services</b>								95.00		
<b>Total General Fund</b>								95.00		

EXHIBIT NO.         

B<sup>5</sup>

**Expenditure Transactions**

Criteria: Post On = 7/1/2002, 2/28/2011

Journal Date	Journal ID	Fund	Department	Account	Program	Project	Class	Amount	Description	Operator
<b>Fund 10000 -- General Fund</b>										
<b>Account 525440 -- Professional Services</b>										
1/9/2008	AP01185507	10000	3140100000	525440		ZCV067365		150.00	PROFESSIONAL SERVICES	E221241
10/14/2008	AP01238892	10000	3140100000	525440		ZCV067365		150.00	REPORTS ON PARCELS/LOTS: MAY I	E221241
								<u>300.00</u>		
<b>Total Professional Services</b>								<u>300.00</u>		
<b>Total General Fund</b>								<u>300.00</u>		

EXHIBIT NO. BC



# INVOICE

Order Number: 23218 Order Date: 3/8/2011

**Customer Information:**

Acct No. 1044

RIVERSIDE COUNTY TLMA-CODE ENFORCEMENT  
4080 Lemon Street  
Riverside, CA 92501

Attn: Brent Steele  
REF: CV06-7365 & CV06-7213/Angela Sarmiento  
IN RE: BERTRAND, KENNETH D.

Product and/or Service ordered for Property known as:	
<b>38875 Indian Road</b>	
<b>Anza, CA 92539</b>	
<b>DESCRIPTION:</b>	<b>FEE:</b>
Lot Book Report	\$120.00
<b>TOTAL DUE:</b>	<b>\$120.00</b>

Payment due upon receipt. Please remit to:

RZ Title Services, Inc.  
P.O. Box 1193  
Whittier, CA 90609

EXHIBIT NO. B7

Assessment Roll For the 2010-2011 Tax Year as of January 1,2010

Assessment #572100030-6		Parcel # 572100030-6	
<b>Assessee:</b>	BERTRAND KENNETH D	<b>Land</b>	56,097
<b>Assessee:</b>	BERTRAND DARLENE L	<b>Structure</b>	11,215
<b>Mail Address:</b>	105 GERONIMO ST	<b>Full Value</b>	67,312
<b>City, State Zip:</b>	PALM SPRINGS CA 92264	<b>Total Net</b>	67,312
<b>Real Property Use Code:</b>	MR		
<b>Base Year</b>	2004		
<b>Conveyance Number:</b>	0082739		
<b>Conveyance (mm/yy):</b>	2/2003		
<b>PUI:</b>	M010012		
<b>TRA:</b>	71-064		
<b>Taxability Code:</b>	0-00		
<b>ID Data:</b>	SEE ASSESSOR MAPS		
<b>Situs Address:</b>	38875 INDIAN RD ANZA CA 92539		

**View Parcel Map**

**EXHIBIT NO.**           c

RIVERSIDE COUNTY GIS

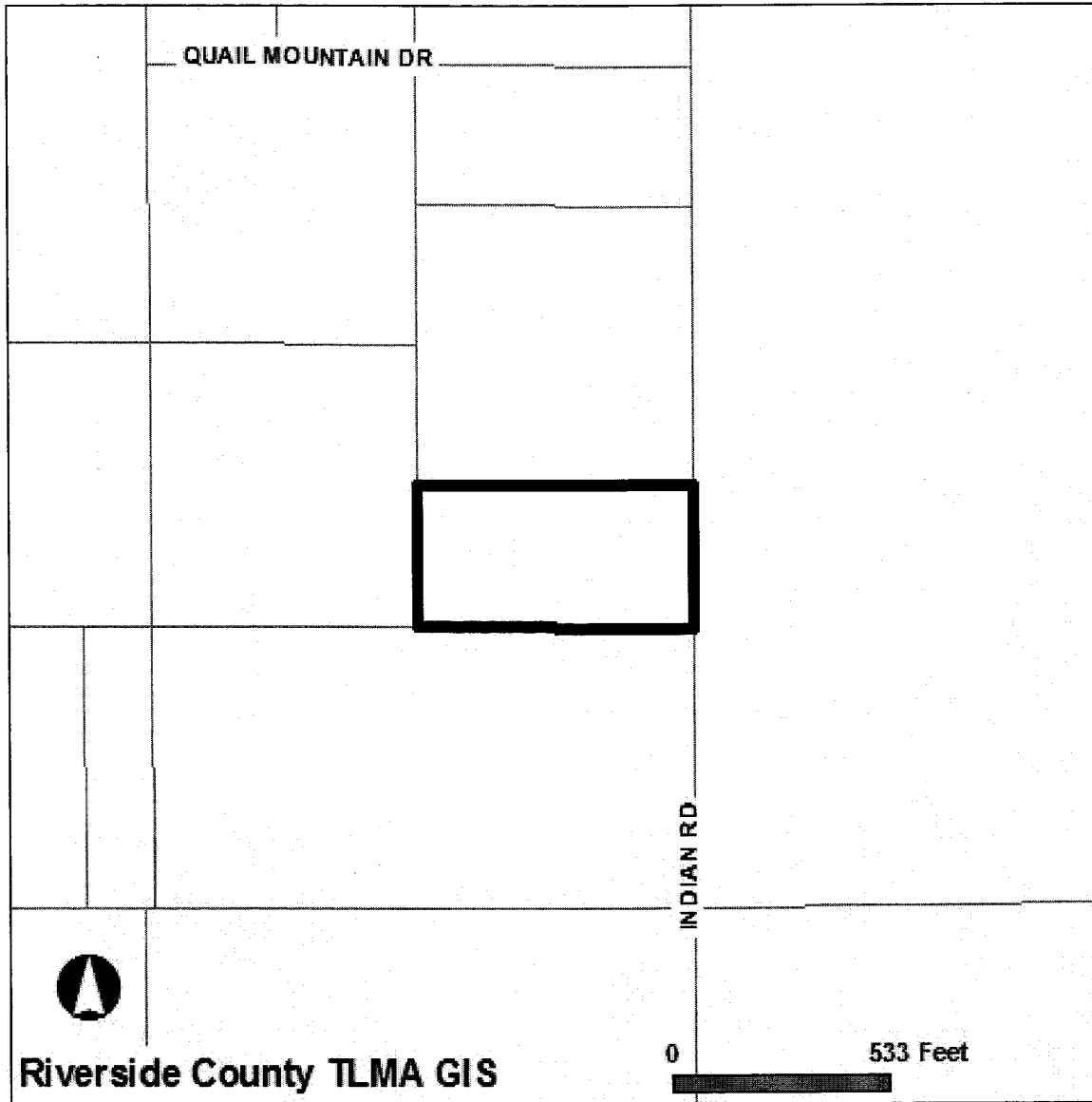

Selected parcel(s):  
572-100-030

**\*IMPORTANT\***

Maps and data are to be used for reference purposes only. Map features are approximate, and are not necessarily accurate to surveying or engineering standards. The County of Riverside makes no warranty or guarantee as to the content (the source is often third party), accuracy, timeliness, or completeness of any of the data provided, and assumes no legal responsibility for the information contained on this map. Any use of this product with respect to accuracy and precision shall be the sole responsibility of the user.

STANDARD REPORT

**APNs**

572-100-030-6

**OWNER NAME / ADDRESS**

KENNETH D BERTRAND  
DARLENE BERTRAND  
38875 INDIAN RD  
ANZA, CA. 92539

**MAILING ADDRESS**

(SEE OWNER)  
105 GERONIMO ST  
PALM SPRINGS CA. 92264

EXHIBIT NO.     C<sup>2</sup>

**LEGAL DESCRIPTION**

LEGAL DESCRIPTION IS NOT AVAILABLE

**LOT SIZE**

RECORDED LOT SIZE IS 5.02 ACRES

**PROPERTY CHARACTERISTICS**

WOOD FRAME, 1220 SQFT., 2 BDRM/ 2 BATH, 1 STORY, CONST'D 1971 COMPOSITION, ROOF, CENTRAL HEATING, CENTRAL COOLING

**THOMAS BROS. MAPS PAGE/GRID**

PAGE: 933 GRID: J4

**CITY BOUNDARY/SPHERE**NOT WITHIN A CITY  
NOT WITHIN A CITY SPHERE  
NO ANNEXATION DATE AVAILABLE  
NO LAFCO CASE # AVAILABLE  
NO PROPOSALS**MARCH JOINT POWERS AUTHORITY**

NOT IN THE JURISDICTION OF THE MARCH JOINT POWERS AUTHORITY

**INDIAN TRIBAL LAND**

NOT IN A TRIBAL LAND

**SUPERVISORIAL DISTRICT (ORD. 813)**

JEFF STONE, DISTRICT 3

**TOWNSHIP/RANGE**

T7SR2E SEC 15

**ELEVATION RANGE**

3704/3772 FEET

**PREVIOUS APN**

NO DATA AVAILABLE

---

***PLANNING***

---

**LAND USE DESIGNATIONS**Zoning not consistent with the General Plan.  
RR**AREA PLAN (RCIP)**

REMAP

**GENERAL PLAN POLICY OVERLAYS**

NOT IN A GENERAL PLAN POLICY OVERLAY AREA

**GENERAL PLAN POLICY AREAS**

NONE

**ZONING CLASSIFICATIONS (ORD. 348)**

R-R-5 (CZ 4717)

**ZONING DISTRICTS AND ZONING AREAS**

CAHUILLA AREA

**ZONING OVERLAYS**

NOT IN A ZONING OVERLAY

**SPECIFIC PLANS**

NOT WITHIN A SPECIFIC PLAN

**AGRICULTURAL PRESERVE**

NOT IN AN AGRICULTURAL PRESERVE

**REDEVELOPMENT AREAS**

NOT IN A REDEVELOPMENT AREA

**AIRPORT INFLUENCE AREAS**

NOT IN AN AIRPORT INFLUENCE AREA

**AIRPORT COMPATIBILITY ZONES**

NOT IN AN AIRPORT COMPATIBILITY ZONE

**CVMSHCP (COACHELLA VALLEY MULTI-SPECIES HABITAT CONSERVATION PLAN) CONSERVATION AREA**  
NOT IN A CONSERVATION AREA

**CVMSHCP FLUVIAL SAND TRANSPORT SPECIAL PROVISION AREAS**  
NOT IN A FLUVIAL SAND TRANSPORT SPECIAL PROVISION AREA

**WRMSHCP (WESTERN RIVERSIDE COUNTY MULTI-SPECIES HABITAT CONSERVATION PLAN) CELL GROUP**  
NOT IN A CELL GROUP

**WRMSHCP CELL NUMBER**  
NOT IN A CELL

**HANS/ERP (HABITAT ACQUISITION AND NEGOTIATION STRATEGY/EXPEDITED REVIEW PROCESS)**  
NONE

**VEGETATION (2005)**  
Chaparral  
Desert Scrub  
Developed/Disturbed Land

***FIRE***

**HIGH FIRE AREA (ORD. 787)**  
IN HIGH FIRE AREA - Grading And Building Permit Applications Require Fire Dept Clearance Prior To Permit Issuance.

**FIRE RESPONSIBILITY AREA**  
STATE RESPONSIBILITY AREA

***DEVELOPMENT FEES***

**CVMSHCP FEE AREA (ORD. 875)**  
NOT WITHIN THE COACHELLA VALLEY MSHCP FEE AREA

**WRMSHCP FEE AREA (ORD. 810)**  
IN OR PARTIALLY WITHIN THE WESTERN RIVERSIDE MSHCP FEE AREA. SEE MAP FOR MORE INFORMATION.

**ROAD & BRIDGE DISTRICT**  
NOT IN A DISTRICT

**EASTERN TUMF (TRANSPORTATION UNIFORM MITIGATION FEE ORD. 673)**  
NOT WITHIN THE EASTERN TUMF FEE AREA

**WESTERN TUMF (TRANSPORTATION UNIFORM MITIGATION FEE ORD. 824)**  
NOT WITHIN THE WESTERN TUMF FEE AREA

**DIF (DEVELOPMENT IMPACT FEE AREA ORD. 659)**  
REMAP

**SKR FEE AREA (STEPHEN'S KANGAROO RAT ORD. 663.10)**  
NOT WITHIN AN SKR FEE AREA.

**DEVELOPMENT AGREEMENTS**  
NOT IN A DEVELOPMENT AGREEMENT AREA

***TRANSPORTATION***

**CIRCULATION ELEMENT ULTIMATE RIGHT-OF-WAY**  
NOT IN A CIRCULATION ELEMENT RIGHT-OF-WAY

**ROAD BOOK PAGE**  
161

**TRANSPORTATION AGREEMENTS**  
NOT IN A TRANSPORTATION AGREEMENT

**CETAP (COMMUNITY AND ENVIRONMENTAL TRANSPORTATION ACCEPTABILITY PROCESS) CORRIDORS**  
NOT IN A CETAP CORRIDOR.

**FLOOD PLAIN REVIEW**

NOT REQUIRED.

**WATER DISTRICT**

DATA NOT AVAILABLE

**FLOOD CONTROL DISTRICT**

RIVERSIDE COUNTY FLOOD CONTROL DISTRICT

**WATERSHED**

SANTA MARGARITA

---

**GEOLOGIC**

---

**FAULT ZONE**

NOT IN A FAULT ZONE

**FAULTS**

NOT WITHIN A 1/2 MILE OF A FAULT

**LIQUEFACTION POTENTIAL**

VERY HIGH

**SUBSIDENCE**

SUSCEPTIBLE

**PALEONTOLOGICAL SENSITIVITY**

LOW POTENTIAL.

FOLLOWING A LITERATURE SEARCH, RECORDS CHECK AND A FIELD SURVEY, AREAS MAY BE DETERMINED BY A QUALIFIED VERTEBRATE PALEONTOLOGIST AS HAVING LOW POTENTIAL FOR CONTAINING SIGNIFICANT PALEONTOLOGICAL RESOURCES SUBJECT TO ADVERSE IMPACTS.

---

**MISCELLANEOUS**

---

**SCHOOL DISTRICT**

HEMET UNIFIED

**COMMUNITIES**

ANZA

**COUNTY SERVICE AREA**

NOT IN A COUNTY SERVICE AREA.

**LIGHTING (ORD. 655)**

ZONE B, 15.21 MILES FROM MT. PALOMAR OBSERVATORY

**2000 CENSUS TRACT**

044402

**FARMLAND**

LOCAL IMPORTANCE

OTHER LANDS

**TAX RATE AREAS**

071-064

- COUNTY FREE LIBRARY
- COUNTY STRUCTURE FIRE PROTECTION
- COUNTY WASTE RESOURCE MGMT DIST
- CSA 152
- CSA 153
- ELS MURRIETA ANZA RESOURCE CONS
- FLOOD CONTROL ADMINISTRATION
- FLOOD CONTROL ZONE 7
- GENERAL
- GENERAL PURPOSE
- HEMET UNIFIED SCHOOL
- MT SAN JACINTO JUNIOR COLLEGE
- RIV CO REG PARK & OPEN SPACE
- RIV. CO. OFFICE OF EDUCATION
- VALLEY HEALTH SYSTEM HOSP DIST

**SPECIAL NOTES**



NO SPECIAL NOTES

**CODE COMPLAINTS**

Case #	Description	Start Date
CV1101001	NEIGHBORHOOD ENFORCEMENT	Feb. 9, 2011

REPORT PRINTED ON...Tue Feb 22 16:07:09 2011  
Version 101221



P.O. Box 1193  
 Whittier, CA 90609  
 Tel # (562) 325-8351  
 Fax # (714) 783-3038

## Lot Book Report

Order Number: **23218**

**Customer:**

RIVERSIDE COUNTY TLMA-CODE INFORCEMENT  
 4080 Lemon Street  
 Riverside CA 92501

Order Date: 3/8/2011  
 Dated as of: 3/3/2011  
 County Name: Riverside

Attn: Brent Steele  
 Reference: CV06-7365 & CV06-7213/Angela Sarmiento  
 IN RE: BERTRAND, KENNETH D.

FEE(s):  
 Report: \$120.00

Property Address: 38875 Indian Road  
 Anza CA 92539

Assessor's Parcel No. : 572-100-030-6

**Assessments:**

Land Value:	\$56,097.00
Improvement Value:	\$11,215.00
Exemption Value:	\$0.00
Total Value:	\$67,312.00

### Tax Information

Property Taxes for the Fiscal Year	2010-2011
First Installment	\$432.61
Penalty	\$0.00
Status	PAID (PAID THRU 01/31/2011)
Second Installment	\$432.61
Penalty	\$0.00
Status	OPEN NOT-PAID (DUE DATE 04/10/2011)

EXHIBIT NO.     D



P.O. Box 1193  
Whittier, CA 90609  
Tel # (562) 325-8351  
Fax # (714) 783-3038

Order Number: 23218

Reference: CV06-7365 & CV0

## Property Vesting

The last recorded document transferring title of said property

Dated	01/15/2003
Recorded	02/04/2003
Document No.	2003-082739
D.T.T.	\$66.00
Grantor	Vincent Bernard, a single man
Grantee	Kenneth D. Bertrand and Darlene L. Bertrand, husband and wife as joint tenants

## Deeds of Trust

Position No.	1st
A Deed of Trust Dated	05/12/2004
Recorded	05/21/2004
Document No.	2004-0385291
Amount	\$60,000.00
Trustor	Kenneth D. Bertrand and Darlene L. Bertrand, husband and wife as joint tenants
Trustee	Fidelity National Title Company, a California Corporation
Beneficiary	Robert P. Zimmer, a married man as his sole and separate property

Assignment Dated	03/10/2006
Recorded	03/28/2006
Document No.	2006-0216872
Assigned to	Robert P. Zimmer, trustee of the 2006 Zimmer Family Trust dated March 10, 2006

Position No.	2nd
A Deed of Trust Dated	10/06/2008
Recorded	2008-0549210



P.O. Box 1193  
Whittier, CA 90609  
Tel # (562) 325-8351  
Fax # (714) 783-3038

Order Number: 23218  
Reference: CV06-7365 & CV0

---

Document No.	2008-0549210
Amount	\$92,700.00
Trustor	Kenneth D. Bertrand and Darlene L. Bertrand, husband and wife as joint tenants
Trustee	First American Title Insurance Company, a California Corporation
Beneficiary	Robert P. Zimmer, Trustee of his Successors under Declaration of Trust dated March 10, 2006 for the benefit of the 2006 Zimmer Family Trust

### Additional Information

Notice of Non-Compliance filed by In the matter of the property of Case No. Recorded Document No.	County of Riverside Department of Code Enforcement Kenneth Bertrand CV06-7365 05/30/2008 2008-0295459
Notice of Non-Compliance filed by In the matter of the property of Case No. Recorded Document No.	County of Riverside Department of Code Enforcement Kenneth Bertrand CV06-7213 05/30/2008 2008-0295460
Abstract of Judgment Filed in the Case No. Recorded Document No. Amount Debtor Creditor	Superior Court of California, Riverside County - Civil Division "Limited Jurisdiction" RIC357939 05/30/2001 2001-238061 \$7,927.31 Kenneth Bertrand and Darlene Bertrand Bank of America National Trust and Savings Association
Abstract of Judgment Filed in the Case No. Recorded	Superior Court of California, County of Riverside - Hemet Dept. HEC023587 06/15/2007



P.O. Box 1193  
Whittier, CA 90609  
Tel # (562) 325-8351  
Fax # (714) 783-3038

Order Number: 23218  
Reference: CV06-7365 & CV0

---

Document No.	2007-0395318
Amount	\$2,484.12
Debtor	Kenneth Bertrand; et al
Creditor	Target National Bank

### Legal Description

THE LAND REFERRED TO IN THIS REPORT IS LOCATED IN AND IS DESCRIBED AS FOLLOWS:

THE SOUTH HALF OF THE NORTHEAST QUARTER OF GOVERNMENT LOT 8 IN SECTION 15, TOWNSHIP 7 SOUTH, RANGE 2 EAST, SAN BERNARDINO MERIDIAN, IN THE COUNTY OF RIVERSIDE, STATE OF CALIFORNIA, ACCORDING TO THE OFFICIAL PLAT THEREOF EXCEPT ANY MOBILE HOME OR MANUFACTURED HOUSING UNIT AND APPURTENANCES, IF ANY, LOCATED ON SAID LAND.