

**SUBMITTAL TO THE BOARD OF SUPERVISORS
COUNTY OF RIVERSIDE, STATE OF CALIFORNIA**

204B



FROM: County Counsel/TLMA
Code Enforcement Department

SUBMITTAL DATE:
March 31, 2011

SUBJECT: Abatement of Public Nuisance [Substandard Structures]
Case No. : CV10-06142 [SANCHEZ]
Subject Property: 1 Parcel West of 21950 Salter Rd., Lake Mathews;
APN: 323-020-020

District: One

RECOMMENDED MOTION: Move that:

1. The two (2) substandard structures on the real property located at 1 Parcel West of 21950 Salter Rd., Lake Mathews, Riverside County, California, APN: 323-020-020 be declared a public nuisance and a violation of Riverside County Ordinance No. 457 which does not permit substandard structures on the property.
2. Roberto Sanchez, the owner of the subject real property or whoever has possession or control of the premises, be directed to abate the substandard structures on the property by removing the same from the real property within ninety (90) days.

[Handwritten Signature]

(Continued)

L. ALEXANDRA FONG, Deputy County Counsel
for PAMELA J. WALLS, County Counsel

FINANCIAL DATA	Current F.Y. Total Cost:	\$ N/A	In Current Year Budget:	N/A
	Current F.Y. Net County Cost:	\$ N/A	Budget Adjustment:	N/A
	Annual Net County Cost:	\$ N/A.	For Fiscal Year:	N/A

SOURCE OF FUNDS:	Positions To Be Deleted Per A-30	<input type="checkbox"/>
	Requires 4/5 Vote	<input type="checkbox"/>

C.E.O. RECOMMENDATION: APPROVE
BY: *[Handwritten Signature]*
Tina Grande
County Executive Office Signature

ATTACHMENTS FILED WITH THE CLERK OF THE BOARD

Departmental Concurrence

Consent Policy
 Consent Policy

MINUTES OF THE BOARD OF SUPERVISORS

On motion of Supervisor Buster, seconded by Supervisor Benoit and duly carried by unanimous vote, IT WAS ORDERED that the above matter is approved as recommended.

Ayes: Buster, Tavaglione, Stone, Benoit and Ashley
Nays: None
Absent: None
Date: April 12, 2011
xc: Co. Co., CED, Prop. Owner, Sheriff

Kecia Harper-Ihem
 Clerk of the Board
 By: *[Handwritten Signature]*
 Deputy

SUB 2011-2 LN 2: 19
 COUNTY OF RIVERSIDE

9.1

Dep't Recomm.:
 Per Exec. Ofc.:

Abatement of Public Nuisance

Case No.: CV10-06142 [SANCHEZ]

1 Parcel west of 21950 Salter Rd., Lake Mathews

District One

APN: 323-020-020

Page 2

3. The owner be ordered to ascertain the existence or non-existence of asbestos containing materials in said structures by survey and materials sample testing through the Industrial Hygiene Specialist of the County Health Department, Division of Special Services; and, prior to the abatement ordered in paragraph number two (2) above, to secure the removal and disposal of all asbestos containing materials discovered through such survey and testing by contract with a duly certified and licensed contractor for the handling of such materials to avoid citations and/or fines imposed by the South Coast Air Quality Management District (SCAQMD) pursuant to SCAQMD Rule No. 1403.

4. If the owner or whoever has possession or control of the real property does not take the above described action within ninety (90) days of the date of the Board's Order to Abate, that representatives of the Code Enforcement Department, Sheriff's Department, and/or a contractor, upon consent of the owner or receipt of a Court Order authorizing entry onto the real property when necessary under applicable law, may abate the substandard structure and contents therein, by removing the same from the real property.

5. The reasonable costs of abatement, after notice and an opportunity for hearing, shall be imposed as a lien on the real property, which may be collected as a special assessment against the real property pursuant to Government Code Section 25845 and Ordinance No. 725.

6. County Counsel be directed to prepare the necessary Findings of Facts and Conclusions that the substandard structure on the real property is declared to be in violation of Riverside County Ordinance No. 457 and a public nuisance, and further, to prepare an Order to Abate for approval by the Board.

BACKGROUND:

1. An inspection was made of the subject property by the Code Enforcement Officer on July 1, 2010. The inspections revealed two (2) substandard structures (main dwelling/house and well shed) on the subject property in violation of Riverside County Ordinance No. 457 (RCC Title 15). The substandard conditions of the structures included, but were not limited to, the following: lack of improper water closet, lavatory, bathtub, shower or kitchen sink; lack of hot and cold running water to plumbing fixtures; lack of connection to required sewage system; lack of required electrical lighting; lack of adequate heating facilities; defective or deteriorated flooring or floor supports; members of ceilings, roofs, ceiling and roof supports or other horizontal members which sag, split or buckle due to defective material or deterioration; dampness of habitable rooms; faulty weather protection; general dilapidation or improper maintenance; and public and attractive nuisance – abandoned/vacant.
2. Follow-up inspections on August 25, 2010 and March 30, 2011, revealed that the property continues to be in violation of Riverside County Ordinance No. 457.

Abatement of Public Nuisance
Case No.: CV10-06142 [SANCHEZ]
1 Parcel west of 21950 Salter Rd., Lake Mathews
District One
APN: 323-020-020
Page 3

3. Staff and the Code Enforcement Department have complied with the notice requirements set forth in the appropriate laws of this jurisdiction pertaining to the administrative abatement proceedings for substandard structures.

Harper-Ihem, Kecia

From: Peeler, Brenda Gayl [BPEELER@rctlma.org]
Sent: Tuesday, April 12, 2011 8:10 AM
To: Harper-Ihem, Kecia; Fong, Alexandra; Black, Brian
Cc: Rector, Kimberly
Subject: RE: 9.1 of 04/12/2011

Good morning,

I just pulled the file and reviewed the GIS ... I believe you are correct. This should be District #1. I will advise the paralegals.

Would you like for us to make the correction?

From: Harper-Ihem, Kecia [<mailto:KHarper-Ihem@rcbos.org>]
Sent: Tuesday, April 12, 2011 8:07 AM
To: Peeler, Brenda Gayl; Fong, Alexandra; Black, Brian
Cc: Rector, Kimberly
Subject: 9.1 of 04/12/2011
Importance: High

Third District Board staff believes this is not in their district, however, the Form 11 states 3rd.

Please advise.

Thanks,
Kecia



Kecia Harper-Ihem
Clerk of the Board
Riverside County, Ca
ph. 951.955.1061 fax 951.955.1071
kharper-ihem@rcbos.org

We will open the book. Its pages are blank. We are going to put words on them ourselves. The book is called Opportunity and its first chapter is New Year's Day. ~Edith Lovejoy Pierce

**Effective August 14, 2009 the County Administrative Center will be closed every Friday until further notice.
Business hours for the Clerk of the Board Office will be Monday through Thursday, 7:30 a.m. to 5:00 p.m.**

This email message, including any attachments, is intended for the sole viewing and use of the individual or entity to which it is addressed, and may contain confidential and privileged information, which is prohibited from disclosure. Any unauthorized review, use, disclosure, distribution, or the taking of any action in reliance on the information contained in this email, including attachments, is prohibited. If you are not the intended recipient, you are hereby notified that any dissemination or copy of this message, or any attachments, is prohibited. If you have received a copy of this email in error, please notify the sender by reply email immediately, and remove all copies of the original message, including attachments, from your computer.

1
2
3
4
5
6
7
8
9
10
11
12
13
14
15
16
17
18
19
20
21
22
23
24
25
26
27
28

**BOARD OF SUPERVISORS
COUNTY OF RIVERSIDE**

IN RE ABATEMENT OF PUBLIC NUISANCE) CASE NO. CV 10-06142
[SUBSTANDARD STRUCTURES]; APN: 323-)
020-020, 1 PARCEL WEST OF 21950 SALTER) DECLARATION OF OFFICER
RD., LAKE MATHEWS, COUNTY OF) RON WELCH
RIVERSIDE, STATE OF CALIFORNIA;)
ROBERTO SANCHEZ,) [R.C.O. No. 457, RCC Title 15]
OWNER.)

I, Ron Welch, declare:

1. I am currently employed by the Riverside County Code Enforcement Department as a Code Enforcement Officer. My current official duties include inspecting property for violations and enforcement of the provisions of Riverside County Ordinances. The following facts contained within this declaration are within my personal knowledge except to the extent that certain information is based on information and belief and if called as a witness in this matter, I could and would competently testify thereto.

2. On July 1, 2010, Code Enforcement Officer Jon Kirchoff and I conducted an initial inspection of the real property known as 1 Parcel west of 21950 Salter Rd., Lake Mathews, Riverside County, California, which is further described as Assessor's Parcel Number 323-020-020 (hereinafter described as "THE PROPERTY"). A true and correct copy of a Thomas Brothers map page indicating the approximate location of THE PROPERTY is attached hereto as Exhibit "A."

3. A review of County records and documents disclosed that THE PROPERTY was owned by Roberto Sanchez (hereinafter referred to as "OWNER"). A certified copy of the County Equalized Assessment Roll for the year 2010-2011 and a report generated from the County Geographic Information System ("GIS") are attached hereto as Exhibit "B" and incorporated herein by reference.

4. Based on the Lot Book Report from RZ Title Service on August 19, 2010 and updated on February 8, 2011, it is determined that other parties potentially hold a legal interest in THE PROPERTY, to-wit: American Raisin Packers, Inc. c/o Wild Carter & Tipton, APC; State of California Franchise Tax Board; and Internal Revenue Service ("INTERESTED PARTIES"). A true and correct copy of the Lot Book Report is attached hereto and incorporated herein as Exhibit "C."

5. On July 1, 2010, Code Enforcement Officer Jon Kirchoff and I arrived at THE

1 PROPERTY to conduct an initial inspection. THE PROPERTY was open and accessible with no signs
2 restricting our access. We entered and observed the following conditions as described below which
3 caused the main dwelling/house and well shed to be substandard and THE PROPERTY to constitute a
4 public nuisance in violation of the provisions set forth in Riverside County Ordinance 457, as codified in
5 Riverside County Code Title 15.

6 Structure #1 (Main dwelling/house):

- 7 1) Lack of improper water closet, lavatory, bathtub, shower or kitchen sink;
- 8 2) Lack of hot and cold running water to plumbing fixtures;
- 9 3) Lack of connection to required sewage system;
- 10 4) Lack of required electrical lighting;
- 11 5) Lack of adequate heating facilities;
- 12 6) Defective or deteriorated flooring or floor supports;
- 13 7) Members of ceilings, roofs, ceiling and roof supports or other horizontal members which
14 sag, split, or buckle due to defective material or deterioration;
- 15 8) Dampness of habitable rooms;
- 16 9) Faulty weather protection – deteriorated or ineffective weather proofing of exterior walls,
17 roof or floors including broken windows or doors, lack of paint or other approved wall
18 covering;
- 19 10) General dilapidation or improper maintenance; and
- 20 11) Public and attractive nuisance – abandoned/vacant.

21 Structure #2 (Well Shed):

- 22 1) Faulty weather protection – deteriorated or ineffective weather proofing of exterior walls,
23 roof or floors including broken windows or doors, lack of paint or other approved wall
24 covering;
- 25 2) General dilapidation or improper maintenance; and
- 26 3) Public and attractive nuisance – abandoned/vacant.

27 6. On July 1, 2010, a Notice of Violation and Notice of Defects was posted on THE
28 PROPERTY for Structure #1- main dwelling/house and a Notice of Defects was posted on Structure #2 -
well shed.

7. On July 27, 2010, a Notice of Violation and Notice of Defects was mailed to OWNER via
certified mail with return receipt requested. These notices were returned as undeliverable.

8. On August 25, 2010, I went to THE PROPERTY for a follow-up inspection and found the
structures remained on THE PROPERTY.

9. On October 14, 2010, a Notice of Violation and Notice of Defects was mailed to OWNER
via certified mail with return receipt requested. These notices were returned as unclaimed.

1 10. A site plan and photographs of the condition of THE PROPERTY are attached hereto and
2 as Exhibit "D" and are incorporated herein by reference.

3 11. True and correct copies of each Notice issued in this matter and other documentation are
4 attached hereto as Exhibit "E" and incorporated herein by reference.

5 12. Based upon my experience, knowledge and visual observations, it is my determination that
6 the substandard structures (main dwelling/house and well shed) on THE PROPERTY creates an extreme
7 health, safety, fire and structural hazard to the neighbors and general public.

8 16. A follow-up inspection on March 30, 2011 showed THE PROPERTY remained in
9 violation of Riverside County Ordinance No. 457 (RCC Title 15).

10 17. Furthermore, based on my observations of THE PROPERTY, I declare that the
11 substandard conditions of THE PROPERTY constitute a public nuisance in violation of the provisions set
12 forth in Riverside County Ordinance No. 457 (RCC Title 15).

13 18. A Notice of Noncompliance was recorded on November 16, 2010 as Document Number
14 2010-0553174 in the Office of the County Recorder, Riverside County, State of California. A true and
15 correct copy of this notice is attached hereto as Exhibit "F" and incorporated herein by reference.

16 19. On March 28, 2011, the second notice, Notice to Correct County Ordinance Violations and
17 Abate Public Nuisance, providing the notification of the Board of Supervisors' hearing was mailed to
18 OWNER and INTERESTED PARTIES by certified mail, return receipt requested and was posted on THE
19 PROPERTY on March 30, 2011. A true and correct copy of the notice, together with proof of service,
20 returned receipt card and the Affidavit of Posting of Notice are attached as Exhibit "G" and incorporated
21 herein by reference.

22 20. Significant rehabilitation, removal and /or demolition of the substandard structures and
23 removal and disposal of all structural debris are required to abate the public nuisance and bring THE
24 PROPERTY into compliance with Riverside County Ordinance Number 457 (RCC Title 15), the Health
25 and Safety, Uniform Housing, Administrative and Abatement of Dangerous Buildings Codes.

26 21. Accordingly, the following findings and conclusions are recommended:

27 (a) the structures (main dwelling/house and well shed) be condemned as substandard
28 buildings, public nuisance and attractive nuisance;

1 (b) the OWNER be required to rehabilitate or demolish said structures, including the
2 removal and disposal of all structural debris and materials, on THE PROPERTY in accordance with the
3 provisions of Riverside County Ordinance No. 457 (RCC Title 15);

4 (c) the OWNER be ordered to ascertain the existence or non-existence of asbestos
5 containing materials in said structures by survey and materials sample testing through the Industrial
6 Hygiene Specialist of the County Health Department, Division of Special Services; and, prior to the
7 abatement ordered in subsection (b) above, to secure the removal and disposal of all asbestos containing
8 materials discovered through such survey and testing by contract with a duly certified and licensed
9 contractor for the handling of such materials to avoid citations an/or fines by South Coast Air Quality
10 Management District ("SCAQMD") pursuant to SCAQMD Rule NO. 1403;

11 (d) if the substandard structures are not razed, removed and disposed of, or
12 reconstructed in strict accordance with all Riverside County Ordinances, including but not limited to
13 Riverside County Ordinance No. 457 (RCC Title 15), within ninety (90) days of the date of the Board's
14 Order to Abate, the substandard structures and contents therein may be abated by representatives of the
15 Riverside County Code Enforcement Department, a contractor or the Sheriff's Department upon receipt of
16 an owner's consent or a Court Order where necessary under applicable law authorizing entry onto THE
17 PROPERTY;

18 (e) that reasonable costs of abatement, after notice and opportunity for hearing, shall be
19 imposed as a lien on THE PROPERTY, which may be collected as a special assessment against THE
20 PROPERTY pursuant to Government Code Section 25845 and Riverside County Ordinance Nos. 457 and
21 725 (RCC Titles 15 and 1).

22 I declare under penalty of perjury under the laws of the State of California that the
23 foregoing is true and correct.

24 Executed this 4 day of April, 2011, at Perris, California.

25
26
27 
28 RON WELCH
Code Enforcement Officer
Code Enforcement Department

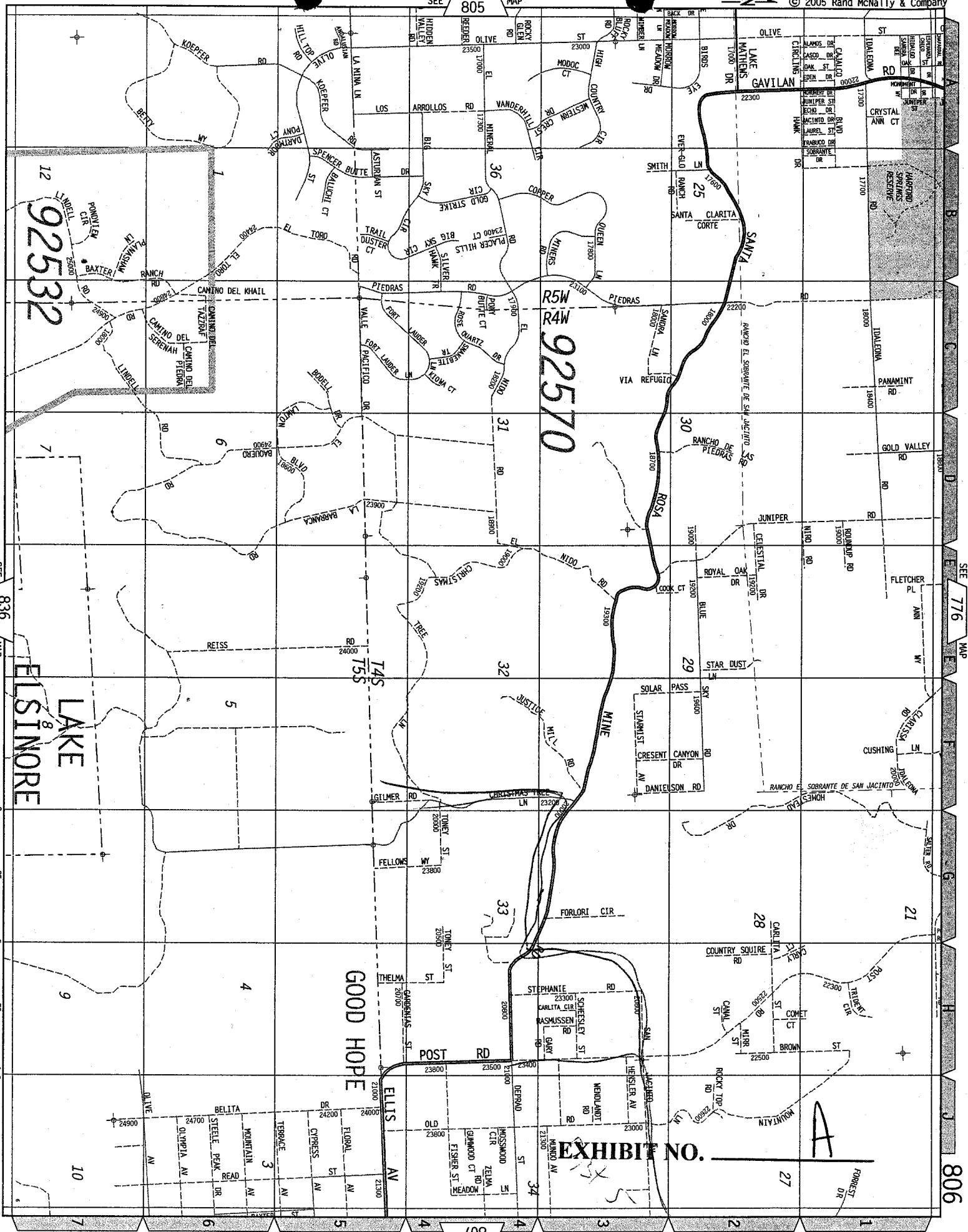

92532

R5W
R4W
92570

LAKE
ELSINORE

GOOD HOPE

EXHIBIT NO.

A

SEE 836 MAP

SEE 776 MAP

0 .25 .5 .75 1.0 miles 1 in. = 2400 ft.

Assessment Roll For the 2010-2011 Tax Year as of January 1,2010

Assessment #323020020-0		Parcel # 323020020-0	
Assessee:	SANCHEZ ROBERTO	Land	9,333
Mail Address:	1427 VINELAND AVE	Structure	153
City, State Zip:	BALDWIN PARK CA 91706	Full Value	9,486
Real Property Use Code:	YS	Total Net	9,486
Base Year	2002		
Conveyance Number:	0040787		
Conveyance (mm/yy):	1/2001		
PUI:	Y010000		
TRA:	87-023		
Taxability Code:	0-00		
ID Data:	SEE ASSESSOR MAPS		

View Parcel Map

EXHIBIT NO. B

RIVERSIDE COUNTY GIS

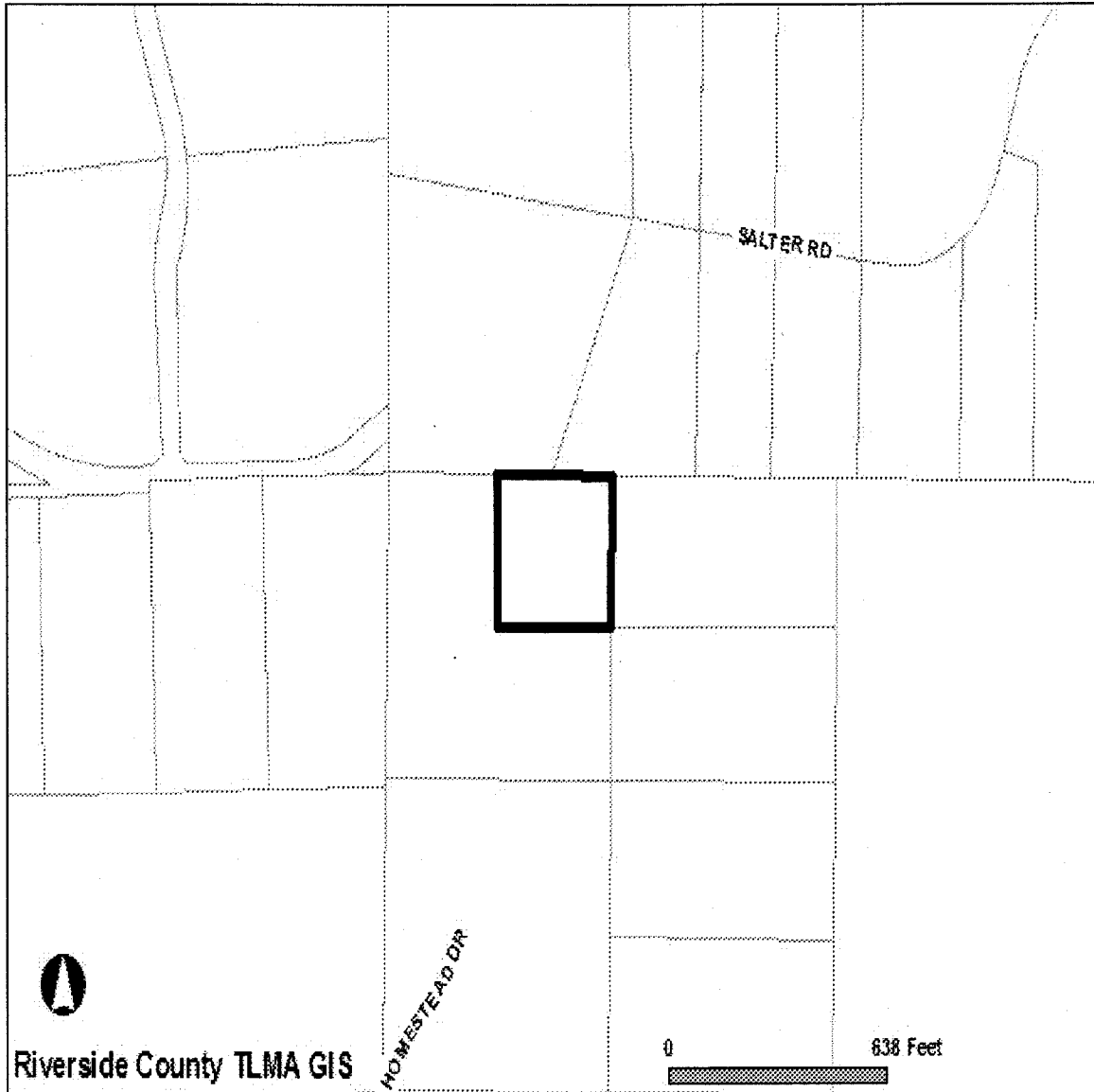

Selected parcel(s):
323-020-020

IMPORTANT

Maps and data are to be used for reference purposes only. Map features are approximate, and are not necessarily accurate to surveying or engineering standards. The County of Riverside makes no warranty or guarantee as to the content (the source is often third party), accuracy, timeliness, or completeness of any of the data provided, and assumes no legal responsibility for the information contained on this map. Any use of this product with respect to accuracy and precision shall be the sole responsibility of the user.

STANDARD WITH PERMITS REPORT

APNs

323-020-020-0

OWNER NAME / ADDRESS

ROBERTO SANCHEZ
ADDRESS NOT AVAILABLE

MAILING ADDRESS

(SEE OWNER)
1427 VINELAND AVE
BALDWIN PARK CA. 91706

LEGAL DESCRIPTION

EXHIBIT NO. B²

LEGAL DESCRIPTION IS NOT AVAILABLE

LOT SIZE

RECORDED LOT SIZE IS 2.5 ACRES

PROPERTY CHARACTERISTICS

NO PROPERTY DESCRIPTION AVAILABLE

THOMAS BROS. MAPS PAGE/GRID

PAGE: 806 GRID: F1, G1

CITY BOUNDARY/SPHERE

NOT WITHIN A CITY
CITY SPHERE: PERRIS
NO ANNEXATION DATE AVAILABLE
NO LAFCO CASE # AVAILABLE
NO PROPOSALS

MARCH JOINT POWERS AUTHORITY

NOT IN THE JURISDICTION OF THE MARCH JOINT POWERS AUTHORITY

INDIAN TRIBAL LAND

NOT IN A TRIBAL LAND

SUPERVISORIAL DISTRICT (ORD. 813)

BOB BUSTER, DISTRICT 1

TOWNSHIP/RANGE

T4SR4W SEC 28

ELEVATION RANGE

2192/2264 FEET

PREVIOUS APN

323-020-001

PLANNING

LAND USE DESIGNATIONS

Zoning not consistent with the General Plan.
RR

AREA PLAN (RCIP)

MEAD VALLEY

GENERAL PLAN POLICY OVERLAYS

NOT IN A GENERAL PLAN POLICY OVERLAY AREA

GENERAL PLAN POLICY AREAS

NONE

ZONING CLASSIFICATIONS (ORD. 348)

R-A-5 (CZ 5086)

ZONING DISTRICTS AND ZONING AREAS

MEAD VALLEY DISTRICT

ZONING OVERLAYS

NOT IN A ZONING OVERLAY

SPECIFIC PLANS

NOT WITHIN A SPECIFIC PLAN

AGRICULTURAL PRESERVE

NOT IN AN AGRICULTURAL PRESERVE

REDEVELOPMENT AREAS

NOT IN A REDEVELOPMENT AREA

AIRPORT INFLUENCE AREAS

NOT IN AN AIRPORT INFLUENCE AREA

AIRPORT COMPATIBILITY ZONES

NOT IN AN AIRPORT COMPATIBILITY ZONE

ENVIRONMENTAL

CVMSHCP (COACHELLA VALLEY MULTI-SPECIES HABITAT CONSERVATION PLAN) CONSERVATION AREA
NOT IN A CONSERVATION AREA

CVMSHCP FLUVIAL SAND TRANSPORT SPECIAL PROVISION AREAS
NOT IN A FLUVIAL SAND TRANSPORT SPECIAL PROVISION AREA

WRMSHCP (WESTERN RIVERSIDE COUNTY MULTI-SPECIES HABITAT CONSERVATION PLAN) CELL GROUP
C

WRMSHCP CELL NUMBER

2747
2859

HANS/ERP (HABITAT ACQUISITION AND NEGOTIATION STRATEGY/EXPEDITED REVIEW PROCESS)
NONE

VEGETATION (2005)

Chaparral
Coastal Sage Scrub

FIRE

HIGH FIRE AREA (ORD. 787)
IN HIGH FIRE AREA - Grading And Building Permit Applications Require Fire Dept Clearance Prior To Permit Issuance.

FIRE RESPONSIBILITY AREA
STATE RESPONSIBILITY AREA

DEVELOPMENT FEES

CVMSHCP FEE AREA (ORD. 875)
NOT WITHIN THE COACHELLA VALLEY MSHCP FEE AREA

WRMSHCP FEE AREA (ORD. 810)
IN OR PARTIALLY WITHIN THE WESTERN RIVERSIDE MSHCP FEE AREA. SEE MAP FOR MORE INFORMATION.

ROAD & BRIDGE DISTRICT
NOT IN A DISTRICT

EASTERN TUMF (TRANSPORTATION UNIFORM MITIGATION FEE ORD. 673)
NOT WITHIN THE EASTERN TUMF FEE AREA

WESTERN TUMF (TRANSPORTATION UNIFORM MITIGATION FEE ORD. 824)
IN OR PARTIALLY WITHIN A TUMF FEE AREA. SEE MAP FOR MORE INFORMATION. NORTHWEST

DIF (DEVELOPMENT IMPACT FEE AREA ORD. 659)
MEAD VALLEY

SKR FEE AREA (STEPHEN'S KANGAROO RAT ORD. 663.10)
IN OR PARTIALLY WITHIN AN SKR FEE AREA. SEE MAP FOR MORE INFORMATION.

DEVELOPMENT AGREEMENTS
NOT IN A DEVELOPMENT AGREEMENT AREA

TRANSPORTATION

CIRCULATION ELEMENT ULTIMATE RIGHT-OF-WAY
NOT IN A CIRCULATION ELEMENT RIGHT-OF-WAY

ROAD BOOK PAGE
61

TRANSPORTATION AGREEMENTS
NOT IN A TRANSPORTATION AGREEMENT

CETAP (COMMUNITY AND ENVIRONMENTAL TRANSPORTATION ACCEPTABILITY PROCESS) CORRIDORS
NOT IN A CETAP CORRIDOR.

HYDROLOGY

FLOOD PLAIN REVIEW

NOT REQUIRED.

WATER DISTRICT

EMWD

FLOOD CONTROL DISTRICT

RIVERSIDE COUNTY FLOOD CONTROL DISTRICT

WATERSHED

SAN JACINTO VALLEY

GEOLOGIC

FAULT ZONE

NOT IN A FAULT ZONE

FAULTS

NOT WITHIN A 1/2 MILE OF A FAULT

LIQUEFACTION POTENTIAL

NO POTENTIAL FOR LIQUEFACTION EXISTS

SUBSIDENCE

NOT IN A SUBSIDENCE AREA

PALEONTOLOGICAL SENSITIVITY

LOW POTENTIAL.

FOLLOWING A LITERATURE SEARCH, RECORDS CHECK AND A FIELD SURVEY, AREAS MAY BE DETERMINED BY A QUALIFIED VERTEBRATE PALEONTOLOGIST AS HAVING LOW POTENTIAL FOR CONTAINING SIGNIFICANT PALEONTOLOGICAL RESOURCES SUBJECT TO ADVERSE IMPACTS.

MISCELLANEOUS

SCHOOL DISTRICT

PERRIS & PERRIS UNION HIGH

COMMUNITIES

LAKE MATHEWS

COUNTY SERVICE AREA

NOT IN A COUNTY SERVICE AREA.

LIGHTING (ORD. 655)

ZONE B, 39.97 MILES FROM MT. PALOMAR OBSERVATORY

2000 CENSUS TRACT

042903

FARMLAND

GRAZING LAND

TAX RATE AREAS

087-023

- COUNTY FREE LIBRARY
- COUNTY STRUCTURE FIRE PROTECTION
- COUNTY WASTE RESOURCE MGMT DIST
- CSA 152
- EASTERN MUNICIPAL WATER
- FLOOD CONTROL ADMINISTRATION
- FLOOD CONTROL ZONE 4
- GENERAL
- GENERAL PURPOSE
- METRO WATER EAST 1301999
- MT SAN JACINTO JUNIOR COLLEGE
- PERRIS AREA ELEM SCHOOL FUND
- PERRIS JR HIGH AREA FUND
- PERRIS SCHOOL
- PERRIS UNION HIGH SCHOOL
- PERRIS VALLEY CEMETERY
- RIV CO REG PARK & OPEN SPACE

- RIV. CO. OFFICE OF EDUCATION
- SAN JACINTO BASIN RESOURCE CONS

SPECIAL NOTES
NO SPECIAL NOTES

CODE COMPLAINTS

Case #	Description	Start Date
CV1006142	ABATEMENT	Jul. 1, 2010

BUILDING PERMITS

ENVIRONMENTAL HEALTH PERMITS
NO ENVIRONMENTAL PERMITS

PLANNING PERMITS

REPORT PRINTED ON...Wed Jan 05 11:24:57 2011
Version 101221



INVOICE

Order Number: 23140 **Order Date:** 2/14/2011

Customer Information:

Acct No. 1044

RIVERSIDE COUNTY TLMA-CODE INFORCEMENT
4080 Lemon Street
Riverside, CA 92501

Attn: Brent Steele
REF: CV10-06142 / Brenda Peeler
IN RE: SANCHEZ, ROBERTO

Product and/or Service ordered for Property known as:	
Vacant Land	
DESCRIPTION:	FEE:
Updated Lot Book	\$60.00
TOTAL DUE:	\$60.00

Payment due upon receipt. Please remit to:

RZ Title Services, Inc.
P.O. Box 1193
Whittier, CA 90609

EXHIBIT NO. C



P.O. Box 1193
 Whittier, CA 90609
 Tel # (562) 325-8351
 Fax # (714) 783-3038

Updated Lot Book

Customer:
 RIVERSIDE COUNTY TLMA-CODE INFORCEMENT

Order Number: **23140**

4080 Lemon Street
 Riverside CA 92501

Order Date: 2/14/2011

Dated as of: 2/8/2011

County Name: Riverside

Attn: Brent Steele
 Reference: CV10-06142 / Brenda Peeler
 IN RE: SANCHEZ, ROBERTO

FEE(s):
 Report: \$60.00

Property Address: Vacant Land

CA

RZ Title Reporting Service hereby reports, as disclosed by the Official Records of the Recorder of said County as of the date shown above, that subsequent to the date of the original report that (i) No document in the chain of title to said land has been recorded purporting to convey the fee title to said land, and (ii) No encumbrances affecting said land have been recorded nor has a homestead been executed on said land, and (iii) No encumbrances affecting said land on the date of the original report have been released or reconveyed.

All exceptions are as follows:

Assessor's Parcel No. : 323-020-020-0

Assessments:	Land Value:	\$9,333.00
	Improvement Value:	\$153.00
	Exemption Value:	\$0.00
	Total Value:	\$9,486.00

Property Taxes for the Fiscal Year	2010-2011
First Installment	\$60.56
Penalty	\$6.04
Status	NOT PAID-DELINQUENT
Second Installment	\$60.56
Penalty	\$0.00
Status	OPEN NOT-PAID (DUE DATE 04/10/2011)

Notice of Non-Compliance filed by	Riverside County Code Enforcement
In the matter of the property of	Roberto Sanchez
Case No.	CV10-06142
Recorded	11/16/2010



P.O. Box 1193
Whittier, CA 90609
Tel # (562) 325-8351
Fax # (714) 783-3038

Order Number: 23140
Reference: CV10-06142 / Bre

Document No.	2010-0553174
A Notice of State Tax Lien Recorded	12/20/2010
Document No.	2010-0609860
Amount	\$7,007.16
Account No.	2300216940
Certificate No.	10343319955
Debtor	Roberto C. Sanchez
Creditor: State of California,	Franchise Tax Board
A Bankruptcy filed by	Roberto Sanchez
Social Security Number(s)	None Shown
Date filed	11/05/2010
Case No.	46066
A Bankruptcy filed by	Robert Patrick Sanchez
Social Security Number(s)	None Shown
Date filed	11/05/2010
Case No.	46014
A Bankruptcy filed by	Bobby June Sanchez
Social Security Number(s)	None Shown
Date filed	11/08/2010
Case No.	46240

NO OTHER EXCEPTIONS

When recorded please mail to:
Riverside County Code Enforcement
District 1 Mead Valley Office
19450 Clark Street
Perris, CA 92570
Mail Stop # 5004

DOC # 2010-0553174
11/16/2010 02:45P Fee:NC
Page 1 of 1
Recorded in Official Records
County of Riverside
Larry W. Ward
Assessor, County Clerk & Recorder



NOTICE OF NONCOMPLIANCE

M
026
026

In the matter of the Property of
SANCHEZ,ROBERTO

Case No. CV10-06142

NOTICE IS HEREBY GIVEN to all persons, pursuant to Section 10 of Ordinance Number 725 of the County of Riverside, State of California, that proceedings have been commenced with respect to violations of Riverside County Ordinance No.457, (RCC Title 15.16.020) described as Substandard Sturcture (quality lower then prescribed by law). Such proceedings are based upon the noncompliance of such real property, located at 1 Parcel West of (21950 Salter Road), Perris, CA, and more particularly described as Assessor's Parcel Number 323-020-020 and having a legal description of 2.50 ACRES M/L IN POR NW 1/4 OF SEC 28 T4S R4W FOR TOTAL DESCRIPTION SEE ASSESSORS MAPS, Records of Riverside County, with the requirements of Ordinance No. 457 (RCC Title 15.16.020).

The owner has been advised to immediately correct the above-referenced violations to avoid further action by the County of Riverside which may include demolition, removal, razing, etc., to abate the public nuisance. Any costs incurred by the County, including, but not limited to investigative, administrative and abatement costs and attorneys' fees, may become a lien on the property. Further details regarding this notice may be obtained by addressing an inquiry to the Code Enforcement Department, 19450 Clark Street, Perris, CA 92570, and Attention Code Enforcement Officer Ron Welch.

NOTICE IS FURTHER GIVEN in accordance with §17274 and §24436.5 of the California Revenue and Taxation Code, that a tax deduction may not be allowed for interest, taxes, depreciation, or amortization paid or incurred in the taxable year affected by these proceedings.

RIVERSIDE COUNTY CODE ENFORCEMENT

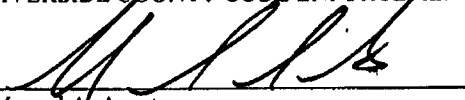
By 
Manuel A. Acueto
Code Enforcement Department

ACKNOWLEDGEMENT

State of California)
County of Riverside)

On 11/09/10 before me, Jessica Morrison, Notary Public, personally appeared Manuel A. Acueto, who proved to me on the basis of satisfactory evidence to be the person(s) whose name(s) is/are subscribed to the within instrument and acknowledged to me that he/she/they executed the same in his/her/their authorized capacity(ies), and that by his/her/their signature(s) on the instrument the person(s), or the entity upon behalf of which the person(s) acted, executed the instrument.

I certify under PENALTY OF PERJURY under the laws of the State of California that the foregoing paragraph is true and correct.

WITNESS my hand and official seal.

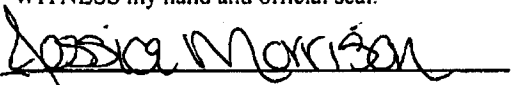
Commission # 1904280 Comm. Expires Sep. 17, 2014

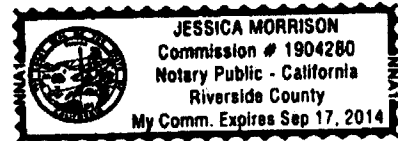

Recording Requested by

STATE OF CALIFORNIA
FRANCHISE TAX BOARD
Sacramento CA 95812-2952

And When Recorded Mail to

Special Procedures Section
PO BOX 2952
Sacramento CA 95812-2952

DOC # 2010-0609860

12/20/2010 04:09P Fee:NC

Page 1 of 1

Recorded in Official Records
County of Riverside

Larry W. Ward
Assessor, County Clerk & Recorder

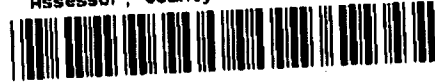

NOTICE OF STATE TAX LIEN



FILED WITH: RIVERSIDE

CERTIFICATE NUMBER: 10343319955

The Franchise Tax Board of the State of California hereby certifies that the following named taxpayer(s) is liable under parts 10 or 11 of Division 2 of the Revenue and Taxation Code to the State of California for amount due and required to be paid by said taxpayer as follows:

Name of Taxpayer(s) : ROBERTO C SANCHEZ

FTB Account Number : 2300216940

Social Security Number(s) : XXX-XX-8726

Last Known Address : 19209 PEMBERTON PL
: RIVERSIDE CA 92508-6022

For Taxable Years : 2006,2005

TAX	PENALTY	INTEREST	COLLECTION FEES	PAYMENTS	ADJUSTMENTS	* TOTAL
\$5,583.00	\$1,034.25	\$1,625.91	\$210.00	\$0.00	\$-1,446.00	\$7,007.16

Further interest and fees will accrue at the rate prescribed by law until paid; that the Franchise Tax Board of the State of California complied with all of the provisions of parts 10 or 11 of Division 2 of the Revenue and Taxation Code of the State of California in computing, levying, determining and assessing the tax; the said amounts are due and payable and have not been paid. Said lien attaches to all property and rights to such property now owned or later acquired by the taxpayer.

IN WITNESS WHEREOF, the Franchise Tax Board of the State of California has duly authorized the undersigned to execute this Notice in its name.

DATED: 12/14/10

FRANCHISE TAX BOARD
of the State of California

Collection Bureau
Telephone Number: (916) 845-4350

By:

*Additional interest is accruing at the rate prescribed by law.

Authorized facsimile signature.

FTB 2930 V1 ARCS (REV 03-2008)

Public Record



P.O. Box 1193
 Whittier, CA 90609
 Tel # (562) 325-8351
 Fax # (714) 783-3038

Lot Book Report

Order Number: **21984**

Customer:

RIVERSIDE COUNTY TLMA-CODE INFORCEMENT

4080 Lemon Street

Riverside

CA 92501

Attn:

Brent Steele

Reference:

CV10-06142/Jessica Morrison

IN RE:

SANCHEZ, ROBERTO

Order Date: 8/26/2010

Dated as of: 8/19/2010

County Name: Riverside

FEE(s):

Report: \$120.00

Property Address: Vacant Land

CA

Assessor's Parcel No. : 323-020-020-0

Assessments:

Land Value:	\$9,356.00
Improvement Value:	\$154.00
Exemption Value:	\$0.00
Total Value:	\$9,510.00

Handwritten:
 21984
 323-020-020-0

Tax Information

Property Taxes for the Fiscal Year	2009-2010
Total Annual Tax	\$161.62
Status: Paid through	06/30/2010

Property Vesting

The last recorded document transferring title of said property

Dated 08/01/2000

Recorded 01/31/2001



P.O. Box 1193
Whittier, CA 90609
Tel # (562) 325-8351
Fax # (714) 783-3038

Order Number: 21984
Reference: CV10-06142/Jessi

Document No.	2001-040787
D.T.T.	\$0.00
Grantor	Phillip Cleveland Wilson, an unmarried man, as his sole and separate property
Grantee	Roberto Sanchez, as his sole and separate property

Deeds of Trust

No Deeds of Trust of Record

Additional Information

JUDGMENT AND/OR LIEN DOCUMENTS LISTED AS FOLLOWS:

Document Type	Abstract of Judgment
Document No.	2003-289732
Recorded	04/24/2003
Document Type	Notice Regarding Payment of Support
Document No.	2005-0192749
Recorded	03/10/2005
Document Type	Abstract of Judgment
Document No.	2005-00303284
Recorded	04/19/2005
Document Type	Abstract of Judgment
Document No.	2008-0299670
Recorded	06/03/2008
Document Type	Abstract of Judgment
Document No.	2008-0299869
Recorded	06/03/2008
Document Type	Certificate of Lien
Document No.	2008-0621710
Recorded	11/21/2008



P.O. Box 1193
Whittier, CA 90609
Tel # (562) 325-8351
Fax # (714) 783-3038

Order Number: 21984
Reference: CV10-06142/Jessi

Document Type	Notice of Federal Tax Lien
Document No.	2009-0173099
Recorded	04/08/2009
Document Type	Notice of Support Judgment
Document No.	2009-0355780
Recorded	07/09/2009
Document Type	Notice of Support Judgment
Document No.	2009-0435929
Recorded	08/20/2009
Document Type	Certificate of Lien
Document No.	2009-0570675
Recorded	11/04/2009
Document Type	Notice of State Tax Lien
Document No.	2009-0673265
Recorded	12/31/2009
Document Type	Notice of State Tax Lien
Document No.	2010-0171373
Recorded	04/14/2010
A Bankruptcy filed by	Roberto Sanchez
Social Security Number(s)	None Shown
Date filed	12/29/2008
Case No.	28611
A Bankruptcy filed by	Roberto Sanchez
Social Security Number(s)	None Shown
Date filed	10/26/2009
Case No.	35544
A Bankruptcy filed by	Roberto Sanchez
Social Security Number(s)	None Shown
Date filed	07/02/2010
Case No.	30746



P.O. Box 1193
Whittier, CA 90609
Tel # (562) 325-8351
Fax # (714) 783-3038

Order Number: 21984

Reference: CV10-06142/Jessi

Legal Description

THE LAND REFERRED TO IN THIS REPORT IS LOCATED IN AND IS DESCRIBED AS FOLLOWS:

THE NORTH 330.00 FEET OF THE EAST 330.00 FEET OF THE WEST 660.00 FEET OF THE WEST 1/2 OF SECTION 28, TOWNSHIP 4 SOUTH, ROUGE 4 WEST, SAN BERNARDINO BASE AND MERIDIAN, IN THE COUNTY OF RIVERSIDE, STATE OF CALIFORNIA, AS SHOWN BY UNITED STATES GOVERNMENT SURVEY, APPROVED AUGUST 8, 19883, AS RECORDED IN BOOK 1834, AT PAGE 595, ON DEEDS, RECORDS OF SAID COUNTY RECORDER.

APR 21 2009

323-02
16-34

TRA. 087-023

SEC 28 T 4S R 4W

THIS MAP WAS PREPARED FOR ASSESSMENT PURPOSES ONLY. NO LIABILITY IS ASSUMED FOR THE ACCURACY OF THE DATA SHOWN. ASSESSOR'S PARCEL MAY NOT COMPLY WITH LOCAL LOT-SPLIT OR BUILDING SITE ORDINANCES.

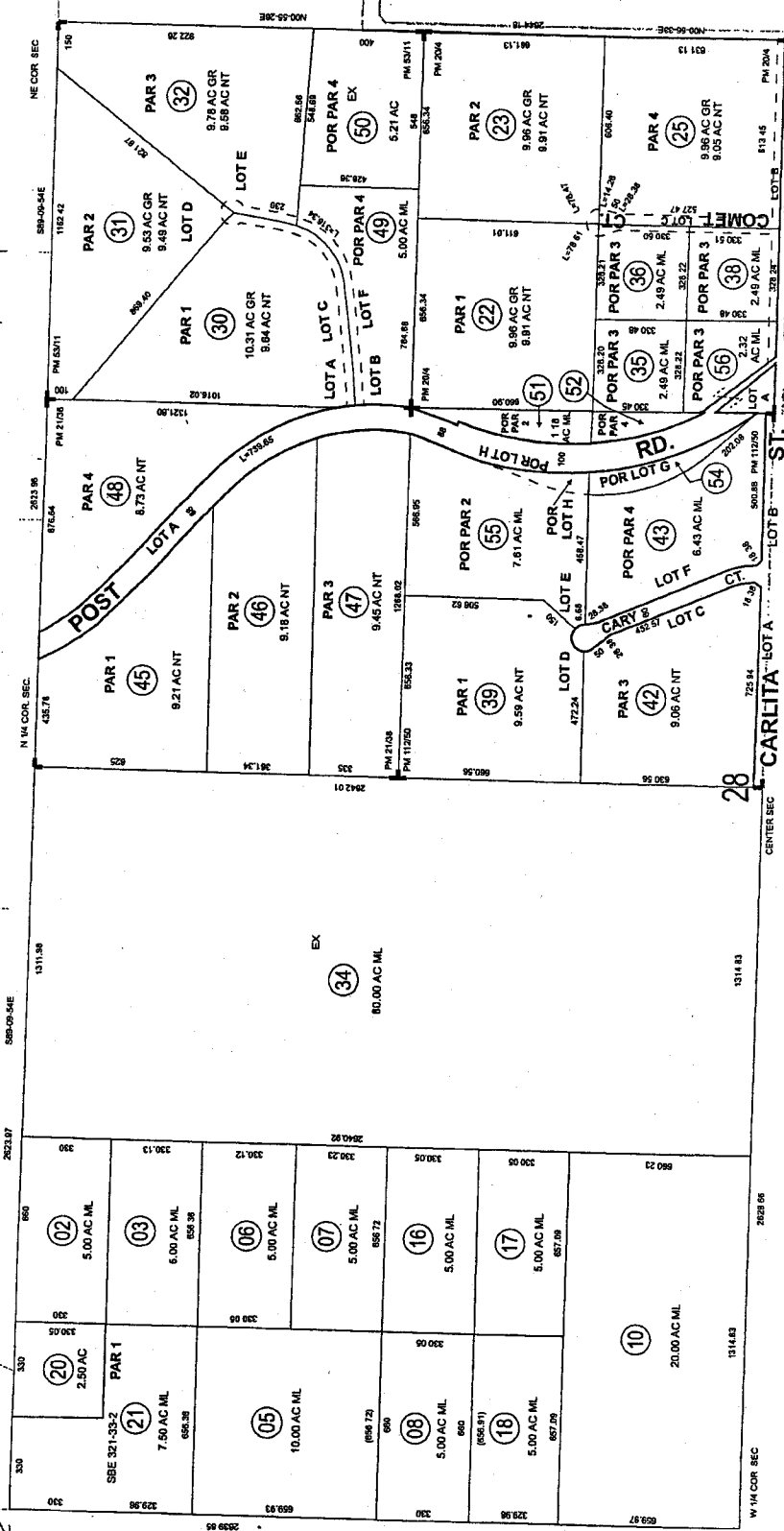
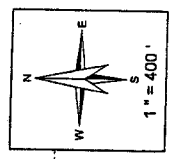

BK 321 Pg 40	BK 322 Pg 08	BK 322 Pg 10
BK 321 Pg 19	BK 321 Pg 20	BK 321 Pg 21
BK 321 Pg 03	BK 321 Pg 04	BK 321 Pg 05

Date	04/20/09
By	CEL/0809
For	P.M. 5311



ASSESSOR'S MAP BK323 PG.02
Riverside County, Calif.

A Vatcharopattas

Dist	Old Num	New Num
10221872	9	1817.08
11071871	1	1818.27
4211874	119	27
11071875	12	28.29
81071876	13	30.33
31071878	811	34
31071883	15	35.31
12071880	24	38.44
11071890	28.27	42.61.33
11071896	28.28	47.81.37
12071900	33	49.50
4202089	141	51.87
4202089	14	52.87
4202089	140.53	53.84
4202089	140.53	55
4202089	37	55.87

April 2009

RECORDING REQUESTED BY

ORDER# Phillip Cleveland Wilson
APN 323-020-020

DOC H 2001-040787

01/31/2001 05:55A Fee:0.00

Page 1 of 1
Recorded in Official Records
County of Riverside
Gary L. Orso
Assessor, County Clerk & Recorder



Name: Roberto Sanchez
Address: 11732 Killian
LEL Monte, CA 91732

LA	S	U	TR	DE	CA	PCOR	MOOR	SW	MAC
						7			
						3			AS

18
C
AS

Quitclaim Deed

ALL
PPL
020
020
323

TRA:087

This conveyance is a bonafide gift and the grantor received nothing in return; R&T 11911

The undersigned grantor(s) declare (s):
Documentary transfer tax is \$ 0
() computed on full value of property conveyed, or
() computed on full value less value of liens and encumbrances remaining at time of sale.
() Unincorporated area: () City of _____
(X) Really not sold.

FOR A VALUABLE CONSIDERATION, receipt of which is hereby acknowledged,
Phillip Cleveland Wilson, an unmarried man, as his sole and separate property,

hereby REMISE(S), RLEASE(S) AND FOREVER QUITCLAIM(S) to Roberto Sanchez, as his sole and separate property,

the property in RIVERSIDE County, State of California, described as:

The North 330 feet of the East 330 feet of the West 660 feet of the West half of Section 28, Township 4 South, Range 4 West, San Bernardino Base and Meridian, as shown by United States Government Survey, approved August 8, 1883, as recorded in Book 1834 at Page 595 of Deeds, in Riverside County Records.

Mail tax statements to Roberto Sanchez, 1427 Vineland Ave., Baldwin Park, CA, 91706

Date Aug 2000
STATE OF CALIFORNIA
COUNTY OF Riverside } SS.
On 1/31/2001 before me, the undersigned,
a Notary Public in and for said State, personally appeared,
Phillip Cleveland Wilson

Phillip Cleveland Wilson
Phillip Cleveland Wilson

personally known to me (or proved to me on the basis of satisfactory evidence) to be the person whose name is subscribed to the within instrument and acknowledged that he executed the same. Witness my hand and official seal.

Signature: *Shannon Mumm*
Name (Typed or Printed)
SHANNON MUMM



LTC-10

MAIL TAX STATEMENTS AS DIRECTED ABOVE

Public Record

DOC # 2003-289732

04/24/2003 08:00A Fee:18.00

Page 1 of 3

Recorded in Official Records
County of Riverside

Gary L. Orso

Assessor, County Clerk & Recorder

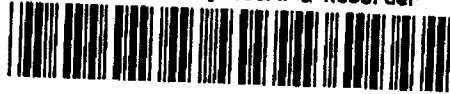

PLEASE COMPLETE THIS INFORMATION
RECORDING REQUESTED BY:
Patrick J. Gorman

AND WHEN RECORDED MAIL TO:
Wild, Carter & Tipton
246 West Shaw Avenue
Fresno, CA 93704

M	S	U	PAGE	SIZE	DA	PCDR	NOCOR	SMF	MSC
			3						
1					1				DM
A	R	L			COPY	LONG	REFUND	NCHG	EXAM

19

M

SPACE ABOVE FOR RECORDER'S USE ONLY

ABSTRACT OF JUDGMENT

Title of Document

**THIS AREA FOR
RECORDER'S
USE ONLY**

THIS PAGE ADDED TO PROVIDE ADEQUATE SPACE FOR RECORDING INFORMATION
(\$3.00 Additional Recording Fee Applies)

ATTORNEY OR PARTY WITHOUT ATTORNEY (Name and address): TEL NO.:
 Recording requested by and return to: (559) 224-2131
 Patrick J. Gorman (SBN 131138)
 WILD, CARTER & TIPTON, APC
 246 West Shaw Avenue
 Fresno, CA 93704

ATTORNEY FOR JUDGMENT CREDITOR ASSIGNEE OF RECORD

SUPERIOR COURT OF CALIFORNIA, COUNTY OF FRESNO
 STREET ADDRESS: 1100 VAN NESS AVENUE
 MAILING ADDRESS: CIVIL-UNLIMITED
 CITY AND ZIP CODE: FRESNO, CA 93721
 BRANCH NAME: CENTRAL DIVISION

FOR RECORDER'S USE ONLY

PLAINTIFF: AMERICAN RAISIN PACKERS, INC.
 DEFENDANT: ATLANTA TRADING & SALES COMPANY, et. al.

ABSTRACT OF JUDGMENT Amended

CASE NUMBER:
 02 CE CG 02102

1. The judgment creditor assignee of record applies for an abstract of judgment and represents the following:
- a. Judgment debtor's
 Name and last known address
 ATLANTA TRADING & SALES COMPANY
 10888 San Sevaime Way, Bld. F
 MIRA LOMA, CA 91752
- b. Driver's license No. and state:
 c. Social security No.:
 d. Summons or notice of entry of sister-state judgment was personally served or mailed to (name and address):

NOTIFICATION MAILED
USA POSTAL SERVICE

FOR COURT USE ONLY

- e. Original abstract recorded in this county:
 (1) Date: FEBRUARY 26, 2003
 (2) Instrument No.: PATRICK J. GORMAN
 (TYPE OR PRINT NAME)
- f. Information on additional judgment debtors is shown on page two

[Signature]
 (SIGNATURE OF APPLICANT OR ATTORNEY)

2. a. I certify that the following is a true and correct abstract of the judgment entered in this action.
 b. A certified copy of the judgment is attached.
3. Judgment creditor (name and address):
 AMERICAN RAISIN PACKERS, INC.
 P.O. BOX 30, SELMA, CA 93602
4. Judgment debtor (full name as it appears in judgment):
 ATLANTA TRADING & SALES COMPANY, ROBERT SANCHEZ individually and dba ATLANTA TRADING & SALES COMPANY, ROSANNA ZAVALLA, individually and dba ATLANTA TRADING & SALES COMPANY

6. Total amount of judgment as entered or last renewed:
 \$ 53,710.00
7. An execution lien attachment lien is endorsed on the judgment as follows:
 a. Amount: \$
 b. In favor of (name and address):

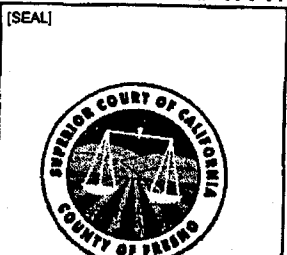

5. a. Judgment entered on (date): 2/24/03
 b. Renewal entered on (date):
 This abstract issued on (date):
 MAR 6 2003

8. A stay of enforcement has
 a. not been ordered by the court.
 b. been ordered by the court effective until (date):
9. This judgment is an installment judgment.
- Clerk, by *[Signature]* Deputy



PLAINTIFF: AMERICAN RAISIN PACKERS, INC.

CASE NUMBER

DEFENDANT: ATLANTA TRADING & SALES COMPANY, et. al.

02 CE CG 02102

INFORMATION ON ADDITIONAL JUDGMENT DEBTORS

10. Name and last known address

ROBERT SANCHEZ
10888 San Sevaine Way, Bld. F
Mira Loma, CA 91752

NOTIFICATION MAILED
USA POSTAL SERVICE

14.

Name and last known address

Driver's license No. & state:

Unknown

Social security No.:

known

Summons was personally served at or mailed to (address):

Service was done by publication

Driver's license No. & state:

Unknown

Social security No.:

Unknown

Summons was personally served at or mailed to (address):

11.

Name and last known address

Rosanna Zavalla
10888 San Servaine Way, Bld. F
Mira Loma, CA 91752

Driver's license No. & state:

Unknown

Social security No.:

known

Summons was personally served at or mailed to (address):

Service was done by publication

15.

Name and last known address

Driver's license No. & state:

Unknown

Social security No.:

Unknown

Summons was personally served at or mailed to (address):

12.

Name and last known address

Driver's license No. & state:

Unknown

Social security No.:

known

Summons was personally served at or mailed to (address):

16.

Name and last known address

Driver's license No. & state:

Unknown

Social security No.:

Unknown

Summons was personally served at or mailed to (address):

13.

Name and last known address

Driver's license No. & state:

Unknown

Social security No.:

known

Summons was personally served at or mailed to (address):

17.

Name and last known address

Driver's license No. & state:

Unknown

Social security No.:

Unknown

Summons was personally served at or mailed to (address):

18. Continued on Attachment 18.



2003-209732
04/24 00:00:00
of 3

RECORDING REQUESTED BY:

Riverside County Department of Child Support Services
JOHN REPLOGLE, Director

DOC # 2005-0192749

03/10/2005 08:00A Fee:NC

Page 1 of 3

Recorded in Official Records
County of Riverside

Larry W. Ward
Assessor, County Clerk & Recorder



AND WHEN RECORDED MAIL TO:

Riverside County Department of Child Support Services
JOHN REPLOGLE, Director
2041 IOWA AVENUE
RIVERSIDE , CA 92507

THIS SPACE FOR RECORDER'S USE ONLY

TITLE(S)

LAP



NOTICE REGARDING PAYMENT OF SUPPORT

ATTORNEY OR PARTY WITHOUT ATTORNEY (Name and Address): <input checked="" type="checkbox"/> Recording requested by and return to: Riverside County Department of Child Support Services JOHN REPLOGLE, Director 2041 IOWA AVENUE RIVERSIDE , CA 92507		TELEPHONE NO.: (951) 955-4100	FOR RECORDER'S USE ONLY
<input type="checkbox"/> ATTORNEY FOR <input type="checkbox"/> JUDGMENT CREDITOR <input type="checkbox"/> ASSIGNEE OF RECORD <input checked="" type="checkbox"/> PURSUANT TO FAMILY CODE 17400, 17406		EXEMPT FROM RECORDING FEE 27383 & 6103.9 GOVT. CODE	
SUPERIOR COURT OF CALIFORNIA, COUNTY OF RIVERSIDE STREET ADDRESS: 4175 MAIN ST MAILING ADDRESS: PO BOX 431 CITY AND ZIP CODE: RIVERSIDE , CA 92501-0431 BRANCH NAME: FAMILY LAW ANNEX			
PETITIONER/PLAINTIFF: ROSIE SANCHEZ		CASE NUMBER: 246744DCS	
RESPONDENT/DEFENDANT: ROBERT SANCHEZ, JR			
OTHER PARENT:			

ROBERT SANCHEZ
8681 KATELLA AVE, #841
STANTON , CA 90680

THIS PAGE ADDED TO PROVIDE ADEQUATE SPACE FOR RECORDING INFORMATION
(Additional recording fee applies)

TRPAY - COVER

RDCSS C# 000246744
(N/01/01/03)

Public Record

PETITIONER/PLAINTIFF: ROSIE SANCHEZ RESPONDENT/DEFENDANT: ROBERT SANCHEZ, JR OTHER PARENT:	CASE NUMBER: 246744DCS
--	---------------------------

7. Both parents must complete a *Child Support Case Registry* (form FL-191) and send (deliver or mail) it to the local child support agency within 10 days of being served with this notice. The parents must notify the local child support agency of any change in the information by submitting an updated form within 10 days of the change.

Date: FEB 14 2005

LISA A. BROOKS

(TYPE OR PRINT NAME)

Lisa A Brooks

(SIGNATURE)

ACKNOWLEDGMENT
 (To be completed only when this form is recorded)

STATE OF CALIFORNIA
 COUNTY OF *Riverside*

On *2-14-05*, before me, *Anneliese Horecka*
 Notary Public, personally appeared: *Lisa A. Brooks*

personally known to me (or proved to me on the basis of satisfactory evidence) to be the person(s) whose name(s) is/are subscribed to the within instrument and acknowledged to me that he/she/they executed the same in his/her/their authorized capacity(ies), and that by his/her/their signature(s) on the instrument the person(s), or the entity upon behalf of which the person(s) acted, executed the instrument.

WITNESS my hand and official seal.

Anneliese Horecka
 (SIGNATURE OF NOTARY)

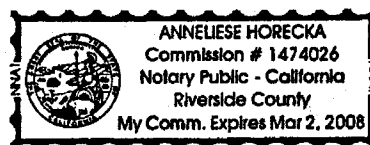

(Seal)

NOTICE REGARDING PAYMENT OF SUPPORT
 (Governmental)

Recorded in Official Records
County of Riverside
Larry W. Ward
Assessor, County Clerk & Recorder

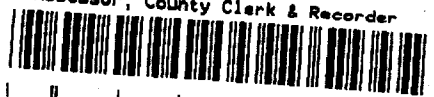

M	S	U	PAGE	SIZE	DA	PCOR	NOCOR	SMF	MBC	
			2							
1					1				SP	
A	R	L				COPY	LONG	REFUND	NCHG	EXAM

FOR RECORDER'S USE ONLY

16
C
SP

ATTORNEY OR PARTY WITHOUT ATTORNEY (Name and address):
 Recording requested by and return to: (760) 902-7772
TEL NO.: EJ-001

Mark Stanley
42335 Washington Street, Suite F186
Palm Desert, CA 92211

ATTORNEY FOR
 JUDGMENT CREDITOR
 ASSIGNEE OF RECORD

SUPERIOR COURT OF CALIFORNIA, COUNTY OF RIVERSIDE
STREET ADDRESS: LARSON JUSTICE CENTER
MAILING ADDRESS: 46-200 Oasis Street
CITY AND ZIP CODE: Indio, CA 92201
BRANCH NAME: Eastern District, Indio Branch

PLAINTIFF: MARK STANLEY

DEFENDANT: ROBERT SANCHEZ, aka ROBERTO SANCHEZ

ABSTRACT OF JUDGMENT Amended

1. The judgment creditor assignee of record applies for an abstract of judgment and represents the following:
a. Judgment debtor's

Name and last known address
Robert Sanchez, aka Roberto Sanchez
45827 Sutter Creek
Indio, CA 92201

NOTIFICATION MAILED
USA POSTAL SERVICE

b. Driver's license No. and state:
c. Social security No.: Unknown
d. Summons or notice of entry of sister-state judgment was personally served or mailed to (name and address): 45080 Golf Center Parkway
Indio, CA 92201 Unknown

e. Original abstract recorded in this county:
(1) Date:
(2) Instrument No.:

Date: 4-18-05
MARK STANLEY
(TYPE OR PRINT NAME)

CASE NUMBER:
INS 072585

FOR COURT USE ONLY

f. Information on additional judgment debtors is shown on page two.

M Stanley
(SIGNATURE OF APPLICANT OR ATTORNEY)

2. a. I certify that the following is a true and correct abstract of the judgment entered in this action.
b. A certified copy of the judgment is attached.

3. Judgment creditor (name and address):
Mark Stanley
42355 Washington Street, Suite F186, Palm Desert, CA 92211

4. Judgment debtor (full name as it appears in judgment):
Robert Sanchez, aka Roberto Sanchez
45827 Sutter Creek, Indio, CA 92201

6. Total amount of judgment as entered or last renewed:
\$ 1,722.00

7. An execution lien attachment lien is endorsed on the judgment as follows:
a. Amount: \$
b. In favor of (name and address):

5. a. Judgment entered on (date): 09/24/2005
b. Renewal entered on (date):

This abstract issued on (date):
APR 18 2005

8. A stay of enforcement has
a. not been ordered by the court.
b. been ordered by the court effective until (date):

9. This judgment is an installment judgment.

Clerk, by [Signature] Deputy



Form Adopted for Mandatory Use
Judicial Council of California
EJ-001 (Rev. January 1, 2003)
Martin Dean's Essential Forms™

ABSTRACT OF JUDGMENT
(CIVIL)

Page 1 of 2
Code of Civil Procedure, §§ 438.480,
674, 700.190

Stanley, Mark

PLAINTIFF: **MARK STANLEY**
 DEFENDANT: **ROBERTO SANCHEZ, aka ROBERTO SANCHEZ**

CASE NUMBER:
INS 072585

INFORMATION ON ADDITIONAL JUDGMENT DEBTORS

10. Name and last known address
 Driver's license No. & state: Unknown
 Social security No.: Unknown
 Summons was personally served at or mailed to (address):

14. Name and last known address
 Driver's license No. & state: Unknown
 Social security No.: Unknown
 Summons was personally served at or mailed to (address):



ad

11. Name and last known address
 Driver's license No. & state: Unknown
 Social security No.: Unknown
 Summons was personally served at or mailed to (address):

15. Name and last known address
 Driver's license No. & state: Unknown
 Social security No.: Unknown
 Summons was personally served at or mailed to (address):

12. Name and last known address
 Driver's license No. & state: Unknown
 Social security No.: Unknown
 Summons was personally served at or mailed to (address):

16. Name and last known address
 Driver's license No. & state: Unknown
 Social security No.: Unknown
 Summons was personally served at or mailed to (address):

13. Name and last known address
 Driver's license No. & state: Unknown
 Social security No.: Unknown
 Summons was personally served at or mailed to (address):

17. Name and last known address
 Driver's license No. & state: Unknown
 Social security No.: Unknown
 Summons was personally served at or mailed to (address):

18. Continued on Attachment 18.

EJ-001 (Rev. January 1, 2003)
 Martin Dean's Essential Forms™

ABSTRACT OF JUDGMENT
 (CIVIL)

Page 2 of 2



2005-0303284
 04/19/2005 09:00A
 2 of 2

Stanley, Mark

Public Record



S	R	U	PAGE	SIZE	DA	MISC	LONG	RFD	COPY
			2			5			
M	<input checked="" type="checkbox"/>	L	465	426	PCOR	NCOR	SMF	NCHG	EXAM
INSTRUCTION									706

EJ-001
 ATTORNEY OR PARTY WITHOUT ATTORNEY (Name, address, State Bar number, and telephone number):
 Recording requested by and return to: 951-929-3219
 MAX ALIRE
 C/O THE EVICTION CENTER
 211 NORTH STATE STREET, SUITE 211
 HEMET, CA 92543
 HEMET, CA 92543
 (951) 929-3219
 ATTORNEY FOR JUDGMENT CREDITOR ASSIGNEE OF RECORD

SUPERIOR COURT OF CALIFORNIA, COUNTY OF RIVERSIDE
 STREET ADDRESS: COUNTY OF RIVERSIDE
 MAILING ADDRESS: 41002 COUNTY CENTER DRIVE, # 100
 CITY AND ZIP CODE: TEMECULA, CALIFORNIA 92591
 BRANCH NAME: Temecula Civil Division

PLAINTIFF: MAX ALIRE
 DEFENDANT: ALBERT VALENCIA & ROBERT SANCHEZ

CASE NUMBER:
 TEC074707

ABSTRACT OF JUDGMENT—CIVIL AND SMALL CLAIMS Amended

FOR COURT USE ONLY

1. The judgment creditor assignee of record applies for an abstract of judgment and represents the following:
 a. Judgment debtor's Name and last known address
 ROBERT SANCHEZ
 29547 CASTLEWOOD DRIVE
 MENIFEE, CA 92586
 b. Driver's license no. [last 4 digits] and state: Unknown
 c. Social security no. [last 4 digits]: Unknown
 d. Summons or notice of entry of sister-state judgment was personally served or mailed to (name and address): ROBERT SANCHEZ
 26537 LAZY CREEK ROAD, SUN CITY, CA 92586

2. Information on additional judgment debtors is shown on page 2.
 3. Judgment creditor (name and address):
 MAX ALIRE-C/O THE EVICTION CENTER-211
 N. STATE ST., # 211, HEMET, CA 92543
 Date: 5/7/08

4. Information on additional judgment creditors is shown on page 2.
 5. Original abstract recorded in this county:
 a. Date:
 b. Instrument No.:

MAX ALIRE
 (TYPE OR PRINT NAME)

(SIGNATURE OF APPLICANT OR ATTORNEY)

6. Total amount of judgment as entered or last renewed:
 \$ 2,942.50
 7. All judgment creditors and debtors are listed on this abstract.
 8. a. Judgment entered on (date): 4/16/08
 b. Renewal entered on (date):

10. An execution lien attachment lien is endorsed on the judgment as follows:
 a. Amount: \$
 b. In favor of (name and address):

9. This judgment is an installment judgment.

11. A stay of enforcement has
 a. not been ordered by the court.
 b. been ordered by the court effective until (date):
 12. a. I certify that this is a true and correct abstract of the judgment entered in this action.
 b. A certified copy of the judgment is attached.
 Clerk, by Deputy

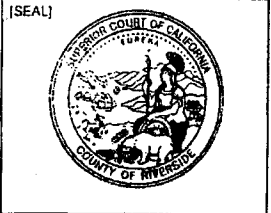

This abstract issued on (date):
 MAY 23 2008

PLAINTIFF: MAX ALIRE	CASE NUMBER:
DEFENDANT: ALBERT VALENCIA & ROBERT SANCHEZ	TEC074707

NAMES AND ADDRESSES OF ADDITIONAL JUDGMENT CREDITORS:

13. Judgment creditor (name and address):

14. Judgment creditor (name and address):

15. Continued on Attachment 15.

INFORMATION ON ADDITIONAL JUDGMENT DEBTORS:

16. Name and last known address

17. Name and last known address

ALBERT VALENCIA
26537 LAZY CREEK ROAD
SUN CITY, CA 92586

Driver's license no. [last 4 digits]
and state: CA-3121

Social security no. [last 4 digits]: 0923

SAME AS ITEM # 16

Unknown
 Unknown

Driver's license no. [last 4 digits]
and state:

Social security no. [last 4 digits]:

Summons was personally served at or mailed to (address):

Unknown
 Unknown

18. Name and last known address

19. Name and last known address

Driver's license no. [last 4 digits]
and state:

Social security no. [last 4 digits]:

Summons was personally served at or mailed to (address):

Unknown
 Unknown

Driver's license no. [last 4 digits]
and state:

Social security no. [last 4 digits]:

Summons was personally served at or mailed to (address):

Unknown
 Unknown

20. Continued on Attachment 20.



Recorded in Official Records
County of Riverside
Larry W. Hard
Assessor, County Clerk & Recorder



S	R	U	PAGE	SIZE	DA	MISC	LONG	RFD	COPY
			2						
M	A	L	465	426	PCOR	NCOR	SMF	NCHG	EXAM
NOTICE SENT									706

EJ-001
ATTORNEY OR PARTY WITHOUT ATTORNEY (Name, address, State Bar number, and telephone number):
Recording requested by and return to: 951-929-3219
MAX ALIRE
C/O THE EVICTION CENTER
211 NORTH STATE STREET, SUITE 211
HEMET, CA 92543
HEMET, CA 92543
(951) 929-3219
 ATTORNEY FOR JUDGMENT CREDITOR ASSIGNEE OF RECORD
SUPERIOR COURT OF CALIFORNIA, COUNTY OF RIVERSIDE
STREET ADDRESS: COUNTY OF RIVERSIDE
MAILING ADDRESS: 41002 COUNTY CENTER DRIVE, # 100
CITY AND ZIP CODE: TEMECULA, CALIFORNIA 92591
BRANCH NAME: Temecula Civil Division

PLAINTIFF: MAX ALIRE
DEFENDANT: ROBERT SANCHEZ

CASE NUMBER:
TES028853

M
706

ABSTRACT OF JUDGMENT—CIVIL AND SMALL CLAIMS Amended

FOR COURT USE ONLY

1. The judgment creditor assignee of record applies for an abstract of judgment and represents the following:
a. Judgment debtor's Name and last known address
ROBERT SANCHEZ
29547 CASTLEWOOD DRIVE
MENIFEE, CA 92586
b. Driver's license no. [last 4 digits] and state: Unknown
c. Social security no. [last 4 digits]: Unknown
d. Summons or notice of entry of sister-state judgment was personally served or mailed to (name and address): ROBERT SANCHEZ
29547 CASTLEWOOD DRIVE, MENIFEE, CA 92586

2. Information on additional judgment debtors is shown on page 2.
3. Judgment creditor (name and address):
MAX ALIRE-C/O THE EVICTION CENTER-211
N. STATE ST., # 211, HEMET, CA 92543
Date: 5/7/08
MAX ALIRE
(TYPE OR PRINT NAME)

4. Information on additional judgment creditors is shown on page 2.
5. Original abstract recorded in this county:
a. Date:
b. Instrument No.:

(SIGNATURE OF APPLICANT OR ATTORNEY)

6. Total amount of judgment as entered or last renewed:
\$ 2,009.62
7. All judgment creditors and debtors are listed on this abstract.
8. a. Judgment entered on (date): 6/11/07
b. Renewal entered on (date):
9. This judgment is an installment judgment.

10. An execution lien attachment lien is endorsed on the judgment as follows:
a. Amount: \$
b. In favor of (name and address):

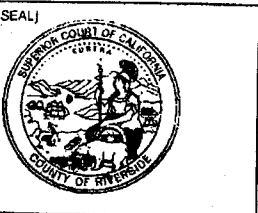

This abstract issued on (date):
MAY 23 2008

11. A stay of enforcement has
a. not been ordered by the court.
b. been ordered by the court effective until (date):
12. a. I certify that this is a true and correct abstract of the judgment entered in this action.
b. A certified copy of the judgment is attached.
Clerk, by Deputy

Form Adopted for Mandatory Use
Judicial Council of California
EJ-001 (Rev. January 1, 2008)

ABSTRACT OF JUDGMENT—CIVIL AND SMALL CLAIMS

PLAINTIFF: MAX ALIRE	CASE NUMBER:
DEFENDANT: ROBERT SANCHEZ	TES028853

NAMES AND ADDRESSES OF ADDITIONAL JUDGMENT CREDITORS:

13. Judgment creditor (name and address):

14. Judgment creditor (name and address):

15. Continued on Attachment 15.

INFORMATION ON ADDITIONAL JUDGMENT DEBTORS:

16. Name and last known address

17. Name and last known address

Driver's license no. [last 4 digits]
and state:

Unknown

Driver's license no. [last 4 digits]
and state:

Unknown

Social security no. [last 4 digits]:

Unknown

Social security no. [last 4 digits]:

Unknown

Summons was personally served at or mailed to (address):

Summons was personally served at or mailed to (address):

18. Name and last known address

19. Name and last known address

Driver's license no. [last 4 digits]
and state:

Unknown

Driver's license no. [last 4 digits]
and state:

Unknown

Social security no. [last 4 digits]:

Unknown

Social security no. [last 4 digits]:

Unknown

Summons was personally served at or mailed to (address):

Summons was personally served at or mailed to (address):

20. Continued on Attachment 20.



THIS IS TO INFORM YOU THAT A TAX LIEN HAS BEEN FILED WITH RESPECT TO UNSECURED PROPERTY

When recorded, mail to:

ROBERTO SANCHEZ
PABLO DELATORRE
RUBEN GARCIA
83161 INDIO BLV
INDIO CA 92201

Doc #. 2008-0621710
11/21/2008 08:00A Fee: NC
Page 1 of 1

Recorded in Official Records
County of Riverside
== Larry W Ward ==

Assessor, County Clerk and Recorder
This document was electronically prepared and recorded by the County of Riverside

CERTIFICATE OF LIEN

(Recorded pursuant to Revenue and Taxation Code Section 2191.3 et seq. and without acknowledgement pursuant to Government Code Section 27282)

STATE OF CALIFORNIA |
COUNTY OF RIVERSIDE | SS

No. 0356206

I, Paul McDonnell, Tax Collector of the County of Riverside, State of California, hereby certify that there are, on record in my office, unpaid taxes which were duly assessed, computed and levied for the fiscal year shown below pursuant to Section 2151 et seq. of the Revenue and Taxation Code.

The person(s) shown below is (are) liable to said County for the unpaid amounts set forth below plus any other penalties and charges which may accrue pursuant to law.

NAME AND ADDRESS

SANCHEZ ROBERTO
DELATORRE PABLO
GARCIA RUBEN
83161 INDIO BLV
INDIO CA 92201

Fiscal Year	Tax Rate Area	Assessment Number	Tax	Penalty	Cost	Recording Fee
2008-2009	007-000	000137415-5	\$141.94	\$14.19		\$13.00

Upon recordation of this certificate of lien, the total amount required to be paid constitutes a lien upon all personal property and real property now owned or subsequently acquired by the person(s) named herein before the date on which this lien expires.

This lien has the force, effect and priority of judgement lien for ten years from the recording of this instrument, unless sooner released or otherwise discharged.

Executed on 10/30/2008

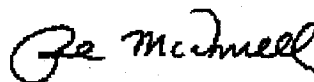

Paul McDonnell, Tax Collector

Public Record

Recording Requested By Internal Revenue Service. When recorded mail to:

INTERNAL REVENUE SERVICE
PO BOX 145585, STOP 8420G
CINCINNATI, OH 45250-5585

DOC # 2009-0173099

04/08/2009 08:00A Fee:9.00

Page 1 of 1

Recorded in Official Records

County of Riverside

Larry W. Ward

Assessor, County Clerk & Recorder



For Optional Use by Recording Office

Form 668 (Y)(c) (Rev. February 2004)	5223 Department of the Treasury - Internal Revenue Service	030	M
Notice of Federal Tax Lien		9	030
Area: WAGE & INVESTMENT AREA #5	Serial Number		
Lien Unit Phone: (800) 829-7650	529065609		

As provided by section 6321, 6322, and 6323 of the Internal Revenue Code, we are giving a notice that taxes (including interest and penalties) have been assessed against the following-named taxpayer. We have made a demand for payment of this liability, but it remains unpaid. Therefore, there is a lien in favor of the United States on all property and rights to property belonging to this taxpayer for the amount of these taxes, and additional penalties, interest, and costs that may accrue.

Name of Taxpayer ROBERT SANCHEZ

Residence 46575 CLINTON ST APT J98
INDIO, CA 92201-5492

IMPORTANT RELEASE INFORMATION: For each assessment listed below, unless notice of the lien is refilled by the date given in column (e), this notice shall, on the day following such date, operate as a certificate of release as defined in IRC 6325(a).

Kind of Tax (a)	Tax Period Ending (b)	Identifying Number (c)	Date of Assessment (d)	Last Day for Refiling (e)	Unpaid Balance of Assessment (f)
1040	12/31/2006	XXX-XX-3623	04/15/2007	05/15/2017	6660.90
1040	12/31/2006	XXX-XX-3623	03/17/2008	04/16/2018	

Place of Filing	COUNTY RECORDER RIVERSIDE COUNTY RIVERSIDE, CA 92502-0751	Total \$	6660.90
-----------------	---	----------	---------

This notice was prepared and signed at OAKLAND, CA, on this, the 26th day of March, 2009.

Signature for SUSAN MEREDITH	<i>R. A. Mitchell</i>	Title ACS (800) 829-7650	15-00-0000
---------------------------------	-----------------------	--------------------------------	------------

(NOTE: Certificate of officer authorized by law to take acknowledgment is not essential to the validity of Notice of Federal Tax lien Rev. Rul. 71-466, 1971 - 2 C.B. 409)

Part 1 - Kept By Recording Office

Form 668(Y)(c) (Rev. 2-2004)
CAT. NO 60025X

Public Record

DOC # 2009-0355780

07/09/2009 08:00A Fee:NC

Page 1 of 2

Recorded in Official Records

County of Riverside

Larry W. Ward

Assessor, County Clerk & Recorder



S	R	U	PAGE	SIZE	DA	MISC	LONG	RFD	COPY
1			2						
M	A	L	465	426	PCOR	NCOR	SMF	NCHG	EXAM
						T:	CTY	UNI	062

RECORDING REQUESTED BY

SAN BERNARDINO COUNTY DEPARTMENT OF CHILD SUPPORT SERVICES

COUNTY CODE: 0607102

M
062

WHEN RECORDED MAIL TO

SAN BERNARDINO COUNTY DEPARTMENT OF CHILD SUPPORT SERVICES

10565 CIVIC CENTER DR STE 250

RANCHO CUCAMONGA CA 91730-3854

DOCUMENT TITLE

NOTICE OF SUPPORT JUDGMENT

NOTICE OF SUPPORT JUDGMENT
DCSS 0239 (03/01/05)

ABSTRACT OF SUPPORT JUDGMENT
(Code of Civil Procedure, §§574, 697.320, 700.190, Family Code § 4508)

STATE OF CALIFORNIA - HEALTH AND HUMAN SERVICES AGENCY
DEPARTMENT OF CHILD SUPPORT SERVICE
Page 1 of 2

RC-GEN-3

Public Record

<p>ATTORNEY OR PARTY WITHOUT ATTORNEY (Name and Address): <input checked="" type="checkbox"/> Recording requested by and return to: JEFF WASS, CHIEF ATTORNEY</p> <p>SAN BERNARDINO COUNTY DEPARTMENT OF CHILD SUPPORT SERVICES 10565 CIVIC CENTER DR STE 250 RANCHO CUCAMONGA CA 91730-3854</p> <p>TELEPHONE NO.:(886) 901-3212</p> <p><input type="checkbox"/> ATTORNEY FOR <input checked="" type="checkbox"/> JUDGMENT CREDITOR <input type="checkbox"/> ASSIGNEE OF RECORD</p>	<p>FOR RECORDER'S USE ONLY</p> <p>0711036784-01</p>
<p>SUPERIOR COURT OF CALIFORNIA, COUNTY OF SAN BERNARDINO STREET ADDRESS: 655 WEST 2ND STREET, 2ND FLOOR MAILING ADDRESS: 655 WEST 2ND STREET, 2ND FLOOR CITY AND ZIP CODE: SAN BERNARDINO 92415-0001 BRANCH NAME: SAN BERNARDINO DISTRICT CHILD SUPPORT DIVISION</p>	
<p>PETITIONER/PLAINTIFF: THE COUNTY OF SAN BERNARDINO</p> <p>RESPONDENT/DEFENDANT: ROBERTO SANCHEZ</p>	
<p>ABSTRACT OF SUPPORT JUDGMENT</p>	
<p>CASE NUMBER: CSSS802784</p>	
<p>1. The <input checked="" type="checkbox"/> judgment creditor <input type="checkbox"/> assignee of record applies for an abstract of a support judgment and represents the following:</p> <p>a. Judgment debtor's Name and last known address ROBERTO SANCHEZ 1009 S BELLE AVE APT 202 CORONA CA 92882-4385</p> <p>b. Driver's license No. and state: D4239306 CALIFORNIA</p> <p>c. Social Security number: ██████████6309</p> <p>d. Birthdate: 01/03/1975</p>	<p style="text-align: center;">FOR COURT USE ONLY</p> <p>(This document is a notice under Family Code Section 4506. Court stamp not required.)</p> <p>Any electronic signature affixed below has been officially adopted by the requesting governmental agency.</p>

Date: 06/15/2009

JEFF WASS
(TYPE OR PRINT NAME)

(SIGNATURE OF APPLICANT OR ATTORNEY)

- | | |
|--|---|
| <p>2. I CERTIFY that the judgment entered in this action contains an order for payment of spousal, family, or child support.</p> <p>3. Judgment creditor (name):
 SAN BERNARDINO County Department of Child Support Services
 whose address appears on this form above the court's name.</p> <p>4. <input checked="" type="checkbox"/> The support is ordered to be paid to the following county officer (name and address):
 SAN BERNARDINO County Department of Child Support Services
 PO BOX 989067
 WEST SACRAMENTO CA 95798-9067</p> | <p>5. Judgment debtor (full name as it appears in judgment):
 ROBERTO SANCHEZ</p> <p>6. a. A judgment was entered on (date): 09/02/2008
 b. Renewal was entered on (date):
 c. Renewal was entered on (date):</p> <p>7. <input type="checkbox"/> An execution lien is endorsed on the judgment as follows:
 a. Amount: \$
 b. In favor of (name and address):</p> <p>8. A stay of enforcement has
 a. <input checked="" type="checkbox"/> not been ordered by the court.
 b. <input type="checkbox"/> been ordered by the court effective until (date):</p> <p>9. <input type="checkbox"/> This is an installment judgment.</p> |
|--|---|

[Seal]

This document is a notice under Family Code Section 4506. No court seal required.

This abstract issued on (date): No date required under FC § 4506

This document is a notice under Family Code section 4506.
 Clerk, by _____, Deputy

DOC # 2009-0435929

08/20/2009 08:00A Fee:NC

Page 1 of 2

Recorded in Official Records

County of Riverside

Larry W. Ward

Assessor, County Clerk & Recorder



PUBLIC RECORD

RECORDING REQUESTED BY

SAN BERNARDINO COUNTY DEPARTMENT OF CHILD SUPPORT SERVICES

COUNTY CODE: 0607100

WHEN RECORDED MAIL TO

SAN BERNARDINO COUNTY DEPARTMENT OF CHILD SUPPORT SERVICES

10417 MOUNTAIN VIEW AVE

LOMA LINDA CA 92354-2030

①
M
039
BJ

DOCUMENT TITLE

NOTICE OF SUPPORT JUDGMENT

NOTICE OF SUPPORT JUDGMENT
DCSS (08/20/09) 1105

ABSTRACT OF SUPPORT JUDGMENT
(Code of Civil Procedure, §§574, 697.320, 700.190, Family Code § 4604)

STATE OF CALIFORNIA - HEALTH AND HUMAN SERVICES AGENCY
DEPARTMENT OF CHILD SUPPORT SERVICE
Page 1 of 2

UIFSA

Public Record

ATTORNEY OR PARTY WITHOUT ATTORNEY (Name and Address): <input checked="" type="checkbox"/> Recording requested by and return to: JEFF WASS, CHIEF ATTORNEY SAN BERNARDINO COUNTY DEPARTMENT OF CHILD SUPPORT SERVICES 10417 MOUNTAIN VIEW AVE LOMA LINDA CA 92354-2030 TELEPHONE NO.: (866) 901-3212 <input type="checkbox"/> ATTORNEY FOR <input type="checkbox"/> JUDGMENT CREDITOR <input checked="" type="checkbox"/> ASSIGNEE OF RECORD 0710183423-01	FOR RECORDER'S USE ONLY
SUPERIOR COURT OF CALIFORNIA, COUNTY OF SAN BERNARDINO STREET ADDRESS: 655 WEST 2ND STREET, 2ND FLOOR MAILING ADDRESS: 655 WEST 2ND STREET, 2ND FLOOR CITY AND ZIP CODE: SAN BERNARDINO 92415-0001 BRANCH NAME: SAN BERNARDINO DISTRICT CHILD SUPPORT DIVISION	
PETITIONER/PLAINTIFF: STATE OF ARKANSAS OFFICE OF CHILD SUPPORT ENFORCEMENT RESPONDENT/DEFENDANT: ROBERT SANCHEZ	
ABSTRACT OF SUPPORT JUDGMENT	CASE NUMBER: SDASS138861

1. The judgment creditor assignee of record applies for an abstract of a support judgment and represents the following:
- a. Judgment debtor's
- | | |
|---|--|
| Name and last known address | |
| ROBERT L SANCHEZ
7422 LARIAT PL
APT D
RANCHO CUCAMONGA CA 91730-7502 | |
- b. Driver's license No. and state: B3209902 CALIFORNIA
- c. Social Security number: ██████████2960
- d. Birthdate: 10/27/1972
- | |
|----------------------------------|
| <input type="checkbox"/> unknown |
| <input type="checkbox"/> unknown |
| <input type="checkbox"/> unknown |

FOR COURT USE ONLY

(This document is a notice under Family Code Section 4506. Court stamp not required.)

Any electronic signature affixed below has been officially adopted by the requesting governmental agency.

Date: 08/12/2009

JEFF WASS
(TYPE OR PRINT NAME)

Jeff Wass
(SIGNATURE OF APPLICANT OR ATTORNEY)

2. I CERTIFY that the judgment entered in this action contains an order for payment of spousal, family, or child support.
3. Judgment creditor (name):
SAN BERNARDINO County Department of Child Support Services whose address appears on this form above the court's name.
4. The support is ordered to be paid to the following county officer (name and address):
SAN BERNARDINO County Department of Child Support Services
PO BOX 989067
WEST SACRAMENTO CA 95798-9067
5. Judgment debtor (full name as it appears in judgment):
ROBERT L SANCHEZ
6. a. A judgment was entered on (date): 07/27/2001
b. Renewal was entered on (date):
c. Renewal was entered on (date):
7. An execution lien is endorsed on the judgment as follows:
a. Amount: \$
b. In favor of (name and address):
8. A stay of enforcement has
a. not been ordered by the court.
b. been ordered by the court effective until (date):
9. This is an installment judgment.

[Seal]

This document is a notice under Family Code Section 4506. No court seal required.

This abstract issued on (date): No date required under FC § 4506

This document is a notice under Family Code section 4506.
Clerk, by _____, Deputy

THIS IS TO INFORM YOU THAT A TAX LIEN HAS BEEN FILED WITH RESPECT TO UNSECURED PROPERTY

When recorded, mail to:

MARIO SANCHEZ
ELIAS SANCHEZ
ROBERTO SANCHEZ
49613 HARRISON ST NO C101
COACHELLA CA 92236

Doc # 2009-0570675
11/04/2009 08:00A Fee: NC
Page 1 of 1

Recorded in Official Records

County of Riverside

= Larry W Ward =

Assessor, County Clerk and Recorder

This document was electronically prepared and recorded by the County of Riverside

CERTIFICATE OF LIEN

(Recorded pursuant to Revenue and Taxation Code Section 2191.3 et seq. and without acknowledgement pursuant to Government Code Section 27282)

STATE OF CALIFORNIA |
COUNTY OF RIVERSIDE |SS

No. 0376666

I, Don Kent, Tax Collector of the County of Riverside, State of California, hereby certify that there are, on record in my office, unpaid taxes which were duly assessed, computed and levied for the fiscal year shown below pursuant to Section 2151 et seq. of the Revenue and Taxation Code.

The person(s) shown below is (are) liable to said County for the unpaid amounts set forth below plus any other penalties and charges which may accrue pursuant to law.

NAME AND ADDRESS

SANCHEZ MARIO
SANCHEZ ELIAS
SANCHEZ ROBERTO
49613 HARRISON ST NO C101
COACHELLA CA 92236

Fiscal Year	Tax Rate Area	Assessment Number	Tax	Penalty	Cost	Recording Fee
2009-2010	012-001	000237207-3	\$1,735.13	\$173.51		\$13.00

Upon recordation of this certificate of lien, the total amount required to be paid constitutes a lien upon all personal property and real property now owned or subsequently acquired by the person(s) named herein before the date on which this lien expires.

This lien has the force, effect and priority of judgement lien for ten years from the recording of this instrument, unless sooner released or otherwise discharged.

Executed on 10/31/2009

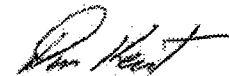

Don Kent, Tax Collector

Public Record

Recording Requested by

STATE OF CALIFORNIA
FRANCHISE TAX BOARD
Sacramento CA 95812-2952

And When Recorded Mail to

Special Procedures Section
PO BOX 2952
Sacramento CA 95812-2952

DOC # 2009-0673265

12/31/2009 08:00A Fee:NC

Page 1 of 1

Recorded in Official Records

County of Riverside

Larry W. Ward

Assessor, County Clerk & Recorder



NOTICE OF STATE TAX LIEN

030



FILED WITH: RIVERSIDE

CERTIFICATE NUMBER: 09356349919

The Franchise Tax Board of the State of California hereby certifies that the following named taxpayer(s) is liable under parts 10 or 11 of Division 2 of the Revenue and Taxation Code to the State of California for amount due and required to be paid by said taxpayer as follows:

Name of Taxpayer(s) : ROBERTO SANCHEZ

FTB Account Number : 2300254111

Social Security Number(s) : XXX-XX-2317

Last Known Address : 19209 PEMBERTON PL
: RIVERSIDE CA 92508-6022

For Taxable Years : 2007,2006

TAX	PENALTY	INTEREST	COLLECTION FEES	PAYMENTS	ADJUSTMENTS	* TOTAL
\$964.00	\$243.75	\$174.03	\$230.00	\$0.00	\$0.00	\$1,611.78

Further interest and fees will accrue at the rate prescribed by law until paid; that the Franchise Tax Board of the State of California complied with all of the provisions of parts 10 or 11 of Division 2 of the Revenue and Taxation Code of the State of California in computing, levying, determining and assessing the tax; the said amounts are due and payable and have not been paid. Said lien attaches to all property and rights to such property now owned or later acquired by the taxpayer.

IN WITNESS WHEREOF, the Franchise Tax Board of the State of California has duly authorized the undersigned to execute this Notice in its name.

DATED: 12/28/09

FRANCHISE TAX BOARD
of the State of California

Collection Bureau
Telephone Number: (916) 845-4350

By:

*Additional interest is accruing at the rate prescribed by law.

Authorized facsimile signature.

FTB 2930 V1 ARCS (REV 03-2008)

Public Record

Recording Requested by

STATE OF CALIFORNIA
FRANCHISE TAX BOARD
Sacramento CA 95812-2952

DOC # 2010-0171373

04/14/2010 08:00A Fee:NC

Page 1 of 1

Recorded in Official Records
County of Riverside

Larry W. Ward
Assessor, County Clerk & Recorder

And When Recorded Mail to

Special Procedures Section
PO BOX 2952
Sacramento CA 95812-2952



NOTICE OF STATE TAX LIEN

062 M 062

FILED WITH: RIVERSIDE

CERTIFICATE NUMBER: 10090649246

The Franchise Tax Board of the State of California hereby certifies that the following named taxpayer(s) is liable under parts 10 or 11 of Division 2 of the Revenue and Taxation Code to the State of California for amount due and required to be paid by said taxpayer as follows:

Name of Taxpayer(s) : ROBERT SANCHEZ

FTB Account Number : 1216560414

Social Security Number(s) : XXX-XX-4745

Last Known Address : 4383 DWIGHT AVE
: RIVERSIDE CA 92507-5221

For Taxable Years : 2007,2006

TAX	PENALTY	INTEREST	COLLECTION FEES	PAYMENTS	ADJUSTMENTS	* TOTAL
\$695.00	\$310.50	\$122.88	\$319.00	\$-3.01	\$-176.00	\$1,268.37

Further interest and fees will accrue at the rate prescribed by law until paid; that the Franchise Tax Board of the State of California complied with all of the provisions of parts 10 or 11 of Division 2 of the Revenue and Taxation Code of the State of California in computing, levying, determining and assessing the tax; the said amounts are due and payable and have not been paid. Said lien attaches to all property and rights to such property now owned or later acquired by the taxpayer.

IN WITNESS WHEREOF, the Franchise Tax Board of the State of California has duly authorized the undersigned to execute this Notice in its name.

DATED: 04/05/10

FRANCHISE TAX BOARD
of the State of California

Collection Bureau
Telephone Number: (916) 845-4350

By: *William S. Jones*

*Additional interest is accruing at the rate prescribed by law.

Authorized facsimile signature.

FTB 2930 V1 ARCS (REV 03-2008)

Public Record

SITE PLAN: Case # CV-1006142

OWNER(S): ROBERTO SANCHEZ
SITE ADDRESS: 1 Parcel W/O (21950 Salter Rd), LAKE MATHEWS
ASSESSOR'S PARCEL: 323-020-020
ACREAGE: 2.500000



REAR PROPERTY LINE

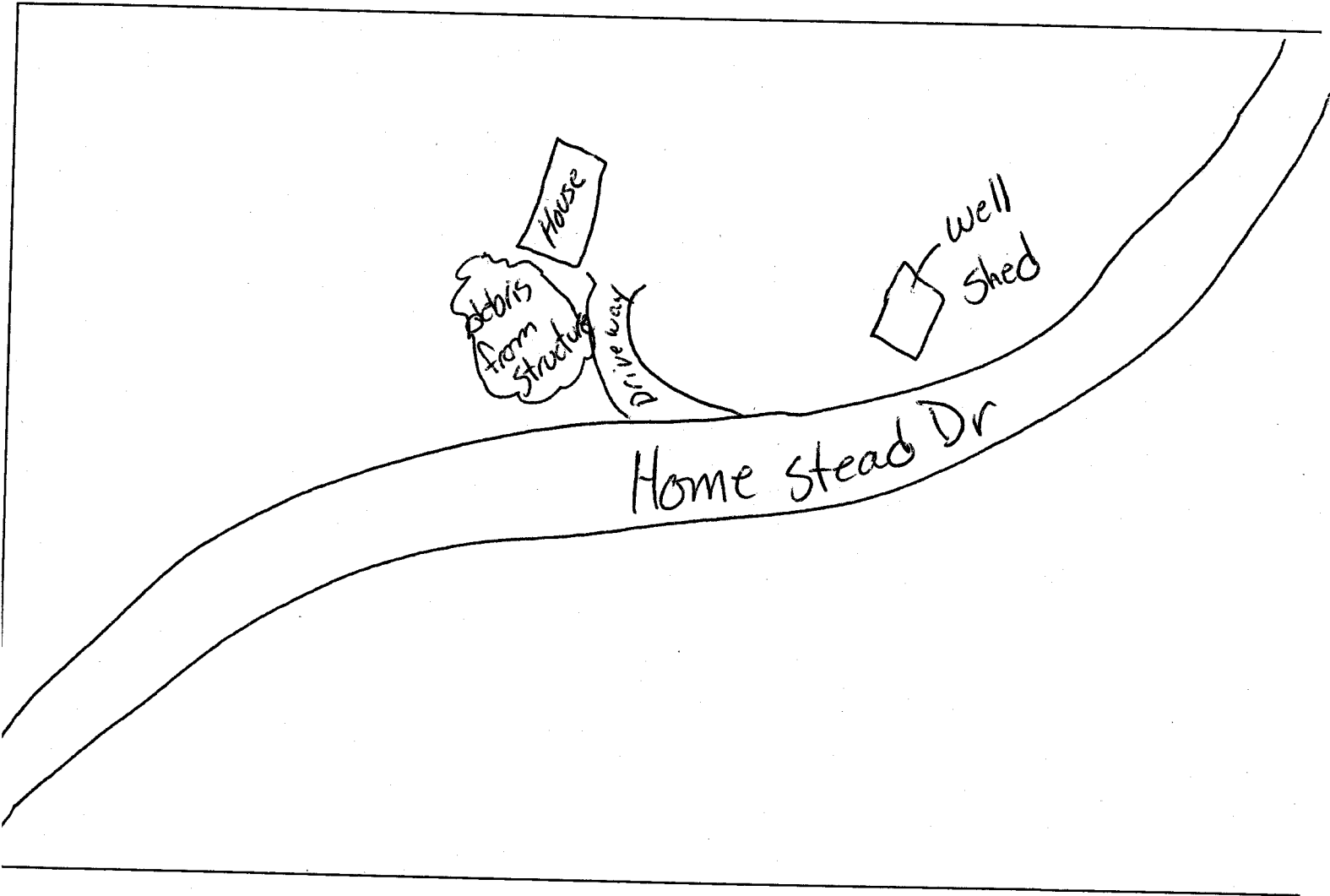

FRONT PROPERTY LINE: 1 Parcel W/O (21950 Salter Rd), LAKE MATHEWS

PREPARED BY: Ron Welch DATE: 11-2-10

EXHIBIT NO. D

Code Enforcement Case: CV1006142

Printed on: 12/01/2010

Photographs



SS STR RW - 07/01/2010

EXHIBIT NO. D²



SS STR RW - 07/01/2010

EXHIBIT NO. D³



SS STR RW - 07/01/2010

EXHIBIT NO. DA



SS STR RW - 07/01/2010

EXHIBIT NO. D⁵



SS STR RW - 07/01/2010

EXHIBIT NO. D6



SS STR RW - 07/01/2010

EXHIBIT NO. D7



SS STR RW - 07/01/2010

EXHIBIT NO. D8

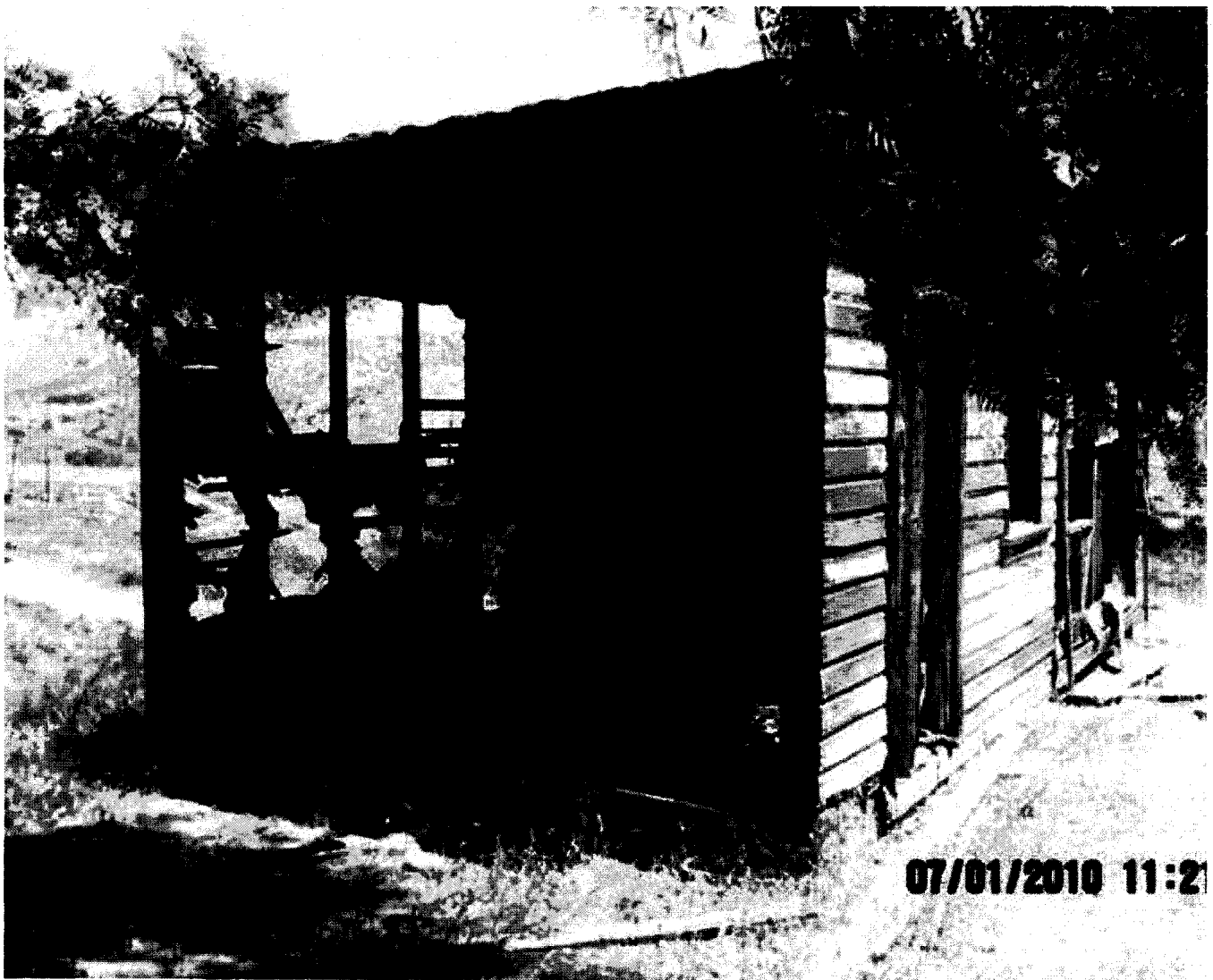

SS STR RW - 07/01/2010

EXHIBIT NO. D⁹

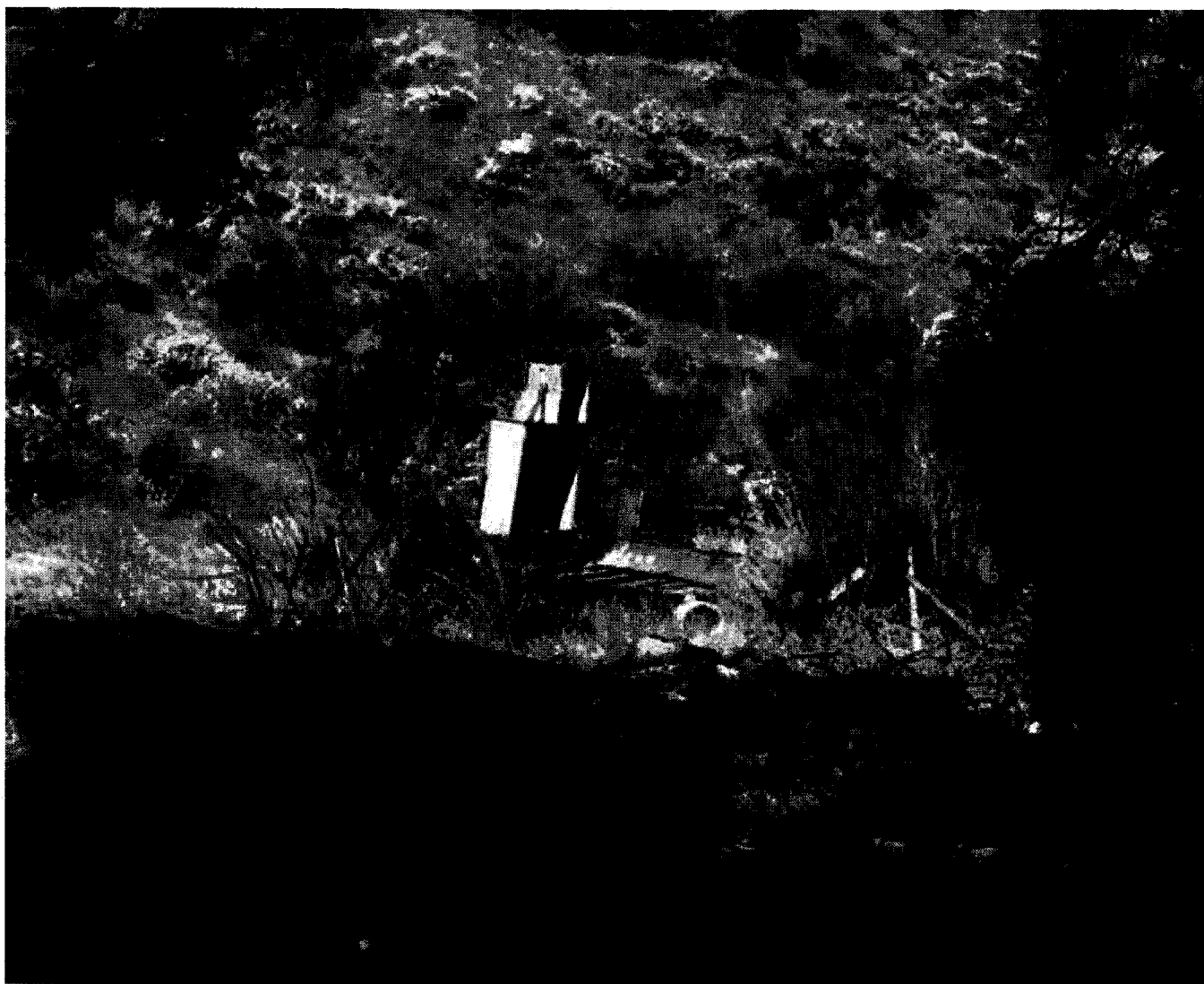

SS STR RW - 07/01/2010

EXHIBIT NO. D¹⁰



SS STR RW - 07/01/2010

EXHIBIT NO. D¹¹



SS STR RW - 07/01/2010

EXHIBIT NO. _____

D12

Code Enforcement Case: CV1006142

Printed on: 12/01/2010

Photographs



Violation remains - 12/01/2010

EXHIBIT NO. D¹³



COUNTY OF RIVERSIDE CODE ENFORCEMENT DEPARTMENT

NOTICE OF VIOLATION

THE PROPERTY AT: 1 Par West of (21950 Sullen Rd) CASE No.: CV 110-06142
 WAS INSPECTED BY OFFICER: Welch APN#: 323-020-020
 ID#: 43 ON 7-1-10 AT 11:20 am/pm

AND FOUND TO BE IN VIOLATION OF RIVERSIDE COUNTY CODE(S) AS FOLLOWS:

<input type="checkbox"/>	5.28.040 (RCO 593)	Excessive Yard Sales - Cease yard sale. Limit of 3 yard sale events, not over 3 consecutive days, per year.	<input type="checkbox"/>	17.252.030 (RCO 348)	Unpermitted Outdoor Advertising Display - Obtain a permit from the Planning Dept. or remove display.
<input type="checkbox"/>	8.28.030 (RCO 821)	Unfenced Pool - Install or provide adequate fencing to secure the pool.	<input type="checkbox"/>	17.172.205 (RCO 348)	Prohibited Fencing - Remove fence. Fences shall not be constructed of garage doors, tires, pallets or other materials not typically used for the construction of fences.
<input checked="" type="checkbox"/>	8.120.010 (RCO 541)	Accumulated Rubbish - Remove all rubbish & dispose of in an approved legal landfill.	<input type="checkbox"/>	17. (RCO 348)	Excessive Outside Storage: Storage of Unpermitted Mobile Home(s) Not Allowed - Remove unpermitted mobile home(s) from the property.
<input type="checkbox"/>	15.08.010 (RCO 457)	Unpermitted Construction - Cease construction. Obtain the appropriate permits from the Bldg. & Safety and Planning Departments or demolish the	<input type="checkbox"/>	17. (RCO 348)	Occupied RV/Trailer - Cease occupancy & disconnect all utilities to RV/Trailer.
<input type="checkbox"/>	15.12.020(J)(2) (RCO 457)	Unapproved Grading/Clearing - Cease grading/clearing/stockpiling/importing fill. Obtain a Restoration Assessment from the Dept. of Building & Safety. Perform complete restoration and remediation of the property affected by the unapproved grading in accordance with the Restoration Assessment.	<input type="checkbox"/>	17. (RCO 348)	Excessive Animals - Remove or reduce the number of _____ to less than _____.
<input checked="" type="checkbox"/>	15.16.020 (RCO 457)	Substandard Structure - Obtain a permit from the Bldg. & Safety Dept. to rehabilitate per Notice of Defects or demolish the structure. <u>House & Wall shed</u>	<input type="checkbox"/>	17. (RCO 348)	Unpermitted Land Use: _____ Cease all business activities. Obtain Planning Dept. approval prior to resuming business operations.
<input type="checkbox"/>	15.48.010 (RCO 457)	Unpermitted Mobile Home - Vacate mobile home. Obtain the appropriate permits from the Planning Dept. & Dept. of Bldg. & Safety prior to occupancy or remove Mobile Home.	<input type="checkbox"/>	17. (RCO 348)	Excessive Outside Storage - Remove or reduce all outside storage to less than _____ square feet at the rear of the property.
<input type="checkbox"/>	15.48.040 (RCO 457)	Substandard Mobile Home/Trailer/RV - Obtain a permit from the Bldg. & Safety Dept. to rehabilitate per Notice of Defects and Title 25 or demolish the Mobile Home/Trailer/RV.	<input type="checkbox"/>		

COMMENTS: _____

IMPORTANT! CORRECTION(S) MUST BE COMPLETED BY: 8-1-10. FAILURE TO COMPLY BY THIS DATE, MAY RESULT IN THE ISSUANCE OF AN ADMINISTRATIVE CITATION WITH FINES UP TO \$500.00 PER DAY, FOR EACH VIOLATION. YOU MAY BE CITED EACH DAY THAT THE VIOLATION(S) EXIST BEYOND THE CORRECTION DATE. IN ADDITION, OTHER ENFORCEMENT ACTION, PENALTIES AND THE IMPOSITION OF A LIEN ON THE PROPERTY FOR THE ABATEMENT AND ENFORCEMENT COSTS MAY RESULT IF COMPLIANCE IS NOT ACHIEVED BY THE CORRECTION DATE.

NOTICE IS HEREBY GIVEN THAT AT THE CONCLUSION OF THIS CASE YOU WILL RECEIVE A SUMMARY OF ADMINISTRATIVE COSTS ASSOCIATED WITH THE PROCESSING OF SUCH VIOLATION(S), AT AN HOURLY RATE OF \$ 109.00 AS DETERMINED BY THE BOARD OF SUPERVISORS. YOU WILL HAVE THE RIGHT TO OBJECT TO THESE CHARGES BY FILING A REQUEST FOR HEARING WITH THE DEPARTMENT OF CODE ENFORCEMENT WITHIN TEN (10) DAYS OF SERVICE OF THE SUMMARY OF CHARGES, PURSUANT TO RIVERSIDE COUNTY ORDINANCE 725 AND RIVERSIDE COUNTY CODE 1.16.

SIGNATURE _____ PRINT NAME _____ DATE _____ PROPERTY OWNER TENANT

CDL/CID# _____ D.O.B. _____ EXHIBIT NO. E TEL. NO. _____

WHITE: VIOLATOR GREEN: CASE FILE YELLOW: POSTING POSTED

House

RIVERSIDE COUNTY DEPARTMENT OF BUILDING AND SAFETY CODE ENFORCEMENT NOTICE OF DEFECTS

SUBSTANDARD BUILDING CONDITIONS:

UNIFORM HOUSING HEALTH & SAFETY
CODE SECTIONS CODE SECTIONS

1. <input checked="" type="checkbox"/> Lack of or improper water closet, lavatory, bathtub, shower or kitchen sink.....	1001(b)1,2,3	17920.3(a)1,2,3
OBTAIN PERMIT TO: []Repair Per Applicable Building Codes []Demolish Or Rehabilitate Structure		
2. <input checked="" type="checkbox"/> Lack of hot and cold running water to plumbing fixtures	1001(b)4,5	17920.3(a)4,5
OBTAIN PERMIT TO: []Repair Per Applicable Building Codes []Demolish Or Rehabilitate Structure		
3. <input checked="" type="checkbox"/> Lack of connection to required sewage system.....	1001(b)14	17920.3(a)14
OBTAIN PERMIT TO: []Repair Per Applicable Building Codes []Demolish Or Rehabilitate Structure		
4. [] Hazardous plumbing.....	1001(f)	17920.3(e)
OBTAIN PERMIT TO: []Repair Per Applicable Building Codes []Demolish Or Rehabilitate Structure		
5. <input checked="" type="checkbox"/> Lack of required electrical lighting.....	1001(b)10	17920.3(a)10
OBTAIN PERMIT TO: []Repair Per Applicable Building Codes []Demolish Or Rehabilitate Structure		
6. [] Hazardous Wiring.....	1001(e)	17920.3(d)
OBTAIN PERMIT TO: []Repair Per Applicable Building Codes []Demolish Or Rehabilitate Structure		
7. <input checked="" type="checkbox"/> Lack of adequate heating facilities.....	1001(o)6	17920.3(a)6
OBTAIN PERMIT TO: []Repair Per Applicable Building Codes []Demolish Or Rehabilitate Structure		
8. [] Deteriorated or inadequate foundation.....	1001(c)1	17920.3(b)1
OBTAIN PERMIT TO: []Repair Per Applicable Building Codes []Demolish Or Rehabilitate Structure		
9. <input checked="" type="checkbox"/> Defective or deteriorated flooring or floor supports.....	1001(c)2	17920.3(b)2
OBTAIN PERMIT TO: []Repair Per Applicable Building Codes []Demolish Or Rehabilitate Structure		
10 [] Members of walls, partitions or other vertical supports that split, lean, list or buckle due to defective material or deterioration.....	1001(c)4	17920.3(b)4
OBTAIN PERMIT TO: []Repair Per Applicable Building Codes []Demolish Or Rehabilitate Structure		
11 <input checked="" type="checkbox"/> Members of ceilings, roofs, ceiling and roof supports or other horizontal members which sag, split, or buckle due to defective material or deterioration.....	1001(c)6	17920.3(b)6
OBTAIN PERMIT TO: []Repair Per Applicable Building Codes []Demolish Or Rehabilitate Structure		
12 <input checked="" type="checkbox"/> Dampness of habitable rooms.....	1001(b)11	17920.3(a)11
OBTAIN PERMIT TO: []Repair Per Applicable Building Codes []Demolish Or Rehabilitate Structure		
13 <input checked="" type="checkbox"/> Faulty weather protection.....	1001(h)1-4	17920.3(g)1-4
A. Deteriorated or ineffective weather proofing of exterior walls, roof or floors including broken windows or doors, lack of paint or other approved wall covering.		
OBTAIN PERMIT TO: []Repair Per Applicable Building Codes <input checked="" type="checkbox"/> Demolish Or Rehabilitate Structure		
14 <input checked="" type="checkbox"/> General dilapidation or improper maintenance.....	1001(b)13	17920.3(a)13
OBTAIN PERMIT TO: []Repair Per Applicable Building Codes <input checked="" type="checkbox"/> Demolish Or Rehabilitate Structure		
15 [] Fire hazard.....	1001(i)	17920.3(h)
OBTAIN PERMIT TO: []Repair Per Applicable Building Codes []Demolish Or Rehabilitate Structure		
16 [] Extensive fire damage.....		
OBTAIN PERMIT TO: []Repair Per Applicable Building Codes []Demolish Or Rehabilitate Structure		
17 <input checked="" type="checkbox"/> Public and attractive nuisance - abandoned/vacant.....		
OBTAIN PERMIT TO: []Repair Per Applicable Building Codes <input checked="" type="checkbox"/> Demolish Or Rehabilitate Structure		
18 [] Improper occupancy.....	1001(n)	17920.3(n)
OBTAIN PERMIT TO: []Repair Per Applicable Building Codes []Demolish Or Rehabilitate Structure		
19 []		
OBTAIN PERMIT TO: []Repair Per Applicable Building Codes []Demolish Or Rehabilitate Structure		
20 []		
OBTAIN PERMIT TO: []Repair Per Applicable Building Codes []Demolish Or Rehabilitate Structure		

*** YOU MUST CORRECT THE ABOVE CONDITIONS WITHIN 30 DAYS OF THE DATE OF THIS NOTICE

Case No. TBA CV1006142 Address 323-020-020

Date 7-1-10 Officer Welch

EXHIBIT NO. E

RIVERSIDE COUNTY DEPARTMENT OF BUILDING AND SAFETY CODE ENFORCEMENT NOTICE OF DEFECTS

SUBSTANDARD BUILDING CONDITIONS:

UNIFORM HOUSING HEALTH & SAFETY
CODE SECTIONS CODE SECTIONS

<p>1. <input type="checkbox"/> Lack of or improper water closet, lavatory, bathtub, shower or kitchen sink.....</p> <p style="padding-left: 20px;">OBTAIN PERMIT TO: <input type="checkbox"/> Repair Per Applicable Building Codes <input type="checkbox"/> Demolish Or Rehabilitate Structure</p> <p>2. <input type="checkbox"/> Lack of hot and cold running water to plumbing fixtures</p> <p style="padding-left: 20px;">OBTAIN PERMIT TO: <input type="checkbox"/> Repair Per Applicable Building Codes <input type="checkbox"/> Demolish Or Rehabilitate Structure</p> <p>3. <input type="checkbox"/> Lack of connection to required sewage system.....</p> <p style="padding-left: 20px;">OBTAIN PERMIT TO: <input type="checkbox"/> Repair Per Applicable Building Codes <input type="checkbox"/> Demolish Or Rehabilitate Structure</p> <p>4. <input type="checkbox"/> Hazardous plumbing.....</p> <p style="padding-left: 20px;">OBTAIN PERMIT TO: <input type="checkbox"/> Repair Per Applicable Building Codes <input type="checkbox"/> Demolish Or Rehabilitate Structure</p> <p>5. <input type="checkbox"/> Lack of required electrical lighting.....</p> <p style="padding-left: 20px;">OBTAIN PERMIT TO: <input type="checkbox"/> Repair Per Applicable Building Codes <input type="checkbox"/> Demolish Or Rehabilitate Structure</p> <p>6. <input type="checkbox"/> Hazardous Wiring.....</p> <p style="padding-left: 20px;">OBTAIN PERMIT TO: <input type="checkbox"/> Repair Per Applicable Building Codes <input type="checkbox"/> Demolish Or Rehabilitate Structure</p> <p>7. <input type="checkbox"/> Lack of adequate heating facilities.....</p> <p style="padding-left: 20px;">OBTAIN PERMIT TO: <input type="checkbox"/> Repair Per Applicable Building Codes <input type="checkbox"/> Demolish Or Rehabilitate Structure</p> <p>8. <input type="checkbox"/> Deteriorated or inadequate foundation.....</p> <p style="padding-left: 20px;">OBTAIN PERMIT TO: <input type="checkbox"/> Repair Per Applicable Building Codes <input type="checkbox"/> Demolish Or Rehabilitate Structure</p> <p>9. <input type="checkbox"/> Defective or deteriorated flooring or floor supports.....</p> <p style="padding-left: 20px;">OBTAIN PERMIT TO: <input type="checkbox"/> Repair Per Applicable Building Codes <input type="checkbox"/> Demolish Or Rehabilitate Structure</p> <p>10 <input type="checkbox"/> Members of walls, partitions or other vertical supports that split, lean, list or buckle due to defective material or deterioration.....</p> <p style="padding-left: 20px;">OBTAIN PERMIT TO: <input type="checkbox"/> Repair Per Applicable Building Codes <input type="checkbox"/> Demolish Or Rehabilitate Structure</p> <p>11 <input type="checkbox"/> Members of ceilings, roofs, ceiling and roof supports or other horizontal members which sag, split, or buckle due to defective material or deterioration.....</p> <p style="padding-left: 20px;">OBTAIN PERMIT TO: <input type="checkbox"/> Repair Per Applicable Building Codes <input type="checkbox"/> Demolish Or Rehabilitate Structure</p> <p>12 <input type="checkbox"/> Dampness of habitable rooms.....</p> <p style="padding-left: 20px;">OBTAIN PERMIT TO: <input type="checkbox"/> Repair Per Applicable Building Codes <input type="checkbox"/> Demolish Or Rehabilitate Structure</p> <p>13 <input checked="" type="checkbox"/> Faulty weather protection.....</p> <p style="padding-left: 20px;">A. Deteriorated or ineffective weather proofing of exterior walls, roof or floors including broken windows or doors, lack of paint or other approved wall covering.</p> <p style="padding-left: 20px;">OBTAIN PERMIT TO: <input type="checkbox"/> Repair Per Applicable Building Codes <input checked="" type="checkbox"/> Demolish Or Rehabilitate Structure</p> <p>14 <input checked="" type="checkbox"/> General dilapidation or improper maintenance.....</p> <p style="padding-left: 20px;">OBTAIN PERMIT TO: <input type="checkbox"/> Repair Per Applicable Building Codes <input checked="" type="checkbox"/> Demolish Or Rehabilitate Structure</p> <p>15 <input type="checkbox"/> Fire hazard.....</p> <p style="padding-left: 20px;">OBTAIN PERMIT TO: <input type="checkbox"/> Repair Per Applicable Building Codes <input type="checkbox"/> Demolish Or Rehabilitate Structure</p> <p>16 <input type="checkbox"/> Extensive fire damage.....</p> <p style="padding-left: 20px;">OBTAIN PERMIT TO: <input type="checkbox"/> Repair Per Applicable Building Codes <input type="checkbox"/> Demolish Or Rehabilitate Structure</p> <p>17 <input checked="" type="checkbox"/> Public and attractive nuisance - abandoned/vacant.....</p> <p style="padding-left: 20px;">OBTAIN PERMIT TO: <input type="checkbox"/> Repair Per Applicable Building Codes <input checked="" type="checkbox"/> Demolish Or Rehabilitate Structure</p> <p>18 <input type="checkbox"/> Improper occupancy.....</p> <p style="padding-left: 20px;">OBTAIN PERMIT TO: <input type="checkbox"/> Repair Per Applicable Building Codes <input type="checkbox"/> Demolish Or Rehabilitate Structure</p> <p>19 <input type="checkbox"/> _____</p> <p style="padding-left: 20px;">OBTAIN PERMIT TO: <input type="checkbox"/> Repair Per Applicable Building Codes <input type="checkbox"/> Demolish Or Rehabilitate Structure</p> <p>20 <input type="checkbox"/> _____</p> <p style="padding-left: 20px;">OBTAIN PERMIT TO: <input type="checkbox"/> Repair Per Applicable Building Codes <input type="checkbox"/> Demolish Or Rehabilitate Structure</p>	<p>1001(b)1,2,3 17920.3(a)1,2,3</p> <p>1001(b)4,5 17920.3(a)4,5</p> <p>1001(b)14 17920.3(a)14</p> <p>1001(f) 17920.3(e)</p> <p>1001(b)10 17920.3(a)10</p> <p>1001(e) 17920.3(d)</p> <p>1001(o)6 17920.3(a)6</p> <p>1001(c)1 17920.3(b)1</p> <p>1001(c)2 17920.3(b)2</p> <p>1001(c)4 17920.3(b)4</p> <p>1001(c)6 17920.3(b)6</p> <p>1001(b)11 17920.3(a)11</p> <p>1001(h)1-4 17920.3(g)1-4</p> <p>1001(b)13 17920.3(a)13</p> <p>1001(i) 17920.3(h)</p> <p>1001(a) 17920.3(n)</p>
---	---

*** YOU MUST CORRECT THE ABOVE CONDITIONS WITHIN 30 DAYS OF THE DATE OF THIS NOTICE

Case No. TBACV100 6142 Address 323 - 020 - 020

Date 7-1-10 Officer WEICK



**CODE ENFORCEMENT DEPARTMENT
COUNTY OF RIVERSIDE**

JOHN BOYD
Director

AFFIDAVIT OF POSTING OF NOTICES

July 23, 2010

RE CASE NO: CV1006142

I, Ron Welch, hereby declare:

I am employed by the Riverside County Code Enforcement Department; that my business address is 19450 Clark Street, Perris, California 92570 .

That on 07/01/10 at 11:20am, I securely and conspicuously posted Notice of Violation and Notice of Defects at the property described as:

Property Address: 0 , LAKE MATHEWS

Assessor's Parcel Number: 323-020-020

I declare under the penalty of perjury that the foregoing is true and correct.

Executed on July 23, 2010 in the County of Riverside, California.

CODE ENFORCEMENT DEPARTMENT

By: Ron Welch, Code Enforcement Officer

YOU WILL HAVE THE RIGHT TO OBJECT TO THESE CHARGES BY FILING A REQUEST FOR HEARING WITH THE DEPARTMENT OF CODE ENFORCEMENT WITHIN TEN (10) DAYS OF SERVICE OF THE SUMMARY OF CHARGES, PURSUANT TO SECTION 1.16.080 OF RIVERSIDE COUNTY CODE.

CODE ENFORCEMENT DEPARTMENT

By: Ron Welch, Code Enforcement Officer

EXHIBIT NO. _____

E6

House

RIVERSIDE COUNTY DEPARTMENT OF BUILDING AND SAFETY CODE ENFORCEMENT NOTICE OF DEFECTS

SUBSTANDARD BUILDING CONDITIONS:	UNIFORM HOUSING	HEALTH & SAFETY
	CODE SECTIONS	CODE SECTIONS
1. <input checked="" type="checkbox"/> Lack of or improper water closet, lavatory, bathtub, shower or kitchen sink.....	1001(b)1,2,3	17920.3(a)1,2,3
OBTAIN PERMIT TO: <input type="checkbox"/> Repair Per Applicable Building Codes <input type="checkbox"/> Demolish Or Rehabilitate Structure		
2. <input checked="" type="checkbox"/> Lack of hot and cold running water to plumbing fixtures	1001(b)4,5	17920.3(a)4,5
OBTAIN PERMIT TO: <input type="checkbox"/> Repair Per Applicable Building Codes <input type="checkbox"/> Demolish Or Rehabilitate Structure		
3. <input checked="" type="checkbox"/> Lack of connection to required sewage system.....	1001(b)14	17920.3(a)14
OBTAIN PERMIT TO: <input type="checkbox"/> Repair Per Applicable Building Codes <input type="checkbox"/> Demolish Or Rehabilitate Structure		
4. <input type="checkbox"/> Hazardous plumbing.....	1001(f)	17920.3(e)
OBTAIN PERMIT TO: <input type="checkbox"/> Repair Per Applicable Building Codes <input type="checkbox"/> Demolish Or Rehabilitate Structure		
5. <input checked="" type="checkbox"/> Lack of required electrical lighting.....	1001(b)10	17920.3(a)10
OBTAIN PERMIT TO: <input type="checkbox"/> Repair Per Applicable Building Codes <input type="checkbox"/> Demolish Or Rehabilitate Structure		
6. <input type="checkbox"/> Hazardous Wiring.....	1001(e)	17920.3(d)
OBTAIN PERMIT TO: <input type="checkbox"/> Repair Per Applicable Building Codes <input type="checkbox"/> Demolish Or Rehabilitate Structure		
7. <input checked="" type="checkbox"/> Lack of adequate heating facilities.....	1001(o)6	17920.3(a)6
OBTAIN PERMIT TO: <input type="checkbox"/> Repair Per Applicable Building Codes <input type="checkbox"/> Demolish Or Rehabilitate Structure		
8. <input type="checkbox"/> Deteriorated or inadequate foundation.....	1001(c)1	17920.3(b)1
OBTAIN PERMIT TO: <input type="checkbox"/> Repair Per Applicable Building Codes <input type="checkbox"/> Demolish Or Rehabilitate Structure		
9. <input checked="" type="checkbox"/> Defective or deteriorated flooring or floor supports.....	1001(c)2	17920.3(b)2
OBTAIN PERMIT TO: <input type="checkbox"/> Repair Per Applicable Building Codes <input type="checkbox"/> Demolish Or Rehabilitate Structure		
10. <input type="checkbox"/> Members of walls, partitions or other vertical supports that split, lean, list or buckle due to defective material or deterioration.....	1001(c)4	17920.3(b)4
OBTAIN PERMIT TO: <input type="checkbox"/> Repair Per Applicable Building Codes <input type="checkbox"/> Demolish Or Rehabilitate Structure		
11. <input checked="" type="checkbox"/> Members of ceilings, roofs, ceiling and roof supports or other horizontal members which sag, split, or buckle due to defective material or deterioration.....	1001(c)6	17920.3(b)6
OBTAIN PERMIT TO: <input type="checkbox"/> Repair Per Applicable Building Codes <input type="checkbox"/> Demolish Or Rehabilitate Structure		
12. <input checked="" type="checkbox"/> Dampness of habitable rooms.....	1001(b)11	17920.3(a)11
OBTAIN PERMIT TO: <input type="checkbox"/> Repair Per Applicable Building Codes <input type="checkbox"/> Demolish Or Rehabilitate Structure		
13. <input checked="" type="checkbox"/> Faulty weather protection.....	1001(h)1-4	17920.3(g)1-4
A. Deteriorated or ineffective weather proofing of exterior walls, roof or floors including broken windows or doors, lack of paint or other approved wall covering.		
OBTAIN PERMIT TO: <input type="checkbox"/> Repair Per Applicable Building Codes <input checked="" type="checkbox"/> Demolish Or Rehabilitate Structure		
14. <input checked="" type="checkbox"/> General dilapidation or improper maintenance.....	1001(b)13	17920.3(a)13
OBTAIN PERMIT TO: <input type="checkbox"/> Repair Per Applicable Building Codes <input checked="" type="checkbox"/> Demolish Or Rehabilitate Structure		
15. <input type="checkbox"/> Fire hazard.....	1001(i)	17920.3(h)
OBTAIN PERMIT TO: <input type="checkbox"/> Repair Per Applicable Building Codes <input type="checkbox"/> Demolish Or Rehabilitate Structure		
16. <input type="checkbox"/> Extensive fire damage.....		
OBTAIN PERMIT TO: <input type="checkbox"/> Repair Per Applicable Building Codes <input type="checkbox"/> Demolish Or Rehabilitate Structure		
17. <input checked="" type="checkbox"/> Public and attractive nuisance - abandoned/vacant.....		
OBTAIN PERMIT TO: <input type="checkbox"/> Repair Per Applicable Building Codes <input checked="" type="checkbox"/> Demolish Or Rehabilitate Structure		
18. <input type="checkbox"/> Improper occupancy.....	1001(n)	17920.3(n)
OBTAIN PERMIT TO: <input type="checkbox"/> Repair Per Applicable Building Codes <input type="checkbox"/> Demolish Or Rehabilitate Structure		
19. <input type="checkbox"/> _____		
OBTAIN PERMIT TO: <input type="checkbox"/> Repair Per Applicable Building Codes <input type="checkbox"/> Demolish Or Rehabilitate Structure		
20. <input type="checkbox"/> _____		
OBTAIN PERMIT TO: <input type="checkbox"/> Repair Per Applicable Building Codes <input type="checkbox"/> Demolish Or Rehabilitate Structure		

*** YOU MUST CORRECT THE ABOVE CONDITIONS WITHIN 30 DAYS OF THE DATE OF THIS NOTICE

Case No. TBA CV1006142 Address 323-020-020

Date 7-1-10 Officer Welch

EXHIBIT NO. E¹

RIVERSIDE COUNTY DEPARTMENT OF BUILDING AND SAFETY

CODE ENFORCEMENT NOTICE OF DEFECTS

SUBSTANDARD BUILDING CONDITIONS:

	UNIFORM HOUSING		HEALTH & SAFETY	
	CODE SECTIONS		CODE SECTIONS	
1. <input type="checkbox"/> Lack of or improper water closet, lavatory, bathtub, shower or kitchen sink.....	1001(b)1,2,3	17920.3(a)1,2,3		
OBTAIN PERMIT TO: <input type="checkbox"/> Repair Per Applicable Building Codes <input type="checkbox"/> Demolish Or Rehabilitate Structure				
2. <input type="checkbox"/> Lack of hot and cold running water to plumbing fixtures	1001(b)4,5	17920.3(a)4,5		
OBTAIN PERMIT TO: <input type="checkbox"/> Repair Per Applicable Building Codes <input type="checkbox"/> Demolish Or Rehabilitate Structure				
3. <input type="checkbox"/> Lack of connection to required sewage system.....	1001(b)14	17920.3(a)14		
OBTAIN PERMIT TO: <input type="checkbox"/> Repair Per Applicable Building Codes <input type="checkbox"/> Demolish Or Rehabilitate Structure				
4. <input type="checkbox"/> Hazardous plumbing.....	1001(f)	17920.3(e)		
OBTAIN PERMIT TO: <input type="checkbox"/> Repair Per Applicable Building Codes <input type="checkbox"/> Demolish Or Rehabilitate Structure				
5. <input type="checkbox"/> Lack of required electrical lighting.....	1001(b)10	17920.3(a)10		
OBTAIN PERMIT TO: <input type="checkbox"/> Repair Per Applicable Building Codes <input type="checkbox"/> Demolish Or Rehabilitate Structure				
6. <input type="checkbox"/> Hazardous Wiring.....	1001(e)	17920.3(d)		
OBTAIN PERMIT TO: <input type="checkbox"/> Repair Per Applicable Building Codes <input type="checkbox"/> Demolish Or Rehabilitate Structure				
7. <input type="checkbox"/> Lack of adequate heating facilities.....	1001(e)6	17920.3(a)6		
OBTAIN PERMIT TO: <input type="checkbox"/> Repair Per Applicable Building Codes <input type="checkbox"/> Demolish Or Rehabilitate Structure				
8. <input type="checkbox"/> Deteriorated or inadequate foundation.....	1001(c)1	17920.3(b)1		
OBTAIN PERMIT TO: <input type="checkbox"/> Repair Per Applicable Building Codes <input type="checkbox"/> Demolish Or Rehabilitate Structure				
9. <input type="checkbox"/> Defective or deteriorated flooring or floor supports.....	1001(c)2	17920.3(b)2		
OBTAIN PERMIT TO: <input type="checkbox"/> Repair Per Applicable Building Codes <input type="checkbox"/> Demolish Or Rehabilitate Structure				
10. <input type="checkbox"/> Members of walls, partitions or other vertical supports that split, lean, list or buckle due to defective material or deterioration.....	1001(c)4	17920.3(b)4		
OBTAIN PERMIT TO: <input type="checkbox"/> Repair Per Applicable Building Codes <input type="checkbox"/> Demolish Or Rehabilitate Structure				
11. <input type="checkbox"/> Members of ceilings, roofs, ceiling and roof supports or other horizontal members which sag, split, or buckle due to defective material or deterioration.....	1001(e)6	17920.3(b)6		
OBTAIN PERMIT TO: <input type="checkbox"/> Repair Per Applicable Building Codes <input type="checkbox"/> Demolish Or Rehabilitate Structure				
12. <input type="checkbox"/> Dampness of habitable rooms.....	1001(b)11	17920.3(a)11		
OBTAIN PERMIT TO: <input type="checkbox"/> Repair Per Applicable Building Codes <input type="checkbox"/> Demolish Or Rehabilitate Structure				
13. <input checked="" type="checkbox"/> Faulty weather protection.....	1001(h)1-4	17920.3(g)1-4		
A. Deteriorated or ineffective weather proofing of exterior walls, roof or floors including broken windows or doors, lack of paint or other approved wall covering.				
OBTAIN PERMIT TO: <input type="checkbox"/> Repair Per Applicable Building Codes <input checked="" type="checkbox"/> Demolish Or Rehabilitate Structure				
14. <input checked="" type="checkbox"/> General dilapidation or improper maintenance.....	1001(b)13	17920.3(a)13		
OBTAIN PERMIT TO: <input type="checkbox"/> Repair Per Applicable Building Codes <input checked="" type="checkbox"/> Demolish Or Rehabilitate Structure				
15. <input type="checkbox"/> Fire hazard.....	1001(i)	17920.3(h)		
OBTAIN PERMIT TO: <input type="checkbox"/> Repair Per Applicable Building Codes <input type="checkbox"/> Demolish Or Rehabilitate Structure				
16. <input type="checkbox"/> Extensive fire damage.....				
OBTAIN PERMIT TO: <input type="checkbox"/> Repair Per Applicable Building Codes <input type="checkbox"/> Demolish Or Rehabilitate Structure				
17. <input checked="" type="checkbox"/> Public and attractive nuisance - abandoned/vacant.....				
OBTAIN PERMIT TO: <input type="checkbox"/> Repair Per Applicable Building Codes <input checked="" type="checkbox"/> Demolish Or Rehabilitate Structure				
18. <input type="checkbox"/> Improper occupancy.....	1001(n)	17920.3(n)		
OBTAIN PERMIT TO: <input type="checkbox"/> Repair Per Applicable Building Codes <input type="checkbox"/> Demolish Or Rehabilitate Structure				
19. <input type="checkbox"/>				
OBTAIN PERMIT TO: <input type="checkbox"/> Repair Per Applicable Building Codes <input type="checkbox"/> Demolish Or Rehabilitate Structure				
20. <input type="checkbox"/>				
OBTAIN PERMIT TO: <input type="checkbox"/> Repair Per Applicable Building Codes <input type="checkbox"/> Demolish Or Rehabilitate Structure				

*** YOU MUST CORRECT THE ABOVE CONDITIONS WITHIN 30 DAYS OF THE DATE OF THIS NOTICE

Case No. TBA CV 100 6142 Address 323 - 020 - 020

Date 7-1-10 Officer Weick

EXHIBIT NO. E8



**CODE ENFORCEMENT DEPARTMENT
COUNTY OF RIVERSIDE**

JOHN BOYD
Director

PROOF OF SERVICE

Case No. CV1006142

STATE OF CALIFORNIA, COUNTY OF RIVERSIDE

I, Jessica Morrison, declare that I am a citizen of the United States and am employed in the County of Riverside, over the age of 18 years and not a party to the within action or proceeding; that my business address is at the footer of this notice.

That on July 27, 2010, I served the following document(s):

NOTICE RE: Notice of Violation and Notice of Defects (x2)

by placing a true copy thereof enclosed in a sealed envelope(s) by **CERTIFIED MAIL, RETURN RECEIPT REQUESTED** addressed as follows:

ROBERTO SANCHEZ 1427 VINELAND AVE, BALDWIN PARK, CA 91706

XX **By First Class Mail.** I am readily familiar with the office's practice of collection and processing correspondence for mailing. Under that practice it would be deposited with the U.S. Postal Service with postage thereon fully prepaid in the County of Riverside, California, in the ordinary course of business.

XX **STATE.** I declare under the penalty of perjury under the laws of the State of California that the above is true and correct.

EXECUTED ON July 27, 2010 in the County of Riverside, California.

CODE ENFORCEMENT DEPARTMENT

J Morrison
By: Jessica Morrison (Code Enforcement Aide)

U.S. Postal Service™
CERTIFIED MAIL™ RECEIPT
(Domestic Mail Only; No Insurance Coverage Provided)

For delivery information visit our website at www.usps.com

OFFICIAL USE

7009 2820 0001 4708 1686

Postage	\$
Certified Fee	
Return Receipt Fee (Endorsement Required)	
Restricted Delivery Fee (Endorsement Required)	

Postmark
Here

**ROBERTO SANCHEZ
1427 VINELAND AVE
BALDWIN PARK, CA 91706
CV10-06142 RW 323**

RIVERSIDE COUNTY CODE ENFORCEMENT
DISTRICT 1 MEAD VALLEY
39493 LOS ALMOS ROAD
MURRIETA, CA 92563-5039

NOT DELIVERABLE
AS ADDRESSED
UNABLE TO FORWARD

7009 2820 0001 4708

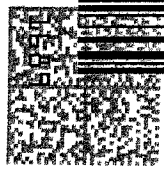

UNITED STATES POSTAGE
FIRST CLASS
PERMIT NO. 1015
MURRIETA, CA
\$05.71
02 1R
0002098661 AUG02 2010
MAILED FROM ZIP CODE 92504

ROBERTO SANCHEZ
1427 VINELAND AVE
BALDWIN PARK, CA 91706
CV10-06142 RW 323

REC'D AUG 20 2010

AUG 03

AUG 14 2010

NL 3.10
8.3.10

917069914 0009

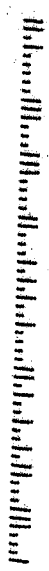

EXHIBIT NO. E10



**CODE ENFORCEMENT DEPARTMENT
COUNTY OF RIVERSIDE**

JOHN BOYD
Director

AFFIDAVIT OF POSTING OF NOTICES

July 23, 2010

RE CASE NO: CV1006142

I, Ron Welch, hereby declare:

I am employed by the Riverside County Code Enforcement Department; that my business address is 19450 Clark Street, Perris, California 92570 .

That on 07/01/10 at 11:20am, I securely and conspicuously posted Notice of Violation and Notice of Defects at the property described as:

Property Address: 0 , LAKE MATHEWS

Assessor's Parcel Number: 323-020-020

I declare under the penalty of perjury that the foregoing is true and correct.

Executed on July 23, 2010 in the County of Riverside, California.

CODE ENFORCEMENT DEPARTMENT



By: Ron Welch, Code Enforcement Officer

EXHIBIT NO. E¹¹

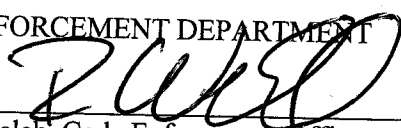

**CODE ENFORCEMENT DEPARTMENT
COUNTY OF RIVERSIDE**

GLENN BAUDE
Director

NOTICE OF VIOLATION

October 14, 2010

ROBERT SANCHEZ
11732 KILLIAN
EL MONTE, CA 91732

RE CASE NO: CV1006142 at 1 Parcel W/O (21950 Salter Rd), LAKE MATHEWS, California, Assessor's Parcel Number 323-020-020

NOTICE IS HEREBY GIVEN that property owned or controlled by you at 1 Parcel W/O (21950 Salter Rd), LAKE MATHEWS California, Assessor's Parcel Number 323-020-020, is in violation of Section(s) RCC Section No. 15.16.020 (Ord. 457), of the Riverside County Code.

Said violation is described as:

- 1) 15.16.020 (Ord. 457) - An inspection was made of the above-referenced subject property in response to complaints received by this office. The structure(s) was/were found to be substandard and a public nuisance in violation of Riverside County Code Section 15.16, and as such, was posted with a "Danger Do Not Enter" sign and a copy of the enclosed "Notice of Defects," which sets forth the conditions that render the building unsafe for human habitation.

NOTICE IS HEREBY GIVEN that failure to comply with this notice will result in further civil, criminal, or administrative proceedings for demolition of the structure(s) and abatement of the public nuisance and could result in the imposition of a lien on the subject property(ies) for costs, including attorney's fees, related to the enforcement of all ordinances and abatement of violative conditions. A "Notice of Noncompliance" has been recorded with the Riverside County Recorder's Office. At the conclusion of this case, you will receive a Statement of Expense associated with the abatement of such nuisance.

NOTICE IS FURTHER GIVEN that in accordance with Sections 17274 and 24436.5 of the Revenue and Taxation Code, a tax deduction may not be allowed for interest, taxes, depreciation, or amortization paid or incurred in the taxable year affected by these abatement proceedings.

YOU ARE HEREBY REQUIRED TO COMPLY with the provisions of the ordinance by:

- 1) THE OWNER OF RECORD of the subject property is hereby noticed and ordered within thirty (30) days of this notice to obtain all necessary permits from the Department of Building and Safety and to correct or abate the unsafe conditions either by repairing all violative conditions indicated in the attached "Notice of Defects" or demolition and removal of the structures (House, well shed). ALL PARTIES WITH INTEREST in the subject property may comply with the provisions of this notice within fifteen (15) days after the expiration of the thirty (30) day period.

COMPLIANCE MUST BE COMPLETED BY November 15, 2010. FAILURE TO COMPLY WILL RESULT IN LEGAL ACTION BEING BROUGHT AGAINST YOU.

NOTICE IS HEREBY GIVEN THAT AT THE CONCLUSION OF THIS CASE YOU WILL RECEIVE A SUMMARY OF ADMINISTRATIVE COSTS ASSOCIATED WITH THE PROCESSING OF SUCH VIOLATION(S), AT AN HOURLY RATE OF \$109.00 AS DETERMINED BY THE BOARD OF SUPERVISORS.

19450 CLARK STREET, PERRIS, CALIFORNIA 92570
(951) 657-0122 • FAX (951) 943-1160

EXHIBIT NO. _____

E12

YOU WILL HAVE THE RIGHT TO OBJECT TO THESE CHARGES BY FILING A REQUEST FOR HEARING WITH THE DEPARTMENT OF CODE ENFORCEMENT WITHIN TEN (10) DAYS OF SERVICE OF THE SUMMARY OF CHARGES, PURSUANT TO SECTION 1.16.080 OF RIVERSIDE COUNTY CODE.

CODE ENFORCEMENT DEPARTMENT

By: Ron Welch, Code Enforcement Officer

EXHIBIT NO. _____

E13
C

House

RIVERSIDE COUNTY DEPARTMENT OF BUILDING AND SAFETY CODE ENFORCEMENT NOTICE OF DEFECTS

SUBSTANDARD BUILDING CONDITIONS:

UNIFORM HOUSING HEALTH & SAFETY
CODE SECTIONS CODE SECTIONS

- | | | |
|--|--|-----------------|
| 1. <input checked="" type="checkbox"/> Lack of or improper water closet, lavatory, bathtub, shower or kitchen sink..... | 1001(b)1,2,3 | 17920.3(a)1,2,3 |
| OBTAIN PERMIT TO: <input type="checkbox"/> Repair Per Applicable Building Codes | <input type="checkbox"/> Demolish Or Rehabilitate Structure | |
| 2. <input checked="" type="checkbox"/> Lack of hot and cold running water to plumbing fixtures | 1001(b)4,5 | 17920.3(a)4,5 |
| OBTAIN PERMIT TO: <input type="checkbox"/> Repair Per Applicable Building Codes | <input type="checkbox"/> Demolish Or Rehabilitate Structure | |
| 3. <input checked="" type="checkbox"/> Lack of connection to required sewage system..... | 1001(b)14 | 17920.3(a)14 |
| OBTAIN PERMIT TO: <input type="checkbox"/> Repair Per Applicable Building Codes | <input type="checkbox"/> Demolish Or Rehabilitate Structure | |
| 4. <input type="checkbox"/> Hazardous plumbing..... | 1001(f) | 17920.3(e) |
| OBTAIN PERMIT TO: <input type="checkbox"/> Repair Per Applicable Building Codes | <input type="checkbox"/> Demolish Or Rehabilitate Structure | |
| 5. <input checked="" type="checkbox"/> Lack of required electrical lighting..... | 1001(b)10 | 17920.3(a)10 |
| OBTAIN PERMIT TO: <input type="checkbox"/> Repair Per Applicable Building Codes | <input type="checkbox"/> Demolish Or Rehabilitate Structure | |
| 6. <input type="checkbox"/> Hazardous Wiring..... | 1001(e) | 17920.3(d) |
| OBTAIN PERMIT TO: <input type="checkbox"/> Repair Per Applicable Building Codes | <input type="checkbox"/> Demolish Or Rehabilitate Structure | |
| 7. <input checked="" type="checkbox"/> Lack of adequate heating facilities..... | 1001(o)6 | 17920.3(a)6 |
| OBTAIN PERMIT TO: <input type="checkbox"/> Repair Per Applicable Building Codes | <input type="checkbox"/> Demolish Or Rehabilitate Structure | |
| 8. <input type="checkbox"/> Deteriorated or inadequate foundation..... | 1001(c)1 | 17920.3(b)1 |
| OBTAIN PERMIT TO: <input type="checkbox"/> Repair Per Applicable Building Codes | <input type="checkbox"/> Demolish Or Rehabilitate Structure | |
| 9. <input checked="" type="checkbox"/> Defective or deteriorated flooring or floor supports..... | 1001(c)2 | 17920.3(b)2 |
| OBTAIN PERMIT TO: <input type="checkbox"/> Repair Per Applicable Building Codes | <input type="checkbox"/> Demolish Or Rehabilitate Structure | |
| 10. <input type="checkbox"/> Members of walls, partitions or other vertical supports that split, lean, list or buckle
due to defective material or deterioration..... | 1001(c)4 | 17920.3(b)4 |
| OBTAIN PERMIT TO: <input type="checkbox"/> Repair Per Applicable Building Codes | <input type="checkbox"/> Demolish Or Rehabilitate Structure | |
| 11. <input checked="" type="checkbox"/> Members of ceilings, roofs, ceiling and roof supports or other horizontal members
which sag, split, or buckle due to defective material or deterioration..... | 1001(c)6 | 17920.3(b)6 |
| OBTAIN PERMIT TO: <input type="checkbox"/> Repair Per Applicable Building Codes | <input type="checkbox"/> Demolish Or Rehabilitate Structure | |
| 12. <input checked="" type="checkbox"/> Dampness of habitable rooms..... | 1001(b)11 | 17920.3(a)11 |
| OBTAIN PERMIT TO: <input type="checkbox"/> Repair Per Applicable Building Codes | <input type="checkbox"/> Demolish Or Rehabilitate Structure | |
| 13. <input checked="" type="checkbox"/> Faulty weather protection..... | 1001(h)1-4 | 17920.3(g)1-4 |
| A. Deteriorated or ineffective weather proofing of exterior walls, roof or floors
including broken windows or doors, lack of paint or other approved wall covering. | | |
| OBTAIN PERMIT TO: <input type="checkbox"/> Repair Per Applicable Building Codes | <input checked="" type="checkbox"/> Demolish Or Rehabilitate Structure | |
| 14. <input checked="" type="checkbox"/> General dilapidation or improper maintenance..... | 1001(b)13 | 17920.3(a)13 |
| OBTAIN PERMIT TO: <input type="checkbox"/> Repair Per Applicable Building Codes | <input checked="" type="checkbox"/> Demolish Or Rehabilitate Structure | |
| 15. <input type="checkbox"/> Fire hazard..... | 1001(i) | 17920.3(h) |
| OBTAIN PERMIT TO: <input type="checkbox"/> Repair Per Applicable Building Codes | <input type="checkbox"/> Demolish Or Rehabilitate Structure | |
| 16. <input type="checkbox"/> Extensive fire damage..... | | |
| OBTAIN PERMIT TO: <input type="checkbox"/> Repair Per Applicable Building Codes | <input type="checkbox"/> Demolish Or Rehabilitate Structure | |
| 17. <input checked="" type="checkbox"/> Public and attractive nuisance - abandoned/vacant..... | | |
| OBTAIN PERMIT TO: <input type="checkbox"/> Repair Per Applicable Building Codes | <input checked="" type="checkbox"/> Demolish Or Rehabilitate Structure | |
| 18. <input type="checkbox"/> Improper occupancy..... | 1001(n) | 17920.3(n) |
| OBTAIN PERMIT TO: <input type="checkbox"/> Repair Per Applicable Building Codes | <input type="checkbox"/> Demolish Or Rehabilitate Structure | |
| 19. <input type="checkbox"/> | | |
| OBTAIN PERMIT TO: <input type="checkbox"/> Repair Per Applicable Building Codes | <input type="checkbox"/> Demolish Or Rehabilitate Structure | |
| 20. <input type="checkbox"/> | | |
| OBTAIN PERMIT TO: <input type="checkbox"/> Repair Per Applicable Building Codes | <input type="checkbox"/> Demolish Or Rehabilitate Structure | |

*** YOU MUST CORRECT THE ABOVE CONDITIONS WITHIN 30 DAYS OF THE DATE OF THIS NOTICE

Case No. TBA CV1006142 Address 323-020-020

Date 7-1-80 Officer Welch

285-025 (4/96)

EXHIBIT NO. E14

Distribution: White-Case File; Canary-Property Owner; Pink-To Be Posted On Structure

**RIVERSIDE COUNTY DEPARTMENT OF BUILDING AND SAFETY
CODE ENFORCEMENT NOTICE OF DEFECTS**

SUBSTANDARD BUILDING CONDITIONS:

UNIFORM HOUSING HEALTH & SAFETY
CODE SECTIONS CODE SECTIONS

1. <input type="checkbox"/>	Lack of or improper water closet, lavatory, bathtub, shower or kitchen sink.....	1001(b)1,2,3	17920.3(a)1,2,3
	OBTAIN PERMIT TO: <input type="checkbox"/> Repair Per Applicable Building Codes <input type="checkbox"/> Demolish Or Rehabilitate Structure		
2. <input type="checkbox"/>	Lack of hot and cold running water to plumbing fixtures	1001(b)4,5	17920.3(a)4,5
	OBTAIN PERMIT TO: <input type="checkbox"/> Repair Per Applicable Building Codes <input type="checkbox"/> Demolish Or Rehabilitate Structure		
3. <input type="checkbox"/>	Lack of connection to required sewage system.....	1001(b)14	17920.3(a)14
	OBTAIN PERMIT TO: <input type="checkbox"/> Repair Per Applicable Building Codes <input type="checkbox"/> Demolish Or Rehabilitate Structure		
4. <input type="checkbox"/>	Hazardous plumbing.....	1001(f)	17920.3(e)
	OBTAIN PERMIT TO: <input type="checkbox"/> Repair Per Applicable Building Codes <input type="checkbox"/> Demolish Or Rehabilitate Structure		
5. <input type="checkbox"/>	Lack of required electrical lighting.....	1001(b)10	17920.3(a)10
	OBTAIN PERMIT TO: <input type="checkbox"/> Repair Per Applicable Building Codes <input type="checkbox"/> Demolish Or Rehabilitate Structure		
6. <input type="checkbox"/>	Hazardous Wiring.....	1001(e)	17920.3(d)
	OBTAIN PERMIT TO: <input type="checkbox"/> Repair Per Applicable Building Codes <input type="checkbox"/> Demolish Or Rehabilitate Structure		
7. <input type="checkbox"/>	Lack of adequate heating facilities.....	1001(o)6	17920.3(a)6
	OBTAIN PERMIT TO: <input type="checkbox"/> Repair Per Applicable Building Codes <input type="checkbox"/> Demolish Or Rehabilitate Structure		
8. <input type="checkbox"/>	Deteriorated or inadequate foundation.....	1001(c)1	17920.3(b)1
	OBTAIN PERMIT TO: <input type="checkbox"/> Repair Per Applicable Building Codes <input type="checkbox"/> Demolish Or Rehabilitate Structure		
9. <input type="checkbox"/>	Defective or deteriorated flooring or floor supports.....	1001(c)2	17920.3(b)2
	OBTAIN PERMIT TO: <input type="checkbox"/> Repair Per Applicable Building Codes <input type="checkbox"/> Demolish Or Rehabilitate Structure		
10 <input type="checkbox"/>	Members of walls, partitions or other vertical supports that split, lean, list or buckle due to defective material or deterioration.....	1001(c)4	17920.3(b)4
	OBTAIN PERMIT TO: <input type="checkbox"/> Repair Per Applicable Building Codes <input type="checkbox"/> Demolish Or Rehabilitate Structure		
11 <input type="checkbox"/>	Members of ceilings, roofs, ceiling and roof supports or other horizontal members which sag, split, or buckle due to defective material or deterioration.....	1001(c)6	17920.3(b)6
	OBTAIN PERMIT TO: <input type="checkbox"/> Repair Per Applicable Building Codes <input type="checkbox"/> Demolish Or Rehabilitate Structure		
12 <input type="checkbox"/>	Dampness of habitable rooms.....	1001(b)11	17920.3(a)11
	OBTAIN PERMIT TO: <input type="checkbox"/> Repair Per Applicable Building Codes <input type="checkbox"/> Demolish Or Rehabilitate Structure		
13 <input checked="" type="checkbox"/>	Faulty weather protection.....	1001(h)1-4	17920.3(g)1-4
	A. Deteriorated or ineffective weather proofing of exterior walls, roof or floors including broken windows or doors, lack of paint or other approved wall covering.		
	OBTAIN PERMIT TO: <input type="checkbox"/> Repair Per Applicable Building Codes <input checked="" type="checkbox"/> Demolish Or Rehabilitate Structure		
14 <input checked="" type="checkbox"/>	General dilapidation or improper maintenance.....	1001(b)13	17920.3(a)13
	OBTAIN PERMIT TO: <input type="checkbox"/> Repair Per Applicable Building Codes <input checked="" type="checkbox"/> Demolish Or Rehabilitate Structure		
15 <input type="checkbox"/>	Fire hazard.....	1001(i)	17920.3(h)
	OBTAIN PERMIT TO: <input type="checkbox"/> Repair Per Applicable Building Codes <input type="checkbox"/> Demolish Or Rehabilitate Structure		
16 <input type="checkbox"/>	Extensive fire damage.....		
	OBTAIN PERMIT TO: <input type="checkbox"/> Repair Per Applicable Building Codes <input type="checkbox"/> Demolish Or Rehabilitate Structure		
17 <input checked="" type="checkbox"/>	Public and attractive nuisance - abandoned/vacant.....		
	OBTAIN PERMIT TO: <input type="checkbox"/> Repair Per Applicable Building Codes <input checked="" type="checkbox"/> Demolish Or Rehabilitate Structure		
18 <input type="checkbox"/>	Improper occupancy.....	1001(n)	17920.3(n)
	OBTAIN PERMIT TO: <input type="checkbox"/> Repair Per Applicable Building Codes <input type="checkbox"/> Demolish Or Rehabilitate Structure		
19 <input type="checkbox"/>			
	OBTAIN PERMIT TO: <input type="checkbox"/> Repair Per Applicable Building Codes <input type="checkbox"/> Demolish Or Rehabilitate Structure		
20 <input type="checkbox"/>			
	OBTAIN PERMIT TO: <input type="checkbox"/> Repair Per Applicable Building Codes <input type="checkbox"/> Demolish Or Rehabilitate Structure		

*** YOU MUST CORRECT THE ABOVE CONDITIONS WITHIN 30 DAYS OF THE DATE OF THIS NOTICE

Case No. TBACV100 6142 Address 323-020-020

Date 7-1-10 Officer WEICK



**CODE ENFORCEMENT DEPARTMENT
COUNTY OF RIVERSIDE**

GLENN BAUDE
Director

PROOF OF SERVICE

Case No. CV1006142

STATE OF CALIFORNIA, COUNTY OF RIVERSIDE

I, Jessica Morrison, declare that I am a citizen of the United States and am employed in the County of Riverside, over the age of 18 years and not a party to the within action or proceeding; that my business address is at the footer of this notice.

That on October 14, 2010, I served the following documents(s):

NOTICE RE: NOTICE OF VIOLATION & (2) NOTICE OF DEFECTS

by placing a true copy thereof enclosed in a sealed envelope(s) by **CERTIFIED MAIL, RETURN RECEIPT REQUESTED** addressed as follows:

ROBERT SANCHEZ 11732 KILLIAN, EL MONTE, CA 91732

XX **By First Class Mail.** I am readily familiar with the office's practice of collection and processing correspondence for mailing. Under that practice it would be deposited with the U.S. Postal Service with postage thereon fully prepaid in the County of Riverside, California, in the ordinary course of business.

XX **STATE.** I declare under the penalty of perjury under the laws of the State of California that the above is true and correct.

EXECUTED ON October 14, 2010 in the County of Riverside, California.

CODE ENFORCEMENT DEPARTMENT

Jessica Morrison
By: Jessica Morrison, Code Enforcement Aide

U.S. Postal Service™	
CERTIFIED MAIL™ RECEIPT	
<i>(Domestic Mail Only; No Insurance Coverage Provided)</i>	
For delivery information visit our website at www.usps.com	
OFFICIAL USE	
Postage \$	Postmark Here
Certified Fee	
Return Receipt Fee (Endorsement Required)	
Restricted Delivery Fee (Endorsement Required)	
ROBERT SANCHEZ 11732 KILLIAN EL MONTE, CA 91732 CV10-06142 rw 323	

9625 4541 5796
2010 1060 0000 4541 5796

19450 CLARK STREET, PERRIS, CALIFORNIA 92570
(951) 657-0122 • FAX (951) 943-1160

EXHIBIT NO. E 16



[Home](#) | [Help](#) | [Sign In](#)

[Track & Confirm](#)

[FAQs](#)

Track & Confirm

Search Results

Label/Receipt Number: **7010 1060 0000 4541 5796**

Service(s): **Certified Mail™**

Status: **Delivered**

Your item was delivered at 11:01 am on November 08, 2010 in PERRIS, CA 92570.

Track & Confirm

Enter Label/Receipt Number.

[Go >](#)

Detailed Results:

- **Delivered, November 08, 2010, 11:01 am, PERRIS, CA 92570**
- **Unclaimed, November 02, 2010, 10:55 am, EL MONTE, CA**

Notification Options

Track & Confirm by email

Get current event information or updates for your item sent to you or others by email.

[Go >](#)

[Site Map](#)

[Customer Service](#)

[Forms](#)

[Gov't Services](#)

[Careers](#)

[Privacy Policy](#)

[Terms of Use](#)

[Business Customer Gateway](#)

Copyright© 2010 USPS. All Rights Reserved.

No FEAR Act EEO Data

FOIA

USA 2010
Marketing, For Work

USA 2010
Marketing, For Work

EXHIBIT NO. _____

E17

When recorded please mail to:
Riverside County Code Enforcement
District 1 Mead Valley Office
19450 Clark Street
Perris, CA 92570
Mail Stop # 5004

DOC # 2010-0553174
11/16/2010

Customer Copy Label
The paper to which this label is
affixed has not been compared
with the recorded document

COPY

Larry W Ward
County of Riverside
Assessor, County Clerk & Recorder

NOTICE OF NONCOMPLIANCE

In the matter of the Property of
SANCHEZ, ROBERTO)

Case No. CV10-06142
)

NOTICE IS HEREBY GIVEN to all persons, pursuant to Section 10 of Ordinance Number 725 of the County of Riverside, State of California, that proceedings have been commenced with respect to violations of Riverside County Ordinance No.457, (RCC Title 15.16.020) described as Substandard Structure (quality lower than prescribed by law). Such proceedings are based upon the noncompliance of such real property, located at 1 Parcel West of (21950 Salter Road), Perris, CA, and more particularly described as Assessor's Parcel Number 323-020-020 and having a legal description of 2.50 ACRES M/L IN POR NW 1/4 OF SEC 28 T4S R4W FOR TOTAL DESCRIPTION SEE ASSESSORS MAPS, Records of Riverside County, with the requirements of Ordinance No. 457 (RCC Title 15.16.020).

The owner has been advised to immediately correct the above-referenced violations to avoid further action by the County of Riverside which may include demolition, removal, razing, etc., to abate the public nuisance. Any costs incurred by the County, including, but not limited to investigative, administrative and abatement costs and attorneys' fees, may become a lien on the property. Further details regarding this notice may be obtained by addressing an inquiry to the Code Enforcement Department, 19450 Clark Street, Perris, CA 92570, and Attention Code Enforcement Officer Ron Welch.

NOTICE IS FURTHER GIVEN in accordance with §17274 and §24436.5 of the California Revenue and Taxation Code, that a tax deduction may not be allowed for interest, taxes, depreciation, or amortization paid or incurred in the taxable year affected by these proceedings.

RIVERSIDE COUNTY CODE ENFORCEMENT

By 
Manuel A. Acueto
Code Enforcement Department

ACKNOWLEDGEMENT

State of California)
County of Riverside)

On 11/09/10 before me, Jessica Morrison, Notary Public, personally appeared Manuel A. Acueto, who proved to me on the basis of satisfactory evidence to be the person(s) whose name(s) ~~is~~ are subscribed to the within instrument and acknowledged to me that he/she/they executed the same in ~~his~~ her/their authorized capacity(ies), and that by ~~his~~ her/their signature(s) on the instrument the person(s), or the entity upon behalf of which the person(s) acted, executed the instrument.

I certify under PENALTY OF PERJURY under the laws of the State of California that the foregoing paragraph is true and correct.

WITNESS my hand and official seal.

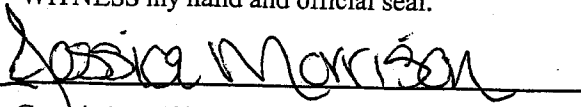

Commission # 1904280 Comm. Expires Sep. 17, 2014

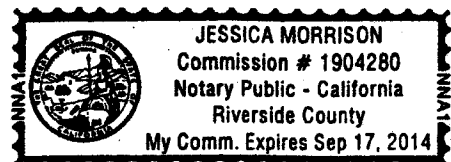

EXHIBIT NO. 7

PAMELA J. WALLS
County Counsel

OFFICE OF COUNTY COUNSEL
COUNTY OF RIVERSIDE



KATHERINE A. LIND
Assistant County Counsel

3960 ORANGE STREET, SUITE 500
RIVERSIDE, CA 92501-3674
TELEPHONE: 951/955-6300
FAX: 951/955-6322 & 951/955-6363

March 28, 2011

NOTICE TO CORRECT COUNTY ORDINANCE VIOLATIONS AND
ABATE PUBLIC NUISANCE

TO: Owners and Interested Parties
(See Attached Proof of Service
and Attached Notice List)

Case No.: CV10-06142
APN: 323-020-020; SANCHEZ
Property: 1 Parcel W/O 21950 Salter Rd., Lake Mathews

NOTICE IS HEREBY GIVEN that a hearing will be held before the Riverside County Board of Supervisors pursuant to Riverside County Ordinance Nos. 457 (RCC Title 15) and 725 (RCC Title 1) to consider the abatement of the substandard structures located on the SUBJECT PROPERTY described as 1 Parcel W/O 21950 Salter Rd., Lake Mathews, **Riverside County, California**, and more particularly described as Assessor's Parcel Number 323-020-020.

YOU ARE HEREBY DIRECTED as owner of the SUBJECT PROPERTY, to appear at this hearing to show cause why the SUBJECT PROPERTY should not be condemned as a public nuisance and be abated by removing the substandard structures from the real property.

SAID HEARING will be held on **Tuesday, April 12, 2011, at 9:30 a.m.** in the Board of Supervisors Room, County Administrative Center, 4080 Lemon Street, 1st Floor Annex, Riverside, California at which time and place pertinent evidence will be received and/or testimony from all concerned parties will be heard. Failure to appear on your behalf will result in the exclusion of your testimony, and facts as known to the Code Enforcement Department ("Department") will be presented to the Board of Supervisors for consideration and deliberation in this matter.

Please be advised that the costs already accrued in this case, including but not limited to, enforcement and investigation costs, are recoverable by the Department, as allowed under Riverside County Ordinance No. 725. The Department may seek recovery of such costs from the property owner(s) which may result in a special assessment lien against the SUBJECT PROPERTY. Additionally, should the Department abate the property, the costs associated therewith, as well as all abatement costs allowed under Riverside County Ordinance No. 725 (RCC Title 1), will be sought from the property owner(s) and/or may result in a special assessment lien against the property.

You are encouraged to contact Supervising Code Enforcement Officer Manuel Acueto at (951) 657-0122 or the undersigned prior to the hearing. Please meet the undersigned and Brian Black, Supervising Code Enforcement Officer, at 8:30 a.m. on the day of the hearing in the lobby of the 1st floor annex in front of the Clerk of the Board's Office to discuss the case.

PAMELA J. WALLS
Riverside County Counsel



L. Alexandra Fong
Deputy County Counsel

EXHIBIT NO. 6

NOTICE LIST

Subject Property: 1 Parcel west of 21950 Salter Rd., Lake Matthews
Case No.: CV10-06142; APN: 323-020-020; District 1

ROBERTO SANCHEZ
1427 VINELAND AVE
BALDWIN PARK CA 91706

ROBERTO SANCHEZ
11732 KILLIAN
EL MONTE CA 91732

STATE OF CALIFORNIA
FRANCHISE TAX BOARD
SACRAMENTO CA 95812-2952

INTERNAL REVENUE SERVICE
PO BOX 145585 STOP 8420G
CINCINNATI OH 45250-5585

AMERICAN RAISIN PACKERS INC
C/O WILD CARTER & TIPTON APC
246 WEST SHAW AVENUE
FRESNO CA 93704

U.S. Postal Service™		
CERTIFIED MAIL™ RECEIPT		
<i>(Domestic Mail Only; No Insurance Coverage Provided)</i>		
For delivery information visit our website at www.usps.com ®		
OFFICIAL USE		
Postage \$ <u>.44</u> Certified Fee <u>2.80</u> Return Receipt Fee (Endorsement Required) <u>2.30</u> Restricted Delivery Fee (Endorsement Required) Total Postage & Fees \$ <u>5.54</u>	Mailed 3/28/11 Postmark Here	
Sent To Street, Apt. or PO Box City, State,		
ROBERTO SANCHEZ 11732 KILLIAN EL MONTE CA 91732		
PS Form 3800, August 2006		See Reverse for Instructions

7010 1670 0001 7232 2859

U.S. Postal Service™		
CERTIFIED MAIL™ RECEIPT		
<i>(Domestic Mail Only; No Insurance Coverage Provided)</i>		
For delivery information visit our website at www.usps.com ®		
OFFICIAL USE		
Postage \$ <u>.44</u> Certified Fee <u>2.80</u> Return Receipt Fee (Endorsement Required) <u>2.30</u> Restricted Delivery Fee (Endorsement Required) Total Postage & Fees \$ <u>5.54</u>	Mailed 3/28/11 Postmark Here	
Sent To Street, Apt. or PO B City, Sta		
ROBERTO SANCHEZ 1427 VINELAND AVE BALDWIN PARK CA 91706		
PS Form 3800, August 2006		See Reverse for Instructions

7010 1670 0001 7232 2876

U.S. Postal Service™		
CERTIFIED MAIL™ RECEIPT		
<i>(Domestic Mail Only; No Insurance Coverage Provided)</i>		
For delivery information visit our website at www.usps.com ®		
OFFICIAL USE		
Postage \$ <u>.44</u> Certified Fee <u>2.80</u> Return Receipt Fee (Endorsement Required) <u>2.30</u> Restricted Delivery Fee (Endorsement Required) Total Postage & Fees \$ <u>5.54</u>	Mailed 3/28/11 Postmark Here	
Sent To Street, Ap or PO Box City, State		
STATE OF CALIFORNIA FRANCHISE TAX BOARD SACRAMENTO CA 95812-2952		
PS Form 3800, August 2006		See Reverse for Instructions

7010 1670 0001 7232 2852

EXHIBIT NO. 62

PROOF OF SERVICE

Case No. CV10-06142

1
2
3
4
5
6
7
8
9
10
11
12
13
14
15
16
17
18
19
20

STATE OF CALIFORNIA, COUNTY OF RIVERSIDE

I, Brenda Peeler, declare that I am a citizen of the United States and am employed in the County of Riverside, over the age of 18 years and not a party to the within action or proceeding; that my business address is 3960 Orange Street, Suite 500, Riverside, California 92501.

That on March 28, 2011, I served the following document(s):

**NOTICE TO CORRECT COUNTY ORDINANCE VIOLATIONS
AND ABATE PUBLIC NUISANCE**

by placing a true copy thereof enclosed in a sealed envelope(s) addressed as follows:

**Owners or Interested Parties
(see attached notice list)**

XX **BY CERTIFIED MAIL, RETURN RECEIPT REQUESTED.** I am "readily familiar" with the office's practice of collection and processing correspondence for mailing. Under that practice it would be deposited with the U.S. Postal Service on that same day with postage thereon fully prepaid at Riverside, California, in the ordinary course of business.

— **BY PERSONAL SERVICE:** I caused to be delivered such envelope(s) by hand to the offices of the addressee(s).

XX **STATE - I declare under penalty of perjury under the laws of the State of California that the above is true and correct.**

— **FEDERAL - I declare that I am employed in the office of a member of the bar of this court at whose direction the service was made.**

EXECUTED ON March 28, 2011, at Riverside, California.

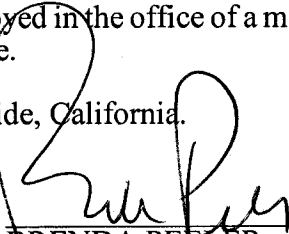
BRENDA PEELER

7010 1670 0001 7232 2836

U.S. Postal Service™	
CERTIFIED MAIL™ RECEIPT	
<i>(Domestic Mail Only; No Insurance Coverage Provided)</i>	
For delivery information visit our website at www.usps.com ®	
OFFICIAL USE	
Postage	\$.44
Certified Fee	2.80
Return Receipt Fee (Endorsement Required)	2.30
Restricted Delivery Fee (Endorsement Required)	
Total Postage & Fees	\$ 5.54
Postmark Here	
MAILED 3/28/11	
Sent To	
Street, or PO B	AMERICAN RAISIN PACKERS INC
City, St	C/O WILD CARTER & TIPTON APC
	246 WEST SHAW AVENUE
	FRESNO CA 93704
PS Form 3800, August 2006	
See Reverse for Instructions	

7010 1670 0001 7232 2845

U.S. Postal Service™	
CERTIFIED MAIL™ RECEIPT	
<i>(Domestic Mail Only; No Insurance Coverage Provided)</i>	
For delivery information visit our website at www.usps.com ®	
OFFICIAL USE	
Postage	\$.44
Certified Fee	2.80
Return Receipt Fee (Endorsement Required)	2.30
Restricted Delivery Fee (Endorsement Required)	
Total Postage & Fees	\$ 5.54
Postmark Here	
MAILED 3/28/11	
Sent To	
Street, or PO	INTERNAL REVENUE SERVICE
City, St	PO BOX 145585 STOP 8420G
	CINCINNATI OH 45250-5585
PS Form 3800, August 2006	
See Reverse for Instructions	

EX-100



**CODE ENFORCEMENT DEPARTMENT
COUNTY OF RIVERSIDE**

GLENN BAUDE
Director

AFFIDAVIT OF POSTING OF NOTICES

March 31, 2011

RE CASE NO: CV1006142

I, Ron Welch, hereby declare:

I am employed by the Riverside County Code Enforcement Department; that my business address is 19450 Clark Street, Perris, California 92570 .

That on 03/30/2011 at 12:45pm, I securely and conspicuously posted a " Notice to correct county ordinance violations and abate public nuisance" at the property described as:

Property Address: 1 Parcel W/O (21950 Salter Rd), LAKE MATHEWS

Assessor's Parcel Number: 323-020-020

I declare under the penalty of perjury that the foregoing is true and correct.

Executed on March 31, 2011 in the County of Riverside, California.

CODE ENFORCEMENT DEPARTMENT

By: Ron Welch, Code Enforcement Officer

EXHIBIT NO. _____

64