

**SUBMITTAL TO THE BOARD OF SUPERVISORS  
COUNTY OF RIVERSIDE, STATE OF CALIFORNIA**

416 B



**FROM:** County Counsel  
Code Enforcement Department

**SUBMITTAL DATE:**  
July 14, 2011

**SUBJECT:** Statement of Abatement Costs [Case No. CV10-02059]  
Subject Property: 23550 Meadow Lane, Perris; ESTATE OF ARREOLA  
APN: 325-060-024  
District Five

Departmental Concurrence

**RECOMMENDED MOTION:** Move that the Board of Supervisors:

- (1) assess the reasonable costs of abatement of a public nuisance (accumulated rubbish) in the above-referenced matter to be **two thousand, eleven dollars and ninety-two cents (US \$2,011.92)**;
- (2) assess the costs of abatement against the above-described subject property;
- (3) authorize the recordation of a notice of abatement lien;
- (4) authorize the abatement costs to be added to the tax roll as a special assessment; and
- (5) authorize and direct the Code Enforcement Department to take any reasonable actions to collect the amount owed.

*Raymond M. Mistica*  
\_\_\_\_\_  
RAYMOND M. MISTICA, Deputy County Counsel  
for PAMELA J. WALLS, County Counsel

<b>FINANCIAL DATA</b>	Current F.Y. Total Cost:	\$ N/A	In Current Year Budget:	N/A
	Current F.Y. Net County Cost:	\$ N/A	Budget Adjustment:	N/A
	Annual Net County Cost:	\$ N/A	For Fiscal Year:	N/A

<b>SOURCE OF FUNDS:</b>	<b>Positions To Be Deleted Per A-30</b>	<input type="checkbox"/>
	<b>Requires 4/5 Vote</b>	<input type="checkbox"/>

**C.E.O. RECOMMENDATION:** APPROVE

BY: *Tina Grande*  
\_\_\_\_\_  
Tina Grande

**County Executive Office Signature**

Consent     Policy  
 Consent     Policy  
  
 Dept't Recomm.:     Per Exec. Ofc.:

**MINUTES OF THE BOARD OF SUPERVISORS**

On motion of Supervisor Stone, seconded by Supervisor Buster and duly carried, IT WAS ORDERED that the above matter is approved as recommended.

Ayes: Buster, Stone, Benoit and Ashley  
Nays: None  
Absent: Tavaglione  
Date: July 26, 2011  
xc: Co. Co., CED, Prop. Owner

Kecia Harper-Ihem  
Clerk of the Board  
By: *Kecia Harper-Ihem*  
\_\_\_\_\_  
Deputy

Prev. Agn. Ref.: \_\_\_\_\_ | District: 5 | Agenda Number: **9.29**

Statement of Abatement Costs [Case No. CV10-02059]  
Subject Property: 23550 Meadow Lane, Perris; ESTATE OF ARREOLA  
APN: 325-060-024  
District Five  
Page 2

**BACKGROUND:** Government Code § 25845, Riverside County Ordinance Nos. 541(RCC Chapter 8.120) and 725 (RCC Chapter 1.16) authorize the recovery of abatement costs in public nuisance cases, the recordation of a notice of abatement lien and inclusion of abatement costs on the tax roll as a special assessment upon approval of the Board of Supervisors.

Notices of Violation were issued. Subsequently, the property was brought into compliance.

The property has a delinquent tax status as of 2008.

The Notice of Hearing re Statement of Abatement Costs has been posted on the property and mailed to the property owner and all interested parties, as required by law. Copies of all relevant notices issued in this matter together with proof of service and posting have been separately filed with the Clerk of the Board and are made a part of the record herein, pursuant to Riverside County Ordinance 725.

**SUBMITTAL TO THE BOARD OF SUPERVISORS  
COUNTY OF RIVERSIDE, STATE OF CALIFORNIA**

**FROM:** County Counsel  
Code Enforcement Department  
**SUBJECT:** Statement of Abatement Costs [Case No. CV10-02059]  
Subject Property: 23550 Meadow Lane, Perris; ESTATE OF ARREOLA  
APN: 325-060-024  
District Five

**TABLE OF SUPPLEMENTAL DOCUMENTS  
FILED WITH THE CLERK OF THE BOARD**

**Hearing Date: JULY 26, 2011**

Notice of Hearing Re: Statement of Abatement Costs (including Proof(s) of Service and Affidavit(s) of Posting .....	Exhibit A
Summary Statement of Abatement Costs and Statement of Abatement Costs with Supporting Documents .....	Exhibit B
Assessment-Roll For The Year 10/11 And Geographic Information System, July 13, 2011 .....	Exhibit C
Lot Book Report.....	Exhibit D

PAMELA J. WALLS  
County Counsel

OFFICE OF COUNTY COUNSEL  
COUNTY OF RIVERSIDE



KATHERINE A. LIND  
Assistant County Counsel

3960 ORANGE STREET, SUITE 500  
RIVERSIDE, CA 92501-3674  
TELEPHONE: 951/955-6300  
FAX: 951/955-6322 & 951/955-6363

July 13, 2011

# NOTICE OF HEARING RE: STATEMENT OF ABATEMENT COSTS

To: Owner(s) or Interested Parties  
(See Attached Proof of Service  
and Notice List)

Subject Property: 23550 Meadow Lane, Perris  
Case No.: CV10-02059; ESTATE OF ARREOLA  
APN: 325-060-024

**NOTICE IS HEREBY GIVEN** that a hearing will be held before the Riverside County Board of Supervisors on **Tuesday, July 26, 2011, at 9:30 a.m.** in the Board of Supervisors Room, 4080 Lemon Street, 1st Floor Annex, Riverside, California, at which time and place pertinent testimony will be heard regarding the expenses incurred by the County of Riverside, Code Enforcement Department ("DEPARTMENT") for the above-referenced abatement case. Said abatement case involved accumulated rubbish located on your real property commonly described as 23550 Meadow Lane, Perris, Riverside County, California and more particularly described as Assessor's Parcel Number 325-060-024.

The total expense due, including all other fees and costs, for the abatement of the above-described dangerous or injurious condition is **two thousand, eleven dollars and ninety-two cents (US \$2,011.92)**. This amount is immediately due and payable. If you have any objections to the Statement of Abatement Costs attached hereto, you must address your objections to the Board of Supervisors at the hearing. If you have any questions about the attached Statement of Abatement Costs, please contact Brian Black at (951) 955-2004. In the event the total amount due is not paid to the DEPARTMENT prior to the Board Hearing, the DEPARTMENT shall seek an order from the Board of Supervisors to place a lien against your property and collect the amount due as a special tax assessment.

Failure to appear at the hearing will result in the exclusion of your testimony. Facts as known to the DEPARTMENT will be presented to the Board of Supervisors for their final consideration and deliberation of this matter.

**You are encouraged to contact Supervising Code Enforcement Officer, Brian Black (951) 955-2004 prior to the hearing. Please meet with the undersigned or Brian Black at 7:30 a.m. on the day of the hearing in Conference Room 2A located on the 1st floor in front of the Human Resources Office to discuss the case.**

PAMELA J. WALLS  
County Counsel

*Raymond M. Mestera for*  
L. ALEXANDRA FONG  
Deputy County Counsel

Enclosure: Statement of Abatement Costs

EXHIBIT NO.     A

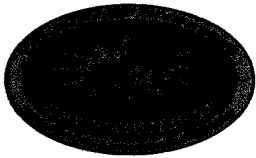

# COUNTY OF RIVERSIDE CODE ENFORCEMENT

P.O. Box 1469, Riverside, CA 92502  
Phone: 951-955-2004 Fax: 951-955-8680

Property Reference/Mailing Address
325-060-024 ARREOLA DIANA L ESTATE OF c/o GEORGE H CHANT III 23550 MEADOW LN PERRIS, CA 92570

## Summary Statement of Abatement Costs

**You are liable to the County for the following abatement costs:**

Date	Invoice Number & Amount	Amount	Balance
04/28/2011	CV1002059- INV #101188. Orig. Amount \$2,011.92.	2,011.92	2,011.92
<b>Total Now Due</b>			<b>\$2,011.92</b>

**The total abatement costs must be paid to the County of Riverside, P.O. Box 1469, Riverside, CA 92502 within thirty (30) days. In the event said costs are not paid within thirty (30) days you will be liable for additional administrative costs, penalties, court fees, or other collection costs incurred in the collection of these abatement costs.**

I affirm and declare under penalty of perjury under the laws of the State of California that the foregoing is true and correct to the best of my knowledge.

*Megand*

Code Enforcement Department

EXHIBIT NO.           A2

**County of Riverside  
Code Enforcement Department**

P.O. Box 1469, Riverside, CA 92502  
Phone: (951) 955-2004 Fax: (951) 955-8680

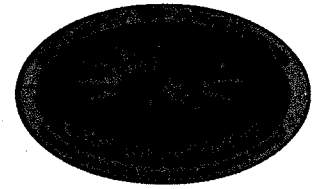

# Statement of Abatement Costs

325-060-024  
ARREOLA DIANA L ESTATE OF  
c/o GEORGE H CHANT III  
23550 MEADOW LN  
PERRIS, CA 92570

Date	Invoice #
4/28/2011	101188

<b>Property Address</b>
325-060-024 ARREOLA DIANA L ESTATE OF 23550 MEADOW LN Perris, Ca 92570

Case Number	District	Class
CV1002059	5	SOAC

**You are liable to the County for the following abatement costs:**

Date	Item	Description	Hours/Qty	Rate	Amount
	Attend SOE Hearing			69.75	69.75
		Subtotal County Counsel Costs			1,491.82
6/4/2010	Lot/Title Report	Lot/Title Report	1	114.00	114.00
11/30/2010	Lot/Title Report	Lot/Title Report	1	60.00	60.00
3/25/2011	Lot/Title Report	Lot/Title Report	1	60.00	60.00
4/28/2011	Lot Book Report			120.00	120.00
		Subtotal Contractor Costs			354.00
				<b>Subtotal</b>	\$2,011.92
				<b>Payments/Credits</b>	\$0.00
				<b>Total Now Due</b>	\$2,011.92

The total abatement costs must be paid to the County of Riverside, P.O. Box 1469, Riverside, CA 92502 within thirty (30) days. In the event said costs are not paid within thirty (30) days you will be liable for additional administrative costs, penalties, court fees or other collection costs incurred in the collection of these abatement costs.

**I affirm and declare under penalty of perjury under the laws of the State of California that the foregoing is true and correct to the best of my knowledge.**

*Mega...*

Code Enforcement Department

**County of Riverside  
Code Enforcement Department**

P.O. Box 1469, Riverside, CA 92502  
Phone: (951) 955-2004 Fax: (951) 955-8680

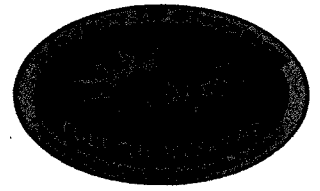

# Statement of Abatement Costs

325-060-024  
ARREOLA DIANA L ESTATE OF  
c/o GEORGE H CHANT III  
23550 MEADOW LN  
PERRIS, CA 92570

Date	Invoice #
4/28/2011	101188

Property Address
325-060-024 ARREOLA DIANA L ESTATE OF 23550 MEADOW LN Perris, Ca 92570

Case Number	District	Class
CV1002059	5	SOAC

**You are liable to the County for the following abatement costs:**

Date	Item	Description	Hours/Qty	Rate	Amount
5/25/2010	Officer Hours	Labor Charges - Officer Time	0.3	82.00	24.60
6/14/2010	Officer Hours	Labor Charges - Officer Time	0.1	82.00	8.20
7/19/2010	Officer Hours	Labor Charges - Officer Time	0.1	82.00	8.20
8/19/2010	Officer Hours	Labor Charges - Officer Time	0.2	82.00	16.40
11/18/2010	Officer Hours	Labor Charges - Officer Time	0.2	82.00	16.40
1/21/2011	Officer Hours	Labor Charges - Officer Time	0.1	109.00	10.90
3/14/2011	Officer Hours	Labor Charges - Officer Time	0.2	82.00	16.40
4/28/2011	SOE Preparation	Prepare Statement of Expense		65.00	65.00
		Subtotal Code Enforcement Costs			166.10
10/15/2010	Attorney Fees	Attorney Fees - County Counsel	2.4	74.97916	179.95
10/18/2010	Attorney Fees	Attorney Fees - County Counsel	1.9	74.97895	142.46
10/19/2010	Attorney Fees	Attorney Fees - County Counsel	0.6	74.98333	44.99
10/21/2010	Attorney Fees	Attorney Fees - County Counsel	0.3	74.96667	22.49
10/26/2010	Attorney Fees	Attorney Fees - County Counsel	1.5	74.98	112.47
10/27/2010	Attorney Fees	Attorney Fees - County Counsel	0.3	74.96667	22.49
11/3/2010	Attorney Fees	Attorney Fees - County Counsel	1.3	74.97692	97.47
11/9/2010	Attorney Fees	Attorney Fees - County Counsel	0.6	74.98333	44.99
11/12/2010	Attorney Fees	Attorney Fees - County Counsel	0.7	143.1857	100.23
11/17/2010	Attorney Fees	Attorney Fees - County Counsel	0.5	74.98	37.49
11/18/2010	Attorney Fees	Attorney Fees - County Counsel	0.3	74.96667	22.49
12/13/2010	Attorney Fees	Attorney Fees - County Counsel	2.2	74.98182	164.96
1/5/2011	Attorney Fees	Attorney Fees - County Counsel	1.1	74.98182	82.48
1/19/2011	Attorney Fees	Attorney Fees - County Counsel	0.4	143.175	57.27
1/19/2011	County Counsel-Mail	County Counsel-Mailing	8	5.54	44.32
2/8/2011	Attorney Fees	Attorney Fees - County Counsel	1.6	74.98125	119.97
4/28/2011	Prepare Case for SOE He...			125.55	125.55

**Subtotal**

**Payments/Credits**

**Total Now Due**

The total abatement costs must be paid to the County of Riverside, P.O. Box 1469, Riverside, CA 92502 within thirty (30) days. In the event said costs are not paid within thirty (30) days you will be liable for additional administrative costs, penalties, court fees or other collection costs incurred in the collection of these abatement costs.

I affirm and declare under penalty of perjury under the laws of the State of California that the foregoing is true and correct to the best of my knowledge.

*Ngan S*

Code Enforcement Department

EXHIBIT NO.                     

A4

# NOTICE LIST

Subject Property: 23550 Meadow Lane, Perris  
Case No.: CV 10-02059 APN: 325-060-024; District 5

ESTATE OF DIANA L ARREOLA  
23550 MEADOW LANE  
PERRIS CA 92570

ANGELICA SANCHEZ AND/OR OCCUPANTS  
23550 MEADOW LANE  
PERRIS CA 92570

LINDA LOERCH EXECUTRIX  
40855 LELE MAY AVENUE  
HEMET CA 92544

GEORGE H CHANT III ESQ  
11741 STERLING AVENUE SUITE E2  
RIVERSIDE CA 92503

JESSICA MARTINEZ  
545 CHESTNUT AVE APT 309  
LONG BEACH CA 90802

ROBERT LOERCH  
29284 WAGON CREEK LN  
MENIFEE CA 92584

JOSEPH & HELEN BEESON  
780 N PERRIS BLVD  
PERRIS CA 92370

FIRST AMERICAN TITLE  
3400 CENRAL AVE STE 100  
RIVERSIDE CA 92505

EXHIBIT NO. \_\_\_\_\_

AS



**PROOF OF SERVICE**

Case No. CV10-02059

STATE OF CALIFORNIA, COUNTY OF RIVERSIDE

I, Brenda G. Peeler, declare that I am a citizen of the United States and am employed in the County of Riverside, over the age of 18 years and not a party to the within action or proceeding; that my business address is 3960 Orange Street, Suite 500, Riverside, California 92501.

That on July 13, 2011, I served the following document(s):

- **NOTICE OF HEARING RE: SUMMARY OF ABATEMENT COSTS**
- **SUMMARY OF ABATEMENT COSTS**
- **STATEMENT OF ABATEMENT COSTS**
- **ADMINISTRATIVE CITATION(S)**
- **NOTICE LIST**

by placing a true copy thereof enclosed in a sealed envelope(s) addressed as follows:

**OWNERS OR INTERESTED PARTIES  
(SEE NOTICE LIST ATTACHED TO NOTICE OF HEARING)**

XX **BY FIRST CLASS MAIL.** I am "readily familiar" with the office's practice of collection and processing correspondence for mailing. Under that practice it would be deposited with the U.S. Postal Service on that same day with postage thereon fully prepaid at Riverside, California, in the ordinary course of business.

     **BY PERSONAL SERVICE:** I caused to be delivered such envelope(s) by hand to the offices of the addressee(s).

XX **STATE - I declare under penalty of perjury under the laws of the State of California that the above is true and correct.**

     **FEDERAL - I declare that I am employed in the office of a member of the bar of this court at whose direction the service was made.**

EXECUTED ON July 13, 2011, at Riverside, California.

  
\_\_\_\_\_  
BRENDA G. PEELER

EXHIBIT NO.                      **AG**





# COUNTY OF RIVERSIDE CODE ENFORCEMENT

P.O. Box 1469, Riverside, CA 92502  
Phone: 951-955-2004 Fax: 951-955-8680

Property Reference/Mailing Address
325-060-024 ARREOLA DIANA L ESTATE OF c/o GEORGE H CHANT III 23550 MEADOW LN PERRIS, CA 92570

## Summary Statement of Abatement Costs

**You are liable to the County for the following abatement costs:**

Date	Invoice Number & Amount	Amount	Balance
04/28/2011	CV1002059- INV #101188. Orig. Amount \$2,011.92.	2,011.92	2,011.92
		<b>Total Now Due</b>	<b>\$2,011.92</b>

The total abatement costs must be paid to the County of Riverside, P.O. Box 1469, Riverside, CA 92502 within thirty (30) days. In the event said costs are not paid within thirty (30) days you will be liable for additional administrative costs, penalties, court fees, or other collection costs incurred in the collection of these abatement costs.

I affirm and declare under penalty of perjury under the laws of the State of California that the foregoing is true and correct to the best of my knowledge.

*Myo...*

EXHIBIT NO.   B  

Code Enforcement Department

**County of Riverside  
Code Enforcement Department**

P.O. Box 1469, Riverside, CA 92502  
Phone: (951) 955-2004 Fax: (951) 955-8680



# Statement of Abatement Costs

325-060-024  
ARREOLA DIANA L ESTATE OF  
c/o GEORGE H CHANT III  
23550 MEADOW LN  
PERRIS, CA 92570

Date	Invoice #
4/28/2011	101188

<b>Property Address</b>
325-060-024 ARREOLA DIANA L ESTATE OF 23550 MEADOW LN Perris, Ca 92570

Case Number	District	Class
CV1002059	5	SOAC

**You are liable to the County for the following abatement costs:**

Date	Item	Description	Hours/Qty	Rate	Amount
	Attend SOE Hearing			69.75	69.75
		Subtotal County Counsel Costs			1,491.82
6/4/2010	Lot/Title Report	Lot/Title Report	1	114.00	114.00
11/30/2010	Lot/Title Report	Lot/Title Report	1	60.00	60.00
3/25/2011	Lot/Title Report	Lot/Title Report	1	60.00	60.00
4/28/2011	Lot Book Report			120.00	120.00
		Subtotal Contractor Costs			354.00

<b>Subtotal</b>	\$2,011.92
<b>Payments/Credits</b>	\$0.00
<b>Total Now Due</b>	\$2,011.92

The total abatement costs must be paid to the County of Riverside, P.O. Box 1469, Riverside, CA 92502 within thirty (30) days. In the event said costs are not paid within thirty (30) days you will be liable for additional administrative costs, penalties, court fees or other collection costs incurred in the collection of these abatement costs.

**I affirm and declare under penalty of perjury under the laws of the State of California that the foregoing is true and correct to the best of my knowledge.**

*Ng...*  
Code Enforcement Department

EXHIBIT NO. B2

**County of Riverside  
Code Enforcement Department**

P.O. Box 1469, Riverside, CA 92502  
Phone: (951) 955-2004 Fax: (951) 955-8680

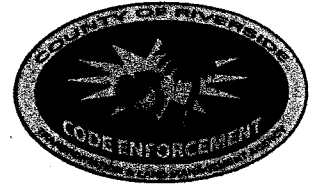

# Statement of Abatement Costs

325-060-024  
ARREOLA DIANA L ESTATE OF  
c/o GEORGE H CHANT III  
23550 MEADOW LN  
PERRIS, CA 92570

Date	Invoice #
4/28/2011	101188

Property Address
325-060-024 ARREOLA DIANA L ESTATE OF 23550 MEADOW LN Perris, Ca 92570

Case Number	District	Class
CV1002059	5	SOAC

**You are liable to the County for the following abatement costs:**

Date	Item	Description	Hours/Qty	Rate	Amount
5/25/2010	Officer Hours	Labor Charges - Officer Time	0.3	82.00	24.60
6/14/2010	Officer Hours	Labor Charges - Officer Time	0.1	82.00	8.20
7/19/2010	Officer Hours	Labor Charges - Officer Time	0.1	82.00	8.20
8/19/2010	Officer Hours	Labor Charges - Officer Time	0.2	82.00	16.40
11/18/2010	Officer Hours	Labor Charges - Officer Time	0.2	82.00	16.40
1/21/2011	Officer Hours	Labor Charges - Officer Time	0.1	109.00	10.90
3/14/2011	Officer Hours	Labor Charges - Officer Time	0.2	82.00	16.40
4/28/2011	SOE Preparation	Prepare Statement of Expense		65.00	65.00
		Subtotal Code Enforcement Costs			166.10
10/15/2010	Attorney Fees	Attorney Fees - County Counsel	2.4	74.97916	179.95
10/18/2010	Attorney Fees	Attorney Fees - County Counsel	1.9	74.97895	142.46
10/19/2010	Attorney Fees	Attorney Fees - County Counsel	0.6	74.98333	44.99
10/21/2010	Attorney Fees	Attorney Fees - County Counsel	0.3	74.96667	22.49
10/26/2010	Attorney Fees	Attorney Fees - County Counsel	1.5	74.98	112.47
10/27/2010	Attorney Fees	Attorney Fees - County Counsel	0.3	74.96667	22.49
11/3/2010	Attorney Fees	Attorney Fees - County Counsel	1.3	74.97692	97.47
11/9/2010	Attorney Fees	Attorney Fees - County Counsel	0.6	74.98333	44.99
11/12/2010	Attorney Fees	Attorney Fees - County Counsel	0.7	143.1857	100.23
11/17/2010	Attorney Fees	Attorney Fees - County Counsel	0.5	74.98	37.49
11/18/2010	Attorney Fees	Attorney Fees - County Counsel	0.3	74.96667	22.49
12/13/2010	Attorney Fees	Attorney Fees - County Counsel	2.2	74.98182	164.96
1/5/2011	Attorney Fees	Attorney Fees - County Counsel	1.1	74.98182	82.48
1/19/2011	Attorney Fees	Attorney Fees - County Counsel	0.4	143.175	57.27
1/19/2011	County Counsel-Mail	County Counsel-Mailing	8	5.54	44.32
2/8/2011	Attorney Fees	Attorney Fees - County Counsel	1.6	74.98125	119.97
4/28/2011	Prepare Case for SOE He...			125.55	125.55

**Subtotal**

**Payments/Credits**

**Total Now Due**

The total abatement costs must be paid to the County of Riverside, P.O. Box 1469, Riverside, CA 92502 within thirty (30) days. In the event said costs are not paid within thirty (30) days you will be liable for additional administrative costs, penalties, court fees or other collection costs incurred in the collection of these abatement costs.

I affirm and declare under penalty of perjury under the laws of the State of California that the foregoing is true and correct to the best of my knowledge.

*Mya...*

Code Enforcement Department

EXHIBIT NO.       33





# INVOICE

**Order Number:** 24060 **Order Date:** 5/23/2011

**Customer Information:**

**Acct No.** 1044

RIVERSIDE COUNTY TLMA-CODE ENFORCEMENT  
4080 Lemon Street  
Riverside, CA 92501

**Attn:** Brent Steele  
**REF:** CV06-7110 & CV08-03981/Angela Sarmiento  
**IN RE:** FARIAS, DAVID

Product and/or Service ordered for Property known as:	
19508 Day Street Perris, CA 92570	
<b>DESCRIPTION:</b>	<b>FEE:</b>
Lot Book Report	\$120.00
<b>TOTAL DUE:</b>	\$120.00

Payment due upon receipt. Please remit to:

RZ Title Services, Inc.  
P.O. Box 1193  
Whittier, CA 90609

EXHIBIT NO. B5





RIVERSIDE COUNTY GIS

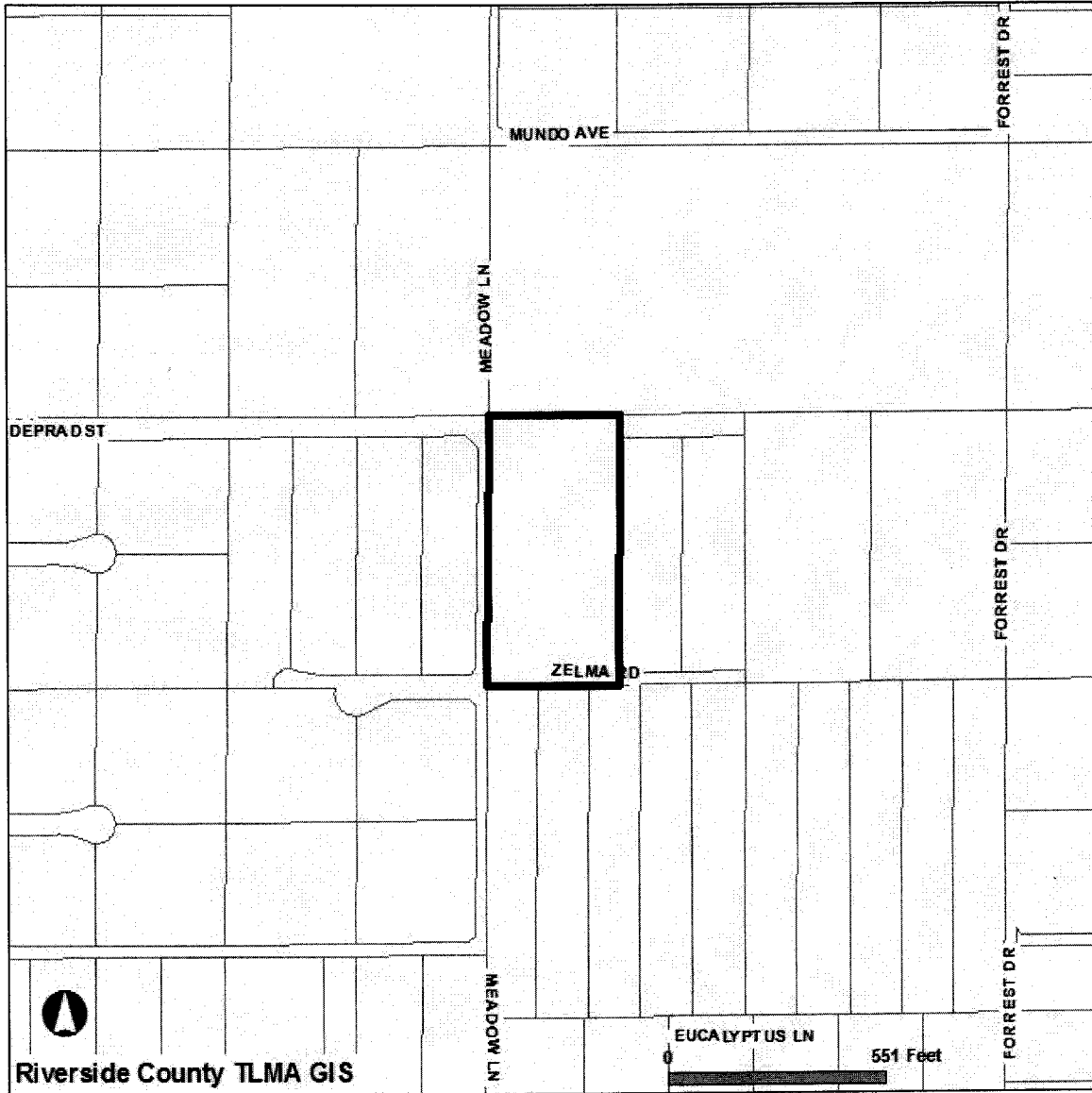

**Selected parcel(s):**  
325-060-024

**\*IMPORTANT\***

Maps and data are to be used for reference purposes only. Map features are approximate, and are not necessarily accurate to surveying or engineering standards. The County of Riverside makes no warranty or guarantee as to the content (the source is often third party), accuracy, timeliness, or completeness of any of the data provided, and assumes no legal responsibility for the information contained on this map. Any use of this product with respect to accuracy and precision shall be the sole responsibility of the user.

STANDARD WITH PERMITS REPORT

**APNs**

325-060-024-2

**OWNER NAME / ADDRESS**

ARREOLA DIANA L ESTATE OF  
23550 MEADOW LN  
PERRIS, CA. 92570

**MAILING ADDRESS**

(SEE OWNER)  
10881 BEL AIR DR  
CHERRY VALLEY CA. 92223

**EXHIBIT NO.**           C2

**LEGAL DESCRIPTION**

RECORDED BOOK/PAGE: PM 72/2  
SUBDIVISION NAME: PM 12648  
LOT/PARCEL: 1, BLOCK: NOT AVAILABLE  
TRACT NUMBER: NOT AVAILABLE

**LOT SIZE**

RECORDED LOT SIZE IS 5.23 ACRES

**PROPERTY CHARACTERISTICS**

WOOD FRAME, 640 SQFT., 1 BDRM/ 1 BATH, 1 STORY, CONST'D 1965 COMPOSITION, ROOF

**THOMAS BROS. MAPS PAGE/GRID**

PAGE: 806 GRID: J4  
PAGE: 807 GRID: A4

**CITY BOUNDARY/SPHERE**

NOT WITHIN A CITY  
CITY SPHERE: PERRIS  
ANNEXATION DATE: NOT APPLICABLE  
LAFCO CASE #: NOT APPLICABLE  
PROPOSALS: NOT APPLICABLE

**MARCH JOINT POWERS AUTHORITY**

NOT IN THE JURISDICTION OF THE MARCH JOINT POWERS AUTHORITY

**INDIAN TRIBAL LAND**

NOT IN A TRIBAL LAND

**SUPERVISORIAL DISTRICT (ORD. 813)**

MARION ASHLEY, DISTRICT 5

**TOWNSHIP/RANGE**

T4SR4W SEC 34

**ELEVATION RANGE**

1692/1716 FEET

**PREVIOUS APN**

325-060-001

**PLANNING**

**LAND USE DESIGNATIONS**

Zoning not consistent with the General Plan.  
RC-VLDR

**AREA PLAN (RCIP)**

MEAD VALLEY

**GENERAL PLAN POLICY OVERLAYS**

NOT IN A GENERAL PLAN POLICY OVERLAY AREA

**GENERAL PLAN POLICY AREAS**

NONE

**ZONING CLASSIFICATIONS (ORD. 348)**

R-R

**ZONING DISTRICTS AND ZONING AREAS**

GOOD HOPE AREA

**ZONING OVERLAYS**

NOT IN A ZONING OVERLAY

**SPECIFIC PLANS**

NOT WITHIN A SPECIFIC PLAN

**AGRICULTURAL PRESERVE**

NOT IN AN AGRICULTURAL PRESERVE

**REDEVELOPMENT AREAS**

NOT IN A REDEVELOPMENT AREA

**AIRPORT INFLUENCE AREAS**

NOT IN AN AIRPORT INFLUENCE AREA

**AIRPORT COMPATIBILITY ZONES**

NOT IN AN AIRPORT COMPATIBILITY ZONE

---

**ENVIRONMENTAL**

**CVMSHCP (COACHELLA VALLEY MULTI-SPECIES HABITAT CONSERVATION PLAN) CONSERVATION AREA**

NOT IN A CONSERVATION AREA

**CVMSHCP FLUVIAL SAND TRANSPORT SPECIAL PROVISION AREAS**

NOT IN A FLUVIAL SAND TRANSPORT SPECIAL PROVISION AREA

**WRMSHCP (WESTERN RIVERSIDE COUNTY MULTI-SPECIES HABITAT CONSERVATION PLAN) CELL GROUP**

NOT IN A CELL GROUP

**WRMSHCP CELL NUMBER**

NOT IN A CELL

**HANS/ERP (HABITAT ACQUISITION AND NEGOTIATION STRATEGY/EXPEDITED REVIEW PROCESS)**

NONE

**VEGETATION (2005)**

DEVELOPED/DISTURBED LAND  
RIPARIAN SCRUB, WOODLAND, FOREST

---

**FIRE**

**HIGH FIRE AREA (ORD. 787)**

NOT IN A HIGH FIRE AREA

**FIRE RESPONSIBILITY AREA**

STATE RESPONSIBILITY AREA

---

**DEVELOPMENT FEES**

**CVMSHCP FEE AREA (ORD. 875)**

NOT WITHIN THE COACHELLA VALLEY MSHCP FEE AREA

**WRMSHCP FEE AREA (ORD. 810)**

IN OR PARTIALLY WITHIN THE WESTERN RIVERSIDE MSHCP FEE AREA. SEE MAP FOR MORE INFORMATION.

**ROAD & BRIDGE DISTRICT**

NOT IN A DISTRICT

**EASTERN TUMF (TRANSPORTATION UNIFORM MITIGATION FEE ORD. 673)**

NOT WITHIN THE EASTERN TUMF FEE AREA

**WESTERN TUMF (TRANSPORTATION UNIFORM MITIGATION FEE ORD. 824)**

IN OR PARTIALLY WITHIN A TUMF FEE AREA. SEE MAP FOR MORE INFORMATION.CENTRAL

**DIF (DEVELOPMENT IMPACT FEE AREA ORD. 659)**

MEAD VALLEY

**SKR FEE AREA (STEPHEN'S KANGAROO RAT ORD. 663.10)**

IN OR PARTIALLY WITHIN AN SKR FEE AREA. SEE MAP FOR MORE INFORMATION.

**DEVELOPMENT AGREEMENTS**

NOT IN A DEVELOPMENT AGREEMENT AREA

---

**TRANSPORTATION**

**CIRCULATION ELEMENT ULTIMATE RIGHT-OF-WAY**

IN OR PARTIALLY WITHIN A CIRCULATION ELEMENT RIGHT-OF-WAY. SEE MAP FOR MORE INFORMATION. CONTACT THE TRANSPORTATION DEPT. PERMITS SECTION AT (951) 955-6790 FOR INFORMATION REGARDING THIS PARCEL IF IT IS IN AN UNINCORPORATED AREA.

**ROAD BOOK PAGE**

61

NOT IN A TRANSPORTATION AGREEMENT

**CETAP (COMMUNITY AND ENVIRONMENTAL TRANSPORTATION ACCEPTABILITY PROCESS) CORRIDORS**  
NOT IN A CETAP CORRIDOR.

---

## **HYDROLOGY**

---

### **FLOOD PLAIN REVIEW**

FLOOD PLAIN MANAGEMENT REVIEW IS REQUIRED. CONTACT THE FLOOD PLAIN MANAGEMENT SECTION AT (951) 955-1200 FOR INFORMATION.

### **WATER DISTRICT**

EMWD

### **FLOOD CONTROL DISTRICT**

RIVERSIDE COUNTY FLOOD CONTROL DISTRICT

### **WATERSHED**

SAN JACINTO VALLEY

---

## **GEOLOGIC**

---

### **FAULT ZONE**

NOT IN A FAULT ZONE

### **FAULTS**

NOT WITHIN A 1/2 MILE OF A FAULT

### **LIQUEFACTION POTENTIAL**

MODERATE

### **SUBSIDENCE**

SUSCEPTIBLE

### **PALEONTOLOGICAL SENSITIVITY**

UNDETERMINED POTENTIAL.

AREAS UNDERLAIN BY SEDIMENTARY ROCKS FOR WHICH LITERATURE AND UNPUBLISHED STUDIES ARE NOT AVAILABLE HAVE UNDETERMINED POTENTIAL FOR CONTAINING SIGNIFICANT PALEONTOLOGICAL RESOURCES. THESE AREAS MUST BE INSPECTED BY A FIELD SURVEY CONDUCTED BY A QUALIFIED VERTEBRATE PALEONTOLOGIST.

---

## **MISCELLANEOUS**

---

### **SCHOOL DISTRICT**

PERRIS & PERRIS UNION HIGH

### **COMMUNITIES**

GOOD HOPE

### **COUNTY SERVICE AREA**

NOT IN A COUNTY SERVICE AREA.

### **LIGHTING (ORD. 655)**

ZONE B, 37.85 MILES FROM MT. PALOMAR OBSERVATORY

### **2000 CENSUS TRACT**

042903

### **FARMLAND**

LOCAL IMPORTANCE  
OTHER LANDS

### **TAX RATE AREAS**

087014

- COUNTY FREE LIBRARY
- COUNTY STRUCTURE FIRE PROTECTION
- COUNTY WASTE RESOURCE MGMT DIST
- CSA 152
- EASTERN MUN WATER IMP DIST 8
- EASTERN MUNICIPAL WATER
- FLOOD CONTROL ADMINISTRATION
- FLOOD CONTROL ZONE 4
- GENERAL

- GENERAL PURPOSE
- METRO WATER EAST 1301999
- MT SAN JACINTO JUNIOR COLLEGE
- PERRIS AREA ELEM SCHOOL FUND
- PERRIS JR HIGH AREA FUND
- PERRIS SCHOOL
- PERRIS UNION HIGH SCHOOL
- PERRIS VALLEY CEMETERY
- RIV CO REG PARK & OPEN SPACE
- RIV. CO. OFFICE OF EDUCATION
- SAN JACINTO BASIN RESOURCE CONS

**SPECIAL NOTES**

NO SPECIAL NOTES

**CODE COMPLAINTS**

Case #	Description	Start Date
CV1103416	ABATEMENT	May. 6, 2011

**BUILDING PERMITS**

Case #	Description	Status
025145	MH SITE PREP/INSTALLATION	CONTACT THE BUILDING AND SAFETY RECORDS DEPARTMENT AT 951-955-2017
027919	NOT AVAILABLE	CONTACT THE BUILDING AND SAFETY RECORDS DEPARTMENT AT 951-955-2017
027921	MH INSTALLATION	CONTACT THE BUILDING AND SAFETY RECORDS DEPARTMENT AT 951-955-2017
031845	ELECTRIC FOR WELL	CONTACT THE BUILDING AND SAFETY RECORDS DEPARTMENT AT 951-955-2017

**ENVIRONMENTAL HEALTH PERMITS**

Case #	Description	Status
NO ENVIRONMENTAL PERMITS	NOT APPLICABLE	NOT APPLICABLE

**PLANNING PERMITS**

Case #	Description	Status
NO PLANNING PERMITS	NOT APPLICABLE	NOT APPLICABLE

REPORT PRINTED ON...Wed Jul 13 16:29:16 2011  
Version 110502



P.O. Box 1193  
 Whittier, CA 90609  
 Tel # (562) 325-8351  
 Fax # (714) 783-3038

## Lot Book Report

Order Number: **24060**

**Customer:**

RIVERSIDE COUNTY TLMA-CODE INFORCEMENT

4080 Lemon Street

Riverside

CA 92501

Attn: Brent Steele

Reference: CV06-7110 & CV08-03981/Angela Sarmiento

IN RE: FARIAS, DAVID

Order Date: 5/23/2011

Dated as of: 5/23/2011

County Name: Riverside

FEE(s):

Report: \$120.00

Property Address: 19508 Day Street

Perris

CA 92570

Assessor's Parcel No. : 317-060-001-2

**Assessments:**

Land Value:	\$4,000.00
Improvement Value:	\$136,000.00
Exemption Value:	\$0.00
Total Value:	\$140,000.00

## Tax Information

Property Taxes for the Fiscal Year	2010-2011
Total Annual Tax	\$1,497.36
Status: Paid through	PAID (PAID THRU 06/30/2011)

**Supplemental Property Tax Assessment for the**

Fiscal Year	2010-2011
Bill Number	052356709-7
First Installment	\$174.67
Penalty	\$17.47
Due Date	06/30/2006
Status	NOT PAID-DELINQUENT

EXHIBIT NO.     D



P.O. Box 1193  
 Whittier, CA 90609  
 Tel # (562) 325-8351  
 Fax # (714) 783-3038

Order Number: 24060

Reference: CV06-7110 & CV0

Second Installment	\$0.00
Penalty	\$0.00
Due Date	10/31/2006
Status	NO TAXES DUE

Prior Delinquencies for tax defaulted year(s)

Redemption Amount

If paid by

Redemption Amount

If paid by

## Property Vesting

The last recorded document transferring title of said property

Dated	10/12/2005
Recorded	12/08/2005
Document No.	2005-1014695
D.T.T.	\$550.00
Grantor	Serafin Aleman, a married man as his sole and separate property
Grantee	David Farias, a married man as his sole and separate property

## Deeds of Trust

Position No.	1st
A Deed of Trust Dated	10/28/2004
Recorded	11/09/2004
Document No.	2004-0891158
Amount	\$380,000.00
Trustor	Serafin Aleman, a married man, as his sole and separate property
Trustee	Westwood Associates, a California Corporation



P.O. Box 1193  
Whittier, CA 90609  
Tel # (562) 325-8351  
Fax # (714) 783-3038

Order Number: 24060

Reference: CV06-7110 & CV0

---

Beneficiary	Mortgage Electronic Registration Systems, Inc., acting as a nominee for WMC Mortgage Corp.
Position No.	2nd
An All-Inclusive Deed of Trust Dated	11/09/2005
Recorded	12/08/2005
Document No.	2005-1014696
Amount	\$157,000.00
Trustor	David Farias, a married man as his sole and separate property
Trustee	First American Title Insurance Company, a California Corporation
Beneficiary	Serafin Aleman, a married man as his sole and separate property
Substitution of Trustee Recorded	10/10/2007
Document No.	2007-0627899
Trustee	Integrated Lender Services
Position No.	3rd
A Deed of Trust Dated	11/06/2006
Recorded	11/07/2006
Document No.	2006-0818751
Amount	\$90,000.00
Trustor	David Farias
Trustee	First American Title Insurance Company, a California Corporation
Beneficiary	Paul C. Torres and Anita Torres, husband and wife

### Additional Information

Notice of Non-Compliance filed by	County of Riverside Code Enforcement Department
In the matter of the property of	David Farias
Case No.	CV08-03981
Recorded	07/24/2008
Document No.	2008-0404028





P.O. Box 1193  
Whittier, CA 90609  
Tel # (562) 325-8351  
Fax # (714) 783-3038

Order Number: 24060

Reference: CV06-7110 & CV0

---

Document Type	Judgment of Foreclosure and Order of Sale
Document No.	2010-0593371
Recorded	12/10/2010
Abstract of Judgment Filed in the	Superior Court of California, County of Riverside - Riverside Branch
Case No.	RIC518183
Recorded	12/10/2010
Document No.	2010-0593372
Amount	\$123,014.50
Debtor	David Farias
Creditor	Paul C. Torres and Anita Torres
A Bankruptcy filed by	David Farias
Social Security Number(s)	None Shown
Date filed	01/31/2008
Case No.	MJ10976
A Bankruptcy filed by	David Farias
Social Security Number(s)	None Shown
Date filed	03/12/2008
Case No.	MJ12624
A Bankruptcy filed by	David Farias
Social Security Number(s)	None Shown
Date filed	04/08/2008
Case No.	MJ13745

### Legal Description

THE LAND REFERRED TO IN THIS REPORT IS LOCATED IN AND IS DESCRIBED AS FOLLOWS:

A PORTION OF THE WEST ONE-HALF OF THE NORTHWEST ONE-QUARTER OF THE SOUTHWEST ONE-QUARTER OF SECTION 11, TOWNSHIP 4 SOUTH, RANGE 4 WEST, SAN BERNARDINO BASE AND MERIDIAN, IN THE COUNTY OF RIVERSIDE, STATE OF CALIFORNIA.

BEGINNING AT THE NORTHWEST CORNER THEREOF;  
THENCE SOUTHERLY ALONG THE WESTERLY LINE 272.00 FEET; THENCE EASTERLY AND PARALLEL WITH THE NORTHERLY LINE 200.00 FEET; THENCE NORTHERLY AND PARALLEL WITH THE WESTERLY LINE 272.00 FEET; THENCE WESTERLY ALONG THE NORTHERLY LINE 232.38 FEET TO THE POINT OF BEGINNING.



P.O. Box 1193  
Whittier, CA 90609  
Tel # (562) 325-8351  
Fax # (714) 783-3038

Order Number: 24060

Reference: CV06-7110 & CV0

---

EXCEPT THEREFROM THE NORTHERLY RECTANGULAR FORTY FEET FOR ROAD PURPOSES.

ALSO SHOWN AS PARCEL 1 OF RECORD OF SURVEY, AS SHOWN BY MAP ON FILE IN BOOK 52, PAGE 49 OF RECORDS OF SURVEY, RECORDS OF RIVERSIDE COUNTY, PURSUANT TO THAT CERTAIN CERTIFICATE OF COMPLIANCE NO. 5250, RECORDED OCTOBER 24, 2002 AS INSTRUMENT NO. 02-599288 OF OFFICIAL RECORDS.