

**SUBMITTAL TO THE BOARD OF SUPERVISORS  
COUNTY OF RIVERSIDE, STATE OF CALIFORNIA**

306B



**FROM:** County Counsel  
Code Enforcement Department

**SUBMITTAL DATE:**  
June 29, 2011

**SUBJECT:** Statement of Abatement Costs [Case No. CV01-0656 & CV03-1017]  
Subject Property: 32905 Turtle Dove Dr., Lake Elsinore; NOETHER  
APN: 371-160-025  
District One

**RECOMMENDED MOTION:** Move that the Board of Supervisors:

- (1) assess the reasonable costs of abatement of a public nuisance (excess outside storage of materials and substandard structure) in the above-referenced matter to be **three thousand, five hundred seventy-six dollars and fifty-four cents (US \$3,576.54)**;
- (2) assess the costs of abatement against the above-described subject property;
- (3) authorize the recordation of a notice of abatement lien; and
- (4) authorize the abatement costs to be added to the tax roll as a special assessment

**BACKGROUND:** Government Code § 25845, Riverside County Ordinance Nos. 348 (RCC Title 17), 457 (RCC Title 15), and 725 (RCC Chapter 1.16) authorize the recovery of abatement costs in public nuisance cases, the recordation of a notice of abatement lien and inclusion of abatement costs on the tax roll as a special assessment upon approval of the Board of Supervisors.

*Raymond M. Mistica*  
\_\_\_\_\_  
RAYMOND M. MISTICA, Deputy County Counsel  
for PAMELA J. WALLS, County Counsel

(Continued)

<b>FINANCIAL DATA</b>	Current F.Y. Total Cost:	\$ N/A	In Current Year Budget:	N/A
	Current F.Y. Net County Cost:	\$ N/A	Budget Adjustment:	N/A
	Annual Net County Cost:	\$ N/A	For Fiscal Year:	N/A

<b>SOURCE OF FUNDS:</b>	Positions To Be Deleted Per A-30	<input type="checkbox"/>
	Requires 4/5 Vote	<input type="checkbox"/>

**C.E.O. RECOMMENDATION:** APPROVE

BY: *Tina Grande*  
\_\_\_\_\_  
Tina Grande

**County Executive Office Signature**

**MINUTES OF THE BOARD OF SUPERVISORS**

On motion of Supervisor Buster, seconded by Supervisor Ashley and duly carried, IT WAS ORDERED that the above matter is approved as recommended with a revised amount of costs to \$500.00.

Ayes: Buster, Tavaglione, Stone and Ashley  
Nays: None  
Absent: Benoit  
Date: August 16, 2011  
xc: Co. Co., CED, Prop. Owner

Kecia Harper-Ihem  
Clerk of the Board  
BY: *Kecia Harper-Ihem*  
\_\_\_\_\_  
Deputy

**Prev. Agn. Ref.:**

**District: 1**

**Agenda Number:**

9.7

Departmental Concurrence

Consent  
 Policy  
 Consent  
 Policy  
 Dept't Recomm.:  
 Per Exec. Ofc.:

Statement of Abatement Costs [Case Nos. CV01-0656 & CV03-1017]  
Subject Property: 32905 Turtle Dove Dr., Lake Elsinore; NOETHER  
APN: 371-160-025  
District One

The Board of Supervisors issued an Order to Abate Nuisance in this case on Nov. 18, 2003 and recorded on Nov. 19, 2003, as document number 2009-910852. Subsequently, the property was brought into compliance

The Notice of Hearing re Statement of Abatement Costs has been posted on the property and mailed to the property owner and all interested parties, as required by law. Copies of all relevant notices issued in this matter together with proof of service and posting have been separately filed with the Clerk of the Board and are made a part of the record herein, pursuant to Riverside County Ordinance 725.

**BOARD OF SUPERVISORS  
PUBLIC HEARING**

August 16, 2011  
(Continued 9.2 of July 12, 2011)

**AGENDA ITEM NO. 9.7**

**Supplemental Documents**

Statement of Abatement Costs  
32905 Turtle Dove Drive, Lake Elsinore  
Case Nos. CV01-0656 & CV03-1017

**DISTRICT ONE**

2011 AUG 12 PM 11:03

CLERK OF SUPERVISORS

2011-8-19042



**CODE ENFORCEMENT DEPARTMENT  
COUNTY OF RIVERSIDE**

Glenn Baude  
Director

July 27, 2011

**CONTINUED NOTICE OF HEARING  
RE: STATEMENT OF ABATEMENT COSTS**

To: Owner(s) or Interested Parties  
(See Attached Notice List and  
Proof of Service)

Subject Property: 32905 Turtle Dove Dr., Lake Elsinore  
Case Nos.: CV01-0656 & CV03-1017; NOETHER  
APN: 371-160-025

**NOTICE IS HEREBY GIVEN** that a hearing that was held before the Riverside County Board of Supervisors on **Tuesday, July 26, 2011, at 9:30 a.m.** in the Board of Supervisors Room, 4080 Lemon Street, 1st Floor Annex, Riverside, California, and **has been continued to Tuesday, August 16, 2011, at 9:30 a.m.** at which time and place pertinent testimony will be heard regarding the expenses incurred by the County of Riverside, Code Enforcement Department ("DEPARTMENT") for the above-referenced abatement case. Said abatement case involved excessive outside storage and substandard structure located on your real property commonly described as 32905 Turtle Dove Dr., Lake Elsinore, Riverside County, California and more particularly described as Assessor's Parcel Number 371-160-025.

The total expense due, including all other fees and costs, for the abatement of the above-described dangerous or injurious condition is **three thousand, five hundred seventy-six dollars and fifty-four cents (US \$3,576.54)**. This amount is immediately due and payable. If you have any objections to the Statement of Abatement Costs attached hereto, you must address your objections to the Board of Supervisors at the hearing. If you have any questions about the attached Statement of Abatement Costs, please contact Ward Komers or Carol Lynn Anderson at (951) 955-2004. In the event the total amount due is not paid to the DEPARTMENT prior to the Board Hearing, the DEPARTMENT shall seek an order from the Board of Supervisors to place a lien against your property and collect the amount due as a special tax assessment.

Failure to appear at the hearing will result in the exclusion of your testimony. Facts as known to the DEPARTMENT will be presented to the Board of Supervisors for their final consideration and deliberation of this matter.

**You are encouraged to contact Ward Komers or Carol Lynn Anderson at (951) 955-2004 prior to the hearing. Please meet with Brian Black at 8:30 a.m. on the day of the hearing in Conference Room 2A located on the 1st floor in front of the Human Resources Office to discuss the case.**

GLENN BAUDE  
DIRECTOR

WARD KOMERS  
Administrative Manager

Enclosure: Statement of Abatement Costs



# COUNTY OF RIVERSIDE CODE ENFORCEMENT

P.O. Box 1469, Riverside, CA 92502  
Phone: 951-955-2004 Fax: 951-955-8680

Property Reference/Mailing Address
371-160-025 DANIEL G NOETHER 32917 TURTLE DOVE DR LAKE ELSINORE, CA. 92530

## Summary Statement of Abatement Costs

**You are liable to the County for the following abatement costs:**

Date	Invoice Number & Amount	Amount	Balance
12/31/1999	Balance forward		0.00
04/05/2011	CV010656- INV #100896.	2,055.44	2,055.44
04/16/2004	CV010656:A09243- INV #322. A09243	200.00	2,255.44
04/26/2011	CV031017- INV #101149.	1,321.10	3,576.54
		<b>Total Now Due</b>	<b>\$3,576.54</b>

The total abatement costs must be paid to the County of Riverside, P.O. Box 1469, Riverside, CA 92502 within thirty (30) days. In the event said costs are not paid within thirty (30) days you will be liable for additional administrative costs, penalties, court fees, or other collection costs incurred in the collection of these abatement costs.

I affirm and declare under penalty of perjury under the laws of the State of California that the foregoing is true and correct to the best of my knowledge.

  
Code Enforcement Department

EXHIBIT NO.     A2

County of Riverside  
Code Enforcement Department

P.O. Box 1469, Riverside, CA 92502  
Phone: (951) 955-2004 Fax: (951) 955-8680



## Statement of Abatement Costs

371-160-025  
DANIEL G NOETHER  
32917 TURTLE DOVE DR  
LAKE ELSINORE, CA 92530

Date	Invoice #
4/5/2011	100896

Case Number	District	Class
CV010656	1	SOAC

Property Address
371-160-025 DANIEL G NOETHER 32905 TURTLE DOVE DR LAKE ELSINORE, CA 92530

You are liable to the County for the following abatement costs:

Date	Item	Description	Hours/Qty	Rate	Amount
0/14/2003	Attorney Fees	Attorney Fees - County Counsel	0.4	91.00	36.40
0/28/2003	Attorney Fees	Attorney Fees - County Counsel	0.9	91.00	81.90
1/9/2004	County Counsel-Mail	County Counsel-Mailing	2	4.65	9.30
4/5/2011	Prepare Case for SOE He...			125.55	125.55
	Attend SOE Hearing			69.75	69.75
		Subtotal County Counsel Costs			486.44
4/5/2011	Lot Book Report			120.00	120.00
		Subtotal Contractor Costs			120.00

**Subtotal** \$2,055.44

**Payments/Credits** \$0.00

**Total Now Due** \$2,055.44

The total abatement costs must be paid to the County of Riverside, P.O. Box 69, Riverside, CA 92502 within thirty (30) days. In the event said costs are not paid within thirty (30) days you will be liable for additional administrative costs, penalties, court fees or other collection costs incurred in the collection of these abatement costs.

I affirm and declare under penalty of perjury under the laws of the State of California that the foregoing is true and correct to the best of my knowledge.

*[Signature]*

Code Enforcement Department

County of Riverside  
Code Enforcement Department

P.O. Box 1469, Riverside, CA 92502  
Phone: (951) 955-2004 Fax: (951) 955-8680



## Statement of Abatement Costs

371-160-025  
DANIEL G NOETHER  
32917 TURTLE DOVE DR  
LAKE ELSINORE, CA 92530

Date	Invoice #
4/5/2011	100896

Case Number	District	Class
CV010656	1	SOAC

Property Address
371-160-025 DANIEL G NOETHER 32905 TURTLE DOVE DR LAKE ELSINORE, CA 92530

**You are liable to the County for the following abatement costs:**

Date	Item	Description	Hours/Qty	Rate	Amount
13/2001	Officer Hours	Labor Charges - Officer Time	1	70.00	70.00
1/26/2001	Officer Hours	Labor Charges - Officer Time	0.5	70.00	35.00
1/3/2002	Officer Hours	Labor Charges - Officer Time	1	70.00	70.00
14/2002	Officer Hours	Labor Charges - Officer Time	0.5	70.00	35.00
10/2003	Officer Hours	Labor Charges - Officer Time	0.5	70.00	35.00
11/2003	Officer Hours	Labor Charges - Officer Time	1	70.00	70.00
14/2003	Officer Hours	Labor Charges - Officer Time	0.5	70.00	35.00
18/2003	Officer Hours	Labor Charges - Officer Time	1	70.00	70.00
27/2003	Officer Hours	Labor Charges - Officer Time	0.5	70.00	35.00
1/4/2003	Officer Hours	Labor Charges - Officer Time	0.5	70.00	35.00
1/6/2003	Officer Hours	Labor Charges - Officer Time	1	70.00	70.00
29/2003	Officer Hours	Labor Charges - Officer Time	0.2	70.00	14.00
1/27/2003	Officer Hours	Labor Charges - Officer Time	1	100.00	100.00
16/2004	Officer Hours	Labor Charges - Officer Time	0.2	100.00	20.00
21/2004	Officer Hours	Labor Charges - Officer Time	1	100.00	100.00
16/2004	Officer Hours	Labor Charges - Officer Time	0.4	100.00	40.00
21/2004	Officer Hours	Labor Charges - Officer Time	2	100.00	200.00
21/2004	Officer Hours	Labor Charges - Officer Time	0.3	100.00	30.00
22/2004	Officer Hours	Labor Charges - Officer Time	0.2	100.00	20.00
24/2004	Officer Hours	Labor Charges - Officer Time	1.5	100.00	150.00
1/21/2004	Officer Hours	Labor Charges - Officer Time	1.5	100.00	150.00
1/5/2011	SOE Preparation	Prepare Statement of Expense		65.00	65.00
		Subtotal Code Enforcement Costs			1,449.00
1/1/2003	Attorney Fees	Attorney Fees - County Counsel	0.5	91.00	45.50
18/2003	Attorney Fees	Attorney Fees - County Counsel	1.2	91.00	109.20
2/26/2003	County Counsel-Mail	County Counsel-Mailing	2	4.42	8.84

**Subtotal**

**Payments/Credits**

**Total Now Due**

All total abatement costs must be paid to the County of Riverside, P.O. Box 1469, Riverside, CA 92502 within thirty (30) days. In the event said costs are not paid within thirty (30) days you will be liable for additional administrative costs, penalties, court fees or other collection costs incurred in the collection of these abatement costs.

I hereby affirm and declare under penalty of perjury under the laws of the State of California that the foregoing is true and correct to the best of my knowledge.

*[Signature]*  
Code Enforcement Department



# County of Riverside Code Enforcement Department

P.O. Box 1469, Riverside, CA 92502  
Phone: (951) 955-2004 Fax: (951) 955-8680  
demands@rctlma.org

## Administrative Citation

Citation Issue Date	Billing Date
4/16/2004	4/5/2011

371-160-025  
DANIEL G NOETHER  
32917 TURTLE DOVE DR  
LAKE ELSINORE, CA 92530

Property Address
371-160-025 DANIEL G NOETHER 32905 TURTLE DOVE DR LAKE ELSINORE, CA 92530

Citation Number	District	Class
A09243	1	SOAC

Item	Description	Hours/Qty	Rate	Amount
Administrative Citations	A09243--CV010656	1	200.00	200.00
			<b>Subtotal</b>	\$200.00
			<b>Payments/Credits</b>	\$0.00
			<b>Total</b>	\$200.00

EXHIBIT NO.           A<sup>5</sup>



County of Riverside  
Code Enforcement Department

P.O. Box 1469, Riverside, CA 92502  
Phone: (951) 955-2004 Fax: (951) 955-8680



## Statement of Abatement Costs

371160025  
DANIEL G NOETHER  
32917 TURTL E DOVE DR  
LAKE ELSINORE, CA. 92530

Date	Invoice #
4/26/2011	101149

Case Number	District	Class
CV031017	I	SOAC

Property Address
371160025 DANIEL G NOETHER 32905 TURTL E DOVE DR LAKE ELSINORE, CA 92530

You are liable to the County for the following abatement costs:

Date	Item	Description	Hours/Qty	Rate	Amount
14/2003	Officer Hours	Labor Charges - Officer Time	1	70.00	70.00
17/2003	Officer Hours	Labor Charges - Officer Time	0.5	70.00	35.00
20/2003	Officer Hours	Labor Charges - Officer Time	2	70.00	140.00
24/2003	Officer Hours	Labor Charges - Officer Time	0.5	70.00	35.00
4/2003	Officer Hours	Labor Charges - Officer Time	0.5	70.00	35.00
5/2003	Officer Hours	Labor Charges - Officer Time	2.5	70.00	175.00
6/2003	Officer Hours	Labor Charges - Officer Time	2	70.00	140.00
28/2003	Officer Hours	Labor Charges - Officer Time	0.5	70.00	35.00
29/2003	Officer Hours	Labor Charges - Officer Time	0.5	70.00	35.00
27/2003	Officer Hours	Labor Charges - Officer Time	1	100.00	100.00
16/2004	Officer Hours	Labor Charges - Officer Time	0.2	100.00	20.00
11/2004	Officer Hours	Labor Charges - Officer Time	1	100.00	100.00
10/2004	Officer Hours	Labor Charges - Officer Time	0.5	100.00	50.00
16/2011	SOE Preparation	Prepare Statement of Expense		65.00	65.00
		Subtotal Code Enforcement Costs			1,035.00
1/2003	Attorney Fees	Attorney Fees - County Counsel		0.00	0.00
8/2003	Attorney Fees	Attorney Fees - County Counsel	1.2	91.00	109.20
28/2003	Attorney Fees	Attorney Fees - County Counsel	0.9	91.00	81.90
		Subtotal County Counsel Costs			191.10
10/2003	Lot/Title Report	Lot/Title Report	1	65.00	65.00
10/2003	Lot/Title Report	Lot/Title Report	1	30.00	30.00
		Subtotal Contractor Costs			95.00

**Subtotal** \$1,321.10

**Payments/Credits** \$0.00

**Total Now Due** \$1,321.10

Total abatement costs must be paid to the County of Riverside, P.O. Box 1469, Riverside, CA 92502 within thirty (30) days. In the event said costs are not paid within thirty (30) days you will be liable for additional administrative costs, penalties, court fees or other collection costs incurred in the collection of these abatement costs.

I hereby certify and declare under penalty of perjury under the laws of the State of California that the foregoing is true and correct to the best of my knowledge.

*[Signature]*  
Code Enforcement Department

EXHIBIT NO. AG

## **NOTICE LIST**

Subject Property: 32917 Turtle Dove Drive, Lake Elsinore; Case Nos.: CV01-0656 &  
CV03-1017; APN: 371-160-025;  
District One

DANIEL G NOETHER  
32917 TURTLE DOVE DRIVE  
LAKE ELSINORE CA 92530

DAN NOETHER  
32905 TURTLE DOVE DRIVE  
LAKE ELSINORE CA 92530

MILAN MANDARIC  
1188 BORDEAUX DRIVE  
SUNNYVALE CA 94089

1 **PROOF OF SERVICE**

2 Case Nos. CV01-0656 & CV03-1017

3 STATE OF CALIFORNIA, COUNTY OF RIVERSIDE

4 I, Brenda G. Peeler, declare that I am a citizen of the United States and am employed in the County  
5 of Riverside, over the age of 18 years and not a party to the within action or proceeding; that my  
6 business address is 3960 Orange Street, Suite 500, Riverside, California 92501.

7 That on July 27, 2011, I served the following document(s):

- 8 - **CONTINUED NOTICE OF HEARING RE: STATEMENT OF**
- 9 **ABATEMENT COSTS**
- 10 - **SUMMARY STATEMENT OF ABATEMENT COSTS AND**
- 11 **STATEMENT OF ABATEMENT COSTS**
- 12 - **ADMINISTRATIVE CITATION(S)**
- 13 - **NOTICE LIST**

14 by placing a true copy thereof enclosed in a sealed envelope(s) addressed as follows:

15 **OWNERS OR INTERESTED PARTIES**  
16 **(SEE NOTICE LIST ATTACHED TO NOTICE OF HEARING)**

17 XX **BY FIRST CLASS MAIL.** I am "readily familiar" with the office's practice of collection  
18 and processing correspondence for mailing. Under that practice it would be deposited with  
19 the U.S. Postal Service on that same day with postage thereon fully prepaid at Riverside,  
20 California, in the ordinary course of business.

21 — **BY PERSONAL SERVICE:** I caused to be delivered such envelope(s) by hand to the offices  
22 of the addressee(s).

23 XX **STATE - I declare under penalty of perjury under the laws of the State of California that the**  
24 **above is true and correct.**

25 — **FEDERAL - I declare that I am employed in the office of a member of the bar of this court at**  
26 **whose direction the service was made.**

27 EXECUTED ON July 27, 2011, at Riverside, California.

28   
\_\_\_\_\_  
BRENDA G. PEELER



**CODE ENFORCEMENT DEPARTMENT  
COUNTY OF RIVERSIDE**

GLENN BAUDE  
Director

**AFFIDAVIT OF POSTING OF NOTICES**

July 28, 2011

RE CASE NO: CV010656

I, Ariana Meza, hereby declare:

I am employed by the Riverside County Code Enforcement Department; that my business address is 39493 Los Alamos Road, Suite #A, Murrieta, California 92563 .

That on 07/28/2011 at 2:00pm, I securely and conspicuously posted Continued Notice of Hearing RE: Statement of Abatement Cost, Notice List & Proof of Service at the property described as:

**Property Address:** 32905 TURTLE DOVE DR, LAKELAND VILLAGE

**Assessor's Parcel Number:** 371-160-025

I declare under the penalty of perjury that the foregoing is true and correct.

Executed on July 28, 2011 in the County of Riverside, California.

CODE ENFORCEMENT DEPARTMENT

  
By: Ariana Meza, Code Enforcement Technician

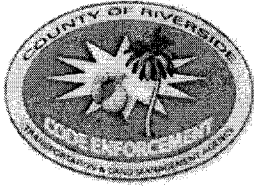

**CODE ENFORCEMENT DEPARTMENT  
COUNTY OF RIVERSIDE**

GLENN BAUDE  
Director

**AFFIDAVIT OF POSTING OF NOTICES**

July 28, 2011

RE CASE NO: CV031017

I, Ariana Meza, hereby declare:

I am employed by the Riverside County Code Enforcement Department; that my business address is 39493 Los Alamos Road, Suite #A, Murrieta, California 92563 .

That on 07/28/2011 at 2:00pm, I securely and conspicuously posted Continued Notice of Hearing RE: Statement of Abatement Cost, Notice List & Proof of Service at the property described as:

**Property Address:** 32905 TURTLE DOVE DR, LAKELAND VILLAGE

**Assessor's Parcel Number:** 371-160-025

I declare under the penalty of perjury that the foregoing is true and correct.

Executed on July 28, 2011 in the County of Riverside, California.

CODE ENFORCEMENT DEPARTMENT

  
By: Ariana Meza, Code Enforcement Technician

MINUTES OF THE BOARD OF SUPERVISORS  
COUNTY OF RIVERSIDE, STATE OF CALIFORNIA



9.2

9:30 a.m. being the time set for public hearing on the recommendation from County Counsel/Code Enforcement regarding a Public Hearing on Statement of Abatement Costs Case Nos. CV 01-0656 & CV 03-1017 located at 32905 Turtle Dove Drive, Lake Elsinore; APN: 371-160-025, 1<sup>st</sup> District.

On motion of Supervisor Buster, seconded by Supervisor Benoit and duly carried, IT WAS ORDERED that the above matter is continued to Tuesday, August 16, 2011 at 9:30 a.m.

Roll Call:

Ayes: Buster, Stone, Benoit and Ashley  
Nays: None  
Absent: Tavaglione

I hereby certify that the foregoing is a full true, and correct copy of an order made and entered on July 12, 2011 of Supervisors Minutes.

(seal)

WITNESS my hand and the seal of the Board of Supervisors  
Dated: July 12, 2011  
Kecia Harper-Ihem, Clerk of the Board of Supervisors, in  
and for the County of Riverside, State of California.

By: *Kecia Harper-Ihem* Deputy

AGENDA NO.  
9.2

xc: Co. Co., CED, Prop. Owner, CØB

**SUBMITTAL TO THE BOARD OF SUPERVISORS  
COUNTY OF RIVERSIDE, STATE OF CALIFORNIA**

**FROM:** County Counsel  
Code Enforcement Department  
**SUBJECT:** Statement of Abatement Costs [Case Nos. CV01-0656 & CV03-1017]  
Subject Property: 32905 Turtle Dove Drive, Lake Elsinore  
APN: 371-160-025  
District One

**TABLE OF SUPPLEMENTAL DOCUMENTS  
FILED WITH THE CLERK OF THE BOARD**

**Hearing Date: JULY 12, 2011**

Notice of Hearing Re: Statement of Abatement Costs (including Proof(s) of Service and Affidavit(s) of Posting .....	Exhibit A
Summary Statement of Abatement Costs and Statement of Abatement Costs with Supporting Documents .....	Exhibit B
Assessment-Roll For The Year 10/11 And Geographic Information System, May 2, 2011 .....	Exhibit C
Lot Book Report .....	Exhibit D
Demand for Payment Statement of Abatement Costs Notice of Special Tax Assessment .....	Exhibit E
Request for Hearing .....	Exhibit F

PAMELA J. WALLS  
County Counsel

OFFICE OF COUNTY COUNSEL  
COUNTY OF RIVERSIDE



KATHERINE A. LIND  
Assistant County Counsel

3960 ORANGE STREET, SUITE 500  
RIVERSIDE, CA 92501-3674  
TELEPHONE: 951/955-6300  
FAX: 951/955-6322 & 951/955-6363

June 21, 2011

# NOTICE OF HEARING RE: STATEMENT OF ABATEMENT COSTS

To: Owner(s) or Interested Parties  
(See Attached Notice List and  
Proof of Service)

Subject Property: 32905 Turtle Dove Dr., Lake Elsinore  
Case Nos.: CV01-0656 & CV03-1017; NOETHER  
APN: 371-160-025

**NOTICE IS HEREBY GIVEN** that a hearing will be held before the Riverside County Board of Supervisors on **Tuesday, July 12, 2011, at 9:30 a.m.** in the Board of Supervisors Room, 4080 Lemon Street, 1st Floor Annex, Riverside, California, at which time and place pertinent testimony will be heard regarding the expenses incurred by the County of Riverside, Code Enforcement Department ("DEPARTMENT") for the above-referenced abatement case. Said abatement case involved excessive outside storage and substandard structure located on your real property commonly described as 32905 Turtle Dove Dr., Lake Elsinore, Riverside County, California and more particularly described as Assessor's Parcel Number 371-160-025.

The total expense due, including all other fees and costs, for the abatement of the above-described dangerous or injurious condition is **three thousand, five hundred seventy-six dollars and fifty-four cents (US \$3,576.54)**. This amount is immediately due and payable. If you have any objections to the Statement of Abatement Costs attached hereto, you must address your objections to the Board of Supervisors at the hearing. If you have any questions about the attached Statement of Abatement Costs, please contact Brian Black at (951) 955-2004. In the event the total amount due is not paid to the DEPARTMENT prior to the Board Hearing, the DEPARTMENT shall seek an order from the Board of Supervisors to place a lien against your property and collect the amount due as a special tax assessment.

Failure to appear at the hearing will result in the exclusion of your testimony. Facts as known to the DEPARTMENT will be presented to the Board of Supervisors for their final consideration and deliberation of this matter.

**You are encouraged to contact Supervising Code Enforcement Officer, Brian Black (951) 955-2004 prior to the hearing. Please meet with the undersigned or Brian Black at 7:30 a.m. on the day of the hearing in Conference Room 2A located on the 1st floor in front of the Human Resources Office to discuss the case.**

PAMELA J. WALLS  
County Counsel

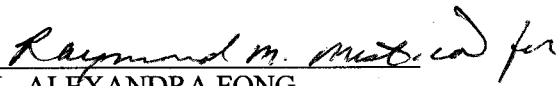
  
L. ALEXANDRA FONG  
Deputy County Counsel

Enclosure: Statement of Abatement Costs

EXHIBIT NO.     A





# COUNTY OF RIVERSIDE CODE ENFORCEMENT

P.O. Box 1469, Riverside, CA 92502  
Phone: 951-955-2004 Fax: 951-955-8680

Property Reference/Mailing Address
371-160-025 DANIEL G NOETHER 32917 TURTLE DOVE DR LAKE ELSINORE, CA. 92530

## Summary Statement of Abatement Costs

**You are liable to the County for the following abatement costs:**

Date	Invoice Number & Amount	Amount	Balance
12/31/1999	Balance forward		0.00
04/05/2011	CV010656- INV #100896.	2,055.44	2,055.44
04/16/2004	CV010656:A09243- INV #322. A09243	200.00	2,255.44
04/26/2011	CV031017- INV #101149.	1,321.10	3,576.54
<b>Total Now Due</b>			<b>\$3,576.54</b>

The total abatement costs must be paid to the County of Riverside, P.O. Box 1469, Riverside, CA 92502 within thirty (30) days. In the event said costs are not paid within thirty (30) days you will be liable for additional administrative costs, penalties, court fees, or other collection costs incurred in the collection of these abatement costs.

I affirm and declare under penalty of perjury under the laws of the State of California that the foregoing is true and correct to the best of my knowledge.

  
Code Enforcement Department

EXHIBIT NO.     A2

**County of Riverside  
Code Enforcement Department**

P.O. Box 1469, Riverside, CA 92502  
Phone: (951) 955-2004 Fax: (951) 955-8680



# Statement of Abatement Costs

371-160-025  
DANIEL G NOETHER  
32917 TURTLE DOVE DR  
LAKE ELSINORE, CA 92530

Date	Invoice #
4/5/2011	100896

Property Address
371-160-025 DANIEL G NOETHER 32905 TURTLE DOVE DR LAKE ELSINORE, CA 92530

Case Number	District	Class
CV010656	1	SOAC

**You are liable to the County for the following abatement costs:**

Date	Item	Description	Hours/Qty	Rate	Amount
10/14/2003	Attorney Fees	Attorney Fees - County Counsel	0.4	91.00	36.40
10/28/2003	Attorney Fees	Attorney Fees - County Counsel	0.9	91.00	81.90
1/9/2004	County Counsel-Mail	County Counsel-Mailing	2	4.65	9.30
4/5/2011	Prepare Case for SOE He...			125.55	125.55
	Attend SOE Hearing			69.75	69.75
		Subtotal County Counsel Costs			486.44
4/5/2011	Lot Book Report			120.00	120.00
		Subtotal Contractor Costs			120.00

**Subtotal** \$2,055.44

**Payments/Credits** \$0.00

**Total Now Due** \$2,055.44

The total abatement costs must be paid to the County of Riverside, P.O. Box 1469, Riverside, CA 92502 within thirty (30) days. In the event said costs are not paid within thirty (30) days you will be liable for additional administrative costs, penalties, court fees or other collection costs incurred in the collection of these abatement costs.

**I affirm and declare under penalty of perjury under the laws of the State of California that the foregoing is true and correct to the best of my knowledge.**

*[Signature]*  
Code Enforcement Department

**EXHIBIT NO.**     A3

**County of Riverside  
Code Enforcement Department**

P.O. Box 1469, Riverside, CA 92502  
Phone: (951) 955-2004 Fax: (951) 955-8680



# Statement of Abatement Costs

371-160-025  
DANIEL G NOETHER  
32917 TURTLE DOVE DR  
LAKE ELSINORE, CA 92530

Date	Invoice #
4/5/2011	100896

<b>Property Address</b>
371-160-025 DANIEL G NOETHER 32905 TURTLE DOVE DR LAKE ELSINORE, CA 92530

Case Number	District	Class
CV010656	1	SOAC

**You are liable to the County for the following abatement costs:**

Date	Item	Description	Hours/Qty	Rate	Amount
3/13/2001	Officer Hours	Labor Charges - Officer Time	1	70.00	70.00
2/26/2001	Officer Hours	Labor Charges - Officer Time	0.5	70.00	35.00
1/3/2002	Officer Hours	Labor Charges - Officer Time	1	70.00	70.00
3/14/2002	Officer Hours	Labor Charges - Officer Time	0.5	70.00	35.00
3/10/2003	Officer Hours	Labor Charges - Officer Time	0.5	70.00	35.00
3/11/2003	Officer Hours	Labor Charges - Officer Time	1	70.00	70.00
3/14/2003	Officer Hours	Labor Charges - Officer Time	0.5	70.00	35.00
3/18/2003	Officer Hours	Labor Charges - Officer Time	1	70.00	70.00
3/27/2003	Officer Hours	Labor Charges - Officer Time	0.5	70.00	35.00
6/4/2003	Officer Hours	Labor Charges - Officer Time	0.5	70.00	35.00
6/6/2003	Officer Hours	Labor Charges - Officer Time	1	70.00	70.00
8/29/2003	Officer Hours	Labor Charges - Officer Time	0.2	70.00	14.00
0/27/2003	Officer Hours	Labor Charges - Officer Time	1	100.00	100.00
1/16/2004	Officer Hours	Labor Charges - Officer Time	0.2	100.00	20.00
1/21/2004	Officer Hours	Labor Charges - Officer Time	1	100.00	100.00
4/16/2004	Officer Hours	Labor Charges - Officer Time	0.4	100.00	40.00
4/21/2004	Officer Hours	Labor Charges - Officer Time	2	100.00	200.00
5/21/2004	Officer Hours	Labor Charges - Officer Time	0.3	100.00	30.00
5/22/2004	Officer Hours	Labor Charges - Officer Time	0.2	100.00	20.00
5/24/2004	Officer Hours	Labor Charges - Officer Time	1.5	100.00	150.00
0/21/2004	Officer Hours	Labor Charges - Officer Time	1.5	100.00	150.00
4/5/2011	SOE Preparation	Prepare Statement of Expense		65.00	65.00
		Subtotal Code Enforcement Costs			1,449.00
7/1/2003	Attorney Fees	Attorney Fees - County Counsel	0.5	91.00	45.50
8/18/2003	Attorney Fees	Attorney Fees - County Counsel	1.2	91.00	109.20
8/26/2003	County Counsel-Mail	County Counsel-Mailing	2	4.42	8.84

**Subtotal**

**Payments/Credits**

**Total Now Due**

The total abatement costs must be paid to the County of Riverside, P.O. Box 1469, Riverside, CA 92502 within thirty (30) days. In the event said costs are not paid within thirty (30) days you will be liable for additional administrative costs, penalties, court fees or other collection costs incurred in the collection of these abatement costs.

I affirm and declare under penalty of perjury under the laws of the State of California that the foregoing is true and correct to the best of my knowledge.

*DG Noether*



# County of Riverside Code Enforcement Department

P.O. Box 1469, Riverside, CA 92502  
Phone: (951) 955-2004 Fax: (951) 955-8680  
demands@rctlma.org

## Administrative Citation

371-160-025  
DANIEL G NOETHER  
32917 TURTLE DOVE DR  
LAKE ELSINORE, CA 92530

Citation Issue Date	Billing Date
4/16/2004	4/5/2011

Property Address
371-160-025 DANIEL G NOETHER 32905 TURTLE DOVE DR LAKE ELSINORE, CA 92530

Citation Number	District	Class
A09243	1	SOAC

Item	Description	Hours/Qty	Rate	Amount
Administrative Citations	A09243--CV010656	1	200.00	200.00

<b>Subtotal</b>	\$200.00
<b>Payments/Credits</b>	\$0.00
<b>Total</b>	\$200.00

EXHIBIT NO. AS

County of Riverside  
Code Enforcement Department

P.O. Box 1469, Riverside, CA 92502  
Phone: (951) 955-2004 Fax: (951) 955-8680



## Statement of Abatement Costs

371160025  
DANIEL G NOETHER  
32917 TURTLE DOVE DR  
LAKE ELSINORE, CA. 92530

Date	Invoice #
4/26/2011	101149

Property Address

371160025  
DANIEL G NOETHER  
32905 TURTLE DOVE DR  
LAKE ELSINORE, CA 92530

Case Number	District	Class
CV031017	1	SOAC

**You are liable to the County for the following abatement costs:**

Date	Item	Description	Hours/Qty	Rate	Amount
3/14/2003	Officer Hours	Labor Charges - Officer Time	1	70.00	70.00
3/17/2003	Officer Hours	Labor Charges - Officer Time	0.5	70.00	35.00
3/20/2003	Officer Hours	Labor Charges - Officer Time	2	70.00	140.00
3/24/2003	Officer Hours	Labor Charges - Officer Time	0.5	70.00	35.00
6/4/2003	Officer Hours	Labor Charges - Officer Time	0.5	70.00	35.00
6/5/2003	Officer Hours	Labor Charges - Officer Time	2.5	70.00	175.00
6/6/2003	Officer Hours	Labor Charges - Officer Time	2	70.00	140.00
8/28/2003	Officer Hours	Labor Charges - Officer Time	0.5	70.00	35.00
8/29/2003	Officer Hours	Labor Charges - Officer Time	0.5	70.00	35.00
10/27/2003	Officer Hours	Labor Charges - Officer Time	1	100.00	100.00
1/16/2004	Officer Hours	Labor Charges - Officer Time	0.2	100.00	20.00
1/21/2004	Officer Hours	Labor Charges - Officer Time	1	100.00	100.00
5/10/2004	Officer Hours	Labor Charges - Officer Time	0.5	100.00	50.00
4/26/2011	SOE Preparation	Prepare Statement of Expense		65.00	65.00
		Subtotal Code Enforcement Costs			1,035.00
7/1/2003	Attorney Fees	Attorney Fees - County Counsel		0.00	0.00
8/18/2003	Attorney Fees	Attorney Fees - County Counsel	1.2	91.00	109.20
10/28/2003	Attorney Fees	Attorney Fees - County Counsel	0.9	91.00	81.90
		Subtotal County Counsel Costs			191.10
3/20/2003	Lot/Title Report	Lot/Title Report	1	65.00	65.00
7/30/2003	Lot/Title Report	Lot/Title Report	1	30.00	30.00
		Subtotal Contractor Costs			95.00

**Subtotal** \$1,321.10

**Payments/Credits** \$0.00

**Total Now Due** \$1,321.10

The total abatement costs must be paid to the County of Riverside, P.O. Box 1469, Riverside, CA 92502 within thirty (30) days. In the event said costs are not paid within thirty (30) days you will be liable for additional administrative costs, penalties, court fees or other collection costs incurred in the collection of these abatement costs.

I affirm and declare under penalty of perjury under the laws of the State of California that the foregoing is true and correct to the best of my knowledge.

*[Signature]*  
Code Enforcement Department

EXHIBIT NO. AG

# NOTICE LIST

Subject Property: 32917 Turtle Dove Drive, Lake Elsinore; Case Nos.: CV01-0656 &  
CV03-1017; APN: 371-160-025;  
District One

DANIEL G NOETHER  
32917 TURTLE DOVE DRIVE  
LAKE ELSINORE CA 92530

DAN NOETHER  
32905 TURTLE DOVE DRIVE  
LAKE ELSINORE CA 92530

MILAN MANDARIC  
1188 BORDEAUX DRIVE  
SUNNYVALE CA 94089

EXHIBIT NO. \_\_\_\_\_

A7

**PROOF OF SERVICE**  
Case Nos. CV01-0656 & CV03-1017

STATE OF CALIFORNIA, COUNTY OF RIVERSIDE

I, Brenda G. Peeler, declare that I am a citizen of the United States and am employed in the County of Riverside, over the age of 18 years and not a party to the within action or proceeding; that my business address is 3960 Orange Street, Suite 500, Riverside, California 92501.

That on June 21, 2011, I served the following document(s):

- NOTICE OF HEARING RE: SUMMARY OF ABATEMENT COSTS
- SUMMARY OF ABATEMENT COSTS
- STATEMENT OF ABATEMENT COSTS
- NOTICE LIST

by placing a true copy thereof enclosed in a sealed envelope(s) addressed as follows:

**OWNERS OR INTERESTED PARTIES**  
**(SEE NOTICE LIST ATTACHED TO NOTICE OF HEARING)**

XX **BY CERTIFIED MAIL, RETURN RECEIPT REQUESTED.** I am "readily familiar" with the office's practice of collection and processing correspondence for mailing. Under that practice it would be deposited with the U.S. Postal Service on that same day with postage thereon fully prepaid at Riverside, California, in the ordinary course of business.

— **BY PERSONAL SERVICE:** I caused to be delivered such envelope(s) by hand to the offices of the addressee(s).

XX **STATE - I declare under penalty of perjury under the laws of the State of California that the above is true and correct.**

— **FEDERAL - I declare that I am employed in the office of a member of the bar of this court at whose direction the service was made.**

EXECUTED ON June 21, 2011, at Riverside, California.

  
\_\_\_\_\_  
BRENDA G. PEELER

EXHIBIT NO.           A<sup>8</sup>



**CODE ENFORCEMENT DEPARTMENT  
COUNTY OF RIVERSIDE**

GLENN BAUDE  
Director

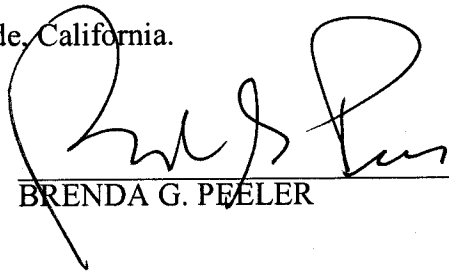
**AFFIDAVIT OF POSTING OF NOTICES**

June 28, 2011

RE CASE NO: CV010656

I, Thomas McMullen, hereby declare:

I am employed by the Riverside County Code Enforcement Department; that my business address is 4080 Lemon Street, 12th Floor, Riverside, California 92501 .

That on 06/23/11 at 1255 hours, I securely and conspicuously posted Notice of Hearing re: Statement of Abatement Costs at the property described as:

**Property Address:** 32905 TURTLE DOVE DR, LAKELAND VILLAGE

**Assessor's Parcel Number:** 371-160-025

I declare under the penalty of perjury that the foregoing is true and correct.

Executed on June 28, 2011 in the County of Riverside, California.

CODE ENFORCEMENT DEPARTMENT

  
By: Thomas McMullen, Code Enforcement Officer

EXHIBIT NO.     A9







# INVOICE

**Order Number:** 23499 **Order Date:** 4/21/2011

**Customer Information:**

**Acct No.** 1044

RIVERSIDE COUNTY TLMA-CODE ENFORCEMENT  
4080 Lemon Street  
Riverside, CA 92501

**Attn:** Brent Steele  
**REF:** CV01-0656 / Angela Sarmiento  
**IN RE:** NOETHER, DANIEL G.

Product and/or Service ordered for Property known as:	
<b>32905 Turtle Dove Drive</b> <b>Lake Elsinore, CA 92530</b>	
<b>DESCRIPTION:</b>	<b>FEE:</b>
Lot Book Report	\$120.00
<b>TOTAL DUE:</b>	<b>\$120.00</b>

**Payment due upon receipt. Please remit to:**

RZ Title Services, Inc.  
P.O. Box 1193  
Whittier, CA 90609

**EXHIBIT NO.**     B

Assessment Roll For the 2010-2011 Tax Year as of January 1,2010

Assessment #371160025-9 #		Parcel # 371160025-9	
<b>Assessee:</b>	NOETHER DANIEL G	<b>Land</b>	37,847
<b>Mail Address:</b>	32917 TURTLE DOVE DR	<b>Structure</b>	174,585
<b>City, State Zip:</b>	LAKE ELSINORE CA 92530	<b>Full Value</b>	212,432
<b>Real Property Use Code:</b>	MF	<b>Total Net</b>	212,432
<b>Base Year</b>	2009		
<b>Conveyance Number:</b>	0790333		
<b>Conveyance (mm/yy):</b>	10/1996		
<b>PUI:</b>	M020012		
<b>TRA:</b>	65-140		
<b>Taxability Code:</b>	0-00		
<b>Assessment Description:</b>	2007 CAVCO 6940A		
<b>ID Data:</b>	Lot 4 PM 052/024 PM 10947		
<b>Situs Address:</b>	32905 TURTLE DOVE DR LAKE ELSINORE CA 92530		



EXHIBIT NO.     C

RIVERSIDE COUNTY GIS

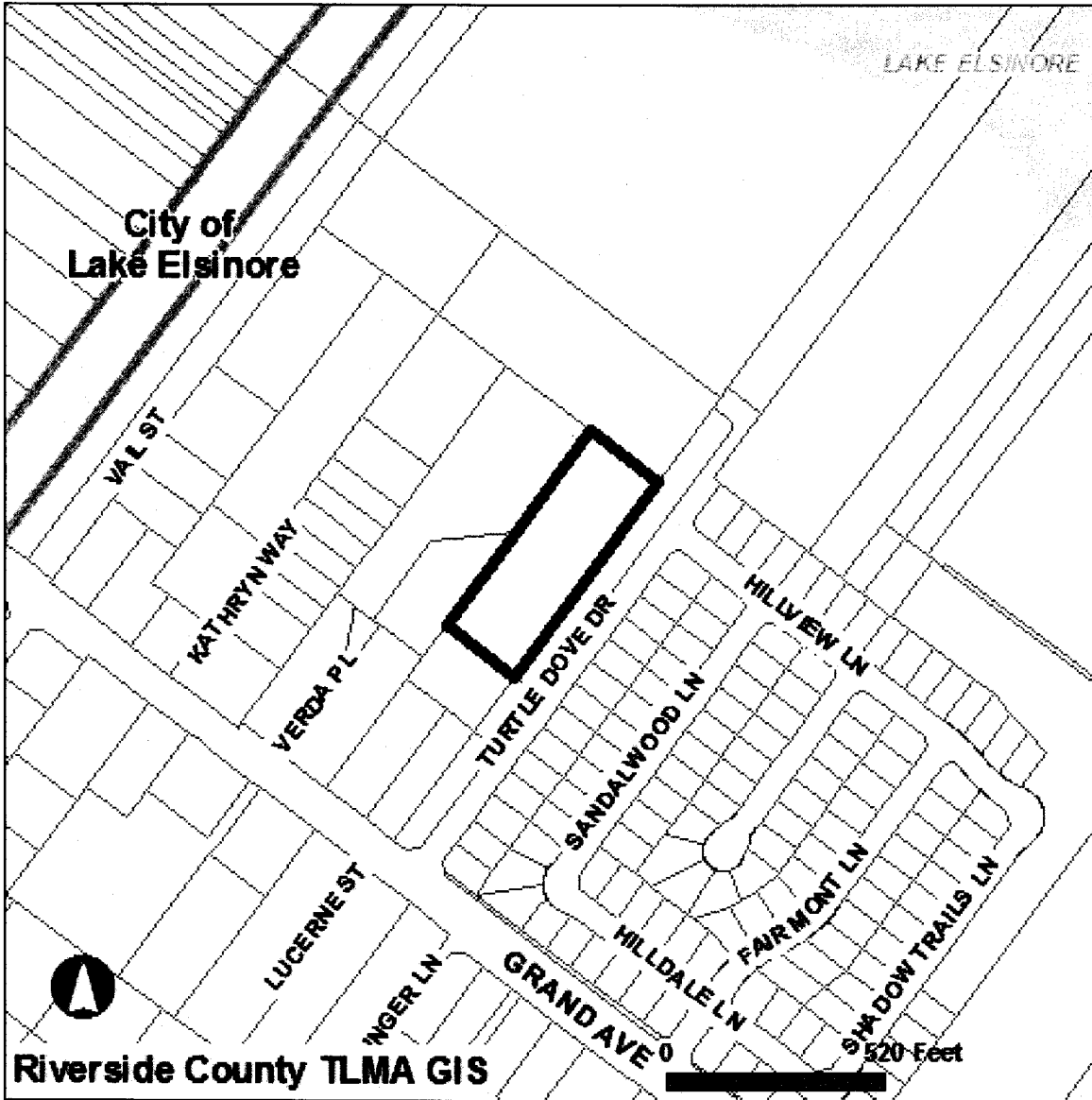

Selected parcel(s):  
371-160-025

**\*IMPORTANT\***

Maps and data are to be used for reference purposes only. Map features are approximate, and are not necessarily accurate to surveying or engineering standards. The County of Riverside makes no warranty or guarantee as to the content (the source is often third party), accuracy, timeliness, or completeness of any of the data provided, and assumes no legal responsibility for the information contained on this map. Any use of this product with respect to accuracy and precision shall be the sole responsibility of the user.

STANDARD REPORT

**APNs**

371-160-025-9

**OWNER NAME / ADDRESS**

DANIEL G NOETHER  
32905 TURTLE DOVE DR  
LAKE ELSINORE, CA. 92530

**MAILING ADDRESS**

(SEE OWNER)  
32917 TURTLE DOVE DR  
LAKE ELSINORE CA. 92530

EXHIBIT NO.     C<sup>2</sup>

**LEGAL DESCRIPTION**

RECORDED BOOK/PAGE: PM 52/24  
SUBDIVISION NAME: PM 10947  
LOT/PARCEL: 4, BLOCK: NOT AVAILABLE  
, Por. TRACT NUMBER: NOT AVAILABLE

**LOT SIZE**

RECORDED LOT SIZE IS 2.28 ACRES

**PROPERTY CHARACTERISTICS**

WOOD FRAME, 2679 SQFT., 3 BDRM/ 2 BATH, 1 STORY, CONST'D 2008 COMPOSITION, ROOF, CENTRAL HEATING, CENTRAL COOLING

**THOMAS BROS. MAPS PAGE/GRID**

PAGE: 896 GRID: E3

**CITY BOUNDARY/SPHERE**

NOT WITHIN A CITY  
NOT WITHIN A CITY SPHERE  
NO ANNEXATION DATE AVAILABLE  
NO LAFCO CASE # AVAILABLE  
NO PROPOSALS

**MARCH JOINT POWERS AUTHORITY**

NOT IN THE JURISDICTION OF THE MARCH JOINT POWERS AUTHORITY

**INDIAN TRIBAL LAND**

NOT IN A TRIBAL LAND

**SUPERVISORIAL DISTRICT (ORD. 813)**

BOB BUSTER, DISTRICT 1

**TOWNSHIP/RANGE**

T6SR4W SEC 19

**ELEVATION RANGE**

1264/1272 FEET

**PREVIOUS APN**

371-160-006

---

**PLANNING**

---

**LAND USE DESIGNATIONS**

Zoning not consistent with the General Plan.  
LDR

**AREA PLAN (RCIP)**

ELSINORE

**GENERAL PLAN POLICY OVERLAYS**

NOT IN A GENERAL PLAN POLICY OVERLAY AREA

**GENERAL PLAN POLICY AREAS**

NONE

**ZONING CLASSIFICATIONS (ORD. 348)**

R-R  
W-1

**ZONING DISTRICTS AND ZONING AREAS**

SOUTH ELSINORE AREA

**ZONING OVERLAYS**

NOT IN A ZONING OVERLAY

**SPECIFIC PLANS**

NOT WITHIN A SPECIFIC PLAN

**AGRICULTURAL PRESERVE**

NOT IN AN AGRICULTURAL PRESERVE

**REDEVELOPMENT AREAS**

PROJECT AREA NAME: 1-1986  
SUBAREA NAME: LAKELAND VILLAGE/WILDOMAR  
AMENDMENT NUMBER: 1  
ADOPTION DATE: JUL. 20, 1999

ACREAGE: 2888 ACRES

**AIRPORT INFLUENCE AREAS**  
NOT IN AN AIRPORT INFLUENCE AREA

**AIRPORT COMPATIBILITY ZONES**  
NOT IN AN AIRPORT COMPATIBILITY ZONE

---

## **ENVIRONMENTAL**

---

**CVMSHCP (COACHELLA VALLEY MULTI-SPECIES HABITAT CONSERVATION PLAN) CONSERVATION AREA**  
NOT IN A CONSERVATION AREA

**CVMSHCP FLUVIAL SAND TRANSPORT SPECIAL PROVISION AREAS**  
NOT IN A FLUVIAL SAND TRANSPORT SPECIAL PROVISION AREA

**WRMSHCP (WESTERN RIVERSIDE COUNTY MULTI-SPECIES HABITAT CONSERVATION PLAN) CELL GROUP**  
NOT IN A CELL GROUP

**WRMSHCP CELL NUMBER**  
NOT IN A CELL

**HANS/ERP (HABITAT ACQUISITION AND NEGOTIATION STRATEGY/EXPEDITED REVIEW PROCESS)**  
NONE

**VEGETATION (2005)**  
Agricultural Land  
Developed/Disturbed Land

---

## **FIRE**

---

**HIGH FIRE AREA (ORD. 787)**  
NOT IN A HIGH FIRE AREA

**FIRE RESPONSIBILITY AREA**  
NOT IN A FIRE RESPONSIBILITY AREA

---

## **DEVELOPMENT FEES**

---

**CVMSHCP FEE AREA (ORD. 875)**  
NOT WITHIN THE COACHELLA VALLEY MSHCP FEE AREA

**WRMSHCP FEE AREA (ORD. 810)**  
IN OR PARTIALLY WITHIN THE WESTERN RIVERSIDE MSHCP FEE AREA. SEE MAP FOR MORE INFORMATION.

**ROAD & BRIDGE DISTRICT**  
NOT IN A DISTRICT

**EASTERN TUMF (TRANSPORTATION UNIFORM MITIGATION FEE ORD. 673)**  
NOT WITHIN THE EASTERN TUMF FEE AREA

**WESTERN TUMF (TRANSPORTATION UNIFORM MITIGATION FEE ORD. 824)**  
IN OR PARTIALLY WITHIN A TUMF FEE AREA. SEE MAP FOR MORE INFORMATION.SOUTHWEST

**DIF (DEVELOPMENT IMPACT FEE AREA ORD. 659)**  
ELSINORE

**SKR FEE AREA (STEPHEN'S KANGAROO RAT ORD. 663.10)**  
NOT WITHIN AN SKR FEE AREA.

**DEVELOPMENT AGREEMENTS**  
NOT IN A DEVELOPMENT AGREEMENT AREA

---

## **TRANSPORTATION**

---

**CIRCULATION ELEMENT ULTIMATE RIGHT-OF-WAY**  
NOT IN A CIRCULATION ELEMENT RIGHT-OF-WAY

**ROAD BOOK PAGE**

72

**TRANSPORTATION AGREEMENTS**

NOT IN A TRANSPORTATION AGREEMENT

**CETAP (COMMUNITY AND ENVIRONMENTAL TRANSPORTATION ACCEPTABILITY PROCESS) CORRIDORS**

NOT IN A CETAP CORRIDOR.

---

**HYDROLOGY**

---

**FLOOD PLAIN REVIEW**

FLOOD PLAIN MANAGEMENT REVIEW IS REQUIRED. CONTACT THE FLOOD PLAIN MANAGEMENT SECTION AT (951) 955-1200 FOR INFORMATION.

**WATER DISTRICT**

WMWD

**FLOOD CONTROL DISTRICT**

RIVERSIDE COUNTY FLOOD CONTROL DISTRICT

**WATERSHED**

SAN JACINTO VALLEY

---

**GEOLOGIC**

---

**FAULT ZONE**

COUNTY FAULT ZONE

CONTACT THE COUNTY'S CHIEF ENGINEERING GEOLOGIST AT (951)955-6863.

**FAULTS**

WITHIN A 1/2 MILE OF

EL SINORE FAULT

EL SINORE FAULTS

WILDOMAR FAULT

WILLARD FAULT

CONTACT THE COUNTY'S CHIEF ENGINEERING GEOLOGIST AT (951)955-6863.

**LIQUEFACTION POTENTIAL**

VERY HIGH

**SUBSIDENCE**

SUSCEPTIBLE

**PALEONTOLOGICAL SENSITIVITY**

LOW POTENTIAL.

FOLLOWING A LITERATURE SEARCH, RECORDS CHECK AND A FIELD SURVEY, AREAS MAY BE DETERMINED BY A QUALIFIED VERTEBRATE PALEONTOLOGIST AS HAVING LOW POTENTIAL FOR CONTAINING SIGNIFICANT PALEONTOLOGICAL RESOURCES SUBJECT TO ADVERSE IMPACTS.

---

**MISCELLANEOUS**

---

**SCHOOL DISTRICT**

LAKE ELSINORE UNIFIED

**COMMUNITIES**

LAKELAND VILLAGE

**COUNTY SERVICE AREA**

NOT IN A COUNTY SERVICE AREA.

**LIGHTING (ORD. 655)**

ZONE B, 32.84 MILES FROM MT. PALOMAR OBSERVATORY

**2000 CENSUS TRACT**

046402

**FARMLAND**

LOCAL IMPORTANCE

OTHER LANDS

**TAX RATE AREAS**

065-140

- COUNTY FREE LIBRARY
- COUNTY ORTEGA TRAIL REC & PK
- COUNTY STRUCTURE FIRE PROTECTION
- COUNTY WASTE RESOURCE MGMT DIST
- CSA 152
- ELSINORE AREA ELEM SCHOOL FUND
- ELSINORE VAL MUN WTR IMP DIST 1
- ELSINORE VALLEY CEMETERY
- ELSINORE VALLEY MUNICIPAL WATER
- ERAF RDV
- FLOOD CONTROL ADMINISTRATION
- FLOOD CONTROL ZONE 3
- GENERAL
- GENERAL PURPOSE
- LAKE ELSINORE UNIF IMP NO 96-1
- LAKE ELSINORE UNIFIED
- METRO WATER WEST 1302999
- MT SAN JACINTO JUNIOR COLLEGE
- PROJECT1-LAKELANDRDV AB1290
- RIV CO REG PARK & OPEN SPACE
- RIV. CO. OFFICE OF EDUCATION
- WESTERN MUNICIPAL WATER

**SPECIAL NOTES**

NO SPECIAL NOTES

**CODE COMPLAINTS**

Case #	Description	Start Date
CV1101738	ABATEMENT	Mar. 14, 2011
CV1101747	VEHICLE ABATEMENT	Mar. 15, 2011

REPORT PRINTED ON...Mon May 02 09:21:07 2011  
Version 101221





P.O. Box 1193  
 Whittier, CA 90609  
 Tel # (562) 325-8351  
 Fax # (714) 783-3038

## Lot Book Report

Order Number: **23499**

**Customer:**

RIVERSIDE COUNTY TLMA-CODE ENFORCEMENT

4080 Lemon Street

Riverside

CA 92501

Attn:

Brent Steele

Reference:

CV01-0656 / Angela Sarmiento

IN RE:

NOETHER, DANIEL G.

Order Date: 4/21/2011

Dated as of: 4/21/2011

County Name: Riverside

FEE(s):

Report: \$120.00

Property Address: 32905 Turtle Dove Drive

Lake Elsinore

CA 92530

Assessor's Parcel No. : 371-160-025-9

**Assessments:**

Land Value:	\$37,847.00
Improvement Value:	\$174,585.00
Exemption Value:	\$0.00
Total Value:	\$212,432.00

## Tax Information

Property Taxes for the Fiscal Year	2010-2011
First Installment	\$1,921.90
Penalty	\$192.16
Status	NOT PAID-DELINQUENT
Second Installment	\$1,921.90
Penalty	\$223.16
Status	NOT PAID-DELINQUENT

EXHIBIT NO.     D



P.O. Box 1193  
Whittier, CA 90609  
Tel # (562) 325-8351  
Fax # (714) 783-3038

Order Number: 23499

Reference: CV01-0656 / Ange

## Property Vesting

The last recorded document transferring title of said property

Dated	07/30/1996
Recorded	10/10/1996
Document No.	390332
D.T.T.	\$60.50
Grantor	Milan Mandaric a married man as his sole and separate property
Grantee	Daniel G. Noether, an unmarried man

Affects Property in Question and Other Property

## Deeds of Trust

Position No.	1st
A Deed of Trust Dated	09/10/1996
Recorded	10/10/1996
Document No.	390333
Amount	\$45,000.00
Trustor	Daniel G. Noether, an unmarried man
Trustee	Orange Coast Title Company, a California Corporation
Beneficiary	Milan Mandaric, a married man as his sole and separate property

Affects Property in Question and Other Property

## Additional Information

Notice of Non-Compliance filed by  
In the matter of the property of

County of Riverside Department of Building and Safety  
Daniel G. Noether



P.O. Box 1193  
Whittier, CA 90609  
Tel # (562) 325-8351  
Fax # (714) 783-3038

Order Number: 23499  
Reference: CV01-0656 / Ange

---

Case No.	CV01-0656
Recorded	04/01/2003
Document No.	2003-227400
Notice of Non-Compliance filed by	County of Riverside Department of Building and Safety
In the matter of the property of	Daniel G. Noether
Case No.	CV03-1017
Recorded	04/09/2003
Document No.	2003-249860
Document Type	Findings of Fact, Conclusions and Order to Abate Nuisance
Document No.	2003-910852
Recorded	11/19/2003
Document Type	Drainage Acceptance
Document No.	2004-0303913
Recorded	04/26/2004
Notice of Non-Compliance filed by	County of Riverside Department of Building and Safety
In the matter of the property of	Daniel G. Noether
Case No.	CV04-2672
Recorded	07/23/2004
Document No.	2004-0571029
Abstract of Support Judgment Filed in the	Superior Court of California, County of Riverside - Family Law Annex
Case No.	RID473494DCS
Recorded	08/16/2004
Document No.	2004-0642026
Debtor	Daniel Gus Noether, aka Daniel G. Noether
Creditor	County of Riverside
Abstract of Judgment Filed in the	Superior Court of California, County of Riverside - Temecula Branch
Case No.	TES027336
Recorded	03/12/2007
Document No.	2007-0168290

---



P.O. Box 1193  
Whittier, CA 90609  
Tel # (562) 325-8351  
Fax # (714) 783-3038

Order Number: 23499  
Reference: CV01-0656 / Ange

---

Amount	\$2,149.00
Debtor	Daniel Noether
Creditor	Rancho Ford Inc. dba Rancho Ford Lincoln Mercury

A Notice of State Tax Lien Recorded	02/11/2008
Document No.	2008-0069104
Amount	\$2,037.42
Account No.	1106158088
Certificate No.	08033636645
Debtor	Dan Noether
Creditor: State of California,	Franchise Tax Board

Abstract of Judgment Filed in the	Superior Court of California, County of Riverside - Temecula
Case No.	TES026126
Recorded	09/17/2008
Document No.	2008-0507416
Amount	\$1,144.62
Debtor	Daniel Noether
Creditor	Debra Carney dba D Carney & Assoc.

A Notice of State Tax Lien Recorded	09/03/2009
Document No.	2009-0461855
Amount	\$933.08
Account No.	1106158088
Certificate No.	09236650238
Debtor	Dan Noether
Creditor: State of California,	Franchise Tax Board

A Federal Tax Lien Recorded	09/02/2010
Document No	2010-0423444
Amount	\$242,472.81
Debtor	Daniel G Noether
ID No.	XXX - XX - 2652
Creditor	Internal Revenue Service





P.O. Box 1193  
Whittier, CA 90609  
Tel # (562) 325-8351  
Fax # (714) 783-3038

Order Number: 23499

Reference: CV01-0656 / Ange

---

Abstract of Judgment Filed in the	Superior Court of California, County of Los Angeles - West
Case No.	SC106262
Recorded	11/16/2010
Document No.	2010-0553364
Amount	\$468,293.25
Debtor	Dan Noether; Dan Noether Steam and Sauna
Creditor	California Joint Powers Insurance Authority; City of Calabasas
A Notice of State Tax Lien Recorded	12/13/2010
Document No.	2010-0597807
Amount	\$13,199.67
Account No.	1106158088
Certificate No.	10340318365
Debtor	Dan Noether
Creditor: State of California,	Franchise Tax Board
Notice of Power to Sell Tax-Defaulted Property	
Recorded	08/19/2002
Document No.	2002-456613

### Legal Description

THE LAND REFERRED TO IN THIS REPORT IS LOCATED IN AND IS DESCRIBED AS FOLLOWS:

THE NORTHWESTERLY 173.00 FEET OF PARCEL 4 OF PARCEL MAP NUMBER 10947, IN THE COUNTY OF RIVERSIDE, STATE OF CALIFORNIA, AS SHOWN BY MAP ON FILE IN BOOK 52, PAGE 24 OF PARCEL MAPS, RECORDS OF SAID COUNTY RECORDER.

SAID NORTHWESTERLY 173.00 FEET BEING MEASURED ALONG THE SOUTHWESTERLY LINE OF SAID PARCEL 4.



# County of Riverside Code Enforcement Department

P.O. Box 1469, Riverside, CA 92502  
Phone: (951) 955-2004 Fax: (951) 955-8680

## DEMAND FOR PAYMENT STATEMENT OF ABATEMENT COSTS NOTICE OF SPECIAL TAX ASSESSMENT

May 4, 2011

Daniel G. Noether  
32917 Turtle Dove Drive  
Lake Elsinore, CA 92530

Subject Property: 32905 Turtle Dove Drive, Lake Elsinore  
Case No(s): CV01-0656 & CV03-1017  
APN No(s): 371-160-025

Dear Mr. Noether:

**NOTICE IS HEREBY GIVEN** that the County of Riverside Code Enforcement Department ("DEPARTMENT") incurred expenses during our efforts to abate the code violation(s) on the Subject Property. Said abatement case involved substandard structure and excess outside storage located on your real property commonly described as 32905 Turtle Dove Drive, Lake Elsinore and more particularly described as Assessor's Parcel Number 371-160-025.

The total amount due for the DEPARTMENT'S actions concerning the above-described dangerous or injurious condition is **three thousand, five hundred seventy-six dollars and fifty-four cents (\$3,576.54)**.

**You have thirty (30) days from the date of this letter to pay the DEPARTMENT at the above address the total amount due on the enclosed "Summary Statement of Abatement Costs" or a special tax assessment and abatement lien will be recorded upon the subject property. Payment must be made in the form of cashier's check or money order, made payable to the County of Riverside. Please note the property APN on the memo line of the check.**

**YOU HAVE A RIGHT TO A HEARING ON THIS MATTER.** You have the right to contest the abatement costs and special assessment against the subject property. If you choose to exercise your right to a public hearing, please complete the enclosed "Request for Public Hearing" form and return it to the Code Enforcement Department within twenty (20) days of the date of this letter.

In the event you do not request a public hearing, a hearing shall be held without further notice to you for a final determination of this matter and authority to place a lien against the Subject Property and adding the amount due as a special tax assessment on the County tax rolls.

If you have any questions regarding this notice, please contact us at (951) 955-2004.

Code Enforcement Department

  
Ward Komers  
Administrative Manager

EXHIBIT NO.       E



**CODE ENFORCEMENT DEPARTMENT  
COUNTY OF RIVERSIDE**

**REQUEST FOR PUBLIC HEARING  
ON STATEMENT OF ABATEMENT COSTS  
AND SPECIAL TAX ASSESSMENT**

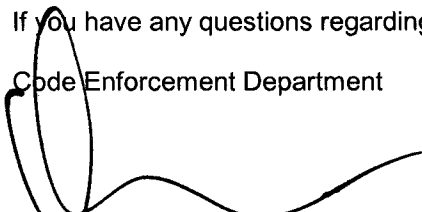
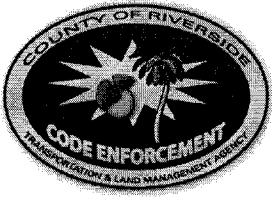
Daniel G. Noether  
32917 Turtle Dove Drive  
Lake Elsinore, CA 92530

Subject Property: 32905 Turtle Dove Drive, Lake Elsinore  
Case No(s): CV01-0656 & CV03-1017  
APN No(s): 371-160-025

I, \_\_\_\_\_, hereby request a public hearing before the Administrative  
(Please PRINT your name here)  
Hearing Officer regarding case number(s) \_\_\_\_\_.

I request notice of the Administrative Hearing date, time, and location (which shall not be less than 10 days from the submission of this request) to be mailed to me at the following address:

Return Mailing Address: \_\_\_\_\_  
\_\_\_\_\_

Signed: \_\_\_\_\_ Date: \_\_\_\_\_  
(Please SIGN your name here)

Print: \_\_\_\_\_  
(Please PRINT your name here)

You may contact me at the following daytime phone number: \_\_\_\_\_

**IMPORTANT**

Keep a copy of this form and mail the original to:  
Riverside County Code Enforcement Department  
P.O. BOX 1469  
Riverside, CA 92502-1469

EXHIBIT NO.       E<sup>2</sup>





# COUNTY OF RIVERSIDE CODE ENFORCEMENT

P.O. Box 1469, Riverside, CA 92502  
Phone: 951-955-2004 Fax: 951-955-8680

Property Reference/Mailing Address
371-160-025 DANIEL G NOETHER 32917 TURTLE DOVE DR LAKE ELSINORE, CA. 92530

## Summary Statement of Abatement Costs

**You are liable to the County for the following abatement costs:**

Date	Invoice Number & Amount	Amount	Balance
12/31/1999	Balance forward		0.00
04/05/2011	CV010656- INV #100896.	2,055.44	2,055.44
04/16/2004	CV010656:A09243- INV #322. A09243	200.00	2,255.44
04/26/2011	CV031017- INV #101149.	1,321.10	3,576.54
		<b>Total Now Due</b>	<b>\$3,576.54</b>

The total abatement costs must be paid to the County of Riverside, P.O. Box 1469, Riverside, CA 92502 within thirty (30) days. In the event said costs are not paid within thirty (30) days you will be liable for additional administrative costs, penalties, court fees, or other collection costs incurred in the collection of these abatement costs.

I affirm and declare under penalty of perjury under the laws of the State of California that the foregoing is true and correct to the best of my knowledge.

  
Code Enforcement Department

EXHIBIT NO. E3

**County of Riverside  
Code Enforcement Department**

P.O. Box 1469, Riverside, CA 92502  
Phone: (951) 955-2004 Fax: (951) 955-8680



# Statement of Abatement Costs

371-160-025  
DANIEL G NOETHER  
32917 TURTLE DOVE DR  
LAKE ELSINORE, CA 92530

Date	Invoice #
4/5/2011	100896

Case Number	District	Class
CV010656	1	SOAC

Property Address
371-160-025 DANIEL G NOETHER 32905 TURTLE DOVE DR LAKE ELSINORE, CA 92530

**You are liable to the County for the following abatement costs:**

Date	Item	Description	Hours/Qty	Rate	Amount
10/14/2003	Attorney Fees	Attorney Fees - County Counsel	0.4	91.00	36.40
10/28/2003	Attorney Fees	Attorney Fees - County Counsel	0.9	91.00	81.90
1/9/2004	County Counsel-Mail	County Counsel-Mailing	2	4.65	9.30
4/5/2011	Prepare Case for SOE He... Attend SOE Hearing			125.55	125.55
				69.75	69.75
		Subtotal County Counsel Costs			486.44
4/5/2011	Lot Book Report			120.00	120.00
		Subtotal Contractor Costs			120.00
<b>Subtotal</b>					<b>\$2,055.44</b>

The total abatement costs must be paid to the County of Riverside, P.O. Box 1469, Riverside, CA 92502 within thirty (30) days. In the event said costs are not paid within thirty (30) days you will be liable for additional administrative costs, penalties, court fees or other collection costs incurred in the collection of these abatement costs.

<b>Payments/Credits</b>	\$0.00
<b>Total Now Due</b>	<b>\$2,055.44</b>

I affirm and declare under penalty of perjury under the laws of the State of California that the foregoing is true and correct to the best of my knowledge.

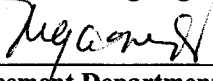
  
Code Enforcement Department

**County of Riverside  
Code Enforcement Department**

P.O. Box 1469, Riverside, CA 92502  
Phone: (951) 955-2004 Fax: (951) 955-8680



# Statement of Abatement Costs

371-160-025  
DANIEL G NOETHER  
32917 TURTLE DOVE DR  
LAKE ELSINORE, CA 92530

Date	Invoice #
4/5/2011	100896

Case Number	District	Class
CV010656	1	SOAC

Property Address
371-160-025 DANIEL G NOETHER 32905 TURTLE DOVE DR LAKE ELSINORE, CA 92530

**You are liable to the County for the following abatement costs:**

Date	Item	Description	Hours/Qty	Rate	Amount
3/13/2001	Officer Hours	Labor Charges - Officer Time	1	70.00	70.00
12/26/2001	Officer Hours	Labor Charges - Officer Time	0.5	70.00	35.00
1/3/2002	Officer Hours	Labor Charges - Officer Time	1	70.00	70.00
3/14/2002	Officer Hours	Labor Charges - Officer Time	0.5	70.00	35.00
3/10/2003	Officer Hours	Labor Charges - Officer Time	0.5	70.00	35.00
3/11/2003	Officer Hours	Labor Charges - Officer Time	1	70.00	70.00
3/14/2003	Officer Hours	Labor Charges - Officer Time	0.5	70.00	35.00
3/18/2003	Officer Hours	Labor Charges - Officer Time	1	70.00	70.00
3/27/2003	Officer Hours	Labor Charges - Officer Time	0.5	70.00	35.00
6/4/2003	Officer Hours	Labor Charges - Officer Time	0.5	70.00	35.00
6/6/2003	Officer Hours	Labor Charges - Officer Time	1	70.00	70.00
8/29/2003	Officer Hours	Labor Charges - Officer Time	0.2	70.00	14.00
10/27/2003	Officer Hours	Labor Charges - Officer Time	1	100.00	100.00
1/16/2004	Officer Hours	Labor Charges - Officer Time	0.2	100.00	20.00
1/21/2004	Officer Hours	Labor Charges - Officer Time	1	100.00	100.00
4/16/2004	Officer Hours	Labor Charges - Officer Time	0.4	100.00	40.00
4/21/2004	Officer Hours	Labor Charges - Officer Time	2	100.00	200.00
6/21/2004	Officer Hours	Labor Charges - Officer Time	0.3	100.00	30.00
6/22/2004	Officer Hours	Labor Charges - Officer Time	0.2	100.00	20.00
6/24/2004	Officer Hours	Labor Charges - Officer Time	1.5	100.00	150.00
10/21/2004	Officer Hours	Labor Charges - Officer Time	1.5	100.00	150.00
4/5/2011	SOE Preparation	Prepare Statement of Expense		65.00	65.00
		Subtotal Code Enforcement Costs			1,449.00
7/1/2003	Attorney Fees	Attorney Fees - County Counsel	0.5	91.00	45.50
8/18/2003	Attorney Fees	Attorney Fees - County Counsel	1.2	91.00	109.20
8/26/2003	County Counsel-Mail	County Counsel-Mailing	2	4.42	8.84

**Subtotal**

**Payments/Credits**

**Total Now Due**

The total abatement costs must be paid to the County of Riverside, P.O. Box 1469, Riverside, CA 92502 within thirty (30) days. In the event said costs are not paid within thirty (30) days you will be liable for additional administrative costs, penalties, court fees or other collection costs incurred in the collection of these abatement costs.

I affirm and declare under penalty of perjury under the laws of the State of California that the foregoing is true and correct to the best of my knowledge.

*[Signature]*

Code Enforcement Department



# County of Riverside Code Enforcement Department

P.O. Box 1469, Riverside, CA 92502  
 Phone: (951) 955-2004 Fax: (951) 955-8680  
 demands@rctlma.org

## Administrative Citation

371-160-025  
 DANIEL G NOETHER  
 32917 TURTLE DOVE DR  
 LAKE ELSINORE, CA 92530

Citation Issue Date	Billing Date
4/16/2004	4/5/2011

<b>Property Address</b>
371-160-025 DANIEL G NOETHER 32905 TURTLE DOVE DR LAKE ELSINORE, CA 92530

<b>Citation Number</b>	<b>District</b>	<b>Class</b>
A09243	1	SOAC

Item	Description	Hours/Qty	Rate	Amount
Administrative Citations	A09243--CV010656	1	200.00	200.00
			<b>Subtotal</b>	\$200.00
			<b>Payments/Credits</b>	\$0.00
			<b>Total</b>	\$200.00

EXHIBIT NO.                     EK

**County of Riverside  
Code Enforcement Department**

P.O. Box 1469, Riverside, CA 92502  
Phone: (951) 955-2004 Fax: (951) 955-8680



# Statement of Abatement Costs

371160025  
DANIEL G NOETHER  
32917 TURTLE DOVE DR  
LAKE ELSINORE, CA. 92530

Date	Invoice #
4/26/2011	101149

Case Number	District	Class
CV031017	1	SOAC

<b>Property Address</b>
371160025 DANIEL G NOETHER 32905 TURTLE DOVE DR LAKE ELSINORE, CA 92530

**You are liable to the County for the following abatement costs:**

Date	Item	Description	Hours/Qty	Rate	Amount
3/14/2003	Officer Hours	Labor Charges - Officer Time	1	70.00	70.00
3/17/2003	Officer Hours	Labor Charges - Officer Time	0.5	70.00	35.00
3/20/2003	Officer Hours	Labor Charges - Officer Time	2	70.00	140.00
3/24/2003	Officer Hours	Labor Charges - Officer Time	0.5	70.00	35.00
6/4/2003	Officer Hours	Labor Charges - Officer Time	0.5	70.00	35.00
6/5/2003	Officer Hours	Labor Charges - Officer Time	2.5	70.00	175.00
6/6/2003	Officer Hours	Labor Charges - Officer Time	2	70.00	140.00
8/28/2003	Officer Hours	Labor Charges - Officer Time	0.5	70.00	35.00
8/29/2003	Officer Hours	Labor Charges - Officer Time	0.5	70.00	35.00
10/27/2003	Officer Hours	Labor Charges - Officer Time	1	100.00	100.00
1/16/2004	Officer Hours	Labor Charges - Officer Time	0.2	100.00	20.00
1/21/2004	Officer Hours	Labor Charges - Officer Time	1	100.00	100.00
6/10/2004	Officer Hours	Labor Charges - Officer Time	0.5	100.00	50.00
4/26/2011	SOE Preparation	Prepare Statement of Expense		65.00	65.00
		Subtotal Code Enforcement Costs			1,035.00
7/1/2003	Attorney Fees	Attorney Fees - County Counsel		0.00	0.00
8/18/2003	Attorney Fees	Attorney Fees - County Counsel	1.2	91.00	109.20
10/28/2003	Attorney Fees	Attorney Fees - County Counsel	0.9	91.00	81.90
		Subtotal County Counsel Costs			191.10
3/20/2003	Lot/Title Report	Lot/Title Report	1	65.00	65.00
7/30/2003	Lot/Title Report	Lot/Title Report	1	30.00	30.00
		Subtotal Contractor Costs			95.00
<b>Subtotal</b>					<b>\$1,321.10</b>

The total abatement costs must be paid to the County of Riverside, P.O. Box 1469, Riverside, CA 92502 within thirty (30) days. In the event said costs are not paid within thirty (30) days you will be liable for additional administrative costs, penalties, court fees or other collection costs incurred in the collection of these abatement costs.

<b>Payments/Credits</b>	\$0.00
<b>Total Now Due</b>	<b>\$1,321.10</b>

I affirm and declare under penalty of perjury under the laws of the State of California that the foregoing is true and correct to the best of my knowledge.

*Shuey*  
Code Enforcement Department

EXHIBIT NO.       E7

# NOTICE LIST

Subject Property: 32917 Turtle Dove Drive, Lake Elsinore; Case Nos.: CV01-0656 &  
CV03-1017; APN: 371-160-025;  
District One

DANIEL G NOETHER  
32917 TURTLE DOVE DRIVE  
LAKE ELSINORE CA 92530

DANIEL G NOETHER  
17700 RALEY  
LAKE ELSINORE CA 92530

DAN NOETHER  
32905 TURTLE DOVE DRIVE  
LAKE ELSINORE CA 92530

MILAN MANDARIC  
1188 BORDEAUX DRIVE  
SUNNYVALE CA 94089

EXHIBIT NO. \_\_\_\_\_

E<sup>8</sup>

**PROOF OF SERVICE**

Case Nos. CV01-0656 & CV03-1017

1  
2  
3  
4  
5  
6  
7  
8  
9  
10  
11  
12  
13  
14  
15  
16  
17  
18  
19  
20  
21  
22  
23  
24  
25  
26  
27  
28

STATE OF CALIFORNIA, COUNTY OF RIVERSIDE

I, Brenda G. Peeler, declare that I am a citizen of the United States and am employed in the County of Riverside, over the age of 18 years and not a party to the within action or proceeding; that my business address is 3960 Orange Street, Suite 500, Riverside, California 92501.

That on May 4, 2011, I served the following document(s):

- DEMAND FOR PAYMENT
- REQUEST FOR HEARING
- SUMMARY STATEMENT OF ABATEMENT COSTS
- STATEMENT OF ABATEMENT COSTS
- ADMINISTRATIVE CITATION(S)
- NOTICE LIST

by placing a true copy thereof enclosed in a sealed envelope(s) addressed as follows:

**OWNERS OR INTERESTED PARTIES  
(SEE NOTICE LIST ATTACHED TO NOTICE OF HEARING)**

XX **BY FIRST CLASS MAIL.** I am "readily familiar" with the office's practice of collection and processing correspondence for mailing. Under that practice it would be deposited with the U.S. Postal Service on that same day with postage thereon fully prepaid at Riverside, California, in the ordinary course of business.

     **BY PERSONAL SERVICE:** I caused to be delivered such envelope(s) by hand to the offices of the addressee(s).

XX **STATE - I declare under penalty of perjury under the laws of the State of California that the above is true and correct.**

     **FEDERAL - I declare that I am employed in the office of a member of the bar of this court at whose direction the service was made.**

EXECUTED ON May 4, 2011, at Riverside, California.

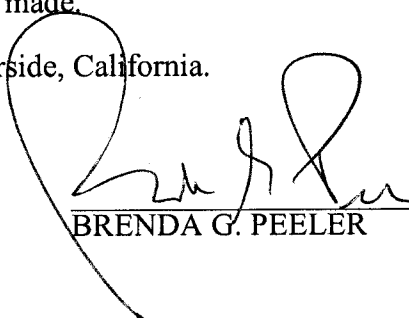

\_\_\_\_\_  
BRENDA G. PEELER

EXHIBIT NO. EA



# CODE ENFORCEMENT DEPARTMENT COUNTY OF RIVERSIDE

## REQUEST FOR PUBLIC HEARING ON STATEMENT OF ABATEMENT COSTS AND SPECIAL TAX ASSESSMENT

Daniel G. Noether  
32917 Turtle Dove Drive  
Lake Elsinore, CA 92530

Subject Property: 32905 Turtle Dove Drive, Lake Elsinore  
Case No(s): CV01-0656 & CV03-1017  
APN No(s): 371-160-025

I, DAN Noether, hereby request a public hearing before the Administrative  
(Please PRINT your name here)  
Hearing Officer regarding case number(s) 371 160 025 CV01-0656  
CV03 1017

I request notice of the Administrative Hearing date, time, and location (which shall not be less than 10 days from the submission of this request) to be mailed to me at the following address:

Return Mailing Address: 32917 TURTLE DOVE Dr.  
LAKE ELSINORE - Cal  
92530

Signed: [Signature] Date: 5/8/11  
(Please SIGN your name here)

Print: DAN Noether  
(Please PRINT your name here)

You may contact me at the following daytime phone number: 310 804 0824

**IMPORTANT**  
Keep a copy of this form and mail the original to:  
Riverside County Code Enforcement Department  
P.O. BOX 1469  
Riverside, CA 92502-1469

EXHIBIT NO. F



EXHIBIT NO. F<sup>2</sup>

RECEIVED MAY 9 - 2011

*Jaf*

**Rector, Kimberly**

✓ done  
7-7-11  
KPK

**From:** Peeler, Brenda Gayl <BPEELER@rctlma.org>  
**Sent:** Thursday, July 07, 2011 3:41 PM  
**To:** Harper-Ihem, Kecia  
**Cc:** Rector, Kimberly; Barton, Karen; Fong, Alexandra  
**Subject:** Agenda Item 9.2 of BOS July 12, 2011 Calendar

Good afternoon, Kecia,

As a result of discussions between Code Enforcement and the property owner, on today's date, additional research needs to be conducted prior to bringing this matter before the Board. Accordingly, Deputy County Counsel, L. Alexandra Fong, will be requesting a continuance of this matter to Aug. 16, 2011.

9.2.

If you have any questions, please let me know.

Thank you.

Riverside County Board of Supervisors  
Request to Speak

Submit request to Clerk of Board (right of podium),  
Speakers are entitled to three (3) minutes, subject  
Board Rules listed on the reverse side of this form.

SPEAKER'S NAME:

DAN Noether

Address:

32917 TURTLEDOVE DR.

(only if follow-up mail response requested)

City:

LAKEVIEW

Zip:

92530

Phone #:

310 604 0824

Date:

8/16/11

Agenda #

9.7

PLEASE STATE YOUR POSITION BELOW:

Position on "Regular" (non-appealed) Agenda Item:

Support

Oppose

Neutral

**Note:** If you are here for an agenda item that is filed  
for "Appeal", please state separately your position on  
the appeal below:

Support

Oppose

Neutral

I give my 3 minutes to: \_\_\_\_\_