

SUBMITTAL TO THE BOARD OF SUPERVISORS  
COUNTY OF RIVERSIDE, STATE OF CALIFORNIA

627B



SUBMITTAL DATE:  
August 4, 2011

FROM: County Counsel  
Code Enforcement Department  
SUBJECT: Statement of Abatement Costs [Case No. CV08-06875]  
Subject Property: 21084 Steel Peak Drive, Perris; GARCIA  
APN: 343-180-006  
District: Five

RECOMMENDED MOTION: Move that the Board of Supervisors:

- (1) assess the reasonable costs of abatement of a public nuisance [unpermitted land use (semi storage yard) and excessive outside storage of materials) in the above-referenced matter to be **seven hundred eleven dollars and ten cents (US \$711.10)**;
- (2) assess the costs of abatement against the above-described subject property;
- (3) authorize the recordation of a notice of abatement lien; and
- (4) authorize the abatement costs to be added to the tax roll as a special assessment
- (5) authorize and direct the Code Enforcement Department to take any reasonable actions to collect the amount owed.

Departmental Concurrence

*[Signature]*  
L. ALEXANDRA FONG, Deputy County Counsel  
for PAMELA J. WALLS, County Counsel

FINANCIAL DATA	Current F.Y. Total Cost:	\$ N/A	In Current Year Budget:	N/A
	Current F.Y. Net County Cost:	\$ N/A	Budget Adjustment:	N/A
	Annual Net County Cost:	\$ N/A	For Fiscal Year:	N/A

SOURCE OF FUNDS:	Positions To Be Deleted Per A-30	<input type="checkbox"/>
	Requires 4/5 Vote	<input type="checkbox"/>

C.E.O. RECOMMENDATION: APPROVE  
BY: *[Signature]*  
Tina Grande

County Executive Office Signature

Dep't Recomm.:  
Per Exec. Ofc.:

MINUTES OF THE BOARD OF SUPERVISORS

On motion of Supervisor Ashley, seconded by Supervisor Buster and duly carried, IT WAS ORDERED that the above matter is approved as recommended with a revised amount of costs to \$500.00.

Ayes: Buster, Tavaglione, Stone and Ashley  
Nays: None  
Absent: Benoit  
Date: August 16, 2011  
xc: Co. Co., CED, Prop. Owner

Kecia Harper-Ihem  
Clerk of the Board  
By: *[Signature]*  
Deputy

Prev. Agn. Ref.: | District: 5 | Agenda Number:

9.19

Statement of Abatement Costs [Case No. CV08-06875]  
Subject Property: 21084 Steel Peak Drive, Perris; GARCIA  
APN: 343-180-006  
District: Five  
Page 2

**BACKGROUND:** Government Code § 25845, Riverside County Ordinance Nos. 348 (RCC Title 17) and 725 (RCC Chapter 1.16) and Section 1618, Article 10, Title 25 of the California Code of Regulations, provide authority for the recovery of abatement costs in public nuisance cases, the recordation of a notice of abatement lien and inclusion of abatement costs on the tax roll as a special assessment upon approval of the Board of Supervisors.

Notices of Violation and administrative citations were issued. On or about Oct. 14, 2009, the property owner brought the subject property into compliance.

The property has a delinquent tax status as of 2009.

The Notice of Hearing re Statement of Abatement Costs has been posted on the property and mailed to the property owner and all interested parties, as required by law. Copies of all relevant notices issued in this matter together with proof of service and posting have been separately filed with the Clerk of the Board and are made a part of the record herein, pursuant to Riverside County Ordinance 725.

**SUBMITTAL TO THE BOARD OF SUPERVISORS  
COUNTY OF RIVERSIDE, STATE OF CALIFORNIA**

**FROM:** County Counsel  
Code Enforcement Department  
**SUBJECT:** Statement of Abatement Costs [Case No. CV08-06875]  
Subject Property: 21084 Steel Peak Drive, Perris; GARCIA  
APN: 343-180-006  
District Five

**TABLE OF SUPPLEMENTAL DOCUMENTS  
FILED WITH THE CLERK OF THE BOARD**

**Hearing Date: AUGUST 16, 2011**

Notice of Hearing Re: Statement of Abatement Costs (including Proof(s) of Service and Affidavit(s) of Posting .....	Exhibit A
Summary Statement of Abatement Costs and Statement of Abatement Costs with Supporting Documents .....	Exhibit B
Assessment-Roll For The Year 10/11 And Geographic Information System, April 19, 2011 .....	Exhibit C
Lot Book Report .....	Exhibit D
Demand for Payment Statement of Abatement Costs Notice of Special Tax Assessment.....	Exhibit E
Request for Hearing.....	Exhibit F



**CODE ENFORCEMENT DEPARTMENT  
COUNTY OF RIVERSIDE**

Glenn Baude  
Director

August 1, 2011

**NOTICE OF HEARING RE:  
STATEMENT OF ABATEMENT COSTS**

To: Owner(s) or Interested Parties  
(See Attached Proof of Service  
and Notice List)

Subject Property: 21084 Steel Peak Drive, Perris  
Case No.: CV08-06875; GARCIA  
APN: 343-180-006

**NOTICE IS HEREBY GIVEN** that a hearing will be held before the Riverside County Board of Supervisors on **Tuesday, August 16, 2011, at 9:30 a.m.** in the Board of Supervisors Room, 4080 Lemon Street, 1st Floor Annex, Riverside, California, at which time and place pertinent testimony will be heard regarding the expenses incurred by the County of Riverside, Code Enforcement Department ("DEPARTMENT") for the above-referenced abatement case. Said abatement case involved unpermitted land use (semi storage yard) and excessive outside storage located on your real property commonly described as 21084 Steel Peak Drive, Perris, Riverside County, California and more particularly described as Assessor's Parcel Number 343-180-006.

The total expense due, including all other fees and costs, for the abatement of the above-described dangerous or injurious condition is **seven hundred eleven dollars and ten cents, (US \$711.10)**. This amount is immediately due and payable. If you have any objections to the Statement of Abatement Costs attached hereto, you must address your objections to the Board of Supervisors at the hearing. If you have any questions about the attached Statement of Abatement Costs, please contact Ward Komers or Carol Lynn Anderson at (951) 955-2004. In the event the total amount due is not paid to the DEPARTMENT prior to the Board Hearing, the DEPARTMENT shall seek an order from the Board of Supervisors to place a lien against your property and collect the amount due as a special tax assessment.

Failure to appear at the hearing will result in the exclusion of your testimony. Facts as known to the DEPARTMENT will be presented to the Board of Supervisors for their final consideration and deliberation of this matter.

**You are encouraged to contact Ward Komers or Carol Lynn Anderson at (951) 955-2004 prior to the hearing. Please meet with Brian Black at 7:30 a.m. on the day of the hearing in Conference Room 2A located on the 1st floor in front of the Human Resources Office to discuss the case.**

GLENN BAUDE  
DIRECTOR

WARD KOMERS  
Administrative Manager  
Enclosure: Statement of Abatement Costs

EXHIBIT NO.     A



# COUNTY OF RIVERSIDE CODE ENFORCEMENT

P.O. Box 1469, Riverside, CA 92502  
Phone: 951-955-2004 Fax: 951-955-8680

Property Reference/Mailing Address
343-180-006 ANTONIO G GARCIA \ ROSALIA GARCIA 21084 STEEL PEAK DR PERRIS, CA. 92570

## Summary Statement of Abatement Costs

**You are liable to the County for the following abatement costs:**

Date	Invoice Number & Amount	Amount	Balance
12/31/2000	Balance forward		0.00
04/19/2011	CV0806875- INV #101085.	511.10	511.10
08/07/2009	CV0806875:A31123- INV #7999. A31123	200.00	711.10
<b>Total Now Due</b>			<b>\$711.10</b>

The total abatement costs must be paid to the County of Riverside, P.O. Box 1469, Riverside, CA 92502 within thirty (30) days. In the event said costs are not paid within thirty (30) days you will be liable for additional administrative costs, penalties, court fees, or other collection costs incurred in the collection of these abatement costs.

I affirm and declare under penalty of perjury under the laws of the State of California that the foregoing is true and correct to the best of my knowledge.

  
Code Enforcement Department

EXHIBIT NO.     A<sup>2</sup>

**County of Riverside  
Code Enforcement Department**

P.O. Box 1469, Riverside, CA 92502  
Phone: (951) 955-2004 Fax: (951) 955-8680



# Statement of Abatement Costs

343-180-006  
ANTONIO G GARCIA \ ROSALIA GARCIA  
21084 STEEL PEAK DR  
PERRIS, CA. 92570

Date	Invoice #
4/19/2011	101085

Case Number	District	Class
CV0806875	5	SOAC

Property Address
343-180-006 ANTONIO G GARCIA \ ROSALIA GARCIA 21084 STEEL PEAK DR PERRIS, CA 92570

**You are liable to the County for the following abatement costs:**

Date	Item	Description	Hours/Qty	Rate	Amount
9/16/2008	Officer Hours	Labor Charges - Officer Time	0.4	109.00	43.60
6/4/2009	Officer Hours	Labor Charges - Officer Time	0.1	109.00	10.90
7/17/2009	Officer Hours	Labor Charges - Officer Time	0.2	109.00	21.80
8/7/2009	Officer Hours	Labor Charges - Officer Time	0.3	109.00	32.70
10/14/2009	Officer Hours	Labor Charges - Officer Time	0.2	109.00	21.80
4/19/2011	SOE Preparation	Prepare Statement of Expense		65.00	65.00
		Subtotal Code Enforcement Costs			195.80
4/19/2011	Prepare Case for SOE He... Attend SOE Hearing			125.55	125.55
				69.75	69.75
		Subtotal County Counsel Costs			195.30
4/19/2011	Lot Book Report			120.00	120.00
		Subtotal Contractor Costs			120.00
<b>Subtotal</b>					<b>\$511.10</b>

The total abatement costs must be paid to the County of Riverside, P.O. Box 1469, Riverside, CA 92502 within thirty (30) days. In the event said costs are not paid within thirty (30) days you will be liable for additional administrative costs, penalties, court fees or other collection costs incurred in the collection of these abatement costs.

<b>Payments/Credits</b>	\$0.00
<b>Total Now Due</b>	<b>\$511.10</b>

I affirm and declare under penalty of perjury under the laws of the State of California that the foregoing is true and correct to the best of my knowledge.

  
Code Enforcement Department

EXHIBIT NO.     A<sup>3</sup>



# County of Riverside Code Enforcement Department

P.O. Box 1469, Riverside, CA 92502  
 Phone: (951) 955-2004 Fax: (951) 955-8680  
 demands@rctlma.org

## Administrative Citation

343-180-006  
 ANTONIO G GARCIA \ ROSALIA GARCIA  
 21084 STEEL PEAK DR  
 PERRIS, CA. 92570

Citation Issue Date	Billing Date
8/7/2009	4/26/2011

Property Address
343-180-006 ANTONIO G GARCIA \ ROSALIA GARCIA 21084 STEEL PEAK DR PERRIS, CA 92570

Citation Number	District	Class
A31123	5	SOAC

Item	Description	Hours/Qty	Rate	Amount
Administrative Citations	A31123--CV0806875	1	200.00	200.00
			<b>Subtotal</b>	\$200.00
			<b>Payments/Credits</b>	\$0.00
			<b>Total</b>	\$200.00

EXHIBIT NO.           A4

# NOTICE LIST

Subject Property: 21084 Steel Peak Drive, Perris; Case No.: CV08-06875;  
APN: 343-180-006; District Five

ANTONIO G GARCIA  
ROALIA GARCIA  
21084 STEEL PEAK DRIVE  
PERRIS CA 92570

MERS  
PO BOX 2026  
FLINT MI 48501-2026

NORMA CID  
C/O 41695 DATE STREET #100  
MURRIETA CA 92563

EMPLOYMENT DEV DEPT  
LIEN GROUP MIC 92G  
PO BOX 826880  
SACRAMENTO CA 94280-0001

FRANCHISE TAX BOARD  
SPECIAL PROCEDURES SECTION  
PO BOX 2952  
SACRAMENTO CA 95812-2952

EXHIBIT NO. \_\_\_\_\_

AS



1 **PROOF OF SERVICE**

2 Case No. CV08-06875

3 STATE OF CALIFORNIA, COUNTY OF RIVERSIDE

4 I, Brenda G. Peeler, declare that I am a citizen of the United States and am employed in the County  
5 of Riverside, over the age of 18 years and not a party to the within action or proceeding; that my  
6 business address is 3960 Orange Street, Suite 500, Riverside, California 92501.

7 That on August 1, 2011, I served the following document(s):

- 8 - **NOTICE OF HEARING RE: STATEMENT OF ABATEMENT COSTS**
- 9 - **SUMMARY STATEMENT OF ABATEMENT COSTS**
- 10 - **STATEMENT OF ABATEMENT COSTS**
- 11 - **ADMINISTRATIVE CITATION(S)**
- 12 - **NOTICE LIST**

13 by placing a true copy thereof enclosed in a sealed envelope(s) addressed as follows:

14 **OWNERS OR INTERESTED PARTIES**  
15 **(SEE NOTICE LIST ATTACHED TO NOTICE OF HEARING)**

16 XX **BY FIRST CLASS MAIL.** I am "readily familiar" with the office's practice of collection  
17 and processing correspondence for mailing. Under that practice it would be deposited with  
18 the U.S. Postal Service on that same day with postage thereon fully prepaid at Riverside,  
19 California, in the ordinary course of business.

20 — **BY PERSONAL SERVICE:** I caused to be delivered such envelope(s) by hand to the offices  
21 of the addressee(s).

22 XX **STATE - I declare under penalty of perjury under the laws of the State of California that the**  
23 **above is true and correct.**

24 — **FEDERAL - I declare that I am employed in the office of a member of the bar of this court at**  
25 **whose direction the service was made.**

26 EXECUTED ON August 1, 2011, at Riverside, California.

27   
28 \_\_\_\_\_  
BRENDA G. PEELER

EXHIBIT NO. AG

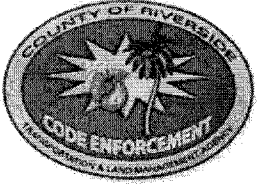

**CODE ENFORCEMENT DEPARTMENT  
COUNTY OF RIVERSIDE**

GLENN BAUDE  
Director

**AFFIDAVIT OF POSTING OF NOTICES**

August 3, 2011

RE CASE NO: CV0806875

I, James Pike, hereby declare:

I am employed by the Riverside County Code Enforcement Department; that my business address is 24318 Hemlock, Ave., Suite C-1, Moreno Valley, California 92557.

That on 08/02/11 at 1617, I securely and conspicuously posted Notice of Hearing Re: Demand for Payment Statement of Abatement Costs Notice of Special Tax Assessment at the property described as:

**Property Address:** 21084 STEEL PEAK DR, PERRIS

**Assessor's Parcel Number:** 343-180-006

I declare under the penalty of perjury that the foregoing is true and correct.

Executed on August 3, 2011 in the County of Riverside, California.

CODE ENFORCEMENT DEPARTMENT

By: James Pike, Code Enforcement Officer

EXHIBIT NO. \_\_\_\_\_

A<sup>7</sup>



# COUNTY OF RIVERSIDE CODE ENFORCEMENT

P.O. Box 1469, Riverside, CA 92502  
Phone: 951-955-2004 Fax: 951-955-8680

Property Reference/Mailing Address
343-180-006 ANTONIO G GARCIA \ ROSALIA GARCIA 21084 STEEL PEAK DR PERRIS, CA. 92570

## Summary Statement of Abatement Costs

**You are liable to the County for the following abatement costs:**

Date	Invoice Number & Amount	Amount	Balance
12/31/2000	Balance forward		0.00
04/19/2011	CV0806875- INV #101085.	511.10	511.10
08/07/2009	CV0806875:A31123- INV #7999. A31123	200.00	711.10
<b>Total Now Due</b>			<b>\$711.10</b>

The total abatement costs must be paid to the County of Riverside, P.O. Box 1469, Riverside, CA 92502 within thirty (30) days. In the event said costs are not paid within thirty (30) days you will be liable for additional administrative costs, penalties, court fees, or other collection costs incurred in the collection of these abatement costs.

I affirm and declare under penalty of perjury under the laws of the State of California that the foregoing is true and correct to the best of my knowledge.

  
Code Enforcement Department

EXHIBIT NO.     B

**County of Riverside  
Code Enforcement Department**

P.O. Box 1469, Riverside, CA 92502  
Phone: (951) 955-2004 Fax: (951) 955-8680



# Statement of Abatement Costs

343-180-006  
ANTONIO G GARCIA \ ROSALIA GARCIA  
21084 STEEL PEAK DR  
PERRIS, CA. 92570

Date	Invoice #
4/19/2011	101085

Case Number	District	Class
CV0806875	5	SOAC

Property Address	
343-180-006 ANTONIO G GARCIA \ ROSALIA GARCIA 21084 STEEL PEAK DR PERRIS, CA 92570	

**You are liable to the County for the following abatement costs:**

Date	Item	Description	Hours/Qty	Rate	Amount
9/16/2008	Officer Hours	Labor Charges - Officer Time	0.4	109.00	43.60
6/4/2009	Officer Hours	Labor Charges - Officer Time	0.1	109.00	10.90
7/17/2009	Officer Hours	Labor Charges - Officer Time	0.2	109.00	21.80
8/7/2009	Officer Hours	Labor Charges - Officer Time	0.3	109.00	32.70
10/14/2009	Officer Hours	Labor Charges - Officer Time	0.2	109.00	21.80
4/19/2011	SOE Preparation	Prepare Statement of Expense		65.00	65.00
		Subtotal Code Enforcement Costs			195.80
4/19/2011	Prepare Case for SOE He... Attend SOE Hearing			125.55	125.55
				69.75	69.75
		Subtotal County Counsel Costs			195.30
4/19/2011	Lot Book Report			120.00	120.00
		Subtotal Contractor Costs			120.00
			<b>Subtotal</b>		<b>\$511.10</b>

The total abatement costs must be paid to the County of Riverside, P.O. Box 1469, Riverside, CA 92502 within thirty (30) days. In the event said costs are not paid within thirty (30) days you will be liable for additional administrative costs, penalties, court fees or other collection costs incurred in the collection of these abatement costs.

<b>Payments/Credits</b>	\$0.00
<b>Total Now Due</b>	<b>\$511.10</b>

I affirm and declare under penalty of perjury under the laws of the State of California that the foregoing is true and correct to the best of my knowledge.

  
Code Enforcement Department

EXHIBIT NO. 82



# County of Riverside Code Enforcement Department

P.O. Box 1469, Riverside, CA 92502  
Phone: (951) 955-2004 Fax: (951) 955-8680  
demands@rctlma.org

## Administrative Citation

343-180-006  
ANTONIO G GARCIA \ ROSALIA GARCIA  
21084 STEEL PEAK DR  
PERRIS, CA. 92570

Citation Issue Date	Billing Date
8/7/2009	4/26/2011

Property Address
343-180-006 ANTONIO G GARCIA \ ROSALIA GARCIA 21084 STEEL PEAK DR PERRIS, CA 92570

Citation Number	District	Class
A31123	5	SOAC

Item	Description	Hours/Qty	Rate	Amount
Administrative Citations	A31123--CV0806875	1	200.00	200.00
			<b>Subtotal</b>	\$200.00
			<b>Payments/Credits</b>	\$0.00
			<b>Total</b>	\$200.00

EXHIBIT NO.       B3

Home

- [New Search](#)
- [Payments & Refunds](#)
- [Citation Changes](#)
- [Adjudication](#)
- [Receipt](#)
- [Add Note](#)
- [Hot Sheet](#)
- [Reports](#)

Found Citations:

A31123

**General Information** ?

Citation: **A31123** Date: **08/07/09** Time: **10:25 AM**  
 Amt Owing this Citation: **\$200.00** This Person: **\$200.00** This Plate:  
 Issuing Agency: **RE-Riverside County Code Enforcement Dept.** Dept: **Code Enforcement**  
 Status: **OPEN: Noticed**  
 Number: **1 of 1**

**Responsible Party Information**

Name: **ROSALIA GARCIA**  
 Address: **21084 STEEL PEAK**  
 City/State/Zip: **PERRIS, CA 92570**

[Show all Panels](#) | [Hide all Panels](#)

**Citation Information**

Location: **21084 STEEL PEAK PERRIS DIST 5** Case: **CV0806875** Badge #: **129**  
 Comments: **343180006**

**Violation Information**

Code	Description	Amount
17.16.010	Unpermitted landuse	\$100.00
17.16.010	Unpermitted landuse	\$100.00

**Fee History**

**Payment History**

Date on Check	Date Received	Type	Num	Location	Amount

**Notice History**

**Appeal History**

**Responsible Party History**

**Citation History**

[Home](#) | [Log Out](#) | [Help](#)

EXHIBIT NO.           B4



# INVOICE

**Order Number:** 23511 **Order Date:** 4/21/2011

**Customer Information:** Acct No. 1044  
RIVERSIDE COUNTY TLMA-CODE ENFORCEMENT  
4080 Lemon Street  
Riverside, CA 92501  
Attn: Brent Steele  
REF: CV08-06875 / Angela Sarmiento  
IN RE: GARCIA, ANTONIO G.

Product and/or Service ordered for Property known as:	
<b>21084 Steel Peak Drive</b> <b>Perris, CA 92570</b>	
<b>DESCRIPTION:</b>	<b>FEE:</b>
Lot Book Report	\$120.00
<b>TOTAL DUE:</b>	<b>\$120.00</b>

**Payment due upon receipt. Please remit to:** RZ Title Services, Inc.  
P.O. Box 1193  
Whittier, CA 90609

EXHIBIT NO. \_\_\_\_\_ <sup>5</sup>  
B

Assessment Roll For the 2010-2011 Tax Year as of January 1,2010

Assessment #343180006-9		Parcel # 343180006-9	
<b>Assessee:</b>	GARCIA ANTONIO G	<b>Land</b>	55,000
<b>Assessee:</b>	GARCIA ROSALIA	<b>Structure</b>	131,000
<b>Mail Address:</b>	21084 STEEL PEAK DR PERRIS CA 92570	<b>Full Value</b>	186,000
<b>Real Property Use Code:</b>	MF	<b>Total Net</b>	186,000
<b>Base Year</b>	2007		
<b>Conveyance Number:</b>	0175459		
<b>Conveyance (mm/yy):</b>	3/2006		
<b>PUI:</b>	M020012		
<b>TRA:</b>	87-014		
<b>Taxability Code:</b>	0-00		
<b>Assessment Description:</b>	2005 CAVCO		
<b>ID Data:</b>	Lot 28 MB 011/520 MOUNTAIN GLEN TRACT		
<b>Situs Address:</b>	21084 STEEL PEAK DR PERRIS CA 92570		



EXHIBIT NO.     C



RIVERSIDE COUNTY GIS

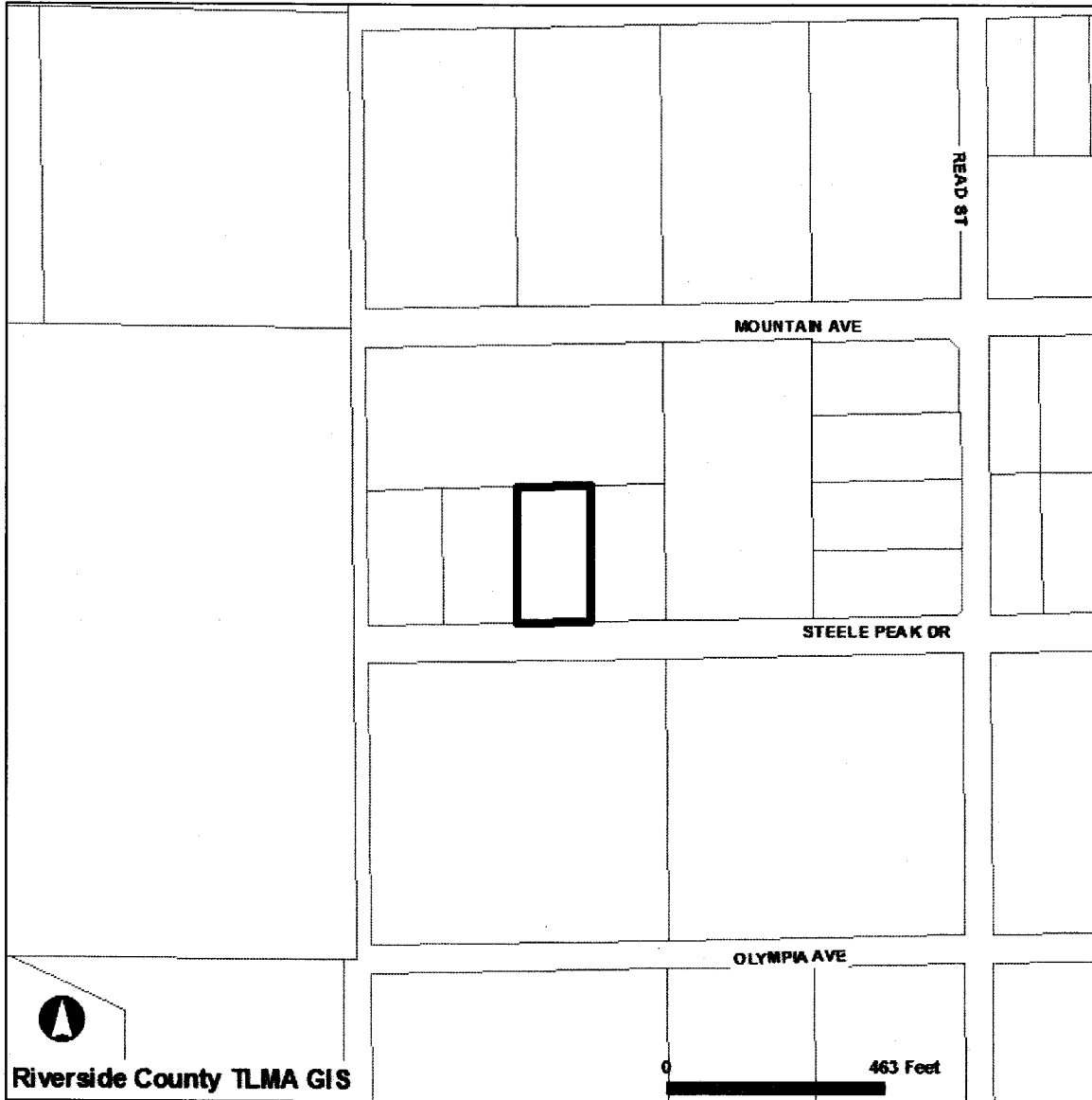

Selected parcel(s):  
343-180-006

**\*IMPORTANT\***

Maps and data are to be used for reference purposes only. Map features are approximate, and are not necessarily accurate to surveying or engineering standards. The County of Riverside makes no warranty or guarantee as to the content (the source is often third party), accuracy, timeliness, or completeness of any of the data provided, and assumes no legal responsibility for the information contained on this map. Any use of this product with respect to accuracy and precision shall be the sole responsibility of the user.

STANDARD REPORT

**APNs**

343-180-006-9

**OWNER NAME / ADDRESS**

ANTONIO G GARCIA  
ROSALIA GARCIA  
21084 STEEL PEAK DR  
PERRIS, CA. 92570

**MAILING ADDRESS**

(SEE OWNER)  
(SEE SITUS)

EXHIBIT NO.           C2

**LEGAL DESCRIPTION**

RECORDED BOOK/PAGE: MB 11/520 SD  
 SUBDIVISION NAME: MOUNTAIN GLEN TRACT  
 LOT/PARCEL: 28, BLOCK: NOT AVAILABLE  
 , Por. TRACT NUMBER: NOT AVAILABLE

**LOT SIZE**

RECORDED LOT SIZE IS 1.05 ACRES

**PROPERTY CHARACTERISTICS**

WOOD FRAME, 2432 SQFT., 4 BDRM/ 2 BATH, 1 STORY, DETACHED GARAGE(576 SQ. FT), CONST'D 2005 COMPOSITION, ROOF, CENTRAL HEATING, CENTRAL COOLING

**THOMAS BROS. MAPS PAGE/GRID**

PAGE: 806 GRID: J6

**CITY BOUNDARY/SPHERE**

NOT WITHIN A CITY  
 NOT WITHIN A CITY SPHERE  
 NO ANNEXATION DATE AVAILABLE  
 NO LAFCO CASE # AVAILABLE  
 NO PROPOSALS

**MARCH JOINT POWERS AUTHORITY**

NOT IN THE JURISDICTION OF THE MARCH JOINT POWERS AUTHORITY

**INDIAN TRIBAL LAND**

NOT IN A TRIBAL LAND

**SUPERVISORIAL DISTRICT (ORD. 813)**

MARION ASHLEY, DISTRICT 5

**TOWNSHIP/RANGE**

T5SR4W SEC 3

**ELEVATION RANGE**

1760/1772 FEET

**PREVIOUS APN**

NO DATA AVAILABLE

**PLANNING****LAND USE DESIGNATIONS**

Zoning not consistent with the General Plan.  
 RR

**AREA PLAN (RCIP)**

MEAD VALLEY

**GENERAL PLAN POLICY OVERLAYS**

NOT IN A GENERAL PLAN POLICY OVERLAY AREA

**GENERAL PLAN POLICY AREAS**

NONE

**ZONING CLASSIFICATIONS (ORD. 348)**

R-R

**ZONING DISTRICTS AND ZONING AREAS**

GOOD HOPE AREA

**ZONING OVERLAYS**

NOT IN A ZONING OVERLAY

**SPECIFIC PLANS**

NOT WITHIN A SPECIFIC PLAN

**AGRICULTURAL PRESERVE**

NOT IN AN AGRICULTURAL PRESERVE

**REDEVELOPMENT AREAS**

PROJECT AREA NAME: I-215 CORRIDOR  
 SUBAREA NAME: GOOD HOPE  
 AMENDMENT NUMBER: 0  
 ADOPTION DATE: FEB. 6, 2009

ACREAGE: 0 ACRES

**AIRPORT INFLUENCE AREAS**

NOT IN AN AIRPORT INFLUENCE AREA

**AIRPORT COMPATIBILITY ZONES**

NOT IN AN AIRPORT COMPATIBILITY ZONE

---

**ENVIRONMENTAL**

**CVMSHCP (COACHELLA VALLEY MULTI-SPECIES HABITAT CONSERVATION PLAN) CONSERVATION AREA**

NOT IN A CONSERVATION AREA

**CVMSHCP FLUVIAL SAND TRANSPORT SPECIAL PROVISION AREAS**

NOT IN A FLUVIAL SAND TRANSPORT SPECIAL PROVISION AREA

**WRMSHCP (WESTERN RIVERSIDE COUNTY MULTI-SPECIES HABITAT CONSERVATION PLAN) CELL GROUP**

NOT IN A CELL GROUP

**WRMSHCP CELL NUMBER**

NOT IN A CELL

**HANS/ERP (HABITAT ACQUISITION AND NEGOTIATION STRATEGY/EXPEDITED REVIEW PROCESS)**

NONE

**VEGETATION (2005)**

Developed/Disturbed Land

---

**FIRE**

**HIGH FIRE AREA (ORD. 787)**

NOT IN A HIGH FIRE AREA

**FIRE RESPONSIBILITY AREA**

STATE RESPONSIBILITY AREA

---

**DEVELOPMENT FEES**

**CVMSHCP FEE AREA (ORD. 875)**

NOT WITHIN THE COACHELLA VALLEY MSHCP FEE AREA

**WRMSHCP FEE AREA (ORD. 810)**

IN OR PARTIALLY WITHIN THE WESTERN RIVERSIDE MSHCP FEE AREA. SEE MAP FOR MORE INFORMATION.

**ROAD & BRIDGE DISTRICT**

NOT IN A DISTRICT

**EASTERN TUMF (TRANSPORTATION UNIFORM MITIGATION FEE ORD. 673)**

NOT WITHIN THE EASTERN TUMF FEE AREA

**WESTERN TUMF (TRANSPORTATION UNIFORM MITIGATION FEE ORD. 824)**

IN OR PARTIALLY WITHIN A TUMF FEE AREA. SEE MAP FOR MORE INFORMATION.SOUTHWEST

**DIF (DEVELOPMENT IMPACT FEE AREA ORD. 659)**

MEAD VALLEY

**SKR FEE AREA (STEPHEN'S KANGAROO RAT ORD. 663.10)**

IN OR PARTIALLY WITHIN AN SKR FEE AREA. SEE MAP FOR MORE INFORMATION.

**DEVELOPMENT AGREEMENTS**

NOT IN A DEVELOPMENT AGREEMENT AREA

---

**TRANSPORTATION**

**CIRCULATION ELEMENT ULTIMATE RIGHT-OF-WAY**

NOT IN A CIRCULATION ELEMENT RIGHT-OF-WAY

**ROAD BOOK PAGE**

63A

NOT IN A TRANSPORTATION AGREEMENT

**CETAP (COMMUNITY AND ENVIRONMENTAL TRANSPORTATION ACCEPTABILITY PROCESS) CORRIDORS**  
NOT IN A CETAP CORRIDOR.

---

## ***HYDROLOGY***

---

**FLOOD PLAIN REVIEW**  
NOT REQUIRED.

**WATER DISTRICT**  
EMWD

**FLOOD CONTROL DISTRICT**  
RIVERSIDE COUNTY FLOOD CONTROL DISTRICT

**WATERSHED**  
SAN JACINTO VALLEY

---

## ***GEOLOGIC***

---

**FAULT ZONE**  
NOT IN A FAULT ZONE

**FAULTS**  
WITHIN A 1/2 MILE OF  
FAULT IN BASEMENT ROCKS  
CONTACT THE COUNTY'S CHIEF ENGINEERING GEOLOGIST AT (951)955-6863.

**LIQUEFACTION POTENTIAL**  
LOW

**SUBSIDENCE**  
SUSCEPTIBLE

**PALEONTOLOGICAL SENSITIVITY**  
LOW POTENTIAL.  
FOLLOWING A LITERATURE SEARCH, RECORDS CHECK AND A FIELD SURVEY, AREAS MAY BE DETERMINED BY A QUALIFIED  
VERTEBRATE PALEONTOLOGIST AS HAVING LOW POTENTIAL FOR CONTAINING SIGNIFICANT PALEONTOLOGICAL RESOURCES SUBJECT  
TO ADVERSE IMPACTS.

---

## ***MISCELLANEOUS***

---

**SCHOOL DISTRICT**  
PERRIS & PERRIS UNION HIGH

**COMMUNITIES**  
GOOD HOPE

**COUNTY SERVICE AREA**  
NOT IN A COUNTY SERVICE AREA.

**LIGHTING (ORD. 655)**  
ZONE B, 37.27 MILES FROM MT. PALOMAR OBSERVATORY

**2000 CENSUS TRACT**  
042902

**FARMLAND**  
OTHER LANDS

**TAX RATE AREAS**  
087-014  
• COUNTY FREE LIBRARY  
• COUNTY STRUCTURE FIRE PROTECTION  
• COUNTY WASTE RESOURCE MGMT DIST  
• CSA 152  
• EASTERN MUN WATER IMP DIST 8  
• EASTERN MUNICIPAL WATER  
• FLOOD CONTROL ADMINISTRATION  
• FLOOD CONTROL ZONE 4  
• GENERAL

- GENERAL PURPOSE
- METRO WATER EAST 1301999
- MT SAN JACINTO JUNIOR COLLEGE
- PERRIS AREA ELEM SCHOOL FUND
- PERRIS JR HIGH AREA FUND
- PERRIS SCHOOL
- PERRIS UNION HIGH SCHOOL
- PERRIS VALLEY CEMETERY
- RIV CO REG PARK & OPEN SPACE
- RIV. CO. OFFICE OF EDUCATION
- SAN JACINTO BASIN RESOURCE CONS

**SPECIAL NOTES**

NO SPECIAL NOTES

**CODE COMPLAINTS**

Case #	Description	Start Date
CV1004735	ABATEMENT	Jun. 9, 2010
CV1004736	NEIGHBORHOOD ENFORCEMENT	Jun. 9, 2010
CV1004737	VEHICLE ABATEMENT	Jun. 9, 2010

REPORT PRINTED ON...Tue Apr 19 13:24:48 2011  
Version 101221



P.O. Box 1193  
 Whittier, CA 90609  
 Tel # (562) 325-8351  
 Fax # (714) 783-3038

## Lot Book Report

Order Number: **23511**

**Customer:**

RIVERSIDE COUNTY TLMA-CODE INFORCEMENT  
 4080 Lemon Street  
 Riverside CA 92501

Order Date: 4/21/2011  
 Dated as of: 4/22/2011  
 County Name: Riverside

Attn: Brent Steele  
 Reference: CV08-06875 / Angela Sarmiento  
 IN RE: GARCIA, ANTONIO G.

FEE(s):  
 Report: \$120.00

Property Address: 21084 Steel Peak Drive  
 Perris CA 92570

Assessor's Parcel No. : 343-180-006-9

**Assessments:**

Land Value:	\$55,000.00
Improvement Value:	\$131,000.00
Exemption Value:	\$0.00
Total Value:	\$186,000.00

## Tax Information

Property Taxes for the Fiscal Year	2010-2011
First Installment	\$992.93
Penalty	\$99.28
Status	NOT PAID-DELINQUENT
Second Installment	\$992.93
Penalty	\$130.28
Status	NOT PAID-DELINQUENT

**Supplemental Property Tax Assessment for the**

Fiscal Year	2005
Bill Number	052499271-9

EXHIBIT NO. \_\_\_\_\_

D



P.O. Box 1193  
Whittier, CA 90609  
Tel # (562) 325-8351  
Fax # (714) 783-3038

Order Number: 23511  
Reference: CV08-06875 / Ang

---

First Installment	\$30.70
Penalty	\$3.07
Due Date	02/28/2007
Status	NOT PAID-DELINQUENT
Second Installment	\$0.00
Penalty	\$0.00
Due Date	06/30/2007
Status	NO TAXES DUE

Prior Delinquencies for tax defaulted year(s)

Redemption Amount

If paid by

Redemption Amount

If paid by

## Property Vesting

The last recorded document transferring title of said property

Dated	11/22/2005
Recorded	03/10/2006
Document No.	2006-0175459
D.T.T.	\$413.60
Grantor	Integra Development Incorporated
Grantee	Antonio G. Garcia and Rosalia Garcia, husband and wife as joint tenants

## Deeds of Trust

Position No.	1st
A Deed of Trust Dated	03/01/2006
Recorded	03/10/2006
Document No.	2006-0175460
Amount	\$296,000.00



P.O. Box 1193  
Whittier, CA 90609  
Tel # (562) 325-8351  
Fax # (714) 783-3038

Order Number: 23511  
Reference: CV08-06875 / Ang

---

Trustor	Antonio G. Garcia and Rosalia Garcia, husband and wife
Trustee	Palos Verdes Escrow, a California Corporation
Beneficiary	Mortgage Electronic Registration Systems, Inc., acting as a nominee for Merit Mortgage Services, Inc.
Position No.	2nd
A Deed of Trust Dated	03/03/2006
Recorded	04/19/2006
Document No.	2006-0282549
Amount	\$40,000.00
Trustor	Antonio G. Garcia and Rosalia Garcia
Trustee	Orange Coast Title Company, a California Corporation
Beneficiary	Norma Cid

### Additional Information

Document Type	Special Assessments and Liens
Document No.	2008-0488690
Recorded	09/04/2008
Notice of Non-Compliance filed by	County of Riverside Code Enforcement Department
In the matter of the property of	Antonio G. Garcia and Rosalio Garcia
Case No.	CV08-07972
Recorded	11/04/2008
Document No.	2008-0586533

#### JUDGMENT AND/OR LIEN DOCUMENTS LISTED AS FOLLOWS:

Document Type	Notice of State Tax Lien
Document No.	2008-0085760
Recorded	02/21/2008
Document Type	Abstract of Judgment
Document No.	2008-0392084
Recorded	07/17/2008





P.O. Box 1193  
Whittier, CA 90609  
Tel # (562) 325-8351  
Fax # (714) 783-3038

Order Number: 23511  
Reference: CV08-06875 / Ang

---

Document Type	Abstract of Judgment
Document No.	2008-0400128
Recorded	07/22/2008
Document Type	Judgment
Document No.	2008-0440037
Recorded	08/11/2008
Document Type	Abstract of Judgment
Document No.	2008-0485510
Recorded	09/03/2008
Document Type	Notice of State Tax Lien
Document No.	2008-0603290
Recorded	11/13/2008
Document Type	Notice of State Tax Lien
Document No.	2008-0646718
Recorded	12/10/2008
Document Type	Abstract of Judgment
Document No.	2009-0173847
Recorded	04/09/2009
Document Type	Abstract of Judgment
Document No.	2009-0186647
Recorded	04/16/2009
Document Type	Abstract of Judgment
Document No.	2009-0460256
Recorded	09/03/2009
Document Type	Notice of State Tax Lien
Document No.	2009-0558478
Recorded	10/28/2009
Document Type	Abstract of Judgment
Document No.	2010-0030483
Recorded	01/25/2010
Document Type	Abstract of Judgment
Document No.	2010-0071945
Recorded	02/17/2010

---



P.O. Box 1193  
Whittier, CA 90609  
Tel # (562) 325-8351  
Fax # (714) 783-3038

Order Number: 23511  
Reference: CV08-06875 / Ang

---

Document Type	Notice of State Tax Lien
Document No.	2010-0309411
Recorded	07/01/2010
Document Type	Notice of State Tax Lien
Document No.	2010-0423816
Recorded	09/02/2010
Document Type	Abstract of Judgment
Document No.	2010-0493402
Recorded	10/14/2010
Document Type	Abstract of Judgment
Document No.	2011-0124748
Recorded	03/21/2011
Document Type	Notice of State Tax Lien
Document No.	2011-0146907
Recorded	04/04/2011
Document Type	Notice of State Tax Lien
Document No.	2011-0163327
Recorded	04/13/2011
Document Type	Abstract of Support Judgment
Document No.	2002-504934
Recorded	09/11/2002
Document Type	Certificate of Lien
Document No.	2003-836835
Recorded	10/23/2003
Document Type	Certificate of Lien
Document No.	2004-0092363
Recorded	02/09/2004
Document Type	Certificate of Lien
Document No.	2004-0906467
Recorded	11/15/2004
Document Type	Abstract of Judgment
Document No.	2005-0042143
Recorded	01/14/2005

---



P.O. Box 1193  
Whittier, CA 90609  
Tel # (562) 325-8351  
Fax # (714) 783-3038

Order Number: 23511  
Reference: CV08-06875 / Ang

---

Document Type	Notice Regarding Payment of Support
Document No.	2005-0047998
Recorded	01/18/2005
Document Type	Abstract of Judgment
Document No.	2005-0057293
Recorded	01/21/2005
Document Type	Certificate of Lien
Document No.	2006-0015435
Recorded	01/06/2006
Document Type	Notice of State Tax Lien
Document No.	2007-0562852
Recorded	09/04/2007
Document Type	Notice of State Tax Lien
Document No.	2008-0069190
Recorded	02/11/2008
Document Type	Abstract of Judgment
Document No.	2009-0102794
Recorded	03/04/2009
Document Type	Abstract of Support Judgment
Document No.	2009-0384339
Recorded	07/24/2009
Document Type	Abstract of Support Judgment
Document No.	2009-0543227
Recorded	10/21/2009
Document Type	Notice of State Tax Lien
Document No.	2010-0327705
Recorded	07/13/2010
Document Type	Abstract of Support Judgment
Document No.	2010-0381744
Recorded	08/13/2010
Document Type	Abstract of Support Judgment
Document No.	2010-0531380
Recorded	11/04/2010

---



P.O. Box 1193  
Whittier, CA 90609  
Tel # (562) 325-8351  
Fax # (714) 783-3038

Order Number: 23511  
Reference: CV08-06875 / Ang

---

Document Type	Abstract of Judgment
Document No.	2010-0562254
Recorded	11/23/2010
Document Type	Abstract of Judgment
Document No.	2011-0093488
Recorded	03/01/2011
A Bankruptcy filed by	Tony Garcia
Social Security Number(s)	None Shown
Date filed	09/22/2005
Case No.	MJ20282
A Bankruptcy filed by	Antonio Garcia
Social Security Number(s)	None Shown
Date filed	03/24/2006
Case No.	DN10595
A Bankruptcy filed by	Antonio Garcia
Social Security Number(s)	None Shown
Date filed	11/07/2006
Case No.	DN13319
A Bankruptcy filed by	Antonio Garcia
Social Security Number(s)	None Shown
Date filed	12/19/2007
Case No.	DN18524
A Bankruptcy filed by	Antonio Garcia
Social Security Number(s)	None Shown
Date filed	12/16/2008
Case No.	28001
A Bankruptcy filed by	Tony Garcia
Social Security Number(s)	None Shown
Date filed	06/17/2009

---



P.O. Box 1193  
Whittier, CA 90609  
Tel # (562) 325-8351  
Fax # (714) 783-3038

Order Number: 23511  
Reference: CV08-06875 / Ang

---

Case No.	23439
A Bankruptcy filed by	Tony Garcia
Social Security Number(s)	None Shown
Date filed	08/04/2009
Case No.	27783
A Bankruptcy filed by	Anthony Garcia
Social Security Number(s)	None Shown
Date filed	09/21/2009
Case No.	32123
A Bankruptcy filed by	Antonio Garcia
Social Security Number(s)	None Shown
Date filed	05/03/2010
Case No.	23353
A Bankruptcy filed by	Antonio Garcia aka Tony Garcia
Social Security Number(s)	None Shown
Date filed	06/25/2010
Case No.	29790
A Bankruptcy filed by	Tony G Garcia
Social Security Number(s)	None Shown
Date filed	08/20/2010
Case No.	36511
A Bankruptcy filed by	Antonio Garcia
Social Security Number(s)	None Shown
Date filed	09/27/2010
Case No.	41067
A Bankruptcy filed by	Anthony Garcia
Social Security Number(s)	None Shown
Date filed	01/07/2011
Case No.	10586

---



P.O. Box 1193  
Whittier, CA 90609  
Tel # (562) 325-8351  
Fax # (714) 783-3038

Order Number: 23511  
Reference: CV08-06875 / Ang

---

A Bankruptcy filed by	Antonio Garcia
Social Security Number(s)	None Shown
Date filed	03/23/2011
Case No.	19351
A Bankruptcy filed by	Rose Andrea Garcia
Social Security Number(s)	None Shown
Date filed	12/19/2003
Case No.	MG28003
A Bankruptcy filed by	Rose Ester Garcia
Social Security Number(s)	None Shown
Date filed	02/09/2004
Case No.	MJ11579
A Bankruptcy filed by	Rosa Elva Garcia
Social Security Number(s)	None Shown
Date filed	02/13/2004
Case No.	DN11790
A Bankruptcy filed by	Rosa Ibanez Garcia
Social Security Number(s)	None Shown
Date filed	02/27/2004
Case No.	MJ12405
A Bankruptcy filed by	Rose Marie Garcia
Social Security Number(s)	None Shown
Date filed	03/05/2004
Case No.	PC12808
A Bankruptcy filed by	Rosa Miriam Garcia
Social Security Number(s)	None Shown
Date filed	08/02/2005
Case No.	MG17835

---



P.O. Box 1193  
Whittier, CA 90609  
Tel # (562) 325-8351  
Fax # (714) 783-3038

Order Number: 23511  
Reference: CV08-06875 / Ang

---

A Bankruptcy filed by Rose Marie Garcia  
Social Security Number(s) None Shown  
Date filed 09/29/2005  
Case No. MG20829

A Bankruptcy filed by Rosa Elva Garcia  
Social Security Number(s) None Shown  
Date filed 04/19/2007  
Case No. MJ12120

A Bankruptcy filed by Rosa Thelma Garcia  
Social Security Number(s) None Shown  
Date filed 10/26/2007  
Case No. DN16771

A Bankruptcy filed by Rosalie C Garcia  
Social Security Number(s) None Shown  
Date filed 11/29/2007  
Case No. DN17850

A Bankruptcy filed by Rosalia Garcia  
Social Security Number(s) None Shown  
Date filed 01/31/2008  
Case No. DN10978

A Bankruptcy filed by Rosie Garcia  
Social Security Number(s) None Shown  
Date filed 08/05/2008  
Case No. 19895

A Bankruptcy filed by Rosa Garcia  
Social Security Number(s) None Shown  
Date filed 11/14/2008  
Case No. 25966

A Bankruptcy filed by Rose Ann Garcia

---



P.O. Box 1193  
Whittier, CA 90609  
Tel # (562) 325-8351  
Fax # (714) 783-3038

Order Number: 23511  
Reference: CV08-06875 / Ang

---

Social Security Number(s)	None Shown
Date filed	02/28/2009
Case No.	13689
A Bankruptcy filed by	Rosie Garcia
Social Security Number(s)	None Shown
Date filed	03/23/2009
Case No.	15404
A Bankruptcy filed by	Rosa Estela Garcia
Social Security Number(s)	None Shown
Date filed	04/17/2009
Case No.	17727
A Bankruptcy filed by	Rosa Isabel Garcia
Social Security Number(s)	None Shown
Date filed	04/30/2009
Case No.	18861
A Bankruptcy filed by	Rosa Garcia
Social Security Number(s)	None Shown
Date filed	05/14/2009
Case No.	20250
A Bankruptcy filed by	Rosa Maria Garcia
Social Security Number(s)	None Shown
Date filed	09/01/2009
Case No.	30547
A Bankruptcy filed by	Rosa Isabel Garcia
Social Security Number(s)	None Shown
Date filed	12/22/2009
Case No.	35177
A Bankruptcy filed by	Rosa Imelda Garcia
Social Security Number(s)	None Shown

---





P.O. Box 1193  
Whittier, CA 90609  
Tel # (562) 325-8351  
Fax # (714) 783-3038

Order Number: 23511  
Reference: CV08-06875 / Ang

---

Date filed	01/27/2010
Case No.	12101
A Bankruptcy filed by	Rosalie Jane Garcia aka Rose Jane Garcia aka Rosalie Peralta Garcia
Social Security Number(s)	None Shown
Date filed	01/30/2010
Case No.	12645
A Bankruptcy filed by	Rosa Hermina Garcia
Social Security Number(s)	None Shown
Date filed	01/18/2010
Case No.	14366
A Bankruptcy filed by	Rosa Maria Garcia
Social Security Number(s)	None Shown
Date filed	07/07/2010
Case No.	31064
A Bankruptcy filed by	Rosa Maria Garcia
Social Security Number(s)	None Shown
Date filed	07/29/2010
Case No.	33778
A Bankruptcy filed by	Rosa Maria Garcia
Social Security Number(s)	None Shown
Date filed	08/30/2010
Case No.	37794
A Bankruptcy filed by	Rosa E Garcia aka Rosa I Garcia
Social Security Number(s)	None Shown
Date filed	09/13/2010
Case No.	39388
A Bankruptcy filed by	Rosa Lemus Garcia
Social Security Number(s)	None Shown
Date filed	10/18/2010

---



P.O. Box 1193  
Whittier, CA 90609  
Tel # (562) 325-8351  
Fax # (714) 783-3038

Order Number: 23511  
Reference: CV08-06875 / Ang

---

Case No.	43676
A Bankruptcy filed by	Rose Garcia
Social Security Number(s)	None Shown
Date filed	12/08/2010
Case No.	49501
A Bankruptcy filed by	Rosa M Garcia
Social Security Number(s)	None Shown
Date filed	03/14/2011
Case No.	18245

### Legal Description

THE LAND REFERRED TO IN THIS REPORT IS LOCATED IN AND IS DESCRIBED AS FOLLOWS:

THE WESTERLY 157.77 FEET OF THE EASTERLY 315.54 FEET OF THE SOUTH HALF OF LOT 28 OF MOUNTAIN GLEN TRACT, IN THE COUNTY OF RIVERSIDE, STATE OF CALIFORNIA, AS PER MAP RECORDED IN BOOK 11, PAGE 520 OF MAPS, IN THE OFFICE OF THE COUNTY RECORDER OF SAID COUNTY.



# County of Riverside Code Enforcement Department

P.O. Box 1469, Riverside, CA 92502  
Phone: (951) 955-2004 Fax: (951) 955-8680

## DEMAND FOR PAYMENT STATEMENT OF ABATEMENT COSTS NOTICE OF SPECIAL TAX ASSESSMENT

May 31, 2011

Antonio Garcia  
Rosalia Garcia  
21084 Steel Peak Drive  
Perris, CA 92570

Subject Property: 21084 Steel Peak Dr., Perris, CA 92570  
Case No(s): CV08-06875  
APN No(s): 343-180-006

Dear Mr. and Mrs. Garcia:

**NOTICE IS HEREBY GIVEN** that the County of Riverside Code Enforcement Department ("DEPARTMENT") incurred expenses during our efforts to abate the code violation(s) on the Subject Property. Said abatement case involved unpermitted land use (semi trucks and trailer storage yard) and excessive outside storage located on your real property commonly described as 21084 Steel Peak Dr., Perris, CA 92570 and more particularly described as Assessor's Parcel Number 343-180-006.

The total amount due for the DEPARTMENT'S actions concerning the above-described dangerous or injurious condition is **Seven Hundred Eleven Dollars And Ten Cents (\$711.1)**.

**You have thirty (30) days from the date of this letter to pay the DEPARTMENT at the above address the total amount due on the enclosed "Summary Statement of Abatement Costs" or a special tax assessment and abatement lien will be recorded upon the subject property. Payment must be made in the form of cashier's check or money order, made payable to the County of Riverside. Please note the property APN on the memo line of the check.**

**YOU HAVE A RIGHT TO A HEARING ON THIS MATTER.** You have the right to contest the abatement costs and special assessment against the subject property. If you choose to exercise your right to a public hearing, please complete the enclosed "Request for Public Hearing" form and return it to the Code Enforcement Department within twenty (20) days of the date of this letter.

In the event you do not request a public hearing, a hearing shall be held without further notice to you for a final determination of this matter and authority to place a lien against the Subject Property and adding the amount due as a special tax assessment on the County tax rolls.

If you have any questions regarding this notice, please contact us at (951) 955-2004.

Code Enforcement Department

  
Ward Komers  
Administrative Manager

EXHIBIT NO.     E

**REQUEST FOR PUBLIC HEARING  
ON STATEMENT OF ABATEMENT COSTS  
AND SPECIAL TAX ASSESSMENT**

Antonio Garcia  
Rosalia Garcia  
21084 Steel Peak Drive  
Perris, CA 92570

Subject Property: 21084 Steel Peak Dr., Perris, CA 92570  
Case No(s): CV08-06875  
APN No(s): 343-180-006

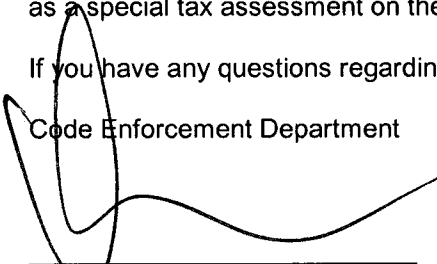
I, \_\_\_\_\_, hereby request a public hearing before the Administrative  
(Please PRINT your name here)  
Hearing Officer regarding case number(s) \_\_\_\_\_.

I request notice of the Administrative Hearing date, time, and location (which shall not be less than 10 days from the submission of this request) to be mailed to me at the following address:

Return Mailing Address: \_\_\_\_\_  
\_\_\_\_\_

Signed: \_\_\_\_\_ Date: \_\_\_\_\_  
(Please SIGN your name here)

Print: \_\_\_\_\_  
(Please PRINT your name here)

You may contact me at the following daytime phone number: \_\_\_\_\_

**IMPORTANT**

Keep a copy of this form and mail the original to:  
Riverside County Code Enforcement Department  
P.O. BOX 1469  
Riverside, CA 92502-1469

EXHIBIT NO.     E<sup>2</sup>



# COUNTY OF RIVERSIDE CODE ENFORCEMENT

P.O. Box 1469, Riverside, CA 92502  
Phone: 951-955-2004 Fax: 951-955-8680

Property Reference/Mailing Address
343-180-006 ANTONIO G GARCIA \ ROSALIA GARCIA 21084 STEEL PEAK DR PERRIS, CA. 92570

## Summary Statement of Abatement Costs

**You are liable to the County for the following abatement costs:**

Date	Invoice Number & Amount	Amount	Balance
12/31/2000	Balance forward		0.00
04/19/2011	CV0806875- INV #101085.	511.10	511.10
08/07/2009	CV0806875:A31123- INV #7999. A31123	200.00	711.10
		<b>Total Now Due</b>	<b>\$711.10</b>

The total abatement costs must be paid to the County of Riverside, P.O. Box 1469, Riverside, CA 92502 within thirty (30) days. In the event said costs are not paid within thirty (30) days you will be liable for additional administrative costs, penalties, court fees, or other collection costs incurred in the collection of these abatement costs.

I affirm and declare under penalty of perjury under the laws of the State of California that the foregoing is true and correct to the best of my knowledge.

  
Code Enforcement Department

EXHIBIT NO. E<sup>3</sup>

**County of Riverside  
Code Enforcement Department**

P.O. Box 1469, Riverside, CA 92502  
Phone: (951) 955-2004 Fax: (951) 955-8680

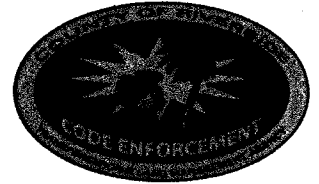

# Statement of Abatement Costs

343-180-006  
ANTONIO G GARCIA \ ROSALIA GARCIA  
21084 STEEL PEAK DR  
PERRIS, CA. 92570

Date	Invoice #
4/19/2011	101085

Case Number	District	Class
CV0806875	5	SOAC

Property Address
343-180-006 ANTONIO G GARCIA \ ROSALIA GARCIA 21084 STEEL PEAK DR PERRIS, CA 92570

**You are liable to the County for the following abatement costs:**

Date	Item	Description	Hours/Qty	Rate	Amount
9/16/2008	Officer Hours	Labor Charges - Officer Time	0.4	109.00	43.60
6/4/2009	Officer Hours	Labor Charges - Officer Time	0.1	109.00	10.90
7/17/2009	Officer Hours	Labor Charges - Officer Time	0.2	109.00	21.80
8/7/2009	Officer Hours	Labor Charges - Officer Time	0.3	109.00	32.70
10/14/2009	Officer Hours	Labor Charges - Officer Time	0.2	109.00	21.80
4/19/2011	SOE Preparation	Prepare Statement of Expense		65.00	65.00
		Subtotal Code Enforcement Costs			195.80
4/19/2011	Prepare Case for SOE He...			125.55	125.55
	Attend SOE Hearing			69.75	69.75
		Subtotal County Counsel Costs			195.30
4/19/2011	Lot Book Report			120.00	120.00
		Subtotal Contractor Costs			120.00
			<b>Subtotal</b>		<b>\$511.10</b>

The total abatement costs must be paid to the County of Riverside, P.O. Box 1469, Riverside, CA 92502 within thirty (30) days. In the event said costs are not paid within thirty (30) days you will be liable for additional administrative costs, penalties, court fees or other collection costs incurred in the collection of these abatement costs.

<b>Payments/Credits</b>	\$0.00
<b>Total Now Due</b>	<b>\$511.10</b>

**I affirm and declare under penalty of perjury under the laws of the State of California that the foregoing is true and correct to the best of my knowledge.**

  
Code Enforcement Department

EXHIBIT NO. EA

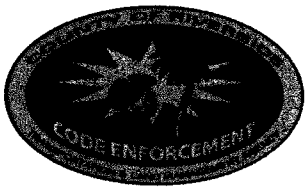

# County of Riverside Code Enforcement Department

P.O. Box 1469, Riverside, CA 92502  
Phone: (951) 955-2004 Fax: (951) 955-8680  
demands@rctlma.org

## Administrative Citation

343-180-006  
ANTONIO G GARCIA \ ROSALIA GARCIA  
21084 STEEL PEAK DR  
PERRIS, CA. 92570

Citation Issue Date	Billing Date
8/7/2009	4/26/2011

Property Address
343-180-006 ANTONIO G GARCIA \ ROSALIA GARCIA 21084 STEEL PEAK DR PERRIS, CA 92570

Citation Number	District	Class
A31123	5	SOAC

Item	Description	Hours/Qty	Rate	Amount
Administrative Citations	A31123--CV0806875	1	200.00	200.00

<b>Subtotal</b>	\$200.00
<b>Payments/Credits</b>	\$0.00
<b>Total</b>	\$200.00

EXHIBIT NO.       E<sup>5</sup>

## NOTICE LIST

Subject Property: 21084 Steel Peak Dr., Perris, CA 92570;  
Case No.: CV08-06875;  
APN: 343-180-006

ANTONIO GARCIA  
ROSALIA GARCIA  
21084 STEEL PEAK DRIVE  
PERRIS CA 92570

MERIT MORT SERV  
1919 WEST REDONDO BEACH BLVD  
GARDENA CA 90247

MERS  
PO BOX 2026  
FLINT MI 48501-2026

NORMA CID  
C/O 41695 DATE STREET #100  
MURRIETA CA 92563

EMPLOYMENT DEVEL DEPT  
LIEN GROUP MIC 92G  
PO BOX 826880  
SACRAMENTO CA 94280-0001

FRANCHISE TAX BOARD  
SPECIAL PROCEDURES SECTION  
PO BOX 2952  
SACRAMENTO CA 95812-2952

EXHIBIT NO. \_\_\_\_\_

EG



**PROOF OF SERVICE**

Case No. CV08-06875

STATE OF CALIFORNIA, COUNTY OF RIVERSIDE

I, Brenda G. Peeler, declare that I am a citizen of the United States and am employed in the County of Riverside, over the age of 18 years and not a party to the within action or proceeding; that my business address is 3960 Orange Street, Suite 500, Riverside, California 92501.

That on 5/31/2011, I served the following document(s):

- DEMAND FOR PAYMENT
- REQUEST FOR HEARING
- SUMMARY STATEMENT OF ABATEMENT COSTS
- STATEMENT OF ABATEMENT COSTS
- ADMINISTRATIVE CITATION(S)
- NOTICE LIST

by placing a true copy thereof enclosed in a sealed envelope(s) addressed as follows:

**OWNERS OR INTERESTED PARTIES  
(SEE NOTICE LIST ATTACHED TO NOTICE OF HEARING)**

XX **BY FIRST CLASS MAIL.** I am "readily familiar" with the office's practice of collection and processing correspondence for mailing. Under that practice it would be deposited with the U.S. Postal Service on that same day with postage thereon fully prepaid at Riverside, California, in the ordinary course of business.

— **BY PERSONAL SERVICE:** I caused to be delivered such envelope(s) by hand to the offices of the addressee(s).

XX **STATE - I declare under penalty of perjury under the laws of the State of California that the above is true and correct.**

— **FEDERAL - I declare that I am employed in the office of a member of the bar of this court at whose direction the service was made.**

EXECUTED ON 5/31/2011, at Riverside, California.

  
BREND A G. PEELER

EXHIBIT NO.                     E7

**REQUEST FOR PUBLIC HEARING  
ON STATEMENT OF ABATEMENT COSTS  
AND SPECIAL TAX ASSESSMENT**

Antonio Garcia  
Rosalia Garcia  
21084 Steel Peak Drive  
Perris, CA 92570

Subject Property: 21084 Steel Peak Dr., Perris, CA 92570  
Case No(s): CV08-06875  
APN No(s): 343-180-006

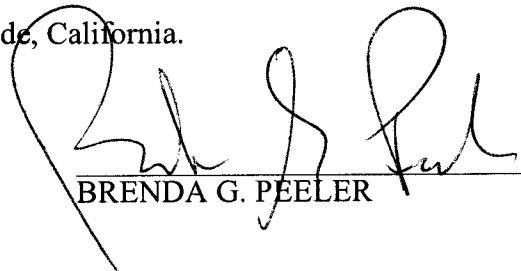
I, Antonio Garcia, hereby request a public hearing before the Administrative  
(Please PRINT your name here)  
Hearing Officer regarding case number(s) CV0806875 - CV080 Brenda G. Peeler

I request notice of the Administrative Hearing date, time, and location (which shall not be less than 10 days from the submission of this request) to be mailed to me at the following address:

Return Mailing Address: 21084 Steele Peak dr.  
Perris CA 92570

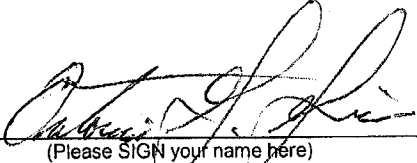
Signed:  Date: 6/19/11  
(Please SIGN your name here)

Print: Antonio Garcia  
(Please PRINT your name here)

You may contact me at the following daytime phone number: (951) 623-7790

**IMPORTANT**

Keep a copy of this form and mail the original to:  
Riverside County Code Enforcement Department  
P.O. BOX 1469  
Riverside, CA 92502-1469

EXHIBIT NO. F

EXHIBIT NO. F<sup>2</sup>

RECEIVED JUN 21 2011

*Saf*