

**SUBMITTAL TO THE BOARD OF SUPERVISORS
COUNTY OF RIVERSIDE, STATE OF CALIFORNIA**

302B



FROM: County Counsel/TLMA
Code Enforcement Department

SUBMITTAL DATE:
September 22, 2011

SUBJECT: Abatement of Public Nuisance [Accumulated Rubbish]
Case Nos. : CV 10-07965 [Klick]
Subject Property: 17175 Palomas Drive, Perris; APN: 287-343-005
District: 1

RECOMMENDED MOTION: Move that:

1. The accumulation of rubbish on the real property located at 17175 Palomas Drive, Perris, Riverside County, California, APN: 287-343-005 be declared a public nuisance and a violation of Riverside County Ordinance No. 541 which does not permit the accumulation of rubbish on the property.
2. Lotte H. Klick and Roland A. Klick, the owners of the subject real property, be directed to abate the accumulation of rubbish on the property by removing the same from the real property within ninety (90) days.

(Continued)

[Signature]
L. ALEXANDRA FONG, Deputy County Counsel
for PAMELA J. WALLS, County Counsel

FINANCIAL DATA	Current F.Y. Total Cost:	\$ N/A	In Current Year Budget:	N/A
	Current F.Y. Net County Cost:	\$ N/A	Budget Adjustment:	N/A
	Annual Net County Cost:	\$ N/A	For Fiscal Year:	N/A

SOURCE OF FUNDS:	Positions To Be Deleted Per A-30	<input type="checkbox"/>
	Requires 4/5 Vote	<input type="checkbox"/>

C.E.O. RECOMMENDATION: APPROVE

BY: *[Signature]*
Tina Grande

County Executive Office Signature

- Policy
- Policy
- Consent
- Consent

MINUTES OF THE BOARD OF SUPERVISORS

On motion of Supervisor Ashley, seconded by Supervisor Stone and duly carried, IT WAS ORDERED that the above matter is approved as recommended.

Ayes: Buster, Stone and Ashley
Nays: None
Absent: Tavaglione and Benoit
Date: October 4, 2011
xc: Co. Co., CED, Prop. Owner, Sheriff

Kecia Harper-Ihem
Clerk of the Board
By: *[Signature]*
Deputy

9.3

Prev. Agn. Ref: | District: 1 | Agenda Number:

ATTACHMENTS FILED
MINUTES OF THE BOARD OF SUPERVISORS

Dep't Recomm.:
Per Exec. Ofc.:

Departmental Concurrence

Abatement of Public Nuisance
Case Nos.: CV 10-07965 [KCLICK]
17175 Palomas Drive, Perris
APN#287-343-005
District 1
Page 2

3. If the owner or whoever has possession or control of the real property does not take the above described action within ninety (90) days of the date of the Board's Order to Abate, that representatives of the Code Enforcement Department, Sheriff's Department, and/or a contractor, upon consent of the owner or receipt of a Court Order authorizing entry onto the real property, when necessary under applicable law, may abate the accumulation of rubbish by removing and disposing of the same from the real property.

4. The reasonable cost of abatement, after notice and an opportunity for hearing, shall be imposed as a lien on the real property, which may be collected as a special assessment against the real property pursuant to Government Code Section 25845 and Riverside County Ordinance No. 725.

5. County Counsel be directed to prepare the necessary Findings of Facts and Conclusions that the accumulation of rubbish on the real property is declared to be in violation of Riverside County Ordinance No. 541, and a public nuisance, and further, to prepare an Order to Abate for approval by the Board.

BACKGROUND:

1. An initial inspection was made of the subject real property by the Code Enforcement Officers on January 24, 2011. The inspection revealed the accumulation of rubbish on the subject property in violation of Riverside County Ordinance No. 541. The rubbish consisted of, but was not limited to: household trash, debris, tires and green waste.

2. Subsequent inspections of the above-described real property on March 22, 2011 and April 26, 2011 and August 25, 2011, revealed the property continues to be in violation of Riverside County Ordinance No. 541.

3. Staff and the Code Enforcement Department have complied with the requirements set forth in the appropriate laws of this jurisdiction pertaining to the administrative abatement proceedings for the removal of accumulated rubbish.

1 **BOARD OF SUPERVISORS**
2 **COUNTY OF RIVERSIDE**

3 IN RE ABATEMENT OF PUBLIC NUISANCE) CASE NO. CV 10-07965
4 [ACCUMULATION OF RUBBISH] APN: 287-)
5 343-005, 17175 PALOMAS DRIVE, PERRIS,) DECLARATION OF CODE
6 COUNTY OF RIVERSIDE, STATE OF) ENFORCEMENT OFFICER
7 CALIFORNIA; LOTTE H. KLICK AND) CYNTHIA BLACK
8 ROLAND A. KLICK, OWNERS.)
9 _____) [R.C.O. No. 541 (RCC Title 8)]

10 I, CYNTHIA BLACK, declare that the facts set forth below are personally known to me except to
11 the extent that certain information is based on information and belief which I believe to be true, and if
12 called as a witness, I could and would competently testify thereto under oath:

13 1. I am currently employed by the Riverside County Code Enforcement Department as a
14 Code Enforcement Officer. My current official duties as a Code Enforcement Officer include inspecting
15 property for violations and enforcement of the provisions of Riverside County Ordinances.

16 2. On January 24, 2011, I conducted an initial inspection of the real property described as
17 17175 Palomas Drive, Perris, Riverside County, California and further described as Assessor's Parcel
18 Number 287-343-005 (hereinafter referred to as "THE PROPERTY"). A true and correct copy of a
19 Thomas Brothers map indicating the location of THE PROPERTY is attached hereto as Exhibit "A" and
20 incorporated herein by reference.

21 3. A review of County records and documents disclosed that THE PROPERTY is owned by
22 Lotte H. Klick and Roland A. Klick (hereinafter referred to as the "OWNERS"). A certified copy of the
23 County Equalized Assessment Roll for the year 2010-2011 and a copy of the County Geographic
24 Information System ("GIS") report are attached hereto as Exhibit "B" and incorporated herein by
25 reference.

26 4. Based on the Lot Book Report from RZ Title Service on March 17, 2011, it is determined
27 that there are no additional parties that may potentially hold a legal interest in THE PROPERTY. True
28 and correct copies of the Lot Book Reports are attached hereto as Exhibit "C" and incorporated herein by
reference.

5. On January 24, 2011, I conducted an initial inspection of THE PROPERTY. I met with
the owner, Mr. Klick at the front of THE PROPERTY, explaining the reason for my visit. I observed that

1 the driveway was covered in accumulated rubbish, which consisted of, but not limited to: household
2 trash, debris, tires and green waste. I determined that the amount of accumulated rubbish on THE
3 PROPERTY covered 100'x15' (1,500 square feet). I issued and posted a Notice of Violation on THE
4 PROPERTY.

5 6. As a result of the accumulation of rubbish, THE PROPERTY constituted a public nuisance in
6 violation of the provisions set forth in Riverside County Ordinance No. (RCO) 541, as codified in
7 Riverside County Code (RCC) Title 8.

8 7. On January 25, 2011, a Notice of Violation was mailed to OWNERS by certified mail,
9 return receipt requested.

10 8. On March 22, 2011, I conducted a follow-up inspection on THE PROPERTY. I observed
11 that the accumulated rubbish had not been removed. I issued an Administrative Citation, A43434, for
12 RCC Title 8 accumulated rubbish and posted the Citation on the front door.

13 9. On April 26, 2011, I conducted a follow-up inspection on THE PROPERTY. I observed
14 that the accumulated rubbish had not been removed and that additional tires were now on THE
15 PROPERTY. I issued an Administrative Citation, A43450, for RCC Title 8 accumulated rubbish and
16 posted the Citation on the gate.

17 10. A site plan and photographs of THE PROPERTY are attached hereto and incorporated
18 herein by reference as Exhibit "D."

19 11. True and correct copies of each Notice issued in this matter and other supporting
20 documentation are attached hereto as Exhibit "E" and incorporated herein by reference.

21 12. Based upon my experience, knowledge and visual observations, it is my determination that
22 the conditions on THE PROPERTY are dangerous to the neighboring property owners and the general
23 public.

24 13. A Notice of Noncompliance regarding the accumulation of rubbish was recorded in the
25 Office of the Assessor, County Clerk & Recorder, County of Riverside, State of California, on February
26 9, 2011, as Instrument Number 2011-0064057. A true and correct copy of the notice is attached hereto
27 and incorporated herein by reference as Exhibit "F".

28 /////

1 14. On August 25, 2011, the second notice, "Notice to Correct County Ordinance Violations
2 and Abate Public Nuisance" providing notification of the Board of Supervisors' hearing scheduled for
3 October 4, 2011, was mailed to OWNERS by US mail, and on August 25, 2011, was posted on THE
4 PROPERTY. True and correct copies of the notice and supporting documentation are attached hereto as
5 Exhibit "G" and incorporated herein by reference.

6 15. A follow-up inspection on August 25, 2011, revealed that THE PROPERTY remains in
7 violation.

8 16. Removal of the accumulation of rubbish on THE PROPERTY is required to bring THE
9 PROPERTY into compliance with Riverside County Ordinance No. 541 (RCC Title 8) and the Health and
10 Safety Code. Under RCO No. 541, no amount of rubbish is allowed to accumulate on THE PROPERTY.

11 17. The Board of Supervisors is requested to issue an Order to Abate the Nuisance described
12 herein. Accordingly, the following findings and conclusions are recommended:

13 (a) the accumulation of rubbish on THE PROPERTY to be deemed and declared a
14 public nuisance;

15 (b) the OWNERS and/or person(s) in possession of THE PROPERTY be required to
16 remove all accumulated rubbish within ninety (90) days of the date of the posting and mailing of the
17 Board's Order to Abate Nuisance, in accordance with all Riverside County Ordinances, including but not
18 limited to the provisions of County Ordinance No. 541;

19 (c) in the event the rubbish is not removed and disposed of according to the above
20 referenced ninety (90) day time period in strict accordance with all Riverside County Ordinances,
21 including but not limited to Riverside County Ordinance No. 541 (RCC Title 8), the rubbish may be
22 abated by representatives of the Riverside County Code Enforcement Department, a contractor or the
23 Sheriff's Department; and

24 /////

25 /////

26 /////

27 /////

28 /////

1 (d) reasonable costs of abatement, after notice and opportunity for hearing, shall be
2 imposed as a lien on THE PROPERTY, which may be collected as a special assessment against THE
3 PROPERTY pursuant to Government Code Section 25845 and Riverside County Ordinance Nos. 541
4 (RCC Title 8) and 725 (RCC Title 1).

5 I declare under penalty of perjury under the laws of the State of California that the foregoing is
6 true and correct.

7 Executed this 25th day of August, 2011, at Perris, California.

8
9
10 
11 CYNTHIA BLACK
12 Code Enforcement Officer
13 Code Enforcement Department
14
15
16
17
18
19
20
21
22
23
24
25
26
27

776

SEE MAP 746

SEE MAP 775

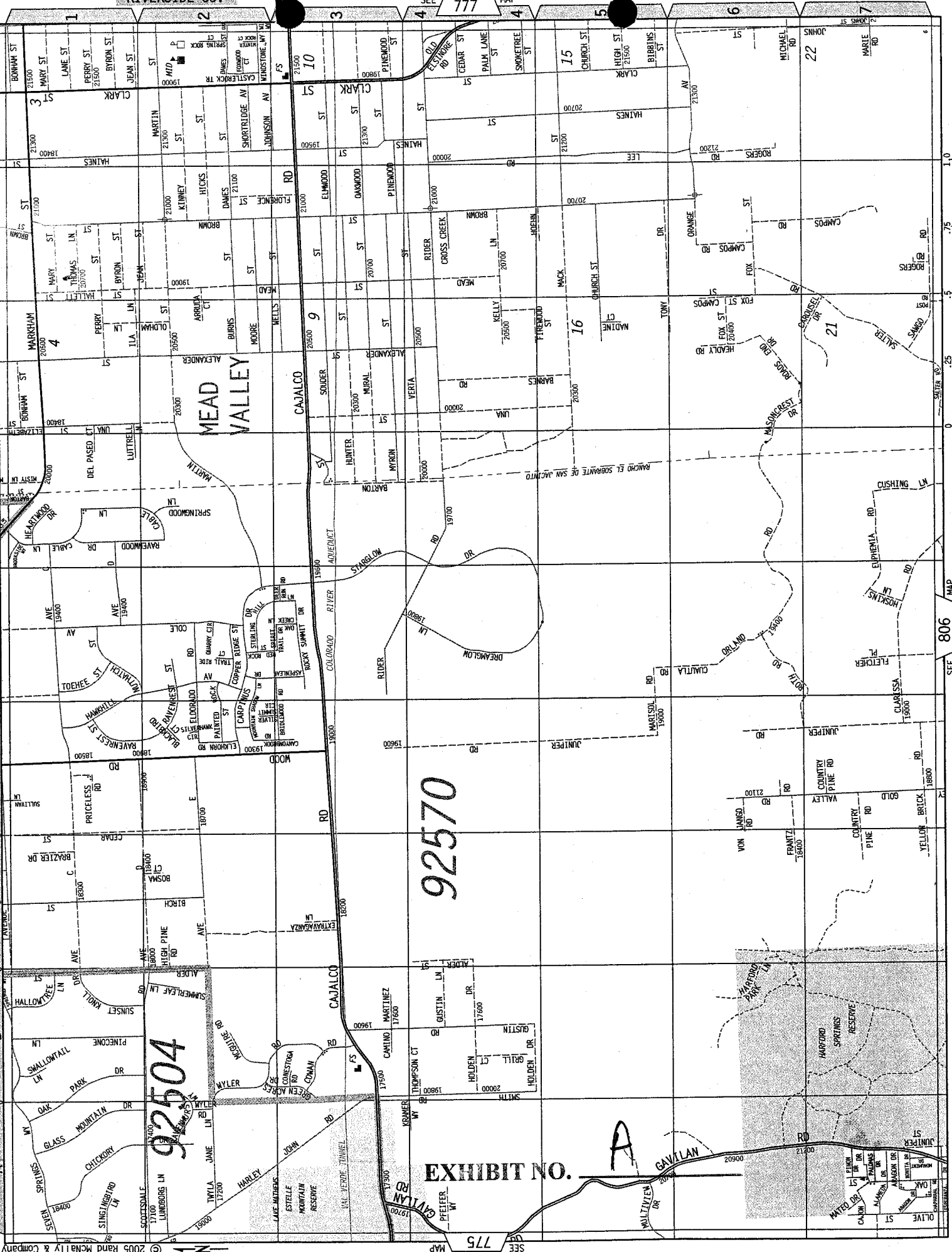

92504

92570

EXHIBIT NO. A

SEE MAP 806

Assessment Roll For the 2010-2011 Tax Year as of January 1,2010

Assessment #287343005-0		Parcel # 287343005-0	
Assessee:	KLICK LOTTE H	Land	26,846
Assessee:	KLICK ROLAND A	Structure	6,976
Mail Address:	17175 PALOMAS DR PERRIS CA 92570	Full Value	33,822
Real Property Use Code:	MR	Homeowners' Exemption	7,000
Base Year	2001	Total Net	26,822
Conveyance Number:	0402312		
Conveyance (mm/yy):	10/2000		
PUI:	M010000		
TRA:	98-007		
Taxability Code:	0-00		
ID Data:	Lot 17 MB 013/028 GAVILAN PARK 2		
Situs Address:	17175 PALOMAS DR PERRIS CA 92570		

EXHIBIT NO. B

RIVERSIDE COUNTY GIS



Selected parcel(s):
287-343-005

IMPORTANT

Maps and data are to be used for reference purposes only. Map features are approximate, and are not necessarily accurate to surveying or engineering standards. The County of Riverside makes no warranty or guarantee as to the content (the source is often third party), accuracy, timeliness, or completeness of any of the data provided, and assumes no legal responsibility for the information contained on this map. Any use of this product with respect to accuracy and precision shall be the sole responsibility of the user.

STANDARD WITH PERMITS REPORT

APNs
287-343-005-0

OWNER NAME / ADDRESS
LOTTE H KLICK
ROLAND A KLICK
17175 PALOMAS DR
PERRIS, CA. 92570

MAILING ADDRESS
(SEE OWNER)
(SEE SITUS)

EXHIBIT NO. B²

LEGAL DESCRIPTION

RECORDED BOOK/PAGE: MB 13/28
SUBDIVISION NAME: GAVILAN PARK 2
LOT/PARCEL: 17, BLOCK: NOT AVAILABLE
TRACT NUMBER: NOT AVAILABLE

LOT SIZE

RECORDED LOT SIZE IS 0.11 ACRES

PROPERTY CHARACTERISTICS

WOOD FRAME, 1000 SQFT., 1 BDRM/ 1 BATH, 1 STORY, CONST'D 1974 COMPOSITION, ROOF, CENTRAL HEATING

THOMAS BROS. MAPS PAGE/GRID

PAGE: 776 GRID: A7

CITY BOUNDARY/SPHERE

NOT WITHIN A CITY
NOT WITHIN A CITY SPHERE
ANNEXATION DATE: NOT APPLICABLE
NO LAFCO CASE # AVAILABLE
NO PROPOSALS

MARCH JOINT POWERS AUTHORITY

NOT IN THE JURISDICTION OF THE MARCH JOINT POWERS AUTHORITY

INDIAN TRIBAL LAND

NOT IN A TRIBAL LAND

SUPERVISORIAL DISTRICT (ORD. 813)

BOB BUSTER, DISTRICT 1

TOWNSHIP/RANGE

T4SR5W SEC 24

ELEVATION RANGE

1936/1936 FEET

PREVIOUS APN

287-252-004

PLANNING

LAND USE DESIGNATIONS

Zoning not consistent with the General Plan.
RC-LDR

AREA PLAN (RCIP)

LAKE MATHEWS / WOODCREST

GENERAL PLAN POLICY OVERLAYS

NOT IN A GENERAL PLAN POLICY OVERLAY AREA

GENERAL PLAN POLICY AREAS

NONE

ZONING CLASSIFICATIONS (ORD. 348)

W-2-M-2

ZONING DISTRICTS AND ZONING AREAS

GAVILAN HILLS DISTRICT

ZONING OVERLAYS

NOT IN A ZONING OVERLAY

SPECIFIC PLANS

NOT WITHIN A SPECIFIC PLAN

AGRICULTURAL PRESERVE

NOT IN AN AGRICULTURAL PRESERVE

REDEVELOPMENT AREAS

NOT IN A REDEVELOPMENT AREA

AIRPORT INFLUENCE AREAS

NOT IN AN AIRPORT INFLUENCE AREA

NOT IN AN AIRPORT COMPATIBILITY ZONE

ENVIRONMENTAL

CVMSHCP (COACHELLA VALLEY MULTI-SPECIES HABITAT CONSERVATION PLAN) CONSERVATION AREA
NOT IN A CONSERVATION AREA

CVMSHCP FLUVIAL SAND TRANSPORT SPECIAL PROVISION AREAS
NOT IN A FLUVIAL SAND TRANSPORT SPECIAL PROVISION AREA

WRMSHCP (WESTERN RIVERSIDE COUNTY MULTI-SPECIES HABITAT CONSERVATION PLAN) CELL GROUP
J

WRMSHCP CELL NUMBER
2736

HANS/ERP (HABITAT ACQUISITION AND NEGOTIATION STRATEGY/EXPEDITED REVIEW PROCESS)
NONE

VEGETATION (2005)
DEVELOPED/DISTURBED LAND

FIRE

HIGH FIRE AREA (ORD. 787)
IN HIGH FIRE AREA - Grading And Building Permit Applications Require Fire Dept Clearance Prior To Permit Issuance.

FIRE RESPONSIBILITY AREA
STATE RESPONSIBILITY AREA

DEVELOPMENT FEES

CVMSHCP FEE AREA (ORD. 875)
NOT WITHIN THE COACHELLA VALLEY MSHCP FEE AREA

WRMSHCP FEE AREA (ORD. 810)
IN OR PARTIALLY WITHIN THE WESTERN RIVERSIDE MSHCP FEE AREA. SEE MAP FOR MORE INFORMATION.

ROAD & BRIDGE DISTRICT
NOT IN A DISTRICT

EASTERN TUMF (TRANSPORTATION UNIFORM MITIGATION FEE ORD. 673)
NOT WITHIN THE EASTERN TUMF FEE AREA

WESTERN TUMF (TRANSPORTATION UNIFORM MITIGATION FEE ORD. 824)
IN OR PARTIALLY WITHIN A TUMF FEE AREA. SEE MAP FOR MORE INFORMATION. NORTHWEST

DIF (DEVELOPMENT IMPACT FEE AREA ORD. 659)
LAKE MATHEWS

SKR FEE AREA (STEPHEN'S KANGAROO RAT ORD. 663.10)
IN OR PARTIALLY WITHIN AN SKR FEE AREA. SEE MAP FOR MORE INFORMATION.

DEVELOPMENT AGREEMENTS
NOT IN A DEVELOPMENT AGREEMENT AREA

TRANSPORTATION

CIRCULATION ELEMENT ULTIMATE RIGHT-OF-WAY
NOT IN A CIRCULATION ELEMENT RIGHT-OF-WAY

ROAD BOOK PAGE
60

TRANSPORTATION AGREEMENTS
NOT IN A TRANSPORTATION AGREEMENT

CETAP (COMMUNITY AND ENVIRONMENTAL TRANSPORTATION ACCEPTABILITY PROCESS) CORRIDORS
NOT IN A CETAP CORRIDOR.

HYDROLOGY

FLOOD PLAIN REVIEW

NOT REQUIRED.

WATER DISTRICT

WMWD

FLOOD CONTROL DISTRICT

RIVERSIDE COUNTY FLOOD CONTROL DISTRICT

WATERSHED

SANTA ANA RIVER

GEOLOGIC

FAULT ZONE

NOT IN A FAULT ZONE

FAULTS

NOT WITHIN A 1/2 MILE OF A FAULT

LIQUEFACTION POTENTIAL

NO POTENTIAL FOR LIQUEFACTION EXISTS

SUBSIDENCE

NOT IN A SUBSIDENCE AREA

PALEONTOLOGICAL SENSITIVITY

LOW POTENTIAL.

FOLLOWING A LITERATURE SEARCH, RECORDS CHECK AND A FIELD SURVEY, AREAS MAY BE DETERMINED BY A QUALIFIED VERTEBRATE PALEONTOLOGIST AS HAVING LOW POTENTIAL FOR CONTAINING SIGNIFICANT PALEONTOLOGICAL RESOURCES SUBJECT TO ADVERSE IMPACTS.

MISCELLANEOUS

SCHOOL DISTRICT

VAL VERDE UNIFIED

COMMUNITIES

LAKE MATHEWS

COUNTY SERVICE AREA

NOT IN A COUNTY SERVICE AREA.

LIGHTING (ORD. 655)

ZONE B, 42.18 MILES FROM MT. PALOMAR OBSERVATORY

2000 CENSUS TRACT

042007

FARMLAND

URBAN-BUILT UP LAND

TAX RATE AREAS

098007

- COUNTY FREE LIBRARY
- COUNTY STRUCTURE FIRE PROTECTION
- COUNTY WASTE RESOURCE MGMT DIST
- CSA 152
- FLOOD CONTROL ADMINISTRATION
- FLOOD CONTROL ZONE 2
- GENERAL
- GENERAL PURPOSE
- METRO WATER WEST
- PERRIS AREA ELEM SCHOOL FUND
- PERRIS JR HIGH AREA FUND
- PERRIS VALLEY CEMETERY
- RIV CO REG PARK & OPEN SPACE
- RIV. CO. OFFICE OF EDUCATION
- RIVERSIDE CITY COMMUNITY COLLEGE
- RIVERSIDE CORONA RESOURCE CONSER
- VAL VERDE UNIF

- WATER
- WESTERN MUN WATER 3RD FRINGE

SPECIAL NOTES
NO SPECIAL NOTES

CODE COMPLAINTS

Case #	Description	Start Date
CV1007965	ABATEMENT	Sep. 21, 2010

BUILDING PERMITS

Case #	Description	Status
BEL041472	METER RESET	FINAL
BEL080334	METER RESET	FINAL
BZ287345	MOBILHOME SITE PREP	CONTACT THE BUILDING AND SAFETY RECORDS DEPARTMENT AT 951-955-2017
BZ287814	TWO AWNINGS TO MOBILE HOME	CONTACT THE BUILDING AND SAFETY RECORDS DEPARTMENT AT 951-955-2017
BZH07599	M/H INSTALLATION (12X60 CHAMPION HOMES)	CONTACT THE BUILDING AND SAFETY RECORDS DEPARTMENT AT 951-955-2017

ENVIRONMENTAL HEALTH PERMITS

Case #	Description	Status
NO ENVIRONMENTAL PERMITS	NOT APPLICABLE	NOT APPLICABLE

PLANNING PERMITS

Case #	Description	Status
NO PLANNING PERMITS	NOT APPLICABLE	NOT APPLICABLE

REPORT PRINTED ON...Wed May 11 11:44:05 2011
Version 110502



P.O. Box 1193
 Whittier, CA 90609
 Tel # (562) 325-8351
 Fax # (714) 783-3038

Lot Book Report

Order Number: **23280**

Customer:

RIVERSIDE COUNTY TLMA-CODE ENFORCEMENT
 4080 Lemon Street
 Riverside CA 92501

Order Date: 3/24/2011
 Dated as of: 3/17/2011
 County Name: Riverside

Attn: Brent Steele
 Reference: CV10-07965 / Jessica Morrison
 IN RE: KLICK, LOTTE H.

FEE(s):
 Report: \$120.00

Property Address: 17175 Palomas Avenue
 Perris CA 92570

Assessor's Parcel No. : 287-343-005-0

Assessments:

Land Value:	\$26,846.00
Improvement Value:	\$6,976.00
Exemption Value:	\$7,000.00
Total Value:	\$26,822.00

Tax Information

Property Taxes for the Fiscal Year	2010-2011
First Installment	\$147.56
Penalty	\$14.75
Status	NOT PAID-DELINQUENT
Second Installment	\$147.56
Penalty	\$0.00
Status	OPEN NOT-PAID (DUE DATE 04/10/2011)

EXHIBIT NO. _____

C



P.O. Box 1193
Whittier, CA 90609
Tel # (562) 325-8351
Fax # (714) 783-3038

Order Number: 23280

Reference: CV10-07965 / Jes

Property Vesting

The last recorded document transferring title of said property

Dated	09/11/2000
Recorded	10/12/2000
Document No.	2000-402312
D.T.T.	\$36.30
Grantor	Gaylord De Forest and Yvonne De Forest, husband and wife
Grantee	Lotte H. Klick, a widower and Roland A. Klick, a single man

Deeds of Trust

No Deeds of Trust of Record

Additional Information

Notice of Non-Compliance filed by	County of Riverside Code Enforcement Department
In the matter of the property of	Lotte H & Roland A Klick
Case No.	CV07-7569
Recorded	03/18/2008
Document No.	2008-0130541

Notice of Non-Compliance filed by	Riverside County Code Enforcement
In the matter of the property of	Lotte H & Roland A Klick
Case No.	CV10-07965
Recorded	02/09/2011
Document No.	2011-0064057



P.O. Box 1193
Whittier, CA 90609
Tel # (562) 325-8351
Fax # (714) 783-3038

Order Number: 23280

Reference: CV10-07965 / Jes

Legal Description

THE LAND REFERRED TO IN THIS REPORT IS LOCATED IN AND IS DESCRIBED AS FOLLOWS:

LOT 17 OF GAVILAN PARK NO. 2, IN THE COUNTY OF RIVERSIDE, STATE OF CALIFORNIA, AS PER MAP RECORDED IN BOOK 13, PAGE(S) 28, OF MAPS IN THE OFFICE OF THE COUNTY RECORDER OF SAID COUNTY.

SITE PLAN: Case # CV-1007965

OWNER(S): LOTTE H KLINK / ROLAND A KLINK
SITE ADDRESS: 17175 PALOMAS DR, PERRIS
ASSESSOR'S PARCEL: 287-343-005
ACREAGE: 0.109999

NORTH ARROW: 

REAR PROPERTY LINE

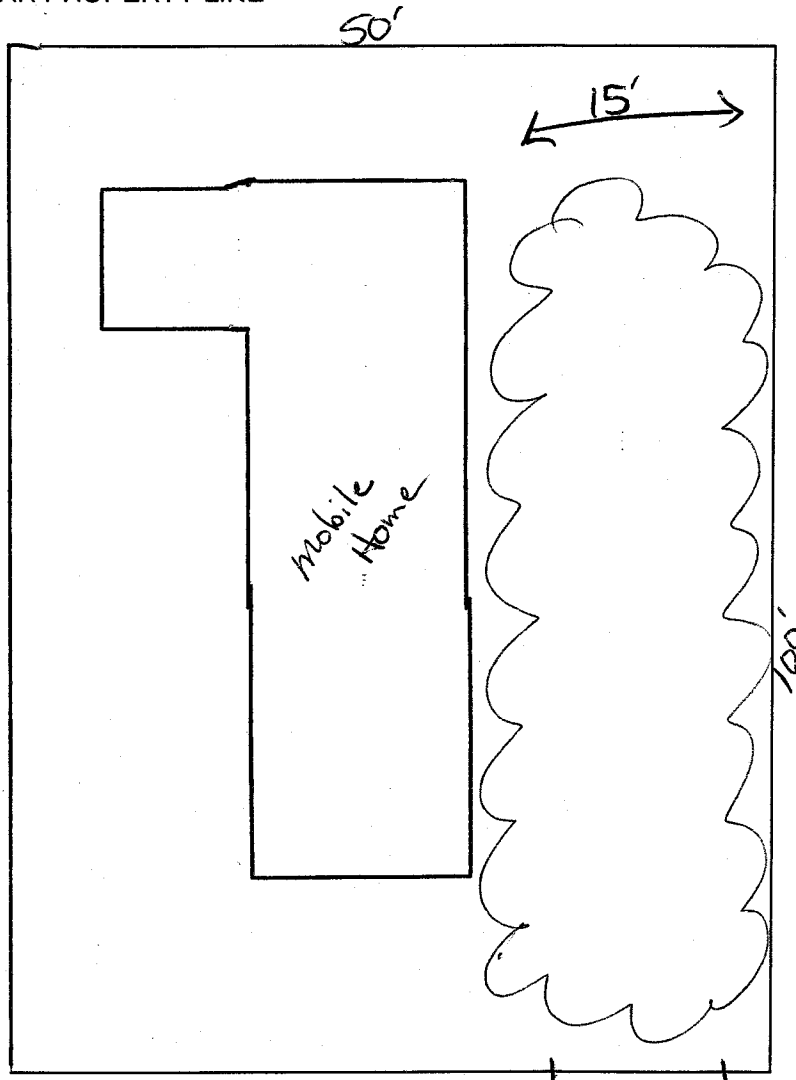

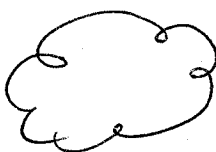
 = Accumulated Rubbish

FRONT PROPERTY LINE: 17175 PALOMAS DR, PERRIS

PREPARED BY: C BLACK DATE: 5-11-11

EXHIBIT NO. D

Code Enforcement Case: CV1007965

Printed on: 05/11/2011

Photographs



Photo #1 - front yard cleaned - 01/24/2011

EXHIBIT NO. D²



Photo #2 - rubbish in driveway area that runs to rear of property (1,500sf) - 01/24/2011

EXHIBIT NO. D³



Photo #1 - front of location - 03/22/2011

EXHIBIT NO. AD



Photo #2 - accumulated rubbish on driveway - 03/22/2011

EXHIBIT NO. D⁵



Photo #3 - front porch area is clean - 03/22/2011

EXHIBIT NO. D6



Photo #4 - posting of citation - 03/22/2011

EXHIBIT NO. D⁷



Photo #5 - some rubbish behind fence - 03/22/2011

EXHIBIT NO. D&



Photo #6 - view of front yard - 03/22/2011

EXHIBIT NO. D⁹



Photo #7 - detail of some of the items behind front gate - 03/22/2011

EXHIBIT NO. D10



Photo #1 - front yard is clean - 04/26/2011

EXHIBIT NO. D¹¹



Photo #2 - rubbish remains - 04/26/2011

EXHIBIT NO. _____

D12



Photo #3 - rubbish remains, and more tires brought in - 04/26/2011

EXHIBIT NO. D13



Photo #4 - rubbish remains - 04/26/2011

EXHIBIT NO. D14

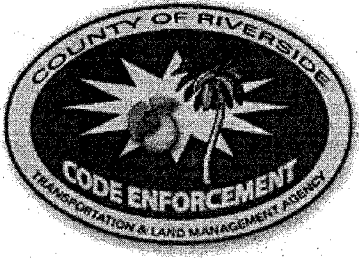

COUNTY OF RIVERSIDE
CODE ENFORCEMENT DEPARTMENT

NOTICE OF VIOLATION

CASE No.: CV 10-07965

THE PROPERTY AT: 17175 Palomas Dr, Perris APN#: 287-343-005

WAS INSPECTED BY OFFICER: C Black ID#: 12 ON 1/24/11 AT 3:30 am/pm

AND FOUND TO BE IN VIOLATION OF RIVERSIDE COUNTY CODE(S) AS FOLLOWS:

<input type="checkbox"/>	5.28.040 (RCO 593)	Excessive Yard Sales - Cease yard sale. Limit of 3 yard sale events, not over 3 consecutive days, per year.	<input type="checkbox"/>	17.252.030 (RCO 348)	Unpermitted Outdoor Advertising Display - Obtain a permit from the Planning Dept. or remove display.
<input type="checkbox"/>	8.28.030 (RCO 821)	Unfenced Pool - Install or provide adequate fencing to secure the pool.	<input type="checkbox"/>	17.172.205 (RCO 348)	Prohibited Fencing - Remove fence. Fences shall not be constructed of garage doors, tires, pallets or other materials not typically used for the construction of fences.
<input checked="" type="checkbox"/>	8.120.010 (RCO 541)	Accumulated Rubbish - Remove all rubbish & dispose of in an approved legal landfill.	<input type="checkbox"/>	17. (RCO 348)	Excessive Outside Storage: Storage of Unpermitted Mobile Home(s) Not Allowed - Remove unpermitted mobile home(s) from the property.
<input type="checkbox"/>	15.08.010 (RCO 457)	Unpermitted Construction - Cease construction. Obtain the appropriate permits from the Bldg. & Safety and Planning Departments or demolish the	<input type="checkbox"/>	17. (RCO 348)	Occupied RV/Trailer - Cease occupancy & disconnect all utilities to RV/Trailer.
<input type="checkbox"/>	15.12.020(J)(2) (RCO 457)	Unapproved Grading/Clearing - Cease grading/clearing/stockpiling/importing fill. Obtain a Restoration Assessment from the Dept. of Building & Safety. Perform complete restoration and remediation of the property affected by the unapproved grading in accordance with the Restoration Assessment.	<input type="checkbox"/>	17. (RCO 348)	Excessive Animals - Remove or reduce the number of to less than
<input type="checkbox"/>	15.16.020 (RCO 457)	Substandard Structure - Obtain a permit from the Bldg. & Safety Dept. to rehabilitate per Notice of Defects or demolish the structure.	<input type="checkbox"/>	17. (RCO 348)	Unpermitted Land Use: Cease all business activities. Obtain Planning Dept. approval prior to resuming business operations.
<input type="checkbox"/>	15.48.010 (RCO 457)	Unpermitted Mobile Home - Vacate mobile home. Obtain the appropriate permits from the Planning Dept. & Dept. of Bldg. & Safety prior to occupancy or remove Mobile Home.	<input type="checkbox"/>	17.12 / 17.150 (RCO 348)	Excessive Outside Storage - Remove or reduce all outside storage to less than square feet at the rear of the property.
<input type="checkbox"/>	15.48.040 (RCO 457)	Substandard Mobile Home/Trailer/RV - Obtain a permit from the Bldg. & Safety Dept. to rehabilitate per Notice of Defects and Title 25 or demolish the Mobile Home/Trailer/RV.	<input type="checkbox"/>		
<input type="checkbox"/>			<input type="checkbox"/>		

COMMENTS:

IMPORTANT! CORRECTION(S) MUST BE COMPLETED BY: 2-24-11. FAILURE TO COMPLY BY THIS DATE, MAY RESULT IN THE ISSUANCE OF AN ADMINISTRATIVE CITATION WITH FINES UP TO \$500.00 PER DAY, FOR EACH VIOLATION. YOU MAY BE CITED EACH DAY THAT THE VIOLATION(S) EXIST BEYOND THE CORRECTION DATE. IN ADDITION, OTHER ENFORCEMENT ACTION, PENALTIES AND THE IMPOSITION OF A LIEN ON THE PROPERTY FOR THE ABATEMENT AND ENFORCEMENT COSTS MAY RESULT IF COMPLIANCE IS NOT ACHIEVED BY THE CORRECTION DATE.

NOTICE IS HEREBY GIVEN THAT AT THE CONCLUSION OF THIS CASE YOU WILL RECEIVE A SUMMARY OF ADMINISTRATIVE COSTS ASSOCIATED WITH THE PROCESSING OF SUCH VIOLATION(S), AT AN HOURLY RATE OF \$129 AS DETERMINED BY THE BOARD OF SUPERVISORS. YOU WILL HAVE THE RIGHT TO OBJECT TO THESE CHARGES BY FILING A REQUEST FOR HEARING WITH THE DEPARTMENT OF CODE ENFORCEMENT WITHIN TEN (10) DAYS OF SERVICE OF THE SUMMARY OF CHARGES, PURSUANT TO RIVERSIDE COUNTY ORDINANCE 725 AND RIVERSIDE COUNTY CODE 1.16.

SIGNATURE _____ PRINT NAME _____ DATE _____ PROPERTY OWNER TENANT

CDL/CID# _____ D.O.B. _____ EXHIBIT NO. E TEL. NO. _____ POSTED



**CODE ENFORCEMENT DEPARTMENT
COUNTY OF RIVERSIDE**

GLENN BAUDE
Director

AFFIDAVIT OF POSTING OF NOTICES

January 25, 2011

RE CASE NO: CV1007965

I, Cynthia Black, hereby declare:

I am employed by the Riverside County Code Enforcement Department; that my business address is 19450 Clark Street, Perris, California 92570 .

That on 01/24/2011 at 3:30 p.m., I securely and conspicuously posted Notice of Violation at the property described as:

Property Address: 17175 PALOMAS DR, PERRIS

Assessor's Parcel Number: 287-343-005

I declare under the penalty of perjury that the foregoing is true and correct.

Executed on January 25, 2011 in the County of Riverside, California.

CODE ENFORCEMENT DEPARTMENT

C Black
By: Cynthia Black, Sr. Code Enforcement Officer

EXHIBIT NO. E2

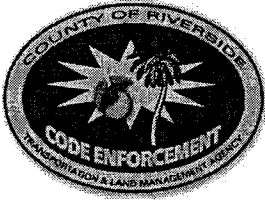

**CODE ENFORCEMENT DEPARTMENT
COUNTY OF RIVERSIDE**

GLENN BAUDE
Director

NOTICE OF VIOLATION

January 25, 2011

LOTTE H KLINK / ROLAND A KLINK
17175 PALOMAS DR
PERRIS, CA. 92570

RE CASE NO: CV1007965 at 17175 PALOMAS DR, in the community of PERRIS, California, Assessor's Parcel Number 287-343-005

NOTICE IS HEREBY GIVEN that property owned or controlled by you at 17175 PALOMAS DR, in the community of PERRIS California, Assessor's Parcel Number 287-343-005, is in violation of Section(s) RCC Section No. 8.120.010 (Ord. 541), of the Riverside County Code.

Said violation is described as:

- 1) 8.120.010 (Ord. 541) - No person or entity shall permit the accumulation of rubbish or other material, dangerous or injurious to the health and welfare of persons or the environment, on any real property in the unincorporated area of Riverside County owned by them or under their control.

YOU ARE HEREBY REQUIRED TO COMPLY with the provisions of the ordinance by:

- 1) Remove all rubbish and dispose of it in an approved, legal landfill.

COMPLIANCE MUST BE COMPLETED BY February 24, 2011. FAILURE TO COMPLY WILL RESULT IN LEGAL ACTION BEING BROUGHT AGAINST YOU.

NOTICE IS HEREBY GIVEN THAT AT THE CONCLUSION OF THIS CASE YOU WILL RECEIVE A SUMMARY OF ADMINISTRATIVE COSTS ASSOCIATED WITH THE PROCESSING OF SUCH VIOLATION(S), AT AN HOURLY RATE OF \$109.00 AS DETERMINED BY THE BOARD OF SUPERVISORS.

YOU WILL HAVE THE RIGHT TO OBJECT TO THESE CHARGES BY FILING A REQUEST FOR HEARING WITH THE DEPARTMENT OF CODE ENFORCEMENT WITHIN TEN (10) DAYS OF SERVICE OF THE SUMMARY OF CHARGES, PURSUANT TO SECTION 1.16.080 OF RIVERSIDE COUNTY CODE.

CODE ENFORCEMENT DEPARTMENT

By: Cynthia Black, Sr. Code Enforcement Officer

EXHIBIT NO. E³



**CODE ENFORCEMENT DEPARTMENT
COUNTY OF RIVERSIDE**

GLENN BAUDE
Director

PROOF OF SERVICE

Case No. CV1007965

STATE OF CALIFORNIA, COUNTY OF RIVERSIDE

I, Jessica Morrison, declare that I am a citizen of the United States and am employed in the County of Riverside, over the age of 18 years and not a party to the within action or proceeding; that my business address is at the footer of this notice.

That on January 25, 2011, I served the following documents(s):

NOTICE RE: NOTICE OF VIOLATION

by placing a true copy thereof enclosed in a sealed envelope(s) by **CERTIFIED MAIL, RETURN RECEIPT REQUESTED AND REGULAR MAIL** addressed as follows:

LOTTE H KLINK / ROLAND A KLINK 17175 PALOMAS DR, PERRIS, CA. 92570

XX **By First Class Mail.** I am readily familiar with the office's practice of collection and processing correspondence for mailing. Under that practice it would be deposited with the U.S. Postal Service with postage thereon fully prepaid in the County of Riverside, California, in the ordinary course of business.

XX **STATE.** I declare under the penalty of perjury under the laws of the State of California that the above is true and correct.

EXECUTED ON January 25, 2011 in the County of Riverside, California.

CODE ENFORCEMENT DEPARTMENT

By: Jessica Morrison
By: Jessica Morrison, Code Enforcement Aide

U.S. Postal Service		CERTIFIED MAIL RECEIPT <i>(Domestic Mail Only; No Insurance Coverage Provided)</i>
For delivery information visit our website at www.usps.com		
OFFICIAL USE		
Postage	\$	Postmark Here
Certified Fee		
Return Receipt Fee <small>(Endorsement Required)</small>		
Restricted Delivery Fee <small>(Endorsement Required)</small>		
LOTTE H KLINK / ROLAND A KLINK 17175 PALOMAS DR PERRIS, CA. 92570 CV10-07965 CB 287		
<small>See Reverse for Instructions</small>		

9506 1454 0000 0901 0102

19450 CLARK STREET, PERRIS, CALIFORNIA 92570
(951) 657-0122 • FAX (951) 943-1160

EXHIBIT NO. E4

SENDER: COMPLETE THIS SECTION

- Complete items 1, 2, and 3. Also complete item 4 if Restricted Delivery is desired.
- Print your name and address on the reverse so that we can return the card to you.
- Attach this card to the back of the mailpiece, or on the front if space permits.

1. Article Addressed to:

LOTTE H KLINK / ROLAND A KLINK
17175 PALOMAS DR
PERRIS, CA 92570
CV10-07965 CB 287

COMPLETE THIS SECTION ON DELIVERY

A. Signature
 Roland Klink Agent
 Addressee

B. Received by (Printed Name) *Roland Klink* C. Date of Delivery *1/27*

D. Is delivery address different from item 1? Yes
 If YES, enter delivery address below: No

- Express Mail
- Return Receipt for Merchandise
- C.O.D.

4. Restricted Delivery? (Extra Fee) Yes

2. Article Number
 (Transfer from service label) **7010 1060 0000 4541 9336**

PS Form 3811, February 2004

Domestic Return Receipt

102595-02-M-1540

EXHIBIT NO. ES



When recorded please mail to:
Riverside County Code Enforcement
District 1 Mead Valley Office
19450 Clark Street
Perris, CA 92570
Mail Stop # 5004

S	R	U	PAGE	SIZE	DA	MISC	LONG	RFD	COPY
1			1						
M	A	L	465	426	PCOR	NCOR	SMF	NCHG	EXAM
NCHG CC						T:	CTY	UNI	062

NOTICE OF NONCOMPLIANCE

In the matter of the Property of
KLICK,LOTTE H & ROLAND A

Case No. CV10-07965



NOTICE IS HEREBY GIVEN to all persons, pursuant to Section 10 of Ordinance Number 725 of the County of Riverside, State of California, that proceedings have been commenced with respect to violations of Riverside County Ordinance No.541, (RCC Title 8.120.010) described as ACCUMULATED RUBBISH. Such proceedings are based upon the noncompliance of such real property, located at 17175 PALOMAS DRIVE, PERRIS, CA, and more particularly described as Assessor's Parcel Number 287-343-005 and having a legal description of .11 ACRES IN LOT 17 MB 013/028 GAVILAN PARK 2, Records of Riverside County, with the requirements of Ordinance No. 541 (RCC Title 8.120.010).

The owner has been advised to immediately correct the above-referenced violations to avoid further action by the County of Riverside which may include demolition, removal, razing, etc., to abate the public nuisance. Any costs incurred by the County, including, but not limited to investigative, administrative and abatement costs and attorneys' fees, may become a lien on the property. Further details regarding this notice may be obtained by addressing an inquiry to the Code Enforcement Department, 19450 Clark Street, Perris, CA 92570, and Attention Code Enforcement Officer Cyndi Black.

NOTICE IS FURTHER GIVEN in accordance with §17274 and §24436.5 of the California Revenue and Taxation Code, that a tax deduction may not be allowed for interest, taxes, depreciation, or amortization paid or incurred in the taxable year affected by these proceedings.

RIVERSIDE COUNTY CODE ENFORCEMENT

By Manuel A. Acueto
Code Enforcement Department

ACKNOWLEDGEMENT

State of California)
County of Riverside)

On 11/07/11 before me, Jessica Morrison, Notary Public, personally appeared Manuel A. Acueto, who proved to me on the basis of satisfactory evidence to be the person(s) whose name(s) is/are subscribed to the within instrument and acknowledged to me that he/she/they executed the same in his/her/their authorized capacity(ies), and that by his/her/their signature(s) on the instrument the person(s), or the entity upon behalf of which the person(s) acted, executed the instrument.

I certify under PENALTY OF PERJURY under the laws of the State of California that the foregoing paragraph is true and correct.

WITNESS my hand and official seal.

Jessica Morrison
Commission # 1904280 Comm. Expires Sep. 17, 2014

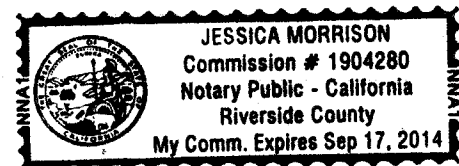

EXHIBIT NO. F



**CODE ENFORCEMENT DEPARTMENT
COUNTY OF RIVERSIDE**

Glenn Baude
Director

August 25, 2011

**NOTICE TO CORRECT COUNTY ORDINANCE VIOLATIONS AND
ABATE PUBLIC NUISANCE**

TO: Owners and Interested Parties
(See Attached Proof of Service
and Attached Notice List)

Case No.: CV10-07965
APN: 287-343-005; KCLICK
Property: 17175 Palomas Drive, Perris

NOTICE IS HEREBY GIVEN that a hearing will be held before the Riverside County Board of Supervisors pursuant to Riverside County Ordinance Nos. 541 (RCC Title 8) and 725 (RCC Title 1) to consider the abatement of the accumulated rubbish located on the SUBJECT PROPERTY described as **17175 Palomas Drive, Perris, Riverside County, California**, and more particularly described as Assessor's Parcel Number 287-343-005.

YOU ARE HEREBY DIRECTED as owner of the SUBJECT PROPERTY, to appear at this hearing to show cause why the SUBJECT PROPERTY should not be condemned as a public nuisance and be abated by removing the accumulated rubbish from the real property.

SAID HEARING will be held on **Tuesday, October 4, 2011, at 9:30 a.m.** in the Board of Supervisors Room, County Administrative Center, 4080 Lemon Street, 1st Floor Annex, Riverside, California at which time and place pertinent evidence will be received and/or testimony from all concerned parties will be heard. Failure to appear on your behalf will result in the exclusion of your testimony, and facts as known to the Code Enforcement Department ("Department") will be presented to the Board of Supervisors for consideration and deliberation in this matter.

Please be advised that the costs already accrued in this case, including but not limited to, enforcement and investigation costs, are recoverable by the Department, as allowed under Riverside County Ordinance No. 725. The Department may seek recovery of such costs from the property owner(s) which may result in a special assessment lien against the SUBJECT PROPERTY. Additionally, should the Department abate the property, the costs associated therewith, as well as all abatement costs allowed under Riverside County Ordinance No. 725 (RCC Title 1), will be sought from the property owner(s) and/or may result in a special assessment lien against the property.

You are encouraged to contact Supervising Code Enforcement Officer, Manuel Acueto at (951) 657-0122 or Supervising Code Enforcement Officer, Brian Black at (951) 955-2004 prior to the hearing. Please meet Brian Black at 8:30 a.m. on the day of the hearing in Conference Room 2A located on the 1st floor in front of the Human Resources Office to discuss the case.

GLENN BAUDE
DIRECTOR

WARD KOMERS
Administrative Manager

EXHIBIT NO. 6

NOTICE LIST

Subject Property: 17175 Palomas Drive, Perris
Case No.: CV 10-07965; APN: 287-343-005; District 1

ROLAND A KCLICK
LOTTE H KCLICK
17175 PALOMAS DRIVE
PERRIS CA 92570

EXHIBIT NO. 6²

1 **PROOF OF SERVICE**

2 Case No. CV10-07965

3 STATE OF CALIFORNIA, COUNTY OF RIVERSIDE

4 I, Brenda Peeler, declare that I am a citizen of the United States and am employed in the County of
5 Riverside, over the age of 18 years and not a party to the within action or proceeding; that my
6 business address is 3960 Orange Street, Suite 500, Riverside, California 92501.

7 That on August 25, 2011, I served the following document(s):

8 **NOTICE TO CORRECT COUNTY ORDINANCE VIOLATIONS
9 AND ABATE PUBLIC NUISANCE**

10 by placing a true copy thereof enclosed in a sealed envelope(s) addressed as follows:

11 **Owners or Interested Parties
12 (see attached notice list)**

13 XX **BY FIRST CLASS MAIL.** I am "readily familiar" with the office's practice of collection
14 and processing correspondence for mailing. Under that practice it would be deposited with
15 the U.S. Postal Service on that same day with postage thereon fully prepaid at Riverside,
16 California, in the ordinary course of business.

17 **BY PERSONAL SERVICE:** I caused to be delivered such envelope(s) by hand to the offices
18 of the addressee(s).

19 XX **STATE - I declare under penalty of perjury under the laws of the State of California that the
20 above is true and correct.**

21 **FEDERAL - I declare that I am employed in the office of a member of the bar of this court at
22 whose direction the service was made.**

23 EXECUTED ON August 25, 2011, at Riverside, California.

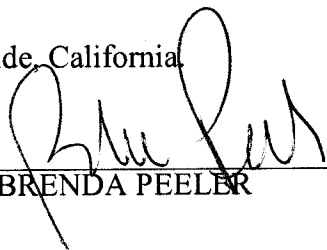
24 
25 _____
26 BRENDA PEELER

27 **EXHIBIT NO.** 63
28



**CODE ENFORCEMENT DEPARTMENT
COUNTY OF RIVERSIDE**

GLENN BAUDE
Director

AFFIDAVIT OF POSTING OF NOTICES

August 25, 2011

RE CASE NO: CV1007965

I, Cynthia Black, hereby declare:

I am employed by the Riverside County Code Enforcement Department; that my business address is 19450 Clark Street, Perris, California 92570 .

That on 08/25/2011 at 3:45 p.m., I securely and conspicuously posted Notice to Correct County Ordinance Violations and Abate Public Nuisance at the property described as:

Property Address: 17175 PALOMAS DR, PERRIS

Assessor's Parcel Number: 287-343-005

I declare under the penalty of perjury that the foregoing is true and correct.

Executed on August 25, 2011 in the County of Riverside, California.

CODE ENFORCEMENT DEPARTMENT

CBlack

By: Cynthia Black, Sr. Code Enforcement Officer

EXHIBIT NO. 64