

**SUBMITTAL TO THE BOARD OF SUPERVISORS
COUNTY OF RIVERSIDE, STATE OF CALIFORNIA**

8138



FROM: County Counsel
Code Enforcement Department

SUBMITTAL DATE:
August 30, 2011

SUBJECT: Statement of Abatement Costs [Case No. CV09-12452]
Subject Property: 42980 Calle Montecillo, Temecula; KITCHINGS
APN: 935-260-025
District One

RECOMMENDED MOTION: Move that the Board of Supervisors:

- 1) assess the reasonable costs of abatement of a public nuisance [construction without permits (carport)] in the above-referenced matter to be **two thousand, four hundred fifty-two dollars and twenty-six cents (US \$2,452.26)** was reasonable and that a refund or reimbursement of the entire or a portion of said amount already paid by the property owner is not warranted.

BACKGROUND: Government Code § 25845, Riverside County Ordinance Nos. 457 (RCC Title 15) and 725 (RCC Title 1.16) authorize the recovery of abatement costs in public nuisance cases, the recordation of a notice of abatement lien and inclusion of abatement costs on the tax roll as a special assessment upon approval of the Board of Supervisors.

[Signature]
PATRICIA MUNROE, Deputy County Counsel
for PAMELA J. WALLS, County Counsel

FINANCIAL DATA	Current F.Y. Total Cost:	\$ N/A	In Current Year Budget:	N/A
	Current F.Y. Net County Cost:	\$ N/A	Budget Adjustment:	N/A
	Annual Net County Cost:	\$ N/A	For Fiscal Year:	N/A
SOURCE OF FUNDS:				Positions To Be Deleted Per A-30 <input type="checkbox"/>
				Requires 4/5 Vote <input type="checkbox"/>

C.E.O. RECOMMENDATION:

APPROVE

BY:

[Signature]
Tina Grande

County Executive Office Signature

MINUTES OF THE BOARD OF SUPERVISORS

On motion of Supervisor Buster, seconded by Supervisor Stone and duly carried by unanimous vote, IT WAS ORDERED that the above matter is approved as recommended with a revised amount of costs to \$500.

Ayes: Buster, Tavaglione, Stone, Benoit and Ashley
Nays: None
Absent: None
Date: October 18, 2011
xc: Co. Co., CED, Prop. Owner

Kecia Harper-Ihem
Clerk of the Board
By: *[Signature]*
Deputy

Prev. Agn. Ref.:

District: 1

Agenda Number:

9.6

Statement of Abatement Costs [Case No. CV09-12452]
Subject Property: 42980 Calle Montecillo, Temecula; KITCHINGS
APN: 935-260-025
District: One
Page 2

Notices of Violation and Administrative Citations were issued. On or about March 9, 2011, the property was brought into compliance; permit number BPT110037 was finalized on Feb. 28, 2011.

The Notice of Hearing re Statement of Abatement Costs has been posted on the property and mailed to the property owner and all interested parties, as required by law. Copies of all relevant notices issued in this matter together with proof of service and posting have been separately filed with the Clerk of the Board and are made a part of the record herein, pursuant to Riverside County Ordinance 725.

BOARD OF SUPERVISORS
PUBLIC HEARING

October 18, 2011
(Continued 9.5 of Sept. 13, 2011)

AGENDA ITEM NO. 9.6

Supplemental Documents

Statement of Abatement Costs
42980 Calle Montecillo, Temecula
Case No. CV09-12452

DISTRICT One

2011 OCT 13 15:10:31

2011-10-109991



**CODE ENFORCEMENT DEPARTMENT
COUNTY OF RIVERSIDE**

Glenn Baude
Director

September 20, 2011

**CONTINUED NOTICE OF HEARING
RE: STATEMENT OF ABATEMENT COSTS**

To: Owner(s) or Interested Parties
(See Attached Proof of Service
and Notice List)

Subject Property: 42980 Calle Montecillo, Temecula
Case No.: CV09-12452; KITCHINGS
APN: 935-260-025

NOTICE IS HEREBY GIVEN that a hearing that was held before the Riverside County Board of Supervisors on **Tuesday, September 13, 2011, at 9:30 a.m.** in the Board of Supervisors Room, 4080 Lemon Street, 1st Floor Annex, Riverside, California, and **has been continued to Tuesday, October 18, 2011, at 9:30 a.m.** at which time and place pertinent testimony will be heard regarding the expenses incurred by the County of Riverside, Code Enforcement Department ("DEPARTMENT") for the above-referenced abatement case. Said abatement case involved landscaping, trash containers and excessive outside storage located on your real property commonly described as 14560 Sleepy Creek Drive, Corona, Riverside County, California and more particularly described as Assessor's Parcel Number 144-470-027.

The total expense due, including all other fees and costs, for the abatement of the above-described condition was **two thousand, four hundred fifty-two dollars and twenty-six cents, (US \$2,452.26)**, which has been paid in full. However, because you have objections to the Summary of Costs attached hereto, you may address your objections to the Board of Supervisors at the hearing.

Failure to appear at the hearing will result in the exclusion of your testimony. Facts as known to the DEPARTMENT will be presented to the Board of Supervisors for their final consideration and deliberation of this matter.

You may contact Ward Komers or Carol Lynn Anderson at (951) 955-2004 prior to the hearing.

GLENN BAUDE
DIRECTOR

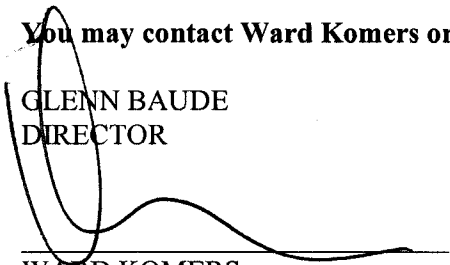
WARD KOMERS
Administrative Manager
Enclosure: Statement of Abatement Costs



County of Riverside Code Enforcement

P.O. Box 1469, Riverside, CA 92502
Phone: 951-955-2004 Fax: 951-955-8680
demands@rctlma.org

Property Reference/Mailing Address
935-260-025 DAVID RAY KITCHINGS DEBRAH KITCHINGS P O BOX 2369 TEMECULA CA. 92593

Property Statement

As of 3/28/2011

Rep
CP

Date	Invoice Number & Amount	Amount
03/28/2011	CV0912452- INV #100793. Orig. Amount \$2,452.26.	2,452.26

Make checks payable to Riverside
County Code Enforcement and remit to
P.O. Box 1469, Riverside CA 92502
with a copy of this statement. Express
or overnight mailings can be sent to
4080 Lemon St. M/S 1012, Riverside
CA 92501.

Balance Due

\$2,452.26

Check #	Date Remitted	Amount Remitted

Registration under County Ordinance 880/881 - Abandoned and Distressed Residential Properties - must be current prior to release of any liens of property. Upon full payment of the above and confirmation of available funds to the County, a release letter for the Notice of Noncompliance will be signed, notarized, and recorded with the Riverside County Recorder Office.

EXHIBIT NO. ²
A



County of Riverside Code Enforcement Department

P.O. Box 1469, Riverside, CA 92502
Phone: (951) 955-2004 Fax: (951) 955-8680
demands@rctlma.org

Summary of Costs

935-260-025
DAVID RAY KITCHINGS
DEBRAH KITCHINGS
P O BOX 2369
TEMECULA CA. 92593

Date	Invoice #
3/28/2011	100793

Amounts are due and payable upon receipt		
Case Number	District	Class
CV0912452	1	Demands

Property Address
935-260-025 DAVID RAY KITCHINGS DEBRAH KITCHINGS 42980 CALLE MONTECILLO TEMECULA, CA 92590

Date	Item	Description	Hours/Qty	Rate	Amount
12/2/2009	Officer Hours	Labor Charges - Officer Time	0.3	109.00	32.70
12/2/2009	Officer Hours	Labor Charges - Officer Time	0.3	109.00	32.70
5/3/2010	Officer Hours	Labor Charges - Officer Time	0.3	109.00	32.70
5/3/2010	Officer Hours	Labor Charges - Officer Time	0.8	109.00	87.20
2/2/2011	Officer Hours	Labor Charges - Officer Time	0.3	109.00	32.70
2/2/2011	Officer Hours	Labor Charges - Officer Time	0.3	109.00	32.70
2/2/2011	Case Management	Officer research, report writing, records preparation		163.50	163.50
		Subtotal Code Enforcement Costs			414.20
3/30/2010	Attorney Fees	Attorney Fees - County Counsel	0.4	139.50	55.80
3/31/2010	Attorney Fees	Attorney Fees - County Counsel	0.1	139.50	13.95
4/5/2010	Attorney Fees	Attorney Fees - County Counsel	3.7	139.5081	516.18
4/7/2010	Attorney Fees	Attorney Fees - County Counsel	0.3	139.50	41.85
4/8/2010	Attorney Fees	Attorney Fees - County Counsel	0.4	139.50	55.80
4/8/2010	Attorney Fees	Attorney Fees - County Counsel	1	69.76	69.76
4/15/2010	Attorney Fees	Attorney Fees - County Counsel	0.3	69.76667	20.93
4/20/2010	Attorney Fees	Attorney Fees - County Counsel	0.75	69.76	52.32
4/22/2010	Attorney Fees	Attorney Fees - County Counsel	0.2	69.75	13.95
4/26/2010	Attorney Fees	Attorney Fees - County Counsel	1	69.76	69.76
4/27/2010	Attorney Fees	Attorney Fees - County Counsel	0.1	139.50	13.95
4/27/2010	Attorney Fees	Attorney Fees - County Counsel	0.5	69.76	34.88
			Subtotal		
			Payments/Credits		
			Total		

Riverside County Ordinance 725 provides for the recovery of abatement and administrative costs reasonably related to Code Enforcement, including costs related to the abatement, collection, attorney's fees and staff time for site inspections, investigation, summaries, reports, and notices

A Request for Hearing to object to the charges must be filed in writing to this department within 10 days of the service of this Summary of Costs. You may submit your signed request via U.S Mail, Fax or Email to any of the address(s)/numbers listed above.

Make checks payable to Riverside County Code Enforcement and remit to P.O. Box 1469, Riverside, CA 92502



County of Riverside Code Enforcement Department

P.O. Box 1469, Riverside, CA 92502
Phone: (951) 955-2004 Fax: (951) 955-8680
demands@rctlma.org

Summary of Costs

935-260-025
DAVID RAY KITCHINGS
DEBRAH KITCHINGS
P O BOX 2369
TEMECULA CA. 92593

Date	Invoice #
3/28/2011	100793

Amounts are due and payable upon receipt		
Case Number	District	Class
CV0912452	1	Demands

Property Address
935-260-025 DAVID RAY KITCHINGS DEBRAH KITCHINGS 42980 CALLE MONTECILLO TEMECULA, CA 92590

Date	Item	Description	Hours/Qty	Rate	Amount
4/29/2010	Attorney Fees	Attorney Fees - County Counsel	1	139.51	139.51
5/4/2010	Attorney Fees	Attorney Fees - County Counsel	0.2	69.75	13.95
5/5/2010	Attorney Fees	Attorney Fees - County Counsel	0.1	139.50	13.95
5/5/2010	Attorney Fees	Attorney Fees - County Counsel	0.9	69.75555	62.78
5/5/2010	Attorney Fees	Attorney Fees - County Counsel	3	139.51	418.53
5/5/2010	Attorney Fees	Attorney Fees - County Counsel	0.2	69.75	13.95
5/6/2010	Attorney Fees	Attorney Fees - County Counsel	2.5	139.512	348.78
5/26/2010	Attorney Fees	Attorney Fees - County Counsel	0.9	74.97778	67.48
8/17/2010	Attorney Fees	Attorney Fees - County Counsel			
		Subtotal County Counsel Costs			2,038.06
				Subtotal	\$2,452.26
				Payments/Credits	\$0.00
				Total	\$2,452.26

Riverside County Ordinance 725 provides for the recovery of abatement and administrative costs reasonably related to Code Enforcement, including costs related to the abatement, collection, attorney's fees and staff time for site inspections, investigation, summaries, reports, and notices

A Request for Hearing to object to the charges must be filed in writing to this department within 10 days of the service of this Summary of Costs. You may submit your signed request via U.S Mail, Fax or Email to any of the address(s)/numbers listed above.

Make checks payable to Riverside County Code Enforcement and remit to P.O. Box 1469, Riverside, CA 92502

NOTICE LIST

Subject Property: 42980 Calle Montecillo, Temecula; Case No.: CV09-12452;
APN: 935-260-025; District One

DAVID RAY KITCHINGS
DEBRAH ANN KITCHINGS
42980 CALLE MONTECILLO
TEMECULA CA 92590

DAVID RAY KITCHINGS
DEBRAH ANN KITCHINGS
PO BOX 2369
TEMECULA CA 92593

COUNTRYWIDE HOME LOANS INC
4500 PARK GRANADA
CALABASAS CA 91302-1613

CTC REAL ESTATE SERVICES
155 NORTH LAKE AVENUE
PASADENA CA 91109

AMERICAN SECURITIES COMPANY
ELLS FARGO BANK NA
PO BOX 31557
BILLINGS MT 59107

1 **PROOF OF SERVICE**

2 Case No. CV09-12452

3 STATE OF CALIFORNIA, COUNTY OF RIVERSIDE

4 I, Brenda G. Peeler, declare that I am a citizen of the United States and am employed in the County
5 of Riverside, over the age of 18 years and not a party to the within action or proceeding; that my
6 business address is 3960 Orange Street, Suite 500, Riverside, California 92501.

7 That on September 20, 2011, I served the following document(s):

- 8 - **CONTINUED NOTICE OF HEARING RE: STATEMENT OF**
9 **ABATEMENT COSTS**
10 - **SUMMARY STATEMENT OF ABATEMENT COSTS**
11 - **STATEMENT OF ABATEMENT COSTS**
12 - **ADMINISTRATIVE CITATION(S)**
13 - **NOTICE LIST**

14 by placing a true copy thereof enclosed in a sealed envelope(s) addressed as follows:

15 **OWNERS OR INTERESTED PARTIES**
16 **(SEE NOTICE LIST ATTACHED TO NOTICE OF HEARING)**

17 XX **BY FIRST CLASS MAIL.** I am "readily familiar" with the office's practice of collection
18 and processing correspondence for mailing. Under that practice it would be deposited with
19 the U.S. Postal Service on that same day with postage thereon fully prepaid at Riverside,
20 California, in the ordinary course of business.

21 — **BY PERSONAL SERVICE:** I caused to be delivered such envelope(s) by hand to the offices
22 of the addressee(s).

23 XX **STATE - I declare under penalty of perjury under the laws of the State of California that the**
24 **above is true and correct.**

25 — **FEDERAL - I declare that I am employed in the office of a member of the bar of this court at**
26 **whose direction the service was made.**

27 EXECUTED ON September 20, 2011, at Riverside, California.

28 
BRENDA G. PEELER



**CODE ENFORCEMENT DEPARTMENT
COUNTY OF RIVERSIDE**

GLENN BAUDE
Director

AFFIDAVIT OF POSTING OF NOTICES

September 21, 2011

RE CASE NO: CV0912452

I, Brett Farlow, hereby declare:

I am employed by the Riverside County Code Enforcement Department; that my business address is 39493 Los Alamos Road, Suite #A, Murrieta, California 92563 .

That on 09/21/11 at 1000 Hrs, I securely and conspicuously posted Continued Notice of Hearing RE: Statement of Abatement Costs at the property described as:

Property Address: 42980 CALLE MONTECILLO, TEMECULA

Assessor's Parcel Number: 935-260-025

I declare under the penalty of perjury that the foregoing is true and correct.

Executed on September 21, 2011 in the County of Riverside, California.

CODE ENFORCEMENT DEPARTMENT

Brett Farlow
By: Brett Farlow, Code Enforcement Officer

**SUBMITTAL TO THE BOARD OF SUPERVISORS
COUNTY OF RIVERSIDE, STATE OF CALIFORNIA**

FROM: County Counsel
Code Enforcement Department
SUBJECT: Statement of Abatement Costs [Case No. CV09-12452]
Subject Property: 42980 Calle Montecillo; KITCHINGS
APN: 935-260-025
District One

**TABLE OF SUPPLEMENTAL DOCUMENTS
FILED WITH THE CLERK OF THE BOARD**

Hearing Date: SEPTEMBER 13, 2011

Notice of Hearing Re: Statement of Abatement Costs (including Proof(s) of Service and Affidavit(s) of Posting	Exhibit A
Property Statement and Statement of Costs with Supporting Documents	Exhibit B
Assessment-Roll For The Year 10/11 And Geographic Information System, Aug. 23, 2011	Exhibit C
Lot Book Report.....	Exhibit D

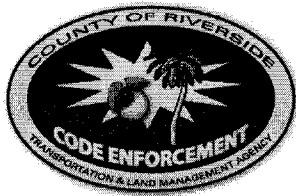

**CODE ENFORCEMENT DEPARTMENT
COUNTY OF RIVERSIDE**

Glenn Baude
Director

August 23, 2011

**NOTICE OF HEARING RE:
STATEMENT OF ABATEMENT COSTS**

To: Owner(s) or Interested Parties
(See Attached Proof of Service
and Notice List)

Subject Property: 42980 Calle Montecillo, Temecula
Case No.: CV09-12452; KITCHINGS
APN: 935-260-025

NOTICE IS HEREBY GIVEN that a hearing will be held before the Riverside County Board of Supervisors on **Tuesday, September 13, 2011, at 9:30 a.m.** in the Board of Supervisors Room, 4080 Lemon Street, 1st Floor Annex, Riverside, California, at which time and place pertinent testimony will be heard regarding the expenses incurred by the County of Riverside, Code Enforcement Department ("DEPARTMENT") for the above-referenced abatement case. Said abatement case involved construction without permit (carport) located on your real property commonly described as 42980 Calle Montecillo, Temecula, Riverside County, California and more particularly described as Assessor's Parcel Number 935-260-025.

The total expense due, including all other fees and costs, for the abatement of the above-described condition was **two thousand, four hundred fifty-two dollars and twenty-six cents, (US \$2,452.26)**, which has been paid in full. However, because you have objections to the Summary of Costs attached hereto, you may address your objections to the Board of Supervisors at the hearing.

Failure to appear at the hearing will result in the exclusion of your testimony and the amount charged will be deemed reasonable. Facts as known to the DEPARTMENT will be presented to the Board of Supervisors for their final consideration and deliberation of this matter.

You may contact Ward Komers or Carol Lynn Anderson at (951) 955-2004 prior to the hearing.

GLENN BAUDE
DIRECTOR

WARD KOMERS

Administrative Manager

Enclosure: Statement of Abatement Costs

EXHIBIT NO. A



County of Riverside Code Enforcement

P.O. Box 1469, Riverside, CA 92502
Phone: 951-955-2004 Fax: 951-955-8680
demands@rctlma.org

Property Reference/Mailing Address
935-260-025 DAVID RAY KITCHINGS DEBRAH KITCHINGS P O BOX 2369 TEMECULA CA. 92593

Property Statement

As of 3/28/2011

Rep
CP

Date	Invoice Number & Amount	Amount
03/28/2011	CV0912452- INV #100793. Orig. Amount \$2,452.26.	2,452.26

Make checks payable to Riverside
County Code Enforcement and remit to
P.O. Box 1469, Riverside CA 92502
with a copy of this statement. Express
or overnight mailings can be sent to
4080 Lemon St. M/S 1012, Riverside
CA 92501.

Balance Due	\$2,452.26
-------------	------------

Check #	Date Remitted	Amount Remitted

Registration under County Ordinance 880/881 - Abandoned and Distressed Residential Properties - must be current prior to release of any liens of property. Upon full payment of the above and confirmation of available funds to the County, a release letter for the Notice of Noncompliance will be signed, notarized, and recorded with the Riverside County Recorder Office.

EXHIBIT NO. A²



County of Riverside Code Enforcement Department

P.O. Box 1469, Riverside, CA 92502
Phone: (951) 955-2004 Fax: (951) 955-8680
demands@rctlma.org

Summary of Costs

935-260-025
DAVID RAY KITCHINGS
DEBRAH KITCHINGS
P O BOX 2369
TEMECULA CA. 92593

Date	Invoice #
3/28/2011	100793

Amounts are due and payable upon receipt		
Case Number	District	Class
CV0912452	1	Demands

Property Address
935-260-025 DAVID RAY KITCHINGS DEBRAH KITCHINGS 42980 CALLE MONTECILLO TEMECULA, CA 92590

Date	Item	Description	Hours/Qty	Rate	Amount
12/2/2009	Officer Hours	Labor Charges - Officer Time	0.3	109.00	32.70
12/2/2009	Officer Hours	Labor Charges - Officer Time	0.3	109.00	32.70
5/3/2010	Officer Hours	Labor Charges - Officer Time	0.3	109.00	32.70
5/3/2010	Officer Hours	Labor Charges - Officer Time	0.8	109.00	87.20
2/2/2011	Officer Hours	Labor Charges - Officer Time	0.3	109.00	32.70
2/2/2011	Officer Hours	Labor Charges - Officer Time	0.3	109.00	32.70
	Case Management	Officer research, report writing, records preparation		163.50	163.50
		Subtotal Code Enforcement Costs			414.20
3/30/2010	Attorney Fees	Attorney Fees - County Counsel	0.4	139.50	55.80
3/31/2010	Attorney Fees	Attorney Fees - County Counsel	0.1	139.50	13.95
4/5/2010	Attorney Fees	Attorney Fees - County Counsel	3.7	139.5081	516.18
4/7/2010	Attorney Fees	Attorney Fees - County Counsel	0.3	139.50	41.85
4/8/2010	Attorney Fees	Attorney Fees - County Counsel	0.4	139.50	55.80
4/8/2010	Attorney Fees	Attorney Fees - County Counsel	1	69.76	69.76
4/15/2010	Attorney Fees	Attorney Fees - County Counsel	0.3	69.76667	20.93
4/20/2010	Attorney Fees	Attorney Fees - County Counsel	0.75	69.76	52.32
4/22/2010	Attorney Fees	Attorney Fees - County Counsel	0.2	69.75	13.95
4/26/2010	Attorney Fees	Attorney Fees - County Counsel	1	69.76	69.76
4/27/2010	Attorney Fees	Attorney Fees - County Counsel	0.1	139.50	13.95
4/27/2010	Attorney Fees	Attorney Fees - County Counsel	0.5	69.76	34.88

Subtotal

Riverside County Ordinance 725 provides for the recovery of abatement and administrative costs reasonably related to Code Enforcement, including costs related to the abatement, collection, attorney's fees and staff time for site inspections, investigation, summaries, reports, and notices

Payments/Credits

Total

A Request for Hearing to object to the charges must be filed in writing to this department within 10 days of the service of this Summary of Costs. You may submit your signed request via U.S Mail, Fax or Email to any of the address(s)/numbers listed above.

Make checks payable to Riverside County Code Enforcement and remit to P.O. Box 1469, Riverside, CA 92502



County of Riverside Code Enforcement Department

P.O. Box 1469, Riverside, CA 92502
Phone: (951) 955-2004 Fax: (951) 955-8680
demands@rctlma.org

Summary of Costs

935-260-025
DAVID RAY KITCHINGS
DEBRAH KITCHINGS
P O BOX 2369
TEMECULA CA. 92593

Date	Invoice #
3/28/2011	100793

Amounts are due and payable upon receipt		
Case Number	District	Class
CV0912452	1	Demands

Property Address
935-260-025 DAVID RAY KITCHINGS DEBRAH KITCHINGS 42980 CALLE MONTECILLO TEMECULA, CA 92590

Date	Item	Description	Hours/Qty	Rate	Amount
4/29/2010	Attorney Fees	Attorney Fees - County Counsel	1	139.51	139.51
5/4/2010	Attorney Fees	Attorney Fees - County Counsel	0.2	69.75	13.95
5/5/2010	Attorney Fees	Attorney Fees - County Counsel	0.1	139.50	13.95
5/5/2010	Attorney Fees	Attorney Fees - County Counsel	0.9	69.75555	62.78
5/5/2010	Attorney Fees	Attorney Fees - County Counsel	3	139.51	418.53
5/6/2010	Attorney Fees	Attorney Fees - County Counsel	0.2	69.75	13.95
5/26/2010	Attorney Fees	Attorney Fees - County Counsel	2.5	139.512	348.78
8/17/2010	Attorney Fees	Attorney Fees - County Counsel	0.9	74.97778	67.48
		Subtotal County Counsel Costs			2,038.06
				Subtotal	\$2,452.26
				Payments/Credits	\$0.00
				Total	\$2,452.26

Riverside County Ordinance 725 provides for the recovery of abatement and administrative costs reasonably related to Code Enforcement, including costs related to the abatement, collection, attorney's fees and staff time for site inspections, investigation, summaries, reports, and notices

A Request for Hearing to object to the charges must be filed in writing to this department within 10 days of the service of this Summary of Costs. You may submit your signed request via U.S Mail, Fax or Email to any of the address(s)/numbers listed above.

Make checks payable to Riverside County Code Enforcement and remit to P.O. Box 1469, Riverside, CA 92502

NOTICE LIST

Subject Property: 42980 Calle Montecillo, Temecula; Case No.: CV09-12452;
APN: 935-260-025; District One

DAVID RAY KITCHINGS
DEBRAH ANN KITCHINGS
42980 CALLE MONTECILLO
TEMECULA CA 92590

DAVID RAY KITCHINGS
DEBRAH ANN KITCHINGS
PO BOX 2369
TEMECULA CA 92593

GREGG A BERGE
40735 POCONA PLACE
MURRIETA CA 92562

COUNTRYWIDE HOME LOANS INC
4500 PARK GRANADA
CALABASAS CA 91302-1613

CTC REAL ESTATE SERVICES
155 NORTH LAKE AVENUE
PASADENA CA 91109

AMERICAN SECURITIES COMPANY
ELLS FARGO BANK NA
PO BOX 31557
BILLINGS MT 59107

EXHIBIT NO. _____

AS

PROOF OF SERVICE

Case No. CV09-12452

STATE OF CALIFORNIA, COUNTY OF RIVERSIDE

I, Brenda G. Peeler, declare that I am a citizen of the United States and am employed in the County of Riverside, over the age of 18 years and not a party to the within action or proceeding; that my business address is 3960 Orange Street, Suite 500, Riverside, California 92501.

That on August 23, 2011, I served the following document(s):

- **NOTICE OF HEARING RE: STATEMENT OF ABATEMENT COSTS**
- **SUMMARY STATEMENT OF ABATEMENT COSTS**
- **STATEMENT OF ABATEMENT COSTS**
- **ADMINISTRATIVE CITATION(S)**
- **NOTICE LIST**

by placing a true copy thereof enclosed in a sealed envelope(s) addressed as follows:

**OWNERS OR INTERESTED PARTIES
(SEE NOTICE LIST ATTACHED TO NOTICE OF HEARING)**

XX **BY FIRST CLASS MAIL.** I am "readily familiar" with the office's practice of collection and processing correspondence for mailing. Under that practice it would be deposited with the U.S. Postal Service on that same day with postage thereon fully prepaid at Riverside, California, in the ordinary course of business.

— **BY PERSONAL SERVICE:** I caused to be delivered such envelope(s) by hand to the offices of the addressee(s).

XX **STATE - I declare under penalty of perjury under the laws of the State of California that the above is true and correct.**

— **FEDERAL - I declare that I am employed in the office of a member of the bar of this court at whose direction the service was made.**

EXECUTED ON August 23, 2011, at Riverside, California.

BRENDA G. PEELER

EXHIBIT NO. Ab

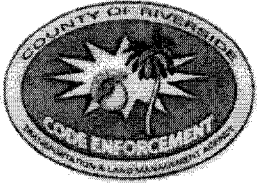

**CODE ENFORCEMENT DEPARTMENT
COUNTY OF RIVERSIDE**

GLENN BAUDE
Director

AFFIDAVIT OF POSTING OF NOTICES

August 24, 2011

RE CASE NO: CV0912452

I, Brett Farlow, hereby declare:

I am employed by the Riverside County Code Enforcement Department; that my business address is 39493 Los Alamos Road, Suite #A, Murrieta, California 92563 .

That on 08/24/11 at 1100 Hrs., I securely and conspicuously posted Notice of Hearing RE: Statement of Abatement Costs at the property described as:

Property Address: 42980 CALLE MONTECILLO, TEMECULA

Assessor's Parcel Number: 935-260-025

I declare under the penalty of perjury that the foregoing is true and correct.

Executed on August 24, 2011 in the County of Riverside, California.

CODE ENFORCEMENT DEPARTMENT

B R
By: Brett Farlow, Code Enforcement Officer

EXHIBIT NO. A7



County of Riverside Code Enforcement

P.O. Box 1469, Riverside, CA 92502
Phone: 951-955-2004 Fax: 951-955-8680
demands@rctlma.org

Property Reference/Mailing Address
935-260-025 DAVID RAY KITCHINGS DEBRAH KITCHINGS P O BOX 2369 TEMECULA CA. 92593

Property Statement

As of 3/28/2011

Rep
CP

Date	Invoice Number & Amount	Amount
03/28/2011	CV0912452- INV #100793. Orig. Amount \$2,452.26.	2,452.26

Make checks payable to Riverside
County Code Enforcement and remit to
P.O. Box 1469, Riverside CA 92502
with a copy of this statement. Express
or overnight mailings can be sent to
4080 Lemon St. M/S 1012, Riverside
CA 92501.

Balance Due	\$2,452.26
-------------	------------

Check #	Date Remitted	Amount Remitted

Registration under County Ordinance 880/881 - Abandoned and Distressed Residential Properties - must be current prior to release of any liens of property. Upon full payment of the above and confirmation of available funds to the County, a release letter for the Notice of Noncompliance will be signed, notarized, and recorded with the Riverside County Recorder Office.

EXHIBIT NO. B



County of Riverside Code Enforcement Department

P.O. Box 1469, Riverside, CA 92502
Phone: (951) 955-2004 Fax: (951) 955-8680
demands@rctlma.org

Summary of Costs

935-260-025
DAVID RAY KITCHINGS
DEBRAH KITCHINGS
P O BOX 2369
TEMECULA CA. 92593

Date	Invoice #
3/28/2011	100793

Amounts are due and payable upon receipt		
Case Number	District	Class
CV0912452	1	Demands

Property Address
935-260-025 DAVID RAY KITCHINGS DEBRAH KITCHINGS 42980 CALLE MONTECILLO TEMECULA, CA 92590

Date	Item	Description	Hours/Qty	Rate	Amount
12/2/2009	Officer Hours	Labor Charges - Officer Time	0.3	109.00	32.70
12/2/2009	Officer Hours	Labor Charges - Officer Time	0.3	109.00	32.70
5/3/2010	Officer Hours	Labor Charges - Officer Time	0.3	109.00	32.70
5/3/2010	Officer Hours	Labor Charges - Officer Time	0.8	109.00	87.20
2/2/2011	Officer Hours	Labor Charges - Officer Time	0.3	109.00	32.70
2/2/2011	Officer Hours	Labor Charges - Officer Time	0.3	109.00	32.70
	Case Management	Officer research, report writing, records preparation		163.50	163.50
		Subtotal Code Enforcement Costs			414.20
3/30/2010	Attorney Fees	Attorney Fees - County Counsel	0.4	139.50	55.80
3/31/2010	Attorney Fees	Attorney Fees - County Counsel	0.1	139.50	13.95
4/5/2010	Attorney Fees	Attorney Fees - County Counsel	3.7	139.5081	516.18
4/7/2010	Attorney Fees	Attorney Fees - County Counsel	0.3	139.50	41.85
4/8/2010	Attorney Fees	Attorney Fees - County Counsel	0.4	139.50	55.80
4/8/2010	Attorney Fees	Attorney Fees - County Counsel	1	69.76	69.76
4/15/2010	Attorney Fees	Attorney Fees - County Counsel	0.3	69.76667	20.93
4/20/2010	Attorney Fees	Attorney Fees - County Counsel	0.75	69.76	52.32
4/22/2010	Attorney Fees	Attorney Fees - County Counsel	0.2	69.75	13.95
4/26/2010	Attorney Fees	Attorney Fees - County Counsel	1	69.76	69.76
4/27/2010	Attorney Fees	Attorney Fees - County Counsel	0.1	139.50	13.95
4/27/2010	Attorney Fees	Attorney Fees - County Counsel	0.5	69.76	34.88
			Subtotal		

Riverside County Ordinance 725 provides for the recovery of abatement and administrative costs reasonably related to Code Enforcement, including costs related to the abatement, collection, attorney's fees and staff time for site inspections, investigation, summaries, reports, and notices

Payments/Credits

Total

A Request for Hearing to object to the charges must be filed in writing to this department within 10 days of the service of this Summary of Costs. You may submit your signed request via U.S Mail, Fax or Email to any of the address(s)/numbers listed above.

Make checks payable to Riverside County Code Enforcement and remit to P.O. Box 1469, Riverside, CA 92502



County of Riverside Code Enforcement Department

P.O. Box 1469, Riverside, CA 92502
Phone: (951) 955-2004 Fax: (951) 955-8680
demands@rctlma.org

Summary of Costs

935-260-025
DAVID RAY KITCHINGS
DEBRAH KITCHINGS
P O BOX 2369
TEMECULA CA. 92593

Date	Invoice #
3/28/2011	100793

Amounts are due and payable upon receipt		
Case Number	District	Class
CV0912452	1	Demands

Property Address
935-260-025 DAVID RAY KITCHINGS DEBRAH KITCHINGS 42980 CALLE MONTECILLO TEMECULA, CA 92590

Date	Item	Description	Hours/Qty	Rate	Amount
4/29/2010	Attorney Fees	Attorney Fees - County Counsel	1	139.51	139.51
5/4/2010	Attorney Fees	Attorney Fees - County Counsel	0.2	69.75	13.95
5/5/2010	Attorney Fees	Attorney Fees - County Counsel	0.1	139.50	13.95
5/5/2010	Attorney Fees	Attorney Fees - County Counsel	0.9	69.75555	62.78
5/5/2010	Attorney Fees	Attorney Fees - County Counsel	3	139.51	418.53
5/6/2010	Attorney Fees	Attorney Fees - County Counsel	0.2	69.75	13.95
5/26/2010	Attorney Fees	Attorney Fees - County Counsel	2.5	139.512	348.78
8/17/2010	Attorney Fees	Attorney Fees - County Counsel	0.9	74.97778	67.48
		Subtotal County Counsel Costs			2,038.06
				Subtotal	\$2,452.26

Riverside County Ordinance 725 provides for the recovery of abatement and administrative costs reasonably related to Code Enforcement, including costs related to the abatement, collection, attorney's fees and staff time for site inspections, investigation, summaries, reports, and notices

Payments/Credits	\$0.00
Total	\$2,452.26

A Request for Hearing to object to the charges must be filed in writing to this department within 10 days of the service of this Summary of Costs. You may submit your signed request via U.S Mail, Fax or Email to any of the address(s)/numbers listed above.

Make checks payable to Riverside County Code Enforcement and remit to P.O. Box 1469, Riverside, CA 92502



Copy

County of Riverside
Official County Receipt
Deposit Business Unit: TLARC

Report ID: RVARA091
Run Date/Time: 3/29/2011 1:46 PM
Page No: 1 of 1
Received Date: 3/29/2011
Accounting Date: 3/30/2011

Receipt Number	Payment ID	Description of Payment	Pmt Amt
Dir Jnl <input checked="" type="checkbox"/>	Speed Type	Fund	
		Department	Account
		Project ID	Program
			Class
19233 -27	CASH	CV09-12452	2,452.26
<input checked="" type="checkbox"/>	314010-R18	10000	3140100000
			731101
Customer Name: DEBRA KITCHINGS			

Operator: E210136

Total Payment:

2,452.26

Assigned: E210136

EXHIBIT NO. 34



County of Riverside Code Enforcement Department

P.O. Box 1469, Riverside, CA 92502
Phone: (951) 955-2004 Fax: (951) 955-8680
demand@co-riverside.ca.gov

PAID
03/30/2011

Summary of Costs

935-260-025
DAVID RAY KITCHINGS
DEBRAH KITCHINGS
P O BOX 2369
TEMECULA CA. 92593

Date	Invoice #
3/28/2011	100793

Amounts are due and payable upon receipt		
Case Number	District	Class
CV0912452	1	Demands

Property Address
935-260-025 DAVID RAY KITCHINGS DEBRAH KITCHINGS 42980 CALLE MONTECILLO TEMECULA, CA 92590

Date	Item	Description	Hours/Qty	Rate	Amount
12/2/2009	Officer Hours	Labor Charges - Officer Time	0.3	109.00	32.70
12/2/2009	Officer Hours	Labor Charges - Officer Time	0.3	109.00	32.70
5/3/2010	Officer Hours	Labor Charges - Officer Time	0.3	109.00	32.70
5/3/2010	Officer Hours	Labor Charges - Officer Time	0.8	109.00	87.20
2/2/2011	Officer Hours	Labor Charges - Officer Time	0.3	109.00	32.70
2/2/2011	Officer Hours	Labor Charges - Officer Time	0.3	109.00	32.70
	Case Management	Officer research, report writing, records preparation		163.50	163.50
		Subtotal Code Enforcement Costs			414.20
3/30/2010	Attorney Fees	Attorney Fees - County Counsel	0.4	139.50	55.80
3/31/2010	Attorney Fees	Attorney Fees - County Counsel	0.1	139.50	13.95
4/5/2010	Attorney Fees	Attorney Fees - County Counsel	3.7	139.5081	516.18
4/7/2010	Attorney Fees	Attorney Fees - County Counsel	0.3	139.50	41.85
4/8/2010	Attorney Fees	Attorney Fees - County Counsel	0.4	139.50	55.80
4/8/2010	Attorney Fees	Attorney Fees - County Counsel	1	69.76	69.76
4/15/2010	Attorney Fees	Attorney Fees - County Counsel	0.3	69.76667	20.93
4/20/2010	Attorney Fees	Attorney Fees - County Counsel	0.75	69.76	52.32
4/22/2010	Attorney Fees	Attorney Fees - County Counsel	0.2	69.75	13.95
4/26/2010	Attorney Fees	Attorney Fees - County Counsel	1	69.76	69.76
4/27/2010	Attorney Fees	Attorney Fees - County Counsel	0.1	139.50	13.95
4/27/2010	Attorney Fees	Attorney Fees - County Counsel	0.5	69.76	34.88

	Subtotal
Riverside County Ordinance 725 provides for the recovery of abatement and administrative costs reasonably related to Code Enforcement, including costs related to the abatement, collection, attorney's fees and staff time for site inspections, investigation, summaries, reports, and notices	Payments/Credits
	Total

A Request for Hearing to object to the charges must be filed in writing to this department within 10 days of the service of this Summary of Costs. You may submit your signed request via U.S Mail, Fax or Email to any of the address(s)/numbers listed above.

Make checks payable to Riverside County Code Enforcement and remit to P.O. Box 1469, Riverside, CA 92502

BS



County of Riverside Code Enforcement Department

P.O. Box 1469, Riverside, CA 92502
Phone: (951) 955-2004 Fax: (951) 955-8680
demand@co-riverside.org

PAID
03/30/2011

Summary of Costs

935-260-025
DAVID RAY KITCHINGS
DEBRAH KITCHINGS
P O BOX 2369
TEMECULA CA. 92593

Date	Invoice #
3/28/2011	100793

Amounts are due and payable upon receipt		
Case Number	District	Class
CV0912452	I	Demands

Property Address
935-260-025 DAVID RAY KITCHINGS DEBRAH KITCHINGS 42980 CALLE MONTECILLO TEMECULA, CA 92590

Date	Item	Description	Hours/Qty	Rate	Amount
4/29/2010	Attorney Fees	Attorney Fees - County Counsel	1	139.51	139.51
5/4/2010	Attorney Fees	Attorney Fees - County Counsel	0.2	69.75	13.95
5/5/2010	Attorney Fees	Attorney Fees - County Counsel	0.1	139.50	13.95
5/5/2010	Attorney Fees	Attorney Fees - County Counsel	0.9	69.75555	62.78
5/5/2010	Attorney Fees	Attorney Fees - County Counsel	3	139.51	418.53
5/6/2010	Attorney Fees	Attorney Fees - County Counsel	0.2	69.75	13.95
5/26/2010	Attorney Fees	Attorney Fees - County Counsel	2.5	139.512	348.78
8/17/2010	Attorney Fees	Attorney Fees - County Counsel	0.9	74.97778	67.48
		Subtotal County Counsel Costs			2,038.06
				Subtotal	\$2,452.26

Riverside County Ordinance 725 provides for the recovery of abatement and administrative costs reasonably related to Code Enforcement, including costs related to the abatement, collection, attorney's fees and staff time for site inspections, investigation, summaries, reports, and notices

Payments/Credits \$-2,452.26

Total \$0.00

A Request for Hearing to object to the charges must be filed in writing to this department within 10 days of the service of this Summary of Costs. You may submit your signed request via U.S Mail, Fax or Email to any of the address(s)/numbers listed above.

Make checks payable to Riverside County Code Enforcement and remit to P.O. Box 1469, Riverside, CA 92502



INVOICE

Order Number: 25891

Order Date: 8/22/2011

Customer Information:

Acct No. 1044

RIVERSIDE COUNTY TLMA-CODE INFORCEMENT
4080 Lemon Street
Riverside, CA 92501

Attn: Brent Steele
REF: CV09-12452/Brenda Peeler
IN RE: KITCHINGS, DAVID R.

Product and/or Service ordered for Property known as:

**42980 Calle Montecillo
Temecula, CA 92590**

DESCRIPTION:

Lot Book Report

FEE:

\$120.00

TOTAL DUE:

\$120.00

Payment due upon receipt. Please remit to:

RZ Title Services, Inc.
P.O. Box 1193
Whittier, CA 90609

EXHIBIT NO. _____

B7

Assessment Roll For the 2011-2012 Tax Year as of January 1,2011

Assessment #935260025-0		Parcel # 935260025-0	
Assessee:	KITCHINGS DAVID RAY	Land	227,000
Assessee:	KITCHINGS DEBRAH ANN	Structure	422,000
Mail Address:	P O BOX 2369	Full Value	649,000
City, State Zip:	TEMECULA CA 92593	Total Net	649,000
Real Property Use Code:	R1		
Base Year	2002		
Conveyance Number:	0053631		
Conveyance (mm/yy):	2/2010		
PUI:	R010012		
TRA:	82-016		
Taxability Code:	0-00		
ID Data:	Lot 3 PM 137/001 PM 16562		
Situs Address:	42980 CALLE MONTECILLO		
	TEMECULA CA 92590		

EXHIBIT NO. C

RIVERSIDE COUNTY GIS

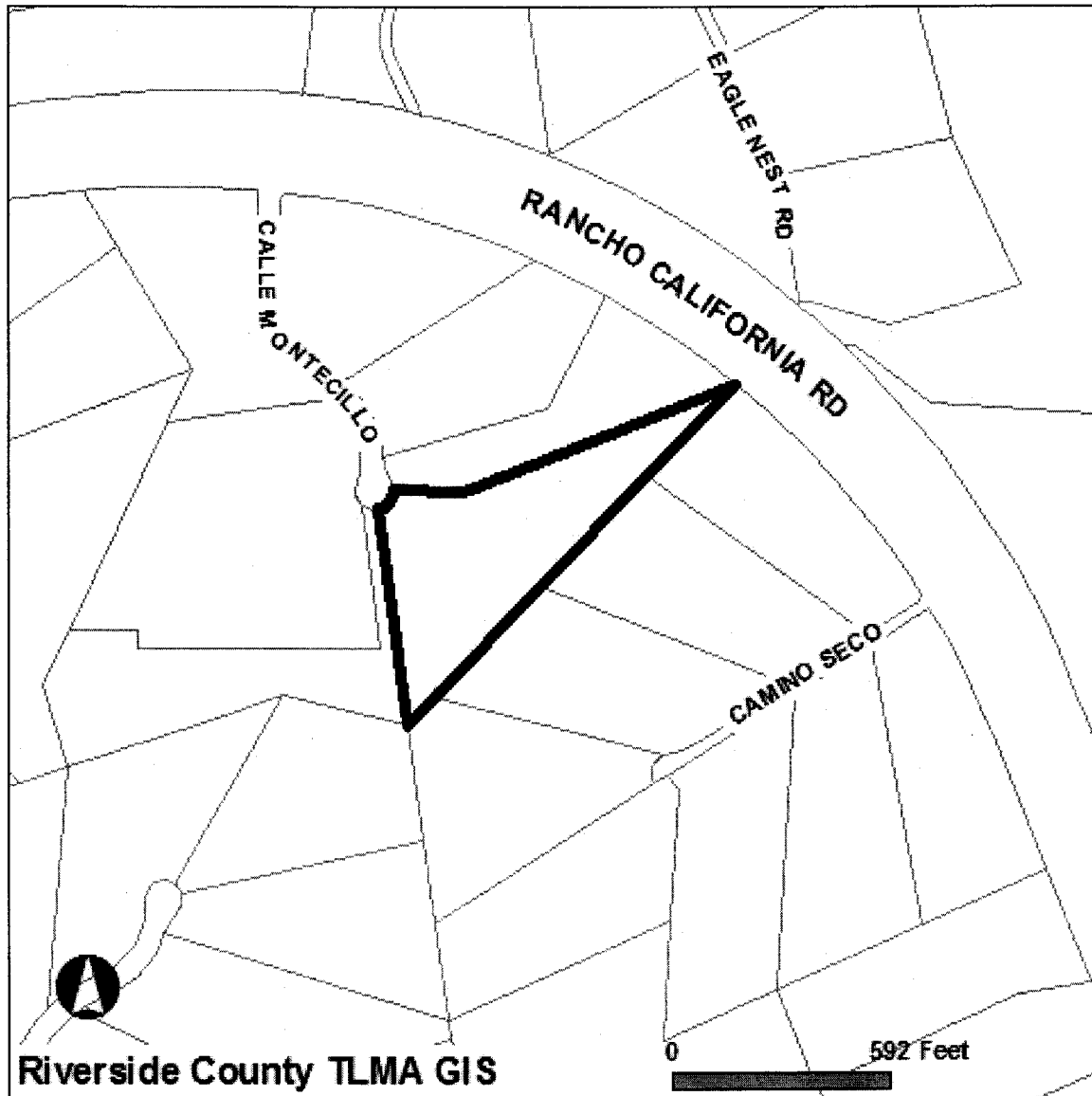

Selected parcel(s):
935-260-025

IMPORTANT

Maps and data are to be used for reference purposes only. Map features are approximate, and are not necessarily accurate to surveying or engineering standards. The County of Riverside makes no warranty or guarantee as to the content (the source is often third party), accuracy, timeliness, or completeness of any of the data provided, and assumes no legal responsibility for the information contained on this map. Any use of this product with respect to accuracy and precision shall be the sole responsibility of the user.

STANDARD REPORT**APNs**

935-260-025-0

OWNER NAME / ADDRESS

DAVID RAY KITCHINGS
DEBRAH ANN KITCHINGS
42980 CALLE MONTECILLO
TEMECULA, CA. 92590

MAILING ADDRESS

(SEE OWNER)
P O BOX 2369
TEMECULA CA. 92593

EXHIBIT NO. C²

LEGAL DESCRIPTION

RECORDED BOOK/PAGE: PM 137/1
SUBDIVISION NAME: PM 16562
LOT/PARCEL: 3, BLOCK: NOT AVAILABLE
, Por. TRACT NUMBER: NOT AVAILABLE

LOT SIZE

RECORDED LOT SIZE IS 6.85 ACRES

PROPERTY CHARACTERISTICS

WOOD FRAME, 3516 SQFT., 4 BDRM/ 3.5 BATH, 1 STORY, ATTACHED GARAGE(938 SQ. FT), CONST'D 2001TILE, ROOF, CENTRAL HEATING, CENTRAL COOLING

THOMAS BROS. MAPS PAGE/GRID

PAGE: 958 GRID: C5, C6

CITY BOUNDARY/SPHERE

NOT WITHIN A CITY
NOT WITHIN A CITY SPHERE
ANNEXATION DATE: NOT APPLICABLE
NO LAFCO CASE # AVAILABLE
NO PROPOSALS

MARCH JOINT POWERS AUTHORITY

NOT IN THE JURISDICTION OF THE MARCH JOINT POWERS AUTHORITY

INDIAN TRIBAL LAND

NOT IN A TRIBAL LAND

SUPERVISORIAL DISTRICT (ORD. 813)

BOB BUSTER, DISTRICT 1

TOWNSHIP/RANGE

T8SR3W SEC 4

ELEVATION RANGE

1592/1732 FEET

PREVIOUS APN

935-260-019

PLANNING

LAND USE DESIGNATIONS

Zoning not consistent with the General Plan.
RM

AREA PLAN (RCIP)

SOUTHWEST AREA

GENERAL PLAN POLICY OVERLAYS

NOT IN A GENERAL PLAN POLICY OVERLAY AREA

GENERAL PLAN POLICY AREAS

SANTA ROSA PLATEAU POLICY AREA

ZONING CLASSIFICATIONS (ORD. 348)

R-A-5

ZONING DISTRICTS AND ZONING AREAS

RANCHO CALIFORNIA AREA

ZONING OVERLAYS

NOT IN A ZONING OVERLAY

SPECIFIC PLANS

NOT WITHIN A SPECIFIC PLAN

AGRICULTURAL PRESERVE

NOT IN AN AGRICULTURAL PRESERVE

REDEVELOPMENT AREAS

NOT IN A REDEVELOPMENT AREA

AIRPORT INFLUENCE AREAS

NOT IN AN AIRPORT INFLUENCE AREA

AIRPORT COMPATIBILITY ZONES

NOT IN AN AIRPORT COMPATIBILITY ZONE

ENVIRONMENTAL

CVMSHCP (COACHELLA VALLEY MULTI-SPECIES HABITAT CONSERVATION PLAN) CONSERVATION AREA

NOT IN A CONSERVATION AREA

CVMSHCP FLUVIAL SAND TRANSPORT SPECIAL PROVISION AREAS

NOT IN A FLUVIAL SAND TRANSPORT SPECIAL PROVISION AREA

WRMSHCP (WESTERN RIVERSIDE COUNTY MULTI-SPECIES HABITAT CONSERVATION PLAN) CELL GROUP

NOT IN A CELL GROUP

WRMSHCP CELL NUMBER

6887

HANS/ERP (HABITAT ACQUISITION AND NEGOTIATION STRATEGY/EXPEDITED REVIEW PROCESS)

NONE

VEGETATION (2005)

CHAPARRAL

COASTAL SAGE SCRUB

DEVELOPED/DISTURBED LAND

FIRE

HIGH FIRE AREA (ORD. 787)

IN HIGH FIRE AREA - Grading And Building Permit Applications Require Fire Dept Clearance Prior To Permit Issuance.

FIRE RESPONSIBILITY AREA

STATE RESPONSIBILITY AREA

DEVELOPMENT FEES

CVMSHCP FEE AREA (ORD. 875)

NOT WITHIN THE COACHELLA VALLEY MSHCP FEE AREA

WRMSHCP FEE AREA (ORD. 810)

IN OR PARTIALLY WITHIN THE WESTERN RIVERSIDE MSHCP FEE AREA. SEE MAP FOR MORE INFORMATION.

ROAD & BRIDGE DISTRICT

NOT IN A DISTRICT

EASTERN TUMF (TRANSPORTATION UNIFORM MITIGATION FEE ORD. 673)

NOT WITHIN THE EASTERN TUMF FEE AREA

WESTERN TUMF (TRANSPORTATION UNIFORM MITIGATION FEE ORD. 824)

IN OR PARTIALLY WITHIN A TUMF FEE AREA. SEE MAP FOR MORE INFORMATION.SOUTHWEST

DIF (DEVELOPMENT IMPACT FEE AREA ORD. 659)

SOUTHWEST AREA

SKR FEE AREA (STEPHEN'S KANGAROO RAT ORD. 663.10)

NOT WITHIN AN SKR FEE AREA.

DEVELOPMENT AGREEMENTS

NOT IN A DEVELOPMENT AGREEMENT AREA

TRANSPORTATION

CIRCULATION ELEMENT ULTIMATE RIGHT-OF-WAY

NOT IN A CIRCULATION ELEMENT RIGHT-OF-WAY

ROAD BOOK PAGE

84B

TRANSPORTATION AGREEMENTS
NOT IN A TRANSPORTATION AGREEMENT**CETAP (COMMUNITY AND ENVIRONMENTAL TRANSPORTATION ACCEPTABILITY PROCESS) CORRIDORS**
NOT IN A CETAP CORRIDOR.

HYDROLOGY

FLOOD PLAIN REVIEW
NOT REQUIRED.**WATER DISTRICT**
WMWD**FLOOD CONTROL DISTRICT**
RIVERSIDE COUNTY FLOOD CONTROL DISTRICT**WATERSHED**
SANTA MARGARITA

GEOLOGIC

FAULT ZONE
NOT IN A FAULT ZONE

FAULTS
WITHIN A 1/2 MILE OF
UNNAMED FAULT IN ELSINORE FAULT ZONE
WILLARD FAULT
CONTACT THE COUNTY'S CHIEF ENGINEERING GEOLOGIST AT (951)955-6863.

LIQUEFACTION POTENTIAL
NO POTENTIAL FOR LIQUEFACTION EXISTS**SUBSIDENCE**
NOT IN A SUBSIDENCE AREA

PALEONTOLOGICAL SENSITIVITY
UNDETERMINED POTENTIAL.
AREAS UNDERLAIN BY SEDIMENTARY ROCKS FOR WHICH LITERATURE AND UNPUBLISHED STUDIES ARE NOT AVAILABLE HAVE
UNDETERMINED POTENTIAL FOR CONTAINING SIGNIFICANT PALEONTOLOGICAL RESOURCES. THESE AREAS MUST BE INSPECTED BY A
FIELD SURVEY CONDUCTED BY A QUALIFIED VERTEBRATE PALEONTOLOGIST.

MISCELLANEOUS

SCHOOL DISTRICT
MURRIETA VALLEY UNIFIED**COMMUNITIES**
SANTA ROSA**COUNTY SERVICE AREA**
NOT IN A COUNTY SERVICE AREA.**LIGHTING (ORD. 655)**
ZONE B, 21.80 MILES FROM MT. PALOMAR OBSERVATORY**2000 CENSUS TRACT**
043215**FARMLAND**
OTHER LANDS
UNIQUE FARMLAND**TAX RATE AREAS**
082016
•COUNTY FREE LIBRARY
•COUNTY STRUCTURE FIRE PROTECTION
•COUNTY WASTE RESOURCE MGMT DIST
•CSA 152
•DE LUZ COMMUNITY SERVICE
•ELS MURRIETA ANZA RESOURCE CONS

- ELSinORE AREA ELEM SCHOOL FUND
- FLOOD CONTROL ADMINISTRATION
- FLOOD CONTROL ZONE 7
- GENERAL
- GENERAL PURPOSE
- METRO WATER WEST
- MT SAN JACINTO JUNIOR COLLEGE
- MURRIETA CEMETERY
- MURRIETA UNIFIED
- MURRIETA UNIFIED B & I
- RANCHO CAL WTR SAN R DIV DEBT SV
- RANCHO CALIF JT WATER
- RIV CO REG PARK & OPEN SPACE
- RIV. CO. OFFICE OF EDUCATION
- VALLEY HEALTH SYSTEM HOSP DIST
- WESTERN MUN WATER 9TH FRINGE

SPECIAL NOTES

NO SPECIAL NOTES

CODE COMPLAINTS

Case #	Description	Start Date
NO CODE COMPLAINTS	NOT APPLICABLE	NOT APPLICABLE

REPORT PRINTED ON...Tue Aug 23 15:36:27 2011
Version 110728



P.O. Box 1193
Whittier, CA 90609
Tel # (562) 325-8351
Fax # (714) 783-3038

Lot Book Report

Order Number: **25891**

Customer:

RIVERSIDE COUNTY TLMA-CODE INFORCEMENT

4080 Lemon Street

Riverside

CA 92501

Attn:

Brent Steele

Reference:

CV09-12452/Brenda Peeler

IN RE:

KITCHINGS, DAVID R.

Order Date: 8/22/2011

Dated as of: 8/15/2011

County Name: Riverside

FEE(s):

Report: \$120.00

Property Address: 42980 Calle Montecillo

Temecula

CA 92590

Assessor's Parcel No. : 935-260-025-0

Assessments:

Land Value:	\$226,000.00
Improvement Value:	\$420,000.00
Exemption Value:	\$0.00
Total Value:	\$646,000.00

Tax Information

Property Taxes for the Fiscal Year	2010-2011
Total Annual Tax	\$9,397.52
Status: Paid through	06/30/2011

Property Vesting

The last recorded document transferring title of said property

Dated

01/25/2000

Recorded

01/31/2000

EXHIBIT NO. D



P.O. Box 1193
Whittier, CA 90609
Tel # (562) 325-8351
Fax # (714) 783-3038

Order Number: 25891

Reference: CV09-12452/Bren

Document No.	2000-036435
D.T.T.	\$0.00
Grantor	Malcolm Curtis and Judy Curtis, husband and wife and Gregg Allen Berge, a married man and Mike Erickson, a married man
Grantee	Malcolm Curtis and Judy Curtis, husband and wife and Gregg Allen Berge, a married man and Mike Erickson, a married man
Vesting Subject to Deed Dated	10/05/2001
Recorded	11/16/2001
Document No.	2001-569304
Grantor	Gregg A. Berge and Denise M. Berge, husband and wife as joint tenants as to an undivided 1/2 interest; Michael Erickson and Denise Erickson, husband and wife as joint tenants as to an undivided 1/2 interest
Grantee	David Ray Kitchings and Debrah Ann Kitchings, husband and wife as joint tenants
Vesting Subject to Deed Dated	01/30/2009
Recorded	01/30/2009
Document No.	2009-0047226
Grantor	Debrah Ann Kitchings
Grantee	David Ray Kitchings
Vesting Subject to Deed Dated	02/04/2010
Recorded	02/04/2010
Document No.	2010-0053631
Grantor	David Ray Kitchings,
Grantee	David Ray Kitchings and Debrah Ann Kitchings, Co-Trustees, of successor trustee(s) of The Kitchings Family Trust dated February 4, 2010



P.O. Box 1193
Whittier, CA 90609
Tel # (562) 325-8351
Fax # (714) 783-3038

Order Number: 25891

Reference: CV09-12452/Bren

Deeds of Trust

Position No.	1st
A Deed of Trust Dated	05/07/2003
Recorded	05/15/2003
Document No.	2003-352015
Amount	\$479,624.00
Trustor	David Ray Kitchings, and Debrah Ann Kitchings, husband and wife as joint tenants
Trustee	CTC Real Estate Services
Beneficiary	Countrywide Home Loans, Inc.

Position No.	2nd
A Line of Credit Deed of Trust Dated	06/17/2005
Recorded	06/27/2005
Document No.	2005-0508705
Amount	\$199,000.00
Trustor	David Ray Kitchins and Debrah Ann Kitchings, husband and wife as joint tenants
Trustee	American Securities Company
Beneficiary	Wells Fargo Bank, N.A.

Additional Information

A Notice of State Tax Lien Recorded	01/23/2002
Document No.	2002-037664
Amount	\$19,825.54
Account No.	SR-AR-015769171
Certificate No.	BE-1177233
Debtor	The Partnership consisting of Bette J. Carlton, Gregory T. Erickson, Michael D. Erickson individually and as Copartners dba Surf'n Style
Creditor: State of California,	Board of Equalization



P.O. Box 1193
Whittier, CA 90609
Tel # (562) 325-8351
Fax # (714) 783-3038

Order Number: 25891

Reference: CV09-12452/Bren

Abstract of Support Judgment Filed in the	Superior Court of California, County of Riverside - Family Law Annex
Case No.	178793
Recorded	08/27/2004
Document No.	2004-0683621
Debtor	Michael J Erickson
Creditor	County of Riverside
A Federal Tax Lien Recorded	07/12/2006
Document No	2006-0510045
Amount	\$8,835.62
Debtor	Michael J Erickson; Everythings Music
ID No.	33-0934032
Creditor	Internal Revenue Service
A Notice of State Tax Lien Recorded	01/26/2011
Document No.	2011-0039871
Amount	\$27,083.73
Account No.	SR AR 015769171
Certificate No.	BE-1264674
Debtor	The Partnership consisting of Bette J. Carlton, Gregory T. Erickson, Michael D. Erickson, individually and as Copartners dba Surf'n Style
Creditor: State of California,	

Legal Description

THE LAND REFERRED TO IN THIS REPORT IS LOCATED IN AND IS DESCRIBED AS FOLLOWS:

PARCEL 3, OF PARCEL MAP 16562, IN THE COUNTY OF RIVERSIDE, STATE OF CALIFORNIA, AS PER MAP RECORDED IN BOOK 137, PAGE(S) 1 AND 2, OF PARCEL MAPS, IN THE OFFICE OF THE COUNTY RECORDER OF SAID COUNTY EXCEPTING THEREFROM THAT PORTION DESCRIBED AS FOLLOWS:

BEGINNING AT THE EASTERLY MOST CORNER OF SAID PARCEL;

THENCE ALONG THE NORTHERLY LINE OF SAID PARCEL, SOUTH 74° 34' 15" WEST, A DISTANCE OF 979.16 FEET; THENCE SOUTH 87° 25' 14" EAST, A DISTANCE OF 194.07 FEET; THENCE NORTH 70° 15' 09" EAST, A DISTANCE OF 796.68 FEET, TO THE POINT OF BEGINNING.

MINUTES OF THE BOARD OF SUPERVISORS
COUNTY OF RIVERSIDE, STATE OF CALIFORNIA



9.5

9:30 a.m. being the time set for public hearing on the recommendation from County Counsel/Code Enforcement regarding Public Hearing on Statement of Abatement Costs Case No. CV 09-12452, located at 42980 Calle Montecillo, Temecula; APN: 935-260-025, 1st District, the chairman called the matter for hearing.

Stephanie Monroe and Brian Black, Supervisor Code Enforcement Officer, presented the matter.

The following people spoke on the matter:

Debrah Kitchings

On motion of Supervisor Buster, seconded by Supervisor Tavaglione and duly carried, IT WAS ORDERED that the above matter is continued to Tuesday, October 18, 2011 at 9:30 a.m.

Roll Call:

Ayes: Buster, Tavaglione, Benoit and Ashley
Nays: None
Absent: Stone

I hereby certify that the foregoing is a full true, and correct copy of an order made and entered on September 13, 2011 of Supervisors Minutes.

(seal)

WITNESS my hand and the seal of the Board of Supervisors
Dated: September 13, 2011
Kecia Harper-Ihem, Clerk of the Board of Supervisors, in
and for the County of Riverside, State of California.

By: [Signature] Deputy

AGENDA NO.
9.5

xc: Co. Co., CED, Prop. Owner, CQB