

**SUBMITTAL TO THE BOARD OF SUPERVISORS
COUNTY OF RIVERSIDE, STATE OF CALIFORNIA**

704 B



FROM: County Counsel
Code Enforcement Department

SUBMITTAL DATE:
October 27, 2011

SUBJECT: Statement of Abatement Costs [Case Nos. CV10-01902]
Subject Property: 14172 Trading Post Court, Corona; GUEVARA
APN: 144-313-023
District Two

RECOMMENDED MOTION: Move that the Board of Supervisors:

- (1) assess the reasonable costs of abatement of a public nuisance (unmaintained landscaping, trash containers in public view and excess outside storage) in the above-referenced matter to be **one thousand, four hundred eleven dollars and ten cents (US \$1,411.10);**
- (2) assess the costs of abatement against the above-described subject property;
- (3) authorize the recordation of a notice of abatement lien;
- (4) authorize the abatement costs to be added to the tax roll as a special assessment; and
- (5) authorize and direct the Code Enforcement Department to take any reasonable actions to collect the amount owed.

PATRICIA MUNROE, Deputy County Counsel
for PAMELA J. WALLS, County Counsel

FINANCIAL DATA	Current F.Y. Total Cost:	\$ N/A	In Current Year Budget:	N/A
	Current F.Y. Net County Cost:	\$ N/A	Budget Adjustment:	N/A
	Annual Net County Cost:	\$ N/A	For Fiscal Year:	N/A

SOURCE OF FUNDS:	Positions To Be Deleted Per A-30	<input type="checkbox"/>
	Requires 4/5 Vote	<input type="checkbox"/>

C.E.O. RECOMMENDATION: APPROVE

BY:
Tina Grande

County Executive Office Signature

☐ Consent ☒ Policy
☐ Consent ☒ Policy

MINUTES OF THE BOARD OF SUPERVISORS

On motion of Supervisor Buster, seconded by Supervisor Ashley and duly carried by unanimous vote, IT WAS ORDERED that the above matter is approved as recommended.

Ayes: Buster, Tavaglione, Stone, Benoit and Ashley
 Nays: None
 Absent: None
 Date: November 8, 2011
 xc: Co. Co., CED, Prop. Owner

Kecia Harper-Ihem
 Clerk of the Board
 By:
 Deputy

Prev. Agn. Ref.: **District:** 2 **Agenda Number:**

ATTACHMENTS FILED
WITH THE CLERK OF THE BOARD

9.7

Statement of Abatement Costs [Case No. CV10-01902]
Subject Property: 14172 Trading Post Court, Corona; GUEVARA
APN: 144-313-023
District Two
Page 2

BACKGROUND: Government Code § 25845, Riverside County Ordinance Nos. 541, 348 and 725 authorize the recovery of abatement costs in public nuisance cases, the recordation of a notice of abatement lien and inclusion of abatement costs on the tax roll as a special assessment upon approval of the Board of Supervisors.

Notices of Violation and Administrative Citations were issued. Subsequently, the property was brought into compliance.

The Notice of Hearing re Statement of Abatement Costs has been posted on the property and mailed to the property owner and all interested parties, as required by law. Copies of all relevant notices issued in this matter together with proof of service and posting have been separately filed with the Clerk of the Board and are made a part of the record herein, pursuant to Riverside County Ordinance 725.

**SUBMITTAL TO THE BOARD OF SUPERVISORS
COUNTY OF RIVERSIDE, STATE OF CALIFORNIA**

FROM: County Counsel
Code Enforcement Department
SUBJECT: Statement of Abatement Costs [Case No. CV10-01902]
Subject Property: 14172 Trading Post Court, Corona; GUEVARA
APN: 144-313-023
District Two

**TABLE OF SUPPLEMENTAL DOCUMENTS
FILED WITH THE CLERK OF THE BOARD**

Hearing Date: NOVEMBER 8, 2011

Notice of Hearing Re: Statement of Abatement Costs (including Proof(s) of Service and Affidavit(s) of Posting	Exhibit A
Summary Statement of Abatement Costs and Statement of Abatement Costs with Supporting Documents	Exhibit B
Assessment-Roll For The Year 10/11 And Geographic Information System, June 8, 2011	Exhibit C
Lot Book Report.....	Exhibit D
Demand for Payment Statement of Abatement Costs Notice of Special Tax Assessment	Exhibit E
Request for Hearing	Exhibit F

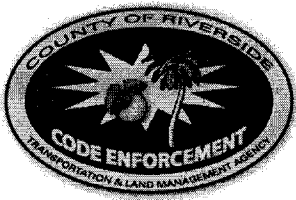

CODE ENFORCEMENT DEPARTMENT COUNTY OF RIVERSIDE

Glenn Baude
Director

October 24, 2011

NOTICE OF HEARING RE: STATEMENT OF ABATEMENT COSTS

To: Owner(s) or Interested Parties
(See Attached Proof of Service
and Notice List)

Subject Property: 14172 Trading Post Court, Corona
Case No.: CV10-01902; GUEVARA
APN: 144-313-023

NOTICE IS HEREBY GIVEN that a hearing will be held before the Riverside County Board of Supervisors on **Tuesday, November 8, 2011, at 9:30 a.m.** in the Board of Supervisors Room, 4080 Lemon Street, 1st Floor Annex, Riverside, California, at which time and place pertinent testimony will be heard regarding the expenses incurred by the County of Riverside, Code Enforcement Department ("DEPARTMENT") for the above-referenced abatement case. Said abatement case involved unmaintained landscaping, trash containers in public view and excessive outside storage located on your real property commonly described as 14172 Trading Post Court, Corona, Riverside County, California and more particularly described as Assessor's Parcel Number 144-313-023.

The total expense due, including all other fees and costs, for the abatement of the above-described dangerous or injurious condition is **one thousand, four hundred eleven dollars and ten cents, (US \$1,411.10)**. This amount is immediately due and payable. If you have any objections to the Statement of Abatement Costs attached hereto, you must address your objections to the Board of Supervisors at the hearing. If you have any questions about the attached Statement of Abatement Costs, please contact Ward Komers or Carol Lynn Anderson at (951) 955-2004. In the event the total amount due is not paid to the DEPARTMENT prior to the Board Hearing, the DEPARTMENT shall seek an order from the Board of Supervisors to place a lien against your property and collect the amount due as a special tax assessment.

Failure to appear at the hearing will result in the exclusion of your testimony. Facts as known to the DEPARTMENT will be presented to the Board of Supervisors for their final consideration and deliberation of this matter.

You are encouraged to contact Code Enforcement Officer, Stacy Baumgartner at (951) 955-2004 prior to the hearing. Please meet with Stacy Baumgartner at 8:30 a.m. on the day of the hearing in the lobby of the first floor annex in front of the Clerk of the Board's Office to discuss the case.

GLENN BAUDE
DIRECTOR

WARD KOMERS
Administrative Manager
Enclosure: Statement of Abatement Costs

4080 LEMON STREET, 12TH FLOOR, RIVERSIDE, CALIFORNIA 92501
(951) 955-2004 • FAX (951) 955-8680

EXHIBIT NO. A



COUNTY OF RIVERSIDE CODE ENFORCEMENT

P.O. Box 1469, Riverside, CA 92502
Phone: 951-955-2004 Fax: 951-955-8680

Property Reference/Mailing Address

144313023
Luz Guevara
2525 Old Farm Rd No. 918
Houston, TX 77063

Date: 5/26/2011

Summary Statement of Abatement Costs

You are liable to the County for the following abatement costs:

Date	Invoice Number & Amount	Amount	Balance
07/01/2009	Balance forward		0.00
05/26/2011	CV1001902- INV #101313.	511.10	511.10
04/27/2010	CV1001902:A31472- INV #20675. A31472	200.00	711.10
06/04/2010	PMT #chk 1068. A31472	-200.00	511.10
10/04/2010	CV1001902:A31555- INV #A31555. A31555	500.00	1,011.10
07/20/2010	CV1001902:A31580- INV #A31580.	200.00	1,211.10
06/08/2010	CV1001902:A31789- INV #21180. A31789	200.00	1,411.10
Total Now Due			\$1,411.10

The total abatement costs must be paid to the County of Riverside, P.O. Box 1469, Riverside, CA 92502 within thirty (30) days. In the event said costs are not paid within thirty (30) days you will be liable for additional administrative costs, penalties, court fees, or other collection costs incurred in the collection of these abatement costs.

I affirm and declare under penalty of perjury under the laws of the State of California that the foregoing is true and correct to the best of my knowledge.

Brent Steele
Code Enforcement Department

EXHIBIT NO. A2

**County of Riverside
Code Enforcement Department**

P.O. Box 1469, Riverside, CA 92502
Phone: (951) 955-2004 Fax: (951) 955-8680



Statement of Abatement Costs

144313023
Luz Guevara
2525 Old Farm Rd No. 918
Houston, TX 77063

Date	Invoice #
5/26/2011	101313

Case Number	District	Class
CV1001902	2	SOAC

Property Address
144313023 Luz Guevara 14172 Trading Post Ct Corona, CA 92880

You are liable to the County for the following abatement costs:

Date	Item	Description	Hours/Qty	Rate	Amount
3/9/2010	Officer Hours	Labor Charges - Officer Time	0.2	109.00	21.80
4/21/2010	Officer Hours	Labor Charges - Officer Time	0.1	109.00	10.90
4/27/2010	Officer Hours	Labor Charges - Officer Time	0.2	109.00	21.80
6/8/2010	Officer Hours	Labor Charges - Officer Time	0.2	109.00	21.80
7/20/2010	Officer Hours	Labor Charges - Officer Time	0.2	109.00	21.80
10/4/2010	Officer Hours	Labor Charges - Officer Time	0.2	109.00	21.80
2/1/2011	Officer Hours	Labor Charges - Officer Time	0.1	109.00	10.90
5/6/2011	SOE Preparation	Prepare Statement of Expense		65.00	65.00
		Subtotal Code Enforcement Costs			195.80
5/6/2011	Prepare Case for SOE He...			125.55	125.55
	Attend SOE Hearing			69.75	69.75
		Subtotal County Counsel Costs			195.30
5/6/2011	Lot Book Report			120.00	120.00
		Subtotal Contractor Costs			120.00
			Subtotal		\$511.10
			Payments/Credits		\$0.00
			Total Now Due		\$511.10

The total abatement costs must be paid to the County of Riverside, P.O. Box 1469, Riverside, CA 92502 within thirty (30) days. In the event said costs are not paid within thirty (30) days you will be liable for additional administrative costs, penalties, court fees or other collection costs incurred in the collection of these abatement costs.

I affirm and declare under penalty of perjury under the laws of the State of California that the foregoing is true and correct to the best of my knowledge.

Brent Steele
Code Enforcement Department

EXHIBIT NO. A3



County of Riverside Code Enforcement Department

P.O. Box 1469, Riverside, CA 92502
Phone: (951) 955-2004 Fax: (951) 955-8680
demands@rctlma.org

Administrative Citation

144313023
Luz Guevara
2525 Old Farm Rd No. 918
Houston, TX 77063

Citation Issue Date	Billing Date
4/27/2010	5/6/2011

Citation Number	District	Class
A31472	2	SOAC

Property Address
144313023 Luz Guevara 14172 Trading Post Ct Corona, CA 92880

Item	Description	Hours/Qty	Rate	Amount
Administrative Citations	A31472--CV1001902	1	200.00	200.00
			Subtotal	\$200.00
			Payments/Credits	\$-200.00
			Total	\$0.00

EXHIBIT NO. A4



County of Riverside Code Enforcement Department

P.O. Box 1469, Riverside, CA 92502
Phone: (951) 955-2004 Fax: (951) 955-8680
demands@rctlma.org

Administrative Citation

144313023
Luz Guevara
2525 Old Farm Rd No. 918
Houston, TX 77063

Citation Issue Date	Billing Date
10/4/2010	5/26/2011

Citation Number	District	Class
A31555	2	SOAC

Property Address
144313023 Luz Guevara 14172 Trading Post Ct Corona, CA 92880

Item	Description	Hours/Qty	Rate	Amount
Administrative Citations	A31555--CV1001902	1	500.00	500.00
			Subtotal	\$500.00
			Payments/Credits	\$0.00
			Total	\$500.00

EXHIBIT NO. A⁵



County of Riverside

Code Enforcement Department

P.O. Box 1469, Riverside, CA 92502
Phone: (951) 955-2004 Fax: (951) 955-8680
demands@rctlma.org

Administrative Citation

144313023
Luz Guevara
2525 Old Farm Rd No. 918
Houston, TX 77063

Citation Issue Date	Billing Date
7/20/2010	5/26/2011

Citation Number	District	Class
A31580	2	SOAC

Property Address
144313023 Luz Guevara 14172 Trading Post Ct Corona, CA 92880

Item	Description	Hours/Qty	Rate	Amount
Administrative Citations	A31580--CV1001902		200.00	200.00
			Subtotal	\$200.00
			Payments/Credits	\$0.00
			Total	\$200.00

EXHIBIT NO. A6



County of Riverside Code Enforcement Department

P.O. Box 1469, Riverside, CA 92502
Phone: (951) 955-2004 Fax: (951) 955-8680
demands@rctlma.org

Administrative Citation

144313023
Luz Guevara
2525 Old Farm Rd No. 918
Houston, TX 77063

Citation Issue Date	Billing Date
6/8/2010	5/26/2011

Citation Number	District	Class
A31789	2	SOAC

Property Address
144313023 Luz Guevara 14172 Trading Post Ct Corona, CA 92880

Item	Description	Hours/Qty	Rate	Amount
Administrative Citations	A31789--CV1001902	1	200.00	200.00
			Subtotal	\$200.00
			Payments/Credits	\$0.00
			Total	\$200.00

EXHIBIT NO. A7

NOTICE LIST

Subject Property: 14172 Trading Post Court, Corona; Case No.: CV10-01902
APN: 144-313-023; District Two

LUZ GUEVARA
14172 TRADING POST COURT
CORONA CA 92880

LUZ GUEVARA
2525 OLD FARM ROAD
NO 918
HOUSTON TX 77063

RYLAND MORTGAGE COMPANY
AN OHIO CORP
14555 NORTH HAYDEN ROAD #100
SCOTTSDALE AR 85260

BAC HOME LOANS SERVICING
LP FKA COUNTRYWIDE HOME LOANS
SRV LP
C/O RECONSTRUST COMPANY
1800 TAPO CANYON ROAD CA6-914-01-94
SIMI VALLEY CA 93063

AMERICAN SURETY COMPANY
C/O GONZALES & GONZALES BONDS
412 E COMMERCIAL STREET
LOS ANGELES CA 90012-3408

CELTIC BANK CORP
340 EAST 400 SOUTH
SALT LAKE CITY UT 84111

EXHIBIT NO. A8

PROOF OF SERVICE

Case No. CV10-01902

STATE OF CALIFORNIA, COUNTY OF RIVERSIDE

I, Brenda G. Peeler, declare that I am a citizen of the United States and am employed in the County of Riverside, over the age of 18 years and not a party to the within action or proceeding; that my business address is 3960 Orange Street, Suite 500, Riverside, California 92501.

That on October 24, 2011, I served the following document(s):

- NOTICE OF HEARING RE: STATEMENT OF ABATEMENT COSTS
- SUMMARY STATEMENT OF ABATEMENT COSTS
- STATEMENT OF ABATEMENT COSTS
- ADMINISTRATIVE CITATION(S)
- NOTICE LIST

by placing a true copy thereof enclosed in a sealed envelope(s) addressed as follows:

**OWNERS OR INTERESTED PARTIES
(SEE NOTICE LIST ATTACHED TO NOTICE OF HEARING)**

XX **BY FIRST CLASS MAIL.** I am "readily familiar" with the office's practice of collection and processing correspondence for mailing. Under that practice it would be deposited with the U.S. Postal Service on that same day with postage thereon fully prepaid at Riverside, California, in the ordinary course of business.

— **BY PERSONAL SERVICE:** I caused to be delivered such envelope(s) by hand to the offices of the addressee(s).

XX **STATE - I declare under penalty of perjury under the laws of the State of California that the above is true and correct.**

— **FEDERAL - I declare that I am employed in the office of a member of the bar of this court at whose direction the service was made.**

EXECUTED ON October 24, 2011, at Riverside, California.

BRENDA G. PEELER

EXHIBIT NO. A9

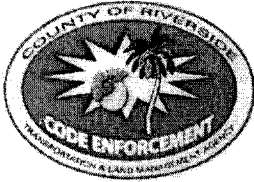

**CODE ENFORCEMENT DEPARTMENT
COUNTY OF RIVERSIDE**

GLENN BAUDE
Director

AFFIDAVIT OF POSTING OF NOTICES

October 26, 2011

RE CASE NO: CV1001902

I, Etita Fohe, hereby declare:

I am employed by the Riverside County Code Enforcement Department; that my business address is 13575 Magnolia Ave, Corona, California 92879.

That on 10/26/11 at 8:10 am, I securely and conspicuously posted Notice of Hearing Re: Demand for Payment Statement of Abatement Costs Notice of Special Tax Assessment at the property described as:

Property Address: 14172 TRADING POST CT, CORONA

Assessor's Parcel Number: 144-313-023

I declare under the penalty of perjury that the foregoing is true and correct.

Executed on October 26, 2011 in the County of Riverside, California.

CODE ENFORCEMENT DEPARTMENT

By: Etita Fohe, Code Enforcement Technician

13575 MAGNOLIA AVE, CORONA, CALIFORNIA 92879
(951) 280-4100; FAX (951) 280-0984

EXHIBIT NO. A¹⁰



COUNTY OF RIVERSIDE CODE ENFORCEMENT

P.O. Box 1469, Riverside, CA 92502
Phone: 951-955-2004 Fax: 951-955-8680

Property Reference/Mailing Address

144313023
Luz Guevara
2525 Old Farm Rd No. 918
Houston, TX 77063

Date: 5/26/2011

Summary Statement of Abatement Costs

You are liable to the County for the following abatement costs:

Date	Invoice Number & Amount	Amount	Balance
07/01/2009	Balance forward		0.00
05/26/2011	CV1001902- INV #101313.	511.10	511.10
04/27/2010	CV1001902:A31472- INV #20675. A31472	200.00	711.10
06/04/2010	PMT #chk 1068. A31472	-200.00	511.10
10/04/2010	CV1001902:A31555- INV #A31555. A31555	500.00	1,011.10
07/20/2010	CV1001902:A31580- INV #A31580.	200.00	1,211.10
06/08/2010	CV1001902:A31789- INV #21180. A31789	200.00	1,411.10
Total Now Due			\$1,411.10

The total abatement costs must be paid to the County of Riverside, P.O. Box 1469, Riverside, CA 92502 within thirty (30) days. In the event said costs are not paid within thirty (30) days you will be liable for additional administrative costs, penalties, court fees, or other collection costs incurred in the collection of these abatement costs.

I affirm and declare under penalty of perjury under the laws of the State of California that the foregoing is true and correct to the best of my knowledge.

Brent Steele
Code Enforcement Department

EXHIBIT NO. B

**County of Riverside
Code Enforcement Department**

P.O. Box 1469, Riverside, CA 92502
Phone: (951) 955-2004 Fax: (951) 955-8680



Statement of Abatement Costs

144313023
Luz Guevara
2525 Old Farm Rd No. 918
Houston, TX 77063

Date	Invoice #
5/26/2011	101313

Case Number	District	Class
CV1001902	2	SOAC

Property Address

144313023
Luz Guevara
14172 Trading Post Ct
Corona, CA 92880

You are liable to the County for the following abatement costs:

Date	Item	Description	Hours/Qty	Rate	Amount
3/9/2010	Officer Hours	Labor Charges - Officer Time	0.2	109.00	21.80
4/21/2010	Officer Hours	Labor Charges - Officer Time	0.1	109.00	10.90
4/27/2010	Officer Hours	Labor Charges - Officer Time	0.2	109.00	21.80
6/8/2010	Officer Hours	Labor Charges - Officer Time	0.2	109.00	21.80
7/20/2010	Officer Hours	Labor Charges - Officer Time	0.2	109.00	21.80
10/4/2010	Officer Hours	Labor Charges - Officer Time	0.2	109.00	21.80
2/1/2011	Officer Hours	Labor Charges - Officer Time	0.1	109.00	10.90
5/6/2011	SOE Preparation	Prepare Statement of Expense		65.00	65.00
		Subtotal Code Enforcement Costs			195.80
5/6/2011	Prepare Case for SOE He...			125.55	125.55
	Attend SOE Hearing			69.75	69.75
		Subtotal County Counsel Costs			195.30
5/6/2011	Lot Book Report			120.00	120.00
		Subtotal Contractor Costs			120.00
			Subtotal		\$511.10

The total abatement costs must be paid to the County of Riverside, P.O. Box 1469, Riverside, CA 92502 within thirty (30) days. In the event said costs are not paid within thirty (30) days you will be liable for additional administrative costs, penalties, court fees or other collection costs incurred in the collection of these abatement costs.

Payments/Credits \$0.00

Total Now Due \$511.10

I affirm and declare under penalty of perjury under the laws of the State of California that the foregoing is true and correct to the best of my knowledge.

EXHIBIT NO. B²

Brent Stalk
Code Enforcement Department



County of Riverside Code Enforcement Department

P.O. Box 1469, Riverside, CA 92502
Phone: (951) 955-2004 Fax: (951) 955-8680
demands@rctlma.org

Administrative Citation

144313023
Luz Guevara
2525 Old Farm Rd No. 918
Houston, TX 77063

Citation Issue Date	Billing Date
4/27/2010	5/6/2011

Citation Number	District	Class
A31472	2	SOAC

Property Address
144313023 Luz Guevara 14172 Trading Post Ct Corona, CA 92880

Item	Description	Hours/Qty	Rate	Amount
Administrative Citations	A31472--CV1001902	1	200.00	200.00
			Subtotal	\$200.00
			Payments/Credits	\$-200.00
			Total	\$0.00

EXHIBIT NO. B³



County of Riverside Code Enforcement Department

P.O. Box 1469, Riverside, CA 92502
Phone: (951) 955-2004 Fax: (951) 955-8680
demands@rctlma.org

Administrative Citation

144313023
Luz Guevara
2525 Old Farm Rd No. 918
Houston, TX 77063

Citation Issue Date	Billing Date
10/4/2010	5/26/2011

Citation Number	District	Class
A31555	2	SOAC

Property Address
144313023 Luz Guevara 14172 Trading Post Ct Corona, CA 92880

Item	Description	Hours/Qty	Rate	Amount
Administrative Citations	A31555--CV1001902	1	500.00	500.00
			Subtotal	\$500.00
			Payments/Credits	\$0.00
			Total	\$500.00

EXHIBIT NO. B4



County of Riverside Code Enforcement Department

P.O. Box 1469, Riverside, CA 92502
Phone: (951) 955-2004 Fax: (951) 955-8680
demands@rctlma.org

Administrative Citation

144313023
Luz Guevara
2525 Old Farm Rd No. 918
Houston, TX 77063

Citation Issue Date	Billing Date
7/20/2010	5/26/2011

Citation Number	District	Class
A31580	2	SOAC

Property Address
144313023 Luz Guevara 14172 Trading Post Ct Corona, CA 92880

Item	Description	Hours/Qty	Rate	Amount
Administrative Citations	A31580--CV1001902		200.00	200.00
			Subtotal	\$200.00
			Payments/Credits	\$0.00
			Total	\$200.00

EXHIBIT NO. B⁵



County of Riverside Code Enforcement Department

P.O. Box 1469, Riverside, CA 92502
Phone: (951) 955-2004 Fax: (951) 955-8680
demands@rctlma.org

Administrative Citation

144313023
Luz Guevara
2525 Old Farm Rd No. 918
Houston, TX 77063

Citation Issue Date	Billing Date
6/8/2010	5/26/2011

Citation Number	District	Class
A31789	2	SOAC

Property Address
144313023 Luz Guevara 14172 Trading Post Ct Corona, CA 92880

Item	Description	Hours/Qty	Rate	Amount
Administrative Citations	A31789--CV1001902	1	200.00	200.00
			Subtotal	\$200.00
			Payments/Credits	\$0.00
			Total	\$200.00

EXHIBIT NO. B6

CITATION CENTER	
Home	
New Search	
Payments & Refunds	
Citation Changes	
Adjudication	
Receipt	
Add Note	
Hot Sheet	
Reports	
Found Citations: A31472 Submit	
General Information	
Citation: A31472	Date: 04/27/10 Time: 10:04 AM
Amt Owing this Citation: \$0.00	This Person: \$200.00 This Plate:
Issuing Agency: RE-Riverside County Code Enforcement Dept.	Dept: Code Enforcement
Status: 06/17/10: Paid In Full	
Number: 1 of 2	
Responsible Party Information	
Name: GUEVARA, LUZ	
Address: 2525 OLD FARM 918	
City/State/Zip: HOUSTON, TX 77063	
Show all Panels Hide all Panels	
Citation Information	
Location: 14172 TRADING POST CORONA CA 92880 DIS 2	Case: CV1001902 Badge #: 58
Comments:	
Violation Information	
Fee History	
Payment History	
Notice History	
Appeal History	
Responsible Party History	
Citation History	
Home Log Out Help	

Â© Copyright 2010 Citation Processing Center. All Rights Reserved

EXHIBIT NO. B⁷

CITATION CENTER	
Home	
New Search	
Payments & Refunds	
Citation Changes	
Adjudication	
Receipt	
Add Note	
Hot Sheet	
Reports	
Found Citations: A31789 Submit	
General Information	
Citation: A31789	Date: 06/08/10 Time: 10:24 AM
Amt Owing this Citation: \$200.00	This Person: \$200.00 This Plate:
Issuing Agency: RE-Riverside County Code Enforcement Dept.	Dept: Code Enforcement
Status: OPEN: Noticed	
Number: 2 of 2	
Responsible Party Information	
Name: GUEVARA, LUZ	
Address: 2525 OLD FARM 918	
City/State/Zip: HOUSTON, TX 77063	
Show all Panels Hide all Panels	
Citation Information	
Location: 14172 TRADING POST CT CORONA CA 92880	Case: CV1001902 Badge #: 58
Comments:	
Violation Information	
Fee History	
Payment History	
Notice History	
Appeal History	
Responsible Party History	
Citation History	
Home Log Out Help	

© Copyright 2010 Citation Processing Center. All Rights Reserved

EXHIBIT NO. B8.

CITATION CENTER	
Home	
<div>New Search Payments & Refunds Citation Changes Adjudication Receipt Add Note Hot Sheet Reports</div>	
Found Citations: A31580 Submit	
<div><div>General Information</div><div><div>Citation: A31580</div><div>Date: 07/20/10</div><div>Time: 11:07 AM</div></div><div><div>Amt Owing this Citation: \$200.00</div><div>This Person: \$200.00</div><div>This Plate:</div></div><div><div>Issuing Agency: RE-Riverside County Code Enforcement Dept.</div><div>Dept: Code Enforcement</div></div><div><div>Status: OPEN: Noticed</div><div>Number: 1 of 1</div></div></div>	
<div>Responsible Party Information</div> <div><div>Name: GUEVARA, LUZ</div><div>Address: 2525 OLD FARM</div><div>City/State/Zip: HOUSTON, TX 77063</div></div>	
Show all Panels Hide all Panels	
<div>Citation Information</div> <div><div>Location: 14172 TRADING POST CORONA CA 92880</div><div>Case: CV1001902</div><div>Badge #: 58</div></div> <div>Comments:</div>	
<div><div> Violation Information</div><div> Fee History</div><div> Payment History</div><div> Notice History</div><div> Appeal History</div><div> Responsible Party History</div><div> Citation History</div></div>	
Home Log Out Help	

Â© Copyright 2010 Citation Processing Center. All Rights Reserved

EXHIBIT NO. B⁹

CITATION CENTER	
Home	
New Search	
Payments & Refunds	
Citation Changes	
Adjudication	
Receipt	
Add Note	
Hot Sheet	
Reports	
Found Citations: A31555 Submit	
General Information	
Citation: A31555	Date: 10/04/10 Time: 09:50 AM
Amt Owing this Citation: \$500.00	This Person: \$500.00 This Plate:
Issuing Agency: RE-Riverside County Code Enforcement Dept.	Dept: Code Enforcement
Status: OPEN: Noticed	
Number: 1 of 1	
Responsible Party Information	
Name: GUEVARA, LUZ	
Address: 2525 OLD FARM RD UNIT 918	
City/State/Zip: HOUSTON, TX 77063	
Show all Panels Hide all Panels	
Citation Information	
Location: 14172 TRADING POST CORONA CA 92880	Case: CV1001902 Badge #: 58
Comments:	
Violation Information	
Fee History	
Payment History	
Notice History	
Appeal History	
Responsible Party History	
Citation History	
Home Log Out Help	

© Copyright 2010 Citation Processing Center. All Rights Reserved

EXHIBIT NO. 610



INVOICE

Order Number: 24254

Order Date: 6/13/2011

Customer Information:

Acct No. 1044

RIVERSIDE COUNTY TLMA-CODE ENFORCEMENT
4080 Lemon Street
Riverside, CA 92501

Attn: Brent Steele
REF: CV10-01902 / Angela Sarmiento
IN RE: GUEVARA, LUZ

Product and/or Service ordered for Property known as: 14172 Trading Post Court Corona, CA 92880	
DESCRIPTION:	FEE:
Lot Book Report	\$120.00
TOTAL DUE:	\$120.00

Payment due upon receipt. Please remit to:

RZ Title Services, Inc.
P.O. Box 1193
Whittier, CA 90609

EXHIBIT NO. B¹¹

Assessment Roll For the 2010-2011 Tax Year as of January 1,2010

Assessment #144313023-9		Parcel # 144313023-9	
Assessee:	GUEVARA LUZ	Land	73,000
Mail Address:	2525 OLD FARM RD NO 918	Structure	333,000
City, State Zip:	HOUSTON TX 77063	Full Value	406,000
Real Property Use Code:	R1	Homeowners' Exemption	7,000
Base Year	2006	Total Net	399,000
Conveyance Number:	1019568		
Conveyance (mm/yy):	12/2005		
PUI:	R010010		
TRA:	59-132		
Taxability Code:	0-00		
ID Data:	Lot 44 MB 341/046 TR 29148-3		
Situs Address:	14172 TRADING POST CT CORONA CA 92880		

[View Parcel Map](#)EXHIBIT NO. C

RIVERSIDE COUNTY GIS

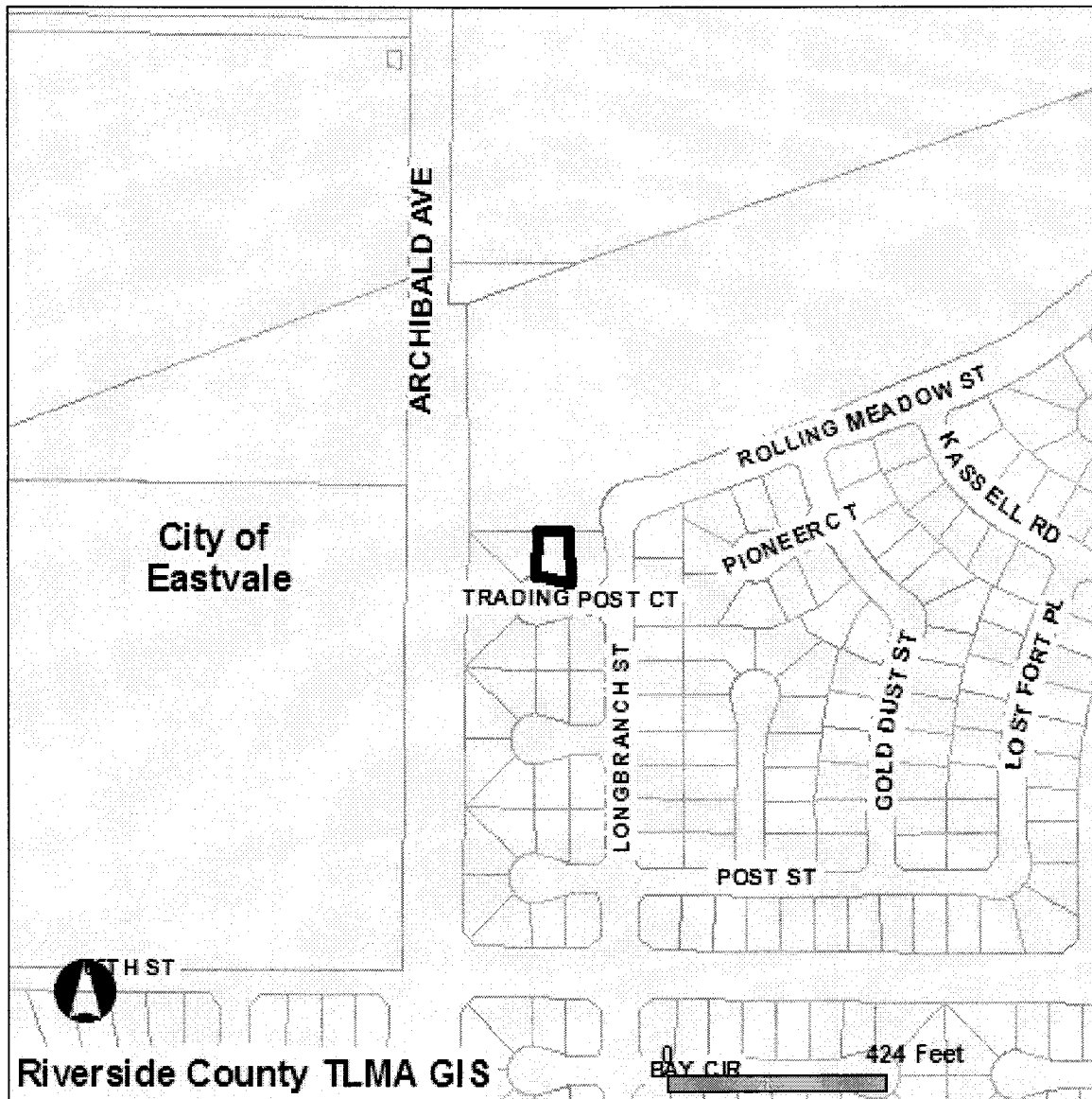

Selected parcel(s):
144-313-023

IMPORTANT

Maps and data are to be used for reference purposes only. Map features are approximate, and are not necessarily accurate to surveying or engineering standards. The County of Riverside makes no warranty or guarantee as to the content (the source is often third party), accuracy, timeliness, or completeness of any of the data provided, and assumes no legal responsibility for the information contained on this map. Any use of this product with respect to accuracy and precision shall be the sole responsibility of the user.

STANDARD REPORT

APNs

144-313-023-9

OWNER NAME / ADDRESS

LUZ GUEVARA
14172 TRADING POST CT
CORONA, CA. 92880

MAILING ADDRESS

(SEE OWNER)
2525 OLD FARM RD NO 918
HOUSTON TX. 77063

EXHIBIT NO. C²

LEGAL DESCRIPTION

RECORDED BOOK/PAGE: MB 341/46
SUBDIVISION NAME: TR 29148-3
LOT/PARCEL: 44, BLOCK: NOT AVAILABLE
TRACT NUMBER: 29148

LOT SIZE

RECORDED LOT SIZE IS 0.14 ACRES

PROPERTY CHARACTERISTICS

WOOD FRAME, 3521 SQFT., 4 BDRM/ 2.5 BATH, 2 STORY, ATTACHED GARAGE(665 SQ. FT), CONST'D 2005 TILE, ROOF, CENTRAL HEATING, CENTRAL COOLING

THOMAS BROS. MAPS PAGE/GRID

PAGE: 683 GRID: A6

CITY BOUNDARY/SPHERE

CITY OF EASTVALE
NOT WITHIN A CITY SPHERE
ANNEXATION DATE: NOT APPLICABLE
LAFCO CASE #: NOT APPLICABLE
PROPOSALS: NOT APPLICABLE

MARCH JOINT POWERS AUTHORITY

NOT IN THE JURISDICTION OF THE MARCH JOINT POWERS AUTHORITY

INDIAN TRIBAL LAND

NOT IN A TRIBAL LAND

SUPERVISORIAL DISTRICT (ORD. 813)

JOHN TAVAGLIONE, DISTRICT 2

TOWNSHIP/RANGE

T2SR7W SEC 26

ELEVATION RANGE

635 FEET

PREVIOUS APN

144-030-019

PLANNING

LAND USE DESIGNATIONS

Consult with the city for land use information.

AREA PLAN (RCIP)

EASTVALE

GENERAL PLAN POLICY OVERLAYS

NOT IN A GENERAL PLAN POLICY OVERLAY AREA

GENERAL PLAN POLICY AREAS

NONE

ZONING CLASSIFICATIONS (ORD. 348)

See the city for more information

ZONING DISTRICTS AND ZONING AREAS

PRADO-MIRA LOMA DISTRICT

ZONING OVERLAYS

IN OR PARTIALLY WITHIN THE EASTVALE NEIGHBORHOOD PRESERVATION OVERLAY

SPECIFIC PLANS

NOT WITHIN A SPECIFIC PLAN

AGRICULTURAL PRESERVE

NOT IN AN AGRICULTURAL PRESERVE

REDEVELOPMENT AREAS

NOT IN A REDEVELOPMENT AREA

AIRPORT INFLUENCE AREAS

CHINO

CHINO ZONE D

ENVIRONMENTAL

CVMSHCP (COACHELLA VALLEY MULTI-SPECIES HABITAT CONSERVATION PLAN) CONSERVATION AREA
NOT IN A CONSERVATION AREA

CVMSHCP FLUVIAL SAND TRANSPORT SPECIAL PROVISION AREAS
NOT IN A FLUVIAL SAND TRANSPORT SPECIAL PROVISION AREA

WRMSHCP (WESTERN RIVERSIDE COUNTY MULTI-SPECIES HABITAT CONSERVATION PLAN) CELL GROUP
NOT IN A CELL GROUP

WRMSHCP CELL NUMBER
NOT IN A CELL

HANS/ERP (HABITAT ACQUISITION AND NEGOTIATION STRATEGY/EXPEDITED REVIEWPROCESS)
NONE

VEGETATION (2005)
AGRICULTURAL LAND

FIRE

HIGH FIRE AREA (ORD. 787)
NOT IN A HIGH FIRE AREA

FIRE RESPONSIBILITY AREA
NOT IN A FIRE RESPONSIBILITY AREA

DEVELOPMENT FEES

CVMSHCP FEE AREA (ORD. 875)
NOT WITHIN THE COACHELLA VALLEY MSHCP FEE AREA

WRMSHCP FEE AREA (ORD. 810)
IN OR PARTIALLY WITHIN THE WESTERN RIVERSIDE MSHCP FEE AREA. SEE MAP FOR MORE INFORMATION.

ROAD & BRIDGE DISTRICT
MIRA LOMA D

EASTERN TUMF (TRANSPORTATION UNIFORM MITIGATION FEE ORD. 673)
NOT WITHIN THE EASTERN TUMF FEE AREA

WESTERN TUMF (TRANSPORTATION UNIFORM MITIGATION FEE ORD. 824)
IN OR PARTIALLY WITHIN A TUMF FEE AREA. SEE MAP FOR MORE INFORMATION. NORTHWEST

DIF (DEVELOPMENT IMPACT FEE AREA ORD. 659)
EASTVALE

SKR FEE AREA (STEPHEN'S KANGAROO RAT ORD. 663.10)
NOT WITHIN AN SKR FEE AREA.

DEVELOPMENT AGREEMENTS
NOT IN A DEVELOPMENT AGREEMENT AREA

TRANSPORTATION

CIRCULATION ELEMENT ULTIMATE RIGHT-OF-WAY
NOT IN A CIRCULATION ELEMENT RIGHT-OF-WAY

ROAD BOOK PAGE
13A

TRANSPORTATION AGREEMENTS
NOT IN A TRANSPORTATION AGREEMENT

CETAP (COMMUNITY AND ENVIRONMENTAL TRANSPORTATION ACCEPTABILITY PROCESS) CORRIDORS
NOT IN A CETAP CORRIDOR.

HYDROLOGY

FLOOD PLAIN REVIEW

NOT REQUIRED.

WATER DISTRICT

WMWD

FLOOD CONTROL DISTRICT

RIVERSIDE COUNTY FLOOD CONTROL DISTRICT

WATERSHEDSANTA ANA RIVER

GEOLOGIC

FAULT ZONE

NOT IN A FAULT ZONE

FAULTS

NOT WITHIN A 1/2 MILE OF A FAULT

LIQUEFACTION POTENTIAL

VERY HIGH

SUBSIDENCE

SUSCEPTIBLE

PALEONTOLOGICAL SENSITIVITY

HIGH SENSITIVITY (HIGH B).

SENSITIVITY EQUIVALENT TO HIGH A, BUT IS BASED ON THE OCCURRENCE OF FOSSILS AT A SPECIFIED DEPTH BELOW THE SURFACE. THE CATEGORY HIGH B INDICATES THAT FOSSILS ARE LIKELY TO BE ENCOUNTERED AT OR BELOW FOUR FEET OF DEPTH, AND MAY BE IMPACTED DURING EXCAVATION BY CONSTRUCTION ACTIVITIES.

MISCELLANEOUS

SCHOOL DISTRICT

CORONA-NORCO UNIFIED

COMMUNITIES

EASTVALE

COUNTY SERVICE AREA

NOT IN A COUNTY SERVICE AREA.

LIGHTING (ORD. 655)

NOT APPLICABLE, 59.55 MILES FROM MT. PALOMAR OBSERVATORY

2000 CENSUS TRACT

040602

FARMLAND

URBAN-BUILT UP LAND

TAX RATE AREAS

INFORMATION NOT AVAILABLE

SPECIAL NOTES

NO SPECIAL NOTES

CODE COMPLAINTS

Case #	Description	Start Date
NO CODE COMPLAINTS	NOT APPLICABLE	NOT APPLICABLE



P.O. Box 1193
Whittier, CA 90609
Tel # (562) 325-8351
Fax # (714) 783-3038

Lot Book Report

Order Number: **24254**

Customer:

RIVERSIDE COUNTY TLMA-CODE INFORCEMENT
4080 Lemon Street
Riverside CA 92501

Attn: Brent Steele
Reference: CV10-01902 / Angela Sarmiento
IN RE: GUEVARA, LUZ

Order Date: 6/13/2011

Dated as of: 6/6/2011

County Name: Riverside

FEE(s):

Report: \$120.00

Property Address: 14172 Trading Post Court
Corona CA 92880

Assessor's Parcel No. : 144-313-023-9

Assessments:

Land Value:	\$73,000.00
Improvement Value:	\$333,000.00
Exemption Value:	\$7,000.00
Total Value:	\$399,000.00

Tax Information

Property Taxes for the Fiscal Year	2010-2011
Total Annual Tax	\$6,779.10
Status: Paid through	PAID (PAID THRU 06/30/2011)

Property Vesting

The last recorded document transferring title of said property

Dated 10/13/2005

Recorded 12/09/2005

EXHIBIT NO. D



P.O. Box 1193
Whittier, CA 90609
Tel # (562) 325-8351
Fax # (714) 783-3038

Order Number: 24254

Reference: CV10-01902 / Ang

Document No.	2005-1019568
D.T.T.	\$672.65
Grantor	Ryland Homes of California, Inc., a Delaware Corporation
Grantee	Luz Guevara, an unmarried woman

Deeds of Trust

Position No.	1st
A Deed of Trust Dated	12/01/2005
Recorded	12/09/2005
Document No.	2005-1019569
Amount	\$411,000.00
Trustor	Luz Guevara, an unmarried woman
Trustee	David Brown
Beneficiary	Mortgage Electronic Registration Systems, Inc., acting as a nominee for Ryland Mortgage Company an Ohio Corporation

Notice of Default Recorded	05/04/2011
Document No.	2011-0195479

Substitution of Trustee Recorded	05/12/2011
Document No.	2011-0210660
Trustee	Recontrust Company, N.A.

Assignment Dated	05/03/2011
Recorded	05/12/2011
Document No.	2011-0210661
Assigned to	Bac Home Loans Servicing, LP fka Countrywide Home Loans Servicing LP

Position No.	2nd
A Deed of Trust Securing Bail Bond No.	A# 91 526 991
on behalf of	Ruben Aguilar-Jairo
Dated	02/13/2007
Recorded	04/06/2007



P.O. Box 1193
Whittier, CA 90609
Tel # (562) 325-8351
Fax # (714) 783-3038

Order Number: 24254
Reference: CV10-01902 / Ang

Document No.	2007-0235402
Amount	None Shown
Trustor	Luz Guevara
Trustee	R-Y-A Reconveyance Service
Beneficiary	American Surety Company, an Indiana Corporation
Position No.	3rd
A Deed of Trust Dated	01/29/2008
Recorded	02/21/2008
Document No.	2008-0086270
Amount	\$411,800.00
Trustor	Luz Guevara, an unmarried woman
Trustee	Public Trustee of Riverside County
Beneficiary	First National Bank of Arizona
Assignment Dated	10/02/2009
Recorded	12/15/2009
Document No.	2009-0644517
Assigned to	Celtic Bank Corporation

Additional Information

Document Type	Notice of Intent to Remove Delinquent Special Tax Installment(s) from the Riverside County
Document No.	2008-0626950
Recorded	11/26/2008

Legal Description

THE LAND REFERRED TO IN THIS REPORT IS LOCATED IN AND IS DESCRIBED AS FOLLOWS:

LOT 44 OF TRACT NO. 29148-3, IN THE COUNTY OF RIVERSIDE, STATE OF CALIFORNIA, AS SHOWN ON THE SUBDIVISION MAP FILED IN BOOK 341, AT PAGES 46 THROUGH 53, INCLUSIVE, OF MAPS IN THE OFFICE OF THE COUNTY RECORDER OF SAID COUNTY.

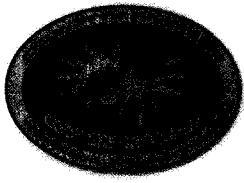

County of Riverside Code Enforcement Department

P.O. Box 1469, Riverside, CA 92502
Phone: (951) 955-2004 Fax: (951) 955-8680

DEMAND FOR PAYMENT STATEMENT OF ABATEMENT COSTS NOTICE OF SPECIAL TAX ASSESSMENT

6/29/2011

Luz Guevara
2525 Old Farm Rd No 918
Houston, TX 77063

Re: Demand for Payment of Statement of Abatement Costs
Subject Property: 14172 Trading Post Ct, Corona, CA 77063
Case No(s): CV10-01902
APN No(s): 144-313-023

Dear Luz Guevara:

NOTICE IS HEREBY GIVEN that the County of Riverside Code Enforcement Department has incurred expenses to enforce and/or abate violations of the Riverside County Ordinance caused by conditions on your real property described as [14172 Trading Post Ct, Corona, CA 77063] and more particularly described as Assessor's Parcel Number [144-313-023] ("Subject Property"). The conditions were deemed violations of Riverside County Ordinances No(s): [348]

Pursuant to Riverside County Ordinance No. 725, as property owner you are liable for reimbursement of all abatement costs incurred by the County, including, but not limited to, staff time for enforcement, investigations, notices, communications, title search, administrative costs and attorney fees.

YOU ARE HEREBY DEMANDED to pay the County of Riverside the total amount due of \$1,411.10 (One Thousand Four Hundred Eleven Dollars And Ten Cents) as set forth in the enclosed "Summary Statement of Abatement Costs." If the amount due is not paid in full within thirty (30) days, a special tax assessment and abatement lien will be recorded against the subject property.

YOU HAVE A RIGHT TO A HEARING ON THIS MATTER. You have the right to contest the abatement costs and special assessment levied against the subject property. If you choose to exercise your right to a public hearing, please complete the enclosed "Request for Public Hearing" form and return it to the Code Enforcement Department within twenty (20) days of the date of this notice.

If you have any questions regarding this notice, please contact Administrative Services at (951) 955-2004.

Code Enforcement Department

Ward Komers
Administrative Manager

EXHIBIT NO. _____

E

REQUEST FOR PUBLIC HEARING ON STATEMENT OF ABATEMENT COSTS AND SPECIAL TAX ASSESSMENT

Luz Guevara
2525 Old Farm Rd No 918
Houston, TX 77063

Subject Property: 14172 Trading Post Ct, Corona, CA 77063
Case No(s): CV10-01902
APN No(s): 144-313-023

I, _____, hereby request a public hearing regarding the above
(Please PRINT your name here)

described Subject Property and Case Number(s).

Please mail notice of the date, time, and location of the hearing to me at the following address:

Return Mailing Address: _____

Signed: _____ Date: _____
(Please SIGN your name here)

Print: _____
(Please PRINT your name here)

You may contact me at the following daytime phone number: _____

IMPORTANT

Keep a copy of this form and mail the original to:
Riverside County Code Enforcement Department
P.O. BOX 1469
Riverside, CA 92502-1469

EXHIBIT NO. Ea



COUNTY OF RIVERSIDE CODE ENFORCEMENT

P.O. Box 1469, Riverside, CA 92502
Phone: 951-955-2004 Fax: 951-955-8680

Property Reference/Mailing Address

144313023
Luz Guevara
2525 Old Farm Rd No. 918
Houston, TX 77063

Date: 5/26/2011

Summary Statement of Abatement Costs

You are liable to the County for the following abatement costs:

Date	Invoice Number & Amount	Amount	Balance
07/01/2009	Balance forward		0.00
05/26/2011	CV1001902- INV #101313.	511.10	511.10
04/27/2010	CV1001902:A31472- INV #20675. A31472	200.00	711.10
06/04/2010	PMT #chk 1068. A31472	-200.00	511.10
10/04/2010	CV1001902:A31555- INV #A31555. A31555	500.00	1,011.10
07/20/2010	CV1001902:A31580- INV #A31580.	200.00	1,211.10
06/08/2010	CV1001902:A31789- INV #21180. A31789	200.00	1,411.10
Total Now Due			\$1,411.10

The total abatement costs must be paid to the County of Riverside, P.O. Box 1469, Riverside, CA 92502 within thirty (30) days. In the event said costs are not paid within thirty (30) days you will be liable for additional administrative costs, penalties, court fees, or other collection costs incurred in the collection of these abatement costs.

I affirm and declare under penalty of perjury under the laws of the State of California that the foregoing is true and correct to the best of my knowledge.

EXHIBIT NO. E3

Burt Steele
Code Enforcement Department

**County of Riverside
Code Enforcement Department**

P.O. Box 1469, Riverside, CA 92502
Phone: (951) 955-2004 Fax: (951) 955-8680

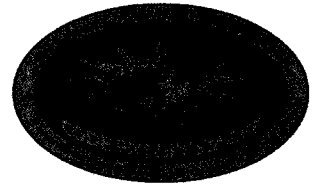

Statement of Abatement Costs

144313023
Luz Guevara
2525 Old Farm Rd No. 918
Houston, TX 77063

Date	Invoice #
5/26/2011	101313

Case Number	District	Class
CV1001902	2	SOAC

Property Address

144313023
Luz Guevara
14172 Trading Post Ct
Corona, CA 92880

You are liable to the County for the following abatement costs:

Date	Item	Description	Hours/Qty	Rate	Amount
3/9/2010	Officer Hours	Labor Charges - Officer Time	0.2	109.00	21.80
4/21/2010	Officer Hours	Labor Charges - Officer Time	0.1	109.00	10.90
4/27/2010	Officer Hours	Labor Charges - Officer Time	0.2	109.00	21.80
6/8/2010	Officer Hours	Labor Charges - Officer Time	0.2	109.00	21.80
7/20/2010	Officer Hours	Labor Charges - Officer Time	0.2	109.00	21.80
10/4/2010	Officer Hours	Labor Charges - Officer Time	0.2	109.00	21.80
2/1/2011	Officer Hours	Labor Charges - Officer Time	0.1	109.00	10.90
5/6/2011	SOE Preparation	Prepare Statement of Expense		65.00	65.00
		Subtotal Code Enforcement Costs			195.80
5/6/2011	Prepare Case for SOE He...			125.55	125.55
	Attend SOE Hearing			69.75	69.75
		Subtotal County Counsel Costs			195.30
5/6/2011	Lot Book Report			120.00	120.00
		Subtotal Contractor Costs			120.00

Subtotal \$511.10

Payments/Credits \$0.00

Total Now Due \$511.10

The total abatement costs must be paid to the County of Riverside, P.O. Box 1469, Riverside, CA 92502 within thirty (30) days. In the event said costs are not paid within thirty (30) days you will be liable for additional administrative costs, penalties, court fees or other collection costs incurred in the collection of these abatement costs.

I affirm and declare under penalty of perjury under the laws of the State of California that the foregoing is true and correct to the best of my knowledge.

EXHIBIT NO. E4

Brent Steele
Code Enforcement Department

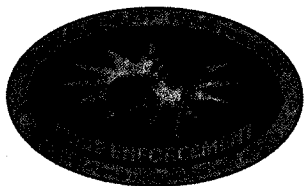

County of Riverside

Code Enforcement Department

P.O. Box 1469, Riverside, CA 92502
Phone: (951) 955-2004 Fax: (951) 955-8680
demands@rctlma.org

Administrative Citation

144313023
Luz Guevara
2525 Old Farm Rd No. 918
Houston, TX 77063

Citation Issue Date	Billing Date
4/27/2010	5/6/2011

Citation Number	District	Class
A31472	2	SOAC

Property Address
144313023 Luz Guevara 14172 Trading Post Ct Corona, CA 92880

Item	Description	Hours/Qty	Rate	Amount
Administrative Citations	A31472--CV1001902	1	200.00	200.00
			Subtotal	\$200.00
			Payments/Credits	\$-200.00
			Total	\$0.00

EXHIBIT NO. E⁵

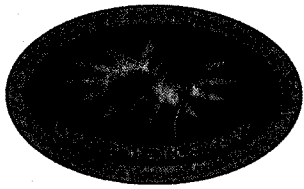

County of Riverside Code Enforcement Department

P.O. Box 1469, Riverside, CA 92502
Phone: (951) 955-2004 Fax: (951) 955-8680
demands@rctlma.org

Administrative Citation

144313023
Luz Guevara
2525 Old Farm Rd No. 918
Houston, TX 77063

Citation Issue Date	Billing Date
10/4/2010	5/26/2011

Citation Number	District	Class
A31555	2	SOAC

Property Address
144313023 Luz Guevara 14172 Trading Post Ct Corona, CA 92880

Item	Description	Hours/Qty	Rate	Amount
Administrative Citations	A31555--CV1001902	1	500.00	500.00

Subtotal \$500.00

Payments/Credits \$0.00

Total \$500.00

EXHIBIT NO. E6

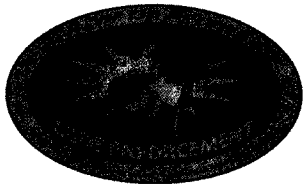

County of Riverside

Code Enforcement Department

P.O. Box 1469, Riverside, CA 92502
Phone: (951) 955-2004 Fax: (951) 955-8680
demands@rctlma.org

Administrative Citation

144313023
Luz Guevara
2525 Old Farm Rd No. 918
Houston, TX 77063

Citation Issue Date	Billing Date
7/20/2010	5/26/2011

Citation Number	District	Class
A31580	2	SOAC

Property Address
144313023 Luz Guevara 14172 Trading Post Ct Corona, CA 92880

Item	Description	Hours/Qty	Rate	Amount
Administrative Citations	A31580--CV1001902		200.00	200.00
			Subtotal	\$200.00
			Payments/Credits	\$0.00
			Total	\$200.00

EXHIBIT NO. E7

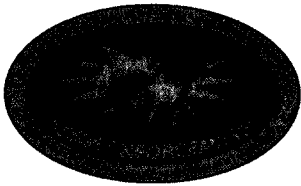

County of Riverside

Code Enforcement Department

P.O. Box 1469, Riverside, CA 92502
Phone: (951) 955-2004 Fax: (951) 955-8680
demands@rctlma.org

Administrative Citation

144313023
Luz Guevara
2525 Old Farm Rd No. 918
Houston, TX 77063

Citation Issue Date	Billing Date
6/8/2010	5/26/2011

Citation Number	District	Class
A31789	2	SOAC

Property Address
144313023 Luz Guevara 14172 Trading Post Ct Corona, CA 92880

Item	Description	Hours/Qty	Rate	Amount
Administrative Citations	A31789--CV1001902	1	200.00	200.00
			Subtotal	\$200.00
			Payments/Credits	\$0.00
			Total	\$200.00

EXHIBIT NO. E8

NOTICE LIST

Subject Property: 14172 Trading Post Ct, Corona, CA 77063;
Case No.: CV10-01902;
APN: 144-313-023

LUZ GUEVARA
2525 OLD FARM RD NO 918
HOUSTON TX 77063

LUZ GUEVARA
14172 TRADING POST CT
CORONA CA 92880

RYLAND MORTGAGE CO
6300 CANOGA AVE 14TH FLOOR
WOODLAND HILLS CA 91367

BAC HOME LOANS SERVICING LP
C/O RECONTRUST COMPANY
1800 TAPO CANYON RD CA6-914-01-94
SIMI VALLEY CA 93063

AMERICAN SURETY COMPANY
C/O GONZALES & GONZALES BONDS
AND INSURANCE AGENCY INC
412 E COMMERCIAL ST
LOS ANGELES CA 90012-3408

CELTIC BANK CORP
340 EAST 400 SOUTH
SALT LAKE CITY UT 84111

EXHIBIT NO. E⁹

PROOF OF SERVICE

Case No. CV10-01902

STATE OF CALIFORNIA, COUNTY OF RIVERSIDE

I, Sue Rush, declare that I am a citizen of the United States and am employed in the County of Riverside, over the age of 18 years and not a party to the within action or proceeding; that my business address is 3960 Orange Street, Suite 500, Riverside, California 92501.

That on June 29, 2011, I served the following document(s):

- DEMAND FOR PAYMENT
- REQUEST FOR HEARING
- SUMMARY STATEMENT OF ABATEMENT COSTS
- STATEMENT OF ABATEMENT COSTS
- ADMINISTRATIVE CITATION(S)
- NOTICE LIST

by placing a true copy thereof enclosed in a sealed envelope(s) addressed as follows:

OWNERS OR INTERESTED PARTIES
(SEE NOTICE LIST ATTACHED TO NOTICE OF HEARING)

XX BY FIRST CLASS MAIL. I am "readily familiar" with the office's practice of collection and processing correspondence for mailing. Under that practice it would be deposited with the U.S. Postal Service on that same day with postage thereon fully prepaid at Riverside, California, in the ordinary course of business.

— BY PERSONAL SERVICE: I caused to be delivered such envelope(s) by hand to the offices of the addressee(s).

XX STATE - I declare under penalty of perjury under the laws of the State of California that the above is true and correct.

— FEDERAL - I declare that I am employed in the office of a member of the bar of this court at whose direction the service was made.

EXECUTED ON 6/29/2011, at Riverside, California.

Sue Rush
SUE RUSH

EXHIBIT NO. E¹⁰

**REQUEST FOR PUBLIC HEARING
ON STATEMENT OF ABATEMENT COSTS
AND SPECIAL TAX ASSESSMENT**

Luz Guevara
2525 Old Farm Rd No 918
Houston, TX 77063

Subject Property: 14172 Trading Post Ct, Corona, CA 77063
Case No(s): CV10-01902
APN No(s): 144-313-023

I, Luz Guevara, hereby request a public hearing regarding the above
(Please PRINT your name here)

described Subject Property and Case Number(s).

Please mail notice of the date, time, and location of the hearing to me at the following address:

Return Mailing Address: 2525 Old Farm Rd 918
Houston TX 77063

Signed: Luz Guevara Date: 6-4-11
(Please SIGN your name here)

Print: Luz Guevara
(Please PRINT your name here)

You may contact me at the following daytime phone number: 562-397-4305

IMPORTANT

Keep a copy of this form and mail the original to:
Riverside County Code Enforcement Department
P.O. BOX 1469
Riverside, CA 92502-1469

EXHIBIT NO. F

EXHIBIT NO. F2

RECEIVED JUL 11 2011