

**SUBMITTAL TO THE BOARD OF SUPERVISORS
COUNTY OF RIVERSIDE, STATE OF CALIFORNIA**

810B



FROM: County Counsel
Code Enforcement Department

SUBMITTAL DATE:
November 3, 2011

SUBJECT: Statement of Abatement Costs [Case Nos. CV02-1273 & CV06-5796]
Subject Property: 28600 Rostrata Lane, Lake Elsinore; STARR
APN: 347-201-023
District Five

RECOMMENDED MOTION: Move that the Board of Supervisors:

Departmental Concurrence

- (1) assess the reasonable costs of abatement of a public nuisance (mobile home installation without permits, accumulated rubbish and excess outside storage) in the above-referenced matter to be **two thousand, eight hundred twenty-one dollars and ninety-five cents (US \$2,821.95)**;
- (2) assess the costs of abatement against the above-described subject property;
- (3) authorize the recordation of a notice of abatement lien;
- (4) authorize the abatement costs to be added to the tax roll as a special assessment; and
- (5) authorize and direct the Code Enforcement Department to take any reasonable actions to collect the amount owed.

BACKGROUND: Government Code § 25845, Riverside County Ordinance Nos. 457, 541 and 725 authorize the recovery of abatement costs in public nuisance cases, the recordation of a notice of abatement lien and inclusion of abatement costs on the tax roll as a special assessment upon approval of the Board of Supervisors.

[Signature]

PATRICIA MUNROE, Deputy County Counsel
for PAMELA J. WALLS, County Counsel

(continued)

FINANCIAL DATA	Current F.Y. Total Cost:	\$ N/A	In Current Year Budget:	N/A
	Current F.Y. Net County Cost:	\$ N/A	Budget Adjustment:	N/A
	Annual Net County Cost:	\$ N/A	For Fiscal Year:	N/A

SOURCE OF FUNDS:	Positions To Be Deleted Per A-30	<input type="checkbox"/>
	Requires 4/5 Vote	<input type="checkbox"/>

C.E.O. RECOMMENDATION: APPROVE

BY: *[Signature]*
Tina Grande

County Executive Office Signature

Consent Policy
 Consent Policy
 Policy

MINUTES OF THE BOARD OF SUPERVISORS

On motion of Supervisor Buster, seconded by Supervisor Stone and duly carried, IT WAS ORDERED that the above matter is approved as recommended.

Ayes: Buster, Stone, Benoit and Ashley
Nays: None
Absent: Tavaglione
Date: November 15, 2011
xc: Co. Co., CED, Prop. Owner

Kecia Harper-Ihem
Clerk of the Board
By: *[Signature]*
Deputy

Dep't Recomm.:
 Per Exec. Ofc.:

Prev. Agn. Ref.:

District: 5

Agenda Number:

9.4

Statement of Abatement Costs [Case Nos. CV02-1273 & CV06-5796]
Subject Property: 28600 Rostrata Lane, Lake Elsinore; STARR
APN: 347-201-023
District Five
Page 2

Notices of Violation and Administrative Citations were issued. On or about May 9, 2005, Case No. CV02-1273 (mobile home installation without permits / accumulated rubbish) was closed. However, one of the two mobile homes in violation remained on the property. Accordingly, a Notice of Noncompliance was placed on the property. Additionally, on or about July 25, 2008, Case No. CV06-5796 (excess outside storage - mobile home) was closed and reopened under Case No. CV08-05859 as a substandard mobile home case.

This Statement of Abatement Costs seeks to recover costs to date regarding Case Nos. CV02-1273 and CV06-5796. However, the Riverside County Code Enforcement Department does not waive its right to seek additional costs associated with any new case(s) regarding the subject property.

The Notice of Hearing re Statement of Abatement Costs has been posted on the property and mailed to the property owner and all interested parties, as required by law. Copies of all relevant notices issued in this matter together with proof of service and posting have been separately filed with the Clerk of the Board and are made a part of the record herein, pursuant to Riverside County Ordinance 725.

**SUBMITTAL TO THE BOARD OF SUPERVISORS
COUNTY OF RIVERSIDE, STATE OF CALIFORNIA**

FROM: County Counsel
Code Enforcement Department
SUBJECT: Statement of Abatement Costs [Case Nos. CV02-1273 & CV06-5796]
Subject Property: 28600 Rostrata Lane, Lake Elsinore; STARR
APN: 347-201-023
District Five

**TABLE OF SUPPLEMENTAL DOCUMENTS
FILED WITH THE CLERK OF THE BOARD**

Hearing Date: NOVEMBER 15, 2011

Notice of Hearing Re: Statement of Abatement Costs (including Proof(s) of Service and Affidavit(s) of Posting	Exhibit A
Summary Statement of Abatement Costs and Statement of Abatement Costs with Supporting Documents	Exhibit B
Assessment-Roll For The Year 10/11 And Geographic Information System, May 2, 2011	Exhibit C
Lot Book Report.....	Exhibit D
Demand for Payment Statement of Abatement Costs Notice of Special Tax Assessment	Exhibit E
Request for Hearing.....	Exhibit F

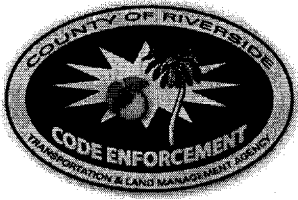

**CODE ENFORCEMENT DEPARTMENT
COUNTY OF RIVERSIDE**

Glenn Baude
Director

October 26, 2011

**NOTICE OF HEARING RE:
STATEMENT OF ABATEMENT COSTS**

To: Owner(s) or Interested Parties
(See Attached Proof of Service
and Notice List)

Subject Property: 28600 Rostrata Lane, Lake Elsinore
Case Nos.: CV02-1273 & CV06-5796
APN: 347-201-023; STARR

NOTICE IS HEREBY GIVEN that a hearing will be held before the Riverside County Board of Supervisors on **Tuesday, November 15, 2011, at 9:30 a.m.** in the Board of Supervisors Room, 4080 Lemon Street, 1st Floor Annex, Riverside, California, at which time and place pertinent testimony will be heard regarding the expenses incurred by the County of Riverside, Code Enforcement Department ("DEPARTMENT") for the above-referenced abatement case. Said abatement case involved mobile home installation without permits, accumulated rubbish and excessive outside storage located on your real property commonly described as 28600 Rostrata Lane, Lake Elsinore, Riverside County, California and more particularly described as Assessor's Parcel Number 347-201-023.

The total expense due, including all other fees and costs, for the abatement of the above-described dangerous or injurious condition is **two thousand, eight hundred twenty-one dollars and ninety-five cents, (US \$2,821.95)**. This amount is immediately due and payable. If you have any objections to the Statement of Abatement Costs attached hereto, you must address your objections to the Board of Supervisors at the hearing. If you have any questions about the attached Statement of Abatement Costs, please contact Ward Komers or Carol Lynn Anderson at (951) 955-2004. In the event the total amount due is not paid to the DEPARTMENT prior to the Board Hearing, the DEPARTMENT shall seek an order from the Board of Supervisors to place a lien against your property and collect the amount due as a special tax assessment.

Failure to appear at the hearing will result in the exclusion of your testimony. Facts as known to the DEPARTMENT will be presented to the Board of Supervisors for their final consideration and deliberation of this matter.

You are encouraged to contact Code Enforcement Officer, Stacy Baumgartner at (951) 955-2004 prior to the hearing. Please meet with Stacy Baumgartner at 8:30 a.m. on the day of the hearing in Conference Room 2A located on the 1st floor in front of the Human Resources Office to discuss the case.

GLENN BAUDE
DIRECTOR

WARD KOMERS
Administrative Manager

Enclosure: Statement of Abatement Costs

4080 LEMON STREET, 12TH FLOOR, RIVERSIDE, CALIFORNIA 92501
(951) 955-2004 • FAX (951) 955-8680

EXHIBIT NO. _____

A



COUNTY OF RIVERSIDE CODE ENFORCEMENT

P.O. Box 1469, Riverside, CA 92502
Phone: 951-955-2004 Fax: 951-955-8680

Property Reference/Mailing Address
347-201-023 BRENDA SUE STARR RANDY STARR 28600 ROSTRATA LN LAKE ELSINORE, CA 92532

Summary Statement of Abatement Costs

You are liable to the County for the following abatement costs:

Date	Invoice Number & Amount	Amount	Balance
12/31/2000	Balance forward		0.00
05/02/2011	CV021273- INV #101143.	931.80	931.80
04/09/2003	CV021273:A04136- INV #8300. A04136	200.00	1,131.80
08/04/2003	CV021273:A07436- INV #8301. A07436	400.00	1,531.80
05/04/2011	CV065796- INV #101259.	490.15	2,021.95
08/03/2007	CV065796:A20330- INV #8302. A20330	200.00	2,221.95
06/19/2007	CV065796:A23042- INV #8303. A23042	100.00	2,321.95
01/03/2008	CV065796:A23838- INV #8304. A23838	500.00	2,821.95
		Total Now Due	\$2,821.95

The total abatement costs must be paid to the County of Riverside, P.O. Box 1469, Riverside, CA 92502 within thirty (30) days. In the event said costs are not paid within thirty (30) days you will be liable for additional administrative costs, penalties, court fees, or other collection costs incurred in the collection of these abatement costs.

I affirm and declare under penalty of perjury under the laws of the State of California that the foregoing is true and correct to the best of my knowledge.

Dee Cull
Code Enforcement Department

EXHIBIT NO. A2

**County of Riverside
Code Enforcement Department**

P.O. Box 1469, Riverside, CA 92502
Phone: (951) 955-2004 Fax: (951) 955-8680



Statement of Abatement Costs

347-201-023
BRENDA SUE STARR
RANDY STARR
28600 ROSTRATA LN
LAKE ELSINORE, CA 92532

Date	Invoice #
5/2/2011	101143

Case Number	District	Class
CV021273	5	SOAC

Property Address
347-201-023 BRENDA SUE STARR RANDY STARR 28600 ROSTRATA LN LAKE ELSINORE, CA 92532

You are liable to the County for the following abatement costs:

Date	Item	Description	Hours/Qty	Rate	Amount
4/9/2003	Officer Hours	Labor Charges - Officer Time	1.5	70.00	105.00
4/10/2003	Officer Hours	Labor Charges - Officer Time	1	70.00	70.00
8/4/2003	Officer Hours	Labor Charges - Officer Time	1	70.00	70.00
8/5/2003	Officer Hours	Labor Charges - Officer Time	1	70.00	70.00
10/8/2003	Officer Hours	Labor Charges - Officer Time	1	70.00	70.00
10/9/2003	Officer Hours	Labor Charges - Officer Time	0.5	70.00	35.00
7/21/2004	Officer Hours	Labor Charges - Officer Time	0.3	100.00	30.00
8/17/2004	Officer Hours	Labor Charges - Officer Time	0.2	100.00	20.00
1/18/2005	Officer Hours	Labor Charges - Officer Time	0.3	100.00	30.00
5/9/2005	Officer Hours	Labor Charges - Officer Time	0.5	103.00	51.50
5/2/2011	SOE Preparation	Prepare Statement of Expense		65.00	65.00
		Subtotal Code Enforcement Costs			616.50
5/2/2011	Prepare Case for SOE He...			125.55	125.55
	Attend SOE Hearing			69.75	69.75
		Subtotal County Counsel Costs			195.30
5/2/2011	Lot Book Report			120.00	120.00
		Subtotal Contractor Costs			120.00
				Subtotal	\$931.80

The total abatement costs must be paid to the County of Riverside, P.O. Box 1469, Riverside, CA 92502 within thirty (30) days. In the event said costs are not paid within thirty (30) days you will be liable for additional administrative costs, penalties, court fees or other collection costs incurred in the collection of these abatement costs.

Payments/Credits	\$0.00
Total Now Due	\$931.80

I affirm and declare under penalty of perjury under the laws of the State of California that the foregoing is true and correct to the best of my knowledge.

[Signature]

Code Enforcement Department

EXHIBIT NO. A3



County of Riverside Code Enforcement Department

P.O. Box 1469, Riverside, CA 92502
Phone: (951) 955-2004 Fax: (951) 955-8680
demands@rctlma.org

Administrative Citation

347-201-023
BRENDA SUE STARR
RANDY STARR
28600 ROSTRATA LN
LAKE ELSINORE, CA 92532

Citation Issue Date	Billing Date
4/9/2003	5/2/2011

Citation Number	District	Class
A04136	5	SOAC

Property Address
347-201-023 BRENDA SUE STARR RANDY STARR 28600 ROSTRATA LN LAKE ELSINORE, CA 92532

Item	Description	Hours/Qty	Rate	Amount
Administrative Citations	A04136--CV021273	1	200.00	200.00
			Subtotal	\$200.00
			Payments/Credits	\$0.00
			Total	\$200.00

EXHIBIT NO. A4



County of Riverside Code Enforcement Department

P.O. Box 1469, Riverside, CA 92502
Phone: (951) 955-2004 Fax: (951) 955-8680
demands@rctlma.org

Administrative Citation

347-201-023
BRENDA SUE STARR
RANDY STARR
28600 ROSTRATA LN
LAKE ELSINORE, CA 92532

Citation Issue Date	Billing Date
8/4/2003	5/2/2011

Citation Number	District	Class
A07436	5	SOAC

Property Address 347-201-023 BRENDA SUE STARR RANDY STARR 28600 ROSTRATA LN LAKE ELSINORE, CA 92532

Item	Description	Hours/Qty	Rate	Amount
Administrative Citations	A07436--CV021273	1	400.00	400.00

Subtotal	\$400.00
Payments/Credits	\$0.00
Total	\$400.00

EXHIBIT NO. AS

**County of Riverside
Code Enforcement Department**

P.O. Box 1469, Riverside, CA 92502
Phone: (951) 955-2004 Fax: (951) 955-8680



Statement of Abatement Costs

347-201-023
BRENDA SUE STARR
RANDY STARR
28600 ROSTRATA LN
LAKE ELSINORE, CA 92532

Date	Invoice #
5/4/2011	101259

Case Number	District	Class
CV065796	5	SOAC

Property Address
347-201-023 BRENDA SUE STARR RANDY STARR 28600 ROSTRATA LN LAKE ELSINORE, CA 92532

You are liable to the County for the following abatement costs:

Date	Item	Description	Hours/Qty	Rate	Amount
1/2/2007	Officer Hours	Labor Charges - Officer Time	0.25	109.00	27.25
3/27/2007	Officer Hours	Labor Charges - Officer Time	0.3	109.00	32.70
6/19/2007	Officer Hours	Labor Charges - Officer Time	0.2	82.00	16.40
6/19/2007	Officer Hours	Labor Charges - Officer Time	0.2	109.00	21.80
6/21/2007	Officer Hours	Labor Charges - Officer Time	0.5	109.00	54.50
7/2/2007	Officer Hours	Labor Charges - Officer Time	0.2	109.00	21.80
8/3/2007	Officer Hours	Labor Charges - Officer Time	0.3	109.00	32.70
8/6/2007	Officer Hours	Labor Charges - Officer Time	0.5	109.00	54.50
8/7/2007	Officer Hours	Labor Charges - Officer Time	0.5	109.00	54.50
1/3/2008	Officer Hours	Labor Charges - Officer Time	0.2	109.00	21.80
1/3/2008	Officer Hours	Labor Charges - Officer Time	0.7	109.00	76.30
5/12/2008	Officer Hours	Labor Charges - Officer Time	0.1	109.00	10.90
	SOE Preparation	Prepare Statement of Expense		65.00	65.00
		Subtotal Code Enforcement Costs			490.15
				Subtotal	\$490.15

The total abatement costs must be paid to the County of Riverside, P.O. Box 1469, Riverside, CA 92502 within thirty (30) days. In the event said costs are not paid within thirty (30) days you will be liable for additional administrative costs, penalties, court fees or other collection costs incurred in the collection of these abatement costs.

Payments/Credits	\$0.00
Total Now Due	\$490.15

I affirm and declare under penalty of perjury under the laws of the State of California that the foregoing is true and correct to the best of my knowledge.

[Signature]

Code Enforcement Department

EXHIBIT NO.

AG



County of Riverside Code Enforcement Department

P.O. Box 1469, Riverside, CA 92502
Phone: (951) 955-2004 Fax: (951) 955-8680
demands@rctlma.org

Administrative Citation

347-201-023
BRENDA SUE STARR
RANDY STARR
28600 ROSTRATA LN
LAKE ELSINORE, CA 92532

Citation Issue Date	Billing Date
8/3/2007	5/4/2011

<p style="text-align: center; margin: 0;">Property Address</p> <p style="margin: 0;">347-201-023 BRENDA SUE STARR RANDY STARR 28600 ROSTRATA LN LAKE ELSINORE, CA 92532</p>
--

Citation Number	District	Class
A20330	5	SOAC

Item	Description	Hours/Qty	Rate	Amount
Administrative Citations	A20330--CV065796	1	200.00	200.00

Subtotal	\$200.00
Payments/Credits	\$0.00
Total	\$200.00

EXHIBIT NO. _____

A7



County of Riverside Code Enforcement Department

P.O. Box 1469, Riverside, CA 92502
Phone: (951) 955-2004 Fax: (951) 955-8680
demands@rctlma.org

Administrative Citation

347-201-023
BRENDA SUE STARR
RANDY STARR
28600 ROSTRATA LN
LAKE ELSINORE, CA 92532

Citation Issue Date	Billing Date
6/19/2007	5/4/2011

Citation Number	District	Class
A23042	5	SOAC

Property Address
347-201-023 BRENDA SUE STARR RANDY STARR 28600 ROSTRATA LN LAKE ELSINORE, CA 92532

Item	Description	Hours/Qty	Rate	Amount
Administrative Citations	A23042--CV065796	1	100.00	100.00

Subtotal	\$100.00
Payments/Credits	\$0.00
Total	\$100.00

EXHIBIT NO. AP



County of Riverside Code Enforcement Department

P.O. Box 1469, Riverside, CA 92502
Phone: (951) 955-2004 Fax: (951) 955-8680
demands@rctlma.org

Administrative Citation

347-201-023
BRENDA SUE STARR
RANDY STARR
28600 ROSTRATA LN
LAKE ELSINORE, CA 92532

Citation Issue Date	Billing Date
1/3/2008	5/4/2011

Citation Number	District	Class
A23838	5	SOAC

Property Address
347-201-023 BRENDA SUE STARR RANDY STARR 28600 ROSTRATA LN LAKE ELSINORE, CA 92532

Item	Description	Hours/Qty	Rate	Amount
Administrative Citations	A23838--CV065796	1	500.00	500.00

Subtotal	\$500.00
Payments/Credits	\$0.00
Total	\$500.00

EXHIBIT NO. A9

NOTICE LIST

Subject Property: 28600 Rostrata Lane, Lake Elsinore; Case Nos.: CV02-1273 &
CV06-5796; APN: 347-201-023; District Five

BRENDA SUE STARR
RANDY STARR
28600 ROSTRATA LANE
LAKE ELSINORE CA 92532

LONG BEACH MORTGAGE CO
1100 TOWN & COUNTRY ROAD
ORANGE CA 92868

LONG BEACH MORTGAGE CO
PO BOX 11490
SANTA ANA CA 92711

CALIF RECONVEYANCE CO
9301 CORBIN AVE - N030204
NORTHRIDGE CA 91324

EXHIBIT NO. _____

A10

1
2
3
4
5
6
7
8
9
10
11
12
13
14
15
16
17
18
19
20
21
22
23
24
25
26
27
28

PROOF OF SERVICE

Case Nos. CV02-1273 & CV06-5796

STATE OF CALIFORNIA, COUNTY OF RIVERSIDE

I, Brenda G. Peeler, declare that I am a citizen of the United States and am employed in the County of Riverside, over the age of 18 years and not a party to the within action or proceeding; that my business address is 3960 Orange Street, Suite 500, Riverside, California 92501.

That on October 26, 2011, I served the following document(s):

- NOTICE OF HEARING RE: STATEMENT OF ABATEMENT COSTS
- SUMMARY STATEMENT OF ABATEMENT COSTS
- STATEMENT OF ABATEMENT COSTS
- ADMINISTRATIVE CITATION(S)
- NOTICE LIST

by placing a true copy thereof enclosed in a sealed envelope(s) addressed as follows:

**OWNERS OR INTERESTED PARTIES
(SEE NOTICE LIST ATTACHED TO NOTICE OF HEARING)**

XX **BY FIRST CLASS MAIL.** I am "readily familiar" with the office's practice of collection and processing correspondence for mailing. Under that practice it would be deposited with the U.S. Postal Service on that same day with postage thereon fully prepaid at Riverside, California, in the ordinary course of business.

— **BY PERSONAL SERVICE:** I caused to be delivered such envelope(s) by hand to the offices of the addressee(s).

XX **STATE - I declare under penalty of perjury under the laws of the State of California that the above is true and correct.**

— **FEDERAL - I declare that I am employed in the office of a member of the bar of this court at whose direction the service was made.**

EXECUTED ON October 26, 2011, at Riverside, California.

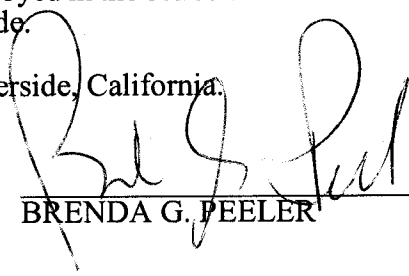

BRENDA G. PEELER

EXHIBIT NO. A"



**CODE ENFORCEMENT DEPARTMENT
COUNTY OF RIVERSIDE**

GLENN BAUDE
Director

AFFIDAVIT OF POSTING OF NOTICES

October 28, 2011

RE CASE NO: CV065796

I, Jim Palmer, hereby declare:

I am employed by the Riverside County Code Enforcement Department; that my business address is 24318 Hemlock, Ave., Suite C-1, Moreno Valley, California 92557.

That on 10/28/11 at 10:20 am, I securely and conspicuously posted NOTICE OF HEARING RE: STATEMENT OF ABATEMENT COSTS at the property described as:

Property Address: 28600 ROSTRATA LN, LAKE ELSINORE

Assessor's Parcel Number: 347-201-023

I declare under the penalty of perjury that the foregoing is true and correct.

Executed on October 28, 2011 in the County of Riverside, California.

CODE ENFORCEMENT DEPARTMENT

By: Jim Palmer, Sr. Code Enforcement Officer

24318 HEMLOCK AVE., SUITE C-1, MORENO VALLEY, CALIFORNIA 92557
(951) 485-5840 • FAX (951) 485-4938

EXHIBIT NO. A12



**CODE ENFORCEMENT DEPARTMENT
COUNTY OF RIVERSIDE**

GLENN BAUDE
Director

AFFIDAVIT OF POSTING OF NOTICES

October 28, 2011

RE CASE NO: CV021273

I, Jim Palmer, hereby declare:

I am employed by the Riverside County Code Enforcement Department; that my business address is 4080 Lemon Street, 12th Floor, Riverside, California 92501 .

That on 10/28/11 at 10:20 am, I securely and conspicuously posted NOTICE OF HEARING RE: STATEMENT OF ABATEMENT COSTS at the property described as:

Property Address: 28600 ROSTRATA LN, LAKE ELSINORE

Assessor's Parcel Number: 347-201-023

I declare under the penalty of perjury that the foregoing is true and correct.

Executed on October 28, 2011 in the County of Riverside, California.

CODE ENFORCEMENT DEPARTMENT

By: Jim Palmer, Sr. Code Enforcement Officer

A13



COUNTY OF RIVERSIDE CODE ENFORCEMENT

P.O. Box 1469, Riverside, CA 92502
Phone: 951-955-2004 Fax: 951-955-8680

Property Reference/Mailing Address
347-201-023 BRENDA SUE STARR RANDY STARR 28600 ROSTRATA LN LAKE ELSINORE, CA 92532

Summary Statement of Abatement Costs

You are liable to the County for the following abatement costs:

Date	Invoice Number & Amount	Amount	Balance
12/31/2000	Balance forward		0.00
05/02/2011	CV021273- INV #101143.	931.80	931.80
04/09/2003	CV021273:A04136- INV #8300. A04136	200.00	1,131.80
08/04/2003	CV021273:A07436- INV #8301. A07436	400.00	1,531.80
05/04/2011	CV065796- INV #101259.	490.15	2,021.95
08/03/2007	CV065796:A20330- INV #8302. A20330	200.00	2,221.95
06/19/2007	CV065796:A23042- INV #8303. A23042	100.00	2,321.95
01/03/2008	CV065796:A23838- INV #8304. A23838	500.00	2,821.95
		Total Now Due	\$2,821.95

The total abatement costs must be paid to the County of Riverside, P.O. Box 1469, Riverside, CA 92502 within thirty (30) days. In the event said costs are not paid within thirty (30) days you will be liable for additional administrative costs, penalties, court fees, or other collection costs incurred in the collection of these abatement costs.

I affirm and declare under penalty of perjury under the laws of the State of California that the foregoing is true and correct to the best of my knowledge.

Code Enforcement Department

EXHIBIT NO. **B**

**County of Riverside
Code Enforcement Department**

P.O. Box 1469, Riverside, CA 92502
Phone: (951) 955-2004 Fax: (951) 955-8680



Statement of Abatement Costs

347-201-023
BRENDA SUE STARR
RANDY STARR
28600 ROSTRATA LN
LAKE ELSINORE, CA 92532

Date	Invoice #
5/2/2011	101143

Case Number	District	Class
CV021273	5	SOAC

Property Address
347-201-023 BRENDA SUE STARR RANDY STARR 28600 ROSTRATA LN LAKE ELSINORE, CA 92532

You are liable to the County for the following abatement costs:

Date	Item	Description	Hours/Qty	Rate	Amount
4/9/2003	Officer Hours	Labor Charges - Officer Time	1.5	70.00	105.00
4/10/2003	Officer Hours	Labor Charges - Officer Time	1	70.00	70.00
8/4/2003	Officer Hours	Labor Charges - Officer Time	1	70.00	70.00
8/5/2003	Officer Hours	Labor Charges - Officer Time	1	70.00	70.00
10/8/2003	Officer Hours	Labor Charges - Officer Time	1	70.00	70.00
10/9/2003	Officer Hours	Labor Charges - Officer Time	0.5	70.00	35.00
7/21/2004	Officer Hours	Labor Charges - Officer Time	0.3	100.00	30.00
8/17/2004	Officer Hours	Labor Charges - Officer Time	0.2	100.00	20.00
1/18/2005	Officer Hours	Labor Charges - Officer Time	0.3	100.00	30.00
5/9/2005	Officer Hours	Labor Charges - Officer Time	0.5	103.00	51.50
5/2/2011	SOE Preparation	Prepare Statement of Expense		65.00	65.00
		Subtotal Code Enforcement Costs			616.50
5/2/2011	Prepare Case for SOE He...			125.55	125.55
	Attend SOE Hearing			69.75	69.75
		Subtotal County Counsel Costs			195.30
5/2/2011	Lot Book Report			120.00	120.00
		Subtotal Contractor Costs			120.00

Subtotal \$931.80

The total abatement costs must be paid to the County of Riverside, P.O. Box 1469, Riverside, CA 92502 within thirty (30) days. In the event said costs are not paid within thirty (30) days you will be liable for additional administrative costs, penalties, court fees or other collection costs incurred in the collection of these abatement costs.

Payments/Credits \$0.00

Total Now Due \$931.80

I affirm and declare under penalty of perjury under the laws of the State of California that the foregoing is true and correct to the best of my knowledge.

Del Cuel
Code Enforcement Department

EXHIBIT NO. _____ *B2*



County of Riverside Code Enforcement Department

P.O. Box 1469, Riverside, CA 92502
 Phone: (951) 955-2004 Fax: (951) 955-8680
 demands@rctlma.org

Administrative Citation

347-201-023
 BRENDA SUE STARR
 RANDY STARR
 28600 ROSTRATA LN
 LAKE ELSINORE, CA 92532

Citation Issue Date	Billing Date
4/9/2003	5/2/2011

Citation Number	District	Class
A04136	5	SOAC

Property Address
347-201-023 BRENDA SUE STARR RANDY STARR 28600 ROSTRATA LN LAKE ELSINORE, CA 92532

Item	Description	Hours/Qty	Rate	Amount
Administrative Citations	A04136--CV021273	1	200.00	200.00
			Subtotal	\$200.00
			Payments/Credits	\$0.00
			Total	\$200.00

EXHIBIT NO. _____ B³



County of Riverside Code Enforcement Department

P.O. Box 1469, Riverside, CA 92502
Phone: (951) 955-2004 Fax: (951) 955-8680
demands@rctlma.org

Administrative Citation

347-201-023
BRENDA SUE STARR
RANDY STARR
28600 ROSTRATA LN
LAKE ELSINORE, CA 92532

Citation Issue Date	Billing Date
8/4/2003	5/2/2011

Citation Number	District	Class
A07436	5	SOAC

Property Address
347-201-023 BRENDA SUE STARR RANDY STARR 28600 ROSTRATA LN LAKE ELSINORE, CA 92532

Item	Description	Hours/Qty	Rate	Amount
Administrative Citations	A07436--CV021273	1	400.00	400.00

Subtotal	\$400.00
Payments/Credits	\$0.00
Total	\$400.00

EXHIBIT NO. _____ **B4**

**County of Riverside
Code Enforcement Department**

P.O. Box 1469, Riverside, CA 92502
Phone: (951) 955-2004 Fax: (951) 955-8680



Statement of Abatement Costs

347-201-023
BRENDA SUE STARR
RANDY STARR
28600 ROSTRATA LN
LAKE ELSINORE, CA 92532

Date	Invoice #
5/4/2011	101259

Case Number	District	Class
CV065796	5	SOAC

Property Address
347-201-023 BRENDA SUE STARR RANDY STARR 28600 ROSTRATA LN LAKE ELSINORE, CA 92532

You are liable to the County for the following abatement costs:

Date	Item	Description	Hours/Qty	Rate	Amount
1/2/2007	Officer Hours	Labor Charges - Officer Time	0.25	109.00	27.25
3/27/2007	Officer Hours	Labor Charges - Officer Time	0.3	109.00	32.70
6/19/2007	Officer Hours	Labor Charges - Officer Time	0.2	82.00	16.40
6/19/2007	Officer Hours	Labor Charges - Officer Time	0.2	109.00	21.80
6/21/2007	Officer Hours	Labor Charges - Officer Time	0.5	109.00	54.50
7/2/2007	Officer Hours	Labor Charges - Officer Time	0.2	109.00	21.80
8/3/2007	Officer Hours	Labor Charges - Officer Time	0.3	109.00	32.70
8/6/2007	Officer Hours	Labor Charges - Officer Time	0.5	109.00	54.50
8/7/2007	Officer Hours	Labor Charges - Officer Time	0.5	109.00	54.50
1/3/2008	Officer Hours	Labor Charges - Officer Time	0.2	109.00	21.80
1/3/2008	Officer Hours	Labor Charges - Officer Time	0.7	109.00	76.30
5/12/2008	Officer Hours	Labor Charges - Officer Time	0.1	109.00	10.90
	SOE Preparation	Prepare Statement of Expense		65.00	65.00
		Subtotal Code Enforcement Costs			490.15

Subtotal \$490.15

Payments/Credits \$0.00

Total Now Due \$490.15

The total abatement costs must be paid to the County of Riverside, P.O. Box 1469, Riverside, CA 92502 within thirty (30) days. In the event said costs are not paid within thirty (30) days you will be liable for additional administrative costs, penalties, court fees or other collection costs incurred in the collection of these abatement costs.

I affirm and declare under penalty of perjury under the laws of the State of California that the foregoing is true and correct to the best of my knowledge.

Del C. Call
Code Enforcement Department

EXHIBIT NO. BS



County of Riverside Code Enforcement Department

P.O. Box 1469, Riverside, CA 92502
 Phone: (951) 955-2004 Fax: (951) 955-8680
 demands@rctlma.org

Administrative Citation

347-201-023
 BRENDA SUE STARR
 RANDY STARR
 28600 ROSTRATA LN
 LAKE ELSINORE, CA 92532

Citation Issue Date	Billing Date
8/3/2007	5/4/2011

Property Address
347-201-023 BRENDA SUE STARR RANDY STARR 28600 ROSTRATA LN LAKE ELSINORE, CA 92532

Citation Number	District	Class
A20330	5	SOAC

Item	Description	Hours/Qty	Rate	Amount
Administrative Citations	A20330--CV065796	1	200.00	200.00
			Subtotal	\$200.00
			Payments/Credits	\$0.00
			Total	\$200.00

EXHIBIT NO. _____ *B^b*



County of Riverside Code Enforcement Department

P.O. Box 1469, Riverside, CA 92502
Phone: (951) 955-2004 Fax: (951) 955-8680
demands@rctlma.org

Administrative Citation

347-201-023
BRENDA SUE STARR
RANDY STARR
28600 ROSTRATA LN
LAKE ELSINORE, CA 92532

Citation Issue Date	Billing Date
6/19/2007	5/4/2011

Citation Number	District	Class
A23042	5	SOAC

Property Address
347-201-023 BRENDA SUE STARR RANDY STARR 28600 ROSTRATA LN LAKE ELSINORE, CA 92532

Item	Description	Hours/Qty	Rate	Amount
Administrative Citations	A23042--CV065796	1	100.00	100.00

Subtotal	\$100.00
Payments/Credits	\$0.00
Total	\$100.00

EXHIBIT NO. _____ **B7**



County of Riverside Code Enforcement Department

P.O. Box 1469, Riverside, CA 92502
Phone: (951) 955-2004 Fax: (951) 955-8680
demands@rctlma.org

Administrative Citation

347-201-023
BRENDA SUE STARR
RANDY STARR
28600 ROSTRATA LN
LAKE ELSINORE, CA 92532

Citation Issue Date	Billing Date
1/3/2008	5/4/2011

Property Address
347-201-023 BRENDA SUE STARR RANDY STARR 28600 ROSTRATA LN LAKE ELSINORE, CA 92532

Citation Number	District	Class
A23838	5	SOAC

Item	Description	Hours/Qty	Rate	Amount
Administrative Citations	A23838--CV065796	1	500.00	500.00
			Subtotal	\$500.00
			Payments/Credits	\$0.00
			Total	\$500.00

EXHIBIT NO. _____ *B8*

CITATION PROCESSING CENTER

Home

- New Search
- Payments & Refunds
- Citation Changes
- Adjudication
- Receipt
- Add Note
- Hot Sheet
- Reports

Found Citations:
A23838 Submit

General Information		
Citation	A23838	Date 01/03/08 Time 10:55 AM
Amt Owing this Citation: \$500.00		This Person: \$500.00 This Plate:
Issuing Agency:	RE-Riverside County Code Enforcement Dept.	Dept: Code Enforcement
Status:	OPEN: Noticed	
Number:	1 of 1	
Responsible Party Information		
Name:	TREVINO, RANDY STARR	
Address:	28600 ROSTRATA	
City/State/Zip:	LAKE ELSINORE, CA 92532	

Show all Panels | Hide all Panels

Citation Information		
Location:	5: 28600 ROSTRATA	Case: CV065796 Badge #: 64
Comments:		

Violation Information		
Code	Description	Amount
17.32.010	Unpermitted landuse	\$500.00

<input type="checkbox"/> Fee History

Payment History						
Date on Check	Date Received	Type	Num	Location	Amount	

<input type="checkbox"/> Notice History

<input type="checkbox"/> Appeal History

<input type="checkbox"/> Responsible Party History
--

<input type="checkbox"/> Citation History

Home | Log Out | Help

EXHIBIT NO.

B9

CITATION PROCESSING CENTER

Home

- New Search
- Payments & Refunds
- Citation Changes
- Adjudication
- Receipt
- Add Note
- Hot Sheet
- Reports

Found Citations:
A20330 Submit

General Information			
Citation	A20330	Date	08/03/07
Time		12:40 PM	
Amt Owing this Citation:		\$200.00	This Person: \$200.00
This Plate:			
Issuing Agency:	RE-Riverside County Code Enforcement Dept.		Dept: Code Enforcement
Status:	OPEN: Noticed		
Number:	1 of 1		
Responsible Party Information			
Name:	STARR-TREVINO, RANDY		
Address:	28600 ROTRATA LN		
City/State/Zip:	LAKE ELSINORE, CA 92532		

Show all Panels | Hide all Panels

Citation Information		
Location:	28600 ROTRATA LN, LK ELS.	Case: CV06-5796
Badge #:	64	
Comments:		

Violation Information		
Code	Description	Amount
17.32.010	Unpermitted landuse	\$200.00

<input type="checkbox"/>	Fee History
--------------------------	-------------

Payment History						
Date on Check	Date Received	Type	Num	Location	Amount	

<input type="checkbox"/>	Notice History
--------------------------	----------------

<input type="checkbox"/>	Appeal History
--------------------------	----------------

<input type="checkbox"/>	Responsible Party History
--------------------------	---------------------------

<input type="checkbox"/>	Citation History
--------------------------	------------------

Home | Log Out | Help

EXHIBIT NO. B¹⁰

CITATION PROCESSING CENTER

Home

- New Search
- Payments & Refunds
- Citation Changes
- Adjudication
- Receipt
- Add Note
- Hot Sheet
- Reports

Found Citations:
A23042 Submit

General Information			
Citation: A23042	Date: 06/19/07	Time: 01:35 PM	
Amt Owing this Citation: \$100.00		This Person: \$100.00	This Plate:
Issuing Agency: RE-Riverside County Code Enforcement Dept.	Dept: Code Enforcement		
Status: OPEN: Noticed			
Number: 1 of 1			
Responsible Party Information			
Name: STARR-TREVINO, RANDY			
Address: 28600 ROSTRATA			
City/State/Zip: LAKE ELSINORE, CA			

Show all Panels | Hide all Panels

Citation Information			
Location: 5; 28600 ROSTRATA LN LAKE ELSI	Case: CV06-5796	Badge #: 64	
Comments:			

Violation Information		
Code	Description	Amount
17.32.010	Unpermitted landuse	\$100.00

<input type="checkbox"/>	Fee History
--------------------------	--------------------

Payment History						
Date on Check	Date Received	Type	Num	Location	Amount	

<input type="checkbox"/>	Notice History
--------------------------	-----------------------

<input type="checkbox"/>	Appeal History
--------------------------	-----------------------

<input type="checkbox"/>	Responsible Party History
--------------------------	----------------------------------

<input type="checkbox"/>	Citation History
--------------------------	-------------------------

[Home](#) | [Log Out](#) | [Help](#)

© Copyright 2010 Citation Processing Center. All Rights Reserved

EXHIBIT NO. B¹¹

CITATION PROCESSING CENTER

Home

Reports

SEARCH RESULTS

Citations Found: 2
TotalDue: \$300.00

Agency: RE-Riverside County Code Enforcement Dept.; Citation Number: A23042
Lic. State/Plate: Date: 06/19/2007
Name: STARR-TREVINO , RANDY
Amt Due: \$100.00
Status: OPEN: Noticed

Agency: RE-Riverside County Code Enforcement Dept.; Citation Number: A20330
Lic. State/Plate: Date: 08/03/2007
Name: STARR-TREVINO, RANDY
Amt Due: \$200.00
Status: OPEN: Noticed

Home | Log Out | Help

©Copyright 2010 Citation Processing Center. All Rights Reserved

EXHIBIT NO. B¹²

COUNTY OF RIVERSIDE
DEPARTMENT OF BUILDING AND SAFETY
CODE ENFORCEMENT DIVISION
ADMINISTRATIVE CITATION

CITATION NO. A04136

DATE	04/09/03	TIME	11:40 AM	DAY OF WEEK	WEDS	CASE NO.	CV02-1273
NAME (First, Middle, Last)	RANDY RAY STARR - AKA						
MAILING ADDRESS	RANDY RAY STARR - RANDY RAY TREVINO						
CITY	LAKES						
STATE	CA						
ZIP	92532						
RESIDENCE ADDRESS	SAME						
DRIVERS LICENSE NO.	A 2120171						
STATE	CA						
CLASS	C						
BIRTH DATE	3/16/70						
LOCATION OF VIOLATION(S)	28600 ROSTRATA LN						
CITY	L. ELS.						
COMMUNITY	L. ELS.						
VIOLATION(S)	ORDINANCE CODE	DESCRIPTION					
1) R-CC B.120.010 - ACCUM. RW.BALSH			<input checked="" type="checkbox"/> \$100.00	<input type="checkbox"/> \$200.00	<input type="checkbox"/> \$500.00		
2) R-CC 15-48 - MOBILE HOME INSTALL w/O PERM			<input checked="" type="checkbox"/> \$100.00	<input type="checkbox"/> \$200.00	<input type="checkbox"/> \$500.00		
NAME OF ISSUING OFFICER			J. PINEDA		I.D.# 48		

TOTAL PENALTY: \$ 200.-

PAYMENT INFORMATION: Payment of penalty must be made within twenty (20) days by mail. Make your check or money order payable to: COUNTY OF RIVERSIDE, DEPARTMENT OF BUILDING & SAFETY. DO NOT SEND CASH. Please write citation number on your check or money order. Penalty and bank charges will be assessed for checks returned, "not honored" by your bank. Mail in the attached envelope to:

COUNTY OF RIVERSIDE
DEPARTMENT OF BUILDING AND SAFETY, CODE ENFORCEMENT DIVISION
P.O. BOX 1440, RIVERSIDE, CA 92502-1440
ATTN.: ADMINISTRATIVE CITATION UNIT

ADMINISTRATIVE REVIEW: If you wish to contest this citation you must file the written request for Administrative Review on the reverse side of the yellow copy with the Department of Building and Safety within twenty (20) days of the issuance date. FAILURE TO FILE THIS WRITTEN REQUEST FOR ADMINISTRATIVE HEARING WITHIN THIS TIME PERIOD SHALL CONSTITUTE A WAIVER OF YOUR RIGHT TO APPEAL THE ADMINISTRATIVE CITATION.

FAILURE TO RESPOND OR CORRECT VIOLATION(S): Failure to respond or to correct the violation(s) will result in a penalty increase. Further legal proceedings may be undertaken resulting in a lien on your property for penalties, the costs of enforcement and collection, including attorney fees.

I HEREBY ACKNOWLEDGE RECEIPT OF THIS CITATION.

Signature X POSTED ON GATE

Distribution: OFFICER-White; AGENCY-Pink; DEFENDANT-Green; REQUEST FOR ADMINISTRATIVE REVIEW-Yellow

COUNTY OF RIVERSIDE
DEPARTMENT OF BUILDING AND SAFETY
CODE ENFORCEMENT DIVISION
ADMINISTRATIVE CITATION

CITATION NO. A0743

DATE	08/04/03	TIME	11:45 PM	DAY OF WEEK	MON	CASE NO.	CV02-1273
NAME (First, Middle, Last)	RANDY RAY STARR (AKA)						
MAILING ADDRESS	RANDY RAY STARR (AKA)						
CITY	LAKES						
STATE	CA						
ZIP	92532						
RESIDENCE ADDRESS	SAME						
DRIVERS LICENSE NO.	A 2120171						
STATE	CA						
CLASS	C						
BIRTH DATE	3/16/70						
LOCATION OF VIOLATION(S)	28600 ROSTRATA LN.						
CITY	L. ELS.						
COMMUNITY	L. ELS.						
VIOLATION(S)	ORDINANCE CODE	DESCRIPTION					
1) R-CC 15-48 - MOBILE HOME INSTALL w/O PERM			<input type="checkbox"/> \$100.00	<input checked="" type="checkbox"/> \$200.00	<input type="checkbox"/> \$500.00		
2) R-CC B.120.010 - ACCUMULATED RW.BALSH			<input type="checkbox"/> \$100.00	<input checked="" type="checkbox"/> \$200.00	<input type="checkbox"/> \$500.00		
NAME OF ISSUING OFFICER			J. PINEDA		I.D.# 48		

TOTAL PENALTY: \$ 400.-

PAYMENT INFORMATION: Payment of penalty must be made within twenty (20) days by mail. Make your check or money order payable to: COUNTY OF RIVERSIDE, DEPARTMENT OF BUILDING & SAFETY. DO NOT SEND CASH. Please write citation number on your check or money order. Penalty and bank charges will be assessed for checks returned, "not honored" by your bank. Mail in the attached envelope to:

COUNTY OF RIVERSIDE
DEPARTMENT OF BUILDING AND SAFETY, CODE ENFORCEMENT DIVISION
P.O. BOX 1440, RIVERSIDE, CA 92502-1440
ATTN.: ADMINISTRATIVE CITATION UNIT

ADMINISTRATIVE REVIEW: If you wish to contest this citation you must file the written request for Administrative Review on the reverse side of the yellow copy with the Department of Building and Safety within twenty (20) days of the issuance date. FAILURE TO FILE THIS WRITTEN REQUEST FOR ADMINISTRATIVE HEARING WITHIN THIS TIME PERIOD SHALL CONSTITUTE A WAIVER OF YOUR RIGHT TO APPEAL THE ADMINISTRATIVE CITATION.

FAILURE TO RESPOND OR CORRECT VIOLATION(S): Failure to respond or to correct the violation(s) will result in a penalty increase. Further legal proceedings may be undertaken resulting in a lien on your property for penalties, the costs of enforcement and collection, including attorney fees.

I HEREBY ACKNOWLEDGE RECEIPT OF THIS CITATION.

Signature X POSTED ON GATE

Distribution: OFFICER-White; AGENCY-Pink; DEFENDANT-Green; REQUEST FOR ADMINISTRATIVE REVIEW-Yellow

EXHIBIT NO. B

13



INVOICE

Order Number: 24045 Order Date: 5/23/2011

Customer Information:

Acct No. 1044

RIVERSIDE COUNTY TLMA-CODE ENFORCEMENT
4080 Lemon Street
Riverside, CA 92501

Attn: Brent Steele
REF: CV02-1273 & CV06-5796/Angela Sarmiento
IN RE: SUE, BRENDA

Product and/or Service ordered for Property known as:	
28600 Rostrata Lane Lake Elsinore, CA 92532	
DESCRIPTION:	FEE:
Lot Book Report	\$120.00
TOTAL DUE:	\$120.00

Payment due upon receipt. Please remit to:

RZ Title Services, Inc.
P.O. Box 1193
Whittier, CA 90609

EXHIBIT NO. B 14

Assessment Roll For the 2010-2011 Tax Year as of January 1,2010

Assessment #347201023-6		Parcel # 347201023-6	
Assessee:	STARR BRENDA SUE	Land	82,188
Assessee:	STARR RANDY	Structure	84,929
Mail Address:	28600 ROSTRATA LN LAKE ELSINORE CA 92532	Full Value	167,117
Real Property Use Code:	MF	Homeowners' Exemption	7,000
Base Year	1992	Total Net	160,117
Conveyance Number:	0351025		
Conveyance (mm/yy):	8/1999		
PUI:	M020000		
TRA:	65-061		
Taxability Code:	0-00		
Assessment Description:	1986 REDMAN FLAMINGO		
ID Data:	Lot 206 MB 008/031 ELSINORE EUCALYPTUS TR B		
Situs Address:	28600 ROSTRATA LN LAKE ELSINORE CA 92532		



EXHIBIT NO. C

RIVERSIDE COUNTY GIS

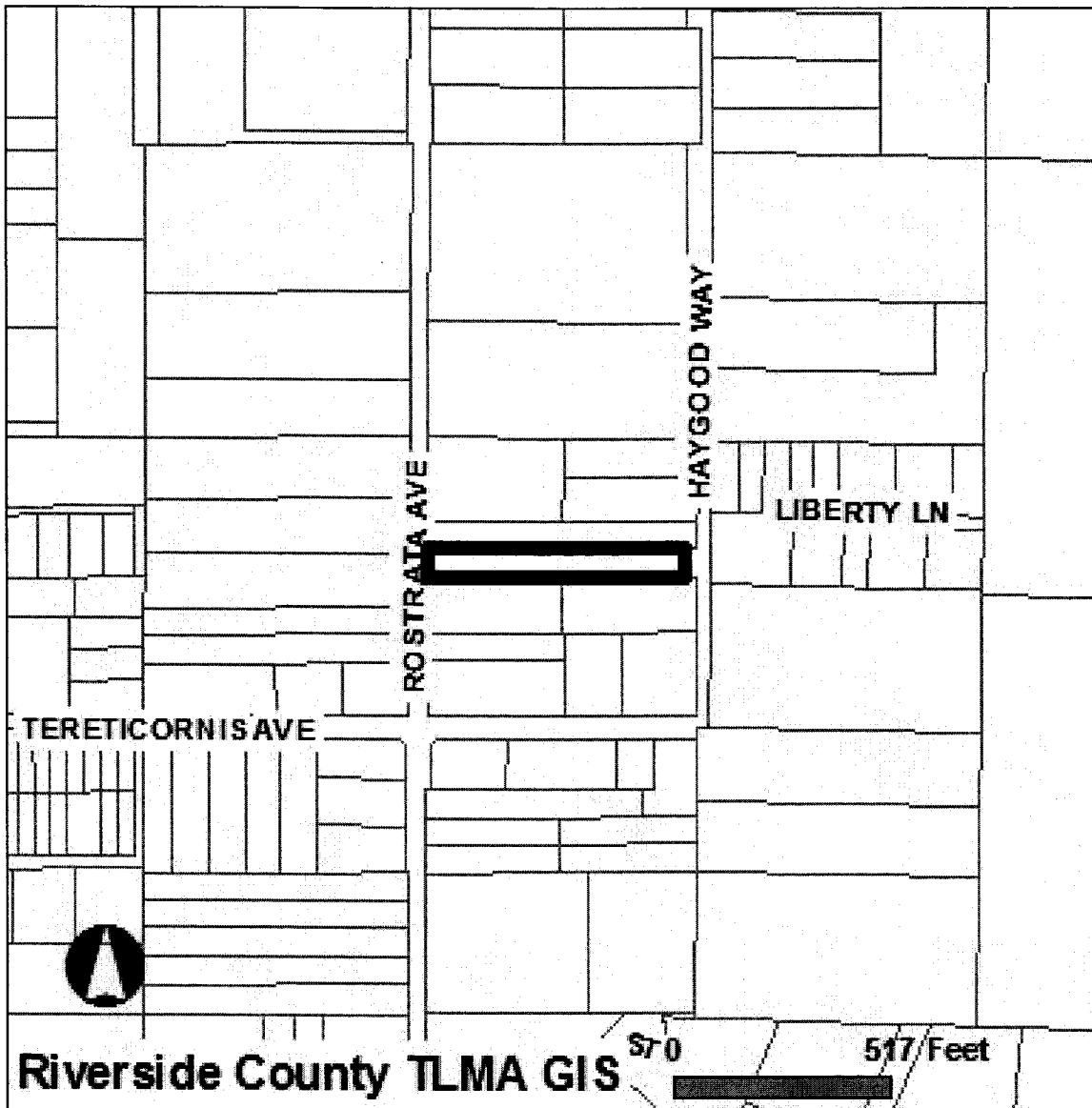

Selected parcel(s):
347-201-023

IMPORTANT

Maps and data are to be used for reference purposes only. Map features are approximate, and are not necessarily accurate to surveying or engineering standards. The County of Riverside makes no warranty or guarantee as to the content (the source is often third party), accuracy, timeliness, or completeness of any of the data provided, and assumes no legal responsibility for the information contained on this map. Any use of this product with respect to accuracy and precision shall be the sole responsibility of the user.

STANDARD REPORT

APNs

347-201-023-6

OWNER NAME / ADDRESS

BRENDA SUE STARR
RANDY STARR
28600 ROSTRATA LN
LAKE ELSINORE, CA. 92532

MAILING ADDRESS

(SEE OWNER)
(SEE SITUS)

EXHIBIT NO. C^a

LEGAL DESCRIPTION

RECORDED BOOK/PAGE: MB 8/31
SUBDIVISION NAME: ELSINORE EUCALYPTUS TR B
LOT/PARCEL: 206, BLOCK: NOT AVAILABLE
TRACT NUMBER: NOT AVAILABLE

LOT SIZE

RECORDED LOT SIZE IS 0.93 ACRES

PROPERTY CHARACTERISTICS

WOOD FRAME, 840 SQFT., 3 BDRM/ 2 BATH, 1 STORY, CONST'D 1987 COMPOSITION, ROOF, CENTRAL HEATING, CENTRAL COOLING

THOMAS BROS. MAPS PAGE/GRID

PAGE: 836 GRID: D7, E7

CITY BOUNDARY/SPHERE

NOT WITHIN A CITY
NOT WITHIN A CITY SPHERE
NO ANNEXATION DATE AVAILABLE
NO LAFCO CASE # AVAILABLE
NO PROPOSALS

MARCH JOINT POWERS AUTHORITY

NOT IN THE JURISDICTION OF THE MARCH JOINT POWERS AUTHORITY

INDIAN TRIBAL LAND

NOT IN A TRIBAL LAND

SUPERVISORIAL DISTRICT (ORD. 813)

MARION ASHLEY, DISTRICT 5

TOWNSHIP/RANGE

T5SR4W SEC 30

ELEVATION RANGE

1384/1384 FEET

PREVIOUS APN

347-201-010

PLANNING

LAND USE DESIGNATIONS

Zoning not consistent with the General Plan.
VLDR

AREA PLAN (RCIP)

ELSINORE

GENERAL PLAN POLICY OVERLAYS

NOT IN A GENERAL PLAN POLICY OVERLAY AREA

GENERAL PLAN POLICY AREAS

WARM SPRINGS POLICY AREA

ZONING CLASSIFICATIONS (ORD. 348)

R-A-20000 (CZ 5845)

ZONING DISTRICTS AND ZONING AREAS

MEADOWBROOK AREA

ZONING OVERLAYS

NOT IN A ZONING OVERLAY

SPECIFIC PLANS

NOT WITHIN A SPECIFIC PLAN

AGRICULTURAL PRESERVE

NOT IN AN AGRICULTURAL PRESERVE

REDEVELOPMENT AREAS

PROJECT AREA NAME: I-215 CORRIDOR
SUBAREA NAME: WARM SPRINGS
AMENDMENT NUMBER: 0
ADOPTION DATE: FEB. 6, 2009
ACREAGE: 853 ACRES

NOT IN AN AIRPORT INFLUENCE AREA

AIRPORT COMPATIBILITY ZONES
NOT IN AN AIRPORT COMPATIBILITY ZONE

ENVIRONMENTAL

CVMSHCP (COACHELLA VALLEY MULTI-SPECIES HABITAT CONSERVATION PLAN) CONSERVATION AREA
NOT IN A CONSERVATION AREA

CVMSHCP FLUVIAL SAND TRANSPORT SPECIAL PROVISION AREAS
NOT IN A FLUVIAL SAND TRANSPORT SPECIAL PROVISION AREA

WRMSHCP (WESTERN RIVERSIDE COUNTY MULTI-SPECIES HABITAT CONSERVATION PLAN) CELL GROUP
NOT IN A CELL GROUP

WRMSHCP CELL NUMBER
NOT IN A CELL

HANS/ERP (HABITAT ACQUISITION AND NEGOTIATION STRATEGY/EXPEDITED REVIEW PROCESS)
NONE

VEGETATION (2005)
Developed/Disturbed Land

FIRE

HIGH FIRE AREA (ORD. 787)
NOT IN A HIGH FIRE AREA

FIRE RESPONSIBILITY AREA
STATE RESPONSIBILITY AREA

DEVELOPMENT FEES

CVMSHCP FEE AREA (ORD. 875)
NOT WITHIN THE COACHELLA VALLEY MSHCP FEE AREA

WRMSHCP FEE AREA (ORD. 810)
IN OR PARTIALLY WITHIN THE WESTERN RIVERSIDE MSHCP FEE AREA. SEE MAP FOR MORE INFORMATION.

ROAD & BRIDGE DISTRICT
NOT IN A DISTRICT

EASTERN TUMF (TRANSPORTATION UNIFORM MITIGATION FEE ORD. 673)
NOT WITHIN THE EASTERN TUMF FEE AREA

WESTERN TUMF (TRANSPORTATION UNIFORM MITIGATION FEE ORD. 824)
IN OR PARTIALLY WITHIN A TUMF FEE AREA. SEE MAP FOR MORE INFORMATION. SOUTHWEST

DIF (DEVELOPMENT IMPACT FEE AREA ORD. 659)
ELSINORE

SKR FEE AREA (STEPHEN'S KANGAROO RAT ORD. 663.10)
IN OR PARTIALLY WITHIN AN SKR FEE AREA. SEE MAP FOR MORE INFORMATION.

DEVELOPMENT AGREEMENTS
NOT IN A DEVELOPMENT AGREEMENT AREA

TRANSPORTATION

CIRCULATION ELEMENT ULTIMATE RIGHT-OF-WAY
NOT IN A CIRCULATION ELEMENT RIGHT-OF-WAY

ROAD BOOK PAGE
37B

TRANSPORTATION AGREEMENTS

NOT IN A TRANSPORTATION AGREEMENT

CETAP (COMMUNITY AND ENVIRONMENTAL TRANSPORTATION ACCEPTABILITY PROCESS) CORRIDORS
NOT IN A CETAP CORRIDOR.

HYDROLOGY

FLOOD PLAIN REVIEW

NOT REQUIRED.

WATER DISTRICT

WMWD

FLOOD CONTROL DISTRICT

RIVERSIDE COUNTY FLOOD CONTROL DISTRICT

WATERSHED

SANTA ANA RIVER

GEOLOGIC

FAULT ZONE

NOT IN A FAULT ZONE

FAULTS

NOT WITHIN A 1/2 MILE OF A FAULT

LIQUEFACTION POTENTIAL

MODERATE

SUBSIDENCE

SUSCEPTIBLE

PALEONTOLOGICAL SENSITIVITY

LOW POTENTIAL.

FOLLOWING A LITERATURE SEARCH, RECORDS CHECK AND A FIELD SURVEY, AREAS MAY BE DETERMINED BY A QUALIFIED VERTEBRATE PALEONTOLOGIST AS HAVING LOW POTENTIAL FOR CONTAINING SIGNIFICANT PALEONTOLOGICAL RESOURCES SUBJECT TO ADVERSE IMPACTS.

MISCELLANEOUS

SCHOOL DISTRICT

LAKE ELSINORE UNIFIED

COMMUNITIES

NORTH ELSINORE

COUNTY SERVICE AREA

IN OR PARTIALLY WITHIN
WARM SPRINGS VALLEY #124 -
ROAD MAINTAINANCE

LIGHTING (ORD. 655)

ZONE B, 36.11 MILES FROM MT. PALOMAR OBSERVATORY

2000 CENSUS TRACT

043005

FARMLAND

URBAN-BUILT UP LAND

TAX RATE AREAS

065-061

- COUNTY FREE LIBRARY
- COUNTY SERVICE AREA 124 *
- COUNTY STRUCTURE FIRE PROTECTION
- COUNTY WASTE RESOURCE MGMT DIST
- CSA 152
- ELS MURRIETA ANZA RESOURCE CONS
- ELSINORE AREA ELEM SCHOOL FUND
- ELSINORE VAL MUN WTR IMP DIST 1
- ELSINORE VALLEY CEMETERY

- ELSINORE VALLEY MUNICIPAL WATER
- FLOOD CONTROL ADMINISTRATION
- FLOOD CONTROL ZONE 3
- GENERAL
- GENERAL PURPOSE
- LAKE ELSINORE UNIF IMP NO 96-1
- LAKE ELSINORE UNIFIED
- METRO WATER WEST 1302999
- MT SAN JACINTO JUNIOR COLLEGE
- RIV CO REG PARK & OPEN SPACE
- RIV. CO. OFFICE OF EDUCATION
- WESTERN MUNICIPAL WATER

SPECIAL NOTES

NO SPECIAL NOTES

CODE COMPLAINTS

Case #	Description	Start Date
CV0805859	ABATEMENT	Jul. 7, 2008
CV0911717	ABATEMENT	Nov. 3, 2009

REPORT PRINTED ON...Mon May 02 09:46:47 2011
Version 101221



P.O. Box 1193
 Whittier, CA 90609
 Tel # (562) 325-8351
 Fax # (714) 783-3038

Lot Book Report

Order Number: **24045**

Customer:

RIVERSIDE COUNTY TLMA-CODE INFORCEMENT
 4080 Lemon Street
 Riverside CA 92501

Order Date: 5/23/2011
 Dated as of: 5/25/2011
 County Name: Riverside

Attn: Brent Steele
 Reference: CV02-1273 & CV06-5796/Angela Sarmiento
 IN RE: SUE, BRENDA

FEE(s):
 Report: \$120.00

Property Address: 28600 Rostrata Lane
 Lake Elsinore CA 92532

Assessor's Parcel No. : 347-201-023-6

Assessments:

Land Value:	\$82,188.00
Improvement Value:	\$84,929.00
Exemption Value:	\$7,000.00
Total Value:	\$160,117.00

Tax Information

Property Taxes for the Fiscal Year	2010-2011
Total Annual Tax	\$1,637.18
Status: Paid through	PAID (PAID THRU 06/30/2011)

Property Vesting

The last recorded document transferring title of said property

Dated	08/02/1999
Recorded	08/05/1999



P.O. Box 1193
Whittier, CA 90609
Tel # (562) 325-8351
Fax # (714) 783-3038

Order Number: 24045
Reference: CV02-1273 & CV0

Document No.	1999-351025
D.T.T.	\$0.00
Grantor	Brenda Sue Starr, a single woman
Grantee	Brenda Sue Starr, a single woman and Randy Starr, a single man, all as joint tenants

Deeds of Trust

Position No.	1st
A Deed of Trust Dated	09/16/1999
Recorded	09/30/1999
Document No.	1999-435067
Amount	\$93,500.00
Trustor	Brenda Sue Starr, a single woman and Randy Starr, a single man all as joint tenants
Trustee	Long Beach Mortgage Company
Beneficiary	Long Beach Mortgage Company
Substitution of Trustee Recorded	10/12/2001
Document No.	2001-496455
Trustee	California Reconveyance Company

Additional Information

A Declaration of Homestead executed by	Brenda Sue Starr
Recorded	06/19/1998
Document No	251006
Notice of Non-Compliance filed by	County of Riverside Department of Building and Safety
In the matter of the property of	Brenda Sue & Randy Starr
Case No.	CV02-1273 & CV03--0747
Recorded	09/02/2004
Document No.	2004-0698044



P.O. Box 1193
Whittier, CA 90609
Tel # (562) 325-8351
Fax # (714) 783-3038

Order Number: 24045
Reference: CV02-1273 & CV0

Notice of Non-Compliance filed by	County of Riverside Code Enforcement Department
In the matter of the property of	Brenda Sue Starr and Randy Starr
Case No.	CV08-05859
Recorded	01/22/2009
Document No.	2009-0031203
A Bankruptcy filed by	Randy Lee Starr
Social Security Number(s)	Not Shown
Date filed	10/14/2005
Case No.	MG23589
A Bankruptcy filed by	Brenda Sue Starr
Social Security Number(s)	554-92-5498
Date filed	01/27/2003
Case No.	MG11172

Legal Description

THE LAND REFERRED TO IN THIS REPORT IS LOCATED IN AND IS DESCRIBED AS FOLLOWS:

LOT 206 OF ELSINORE EUCALYPTUS TRACT B, IN THE COUNTY OF RIVERSIDE, STATE OF CALIFORNIA, AS SHOWN BY MAP ON FILE IN BOOK 8, PAGE 31 OF MAPS, ECORDS OF SAID COUNTY.

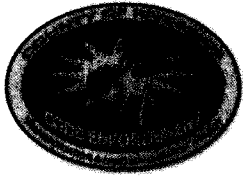

County of Riverside Code Enforcement Department

P.O. Box 1469, Riverside, CA 92502
Phone: (951) 955-2004 Fax: (951) 955-8680

DEMAND FOR PAYMENT STATEMENT OF ABATEMENT COSTS NOTICE OF SPECIAL TAX ASSESSMENT

6/28/2011

Brenda Sue and Randy Starr
28600 Rostrada Ln
Lake Elsinore, CA 92532

Re: Demand for Payment of Statement of Abatement Costs
Subject Property: 28600 Rostrada Ln, Lake Elsinore, CA 92532
Case No(s): CV02-1273, CV06-5796
APN No(s): 347-201-023

Dear Brenda Sue and Randy Starr:

NOTICE IS HEREBY GIVEN that the County of Riverside Code Enforcement Department has incurred expenses to enforce and/or abate violations of the Riverside County Ordinance caused by conditions on your real property described as [28600 Rostrada Ln, Lake Elsinore, CA 92532] and more particularly described as Assessor's Parcel Number [347-201-023] ("Subject Property"). The conditions were deemed violations of Riverside County Ordinances No(s): [457, 348]

Pursuant to Riverside County Ordinance No. 725, as property owner you are liable for reimbursement of all abatement costs incurred by the County, including, but not limited to, staff time for enforcement, investigations, notices, communications, title search, administrative costs and attorney fees.

YOU ARE HEREBY DEMANDED to pay the County of Riverside the total amount due of \$2,821.95 (Two Thousand Eight Hundred Twenty One Dollars And Ninety Five Cents) as set forth in the enclosed "Summary Statement of Abatement Costs." If the amount due is not paid in full within thirty (30) days, a special tax assessment and abatement lien will be recorded against the subject property.

YOU HAVE A RIGHT TO A HEARING ON THIS MATTER. You have the right to contest the abatement costs and special assessment levied against the subject property. If you choose to exercise your right to a public hearing, please complete the enclosed "Request for Public Hearing" form and return it to the Code Enforcement Department within twenty (20) days of the date of this notice.

If you have any questions regarding this notice, please contact Administrative Services at (951) 955-2004.

Code Enforcement Department

Ward Komers
Administrative Manager

EXHIBIT NO. E

REQUEST FOR PUBLIC HEARING ON STATEMENT OF ABATEMENT COSTS AND SPECIAL TAX ASSESSMENT

Brenda Sue and Randy Starr
28600 Rostrada Ln
Lake Elsinore, CA 92532

Subject Property: 28600 Rostrada Ln, Lake Elsinore, CA 92532
Case No(s): CV02-1273, CV06-5796
APN No(s): 347-201-023

I, _____, hereby request a public hearing regarding the above
(Please PRINT your name here)

described Subject Property and Case Number(s).

Please mail notice of the date, time, and location of the hearing to me at the following address:

Return Mailing Address: _____

Signed: _____ Date: _____
(Please SIGN your name here)

Print: _____
(Please PRINT your name here)

You may contact me at the following daytime phone number: _____

IMPORTANT

Keep a copy of this form and mail the original to:
Riverside County Code Enforcement Department
P.O. BOX 1469
Riverside, CA 92502-1469

EXHIBIT NO. E



COUNTY OF RIVERSIDE CODE ENFORCEMENT

P.O. Box 1469, Riverside, CA 92502
Phone: 951-955-2004 Fax: 951-955-8680

Property Reference/Mailing Address
347-201-023 BRENDA SUE STARR RANDY STARR 28600 ROSTRATA LN LAKE ELSINORE, CA 92532

Summary Statement of Abatement Costs

You are liable to the County for the following abatement costs:

Date	Invoice Number & Amount	Amount	Balance
12/31/2000	Balance forward		0.00
05/02/2011	CV021273- INV #101143.	931.80	931.80
04/09/2003	CV021273:A04136- INV #8300. A04136	200.00	1,131.80
08/04/2003	CV021273:A07436- INV #8301. A07436	400.00	1,531.80
05/04/2011	CV065796- INV #101259.	490.15	2,021.95
08/03/2007	CV065796:A20330- INV #8302. A20330	200.00	2,221.95
06/19/2007	CV065796:A23042- INV #8303. A23042	100.00	2,321.95
01/03/2008	CV065796:A23838- INV #8304. A23838	500.00	2,821.95
		Total Now Due	\$2,821.95

The total abatement costs must be paid to the County of Riverside, P.O. Box 1469, Riverside, CA 92502 within thirty (30) days. In the event said costs are not paid within thirty (30) days you will be liable for additional administrative costs, penalties, court fees, or other collection costs incurred in the collection of these abatement costs.

I affirm and declare under penalty of perjury under the laws of the State of California that the foregoing is true and correct to the best of my knowledge.

Code Enforcement Department

EXHIBIT NO. E

**County of Riverside
Code Enforcement Department**

P.O. Box 1469, Riverside, CA 92502
Phone: (951) 955-2004 Fax: (951) 955-8680



Statement of Abatement Costs

347-201-023
BRENDA SUE STARR
RANDY STARR
28600 ROSTRATA LN
LAKE ELSINORE, CA 92532

Date	Invoice #
5/2/2011	101143

Case Number	District	Class
CV021273	5	SOAC

Property Address
347-201-023 BRENDA SUE STARR RANDY STARR 28600 ROSTRATA LN LAKE ELSINORE, CA 92532

You are liable to the County for the following abatement costs:

Date	Item	Description	Hours/Qty	Rate	Amount
4/9/2003	Officer Hours	Labor Charges - Officer Time	1.5	70.00	105.00
4/10/2003	Officer Hours	Labor Charges - Officer Time	1	70.00	70.00
8/4/2003	Officer Hours	Labor Charges - Officer Time	1	70.00	70.00
8/5/2003	Officer Hours	Labor Charges - Officer Time	1	70.00	70.00
10/8/2003	Officer Hours	Labor Charges - Officer Time	1	70.00	70.00
10/9/2003	Officer Hours	Labor Charges - Officer Time	0.5	70.00	35.00
7/21/2004	Officer Hours	Labor Charges - Officer Time	0.3	100.00	30.00
8/17/2004	Officer Hours	Labor Charges - Officer Time	0.2	100.00	20.00
1/18/2005	Officer Hours	Labor Charges - Officer Time	0.3	100.00	30.00
5/9/2005	Officer Hours	Labor Charges - Officer Time	0.5	103.00	51.50
5/2/2011	SOE Preparation	Prepare Statement of Expense		65.00	65.00
		Subtotal Code Enforcement Costs			616.50
5/2/2011	Prepare Case for SOE He...			125.55	125.55
	Attend SOE Hearing			69.75	69.75
		Subtotal County Counsel Costs			195.30
5/2/2011	Lot Book Report			120.00	120.00
		Subtotal Contractor Costs			120.00
				Subtotal	\$931.80

The total abatement costs must be paid to the County of Riverside, P.O. Box 1469, Riverside, CA 92502 within thirty (30) days. In the event said costs are not paid within thirty (30) days you will be liable for additional administrative costs, penalties, court fees or other collection costs incurred in the collection of these abatement costs.

Payments/Credits	\$0.00
Total Now Due	\$931.80

I affirm and declare under penalty of perjury under the laws of the State of California that the foregoing is true and correct to the best of my knowledge.



Code Enforcement Department

EXHIBIT NO. E4



County of Riverside Code Enforcement Department

P.O. Box 1469, Riverside, CA 92502
Phone: (951) 955-2004 Fax: (951) 955-8680
demands@rctlma.org

Administrative Citation

347-201-023
BRENDA SUE STARR
RANDY STARR
28600 ROSTRATA LN
LAKE ELSINORE, CA 92532

Citation Issue Date	Billing Date
4/9/2003	5/2/2011

Citation Number	District	Class
A04136	5	SOAC

Property Address
347-201-023 BRENDA SUE STARR RANDY STARR 28600 ROSTRATA LN LAKE ELSINORE, CA 92532

Item	Description	Hours/Qty	Rate	Amount
Administrative Citations	A04136--CV021273	1	200.00	200.00
			Subtotal	\$200.00
			Payments/Credits	\$0.00
			Total	\$200.00

EXHIBIT NO. E15



County of Riverside Code Enforcement Department

P.O. Box 1469, Riverside, CA 92502
Phone: (951) 955-2004 Fax: (951) 955-8680
demands@rctlma.org

Administrative Citation

347-201-023
BRENDA SUE STARR
RANDY STARR
28600 ROSTRATA LN
LAKE ELSINORE, CA 92532

Citation Issue Date	Billing Date
8/4/2003	5/2/2011

Citation Number	District	Class
A07436	5	SOAC

Property Address
347-201-023 BRENDA SUE STARR RANDY STARR 28600 ROSTRATA LN LAKE ELSINORE, CA 92532

Item	Description	Hours/Qty	Rate	Amount
Administrative Citations	A07436--CV021273	1	400.00	400.00

Subtotal	\$400.00
Payments/Credits	\$0.00
Total	\$400.00

EXHIBIT NO. E⁶

**County of Riverside
Code Enforcement Department**

P.O. Box 1469, Riverside, CA 92502
Phone: (951) 955-2004 Fax: (951) 955-8680

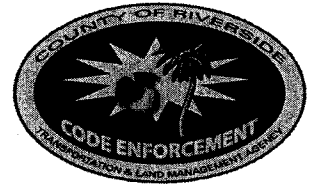

Statement of Abatement Costs

347-201-023
BRENDA SUE STARR
RANDY STARR
28600 ROSTRATA LN
LAKE ELSINORE, CA 92532

Date	Invoice #
5/4/2011	101259

Case Number	District	Class
CV065796	5	SOAC

Property Address
347-201-023 BRENDA SUE STARR RANDY STARR 28600 ROSTRATA LN LAKE ELSINORE, CA 92532

You are liable to the County for the following abatement costs:

Date	Item	Description	Hours/Qty	Rate	Amount
1/2/2007	Officer Hours	Labor Charges - Officer Time	0.25	109.00	27.25
3/27/2007	Officer Hours	Labor Charges - Officer Time	0.3	109.00	32.70
6/19/2007	Officer Hours	Labor Charges - Officer Time	0.2	82.00	16.40
6/19/2007	Officer Hours	Labor Charges - Officer Time	0.2	109.00	21.80
6/21/2007	Officer Hours	Labor Charges - Officer Time	0.5	109.00	54.50
7/2/2007	Officer Hours	Labor Charges - Officer Time	0.2	109.00	21.80
8/3/2007	Officer Hours	Labor Charges - Officer Time	0.3	109.00	32.70
8/6/2007	Officer Hours	Labor Charges - Officer Time	0.5	109.00	54.50
8/7/2007	Officer Hours	Labor Charges - Officer Time	0.5	109.00	54.50
1/3/2008	Officer Hours	Labor Charges - Officer Time	0.2	109.00	21.80
1/3/2008	Officer Hours	Labor Charges - Officer Time	0.7	109.00	76.30
5/12/2008	Officer Hours	Labor Charges - Officer Time	0.1	109.00	10.90
	SOE Preparation	Prepare Statement of Expense		65.00	65.00
		Subtotal Code Enforcement Costs			490.15

Subtotal \$490.15

The total abatement costs must be paid to the County of Riverside, P.O. Box 1469, Riverside, CA 92502 within thirty (30) days. In the event said costs are not paid within thirty (30) days you will be liable for additional administrative costs, penalties, court fees or other collection costs incurred in the collection of these abatement costs.

Payments/Credits \$0.00

Total Now Due \$490.15

I affirm and declare under penalty of perjury under the laws of the State of California that the foregoing is true and correct to the best of my knowledge.

Del Cull
Code Enforcement Department

EXHIBIT NO. E7



County of Riverside Code Enforcement Department

P.O. Box 1469, Riverside, CA 92502
Phone: (951) 955-2004 Fax: (951) 955-8680
demands@rctlma.org

Administrative Citation

347-201-023
BRENDA SUE STARR
RANDY STARR
28600 ROSTRATA LN
LAKE ELSINORE, CA 92532

Citation Issue Date	Billing Date
8/3/2007	5/4/2011

Property Address
347-201-023 BRENDA SUE STARR RANDY STARR 28600 ROSTRATA LN LAKE ELSINORE, CA 92532

Citation Number	District	Class
A20330	5	SOAC

Item	Description	Hours/Qty	Rate	Amount
Administrative Citations	A20330--CV065796	1	200.00	200.00
			Subtotal	\$200.00
			Payments/Credits	\$0.00
			Total	\$200.00

EXHIBIT NO. E⁸

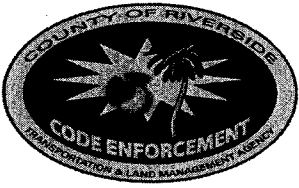

County of Riverside Code Enforcement Department

P.O. Box 1469, Riverside, CA 92502
Phone: (951) 955-2004 Fax: (951) 955-8680
demands@rctlma.org

Administrative Citation

347-201-023
BRENDA SUE STARR
RANDY STARR
28600 ROSTRATA LN
LAKE ELSINORE, CA 92532

Citation Issue Date	Billing Date
6/19/2007	5/4/2011

Citation Number	District	Class
A23042	5	SOAC

Property Address
347-201-023 BRENDA SUE STARR RANDY STARR 28600 ROSTRATA LN LAKE ELSINORE, CA 92532

Item	Description	Hours/Qty	Rate	Amount
Administrative Citations	A23042--CV065796	1	100.00	100.00
			Subtotal	\$100.00

	Payments/Credits	\$0.00
Total		\$100.00

EXHIBIT NO. E⁹



County of Riverside Code Enforcement Department

P.O. Box 1469, Riverside, CA 92502
Phone: (951) 955-2004 Fax: (951) 955-8680
demands@rctlma.org

Administrative Citation

347-201-023
BRENDA SUE STARR
RANDY STARR
28600 ROSTRATA LN
LAKE ELSINORE, CA 92532

Citation Issue Date	Billing Date
1/3/2008	5/4/2011

Property Address
347-201-023 BRENDA SUE STARR RANDY STARR 28600 ROSTRATA LN LAKE ELSINORE, CA 92532

Citation Number	District	Class
A23838	5	SOAC

Item	Description	Hours/Qty	Rate	Amount
Administrative Citations	A23838--CV065796	1	500.00	500.00

Subtotal	\$500.00
Payments/Credits	\$0.00
Total	\$500.00

EXHIBIT NO. E10

NOTICE LIST

Subject Property: 28600 Rostrada Ln, Lake Elsinore, CA 92532;

Case No.: CV02-1273, CV06-5796;

APN: 347-201-023

BRENDA STARR
RANDY STARR
28600 ROSTRATA LN
LAKE ELSINORE CA 92532

LONG BEACH MORTGAGE COMP
1100 TOWN & COUNTRY RD
ORANGE CA 92868

LONG BEACH MORTGAGE COMP
PO BOX 11490
SANTA ANA CA 92711

CA RECONVEYANCE COMPANY
9301 CORBIN AVE N030204
NORTHRIDGE CA 91324

EXHIBIT NO. E''

PROOF OF SERVICE
Case No. CV02-1273, CV06-5796

STATE OF CALIFORNIA, COUNTY OF RIVERSIDE

I, Sue Rush, declare that I am a citizen of the United States and am employed in the County of Riverside, over the age of 18 years and not a party to the within action or proceeding; that my business address is 3960 Orange Street, Suite 500, Riverside, California 92501.

That on June 28, 2011, I served the following document(s):

- **DEMAND FOR PAYMENT**
- **REQUEST FOR HEARING**
- **SUMMARY STATEMENT OF ABATEMENT COSTS**
- **STATEMENT OF ABATEMENT COSTS**
- **ADMINISTRATIVE CITATION(S)**
- **NOTICE LIST**

by placing a true copy thereof enclosed in a sealed envelope(s) addressed as follows:

OWNERS OR INTERESTED PARTIES
(SEE NOTICE LIST ATTACHED TO NOTICE OF HEARING)

XX **BY FIRST CLASS MAIL.** I am "readily familiar" with the office's practice of collection and processing correspondence for mailing. Under that practice it would be deposited with the U.S. Postal Service on that same day with postage thereon fully prepaid at Riverside, California, in the ordinary course of business.

___ **BY PERSONAL SERVICE:** I caused to be delivered such envelope(s) by hand to the offices of the addressee(s).

XX **STATE - I declare under penalty of perjury under the laws of the State of California that the above is true and correct.**

___ **FEDERAL - I declare that I am employed in the office of a member of the bar of this court at whose direction the service was made.**

EXECUTED ON 6/28/2011, at Riverside, California.



SUE RUSH

EXHIBIT NO. _____ E12

✓

REQUEST FOR PUBLIC HEARING ON STATEMENT OF ABATEMENT COSTS AND SPECIAL TAX ASSESSMENT

Brenda Sue and Randy Starr
28600 Rostrada Ln
Lake Elsinore, CA 92532

Subject Property: 28600 Rostrada Ln, Lake Elsinore, CA 92532
Case No(s): CV02-1273, CV06-5796
APN No(s): 347-201-023

I, Brenda Starr, hereby request a public hearing regarding the above
(Please PRINT your name here)

described Subject Property and Case Number(s).

Please mail notice of the date, time, and location of the hearing to me at the following address:

Return Mailing Address: 28600 Rostrada
Lake Elsinore, CA 92532

Signed: Brenda Starr Date: 7-7-11
(Please SIGN your name here)

Print: Brenda Starr
(Please PRINT your name here)

You may contact me at the following daytime phone number: 951-490-6148

IMPORTANT

Keep a copy of this form and mail the original to:
Riverside County Code Enforcement Department
P.O. BOX 1469
Riverside, CA 92502-1469

EXHIBIT NO. F

EXHIBIT NO. F2

RECEIVED JUL 5 - 2011