

**SUBMITTAL TO THE BOARD OF SUPERVISORS
COUNTY OF RIVERSIDE, STATE OF CALIFORNIA**

902B



FROM: County Counsel
Code Enforcement Department

SUBMITTAL DATE:
November 10, 2011

SUBJECT: Statement of Abatement Costs [Case No. CV09-03811]
Subject Property: 40195 Chaparral Drive, Temecula; BRADLEY
APN: 927-210-018
District Three

RECOMMENDED MOTION: Move that the Board of Supervisors:

- 1) assess the reasonable costs of abatement of a public nuisance (construction without permits – retainer wall) in the above-referenced matter to be **two thousand, five hundred sixty-one dollars and forty cents, (US \$2,561.40)**;
- (2) assess the costs of abatement against the above-described subject property;
- (3) authorize the recordation of a notice of abatement lien;
- (4) authorize the abatement costs to be added to the tax roll as a special assessment; and
- (5) authorize and direct the Code Enforcement Department to take any reasonable actions to collect the amount owed.

BACKGROUND: Government Code § 25845, Riverside County Ordinance Nos. 457 and 725 authorize the recovery of abatement costs in public nuisance cases, the recordation of a notice of abatement lien and inclusion of abatement costs on the tax roll as a special assessment upon approval of the Board of Supervisors.

PATRICIA MUNROE, Deputy County Counsel
for PAMELA J. WALLS, County Counsel

FINANCIAL DATA

Current F.Y. Total Cost:	\$ N/A	In Current Year Budget:	N/A
Current F.Y. Net County Cost:	\$ N/A	Budget Adjustment:	N/A
Annual Net County Cost:	\$ N/A	For Fiscal Year:	N/A

SOURCE OF FUNDS:

Positions To Be Deleted Per A-30	<input type="checkbox"/>
Requires 4/5 Vote	<input type="checkbox"/>

C.E.O. RECOMMENDATION:

APPROVE

BY:
Tina Grande

County Executive Office Signature

Policy
 Policy
 Consent
 Consent
 Dept's Recomm.:
 Per Exec. Ofc.:

MINUTES OF THE BOARD OF SUPERVISORS

On motion of Supervisor Stone, seconded by Supervisor Ashley and duly carried, IT WAS ORDERED that the above matter is approved as recommended.

Ayes: Buster, Stone, Benoit and Ashley
 Nays: None
 Absent: Tavaglione
 Date: November 22, 2011
 xc: Co. Co., CED, Prop. Owner

Kecia Harper-Ihem
 Clerk of the Board
 By:
 Deputy

Prev. Agn. Ref.:

District: 3

Agenda Number:

9.3

Statement of Abatement Costs [Case No. CV09-03811]
Subject Property: 40195 Chaparral Drive, Temecula; BRADLEY
APN: 927-210-018
District: Three
Page 2

Notice of Violation and Administrative Citations were issued. Subsequently, on or about April 21, 2010 the property was brought into compliance, permit #BWL100266 was issued.

The Notice of Hearing re Statement of Abatement Costs has been posted on the property and mailed to the property owner and all interested parties, as required by law. Copies of all relevant notices issued in this matter together with proof of service and posting have been separately filed with the Clerk of the Board and are made a part of the record herein, pursuant to Riverside County Ordinance 725.

**SUBMITTAL TO THE BOARD OF SUPERVISORS
COUNTY OF RIVERSIDE, STATE OF CALIFORNIA**

FROM: County Counsel
Code Enforcement Department
SUBJECT: Statement of Abatement Costs [Case No. CV09-03811]
Subject Property: 40195 Chaparral Drive, Temecula; BRADLEY
APN: 927-210-018
District Three

**TABLE OF SUPPLEMENTAL DOCUMENTS
FILED WITH THE CLERK OF THE BOARD**

Hearing Date: NOVEMBER 22, 2011

Notice of Hearing Re: Statement of Abatement Costs (including Proof(s) of Service and Affidavit(s) of Posting	Exhibit A
Summary Statement of Abatement Costs and Statement of Abatement Costs with Supporting Documents	Exhibit B
Assessment-Roll For The Year 10/11 And Geographic Information System, Nov. 4, 2011.....	Exhibit C
Lot Book Report.....	Exhibit D
Demand for Payment Statement of Abatement Costs Notice of Special Tax Assessment	Exhibit E

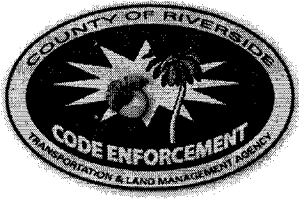

**CODE ENFORCEMENT DEPARTMENT
COUNTY OF RIVERSIDE**

Glenn Baude
Director

November 3, 2011

**NOTICE OF HEARING RE:
STATEMENT OF ABATEMENT COSTS**

To: Owner(s) or Interested Parties
(See Attached Proof of Service
and Notice List)

Subject Property: 40195 Chaparral Drive, Temecula
Case No.: CV09-03811; BRADLEY
APN: 927-210-018

NOTICE IS HEREBY GIVEN that a hearing will be held before the Riverside County Board of Supervisors on **Tuesday, November 22, 2011, at 9:30 a.m.** in the Board of Supervisors Room, 4080 Lemon Street, 1st Floor Annex, Riverside, California, at which time and place pertinent testimony will be heard regarding the expenses incurred by the County of Riverside, Code Enforcement Department ("DEPARTMENT") for the above-referenced abatement case. Said abatement case involved construction without permit – retainer wall located on your real property commonly described as 40195 Chaparral Drive, Temecula, Riverside County, California and more particularly described as Assessor's Parcel Number 927-210-018.

The total expense due, including all other fees and costs, for the abatement of the above-described dangerous or injurious condition is **two thousand, five hundred sixty-one dollars and forty cents, (US \$2,561.40)**. This amount is immediately due and payable. If you have any objections to the Statement of Abatement Costs attached hereto, you must address your objections to the Board of Supervisors at the hearing. If you have any questions about the attached Statement of Abatement Costs, please contact Ward Komers or Carol Lynn Anderson at (951) 955-2004. In the event the total amount due is not paid to the DEPARTMENT prior to the Board Hearing, the DEPARTMENT shall seek an order from the Board of Supervisors to place a lien against your property and collect the amount due as a special tax assessment.

Failure to appear at the hearing will result in the exclusion of your testimony. Facts as known to the DEPARTMENT will be presented to the Board of Supervisors for their final consideration and deliberation of this matter.

You are encouraged to contact Code Enforcement Officer, Stacy Baumgartner (951) 955-2004 prior to the hearing. Please meet with Stacy Baumgartner at 8:30 a.m. on the day of the hearing in Conference Room 2A located on the 1st floor in front of the Human Resources Office to discuss the case.

GLENN BAUDE
DIRECTOR

WARD KOMERS
Administrative Manager
Enclosure: Statement of Abatement Costs

EXHIBIT NO. A

**County of Riverside
Code Enforcement Department**

P.O. Box 1469, Riverside, CA 92502
Phone: (951) 955-2004 Fax: (951) 955-8680



Statement of Abatement Costs

927-210-018
JAMES BRADLEY
DEANNA BRADLEY
42225 REMINGTON AVE STE 23
TEMECULA CA. 92590

Date	Invoice #
3/9/2011	100590

Property Address
927-210-018 JAMES BRADLEY DEANNA BRADLEY 40195 CHAPARRAL DR TEMECULA, CA 92592

Case Number	District	Class
CV0903811	3	SOAC

You are liable to the County for the following abatement costs:

Date	Item	Description	Hours/Qty	Rate	Amount
6/24/2009	Officer Hours	Labor Charges - Officer Time	0.8	109.00	87.20
8/13/2009	Officer Hours	Labor Charges - Officer Time	0.3	109.00	32.70
9/16/2009	Officer Hours	Labor Charges - Officer Time	0.4	109.00	43.60
10/21/2009	Officer Hours	Labor Charges - Officer Time	0.2	109.00	21.80
12/1/2009	Officer Hours	Labor Charges - Officer Time	0.5	109.00	54.50
1/4/2010	Officer Hours	Labor Charges - Officer Time	0.2	109.00	21.80
2/4/2010	Officer Hours	Labor Charges - Officer Time	0.2	109.00	21.80
3/16/2010	Officer Hours	Labor Charges - Officer Time	0.3	109.00	32.70
3/9/2011	SOE Preparation	Prepare Statement of Expense		65.00	65.00
		Subtotal Code Enforcement Costs			381.10
3/9/2011	Prepare Case for SOE He... Attend SOE Hearing			125.55	125.55
		Subtotal County Counsel Costs		69.75	69.75
					195.30
3/9/2011	Lot Book Report			120.00	120.00
		Subtotal Contractor Costs			120.00
Subtotal					\$696.40

The total abatement costs must be paid to the County of Riverside, P.O. Box 1469, Riverside, CA 92502 within thirty (30) days. In the event said costs are not paid within thirty (30) days you will be liable for additional administrative costs, penalties, court fees or other collection costs incurred in the collection of these abatement costs.

Payments/Credits	\$0.00
Total Now Due	\$696.40

I affirm and declare under penalty of perjury under the laws of the State of California that the foregoing is true and correct to the best of my knowledge.

Al Cell

Code Enforcement Department

EXHIBIT NO.

A3



County of Riverside Code Enforcement Department

P.O. Box 1469, Riverside, CA 92502
Phone: (951) 955-2004 Fax: (951) 955-8680
demands@rctlma.org

Administrative Citation

927-210-018
JAMES BRADLEY
DEANNA BRADLEY
42225 REMINGTON AVE STE 23
TEMECULA CA. 92590

Citation Issue Date	Billing Date
10/21/2009	3/11/2010

Property Address
927-210-018 JAMES BRADLEY DEANNA BRADLEY 40195 CHAPARRAL DR TEMECULA, CA 92592

Citation Number	District	Class
A24559	3	SOAC

Item	Description	Hours/Qty	Rate	Amount
Administrative Citations	A24559--CV0903811	1	500.00	500.00

Subtotal	\$500.00
Payments/Credits	\$-235.00
Total	\$265.00

EXHIBIT NO. _____

AA



County of Riverside Code Enforcement Department

P.O. Box 1469, Riverside, CA 92502
 Phone: (951) 955-2004 Fax: (951) 955-8680
 demands@rctlma.org

Administrative Citation

927-210-018
 JAMES BRADLEY
 DEANNA BRADLEY
 42225 REMINGTON AVE STE 23
 TEMECULA CA. 92590

Citation Issue Date	Billing Date
8/13/2009	3/9/2011

Citation Number	District	Class
A26174	3	SOAC

Property Address
927-210-018 JAMES BRADLEY DEANNA BRADLEY 40195 CHAPARRAL DR TEMECULA, CA 92592

Item	Description	Hours/Qty	Rate	Amount
Administrative Citations	A26174-CV0903811	1	100.00	100.00

Subtotal	\$100.00
Payments/Credits	\$0.00
Total	\$100.00

EXHIBIT NO. AS



County of Riverside Code Enforcement Department

P.O. Box 1469, Riverside, CA 92502
Phone: (951) 955-2004 Fax: (951) 955-8680
demands@rctlma.org

Administrative Citation

927-210-018
JAMES BRADLEY
DEANNA BRADLEY
42225 REMINGTON AVE STE 23
TEMECULA CA. 92590

Citation Issue Date	Billing Date
1/4/2010	3/9/2011

Citation Number	District	Class
A32071	3	SOAC

Property Address
927-210-018 JAMES BRADLEY DEANNA BRADLEY 40195 CHAPARRAL DR TEMECULA, CA 92592

Item	Description	Hours/Qty	Rate	Amount
Administrative Citations	A32071--CV0903811	1	500.00	500.00

Subtotal	\$500.00
Payments/Credits	\$0.00
Total	\$500.00

DEPARTMENT NO. _____

A6



County of Riverside Code Enforcement Department

P.O. Box 1469, Riverside, CA 92502
 Phone: (951) 955-2004 Fax: (951) 955-8680
 demands@rctlma.org

Administrative Citation

927-210-018
 JAMES BRADLEY
 DEANNA BRADLEY
 42225 REMINGTON AVE STE 23
 TEMECULA CA. 92590

Citation Issue Date	Billing Date
2/4/2010	3/9/2011

Property Address
927-210-018 JAMES BRADLEY DEANNA BRADLEY 40195 CHAPARRAL DR TEMECULA, CA 92592

Citation Number	District	Class
A24565	3	SOAC

Item	Description	Hours/Qty	Rate	Amount
Administrative Citations	A24565--CV0903811	1	500.00	500.00
			Subtotal	\$500.00
			Payments/Credits	\$0.00
			Total	\$500.00

EXHIBIT NO. A7



County of Riverside Code Enforcement Department

P.O. Box 1469, Riverside, CA 92502
Phone: (951) 955-2004 Fax: (951) 955-8680
demands@rctlma.org

Administrative Citation

927-210-018
JAMES BRADLEY
DEANNA BRADLEY
42225 REMINGTON AVE STE 23
TEMECULA CA. 92590

Citation Issue Date	Billing Date
3/16/2010	3/9/2011

Property Address
927-210-018 JAMES BRADLEY DEANNA BRADLEY 40195 CHAPARRAL DR TEMECULA, CA 92592

Citation Number	District	Class
A32493	3	SOAC

Item	Description	Hours/Qty	Rate	Amount
Administrative Citations	A32493--CV0903811	1	500.00	500.00
			Subtotal	\$500.00
			Payments/Credits	\$0.00
			Total	\$500.00

A8

NOTICE LIST

Subject Property: 40195 Chaparral Drive, Temecula;
Case No.: CV09-03811; APN: 927-210-018;
District Three

JAMES BRADLEY
DEANNA BRADLEY
40195 CHAPARRAL DRIVE
TEMECULA CA 92592

JAMES BRADLEY
DEANNA BRADLEY
42225 REMINGTON AVE
SUITE 23 (AKA UNIT A23)
TEMECULA CA 92590

JAMES BRADLEY
DEANNA BRADLEY
32840 WOLF STORE ROAD
TEMECULA CA 92592

FIRST MAGNUS FINANCIAL CORP
603 N WILMOT
TUCSON AZ 85711

MERS
PO BOX 2026
FLINT MI 48501-2026

INTERNAL REVENUE SERVICE
PO BOX 145585
STOP 8420G
CINCINNATI OH 45250-5585

FRANCHISE TAX BOARD
SPECIAL PROCEDURES SECTION
PO BOX 2952
SACRAMENTO CA 95812-2952

STATE BOARD OF EQUALIZATION
PO BOX 942879
SACRAMENTO CA 94279-0055

1 **PROOF OF SERVICE**

2 Case No. CV09-03811

3 STATE OF CALIFORNIA, COUNTY OF RIVERSIDE

4 I, Brenda G. Peeler, declare that I am a citizen of the United States and am employed in the County
5 of Riverside, over the age of 18 years and not a party to the within action or proceeding; that my
6 business address is 3960 Orange Street, Suite 500, Riverside, California 92501.

7 That on November 3, 2011, I served the following document(s):

- 8 - NOTICE OF HEARING RE: STATEMENT OF ABATEMENT COSTS
- 9 - SUMMARY STATEMENT OF ABATEMENT COSTS
- 10 - STATEMENT OF ABATEMENT COSTS
- 11 - ADMINISTRATIVE CITATION(S)
- 12 - NOTICE LIST

13 by placing a true copy thereof enclosed in a sealed envelope(s) addressed as follows:

14 **OWNERS OR INTERESTED PARTIES**
15 **(SEE NOTICE LIST ATTACHED TO NOTICE OF HEARING)**

16 XX **BY FIRST CLASS MAIL.** I am "readily familiar" with the office's practice of collection
17 and processing correspondence for mailing. Under that practice it would be deposited with
18 the U.S. Postal Service on that same day with postage thereon fully prepaid at Riverside,
19 California, in the ordinary course of business.

20 **BY PERSONAL SERVICE:** I caused to be delivered such envelope(s) by hand to the offices
21 of the addressee(s).

22 XX **STATE - I declare under penalty of perjury under the laws of the State of California that the**
23 **above is true and correct.**

24 **FEDERAL - I declare that I am employed in the office of a member of the bar of this court at**
25 **whose direction the service was made.**

26 EXECUTED ON November 3, 2011, at Riverside, California.

27 
28 _____
BRENDA G. PEELER

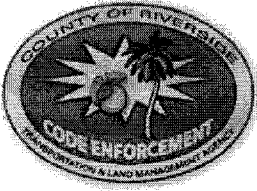

**CODE ENFORCEMENT DEPARTMENT
COUNTY OF RIVERSIDE**

GLENN BAUDE
Director

AFFIDAVIT OF POSTING OF NOTICES

November 5, 2011

RE CASE NO: CV0903811

I, Daniel Gregorio, hereby declare:

I am employed by the Riverside County Code Enforcement Department; that my business address is 39493 Los Alamos Road, Suite #A, Murrieta, California 92563 .

That on 11/05/2011 at 2:25 pm, I securely and conspicuously posted Notice of Hearing Re: Demand for Payment Statement of Abatement Costs at the property described as:

Property Address: 40195 CHAPARRAL DR, TEMECULA

Assessor's Parcel Number: 927-210-018

I declare under the penalty of perjury that the foregoing is true and correct.

Executed on November 5, 2011 in the County of Riverside, California.

CODE ENFORCEMENT DEPARTMENT

By: Daniel Gregorio, Code Enforcement Officer

39493 LOS ALAMOS ROAD, SUITE #A, MURRIETA, CALIFORNIA 92563
(951) 600-6140 • FAX (951) 600-6190

INDEXED NO.

A11



COUNTY OF RIVERSIDE CODE ENFORCEMENT

P.O. Box 1469, Riverside, CA 92502
Phone: 951-955-2004 Fax: 951-955-8680

Property Reference/Mailing Address
927-210-018 JAMES BRADLEY DEANNA BRADLEY 42225 REMINGTON AVE STE 23 TEMECULA CA. 92590

Summary Statement of Abatement Costs

You are liable to the County for the following abatement costs:

Date	Invoice Number & Amount	Amount	Balance
12/31/2000	Balance forward		0.00
03/09/2011	CV0903811- INV #100590.	696.40	696.40
09/16/2009 10/15/2010	CV0903811:A24551- INV #12178. A24551 PMT #FTB. A24551	200.00 -200.00	896.40 696.40
10/21/2009 10/28/2010 03/09/2011	CV0903811:A24559- INV #12179. A24559 PMT #FTB. A24559:Payment entered in error PMT #FTB PMT DAT. A24559	500.00 0.00 -235.00	1,196.40 1,196.40 961.40
02/04/2010	CV0903811:A24565- INV #12997. A24565	500.00	1,461.40
08/13/2009	CV0903811:A26174- INV #12180. A26174	100.00	1,561.40
01/04/2010	CV0903811:A32071- INV #12999. A32071	500.00	2,061.40
03/16/2010	CV0903811:A32493- INV #12998. A32493	500.00	2,561.40
		Total Now Due	\$2,561.40

The total abatement costs must be paid to the County of Riverside, P.O. Box 1469, Riverside, CA 92502 within thirty (30) days. In the event said costs are not paid within thirty (30) days you will be liable for additional administrative costs, penalties, court fees, or other collection costs incurred in the collection of these abatement costs.

I affirm and declare under penalty of perjury under the laws of the State of California that the foregoing is true and correct to the best of my knowledge.

Code Enforcement Department

EXHIBIT NO. B

**County of Riverside
Code Enforcement Department**

P.O. Box 1469, Riverside, CA 92502
Phone: (951) 955-2004 Fax: (951) 955-8680



Statement of Abatement Costs

927-210-018
JAMES BRADLEY
DEANNA BRADLEY
42225 REMINGTON AVE STE 23
TEMECULA CA. 92590

Date	Invoice #
3/9/2011	100590

Case Number	District	Class
CV0903811	3	SOAC

Property Address
927-210-018 JAMES BRADLEY DEANNA BRADLEY 40195 CHAPARRAL DR TEMECULA, CA 92592

You are liable to the County for the following abatement costs:

Date	Item	Description	Hours/Qty	Rate	Amount
6/24/2009	Officer Hours	Labor Charges - Officer Time	0.8	109.00	87.20
8/13/2009	Officer Hours	Labor Charges - Officer Time	0.3	109.00	32.70
9/16/2009	Officer Hours	Labor Charges - Officer Time	0.4	109.00	43.60
10/21/2009	Officer Hours	Labor Charges - Officer Time	0.2	109.00	21.80
12/1/2009	Officer Hours	Labor Charges - Officer Time	0.5	109.00	54.50
1/4/2010	Officer Hours	Labor Charges - Officer Time	0.2	109.00	21.80
2/4/2010	Officer Hours	Labor Charges - Officer Time	0.2	109.00	21.80
3/16/2010	Officer Hours	Labor Charges - Officer Time	0.3	109.00	32.70
3/9/2011	SOE Preparation	Prepare Statement of Expense		65.00	65.00
Subtotal Code Enforcement Costs					381.10
3/9/2011	Prepare Case for SOE He... Attend SOE Hearing			125.55	125.55
				69.75	69.75
Subtotal County Counsel Costs					195.30
3/9/2011	Lot Book Report			120.00	120.00
Subtotal Contractor Costs					120.00
Subtotal					\$696.40

The total abatement costs must be paid to the County of Riverside, P.O. Box 1469, Riverside, CA 92502 within thirty (30) days. In the event said costs are not paid within thirty (30) days you will be liable for additional administrative costs, penalties, court fees or other collection costs incurred in the collection of these abatement costs.

Payments/Credits	\$0.00
Total Now Due	\$696.40

I affirm and declare under penalty of perjury under the laws of the State of California that the foregoing is true and correct to the best of my knowledge.

[Signature]
Code Enforcement Department

EXHIBIT NO. B2



County of Riverside Code Enforcement Department

P.O. Box 1469, Riverside, CA 92502
Phone: (951) 955-2004 Fax: (951) 955-8680
demands@rctlma.org

Administrative Citation

927-210-018
JAMES BRADLEY
DEANNA BRADLEY
42225 REMINGTON AVE STE 23
TEMECULA CA. 92590

Citation Issue Date	Billing Date
10/21/2009	3/11/2010

Citation Number	District	Class
A24559	3	SOAC

Property Address
927-210-018 JAMES BRADLEY DEANNA BRADLEY 40195 CHAPARRAL DR TEMECULA, CA 92592

Item	Description	Hours/Qty	Rate	Amount
Administrative Citations	A24559--CV0903811	1	500.00	500.00

Subtotal	\$500.00
Payments/Credits	\$-235.00
Total	\$265.00

EXHIBIT NO. B3



County of Riverside Code Enforcement Department

P.O. Box 1469, Riverside, CA 92502
Phone: (951) 955-2004 Fax: (951) 955-8680
demands@rctlma.org

Administrative Citation

927-210-018
JAMES BRADLEY
DEANNA BRADLEY
42225 REMINGTON AVE STE 23
TEMECULA CA. 92590

Citation Issue Date	Billing Date
8/13/2009	3/9/2011

Citation Number	District	Class
A26174	3	SOAC

Property Address
927-210-018 JAMES BRADLEY DEANNA BRADLEY 40195 CHAPARRAL DR TEMECULA, CA 92592

Item	Description	Hours/Qty	Rate	Amount
Administrative Citations	A26174-CV0903811	1	100.00	100.00

Subtotal	\$100.00
Payments/Credits	\$0.00
Total	\$100.00

EXHIBIT NO. B4



County of Riverside Code Enforcement Department

P.O. Box 1469, Riverside, CA 92502
Phone: (951) 955-2004 Fax: (951) 955-8680
demands@rctlma.org

Administrative Citation

927-210-018
JAMES BRADLEY
DEANNA BRADLEY
42225 REMINGTON AVE STE 23
TEMECULA CA. 92590

Citation Issue Date	Billing Date
1/4/2010	3/9/2011

Citation Number	District	Class
A32071	3	SOAC

Property Address
927-210-018 JAMES BRADLEY DEANNA BRADLEY 40195 CHAPARRAL DR TEMECULA, CA 92592

Item	Description	Hours/Qty	Rate	Amount
Administrative Citations	A32071--CV0903811	1	500.00	500.00

Subtotal	\$500.00
Payments/Credits	\$0.00
Total	\$500.00

EXHIBIT NO. **8⁵**



County of Riverside Code Enforcement Department

P.O. Box 1469, Riverside, CA 92502
 Phone: (951) 955-2004 Fax: (951) 955-8680
 demands@rctlma.org

Administrative Citation

927-210-018
 JAMES BRADLEY
 DEANNA BRADLEY
 42225 REMINGTON AVE STE 23
 TEMECULA CA. 92590

Citation Issue Date	Billing Date
2/4/2010	3/9/2011

Citation Number	District	Class
A24565	3	SOAC

Property Address
927-210-018 JAMES BRADLEY DEANNA BRADLEY 40195 CHAPARRAL DR TEMECULA, CA 92592

Item	Description	Hours/Qty	Rate	Amount
Administrative Citations	A24565--CV0903811	1	500.00	500.00

Subtotal	\$500.00
Payments/Credits	\$0.00
Total	\$500.00

EXHIBIT NO. B6



County of Riverside Code Enforcement Department

P.O. Box 1469, Riverside, CA 92502
Phone: (951) 955-2004 Fax: (951) 955-8680
demands@rctlma.org

Administrative Citation

927-210-018
JAMES BRADLEY
DEANNA BRADLEY
42225 REMINGTON AVE STE 23
TEMECULA CA. 92590

Citation Issue Date	Billing Date
3/16/2010	3/9/2011

Citation Number	District	Class
A32493	3	SOAC

Property Address
927-210-018 JAMES BRADLEY DEANNA BRADLEY 40195 CHAPARRAL DR TEMECULA, CA 92592

Item	Description	Hours/Qty	Rate	Amount
Administrative Citations	A32493--CV0903811	1	500.00	500.00

Subtotal	\$500.00
Payments/Credits	\$0.00
Total	\$500.00

EXHIBIT NO. B⁷

Home

Reports

CJ0903811

SEARCH RESULTS

Citations Found: 6
Total Due: \$1865.00

Agency: RE-Riverside County Code Enforcement Dept.: Citation Number: A26174
Lic. State/Plate: Date: 08/13/2009
Name: BRADLEY, JAMES
Amt Due: \$100.00
Status: OPEN: Noticed (sent to FTB)

Agency: RE-Riverside County Code Enforcement Dept.: Citation Number: A24551
Lic. State/Plate: Date: 09/16/2009
Name: BRADLEY, JAMES
Amt Due: \$0.00
Status: 10/15/10: Paid In Full

Agency: RE-Riverside County Code Enforcement Dept.: Citation Number: A24559
Lic. State/Plate: Date: 10/21/2009
Name: BRADLEY, JAMES
Amt Due: \$265.00
Status: OPEN: Noticed (sent to FTB)

Agency: RE-Riverside County Code Enforcement Dept.: Citation Number: A32071
Lic. State/Plate: Date: 01/04/2010
Name: BRADLEY, JAMES
Amt Due: \$500.00
Status: OPEN: Noticed

Agency: RE-Riverside County Code Enforcement Dept.: Citation Number: A24565
Lic. State/Plate: Date: 02/04/2010
Name: BRADLEY, JAMES
Amt Due: \$500.00
Status: OPEN: Noticed (sent to FTB)

Agency: RE-Riverside County Code Enforcement Dept.: Citation Number: A32493
Lic. State/Plate: Date: 03/16/2010
Name: BRADLEY, JAMES
Amt Due: \$500.00
Status: OPEN: Noticed (sent to FTB)

Home | Log Out | Help

EXHIBIT NO. B⁸



INVOICE

Order Number: 23387 **Order Date:** 4/11/2011

Customer Information:

Acct No. 1044

RIVERSIDE COUNTY TLMA-CODE ENFORCEMENT
4080 Lemon Street
Riverside, CA 92501

Attn: Brent Steele
REF: CV09-03811 / Angela Sarmiento
IN RE: BRADLEY, JAMES

Product and/or Service ordered for Property known as:	
40195 Chaparral Drive Temecula, CA 92592	
DESCRIPTION:	FEE:
Lot Book Report	\$120.00
TOTAL DUE:	\$120.00

Payment due upon receipt. Please remit to:

RZ Title Services, Inc.
P.O. Box 1193
Whittier, CA 90609

EXHIBIT NO. 39

Assessment Roll For the 2010-2011 Tax Year as of January 1, 2010

Assessment #927210018-0		Parcel # 927210018-0	
Assessee:	BRADLEY JAMES	Land	183,576
Assessee:	BRADLEY DEANNA	Structure	529,132
Mail Address:	42225 REMINGTON AVE STE 23	Full Value	712,708
City, State Zip:	TEMECULA CA 92590	Total Net	712,708
Real Property Use Code:	R1		
Base Year	2005		
Conveyance Number:	0520238		
Conveyance (mm/yy):	7/2004		
PUI:	R010000		
TRA:	94-021		
Taxability Code:	0-00		
ID Data:	Lot 165 MB 064/052 TR 3944		
Situs Address:	40195 CHAPARRAL DR TEMECULA CA 92592		

View Parcel Map

EXHIBIT NO. C

RIVERSIDE COUNTY GIS

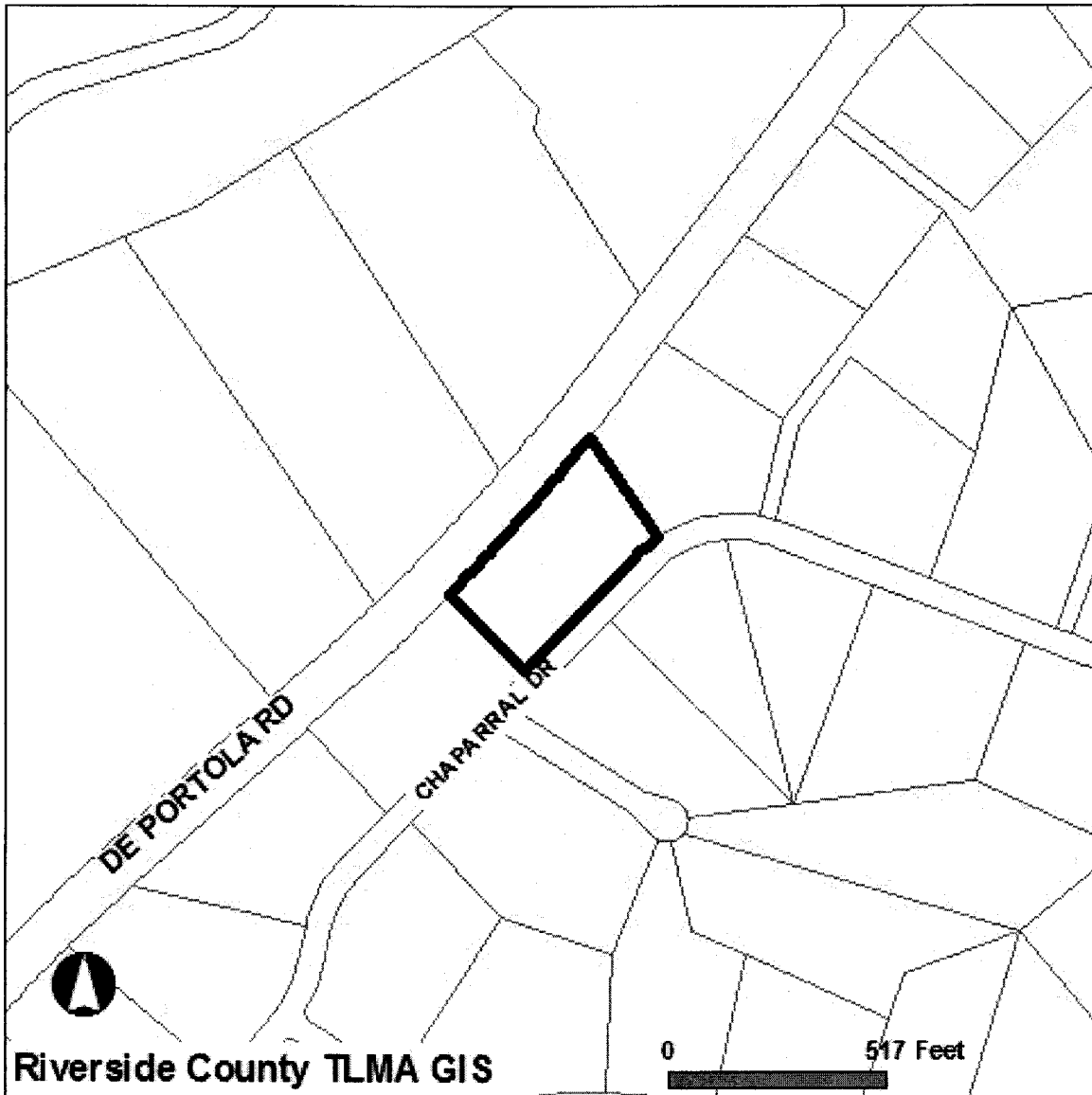

Selected parcel(s):
927-210-018

IMPORTANT

Maps and data are to be used for reference purposes only. Map features are approximate, and are not necessarily accurate to surveying or engineering standards. The County of Riverside makes no warranty or guarantee as to the content (the source is often third party), accuracy, timeliness, or completeness of any of the data provided, and assumes no legal responsibility for the information contained on this map. Any use of this product with respect to accuracy and precision shall be the sole responsibility of the user.

STANDARD REPORT

APNs

927-210-018-0

OWNER NAME / ADDRESS

JAMES BRADLEY
DEANNA BRADLEY
40195 CHAPARRAL DR
TEMECULA, CA. 92592

MAILING ADDRESS

(SEE OWNER)
42225 REMINGTON AVE STE 23
TEMECULA CA. 92590

EXHIBIT NO. _____

C2

LEGAL DESCRIPTION

RECORDED BOOK/PAGE: MB 64/52
SUBDIVISION NAME: TR 3944
LOT/PARCEL: 165, BLOCK: NOT AVAILABLE
TRACT NUMBER: 3944

LOT SIZE

RECORDED LOT SIZE IS 2.84 ACRES

PROPERTY CHARACTERISTICS

WOOD FRAME, 4200 SQFT., 4 BDRM/ 4.5 BATH, 2 STORY, ATTACHED GARAGE(2005 SQ. FT), CONST'D 2004TILE, ROOF, CENTRAL HEATING, CENTRAL COOLING, POOL

THOMAS BROS. MAPS PAGE/GRID

PAGE: 930 GRID: G7
PAGE: 960 GRID: G1

CITY BOUNDARY/SPHERE

NOT WITHIN A CITY
NOT WITHIN A CITY SPHERE
ANNEXATION DATE: NOT APPLICABLE
NO LAFCO CASE # AVAILABLE
NO PROPOSALS

MARCH JOINT POWERS AUTHORITY

NOT IN THE JURISDICTION OF THE MARCH JOINT POWERS AUTHORITY

INDIAN TRIBAL LAND

NOT IN A TRIBAL LAND

SUPERVISORIAL DISTRICT (ORD. 813)

JEFF STONE, DISTRICT 3

TOWNSHIP/RANGE

T7SR1W SEC 29

ELEVATION RANGE

1560/1580 FEET

PREVIOUS APN

205-501-004

PLANNING

LAND USE DESIGNATIONS

Zoning not consistent with the General Plan.
RR

SANTA ROSA ESCARPMENT BOUNDARY

NOT IN THE SANTA ROSA ESCARPMENT BOUNDARY

AREA PLAN (RCIP)

SOUTHWEST AREA

GENERAL PLAN POLICY OVERLAYS

NOT IN A GENERAL PLAN POLICY OVERLAY AREA

GENERAL PLAN POLICY AREAS

NONE

ZONING CLASSIFICATIONS (ORD. 348)

R-A-2 1/2

ZONING DISTRICTS AND ZONING AREAS

RANCHO CALIFORNIA AREA

ZONING OVERLAYS

NOT IN A ZONING OVERLAY

HISTORIC PRESERVATION DISTRICTS

NOT IN AN HISTORIC PRESERVATION DISTRICT

SPECIFIC PLANS

NOT WITHIN A SPECIFIC PLAN

NOT IN AN AGRICULTURAL PRESERVE

REDEVELOPMENT AREAS

NOT IN A REDEVELOPMENT AREA

AIRPORT INFLUENCE AREAS

NOT IN AN AIRPORT INFLUENCE AREA

AIRPORT COMPATIBILITY ZONES

NOT IN AN AIRPORT COMPATIBILITY ZONE

ENVIRONMENTAL

CVMSHCP (COACHELLA VALLEY MULTI-SPECIES HABITAT CONSERVATION PLAN) CONSERVATION AREA

NOT IN A CONSERVATION AREA

CVMSHCP FLUVIAL SAND TRANSPORT SPECIAL PROVISION AREAS

NOT IN A FLUVIAL SAND TRANSPORT SPECIAL PROVISION AREA

WRMSHCP (WESTERN RIVERSIDE COUNTY MULTI-SPECIES HABITAT CONSERVATION PLAN) CELL GROUP

NOT IN A CELL GROUP

WRMSHCP CELL NUMBER

NOT IN A CELL

HANS/ERP (HABITAT ACQUISITION AND NEGOTIATION STRATEGY/EXPEDITED REVIEW PROCESS)

NONE

VEGETATION (2005)

DEVELOPED/DISTURBED LAND
RIPARIAN SCRUB, WOODLAND, FOREST
WOODLAND AND FORESTS

FIRE

HIGH FIRE AREA (ORD. 787)

NOT IN A HIGH FIRE AREA

FIRE RESPONSIBILITY AREA

STATE RESPONSIBILITY AREA

DEVELOPMENT FEES

CVMSHCP FEE AREA (ORD. 875)

NOT WITHIN THE COACHELLA VALLEY MSHCP FEE AREA

WRMSHCP FEE AREA (ORD. 810)

IN OR PARTIALLY WITHIN THE WESTERN RIVERSIDE MSHCP FEE AREA. SEE MAP FOR MORE INFORMATION.

ROAD & BRIDGE DISTRICT

NOT IN A DISTRICT

EASTERN TUMF (TRANSPORTATION UNIFORM MITIGATION FEE ORD. 673)

NOT WITHIN THE EASTERN TUMF FEE AREA

WESTERN TUMF (TRANSPORTATION UNIFORM MITIGATION FEE ORD. 824)

IN OR PARTIALLY WITHIN A TUMF FEE AREA. SEE MAP FOR MORE INFORMATION.SOUTHWEST

DIF (DEVELOPMENT IMPACT FEE AREA ORD. 659)

SOUTHWEST AREA

SKR FEE AREA (STEPHEN'S KANGAROO RAT ORD. 663.10)

IN OR PARTIALLY WITHIN AN SKR FEE AREA. SEE MAP FOR MORE INFORMATION.

DEVELOPMENT AGREEMENTS

NOT IN A DEVELOPMENT AGREEMENT AREA

TRANSPORTATION

IN OR PARTIALLY WITHIN A CIRCULATION ELEMENT RIGHT-OF-WAY. SEE MAP FOR MORE INFORMATION. CONTACT THE TRANSPORTATION DEPT. PERMITS SECTION AT (951) 955-6790 FOR INFORMATION REGARDING THIS PARCEL IF IT IS IN AN UNINCORPORATED AREA.

ROAD BOOK PAGE

130

TRANSPORTATION AGREEMENTS

NOT IN A TRANSPORTATION AGREEMENT

CETAP (COMMUNITY AND ENVIRONMENTAL TRANSPORTATION ACCEPTABILITY PROCESS) CORRIDORS

NOT IN A CETAP CORRIDOR.

HYDROLOGY

FLOOD PLAIN REVIEW

WITHIN AREAS OF FLOODING SENSITIVITY. CONTACT THE FLOOD PLAIN MANAGEMENT SECTION AT (951) 955-1200 FOR INFORMATION

WATER DISTRICT

EMWD

FLOOD CONTROL DISTRICT

RIVERSIDE COUNTY FLOOD CONTROL DISTRICT

WATERSHED

SANTA MARGARITA

GEOLOGIC

FAULT ZONE

NOT IN A FAULT ZONE

FAULTS

WITHIN A 1/2 MILE OF

BUCK MESA FAULT

COUNTY FAULTS

CONTACT THE COUNTY'S CHIEF ENGINEERING GEOLOGIST AT (951)955-6863.

LIQUEFACTION POTENTIAL

MODERATE

VERY LOW

SUBSIDENCE

SUSCEPTIBLE

PALEONTOLOGICAL SENSITIVITY

HIGH SENSITIVITY (HIGH A).

BASED ON GEOLOGIC FORMATIONS OR MAPPABLE ROCK UNITS THAT ARE ROCKS THAT CONTAIN FOSSILIZED BODY ELEMENTS, AND TRACE FOSSILS SUCH AS TRACKS, NESTS AND EGGS. THESE FOSSILS OCCUR ON OR BELOW THE SURFACE.

MISCELLANEOUS

SCHOOL DISTRICT

TEMECULA VALLEY UNIFIED

COMMUNITIES

RANCHO CALIFORNIA

COUNTY SERVICE AREA

NOT IN A COUNTY SERVICE AREA.

LIGHTING (ORD. 655)

ZONE B, 15.06 MILES FROM MT. PALOMAR OBSERVATORY

2000 CENSUS TRACT

043203

FARMLAND

OTHER LANDS

TAX RATE AREAS

094021

- COUNTY FREE LIBRARY
- COUNTY STRUCTURE FIRE PROTECTION
- COUNTY WASTE RESOURCE MGMT DIST
- CSA 152
- EASTERN MUN WATER IMP DIST B
- EASTERN MUNICIPAL WATER
- ELS MURRIETA ANZA RESOURCE CONS
- ELSINORE AREA ELEM SCHOOL FUND
- FLOOD CONTROL ADMINISTRATION
- FLOOD CONTROL ZONE 7
- GENERAL
- GENERAL PURPOSE
- METRO WATER EAST 1301999
- MT SAN JACINTO JUNIOR COLLEGE
- RANCHO CAL WTR R DIV DEBT SV
- RANCHO CALIF JT WATER
- RIV CO REG PARK & OPEN SPACE
- RIV. CO. OFFICE OF EDUCATION
- TEMECULA PUBLIC CEMETERY
- TEMECULA UNIFIED
- TEMECULA UNIFIED B & I

SPECIAL NOTES

NO SPECIAL NOTES

CODE COMPLAINTS

Case #	Description	Start Date
NO CODE COMPLAINTS	NOT APPLICABLE	NOT APPLICABLE

REPORT PRINTED ON...Fri Nov 04 07:48:31 2011
Version 111019



P.O. Box 1193
 Whittier, CA 90609
 Tel # (562) 325-8351
 Fax # (714) 783-3038

Lot Book Report

Order Number: **23387**

Customer:

RIVERSIDE COUNTY TLMA-CODE ENFORCEMENT
 4080 Lemon Street
 Riverside CA 92501

Order Date: 4/11/2011
 Dated as of: 4/8/2011
 County Name: Riverside

Attn: Brent Steele
 Reference: CV09-03811 / Angela Sarmiento
 IN RE: BRADLEY, JAMES

FEE(s):
 Report: \$120.00

Property Address: 40195 Chaparral Drive
 Temecula CA 92592

Assessor's Parcel No. : 927-210-018-0

Assessments:

Land Value:	\$183,576.00
Improvement Value:	\$529,132.00
Exemption Value:	\$0.00
Total Value:	\$712,708.00

Tax Information

Property Taxes for the Fiscal Year	2010-2011
First Installment	\$4,695.65
Penalty	\$0.00
Status	PAID (PAID THRU 01/31/2011)
Second Installment	\$4,695.65
Penalty	\$0.00
Status	OPEN NOT-PAID (DUE DATE 04/10/2011)

EXHIBIT NO. _____

D



P.O. Box 1193
Whittier, CA 90609
Tel # (562) 325-8351
Fax # (714) 783-3038

Order Number: 23387
Reference: CV09-03811 / Ang

Property Vesting

The last recorded document transferring title of said property

Dated	06/18/2004
Recorded	07/06/2004
Document No.	2004-0520238
D.T.T.	\$726.00
Grantor	Kevin B. Kovacs, a married man as his sole and separate property as to an undivided 50% interest and Graham C. Kovacs, a single man as to an undivided 50% interest
Grantee	James Bradley and Deanna Bradley, husband and wife as joint tenants

Deeds of Trust

Position No.	1st
A Deed of Trust Dated	12/03/2004
Recorded	12/17/2004
Document No.	2004-1002930
Amount	\$650,000.00
Trustor	James Bradley and Deanna Bradley, husband and wife as joint tenants
Trustee	Fidelity National Title Company
Beneficiary	Mortgage Electronic Registration Systems, Inc., acting as a nominee for First Magnus Financial Corporation, an Arizona Corporation

Position No.	2nd
A Deed of Trust Dated	05/10/2007
Recorded	05/16/2007
Document No.	2007-0325957
Amount	\$390,000.00
Trustor	James Bradley and Deanna Bradley, husband and wife, as joint tenants



P.O. Box 1193
Whittier, CA 90609
Tel # (562) 325-8351
Fax # (714) 783-3038

Order Number: 23387
Reference: CV09-03811 / Ang

Trustee	New Century Title Company
Beneficiary	Mortgage Electronic Registration Systems, Inc., acting as a nominee for Wholesale Capital Corporation, a California Corporation

Additional Information

Notice of Non-Compliance filed by	County of Riverside Department of Code Enforcement
In the matter of the property of	James Bradley; Deanna Bradley
Case No.	CV09-03811
Recorded	07/10/2009
Document No.	2009-0356180
A Federal Tax Lien Recorded	01/12/2011
Document No	2011-0016870
Amount	\$97,863.14
Debtor	James A & Deanna C Bradley
ID No.	XXX - XX- 1971
Creditor	Internal Revenue Service
A Notice of State Tax Lien Recorded	02/08/2006
Document No.	2006-0096556
Amount	\$2,015.80
Account No.	572158731
Certificate No.	06024384127
Debtor	James A Bradley
Creditor: State of California,	Franchise Tax Board
A Notice of State Tax Lien Recorded	02/20/2007
Document No.	2007-0114734
Amount	\$36,885.19
Account No.	SR -EH -099759705
Certificate No.	BE- 1213768
Debtor	James Albert Bradley dba Ultra Custom Boats
Creditor: State of California,	Board of Equalization



P.O. Box 1193
Whittier, CA 90609
Tel # (562) 325-8351
Fax # (714) 783-3038

Order Number: 23387

Reference: CV09-03811 / Ang

Abstract of Judgment Filed in the	Superior Court of California, County of Los Angeles - Santa Monica Court
Case No.	09C03899
Recorded	12/07/2010
Document No.	2010-0582762
Amount	\$19,797.96
Debtor	J.A. Bradley Construction & Restoration, Inc.; James A. Bradley
Creditor	American Contractors Indemnity Company

Legal Description

THE LAND REFERRED TO IN THIS REPORT IS LOCATED IN AND IS DESCRIBED AS FOLLOWS:

LOT 165 OF TRACT 3944, IN THE COUNTY OF RIVERSIDE, STATE OF CALIFORNIA, AS PER MAP RECORDED IN BOOK 64, PAGE(S) 52 TO 82, OF MAPS, IN THE OFFICE OF THE COUNTY RECORDER OF SAID COUNTY.



County of Riverside Code Enforcement Department

P.O. Box 1469, Riverside, CA 92502
Phone: (951) 955-2004 Fax: (951) 955-8680

DEMAND FOR PAYMENT STATEMENT OF ABATEMENT COSTS NOTICE OF SPECIAL TAX ASSESSMENT

May 3, 2011

James Bradley
Deanna Bradley
40195 Chaparral Drive
Temecula, CA 92592

Subject Property: 40195 Chaparral Drive, Temecula
APN No(s): 927-210-018
Case No(s): CV09-03811

Dear Mr. & Mrs. Bradley:

NOTICE IS HEREBY GIVEN that the County of Riverside Code Enforcement Department ("DEPARTMENT") incurred expenses during our efforts to abate the code violation(s) on the Subject Property. Said abatement case involved construction without permits (retaining / garden wall) located on your real property commonly described as 40195 Chaparral Drive, Temecula and more particularly described as Assessor's Parcel Number 927-210-018.

The total amount due for the DEPARTMENT'S actions concerning the above-described dangerous or injurious condition is **two thousand, five hundred sixty-one dollars and forty cents (\$2,561.40)**.

You have thirty (30) days from the date of this letter to pay the DEPARTMENT at the above address the total amount due on the enclosed "Summary Statement of Abatement Costs" or a special tax assessment and abatement lien will be recorded upon the subject property. Payment must be made in the form of cashier's check or money order, made payable to the County of Riverside. Please note the property APN on the memo line of the check.

YOU HAVE A RIGHT TO A HEARING ON THIS MATTER. You have the right to contest the abatement costs and special assessment against the subject property. If you choose to exercise your right to a public hearing, please complete the enclosed "Request for Public Hearing" form and return it to the Code Enforcement Department within twenty (20) days of the date of this letter.

In the event you do not request a public hearing, a hearing shall be held without further notice to you for a final determination of this matter and authority to place a lien against the Subject Property and adding the amount due as a special tax assessment on the County tax rolls.

If you have any questions regarding this notice, please contact us at (951) 955-2004.

Code Enforcement Department

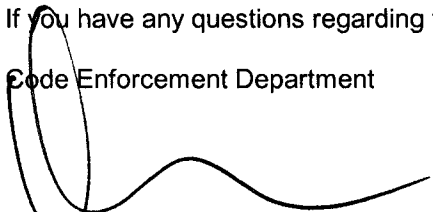

Ward Komers
Administrative Manager

EXHIBIT NO. E

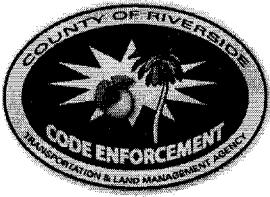

CODE ENFORCEMENT DEPARTMENT COUNTY OF RIVERSIDE

REQUEST FOR PUBLIC HEARING ON STATEMENT OF ABATEMENT COSTS AND SPECIAL TAX ASSESSMENT

James Bradley
Deanna Bradley
40195 Chaparral Drive
Temecula, CA 92592

Subject Property: 40195 Chaparral Drive, Temecula
APN No(s): 927-210-018
Case No(s): CV09-03811

I, _____, hereby request a public hearing before the Administrative
(Please PRINT your name here)
Hearing Officer regarding case number(s) _____.

I request notice of the Administrative Hearing date, time, and location (which shall not be less than 10 days from the submission of this request) to be mailed to me at the following address:

Return Mailing Address: _____

Signed: _____ Date: _____
(Please SIGN your name here)

Print: _____
(Please PRINT your name here)

You may contact me at the following daytime phone number: _____

IMPORTANT

Keep a copy of this form and mail the original to:
Riverside County Code Enforcement Department
P.O. BOX 1469
Riverside, CA 92502-1469

EXHIBIT NO. _____

E²



COUNTY OF RIVERSIDE CODE ENFORCEMENT

P.O. Box 1469, Riverside, CA 92502
Phone: 951-955-2004 Fax: 951-955-8680

Property Reference/Mailing Address
927-210-018 JAMES BRADLEY DEANNA BRADLEY 42225 REMINGTON AVE STE 23 TEMECULA CA. 92590

Summary Statement of Abatement Costs

You are liable to the County for the following abatement costs:

Date	Invoice Number & Amount	Amount	Balance
12/31/2000	Balance forward		0.00
03/09/2011	CV0903811- INV #100590.	696.40	696.40
09/16/2009 10/15/2010	CV0903811:A24551- INV #12178. A24551 PMT #FTB. A24551	200.00 -200.00	896.40 696.40
10/21/2009 10/28/2010 03/09/2011	CV0903811:A24559- INV #12179. A24559 PMT #FTB. A24559:Payment entered in error PMT #FTB PMT DAT. A24559	500.00 0.00 -235.00	1,196.40 1,196.40 961.40
02/04/2010	CV0903811:A24565- INV #12997. A24565	500.00	1,461.40
08/13/2009	CV0903811:A26174- INV #12180. A26174	100.00	1,561.40
01/04/2010	CV0903811:A32071- INV #12999. A32071	500.00	2,061.40
03/16/2010	CV0903811:A32493- INV #12998. A32493	500.00	2,561.40
		Total Now Due	\$2,561.40

The total abatement costs must be paid to the County of Riverside, P.O. Box 1469, Riverside, CA 92502 within thirty (30) days. In the event said costs are not paid within thirty (30) days you will be liable for additional administrative costs, penalties, court fees, or other collection costs incurred in the collection of these abatement costs.

I affirm and declare under penalty of perjury under the laws of the State of California that the foregoing is true and correct to the best of my knowledge.

Code Enforcement Department

EXHIBIT NO. E³

**County of Riverside
Code Enforcement Department**

P.O. Box 1469, Riverside, CA 92502
Phone: (951) 955-2004 Fax: (951) 955-8680



Statement of Abatement Costs

927-210-018
JAMES BRADLEY
DEANNA BRADLEY
42225 REMINGTON AVE STE 23
TEMECULA CA. 92590

Date	Invoice #
3/9/2011	100590

Case Number	District	Class
CV0903811	3	SOAC

Property Address
927-210-018 JAMES BRADLEY DEANNA BRADLEY 40195 CHAPARRAL DR TEMECULA, CA 92592

You are liable to the County for the following abatement costs:

Date	Item	Description	Hours/Qty	Rate	Amount
6/24/2009	Officer Hours	Labor Charges - Officer Time	0.8	109.00	87.20
8/13/2009	Officer Hours	Labor Charges - Officer Time	0.3	109.00	32.70
9/16/2009	Officer Hours	Labor Charges - Officer Time	0.4	109.00	43.60
10/21/2009	Officer Hours	Labor Charges - Officer Time	0.2	109.00	21.80
12/1/2009	Officer Hours	Labor Charges - Officer Time	0.5	109.00	54.50
1/4/2010	Officer Hours	Labor Charges - Officer Time	0.2	109.00	21.80
2/4/2010	Officer Hours	Labor Charges - Officer Time	0.2	109.00	21.80
3/16/2010	Officer Hours	Labor Charges - Officer Time	0.3	109.00	32.70
3/9/2011	SOE Preparation	Prepare Statement of Expense		65.00	65.00
		Subtotal Code Enforcement Costs			381.10
3/9/2011	Prepare Case for SOE He... Attend SOE Hearing			125.55 69.75	125.55 69.75
		Subtotal County Counsel Costs			195.30
3/9/2011	Lot Book Report			120.00	120.00
		Subtotal Contractor Costs			120.00

Subtotal \$696.40

The total abatement costs must be paid to the County of Riverside, P.O. Box 1469, Riverside, CA 92502 within thirty (30) days. In the event said costs are not paid within thirty (30) days you will be liable for additional administrative costs, penalties, court fees or other collection costs incurred in the collection of these abatement costs.

Payments/Credits \$0.00

Total Now Due \$696.40

I affirm and declare under penalty of perjury under the laws of the State of California that the foregoing is true and correct to the best of my knowledge.

Code Enforcement Department

EXHIBIT NO. E4



County of Riverside Code Enforcement Department

P.O. Box 1469, Riverside, CA 92502
Phone: (951) 955-2004 Fax: (951) 955-8680
demands@rctlma.org

Administrative Citation

927-210-018
JAMES BRADLEY
DEANNA BRADLEY
42225 REMINGTON AVE STE 23
TEMECULA CA. 92590

Citation Issue Date	Billing Date
10/21/2009	3/11/2010

Citation Number	District	Class
A24559	3	SOAC

Property Address
927-210-018 JAMES BRADLEY DEANNA BRADLEY 40195 CHAPARRAL DR TEMECULA, CA 92592

Item	Description	Hours/Qty	Rate	Amount
Administrative Citations	A24559--CV0903811	1	500.00	500.00

Subtotal	\$500.00
Payments/Credits	\$-235.00
Total	\$265.00

EXHIBIT NO. E⁵



County of Riverside Code Enforcement Department

P.O. Box 1469, Riverside, CA 92502
Phone: (951) 955-2004 Fax: (951) 955-8680
demands@rctlma.org

Administrative Citation

927-210-018
JAMES BRADLEY
DEANNA BRADLEY
42225 REMINGTON AVE STE 23
TEMECULA CA. 92590

Citation Issue Date	Billing Date
8/13/2009	3/9/2011

Citation Number	District	Class
A26174	3	SOAC

Property Address
927-210-018 JAMES BRADLEY DEANNA BRADLEY 40195 CHAPARRAL DR TEMECULA, CA 92592

Item	Description	Hours/Qty	Rate	Amount
Administrative Citations	A26174-CV0903811	1	100.00	100.00

Subtotal	\$100.00
Payments/Credits	\$0.00
Total	\$100.00

EXHIBIT NO. _____ *EL*

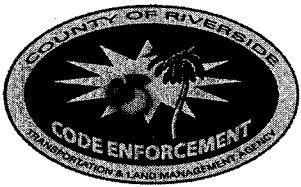

County of Riverside Code Enforcement Department

P.O. Box 1469, Riverside, CA 92502
Phone: (951) 955-2004 Fax: (951) 955-8680
demands@rctlma.org

Administrative Citation

927-210-018
JAMES BRADLEY
DEANNA BRADLEY
42225 REMINGTON AVE STE 23
TEMECULA CA. 92590

Citation Issue Date	Billing Date
1/4/2010	3/9/2011

Citation Number	District	Class
A32071	3	SOAC

Property Address
927-210-018 JAMES BRADLEY DEANNA BRADLEY 40195 CHAPARRAL DR TEMECULA, CA 92592

Item	Description	Hours/Qty	Rate	Amount
Administrative Citations	A32071--CV0903811	1	500.00	500.00
			Subtotal	\$500.00
			Payments/Credits	\$0.00
			Total	\$500.00

EXHIBIT NO. _____

E⁷

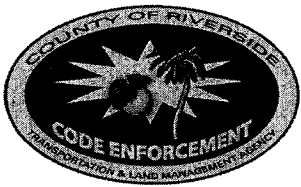

County of Riverside Code Enforcement Department

P.O. Box 1469, Riverside, CA 92502
Phone: (951) 955-2004 Fax: (951) 955-8680
demands@rctlma.org

Administrative Citation

927-210-018
JAMES BRADLEY
DEANNA BRADLEY
42225 REMINGTON AVE STE 23
TEMECULA CA. 92590

Citation Issue Date	Billing Date
2/4/2010	3/9/2011

Citation Number	District	Class
A24565	3	SOAC

Property Address
927-210-018 JAMES BRADLEY DEANNA BRADLEY 40195 CHAPARRAL DR TEMECULA, CA 92592

Item	Description	Hours/Qty	Rate	Amount
Administrative Citations	A24565--CV0903811	1	500.00	500.00

	Subtotal	\$500.00
	Payments/Credits	\$0.00
	Total	\$500.00

EXHIBIT NO. E8



County of Riverside Code Enforcement Department

P.O. Box 1469, Riverside, CA 92502
 Phone: (951) 955-2004 Fax: (951) 955-8680
 demands@rctlma.org

Administrative Citation

927-210-018
 JAMES BRADLEY
 DEANNA BRADLEY
 42225 REMINGTON AVE STE 23
 TEMECULA CA. 92590

Citation Issue Date	Billing Date
3/16/2010	3/9/2011

Citation Number	District	Class
A32493	3	SOAC

Property Address
927-210-018 JAMES BRADLEY DEANNA BRADLEY 40195 CHAPARRAL DR TEMECULA, CA 92592

Item	Description	Hours/Qty	Rate	Amount
Administrative Citations	A32493--CV0903811	1	500.00	500.00

Subtotal	\$500.00
Payments/Credits	\$0.00
Total	\$500.00

EXHIBIT NO. E9

NOTICE LIST

Subject Property: 40195 Chaparral Drive, Temecula; Case No.: CV09-03811;
APN: 927-210-018; District Three

JAMES & DEANNA BRADLEY
40195 CHAPARRAL DRIVE
TEMECULA CA 92590

JAMES & DEANNA BRADLEY
32840 WOLF STORE ROAD
TEMECULA CA 92592

FIRST MAGNUS FINANCIAL CORP
603 N WILMOT
TUCSON AZ 85711

MERS
PO BOX 2026
FLINT MI 48501-2026

WHOLESALE CAPITAL CORP
23328 OLIVEWOOD PLAZA DRIVE
MORENO VALLEY CA 92553

INTERNAL REVENUE SERVICE
PO BOX 145585, STOP 8420G
CINCINNATI OH 45250-5585

FRANCHISE TAX BOARD
SPECIAL PROCEDURES SECTION
PO BOX 2952
SACRAMENTO CA 95812-2952

STATE BOARD OF EQUALIZATION
PO BOX 942879
SACRAMENTO CA 94279-0055

EXHIBIT NO. _____

E10

PROOF OF SERVICE

Case No. CV09-03811

1
2
3
4
5
6
7
8
9
10
11
12
13
14
15
16
17
18
19
20
21
22
23
24
25
26
27
28

STATE OF CALIFORNIA, COUNTY OF RIVERSIDE

I, Brenda G. Peeler, declare that I am a citizen of the United States and am employed in the County of Riverside, over the age of 18 years and not a party to the within action or proceeding; that my business address is 3960 Orange Street, Suite 500, Riverside, California 92501.

That on May 3, 2011, I served the following document(s):

- DEMAND FOR PAYMENT
- REQUEST FOR HEARING
- SUMMARY STATEMENT OF ABATEMENT COSTS
- STATEMENT OF ABATEMENT COSTS
- ADMINISTRATIVE CITATION(S)
- NOTICE LIST

by placing a true copy thereof enclosed in a sealed envelope(s) addressed as follows:

**OWNERS OR INTERESTED PARTIES
(SEE NOTICE LIST ATTACHED TO NOTICE OF HEARING)**

XX **BY FIRST CLASS MAIL.** I am "readily familiar" with the office's practice of collection and processing correspondence for mailing. Under that practice it would be deposited with the U.S. Postal Service on that same day with postage thereon fully prepaid at Riverside, California, in the ordinary course of business.

 BY PERSONAL SERVICE: I caused to be delivered such envelope(s) by hand to the offices of the addressee(s).

XX **STATE - I declare under penalty of perjury under the laws of the State of California that the above is true and correct.**

 FEDERAL - I declare that I am employed in the office of a member of the bar of this court at whose direction the service was made.

EXECUTED ON May 3, 2011, at Riverside, California.

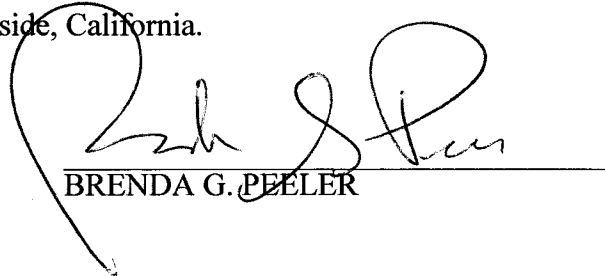

BRENDA G. PEELER

EXHIBIT NO. _____ E¹¹