

**SUBMITTAL TO THE BOARD OF SUPERVISORS  
COUNTY OF RIVERSIDE, STATE OF CALIFORNIA**

507B



**FROM:** County Counsel  
Code Enforcement Department

**SUBMITTAL DATE:**  
January 11, 2012

**SUBJECT:** Statement of Abatement Costs [Case No. CV10-07596]  
Subject Property: 3627 Lindsay Street, Riverside; PLASCENCIA  
APN: 173-050-011  
District Two

**RECOMMENDED MOTION:** Move that the Board of Supervisors:

- (1) assess the reasonable costs of abatement of a public nuisance (accumulated rubbish) in the above-referenced matter to be **one thousand, four hundred fifty-two dollars and eighty cents, (US \$1,452.80)**;
- (2) assess the costs of abatement against the above-described subject property;
- (3) authorize the recordation of a notice of abatement lien;
- (4) authorize the abatement costs to be added to the tax roll as a special assessment; and
- (5) authorize and direct the Code Enforcement Department to take any reasonable actions to collect the amount owed.

PATRICIA MUNROE, Deputy County Counsel  
for PAMELA J. WALLS, County Counsel

|                       |                               |        |                         |     |
|-----------------------|-------------------------------|--------|-------------------------|-----|
| <b>FINANCIAL DATA</b> | Current F.Y. Total Cost:      | \$ N/A | In Current Year Budget: | N/A |
|                       | Current F.Y. Net County Cost: | \$ N/A | Budget Adjustment:      | N/A |
|                       | Annual Net County Cost:       | \$ N/A | For Fiscal Year:        | N/A |

|                         |                                  |                          |
|-------------------------|----------------------------------|--------------------------|
| <b>SOURCE OF FUNDS:</b> | Positions To Be Deleted Per A-30 | <input type="checkbox"/> |
|                         | Requires 4/5 Vote                | <input type="checkbox"/> |

**C.E.O. RECOMMENDATION:** APPROVE

BY:   
Tina Grande

**County Executive Office Signature**

- Consent
- Policy
- Consent
- Policy

**MINUTES OF THE BOARD OF SUPERVISORS**

On motion of Supervisor Stone, seconded by Supervisor Buster and duly carried, IT WAS ORDERED that the above matter is approved as recommended with a revised amount of costs to \$650.00.

Ayes: Buster, Tavaglione, Stone and Benoit  
Nays: None  
Absent: Ashley  
Date: January 24, 2012  
xc: Co. Co., CED, Prop. Owner

Kecia Harper-Ihem  
Clerk of the Board  
By:   
Deputy

**Prev. Agn. Ref.:** | **District: 2** | **Agenda Number:**

9.3

Departmental Concurrence

Dept's Recomm.:  
Per Exec. Ofc.:

Statement of Abatement Costs [Case No. CV10-07596]  
Subject Property: 3627 Lindsay Street, Riverside; PLASCENCIA  
APN: 173-050-011  
District Two  
Page 2

**BACKGROUND:** Government Code § 25845, Riverside County Ordinance Nos. 541 and 725 authorize the recovery of abatement costs in public nuisance cases, the recordation of a notice of abatement lien and inclusion of abatement costs on the tax roll as a special assessment upon approval of the Board of Supervisors.

Multiple Notices of Violation and Administrative Citations were issued. Subsequently, on or about April 14, 2011, the property was brought into compliance.

The Notice of Hearing re Statement of Abatement Costs has been posted on the property and mailed to the property owner and all interested parties, as required by law. Copies of all relevant notices issued in this matter together with proof of service and posting have been separately filed with the Clerk of the Board and are made a part of the record herein, pursuant to Riverside County Ordinance 725.

**SUBMITTAL TO THE BOARD OF SUPERVISORS  
COUNTY OF RIVERSIDE, STATE OF CALIFORNIA**

**FROM:** County Counsel  
Code Enforcement Department  
**SUBJECT:** Statement of Abatement Costs [Case No. CV10-07596]  
Subject Property: 3627 Lindsay Street, Riverside; PLASCENCIA  
APN: 173-050-011  
District Two

**TABLE OF SUPPLEMENTAL DOCUMENTS  
FILED WITH THE CLERK OF THE BOARD**

**Hearing Date: JANUARY 24, 2012**

|   |           |
|---|-----------|
| Notice of Hearing Re: Statement of Abatement Costs (including Proof(s) of Service and Affidavit(s) of Posting . . . . . | Exhibit A |
| Summary Statement of Abatement Costs and Statement of Abatement Costs with Supporting Documents . . . . .               | Exhibit B |
| Assessment-Roll For The Year 10/11 And Geographic Information System, Dec. 21, 2011 .. . . .                            | Exhibit C |
| Lot Book Report.....  | Exhibit D |
| Demand for Payment Statement of Abatement Costs Notice of Special Tax Assessment . . . . .                              | Exhibit E |
| Request for Hearing.....  | Exhibit F |



**CODE ENFORCEMENT DEPARTMENT  
COUNTY OF RIVERSIDE**

Glenn Baude  
Director

December 21, 2011

**NOTICE OF HEARING RE:  
STATEMENT OF ABATEMENT COSTS**

To: Owner(s) or Interested Parties  
(See Attached Proof of Service  
and Notice List)

Subject Property: 3627 Lindsay Street, Riverside  
Case No.: CV10-07596; PLASCENCIA  
APN: 173-050-011

**NOTICE IS HEREBY GIVEN** that a hearing will be held before the Riverside County Board of Supervisors on **Tuesday, January 24, 2012, at 9:30 a.m.** in the Board of Supervisors Room, 4080 Lemon Street, 1st Floor Annex, Riverside, California, at which time and place pertinent testimony will be heard regarding the expenses incurred by the County of Riverside, Code Enforcement Department ("DEPARTMENT") for the above-referenced abatement case. Said abatement case involved accumulated rubbish located on your real property commonly described as 3627 Lindsay Street, Riverside, Riverside County, California and more particularly described as Assessor's Parcel Number 173-050-011.

The total expense due, including all other fees and costs, for the abatement of the above-described dangerous or injurious condition is **one thousand, four hundred fifty-two dollars and eighty cents, (US \$1,452.80)**. This amount is immediately due and payable. If you have any objections to the Statement of Abatement Costs attached hereto, you must address your objections to the Board of Supervisors at the hearing. If you have any questions about the attached Statement of Abatement Costs, please contact Carol Lynn Anderson at (951) 955-2004. In the event the total amount due is not paid to the DEPARTMENT prior to the Board Hearing, the DEPARTMENT shall seek an order from the Board of Supervisors to place a lien against your property and collect the amount due as a special tax assessment.

Failure to appear at the hearing will result in the exclusion of your testimony. Facts as known to the DEPARTMENT will be presented to the Board of Supervisors for their final consideration and deliberation of this matter.

**You are encouraged to contact Code Enforcement Officer, Stacy Baumgartner (951) 955-2004 prior to the hearing. Please meet with Stacy Baumgartner at 8:30 a.m. on the day of the hearing in Conference Room 2A located on the 1st floor in front of the Human Resources Office to discuss the case.**

GLENN BAUDE  
DIRECTOR

  
CAROL LYNN ANDERSON  
Administrative Services Officer  
Enclosure: Statement of Abatement Costs

EXHIBIT NO.   A



# COUNTY OF RIVERSIDE CODE ENFORCEMENT

P.O. Box 1469, Riverside, CA 92502  
Phone: 951-955-2004 Fax: 951-955-8680

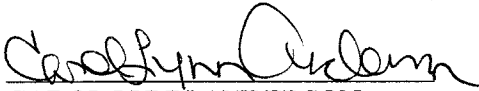
Date: 6/29/2011

|  |
|--|
| Property Reference/Mailing Address                                     |
| 173050011<br>SAUL PLASCENCIA<br>3627 LINDSAY ST<br>RIVERSIDE, CA 92509 |

## Summary Statement of Abatement Costs

You are liable to the County for the following abatement costs:

| Date                 | Invoice Number & Amount                  | Amount | Balance           |
|----------------------|--|--------|-------------------|
| 12/31/2000           | Balance forward                          |        | 0.00              |
| 06/27/2011           | CV1007596-<br>INV #101913.               | 652.80 | 652.80            |
| 10/27/2010           | CV1007596:A28137-<br>INV #A28137. A28137 | 100.00 | 752.80            |
| 01/19/2011           | CV1007596:A28150-<br>INV #A28150. A28150 | 200.00 | 952.80            |
| 02/23/2011           | CV1007596:A40285-<br>INV #A40285. A40285 | 500.00 | 1,452.80          |
| <b>Total Now Due</b> |  |        | <b>\$1,452.80</b> |

The total abatement costs must be paid to the County of Riverside, P.O. Box 1469, Riverside, CA 92502 within thirty (30) days. In the event said costs are not paid within thirty (30) days you will be liable for additional administrative costs, penalties, court fees, or other collection costs incurred in the collection of these abatement costs.

I affirm and declare under penalty of perjury under the laws of the State of California that the foregoing is true and correct to the best of my knowledge.

Code Enforcement Department

EXHIBIT NO.     A2

**County of Riverside  
Code Enforcement Department**

P.O. Box 1469, Riverside, CA 92502  
Phone: (951) 955-2004 Fax: (951) 955-8680



# Statement of Abatement Costs

173050011  
SAUL PLASCENCIA  
3627 LINDSAY ST  
RIVERSIDE, CA 92509

| Date      | Invoice # |
|-----------|-----------|
| 6/27/2011 | 101913    |

|  |
|--|
| Property Address   |
| 173050011<br>SAUL PLASCENCIA<br>3627 LINDSAY ST<br>RIVERSIDE, CA 92509 |

| Case Number | District | Class |
|-------------|----------|-------|
| CV1007596   | 2        | SOAC  |

**You are liable to the County for the following abatement costs:**

| Date            | Item                       | Description                     | Hours/Qty | Rate   | Amount          |
|-----------------|----------------------------|---------------------------------|-----------|--------|-----------------|
| 9/13/2010       | Officer Hours              | Labor Charges - Officer Time    | 0.5       | 109.00 | 54.50           |
| 10/27/2010      | Officer Hours              | Labor Charges - Officer Time    | 0.6       | 109.00 | 65.40           |
| 1/19/2011       | Officer Hours              | Labor Charges - Officer Time    | 0.5       | 109.00 | 54.50           |
| 2/23/2011       | Officer Hours              | Labor Charges - Officer Time    | 0.5       | 109.00 | 54.50           |
| 4/13/2011       | Officer Hours              | Labor Charges - Officer Time    | 0.4       | 109.00 | 43.60           |
| 6/27/2011       | SOE Preparation            | Prepare Statement of Expense    |           | 65.00  | 65.00           |
|                 |                            | Subtotal Code Enforcement Costs |           |        | 337.50          |
| 6/27/2011       | Prepare Case for SOE He... |                                 |           | 125.55 | 125.55          |
|                 | Attend SOE Hearing         |                                 |           | 69.75  | 69.75           |
|                 |                            | Subtotal County Counsel Costs   |           |        | 195.30          |
| 6/27/2011       | Lot Book Report            |                                 |           | 120.00 | 120.00          |
|                 |                            | Subtotal Contractor Costs       |           |        | 120.00          |
| <b>Subtotal</b> |                            |                                 |           |        | <b>\$652.80</b> |

The total abatement costs must be paid to the County of Riverside, P.O. Box 1469, Riverside, CA 92502 within thirty (30) days. In the event said costs are not paid within thirty (30) days you will be liable for additional administrative costs, penalties, court fees or other collection costs incurred in the collection of these abatement costs.

|                         |                 |
|-------------------------|-----------------|
| <b>Payments/Credits</b> | \$0.00          |
| <b>Total Now Due</b>    | <b>\$652.80</b> |

I affirm and declare under penalty of perjury under the laws of the State of California that the foregoing is true and correct to the best of my knowledge.

Walt  
Code Enforcement Department

EXHIBIT NO. A3



# County of Riverside Code Enforcement Department

P.O. Box 1469, Riverside, CA 92502  
Phone: (951) 955-2004 Fax: (951) 955-8680  
demands@rctlma.org

## Administrative Citation

173050011  
SAUL PLASCENCIA  
3627 LINDSAY ST  
RIVERSIDE, CA 92509

|                     |              |
|---------------------|--------------|
| Citation Issue Date | Billing Date |
| 10/27/2010          | 6/27/2011    |

|  |
|--|
| Property Address   |
| 173050011<br>SAUL PLASCENCIA<br>3627 LINDSAY ST<br>RIVERSIDE, CA 92509 |

| Citation Number | District | Class |
|-----------------|----------|-------|
| A28137          | 2        | SOAC  |

| Item                     | Description      | Hours/Qty | Rate                    | Amount   |
|--------------------------|------------------|-----------|-------------------------|----------|
| Administrative Citations | CV1007596:A28137 | 1         | 100.00                  | 100.00   |
|                          |                  |           | <b>Subtotal</b>         | \$100.00 |
|                          |                  |           | <b>Payments/Credits</b> | \$0.00   |
|                          |                  |           | <b>Total</b>            | \$100.00 |

EXHIBIT NO. AA

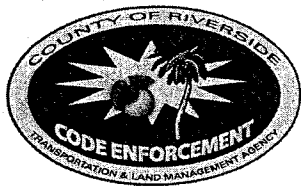

# County of Riverside Code Enforcement Department

P.O. Box 1469, Riverside, CA 92502  
Phone: (951) 955-2004 Fax: (951) 955-8680  
demands@rctlma.org

## Administrative Citation

173050011  
SAUL PLASCENCIA  
3627 LINDSAY ST  
RIVERSIDE, CA 92509

|                     |              |
|---------------------|--------------|
| Citation Issue Date | Billing Date |
| 1/19/2011           | 6/27/2011    |

|  |
|--|
| Property Address   |
| 173050011<br>SAUL PLASCENCIA<br>3627 LINDSAY ST<br>RIVERSIDE, CA 92509 |

|                 |          |       |
|-----------------|----------|-------|
| Citation Number | District | Class |
| A28150          | 2        | SOAC  |

| Item                     | Description      | Hours/Qty | Rate                    | Amount   |
|--------------------------|------------------|-----------|-------------------------|----------|
| Administrative Citations | CV1007596:A28150 | 1         | 200.00                  | 200.00   |
|                          |                  |           | <b>Subtotal</b>         | \$200.00 |
|                          |                  |           | <b>Payments/Credits</b> | \$0.00   |
|                          |                  |           | <b>Total</b>            | \$200.00 |

EXHIBIT NO. \_\_\_\_\_

AS





# County of Riverside Code Enforcement Department

P.O. Box 1469, Riverside, CA 92502  
Phone: (951) 955-2004 Fax: (951) 955-8680  
demands@rctlma.org

## Administrative Citation

173050011  
SAUL PLASCENCIA  
3627 LINDSAY ST  
RIVERSIDE, CA 92509

|                     |              |
|---------------------|--------------|
| Citation Issue Date | Billing Date |
| 2/23/2011           | 6/27/2011    |

| Citation Number | District | Class |
|-----------------|----------|-------|
| A40285          | 2        | SOAC  |

|  |
|--|
| Property Address   |
| 173050011<br>SAUL PLASCENCIA<br>3627 LINDSAY ST<br>RIVERSIDE, CA 92509 |

| Item                     | Description      | Hours/Qty | Rate   | Amount |
|--------------------------|------------------|-----------|--------|--------|
| Administrative Citations | CV1007596:A40285 | 1         | 500.00 | 500.00 |

|                         |          |
|-------------------------|----------|
| <b>Subtotal</b>         | \$500.00 |
| <b>Payments/Credits</b> | \$0.00   |
| <b>Total</b>            | \$500.00 |

EXHIBIT NO. *AP*

# NOTICE LIST

Subject Property: 3627 Lindsay Street, Riverside; Case No.: CV10-07596  
APN: 173-050-011; District Two

SAUL PLASCENCIA  
3627 LINDSAY STREET  
RIVERSIDE CA 92509

NEW CENTURY MORT CORP  
18400 VON KARMAN  
SUITE 1000  
IRVINE CA 92612

EXHIBIT NO.           A7

1 **PROOF OF SERVICE**

2 Case No. CV10-07596

3 STATE OF CALIFORNIA, COUNTY OF RIVERSIDE

4 I, Brenda G. Peeler, declare that I am a citizen of the United States and am employed in the County  
5 of Riverside, over the age of 18 years and not a party to the within action or proceeding; that my  
6 business address is 3960 Orange Street, Suite 500, Riverside, California 92501.

7 That on December 21, 2011, I served the following document(s):

- 8 - **NOTICE OF HEARING RE: STATEMENT OF ABATEMENT COSTS**
- 9 - **SUMMARY STATEMENT OF ABATEMENT COSTS**
- 10 - **STATEMENT OF ABATEMENT COSTS**
- 11 - **ADMINISTRATIVE CITATION(S)**
- 12 - **NOTICE LIST**

13 by placing a true copy thereof enclosed in a sealed envelope(s) addressed as follows:

14 **OWNERS OR INTERESTED PARTIES**  
15 **(SEE NOTICE LIST ATTACHED TO NOTICE OF HEARING)**

16 XX **BY FIRST CLASS MAIL.** I am "readily familiar" with the office's practice of collection  
17 and processing correspondence for mailing. Under that practice it would be deposited with  
18 the U.S. Postal Service on that same day with postage thereon fully prepaid at Riverside,  
19 California, in the ordinary course of business.

20      **BY PERSONAL SERVICE:** I caused to be delivered such envelope(s) by hand to the offices  
21 of the addressee(s).

22 XX **STATE - I declare under penalty of perjury under the laws of the State of California that the**  
23 **above is true and correct.**

24      **FEDERAL - I declare that I am employed in the office of a member of the bar of this court at**  
25 **whose direction the service was made.**

26 EXECUTED ON December 21, 2011, at Riverside, California.

27   
28 \_\_\_\_\_  
BRENDA G. PEELER

EXHIBIT NO.     AS



**CODE ENFORCEMENT DEPARTMENT  
COUNTY OF RIVERSIDE**

GLENN BAUDE  
Director

**AFFIDAVIT OF POSTING OF NOTICES**

December 23, 2011

RE CASE NO: CV10-07596

I, Carol Lucero, hereby declare:

I am employed by the Riverside County Code Enforcement Department; that my business address is 5317 Mission Blvd, Riverside, California 92509.

That on 12/22/11 at 10:02am, I securely and conspicuously posted NOTICE OF HEARING RE: STATEMENT OF ABATEMENT COSTS at the property described as:

**Property Address:** 3627 LINDSAY ST, GLEN AVON

**Assessor's Parcel Number:** 173-050-011

I declare under the penalty of perjury that the foregoing is true and correct.

Executed on December 23, 2011 in the County of Riverside, California.

CODE ENFORCEMENT DEPARTMENT

Carol Lucero  
By: Carol Lucero, Code Enforcement Technician

EXHIBIT NO. 19



# COUNTY OF RIVERSIDE CODE ENFORCEMENT

P.O. Box 1469, Riverside, CA 92502  
Phone: 951-955-2004 Fax: 951-955-8680

Date: 6/29/2011

|  |
|--|
| Property Reference/Mailing Address                                     |
| 173050011<br>SAUL PLASCENCIA<br>3627 LINDSAY ST<br>RIVERSIDE, CA 92509 |

## Summary Statement of Abatement Costs

**You are liable to the County for the following abatement costs:**

| Date                 | Invoice Number & Amount                  | Amount | Balance           |
|----------------------|--|--------|-------------------|
| 12/31/2000           | Balance forward                          |        | 0.00              |
| 06/27/2011           | CV1007596-<br>INV #101913.               | 652.80 | 652.80            |
| 10/27/2010           | CV1007596:A28137-<br>INV #A28137. A28137 | 100.00 | 752.80            |
| 01/19/2011           | CV1007596:A28150-<br>INV #A28150. A28150 | 200.00 | 952.80            |
| 02/23/2011           | CV1007596:A40285-<br>INV #A40285. A40285 | 500.00 | 1,452.80          |
| <b>Total Now Due</b> |  |        | <b>\$1,452.80</b> |

The total abatement costs must be paid to the County of Riverside, P.O. Box 1469, Riverside, CA 92502 within thirty (30) days. In the event said costs are not paid within thirty (30) days you will be liable for additional administrative costs, penalties, court fees, or other collection costs incurred in the collection of these abatement costs.

I affirm and declare under penalty of perjury under the laws of the State of California that the foregoing is true and correct to the best of my knowledge.

Code Enforcement Department

EXHIBIT NO.     B

**County of Riverside  
Code Enforcement Department**

P.O. Box 1469, Riverside, CA 92502  
Phone: (951) 955-2004 Fax: (951) 955-8680

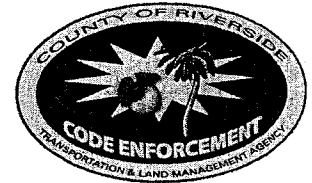

# Statement of Abatement Costs

173050011  
SAUL PLASCENCIA  
3627 LINDSAY ST  
RIVERSIDE, CA 92509

| Date      | Invoice # |
|-----------|-----------|
| 6/27/2011 | 101913    |

| Case Number | District | Class |
|-------------|----------|-------|
| CV1007596   | 2        | SOAC  |

|  |
|--|
| <b>Property Address</b>  |
| 173050011<br>SAUL PLASCENCIA<br>3627 LINDSAY ST<br>RIVERSIDE, CA 92509 |

**You are liable to the County for the following abatement costs:**

| Date       | Item                       | Description                     | Hours/Qty | Rate            | Amount          |
|------------|----------------------------|---------------------------------|-----------|-----------------|-----------------|
| 9/13/2010  | Officer Hours              | Labor Charges - Officer Time    | 0.5       | 109.00          | 54.50           |
| 10/27/2010 | Officer Hours              | Labor Charges - Officer Time    | 0.6       | 109.00          | 65.40           |
| 1/19/2011  | Officer Hours              | Labor Charges - Officer Time    | 0.5       | 109.00          | 54.50           |
| 2/23/2011  | Officer Hours              | Labor Charges - Officer Time    | 0.5       | 109.00          | 54.50           |
| 4/13/2011  | Officer Hours              | Labor Charges - Officer Time    | 0.4       | 109.00          | 43.60           |
| 6/27/2011  | SOE Preparation            | Prepare Statement of Expense    |           | 65.00           | 65.00           |
|            |                            | Subtotal Code Enforcement Costs |           |                 | 337.50          |
| 6/27/2011  | Prepare Case for SOE He... |                                 |           | 125.55          | 125.55          |
|            | Attend SOE Hearing         |                                 |           | 69.75           | 69.75           |
|            |                            | Subtotal County Counsel Costs   |           |                 | 195.30          |
| 6/27/2011  | Lot Book Report            |                                 |           | 120.00          | 120.00          |
|            |                            | Subtotal Contractor Costs       |           |                 | 120.00          |
|            |                            |                                 |           | <b>Subtotal</b> | <b>\$652.80</b> |

The total abatement costs must be paid to the County of Riverside, P.O. Box 1469, Riverside, CA 92502 within thirty (30) days. In the event said costs are not paid within thirty (30) days you will be liable for additional administrative costs, penalties, court fees or other collection costs incurred in the collection of these abatement costs.

|                         |                 |
|-------------------------|-----------------|
| <b>Payments/Credits</b> | \$0.00          |
| <b>Total Now Due</b>    | <b>\$652.80</b> |

I affirm and declare under penalty of perjury under the laws of the State of California that the foregoing is true and correct to the best of my knowledge.

*Wade*

Code Enforcement Department

EXHIBIT NO. B<sup>2</sup>

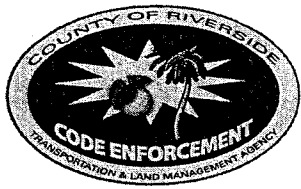

# County of Riverside Code Enforcement Department

P.O. Box 1469, Riverside, CA 92502  
Phone: (951) 955-2004 Fax: (951) 955-8680  
demands@rctlma.org

## Administrative Citation

173050011  
SAUL PLASCENCIA  
3627 LINDSAY ST  
RIVERSIDE, CA 92509

|                     |              |
|---------------------|--------------|
| Citation Issue Date | Billing Date |
| 10/27/2010          | 6/27/2011    |

|  |
|--|
| Property Address   |
| 173050011<br>SAUL PLASCENCIA<br>3627 LINDSAY ST<br>RIVERSIDE, CA 92509 |

| Citation Number | District | Class |
|-----------------|----------|-------|
| A28137          | 2        | SOAC  |

| Item                     | Description      | Hours/Qty | Rate                    | Amount   |
|--------------------------|------------------|-----------|-------------------------|----------|
| Administrative Citations | CV1007596:A28137 | 1         | 100.00                  | 100.00   |
|                          |                  |           | <b>Subtotal</b>         | \$100.00 |
|                          |                  |           | <b>Payments/Credits</b> | \$0.00   |
|                          |                  |           | <b>Total</b>            | \$100.00 |

EXHIBIT NO.     B<sup>3</sup>



# County of Riverside Code Enforcement Department

P.O. Box 1469, Riverside, CA 92502  
Phone: (951) 955-2004 Fax: (951) 955-8680  
demands@rctlma.org

## Administrative Citation

173050011  
SAUL PLASCENCIA  
3627 LINDSAY ST  
RIVERSIDE, CA 92509

|                     |              |
|---------------------|--------------|
| Citation Issue Date | Billing Date |
| 1/19/2011           | 6/27/2011    |

| Citation Number | District | Class |
|-----------------|----------|-------|
| A28150          | 2        | SOAC  |

|  |
|--|
| Property Address   |
| 173050011<br>SAUL PLASCENCIA<br>3627 LINDSAY ST<br>RIVERSIDE, CA 92509 |

| Item                     | Description      | Hours/Qty | Rate                    | Amount   |
|--------------------------|------------------|-----------|-------------------------|----------|
| Administrative Citations | CV1007596:A28150 | 1         | 200.00                  | 200.00   |
|                          |                  |           | <b>Subtotal</b>         | \$200.00 |
|                          |                  |           | <b>Payments/Credits</b> | \$0.00   |
|                          |                  |           | <b>Total</b>            | \$200.00 |

EXHIBIT NO.     B





# County of Riverside Code Enforcement Department

P.O. Box 1469, Riverside, CA 92502  
Phone: (951) 955-2004 Fax: (951) 955-8680  
demands@rctlma.org

## Administrative Citation

173050011  
SAUL PLASCENCIA  
3627 LINDSAY ST  
RIVERSIDE, CA 92509

|                     |              |
|---------------------|--------------|
| Citation Issue Date | Billing Date |
| 2/23/2011           | 6/27/2011    |

|  |
|--|
| Property Address   |
| 173050011<br>SAUL PLASCENCIA<br>3627 LINDSAY ST<br>RIVERSIDE, CA 92509 |

| Citation Number | District | Class |
|-----------------|----------|-------|
| A40285          | 2        | SOAC  |

| Item                     | Description      | Hours/Qty | Rate                    | Amount   |
|--------------------------|------------------|-----------|-------------------------|----------|
| Administrative Citations | CV1007596:A40285 | 1         | 500.00                  | 500.00   |
|                          |                  |           | <b>Subtotal</b>         | \$500.00 |
|                          |                  |           | <b>Payments/Credits</b> | \$0.00   |
|                          |                  |           | <b>Total</b>            | \$500.00 |

EXHIBIT NO.       B<sup>5</sup>



Home

- New Search
- Payments & Refunds
- Citation Changes
- Adjudication
- Receipt
- Add Note
- Hot Sheet
- Reports

Found Citations:  
A28137  Submit

| General Information  |                        |                |  |
|--|------------------------|----------------|--|
| Citation: A28137   | Date: 10/27/10         | Time: 01:35 PM |  |
| Amnt Owing this Citation: \$100.00                         | This Person: \$100.00  | This Plate:    |  |
| Issuing Agency: RE-Riverside County Code Enforcement Dept. | Dept: Code Enforcement |                |  |
| Status: OPEN: Noticed                                      |                        |                |  |
| Number: 1 of 1   |                        |                |  |
| Responsible Party Information                              |                        |                |  |
| Name: PLASCENCIA, SAUL                                     |                        |                |  |
| Address: 6556 ARLINGTON AVE APT 6A                         |                        |                |  |
| City/State/Zip: RIVERSIDE, CA 92504                        |                        |                |  |

Show all Panels | Hide all Panels

| Citation Information                         |                 |             |  |
|--|-----------------|-------------|--|
| Location: 3627 LINDSAY ST RIVERSIDE CA 92509 | Case: CV1007596 | Badge #: 27 |  |
| Comments:                                    |                 |             |  |

| Violation Information |                   |          |
|-----------------------|-------------------|----------|
| Code                  | Description       | Amount   |
| 81.20.010             | REMOVE ALL RUBISH | \$100.00 |

- Fee History
- Payment History
- Notice History
- Appeal History
- Responsible Party History

| Citation History |                           |             |  |        |
|------------------|---------------------------|-------------|--|--------|
| Date             | Transaction               | Rep Name    | Description                                    | W.O.   |
| 11/16/2010       | New Citation Added        | N Soriano   | .  | 619828 |
| 11/16/2010       | Citation Data Entered     | E Johnson   | .  | 619828 |
| 11/16/2010       | Responsible party entered | N Soriano   | .  | 619828 |
| 11/29/2010       | Notice sent               | T FEES      | Inserted during Extract Commit                 | 623441 |
| 12/30/2010       | Notice sent               | T FEES      | Inserted during Extract Commit                 | 630693 |
| 1/6/2011         | Address Changed           | L Hernandez | New address entered                            | 632045 |
| 2/3/2011         | FTB Notice sent           | T FEES      | Inserted during Extract Commit for FTB Notice  | 638803 |
| 3/29/2011        | SSN Requested             | T FEES      | Inserted during Extract Commit for SSN REQUEST | 652068 |
| 3/29/2011        | SSN Miss                  | H Akolawala | SSN NO HIT                                     | 652320 |

[Home](#) | [Log Out](#) | [Help](#)

EXHIBIT NO. B6

Home

- New Search
- Payments & Refunds
- Citation Changes
- Adjudication
- Receipt
- Add Note
- Hot Sheet
- Reports

Found Citations:  
A28150  Submit

| General Information  |                        |                |  |
|--|------------------------|----------------|--|
| Citation: A28150   | Date: 01/19/11         | Time: 01:40 PM |  |
| Amt Owing this Citation: \$200.00                          | This Person: \$200.00  | This Plate:    |  |
| Issuing Agency: RE-Riverside County Code Enforcement Dept. | Dept: Code Enforcement |                |  |
| Status: OPEN: Noticed                                      | Number: 1 of 1         |                |  |
| Responsible Party Information                              |                        |                |  |
| Name: PLASCENSIA SAUL                                      |                        |                |  |
| Address: 65558 ARLINGTON AVE APT 6A                        |                        |                |  |
| City/State/Zip: RIVERSIDE, CA 92504                        |                        |                |  |

Show all Panels | Hide all Panels

**Citation Information**

|  |                 |             |
|--|-----------------|-------------|
| Location: 3627 LINDSAY ST RIVERSIDE CA 92509 | Case: CV1007596 | Badge #: 27 |
| Comments:                                    |                 |             |

**Violation Information**

| Code      | Description        | Amount   |
|-----------|--------------------|----------|
| 81.20.010 | REMOVE ALL RUBBISH | \$200.00 |

- Fee History
- Payment History
- Notice History
- Appeal History
- Responsible Party History
- Citation History

| Date      | Transaction               | Rep Name   | Description                                   | W.O.   |
|-----------|---------------------------|------------|---|--------|
| 2/10/2011 | New Citation Added        | H Espinosa | .   | 639043 |
| 2/10/2011 | Citation Data Entered     | S Choi     | .   | 639043 |
| 2/10/2011 | Responsible party entered | H Espinosa | .   | 639043 |
| 2/21/2011 | Notice sent               | T FEES     | Inserted during Extract Commit                | 643118 |
| 3/24/2011 | Notice sent               | T FEES     | Inserted during Extract Commit                | 651025 |
| 3/29/2011 | Address Changed           | P Ayala    | New address entered                           | 652064 |
| 4/28/2011 | FTB Notice sent           | T FEES     | Inserted during Extract Commit for FTB Notice | 659410 |

Home | Log Out | Help

EXHIBIT NO.       B7

Home

- New Search
- Payments & Refunds
- Citation Changes
- Adjudication
- Receipt
- Add Note
- Hot Sheet
- Reports

Found Citations:  
 A40285  Submit

| General Information  |                        |                |
|--|------------------------|----------------|
| Citation: A40285   | Date: 02/23/11         | Time: 01:00 PM |
| Amt Owing this Citation: \$500.00                          | This Person: \$500.00  | This Plate:    |
| Issuing Agency: RE-Riverside County Code Enforcement Dept. | Dept: Code Enforcement |                |
| Status: OPEN: Noticed                                      |                        |                |
| Number: 1 of 1   |                        |                |
| Responsible Party Information                              |                        |                |
| Name: PLASCENSIA, SAUL                                     |                        |                |
| Address: 3627 LINDSAY ST                                   |                        |                |
| City/State/Zip: RIVERSIDE, CA 92509                        |                        |                |

Show all Panels | Hide all Panels

| Citation Information      |                 |             |
|---------------------------|-----------------|-------------|
| Location: 3627 LINDSAY ST | Case: CV1007596 | Badge #: 27 |
| Comments: APN 173 050 011 |                 |             |

| Violation Information |                     |          |
|-----------------------|---------------------|----------|
| Code                  | Description         | Amount   |
| 81.20.010             | ACCUMULATED RUBBISH | \$500.00 |

- Fee History
- Payment History
- Notice History
- Appeal History
- Responsible Party History

| Citation History |                           |            |   |        |
|------------------|---------------------------|------------|---|--------|
| Date             | Transaction               | Rep Name   | Description                                   | W.O.   |
| 3/31/2011        | New Citation Added        | J Williams | .   | 652132 |
| 3/31/2011        | Citation Data Entered     | S Choi     | .   | 652132 |
| 3/31/2011        | Responsible party entered | J Williams | .   | 652132 |
| 4/4/2011         | Notice sent               | T FEES     | Inserted during Extract Commit                | 653346 |
| 5/5/2011         | Notice sent               | T FEES     | Inserted during Extract Commit                | 661079 |
| 6/9/2011         | FTB Notice sent           | T FEES     | Inserted during Extract Commit for FTB Notice | 669296 |

Home | Log Out | Help

EXHIBIT NO.           

38



# INVOICE

|                     |                       |
|---------------------|-----------------------|
| Order Number: 25960 | Order Date: 9/21/2011 |
|---------------------|-----------------------|

**Customer Information:**

Acct No. 1044

RIVERSIDE COUNTY TLMA-CODE INFORCEMENT  
4080 Lemon Street  
Riverside, CA 92501

Attn: Brent Steele  
REF: CV10-07596/Ericka Edwards  
IN RE: PLASCENCIA, SAUL

|   |                 |
|---|-----------------|
| Product and/or Service ordered for Property known as:<br><br><b>3627 Lindsay Street</b><br><b>Riverside, CA 92509</b> |                 |
| <b>DESCRIPTION:</b>   | <b>FEE:</b>     |
| Lot Book Report   | \$120.00        |
| <b>TOTAL DUE:</b>   | <b>\$120.00</b> |

**Payment due upon receipt. Please remit to:**

RZ Title Services, Inc.  
P.O. Box 1193  
Whittier, CA 90609

DEBIT NO. \_\_\_\_\_

*B9*

Assessment Roll For the 2011-2012 Tax Year as of January 1,2011

| Assessment #173050011-8        |  | Parcel # 173050011-8         |         |
|--------------------------------|--|------------------------------|---------|
| <b>Assessee:</b>               | PLASCENCIA SAUL                              | <b>Land</b>                  | 35,985  |
| <b>Mail Address:</b>           | 3627 LINDSAY ST<br>RIVERSIDE CA 92509        | <b>Structure</b>             | 152,952 |
| <b>Real Property Use Code:</b> | R1   | <b>Full Value</b>            | 188,937 |
| <b>Base Year</b>               | 2001   | <b>Homeowners' Exemption</b> | 7,000   |
| <b>Conveyance Number:</b>      | 0137403                                      | <b>Total Net</b>             | 181,937 |
| <b>Conveyance (mm/yy):</b>     | 4/2000                                       |                              |         |
| <b>PUI:</b>                    | R010010                                      |                              |         |
| <b>TRA:</b>                    | 99-098                                       |                              |         |
| <b>Taxability Code:</b>        | 0-00   |                              |         |
| <b>ID Data:</b>                | Lot 14 MB 010/100 RESUB<br>GLEN AVON HEIGHTS |                              |         |
| <b>Situs Address:</b>          | 3627 LINDSAY ST<br>RIVERSIDE CA 92509        |                              |         |



EXHIBIT INC.

RIVERSIDE COUNTY GIS

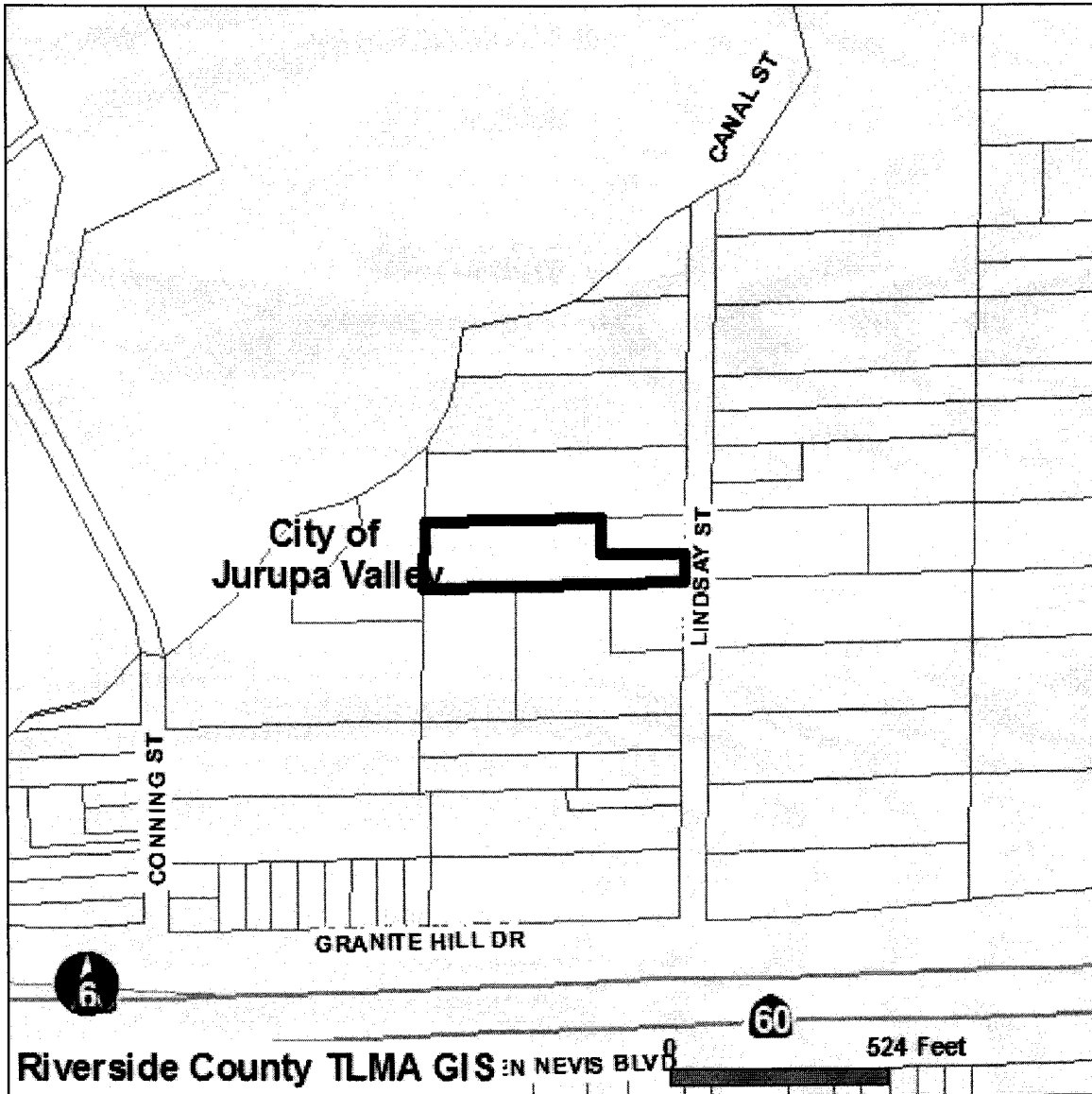

**Selected parcel(s):**  
173-050-011

**\*IMPORTANT\***

Maps and data are to be used for reference purposes only. Map features are approximate, and are not necessarily accurate to surveying or engineering standards. The County of Riverside makes no warranty or guarantee as to the content (the source is often third party), accuracy, timeliness, or completeness of any of the data provided, and assumes no legal responsibility for the information contained on this map. Any use of this product with respect to accuracy and precision shall be the sole responsibility of the user.

**STANDARD REPORT**

**APNs**

173-050-011-8

**OWNER NAME / ADDRESS**

SAUL PLASCENCIA  
3627 LINDSAY ST  
RIVERSIDE, CA. 92509

**MAILING ADDRESS**

(SEE OWNER)  
(SEE SITUS)

**LEGAL DESCRIPTION**

EXHIBIT NO. \_\_\_\_\_

C<sup>2</sup>

RECORDED BOOK/PAGE: MB 10/100  
SUBDIVISION NAME: RESUB GLEN AVON HEIGHTS  
LOT/PARCEL: 14, BLOCK: NOT AVAILABLE  
, Por. TRACT NUMBER: NOT AVAILABLE

**LOT SIZE**

RECORDED LOT SIZE IS 2.07 ACRES

**PROPERTY CHARACTERISTICS**

WOOD FRAME, 1362 SQFT., 3 BDRM/ 1 BATH, 1 STORY, CONST'D 1920 COMPOSITION, ROOF, POOL

**THOMAS BROS. MAPS PAGE/GRID**

PAGE: 644 GRID: B6

**CITY BOUNDARY/SPHERE**

CITY OF JURUPA VALLEY  
NOT WITHIN A CITY SPHERE  
ANNEXATION DATE: NOT APPLICABLE  
LAFCO CASE #: NOT APPLICABLE  
PROPOSALS: NOT APPLICABLE

**MARCH JOINT POWERS AUTHORITY**

NOT IN THE JURISDICTION OF THE MARCH JOINT POWERS AUTHORITY

**INDIAN TRIBAL LAND**

NOT IN A TRIBAL LAND

**SUPERVISORIAL DISTRICT 2011 (ORD. 813)**

JOHN TAVAGLIONE, DISTRICT 2

**SUPERVISORIAL DISTRICT (2001 BOUNDARIES)**

JOHN TAVAGLIONE, DISTRICT 2

**TOWNSHIP/RANGE**

T2SR6W SEC 3

**ELEVATION RANGE**

792/812 FEET

**PREVIOUS APN**

072-901-128

---

***PLANNING***

---

**LAND USE DESIGNATIONS**

Consult with the city for land use information.

**SANTA ROSA ESCARPMENT BOUNDARY**

NOT IN THE SANTA ROSA ESCARPMENT BOUNDARY

**AREA PLAN (RCIP)**

JURUPA

**GENERAL PLAN POLICY OVERLAYS**

NOT IN A GENERAL PLAN POLICY OVERLAY AREA

**GENERAL PLAN POLICY AREAS**

PROTECTED EQUESTRIAN SPHERE POLICY AREA

**ZONING CLASSIFICATIONS (ORD. 348)**

See the city for more information

**ZONING DISTRICTS AND ZONING AREAS**

GLEN AVON DISTRICT

**ZONING OVERLAYS**

NOT IN A ZONING OVERLAY

**HISTORIC PRESERVATION DISTRICTS**

NOT IN AN HISTORIC PRESERVATION DISTRICT

**SPECIFIC PLANS**

NOT WITHIN A SPECIFIC PLAN

**AGRICULTURAL PRESERVE**



NOT IN AN AGRICULTURAL PRESERVE

**REDEVELOPMENT AREAS**

PROJECT AREA NAME: JVPA  
SUBAREA NAME: JURUPA VALLEY AMENDMENT AREA  
AMENDMENT NUMBER: 0  
ADOPTION DATE: JUL. 9, 1996  
ACREAGE: 10692 ACRES

**AIRPORT INFLUENCE AREAS**

NOT IN AN AIRPORT INFLUENCE AREA

**AIRPORT COMPATIBILITY ZONES**

NOT IN AN AIRPORT COMPATIBILITY ZONE

***ENVIRONMENTAL***

**CVMSHCP (COACHELLA VALLEY MULTI-SPECIES HABITAT CONSERVATION PLAN) CONSERVATION AREA**

NOT IN A CONSERVATION AREA

**CVMSHCP FLUVIAL SAND TRANSPORT SPECIAL PROVISION AREAS**

NOT IN A FLUVIAL SAND TRANSPORT SPECIAL PROVISION AREA

**WRMSHCP (WESTERN RIVERSIDE COUNTY MULTI-SPECIES HABITAT CONSERVATION PLAN) CELL GROUP**

B

**WRMSHCP CELL NUMBER**

42

**HANS/ERP (HABITAT ACQUISITION AND NEGOTIATION STRATEGY/EXPEDITED REVIEW PROCESS)**

NONE

**VEGETATION (2005)**

DEVELOPED/DISTURBED LAND  
GRASSLAND

***FIRE***

**HIGH FIRE AREA (ORD. 787)**

NOT IN A HIGH FIRE AREA

**FIRE RESPONSIBILITY AREA**

STATE RESPONSIBILITY AREA

***DEVELOPMENT FEES***

**CVMSHCP FEE AREA (ORD. 875)**

NOT WITHIN THE COACHELLA VALLEY MSHCP FEE AREA

**WRMSHCP FEE AREA (ORD. 810)**

IN OR PARTIALLY WITHIN THE WESTERN RIVERSIDE MSHCP FEE AREA. SEE MAP FOR MORE INFORMATION.

**ROAD & BRIDGE DISTRICT**

NOT IN A DISTRICT

**EASTERN TUMF (TRANSPORTATION UNIFORM MITIGATION FEE ORD. 673)**

NOT WITHIN THE EASTERN TUMF FEE AREA

**WESTERN TUMF (TRANSPORTATION UNIFORM MITIGATION FEE ORD. 824)**

IN OR PARTIALLY WITHIN A TUMF FEE AREA. SEE MAP FOR MORE INFORMATION. NORTHWEST

**DIF (DEVELOPMENT IMPACT FEE AREA ORD. 659)**

JURUPA

**SKR FEE AREA (STEPHEN'S KANGAROO RAT ORD. 663.10)**

NOT WITHIN AN SKR FEE AREA.

**DEVELOPMENT AGREEMENTS**

NOT IN A DEVELOPMENT AGREEMENT AREA

**CIRCULATION ELEMENT ULTIMATE RIGHT-OF-WAY**

NOT IN A CIRCULATION ELEMENT RIGHT-OF-WAY

**ROAD BOOK PAGE**

3

**TRANSPORTATION AGREEMENTS**

NOT IN A TRANSPORTATION AGREEMENT

**CETAP (COMMUNITY AND ENVIRONMENTAL TRANSPORTATION ACCEPTABILITY PROCESS) CORRIDORS**

NOT IN A CETAP CORRIDOR.

---

**HYDROLOGY**

---

**FLOOD PLAIN REVIEW**

NOT REQUIRED

**WATER DISTRICT**

WMWD

**FLOOD CONTROL DISTRICT**

RIVERSIDE COUNTY FLOOD CONTROL DISTRICT

**WATERSHED**

SANTA ANA RIVER

---

**GEOLOGIC**

---

**FAULT ZONE**

NOT IN A FAULT ZONE

**FAULTS**

NOT WITHIN A 1/2 MILE OF A FAULT

**LIQUEFACTION POTENTIAL**

LOW

**SUBSIDENCE**

SUSCEPTIBLE

**PALEONTOLOGICAL SENSITIVITY**

HIGH SENSITIVITY (HIGH A).

BASED ON GEOLOGIC FORMATIONS OR MAPPABLE ROCK UNITS THAT ARE ROCKS THAT CONTAIN FOSSILIZED BODY ELEMENTS, AND TRACE FOSSILS SUCH AS TRACKS, NESTS AND EGGS. THESE FOSSILS OCCUR ON OR BELOW THE SURFACE.

LOW POTENTIAL.

FOLLOWING A LITERATURE SEARCH, RECORDS CHECK AND A FIELD SURVEY, AREAS MAY BE DETERMINED BY A QUALIFIED VERTEBRATE PALEONTOLOGIST AS HAVING LOW POTENTIAL FOR CONTAINING SIGNIFICANT PALEONTOLOGICAL RESOURCES SUBJECT TO ADVERSE IMPACTS.

---

**MISCELLANEOUS**

---

**SCHOOL DISTRICT**

JURUPA UNIFIED

**COMMUNITIES**

GLEN AVON

**COUNTY SERVICE AREA**

NOT IN A COUNTY SERVICE AREA.

**LIGHTING (ORD. 655)**

NOT APPLICABLE, 58.62 MILES FROM MT. PALOMAR OBSERVATORY

**2000 CENSUS TRACT**

040502

**FARMLAND**

OTHER LANDS

URBAN-BUILT UP LAND

099098

- COUNTY FREE LIBRARY
- COUNTY STRUCTURE FIRE PROTECTION
- COUNTY WASTE RESOURCE MGMT DIST
- CSA 152
- ERAF RDV
- FLOOD CONTROL ADMINISTRATION
- FLOOD CONTROL ZN 1
- FLOOD CONTROL ZONE 1
- GENERAL
- GENERAL PURPOSE
- INLAND EMPIRE JT(33,36)RES.
- JURUPA AREA REC & PARK
- JURUPA COMMUNITY SERVICES
- JURUPA CSD #1
- JURUPA UNIFIED SCHOOL
- JURUPA UNION JT-COMP UNIF
- JURUPA VALLEY RDV AMEND AB1290
- METRO WATER WEST
- N.W. MOSQUITO & VECTOR CONT DIST
- RIV CO REG PARK & OPEN SPACE
- RIV. CO. OFFICE OF EDUCATION
- RIVERSIDE CITY COMMUNITY COLLEGE
- WESTERN MUNICIPAL WATER

**SPECIAL NOTES**

Mira Loma Warehouse/Distribution Center policy area PLEASE CONTACT THE PLANNING DEPARTMENT AT 951-955-3200.

**CODE COMPLAINTS**

| Case #             | Description    | Start Date     |
|--------------------|----------------|----------------|
| NO CODE COMPLAINTS | NOT APPLICABLE | NOT APPLICABLE |

REPORT PRINTED ON...Wed Dec 21 12:29:32 2011  
Version 111114



P.O. Box 1193  
 Whittier, CA 90609  
 Tel # (562) 325-8351  
 Fax # (714) 783-3038

## Lot Book Report

Order Number: **25960**

**Customer:**

RIVERSIDE COUNTY TLMA-CODE ENFORCEMENT  
 4080 Lemon Street  
 Riverside CA 92501

Order Date: 9/21/2011  
 Dated as of: 9/16/2011  
 County Name: Riverside

Attn: Brent Steele  
 Reference: CV10-07596/Ericka Edwards  
 IN RE: PLASCENCIA, SAUL

FEE(s):  
 Report: \$120.00

Property Address: 3627 Lindsay Street  
 Riverside CA 92509

Assessor's Parcel No. : 173-050-011-8

**Assessments:**

|                    |              |
|--------------------|--------------|
| Land Value:        | \$35,717.00  |
| Improvement Value: | \$151,810.00 |
| Exemption Value:   | \$7,000.00   |
| Total Value:       | \$180,527.00 |

### Tax Information

|                                    |            |
|------------------------------------|------------|
| Property Taxes for the Fiscal Year | 2010-2011  |
| Total Annual Tax                   | \$1,960.56 |
| Status: Paid through               | 06/30/2011 |

### Property Vesting

The last recorded document transferring title of said property

|          |            |
|----------|------------|
| Dated    | 03/14/2000 |
| Recorded | 04/13/2000 |

EXHIBIT NO.     D



P.O. Box 1193  
Whittier, CA 90609  
Tel # (562) 325-8351  
Fax # (714) 783-3038

Order Number: 25960  
Reference: CV10-07596/Erick

---

|              |  |
|--------------|--|
| Document No. | 2000-137403  |
| D.T.T.       | \$173.25   |
| Grantor      | Kai Lun Tsal and Shu Hue Tsal, husband and wife                  |
| Grantee      | Saul Plascencia, a married man as his sole and separate property |

## Deeds of Trust

|                       |  |
|-----------------------|--|
| Position No.          | 1st  |
| A Deed of Trust Dated | 04/08/2004   |
| Recorded              | 04/22/2004   |
| Document No.          | 2004-0292277   |
| Amount                | \$300,000.00   |
| Trustor               | Saul Plascencia, a married man as his sole and separate property |
| Trustee               | Southland Title  |
| Beneficiary           | New Century Mortgage Corporation                                 |

## Additional Information

|   |   |
|---|---|
| Notice of Non-Compliance filed by         | County of Riverside Department of Building and Safety                           |
| In the matter of the property of          | Saul Plascencia   |
| Case No.                                  | CV06-1300   |
| Recorded                                  | 06/01/2006  |
| Document No.                              | 2006-0400303  |
| Abstract of Support Judgment Filed in the | Superior Court of California, County of Riverside -<br>Riverside Superior Court |
| Case No.                                  | 215649  |
| Recorded                                  | 08/02/2007  |
| Document No.                              | 2007-0500359  |
| Debtor                                    | Saul Plascencia   |
| Creditor                                  | County of Riverside Department of Child Support<br>Services                     |



P.O. Box 1193  
Whittier, CA 90609  
Tel # (562) 325-8351  
Fax # (714) 783-3038

Order Number: 25960

Reference: CV10-07596/Erick

---

## Legal Description

THE LAND REFERRED TO IN THIS REPORT IS LOCATED IN AND IS DESCRIBED AS FOLLOWS:

THE NORTHERLY 165.00 FEET OF LOT 14 OF THE RE-SUBDIVISION OF GLEN AVON HEIGHTS, IN THE COUNTY OF RIVERSIDE, STATE OF CALIFORNIA, AS PER MAP RECORDED IN BOOK 10 PAGE 100 OF MAPS, IN THE OFFICE OF THE COUNTY RECORDER OF SAID COUNTY, EXCEPT THE NORTHERLY 91.00 FEET OF THE EASTERLY 205.00 FEET THEREOF.



# County of Riverside Code Enforcement Department

P.O. Box 1469, Riverside, CA 92502  
Phone: (951) 955-2004 Fax: (951) 955-8680

## DEMAND FOR PAYMENT STATEMENT OF ABATEMENT COSTS NOTICE OF SPECIAL TAX ASSESSMENT

November 30, 2011

Saul Plascencia  
3627 Lindsay Street  
Riverside, CA 92509

Subject Property: 3627 Lindsay Street, Riverside  
Case No(s): CV10-07596  
APN No(s): 173-050-011

Dear Saul Plascencia:

**NOTICE IS HEREBY GIVEN** that the County of Riverside Code Enforcement Department ("DEPARTMENT") incurred expenses during our efforts to abate the code violation(s) on the Subject Property. Said abatement case involved Construction without Permit, Accumulated Rubbish, Vehicle Storage on Vacant Land located on your real property commonly described as 3627 Lindsay Street, Riverside and more particularly described as Assessor's Parcel Number 173-050-011.

The total amount due for the DEPARTMENT'S actions concerning the above-described dangerous or injurious condition is **one thousand, four hundred fifty-two dollars and eighty cents (\$1,452.80)**.

**You have thirty (30) days from the date of this letter to pay the DEPARTMENT at the above address the total amount due on the enclosed "Summary Statement of Abatement Costs" or a special tax assessment and abatement lien will be recorded upon the subject property. Payment must be made in the form of cashier's check or money order, made payable to the County of Riverside. Please note the property APN on the memo line of the check.**

**YOU HAVE A RIGHT TO A HEARING ON THIS MATTER.** You have the right to contest the abatement costs and special assessment against the subject property. If you choose to exercise your right to a public hearing, please complete the enclosed "Request for Public Hearing" form and return it to the Code Enforcement Department within twenty (20) days of the date of this letter.

In the event you do not request a public hearing, a hearing shall be held without further notice to you for a final determination of this matter and authority to place a lien against the Subject Property and adding the amount due as a special tax assessment on the County tax rolls.

If you have any questions regarding this notice, please contact us at (951) 955-2004.

Code Enforcement Department

  
Carol Lynn Anderson  
Administrative Service Officer

EXHIBIT NO.   E

**REQUEST FOR PUBLIC HEARING  
ON STATEMENT OF ABATEMENT COSTS  
AND SPECIAL TAX ASSESSMENT**

Saul Plascencia  
3627 Lindsay Street  
Riverside, CA 92509

Subject Property: 3627 Lindsay Street, Riverside  
Case No(s): CV10-07596  
APN No(s): 173-050-011

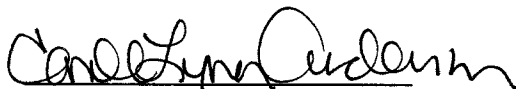
I, \_\_\_\_\_, hereby request a public hearing before the Administrative  
(Please PRINT your name here)  
Hearing Officer regarding case number(s) \_\_\_\_\_.

I request notice of the Administrative Hearing date, time, and location (which shall not be less than 10 days from the submission of this request) to be mailed to me at the following address:

Return Mailing Address: \_\_\_\_\_  
\_\_\_\_\_

Signed: \_\_\_\_\_ Date: \_\_\_\_\_  
(Please SIGN your name here)

Print: \_\_\_\_\_  
(Please PRINT your name here)

You may contact me at the following daytime phone number: \_\_\_\_\_

**IMPORTANT**

Keep a copy of this form and mail the original to:  
Riverside County Code Enforcement Department  
P.O. BOX 1469  
Riverside, CA 92502-1469

EXHIBIT NO. E2





# COUNTY OF RIVERSIDE CODE ENFORCEMENT

P.O. Box 1469, Riverside, CA 92502  
Phone: 951-955-2004 Fax: 951-955-8680

Date: 6/29/2011

|  |
|--|
| Property Reference/Mailing Address                                     |
| 173050011<br>SAUL PLASCENCIA<br>3627 LINDSAY ST<br>RIVERSIDE, CA 92509 |

## Summary Statement of Abatement Costs

You are liable to the County for the following abatement costs:

| Date       | Invoice Number & Amount                  | Amount               | Balance           |
|------------|--|----------------------|-------------------|
| 12/31/2000 | Balance forward                          |                      | 0.00              |
| 06/27/2011 | CV1007596-<br>INV #101913.               | 652.80               | 652.80            |
| 10/27/2010 | CV1007596:A28137-<br>INV #A28137. A28137 | 100.00               | 752.80            |
| 01/19/2011 | CV1007596:A28150-<br>INV #A28150. A28150 | 200.00               | 952.80            |
| 02/23/2011 | CV1007596:A40285-<br>INV #A40285. A40285 | 500.00               | 1,452.80          |
|            |  | <b>Total Now Due</b> | <b>\$1,452.80</b> |

The total abatement costs must be paid to the County of Riverside, P.O. Box 1469, Riverside, CA 92502 within thirty (30) days. In the event said costs are not paid within thirty (30) days you will be liable for additional administrative costs, penalties, court fees, or other collection costs incurred in the collection of these abatement costs.

I affirm and declare under penalty of perjury under the laws of the State of California that the foregoing is true and correct to the best of my knowledge.

Code Enforcement Department

EXHIBIT NO. 3

**County of Riverside  
Code Enforcement Department**

P.O. Box 1469, Riverside, CA 92502  
Phone: (951) 955-2004 Fax: (951) 955-8680



# Statement of Abatement Costs

173050011  
SAUL PLASCENCIA  
3627 LINDSAY ST  
RIVERSIDE, CA 92509

| Date      | Invoice # |
|-----------|-----------|
| 6/27/2011 | 101913    |

|  |
|--|
| <b>Property Address</b>  |
| 173050011<br>SAUL PLASCENCIA<br>3627 LINDSAY ST<br>RIVERSIDE, CA 92509 |

| Case Number | District | Class |
|-------------|----------|-------|
| CV1007596   | 2        | SOAC  |

**You are liable to the County for the following abatement costs:**

| Date       | Item                       | Description                     | Hours/Qty | Rate            | Amount          |
|------------|----------------------------|---------------------------------|-----------|-----------------|-----------------|
| 9/13/2010  | Officer Hours              | Labor Charges - Officer Time    | 0.5       | 109.00          | 54.50           |
| 10/27/2010 | Officer Hours              | Labor Charges - Officer Time    | 0.6       | 109.00          | 65.40           |
| 1/19/2011  | Officer Hours              | Labor Charges - Officer Time    | 0.5       | 109.00          | 54.50           |
| 2/23/2011  | Officer Hours              | Labor Charges - Officer Time    | 0.5       | 109.00          | 54.50           |
| 4/13/2011  | Officer Hours              | Labor Charges - Officer Time    | 0.4       | 109.00          | 43.60           |
| 6/27/2011  | SOE Preparation            | Prepare Statement of Expense    |           | 65.00           | 65.00           |
|            |                            | Subtotal Code Enforcement Costs |           |                 | 337.50          |
| 6/27/2011  | Prepare Case for SOE He... |                                 |           | 125.55          | 125.55          |
|            | Attend SOE Hearing         |                                 |           | 69.75           | 69.75           |
|            |                            | Subtotal County Counsel Costs   |           |                 | 195.30          |
| 6/27/2011  | Lot Book Report            |                                 |           | 120.00          | 120.00          |
|            |                            | Subtotal Contractor Costs       |           |                 | 120.00          |
|            |                            |                                 |           | <b>Subtotal</b> | <b>\$652.80</b> |

The total abatement costs must be paid to the County of Riverside, P.O. Box 1469, Riverside, CA 92502 within thirty (30) days. In the event said costs are not paid within thirty (30) days you will be liable for additional administrative costs, penalties, court fees or other collection costs incurred in the collection of these abatement costs.

|                         |                 |
|-------------------------|-----------------|
| <b>Payments/Credits</b> | \$0.00          |
| <b>Total Now Due</b>    | <b>\$652.80</b> |

I affirm and declare under penalty of perjury under the laws of the State of California that the foregoing is true and correct to the best of my knowledge.

*[Signature]*

Code Enforcement Department

EXHIBIT NO. EA



# County of Riverside Code Enforcement Department

P.O. Box 1469, Riverside, CA 92502  
Phone: (951) 955-2004 Fax: (951) 955-8680  
demands@rctlma.org

## Administrative Citation

173050011  
SAUL PLASCENCIA  
3627 LINDSAY ST  
RIVERSIDE, CA 92509

|                     |              |
|---------------------|--------------|
| Citation Issue Date | Billing Date |
| 10/27/2010          | 6/27/2011    |

| Citation Number | District | Class |
|-----------------|----------|-------|
| A28137          | 2        | SOAC  |

|   |
|---|
| <b>Property Address</b><br><br>173050011<br>SAUL PLASCENCIA<br>3627 LINDSAY ST<br>RIVERSIDE, CA 92509 |
|---|

| Item                     | Description      | Hours/Qty | Rate                    | Amount   |
|--------------------------|------------------|-----------|-------------------------|----------|
| Administrative Citations | CV1007596:A28137 | 1         | 100.00                  | 100.00   |
|                          |                  |           | <b>Subtotal</b>         | \$100.00 |
|                          |                  |           | <b>Payments/Credits</b> | \$0.00   |
|                          |                  |           | <b>Total</b>            | \$100.00 |

EXHIBIT NO. ES



# County of Riverside Code Enforcement Department

P.O. Box 1469, Riverside, CA 92502  
Phone: (951) 955-2004 Fax: (951) 955-8680  
demands@rctlma.org

## Administrative Citation

173050011  
SAUL PLASCENCIA  
3627 LINDSAY ST  
RIVERSIDE, CA 92509

|                     |              |
|---------------------|--------------|
| Citation Issue Date | Billing Date |
| 1/19/2011           | 6/27/2011    |

|  |
|--|
| Property Address   |
| 173050011<br>SAUL PLASCENCIA<br>3627 LINDSAY ST<br>RIVERSIDE, CA 92509 |

|                 |          |       |
|-----------------|----------|-------|
| Citation Number | District | Class |
| A28150          | 2        | SOAC  |

| Item                     | Description      | Hours/Qty | Rate            | Amount   |
|--------------------------|------------------|-----------|-----------------|----------|
| Administrative Citations | CV1007596:A28150 | 1         | 200.00          | 200.00   |
|                          |                  |           | <b>Subtotal</b> | \$200.00 |

|              |                         |          |
|--------------|-------------------------|----------|
|              | <b>Payments/Credits</b> | \$0.00   |
| <b>Total</b> |                         | \$200.00 |



# County of Riverside Code Enforcement Department

P.O. Box 1469, Riverside, CA 92502  
Phone: (951) 955-2004 Fax: (951) 955-8680  
demands@rctlma.org

## Administrative Citation

173050011  
SAUL PLASCENCIA  
3627 LINDSAY ST  
RIVERSIDE, CA 92509

|                     |              |
|---------------------|--------------|
| Citation Issue Date | Billing Date |
| 2/23/2011           | 6/27/2011    |

|  |
|--|
| Property Address   |
| 173050011<br>SAUL PLASCENCIA<br>3627 LINDSAY ST<br>RIVERSIDE, CA 92509 |

| Citation Number | District | Class |
|-----------------|----------|-------|
| A40285          | 2        | SOAC  |

| Item                     | Description      | Hours/Qty | Rate            | Amount   |
|--------------------------|------------------|-----------|-----------------|----------|
| Administrative Citations | CV1007596:A40285 | 1         | 500.00          | 500.00   |
|                          |                  |           | <b>Subtotal</b> | \$500.00 |

|              |                         |          |
|--------------|-------------------------|----------|
|              | <b>Payments/Credits</b> | \$0.00   |
| <b>Total</b> |                         | \$500.00 |

EX-100-110         E



**CODE ENFORCEMENT DEPARTMENT  
COUNTY OF RIVERSIDE**

**GLENN BAUDE**  
Director

**RESPONSIBLE PARTIES**

November 30, 2011

SAUL PLASCENCIA  
3627 LINDSAY ST  
RIVERSIDE, CA 92509

MARIA PLASCENCIA  
3627 LINDSAY ST  
GLEN AVON, CA 92509

NEW CENTURY MORTGAGE CORPORATION  
18400 VON KARMAN, SUITE 1000  
IRVINE, CA 92612

EXHIBIT NO. ES

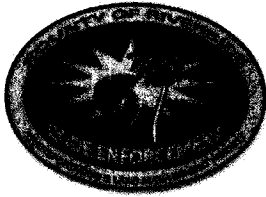

**CODE ENFORCEMENT DEPARTMENT  
COUNTY OF RIVERSIDE**

GLENN BAUDE  
Director

**PROOF OF SERVICE**

Case No. CV1007596

STATE OF CALIFORNIA, COUNTY OF RIVERSIDE

I, Ericka Edwards, declare that I am a citizen of the United States and am employed in the County of Riverside, over the age of 18 years and not a party to the within action or proceeding; that my business address is at the footer of this notice.

That on November 30, 2011, I served the following documents(s):

**NOTICE OF HEARING RE: DEMAND FOR PAYMENT STATEMENT OF  
ABATEMENT COSTS NOTICE OF SPECIAL TAX ASSESSMENT**

**REQUEST FOR PUBLIC HEARING ON STATEMENT OF ABATEMENT COSTS  
AND SPECIAL TAX ASSESSMENT**

**NOTICE LIST**

by placing a true copy thereof enclosed in a sealed envelope(s) by **REGULAR MAIL** addressed as follows:

SAUL PLASCENCIA 3627 LINDSAY ST, RIVERSIDE, CA 92509  
OCCUPANT 3627 LINDSAY ST, GLEN AVON, CA 92509  
NEW CENTURY MORTGAGE CORPORATION 18400 VON KARMAN, SUITE 1000, IRVINE, CA 92612

XX **By First Class Mail.** I am readily familiar with the office's practice of collection and processing correspondence for mailing. Under that practice it would be deposited with the U.S. Postal Service with postage thereon fully prepaid in the County of Riverside, California, in the ordinary course of business.

XX **STATE.** I declare under the penalty of perjury under the laws of the State of California that the above is true and correct.

EXECUTED ON November 30, 2011 in the County of Riverside, California.

CODE ENFORCEMENT DEPARTMENT

  
\_\_\_\_\_  
Ericka Edwards, OAIH

EXHIBIT NO. EA



**CODE ENFORCEMENT DEPARTMENT  
COUNTY OF RIVERSIDE**

GLENN BAUDE  
Director

**AFFIDAVIT OF POSTING OF NOTICES**

December 1, 2011

RE CASE NO: CV10-07596

I, Carol Lucero, hereby declare:

I am employed by the Riverside County Code Enforcement Department; that my business address is 5317 Mission Blvd, Riverside, California 92509 .

That on 12/01/11 at 10:50am, I securely and conspicuously posted DEMAND FOR PAYMENT STATEMENT OF ABATEMENT COSTS NOTICE OF SPECIAL TAX ASSESSMENT at the property described as:

**Property Address:** 3627 LINDSAY ST, GLEN AVON

**Assessor's Parcel Number:** 173-050-011

I declare under the penalty of perjury that the foregoing is true and correct.

Executed on December 1, 2011 in the County of Riverside, California.

CODE ENFORCEMENT DEPARTMENT

By: Carol Lucero  
Carol Lucero, Code Enforcement Technician

EXHIBIT NO. E10



**REQUEST FOR PUBLIC HEARING  
ON STATEMENT OF ABATEMENT COSTS  
AND SPECIAL TAX ASSESSMENT**

Saul Plascencia  
3627 Lindsay Street  
Riverside, CA 92509

Subject Property: 3627 Lindsay Street, Riverside  
Case No(s): CV10-07596  
APN No(s): 173-050-011

I, Saul Plascencia, hereby request a public hearing before the Administrative  
(Please PRINT your name here)  
Hearing Officer regarding case number(s) CV10-07596

I request notice of the Administrative Hearing date, time, and location (which shall not be less than 10 days from the submission of this request) to be mailed to me at the following address:

Return Mailing Address: 3627 Lindsay St.  
Riverside CA. 92509

Signed: Saul P. Date: 12/01/11  
(Please SIGN your name here)

Print: Saul Plascencia  
(Please PRINT your name here)

You may contact me at the following daytime phone number: (909) 815-0234

**IMPORTANT**  
Keep a copy of this form and mail the original to:  
Riverside County Code Enforcement Department  
P.O. BOX 1469  
Riverside, CA 92502-1469

EXHIBIT NO. F

RECEIVED DEC 6 - 2011