

**SUBMITTAL TO THE BOARD OF SUPERVISORS
COUNTY OF RIVERSIDE, STATE OF CALIFORNIA**

840A



FROM: TLMA - Transportation Department

SUBMITTAL DATE:
February 15, 2012

SUBJECT: Notice of Completion - Pavement Resurfacing of Pedley Road from Jurupa Road to State Route 60 in the Glen Avon area of Riverside County

RECOMMENDED MOTION: That the Board execute and file the attached "Notice of Completion"

BACKGROUND: By Minute Order 3.33 on February 8, 2011, the Board entered into a contract with All American Asphalt of Corona, California, for pavement resurfacing of Pedley Road from Jurupa Road to SR 60 in the Glen Avon area. The originally authorized amount of the contract was \$1,019,662. The total amended contract is \$1,026,434 which is 0.7% more than the originally authorized amount.

Departmental Concurrence

Juan C. Perez
Director of Transportation

dj
(Continued On Attached Page)

FINANCIAL DATA	Current F.Y. Total Cost:	\$1,026,434	In Current Year Budget:	Yes
	Current F.Y. Net County Cost:	\$ 0	Budget Adjustment:	No
	Annual Net County Cost:	\$ 0	For Fiscal Year:	2011/2012

SOURCE OF FUNDS: Proposition 1B [State bond funds-Local Roads] (99.34%), Jurupa Community Service District (0.66%) There were no general funds used in this project.	Positions To Be Deleted Per A-30	<input type="checkbox"/>
	Requires 4/5 Vote	<input type="checkbox"/>

C.E.O. RECOMMENDATION: APPROVE

BY: Tina Grande

County Executive Office Signature

MINUTES OF THE BOARD OF SUPERVISORS

On motion of Supervisor Tavaglione, seconded by Supervisor Buster and duly carried, IT WAS ORDERED that the above matter is approved as recommended.

Ayes: Buster, Tavaglione, Stone and Benoit
Nays: None
Absent: Ashley
Date: February 28, 2012
xc: Transp., Recorder

Kecia Harper-Ihem
Clerk of the Board
By: Deputy

Prev. Agn. Ref. 2/8/11, Item 3.33 | District: 2/2 | Agenda Number:

3.59

Dept't Recomm.: Consent Policy
 Per Exec. Ofc.: Consent Policy

The Honorable Board of Supervisors

RE: Notice of Completion - Pavement Resurfacing of Pedley Road from Jurupa Road to State Route 60 in the Glen Avon area of Riverside County

February 15, 2012

Page 2 of 2

This work was completed at the direction of the Department on April 18, 2011, and was inspected by the Construction Engineering Section of the Transportation Department. Work Order C1-0528.

Budget

Original Contract Amount		\$1,019,662.50
Tot. Chg Orders Authorized -	5.4%	\$54,577.70
Est. Pending Change Orders	0.0%	\$0.00
Amended Contract Amount		\$1,074,240.20
* Quantity Adjustments	-4.7%	(\$47,806.08)
+ CCO FA Adjustments	0.0%	\$0.00
Total Amended Contract Amount	100.7%	\$1,026,434.12

Expenditures

Total Progress Payments -	\$964,139.04
Estimated Pending Payments	\$62,295.08
Total Expenditures	\$1,026,434.12

(Over)\Under Contract Amount \$0.00

+ Change Orders using the Force Account method of payment issued prior to the work being completed generally do not use the total authorized amount.

* CAL-Trans Standard Specifications 4-1.03B. Increases or decreases in the quantity of a contract item of work will be determined by comparing the total pay quantity of such item of work with the Engineer's Estimate. If the total pay quantity of any item of work required under the contract varies from the Engineers Estimate by 25 percent or less, payment will be made for the quantity of work of said item performed at contract unit price, unless eligible for adjustment pursuant to Section 4-1.03C, "Changes in Character of Work."

PLEASE COMPLETE THIS INFORMATION
RECORDING REQUESTED BY:

KECIA HARPER-IHEM, CLERK OF THE BOARD
RIVERSIDE CO. CLERK OF THE BOARD
4080 LEMON STREET, 1ST FLOOR CAC
P O BOX 1147 - RIVERSIDE, CA 92502
MAIL STOP # 1010

AND WHEN RECORDED MAIL TO:

RETURN TO: STOP #1010
RIVERSIDE COUNTY CLERK OF THE BOARD
P. O. BOX 1147 - RIVERSIDE, CA 92502

DOC # 2012-0101567
03/06/2012

Customer Copy Label
The paper to which this label is
affixed has not been compared
with the recorded document

Larry W Ward
County of Riverside
Assessor, County Clerk & Recorder

THIS SPACE FOR RECORDERS USE ONLY

NOTICE OF COMPLETION

To be recorded with County Recorder
within 10 days after completion.
No recording fee.

Notice is hereby given by the undersigned owner, a public entity of the State of California, that a public work of
improvement has been completed, as follows:

Project title or description of work: Pavement resurfacing

Date of Completion: Date of this notice 2/28/12

Nature of owner: County of Riverside, public entity

Interest or estate of owner: Public Roadway

Address of owner: 4080 Lemon Street, 8th Floor, Riverside, CA 92501

Name of contractor: All American Asphalt

Street or legal description of site: Pedley Road, from Jurupa Road to SR 60

Dated: February 28, 2012

Owner: County of Riverside
(Name of Public Entity)

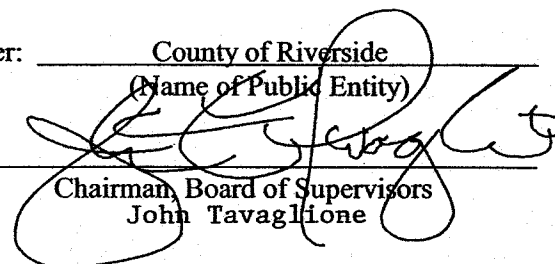
By: 
Chairman, Board of Supervisors
John Tavaglione

STATE OF CALIFORNIA)

ss

COUNTY OF RIVERSIDE)

I am the Chairman of the governing board of the County of Riverside, the public entity which executed the
foregoing notice and on whose behalf I make this verification; I have read this notice, know its contents, and the same is
true. I certify under penalty of perjury that the foregoing is true and correct.

Executed at Riverside California on 2/28/12 (Date)

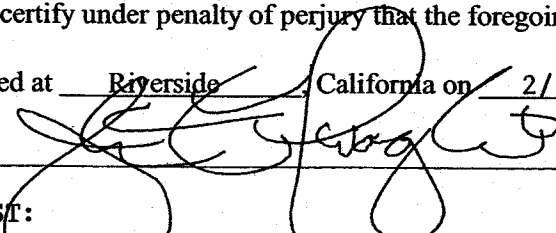
Chairman of the Board of Supervisors
John Tavaglione

ATTEST:
Kecia Harper-Ihem, Clerk

By 
Deputy

02.28.12 3.59

COPY

COUNTY OF RIVERSIDE
DEPARTMENT OF TRANSPORTATION

PEDLEY ROAD
RESURFACING PROJECT

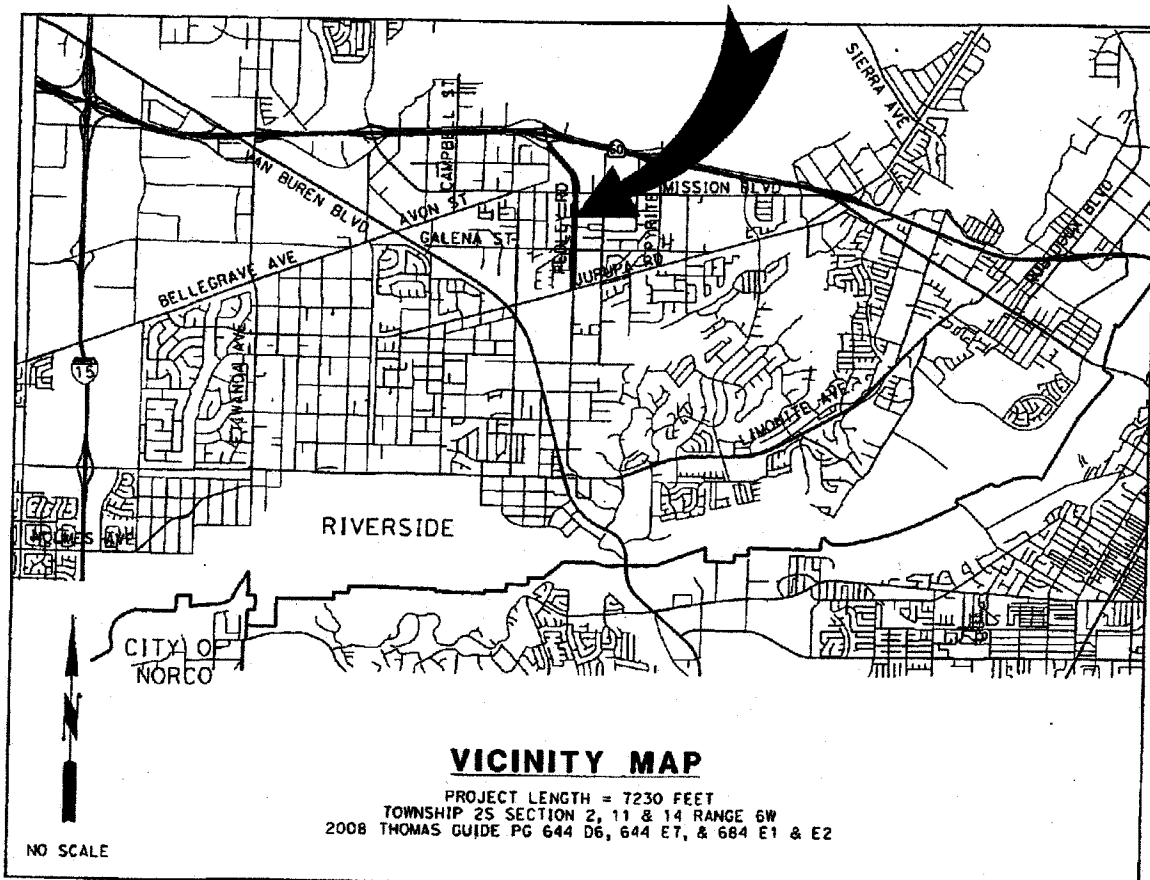
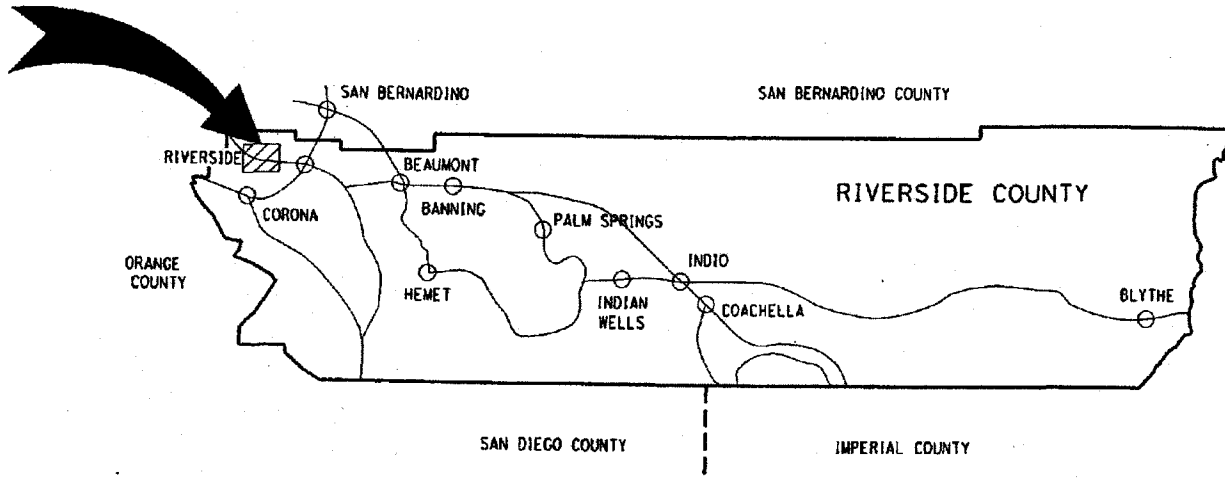

PROGRESS ESTIMATE RECORD - COUNTY OF RIVERSIDE

PROJECT: Peabody Road Resurfacing Project, From Jurupa Road to SR 60
 County Project No.: C1-0828
 Contract No.: 11-01-013

Contractor: All American Asphalt
 Address: P.O. Box 2228
 City, State, Zip: Corona, CA 92678

SHEET 4 of 4
 Processed Construction Inspection 5/31/2011



Estimate No. 3 Final
 From: April 28, 2011
 To: May 28, 2011

Item No.	Item Description	Units	Quantity	Unit Price	Original Contract		Change Authorized		This Estimate		Previous Quantity	Total Estimate To Date		% Auth.
					Amount	Quantity	Amount	Quantity	Amount	Quantity		Amount	Quantity	
SS	ADJUST SEWER MANHOLE	EA	16	510.00	8,160.00	16.00	8,160.00				12.00	12.00	6,120.00	75%
CCC 1	PRICE INDEX FLUCTUATION	AD	0	50,282.55	0.00	1.00	50,282.55			1.00		1.00	50,282.55	100%
PROJECT TOTAL						1,019,682.50		1,074,240.20					1,026,434.12	

Made by: JUSTIN ROBBINS/STEVE KESTLEY
 Checked by: [Signature]
 OK Const. Supv. [Signature]

Working Days: 30
 Days Added: 0
 Subtotal: 30
 Days Used: 30
 % Time Elapsed: 100%

Start Date: 3-8-11
 End Date: 4-18-11
 % Complete: 98%
 Original Contract: \$1,019,682.50
 Amended Contract: \$1,074,240.20

TOTAL VALUE OF WORK TO DATE: \$1,026,434.12
 LESS RETENTION: 10% 102,643.41
 TOTAL DUE TO DATE: \$923,790.71
 LESS PREVIOUSLY INVOICED: \$67,226.15
 LESS LABOR NON COMPLIANCE: 0.00
 TOTAL DUE THIS PAYMENT: \$56,065.57

This Estimate Approved _____ Date: _____ for: _____
 Juan C. Perez, Director of Transportation

Received by Accounts Payable: _____
 By: _____

Quantities on This Estimate Approved _____ Date: 10/24/11

[Signature]
 All American Asphalt

PAYMENT APPROVAL
 Fund 20000
 Dept ID 31305
 Account 527980
 Project ZC1-0528F
 Activity ID Z8500
 Resource Type CNT
 Signature [Signature]
 Date 10/26/11

PROGRESS ESTIMATE RECORD - COUNTY OF RIVERSIDE
 PROJECT: Peary Road Resurfacing Project, From Jurupa Road to SR 60
 County Project No.: C1-0028
 Contract No.: 11-01-013

SHEET 1 of 4

Processed Construction Inspection 9/25/2011

Estimate No. 3 Final
 Price April 26, 2011
 Tot May 26, 2011



Contractor: All American Asphalt
 Address: P.O. Box 2229
 City, State, Zip: Corona, CA 92678

Item No.	Item Description	Units	Quantity	Unit Price	Original Contract Amount	Change Authorized Quantity	Change Authorized Amount	Total Authorized Quantity	Total Authorized Amount	This Estimate Quantity	This Estimate Amount	Previous Quantity	Total Estimate To Date Quantity	Total Estimate To Date Amount	% Auct.
1	DUST ABATEMENT	LS	1	770.00	770.00			1.00	770.00	1.00	770.00	1.00	1.00	770.00	100%
2	WATER POLLUTION CONTROL	LS	1	6,000.00	6,000.00			1.00	6,000.00	1.00	6,000.00	1.00	1.00	6,000.00	100%
3	TRAFFIC CONTROL SYSTEM	LS	1	61,500.00	61,500.00			1.00	61,500.00	1.00	61,500.00	1.00	1.00	61,500.00	100%
4	RELOCATE ROADSIDE SIGN-ONE POST	EA	6	153.00	918.00			6.00	918.00	6.00	918.00	6.00	6.00	918.00	100%
5	COLD PLANE ASPHALT CONCRETE PAVEMENT	SQYD	22,700	0.53	12,031.00			22,700.00	12,031.00	16,362.40	8,672.07	16,362.40	16,362.40	8,672.07	72%
6	CLEARING AND GRUBBING	LS	1	765.00	765.00			1.00	765.00	1.00	765.00	1.00	1.00	765.00	100%
7	DEVELOP WATER SUPPLY	LS	1	510.00	510.00			1.00	510.00	1.00	510.00	1.00	1.00	510.00	100%
8	ROADWAY EXCAVATION & CCO 1	CY	2,100	11.35	23,835.00	305.20	3,484.02	2,405.20	27,299.02	2,625.00	2,625.00	2,625.00	2,625.00	2,625.00	109%
9	SHOULDER BACKING	LF	2,800	1.55	4,340.00			2,800.00	4,340.00	2,887.00	2,887.00	2,887.00	2,887.00	4,474.85	103%
10	FINISHING ROADWAY	LS	1	1,300.00	1,300.00			1.00	1,300.00	1.00	1,300.00	1.00	1.00	1,300.00	100%
11	PLACE ASPHALT CONCRETE DIKE (CRS 212) (R) & CCO 1	LF	110	7.65	841.50	39.50	302.18	149.50	1,143.68	137.50	137.50	137.50	137.50	1,051.86	92%
12	PLACE ASPHALT CONCRETE DIKE (CRS 212) (R) & CCO 1	LF	450	7.45	3,352.50	71.00	528.95	521.00	3,881.45	582.50	582.50	582.50	582.50	4,190.89	108%
13	HOT MIX ASPHALT	TON	6,900	57.00	393,300.00			6,900.00	393,300.00	6,579.40	373,025.80	6,579.40	6,579.40	373,025.80	95%
14	PLACE ASPHALT CONCRETE (MISCELLANEOUS AREA)	SQYD	30	16.00	540.00			30.00	540.00	30.00	540.00	30.00	30.00	540.00	100%
15	ROUT AND SEAL RANDOM CRACKS	LS	1	11,200.00	11,200.00			1.00	11,200.00	1.00	11,200.00	1.00	1.00	11,200.00	100%
16	MINOR CONCRETE (CURB AND GUTTER) (CRS 201)	LF	400	33.00	13,200.00			400.00	13,200.00	160.00	5,280.00	160.00	160.00	5,280.00	40%
17	MINOR CONCRETE (CURB RAMP) (CRS 403)	EA	9	2,240.00	20,160.00			9.00	20,160.00	9.00	20,160.00	9.00	9.00	20,160.00	100%
18	MINOR CONCRETE (DRIVEWAY APPROACH) (CRS 207)	EA	5	2,240.00	11,200.00			5.00	11,200.00	1.00	2,240.00	1.00	1.00	2,240.00	20%
19	MINOR CONCRETE (SIDEWALK)	SQFT	1,000	6.30	6,300.00			1,000.00	6,300.00	885.00	5,575.50	885.00	885.00	5,575.50	89%
20	OBJECT MARKER (TYPE L-1 OR TYPE N-1)	EA	21	80.00	1,680.00			21.00	1,680.00	18.00	1,440.00	18.00	18.00	1,440.00	86%
21	METAL BEAM GUARD RAILING	LF	50	50.50	2,525.00			50.00	2,525.00	50.00	2,525.00	50.00	50.00	2,525.00	100%
22	THERMOPLASTIC PAVEMENT MARKING	SQFT	1,000	4.40	4,400.00			1,000.00	4,400.00	1,250.00	5,500.00	1,250.00	1,250.00	5,500.00	125%



Contractor: All American Asphalt
 Address: P.O. Box 2229
 City, State, Zip: Corona, CA 92678

Item No.	Item Description	Units	Quantity	Unit Price	Original Contract Amount	Change Authorized		This Estimate		Previous		Total Estimate To Date	% Auth.
						Quantity	Amount	Quantity	Amount	Quantity	Amount		
23	PAINT TRAFFIC STRIPE (2-COAT)	LF	21,000	0.18	3,780.00					18,720.00		18,720.00	89%
24	PAVEMENT MARKER (REFLECTIVE)	EA	860	3.08	2,601.00					761.00		3,368.00	89%
25	DETECTOR LOOP	EA	35	180.00	6,300.00					35.00		2,328.66	90%
26	ADJUST MANHOLE TO GRADE (RCFC)	EA	2	510.00	1,020.00					2.00		6,300.00	100%
27	CONSTRUCTION PROJECT FUNDING IDENTIFICATION SIGN	EA	2	770.00	1,540.00					2.00		1,020.00	100%
28	WEDGE PLANE	LF	1,000	4.60	4,600.00					2.00		1,540.00	100%
29	ASPHALT RUBBER HOT MIX	TON	4,800	71.00	340,800.00					970.00		1,540.00	100%
30	DEMOLITION of SELECT EXISTING CONCRETE	SOFT	775	2.30	1,782.50					4,671.80		4,462.00	97%
31	DEMOLITION of ALL EXISTING PLANT MATERIAL	LS	1	5,700.00	5,700.00					775.00		331,687.80	97%
32	FINE GRADE for CONCRETE/PLANT MATERIAL	LS	1	4,900.00	4,900.00					1.00		1,782.50	100%
33	SOIL PREPARATION (FERTILIZERS & WEED)	SOFT	6,400	0.20	1,280.00					1.00		5,700.00	100%
34	MULCHING (RECYCLED ORGANIC, 5T)	SOFT	6,400	0.36	2,304.00					1.00		4,900.00	100%
35	5 GALLON SHRUBS	EA	215	12.00	2,580.00					6,400.00		1,280.00	100%
36	1 GALLON SHRUBS	EA	405	4.80	1,963.00					215.00		2,304.00	100%
37	DECORATIVE CONCRETE PAVING (MAINT STRIP/WALK)	SOFT	2,150	8.28	17,802.00					405.00		2,580.00	100%
38	PRESSURE WASH EXISTING CONCRETE PAVING	LS	1	6,400.00	6,400.00					2,150.00		17,802.00	100%
39	MAINTENANCE (30 TO 90 DAYS)	EA	3	768.00	2,295.00					1.00		6,400.00	100%
40	BROWN PRESSURE COMPENSATING DRIP LINE SYSTEM	LS	1	3,315.00	3,315.00					3.00	2,295.00	2,295.00	100%
41	1" ELECTRIC CONTROL VALVE SYSTEM	EA	2	485.00	970.00					1.00		3,315.00	100%
42	GREEN PLASTIC 10" ROUND VALVE BOX	EA	4	250.00	1,000.00					2.00		970.00	100%
43	GREEN PLASTIC STANDARD ROUND VALVE BOX	EA	2	285.00	570.00					4.00		1,000.00	100%
44	QUICK COUPLING VALVE - RAINBIRD 350LRC	EA	2	357.00	714.00					2.00		570.00	100%
					714.00					2.00		714.00	100%

PROGRESS ESTIMATE RECORD - COUNTY OF RIVERSIDE
 PROJECT: Pothay Road Resurfacing Project, From Jurupa Road to SR 66
 County Project No.: C1-0028
 Contract No.: 11-01-013

Contractor: All American Asphalt
 Address: P.O. Box 2228
 City, State, Zip: Corona, CA 92676

Estimate No. 3 Final
 From: April 26, 2011
 To: May 28, 2011

SHEET 3 of 4

Processed Construction Inspection 5/23/2011

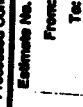

Item No.	Item Description	Units	Quantity	Unit Price	Original Contract Amount	Change Authorized		Total Authorized		This Estimate		Previous		Total Estimate To Date		% Auth.
						Quantity	Amount	Quantity	Amount	Quantity	Amount	Quantity	Amount	Quantity	Amount	
45	NIBCO T-113-K BRONZE GATE VALVE (1')	EA	1	350.00	350.00			1.00	350.00			1.00		1.00	350.00	100%
46	NON-PRESSURE LATERAL LINE - SCH-40 (3/4")	LF	50	7.15	357.50			50.00	357.50			50.00		50.00	357.50	100%
47	NON-PRESSURE LATERAL LINE - SCH-40 (1')	LF	225	7.40	1,665.00			225.00	1,665.00			225.00		225.00	1,665.00	100%
48	PRESSURE SUPPLY LINE - SCH 40 (1 1/4")	LF	150	7.65	1,147.50			150.00	1,147.50			150.00		150.00	1,147.50	100%
49	IRRIGATION CONTROLLER - LEFT	EA	1	2,040.00	2,040.00			1.00	2,040.00			1.00		1.00	2,040.00	100%
50	14 GAUGE DIRECT BURIAL WIRE	LS	1	408.00	408.00			1.00	408.00			1.00		1.00	408.00	100%
51	MISCELLANEOUS FITTINGS	LS	1	540.00	540.00			1.00	540.00			1.00		1.00	540.00	100%
52	MISCELLANEOUS DIRECTED WORK	FA	10,000	1.00	10,000.00			10,000.00	10,000.00		9,717.53			9,717.53	97%	

Pedley Road Resurfacing from Jurupa Road to SR 60
Contract CCO History

Contract No. 11-01-013
 Work Order No. C1-0528
 Contract Amount \$1,019,662.50

Single Maximum CCO \$63,483.13
 Maximum CCO's \$101,966.25
 Tip Budget

Tip Comments:
No Change



CCO No.	Amount This CCO	Authority	Cumulative CCO's	% Original Authorized	Cumulative CCO %	Classification
1	\$54,577.70	Trans. Director	\$54,577.70	5.35%	5.35%	Extra/Unavoidable

\$54,577.70

5.35%

New Authorized Contract Total	\$1,074,240.20
Total CCO Dollars To Date	\$54,577.70
Total % Increased by CCO's	5.35%