

**SUBMITTAL TO THE BOARD OF SUPERVISORS
COUNTY OF RIVERSIDE, STATE OF CALIFORNIA**

9128



FROM: County Counsel
Code Enforcement Department

SUBMITTAL DATE:
March 1, 2012

SUBJECT: Statement of Abatement Costs [Case Nos. CV09-06580 & CV09-05340]
Subject Property: 27285 Citrus Ave., Perris; SAVELLANO
APN: 307-260-012
District Five / Five

RECOMMENDED MOTION: Move that the Board of Supervisors:

- (1) assess the reasonable costs of abatement of a public nuisance (substandard structures and accumulated rubbish) in the above-referenced matter to be **two thousand three hundred two dollars and forty-three cents (US \$2,302.43)**;
- (2) assess the costs of abatement against the above-described subject property;
- (3) authorize the recordation of a notice of abatement lien;
- (4) authorize the abatement costs to be added to the tax roll as a special assessment; and
- (5) authorize and direct the Code Enforcement Department to take any reasonable actions to collect the amount owed.

BACKGROUND: Government Code § 25845, Riverside County Ordinance Nos. 457, 541 and 725 authorize the recovery of abatement costs in public nuisance cases, the recordation of a notice of abatement lien and inclusion of abatement costs on the tax roll as a special assessment upon approval of the Board of Supervisors.

[Signature]
PATRICIA MUNROE, Deputy County Counsel
for PAMELA J. WALLS, County Counsel

(continued)

FINANCIAL DATA	Current F.Y. Total Cost:	\$ N/A	In Current Year Budget:	N/A
	Current F.Y. Net County Cost:	\$ N/A	Budget Adjustment:	N/A
	Annual Net County Cost:	\$ N/A	For Fiscal Year:	N/A

SOURCE OF FUNDS:	Positions To Be Deleted Per A-30	<input type="checkbox"/>
	Requires 4/5 Vote	<input type="checkbox"/>

C.E.O. RECOMMENDATION: APPROVE

BY *[Signature]*
Tina Grande

County Executive Office Signature

MINUTES OF THE BOARD OF SUPERVISORS

On motion of Supervisor Ashley, seconded by Supervisor Tavaglione and duly carried, IT WAS ORDERED that the above matter is approved as recommended with a revised amount of costs to \$1,500.00.

Ayes: Buster, Tavaglione, Benoit and Ashley
Nays: None
Absent: Stone
Date: March 13, 2012
xc: Co. Co.

Kecia Harper-Ihem
Clerk of the Board
By *[Signature]*
Deputy

Prev. Agn. Ref.:

District: 5 / 5

Agenda Number:

9.8

Departmental Concurrence

Consent
 Policy
 Consent
 Policy
 Dept't Recomm.:
 Per Exec. Ofc.:

Statement of Abatement Costs [Case Nos. CV09-06580 & CV09-05340]
Subject Property: 27285 Citrus Ave., Perris; SAVELLANO
APN: 307-260-012
District Five / Five
Page 2

The Board of Supervisors issued an Order to Abate in this case on August 10, 2012 and recorded on August 16, 2010, as document number 2010-0385456. On or about May 26, 2011, the property owners voluntarily brought the property into compliance.

The Notice of Hearing re Statement of Abatement Costs has been posted on the property and mailed to the property owner and all interested parties, as required by law. Copies of all relevant notices issued in this matter together with proof of service and posting have been separately filed with the Clerk of the Board and are made a part of the record herein, pursuant to Riverside County Ordinance 725.

**SUBMITTAL TO THE BOARD OF SUPERVISORS
COUNTY OF RIVERSIDE, STATE OF CALIFORNIA**

FROM: County Counsel
Code Enforcement Department
SUBJECT: Statement of Abatement Costs [Case Nos. CV09-06580 & CV09-05340]
Subject Property: 27285 Citrus Ave., Perris; SAVELLANO
APN: 307-260-012
District Five / District Five

**TABLE OF SUPPLEMENTAL DOCUMENTS
FILED WITH THE CLERK OF THE BOARD**

Hearing Date: MARCH 13, 2012

Notice of Hearing Re: Statement of Abatement Costs (including Proof(s) of Service and Affidavit(s) of Posting	Exhibit A
Summary Statement of Abatement Costs and Statement of Abatement Costs with Supporting Documents	Exhibit B
Assessment-Roll For The Year 10/11 And Geographic Information System, Feb. 16, 2012...	Exhibit C
Lot Book Report.....	Exhibit D
Demand for Payment Statement of Abatement Costs Notice of Special Tax Assessment	Exhibit E
Request for Hearing.....	Exhibit F



**CODE ENFORCEMENT DEPARTMENT
COUNTY OF RIVERSIDE**

Glenn Baude
Director

February 21, 2012

**NOTICE OF HEARING RE:
STATEMENT OF ABATEMENT COSTS**

To: Owner(s) or Interested Parties
(See Attached Proof of Service
and Notice List)

Subject Property: 27285 Citrus Ave., Perris
Case Nos.: CV09-06580 & CV09-05340
APN: 307-260-012; SAVELLANO

NOTICE IS HEREBY GIVEN that a hearing will be held before the Riverside County Board of Supervisors on **Tuesday, March 13, 2012, at 9:30 a.m.** in the Board of Supervisors Room, 4080 Lemon Street, 1st Floor Annex, Riverside, California, at which time and place pertinent testimony will be heard regarding the expenses incurred by the County of Riverside, Code Enforcement Department ("DEPARTMENT") for the above-referenced abatement case. Said abatement case involved accumulated rubbish and substandard structures located on your real property commonly described as 27285 Citrus Ave., Perris, Riverside County, California and more particularly described as Assessor's Parcel Number 307-260-012.

The total expense due, including all other fees and costs, for the abatement of the above-described dangerous or injurious condition is **two thousand three hundred two dollars and forty-three cents, (US \$2,302.43)**. This amount is immediately due and payable. If you have any objections to the Statement of Abatement Costs attached hereto, you must address your objections to the Board of Supervisors at the hearing. If you have any questions about the attached Statement of Abatement Costs, please contact Carol Lynn Anderson at (951) 955-2004. In the event the total amount due is not paid to the DEPARTMENT prior to the Board Hearing, the DEPARTMENT shall seek an order from the Board of Supervisors to place a lien against your property and collect the amount due as a special tax assessment.

Failure to appear at the hearing will result in the exclusion of your testimony. Facts as known to the DEPARTMENT will be presented to the Board of Supervisors for their final consideration and deliberation of this matter.

You are encouraged to contact Code Enforcement Officer, Stacy Baumgartner (951) 955-2004 prior to the hearing. Please meet with Stacy Baumgartner at 8:30 a.m. on the day of the hearing in Conference Room 2A located on the 1st floor in front of the Human Resources Office to discuss the case.

GLENN BAUDE
DIRECTOR

CAROL LYNN ANDERSON
Administrative Services Officer
Enclosure: Statement of Abatement Costs

EXHIBIT NO. A



COUNTY OF RIVERSIDE CODE ENFORCEMENT

P.O. Box 1469, Riverside, CA 92502
Phone: 951-955-2004 Fax: 951-955-8680

Date: 11/7/2011

Property Reference/Mailing Address
307-260-012 DAVID P SAVELLANO ELIZABETH S SAVELLANO 10409 PARK ST BELLFLOWER, CA 90706

Summary Statement of Abatement Costs

You are liable to the County for the following abatement costs:

Date	Invoice Number & Amount	Amount	Balance
12/31/2000	Balance forward		0.00
06/09/2011	CV0905340- INV #101797.	2,052.13	2,052.13
04/25/2011	CV0905340:A29990- INV #A29990. A29990	100.00	2,152.13
08/02/2011	PMT #CK 1024 PAI. A29990	-100.00	2,052.13
06/09/2011	CV0906580- INV #101809.	250.30	2,302.43
04/25/2011	CV0906580:A29989- INV #A29989. A29989	100.00	2,402.43
08/02/2011	PMT #CK 1024 PAI. A29989	-100.00	2,302.43
		Total Now Due	\$2,302.43

The total abatement costs must be paid to the County of Riverside, P.O. Box 1469, Riverside, CA 92502 within thirty (30) days. In the event said costs are not paid within thirty (30) days you will be liable for additional administrative costs, penalties, court fees, or other collection costs incurred in the collection of these abatement costs.

I affirm and declare under penalty of perjury under the laws of the State of California that the foregoing is true and correct to the best of my knowledge.

Wade

EXHIBIT NO. A2

Code Enforcement Department

**County of Riverside
Code Enforcement Department**

P.O. Box 1469, Riverside, CA 92502
Phone: (951) 955-2004 Fax: (951) 955-8680



Statement of Abatement Costs

307-260-012
DAVID P SAVELLANO
ELIZABETH S SAVELLANO
10409 PARK ST
BELLFLOWER, CA 90706

Date	Invoice #
6/9/2011	101797

Case Number	District	Class
CV0905340	5	SOAC

Property Address
307-260-012 DAVID P SAVELLANO ELIZABETH S SAVELLANO 27285 CITRUS AVE PERRIS, CA 92571

You are liable to the County for the following abatement costs:

Date	Item	Description	Hours/Qty	Rate	Amount
8/28/2009	Officer Hours	Labor Charges - Officer Time	1.5	109.00	163.50
8/28/2009	Officer Hours	Labor Charges - Officer Time	1.5	109.00	163.50
12/16/2009	Officer Hours	Labor Charges - Officer Time	0.1	109.00	10.90
1/8/2010	Officer Hours	Labor Charges - Officer Time	0.2	109.00	21.80
3/24/2010	Officer Hours	Labor Charges - Officer Time	0.1	109.00	10.90
6/17/2010	Officer Hours	Labor Charges - Officer Time	0.2	109.00	21.80
7/9/2010	Officer Hours	Labor Charges - Officer Time	0.2	109.00	21.80
9/1/2010	Officer Hours	Labor Charges - Officer Time	0.1	109.00	10.90
11/5/2010	Officer Hours	Labor Charges - Officer Time	0.1	109.00	10.90
12/1/2010	Officer Hours	Labor Charges - Officer Time	0.8	109.00	87.20
3/4/2011	Officer Hours	Labor Charges - Officer Time	0.1	109.00	10.90
3/8/2011	Officer Hours	Labor Charges - Officer Time	0.4	109.00	43.60
3/8/2011	Officer Hours	Labor Charges - Officer Time	0.4	109.00	43.60
3/16/2011	Officer Hours	Labor Charges - Officer Time	0.1	109.00	10.90
4/25/2011	Officer Hours	Labor Charges - Officer Time	0.2	109.00	21.80
5/25/2011	Officer Hours	Labor Charges - Officer Time	0.1	109.00	10.90
6/9/2011	SOE Preparation	Prepare Statement of Expense		65.00	65.00
		Subtotal Code Enforcement Costs			729.90
7/14/2010	Attorney Fees	Attorney Fees - County Counsel	2.1	74.98095	157.46
7/20/2010	Attorney Fees	Attorney Fees - County Counsel	0.5	143.18	71.59
7/20/2010	Attorney Fees	Attorney Fees - County Counsel	0.4	74.975	29.99
7/22/2010	Attorney Fees	Attorney Fees - County Counsel	0.2	143.20	28.64
6/16/2010	County Counsel-Mail	County Counsel-Mailing	3	5.54	16.62
8/31/2010	County Counsel-Mail	County Counsel-Mailing	3	5.71	17.13
6/9/2011	Prepare Case for SOE He...			125.55	125.55
	Attend SOE Hearing			69.75	69.75

Subtotal

Payments/Credits

Total Now Due

The total abatement costs must be paid to the County of Riverside, P.O. Box 1469, Riverside, CA 92502 within thirty (30) days. In the event said costs are not paid within thirty (30) days you will be liable for additional administrative costs, penalties, court fees or other collection costs incurred in the collection of these abatement costs.

I affirm and declare under penalty of perjury under the laws of the State of California that the foregoing is true and correct to the best of my knowledge.

Dee Cell
Code Enforcement Department

**County of Riverside
Code Enforcement Department**

P.O. Box 1469, Riverside, CA 92502
Phone: (951) 955-2004 Fax: (951) 955-8680



Statement of Abatement Costs

307-260-012
DAVID P SAVELLANO
ELIZABETH S SAVELLANO
10409 PARK ST
BELLFLOWER, CA 90706

Date	Invoice #
6/9/2011	101809

Case Number	District	Class
CV0906580	5	SOAC

Property Address

307-260-012
DAVID P SAVELLANO
ELIZABETH S SAVELLANO
27285 CITRUS AVE
PERRIS, CA 92571

You are liable to the County for the following abatement costs:

Date	Item	Description	Hours/Qty	Rate	Amount
12/16/2009	Officer Hours	Labor Charges - Officer Time	0.1	109.00	10.90
1/8/2010	Officer Hours	Labor Charges - Officer Time	0.1	109.00	10.90
3/24/2010	Officer Hours	Labor Charges - Officer Time	0.1	109.00	10.90
6/17/2010	Officer Hours	Labor Charges - Officer Time	0.2	109.00	21.80
7/9/2010	Officer Hours	Labor Charges - Officer Time	0.1	109.00	10.90
9/1/2010	Officer Hours	Labor Charges - Officer Time	0.1	109.00	10.90
11/5/2010	Officer Hours	Labor Charges - Officer Time	0.1	109.00	10.90
12/1/2010	Officer Hours	Labor Charges - Officer Time	0.2	109.00	21.80
3/8/2011	Officer Hours	Labor Charges - Officer Time	0.3	109.00	32.70
3/8/2011	Officer Hours	Labor Charges - Officer Time	0.3	109.00	32.70
4/25/2011	Officer Hours	Labor Charges - Officer Time	0.1	109.00	10.90
6/9/2011	SOE Preparation	Prepare Statement of Expense		65.00	65.00
		Subtotal Code Enforcement Costs			250.30
Subtotal					\$250.30
Payments/Credits					\$0.00
Total Now Due					\$250.30

The total abatement costs must be paid to the County of Riverside, P.O. Box 1469, Riverside, CA 92502 within thirty (30) days. In the event said costs are not paid within thirty (30) days you will be liable for additional administrative costs, penalties, court fees or other collection costs incurred in the collection of these abatement costs.

I affirm and declare under penalty of perjury under the laws of the State of California that the foregoing is true and correct to the best of my knowledge.

Code Enforcement Department

EXHIBIT NO. AS

NOTICE LIST

Subject Property: 27285 Citrus Ave., Perris; Case Nos.: Cv09-05340 &
CV09-06580; APN: 307-260-012;
District 5 / District 5

DAVID P SAVELLANO
ELIZABETH S SAVELLANO
MR & MRS ROCHUS SCHELLING
27285 CITRUS AVE
PERRIS CA 92571

DAVID P SAVELLANO
ELIZABETH S SAVELLANO
10409 PARK STREET
BELLFLOWER CA 90706

MR & MRS DAVID P SAVELLANO
1078 SO PLYMOUTH BLVD
LOS ANGELES CA 90019

MR & MRS JOSE E DE CASTRO
869 JUAREZ STREET
MONTEBELLO CA 90640

EXHIBIT NO. _____

A6

1
2
3
4
5
6
7
8
9
10
11
12
13
14
15
16
17
18
19
20
21
22
23
24
25
26
27
28

PROOF OF SERVICE

Case Nos. CV09-05340 & CV09-06580

STATE OF CALIFORNIA, COUNTY OF RIVERSIDE

I, Brenda G. Peeler, declare that I am a citizen of the United States and am employed in the County of Riverside, over the age of 18 years and not a party to the within action or proceeding; that my business address is 3960 Orange Street, Suite 500, Riverside, California 92501.

That on February 21, 2012, I served the following document(s):

- **NOTICE OF HEARING RE: STATEMENT OF ABATEMENT COSTS**
- **SUMMARY STATEMENT OF ABATEMENT COSTS**
- **STATEMENT OF ABATEMENT COSTS**
- **NOTICE LIST**

by placing a true copy thereof enclosed in a sealed envelope(s) addressed as follows:

**OWNERS OR INTERESTED PARTIES
(SEE NOTICE LIST ATTACHED TO NOTICE OF HEARING)**

XX **BY FIRST CLASS MAIL.** I am "readily familiar" with the office's practice of collection and processing correspondence for mailing. Under that practice it would be deposited with the U.S. Postal Service on that same day with postage thereon fully prepaid at Riverside, California, in the ordinary course of business.

— **BY PERSONAL SERVICE:** I caused to be delivered such envelope(s) by hand to the offices of the addressee(s).

XX **STATE - I declare under penalty of perjury under the laws of the State of California that the above is true and correct.**

— **FEDERAL - I declare that I am employed in the office of a member of the bar of this court at whose direction the service was made.**

EXECUTED ON February 21, 2012, at Riverside, California.

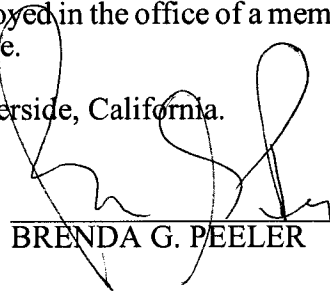

BRENDA G. PEELER

EXHIBIT NO. A7

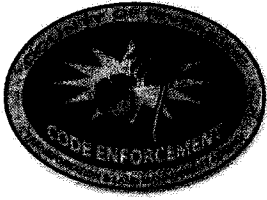

**CODE ENFORCEMENT DEPARTMENT
COUNTY OF RIVERSIDE**

GLENN BAUDE
Director

AFFIDAVIT OF POSTING OF NOTICES

February 22, 2012

RE CASE NO: CV0906580

I, James Pike, hereby declare:

I am employed by the Riverside County Code Enforcement Department; that my business address is 24318 Hemlock, Ave., Suite C-1, Moreno Valley, California 92557 .

That on 02/22/12 at 1000, I securely and conspicuously posted Notice of Hearing Re: Demand for Payment Statement of Abatement Costs Notice of Special Tax Assessment at the property described as:

Property Address: 27285 CITRUS AVE, PERRIS

Assessor's Parcel Number: 307-260-012

I declare under the penalty of perjury that the foregoing is true and correct.

Executed on February 22, 2012 in the County of Riverside, California.

CODE ENFORCEMENT DEPARTMENT

 #59
By: James Pike, Code Enforcement Officer

EXHIBIT NO. AS



**CODE ENFORCEMENT DEPARTMENT
COUNTY OF RIVERSIDE**

GLENN BAUDE
Director

AFFIDAVIT OF POSTING OF NOTICES

February 22, 2012

RE CASE NO: CV0905340

I, James Pike, hereby declare:

I am employed by the Riverside County Code Enforcement Department; that my business address is 24318 Hemlock, Ave., Suite C-1, Moreno Valley, California 92557 .

That on 02/22/12 at 1000, I securely and conspicuously posted Notice of Hearing Re: Demand for Payment Statement of Abatement Costs Notice of Special Tax Assessment at the property described as:

Property Address: 27285 CITRUS AVE, PERRIS

Assessor's Parcel Number: 307-260-012

I declare under the penalty of perjury that the foregoing is true and correct.

Executed on February 22, 2012 in the County of Riverside, California.

CODE ENFORCEMENT DEPARTMENT

 #57

By: James Pike, Code Enforcement Officer

EXHIBIT NO. _____

A9



COUNTY OF RIVERSIDE CODE ENFORCEMENT

P.O. Box 1469, Riverside, CA 92502
Phone: 951-955-2004 Fax: 951-955-8680

Property Reference/Mailing Address
307-260-012 DAVID P SAVELLANO ELIZABETH S SAVELLANO 10409 PARK ST BELLFLOWER, CA 90706

Date: 11/7/2011

Summary Statement of Abatement Costs

You are liable to the County for the following abatement costs:

Date	Invoice Number & Amount	Amount	Balance
12/31/2000	Balance forward		0.00
06/09/2011	CV0905340- INV #101797.	2,052.13	2,052.13
04/25/2011	CV0905340:A29990- INV #A29990. A29990	100.00	2,152.13
08/02/2011	PMT #CK 1024 PAI. A29990	-100.00	2,052.13
06/09/2011	CV0906580- INV #101809.	250.30	2,302.43
04/25/2011	CV0906580:A29989- INV #A29989. A29989	100.00	2,402.43
08/02/2011	PMT #CK 1024 PAI. A29989	-100.00	2,302.43
		Total Now Due	\$2,302.43

The total abatement costs must be paid to the County of Riverside, P.O. Box 1469, Riverside, CA 92502 within thirty (30) days. In the event said costs are not paid within thirty (30) days you will be liable for additional administrative costs, penalties, court fees, or other collection costs incurred in the collection of these abatement costs.

I affirm and declare under penalty of perjury under the laws of the State of California that the foregoing is true and correct to the best of my knowledge.

EXHIBIT NO. 3

Code Enforcement Department

**County of Riverside
Code Enforcement Department**

P.O. Box 1469, Riverside, CA 92502
Phone: (951) 955-2004 Fax: (951) 955-8680



Statement of Abatement Costs

307-260-012
DAVID P SAVELLANO
ELIZABETH S SAVELLANO
10409 PARK ST
BELLFLOWER, CA 90706

Date	Invoice #
6/9/2011	101797

Case Number	District	Class
CV0905340	5	SOAC

Property Address
307-260-012 DAVID P SAVELLANO ELIZABETH S SAVELLANO 27285 CITRUS AVE PERRIS, CA 92571

You are liable to the County for the following abatement costs:

Date	Item	Description	Hours/Qty	Rate	Amount
8/28/2009	Officer Hours	Labor Charges - Officer Time	1.5	109.00	163.50
8/28/2009	Officer Hours	Labor Charges - Officer Time	1.5	109.00	163.50
12/16/2009	Officer Hours	Labor Charges - Officer Time	0.1	109.00	10.90
1/8/2010	Officer Hours	Labor Charges - Officer Time	0.2	109.00	21.80
3/24/2010	Officer Hours	Labor Charges - Officer Time	0.1	109.00	10.90
6/17/2010	Officer Hours	Labor Charges - Officer Time	0.2	109.00	21.80
7/9/2010	Officer Hours	Labor Charges - Officer Time	0.2	109.00	21.80
9/1/2010	Officer Hours	Labor Charges - Officer Time	0.1	109.00	10.90
11/5/2010	Officer Hours	Labor Charges - Officer Time	0.1	109.00	10.90
12/1/2010	Officer Hours	Labor Charges - Officer Time	0.8	109.00	87.20
3/4/2011	Officer Hours	Labor Charges - Officer Time	0.1	109.00	10.90
3/8/2011	Officer Hours	Labor Charges - Officer Time	0.4	109.00	43.60
3/8/2011	Officer Hours	Labor Charges - Officer Time	0.4	109.00	43.60
3/16/2011	Officer Hours	Labor Charges - Officer Time	0.1	109.00	10.90
4/25/2011	Officer Hours	Labor Charges - Officer Time	0.2	109.00	21.80
5/25/2011	Officer Hours	Labor Charges - Officer Time	0.1	109.00	10.90
6/9/2011	SOE Preparation	Prepare Statement of Expense		65.00	65.00
		Subtotal Code Enforcement Costs			729.90
7/14/2010	Attorney Fees	Attorney Fees - County Counsel	2.1	74.98095	157.46
7/20/2010	Attorney Fees	Attorney Fees - County Counsel	0.5	143.18	71.59
7/20/2010	Attorney Fees	Attorney Fees - County Counsel	0.4	74.975	29.99
7/22/2010	Attorney Fees	Attorney Fees - County Counsel	0.2	143.20	28.64
6/16/2010	County Counsel-Mail	County Counsel-Mailing	3	5.54	16.62
8/31/2010	County Counsel-Mail	County Counsel-Mailing	3	5.71	17.13
6/9/2011	Prepare Case for SOE He... Attend SOE Hearing			125.55	125.55
				69.75	69.75

Subtotal

Payments/Credits

Total Now Due

The total abatement costs must be paid to the County of Riverside, P.O. Box 1469, Riverside, CA 92502 within thirty (30) days. In the event said costs are not paid within thirty (30) days you will be liable for additional administrative costs, penalties, court fees or other collection costs incurred in the collection of these abatement costs.

I affirm and declare under penalty of perjury under the laws of the State of California that the foregoing is true and correct to the best of my knowledge.

Dee Cell

Code Enforcement Department

EXHIBIT NO. 32

**County of Riverside
Code Enforcement Department**

P.O. Box 1469, Riverside, CA 92502
Phone: (951) 955-2004 Fax: (951) 955-8680



Statement of Abatement Costs

307-260-012
DAVID P SAVELLANO
ELIZABETH S SAVELLANO
10409 PARK ST
BELLFLOWER, CA 90706

Date	Invoice #
6/9/2011	101797

Case Number	District	Class
CV0905340	5	SOAC

Property Address
307-260-012 DAVID P SAVELLANO ELIZABETH S SAVELLANO 27285 CITRUS AVE PERRIS, CA 92571

You are liable to the County for the following abatement costs:

Date	Item	Description	Hours/Qty	Rate	Amount
		Subtotal County Counsel Costs			516.73
2/4/2010	Lot/Title Report	Lot/Title Report	1	114.00	114.00
1/5/2011	Asbestos Survey & Abate...	Asbestos Survey & Abatement	1	571.50	571.50
6/9/2011	Lot Book Report			120.00	120.00
		Subtotal Contractor Costs			805.50
Subtotal					\$2,052.13
Payments/Credits					\$0.00
Total Now Due					\$2,052.13

The total abatement costs must be paid to the County of Riverside, P.O. Box 1469, Riverside, CA 92502 within thirty (30) days. In the event said costs are not paid within thirty (30) days you will be liable for additional administrative costs, penalties, court fees or other collection costs incurred in the collection of these abatement costs.

I affirm and declare under penalty of perjury under the laws of the State of California that the foregoing is true and correct to the best of my knowledge.

David P Savellano
Code Enforcement Department

EXHIBIT NO. B3

County of Riverside
Code Enforcement Department

P.O. Box 1469, Riverside, CA 92502
Phone: (951) 955-2004 Fax: (951) 955-8680



Statement of Abatement Costs

307-260-012
DAVID P SAVELLANO
ELIZABETH S SAVELLANO
10409 PARK ST
BELLFLOWER, CA 90706

Date	Invoice #
6/9/2011	101809

Case Number	District	Class
CV0906580	5	SOAC

Property Address
307-260-012 DAVID P SAVELLANO ELIZABETH S SAVELLANO 27285 CITRUS AVE PERRIS, CA 92571

You are liable to the County for the following abatement costs:

Date	Item	Description	Hours/Qty	Rate	Amount
12/16/2009	Officer Hours	Labor Charges - Officer Time	0.1	109.00	10.90
1/8/2010	Officer Hours	Labor Charges - Officer Time	0.1	109.00	10.90
3/24/2010	Officer Hours	Labor Charges - Officer Time	0.1	109.00	10.90
6/17/2010	Officer Hours	Labor Charges - Officer Time	0.2	109.00	21.80
7/9/2010	Officer Hours	Labor Charges - Officer Time	0.1	109.00	10.90
9/1/2010	Officer Hours	Labor Charges - Officer Time	0.1	109.00	10.90
11/5/2010	Officer Hours	Labor Charges - Officer Time	0.1	109.00	10.90
12/1/2010	Officer Hours	Labor Charges - Officer Time	0.2	109.00	21.80
3/8/2011	Officer Hours	Labor Charges - Officer Time	0.3	109.00	32.70
3/8/2011	Officer Hours	Labor Charges - Officer Time	0.3	109.00	32.70
4/25/2011	Officer Hours	Labor Charges - Officer Time	0.1	109.00	10.90
6/9/2011	SOE Preparation	Prepare Statement of Expense		65.00	65.00
		Subtotal Code Enforcement Costs			250.30
				Subtotal	\$250.30
				Payments/Credits	\$0.00
				Total Now Due	\$250.30

The total abatement costs must be paid to the County of Riverside, P.O. Box 1469, Riverside, CA 92502 within thirty (30) days. In the event said costs are not paid within thirty (30) days you will be liable for additional administrative costs, penalties, court fees or other collection costs incurred in the collection of these abatement costs.

I affirm and declare under penalty of perjury under the laws of the State of California that the foregoing is true and correct to the best of my knowledge.

Code Enforcement Department

EXHIBIT NO. 34

Vouchers

Criteria: Accounting Date = 8/1/2002..6/30/2011

Accounting Date	Voucher ID	Invoice ID	Vendor ID	Vendor Name	Amount Invoiced	Amount Paid	Amount Due
Fund 10000 -- General Fund							
3/22/2010	TLARC-00244238	RZ00018	RIVCO-0000054864	RZ Title Services Inc	114.00	114.00	0.00
Total General Fund					114.00	114.00	0.00

EXHIBIT NO. _____ **B5**

LIBRARY NO. _____

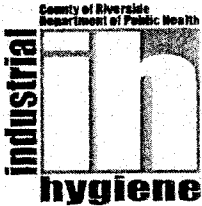

Dedicated to delivering state-of-the-art occupational and environmental consultation to businesses, governmental agencies and communities of Riverside County

DATE: December 22, 2010

INVOICE # 96790

TO: Code Enforcement

ATTN: Fiscal/Account Payable

MS#2715

RECEIVED DEC 29 2010

PAYMENT APPROVAL	
Fund	10000
DeptID	3140100000
Account	52340
Project	ZCV0905340
Amount Paid	\$571.50
Signature	<i>[Signature]</i>
Date	1/11/11

SERVICES PROVIDED: AQMD Survey
SITE(s) OF WORK: 27285 Citrus Avenue, Perris
DATE OF SERVICES: 11/23/10 - 12/22/10
REQUESTOR: Regina Keyes

CHARGES FOR ANY: Field, Office, Report, and Travel Time, Lab & Mileage cost

LABOR:	4.50	Hours X	\$105.00	\$472.50
TRAVEL:	28.00	Miles X	\$0.500	\$14.00
LABORATORY:				\$70.00
POSTAGE:				\$15.00

TOTAL INVOICE: \$571.50

PAYABLE TO: INDUSTRIAL HYGIENE
INVOICE #: 96790
MAIL TO: County of Riverside, CHA
Fiscal Dept. / Accounts Receivable
P.O. Box 7849
Riverside, CA 92513-7600

Steven Hinde
Steven Hinde, REHS, CIH
Senior Industrial Hygienist

COUNTY ONLY:	FUND:	10000
Our accounting string for JE	DEPT ID:	4200101500
	PROGRAM:	94800
Fiscal = 358.7433 / 358.5374	CLASS:	6610
Send copies to M/S # 3320	INTRA FUND:	572800
CHA / Fiscal - A/R	INTER FUND:	774630

cc: Fiscal Accountant - CHA
0509

County of Riverside, Department of Public Health, Office of Industrial Hygiene
 3900 Sherman Dr. Suite G Riverside, California 92503
 phone 951.358.5050, fax 951.358.5443, tdd 951.358.5124

RECEIVED DEC 29 2010

To Brent 11/12/10

EXHIBIT NO. B6



INVOICE

Order Number: 26047	Order Date: 11/22/2011
----------------------------	-------------------------------

Customer Information:

Acct No. 1044

RIVERSIDE COUNTY TLMA-CODE INFORCEMENT
4080 Lemon Street
Riverside, CA 92501

Attn: Brent Steele
REF: CV09-05340 & CV09-06580/Angela Sarmiento
IN RE: SAVELLANO, DAVID & SAVELLANO ELIZABETH

Product and/or Service ordered for Property known as:	
27285 Citrus Avenue Perris, CA 92571	
DESCRIPTION:	FEE:
Lot Book Report	\$120.00
TOTAL DUE:	\$120.00

Payment due upon receipt. Please remit to:

RZ Title Services, Inc.
P.O. Box 1193
Whittier, CA 90609

EXHIBIT NO. B7

Assessment Roll For the 2011-2012 Tax Year as of January 1,2011

Assessment #307260012-7		Parcel # 307260012-7	
Assessee:	SAVELLANO DAVID P	Land	140,301
Assessee:	SAVELLANO ELIZABETH S	Structure	10,251
Mail Address:	10409 PARK ST	Full Value	150,552
City, State Zip:	BELLFLOWER CA 90706	Total Net	150,552
Real Property Use Code:	R1		
Base Year	1985		
Conveyance Number:	9999998		
Conveyance (mm/yy):	5/1989		
PUI:	R010022		
TRA:	83-007		
Taxability Code:	0-00		
ID Data:	Lot 50 MB 008/015 ORANGE VISTA ACRES		
Situs Address:	27285 CITRUS AVE PERRIS CA 92571		

View Parcel Map

EXHIBIT NO. C

RIVERSIDE COUNTY GIS

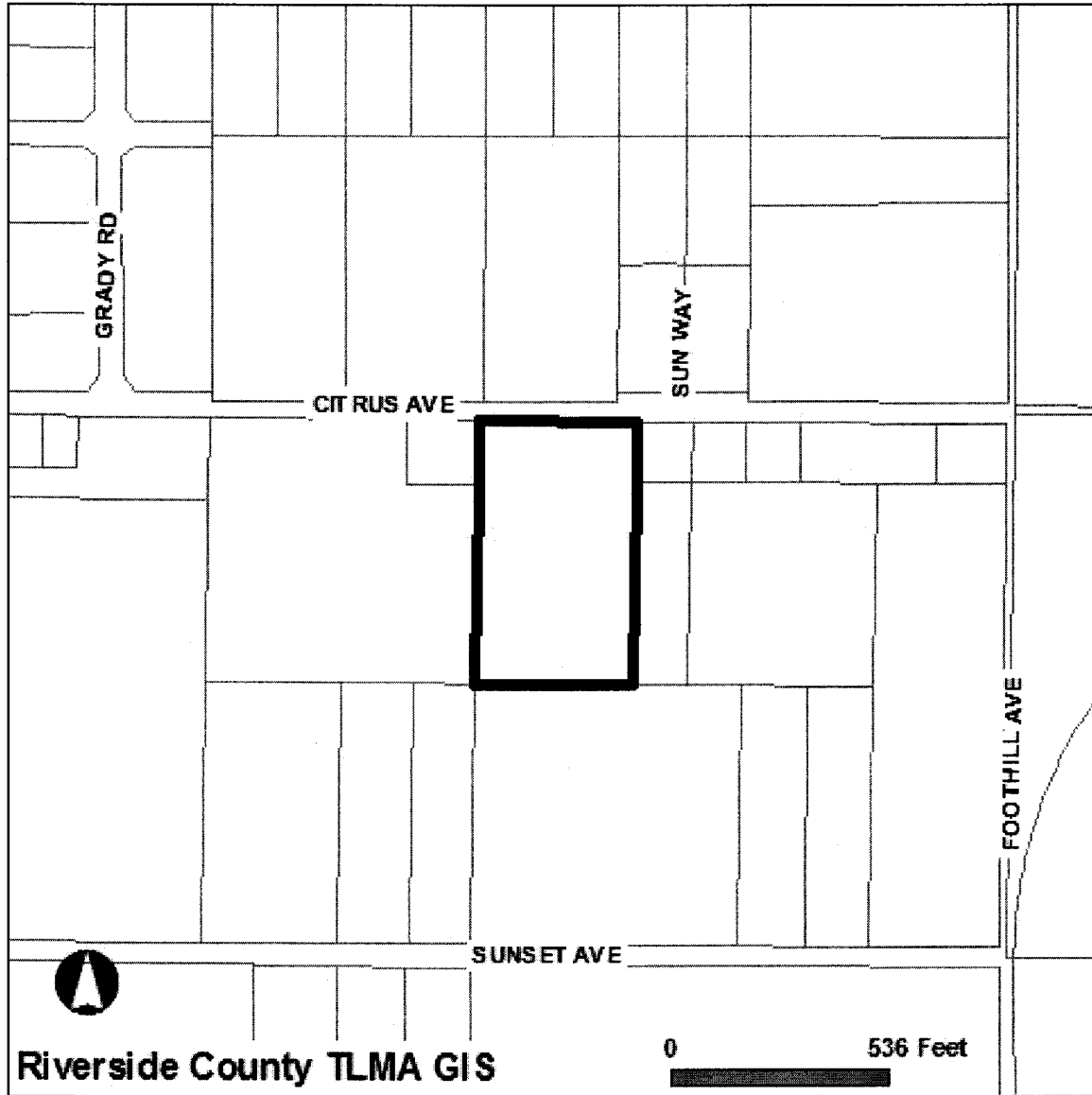

Selected parcel(s):
307-260-012

IMPORTANT

Maps and data are to be used for reference purposes only. Map features are approximate, and are not necessarily accurate to surveying or engineering standards. The County of Riverside makes no warranty or guarantee as to the content (the source is often third party), accuracy, timeliness, or completeness of any of the data provided, and assumes no legal responsibility for the information contained on this map. Any use of this product with respect to accuracy and precision shall be the sole responsibility of the user.

STANDARD REPORT

APNs

307-260-012-7

OWNER NAME / ADDRESS

DAVID P SAVELLANO
ELIZABETH S SAVELLANO
27285 CITRUS AVE
PERRIS, CA. 92571

MAILING ADDRESS

(SEE OWNER)
10409 PARK ST
BELLFLOWER CA. 90706

EXHIBIT NO. C²

LEGAL DESCRIPTION

RECORDED BOOK/PAGE: MB 8/15
SUBDIVISION NAME: ORANGE VISTA ACRES
LOT/PARCEL: 50, BLOCK: NOT AVAILABLE
, Por. TRACT NUMBER: NOT AVAILABLE

LOT SIZE

RECORDED LOT SIZE IS 5.84 ACRES

PROPERTY CHARACTERISTICS

307-260-012

CONCRETE BLOCK THROUGHOUT, 1271 SQFT., 4 BDRM/ 1 BATH, 2 STORY, DETACHED GARAGE(323 SQ. FT), CONST'D 1946 COMPOSITION, ROOF

307-260-012

WOOD FRAME, 1224 SQFT., 3 BDRM/ 1.75 BATH, 1 STORY, DETACHED GARAGE(480 SQ. FT), CONST'D 1966 COMPOSITION, ROOF, CENTRAL HEATING, CENTRAL COOLING

THOMAS BROS. MAPS PAGE/GRID

PAGE: 778 GRID: C6, C7

CITY BOUNDARY/SPHERE

NOT WITHIN A CITY
NOT WITHIN A CITY SPHERE
ANNEXATION DATE: NOT APPLICABLE
NO LAFCO CASE # AVAILABLE
NO PROPOSALS

MARCH JOINT POWERS AUTHORITY

NOT IN THE JURISDICTION OF THE MARCH JOINT POWERS AUTHORITY

INDIAN TRIBAL LAND

NOT IN A TRIBAL LAND

SUPERVISORIAL DISTRICT 2011 (ORD. 813)

MARION ASHLEY, DISTRICT 5

SUPERVISORIAL DISTRICT (2001 BOUNDARIES)

MARION ASHLEY, DISTRICT 5

TOWNSHIP/RANGE

T4SR3W SEC 22

ELEVATION RANGE

1464/1472 FEET

PREVIOUS APN

307-250-007

PLANNING

LAND USE DESIGNATIONS

Zoning not consistent with the General Plan.
MDR

SANTA ROSA ESCARPMENT BOUNDARY

NOT IN THE SANTA ROSA ESCARPMENT BOUNDARY

AREA PLAN (RCIP)

LAKEVIEW / NUEVO

GENERAL PLAN POLICY OVERLAYS

NOT IN A GENERAL PLAN POLICY OVERLAY AREA

GENERAL PLAN POLICY AREAS

NONE

ZONING CLASSIFICATIONS (ORD. 348)

R-R

ZONING DISTRICTS AND ZONING AREAS

NUEVO AREA

ZONING OVERLAYS

NOT IN A ZONING OVERLAY

NOT IN AN HISTORIC PRESERVATION DISTRICT

SPECIFIC PLANS

NOT WITHIN A SPECIFIC PLAN

AGRICULTURAL PRESERVE

NOT IN AN AGRICULTURAL PRESERVE

REDEVELOPMENT AREAS

NOT IN A REDEVELOPMENT AREA

AIRPORT INFLUENCE AREAS

MARCH AIR RESERVE BASE

AIRPORT COMPATIBILITY ZONES

NOT IN AN AIRPORT COMPATIBILITY ZONE

ENVIRONMENTAL

CVMSHCP (COACHELLA VALLEY MULTI-SPECIES HABITAT CONSERVATION PLAN) CONSERVATION AREA

NOT IN A CONSERVATION AREA

CVMSHCP FLUVIAL SAND TRANSPORT SPECIAL PROVISION AREAS

NOT IN A FLUVIAL SAND TRANSPORT SPECIAL PROVISION AREA

WRMSHCP (WESTERN RIVERSIDE COUNTY MULTI-SPECIES HABITAT CONSERVATION PLAN) CELL GROUP

NOT IN A CELL GROUP

WRMSHCP CELL NUMBER

NOT IN A CELL

HANS/ERP (HABITAT ACQUISITION AND NEGOTIATION STRATEGY/EXPEDITED REVIEW PROCESS)

NONE

VEGETATION (2005)

AGRICULTURAL LAND
DEVELOPED/DISTURBED LAND

FIRE

HIGH FIRE AREA (ORD. 787)

NOT IN A HIGH FIRE AREA

FIRE RESPONSIBILITY AREA

NOT IN A FIRE RESPONSIBILITY AREA

DEVELOPMENT FEES

CVMSHCP FEE AREA (ORD. 875)

NOT WITHIN THE COACHELLA VALLEY MSHCP FEE AREA

WRMSHCP FEE AREA (ORD. 810)

IN OR PARTIALLY WITHIN THE WESTERN RIVERSIDE MSHCP FEE AREA. SEE MAP FOR MORE INFORMATION.

ROAD & BRIDGE DISTRICT

NOT IN A DISTRICT

EASTERN TUMF (TRANSPORTATION UNIFORM MITIGATION FEE ORD. 673)

NOT WITHIN THE EASTERN TUMF FEE AREA

WESTERN TUMF (TRANSPORTATION UNIFORM MITIGATION FEE ORD. 824)

IN OR PARTIALLY WITHIN A TUMF FEE AREA. SEE MAP FOR MORE INFORMATION. CENTRAL

DIF (DEVELOPMENT IMPACT FEE AREA ORD. 659)

LAKEVIEW/NUEVO

SKR FEE AREA (STEPHEN'S KANGAROO RAT ORD. 663.10)

IN OR PARTIALLY WITHIN AN SKR FEE AREA. SEE MAP FOR MORE INFORMATION.

DEVELOPMENT AGREEMENTS

NOT IN A DEVELOPMENT AGREEMENT AREA

TRANSPORTATION

CIRCULATION ELEMENT ULTIMATE RIGHT-OF-WAY
NOT IN A CIRCULATION ELEMENT RIGHT-OF-WAY

ROAD BOOK PAGE
62

TRANSPORTATION AGREEMENTS
NOT IN A TRANSPORTATION AGREEMENT

CETAP (COMMUNITY AND ENVIRONMENTAL TRANSPORTATION ACCEPTABILITY PROCESS) CORRIDORS
NOT IN A CETAP CORRIDOR.

HYDROLOGY

FLOOD PLAIN REVIEW
NOT REQUIRED

WATER DISTRICT
EMWD

FLOOD CONTROL DISTRICT
RIVERSIDE COUNTY FLOOD CONTROL DISTRICT

WATERSHED
SAN JACINTO VALLEY

GEOLOGIC

FAULT ZONE
NOT IN A FAULT ZONE

FAULTS
NOT WITHIN A 1/2 MILE OF A FAULT

LIQUEFACTION POTENTIAL
LOW

SUBSIDENCE
SUSCEPTIBLE

PALEONTOLOGICAL SENSITIVITY
HIGH SENSITIVITY (HIGH B).
SENSITIVITY EQUIVALENT TO HIGH A, BUT IS BASED ON THE OCCURRENCE OF FOSSILS AT A SPECIFIED DEPTH BELOW THE SURFACE.
THE CATEGORY HIGH B INDICATES THAT FOSSILS ARE LIKELY TO BE ENCOUNTERED AT OR BELOW FOUR FEET OF DEPTH, AND MAY BE IMPACTED DURING EXCAVATION BY CONSTRUCTION ACTIVITIES.

MISCELLANEOUS

SCHOOL DISTRICT
NUVIEW UNION & PERRIS UNION HIGH

COMMUNITIES
NUEVO

COUNTY SERVICE AREA
IN OR PARTIALLY WITHIN
LAKEVIEW/NUEVO/ROMOLAND/HOMELAND #146 -
STREET LIGHTING
LIBRARY

LIGHTING (ORD. 655)
ZONE B, 36.13 MILES FROM MT. PALOMAR OBSERVATORY

2000 CENSUS TRACT
042602

FARMLAND
OTHER LANDS

- 083007
- COUNTY FREE LIBRARY
- COUNTY STRUCTURE FIRE PROTECTION
- COUNTY WASTE RESOURCE MGMT DIST
- CSA 146
- CSA 152
- EASTERN MUN WATER IMP DIST 13
- EASTERN MUN WATER IMP DIST A
- EASTERN MUNICIPAL WATER
- FLOOD CONTROL ADMINISTRATION
- FLOOD CONTROL ZONE 4
- GENERAL
- GENERAL PURPOSE
- METRO WATER EAST 1301999
- MT SAN JACINTO JUNIOR COLLEGE
- NUVIEW SCHOOL
- PERRIS AREA ELEM SCHOOL FUND
- PERRIS JR HIGH AREA FUND
- PERRIS UNION HIGH SCHOOL
- PERRIS VALLEY CEMETERY
- RIV CO REG PARK & OPEN SPACE
- RIV. CO. OFFICE OF EDUCATION
- SAN JACINTO BASIN RESOURCE CONS
- VALLEY HEALTH SYSTEM HOSP DIST

SPECIAL NOTES

NO SPECIAL NOTES

CODE COMPLAINTS

Case #	Description	Start Date
NO CODE COMPLAINTS	NOT APPLICABLE	NOT APPLICABLE

REPORT PRINTED ON...Thu Feb 16 10:49:22 2012
Version 120118



P.O. Box 1193
 Whittier, CA 90609
 Tel # (562) 325-8351
 Fax # (714) 783-3038

Lot Book Report

Order Number: **26047**

Customer:

RIVERSIDE COUNTY TLMA-CODE INFORCEMENT
 4080 Lemon Street
 Riverside CA 92501

Order Date: 11/22/2011
 Dated as of: 11/21/2011
 County Name: Riverside

Attn: Brent Steele
 Reference: CV09-05340 & CV09-06580/Angela Sarmiento
 IN RE: SAVELLANO, DAVID & SAVELLANO ELIZABET

FEE(s):
 Report: \$120.00

Property Address: 27285 Citrus Avenue
 Perris CA 92571

Assessor's Parcel No. : 307-260-012-7

Assessments:

Land Value:	\$140,301.00
Improvement Value:	\$10,251.00
Exemption Value:	\$0.00
Total Value:	\$150,552.00

Tax Information

Property Taxes for the Fiscal Year	2011-2012
Total Annual Tax	\$1,717.68
Status: Paid through	06/30/2012

Property Vesting

The last recorded document transferring title of said property

Dated	08/27/1984
Recorded	09/27/1984

EXHIBIT NO. D



P.O. Box 1193
Whittier, CA 90609
Tel # (562) 325-8351
Fax # (714) 783-3038

Order Number: 26047
Reference: CV09-05340 & CV

Document No.	209604
D.T.T.	None Shown
Grantor	Jose Esguerra De Castro and Lina P. De Castro, husband and wife
Grantee	David P. Savellano and Elizabeth S Savellano, husband and wife, as joint tenants

Deeds of Trust

Position No.	1st
A Deed of Trust Dated	01/24/1983
Recorded	02/01/1983
Document No.	19759
Amount	\$128,125.00
Trustor	Jose Esguerra De Castro and Lina P. De Castro, husband and wife
Trustee	John J. Pearce Escrows, Inc., a California corporation
Beneficiary	Rochus Schelling and Alice Schelling, husband and wife, as joint tenants

Position No.	2nd
A Deed of Trust Dated	09/04/1984
Recorded	09/27/1984
Document No.	209605
Amount	\$28,818.98
Trustor	David P. Savellano and Elizabeth S. Savellano, husband and wife
Trustee	John J. Pearce Escrows, Inc., a California corporation
Beneficiary	Jose Esguerra De Castro and Lina P. De Castro, husband and wife, as joint tenants

Additional Information

Notice of Non-Compliance filed by	County of Riverside Code Enforcement Department
In the matter of the property of	David P. Savellano and Elizabeth S. Savellano
Case No.	CV09-05340 & CV09-06580



P.O. Box 1193
Whittier, CA 90609
Tel # (562) 325-8351
Fax # (714) 783-3038

Order Number: 26047

Reference: CV09-05340 & CV

Recorded	01/06/2010
Document No.	2010-0003523
Document Type	Findings of Fact, Conclusions and Order to Abate Nuisance
Document No.	2010-0385456
Recorded	08/16/2010

Legal Description

THE LAND REFERRED TO IN THIS REPORT IS LOCATED IN AND IS DESCRIBED AS FOLLOWS:

LOT 50 OF ORANGE VISTA ACRES, IN THE COUNTY OF RIVERSIDE, STATE OF CALIFORNIA, AS SHOWN BY MAP ON FILE IN BOOK 8, PAGE 15 OF MAPS, RECORDS OF SAID COUNTY RECORDER.

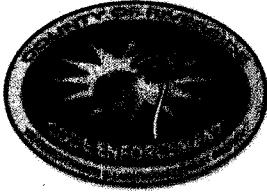

County of Riverside Code Enforcement Department

P.O. Box 1469, Riverside, CA 92502
Phone: (951) 955-2004 Fax: (951) 955-8680

DEMAND FOR PAYMENT STATEMENT OF ABATEMENT COSTS NOTICE OF SPECIAL TAX ASSESSMENT

January 3, 2012

David P & Elizabeth S Savellano
10409 Park St
Bellflower, CA 90706

Subject Property: 27285 Citrus Ave, Perris
Case No(s): CV09-05340 & CV09-06580
APN No(s): 307-260-012

Dear David P & Elizabeth S Savellano:

NOTICE IS HEREBY GIVEN that the County of Riverside Code Enforcement Department ("DEPARTMENT") incurred expenses during our efforts to abate the code violation(s) on the Subject Property. Said abatement case involved Substandard Structure and Accumulated Rubbish (AR) located on your real property commonly described as 27285 Citrus Ave, Perris and more particularly described as Assessor's Parcel Number 307-260-012.

The total amount due for the DEPARTMENT'S actions concerning the above-described dangerous or injurious condition is **Two Thousand Three Hundred Two Dollars and Forty-Three Cents (\$2,302.43)**.

You have thirty (30) days from the date of this letter to pay the DEPARTMENT at the above address the total amount due on the enclosed "Summary Statement of Abatement Costs" or a special tax assessment and abatement lien will be recorded upon the subject property. Payment must be made in the form of cashier's check or money order, made payable to the County of Riverside. Please note the property APN on the memo line of the check.

YOU HAVE A RIGHT TO A HEARING ON THIS MATTER BEFORE THE RIVERSIDE COUNTY BOARD OF SUPERVISORS OR AN ADMINISTRATIVE HEARING OFFICER. You have the right to contest the abatement costs and special assessment against the subject property. If you choose to exercise your right to a public hearing before the Board of Supervisors, please complete the enclosed "Board of Supervisors Request for Public Hearing" form and return it to the Code Enforcement Department within twenty (20) days of the date of this letter.

In the event you do not request a public hearing before the Board of Supervisors, a public hearing before an Administrative Hearing Officer shall be scheduled and held for a final determination of this matter and authority to place a lien against the Subject Property and adding the amount due as a special tax assessment on the County tax rolls.

If you have any questions regarding this notice, please contact us at (951) 955-2004.

Code Enforcement Department

Carol Lynn Anderson
Administrative Services Officer

EXHIBIT NO. E

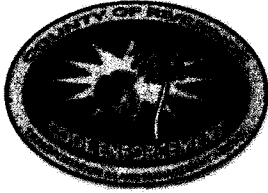

**CODE ENFORCEMENT DEPARTMENT
COUNTY OF RIVERSIDE**

**BOARD OF SUPERVISORS
REQUEST FOR PUBLIC HEARING
ON STATEMENT OF ABATEMENT COSTS
AND SPECIAL TAX ASSESSMENT**

David P & Elizabeth S Savellano
10409 Park St
Bellflower, CA 90706

Subject Property: 27285 Citrus Ave, Perris
Case No(s): CV09-05340 & CV09-06580
APN No(s): 307-260-012

I, _____, hereby request a public hearing before the Board of Supervisors
(Please PRINT your name here)

regarding case number(s) _____.

I request notice of the Board of Supervisors hearing date, time, and location (which shall not be less than 10 days from the submission of this request) to be mailed to me at the following address:

Return Mailing Address: _____

Signed: _____
(Please SIGN your name here)

Date: _____

Print: _____
(Please PRINT your name here)

You may contact me at the following daytime phone number: _____

IMPORTANT

Keep a copy of this form and mail the original to:
Riverside County Code Enforcement Department
P.O. BOX 1469
Riverside, CA 92502-1469

EXHIBIT NO. E²



COUNTY OF RIVERSIDE CODE ENFORCEMENT

P.O. Box 1469, Riverside, CA 92502
Phone: 951-955-2004 Fax: 951-955-8680

Property Reference/Mailing Address

Date: 11/7/2011

307-260-012
DAVID P SAVELLANO
ELIZABETH S SAVELLANO
10409 PARK ST
BELLFLOWER, CA 90706

Summary Statement of Abatement Costs

You are liable to the County for the following abatement costs:

Date	Invoice Number & Amount	Amount	Balance
12/31/2000	Balance forward		0.00
06/09/2011	CV0905340- INV #101797.	2,052.13	2,052.13
04/25/2011	CV0905340:A29990- INV #A29990. A29990	100.00	2,152.13
08/02/2011	PMT #CK 1024 PAI. A29990	-100.00	2,052.13
06/09/2011	CV0906580- INV #101809.	250.30	2,302.43
04/25/2011	CV0906580:A29989- INV #A29989. A29989	100.00	2,402.43
08/02/2011	PMT #CK 1024 PAI. A29989	-100.00	2,302.43
		Total Now Due	\$2,302.43

The total abatement costs must be paid to the County of Riverside, P.O. Box 1469, Riverside, CA 92502 within thirty (30) days. In the event said costs are not paid within thirty (30) days you will be liable for additional administrative costs, penalties, court fees, or other collection costs incurred in the collection of these abatement costs.

I affirm and declare under penalty of perjury under the laws of the State of California that the foregoing is true and correct to the best of my knowledge.

EXHIBIT NO. E3

Code Enforcement Department

**County of Riverside
Code Enforcement Department**

P.O. Box 1469, Riverside, CA 92502
Phone: (951) 955-2004 Fax: (951) 955-8680



Statement of Abatement Costs

307-260-012
DAVID P SAVELLANO
ELIZABETH S SAVELLANO
10409 PARK ST
BELLFLOWER, CA 90706

Date	Invoice #
6/9/2011	101797

Case Number	District	Class
CV0905340	5	SOAC

Property Address
307-260-012 DAVID P SAVELLANO ELIZABETH S SAVELLANO 27285 CITRUS AVE PERRIS, CA 92571

You are liable to the County for the following abatement costs:

Date	Item	Description	Hours/Qty	Rate	Amount
8/28/2009	Officer Hours	Labor Charges - Officer Time	1.5	109.00	163.50
8/28/2009	Officer Hours	Labor Charges - Officer Time	1.5	109.00	163.50
12/16/2009	Officer Hours	Labor Charges - Officer Time	0.1	109.00	10.90
1/8/2010	Officer Hours	Labor Charges - Officer Time	0.2	109.00	21.80
3/24/2010	Officer Hours	Labor Charges - Officer Time	0.1	109.00	10.90
6/17/2010	Officer Hours	Labor Charges - Officer Time	0.2	109.00	21.80
7/9/2010	Officer Hours	Labor Charges - Officer Time	0.2	109.00	21.80
9/1/2010	Officer Hours	Labor Charges - Officer Time	0.1	109.00	10.90
11/5/2010	Officer Hours	Labor Charges - Officer Time	0.1	109.00	10.90
12/1/2010	Officer Hours	Labor Charges - Officer Time	0.8	109.00	87.20
3/4/2011	Officer Hours	Labor Charges - Officer Time	0.1	109.00	10.90
3/8/2011	Officer Hours	Labor Charges - Officer Time	0.4	109.00	43.60
3/8/2011	Officer Hours	Labor Charges - Officer Time	0.4	109.00	43.60
3/16/2011	Officer Hours	Labor Charges - Officer Time	0.1	109.00	10.90
4/25/2011	Officer Hours	Labor Charges - Officer Time	0.2	109.00	21.80
5/25/2011	Officer Hours	Labor Charges - Officer Time	0.1	109.00	10.90
6/9/2011	SOE Preparation	Prepare Statement of Expense		65.00	65.00
		Subtotal Code Enforcement Costs			729.90
7/14/2010	Attorney Fees	Attorney Fees - County Counsel	2.1	74.98095	157.46
7/20/2010	Attorney Fees	Attorney Fees - County Counsel	0.5	143.18	71.59
7/20/2010	Attorney Fees	Attorney Fees - County Counsel	0.4	74.975	29.99
7/22/2010	Attorney Fees	Attorney Fees - County Counsel	0.2	143.20	28.64
6/16/2010	County Counsel-Mail	County Counsel-Mailing	3	5.54	16.62
8/31/2010	County Counsel-Mail	County Counsel-Mailing	3	5.71	17.13
6/9/2011	Prepare Case for SOE He... Attend SOE Hearing			125.55 69.75	125.55 69.75

Subtotal

The total abatement costs must be paid to the County of Riverside, P.O. Box 1469, Riverside, CA 92502 within thirty (30) days. In the event said costs are not paid within thirty (30) days you will be liable for additional administrative costs, penalties, court fees or other collection costs incurred in the collection of these abatement costs.

Payments/Credits

Total Now Due

I affirm and declare under penalty of perjury under the laws of the State of California that the foregoing is true and correct to the best of my knowledge.

David P Savellano
Code Enforcement Department

**County of Riverside
Code Enforcement Department**

P.O. Box 1469, Riverside, CA 92502
Phone: (951) 955-2004 Fax: (951) 955-8680

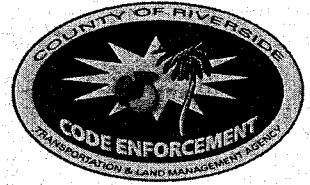

Statement of Abatement Costs

307-260-012
DAVID P SAVELLANO
ELIZABETH S SAVELLANO
10409 PARK ST
BELLFLOWER, CA 90706

Date	Invoice #
6/9/2011	101797

Case Number	District	Class
CV0905340	5	SOAC

Property Address
307-260-012 DAVID P SAVELLANO ELIZABETH S SAVELLANO 27285 CITRUS AVE PERRIS, CA 92571

You are liable to the County for the following abatement costs:

Date	Item	Description	Hours/Qty	Rate	Amount
		Subtotal County Counsel Costs			516.73
2/4/2010	Lot/Title Report	Lot/Title Report	1	114.00	114.00
1/5/2011	Asbestos Survey & Abate...	Asbestos Survey & Abatement	1	571.50	571.50
6/9/2011	Lot Book Report			120.00	120.00
		Subtotal Contractor Costs			805.50
Subtotal					\$2,052.13
Payments/Credits					\$0.00
Total Now Due					\$2,052.13

The total abatement costs must be paid to the County of Riverside, P.O. Box 1469, Riverside, CA 92502 within thirty (30) days. In the event said costs are not paid within thirty (30) days you will be liable for additional administrative costs, penalties, court fees or other collection costs incurred in the collection of these abatement costs.

I affirm and declare under penalty of perjury under the laws of the State of California that the foregoing is true and correct to the best of my knowledge.

David P Savellano
Code Enforcement Department

EXHIBIT NO. E⁵



**CODE ENFORCEMENT DEPARTMENT
COUNTY OF RIVERSIDE**

GLENN BAUDE
Director

RESPONSIBLE PARTIES

January 3, 2012

OWNER

DAVID P SAVELLANO / ELIZABETH S SAVELLANO
10409 PARK ST
BELLFLOWER, CA 90706

DAVID P SAVELLANO / ELIZABETH S SAVELLANO
27285 CITRUS AVE
PERRIS, CA 92571

MR. AND MRS. DAVID P. SAVELLANO
1078 SO. PLYMOUTH BLVD
LOS ANGELES, CA 90019

JOSE ESGUERRA DE CASTRO AND LINA P. DE CASTRO
869 JUAREZ STREET
MONTEBELLO, CA 90640

MR. AND MRS. ROCHUS SCHELLING
27285 CITRUS AVE
PERRIS, CA 92370

SOUTHERN CALIFORNIA GAS CO.
P.O. BOX 3150
SAN DIMAS, CA 91773

EXHIBIT NO. E7



**CODE ENFORCEMENT DEPARTMENT
COUNTY OF RIVERSIDE**

GLENN BAUDE
Director

PROOF OF SERVICE

Case No. CV09-05340 & CV09-06580

STATE OF CALIFORNIA, COUNTY OF RIVERSIDE

I, Tamara Greaves, declare that I am a citizen of the United States and am employed in the County of Riverside, over the age of 18 years and not a party to the within action or proceeding; that my business address is at the footer of this notice.

That on January 3, 2012, I served the following documents(s):

**Notice of Hearing Re: Demand for Payment Statement of Abatement Costs
Notice of Special Tax Assessment**

**Request for Public Hearing on Statement of Abatement Costs
and Special Tax Assessment**

Notice List

by placing a true copy thereof enclosed in a sealed envelope(s) by **REGULAR MAIL** addressed as follows:

DAVID P SAVELLANO / ELIZABETH S SAVELLANO 10409 PARK ST, BELLFLOWER, CA 90706
DAVID P SAVELLANO / ELIZABETH S SAVELLANO 27285 CITRUS AVE, PERRIS, CA 92571
MR. AND MRS. DAVID P. SAVELLANO 1078 SO. PLYMOUTH BLVD, LOS ANGELES, CA 90019
JOSE ESGUERRA DE CASTRO AND LINA P. DE CASTRO 869 JUAREZ STREET, MONTEBELLO, CA 90640
MR. AND MRS. ROCHUS SCHELLING 27285 CITRUS AVE, PERRIS, CA 92370
SOUTHERN CALIFORNIA GAS CO. P.O. BOX 3150, SAN DIMAS, CA 91773

XX **By First Class Mail.** I am readily familiar with the office's practice of collection and processing correspondence for mailing. Under that practice it would be deposited with the U.S. Postal Service with postage thereon fully prepaid in the County of Riverside, California, in the ordinary course of business.

XX **STATE.** I declare under the penalty of perjury under the laws of the State of California that the above is true and correct.

EXECUTED ON January 3, 2012 in the County of Riverside, California.

CODE ENFORCEMENT DEPARTMENT

By: Tamara Greaves, OAIH

EXHIBIT NO. E⁸

4080 LEMON STREET, 12TH FLOOR, RIVERSIDE, CALIFORNIA 92501
(951) 955-2004 • FAX (951) 955-8680



**CODE ENFORCEMENT DEPARTMENT
COUNTY OF RIVERSIDE**

GLENN BAUDE
Director

AFFIDAVIT OF POSTING OF NOTICES

January 5, 2012

RE CASE NO: CV0905340 & CV0906580

I, Edward Torres, hereby declare:

I am employed by the Riverside County Code Enforcement Department; that my business address is 24318 Hemlock, Ave., Suite C-1, Moreno Valley, California 92557.

That on 01/04/2012 at 1253 hours, I securely and conspicuously posted Notice of Hearing Re: Demand for Payment Statement of Abatement Costs Notice of Special Tax Assessment at the property described as:

Property Address: 27285 CITRUS AVE, PERRIS

Assessor's Parcel Number: 307-260-012

I declare under the penalty of perjury that the foregoing is true and correct.

Executed on January 5, 2012 in the County of Riverside, California.

CODE ENFORCEMENT DEPARTMENT



By: Edward Torres, Code Enforcement Officer

EXHIBIT NO. E9



**CODE ENFORCEMENT DEPARTMENT
COUNTY OF RIVERSIDE**

**BOARD OF SUPERVISORS
REQUEST FOR PUBLIC HEARING
ON STATEMENT OF ABATEMENT COSTS
AND SPECIAL TAX ASSESSMENT**

David P & Elizabeth S Savellano
10409 Park St
Bellflower, CA 90706

Subject Property: 27285 Citrus Ave, Perris
Case No(s): CV09-05340 & CV09-06580
APN No(s): 307-260-012

I, DAVID SAVELLANO, hereby request a public hearing before the Board of Supervisors
(Please PRINT your name here)

regarding case number(s) CV09-05340 & CV09-06580

I request notice of the Board of Supervisors hearing date, time, and location (which shall not be less than 10 days from the submission of this request) to be mailed to me at the following address:

Return Mailing Address: 10409 PARK ST
BELLFLOWER CA 90706

Signed: D Savellano Date: 1/10/12
(Please SIGN your name here)

Print: DAVID SAVELLANO
(Please PRINT your name here)

You may contact me at the following daytime phone number: 562-984-2540
I'll be out of the country until Feb 1, 2012.

IMPORTANT
Keep a copy of this form and mail the original to:
Riverside County Code Enforcement Department
P.O. BOX 1469
Riverside, CA 92502-1469

EXHIBIT NO. F

Scanned Saf

RECEIVED JAN 17 2012
Demond 12/29