

**SUBMITTAL TO THE BOARD OF SUPERVISORS
COUNTY OF RIVERSIDE, STATE OF CALIFORNIA**

547



SUBMITTAL DATE:
July 5, 2012

FROM: Successor Agency to the Redevelopment Agency

SUBJECT: Big League Dreams Perris Valley – Change Order No. 13

RECOMMENDED MOTION: That the Board of Supervisors approve and authorize the Chairman of the Board to execute the attached Change Order No. 13 between Soltek Pacific Construction and the County of Riverside in the amount of \$804,025.

BACKGROUND: The Big League Dreams Perris Valley Project was awarded to Soltek Pacific Construction Company on June 8, 2010.

The attached Change Order No. 13 includes work that is necessary for proper completion of the project and involves mitigation of storm water impacts to surrounding properties that were not addressed in the original design of the project.

(Continued)

REVIEWED BY CIP

Christoph...
Christoph...

Robert Field

Robert Field
Assistant County Executive Officer/EDA

FINANCIAL DATA	Current F.Y. Total Cost:	\$ 804,025	In Current Year Budget:	Yes
	Current F.Y. Net County Cost:	\$ 0	Budget Adjustment:	No
	Annual Net County Cost:	\$ 0	For Fiscal Year:	2012/13

COMPANION ITEM ON BOARD AGENDA: No

SOURCE OF FUNDS: Interstate 215 Corridor Redevelopment Project Area Capital Improvement Funds – Romoland Sub-Area (previously approved budget)	Positions To Be Deleted Per A-30	<input type="checkbox"/>
	Requires 4/5 Vote	<input type="checkbox"/>

C.E.O. RECOMMENDATION:

APPROVE

Jennifer L. Sargent

County Executive Office Signature

**MINUTES OF THE BOARD OF SUPERVISORS OF THE SUCCESSOR AGENCY TO
THE REDEVELOPMENT AGENCY**

On motion of Supervisor Tavaglione, seconded by Supervisor Ashley and duly carried, IT WAS ORDERED that the above matter is approved as recommended.

Ayes: Buster, Tavaglione, Benoit and Ashley
Nays: None
Absent: Stone
Date: July 17, 2012
xc: RDA, EDA, CIP

Kecia Harper-Ihem
Clerk of the Board
By: *Kecia Harper-Ihem*
Deputy

Prev. Agn. Ref.: 4.1 of 6/8/10; 4.1 of 4/17/12

District: 5/5

Agenda Number:

4.9

FORM APPROVED COUNTY COUNSEL
DATE 6/21/12 BY MARSHAL VICTOR
DATE 7/3/12 BY PAUL ANGULO, CPA, AUDITOR-CONTROLLER
Department of SAMUEL WONG

Policy Policy
Consent Consent
Dep't Recomm.:
Per Exec. Ofc.:

BACKGROUND:

A final negotiation meeting was held on May 24, 2012 between Soltek Pacific Construction and the County to discuss the costs of these items. It was determined at that time that the County would bare the costs of these items and the final figures were recently finalized. The change order is within the 10% contingency established in the project budget, which was approved on June 8, 2010.

The original construction contract is an enforceable obligation. The original construction contract was executed on June 8, 2010, a date prior to the enactment of AB x1 26 regarding redevelopment that was signed by Governor Brown on June 29, 2011, enacted by the California Legislature. Change Order No. 13 has been processed in accordance with the terms of the original construction contract.

The cost of Change Order No. 13 will not be an additional cost to the project as it is accounted for in the approved budget and a budget adjustment is not required. The contract is reflected on the Initial Recognized Obligation Schedule prepared by Successor Agency staff. Staff recommends approval of the motions listed above.

Attachment:

- Change Order No. 13

COUNTY OF RIVERSIDE EDA AS SUCCESSOR AGENCY TO THE REDEVELOPMENT AGENCY FOR THE COUNTY OF RIVERSIDE

CHANGE ORDER NO. 13

Date: 5/24/2012 Project: Big League Dreams Peris Valley
 To Contractor: Soltek Pacific Construction Project No: ED1508001712
2424 Congress Street Distribution:
San Diego, CA Project Manager Construction Manager
 Contractor Inspector
 Fiscal Architect/Engineer

You are directed to make the following changes. Changes shall include labor, material and equipment; each item to include all charges or indirect arising out of this work:

- 1) Trumble Road Street Improvements PCO #3 \$ 658,950.00
- 2) Rip Rap Drainage Swale PCO #4 \$ 64,800.00
- 3) Temporary Grading & Paving for Sherman Ave PCO #5 \$ 43,775.00
- 4) Miscellaneous Grading/Debris Removal behind BLD Fence PCO #6 \$ 36,500.00
- 5) Non Compensatory Time Extension
 Extension of time up to complete drainage issues \$

The specifications, where pertinent, shall apply to these changes.
 This Change Order provides for a time extension of 140 working days
 Original Contract Duration (working days): 270
 Prior Authorized Time Extension (working days): 148
 Revised Construction Duration (working days): 558
 Original Contract Completion Date: 8/30/2011
 Revised Contract Completion Date: 9/28/2012

NOTE: This change order is not effective until ALL signatures below are obtained, and if applicable, signature authority approval by Form 11 as indicated per Change Order Guidelines.

The undersigned contractor has given careful consideration to the change proposed, including its effect on other work already contracted for, and hereby agrees, if this change order is approved, that he will provide all equipment, furnish all materials, except as may otherwise be noted above, and perform all services necessary for the work above specified, and will accept as full payment for all costs related in any way thereto the prices shown above.

ATTEST:
 KECIA HARPER-IHEM, Clerk
 By: [Signature]
 DEPUTY

1) RUME 5/29/12
 Contractor (signature) Date
BRANDON RUME
 Contractor's Printed name

Original Contract \$ 19,935,225.00
 Prior Authorized [x] ADD [] DED \$ 1,018,524.00
 Total Contract Prior to this Change \$ 20,943,749.00

2) [Signature] 5/29/12
 Chairman, Board of Supervisors (signature) Date
John F. Taugelone
 Chairman, Board of Supervisors Printed name

Authorized Changes on this C.O.:
 Negotiated _____
 Addition \$ 804,025.00
 Deduction \$ _____
 NET: [x] Addition [] Deduction \$ 804,025.00

3) [Signature] 5/29/12
 Construction Manager (signature) Date
ROBERT GOOD
 Construction Manager's Printed name

Amount of Contract Authorized Including this Change Order \$ 21,762,774.00

4) [Signature] 5/30/12
 Project Manager (signature) Date
DOMINICK LAMBERTO
 Project Manager's Printed name

Pursuant to:
 [x] Board Resolution 2012-034
 [] M.O. and Date _____

RDA Change Order Form - Revised 1-18-12

JUL 17 2012 4.9

FORM APPROVED COUNTY COUNSEL
 BY: [Signature] 6/21/12
 MARSHA L. VICTOR DATE

**COUNTY OF RIVERSIDE EDA AS SUCCESSOR AGENCY TO THE REDEVELOPMENT AGENCY
FOR THE COUNTY OF RIVERSIDE**

CHANGE ORDER NO. 13

Date: 5/24/2012

Project: Big League Dreams Perris Valley

To Contractor:

Soltek Pacific Construction
2424 Congress Street
San Diego, CA

Project No: ED1506001712

Distribution:

Project Manager	Construction Manager
Contractor	Inspector
Fiscal	Architect/Engineer

You are directed to make the following changes. Changes shall include labor, material and equipment; each item to include all charges or indirect arising out of this work:

- 1) Trumble Road Street Improvements
PCO #3

Provide all labor, material and equipment to complete the Work as described in the following documents:

Street Improvement Plans for Trumble Road and Vista Road from GHD Engineering, dated 05/07/12

Sheet 1 - Title Sheet; Sheet 2 - Typical Sections; Sheet 3 - Plan Profile; Sheet 4 Plan Profile; Sheet 5 - Details; Sheet 6 - Signage and Striping; Sheet 7 - Demolition; Sheet 8 - Erosion Control; Sheet 9 - Irrigation Plan; Sheet 10 - Irrigation Plan; Sheet 11 - Irrigation Schedule & Details; Sheet 12 - Irrigation Details; Sheet 13 - Planting Plan; Sheet 14 - Planting Plan; Sheet 15 - Planting Notes and Details

Geotechnical Investigation Report -

Construction Testing & Engineering, Inc., dated 02/29/12

- 2) Rip Rap Drainage Swale
PCO #4

Provide all labor, material and equipment to complete the Work as described below and in the following documents:

Erosion Control Plans for property north of BLD site from GHD Engineering, dated 05/07/12
Sheet C-4.00 - Erosion Control Notes and Legend; Sheet C-4.01 - Erosion Control Plan; Sheet C-4.02 - Erosion Control Plan; Sheet C-4.03 - Erosion Control Plan; C-4.04 - Erosion Control Plan

Install engineered rip rap along northern County of Riverside property directly adjacent to Vista Road; include grouting in place; concrete headwall

- 3) Temporary Grading & Paving for Sherman Ave
PCO #5

Provide all labor, material and equipment to complete the Work as described:

Install 30" reinforced concrete pipe in existing drainage swale; backfill; grade roadway; install temporary base and asphaltic concrete pavement; work to be performed pursuant to County of Riverside Standards for Construction

- 4) Miscellaneous Grading/Debris Removal behind BLD Fence
PCO #6

Provide all labor, material and equipment to complete the Work as described:

Remove existing debris behind BLD northerly fence; fine grade area behind BLD northerly fence; finish grade area around drainage swale & rip rap along northern boundary adjacent to Vista Road



MEMORANDUM

ECONOMIC DEVELOPMENT AGENCY Design and Construction Division

TO: PMO Project Management staff for Big League Dreams Project

FROM: Jon Braginton
Environmental Planner II

DATE: May 31, 2012

Re: *Health and Safety Issues due to Storm Drainage Impact of Big League Dreams Construction*

Sherman Road is a north/south trending road in Perris, California, which today, remains as an undeveloped portion of dirt road extending from northeastern corner of Big League Dreams to Vista Road. A residential tract development exists along the east side of Sherman Road at Blue Topaz Drive and at Citrine Way. The development of this portion has increased runoff potential from impermeable conditions created (i.e., paved streets, driveways, housing), thus increasing the discharge load potential into the County's recently installed 36" reinforced concrete pipeline (RCP). This underground pipeline conveys discharge northward along the west side of Sherman Road to a discharge point 60 feet north of the northeast corner of Big League Dreams property (refer to Attachment A). Along this stretch, the RCP initially draws discharge from a 21" RCP line connecting to a retention basin approximately 60 feet south of Blue Topaz Drive. This discharge has a potential of 41.2 cfs (cubic feet per second) during a 100-year storm event (Q^{100}). The next conveyance occurs 20 feet shy of the 36" RCP's terminus which receives additional discharge from an 18" RCP line and has a discharge potential of 19.3 cfs to occur during a 100-year storm event (Q^{100}). Therefore, based on estimates from the Perris Valley Big League Dreams Hydrological Study (Walden and Associates, 2009), the total potential for discharge at the northern terminus during a 100-year storm event (rainfall intensity of 2.149 inches per hour) is estimated

to be at 58.74 cfs. At this point, the RCP terminus exits onto open space land with discharge conveyed northward along west side of undeveloped Sherman Road. Approximately 100 feet south of Vista Road, an additional source from rural residential enclaves northeast of Vista Road (approximately 14.4 cfs/ Q^{100}) joins the 58.74 cfs/ Q^{100} discharge by raising the total to 73.14 cfs/ Q^{100} .

From this point, the 73.14 cfs/ Q^{100} discharge would bend to the left and drain westward along the south side of Vista Road towards the corner of Vista Road and Trumble Road. At this location additional discharge is received from upstream drainage in draining northward along the east side of Trumble Road with estimates limited, but calculated at 5.1 cfs/ Q^{100} of discharge coming off of Big League Dreams during a 100-year storm event (discharge from Eastern Municipal Water District not available). Therefore, the total estimate for discharge at the confluence of Trumble and Vista Roads is approximately 78.64 cfs/ Q^{100} . At this point, discharge would exit the northwestern corner of Trumble and Vista Roads by flowing westward along northern boundary of Eastern Municipal Water District

Since no engineered paving, gutter, swale ditches or RCP's have been developed at present to adequately convey this discharge along these locations (as discussed above), the potential for flooding along these roads would present a significant impediment to fire and police response times for local rural residences northeast of Vista Road. It is therefore and highly recommended that options be discussed to direct the General Contractor for the Big League Dreams project to undertake construction of the necessary mitigating street improvement and storm drainage infrastructure along the undeveloped portions of Trumble, Vista, and Sherman Roads.

Attachment A

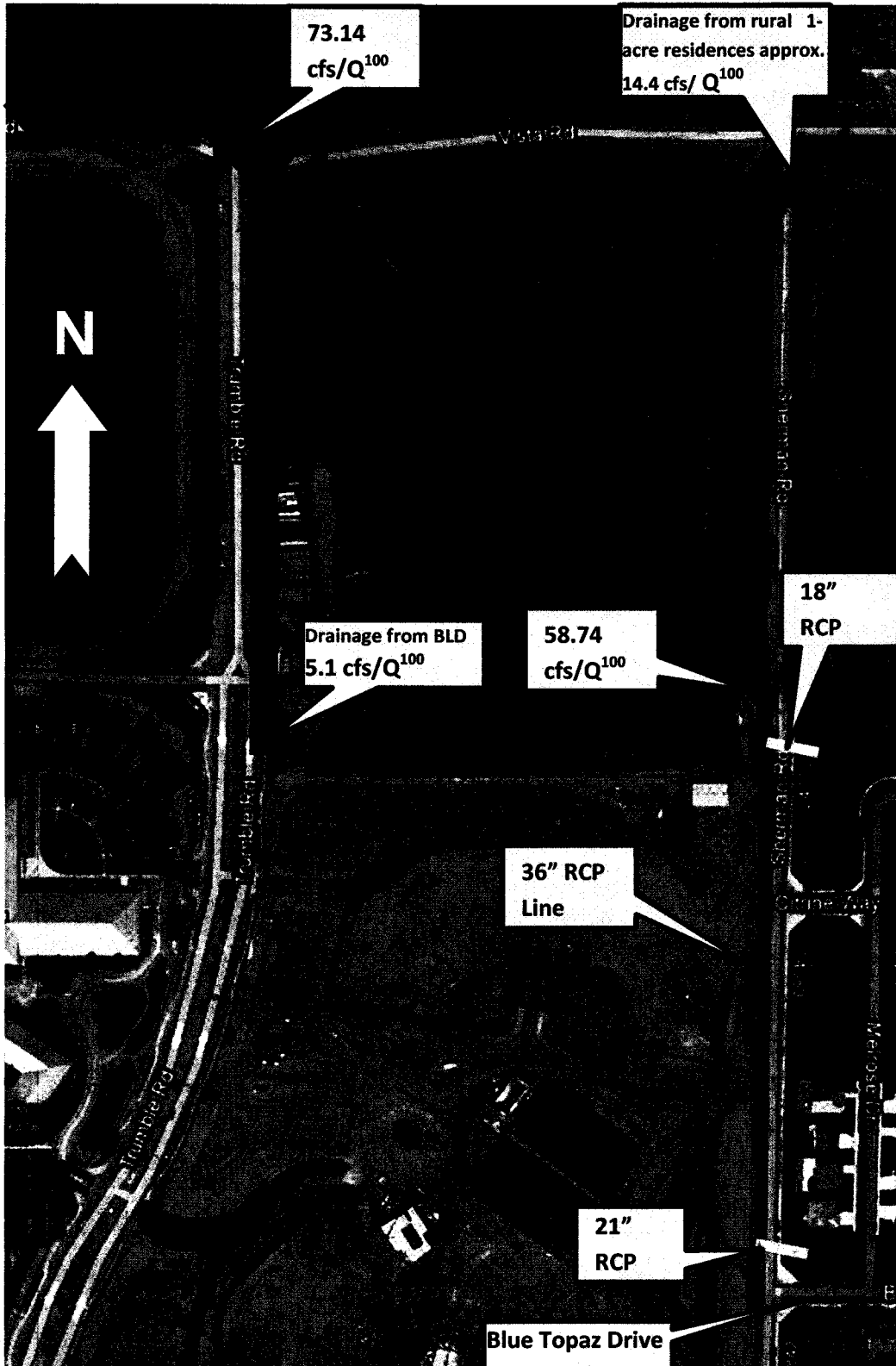

**Riverside County Board of Supervisors
Request to Speak**

Submit request to Clerk of Board (right of podium),
Speakers are entitled to three (3) minutes, subject
Board Rules listed on the reverse side of this form.

SPEAKER'S NAME: G. A. GRANT

Address: 27068 TARBUS ST
(only if follow-up mail response requested)

City: PERDUE **Zip:** _____

Phone #: 657-9319

Date: 17TH JULY **Agenda #** 4.9.

PLEASE STATE YOUR POSITION BELOW:

Position on "Regular" (non-appealed) Agenda Item:

_____ **Support** _____ **Oppose** **Neutral**

Note: If you are here for an agenda item that is filed
for "Appeal", please state separately your position on
the appeal below:

_____ **Support** _____ **Oppose** _____ **Neutral**

I give my 3 minutes to: _____