

**SUBMITTAL TO THE BOARD OF SUPERVISORS
COUNTY OF RIVERSIDE, STATE OF CALIFORNIA**

663



FROM: Successor Agency to the Redevelopment Agency

SUBMITTAL DATE:
July 19, 2012

SUBJECT: Mecca Fire Station Construction Project

RECOMMENDED MOTION: That the Board of Supervisors approve and authorize the Chairman of the Board to execute Change Order No. 6 for the Mecca Fire Station Construction Project in the amount of \$30,241.

BACKGROUND: On December 14, 2010, the Board of Directors for the Redevelopment Agency executed a construction contract with Eberhardt Construction, Inc. for the Mecca Fire Station construction project. During construction, adjustments were necessary to correct and/or address issues as they arose in the field.

(Continued)

REVIEWED BY CIP
Christopher Hans
Christopher Hans

Robert Field
Robert Field
Assistant County Executive Officer/EDA

FINANCIAL DATA	Current F.Y. Total Cost:	\$30,241	In Current Year Budget:	Yes
	Current F.Y. Net County Cost:	\$ 0	Budget Adjustment:	No
	Annual Net County Cost:	\$ 0	For Fiscal Year:	2012/13

COMPANION ITEM ON BOARD AGENDA: No

SOURCE OF FUNDS: Desert Communities Project Area Capital Improvement Bond Proceeds (previously approved budget)	Positions To Be Deleted Per A-30	<input type="checkbox"/>
	Requires 4/5 Vote	<input type="checkbox"/>

C.E.O. RECOMMENDATION: APPROVE

County Executive Office Signature *Jennifer L. Sargent*
BY: **Jennifer L. Sargent**

**MINUTES OF THE BOARD OF SUPERVISORS OF THE SUCCESSOR AGENCY TO
THE REDEVELOPMENT AGENCY**

On motion of Supervisor Tavaglione, seconded by Supervisor Stone and duly carried by unanimous vote, IT WAS ORDERED that the above matter is approved as recommended.

Ayes: Buster, Tavaglione, Stone, Benoit and Ashley
Nays: None
Absent: None
Date: July 31, 2012
xc: RDA, EDA, Auditor, CIP

Kecia Harper-Ihem
Clerk of the Board
By: *Kecia Harper-Ihem*
Deputy

FORM APPROVED COUNTY COUNSEL
DATE: 7/11/12
BY: MARSHAL L. VICTOR
PAUL ANGIULO, CPA, AUDITOR-CONTROLLER
BY: Samuel Wong 7/18/12
SAMUEL WONG
Departmental Concurrence

Dept's Recomm.: Consent Policy
Per Exec. Ofc.: Consent Policy

BACKGROUND: (Continued)

Change Order No. 6 will result in a net increase of \$30,241 to the construction contract. For the following items:

COR11	Anti-climb railing	849.25
COR12	Relocate/delete light fixtures	4,350.52
COR13	Splitface block	1,967.25
COR14	Showerhead revisions	(154.80)
COR15	Half wall support	1,386.75
COR16	Additional blocking	1,968.00
COR17	Insurance and bond	2,686.29
COR19	Sand Oil Interceptor	2,156.06
PR09	911 phone electrical revision	159.00
PR10	Delete 1" dry pack	(200.00)
PR12	Type SD light fixture	(53.75)
PR13	Type K light fixture	1,525.40
PR14	Delete solenoid valve	(414.13)
PR15r	Add utilities for dryer	3,020.81
PR16	Electrical revision for SCBA compressor	2,631.60
PR17	Add exterior lights	5,726.52
PR18	Install sampling box	2,636.01
Total		30,240.78

The funds for this change order are shown on the Recognized Obligation Payment Schedule (ROPS) which has been approved by the Oversight Board and the California Department of Finance. The project cannot be completed without the changes. The funds for Change Order No. 6 will come from the previously approved project budget and will not require additional funds from the agency and will not impact the General Fund.

County Counsel has reviewed and approved the attached documents as to form. Staff recommends that the Board of Supervisors execute Change Order No. 6.

Attached:

- Eberhardt Construction Change Order No. 6 (3)
- Change Order Requests 11-17 and 19 (1)

**COUNTY OF RIVERSIDE
ECONOMIC DEVELOPMENT AGENCY**

CHANGE ORDER NO. [REDACTED]

Date: [REDACTED] Project: [REDACTED]

To Contractor: [REDACTED] Project No.: [REDACTED]
 Distribution:
 Project Manager Construction Manager
 Contractor Inspector
 Fiscal Architect/Engineer

You are directed to make the following changes. Changes shall include labor, material and equipment; each item to include all charges or indirect arising out of this work:

1) COR #11		
2) COR #12	ADD	\$ 4,500.00
3) COR #13	ADD	\$ 1,887.25
4) COR #14	DEDUCT	\$ 154.00
5) COR #15	ADD	\$ 1,388.75
6) COR #16	ADD	\$ 1,968.00
7) COR #17	ADD	\$ 2,686.29
8) COR #19	ADD	\$ 2,156.06
9) PR #9	ADD	\$ 159.00
10) PR #10	DEDUCT	\$ 200.00
11) PR #12	DEDUCT	\$ 53.75
12) PR #13	ADD	\$ 1,525.40
13) PR #14	DEDUCT	\$ 414.13
14) PR #15	ADD	\$ 3,020.81
15) PR #16	ADD	\$ 2,631.60
16) PR #17	ADD	\$ 5,726.52
17) PR #18	ADD	\$ 2,636.01

The specifications, where pertinent, shall apply to these changes.
 This Change Order provides for a time extension of 0 calendar days.
 Original Contract Duration (calendar days): [REDACTED]
 Prior Authorized Time Extension (calendar days): 365
 Revised Construction Duration (calendar days): 0
 Original Contract Completion Date: [REDACTED]
 Revised Contract Completion Date: [REDACTED]

NOTE: This change order is not effective until approved by the Chair, Board of Supervisors, Assistant County Executive Officer EDA or designee, as indicated.

The undersigned contractor has given careful consideration to the change proposed, including its effect on other work already contracted for, and hereby agrees, if this change order is approved, that he will provide all equipment, furnish all materials, except as may otherwise be noted above, and perform all services necessary for the work above specified, and will accept as full payment for all costs related in any way thereto the prices shown above.

[Signature]
 Contractor Date 7/31/12
[Signature]
 Chairman, Board of Supervisors Date 7/31/12
[Signature]
 Architect Date
[Signature]
 Project Manager Date

Original Contract \$ [REDACTED]
 Total Contract Prior to this Change \$ 4,072,641.64
 Authorized Changes on this C.O.:
 Addition \$ [REDACTED]
 Deduction \$ [REDACTED]
 \$ 30,240.78
 Amount of Contract Authorized Including this Change Order \$ 4,102,882.42

Pursuant to: [REDACTED]
 * Original contract amount revised to include alternates.

KN:brP50724400x6-co Change Order Form - Rev 10-28-09
 ATTEST:
 KECIA HARPER-IHEM, Clerk
 By *[Signature]* DEPUTY
 FORM APPROVED COUNTY COUNSEL
 BY: *[Signature]* MARSHAL L. VICTOR 7/11/12 DATE

JUL 31 2012 4.5

Eberhardt Construction, Inc.

19031 Hwy. 18, Suite 250

Apple Valley, CA 92307

Phone: (760) 242-0161

Fax: (760) 242-0380

CHANGE ORDER REQUEST

No. 00011

07244.53

TITLE: COR No. 11: Anti Climb Railing

DATE: 11/22/2011

PROJECT: Mecca Fire Station

JOB: 0610

TO: Attn: Leah Rodriguez
Riverside County Economic Devel Agen
44-199 Monroe, Suite B
Indio, CA 92201
Phone: 760-863-2534 Fax: 760-863-2551

CONTRACT NO: 0610-001

RE: To: From: Number:

DESCRIPTION OF PROPOSAL

Cost to re-install the anti-climb railing at the Sheriffs Building.

Item	Description	Stock#	Quantity	Units	Unit Price	Tax Rate	Tax Amount	Net Amount
00001	Cost to re-install anti-climb railing on top of block wall as requested. Reference Sunset Iron's Invoice No. 2127.		1.000		\$790.00	0.00%	\$0.00	\$790.00
00002	ECI OH & P @ 5%		1.000		\$39.50	0.00%	\$0.00	\$39.50
00003	ECI Insurance @ 1%		1.000		\$7.90	0.00%	\$0.00	\$7.90
00004	ECI Bond @ 1.5%		1.000		\$11.85	0.00%	\$0.00	\$11.85

Unit Cost: \$849.25
Unit Tax: \$0.00
Total: \$849.25

APPROVAL:

By: _____
Leah Rodriguez

By: _____
Kelley Needham

By: _____
Daniel J Eberhardt

Date: _____

Date: 12.7.11

Date: 11-22-11



Sunset Iron & Automation
22276 Ottawa Rd. #3
Apple Valley, CA 92308
Lic. 601192

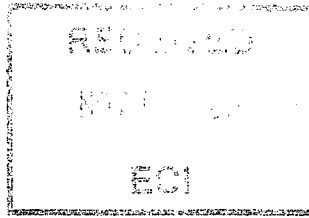

Date 10/14/2011
Invoice # 2127

Bill To
Eberhardt Construction, Inc.
19031 Hwy 18 Suite 250
Apple Valley CA 92307

Ship To
Police Station (Next to Fire Station)
Mecca, CA

P.O. #
Terms

Ship Date 10/14/2011
Due Date 10/14/2011
Other

Item	Description	Qty	Price	Amount
Custom Iron ...	Re Install Curve Picket Rail Fence on top block wall-4 men @ 3 hrs. labor & material		790.00	790.00

POSTED

Sunset Iron & Automation sunsetironauto@verizon.net sunsetironautomation.com	760-240-6577 760-240-9825-FAX
---	----------------------------------

Total	\$790.00
Payments/Credits	\$0.00
Balance Due	\$790.00

Eberhardt Construction, Inc.

19031 Hwy. 18, Suite 250

Apple Valley, CA 92307

Phone: (760) 242-0161

Fax: (760) 242-0380

CHANGE ORDER REQUEST**No. 00012****TITLE:** COR No. 12: Cost per RFI No. 6**DATE:** 1/17/2012**PROJECT:** Mecca Fire Station**JOB:** 0610

TO: Attn: Leah Rodriguez
 Riverside County Economic Devel Agen
 44-199 Monroe, Suite B
 Indio, CA 92201
 Phone: 760-863-2534 Fax: 760-863-2551

CONTRACT NO: 0610-001

RE: To: From: Number:

DESCRIPTION OF PROPOSAL

Per Architect's response to RFI No. 6:

Item	Description	Stock#	Quantity	Units	Unit Price	Tax Rate	Tax Amount	Net Amount
00001	Per Architect's response to RFI No. 6: Cost to install additional wire and conduit for ceiling fans, also includes the installation of the intellitouch light switches. Reference WB Walton's COR No. 009R1 dated 1/16/12.		1.000		\$4,047.00	0.00%	\$0.00	\$4,047.00
00002	ECI OH & P @ 5%		1.000		\$202.35	0.00%	\$0.00	\$202.35
00003	ECI Insurance @ 1%		1.000		\$40.47	0.00%	\$0.00	\$40.47
00004	ECI Bond @ 1.5%		1.000		\$60.70	0.00%	\$0.00	\$60.70

Unit Cost: \$4,350.52**Unit Tax:** \$0.00**Total:** \$4,350.52**APPROVAL:**

By: _____ **By:** _____
 Leah Rodriguez Kelley Needham

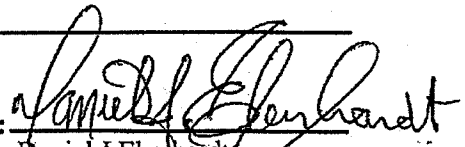
By: 
 Daniel J Eberhardt

Date: _____ **Date:** _____

Date: 1-18-12



330 E 3rd St
 Beaumont, CA 92223
 Phone: (951) 769-2280
 Fax: (951) 769-7255

Change Request Form

Project No.: 724400.4

Project Name: Mecca Fire Station

Change #: 009 R1

Date Requested: January 6, 2011

Date Submitted: 1/16/2012

Description of Change: This is for the added cost for installing additional wire & conduit for ceiling fans. This also includes the installation of the intellitouch light switches. . RFI #6 drawing ESK-1

1	Material		1,040.24
2	Sales Tax on Material	8.75%	91.02
3	Labor Costs		2,387.55
4	Freight		
5	Equipment and Major Tools		
6	Gas and Oil		
7	Other Direct Costs		
8	Insurance		
9	Other: Concrete Pump		
10	Truck @ \$48.00 /Day	1 Days	
11	Permit Fee		
12	Other:		
13	Sub-Total:		3,518.81
14	General and Administrative	15.00%	527.82
15	Sub-Total:		4,046.63
16	Sub-Contract:		
17	General and Administrative		
18	Other		
19	Other		
20	Sub-Total:		4,046.63
21	Bond Premium	1.00%	
22	Total Price of This Change Proposal		\$4,047
23	Extension of time due to this Change is:	1	Days or Deferred **
24	This Proposal is based on:	St. Time	O. Time
25	This proposal is subject to upward escalation unless notice to proceed is received by	{20 C. Days if no date shown}	
26	Extended Overhead Cost	Included	Deferred **

** If Deferred, cover letter will describe

Submitted by: _____ Date _____
 Signature Title

Approved by: _____ Date _____
 Signature Title

This proposal is based solely on the direct cost elements such as labor, material, and normal mark-ups and does not include any amount for changes in the sequence of work delays, disruptions, rescheduling, extended overhead, acceleration, and/or impact costs not specifically noted and mutually agreed upon on the enclosed "labor factors and corrections" and inclusive of an equitable and compensable contract extension requested herein. Notwithstanding, the right is hereby clearly and expressly reserved to make claim for any and all impacts, restraints and related items of cost prior to any final settlement of this contract.

Change Request Form

Labor Factors & Corrections

Percentages are to be applied to the total affected manhours of the current contract, and to the Labor of the proposed change.	Affected Manhours of Current Contract		Manhours of Proposed Change	
	Manhours *		8.00 {1}	
	As of			
	Percentage of Loss	Manhours Lost	Percentage of Loss	Manhours Lost
Negative Productivity Factors				
Reassignment of Manpower	1.3%		5.0%	
Crew Size Inefficiency	2.5%		10.0%	
Site Access	1.3%		5.0%	
Logistics	2.5%		10.0%	
Stacking of Trades	2.5%		10.0%	
Dilution of Supervision	2.5%		10.0%	
Errors and Omissions	0.3%		1.0%	
Fatigue	2.0%		8.0%	
Learning Curve	1.3%		5.0%	
Ripple	2.5%		10.0%	
Morale and Attitude	1.3%		5.0%	
Concurrent Operations	1.3%		5.0%	
Beneficial Occupancy	3.8%		15.0%	
Joint Occupancy (Other Trades)	1.3%		5.0%	
Weather Factor	2.5%		10.0%	
Height Factor				
Overtime Adjustment	3%		10.0%	
1 + 2 + 3 =	(2)		(3)	

* Estimated

{4} Journeyman	33.00	Hrs. @	\$72.35	2,387.55
{5} Foreman		Hrs. @	\$78.28	
{6} General Foreman		Hrs. @	\$86.88	
{7} Superintendent		Hrs. @	\$95.56	
{8} Sound Tech		Hrs. @		
{9} Foreman S T		Hrs. @		
{10} Other: _____		Hrs. @		
{11}				
{12} Total Direct Labor (Lines 4 - 11)	33.00	Hrs.		2,387.55
{13} Small Tools @ 3%				
{14} Total Labor (Lines 12+13)				\$2,387.55

Change Request Form

Labor Summary

Hourly Rates

Job Description	Base Rate	Payroll Tax Insurance Fringes	Wage, Tax & Fringe Escalation	Other	Total Hourly Rate
Journeyman	\$36.50	\$28.35	\$4.50	\$3.00	72.35
Foreman	\$42.00	\$30.24	\$2.89	\$3.15	78.28
General Foreman	\$46.75	\$33.66	\$3.22	\$3.25	86.88
Sound Tech					
Foreman S. T.					
Other:					

1. Journeyman Hours	8.00	Hrs.
2. Nonproductive Travel		Hrs.
3. Remobilization Hours		Hrs.
4. Material Handling		Hrs.
5. Punch and Demo		Hrs.
6. Safety		Hrs.
7. Clean Up		Hrs.
8. Warranty		Hrs.
9. Permit Acquisition		Hrs.
10. Logistical Inefficiency		Hrs.
11. Labor Difficulty		Hrs.
12. Base J.W. Hours 1 thru 11	8.00	

Takeoff Sheet

Project No.: cca Fire Station RF

RFC# : 009 R1

U = E for Each, C for 100, M for 1000

Project Name:

#REF!

Item	Description	Qty	Mat Price	U	Labor	U	Total Mat(\$)	Total Hours
1				E		E		
2	Ceiling Fan Bracket "B-Line" BA 50F			E		E		
3	3/4" EMT CONDUIT	240	\$176.43	C	5.00	C	\$423.43	12.00
4	3/4" EMT STL SS CONN	18	\$485.00	C	10.00	C	\$87.30	1.80
5	3/4" EMT STL SS CPLG	30	\$503.40	C	5.00	C	\$151.02	1.50
6	3/4" Appleton Flex to EMT	13	\$511.70	C	10.00	C	\$66.52	1.30
7	3/4" Steel Flex	50	\$89.06	C	5.00	C	\$44.53	2.50
8	3/4" EMT 2-H STEEL STRAP	40	\$47.00	C	4.00	C	\$18.80	1.60
9	#12 THHN BLACK	520	\$210.05	M	6.00	M	\$109.23	3.12
10	B2-1 RED WIRE CONN	39	\$131.00	C	6.20	C	\$51.09	2.42
11	4x1 1/2" SQ BOX COMB KO			C	30.00	C		
12	4" SQ 2G PLSTR RING 5/8" RISE		\$260.00	C	15.00	C		
13	Ceiling Wire		\$83.38	C	16.25	C		
14	Eye Lag		\$17.85	C	8.00	C		
15								
16	#10x1" P/H SELF-TAP SCREW	85	\$28.96	C	1.00	C	\$24.62	0.85
17	SS wall plate single switch	-13	\$1.50	E			-\$19.50	
18	SS double gang wall switch w décor & Toggle Swit	13	\$5.95	E			\$77.35	
19	Intellitouch wall switch	13			0.45	E	\$5.85	5.85
20								
21								
22								
23								
24								
25								
26								32.94
27								
28								
29								
30								
31								
32								
33								
34								
35								
36								
37								
38								
39								
40								
41								
42								
43								
44								
45								
46								
47								
48								
49								
50								
51								
52								
53								
Totals							1,040.24	33.00

Eberhardt Construction, Inc.

19031 Hwy. 18, Suite 250

Apple Valley, CA 92307

Phone: 760-242-0161

Fax: 760-242-0380

REQUEST FOR INFORMATION**No. 0006****TITLE:** FC RFI No. 6: Ceiling Fans**DATE:** 12/8/2010**PROJECT:** Mecca Fire Station**JOB:** 0610

TO: Attn: Kelley Needham
 WLC Architects, Inc.
 8163 Rochester Avenue
 Suite 100
 Rancho Cucamonga, CA 91730
 Phone: 909-987-0909 Fax: 909-980-9980

STARTED:
COMPLETED:
REQUIRED: 12/15/2010

WORK**IMPACT:** Unknown**SCHEDULE****IMPACT:** Unknown**COST****IMPACT:** Unknown**QUESTION:**

Please note that Detail 2 on Sheet E-2.1 shows circuitry for 2 ea. ceiling fans at the Dayroom and 2 ea. ceiling fans at what is depicted as the Exercise Room on this detail. Note that this room is referred to as a "Multi Purpose Room" on the revised Architectural sheets. The new "lemon fresh" A-2.1 shows a completely different configuration with more ceiling fans. Please review and clarify.

If the configuration is correct on Sheet A-2.1 please provide a revised Detail 2 on Sheet E-2.1 to include new circuitry.

PROPOSED SOLUTION:**ANSWER:**

Refer to attached A&F correspondence and sketch ESK-1 for response.

Note: The receptacles with "F" adjacent are not fan outlets. These are flush floor mounted receptacles.

Luis Flores / A&F
 12/14/10

Requested By: Eberhardt Construction, Inc.

Signed: 

Dan Eberhardt

Date: 12/8/2010

A&F ENGINEERING GROUP, INC.

CONSULTING ELECTRICAL ENGINEERS

December 14, 2010

Mr. Shih-Jing Yen
WLC Architects, Inc.
8163 Rochester Ave., Suite 100
Rancho Cucamonga, CA 91730

Re: **Mecca Fire Station #40**
County of Riverside

Mr. Yen,

Please issue the following response to RFI #6:

Reference - Sheet E2.1 and ESK-1 (attached):

1. Replace the spare 20 amps, 1 pole circuit breaker in panel "LC" circuit 37 with a 20 amps, 1 pole arc fault circuit breaker and identify this circuit breaker as "BC Dorm Fan". Route 2#12 from LC-37 to the BC Dorm fan in the specified conduit system.
2. Replace the spare 20 amps, 1 pole circuit breaker in panel "LC" circuit 33 with a 20 amps, 1 pole arc fault circuit breaker and identify this circuit breaker as "Day Room Fans". Route 2#12 from LC-33 to the Day Room fans in the specified conduit system.
3. Connect the Dormitory 1 and 3 fans to circuit LC-23.
4. Connect the Dormitory 2 and 4 fans to circuit LC-21.
5. Mount the Intelli-Touch fan controller along side the light switch in the 4" square outlet box specified for the light switch and provide a combination toggle switch/decora style switch wall-plate. Locate the light switch and Intelli-Touch switch at the locations indicated on ESK-1. Route 2#12 from each fan to the Intelli-Touch controller.

Please contact our office if you have any questions or require additional information.

Sincerely,

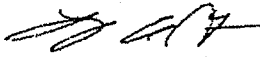

Luis E. Flores
Principal

Attachment: ESK-1

LJF:ms

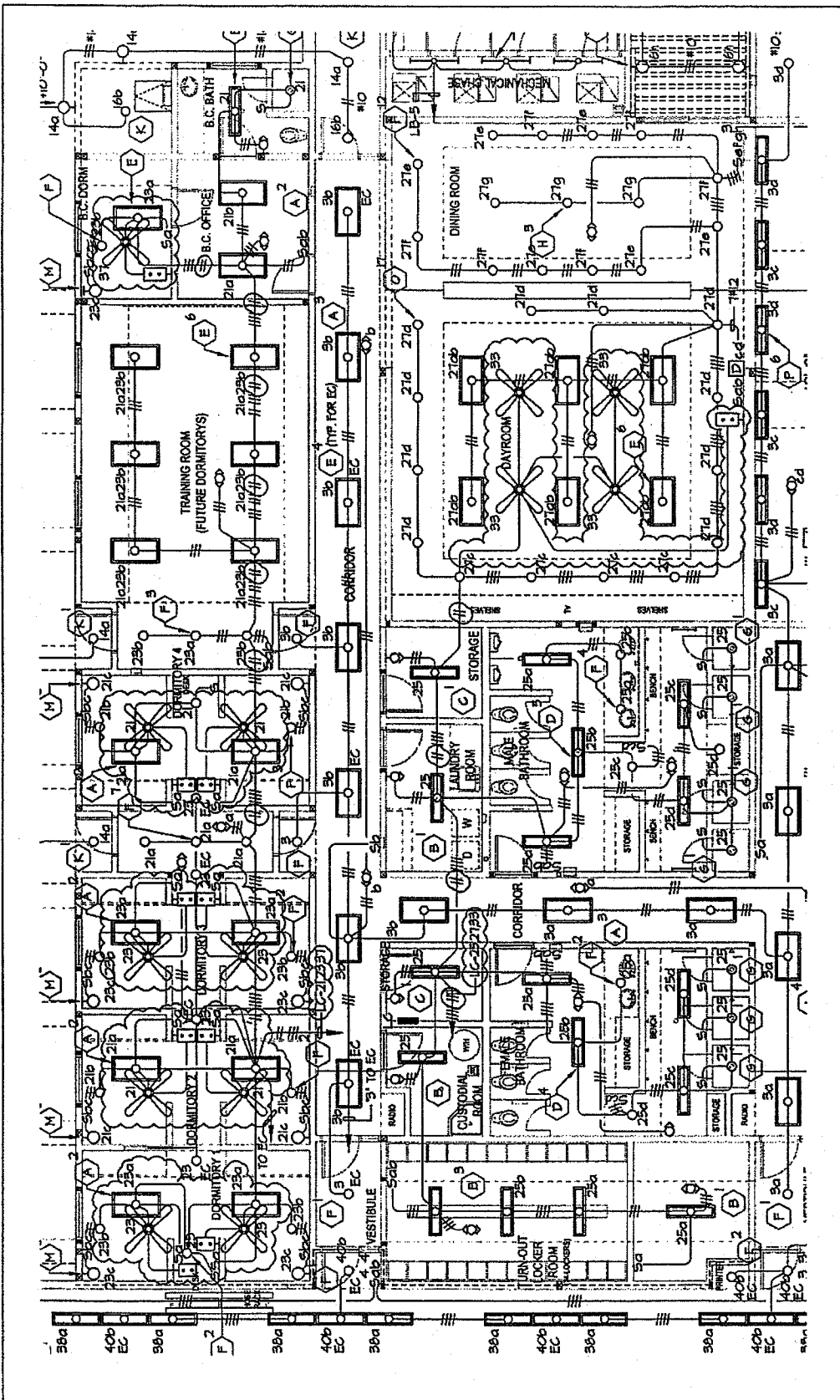

LIGHTING PLAN	
DRWN:	KMC
CHKD:	RES
DATE:	12-13-10
SCALE:	1/8" = 1'-0"
JOB NO.:	07244

MECCA FIRE STATION NO. 40
 COUNTY OF RIVERSIDE
 MECCA, CA

NO	DATE	REVISION SCHEDULE	DESCRIPTION
1	12/13/10	RF1 #6	

WLC
Architects, Inc.
 8163 ROCHESTER AVE.
 SUITE 100
 RANCHO CUCAMONGA
 CALIFORNIA 91730



A&F ENGINEERING GROUP, INC.
 9333 BASELINE RD., SUITE 100, RANCHO CUCAMONGA, CA 91730
 TEL: (909) 941-3008 FAX: (909) 941-8211

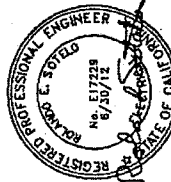

CONSULTANT

Eberhardt Construction, Inc.

19031 Hwy. 18, Suite 250

Apple Valley, CA 92307

Phone: (760) 242-0161
Fax: (760) 242-0380**CHANGE ORDER REQUEST****No. 00013****TITLE:** COR No. 13: Splitface Block**DATE:** 1/19/2012**PROJECT:** Mecca Fire Station**JOB:** 0610**TO:** Attn: Kelley Needham
WLC Architects, Inc.
8163 Rochester Avenue
Suite 100
Rancho Cucamonga, CA 91730
Phone: 909-987-0909 Fax: 909-980-9980**CONTRACT NO:** 0610-001**RE: To: From: Number:****DESCRIPTION OF PROPOSAL**

Cost to change approximately 1074 SF of splitface one side block to splitface two sides as per Architect's response to Submittal 04820-2.

Item	Description	Stock#	Quantity	Units	Unit Price	Tax Rate	Tax Amount	Net Amount
00001	Cost to change splitface one side to splitface two sides as requested. Reference J Ginger Masonry's COR No. 3.		1.000		\$1,830.00	0.00%	\$0.00	\$1,830.00
00002	ECl OH & P @ 5%		1.000		\$91.50	0.00%	\$0.00	\$91.50
00003	ECl Insurance @ 1%		1.000		\$18.30	0.00%	\$0.00	\$18.30
00004	ECl Bond at 1.5%		1.000		\$27.45	0.00%	\$0.00	\$27.45

Unit Cost: \$1,967.25
Unit Tax: \$0.00
Total: \$1,967.25

APPROVAL:

By: _____ **By:** _____
Kelley Needham Leah Rodriguez

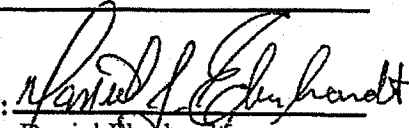
By: 
Daniel Eberhardt

Date: _____ **Date:** _____

Date: 1-19-12



J Ginger Masonry, LP
 8188 Lincoln Avenue, Suite 100
 Riverside, CA 92504
 T 951.509.5300
 F 951.688.1434
 License #940581

Eberhardt Construction
Sheila Larsen
 19031 Hwy 18 Suite 250
 Apple Valley, Ca 92307

Project: **Mecca Fire Station 40**
 Phone: (760) 242-0161
 Fax: (760) 242-0380
 E-Mail: sheila@eberhardtconstruction.com

Date: June 14, 2011

Proposal #: **13042**

Project Location : Mecca, CA

Plans By : WLC Architects

Project Manager: **Suliman Noorzay** (661) 510-1267

Description	Total Cost
-------------	------------

COR #3 - Split Two Side Block

Change approximately 1074 SF of splitface one side block to splitfact two sides

Cost Breakdown

8" Block	1,300 EA	\$	1.10	\$	1,430.00
Tax @ 8.75%				\$	125.13
Subtotal				\$	1,555.13
OH&P @ 15%				\$	274.43

Total \$ 1,830.00

Respectfully submitted by : _____ June 14, 2011
 Jason Pendleton / Director, Business Development Date

ACCEPTANCE

I the undersigned, do hereby agree to the conditions of this proposal and authorize J Ginger Masonry, LP to proceed

 Signature and Title

 Date

Eberhardt Construction, Inc.

19031 Hwy. 18, Suite 250

Apple Valley, CA 92307

Phone: (760) 242-0161

Fax: (760) 242-0380

CHANGE ORDER REQUEST

No. 00014

TITLE: COR No. 14: Change in Showerheads

DATE: 1/19/2012

PROJECT: Mecca Fire Station

JOB: 0610

TO: Attn: Kelley Needham
WLC Architects, Inc.
8163 Rochester Avenue
Suite 100
Rancho Cucamonga, CA 91730
Phone: 909-987-0909 Fax: 909-980-9980

CONTRACT NO: 0610-001

RE: To: From: Number:

DESCRIPTION OF PROPOSAL

Credit to change showerheads as requested by Architect.

Item	Description	Stock#	Quantity	Units	Unit Price	Tax Rate	Tax Amount	Net Amount
00001	Credit to change showerheads as requested by Architect and revised schedule. Reference MRL Commercial Plumblings Credit Memo No. 1093.		1.000		(\$144.00)	0.00%	\$0.00	(\$144.00)
00002	ECI OH & P @ 5%		1.000		(\$7.20)	0.00%	\$0.00	(\$7.20)
00003	ECI Insurance @ 1%		1.000		(\$1.44)	0.00%	\$0.00	(\$1.44)
00004	ECI Bond @ 1.5%		1.000		(\$2.16)	0.00%	\$0.00	(\$2.16)

Unit Cost: (\$154.80)
Unit Tax: \$0.00
Total: (\$154.80)

APPROVAL:

By: _____ **By:** _____
Kelley Needham Leah Rodriguez

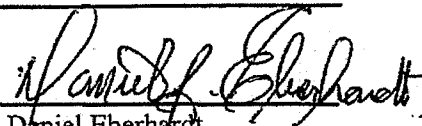
By: 
Daniel Eberhardt

Date: _____ **Date:** _____

Date: 1-19-12

MRL Commercial Plumbing

22810 Del Oro Rd.
Apple Valley, CA 92308

Credit Memo

DATE	CREDIT NO.
1/18/2012	1093

CUSTOMER
Eberhardt Construction 19031 Hwy 18, Suite 250 Apple Valley, CA 92307

RECEIVED
 JAN 19 2012
 ECI

PROJECT

DESCRIPTION	AMOUNT
CHANGE REQUEST FOR MECCA FIRE STATION Price difference to change shower heads (\$18.00/ showerhead)	-144.00
Total	
	\$-144.00

Sheila Larsen

From: Shih-Jing Yen [syen@wlcarchitects.com]
Sent: Wednesday, December 14, 2011 10:19 AM
To: 'Dan Eberhardt' (dan@eberhardtconstruction.com)
Cc: Sheila Larsen; Dave Kalata; Kelley Needham
Subject: FW: Mecca FS 40- Shower heads
Attachments: MeccaFS#40-Showerhead.pdf

Dan,

We would like to change the shower head per the attached revised schedule. There should be a credit.

Thanks,

Shih-Jing Yen, Architect, LEED™ AP BD+C

WLC Architects Inc. | 8163 Rochester Avenue, Suite 100 | Rancho Cucamonga, CA 91730
909.987.0909 | syen@wlcarchitects.com

From: Sandra Pardo [<mailto:spardo@bpa-inc.com>]

Sent: Tuesday, December 13, 2011 3:10 PM

To: Shih-Jing Yen

Subject: Mecca

Hi Shih-Jing,

Enclosed is the PDF with the revised showerhead for Mecca FS. The previous showerhead is \$167 and the new showerhead is \$119, so it's actually cheaper. If you need anything else just let me know.

Thanks!

BP & Associates, Inc.

Sandra Pardo

Plumbing Designer

Ph. (949) 417-3900

Fax (949) 417-3908

spardo@bpa-inc.com

www.bpa-inc.com

No virus found in this message.

Checked by AVG - www.avg.com

Version: 10.0.1415 / Virus Database: 2102/4080 - Release Date: 12/14/11

FIXTURE SCHEDULE

ITEM	FIXTURE	ROUGH-IN CONNECTIONS						DESCRIPTION
		TRAP	WASTE	VENT	HOT WATER	COLD WATER	GAS	
SH 1	SHOWER	--	--	--	3/4"	3/4"	--	SYMMONS NO. C-98-1-285-X TEMPTRON SHOWER SYSTEM, COMPLETE WITH PRESSURE BALANCING MIXING VALVE WITH LEVER HANDLE, INTEGRAL STOPS, #412SH 2.0 GPM CHROME SHOWER HEAD WITH BACK PLATE.



SOUTHERN CALIFORNIA
8163 Rochester Ave., Suite 100
Rancho Cucamonga
California 91730-0729
tel: 909-987-0909
fax: 909-980-9980

MECCA FIRE STATION No. 40

DRAWN	SP
CHECKED	TP
DATE	12/13/11
SCALE	AS NOTED
JOB NO.	07244

REF. P-0.2

Eberhardt Construction, Inc.

19031 Hwy. 18, Suite 250

Apple Valley, CA 92307

Phone: (760) 242-0161

Fax: (760) 242-0380

CHANGE ORDER REQUEST

No. 00015

TITLE: COR No. 15: Half Wall Supports

DATE: 1/30/2012

PROJECT: Mecca Fire Station

JOB: 0610

TO: Attn: Shih-Jing Yen
WLC Architects, Inc.
8163 Rochester Avenue
Suite 100
Rancho Cucamonga, CA 91730
Phone: 909-987-0909 Fax: 909-980-9980

CONTRACT NO: 0610-001

RE: To: From: Number:

DESCRIPTION OF PROPOSAL

Cost for half wall supports as per Detail provided by WLC Architects, Inc. dated January 24, 2012.

NOTE: This cost is based upon completing this work concurrent with setting the poles with the gates.

Item	Description	Stock#	Quantity	Units	Unit Price	Tax Rate	Tax Amount	Net Amount
00001	Cost to provide and install half wall supports as per detail by Architect. Includes powdercoat, carpentry and installation. Reference Sunset Iron's quote dated 1/24/12.		1.000		\$1,290.00	0.00%	\$0.00	\$1,290.00
00002	ECI OH & P @ 5%		1.000		\$64.50	0.00%	\$0.00	\$64.50
00003	ECI Insurance @ 1%		1.000		\$12.90	0.00%	\$0.00	\$12.90
00004	ECI Bond Fee @ 1.5%		1.000		\$19.35	0.00%	\$0.00	\$19.35

Unit Cost: \$1,386.75

Unit Tax: \$0.00

Total: \$1,386.75

APPROVAL:

By: _____
Kelley Needham

By: _____
Leah Rodriguez

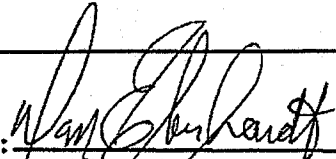
By: 
Daniel Eberhardt

Date: _____

Date: _____

Date: 1-30-12

Sunset Iron & Automation
22276 Ottawa Rd. #3
Apple Valley, Ca 92308
760-240-6577

Fax

Eberhardt Construction

1-24-2012

Mecca Fire station

Quantity – 5 Half Wall Supports

Includes: Powdercoated, Carpentry & Installed

\$ 1,290.00

Eberhardt Construction, Inc.

19031 Hwy. 18, Suite 250

Apple Valley, CA 92307

Phone: (760) 242-0161

Fax: (760) 242-0380

CHANGE ORDER REQUEST

No. 00016

TITLE: COR No. 16: Blocking for Fixtures**DATE:** 2/29/2012**PROJECT:** Mecca Fire Station**JOB:** 0610

TO: Attn: Kelley Needham
 WLC Architects, Inc.
 8163 Rochester Avenue
 Suite 100
 Rancho Cucamonga, CA 91730
 Phone: 909-987-0909 Fax: 909-980-9980

CONTRACT NO: 0610-001

RE: To: From: Number:

DESCRIPTION OF PROPOSAL

Added cost for blocking for B, C & D fixtures.

Item	Description	Stock#	Quantity	Units	Unit Price	Tax Rate	Tax Amount	Net Amount
00001	Cost for 56 fixtures that need blocking to accommodate trim kits. Includes labor, material and equipment. Reference WB Walton Email dated 1/11/12.		1.000		\$1,830.70	0.00%	\$0.00	\$1,830.70
00002	ECI OH & P @ 5%		1.000		\$91.53	0.00%	\$0.00	\$91.53
00003	ECI Insurance @ 1%		1.000		\$18.30	0.00%	\$0.00	\$18.30
00004	ECI Bond @ 1.5%		1.000		\$27.47	0.00%	\$0.00	\$27.47

Unit Cost: \$1,968.00
Unit Tax: \$0.00
Total: \$1,968.00

APPROVAL:

By: _____ **By:** _____
 Kelley Needham Leah Rodriguez

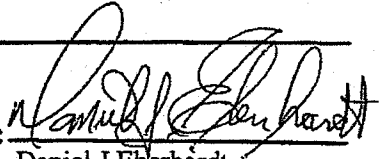
By: 
 Daniel J Eberhardt

Date: _____ **Date:** _____

Date: 3-7-12

Eberhardt Construction, Inc.

19031 Hwy. 18, Suite 250

Apple Valley, CA 92307

Phone: 760-242-0161

Fax: 760-242-0380

CHANGE ORDER REQUEST

No. 00017

TITLE: COR 17: ECI Insurance & Bond

DATE: 2/29/2012

PROJECT: Mecca Fire Station

JOB: 0610

TO: Attn: Kelley Needham
WLC Architects, Inc.
8163 Rochester Avenue
Suite 100
Rancho Cucamonga, CA 91730
Phone: 909-987-0909 Fax: 909-980-9980

CONTRACT NO: 0610-001

RE: To: From: Number:

DESCRIPTION OF PROPOSAL

Eberhardt Construction, Inc. insurance and bond cost inadvertently left off of original COR's.

Item	Description	Stock#	Quantity	Units	Unit Price	Tax Rate	Tax Amount	Net Amount
00001	Ref COR No. 1 - Added Utility Work, ECI Insurance @ 1% was not included.		1.000		\$997.35	0.00%	\$0.00	\$997.35
00002	Ref COR No. 1 - Added Utility Work, ECI Bond @ 1.5% was not included.		1.000		\$1,496.02	0.00%	\$0.00	\$1,496.02
00003	Ref COR No. 2 - Grind & Overlay Parking Lot, ECI Insurance @ 1% was not included.		1.000		\$77.17	0.00%	\$0.00	\$77.17
00004	Ref COR No. 2 - Grind & Overlay Parking Lot, ECI Bond @ 1.5% was not included.		1.000		\$115.75	0.00%	\$0.00	\$115.75

Unit Cost: \$2,686.29
 Unit Tax: \$0.00
Total: \$2,686.29

APPROVAL:

By: _____ By: _____
Kelley Needham Leah Rodriguez

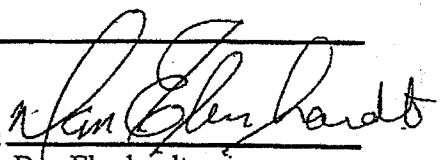
By: 
Dan Eberhardt

Date: _____ Date: _____

Date: 3-7-12

Eberhardt Construction, Inc.

19031 Hwy. 18, Suite 250

Apple Valley, CA 92307

Phone: (760) 242-0161

Fax: (760) 242-0380

CHANGE ORDER REQUEST

No. 00019

TITLE: COR No. 19: Change to Interceptor

DATE: 4/10/2012

PROJECT: Mecca Fire Station

JOB: 0610

TO: Attn: Kelley Needham
WLC Architects, Inc.
8163 Rochester Avenue
Suite 100
Rancho Cucamonga, CA 91730
Phone: 909-987-0909 Fax: 909-980-9980

CONTRACT NO: 0610-001

RE: To: From: Number:

DESCRIPTION OF PROPOSAL

Cost to change from specified 2 compartment to a 3 compartment as required by CVWD.

Item	Description	Stock#	Quantity	Units	Unit Price	Tax Rate	Tax Amount	Net Amount
00001	Cost for labor and materials to change from Sand Oil Interceptor to 1000 Gallon Clarifier Tank, Model CL 1000 as a 3 compartment interceptor must be installed and only a 2 compartment was specified. Reference Orizon's proposal COR No. 1.		1.000		\$2,005.65	0.00%	\$0.00	\$2,005.65
00002	ECI OH & P @ 5%		1.000		\$100.28	0.00%	\$0.00	\$100.28
00003	ECI Insurance @ 1%		1.000		\$20.05	0.00%	\$0.00	\$20.05
00004	ECI Bond @ 1.5%		1.000		\$30.08	0.00%	\$0.00	\$30.08

Unit Cost: \$2,156.06
Unit Tax: \$0.00
Total: \$2,156.06

APPROVAL:

By: _____

Kelley Needham

By: _____

Leah Rodriguez

By: _____

Daniel J Eberhardt

Date: _____

Date: _____

Date: _____

SUBCONTRACTOR COST PROPOSAL SUMMARY SHEET- Form II

Subcontractor Name: Orizon Construction, Inc. Cost Proposal/ Field Order No. _____
 Project: Mecca Fire Staton Contract No. 0610-004

Description: Changes from Sand Oil Interceptor to 1000 Gallon Clarifier Tank, Model CL1000

per

NET COSTS: Attach supporting documentation for each line item	COSTS (1)
1. TOTAL NET COSTS (From form III)	\$ 1,947.23
2. Royalties, Permits, Utilities, Etc.:	\$ -
3 SUBTOTAL LINES 1 & 2	\$ 1,947.23
4 Insurance: - 3% of line 3.	\$ 58.42
5 COSTS OF EXTRA WORK. This Subcontractor Only. Total Lines 3 & 4	\$ 2,005.65
6 MARKUP FEE: for actual work performed- 5% of Line 5.	
7 SUBTOTAL THIS SUBCONTRACTOR- Lines 5 & 6	
8 SUMMARY OF COSTS: Lower Tier Subcontractors- Sub - subcontractors (From Form II Subcontractors)	
9 SUBTOTAL LINE 8	
10 PROFIT: Maximum 5% of line 9	\$ -
11 TOTAL THIS SUBCONTRACTOR: Total Lines 7, 9, & 10 (carry line 8 Gen. Contractor Summary Sheet - Form I)	\$ 2,005.65

NOTE: (1) Round- off all Costs to the nearest dollar. Costs from Labor Rate Breakdown Sheet.

07244.55

Eberhardt Construction, Inc.

REQUEST FOR PROPOSAL

No. 00009

19031 Hwy. 18, Suite 250

Phone: (760) 242-0161

Apple Valley, CA 92307

Fax: (760) 242-0380

TITLE: RFP No. 9: Del Wire/Cable for 911

DATE: 10/31/2011

PROJECT: Mecca Fire Station

JOB: 0610

TO: Attn: Kelley Needham
WLC Architects, Inc.
8163 Rochester Avenue
Suite 100
Rancho Cucamonga, CA 91730
Phone: 909-987-0909 Fax: 909-980-9980

CONTRACT NO: 0610-001

RE: To: From: Number:

DESCRIPTION OF PROPOSAL

Proposal Request No. 9
9.1 Delete 4" square back-box, conduit and wire/cable associated with 911 phone.
9.2 Refer to E-2.2 for location of the 911 phone outlet and conduit home-run equipment.

Item	Description	Stock#	Quantity	Units	Unit Price	Tax Rate	Tax Amount	Net Amount
00001	Credit to delete the 4" square back box, conduit and wire/cable associated with 911 phone as per PR No. 9. Reference Waltons response to PR No. 9.		1.000		(\$159.00)	0.00%	\$0.00	(\$159.00)

Unit Cost: (\$159.00)
Unit Tax: \$0.00
Total: (\$159.00)

APPROVAL:

By: 
Kelley Needham

By: 
Dan Eberhardt

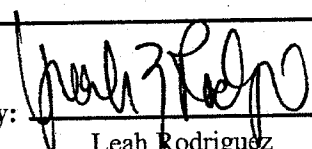
By: 
Leah Rodriguez

Date: 11.29.11

Date:

Date:



330 E 3rd St
Beaumont, CA 92223
Phone: (951) 769-2280
Fax: (951) 769-7255

Change Request Form

Project No.: 724400.4
Project Name: Mecca Fire Station POR # 9 Change # 007
Date Requested: July 29, 2011 Date Submitted: 8/11/2011

Description of Change: This is for the deleting of the 911 call box on the south outside wall of station. Proposal Request #9.

1	Material		(14.30)
2	Sales Tax on Material	8.75%	
3	Labor Costs		-144.70
4	Freight		
5	Equipment and Major Tools		
6	Gas and Oil		
7	Other Direct Costs		
8	Insurance		
9	Other		
10	Truck @ \$48.00 /Day	1 Days	
11	Permit Fee		
12	Other		
13	Sub-Total:		-159.00
14	General and Administrative	15.00%	
15	Sub-Total:		-159.00
16	Sub-Contract		
17	General and Administrative		
18	Other		
19	Other		
20	Sub-Total:		-159.00
21	Bond Premium	1.00%	
22	Total Price of This Change Proposal		(\$159)
23	Extension of time due to this Change is:		Days or Deferred **
24	This Proposal is based on:	St. Time O. Time Shift	
25	This proposal is subject to upward escalation unless notice to proceed is received by	(0.C. Days if no date shown)	
26	Extended Overhead Cost	Included Deferred **	

** If Deferred, cover letter will describe

Submitted by: _____ Date _____
Signature Title

Approved by: _____ Date _____
Signature Title

This proposal is based solely on the direct cost elements such as labor, material, and normal mark-ups and does not include any amount for changes in the sequence of work delays, disruptions, rescheduling, extended overhead, acceleration, and/or impact costs not specifically noted and mutually agreed upon on the enclosed "labor factors and corrections" and inclusive of an equitable and compensable contract extension requested herein. Notwithstanding, the right is hereby clearly and expressly reserved to make claim for any and all impacts, restraints and related items of cost prior to any final settlement of this contract.

Change Request Form

Labor Factors & Corrections

Percentages are to be applied to the total affected manhours of the current contract, and to the Labor of the proposed change.	Affected Manhours of Current Contract		Manhours of Proposed Change	
	Manhours *	As of _____	-2.00 (1)	
	Percentage of Loss	Manhours Lost	Percentage of Loss	Manhours Lost
Negative Productivity Factors				
Reassignment of Manpower	1.3%		5.0%	
Crew Size Inefficiency	2.5%		10.0%	
Site Access	1.3%		5.0%	
Logistics	2.5%		10.0%	
Stacking of Trades	2.5%		10.0%	
Dilution of Supervision	2.5%		10.0%	
Errors and Omissions	0.3%		1.0%	
Fatigue	2.0%		8.0%	
Learning Curve	1.3%		5.0%	
Ripple	2.5%		10.0%	
Morale and Attitude	1.3%		5.0%	
Concurrent Operations	1.3%		5.0%	
Beneficial Occupancy	3.8%		15.0%	
Joint Occupancy (Other Trades)	1.3%		5.0%	
Weather Factor	2.5%		10.0%	
Height Factor				
Overtime Adjustment	3%		10.0%	
1 + 2 + 3 =		(2)		(3)

* Estimated

(4) Journeyman	2.00	Hrs. @	(\$72.35)	-144.70
(5) Foreman		Hrs. @	\$78.28	
(6) General Foreman		Hrs. @	\$86.88	
(7) Superintendent		Hrs. @	\$95.56	
(8) Sound Tech		Hrs. @		
(9) Foreman S T		Hrs. @		
(10) Other: _____		Hrs. @		
(11)				
(12) Total Direct Labor (Lines 4 - 11)	2.00	Hrs.		-144.70
(13) Small Tools @ 3%				
(14) Total Labor (Lines 12+13)				(\$144.70)

Change Request Form

Labor Summary

Hourly Rates

Job Description	Base Rate	Payroll Tax Insurance Fringes	Wage, Tax & Fringe Escalation	Other	Total Hourly Rate
Journeyman	\$36.50	\$28.35	\$4.50	\$3.00	72.35
Foreman	\$42.00	\$30.24	\$2.89	\$3.15	78.28
General Foreman	\$46.75	\$33.66	\$3.22	\$3.25	86.88
Sound Tech					
Foreman S. T.					
Other:					

1. Journeyman Hours	(2.00) Hrs.
2. Nonproductive Travel	_____ Hrs.
3. Remobilization Hours	_____ Hrs.
4. Material Handling	_____ Hrs.
5. Punch and Demo	_____ Hrs.
6. Safety	_____ Hrs.
7. Clean Up	_____ Hrs.
8. Warranty	_____ Hrs.
9. Permit Acquisition	_____ Hrs.
10. Logistical Inefficiency	_____ Hrs.
11. Labor Difficulty	_____ Hrs.
12. Base J.W. Hours 1 thru 11	-2.00

Takeoff Sheet

Project No.: Mecca Fire Station

RFC#: 007

U = E for Each, C for 100, M for 1000

Item	Description	Qty	Mat Price	Project Name:		#REF!			
				U	Labor	U	Total Mat(\$)	Total Hours	
1	1" EMT CONDUIT	20	(\$48.32)	C	0.25	E	-\$9.66	-0.85	
2	1" EMT STL SS CONN	2	(\$51.00)	C		C	-\$1.02	-0.30	
3	1" EMT STL COMP CONN	1	(\$73.00)	C		C	-\$0.73	-0.20	
4	4x2 1/8" SQ BOX 1" KO	1	(\$144.00)	C	1.30	E	-\$1.44	-0.10	
5	single gang extension ring	1	(\$1.45)	E		C	-\$1.45	-0.30	
6				C		C			
7				E		M			
8				M		M			
9				E		E			
10				M					
11				C					
12				C					
13				C					
14				C					
15				C					
16				E					
17				E					
18				C					
19				C					
20				C					
21				C					
22				C					
23				E					
24									
25									
26									
27									
28									
29									
30									
31									
32									
33									
34									
35									
36									
37									
38									
39									
40									
41									
42									
43									
44									
45									
46									
47									
48									
49									
50									
51									
52									
53									
Totals								(14.30)	(2.00)

Sheila Larsen

From: Brenda Gooch [b-gooch@wbwaltonelectric.com]
Sent: Monday, October 31, 2011 10:18 AM
To: 'Sheila Larsen'
Attachments: POR 9 Mecca.pdf

Sheila,

See attached COR 7 for your POR 9.

Thank you

Brenda Gooch

Project Administrator

Pacific ELS Inc. DBA WB Walton Electric

An Electrical & Energy Solutions Company

951.769.2280(office) 951.769.7255 (fax)

b-gooch@wbwaltonelectric.com

No virus found in this message.

Checked by AVG - www.avg.com

Version: 10.0.1411 / Virus Database: 2092/3986 - Release Date: 10/31/11

Eberhardt Construction, Inc.

19031 Hwy. 18, Suite 250

Apple Valley, CA 92307

Phone: (760) 242-0161

Fax: (760) 242-0380

REQUEST FOR PROPOSAL

No. 00010

TITLE: RFP No. 10: Delete Drypack

DATE: 11/10/2011

PROJECT: Mecca Fire Station

JOB: 0610

TO: Attn: Leah Rodriguez
Riverside County Economic Devel Agen
44-199 Monroe, Suite B
Indio, CA 92201
Phone: 760-863-2534 Fax: 760-863-2551

CONTRACT NO: 0610-001

RE:

To:

From:

Number:

DESCRIPTION OF PROPOSAL:

Proposal Request No. 10: Delete 1" drypack below 3X P.T. sill plate throughout.

Item	Description	Stock#	Quantity	Units	Unit Price	Tax Rate	Tax Amount	Net Amount
00001	Credit to delete drypack as per PR No. 10.		1.000		(\$200.00)	0.00%	\$0.00	(\$200.00)

Unit Cost: (\$200.00)
Unit Tax: \$0.00
Total: (\$200.00)

APPROVAL:

By: _____
Leah Rodriguez

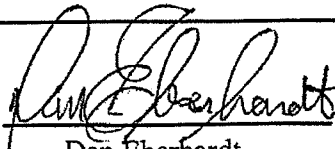
By: 
Dan Eberhardt

By: _____
Kelley Needham

Date: _____

Date: _____

Date: _____

Eberhardt Construction, Inc.

19031 Hwy. 18, Suite 250

Apple Valley, CA 92307

Phone: (760) 242-0161

Fax: (760) 242-0380

REQUEST FOR PROPOSAL

No. 0012

TITLE: RFP No. 12: Ref RFI 81RR

DATE: 1/30/2012

PROJECT: Mecca Fire Station

JOB: 0610

TO: Attn: Kelley Needham
WLC Architects, Inc.
8163 Rochester Avenue
Suite 100
Rancho Cucamonga, CA 91730
Phone: 909-987-0909 Fax: 909-980-9980

CONTRACT NO: 0610-001

RE: To: From: Number:

DESCRIPTION OF PROPOSAL

Per response to RFI 81 RR, change Type SD light fixture mounting locations from between sectional overhead doors to above the sectional overhead doors. Change quantity from eight (8) to six (6). See attached Drawing A1.

Item	Description	Stock#	Quantity	Units	Unit Price	Tax Rate	Tax Amount	Net Amount
00001	Per RFI No. 81: Cost to change mounting height/location to 16'-0" for SD fixtures. Includes credit for labor to install (2) deleted lights. No material credit, as lights could not be returned, however will be given to Owner upon completion of project. Reference WB Walton Electric's COR No. 10 dated 1/26/12.		1.000		(\$50.00)	0.00%	\$0.00	(\$50.00)
00002	ECI OH & P @ 5%		1.000		(\$2.50)	0.00%	\$0.00	(\$2.50)
00003	ECI Insurance @ 1%		1.000		(\$0.50)	0.00%	\$0.00	(\$0.50)
00004	ECI Bond Fee @ 1.5%		1.000		(\$0.75)	0.00%	\$0.00	(\$0.75)
							Unit Cost:	(\$53.75)
							Unit Tax:	\$0.00
							Total:	(\$53.75)

APPROVAL:

By: _____
Kelley Needham

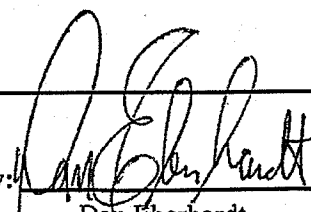
By: 
Dan Eberhardt

By: _____
Leah Rodriguez

Date: _____

Date: 1-30-12

Date: _____



330 E 3rd St
 Beaumont, CA 92223
 Phone: (951) 769-2280
 Fax: (951) 769-7255

Change Request Form

Project No.: 724400.4
 Project Name: Mecca Fire Station Change #: 010 per RFI 81
 Date Requested: December 22, 2011 Date Submitted: 1/26/2012

Description of Change:		For deleting (2) SD light fixtures. Due to conflicts with the framing. Also, the costs for moving the lights to being mounted at a higher elevation (16' AFF)
1	Material	(68.76)
2	Sales Tax on Material 7.75%	-5.33
3	Labor Costs	-144.70
4	Freight	
5	Equipment and Major Tools	
6	Gas and Oil	
7	Other Direct Costs	
8	Insurance	
9	Other: Scissor Lift	175.00
10	Truck @ \$48.00 /Day 1 Days	
11	Permit Fee	
12	Other:	
13	Sub-Total:	-43.79
14	General and Administrative 15%	6.56
15	Sub-Total:	-43.79
16	Sub-Contract:	
17	General and Administrative	
18	Other	
19	Other	
20	Sub-Total:	-43.79
21	Bond Premium 1.00%	(50.35)
22	Total Price of This Change Proposal	(\$44) (50.00)
23	Extension of time due to this Change is:	1 Days or Deferred **
24	This Proposal is based on:	St. Time O. Time Shift
25	This proposal is subject to upward escalation unless notice to proceed is received by {20 C. Days if no date shown}	
26	Extended Overhead Cost	Included Deferred **

** If Deferred, cover letter will describe

Submitted by: _____ Date _____
 Signature Title

Approved by: _____ Date _____
 Signature Title

This proposal is based solely on the direct cost elements such as labor, material, and normal mark-ups and does not include any amount for changes in the sequence of work delays, disruptions, rescheduling, extended overhead, acceleration, and/or impact costs not specifically noted and mutually agreed upon on the enclosed "labor factors and corrections" and inclusive of an equitable and compensable contract extension requested herein. Notwithstanding, the right is hereby clearly and expressly reserved to make claim for any and all impacts, restraints and related items of cost prior to any final settlement of this contract.

Change Request Form

Labor Factors & Corrections

Percentages are to be applied to the total affected manhours of the current contract, and to the Labor of the proposed change.	Affected Manhours of Current Contract		Manhours of Proposed Change	
	Manhours *		8.00 (1)	
	As of			
Negative Productivity Factors	Percentage of Loss	Manhours Lost	Percentage of Loss	Manhours Lost
Reassignment of Manpower	1.3%		5.0%	
Crew Size Inefficiency	2.5%		10.0%	
Site Access	1.3%		5.0%	
Logistics	2.5%		10.0%	
Stacking of Trades	2.5%		10.0%	
Dilution of Supervision	2.5%		10.0%	
Errors and Omissions	0.3%		1.0%	
Fatigue	2.0%		8.0%	
Learning Curve	1.3%		5.0%	
Ripple	2.5%		10.0%	
Morale and Attitude	1.3%		5.0%	
Concurrent Operations	1.3%		5.0%	
Beneficial Occupancy	3.8%		15.0%	
Joint Occupancy (Other Trades)	1.3%		5.0%	
Weather Factor	2.5%		10.0%	
Height Factor				
Overtime Adjustment	3%		10.0%	
1 + 2 + 3 =		(2)		(3)

* Estimated

{4} Journeyman	-2.00	Hrs. @	\$72.35	-144.70
{5} Foreman		Hrs. @	\$78.28	
{6} General Foreman		Hrs. @	\$86.88	
{7} Superintendent		Hrs. @	\$95.56	
{8} Sound Tech		Hrs. @		
{9} Foreman S T		Hrs. @		
{10} Other: _____		Hrs. @		
{11}				
{12} Total Direct Labor (Lines 4 - 11)	-2.00	Hrs.		-144.70
{13} Small Tools @ 3%				
{14} Total Labor (Lines 12+13)				(\$144.70)

Change Request Form

Labor Summary

Hourly Rates

Job Description	Base Rate	Payroll Tax Insurance Fringes	Wage, Tax & Fringe Escalation	Other	Total Hourly Rate
Journeyman	\$36.50	\$28.35	\$4.50	\$3.00	72.35
Foreman	\$42.00	\$30.24	\$2.89	\$3.15	78.28
General Foreman	\$46.75	\$33.66	\$3.22	\$3.25	86.88
Sound Tech					
Foreman S. T.					
Other:					

- 1. Journeyman Hours 8.00 Hrs.
- 2. Nonproductive Travel _____ Hrs.
- 3. Remobilization Hours _____ Hrs.
- 4. Material Handling _____ Hrs.
- 5. Punch and Demo _____ Hrs.
- 6. Safety _____ Hrs.
- 7. Clean Up _____ Hrs.
- 8. Warranty _____ Hrs.
- 9. Permit Acquisition _____ Hrs.
- 10. Logistical Inefficiency _____ Hrs.
- 11. Labor Difficulty _____ Hrs.
- 12. Base J.W. Hours 1 thru 11 8.00

Takeoff Sheet

Project No.: Mecca Fire Station

RFC#: 010

U = E for Each, C for 100, M for 1000

Project Name:

#REF!

Item	Description	Qty	Mat Price	U	Labor	U	Total Mat(\$)	Total Hours
1	Adder for higher mounting height	1		E	0.75	E		4.50
2	Scissor Lift needed to mount the lights higher	1	\$265.00	E		E		
3	Installation of SC Lights	-2			0.65	E		-1.30
4	3/4" EMT STL SS CONN	-3	\$485.00	C	10.00	C	-\$14.55	-0.30
5	3/4" EMT STL SS CPLG	-4	\$503.40	C	5.00	C	-\$20.14	-0.20
6	#10x1" P/H SELF-TAP SCREW	-8	\$28.96	C	1.00	C	-\$2.32	-0.08
7	3/4" EMT conduit	40	(\$79.39)	C	3.52	C	-\$31.76	1.30
8				C	4.00	C		
9				M		M		
10				C		C		
11				C		C		
12				C		C		
13				C		C		
14				C		C		
15				C		C		
16								
17								
18								
19								
20								
21								
22								
23								
24								
25								
26								-0.58
27								
28								
29								
30								
31								
32								
33								
34								
35								
36								
37								
38								
39								
40								
41								
42								
43								
44								
45								
46								
47								
48								
49								
50								
51								
52								
53								

Totals (68.75) (1.88)

PROPOSAL REQUEST

OWNER L. Rodriguez, County of Riverside
ARCHITECT K. Needham, WLC Architects, Inc.
CONTRACTOR D. Eberhardt, Eberhardt Construction, Inc.
FIELD _____
OTHER _____
OTHER _____

PROJECT: Mecca Fire Station No. 40

PROPOSAL REQUEST NO: 12

DATE OF ISSUANCE: January 10, 2012

OWNER: County of Riverside
Economic Development Agency
44-199 Monroe, Suite B
Indio, CA 92201

ARCHITECT'S PROJECT NO: 0724400.53

TO: Eberhardt Construction, Inc.
19031 Highway 18, Suite 250
Apple Valley, CA 92307

CONTRACT FOR: Construction

CONTRACT DATED: December 2010

Please submit an itemized quotation for changes in the Contract sum and/or Time incidental to proposed modifications to the Contract Documents described herein.

THIS IS NOT A CHANGE ORDER NOR A DIRECTION TO PROCEED WITH THE WORK DESCRIBED HEREIN.

Description: (Written description of the Work)

- 12.1 Per response to RFI 81^{RR}, change Type SD light fixture mounting locations from between sectional overhead doors to above the sectional overhead doors. Change quantity from eight (8) to six (6). See attached Drawing A1.

Attachments: (List attached documentation that support description)

A1

ARCHITECT: WLC ARCHITECTS, INC.

BY: *Shih-Jing Yen*

SHIH-JING YEN, Architect, LEED™ AP

/rg

P5072440012-pr

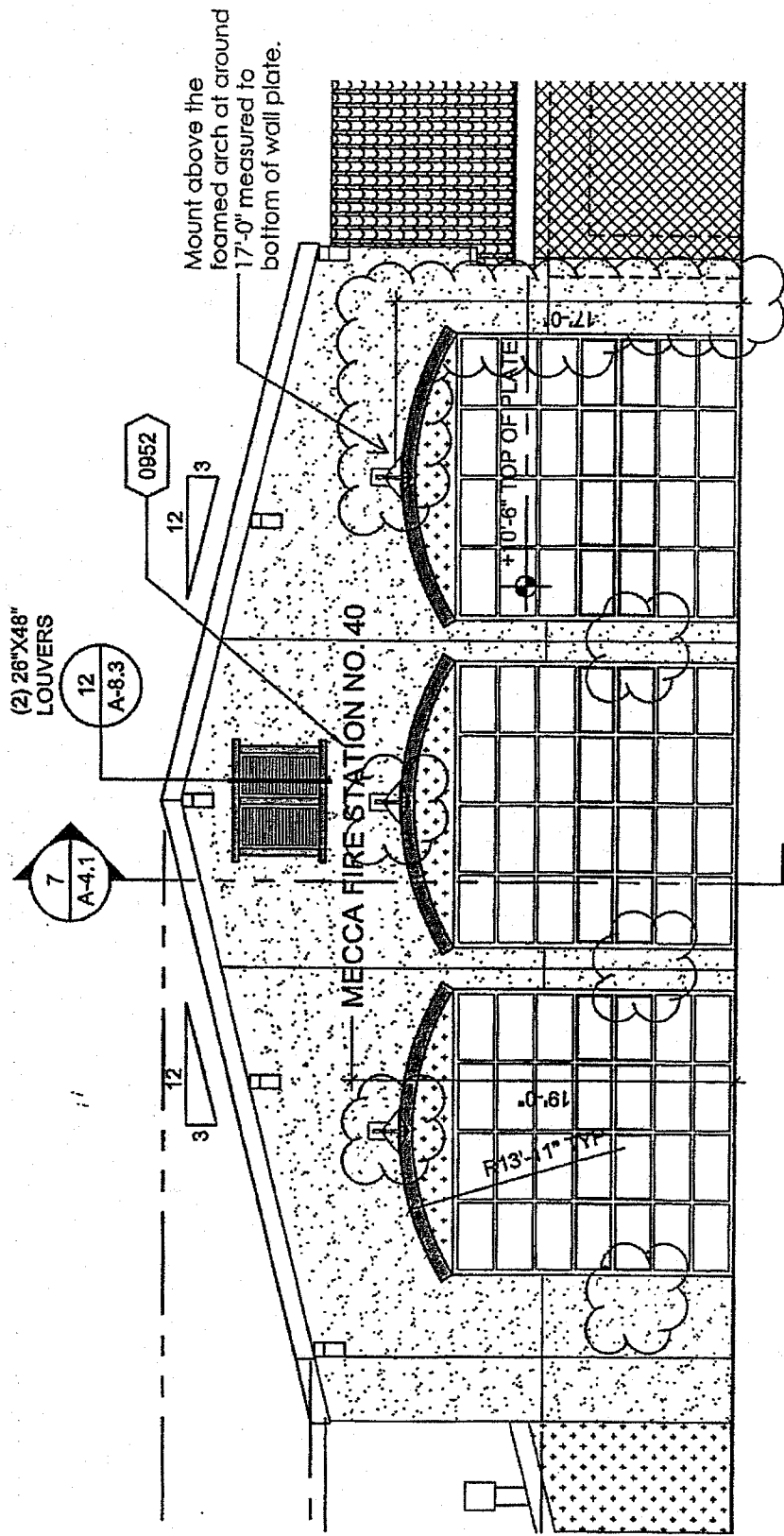

SOUTH ELEVATION

Eberhardt Construction, Inc.**REQUEST FOR INFORMATION**

19031 Hwy. 18, Suite 250

No. 0081

Phone: 760-242-0161

Apple Valley, CA 92307

Fax: 760-242-0380

TITLE: FC RFI No. 81: Fixture SD**DATE:** 12/6/2011**PROJECT:** Mecca Fire Station**JOB:** 0610

TO: Attn: Shih-Jing Yen
 WLC Architects, Inc.
 8163 Rochester Avenue
 Suite 100
 Rancho Cucamonga, CA 91730
 Phone: 909-987-0909 Fax: 909-980-9980

STARTED:**COMPLETED:****REQUIRED:** 12/13/2011**WORK****SCHEDULE****COST****IMPACT:** Unknown**IMPACT:** Unknown**IMPACT:** Unknown**QUESTION:**

Please provide new location or mounting method for fixture type SD mounted at +7'-6" between apparatus bay doors, as the 12'x10" TS columns will not allow for the electrical junction box required to mount fixture. Typical 4 locations.

cc: Jobsite
 cc: Walton Electric

PROPOSED SOLUTION:**ANSWER:**

~~Provide type SD light fixtures with 70W metal halide lamp (70MHT6EB option) and mount the light fixtures at +16'-0". Coordinate exact location with the Architect.~~

Luis Flores / A&F
 12/21/11

See attached elevation for location. Change quantity from eight (8) to six (6).
 Fixture type and lamping remain the same.

Shih-Jing Yen
 WLC Architects
 12-27-2011
 1-11-2011

Requested By: Eberhardt Construction, Inc.

Date: 12/6/2011

Signed: 
 Dave Kalata

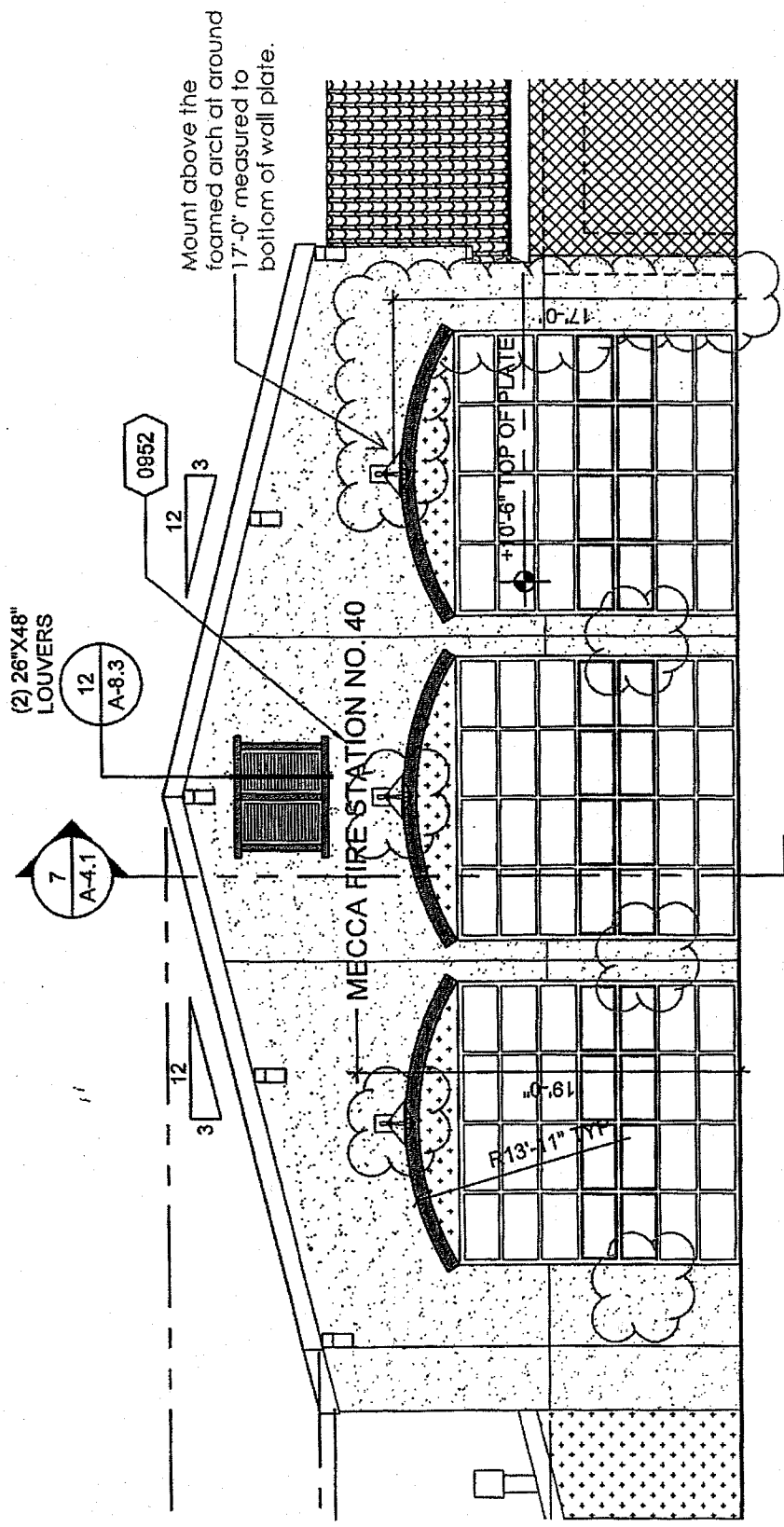

SOUTH ELEVATION

Eberhardt Construction, Inc.

19031 Hwy. 18, Suite 250

Apple Valley, CA 92307

Phone: (760) 242-0161

Fax: (760) 242-0380

REQUEST FOR PROPOSAL

No. 0013

TITLE: RFP No. 13: Type K Fixture Changes

DATE: 1/17/2012

PROJECT: Mecca Fire Station

JOB: 0610

TO: Attn: Kelley Needham
WLC Architects, Inc.
8163 Rochester Avenue
Suite 100
Rancho Cucamonga, CA 91730
Phone: 909-987-0909 Fax: 909-980-9980

CONTRACT NO: 0610-001

RE: To: From: Number:

DESCRIPTION OF PROPOSAL

As per PR No. 13:

13.1: Per response to RFI 82, replace the specified type K fixture with a Fail Safe FSS-W-126-120-EBT1-VRSD. Color Bronze, see attached cut sheets.

13.2: See attached drawing A1 for location and quantity changes.

Item	Description	Stock#	Quantity	Units	Unit Price	Tax Rate	Tax Amount	Net Amount
00001	Per Architect's response to RFI No. 82: Cost for labor and material to change out the K Fixtures from recessed lights to Surface Mount. Reference WB Walton Electric's COR No. 11 received 1/26/12.		1.000		\$1,419.00	0.00%	\$0.00	\$1,419.00
00002	ECI OH & P @ 5%		1.000		\$70.95	0.00%	\$0.00	\$70.95
00003	ECI Insurance @ 1%		1.000		\$14.19	0.00%	\$0.00	\$14.19
00004	ECI Bond @ 1.5%		1.000		\$21.26	0.00%	\$0.00	\$21.26

Unit Cost: \$1,525.40
Unit Tax: \$0.00
Total: \$1,525.40

APPROVAL:

By: _____
Kelley Needham

By: 
Dan Eberhardt

By: _____
Leah Rodriguez

Date: _____

Date: 1-30-12

Date: _____

Change Request Form

Labor Factors & Corrections

Percentages are to be applied to the total affected manhours of the current contract, and to the Labor of the proposed change.	Affected Manhours of Current Contract		Manhours of Proposed Change	
	Manhours * _____	As of _____	8.00 {1}	
Negative Productivity Factors	Percentage of Loss	Manhours Lost	Percentage of Loss	Manhours Lost
Reassignment of Manpower	1.3%		5.0%	
Crew Size Inefficiency	2.5%		10.0%	
Site Access	1.3%		5.0%	
Logistics	2.5%		10.0%	
Stacking of Trades	2.5%		10.0%	
Dilution of Supervision	2.5%		10.0%	
Errors and Omissions	0.3%		1.0%	
Fatigue	2.0%		8.0%	
Learning Curve	1.3%		5.0%	
Ripple	2.5%		10.0%	
Morale and Attitude	1.3%		5.0%	
Concurrent Operations	1.3%		5.0%	
Beneficial Occupancy	3.8%		15.0%	
Joint Occupancy (Other Trades)	1.3%		5.0%	
Weather Factor	2.5%		10.0%	
Height Factor				
Overtime Adjustment	3%		10.0%	
1 + 2 + 3 =		{2}		{3}

* Estimated

{4} Journeyman	-5.00	Hrs. @	\$72.35	-361.75
{5} Foreman		Hrs. @	\$78.28	
{6} General Foreman		Hrs. @	\$86.88	
{7} Superintendent		Hrs. @	\$95.56	
{8} Sound Tech		Hrs. @		
{9} Foreman S T		Hrs. @		
{10} Other: _____		Hrs. @		
{11}				
{12} Total Direct Labor (Lines 4 - 11)	-5.00	Hrs.		-361.75
{13} Small Tools @ 3%				
{14} Total Labor (Lines 12+13)				(\$361.75)

Change Request Form

Labor Summary

Hourly Rates

Job Description	Base Rate	Payroll Tax Insurance Fringes	Wage, Tax & Fringe Escalation	Other	Total Hourly Rate
Journeyman	\$36.50	\$28.35	\$4.50	\$3.00	72.35
Foreman	\$42.00	\$30.24	\$2.89	\$3.15	78.28
General Foreman	\$46.75	\$33.66	\$3.22	\$3.25	86.88
Sound Tech					
Foreman S. T.					
Other:					

1. Journeyman Hours	8.00	Hrs.
2. Nonproductive Travel	_____	Hrs.
3. Remobilization Hours	_____	Hrs.
4. Material Handling	_____	Hrs.
5. Punch and Demo	_____	Hrs.
6. Safety	_____	Hrs.
7. Clean Up	_____	Hrs.
8. Warranty	_____	Hrs.
9. Permit Acquisition	_____	Hrs.
10. Logistical Inefficiency	_____	Hrs.
11. Labor Difficulty	_____	Hrs.
12. Base J.W. Hours 1 thru 11	8.00	

Takeoff Sheet

Project No.: Mecca Fire Station

RFC#: 010

U = E for Each, C for 100, M for 1000

Project Name:

#REF!

Item	Description	Qty	Mat Price	U	Labor	U	Total Mat(\$)	Total Hours
1				E		E		
2	FSS-W-126-120-EBTI	4	\$364.00	E	0.65	E	\$1,456.00	2.60
3	Installation of "K" Lights that were eliminated	-22			0.40	E		-8.80
4	#10x1" P/H SELF-TAP SCREW	-12	\$28.96	C	1.00	C	-\$3.48	-0.12
5	B2-1 RED WIRE CONN	-15	\$33.33	C	6.20	C	-\$5.00	-0.93
6	4x1 1/2" SQ BOX COMB KO	4	\$285.00	C	30.00	C	\$11.40	1.20
7	4" SQ 3"O" PLSTR RING 1 1/4" RISE	4	\$260.00	C	15.00	C	\$10.40	0.60
8	Ground Pigtails	4	\$1.25	E	10.00	C	\$5.00	0.40
9	Toggle Bolts	8	\$0.78	E	9.00	C	\$6.24	0.72
10				C		C		
11				C		C		
12				C		C		
13				C		C		
14				C		C		
15				C		C		
16								
17								
18								
19								
20								
21								
22								
23								
24								
25								
26								-4.33
27								
28								
29								
30								
31								
32								
33								
34								
35								
36								
37								
38								
39								
40								
41								
42								
43								
44								
45								
46								
47								
48								
49								
50								
51								
52								
53								
Totals							1,480.57	(5.00)

PROPOSAL REQUEST

OWNER L Rodriguez, County of Riverside
ARCHITECT K. Needham, WLC Architects, Inc.
CONTRACTOR D. Eberhardt, Eberhardt Construction, Inc.
FIELD _____
OTHER _____
OTHER _____

PROJECT: Mecca Fire Station No. 40

PROPOSAL REQUEST NO: 13

DATE OF ISSUANCE: January 17, 2012

OWNER: County of Riverside
Economic Development Agency
44-199 Monroe, Suite B
Indio, CA 92201

ARCHITECT'S PROJECT NO: 0724400.53

TO: Eberhardt Construction, Inc.
19031 Highway 18, Suite 250
Apple Valley, CA 92307

CONTRACT FOR: Construction

CONTRACT DATED: December 2010

Please submit an itemized quotation for changes in the Contract sum and/or Time incidental to proposed modifications to the Contract Documents described herein.

THIS IS NOT A CHANGE ORDER NOR A DIRECTION TO PROCEED WITH THE WORK DESCRIBED HEREIN.

Description: (Written description of the Work)

- 13.1 Per response to RFI 82, replace the specified Type K fixture with a Fail-Safe FSS-W-126-120-EBT1-VRSD, color "Bronze". See attached cut sheets.
- 13.2 See attached Drawing A1 for location and quantity changes.

Attachments: (List attached documentation that support description)

Fail-Safe cut sheets
Drawing A1

ARCHITECT: WLC ARCHITECTS, INC.

BY: *Shih-Jing Yen*

SHIH-JING YEN, Architect, LEED™ AP

/rg

P5072440013-pr

FAIL-SAFE®

DESCRIPTION

Fail-Safe's FSS bridges the gap between vandal resistant durability and architectural aesthetics. In decorative applications where a broken fixture could increase owner liability, the FSS's one-piece, polycarbonate housing/lens provides a low profile, unbreakable, surface-mounted unit, ideal for low ceiling heights and narrow corridors. A maximum of three compact fluorescent lamps provide high illumination while reducing costly maintenance. Designed to decorate as it protects, the FSS will surpass the commercial fixture for a one time installation. Its low profile meets ADA requirements.

Catalog #		Type	
Project		Date	
Comments			
Prepared by			

SPECIFICATION FEATURES

Housing/Lens
Integrated, impact-resistant polycarbonate housing/lens with internal side prisms mounts to base. Textured white housing with prismatic lens standard.

Fasteners
Four captive, stainless steel tamperproof TORX®-head T-20 screws prevent unauthorized access.

Gasket
Wet location only. Non-shrinking, double-baked neoprene gasketing seals out the environment.

Mounting Base
One-piece, cast aluminum mounting base provides a rigid mounting anchor for housing and ensures secure installation.

Lamps
By others.

Reflector
Standard white high reflectance polyester powder coat finish. Gloss: 85%; Reflectance: 93%; Hardness Minimum: 2H.

Ballast
Standard Class P, CBM/ETL ballast.

Auxiliary Lighting
During power outages, self-contained EBP option supplies supplemental lighting.

Labels
UL/cUL listed, suitable for damp locations (FSS-D) or wet locations (FSS-W). Low proximity mounting rated.

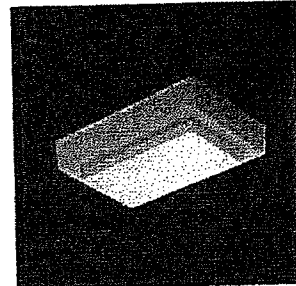

FSS

Quad
TT
Compact Fluorescent
Vandal Resistant

SURFACE MOUNT
Polycarbonate
Low Profile

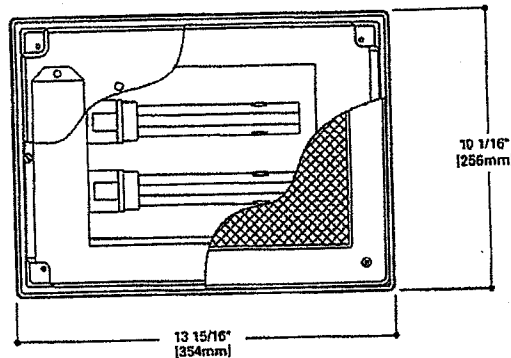

MOUNTING DIMENSIONS

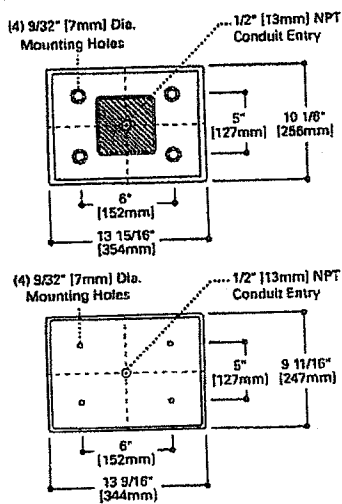

SIDE DIMENSIONS

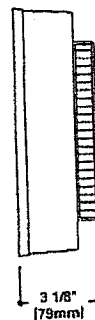

TORX® is a registered trademark of Camcar Division of Textron Inc.

COOPER Lighting
www.cooperlighting.com

TORX® is a registered trademark of Camcar Division of Textron Inc.

Specifications and dimensions subject to change without notice.
Consult your representative for additional options and finishes.

ENERGY DATA

For Energy Management related technical data to support the performance of this fixture series, refer to the ordering information for input wattage

ADC041532
2011-01-19 11:51:30

ORDERING INFORMATION

SAMPLE NUMBER: FSS-D-226-UNV-EBT2-BRZ

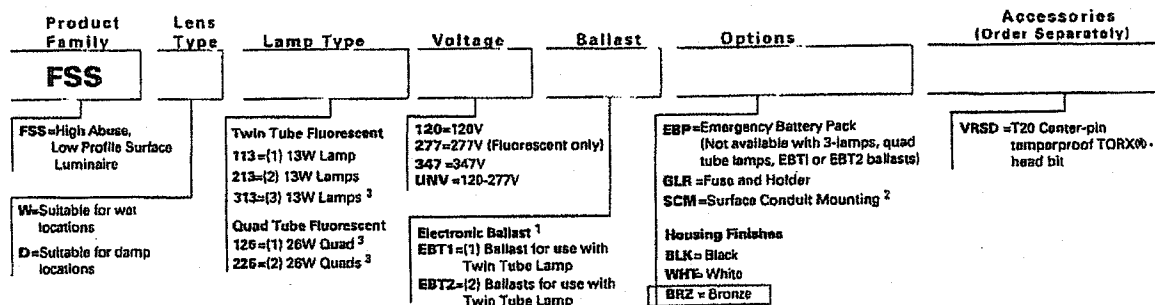

PHOTOMETRICS

Candlepower Distribution

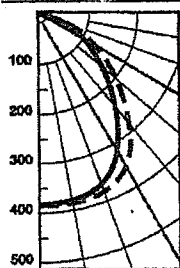

Test No. 5452
 FSS-2/B13
 Lamp=(2) F13T7/21
 Lumens=900
 Spacing Criteria
 I=1.3 II=1.2
 Efficiency=54.1%

Candlepower

Deg.	I	II
0	379	379
5	378	379
15	375	367
25	365	338
35	324	286
45	241	206
65	139	124
85	88	83
75	56	63
85	26	15
90	6	7

Zonal Lumen Summary

Zone	Lumens	%Lamp	%Luminaire
0-30	303	16.8	31.1
0-40	496	27.5	50.9
0-50	792	44.0	81.4
0-80	907	53.7	99.4
90-180	6.0	0.3	0.6
0-180	973	54.1	100.0

Coefficient of Utilization

rc	80%				70%			50%		30%		10%		0%
	70	50	30	10	50	30	10	50	10	50	10	50	10	
RCR														
0	84	84	84	84	63	63	63	80	60	57	57	55	55	54
1	59	57	55	53	56	54	52	53	50	51	49	49	47	46
2	55	50	47	44	49	45	44	47	43	46	42	44	41	40
3	50	45	41	38	44	40	37	43	37	41	36	40	35	34
4	46	40	36	33	40	36	32	38	32	37	32	36	31	30
5	43	36	32	28	35	31	28	34	28	33	27	32	27	26
6	39	33	28	25	32	28	25	31	24	30	24	29	24	23
7	36	29	25	22	29	25	22	28	21	27	21	27	21	20
8	34	27	22	19	26	22	19	25	19	25	19	24	19	18
9	31	24	19	17	23	19	16	23	16	22	16	22	16	15
10	29	22	17	15	21	17	15	21	15	20	14	20	14	13

rc= Ceiling reflectance, rw=Wall reflectance, RCR=Room cavity ratio
 CU Data Based on 20% Effective Floor Cavity Reflectance.

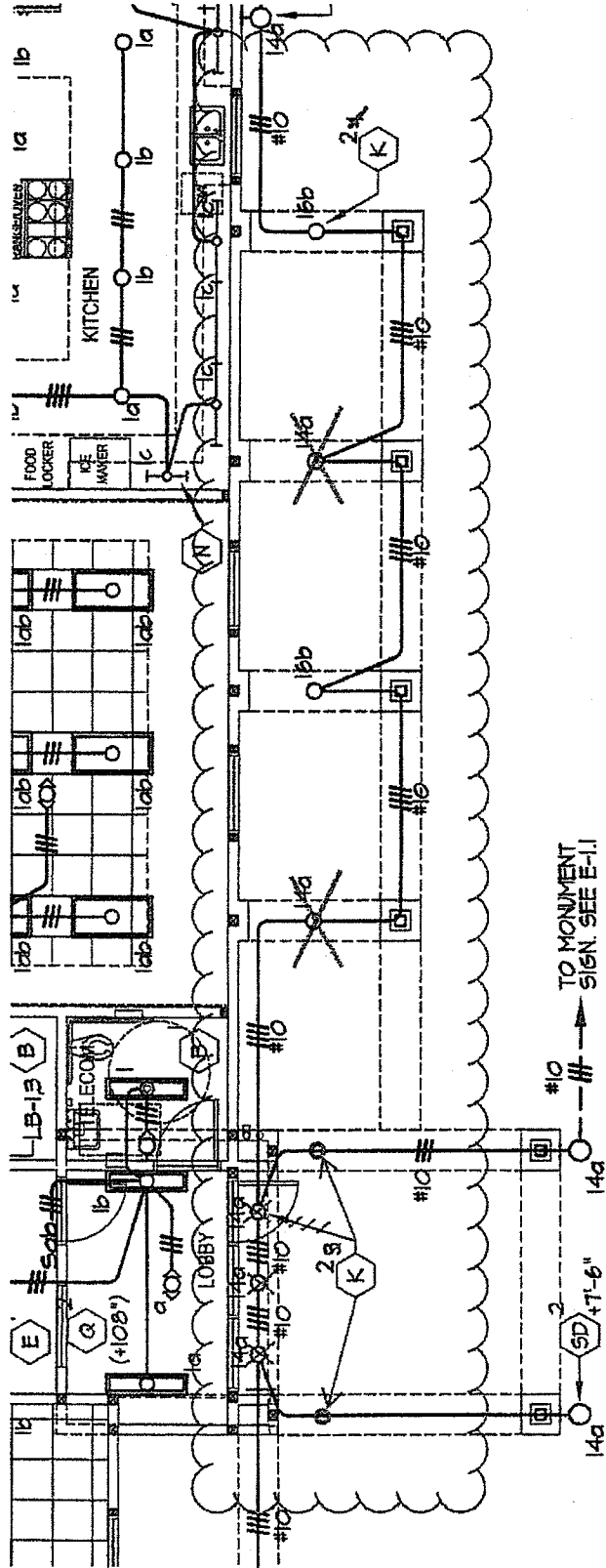

A1
 PROPOSAL REQUEST 13
 07244

Eberhardt Construction, Inc.

REQUEST FOR INFORMATION

No. 0082

19031 Hwy. 18, Suite 250

Phone: 760-242-0161

Apple Valley, CA 92307

Fax: 760-242-0380

TITLE: FC RFI No. 82: Fixture Type K

DATE: 12/6/2011

PROJECT: Mecca Fire Station

JOB: 0610

TO: Attn: Shih-Jing Yen
WLC Architects, Inc.
8163 Rochester Avenue
Suite 100
Rancho Cucamonga, CA 91730
Phone: 909-987-0909 Fax: 909-980-9980

STARTED:

COMPLETED:

REQUIRED: 12/13/2011

WORK

IMPACT: Unknown

SCHEDULE

IMPACT: Unknown

COST

IMPACT: Unknown

QUESTION:

Please provide direction for lighting requirements underneath all trellis as TS beam and framing configuration does not allow for light fixture type K installation. If lighting is required it would have to be surface mount and not in front of door #1 as there is only 1" between top of door and bottom of stucco wrapped beam.

cc: Jobsite
cc: Walton Electric

PROPOSED SOLUTION:

ANSWER:

Replace the specified type "K" light fixture with a Fail-Safe #FSS-W-126-120-EBT1-VRSD-Color as selected by the Architect.

Luis Flores / A&F
12/21/11

See attached revised partial Lighting Plan for location and quantity changes.

Shih-Jing Yen
WLC Architects
12-22-2011

Requested By: Eberhardt Construction, Inc.

Date: 12/6/2011

Signed: Dave Kalata

Dave Kalata

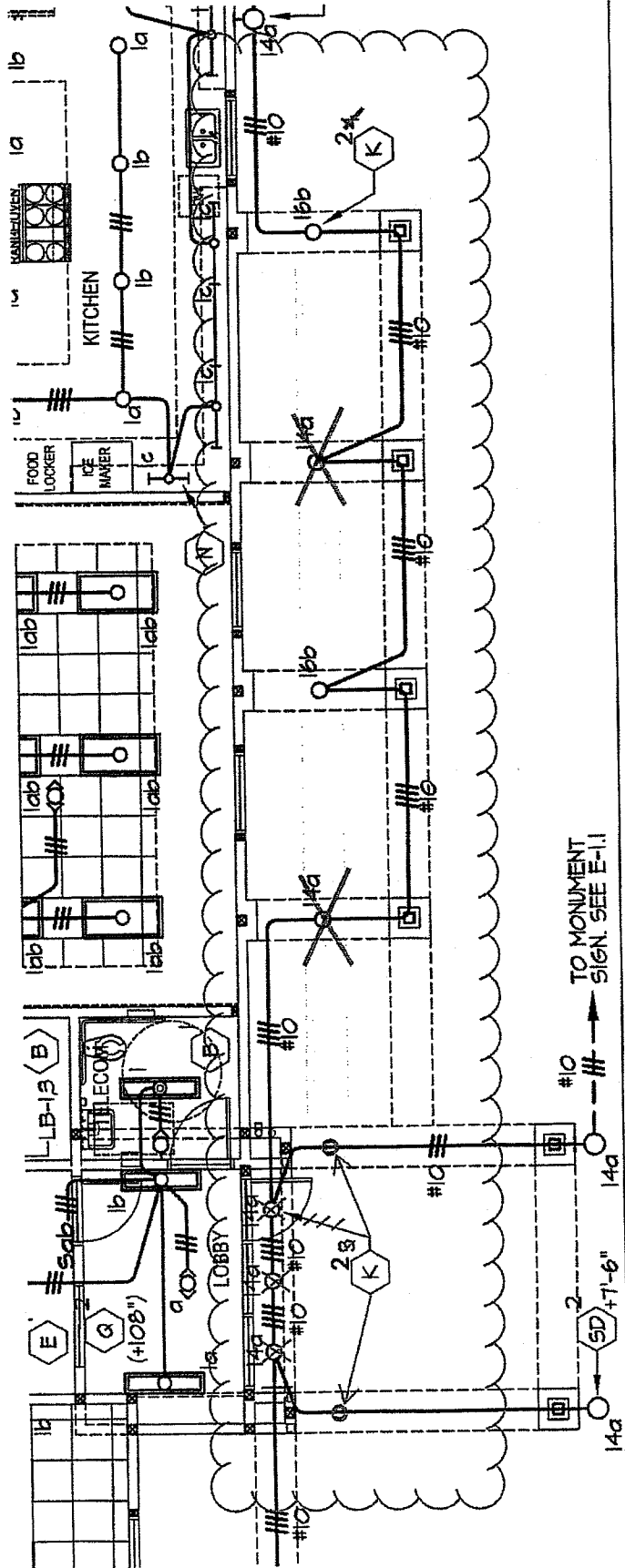

TO MONUMENT
SIGN. SEE E-11

SD 1-1-6"
2

FAIL-SAFE®

DESCRIPTION

Fail-Safe's FSS bridges the gap between vandal resistant durability and architectural aesthetics. In decorative applications where a broken fixture could increase owner liability, the FSS's one-piece, polycarbonate housing/lens provides a low profile, unbreakable, surface-mounted unit, ideal for low ceiling heights and narrow corridors. A maximum of three compact fluorescent lamps provide high illumination while reducing costly maintenance. Designed to decorate as it protects, the FSS will surpass the commercial fixture for a one time installation. Its low profile meets ADA requirements.

SPECIFICATION FEATURES

Housing/Lens

Integrated, impact-resistant polycarbonate housing/lens with internal side prisms mounts to base. Textured white housing with prismatic lens standard.

Fasteners

Four captive, stainless steel tamperproof TORX®-head T-20 screws prevent unauthorized access.

Gasket

Wet location only. Non-shrinking, double-baked neoprene gasketing seals out the environment.

Mounting Base

One-piece, cast aluminum mounting base provides a rigid mounting anchor for housing and ensures secure installation.

Lamps

By others.

Reflector

Standard white high reflectance polyester powder coat finish. Gloss: 85%; Reflectance: 93%; Hardness Minimum: 2H.

Ballast

Standard Class P, CBM/ETL ballast.

Auxiliary Lighting

During power outages, self-contained EBP option supplies supplemental lighting.

Labels

UL/cUL listed, suitable for damp locations (FSS-D) or wet locations (FSS-W). Low proximity mounting rated.

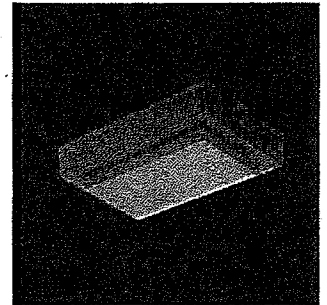

FSS

Quad
TT
Compact Fluorescent
Vandal Resistant

SURFACE MOUNT
Polycarbonate
Low Profile

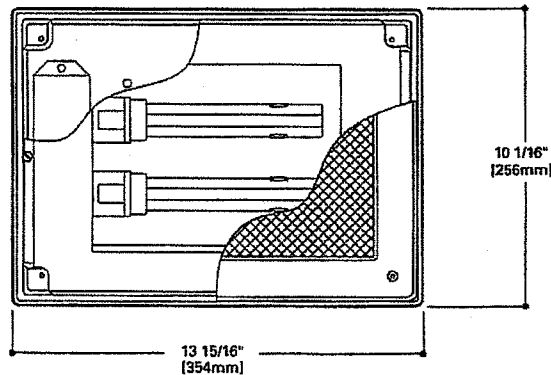

MOUNTING DIMENSIONS

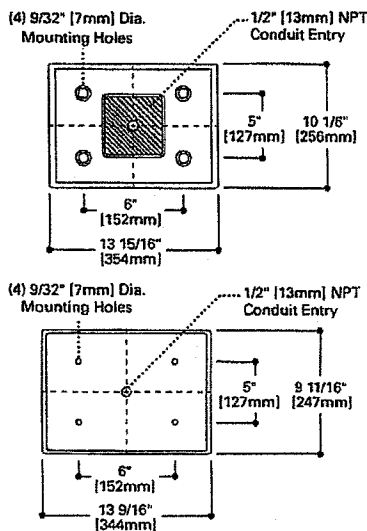

SIDE DIMENSIONS

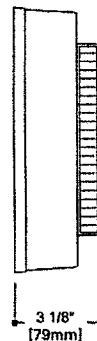

ENERGY DATA

For Energy Management related technical data to support the performance of this fixture series, refer to the ordering information for input wattage.

TORX® is a registered trademark of Camcar Division of Textron Inc.

ORDERING INFORMATION

SAMPLE NUMBER: FSS-D-226-UNV-EBT2-BRZ

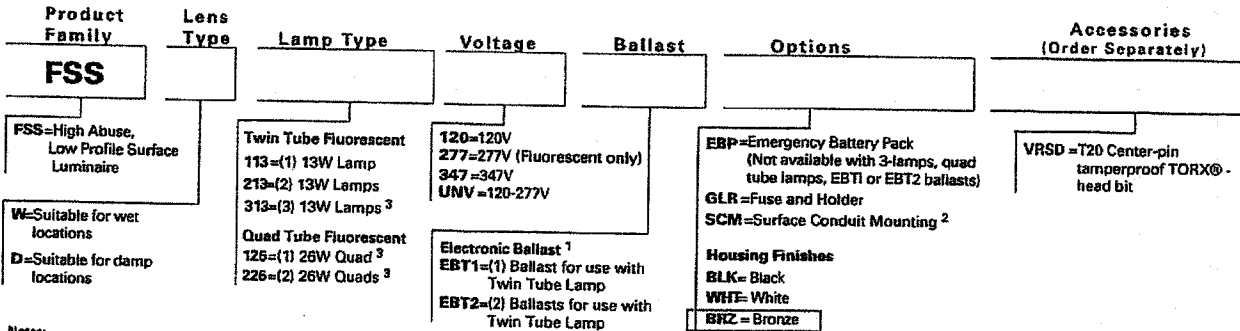

Notes:
Electronic ballast may cause interference with other electronic devices. If interference occurs, move the device away from the product or plug/connect into a different circuit/outlet.

¹ For specific electronic ballast, specify brand and catalog number.
² SCM option must be factory installed.
³ Emergency Battery Pack not available.

PHOTOMETRICS

Candlepower Distribution

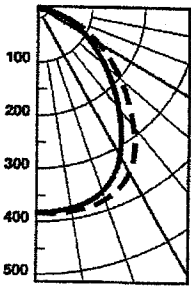

Test No. 5452
FSS-2/B13
Lamp=(2) F13TT/21
Lumens=900
Spacing Criteria
I=1.3 II=1.2
Efficiency=54.1%

Candlepower

Deg.	I	II
0	379	379
5	378	379
15	375	367
25	365	338
35	324	286
45	241	206
55	139	124
65	86	83
75	56	53
85	26	15
90	6	7

Zonal Lumen Summary

Zone	Lumens	%Lamp	%Luminaire
0-30	303	16.8	31.1
0-40	496	27.5	50.9
0-60	792	44.0	81.4
0-90	967	53.7	99.4
90-180	6.0	0.3	0.6
0-180	973	54.1	100.0

Coefficient of Utilization

rc	80%				70%			50%		30%		10%		0%
	70	50	30	10	50	30	10	50	10	50	10	50	10	0
0	64	64	64	64	63	63	63	60	60	57	57	55	55	54
1	59	57	55	53	56	54	52	53	50	51	49	49	47	46
2	55	50	47	44	48	46	44	47	43	46	42	44	41	40
3	50	45	41	38	44	40	37	43	37	41	36	40	35	34
4	46	40	36	33	40	36	32	36	32	37	32	36	31	30
5	43	36	32	28	35	31	28	34	28	33	27	32	27	26
6	39	33	28	25	32	28	25	31	24	30	24	29	24	23
7	36	29	25	22	29	25	22	28	21	27	21	27	21	20
8	34	27	22	19	26	22	19	25	19	25	19	24	19	18
9	31	24	19	17	23	19	16	23	16	22	16	22	16	15
10	29	22	17	15	21	17	15	21	15	20	14	20	14	13

rc=Ceiling reflectance, rw=Wall reflectance, RCR=Room cavity ratio
CU Data Based on 20% Effective Floor Cavity Reflectance.

Eberhardt Construction, Inc.

19031 Hwy. 18, Suite 250

Apple Valley, CA 92307

Phone: (760) 242-0161

Fax: (760) 242-0380

REQUEST FOR PROPOSAL

No. 0014

TITLE: RFP No. 14: Delete Gas Solenoid, etc

DATE: 2/13/2012

PROJECT: Mecca Fire Station

JOB: 0610

TO: Attn: Shih-Jing Yen
WLC Architects, Inc.
8163 Rochester Avenue
Suite 100
Rancho Cucamonga, CA 91730
Phone: 909-987-0909 Fax: 909-980-9980

CONTRACT NO: 0610-001

RE: To: From: Number:

DESCRIPTION OF PROPOSAL

Per Proposal Request No. 14:

14.1 Delete gas solenoid valve, control station, electrical contact enclosure, and associated electrical works per the attached letter from BP & Associates dated January 18, 2012, letter from A & F Engineering Group, Inc. dated January 24, 2012 and Drawings PI, P2, P3, P4, E22, E23, and E24.

Item	Description	Stock#	Quantity	Units	Unit Price	Tax Rate	Tax Amount	Net Amount
00001	No cost or credit per MRL Plumbing. All items were special ordered therefore no credit. Items to be turned over to Owner once project is complete. Reference MRL Plumbings fax received 2/6/12.		1.000		\$0.00	0.00%	\$0.00	\$0.00
00002	Credit for deletion of solenoid control wiring. The conduit and wire was already installed inside of the kitchen area. Also, the conduit/home run was completed back to the "EC" cabinet. Reference WB Walton Electric's COR No. 12 dated 2/9/12.		1.000		(\$385.25)	0.00%	\$0.00	(\$385.25)
00003	ECI OH & P @ 5%		1.000		(\$19.26)	0.00%	\$0.00	(\$19.26)
00004	ECI Insurance @ 1%		1.000		(\$3.85)	0.00%	\$0.00	(\$3.85)
00005	ECI Bond @ 1.5%		1.000		(\$5.77)	0.00%	\$0.00	(\$5.77)

Unit Cost: (\$414.13)

Unit Tax: \$0.00

Total: (\$414.13)

APPROVAL:

By: _____
Kelley Needham

By: 
Dan Eberhardt

By: _____
Leah Rodriguez

Date: _____

Date: 2-13-12

Date: _____



330 E 3rd St
 Beaumont, CA 92223
 Phone: (951) 769-2280
 Fax: (951) 769-7255

Change Request Form

Project No.: 724400.4 Change #: COR#12, PR#14
 Project Name: Mecca Fire Station
 Date Requested: January 30, 2012 Date Submitted: 2/9/2012

Description of Change: Deletion of gas solenoid control wiring. The conduit & wire was already installed inside of the kitchen area. Also, the conduit/home run was completed back to the "EC" cabinet.

1	Material		(108.50)
2	Sales Tax on Material	8.75%	-9.49
3	Labor Costs		-217.05
4	Freight		
5	Equipment and Major Tools		
6	Gas and Oil		
7	Other Direct Costs		
8	Insurance		
9	Other:		
10	Truck @ \$48.00 /Day	1 Days	
11	Permit Fee		
12	Other:		
13	Sub-Total:		
14	General and Administrative	15.00%	-50.25
15	Sub-Total:		
16	Sub-Contract:		
17	General and Administrative		
18	Other		
19	Other		
20	Sub-Total:		
21	Bond Premium	1.00%	
22	Total Price of This Change Proposal		\$385 (385.25)
23	Extension of time due to this Change is:	1 Days or Deferred **	
24	This Proposal is based on:	St. Time O. Time Shift	
25	This proposal is subject to upward escalation unless notice to proceed is received by	(20 C. Days if no date shown)	
26	Extended Overhead Cost	Included Deferred **	

** If Deferred, cover letter will describe

Submitted by: _____ Date _____
 Signature Title

Approved by: _____ Date _____
 Signature Title

This proposal is based solely on the direct cost elements such as labor, material, and normal mark-ups and does not include any amount for changes in the sequence of work delays, disruptions, rescheduling, extended overhead, acceleration, and/or impact costs not specifically noted and mutually agreed upon on the enclosed "labor factors and corrections" and inclusive of an equitable and compensable contract extension requested herein. Notwithstanding, the right is hereby clearly and expressly reserved to make claim for any and all impacts, restraints and related items of cost prior to any final settlement of this contract.

Change Request Form

Labor Factors & Corrections

Percentages are to be applied to the total affected manhours of the current contract, and to the Labor of the proposed change.	Affected Manhours of Current Contract		Manhours of Proposed Change	
	Manhours *	_____	8.00 (1)	
As of _____				
	Percentage of Loss	Manhours Lost	Percentage of Loss	Manhours Lost
Negative Productivity Factors				
Reassignment of Manpower	1.3%		5.0%	
Crew Size Inefficiency	2.5%		10.0%	
Site Access	1.3%		5.0%	
Logistics	2.5%		10.0%	
Stacking of Trades	2.5%		10.0%	
Dilution of Supervision	2.5%		10.0%	
Errors and Omissions	0.3%		1.0%	
Fatigue	2.0%		8.0%	
Learning Curve	1.3%		5.0%	
Ripple	2.5%		10.0%	
Morale and Attitude	1.3%		5.0%	
Concurrent Operations	1.3%		5.0%	
Beneficial Occupancy	3.8%		15.0%	
Joint Occupancy (Other Trades)	1.3%		5.0%	
Weather Factor	2.5%		10.0%	
Height Factor				
Overtime Adjustment	3%		10.0%	
1 + 2 + 3 =	(2)		(3)	

* Estimated

(4) Journeyman	-3.00	Hrs. @	\$72.35	-217.05
(5) Foreman	_____	Hrs. @	\$78.28	
(6) General Foreman	_____	Hrs. @	\$86.88	
(7) Superintendent	_____	Hrs. @	\$95.56	
(8) Sound Tech	_____	Hrs. @		
(9) Foreman S T	_____	Hrs. @		
{10} Other: _____	_____	Hrs. @		
{11}				
{12} Total Direct Labor (Lines 4 - 11)	-3.00	Hrs.		-217.05
{13} Small Tools @ 3%				
{14} Total Labor (Lines 12+13)				(\$217.05)

Change Request Form

Labor Summary

Hourly Rates

Job Description	Base Rate	Payroll Tax Insurance Fringes	Wage, Tax & Fringe Escalation	Other	Total Hourly Rate
Journeyman	\$36.50	\$28.35	\$4.50	\$3.00	72.35
Foreman	\$42.00	\$30.24	\$2.89	\$3.15	78.28
General Foreman	\$46.75	\$33.66	\$3.22	\$3.25	86.88
Sound Tech					
Foreman S. T.					
Other:					

1. Journeyman Hours	8.00	Hrs.
2. Nonproductive Travel	_____	Hrs.
3. Remobilization Hours	_____	Hrs.
4. Material Handling	_____	Hrs.
5. Punch and Demo	_____	Hrs.
6. Safety	_____	Hrs.
7. Clean Up	_____	Hrs.
8. Warranty	_____	Hrs.
9. Permit Acquisition	_____	Hrs.
10. Logistical Inefficiency	_____	Hrs.
11. Labor Difficulty	_____	Hrs.
12. Base J.W. Hours 1 thru 11	<u>8.00</u>	

Takeoff Sheet

Project No.: Mecca Fire Station

RFC# : OR#12, PR#14

U = E for Each, C for 100, M for 1000

Project Name:

#REF!

Item	Description	Qty	Mat Price	U	Labor	U	Total Mat(\$)	Total Hours
1	#12 THHN	-620	\$175.00	M	0.50	C	-\$108.50	-3.10
2								
3								
4								
5								
6								
7								
8								
9								
10								
11								
12								
13								
14								
15								
16								
17								
18								
19						C		
20						C		
21						C		
22						E		
23						C		
24								
25								
26								-3.10
27								
28								
29								
30								
31								
32								
33								
34								
35								
36								
37								
38								
39								
40								
41								
42								
43								
44								
45								
46								
47								
48								
49								
50								
51								
52								
53								

Totals (108.50) (3.10)



Consulting Engineers

January 18, 2012
TO : Shih-Jing
FROM : BP & Associates, Inc.
PROJECT : Mecca Fire Station #40
SUBJECT : Proposal Request

1. Proposal Request 14
Sketch P1
Ref. Sheet P0.2 - Plumbing Fixture Schedule
A. Deleted SV-1(Solenoid Valve), CS-1(Control Station) and ECE-1(Electrical Contact Enclosure) from fixture schedule.

Sketch P2
Ref. Sheet P2.1- Plumbing Floor Plan
A. Deleted SV-1(Solenoid Valve) from above exercise room.
B. Deleted ECE-1(Electrical Contact Enclosure) from storage room.

Sketch P3
Ref. Sheet P4.1- Enlarged Plumbing Plans
A. Deleted CS-1(Control station) from detail 2 kitchen plan.

Sketch P4
Ref. Sheet P5.1- Plumbing Details
A. Deleted SV-1(Solenoid Valve), CS-1(Control Station) and ECE-1(Electrical Contact Enclosure) detail 7 from sheet.

*ALL items were special
ordered no returns fixtures.*

BP&Associates
Felipe Serrano
Plumbing Designer

Shipped to JOB.

No RETURN

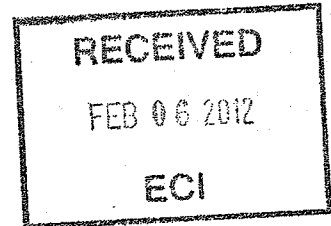

3 Peters Canyon, Suite 100, Irvine, CA 92606 Phone (949) 417-3900 Fax (949) 417-3908

Eberhardt Construction, Inc.

19031 Hwy. 18, Suite 250

Apple Valley, CA 92307

REQUEST FOR PROPOSAL**No. 0015**

Phone: (760) 242-0161

Fax: (760) 242-0380

TITLE: RFP No. 15: Mech/Elec Changes**DATE:** 2/14/2012**PROJECT:** Mecca Fire Station**JOB:** 0610

TO: Attn: Kelley Needham
 WLC Architects, Inc.
 8163 Rochester Avenue
 Suite 100
 Rancho Cucamonga, CA 91730
 Phone: 909-987-0909 Fax: 909-980-9980

CONTRACT NO: 0610-001

RE: To: From: Number:

DESCRIPTION OF PROPOSAL

Per Proposal Request No. 15:

15.1 Add 8" diameter dryer vent duct for future dryer per the attached Drawings MSK01 and MSK02.

15.2 Revise gas line and gas load per the attached letter from BP & Associates dated January 23, 2012, and Drawings PI. P2. P3. P4 and P5.

15.3 Relocate receptacle and revise circuit per the attached letter from A & F Engineering, Inc. dated January 24, 2012. and Drawing E25.

Item	Description	Stock#	Quantity	Units	Unit Price	Tax Rate	Tax Amount	Net Amount
00001	15.1: Cost for labor and materials for dryer vent duct for future dryer as per PR No. 15. Reference Franklin Mechanical's quote received 2/13/12.		1.000		\$1,160.06	0.00%	\$0.00	\$1,160.06
00002	15.2: Cost for additional labor and material to change gas size as requested. Reference MRL Plumbing's Quote 639.		1.000		\$1,265.00	0.00%	\$0.00	\$1,265.00
00003	15.3: Relocate receptacle and revise circuit as requested. Reference WB Walton Electric's COR No. 13 dated 2/10/12.		1.000		\$385.00	0.00%	\$0.00	\$385.00
00004	ECI OH & P @ 5%		1.000		\$140.50	0.00%	\$0.00	\$140.50
00005	ECI Insurance @ 1%		1.000		\$28.10	0.00%	\$0.00	\$28.10
00006	ECI Bond @ 1.5%		1.000		\$42.15	0.00%	\$0.00	\$42.15

Unit Cost: \$3,020.81

Unit Tax: \$0.00

Total: \$3,020.81

APPROVAL:

By: _____ By: _____ By: _____
 Kelley Needham Dan Eberhardt Leah Rodriguez

Date: _____ Date: _____ Date: _____

Bid Spread Sheet

Job Name MECCA FIRE STATION

Bid # PR_15

	Amount	Rate / Per	Quote / Bid
Equipment			
Split Systems			0.00
Evaporative Cooler			0.00
Exhaust Fans			0.00
Ductless Split Systems			0.00
Vent Cap with pitched curb	1	225	225.00
Dryer Booster Fan			0.00
			0.00
			0.00
			0.00
			0.00
			0.00
			0.00
Controls			
Duct			
S/A Round			0.00
Bare Round	15	10	150.00
			0.00
Lined Rectangle			0.00
Aluminum			0.00
Stainless Steel			0.00
Grease			0.00
Plenums			0.00
Air Distribution			
Accessories			
Rental			
Misc			
General Metal			0.00
Filters			0.00
Cap Flashing			0.00
			0.00
Total Material			375.00
Tax		9.00%	33.75
Subtotal			408.75
Subs w/ markup			
	Air Balance		0.00
	Insulation		0.00
	Water Treatment		0.00
Total			0.00

MRL Commercial Plumbing

22810 Del Oro Rd.
Apple Valley, CA 92308

Estimate

Date	Estimate #
1/28/2012	639

Name / Address
Eberhardt Construction 19031 Hwy 18, Suite 250 Apple Valley, CA 92307

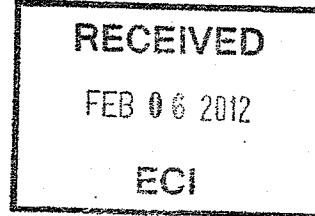

			Project
Description	Qty	Rate	Total
MECCA Fire Station No. 40 Proposal Request No:15			
Change gas size from 1" to 1 1/2" on dryer		800.00	800.00
Labor		300.00	300.00
Material		165.00	165.00
Profit/mark up (15%)			
		Total	\$1,265.00

Change Request Form

Labor Factors & Corrections

Percentages are to be applied to the total affected manhours of the current contract, and to the Labor of the proposed change.	Affected Manhours of Current Contract		Manhours of Proposed Change	
	Manhours * _____	As of _____	_____ {1}	
Negative Productivity Factors	Percentage of Loss	Manhours Lost	Percentage of Loss	Manhours Lost
Reassignment of Manpower	1.3%		5.0%	
Crew Size Inefficiency	2.5%		10.0%	
Site Access	1.3%		5.0%	
Logistics	2.5%		10.0%	
Stacking of Trades	2.5%		10.0%	
Dilution of Supervision	2.5%		10.0%	
Errors and Omissions	0.3%		1.0%	
Fatigue	2.0%		8.0%	
Learning Curve	1.3%		5.0%	
Ripple	2.5%		10.0%	
Morale and Attitude	1.3%		5.0%	
Concurrent Operations	1.3%		5.0%	
Beneficial Occupancy	3.8%		15.0%	
Joint Occupancy (Other Trades)	1.3%		5.0%	
Weather Factor	2.5%		10.0%	
Height Factor				
Overtime Adjustment	3%		10.0%	
1 + 2 + 3 =		{2}		{3}

* Estimated

(4) Journeyman	3.00	Hrs. @	\$72.35	217.05
(5) Foreman		Hrs. @	\$78.28	
(6) General Foreman		Hrs. @	\$86.88	
(7) Superintendent		Hrs. @	\$95.56	
(8) Sound Tech		Hrs. @		
(9) Foreman S T		Hrs. @		
{10} Other: _____		Hrs. @		
{11}				
{12} Total Direct Labor (Lines 4 - 11)	3.00	Hrs.		217.05
{13} Small Tools @ 3%				
{14} Total Labor (Lines 12+13)				\$217.05

Change Request Form

Labor Summary

Hourly Rates

Job Description	Base Rate	Payroll Tax Insurance Fringes	Wage, Tax & Fringe Escalation	Other	Total Hourly Rate
Journeyman	\$36.50	\$28.35	\$4.50	\$3.00	72.35
Foreman	\$42.00	\$30.24	\$2.89	\$3.15	78.28
General Foreman	\$46.75	\$33.66	\$3.22	\$3.25	86.88
Sound Tech					
Foreman S. T.					
Other:					

- | | |
|-------------------------------|------------|
| 1. Journeyman Hours | 8.00 Hrs. |
| 2. Nonproductive Travel | _____ Hrs. |
| 3. Remobilization Hours | _____ Hrs. |
| 4. Material Handling | _____ Hrs. |
| 5. Punch and Demo | _____ Hrs. |
| 6. Safety | _____ Hrs. |
| 7. Clean Up | _____ Hrs. |
| 8. Warranty | _____ Hrs. |
| 9. Permit Acquisition | _____ Hrs. |
| 10. Logistical Inefficiency | _____ Hrs. |
| 11. Labor Difficulty | _____ Hrs. |
| 12. Base J.W. Hours 1 thru 11 | |

Takeoff Sheet

Project No.: Mecca Fire Station

RFC# : JOR#13, PR#15

U = E for Each, C for 100, M for 1000

Project Name:

#REF!

Item	Description	Qty	Mat Price	U	Labor	U	Total Mat(\$)	Total Hours
1	3/4" EMT CONDUIT	30	\$89.00	C	6.20	C	\$26.70	1.86
2	3/4" EMT DC SS CONN	2	\$86.98	C	6.20	C	\$1.74	0.12
3	3/4" EMT DC SS COUP	6	\$91.00	C	6.20	C	\$5.46	0.37
4	4S JUNCTION BOX	1	\$4.25	E	6.20	C	\$4.25	0.06
5	1" WOOD SCREWS	8	\$93.00	C	6.20	C	\$7.44	0.50
6	Ground Pigtail	1	\$1.25	E	10.00	C	\$1.25	0.10
7								
8								
9								
10								
11								
12								
13								
14								
15								
16								
17								
18								
19								
20								
21								
22								
23								
24								
25								
26								3.01
27								
28								
29								
30								
31								
32								
33								
34								
35								
36								
37								
38								
39								
40								
41								
42								
43								
44								
45								
46								
47								
48								
49								
50								
51								
52								
53								
Totals							46.84	3.01

Eberhardt Construction, Inc.

19031 Hwy. 18, Suite 250

Apple Valley, CA 92307

Phone: (760) 242-0161

Fax: (760) 242-0380

REQUEST FOR PROPOSAL

No. 0016

TITLE: RFP No. 16: Add SCBA Compressor

DATE: 2/13/2012

PROJECT: Mecca Fire Station

JOB: 0610

TO: Attn: Kelley Needham
WLC Architects, Inc.
8163 Rochester Avenue
Suite 100
Rancho Cucamonga, CA 91730
Phone: 909-987-0909 Fax: 909-980-9980

CONTRACT NO: 0610-001

RE: To: From: Number:

DESCRIPTION OF PROPOSAL

Proposal Request No. 16:

16.1 Revise electrical plans EO.2 and El.1 per the attached letter from A&F Engineering Group, Inc. dated January 24, 2012 and Drawing E 26.

Item	Description	Stock#	Quantity	Units	Unit Price	Tax Rate	Tax Amount	Net Amount
00001	16.1 Cost for additional electrical work as described in PR No. 16. Reference WB Walton Electric's COR No. 15 received 2/10/12.		1.000		\$2,448.00	0.00%	\$0.00	\$2,448.00
00002	ECI OH & P @ 5%		1.000		\$122.40	0.00%	\$0.00	\$122.40
00003	ECI Insurance @ 1%		1.000		\$24.48	0.00%	\$0.00	\$24.48
00004	ECI Bond @ 1.5%		1.000		\$36.72	0.00%	\$0.00	\$36.72

Unit Cost: \$2,631.60

Unit Tax: \$0.00

Total: \$2,631.60

APPROVAL:

By: _____
Kelley Needham

By: 
Dan Eberhardt

By: _____
Leah Rodriguez

Date: _____

Date: 2-13-12

Date: _____

Change Request Form

Labor Factors & Corrections

Percentages are to be applied to the total affected manhours of the current contract, and to the Labor of the proposed change.	Affected Manhours of Current Contract		Manhours of Proposed Change	
	Manhours * _____	As of _____	8.00 {1}	
	Percentage of Loss	Manhours Lost	Percentage of Loss	Manhours Lost
Negative Productivity Factors				
Reassignment of Manpower	1.3%		5.0%	
Crew Size Inefficiency	2.5%		10.0%	
Site Access	1.3%		5.0%	
Logistics	2.5%		10.0%	
Stacking of Trades	2.5%		10.0%	
Dilution of Supervision	2.5%		10.0%	
Errors and Omissions	0.3%		1.0%	
Fatigue	2.0%		8.0%	
Learning Curve	1.3%		5.0%	
Ripple	2.5%		10.0%	
Morale and Attitude	1.3%		5.0%	
Concurrent Operations	1.3%		5.0%	
Beneficial Occupancy	3.8%		15.0%	
Joint Occupancy (Other Trades)	1.3%		5.0%	
Weather Factor	2.5%		10.0%	
Height Factor				
Overtime Adjustment	3%		10.0%	
1 + 2 + 3 =	(2)		(3)	

* Estimated

(4) Journeyman	13.68	Hrs. @	\$72.35	989.75
(5) Foreman		Hrs. @	\$78.28	
(6) General Foreman		Hrs. @	\$86.88	
(7) Superintendent		Hrs. @	\$95.56	
(8) Sound Tech		Hrs. @		
(9) Foreman S T		Hrs. @		
{10} Other: _____		Hrs. @		
{11}				
{12} Total Direct Labor (Lines 4 - 11)	13.68	Hrs.		989.75
{13} Small Tools @ 3%				
{14} Total Labor (Lines 12+13)				\$989.75

Change Request Form

Labor Summary

Hourly Rates

Job Description	Base Rate	Payroll Tax Insurance Fringes	Wage, Tax & Fringe Escalation	Other	Total Hourly Rate
Journeyman	\$36.50	\$28.35	\$4.50	\$3.00	72.35
Foreman	\$42.00	\$30.24	\$2.89	\$3.15	78.28
General Foreman	\$46.75	\$33.66	\$3.22	\$3.25	86.88
Sound Tech					
Foreman S. T.					
Other:					

1. Journeyman Hours	8.00	Hrs.
2. Nonproductive Travel		Hrs.
3. Remobilization Hours		Hrs.
4. Material Handling		Hrs.
5. Punch and Demo		Hrs.
6. Safety		Hrs.
7. Clean Up		Hrs.
8. Warranty		Hrs.
9. Permit Acquisition		Hrs.
10. Logistical Inefficiency		Hrs.
11. Labor Difficulty		Hrs.
12. Base J.W. Hours 1 thru 11	8.00	

Takeoff Sheet

Project No.: Mecca Fire Station

RFC# : JOR#15, PR#16

U = E for Each, C for 100, M for 1000

Project Name:

#REF!

Item	Description	Qty	Mat Price	U	Labor	U	Total Mat(\$)	Total Hours
1	60 amp Fused Disconnect	1	\$186.25	C	1.20	E	\$1.86	1.20
2	50 amp Fuses	6	\$8.20	E	10.00	C	\$49.20	0.60
3	60 AMP 3 pole circuit breaker	1	\$68.25	E	0.65	E	\$68.25	0.65
4	70 amp main breaker in "DPLA" CHDISFD3070	1	\$759.00	E	2.00	E	\$759.00	2.00
5	4" PVC 90 degree sweep	1	\$65.00	E		C	\$65.00	1.00
6	1" EMT CONDUIT	35	\$132.39	C	6.72	C	\$46.34	2.00
7	1" EMT STL SS CONN	4	\$28.49	C	18.00	C	\$1.14	2.00
8	1" EMT STL SS CPLG	4	\$31.98	C	20.00	C	\$1.28	0.80
9	1" EMT 1-H STEEL STRAP	4	\$24.31	C	8.85	C	\$0.97	0.35
10	#8 THHN BLACK	185	\$329.84	M	10.50	M	\$61.02	1.94
11	1/4" wood Lag bolts	4	\$65.00	C	9.00	C	\$2.60	0.36
12	#10x1" P/H SELF-TAP SCREW	10	\$5.11	C	3.75	C	\$0.51	0.38
13				C				
14				C				
15				E				
16				E				
17				C				
18				C				
19				C				
20				C				
21				C				
22				E				
23								
24								
25								
26								13.28
27								
28								
29								
30								
31								
32								
33								
34								
35								
36								
37								
38								
39								
40								
41								
42								
43								
44								
45								
46								
47								
48								
49								
50								
51								
52								
53								
Totals							1,057.17	13.58

Eberhardt Construction, Inc.

19031 Hwy. 18, Suite 250

Apple Valley, CA 92307

Phone: (760) 242-0161

Fax: (760) 242-0380

REQUEST FOR PROPOSAL**No. 0017****TITLE:** RFP No. 17: Add Exterior Lights**DATE:** 3/15/2012**PROJECT:** Mecca Fire Station**JOB:** 0610

TO: Attn: Kelley Needham
 WLC Architects, Inc.
 8163 Rochester Avenue
 Suite 100
 Rancho Cucamonga, CA 91730
 Phone: 909-987-0909 Fax: 909-980-9980

CONTRACT NO: 0610-001

RE: **To:** **From:** **Number:**

DESCRIPTION OF PROPOSAL

PR No. 17: Add exterior wall mounted light fixtures to the barbeque area and mechanical yard per PR 17.1.

Item	Description	Stock#	Quantity	Units	Unit Price	Tax Rate	Tax Amount	Net Amount
00001	Per PR 17: Add exterior lights as requested. Reference WB Walton's COR 16.		1.000		\$5,327.00	0.00%	\$0.00	\$5,327.00
00002	ECI OH & P @ 5%		1.000		\$266.35	0.00%	\$0.00	\$266.35
00003	ECI Insurance @ 1%		1.000		\$53.27	0.00%	\$0.00	\$53.27
00004	ECI Bond @ 1.5%		1.000		\$79.90	0.00%	\$0.00	\$79.90

Unit Cost: \$5,726.52**Unit Tax:** \$0.00**Total:** \$5,726.52**APPROVAL:**

By: _____
 Kelley Needham

By: 
 Dan Eberhardt

By: _____
 Leah Rodriguez

Date: _____

Date: 3-15-12

Date: _____



330 E 3rd St
 Beaumont, CA 92223
 Phone: (951) 769-2280
 Fax: (951) 769-7255

Change Request Form

Project No.: 724400.4

Project Name: Mecca Fire Station

Change #: COR#16, PR#17

Date Requested: March 5, 2012

Date Submitted: 3/14/2012

Description of Change: This is for adding (3) lights on the patio. Because the walls have plywood sheeting & the exterior stucco is installed this will be difficult to install.

1	Material	2,553.02
2	Sales Tax on Material 7.75%	197.86
3	Labor Costs	1,881.10
4	Freight	
5	Equipment and Major Tools	
6	Gas and Oil	
7	Other Direct Costs	
8	Insurance	
9	Other:	
10	Truck @ <u>\$48.00 /Day</u> <u>1 Days</u>	
11	Permit Fee	
12	Other:	
13	Sub-Total:	4,631.98
14	General and Administrative 15.00%	694.80
15	Sub-Total:	5,326.78
16	Sub-Contract:	
17	General and Administrative	
18	Other	
19	Other	
20	Sub-Total:	5,326.78
21	Bond Premium	
22	Total Price of This Change Proposal	\$5,327
23	Extension of time due to this Change is: <u>1</u> Days or Deferred **	
24	This Proposal is based on: <u>St. Time</u> <u>O. Time</u> <u>Shift</u>	
25	This proposal is subject to upward escalation unless notice to proceed is received by <u>{20 C. Days if no date shown}</u>	
26	Extended Overhead Cost <u>Included</u> <u>Deferred **</u>	

** If Deferred, cover letter will describe

Submitted by: _____ Date _____
Signature Title

Approved by: _____ Date _____
Signature Title

This proposal is based solely on the direct cost elements such as labor, material, and normal mark-ups and does not include any amount for changes in the sequence of work delays, disruptions, rescheduling, extended overhead, acceleration, and/or impact costs not specifically noted and mutually agreed upon on the enclosed "labor factors and corrections" and inclusive of an equitable and compensable contract extension requested herein. Notwithstanding, the right is hereby clearly and expressly reserved to make claim for any and all impacts, restraints and related items of cost prior to any final settlement of this contract.



330 E 3rd St
 Beaumont, CA 92223
 Phone: (951) 769-2280
 Fax: (951) 769-7255

Change Request Form

Project No.: 724400.4

Project Name: Mecca Fire Station

Change #: COR#16, PR#17

Date Requested: March 5, 2012

Date Submitted: 3/14/2012

Description of Change: This is for adding (3) lights on the patio. Because the walls have plywall sheeting & the exterior stucco is installed this will be difficult to install.

1	Material		2,553.02
2	Sales Tax on Material	7.75%	197.86
3	Labor Costs		1,881.10
4	Freight		
5	Equipment and Major Tools		
6	Gas and Oil		
7	Other Direct Costs		
8	Insurance		
9	Other:		
10	Truck @ \$48.00 /Day	1 Days	
11	Permit Fee		
12	Other:		
13	Sub-Total:		4,631.98
14	General and Administrative	15.00%	694.80
15	Sub-Total:		5,326.78
16	Sub-Contract:		
17	General and Administrative		
18	Other		
19	Other		
20	Sub-Total:		5,326.78
21	Bond Premium		
22	Total Price of This Change Proposal		\$5,327
23	Extension of time due to this Change is:	1	Days or Deferred **
24	This Proposal is based on:	St. Time	O. Time
25	This proposal is subject to upward escalation unless notice to proceed is received by	(20 C. Days if no date shown)	
26	Extended Overhead Cost	Included	Deferred **

** If Deferred, cover letter will describe

Submitted by: _____ Date _____
 Signature Title

Approved by: _____ Date _____
 Signature Title

This proposal is based solely on the direct cost elements such as labor, material, and normal mark-ups and does not include any amount for changes in the sequence of work delays, disruptions, rescheduling, extended overhead, acceleration, and/or impact costs not specifically noted and mutually agreed upon on the enclosed "labor factors and corrections" and inclusive of an equitable and compensable contract extension requested herein. Notwithstanding, the right is hereby clearly and expressly reserved to make claim for any and all impacts, restraints and related items of cost prior to any final settlement of this contract.

Change Request Form

Labor Factors & Corrections

Percentages are to be applied to the total affected manhours of the current contract, and to the Labor of the proposed change.	Affected Manhours of Current Contract		Manhours of Proposed Change	
	Manhours *	_____	8.00 (1)	
As of _____				
	Percentage of Loss	Manhours Lost	Percentage of Loss	Manhours Lost
Negative Productivity Factors				
Reassignment of Manpower	1.3%		5.0%	
Crew Size Inefficiency	2.5%		10.0%	
Site Access	1.3%		5.0%	
Logistics	2.5%		10.0%	
Stacking of Trades	2.5%		10.0%	
Dilution of Supervision	2.5%		10.0%	
Errors and Omissions	0.3%		1.0%	
Fatigue	2.0%		8.0%	
Learning Curve	1.3%		5.0%	
Ripple	2.5%		10.0%	
Morale and Attitude	1.3%		5.0%	
Concurrent Operations	1.3%		5.0%	
Beneficial Occupancy	3.8%		15.0%	
Joint Occupancy (Other Trades)	1.3%		5.0%	
Weather Factor	2.5%		10.0%	
Height Factor				
Overtime Adjustment	3%		10.0%	
1 + 2 + 3 =	{2}		{3}	

* Estimated

(4) Journeyman	26.00	Hrs. @	\$72.35	1,881.10
(5) Foreman	_____	Hrs. @	\$78.28	
(6) General Foreman	_____	Hrs. @	\$86.88	
(7) Superintendent	_____	Hrs. @	\$95.56	
(8) Sound Tech	_____	Hrs. @		
(9) Foreman S T	_____	Hrs. @		
(10) Other: _____	_____	Hrs. @		
(11) _____	_____			
(12) Total Direct Labor (Lines 4 - 11)	26.00	Hrs.		1,881.10
(13) Small Tools @ 3%				
(14) Total Labor (Lines 12+13)				\$1,881.10

Change Request Form

Labor Summary

Hourly Rates

Job Description	Base Rate	Payroll Tax Insurance Fringes	Wage, Tax & Fringe Escalation	Other	Total Hourly Rate
Journeyman	\$36.50	\$28.35	\$4.50	\$3.00	72.35
Foreman	\$42.00	\$30.24	\$2.89	\$3.15	78.28
General Foreman	\$46.75	\$33.66	\$3.22	\$3.25	86.88
Sound Tech					
Foreman S. T.					
Other:					

1. Journeyman Hours	8.00	Hrs.
2. Nonproductive Travel	_____	Hrs.
3. Remobilization Hours	_____	Hrs.
4. Material Handling	_____	Hrs.
5. Punch and Demo	_____	Hrs.
6. Safety	_____	Hrs.
7. Clean Up	_____	Hrs.
8. Warranty	_____	Hrs.
9. Permit Acquisition	_____	Hrs.
10. Logistical Inefficiency	_____	Hrs.
11. Labor Difficulty	_____	Hrs.
12. Base J.W. Hours 1 thru 11	8.00	

Takeoff Sheet

Project No.: Mecca Fire Station

RFC# : JOR#16, PR#17

U = E for Each, C for 100, M for 1000

Project Name:

#REF!

Item	Description	Qty	Mat Price	U	Labor	U	Total Mat(\$)	Total Hours
1	15' Architectural Light Fixture	3	\$752.00	E	1.20	E	\$2,256.00	3.60
2	3/4" EMT CONDUIT	85	\$79.39	C	5.00	C	\$67.48	4.25
3	3/4" EMT STL COMP CONN	8	\$58.75	C	14.00	C	\$4.70	1.12
4	3/4" EMT STL COMP CPLG	9	\$68.94	C	30.00	C	\$6.20	2.70
5	3/4" EMT 1-H STEEL STRAP	11	\$13.73	C	4.00	C	\$1.51	0.44
6	B2-1 RED WIRE CONN	16	\$132.39	C	6.72	C	\$21.18	1.08
7	DEV BOX 2 1/2" DEEP 1/2" KO+TS-BRKT	3	\$455.94	C	25.00	C	\$13.68	0.75
8	#12 THHN BLACK	340	\$31.98	C	6.00	M	\$108.73	2.04
9				C	8.85	C		
10	#8 THHN BLACK	185	\$329.84	M	10.50	M	\$61.02	1.94
11	Remove the plywood sheefing	4		C	0.75	E		3.00
12	Install plywood sheefing	10	\$5.11	C	3.75	C	\$0.51	0.38
13	Nails	120	\$10.00	C	4.30	C	\$12.00	5.16
14				C				
15				E				
16				E				
17				C				
18				C				
19				C				
20				C				
21				C				
22				E				
23								
24								
25								
26								28.45
27								
28								
29								
30								
31								
32								
33								
34								
35								
36								
37								
38								
39								
40								
41								
42								
43								
44								
45								
46								
47								
48								
49								
50								
51								
52								
53								
Totals							2,553.02	28.00

8.51

07244.55

Eberhardt Construction, Inc.

REQUEST FOR PROPOSAL

19031 Hwy. 18, Suite 250

No. 00009

Apple Valley, CA 92307

Phone: (760) 242-0161
Fax: (760) 242-0380

TITLE: RFP No. 9: Del Wire/Cable for 911

DATE: 10/31/2011

PROJECT: Mecca Fire Station

JOB: 0610

TO: Attn: Kelley Needham
WLC Architects, Inc.
8163 Rochester Avenue
Suite 100
Rancho Cucamonga, CA 91730
Phone: 909-987-0909 Fax: 909-980-9980

CONTRACT NO: 0610-001

RE: To: From: Number:

DESCRIPTION OF PROPOSAL

Proposal Request No. 9

9.1 Delete 4" square back-box, conduit and wire/cable associated with 911 phone.

9.2 Refer to E-2.2 for location of the 911 phone outlet and conduit home-run equipment.

Item	Description	Stock#	Quantity	Units	Unit Price	Tax Rate	Tax Amount	Net Amount
00001	Credit to delete the 4" square back box, conduit and wire/cable associated with 911 phone as per PR No. 9. Reference Waltons response to PR No. 9.		1.000		(\$159.00)	0.00%	\$0.00	(\$159.00)

Unit Cost: (\$159.00)
Unit Tax: \$0.00
Total: (\$159.00)

APPROVAL:

By: 
Kelley Needham

By: 
Dan Eberhardt

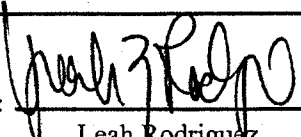
By: 
Leah Rodriguez

Date: 11.29.11

Date: _____

Date: _____



330 E 3rd St
 Beaumont, CA 92223
 Phone: (951) 769-2280
 Fax: (951) 769-7255

Change Request Form

Project No.: 724400.4
 Project Name: Mecca Fire Station POR # 9 Change #: 007
 Date Requested: July 29, 2011 Date Submitted: 8/11/2011

Description of Change: This is for the deleting of the 911 call box on the south outside wall of station. Proposal Request #9.

1	Material			(14.30)
2	Sales Tax on Material	8.75%		
3	Labor Costs			-144.70
4	Freight			
5	Equipment and Major Tools			
6	Gas and Oil			
7	Other Direct Costs			
8	Insurance			
9	Other			
10	Truck @ \$48.00 /Day		1 Days	
11	Permit Fee			
12	Other			
13	Sub-Total:			-159.00
14	General and Administrative	15.00%		
15	Sub-Total:			-159.00
16	Sub-Contract			
17	General and Administrative			
18	Other			
19	Other			
20	Sub-Total:			-159.00
21	Bond Premium	1.00%		
22	Total Price of This Change Proposal			(\$159)
23	Extension of time due to this Change is:		Days or Deferred **	
24	This Proposal is based on:		St. Time O. Time Shift	
25	This proposal is subject to upward escalation unless notice to proceed is received by:		(0 C. Days if no date shown)	
26	Extended Overhead Cost		Included: Deferred **	

** If Deferred, cover letter will describe

Submitted by: _____ Date _____
 Signature Title

Approved by: _____ Date _____
 Signature Title

This proposal is based solely on the direct cost elements such as labor, material, and normal mark-ups and does not include any amount for changes in the sequence of work delays, disruptions, rescheduling, extended overhead, acceleration, and/or impact costs not specifically noted and mutually agreed upon on the enclosed "labor factors and corrections" and inclusive of an equitable and compensable contract extension requested herein. Notwithstanding, the right is hereby clearly and expressly reserved to make claim for any and all impacts, restraints and related items of cost prior to any final settlement of this contract.

Change Request Form

Labor Factors & Corrections

Percentages are to be applied to the total affected manhours of the current contract, and to the Labor of the proposed change.	Affected Manhours of Current Contract		Manhours of Proposed Change	
	Manhours * As of _____	_____	-2.00 (1)	
Negative Productivity Factors	Percentage of Loss	Manhours Lost	Percentage of Loss	Manhours Lost
Reassignment of Manpower	1.3%		5.0%	
Crew Size Inefficiency	2.5%		10.0%	
Site Access	1.3%		5.0%	
Logistics	2.5%		10.0%	
Stacking of Trades	2.5%		10.0%	
Dilution of Supervision	2.5%		10.0%	
Errors and Omissions	0.3%		1.0%	
Fatigue	2.0%		8.0%	
Learning Curve	1.3%		5.0%	
Ripple	2.5%		10.0%	
Morale and Attitude	1.3%		5.0%	
Concurrent Operations	1.3%		5.0%	
Beneficial Occupancy	3.8%		15.0%	
Joint Occupancy (Other Trades)	1.3%		5.0%	
Weather Factor	2.5%		10.0%	
Height Factor				
Overtime Adjustment	3%		10.0%	
1 + 2 + 3 =		(2)		(3)

* Estimated

(4) Journeyman	2.00	Hrs. @	(\$72.35)	-144.70
(5) Foreman		Hrs. @	\$78.28	
(6) General Foreman		Hrs. @	\$86.88	
(7) Superintendent		Hrs. @	\$95.56	
(8) Sound Tech		Hrs. @		
(9) Foreman S T		Hrs. @		
(10) Other _____		Hrs. @		
(11)				
(12) Total Direct Labor (Lines 4 - 11)	2.00	Hrs.		-144.70
(13) Small Tools @ 3%				
(14) Total Labor (Lines 12+13)				(\$144.70)

Change Request Form

Labor Summary

Hourly Rates

Job Description	Base Rate	Payroll Tax Insurance Fringes	Wage, Tax & Fringe Escalation	Other	Total Hourly Rate
Journeyman	\$36.50	\$28.35	\$4.50	\$3.00	72.35
Foreman	\$42.00	\$30.24	\$2.89	\$3.15	78.28
General Foreman	\$46.75	\$33.66	\$3.22	\$3.25	86.88
Sound Tech					
Foreman S. T.					
Other					

1. Journeyman Hours	(2.00) Hrs.
2. Nonproductive Travel	_____ Hrs.
3. Remobilization Hours	_____ Hrs.
4. Material Handling	_____ Hrs.
5. Punch and Demo	_____ Hrs.
6. Safety	_____ Hrs.
7. Clean Up	_____ Hrs.
8. Warranty	_____ Hrs.
9. Permit Acquisition	_____ Hrs.
10. Logistical Inefficiency	_____ Hrs.
11. Labor Difficulty	_____ Hrs.
12. Base J.W. Hours 1 thru 11	_____ Hrs.
	-2.00

Takeoff Sheet

Project No.: Mecca Fire Station

RFC#: 007

U = E for Each, C for 100, M for 1000

Item	Description	Qty	Mat Price	Project Name:		#REF!		
				U	Labor	U	Total Mat(\$)	Total Hours
1	1" EMT CONDUIT	20	(\$48.32)	C	0.25	E		
2	1" EMT STL SS CONN	2	(\$51.00)	C		C	-\$9.66	-0.85
3	1" EMT STL COMP CONN	1	(\$73.00)	C		C	-\$1.02	-0.30
4	4x2 1/8" SQ BOX 1" KO	1	(\$144.00)	C	1.30	E	-\$0.73	-0.20
5	single gang extension ring	1	(\$1.45)	E		C	-\$1.44	-0.10
6				E		C	-\$1.45	-0.30
7				C		C		
8				E		M		
9				M		M		
10				E		E		
11				M				
12				C				
13				C				
14				C				
15				C				
16				E				
17				E				
18				C				
19				C				
20				C				
21				C				
22				C				
23				E				
24								
25								
26								
27								
28								
29								
30								
31								
32								
33								
34								
35								
36								
37								
38								
39								
40								
41								
42								
43								
44								
45								
46								
47								
48								
49								
50								
51								
52								
53								

Totals (14.30) -1.75
(2.00)

Sheila Larsen

From: Brenda Gooch [b-gooch@wbwaltonelectric.com]
Sent: Monday, October 31, 2011 10:18 AM
To: 'Sheila Larsen'
Attachments: POR 9 Mecca.pdf

Sheila,

See attached COR 7 for your POR 9.

Thank you

Brenda Gooch

Project Administrator
Pacific ELS Inc. DBA WB Walton Electric
An Electrical & Energy Solutions Company
951.769.2280(office) 951.769.7255 (fax)
b-gooch@wbwaltonelectric.com

No virus found in this message.

Checked by AVG - www.avg.com

Version: 10.0.1411 / Virus Database: 2092/3986 - Release Date: 10/31/11

Eberhardt Construction, Inc.

19031 Hwy. 18, Suite 250

Apple Valley, CA 92307

Phone: (760) 242-0161

Fax: (760) 242-0380

REQUEST FOR PROPOSAL**No. 0018****TITLE:** RFP No. 18: Add Sampling Box**DATE:** 3/22/2012**PROJECT:** Mecca Fire Station**JOB:** 0610

TO: Attn: Kelley Needham
 WLC Architects, Inc.
 8163 Rochester Avenue
 Suite 100
 Rancho Cucamonga, CA 91730
 Phone: 909-987-0909 Fax: 909-980-9980

CONTRACT NO: 0610-001

RE: To: From: Number:

DESCRIPTION OF PROPOSAL

PR No. 18: Add sampling box to the sand/oil interceptor per the attached letter from B.P. and Associates dated March 14, 2012 and Drawings P1, P2 and P3.

Item	Description	Stock#	Quantity	Units	Unit Price	Tax Rate	Tax Amount	Net Amount
00001	Per PR No. 18: Labor and material to provide and install sampling box as requested. Reference Orizon Construction's COR dated 3/20/12.		1.000		\$2,452.11	0.00%	\$0.00	\$2,452.11
00002	ECL OH & P @ 5%		1.000		\$122.60	0.00%	\$0.00	\$122.60
00003	ECL Insurance @ 1%		1.000		\$24.52	0.00%	\$0.00	\$24.52
00004	ECL Bond @ 1.5%		1.000		\$36.78	0.00%	\$0.00	\$36.78

Unit Cost: \$2,636.01**Unit Tax:** \$0.00**Total:** \$2,636.01**APPROVAL:**

By: _____
 Kelley Needham

By: 
 Dan Eberhardt

By: _____
 Leah Rodriguez

Date: _____

Date: 3-22-12

Date: _____

SUBCONTRACTOR COST PROPOSAL SUMMARY SHEET- Form II

Date: March 20th, 2012

Subcontractor Name: Orizon Construction, Inc. Cost Proposal/ Field Order No. Change order request.

MECCA FIRE STATION CONTRACT NO. 0610-004

Labor and material to install 2432Z Sample Well with cast iron, traffic lid -

NET COSTS: Attach supporting documentation for each line item	COSTS (1)
1. TOTAL NET COSTS (From form III)	\$ 2,452.11
2. Royalties, Permits, Utilities, Etc.:	
3 SUBTOTAL LINES 1 & 2	\$ 2,452.11
4 Insurance:	
5 COSTS OF EXTRA WORK. This Subcontractor Only. Total Lines 3 & 4	\$ 2,452.11
6 MARKUP FEE: for actual work performed- 10% of Line 5 This Subcontractor only (7.3)	\$ -
7 SUBTOTAL THIS SUBCONTRACTOR- Lines 5 & 6	\$ 2,452.11
8 SUMMARY OF COSTS: Lower Tier Subcontractors- Sub - subcontractors (From Form II Subcontractors)	
9 SUBTOTAL LINE 8	\$ 2,452.11
10 HANDLING FEE: Maximum 5% of line 9	\$ -
11 TOTAL THIS SUBCONTRACTOR: Total Lines 7, 9, & 10 (carry line 8 Gen. Contractor Summary Sheet - Form I)	\$ 2,452.11

ACCEPTED: _____

DATE: _____

