

305A



**SUBMITTAL TO THE BOARD OF SUPERVISORS  
COUNTY OF RIVERSIDE, STATE OF CALIFORNIA**

**FROM:** TLMA - Transportation Department

**SUBMITTAL DATE:**  
September 20, 2012

**SUBJECT:** Notice of Completion - Construction of traffic signal at the intersection of Ramona Expressway Avenue, Lakeview area

**RECOMMENDED MOTION:** That the Board of Supervisors execute and file the attached "Notice of Completion"

**BACKGROUND:** By Minute Order 3.34 of December 6, 2011, the Board of Supervisors entered into a contract with PTM General Engineering Services, Inc. of Riverside, CA, for the construction of traffic signal, lighting and associated improvements at the intersection Ramona Expressway and Lakeview Avenue.

Departmental Concurrence

Juan C. Perez  
Director of Transportation and Land Management

dj  
(Continued On Attached Page)

<b>FINANCIAL DATA</b>	Current F.Y. Total Cost:	\$207,255	In Current Year Budget:	Yes
	Current F.Y. Net County Cost:	\$ 0	Budget Adjustment:	No
	Annual Net County Cost:	\$ 0	For Fiscal Year:	2012/2013

<b>SOURCE OF FUNDS:</b> West County DIF Signal Mitigation Fund (100%)	<b>Positions To Be Deleted Per A-30</b>	<input type="checkbox"/>
There were no General Funds used in this project	<b>Requires 4/5 Vote</b>	<input type="checkbox"/>

**C.E.O. RECOMMENDATION:**

APPROVE

BY   
Tina Grande

County Executive Office Signature

**MINUTES OF THE BOARD OF SUPERVISORS**

On motion of Supervisor Stone, seconded by Supervisor Tavaglione and duly carried by unanimous vote, IT WAS ORDERED that the above matter is approved as recommended.

Ayes: Buster, Tavaglione, Stone, Benoit and Ashley  
Nays: None  
Absent: None  
Date: October 16, 2012  
xc: Transp., Recorder

Kecia Harper-Ihem  
Clerk of the Board  
By:   
Deputy

Dep't Recomm.:  Consent  Policy   
Per Exec. Ofc.:  Consent  Policy

Prev. Agn. Ref. 12/06/11, Item 3.34 | District: 5/5 | Agenda Number:

ATTACHMENTS FILED  
WITH THE CLERK OF THE BOARD

3.42

The Honorable Board of Supervisors  
 RE: Notice of Completion - Construction of traffic signal at the intersection of Ramona  
 Expressway Avenue, Lakeview area

Page 2 of 2

The originally authorized amount of the contract was \$209,902. The total amended contract is \$207,255, which is 1.3% less than the originally authorized amount.

This work was completed at the direction of the Department on June 19, 2012, and was inspected by the Construction Engineering Section of the Transportation Department. Work Order C1-0624.

**Budget**

Original Contract Amount		\$209,902.00
Tot. Chg Orders Authorized -	0.0%	\$0.00
Est. Pending Change Orders	0.0%	\$0.00
Amended Contract Amount		\$209,902.00
* Quantity Adjustments	-1.3%	(\$2,647.40)
+ CCO FA Adjustments	0.0%	\$0.00
Total Amended Contract Amount	98.7%	<u>\$207,254.60</u>

**Expenditures**

Total Progress Payments -		\$207,254.60
Estimated Pending Payments		
Total Expenditures		<u>\$207,254.60</u>
<b>(Over)\Under Contract Amount</b>		<u><u>\$0.00</u></u>

+ Change Orders using the Force Account method of payment issued prior to the work being completed generally do not use the total authorized amount.

\* CAL-Trans Standard Specifications 4-1.03B. Increases or decreases in the quantity of a contract item of work will be determined by comparing the total pay quantity of such item of work with the Engineer's Estimate. If the total pay quantity of any item of work required under the contract varies from the Engineer's Estimate by 25 percent or less, payment will be made for the quantity of work of said item performed at contract unit price, unless eligible for adjustment pursuant to Section 4-1.03C, "Changes in Character of Work."

PLEASE COMPLETE THIS INFORMATION  
RECORDING REQUESTED BY:

**KECIA HARPER-IHEM, CLERK OF THE BOARD  
RIVERSIDE CO. CLERK OF THE BOARD  
4080 LEMON STREET, 1<sup>ST</sup> FLOOR CAC  
P O BOX 1147 - RIVERSIDE, CA 92502  
MAIL STOP # 1010**

**DOC # 2012-0495885  
10/17/2012**

**Customer Copy Label**  
The paper to which this label is  
affixed has not been compared  
with the filed/recorded document

**Larry W Ward**  
County of Riverside  
Assessor, County Clerk & Recorder

AND WHEN RECORDED MAIL TO:

**RETURN TO: STOP #1010**  
RIVERSIDE COUNTY CLERK OF THE BOARD  
P. O. BOX 1147 - RIVERSIDE, CA 92502

**THIS SPACE FOR RECORDERS USE ONLY**

**NOTICE OF COMPLETION**

To be recorded with County Recorder  
within 10 days after completion.  
No recording fee.

**Notice is hereby given by the undersigned owner, a public entity of the State of California, that a public work of improvement has been completed, as follows:**

**Project title or description of work:** Traffic Signal, Lighting, and Associated Improvements

**Date of Completion:** Date of this notice 10/16/12

**Nature of owner:** County of Riverside, public entity

**Interest or estate of owner:** Public Roadway

**Address of owner:** 4080 Lemon Street, 8th Floor, Riverside, CA 92501

**Name of contractor:** PTM General Engineering

**Street or legal description of site:** Ramona Expressway and Lakeview Avenue Intersection

Dated: October 16, 2012

Owner: County of Riverside  
(Name of Public Entity)

By: [Signature]  
Chairman, Board of Supervisors  
John Tavaglione

STATE OF CALIFORNIA )  
  ss  
COUNTY OF RIVERSIDE )

I am the Chairman of the governing board of the County of Riverside, the public entity which executed the foregoing notice and on whose behalf I make this verification; I have read this notice, know its contents, and the same is true. I certify under penalty of perjury that the foregoing is true and correct.

Executed at Riverside, California on 10/16/12 (Date)

[Signature], Chairman of the Board of Supervisors  
John Tavaglione

ATTEST:  
Kecia Harper-Ihem, Clerk

**COPY**

By [Signature] Deputy



LARRY W. WARD  
COUNTY OF RIVERSIDE  
ASSESSOR-COUNTY CLERK-RECORDER

Recorder  
P.O. Box 751  
Riverside, CA 92502-0751  
(951) 486-7000

<http://riverside.asrclrec.com>

CERTIFICATION

Pursuant to the provisions of Government Code 27361.7, I certify under the penalty of perjury that the following is a true copy of illegible wording found in the attached document:

(Print or type the page number(s) and wording below):

CLARIFICATION OF THE SEAL for the Riverside County Board of Supervisors  
(embossed on document)

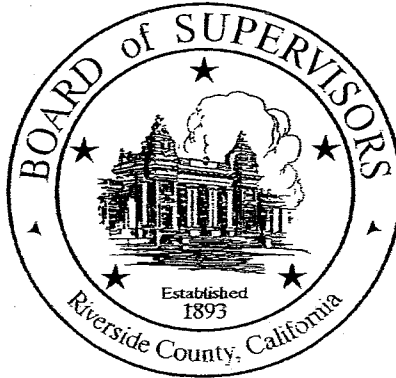

Date:

10-16-12

Signature:

Karen Barton

Print Name:

Karen Barton, Board Assistant, Riverside County Clerk of the Board

PROJECT: Ramona Expressway and Lakeview Avenue Traffic Signal and Lighting  
 County Project No.: C1-0624  
 Contract No. 11-11-001

Contractor: PTM General Engineering Services, Inc.  
 Address: 5942 Acorn Street  
 City, State, Zip: Riverside, CA 92504

Estimate No. 3 Final  
 From: May 26, 2012  
 To: July 25, 2012

Item No.	Item Description	Units	Quantity	Unit Price	Original Contract		Change Authorized		Total Authorized		This Estimate		Previous		Total Estimate To Date		% Auth.
					Amount	Quantity	Amount	Quantity	Amount	Quantity	Amount	Quantity	Amount	Quantity	Amount	Quantity	
24	PAINT TRAFFIC STRIPE (2-COAT)	LF	4,150	0.33	1,369.50	4,150.00	1,369.50	1,369.50	4,150.00	3,470.00	1,145.10	3,470.00	3,470.00	1,145.10	1,145.10	3,470.00	84%
	CCO 1 IMPORT MATERIAL FOR FILL		0	2,964.00	0.00	1.00	2,964.00	2,964.00	1.00	2,964.00	1.00	2,964.00	1.00	2,964.00	2,964.00	1.00	100%
<b>PROJECT TOTAL</b>					209,902.00		0.00	212,866.00		61,196.35		207,254.60					

Made by Ivan Mendoza/Steve Kestly

Checked by [Signature]

OK Const. Supv. [Signature]

Working Days: 35  
 Days Added: 10  
 Subtotal: 45  
 Days Used: 45  
 % Time Elapsed: 100%

Start Date: 4-9-12  
 End Date: 6-19-12  
 % \$ Complete: 97%  
 Original Contract: \$209,902.00  
 Amended Contract: \$212,866.00

TOTAL VALUE OF WORK TO DATE: \$207,254.60  
 LESS RETENTION: 10% 20,725.46  
 TOTAL DUE TO DATE: \$186,529.14  
 LESS PREVIOUSLY INVOICED: 131,452.42  
 LESS LABOR NON COMPLIANCE: 0.00  
 TOTAL DUE THIS PAYMENT: \$55,076.72

This Estimate Approved \_\_\_\_\_ Date: \_\_\_\_\_ for: \_\_\_\_\_  
 Juan C. Perez, Director of Transportation and Land Management

Received by Accounts Payable: \_\_\_\_\_  
 By: \_\_\_\_\_

**PAYMENT APPROVAL**

Quantities on This Estimate Approved [Signature] Date: 8-17-12

PTM General Engineering Service, Inc.

Fund 20000  
 Dept ID 31305  
 Account 527980

Project Z-C1-0624E  
 Activity ID Z3500  
 Resource Type CNT  
 Signature [Signature]  
 Date 8/24/12





Estimate No. 3 Final  
 From: May 26, 2012  
 To: July 25, 2012

Item No.	Item Description	Units	Quantity	Unit Price	Original Contract Amount	Change Authorized		Total Authorized		This Estimate		Total Estimate To Date		% Auth.
						Quantity	Amount	Quantity	Amount	Quantity	Amount	Quantity	Amount	
1	TRAFFIC CONTROL SYSTEM	LS	1	2,000.00	2,000.00			1.00	2,000.00	0.30	600.00	0.70	2,000.00	100%
2	DUST ABATEMENT	LS	1	1,540.00	1,540.00			1.00	1,540.00	0.30	462.00	0.70	1,540.00	100%
3	SIGNAL AND LIGHTING	LS	1	130,002.50	130,002.50			1.00	130,002.50	0.38	49,400.95	0.62	130,002.50	100%
4	WATER POLLUTION CONTROL	LS	1	500.00	500.00			1.00	500.00	0.30	150.00	0.70	500.00	100%
5	CLEARING AND GRUBBING	LS	1	1,340.00	1,340.00			1.00	1,340.00			1.00	1,340.00	100%
6	ROADWAY EXCAVATION	CY	130	55.00	7,150.00			130.00	7,150.00			129.00	7,095.00	99%
7	CLASS 2 AGGREGATE BASE	CY	65	54.00	3,510.00			65.00	3,510.00			65.00	3,510.00	100%
8	HOT MIX ASPHALT PLACE ASPHALT CONCRETE (MISCELLANEOUS AREA) [SIDEWALK RAMP PAVING]	TON	160	145.00	23,200.00			160.00	23,200.00			126.50	18,342.50	79%
9	COLD PLANE ASPHALT CONCRETE PAVEMENT (0.11 SQYD)	SQYD	40	50.00	2,000.00			40.00	2,000.00			40.00	2,000.00	100%
10	MINOR CONCRETE (CURB RAMP) (CRS 403 CASE A)	EA	1	3,100.00	3,100.00			1.00	3,100.00			1.00	3,100.00	100%
11	MINOR CONCRETE (CURB RAMP) (CRS 403 CASE A)	EA	2	2,980.00	5,960.00			2.00	5,960.00			2.00	5,960.00	100%
12	MINOR CONCRETE (TYPE D CURB) (CRS 204)	LF	130	26.50	3,445.00			130.00	3,445.00			130.00	3,445.00	100%
13	MINOR CONCRETE (CURB AND GUTTER) (CRS 200)	LF	165	28.60	4,719.00			165.00	4,719.00			165.00	4,719.00	100%
14	21"x15" CORRUGATED STEEL PIPE ARCH (.109" THICK)	LF	32	121.00	3,872.00			32.00	3,872.00	8.00	968.00	32.00	4,840.00	125%
15	CORRUGATED STEEL PIPE COLLAR	EA	2	1,050.00	2,100.00			2.00	2,100.00			2.00	2,100.00	100%
16	SHOULDER BACKING	LF	750	4.20	3,150.00			750.00	3,150.00			750.00	3,150.00	100%
17	REMOVE SIGN	EA	3	55.00	165.00			3.00	165.00	3.00	165.00	3.00	165.00	100%
18	ROADSIDE SIGN - ONE POST	EA	5	250.00	1,250.00			5.00	1,250.00	5.00	1,250.00	5.00	1,250.00	100%
19	RELOCATE SIGNS	EA	2	150.00	300.00			2.00	300.00	2.00	300.00	2.00	300.00	100%
20	PAVEMENT MARKER (REFLECTIVE)	EA	330	3.30	1,089.00			330.00	1,089.00	161.00	531.30	161.00	531.30	49%
21	REMOVE TRAFFIC STRIPE AND PAVEMENT MARKING	SQFT	1,120	2.00	2,240.00			1,120.00	2,240.00	406.00	812.00	406.00	812.00	36%
22	THERMOPLASTIC PAVEMENT MARKING	SQFT	650	4.00	2,600.00			650.00	2,600.00	612.00	2,448.00	612.00	2,448.00	94%





# VICINITY MAP

RAMONA EXPY AND LAKEVIEW AVE  
TRAFFIC SIGNAL

TOWNSHIP 4 SECTION 7 RANGE 2W  
2009 THOMAS GUIDE PG 779, A-2

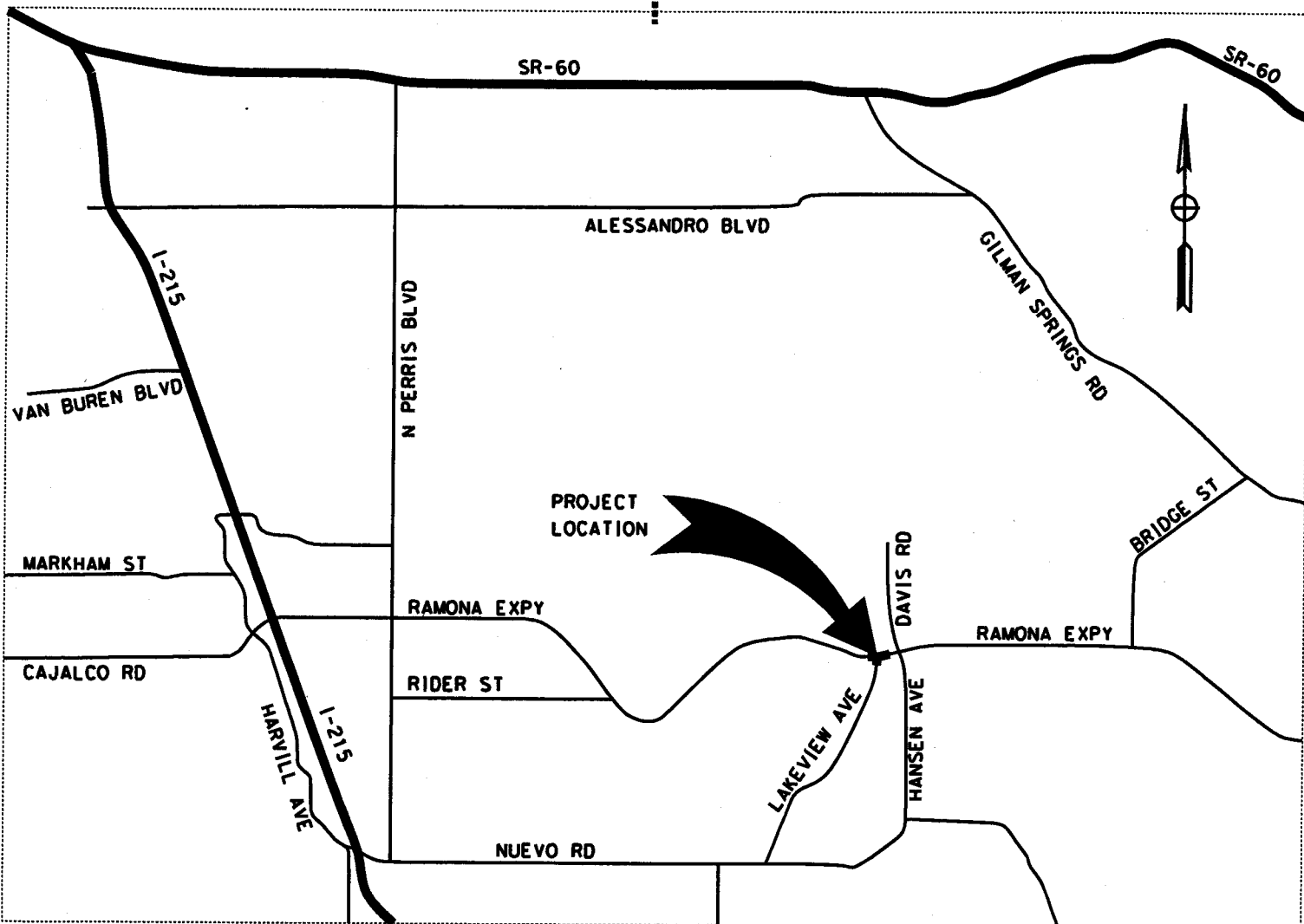
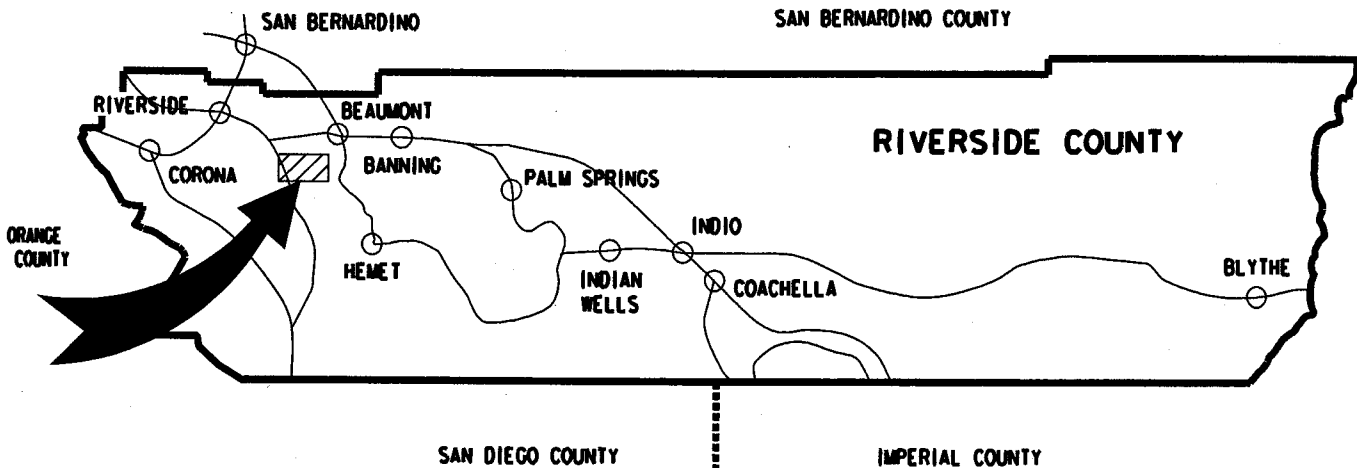

# Attachment "A"

Riverside County Transportation Department

Project: **Ramona Expressway & Lakeview Avenue Traffic Signal**

Project No.(s) **C1-0624**

### Project Costs and Budget

Activity	Incurred Costs	Projected Costs	Total Costs	Existing Budget
Preliminary Survey	17,720	280	18,000	30,000
Environmental	1,754	246	2,000	1,000
Design	37,935	2,065	40,000	40,000
Right-of-way				
Utilities	3,572	1,428	5,000	
Construction		209,902	209,902	
Construction Contingency 10%		20,990	20,990	
Signal Pole Equipment		28,000	28,000	28,000
Construction Engineering & Inspector 15%	170	31,315	31,485	60,000
Construction Survey 5%		10,495	10,495	40,000
<b>Totals:</b>	<b>61,151</b>	<b>304,722</b>	<b>365,873</b>	<b>571,000</b>

### Project Funding

Code	Name	Existing Budget
369	West County DIF Signal Mitigation Fund	571,000
<b>Totals</b>		<b>571,000</b>

### Comments