

**SUBMITTAL TO THE FLOOD CONTROL AND  
WATER CONSERVATION DISTRICT BOARD  
COUNTY OF RIVERSIDE, STATE OF CALIFORNIA**



603B

**FROM:** General Manager-Chief Engineer

**SUBMITTAL DATE:**  
November 27, 2012

**SUBJECT:** Public Hearing for Pyrite Channel Bypass, Stage 1  
Project No. 1-0-00109-01  
District 2/District 2

**RECOMMENDED MOTION:**

1. Adopt Resolution No. F2012-22 which finds that the project will not have a significant adverse effect upon the environment and is in compliance with the Western Riverside County Multiple Species Habitat Conservation Plan; and
2. Adopt a Mitigated Negative Declaration for the project based on the findings incorporated in the initial study and the conclusion that the project will not have a significant effect on the environment; and
3. Approve and Authorize the District to proceed with the Project; and
4. Direct the Clerk of the Board to deliver the Mitigated Negative Declaration and the Notice of Determination to the office of the County Clerk and the State Office of Planning and Research for filing within five (5) working days of this Board hearing.

**BACKGROUND:**

See Page 2.

**FINANCIAL:**

N/A

**WARREN D. WILLIAMS**  
General Manager-Chief Engineer

**FINANCIAL  
DATA**

Current F.Y. District Cost:	N/A	In Current Year Budget:	N/A
Current F.Y. County Cost:	N/A	Budget Adjustment:	N/A
Annual Net District Cost:	N/A	For Fiscal Year:	N/A

**SOURCE OF FUNDS:** N/A

**Positions To Be  
Deleted Per A-30** ☐

**Requires 4/5 Vote** ☐

**C.E.O. RECOMMENDATION:** APPROVE

BY:   
Michael R. Shetler

**County Executive Office Signature**

**MINUTES OF THE FLOOD CONTROL AND WATER CONSERVATION DISTRICT**

On motion of Supervisor Tavaglione, seconded by Supervisor Buster and duly carried by unanimous vote, IT WAS ORDERED that the above matter is approved as recommended.

**Ayes:** Buster, Tavaglione, Stone, Benoit and Ashley  
**Nays:** None  
**Absent:** None  
**Date:** November 27, 2012  
**xc:** Flood, Recorder

Kecia Harper-Ihem  
Clerk of the Board  
By:   
Deputy

**Prev. Agn. Ref.:** 11.1 of 9/25/12 **District:** 2<sup>nd</sup>/2<sup>nd</sup> **Agenda Number:**

ATTACHMENTS FILED  
WITH THE CLERK OF THE BOARD

**11.3**

FORM APPROVED COUNTY COUNSEL

BY: DATE: 9/15/12  
MICHELLE CLACK

☐ Policy

☐ Consent

Dept Recomm.:

☐ Policy

☐ Consent

Per Exec. Ofc.:

**FLOOD CONTROL AND WATER CONSERVATION DISTRICT BOARD SUBMITTAL  
COUNTY OF RIVERSIDE, STATE OF CALIFORNIA**

**SUBJECT:** Pyrite Channel Bypass, Stage 1  
Project No. 1-0-00109-01  
District 2/District 2

**SUBMITTAL DATE:** November 27, 2012

**Page 2**

**BACKGROUND:**

The public hearing is in accordance with the requirements for Section 18 of the District Act.

The Pyrite Channel Bypass, Stage 1 Project (Project) entails the construction and subsequent maintenance of a 1,700-foot long underground storm drain system and the installation of curb and gutter and new pavement along Pyrite Street.

The District's concrete-lined Pyrite Channel ends at Pyrite Street where flows are discharged into a natural wash that runs through a residential community west of Pyrite Street. The property owners have encroached into the wash with their development and have experienced flood damage in the past. The proposed storm drain would intercept low flows in Pyrite Channel before they run through the residential area and redirect them to the District's existing concrete-lined Jurupa Channel. Jurupa Channel would return the low flows to the natural wash after they have bypassed the residential area. The curb and gutter would improve drainage along Pyrite Street.

In June 2011, the Redevelopment Agency for the County of Riverside (RDA) prepared a final initial study for a project entitled "Pyrite Street Improvement Project" in accordance with the California Environmental Quality Act (CEQA). The Project was included in RDA's initial study. With the recent ruling by the California Supreme Court to phase out economic development programs, RDA has decided not to construct their project or adopt a Mitigated Negative Declaration based on the findings in the initial study. In order to alleviate flooding in the area, the District has decided to assume the CEQA lead agency role for the portion of the "Pyrite Street Improvement Project" that includes the storm drain system and associated street improvements.

A new MND and IS was prepared by the District to reflect the lead agency change, smaller scope of the project, and changes in local jurisdiction (e.g., incorporation of the City of Jurupa Valley). However, since the RDA's IS analyzed most of the proposed Project impacts, applicable portions of the RDA's IS have been incorporated into the District's IS.

All provisions of the California Environmental Quality Act and the District Rules to Implement the Act have been met and the General Manager-Chief Engineer of the District has found that the Project will not have a significant adverse effect upon the environment and has completed a Mitigated Negative Declaration.

BOARD OF SUPERVISORSRIVERSIDE COUNTY FLOOD CONTROL  
AND WATER CONSERVATION DISTRICTRESOLUTION NO. F2012-22  
APPROVING PYRITE CHANNEL BYPASS, STAGE 1 PROJECT

WHEREAS, on September 25, 2012, the Board adopted Resolution No. F2012-21 pursuant to Section 18 of the District Act giving notice of its intention to construct a project in Zone 1, within the city of Jurupa Valley, designated as Pyrite Channel Bypass, Stage 1 Project ("Project") and giving further notice that the Project would be considered at a public hearing on November 27, 2012; and

WHEREAS, notice of the public hearing was properly made by publication and posting as required by law, and all persons desiring to be heard on the matter were given the opportunity to appear and present testimony, both oral and written; and

WHEREAS, the Redevelopment Agency for the County of Riverside (RDA) prepared a California Environmental Quality Act (CEQA) initial study that included the Project; and

WHEREAS, with the recent ruling by the California Supreme Court to phase out economic development programs, RDA has decided not to construct their project or adopt a Mitigated Negative Declaration based on the findings in the initial study; and

WHEREAS, in order to alleviate flooding in the area, the District has assumed the CEQA Lead Agency role for the proposed Project; and

WHEREAS, all provisions of the CEQA and the District Rules to Implement the CEQA have been met and the General Manager-Chief Engineer of the District has found that the Project will not have a significant adverse effect upon the environment and has completed a Mitigated Negative Declaration; now, therefore,

BE IT RESOLVED, FOUND, DETERMINED AND ORDERED by the Board of Supervisors of the Riverside County Flood Control and Water Conservation District in regular session assembled on November 27, 2012 based upon the evidence and testimony presented on the matter, both written and oral, that:

1  
2 1. The Project is not within the Criteria Area set forth in and established by the  
3 Western Riverside County Multiple Species Habitat Conservation Plan (MSHCP).

4 2. The Project is consistent with the Riparian/Riverine Area and Vernal Pool  
5 requirements of the MSHCP. Pursuant to Section 6.1.2 of the MSHCP, Riparian/Riverine areas  
6 are lands which contain habitat dominated by trees, shrubs, persistent emergents, or emergent  
7 mosses and lichens, which occur close to or which depend upon soil moisture from a nearby  
8 freshwater source, or areas with freshwater flow during all or a portion of the year. Vernal Pools  
9 are seasonal wetlands that occur in depression areas that have wetland indicators of all three  
10 parameters (soils, vegetation and hydrology) during the wetter portion of the growing season. It  
11 has been determined that the Project area does not contain any Vernal Pools, nor does it include  
12 Riparian/Riverine Areas as defined by the MSHCP. In addition, the proposed storm drain  
13 alignment does not contain suitable habitat for least Bell's vireo, Southwestern Willow  
14 Flycatcher or Western Yellow-Billed Cuckoo. Therefore, no further surveys or conservation  
15 measures are required.

16 3. The Project is consistent with the Narrow Endemic Plant Species requirements of  
17 the MSHCP. Pursuant to Section 6.1.3 of the MSHCP, habitat assessments and/or focused  
18 surveys for certain narrow endemic plant species are required for properties within mapped  
19 survey areas. The survey area maps included within the MSHCP have been reviewed and the  
20 Project is partially located within the survey areas for San Diego ambrosia, Brand's phacelia, and  
21 San Miguel savory. A habitat assessment was conducted and it was determined that suitable  
22 habitat for the above plant species does not occur on the Project site. Therefore, no further  
23 assessments and/or surveys or conservation measures are required.

24 4. The Project is consistent with the Urban-Wildlands Interface requirements of the  
25 MSHCP. Section 6.1.4 of the MSHCP presents guidelines to minimize indirect effects of a  
26 project in proximity to the MSHCP Conservation Area. This section provides mitigation  
27 measures for impacts associated with: Drainage, Toxics, Lighting, Noise, Invasives, Barriers  
28 and Grading/Land Development. The Project has been reviewed and it has been determined the

1  
2 Project does not occur within or adjacent to the Criteria Area or MSHCP designated  
3 Public/Quasi-Public conservation lands. Therefore, no further analysis or implementation of any  
4 conservation measures is required.

5         5. The Project is consistent with the Database Updates/Additional Surveys  
6 requirements of the MSHCP. Pursuant to Section 6.3.2 of the MSHCP, habitat assessments  
7 and/or focused surveys for certain additional plant and animal species are required for properties  
8 within mapped survey areas. The survey area maps have been reviewed and the Project is only  
9 within a mapped survey area for the Burrowing Owl. A habitat assessment was conducted for  
10 the Burrowing Owl pursuant to accepted protocol during October 2010 and a focused survey was  
11 conducted during March 2011. No Burrowing Owls or Burrowing Owl signs were observed  
12 within the surveyed area in 2010 or 2011. In accordance with the MSHCP, a pre-construction  
13 survey for Burrowing Owls will be conducted within 30 days prior to disturbance of the property  
14 for construction purposes. The Project satisfies the plant, mammal, amphibian, and bird  
15 Additional Survey Needs and Procedures requirements of the MSHCP.

16         6. The Project is consistent with the Pubic/Quasi-Public Land provisions contained in  
17 Section 3.2.1 of the MSHCP. Section 3.2.1 describes lands within the MSHCP conservation area  
18 including those designated as Public/Quasi-Public (PQP) Lands. Section 3.2.1 states that if a  
19 Permittee elects to use property currently depicted as PQP Lands in a way that alters the land use  
20 such that it would not contribute to Reserve Assembly, the Permittee shall locate and acquire or  
21 otherwise encumber replacement acreage at a minimum ratio of 1:1. The Permittee must make  
22 findings that the replacement acreage is biologically equivalent or superior to the existing  
23 property. The Project has been reviewed and it has been determined the Project does not occur  
24 within MSHCP designated PQP Lands. Therefore, no further analysis is required.

25         7. The Project will not have a significant adverse effect upon the environment and a  
26 Mitigated Negative Declaration is adopted based on the findings incorporated in the initial study.

27         8. The Project is approved and the District is hereby authorized to proceed with the  
28 Project.

1  
2 BE IT FURTHER RESOLVED that, within five (5) working days of this Board meeting,  
3 the Clerk of the Board is directed to deliver the adopted Mitigated Negative Declaration and the  
4 Notice of Determination to the Office of the County Clerk and Recorder, who is thereby directed  
5 to file same, and the Clerk of the Board is further directed to deliver the Notice of Determination  
6 to the State Office of Planning and Research, all as required by law.

7 ROLL CALL:

8 Ayes: Buster, Tavaglione, Stone, Benoit, and Ashley  
9 Nays: None  
Absent: None

10 The foregoing is certified to be a true copy of a resolution duly  
11 adopted by said Board of Supervisors on the date therein set forth.

12 KECIA HARPER-IHEM, Clerk of said Board

13 By: \_\_\_\_\_  
14 Deputy

**PYRITE CHANNEL BYPASS, STAGE 1**  
**PROJECT NO. 1-0-00109-01**

**ENGINEER'S STATEMENT**

The proposed project is located within the city of Jurupa Valley in Riverside County, California. The Pyrite Channel Bypass Project entails the construction and subsequent maintenance of a 1,700-foot long underground storm drain system and the installation of curb and gutter and new pavement along Pyrite Street. Utility services to be relocated may include cable, telephone, gas, water and sewer within the road rights-of-way.

The District's concrete-lined Pyrite Channel ends at Pyrite Street where flows are discharged into a natural wash that runs through a residential community west of Pyrite Street. The property owners have encroached into the wash with their development and have experienced flood damage in the past. The proposed storm drain would intercept low flows in Pyrite Channel before they run through the residential area and redirect them to the District's existing concrete-lined Jurupa Channel. Jurupa Channel would return the low flows to the natural wash after they have bypassed the residential area. The curb and gutter would improve drainage along Pyrite Street.

The proposed project area may be found within Township 2 South, Range 6 West, Sections 12 and 13 of the Fontana 7.5 Series USGS Topographic Quadrangle map. The cost of the proposed project is approximately \$940,000.

P8\147287

## PROJECT LOCATION

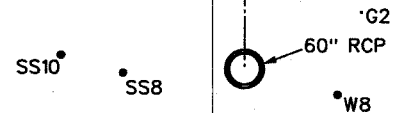

LOCATION MAP

N.T.S.

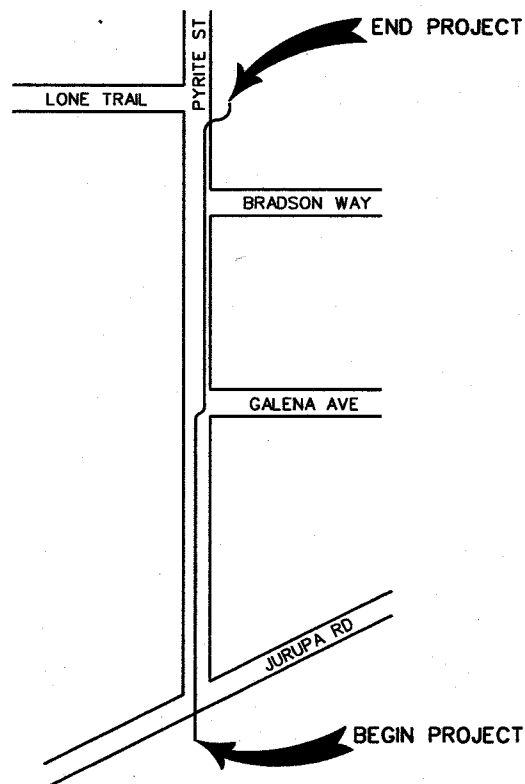



# RIVERSIDE COUNTY CLERK-RECORDER

## AUTHORIZATION TO BILL

### TO BE FILLED OUT BY SUBMITTING AGENCY

DATE: 7/17/2012 BUSINESS  
UNIT/AGENCY: FLOOD CONTROL - FCARC

#### ACCOUNTING STRING:

ACCOUNT: 526410 FUND: 25110  
DEPT ID: 947400 PROGRAM: \_\_\_\_\_

AMOUNT: \$2,101.50  
\$ 64.00 - Doc Handling Fee  
\$2,165.50

REF: FINAL CEQA POSTING FOR PYRITE CHANNEL BYPASS,STAGE 1-0-00109-01

THIS AUTHORIZES THE COUNTY CLERK & RECORDER TO ISSUE AN INVOICE  
FOR PAYMENT OF ALL FEES FOR THE ACCOMPANYING DOCUMENTS.

NUMBER OF DOCUMENTS INCLUDED: 7

AUTHORIZED BY: Lisa McFarland 

PRESENTED BY: Art Diaz

CONTACT: Lisa McFarland (951) 955-8454

### TO BE FILLED OUT BY COUNTY CLERK

ACCEPTED BY: \_\_\_\_\_

DATE: \_\_\_\_\_

DOCUMENT NO(S)/INVOICE NO(S): \_\_\_\_\_

**Notice of Determination**

To: Office of Planning and Research

From: Riverside County Flood Control  
1995 Market Street  
Riverside, CA 92501  
Contact: Art Diaz  
Phone: 951.955.1233For U.S. Mail:  
P.O. Box 3044  
Sacramento, CA 95812-3044Street Address:  
1400 Tenth Street  
Sacramento, CA 95814County Clerk  
County of Riverside  
2724 Gateway Drive  
Riverside, CA 92507

Lead Agency (if different from above):

Original Negative Declaration/Notice of  
Determination was routed to County  
Clerk for posting on. *KB*

SUBJECT:

Filing of Notice of Determination in compliance with Section 21068 of 21152 of the Public Resources Code. *11/28/12* *KB*State Clearinghouse Number (if submitted to State Clearinghouse): 2012091027

Project Title: Pyrite Channel Bypass, Stage 1

**Project Location (include county)**

The proposed project is generally located along Pyrite Street from Lone Trail to approximately 60 feet south of Jurupa Road in the city of Jurupa Valley in Riverside County, California. The proposed project area may be found within Township 2 South, Range 6 West, Sections 12 and 13 of the Fontana 7.5 Series USGS Topographic Quadrangle map.

**Project Description**

The Pyrite Channel Bypass Project entails the construction and subsequent maintenance of a 1,700-foot long underground storm drain system and the installation of curb and gutter and new pavement along Pyrite Street. Utility services to be relocated may include cable, telephone, gas, water and sewer within the road rights-of-way.

The District's concrete-lined Pyrite Channel ends at Pyrite Street where flows are discharged into a natural wash that runs through a residential community west of Pyrite Street. The property owners have encroached into the wash with their development and have experienced flood damage in the past. The proposed storm drain would intercept low flows in Pyrite Channel before they run through the residential area and redirect them to the District's existing concrete-lined Jurupa Channel. Jurupa Channel would return the low flows to the natural wash after they have bypassed the residential area. The curb and gutter would improve drainage along Pyrite Street.

This is to advise that the Riverside County Flood Control and Water Conservation District (Lead Agency) has approved the above described project on November 27, 2012 and has made the following determinations regarding the above described project:

1. The project will not have a significant effect on the environment.
2. A Mitigated Negative Declaration was prepared for this project pursuant to the provisions of CEQA.
3. Mitigation measures were made a condition of the approval of the project.
4. A Mitigation Monitoring Program was adopted for this project.
5. A statement of Overriding Considerations was not adopted for this project.
6. Findings were not made pursuant to the provisions of CEQA.

This is to certify that the Mitigated Negative Declaration is available to the General Public at: The Office of the Clerk of the Board, County Administrative Center, 4080 Lemon Street, Riverside, CA 92501.

*[Signature]*  
Signature (Public Agency)*Board Assistant*  
Title*11/27/12*  
Date

Date received for filing at OPR:

Authority cited: Sections 21083 and 21087, Public Resources Code.

Reference: Sections 21000-21174, Public Resources Code.

Revised 2004

NOV 27 2012 *11.3*

## MITIGATED NEGATIVE DECLARATION

State Clearinghouse Number: 2012091027      Contact Person: Art Diaz      Telephone Number: 951.955.1233      Email: aadiaz@rcflood.org

Lead Agency and Project Sponsor:  
Riverside County Flood Control and Water Conservation District

Address: 1995 Market Street      City: Riverside      Zip: 92501

### Project Title and Description:

**Pyrite Channel Bypass, Stage 1** – The proposed project entails the construction and subsequent maintenance of an underground storm drain system and associated street improvements. The proposed storm drain project consists of approximately 1700 lineal feet of reinforced concrete pipe (RCP) that will convey minor flows from the District's existing concrete lined trapezoidal Pyrite Channel and discharge them to the District's existing concrete lined rectangular Jurupa Channel. Street improvements along Pyrite Street between Jurupa Road and Lone Trail will ensure that the storm drain system functions properly. Utility services to be relocated may include cable, telephone, gas, water and sewer within the road rights-of-way. Refer to the attached exhibits for additional information.

### Project Location:

The proposed project is generally located along Pyrite Street from Lone Trail to approximately 60 feet south of Jurupa Road in the city of Jurupa Valley in Riverside County, California. The proposed project area may be found within Township 2 South, Range 6 West, Sections 12 and 13 of the Fontana 7.5 Series USGS Topographic Quadrangle map.

The General Manager-Chief Engineer of the Riverside County Flood Control and Water Conservation District has made a finding that the proposed Pyrite Channel Bypass, Stage 1 project will not have a significant adverse effect on the environment. An Initial Study supporting this finding is attached. This finding will become final upon adoption of this Mitigated Negative Declaration by the Board of Supervisors of the Riverside County Flood Control and Water Conservation District. Mitigation measures are as follows:

Refer to attached Environmental Commitments & Mitigation Monitoring Program Table

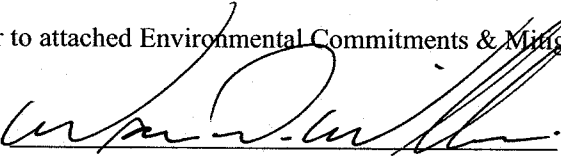
Signature:   
WARREN D. WILLIAMS  
General Manager-Chief Engineer

Dated: 11/7/12

The Board of Supervisors of the Riverside County Flood Control and Water Conservation District, assembled in regular session on November 27, 2012, has determined that the Pyrite Channel Bypass, Stage 1 project will not have a significant adverse effect on the environment and has adopted this Mitigated Negative Declaration.

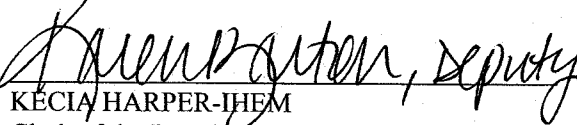
Signature:   
KECIA HARPER-IHEM  
Clerk of the Board

Dated: 11/27/12

### Attachment

Copies to: 1) County Clerk  
2) Flood Control

JDS:bjp:mcv  
P8\150086

## CERTIFICATE OF POSTING

(Original copy, duly executed, must be attached to original at the time of filing)

I, Mary Ann Meyer, do hereby certify that I am  
not

(NAME AND TITLE)

a party to the within action or proceeding; that on 10.1.12, I posted a  
(DATE)

copy of the following document:

**RESOLUTION NO. F2012-21 SETTING A PUBLIC HEARING DATE FOR PYRITE CHANNEL  
BYPASS, STAGE 1 PROJECT AND GIVING NOTICE OF INTENT TO ADOPT A MITIGATED  
NEGATIVE DECLARATION THEREFOR IN ACCORDANCE WITH SECTION 18 OF THE  
DISTRICT ACT AND THE CALIFORNIA ENVIRONMENTAL QUALITY ACT (CEQA)**

by posting at Riverside County Clerk and Recorder's Office, 2724 Gateway Drive, Riverside, California  
92507.

Date:

10.1.12

M. Meyer  
(Signature)

## CERTIFICATE OF POSTING

(Original copy, duly executed, must be attached to original at the time of filing)

I, Berlyn Castaneda, do hereby certify that I am  
not

(NAME AND TITLE)

a party to the within action or proceeding; that on 10 / 1 / 12, I posted a  
(DATE)

copy of the following document:

**RESOLUTION NO. F2012-21 SETTING A PUBLIC HEARING DATE FOR PYRITE CHANNEL  
BYPASS, STAGE 1 PROJECT AND GIVING NOTICE OF INTENT TO ADOPT A MITIGATED  
NEGATIVE DECLARATION THEREFOR IN ACCORDANCE WITH SECTION 18 OF THE  
DISTRICT ACT AND THE CALIFORNIA ENVIRONMENTAL QUALITY ACT (CEQA)**

by posting at City of Jurupa Valley City Hall, 8304 Limonite Avenue, Suite "M", Jurupa Valley,  
California 92509.

Date:

10 / 1 / 12

Berlyn Castaneda

(Signature)



**SUBMITTAL TO THE FLOOD CONTROL AND  
WATER CONSERVATION DISTRICT BOARD  
COUNTY OF RIVERSIDE, STATE OF CALIFORNIA**

**FROM:** General Manager-Chief Engineer

**SUBMITTAL DATE:**  
September 25, 2012

**SUBJECT:** Pyrite Channel Bypass, Stage 1  
Project No. 1-0-00109-01  
District 2/District 2

**RECOMMENDED MOTION:**

1. Adopt Resolution No. F2012-21 which sets November 27, 2012 as the date for a Public Hearing concerning the construction of the above referenced project in accordance with Section 18 of the District Act and gives Notice of Intent to Adopt a Mitigated Negative Declaration in accordance with the California Environmental Quality Act (CEQA); and
2. Direct the Clerk of the Board to advertise and post said notice of public hearing and intent to adopt a Mitigated Negative Declaration in accordance with Section 18 of the District Act and CEQA.

**BACKGROUND:**

See Page 2.

**FINANCIAL:**

N/A

**WARREN D. WILLIAMS**  
General Manager-Chief Engineer

**FINANCIAL  
DATA**

Current F.Y. District Cost: N/A  
Current F.Y. County Cost: N/A  
Annual Net District Cost: N/A

In Current Year Budget: N/A  
Budget Adjustment: N/A  
For Fiscal Year: N/A

**SOURCE OF FUNDS:** N/A

**Positions To Be  
Deleted Per A-30** ☐

**Requires 4/5 Vote** ☐

**C.E.O. RECOMMENDATION:**

APPROVE

BY:

Michael R. Shetler

**County Executive Office Signature**

**MINUTES OF THE FLOOD CONTROL AND WATER CONSERVATION DISTRICT**

On motion of Supervisor Tavaglione, seconded by Supervisor Benoit and duly carried by unanimous vote, IT WAS ORDERED that the above matter is approved as recommended, and is set for public hearing on Tuesday, November 27, 2012, at 11:00 a.m.

Ayes: Buster, Tavaglione, Stone, Benoit and Ashley  
Nays: None  
Absent: None  
Date: September 25, 2012  
xc: Flood *Cob*

Kecia Harper-Ihem  
Clerk of the Board  
By:   
Deputy

**Prev. Agn. Ref.:**

**District:** 2<sup>nd</sup>/2<sup>nd</sup>

**Agenda Number:**

FORM APPROVED COUNTY COUNSEL

BY:   
MICHELLE CLACK  
DATE: 9/5/12

☐ Policy

☐ Consent

Dept's Recomm.:

☐ Policy

☐ Consent

Per Exec. Ofc.:

**FLOOD CONTROL AND WATER CONSERVATION DISTRICT BOARD SUBMITTAL  
COUNTY OF RIVERSIDE, STATE OF CALIFORNIA**

**SUBJECT:** Pyrite Channel Bypass, Stage 1  
Project No. 1-0-00109-01  
District 2/District 2

**SUBMITTAL DATE:** September 25, 2012  
**Page 2**

**BACKGROUND:**

Section 18 of the District's Enabling Act requires the Board to hold a Public Hearing for the purpose of considering all comments regarding any proposed facilities before authorizing the construction of such facilities.

The Pyrite Channel Bypass Project (Project) entails the construction and subsequent maintenance of an underground storm drain system and associated street improvements. The proposed storm drain project consists of approximately 1,700 lineal feet of reinforced concrete pipe (RCP) that will convey minor flows from the District's existing concrete lined trapezoidal Pyrite Channel and discharge them to the District's existing concrete lined rectangular Jurupa Channel. Street improvements along Pyrite Street between Jurupa Road and Lone Trail will ensure that the storm drain system functions properly.

In June 2011, the Redevelopment Agency for the County of Riverside (RDA) prepared a final initial study for a project entitled "Pyrite Street Improvement Project" in accordance with the California Environmental Quality Act (CEQA). The Pyrite Channel Bypass, Stage 1 Project (Project) was included in RDA's initial study. With the recent ruling by the California Supreme Court to phase out economic development programs, RDA has decided not to construct their project or adopt a Mitigated Negative Declaration based on the findings in the initial study. In order to alleviate flooding in the area, the District has decided to assume the CEQA lead agency role for the portion of the "Pyrite Street Improvement Project" that includes the storm drain system and associated street improvements.

A new MND and IS was prepared by the District to reflect the lead agency change, smaller scope of the project, and changes in local jurisdiction (e.g., incorporation of the City of Jurupa Valley). However, since the RDA's IS analyzed the proposed Project impacts, applicable portions of the RDA's IS have been incorporated into the District's IS.

In accordance with the State guidelines implementing the CEQA, the General Manager-Chief Engineer of the District has found that the proposed project will not have a significant adverse effect on the environment and has completed a Mitigated Negative Declaration which will not be final until approved and adopted by this Board.

BOARD OF SUPERVISORSRIVERSIDE COUNTY FLOOD CONTROL  
AND WATER CONSERVATION DISTRICT

**RESOLUTION NO. F2012-21  
SETTING A PUBLIC HEARING DATE FOR  
PYRITE CHANNEL BYPASS, STAGE 1 PROJECT  
AND GIVING NOTICE OF INTENT TO ADOPT A  
MITIGATED NEGATIVE DECLARATION THEREFOR  
IN ACCORDANCE WITH SECTION 18 OF THE DISTRICT ACT  
AND THE CALIFORNIA ENVIRONMENTAL QUALITY ACT (CEQA)**

WHEREAS, this Board intends to undertake a project within the city of Jurupa Valley, designated as Pyrite Channel Bypass, Stage 1 Project ["Proposed Project"]; and

WHEREAS, the Proposed Project is generally located along Pyrite Street from Lone Trail to approximately 60 feet south of Jurupa Road; and

WHEREAS, the Proposed Project consists of the construction and subsequent operation and maintenance of approximately 1,700 lineal feet of underground storm drain system and street improvements; and

WHEREAS, reference is made to the engineering cost estimate for the Proposed Project, included in the "Engineer's Statement" on file with the Clerk of the Board; and

WHEREAS, reference is made to a map dated June 2012, bearing the name and showing the general location and typical section of the Proposed Project which is also on file with the Clerk of the Board; and

WHEREAS, the Redevelopment Agency (RDA) for the County of Riverside prepared a California Environmental Quality Act (CEQA) initial study that included the Proposed Project; and

WHEREAS, with the recent ruling by the California Supreme Court to phase out economic development programs, RDA has decided not to construct their project or adopt a Mitigated Negative Declaration based on the findings in the initial study; and

WHEREAS, in order to alleviate flooding in the area, the District has assumed the CEQA Lead Agency role for the Proposed Project; and



1 WHEREAS, the General Manager-Chief Engineer of the District has found that the  
2 Proposed Project will not have a significant adverse effect on the environment and has prepared  
3 a Mitigated Negative Declaration which will not become final until adopted by this Board; and

4 WHEREAS, any person wishing to comment on the Proposed Project or the Mitigated  
5 Negative Declaration may do so in writing between the date of this notice and the public hearing,  
6 or may appear and be heard at the time and place noted below; and

7 WHEREAS, in a subsequent legal challenge any person may be limited to raising only  
8 those issues he, she or someone else raised at the public hearing described in this notice, or in  
9 written comments delivered before or at the public hearing; and

10 WHEREAS, prior to making a decision on the Proposed Project or the Mitigated  
11 Negative Declaration, this Board will consider all written and oral comments; and

12 WHEREAS, the above-listed documents can be inspected at the District office, 1995  
13 Market Street, Riverside, California 92501 and written comments will be received at the above  
14 address.

15 NOW, THEREFORE, BE IT RESOLVED, DETERMINED AND ORDERED by the  
16 Board of Supervisors of the Riverside County Flood Control and Water Conservation District in  
17 regular session assembled on September 25, 2012 that:

18 1. A public hearing concerning the intent to approve the Proposed Project and adopt  
19 the Mitigated Negative Declaration will be held at 11:00 a.m. on November 27, 2012, at the  
20 meeting room of this Board, 1<sup>st</sup> Floor, County Administrative Center, 4080 Lemon Street,  
21 Riverside, California 92501, at which time all public comment shall be heard.

22 2. A copy of this resolution and copies of the above listed documents shall be posted  
23 at least thirty (30) days before said hearing at the City of Jurupa Valley City Hall, 8304 Limonite  
24 Avenue, Suite "M", Jurupa Valley, California 92509.

25 3. A copy of this resolution shall be posted at least thirty (30) days before said hearing  
26 at the Riverside County Clerk and Recorder's Office, 2724 Gateway Drive, Riverside, California  
27 92507.  
28

1  
2 4. The Clerk of this Board is directed to cause a copy of this resolution to be published  
3 twice, once at least thirty (30) days before said hearing, and once seven (7) days following the  
4 initial publication in a newspaper of general circulation in accordance with Section 18 of the  
5 District Act and CEQA.

6  
7  
8 ROLL CALL:

9 Ayes: Buster, Tavaglione, Stone, Benoit, and Ashley  
10 Nays: None  
11 Absent: None

12 The foregoing is certified to be a true copy of a resolution duly  
13 adopted by said Board of Supervisors on the date therein set forth.

14 KECIA HARPER-IHEM, Clerk of said Board

15 By:   
16 Deputy

**PYRITE CHANNEL BYPASS, STAGE 1**  
**PROJECT NO. 1-0-00109-01**

**ENGINEER'S STATEMENT**

The proposed project is located within the city of Jurupa Valley in Riverside County, California. The proposed project entails the construction and subsequent maintenance of an underground storm drain system and associated street improvements. The proposed storm drain project consists of approximately 1,700 lineal feet of reinforced concrete pipe (RCP) that will convey minor flows from the District's existing concrete lined trapezoidal Pyrite Channel and discharge them to the District's existing concrete lined rectangular Jurupa Channel. Street improvements along Pyrite Street between Jurupa Road and Lone Trail will ensure that the storm drain system functions properly. Utility services to be relocated may include cable, telephone, gas, water and sewer within the road rights-of-way. When completed, this storm drain system will provide flood protection for neighboring residential areas.

The proposed project area may be found within Township 2 South, Range 6 West, Sections 12 and 13 of the Fontana 7.5 Series USGS Topographic Quadrangle map. The cost of the proposed project is approximately \$940,000.

# SECTION 18 PUBLIC HEARING MAP

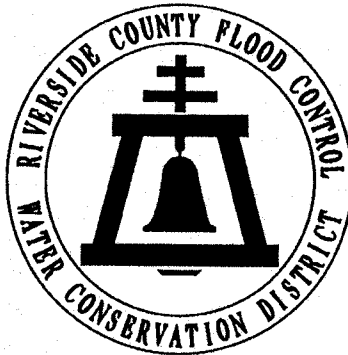

PYRITE CHANNEL BYPASS  
STAGE 1  
1-0-0109  
JUNE 2012

PROJECT  
LOCATION

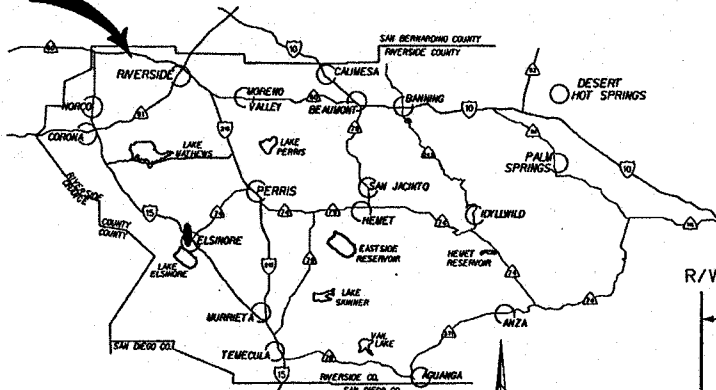

VICINITY MAP  
NTS

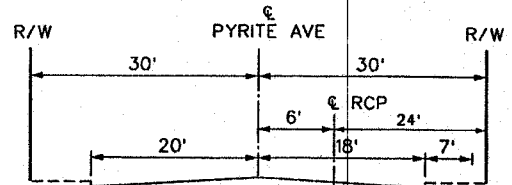

SS10  
SS8  
G2  
60" RCP  
W8

TYPICAL SECTION

LOCATION MAP

N.T.S.

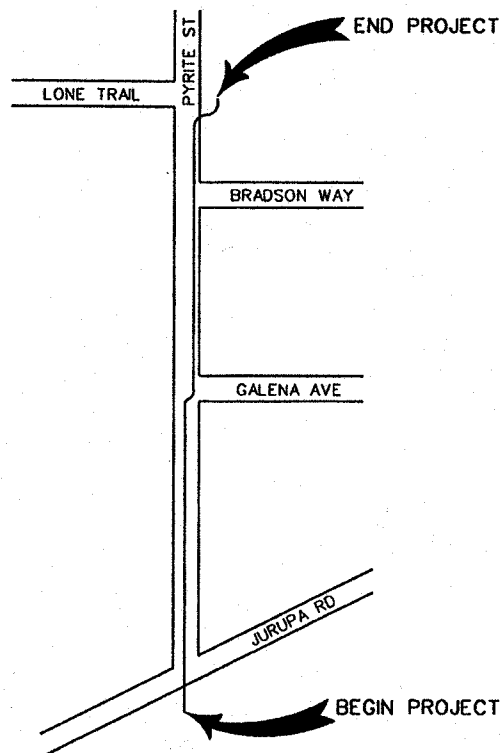



OFFICE OF  
CLERK OF THE BOARD OF SUPERVISORS  
1st FLOOR, COUNTY ADMINISTRATIVE CENTER  
P.O. BOX 1147, 4080 LEMON STREET  
RIVERSIDE, CA 92502-1147  
PHONE: (951) 955-1060  
FAX: (951) 955-1071

KECIA HARPER-IHEM  
Clerk of the Board of Supervisors

KIMBERLY A. RECTOR  
Assistant Clerk of the Board

October 22, 2012

RIVERSIDE COUNTY RECORD  
ATTN: LEGALS  
P.O. Box 3187  
RIVERSIDE, CA 92519

FAX (951) 685-2951  
E-MAIL: recordsmde@aol.com

**RE: NOTICE OF PUBLIC HEARING: RESOLUTION NO. F2012-21 PYRITE CHANNEL  
BYPASS, STAGE 1**

To Whom It May Concern:

Attached is a copy for publication in your newspaper for **TWO (2) TIMES** on **TWO THURSDAYS:**  
**October 25 and November 1, 2012.**

We require your affidavit of publication immediately upon completion of the last publication.

Your invoice must be submitted to this office in duplicate, WITH TWO CLIPPINGS OF THE  
PUBLICATION.

NOTE: PLEASE COMPOSE THIS PUBLICATION INTO A SINGLE COLUMN FORMAT.

Thank you in advance for your assistance and expertise.

Sincerely,

*McGil*

Cecilia Gil, Board Assistant to  
KECIA HARPER-IHEM, CLERK OF THE BOARD

**Gil, Cecilia**

---

**From:** Michael Evans <recordmde@aol.com>  
**Sent:** Monday, October 22, 2012 8:36 AM  
**To:** Gil, Cecilia  
**Subject:** Re: FOR PUBLICATION: Res. No. F2012-21 Pyrite Channel Bypass Stage 1

Good Morning Cecilia,/

I have received the notice for publication.

Thank you and have a nice day.

-----Original Message-----

**From:** Gil, Cecilia <[CCGIL@rcbos.org](mailto:CCGIL@rcbos.org)>  
**To:** recordmde <[recordmde@aol.com](mailto:recordmde@aol.com)>  
**Sent:** Mon, Oct 22, 2012 8:23 am  
**Subject:** FOR PUBLICATION: Res. No. F2012-21 Pyrite Channel Bypass Stage 1

Good morning! Attached is a Notice of Public hearing, for publication on 2 Thursdays, Oct. 25 and Nov. 1, 2012. Please confirm. THANK YOU!

**Cecilia Gil**

Board Assistant to the  
Clerk of the Board of Supervisors  
951-955-8464

*THE COUNTY ADMINISTRATIVE CENTER IS CLOSED EVERY FRIDAY UNTIL FURTHER NOTICE.  
PLEASE CONSIDER THE ENVIRONMENT BEFORE PRINTING.*

**NOTICE OF PUBLIC HEARING BEFORE THE BOARD OF SUPERVISORS OF THE RIVERSIDE COUNTY FLOOD CONTROL AND WATER CONSERVATION DISTRICT**

**RESOLUTION NO. F2012-21  
SETTING A PUBLIC HEARING DATE FOR  
PYRITE CHANNEL BYPASS, STAGE 1 PROJECT  
AND GIVING NOTICE OF INTENT TO ADOPT A  
MITIGATED NEGATIVE DECLARATION THEREFOR  
IN ACCORDANCE WITH SECTION 18 OF THE DISTRICT ACT  
AND THE CALIFORNIA ENVIRONMENTAL QUALITY ACT (CEQA)**

WHEREAS, this Board intends to undertake a project within the city of Jurupa Valley, designated as Pyrite Channel Bypass, Stage 1 Project ["Proposed Project"]; and

WHEREAS, the Proposed Project is generally located along Pyrite Street from Lone Trail to approximately 60 feet south of Jurupa Road; and

WHEREAS, the Proposed Project consists of the construction and subsequent operation and maintenance of approximately 1,700 lineal feet of underground storm drain system and street improvements; and

WHEREAS, reference is made to the engineering cost estimate for the Proposed Project, included in the "Engineer's Statement" on file with the Clerk of the Board; and

WHEREAS, reference is made to a map dated June 2012, bearing the name and showing the general location and typical section of the Proposed Project which is also on file with the Clerk of the Board; and

WHEREAS, the Redevelopment Agency (RDA) for the County of Riverside prepared a California Environmental Quality Act (CEQA) initial study that included the Proposed Project; and

WHEREAS, with the recent ruling by the California Supreme Court to phase out economic development programs, RDA has decided not to construct their project or adopt a Mitigated Negative Declaration based on the findings in the initial study; and

WHEREAS, in order to alleviate flooding in the area, the District has assumed the CEQA Lead Agency role for the Proposed Project; and

WHEREAS, the General Manager-Chief Engineer of the District has found that the Proposed Project will not have a significant adverse effect on the environment and has prepared a Mitigated Negative Declaration which will not become final until adopted by this Board; and

WHEREAS, any person wishing to comment on the Proposed Project or the Mitigated Negative Declaration may do so in writing between the date of this notice and the public hearing, or may appear and be heard at the time and place noted below; and

WHEREAS, in a subsequent legal challenge any person may be limited to raising only those issues he, she or someone else raised at the public hearing described in this notice, or in written comments delivered before or at the public hearing; and

WHEREAS, prior to making a decision on the Proposed Project or the Mitigated Negative Declaration, this Board will consider all written and oral comments; and

WHEREAS, the above-listed documents can be inspected at the District office, 1995 Market Street, Riverside, California 92501 and written comments will be received at the above address.

NOW, THEREFORE, BE IT RESOLVED, DETERMINED AND ORDERED by the Board of Supervisors of the Riverside County Flood Control and Water Conservation District in regular session assembled on September 25, 2012 that:

1. A public hearing concerning the intent to approve the Proposed Project and adopt the Mitigated Negative Declaration will be held at 11:00 a.m. on November 27, 2012, at the meeting room of this Board, 1<sup>st</sup> Floor, County Administrative Center, 4080 Lemon Street, Riverside, California 92501, at which time all public comment shall be heard.

2. A copy of this resolution and copies of the above listed documents shall be posted at least thirty (30) days before said hearing at the City of Jurupa Valley City Hall, 8304 Limonite Avenue, Suite "M", Jurupa Valley, California 92509.

3. A copy of this resolution shall be posted at least thirty (30) days before said hearing at the Riverside County Clerk and Recorder's Office, 2724 Gateway Drive, Riverside, California 92507.

4. The Clerk of this Board is directed to cause a copy of this resolution to be published twice, once at least thirty (30) days before said hearing, and once seven (7) days following the initial publication in a newspaper of general circulation in accordance with Section 18 of the District Act and CEQA.

**ROLL CALL:**

Ayes: Buster, Tavaglione, Stone, Benoit and Ashley

Nays: None

Absent: None

The foregoing is certified to be a true copy of a resolution duly adopted by said Board of Supervisors on September 25, 2012.

KECIA HARPER-IHEM, Clerk of said Board

By: Cecilia Gil, Board Assistant

Any person affected by the above matter(s) may submit written comments to the Clerk of the Board before the public hearing or may appear and be heard in support of or opposition to the project at the time of the hearing. If you challenge the above item(s) in court, you may be limited to raising only those issues you or someone else raised at the public hearing described in this notice, or in written correspondence, to the Board of Supervisors at, or prior to, the public hearing.

Please send all written correspondence to: Clerk of the Board, 4080 Lemon Street, 1st Floor, Post Office Box 1147, Riverside, CA 92502-1147

Dated: October 22, 2012      Kecia Harper-Ihem, Clerk of the Board  
By: Cecilia Gil, Board Assistant



**Riverside County Flood Control and  
Water Conservation District**

**Riverside, California**

**FINAL  
CEQA INITIAL STUDY  
FOR  
PYRITE CHANNEL BYPASS, STAGE 1  
  
ZONE 1**

**November 2012**

**Warren D. Williams  
General Manager-Chief Engineer**

## **TABLE OF CONTENTS**

1. Introduction
2. Mitigated Negative Declaration
3. Environmental Commitments & Mitigation Monitoring Program Table
4. California Environmental Quality Act Initial Study

### **Appendices**

Air Quality Supporting Information

Written Comments and Replies

## INTRODUCTION

In June 2011, the Redevelopment Agency for the County of Riverside (RDA) prepared a final initial study for a project entitled "Pyrite Street Improvement Project" in accordance with the California Environmental Quality Act (CEQA). The Pyrite Channel Bypass, Stage 1 Project (Project) was included in RDA's initial study and circulated in May 2007 (SCH No. 2011041091). With the recent ruling by the California Supreme Court to phase out economic development programs, RDA has decided not to construct their project or adopt a Mitigated Negative Declaration based on the findings in the initial study. In order to alleviate flooding in the area, the District has decided to assume the CEQA lead agency role for the portion of the "Pyrite Street Improvement Project" that includes the storm drain system and associated street improvements as described in the District's Mitigated Negative Declaration (MND) and Initial Study (IS).

A new MND and IS has been prepared by the District to reflect the lead agency change, smaller scope of the project, and changes in local jurisdiction (e.g., incorporation of the City of Jurupa Valley). The District also completed additional design work in regards to the connection between the proposed Project and the existing concrete lined Pyrite and Jurupa Channels. Since the RDA's IS analyzed most of the proposed Project impacts; applicable portions of the RDA's IS have been incorporated into the District's IS.

# RIVERSIDE COUNTY FLOOD CONTROL AND WATER CONSERVATION DISTRICT

## Pyrrite Channel Bypass, Stage 1

### ENVIRONMENTAL COMMITMENTS & MITIGATION MONITORING PROGRAM TABLE

Issue	Potential Impact	Environmental Commitment, Avoidance, Minimization, and/or Mitigation Measures	Action	Implementation Responsibility	Governing Agency	Implementation Timing
IV. Biological Resources	During construction, there is potential to disturb burrowing owl.	<b>Bio MM-1:</b> A pre-construction survey for burrowing owls shall be conducted no more than 30 days prior to grading or ground disturbing activity. The pre-construction survey and any relocation of burrowing owls, if present, shall be conducted in accordance with current MSHCP survey guidelines and protocols.	Conduct a 30 day pre-construction presence/absence burrowing owl survey.	RCFC&WCD (Regulatory Division)	CDFG	No more than 30 days prior to grading or ground disturbing activity.
IV. Biological Resources	During construction, there is potential to disturb nesting birds.	<b>Bio EC- 1:</b> If tree removal takes place during the nesting season (February 1 <sup>st</sup> through August 31 <sup>st</sup> , a pre-activity field survey shall be conducted to determine if active nests of species protected by the Migratory Bird Treaty Act (MBTA) or California Fish and Game Code are present in the construction zone. If active nests are located, no grading or use of heavy equipment shall take place within at least 500 feet of birds of-prey and 100 to 300 feet of songbirds (to be determined by a qualified biologist on a case-by-case basis). For Project activities taking place outside the nesting season (September 1 <sup>st</sup> through January 31 <sup>st</sup> ), no nesting surveys shall be required.	Conduct a pre-activity field survey for nesting birds if tree removal takes place during the nesting season.	RCFC&WCD (Regulatory Division)	CDFG; USFWS	Prior to tree removal.

Issue	Potential Impact	Environmental Commitment, Avoidance, Minimization, and/or Mitigation Measures	Action	Implementation Responsibility	Governing Agency	Implementation Timing
V. Cultural Resources	During construction, there is potential to impact unknown buried cultural resources.	<b>Cult EC-1:</b> If any archaeological or historical resources are discovered during project construction, all work in the area of the find shall cease, and a qualified archaeologist shall investigate the find. If any discovered archaeological or historical resources merit long-term consideration, adequate funding, as determined by the District, will be provided to collect, curate and report these resources in accordance with standard archaeological management requirements.	Excavation activities will cease if potential archaeological or historical resources are encountered. A qualified historical resources specialist will be retained to evaluate the resources.	RCFC&WCD (Design and Construction Division)	State Historic Preservation Office	During excavation activities
V. Cultural Resources	During construction, there is potential to impact unknown buried cultural resources.	<b>Cult EC-2:</b> If any paleontological resources are discovered during project construction, all work in the area of the find shall cease, and a qualified paleontological resources specialist will evaluate the find. Any discovered paleontological resources that merit long-term consideration, shall be collected and reported in accordance with standard paleontological management requirements.	Excavation activities will cease if potential paleontological resources are encountered. A qualified paleontological resources specialist will be retained to evaluate the resources.	RCFC&WCD (Design and Construction Division)	None	During excavation activities

Issue	Potential Impact	Environmental Commitment, Avoidance, Minimization, and/or Mitigation Measures	Action	Implementation Responsibility	Governing Agency	Implementation Timing
V. Cultural Resources	During construction, there is potential to encounter unknown buried human remains.	<b>Cult EC-3:</b> Per State Health and Safety Code Section 7050.5, if human remains are encountered during construction, no further disturbance shall occur until the Riverside County Coroner has made a determination of their origin pursuant to Health and Safety Code 7050.5 and Public Resources Code Section 5097.98. The Riverside County Coroner must be notified within 24 hours of the discovery. If the County Coroner determines that the remains are of Native American descent, the Native American Heritage Commission (NAHC) must be contacted within 24 hours to determine the most likely descendent for this area. Once the most likely descendent is determined, treatment of the Native American human remains will proceed pursuant to Public Resources 5097.98.	Halt construction and notify the County Coroner's Office for proper identification of any human remains found onsite. Contact NAHC to assist, if human remains are of Native American descent.	RCFC&WCD (Design and Construction Division)	Riverside County Coroner and NAHC	During excavation activities
XI. Noise	The use of heavy equipment during project construction may temporarily increase noise levels within nearby residential areas.	<b>Noise MM-1:</b> Operation of Heavy equipment that may impact adjacent residential structures shall be limited from 7 a.m. to 5 p.m. Monday through Friday, except under special circumstances approved by the District's General Manager-Chief Engineer.	Limit use of heavy equipment to between 7 a.m. and 5 p.m.	RCFC&WCD (Design and Construction Division)	None	During construction
XI. Noise	The use of heavy equipment during project construction may temporarily increase noise levels within nearby residential areas.	<b>Noise MM-2</b> Each resident adjacent to the storm drain construction site shall be notified in writing three days prior to operation of heavy construction equipment near the residences. The notice shall include the expected work schedule and the District's contact information. The District shall alert the construction contractor of any noise complaints and incorporate any feasible and practical techniques which minimize the noise impacts on adjacent residences.	Ensure that the described notices are provided to each resident adjacent to the storm drain construction site and inform the construction contractor of any complaints and feasible corrective measures.	RCFC&WCD (Design and Construction Division)	None	During construction

**RIVERSIDE COUNTY FLOOD CONTROL  
AND WATER CONSERVATION DISTRICT**

**California Environmental Quality Act (CEQA)  
Initial Study**

- 1. Project title:**  
Pyrite Channel Bypass, Stage 1
- 2. Lead agency name and address:**  
Riverside County Flood Control and Water Conservation District  
Attention: Environmental/Regulatory Services  
1995 Market Street  
Riverside, CA 92501
- 3. Contact person email address and phone number:**  
Art Diaz  
aadiaz@rcflood.org  
951.955.1233
- 4. Project location:**  
The proposed project is generally located along Pyrite Street from Lone Trail to approximately 60 feet south of Jurupa Road in the city of Jurupa Valley in Riverside County, California. The proposed project area may be found within Township 2 South, Range 6 West, Sections 12 and 13 of the Fontana 7.5 Series USGS Topographic Quadrangle map.
- 5. Project sponsor's name and address:**  
None
- 6. General plan designation:**  
The proposed project site is located within the City of Jurupa Valley which currently uses the Riverside County General Plan. The proposed project is located within the Jurupa Area Plan of the Riverside County General Plan. Land uses adjacent to the proposed project include:
  - LDR: Low Density Residential.
  - HDR: High Density Residential.
  - LDR-RC: Rural Community – Low Density Residential.
- 7. Description of project:** *(Describe the whole action involved, including but not limited to later phases of the project, and any secondary, support, or offsite features necessary for its implementation. Attach additional sheets if necessary.)*  
The proposed project entails the construction and subsequent maintenance of an underground storm drain system and associated street improvements. The proposed storm drain project consists of approximately 1700 lineal feet of reinforced concrete pipe (RCP) that will convey minor flows from the District's existing concrete lined trapezoidal Pyrite Channel and discharge them to the District's existing concrete lined rectangular Jurupa Channel. Street improvements along Pyrite Street between Jurupa Road and Lone Trail will ensure that the storm drain system functions properly. Utility services to be relocated may include cable, telephone, gas, water and sewer within the road rights-of-way. Refer to the attached exhibits for additional information.

**8. Surrounding land uses and setting:** *(Briefly describe the project's surroundings)*

The majority of the storm drain alignment and street improvements are located within existing paved roads. However, a portion of the storm drain alignment between Jurupa Road and Jurupa Channel crosses a highly disturbed roadside and railroad. The street improvements will also be located in highly disturbed dirt road shoulders. The outlet and inlet areas are located within the District's existing concrete lined Jurupa and Pyrite Channels.

**9. Other public agencies whose approval may be required:** *(e.g., permits, financing approval, or participation agreement)*

**Federal Agencies** *(not "public agencies" as defined by CEQA)*

U.S. Army Corps of Engineers

**State Agencies**

California Department of Fish and Game

Regional Water Quality Control Board – Santa Ana Region

**City/County Agencies**

City of Jurupa Valley

**10. Earlier Analysis Used:**

Final Initial Study/Mitigated Negative Declaration for the Pyrite Street Improvement Project prepared for the Redevelopment Agency for the County of Riverside, July 2011 (SCH No. 2011041091).



# SECTION 18 PUBLIC HEARING MAP

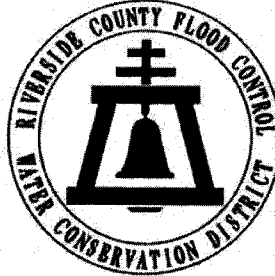

PYRITE CHANNEL BYPASS  
STAGE 1  
1-0-0109  
JUNE 2012

PROJECT  
LOCATION

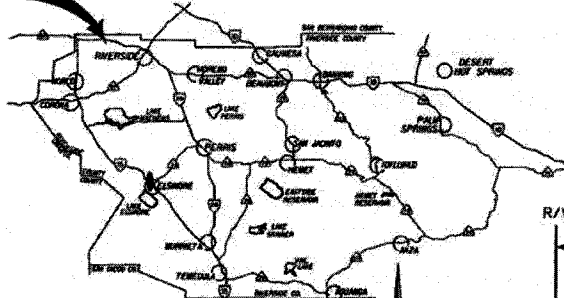

VICINITY MAP  
N.T.S.

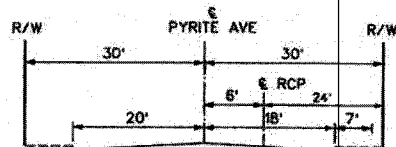

TYPICAL SECTION

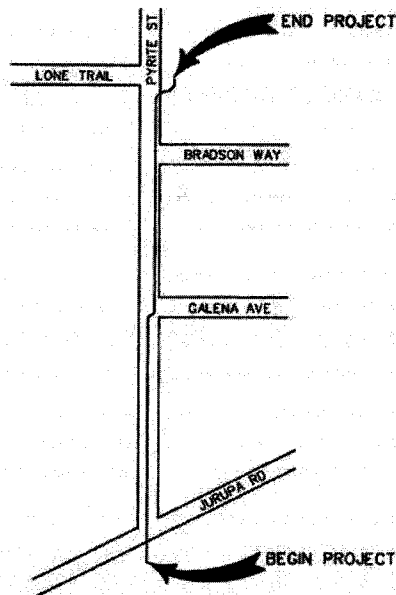

LOCATION MAP  
N.T.S.



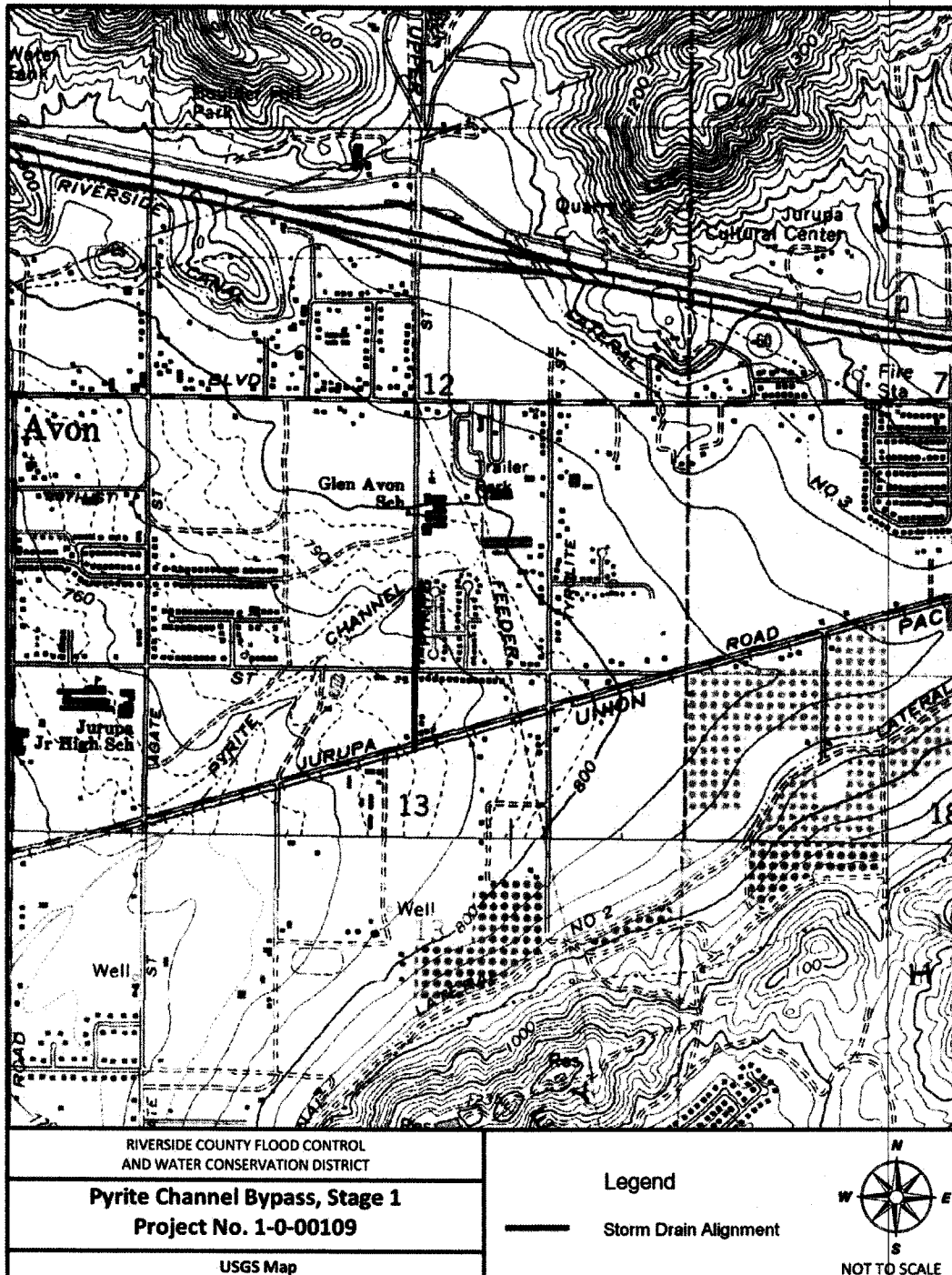



View of Proposed Pyrite Channel Inlet Connection Area

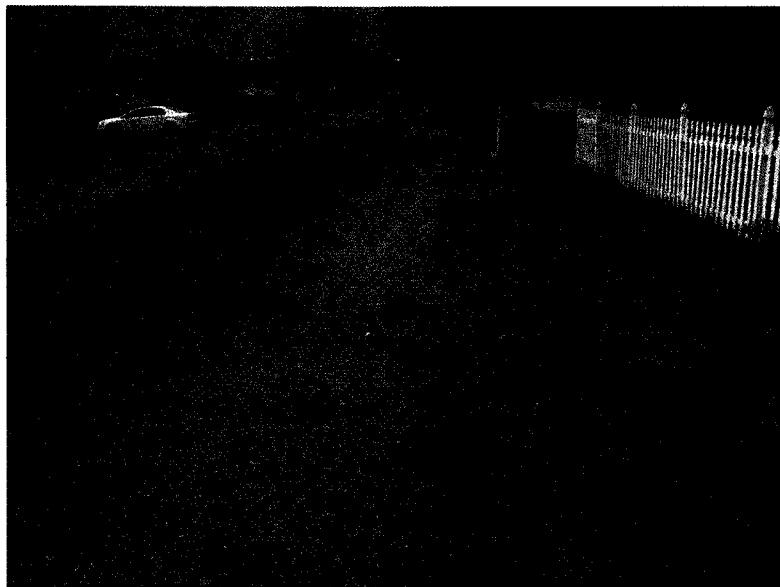

View of Pyrite Street South of Galena Street



View of Proposed Jurupa Channel Outlet Connection Area

### ENVIRONMENTAL FACTORS POTENTIALLY AFFECTED:

The environmental factors, as checked below, would potentially be affected by this project.

<input type="checkbox"/> Aesthetics	<input type="checkbox"/> Mineral Resources
<input type="checkbox"/> Agriculture Resources	<input checked="" type="checkbox"/> Noise
<input type="checkbox"/> Air Quality and Greenhouse Gas Emissions	<input type="checkbox"/> Population/Housing
<input checked="" type="checkbox"/> Biological Resources	<input type="checkbox"/> Public Services
<input type="checkbox"/> Cultural Resources	<input type="checkbox"/> Recreation
<input type="checkbox"/> Geology/Soils	<input type="checkbox"/> Transportation/Traffic
<input type="checkbox"/> Hazards & Hazardous Materials	<input type="checkbox"/> Utilities/Service Systems
<input type="checkbox"/> Hydrology/Water Quality	<input type="checkbox"/> Mandatory Findings of Significance
<input type="checkbox"/> Land Use/Planning	

### Evaluation of Environmental Impacts:

1. A brief explanation is required for all answers except "No Impact" answers that are adequately supported by the information sources a lead agency cites in the parentheses following each question. A "No Impact" answer is adequately supported if the referenced information sources show that the impact simply does not apply to projects like the one involved (*e.g., the project falls outside a fault rupture zone*). A "No Impact" answer should be explained where it is based on project-specific factors as well as general standards (*e.g., the project will not expose sensitive receptors to pollutants, based on a project-specific screening analysis*).
2. All answers must take account of the whole action involved, including off-site as well as onsite, cumulative as well as project-level, indirect as well as direct, and construction as well as operational impacts.
3. Once the lead agency has determined that a particular physical impact may occur, then the checklist answers must indicate whether the impact is potentially significant, less than significant with mitigation, or less than significant. "Potentially Significant Impact" is appropriate if there is substantial evidence that an effect may be significant. If there are one or more "Potentially Significant Impact" entries when the determination is made, an EIR is required.
4. "Negative Declaration: No Impact or Less Than Significant" applies when the proposed project will not have a significant effect on the environment, does not require the incorporation of mitigation measures, and does not require the preparation of an Environmental Impact Report. The lead agency must briefly describe the reasons that a proposed project will not have significant effect on the environment and does not require the preparation of an environmental impact report.
5. "Mitigated Negative Declaration: Less Than Significant With Mitigation Incorporated" applies where the incorporation of mitigation measures has reduced any effect from "Potentially Significant Impact" to a "Less Than Significant Impact". The lead agency must describe the mitigation measures, and briefly explain how they reduce the effect to a less than significant level (mitigation measures from "Earlier Analyses", as described in (5) below, may be cross-referenced).
6. Earlier analyses may be used where, pursuant to the tiering, program EIR, or other CEQA process, an effect has been adequately analyzed in an earlier EIR or negative declaration. (CEQA

Guidelines Section 15063(c)(3)(D)). The use of an earlier analysis as a reference should include a brief discussion that identifies the following:

- a. Earlier Analysis Used. Identify and state where they are available for review.
  - b. Impacts Adequately Addressed. Identify which effects from the above checklist were within the scope of and adequately analyzed in an earlier document pursuant to applicable legal standards, and state whether such effects were addressed by mitigation measures based on the earlier analysis.
  - c. Mitigation Measures. For effects that are "Less than Significant with Mitigation Measures Incorporated", describe the mitigation measures which were incorporated or refined from the earlier document and the extent to which they address site-specific conditions for the project.
7. Lead agencies are encouraged to incorporate into the checklist references to information sources for potential impacts (*e.g., general plans, zoning ordinances*). Reference to a previously prepared or outside document should, where appropriate, include a reference to the page or pages where the statement is substantiated.
  8. Supporting Information Sources: A source list should be attached, and other sources used or individuals contacted should be cited in the discussion.
  9. The explanation of each issue should identify:
    - a. The significance criteria or threshold, if any, used to evaluate each question; and
    - b. The mitigation measure identified, if any, to reduce the impact to less than significance.

Potential Significant Impact	Potentially Significant Unless Mitigation Incorporated	Less than Significant Impact	No Impact
------------------------------------	--	------------------------------------	--------------

**I. AESTHETICS.** Would the project:

- |    |  |                          |                          |                                     |                                     |
|----|--|--------------------------|--------------------------|-------------------------------------|-------------------------------------|
| a) | Have a substantial adverse effect on a scenic vista?   | <input type="checkbox"/> | <input type="checkbox"/> | <input type="checkbox"/>            | <input checked="" type="checkbox"/> |
| b) | Substantially damage scenic resources, including, but not limited to trees, rock outcroppings, and historic buildings within a state scenic highway? | <input type="checkbox"/> | <input type="checkbox"/> | <input type="checkbox"/>            | <input checked="" type="checkbox"/> |
| c) | Substantially degrade the existing visual character or quality of the site and its surroundings?   | <input type="checkbox"/> | <input type="checkbox"/> | <input checked="" type="checkbox"/> | <input type="checkbox"/>            |
| d) | Create a new source of substantial light or glare, which would adversely affect day or nighttime views in the area?                                  | <input type="checkbox"/> | <input type="checkbox"/> | <input type="checkbox"/>            | <input checked="" type="checkbox"/> |

**II. AGRICULTURAL & FOREST RESOURCES.** In determining whether impacts to agricultural resources are significant environmental effects, lead agencies may refer to the California Agricultural Land Evaluation and Site Assessment Model (1997) prepared by the California Department of Conservation as an optional model to use in assessing impacts on agriculture and farmland. Would the project:

- |    |   |                          |                          |                          |                                     |
|----|---|--------------------------|--------------------------|--------------------------|-------------------------------------|
| a) | Convert Prime Farmland, Unique Farmland, or Farmland of Statewide Importance (Farmland), as shown on the maps prepared pursuant to the Farmland Mapping and Monitoring Program of the California Resources Agency, to non-agricultural use?   | <input type="checkbox"/> | <input type="checkbox"/> | <input type="checkbox"/> | <input checked="" type="checkbox"/> |
| b) | Conflict with existing agricultural zoning, agricultural use or land subject to a Williamson Act contract or land within a Riverside County Agricultural Preserve?  | <input type="checkbox"/> | <input type="checkbox"/> | <input type="checkbox"/> | <input checked="" type="checkbox"/> |
| c) | Involve other changes in the existing environment which, due to their location or nature, could result in conversion of Farmland, to non-agricultural use?  | <input type="checkbox"/> | <input type="checkbox"/> | <input type="checkbox"/> | <input checked="" type="checkbox"/> |
| d) | Conflict with existing zoning for, or cause rezoning of, forest land (as defined in Public Resources Code section 12220(g)), timberland (as defined by Public Resources Code section 4526), or timberland zoned Timberland Production (as defined by Government Code section 51104(g))? | <input type="checkbox"/> | <input type="checkbox"/> | <input type="checkbox"/> | <input checked="" type="checkbox"/> |
| e) | Result in the loss of forest land or conversion of forest land to non-forest use?   | <input type="checkbox"/> | <input type="checkbox"/> | <input type="checkbox"/> | <input checked="" type="checkbox"/> |

**III. AIR QUALITY AND GREENHOUSE GAS EMISSIONS.** Where available, the significance criteria established by the applicable air quality management or air pollution control district may be relied upon to make the following determinations. Would the project:

- |    |   |                          |                          |                                     |                                     |
|----|---|--------------------------|--------------------------|-------------------------------------|-------------------------------------|
| a) | Conflict with or obstruct implementation of the applicable air quality plan?                                    | <input type="checkbox"/> | <input type="checkbox"/> | <input type="checkbox"/>            | <input checked="" type="checkbox"/> |
| b) | Violate any air quality standard or contribute substantially to an existing or projected air quality violation? | <input type="checkbox"/> | <input type="checkbox"/> | <input checked="" type="checkbox"/> | <input type="checkbox"/>            |



	Potential Significant Impact	Potentially Significant Unless Mitigation Incorporated	Less than Significant Impact	No Impact
c) Result in cumulatively considerable net increase of any criteria pollutant for which the project region is non-attainment under an applicable federal or state ambient air quality standard <i>(including releasing emissions which exceed quantitative thresholds for ozone precursors)?</i>	<input type="checkbox"/>	<input type="checkbox"/>	<input checked="" type="checkbox"/>	<input type="checkbox"/>
d) Expose sensitive receptors to substantial pollutant concentrations?	<input type="checkbox"/>	<input type="checkbox"/>	<input checked="" type="checkbox"/>	<input type="checkbox"/>
e) Create objectionable odors affecting a substantial number of people?	<input type="checkbox"/>	<input type="checkbox"/>	<input checked="" type="checkbox"/>	<input type="checkbox"/>
f) Generate greenhouse gas emissions, either directly or indirectly, that may have a significant impact on the environment?	<input type="checkbox"/>	<input type="checkbox"/>	<input checked="" type="checkbox"/>	<input type="checkbox"/>
g) Conflict with an applicable plan, policy or regulation adopted for the purpose of reducing the emissions of greenhouse gases?	<input type="checkbox"/>	<input type="checkbox"/>	<input type="checkbox"/>	<input checked="" type="checkbox"/>

**IV. BIOLOGICAL RESOURCES.** Would the project:

a) Have a substantial adverse effect, either directly or through habitat modifications, on any species identified as a candidate, sensitive, or special status species in local or regional plans, policies, or regulations, or by the California Department of Fish and Game or U.S. Fish and Wildlife Service?	<input type="checkbox"/>	<input checked="" type="checkbox"/>	<input type="checkbox"/>	<input type="checkbox"/>
b) Have a substantial adverse effect on any riparian habitat or other sensitive natural community identified in local or regional plans, policies, and regulations, or by the California Department of Fish and Game or U.S. Fish and Wildlife Service?	<input type="checkbox"/>	<input type="checkbox"/>	<input checked="" type="checkbox"/>	<input type="checkbox"/>
c) Have a substantial adverse effect on biological resources involved within a jurisdictional water feature as defined by federal, state or local regulations (e.g., Section 404 of the Clean Water Act, Section 401 of the Clean Water Act, Section 1602 of California Fish and Game Code, Porter-Cologne Water Quality Control Act, etc.) through direct removal, filing, hydrological interruption, or other means?	<input type="checkbox"/>	<input type="checkbox"/>	<input checked="" type="checkbox"/>	<input type="checkbox"/>
d) Interfere substantially with the movement of any native resident or migratory fish or wildlife species or with established native resident or migratory wildlife corridors, or impede the use of native wildlife nursery sites?	<input type="checkbox"/>	<input type="checkbox"/>	<input type="checkbox"/>	<input checked="" type="checkbox"/>
e) Conflict with any local policies or ordinances protecting biological resources, such as a tree preservation policy or ordinance?	<input type="checkbox"/>	<input type="checkbox"/>	<input type="checkbox"/>	<input checked="" type="checkbox"/>
f) Conflict with the provisions of an adopted Habitat Conservation Plan, Natural Community Conservation Plan, or other approved local, regional, or state habitat conservation plan?	<input type="checkbox"/>	<input type="checkbox"/>	<input checked="" type="checkbox"/>	<input type="checkbox"/>

Potential Significant Impact	Potentially Significant Unless Mitigation Incorporated	Less than Significant Impact	No Impact
------------------------------------	--	------------------------------------	--------------

**V. CULTURAL RESOURCES.** Would the project:

- |    |  |                          |                          |                                     |                                     |
|----|--|--------------------------|--------------------------|-------------------------------------|-------------------------------------|
| a) | Cause a substantial adverse change in the significance of a historical resource as defined in §15064.5?    | <input type="checkbox"/> | <input type="checkbox"/> | <input type="checkbox"/>            | <input checked="" type="checkbox"/> |
| b) | Cause a substantial adverse change in the significance of an archaeological resource pursuant to §15064.5? | <input type="checkbox"/> | <input type="checkbox"/> | <input checked="" type="checkbox"/> | <input type="checkbox"/>            |
| c) | Directly or indirectly destroy a unique paleontological resource or site or unique geologic feature?       | <input type="checkbox"/> | <input type="checkbox"/> | <input checked="" type="checkbox"/> | <input type="checkbox"/>            |
| d) | Disturb any human remains, including those interred outside of formal cemeteries?                          | <input type="checkbox"/> | <input type="checkbox"/> | <input checked="" type="checkbox"/> | <input type="checkbox"/>            |

**VI. GEOLOGY AND SOILS.** Would the project:

- |      |   |                          |                          |                                     |                                     |
|------|---|--------------------------|--------------------------|-------------------------------------|-------------------------------------|
| a)   | Expose people or structures to potential substantial adverse effects, including the risk of loss, injury or death involving:  |                          |                          |                                     |                                     |
| i)   | Rupture of a known earthquake fault, as delineated on the most recent Alquist-Priolo Earthquake Fault Zoning Map issued by the State Geologist for the area or based on other substantial evidence of a Known fault? Refer to Division of Mines and Geology Special Publication 42. | <input type="checkbox"/> | <input type="checkbox"/> | <input type="checkbox"/>            | <input checked="" type="checkbox"/> |
| ii)  | Strong seismic ground shaking?  | <input type="checkbox"/> | <input type="checkbox"/> | <input checked="" type="checkbox"/> | <input type="checkbox"/>            |
| iii) | Seismic-related ground failure, including liquefaction?   | <input type="checkbox"/> | <input type="checkbox"/> | <input checked="" type="checkbox"/> | <input type="checkbox"/>            |
| iv)  | Landslides or mudflows?   | <input type="checkbox"/> | <input type="checkbox"/> | <input type="checkbox"/>            | <input checked="" type="checkbox"/> |
| b)   | Result in substantial changes in topography, unstable soil conditions from excavation, grading or fill, or soil erosion or the loss of topsoil?   | <input type="checkbox"/> | <input type="checkbox"/> | <input checked="" type="checkbox"/> | <input type="checkbox"/>            |
| c)   | Be located on a geologic unit or soil that is unstable, or that would become unstable as a result of the project, and potentially result in on- or off-site landslide, lateral spreading, subsidence, liquefaction or collapse?   | <input type="checkbox"/> | <input type="checkbox"/> | <input checked="" type="checkbox"/> | <input type="checkbox"/>            |
| d)   | Be located on expansive soil, as defined in Table 18-1-B of the Uniform Building Code (1994 or most current edition), creating substantial risks to life or property?   | <input type="checkbox"/> | <input type="checkbox"/> | <input checked="" type="checkbox"/> | <input type="checkbox"/>            |
| e)   | Have soils incapable of adequately supporting any structures, fill or other improvements associated with the project?   | <input type="checkbox"/> | <input type="checkbox"/> | <input checked="" type="checkbox"/> | <input type="checkbox"/>            |

**VII. HAZARDS AND HAZARDOUS MATERIALS.** Would the project:

- |    |  |                          |                          |                                     |                          |
|----|--|--------------------------|--------------------------|-------------------------------------|--------------------------|
| a) | Create a significant hazard to the public or the environment through the routine transport, use, or disposal of hazardous materials? | <input type="checkbox"/> | <input type="checkbox"/> | <input checked="" type="checkbox"/> | <input type="checkbox"/> |
|----|--|--------------------------|--------------------------|-------------------------------------|--------------------------|

		Potential Significant Impact	Potentially Significant Unless Mitigation Incorporated	Less than Significant Impact	No Impact
b)	Create a significant hazard to the public or the environment through reasonably foreseeable upset and accident conditions involving the release of hazardous materials into the environment?	<input type="checkbox"/>	<input type="checkbox"/>	<input checked="" type="checkbox"/>	<input type="checkbox"/>
c)	Emit hazardous emissions or handle hazardous or acutely hazardous materials, substances, or waste within one-quarter mile of an existing or proposed school?	<input type="checkbox"/>	<input type="checkbox"/>	<input checked="" type="checkbox"/>	<input type="checkbox"/>
d)	Be located on a site, which is included on a list of hazardous materials sites compiled pursuant to Government Code Section 65962.5 and, as a result, would it create a significant hazard to the public or the environment?	<input type="checkbox"/>	<input type="checkbox"/>	<input checked="" type="checkbox"/>	<input type="checkbox"/>
e)	For a project located within an airport land use plan, or, where such a plan has not been adopted, within two miles of a public airport or public use airport, would the project result in a safety hazard for people residing or working in the project area?	<input type="checkbox"/>	<input type="checkbox"/>	<input type="checkbox"/>	<input checked="" type="checkbox"/>
f)	For a project within the vicinity of a private airstrip, would the project result in a safety hazard for people residing or working in the project area?	<input type="checkbox"/>	<input type="checkbox"/>	<input type="checkbox"/>	<input checked="" type="checkbox"/>
g)	Impair implementation of or physically interfere with an adopted emergency response plan or emergency evacuation plan?	<input type="checkbox"/>	<input type="checkbox"/>	<input checked="" type="checkbox"/>	<input type="checkbox"/>
h)	Expose people or structures to a significant risk of loss, injury or death involving wildland fires, including where Wildlands are adjacent to urbanized areas or where residences are intermixed with wildlands?	<input type="checkbox"/>	<input type="checkbox"/>	<input type="checkbox"/>	<input checked="" type="checkbox"/>

**VIII. HYDROLOGY AND WATER QUALITY.** Would the project:

a)	Violate or conflict with any adopted water quality standards or waste discharge requirements?	<input type="checkbox"/>	<input type="checkbox"/>	<input checked="" type="checkbox"/>	<input type="checkbox"/>
b)	Result in substantial discharges of typical stormwater pollutants ( <i>e.g. sediment from construction activities, hydrocarbons, and metals from motor vehicles, nutrients and pesticides from landscape maintenance activities, metals of other pollutants from industrial operation,</i> ) or substantial changes to surface water quality including, but not limited to, temperature, dissolved oxygen, pH, or turbidity?	<input type="checkbox"/>	<input type="checkbox"/>	<input checked="" type="checkbox"/>	<input type="checkbox"/>
c)	Substantially deplete groundwater supplies or interfere substantially with groundwater recharge such that there would be a net deficit in aquifer volume or a lowering of the local groundwater table level ( <i>e.g., the production rate of pre-existing nearby wells would drop to a level which would not support existing land uses or planned uses for which permits have been granted</i> )?	<input type="checkbox"/>	<input type="checkbox"/>	<input checked="" type="checkbox"/>	<input type="checkbox"/>

	Potential Significant Impact	Potentially Significant Unless Mitigation Incorporated	Less than Significant Impact	No Impact
d) Substantially alter the existing drainage pattern of the site or area, including through the alteration of a watercourse or wetland, in a manner which would result in substantial erosion or siltation on- or off-site?	<input type="checkbox"/>	<input type="checkbox"/>	<input checked="" type="checkbox"/>	<input type="checkbox"/>
e) Substantially alter the existing drainage pattern of the site or area, including through the alteration of the course of a stream or river, or substantially increase the rate or amount of surface runoff in a manner which would result in flooding on- or off-site?	<input type="checkbox"/>	<input type="checkbox"/>	<input checked="" type="checkbox"/>	<input type="checkbox"/>
f) Create or contribute runoff water, which would exceed the capacity of existing or planned stormwater drainage systems?	<input type="checkbox"/>	<input type="checkbox"/>	<input type="checkbox"/>	<input checked="" type="checkbox"/>
g) Place housing within a 100-year flood hazard area as mapped on Federal Flood Hazard boundary of Flood Insurance Rate Map or other flood hazard delineation map?	<input type="checkbox"/>	<input type="checkbox"/>	<input type="checkbox"/>	<input checked="" type="checkbox"/>
h) Place structures or fill within a 100-year flood hazard area, which would impede or redirect flood flows?	<input type="checkbox"/>	<input type="checkbox"/>	<input type="checkbox"/>	<input checked="" type="checkbox"/>
i) Expose people or structures to a significant risk of loss, injury or death involving flooding, including flooding as a result of the failure of a levee or dam?	<input type="checkbox"/>	<input type="checkbox"/>	<input type="checkbox"/>	<input checked="" type="checkbox"/>
j) Expose people or structures to a significant risk of loss, injury or death involving inundation by seiche, tsunami, or mudflow?	<input type="checkbox"/>	<input type="checkbox"/>	<input type="checkbox"/>	<input checked="" type="checkbox"/>

**IX. LAND USE PLANNING.** Would the project:

a) Physically divide an established community?	<input type="checkbox"/>	<input type="checkbox"/>	<input type="checkbox"/>	<input checked="" type="checkbox"/>
b) Conflict with any applicable land use plan, policy, or regulation of an agency with jurisdiction over the project (including, but not limited to the general plan, specific plan, local coastal program, or zoning ordinance) adopted for the purpose of avoiding or mitigating an environmental effect?	<input type="checkbox"/>	<input type="checkbox"/>	<input type="checkbox"/>	<input checked="" type="checkbox"/>

**X. MINERAL RESOURCES.** Would the project:

a) Result in the loss of availability of a known mineral resource that would be of value to the region and the residents of the state?	<input type="checkbox"/>	<input type="checkbox"/>	<input checked="" type="checkbox"/>	<input type="checkbox"/>
b) Result in the loss of availability of a locally-important mineral resource recovery site delineated on a local general plan, specific plan or other land use plan?	<input type="checkbox"/>	<input type="checkbox"/>	<input type="checkbox"/>	<input checked="" type="checkbox"/>

Potential Significant Impact	Potentially Significant Unless Mitigation Incorporated	Less than Significant Impact	No Impact
------------------------------------	--	------------------------------------	--------------

**XI. NOISE.** Would the project result in:

- |    |  |                          |                                     |                                     |                                     |
|----|--|--------------------------|-------------------------------------|-------------------------------------|-------------------------------------|
| a) | Exposure of persons to or generation of noise levels in excess of standards established in the local general plan or noise ordinance, or applicable standards of other agencies?   | <input type="checkbox"/> | <input type="checkbox"/>            | <input type="checkbox"/>            | <input checked="" type="checkbox"/> |
| b) | Exposure of persons to or generation of excessive ground-borne vibration or ground-borne noise levels?   | <input type="checkbox"/> | <input type="checkbox"/>            | <input checked="" type="checkbox"/> | <input type="checkbox"/>            |
| c) | A substantial permanent increase in ambient noise levels in the project vicinity above levels existing without the project?  | <input type="checkbox"/> | <input type="checkbox"/>            | <input type="checkbox"/>            | <input checked="" type="checkbox"/> |
| d) | A substantial temporary or periodic increase in ambient noise levels in the project vicinity above levels existing without the project?  | <input type="checkbox"/> | <input checked="" type="checkbox"/> | <input type="checkbox"/>            | <input type="checkbox"/>            |
| e) | For a project located within an airport land use plan or, where such a plan has not been adopted, within two miles of a public airport or public use airport, would the project expose people residing or working in the project area to excessive noise levels? | <input type="checkbox"/> | <input type="checkbox"/>            | <input type="checkbox"/>            | <input checked="" type="checkbox"/> |
| f) | For a project within the vicinity of a private airstrip, would the project expose people residing or working in the project area to excessive noise levels?  | <input type="checkbox"/> | <input type="checkbox"/>            | <input type="checkbox"/>            | <input checked="" type="checkbox"/> |

**XII. POPULATION AND HOUSING.** Would the project:

- |    |   |                          |                          |                          |                                     |
|----|---|--------------------------|--------------------------|--------------------------|-------------------------------------|
| a) | Induce substantial population growth in an area, either directly ( <i>for example, by proposing new homes and businesses</i> ) or indirectly ( <i>for example, through extension of roads or other infrastructure</i> ) resulting in substantial adverse physical impacts or conflicts with the adopted general plan, specific plan, or other applicable land use or regional plan? | <input type="checkbox"/> | <input type="checkbox"/> | <input type="checkbox"/> | <input checked="" type="checkbox"/> |
| b) | Displace substantial numbers of existing housing, necessitating the construction of replacement housing elsewhere?  | <input type="checkbox"/> | <input type="checkbox"/> | <input type="checkbox"/> | <input checked="" type="checkbox"/> |
| c) | Displace substantial numbers of people, necessitating the construction of replacement housing elsewhere?  | <input type="checkbox"/> | <input type="checkbox"/> | <input type="checkbox"/> | <input checked="" type="checkbox"/> |

**XIII. PUBLIC SERVICES.**

- |    |  |                          |                          |                          |                                     |
|----|--|--------------------------|--------------------------|--------------------------|-------------------------------------|
| a) | Would the project result in substantial adverse physical impacts associated with the provision of new or physically altered governmental facilities, need for new or physically altered governmental facilities, the construction of which could cause significant environmental impacts, in order to maintain acceptable service ratios, response times or other performance objectives for any of the following public services: |                          |                          |                          |                                     |
|    | Fire protection?   | <input type="checkbox"/> | <input type="checkbox"/> | <input type="checkbox"/> | <input checked="" type="checkbox"/> |
|    | Police protection?   | <input type="checkbox"/> | <input type="checkbox"/> | <input type="checkbox"/> | <input checked="" type="checkbox"/> |

	Potential Significant Impact	Potentially Significant Unless Mitigation Incorporated	Less than Significant Impact	No Impact
Schools?	<input type="checkbox"/>	<input type="checkbox"/>	<input type="checkbox"/>	<input checked="" type="checkbox"/>
Parks?	<input type="checkbox"/>	<input type="checkbox"/>	<input type="checkbox"/>	<input checked="" type="checkbox"/>
Other public facilities?	<input type="checkbox"/>	<input type="checkbox"/>	<input type="checkbox"/>	<input checked="" type="checkbox"/>

#### XIV. RECREATION

- |    |   |                          |                          |                          |                                     |
|----|---|--------------------------|--------------------------|--------------------------|-------------------------------------|
| a) | Would the project increase the use of existing neighborhood and regional parks or other recreational facilities such that substantial physical deterioration of the facility would occur or be accelerated? | <input type="checkbox"/> | <input type="checkbox"/> | <input type="checkbox"/> | <input checked="" type="checkbox"/> |
| b) | Does the project include recreational facilities or require the construction or expansion of recreational facilities which might have an adverse physical effect on the environment?                        | <input type="checkbox"/> | <input type="checkbox"/> | <input type="checkbox"/> | <input checked="" type="checkbox"/> |

#### XV. TRANSPORTATION AND TRAFFIC. Would the project:

- |    |   |                          |                          |                                     |                                     |
|----|---|--------------------------|--------------------------|-------------------------------------|-------------------------------------|
| a) | Conflict with an adopted plan, ordinance or policy establishing measures of effectiveness for the performance of the circulation system, taking into account all modes of transportation including mass transit and non-motorized travel and relevant components of the circulation system, including but not limited to intersections, streets, highways and freeways, pedestrian and bicycle paths, and mass transit? | <input type="checkbox"/> | <input type="checkbox"/> | <input checked="" type="checkbox"/> | <input type="checkbox"/>            |
| b) | Conflict with an adopted congestion management program, including, but not limited to level of service standards and travel demand measures, or other standards established by the appropriate congestion management agency for designated roads or highways?   | <input type="checkbox"/> | <input type="checkbox"/> | <input checked="" type="checkbox"/> | <input type="checkbox"/>            |
| c) | Substantially increase hazards due to a design feature ( <i>e.g., sharp curves or dangerous intersections</i> ) or incompatible uses ( <i>e.g., farm equipment</i> )?   | <input type="checkbox"/> | <input type="checkbox"/> | <input type="checkbox"/>            | <input checked="" type="checkbox"/> |
| d) | Would the project result in inadequate emergency access?  | <input type="checkbox"/> | <input type="checkbox"/> | <input checked="" type="checkbox"/> | <input type="checkbox"/>            |
| e) | Would the project result in inadequate parking capacity?  | <input type="checkbox"/> | <input type="checkbox"/> | <input type="checkbox"/>            | <input checked="" type="checkbox"/> |
| f) | Conflict with adopted policies, plans, or programs regarding public transit, bicycle, pedestrian facilities, or other alternate transportation or otherwise decrease the performance or safety of such facilities?  | <input type="checkbox"/> | <input type="checkbox"/> | <input checked="" type="checkbox"/> | <input type="checkbox"/>            |

#### XVI. UTILITIES AND SERVICE SYSTEMS. Would the project:

- |    |  |                          |                          |                          |                                     |
|----|--|--------------------------|--------------------------|--------------------------|-------------------------------------|
| a) | Impact the following facilities requiring or resulting in the construction of new facilities or expansion of existing facilities, the construction of which could cause significant environmental effects? |                          |                          |                          |                                     |
|    | Electricity  | <input type="checkbox"/> | <input type="checkbox"/> | <input type="checkbox"/> | <input checked="" type="checkbox"/> |
|    | Natural Gas  | <input type="checkbox"/> | <input type="checkbox"/> | <input type="checkbox"/> | <input checked="" type="checkbox"/> |

	Potential Significant Impact	Potentially Significant Unless Mitigation Incorporated	Less than Significant Impact	No Impact
Communication System	<input type="checkbox"/>	<input type="checkbox"/>	<input type="checkbox"/>	<input checked="" type="checkbox"/>
Street lighting	<input type="checkbox"/>	<input type="checkbox"/>	<input type="checkbox"/>	<input checked="" type="checkbox"/>
Public facilities, including roads and bridges	<input type="checkbox"/>	<input type="checkbox"/>	<input type="checkbox"/>	<input checked="" type="checkbox"/>
b) Require or result in the construction of new stormwater drainage facilities or expansion of existing facilities, the construction of which could cause significant environmental effects?	<input type="checkbox"/>	<input type="checkbox"/>	<input type="checkbox"/>	<input checked="" type="checkbox"/>
c) Have sufficient water supplies available to serve the project from existing entitlements and resources, or are new or expanded entitlements needed?	<input type="checkbox"/>	<input type="checkbox"/>	<input type="checkbox"/>	<input checked="" type="checkbox"/>
d) Result in a determination by the wastewater treatment provider which serves or may serve the project that it has adequate capacity to serve the project's projected demand in addition to the provider's existing commitments?	<input type="checkbox"/>	<input type="checkbox"/>	<input type="checkbox"/>	<input checked="" type="checkbox"/>
e) Be served by a landfill with sufficient permitted capacity to accommodate the project's solid waste disposal needs?	<input type="checkbox"/>	<input type="checkbox"/>	<input checked="" type="checkbox"/>	<input type="checkbox"/>
f) Comply with federal, state, and local statutes and regulations related to solid waste?	<input type="checkbox"/>	<input type="checkbox"/>	<input type="checkbox"/>	<input checked="" type="checkbox"/>

#### **XVII. MANDATORY FINDINGS OF SIGNIFICANCE.**

a) Does the project have the potential to degrade the quality of the environment, substantially reduce the habitat of a fish or wildlife species, cause a fish or wildlife population to drop below self-sustaining levels, threaten to eliminate a plant or animal community, reduce the number or restrict the range of a rare or endangered plant or animal or eliminate important examples of the major periods of California history or prehistory?	<input type="checkbox"/>	<input type="checkbox"/>	<input checked="" type="checkbox"/>	<input type="checkbox"/>
b) Does the project have impacts that are individually limited, but cumulatively considerable? (" <i>Cumulatively considerable</i> " means that the incremental effects of a project are considerable when viewed in connection with the effects of past projects, the effects of other current projects, and the effects of probable future projects.)	<input type="checkbox"/>	<input type="checkbox"/>	<input checked="" type="checkbox"/>	<input type="checkbox"/>
c) Does the project have environmental effects which will cause substantial adverse effects on human beings, either directly or indirectly?	<input type="checkbox"/>	<input type="checkbox"/>	<input checked="" type="checkbox"/>	<input type="checkbox"/>

**DETERMINATION:** (To be completed by the Lead Agency)

On the basis of this initial evaluation:

- ☐ I find that the proposed project COULD NOT have a significant effect on the environment, and a NEGATIVE DECLARATION will be prepared.
- ☒ I find that although the proposed project could have a significant effect on the environment, there will not be a significant effect in this case because the mitigation measures described on an attached sheet have been added to the project. A MITIGATED NEGATIVE DECLARATION will be prepared.
- ☐ I find that the proposed project MAY have a significant effect on the environment, and an ENVIRONMENTAL IMPACT REPORT is required.
- ☐ I find that the proposed project MAY have a "potentially significant impact" or "potentially significant unless mitigated" impact on the environment, but at least one effect 1) has been adequately analyzed in an earlier document pursuant to applicable legal standards, and 2) has been addressed by mitigation measures based on the earlier analysis as described on attached sheets, if the effect is a "potentially significant impact" or "potentially significant unless mitigated." An ENVIRONMENTAL IMPACT REPORT is required, but it must analyze only the effects that remain to be addressed.
- ☐ I find that although the proposed project could have a significant effect on the environment, there WILL NOT be a significant effect in this case because all potentially significant effects (a) have been analyzed adequately in an earlier EIR pursuant to applicable standards, and (b) have been avoided or mitigated pursuant to that earlier EIR, including revisions or mitigation measures that are imposed upon the proposed project.

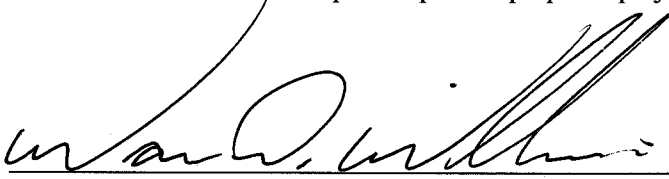
  
Signature

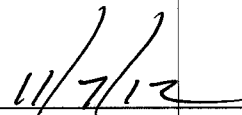
  
Date

WARREN D. WILLIAMS, General Manager-Chief Engineer  
Printed Name and Title



## Discussion of Potential Environmental Impacts

### I. AESTHETICS. Would the project:

#### a) Have a substantial adverse effect on a scenic vista?

**No Impact.** According to the Riverside County General Plan, the Project alignment is not located within a scenic corridor. The nearest identified scenic highway, including County Eligible, State Designated or State Eligible status, is La Sierra Avenue, approximately 10 miles south of the Project alignment. Therefore, with regards to a substantial effect upon a scenic highway corridor, no impact will occur.

**Source:** Project Design; RCIP; RDA's IS

#### b) Substantially damage scenic resources, including, but not limited to, trees, rock outcroppings, and historic buildings within a state scenic highway?

**No Impact.** According to the Riverside County General Plan Multipurpose Open Space Element, in general terms, scenic resources include areas that are visible to the general public and considered visually attractive. In addition to scenic corridors, as discussed above, scenic resources include natural landmarks and prominent or unusual features of the landscape. Scenic backdrops include hillsides and ridges that rise above urban or rural areas, or highways. Scenic vistas are points, accessible to the general public, which provide a view of the countryside.

As discussed in the response to item 1.a), the Project alignment is not located within or near to a scenic corridor. Additionally, the Project alignment does not contain other scenic resources as described in the General Plan, such as natural landmarks or prominent or unusual features of the landscape. The Project does not propose any substantive vertical structures that would potentially block the view of any scenic backdrop, such as that of the surrounding hills. Furthermore, the Project alignment does not contain any scenic vista points that could be compromised. Thus, with regard to Project's potential to substantially damage scenic resources, obstruct any prominent scenic vista or result in the creation of an aesthetically offensive site open to public view, no impact will occur.

**Source:** Project Design; RCIP; RDA's IS

#### c) Substantially degrade the existing visual character or quality of the site and its surroundings?

**Less Than Significant Impact.** The visual character of the Project site and its surroundings could be affected in the short-term by construction activities. Construction related activities such as excavating, stockpiling, and material and equipment storage could result in temporary impacts to the visual character of the site. These visual disturbances are short-term and would cease once construction is completed. Therefore, the Project will not significantly degrade the long-term visual character of the site and surrounding areas.

**Source:** Project Design; RCIP; RDA's IS

#### d) Create a new source of substantial light or glare, which would adversely affect day or nighttime views in the area?

**No Impact.** There are no Project components that contain new sources of substantial light or that could result in any substantial glare. Additionally, the Project area is currently developed, including lighted buildings and parking areas. Therefore, Project implementation will not adversely affect day or nighttime views and will not create a new source of substantial light or glare. Therefore, impacts will be less than significant.

**Source:** Project Design; RDA's IS

**II. AGRICULTURE & FOREST RESOURCES.** In determining whether impacts to agricultural resources are significant environmental effects, lead agencies may refer to the California Agricultural Land Evaluation and Site Assessment Model (1997) prepared by the California Department of Conservation as an optional model to use in assessing impacts on agriculture and farmland. Would the project:

- a) **Convert Prime Farmland, Unique Farmland, or Farmland of Statewide Importance (Farmland), as shown on the maps prepared pursuant to the Farmland Mapping and Monitoring Program of the California Resources Agency, to non-agricultural use?**

**No Impact.** The Project alignment is primarily located within the existing Pyrite Street right-of-way. Some right-of-way acquisition of Pyrite Street will be required; however, the Project alignment and surrounding area, including land to be acquired for right-of-way, are located on land identified as Urban-Built Up Land in the General Plan. Additionally, the proposed street improvements will not indirectly contribute to the conversion of Farmland because the proposed improvements will not generate additional vehicular trips or otherwise induce growth in the area. Therefore, with regard to the potential for the Project to convert Prime Farmland, Unique Farmland or Farmland of Statewide Importance to non-agricultural use, there will be no impact.

**Source:** Project Design; RCIP; GIS; RDA's IS

- b) **Conflict with existing agricultural zoning, agricultural use or land subject to a Williamson Act Contract or land within a Riverside County Agricultural Preserve?**

**No Impact.** The Project alignment is primarily located within existing roadway right-of-way. Some additional right-of-way land acquisition outside of the existing right-of-way will be required; however, the Project alignment and surrounding area, including land to be acquired for right-of-way, are located on land identified as Urban-Built Up Land in the General Plan. Additionally, the existing and future right-of-way is not within an agricultural preserve contract. Therefore, with regard to the Project conflicting with existing agricultural uses or with land subject to a Williamson Act contract or agricultural preserve, no impact will occur.

**Source:** Project Design; RCIP; GIS; RDA's IS

- c) **Involve other changes in the existing environment, which due to their location or nature, could result in conversion of Farmland to non-agricultural use?**

**No Impact.** In general terms, the majority of the proposed storm drain is within existing road right of way and the roadway improvements fall within the General Plan roadway designation. Some land acquisition for right-of-way will occur as a result of Project

implementation. None of the property to be acquired for right-of-way is Farmland. Furthermore, because the Project is not changing land uses or inducing growth the Project implementation will not have any indirect effects that could result in the conversion of Farmland to non-agricultural use; thus, no impact will occur.

**Source:** Project Design; RCIP; GIS; RDA's IS

- d) **Conflict with existing zoning for, or cause rezoning of, forest land (as defined in Public Resources Code section 12220(g)), timberland (as defined by Public Resources Code section 4526), or timberland zoned Timberland Production (as defined by Government Code section 51104(g))?**

**No Impact.** The Project alignment is located within existing or immediately adjacent to Pyrite Street. There are a few vacant parcels located along the Project alignment; however, there is no forest land or timberland on any of these parcels. The Project alignment and surrounding area does not contain forest land or timberland, nor is it zoned for forest land or timberland. For these reasons Project implementation would not conflict with existing zoning or cause rezoning of forest land or timberland. No impact will occur.

**Source:** Project Design; RCIP; PRC; RDA's IS

- e) **Result in the loss of forest land or conversion of forest land to non-forest use?**

**No Impact.** The majority of the Project alignment is located within existing right-of-way of Pyrite Street. Additionally, the proposed Project will not induce growth or otherwise indirectly result in the loss or conversion of forest land elsewhere in the County, for these reasons with regard to the conversion of forest land to non-forest land, no impact will occur.

**Source:** Project Design; RCIP; PRC; RDA's IS

**III. AIR QUALITY & GREENHOUSE GAS EMISSIONS. Where available, the significance criteria established by the applicable air quality management or air pollution control district may be relied upon to make the following determinations. Would the project:**

- a) **Conflict with or obstruct implementation of the applicable air quality plan?**

**No Impact.** The 2007 Air Quality Management Plan (AQMP) for the South Coast Air Basin (Basin) sets forth a comprehensive program that will lead the Basin into compliance with all Federal and State air quality standards. The AQMP control measures and related emission reduction estimates are based upon emissions projections for a future development scenario derived from land use, population and employment characteristics defined in consultation with local governments. Accordingly, conformance with the AQMP for development projects is determined by demonstrating compliance with local land use plans and/or population projections.

Since the proposed Project will not result in any changes to the existing land use patterns in the Project area and do not generate significant amounts of criteria air pollutants, the Project does not conflict with or obstruct implementation of the AQMP. Therefore, no impacts would occur in this regard.

Source: AQMP; AQ Analysis; RDA's IS

- b) **Violate any air quality standard or contribute substantially to an existing or projected air quality violation?**

**Less than Significant Impact.** The Project consists of construction and subsequent maintenance of an underground storm drain system and associated street improvements. Air quality impacts can be described in a short-term and long-term perspective. Short-term impacts will occur during project construction and consist of fugitive dust and other particulate matter, as well as exhaust emissions generated by construction-related vehicles. Long-term air quality impacts will occur once the project is in operation. Operational emissions would be from the infrequent visits by vehicles driven by maintenance personnel and would be negligible; therefore, only short-term impacts were evaluated.

The short-term construction emissions of criteria pollutants from this Project were modeled using URBEMIS 2007, Version 9.2.4 for Windows computer program (Appendix A). Maximum daily emissions are estimated to be 6.75 pounds per day (lbs/day) for volatile organic compounds (VOC), 37.12 lbs/day for oxides of nitrogen (NO<sub>2</sub>), 22.32 lbs/day for carbon monoxide (CO), 0.02 lbs/day for sulfur dioxide (SO<sub>2</sub>), 21.95 lbs/day for particulate matter less than 10 microns (PM-10), and 6.30 lbs/day for particulate matter less than 2.5 microns (PM-2.5), which do not exceed the regional thresholds set by the South Coast Air Quality Management District (SCAQMD). The short-term emissions do not exceed SCAQMD's localized significance thresholds either, as contained in supporting analysis in Appendix A. Therefore, the impacts to air quality from construction and operation of this Project will be less than significant.

Source: AQMP; AQ Analysis; RDA's IS

- c) **Result in a cumulatively considerable net increase of any criteria pollutant for which the project region is in non-attainment under an applicable federal or state ambient air quality standard (including releasing emissions which exceed quantitative thresholds for ozone precursors)?**

**Less than Significant Impact.** The South Coast Air Basin within which the Project is located is designated as a non-attainment area for NO<sub>2</sub> under State standards and for ozone, PM-10, and PM-2.5 under both State and Federal standards.

Since the proposed Project does not conflict with any land uses, it is in conformance with the AQMP, and the Project's short-term and long-term emissions do not exceed the SCAQMD established thresholds of significance; the Project's net increase in criteria pollutant emissions for which the Project region is non-attainment is not cumulatively considerable and impacts are considered less than significant.

Source: AQMP; AQ Analysis; RDA's IS

- d) **Expose sensitive receptors to substantial pollutant concentrations?**

**Less than Significant Impact.** As described in Appendix A, the closest sensitive receptors are the existing residences adjacent to Pyrite Street. To ensure a worst-case analysis, the nearest sensitive receptor position of 85 feet (25 meters) was used.

Short-term emissions will be generated in the Project area during construction of the Project and have been found to be less than significant (Appendix A). In addition, the operational emissions were also found to be less than significant, as indicated above; hence the Project will not expose sensitive receptors to substantial pollutant concentrations and the impact is less than significant.

**Source:** AQMP; AQ Analysis; RDA's IS

**e) Create objectionable odors affecting a substantial number of people?**

**Less than Significant Impact.** The Project presents the potential for generation of objectionable odors in the form of diesel exhaust during construction in the immediate vicinity of the Project site. Recognizing the short-term duration and quantity of emissions in the Project area, the Project will result in less than significant impact relating to objectionable odors.

**Source:** AQMP; AQ Analysis; RDA's IS

**f) Generate greenhouse gas emissions, either directly or indirectly, that may have a significant impact on the environment?**

**Less than Significant Impact.** As described in Appendix A, the proposed Project does not fit into the categories provided (industrial, commercial, and residential) in either the draft thresholds from the California Air Resources Board (CARB) or SCAQMD (both of which are accepted by Riverside County). However, the total greenhouse gas (GHG) emissions from Project construction is estimated at 238 metric tons of carbon dioxide equivalents (MTCO<sub>2</sub>E) which is below the lowest SCAQMD recommended screening level of 3,000 MTCO<sub>2</sub>E/year for residential/commercial/mixed use projects currently recommended by SCAQMD and accepted by Riverside County. Due to the estimated amount of emissions from Project construction and infrequent operational emissions from maintenance vehicles, the proposed Project will not generate a significant amount of GHG emissions and the impact is considered less than significant.

**Source:** AQ Analysis; RDA's IS

**g) Conflict with any applicable plan, policy or regulation of an agency adopted for the purpose of reducing the emissions of greenhouse gases?**

**No Impact.** As discussed above, the Project's GHG emissions are below the recommended draft thresholds. Therefore, the Project will not conflict any plan, policy or regulation adopted for the purpose of reducing GHG emissions. No impacts are anticipated.

**IV. BIOLOGICAL RESOURCES. Would the project:**

**a) Have a substantial adverse effect, either directly or through habitat modifications, on any species identified as a candidate, sensitive, or special status species in local or regional plans, policies, or regulations, or by the California Department of Fish and Game or the U.S. Fish and Wildlife Service?**

**Potentially Significant Unless Mitigation Incorporated.** The proposed project area is located within Western Riverside County Multiple Species Habitat Conservation Plan

(MSHCP) habitat assessment and/or survey areas for narrow endemic plant species and burrowing owl.

The Project is partially located within the MSHCP narrow endemic plant species survey areas for San Diego ambrosia, Brand's phacelia and San Miguel savory. A habitat assessment for these species was conducted and it was determined that suitable habitat for the above plant species does not occur on the Project site. Therefore, no further assessments and/or surveys or conservation measures are required.

A focused burrowing owl survey was conducted per Riverside County guidelines whereby all suitable habitats on and within the Zone of Influence of a Project site were systematically surveyed at least four times on different days/nights between March 1<sup>st</sup> and August 31<sup>st</sup>. Specifically, the Survey was conducted on March 4, 5, 6 and 11, 2011. A total of 17 burrows capable of supporting the burrowing owl were identified within the survey area as well as 12 burrow complexes, each containing numerous suitable burrow openings. It appeared that all burrows within the survey area were created by common ground squirrels, however, there were two pipes along the Pyrite Channel that were suitable cover sites for owls. In the southern portion of the survey area were some refuse piles that could be used as refuge for owls. The 2011 Survey concluded no presence of burrowing owls or their sign (pellets, feathers, tracks, scat, excrement, prey remains or nest materials) being found onsite or within the Zone of Influence. The quality of habitat onsite for the burrowing owl is considered moderate-high for nesting and foraging despite the owl being absent. Reasons for the Project site not supporting extant owl pairs could include lack of prey, distance to nearest known populations, natal dispersal tendencies, past disturbances, and abundance of both mammalian and avian predators.

As the probability remains high for the presence of burrowing owls on the Project site, the following mitigation measure shall be implemented to reduce potential impacts to the burrowing owl to a less than significant level:

**Bio MM-1:** A pre-construction survey for burrowing owls shall be conducted no more than 30 days prior to grading or ground disturbing activity. The pre-construction survey and any relocation of burrowing owls, if present, shall be conducted in accordance with current MSHCP survey guidelines and protocols.

One tree may need to be removed to install the inlet connection at Pyrite Channel. The Federal Migratory Bird Treaty Act (MBTA) and California Department of Fish and Game (CDFG) Code Sections 3503, 3503.5 and 3800 prohibit the take, possession or destruction of any birds, their nests or eggs. Although the potential removal of the tree is considered less than significant, the District will comply with the MBTA and CDFG Code through the implementation of the following environmental commitment:

**Bio EC- 1:** If tree removal takes place during the nesting season (February 1<sup>st</sup> through August 31<sup>st</sup>), a pre-activity field survey shall be conducted to determine if active nests of species protected by the Migratory Bird Treaty Act (MBTA) or California Fish and Game Code are present in the construction zone. If active nests are located, no grading or use of heavy equipment shall take place within at least 500 feet of birds of-prey and 100 to 300 feet of songbirds (to be determined by a qualified biologist on a case-by-case basis). For Project activities taking place outside the nesting season (September 1<sup>st</sup> through January 31<sup>st</sup>), no nesting surveys shall be required.

For these reasons, the proposed Project will have a less than significant impact, with mitigation measures implemented, with respect to incurring a substantial adverse effect, either directly or through habitat modifications on any species identified as a candidate, sensitive, or special status species in local or regional plans, policies, or regulations, or by CDFG or USFWS.

**Source:** MSHCP Report; Burrowing Owl; RDA's IS

- b) **Have a substantial adverse effect on any riparian habitat or other sensitive natural community identified in local or regional plans, policies, regulations or by the California Department of Fish and Game or the U.S. Fish and Wildlife Service?**

**Less Than Significant Impact.** A *Jurisdictional Delineation/Resources and Impact Analysis* (JD) was prepared for the proposed Project by Regulatory Permitting Specialists in November 2010, to determine the potential for wetlands; permanent, intermittent or ephemeral drainages; and the resources and Project impacts associated with the wetland, riparian, or streambed resources onsite. A subsequent field investigation was conducted prior to the JD on October 15, 2010. The JD's Summary of Findings concluded that the proposed Project would not result in impacts to riparian vegetation or fish and wildlife resources. Furthermore, no other sensitive natural communities are located within the Project. The Project would not have a substantial adverse effect on any riparian habitat or other sensitive natural community identified in local or regional plans, policies and regulations, or by the CDFG or USFWS. Therefore, impacts in this regard would be less than significant.

**Source:** JD; RDA's IS

- c) **Have a substantial adverse effect on biological resources involved within a jurisdictional water feature as defined by federal, state or local regulations (e.g., Section 404 of the Clean Water Act, Section 401 of the Clean Water Act, Section 1602 of California Fish and Game Code, Porter-Cologne Water Quality Control Act, etc.) through direct removal, filling, hydrological interruption, or other means?**

**Less Than Significant Impact.** As discussed in response to item IVb), a JD analysis was prepared to determine the potential for wetlands, permanent, intermittent or ephemeral drainages. The analysis determined whether "waters of the United States," which are under the jurisdiction of the U.S. Army Corps of Engineers ("ACOE") per Section 401-404 of the Clean Water Act, and/or "streambeds," which are under the jurisdiction of CDFG per Sections 1600-1603 of the CDFG Code, are present on the Project site. The analysis determined that the proposed Project will result in impacts to approximately 0.002 acre of the Pyrite Creek Channel due to the installation of a channel inlet structure measuring approximately 8 feet by 10 feet. In addition, the proposed project will result in impacts to approximately 0.001 acre of the Jurupa Channel due to the installation of a storm drain outlet structure measuring approximately 7 feet by 8 feet. The Project components will impact a total of approximately 0.003 acre of California Department of Fish and Game jurisdictional streambed and "waters of the United States". As such, the proposed impacts to the Pyrite Creek Channel and Jurupa Channel may require a Section 404 Permit from the ACOE and a Section 401 Certification from the California Regional Water Quality Control Board. The JD analysis determined that the proposed Project would not result in impacts to riparian vegetation or fish and wildlife resources. The proposed impacts to the Pyrite Creek and Jurupa Channels may require notification to the CDFG's Streambed Alteration

Program. Therefore, the proposed Project would result in less than significant impacts to riparian vegetation or fish and wildlife resources.

Source: JD; RDA's IS

- d) **Interfere substantially with the movement of any native resident or migratory fish or wildlife species or with established native resident or migratory wildlife corridors, or impede the use of native wildlife nursery sites?**

**No Impact.** According to Figure 3-2 of the MSHCP, the project will not interfere with the movement of any native resident or migratory fish or wildlife species or with established native resident or migratory wildlife corridors, or impede the use of native wildlife nursery sites.

Source: MSHCP

- e) **Conflict with any local policies or ordinances protecting biological resources, such as a tree preservation policy or ordinance?**

**No Impact.** Implementation of the proposed Project would not conflict with any local policies protecting biological resources identified in the Jurupa Area Plan of the Riverside County General Plan or ordinances protecting biological resources. Therefore, no impacts are anticipated.

Source: RCIP

- f) **Conflict with the provisions of an adopted Habitat Conservation Plan, Natural Community Conservation Plan, or other approved local, regional, or state habitat conservation plan?**

**Less Than Significant Impact.** On June 17, 2003, the Riverside County Board of Supervisors adopted the Western Riverside County Multiple Species Habitat Conservation Plan (MSHCP). The U.S. Fish and Wildlife Service and California Department of Fish and Game issued "take" permits on June 22, 2004 for the implementation of the MSHCP. The MSHCP is a comprehensive, multi-jurisdictional habitat conservation plan focusing on the conservation of species and their associated habitats in Western Riverside County. The Riverside County Flood Control and Water Conservation District (District) is a MSHCP permittee and the proposed project must fulfill all applicable MSHCP requirements. The following addresses consistency of the proposed project with the District's MSHCP requirements:

**Section 3.2.1, P/QP Lands and Criteria Cells** – The proposed project is not located within areas designated as Criteria Areas or Public/Quasi-Public (P/QP) Lands by the MSHCP.

**Section 6.1.2, Protection of Species Associated with Riparian/Riverine Areas and Vernal Pools** – The proposed project area does not meet the MSHCP definition of riparian/riverine areas or vernal pools. In addition, the proposed project area lacks suitable habitat for the species listed in Sections 6.1.2 of the MSHCP. Therefore, no analysis or survey is required.



**Section 6.1.3, Protection of Narrow Endemic Species** – Habitat assessments and/or focused surveys for certain narrow endemic plant species are required for projects within MSHCP mapped survey areas. The survey area maps included within the MSHCP have been reviewed and the Project is partially located within the survey areas for San Diego ambrosia, Brand's phacelia, and San Miguel savory. A habitat assessment was conducted and it was determined that suitable habitat for the above plant species does not occur on the Project site. Therefore, no further assessments and/or surveys or conservation measures are required.

**Section 6.1.4, Urban/Wildlands interface requirements** – Section 6.1.4 of the MSHCP provides guidelines to minimize indirect effects of a project in proximity to a MSHCP conservation area. The proposed project is not located within the Criteria Area or Public/Quasi Public Lands as designated in the MSHCP, and is therefore not subject to further analysis or implementation of any conservation measures as shown in the guidelines.

**Section 6.3.2, Additional Survey Needs and Procedures** - Habitat assessments and/or focused surveys for certain additional plant and animal species are required for projects within MSHCP mapped survey areas. The survey area maps have been reviewed and the Project is only within a mapped survey area for the Burrowing Owl. A habitat assessment was conducted for the Burrowing Owl pursuant to accepted protocol during October 2010 and a focused survey was conducted during March 2011. No Burrowing Owls or Burrowing Owl signs were observed within the surveyed area in 2010 or 2011. In accordance with the MSHCP, a pre-construction survey for Burrowing Owls will be conducted within 30 days prior to disturbance of the property for construction purposes. The Project satisfies the plant, mammal, amphibian and bird Additional Survey Needs and Procedures requirements of the MSHCP.

The District will consider and implement all appropriate Standard Best Management Practices as listed in Appendix C of the MSHCP. Additionally, the District will pay the MSHCP mitigation fee in accordance with Section 13.4 Provision B of the MSHCP Implementing Agreement.

Based on the above discussion, the proposed project is consistent with the MSHCP.

**Source:** MSHCP; JD; MSHCP Report; Burrowing Owl; RDA's IS

**V. CULTURAL RESOURCES. Would the project:**

- a) **Cause a substantial adverse change in the significance of a historical resource as defined in § 15064.5?**

**No Impact.** Based on a record search of prehistoric and historic cultural resources conducted for the Project, there are no known cultural resources within or adjacent to the Project area. The Project will not cause a substantial adverse change in the significance of a historical resource. The majority of the Project alignment is located within the existing Pyrite Street and District rights of way. There are no known historic resources that exist within the Project area. Therefore, there will be no impact.

**Source:** Project Design; RCIP; RDA's IS; EIC

- b) **Cause a substantial adverse change in the significance of an archaeological resource pursuant to § 15064.5?**

**Less Than Significant Impact.** Based on a record search of prehistoric and historic cultural resources conducted for the Project, there are no known cultural resources within or adjacent to the Project area. The Project alignment has experienced substantial prior ground disturbance as a result of grading performed for the existing Pyrite Street improvements and from adjacent developed properties. Existing water, sewer, gas, and communication utilities have been installed and subsequent associated work performed on underground or aboveground lines within or adjacent to the Project alignment; therefore, it is unlikely that there are any intact archaeological sites present on the Project alignment. However, in the event of an accidental discovery of a cultural and/or an archaeological resource, implementation of the following environmental commitment would ensure potential impacts to archaeological resources will be less than significant.

**Cult EC-1:** If any archaeological or historical resources are discovered during project construction, all work in the area of the find shall cease, and a qualified archaeologist shall investigate the find. If any discovered archaeological or historical resources merit long-term consideration, adequate funding, as determined by the District, will be provided to collect, curate and report these resources in accordance with standard archaeological management requirements.

**Source:** Project Design; RCIP; RDA's IS; EIC

- c) **Directly or indirectly destroy a unique paleontological resource or site or unique geologic feature?**

**Less Than Significant Impact.** The Project alignment is located within an area designated in the Riverside County General Plan as having a high paleontological potential/sensitivity; however, there are no unique geologic features located within the Project alignment boundaries. Although the Project alignment and area are designated as having a high potential for an occurrence of paleontological resource discovery, the Project alignment and the majority of its adjacent properties have undergone substantial ground disturbance related to development and infrastructure construction activities. Because of past ground disturbing activities, Project construction is not anticipated to destroy any unique paleontological resource or site, or geologic feature and impacts are considered less than significant. However, in the event of an accidental discovery of paleontological resources, implementation of the following environmental commitment would ensure potential impacts to paleontological resources will be less than significant.

**Cult EC-2:** If any paleontological resources are discovered during project construction, all work in the area of the find shall cease, and a qualified paleontological resources specialist will evaluate the find. Any discovered paleontological resources that merit long-term consideration, shall be collected and reported in accordance with standard paleontological management requirements.

**Source:** Project Design; RCIP; RDA's IS

- d) **Disturb any human remains, including those interred outside of formal cemeteries?**

**Less than Significant Impact.** The Project alignment is not located on or adjacent to a known formal or informal cemetery. No impacts to human remains, including those interred outside of formal cemeteries are anticipated. In the unlikely event that human remains are encountered on the project site, the implementation of the following environmental commitment will ensure that potential impacts remain less than significant:

**Cult EC-3:** Per State Health and Safety Code Section 7050.5, if human remains are encountered during construction, no further disturbance shall occur until the Riverside County Coroner has made a determination of their origin pursuant to Health and Safety Code 7050.5 and Public Resources Code Section 5097.98. The Riverside County Coroner must be notified within 24 hours of the discovery. If the County Coroner determines that the remains are of Native American descent, the Native American Heritage Commission (NAHC) must be contacted within 24 hours to determine the most likely descendent for this area. Once the most likely descendent is determined, treatment of the Native American human remains will proceed pursuant to Public Resources 5097.98.

**Source:** Project Design; RCIP; RDA's IS

## **VI. GEOLOGY AND SOILS. Would the project:**

### **a) Expose people or structures to potential substantial adverse effects, including the risk of loss, injury or death involving:**

#### **i. Rupture of a known earthquake fault, as delineated on the most recent Alquist-Priolo Earthquake Fault Zoning Map issued by the State Geologist for the area or based on other substantial evidence of a known fault? Refer to the Division of Mines and Geology Special Publication 42.**

**No Impact.** The State of California Alquist-Priolo Earthquake Fault Zoning Act was passed in 1972 to mitigate the hazard of surface rupture along earthquake faults. The main purpose of the Alquist-Priolo Earthquake Fault Zoning Act is to prevent the construction of buildings used for human occupancy along fault lines. In general, Southern California as a whole is a seismically active region that contains many earthquake faults. The Project area is not within an Alquist-Priolo fault zone or County Hazard fault zone. At its closest point, the Project alignment is located approximately 14 miles northeast and 20 miles west of the two nearest Alquist-Priolo earthquake fault zones. In general terms the Project proposes improvements to Pyrite Street and improvements to existing storm drainage infrastructure. The Project is a non-residential, infrastructure improvement that does not propose habitable structures that could subject people to such an event. Therefore, there will be no impact.

**Source:** GIS; RCIP; RDA's IS

#### **ii. Strong seismic groundshaking?**

**Less than Significant Impact.** The Project area, like all of Southern California is located in a seismically active region. However, the Riverside County General Plan indicates that the Project alignment is not located in an area that is susceptible to earthquake-induced slope instability. The Jurupa Area Plan indicates that the Project alignment is not in an area with steep slopes or within an area that experiences slope instability. The proposed Project does not include the creation of manufactured

slopes. Furthermore, the Project does not propose any substantive, vertical or habitable structures that could be put at risk due to strong seismic ground shaking. Because the Project will be constructed in accordance with the recommendations of the Geotechnical Investigation Report, potential impacts with regard to strong seismic ground shaking would be less than significant.

**Source:** Project Design; RCIP; RDA's IS

**iii. Seismic-related ground failure including liquefaction?**

**Less than Significant Impact.** The Project alignment is located in an area identified as having a "moderate" to "high" susceptibility for liquefaction. In general, for the effects of liquefaction to be manifested at the surface, groundwater levels must be within 50 feet of the ground surface and the soils within the saturated zone must be susceptible to liquefaction. Geotechnical borings up to 30 feet in depth were conducted during the Project's design phase and no free groundwater was encountered. The *Geotechnical Investigation Report* identifies a number of recommendations relative to grading, site preparation, fill, trenching, pavement design and construction observation. The Project will be constructed in accordance with the recommendations of the geotechnical report. Therefore, impacts would be less than significant.

**Source:** GeoTech; RCIP; GIS; RDA's IS

**iv. Landslides or mudflows?**

**No Impact.** According to Figure 12 of the Jurupa Area Plan of the Riverside County General Plan, the Project alignment is not located in an area subject to slope instability. The proposed Project will not result in a change in topography as the site is relatively flat and has previously been graded. Mudflows are typically associated with steep slopes; however, the Project alignment does not contain nor is it near slopes conducive for a mudflow to occur.

**Source:** RCIP; RDA's IS

**b) Result in substantial changes in topography, unstable soil conditions from excavation, grading or fill, or soil erosion or the loss of topsoil?**

**Less than Significant Impact.** The excavation operation will be conducted in accordance with the Division of Occupational Safety and Health (CAL/OSHA) standards to ensure that unstable soil conditions do not occur. The backfill operation will be conducted in accordance with the applicable recommendations of the Geotechnical Report. During the construction phase, appropriate Best Management Practices (BMPs) will be implemented by the construction contractor to minimize erosion. The proposed project finish grade will also match existing conditions. Therefore, potential impacts will be reduced to less than significant.

**Source:** Project Design; GeoTech; RDA

- c) **Be located on a geologic unit or soil that is unstable, or that would become unstable as a result of the project, and potentially result in on- or off-site landslide, lateral spreading, subsidence, liquefaction or collapse?**

**Less Than Significant Impact.** The proposed Project alignment is generally flat with slopes of less than three percent. Seismically-induced landslides and other slope failures are common occurrences in areas with significant ground slopes; especially during or immediately after earthquake events. The Project alignment is relatively flat and will not contribute to on or off-site landslide, lateral spreading, collapse, or liquefaction.

The Riverside County Land Information System identifies the Project alignment and surrounding area as susceptible to subsidence. Subsidence is compaction of soil and other surface material with little or no horizontal motion. Causes of subsidence include earthquake and changes in groundwater tables. According to the *Geotechnical Investigation Report*, the soils along the Project alignment do not appear to be subject to significant settlement or hydroconsolidation. The proposed Project will be constructed in accordance with the requirements of geotechnical report. Therefore, potential impacts with respect to ground subsidence would be less than significant.

**Source:** RCIP; GeoTech; GIS; RDA's IS

- d) **Be located on expansive soil, as defined in table 18-1-B of the Uniform Building Code (1994), creating substantial risks to life or property?**

**Less Than Significant Impact.** Expansive soils are generally considered a threat because of the pressure that may be induced upon structures. In general, these types of soils include characteristics that may result in expansion or contraction when exposed to water. The extent of contraction (shrink) or expansion (swell) may be influenced by the amount and type of clay in the soil. According to the *Geotechnical Investigation Report*, the soils that occur in the Project area are granular and are considered to be non-critically expansive. Therefore, the potential risks to life or property associated with expansive soils are anticipated to be less than significant.

**Source:** GeoTech; RDA's IS

- e) **Have soils incapable of adequately supporting any structures, fill or other improvements associated with the project?**

**Less than Significant Impact.** The Geotechnical Investigation did not identify any support issues with existing soils. The proposed project will follow the recommendations of the Geotechnical Investigation Report to ensure that the soils are capable of adequately supporting the storm drain system.

**Source:** GeoTech; Project Design; RDA's IS

## **VII. HAZARDS AND HAZARDOUS MATERIALS. Would the project:**

- a) **Create a significant hazard to the public or the environment through the routine transport, use, or disposal of hazardous materials?**

**Less than Significant Impact.** Construction and subsequent maintenance of the proposed Project does not involve the routine use or transport of hazardous materials beyond the short-term use of petroleum-based fuels, lubricants, pesticides and other similar materials during construction and maintenance activities. The construction phase may include the transport of gasoline and diesel fuel to the project site and onsite storage for the sole purpose of fueling construction equipment. BMPs stipulating proper storage of hazardous materials and vehicle fueling will be implemented during construction. All transport, handling, use and disposal of substances such as petroleum products, solvents and paints related to operation and maintenance of the proposed project will comply with all Federal, State and local laws regulating the management and use of hazardous materials. Therefore, impacts related to creating a significant hazard to the public or the environment through the routine transport, use or disposal of hazardous materials will be less than significant.

**Source:** Project Design

- b) **Create a significant hazard to the public or the environment through reasonably foreseeable upset and accident conditions involving the release of hazardous materials into the environment?**

**Less than Significant Impact.** Since the proposed project will comply with measures including construction BMPs, transport and handling laws regulating the management and use of hazardous materials, potential impacts will be less than significant. See response VIIa.

**Source:** Project Design

- c) **Emit hazardous emissions or handle hazardous or acutely hazardous materials, substances, or waste within one-quarter mile of an existing or proposed school?**

**Less Than Significant Impact.** Two elementary schools: Glen Avon Elementary School and Glen Avon Elementary School South are both located adjacent to the east side of Pyrite Street between Stonewood Lane and Lone Trail. As discussed in response VIIa), the Project will not create significant hazards to the public or the environment.

**Source:** Project Design; RDA's IS

- d) **Be located on a site, which is included on a list of hazardous materials sites compiled pursuant to Government Code Section 65962.5 and, as a result, would it create a significant hazard to the public or the environment?**

**Less than Significant Impact.** The Project alignment is not identified as containing any hazardous materials sites.

Wells to monitor the plume from the Stringfellow Superfund site are located along the Project alignment. Implementation of the Project will require the top of these existing monitoring wells to be adjusted to match the new street grade. All adjustments to the Stringfellow monitoring wells will be performed by the contractor. Other than adjusting the wells to grade, implementation of the Project will not affect the wells or the ongoing monitoring and testing.

For the reasons identified above, potential impacts related to the Project being located on a site included on a list of hazardous materials sites will be less than significant.

**Source:** EnviroStor; RDA's IS

- e) **For a project located within an airport land use plan, or where such a plan has not been adopted, within two miles of a public airport or public use airport, would the project result in a safety hazard for people residing or working in the project area?**

**No Impact.** The Project alignment is located within approximately three miles northwest of Flabob Airport and approximately three and one-half mile north of the Riverside Municipal Airport. The Project alignment is not located within an Airport Master Plan or an airport land use plan. The Project area is not within the Airport Influence Area or Safety Area of Flabob Airport or the Riverside Municipal Airport. The Project does not propose any habitable structures or any substantive vertical structures that would conflict with either of the aforementioned airport uses. Therefore, with regard to the Project resulting in an Airport Master Plan inconsistency, needed review by the Airport Land Use Commission, or a safety hazard for people residing or working in the Project area, no impact will occur.

**Source:** RCIP; RDA's IS

- f) **For a project within the vicinity of a private airstrip, would the project result in a safety hazard for people residing or working in the project area?**

**No Impact.** See response VIIe). No impacts are anticipated.

**Source:** RCIP; RDA's IS

- g) **Impair implementation of or physically interfere with an adopted emergency response plan or emergency evacuation plan?**

**Less than Significant Impact.** Neither the construction nor subsequent maintenance of the proposed project is expected to impair implementation of or physically interfere with the County's Emergency Operation Plan and Multi-Jurisdictional Local Hazard Mitigation Plan. Vehicular access will be maintained and/or detours will be provided during project construction. It is also standard practice for the District to notify public safety agencies prior to commencing project construction activity.

**Source:** Project Design

- h) **Expose people or structures to a significant risk of loss, injury or death involving wildland fires, including where Wildlands are adjacent to urbanized areas or where residences are intermixed with Wildlands?**

**No Impact.** The Project alignment is located in an area designated as having no wildfire susceptibility in the County of Riverside General Plan Jurupa Area Plan. Therefore, in this regard the Project will have no impact.

**Source:** RCIP; RDA's IS

**VIII. HYDROLOGY AND WATER QUALITY. Would the project:**

- a) **Violate or conflict with any adopted water quality standards or waste discharge requirements?**

**Less than Significant Impact.** The District is required to comply with the NPDES Municipal Separate Storm Sewer System (MS4) permit issued by the Santa Ana Regional Water Quality Control Board (SARWQCB). The Project would not create new sources of stormwater pollutants and, therefore, would be in compliance with the MS4 permit.

**Source:** Project Design; NPDES

- b) **Result in substantial discharges of typical stormwater pollutants (e.g., sediment from construction activities, hydrocarbons, and metals from motor vehicles, nutrients and pesticides from landscape maintenance activities, metals of other pollutants from industrial operation,) or substantial changes to surface water quality including, but not limited to, temperature, dissolved oxygen, pH, or turbidity?**

**Less than Significant Impact.** The proposed project will not result in substantial discharges of typical stormwater pollutants. See response VIIIa.

- c) **Substantially deplete groundwater supplies or interfere substantially with groundwater recharge such that there would be a net deficit in aquifer volume or a lowering of the local groundwater table level (e.g. the production rate of pre-existing nearby wells would drop to a level which would not support existing land uses or planned use for which permits have been granted)?**

**Less Than Significant Impact.** The Project will not have a need for water supply once operational. Relatively minor amounts of water will be used during the construction process; however, this water is typically trucked in to the construction site. Additionally, any water used during the construction process will not be substantial in quantity enough to risk depleting groundwater supplies. Therefore, with regard to substantially depleting groundwater supplies or interfering substantially with groundwater recharge, impacts will be less than significant.

**Source:** Project Design; RDA's IS

- d) **Substantially alter the existing drainage pattern of the site or area, including through the alteration of a watercourse or wetland, in a manner which would result in substantial erosion or siltation on- or off-site?**

**Less than Significant Impact.** The Pyrite Channel conveys flows southwesterly across Pyrite Street. East of Pyrite Street, the Pyrite Channel is a concrete lined channel. The concrete portion of this channel ends at the westerly side of Pyrite Street and all flows continue to be conveyed southwesterly through an existing natural channel until the flows reach the confluence with the Jurupa Channel near the Agate Street/Jurupa Road intersection. During large storm events, flows through the natural portion of the Pyrite Channel flood backyards and disturbs objects placed in the normally dry channel by adjacent property owners. The Project proposes to collect up to 200 cfs and transmit flows southerly in a more direct manner to be discharged in to the Jurupa Channel. The Pyrite Channel Bypass Storm Drain is not an ultimate capacity facility; it is only designed to



convey a portion of the ultimate flow so as to alleviate drainage problems and relieve the residents of downstream homes of flows during marginal storm events.

Surface flows from the paved areas of Pyrite Street will not be altered in that the street improvements will continue to direct flows into the same catches. Therefore, with regards to the Project substantially altering the existing drainage pattern of the site or area, in a manner that would result in substantial erosion or siltation off site, impacts will be less than significant.

**Source:** Project Design; RDA's IS

- e) **Substantially alter the existing drainage pattern of the site or area, including through the alteration of the course of a stream or river, or substantially increase the rate or amount of surface runoff in a manner which would result in flooding on- or off-site?**

**Less than Significant Impact.** The areas surrounding the Project area along Pyrite Creek, west of Pyrite Street experience flooding during rain events. The County of Riverside General Plan indicates the Project alignment is transected by a 100-Year Flood Zone which is the Pyrite Channel. The Project itself is an infrastructure improvement project that includes improvements to the Pyrite Channel. Implementation of the Project will alter the Pyrite Channel. However, these improvements will improve and upgrade the existing facilities and will have a beneficial impact with regards to drainage and eliminating problematic flooding issues downstream.

**Source:** Project Design; RDA's IS

- f) **Create or contribute runoff water, which would exceed the capacity of existing or planned stormwater drainage systems?**

**No Impact.** The proposed project will not create or contribute runoff water which would exceed the capacity of existing or planned stormwater drainage systems. Runoff from the project area will not exceed the current condition.

**Source:** Project Design; RDA's IS

- g) **Place housing within a 100-year flood hazard area as mapped on a Federal Flood Hazard Boundary or Flood Insurance Rate Map or other flood hazard delineation map?**

**No Impact.** The County of Riverside General Plan indicates the Project alignment is transected by a 100-Year Flood Zone which is the Pyrite Channel. However, the Project does not include any housing component and does not propose any structure within the hazard area that would impede or redirect flows. Therefore, in this regard, no impact will occur.

**Source:** Project Design, RCIP; RDA's IS

- h) **Place structures or fill within a 100-year flood hazard area, which would impede or redirect flood flows?**

**No Impact.** See response to VIIIg.

Source: Project Design, RCIP; RDA's IS

- i) **Expose people or structures to a significant risk of loss, injury or death involving flooding, including flooding as a result of the failure of a levee or a dam?**

**No Impact.** The Project does not involve levees or dams. The proposed underground storm drain system will not expose people or structures to a significant risk of loss, injury or death involving flooding, including flooding as a result of the failure of a levee or a dam. Conversely, the proposed project will increase the level of flood protection for local residents.

Source: Project Design

- j) **Expose people or structures to a significant risk of loss, injury or death involving by seiche, tsunami, or mudflow?**

**No Impact.** The proposed project area is not subject to inundation by a seiche or tsunami. The proposed flood control facility will not increase the potential for mudflows.

Source: Project Design; RDA's IS

**IX. LAND USE PLANNING. Would the project:**

- a) **Physically divide an established community?**

**No Impact.** The proposed project consists of an underground storm drain system and would not physically divide an established community.

Source: Project Design

- b) **Conflict with any applicable land use plan, policy, or regulation of an agency with jurisdiction over the project (including, but not limited to the general plan, specific plan, local coastal program, or zoning ordinance) adopted for the purpose of avoiding or mitigating an environmental effect?**

**No Impact.** The proposed project will not conflict with any land use designations or policies adopted for the purpose of avoiding or mitigating an environmental effect. The proposed project is subject to compliance with the Western Riverside County MSHCP. Based on the discussion in IV.f. the project is consistent with the MSHCP component of the RCIP.

Source: Project Design; MSHCP

**X. MINERAL RESOURCES: Would the project.**

- a) **Result in the loss of availability of a known mineral resource that would be of value to the region and the residents of the state?**

**Less than Significant Impact.** According to the Riverside County General Plan, much of the project vicinity is classified by the State of California as a Mineral Resource Zone 3

(MRZ-3). This classification denotes mineral deposits are likely to exist; however, the significance of the deposit is undetermined. The proposed project includes excavation to install the storm drain system; however, due to previous disturbances and the relatively small impact area, the project will have a less than significant impact.

Source: RCIP; RDA's IS

- b) **Result in the loss of availability of a locally-important mineral resource recovery site delineated on a local general plan, specific plan or other land use plan?**

**No Impact.** The proposed project is not located within a delineated mineral resource recovery site.

Source: RCIP

**XI. NOISE. Would the project result in:**

- a) **Exposure of persons to or generation of noise levels in excess of standards established in the local general plan or noise ordinance, or applicable standards of other agencies?**

**No Impact.** Riverside County Ordinance 847 Section 2 (b) states that capital improvement projects of a governmental agency are exempt from noise regulations. Therefore, the proposed project will not exceed standards established in the local general plan or noise ordinance or applicable standards of other agencies.

Source: RCIP

- b) **Exposure of persons to or generation of excessive ground-borne vibration or ground-borne noise levels?**

**Less than Significant Impact.** The proposed project would involve the temporary intermittent use of construction equipment for various construction and maintenance activities over the life of the project and may result in temporary ground-borne vibration impacts in the project area.

Caltrans' Transportation and Construction Induced Vibration Guidance Manual (Manual) provides methods to estimate construction induced ground-borne vibration, and provides criteria for acceptable levels of ground-borne vibration for human perception and potential damage to buildings. Tables 1 and 2 list criteria for both human perception and building damage resulting from construction induced vibration.

**Table 1: Guidance Vibration Annoyance Potential Criteria**

Human Response	Maximum PPV (in/sec)	
	Transient Sources	Continuous/Frequent Intermittent Sources
Barely Perceptible	0.04	0.01
Distinctly Perceptible	0.25	0.04
Strongly Perceptible	0.90	0.10
Severe	2.00	0.40

**Table 2: Guidance Vibration Damage Potential Threshold Criteria**

Structure and Condition	Maximum PPV (in/sec)	
	Transient Sources	Continuous/Frequent Intermittent Sources
Extremely fragile historic buildings, ruins, ancient monuments	0.12	0.08
Fragile buildings	0.20	0.10
Historic and some old buildings	0.50	0.25
Older residential structures	0.50	0.30
New residential structures	1.00	0.50
Modern industrial/commercial buildings	2.00	0.50

Ground-borne vibration resulting from construction of the proposed project would be similar to a large bulldozer. Table 3 lists the estimated minimum and maximum construction induced vibration impacts at various points in the proposed project area using methods described in the Manual. Construction induced ground-borne vibration varies from 0.03 inch/second to 0.07 inch/second within the proposed project area.

**Table 3: Project Construction Induced Impacts (in/sec)**

Estimated Construction Induced Vibration Impacts (large bulldozer)		Threshold Intermittent Construction Induced Vibration	
Minimum (at 50 feet)	Maximum (at 25 feet)	Human Perception ("Distinctly Perceptible")	Building Damage
0.03	0.07	0.04	0.50

The maximum estimated vibration is slightly above levels categorized as "Distinctly Perceptible" and near levels categorized as "Strongly Perceptible". However, vibration levels estimated using the Manual assumes worst-case situations and actual levels are typically lower. The maximum estimated vibration is also well below the threshold for potentially causing damage to buildings. Therefore, no damage to buildings because of construction induced ground-borne vibration is expected.

**Source:** Project Design; Caltrans

- c) **A substantial permanent increase in ambient noise levels in the project vicinity above levels existing without the project?**

**No Impact.** The construction, operation or maintenance of a flood control facility will not result in a permanent substantial ambient noise increase. Potential noise impacts will be limited to the temporary impacts.

**Source:** Project Design

- d) **A substantial temporary or periodic increase in ambient noise levels in the project vicinity above levels existing without the project?**

**Potentially Significant Unless Mitigation Incorporated.** The proposed project would involve the temporary intermittent use of construction equipment for various construction and maintenance activities over the life of the project. Construction and maintenance equipment may result in temporary increases above existing noise levels. Construction equipment noise generally ranges from 70 to 95 dBA at 50 feet from the source. At about 500 feet from the source, intermittent levels from the loudest construction equipment would be about 75 dBA. Maintenance activities would be infrequent and involve less equipment than the initial construction of the proposed project. Residential areas are located adjacent to the project site and could be temporarily affected by increased noise levels during construction. The long-term operation and maintenance of the proposed project would not cause a significant increase in noise levels. To ensure that potential short-term impacts are less than significant, the proposed project will incorporate the following mitigation measures:

**Noise MM-1:** Operation of heavy equipment that may impact adjacent residential structures shall be limited from 7 a.m. to 5 p.m. Monday through Friday, except under special circumstances approved by the District's General Manager-Chief Engineer.

**Noise MM-2:** Each resident adjacent to the storm drain construction site shall be notified in writing three days prior to operation of heavy construction equipment near the residences. The notice shall include the expected work schedule and the District's contact information. The District shall alert the construction contractor of any noise complaints and incorporate any feasible and practical techniques which minimize the noise impacts on adjacent residences.

**Source:** Project Design, RCIP

- e) **For a project located within an airport land use plan or, where such a plan has not been adopted, within two miles of a public airport or public use airport, would the project expose people residing or working in the project area to excessive noise levels?**

**No Impact.** The Project alignment is not located within an airport land use plan, or within two miles of a public airport, public use airport or private airstrip. The two nearest airports are Flabob Airport and Riverside Municipal Airport located at approximate distances of two and three-quarter and three and one-half miles from the Project alignment respectively. Additionally, the Project does not propose any housing component and, apart from temporary construction work, does not propose any component that would employ regular

onsite workers. Therefore, with regard to exposing people to excessive noise levels sourced from airports, no impact will occur.

Source: Project Design; RDA's IS

- f) **For a project within the vicinity of a private airstrip, would the project expose people residing or working in the project area to excessive noise levels?**

**No Impact.** See response XIe). No impacts are anticipated.

Source: Project Design

## **XII. POPULATION AND HOUSING. Would the project:**

- a) **Induce substantial population growth in an area, either directly (*for example, by proposing new homes and businesses*) or indirectly (*for example, through extension of roads or other infrastructure*) resulting in substantial adverse physical impacts or conflicts with the adopted general plan, specific plan, or other applicable land use or regional plan?**

**No Impact.** The proposed project does not include the construction of any new homes or businesses and is not expected to result in any change to existing land use patterns or trigger substantial growth in the area. Portions of the project area are currently zoned for residential uses and are already developed. Any development that may occur is subject to the policies of the Riverside County General Plan and to further review by the City of Jurupa Valley.

Source: Project Design

- b) **Displace substantial number of existing housing, necessitating the construction of replacement housing elsewhere?**

**No Impact.** The proposed project will not displace any existing housing.

Source: Project Design

- c) **Displace substantial numbers of people, necessitating the construction of replacement housing elsewhere?**

**No Impact.** The proposed project will not displace people, and therefore, will not necessitate the construction of replacement housing elsewhere.

Source: Project Design

## **XIII. PUBLIC SERVICES**

- a) **Would the project result in substantial adverse physical impacts associated with the provision of new or physically altered governmental facilities, need for new or physically altered government facilities, the construction of which could cause significant environmental impacts, in order to maintain acceptable service rations,**

response times or other performance objectives for any of the following public services?

i. **Fire protection?**

**No Impact.** The proposed project would not require new fire protection services.

ii. **Police protection?**

**No Impact.** The proposed project would not require new police services.

iii. **Schools?**

**No Impact.** The proposed project would not affect existing schools or require new schools within the area.

iv. **Parks?**

**No Impact.** Additional demands on existing public parks would not occur. New or improved park facilities would not be necessary as a result of the proposed project.

v. **Other public facilities?**

**No Impact.** Public roads and flood control facilities are the only public facilities that may be impacted by the proposed project. Once completed, the proposed project will reduce the potential for flood damages to public roads and reduce the need for flood control facilities located in the vicinity of the project area. Thus, the need to maintain and repair public facilities due to flood associated damage will be reduced. Other public facilities will not be impacted by the proposed project.

**Source:** Project Design; RDA's IS

#### **XIV. RECREATION**

a) **Would the project increase the use of existing neighborhood and regional parks or other recreational facilities such that substantial physical deterioration of the facility would occur or be accelerated?**

**No Impact.** The proposed project would not impact or increase the use of recreational facilities, neighborhood parks or regional parks.

**Source:** Project Design

b) **Does the project include recreational facilities or require the construction or expansion of recreational facilities which might have an adverse physical effect on the environment?**

**No Impact.** The proposed project does not require the construction or expansion of recreational facilities.

**Source:** Project Design

**XV. TRANSPORTATION/TRAFFIC. Would the project:**

- a) **Conflict with an adopted plan, ordinance or policy establishing measures of effectiveness for the performance of the circulation system, taking into account all modes of transportation including mass transit and non-motorized travel and relevant components of the circulation system, including but not limited to intersections, streets, highways and freeways, pedestrian and bicycle paths, and mass transit?**

**Less than Significant Impact.** The adopted Congestion Management Plan (CMP) includes a Travel Demand Management (TDM) element, which consists of programs and strategies that are intended to reduce and reshape use of the transportation systems. By promoting alternative modes of transportation, increasing vehicle occupancy, maximizing the efficient use of parking, reducing travel distances, and easing peak-hour congestion, these strategies and programs help to increase the efficiency and effectiveness of the transportation system.

Examples of TDM programs include rideshare, bus rapid transit, and the development of a system of pedestrian and bike paths. The TDM also includes the Western Riverside County Non-Motorized Transportation Plan (WROCG-NMTP) which provides a regional network of bicycle and pedestrian facilities. While the TDM does not provide a specific measure of effectiveness for the performance of the circulation system, which takes into account various alternative modes of transportation, disruption of TDM programs may conflict with the TDM goal of increasing the effectiveness of the transportation system.

Evaluations of potential impacts to various alternative modes of transportation located near the Project are listed below:

- The Project is not located near existing or proposed bike routes designated in the WROCG-NMTP network (exhibit 5.0.1 and in Corridor 1 Santa Ana River Trail Non-Motorized Transportation Plan Network). Therefore, the Project will not conflict with the WROCG-NMTP.
- Transit routes near the Project include the Riverside Transit Agency (RTA) bus routes. An RTA route is not located within Pyrite Street/Jurupa Road. Therefore, the Project will not conflict with the WROCG-NMTP.

Any potential traffic impacts will be limited to the construction phase. Long-term traffic impacts will not occur, as the Project would not create uses that would increase trip generation to the site. The Project will include the implementation of a Traffic Control Plan (TCP). Temporary street and lane closures during construction will be kept at minimum and will be coordinated with the City of Jurupa Valley to ensure that adverse impacts to traffic flow remain less than significant.

Since impacts to TDM elements will not occur, and the Project will minimize temporary impacts with the implementation of a TCP, impacts are expected to be less than significant.

**Source:** Project Design, CMP

- b) **Conflict with an adopted congestion management program, including, but not limited to level of service standards and travel demand measures, or other standards**



**established by the appropriate congestion management agency for designated roads or highways?**

**Less than Significant Impact.** The proposed project is not located within a State Highway or Principal Arterial designated within the RCTC 2010 CMP. Although the proposed project would generate a minor amount of daily construction-related trips during construction, and fewer maintenance-related trips, as discussed in Response XVa), these trips would not be substantial in relation to the existing traffic load, capacity of intersections, street segments and freeways within the project area. Therefore, the project is not expected to conflict with the CMP.

**Source:** CMP, Project Design

- c) Substantially increase hazards due to a design feature (e.g., sharp curves or dangerous intersections) or incompatible uses (e.g., farm equipment)?**

**No Impact.** The proposed project does not change the existing design of the roads. Infrequent maintenance traffic would be compatible with the road use in its post-project condition.

**Source:** Project Design

- d) Result in inadequate emergency access?**

**Less Than Significant Impact.** Although the operation and maintenance of the proposed project would not result in inadequate emergency access, the construction of the proposed project is expected to result in temporary lane closures of local roads for approximately eight (8) hours per day. The Traffic Control Plan (TCP) will detail and coordinate all traffic movement through the project area and will be implemented throughout project construction. The TCP will also ensure that private property and emergency access will be maintained at all times. Methods to maintain access may include, but are not limited to: temporary bridge crossings (i.e., steel plates or structural design bridges); for all driveway entrances to be closed to vehicular access for any period exceeding four (4) hours; use of construction signs, barricades and delineators; and the use of flaggers during construction. With the implementation of the TCP, combined with the short-term nature of the lane closures, impacts to emergency access will be less than significant.

**Source:** Project Design

- e) Result in inadequate parking capacity?**

**No Impact.** The proposed project site will not affect any existing parking facilities. The project site is expected to provide sufficient temporary parking areas for construction workers and equipment. Temporary parking related to construction activities is typically on or adjacent to the construction site. The project will not create long-term trip generation requiring parking.

**Source:** Project Design

- f) **Conflict with adopted policies, plans, or programs regarding public transit, bicycle, pedestrian facilities, or other alternate transportation or otherwise decrease the performance or safety of such facilities?**

**Less than Significant Impact.** As discussed in response XV.a. potential impacts to public transit, bicycle or pedestrian facilities are considered to be less than significant.

**Source:** Project Design, CMP

**XVI. UTILITIES AND SERVICE SYSTEMS. Would the project:**

- a) **Impact the following facilities requiring or resulting in the construction of new facilities or expansion of existing facilities, the construction of which could cause significant environmental effects?**

**Electricity?**

**No Impact.** The construction of the project would not require additional electrical facilities.

**Natural Gas?**

**No Impact.** The construction of the project would not require additional natural gas facilities.

**Communication System?**

**No Impact.** The construction of the project would not require additional communication systems facilities.

**Street lighting?**

**No Impact.** The construction of the project would not require additional street lighting facilities.

**Public facilities, including roads and bridges?**

**No Impact.** The construction of the project would not require additional public facilities.

**Source:** Project Design

- b) **Require or result in the construction of new stormwater drainage facilities or expansion of existing facilities, the construction of which could cause significant environmental effects?**

**No Impact.** The proposed project consists of the construction of a new storm drain facility and street improvements to alleviate flooding within the project area. Additional drainage facilities will not be required as a result of the proposed project.

**Source:** Project Design

- c) **Have sufficient water supplies available to serve the project from existing entitlements and resources, or are new expanded entitlements needed?**

**No Impact.** The proposed project will not require the long-term use of water supplies. The proposed project will only require the temporary use of water during construction. Existing water supplies are expected to be adequate.

Source: Project Design

- d) **Result in determination by the wastewater treatment provider which serves or may serve the project that it has adequate capacity to serve the project's projected demands in addition to the provider's existing commitments?**

**No Impact.** The proposed project would not generate wastewater or require wastewater treatment services. No new wastewater facilities are required as a result of the proposed project.

Source: Project Design

- e) **Be served by a landfill with sufficient permitted capacity to accommodate the project's solid waste disposal needs?**

**Less than Significant Impact.** The proposed project may generate a limited amount of solid waste during construction. In addition, subsequent maintenance may involve occasional trash and debris removal from the facility. However, the limited amount of solid waste generated during construction and subsequent maintenance of the project would not be substantial or interfere with the capacity of nearby existing solid waste disposal facilities.

Source: Project Design

- f) **Comply with federal, state, and local statutes and regulations related to solid waste?**

**No Impact.** Any waste disposal that is required during project construction or maintenance will be done in compliance with the appropriate statutes and regulations.

Source: Project Design

## **XVII. MANDATORY FINDINGS OF SIGNIFICANCE**

- a) **Does the project have the potential to degrade the quality of the environment, substantially reduce the habitat of a fish or wildlife species, cause a fish or wildlife population to drop below self-sustaining levels, threaten to eliminate a plant or animal community, reduce the number or restrict the range of a rare or endangered plant or animal or eliminate important examples of the major periods of California history or prehistory?**

**Less than Significant Impact.** As indicated in this Initial Study, the project's potential impacts to the environment, wildlife species, plant or animal community and cultural resources will not occur, will be less than significant or will be mitigated below a level of significance.

- b) **Does the project have impacts that are individually limited, but cumulatively considerable? ("Cumulatively considerable" means that incremental effects of a project are considerable when viewed in connection with the effects of past projects, the effects of other current projects, and the effects of probable future projects)?**

**Less than Significant Impact.** As discussed in this document, potential adverse impacts are temporary and will cease upon construction completion. Further, due to the project's relatively small area of impact and short construction duration, potential impacts would not be cumulatively considerable.

- c) **Does the project have environmental effects which will cause substantial adverse effects on human beings, either directly or indirectly?**

**Less than Significant Impact.** As discussed previously in this document, the construction of the proposed project will temporarily increase noise levels to those persons who reside near the existing channel. With the incorporation of the mitigation measures described in Section XI, potential noise impacts will be less than significant. Other potential adverse impacts to human beings are not expected to occur.

## INITIAL STUDY CHECKLIST REFERENCE LIST

The following documents were referred to as information sources during preparation of this document. They are available for public review at the locations abbreviated after each listing and spelled out at the end of this section. Some of these documents may also be available at the Riverside City and County Public Library, 3581 Seventh Street, Riverside CA 92502-0468, and/or branches of the library.

<u>Cited As:</u>	<u>Source:</u>
AQ Analysis	Pyrite Street Improvement Project Air Quality Supporting Information. (Webb, March 9, 2011)
AQMP	South Coast Air Quality Management District, <i>Air Quality Management Plan 2007</i> , June 2007. (Available at: SCAQMD)
Burrowing Owl	Focused Burrowing Owl Surveys for the proposed "Pyrite Road Widening" Project. (Kidd Biological, Inc. March 15, 2011)
Caltrans	Jones & Stokes, 2004, Transportation and construction induced vibration guidance manual, June (J&S 02-039). Sacramento, CA. Prepared for California Department of Transportation, Noise, Vibration and Hazardous Waste Management Office, Sacramento, CA
CMP	Riverside County Transportation Commission, <i>2010 Riverside County Congestion Management Program</i> , March 10, 2010
EIC	Cultural Resources Review for Project No. 1-0-00109. (Eastern Information Center, August 22, 2012)
EnviroStor	EnviroStor Online Database, (Available at <a href="http://www.envirostor.dtsc.ca.gov/public/">http://www.envirostor.dtsc.ca.gov/public/</a> )
GeoTech	Geotechnical Investigation Proposed Street and Storm Drain Improvements Pyrite Street, Glen Avon Area, Riverside County, California. (CHJ Incorporated, August 27, 2010)
GIS	County of Riverside, Geographic Information System Database. (Available at: <a href="http://www3.tlma.co.riverside.ca.us/pa/rcgis/index.html">http://www3.tlma.co.riverside.ca.us/pa/rcgis/index.html</a> )
JD	Jurisdictional Delineation/Resources and Impact Analysis, Pyrite Street Improvement Project, Riverside County Redevelopment Agency, Community of Glen Avon, Riverside County, California. (Regulatory Permitting Specialist, November 15, 2010)
MSHCP	Western Riverside County, Multiple Species Habitat Conservation Plan, Final Version, Adopted June 17, 2003. (Available at Riverside County Planning and at: <a href="http://www.rctlma.org/mshcp/index.html">http://www.rctlma.org/mshcp/index.html</a> )
MSHCP Report	MSHCP Consistency Analysis and Focused Burrowing Owl Habitat Assessment for the Proposed "Pyrite Road Widening" Project. (Kidd Biological, Inc., November 22, 2010)
NPDES	National Pollutant Discharge Elimination System compliance documentation. (Available at: <a href="http://rcflood.org/NPDES/">http://rcflood.org/NPDES/</a> )
PRC	Public Resources Code. (Available at: <a href="http://www.leginfo.ca.gov/calaw.html">http://www.leginfo.ca.gov/calaw.html</a> )
RCIP	Riverside County Integrated Project, County of Riverside General Plan, Final Version, Adopted October 7, 2003. (Available at Riverside County Planning and at: <a href="http://www.rctlma.org">www.rctlma.org</a> )
RDA's IS	Final Initial Study/Mitigated Negative Declaration for the Pyrite Street Improvement Project prepared for the Redevelopment Agency for the County of Riverside, by Webb Associates, July 2011 (SCH No. 2011041091)

Appendix A

Air Quality Supporting Information

# **Pyrite Street Improvement Project**

## **Air Quality Supporting Information**

March 9, 2011

### ***Regional Significance Threshold Analysis***

The thresholds contained in the SCAQMD CEQA Air Quality Handbook (SCAQMD 1993) are considered regional thresholds and are shown in the table below. These regional thresholds were developed based on the SCAQMD's treatment of a major stationary source.

**SCAQMD CEQA Daily Regional Significance Thresholds**

<b>Emission Threshold</b>	<b>Units</b>	<b>VOC</b>	<b>NO<sub>x</sub></b>	<b>CO</b>	<b>SO<sub>x</sub></b>	<b>PM-10</b>	<b>PM-2.5</b>
Construction	lbs/day	75	100	550	150	150	55

Air quality impacts can be described in a short-term and long-term perspective. Short-term impacts will occur during project construction and consist of fugitive dust and other particulate matter, as well as exhaust emissions generated by construction-related vehicles. Long-term air quality impacts will occur once the project is in operation. The project consists of street improvements. Operational emissions would be from the infrequent visits by vehicles driven by maintenance personnel and would be negligible; therefore, only short-term impacts were evaluated.

The project will be required to comply with existing SCAQMD rules for the reduction of fugitive dust emissions. SCAQMD Rule 403 establishes these procedures. Compliance with this rule is achieved through application of standard best management practices in construction and operation activities, such as application of water or chemical stabilizers to disturbed soils, managing haul road dust by application of water, covering haul vehicles, restricting vehicle speeds on unpaved roads to 15 mph, sweeping loose dirt from paved site access roadways, cessation of construction activity when winds exceed 25 mph and establishing a permanent, stabilizing ground cover on finished sites. In addition, projects that disturb 50 acres or more of soil or move 5,000 cubic yards of materials per day are required to submit a Fugitive Dust Control Plan or a Large Operation Notification Form to SCAQMD. Based on the size of the project area (approximately eight acres) a Fugitive Dust Control Plan or Large Operation Notification would not be required.

The proposed project would improve approximately 3,400 lineal feet of roadway including grinding and overlay of existing pavement; replacement of existing pavement; construction of curb, gutters, and sidewalks; replacement of deficient handicapped access ramps; replacement of damaged cross gutters; and installation of 50 feet of raised median in front of the school.

Short-term emissions were evaluated using the URBEMIS 2007 version 9.2.4 for Windows computer program. The construction period for the proposed project is approximately five months, beginning no sooner than July 2011. The default parameters within URBEMIS were used and these default values reflect a worst-case scenario, which means that project emissions are expected to be equal to or less than the estimated construction emissions. In addition to the default values used, several assumptions relevant to model inputs for short-term construction emission estimates used are:

- The project will begin July 2011 and be completed in December 2011.
- Approximately two acres could be disturbed in one day. Roadway construction will not overlap with paving activities.
- To evaluate project compliance with SCAQMD Rule 403 for fugitive dust control, the project utilized the mitigation option of watering the project site three times daily which achieves a control efficiency of 61 percent for PM-10 and PM-2.5 emissions.
- The estimated construction equipment list is provided in the modeling output.

The results of this analysis are summarized below.

#### **Estimated Daily Construction Emissions**

Activity/Year	Peak Daily Emissions (lb/day)					
	VOC	NO <sub>x</sub>	CO	SO <sub>2</sub>	PM-10	PM-2.5
<b>SCAQMD Daily Construction Thresholds</b>	<b>75</b>	<b>100</b>	<b>550</b>	<b>150</b>	<b>150</b>	<b>55</b>
Site Grading	5.07	37.12	22.32	0.00	21.95	6.30
Paving	6.75	28.64	15.97	0.02	2.02	1.82
<b>Maximum</b>	<b>6.75</b>	<b>37.12</b>	<b>22.32</b>	<b>0.02</b>	<b>21.95</b>	<b>6.30</b>
<b>Exceeds Threshold?</b>	<b>No</b>	<b>No</b>	<b>No</b>	<b>No</b>	<b>No</b>	<b>No</b>

As shown in the table above, the emissions from the construction of the project are below the SCAQMD Daily Construction Thresholds for all of the criteria pollutants; therefore, the impact is less than significant.

#### ***Localized Significance Threshold Analysis***

##### ***Background***

Recently, as part of the SCAQMD's environmental justice program, attention has been focused on localized effects of air quality. Staff at SCAQMD has developed localized significance threshold (LST) methodology that can be used by public agencies to determine whether or not a project may generate significant adverse localized air quality impacts (both short-term and long-term). LSTs represent the maximum emissions from a project that will not cause or contribute to an exceedance of the most stringent applicable federal or state ambient air quality standard, and are developed based on the ambient



concentrations of that pollutant for each source receptor area (SRA). The project is located within SRA 23.

#### *Short-Term Analysis*

According to the LST methodology, only on-site emissions need to be analyzed. SCAQMD has provided LST lookup tables and sample construction scenarios (available on the internet at <http://www.aqmd.gov/ceqa/handbook/LST/LST.html>) to allow users to readily determine if the daily emissions for proposed construction or operational activities could result in significant localized air quality impacts for projects five acres or smaller. A maximum of two acres could be disturbed per day, so the 2-acre LST lookup table was utilized to estimate the construction emissions.

The LST thresholds are estimated using the maximum daily disturbed area (in acres) and the distance of the project to the nearest sensitive receptors (in meters). The closest sensitive receptors are the existing residences adjacent to Pyrite Road. To ensure a worst-case analysis, the nearest sensitive receptor position of 25 meters was used. The results are summarized below.

**LST Results for Daily Construction Emissions**

<b>Pollutant</b>	<b>NO<sub>x</sub> (lbs/day)</b>	<b>CO (lbs/day)</b>	<b>PM-10 (lbs/day)</b>	<b>PM-2.5 (lbs/day)</b>
LST Threshold for 2-acre at 25 meters	<b>170</b>	<b>883</b>	<b>7</b>	<b>4</b>
Site Grading	40.9	21.5	3.7	2.6
Paving	29.7	16.5	2.1	1.9
<b>Exceeds Threshold?</b>	<b>No</b>	<b>No</b>	<b>No</b>	<b>No</b>

Emissions from construction of the project will be below the LST established by SCAQMD for the project; therefore, the impact is considered less than significant.

#### *Long-Term Analysis*

This project involves the construction of roadway improvements. The long-term emissions, as discussed previously, from the operation of the facility are in the form of mobile source emissions, without any stationary sources present. According to SCAQMD LST methodology, LSTs would apply to the operational phase of a project, if the project includes stationary sources, or attracts mobile sources that may spend long periods queuing and idling at the site; such as warehouse/transfer facilities. The proposed project does not include such uses. Therefore; due to the lack of stationary source emissions, no long-term localized significance threshold analysis is needed.

#### *Greenhouse Gas Analysis*

Greenhouse gases (GHG) are not presented in lbs/day like criteria pollutants; they are typically evaluated on an annual basis using the metric system. Additionally, unlike the criteria pollutants, GHG do not have adopted significance thresholds associated with them at this time. Several agencies, at various levels, have proposed draft GHG significance thresholds for use in CEQA documents. The California Air Resources Board (CARB) released in 2008 draft, GHG thresholds for industrial and residential and commercial projects. These draft GHG thresholds from CARB have yet to identify a performance standard for construction-related emissions for industrial or residential and commercial projects.

Similarly, the SCAQMD has been working on GHG thresholds for development projects as well. In December 2008, the SCAQMD adopted a threshold of 10,000 metric tonnes per year of CO<sub>2</sub> equivalents (MTCO<sub>2</sub>E) for stationary sources project for which SCAQMD was the lead agency. Since December of 2008, the SCAQMD continued hosting the working group meetings and revised the draft threshold proposal several times although it did not officially provide these proposals in a subsequent document. The most recent working group meeting on September 28, 2010<sup>1</sup> proposed two options lead agencies can select from for screening thresholds of significance for GHG emissions in residential and commercial projects proposes to expand the industrial threshold to other lead agency industrial projects. Option 1 proposes a threshold of 3,000 MTCO<sub>2</sub>E/year for all residential and commercial projects; Option 2 proposes a threshold value by land use type where the numeric threshold is 3,500 MTCO<sub>2</sub>E/year for residential projects; 1,400 MTCO<sub>2</sub>E/year for commercial projects; and 3,000 MTCO<sub>2</sub>E/year for mixed use projects. Although both Options are recommended, a lead agency is advised to use only one Option and to use it consistently. The SCAQMD significance thresholds evaluate construction emissions by amortizing them over an expected project life of 30 years.

In May 2010, the County of Riverside Transportation and Land Management Agency Planning Department came out with a Draft Standard Operating Procedure regarding Greenhouse Gases and CEQA Compliance (Riverside County SOP). The intent of this standard operating procedure (SOP) was to provide guidance to County Planning Department staff on how to evaluate applications for discretionary projects to determine what level of analysis is appropriate regarding the proposed project's potential impact, if any, on global climate change in accordance with CEQA. Current County requirements include the use of the screening thresholds recommended by SCAQMD and indicate that an industrial project will have a less than significant impact on GHG and climate change if it emits no more than 10,000 MTCO<sub>2</sub>e per year and a residential, commercial, or mixed use project will have a less than significant impact on GHG and climate change if it emits no more than 3,000 MTCO<sub>2</sub>e per year<sup>2</sup>. This analysis is utilizes the Riverside County SOP recommendations.

---

<sup>1</sup> <http://www.aqmd.gov/ceqa/handbook/GHG/nov19mtg/nov19.html>

<sup>2</sup> The Riverside County Planning Department's Draft SOP calls for an industrial project screening threshold of 7,000 MTCO<sub>2</sub>e per year and does not indicate a numeric threshold for residential or commercial projects (draft CARB thresholds). Per phone conversation on 11-4-10 with Cindy Thielman-Braun at RCTLMA, the Department would also accept the use of the SCAQMD standards, that is, an

The following analysis estimates the project's GHG emissions primarily through the quantification of carbon dioxide (CO<sub>2</sub>) emissions.

The recently updated URBEMIS model calculates carbon dioxide emissions from fuel usage by construction equipment and construction-related activities, like worker trips, for the project in tons per year (one ton equals 2,000 pounds).

The following table summarizes the output results and presents the emissions estimates in metric tonnes (MT) of CO<sub>2</sub> (one metric tonne equals approximately 2,205 pounds).

#### Project Construction Equipment CO<sub>2</sub> Emissions

2011 Activity	Total Tons CO <sub>2</sub> <sup>1</sup>	Total MTCO <sub>2</sub> /year
Site Grading	208.71	189.34
Paving	11.84	10.74
Total	220.55	200.08

<sup>1</sup> calculations based on URBEMIS output.

Evaluation of the table above indicates that an estimated 200 MTCO<sub>2</sub> will occur from project construction equipment over the course of the estimated construction period of five months. CO<sub>2</sub> emissions accounted for approximately 84 percent of the state's total GHG emissions in 2004.<sup>3</sup> Methane (CH<sub>4</sub>) and nitrous oxide (NO<sub>2</sub>) accounted for 5.7 and 6.8 percent, respectively. Therefore, while not intended to be an all-inclusive inventory of overall GHG emissions from the project; the estimation of CO<sub>2</sub> from the most important construction and operation related sources is illustrative of much of the project's contribution to GHG. However, the 2004 statewide percentages for CH<sub>4</sub>, N<sub>2</sub>O and high global warming potential (GWP) emissions can be used to extrapolate an estimate of the emissions of total GHG emissions related to the project. The project's total GHG emissions are 238.19 MTCO<sub>2</sub>E (200.08 MTCO<sub>2</sub>/84% CO<sub>2</sub>).

The proposed project does not fit into the categories provided (industrial, commercial, and residential) in the draft thresholds from CARB or SCAQMD (either are accepted by Riverside County). However, the total GHG emissions from project construction is below the lowest SCAQMD recommended screening level of 3,000 MTCO<sub>2</sub>E/year for residential/commercial/mixed use projects. Due to the estimated amount of emissions from project construction and infrequent operational emissions from maintenance vehicles, the proposed project will not generate a significant amount of GHG emissions and the impact is considered less than significant.

---

industrial threshold of 10,000 MTCO<sub>2</sub>e per year and a residential/commercial threshold of 3,000 MTCO<sub>2</sub>e per year.

<sup>3</sup> California Energy Commission, *Inventory of California Greenhouse Gas Emissions and Sinks: 1990 to 2004*, Publication CEC-600-2006-013-SF, December 2006. (Available at <http://www.energy.ca.gov/2006publications/CEC-600-2006-013/CEC-600-2006-013-SF.PDF>)

## REFERENCES

The following documents were referred to as general information sources during preparation of this document. They are available for public review at the locations abbreviated after each listing and spelled out at the end of this section. Some of these documents are also available at public libraries and at other public agency offices.

CARB 2008                      California Air Resources Board, *Preliminary Draft Staff Proposal, Recommended Approaches for Setting Interim Significance Thresholds for Greenhouse Gases under the California Environmental Quality Act*, October 24, 2008. (Available at [www.arb.ca.gov/cc/localgov/ceqa/ceqa.htm](http://www.arb.ca.gov/cc/localgov/ceqa/ceqa.htm)) (CARB 2008)

Riverside County SOP      County of Riverside, *County of Riverside Transportation and Land Management Agency Planning Department Draft Standard Operating Procedure, Greenhouse Gases and CEQA Compliance*. May 10, 2010. (Available at Riverside County.)

SCAQMD 1993                South Coast Air Quality Management District, *CEQA Air Quality Handbook*, November 1993. (Available at SCAQMD.)

URBEMIS                      Rimpo and Associates Inc, *URBEMIS 2007 for Windows Computer Program and User's Guide, Version 9.2.4.*, February 2008. (Available at <http://www.urbemis.com/>)

### Location

### Address

Riverside County            County of Riverside Planning Department  
4080 Lemon Street  
Riverside, CA 92502-1409

SCAQMD                      South Coast Air Quality Management District  
21865 East Copley Drive  
Diamond Bar, CA 91765-4182

3/9/2011 03:04:51 PM

Urbemis 2007 Version 9.2.4

Combined Summer Emissions Reports (Pounds/Day)

File Name: G:\2010\10-0153\Environmental\Initial Study\Technical Studies\Air\project.urb924

Project Name: Pyrite Street Improvement Project

Project Location: Riverside County

On-Road Vehicle Emissions Based on: Version : Emfac2007 V2.3 Nov 1 2006

Off-Road Vehicle Emissions Based on: OFFROAD2007

Summary Report:

CONSTRUCTION EMISSION ESTIMATES

	ROG	NOx	CO	SO2	PM10 Dust	PM10 Exhaust	PM2.5 Dust	PM2.5 Exhaust	PM2.5	CO2
2011 TOTALS (lbs/day unmitigated)	6.75	37.12	22.32	0.02	37.71	2.41	7.88	2.22	10.10	3,829.61
2011 TOTALS (lbs/day mitigated)	6.75	37.12	22.32	0.02	19.54	2.41	4.08	2.22	6.30	3,829.61

Construction Unmitigated Detail Report:

CONSTRUCTION EMISSION ESTIMATES Summer Pounds Per Day, Unmitigated

	ROG	NOx	CO	SO2	PM10 Dust	PM10 Exhaust	PM2.5 Dust	PM2.5 Exhaust	PM2.5	CO2
Time Slice 7/1/2011-11/30/2011 Active Days: 109	5.07	37.12	22.32	0.00	37.71	2.41	7.88	2.22	10.10	3,829.61
Fine Grading 07/01/2011-11/30/2011	5.07	37.12	22.32	0.00	37.71	2.41	7.88	2.22	10.10	3,829.61
Fine Grading Dust	0.00	0.00	0.00	0.00	37.70	0.00	7.87	0.00	7.87	0.00
Fine Grading Off Road Diesel	5.02	37.02	20.63	0.00	0.00	2.41	0.00	2.21	2.21	3,611.95
Fine Grading On Road Diesel	0.00	0.00	0.00	0.00	0.00	0.00	0.00	0.00	0.00	0.00
Fine Grading Worker Trips	0.05	0.10	1.69	0.00	0.01	0.01	0.00	0.01	0.01	217.66
Time Slice 12/1/2011-12/9/2011 Active Days: 7	6.75	28.64	15.97	0.02	0.07	1.95	0.02	1.79	1.82	3,382.78
Asphalt 12/01/2011-12/09/2011	6.75	28.64	15.97	0.02	0.07	1.95	0.02	1.79	1.82	3,382.78
Paving Off-Gas	2.99	0.00	0.00	0.00	0.00	0.00	0.00	0.00	0.00	0.00
Paving Off Road Diesel	2.89	17.44	10.07	0.00	0.00	1.52	0.00	1.40	1.40	1,395.24
Paving On Road Diesel	0.81	11.09	3.98	0.02	0.06	0.42	0.02	0.39	0.41	1,738.79
Paving Worker Trips	0.06	0.11	1.93	0.00	0.01	0.01	0.00	0.01	0.01	248.75

3/9/2011 03:04:51 PM

Phase Assumptions

Phase: Fine Grading 7/1/2011 - 11/30/2011 - Default Fine Site Grading/Excavation Description

Total Acres Disturbed: 8

Maximum Daily Acreage Disturbed: 2

Fugitive Dust Level of Detail: Low

Onsite Cut/Fill: 150 cubic yards/day; Offsite Cut/Fill: 0 cubic yards/day

On Road Truck Travel (VMT): 0

Off-Road Equipment:

- 1 Crushing/Processing Equip (142 hp) operating at a 0.78 load factor for 8 hours per day
- 1 Excavators (168 hp) operating at a 0.57 load factor for 8 hours per day
- 1 Graders (174 hp) operating at a 0.61 load factor for 8 hours per day
- 2 Tractors/Loaders/Backhoes (108 hp) operating at a 0.55 load factor for 8 hours per day
- 1 Trenchers (63 hp) operating at a 0.75 load factor for 8 hours per day
- 1 Water Trucks (189 hp) operating at a 0.5 load factor for 8 hours per day

Phase: Paving 12/1/2011 - 12/9/2011 - Default Paving Description

Acres to be Paved: 8

Off-Road Equipment:

- 4 Cement and Mortar Mixers (10 hp) operating at a 0.56 load factor for 8 hours per day
- 1 Pavers (100 hp) operating at a 0.62 load factor for 8 hours per day
- 2 Paving Equipment (104 hp) operating at a 0.53 load factor for 8 hours per day
- 1 Rollers (95 hp) operating at a 0.56 load factor for 8 hours per day

3/9/2011 03:04:51 PM

Construction Mitigated Detail Report:

CONSTRUCTION EMISSION ESTIMATES Summer Pounds Per Day, Mitigated

	ROG	NOx	CO	SO2	PM10 Dust	PM10 Exhaust	PM10	PM2.5 Dust	PM2.5 Exhaust	PM2.5	CO2
Time Slice 7/1/2011-11/30/2011 Active Days: 109	5.07	37.12	22.32	0.00	19.54	2.41	21.95	4.08	2.22	6.30	3,829.61
Fine Grading 07/01/2011-11/30/2011	5.07	37.12	22.32	0.00	19.54	2.41	21.95	4.08	2.22	6.30	3,829.61
Fine Grading Dust	0.00	0.00	0.00	0.00	19.53	0.00	19.53	4.08	0.00	4.08	0.00
Fine Grading Off Road Diesel	5.02	37.02	20.63	0.00	0.00	2.41	2.41	0.00	2.21	2.21	3,611.95
Fine Grading On Road Diesel	0.00	0.00	0.00	0.00	0.00	0.00	0.00	0.00	0.00	0.00	0.00
Fine Grading Worker Trips	0.05	0.10	1.69	0.00	0.01	0.01	0.02	0.00	0.01	0.01	217.66
Time Slice 12/1/2011-12/9/2011 Active Days: 7	6.75	28.64	15.97	0.02	0.07	1.95	2.02	0.02	1.79	1.82	3,382.78
Asphalt 12/01/2011-12/09/2011	6.75	28.64	15.97	0.02	0.07	1.95	2.02	0.02	1.79	1.82	3,382.78
Paving Off-Gas	2.99	0.00	0.00	0.00	0.00	0.00	0.00	0.00	0.00	0.00	0.00
Paving Off Road Diesel	2.89	17.44	10.07	0.00	0.00	1.52	1.52	0.00	1.40	1.40	1,395.24
Paving On Road Diesel	0.81	11.09	3.98	0.02	0.06	0.42	0.48	0.02	0.39	0.41	1,738.79
Paving Worker Trips	0.06	0.11	1.93	0.00	0.01	0.01	0.02	0.00	0.01	0.01	248.75

Construction Related Mitigation Measures

The following mitigation measures apply to Phase: Fine Grading 7/1/2011 - 11/30/2011 - Default Fine Site Grading/Excavation Description  
For Soil Stabilizing Measures, the Water exposed surfaces 3x daily watering mitigation reduces emissions by:  
PM10: 61% PM25: 61%

3/9/2011 03:05:01 PM

Urbemis 2007 Version 9.2.4

Combined Winter Emissions Reports (Pounds/Day)

File Name: G:\2010\10-0153\Environmental\Initial Study\Technical Studies\Airproject.urb924

Project Name: Pyrite Street Improvement Project

Project Location: Riverside County

On-Road Vehicle Emissions Based on: Version : Emfac2007 V2.3 Nov 1 2006

Off-Road Vehicle Emissions Based on: OFFROAD2007

Summary Report:

CONSTRUCTION EMISSION ESTIMATES

	ROG	NOx	CO	SO2	PM10 Dust	PM10 Exhaust	PM10	PM2.5 Dust	PM2.5 Exhaust	PM2.5	CO2
2011 TOTALS (lbs/day unmitigated)	6.75	37.12	22.32	0.02	37.71	2.41	40.12	7.88	2.22	10.10	3,829.61
2011 TOTALS (lbs/day mitigated)	6.75	37.12	22.32	0.02	19.54	2.41	21.95	4.08	2.22	6.30	3,829.61

Construction Unmitigated Detail Report:

CONSTRUCTION EMISSION ESTIMATES Winter Pounds Per Day, Unmitigated

	ROG	NOx	CO	SO2	PM10 Dust	PM10 Exhaust	PM10	PM2.5 Dust	PM2.5 Exhaust	PM2.5	CO2
Time Slice 7/1/2011-11/30/2011 Active Days: 109	5.07	37.12	22.32	0.00	37.71	2.41	40.12	7.88	2.22	10.10	3,829.61
Fine Grading 07/01/2011-11/30/2011	5.07	37.12	22.32	0.00	37.71	2.41	40.12	7.88	2.22	10.10	3,829.61
Fine Grading Dust	0.00	0.00	0.00	0.00	37.70	0.00	37.70	7.87	0.00	7.87	0.00
Fine Grading Off Road Diesel	5.02	37.02	20.63	0.00	0.00	2.41	2.41	0.00	2.21	2.21	3,611.95
Fine Grading On Road Diesel	0.00	0.00	0.00	0.00	0.00	0.00	0.00	0.00	0.00	0.00	0.00
Fine Grading Worker Trips	0.05	0.10	1.69	0.00	0.01	0.01	0.02	0.00	0.01	0.01	217.66
Time Slice 12/1/2011-12/9/2011 Active Days: 7	6.75	28.64	15.97	0.02	0.07	1.95	2.02	0.02	1.79	1.82	3,382.78
Asphalt 12/01/2011-12/09/2011	6.75	28.64	15.97	0.02	0.07	1.95	2.02	0.02	1.79	1.82	3,382.78
Paving Off-Gas	2.99	0.00	0.00	0.00	0.00	0.00	0.00	0.00	0.00	0.00	0.00
Paving Off Road Diesel	2.89	17.44	10.07	0.00	0.00	1.52	1.52	0.00	1.40	1.40	1,395.24
Paving On Road Diesel	0.81	11.09	3.98	0.02	0.06	0.42	0.48	0.02	0.39	0.41	1,738.79
Paving Worker Trips	0.06	0.11	1.93	0.00	0.01	0.01	0.02	0.00	0.01	0.01	248.75



3/9/2011 03:05:01 PM

Phase Assumptions

Phase: Fine Grading 7/1/2011 - 11/30/2011 - Default Fine Site Grading/Excavation Description

Total Acres Disturbed: 8

Maximum Daily Acreage Disturbed: 2

Fugitive Dust Level of Detail: Low

Onsite Cut/Fill: 150 cubic yards/day; Offsite Cut/Fill: 0 cubic yards/day

On Road Truck Travel (VMT): 0

Off-Road Equipment:

1 Crushing/Processing Equip (142 hp) operating at a 0.78 load factor for 8 hours per day

1 Excavators (168 hp) operating at a 0.57 load factor for 8 hours per day

1 Graders (174 hp) operating at a 0.61 load factor for 8 hours per day

2 Tractors/Loaders/Backhoes (108 hp) operating at a 0.55 load factor for 8 hours per day

1 Trenchers (63 hp) operating at a 0.75 load factor for 8 hours per day

1 Water Trucks (189 hp) operating at a 0.5 load factor for 8 hours per day

Phase: Paving 12/1/2011 - 12/9/2011 - Default Paving Description

Acres to be Paved: 8

Off-Road Equipment:

4 Cement and Mortar Mixers (10 hp) operating at a 0.56 load factor for 8 hours per day

1 Pavers (100 hp) operating at a 0.62 load factor for 8 hours per day

2 Paving Equipment (104 hp) operating at a 0.53 load factor for 8 hours per day

1 Rollers (95 hp) operating at a 0.56 load factor for 8 hours per day

3/9/2011 03:05:01 PM

Construction Mitigated Detail Report:

CONSTRUCTION EMISSION ESTIMATES Winter Pounds Per Day, Mitigated

	ROG	NOx	CO	SO2	PM10 Dust	PM10 Exhaust	PM10	PM2.5 Dust	PM2.5 Exhaust	PM2.5	CO2
Time Slice 7/1/2011-11/30/2011 Active Days: 109	5.07	37.12	22.32	0.00	19.54	2.41	21.95	4.08	2.22	6.30	3,829.61
Fine Grading 07/01/2011-11/30/2011	5.07	37.12	22.32	0.00	19.54	2.41	21.95	4.08	2.22	6.30	3,829.61
Fine Grading Dust	0.00	0.00	0.00	0.00	19.53	0.00	19.53	4.08	0.00	4.08	0.00
Fine Grading Off Road Diesel	5.02	37.02	20.63	0.00	0.00	2.41	2.41	0.00	2.21	2.21	3,611.95
Fine Grading On Road Diesel	0.00	0.00	0.00	0.00	0.00	0.00	0.00	0.00	0.00	0.00	0.00
Fine Grading Worker Trips	0.05	0.10	1.69	0.00	0.01	0.01	0.02	0.00	0.01	0.01	217.66
Time Slice 12/1/2011-12/9/2011 Active Days: 7	6.75	28.64	15.97	0.02	0.07	1.95	2.02	0.02	1.79	1.82	3,382.78
Asphalt 12/01/2011-12/09/2011	6.75	28.64	15.97	0.02	0.07	1.95	2.02	0.02	1.79	1.82	3,382.78
Paving Off-Gas	2.99	0.00	0.00	0.00	0.00	0.00	0.00	0.00	0.00	0.00	0.00
Paving Off Road Diesel	2.89	17.44	10.07	0.00	0.00	1.52	1.52	0.00	1.40	1.40	1,395.24
Paving On Road Diesel	0.81	11.09	3.98	0.02	0.06	0.42	0.48	0.02	0.39	0.41	1,738.79
Paving Worker Trips	0.06	0.11	1.93	0.00	0.01	0.01	0.02	0.00	0.01	0.01	248.75

Construction Related Mitigation Measures

The following mitigation measures apply to Phase: Fine Grading 7/1/2011 - 11/30/2011 - Default Fine Site Grading/Excavation Description

For Soil Stabilizing Measures, the Water exposed surfaces 3x daily watering mitigation reduces emissions by:

PM10: 61% PM25: 61%

3/9/2011 03:05:10 PM

Urbemis 2007 Version 9.2.4

Combined Annual Emissions Reports (Tons/Year)

File Name: G:\2010\10-0153\Environmental\Initial Study\Technical Studies\Air\project.urb924

Project Name: Pyrite Street Improvement Project

Project Location: Riverside County

On-Road Vehicle Emissions Based on: Version : Emfac2007 V2.3 Nov 1 2006

Off-Road Vehicle Emissions Based on: OFFROAD2007

Summary Report:

CONSTRUCTION EMISSION ESTIMATES

	<u>CO2</u>
2011 TOTALS (tons/year unmitigated)	220.55
2011 TOTALS (tons/year mitigated)	220.55
Percent Reduction	0.00

Construction Unmitigated Detail Report:

CONSTRUCTION EMISSION ESTIMATES Annual Tons Per Year, Unmitigated

	<u>CO2</u>
2011	220.55
Fine Grading 07/01/2011-11/30/2011	208.71
Fine Grading Dust	0.00
Fine Grading Off Road Diesel	196.85
Fine Grading On Road Diesel	0.00
Fine Grading Worker Trips	11.86
Asphalt 12/01/2011-12/09/2011	11.84
Paving Off-Gas	0.00
Paving Off Road Diesel	4.88
Paving On Road Diesel	6.09
Paving Worker Trips	0.87

Phase Assumptions

Phase: Fine Grading 7/1/2011 - 11/30/2011 - Default Fine Site Grading/Excavation Description

Total Acres Disturbed: 8

Maximum Daily Acreage Disturbed: 2

Fugitive Dust Level of Detail: Low

Onsite Cut/Fill: 150 cubic yards/day; Offsite Cut/Fill: 0 cubic yards/day

3/9/2011 03:05:10 PM

On Road Truck Travel (VMT): 0

Off-Road Equipment:

- 1 Crushing/Processing Equip (142 hp) operating at a 0.78 load factor for 8 hours per day
- 1 Excavators (168 hp) operating at a 0.57 load factor for 8 hours per day
- 1 Graders (174 hp) operating at a 0.61 load factor for 8 hours per day
- 2 Tractors/Loaders/Backhoes (108 hp) operating at a 0.55 load factor for 8 hours per day
- 1 Trenchers (63 hp) operating at a 0.75 load factor for 8 hours per day
- 1 Water Trucks (189 hp) operating at a 0.5 load factor for 8 hours per day

Phase: Paving 12/1/2011 - 12/9/2011 - Default Paving Description

Acres to be Paved: 8

Off-Road Equipment:

- 4 Cement and Mortar Mixers (10 hp) operating at a 0.56 load factor for 8 hours per day
- 1 Pavers (100 hp) operating at a 0.62 load factor for 8 hours per day
- 2 Paving Equipment (104 hp) operating at a 0.53 load factor for 8 hours per day
- 1 Rollers (95 hp) operating at a 0.56 load factor for 8 hours per day

Construction Mitigated Detail Report:

CONSTRUCTION EMISSION ESTIMATES Annual Tons Per Year, Mitigated

	<u>CO2</u>
2011	220.55
Fine Grading 07/01/2011-11/30/2011	208.71
Fine Grading Dust	0.00
Fine Grading Off Road Diesel	196.85
Fine Grading On Road Diesel	0.00
Fine Grading Worker Trips	11.86
Asphalt 12/01/2011-12/09/2011	11.84
Paving Off-Gas	0.00
Paving Off Road Diesel	4.88
Paving On Road Diesel	6.09
Paving Worker Trips	0.87

Construction Related Mitigation Measures

The following mitigation measures apply to Phase: Fine Grading 7/1/2011 - 11/30/2011 - Default Fine Site Grading/Excavation Description

For Soil Stabilizing Measures, the Water exposed surfaces 3x daily watering mitigation reduces emissions by:

PM10: 61% PM25: 61%

**Appendix B**  
**Written Comments and Replies**



EDMUND G. BROWN JR.  
GOVERNOR

STATE OF CALIFORNIA  
GOVERNOR'S OFFICE of PLANNING AND RESEARCH  
STATE CLEARINGHOUSE AND PLANNING UNIT



KEN ALEX  
DIRECTOR

October 15, 2012

Arturo Diaz  
Riverside County Flood Control and Water Conservation  
1995 Market Street  
Riverside, CA 92501

Subject: Pyrite Channel Bypass, Stage 1  
SCH#: 2012091027

Dear Arturo Diaz:

The State Clearinghouse submitted the above named Mitigated Negative Declaration to selected state agencies for review. The review period closed on October 12, 2012, and no state agencies submitted comments by that date. This letter acknowledges that you have complied with the State Clearinghouse review requirements for draft environmental documents, pursuant to the California Environmental Quality Act.

Please call the State Clearinghouse at (916) 445-0613 if you have any questions regarding the environmental review process. If you have a question about the above-named project, please refer to the ten-digit State Clearinghouse number when contacting this office.

Sincerely,

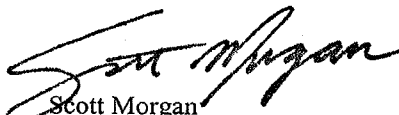
  
Scott Morgan  
Director, State Clearinghouse

RECEIVED  
OCT 18 2012  
RIVERSIDE COUNTY FLOOD CONTROL  
AND WATER CONSERVATION DISTRICT

**Document Details Report  
State Clearinghouse Data Base**

**SCH#** 2012091027  
**Project Title** Pyrite Channel Bypass, Stage 1  
**Lead Agency** Riverside County Flood Control and Water Conservation

**Type** MND Mitigated Negative Declaration

**Description** The proposed project entails the construction and subsequent maintenance of an underground storm drain system and associated street improvements. The proposed storm drain project consists of approximately 1700 lineal feet of reinforced concrete pipe that will convey minor flows from the District's existing concrete lined rectangular Jurupa Channel. Street improvements along Pyrite Street between Jurupa Road and Lone Trail will ensure that the storm drain system functions properly. Utility services to be relocated may include cable, telephone, gas, water and sewer within the road rights-of-way.

**Lead Agency Contact**

**Name** Arturo Diaz  
**Agency** Riverside County Flood Control and Water Conservation  
**Phone** 951-955-1200 **Fax**  
**email**  
**Address** 1995 Market Street  
**City** Riverside **State** CA **Zip** 92501

**Project Location**

**County** Riverside  
**City** Jurupa Valley  
**Region**  
**Lat / Long** 34° 0' 16" N / 117° 27' 44" W  
**Cross Streets** Galena Street and Pyrite Street  
**Parcel No.**  
**Township** 2S **Range** 6W **Section** 12/13 **Base** SBB&M

**Proximity to:**

**Highways** Hwy 60  
**Airports**  
**Railways** UPRR  
**Waterways** Pyrite Channel; Jurupa Channel  
**Schools** Jurupa Unified  
**Land Use** Residential

**Project Issues** Noise; Biological Resources

**Reviewing Agencies** Resources Agency; Department of Fish and Game, Region 6; Department of Parks and Recreation; Department of Water Resources; California Highway Patrol; Caltrans, District 8; State Water Resources Control Board, Division of Water Rights; Regional Water Quality Control Board, Region 9; Native American Heritage Commission; Public Utilities Commission; State Lands Commission

**Date Received** 09/13/2012 **Start of Review** 09/13/2012 **End of Review** 10/12/2012

**NATIVE AMERICAN HERITAGE COMMISSION**

915 CAPITOL MALL, ROOM 364  
SACRAMENTO, CA 95814  
(916) 653-6251  
Fax (916) 657-5390  
Web Site [www.nahc.ca.gov](http://www.nahc.ca.gov)  
[ds\\_nahc@pacbell.net](mailto:ds_nahc@pacbell.net)



September 26, 2012

**RECEIVED**  
OCT 01 2012RIVERSIDE COUNTY FLOOD CONTROL  
AND WATER CONSERVATION DISTRICT

Mr. Arturo Diaz, Project Planner

**Riverside County Flood Control &  
Water Conservation District**

1995 Market Street  
Riverside, CA 92501

Re: SCH#2012091025; CEQA Notice of Completion; proposed Mitigated Negative  
Declaration; for the "Pyrite Channel Bypass Stage 1 Project;" located in the City of  
Jurupa Valley; Riverside County, California

Dear Mr. Diaz

The Native American Heritage Commission (NAHC) is the State of California 'Trustee Agency' for the protection and preservation of Native American cultural resources pursuant to California Public Resources Code §21070 and affirmed by the Third Appellate Court in the case of EPIC v. Johnson (1985: 170 Cal App. 3<sup>rd</sup> 604).

This letter includes state and federal statutes relating to Native American historic properties or resources of religious and cultural significance to American Indian tribes and interested Native American individuals as 'consulting parties' under both state and federal law. State law also addresses the freedom of Native American Religious Expression in Public Resources Code §5097.9.

The California Environmental Quality Act (CEQA – CA Public Resources Code 21000-21177, amendments effective 3/18/2010) requires that any project that causes a substantial adverse change in the significance of an historical resource, that includes archaeological resources, is a 'significant effect' requiring the preparation of an Environmental Impact Report (EIR) per the CEQA Guidelines defines a significant impact on the environment as 'a substantial, or potentially substantial, adverse change in any of physical conditions within an area affected by the proposed project, including ... objects of historic or aesthetic significance.' In order to comply with this provision, the lead agency is required to assess whether the project will have an adverse impact on these resources within the 'area of potential effect (APE)', and if so, to mitigate that effect. The NAHC recommends that the lead agency request that the NAHC do a Sacred Lands File search as part of the careful planning for the proposed project.

The NAHC "Sacred Sites," as defined by the Native American Heritage Commission and the California Legislature in California Public Resources Code §§5097.94(a) and 5097.96. Items in the NAHC Sacred Lands Inventory are confidential and exempt from the Public Records Act pursuant to California Government Code §6254 (r).

**SCANNED**  
149476



Early consultation with Native American tribes in your area is the best way to avoid unanticipated discoveries of cultural resources or burial sites once a project is underway. Culturally affiliated tribes and individuals may have knowledge of the religious and cultural significance of the historic properties in the project area (e.g. APE). We strongly urge that you make contact with the list of Native American Contacts on the attached list of Native American contacts, to see if your proposed project might impact Native American cultural resources and to obtain their recommendations concerning the proposed project. Pursuant to CA Public Resources Code § 5097.95, the NAHC requests cooperation from other public agencies in order that the Native American consulting parties be provided pertinent project information. Consultation with Native American communities is also a matter of environmental justice as defined by California Government Code §65040.12(e). Pursuant to CA Public Resources Code §5097.95, the NAHC requests that pertinent project information be provided consulting tribal parties, including archaeological studies. The NAHC recommends *avoidance* as defined by CEQA Guidelines §15370(a) to pursuing a project that would damage or destroy Native American cultural resources and California Public Resources Code Section 21083.2 (Archaeological Resources) that requires documentation, data recovery of cultural resources, construction to avoid sites and the possible use of covenant easements to protect sites.

Furthermore, the NAHC if the proposed project is under the jurisdiction of the statutes and regulations of the National Environmental Policy Act (e.g. NEPA; 42 U.S.C. 4321-43351). Consultation with tribes and interested Native American consulting parties, on the NAHC list, should be conducted in compliance with the requirements of federal NEPA and Section 106 and 4(f) of federal NHPA (16 U.S.C. 470 *et seq.*), 36 CFR Part 800.3 (f) (2) & .5, the President's Council on Environmental Quality (CSQ, 42 U.S.C 4371 *et seq.* and NAGPRA (25 U.S.C. 3001-3013) as appropriate. The 1992 *Secretary of the Interiors Standards for the Treatment of Historic Properties* were revised so that they could be applied to all historic resource types included in the National Register of Historic Places and including cultural landscapes. Also, federal Executive Orders Nos. 11593 (preservation of cultural environment), 13175 (coordination & consultation) and 13007 (Sacred Sites) are helpful, supportive guides for Section 106 consultation. The aforementioned Secretary of the Interior's *Standards* include recommendations for all 'lead agencies' to consider the historic context of proposed projects and to "research" the cultural landscape that might include the 'area of potential effect.'

Confidentiality of "historic properties of religious and cultural significance" should also be considered as protected by California Government Code §6254( r) and may also be protected under Section 304 of the NHPA or at the Secretary of the Interior discretion if not eligible for listing on the National Register of Historic Places. The Secretary may also be advised by the federal Indian Religious Freedom Act (cf. 42 U.S.C., 1996) in issuing a decision on whether or not to disclose items of religious and/or cultural significance identified in or near the APEs and possibility threatened by proposed project activity.

Furthermore, Public Resources Code Section 5097.98, California Government Code §27491 and Health & Safety Code Section 7050.5 provide for provisions for inadvertent discovery of human remains mandate the processes to be followed in the event of a discovery of human remains in a project location other than a 'dedicated cemetery'.

To be effective, consultation on specific projects must be the result of an ongoing relationship between Native American tribes and lead agencies, project proponents and their contractors, in the opinion of the NAHC. Regarding tribal consultation, a relationship built around regular meetings and informal involvement with local tribes will lead to more qualitative consultation tribal input on specific projects.

Finally, when Native American cultural sites and/or Native American burial sites are prevalent within the project site, the NAHC recommends 'avoidance' of the site as referenced by CEQA Guidelines Section 15370(a).

If you have any questions about this response to your request, please do not hesitate to contact me at (916) 658-6251.

Sincerely,



Dave Singleton  
Program Analyst

Cc: State Clearinghouse

Attachment: Native American Contact List

**Native American Contacts  
Riverside County  
September 26, 2012**

Pala Band of Mission Indians  
Historic Preservation Office/Shasta Gaughen  
35008 Pala Temecula Road, Luiseno  
Pala, CA 92059 Cupeno  
PMB 50  
(760) 891-3515  
sgaughen@palatribe.com  
(760) 742-3189 Fax

Pauma & Yuima Reservation  
Randall Majel, Chairperson  
P.O. Box 369 Luiseno  
Pauma Valley CA 92061  
paumareservation@aol.com  
(760) 742-1289  
(760) 742-3422 Fax

Pechanga Band of Mission Indians  
Paul Macarro, Cultural Resources Manager  
P.O. Box 1477 Luiseno  
Temecula, CA 92593  
(951) 770-8100  
pmacarro@pechanga-nsn.  
gov  
(951) 506-9491 Fax

Ramona Band of Cahuilla Mission Indians  
Joseph Hamilton, Chairman  
P.O. Box 391670 Cahuilla  
Anza, CA 92539  
admin@ramonatribe.com  
(951) 763-4105  
(951) 763-4325 Fax

Rincon Band of Mission Indians  
Vincent Whipple, Tribal Historic Preservation Officer  
P.O. Box 68 Luiseno  
Valley Center, CA 92082  
twolfe@rincontri.org  
(760) 297-2635  
(760) 297-2639 Fax

Gabrielino/Tongva San Gabriel Band of Mission  
Anthony Morales, Chairperson  
PO Box 693 Gabrielino Tongva  
San Gabriel, CA 91778  
GTTribalcouncil@aol.com  
(626) 286-1632  
(626) 286-1758 - Home  
(626) 286-1262 -FAX

Santa Rosa Band of Mission Indians  
John Marcus, Chairman  
P.O. Box 391820 Cahuilla  
Anza, CA 92539  
(951) 659-2700  
(951) 659-2228 Fax

Gabrielino Tongva Nation  
Sam Dunlap, Cultural Resources Director  
P.O. Box 86908 Gabrielino Tongva  
Los Angeles, CA 90086  
samdunlap@earthlink.net  
(909) 262-9351 - cell

This list is current only as of the date of this document.

Distribution of this list does not relieve any person of the statutory responsibility as defined in Section 7050.5 of the Health and Safety Code, Section 5097.94 of the Public Resources Code and Section 5097.98 of the Public Resources Code.

This list is applicable for contacting local Native Americans with regard to cultural resources for the proposed SSCH#2012091027; CEQA Notice of Completion; proposed Mitigated Negative Declaration for the Pyrite Channel Bypass Sstage 1 Project; located in the Jurupa Valley; Riverside County, California.

**Native American Contacts  
Riverside County  
September 26, 2012**

Morongo Band of Mission Indians  
Michael Contreras, Cultural Heritage Prog.  
12700 Pumarra Road                      Cahuilla  
Banning                      , CA 92220                      Serrano  
**(951) 201-1866 - cell**  
mcontreras@morongo-nsn.  
gov  
(951) 922-0105 Fax

San Manuel Band of Mission Indians  
Ann Brierty, Policy/Cultural Resources Department  
26569 Community Center Drive                      Serrano  
Highland                      , CA 92346  
(909) 864-8933, Ext 3250  
abrierty@sanmanuel-nsn.  
gov  
(909) 862-5152 Fax

Rincon Band of Mission Indians  
Bo Mazzetti, Chairperson  
P.O. Box 68                      Luiseno  
Valley Center, CA 92082  
bomazzetti@aol.com  
(760) 749-1051  
(760) 749-8901 Fax

Cabazon Band of Mission Indians  
Judy Stapp, Director of Cultural Affairs  
84-245 Indio Springs                      Cahuilla  
Indio                      , CA 92203-3499  
**markwardt@cabazonindia**  
  
(760) 342-2593  
(760) 347-7880 Fax

Pechanga Band of Mission Indians  
Mark Macarro, Chairperson  
P.O. Box 1477                      Luiseno  
Temecula                      , CA 92593  
tbrown@pechanga-nsn.gov  
(951) 770-6100  
(951) 695-1778 Fax

William J. Pink  
48310 Pechanga Road                      Luiseno  
Temecula                      , CA 92592  
wjpink@hotmail.com  
(909) 936-1216  
Prefers e-mail contact

Cahuilla Band of Indians  
Uther Salgado, Chairperson  
PO Box 391760                      Cahuilla  
Anza                      , CA 92539  
tribalcouncil@cahuilla.net  
915-763-5549

Pechanga Cultural Resources Department  
Anna Hoover, Cultural Analyst  
P.O. Box 2183                      Luiseño  
Temecula                      , CA 92593  
ahoover@pechanga-nsn.gov  
951-770-8104  
(951) 694-0446 - FAX

This list is current only as of the date of this document.

Distribution of this list does not relieve any person of the statutory responsibility as defined in Section 7050.5 of the Health and Safety Code, Section 5097.94 of the Public Resources Code and Section 5097.98 of the Public Resources Code.

This list is applicable for contacting local Native Americans with regard to cultural resources for the proposed SSCH#2012091027; CEQA Notice of Completion; proposed Mitigated Negative Declaration for the Pyrite Channel Bypass Sstage 1 Project; located in the Jurupa Valley; Riverside County, California.

**Native American Contacts  
Riverside County  
September 26, 2012**

Ernest H. Siva  
Morongo Band of Mission Indians Tribal Elder  
9570 Mias Canyon Road      Serrano  
Banning      , CA 92220      Cahuilla  
**siva@dishmail.net**  
(951) 849-4676

**SOBOBA BAND OF LUISENO INDIANS**  
Joseph Ontiveros, Cultural Resource Department  
P.O. BOX 487      Luiseno  
San Jacinto      , CA 92581  
jontiveros@soboba-nsn.gov  
(951) 663-5279  
(951) 654-5544, ext 4137

This list is current only as of the date of this document.

Distribution of this list does not relieve any person of the statutory responsibility as defined in Section 7050.5 of the Health and Safety Code, Section 5097.94 of the Public Resources Code and Section 5097.98 of the Public Resources Code.

This list is applicable for contacting local Native Americans with regard to cultural resources for the proposed SSCH#2012091027; CEQA Notice of Completion; proposed Mitigated Negative Declaration for the Pyrite Channel Bypass Sstage 1 Project; located in the Jurupa Valley; Riverside County, California.

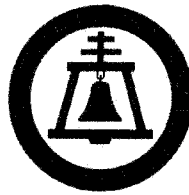

RIVERSIDE COUNTY FLOOD CONTROL  
AND WATER CONSERVATION DISTRICT

October 31, 2012

Mr. Dave Singleton  
Native American Heritage Commission  
915 Capitol Mall, Room 364  
Sacramento, CA 95814

Dear Mr. Singleton:

Re: Pyrite Channel Bypass, Stage 1  
Project No. 1-0-00109-01

Thank you for your letter dated October 24, 2012 commenting on the District's Pyrite Channel Bypass, Stage 1 project (Project). As requested in your letter, the District had a Sacred Lands File Search conducted for the Project area. The results of the search concluded that Native American cultural resource sites were not identified within one-half mile of the Project site.

Based on a record search of prehistoric and historic cultural resources conducted for the Project, there are no known cultural resources within or adjacent to the Project area. The Project alignment has experienced substantial prior ground disturbance as a result of grading performed for the existing Pyrite Street improvements and from adjacent developed properties. Existing water, sewer, gas and communication utilities have been installed within or adjacent to the Project alignment, therefore, it is unlikely that there are any intact archaeological sites present on the Project alignment. However, in the event of an accidental discovery of a cultural and/or an archaeological resource, implementation of the following environmental commitments would ensure potential impacts to archaeological resources will be less than significant:

**Cult EC-1:** If any archaeological or historical resources are discovered during project construction, all work in the area of the find shall cease, and a qualified archaeologist shall investigate the find. If any discovered archaeological or historical resources merit long-term consideration, adequate funding, as determined by the District, will be provided to collect, curate and report these resources in accordance with standard archaeological management requirements.

**Cult EC-3:** Per State Health and Safety Code Section 7050.5, if human remains are encountered during construction, no further disturbance shall occur until the Riverside County Coroner has made a determination of their origin pursuant to State Health and Safety Code Section 7050.5 and Public Resources Code Section 5097.98. The Riverside County Coroner must be notified within 24-hours of the discovery. If the County Coroner determines that the remains are of Native American descent, the Native American Heritage Commission must be contacted within 24-hours to determine the most likely descendent for this area. Once the most likely descendent is determined, treatment of the Native American human remains will proceed pursuant to Public Resources Code Section 5097.98.

Mr. Dave Singleton  
Re: Pyrite Channel Bypass, Stage 1  
Project No. 1-0-00109-01

-2-

October 31, 2012

The proposed Project and Mitigated Negative Declaration are tentatively scheduled to be approved by the District's Board on November 27, 2012. Should you have any further questions, please call Jason Swenson at 951.955.8082 or me at 951.955.1233.

Very truly yours,

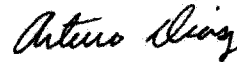

ARTURO DIAZ  
Senior Civil Engineer

cc: Stuart McKibbin  
Bob Cullen  
Mekbib Degaga

JDS:mcv  
P8\150048