

**SUBMITTAL TO THE BOARD OF SUPERVISORS  
COUNTY OF RIVERSIDE, STATE OF CALIFORNIA**

817



**SUBMITTAL DATE:**  
November 29, 2012

**FROM:** Economic Development Agency / Facilities Management

**SUBJECT:** Lease – Department of Public Social Services

**RECOMMENDED MOTION:** That the Board of Supervisors:

1. Approve the attached lease and authorize the Chairman of the Board to execute the same on behalf of the County of Riverside; and
2. Find that the project is exempt from the California Environmental Quality Act (CEQA) pursuant to CEQA Guidelines Section 15301, Existing Facilities.

**BACKGROUND:** (Commences on Page 2)

FISCAL PROCEDURES APPROVED  
PAUL ANGULO, CPA, AUDITOR-CONTROLLER  
BY: Samuel Wong 4/28/12  
SAMUEL WONG

*Robert Field*

Robert Field  
Assistant County Executive Officer/EDA

<b>FINANCIAL DATA</b>	Current F.Y. Total Cost:	\$ (58,858)	In Current Year Budget:	Yes
	Current F.Y. Net County Cost:	\$ (865)	Budget Adjustment:	No
	Annual Net County Cost:	\$10,856	For Fiscal Year:	2012/13

**COMPANION ITEM ON BOARD AGENDA:** No

<b>SOURCE OF FUNDS:</b> Federal 61.11%; State 6.51%; County 1.47%; Realignment 8.61%; Realignment 2011 22.30%	<b>Positions To Be Deleted Per A-30</b>	<input type="checkbox"/>
	<b>Requires 4/5 Vote</b>	<input type="checkbox"/>

**C.E.O. RECOMMENDATION:**

APPROVE

*Jennifer L. Sargent*  
BY: \_\_\_\_\_  
Jennifer L. Sargent

**County Executive Office Signature**

**MINUTES OF THE BOARD OF SUPERVISORS**

On motion of Supervisor Stone, seconded by Supervisor Benoit and duly carried by unanimous vote, IT WAS ORDERED that the above matter is approved as recommended.

**Ayes:** Buster, Tavaglione, Stone, Benoit and Ashley  
**Nays:** None  
**Absent:** None  
**Date:** December 11, 2012  
**xc:** EDA, DPSS, Auditor

Kecia Harper-Ihem  
Clerk of the Board  
By: *Kecia Harper-Ihem*  
Deputy

**Prev. Agn. Ref.:** 3.33 of 12/18/07; 3.11 of 7/25/00; 3.36 of 6/05/01;  
3.26 of 8/13/02; 3.9 of 4/26/05

**District:** 5/5

**Agenda Number:**

**3.7**

ATTACHMENTS FILED  
WITH THE CLERK OF THE BOARD

FORM APPROVED COUNTY COUNSEL  
BY: *Patricia Munroe*  
DATE: 11/5/12  
CONCURRENCE

By: *Susan Loew*  
Susan Loew, Director  
Department of Public Social Services

Dept' Recomm.:  Consent  Policy   
Per Exec. Ofc.:  Consent  Policy

**BACKGROUND:**

The County has been under lease and the Department of Public Social Services (DPSS) has occupied the Bel Air Plaza 3-building complex located at 23119 Cottonwood Avenue, Moreno Valley, since 1995. The attached lease, representing building B, has been in effect and occupied by DPSS' 24-hour Children's Services Division and Self Sufficiency Greater Avenues for Independence (GAIN) program since 2000. The location continues to meet the requirements of DPSS, and this new lease document submitted for approval represents a 5-year renewal.

The Lease was reviewed and determined to be categorically exempt from CEQA Guidelines Section 15301, Class 1 – Existing Facilities. The proposed project, the Lease, is the letting of property involving existing facilities. No expansion of an existing use will occur. A summary of the Lease is as follows:

Location: 23119 Cottonwood Avenue, Building B  
Moreno Valley, CA 92553

Lessor: Bel Air Plaza, LTD  
9201 Wilshire Blvd., Suite 103  
Beverly Hills, CA 90210

Size: 30,656 square feet.

Term: Five years commencing December 1, 2012, and expiring November 30, 2017.

Rent:

	<u>Current</u>	<u>New</u>
	\$ 2.05 per sq. ft.	\$ 1.79 per sq. ft.
	\$ 62,964.59 per month	\$ 54,874.24 per month
	\$755,575.08 per year	\$658,490.88 per year

Rent Adjustments: 2.5% Annually.

Utilities: County pays electric. Lessor pays all others.

Custodial: Provided by Lessor.

Interior/Exterior Maintenance: Provided by Lessor.

Improvements: Paint and carpet replacement at Lessor's expense.

RCIT: None.

The attached Lease has been reviewed and approved by County Counsel as to legal form.

**FINANCIAL DATA:** (Commences on Page 3)

**FINANCIAL DATA:**

All associated costs for this Lease will be fully funded through the DPSS budget. While the EDA will front the costs for the Lease with the Lessor, DPSS will reimburse the EDA for all associated lease costs. The amount of the cost decrease is not material; therefore, DPSS and EDA are not requesting a budget adjustment at this time.

**Attachments:**

Lease  
Exhibit A  
Exhibit B

# Exhibit A

## DPSS Lease Cost Analysis FY 2012/13 23119 Cottonwood Avenue, Building B, Moreno Valley, California

### Total Square Footage to be Leased:

#### **EXPECTED AMOUNTS**

Current office: 30,656 SQFT  
**Total Expected Lease Cost for FY 2012/13** \$ 755,575.08

#### **ACTUAL AMOUNTS**

Proposed Office: 30,656 SQFT

Approximate Cost per SQFT (July - Nov)	\$ 2.05	
Approximate Cost per SQFT (Dec - June)	\$ 1.79	
Lease Cost per Month (July - Nov)	\$ 62,964.59	
Lease Cost per Month (Dec - June)	\$ 54,874.24	
Total Lease Cost (July - Nov)	\$ 314,822.95	
Total Lease Cost (Dec - June)	\$ 384,119.68	
<b>Total Actual Lease Cost for FY 2012/13</b>		\$ 698,942.63
<b>Total Lease Cost Variance for FY 2012/13</b>		\$ (56,632.45)

### Estimated Additional Costs:

#### **EXPECTED AMOUNTS**

Utility Cost per Square Foot	\$ 0.12	
Estimated Utility Costs per Month (July - June)	\$ 3,678.72	
Total Estimated Utility Cost for FY 2012/13	\$ 44,144.64	
RCIT	\$ -	
Tenant Improvements	\$ -	
EDA Lease Management Fee (Based @ 3.93%)	\$ 29,694.10	
<b>Total Estimated Expected Cost for FY 2012/13</b>		\$ 73,838.74

#### **ACTUAL AMOUNTS**

Utility Cost per Square Foot	\$ 0.12	
Costs per Month (July - June)	\$ 3,678.72	
Total Estimated Actual Utility Cost for FY 2012/13	\$ 44,144.64	
RCIT		
Tenant Improvements		
EDA Lease Management Fee (Based @ 3.93%)	\$ 27,468.45	
<b>Total Estimated Actual Cost for FY 2012/13</b>		\$ 71,613.09
<b>Total Estimated Cost Variance for FY 2012/13</b>		\$ (2,225.66)
<b>TOTAL ESTIMATED COST FOR FY 2012/13</b>		\$ (58,858.11)
<b>TOTAL COUNTY COST: 1.47%</b>		\$ (865.21)

# Exhibit B

## DPSS Lease Cost Analysis FY 2013/14 23119 Cottonwood Avenue, Building B, Moreno Valley, California

### Current Square Feet Occupied:

Current Office:	30,656	SQFT	
Approximate Cost per SQFT (July - Nov)	\$	1.79	
Approximate Cost per SQFT (Dec - June)	\$	1.83	
Lease Cost per Month (July - Nov)		\$	54,874.24
Lease Cost per Month (Dec - June)		\$	56,246.10
Total Lease Cost (July - Nov)		\$	274,371.20
Total Lease Cost (Dec - June)		\$	393,722.67
<b>Total Expected Lease Cost for FY 2013/14</b>		<b>\$</b>	<b>668,093.87</b>

### Estimated Additional Costs:

Utility Cost per Square Foot	\$	0.12	
Estimated Utility Costs per Month (July - June)		\$	<u>3,678.72</u>
Total Estimated Utility Cost for FY 2013/14		\$	44,144.64
Tenant Improvement			
EDA Lease Management Fee (Based @ 3.93%)		\$	<u>26,256.09</u>
<b>TOTAL ESTIMATED COST FOR FY 2013/14</b>		<b>\$</b>	<b><u>738,494.60</u></b>
<b>TOTAL COUNTY COST: 1.47%</b>		<b>\$</b>	<b>10,855.87</b>

# LEASE

Department of Public Social Services  
23119 Cottonwood Ave., Building B  
Moreno Valley, California

## Table of Contents

1.	Parties.....	1
2.	Premises.....	1
	2.1 Letting.....	1
	2.2 Defined.....	1
	2.3 Common Area Defined.....	1
	2.4 County's Rights – Common Area.....	1
	2.5 Condition of Premises.....	2
3.	Use.....	2
4.	Term.....	2
	4.1 Commencement.....	2
	4.2 Holding Over.....	2
5.	Rent.....	2
	5.1 Rent.....	2
	5.2 Percentage Increase.....	2
6.	Options.....	2
	6.1 Option to Extend Term.....	2
	6.2 Right of First Refusal to Lease Additional Space.....	3
	6.3 Right of First Refusal to Extend Lease Term.....	3
	6.4 County's Right to Early Termination.....	3
7.	Compliance.....	4
	7.1 Compliance.....	4
	7.2 Americans With Disabilities.....	4
	7.3 Asbestos and Lead Based Paint.....	4
	7.4 Hazardous Substance.....	4
	7.5 Sick Building Syndrome.....	5
	7.6 Waste Water.....	5
8.	Custodial Services.....	5
	8.1 Custodial Services.....	5
	8.2 County's Right to Provide Custodial Services and Deduct Costs.....	5
9.	Utilities.....	6
10.	Repairs and Maintenance.....	6
	10.1 Lessor's Repair and Maintenance Obligations.....	6
	10.2 Lessor's Default.....	6
	10.3 County's Right to Make Repairs and Deduct Cost.....	7
	10.4 Emergency Repairs.....	7
	10.5 Periodic Services.....	8
11.	Alterations and Additions.....	8
	11.1 Improvements by Lessor.....	8
	11.2 Improvements by County.....	9
	11.3 Communications Equipment.....	9

12.	Exculpation, Indemnification, and Insurance.....	9
	12.1 Exculpation.....	9
	12.2 Indemnification and Hold Harmless.....	10
	12.3 Insurance.....	11
13.	Damage and Destruction.....	13
	13.1 Repair of Damage.....	13
	13.2 Repair Period Notice.....	14
	13.3 Lessor's Option to Terminate or Repair .....	14
	13.4 County's Option to Terminate .....	14
	13.5 Rent Abatement Due to Casualty.....	14
	13.6 Damage Near End of Term.....	14
	13.7 Effective Date of Termination; Rent Apportionment .....	14
	13.8 Waiver of Statutory Provisions .....	15
	13.9 Release on Termination.....	15
14.	Eminent Domain.....	15
	14.1 Total Condemnation .....	15
	14.2 Partial Condemnation .....	15
	14.3 Award .....	15
	14.4 Temporary Condemnation .....	15
15.	Estoppel Certificates .....	16
16.	Subordination, Non-Disturbance and Attornment .....	16
	16.1 Subordination, Non-Disturbance and Attornment Agreement.....	16
	16.2 Subordination .....	16
	16.3 Attornment.....	16
17.	Breach by Lessor .....	16
	17.1 Lessor's Default.....	16
	17.2 County's Right to Cure Lessor's Default and Deduct Cost .....	16
	17.3 Rent Setoff.....	17
18.	Lessor's Representations and Warranties .....	17
	18.1 Title.....	17
	18.2 Certificate of Authority.....	17
	18.3 No Litigation.....	17
	18.4 Easements.....	17
19.	Miscellaneous .....	17
	19.1 Quiet Enjoyment .....	17
	19.2 Non Waiver.....	17
	19.3 Binding on Successors .....	17
	19.4 Severability .....	18
	19.5 Venue .....	18
	19.6 Attorney's Fees.....	18
	19.7 County's Representative.....	18
	19.8 Agent for Service of Process.....	18
	19.9 Entire Lease .....	18
	19.10 Interpretation .....	18
	19.11 Time of Essence.....	18
	19.12 Recording .....	19
	19.13 Consent.....	19

19.14	Title.....	19
19.15	Conveyance by Lessor .....	19
19.16	Mechanic's Liens .....	19
19.17	Surrender.....	19
19.18	Notice .....	19
19.19	Authority .....	20
19.20	Approval of Supervisors.....	21

## EXHIBITS

The following exhibits are attached hereto and made a part of this Lease:

Site Plan.....	Exhibit A
Floor Plan.....	Exhibit B
Asbestos.....	Exhibit C
Custodial Services Agreement.....	Exhibit D
General Construction Specifications for Leased Facilities.....	Exhibit E
Estoppel Certificate.....	Exhibit F
Subordination, Non-Disturbance & Attornment Agreement.....	Exhibit G



1 **LEASE**

2 Department of Public Social Services

3 23119 Cottonwood Ave., Building B

4 Moreno Valley, California

5 **1. Parties.**

6 **1.1** This Lease ("Lease") is made by and between the **COUNTY OF RIVERSIDE**,  
7 hereinafter referred to as "County" and **BEL AIR PLAZA, LP**, a California limited partnership,  
8 hereinafter referred to as "Lessor." County and Lessor are hereinafter collectively referred to  
9 as the "Parties" or individually as a "Party."

10 **2. Premises.**

11 **2.1 Letting.** Lessor hereby leases to County, and County hereby leases from  
12 Lessor, the Premises, for the term, at the rental, and upon all terms, covenants and conditions  
13 set forth in this Lease.

14 **2.2 Defined.** The Premises shall consist of that certain portion of the Project, as  
15 defined herein, including all improvements therein or to be provided by Lessor under the terms  
16 of this Lease, and commonly known as 23119 Cottonwood Avenue, Building B, located in the  
17 City of Moreno Valley, County of Riverside, State of California, also identified as Assessor's  
18 Parcel Number 296-151-029-5 and generally described as office space consisting of  
19 approximately 30,656 square feet with a minimum of 123 reserved, secured, and non-exclusive  
20 common area parking spaces, all as shown on the site plan attached as Exhibit "A." It is  
21 understood that the Premises include all appurtenances and easements thereto and the non-  
22 exclusive right of ingress and egress at all times to and from the public streets and highways  
23 for County, its employees and invitees. The Premises, the building, the Common Areas, the  
24 land upon which they are located, along with all other buildings and improvements thereon, are  
25 herein collectively referred to as the "Project."

26 **2.3 Common Areas Defined.** The term "Common Areas" is defined as all areas  
27 and facilities outside the Premises and within the exterior boundary line of the Project and  
28 interior utility raceways and installations within the Premises that are provided by and

1 designated by the Lessor from time to time for the general non-exclusive use of Lessor,  
2 County, and other tenants of the Project and their respective employees, suppliers, shippers,  
3 customers, contractors, and invitees, including but not limited to common restrooms, parking  
4 areas, loading and unloading zones, trash areas, roadways, walkways, driveways, and  
5 landscaped areas.

6 **2.4 County's Rights-Common Areas.** Lessor grants to County, for the benefit of  
7 the County and its employees, suppliers, shippers, customers, contractors, and invitees, during  
8 the term of this Lease, the non-exclusive right to use, in common with others entitled to such  
9 use, the Common Areas as same may from time to time exist. Lessor shall have the right to  
10 promulgate rules and regulations for the management, safety, care, and cleanliness of the  
11 Common Areas provided, however, that said rules and regulations shall be subject to the  
12 approval of County. County's prior approval shall be required for any changes to the Common  
13 Areas which adversely affect County's use and occupancy of the Premises, the parking, or  
14 accessibility of the Premises.

15 **2.5 Condition of Premises.** Lessor shall deliver the Premises to County in a fully  
16 clean and safe condition, free of hazards and debris, entirely permitted and inspected by local  
17 authorities, on the Commencement Date, and Lessor warrants for the term of this Lease, that  
18 all systems and equipment, including, but not limited to, electrical, plumbing, fire sprinkler, fire  
19 suppression system, fire/life/safety system, elevators, security systems, lighting, heating,  
20 ventilating and air conditioning systems ("HVAC"), loading doors, if any, that serve the  
21 Premises and all other such elements in the Premises (herein defined as the "Base Building  
22 Systems"), other than those installed or constructed by County, shall be in safe, hazard free,  
23 good operating condition, and, the roof, bearing walls and foundation of the Premises shall be  
24 free of material defect.

25 **3. Use.** County shall use and occupy the Premises for the purpose of providing office  
26 space for use by the Department of Public Social Services, but the Premises may be used for  
27 any official business of County government or any other legal use which is reasonably  
28

1 comparable thereto. Nothing contained in this Lease shall be construed to require County to  
2 occupy the Premises continuously.

3 **4. Term.**

4 **4.1 Commencement.** This Lease shall be effective upon the date of its full  
5 execution by the parties hereto. The Term of this Lease shall be for a period of five (5) years  
6 ("Original Term") commencing December 1, 2012. The Original Term shall expire at midnight  
7 on November 30, 2017 ("Expiration Date").

8 **4.2 Holding Over.** Any holding over by County after the expiration of said term or  
9 any extension thereof shall be deemed a month to month tenancy upon the same terms and  
10 conditions of this Lease.

11 **5. Rent.** The anniversary dates shall be deemed to fall on the first day of the first full  
12 month of each lease year following commencement of the Lease term.

13 **5.1 Rent.** County shall pay the sum of Fifty Four Thousand Eight Hundred Seventy  
14 Four Dollars and 24/100ths (\$54,874.24) per month to Lessor as rent for the Leased Premises,  
15 payable, in advance, on the first day of the month or as soon thereafter as a warrant can be  
16 issued in the normal course of County's business.

17 **5.2 Percentage Increase.** Notwithstanding the provisions of Section 5.1 herein, the  
18 monthly rent shall be increased on each anniversary of this Lease by an amount equal to two  
19 and one half percent (2.5 %) of such monthly rental.

20 **6. Options.**

21 **6.1 Option to Extend Term.** Lessor grants to County two option(s) to extend the  
22 Lease term ("Extension Option(s)"). Each Extension Option shall be for a period of two years  
23 ("Extended Term"), subject to the conditions described in this Section 6.1.

24 **6.1.1 Exercise of Option.** The Extension Option(s) shall be exercised by  
25 County delivering to Lessor written notice thereof no later than sixty (60) days prior to the  
26 expiration of the Original Term or any extension thereof.

27 **6.1.2 Option Rent.** The rent payable by County during any Extended Term  
28 shall be increased two and one half percent (2.5%) of the previous month's rent.

1           **6.1.3** All terms and conditions of this Lease with exception of Rent and  
2 Lease Term shall remain in full force and effect during the Extended Term.

3           **6.2 Right of First Refusal to Lease Additional Space.** Lessor hereby grants to  
4 County a right of first refusal to lease the other premises in the building containing the leased  
5 Premises ("Adjacent Premises"), in the event Lessor received a bona fide offer from a third  
6 party to lease any portion of the Adjacent Premises, which offer is acceptable to Lessor. Lessor  
7 shall promptly notify County in writing of the offer, including the square footage of the portion of  
8 the Adjacent Premises proposed to be let and other terms and conditions of the offer. County  
9 shall have thirty (30) days within which to notify Lessor in writing whether County agrees to  
10 lease the portion of the Adjacent Premises under such offer upon the terms and conditions set  
11 forth in such offer. In the event County fails to give written notice of its election to lease the  
12 proposed additional space, Lessor shall be free to accept the bona fide offer and lease the  
13 Adjacent Premises to the third party. If the third party fails to lease such portion of the  
14 Adjacent Premises and the Adjacent Premises (or remaining portion of the Adjacent Premises)  
15 remains available; County shall have the same right of first refusal granted herein with regard  
16 to any future offer to lease such portion of the Adjacent Premises.

17           **6.3 Right of First Refusal to Extend Lease Term.** At such time as the Original  
18 Term and/or Extended Terms have expired, in further consideration of the Rent, Covenants,  
19 and Conditions to be paid, performed, and observed by County, Lessor hereby grants to  
20 County a right of first refusal to extend the Lease of the Premises. In the event Lessor receives  
21 a bona fide offer from a third party to lease the Premises, which offer is acceptable to Lessor,  
22 Lessor shall promptly notify County in writing of the offer, including the amount of rent offered  
23 and other terms and conditions of the offer. County shall have thirty (30) business days within  
24 which to notify Lessor in writing whether County agrees to extend the Lease of the Premises on  
25 the same terms and conditions as the third party offer. In the event County elects to extend the  
26 Lease of the Premises, the Lease shall be subject to the same terms and conditions as the  
27 third party offer, including, but not limited to, amount of rent, term, and commencement date. In  
28 the event County fails to give written notice of its election to extend the Lease of the Premises,

1 Lessor shall be free to accept the bona fide offer and lease the Premises to the third party. If  
2 the third party fails to lease the Premises and the Premises remains available, County shall  
3 have the same right of first refusal granted herein with respect to a bona fide offer to lease the  
4 Premises by a subsequent third party offerer.

5 **6.4 County's Right to Early Termination.** The Parties hereto recognize and  
6 understand that the rental consideration hereunder originates from County, State and/or  
7 Federal sources, and therefore County shall have the right to terminate this Lease (a) if such  
8 funding is reduced or otherwise becomes unavailable, based on County's annual fiscal budget,  
9 or (b) if any law, rule or regulation precludes, prohibits or materially adversely impairs County's  
10 ability to use the Premises for the use permitted herein, or (c) if County in its sole discretion  
11 determines that the Premises are no longer suitable for its use for any reason or cause.

12 **6.4.1 Notice.** County shall provide Lessor with written notification of its  
13 election to terminate this Lease at least sixty (60) days prior to the date of termination. County's  
14 notice shall state the reason for its termination of this Lease. County's obligation to pay Rent  
15 shall continue through the termination date.

16 **7. Compliance.**

17 **7.1 Compliance.** Lessor warrants that the Premises and improvements on the  
18 Premises shall comply with all applicable State and Federal laws, covenants or restrictions of  
19 record, building codes, regulations and ordinances ("Applicable Requirements") in effect on the  
20 Commencement Date of this Lease, regardless of the use to which County will put the  
21 Premises. If the Premises do not comply with said warranty, Lessor shall, promptly after  
22 receipt of written notice from County or any governmental agency having jurisdiction over such  
23 matters setting forth the nature and extent of such non-compliance, rectify the same at Lessor's  
24 expense. If the Applicable Requirements are hereinafter changed so as to require during the  
25 term of this Lease, unless same is the result of the use to which County puts the Premises, the  
26 construction of an addition to or an alteration of the Premises, the remediation of any  
27 Hazardous Substance as hereinafter defined, or the reinforcement or other physical  
28 modification of the Premises Lessor shall, promptly after receipt of written notice from County

1 or any governmental agency having jurisdiction over such matters setting forth the nature and  
2 extent of such non-compliance, rectify the same at Lessor's expense.

3 **7.2 Americans with Disabilities.** Lessor warrants and represents the Premises  
4 shall be readily accessible to and usable by individuals with disabilities in compliance with Title  
5 III of the Americans with Disabilities Act of 1990 and California Title 24, as amended from time  
6 to time and regulations issued pursuant thereto and in effect from time to time. Any cost  
7 incurred to cause the Premises to comply with said Act shall be borne by Lessor.

8 **7.3 Asbestos and Lead Based Paint.** Lessor warrants and represents the  
9 Premises shall be constructed, operated and maintained free of hazard from asbestos and lead  
10 based paint, as more fully set forth in the attached Exhibit "C."

11 **7.4 Hazardous Substance.** It is the intent of the Parties to construe the term  
12 "Hazardous Substances" in its broadest sense. Hazardous Substance shall be defined as any  
13 product, substance, or waste whose presence, use, manufacture, disposal, transportation, or  
14 release, either by itself or in combination with other materials, is either: (a) potentially injurious  
15 to the public health, safety or welfare, the environment or the Premises; (b) regulated or  
16 monitored by any governmental authority; or (c) a basis for potential liability of County to any  
17 governmental agency or third party under any applicable statute or common law theory.

18 Lessor acknowledges that County's use may from time to time require the presence of  
19 Hazardous Substances at the Premises. County agrees that all such Hazardous Substances  
20 located in, at, or on the Premises shall be used, stored, handled, treated, transported, and  
21 disposed of in compliance with all applicable laws.

22 Lessor warrants and represents to County that Lessor has not used, discharged,  
23 dumped, spilled or stored any Hazardous Substances on or about the Premises, whether  
24 accidentally or intentionally, legally or illegally, and has received no notice of such occurrence  
25 and has no knowledge that any such condition exists at the Premises. If any claim is ever  
26 made against County relating to Hazardous Substances present at or around the Premises,  
27 whether or not such substances are present as of the date hereof, or any such Hazardous  
28 Substances are hereafter discovered at the Premises (unless introduced by County, its agents

1 or employees), all costs of removal incurred by, all liability imposed upon, or damages suffered  
2 by County because of the same shall be borne by Lessor, and Lessor hereby indemnifies and  
3 agrees to be responsible for and defend and hold County harmless from and against all such  
4 costs, losses, liabilities and damages, including, without limitation, all third-party claims  
5 (including sums paid in settlement thereof, with or without legal proceedings) for personal injury  
6 or property damage and other claims, actions, administrative proceedings, judgments,  
7 compensatory and punitive damages, lost profits, penalties, fines, costs, losses, attorneys' fees  
8 and expenses (through all levels of proceedings), consultants or experts fees and costs  
9 incurred in enforcing this indemnity. The representation, warranty and indemnity of Lessor  
10 described in this Paragraph shall survive the termination or expiration of this Lease.

11 **7.5 Sick Building Syndrome.** Lessor warrants and represents the Premises shall  
12 be constructed, operated and maintained free of certain hazards, including, but not limited to:  
13 spores, fungus, molds, bacteria, chemicals or fumes or other causes of any hazardous micro-  
14 environments, sometimes known as "Sick Building Syndrome," emanating from or within the  
15 Premises that may potentially cause discomfort, bodily injury, sickness or death. Should it be  
16 determined that remediation is necessary based on a report by a trained investigator, Lessor  
17 will promptly contract with a qualified and experienced company to safely remove the micro-  
18 environments using remediation guidelines recommended or required by the appropriate  
19 governmental agency. Any cost incurred to cause the Premises to be free of such hazard shall  
20 be borne by Lessor.

21 **7.6 Waste Water.** Lessor shall be responsible for compliance with all Federal, state  
22 or local laws, regulations or permits pertaining to storm water pollution, prevention plans  
23 ("SWPP") and all National Pollution Discharge Elimination System ("NPDES") laws or  
24 regulations adopted or to be adopted by the United States Environmental Protection Agency.  
25 Parking lot sweeping shall be done as required by NPDES rules or as needed, at least two  
26 times per year, once prior to the rainy season.

27 ///

28 ///

1 **8. Custodial Services.**

2 **8.1 Custodial Services.** Lessor shall provide, or cause to be provided, and pay for  
3 all custodial services in connection with the Leased Premises and such services shall be  
4 provided as set forth in the attached Exhibit "D." The provider of such custodial services will  
5 perform background checks through Live Scan or in the manner specified by County, of  
6 qualified permanent and temporary employees to determine their suitability for employment.  
7 The provider will be bonded in the sum of \$10,000.00, and proof of such insurance, as supplied  
8 by the Lessor, shall be furnished prior to occupancy of Premises by County. In addition to  
9 bonding as required herein, Lessor shall also receive proof of statutory workers' compensation  
10 insurance, commercial general liability and vehicle liability insurance from the provider of any  
11 custodial functions performed at the Premises location.

12 **8.2 County's Right to Provide Custodial Service and Deduct Cost.** If County  
13 provides written notice to Lessor of an event or circumstance that requires the action of Lessor  
14 with respect to the custodial services as set forth in Section 8.1 and Exhibit "D," and Lessor  
15 fails to provide such action as required by the terms of this Lease within three (3) days of  
16 County's notice, County may take the required action to provide custodial services by its staff  
17 or those of a custodial contractor if: (1) County delivers to Lessor an additional written notice  
18 advising Lessor that County intends to take the required action if Lessor does not begin the  
19 required action within forty-eight (48) hours after the written notice; and (2) Lessor fails to begin  
20 the required work within this forty-eight (48) hour period. Upon demand by County, Lessor  
21 shall promptly reimburse County the actual cost and expenses thereof, provided said costs and  
22 expenses are reasonable. Should Lessor fail to promptly pay the cost and expenses, County  
23 may deduct and offset that amount from Rent payable under this Lease. For purposes of this  
24 Section, notice given by fax or e-mail shall be deemed sufficient.

25 **9. Utilities.**

26 **9.1** Lessor warrants and represents to County that during the term of this Lease and  
27 any extension thereof that sufficient utility service to provide water, telecommunications electric  
28 power, natural gas and sewers necessary to meet County's requirements exists or are



1 available for use by County within the Premises.

2       **9.2** County shall pay for all telephone and electrical services within the leased space  
3 which will be used in connection with the Leased Premises. Lessor shall provide, or cause to  
4 be provided, and pay for all other utility services, including, but not limited to, water, natural  
5 gas, refuse collection and sewer services, as may be required in the maintenance, operation  
6 and use of the Leased Premises.

7 **10. Repairs and Maintenance.**

8       **10.1 Lessor's Repair and Maintenance Obligations.** Lessor shall, at Lessor's sole  
9 expense and in accordance with the terms of this Lease, repair, replace and maintain in  
10 attractive condition, good order and function throughout the term in accordance with Exhibit  
11 "E," General Construction Specifications for Leased Facilities, (a) the structural portions of the  
12 Premises (understood to include the roof, foundation and load bearing walls); (b) the  
13 nonstructural portions of the Premises (understood to include the roof covering and membrane)  
14 including, but not limited to, all improvements, alterations, fixtures, but excluding furnishings;  
15 (c) all systems and equipment, including, but not limited to, Base Premises Systems as  
16 heretofore described that serve the Premises; and (d) the exterior portions of the Premises,  
17 and real property including, but not limited to, landscaping, driveways, sidewalks, lighting and  
18 parking facilities servicing the Premises. It is the intent of this paragraph that Lessor performs  
19 any and all building repairs, replacements and maintenance. Lessor agrees to make all repairs  
20 to or alterations of the Premises that may become necessary by reason of industry standard for  
21 age, wear and tear, deferred maintenance or defects in any construction thereof by Lessor.

22       **10.2 Lessor's Default.** Repairs shall be made promptly when appropriate to keep  
23 the applicable portion of the Premises and other items in the condition described in this  
24 Section. Lessor understands certain response time is required to ensure County operations  
25 continue with minimal interruption to ensure the safety of employees and delivery of services.  
26 The commencement of repairs within eight (8) hours from written notice include electrical  
27 power, HVAC operations and certain essential daily custodial services. Lessor shall not be in  
28 default of its repair and maintenance obligations under this Section 10, if Lessor commences

1 the repairs and maintenance within eight (8) hours of the aforementioned areas and thirty (30)  
2 days for all others after written notice by County to Lessor of the need for such repairs and  
3 maintenance. If, due to the nature of the particular repair or maintenance obligation, more than  
4 thirty (30) days are reasonably required to complete it, Lessor shall not be in default under this  
5 Section 10 if Lessor begins work within this thirty (30) day period and diligently pursues this  
6 work to completion.

7 **10.3 County's Right to Make Repairs and Deduct Cost.** If County provides notice  
8 to Lessor of an event or circumstance that requires the action of Lessor with respect to the  
9 replacement, repair or maintenance to the Premises or Base Building Systems serving the  
10 Premises as set forth in Section 10.1 and Lessor fails to provide such action as required by the  
11 terms of this Lease within the period specified in Section 10.2, County may (but shall not be  
12 obligated to do so) take the required action if: (1) County delivers to Lessor an additional  
13 written notice advising Lessor that County intends to take the required action if Lessor does not  
14 begin the required repair or maintenance within twenty four (24) hours, after the written notice;  
15 and (2) Lessor fails to begin the required work within this twenty four (24) hour period.

16 **10.3.1** Lessor grants to County a license, effective during the Lease Term, to  
17 enter upon those portions of the Premises access to which is reasonably necessary for County  
18 to take such action.

19 **10.3.2** If such action was required under the terms of this Lease to be taken  
20 by Lessor, County shall be entitled to prompt reimbursement by Lessor of County's reasonable  
21 costs and expenses in taking such action, plus interest at the then prevailing legal rate of  
22 interest from the date these costs are incurred until the date of Lessor's repayment. Lessor's  
23 obligation to reimburse County shall survive expiration or earlier termination of this Lease.

24 **10.3.3** If, within thirty (30) days after receipt of County's written demand for  
25 payment of County's costs incurred in taking such action on Lessor's behalf, Lessor has not  
26 paid the invoice or delivered to County a detailed written objection to it, County may deduct  
27 from Rent payable by County under this Lease the amount set forth in the invoice, plus interest  
28

1 at the interest rate described above from the date these costs are incurred until the date of  
2 County's Rent set off.

3 **10.4 Emergency Repairs.**

4 **10.4.1** An "Emergency Repair Situation" is defined as the existence of any  
5 condition that requires prompt repair, replacement or service to minimize the impact of an  
6 event or situation which affects County's ability to conduct business in a neat, clean, safe and  
7 functional environment.

8 **10.4.2** If County notifies Lessor of an Emergency Repair Situation which  
9 occurs in or about the Premises which is the responsibility of the Lessor to repair or maintain,  
10 then Lessor shall commence appropriate repairs or maintenance immediately after notice of  
11 the condition is given by County, which notice may be via telephone, facsimile, personal  
12 contact or any other means, and Lessor shall thereafter diligently pursue to completion said  
13 repairs or maintenance.

14 **10.4.3** If Lessor fails to commence repairs within twenty four (24) hours of the  
15 aforementioned notice, or if the County is unable to contact Lessor or any designated  
16 agent within a reasonable time based upon the seriousness of the event or situation, County  
17 may, but shall not be so obligated to, cause said repairs or replacements to be made or such  
18 maintenance to be performed. Upon demand by County, Lessor shall promptly reimburse  
19 County the actual cost and expenses thereof, provided said costs and expenses are  
20 reasonable. Should Lessor fail to promptly pay the cost and expenses, County may deduct and  
21 offset that amount from Rent payable under this Lease.

22 **10.5 Periodic Services.** Lessor shall provide, or cause to be provided, and  
23 pay for all Periodic Services, including, interior painting of common areas every three years, if  
24 so requested by County; monthly pest control services; quarterly HVAC standard preventative  
25 maintenance and changing of air filters; annual fire extinguisher inspections; reset interior and  
26 exterior time clocks for time changes; annual roof inspections and maintenance to include roof  
27 repairs/replacement; cleaning of roof gutters, drains, and down spouts prior to rainy season.

28

1 **11. Alterations and Additions.**

2 **11.1 Improvements by Lessor.**

3 **11.1.1** Upon full execution of this Lease, Lessor shall, at Lessor's sole  
4 expense, replace all flooring throughout the premises and repaint the interior walls. Carpet  
5 shall be replaced with carpet tiles and new top set base. Existing vinyl, VCT, and base shall be  
6 replaced with like kind. Carpet shall be Shaw, No Rules Collection, Style: 75715 Voyage,  
7 Pattern: Diffuse, 24" x 24" tiles. Paint colors to be selected by County. Lessor's responsibility  
8 shall include lifting of workstations, removal of all existing flooring and new installation. Work to  
9 be performed after hours and/or on weekends. Work to be completed on or before June 30,  
10 2013.

11 **11.1.2** Lessor recognizes and understands that any County improvements  
12 requested by the County to be completed by Lessor during the term of this Lease shall be  
13 undertaken according to Exhibit "D," General Construction Specifications for Leased Facilities.

14 **11.1.3** Lessor recognizes and understands that any County improvements  
15 requested by County may be subject to the provisions contained in the California Labor Code  
16 (commencing with Section 1720) relating to general prevailing wage rates and other pertinent  
17 provisions therein. Lessor and Lessor's contractors may be subject to audit to confirm  
18 compliance with wage scale regulations.

19 **11.1.4** Lessor shall comply and stay current with all applicable local, state and  
20 federal building codes and laws as from time to time amended, including, but not limited to, the  
21 Americans with Disabilities Act requirements in providing the County with any requested  
22 County improvements.

23 **11.1.5** If any agency, division or department of any governmental entity with  
24 appropriate jurisdiction condemns the Premises or any part of the Premises as unsafe or not in  
25 conformity with any of the laws or regulations controlling their construction, occupation or use,  
26 or orders or requires any alteration, repair or reconstruction of the Premises the responsible  
27 party shall be the Lessor who at its sole cost and expense (and without any right of  
28

1 reimbursement from County) immediately affect all necessary alterations and repairs required  
2 for the Premises full and exact compliance.

3           **11.1.6** Lessor shall cause all County improvements to be lien free, completed  
4 at Lessor's cost in a workmanlike manner and in compliance with all applicable law.

5           **11.1.7** County agrees when requested by Lessor to execute and deliver any  
6 applications, consents or other instruments required to permit Lessor to complete such County  
7 improvements or to obtain permits for the work.

8           **11.1.8** Post occupancy tenant improvements requested by County and  
9 completed by Lessor shall be reimbursed by County at Lessor's cost plus ten percent (10%)  
10 overhead handling charge. Lessor's invoices for such improvements shall be itemized  
11 according to material, sales tax, labor, and Lessor's ten percent (10%) overhead handling  
12 charge.

13           **11.1.9** Due to County fiscal year funding and accounting practices, any costs  
14 due to Lessor for reimbursement of tenant improvements during the term must be invoiced and  
15 received by the County prior to May 1<sup>st</sup> of each fiscal year in which services to County were  
16 provided to ensure payment.

17           **11.2 Improvements by County.**

18           **11.2.1** Any alterations, improvements or installation of fixtures to be  
19 undertaken by County shall have the prior written consent of Lessor. Such consent shall not  
20 be unreasonably withheld, conditioned or delayed by Lessor.

21           **11.2.2** All alterations and improvements made, and fixtures installed, by  
22 County shall remain County property and may be removed by County at or prior to the  
23 expiration of this Lease; provided, however, that such removal does not cause injury or  
24 damage to the Leased Premises beyond normal wear and tear.

25           **11.3 Communications Equipment.** County may, from time to time, install maintain,  
26 replace and/or remove any satellite dishes, links, duct bank or antennas on the grounds, roof  
27 and/or exterior walls or parapet of the Premises as County deems reasonably necessary or  
28 desirable, provided County shall first obtain Lessor's written approval, which approval shall not

1 be unreasonably withheld, conditioned, or delayed. Upon the removal by County of any such  
2 satellite dishes, links or antennas, County shall repair any damage incurred in connection with  
3 such removal.

4 **12. Exculpation, Indemnification, and Insurance.**

5 **12.1 Exculpation.** To the fullest extent permitted by law, Lessor, on its behalf and  
6 on behalf of all Lessor Parties, as hereinafter defined, waives all claims (in law, equity, or  
7 otherwise) against County Parties, as hereinafter defined, arising out of, knowingly and  
8 voluntarily assumes the risk of, and agrees that County Parties shall not be liable to Lessor  
9 Parties for any of the following: 1) injury to or death of any person; or 2) loss of, injury or  
10 damage to, or destruction of any tangible or intangible property, including the resulting loss of  
11 use, economic losses, and consequential or resulting damage of any kind from any cause.  
12 County Parties shall not be liable under this Section regardless of whether the liability results  
13 from any active or passive act, error, omission, or negligence of any of County Parties; or is  
14 based on claims in which liability without fault or strict liability is imposed or sought to be  
15 imposed on any of County Parties. This exculpation Section shall not apply to claims against  
16 County Parties to the extent that a final judgment of a court of competent jurisdiction  
17 establishes that the injury, loss, damage, or destruction was proximately caused by County  
18 Parties' fraud, willful injury to person or property, or violation of law.

19 **12.1.1 Definition of "County Parties" and "Lessor Parties."** For purposes  
20 of this Section 12, the term "County Parties" refers singularly and collectively to County,  
21 Special Districts, their respective Directors, Officers, Board of Supervisors, agents, employees,  
22 and independent contractors as well as to all persons and entities claiming through any of  
23 these persons or entities. The term "Lessor Parties" refers singularly and collectively to Lessor  
24 and the partners, venturers, trustees, and ancillary trustees of Lessor and the respective  
25 officers, directors, shareholders, members, parents, subsidiaries, and any other affiliated  
26 entities, personal representatives, executors, heirs, assigns, licensees, invites, beneficiaries,  
27 agents, servants, employees, and independent contractors of these persons or entities.

1           **12.1.2 Survival of Exculpation.** The paragraphs of this Section 12 shall  
2 survive the expiration or earlier termination of this Lease until all claims within the scope of this  
3 Section 12 are fully, finally, and absolutely barred by the applicable statutes of limitations.

4           **12.1.3 Lessor's Acknowledgment of Fairness.** Lessor acknowledges that  
5 this Section 12 was negotiated with County, that the consideration for it is fair and adequate,  
6 and that Lessor had a fair opportunity to negotiate, accept, reject, modify, or alter it.

7           **12.1.4 Waiver of Civil Code Section 1542.** With respect to the exculpation  
8 provided in this Section 12, Lessor waives the benefits of Civil Code Section 1542, which  
9 provides:

A GENERAL RELEASE DOES NOT EXTEND TO CLAIMS  
WHICH THE CREDITOR DOES NOT KNOW OR  
SUSPECT TO EXIST IN HIS FAVOR AT THE TIME OF  
EXECUTING THE RELEASE, WHICH IF KNOWN BY HIM  
MUST HAVE MATERIALLY AFFECTED HIS  
SETTLEMENT WITH THE DEBTOR.

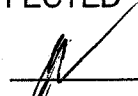
  
Initial

10  
11  
12  
13  
14  
15           **12.2 Indemnification and Hold Harmless.**

16           **12.2.1** Lessor shall indemnify and hold harmless the County Parties from any  
17 liability, including but not limited to, property damage, bodily damage, bodily injury, or death, or  
18 from any services provided by Lessor Parties or any act, error, omission, of Lessor Parties or of  
19 any invitee, guest, or licensee of Lessor in, on, or about the Project arising out of, from or in  
20 any way relating to this Lease. When indemnifying County Parties, Lessor shall defend at its  
21 sole cost and expense, including but not limited to, attorney fees, cost of investigation, defense  
22 and settlements or awards, on behalf of the County parties in any claim or action based upon  
23 such liability.

24           **12.2.2** County shall indemnify and hold harmless the Lessor Parties from any  
25 liability whatsoever, including but not limited to, property damage, bodily injury, or death, based  
26 or asserted on events which may occur within the County leased premises and is under the  
27 control of the County arising out of or from its use and occupancy relating to this Lease. County  
28 Parties shall not indemnify Lessor Parties for liability arising within the County leased Premises

1 when such liability arose out of or from Lessor's responsibilities under the terms of this Lease.  
2 County shall defend at its sole cost and expense, including but not limited to, attorney fees,  
3 cost of investigation, defense and settlements or awards, on behalf of the Lessor Parties in any  
4 claim or action based upon such liability.

5 **12.2.3** With respect to any action or claim subject to indemnification herein,  
6 the indemnifying party shall, at their sole cost, have the right to use counsel of their choice and  
7 shall have the right to adjust, settle, or compromise any such action or claim without the prior  
8 consent of the indemnified party; provided, however, that any such adjustment, settlement or  
9 compromise in no manner whatsoever limits or circumscribes the indemnifying party's  
10 obligation to indemnify as set forth herein.

11 **12.2.4** The indemnifying party's obligation hereunder shall be satisfied when  
12 they have provided the indemnified party the appropriate form of dismissal relieving the  
13 indemnified party from any liability for the action or claim involved.

14 **12.2.5** The specified insurance limits required in this Lease shall in no way  
15 limit or circumscribe the indemnifying party's obligation to indemnify as set forth herein.

16 **12.2.6** In the event there is conflict between this clause and California Civil  
17 Code Section 2782, this clause shall be interpreted to comply with Civil Code 2782. Such  
18 interpretation shall not relieve the indemnifying party's obligation to provide indemnification to  
19 the fullest extent allowed by law.

20 **12.2.7 Survival of Indemnification.** The paragraphs of this Section 12 shall  
21 survive the expiration or earlier termination of this Lease until all claims against County Parties  
22 involving any of the indemnified matters are fully, finally, and absolutely barred by the  
23 applicable statutes of limitations.

24 **12.3 Insurance.**

25 **12.3.1 Lessor's Insurance.** Without limiting or diminishing any  
26 indemnification contained within this Lease, Lessor and/or their authorized representatives,  
27 including, if any, a property management company, shall procure and maintain or cause to be  
28



1 maintained, at its sole cost and expense, the following insurance coverage during the term of  
2 this Lease:

3 **12.3.1.1 Workers' Compensation.** Workers' Compensation  
4 Insurance (Coverage A) as prescribed by the laws of the State of California. Policy shall  
5 include Employers' Liability (Coverage B) including Occupational Disease with limits not less  
6 than \$1,000,000 per person per accident. The policy shall be endorsed to waive subrogation in  
7 favor of The County of Riverside.

8 **12.3.1.2 Commercial General Liability.** Commercial General  
9 Liability Insurance coverage, including but not limited to, premises liability, contractual liability,  
10 products/completed operations, personal and advertising injury, cross liability coverage and  
11 employment practices liability covering bodily injury, property damage, and personal injury  
12 arising out of or relating, directly or indirectly, to the design, construction, maintenance, repair,  
13 alteration and ownership of the Premises and all areas appurtenant thereto including claims  
14 which may arise from or out of Lessor's operations, use, and management of the Premises, or  
15 the performance of its obligations hereunder. Policy shall name the County of Riverside, its  
16 Special Districts, Agencies, Districts and Departments, their respective Directors, Officers,  
17 Board of Supervisors, elected and appointed officials, employees, agents, independent  
18 contractors or representatives as an Additional Insured. Policy limits shall not be less than One  
19 Million Dollars (\$1,000,000) per occurrence. If such insurance contains a general aggregate  
20 limit, it shall apply separately to this Lease or be no less than two (2) times the occurrence limit.

21 **12.3.1.3 Vehicle Liability.** If vehicles or licensed mobile  
22 equipment are used on the Project, Lessor shall maintain auto liability insurance for all owned,  
23 non-owned or hired automobiles in an amount not less than One Million Dollars (\$1,000,000)  
24 per occurrence combined single limit. Policy shall name the County of Riverside, its Special  
25 Districts, Agencies, Districts, and Departments, their respective Directors, Officers, Board of  
26 Supervisors, elected and appointed officials, employees, agents, independent contractors or  
27 representatives as Additional Insured.

1                                   **12.3.1.4    Property (Physical Damage).**

2                                   (a)    All-Risk    real    property    insurance    coverage,  
3 including earthquake and flood, if applicable, for the full replacement cost value of buildings,  
4 structures, fixtures, all improvements therein, and building systems on the Project as the same  
5 exists at each early anniversary of the term. Policy shall include Business Interruption, Extra  
6 Expense, and Expediting Expense coverage as well as coverage for off-premises power  
7 failure. Policy shall name the County as a Loss Payee as their interests may appear.

8                                   (b)    Boiler    and    Machinery    insurance    providing  
9 coverage for at least, but not limited to, all high voltage electrical and rotating mechanical  
10 equipment on a full replacement cost value basis. Policy shall provide Business Interruption,  
11 Extra Expense, and Expediting Expense coverage as well as coverage for off-premises power  
12 failure. Policy shall name the County as a Loss Payee as their interests may appear.

13                                   **12.3.1.5    General Insurance Provisions – All Lines.**

14                                   (a)    Any insurance carrier providing Lessor's insurance  
15 coverage hereunder shall be admitted to the State of California and have an A.M. BEST rating  
16 of not less than an A:VIII (A:8) unless such requirements are waived, in writing, by the County  
17 Risk Manager. If the County's Risk Manager waives a requirement for a particular insurer such  
18 waiver is only valid for that specific insurer and only for one policy term.

19                                   (b)    The Lessor or Lessor's insurance carrier(s) must  
20 declare its insurance deductibles or self-insured retentions. If such deductibles or self-insured  
21 retentions exceed Five Hundred Thousand Dollars (\$500,000.00) per occurrence such  
22 deductibles and/or retentions shall have the prior written consent of the County Risk Manager  
23 before the commencement of the Lease term. Upon notification of deductibles or self-insured  
24 retentions which are deemed unacceptable to the County, at the election of the County's Risk  
25 Manager, Lessor's carriers shall either: 1) reduce or eliminate such deductibles or self-insured  
26 retentions as respects this Agreement with the County, or 2) procure a bond which guarantees  
27 payment of losses and related investigations, claims administration, defense costs and  
28 expenses.

1 (c) At the inception of this Lease and annually at the  
2 Lessor's insurance policy renewal date(s), the Lessor shall cause their insurance carrier(s) to  
3 furnish the County of Riverside with 1) a properly executed original Certificate(s) of Insurance  
4 and certified original copies of Endorsements effecting coverage as required herein; or 2) if  
5 requested to do so orally or in writing by the County Risk Manager, provide original Certified  
6 copies of policies including all Endorsements and all attachments thereto, showing such  
7 insurance is in full force and effect. Further, said Certificate(s) and policies of insurance shall  
8 contain the covenant of the insurance carrier(s) shall provide no less than thirty (30) days  
9 written notice be given to the County of Riverside prior to any material modification or  
10 cancellation of such insurance. In the event of a material modification or cancellation of  
11 coverage, this Lease shall terminate forthwith, unless the County of Riverside receives, prior to  
12 such effective date, another properly executed original Certificate of Insurance and original  
13 copies of endorsements or certified original policies, including all endorsements and  
14 attachments thereto evidencing coverage and the insurance required herein is in full force and  
15 effect. Individual(s) authorized by the insurance carrier to do so on its behalf shall sign the  
16 original endorsements for each policy and the Certificate of Insurance. The Lease term shall  
17 not commence until the County of Riverside has been furnished original Certificate(s) of  
18 Insurance and certified original copies of endorsements or policies of insurance including all  
19 endorsements and any and all other attachments as required in this Section.

20 (d) It is understood and agreed by the parties hereto  
21 and the Lessor's insurance company(s) that the Certificate(s) of Insurance and policies shall so  
22 covenant and shall be construed as primary insurance, and the County's insurance and/or  
23 deductibles and/or self-insured retentions or self-insured programs shall not be construed as  
24 contributory.

25 **12.3.2 County's Insurance:** County maintains funded programs of Self-  
26 Insurance. County shall provide to Lessor a Certificate of Self-Insurance evidencing the  
27 County's Self-Insurance for the following coverage, if so requested by Lessor:  
28

1	12.3.2.1 Workers' Compensation	\$1,000,000 per occurrence
2	12.3.2.2 Commercial General Liability	\$1,000,000 per occurrence
3	12.3.2.3 Automobile Liability	\$1,000,000 per occurrence

4 **13. Damage and Destruction.**

5 **13.1 Repair of Damage.** County agrees to notify Lessor in writing promptly of any  
6 damage to the Premises resulting from fire, earthquake, or any other identifiable event of a  
7 sudden, unexpected, or unusual nature ("Casualty"). If the Premises, whether covered by  
8 insurance or not, are damaged by a Casualty, or the Casualty results in the Premises not being  
9 provided with Base Building Systems or parking facilities, and if neither Lessor nor County has  
10 elected to terminate this Lease under this Section 13, Lessor shall promptly and diligently  
11 restore Premises, the County Improvements originally constructed by Lessor, Base Building  
12 Systems, and County's parking facilities to substantially the same condition as existed before  
13 the Casualty, subject to modifications required by building codes and other laws. If County  
14 requests that Lessor make any modifications to the County Improvements in connection with  
15 the rebuilding, Lessor may condition its consent to those modifications on: (a)  
16 confirmation by Lessor's contractor that the modifications shall not increase the time needed to  
17 complete the County Improvements; or (b) an agreement by County that the additional  
18 construction period shall not extend the rent abatement period.

19 **13.2 Repair Period Notice.** Lessor shall, within thirty (30) days after the date of the  
20 Casualty, provide written notice to County indicating the anticipated period for repairing the  
21 Casualty ("Repair Period Notice"). The Repair Period Notice shall be accompanied by a  
22 certified statement executed by the Contractor retained by Lessor to complete the repairs or, if  
23 Lessor has not retained a Contractor, a licensed Contractor not affiliated with Lessor, certifying  
24 the Contractor's opinion about the anticipated period for repairing the Casualty. The Repair  
25 Period Notice shall also state, if applicable, Lessor's election either to repair or to terminate the  
26 Lease under Section 13.3.

27 **13.3 Lessor's Option to Terminate or Repair.** Lessor may elect either to terminate  
28 this Lease or to effectuate repairs if: (a) the Repair Period Notice estimates that the period for

1 repairing the Casualty exceeds ninety (90) days from the date of the Casualty; or (b) the  
2 estimated repair cost of the Premises, even though covered by insurance, exceeds fifty percent  
3 (50%) of the full replacement cost.

4 **13.4 County's Option to Terminate.** If (a) the Repair Period Notice provided by  
5 Lessor indicates that the anticipated period for repairing the Casualty exceeds ninety (90) days,  
6 or (b) notwithstanding the above, in the event of a substantial or total casualty to the Premises  
7 or improvements, County may by written notice to Lessor within thirty (30) days after such  
8 damage or destruction of its intention to terminate this Lease, elect to terminate this Lease by  
9 providing written notice (County's Termination Notice) to Lessor within thirty (30) days after  
10 receiving the Repair Period Notice. If County does not elect to terminate within said thirty (30)  
11 day period, County shall be considered to have waived its' option to terminate.

12 **13.5 Rent Abatement Due to Casualty.** Lessor and County agree that County's  
13 Rent shall be fully abated during the period beginning on the later of: (a) the date of the  
14 Casualty; or (b) the date on which County ceases to occupy the Premises and ending on the  
15 date of Substantial Completion of Lessor's restoration obligations as provided in this Section 13  
16 ("Abatement Period"). If, however, County is able to occupy and does occupy a portion of the  
17 Premises, Rent shall be abated during the Abatement Period only for the portion of the  
18 Premises not occupied by County.

19 **13.6 Damage Near End of Term.** Despite any other provision of this Section 13, if  
20 the Premises are destroyed or damaged by a Casualty during the last eighteen (18) months of  
21 the original Lease Term, Lessor and County shall each have the option to terminate this Lease  
22 by giving written notice to the other of the exercise of that option within thirty (30) days after  
23 that damage or destruction, provided, however, County may negate Lessor's election to  
24 terminate under this Section 13.6 by electing, within ten (10) days after receipt of Lessor's  
25 termination notice, to exercise any unexercised option to extend this Lease. If County  
26 negates Lessor's election, this Lease shall continue in effect unless Lessor has the right to,  
27 and elects to, terminate this Lease under Section 13.3.

1           **13.7 Effective Date of Termination; Rent Apportionment.** If Lessor or County  
2 elects to terminate this Lease under this Section 13 in connection with a Casualty, this  
3 termination shall be effective thirty (30) days after delivery of notice of such election. County  
4 shall pay Rent, properly apportioned up to the date of the Casualty. After the effective date of  
5 the termination, Lessor and County shall be discharged of all future obligations under this  
6 Lease, except for those provisions that, by their terms, survive the expiration or earlier  
7 termination of the Lease.

8           **13.8 Waiver of Statutory Provisions.** The provisions of this Lease, including those  
9 in this Section 13, constitute an express agreement between Lessor and County that applies in  
10 the event of any Casualty to the Premises. Lessor and County, therefore, fully waive the  
11 provisions of any statute or regulation, for any rights or obligations concerning a Casualty  
12 including California Civil Code Sections 1932(2) and 1933(4).

13           **13.9 Release on Termination.** In the event of any termination of this Lease in  
14 accordance with Section 13, the Parties shall be released there from without further obligation  
15 to the other Party, except as may otherwise be specifically set forth in this Lease and items that  
16 have accrued and are unpaid.

17 **14. Eminent Domain.**

18           **14.1 Total Condemnation.** If all of the Premises are condemned by eminent  
19 domain, inversely condemned, or sold in lieu of condemnation for any public or quasi-public  
20 use or purpose, this Lease will terminate as of the date of title vesting in that proceeding and  
21 the Rent will be abated from the date of termination.

22           **14.2 Partial Condemnation.** If any portion of the Premises is condemned by  
23 eminent domain, inversely condemned, or sold in lieu of condemnation for any public or quasi-  
24 public use or purpose and the partial condemnation renders the Premises unusable for  
25 County's business, this Lease will terminate as of the date of title vesting or order of immediate  
26 possession in that proceeding and the Rent will be abated to the date of termination. If the  
27 partial condemnation does not render the Premises unusable for the business of County and  
28 less than a substantial portion of the Premises is condemned, Lessor must promptly restore the

1 Premises to the extent of any condemnation proceeds recovered by Lessor, excluding the  
2 portion lost in the condemnation, and this Lease will continue in full force, except that after the  
3 date of the title vesting, the Rent will be adjusted, as reasonably determined by Lessor and  
4 County.

5 **14.3 Award.** If the Premises are wholly or partially condemned, Lessor will be  
6 entitled to the entire award paid for the condemnation, and County waives any claim to any part  
7 of the award from Lessor or the condemning authority. County, however, will have the right to  
8 recover from the condemning authority any compensation that may be separately awarded to  
9 County in connection with costs in removing County's merchandise, furniture, fixtures,  
10 leasehold improvements, and equipment to a new location.

11 **14.4 Temporary Condemnation.** In the event of a temporary condemnation, this  
12 Lease will remain in effect, County will continue to pay Rent, and County will receive any award  
13 made for the condemnation. If a temporary condemnation remains in effect at the expiration or  
14 earlier termination of this Lease, County will pay Lessor the reasonable cost of performing any  
15 obligations required of County with respect to the surrender of the Premises. If a temporary  
16 condemnation is for a period that extends beyond the Term, this Lease will terminate as of the  
17 date of occupancy by the condemning authority and any award will be distributed in  
18 accordance with Section 14.3.

19 **15. Estoppel Certificates.** Within twenty (20) business days after receipt of a written  
20 request by either party, the other party shall execute and deliver to the requesting party an  
21 Estoppel Certificate, in the form of the attached Exhibit "F," indicating in the certificate any  
22 exceptions to the statements in the certificate that may exist at that time.

23 **16. Subordination, Non-Disturbance, and Attornment.**

24 **16.1 Subordination, Non-Disturbance, and Attornment Agreement.** To carry out  
25 the purposes of Section 16.2 and Section 16.3, the Parties agree to execute a Subordination,  
26 Non-Disturbance and Attornment Agreement in the form set forth in the attached Exhibit "H."

27 **16.2 Subordination.** County agrees that within forty-five (45) business days after  
28 Lessor's written request, it shall execute the agreement referred to in Section 16.1 that Lessor

1 reasonably considers necessary to evidence or confirm the subordination or inferiority of this  
2 Lease to the lien of any mortgage, deed of trust or other encumbrance of the Premises or any  
3 renewal, extension, modification, replacement thereof, provided however, that such  
4 Subordination Agreement shall be strictly limited to matters contained in the Agreement  
5 referred to in Section 16.1 and no such Subordination Agreement shall materially increase any  
6 of County's obligations or materially decrease any of County's rights under this Lease, nor shall  
7 the possession of County be disturbed, by reason of any foreclosure, sale or other action under  
8 any such trust deed, mortgage or other encumbrance.

9       **16.3 Attornment.** If Lessor's interest in the Premises passes to a successor, and  
10 provided County has received the Non-Disturbance agreement referred to in Section 16.1,  
11 County shall, within forty-five (45) business days after Lessor's transferee's request, execute  
12 the agreement referred to in Section 16.1, thereby agreeing to attorn and to recognize the  
13 transferee as the Lessor under this Lease; provided the transfer of Lessor's interest in the  
14 Premises was by sale, lease, foreclosure, deed in lieu of foreclosure, exercise of any remedy  
15 provided in any encumbrance or operation of law.

16 **17. Breach by Lessor.**

17       **17.1 Lessor's Default.** Except as provided to the contrary in this Lease, Lessor's  
18 failure to perform any of its obligations under this Lease shall constitute a default by Lessor  
19 under the Lease if the failure continues for thirty (30) days after written notice of the failure from  
20 County to Lessor. If the required performance cannot be completed within thirty (30) days,  
21 Lessor's failure to perform shall constitute a default under the Lease unless Lessor undertakes  
22 to cure the failure within thirty (30) days and diligently and continuously attempts to complete  
23 this cure as soon as reasonably possible.

24       **17.2 County's Right to Cure Lessor's Default and Deduct Cost.** Except as  
25 provided to the contrary in this Lease, if County provides notice to Lessor of Lessor's failure to  
26 perform any of its obligations under this Lease and Lessor fails to provide such action as  
27 required by the terms of this Lease within the period specified, County may take the required  
28 action if: (a) County delivers to Lessor an additional written notice advising Lessor that County



1 intends to take the required action if Lessor does not begin the required action within ten (10)  
2 days after the written notice; and (b) Lessor fails to begin the required action within this ten (10)  
3 day period.

4 **17.3 Rent Setoff.** If, within thirty (30) days after receipt of County's written demand  
5 for payment of County's costs incurred in taking such action on Lessor's behalf, Lessor has not  
6 paid the invoice or delivered to County a detailed written objection to it, County may deduct  
7 from Rent payable by County under this Lease the amount set forth in the invoice, including  
8 transaction costs and attorneys' fees, plus interest at the then legal rate of interest from the  
9 date these costs are incurred until the date of County's Rent setoff.

10 **18. Lessor's Representations and Warranties.** Lessor represents and warrants to  
11 County that:

12 **18.1 Title.** County's Leasehold interest in the Premises is free and clear of  
13 restrictions which would restrict County's rights under this Lease.

14 **18.2 Certificate of Authority.** Lessor covenants that it is a duly constituted under  
15 the laws of the state of its organization, and that the person(s) who is acting as its signatory in  
16 this Lease is duly authorized and empowered to act for and on behalf of the Lessor. Lessor  
17 shall furnish County prior to the execution hereof with evidence of the authority of the signatory  
18 to bind the entity or trust as contemplated herein.

19 **18.3 No Litigation.** There are no judicial, quasi-judicial, administrative or other  
20 orders, injunctions, moratoria or pending proceedings against Lessor or the Premises which  
21 preclude or interfere with, or would preclude or interfere with, the construction contemplated  
22 herein or the occupancy and use of the Premises by County for the purposes herein  
23 contemplated.

24 **18.4 Easements.** Lessor shall not (a) subdivide, parcel or otherwise divide the  
25 Premises, (b) create, modify or terminate any ingress or egress to or from the premises, or (c)  
26 create any easements in the Premises, without County's prior written approval.  
27  
28

1 **19. Miscellaneous.**

2 **19.1 Quiet Enjoyment.** Lessor covenants that County shall at all times during the  
3 term of this Lease peaceably and quietly have, hold and enjoy the use of the Premises so long  
4 as County shall fully and faithfully perform the terms and conditions that it is required to do  
5 under this Lease. If the Premises are part of a building shared with other tenants of Lessor,  
6 during County's tenancy, Lessor may make or permit other tenants to make alterations,  
7 renovations and improvements to those portions of the building not occupied by County. Lessor  
8 covenants for itself and anyone deriving title from or holding title under Lessor that County's  
9 access, ingress, loading and unloading and sufficient parking for County's business shall not  
10 unreasonably be obstructed nor shall the daily business of County be disrupted as a result of  
11 such alterations, renovations and improvements.

12 **19.2 Non-Waiver.** No waiver of any provision of this Lease shall be implied by any  
13 failure of either party to enforce any remedy for the violation of that provision, even if that  
14 violation continues or is repeated. Any waiver by a party of any provision of this Lease must be  
15 in writing. Such written waiver shall affect only the provision specified and only for the time and  
16 in the manner stated in the writing.

17 **19.3 Binding on Successors.** The terms and conditions herein contained shall  
18 apply to and bind the heirs, successors in interest, executors, administrators, representatives  
19 and assigns of all the Parties hereto.

20 **19.4 Severability.** The invalidity of any provision in this Lease as determined by a  
21 court of competent jurisdiction shall in no way affect the validity of any other provision hereof.

22 **19.5 Venue.** Any action at law or in equity brought by either of the Parties hereto for  
23 the purpose of enforcing a right or rights provided for by this Lease shall be tried in a court of  
24 competent jurisdiction in the County of Riverside, State of California, and the Parties hereto  
25 waive all provisions of law providing for a change of venue in such proceedings to any other  
26 county.

27 **19.6 Attorneys' Fees.** In the event of any litigation or arbitration between Lessor  
28 and County to enforce any of the provisions of this Lease or any right of either party hereto, the

1 unsuccessful party to such litigation or arbitration agrees to pay to the successful party all costs  
2 and expenses, including reasonable attorneys' fees, incurred therein by the successful party,  
3 all of which shall be included in and as a part of the judgment rendered in such litigation or  
4 arbitration.

5 **19.7 County's Representative.** County hereby appoints the Assistant County  
6 Executive Officer/EDA as its authorized representative to administer this Lease.

7 **19.8 Agent for Service of Process.** It is expressly understood and agreed that in  
8 the event Lessor is not a resident of the State of California or it is an association or partnership  
9 without a member or partner resident of the State of California, or it is a foreign corporation,  
10 then in any such event, Lessor shall file with County's Assistant County Executive Officer/EDA,  
11 upon its execution hereof, a designation of a natural person residing in the State of California,  
12 giving his or her name, residence and business addresses, as its agent for the purpose of  
13 service of process in any court action arising out of or based upon this Lease, and the delivery  
14 to such agent of a copy of any process in any such action shall constitute valid service upon  
15 Lessor. It is further expressly understood and agreed that if for any reason service of such  
16 process upon such agent is not feasible, then in such event, Lessor may be personally served  
17 with such process out of this county and that such service shall constitute valid service upon  
18 Lessor. It is further expressly understood and agreed that Lessor is amenable to the process  
19 so served, submits to the jurisdiction of the court so obtained and waives any and all objections  
20 and protests thereto.

21 **19.9 Entire Lease.** This Lease is intended by the Parties hereto as a final  
22 expression of their understanding with respect to the subject matter hereof and as a complete  
23 and exclusive statement of the terms and conditions thereof and supersedes any and all prior  
24 and contemporaneous leases, agreements and understandings, oral or written, in connection  
25 therewith. This Lease may be changed or modified only upon the written consent of the Parties  
26 hereto.

27 **19.10 Interpretation.** The Parties hereto have negotiated this Lease at arms length  
28 and have been advised by their respective attorneys, or if not represented by an attorney,

1 represent that they had an opportunity to be so represented and no provision contained herein  
2 shall be construed against County solely because it prepared this Lease in its executed form.

3 **19.11 Time of Essence.** Time is of the essence with respect to the performance of all  
4 obligations to be performed or observed by the Parties under this Lease.

5 **19.12 Recording.** Either Lessor or County shall, upon request of the other, execute,  
6 acknowledge and deliver to the other a short form memorandum of this Lease for  
7 recording purposes. The Party requesting recordation shall be responsible for payment of any  
8 fees applicable thereto.

9 **19.13 Consent.** Whenever Lessor's or County's consent is required under any  
10 provision of this Lease, it shall not be unreasonably withheld, conditioned or delayed.

11 **19.14 Title.** Lessor covenants that Lessor is well seized of and has good title to the  
12 Premises, and Lessor does warrant and will defend the title thereto, and will indemnify County  
13 against any damage and expense which County may suffer by reason of any lien,  
14 encumbrance, restriction or defect in title or description herein of the Premises. If, at any time,  
15 Lessor's title or right to receive Rent and any other sums due hereunder is disputed, County  
16 may withhold such sums thereafter accruing until County is furnished satisfactory evidence as  
17 to the Party entitled thereto.

18 **19.15 Conveyance by Lessor.** Should Lessor convey the Premises, all rights and  
19 obligations inuring to the Lessor by virtue of this Lease shall pass to the grantee named in such  
20 conveyance, and the grantor shall be relieved of all obligations or liabilities hereunder, except  
21 those theretofore accrued and not discharged.

22 **19.16 Mechanic's Liens.** If any mechanic's or materialmen's lien or liens shall be filed  
23 against the Premises for work done or materials furnished to a Party, that Party shall, at its own  
24 cost and expense, cause such lien or liens to be discharged within fifteen (15) days after notice  
25 thereof by filing or causing to be filed a bond or bonds for that purpose. In the event any notice  
26 preliminary to establishing such a lien (such as the California Preliminary 20-Day Notice) is  
27 served on Lessor for work done on the Premises, Lessor shall immediately forward a copy of  
28 such notice to Lessee.

1           **19.17 Surrender.** County shall, after the last day of the term or any extension thereof  
2 or upon any earlier termination of such term, surrender and yield up to Lessor the Premises in  
3 good order, condition and state of repair, reasonable wear and tear and damage by fire or  
4 other casualty excepted. County may, but shall not be required to: (a) patch or paint any  
5 walls/surfaces; (b) remove any leasehold improvements constructed or installed prior to or  
6 during the term of this Lease or any extension thereof; or (c) remove any fixtures or equipment  
7 installed prior to or during the term of this Lease or any extension thereof.

8           **19.18 Notice.** Except as expressly provided elsewhere in this Lease, all notices and  
9 other communication required under this Lease shall be in writing and delivered by: (a)  
10 Certified Mail, postage prepaid, return receipt requested, in the United States mail; or (b) via an  
11 overnight courier that provides written evidence of delivery and addressed to the Party hereto  
12 to whom the same is directed at the addresses set forth in Section 19.18 herein. Either Party  
13 hereto may from time to time change its mailing address by written notice to the other Party.

14                   **County's Notification Address:**

15                   County of Riverside  
16                   Economic Development Agency, Real Estate Division  
17                   3403 Tenth St., Suite 400  
18                   Riverside, California 92501  
19                   Attention: Deputy Director of Real Estate

20                   **Lessor's Notification Address:**

21                   Mark Rubin  
22                   Bel Air Plaza, LTD  
23                   9201 Wilshire Blvd., Suite 103  
24                   Beverly Hills, California 90210

25  
26           **19.19 Authority.** If Lessor is a corporation, general or limited partnership or individual  
27 owner, each individual executing this Lease on behalf of said corporation, partnership, or  
28 individual represents and warrants that he or she is duly authorized to execute and deliver this

1 Lease on behalf of said corporation, in accordance with bylaws of said corporation, or as a  
2 partner or individual is authorized to execute this Lease and that this Lease is binding upon  
3 said corporation and/or partnership or individual.

4 *///*

5 *///*

6 *///*

7 *///*

8 *///*

9 *///*

10 *///*

11 *///*

12 *///*

13 *///*

14 *///*

15 *///*

16 *///*

17 *///*

18 *///*

19 *///*

20 *///*

21 *///*

22 *///*

23 *///*

24 *///*

25 *///*

26 *///*

27 *///*

28 *///*

1  
2  
3  
4  
5  
6  
7  
8  
9  
10  
11  
12  
13  
14  
15  
16  
17  
18  
19  
20  
21  
22  
23  
24  
25  
26  
27  
28

**19.20 Approval of Supervisors.** Anything to the contrary notwithstanding, this Lease shall not be binding or effective until its approval and execution by the Chairman of the Riverside County Board of Supervisors.

Dated: \_\_\_\_\_

**BEL AIR PLAZA, LP, a California limited partnership**

By:   
Mark Rubin, General Partner

By: \_\_\_\_\_

**COUNTY OF RIVERSIDE**

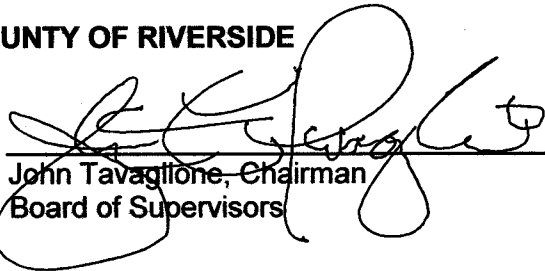
By:   
John Tavaglione, Chairman  
Board of Supervisors

**ATTEST:**  
Kecia Harper-Ihem  
Clerk of the Board

By:   
Deputy

**APPROVED AS TO FORM:**  
Pamela J. Walls  
County Counsel

By:   
Patricia Munroe  
Deputy County Counsel

23119 Cottonwood Avenue, Building "B"  
Moreno Valley  
31,000 Square Feet

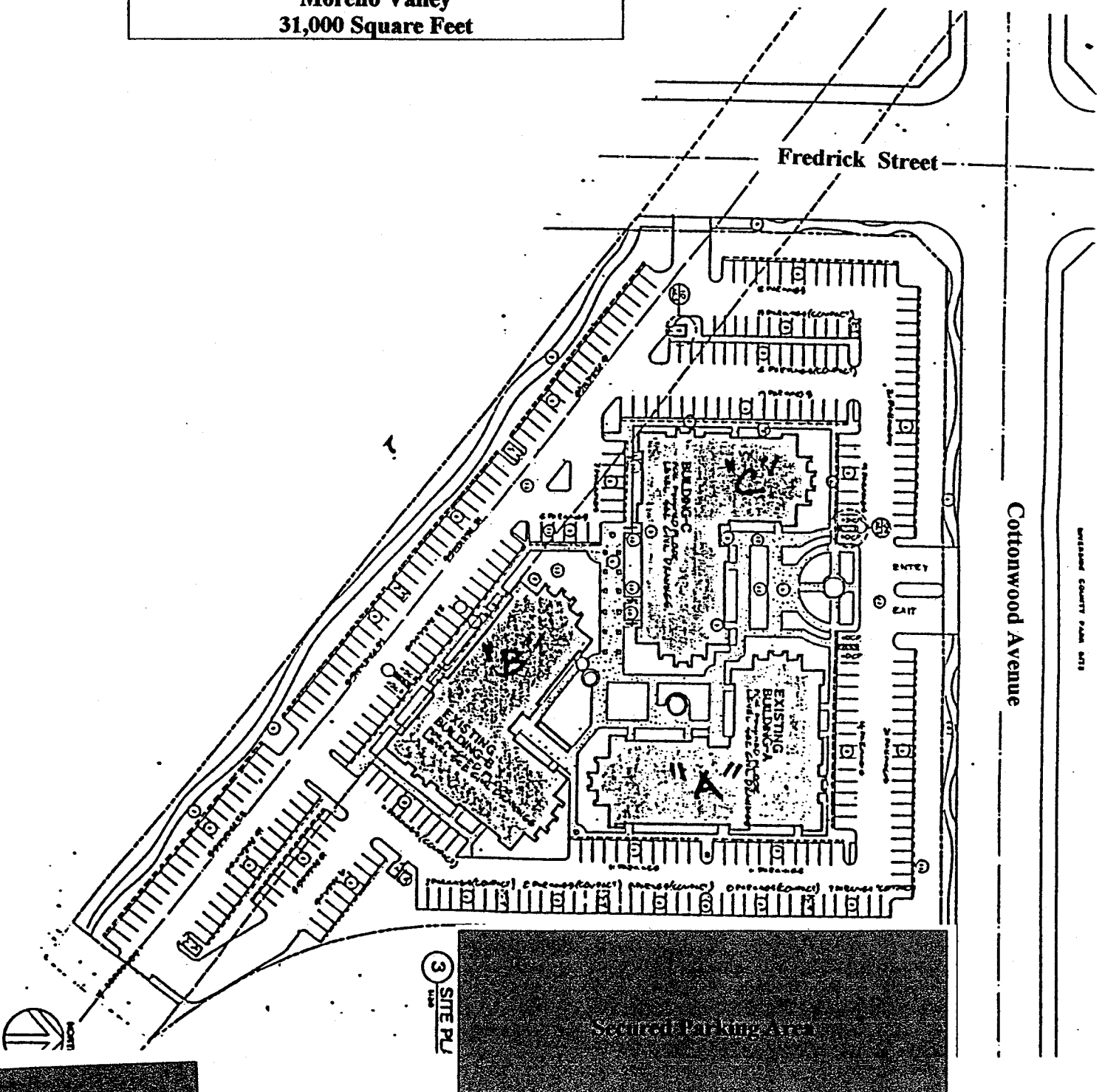

Cottonwood Avenue

Fredrick Street

UNIVERSITY COUNTY PLANNING DEPARTMENT

Additional Parking Area (not shown on map)

Secured Parking Area

3 SITE PL PLAN

EXHIBIT "A"



**LEASEHOLD IMPROVEMENT AGREEMENT**  
23119 Cottonwood Ave., Bldg. B, Moreno Valley, CA

This Leasehold Improvement Agreement shall set forth the terms and conditions relating to the construction of the County improvements in the Premises. This Leasehold Improvement Agreement is essentially organized chronologically and addresses the issues of the construction of the Premises, in sequence, as such issues will arise during the actual construction of the Premises. All references in this Leasehold Improvement Agreement to Paragraphs or Sections of the "Lease" shall mean the relevant portion of that certain Office Lease to which this Leasehold Improvement Agreement is attached as Exhibit "B" and of which this Leasehold Improvement Agreement forms a part, and all references in the Lease to Sections of "Leasehold Improvement Agreement" shall mean the relevant portion of this Leasehold Improvement Agreement and all references in this Leasehold Improvement Agreement to Sections of this Leasehold Improvement Agreement shall mean the relevant portion of this Leasehold Improvement Agreement.

**SECTION 1 - LESSOR'S INITIAL CONSTRUCTION OF PREMISES**

1.1 Lessor will cause the construction of, at its sole cost and expense, or has acquired or constructed, that certain free standing building described in Section 2 of the Lease, hereinafter referred to as the "Base Building."

**SECTION 2 - CONSTRUCTION DRAWINGS FOR THE PREMISES**

2.1 Lessor shall, at its sole cost and expense, and subject to reimbursement as hereinafter set forth, construct the improvements in the Premises (the "Leasehold Improvements") pursuant to those certain blueprints, floor and space plans, specification and finalize construction prices, collectively, the approved "Working drawings" prepared by Lessor's architect. Lessor shall make no changes or modifications to the Approved Working Drawings without the prior written consent of County, which consent may be withheld if such change or modification would directly or indirectly delay the "Substantial Completion," as that term is defined in Section 7.1 of this Leasehold Improvement Agreement, of the Premises or increase the cost of designing or constructing the Leasehold Improvements. Any changes or modifications approved by the County shall be at Lessor's sole cost and expense.

**SECTION 3 - CONSTRUCTION DRAWINGS**

3.1 Selection of Architect/Construction Drawings. Lessor shall retain an architect or space planner (the "Architect") to prepare the Construction Drawings. Lessor shall retain the engineering consultants (the "Engineers") to prepare all plans and engineering working drawings relating to the structural, mechanical, electrical, plumbing, HVAC, life safety, and sprinkler work of the Leasehold Improvements. The plans and drawings to be prepared by Architect and the Engineers hereunder shall be known collectively as the "Construction Drawings." All Construction Drawings shall comply with

the drawing format and specifications as determined by Lessor, and shall be subject to County's approval. Lessor and Architect shall verify, in the field, the dimensions and conditions as shown on the relevant portions of the Base Building Plans, and Lessor and Architect shall be solely responsible for the same, and County shall have no responsibility in connection therewith. County's review of the Construction Drawings as set forth in this Section 3, shall be for its sole purpose and shall not imply County's review of the same, or obligate Lessor to review the same, for quality, design, Code compliance or other like matters. Accordingly, notwithstanding that any Construction Drawings are reviewed by County or its agents and consultants, and notwithstanding any advice or assistance which may be rendered to Lessor by County or County's agents or consultants, County shall have no liability whatsoever in connection therewith and shall not be responsible for any omissions or errors contained in the Construction Drawings, and Lessor's waiver and indemnity set forth in this Lease shall specifically apply to the Construction Drawings.

**3.2 Final Space Plan.** Prior to execution of the Lease by County, Lessor and the Architect shall prepare the final space plan for Leasehold Improvements in the Premises (collectively, the "Final Space Plan"), which Final Space Plan shall include a layout and designation of all offices, rooms and other partitioning, their intended use, and equipment to be contained therein, and shall deliver the Final Space Plan County for County's approval.

**3.3 Final Working Drawings.** Within ten (10) working days after execution of the Lease by County and delivery of a copy of the Lease to Lessor, Lessor, the Architect and the Engineers shall complete the architectural and engineering drawings for the Leasehold Improvements, and the final architectural working drawings in a form which is complete to allow subcontractors to perform the work and to obtain all applicable permits (collectively, the "Final Working Drawings") and shall submit the same to County for County's approval.

**3.4 Permits.** The Final Working Drawings shall be approved by County (the "Approved Working Drawings") prior to the commencement of the construction of the Leasehold Improvements. Lessor shall immediately submit the Approved Working Drawings to the appropriate municipal authorities for all applicable building permits necessary to commence and fully complete the construction of the Leasehold Improvements (the "Permits"). Lessor hereby agrees that neither County nor County's agents or consultants shall be responsible for obtaining any building permit or certificate of occupancy for the Premises and that the obtaining of the same shall be Lessor's responsibility; provided however that County shall, in any event, cooperate with Lessor in executing permit applications and performing other ministerial acts reasonably necessary to enable Lessor to obtain any such permit or certificate of occupancy. No changes, modifications or alterations in the Approved Working Drawings may be made without the prior written consent of County, provided that County may withhold its consent, in its sole discretion, to any change in the Approved Working Drawings if such change would directly or indirectly delay the "Substantial Completion" of the Premises as that term is defined in Section 7.1 of this Leasehold Improvement Agreement.

3.5 County shall use its best, good faith, efforts and all due diligence to cooperate with the Architect, the Engineers, and Lessor to complete all phases of the Construction Drawings and the permitting process and to receive the permits, and approval of the "Construction Costs," as set forth in Section 8.1 below, as soon as possible after the execution of the Lease, and, in that regard, shall meet with Lessor on a scheduled basis to be determined by County, to discuss Lessor's progress in connection with the same. Upon County's execution of this Lease, Lessor shall provide County with a construction schedule including time projections for planning, entitlement process, related preparation and construction of the Leasehold Improvements.

#### **SECTION 4 – CHANGE ORDERS**

4.1 As outlined in Section 3 above, Lessor and County shall work with the Project Architect to complete the "Approved Working Drawings". If prior to commencement, or during the construction process, County wishes to make changes to the "Approved Working Drawings", County shall provide details of the requested change to the Project Architect. Architect shall then prepare the necessary plan of such material or construction change and submit to General Contractor for pricing. General Contractor shall prepare change order with price to complete the change order. County shall be responsible for the total cost of all approved change orders and shall pay to Lessor the total amount of all approved change orders as defined in Section 9 herein.

#### **SECTION 5 - LESSOR COVENANTS**

5.1 Lessor recognizes, understands and covenants that any and all improvements shall be undertaken according to Exhibit "F", General Construction Specifications for Leased Facilities, attached thereto and made a part of the Lease.

5.2 Lessor recognizes, understands and covenants that improvements contemplated herein may be subject to the provisions contained in the California Labor Code (commencing with Section 1720) relating to general prevailing wage rates and other pertinent provisions therein.

5.3 Lessor shall comply and stay current with all applicable building standards, which may change from time to time, including but not limited to, the Americans with Disabilities Act of 1990 and any regulations issued pursuant thereto in providing improvements contemplated herein.

#### **SECTION 6 - CONSTRUCTION**

6.1 Lessor shall diligently pursue the planning, entitlement process, related preparation and construction of the Leasehold Improvements. Lessor shall provide County with periodic written progress reports, which reports shall contain, without limitation, updated information relative to permit approvals and construction.

6.2 Lessor shall notify County, in writing, forthwith when such planning, entitlement process, related preparation and construction of the Leasehold Improvements have been completed, a Certificate of Occupancy has been issued by the City of Moreno Valley, or if no new Certificate of Occupancy is required, then upon acceptance of the improvements by the City of Moreno Valley upon final inspection, all required permits have been obtained and electrical power has been turned on. Within ten (10) days thereafter, County shall schedule and conduct a "job walk" with Lessor for the purpose of accepting the Premises for occupancy. County shall accept the Premises if the improvements are Substantially Complete and the Premises are available for useful occupancy, as hereinafter defined. County reserves the right to determine if the Premises are Substantially Complete and available for useful occupancy.

6.3 In addition, immediately after the Substantial Completion of the Premises, Lessor shall have prepared and delivered to the County (1) a complete set of "As-Built" drawings showing every detail, latent or otherwise, of such improvements, including but not limited to electrical circuitry and plumbing, and (2) the same complete set of "As-Built" drawings on a computer disk in a CADD format.

#### **SECTION 7 - COMPLETION OF THE COUNTY IMPROVEMENTS; LEASE COMMENCEMENT DATE**

7.1 For purposes of this Lease, "Substantial Completion" of the Premises shall occur upon the completion of construction of the Leasehold Improvements in the Premises pursuant to the Approved Working Drawings, with the exception of any punch list items and any County fixtures, work-stations, built-in furniture, or equipment to be installed by County. Provided however, that such punch list items do not preclude the useful occupancy of the Premises. Useful occupancy herein defined as the Premises being safe, free of hazard, free of any risk to the safety of County employees and available for the use set forth in the Lease.

7.2 The Lease Commencement Date shall occur as set forth in Section 7.1, above.

#### **SECTION 8 - CONSTRUCTION COSTS**

8.1 Prior to County's execution of this Lease, Lessor shall provide County an itemized cost breakdown of the construction costs of the leasehold improvements, attached hereto and made a part hereof as Addendum 1. The total costs of all the Leasehold Improvements subject to reimbursement, including but not limited to fixtures, equipment, architectural fees and permits, and as reflected in the cost breakdowns, shall not exceed the sum of \$\_\_\_\_\_ which sum represents Lessor's estimate of such construction costs shown on Addendum 1 in the amount \$\_\_\_\_\_ plus a contingency amount budgeted by the County for the sole purpose of paying for extra items requested by County during the course of construction or installation of leasehold improvements.

8.2 Upon completion of the Leasehold Improvements and within fourteen (14) days of Substantial Completion and acceptance of the Premises by County, Lessor shall provide County with an itemized statement, similar to the cost breakdown form attached as Addendum 1, of the actual costs of the Leasehold Improvements incurred by Lessor, accompanied by vendor, contractor, subcontractor, material man invoices if requested by the County along with request for reimbursement of actual costs incurred.

## **SECTION 9 - REIMBURSEMENT FOR LEASEHOLD IMPROVEMENTS**

9.1 In addition to the base rent as stated in the Lease, County shall reimburse Lessor, as hereinafter set forth, the actual cost of the Leasehold Improvements as substantiated by the itemized statement required in Section 8.2 above and related supporting documentation as requested by the County. In no event shall Lessor be reimbursed an amount in excess of actual costs pursuant to Section 8.2 nor in excess of the total amount set forth in Section 8.1, whichever is less. Reimbursement shall be made in the following manner:

(a) One third (1/3) of the reimbursement amount of \_\_\_\_\_ (\$\_\_\_\_\_) plus one third (1/3) of any County contingency amount used, shall be paid within forty five (45) days after substantial completion of the leasehold improvements and receipt of invoice with supporting documentation as required.

(b) One half (1/2) of the remaining balance, together with interest thereon at the rate of \_\_\_\_percent (\_\_\_%) per annum from the date of substantial completion until the date of payment, shall be paid on or before October 1<sup>st</sup> of the County fiscal year following the fiscal year in which the initial payment referenced in Section 9.1(a) was paid.

(c) The remaining balance together with interest thereon at the rate of \_\_\_\_ percent (\_\_\_%) per annum, from the date of substantial completion until the date of payment, shall be paid on or before October 1<sup>st</sup> of the County fiscal year following the fiscal year in which the payment referenced in Section 9.1(b) above was paid.

9.2 In the event that County terminates the Lease as provided in Section 6.4 of the Lease, County agrees to pay Lessor upon such termination the balance of all payments which would otherwise be due pursuant to Section 8.2 for Leasehold Improvements.

## **SECTION 10 - MISCELLANEOUS**

10.1 County's Entry Prior to Substantial Completion. Provided that County and its agents do not interfere with Lessor's work in the Premises, Lessor shall allow County access to the Premises prior to the Substantial Completion of the Premises for the purpose of County installing over standard equipment or fixtures (including County's data and telephone equipment) in the Premises. Prior to County's entry into the Premises as permitted by the terms of this Section 10.1, County shall submit a schedule to Lessor, for approval, which schedule shall detail the timing and purpose of County's entry. County shall hold Lessor harmless from and indemnify, protect and defend

Lessor against any loss or damage to the Premises and against injury to any persons caused by County's actions pursuant to this Section 10.1.

10.2 County's Representative. County has designated its Assistant County Executive Officer/EDA as its sole representative with respect to the matters set forth in this Leasehold Improvement Agreement, who, until further notice to Lessor, shall have full authority and responsibility to act on behalf of the County as required in this Leasehold Improvement Agreement.

10.3 Lessor's Representative. Lessor has designated Mark Rubin as its sole representative with respect to the matters set forth in this Leasehold Improvement Agreement, who, until further notice to County, shall have full authority and responsibility to act on behalf of the Lessor as required in this Leasehold Improvement Agreement.

10.4 County's Agents. All subcontractors, laborers, material men, and suppliers retained directly by County shall conduct their activities in and around the Premises, in a harmonious relationship with all other subcontractors, laborers, material men and suppliers at the Premises.

10.5 Time of the Essence in this Leasehold Improvement Agreement. Unless otherwise indicated, all references herein to a "number of days" shall mean and refer to calendar days. In all instances where County is required to approve, if no written notice of approval is given within the stated time period, at the end of such period the item shall automatically be deemed not approved

10.6 Lessor's Lease Default. Notwithstanding any provision to the contrary contained in this Lease, if an event of default by Lessor of this Leasehold Improvement Agreement, and said default has occurred at any time on or before the Substantial Completion of the Premises, then (i) in addition to all other rights and remedies granted to County pursuant to the Lease, County shall have the right to cause Lessor to cease the construction of the Leasehold Improvements and (ii) all other obligations of County under the terms of this Leasehold Improvement Agreement shall be forgiven until such time as such default is cured pursuant to the terms of the Lease or this Leasehold Improvement Agreement.

## **ASBESTOS**

- A. Lessor shall operate and maintain the below described spaces free of hazard from asbestos containing construction materials (ACCM's) as defined in Title 15, Sections 1601 and 2607 of the United States Code. An asbestos hazard will be recognized if an average concentration exceeds 0.01 fibers longer than five microns per cubic centimeter of air measured over an eight hour period as determined by the Transmission Electron Microscopy (TEM) method. TEM testing will be mandatory if samples tested by the Phase Contrast Microscopy (PCM) method indicate .1 or more fibers per cc of air.
1. Space leased to the County and plenums in the same HVAC zone.
  2. Common public areas which County employees or its invitees would normally/reasonably use.
  3. Building maintenance areas, utility spaces, and elevator shafts within or serving areas described in items 1 and 2 above.
- B. In the event construction of the building wherein leased premises are located was completed prior to 1979, the Lessor shall provide the County with certification that the areas referred to above are free of asbestos hazard from ACCM's prior to the execution of this lease. If said premises were constructed after 1979, Lessor shall provide County with a written statement to that effect.
- C. Certification shall be in the form of an ACCM's Survey and Evaluation Report prepared by a qualified Industrial Hygienist who shall be certified by the American Board of Industrial Hygiene (ABIH) or an Environmental Protection Agency (EPA) – Asbestos Hazard Emergency Response Act (AHERA) certified inspector. Said survey shall include those areas listed in paragraph (A). Survey requirements are: visual walk-through inspection and testing of suspected ACCM's. Bulk samples of suspected ACCM's shall be analyzed by a laboratory certified by the Department of Health Services and recognized by the EPA Quality Assurance Program using the polarized light microscopy (PLM) method. If friable asbestos is found or the physical condition of suspected ACCM's indicate possible fiber release, air sampling and testing by the Phase Contrast Microscopy (PCM) method must be performed. If asbestos fiber concentrations of .1 fibers per cc of air or greater are found, further testing by the Transmission Electron Microscopy (TEM) method is mandatory. Said survey and evaluation report shall identify all ACCM's found and recommend abatement procedures. If necessary, the report shall also specify guidelines for the implementation of an operation and maintenance plan inclusive of any required monitoring and testing intervals. The report is subject to review and approval by the County and the Lessor shall agree to all conditions contained therein.

- D. If at any time during the term of this lease, or during any extension or renewal hereof, previously unidentified ACCM's hazard is discovered, or airborne asbestos fibers above the maximum allowable limits are found to be entering the County-leased space from any other area within the building or buildings in which the County-leased space is located, the Lessor shall immediately, at Lessor's sole cost and expense, control such release and perform abatement of all hazardous ACCM's that are determined to be affecting the County-leased space.
- E. Lessor shall perform asbestos notification as required by Chapter 10.4 of the Health and Safety Code and shall guarantee that all abatement work as required under the conditions of this lease is performed by a licensed contractor certified by the Contractors State License Board and registered with the Division of Occupational Safety and Health. The County reserves the right to establish consultant oversight of any asbestos related work program at its expense.
- F. Additionally, Lessor shall be responsible for any and all direct or indirect costs associated with the abatement of the above described ACCM's which include, but is not limited to the actual costs to the Lessor for ACCM's abatement and for all required monitoring reports before, during, and after abatement. In effect, all costs shall be borne by the Lessor that are in any way associated with the abatement of ACCM's from the Lessor's building including clean up of contaminated County-owned equipment, furnishings, and materials. Copies of the air monitoring reports shall be furnished to the County together with certification by an Industrial Hygienist Consultant registered with Cal/OSHA that the area is free of hazard from ACCM's.
- G. If it is determined that for safety reasons its employees should be relocated at any time prior to or during the abatement of ACCM's, the Lessor shall provide comparable accommodating space (at no cost to the County) throughout the abatement process. Said determination shall be made by a qualified representative of Cal/OSHA. The Lessor specifically agrees to pay for all costs associated with this move or reimburse the County, if the County paid for this cost, including all reasonable administrative costs and cost of moving or renting furniture, data processing, and telephone equipment.
- H. In the event, after written notice is provided by the County, the Lessor fails, refuses, or neglects to diligently pursue abatement of above described asbestos hazard from ACCM's, the County may effect such abatement; and, in addition to any other remedies it may have, deduct all reasonable costs of such abatement and all costs associated in any way with the abatement of the above described ACCM's from the rent that may then be or thereafter become due throughout the term of this lease. For this purpose and as a condition of this lease agreement, the Lessor shall obtain an EPA generator number and grant license to the County for its use.



- I. In addition to any other remedies it may have, in the event the Lessor fails to diligently pursue abatement of asbestos hazard from ACCM's, as required under the provisions of this lease, the County may, by notice in writing, terminate this lease. Lessor shall be liable to the County for all expenses, losses, and damages reasonably incurred by the County as a result of such termination; including, but not limited to additional rental necessary to pay for an available similar replacement facility over the period of what would have been the remaining balance of the lease term plus any option periods, costs of any necessary alterations to the replacement facility, administrative costs, and costs of moving furniture, data processing, and telephone equipment.
  
- J. The Lessor shall indemnify, defend, and hold the County of Riverside, its officers, and employees harmless from and against any and all losses, damages, judgements, expenses (including court costs and reasonable attorney fees), or claims whatsoever, arising out of, or in any way connected with or related to, directly or indirectly, the presence of asbestos hazard from ACCM's within the County-leased space or the building in which the leased premises are located.

**EXHIBIT "D"**  
**CONFIRMATION OF LEASE INFORMATION**

1. LEASE REFERENCE DATE: \_\_\_\_\_
2. PREMISES:
3. COMMENCEMENT DATE: Construction of the leasehold improvements is substantially complete and the lease term shall commence as of \_\_\_\_\_, for a term of \_\_\_\_\_ ending on \_\_\_\_\_, unless extended as provided in the Lease.
4. RENT: In accordance with the Lease, Rent began to accrue on \_\_\_\_\_, in the initial amount of \_\_\_\_\_ per month. Rent is due and payable in advance on the first day of each month during the Lease Term.

AGREED and ACCEPTED

**LESSOR:**

**COUNTY:**

\_\_\_\_\_

\_\_\_\_\_

Dated: \_\_\_\_\_

Dated: \_\_\_\_\_

**COUNTY OF RIVERSIDE**  
**Department of Facilities Management**  
**Real Estate Division**

**CUSTODIAL SERVICES REQUIREMENTS**  
**FOR LEASED FACILITIES**

1. Background checks shall be performed, in a manner specified by County, of all qualified permanent and temporary employees.
2. Provide all required services and supplies.
3. Perform services five days a week during the hours of 5:00 pm to 1:00 am only.
4. Provide and replace all fluorescent light tubes and incandescent light bulbs using only those types of tubes and bulbs that are energy efficient as indicated by manufacturer. Fixture reflectors shall be wiped clean with each relamping.
5. Lessor and custodial staff shall be responsible for key control. Issuing keys to workers, collecting said keys at shift end and retrieving keys at the end of custodian's employment. If keys are lost, stolen or misplaced, rekeying costs are landlord's responsibility.
6. **SPECIFIC SERVICES – Frequency and coverage:**
  - A. **Daily:**
    1. Rest Rooms:

Empty all trash containers, refill dispensers, damp mop floors, clean, sanitize and polish all plumbing fixtures, chrome fittings, flush rings, drain and overflow outlets, clean and polish mirrors, clean wall adjacent to hand basins/urinals, dust metal partitions, remove finger prints from walls, switches, etc.
    2. Lobby Area – Main Corridors – Stairways:

Remove trash, vacuum, vacuum/damp mop tile, clean lobby and entrance doors, clean and sanitize drinking fountains.
    3. Employee Break Rooms/Kitchen:

Remove trash from building and deposit in dumpster, vacuum rugs and carpet, wipe spills, mop tile floor, remove fingerprints from doors, light switches, etc., and refill dispensers.
    4. General and Private Areas:

Remove trash, vacuum carpets, mop tile floors, spot clean interior partition glass, clean counter tops and blackboards, dust desks,

conference tables, credenza/file cabinets and bookcases.

5. Building Security:

- a. Turn off all lights (except security and night lights).
- b. Close windows.
- c. Reset alarms and lock all doors.

**B. Weekly – All Areas:**

Polish buff hard resilient floors in traffic areas, spot clean carpeted areas.

Dust all high and low horizontal surfaces, including sills, ledges, moldings, shelves, locker tops, frames and file cabinets, damp wipe plastic and leather furniture.

Remove fingerprints from doors, elevator walls and controls, frames and light switches in office areas, clean and polish bright metal to 70" height, clean and sanitize waste containers in rest rooms and break rooms.

**C. Monthly – All Areas:**

Clean interior glass partitions/doors, dry dust wood paneling, remove dust/cobwebs from ceiling areas.

Spray buff resilient/hard floor areas, detail vacuum carpet edges, under desk/office furniture.

**D. Quarterly – All Areas:**

Spray buff resilient and hard surface floors and apply floor finish.

Clean interior/exterior windows, clean/polish office furniture, damp clean diffuser outlets in ceiling/wall, wash waste containers, clean/dust blinds, wash sanitize.

**E. Semi-Annually – All Areas:**

1. All Areas:
  - a. Clean and polish all baseboards.
  - b. Damp clean lobby and reception chairs.
  - c. Clean carpeted surfaces-use a water extraction method.

**F. Annually – All Areas:**

1. All resilient and hard surface floors:
  - a. Move furniture, strip, seal and apply floor finish to all resilient and hard surface floors.

**COUNTY OF RIVERSIDE  
ECONOMIC DEVELOPMENT AGENCY  
Real Estate Division**

**GENERAL CONSTRUCTION SPECIFICATIONS  
FOR LEASED FACILITIES**

**A. INTENT**

1. It is the intent of these instructions to convey to the Lessor and his bidders the construction requirements for obtaining a complete and usable facility under lease agreement. These instructions apply to all new construction (build-to-suit), alterations and repair and/or renovation in facilities leased to the County of Riverside.
2. All references to the County in this or any other specification means the Director of Facilities Management or his designee.
3. All work in accordance with these specifications or any other specifications and plans must be coordinated with the Director of Facilities Management or his designee. Specifications contained on or with specific plans for construction may contain more stringent provisions than the minimum requirements stated herein. The more stringent requirements shall govern.
4. When fully justified, Lessor may request waiver of any portion of these specifications. Such requests must be submitted in writing to the Economic Development Agency with full justification. All specifications will be enforced unless specifically waived by the Economic Development Agency in writing.

**B. COMPLIANCE WITH LOCAL REGULATIONS**

1. In the absence of such codes, ordinances or regulations, the Lessor's contractor shall use the latest edition of the "Uniform Building Code". However, when such local, County or State requirements contain more stringent provisions than the minimum requirements stated herein, the more stringent requirements shall govern.
2. The Lessor shall, without additional expense to the County, be responsible for obtaining and paying for any necessary construction fees, licenses and permits required for privately owned buildings. Lessor shall comply with any applicable Federal, State and Municipal laws, codes, and regulations in connection with the prosecution of the work, and shall take proper safety and health precautions to protect work, the workers, the public, and the property of others.
3. All work in accordance with these specifications must be done in strict compliance with the Americans with Disabilities Act of 1990 and any regulations issued pursuant thereto.

**C. DRAWINGS**

1. A site plan, clearly indicating employee, visitor and open parking spaces, shall be prepared. Floor plans, elevations, mechanical and electrical drawings shall be prepared, preferably at one eighth inch (1/8") scale.
2. The Economic Development Agency shall be provided four (4) complete sets of the aforementioned drawings and specifications for review and approval.
3. Prior to start of construction, two (2) complete approved sets of construction plans and specifications shall be provided to the Economic Development Agency. These sets shall be signed to indicate approval by Information Technology and the user department. One set will be returned to Lessor for construction, the second set shall be retained by Economic Development Agency.
4. Any changes or deviation from the approved plans and specifications will not be accepted without prior written approval from the Economic Development Agency.

**D. CONSTRUCTION**

1. A pre-construction conference with Lessor, contractor and County shall be conducted at a mutually agreed-upon site for reviewing and defining the construction requirements.
2. Inspections by the Economic Development Agency will be conducted at random times during the course of construction. The successful bidder shall maintain, on the job site, a complete set of approved final drawings and specifications marked up to show any changes and as-built conditions. Normally, three (3) unscheduled and one (1) final inspection will be conducted. At the final inspection, a punch list will be developed, and any deficiencies noted will be corrected prior to County's acceptance of the facility.

**E. SPECIFICATIONS**

1. The Lessor shall be responsible, in all cases, for the proper design and coordination of architectural, structural, plumbing, electrical, heating, ventilation, air conditioning, site elements, etc., of the proposed facility. Accessibility for physically handicapped is required, unless specifically waived in writing by the Economic Development Agency.
2. Lessor shall verify the accuracy of all dimensions, and he shall be responsible for correcting and recording any discrepancies.

**(SITE REQUIREMENTS)**

**A. SITE**

1. The Lessor shall be responsible for determining site conditions, including sub-

surface soil conditions, adequate public utilities and load-bearing characteristics, the installation of retaining walls, demolition, relocation of utilities, and other site improvements.

**B. GRADING**

1. The finish grades and contours shall be correlated with street and sidewalk grades established by the local municipality. Floors, driveways, etc., shall be adjusted by the Lessor's architect as necessary, to insure property clearances, surface drainage, slope gradients, storm and sanitary sewer gradients and connections. All paved areas shall be graded as necessary to provide positive drainage of surface runoff water away from the buildings.

**C. DRAINAGE**

1. Walks, parking areas, driveways and maneuvering areas shall be provided with positive natural drainage whenever possible. The floor of the building and adjacent grades may be raised sufficiently to provide natural drainage.

**D. RETAINING WALLS**

1. The determination of the location and extent of retaining walls required is the responsibility of the Lessor.

**E. LANDSCAPING**

1. Suitable regionally appropriate, water conserving, low-maintenance planting shall be provided. Preservation of existing vegetation and the providing of additional landscaping shall meet local environmental requirements.

**F. CLEANUP**

1. Upon completion of the facility and prior to move-in and acceptance for lease by the County, the Lessor shall clean, seal and wax floors, clean windows, fixtures and finishes, interior and exterior, and remove surplus materials and debris from the site.

**(ARCHITECTURAL REQUIREMENTS)**

**A. FLOORS**

1. Floor elevations shall be at least eight inches above finished exterior grade whenever possible. When floor slab is below grade, it shall be waterproof.
2. Floors shall be designed in accordance with uniform, concentrated and special loads given in the "Uniform Building Code", chapter 23.
3. Carpet – One hundred percent (100%) continuous filament nylon or olefin with static control; minimum yarn weight - 28 oz. Require statement of pile weight

from vendor or manufacturer. Minimum five (5) year warranty excluding the use of protective chair pads against ten percent (10%) surface wears when properly maintained. Four inch (4") rubber cove base shall be used for base in all carpeted areas. Colors/patterns must be approved by the Economic Development Agency.

4. Carpet tiles may be used. Pile weight 28 oz. static control 2.0 K.V. or less. Color shall meet County color standards.
5. Non-carpeted floors - rest rooms, coffee rooms, etc., shall have sheet vinyl covering, including base. Vinyl tile may be used in other non-carpeted areas. Vinyl shall be commercial grade with colors and patterns full depth. Colors/patterns of sheet vinyl and vinyl tile must be approved by the Economic Development Agency.

**B. WALLS**

1. Interior walls - all interior partition construction shall comply with applicable Federal, State, County and City codes. The types of interior partitions to be used must be approved by the Economic Development Agency. Systems furniture may be used.
2. Toilet room walls adjacent to occupied spaces shall be sound insulating double-wall construction and filled with sound-absorbing materials.
3. Exterior walls - Exterior walls constructed of wood or steel stud shall be insulated to R-11 specifications.

**C. ROOF AND INSULATION**

1. Roof construction and insulation shall be appropriate to the overall design of the building and prevailing weather conditions. Light colored materials are encouraged.
2. All roof designs shall include a minimum one-half inch (½") to one foot (1') slopes for positive drainage.
3. Roofs on existing buildings shall be subject to (a) an inspection by a licensed roofing contractor, (b) County's review of roofing contractor's findings and (c) proof of corrective action.

**D. TIMBER AND WOOD**

1. All lumber used structurally shall be stress-graded with the stamp of the Lumber Association indicated on each piece showing the stress grade.

**E. CEILING CONSTRUCTION**

1. All ceilings shall be placed at nine feet (9'0") above finish floor level, unless



otherwise specified.

2. A suspended acoustical ceiling system with integrated lighting shall be installed in all occupied areas.
3. Rest rooms and coffee rooms shall have solid ceilings (drywall, etc.).

**F. WINDOWS**

1. Windows shall generally be limited to the lobby area and offices.
2. Glazing that extends below thirty-two inches (32") above the floor shall be protected with a horizontal railing or similar safety barrier. Individual windows may be metal or wood of commercial quality. All window openings shall be properly flashed to prevent moisture intrusion.
3. Low energy and reflective glazing shall be used in high heat gain areas.

**G. DOORS**

1. Exterior doors - all wood doors will be solid core. Exterior doors will be weather-stripped and have stops. Exterior doors to be not less than thirty-six inches (36") wide. Appropriate metal doors are acceptable.
2. Exterior doors shall have automatic closers.

**H. CABINET WORK**

1. Cabinet work shall conform to the standards as defined in the Woodwork Institute of California, Manual of Millwork, (reference "WIC #102", standard cabinet design).
2. Acceptable cabinet work quality is laminated plastic covered deluxe (D) grade, or wood factory finished deluxe (D) grade, except utility (U) grade in utility storage areas.
3. Countertops and splashes shall be laminated plastic, custom grade, self-edge trim. Minimum four inch (4") high splashes where abutting vertical wall surfaces.
4. Cabinet work to be complete with knobs, pulls, hinges, catches, etc.
5. Colors/patterns of laminated plastic and finishes of casework must be approved by the Economic Development Agency.

**I. HARDWARE**

1. Hardware will be of good commercial quality grade and type. Automatic door closers shall be provided on public and employee entrance doors, toilet room

doors, and coffee room doors. Public entrance and glazed partition lobby doors shall be equipped with push bars with integral PUSH AND PULL signs. Toilet and coffee room doors will have push plates and door pulls. When public entrance, lobby, toilet or coffee room doors are wood or metal with enameled finish, kick plates shall be provided. At buildings where only one (1) toilet is provided, the door closer will be omitted and the door fitted with a privacy lockset. Door locks will be operable by a master key system. Panic hardware must be installed where required by code. Simplex cipher locks (or equal) may be used in lieu of keyed locks when approved by the Economic Development Agency.

2. Exterior doors with hinges exposed to the public (out- swinging doors) will be equipped with door butts that have "fast" pins to prevent removal or tampering.
3. All doors to be provided with adequate hardware. Interior door locksets to be provided only where indicated on plans. Interior doors to be provided with doorstops.
4. Double doors (pair) - shall be avoided on exterior openings wherever possible. When pair is required by design, use removable mullion, unless specifically approved otherwise.
5. Exterior doors - all exterior doors must have a deadbolt lock, except where panic hardware is required.
6. Door lock keying - Simplex or equal may be substituted for keyed locks when approved by the County.
  - a. All keyed locks shall be equipped with six (6) pin keyways.
  - b. Three (3) keys shall be furnished for each lock.
  - c. All locks shall be keyed as specified by County, except that all locks within the following individual groups shall be keyed alike:
    - (1) Mechanical equipment rooms.
    - (2) Janitor's closets.
    - (3) Employee entrances (interior & exterior).
    - (4) Bulletin boards.
    - (5) Electrical panel boxes.
  - d. A master key system shall be provided and three (3) master keys shall be furnished, unless otherwise specified.
  - e. Keying - locks will incorporate a security system to assure that keys used during construction will not open doors after County occupancy. The key

side of all locks will be on the public side.

**J. TOILET ENCLOSURES AND ACCESSORIES**

Facilities must comply with all existing codes.

1. All toilet and urinal enclosures shall be secured to the floor and ceiling.
2. Doors shall be installed in men's and women's restrooms. Entrance doors to toilet enclosures shall be fitted with specific locking devices. Toilet enclosures for non ADA stalls shall be 34" wide, or more, on all new construction.
3. Each toilet compartment shall be provided with a metal coat hook and double roll toilet paper holder, suitable for dispensing rolled tissue.
4. Install one single-fold paper towel or roll towel dispensing cabinet for each multiple of two (2) lavatories or less in all rest rooms. Towel dispensers shall be designed to dispense paper towels.
5. Each pair of lavatories in all rest rooms shall be provided with soap dispensers.
6. Each lavatory in all rest rooms shall be provided with a 24" x 30" wall-mounted mirror. Provide a stainless steel shelf at each mirror.
7. Women's rest rooms shall be provided with feminine napkin dispenser. Women's toilet compartments shall be provided with one (1) feminine napkin disposal container.
8. Trash bins shall be provided in rest rooms.
9. Both men's and women's toilets shall be designed and constructed to accommodate the physically handicapped. One water closet compartment shall be sized to meet handicapped requirements, provided with out swinging door and grab bars. The toilet fixtures, lavatory, mirrors, etc., shall be located at the correct height for handicapped.

**K. PAINING**

1. All exterior painted surfaces shall be given a minimum of two (2) coats. Colors must be approved by the Economic Development Agency.
2. Interior surfaces and trim shall be given two (2) coats minimum. One hundred percent (100%) coverage required. Prefinished acoustical ceiling shall not be painted. Finish coat shall be in accordance with colors as prescribed by County and shall match color chips.
3. Paint colors must be approved by the Economic Development Agency.
4. All interior painted surfaces shall receive two (2) coats of semi-gloss enamel.

5. Wall coverings other than painted surfaces (i.e., wood paneling, vinyl material, etc.) shall be permitted. Location and colors must be approved by the Economic Development Agency.
6. Parking strips four inches (4") wide of highway traffic paint are to be provided.
7. Street number - Minimum six inches (6") high number - by Lessor.

L. **WINDOW TREATMENT**

1. Minimum treatment - Vertical blinds or other as specified by the Economic Development Agency.

M. **SIGNS**

1. Identification sign to be installed on exterior of building. Sign will be specifically identified by the Economic Development Agency. Placement and specific size of letters will be determined according to layout and location of structure. Letters will be black injection molded plastic, Helvetica in style.
2. Interior signs to be black phenolic material laminated with white letters. Signs will be specifically identified by the Economic Development Agency.
3. Lettering on entrance doors will be specifically identified by the Economic Development Agency.

N. **ASBESTOS & LEAD BASED PAINT**

1. All buildings constructed prior to 1978 will have asbestos and lead based paint check to ascertain that no friable asbestos or flaking lead based paint is in evidence. A copy of the report is to be filed with the Economic Development Agency.

O. **PLUMBING FIXTURES AND FITTINGS**

1. All rest room lavatories shall have self-closing faucets.
2. All toilets and urinals shall be equipped with flush valves.
3. Refrigerated water fountains - provide refrigerated water fountains at location indicated.
4. "Water-Saver" toilets will not be acceptable.
5. Provide hot water in rest rooms and break rooms.
6. Health Clinics-provide hot water in examination rooms, labs, restrooms and break rooms.

7. All work in accordance with these specifications must be done in strict compliance with the Americans with Disabilities Act of 1990, the California Title 24 section which implements it, and any regulations issued pursuant thereto.

**P. FIRE PROTECTION**

1. Provide all necessary fire extinguishers as required by local fire regulations.
2. Provide sprinkler inspection and test prior to occupancy.
3. Provide all other necessary protective devices and equipment as required by local fire regulations.
4. Building alarms and fire monitoring equipment shall not be installed in the telephone/data room without written permission of the IT Department.

**Q. ELEVATORS**

1. Provide documentation of inspection and routine maintenance prior to and during occupancy.

**SPACE CONDITIONING**  
**(Heating, Ventilation and Air Conditioning)**

**A. GENERAL REQUIREMENTS**

1. Space conditioning shall be considered the year-round control of temperature, humidity, air circulation, ventilation and air cleaning to the degree required to assure satisfactory and efficient use of the space for occupants and equipment. Follow good accepted practices as reflected in the latest issue of the American Society of Heating, Refrigeration and Air Conditioning Engineer's Guide (ASHRAE).

**B. VENTILATION**

1. Ventilation for air-conditioning system - Provide ventilation makeup air in the amount of 10% of total air requirement for cooling or two (2) air changes per hour, whichever is greatest, plus all exhaust air requirements.
2. Prior to construction of office space over 5,000 square feet, existing systems over ten (10) years of age shall be inspected by a licensed HVAC company and a statement of condition detailing the reliability and efficiency of the systems shall be provided.

**C. EXHAUST SYSTEMS**

1. Exhaust toilet areas - the exhaust fan shall be connected to the light switch or interconnected with the air conditioning time clock.

2. Air shall not be directly exhausted, except in the following instances:
  - a. Air used to make up exhaust for toilet rooms.
  - b. Air exhausted specifically for cooking, food preparation or removal of excessive heat generated by vending or various other machines.
  - c. When specified for coffee rooms.

**D. SPACE TEMPERATURE CONTROLS**

1. Central control system for the various areas or provide a thermostat for each heating and/or air-conditioning system. Use separate slide lever adjustments for heating and cooling with lock covers.
2. All systems shall be controlled by seven (7) day, twenty-four (24) hour time clocks set to the Economic Development Agency requirements.
3. Thermostats controlling space conditions during occupied hours shall be adjustable from sixty eight degrees (68°) to eighty degrees (80°) with the normal set at seventy degrees (70°) for heating and seventy-six degrees (76°) for cooling.
4. Simultaneous heating and cooling will not be acceptable.
5. Lessor shall comply with existing codes.
6. Heat-generated equipment shall be of adequate capacity to heat the building under design conditions.
7. All gas furnaces shall be approved by the American Gas Association.
8. All electric components shall be UL-approved and comply with the California Electric Code.
9. Electric strip heating is not acceptable.

**E. AIR FILTERS**

1. All recirculated and outside air shall pass through filters before entering air-handling units.
2. Filters shall be replaceable types and changed a minimum of four (4) times a year.
3. A location map showing filter locations shall be provided to County.

**F. PIPING**

1. Piping in finished areas, such as lobbies and offices, shall be concealed. No water piping of any description shall be installed near electrical switchgear. Provide shutoff valves at all locations necessary to isolate separate zones of the

system served.

2. All hot and chilled water piping shall be insulated.

**G. AIR DISTRIBUTION**

1. Ductwork shall be provided, as required, for proper air distribution with supply outlets spaced so as to avoid excessive throws and dead spots. In order to maintain sound privacy, door louvers will not be used to return air from offices. Sound-attenuating, acoustically lined transfer ducts or return air ducts must be used. All supply and return air ductwork shall be constructed and installed in accordance with ASHRAE Standards and shall comply with state and local building codes.
2. All air handling units, except unit heaters, must be provided with outside air intakes. Intakes shall be located to avoid the introduction of boiler flue gases or vehicle and condenser unit exhausts.
3. Diffusers shall be selected and spaced so that, at the occupied level, the movement of air will be uniform and not be less than ten (10) cubic feet per minute, nor more than fifty (50) cubic feet per minute when measured at four feet (4") above the floor. They shall be selected so that the throw from an air diffuser does not impinge on walls, columns, or the throws from other diffusers based on a terminal velocity of one hundred feet (100') per minute. Diffusers located in offices shall be of the fully adjustable air pattern type.

**H. BALANCING AND ADJUSTING**

1. Space conditioning equipment shall be balanced and adjusted by persons certified to perform such functions prior to occupancy.
2. Copy of air balance report shall be provided to the Economic Development Agency.

**I. NOISE AND VIBRATION**

1. Particular care shall be exercised in the design, selection and installation of all mechanical equipment and components to attain reasonable noise levels in occupied space. In general, sound levels for various spaces shall be maintained in accordance with the recommendations of the ASHRAE Guide.

**J. OPERATING INSTRUCTIONS**

1. The Lessor shall provide simplified consolidated equipment and control diagrams with specific operating instructions posted on a readily accessible label on each utility system, such as furnaces, refrigeration equipment, air handling systems, and pumping systems. These instructions shall clearly indicate how to stop and start systems, what adjustments must or may be made by County personnel to assure proper operation, and what action shall be taken in emergencies.

## (ELECTRICAL)

### A. GENERAL REQUIREMENTS

1. All electrical work shall be designed and installed in accordance with the plan requirements.
2. Codes and ordinances - shall conform to standards of the National Electrical Code (NEC), O.S.H.A., serving public telephone company, State Fire Marshal and local ordinances.
3. Service equipment shall be located in separate electrical/mechanical room with proper working clearances and grounding. All breakers shall be clearly identified.

### B. INTERIOR LIGHTING

1. Fluorescent lamps shall generally be 34 watt, 430-milli-amp, rapid-start, cool-white, including energy efficient ballasts.
2. The lighting shall be designed to maintain a uniform level of illumination of the minimum foot -candles designated. Lighting levels shall be based on working plan thirty inches (30") above floor, appropriate coefficient of utilization for the fixture and maintenance factor. Conform to Title 24, Division 9 for lighting requirements. Provide not less than ten foot-candles in halls, thirty foot-candles in rest rooms and fifty foot-candles in all other areas, unless specifically noted otherwise. (eighty foot-candles in drafting room areas).
3. Each working space, utility or storage room shall have at least one receptacle. Each office shall have a minimum of one (1) receptacle on each twelve feet (12') of wall space. See plans for additional and/or special outlets.
4. Provide twenty-four (24) hour lighting for security.
5. Emergency lighting - Shall be provided where required by applicable codes, or natural lighting will not provide sufficient lumens for emergency exiting of building.

### C. EXTERIOR LIGHTING

1. Install sufficient lighting to provide a minimum of five (5) foot-candles of illumination at each building entrance, around the perimeter of the building, in the parking and maneuvering areas and on driveways.
2. All exterior lighting shall be high or low-pressure sodium as specified by the County. Fixtures shall be controlled by photocell, time clocks, or combinations of both.



## (TELEPHONE AND COMMUNICATIONS)

(Updated November 10, 2008)

### A. GENERAL REQUIREMENTS

1. All communications requirements shall conform to the standards of Riverside County Information Technology (RCIT) and the serving public telephone company as noted below.
2. **The RIVERSIDE COUNTY INFORMATION TECHNOLOGY (RCIT) COMMUNICATIONS BUREAU TELECOMMUNICATIONS ENGINEER shall be consulted during the Programming, Conceptual Design, Design Development, and Construction Design stages to plan the design and provide input for the Telecommunications Infrastructure.**

### B. TELECOMMUNICATIONS ROOM SPECIFICATIONS

1. **Dedicated Use: Telecommunications Rooms must be dedicated to the telecommunications function and related support facilities.** Equipment not related to the support of the Telecommunications Room, such as piping, duct work, and distribution of building power, must not be located in, or pass through the room. The Telecommunications Room may not be shared with building or custodial services. Cleaning materials such as mops, buckets or solvents must not be located or stored in the Telecommunications Room. Building alarms, fire monitoring equipment and building automation equipment shall not be installed in the Telecommunications Room without written permission of the RCIT Communications Bureau Telecommunications Engineer. In the event the RCIT Communications Bureau Telecommunications Engineer grants such permission, all building alarms and fire-monitoring equipment shall be installed only in the location designated.
2. **Room Physical Specifications - the room must be completed a minimum of thirty (30) days prior to occupancy.** Large projects (more than 20,000 sq. ft.) will require the Telecommunications Room (s) to be completed a minimum of 45 days or as directed by RCIT Communications Bureau Telecommunications Engineer prior to beneficial occupancy. All specifications for said room as outlined in this agreement shall be completed, including, but not limited to, installation of plywood, lighting, electrical circuits, HVAC, ceiling tiles, ground, floor tile and door with lock and three (3) sets of keys.

**It should be understood that the contractor will have to schedule various trades in sooner than the normal construction schedule to complete the Telecommunications Room (HVAC, Electrician, Painter, etc.) as required by the RCIT Communications Bureau Telecommunications Engineer.**

- a. **Location:** The Telecommunications Room shall be as close to the geographic center of the occupied space as possible. **Maximum distance from the center of the Telecommunications Room to the farthest WAO location shall not exceed a radius of 175 feet unless**

reviewed by RCIT Communications Bureau Telecommunications Engineer. If occupying more than one floor of a building, a **separate Telecommunications Room shall be required on each floor**, preferably stacked above one another. Provisions shall be made available for easy access into the Telecommunications Room for telephone and data wiring and shall be dedicated for telephone and data use only. Telecommunications Rooms should not be planned next to elevators, restrooms, electrical rooms, air shafts, mechanical rooms, and outside walls. If occupying more than one building, each building will require Telecommunications Rooms that meet the above requirements.

- b. **Minimum Room Sizes:** The Telecommunications Room shall be rectangular in shape and conform to the following inside room dimensions:

<u>Leased Premises – sq. ft.</u>	<u>Room Size</u>
5,000 sq. ft. or <b>less</b>	12' x 9'
5,000 – 10,000 sq. ft.	12' x 12'
10,000 – 30,000 sq. ft.*	12' x 14'
30,000 sq. ft. or <b>larger**</b>	12' x 14'

\* May require more than one room

\*\* Will require more than one room.

- c. **Plywood Wall Lining:** All walls will be lined with AC grade or better, void-free, 4'x8' sheets of 3/4" plywood. Plywood sheets shall be mounted vertically from ceiling height towards floor. Plywood must be painted on all sides with one coat of primer and two coats of white fire resistant paint. The plywood should be installed with the grade "C" surface facing the wall.
- d. **Doors:** The door will be a minimum of three (3) feet wide and 80 inches tall and be located as near as possible to a room corner. The door shall be equipped with a lock. Where practical, the door should open outward to provide additional usable space.
- e. **Air Conditioning:** The environmental control systems for the Telecommunications Room should be able to maintain a room temperature between 18°C and 24°C (64°F and 75°F) at all times (24 hours per day, 365 days per year). All building supplied HCAC inlets to the Telecommunications Room shall be controlled using a Variable Air Valve (VAV) with its own thermostat to prohibit heating the Telecommunications Room. The VAV will be installed in such a fashion to introduce conditioned air if the primary split A/C unit fails to cool the room. It will serve two purposes:
  1. Provide ventilation air to the room, cooling only.
  2. Serve as an additional backup.

If a building's HVAC system cannot ensure continuous operation

(including weekends and holidays), provide a standalone HVAC unit with independent controls for the Telecommunications Room. If an emergency power source is available in the building, connect the HVAC system that serves the Telecommunications Room to the emergency power source. Sensors and controls must be located in the Telecommunications Room, ideally placed 5 feet AFF (thermostat location will be specified on the Telecommunications Room drawing provided by RCIT Communications Bureau Telecommunications Engineer). If an in-room air conditioner is installed, the air conditioner will be hard wired to the thermostat and the location must be approved by RCIT Communications Bureau Telecommunications Engineer before installation. If remote-monitoring equipment is available, this room should have its own independent sensor. Average heat load for equipment is approximately 150 BTU/SQ Ft of Telecommunications Room space (specific heat load will be provided for each room).

- f. If **fire sprinklers** are located in the Telecommunications Room, the sprinkler shall have a high temperature standard response full circle head with a heavy-duty cover. Sprinkler lines located inside the TR shall not be "charged" under normal conditions. Coordinate placement of the sprinklers with RCIT Communications Bureau Telecommunications Engineer. Sprinkler heads must be a minimum of 10 ft. AFF.
- g. **Room Lighting** – Lighting to provide a minimum of 500 lux (50 foot candles) measured 3 ft. AFF. Coordinate placement of light fixtures with RCIT Communications Bureau Telecommunications Engineer to avoid interference with low voltage equipment. Light fixtures must be a minimum of 10 ft. AFF. Use white paint on the walls and ceiling to enhance room lighting. Power for the lighting should not come from the power panel located inside the Telecommunications Room.
- h. **Emergency Lighting** – Emergency lighting within the Telecommunication Room shall be provided to ensure that the loss of power to normal lights will not hamper an emergency exit from the room.
- i. **Floors:** The floor shall be capable of supporting a minimum load bearing of one hundred (100) pounds per square foot and maximum concentration loading of 2,000 lbs. per foot. Standard VCT floor covering shall be installed unless otherwise specified.
- j. **Ceiling:** If a ceiling will be installed in the Telecommunications Room it must be installed at a **minimum of 10' AFF**. Ceiling protrusions (e.g. sprinkler heads) must be placed to assure a minimum clear height of 10 feet that is clear of obstructions, to provide space over the equipment frames for cables and suspended cable trays. Ceiling finish must minimize dust and be light colored to enhance the room lighting. A hard ceiling shall not be allowed in the Telecommunications Room.

## C. ELECTRICAL REQUIREMENTS

- a. **Dedicated Power Feeder** – The Telecommunications Room will have its own dedicated power feeder terminated in an electrical panel located inside the room and flush mounted in the wall. **Location of this electrical sub-panel shall be closely coordinated with RCIT Communications Bureau Telecommunications Engineer to ensure it does not impact the overall design and use of the space within the room. Power required for other equipment in the room (e.g. fluorescent lighting, motors, air conditioning equipment) should be supplied by a separate feeder, conduit, and distribution panel.** If an emergency power source is available, connect the Telecommunications Room electrical sub-panel into it.
- b. **General Purpose Outlets:** Provide 110 Volt, 20 Amp duplex outlets installed at standard height on all walls of the Telecommunications Room; maximum spacing between outlets shall not exceed 12 feet.
- c. **Telephone System:** Install one (1) dedicated 208 VAC, 20 Amp circuits terminated into a single surface mounted 4S electrical box with a NEMA L6-20 outlet at a height of 18 inches AFF from center. The circuit will have its own separate hot, neutral, and ground wire all the way back to the power distribution panel. The circuit will be clearly labeled on the cover plate and sub-panel.
- d. **Equipment Racks:** Install two (2) dedicated 20 Amp, 110 VAC circuit with isolated ground for each equipment rack (9' x 12' room – 2 racks, 12' x 12' room – 3 racks, 12' x 14' room – 4 racks). Install one (1) dedicated 30 Amp, 208 VAC circuit with isolated ground for every two equipment racks. The breaker number shall be identified on each of these outlets. Terminate each circuit on double duplex outlets in a surface mounted 4S box in the vertical cable manager 23" above the floor. Equipment Rack locations, circuit locations and quantity will be specified in the room layout provided by the RCIT Communications Bureau Telecommunications Engineer.
- e. **Paging – AV: If required, install** one dedicated 20 Amp, 110 VAC circuit with isolated ground. Terminate on a double duplex outlet in a 4S box. The location of the outlet will be specified in the Telecommunications Room layout provided by the RCIT Communications Bureau Telecommunications Engineer.
- f. **Security:** Install one dedicated 20 Amp, 110 VAC circuit with isolated ground. Terminate on double duplex outlets in a 4S box. The location of the outlet(s) will be specified in the Telecommunications Room layout provided by the RCIT Communications Bureau Telecommunications Engineer.
- g. **Emergency Air Conditioner Outlet (To Support IT Telephone System):** Install one dedicated 208/220 VAC, 20 Amp circuit terminated on a single NEMA 6-20 receptacle. The location of the outlet will be specified in the Telecommunications Room layout provided by the RCIT

Communications Bureau Telecommunications Engineer.

- h. **Grounding** – A Telecommunications Main Grounding Busbar (TMGB) shall be installed in the Telecommunications Room at the location specified in the room layout that will be provided by the RCIT Communications Bureau Telecommunications Engineer. **The Grounding Busbar must be CPI Chatsworth Products, part #13622-020.** The Busbar shall be insulated from its supporting structure by at least two inches of separation. Bond the Busbar to the building AC grounding electrode system. The minimum size of the bonding conductor should be #3 AWG and be sized to carry the maximum short time rating Amps of the building grounding electrode conductor. A supplemental bonding connection is required to be Exothermically Welded to the structural steel of the building and local AC sub-panel located inside the Telecommunications Room. Resistance should be no more than .1 ohms between the TMGB and the building main grounding source measured following the two-point bonding test method using an earth ground resistance tester. All grounding conductors shall be run in rigid conduit.

#### D. CONDUIT REQUIREMENTS

##### 1. Work Area Outlets (WAO):

- a. **General Specifications:** Each WAO shall consist of one 4 in. by 4 in. by 2.5 in. deep outlet box with a 2 in. by 4 in. reducing adapter installed.
- b. **Height Requirements:** Each WAO shall be installed at the same height as the adjacent electrical outlet. The height of jacks for wall telephones shall conform to any ADA rules pertaining to handicapped use. This height is typically 44 inches AFF to the center of the outlet box.
- c. **Conduits Specifications:**
- (1) **Accessible Ceilings:** When there is an accessible ceiling such as suspended acoustical tile, provide a rigid trade size 1 conduit (**flex not allowed**) stubbed into the ceiling space from the outlet box. Ceiling must be accessible from the WAO location back to the Telecommunications Room. If a WAO location is at wall phone height (+44"), install an additional outlet box at standard floor height. Connect a rigid 1-inch conduit from the bottom of the wall height box to the top of the standard floor height box. Ream all conduit ends and fit with insulated bushings.
  - (2) **Non-Accessible Ceilings:** When the ceiling is not accessible, provide a rigid 1¼-inch conduit (**flex not allowed**) run from the WAO location all the way to the Telecommunications Room or to the nearest accessible ceiling space. Runs cannot have more than the equivalent of two 90-degree bends without installing a pull box (pull box must be accessible upon completion of construction). **All conduits will have a pull string installed.**

Where multiple outlets are installed, each location will have its own dedicated conduit run; no daisy chaining is allowed.

2. **System Furniture Wall In-feeds:** Wall in-feeds will be one rigid 1.25 in. conduit per 3 WAO locations of systems furniture. The conduit shall be stubbed into the ceiling area from a 4 in. by 4 in. by 2.5 in. deep outlet box. Ream all conduit ends and fit with insulated bushings. In-feed location will be accessible either by cutout or access panel in furniture or placed next to furniture where location will be accessible for service. Consult RCIT Communications Bureau Telecommunications Engineer for location, quantity, and size of in-feeds. Exact location will be verified with furniture vendor.
3. **System Furniture Floor Poke-Thru In-feeds:** Poke-Thru locations requiring power/voice/data will require Wiremold P/N RC9FFTC Poke-Thru's with EMT 1.25 in. conduit per 3 WAO locations of systems furniture. Color to be specified by Architect. The conduit shall be continuous and stubbed into the ceiling area of that floor being serviced with pull string installed. No more than two 90's will be allowed, J-Box for furniture supplier power whip connections to be anchored to the ceiling of the floor below with unistrut. J-Box must be with-in 6' of furniture whip connection. Ream all conduit ends and fit with insulated bushings. Consult RCIT Communications Bureau Telecommunications Engineer for location, and quantity. Exact location will be verified with furniture vendor.
4. **System Furniture Power and Data Floor Boxes:** Floor Box locations requiring power/voice/data will require Wiremold P/N RFB4-C1-1 Floor Box with EMT 1.25 in conduit per 3 WAO locations of systems furniture for communications. Color to be specified by Architect. The conduit shall be continuous and stubbed into the ceiling area of that floor being serviced with pull string installed. O more than two 90's will be allowed. All boxes shall be configured for dual service which will require accessory items for separation of power and data. All boxes shall include (1) internal duplex receptacle for power, (1) Wiremold P/N RFB-2-SSRT for communications and (1) flanged cover P/N S28BBTCAL. Ream all conduit ends and fit with insulated bushings. Consult RCIT Communications Bureau Telecommunications Engineer for location, and quantity. Exact location will be verified with furniture vendor.
5. **Hard Wall Office Floor Poke-Thru:** Poke-Thru locations requiring power/voice/data will require Wiremold P/N RC4ATC Poke-Thru's with the optional Communications Adapter P/N Com75 installed for Voice and Data conduits. Install two (2) EMT 0.75 in. conduits per location. The conduits shall be continuous and stubbed into the ceiling area of that floor being serviced with pull sting installed. No more than two 90's will be allowed. Ream all conduit ends and fit with insulated bushings. Consult RCIT Communications Bureau Telecommunications Engineer for location, quantity, and size of in-feeds. Exact location will be verified with furniture vendor.
6. **Hard Wall Power and Data Floor Boxes:** Floor Box locations required power/voice data will require Wiremold P/N RFB4-C1-1 Floor Box with (1) EMT 1.25 in. conduit for communications. Color to be specified by Architect. The conduit shall be continuous and stubbed into the ceiling area of that floor being

serviced with pull string installed. No more than two 90's will be allowed. All boxes shall be configured for dual service which will require accessory items for separation of power and data. All boxes shall include (1) internal duplex receptacle for power, (1) Wiremold P/N RFB-2-SSRT for communications and (1) flanged cover P/N S38BBTCAL. Ream all conduit ends and fit with insulated bushings. Consult RCIT Communications Bureau Telecommunications Engineer for location, and quantity. Exact location will be verified with furniture vendor.

7. **Backbone Pathways:**

- a. **Telecommunications Rooms On the Same Floor:** When two or more Telecommunications Rooms exist on the same floor, provide two (2) rigid metallic trade size 4 conduits between the main Telecommunications Room and each secondary Telecommunications Room. Conduits are to be run in the most direct route possible with no more than the equivalent of two 90-degree sweeps without a pull box. The minimum size of a pull box shall be 24" W x 36" L x 12" D. Ream all conduit ends and fit with insulated bushings. Conduits are to be bonded to ground in accordance with all local and national requirements. Location of conduits will be identified on drawings provided by the RCIT Communications Bureau Telecommunications Engineer and provided on a site-by-site basis. The bend radius of the conduit shall be 10 times the outside conduit diameter. **Install a pull string with minimum tensile strength of 30 lbs in each conduit.**
  
- b. **Telecommunications Rooms On Different Floors:** When two or more Telecommunications Rooms exist on different floors, provide a minimum of two (2) rigid trade size 4 conduits between the main Telecommunications Room and each secondary Telecommunications Room. Conduits are to be run in the most direct route possible with no more than the equivalent of two 90-degree bends without a pull box. The minimum size of a pull box shall be 24" W x 36" L x 12" D. Ream all conduit ends and fit with insulated bushings. Conduits are to be bonded to ground in accordance with all local and national requirements. The bend radius of the conduit shall be 10 times the outside conduit diameter. **Install a pull string with minimum tensile strength of 30 lbs in each conduit.** In multi-level buildings with **stacked Telecommunications Rooms**, sleeves shall be provided from the ceiling of the lowest level to the floor of the top level. Size, quantity, and location will be provided by the RCIT Communications Bureau Telecommunications Engineer.
  
- c. **MPOE:** If the MPOE (minimum point of entry) is not physically located in the Telecommunications Room it shall be necessary to install two (2) trade size 4 conduits from the MPOE to the Telecommunications Room. Conduits are to be run in the most direct route possible with no more than the equivalent of two 90-degree bends without a pull box. The minimum size of a pull box shall be 24" W x 36" L x 12" D. Ream all conduit ends and fit with insulated bushings. Conduits are to be bonded to ground in accordance with all local and national requirements. Location of conduits will be identified on drawings provided by the RCIT Communications

Bureau Telecommunications Engineer and provided on a site-by-site basis. The bend radius of the conduit shall be 10 times the outside conduit diameter. **Install a pull string with minimum tensile strength of 30 lbs in each conduit.**

d. **Telecommunications Rooms in Multiple Buildings on Same or Adjacent Properties:** The number of conduits will be determined by the **size and scope of each project. The items listed below are BASIC** requirements only as the scope of the project increases, some or all of the items listed below may undergo major changes:

- (1) Conduits shall be rigid and shall be four (4) trade size 4. A **minimum** of two (2) conduits will be installed from the primary Telecommunications Room and each building as defined by the RCIT Communications Bureau Telecommunications Engineer. Conduits shall be installed in the most direct route possible.
- (2) Conduits shall be buried a minimum of 36 inches below finish grade.
- (3) Conduits shall be encased in 2,000 PSI concrete where vehicle traffic occurs and encased in slurry everywhere else for the entire length.
- (4) Tracer tape shall be installed the entire conduit length. Tracer tape shall be 12 inches wide, flat, and metallic and shall be installed 12 inches above concrete encasement. Tape shall be imprinted with the words "WARNING – FIBER OPTIC CABLE" spaced at a minimum of 24 inches on center.
- (5) No more than the equivalent of two (2) 90-degree bends shall be installed without the addition of a pull box, vault, or maintenance hole, which size and requirements will be defined by the RCIT Communications Bureau Telecommunications Engineer.
- (6) Conduit runs in excess of 500 feet shall have a pull box, vault, or maintenance hole installed, which size and requirements will be defined by the RCIT Communications Bureau Telecommunications Engineer. All sweeps shall have a minimum bending-radius of 10 times the diameter of the conduit.
- (7) All four inch conduits should have a minimum ¼-inch nylon pull rope. All four inch conduits over 400 feet should have a minimum 3/8-inch nylon pull rope. The size and requirements of pull boxes, vaults, or maintenance holes can only be determined by the scope of the project and will be defined by the RCIT Communications Bureau Telecommunications Engineer.

8. **Firewalls:** If any firewalls are present, conduit/sleeve access through the wall must be provided by the contractor. The ends of any conduit/sleeve penetrating



a firewall will be sealed with the appropriate fire stop. Identification of the areas that must be sealed shall be identified by the contractor at the time of wiring. Size and location of the sleeves will be determined by the RCIT Communications Bureau Telecommunications Engineer. Sleeves should penetrate the wall a minimum of 3 inches. Ream each end of conduit and fit with insulated bushing.

9. **Primary Service Conduit Requirements (New Construction):**

- a. The number of all primary service conduits will be determined by the **size and scope of each project**. The items listed below are **BASIC** requirements only and as the scope of the job increases, some or all of the items listed below may undergo major changes:
- (1) Entrance conduits shall be rigid and shall be four (4) trade size 4. **A minimum** of two (2) conduits will be installed into the Telecommunications Room. Conduits shall be installed in the most direct route possible.
  - (2) Conduits shall be buried a minimum of 36 inches below finish grade.
  - (3) Conduits shall be encased in slurry for sections identified by RCIT Communications Bureau Telecommunications Engineer as no traffic or low risk.
  - (4) Conduits shall be encased in 2,000 PSI concrete for sections not identified in section 5a3.
  - (5) Tracer tape shall be installed the entire conduit length. Tracer tape shall be 12 inches wide, flat, and metallic and shall be installed 12 inches above concrete encasement. Tape shall be imprinted with the words "WARNING – FIBER OPTIC CABLE" spaced at a minimum of 24 inches on center.
  - (6) No more than the equivalent of two (2) 90-degree sweeps shall be installed without the addition of a pull box, vault, or maintenance hole, which size and requirements will be defined by the RCIT Communications Bureau Telecommunications Engineer.
  - (7) Conduit runs in excess of 500 feet shall have a pull box, vault, or maintenance hole installed, which size and requirements will be defined by the RCIT Communications Bureau Telecommunications Engineer. All bends shall have a minimum-bending radius of 10 times the diameter of the conduit.
  - (8) All four-inch conduits should have a minimum ¼-inch nylon pull rope. All four-inch conduits over 400 feet should have a minimum 3/8-inch nylon pull rope. The size and requirements of pull boxes, vaults, or maintenance holes can only be determined by the scope of the project and will be defined by the RCIT Communications

Bureau Telecommunications Engineer.

E. **CABLE TRAYS:**

1. If the structural ceiling height is greater than 16' AFF or the occupied space is greater than 25,000 square feet, a cable tray system will be required to support the voice and data wiring. Consult with the RCIT Communications Bureau Telecommunications Engineer requirements to assist in the design of the cable tray system. A structural Engineer will be required to design the cable tray system to code and manufacturer specification and submit design to the RCIT Communications Bureau Telecommunications Engineer for approval.

**RCIT  
System's Furniture  
Telecommunications Standards  
June 16, 2004**

1. **Work Area Outlets**

- 1.1. **Definition: Work Area Outlet (WAO)** – consists of a telecommunications faceplate and its component (s) – what telephones and PC's are plugged into at a user's desk location or work area.
- 1.2. Furniture communications outlet openings shall accommodate the installation of an industry-standard, single gang faceplate, with a minimum opening of 2 inches by 3 inches.
  - 1.2.1. Two (2) factor or field-installed threaded openings shall be provided for single gang faceplate mounting and shall accommodate a 10x22 screw.
- 1.3. Furniture communications outlet openings shall provide a minimum mounting depth of 44.5 mm (1.75 in).
- 1.4. Extender plates shall be provided for WAO's (Work Area Outlet's) within furniture system – one for each workstation space, fax location, and printer location.
  - 1.4.1. Extender plates shall be a minimum 7/8 inch deep.

2. **Cabling Pathways**

- 2.1. Furniture pathways shall have capacity for a minimum of (12) communications cables with an outside diameter of .25 inches and not exceed 40% of pathway capacity.
  - 2.1.1. Remaining pathway capacity will be utilized to accommodate future moves, adds, and changes (MAC's).
  - 2.1.2. This requirement applies to ALL areas of the furniture pathway

INCLUDING corners, panel to panel pathways, etc.

- 2.1.3. Consideration will include space used in furniture for connecting hardware.
- 2.2. Furniture system shall completely conceal all communications cabling in all cabling pathways.
- 2.3. Entire communications cabling pathway shall contain a continuous and rigid support infrastructure within each panel.
- 2.4. When communications cabling pathways run parallel to electrical pathways:
  - 2.4.1. A metallic barrier shall be provided (i.e. metallic divider, conduit, corrugated or solid) and shall be bonded to ground.
  - 2.4.2. Electrical components shall not impede on communications cabling pathways so as to restrict in any way the fill requirements noted above.
- 2.5. The minimum size pathway shall not force the cable bend radius to be less than 25 mm (1 in) under conditions of maximum cable fill.
- 2.6. Metallic pathway edges shall utilize protective bushings.
- 2.7. All panels shall be equipped with at least one (1) of the following raceways and shall singularly conform to all of the above noted cabling pathway requirements:
  - 2.7.1. Base Raceway
  - 2.7.2. Top Raceway

### **3. Furniture In-Feeds**

- 3.1. Furniture in-feeds shall have capacity for a minimum of (12) communications cables with an outside diameter of .25 inches and not exceed 40% of pathway capacity.
  - 3.1.1. Remaining pathway capacity will be utilized to accommodate future moves, adds, and changes (MAC's).
  - 3.1.2. Consideration will include space used in furniture for connecting hardware.
- 3.2. Furniture in-feeds shall have the ability to provide for separate entry points for power and communications cabling.

- 3.2.1. Where entry points are closer than 6 inches, a physical / mechanical barrier shall be provided to separate cabling entry points.
- 3.3. Metallic in-feed edges shall utilize protective bushings.
- 3.4. One furniture in-feed shall be provided for every four (4) WAO's (Work Area Outlets).
- 3.5. Placement of furniture in-feeds shall be coordinated and verified by County IT.

## ESTOPPEL CERTIFICATE

1. The County of Riverside, as Tenant, for the purpose of providing office space for use by \_\_\_\_\_ and \_\_\_\_\_, as Lessor, entered into a written office lease dated \_\_\_\_\_ in which Lessor leased to County and County leased from Lessor those certain premises consisting of approximately \_\_\_\_\_ square feet of office space located at \_\_\_\_\_. The office lease, as amended, modified, and supplemented, is referred to in this Certificate as the "Lease".
2. The Lease has not been amended, modified, nor supplemented, except \_\_\_\_\_.
3. County has paid Rent through \_\_\_\_\_. The next payment of Rent is due on \_\_\_\_\_. The current rent is \_\_\_\_\_. County has not paid Lessor a security deposit.
4. Under the Lease, the term began on \_\_\_\_\_, and the expiration date of the Lease is \_\_\_\_\_ subject to County's right to terminate the Lease and any options the County may have to extend the term as identified in this Certificate.
5. The Lease provides for \_\_\_\_\_ option(s) to extend the term of the Lease for \_\_\_\_\_ years each. The rental rate for each extension period is \_\_\_\_\_.
6. The County has the right of first refusal to renew the Lease, after the original term and any options to extend have expired, on the same terms and conditions as are then being offered by Lessor to bona fide third party prospective lessees.
7. The County has the right to early termination of this Lease if funding is reduced or becomes unavailable or if the County determines for any reason or cause that the Premises are no longer suitable for its use.
8. There are no oral or written amendments, modifications, or supplements to the Lease except as previously stated in this Certificate. A true, correct, and complete copy of the Lease, including all amendments, modifications, and supplements, is attached to this Certificate. The Lease, as amended, modified and supplemented, is in full force and effect and represents the entire agreement between Lessor and the County pertaining to the Premises.
9. All space and improvements leased by County have been completed and furnished in accordance with the provisions of the Lease, and County has accepted and taken possession of the Premises. All contributions required to be paid by Lessor to date for improvements to the Premises have been paid in full.
10. Lessor and County are not in default in the performance of any of the terms and provisions of the Lease. To the best knowledge of each Party, no event or condition has

occurred that, with the giving of notice or passage of time, or both, would constitute such default by Lessor or County.

11. Lessor has not assigned, transferred, or hypothecated the Real Property or any interest in the Real Property.
12. The County has not assigned, transferred, or hypothecated the Lease or any interest in the Lease or subleased all or part of the Premises.
13. There are no mortgagees, beneficiaries under deeds of trust, or other holders of a security interest in the Real Property, except as follows: \_\_\_\_\_.
14. There are no setoffs or credits against Rent payable under the Lease. No free periods or rental abatements, rebates, or concessions have been granted to County, except as follows: \_\_\_\_\_.
15. There are no pending actions, voluntary or involuntary, under any bankruptcy or insolvency laws of the United States or any state against either Lessor or County
16. The execution of this Certificate by Lessor and the County does not amend the Lease or waive any of Lessor's or County's rights under the Lease.
17. This Certificate is given to \_\_\_\_\_ with the understanding that as a lender or purchaser of the above described real property or assignee of either Lessor or County \_\_\_\_\_ may rely on it in connection with either the assignment or acquisition of the above described real property or making a loan secured by the above described real property. Following that acquisition, assignment by Lessor or loan, County intends to keep the Lease full force and effect and shall bind and inure to the benefit of \_\_\_\_\_ and its successor in interest.

COUNTY:

\_\_\_\_\_  
Robert Field  
Assistant County Executive Officer/EDA

APPROVED AS TO FORM:  
Pamela J. Walls, County Counsel

By: \_\_\_\_\_  
Patricia Munroe  
Deputy County Counsel

RECORDED AT REQUEST OF AND WHEN  
RECORDED RETURN TO:

\_\_\_\_\_  
\_\_\_\_\_  
\_\_\_\_\_  
\_\_\_\_\_

Attention: \_\_\_\_\_

**SUBORDINATION, NON-DISTURBANCE, AND ATTORNMENT AGREEMENT**

This Subordination, Non-disturbance, and Attornment Agreement ("Agreement") is made as of \_\_\_\_\_ between \_\_\_\_\_ (Lender), a \_\_\_\_\_, having its principal place of business at \_\_\_\_\_ and the County of Riverside (County), by its authorized representative the Assistant County Executive Officer/EDA having its address for notification at 3403 Tenth Street, Suite 500, Riverside, California 92501.

**Recitals:**

A. Lender has agreed to make a loan to \_\_\_\_\_, a \_\_\_\_\_ (Lessor), to be secured by a deed of trust, dated \_\_\_\_\_, \_\_\_\_\_, and recorded on \_\_\_\_\_, \_\_\_\_\_, as Instrument No. \_\_\_\_\_, in the Official Records of \_\_\_\_\_ County, California (together with all amendments, increases, renewals, modifications, consolidations, replacements, substitutions, and extensions, either current or future, referred to hereafter as the "Mortgage") encumbering Lessor's ownership interest in real property located in \_\_\_\_\_, \_\_\_\_\_, State of California. The legal description of the encumbered real property (the "Mortgage Premises") is set forth in Exhibit A, attached to this Agreement. The Mortgage, together with the promissory note or notes, the loan agreement(s), and other documents executed in connection with it are hereafter collectively referred to as the "Loan Documents".

B. On \_\_\_\_\_, \_\_\_\_\_, County and Lessor entered into a lease for the Mortgage Premises (the Lease). The Lease creates a leasehold estate in favor of County for space (the "Premises") located on the Mortgage Premises.

C. In connection with execution of the Mortgage, Lessor also executed and delivered to Lender an Assignment of Leases, Rents and Profits dated \_\_\_\_\_, \_\_\_\_\_, and recorded on \_\_\_\_\_, \_\_\_\_\_, as Instrument No. \_\_\_\_\_, in the Official Records of the County Recorder of \_\_\_\_\_, California concerning all rents, issues and profits from the Mortgage Premises. This document, together with all amendments, renewals, modifications consolidations, replacements, substitutions and extensions, is hereafter referred to as the "Assignment of Rents."

To confirm their understanding concerning the legal effect of the Mortgage and the Lease, in consideration of the mutual covenants and agreements contained in this Agreement and other valuable consideration, the receipt and sufficiency of which are hereby acknowledged,

Lender and County, intending to be legally bound, agree and covenant as follows:

1. **Representations and Warranties.** County warrants and represents that the Lease is in full force and effect and that, as of the date of this Agreement and to the best of County's knowledge, there is no default under the Lease by Lessor or County.

2. **County Subordination.**

2.1. Subject to the provisions of Section 3, the Loan Documents shall constitute a lien or charge on the Mortgage Premises that is prior and superior to the Lease, to the leasehold estate created by it, and to all rights and privileges of County under it; by this Agreement, the Lease, the leasehold estate created by it, together with all rights and privileges of County under it, is subordinated, at all times, to the lien or charge of the Loan Documents in favor of Lender.

2.2. By executing this Agreement, County subordinates the Lease and County's interest under it to the lien right and security title, and terms of the Loan Documents, and to all advances or payments made, or to be made, under any Loan Document.

3. **Non-disturbance.**

3.1. Lender consents to the Lease.

3.2. Despite County's subordination under Section 2, County's peaceful and quiet possession of the Premises shall not be disturbed and County's rights and privileges under the Lease, including its right to early termination, its right to extend the term of the Lease, its right of first refusal to lease the property after expiration of the original term and any extensions thereof, shall not be diminished by Lender's exercise of its rights or remedies under the Loan Documents, provided that County has not canceled or terminated the Lease, nor surrendered, or abandoned the Premises.

3.3. If (a) Lender shall acquire title to, and possession of, the Premises on foreclosure in an action in which Lender shall have been required to name County as a party defendant, and (b) County is not in default under the Lease beyond any applicable cure or grace periods, has not canceled or terminated the Lease, nor surrendered, vacated or abandoned the Premises and remains in actual possession of the Premises at the time Lender shall so acquire title to, and possession of, the Premises, Lender and County shall enter into a new lease on the same terms and conditions as were contained in the Lease, except that:

(a) The obligations and liabilities of Lender under a new lease shall be subject to the terms and conditions of this Agreement (including the provisions of Sections 5-7);

(b) Lender shall have no obligations or liabilities to County under any such new lease beyond those of Lessor as were contained in the Lease; and

(c) The expiration date of any new lease shall coincide with the original expiration date of the Lease.

3.4. County shall not be named or joined in any foreclosure, trustee's sale, or other proceeding to enforce the Loan Documents unless such joinder shall be legally required to



perfect the foreclosure, trustee's sale, or other proceeding.

**4. Attornment.**

4.1. If Lender shall succeed to Lessor's interest in the Mortgage Premises by foreclosure of the Mortgage, by deed in lieu of foreclosure, or in any other manner, County shall be bound to Lender under all the terms, covenants and conditions of the Lease for the balance of its term with the same force and effect as if Lender were the Lessor under the Lease. County shall be deemed to have full and complete attornment to, and to have established direct privity between County and:

- (a) Lender when in possession of the Mortgage Premises;
- (b) a receiver appointed in any action or proceeding to foreclose the Mortgage;
- (c) any party acquiring title to the Mortgage Premises; or
- (d) any successor to Lessor.

4.2. County's attornment is self-operating, and it shall continue to be effective without execution of any further instrument by any of the parties to this Agreement or the Lease. Lender agrees to give County written notice if Lender has succeeded to the interest of the Lessor under the Lease. The terms of the Lease are incorporated into this Agreement by reference.

4.3. If the interests of Lessor under the Lease are transferred by foreclosure of the Mortgage, deed in lieu of foreclosure, or otherwise, to a party other than Lender (Transferee), in consideration of, and as condition precedent to, County's agreement to attorn to any such Transferee, Transferee shall be deemed to have assumed all terms, covenants, and conditions of the Lease to be observed or performed by Lessor from the date on which the Transferee succeeds to Lessor's interests under the Lease.

**5. Lender as Lessor.** If Lender shall succeed to the interest of Lessor under the Lease, Lender shall be bound to County under all the terms, covenants and conditions of the Lease, and County shall, from the date of Lender's succession to the Lessor's interest under the Lease, have the same remedies against Lender for breach of the Lease that County would have had under the Lease against Lessor; provided, however, that despite anything to the contrary in this Agreement or the Lease, Lender, as successor to the Lessor's interest, shall be:

- (a) liable for any act or omission of the Lessor; provided that the Lender may elect either to perform the pre-existing obligation or to permit the County to perform it and to recover the cost out of Rent;
- (b) subject to any offsets or defenses expressly permitted under the Lease, including abatement rights which County might have had against Lessor;
- (c) bound by any rent or additional rent that County might have paid for more than one month in advance to Lessor; or
- (d) bound by an amendment or modification of the Lease even though

made without Lender's written consent and whether or not the amendment or modification materially adversely affect any right of Lessor under the Lease.

(e) subject to the County 's right to assert continuing claims, such as material interference with the County's use and enjoyment of the premises, against the Lender.

6. **Right To Cure.** County agrees that, before County exercises any of its rights or remedies under the Lease, Lender shall have the right, but not the obligation, to cure the default within the same time given Lessor in the lease to cure the default, plus an additional thirty (30) days or ten (10) days in the case of defaults in the payment of money from Lessor to County. County agrees that the cure period shall be extended by the time necessary for Lender to commence foreclosure proceedings and to obtain possession of the Mortgage Premises, provided that:

(a) Lender shall notify County of Lender's intent to effect its remedy;

(b) Lender initiates immediate steps to foreclose on or to recover possession of the Mortgage Premises;

(c) Lender initiates immediate legal proceedings to appoint a receiver for the Mortgage Premises or to foreclose on or recover possession of the Mortgage Premises within the thirty (30) day period; and

(d) Lender prosecutes such proceedings and remedies with due diligence and continuity to completion.

7. **Assignment of Rents.** If Lessor defaults in its performance of the terms of the Loan Documents, County agrees to recognize the Assignment of Rents made by Lessor to Lender and shall pay to Lender, as assignee, from the time Lender gives County notice that Lessor is in default under the terms of the Loan Documents, the rents under the Lease, but only those rents that are due or that become due under the terms of the Lease after notice by Lender. Payments of rents to Lender by County under the assignment of rents and Lessor's default shall continue until the first of the following occurs:

(a) No further rent is due or payable under the Lease;

(b) Lender gives County notice that the Lessor's default under the Loan Documents has been cured and instructs County that the rents shall thereafter be payable to Lessor;

(c) The lien of the Mortgage has been foreclosed and the purchaser at the foreclosure sale (whether Lender or a Transferee) gives County notice of the foreclosure sale. On giving notice, the purchaser shall succeed to Lessor's interests under the Lease, after which time the rents and other benefits due Lessor under the Lease shall be payable to the purchaser as the owner of the Mortgage Premises.

8. **County's Reliance.** When complying with the provisions of Section 7, County shall be entitled to rely on the notices given by Lender under Section 7, and Lessor agrees to release, relieve, and protect County from and against any and all loss, claim, damage, or liability (including reasonable attorney's fees) arising out of County's compliance with such notice.

County shall be entitled to full credit under the Lease for any rents paid to Lender in accordance with Section 7 to the same extent as if such rents were paid directly to Lessor. Any dispute between Lender (or Lender's Transferee) and Lessor as to the existence of a default by Lessor under the terms of the Mortgage, the extent or nature of such default, or Lender's right to foreclosure of the Mortgage, shall be dealt with and adjusted solely between Lender (or Transferee) and Lessor, and County shall not be made a party to any such dispute (unless required by law).

9. **Lender's Status.** Nothing in this Agreement shall be construed to be an agreement by Lender to perform any covenant of the Lessor under the Lease unless and until it obtains title to the Mortgage Premises by power of sale, judicial foreclosure, or deed in lieu of foreclosure, or obtains possession of the Mortgage Premises under the terms of the Loan Documents.

10. **Cancellation of Lease.** County agrees that it will not cancel, terminate, or surrender the Lease, except at the normal expiration of the Lease term or as provided in the Lease.

11. **Special Covenants.** Despite anything in this Agreement or the Lease to the contrary, if Lender acquires title to the Mortgage Premises, County agrees that: Lender shall have the right at any time in connection with the sale or other transfer of the Mortgage Premises to assign the Lease or Lender's rights under it to any person or entity, and that Lender, its officers, directors, shareholders, agents, and employees shall be released from any further liability under the Lease arising after the date of such transfer, provided that the assignee of Lender's interest assumes Lender's obligations under the Lease, in writing, from the date of such transfer.

12. **Transferee's Liability (Non Recourse).** If a Transferee acquires title to the Mortgage Premises:

(a) County's recourse against Transferee for default under the Lease shall be limited to the Mortgage Premises or any sale, insurance, or condemnation proceeds from the Mortgage Premises;

(b) County shall look exclusively to Transferee's interests described in (a) above for the payment and discharge of any obligations imposed on Transferee under this Agreement or the Lease ; and

(i) Transferee, its officers, directors, shareholders, agents, and employees are released and relieved of any personal liability under the Lease;

(ii) County shall look solely to the interests of Transferee set forth in (a) above, and

(iii) County shall not collect or attempt to collect any judgment out of any other assets, or from any general or limited partners or shareholders of Transferee.

13. **Transferee's Performance Obligations.** Subject to the limitations provided in Sections 11 and 12, if a Transferee acquires title to the Mortgage Premises, the Transferee shall perform and recognize all County improvement allowance provisions, all rent-free and rent rebate provisions, and all options and rights of offer, in addition to Lessor's other obligations under the Lease.

14. **Notice.** All notices required by this Agreement shall be given in writing and shall be deemed to have been duly given for all purposes when:

(a) deposited in the United States mail (by registered or certified mail, return receipt requested, postage prepaid); or

(b) deposited with a nationally recognized overnight delivery service such as Federal Express or Airborne.

Each notice must be directed to the party to receive it at its address stated below or at such other address as may be substituted by notice given as provided in this section.

The addresses are:

Lender: \_\_\_\_\_

\_\_\_\_\_

Attention: \_\_\_\_\_

Copy to: \_\_\_\_\_

\_\_\_\_\_

Attention: \_\_\_\_\_

County: Economic Development Agency  
3403 Tenth Street, Suite 500  
Riverside, CA 92501  
Attention: Deputy Director of Real Estate

Copy to: \_\_\_\_\_

\_\_\_\_\_

Attention: \_\_\_\_\_

Copies of notices sent to the parties' attorneys or other parties are courtesy copies, and failure to provide such copies shall not affect the effectiveness of a notice given hereunder.

15. **Miscellaneous Provisions.**

15.1. This Agreement may not be modified orally; it may be modified only by an agreement in writing signed by the parties or their successors-in-interest. This Agreement shall inure to the benefit of and bind the parties and their successors and assignees.

15.2. The captions contained in this Agreement are for convenience only and in no way limit or alter the terms and conditions of the Agreement.

15.3. This Agreement has been executed under and shall be construed, governed, and enforced, in accordance with the laws of the State of California except to the extent that California law is preempted by the U.S. federal law. The invalidity or unenforceability of one or more provisions of this Agreement does not affect the validity or enforceability of any other provisions.

15.4. This Agreement has been executed in duplicate. Lender and County agree that one (1) copy of the Agreement will be recorded.

15.5. This Agreement shall be the entire and only agreement concerning subordination of the Lease and the leasehold estate created by it, together with all rights and privileges of County under it, to the lien or charge of the Loan Documents and shall supersede and cancel, to the extent that it would affect priority between the Lease and the Loan Documents, any previous subordination agreements, including provisions, if any, contained in the Lease that provide for the subordination of the Lease and the leasehold estate created by it to a deed of trust or mortgage. This Agreement supersedes any inconsistent provision of the Lease.

15.6. This Agreement may be executed in any number of counterparts, each of which when so executed and delivered shall be deemed to be an original and all of which copies, taken together, shall constitute but one and the same instrument. Signature and acknowledgment pages may be detached from the copies and attached to a single copy of this Agreement to physically form one original document, which may be recorded without an attached copy of the Lease.

15.7. If any legal action or proceeding is commenced to interpret or enforce the terms of this Agreement or obligations arising out of it, or to recover damages for the breach of the Agreement, the party prevailing in such action or proceeding shall be entitled to recover from the non-prevailing party or parties all reasonable attorneys' fees, costs, and expenses it has incurred.

15.8. Word Usage. Unless the context clearly requires otherwise, (a) the plural and singular numbers will each be deemed to include the other; (b) the masculine, feminine, and neuter genders will each be deemed to include the others; (c) "shall," "will," "must," "agrees," and "covenants" are each mandatory; (d) "may" is permissive; (e) "or" is not exclusive; and (f) "includes" and "including" are not limiting.

Executed on the date first above written.

**Lender:**

\_\_\_\_\_

a \_\_\_\_\_

By: \_\_\_[signature]\_\_\_\_\_

Its: \_\_\_[state title]\_\_\_\_\_

**COUNTY OF RIVERSIDE:**

By: \_\_\_\_\_  
Bob Buster  
Chairman, Board of Supervisors

**ATTEST:**  
Kecia Harper-Ihem  
Clerk to the Board

By: \_\_\_\_\_

**APPROVED AS TO FORM:**  
PAMELA J. WALLS, County Counsel

By: \_\_\_\_\_  
Deputy

Accepted and Agreed To:

**Lessor:**

\_\_\_\_\_,  
a \_\_\_\_\_

By: \_\_\_[signature]\_\_\_\_\_  
Its: \_\_\_[state title]\_\_\_\_\_

[Exhibit A: Legal description of Mortgage Premises]