

MINUTES OF THE BOARD OF SUPERVISORS
COUNTY OF RIVERSIDE, STATE OF CALIFORNIA



3.69

On motion of Supervisor Ashley, seconded by Supervisor Buster and duly carried, IT WAS ORDERED the reading being waived, that an ordinance bearing the following title, is adopted:

ORDINANCE NO. 452.231

AN ORDINANCE OF THE COUNTY OF RIVERSIDE, AMENDING ORDINANCE NO. 452 RELATING TO PRIMA FACIE SPEED LIMITS

Roll Call:

Ayes: Buster, Stone, Benoit and Ashley
Nays: None
Absent: Tavaglione

I hereby certify that the foregoing is a full true, and correct copy of an order made and entered on January 10, 2012 of Supervisors Minutes.

WITNESS my hand and the seal of the Board of Supervisors
Dated: January 10, 2012
Kecia Harper-Ihem, Clerk of the Board of Supervisors, in
and for the County of Riverside, State of California.

(seal)

By:  Deputy

AGENDA NO.
3.69

xc: Transp., MC, COB

1
2
3
4
5
6
7
8
9
10
11
12
13
14
15
16
17
18
19
20
21
22
23
24
25
26
27
28

ORDINANCE NO. 452.231
AN ORDINANCE OF THE COUNTY OF RIVERSIDE
AMENDING ORDINANCE NO. 452
RELATING TO PRIMA FACIE SPEED LIMITS

The Board of Supervisors of the County of Riverside ordains as follows:

Section 1. Section 2.3 of Ordinance No. 452, entitled “Thirty-five miles per hour,” is amended to add new subsections 108, 109, 110, 111, and 112 thereto to read as follows:

- “108. On Central Park Drive between the centerline of Calistoga Drive and a point 575 feet east of Sugar Pine Way, a total distance of approximately 0.60 miles, in the Temecula area.
- 109. On Clay Canyon Drive between the centerline of Knabe Road (N) and the centerline of Knabe Road (S), a total distance of approximately 0.75 miles, in the Temescal Canyon area.
- 110. On Haines Street between the centerline of Rider Street and the centerline of Cajalco Road, a total distance of approximately 0.5 miles, in the Woodcrest area.
- 111. On Hemet Street between the centerline of Little Lake Road and the centerline of Florida Avenue/SH-74, a total distance of approximately 1.1 mile, in the Hemet area.
- 112. On Willows Avenue between the centerline of North General Kearney Road and the centerline of Central Park Drive, a total distance of approximately 0.78 miles, in the Temecula area.”

Section 2. Section 2.4 of Ordinance No. 452, entitled “Forty miles per hour,” is amended to add new subsection 130 thereto to read as follows:

- “130. On Machado Street between the centerline of Grand Avenue and 200 feet north of Alvarado Street, a total distance of approximately 0.59 miles, in the Lake Elsinore area.”

1
2
3
4
5
6
7
8
9
10
11
12
13
14
15
16
17
18
19
20
21
22
23
24
25
26
27
28

Section 6. This ordinance shall take effect 30 days after its adoption.

BOARD OF SUPERVISORS OF THE COUNTY
OF RIVERSIDE, STATE OF CALIFORNIA

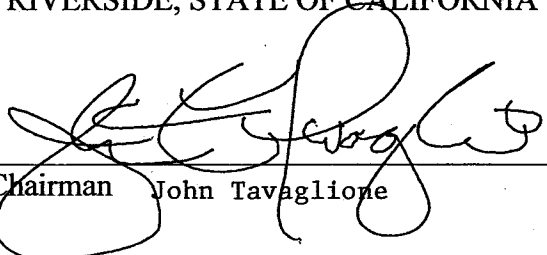
BY:  _____
Chairman John Tavaglione

ATTEST:
KECIA HARPER-IHEM, Clerk of the Board

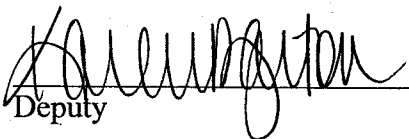
By:  _____
Deputy

APPROVED AS TO FORM:
PAMELA J. WALLS, County Counsel

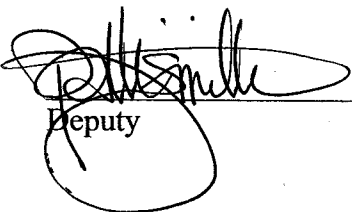
By:  _____
Deputy

1
2
3
4
5
6
7
8
9
10
11
12
13
14
15
16
17
18
19
20
21
22
23
24
25
26
27
28

STATE OF CALIFORNIA)
)
COUNTY OF RIVERSIDE) SS

I HEREBY CERTIFY that at a regular meeting of the Board of Supervisors of said county held on January 10, 2012, the foregoing ordinance consisting of 6 Sections was adopted by the following vote:

AYES: Buster, Stone, Benoit and Ashley
NAYS: None
ABSENT: Tavaglione

DATE: January 10, 2012

KECIA HARPER-IHEM
Clerk of the Board
BY: *Kecia Harper-Ihem*
Deputy

SEAL

**LIST OF SPEED ZONE SUBMITTALS
ORDINANCE AMENDMENT NO 452.231
SUPERVISORIAL DISTRICT NO. 1**

AREA	ROAD NAME/ LIMITS	EXISTING SPEED LIMIT	PROPOSED SPEED LIMIT	NOTES
TEMESCAL CANYON	CLAY CANYON DRIVE Between the centerline of Knabe Road (N) and the centerline of Knabe Road (S)	* Not Posted	35	NEW
WOODCREST	HAINES STREET Between the centerline of Rider Street and the centerline of Cajalco Road	* Not Posted	35	NEW
WOODCREST	HAINES STREET Between the centerline of Cajalco Road and the centerline of Nandina Avenue	* Not Posted	45	NEW
LAKE ELSINORE	MACHADO STREET Between the centerline of Grand Avenue and 200' N/O Alvarado Street	* Not Posted	40	NEW

* Maximum allowable speed limit for a two-lane highway is 55 mph
 **Maximum allowable speed limit for a multi-lane highway is 65 mph
 ***Change in speed zone boundary

CLAY CANYON DRIVE (#1480)

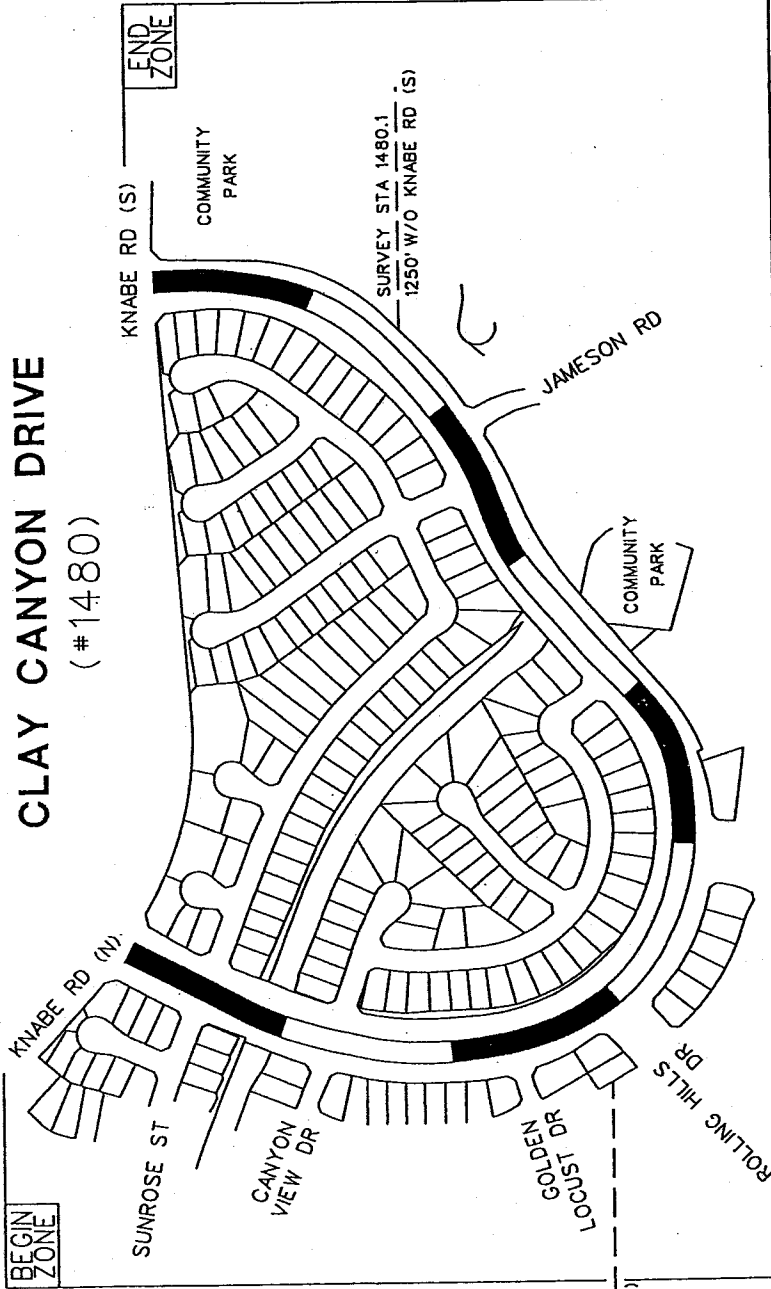

- LEGEND:**
- ////// CITY LIMITS
 - ▬ RADAR ZONE
 - ▬ SURVEY STATION
 - ▬ OTHER STREET OR ROAD
 - ↑ SCHOOL



NO SCALE

RECOMMENDED SPEED LIMIT	RESIDENTIAL AREA - COMMUNITY PARK - REDUCE TO 35 MPH
85th/15 MPH	35 MPH
VEHICLES IN 24 HR (2 WAY)	40.5 MPH (AVERAGE OF TWO SIMILAR STATIONS OF 44.0 MPH & 37.0 MPH)
SEGMENT LENGTH	970
ALL ACCIDENTS IN 2 YRS.	0.75 MILE
ACCIDENT RATE ★	0
EXISTING SPEED LIMIT	0.00 ACC/MVM
	NOT POSTED

★ RATE: NO. OF ACCIDENT x 1,000,000
VEH x 365 x 2 x MILE

APPROVED BY:

Lawrence J. Talpe
DATE: 8/29/2011

LAWRENCE J. TALPE,
COUNTY TRAFFIC ENGINEER

COUNTY OF RIVERSIDE
TRANSPORTATION DEPARTMENT
TRAFFIC ENGINEERING DIVISION

ENGINEERING AND TRAFFIC SURVEY
AT

CLAY CANYON DRIVE



PAGE
1 OF 1

SURVEY DATE:	FEB 17, 2011
MAP DATE:	AUG 8, 2011
DRAWN BY:	N AHMAD
CAD FILE:	CLAY CYN DR.DGN
COUNTY AREA:	TEMESCAL CANYON
COUNTY MAP:	33A
SUPERVISOR DISTRICT:	1

HAINES STREET (#1479)

- LEGEND:**
- CITY LIMITS
 - RADAR ZONE
 - SURVEY STATION
 - OTHER STREET OR ROAD
 - SCHOOL

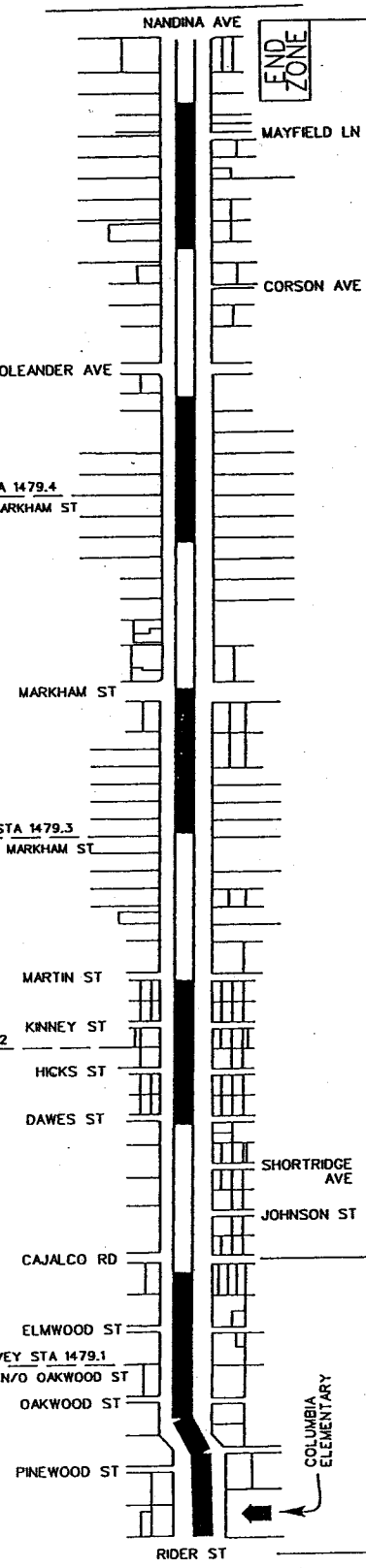

NO SCALE	RESIDENTIAL AREA - HIDDEN DRIVEWAYS - NO SIDEWALKS - NO CURB/GUTTER - DIRT SHOULDERS - REDUCE TO 45 MPH.		
RECOMMENDED SPEED LIMIT	35 MPH	45 MPH	48.0 MPH
85th%TILE SPEED	37.0 MPH	48.0 MPH	1,100
VEHICLES IN 24 HR (2 WAY)	1,000	2.0 MILE	9
SEGMENT LENGTH	0.5 MILE	5.60 ACC/MVM	NOT POSTED
ALL ACCIDENTS IN 2 YRS.	3		
ACCIDENT RATE ☆	8.22 MVM		
EXISTING SPEED LIMIT	NOT POSTED		

★ RATE: $\frac{\text{NO. OF ACCIDENT} \times 1,000,000}{\text{VEH} \times 365 \times 2 \times \text{MILE}}$

COUNTY AREA: WOODCREST

COUNTY MAP: 58A.58B

SUPERVISOR DISTRICT: 1

APPROVED BY:

DATE: 8/25/2011

LAWRENCE T. TAI, P.E.
COUNTY TRAFFIC ENGINEER

COUNTY OF RIVERSIDE
TRANSPORTATION DEPARTMENT
TRAFFIC ENGINEERING DIVISION

ENGINEERING AND TRAFFIC SURVEY
AT
HAINES STREET

PAGE 1 OF 1

MACHADO STREET

(#1485)

- LEGEND:**
- CITY LIMITS
 - RADAR ZONE
 - SURVEY STATION
 - OTHER STREET OR ROAD
 - SCHOOL

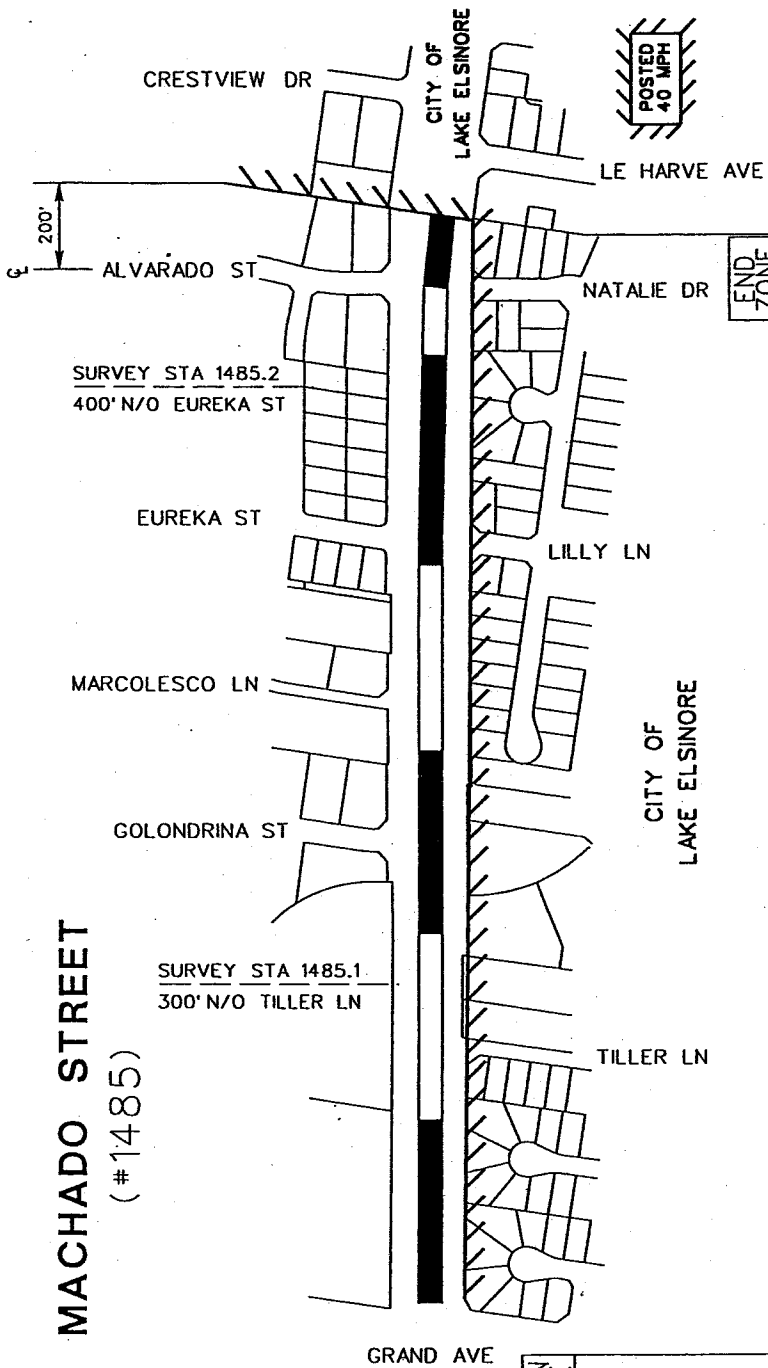

BEGIN ZONE

END ZONE

VARYING ROADWAY WIDTHS - VARYING SIDEWALK IMPROVEMENTS - VARYING C/G IMPROVEMENTS - SCHOOL ZONE XING - REDUCE TO 40 MPH

RECOMMENDED SPEED LIMIT	40 MPH
85th/TILE SPEED	45.5 MPH (AVERAGE OF TWO SIMILAR STATIONS OF 49 MPH & 42 MPH)
VEHICLES IN 24 HR (2 WAY)	4,300
SEGMENT LENGTH	0.59 MILE
ALL ACCIDENTS IN 2 YRS.	1
ACCIDENT RATE ☆	0.54 ACC/MVM
EXISTING SPEED LIMIT	NOT POSTED

☆ RATE. $\frac{\text{NO. OF ACCIDENT} \times 1,000,000}{\text{VEH} \times 365 \times 2 \times \text{MILE}}$

COUNTY AREA:	LAKE ELSINORE	SURVEY DATE:	AUG 23, 2011
COUNTY MAP:	38	MAP DATE:	AUG 29, 2011
SUPERVISOR DISTRICT:	1	DRAWN BY:	N AHMAD
		CAD FILE:	MACHADO.DGN

APPROVED BY: *Lawrence T. Talpe*
 DATE: 8/31/2011
 LAWRENCE T. TALPE.
 COUNTY TRAFFIC ENGINEER





**LIST OF SPEED ZONE SUBMITTALS
ORDINANCE AMENDMENT NO 452.231
SUPERVISORIAL DISTRICT NO. 3**

AREA	ROAD NAME/ LIMITS	EXISTING SPEED LIMIT	PROPOSED SPEED LIMIT	NOTES
TEMECULA	CALLE NOPAL Between the centerline of Anza Road and the centerline of Cruz Way	45	50	UPDATE
TEMECULA	CENTRAL PARK DRIVE Between the centerline of Calistoga Drive and a point 575' E/O Sugar Pine Way	* Not Posted	35	NEW
HEMET	HEMET STREET Between the centerline of Little Lake Road and the centerline of Florida Avenue/SH-74	40	35	UPDATE
MURRIETA	LEON ROAD Between the centerline of Clinton Keith Road and the centerline of Baxter Road	** Not Posted	50	NEW
TEMECULA	WILLOWS AVENUE Between the centerline of North General Kearny Road and the centerline of Central Park Drive	* Not Posted	35	NEW

- * Maximum allowable speed limit for a two-lane highway is 55 mph
- ***Maximum allowable speed limit for a multi-lane highway is 65 mph
- ****Change in speed zone boundary

CALLE NOPAL

(#1407)

- LEGEND:**
-  CITY LIMITS
 -  RADAR ZONE
 -  SURVEY STATION
 -  OTHER STREET OR ROAD

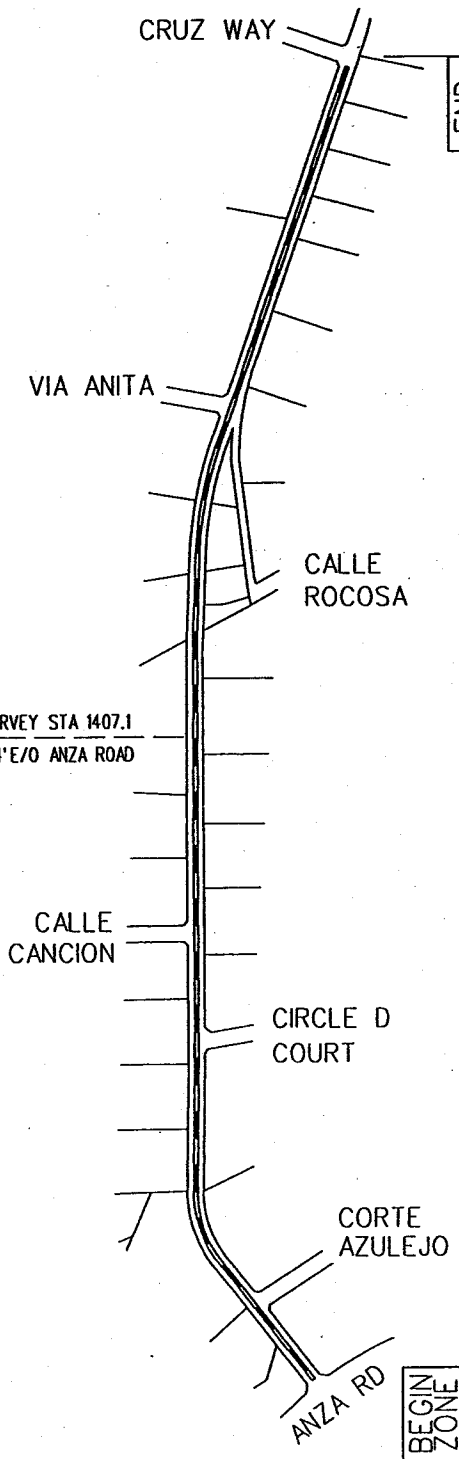

BEGIN ZONE

END ZONE

NO SCALE	NARROW ROADWAY - EQUESTRIANS - HIDDEN RESIDENTIAL DRIVEWAYS - REDUCE SPEED LIMIT TO 50 MPH
RECOMMENDED SPEED LIMIT	50 MPH
PREVAILING SPEED (85%)	54.0 MPH
VEHICLES IN 24 HR (2 WAY)	1,000
SEGMENT LENGTH	1.0 MILE
ALL ACCIDENTS IN 2 YRS.	1
ACCIDENT RATE ☆	1.37 MVM
EXISTING SPEED LIMIT	45 MPH (Ord. 452.221 Sec. 2.5 No. 106)

☆ RATE: ACCIDENT x 1,000 000.
VEH x 365 x 2 x MILE

COUNTY AREA:	TEMECULA	SURVEY DATE:	AUG 23, 2011	APPROVED BY:	<i>Lawrence T. Tai, P.E.</i>
COUNTY MAP PAGE:	129	MAP DATE:	SEP 12, 2011	DATE:	9/20/2011
SUPERVISOR DISTRICT:	3	DRAWN BY:	N AHMAD	COUNTY TRAFFIC ENGINEER	LAWRENCE T. TAI, P.E.
CAD FILE:	CALLE NOPAL.DGN				

COUNTY OF RIVERSIDE
TRANSPORTATION DEPARTMENT
TRAFFIC ENGINEERING SECTION

ENGINEERING AND TRAFFIC SURVEY
AT
CALLE NOPAL

PAGE
10F 1

CENTRAL PARK DRIVE (#1484)

- LEGEND:
- ////// CITY LIMITS
 - ▬ RADAR ZONE
 - - - SURVEY STATION
 - ▬ OTHER STREET OR ROAD
 - ↑ SCHOOL

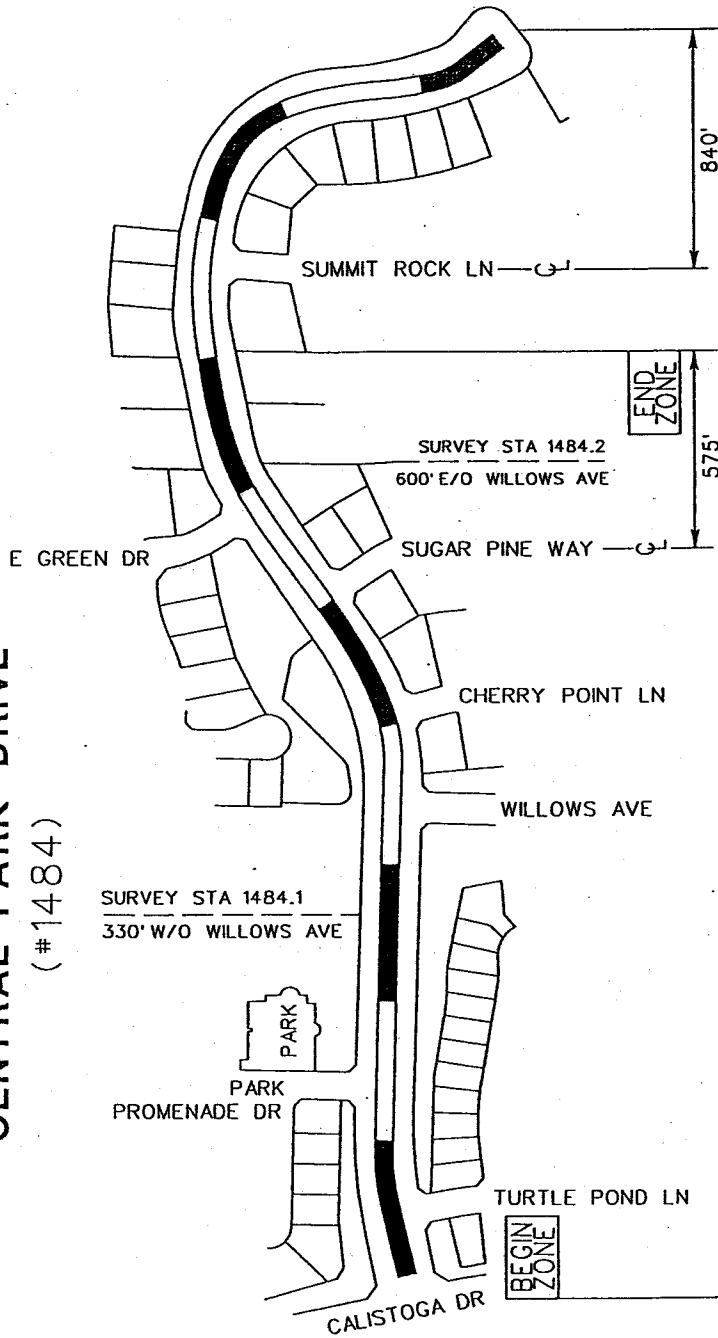

NO SCALE

RECOMMENDED SPEED LIMIT	35 MPH	* 25 MPH
85th/TILE SPEED /	37.0 MPH (AVERAGE OF TWO SIMILAR STATIONS OF 40.0 MPH & 34.0 MPH)	
VEHICLES IN 24 HR (2 WAY)	930	
SEGMENT LENGTH	0.60 MILE	
ALL ACCIDENTS IN 2 YRS.	0	
ACCIDENT RATE ☆	0.00 ACC/MVM	
EXISTING SPEED LIMIT	NOT POSTED	* Per CVC 515

☆ RATE: NO. OF ACCIDENT x 1,000,000
VEH x 365 x 2 x MILE

APPROVED BY:

Lawrence T. Tai
DATE: 8/29/2011

LAWRENCE T. TAI, P.E.
COUNTY TRAFFIC ENGINEER

COUNTY OF RIVERSIDE
TRANSPORTATION DEPARTMENT
TRAFFIC ENGINEERING DIVISION

ENGINEERING AND TRAFFIC SURVEY
AT
CENTRAL PARK DRIVE

SURVEY DATE:	FEB 17, 2011
MAP DATE:	AUG 16, 2011
DRAWN BY:	N AHMAD
CAD FILE:	CENTRAL_PARK.DGN
COUNTY AREA:	TEMECULA
COUNTY MAP:	124C
SUPERVISOR DISTRICT:	3

HEMET STREET (#1107)

- LEGEND:**
- ////// CITY LIMITS
 - ▬ RADAR ZONE
 - - - SURVEY STATION
 - ==== OTHER STREET OR ROAD
 - SCHOOL

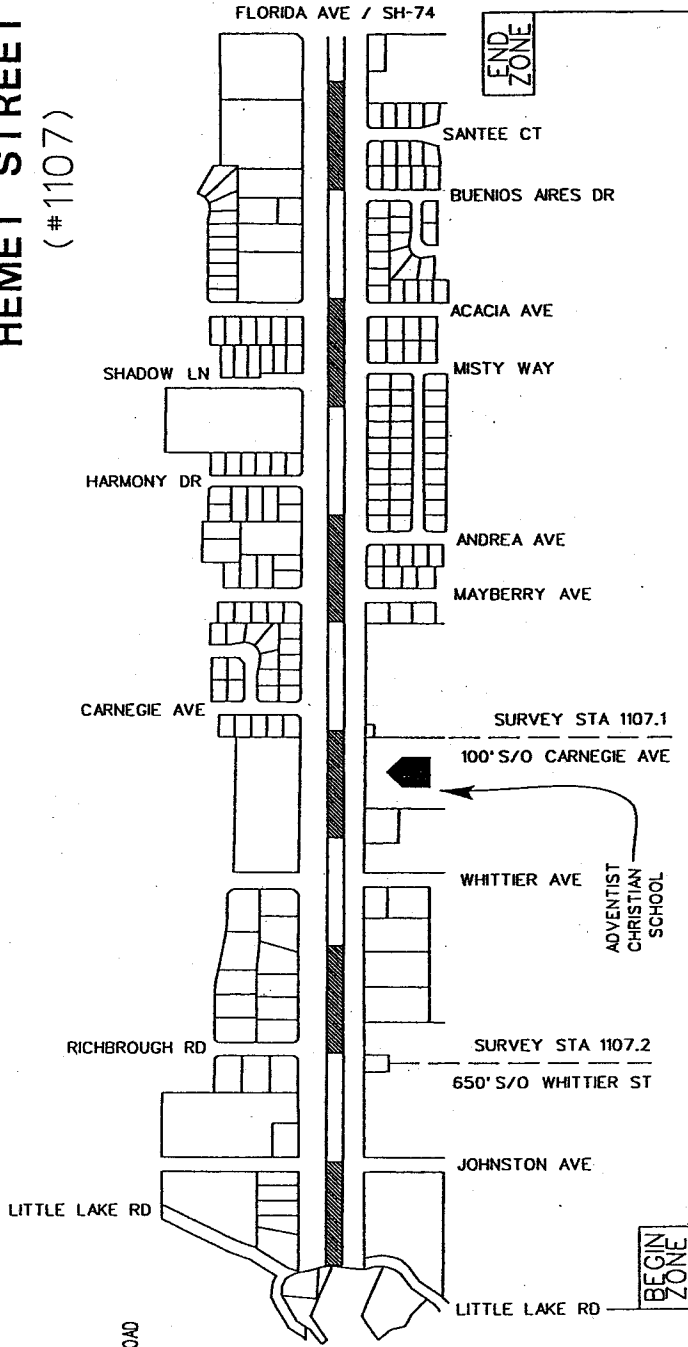

GAP IN R/W
SEE SHEET
1 OF 2



NO SCALE

RECOMMENDED SPEED LIMIT	35 MPH
PREVAILING SPEED (85th%)	36.0 MPH (AVERAGE OF TWO SIMILAR STATIONS OF 38.0 & 34.0 MPH)
VEHICLES IN 24 HR (2 WAY)	675
SEGMENT LENGTH	1.1 MILE
ALL ACCIDENTS IN 2 YRS.	1
ACCIDENT RATE ☆	1.84 ACC/MVM
EXISTING SPEED LIMIT	40 MPH (Ord. 452.214 Sec. 2.4 No. 9)

☆ RATE = $\frac{\text{ACCIDENT} \times 1,000,000}{\text{VEH} \times 365 \times 2 \times \text{MILE}}$

	 COUNTY OF RIVERSIDE TRANSPORTATION DEPARTMENT TRAFFIC ENGINEERING DIVISION	ENGINEERING AND TRAFFIC SURVEY AT HEMET STREET	PAGE 2 OF 2
APPROVED BY: <i>Lawrence T. Tai, P.E.</i> DATE: 8/29/2011		COUNTY AREA: HEMET COUNTY MAP: 112, 116A SUPERVISOR DISTRICT: 3	
SURVEY DATE: MAY 3, 2011 MAP DATE: AUG 17, 2011		DRAWN BY: N AHMAD CAD FILE: HEMET.DGN	

LEON ROAD (#1481)

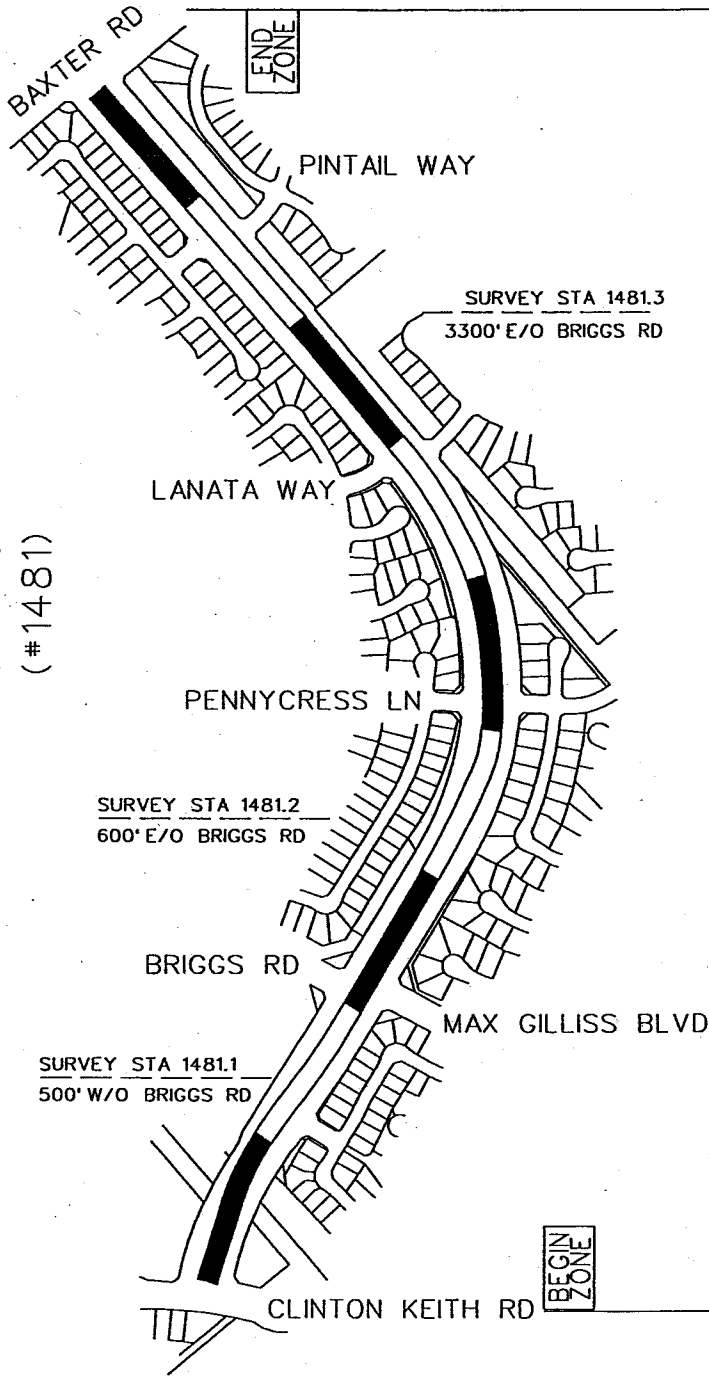

- LEGEND:**
- CITY LIMITS
 - RADAR ZONE
 - SURVEY STATION
 - OTHER STREET OR ROAD
 - SCHOOL

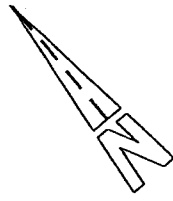

NO SCALE

RECOMMENDED SPEED LIMIT	50 MPH
85th/ILE SPEED	52.0 MPH (AVERAGE OF THREE SIMILAR STATIONS OF 42.0 MPH & 51.0 MPH & 63.0 MPH)
VEHICLES IN 24 HR (2 WAY)	7,180
SEGMENT LENGTH	1.15 MILES
ALL ACCIDENTS IN 2 YRS.	3
ACCIDENT RATE ☆	0.50 ACC/MVM
EXISTING SPEED LIMIT	NOT POSTED

☆ RATE: $\frac{\text{NO. OF ACCIDENT} \times 1,000,000}{\text{VEH} \times 365 \times 2 \times \text{MILE}}$

		COUNTY OF RIVERSIDE TRANSPORTATION DEPARTMENT TRAFFIC ENGINEERING DIVISION		PAGE 1 OF 1
APPROVED BY: <i>Lawrence T. Tai</i> DATE: 8/25/2011		ENGINEERING AND TRAFFIC SURVEY AT LEON ROAD		
SURVEY DATE: MAY 25, 2011	MAP DATE: AUG 10, 2011	DRAWN BY: N AHMAD	COUNTY TRAFFIC ENGINEER	
COUNTY AREA: MURRIETA	COUNTY MAP: 121B	CAD FILE: LEON RD.DGN	SUPERVISOR DISTRICT: 3	

LEGEND:

- ////// CITY LIMITS
- ▬ RADAR ZONE
- - - SURVEY STATION
- ▬ OTHER STREET OR ROAD
- ↑ SCHOOL

• SEE SHEET 1 OF 2



NO SCALE

SURVEY STA 1363.3
900' N/O M.H.S. RD

WILLOWS AVENUE
(#1363)

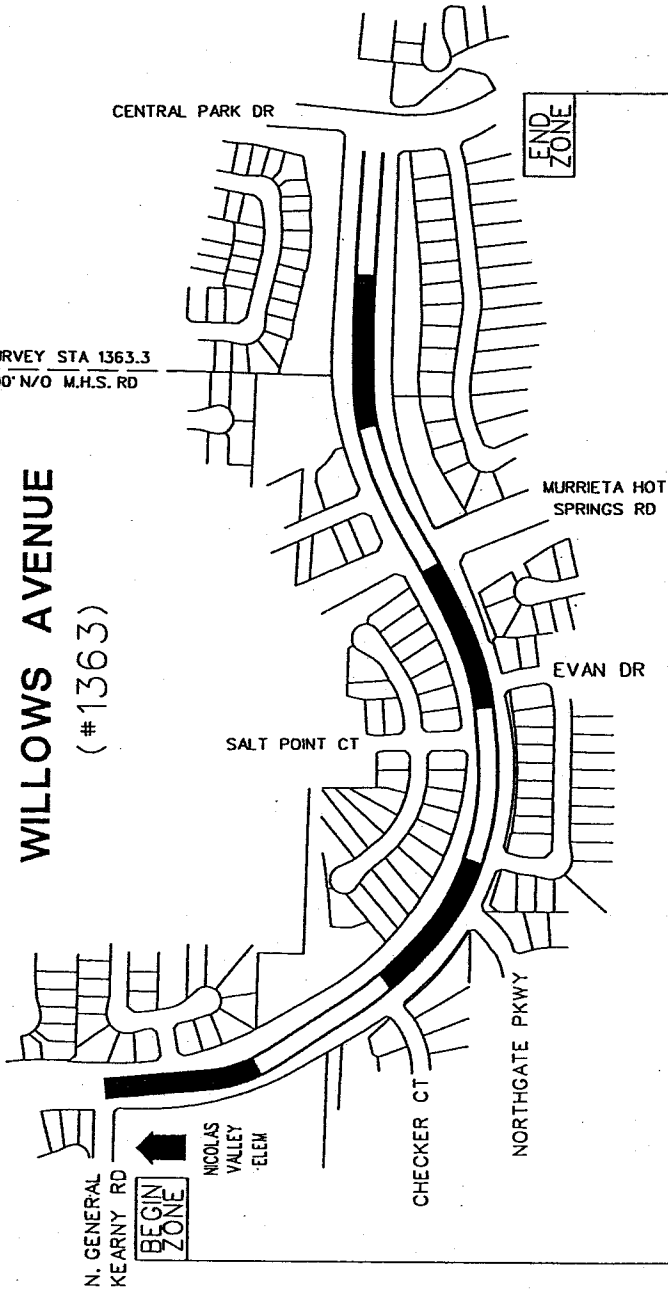

RECOMMENDED SPEED LIMIT	RESIDENTIAL AREA - SCHOOL ZONE - RECREATIONAL COMMUNITY PARK - STUDENT PEDESTRIANS - REDUCE TO 35 MPH	35 MPH
85th/75th PERCENTILE SPEED /	* 42.5 MPH (AVERAGE OF TWO SIMILAR STATIONS OF 45.0 MPH & 40.0 MPH)	3,470
VEHICLES IN 24 HR (2 WAY)		0.78 MILE
SEGMENT LENGTH		6
ALL ACCIDENTS IN 2 YRS.		3.04 ACC/MVM
ACCIDENT RATE ☆		NOT POSTED
EXISTING SPEED LIMIT		

☆ RATE. NO. OF ACCIDENT x 1,000,000
VEH x 365 x 2 x MILE

COUNTY AREA:	TEMECULA	SURVEY DATE:	MAY 7, 2008
COUNTY MAP:	128B	MAP DATE:	AUG 16, 2011
SUPERVISOR DISTRICT:	3	DRAWN BY:	N AHMAD
		CAD FILE:	WILLOWS.DGN

APPROVED BY: *Lawrence T. Tai*
DATE: 8/31/2011
LAWRENCE T. TAI, P.E.
COUNTY TRAFFIC ENGINEER

COUNTY OF RIVERSIDE
TRANSPORTATION DEPARTMENT
TRAFFIC ENGINEERING DIVISION

ENGINEERING AND TRAFFIC SURVEY
AT
WILLOWS AVENUE

PAGE 2 OF 2

**SUBMITTAL TO THE BOARD OF SUPERVISORS
COUNTY OF RIVERSIDE, STATE OF CALIFORNIA**

321A



FROM: TLMA - Transportation Department

SUBMITTAL DATE:
December 8, 2011

SUBJECT: Ordinance No. 452.231 to establish speed zones enforceable by radar speed detection equipment - Hemet, Lake Elsinore, Murrieta, Temecula, Temescal Canyon and Woodcrest areas

RECOMMENDED MOTION: That the Board of Supervisors:

1. Introduce and adopt, on successive weeks, Ordinance No. 452.231, amending Ordinance No. 452 relating to prima facie speed limits to establish various speed zones in the above-referenced areas of Riverside County.

BACKGROUND: Transportation Department staff has conducted Engineering and Traffic Surveys (E&TS) for various roads in the subject areas, as required by the California Vehicle Code.

Juan C. Perez
Director of Transportation

(Continued On Attached Page)

FINANCIAL DATA	Current F.Y. Total Cost:	\$ 0	In Current Year Budget:	N/A
	Current F.Y. Net County Cost:	\$ 0	Budget Adjustment:	N/A
	Annual Net County Cost:	\$ 0	For Fiscal Year:	N/A
SOURCE OF FUNDS:				Positions To Be Deleted Per A-30 <input type="checkbox"/>
				Requires 4/5 Vote <input type="checkbox"/>

C.E.O. RECOMMENDATION:

APPROVE

BY:
Tina Grande

County Executive Office Signature

MINUTES OF THE BOARD OF SUPERVISORS

On motion of Supervisor Buster, seconded by Supervisor Tavaglione and duly carried, IT WAS ORDERED that the above ordinance is approved as introduced with waiver of reading.

Ayes: Buster, Tavaglione and Benoit
Nays: None
Absent: Stone and Ashley
Date: December 20, 2011
xc: Transp., COB

Kecia Harper-Ihem
Clerk of the Board
By:
Deputy

Prev. Agn. Ref. 06/28/11, 3.110 | District: 1 & 3 | Agenda Number:

3.20

FORM APPROVED COUNTY COUNSEL
 BY:
 PATRICIA F. SMITH
 DATE: 12/7/11
 Departmental Concurrence

Dept's Recomm.: Consent Policy
 Per Exec. Ofc.: Consent Policy

The Honorable Board of Supervisors

RE: Ordinance No. 452.231 to establish speed zones enforceable by radar speed detection equipment - Hemet, Lake Elsinore, Murrieta, Temecula, Temescal Canyon and Woodcrest areas

December 8, 2011

Page 2 of 2

Based upon the results of the E&TS for these roads, the radar-enforceable speed limits recommended by the Department are summarized in the attached tables. Speed zone diagrams are also provided as a reference.

It is recommended that the Board of Supervisors adopt this amendment at the next regularly scheduled meeting.

County Counsel has approved the ordinance amendment.

Transportation Department staff has contacted the Riverside and Temecula area offices of the California Highway Patrol regarding the proposed speed zones.



OFFICE OF
CLERK OF THE BOARD OF SUPERVISORS
1st FLOOR, COUNTY ADMINISTRATIVE CENTER
P.O. BOX 1147, 4080 LEMON STREET
RIVERSIDE, CA 92502-1147
PHONE: (951) 955-1060
FAX: (951) 955-1071

KECIA HARPER-IHEM
Clerk of the Board of Supervisors

KIMBERLY A. RECTOR
Assistant Clerk of the Board

January 12, 2012

THE PRESS ENTERPRISE
ATTN: LEGALS
PO BOX 792
RIVERSIDE, CA 92501

FAX: (951) 368-9018
E-MAIL: legals@pe.com

RE: ADOPTION OF ORDINANCE NO. 452.231

To Whom It May Concern:

Attached is a copy for publication in your newspaper for **ONE (1) TIME** on **Sunday, January 15, 2012**.

We require your affidavit of publication immediately upon completion of the last publication.

Your invoice must be submitted to this office in duplicate, WITH TWO CLIPPINGS OF THE PUBLICATION.

NOTE: PLEASE COMPOSE THIS PUBLICATION INTO A SINGLE COLUMN FORMAT.

Thank you in advance for your assistance and expertise.

Sincerely,

Mcgil

Cecilia Gil, Board Assistant to
KECIA HARPER-IHEM, CLERK OF THE BOARD

Gil, Cecilia

From: PE Legals <legals@pe.com>
Sent: Thursday, January 12, 2012 8:27 AM
To: Gil, Cecilia
Subject: RE: FOR PUBLICATION: ADOPTION OF ORD. NO. 452.231

Received for publication on Jan. 15

PLEASE NOTE: The Press-Enterprise offices will be closed on Monday, January 16th in Observance of Martin Luther King Jr. Day. Our holiday deadlines are as follows:

Martin Luther King Jr. Deadlines	
Publication Date	Date to be submitted to the PE
Sat 1/14	Thurs 1/12 @10:30am
Sun 1/15	Thurs 1/12 @10:30am
Mon 1/16	Thurs 1/12 @10:30am
Tues 1/17	Thurs 1/12 @10:30am
Wed 1/18	Fri 1/13 @10:30am

From: Gil, Cecilia [<mailto:CCGIL@rcbos.org>]
Sent: Thursday, January 12, 2012 7:30 AM
To: PE Legals
Subject: FOR PUBLICATION: ADOPTION OF ORD. NO. 452.231

Good Morning!

Attached is an Adoption of Ordinance, for publication on Sunday, January 15, 2012. Please confirm. THANK YOU!

Cecilia Gil

Board Assistant to the
Clerk of the Board of Supervisors
951-955-8464

**THE COUNTY ADMINISTRATIVE CENTER IS CLOSED EVERY FRIDAY UNTIL FURTHER NOTICE.
PLEASE CONSIDER THE ENVIRONMENT BEFORE PRINTING.**



OFFICE OF
CLERK OF THE BOARD OF SUPERVISORS
1st FLOOR, COUNTY ADMINISTRATIVE CENTER
P.O. BOX 1147, 4080 LEMON STREET
RIVERSIDE, CA 92502-1147
PHONE: (951) 955-1060
FAX: (951) 955-1071

KECIA HARPER-IHEM
Clerk of the Board of Supervisors

KIMBERLY A. RECTOR
Assistant Clerk of the Board

January 12, 2012

THE DESERT SUN
ATTN: LEGALS
PO BOX 2734
PALM SPRINGS, CA 92263

FAX: (760) 778-4731
E-MAIL: legals@thedesertsun.com

RE: ADOPTION OF ORDINANCE NO. 452.231

To Whom It May Concern:

Attached is a copy for publication in your newspaper for **ONE (1) TIME** on **Sunday, January 15, 2012**.

We require your affidavit of publication immediately upon completion of the last publication.

Your invoice must be submitted to this office in duplicate, **WITH TWO CLIPPINGS OF THE PUBLICATION**.

NOTE: PLEASE COMPOSE THIS PUBLICATION INTO A SINGLE COLUMN FORMAT.

Thank you in advance for your assistance and expertise.

Sincerely,

Mcgil

Cecilia Gil, Board Assistant to
KECIA HARPER-IHEM, CLERK OF THE BOARD

Gil, Cecilia

From: Moeller, Charlene <CMOELLER@palmspri.gannett.com>
Sent: Thursday, January 12, 2012 8:44 AM
To: Gil, Cecilia
Subject: RE: FOR PUBLICATION: ADOPTION OF ORD. NO. 452.231

Ad received and will publish on date(s) requested.

Charlene Moeller | Media Sales Legal Notice Coordinator

The Desert Sun Media Group
750 N. Gene Autry Trail, Palm Springs, CA 92262
t 760.778.4578 | f 760.778.4731
legals@thedesertsun.com | dpwlegals@thedesertsun.com

The Coachella Valley's #1 Source in News & Advertising!
www.mydesert.com | twitter @MyDesert | facebook MyDesert.com

This email and any files transmitted with it are confidential and intended for the individual to whom they are addressed. If you have received this email in error, please notify the sender and delete the message from your system

From: Gil, Cecilia [<mailto:CCGIL@rcbos.org>]
Sent: Thursday, January 12, 2012 7:30 AM
To: tds-legals
Subject: FOR PUBLICATION: ADOPTION OF ORD. NO. 452.231

Good Morning!

Attached is an Adoption of Ordinance, for publication on Sunday, January 15, 2012. Please confirm. THANK YOU!

Cecilia Gil

Board Assistant to the
Clerk of the Board of Supervisors
951-955-8464

**THE COUNTY ADMINISTRATIVE CENTER IS CLOSED EVERY FRIDAY UNTIL FURTHER NOTICE.
PLEASE CONSIDER THE ENVIRONMENT BEFORE PRINTING.**

BOARD OF SUPERVISORS OF THE COUNTY OF RIVERSIDE, STATE OF CALIFORNIA

ORDINANCE NO. 452.231
AN ORDINANCE OF THE COUNTY OF RIVERSIDE
AMENDING ORDINANCE NO. 452
RELATING TO PRIMA FACIE SPEED LIMITS

The Board of Supervisors of the County of Riverside ordains as follows:

Section 1. Section 2.3 of Ordinance No. 452, entitled "Thirty-five miles per hour," is amended to add new subsections 108, 109, 110, 111, and 112 thereto to read as follows:

- "108. On Central Park Drive between the centerline of Calistoga Drive and a point 575 feet east of Sugar Pine Way, a total distance of approximately 0.60 miles, in the Temecula area.
109. On Clay Canyon Drive between the centerline of Knabe Road (N) and the centerline of Knabe Road (S), a total distance of approximately 0.75 miles, in the Temescal Canyon area.
110. On Haines Street between the centerline of Rider Street and the centerline of Cajalco Road, a total distance of approximately 0.5 miles, in the Woodcrest area.
111. On Hemet Street between the centerline of Little Lake Road and the centerline of Florida Avenue/SH-74, a total distance of approximately 1.1 mile, in the Hemet area.
112. On Willows Avenue between the centerline of North General Kearney Road and the centerline of Central Park Drive, a total distance of approximately 0.78 miles, in the Temecula area."

Section 2. Section 2.4 of Ordinance No. 452, entitled "Forty miles per hour," is amended to add new subsection 130 thereto to read as follows:

- "130. On Machado Street between the centerline of Grand Avenue and 200 feet north of Alvarado Street, a total distance of approximately 0.59 miles, in the Lake Elsinore area."

Section 3. Section 2.5 of Ordinance No. 452, entitled "Forty-five miles per hour," is amended to add new subsection 152 thereto to read as follows:

- "152. On Haines Street between the centerline of Cajalco Road and the centerline of Nandina Avenue, a total distance of approximately 2.0 miles, in the Woodcrest area."

Section 4. Section 2.6 of Ordinance No. 452, entitled "Fifty miles per hour," is amended to add new subsection 69 and 70 thereto to read as follows:

- "69. On Calle Nopal between the centerline of Anza Road and the centerline of Cruz Way, a total distance of approximately 1.0 mile, in the Temecula area.
70. On Leon Road between the centerline of Clinton Keith Road and the centerline of Baxter Road, a total distance of approximately 1.15 miles, in the Murrieta area."

Section 5. Subsection 9 of Section 2.4 of Ordinance No. 452 adopted on February 4, 2003, pursuant to Ordinance No. 452.214 is repealed in its entirety. Subsection 9 of Section 2.4 established a forty miles per hour speed limit on Hemet Street between the centerline of Little Lake Road and the south curb line of State Highway 74.

Subsection 106 of Section 2.5 of Ordinance No. 452 adopted on September 13, 2005, pursuant to Ordinance No. 452.221 is repealed in its entirety. Subsection 106 of Section 2.5 established a forty-five miles per hour speed limit on Calle Nopal between Anza Road and Cruz Way.

Section 6. This ordinance shall take effect 30 days after its adoption.

John Tavaglione, Chairman of the Board

I HEREBY CERTIFY that at a regular meeting of the Board of Supervisors of said County, held on **January 10, 2012**, the foregoing Ordinance consisting of six (6) sections was adopted by said Board by the following vote:

AYES: Buster, Stone, Benoit and Ashley
NAYS: None
ABSENT: Tavaglione

Kecia Harper-Ihem, Clerk of the Board
By: Cecilia Gil, Board Assistant

FOR BILLING INQUIRIES:
CALL (951) 368-9710
EMAIL billing@airy@pe.com



THE PRESS-ENTERPRISE **PE.com**



10	11	12	13	15	16	17	18	19	20
DATE	REFERENCE NUMBER	DESCRIPTION - OTHER COMMENTS/CHARGES	PRODUCT/ZONE	SIZE	BILLED UNITS	TIMES RUN	RATE	GROSS AMOUNT	NET AMOUNT

01/15/2012	I00712970-01152012	PO# Ord. 452.231, BOARD OF SUPERV	Press-Enterprise	2 x 102 LI	204	1	1.29	263.90	263.90
------------	--------------------	-----------------------------------	------------------	------------	-----	---	------	--------	--------

Order Placed by: Cecilia Gil

RECEIVED RIVERSIDE COUNTY
 CLERK / BOARD OF SUPERVISORS
 2012 JAN 26 AM 7:36

*Transp.
3.69 of 01/10/12*

Legal Advertising Invoice

BALANCE
\$263.90

SALES CONTACT INFORMATION		ADVERTISER INFORMATION			
25	1	6	7	2	
Nick Eller 951-368-9229	BILLING PERIOD 01/15/2012 - 01/15/2012	BILLED ACCOUNT NUMBER 100141323	ADVERTISER/CLIENT NUMBER 100141323	ADVERTISER/CLIENT NAME BOARD OF SUPERVISORS	

PLEASE DETACH AND RETURN THIS PORTION WITH YOUR REMITTANCE

2			ADVERTISER/CLIENT NAME		
			BOARD OF SUPERVISORS		
1	6	7			
BILLING PERIOD	BILLED ACCOUNT NUMBER	ADVERTISER/CLIENT NUMBER			
01/15/2012 - 01/15/2012	100141323	100141323			
23	24	3			
BALANCE	INVOICE NUMBER	TERMS OF PAYMENT			
\$263.90	I00712970-01152012	DUE UPON RECEIPT			



Legal Advertising Invoice

8 BILLING ACCOUNT NAME AND ADDRESS

9 REMITTANCE ADDRESS

BOARD OF SUPERVISORS
P.O. BOX 1147
COUNTY OF RIVERSIDE
RIVERSIDE, CA 92502

Enterprise Media
POST OFFICE BOX 12009
RIVERSIDE, CA 92502-2209

THE PRESS-ENTERPRISE

3450 Fourteenth Street
Riverside, CA 92501-3878
951-684-1200
951-368-9018 FAX

PROOF OF PUBLICATION (2010, 2015.5 C.C.P)

Publication(s): Press-Enterprise

PROOF OF PUBLICATION OF

Ad Desc.: / Ord. 452.231

I am a citizen of the United States. I am over the age of eighteen years and not a party to or interested in the above entitled matter. I am an authorized representative of THE PRESS-ENTERPRISE, a newspaper in general circulation, printed and published daily in the County of Riverside, and which newspaper has been adjudicated a newspaper of general circulation by the Superior Court of the County of Riverside, State of California, under date of April 25, 1952, Case Number 54446, under date of March 29, 1957, Case Number 65673, and under date of August 25, 1995, Case Number 267864; that the notice, of which the annexed is a printed copy, has been published in said newspaper in accordance with the instructions of the person(s) requesting publication, and not in any supplement thereof on the following dates, to wit:

01/15/2012

I certify (or declare) under penalty of perjury that the foregoing is true and correct.

Date: January 17, 2012
At: Riverside, California



BOARD OF SUPERVISORS
P.O. BOX 1147
COUNTY OF RIVERSIDE
RIVERSIDE, CA 92502

Ad Number: 0000712970-01

P.O. Number: Ord. 452.231

Ad Copy:

BOARD OF SUPERVISORS OF THE COUNTY OF
RIVERSIDE, STATE OF CALIFORNIA
ORDINANCE NO. 452.231

AN ORDINANCE OF THE COUNTY OF RIVERSIDE
AMENDING ORDINANCE NO. 452

RELATING TO PRIMA FACIE SPEED LIMITS

The Board of Supervisors of the County of Riverside ordains as follows:

Section 1. Section 2.3 of Ordinance No. 452, entitled "Thirty-five miles per hour," is amended to add new subsections 108, 109, 110, 111, and 112 thereto to read as follows:

- "108. On Central Park Drive between the centerline of Calistoga Drive and a point 575 feet east of Sugar Pine Way, a total distance of approximately 0.60 miles, in the Temecula area.
109. On Clay Canyon Drive between the centerline of Knabe Road (N) and the centerline of Knabe Road (S), a total distance of approximately 0.75 miles, in the Temescal Canyon area.
110. On Haines Street between the centerline of Rider Street and the centerline of Cajalco Road, a total distance of approximately 0.5 miles, in the Woodcrest area.
111. On Hemet Street between the centerline of Little Lake Road and the centerline of Florida Avenue/SH-74, a total distance of approximately 1.1 mile, in the Hemet area.
112. On Willows Avenue between the centerline of North General Kearney Road and the centerline of Central Park Drive, a total distance of approximately 0.78 miles, in the Temecula area."

Section 2. Section 2.4 of Ordinance No. 452, entitled "Forty miles per hour," is amended to add new subsection 130 thereto to read as follows:

- "130. On Machado Street between the centerline of Grand Avenue and 200 feet north of Alvarado Street, a total distance of approximately 0.59 miles, in the Lake Elsinore area."

Section 3. Section 2.5 of Ordinance No. 452, entitled "Forty-five miles per hour," is amended to add new subsection 152 thereto to read as follows:

- "152. On Haines Street between the centerline of Cajalco Road and the centerline of Nandina Avenue, a total distance of approximately 2.0 miles, in the Woodcrest area."

Section 4. Section 2.6 of Ordinance No. 452, entitled "Fifty miles per hour," is amended to add new subsection 69 and 70 thereto to read as follows:

- "69. On Calle Nopal between the centerline of Anza Road and the centerline of Cruz Way, a total distance of approximately 1.0 mile, in the Temecula area.
70. On Leon Road between the centerline of Clinton Keith Road and the centerline of Baxter Road, a total distance of approximately 1.15 miles, in the Murrieta area."

Section 5. Subsection 9 of Section 2.4 of Ordinance No. 452 adopted on February 4, 2003, pursuant to Ordinance No. 452.214 is repealed in its entirety. Subsection 9 of Section 2.4 established a forty miles per hour speed limit on Hemet Street between the centerline of Little Lake Road and the south curb line of State Highway 74.

Subsection 106 of Section 2.5 of Ordinance No. 452 adopted on September 13, 2005, pursuant to Ordinance No. 452.221 is repealed in its entirety. Subsection 106 of Section 2.5 established a forty-five miles per hour speed limit on Calle Nopal between Anza Road and Cruz Way.

Section 6. This ordinance shall take effect 30 days after its adoption.

John Tavaglione, Chairman of the Board

I HEREBY CERTIFY that at a regular meeting of the Board of Supervisors of said County, held on **January 10, 2012**, the foregoing Ordinance consisting of six (6) sections was adopted by said Board by the following vote:

AYES: Buster, Stone, Benoit and Ashley
NAYS: None
ABSENT: Tavaglione

Kecia Harper-Ihem, Clerk of the Board
By: Cecilia Gil, Board Assistant

1/15