

**SUBMITTAL TO THE BOARD OF SUPERVISORS
COUNTY OF RIVERSIDE, STATE OF CALIFORNIA**

831A



FROM: TLMA - Transportation Department

SUBMITTAL DATE:

May 10, 2012

SUBJECT: Notice of Completion - Gavilan Road Reconstruction Project, and Gavilan Road, Lake Mathews Drive and Santa Rosa Mine Road Guardrail Construction Safety Projects, in the Lake Mathews Area

RECOMMENDED MOTION: That the Board execute and file the attached "Notice of Completion"

BACKGROUND: By Minute Order 3.36 of November 1, 2011, the Board entered into a contract with All American Asphalt of Corona, California, for the reconstruction of Gavilan Road from Multiview Drive to Hidalgo Drive and the construction of guardrail at three separate locations; 1) Gavilan Road south of Elderidge Drive, 2) Santa Rosa Mine Road at the transition to Gavilan Road, south of Lake Mathews Drive.

Juan C. Perez
Director of Transportation

dj
(Continued On Attached Page)

FINANCIAL DATA	Current F.Y. Total Cost:	\$1,197,397	In Current Year Budget:	Yes
	Current F.Y. Net County Cost:	\$ 0	Budget Adjustment:	No
	Annual Net County Cost:	\$ 0	For Fiscal Year:	2011/2012

SOURCE OF FUNDS: Prop 1B (State Bond Funds-Local Roads) (80%), Measure A/Western (17%), and Developer Contributions (3%) There were no General Funds used in this project	Positions To Be Deleted Per A-30	<input type="checkbox"/>
	Requires 4/5 Vote	<input type="checkbox"/>

C.E.O. RECOMMENDATION:

APPROVE

BY:
Tina Grande

County Executive Office Signature

MINUTES OF THE BOARD OF SUPERVISORS

On motion of Supervisor Tavaglione, seconded by Supervisor Benoit and duly carried by unanimous vote, IT WAS ORDERED that the above matter is approved as recommended.

Ayes: Buster, Tavaglione, Stone, Benoit and Ashley
Nays: None
Absent: None
Date: May 15, 2012
xc: Transp., Recorder

Kecia Harper-Ihem
Clerk of the Board
By:
Deputy

Prev. Agn. Ref. 11/1/11, Item 3.36 | **District:** 1/1 | **Agenda Number:**

3.25

ATTACHMENTS FILED
WITH THE CLERK OF THE BOARD

Departmental Concurrence

Dept't Recomm.: Policy Consent
Per Exec. Ofc.: Policy Consent

The Honorable Board of Supervisors

RE: Notice of Completion - Gavilan Road Reconstruction Project, and Gavilan Road, Lake Mathews Drive and Santa Rosa Mine Road Guardrail Construction Safety Projects, in the Lake Mathews Area

Page 2 of 2

The originally authorized amount of the contract was \$1,202,897. The total amended contract is \$1,197,379, which is 0.5% less than the originally authorized amount.

This work was completed at the direction of the Department on January 31, 2012, and was inspected by the Construction Engineering Section of the Transportation Department. Work Order B8-0668, C0-0510, B5-0671.

Budget

Original Contract Amount		\$1,202,897.00
Tot. Chg Orders Authorized -	0.0%	\$0.00
Est. Pending Change Orders	0.0%	\$0.00
Amended Contract Amount		\$1,202,897.00
* Quantity Adjustments	-0.5%	(\$5,517.99)
+ CCO FA Adjustments	0.0%	\$0.00
Total Amended Contract Amount	99.5%	\$1,197,379.01

Expenditures

Total Progress Payments -	\$1,197,379.01
Estimated Pending Payments	
Total Expenditures	<u>\$1,197,379.01</u>

(Over)\Under Contract Amount \$0.00

+ Change Orders using the Force Account method of payment issued prior to the work being completed generally do not use the total authorized amount.

* CAL-Trans Standard Specifications 4-1.03B. Increases or decreases in the quantity of a contract item of work will be determined by comparing the total pay quantity of such item of work with the Engineer's Estimate. If the total pay quantity of any item of work required under the contract varies from the Engineers Estimate by 25 percent or less, payment will be made for the quantity of work of said item performed at contract unit price, unless eligible for adjustment pursuant to Section 4-1.03C, "Changes in Character of Work."

**COUNTY OF RIVERSIDE
DEPARTMENT OF TRANSPORTATION**

**LAKE MATHEWS DR, GAVILAN RD
AND SANTA ROSA MINE RD
METAL BEAM GUARD RAIL PROJECT**

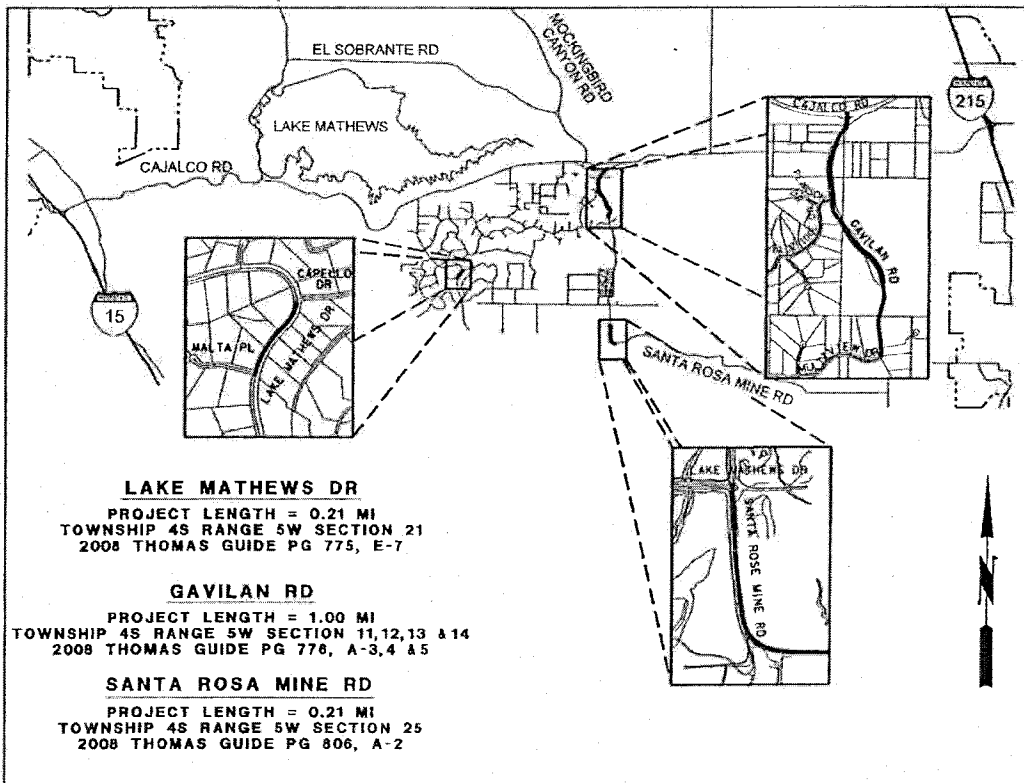
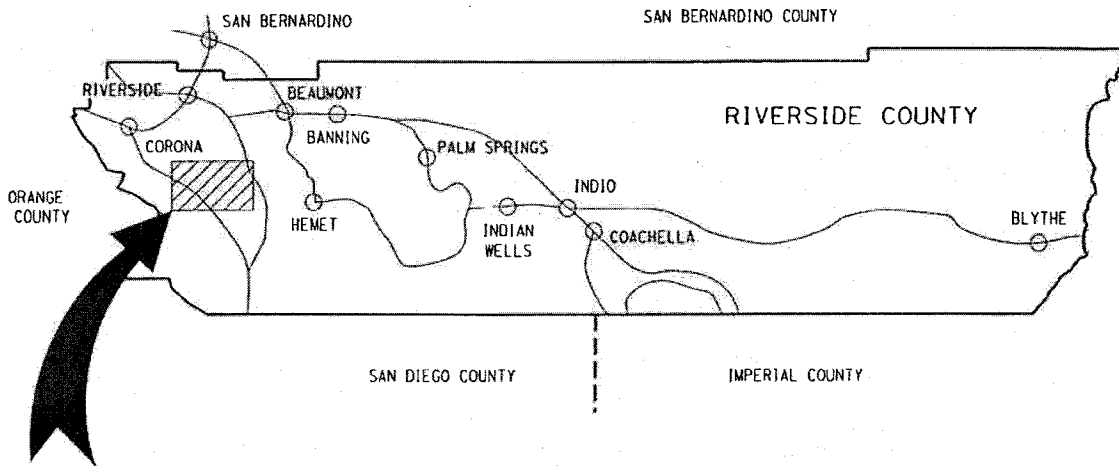

PROJECT: Gavilan Road/Lake Mathews/Santa Rosa Rehab & MBGR
 County Project No.: B8-0668, C0-0510, and B5-0671
 Contract No. 11-10-001

Contractor: All American Asphalt
 Address: P.O. Box 2229
 City, State, Zip: Corona, CA 92878-2229

Item No.	Item Description	Units	Quantity	Unit Price	Original Contract Amount	Change Authorized Quantity	Change Authorized Amount	Total Authorized Quantity	Total Authorized Amount	This Estimate		Previous Quantity	Total Estimate To Date		% Auth.
										Quantity	Amount		Quantity	Amount	
					1,202,897.00		0.00		1,202,897.00	42,908.05				1,197,379.01	
PROJECT TOTAL															



Estimate No. 3 Final
 From: January 26, 2012
 To: March 25, 2012

Made by: Eric Light
 Checked by: [Signature]
 OK Const. Supv. [Signature]

Working Days: 11-28-11
 Days Added: 0
 Subtotal: 1-31-12
 Days Used: 40
 % Time Elapsed: 100%

TOTAL VALUE OF WORK TO DATE: \$1,197,379.01
 LESS RETENTION: 10% 119,737.91
 TOTAL DUE TO DATE: \$1,077,641.10
 LESS PREVIOUSLY INVOICED: 1,039,023.86
 LESS LABOR NON COMPLIANCE: 0.00
 TOTAL DUE THIS PAYMENT: \$38,617.24

This Estimate Approved _____ Date: _____ for: _____ \$38,617.24

Juan C. Perez, Director of Transportation

Carroll Ober for Brett Schulte
 Date: 4/13/12

PAYMENT APPROVAL

Fund 20000

Dept ID 31305

Account 527980

Project Z 68-0668 E 265-0671 E

Activity ID Z 3600

Resource Type CNT

Signature [Signature]

Date 4/19/12



PROJECT: Gavilan Road/Lake Mathews/Santa Rosa Rehab & MBGR
 County Project No.: B8-0668, C0-0510, and B5-0671
 Contract No. 11-10-001

Contractor: All American Asphalt
 Address: P.O. Box 2229
 City, State, Zip: Corona, CA 92878-2229



Estimate No. 3 Final
 From: January 26, 2012
 To: March 25, 2012

Work Orders Breakdown:

Gavilan Rd - B8-0668

ESTIMATE TO DATE: \$1,110,029.75
 LESS RETENTION: 10% 111,002.98
 LESS PREVIOUSLY INVOICED: 977,521.43
 LESS LABOR NON COMPLIANCE: 0.00
 TOTAL DUE THIS PAYMENT: 21,505.34

Gavilan & Lake Mathews MBGR - C0-0510

ESTIMATE TO DATE: \$62,224.06
 LESS RETENTION: 10% 6,222.41
 LESS PREVIOUSLY INVOICED: 53,230.53
 LESS LABOR NON COMPLIANCE: 0.00
 TOTAL DUE THIS PAYMENT: 2,771.12

Santa Rosa Mine MBGR - B5-0671

ESTIMATE TO DATE: \$25,125.20
 LESS RETENTION: 10% 2,512.52
 LESS PREVIOUSLY INVOICED: 8,271.90
 LESS LABOR NON COMPLIANCE: 0.00
 TOTAL DUE THIS PAYMENT: 14,340.78

TOTAL DUE THIS PAYMENT: 38,617.24

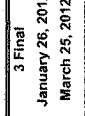

Contractor: All American Asphalt
 P.O. Box 2229
 Corona, CA 92878-2229

Estimate No. 3 Final
 From: January 26, 2012
 To: March 25, 2012

PROJECT: Gavilan Road/Lake Mathews/Santa Rosa Rehab & MBGR
 County Project No.: 88-0668, CO-0510, and B5-0671
 Contract No. 11-10-001

Item No.	Item Description	Units	Quantity	Unit Price	Original Contract Amount	Change Authorized		Total Authorized		This Estimate Quantity	This Estimate Amount	Previous Quantity	Total Estimate To Date		% Auth.
						Quantity	Amount	Quantity	Amount				Quantity	Amount	
1	Dust Abatement	LS	1	1,530.00	1,530.00			1.00	1,530.00	1.00		1.00	1,530.00	100%	
2	Water Pollution Control	LS	1	5,300.00	5,300.00			1.00	5,300.00	1.00		1.00	5,300.00	100%	
3	Develop Water Supply	LS	1	510.00	510.00			1.00	510.00	1.00		1.00	510.00	100%	
4	Traffic Control System	LS	1	56,000.00	56,000.00			1.00	56,000.00	1.00		1.00	56,000.00	100%	
5	Clearing & Grubbing	LS	1	1,530.00	1,530.00			1.00	1,530.00	1.00		1.00	1,530.00	100%	
6	Finish Roadway	LS	1	510.00	510.00			1.00	510.00	1.00		1.00	510.00	100%	
7	Roadway Excavation	CY	1,000	20.80	20,800.00			1,000.00	20,800.00	992.00	4,118.40	1,190.00	24,752.00	119%	
8	Grinding Asphalt Concrete in Place	SQYD	22,000	3.70	81,400.00			22,000.00	81,400.00			22,100.00	81,770.00	100%	
9	Asphalt Treated Permeable Base	CY	700	134.00	93,800.00			700.00	93,800.00			644.00	86,296.00	92%	
10	Hot Mix Asphalt	TON	6,500	74.00	481,000.00			6,500.00	481,000.00			6,633.55	490,882.70	102%	
11	Place Asphalt Concrete (Misc Areas)	TON	700	80.00	56,000.00			700.00	56,000.00		1,202.40	792.01	63,360.80	113%	
12	Place Asphalt Concrete Dike (Type E)	LF	11,500	1.09	12,535.00			11,500.00	12,535.00			11,397.00	12,422.73	99%	
13	Asphalt Concrete Overside Drain	EA	10	306.00	3,060.00			10.00	3,060.00			11.00	3,366.00	110%	
14	Shoulder Backing	LF	14,000	2.12	29,680.00			14,000.00	29,680.00	1,182.00	2,505.84	14,114.00	32,427.52	109%	
15	3" Plastic Pipe (Edge Drain)	LF	5,000	15.50	77,500.00			5,000.00	77,500.00			4,533.00	70,261.50	91%	
16	3" Plastic Pipe (Edge Drain Outlet)	EA	10	255.00	2,550.00			10.00	2,550.00			11.00	2,805.00	110%	
17	Minor Concrete (Curb & Gutter) (CRS201)	LF	2,000	13.30	26,600.00			2,000.00	26,600.00			1,816.00	24,152.80	91%	
18	Minor Concrete (Type "C" Curb) (CRS 202)	LF	500	14.30	7,150.00			500.00	7,150.00			498.00	7,121.40	100%	
19	Minor Concrete (Cross-gutter & Spandrel)	SQFT	7,500	8.40	63,000.00			7,500.00	63,000.00			7,800.00	65,520.00	104%	
20	Minor Concrete (Driveway)	SQFT	1,000	6.70	6,700.00			1,000.00	6,700.00			1,100.00	7,370.00	110%	

PROJECT: Gavilan Road/Lake Mathews/Santa Rosa Rehab & MBGR
County Project No.: BS-0668, CB-0510, and BS-0671
Contract No.: 11-10-001

Contractor: All American Asphalt
Address: P.O. Box 2229
City, State, Zip: Corona, CA 92878-2229

Estimate No.: 3 Final
From: January 26, 2012
To: March 25, 2012



Item No.	Item Description	Units	Quantity	Unit Price	Original Contract Amount	Change Authorized		Total Authorized		This Estimate Quantity	This Estimate Amount	Total Estimate To Date		% Auth.
						Quantity	Amount	Quantity	Amount			Quantity	Amount	
21	Rumble Strip	LF	4,000	1.40	5,600.00			4,000.00	5,600.00			4,089.00	5,724.60	102%
22	Object Marker (Type L-1)	EA	10	51.00	510.00			10.00	510.00					0%
23	Thermoplastic Pavement Marking	SQFT	200	3.06	612.00			200.00	612.00			250.00	765.00	125%
24	Paint Traffic Stripe (2-coat)	LF	2,800	0.26	728.00			2,800.00	728.00			2,800.00	728.00	100%
25	Pavement Marker (Reflective)	EA	600	2.55	1,530.00			600.00	1,530.00	341.00	869.55	341.00	869.55	57%
26	Construction Funding Sign	EA	2	770.00	1,540.00			2.00	1,540.00			2.00	1,540.00	100%
27	Street Name Sign	EA	10	380.00	3,800.00			10.00	3,800.00	12.00	4,560.00	12.00	4,560.00	120%
28	Dust Abatement	LS	1	510.00	510.00			1.00	510.00			1.00	510.00	100%
29	Water Pollution Control	LS	1	510.00	510.00			1.00	510.00			1.00	510.00	100%
30	Develop Water Supply	LS	1	255.00	255.00			1.00	255.00			1.00	255.00	100%
31	Traffic Control System	LS	1	21,500.00	21,500.00			1.00	21,500.00			1.00	21,500.00	100%
32	Cleaning & Grubbing	LS	1	255.00	255.00			1.00	255.00			1.00	255.00	100%
33	Roadway Excavation	CY	300	70.00	21,000.00			300.00	21,000.00			330.00	23,100.00	110%
34	Relocate Mailboxes	EA	1	255.00	255.00			1.00	255.00			1.00	255.00	100%
35	Class 2 Aggregate Base	CY	130	85.00	11,050.00			130.00	11,050.00			122.00	10,370.00	94%
36	Hot Mix Asphalt	TON	200	101.00	20,200.00			200.00	20,200.00			102.00	10,302.00	51%
37	Place Asphalt Concrete Dike (CRS 212) (8")	LF	140	1.10	154.00			140.00	154.00			110.00	121.00	79%
38	Place Asphalt Concrete Dike (Type F)	LF	1,600	1.10	1,760.00			1,600.00	1,760.00			1,558.00	1,713.80	97%
39	Asphalt Concrete Overside Drain	EA	1	306.00	306.00			1.00	306.00			1.00	306.00	100%
40	Shoulder Backing	LF	1,700	2.44	4,148.00			1,700.00	4,148.00	1,680.00	4,099.20	1,680.00	4,099.20	99%

PROJECT: Gavilan Road/Lake Mathews/Santa Rosa Rehab & MBGR
 County Project No.: BS-0668, CO-0510, and BS-0671
 Contract No. 11-10-001

Contractor: All American Asphalt
 Address: P.O. Box 2229
 City, State, Zip: Corona, CA 92878-2229



Estimate No. 3 Final
 From: January 26, 2012
 To: March 25, 2012

Item No.	Item Description	Units	Quantity	Unit Price	Original Contract Amount	Change Authorized		Total Authorized		This Estimate		Previous Quantity	Total Estimate To Date		% Auth.
						Quantity	Amount	Quantity	Amount	Quantity	Amount		Quantity	Amount	
41	MBGR (7" Wood Post)	LF	1,440	22.00	31,680.00			1,440.00	31,680.00			1,314.00	1,314.00	28,908.00	91%
42	MBGR (Steel Post)	LF	390	32.40	12,636.00			390.00	12,636.00	323.00	10,465.20		323.00	10,465.20	83%
43	Terminal Anchor Assembly (Type SFT)	EA	1	710.00	710.00			1.00	710.00			1.00	1.00	710.00	100%
44	Terminal System (Type SKT)	EA	1	2,940.00	2,940.00			1.00	2,940.00						0%
45	Terminal System (Type SRT)	EA	6	2,450.00	14,700.00			6.00	14,700.00	3.00	7,350.00	3.00	6.00	14,700.00	100%
46	Guard Railing Delineator	EA	90	20.00	1,800.00			90.00	1,800.00	64.00	1,280.00	26.00	90.00	1,800.00	100%
47	Rumble Strip	LF	3,400	0.87	2,958.00			3,400.00	2,958.00			3,281.00	3,281.00	2,854.47	97%
48	Thermoplastic Pavement Marking	SQFT	200	3.06	612.00			200.00	612.00			250.00	250.00	765.00	125%
49	4" Thermoplastic Traffic Stripe	LF	10,000	0.61	6,100.00			10,000.00	6,100.00	10,586.00	6,457.46	240.79	10,826.79	6,604.34	108%
50	Paint Traffic Stripe (2-coat)	LF	7,800	0.26	2,028.00			7,800.00	2,028.00			7,800.00	7,800.00	2,028.00	100%
51	Pavement Marker (Reflective)	EA	900	2.55	2,295.00			900.00	2,295.00			828.00	828.00	2,111.40	92%
52	Delineator (class 1)	EA	40	26.50	1,060.00			40.00	1,060.00			40.00	40.00	1,060.00	100%

PLEASE COMPLETE THIS INFORMATION
RECORDING REQUESTED BY:

KECIA HARPER-IHEM, CLERK OF THE BOARD
RIVERSIDE CO. CLERK OF THE BOARD
4080 LEMON STREET, 1ST FLOOR CAC
P O BOX 1147 - RIVERSIDE, CA 92502
MAIL STOP # 1010

AND WHEN RECORDED MAIL TO:
RETURN TO: STOP #1010
RIVERSIDE COUNTY CLERK OF THE BOARD
P. O. BOX 1147 - RIVERSIDE, CA 92502

DOC # 2012-0224938
05/15/2012

Customer Copy Label
The paper to which this label is
affixed has not been compared
with the recorded document

Larry W Ward
County of Riverside
Assessor, County Clerk & Recorder

THIS SPACE FOR RECORDERS USE ONLY

NOTICE OF COMPLETION

To be recorded with County Recorder
within 10 days after completion.
No recording fee.

Notice is hereby given by the undersigned owner, a public entity of the State of California, that a public work of
improvement has been completed, as follows:

Project title or description of work: Reconstruction and Safety Projects

Date of Completion: Date of this notice 05/15/2012

Nature of owner: County of Riverside, public entity

Interest or estate of owner: Public Roadway

Address of owner: 4080 Lemon Street, 8th Floor, Riverside, CA 92501

Name of contractor: All American Asphalt, Inc.

Street or legal description of site: Gavilan Road, Lake Mathews Drive and Santa Rosa Mine Road

Dated: 05/15/2012

Owner: County of Riverside
(Name of Public Entity)

By: 
Chairman, Board of Supervisors
John Tavaglione

STATE OF CALIFORNIA)

ss

COUNTY OF RIVERSIDE)

I am the Chairman of the governing board of the County of Riverside, the public entity which executed the
foregoing notice and on whose behalf I make this verification, I have read this notice, know its contents, and the same is
true. I certify under penalty of perjury that the foregoing is true and correct.

Executed at Riverside, California on 05/15/2012 (Date)

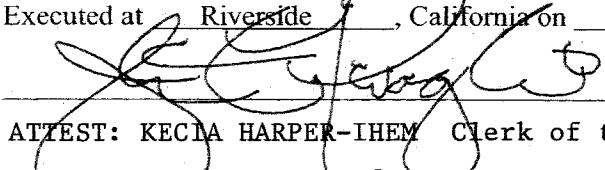
Chairman of the Board of Supervisors
John Tavaglione

ATTEST: KECIA HARPER-IHEM Clerk of the Board

By:  Deputy

COPY

3.25 05/15/2012



**LARRY W. WARD
COUNTY OF RIVERSIDE
ASSESSOR-COUNTY CLERK-RECORDER**

Recorder
P.O. Box 751
Riverside, CA 92502-0751
(951) 486-7000

<http://riverside.asrclkrec.com>

CERTIFICATION

Pursuant to the provisions of Government Code 27361.7, I certify under the penalty of perjury that the following is a true copy of illegible wording found in the attached document:

(Print or type the page number(s) and wording below):

CLARIFICATION OF THE SEAL for the Riverside County Board of Supervisors
(embossed on document)

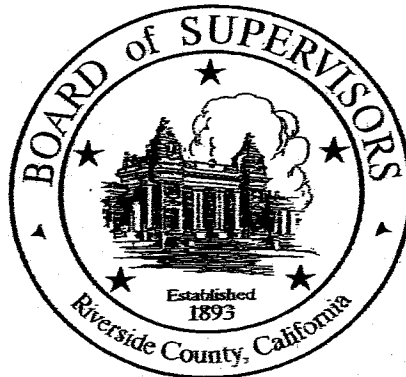

Date: May 15, 2012

Signature: April Eckles

Print Name: April Eckles, Board Assistant, Riverside County Clerk of the Board