

**SUBMITTAL TO THE BOARD OF SUPERVISORS
COUNTY OF RIVERSIDE, STATE OF CALIFORNIA**

223



FROM: Successor Agency to the Redevelopment Agency

SUBMITTAL DATE:
May 23, 2012

SUBJECT: Cabazon Civic Center – Change Order No. 6

RECOMMENDED MOTION: That the Board of Supervisors:

1. Approve and authorize the Chairman of the Board to execute the attached Change Order No. 6 between Doug Wall Construction and the County of Riverside in the amount of \$143,800;
2. Approve and authorize the attached Purchase Order #EDARC-EDA0003684 between Westgroup Designs, Inc. and the County of Riverside for furniture design services in the amount of \$10,647; and
3. Direct the Successor Agency to submit Change Order No. 6 and the attached Purchase Order #EDARC-EDA0003684 for approval at the next Oversight Board meeting.

BACKGROUND: (Commences on Page 2)

REVIEWED BY CIP
Christopher Hans
Christopher Hans

Robert Field
Robert Field
Assistant County Executive Officer/EDA

| | | | | |
|-----------------------|-------------------------------|------------|-------------------------|---------|
| FINANCIAL DATA | Current F.Y. Total Cost: | \$ 154,447 | In Current Year Budget: | Yes |
| | Current F.Y. Net County Cost: | \$ 0 | Budget Adjustment: | No |
| | Annual Net County Cost: | \$ 0 | For Fiscal Year: | 2011/12 |

| | |
|---|--|
| COMPANION ITEM ON BOARD AGENDA: No | |
| SOURCE OF FUNDS: Mid-County Redevelopment Project Area Capital Improvement Funds – Cabazon Sub-Area (Bond proceeds), previously approved budget. | Positions To Be Deleted Per A-30 <input type="checkbox"/> |
| | Requires 4/5 Vote <input type="checkbox"/> |

C.E.O. RECOMMENDATION: APPROVE
BY: *Jennifer L. Sargent*
County Executive Office Signature Jennifer L. Sargent

**MINUTES OF THE BOARD OF SUPERVISORS OF THE SUCCESSOR AGENCY TO
THE REDEVELOPMENT AGENCY**

On motion of Supervisor Tavaglione, seconded by Supervisor Stone and duly carried, IT WAS ORDERED that the above matter is approved as recommended.

Ayes: Tavaglione, Stone and Ashley
Nays: None
Absent: Buster and Benoit
Date: June 19, 2012
xc: RDA, EDA, Auditor, CIP

Kecia Harper-Ihem
Clerk of the Board
By: *Kecia Harper-Ihem*
Deputy

Prev. Agn. Ref.: 4.7 of 6/14/11; 4.2 of 4/10/12 | **District:** 5/5 | **Agenda Number** 4.1

ATTACHMENTS FILED
WITH THE CLERK OF THE BOARD

FISCAL PROCEDURES APPROVED
 PAUL ANGULO, CPA, AUDITOR-CONTROLLER
 DATE BY: *5/21/12 Samuel Wong* 5/26/12
 SAMUEL WONG
 Departmental Concurrence
 FORM APPROVED COUNTY COUNSEL
 BY: *5/21/12*
 MARSHAL VICTOR

Dept Recomm.: Consent Policy
 Per Exec. Ofc.: Consent Policy

BACKGROUND:

The Cabazon Civic Center Project was awarded to Doug Wall Construction, Inc. on June 14, 2011.

The attached Change Order No. 6 includes work arising from unforeseen circumstances during construction, changes requested by the various building operators, and changes requested by Economic Development Agency (EDA). The change order is well within the 10% contingency established in the project budget, which was approved on June 14, 2011.

The attached purchase order EDARC-EDA0003684 with Westgroup Designs, Inc. includes work for designing a furniture package for the Cabazon Child Development and Counseling Center that can formally be bid out to furniture vendors. The Child Development building is only one portion of the larger Cabazon Civic Center Project. The RFQ for these design services was administered by the Riverside County Purchasing Department per the proper procurement policy. It was the intention of the Redevelopment Agency for the County of Riverside to provide furniture for the facility when the project began in 2008. The project began with the cooperation of Family Services Association (FSA) who was already providing child care services in small trailers on the subject property. They were the logical choice to continue once the facility was built and had continuous input throughout the design process. FSA is a non-profit organization with limited funds to furnish a 13,000 square foot facility. The facility cannot operate as intended without the purchase of furniture and equipment by the County.

The original contract for construction and the total project budget were executed and approved on June 14, 2011, a date prior to the enactment of ABx126, enacted by the California Legislature regarding redevelopment that was signed by Governor Brown on June 28, 2011. Change Order No. 6 has been processed in accordance with the terms of the original construction contract.

The cost of Change Order No. 6 and Purchase Order #EDARC-EDA0003684 will not add additional cost to the project as they are accounted for in the approved budget and a budget adjustment is not required.

The construction contract, including contingency amount, is reflected on the Initial Recognized Obligation Payment Schedule prepared by Successor Agency's staff and Purchase Order #EDARC-EDA0003684 is reflected on the Recognized Obligation Payment Schedule July – December 2012 prepared by Successor Agency Staff. Staff recommends approval of the motions listed above.

Attachments:

- Change Order No. 6 with backup documentation
- Purchase Order #EDARC-EDA0003684

**COUNTY OF RIVERSIDE EDA AS SUCCESSOR AGENCY TO THE REDEVELOPMENT AGENCY
FOR THE COUNTY OF RIVERSIDE**

CHANGE ORDER NO. 6

Date: 4/10/2012

Project: Cabazon Civic Center

To Contractor:
Doug Wall Construction, Inc
78450 Avenue 41
Bermuda Dunes, CA 92203

Project No: ED1308004
Distribution:
Project Manager Construction Manager
Contractor Inspector
Fiscal Architect/Engineer

You are directed to make the following changes. Changes shall include labor, material and equipment; each item to include all charges or indirect arising out of this work:

| | | |
|--|--------|---------------|
| 1) Sewer Laterals COR #27R2 | ADD | \$ 71,251.00 |
| 2) Credit for Waterproofing COR #50 | DEDUCT | \$ (3,684.00) |
| 3) Roof Drain Fabrication COR #51 | ADD | \$ 1,767.00 |
| 4) Data Cabling COR #52R1 | ADD | \$ 73,280.00 |
| 5) Site Security - Allowance COR #53 | ADD | \$ - |
| 6) Building B Drain and Downspout COR #57 | ADD | \$ 1,186.00 |

The specifications, where pertinent, shall apply to these changes.

| | | |
|--|------------------|---------------|
| This Change Order provides for a time extension of | <u>30</u> | calendar days |
| Original Contract Duration (calendar days): | <u>450</u> | |
| Prior Authorized Time Extension (calendar days): | <u>0</u> | |
| Revised Construction Duration (calendar days): | <u>480</u> | |
| Original Contract Completion Date: | <u>10/5/2012</u> | |
| Revised Contract Completion Date: | <u>11/6/2012</u> | |

NOTE: This change order is not effective until ALL signatures below are obtained, and if applicable, signature authority approval by Form 11 as indicated per Change Order Guidelines.

The undersigned contractor has given careful consideration to the change proposed, including its effect on other work already contracted for, and hereby agrees, if this change order is approved, that he will provide all equipment, furnish all materials, except as may otherwise be noted above, and perform all services necessary for the work above specified, and will accept as full payment for all costs related in any way thereto the prices shown above.

1) [Signature] 4-10-12
Contractor (signature) Date
Mike Gleason
Contractor's Printed name

Original Contract \$ 11,990,000.00
Prior Authorized ADD DED \$ 220,986.10
Total Contract Prior to this Change \$ 12,210,986.10

2) [Signature] 6/19/12
Chairman, Board of Supervisors (signature) Date
JOHN TAVAGNONE
Chairman, Board of Supervisors Printed name

Authorized Changes on this C.O.:
Addition \$ 147,494.00
Deduction \$ -3,684.00

NET: Addition Deduction \$ 143,800.00

3) [Signature] 4/23/12
Architect (signature) Date
Thomas Howell
Architect's Printed name

Amount of Contract Authorized Including this Change Order \$ 12,354,766.10

4) [Signature] 4/25/12
Project Manager (signature) Date
Dominick Lombardi
Project Manager's Printed name

Pursuant to:
 Board Resolution 2012-034
 M.O. and Date _____

ATTEST:
KECIA HARPER-IHEM, Clerk
By [Signature]
DEPUTY

RDA Change Order Form - Revised 1-10-12

FORM APPROVED COUNTY COUNSEL
BY: [Signature] 5/22/12
MARSHAL L. VICTOR DATE

4.1 JUN 19 2012



COUNTY OF RIVERSIDE
 Purchasing and Fleet Services Department
 2980 Washington St.
 Riverside, CA 92504
 Phone: (951) 955-4937
 Fax: (951) 955-4948

PURCHASE ORDER
CHANGE ORDER - REPRINT

Vendor Instructions

1. Packaging Slip showing P.O. number and contents must accompany each shipment.
2. No charge for packaging or drayage will be allowed except when specified in order.
3. No partial billings except when specified in the order.
4. THIS ORDER EXPRESSLY LIMITS ACCEPTANCE TO THE TERMS OF THIS ORDER. ANY ADDITIONAL OR DIFFERENT TERMS PROPOSED BY THE SELLER ARE REJECTED UNLESS EXPRESSLY ASSENTED TO IN WRITING BY THE BUYER.
5. MAIL INVOICE TO THE ADDRESS SHOWN BELOW. SHOW PURCHASE ORDER NUMBER AND ORDERING DEPARTMENT.
6. Out of state vendors MUST show CA Board of Equalization Permit Number. Otherwise, sales tax will be deducted.
7. IMPORTANT: Seller shall provide material safety data sheets for each product containing hazardous substances as listed by CA Dir. Ind. Ref. in CA Adm. Code, Title 8, Section 5194 and labor codes
8. If work is to be carried out on county property, vendor shall call purchasing and ascertain amounts and types of insurance required and provide proof of insurance before beginning work

Vendor: 000012206
 Westgroup Designs Inc
 19520 Jamboree Rd Suite 100
 Irvine CA 92612
 United States

| | | |
|---|---------------------------|-----------------------------------|
| Purchase Order EDARC-EDA0003684 | Date 04/23/2012 | Revision 1 - 04/23/2012 |
| Payment Terms: Net 30 | RFQ/P# | PO Type: RBGS |
| Freight Terms: FOB Destination, Freight Paid | | |
| Ship Via: BEST WAY | | |

Invoice To : United States

Ship To: Eda
 EDA-ReDev Agency
 3525 Fourteenth St
 Riverside CA 92501
 United States

| Line No. | Sched. No. | County Item No. | Quantity | Unit of Measure | Taxable? | Due Date | Vendor Cat. No. | Unit Price | Extended Cost |
|----------|------------|-----------------|-----------|-----------------|----------|------------|-----------------|------------|---------------|
| 1 | 1 | 90735 | 10,647.00 | HR | Y | 04/23/2012 | | 1.00 | 10,647.00 |

Description:
 Furniture Design Services for the
 Cabazon Child Development Center -
 per RFQ: RAARC-006

| | |
|------------------------|-----------|
| Schedule Total | 10,647.00 |
| Item Total | 10,647.00 |
| Total PO Amount | 10,647.00 |

PO Comments:
 Send INVOICES to:
 County of Riverside - EDA
 EDA Redevelopment Agency
 3403 10th St., 5th Floor
 Riverside, CA 92501
 *** Attention: ACCOUNTS PAYABLE

This Project: ED1308000412, Purchase Order issued at the request of Economic Development Agency / Purchasing & Supply Services Division with all necessary approvals; back-up documentation, etc. on file.

This Purchase Order is per Westgroups RFQ response dated April 4, 2012, to deliver an integrated and complete design package based on documents and project walk for Building A & B, along with Addendum #1; floor plans; and described scope of work. Pricing includes all labor, delivery and taxes.

Vendor was selected thru a competitive bid selection process.

TO ENSURE PROMPT PAYMENT THE PURCHASE ORDER NUMBER SHALL BE REFERENCED ON ALL INVOICES AND DOCUMENTS.

Please refer to <http://www.purchasing.co.riverside.ca.us/> to view/print County Terms and Conditions
 *116-200 General Terms
 *116-210 General Conditions - Materials and/or Services

Authorized Signature

 Apr 26, 2012



COUNTY OF RIVERSIDE
Purchasing and Fleet Services Department
2980 Washington St.
Riverside, CA 92504
Phone: (951) 955-4937
Fax: (951) 955-4948

Page 2 of 2

PURCHASE ORDER
CHANGE ORDER - REPRINT

| Purchase Order | Date | Revision |
|--|------------|----------------|
| EDARC-EDA0003684 | 04/23/2012 | 1 - 04/23/2012 |
| Payment Terms: Net 30 | RFQ/P# | PO Type:REGS |
| Freight Terms: FOB Destination, Freight Paid | | |
| Ship Via: BEST WAY | | |

*116-230 General Conditions and Equipment

Payment Terms - For calculating due dates for payment terms, the County will use either the date that the invoice is received by the County or the date the goods/services are received, whichever is later. Terms: Net 30.

Please contact: Dominick Lombardi, EDA Project Manager for RAARC-006, Furniture Designs Fee Proposal for the Cabazon Child Development Center project, Phone: (951) 955-6622; E-mail: DLOMBARDI@rivcoeda.org for questions regarding this order and /or delivery instructions.

Approved by:
Joseph Angelone
Procurement Contract Specialist
Voice: 951-222-3239
Email: JoeAngelone@rivcoeda.org

Michael Dickey, MAM
Administrative Services Supervisor
Purchasing and Supply Services
MDDickey@rivcoeda.org
phone: 951.222.3237

Authorized Signature

 Apr 26, 2012



DOUG WALL CONSTRUCTION, INC.
CA 92446-7402

PROPOSED CHANGE ITEM

| | |
|-------------|---|
| PENDING | X |
| Approved | |
| OWNER | X |
| SUBCONTRACT | |
| Internal | |

PROJECT: Cabazon Civic Center

Proposed Change Number 27R2

RFP #

DATE: 2/7/2012

TO: Dominick Lombardi
Tom Howell

COST CODE:

JOB # 1032

The Original Construction Agreement is hereby modified and amended by the following deviations from original plans and specifications.

Proposed Change Item:
Add Sewer per CU1.101 **\$66,855.00**

| | |
|------------------------|--------------------|
| Subtotal | \$66,855.00 |
| Profit and Overhead 5% | \$3,343.00 |
| Subtotal | \$70,198.00 |
| Bonding 1.5% | \$1,053.00 |
| Total | \$71,251.00 |

Original Contract Amount

| | |
|--------------------------------|----------------------------|
| Total Previous Change Orders | _____ |
| Total Before this Change Order | _____ |
| Amount of this Change Order | Pending \$71,251.00 |
| Revised Contract Amount | _____ |
| Revised Contract Days | 30 Days |

Riverside County EDA

SIGNED: _____
DATED: _____
TITLE: _____

DOUG WALL CONSTRUCTION INC.

SIGNED: _____
DATED: _____
TITLE: _____

Architect: _____
SIGNED: _____
DATED: _____
TITLE: _____

SOCAL AND ASSOCIATES PLUMBING INC:

PROPOSAL: CABAZON CIVIC CENTER

SUBMITTED TO: DWC: MIKE GLEN
REF: SEWER

DESCRIPTION:SEWER

ITEM:PER PLANS AND SPECS.INCLUDES:

| | | |
|--|------------------------|-------------|
| ITEM:1; INSTALL 410 LF OF SDR-35 SEWER PIPE AND SANITARY SEWER CLEAN OUTS PER PLANS MATERIAL | | \$10,275.00 |
| LABOR 5 MEN @ 60 HRS @ 60.00HR | | \$18,000.00 |
| ITEM:2; BACKFILL/COMPACT/CLEANUP LABOR 4 MEN @ 20 HRS@ \$60.00HR | | \$4,800.00 |
| ITEM:3; (EQUIPMENT) 710 BACK HOE 33 HRS @ \$150.00 HR | | \$4,950.00 |
| ITEM:4;(EQUIPMENT) 310 BACKHOE 33 HRS @ \$150.00 HR | | \$4,950.00 |
| ITEM:5;(EQUIPMENT) WATER TRUCK 13 HRS @ \$85.00 HR | | \$1,105.00 |
| ITEM:7; SHORING AND PLATES RENTAL @ 2,900.00/WK @ 3WKS | | \$8,700.00 |
| ITEM:8; IMPORT CRUSHED ROCK-7- 25YD TRUCKS @ 765.00 | | \$5,355.00 |
| | SUBTOTAL | \$58,135.00 |
| | PROFIT & OVERHEAD- 15% | \$8,720.00 |

JOB TOTAL \$66,855.00

ALL MATERIAL IS GUARANTEED TO BE AS SPECIFIED AND ALL WORK TO BE PERFORMED ACCORDING TO PLANS AND SPECIFICATIONS AS NOTED OR, IN THE ABSENCE THEREOF, ACCEPTABLE STANDARD PRACTICE AND COMPLETED IN A SUBSTANTIAL WORKMANLIKE MANNER. ANY ALTERATION OF DEVIATION FROM ABOVE SPECIFICATIONS INVOLVING EXTRA COSTS WILL BE EXECUTED ONLY UPON WRITTEN ORDERS, AND WILL BECOME AN EXTRA CHARGE OVER AND ABOVE THE ESTIMATE. ALL AGREEMENTS CONTINGENT UPON STRIKES, ACCIDENTS OR DELAYS BEYOND SO CAL AND ASSOCIATES CONTROL. SO CAL AND ASSOCIATES' WORKERS ARE COVERED BY WORKMAN'S COMPENSATION INSURANCE. IT IS THE OWNERS RESPONSIBILITY TO CARRY FIRE, EARTHQUAKE, AND/OR OTHER NECESSARY INSURANCE.
SO CAL AND ASSOCIATES HEREBY PROPOSE IN COMPLETE ACCORDANCE WITH THE ABOVE SPECIFICATIONS, THE AND SUM OF **(\$66,855.00)**.

PROPOSAL PREPARED BY: _____
JOSH THOMPSON
760.464.3140 FIELD CELL

DATED: 2-7-2012

ACCEPCANCE OF THE ABOVE PRICES, SPECIFICATIONS AND CONDITIONS ARE SATISFACTORY AND HEREBY ACCEPTED. SO CAL AND ASSOCIATES IS AUTHORIZED TO DO THE WORK AS SPECIFIED. OUR CONTRACT CANNOT BE SOLD OR ASSIGNED TO ANY OTHER PARTY UNLESS SO CAL AND ASSOCIATES PLUMBING, INC. AGREES IN WRITING TO THE SALE OR ASSIGNMENT.

PROPOSAL ACCEPTED BY/POSITION: _____ DATED: _____

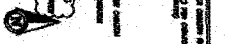
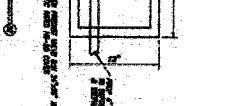
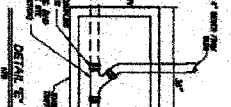
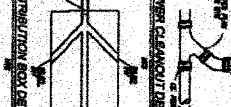
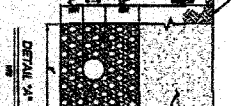
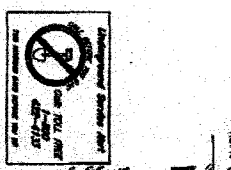
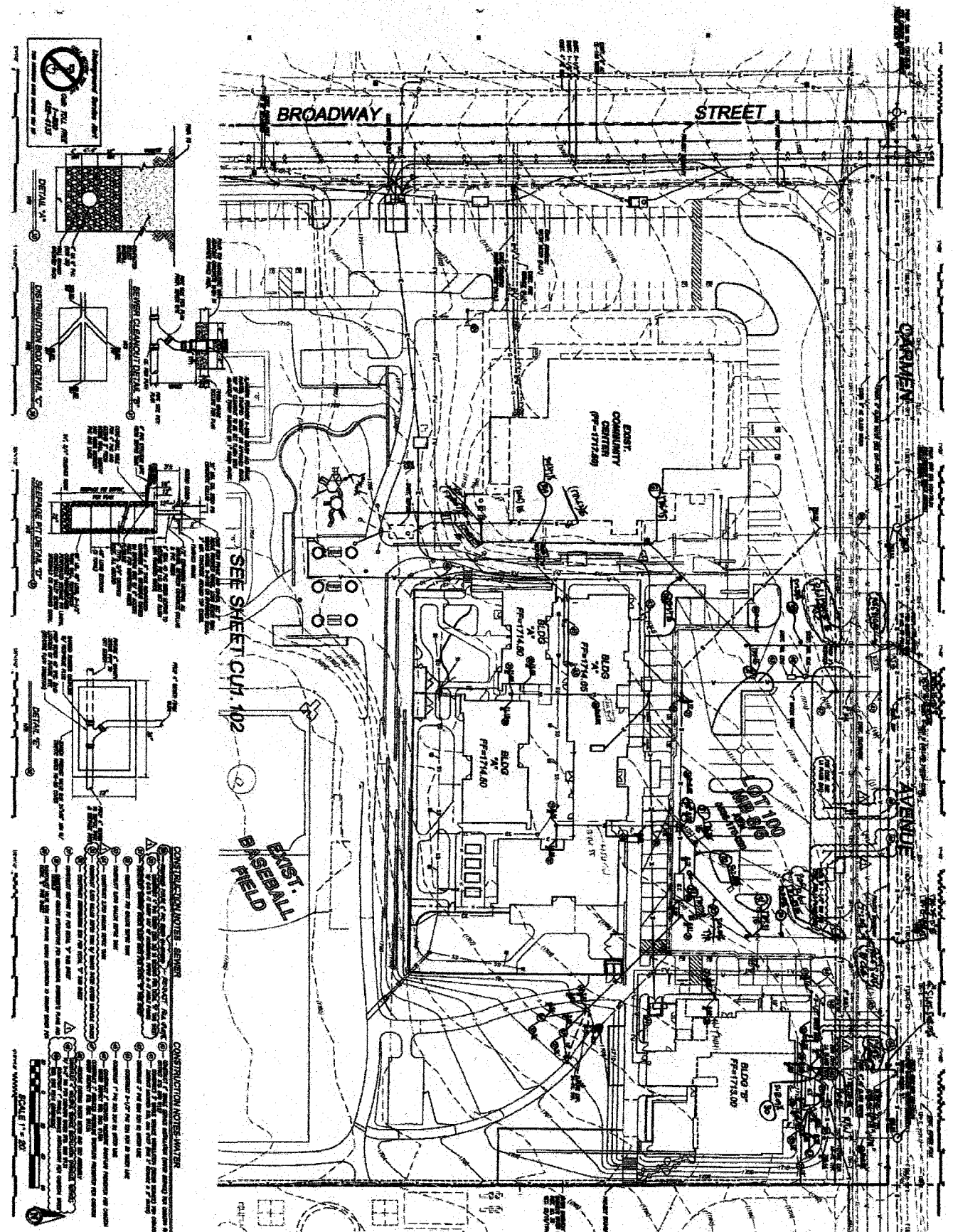

SEE SHEET CUM. 102

EXIST. BASEBALL FIELD

- CONSTRUCTION NOTES - SEWER**
1. ALL SEWER LINES SHALL BE 12\"/>
 - 2. ALL SEWER LINES SHALL BE 12\"/>
 - 3. ALL SEWER LINES SHALL BE 12\"/>
 - 4. ALL SEWER LINES SHALL BE 12\"/>
 - 5. ALL SEWER LINES SHALL BE 12\"/>
 - 6. ALL SEWER LINES SHALL BE 12\"/>
 - 7. ALL SEWER LINES SHALL BE 12\"/>
 - 8. ALL SEWER LINES SHALL BE 12\"/>
 - 9. ALL SEWER LINES SHALL BE 12\"/>
 - 10. ALL SEWER LINES SHALL BE 12\"/>
 - 11. ALL SEWER LINES SHALL BE 12\"/>
 - 12. ALL SEWER LINES SHALL BE 12\"/>
 - 13. ALL SEWER LINES SHALL BE 12\"/>
 - 14. ALL SEWER LINES SHALL BE 12\"/>
 - 15. ALL SEWER LINES SHALL BE 12\"/>

SCALE: 1/8\"/>

101
WATNEY BROS.
SEWERAGE

CARAZON CIVIC CENTER
 Economic Development Agency
 11111 Broadway Street
 Suite 100
 Carazon, VA

ed
 Riverside County
 Economic Development Agency



DOUG WALL CONSTRUCTION, INC.
 CA SL Lic # 743112

PROPOSED CHANGE ITEM

| | |
|-------------|---|
| PENDING | X |
| Approved | |
| OWNER | X |
| SUBCONTRACT | |
| Internal | |

PROJECT: Cabazon Civic Center

Proposed Change Number 051

RFP #

DATE: 3/10/2012

TO: Dominick Lombardi
 Tom Howell

COST CODE:

JOB # 1032

The Original Construction Agreement is hereby modified and amended by the following deviations from original plans and specifications:

Proposed Change Item:

Fabricate and install 4 External Leader Heads- Bldg A (3) and Bldg C (1) \$1,658.00

| | |
|------------------------|------------|
| Subtotal | \$1,658.00 |
| Profit and Overhead 5% | \$83.00 |
| Subtotal | \$1,741.00 |
| Bonding/Ins 1.5% | \$26.00 |
| Total | \$1,767.00 |

Original Contract Amount

| | |
|--------------------------------|------------|
| Total Previous Change Orders | |
| Total Before this Change Order | |
| Amount of this Change Order | Pending |
| Revised Contract Amount: | \$1,767.00 |

Riverside County EDA

SIGNED: _____
 DATED: _____
 TITLE: _____

DOUG WALL CONSTRUCTION INC.

SIGNED: _____
 DATED: _____
 TITLE: _____

Architect:

SIGNED: _____
 DATED: _____
 TITLE: _____

TN SHEET METAL, INC.

18385 Bandilier Circle, Fountain Valley, CA 92708
Tel: (714) 593-0100 Fax: (714) 593-0102

PROJECT CHANGE ORDER

#4 REvised 3-8-12

ARCHITECTURAL SHEET METAL

Name: CABAZON CIVIC CENTER

Date: Friday, February 10, 2012

Address: Cabazon, CA

ATTN: MIKE

Phone #: 760-777-0075

Fax #:

E-Mail:

SCOPE OF WORK:

Cost to supply and install:

External leader head & outlet connection at metal roof in lieu of roof drains & overflows ~~4~~ of
2 options - 1) for galv. or 2) for stainless steel

| | <u>20 ga. galv.</u> | 20 ga. ss |
|----------------------------|--------------------------------|-----------------------|
| Material: | \$246.00 197.00 | \$670.00 |
| 8.75% Tax: | \$21.52 17.23 | \$58.62 |
| 15% M/U: | \$36.90 29.55 | \$100.50 |
| Shop Labor: | \$825.00 660.00 | \$1,040.00 |
| Field Labor: | \$780.00 624.00 | \$910.00 |
| Freight: | \$130.00 130.00 | \$130.00 |
| TOTAL CHANGE ORDER: | \$2,039.42 1,658.00 | \$2,989.12 |

If you should have any questions, please feel free to call me.

Respectfully submitted by Karen Simpson

COMPANY NAME

APPROVED BY

DATE



DOUG WALL CONSTRUCTION, INC.
CARTEL #745113

REQUEST FOR INFORMATION

114a

| | | | |
|-------|-----------------|--------------|----------------------|
| TO: | Holt Architects | DWC JOB #: | 1032 |
| FAX: | | JOB NAME: | Cabazon Civic Center |
| ATTN: | Tom Howell | JOB ADDRESS: | Cabazon, CA 92330 |

THE FOLLOWING INFORMATION IS REQUIRED ON THE ABOVE REFERENCED PROJECT:

| | | | |
|--------------------------|----------------|--------------------------|----------------|
| <input type="checkbox"/> | CLARIFICATIONS | <input type="checkbox"/> | SPECIFICATIONS |
|--------------------------|----------------|--------------------------|----------------|

Reference: Attached Sketch
Regarding: Roof Drains at Standing Seam Roofs

Please see the attached detail for revised roof drains for the standing seam roofs. Is this acceptable standing seam roof installed. Plans show the drains installed flush with the roofing deck.

Cost Impact:

Schedule Impact:

cc:
cc:

Dated: 2/8/2012
By: Mike Glenn

REPLY:

- Make the height drain inlet box (Scupper) the same as the height of the fascia
 - Add a scupper overflow outlet drain similar to the attached jpeg
- Provide* • ~~Have DWC make~~ a prototype of the Scupper to test that water will not flow over or around the Scupper in the proposed dimensions.

THOMAS C HOWELL, AIA | PROJECT ARCHITECT

2/8/12

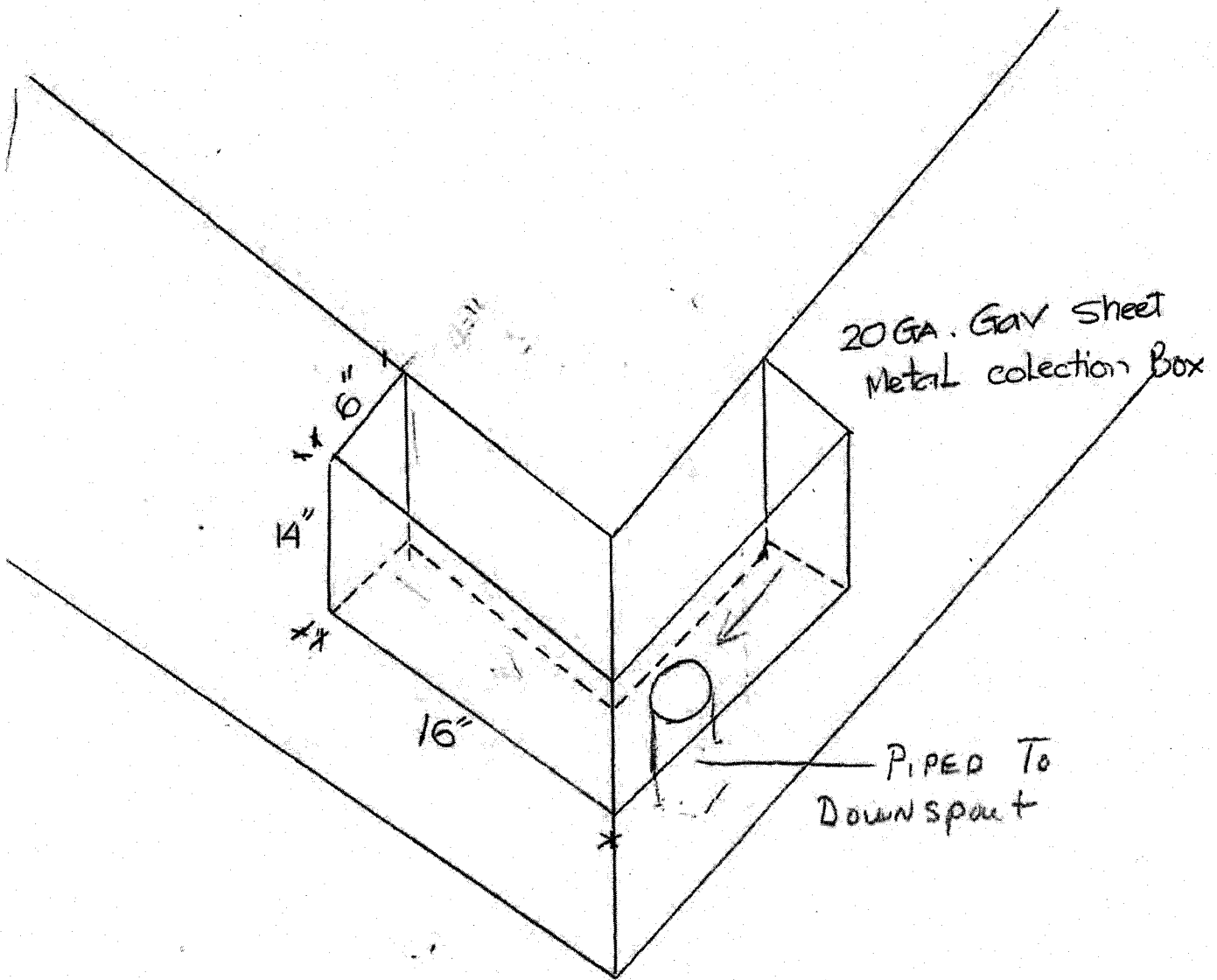

Metal Fascia will cover leader boxes



DOUG WALL CONSTRUCTION, INC.
CA St. Lic # 743112

| | |
|-------------|---|
| PENDING | X |
| Approved | |
| OWNER | X |
| SUBCONTRACT | |
| Internal | |

PROPOSED CHANGE ITEM

PROJECT: Cabazon Civic Center

Proposed Change Number 053R

RFP #

DATE: 4/30/2012

TO: Dominick Lombardi
Tom Howell

COST CODE:

JOB # 1032

The Original Construction Agreement is hereby modified and amended by the following deviations from original plans and specifications:

Proposed Change Item:

| | |
|---|---------------|
| Site Security per JMG Addedum attached. | \$75,000.00 |
| Allowance from Line Item 3179 | (\$75,000.00) |

| | |
|------------------------|--------|
| Subtotal | \$0.00 |
| Profit and Overhead 5% | \$0.00 |
| Subtotal | \$0.00 |
| Bonding and Ins 1.5% | \$0.00 |
| Total | \$0.00 |
| Allowance | \$0.00 |
| Total | \$0.00 |

Original Contract Amount

| | |
|--------------------------------|---------------|
| Total Previous Change Orders | _____ |
| Total Before this Change Order | _____ |
| Amount of this Change Order | Pending _____ |
| Revised Contract Amount: | _____ |

Riverside County EDA
SIGNED: _____
DATED: _____
TITLE: _____

DOUG WALL CONSTRUCTION INC.
SIGNED: _____
DATED: _____
TITLE: _____

Architect:
SIGNED: _____
DATED: _____
TITLE: _____

Doug Wall Construction, Inc.

Revised Per Addendum #3

| | | |
|-------|---|----------------------|
| 16140 | Wiring Devices | 15,000.00 |
| 16145 | Lighting Control Devices | 4,000.00 |
| 16420 | Enclosed Controllers | 13,000.00 |
| 16425 | Switchboards | 24,000.00 |
| 16430 | Enclosed Switches and Circuit Breakers | 6,500.00 |
| 16450 | Grounding | 8,000.00 |
| 16455 | Underground Electrical Service | 317,300.00 |
| 16470 | Panelboards | 9,000.00 |
| 16480 | Motor Control | 7,000.00 |
| 16491 | Fuses | 400.00 |
| 16500 | Lighting Systems | 414,200.00 |
| 16515 | Lighting Control Systems | 50,000.00 |
| 16671 | Transient Voltage Surge Suppression (Tvss) System | 2,000.00 |
| 16720 | Fire Alarm System | 55,000.00 |
| 16726 | Public Address and Mass Notification Systems | 95,000.00 |
| 16950 | Electrical Power Systems Test | 10,000.00 |
| | Allowance | 75,000.00 |
| | SKATE PARK | 219,195.00 |
| | | |
| | | |
| | | |
| | | |
| | TOTAL | 11,990,000.00 |

***** END OF SECTION *****

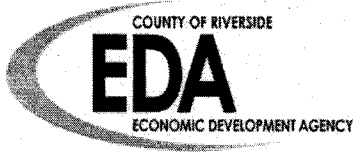

Cabazon Civic Center – Bid Addendum #4

Date: March 21, 2011

Bid Date: March 24, 2011 – 2PM

Bid Location: Office of the Clerk of the Board of Supervisors
Riverside County Administrative Center
4080 Lemon Street
Riverside, CA 92501

Please indicate receipt of this addendum as required on “Contractor’s Proposal.” Failure to do so may cause disqualification of your bid.

CONTENTS OF ADDENDUM #4 TO THE CONTRACT DOCUMENTS PREPARED BY HARLEY ELLIS DEVEREAUX, DATED 1/1/2011

The following changes, additions, and deletions shall be made to the following documents; all other conditions shall remain the same:

I. Project Manual, including Specifications

1. Please provide an allowance of \$75,000 for a security and surveillance system for all buildings, and including the site. This will be written in by the general contractor on the Schedule of Values which is due 48 hours after bid.

II. Drawings

III. Responses to Pre-Bid Requests for Information

1. Response to Addendum #3, Pre-Bid RFI 046, to be revised as follows: “On-site sidewalks to be 6” thick, per Keynote 2 on Sheets L-1 and L-2.

IV. Attachments

None

END OF ADDENDUM #4



Alarm Lic.#ACO3759 Cont. Lic.#575070

Addendum

17150 Newhope St, Ste. 109
Fountain Valley, CA 92708
Tel: 800-900-4564 Fax: 714-545-0352
www.jmgsecurity.com
Agent: G HANOIAN # 63514

Client: CABAZON CIVIC CENTER C/O DOUG WALL CONSTRUCTION

Site Address: _____, CABAZON, CA 92230

This is an Addendum to Commercial Alarm System/ Fire Alarm Agreement Dated _____ ("Agreement")
This attachment is incorporated into the Agreement as though set forth in full there.

THE CLIENT REQUESTS AND JMG SECURITY SYSTEMS, INC. AGREES TO PROVIDE THE FOLLOWING PROTECTION:

- Which will be owned by the client upon payment of the installation fee in full, or
- Which will remain the sole property of JMG and be provided for the client use for a monthly fee

SITE CCTV SYSTEM FOR COMMON AREAS:

- 1 DVR-650-16A200 DVR 600 SERIES 16 CH. VIDEO, 4 CH. AUDIO, INTERNAL DVD, 2TB HDD
INT. DVD-RW, 2TB, 1 GB ETHERNET PORT
- 16 VDN-498V06-21S FLEXIDOME 2X, DAY/NIGHT, WDR, 540TVL, NTSC, 12VDC/24VAC, 60HZ, 6-50MM F1.4
VARIFOVAL, WHITE, SURFACE MOUNT
- 16 VDA-WMT-DOME WALL MOUNT FOR FLEXIDOME
- 10 UPA-2410-60 POWER SUPPLY, 120 VAC 60 Hz INPUT, 24 VAC 10 VA OUTPUT
- 16 LTC 9213/01 POLE MOUNT ADAPTER WITH STAINLESS STEEL STRAPS, FOR LTC 9210, LTC 9212, LTC 9215
& VDA-WMT-DOME
- 1 VZ-23LED-P 23" Black Flat Panel Widescreen LED "A" Commerical- Grade Monitor, Full HD 1920x1080, 2 Looping
BNC(NTSC/PAL)/ HDMI/DVI/VGA Inputs, 3D Comb Filter, OSD/Remote Control, PIP/VOV, Auto Switching, Auto Power
and Source Recovery, Speakers, LCD Protection Glass, DC 12V, 50Khrs,
- 1 Wall Mount
- 1 ELECTRICAL POWER AND ALL CONDUIT INCLUDED
- 1 SCISSOR LIFT RENTAL

CLIENT TO PROVIDE:

- 20% PROGRESS PAYMENT AND FINAL BALANCE PAYMENT ONCE COMPLETED
- STATIC IP ADDRESS FOR NETWORK VIEWING (PROVIDED BY COUNTY OF RIVERSIDE)

CLIENT AGREES TO PAY \$75,000.00 IN ADDITIONAL SALES/ INSTALLATION FEE (½ DEPOSIT DUE NOW) AND
AN ADDITIONAL _____ PER MONTH IN USE/MONITORING/ PREFERRED SERVICE PLAN FEES.

| TO BE COMPLETED BY JMG | |
|------------------------|---------------|
| Accepted by _____ | |
| Date _____ | TITLE _____ |
| Alarm Agent G HANOIAN | Agent # 63514 |

| TO BE COMPLETED BY CLIENT | |
|--|-----------|
| Authorized Signature _____ | |
| Signer's Name (printed or typed) Title _____ | |
| Business/Residence Phone _____ | Fax _____ |
| E-mail _____ | |



Alarm Lic.#ACO3759 Cont. Lic.#575070

Attachment to Commercial Security/Fire Alarm Agreement

17150 Newhope Street, Suite 109
Fountain Valley, CA 92708
TEL: 800-900-4564 Fax: 714-545-0352
www.jmgsecurity.com
Agent G HANOIAN ACE# 63514

Client: CABAZON CIVIC CENTER C/O DOUG WALL CONSTRUCTION

Site Address: _____, CABAZON CA 92230

This Schedule of Protection is and attachment to the Commercial Alarm System/ Fire Alarm Agreement Dated _____ ("Agreement") This attachment is incorporated into the Agreement as though set forth in full there.

FOR THE SYSTEM DESCRIBED ON THE SCHEDULE OF PROTECTION:

JMG TO PROVIDE:

- LABOR FOR THE COMPLETION OF THE SYSTEM
- CABLE, MATERIALS, AS NEEDED FOR THE COMPLETION OF THE SYSTEM
- EQUIPMENT AS SPECIFIED ON THE ATTACHED SCHEDULE OF PROTECTION
- INITIAL PROGRAMMING OF THE SYSTEMS
- INITIAL TRAINING OF CLIENT AND/OR REPRESENTATIVES UPON COMPLETION OF THE SYSTEM(S). FOLLOW UP TRAINING AS NEEDED FOR 90 DAYS.
- ELECTRIFIED LOCKING HARDWARE AND INSTALLATION BY OTHERS) COSTS ESTIMATED AT \$ _____. SHOULD ACTUAL LOCKING HARDWARE COSTS BE MORE OR LESS THAN ESTIMATED CLIENT WILL BE BILLED OR CREDITED AS APPLICABLE.
- _____ RJ38X PHONE JACK(S)
- PROCUREMENT OF PLANS, PERMITS & SUBMITTALS (FEES BY CLIENT/ FEES BY JMG)
- FIRE TESTING IN ACCORDANCE WITH NFPA 72
- RUNNER SERVICE IN ACCORDANCE WITH NFPA72

CLIENT TO PROVIDE:

- TWENTY-FOUR HOUR, 110V DEDICATED POWER CIRCUIT CONNECTED TO FACP IF A FIRE ALARM SYSTEM IS BEING INSTALLED.
- _____ LOOP START PHONE LINE(S) (WITH RJ38X PHONE JACK(S). **TELEPHONE LINES MUST BE DEDICATED FOR A FIRE ALARM SYSTEM.**
- BURGLAR ALARM PERMITS, IF REQUIRED BY YOUR LOCAL MUNICIPALITY. THESE PERMITS ARE OFTEN REQUIRED FOR THE USE AND MONITORING OF BURGLAR ALARM SYSTEMS. FAILURE TO PROCURE A PERMIT MAY PREVENT JMG FROM MONITORING YOUR SYSTEM AND LOCAL AUTHORITIES FROM RESPONDING TO ANY SIGNALS.
- ACCESS TO WALLS, CEILING AND/ OR ROOF AS NECESSARY. _____
- ROOF PENETRATIONS WITH ROOF JACKS. _____
- ENGINEERED DRAWING FEES, BLUEPRINT FEES, FIRE PERMIT/SUBMITTAL FEES AND/OR COURIER FEES NECESSARY FOR COMPLETION OF THE SYSTEM. **THESE FEES ARE NOT INCLUDED IN THE CONTRACT PRICE UNLESS SPECIFICALLY INDICATED ABOVE.**
- LIFT OR LIFT FEES, AS NEEDED FOR COMPLETION OF THE SYSTEM. _____
- All CONDUIT, PULL STRING AND BACK BOXES AS REQUIRED. _____
- IBM COMPATIBLE PC WITH WINDOWS SOFTWARE TO MEET MANUFACTURERS SPECIFICATIONS W/ LOCAL PRINTER AS NECESSARY.
- _____ NETWORK DROP(S) AND/OR _____ STATIC IP ADDRESS(ES) FOR NETWORK COMMUNICATION OF APPLICABLE DEVICES.
- RELAYS OR OTHER FACILITIES REQUIRED FOR THE CONNECTION OF CLIENT-OWNED EQUIPMENT.
- ELECTRIFIED LOCKING HARDWARE, APPROPRIATE POWER SUPPLY AND HARDWARE WIRING.
- DUCT SMOKE DETECTORS INCLUDING INSTALLATION & CALIBRATION.
- PLYWOOD BACKBOARD FOR JMG'S ALARM CONTROL PANEL.
- MOUNTING OF JMG PROVIDED TRANSFORMER ENCLOSURE. (FIRE ALARM ONLY)
- KNOX BOX.
- UNINTERRUPTED POWER SUPPLY (UPS).
- ADEQUATE LIGHTING FOR CAMERAS
- UNIVERSAL OR INDEPENDENT SHUTDOWN OF ALL HVAC UNITS AS NEEDED BY THE FIRE DEPARTMENT
- SWITCHES AS FOLLOWS: TAMPER SWITCHES, BUTTERFLY SWITCHES, FLOW SWITCHES, REMOTE TEST SWITCHES
- OTHER: _____

ADDITIONAL CLAUSES:

- THE LOCATION AND DESCRIPTION OF THE PROTECTION EQUIPMENT HAS BEEN TAKEN FROM PLANS OR ESTIMATES PROVIDED BY _____. IT IS UNDERSTOOD AND AGREED THAT SHOULD THE SYSTEM, WHEN FINALLY COMPLETED, CONSIST OF MORE OR LESS PROTECTION EQUIPMENT THAN SPECIFIED, THE MONTHLY SERVICE CHARGE AND THE INSTALLATION CHARGE SHALL BE INCREASED OR DECREASED, IN ACCORDANCE WITH THE PREVAILING SERVICE CHARGES FOR THE NUMBER OF UNITS ADDED OR DEDUCTED.
- IT IS UNDERSTOOD THE LOCATION, DESCRIPTION AND QUANTITY OF FIRE DEVICES TO BE INSTALLED MAY BE SUBJECT TO APPROVAL OF THE LOCAL AUTHORITY HAVING JURISDICTION (AHJ). COST FOR CHANGES OR ADDITIONS REQUIRED BY THE LOCAL (AHJ) WILL BE THE SOLE RESPONSIBILITY OF THE CLIENT.
- ANY REPAIR, REPLACEMENTS OR ADDITIONS TO EXISTING EQUIPMENT WILL BE RENDERED ON A TIME AND MATERIAL BASIS AT JMG'S THEN PREVAILING RATES. JMG ASSUMES NO RESPONSIBILITY WHATSOEVER FOR THE SERVICE, OPERATION, NON-OPERATION OR ACTUATION OF CLIENT-OWNED EQUIPMENT.
- JMG HAS INCLUDED IN COST ESTIMATED: BLUEPRINT FEES OF \$ _____, PLAN CHECK/PERMIT FEES OF \$ _____ AND/OR LIFT FEES OF \$ _____. IF THE COST OF THE BLUEPRINTS, PLAN CHECK/PERMITS AND/OR LIFT FEES BE MORE OR LESS THAN ESTIMATED CLIENT WILL PAY OR BE CREDITED THE DIFFERENCE AS APPLICABLE.
- CLIENT ACKNOWLEDGES THAT THE DIGITAL VIDEO RECORDER (DVR) USED TO STORE CCTV DATA IS BASED ON STANDARD COMPUTER HARD DRIVE TECHNOLOGY AND THAT IN THE UNCOMMON EVENT OF HARD DRIVE FAILURE THE DATA MAY NOT BE ABLE TO BE EXTRACTED. REDUNDANT AND/OR ARCHIVE CAPABLE HARD DRIVE SYSTEMS ARE AVAILABLE AT ADDITIONAL COSTS.
- OTHER: CLIENT UNDERSTANDS THAT THE WIRELESS DEVICES ARE BATTERY POWERED AND MAY FAIL TO OPERATE WHEN ACTIVATED OR MAY CREATE FALSE ALARMS AS THE RESULT OF WEAKENED OR DEAD BATTERIES. JMG ACCEPTS NO RESPONSIBILITY FOR SUCH MALFUNCTIONS AND/OR BATTERY REPLACEMENTS.

JMG SECURITY SYSTEMS, INC.

DATE

CLIENT SIGNATURE

DATE



DOUG WALL CONSTRUCTION, INC.

CA SL LK # 740112

PROPOSED CHANGE ITEM

| | |
|-------------|---|
| PENDING | X |
| Approved | |
| OWNER | X |
| SUBCONTRACT | |
| Internal | |

PROJECT: Cabazon Civic Center

Proposed Change Number 057

RFP #

DATE: 3/27/2012

TO: Dominick Lombardi
Tom Howell

COST CODE:

JOB # 1032

The Original Construction Agreement is hereby modified and amended by the following deviations from original plans and specifications:

Proposed Change Item:

Add Drain and Downspout at Bldg B east side. \$1,112.00

| | |
|----------------------------|------------|
| Subtotal | \$1,112.00 |
| Profit and Overhead 5% | \$66.00 |
| Subtotal | \$1,168.00 |
| Bonding and Insurance 1.5% | \$18.00 |
| Total | \$1,186.00 |

Original Contract Amount

| | |
|--------------------------------|---|
| Total Previous Change Orders | _____ |
| Total Before this Change Order | _____ |
| Amount of this Change Order | Pending \$1,186.00 |
| Revised Contract Amount: | _____ |

Riverside County EDA

SIGNED: _____
DATED: _____
TITLE: _____

DOUG WALL CONSTRUCTION INC.

SIGNED: _____
DATED: _____
TITLE: _____

Architect:

SIGNED: _____
DATED: _____
TITLE: _____

TN SHEET METAL, INC.

18385 Bandilier Circle, Fountain Valley, CA 92708

Tel: (714) 593-0100 Fax: (714) 593-0102

PROJECT CHANGE ORDER

#6

ARCHITECTURAL SHEET METAL

Name: CABAZON CIVIC CENTER

Date: Monday, March 26, 2012

Address: Cabazon, CA

ATTN: MIKE

Phone #: 760-777-0075

Fax #:

E-Mail:

SCOPE OF WORK:

Cost to supply and install:

1 of external leader head in 20 ga. galv. at bldg B
40' of 4" round downspout in 24 ga. galv. at bldg B

Material: \$299.00

8.75% Tax: \$26.16

15% M/U: \$44.85

Shop Labor: \$260.00

Field Labor: \$352.00

Freight: \$130.00

TOTAL CHANGE ORDER: \$1,112.01

If you should have any questions, please feel free to call me.

Respectfully submitted by Karen Simpson

COMPANY NAME

APPROVED BY

DATE

Riverside Court
Economic
Development
Agency

CABAZON
CIVIC
CENTER

Cabazon, CA

| Date | Issue |
|------------|-------------------------|
| 12/12/2008 | DESIGN DEVELOPMENT |
| 3/13/2009 | 50% CONSTRUCT DOCUMENTS |
| 5/15/2009 | PLAN CHECK SUB |
| 8/21/2009 | PLAN CHECK |
| 1/1/2011 | RESUBMITTAL BID SET |

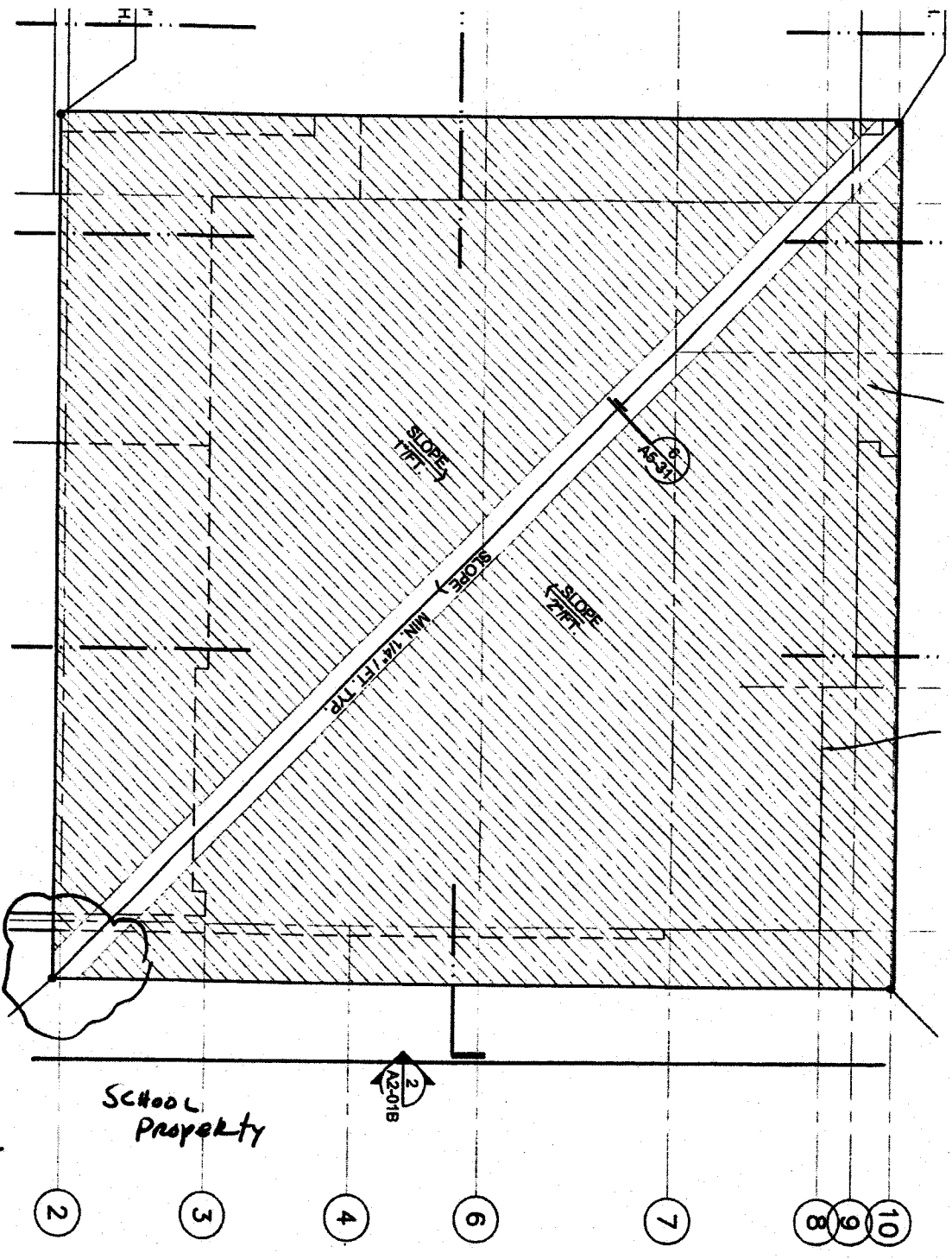

SCHOOL
PROPERTY

NO ROOF DRAIN
SHOWN

Water from THIS ROOF Dumps
onto School Property.

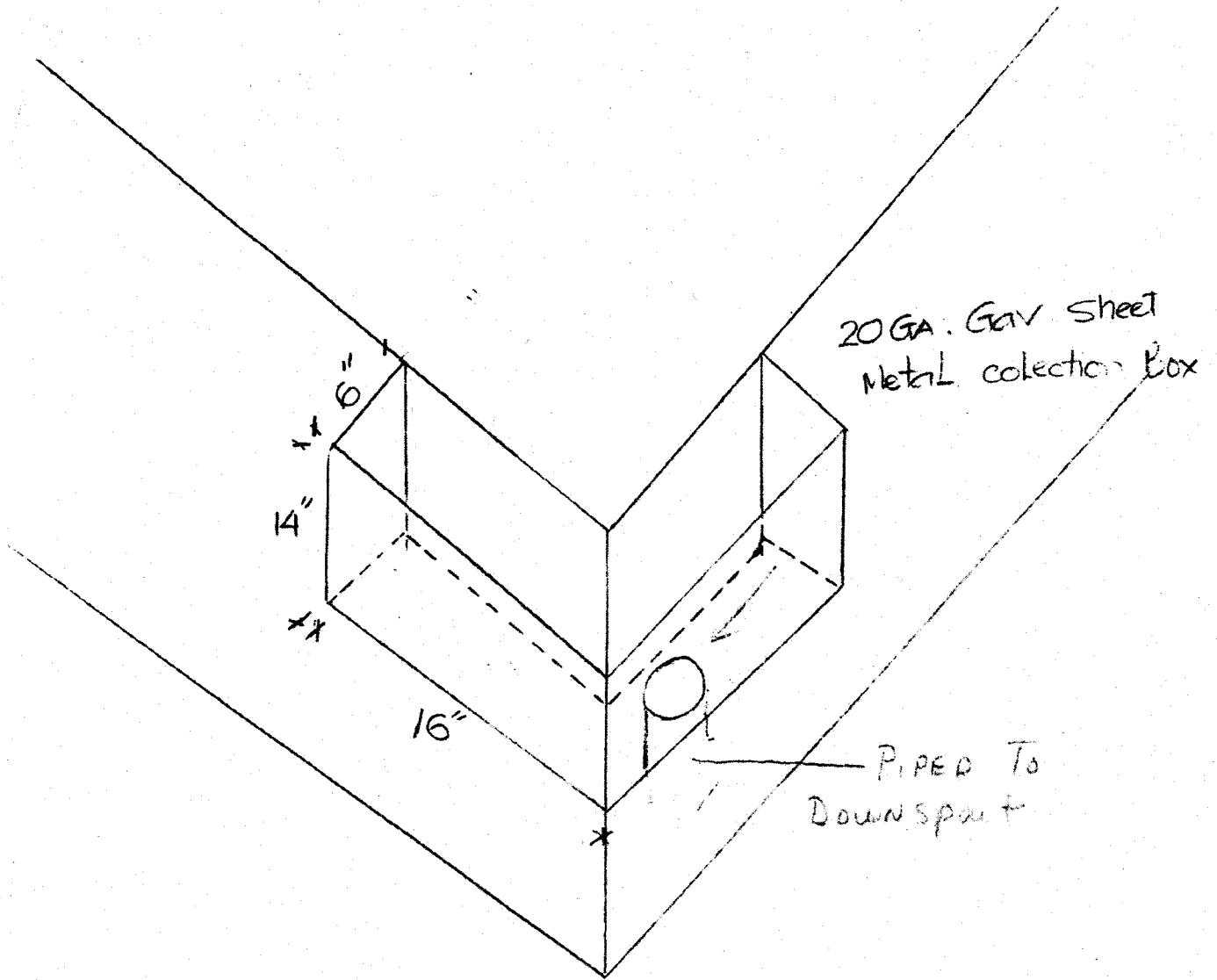

Metal FASCIA will cover leader boxes



DOUG WALL CONSTRUCTION, INC.
CA SL LK # 743112

| | |
|-------------|---|
| PENDING | X |
| Approved | |
| OWNER | X |
| SUBCONTRACT | |
| Internal | |

PROPOSED CHANGE ITEM

PROJECT: Cabazon Civic Center

Proposed Change Number 052R1

RFP #

DATE: 4/3/2012

TO: Dominick Lombardi
Tom Howell

COST CODE:

JOB # 1032

The Original Construction Agreement is hereby modified and amended by the following deviations from original plans and specifications:

Proposed Change Item:

| | |
|---|-------------|
| Labor and Materials for Cabling at Building A-1 thru A-5 per Contract | \$12,405.00 |
| Labor and materials for AV Display System for Bldg A per Contract | \$16,421.00 |
| Labor and materials for Cabling at Building B per Contract | \$26,074.00 |
| Labor and materials for AV Display System for Bldg B per Contract | \$7,553.00 |
| Labor and Materials for Cabling at Building D per Contract | \$6,646.00 |

Note 1: The scope and extent of work is based solely on the language of the proposals and any additional work found to be needed at a later date that is not in the proposal will be addressed in an additional change order request.
Note 2: The late start for Vector may affect the schedule and need to be addressed at a later date.

| | |
|----------------------------|-------------|
| Subtotal | \$69,099.00 |
| Profit and Overhead 5% | \$3,455.00 |
| Subtotal | \$72,554.00 |
| Bonding and Insurance 1.5% | \$726.00 |
| Total | \$73,280.00 |

Original Contract Amount

| | |
|--------------------------------|-------------|
| Total Previous Change Orders | |
| Total Before this Change Order | |
| Amount of this Change Order | Pending |
| Revised Contract Amount: | \$73,280.00 |

Riverside County EDA
SIGNED: _____
DATED: _____
TITLE: _____

DOUG WALL CONSTRUCTION INC.
SIGNED: _____
DATED: _____
TITLE: _____

Architect:
SIGNED: _____
DATED: _____
TITLE: _____



VECTOR RESOURCES
ENTERPRISE NETWORK SOLUTIONS

VRN-048547-001
March 19, 2012

Doug Wall Construction, Inc.
Cabazon, CA

Project
Cabazon Civic Center BLDG A

Prepared For
Doug Wall Construction, Inc.

Prepared By
Vector Resources, Inc.
Skyler Peterson

Vector Resources, Inc.

8647 Ninth Street, Rancho Cucamonga, CA 91730
(800) 929-4516

TABLE OF CONTENTS

- 1.0 Vector Resources
- 2.0 Project
- 3.0 Project Team
- 4.0 Codes and Standards
- 5.0 Post Support
- 6.0 Project Parameters
 - Detailed Pricing
 - Terms and Conditions of Contract
(Signature Required)

Vector Resources, Inc.

8647 Ninth Street, Rancho Cucamonga, CA 91730
(800) 929-4516

1.0 Vector Resources

1.1 Company Overview

Vector Resources, Inc. ("Vector") is a leading converged telephony and enterprise network systems integration firm committed to delivering innovation. With over 20 years experience, we are a turnkey systems provider, specializing in the design and implementation of high performance networking solutions. We offer a wide range of services in the areas of structured communications cabling, wireless, surveillance, access control, Voice over Internet Protocol (VoIP), network security, and remote monitoring.

Recognized widely for our engineering capabilities and management excellence, Vector's team consists of the 4 original partners and over 350 employees, including engineers, technical personnel, business development and customer service agents. Vector is headquartered in Torrance, California, with additional offices in San Diego, Rancho Cucamonga, and Tempe, Arizona.

Vector's certifications and partnerships allow us to serve as a full-service solution provider. We maintain C7, C10 electrical contractor licenses and a General Contractor "B" license. Our business partners include AMP (one of the largest ND&I contractor in the country), Ascom Wireless, Avaya, Cisco, HP Networking, Hirsch, OnSSI, PCSC, Sony and other world class IT and integration solution vendors.

Vector Resources, Inc.

8647 Ninth Street, Rancho Cucamonga, CA 91730
(800) 929-4516

2.0 Project

2.1 Scope Of Work

Water District AV System

Cabazon Water District AV Scope of Work (SOW) is based off of client request to duplicate an AV design from the Cabazon Library Project; Vector Resources will provide and install (1) 60", 16:9 Permanent LCD displays with landscape mounting bracket. The display connection will allow (1) HDMI digital, (1) VGA analog with 3.5mm and (1) RCA composite video with (L/R) audio via wall plate. All sources will be hardwire and routed to the permanent wall mounted LCD Display. Client will have the ability to connect a laptop via local connections plate and present a small presentation, connection points will be provided to the right of the display at Standard electrical height. Vector Resources will also provide and install (1) 46", 16:9 Permanent LCD displays with Swivel mounting bracket. The display connection will allow (1) HDMI digital, (1) VGA analog with 3.5mm and (1) RCA composite video with (L/R) audio via wall plate. All sources will be hardwire and routed to the permanent wall mounted LCD Display. Client will have the ability to connect a laptop via local connections plate and present a small presentation, connection points will be provided to the right of the display at Standard electrical height

System Elements

- **SOURCES**

All OFE video sources will be provided by end user, i.e. computer, laptop and other original video feeds. Connection point will be on (2) 2gang wall plate with VGA, HDMI and Composite video. All sound will be provided through the LCD display.

Equipment:

- (1) 60" 16:9 1080p with 10w built in speakers and Wifi
- (1) Landscape mount
- (1) Extron pass through plate
- (1) 46" 16:9 1080p with 10w built in speakers and Wifi
- (1) Swivel mount
- (1) Extron pass through plate

Vector Resources, Inc.

8647 Ninth Street, Rancho Cucamonga, CA 91730
(800) 929-4516

3.0 Project Team

3.1 Installation Procedure

Vector will establish a project team comprised of several individuals with relevant knowledge and experience. An experienced Project Manager/Coordinator will head the project team to ensure the project is on schedule and within budget.

In addition to the core project team, Vector has over 350 employees with a full range of specialties that can be utilized to assist in the project as needed. Among these employee resources are Vector's quality control officials who will visit the project site throughout the duration of the project to ensure that the highest quality installation practices are being used.

Vector recommends that the client create its own project team prior to the project's implementation. This team will work in conjunction with Vector's team to determine the implementation schedule, establish policies and procedures, and decide how best to handle the distribution of information to client's staff members, technical issues, training, device management and maintenance, and system maintenance.

4.0 Codes and Standards

4.1

All work performed on this project will be installed in accordance with IEEE 802.11 installation guidelines, the current edition of the NEC, NESC, Bicsi Telecommunications Distribution Methods Manual (TDMM), BICSI Cabling Installation Manual, and the latest issue of the ANSI/TIA/EIA Standards, along with all state/local codes and ordinances.

Vector Resources, Inc.

8647 Ninth Street, Rancho Cucamonga, CA 91730
(800) 929-4516

5.0 Post Support

5.1

Vector offers several post-project support options that can assist the client once its system is operational. These options include quarterly, semi-annual, or annual on-site preventive maintenance and audits; blocks of time for on-site maintenance and upgrades; and management of the RMA process.

Upon request, Vector will customize a post-installation project support and maintenance plan to suit the client's needs.

Vector's most popular support options include the following:

Vector Insight Managed Services

Vector provides complete systems management services that include:

- 24x7 systems monitoring
- Guaranteed hourly services from network engineers and service technicians for onsite/offsite maintenance and upgrades, RMA management, and system moves, adds and changes
- Monthly performance reporting and quarterly consulting analysis

Vector Hourly IS Services

With this option, Vector provides "time and materials" post-installation services and support. The standard support package includes access to the Vector Help Desk during normal business hours, and emergency assistance for critical issues. For manufacturer warranties that include monitoring, Vector will also receive manufacturer alerts directly to its Help Desk upon the client's request.

The Help Desk is available from 8:00 a.m. to 5:00 p.m. Pacific Standard Time, Monday through Friday, excluding the six national holidays, to provide assistance. Emergency assistance for critical problems is available at all times. The client can contact the Help Desk by telephone at 877.569.8800 within the 48 contiguous states or by email at helpdesk@vectorusa.com.

6.0 Project Parameters

6.1 Access

Vector has access to all areas required to perform the proposed scope of work in a timely manner.

6.2 Change Order

Any work that is added to or deleted from the original scope of this proposal and which alters the original costs or completion date must be agreed upon by both parties in the form of a written change order.

Vector Resources, Inc.

8647 Ninth Street, Rancho Cucamonga, CA 91730
(800) 929-4516

6.3 Delays

The client must provide five working days' advance notice of any factor that will delay this project or Vector will issue a work stoppage change order. Additionally, idle time incurred by Vector due to the absence of required escorts, clearance, permits, inability to enter the work place, delays by other trades or other factors beyond Vector's control will be addressed with a written change order.

6.4 Work Days/Overtime

This work will be performed during Vector's regular standard business hours of 7:00 a.m. to 5:00 p.m. Pacific Standard Time, Monday through Friday, except holidays. Work outside of regular business hours is available, but requires a written change order.

6.5 Schedule

Vector plans to implement this project in a continuous fashion or as outlined within the RFP. If any additional mobilization is required, as a result of a change in the project schedule, not caused by Vector, it will be addressed with a written change order.

6.6 Asbestos/Hazardous Materials

Vector assumes that the installation teams will be working in areas that will not contain asbestos or any other hazardous material that would require additional time or alternative installation procedures.

It is the responsibility of the client to give written notification to Vector, prior to the start of a project, of any asbestos contained material (ACMs) in or around the area of the project. In the event that ACMs are present prior to job commencement or if ACMs are encountered during the project, additional cost, damages and/or delays attributed to necessary procedures for working in this environment will be the responsibility of the client.

6.7 Adequate Room

The client must provide adequate room for the installation of the proposed termination hardwired at the station and in the communications closets.

6.8 Storage Area

The client will provide a secured storage area inside the building for Vector's materials and tools.

6.9 Ceiling Tile

Vector exercises care in the removal, storage and reinstallation of existing (used) ceiling tiles; however, Vector accepts no liability for any incidental damages that may result from the handling of ceiling tiles.

6.10 Patch Cords

Vector will not be responsible for providing and installing voice and data patch cables.

Vector Resources, Inc.

8647 Ninth Street, Rancho Cucamonga, CA 91730
(800) 929-4516

6.11 Defective Materials

If there is a delay and/or Vector is unable to perform its scope of work, due to problems with the existing hardware and/or materials provided by the client or other third parties, it will be addressed with a written change order.

6.12 Taxes

Taxes will be billed on tax rates and guidelines at time of invoice.

6.13 Non-Prevailing Wage

Vector has based this proposal on using non-prevailing wage labor. If we are informed or it is determined, at a later date, that the project is subject to prevailing wage rates for the performance of the public work portion of the contract, Vector will address any changes/additional costs that the project may incur with a written change order outlining the changes.

6.14 Extraordinary Service

Certain additional charges related to extraordinary levels of support or out-of-pocket costs incurred by Vector, through no fault of its own, will be reimbursable by the client under this agreement.

Examples of costs reimbursable under this section include, but are not limited to 1) shipping expenses related to unusual site handling expenses (e.g. extra distance, no loading dock, extra stairs, extra demurrage charges), 2) storage or special handling expenses incurred if an installation site is not able to accept delivery as scheduled, 3) expenses incurred by Vector to resolve network compatibility issues caused by a client's election to substitute non-Vector provided equipment or services, and 4) expenses incurred by Vector for additional installation time and/or materials caused by a site not being prepared as called for in this proposal.

Vector shall promptly notify the client in writing of such charges. Notification will be provided, when feasible, prior to the incurrence of such charges, unless circumstances preclude such prior written notification (by way of example, but not limited to, unusual site handling charges). Provided the incurrence of such charges is not due to Vector's fault or negligence, Vector shall be entitled to an equitable adjustment in the prices herein, the delivery schedule, or both to reflect such charges and any related delay.

6.15 Proprietary Information

The information contained in this document is proprietary to Vector and intended to be used as evaluative and/or bidding information only. No part of this document may be disclosed, reproduced and/or distributed to anyone except the listed recipients within this package without written permission from Vector.

Vector Resources, Inc.

8647 Ninth Street, Rancho Cucamonga, CA 91730
(800) 929-4516

DETAILED PRICING

AUDIO VISUAL

| | Quantity | Unit Cost | Material | Labor | Total |
|---|----------|--------------------------|----------|----------|-----------|
| MISC PARTS | | | | | |
| 1 HDMI Female to female 10" pigtail (AAP) | 2 | 50.00 | 100.00 | 150.00 | 250.00 |
| 1 VGA w/3.5mm (AAP) | 2 | 81.25 | 162.50 | 0.00 | 162.50 |
| 2 RCA Female w/RCA to BNC (AAP) | 2 | 56.25 | 112.50 | 0.00 | 112.50 |
| AAP 102 plate (2Gang) | 2 | 68.75 | 137.50 | 0.00 | 137.50 |
| MONITOR AND MOUNT | | | | | |
| 60" LCD Monitor for 24/7 use 1920X1080 res (59"W) | 1 | 4,403.65 | 4,403.65 | 75.00 | 4,478.65 |
| 60" Additional input board | 1 | 357.74 | 357.74 | 75.00 | 432.74 |
| Swivel Mount | 1 | 218.99 | 218.99 | 75.00 | 293.99 |
| Low Profile Mount for Flap Panel | 1 | 74.52 | 74.52 | 75.00 | 149.52 |
| 47" LCD Monitor | 1 | 1,737.49 | 1,737.49 | 75.00 | 1,812.49 |
| 47" Additional input board | 1 | 357.74 | 357.74 | 75.00 | 432.74 |
| MISC PARTS 2 | | | | | |
| 25' Pro Series Plenum HDMI Cable | 2 | 211.25 | 422.50 | 150.00 | 572.50 |
| WPBC 107-35', Plenum VGA to BNC & Video w L/R | 2 | 200.00 | 400.00 | 150.00 | 550.00 |
| BNC Male MHR Compression (Qty 50) | 2 | 121.25 | 242.50 | 0.00 | 242.50 |
| BNC Make RG59p (Qty 50) | 2 | 115.00 | 230.00 | 0.00 | 230.00 |
| Mics Connectors, Materials, panduit, etc... | 2 | 125.00 | 250.00 | 0.00 | 250.00 |
| VECTOR SERVICES | | | | | |
| Sales Design & Engineering | 1 | 0.00 | 0.00 | 300.00 | 300.00 |
| Project Management | 1 | 0.00 | 0.00 | 600.00 | 600.00 |
| Installation Labor | 1 | 0.00 | 0.00 | 4,400.00 | 4,400.00 |
| OnSite System Commissioning | 1 | 0.00 | 0.00 | 300.00 | 300.00 |
| | | | <hr/> | <hr/> | <hr/> |
| | | Sub-Total | 9,207.63 | 6,500.00 | 15,707.63 |
| | | Project Sub-Total | 9,207.63 | 6,500.00 | 15,707.63 |
| | | Sales Tax | | | 713.59 |
| | | Project Total | | | 16,421.22 |

Vector Resources, Inc.

8647 Ninth Street, Rancho Cucamonga, CA 91730
 (800) 929-4516



VECTOR RESOURCES
ENTERPRISE NETWORK SOLUTIONS

VRN-048232-001
March 7, 2012

Doug Wall Construction, Inc.
Cabazon, CA

Project
Cabazon Civic Center "BLDG A"
Proposal 1 Version 1

Prepared For
Doug Wall Construction, Inc.

Prepared By
Vector Resources, Inc.
Skyler Peterson

Vector Resources, Inc.

8647 Ninth Street, Rancho Cucamonga, CA 91730
(800) 929-4516

TABLE OF CONTENTS

- 1.0 Vector Resources
 - 2.0 Project
 - 3.0 Project Team
 - 4.0 Codes and Standards
 - 5.0 Cable Infrastructure
 - 6.0 Post Support
 - 7.0 Project Parameters
- Detailed Pricing
- Terms and Conditions of Contract
(SignatureRequired)

Vector Resources, Inc.

8647 Ninth Street, Rancho Cucamonga, CA 91730
(800) 929-4516

1.0 Vector Resources

1.1 Company Overview

Vector Resources, Inc. ("Vector") is a leading converged telephony and enterprise network systems integration firm committed to delivering innovation. With over 20 years experience, we are a turnkey systems provider, specializing in the design and implementation of high performance networking solutions. We offer a wide range of services in the areas of structured communications cabling, wireless, surveillance, access control, Voice over Internet Protocol (VoIP), network security, and remote monitoring.

Recognized widely for our engineering capabilities and management excellence, Vector's team consists of the 4 original partners and over 350 employees, including engineers, technical personnel, business development and customer service agents. Vector is headquartered in Torrance, California, with additional offices in San Diego, Rancho Cucamonga, and Tempe, Arizona.

Vector's certifications and partnerships allow us to serve as a full-service solution provider. We maintain C7, C10 electrical contractor licenses and a General Contractor "B" license. Our business partners include AMP (one of the largest ND&I contractor in the country), Ascom Wireless, Avaya, Cisco, HP Networking, Hirsch, OnSSI, PCSC, Sony and other world class IT and integration solution vendors.

2.0 Project

2.1 Project Overview

Vector is pleased to present the following proposal to Doug Wall Construction ("client") for the Riverside County Cabazon Civic Center Building "A" project. This proposal includes:

-Specifications for the installation of new structured communication cabling

This proposal was based on the information gathered from meetings and conversations, the site walk and our experience with similar types of projects. The proposal includes the furnishing of all materials, labor, transportation, tools, permits, fees, utilities and incidentals necessary for the complete installation of all work specified within this document.

Scope of Work:

Vector Resources will provide and install Voice and Data cabling as outlined in the provided project drawings.

Vector Resources, Inc.

8647 Ninth Street, Rancho Cucamonga, CA 91730
(800) 929-4516

3.0 Project Team

3.1 Installation Procedure

Vector will establish a project team comprised of several individuals with relevant knowledge and experience. An experienced Project Manager/Coordinator will head the project team to ensure the project is on schedule and within budget.

In addition to the core project team, Vector has over 350 employees with a full range of specialties that can be utilized to assist in the project as needed. Among these employee resources are Vector's quality control officials who will visit the project site throughout the duration of the project to ensure that the highest quality installation practices are being used.

Vector recommends that the client create its own project team prior to the project's implementation. This team will work in conjunction with Vector's team to determine the implementation schedule, establish policies and procedures, and decide how best to handle the distribution of information to client's staff members, technical issues, training, device management and maintenance, and system maintenance.

4.0 Codes and Standards

4.1

All work performed on this project will be installed in accordance with IEEE 802.11 installation guidelines, the current edition of the NEC, NESC, Bicsi Telecommunications Distribution Methods Manual (TDMM), BICSI Cabling Installation Manual, and the latest issue of the ANSI/TIA/EIA Standards, along with all state/local codes and ordinances.

Vector Resources, Inc.

8647 Ninth Street, Rancho Cucamonga, CA 91730
(800) 929-4516

5.0 Cable Infrastructure

5.1 Horizontal

Vector Resources will install approximately Thirty (30) telecommunication outlets, equaling Fifty Eight (58) Cat-6 cables for voice and data purposes. See the following information and installation matrix for details:

Note: These breakdowns are not exact but account for a total of (58) Cat-6 cables.

| Quantity | Description |
|----------|--|
| (28) | 1-Cat-6 data cable and 1-Cat-6 voice cable - Combo outlets |
| (01) | 1-Cat-6 data cable only - Wall outlet |
| (01) | 1-Cat-6 data cable only - Floor outlet |

Total Cables - 58 Cat-6 cables

Cable Hangers and Supports:

Vector Resources shall install cable hangers, J-hooks, or other supporting assemblies in order to properly secure and support all horizontal cables. Within the ceiling space, supports will be installed every 4-5 ft. or as needed.

No cables will be attached to support wire for ceiling tile grid, support assemblies for electrical conduits or the conduits themselves, or support assemblies for the fire protections systems.

Cable - Data Applications:

All horizontal data cables designated for data applications will be Unshielded Twisted Pair (UTP) 4 pair 24 AWG Cat-6 rated.

All horizontal data cables will be plenum rated.

The jacket of the cable will be blue.

All horizontal data cables shall terminate on modular patch panels in their respective Telecommunications Room.

Cable - Voice Applications:

All horizontal voice cables designated for voice applications will be Unshielded Twisted Pair (UTP) 4 pair 24 AWG Cat-6 rated.

All horizontal voice cables will be plenum rated.

The jacket of the cable will be white.

All horizontal voice cables shall terminate on modular patch panels in their respective Telecommunications Room.

Work Area Outlets:

All horizontal cables will be dressed into faceplates installed at the designated work or device area location. All connector assemblies shall snap into the faceplates.

Vector Resources, Inc.

8647 Ninth Street, Rancho Cucamonga, CA 91730
(800) 929-4516

All wall mounted faceplates shall be white, single-gang and available in 4-ports.

All faceplates shall have recessed designation windows to facilitate labeling and identification. All faceplates will be labeled with adhesive labels (white background / black lettering) and be given a unique labeling/numbering scheme.

Work Area Data Inserts:

All data inserts shall be 8-position modular inserts.

All data inserts shall be Cat-6 rated.

All data inserts shall be blue.

All cables will be terminated with a 568 B-wiring scheme unless otherwise specified.

Work Area Voice Inserts:

All voice inserts shall be 8-position modular inserts.

All voice inserts shall be Cat-6 rated.

All voice inserts shall be white.

Vector Resources, Inc.

8647 Ninth Street, Rancho Cucamonga, CA 91730
(800) 929-4516

5.2 MDF

Within the MDF, one new wall mounted cabinet will be installed.

Horizontal Wire Management

Horizontal wire managers will be provided above, below and in between each patch panel.

The horizontal wire managers will be double sided (front and rear) and shall be 2 RMU in height.

The horizontal wire managers include snap-on hinged doors/covers.

The horizontal wire management will be black in color.

The following applies to the MDF.

UTP - Data Patch Panels:

All horizontal data cables will be terminated onto rack mounted patch panels.

All patch panels will be Cat-6 rated.

All patch panels will be available in 48-port high-density configurations with designation label strips.

All patch panels will be 2 RMU (Rack Mount Unit) in height.

UTP - Voice Termination:

All horizontal voice cables will be terminated onto wall mounted 110 blocks.

Vector Resources, Inc.

8647 Ninth Street, Rancho Cucamonga, CA 91730
(800) 929-4516

5.3 IDF

For this project, two (2) IDFs have been identified. The following applies to the IDF.

This proposal includes the installation of two (2) 7' 2-post racks.

The racks shall be braced to the floor utilizing properly sized anchors and bolts.

Rack to runway mounting plates will be installed above each rack in order to attach to cable runway.

All installed equipment shall be grounded to the telecommunications ground bus bar.

The General Contractor shall be responsible for providing a ground bus bar within the IDF.

Cable Runway

Overhead 12" cable runway/ladder rack will be installed in order to serve as a pathway for the installation of all horizontal and backbone cables.

The cable runway will be black in color.

Wall angle supports and junction splice kits will be provided in order to properly support all cables.

Vertical Wire Management

Vertical wire managers will be provided on the outside and in between each rack.

The vertical wire management will be black in color.

Horizontal Wire Management

Horizontal wire managers will be provided above, below and in between each patch panel.

The horizontal wire managers will be double sided (front and rear) and shall be 2 RMU in height.

The horizontal wire managers include snap-on hinged doors/covers.

The horizontal wire management will be black in color.

Plywood Backboard

Vector Resources shall provide (1) ¾ inch A/C fire-rated plywood backboard.

The plywood backboard will be painted with insulating fire-retardant white paint.

The plywood backboard shall be mounted vertically, 6 inches above the finished floor and mounted on the wall.

UTP - Data Patch Panels:

All horizontal data cables will be terminated onto rack mounted patch panels.

Vector Resources, Inc.

8647 Ninth Street, Rancho Cucamonga, CA 91730
(800) 929-4516

All patch panels will be Cat-6 rated.

All patch panels will be available in 48-port high-density configurations with designation label strips.

All patch panels will be 2 RMU (Rack Mount Unit) in height.

UTP - Voice Patch Panels:

All horizontal voice cables will be terminated onto wall mounted 110-blocks.

5.4 Backbone Indoor

No indoor backbone cable will be installed as part of this project.

5.5 Backbone Outdoor

No outdoor backbone cable will be installed as part of this project.

5.6 Testing and Labeling

Copper Testing:

All cables and termination hardware shall be tested.

All cables shall be tested in accordance with ANSI/TIA/EIA standards, manufacturer specifications and best industry practice.

All twisted pair copper cables links shall be tested for continuity, pair reversals, shorts, opens and performance as indicated for the type of cable installed.

This project includes the testing for Cat-6 cables.

All cables tested for data and voice applications will be recorded and submitted as part of a final documentation package.

Fiber Optic Testing:

No Fiber Optic cabling has been included as part of this project.

Vector Resources, Inc.

8647 Ninth Street, Rancho Cucamonga, CA 91730
(800) 929-4516

5.7 Documentation

Package Includes:

This project includes the delivery and submittal of:

1. Test results for all copper data cable(s)
 - a. Summary
 - b. Detail
2. Test results for all copper voice cable(s)
 - a. Summary
 - b. Detail
3. CAD drawing(s) – AutoCAD drawings depicting all work performed.
 - a. Plan View
 - i. Space layout with identification labels for all NEW work.
 - b. Backbone Diagram (TR to TR, Riser, Campus)
 - i. Copper
 - ii. Fiber
4. Warranty Information
 - a. Vector Resources 1-year warranty
 - b. Manufacturer warranty - 25 year

Upon completion, one (1) hard copy set shall be delivered to the primary contact within one (1) week of completing the project. Soft copy drawings are available upon request.

Customer Responsibilities

If applicable/available, preliminary soft copy drawings must be provided by the customer in an AutoCAD format. Drawings must be provided three (3) days after approving the contract proposal/quote. Drawings must contain a core, a shell and a space layout of the most recent configuration.

Vector Resources, Inc.

8647 Ninth Street, Rancho Cucamonga, CA 91730
(800) 929-4516

6.0 Post Support

6.1

Vector offers several post-project support options that can assist the client once its system is operational. These options include quarterly, semi-annual, or annual on-site preventive maintenance and audits; blocks of time for on-site maintenance and upgrades; and management of the RMA process.

Upon request, Vector will customize a post-installation project support and maintenance plan to suit the client's needs.

Vector's most popular support options include the following:

Vector Insight Managed Services

Vector provides complete systems management services that include:

- 24x7 systems monitoring
- Guaranteed hourly services from network engineers and service technicians for onsite/offsite maintenance and upgrades, RMA management, and system moves, adds and changes
- Monthly performance reporting and quarterly consulting analysis

Vector Hourly IS Services

With this option, Vector provides "time and materials" post-installation services and support. The standard support package includes access to the Vector Help Desk during normal business hours, and emergency assistance for critical issues. For manufacturer warranties that include monitoring, Vector will also receive manufacturer alerts directly to its Help Desk upon the client's request.

The Help Desk is available from 8:00 a.m. to 5:00 p.m. Pacific Standard Time, Monday through Friday, excluding the six national holidays, to provide assistance. Emergency assistance for critical problems is available at all times. The client can contact the Help Desk by telephone at 877.569.8800 within the 48 contiguous states or by email at helpdesk@vectorusa.com.

7.0 Project Parameters

7.1 Access

Vector has access to all areas required to perform the proposed scope of work in a timely manner.

7.2 Change Order

Any work that is added to or deleted from the original scope of this proposal and which alters the original costs or completion date must be agreed upon by both parties in the form of a written change order.

Vector Resources, Inc.

8647 Ninth Street, Rancho Cucamonga, CA 91730
(800) 929-4516

7.3 Delays

The client must provide five working days' advance notice of any factor that will delay this project or Vector will issue a work stoppage change order. Additionally, idle time incurred by Vector due to the absence of required escorts, clearance, permits, inability to enter the work place, delays by other trades or other factors beyond Vector's control will be addressed with a written change order.

7.4 Work Days/Overtime

This work will be performed during Vector's regular standard business hours of 7:00 a.m. to 5:00 p.m. Pacific Standard Time, Monday through Friday, except holidays. Work outside of regular business hours is available, but requires a written change order.

7.5 Schedule

Vector plans to implement this project in a continuous fashion or as outlined within the RFP. If any additional mobilization is required, as a result of a change in the project schedule, not caused by Vector, it will be addressed with a written change order.

7.6 Asbestos/Hazardous Materials

Vector assumes that the installation teams will be working in areas that will not contain asbestos or any other hazardous material that would require additional time or alternative installation procedures.

It is the responsibility of the client to give written notification to Vector, prior to the start of a project, of any asbestos contained material (ACMs) in or around the area of the project. In the event that ACMs are present prior to job commencement or if ACMs are encountered during the project, additional cost, damages and/or delays attributed to necessary procedures for working in this environment will be the responsibility of the client.

7.7 Adequate Room

The client must provide adequate room for the installation of the proposed termination hardwired at the station and in the communications closets.

7.8 Storage Area

The client will provide a secured storage area inside the building for Vector's materials and tools.

7.9 Office Furniture

Vector will not be responsible for disassembling or moving desks or other office furniture to gain proper access to perform installation tasks.

7.10 Ceiling Tile

Vector exercises care in the removal, storage and reinstallation of existing (used) ceiling tiles; however, Vector accepts no liability for any incidental damages that may result from the handling of ceiling tiles.

Vector Resources, Inc.

8647 Ninth Street, Rancho Cucamonga, CA 91730
(800) 929-4516

7.11 Cross-Connections

Vector will not be responsible for providing and installing the cross-connects to the phone system.

7.12 Patch Cords

Vector will not be responsible for providing and installing voice and data patch cables.

7.13 Existing Cable

Vector has not confirmed that the existing cable infrastructure is usable (e.g. labeled, correct pin configurations, etc.). The client will be responsible for providing technician(s) (e.g. cable vendor) to troubleshoot any wiring issues that may arise during installation.

Vector will troubleshoot or resolve in-house wire issues if requested by the client in the form of a written change order.

7.14 Existing Conduit

The client is responsible for ensuring that the existing conduit/pathway is free and clear from defects. If the conduit/pathway is not free and clear from defects, the client will be responsible for making it free and clear.

Vector can assist with making the existing conduit/pathway free and clear if requested by the client in the form of a written change order.

7.15 Coring

If coring is necessary, it will be address with a written change order.

7.16 Add & Delete

This proposal is not to be used as an "Add & Delete" schedule; it only applies to the work specified in the original RFP. Any additional work requested will be considered as separate work and addressed with a written change order.

7.17 Defective Materials

If there is a delay and/or Vector is unable to perform its scope of work, due to problems with the existing hardware and/or materials provided by the client or other third parties, it will be addressed with a written change order.

7.18 Dial Tone/Data Circuits

It is the responsibility of the client to ensure that dial tone and data circuits are installed and operational in the communications room as needed. Time spent troubleshooting and correcting circuit issues will be addressed with a written change order.

Vector Resources, Inc.

8647 Ninth Street, Rancho Cucamonga, CA 91730
(800) 929-4516

7.19 Network Equipment

Vector has based this proposal on the client's provision of all network switches/equipment. All network switches must be PoE and will be in place and operational prior to the cutover date.

In addition, the network equipment must meet the minimum standards set by the systems manufacturer.

7.20 Server(s)

Vector has based this proposal on the client's provision of the server(s) with all server applications, unless outlined otherwise in the proposal. The server must meet the minimum standards set by the systems manufacturer.

7.21 Taxes

Taxes will be billed on tax rates and guidelines at time of invoice.

7.22 Extraordinary Service

Certain additional charges related to extraordinary levels of support or out-of-pocket costs incurred by Vector, through no fault of its own, will be reimbursable by the client under this agreement.

Examples of costs reimbursable under this section include, but are not limited to 1) shipping expenses related to unusual site handling expenses (e.g. extra distance, no loading dock, extra stairs, extra demurrage charges), 2) storage or special handling expenses incurred if an installation site is not able to accept delivery as scheduled, 3) expenses incurred by Vector to resolve network compatibility issues caused by a client's election to substitute non-Vector provided equipment or services, and 4) expenses incurred by Vector for additional installation time and/or materials caused by a site not being prepared as called for in this proposal.

Vector shall promptly notify the client in writing of such charges. Notification will be provided, when feasible, prior to the incurrence of such charges, unless circumstances preclude such prior written notification (by way of example, but not limited to, unusual site handling charges). Provided the incurrence of such charges is not due to Vector's fault or negligence, Vector shall be entitled to an equitable adjustment in the prices herein, the delivery schedule, or both to reflect such charges and any related delay.

7.23 Proprietary Information

The information contained in this document is proprietary to Vector and intended to be used as evaluative and/or bidding information only. No part of this document may be disclosed, reproduced and/or distributed to anyone except the listed recipients within this package without written permission from Vector.

Vector Resources, Inc.

8647 Ninth Street, Rancho Cucamonga, CA 91730
(800) 929-4516

DETAILED PRICING

HORIZONTAL INSTALLATION

| | Quantity | Unit Cost | Material | Labor | Total |
|--|----------|-----------|-----------------|-----------------|------------------|
| COPPER CABLING | | | | | |
| 23/4PR SOL NS CAT6 CMP BLUE | 5,500 | 0.32 | 1,760.00 | 1,695.83 | 3,455.83 |
| CAT6 4 Pair Plenum White Cable | 5,000 | 0.32 | 1,600.00 | 1,541.67 | 3,141.67 |
| TELECOMMUNICATIONS OUTLET | | | | | |
| CAT6 Clarity TracJack Insert White | 28 | 6.78 | 189.84 | 0.00 | 189.84 |
| CAT6 Clarity TracJack Insert White | 28 | 6.78 | 189.84 | 310.80 | 500.64 |
| CAT6 Clarity TracJack Insert Dark Blue | 30 | 6.78 | 203.40 | 333.00 | 536.40 |
| 4 Port TracJack Faceplate Cloud White | 29 | 1.73 | 50.17 | 178.83 | 229.00 |
| Blank Insert Cloud White | 58 | 3.00 | 174.00 | 35.77 | 209.77 |
| TELECOMMUNICATIONS ROOM | | | | | |
| 48 Port Cat6 Angled Patch Panel | 1 | 356.01 | 356.01 | 532.80 | 888.81 |
| CAT6 24 Port Patch Panel | 1 | 193.20 | 193.20 | 266.40 | 459.60 |
| HANGERS AND SUPPORT | | | | | |
| 8ft 12AWG Seismic Ceiling Wire With Clip | 25 | 1.27 | 31.75 | 154.17 | 185.92 |
| 2" J Hook W/ Multifunction Clip | 25 | 3.69 | 92.25 | 154.17 | 246.42 |
| TESTING | | | | | |
| Testing & Labeling - Copper | 58 | 0.60 | 34.80 | 572.27 | 607.07 |
| MISCELLANEOUS | | | | | |
| 3/4" x 75ft Velcro One Wrap Black | 1 | 31.20 | 31.20 | 74.00 | 105.20 |
| Fire Barrier Moldable Putty Stick | 2 | 18.54 | 37.08 | 37.00 | 74.08 |
| Sub-Total | | | 4,943.54 | 5,886.70 | 10,830.24 |

DISTRIBUTION RACKS & CABINETS

| | Quantity | Unit Cost | Material | Labor | Total |
|--|----------|-----------|---------------|---------------|-----------------|
| CABLE MANAGEMENT | | | | | |
| 2 Space Horizontal Wire Manger w/ 5 Distribution Rings | 3 | 51.92 | 155.76 | 55.50 | 211.26 |
| WALL CABINET | | | | | |
| MM WALL CABINET 26U PLEXI | 1 | 765.60 | 765.60 | 296.00 | 1,061.60 |
| WALL CABINET FAN KIT | 1 | 39.71 | 39.71 | 24.67 | 64.38 |
| Sub-Total | | | 961.07 | 376.17 | 1,337.24 |

BACKBONE INSTALLATION INDOOR

| | Quantity | Unit Cost | Material | Labor | Total |
|------------------------------------|----------|-----------|---------------|---------------|---------------|
| COPPER TERMINATION HARDWARE | | | | | |
| 300PR 110 BLK W/O LEGS-X | 1 | 263.08 | 263.08 | 111.00 | 374.08 |
| Sub-Total | | | 263.08 | 111.00 | 374.08 |

PROFESSIONAL SERVICES

| | Quantity | Unit Cost | Material | Labor | Total |
|--------------------------|----------|-----------|-------------|---------------|---------------|
| CAD | 1 | 0.00 | 0.00 | 74.00 | 74.00 |
| Mobilization & Logistics | 1 | 0.00 | 0.00 | 148.00 | 148.00 |
| Project Management | 1 | 0.00 | 0.00 | 592.00 | 592.00 |
| Sub-Total | | | 0.00 | 814.00 | 814.00 |

| | | | | | |
|----------------------|--|--|-----------------|-----------------|------------------|
| Project Sub-Total | | | 6,167.69 | 7,187.87 | 13,355.56 |
| Sales Tax | | | | | 478.00 |
| Project Total | | | | | 13,833.55 |

Vector Resources, Inc.

8647 Ninth Street, Rancho Cucamonga, CA 91730
 (800) 929-4516

TERMS AND CONDITIONS OF CONTRACT

TERMS AND CONDITIONS

All work is to be completed in a workmanlike manner according to standard practices. All material is to be as specified. Any alterations or deviation from above specifications involving extra costs will be executed only upon written orders, and will become an extra charge over the estimate. All agreements contingent upon strikes, accidents or delays beyond our control will be settled in a formal agreement. Owner is responsible to carry fire, tornado and other necessary insurance. Our workers are fully covered by Workman's Compensation Insurance.

PAYMENT REQUIREMENTS

Purchase Order Number Due Upon Signing,
Monthly Progress Invoices to be Billed due Net 30,
Balance Due Upon Completion due Net 30
This proposal is valid for 30 days only

Doug Wall Construction, Inc.
Cabazon, CA

Job Total \$13,833.55

Skyler Peterson

Vector Resources, Inc. Authorized Signature

Date

ACCEPTANCE OF PROPOSAL

The prices, specifications and conditions are satisfactory and are hereby accepted. You are authorized to do the work as specified. Payment will be made as outlined above.

Authorized Signature

Date

Print Name



VECTOR RESOURCES
ENTERPRISE NETWORK SOLUTIONS

VRN-048674-001
March 20, 2012

Doug Wall Construction, Inc.
Cabazon, CA

Project
Cabazon Civic Center BLDG B (AV)
Version 1

Prepared For
Doug Wall Construction, Inc.

Prepared By
Vector Resources, Inc.

Vector Resources, Inc.

8647 Ninth Street, Rancho Cucamonga, CA 91730
(800) 929-4516

TABLE OF CONTENTS

1.0 Vector Resources

2.0 Project

3.0 Project Team

4.0 Codes and Standards

5.0 Post Support

6.0 Project Parameters

Detailed Pricing

Terms and Conditions of Contract
(Signature Required)

Vector Resources, Inc.

8647 Ninth Street, Rancho Cucamonga, CA 91730
(800) 929-4516

1.0 Vector Resources

1.1 Company Overview

Vector Resources, Inc. ("Vector") is a leading converged telephony and enterprise network systems integration firm committed to delivering innovation. With over 20 years experience, we are a turnkey systems provider, specializing in the design and implementation of high performance networking solutions. We offer a wide range of services in the areas of structured communications cabling, wireless, surveillance, access control, Voice over Internet Protocol (VoIP), network security, and remote monitoring.

Recognized widely for our engineering capabilities and management excellence, Vector's team consists of the 4 original partners and over 350 employees, including engineers, technical personnel, business development and customer service agents. Vector is headquartered in Torrance, California, with additional offices in San Diego, Rancho Cucamonga, and Tempe, Arizona.

Vector's certifications and partnerships allow us to serve as a full-service solution provider. We maintain C7, C10 electrical contractor licenses and a General Contractor "B" license. Our business partners include AMP (one of the largest ND&I contractor in the country), Ascom Wireless, Avaya, Cisco, HP Networking, Hirsch, OnSSI, PCSC, Sony and other world class IT and integration solution vendors.

Vector Resources, Inc.

8647 Ninth Street, Rancho Cucamonga, CA 91730
(800) 929-4516

2.0 Project

2.1 Scope Of Work

- **Multipurpose Room B118**
Cabazon Library AV Scope of Work (SOW) is based off of client information and drawings #AC-01B; Vector Resources will provide and install (1) 70", 16:9 Permanent LCD displays with landscape mounting bracket. The display connection will allow (1) HDMI digital, (1) VGA analog with 3.5mm and (1) RCA composite video with (L/R) audio via wall plate. All sources will be hardwire and routed to the permanent wall mounted LCD Display. Client will have the ability to connect a laptop via local connections plate and present a small presentation, connection points will be provided to the right of the display at Standard electrical height.

System Elements

- **SOURCECS**
All OFE video sources will be provided by end user, i.e. computer, laptop and other original video feeds. Connection point will be on (1) 2gang wall plate with VGA, HDMI and Composite video. All sound will be provided through the LCD display.

Equipment:

- (1) 70" 16:9 1080p with 10w built in speakers and Wifi
- (1) Landscape mount
- (1) Extron pass through plate

Note:

Client is responsible for all Wifi setup and connecting to TV Display device.

3.0 Project Team

3.1 Installation Procedure

Vector will establish a project team comprised of several individuals with relevant knowledge and experience. An experienced Project Manager/Coordinator will head the project team to ensure the project is on schedule and within budget.

In addition to the core project team, Vector has over 350 employees with a full range of specialties that can be utilized to assist in the project as needed. Among these employee resources are Vector's quality control officials who will visit the project site throughout the duration of the project to ensure that the highest quality installation practices are being used.

Vector recommends that the client create its own project team prior to the project's implementation. This team will work in conjunction with Vector's team to determine the implementation schedule, establish policies and procedures, and decide how best to handle the distribution of information to client's staff members, technical issues, training, device management and maintenance, and system maintenance.

Vector Resources, Inc.

8647 Ninth Street, Rancho Cucamonga, CA 91730
(800) 929-4516

4.0 Codes and Standards

4.1

All work performed on this project will be installed in accordance with IEEE 802.11 installation guidelines, the current edition of the NEC, NESC, Bicsi Telecommunications Distribution Methods Manual (TDMM), BICSI Cabling Installation Manual, and the latest issue of the ANSI/TIA/EIA Standards, along with all state/local codes and ordinances.

5.0 Post Support

5.1

Vector offers several post-project support options that can assist the client once its system is operational. These options include quarterly, semi-annual, or annual on-site preventive maintenance and audits; blocks of time for on-site maintenance and upgrades; and management of the RMA process.

Upon request, Vector will customize a post-installation project support and maintenance plan to suit the client's needs.

Vector's most popular support options include the following:

Vector Insight Managed Services

Vector provides complete systems management services that include:

- 24x7 systems monitoring
- Guaranteed hourly services from network engineers and service technicians for onsite/offsite maintenance and upgrades, RMA management, and system moves, adds and changes
- Monthly performance reporting and quarterly consulting analysis

Vector Hourly IS Services

With this option, Vector provides "time and materials" post-installation services and support. The standard support package includes access to the Vector Help Desk during normal business hours, and emergency assistance for critical issues. For manufacturer warranties that include monitoring, Vector will also receive manufacturer alerts directly to its Help Desk upon the client's request.

The Help Desk is available from 8:00 a.m. to 5:00 p.m. Pacific Standard Time, Monday through Friday, excluding the six national holidays, to provide assistance. Emergency assistance for critical problems is available at all times. The client can contact the Help Desk by telephone at 877.569.8800 within the 48 contiguous states or by email at helpdesk@vectorusa.com.

6.0 Project Parameters

6.1 Access

Vector has access to all areas required to perform the proposed scope of work in a timely manner.

Vector Resources, Inc.

8647 Ninth Street, Rancho Cucamonga, CA 91730
(800) 929-4516

6.2 Change Order

Any work that is added to or deleted from the original scope of this proposal and which alters the original costs or completion date must be agreed upon by both parties in the form of a written change order.

6.3 Delays

The client must provide five working days' advance notice of any factor that will delay this project or Vector will issue a work stoppage change order. Additionally, idle time incurred by Vector due to the absence of required escorts, clearance, permits, inability to enter the work place, delays by other trades or other factors beyond Vector's control will be addressed with a written change order.

6.4 Work Days/Overtime

This work will be performed during Vector's regular standard business hours of 7:00 a.m. to 5:00 p.m. Pacific Standard Time, Monday through Friday, except holidays. Work outside of regular business hours is available, but requires a written change order.

6.5 Schedule

Vector plans to implement this project in a continuous fashion or as outlined within the RFP. If any additional mobilization is required, as a result of a change in the project schedule, not caused by Vector, it will be addressed with a written change order.

6.6 Asbestos/Hazardous Materials

Vector assumes that the installation teams will be working in areas that will not contain asbestos or any other hazardous material that would require additional time or alternative installation procedures.

It is the responsibility of the client to give written notification to Vector, prior to the start of a project, of any asbestos contained material (ACMs) in or around the area of the project. In the event that ACMs are present prior to job commencement or if ACMs are encountered during the project, additional cost, damages and/or delays attributed to necessary procedures for working in this environment will be the responsibility of the client.

6.7 Adequate Room

The client must provide adequate room for the installation of the proposed termination hardware at the station and in the communications closets.

6.8 Storage Area

The client will provide a secured storage area inside the building for Vector's materials and tools.

Vector Resources, Inc.

8647 Ninth Street, Rancho Cucamonga, CA 91730
(800) 929-4516

6.9 Ceiling Tile

Vector exercises care in the removal, storage and reinstallation of existing (used) ceiling tiles; however, Vector accepts no liability for any incidental damages that may result from the handling of ceiling tiles.

6.10 Patch Cords

Vector will not be responsible for providing and installing voice and data patch cables.

6.11 Defective Materials

If there is a delay and/or Vector is unable to perform its scope of work, due to problems with the existing hardware and/or materials provided by the client or other third parties, it will be addressed with a written change order.

6.12 Taxes

Taxes will be billed on tax rates and guidelines at time of invoice.

6.13 Non-Prevailing Wage

Vector has based this proposal on using non-prevailing wage labor. If we are informed or it is determined, at a later date, that the project is subject to prevailing wage rates for the performance of the public work portion of the contract, Vector will address any changes/additional costs that the project may incur with a written change order outlining the changes.

6.14 Extraordinary Service

Certain additional charges related to extraordinary levels of support or out-of-pocket costs incurred by Vector, through no fault of its own, will be reimbursable by the client under this agreement.

Examples of costs reimbursable under this section include, but are not limited to 1) shipping expenses related to unusual site handling expenses (e.g. extra distance, no loading dock, extra stairs, extra demurrage charges), 2) storage or special handling expenses incurred if an installation site is not able to accept delivery as scheduled, 3) expenses incurred by Vector to resolve network compatibility issues caused by a client's election to substitute non-Vector provided equipment or services, and 4) expenses incurred by Vector for additional installation time and/or materials caused by a site not being prepared as called for in this proposal.

Vector shall promptly notify the client in writing of such charges. Notification will be provided, when feasible, prior to the incurrence of such charges, unless circumstances preclude such prior written notification (by way of example, but not limited to, unusual site handling charges). Provided the incurrence of such charges is not due to Vector's fault or negligence, Vector shall be entitled to an equitable adjustment in the prices herein, the delivery schedule, or both to reflect such charges and any related delay.

Vector Resources, Inc.

8647 Ninth Street, Rancho Cucamonga, CA 91730
(800) 929-4516

6.15 Proprietary Information

The information contained in this document is proprietary to Vector and intended to be used as evaluative and/or bidding information only. No part of this document may be disclosed, reproduced and/or distributed to anyone except the listed recipients within this package without written permission from Vector.

Vector Resources, Inc.

8647 Ninth Street, Rancho Cucamonga, CA 91730
(800) 929-4516

DETAILED PRICING

AUDIO VISUAL

| | Quantity | Unit Cost | Material | Labor | Total |
|---|----------|-------------------|----------|----------|----------|
| 1 HDMI Female to female 10" pigtail (AAP) | 1 | 56.00 | 56.00 | 75.00 | 131.00 |
| 1 VGA w/3.5mm (AAP) | 1 | 91.00 | 91.00 | 0.00 | 91.00 |
| 2 RCA Female w/RCA to BNC (AAP) | 1 | 63.00 | 63.00 | 0.00 | 63.00 |
| AAP 102 plate (2Gang) | 1 | 77.00 | 77.00 | 0.00 | 77.00 |
| 70" LCD Monitor 1920 x 1080 res | 1 | 3,358.60 | 3,358.60 | 75.00 | 3,433.60 |
| Low Profile Mount For Flat Panel | 1 | 201.60 | 201.60 | 75.00 | 276.60 |
| 25' Pro Series Plenum HDMI Cable | 1 | 236.60 | 236.60 | 75.00 | 311.60 |
| WPBC 107-35', Plenum VGA to BNC & Video w L/R | 1 | 224.00 | 224.00 | 75.00 | 299.00 |
| BNC Male MHR Compression (Qty 50) | 1 | 135.80 | 135.80 | 0.00 | 135.80 |
| BNC Make RG59p (Qty 50) | 1 | 128.80 | 128.80 | 0.00 | 128.80 |
| Mics Connectors, Materials, panduit, etc... | 1 | 140.00 | 140.00 | 0.00 | 140.00 |
| Sales Design & Engineering | 1 | 0.00 | 0.00 | 150.00 | 150.00 |
| Project Management | 1 | 0.00 | 0.00 | 300.00 | 300.00 |
| Installation Labor | 1 | 0.00 | 0.00 | 1,500.00 | 1,500.00 |
| OnSite System Commissioning | 1 | 0.00 | 0.00 | 150.00 | 150.00 |
| | | | <hr/> | <hr/> | <hr/> |
| | | Sub-Total | 4,712.40 | 2,475.00 | 7,187.40 |
| | | Project Sub-Total | 4,712.40 | 2,475.00 | 7,187.40 |
| | | Sales Tax | | | 365.21 |
| | | Project Total | | | 7,552.61 |

Vector Resources, Inc.

8647 Ninth Street, Rancho Cucamonga, CA 91730
 (800) 929-4516

TERMS AND CONDITIONS OF CONTRACT

TERMS AND CONDITIONS

All work is to be completed in a workmanlike manner according to standard practices. All material is to be as specified. Any alterations or deviation from above specifications involving extra costs will be executed only upon written orders, and will become an extra charge over the estimate. All agreements contingent upon strikes, accidents or delays beyond our control will be settled in a formal agreement. Owner is responsible to carry fire, tornado and other necessary insurance. Our workers are fully covered by Workman's Compensation Insurance.

PAYMENT REQUIREMENTS

Purchase Order Number Due Upon Signing,
Monthly Progress Invoices to be Billed due Net 30,
Balance Due Upon Completion due Net 30
This proposal is valid for 30 days only

Doug Wall Construction, Inc.
Cabazon, CA

Job Total \$7,552.61

Skyler Peterson

Vector Resources, Inc. Authorized Signature

Date

ACCEPTANCE OF PROPOSAL

The prices, specifications and conditions are satisfactory and are hereby accepted. You are authorized to do the work as specified. Payment will be made as outlined above.

Authorized Signature

Date

Print Name



VECTOR RESOURCES
ENTERPRISE NETWORK SOLUTIONS

VRN-048282-001
March 9, 2012

Library Systems & Services LSSI

5840 Mission Blvd
Riverside, CA 92509

Project

Cabazon Library Cabling
Proposal 1 Version 1

Prepared For

Library Systems & Services LSSI
Aaron Hodge

Prepared By

Vector Resources, Inc.
Skyler Peterson

Vector Resources, Inc.

8647 Ninth Street, Rancho Cucamonga, CA 91730
(800) 929-4516

TABLE OF CONTENTS

- 1.0 Vector Resources
- 2.0 Project
- 3.0 Project Team
- 4.0 Codes and Standards
- 5.0 Cable Infrastructure
- 6.0 Post Support
- 7.0 Project Parameters
- Detailed Pricing
- Terms and Conditions of Contract
(Signature Required)

Vector Resources, Inc.

8647 Ninth Street, Rancho Cucamonga, CA 91730
(800) 929-4516

1.0 Vector Resources

1.1 Company Overview

Vector Resources, Inc. ("Vector") is a leading converged telephony and enterprise network systems integration firm committed to delivering innovation. With over 20 years experience, we are a turnkey systems provider, specializing in the design and implementation of high performance networking solutions. We offer a wide range of services in the areas of structured communications cabling, wireless, surveillance, access control, Voice over Internet Protocol (VoIP), network security, and remote monitoring.

Recognized widely for our engineering capabilities and management excellence, Vector's team consists of the 4 original partners and over 350 employees, including engineers, technical personnel, business development and customer service agents. Vector is headquartered in Torrance, California, with additional offices in San Diego, Rancho Cucamonga, and Tempe, Arizona.

Vector's certifications and partnerships allow us to serve as a full-service solution provider. We maintain C7, C10 electrical contractor licenses and a General Contractor "B" license. Our business partners include AMP (one of the largest ND&I contractor in the country), Ascom Wireless, Avaya, Cisco, HP Networking, Hirsch, OnSSI, PCSC, Sony and other world class IT and integration solution vendors.

2.0 Project

2.1 Project Overview

Vector is pleased to present the following proposal to LSSI ("client") for the Riverside County Cabazon library project. This proposal includes:

-Specifications for the installation of new structured communication cabling

This proposal was based on the information gathered from meetings and conversations, the site walk and our experience with similar types of projects. The proposal includes the furnishing of all materials, labor, transportation, tools, permits, fees, utilities and incidentals necessary for the complete installation of all work specified within this document.

Scope of Work:

Vector Resources will provide and install Voice and Data cabling as outlined in the provided project drawings.

Vector Resources, Inc.

8647 Ninth Street, Rancho Cucamonga, CA 91730
(800) 929-4516

3.0 Project Team

3.1 Installation Procedure

Vector will establish a project team comprised of several individuals with relevant knowledge and experience. An experienced Project Manager/Coordinator will head the project team to ensure the project is on schedule and within budget.

In addition to the core project team, Vector has over 350 employees with a full range of specialties that can be utilized to assist in the project as needed. Among these employee resources are Vector's quality control officials who will visit the project site throughout the duration of the project to ensure that the highest quality installation practices are being used.

Vector recommends that the client create its own project team prior to the project's implementation. This team will work in conjunction with Vector's team to determine the implementation schedule, establish policies and procedures, and decide how best to handle the distribution of information to client's staff members, technical issues, training, device management and maintenance, and system maintenance.

4.0 Codes and Standards

4.1

All work performed on this project will be installed in accordance with IEEE 802.11 installation guidelines, the current edition of the NEC, NESC, Bicsi Telecommunications Distribution Methods Manual (TDMM), BICSI Cabling Installation Manual, and the latest issue of the ANSI/TIA/EIA Standards, along with all state/local codes and ordinances.

Vector Resources, Inc.

8647 Ninth Street, Rancho Cucamonga, CA 91730
(800) 929-4516

5.0 Cable Infrastructure

5.1 Horizontal

Vector Resources will install approximately Thirty (35) telecommunication outlets, equaling Fifty Eight (82) Cat-6 cables for voice and data purposes. See the following information and installation matrix for details:

Note: These breakdowns are not exact but account for a total of (58) Cat-6 cables.

| Quantity | Description |
|----------|--|
| (32) | 1-Cat-6 data cable and 1-Cat-6 voice cable - Combo outlets |
| (3) | 1-Cat-6 data cable only - Wall outlet |
| (15) | 1-Cat-6 data cable only - Floor outlet |

Total Cables - 82 Cat-6 cables

Cable Hangers and Supports:

Vector Resources shall install cable hangers, J-hooks, or other supporting assemblies in order to properly secure and support all horizontal cables. Within the ceiling space, supports will be installed every 4-5 ft. or as needed.

No cables will be attached to support wire for ceiling tile grid, support assemblies for electrical conduits or the conduits themselves, or support assemblies for the fire protections systems.

Cable - Data Applications:

All horizontal data cables designated for data applications will be Unshielded Twisted Pair (UTP) 4 pair 24 AWG Cat-6 rated.

All horizontal data cables will be plenum rated.

The jacket of the cable will be blue.

All horizontal data cables shall terminate on modular patch panels in their respective Telecommunications Room.

Cable - Voice Applications:

All horizontal voice cables designated for voice applications will be Unshielded Twisted Pair (UTP) 4 pair 24 AWG Cat-6 rated.

All horizontal voice cables will be plenum rated.

The jacket of the cable will be white.

All horizontal voice cables shall terminate on modular patch panels in their respective Telecommunications Room.

Work Area Outlets:

All horizontal cables will be dressed into faceplates installed at the designated work or device area location. All connector assemblies shall snap into the faceplates.

Vector Resources, Inc.

8647 Ninth Street, Rancho Cucamonga, CA 91730
(800) 929-4516

All wall mounted faceplates shall be white, single-gang and available in 4-ports.

All faceplates shall have recessed designation windows to facilitate labeling and identification. All faceplates will be labeled with adhesive labels (white background / black lettering) and be given a unique labeling/numbering scheme.

Work Area Data Inserts:

All data inserts shall be 8-position modular inserts.

All data inserts shall be Cat-6 rated.

All data inserts shall be blue.

All cables will be terminated with a 568 B-wiring scheme unless otherwise specified.

Work Area Voice Inserts:

All voice inserts shall be 8-position modular inserts.

All voice inserts shall be Cat-6 rated.

All voice inserts shall be white.

Vector Resources, Inc.

8647 Ninth Street, Rancho Cucamonga, CA 91730
(800) 929-4516

5.2 MDF

Within the MDF, one new floor mounted cabinet will be installed.

Horizontal Wire Management

Horizontal wire managers will be provided above, below and in between each patch panel.

The horizontal wire managers will be double sided (front and rear) and shall be 2 RMU in height.

The horizontal wire managers include snap-on hinged doors/covers.

The horizontal wire management will be black in color.

The following applies to the MDF.

UTP - Data Patch Panels:

All horizontal data cables will be terminated onto rack mounted patch panels.

All patch panels will be Cat-6 rated.

All patch panels will be available in 48-port high-density configurations with designation label strips.

All patch panels will be 2 RMU (Rack Mount Unit) in height.

UTP - Voice Termination:

All horizontal voice cables will be terminated onto wall mounted 110 blocks.

5.3 Backbone Indoor

No indoor backbone cable will be installed as part of this project.

5.4 Backbone Outdoor

No outdoor backbone cable will be installed as part of this project.

Vector Resources, Inc.

8647 Ninth Street, Rancho Cucamonga, CA 91730
(800) 929-4516

5.5 Testing and Labeling

Copper Testing:

All cables and termination hardware shall be tested.

All cables shall be tested in accordance with ANSI/TIA/EIA standards, manufacturer specifications and best industry practice.

All twisted pair copper cables links shall be tested for continuity, pair reversals, shorts, opens and performance as indicated for the type of cable installed.

This project includes the testing for Cat-6 cables.

All cables tested for data and voice applications will be recorded and submitted as part of a final documentation package.

Fiber Optic Testing:

No Fiber Optic cabling has been included as part of this project.

Vector Resources, Inc.

8647 Ninth Street, Rancho Cucamonga, CA 91730
(800) 929-4516

5.6 Documentation

Package Includes:

This project includes the delivery and submittal of:

1. Test results for all copper data cable(s)
 - a. Summary
 - b. Detail
2. Test results for all copper voice cable(s)
 - a. Summary
 - b. Detail
3. CAD drawing(s) – AutoCAD drawings depicting all work performed.
 - a. Plan View
 - i. Space layout with identification labels for all NEW work.
 - b. Backbone Diagram (TR to TR, Riser, Campus)
 - i. Copper
 - ii. Fiber
4. Warranty Information
 - a. Vector Resources 1-year warranty
 - b. Manufacturer warranty - 25 year

Upon completion, one (1) hard copy set shall be delivered to the primary contact within one (1) week of completing the project. Soft copy drawings are available upon request.

Customer Responsibilities

If applicable/available, preliminary soft copy drawings must be provided by the customer in an AutoCAD format. Drawings must be provided three (3) days after approving the contract proposal/quote. Drawings must contain a core, a shell and a space layout of the most recent configuration.

Vector Resources, Inc.

8647 Ninth Street, Rancho Cucamonga, CA 91730
(800) 929-4516

6.0 Post Support

6.1

Vector offers several post-project support options that can assist the client once its system is operational. These options include quarterly, semi-annual, or annual on-site preventive maintenance and audits; blocks of time for on-site maintenance and upgrades; and management of the RMA process.

Upon request, Vector will customize a post-installation project support and maintenance plan to suit the client's needs.

Vector's most popular support options include the following:

Vector Insight Managed Services

Vector provides complete systems management services that include:

- 24x7 systems monitoring
- Guaranteed hourly services from network engineers and service technicians for onsite/offsite maintenance and upgrades, RMA management, and system moves, adds and changes
- Monthly performance reporting and quarterly consulting analysis

Vector Hourly IS Services

With this option, Vector provides "time and materials" post-installation services and support. The standard support package includes access to the Vector Help Desk during normal business hours, and emergency assistance for critical issues. For manufacturer warranties that include monitoring, Vector will also receive manufacturer alerts directly to its Help Desk upon the client's request.

The Help Desk is available from 8:00 a.m. to 5:00 p.m. Pacific Standard Time, Monday through Friday, excluding the six national holidays, to provide assistance. Emergency assistance for critical problems is available at all times. The client can contact the Help Desk by telephone at 877.569.8800 within the 48 contiguous states or by email at helpdesk@vectorusa.com.

7.0 Project Parameters

7.1 Access

Vector has access to all areas required to perform the proposed scope of work in a timely manner.

7.2 Change Order

Any work that is added to or deleted from the original scope of this proposal and which alters the original costs or completion date must be agreed upon by both parties in the form of a written change order.

Vector Resources, Inc.

8647 Ninth Street, Rancho Cucamonga, CA 91730
(800) 929-4516

7.3 Delays

The client must provide five working days' advance notice of any factor that will delay this project or Vector will issue a work stoppage change order. Additionally, idle time incurred by Vector due to the absence of required escorts, clearance, permits, inability to enter the work place, delays by other trades or other factors beyond Vector's control will be addressed with a written change order.

7.4 Work Days/Overtime

This work will be performed during Vector's regular standard business hours of 7:00 a.m. to 5:00 p.m. Pacific Standard Time, Monday through Friday, except holidays. Work outside of regular business hours is available, but requires a written change order.

7.5 Schedule

Vector plans to implement this project in a continuous fashion or as outlined within the RFP. If any additional mobilization is required, as a result of a change in the project schedule, not caused by Vector, it will be addressed with a written change order.

7.6 Asbestos/Hazardous Materials

Vector assumes that the installation teams will be working in areas that will not contain asbestos or any other hazardous material that would require additional time or alternative installation procedures.

It is the responsibility of the client to give written notification to Vector, prior to the start of a project, of any asbestos contained material (ACMs) in or around the area of the project. In the event that ACMs are present prior to job commencement or if ACMs are encountered during the project, additional cost, damages and/or delays attributed to necessary procedures for working in this environment will be the responsibility of the client.

7.7 Adequate Room

The client must provide adequate room for the installation of the proposed termination hardware at the station and in the communications closets.

7.8 Storage Area

The client will provide a secured storage area inside the building for Vector's materials and tools.

7.9 Office Furniture

Vector will not be responsible for disassembling or moving desks or other office furniture to gain proper access to perform installation tasks.

7.10 Ceiling Tile

Vector exercises care in the removal, storage and reinstallation of existing (used) ceiling tiles; however, Vector accepts no liability for any incidental damages that may result from the handling of ceiling tiles.

Vector Resources, Inc.

8647 Ninth Street, Rancho Cucamonga, CA 91730
(800) 929-4516

7.11 Cross-Connections

Vector will not be responsible for providing and installing the cross-connects to the phone system.

7.12 Patch Cords

Vector will not be responsible for providing and installing voice and data patch cables.

7.13 Existing Cable

Vector has not confirmed that the existing cable infrastructure is usable (e.g. labeled, correct pin configurations, etc.). The client will be responsible for providing technician(s) (e.g. cable vendor) to troubleshoot any wiring issues that may arise during installation.

Vector will troubleshoot or resolve in-house wire issues if requested by the client in the form of a written change order.

7.14 Existing Conduit

The client is responsible for ensuring that the existing conduit/pathway is free and clear from defects. If the conduit/pathway is not free and clear from defects, the client will be responsible for making it free and clear.

Vector can assist with making the existing conduit/pathway free and clear if requested by the client in the form of a written change order.

7.15 Coring

If coring is necessary, it will be address with a written change order.

7.16 Add & Delete

This proposal is not to be used as an "Add & Delete" schedule; it only applies to the work specified in the original RFP. Any additional work requested will be considered as separate work and addressed with a written change order.

7.17 Defective Materials

If there is a delay and/or Vector is unable to perform its scope of work, due to problems with the existing hardware and/or materials provided by the client or other third parties, it will be addressed with a written change order.

7.18 Dial Tone/Data Circuits

It is the responsibility of the client to ensure that dial tone and data circuits are installed and operational in the communications room as needed. Time spent troubleshooting and correcting circuit issues will be addressed with a written change order.

Vector Resources, Inc.

8647 Ninth Street, Rancho Cucamonga, CA 91730
(800) 929-4516

7.19 Network Equipment

Vector has based this proposal on the client's provision of all network switches/equipment. All network switches must be PoE and will be in place and operational prior to the cutover date.

In addition, the network equipment must meet the minimum standards set by the systems manufacturer.

7.20 Server(s)

Vector has based this proposal on the client's provision of the server(s) with all server applications, unless outlined otherwise in the proposal. The server must meet the minimum standards set by the systems manufacturer.

7.21 Taxes

Taxes will be billed on tax rates and guidelines at time of invoice.

7.22 Extraordinary Service

Certain additional charges related to extraordinary levels of support or out-of-pocket costs incurred by Vector, through no fault of its own, will be reimbursable by the client under this agreement.

Examples of costs reimbursable under this section include, but are not limited to 1) shipping expenses related to unusual site handling expenses (e.g. extra distance, no loading dock, extra stairs, extra demurrage charges), 2) storage or special handling expenses incurred if an installation site is not able to accept delivery as scheduled, 3) expenses incurred by Vector to resolve network compatibility issues caused by a client's election to substitute non-Vector provided equipment or services, and 4) expenses incurred by Vector for additional installation time and/or materials caused by a site not being prepared as called for in this proposal.

Vector shall promptly notify the client in writing of such charges. Notification will be provided, when feasible, prior to the incurrence of such charges, unless circumstances preclude such prior written notification (by way of example, but not limited to, unusual site handling charges). Provided the incurrence of such charges is not due to Vector's fault or negligence, Vector shall be entitled to an equitable adjustment in the prices herein, the delivery schedule, or both to reflect such charges and any related delay.

7.23 Proprietary Information

The information contained in this document is proprietary to Vector and intended to be used as evaluative and/or bidding information only. No part of this document may be disclosed, reproduced and/or distributed to anyone except the listed recipients within this package without written permission from Vector.

Vector Resources, Inc.

8647 Ninth Street, Rancho Cucamonga, CA 91730
(800) 929-4516

DETAILED PRICING

HORIZONTAL INSTALLATION

| | Quantity | Unit Cost | Material | Labor | Total |
|--|----------|-----------|-----------------|------------------|------------------|
| COPPER CABLING | | | | | |
| 23/4PR SOL NS CAT6 CMR BLUE | 9,000 | 0.18 | 1,620.00 | 3,900.00 | 5,520.00 |
| CAT6 4 Pair Plenum White Cable | 5,000 | 0.32 | 1,600.00 | 2,166.67 | 3,766.67 |
| TELECOMMUNICATIONS OUTLET | | | | | |
| CAT6 Clarity TracJack Insert White | 32 | 7.91 | 253.12 | 346.67 | 599.79 |
| CAT6 Clarity TracJack Insert Dark Blue | 54 | 6.78 | 366.12 | 526.50 | 892.62 |
| 4 Port TracJack Faceplate Cloud White | 51 | 1.73 | 88.23 | 276.25 | 364.48 |
| Blank Insert Cloud White | 104 | 3.00 | 312.00 | 56.33 | 368.33 |
| 10Ft CAT6 Patch Cord Blue | 50 | 9.74 | 487.00 | 108.33 | 595.33 |
| 2 Port Surface Mount Box Fog White | 4 | 2.90 | 11.60 | 65.00 | 76.60 |
| TELECOMMUNICATIONS ROOM | | | | | |
| 5 FT CAT6 Patch Cord Blue | 50 | 7.19 | 359.50 | 108.33 | 467.83 |
| 48 Port Cat6 Angled Patch Panel | 2 | 356.01 | 712.02 | 936.00 | 1,648.02 |
| HANGERS AND SUPPORT | | | | | |
| KX Kon Clips | 4 | 0.34 | 1.36 | 21.67 | 23.03 |
| 8ft 12AWG Seismic Ceiling Wire With Clip | 113 | 1.27 | 143.51 | 612.08 | 755.59 |
| 2" J Hook W/ Multifunction Clip | 113 | 3.69 | 416.97 | 612.08 | 1,029.05 |
| Multi Function Clip | 4 | 0.31 | 1.24 | 21.67 | 22.91 |
| TESTING | | | | | |
| Testing & Labeling - Copper | 54 | 0.60 | 32.40 | 468.00 | 500.40 |
| MISCELLANEOUS | | | | | |
| 3/4" x 75ft Velcro One Wrap Black | 1 | 31.20 | 31.20 | 65.00 | 96.20 |
| Fire Barrier Moldable Putty Stick | 2 | 18.54 | 37.08 | 32.50 | 69.58 |
| Sub-Total | | | 6,473.35 | 10,323.08 | 16,796.43 |

RACEWAY PRODUCTS

| | Quantity | Unit Cost | Material | Labor | Total |
|--|----------|-----------|--------------|---------------|---------------|
| TELECOMMUNICATIONS OUTLET | | | | | |
| Deep Single Gang Device Box- Off White | 4 | 6.30 | 25.20 | 65.00 | 90.20 |
| 1" Split Loom Tubing Black | 50 | 0.54 | 27.00 | 108.33 | 135.33 |
| Sub-Total | | | 52.20 | 173.33 | 225.53 |

DISTRIBUTION RACKS & CABINETS

| | Quantity | Unit Cost | Material | Labor | Total |
|--|----------|-----------|-----------------|---------------|-----------------|
| CABLE MANAGEMENT | | | | | |
| 2 Space Horizontal Wire Manger w/ 5 Distribution Rings | 2 | 51.92 | 103.84 | 32.50 | 136.34 |
| FLOOR CABINET | | | | | |
| Mighty Mo Pre-Configured Network Cabinet | 1 | 2,262.00 | 2,262.00 | 260.00 | 2,522.00 |
| Cabinet Shelf | 2 | 151.47 | 302.94 | 65.00 | 367.94 |
| MISCELLANEOUS MATERIALS | | | | | |
| 120V 15A 10-NEMA 5-15 OUTLET w/10' cord | 1 | 177.78 | 177.78 | 16.25 | 194.03 |
| Floor Mounting Hardware | 1 | 60.00 | 60.00 | 97.50 | 157.50 |
| Deep Unistrut Slotted 1 x 5/8 | 10 | 3.43 | 34.30 | 56.88 | 91.18 |
| 2 IN EMT Conduit | 4 | 1.66 | 6.64 | 41.60 | 48.24 |
| 2" Snap-On Plastic Bushing | 4 | 1.38 | 5.52 | 43.33 | 48.85 |
| Sub-Total | | | 2,953.02 | 613.06 | 3,566.08 |

BACKBONE INSTALLATION INDOOR

| | Quantity | Unit Cost | Material | Labor | Total |
|------------------------------------|----------|-----------|----------|-------|--------|
| COPPER CABLE | | | | | |
| Cat3 100 Pair Riser Cable | 50 | 3.13 | 156.50 | 27.08 | 183.58 |
| COPPER TERMINATION HARDWARE | | | | | |
| 300PR 110 BLK W/O LEGS-X | 1 | 263.08 | 263.08 | 97.50 | 360.58 |

Vector Resources, Inc.

8647 Ninth Street, Rancho Cucamonga, CA 91730
 (800) 929-4516

| | | | | | |
|--|----|--------|-----------------|-----------------|-----------------|
| CAT6 48 Port Patch Panel W/ 6 Port Modules | 2 | 318.70 | 637.40 | 520.00 | 1,157.40 |
| 300PR 110 BLK W/O LEGS-X | 1 | 263.08 | 263.08 | 111.00 | 374.08 |
| COPPER TESTING | | | | | |
| Testing & Labeling - Copper | 32 | 0.60 | 19.20 | 277.33 | 296.53 |
| <u>Sub-Total</u> | | | <u>1,339.26</u> | <u>1,032.92</u> | <u>2,372.18</u> |

PROFESSIONAL SERVICES

| | Quantity | Unit Cost | Material | Labor | Total |
|---------------------------------------|----------|-----------|-------------|-----------------|-----------------|
| Rack Client equipment | 1 | 0.00 | 0.00 | 520.00 | 520.00 |
| Design & Engineering | 1 | 0.00 | 0.00 | 260.00 | 260.00 |
| Install Client provided APC UPS units | 1 | 0.00 | 0.00 | 260.00 | 260.00 |
| CAD | 1 | 0.00 | 0.00 | 195.00 | 195.00 |
| Mobilization & Logistics | 1 | 0.00 | 0.00 | 520.00 | 520.00 |
| Project Management | 1 | 0.00 | 0.00 | 520.00 | 520.00 |
| <u>Sub-Total</u> | | | <u>0.00</u> | <u>2,275.00</u> | <u>2,275.00</u> |

| | | | |
|-------------------|-----------|-----------|-----------|
| Project Sub-Total | 10,817.83 | 14,417.39 | 25,235.22 |
| Sales Tax | | | 838.38 |
| Project Total | | | 26,073.60 |

Vector Resources, Inc.

8647 Ninth Street, Rancho Cucamonga, CA 91730
 (800) 929-4516

TERMS AND CONDITIONS OF CONTRACT

TERMS AND CONDITIONS

All work is to be completed in a workmanlike manner according to standard practices. All material is to be as specified. Any alterations or deviation from above specifications involving extra costs will be executed only upon written orders, and will become an extra charge over the estimate. All agreements contingent upon strikes, accidents or delays beyond our control will be settled in a formal agreement. Owner is responsible to carry fire, tornado and other necessary insurance. Our workers are fully covered by Workman's Compensation Insurance.

PAYMENT REQUIREMENTS

Purchase Order Number Due Upon Signing,
Monthly Progress Invoices to be Billed due Net 30,
Balance Due Upon Completion due Net 30
This proposal is valid for 30 days only

Library Systems & Services LSSI
5840 Mission Blvd
Riverside, CA 92509

Job Total \$26,073.60

Vector Resources, Inc. Authorized Signature Date

ACCEPTANCE OF PROPOSAL

The prices, specifications and conditions are satisfactory and are hereby accepted. You are authorized to do the work as specified. Payment will be made as outlined above.

Authorized Signature Date

Print Name



VECTOR RESOURCES
ENTERPRISE NETWORK SOLUTIONS

VRN-048234-001
March 7, 2012

Doug Wall Construction, Inc.
Cabazon, CA

Project
Cabazon Civic Center "BLDG D"
Proposal 1 Version 1

Prepared For
Doug Wall Construction, Inc.

Prepared By
Vector Resources, Inc.
Skyler Peterson

Vector Resources, Inc.

8647 Ninth Street, Rancho Cucamonga, CA 91730
(800) 929-4516

TABLE OF CONTENTS

- 1.0 Vector Resources
 - 2.0 Project
 - 3.0 Project Team
 - 4.0 Codes and Standards
 - 5.0 Cable Infrastructure
 - 6.0 Post Support
 - 7.0 Project Parameters
- Detailed Pricing
- Terms and Conditions of Contract
(SignatureRequired)

Vector Resources, Inc.

8647 Ninth Street, Rancho Cucamonga, CA 91730
(800) 929-4516

1.0 Vector Resources

1.1 Company Overview

Vector Resources, Inc. ("Vector") is a leading converged telephony and enterprise network systems integration firm committed to delivering innovation. With over 20 years experience, we are a turnkey systems provider, specializing in the design and implementation of high performance networking solutions. We offer a wide range of services in the areas of structured communications cabling, wireless, surveillance, access control, Voice over Internet Protocol (VoIP), network security, and remote monitoring.

Recognized widely for our engineering capabilities and management excellence, Vector's team consists of the 4 original partners and over 350 employees, including engineers, technical personnel, business development and customer service agents. Vector is headquartered in Torrance, California, with additional offices in San Diego, Rancho Cucamonga, and Tempe, Arizona.

Vector's certifications and partnerships allow us to serve as a full-service solution provider. We maintain C7, C10 electrical contractor licenses and a General Contractor "B" license. Our business partners include AMP (one of the largest ND&I contractor in the country), Ascom Wireless, Avaya, Cisco, HP Networking, Hirsch, OnSSI, PCSC, Sony and other world class IT and integration solution vendors.

2.0 Project

2.1 Project Overview

Vector is pleased to present the following proposal to Doug Wall Construction ("client") for the Riverside County Cabazon Civic Center Building "D" project. This proposal includes:

-Specifications for the installation of new structured communication cabling

This proposal was based on the information gathered from meetings and conversations, the site walk and our experience with similar types of projects. The proposal includes the furnishing of all materials, labor, transportation, tools, permits, fees, utilities and incidentals necessary for the complete installation of all work specified within this document.

Scope of Work:

Vector Resources will provide and install Voice and Data cabling as outlined in the provided project drawings.

Vector Resources, Inc.

8647 Ninth Street, Rancho Cucamonga, CA 91730
(800) 929-4516

3.0 Project Team

3.1 Installation Procedure

Vector will establish a project team comprised of several individuals with relevant knowledge and experience. An experienced Project Manager/Coordinator will head the project team to ensure the project is on schedule and within budget.

In addition to the core project team, Vector has over 350 employees with a full range of specialties that can be utilized to assist in the project as needed. Among these employee resources are Vector's quality control officials who will visit the project site throughout the duration of the project to ensure that the highest quality installation practices are being used.

Vector recommends that the client create its own project team prior to the project's implementation. This team will work in conjunction with Vector's team to determine the implementation schedule, establish policies and procedures, and decide how best to handle the distribution of information to client's staff members, technical issues, training, device management and maintenance, and system maintenance.

4.0 Codes and Standards

4.1

All work performed on this project will be installed in accordance with IEEE 802.11 installation guidelines, the current edition of the NEC, NESC, Bicsi Telecommunications Distribution Methods Manual (TDMM), BICSI Cabling Installation Manual, and the latest issue of the ANSI/TIA/EIA Standards, along with all state/local codes and ordinances.

Vector Resources, Inc.

8647 Ninth Street, Rancho Cucamonga, CA 91730
(800) 929-4516

5.0 Cable Infrastructure

5.1 Horizontal

Vector Resources will install approximately Thirty (5) telecommunication outlets, equaling Fifty Eight (8) Cat-6 cables for voice and data purposes. See the following information and installation matrix for details:

Note: These breakdowns are not exact but account for a total of (8) Cat-6 cables.

| Quantity | Description |
|----------|--|
| (3) | 1-Cat-6 data cable and 1-Cat-6 voice cable - Combo outlets |
| (2) | 1-Cat-6 data cable only - wall outlets |

Total Cables - 8 Cat-6 cables

Cable Hangers and Supports:

Vector Resources shall install cable hangers, J-hooks, or other supporting assemblies in order to properly secure and support all horizontal cables. Within the ceiling space, supports will be installed every 4-5 ft. or as needed.

No cables will be attached to support wire for ceiling tile grid, support assemblies for electrical conduits or the conduits themselves, or support assemblies for the fire protections systems.

Cable - Data Applications:

All horizontal data cables designated for data applications will be Unshielded Twisted Pair (UTP) 4 pair 24 AWG Cat-6 rated.

All horizontal data cables will be plenum rated.

The jacket of the cable will be blue.

All horizontal data cables shall terminate on modular patch panels in their respective Telecommunications Room.

Cable - Voice Applications:

All horizontal voice cables designated for voice applications will be Unshielded Twisted Pair (UTP) 4 pair 24 AWG Cat-6 rated.

All horizontal voice cables will be plenum rated.

The jacket of the cable will be white.

All horizontal voice cables shall terminate on modular patch panels in their respective Telecommunications Room.

Work Area Outlets:

All horizontal cables will be dressed into faceplates installed at the designated work or device area location. All connector assemblies shall snap into the faceplates.

All wall mounted faceplates shall be white, single-gang and available in 4-ports.

Vector Resources, Inc.

All faceplates shall have recessed designation windows to facilitate labeling and identification. All faceplates will be labeled with adhesive labels (white background / black lettering) and be given a unique labeling/numbering scheme.

Work Area Data Inserts:

All data inserts shall be 8-position modular inserts.

All data inserts shall be Cat-6 rated.

All data inserts shall be blue.

All cables will be terminated with a 568 B-wiring scheme unless otherwise specified.

Work Area Voice Inserts:

All voice inserts shall be 8-position modular inserts.

All voice inserts shall be Cat-6 rated.

All voice inserts shall be white.

Vector Resources, Inc.

8647 Ninth Street, Rancho Cucamonga, CA 91730
(800) 929-4516

5.2 MDF

Within the MDF, one new wall mounted cabinet will be installed.

Horizontal Wire Management

Horizontal wire managers will be provided above, below and in between each patch panel.

The horizontal wire managers will be double sided (front and rear) and shall be 2 RMU in height.

The horizontal wire managers include snap-on hinged doors/covers.

The horizontal wire management will be black in color.

The following applies to the MDF.

UTP - Data Patch Panels:

All horizontal data cables will be terminated onto rack mounted patch panels.

All patch panels will be Cat-6 rated.

All patch panels will be available in 48-port high-density configurations with designation label strips.

All patch panels will be 2 RMU (Rack Mount Unit) in height.

UTP - Voice Termination:

All horizontal voice cables will be terminated onto wall mounted 110 blocks.

5.3 Backbone Indoor

No indoor backbone cable will be installed as part of this project.

5.4 Backbone Outdoor

No outdoor backbone cable will be installed as part of this project.

Vector Resources, Inc.

8647 Ninth Street, Rancho Cucamonga, CA 91730
(800) 929-4516

5.5 Testing and Labeling

Copper Testing:

All cables and termination hardware shall be tested.

All cables shall be tested in accordance with ANSI/TIA/EIA standards, manufacturer specifications and best industry practice.

All twisted pair copper cables links shall be tested for continuity, pair reversals, shorts, opens and performance as indicated for the type of cable installed.

This project includes the testing for Cat-6 cables.

All cables tested for data and voice applications will be recorded and submitted as part of a final documentation package.

Fiber Optic Testing:

No Fiber Optic cabling has been included as part of this project.

Vector Resources, Inc.

8647 Ninth Street, Rancho Cucamonga, CA 91730
(800) 929-4516

5.6 Documentation

Package Includes:

This project includes the delivery and submittal of:

1. Test results for all copper data cable(s)
 - a. Summary
 - b. Detail
2. Test results for all copper voice cable(s)
 - a. Summary
 - b. Detail
3. CAD drawing(s) – AutoCAD drawings depicting all work performed.
 - a. Plan View
 - i. Space layout with identification labels for all NEW work.
 - b. Backbone Diagram (TR to TR, Riser, Campus)
 - i. Copper
 - ii. Fiber
4. Warranty Information
 - a. Vector Resources 1-year warranty
 - b. Manufacturer warranty - 25 year

Upon completion, one (1) hard copy set shall be delivered to the primary contact within one (1) week of completing the project. Soft copy drawings are available upon request.

Customer Responsibilities

If applicable/available, preliminary soft copy drawings must be provided by the customer in an AutoCAD format. Drawings must be provided three (3) days after approving the contract proposal/quote. Drawings must contain a core, a shell and a space layout of the most recent configuration.

Vector Resources, Inc.

8647 Ninth Street, Rancho Cucamonga, CA 91730
(800) 929-4516

6.0 Post Support

6.1

Vector offers several post-project support options that can assist the client once its system is operational. These options include quarterly, semi-annual, or annual on-site preventive maintenance and audits; blocks of time for on-site maintenance and upgrades; and management of the RMA process.

Upon request, Vector will customize a post-installation project support and maintenance plan to suit the client's needs.

Vector's most popular support options include the following:

Vector Insight Managed Services

Vector provides complete systems management services that include:

- 24x7 systems monitoring
- Guaranteed hourly services from network engineers and service technicians for onsite/offsite maintenance and upgrades, RMA management, and system moves, adds and changes
- Monthly performance reporting and quarterly consulting analysis

Vector Hourly IS Services

With this option, Vector provides "time and materials" post-installation services and support. The standard support package includes access to the Vector Help Desk during normal business hours, and emergency assistance for critical issues. For manufacturer warranties that include monitoring, Vector will also receive manufacturer alerts directly to its Help Desk upon the client's request.

The Help Desk is available from 8:00 a.m. to 5:00 p.m. Pacific Standard Time, Monday through Friday, excluding the six national holidays, to provide assistance. Emergency assistance for critical problems is available at all times. The client can contact the Help Desk by telephone at 877.569.8800 within the 48 contiguous states or by email at helpdesk@vectorusa.com.

7.0 Project Parameters

7.1 Access

Vector has access to all areas required to perform the proposed scope of work in a timely manner.

7.2 Change Order

Any work that is added to or deleted from the original scope of this proposal and which alters the original costs or completion date must be agreed upon by both parties in the form of a written change order.

Vector Resources, Inc.

8647 Ninth Street, Rancho Cucamonga, CA 91730
(800) 929-4516

7.3 Delays

The client must provide five working days' advance notice of any factor that will delay this project or Vector will issue a work stoppage change order. Additionally, idle time incurred by Vector due to the absence of required escorts, clearance, permits, inability to enter the work place, delays by other trades or other factors beyond Vector's control will be addressed with a written change order.

7.4 Work Days/Overtime

This work will be performed during Vector's regular standard business hours of 7:00 a.m. to 5:00 p.m. Pacific Standard Time, Monday through Friday, except holidays. Work outside of regular business hours is available, but requires a written change order.

7.5 Schedule

Vector plans to implement this project in a continuous fashion or as outlined within the RFP. If any additional mobilization is required, as a result of a change in the project schedule, not caused by Vector, it will be addressed with a written change order.

7.6 Asbestos/Hazardous Materials

Vector assumes that the installation teams will be working in areas that will not contain asbestos or any other hazardous material that would require additional time or alternative installation procedures.

It is the responsibility of the client to give written notification to Vector, prior to the start of a project, of any asbestos contained material (ACMs) in or around the area of the project. In the event that ACMs are present prior to job commencement or if ACMs are encountered during the project, additional cost, damages and/or delays attributed to necessary procedures for working in this environment will be the responsibility of the client.

7.7 Adequate Room

The client must provide adequate room for the installation of the proposed termination hardwired at the station and in the communications closets.

7.8 Storage Area

The client will provide a secured storage area inside the building for Vector's materials and tools.

7.9 Office Furniture

Vector will not be responsible for disassembling or moving desks or other office furniture to gain proper access to perform installation tasks.

7.10 Ceiling Tile

Vector exercises care in the removal, storage and reinstallation of existing (used) ceiling tiles; however, Vector accepts no liability for any incidental damages that may result from the handling of ceiling tiles.

Vector Resources, Inc.

8647 Ninth Street, Rancho Cucamonga, CA 91730
(800) 929-4516

7.11 Cross-Connections

Vector will not be responsible for providing and installing the cross-connects to the phone system.

7.12 Patch Cords

Vector will not be responsible for providing and installing voice and data patch cables.

7.13 Existing Cable

Vector has not confirmed that the existing cable infrastructure is usable (e.g. labeled, correct pin configurations, etc.). The client will be responsible for providing technician(s) (e.g. cable vendor) to troubleshoot any wiring issues that may arise during installation.

Vector will troubleshoot or resolve in-house wire issues if requested by the client in the form of a written change order.

7.14 Existing Conduit

The client is responsible for ensuring that the existing conduit/pathway is free and clear from defects. If the conduit/pathway is not free and clear from defects, the client will be responsible for making it free and clear.

Vector can assist with making the existing conduit/pathway free and clear if requested by the client in the form of a written change order.

7.15 Coring

If coring is necessary, it will be address with a written change order.

7.16 Add & Delete

This proposal is not to be used as an "Add & Delete" schedule; it only applies to the work specified in the original RFP. Any additional work requested will be considered as separate work and addressed with a written change order.

7.17 Defective Materials

If there is a delay and/or Vector is unable to perform its scope of work, due to problems with the existing hardware and/or materials provided by the client or other third parties, it will be addressed with a written change order.

7.18 Dial Tone/Data Circuits

It is the responsibility of the client to ensure that dial tone and data circuits are installed and operational in the communications room as needed. Time spent troubleshooting and correcting circuit issues will be addressed with a written change order.

Vector Resources, Inc.

8647 Ninth Street, Rancho Cucamonga, CA 91730
(800) 929-4516

7.19 Network Equipment

Vector has based this proposal on the client's provision of all network switches/equipment. All network switches must be PoE and will be in place and operational prior to the cutover date.

In addition, the network equipment must meet the minimum standards set by the systems manufacturer.

7.20 Server(s)

Vector has based this proposal on the client's provision of the server(s) with all server applications, unless outlined otherwise in the proposal. The server must meet the minimum standards set by the systems manufacturer.

7.21 Taxes

Taxes will be billed on tax rates and guidelines at time of invoice.

7.22 Extraordinary Service

Certain additional charges related to extraordinary levels of support or out-of-pocket costs incurred by Vector, through no fault of its own, will be reimbursable by the client under this agreement.

Examples of costs reimbursable under this section include, but are not limited to 1) shipping expenses related to unusual site handling expenses (e.g. extra distance, no loading dock, extra stairs, extra demurrage charges), 2) storage or special handling expenses incurred if an installation site is not able to accept delivery as scheduled, 3) expenses incurred by Vector to resolve network compatibility issues caused by a client's election to substitute non-Vector provided equipment or services, and 4) expenses incurred by Vector for additional installation time and/or materials caused by a site not being prepared as called for in this proposal.

Vector shall promptly notify the client in writing of such charges. Notification will be provided, when feasible, prior to the incurrence of such charges, unless circumstances preclude such prior written notification (by way of example, but not limited to, unusual site handling charges). Provided the incurrence of such charges is not due to Vector's fault or negligence, Vector shall be entitled to an equitable adjustment in the prices herein, the delivery schedule, or both to reflect such charges and any related delay.

7.23 Proprietary Information

The information contained in this document is proprietary to Vector and intended to be used as evaluative and/or bidding information only. No part of this document may be disclosed, reproduced and/or distributed to anyone except the listed recipients within this package without written permission from Vector.

Vector Resources, Inc.

8647 Ninth Street, Rancho Cucamonga, CA 91730
(800) 929-4516

DETAILED PRICING

| | | | | | |
|------------------------------------|---|------|-------|-------|-------|
| CAT6 Clarity TracJack Insert White | 3 | 6.78 | 20.34 | 33.30 | 53.64 |
|------------------------------------|---|------|-------|-------|-------|

HORIZONTAL INSTALLATION

| COPPER CABLING | Quantity | Unit Cost | Material | Labor | Total |
|--|----------|-----------|-----------------|-----------------|-----------------|
| CAT6 4 Pair Plenum White Cable | 1,000 | 0.32 | 320.00 | 308.33 | 628.33 |
| 23/4PR SOL NS CAT6 CMP BLUE | 1,000 | 0.32 | 320.00 | 433.33 | 753.33 |
| TELECOMMUNICATIONS OUTLET | | | | | |
| CAT6 Clarity TracJack Insert Dark Blue | 5 | 6.78 | 33.90 | 48.75 | 82.65 |
| 4 Port TracJack Faceplate Cloud White | 5 | 1.73 | 8.65 | 27.08 | 35.73 |
| Blank Insert Cloud White | 10 | 3.00 | 30.00 | 5.42 | 35.42 |
| TELECOMMUNICATIONS ROOM | | | | | |
| CAT6 24 Port Patch Panel | 1 | 193.20 | 193.20 | 234.00 | 427.20 |
| HANGERS AND SUPPORT | | | | | |
| 8ft 12AWG Seismic Ceiling Wire With Clip | 25 | 1.27 | 31.75 | 135.42 | 167.17 |
| 2" J Hook W/ Multifunction Clip | 25 | 3.69 | 92.25 | 135.42 | 227.67 |
| Multi Function Clip | 2 | 0.31 | 0.62 | 10.83 | 11.45 |
| TESTING | | | | | |
| Testing & Labeling - Copper | 8 | 0.60 | 4.80 | 69.33 | 74.13 |
| MISCELLANEOUS | | | | | |
| 3/4" x 75ft Velcro One Wrap Black | 1 | 31.20 | 31.20 | 65.00 | 96.20 |
| Sub-Total | | | 1,066.37 | 1,472.92 | 2,539.29 |

DISTRIBUTION RACKS & CABINETS

| WALL CABINET | Quantity | Unit Cost | Material | Labor | Total |
|--|----------|-----------|-----------------|---------------|-----------------|
| MM WALL CABINET 26U PLEXI | 1 | 765.60 | 765.60 | 296.00 | 1,061.60 |
| WALL CABINET FAN KIT | 1 | 39.71 | 39.71 | 24.67 | 64.38 |
| CABLE MANAGEMENT | | | | | |
| WIREMANAGER VERTICAL DBL SIDED | 2 | 281.84 | 563.68 | 65.00 | 628.68 |
| 2 Space Horizontal Wire Manger w/ 5 Distribution Rings | 2 | 51.92 | 103.84 | 32.50 | 136.34 |
| Sub-Total | | | 1,472.83 | 418.17 | 1,891.00 |

BACKBONE INSTALLATION INDOOR

| COPPER TERMINATION HARDWARE | Quantity | Unit Cost | Material | Labor | Total |
|-----------------------------|----------|-----------|---------------|---------------|---------------|
| 300PR 110 BLK W/O LEGS-X | 1 | 263.08 | 263.08 | 111.00 | 374.08 |
| COPPER TESTING | | | | | |
| Testing & Labeling - Copper | 8 | 0.60 | 4.80 | 69.33 | 74.13 |
| Sub-Total | | | 267.88 | 180.33 | 448.21 |

PROFESSIONAL SERVICES

| | Quantity | Unit Cost | Material | Labor | Total |
|--------------------------|----------|-----------|-------------|-----------------|-----------------|
| Design & Engineering | 1 | 0.00 | 0.00 | 260.00 | 260.00 |
| CAD | 1 | 0.00 | 0.00 | 195.00 | 195.00 |
| Mobilization & Logistics | 1 | 0.00 | 0.00 | 520.00 | 520.00 |
| Project Management | 1 | 0.00 | 0.00 | 520.00 | 520.00 |
| Sub-Total | | | 0.00 | 1,495.00 | 1,495.00 |

| | | | |
|----------------------|----------|----------|-----------------|
| Project Sub-Total | 2,827.42 | 3,599.72 | 6,427.14 |
| Sales Tax | | | 219.13 |
| Project Total | | | 6,646.26 |

Vector Resources, Inc.

8647 Ninth Street, Rancho Cucamonga, CA 91730
 (800) 929-4516

TERMS AND CONDITIONS OF CONTRACT

TERMS AND CONDITIONS

All work is to be completed in a workmanlike manner according to standard practices. All material is to be as specified. Any alterations or deviation from above specifications involving extra costs will be executed only upon written orders, and will become an extra charge over the estimate. All agreements contingent upon strikes, accidents or delays beyond our control will be settled in a formal agreement. Owner is responsible to carry fire, tornado and other necessary insurance. Our workers are fully covered by Workman's Compensation Insurance.

PAYMENT REQUIREMENTS

Purchase Order Number Due Upon Signing,
Monthly Progress Invoices to be Billed due Net 30,
Balance Due Upon Completion due Net 30

This proposal is valid for 30 days only

Doug Wall Construction, Inc.
Cabazon, CA

Job Total \$6,646.26

Skyler Peterson

Vector Resources, Inc. Authorized Signature

Date

ACCEPTANCE OF PROPOSAL

The prices, specifications and conditions are satisfactory and are hereby accepted. You are authorized to do the work as specified. Payment will be made as outlined above.

Authorized Signature

Date

Print Name