

**SUBMITTAL TO THE BOARD OF SUPERVISORS  
COUNTY OF RIVERSIDE, STATE OF CALIFORNIA**

210 A



**FROM:** TLMA - Transportation Dept.

**SUBMITTAL DATE:**  
June 7, 2012

**SUBJECT:** Landscaping and Lighting Maintenance District No. 89-1-Consolidated,  
Annexation of Zone 172 (French Valley).

**RECOMMENDED MOTION:** That the Board:

With regard to the annexation of Zone 172 to Landscaping and Lighting Maintenance District No. 89-1-Consolidated, conduct the public hearing and, after closing the public hearing, direct the Director of Transportation, or his designee, who the Board finds to be an impartial person as that term is used in Section 53753(e) of the Government Code, to tally all ballots received prior to the close of the public hearing. All ballots received prior to the close of the public hearing will be tallied at 10:00 a.m. on Wednesday, June 20, 2012 in Conference Room C on the 8<sup>th</sup> Floor of the County Administrative Center, 4080 Lemon Street, Riverside, California. Staff is directed to

\_\_\_\_\_  
Juan C. Perez  
Director of Transportation

MH:jp

FORM APPROVED COUNTY COUNSEL  
BY:   
DALE A. GARDNER  
DATE: 5/22/12  
Departmental Concurrence

<b>FINANCIAL DATA</b>	Current F.Y. Total Cost:	\$0	In Current Year Budget:	N/A
	Current F.Y. Net County Cost:	\$0	Budget Adjustment:	N/A
	Annual Net County Cost:	\$0	For Fiscal Year:	2011-12

<b>SOURCE OF FUNDS:</b> Landscaping and Lighting Maintenance District No. 89-1-Consolidated – 100%	<b>Positions To Be Deleted Per A-30</b>	<input type="checkbox"/>
	<b>Requires 4/5 Vote</b>	<input type="checkbox"/>

There are no General Funds used in this project.

**C.E.O. RECOMMENDATION:**

APPROVE

BY:   
Tina Grande

County Executive Office Signature

**MINUTES OF THE BOARD OF SUPERVISORS**

On motion of Supervisor Stone, seconded by Supervisor Ashley and duly carried, IT WAS ORDERED that the above matter is approved as recommended.

Ayes: Buster, Tavaglione, Stone and Ashley  
Nays: None  
Absent: Benoit  
Date: June 19, 2012  
xc: Transp.

Kecia Harper-Ihem  
Clerk of the Board  
By:   
Deputy

Prev. Agn. Ref. 05/01/12, 3.34 | District: 3/3 | Agenda Number:

9.4

The Honorable Board of Supervisors

RE: Landscaping and Lighting Maintenance District No. 89-1-Consolidated, Annexation of Zone 172 (French Valley).

June 7, 2012

Page 2 of 2

cause the appropriate resolution, based on the election tally, to be prepared and returned to the Board for its consideration.

**BACKGROUND:** Pursuant to the Landscaping and Lighting Act of 1972 and Resolution 2012-091 adopted May 1, 2012, the Board of Supervisors noticed a public hearing for June 19, 2012, to receive testimony regarding the annexation of Zone 172 to Landscaping and Lighting Maintenance District No. 89-1-Consolidated (L&LMD No. 89-1-C). Annexation of Zone 172 will fund the maintenance and servicing of fossil filters and traffic signals, and the provision of electricity for traffic signals within public rights-of-way located northerly and southerly of Pat Rd, northerly and southerly of Baxter Rd, easterly and westerly of Briggs Rd, and westerly of Lasker Ln in the French Valley area and includes 503 single-family residential lots.

On May 12, 2012 a notice of the public hearing and mail-in ballot, an impartial analysis, a copy of Resolution No. 2012-091, and an information sheet was mailed to all property owners within Zone 172, proposed for annexation to L&LMD No. 89-1-C. Pursuant to the notice, all ballots must be returned prior to the conclusion of the public hearing.

Notice of the public hearing was also given by publication of a certified copy of Resolution No. 2012-091 in an appropriate newspaper at least ten (10) days prior to the public hearing date and by posting a certified copy of the Resolution No. 2012-091 on the official bulletin board customarily used by the Board of Supervisors for the posting of notices and in two other public locations within the County.



OFFICE OF  
CLERK OF THE BOARD OF SUPERVISORS  
1st FLOOR, COUNTY ADMINISTRATIVE CENTER  
P.O. BOX 1147, 4080 LEMON STREET  
RIVERSIDE, CA 92502-1147  
PHONE: (951) 955-1060  
FAX: (951) 955-1071

KECIA HARPER-IHEM  
Clerk of the Board of Supervisors

KIMBERLY A. RECTOR  
Assistant Clerk of the Board

May 23, 2012

THE PRESS ENTERPRISE  
ATTN: LEGALS  
P.O. BOX 792  
RIVERSIDE, CA 92501

FAX: (951) 368-9018  
E-MAIL: [legals@pe.com](mailto:legals@pe.com)

**RE: NOTICE OF PUBLIC HEARING: RESOLUTION 2012-091 ZONE 172**

To Whom It May Concern:

Attached is a copy for publication in your newspaper for **ONE (1) TIME** on **Saturday, May 26, 2012.**

We require your affidavit of publication immediately upon completion of the last publication.

Your invoice must be submitted to this office in duplicate, WITH TWO CLIPPINGS OF THE PUBLICATION.

NOTE: PLEASE COMPOSE THIS PUBLICATION INTO A SINGLE COLUMN FORMAT.

Thank you in advance for your assistance and expertise.

Sincerely,

*Mcgil*

Cecilia Gil, Board Assistant to  
KECIA HARPER-IHEM, CLERK OF THE BOARD

3.34b of 05-01-12

6-19-2012  
9.4

## Gil, Cecilia

---

**From:** mtinajero@pe.com on behalf of Master, PEC Legals <legalsmaster@pe.com>  
**Sent:** Wednesday, May 23, 2012 8:11 AM  
**To:** Gil, Cecilia  
**Subject:** Re: [Legals] FOR PUBLICATION: RES. 2012-091 ZONE 172

Received for publication on May 26. Proof with cost to follow.

On Wed, May 23, 2012 at 7:35 AM, Gil, Cecilia <[CCGIL@rcbos.org](mailto:CCGIL@rcbos.org)> wrote:

-----  
Good Morning!

Attached is a Notice of Public Hearing, for publication on Saturday, May 26, 2012. Please confirm. THANK YOU!

*Cecilia Gil*

Board Assistant to the  
Clerk of the Board of Supervisors  
[951-955-8464](tel:951-955-8464)

***THE COUNTY ADMINISTRATIVE CENTER IS CLOSED EVERY FRIDAY UNTIL FURTHER NOTICE.***

**PLEASE CONSIDER THE ENVIRONMENT BEFORE PRINTING.**

--

Legal Advertising



Publisher of The Press-Enterprise  
Phone: 1.800.880.0345  
Fax: 951.368.9018

**NOTICE OF PUBLIC HEARING BEFORE THE BOARD OF SUPERVISORS OF THE COUNTY OF RIVERSIDE**

NOTICE IS HEREBY GIVEN that a public hearing at which all interested persons will be heard, will be held before the Board of Supervisors of Riverside County, California, on the 1<sup>st</sup> Floor, County Administrative Center, Board of Supervisors Chambers, 4080 Lemon Street, Riverside, on **Tuesday, June 19, 2012 at 9:30 a.m.** to consider the following:

**RESOLUTION NO. 2012-091**

RESOLUTION OF THE BOARD OF SUPERVISORS OF THE COUNTY OF RIVERSIDE DECLARING ITS INTENT TO ORDER THE ANNEXATION OF ZONE 172 TO LANDSCAPING AND LIGHTING MAINTENANCE DISTRICT NO. 89-1-CONSOLIDATED OF THE COUNTY OF RIVERSIDE PURSUANT TO THE LANDSCAPING AND LIGHTING ACT OF 1972 FOR THE MAINTENANCE AND SERVICING OF FOSSIL FILTERS AND TRAFFIC SIGNALS; ADOPTING THE PRELIMINARY ENGINEER'S REPORT; GIVING NOTICE OF AND SETTING THE TIME AND PLACE OF THE PUBLIC HEARING ON THE ANNEXATION OF ZONE 172; ORDERING AN ASSESSMENT PROCEEDING; ORDERING A MAILED BALLOT ELECTION; AND DIRECTING NOTICE OF THE PUBLIC HEARING AND THE ASSESSMENT BALLOT TO BE MAILED PURSUANT TO SAID ACT AND ARTICLE XIID OF THE CALIFORNIA CONSTITUTION AND SECTION 4000 OF THE ELECTIONS CODE

**WHEREAS**, the Board of Supervisors (hereinafter the "Board of Supervisors") of the County of Riverside (hereinafter the "County") has adopted Resolution No. 2012-090 on May 1, 2012 initiating proceedings for the annexation of Zone 172 (hereinafter "Zone 172"), as described and shown in Exhibit "A", which is attached hereto and incorporated herein, to Landscaping and Lighting Maintenance District No. 89-1-Consolidated of the County of Riverside, State of California, (hereinafter "L&LMD No. 89-1-C") pursuant to the Landscaping and Lighting Act of 1972 (hereinafter the "Act"), which is Part 2 (commencing with Section 22500) of Division 15 of the Streets and Highways Code (hereinafter the "Street and Highways Code"), and ordering the preparation of a report (hereinafter the "Report") regarding the proposed annexation of Zone 172 and the assessments to be levied within Zone 172 each fiscal year beginning fiscal year 2012-13 for the maintenance and servicing of fossil filters and traffic signals, and the provision of electricity for traffic signals within the public right-of-way within said Zone; and

**WHEREAS**, such proceedings shall comply with the requirements of Article XIID of the California Constitution (hereinafter "Article XIID."), the Act, and Section 4000 of the Elections Code requiring voter approval of the proposed assessment to be levied by L&LMD No. 89-1-C for Zone 172; and

**WHEREAS**, the Board of Supervisors by Resolution No. 2012-090 directed the Director of the Transportation Department, or his designee (hereinafter the "Engineer"), to prepare and file the Report with the Clerk of the Board of Supervisors in accordance with Sections 22608 and 22585 et. seq. of the Street and Highways Code and Section 4 of Article XIID; and

**WHEREAS**, said Engineer has filed the Report with the Clerk of the Board of Supervisors and the Report has been presented to and considered by the Board of Supervisors; and

**WHEREAS**, the Applicant has executed a "Waiver and Consent Regarding Date of Assessment Ballot Election" allowing for the election to be held on June 19, 2012; and

**WHEREAS**, it is necessary that the Board of Supervisors adopt a resolution of intention pursuant to Section 22624 of the Streets and Highways Code, which fixes and gives notice, pursuant to Section 22626 of the Streets and Highways Code, of the time and place of a public hearing on said Report, the annexation of Zone 172, and the assessments to be levied on parcels within Zone 172 beginning in fiscal year 2012-13;

**NOW, THEREFORE, BE IT RESOLVED, FOUND, DETERMINED AND ORDERED** by the Board of Supervisors in regular session assembled on May 1, 2012 as follows:

**Section 1. Findings.** The Board of Supervisors, after reviewing the Report, finds that:

- (a) The foregoing recitals are true and correct;
- (b) The Report contains all matters required by Sections 22565 through 22574 of the Streets and Highways Code and Section 4 of Article XIID and may, therefore, be approved by the Board of Supervisors;

(c) The annual assessment for fiscal year 2012-13 on all parcels within Zone 172 will be \$92.56 per parcel.

**Section 2. Intent.** The Board of Supervisors hereby declares its intention to order the annexation of Zone 172, as described and shown in Exhibit "A", to L&LMD No. 89-1-C, and to levy and collect an annual assessment on all assessable lots and parcels of property within Zone 172 commencing with the fiscal year 2012-13 as set forth in the Report. The Report expressly states that there are no parcels or lots within Zone 172 that are owned by a federal, state or other local governmental agency that will benefit from the services to be financed by the annual assessments. The annual assessments will be collected at the same time and in the same manner as property taxes are collected, and all laws providing for the collection and enforcement of property taxes shall apply to the collection and enforcement of said assessments.

**Section 3. Boundaries.** All the property within boundaries of Zone 172 is proposed to be annexed to L&LMD No. 89-1-C and shall include that property in the unincorporated area of the County as described and shown in Exhibit "A".

**Section 4. Description of Services to be Provided.** The services associated with fossil filters and traffic signals authorized for Zone 172 of L&LMD No. 89-1-C are:

(a) The maintenance and servicing of fossil filters within the public right-of-way including the removal of petroleum hydrocarbons and other pollutants from water runoff; and

(b) Providing electricity to and the maintenance and servicing of traffic signals within the public right-of-way including incidental costs and expenses.

**Section 5. Amount to be Levied.** The assessment to be levied upon each parcel that benefits from the annexation of Zone 172 to L&LMD No. 89-1-C will be \$92.56 per parcel for fiscal year 2012-13. As stated in the Report, the total budget for Zone 172 for the fiscal year 2012-13 is \$46,559; there are 503 parcels that are to be assessed. Each succeeding fiscal year the special assessment may be subject to an annual adjustment that is the greater of two percent (2%) or the cumulative percentage increase, if any, in the Consumer Price Index for all Urban Consumers ("CPI-U") for the Los Angeles-Riverside-Orange County California Standard Metropolitan Statistical area ("Index") published by the Bureau of Labor Statistics of the United States Department of Labor. The annual CPI-U adjustment will be based on the cumulative increase, if any, in the "Index" as it stands on March of each year over the base Index for March of 2012. Any increase larger than the greater of 2% or the CPI-U annual adjustment requires a majority approval of all the property owners in Zone 172. The Board of Supervisors will levy the assessment in each subsequent fiscal year until the Board of Supervisors undertakes proceedings for the dissolution of Zone 172 of L&LMD No. 89-1-C. The annual assessment will fund the services described in Section 4 of this Resolution. For further particulars, reference is to be made to the Report on file in the Office of the Clerk of the Board of Supervisors.

**Section 6. The Property to be Annexed.** The property to be annexed to L&LMD No. 89-1-C is Zone 172. The boundaries of Zone 172 are located within the unincorporated area of the County and are described and shown in the Report and Exhibit "A".

**Section 7. Report.** The Report, which is on file with the Clerk of the Board of Supervisors and which has been presented to the Board of Supervisors, is hereby approved. Reference is made to the Report for a full and detailed description of the services, the boundaries of Zone 172, and the annual assessment to be levied upon assessable lots and parcels within Zone 172 proposed to be annexed to L&LMD No. 89-1-C.

**Section 8. Public Hearing.** The question of whether Zone 172 shall be annexed to L&LMD No. 89-1-C and an annual assessment levied beginning with fiscal year 2012-13 shall be considered at a public hearing (hereinafter the "Public Hearing") to be held on June 19, 2012, at 9:30 a.m. at the meeting room of the Board of Supervisors of the County at 4080 Lemon Street, 1<sup>st</sup> Floor, Riverside, California.

**Section 9. Majority Protest.** Each owner of record of property within Zone 172 is to receive by mail an assessment ballot that shall conform to the requirements of Section 4 of Article XIID and Section 4000 of the California Elections Code. The assessment ballots are to be returned prior to the Public Hearing. The agency shall not impose an assessment if there is a majority protest. A majority protest exists if, upon the conclusion of the hearing, ballots submitted in opposition to the assessment exceed the ballots submitted in favor of the assessment. In tabulating the ballots, the ballots shall be weighted according to the proportional financial obligation of the affected property.

**Section 10. Information.** Any property owner desiring additional information regarding Zone 172 of L&LMD No. 89-1-C, the Report, or the proposed assessment is to contact Ms. Joan Pickering, Engineering Technician II, Transportation Department of the County of Riverside, 4080 Lemon Street, 8th Floor, Riverside, California, 92501, or by telephone at 951-955-6748, or by e-mail at [jpickeri@rctlma.org](mailto:jpickeri@rctlma.org).

**Section 11. Notice of the Public Hearing.** Notice of Public Hearing with regard to the annexation of Zone 172 to L&LMD No. 89-1-C shall be given consistent with Section 22626 of the Streets and Highways Code and Section 4 of Article XIID. The Clerk of the Board of Supervisors shall give notice of the Public Hearing by causing a certified copy of this Resolution to be published once in an appropriate newspaper at least ten (10) days prior to the date of the Public Hearing that is June 19, 2012. Publication of this Resolution is to be effected by the Clerk of the Board of Supervisors. Notice shall also be given by mailing first-class, postage prepaid, those notices, as prepared by County Counsel, assessment ballot and information sheets as required by Section 4 of Article XIID and Section 4000 of the California Elections Code to all owners of record of property within Zone 172 as shown on the last equalized assessment roll of the County. Mailing is to be made by the Engineer and deposited with the U. S. Post Office at least forty-five (45) days prior to the Public Hearing on June 19, 2012.

**Section 12 Effective Date.** This Resolution shall take effect from and after its date of adoption.

**EXHIBIT "A"**  
**DESCRIPTION OF BOUNDARIES**

The boundaries of Zone 172 to be annexed into Landscaping and Lighting Maintenance District No. 89-1-Consolidated, of the County of Riverside, are coterminous with the boundaries of 503 parcel(s) as shown on Tract Map No. 30433 in the County of Riverside, State of California for fiscal year 2012-13.



**ROLL CALL:**

**AYES:** Buster, Tavaglione, Stone, Ashley  
**NAYS:** None  
**ABSENT:** Benoit

The foregoing is certified to be a true copy of a resolution duly adopted by said Board of Supervisors on May 1, 2012.

Kecia Harper-Ihem, Clerk of said Board  
By: Cecilia Gil, Board Assistant

Any person affected by the above matter(s) may submit written comments to the Clerk of the Board before the public hearing or may appear and be heard in support of or opposition to the project at the time of the hearing. If you challenge the above item(s) in court, you may be limited to raising only those issues you or someone else raised at the public hearing described in this notice, or in written correspondence, to the Board of Supervisors at, or prior to, the public hearing.

Please send all written correspondence to: Clerk of the Board, 4080 Lemon Street, 1st Floor, Post Office Box 1147, Riverside, CA 92502-1147

Dated: May 23, 2012

Kecia Harper-Ihem, Clerk of the Board  
By: Cecilia Gil, Board Assistant

# ZONE 172

PORTION OF SECTIONS 30 & 31, T.6S., R.2W.

TRACT MAP NO. 30433

503 PARCELS



The County of Riverside assumes no warranty or legal responsibility for the information contained on this map. Data and information represented on this map is subject to update, modifications and may not be complete or appropriate for all purposes. County GIS and other sources should be queried for the most current information. Do not copy or reuse this map.

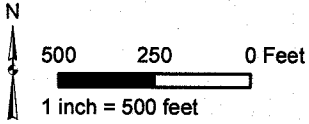

## ASSESSMENT DIAGRAM

Printed by jpickeri on 3/15/12

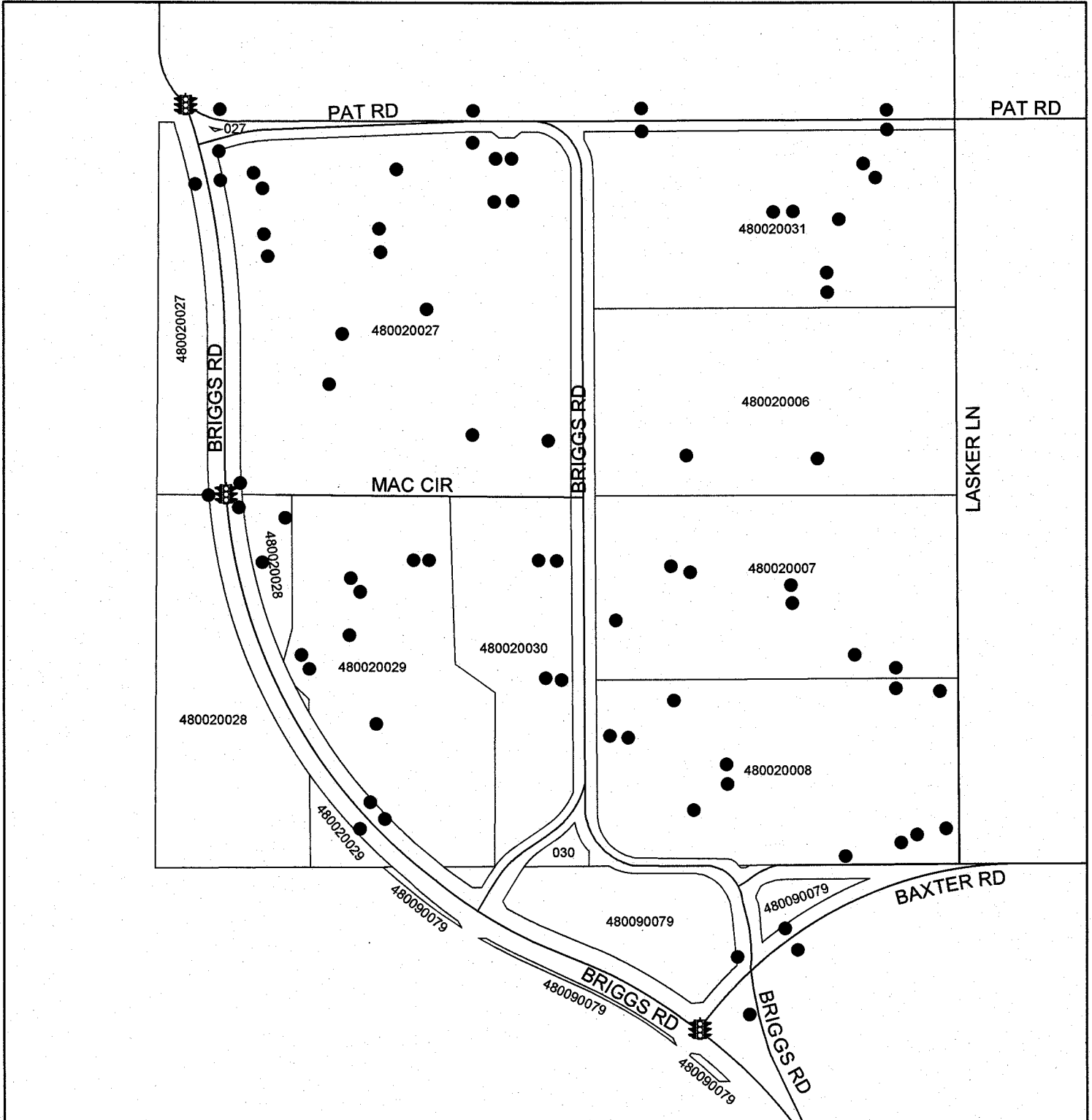

 DENOTES MAINTAINED TRAFFIC SIGNAL

 DENOTES MAINTAINED FOSSIL FILTER