

**SUBMITTAL TO THE BOARD OF SUPERVISORS
COUNTY OF RIVERSIDE, STATE OF CALIFORNIA**

gob



FROM: Economic Development Agency / Facilities Management

SUBMITTAL DATE:
March 14, 2013

SUBJECT: Resolution No. 2013-010, Notice of Intention to Convey Fee Simple Interests in Real Property from the County of Riverside to the Western Riverside County Regional Conservation Authority

RECOMMENDED MOTION: That the Board of Supervisors:

1. Adopt Resolution No. 2013-010, Notice of Intention to Convey Fee Simple Interests in Real Property from the County of Riverside (Assessor's Parcel Numbers per Attachment A) by Grant Deed to the Western Riverside County Regional Conservation Authority (RCA); and
2. Direct the Clerk of the Board to give notice pursuant to Government Code Section 6061.

BACKGROUND: (Commences on Page 2)

Robert Field
Assistant County Executive Officer/EDA

FINANCIAL DATA	Current F.Y. Total Cost:	\$ 0	In Current Year Budget:	Yes
	Current F.Y. Net County Cost:	\$ 0	Budget Adjustment:	No
	Annual Net County Cost:	\$ 0	For Fiscal Year:	2012/13

COMPANION ITEM ON BOARD AGENDA: No

SOURCE OF FUNDS: N/A

Positions To Be Deleted Per A-30	<input type="checkbox"/>
Requires 4/5 Vote	<input type="checkbox"/>

C.E.O. RECOMMENDATION:

APPROVE

BY:
Jennifer L. Sargent

County Executive Office Signature

MINUTES OF THE BOARD OF SUPERVISORS

On motion of Supervisor Tavaglione, seconded by Supervisor Stone and duly carried by unanimous vote, IT WAS ORDERED that the above matter is approved as recommended and is set for public meeting on or after April 9, 2013 @ 9:00 a.m.

Ayes: Jeffries, Tavaglione, Stone, Benoit and Ashley
Nays: None
Absent: None
Date: March 26, 2013
xc: EDA, COB

Kecia Harper-Ihem
Clerk of the Board
By:
Deputy

Prev. Agn. Ref.:

District: 1/3

Agenda Number: 3-9

FORM APPROVED COUNTY COUNSEL
BY:
CYNTHIA M. GUNZEL
DATE: 3-7-13
Digital Concurrence

Dep't Recomm.: Consent
Per Exec. Ofc.: Consent
Policy: Policy

BACKGROUND:

Western Riverside County has a diverse ecosystem supporting a wide range of plant and animal species, including 32 currently listed species, with additional listed species anticipated in the future. Riverside County faces the doubling of its population over the next 20 to 25 years, which will require new infrastructure development. To ensure sensitive species and their habitat are protected in spite of anticipated development, the Western Riverside County Multiple Species Habitat Conservation Plan (MSHCP) was created. Western Riverside County Regional Conservation Authority (RCA) was created to implement and administer the MSHCP.

The MSHCP is a multi-jurisdictional habitat conservation plan focusing on the conservation of both sensitive species and associated habitats to address biological and ecological diversity conservation needs in western Riverside County, setting aside undisturbed land for the conservation of sensitive habitats while preserving open space and recreational opportunities. The MSHCP addresses the potential impacts of urban growth, natural habitat loss and species endangerment, and creates a plan to mitigate for the potential loss of covered species and their habitats due to direct and indirect impacts of future development of both private and public lands within the MSHCP Plan Area.

In anticipation of the then-forthcoming MSHCP, the County began acquiring real property that possessed important wildlife and habitat value for future inclusion in the MSHCP with funds received from the California Wildlife Conservation Board (WCB) grant programs and funds collected through the MSHCP mitigation fee program (Riverside County Ordinance No. 810).

Pursuant to Government Code Section 25365, the County may transfer interests in real property or interest therein, belonging to the County to another public agency, upon the terms and conditions as are agreed upon and without complying with any other provisions of the Government Code, if the property or interest therein to be conveyed is not required for county use. The County and RCA intend to enter into a Memorandum of Understanding to provide the terms and conditions for the conveyances made by the County to RCA.

The County intends to convey the described properties listed in Attachment A and depicted in Attachment B to the RCA by Grant Deed. RCA will take all responsibilities of ownership, including but not limited to managing, monitoring and maintaining the above-referenced real properties consistent with the wildlife and plant life conservation purposes of the MSHCP.

This Form 11 and Resolution has been approved as to form by County Counsel.

FINANCIAL DATA:

There are no costs associated with this transaction.

1 Board of Supervisors

County of Riverside

2
3 **RESOLUTION NO. 2013-010**

4
5 **NOTICE OF INTENTION TO CONVEY FEE SIMPLE INTERESTS IN REAL PROPERTY**
6 **FROM THE COUNTY OF RIVERSIDE TO THE WESTERN RIVERSIDE COUNTY REGIONAL**
7 **CONSERVATION AUTHORITY**

8
9 (Assessor's Parcel Numbers listed on Attachment A)

10 WHEREAS, Western Riverside County has a diverse ecosystem supporting a wide
11 range of plant and animal species; and

12 WHEREAS, to ensure sensitive species and their habitat are protected in spite of
13 anticipated development, the Multiple Species Habitat Conservation Plan (MSHCP) was
14 created; and

15 WHEREAS, the County of Riverside (County) began acquiring real property between
16 2001 and 2004 with Wildlife Conservation Board grant funds and other funds designated for
17 the purchase of MSHCP properties that possess important wildlife and habitat value in
18 anticipation and future inclusion of the then-forthcoming MSHCP with the intention to transfer
19 all real property interests to the Western Riverside County Regional Conservation Authority
20 (RCA) at a later date; and

21 WHEREAS, the Western Riverside County Regional Conservation Authority (RCA) was
22 created in 2004 to implement the MSHCP; and

23 WHEREAS, the County and RCA intend to enter into a Memorandum of Understanding
24 to provide the terms and conditions for the conveyance of the real property interests from
25 County to RCA; now, therefore,

26 **BE IT RESOLVED, DETERMINED AND ORDERED AND NOTICE IS HEREBY GIVEN**
27 **by the Board of Supervisors of the County of Riverside, California that the County intends to**
28 **convey the properties listed in Attachment A and depicted in Attachment B to the Western**

FORM APPROVED COUNTY COUNSEL
BY: *Synthia M. Guzel* 3-7-13
DATE: *SYNTHIA M. GUNZEL*

1 Riverside County Regional Conservation Authority by Grant Deed. The terms and conditions
2 of the proposed conveyance are as follows: Western Riverside County Regional Conservation
3 Authority will take all responsibilities of ownership, including but not limited to managing,
4 monitoring and maintaining the above-referenced real properties consistent with the wildlife
5 and plant life conservation purposes of the Multiple Species Habitat Conservation Plan.

6 BE IT FURTHER RESOLVED AND ORDERED THAT the Board of Supervisors intends
7 to meet to conclude the proposed transaction on or after April 9, 2013, at 9:00 am at the
8 meeting room of the Board of Supervisors located on the 1st floor of the County Administrative
9 Center, 4080 Lemon Street, Riverside, California.

10 BE IT FURTHER RESOLVED AND DETERMINED that the Clerk of the Board of
11 Supervisors is directed to give notice hereof as provided in Section 6061 of the Government
12 Code.

13
14 ROLL CALL:

15 Ayes: Jeffries, Tavaglione, Stone, Benoit and Ashley
16 Nays: None
17 Absent: None

18 The foregoing is certified to be a true copy of a resolution duly
19 adopted by said Board of Supervisors on the date therein set forth.

20 KECIA HARPER-IHEM, Clerk of said Board

21 By: _____
22 Deputy

23
24
25
26
27 JF:ra/020413/15.542 S:\Real Property\TYPING\Docs-15.500 to 15.999\15.542.doc

28
03.26.13 3-9

ATTACHMENT "A"

State Parcel References	County Parcel References	Area	Assessor Parcel Numbers	Parcel Size (Acres)
North Warm Springs Creek Conservation Area (ID# 2004017)	#1 Gentry	Southwest	900-050-036	29.49 acres
Alberhill Conservation Area, (ID# 2001152)	#2 Gritton	Elsinore	347-020-012	147.71 acres
Wilson Creek Riparian Corridor (ID # 2003063)	#3 JPR	REMAP	579-390-011; 579-160-022, -023, -024, -025	887.68 acres
Triple Creeks Conservation Area (Bachelor Mountain)	#4 Lake Skinner	Southwest	472-200-003, -004; 472-210-001, -005	293.08 acres
Triple Creeks Conservation Area (Endres)(ID# 2001180)	#5 Larson Endres	Southwest	472-090-006	40.66 acres
French Valley Conservation Area, Exp. 1	#6 Ledbetter	Southwest	964-110-040, -041	41.27 acres
Triple Creeks Conservation Area (Briggs Ranch)(ID# 2001180)	#7 McElhinney Stimmel	Southwest	388-270-008, -009, -010, -015; 472-050-001, -004, -005; 480-010-001, -002	365.91 acres
Alberhill Conservation Area (ID# 2001152)	#8 North Peak #2	Elsinore	347-020-004, -008, -010, -011; 347-110-066, -067, -080, -081, -085	333 acres
North Peak Preserve (ID# 2003027)	#9 North Peak #3	Elsinore	346-060-003, -004, -005, -006, -012, -013, -017, -021, -025, -029, -033, -037, -059, -061, -063, -065, -067, -069, -071, -073, -075; 346-080-006; 346-140-003 through -018, -020; 346-150-001 through -021; 346-180-002 through 017; 346-190-010	193 acres
Alberhill Conservation Area (Whiterock 1)	#10 White Rock #1	Elsinore	347-110-028, -079; 347-340-008, -018, -019, -020, -026, -029; 349-240-063, -064, -065, -066, -067, -068; 349-270-003	244.48 acres
Alberhill Conservation Area, Expansion 1 (White Rock 2 ID# 2003064)	#11 White Rock #2	Elsinore	349-240-071, 349-240-073, 349-240-074, 349-260-005, 349-240-036, 349-240-035, 349-270-004	319.67 acres
Alberhill Conservation Area, Expansion 2 (White Rock 3 ID# 2004053)	#12 White Rock #3	Elsinore	349-240-076, 349-260-004, 349-270-006	112.69 acres

County Parcel #1

900070001
Gentry Parcel #1

900070001
Winchester 700 (#1)



County Parcel #2

34618022

34618010
North Peak Habitat

34618008
North Peak Habitat

346180018

34618006
North Peak Habitat

34618007
North Peak Habitat

346190011

34619007

346170025

34619005
34619002

34619003

347020012
Gallon Habitat Acquisition

347020004
North Peak Habitat #2

347020010
North Peak Habitat #2

347020001
North Peak Habitat #2

347110080
North Peak Habitat #2

347110067
North Peak Habitat #2

County Parcel #3
5 APNs

579020010
JPR Acquisition

579420004
Reden Phase III

579420020
Walker Acquisition

579430002
Walker #2

579430003
Walker #1

579430003
Walker #2

579160027
Reden Phase II

579160025
Reden Phase I

579430007
Jesus Acquisition

579430006
Walker #1

579430006
Walker #2

579160023
JPR Habitat Acquisition

579160022
Habitat Acquisition

579160024
PR Habitat Acquisition

579160025
Habitat Acquisition

579230017
Jennings Acquisition

579390011
PR Habitat Acquisition

579230002

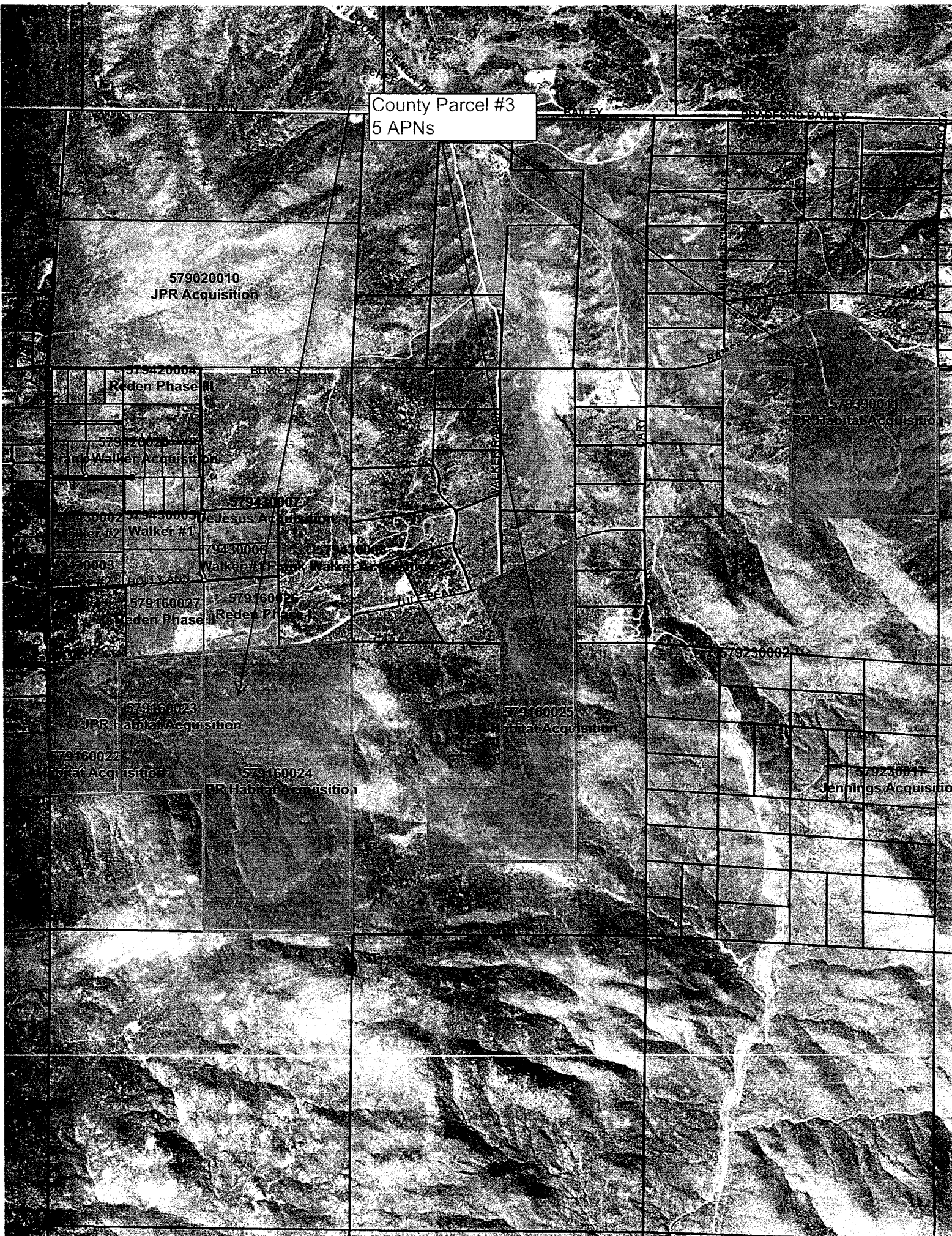

County Parcel #4
4 APNs

47220004
Lake Skinner Habitat Acquisition

47220003
Lake Skinner Habitat Acquisition

472210004
Lake Skinner Habitat Acquisition

472210005
Lake Skinner Habitat Acquisition

472230001
Lake Skinner Recreation Area



County Parcel #5

472090006
MS ICP Larson/Endres Acquisition

LUKE FIA

ELMER STAIRS

50314

100

ROBINSON

TEJAL

WISLLEN

SCENIC HILLS

REGGIE

EFFERT

LOOSIE

OSGIE

WINCHESTER



County Parcel #6
2 APNs

96419841
Leadbetter Trust Habitat Acquisition

County Parcel #7
9 APNs

MSHCP McElhinney/Stimmel Acquisition

472050001

MSHCP McElhinney/Stimmel Acquisition

472050005

MSHCP McElhinney/Stimmel Acquisition

388270008

MSHCP McElhinney/Stimmel Acquisition

472050004

MSHCP McElhinney/Stimmel Acquisition

388270015

MSHCP McElhinney/Stimmel Acquisition

480010002

MSHCP McElhinney/Stimmel Acquisition

480010001

MSHCP McElhinney/Stimmel Acquisition



County Parcel #8
9 APNs

34618001
North Peak Habitat #2

346190011

34617001

346190062

346190000

346190000

347020012
Griffith Habitat Acquisition

347020005
North Peak Habitat #2

347020004
North Peak Habitat #2

347020000
North Peak Habitat #2

347020000
North Peak Habitat #2

347110006
North Peak Habitat #2

347110085
North Peak Habitat #2

347110013
Sale Agreement

347110010
White Rock #1 Habitat Acquisition

349240063
White Rock #1 Habitat Acquisition

White Rock #1 Habitat Acquisition

349240063
White Rock #1 Habitat Acquisition

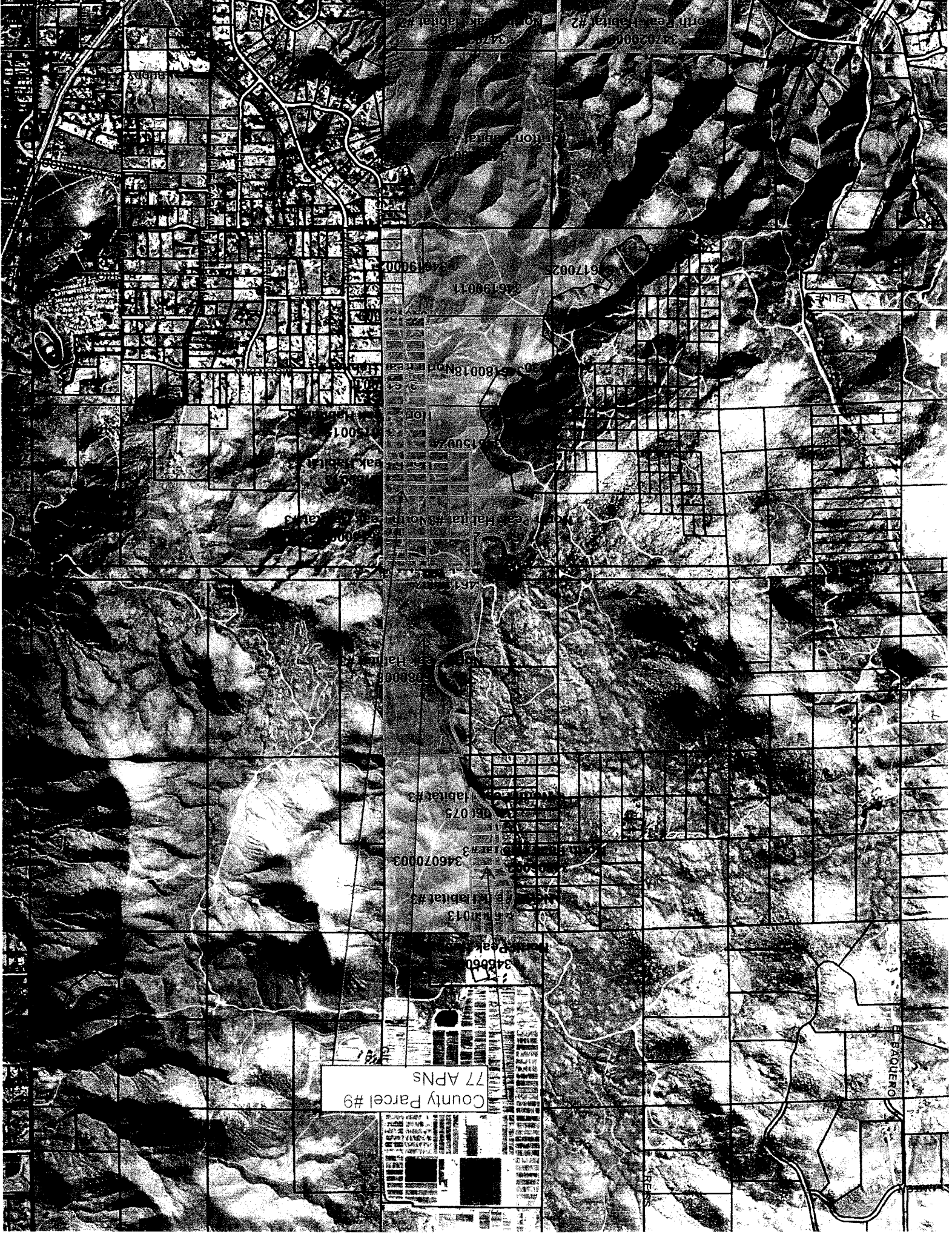

County Parcel #9
77 APNs

E. BAQUERO

348860

3488013
34607003

06075

34670003

3488006

346190011

346190007

617002

346190011

346190011

34620006

34620006

Table with 2 columns and multiple rows of small text, likely a legend or metadata.

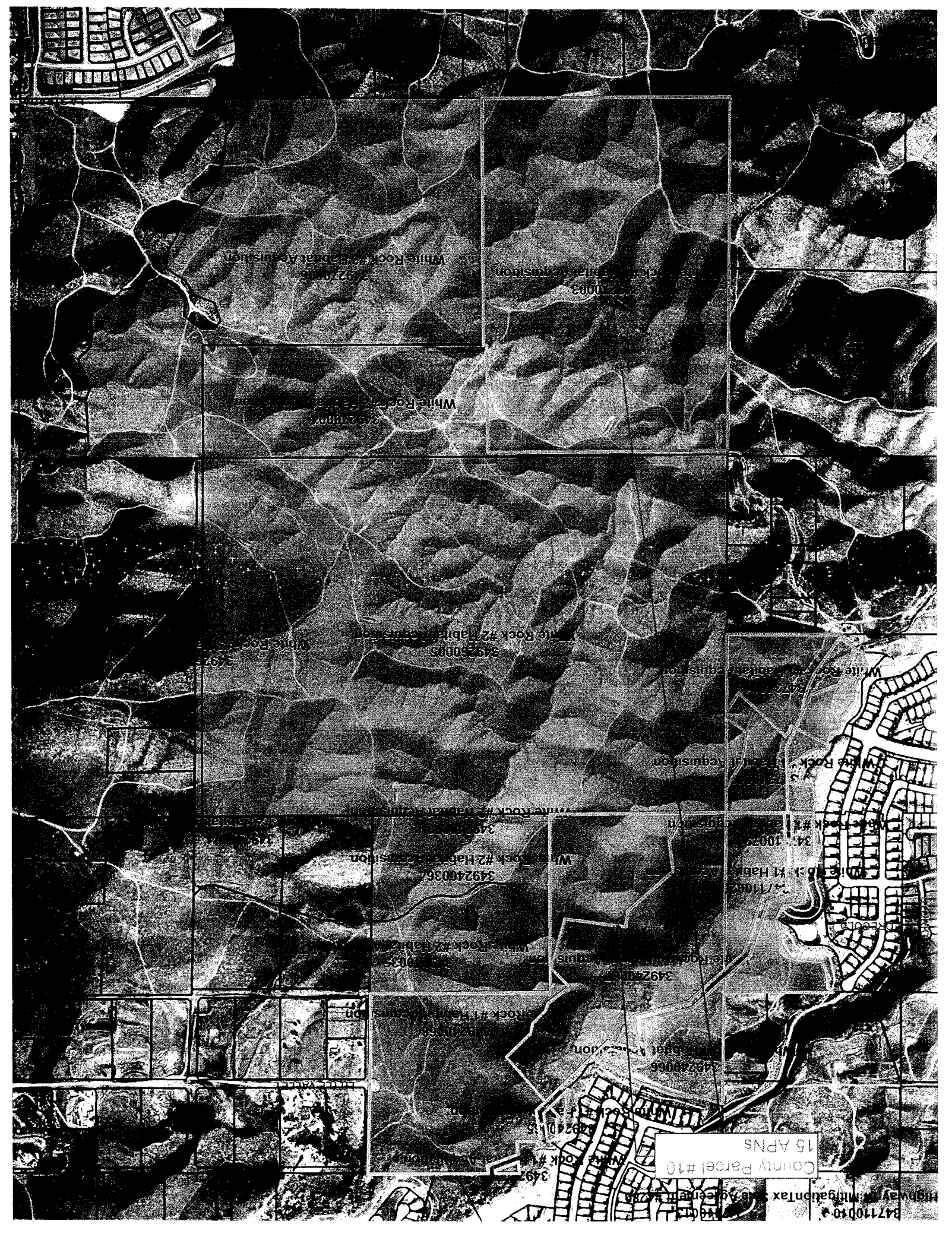

White Rock #2 Habitat Acquisition
34927006

White Rock #2 Habitat Acquisition
34927003

White Rock #2 Habitat Acquisition
34927007

White Rock #2 Habitat Acquisition
34925005

White Rock #2 Habitat Acquisition
34925008

White Rock #2 Habitat Acquisition
34925009

White Rock #2 Habitat Acquisition
34924007

White Rock #2 Habitat Acquisition
349240036

White Rock #2 Habitat Acquisition
34924004

White Rock #2 Habitat Acquisition
34924005

White Rock #1 Habitat Acquisition
34924008

White Rock #2 Habitat Acquisition
34924009

White Rock #2 Habitat Acquisition
34924006

County Parcel #10
15 APNS

Highway 101
84710010

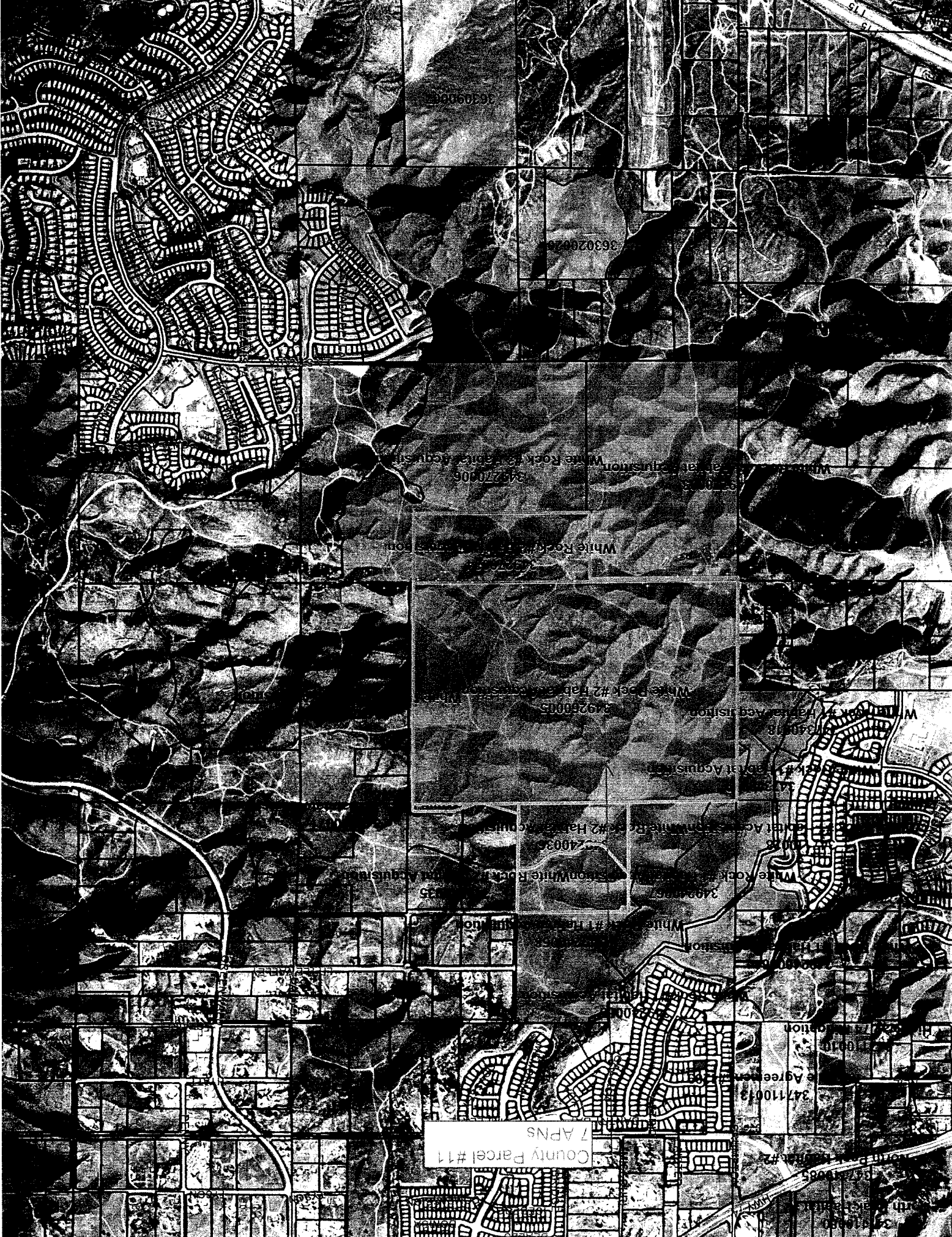

515

16300026

363029026

White Rock #2 Acquisition
34927006

White Rock #2 Acquisition
34927006

White Rock #2 Acquisition
34926005

White Rock #2 Acquisition
34926005

White Rock #2 Acquisition
34926005

White Rock #2 Acquisition
34926005

White Rock #2 Acquisition
34926005

White Rock #2 Acquisition
34926005

County Parcel #11
7 APNS

White Rock #2 Acquisition
34926005

White Rock #2 Acquisition
34926005

White Rock #2 Acquisition
34926005

White Rock #2 Acquisition
34926005

White Rock #2 Acquisition
34926005

White Rock #2 Acquisition
34926005

White Rock #2 Acquisition
34926005

White Rock #2 Acquisition
34926005

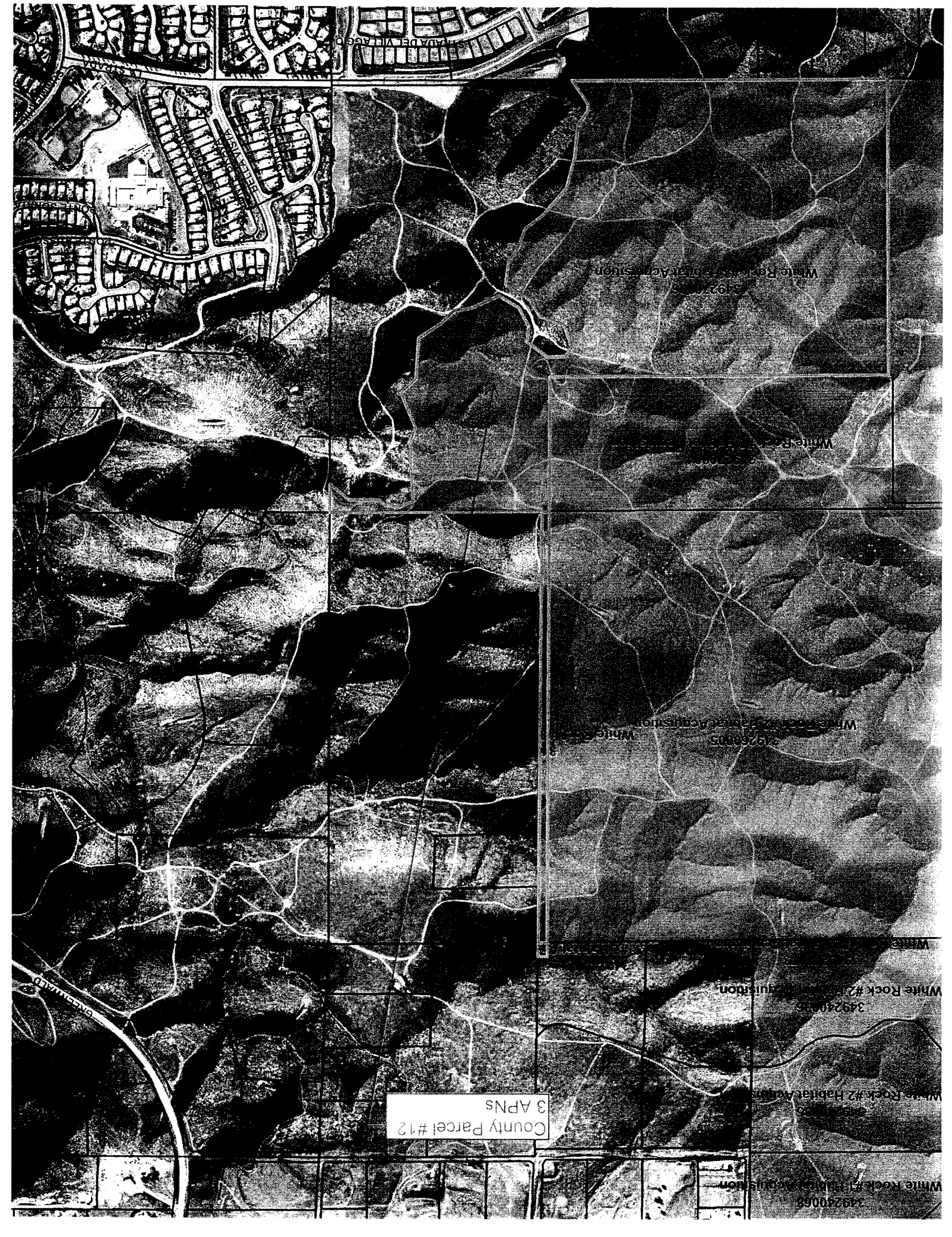

County Parcel #12
3 APNs

White Rock #2 Habit Acquisition
34924006

White Rock #2 Habit Acquisition
34924007

White Rock #2 Habit Acquisition
34924008

White Rock #2 Habit Acquisition
34924009

White Rock #2 Habit Acquisition
34924010

White Rock #1 Habit Acquisition
34924006