

**SUBMITTAL TO THE BOARD OF SUPERVISORS
COUNTY OF RIVERSIDE, STATE OF CALIFORNIA**

905 A



FROM: TLMA - Transportation Department

SUBMITTAL DATE:
February 28, 2013

SUBJECT: Resolution 2013-047 Authorizing the Submittal of Functional Classification Change for Local Streets and Roads within its Jurisdiction

RECOMMENDED MOTION: That the Board of Supervisors adopt Resolution 2013-047, authorizing the submittal of functional classification changes for local streets and roads within its jurisdiction as shown on the California Road System (CRS) maps.

BACKGROUND: The Federal Highway Administration (FHWA) identifies functional classifications as key items in determining federal funding to build and maintain roads. Functional classifications are grouped according to the character of the service they provide in the highway network. All functionally classified roads in California appear on the CRS maps published by Caltrans. It is the responsibility of each local jurisdiction to update the maps as

Juan C. Perez
Director of Transportation and Land Management

SV

FORM APPROVED COUNTY COUNSEL
BY: Synthia M. Gunzel 3-13-13
SYNTHIA M. GUNZEL
Departmental Concurrence
DATE

FINANCIAL DATA	Current F.Y. Total Cost:	\$ 0	In Current Year Budget:	Yes
	Current F.Y. Net County Cost:	\$ 0	Budget Adjustment:	No
	Annual Net County Cost:	\$ 0	For Fiscal Year:	2012/2013

SOURCE OF FUNDS:

There are no General Funds used in this project.

Positions To Be Deleted Per A-30	<input type="checkbox"/>
Requires 4/5 Vote	<input type="checkbox"/>

C.E.O. RECOMMENDATION:

APPROVE

BY:
Tina Grande

County Executive Office Signature

MINUTES OF THE BOARD OF SUPERVISORS

On motion of Supervisor Ashley, seconded by Supervisor Benoit and duly carried by unanimous vote, IT WAS ORDERED that the above matter is approved as recommended.

Ayes: Jeffries, Tavaglione, Stone, Benoit and Ashley
Nays: None
Absent: None
Date: April 2, 2013
xc: Transp.

Kecia Harper-Ihem
Clerk of the Board
By:
Deputy

Prev. Agn. Ref.

District: 5/5

Agenda Number:

3-11

The Honorable Board of Supervisors

RE: Resolution 2013-047 Authorizing the Submittal of Functional Classification Change for Local Streets and Roads within its Jurisdiction

February 13, 2013

Page 2 of 2

development occurs, land use changes, and roads are built and widened. A resolution by the governing body authorizing the request for changes is required. Resolution No. 2013-047 will authorize this request for change for the streets and roads described in the attachments. Inclusion in the CRS allows the County to apply for future federal dollars for improvement or maintenance of the facilities.

This submittal was initiated to address the Interstate 10 (I-10) Bypass Project, which will add a new roadway link between the communities of Cabazon and Banning, parallel to the I-10. This critical link will be built utilizing, in part, federal funds. The roadway must be functionally classified in order to qualify for federal funding.

The Transportation Department has looked at other functional classification needs in the territory spanning from Calimesa to Cabazon, known as the Pass area, specifically related to the bigger I-10 Lifeline Emergency Access Plan. Additional roadways paralleling I-10 will be considered as part of that larger plan and are being added to the CRS maps with this action. Some portions of those connections already exist, but are either under-classified as local roads or are not yet classified. Segments outside the County's jurisdiction will require updates by the appropriate agencies. The County will continue to coordinate with other agencies to ensure the roadway network is represented appropriately.

In addition to the Board's approval, the County has asked the Southern California Association of Governments for concurrence as the County's metropolitan planning organization. The completed package will be submitted to Caltrans District 8 for their concurrence and submittal to Caltrans headquarters, which will submit the request to the FHWA for approval. Once approved, the CRS maps will be updated.

SOUTHERN CALIFORNIA

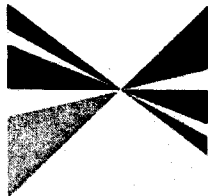

**ASSOCIATION of
GOVERNMENTS**

Main Office

818 West Seventh Street

12th Floor

Los Angeles, California

90017-3435

t (213) 236-1800

f (213) 236-1825

www.scag.ca.gov

Officers

President

Glen Becerra, Simi Valley

First Vice President

Greg Pettis, Cathedral City

Second Vice President

Carl Morehouse, San Buenaventura

Immediate Past President

Pam O'Connor, Santa Monica

**Executive/Administration
Committee Chair**

Glen Becerra, Simi Valley

Policy Committee Chairs

**Community, Economic and
Human Development**
Paula Lantz, Pomona

Energy & Environment
Cheryl Viegas-Walker, El Centro

Transportation
Keith Millhouse, Ventura County
Transportation Commission

February 1, 2013

Maria Aranguiz
Division of Planning
Caltrans-District 8
464 West 4th Street
San Bernardino, CA 92401

**RE: FUNCTIONAL CLASSIFICATION CHANGE –
RIVERSIDE COUNTY TRANSPORTATION & LAND MANAGEMENT
AGENCY (TLMA)**

Ms. Aranguiz:

SCAG has received a request from the Riverside County Transportation & Land Management Agency (TLMA) regarding the Functional Classification Change Request Form to be submitted to Caltrans (attached). Caltrans' Functional Classification Guidelines require that local agencies submit a metropolitan planning organization/regional transportation planning agency (MPO/RTPA) concurrence letter along with the Functional Classification Change Form to the Caltrans District Coordinator.

This letter serves as the concurrence from SCAG on the changes requested by the Riverside County TLMA.

The SCAG regional travel demand model includes roadway facilities from interstates (1) down to the equivalent of major collectors (5) on the FHWA's revised functional classification codes. To the extent that these changes affect the SCAG regional highway network, SCAG will update the network to reflect the changes requested by the Riverside County TLMA upon the final approval by Caltrans and the Federal Highway Administration.

If you have any further questions, please contact Ryan Kuo of my staff at 213-236-1813 or kuo@scag.ca.gov.

Sincerely,

Naresh Amatya
Manager, Transportation Planning

NA:rk

Enclosure: Functional Classification Change Request

Cc (email): Susan Vombaur, Riverside County TLMA

2
3 RESOLUTION NO. 2013-047

4 AUTHORIZING THE SUBMITTAL OF A FUNCTIONAL CLASSIFICATION CHANGE
5 FOR LOCAL STREETS AND ROADS WITHIN ITS JURISDICTION
6 TO THE STATE OF CALIFORNIA, DEPARTMENT OF TRANSPORTATION
7

8 WHEREAS, local agencies are responsible for initiating requests for changes to the functional
9 classifications of streets and roads within their respective jurisdictions as they appear on the California
10 Road System maps; and

11 WHEREAS, the County of Riverside (County) receives State and Federal road improvement and
12 maintenance funding based on street and road functional classification; and

13 WHEREAS the County Transportation Department has identified the need to change certain
14 roadway classifications or add newly planned roadways as identified in Exhibit A; now, therefore,

15 BE IT RESOLVED, DETERMINED AND ORDERED by the Board of Supervisors of the County
16 of Riverside, in regular session assembled on April 2, 2013 in the meeting room of the
17 Board of Supervisors (Board), located on the 1st floor of the County Administrative Center, 4080 Lemon
18 Street, Riverside, California, that the Board hereby approves the submittal of the Functional Classification
19 Change for local streets and roads within its jurisdiction to the State of California, Department of
20 Transportation as recommended by the County of Riverside Director of Transportation and Land
21 Management.

22 BE IT FURTHER RESOLVED THAT the forgoing resolution was properly adopted by the Board
23 on behalf of the County at a regular meeting of the Riverside County Board of Supervisors held on
24 April 2, 2013.

25 ROLL CALL:

26 Ayes: Jeffries, Tavaglione, Stone, Benoit and Ashley
27 Nays: None
28 Absent: None

The foregoing is certified to be a true copy of a
resolution duly adopted by said Board of Super-
visors on the date therein set forth.
KECIA HARPER-IHEM Clerk of said Board
By _____ Deputy

FORM APPROVED COUNTY COUNSEL
BY: Cynthia M. Gunzel 3-13-13
DATE: CYNTHIA M. GUNZEL

EXHIBIT A

Functional Classification Request Forms and Maps

(10 Pages)



I-10 "Lifeline" EMERGENCY ACTION PLAN

Road Conditions
 Emergency
 9-1-1
 Inland Empire Real Time Traffic Information
 www.ies11.org

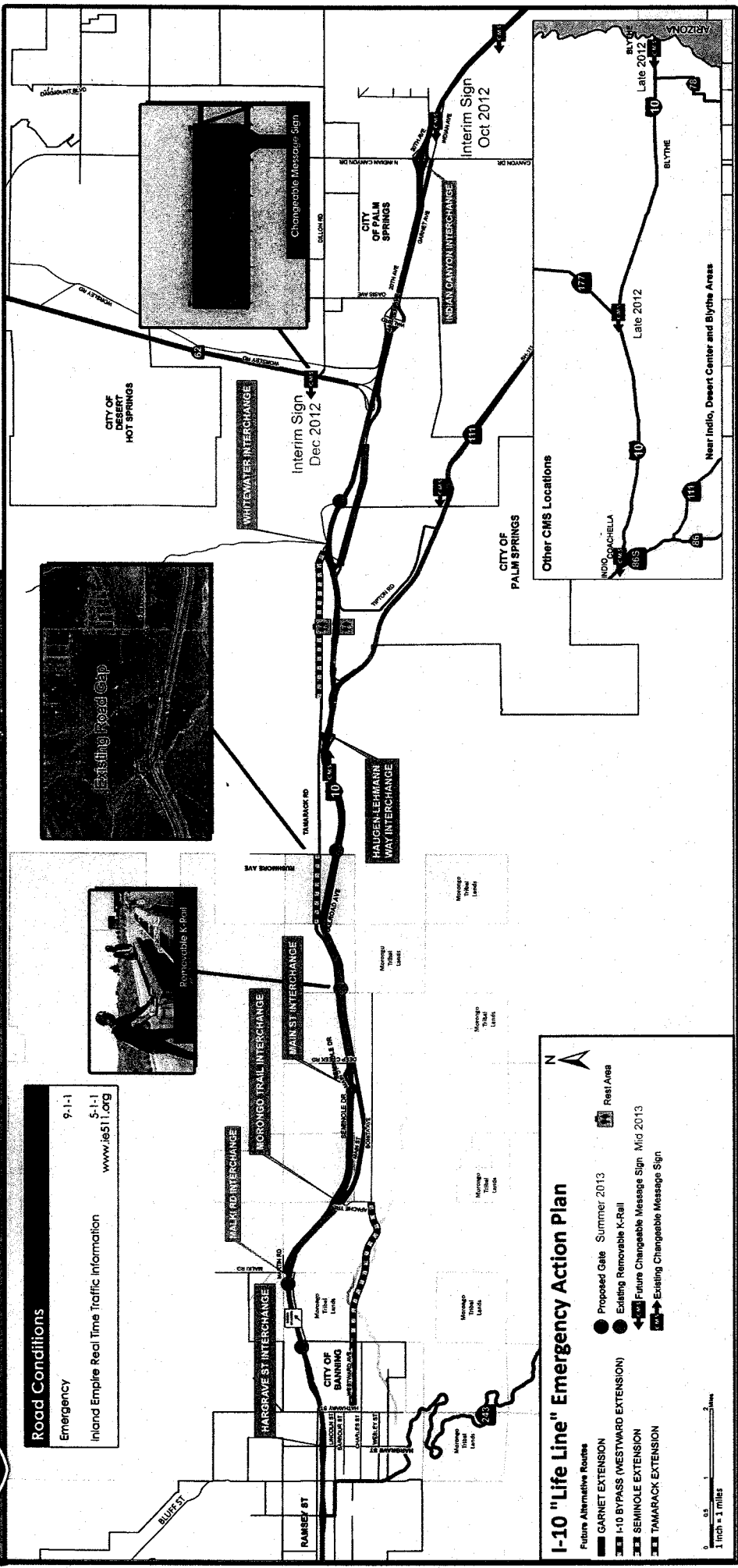

- I-10 "Life Line" Emergency Action Plan**
- Future Alternative Routes
 - GARNET EXTENSION
 - I-10 BYPASS (WESTWARD EXTENSION)
 - SEMINOLE EXTENSION
 - TAMARACK EXTENSION
 - Proposed Gate Summer 2013
 - Existing Removable K-Rail
 - Future Changeable Message Sign Mid 2013
 - Existing Changeable Message Sign
 - Rest Area



MORONGO BAND OF MISSION INDIANS
 A CORPORATION

RCTC
 Riverside County Transportation Commission

CVAG

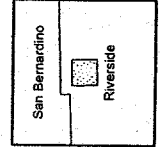
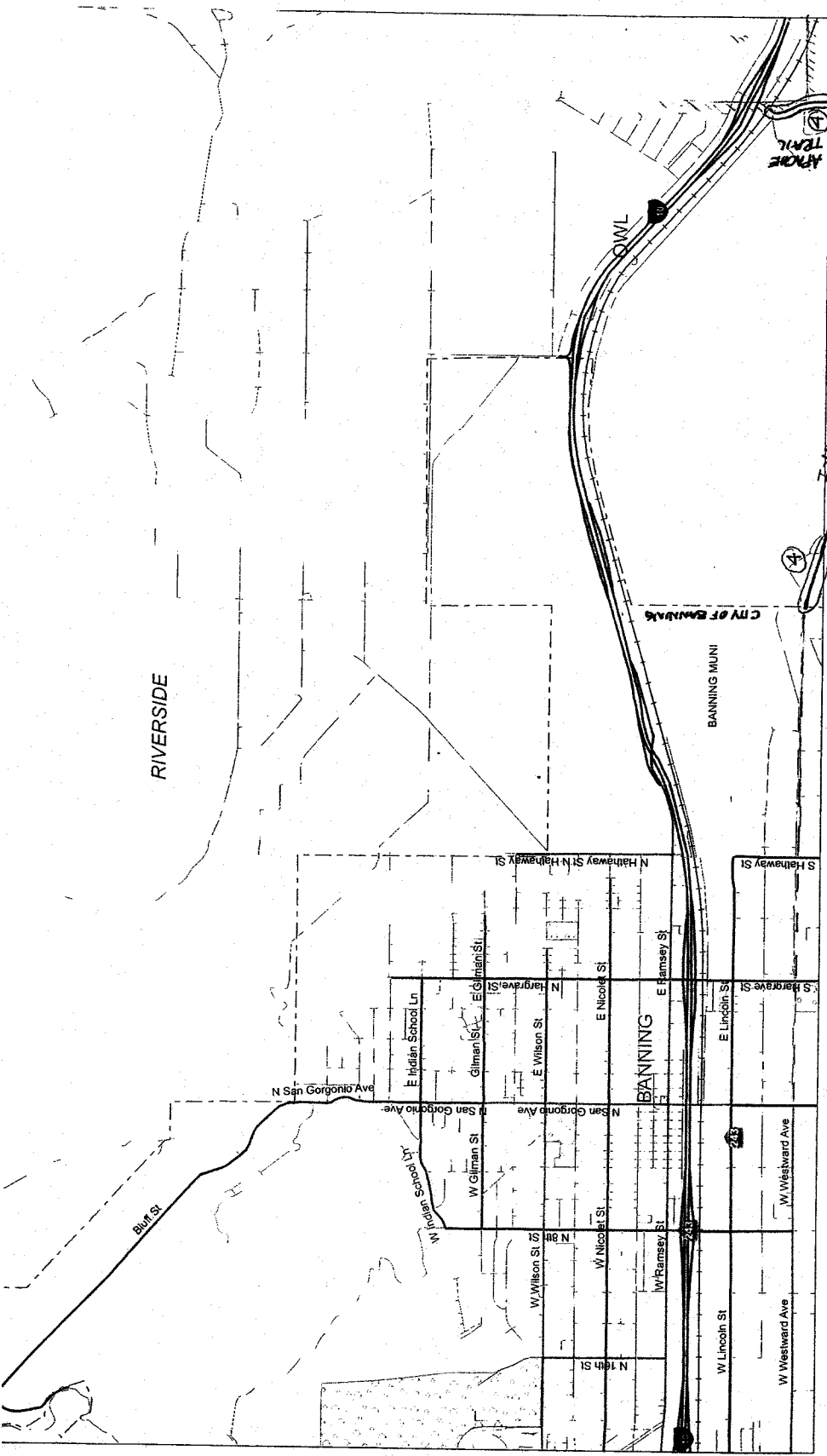

MAP 16V32

Riverside CALIFORNIA ROAD SY

FUNCTIONAL CLASSIFICATION - S&S/ETL

INTERSTATE	1
OTHER FRY OR EMPWY	2
OTHER PRINCIPAL	3
MAJOR ARTERIAL	4
MAJOR COLLECTOR	5
MINOR COLLECTOR	6
LOCAL	7

SIGN ROUTES

INTERSTATE	1
U.S.	3
STATE	1
COUNTY	7

SEE MAP 16V42

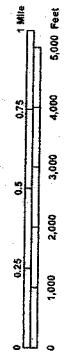

STATE OF CALIFORNIA
DEPARTMENT OF TRANSPORTATION
FEDERAL HIGHWAY ADMINISTRATION
AND LOCAL AGENCIES



APPROVED Date 8/5/11
FEDERAL HIGHWAY ADMINISTRATION
Wesley D'Antonio
FOR: VINCENT P. MAMMANO
DIVISION ADMINISTRATOR

SEE MAP

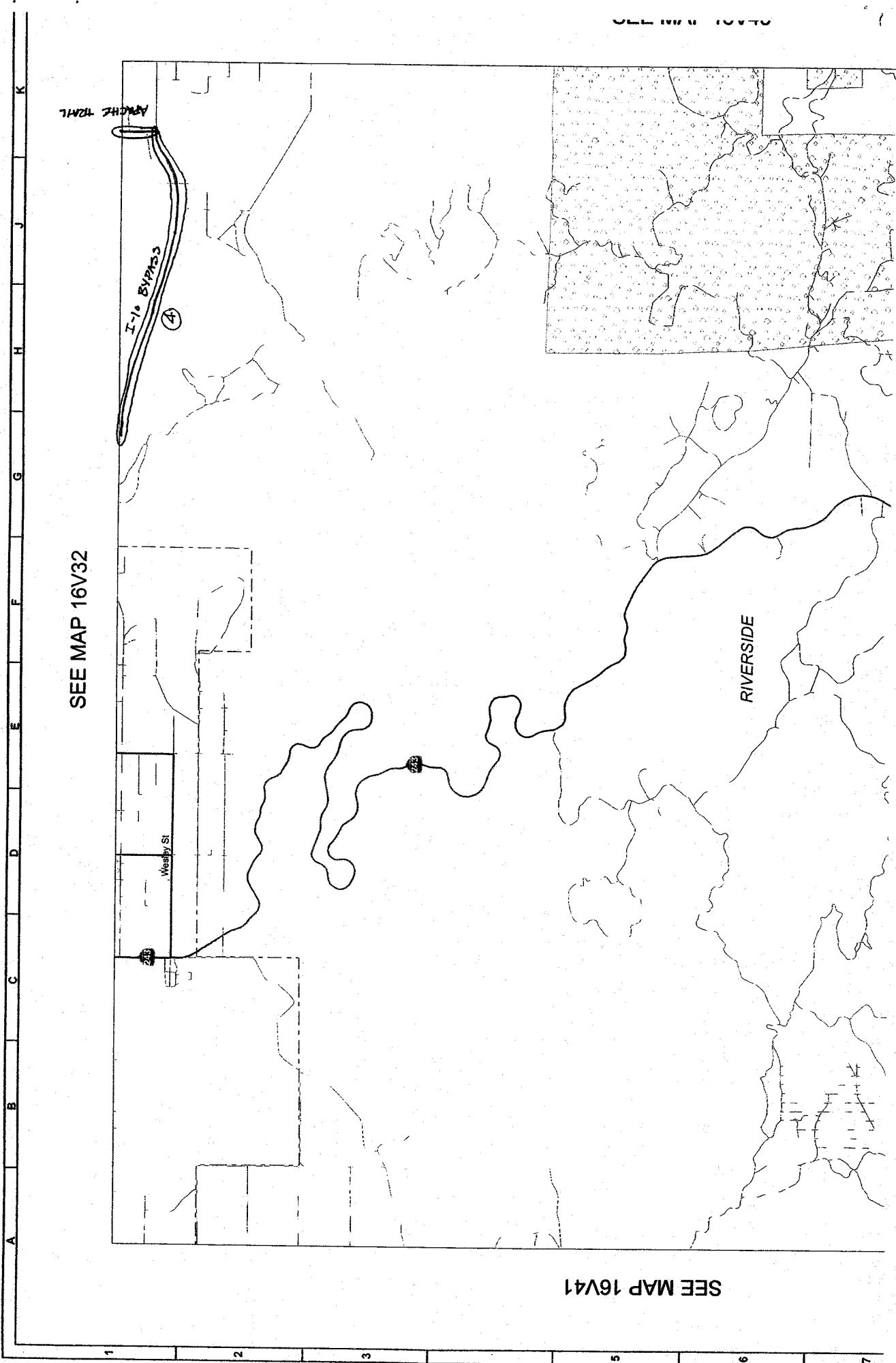

SEE MAP 16V32

SEE MAP 16V32

SEE MAP 16V41

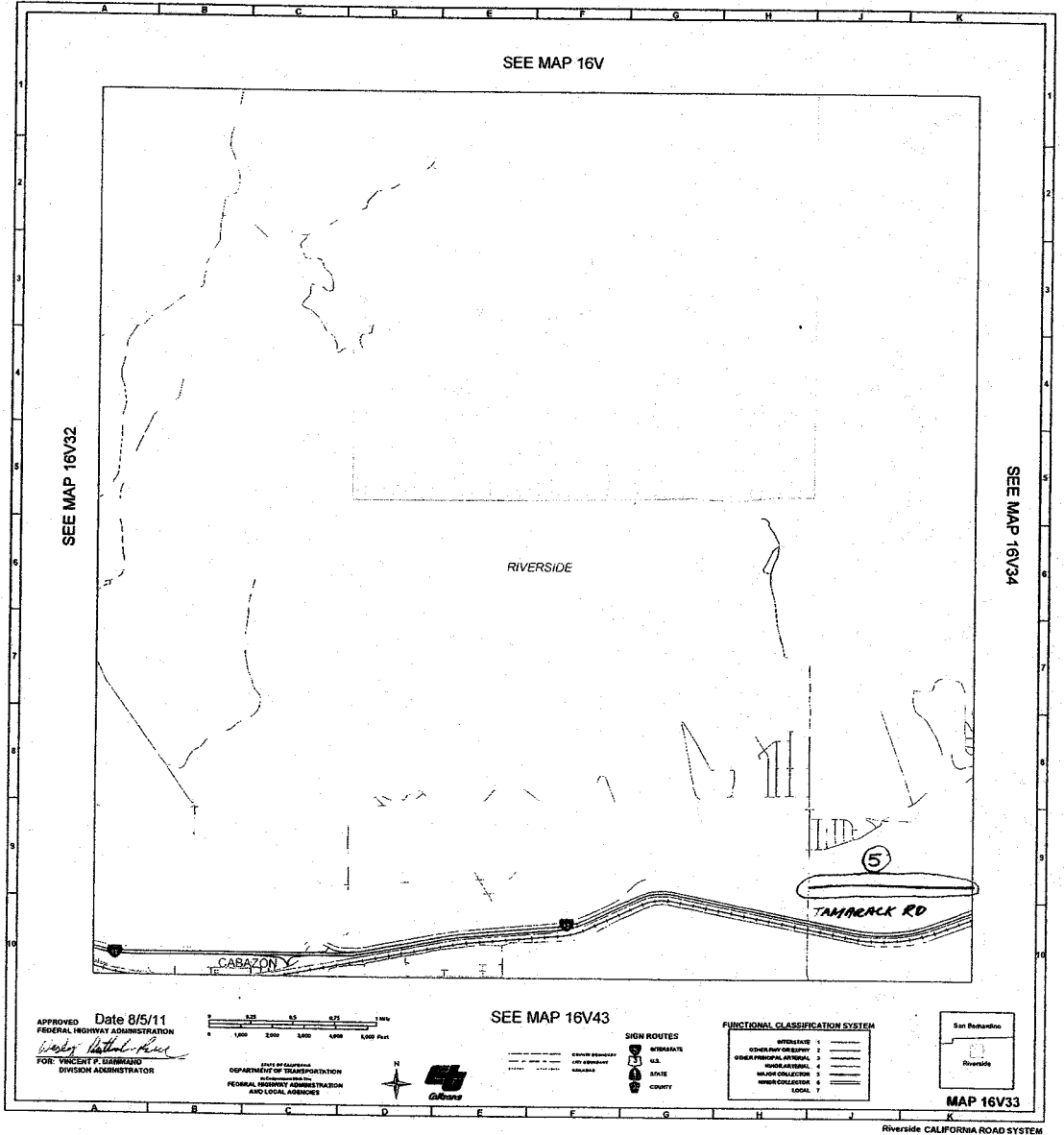

APPROVED Date 8/5/11
 FEDERAL HIGHWAY ADMINISTRATION
Vincent F. Zambrano
 FOR: VINCENT F. ZAMBRANO
 DIVISION ADMINISTRATOR



SEE MAP 16V43

STATE OF CALIFORNIA
 DEPARTMENT OF TRANSPORTATION
 COUNTY AND
 FEDERAL HIGHWAY ADMINISTRATION
 AND LOCAL AGENCIES



SIGN ROUTES

	STATE ROUTE
	COUNTY ROUTE
	MILEAGE MARKER
	OTHER SHIELD

FUNCTIONAL CLASSIFICATION SYSTEM

	INTERSTATE
	OTHER DIV OR BYPASS
	OTHER PRINCIPAL ARTERIAL
	ROAD COLLECTOR
	MINOR COLLECTOR
	LOCAL



MAP 16V33

Riverside CALIFORNIA ROAD SYSTEM

SEE MAP 16V35

SEE MAP 16V33

RIVERSIDE

BONNIE BELL

WHITE WATER

GARNET AVE EXTENSION

THATCHER RD.

MESQUITE RD.

5

5

5

5

5

APPROVED Date 8/5/11
 FEDERAL HIGHWAY ADMINISTRATION
Wesley Smith-Kear
 FOR: VINCENT P. MAMMARO
 DIVISION ADMINISTRATOR

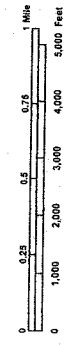

STATE OF CALIFORNIA
 DEPARTMENT OF TRANSPORTATION
 FEDERAL HIGHWAY ADMINISTRATION
 AND LOCAL AGENCIES



SEE MAP 16V44

SIGN ROUTES

- INTERSTATE (Shield with 'I' and number)
- U.S. (Shield with 'U.S.' and number)
- STATE (Shield with 'S' and number)
- COUNTY (Shield with 'C' and number)

BOUNDARIES

- COUNTY BOUNDARY (Dashed line)
- CITY BOUNDARY (Dotted line)
- RAILROAD (Line with cross-ticks)

FUNCTIONAL CLASSIFICATION SYSTEM

- INTERSTATE 1
- OTHER FRY OR EXPWY 2
- OTHER PRINCIPAL ARTERIAL 3
- MINOR ARTERIAL 4
- MAJOR COLLECTOR 5
- MINOR COLLECTOR 6
- LOCAL 7

San Bernardino
 Riverside

MAP 16V34

Riverside CALIFORNIA ROAD SYS

SEE MAP 16V43

SEE MAP 16V34

SEE MAP 16V43

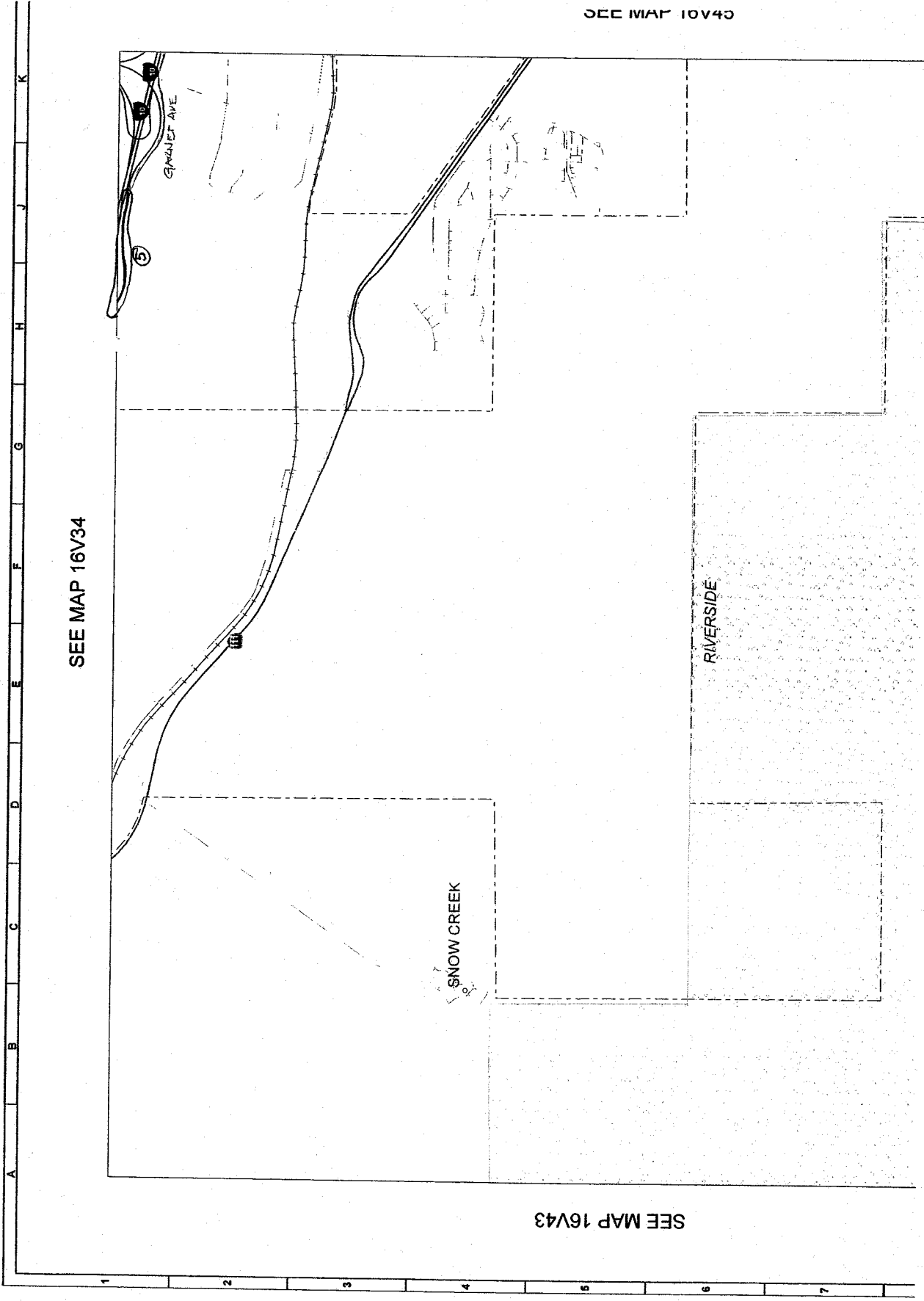

4 5 6 7 8 9 10

SEE MAP 15V51

SEC 15V51

HUNTRD

TRILLOSY PKY

KNASSE RD

KNASSE RD

(6)

(5)

(7)

RIVERSIDE

ORANGE

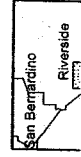

FUNCTIONAL CLASSIFICATION SYSTEM
INTERSTATE 1

SIGN ROUTES

SEE MAP 14W15

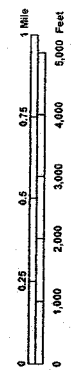

1/11
FATION

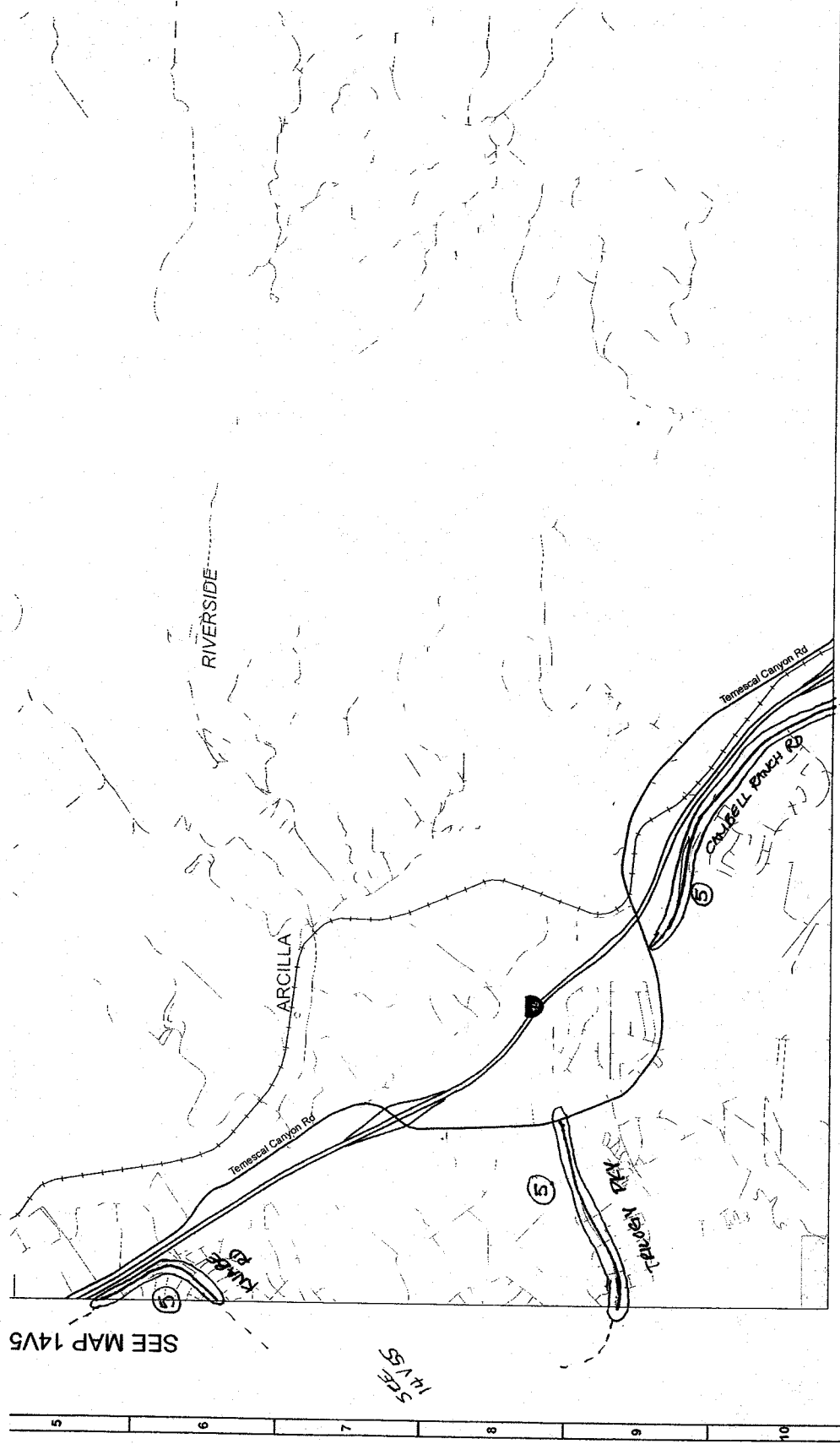

SEE MAP 14V5

SEE MAP 14V5

APPROVED
FEDERAL HIGHWAY ADMINISTRATION

Wesley Mitchell-River
FOR: VINCENT P. MAMMARIO
DIVISION ADMINISTRATOR

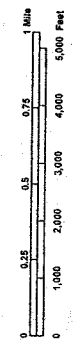

STATE OF CALIFORNIA
DEPARTMENT OF TRANSPORTATION
In Cooperation with the
FEDERAL HIGHWAY ADMINISTRATION
AND LOCAL AGENCIES



SEE MAP 15W11

SIGN ROUTES
 INTERSTATE
 U.S.
 STATE
 COUNTY

COUNTY BOUNDARY
 CITY BOUNDARY
 RAILROAD

FUNCTIONAL CLASSIFICATION SYSTEM

INTERSTATE	1
OTHER FRY OR EXPMY	2
OTHER PRINCIPAL ARTERIAL	3
MINOR ARTERIAL	4
MAJOR COLLECTOR	5
MINOR COLLECTOR	6
LOCAL	7

A B C D E F G H J
 5 6 7 8 9 10
 Riverside C

