

MINUTES OF THE BOARD OF SUPERVISORS  
COUNTY OF RIVERSIDE, STATE OF CALIFORNIA



3-106

On motion of Supervisor Stone, seconded by Supervisor Ashley and duly carried by unanimous vote, IT WAS ORDERED the reading being waived, that an ordinance bearing the following title, is adopted:

ORDINANCE NO. 452.234

AN ORDINANCE OF THE COUNTY OF RIVERSIDE, AMENDING ORDINANCE NO. 452 RELATING TO PRIMA FACIE SPEED LIMITS

I hereby certify that the foregoing is a full true, and correct copy of an order made and entered on August 20, 2013 of Supervisors Minutes.

WITNESS my hand and the seal of the Board of Supervisors  
Dated: August 20, 2013  
Kecia Harper-Ihem, Clerk of the Board of Supervisors, in  
and for the County of Riverside, State of California.

(seal)

By:  Deputy

AGENDA NO.  
3-106

xc: Transp., MC, COB

1 ORDINANCE NO. 452.234

2 AN ORDINANCE OF THE COUNTY OF RIVERSIDE

3 AMENDING ORDINANCE NO. 452

4 RELATING TO PRIMA FACIE SPEED LIMITS

5 The Board of Supervisors of the County of Riverside ordains as follows:

6 Section 1. Section 2.3 of Ordinance No. 452, entitled "Thirty-Five miles per hour," is  
7 hereby amended to add new subsections 117 and 118 to read as follows:

- 8 "117. On Briggs Road between Barn Road and Thorens Road, a total  
9 distance of approximately 0.75 miles, in the Murrieta area.  
10 118. On Dale Kiler Road between 7<sup>th</sup> Street and a point 2,860' north of  
11 7<sup>th</sup> Street, a total distance of approximately 0.54 miles, in the  
12 Mecca area."

13 Section 2. Section 2.4 of Ordinance No. 452, entitled "Forty miles per hour," is hereby  
14 amended to add new subsections 137, 138, and 139 to read as follows:

- 15 "137. On El Chimisal Road between a point 830' east of Redhawk Parkway and  
16 Anza Road, a total distance of approximately 0.6 miles, in the Temecula  
17 area.  
18 138. On Morgan Hill Drive between Villa Helena Street and a point  
19 260' north of Coppola Street, a total distance of approximately 0.3  
20 miles, in the Temecula area.  
21 139. On Wisteria Loop between Pourroy Road (south) and Pourroy  
22 Road (north), a total distance of approximately 1.1 miles, in the  
23 Murrieta area."

24 Section 3. Section 2.5 of Ordinance No. 452, entitled "Forty-Five miles per hour," is  
25 hereby amended to add new subsections 155, 156, and 157 to read as follows:

- 26 "155. On Briggs Road between Thorens Road and Leon Road, a total  
27 distance of approximately 0.31 miles, in the Murrieta area.  
28 156. On Max Gilliss Boulevard between Leon Road and Winchester

1 Road, a total distance of approximately 0.43 miles, in the Murrieta  
2 area.

3 157. On Orange Avenue between Brown Street and Old Elsinore Road,  
4 a total distance of approximately 0.9 miles, in the Perris area.”

5 Section 4. This ordinance shall take effect 30 days after its adoption.

6 BOARD OF SUPERVISORS OF THE COUNTY  
7 OF RIVERSIDE, STATE OF CALIFORNIA

8  
9 BY:

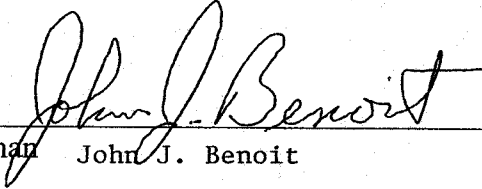
10   
Chairman John J. Benoit

11 ATTEST:

12 KECIA HARPER-IHEM, Clerk of the Board

13  
14 By:

  
Deputy

15  
16 APPROVED AS TO FORM:

17 PAMELA J. WALLS, County Counsel

18  
19 By:

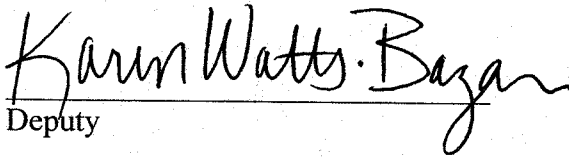
  
Deputy

1  
2  
3  
4  
5  
6  
7  
8  
9  
10  
11  
12  
13  
14  
15  
16  
17  
18  
19  
20  
21  
22  
23  
24  
25  
26  
27  
28

STATE OF CALIFORNIA            )  
  )  
COUNTY OF RIVERSIDE        )        SS

I HEREBY CERTIFY that at a regular meeting of the Board of Supervisors of said county held on August 20, 2013, the foregoing ordinance consisting of 4 Sections was adopted by the following vote:

AYES:           Jeffries, Tavaglione, Stone, Benoit and Ashley

NAYS:           None

ABSENT:       None

DATE:           August 20, 2013

KECIA HARPER-IHEM  
Clerk of the Board

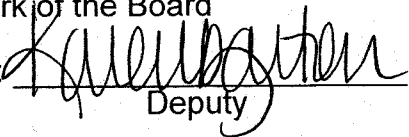
BY:   
Deputy

SEAL

**SUBMITTAL TO THE BOARD OF SUPERVISORS  
COUNTY OF RIVERSIDE, STATE OF CALIFORNIA**

326  
A



**FROM:** TLMA - Transportation Department

**SUBMITTAL DATE:**  
July 18, 2013

**SUBJECT:** Ordinance No. 452.234 to Establish Speed Zones Enforceable by Radar Speed detection Equipment - Mecca, Murrieta, Perris, and Temecula Areas

**RECOMMENDED MOTION:** That the Board of Supervisors introduce and adopt, on successive meetings, Ordinance No. 452.234, amending Ordinance No. 452 relating to prima facie speed limits to establish various speed zones in the above-referenced areas of Riverside County.

**BACKGROUND:** Transportation Department staff has conducted Engineering and Traffic Surveys (E&TS) for various roads in Mecca, Murrieta, Perris, and Temecula areas of Riverside County, as required by the California Vehicle Code.

Based upon the results of the E&TS for these roads, the radar-enforceable speed limits

Juan C. Perez  
Director of Transportation and Land Management

PR/ds  
(Continued On Attached Page)

<b>FINANCIAL DATA</b>	Current F.Y. Total Cost:	\$ 0	In Current Year Budget:	N/A
	Current F.Y. Net County Cost:	\$ 0	Budget Adjustment:	N/A
	Annual Net County Cost:	\$ 0	For Fiscal Year:	N/A

<b>SOURCE OF FUNDS:</b>  There are no General Funds used in this project.	Positions To Be Deleted Per A-30	<input type="checkbox"/>
	Requires 4/5 Vote	<input type="checkbox"/>

**C.E.O. RECOMMENDATION:**

APPROVE  
BY:   
Tina Grande

County Executive Office Signature

**MINUTES OF THE BOARD OF SUPERVISORS**

On motion of Supervisor Ashley, seconded by Supervisor Stone and duly carried by unanimous vote, IT WAS ORDERED that the above ordinance is approved as introduced with waiver of reading.

Ayes: Jeffries, Tavaglione, Stone, Benoit and Ashley  
Nays: None  
Absent: None  
Date: July 30, 2013  
xc: Transp., COB

Kecia Harper-Ihem  
Clerk of the Board  
By:   
Deputy

Prev. Agn. Ref: 9/11/12, 3-52 | District: 5/1, 3/3, 4/4 | Agenda Number:

**3-59**

ATTACHMENTS FILED  
WITH THE CLERK OF THE BOARD

FORM APPROVED COUNTY COUNSEL  
BY: KARIN L. WATTS-BAZAN  
DATE: 7/11/13  
Departmental Concurrence

Dep't Recomm.:  Consent  Policy  
Per Exec. Ofc.:  Consent  Policy

The Honorable Board of Supervisors

RE: Ordinance No. 452.234 to Establish Speed Zones Enforceable by Radar Speed detection Equipment - Mecca, Murrieta, Perris, and Temecula Areas

July 18, 2013

Page 2 of 2

recommended by the Transportation Department are summarized in the attached tables and have been determined to be appropriate to facilitate the safe and orderly movement of traffic.

County Counsel has approved the ordinance amendment.

Transportation Department staff has contacted the Temecula, San Geronio, and Indio area offices of the California Highway Patrol regarding the proposed speed zones.

**ATTACHMENTS TO  
FORM 11 RE: AMENDING ORDINANCE 452.234  
SUBMITTAL DATE: 7/18/13**

**LIST OF SPEED ZONE SUBMITTALS  
ORDINANCE AMENDMENT NO 452.234  
SUPERVISORIAL DISTRICT NO. 1**

AREA	ROAD NAME/ LIMITS	EXISTING SPEED LIMIT	PROPOSED SPEED LIMIT	NOTES
PERRIS	<b>ORANGE AVENUE †</b> Between Brown Street and Old Elsinore Road	Not Posted*	45	NEW

† Redistricting from Supervisorial District No. 5

- \* Maximum allowable speed limit for a two-lane highway is 55 mph
- \*\*Maximum allowable speed limit for a multi-lane highway is 65 mph
- \*\*\*Change in speed zone boundary



# ORANGE AVENUE (#1502)

REQ NO. R12016  
STA NO. S2019  
715' E/O CLARK ST

REQ NO. R12017  
STA NO. S2020  
380' W/O HAINES ST

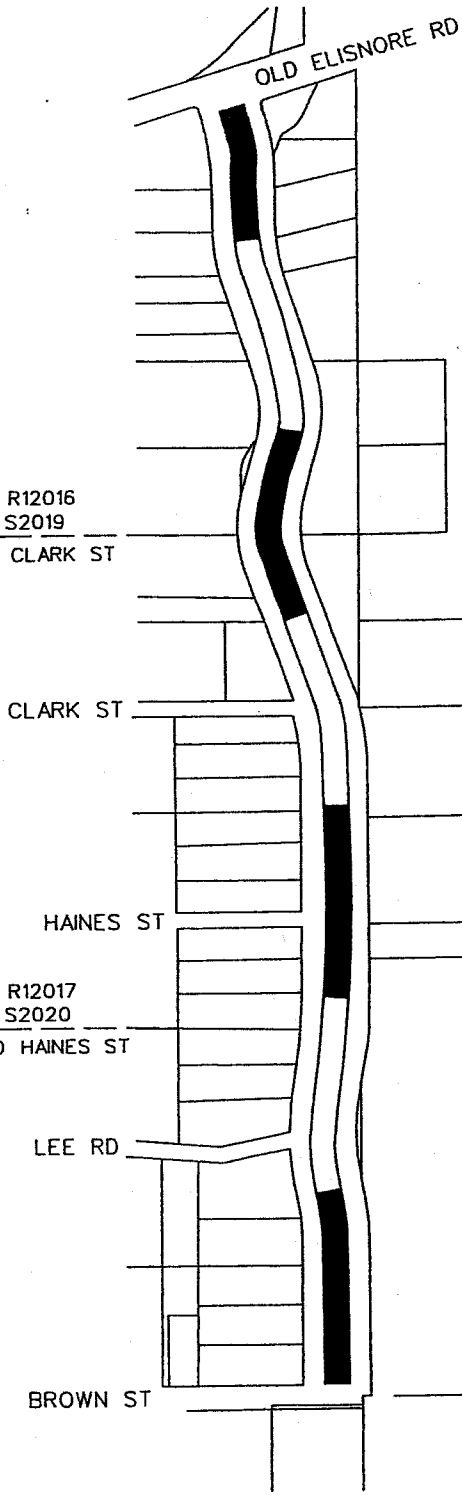

BEGIN ZONE

END ZONE

NO SCALE

- LEGEND:
- CITY LIMITS
  - RADAR ZONE
  - SURVEY STATION
  - OTHER STREET OR ROAD
  - SCHOOL

RECOMMENDED SPEED LIMIT	45 MPH
85th/7ILE SPEED	46.5 MPH
VEHICLES IN 24 HR (2 WAY)	1000
SEGMENT LENGTH	0.9 MILE
ALL ACCIDENTS IN 2 YRS.	2
ACCIDENT RATE ☆	3.04 ACC/MVM
EXISTING SPEED LIMIT	NOT POSTED

☆ RATE =  $\frac{\text{NO. OF ACCIDENT} \times 1000,000}{\text{VEH} \times 365 \times 2 \times \text{MILE}}$

APPROVED BY:

*Lawrence T. Tai*  
DATE: 6/21/2012  
LAWRENCE T. TAI, P.E.  
COUNTY TRAFFIC ENGINEER

SURVEY DATE: MAY 16, 2012  
MAP DATE: JUN 20, 2012  
DRAWN BY: N AHMAD  
CAD FILE: ORANGE\_AVE.DGN

COUNTY AREA: PERRIS  
COUNTY MAP: 58  
SUPERVISOR DISTRICT: 1/1 & 5/5

**LIST OF SPEED ZONE SUBMITTALS  
ORDINANCE AMENDMENT NO 452.234  
SUPERVISORIAL DISTRICT NO. 3**

AREA	ROAD NAME/ LIMITS	EXISTING SPEED LIMIT	PROPOSED SPEED LIMIT	NOTES
MURRIETA	<b>BRIGGS ROAD</b> Between Barn Road and Thorens Road	Not Posted*	35	NEW
MURRIETA	<b>BRIGGS ROAD</b> Between Thorens Road and Leon Road	Not Posted*	45	NEW
TEMECULA	<b>EL CHIMISAL ROAD</b> Between a point 830' east of Redhawk Parkway and Anza Road	Not Posted*	40	NEW
MURRIETA	<b>MAX GILLISS BOULEVARD</b> Between Leon Road and Winchester Road	Not Posted*	45	NEW
TEMECULA	<b>MORGAN HILL DRIVE</b> Between Villa Helena Street and a point 260' north of Coppola Street	Not Posted*	40	NEW
MURRIETA	<b>WISTERIA LOOP</b> Between Pourroy Road (south) and Pourroy Road (north)	Not Posted*	40	NEW

\* Maximum allowable speed limit for a two-lane highway is 55 mph  
 \*\*Maximum allowable speed limit for a multi-lane highway is 65 mph  
 \*\*\*Change in speed zone boundary

# BRIGGS ROAD

(#1482)

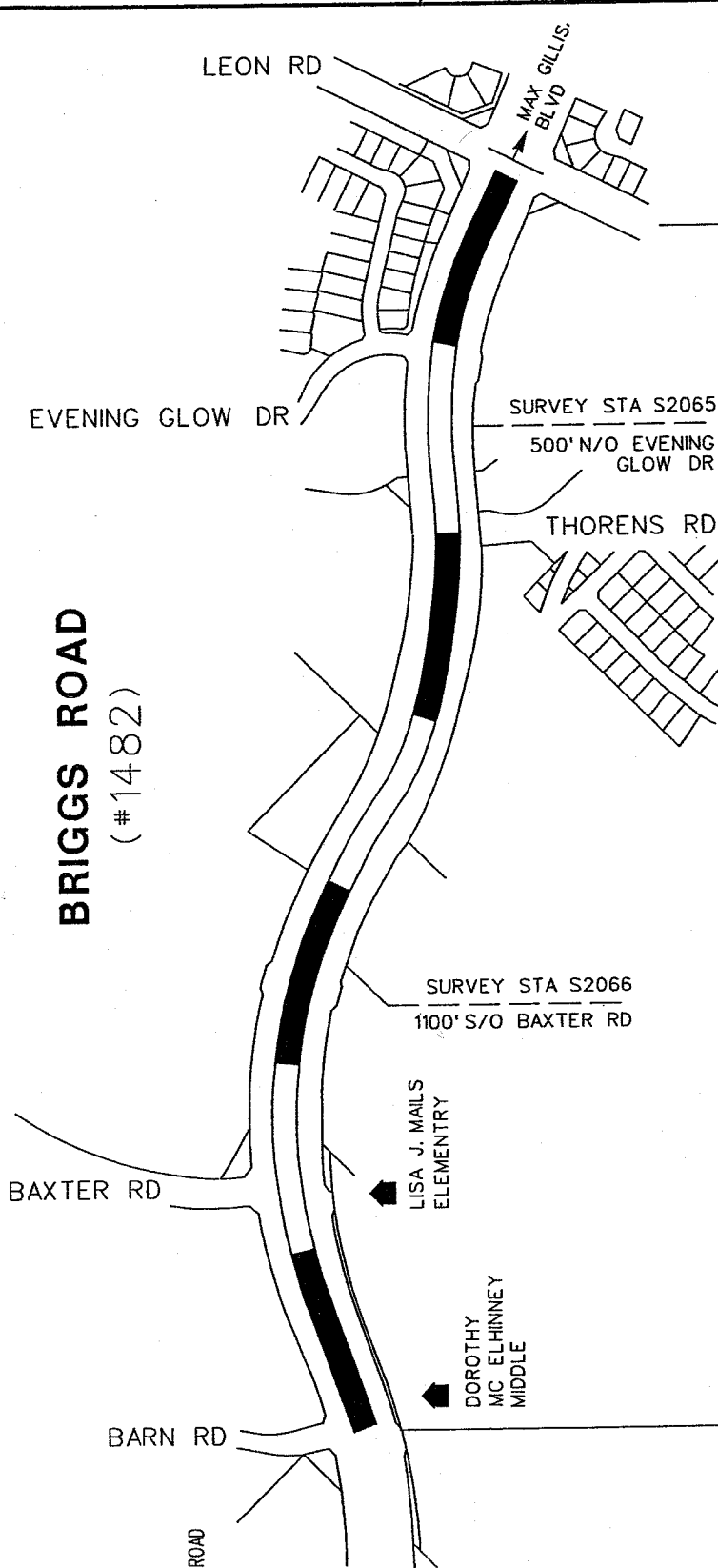

- LEGEND:**
- ////// CITY LIMITS
  - ▬ RADAR ZONE
  - - - SURVEY STATION
  - ==== OTHER STREET OR ROAD
  - ▲ SCHOOL

	<b>BEGIN ZONE</b>	<b>END ZONE</b>
RECOMMENDED SPEED LIMIT	35 MPH	45 MPH
85th% TILE SPEED	37.5 MPH	45.7 MPH
VEHICLES IN 24 HR (2 WAY)	3,675	4,000
SEGMENT LENGTH	0.75 MILE	0.31 MILE
ALL ACCIDENTS IN 2 YRS.	0	0
ACCIDENT RATE ☆	0.00 ACC/MVM	0.00 ACC/MVM
EXISTING SPEED LIMIT	NOT POSTED	NOT POSTED

☆ RATE: NO. OF ACCIDENT x 1,000,000  
VEH x 365 x 2 x MILE

COUNTY AREA:	MURRIETA	SURVEY DATE:	MAR 21, 2013
COUNTY MAP:	121B	MAP DATE:	MAY 1, 2013
SUPERVISOR DISTRICT:	3/3	DRAWN BY:	N AHMAD
		CAD FILE:	BRIGGS_RD.DGN

APPROVED BY:  
  
 DATE: 5/16/2013  
**LAWRENCE T. TALPE**  
 COUNTY TRAFFIC ENGINEER

# EL CHIMISAL ROAD

(#1510)

## LEGEND:

- CITY LIMITS
- RADAR ZONE
- SURVEY STATION
- OTHER STREET OR ROAD
- SCHOOL

CITY OF TEMECULA

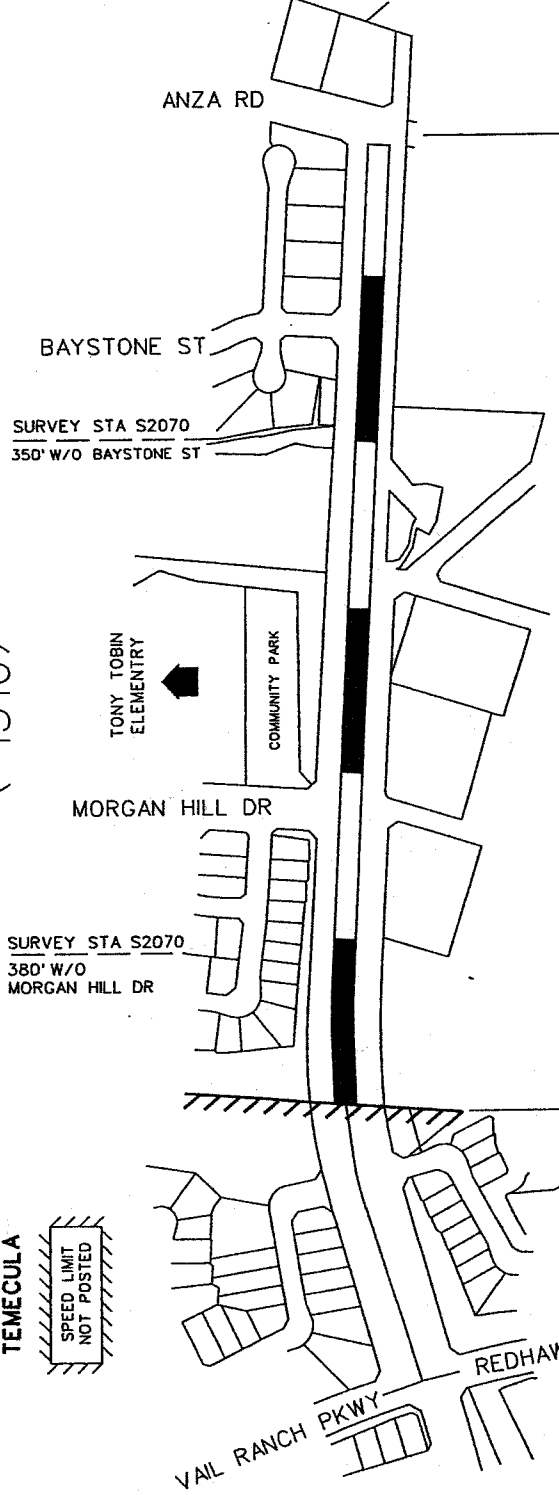

BEGIN ZONE

END ZONE

NO SCALE

RECOMMENDED SPEED LIMIT	40 MPH
85th/TILE SPEED	41.8 MPH (Avg of two similar segments of 40.6 & 42.9 MPH)
VEHICLES IN 24 HR (2 WAY)	1,800
SEGMENT LENGTH	0.60 MILE
ALL ACCIDENTS IN 2 YRS.	0
ACCIDENT RATE ☆	0.00 ACC/MVM
EXISTING SPEED LIMIT	NOT POSTED

☆ RATE: NO. OF ACCIDENT x 1,000,000  
VEH x 365 x 2 x MILE

COUNTY AREA:	TEMECULA
COUNTY MAP:	135C
SUPERVISOR DISTRICT:	3/3

APPROVED BY: *Lawrence T. Tai, P.E.*  
DATE: 5/22/2013  
LAWRENCE T. TAI, P.E.  
COUNTY TRAFFIC ENGINEER

LEGEND:

- ////// CITY LIMITS
- ▬ RADAR ZONE
- - - SURVEY STATION
- ▬ OTHER STREET OR ROAD

# MAX GILLISS BLVD

(#1483)

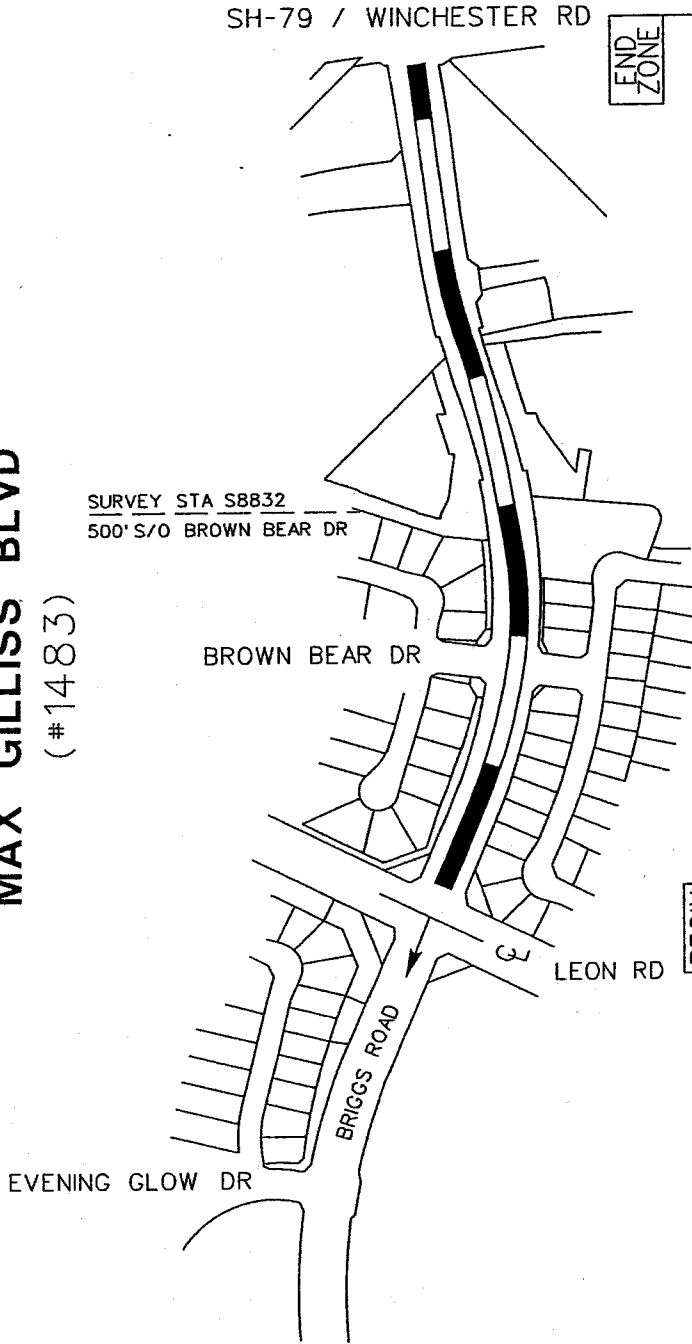

END ZONE

BEGIN ZONE

RECOMMENDED SPEED LIMIT	45 MPH
85th/7ILE SPEED	42.8 MPH
VEHICLES IN 24 HR (2 WAY)	14,100
SEGMENT LENGTH	0.43 MILE
ALL ACCIDENTS IN 2 YRS.	1
ACCIDENT RATE ★	0.23 ACC/MVM
EXISTING SPEED LIMIT	NOT POSTED

SEE BRIGGS ROAD  
(\*1482)  
ENGINEERING & TRAFFIC  
SURVEY

★ RATE:  $\frac{\text{NO. OF ACCIDENT} \times 1000.000}{\text{VEH} \times 365 \times 2 \times \text{MILE}}$

APPROVED BY: *Lawrence T. Tai*  
DATE: 5/13/2013  
LAWRENCE T. TAI, P.E.  
COUNTY TRAFFIC ENGINEER

SURVEY DATE: MAR 21, 2013  
MAP DATE: MAY 1, 2013  
DRAWN BY: N AHMAD  
CAD FILE: MAX\_GILLISS.DGN

COUNTY AREA: MURRIETA  
COUNTY MAP: 121B  
SUPERVISOR DISTRICT: 3/3

COUNTY OF RIVERSIDE  
TRANSPORTATION DEPARTMENT  
TRAFFIC ENGINEERING DIVISION  
ENGINEERING AND TRAFFIC SURVEY  
AT  
MAX GILLISS BLVD

LEGEND:

- ////// CITY LIMITS
- ▬ RADAR ZONE
- - - SURVEY STATION
- ▬ OTHER STREET OR ROAD

BEGIN ZONE

END ZONE

# WISTERIA LOOP

(#1511)



NO SCALE

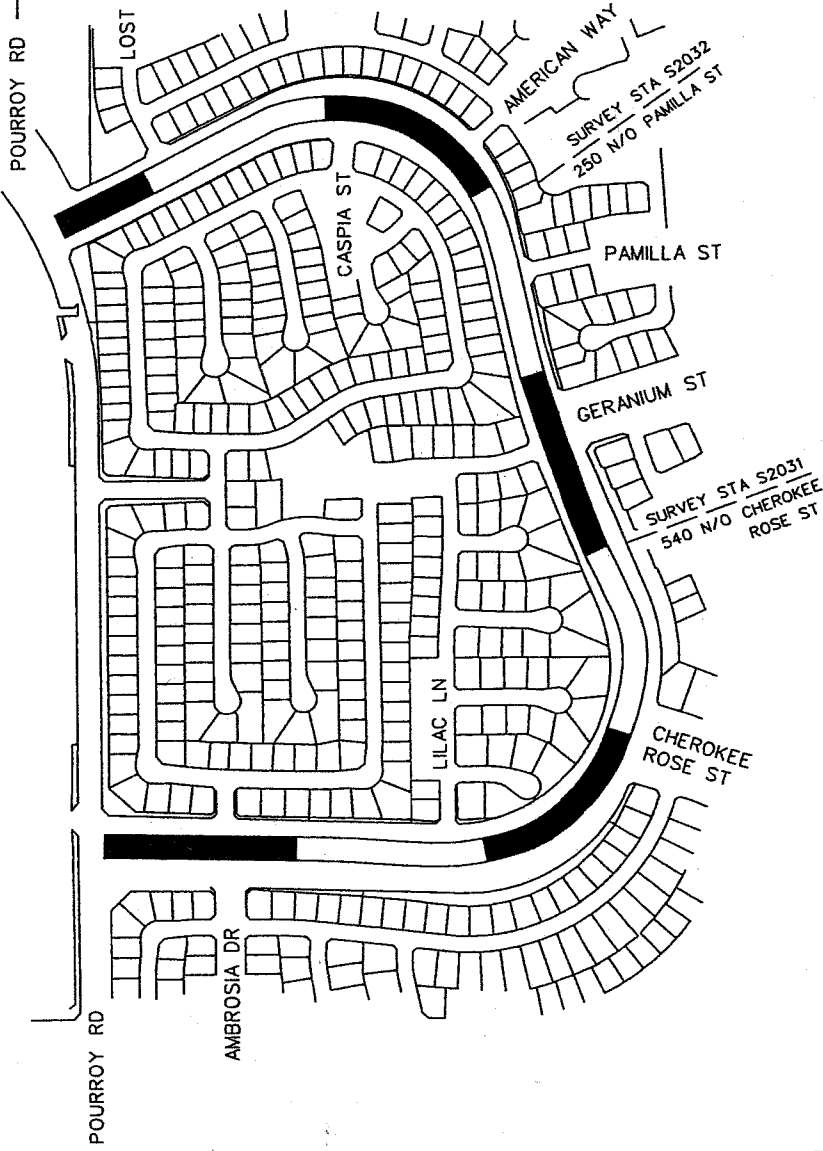

RECOMMENDED SPEED LIMIT	40 MPH
85th% TILE SPEED	42.0 MPH
VEHICLES IN 24 HR (2 WAY)	440
SEGMENT LENGTH	1.1 MILE
ALL ACCIDENTS IN 2 YRS.	1
ACCIDENT RATE ☆	2.83 ACC/MVM
EXISTING SPEED LIMIT	NOT POSTED

☆ RATE • NO. OF ACCIDENT x 1000 000  
VEH x 365 x 2 x MILE

COUNTY AREA:	MURRIETA	SURVEY DATE:	AUG 2, 2012
COUNTY MAP:	122C	MAP DATE:	MAY 6, 2013
SUPERVISOR DISTRICT:	3/3	DRAWN BY:	N AHMAD
		CAD FILE:	WISTERIA_LOOP.DGN

APPROVED BY:

*Lawrence T. Tai*  
DATE: 5/16/2013

LAWRENCE T. TAI, P.E.  
COUNTY TRAFFIC ENGINEER

COUNTY OF RIVERSIDE  
TRANSPORTATION DEPARTMENT  
TRAFFIC ENGINEERING DIVISION

ENGINEERING AND TRAFFIC SURVEY  
AT

WISTERIA LOOP



**LIST OF SPEED ZONE SUBMITTALS  
ORDINANCE AMENDMENT NO 452.234  
SUPERVISORIAL DISTRICT NO. 4**

AREA	ROAD NAME/ LIMITS	EXISTING SPEED LIMIT	PROPOSED SPEED LIMIT	NOTES
MECCA	<b>DALE KILER ROAD</b> Between 7 <sup>th</sup> Street and a point 2,860' north of 7 <sup>th</sup> Street	Not Posted*	35	NEW

- \* Maximum allowable speed limit for a two-lane highway is 55 mph
- \*\*Maximum allowable speed limit for a multi-lane highway is 65 mph
- \*\*\*Change in speed zone boundary

# DALE KILER ROAD (#1503)

- LEGEND:
- ////// CITY LIMITS
  - ▬ RADAR ZONE
  - - - SURVEY STATION
  - ==== OTHER STREET OR ROAD
  - ↑ SCHOOL

SURVEY STA 1503.1  
750' N/O 7TH ST

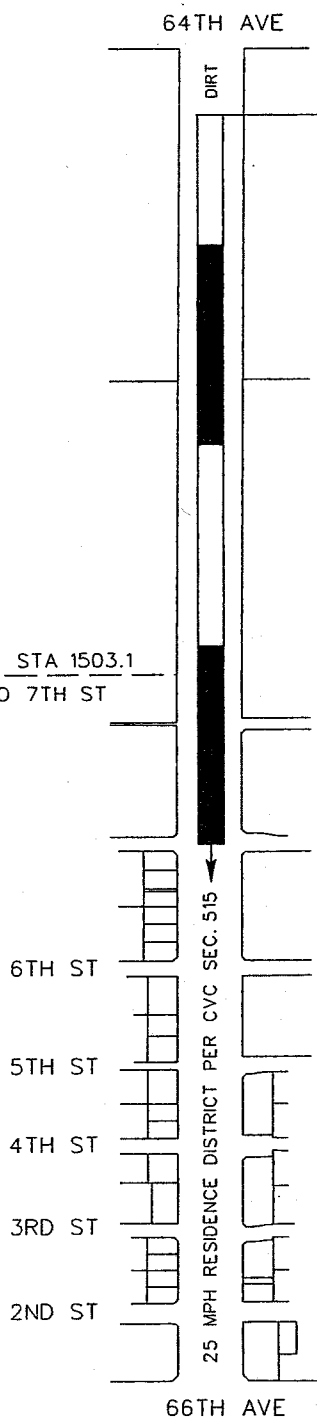

NO SCALE

RECOMMENDED SPEED LIMIT	35 MPH
85th/TILE SPEED	34.7 MPH
VEHICLES IN 24 HR (2 WAY)	1,750
SEGMENT LENGTH	0.54 MI
ALL ACCIDENTS IN 2 YRS.	1
ACCIDENT RATE ☆	1.45 ACC/MVM
EXISTING SPEED LIMIT	NOT POSTED

☆ RATE:  $\frac{\text{NO. OF ACCIDENT} \times 1000.000}{\text{VEH} \times 365 \times 2 \times \text{MILE}}$

COUNTY AREA:	MECCA	SURVEY DATE:	OCT 2, 2012
COUNTY MAP:	230, 230A	MAP DATE:	NOV 13, 2012
SUPERVISOR DISTRICT:	4/4	DRAWN BY:	N AHMAD
		CAD FILE:	DALE KILER RD.DGN

APPROVED BY: *Lawrence T. Tai*  
 DATE: 11/21/12  
 LAWRENCE T. TAI, P.E.  
 COUNTY TRAFFIC ENGINEER

COUNTY OF RIVERSIDE  
 TRANSPORTATION DEPARTMENT  
 TRAFFIC ENGINEERING DIVISION

ENGINEERING AND TRAFFIC SURVEY  
 AT  
**DALE KILER ROAD**





**LIST OF SPEED ZONE SUBMITTALS  
ORDINANCE AMENDMENT NO 452.234  
SUPERVISORIAL DISTRICT NO. 5**

AREA	ROAD NAME/ LIMITS	EXISTING SPEED LIMIT	PROPOSED SPEED LIMIT	NOTES
PERRIS	<b>ORANGE AVENUE †</b> Between Brown Street and Old Elsinore Road	Not Posted*	45	NEW

† Redistricting to Supervisorial District No. 5

\* Maximum allowable speed limit for a two-lane highway is 55 mph

\*\*Maximum allowable speed limit for a multi-lane highway is 65 mph

\*\*\*Change in speed zone boundary

# ORANGE AVENUE (#1502)

REQ NO. R12016  
STA NO. S2019  
715' E/O CLARK ST

REQ NO. R12017  
STA NO. S2020  
380' W/O HAINES ST

- LEGEND:
- CITY LIMITS
  - RADAR ZONE
  - SURVEY STATION
  - OTHER STREET OR ROAD
  - SCHOOL

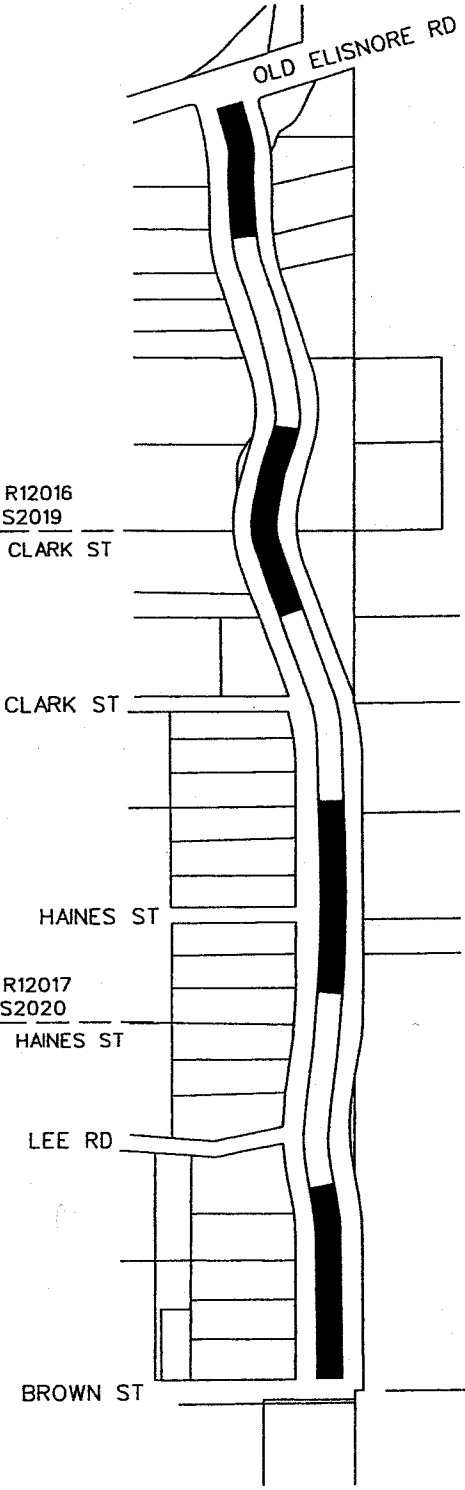

BEGIN ZONE

END ZONE

RECOMMENDED SPEED LIMIT	45 MPH.
85th% TILE SPEED	46.5 MPH
VEHICLES IN 24 HR (2 WAY)	1000
SEGMENT LENGTH	0.9 MILE
ALL ACCIDENTS IN 2 YRS.	2
ACCIDENT RATE ★	3.04 ACC/MVM
EXISTING SPEED LIMIT	NOT POSTED

★ RATE:  $\frac{\text{NO. OF ACCIDENT} \times 1000.000}{\text{VEH} \times 365 \times 2 \times \text{MILE}}$

APPROVED BY: *Lawrence T. Tai*  
DATE: 6/21/2012  
LAWRENCE T. TAI, P.E.  
COUNTY TRAFFIC ENGINEER

SURVEY DATE: MAY 16, 2012  
MAP DATE: JUN 20, 2012  
DRAWN BY: N. AHMAD  
CAD FILE: ORANGE\_AVE.DGN

COUNTY AREA: PERRIS  
COUNTY MAP: 58  
SUPERVISOR DISTRICT: 1/1 & 5/5

COUNTY OF RIVERSIDE  
TRANSPORTATION DEPARTMENT  
TRAFFIC ENGINEERING DIVISION  
ENGINEERING AND TRAFFIC SURVEY  
AT  
**ORANGE AVENUE**



OFFICE OF  
CLERK OF THE BOARD OF SUPERVISORS  
1st FLOOR, COUNTY ADMINISTRATIVE CENTER  
P.O. BOX 1147, 4080 LEMON STREET  
RIVERSIDE, CA 92502-1147  
PHONE: (951) 955-1060  
FAX: (951) 955-1071

KECIA HARPER-IHEM  
Clerk of the Board of Supervisors

KIMBERLY A. RECTOR  
Assistant Clerk of the Board

August 28, 2013

THE PRESS ENTERPRISE  
ATTN: LEGALS  
PO BOX 792  
RIVERSIDE, CA 92501

FAX: (951) 368-9018  
E-MAIL: [legals@pe.com](mailto:legals@pe.com)

RE: ADOPTION OF ORDINANCE NO. 452.234

To Whom It May Concern:

Attached is a copy for publication in your newspaper for **ONE (1) TIME** on **Friday, August 30, 2013**.

We require your affidavit of publication immediately upon completion of the last publication.

Your invoice must be submitted to this office in duplicate, **WITH TWO CLIPPINGS OF THE PUBLICATION**.

NOTE: PLEASE COMPOSE THIS PUBLICATION INTO A SINGLE COLUMN FORMAT.

Thank you in advance for your assistance and expertise.

Sincerely,

*Cecilia Gil*

Board Assistant to:  
KECIA HARPER-IHEM, CLERK OF THE BOARD

**Gil, Cecilia**

---

**From:** mtinajero@pe.com on behalf of Master, PEC Legals <legalsmaster@pe.com>  
**Sent:** Tuesday, August 27, 2013 8:26 AM  
**To:** Gil, Cecilia  
**Subject:** Re: [Legals] FOR PUBLICATION: Adoption of Ord. No. 452.234

Received for publication on Aug. 30. Proof with cost to follow.

**Please Note: The Press-Enterprise offices will be closed on Monday, September 2, 2013 in observance of the Labor Day Holiday. Advanced deadlines will apply. Below are our Labor Day deadlines:**

<b>Publication Date:</b>	<b>Deadline:</b>
Fri., Aug. 30 – Sat., Aug. 31	Wed., Aug. 28 @ 10:30 AM
Sun., Sept. 1 – Tues., Sept. 3	Thurs., Aug. 29 @ 10:30 AM
Wed., Sept. 4	Fri., Aug. 30 @ 10:30 AM
Thurs., Sept. 5	Tues., Sept. 3 @ 10:30 AM

Thank You!



Publisher of The Press-Enterprise  
*Inland Southern California's News Leader*

**Legal Advertising**

Phone: 1.800.880.0345

Fax: 951.368.9018

E-mail: [legals@pe.com](mailto:legals@pe.com)

Please Note: Deadline is 10:30 AM two (2) business days prior to the date you would like to publish.

**\*\*Additional days required for larger ad sizes\*\***

On Tue, Aug 27, 2013 at 8:13 AM, Gil, Cecilia <[CCGIL@rcbos.org](mailto:CCGIL@rcbos.org)> wrote:

Hello again! Adoption of Ordinance, for publication on Friday, August 30, 2013. Please confirm. THANK YOU!

*Cecilia Gil*

Board Assistant

Clerk of the Board

951-955-8464

MS# 1010



OFFICE OF  
CLERK OF THE BOARD OF SUPERVISORS  
1st FLOOR, COUNTY ADMINISTRATIVE CENTER  
P.O. BOX 1147, 4080 LEMON STREET  
RIVERSIDE, CA 92502-1147  
PHONE: (951) 955-1060  
FAX: (951) 955-1071

KECIA HARPER-IHEM  
Clerk of the Board of Supervisors

KIMBERLY A. RECTOR  
Assistant Clerk of the Board

August 28, 2013

THE DESERT SUN  
ATTN: LEGALS  
PO BOX 2734  
PALM SPRINGS, CA 92263

FAX: (760) 778-4731  
E-MAIL: [legals@thedesertsun.com](mailto:legals@thedesertsun.com)

RE: ADOPTION OF ORDINANCE NO. 452.234

To Whom It May Concern:

Attached is a copy for publication in your newspaper for **ONE (1) TIME** on **Friday, August 30, 2013**.

We require your affidavit of publication immediately upon completion of the last publication.

Your invoice must be submitted to this office in duplicate, WITH TWO CLIPPINGS OF THE PUBLICATION.

NOTE: PLEASE COMPOSE THIS PUBLICATION INTO A SINGLE COLUMN FORMAT.

Thank you in advance for your assistance and expertise.

Sincerely,

*Cecilia Gil*

Board Assistant to:  
KECIA HARPER-IHEM, CLERK OF THE BOARD

## Gil, Cecilia

---

**From:** Moeller, Charlene <CMOELLER@palmspri.gannett.com>  
**Sent:** Tuesday, August 27, 2013 8:53 AM  
**To:** Gil, Cecilia  
**Subject:** RE: FOR PUBLICATION: Adoption of Ord. No. 452.234

Ad received and will publish on date(s) requested.

**Charlene Moeller** | Media Sales Legal Notice Coordinator

The Desert Sun Media Group  
750 N. Gene Autry Trail, Palm Springs, CA 92262  
t 760.778.4578 | f 760.778.4731  
[legals@thedesertsun.com](mailto:legals@thedesertsun.com) / [dpwlegals@thedesertsun.com](mailto:dpwlegals@thedesertsun.com)

The Coachella Valley's #1 Source in News & Advertising!  
[www.mydesert.com](http://www.mydesert.com) | twitter @MyDesert | facebook MyDesert.com

This email and any files transmitted with it are confidential and intended for the individual to whom they are addressed. If you have received this email in error, please notify the sender and delete the message from your system

---

**From:** Gil, Cecilia [<mailto:CCGIL@rcbos.org>]  
**Sent:** Tuesday, August 27, 2013 8:14 AM  
**To:** tds-legals  
**Subject:** FOR PUBLICATION: Adoption of Ord. No. 452.234

Hello again! Adoption of Ordinance, for publication on Friday, August 30, 2013. Please confirm. THANK YOU!

*Cecilia Gil*  
Board Assistant  
Clerk of the Board  
951-955-8464  
MS# 1010

BOARD OF SUPERVISORS OF THE COUNTY OF RIVERSIDE, STATE OF CALIFORNIA

**ORDINANCE NO. 452.234**

**AN ORDINANCE OF THE COUNTY OF RIVERSIDE  
AMENDING ORDINANCE NO. 452  
RELATING TO PRIMA FACIE SPEED LIMITS**

The Board of Supervisors of the County of Riverside ordains as follows:

Section 1. Section 2.3 of Ordinance No. 452, entitled "Thirty-Five miles per hour," is hereby amended to add new subsections 117 and 118 to read as follows:

- "117. On Briggs Road between Barn Road and Thorens Road, a total distance of approximately 0.75 miles, in the Murrieta area.
- 118. On Dale Kiler Road between 7<sup>th</sup> Street and a point 2,860' north of 7<sup>th</sup> Street, a total distance of approximately 0.54 miles, in the Mecca area."

Section 2. Section 2.4 of Ordinance No. 452, entitled "Forty miles per hour," is hereby amended to add new subsections 137, 138, and 139 to read as follows:

- "137. On El Chimisal Road between a point 830' east of Redhawk Parkway and Anza Road, a total distance of approximately 0.6 miles, in the Temecula area.
- 138. On Morgan Hill Drive between Villa Helena Street and a point 260' north of Coppola Street, a total distance of approximately 0.3 miles, in the Temecula area.
- 139. On Wisteria Loop between Pourroy Road (south) and Pourroy Road (north), a total distance of approximately 1.1 miles, in the Murrieta area."

Section 3. Section 2.5 of Ordinance No. 452, entitled "Forty-Five miles per hour," is hereby amended to add new subsections 155, 156, and 157 to read as follows:

- "155. On Briggs Road between Thorens Road and Leon Road, a total distance of approximately 0.31 miles, in the Murrieta area.
- 156. On Max Gilliss Boulevard between Leon Road and Winchester Road, a total distance of approximately 0.43 miles, in the Murrieta area.
- 157. On Orange Avenue between Brown Street and Old Elsinore Road, a total distance of approximately 0.9 miles, in the Perris area."

Section 4. This ordinance shall take effect 30 days after its adoption.

John J. Benoit, Chairman of the Board

I HEREBY CERTIFY that at a regular meeting of the Board of Supervisors of said County, held on **August 20, 2013**, the foregoing Ordinance consisting of four (4) sections was adopted by said Board by the following vote:

AYES: Jeffries, Tavaglione, Stone, Benoit and Ashley  
NAYS: None  
ABSENT: None

Kecia Harper-Ihem, Clerk of the Board  
By: Cecilia Gil, Board Assistant