

**SUBMITTAL TO THE BOARD OF SUPERVISORS
COUNTY OF RIVERSIDE, STATE OF CALIFORNIA**

504B



FROM: TLMA – Code Enforcement Department

SUBMITTAL DATE:
November 20, 2013

SUBJECT: Abatement of Public Nuisance [Accumulated Rubbish]
Case No: CV12-05595 [BAC HOME LOANS, SERVICING L.P.]
Subject Property: 33649 El Centro Ave., Hemet; APN: 458-225-005
District: 3/3 [\$0.00]

RECOMMENDED MOTION: That the Board of Supervisors move that:

1. The accumulation of rubbish on the real property located at 33649 El Centro Ave., Hemet, Riverside County, California, APN: 458-225-005 be declared a public nuisance and a violation of Riverside County Ordinance No. 541 which does not permit the accumulation of rubbish on the property.
2. BAC Home Servicing L.P., the owner of the subject real property, be directed to abate the accumulation of rubbish on the property by removing the same from the real property within ninety (90) days.

Greg Flannery

GREG FLANNERY
Interim Code Enforcement Official

(Continued)

FINANCIAL DATA	Current Fiscal Year	Next Fiscal Year	Total Cost	Ongoing Cost	POLICY/CONSENT (per Exec. Office)
COST	\$ N/A	\$ N/A	\$ N/A	\$ N/A	Consent <input type="checkbox"/> Policy <input checked="" type="checkbox"/>
NET COUNTY COST	\$ N/A	\$ N/A	\$ N/A	\$ N/A	
SOURCE OF FUNDS				Budget Adjustment:	
				For Fiscal Year:	

C.E.O. RECOMMENDATION:

APPROVE

BY: *Tina Grande*
Tina Grande

County Executive Office Signature

MINUTES OF THE BOARD OF SUPERVISORS

On motion of Supervisor Benoit, seconded by Supervisor Stone and duly carried, IT WAS ORDERED that the above matter is approved as recommended.

Ayes: Jeffries, Stone, Benoit and Ashley
Nays: None
Absent: Tavaglione
Date: December 3, 2013
xc: TLMA/CED, Sheriff

Kecia Harper-Ihem
Clerk of the Board
By: *Faquel Lopez*
Deputy

5013 NOV 22 04 08:50

Prev. Agn. Ref.:

District: 3/3

Agenda Number:

9-4

CRM APPROVED COUNTY COUNSEL
10/30/13
PATRICIA MUNROE / DATE

Departmental Concurrence

- A-30
- Positions Added
- 4/5 Vote
- Change Order

SUBMITTAL TO THE BOARD OF SUPERVISORS, COUNTY OF RIVERSIDE, STATE OF CALIFORNIA

FORM 11: Abatement of Public Nuisance [Accumulated Rubbish]

Case No: 12-05595 [BAC HOME LOANS SERVICING, L.P.]

Subject Property: 33649 El Centro Ave., Hemet; APN: 458-225-005

District: 3/3

DATE: November 20, 2013

PAGE: 2 of 2

RECOMMENDED MOTION (continued):

3. If the owner or whoever has possession or control of the real property does not take the above described action within ninety (90) days of the date of the Board's Order to Abate, that representatives of the Code Enforcement Department, Sheriff's Department, and/or a contractor, upon consent of the owner or receipt of a Court Order authorizing entry onto the real property, when necessary under applicable law, may abate the accumulation of rubbish by removing and disposing of the same from the real property.

4. The reasonable costs of abatement, after notice and an opportunity for hearing, shall be imposed as a lien on the real property, which may be collected as a special assessment against the real property pursuant to Government Code Section 25845 and Riverside County Ordinance No. 725.

5. County Counsel be directed to prepare the necessary Findings of Fact and Conclusions that the accumulation of rubbish on the real property is declared to be in violation of Riverside County Ordinance No. 541, and a public nuisance, and further, to prepare an Order to Abate for approval by the Board.

BACKGROUND:

1. An initial inspection was made on the subject property by Code Enforcement Officer Matt Jones on October 17, 2012. The inspection revealed accumulated rubbish on the subject property in violation of Riverside County Ordinance 541. The rubbish consisted of, but was not limited to: plastic containers, tires, wood, metal, debris, trailer, broken furniture and miscellaneous debris.

2. Follow up inspections of the above-described real property on October 30, 2012, November 13, 2012, February 20, 2013, March 6, 2013, April 25, 2013 and September 9, 2013, revealed the property continues to be in violation of Riverside County Ordinance No. 541.

3. Staff and the Code Enforcement Department have complied with the notice requirements set forth in the appropriate laws of this jurisdiction pertaining to the administrative abatement proceedings for the removal of accumulated rubbish.

Impact on Citizens and Businesses

N/A

SUPPLEMENTAL:

Additional Fiscal Information

N/A

Contract History and Price Reasonableness

N/A

ATTACHMENTS

1
2
3
4
5
6
7
8
9
10
11
12
13
14
15
16
17
18
19
20
21
22
23
24
25
26
27
28

**BOARD OF SUPERVISORS
COUNTY OF RIVERSIDE**

IN RE ABATEMENT OF PUBLIC NUISANCE) CASE NO. CV 12-05595
[ACCUMULATED RUBBISH]; APN: 458-225-005,)
33649 EL CENTRO AVE., HEMET, COUNTY OF) DECLARATION OF CODE
RIVERSIDE, STATE OF CALIFORNIA; BAC HOME) ENFORCEMENT OFFICER
LOANS SERVICING, L.P., OWNER.) SAMATHA PHILLIPS
)
)
) [RCO No. 541]

I, Samantha Phillips, declare that the facts set forth below are personally known to me except to the extent that certain information is based on information and belief which I believe to be true, and if called as a witness, I could and would competently testify thereof under oath:

1. I am currently employed by the Riverside County Code Enforcement Department as a Code Enforcement Officer. My current official duties as a Code Enforcement Officer include inspecting properties for violations and enforcement of the provisions of Riverside County Ordinances.

2. I am informed and believe and based thereon allege that on October 17, 2012, Officer Jones conducted an initial inspection of the real property described as 33649 El Centro Ave., Hemet, Riverside County, California and further described as Assessor's Parcel Number 458-225-005 (hereinafter described as "THE PROPERTY"). A true and correct copy of a Thomas Brothers map page indicating the location of THE PROPERTY is attached hereto and incorporated herein by reference as Exhibit "A."

3. A review of County records and documents disclosed that THE PROPERTY is owned by BAC Home Loans Servicing, L.P. (hereinafter referred to as "OWNER"). A certified copy of the County Equalized Assessment Roll for 2013-2014 tax year and a copy of the report generated from the County Geographic Information System ("GIS") is attached hereto and incorporated herein by reference as Exhibit "B."

4. Based on the Lot Book Report from RZ Title Service dated March 6, 2013 and updated on August 6, 2013, it is determined that other parties may potentially hold a legal interest in THE PROPERTY, to wit: Warren W. Markel, Sr. and Martha L. Markel and NDEX West, LLC, (hereinafter referred to as "INTERESTED PARTIES"). True and correct copies of the Lot Book Reports are attached

1 hereto and incorporated herein by reference as Exhibit "C."

2 5. I am informed and believe and thereon allege that on October 17, 2012, Officer Jones
3 drove to THE PROPERTY to conduct an initial inspection. Officer Jones observed accumulated rubbish,
4 which consisted of, but was not limited to the following materials: plastic containers, tires, wood, metal,
5 debris, trailer, broken furniture and miscellaneous items. Officer Jones estimated the accumulated
6 rubbish to be approximately 500 square feet.

7 6. As a result of the accumulated rubbish, THE PROPERTY constituted a public nuisance in
8 violation of the provisions set forth in Riverside County Ordinance ("RCO") No. 541.

9 7. On October 17, 2012, a Notice of Violation for accumulated rubbish was posted on THE
10 PROPERTY.

11 8. On October 18, 2012, a Notice of Violation was mailed to OWNER by first class mail. On
12 May 1, 2013 and September 5, 2013, a Notice of Violation was mailed to OWNER by certified mail with
13 return receipt requested. On September 5, 2013, a Notice of Violation was mailed certified mail to
14 INTERESTED PARTIES with return receipt requested.

15 9. A true and correct copy of each Notice issued in this matter and other supporting
16 documentation are attached hereto and incorporated herein by reference as Exhibit "D."

17 10. A site plan and photographs depicting the conditions of THE PROPERTY are attached
18 hereto and incorporated herein by reference as Exhibit "E."

19 11. On October 30, 2012, November 13, 2012, February 20, 2013, March 6, 2013, and April
20 25, 2013, Officer Jones conducted follow up inspections and observed THE PROPERTY remained
21 unchanged and in violation of RCO No. 541.

22 12. On September 5, 2013, I conducted a follow up inspection of THE PROPERTY which
23 revealed the accumulated rubbish remained on THE PROPERTY and in violation of RCO No. 541.

24 13. Based upon my experience, knowledge and visual observations, it is my determination
25 that the conditions on THE PROPERTY are dangerous to the neighboring property owners and the
26 general public.

27 14. I am informed and believe and based upon said information and beliefs allege that the
28 OWNER does not have legal authority or permission to store or accumulate the above described

1 materials on THE PROPERTY.

2 15. A Notice of Pendency of Administrative Proceedings was recorded in the Office of the
3 County Recorder, County of Riverside, State of California, on December 4, 2012, as Instrument Number
4 2012-0586882. A true and correct copy of which is attached hereto and incorporated herein by reference
5 as Exhibit "F."

6 16. A "Notice to Correct County Ordinance Violations and Abate Public Nuisance" providing
7 notification of the Board of Supervisors' hearing as required by RCO No. 725 was mailed to OWNER and
8 INTERESTED PARTIES by U.S.P.S. and was posted on THE PROPERTY. True and correct copies of
9 the notice, together with the proof of service, and the affidavit of posting of notices are attached hereto
10 and incorporated herein by reference as Exhibit "G."

11 17. Removal of all accumulated rubbish on THE PROPERTY is required to bring THE
12 PROPERTY into compliance with RCO No. 541, and the Health and Safety Code. Under RCO No. 541,
13 no amount of rubbish is allowed to accumulate on THE PROPERTY.

14 18. Accordingly, the following findings and conclusions are recommended:

15 (a) the accumulation of rubbish on THE PROPERTY to be deemed and declared a
16 public nuisance;

17 (b) the OWNER or whoever has possession or control of THE PROPERTY, be
18 required to remove all accumulated rubbish within ninety (90) days of the date of the posting and mailing
19 of the Board's Order to Abate Nuisance, in accordance with all Riverside County Ordinances, including
20 but not limited to the provision of RCO No. 541;

21 (c) in the event the rubbish is not removed and disposed of according to the above
22 referenced ninety (90) day time period in strict accordance with all Riverside County Ordinances,
23 including but not limited to RCO No. 541, the rubbish may be abated and disposed of by representatives
24 of the Riverside County Code Enforcement Department, a contractor or the Sheriff's Department upon
25 receipt of an owner's consent or a Court Order when necessary under applicable law.

26 ///

27 ///

28 ///

1
2
3
4
5
6
7
8
9
10
11
12
13
14
15
16
17
18
19
20
21
22
23
24
25
26
27
28

(d) that reasonable costs of abatement, after notice and opportunity for hearing, shall be imposed as a lien on THE PROPERTY, which may be collected as a special assessment against THE PROPERTY pursuant to Government Code Section 25845 and RCO No. 541.

I declare under penalty of perjury under the laws of the State of California that the foregoing is true and correct.

Executed this 1 day of NOVEMBER, 2013, at MURRIETA, California



SAMANTHA PHILLIPS
Code Enforcement Officer
Code Enforcement Department

Abatement Exhibit List

Exhibit A – Thomas Bros Map with arrow to situs

Exhibit B – Assessors Roll and GIS report

Exhibit C – Lot Book Report(s) (current on top)

Exhibit D – Site Plan and Photographs

Exhibit E – Notice of Violation, AOP, POS and green cards

Exhibit F – Notice of Non-Compliance/ Notice of Pendency of
Administrative Proceedings

Exhibit G – Notice of BOS hearing, Notice List, POS and AOP

EXHIBIT “A”

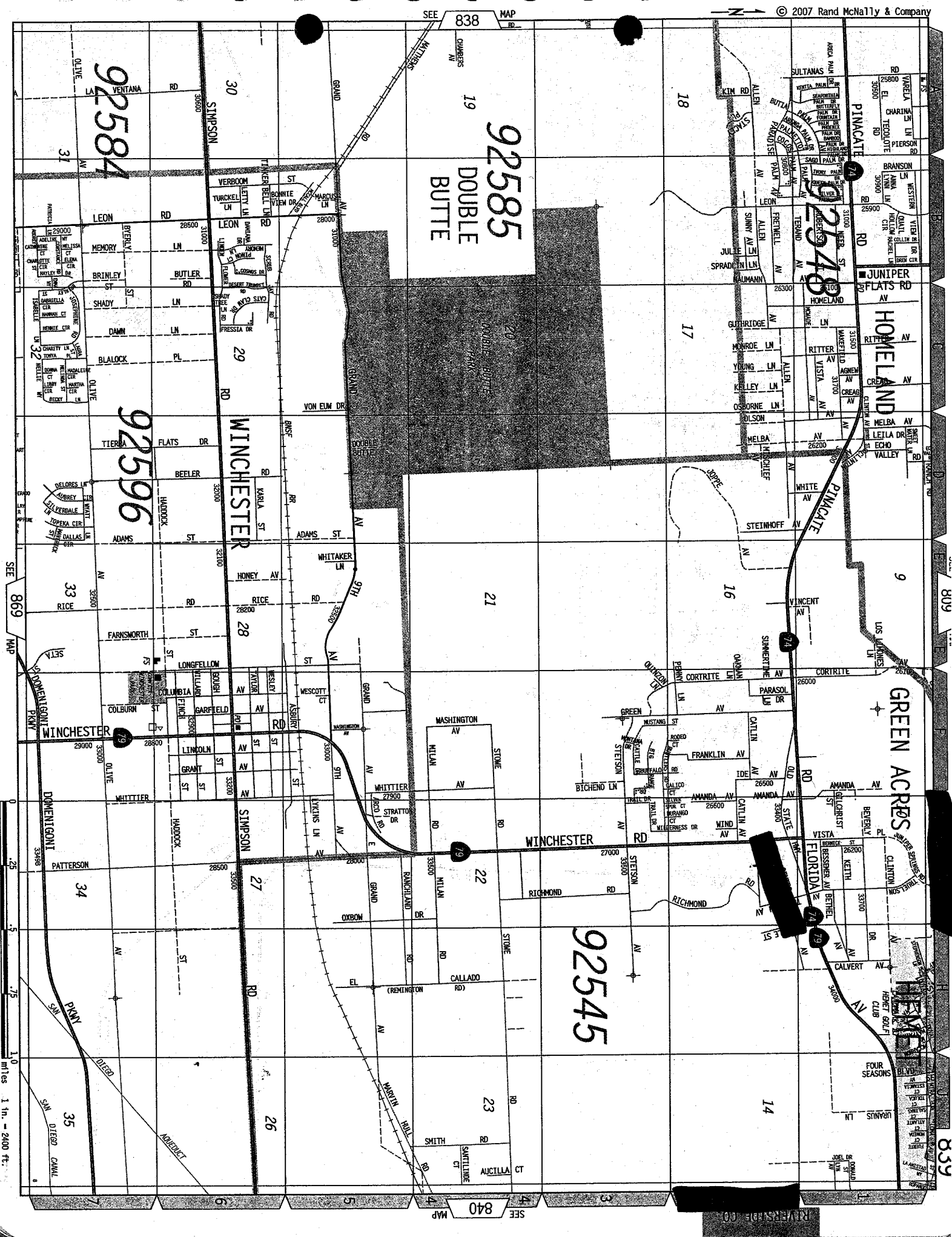

SEE 838 MAP

92584

92585
DOUBLE BUTTE

92596

92545

SEE 869 MAP

0 .25 .5 1.0 miles 1 in. = 2400 ft.

SEE 840 MAP

839

EXHIBIT “B”

Assessment Roll For the 2013-2014 Tax Year as of January 1, 2013

Assessment #458225005-5		Parcel # 458225005-5	
Assessee:	BAC HOME LOANS SERVICING	Land	36,687
Mail Address:	7105 CORPORATE	Structure	89,099
City, State Zip:	PLANO TX 75024	Full Value	125,786
Real Property Use Code:	MF	Total Net	125,786
Base Year	2011		
Conveyance Number:	0122023		
Conveyance (mm/yy):	3/2010		
PUI:	M020012		
TRA:	71-319		
Taxability Code:	0-00		
Assessment Description:	2007 FLEETWOOD		
ID Data:	Lot 11 MB 014/001 VALLEY VISTA AC		
Situs Address:	33649 EL CENTRO AVE HEMET CA 92545		

[View Parcel Map](#)

RIVERSIDE COUNTY GIS



Selected parcel(s):
458-225-005

IMPORTANT

Maps and data are to be used for reference purposes only. Map features are approximate, and are not necessarily accurate to surveying or engineering standards. The County of Riverside makes no warranty or guarantee as to the content (the source is often third party), accuracy, timeliness, or completeness of any of the data provided, and assumes no legal responsibility for the information contained on this map. Any use of this product with respect to accuracy and precision shall be the sole responsibility of the user.

STANDARD WITH PERMITS REPORT

APNs

458-225-005-5

OWNER NAME / ADDRESS

BAC HOME LOANS SERVICING
33649 EL CENTRO AVE
HEMET, CA. 92545

MAILING ADDRESS

(SEE OWNER)
7105 CORPORATE
PLANO TX. 75024

LEGAL DESCRIPTION

RECORDED BOOK/PAGE: MB 14/1
SUBDIVISION NAME: VALLEY VISTA AC
LOT/PARCEL: 11, BLOCK:
TRACT NUMBER: NOT AVAILABLE

LOT SIZE

RECORDED LOT SIZE IS 0.37 ACRES

PROPERTY CHARACTERISTICS

WOOD FRAME, 2280 SQFT., 4 BDRM/ 2 BATH, 1 STORY, CONST'D 2007 COMPOSITION, ROOF, CENTRAL HEATING, CENTRAL COOLING

THOMAS BROS. MAPS PAGE/GRID

PAGE: 839 GRID: G2

CITY BOUNDARY/SPHERE

NOT WITHIN A CITY
NOT WITHIN A CITY SPHERE
ANNEXATION DATE: NOT APPLICABLE
NO LAFCO CASE # AVAILABLE
NO PROPOSALS

MARCH JOINT POWERS AUTHORITY

NOT IN THE JURISDICTION OF THE MARCH JOINT POWERS AUTHORITY

INDIAN TRIBAL LAND

NOT IN A TRIBAL LAND

SUPERVISORIAL DISTRICT 2011 (ORD. 813)

JEFF STONE, DISTRICT 3

SUPERVISORIAL DISTRICT (2001 BOUNDARIES)

JEFF STONE, DISTRICT 3

TOWNSHIP/RANGE

T5SR2W SEC 15

ELEVATION RANGE

1584/1604 FEET

PREVIOUS APN

NO DATA AVAILABLE

PLANNING

LAND USE DESIGNATIONS

RC-LDR

SANTA ROSA ESCARPMENT BOUNDARY

NOT IN THE SANTA ROSA ESCARPMENT BOUNDARY

AREA PLAN (RCIP)

HARVEST VALLEY / WINCHESTER

COMMUNITY ADVISORY COUNCILS

WINCHESTER/HOMELAND (MAC)

GENERAL PLAN POLICY OVERLAYS

NOT IN A GENERAL PLAN POLICY OVERLAY AREA

GENERAL PLAN POLICY AREAS

GREEN ACRES POLICY AREA
HIGHWAY 79 POLICY AREA

ZONING CLASSIFICATIONS (ORD. 348)

R-R

ZONING DISTRICTS AND ZONING AREAS

HOMELAND AREA

ZONING OVERLAYS

NOT IN A ZONING OVERLAY

HISTORIC PRESERVATION DISTRICTS

NOT IN AN HISTORIC PRESERVATION DISTRICT

NOT WITHIN A SPECIFIC PLAN

AGRICULTURAL PRESERVE
NOT IN AN AGRICULTURAL PRESERVE

REDEVELOPMENT AREAS
PROJECT AREA NAME: MCPA
SUBAREA NAME: HOMELAND/GREEN ACRES
AMENDMENT NUMBER: 1
ADOPTION DATE: MAY. 11, 1999
ACREAGE: 1260 ACRES

AIRPORT INFLUENCE AREAS
NOT IN AN AIRPORT INFLUENCE AREA

AIRPORT COMPATIBILITY ZONES
NOT IN AN AIRPORT COMPATIBILITY ZONE

ENVIRONMENTAL

CVMSHCP (COACHELLA VALLEY MULTI-SPECIES HABITAT CONSERVATION PLAN) CONSERVATION AREA
NOT IN A CONSERVATION AREA

CVMSHCP FLUVIAL SAND TRANSPORT SPECIAL PROVISION AREAS
NOT IN A FLUVIAL SAND TRANSPORT SPECIAL PROVISION AREA

WRMSHCP (WESTERN RIVERSIDE COUNTY MULTI-SPECIES HABITAT CONSERVATION PLAN) CELL GROUP
NOT IN A CELL GROUP

WRMSHCP CELL NUMBER
NOT IN A CELL

HANS/ERP (HABITAT ACQUISITION AND NEGOTIATION STRATEGY/EXPEDITED REVIEW PROCESS)
NONE

VEGETATION (2005)
DEVELOPED/DISTURBED LAND

FIRE

HIGH FIRE AREA (ORD. 787)
NOT IN A HIGH FIRE AREA

FIRE RESPONSIBILITY AREA
NOT IN A FIRE RESPONSIBILITY AREA

DEVELOPMENT FEES

CVMSHCP FEE AREA (ORD. 875)
NOT WITHIN THE COACHELLA VALLEY MSHCP FEE AREA

WRMSHCP FEE AREA (ORD. 810)
IN OR PARTIALLY WITHIN THE WESTERN RIVERSIDE MSHCP FEE AREA. SEE MAP FOR MORE INFORMATION.

ROAD & BRIDGE DISTRICT
NOT IN A DISTRICT

EASTERN TUMF (TRANSPORTATION UNIFORM MITIGATION FEE ORD. 673)
NOT WITHIN THE EASTERN TUMF FEE AREA

WESTERN TUMF (TRANSPORTATION UNIFORM MITIGATION FEE ORD. 824)
IN OR PARTIALLY WITHIN A TUMF FEE AREA. SEE MAP FOR MORE INFORMATION.SAN JACINTO

DIF (DEVELOPMENT IMPACT FEE AREA.ORD. 659)
HIGHWAY 74/79 CORRIDOR

SKR FEE AREA (STEPHEN'S KANGAROO RAT ORD. 663.10)
IN OR PARTIALLY WITHIN AN SKR FEE AREA. SEE MAP FOR MORE INFORMATION.

DEVELOPMENT AGREEMENTS
NOT IN A DEVELOPMENT AGREEMENT AREA

TRANSPORTATION

CIRCULATION ELEMENT ULTIMATE RIGHT-OF-WAY

NOT IN A CIRCULATION ELEMENT RIGHT-OF-WAY

ROAD BOOK PAGE

104A

TRANSPORTATION AGREEMENTS

NOT IN A TRANSPORTATION AGREEMENT

CETAP (COMMUNITY AND ENVIRONMENTAL TRANSPORTATION ACCEPTABILITY PROCESS) CORRIDORS

NOT IN A CETAP CORRIDOR.

HYDROLOGY

FLOOD PLAIN REVIEW

NOT REQUIRED

WATER DISTRICT

EMWD

FLOOD CONTROL DISTRICT

RIVERSIDE COUNTY FLOOD CONTROL DISTRICT

WATERSHED

SAN JACINTO VALLEY

GEOLOGIC

FAULT ZONE

NOT IN A FAULT ZONE

FAULTS

NOT WITHIN A 1/2 MILE OF A FAULT

LIQUEFACTION POTENTIAL

NO POTENTIAL FOR LIQUEFACTION EXISTS

SUBSIDENCE

NOT IN A SUBSIDENCE AREA

PALEONTOLOGICAL SENSITIVITY

LOW POTENTIAL.

FOLLOWING A LITERATURE SEARCH, RECORDS CHECK AND A FIELD SURVEY, AREAS MAY BE DETERMINED BY A QUALIFIED VERTEBRATE PALEONTOLOGIST AS HAVING LOW POTENTIAL FOR CONTAINING SIGNIFICANT PALEONTOLOGICAL RESOURCES SUBJECT TO ADVERSE IMPACTS.

MISCELLANEOUS

SCHOOL DISTRICT

HEMET UNIFIED

COMMUNITIES

GREEN ACRES

COUNTY SERVICE AREA

IN OR PARTIALLY WITHIN
HOMELAND #80 -
STREET LIGHTING

LIGHTING (ORD. 655)

ZONE B, 28.87 MILES FROM MT. PALOMAR OBSERVATORY

2000 CENSUS TRACT

042723

FARMLAND

URBAN-BUILT UP LAND

071319

- COUNTY FREE LIBRARY
- COUNTY SERVICE AREA 80 *
- COUNTY STRUCTURE FIRE PROTECTION
- COUNTY WASTE RESOURCE MGMT DIST
- CSA 146
- CSA 152
- EASTERN MUN WATER IMP DIST 2
- EASTERN MUNICIPAL WATER
- ERAF RDV
- FLOOD CONTROL ADMINISTRATION
- FLOOD CONTROL ZONE 4
- GENERAL
- GENERAL PURPOSE
- HEMET UNIFIED SCHOOL
- METRO WATER EAST 1301999
- MT SAN JACINTO JUNIOR COLLEGE
- PROJECT 3-HOMELAND 2000 AB1290
- RIV CO REG PARK & OPEN SPACE
- RIV. CO. OFFICE OF EDUCATION
- SAN JACINTO BASIN RESOURCE CONS
- SAN JACINTO VALLEY CEMETERY
- VALLEY HEALTH SYSTEM HOSP DIST
- VALLEY WIDE REC & PARK

SPECIAL NOTES

NO SPECIAL NOTES

CODE COMPLAINTS

Case #	Description	Start Date
CV1205595	ABATEMENT	Oct. 17, 2012

BUILDING PERMITS

Case #	Description	Status
287849	DEMO SEPTIC/SEWER HOOKUP	CONTACT THE BUILDING AND SAFETY RECORDS DEPARTMENT AT 951-955-2017
BMR070358	SITE PREP FOR NEW MOBILE HOME	VOID
BMR070367	SITE PREP FOR 'REPLACEMENT' MH *2280 SF* ON PF	FINAL
BMR071256	PERMANENT FOUNDATION TO REPLACEMENT MOBILE HOME	FINAL
BMR071754	INSTALL FOR 'REPLACEMENT' MH - ON PF *2,280sq**	FINAL
BZ194027	CONV TO NAT GAS	CONTACT THE BUILDING AND SAFETY RECORDS DEPARTMENT AT 951-955-2017

ENVIRONMENTAL HEALTH PERMITS

Case #	Description	Status
NO ENVIRONMENTAL PERMITS	NOT APPLICABLE	NOT APPLICABLE

PLANNING PERMITS

Case #	Description	Status
NO PLANNING PERMITS	NOT APPLICABLE	NOT APPLICABLE

REPORT PRINTED ON...Mon Aug 19 11:21:08 2013
Version 130624

EXHIBIT “C”



P.O. Box 1193
Whittier, CA 90609
Tel # (562) 325-8351
Fax # (714) 783-3038

Lot Book Report

Order Number: **29094**

Customer:

RIVERSIDE COUNTY TLMA-CODE ENFORCEMENT
4080 Lemon Street
Riverside CA 92501

Order Date: 8/1/2013
Dated as of: 8/6/2013
County Name: Riverside

Attn: Brent Steele
Reference: CV12-05595 / Samantha Phillips
IN RE: BAC HOME LOANS SERVICING

FEE(s):
Report: \$120.00

Property Address: 33649 El Centro Ave.
Hemet CA 92545

Assessor's Parcel No. : 458-225-005-5

Assessments:

Land Value:	\$28,000.00
Improvement Value:	\$67,000.00
Exemption Value:	\$0.00
Total Value:	\$95,000.00

Tax Information

Property Taxes for the Fiscal Year	2012-2013
Total Annual Tax	\$1,245.42
Status: Paid through	06/30/2013

Property Vesting

The last recorded document transferring title of said property

Dated	03/15/2010
Recorded	03/17/2010



P.O. Box 1193
 Whittier, CA 90609
 Tel # (562) 325-8351
 Fax # (714) 783-3038

Order Number: 29094
 Reference: CV12-05595 / Sa

Document No. 2010-0122023
 D.T.T. \$0.00
 Grantor NDEX West, L.L.C., as Trustee
 Grantee - Bac Home Loans Servicing, Lp formerly known as
 Countrywide Home Loans Servicing Lp.

Affects Property in Question and Other Property

Deeds of Trust

Position No. 1st
 A Deed of Trust Dated 05/27/1975
 Recorded 06/04/1975
 Document No. 64812
 Amount \$6,875.00 ✓
 Trustor Thomas Ernest Taylor and Dorothy Ileen Taylor,
 husband and wife
 Trustee Southern Cities Escrow Company
 Beneficiary Warren W. Markel, Sr. and Martha L. Markel, husband
 and wife as joint tenants ✓

Affects Property in Question and Other Property

Additional Information

Document Type Notice
 Document No. 2006-0814616
 Recorded 11/03/2006
 Notice of Non-Compliance filed by County of Riverside Department of Code Enforcement
 In the matter of the property of Bac Home Loans Servicing
 Case No. CV11-00193
 Recorded 05/27/2011
 Document No. 2011-0236540



P.O. Box 1193
Whittier, CA 90609
Tel # (562) 325-8351
Fax # (714) 783-3038

Order Number: 29094
Reference: CV12-05595 / Sa

A Notice of Administrative Proceedings by the	County of Riverside Department of Code Enforcement
City of	Murrieta
County of	Riverside
Recorded	12/04/2012
Document No.	2012-0586882

DUE TO COMMON NAME JUDGMENT AND LIEN FOR COUNTRYWIDE HOME LOANS SERVICING ARE SHOW FROM THE DATE THEY ACQUIRED TITLE TO PRESENT.

Document Type	Certificate of Lien
Document No.	2010-0372828
Recorded	08/10/2010
Document Type	Certificate of Lien
Document No.	2010-0372890
Recorded	08/10/2010
Document Type	Certificate of Lien
Document No.	2010-0442201
Recorded	09/15/2010
Document Type	Certificate of Lien
Document No.	2011-0196910
Recorded	05/04/2011
Document Type	Certificate of Lien
Document No.	2011-0197064
Recorded	05/04/2011
Document Type	Certificate of Lien
Document No.	2011-0197291
Recorded	05/04/2011
Document Type	Certificate of Lien
Document No.	2011-0197413
Recorded	05/04/2011
Document Type	Certificate of Lien
Document No.	2011-0398285
Recorded	09/07/2011
Document Type	Certificate of Lien
Document No.	2012-0273327



P.O. Box 1193
Whittier, CA 90609
Tel # (562) 325-8351
Fax # (714) 783-3038

Order Number: 29094
Reference: CV12-05595 / Sa

Recorded	06/13/2012
Document Type	Certificate of Lien
Document No.	2012-0273397
Recorded	06/13/2012
Document Type	Certificate of Lien
Document No.	2012-0616274
Recorded	12/18/2012
Document Type	Certificate of Lien
Document No.	2013-0031590
Recorded	01/22/2013
Document Type	Certificate of Lien
Document No.	2013-0031681
Recorded	01/22/2013
Document Type	Certificate of Lien
Document No.	2010-0154701
Recorded	04/06/2010
Document Type	Certificate of Lien
Document No.	2010-0154815
Recorded	04/06/2010
Document Type	Certificate of Lien
Document No.	2010-0500378
Recorded	10/19/2010
Document Type	Certificate of Lien
Document No.	2010-0534855
Recorded	11/08/2010
Document Type	Certificate of Lien
Document No.	2010-0535226
Recorded	11/08/2010
Document Type	Certificate of Lien
Document No.	2010-0541445
Recorded	11/10/2010
Document Type	Certificate of Lien



P.O. Box 1193
Whittier, CA 90609
Tel # (562) 325-8351
Fax # (714) 783-3038

Order Number: 29094
Reference: CV12-05595 / Sa

Document No.	2010-0594072
Recorded	12/10/2010
Document Type	Certificate of Lien
Document No.	2011-0025766
Recorded	01/19/2011
Document Type	Certificate of Lien
Document No.	2011-0485414
Recorded	11/02/2011
Document Type	Certificate of Lien
Document No.	2011-0495194
Recorded	11/07/2011
Document Type	Certificate of Lien
Document No.	2012-0030157
Recorded	01/24/2012
Document Type	Certificate of Lien
Document No.	2012-0030165
Recorded	01/24/2012
Document Type	Certificate of Lien
Document No.	2012-0540054
Recorded	11/08/2012
Document Type	Certificate of Lien
Document No.	2012-0540199
Recorded	11/08/2012
Document Type	Certificate of Lien
Document No.	2013-0042039
Recorded	01/28/2013
Document Type	Certificate of Lien
Document No.	2013-0043251
Recorded	01/28/2013
Document Type	Certificate of Lien
Document No.	2013-0047603
Recorded	01/29/2013
Document Type	Certificate of Lien



P.O. Box 1193
Whittier, CA 90609
Tel # (562) 325-8351
Fax # (714) 783-3038

Order Number: 29094
Reference: CV12-05595 / Sa

Document No.	2013-0047609
Recorded	01/29/2013
Document Type	Certificate of Lien
Document No.	2013-0047634
Recorded	01/29/2013

Legal Description

THE LAND REFERRED TO IN THIS REPORT IS LOCATED IN AND IS DESCRIBED AS FOLLOWS:

LOT 11 IN BLOCK "C", OF VALLEY VISTA ACRES, IN THE COUNTY OF RIVERSIDE, STATE OF CALIFORNIA, AS PER MAP RECORDED IN BOOK 14, PAGE 1, OF MAPS, IN THE OFFICE OF THE COUNTY RECORDER OF SAID COUNTY.

T.R.A. 071-319

Por. NE 1/4 Sec. 15, T.5S., R.2W

THIS MAP IS FOR ASSESSMENT PURPOSES ONLY*

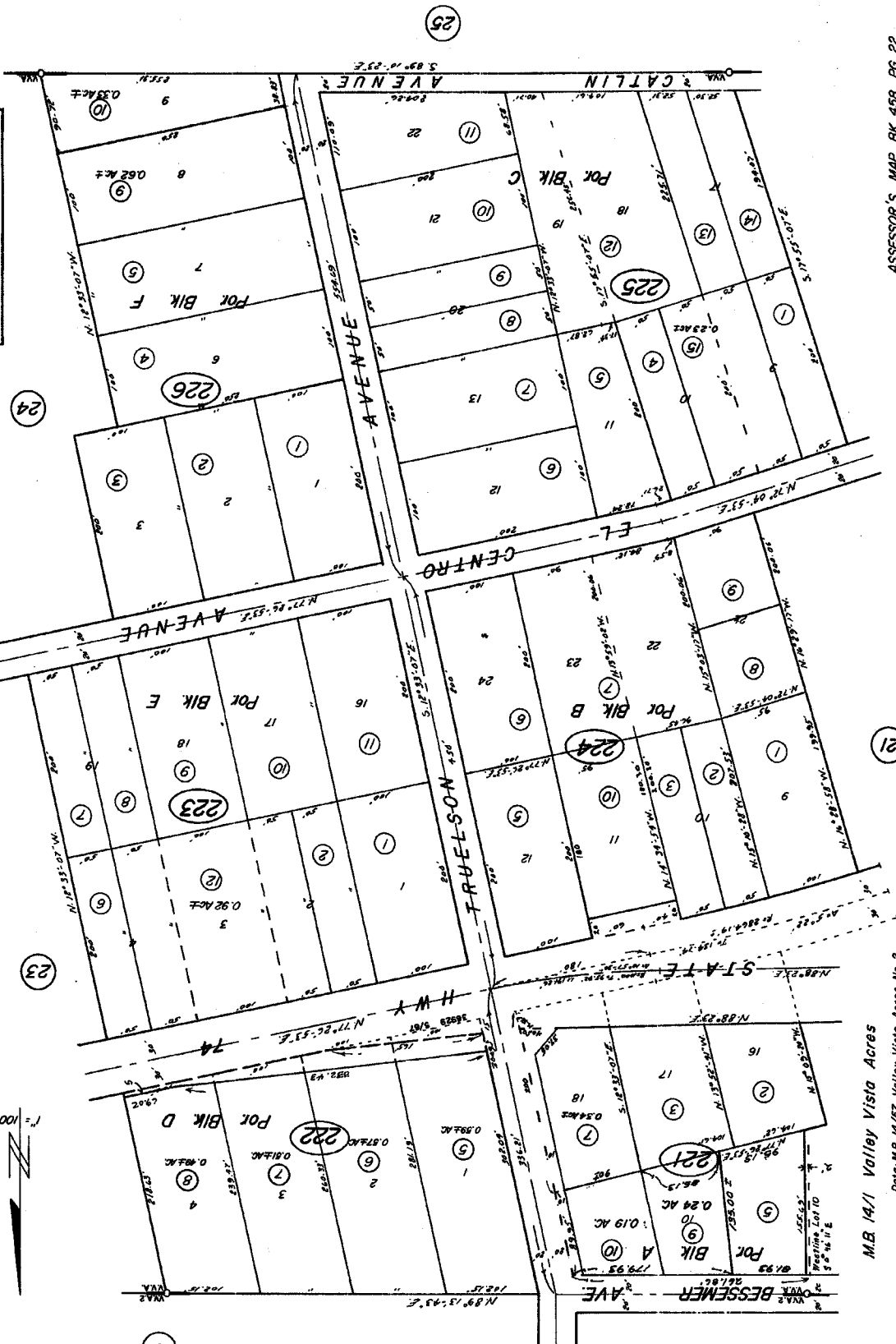

DATE	OLD NO.	NEW NO.
11/78	221-1	221-1
7/78	222-1	222-1
7/78	223-1	223-1
7/78	224-1	224-1
7/78	225-1	225-1
7/78	226-1	226-1
7/78	221-2	221-2
7/78	222-2	222-2
7/78	223-2	223-2
7/78	224-2	224-2
7/78	225-2	225-2
7/78	226-2	226-2
7/78	221-3	221-3
7/78	222-3	222-3
7/78	223-3	223-3
7/78	224-3	224-3
7/78	225-3	225-3
7/78	226-3	226-3
7/78	221-4	221-4
7/78	222-4	222-4
7/78	223-4	223-4
7/78	224-4	224-4
7/78	225-4	225-4
7/78	226-4	226-4
7/78	221-5	221-5
7/78	222-5	222-5
7/78	223-5	223-5
7/78	224-5	224-5
7/78	225-5	225-5
7/78	226-5	226-5

M.B. 14/1 Valley Vista Acres

Date: M.B. 14/57 Valley Vista Acres No. 2

March 1971

ASSESSOR'S MAP BK 458 PG. 22
RIVERSIDE COUNTY, CALIF

Recording requested by:
 NDEX West, L.L.C. *13km*
 15000 Surveyor Boulevard, Suite 500
 Addison, Texas 75001-9013

When Recorded Mail to and Mail Tax Statement to:
 BAC HOME LOANS SERVICING, LP .et al
 c/o BAC HOME LOANS SERVICING, LP F .et al
 PTX-C-32
 7105 CORPORATE
 PLANO, TX 75024



DOC # 2010-0122023
 03/17/2010 08:00A Fee:18.00
 Page 1 of 2
 Recorded in Official Records
 County of Riverside
 Larry W. Ward
 Assessor, County Clerk & Recorder



S	R	U	PAGE	SIZE	DA	MISC	LONG	RFD	COPY
1			2						
M	A	L	465	426	PCOR	NCOR	SMF	NCHG	EXAM
							T:	CTY	UNI
									012

Trustee Sale No. : 20090196100135

Title Order No.: 090400262

TRUSTEE'S DEED UPON SALE

18 T
012

The undersigned grantor declares:

- 1) The Grantee herein WAS the foreclosing beneficiary
- 2) The amount of the unpaid debt together with cost was **\$242,073.54**
- 3) The amount paid by the grantee at the trustee sale was **\$242,073.54**
- 4) The documentary transfer tax is N/A *0*
- 5) Said property is in the city of HEMET
- 6) APN# 458-225-005-5 & 458-225-004-4

NDEX West, L.L.C. , as the duly appointed Trustee under the Deed of Trust hereinafter described, does hereby grant and convey, but without covenant or warranty, express or implied, to:

BAC HOME LOANS SERVICING, LP FORMERLY KNOWN AS COUNTRYWIDE HOME LOANS SERVICING LP

(herein called Grantee), all of its right, title and interest in and to that certain property situated in the County of RIVERSIDE, State of California, described as follows:

PARCEL 1:

LOT 11 IN BLOCK 'C'; OF VALLEY VISTA ACRES, IN THE COUNTY OF RIVERSIDE, STATE OF CALIFORNIA, AS PER MAP RECORDED IN BOOK 14, PAGE(S) 1, OF MAPS, IN THE OFFICE OF THE COUNTY RECORDER OF RIVERSIDE COUNTY.

PARCEL 2:

THE EAST HALF OF LOT 10 IN BLOCK "C" OF VALLEY VISTA ACRES AS SHOWN BY MAP ON FILE IN BOOK 14 PAGE 1 OF MAPS, RECORDS OF RIVERSIDE COUNTY, CALIFORNIA.

"This instrument is being recorded as an ACCOMMODATION ONLY, with no Representation as to its effect upon title"

MAIL TAX STATEMENTS AS DIRECTED ABOVE

RECITALS:

This conveyance is made pursuant to the powers conferred upon Trustee by that certain Deed of Trust dated 03/19/2008 and executed by GILBERT REA AND STACEY REA Trustor(s), and Recorded on 03/28/2008 as Instrument No. 2008-0155197 of official records of RIVERSIDE County, California, and after fulfillment of the conditions specified in said Deed of Trust authorizing this conveyance.

Default occurred as set forth in a Notice of Default and Election to Sell which was recorded in the Office of the Recorder of said County, and such default still existed at the time of sale.

All requirements of law regarding the mailing of copies of notices or the publication of a copy of the Notice of Default or the personal delivery of the copy of the Notice of Default and the posting and publication of copies of the Notice of a Sale have been complied with.

Trustee, in compliance with said Notice of Trustee's Sale and in exercise of its powers under said Deed of Trust, sold the herein described property at public auction on 03/15/2010. Grantee, being the highest bidder at said sale, became the purchaser of said property for the amount bid being 242,073.54 in lawful money of the United States, or by credit bid if the Grantee was the beneficiary of said Deed of Trust at the Time of said Trustee's Sale.

DATED: 03/15/2010

NDEx West, L.L.C., as Trustee

[Handwritten Signature]

Ric Juarez

Authorized Agent

3/15/2010
DATED

State of TEXAS }
County of DALLAS }

Felicia Deanne Cantu

On 3/15/2010 before me, _____ Notary Public, personally appeared Ric Juarez personally known to me (or proved to me on the basis of satisfactory evidence) to be the person(s) whose name(s) is/are subscribed to the within instrument and acknowledged to me that he/she/they executed the same in his/her/their authorized capacity(ies), and that by his/her/their signature(s) on the instrument the person(s), or the entity upon behalf of which the person(s) acted, executed the instrument.

WITNESS my hand and official seal.

Signature: *Felicia Deanne Cantu* (Seal)

My commission expires: 11-14-11

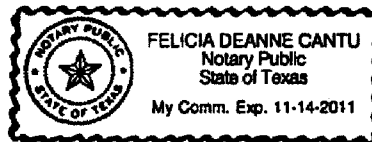

64812

Recording Requested By

When Recorded Mail To

Mr. and Mrs. Warren W. Marshall, Jr.
33648 El Cerrito
Hayward, California 92343

RECEIVED FOR RECORD

JAN 4 1975

AT THE COUNTY A.M.

BY THE COUNTY CLERK

IN THE COUNTY OF RIVERSIDE

BOOK PAGE 64812

RECORDED

W.D. BALOGH, Recorder

DEED OF TRUST AND ASSIGNMENT OF RENTS

THIS DEED OF TRUST, made this 27th day of May, 1975, BY AND BETWEEN
THOMAS ERNEST TAYLOR and DOROTHY ELLEN TAYLOR, Husband and Wife
4777 West 157th Place, Hawthorne, California 90250
hereinafter called Trustor,

SOUTHERN CITIES BROWNS COMPANY, a corporation, Trustee, hereinafter called Trustee, and
WARREN W. MARSHALL, JR. and MARINA L. MARSHALL, Husband and Wife as Joint Tenants,
hereinafter called Beneficiary;

WITNESSETH That whereas the said Trustor is indebted to the Beneficiary in the sum of \$ 6,875.00 and has agreed to repay the same with interest in the said Beneficiary, according to the terms and conditions of a certain promissory note or notes of even date herewith executed and delivered by the Trustor to Beneficiary;

NOW THIS SOUTHERN BROWNS COMPANY Trustee, to secure payment of said note(s) and any indebtedness evidenced thereby, including any renewal or extension thereof, and payment of additional sums which may be paid or advanced by Beneficiary to one or more of Trustor, or to any then owner of any of the property assigned to this deed of trust, does hereby grant and warrant unto said Trustor, and to the assignor or assignors of said Trustor in the trusts hereby created, with power of sale, all that certain property therein, being and being in the County of Riverside, and described as follows to-wit:

The East half of Lot 10, Lot 11 and Lot 12 in Block "C" of Valley Vista Acres, as shown by map on file in Book 14, page 1 of Maps, Riverside County Records.

"Upon payment of 40% of the remaining principal, Lot 12 will be released."

This Deed of Trust is a purchase money Deed of Trust and is given to secure a portion of the purchase price of the property herein described.

ALSO, all structures, fixtures and improvements thereon or that may at any time be placed thereon, together with all shares of the capital stock of any water company, existing in the name of or owned by one or more of Trustor, and representing water used on said premises or entitling any water right connected with said premises.

AND ALSO, all the rents and interest, scheduled or other date or demand, as well as in law as to equity, which said Trustor now may have or may hereafter acquire, of, in and to the said premises, with the appurtenances, (all of the aforesaid property being hereto collectively designated "premises"),

TO HAVE AND TO HOLD and grant upon and subject to each and all of the hereinafter designated trusts, agreements and covenants specifically set forth in that certain INSTRUMENT OF TRUST recorded on November 8, 1973, in the book and on the page of Official Records in the office of the County Recorder of the County of Riverside, California, as hereinafter specified, the same of each county, to-wit:

County	Book	Page	County	Book	Page	County	Book	Page
Imperial	1888	240	Orange	10091	998	San Bernardino	8899	842
Kern	4911	228	Riverside	1278	140815	Ventura	4182	803
Los Angeles	7622	250	Santa Barbara	2488	711	San Diego	1573	
Placer	8821	778						

FILE/PAGE NO. 73-81802

Each and all of which trusts, agreements and provisions are respectively contained in the various paragraphs of said recorded deed of trust as paragraphs "A" to "M", inclusive, and each thereof together with all subdivisions and all of the provisions contained therein, respectively, are hereby referred to and made a part hereof in all respects with the same force and effect as if each and all of said paragraphs, subdivisions and provisions were specifically set forth and incorporated verbatim in this deed of trust. Trustor acknowledges that he has seen a copy of each and all of the heretofore designated paragraphs and subdivisions which constitute a part of this deed of trust, as aforesaid.

Trustor shall pay a reasonable charge not to exceed fifteen dollars to Beneficiary for each statement requested by Trustor from Beneficiary regarding the obligations secured by this deed of trust.

Trustor hereby warrants that a copy of any notice of default and a copy of any notice of sale under this deed of trust is mailed and addressed to Trustor at "Special Delivery" at the City in which the deed of trust is recorded, which is hereby defined as Trustor's address unless another address is set out above in which latter event Trustor admits the address set out above as his address and requests that a copy of each such notice be mailed to Trustor at such address.

Trustor authorizes Trustor to deliver the original note(s) and Trust Deed upon issuance of a full reconveyance from Trustor to Trustor within not more than ten days after the date of recording of the said reconveyance a written request for the return of said instruments.

STATE OF CALIFORNIA

COUNTY OF RIVERSIDE

On this 27th day of May, 1975, before me, the undersigned,

a Notary Public in and for the above named County and State, personally appeared

Thomas Ernest Taylor and Dorothy Ellen Taylor

known to me to be the persons whose names are subscribed to

the within instrument, and acknowledged to me that they executed the same.

WITNESS my hand and official seal.

Notary Public in and for said County and State

NOTARY PUBLIC STATE

BEFORE ME, TRUSTOR has executed this instrument

Thomas Ernest Taylor
Dorothy Ellen Taylor



END RECORDED DOCUMENT

W. D. BALOGH, COUNTY RECORDER

DOC # 2006-0814616

11/03/2006 08:00A Fee:NC

Page 1 of 6

Recorded in Official Records

County of Riverside

Larry W. Ward

Assessor, County Clerk & Recorder



S	R	U	PAGE	SIZE	DA	MISC	LONG	RFD	COPY
1			6						
M	A	L	465	426	PCOR	NCOR	SMF	NCHG	EXAM 036

RECORDING REQUESTED BY
AND WHEN RECORDED MAIL TO:

NO RECORDING FEE REQUIRED
PURSUANT TO GOVERNMENT
CODE SECTION 27383

EASTERN MUNICIPAL WATER DISTRICT
P.O. BOX 8300
PERRIS, CA 92572-8300



**NOTICE
HIGH WATER PRESSURE CONDITION**

THIS NOTICE is made this 9th day of October, 20 06, by EASTERN MUNICIPAL WATER DISTRICT (hereinafter referred to as "District"), a public agency organized, existing and operating under the Municipal Water District Law of 1911, ("Municipal Water District Law") California Water Code §71000, et seq., and **GILBERT & STACEY REA**, (hereinafter referred to as the "Declarant").

RECITALS

- A. Pursuant to the authority cited above, District provides water and/or sewer service in portions of Riverside County, California.
- B. The Declarant of Property, County of Riverside, legally described as follows:

**PSN#2959072,
ASSESSOR'S PARCEL #: 458-225-005
ADDRESS: 33649 EL CENTRO AV, HEMET
LEGAL DESCRIPTION: LOT 11 BLK C MB 014/001 VALLEY VISTA AC**

is requesting that District provide water service to the above real property. Said property is situated in a location which could result in pressure problems.

The water pressures available to Lot Number(s) 11 has been determined to be above normal pressures. Declarant hereby agrees to install, at his cost, a pressure regulator to be owned, operated and maintained by the Declarant, his successors and assigns.

Declarant, his successors and assigns, hereby agrees to hold the District harmless from or on account of any damages arising from high pressure on the above described property.

Document ID: 2959371

DECLARANT HEREBY DECLARES:

1. The foregoing Recitals are hereby incorporated into this Agreement.
2. This Notice shall inure to the benefit of, be binding upon, and become a covenant that runs with the real property. Every person who now or hereafter owns or acquires any right, title or interest in or to any portions of the real property is and shall, by recordation of this Notice in the Office of the County Recorder, Riverside County, California, be conclusively deemed to have notice of the stated water pressure condition, whether or not any reference to this Notice is contained in the instrument by which such person acquires an interest in the real property.
3. Declarant hereby subjects the real property (and all portions thereof) to this Notice and declares that it is its specific intent that this Notice set forth herein shall be deemed a covenant running with the land and shall pass to and be binding upon the Declarant's successors entitled to the real property (or any portions thereof).
4. Each and every contract, deed or other instrument hereafter executed covering or conveying the real property (or any portion thereof) shall conclusively be deemed to have been executed, delivered and accepted subject to this Notice by recordation of this Notice in the Office of the County Recorder, Riverside County, California. Declarant affirms that the circumstances of the water pressure condition, and the installation, operation and maintenance of a pressure regulator, touch and concern the land in that they relate to and affect the use of the property. Declarant also acknowledges that the Notice benefits the property, in that it allows for the provision of water service to the property.
5. The terms of this Notice may be enforced by District or its successors or assigns. In the event of any controversy, claim or dispute relating to this Notice of the breach thereof, which District is or shall attempt to enforce, District shall be entitled to recover from said party reasonable expenses, attorney's fees and costs, if the District prevails in such controversy.

IN WITNESS WHEREOF, the undersigned have executed this Notice on the date first hereinabove written.

ACCEPTED BY:
EASTERN MUNICIPAL WATER DISTRICT

By Ronni Haworth
Ronni Haworth, Executive Assistant

DECLARANT Property Owner(s)

By Gilbert Rea
GILBERT REA,
By Stacey Rea
STACEY REA,

Document ID: 2959371

STATIC PRESSURE CALCULATIONS

Project: **General**

Pressure Zone HWL/Nearest Tank: 1811- CREAG
 Height of Nearest Tank in PZ (ft): 40

APN or Tract: 458-225-005

PRESSURE RANGE			
PAD	LOT	ELEVATION (ft)	PRESSURE (psi)
HIGHEST	1	1615	67.5
LOWEST	1	1575	102.2

CAUTION: HIGH Pressures will occur!!! See Below.
See Table Below and list ALL applicable Lot Numbers.

STATIC PRESSURE VS. ELEVATION & REQUIREMENTS			
	(psi)	ELEVATION (ft)	REQUIREMENTS
LOW	20	1725	LPN, BBA
	40	1679	LPN, BBA
HIGH	80	1627	HPN, CPR
	150	1465	HPN, CPR, DPR

LPN = Low Pressure Notice recorded at the County
 HPN = High Pressure Notice recorded at the County
 BBA = Booster and Backflow Assembly
 CPR = Customer pressure regulator
 DPR = District pressure regulator and stronger piping.

Lot numbers with HIGH Pressure:

Prepared By: Mike.P

October 5, 2006

10/5/2006

Engineering Department Pressure Calculator.xls

CALIFORNIA ALL-PURPOSE ACKNOWLEDGMENT

State of California }
County of Riverside } ss.

On 9th October 2006 before me, Douglas L. Hefley, Notary Public
Date Name and Title of Officer (e.g., "Jane Doe, Notary Public")

personally appeared Stacey M. Rea
Name(s) of Signer(s)

- personally known to me
- proved to me on the basis of satisfactory evidence

to be the person~~(s)~~ whose name~~(s)~~ is/~~are~~ subscribed to the within instrument and acknowledged to me that ~~he/she/they~~ executed the same in ~~his/her/their~~ authorized capacity~~(ies)~~, and that by ~~his/her/their~~ signature~~(s)~~ on the instrument the person~~(s)~~, or the entity upon behalf of which the person~~(s)~~ acted, executed the instrument.



WITNESS my hand and official seal.
Douglas L. Hefley
Signature of Notary Public

OPTIONAL

Though the information below is not required by law, it may prove valuable to persons relying on the document and could prevent fraudulent removal and reattachment of this form to another document.

Description of Attached Document

Title or Type of Document: Notice High Water Pressure Condition

Document Date: 9th October 2006 Number of Pages: 2

Signer(s) Other Than Named Above: Gilbert Rea

Capacity(ies) Claimed by Signer

Signer's Name: Stacey M. Rea

- Individual
- Corporate Officer — Title(s): _____
- Partner — Limited General
- Attorney-in-Fact
- Trustee
- Guardian or Conservator
- Other: _____

Signer Is Representing: _____

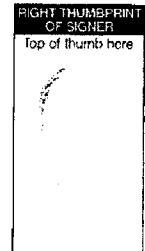

CALIFORNIA ALL- PURPOSE ACKNOWLEDGEMENT

State of California }
County of Riverside } ss.

On October 9, 2006, before me, Alicia Arana, Notary Public, personally appeared

Gilbert Rea

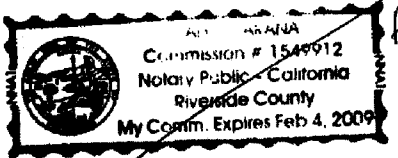
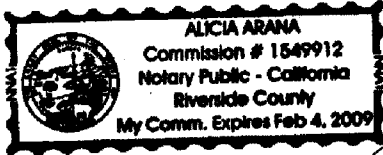

- personally known to me
- proved to me on the basis of satisfactory evidence

to be the person whose name is subscribed to the within instrument and acknowledged to me that he executed the same in his authorized capacity, and that by his signature on the instrument the person, or the entity upon behalf of which the person acted, executed the instrument.

WITNESS my hand and official seal.

Alicia Arana

Description of Attached Document

Title or Type of Document: Notice of High Water Pressure (APN 458-225-005)

Document Date: October 9, 2006 Number of Pages: 3

Signer(s) Other Than Named Above: Stacey Rea

Capacity(ies) Claimed by Signer

Signer's Name: Gilbert Rea

- Individual
- Corporate Officer - Title(s): _____
- Partner - Limited General
- Attorney in Fact
- Trustee
- Guardian or Conservator
- Other: _____

Signer is Representing: Self

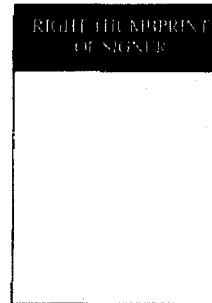

NOTARY ACKNOWLEDGEMENT

STATE OF CALIFORNIA)
) SS.
COUNTY OF RIVERSIDE)

On **October 27, 2006** before me, **Stena G. Copeland**, Notary Public, personally appeared **Ronni Haworth**, personally known to me to be the person whose name is subscribed to the within instrument and acknowledged to me that she executed the same in her authorized capacity, and that by her signature on the instrument the person, or the entity upon behalf of which the person acted, executed the instrument.

WITNESS my hand and official seal.

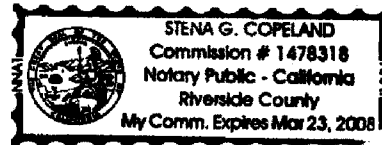

Stena G. Copeland
Notary Public in and for said County and State

Description of Attached Document:

Title or Type of Document: High Water Pressure Condition

APN 458-225-005

Document Date: October 9, 2006

Number of Pages: 5

When recorded please mail to:
 Riverside County
 Code Enforcement Department
 39493 Los Alamos Rd.
 Murrieta, CA 92563
 Mail Stop No. 5155

DOC # 2011-0236540

05/27/2011 04:21P Fee:NC

Page 1 of 1

Recorded in Official Records

County of Riverside

Larry W. Ward

Assessor, County Clerk & Recorder



S	R	U	PAGE	SIZE	DA	MISC	LONG	RFD	COPY
M	A	L	465	426	PCOR	NCOR	SMF	NCHG	EXAM
No Hgce						T:	CTY	UNI	026

NOTICE OF NONCOMPLIANCE



In the matter of the Property of)
 BAC Home Loans Servicing)

Case No.: CV11-00193

NOTICE IS HEREBY GIVEN to all persons, pursuant to Section 10 of Ordinance Number 725 of the County of Riverside, State of California, that proceedings have been commenced with respect to violations of Riverside County Ordinance No.881, (RCC Title 15.88.040 & 15.88.050 & 15.88.060 & 15.88.070) described as Failure to register abandoned & distressed residential property, Failure to maintain property, Failure to secure property and Failure to post required signage. Such Proceedings are based upon the noncompliance of such real property, located at 33649 El Centro Ave., Hemet, CA, and more particularly described as Assessor's Parcel Number 458-225-005 and having a legal description of 0.37 Acres, LOT 11 BLK C MB 014/001 VALLEY VISTA AC, Records of Riverside County, with the requirements of Ordinance No. 881 (RCC Title 15.88.040, 15.88.050, 15.88.060, 15.88.070).

The owner has been advised to immediately correct the above-referenced violation to avoid further action by the County of Riverside, which may include remediation or restoration to abate the public nuisance or other remedies available to the department by a court of competent jurisdiction. Any costs incurred by the County, including, but not limited to investigative, administrative and abatement costs and attorneys' fees, may become a lien on the property. Further details regarding this notice may be obtained by addressing an inquiry to the Code Enforcement Department, 39493 Los Alamos Road, Murrieta, CA 92563; Attention: Code Enforcement Officer W. Durant (951) 600-6140.

NOTICE IS FURTHER GIVEN in accordance with §17274 and §24436.5 of the California Revenue and Taxation Code, that a tax deduction may not be allowed for interest, taxes, depreciation, or amortization paid or incurred in the taxable year affected by these proceedings.

COUNTY OF RIVERSIDE
 DEPARTMENT OF CODE ENFORCEMENT

By: Hector Viray
 Hector Viray
 Code Enforcement Department

ACKNOWLEDGEMENT

State of California)
 County of Riverside)

On 05/19/11 before me, Elizabeth B. Ross, Notary Public, personally appeared Hector Viray, who proved to me on the basis of satisfactory evidence to be the person(s) whose name(s) is/are subscribed to the within instrument and acknowledged to me that he/she/they executed the same in his/her/their authorized capacity(ies), and that by his/her/their signature(s) on the instrument the person(s), or the entity upon behalf of which the person(s) acted, executed the instrument.

I certify under PENALTY OF PERJURY under the laws of the State of California that the foregoing paragraph is true and correct.

WITNESS my hand and official seal.

Elizabeth B. Ross
 Commission #1838743 Comm. Expires March 12, 2013



When recorded please mail to:
Riverside County Code Enforcement Department
(District 3 French Valley Office)
37600 Sky Canyon Dr. Ste G #507, Murrieta, CA 92563
Mail Stop No. 5155

DOC # 2012-0586882
12/04/2012 09:38A Fee:NC
Page 1 of 1
Recorded in Official Records
County of Riverside
Larry W. Ward
Assessor, County Clerk & Recorder



NOTICE OF PENDENCY OF ADMINISTRATIVE PROCEEDINGS

In the matter of the public nuisance or other code violation(s) on Property of)
BAC HOME LOANS SERVICING) Case No.: CV12-05595

And DOES I through X, owners

NOTICE IS HEREBY GIVEN to all persons, pursuant to Section 14 of Ordinance Number 725 of the County of Riverside, State of California, that administrative proceedings have been commenced with respect to the structure or land located upon the following described real property in the County of Riverside:

ADDRESS: 33649 EL CENTRO AVENUE,HEMET, CA 92545
PARCEL #: 458-225-005
LEGAL DESCRIPTION: 0.37 Acres, LOT 11 BLK C MB 014/001 VALLEY VISTA AC

VIOLATIONS: RCO 541-RCC Title 8.120.010- Accumulated Rubbish

that such proceedings are based upon the noncompliance of such structure or land with the requirements of Ordinances (Riverside County Codes) listed above that every owner of said real property waives his right to hearing on such proceedings unless he makes a proper request in the form and within the time prescribed by the Code cited; and that failure to comply with the lawful orders of the Code Enforcement Director and/or authorized agents of the County of Riverside heretofore and hereafter issued relative to the above matter may result in demolition of the offending structure, abatement of the public nuisance or other available legal remedies and assessment of the costs, expenses, and administrative costs thereof to the property heretofore described as a tax and special assessment lien on such property; that any purchaser, his heirs, or assigns acquiring said property subsequent to the recording of the Notice with the County Recorder shall have such interest subject and subordinate to said tax and assessment lien.

Notice is Further Given in accordance with §17274 and §24436.5 of the California Revenue and Taxation Code, that a tax deduction may not be allowed for interest, taxes, depreciation or amortization paid or incurred in the taxable year affected by these proceedings.

COUNTY OF RIVERSIDE
DEPARTMENT OF CODE ENFORCEMENT

Date: November 20, 2012

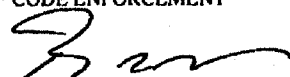
By: 
Brian Black, Code Enforcement Department

ACKNOWLEDGEMENT

State of California)
County of Riverside)

On 11/21/2012 before me, Elizabeth B. Ross, Notary Public, personally appeared Brian Black who proved to me on the basis of satisfactory evidence to be the person(s) whose name(s) is/are subscribed to the within instrument and acknowledged to me that he/~~she~~/they executed the same in his/~~her~~/their authorized capacity(ies), and that by his/~~her~~/their signature(s) on the instrument the person(s), or the entity upon behalf of which the person(s) acted, executed the instrument.

I certify under PENALTY OF PERJURY under the laws of the State of California that the foregoing paragraph is true and correct.

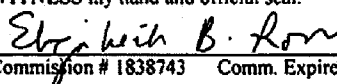
WITNESS my hand and official seal.

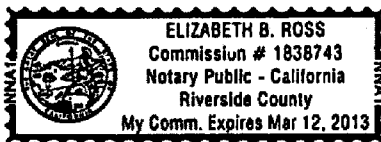
Commission # 1838743 Comm. Expires March 12, 2013



THIS IS TO INFORM YOU THAT A TAX LIEN HAS BEEN FILED WITH RESPECT TO UNSECURED PROPERTY

When recorded, mail to:

BAC HOME LOANS SERVICING
1757 TAPO CANYON RD SVW88
SIMI VALLEY CA 93063

Doc #. 2010-0372828
08/10/2010 08:00A Fee: NC
Page 1 of 1

Recorded in Official Records

County of Riverside
== Larry W Ward ==
Assessor, County Clerk and Recorder
This document was electronically prepared and recorded by the County of Riverside

CERTIFICATE OF LIEN

(Recorded pursuant to Revenue and Taxation Code Section 2191.3 et seq. and without acknowledgement pursuant to Government Code Section 27282)

STATE OF CALIFORNIA | SS
COUNTY OF RIVERSIDE

No. 0385370

I, Don Kent, Tax Collector of the County of Riverside, State of California, hereby certify that there are, on record in my office, unpaid taxes which were duly assessed, computed and levied for the fiscal year shown below pursuant to Section 2151 et seq. of the Revenue and Taxation Code.

The person(s) shown below is (are) liable to said County for the unpaid amounts set forth below plus any other penalties and charges which may accrue pursuant to law.

NAME AND ADDRESS

BAC HOME LOANS SERVICING
1757 TAPO CANYON RD SVW88
SIMI VALLEY CA 93063

<u>Fiscal Year</u>	<u>Tax Rate Area</u>	<u>Assessment Number</u>	<u>Tax</u>	<u>Penalty</u>	<u>Cost</u>	<u>Recording Fee</u>
2008-2010	026-172	052880606-7	\$207.27	\$20.72		\$13.00

Upon recordation of this certificate of lien, the total amount required to be paid constitutes a lien upon all personal property and real property now owned or subsequently acquired by the person(s) named herein before the date on which this lien expires.

This lien has the force, effect and priority of judgement lien for ten years from the recording of this instrument, unless sooner released or otherwise discharged.

Executed on 08/03/2010

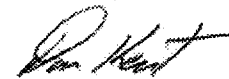

Don Kent, Tax Collector

THIS IS TO INFORM YOU THAT A TAX LIEN HAS BEEN FILED WITH RESPECT TO UNSECURED PROPERTY

When recorded, mail to:

BAC HOME LOANS SERVICING
1800 TAPO CANYON SV2202
SIMI VALLEY CA 93063

Doc # 2010-0372890
08/10/2010 08:00A Fee: NC
Page 1 of 1

Recorded in Official Records

County of Riverside
== Larry W Ward ==
Assessor, County Clerk and Recorder
This document was electronically prepared and recorded by the County of Riverside

CERTIFICATE OF LIEN

(Recorded pursuant to Revenue and Taxation Code Section 2191.3 et seq. and without acknowledgement pursuant to Government Code Section 27282)

STATE OF CALIFORNIA | SS
COUNTY OF RIVERSIDE

No. 0385437

I, Don Kent, Tax Collector of the County of Riverside, State of California, hereby certify that there are, on record in my office, unpaid taxes which were duly assessed, computed and levied for the fiscal year shown below pursuant to Section 2151 et seq. of the Revenue and Taxation Code.

The person(s) shown below is (are) liable to said County for the unpaid amounts set forth below plus any other penalties and charges which may accrue pursuant to law.

NAME AND ADDRESS

BAC HOME LOANS SERVICING
1800 TAPO CANYON SV2202
SIMI VALLEY CA 93063

Fiscal Year	Tax Rate Area	Assessment Number	Tax	Penalty	Cost	Recording Fee
2009-2010	009-002	052929504-8	\$304.49	\$30.44		\$13.00

Upon recordation of this certificate of lien, the total amount required to be paid constitutes a lien upon all personal property and real property now owned or subsequently acquired by the person(s) named herein before the date on which this lien expires.

This lien has the force, effect and priority of judgement lien for ten years from the recording of this instrument, unless sooner released or otherwise discharged.

Executed on 08/03/2010

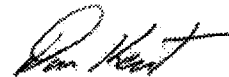

Don Kent, Tax Collector

THIS IS TO INFORM YOU THAT A TAX LIEN HAS BEEN FILED WITH RESPECT TO UNSECURED PROPERTY

When recorded, mail to:

BAC HOME LOANS SERVICING
1757 TAPO CANYON RD SVW88
SIMI VALLEY CA 93063

Doc #. 2010-0442201
09/15/2010 08:00A Fee: NC
Page 1 of 1

Recorded in Official Records

County of Riverside
== Larry W Ward ==
Assessor, County Clerk and Recorder
This document was electronically prepared and recorded by the County of Riverside

CERTIFICATE OF LIEN

(Recorded pursuant to Revenue and Taxation Code Section 2191.3 et seq. and without acknowledgement pursuant to Government Code Section 27282)

STATE OF CALIFORNIA | SS
COUNTY OF RIVERSIDE

No. 0385659

I, Don Kent, Tax Collector of the County of Riverside, State of California, hereby certify that there are, on record in my office, unpaid taxes which were duly assessed, computed and levied for the fiscal year shown below pursuant to Section 2151 et seq. of the Revenue and Taxation Code.

The person(s) shown below is (are) liable to said County for the unpaid amounts set forth below plus any other penalties and charges which may accrue pursuant to law.

NAME AND ADDRESS

BAC HOME LOANS SERVICING
1757 TAPO CANYON RD SVW88
SIMI VALLEY CA 93063

Fiscal Year	Tax Rate Area	Assessment Number	Tax	Penalty	Cost	Recording Fee
2009-2010	004-047	052920651-0	\$150.81	\$15.08		\$13.00

Upon recordation of this certificate of lien, the total amount required to be paid constitutes a lien upon all personal property and real property now owned or subsequently acquired by the person(s) named herein before the date on which this lien expires.

This lien has the force, effect and priority of judgement lien for ten years from the recording of this instrument, unless sooner released or otherwise discharged.

Executed on 09/02/2010

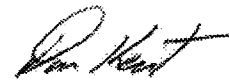

Don Kent, Tax Collector

THIS IS TO INFORM YOU THAT A TAX LIEN HAS BEEN FILED WITH RESPECT TO UNSECURED PROPERTY

When recorded, mail to:

BAC HOME LOANS SERVICING
1800 TAPO CANYON SV2202
SIMI VALLEY CA 93063

Doc #. 2011-0196910
05/04/2011 01:56 PM Fee: NC
Page 1 of 1

Recorded in Official Records

County of Riverside
== Larry W Ward ==
Assessor, County Clerk and Recorder
This document was electronically prepared and recorded by the County of Riverside

CERTIFICATE OF LIEN

(Recorded pursuant to Revenue and Taxation Code Section 2191.3 et seq. and without acknowledgement pursuant to Government Code Section 27282)

STATE OF CALIFORNIA | SS
COUNTY OF RIVERSIDE

No. 0393315

I, Don Kent, Tax Collector of the County of Riverside, State of California, hereby certify that there are, on record in my office, unpaid taxes which were duly assessed, computed and levied for the fiscal year shown below pursuant to Section 2151 et seq. of the Revenue and Taxation Code.

The person(s) shown below is (are) liable to said County for the unpaid amounts set forth below plus any other penalties and charges which may accrue pursuant to law.

NAME AND ADDRESS

BAC HOME LOANS SERVICING
1800 TAPO CANYON SV2202
SIMI VALLEY CA 93063

Fiscal Year	Tax Rate Area	Assessment Number	Tax	Penalty	Cost	Recording Fee
2009-2010	018-126	052915724-7	\$129.89	\$12.98		\$13.00

Upon recordation of this certificate of lien, the total amount required to be paid constitutes a lien upon all personal property and real property now owned or subsequently acquired by the person(s) named herein before the date on which this lien expires.

This lien has the force, effect and priority of judgement lien for ten years from the recording of this instrument, unless sooner released or otherwise discharged.

Executed on 03/02/2011



Don Kent, Tax Collector

THIS IS TO INFORM YOU THAT A TAX LIEN HAS BEEN FILED WITH RESPECT TO UNSECURED PROPERTY

When recorded, mail to:

BAC HOME LOANS SERVICING
1800 TAPO CANYON SV2202
SIMI VALLEY CA 93063

Doc # 2011-0197064
05/04/2011 01:56 PM Fee: NC
Page 1 of 1

Recorded in Official Records

County of Riverside
= Larry W Ward =
Assessor, County Clerk and Recorder
This document was electronically prepared and recorded by the County of Riverside

CERTIFICATE OF LIEN

(Recorded pursuant to Revenue and Taxation Code Section 2191.3 et seq.
and without acknowledgement pursuant to Government Code Section 27282)

STATE OF CALIFORNIA | SS
COUNTY OF RIVERSIDE

No. 0393512

I, Don Kent, Tax Collector of the County of Riverside, State of California, hereby certify that there are, on record in my office, unpaid taxes which were duly assessed, computed and levied for the fiscal year shown below pursuant to Section 2151 et seq. of the Revenue and Taxation Code.

The person(s) shown below is (are) liable to said County for the unpaid amounts set forth below plus any other penalties and charges which may accrue pursuant to law.

NAME AND ADDRESS

BAC HOME LOANS SERVICING
1800 TAPO CANYON SV2202
SIMI VALLEY CA 93063

Fiscal Year	Tax Rate Area	Assessment Number	Tax	Penalty	Cost	Recording Fee
2009-2011	005-084	052952829-4	\$118.44	\$11.84		\$13.00

Upon recordation of this certificate of lien, the total amount required to be paid constitutes a lien upon all personal property and real property now owned or subsequently acquired by the person(s) named herein before the date on which this lien expires.

This lien has the force, effect and priority of judgement lien for ten years from the recording of this instrument, unless sooner released or otherwise discharged.

Executed on 03/02/2011



Don Kent, Tax Collector

THIS IS TO INFORM YOU THAT A TAX LIEN HAS BEEN FILED WITH RESPECT TO UNSECURED PROPERTY

When recorded, mail to:

BAC HOME LOAN SERVICING
1800 TAPO CANYON SV2202
SIMI VALLEY CA 93063

Doc # 2011-0197291
05/04/2011 01:56 PM Fee: NC
Page 1 of 1

Recorded in Official Records

County of Riverside

== Larry W Ward ==

Assessor, County Clerk and Recorder

This document was electronically prepared and recorded by the County of Riverside

CERTIFICATE OF LIEN

(Recorded pursuant to Revenue and Taxation Code Section 2191.3 et seq. and without acknowledgement pursuant to Government Code Section 27282)

STATE OF CALIFORNIA | SS
COUNTY OF RIVERSIDE

No. 0393078

I, Don Kent, Tax Collector of the County of Riverside, State of California, hereby certify that there are, on record in my office, unpaid taxes which were duly assessed, computed and levied for the fiscal year shown below pursuant to Section 2151 et seq. of the Revenue and Taxation Code.

The person(s) shown below is (are) liable to said County for the unpaid amounts set forth below plus any other penalties and charges which may accrue pursuant to law.

NAME AND ADDRESS

BAC HOME LOAN SERVICING
1800 TAPO CANYON SV2202
SIMI VALLEY CA 93063

<u>Fiscal Year</u>	<u>Tax Rate Area</u>	<u>Assessment Number</u>	<u>Tax</u>	<u>Penalty</u>	<u>Cost</u>	<u>Recording Fee</u>
2010-2011	006-130	001199847-1	\$3,153.08	\$315.30		\$13.00

Upon recordation of this certificate of lien, the total amount required to be paid constitutes a lien upon all personal property and real property now owned or subsequently acquired by the person(s) named herein before the date on which this lien expires.

This lien has the force, effect and priority of judgement lien for ten years from the recording of this instrument, unless sooner released or otherwise discharged.

Executed on 03/01/2011



Don Kent, Tax Collector

THIS IS TO INFORM YOU THAT A TAX LIEN HAS BEEN FILED WITH RESPECT TO UNSECURED PROPERTY

When recorded, mail to:

BAC HOME LOANS SERVICING
1800 TAPO CANYON SV2202
SIMI VALLEY CA 93063

Doc # 2011-0197413
05/04/2011 01:57 PM Fee: NC
Page 1 of 1

Recorded in Official Records

County of Riverside
== Larry W Ward ==
Assessor, County Clerk and Recorder
This document was electronically prepared and recorded by the County of Riverside

CERTIFICATE OF LIEN

(Recorded pursuant to Revenue and Taxation Code Section 2191.3 et seq. and without acknowledgement pursuant to Government Code Section 27282)

STATE OF CALIFORNIA | SS
COUNTY OF RIVERSIDE

No. 0393077

I, Don Kent, Tax Collector of the County of Riverside, State of California, hereby certify that there are, on record in my office, unpaid taxes which were duly assessed, computed and levied for the fiscal year shown below pursuant to Section 2151 et seq. of the Revenue and Taxation Code.

The person(s) shown below is (are) liable to said County for the unpaid amounts set forth below plus any other penalties and charges which may accrue pursuant to law.

NAME AND ADDRESS

BAC HOME LOANS SERVICING
1800 TAPO CANYON SV2202
SIMI VALLEY CA 93063

Fiscal Year	Tax Rate Area	Assessment Number	Tax	Penalty	Cost	Recording Fee
2010-2011	002-026	001199846-0	\$4,271.18	\$427.11		\$13.00

Upon recordation of this certificate of lien, the total amount required to be paid constitutes a lien upon all personal property and real property now owned or subsequently acquired by the person(s) named herein before the date on which this lien expires.

This lien has the force, effect and priority of judgement lien for ten years from the recording of this instrument, unless sooner released or otherwise discharged.

Executed on 03/01/2011



Don Kent, Tax Collector

THIS IS TO INFORM YOU THAT A TAX LIEN HAS BEEN FILED WITH RESPECT TO UNSECURED PROPERTY

When recorded, mail to:

BAC HOME LOANS SERVICING
CALIFORNIA HOUSING FINANCE AGENCY
P O BOX 4034 MS #125B
SACRAMENTO CA 95812

Doc # 2011-0398285
09/07/2011 03:05 PM Fee: NC
Page 1 of 1

Recorded in Official Records

County of Riverside
== Larry W Ward ==
Assessor, County Clerk and Recorder
This document was electronically prepared and recorded by the County of Riverside

CERTIFICATE OF LIEN

(Recorded pursuant to Revenue and Taxation Code Section 2191.3 et seq. and without acknowledgement pursuant to Government Code Section 27282)

STATE OF CALIFORNIA |
COUNTY OF RIVERSIDE | SS

No. 0398206

I, Don Kent, Tax Collector of the County of Riverside, State of California, hereby certify that there are, on record in my office, unpaid taxes which were duly assessed, computed and levied for the fiscal year shown below pursuant to Section 2151 et seq. of the Revenue and Taxation Code.

The person(s) shown below is (are) liable to said County for the unpaid amounts set forth below plus any other penalties and charges which may accrue pursuant to law.

NAME AND ADDRESS

BAC HOME LOANS SERVICING GDN
CALIFORNIA HOUSING FINANCE AGENCY BEN
P O BOX 4034 MS #125B
SACRAMENTO CA 95812

Fiscal Year	Tax Rate Area	Assessment Number	Tax	Penalty	Cost	Recording Fee
2009-2010	012-033	053045069-8	\$302.51	\$30.25		\$13.00

Upon recordation of this certificate of lien, the total amount required to be paid constitutes a lien upon all personal property and real property now owned or subsequently acquired by the person(s) named herein before the date on which this lien expires.

This lien has the force, effect and priority of judgement lien for ten years from the recording of this instrument, unless sooner released or otherwise discharged.

Executed on 09/01/2011

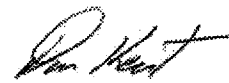

Don Kent, Tax Collector

THIS IS TO INFORM YOU THAT A TAX LIEN HAS BEEN FILED WITH RESPECT TO UNSECURED PROPERTY

When recorded, mail to:

BAC HOME LOANS SERVICING
1800 TAPO CANYON SV2202
SIMI VALLEY CA 93063

Doc #. 2012-0273327
06/13/2012 04:14 PM Fee: NC
Page 1 of 1

Recorded in Official Records

County of Riverside
== Larry W Ward ==
Assessor, County Clerk and Recorder
This document was electronically prepared and recorded by the County of Riverside

CERTIFICATE OF LIEN

(Recorded pursuant to Revenue and Taxation Code Section 2191.3 et seq. and without acknowledgement pursuant to Government Code Section 27282)

STATE OF CALIFORNIA | SS
COUNTY OF RIVERSIDE

No. 0404632

I, Don Kent, Tax Collector of the County of Riverside, State of California, hereby certify that there are, on record in my office, unpaid taxes which were duly assessed, computed and levied for the fiscal year shown below pursuant to Section 2151 et seq. of the Revenue and Taxation Code.

The person(s) shown below is (are) liable to said County for the unpaid amounts set forth below plus any other penalties and charges which may accrue pursuant to law.

NAME AND ADDRESS

BAC HOME LOANS SERVICING
1800 TAPO CANYON SV2202
SIMI VALLEY CA 93063

Fiscal Year	Tax Rate Area	Assessment Number	Tax	Penalty	Cost	Recording Fee
2010-2012	011-005	053042415-8	\$454.92	\$45.49		\$13.00

Upon recordation of this certificate of lien, the total amount required to be paid constitutes a lien upon all personal property and real property now owned or subsequently acquired by the person(s) named herein before the date on which this lien expires.

This lien has the force, effect and priority of judgement lien for ten years from the recording of this instrument, unless sooner released or otherwise discharged.

Executed on 06/04/2012

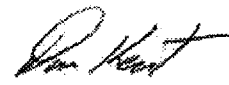

Don Kent, Tax Collector

THIS IS TO INFORM YOU THAT A TAX LIEN HAS BEEN FILED WITH RESPECT TO UNSECURED PROPERTY

When recorded, mail to:

BAC HOME LOANS SERVICING
1800 TAPO CANYON SV2202
SIMI VALLEY CA 93063

Doc # 2012-0273397
06/13/2012 04:14 PM Fee: NC
Page 1 of 1

Recorded in Official Records

County of Riverside
== Larry W Ward ==

Assessor, County Clerk and Recorder
This document was electronically prepared and recorded by the County of Riverside

CERTIFICATE OF LIEN

(Recorded pursuant to Revenue and Taxation Code Section 2191.3 et seq.
and without acknowledgement pursuant to Government Code Section 27282)

STATE OF CALIFORNIA | SS
COUNTY OF RIVERSIDE

No. 0404708

I, Don Kent, Tax Collector of the County of Riverside, State of California, hereby certify that there are, on record in my office, unpaid taxes which were duly assessed, computed and levied for the fiscal year shown below pursuant to Section 2151 et seq. of the Revenue and Taxation Code.

The person(s) shown below is (are) liable to said County for the unpaid amounts set forth below plus any other penalties and charges which may accrue pursuant to law.

NAME AND ADDRESS

BAC HOME LOANS SERVICING
1800 TAPO CANYON SV2202
SIMI VALLEY CA 93063

<u>Fiscal Year</u>	<u>Tax Rate Area</u>	<u>Assessment Number</u>	<u>Tax</u>	<u>Penalty</u>	<u>Cost</u>	<u>Recording Fee</u>
2010-2012	082-003	053062067-9	\$790.85	\$79.07		\$13.00

Upon recordation of this certificate of lien, the total amount required to be paid constitutes a lien upon all personal property and real property now owned or subsequently acquired by the person(s) named herein before the date on which this lien expires.

This lien has the force, effect and priority of judgement lien for ten years from the recording of this instrument, unless sooner released or otherwise discharged.

Executed on 06/04/2012



Don Kent, Tax Collector

THIS IS TO INFORM YOU THAT A TAX LIEN HAS BEEN FILED WITH RESPECT TO UNSECURED PROPERTY

When recorded, mail to:

THOMAS YANES
BAC HOME LOANS SERVICING
1800 TAPO CANYON SV2202
SIMI VALLEY CA 93063

Doc # 2012-0616274
12/18/2012 01:30 PM Fee: NC
Page 1 of 1

Recorded in Official Records

County of Riverside
== Larry W Ward ==
Assessor, County Clerk and Recorder
This document was electronically prepared and recorded by the County of Riverside

CERTIFICATE OF LIEN

(Recorded pursuant to Revenue and Taxation Code Section 2191.3 et seq. and without acknowledgement pursuant to Government Code Section 27282)

STATE OF CALIFORNIA |
COUNTY OF RIVERSIDE |SS

No. 0414351

I, Don Kent, Tax Collector of the County of Riverside, State of California, hereby certify that there are, on record in my office, unpaid taxes which were duly assessed, computed and levied for the fiscal year shown below pursuant to Section 2151 et seq. of the Revenue and Taxation Code.

The person(s) shown below is (are) liable to said County for the unpaid amounts set forth below plus any other penalties and charges which may accrue pursuant to law.

NAME AND ADDRESS

YANES THOMAS
BAC HOME LOANS SERVICING
1800 TAPO CANYON SV2202
SIMI VALLEY CA 93063

<u>Fiscal Year</u>	<u>Tax Rate Area</u>	<u>Assessment Number</u>	<u>Tax</u>	<u>Penalty</u>	<u>Cost</u>	<u>Recording Fee</u>
2010-2011	009-000	000910583-2	\$1,271.81	\$127.17	\$31.00	\$13.00

Upon recordation of this certificate of lien, the total amount required to be paid constitutes a lien upon all personal property and real property now owned or subsequently acquired by the person(s) named herein before the date on which this lien expires.

This lien has the force, effect and priority of judgement lien for ten years from the recording of this instrument, unless sooner released or otherwise discharged.

Executed on 11/29/2012

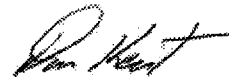

Don Kent, Tax Collector

THIS IS TO INFORM YOU THAT A TAX LIEN HAS BEEN FILED WITH RESPECT TO UNSECURED PROPERTY

When recorded, mail to:

BAC HOME LOANS SERVICING
1800 TAPO CANYON SV2202
SIMI VALLEY CA 93063

Doc # 2013-0031590
01/22/2013 07:57 AM Fee: NC
Page 1 of 1

Recorded in Official Records

County of Riverside
== Larry W Ward ==
Assessor, County Clerk and Recorder
This document was electronically prepared and recorded by the County of Riverside

CERTIFICATE OF LIEN

(Recorded pursuant to Revenue and Taxation Code Section 2191.3 et seq.
and without acknowledgement pursuant to Government Code Section 27282)

STATE OF CALIFORNIA | SS
COUNTY OF RIVERSIDE

No. 0415279

I, Don Kent, Tax Collector of the County of Riverside, State of California, hereby certify that there are, on record in my office, unpaid taxes which were duly assessed, computed and levied for the fiscal year shown below pursuant to Section 2151 et seq. of the Revenue and Taxation Code.

The person(s) shown below is (are) liable to said County for the unpaid amounts set forth below plus any other penalties and charges which may accrue pursuant to law.

NAME AND ADDRESS

BAC HOME LOANS SERVICING
1800 TAPO CANYON SV2202
SIMI VALLEY CA 93063

<u>Fiscal Year</u>	<u>Tax Rate Area</u>	<u>Assessment Number</u>	<u>Tax</u>	<u>Penalty</u>	<u>Cost</u>	<u>Recording Fee</u>
2011-2012	009-000	053087030-2	\$481.59	\$48.15		\$16.00

Upon recordation of this certificate of lien, the total amount required to be paid constitutes a lien upon all personal property and real property now owned or subsequently acquired by the person(s) named herein before the date on which this lien expires.

This lien has the force, effect and priority of judgement lien for ten years from the recording of this instrument, unless sooner released or otherwise discharged.

Executed on 01/03/2013



Don Kent, Tax Collector

THIS IS TO INFORM YOU THAT A TAX LIEN HAS BEEN FILED WITH RESPECT TO UNSECURED PROPERTY

When recorded, mail to:

BAC HOME LOANS SERVICING
400 NATIONAL WAY
SIMI VALLEY CA 93065

Doc #. 2013-0031681
01/22/2013 07:57 AM Fee: NC
Page 1 of 1
Recorded in Official Records
County of Riverside
== Larry W Ward ==
Assessor, County Clerk and Recorder
This document was electronically prepared and recorded by the County of Riverside

CERTIFICATE OF LIEN

(Recorded pursuant to Revenue and Taxation Code Section 2191.3 et seq. and without acknowledgement pursuant to Government Code Section 27282)

STATE OF CALIFORNIA |
COUNTY OF RIVERSIDE | SS

No. 0415375

I, Don Kent, Tax Collector of the County of Riverside, State of California, hereby certify that there are, on record in my office, unpaid taxes which were duly assessed, computed and levied for the fiscal year shown below pursuant to Section 2151 et seq. of the Revenue and Taxation Code.

The person(s) shown below is (are) liable to said County for the unpaid amounts set forth below plus any other penalties and charges which may accrue pursuant to law.

NAME AND ADDRESS

BAC HOME LOANS SERVICING
400 NATIONAL WAY
SIMI VALLEY CA 93065

Fiscal Year	Tax Rate Area	Assessment Number	Tax	Penalty	Cost	Recording Fee
2011-2012	020-035	053131370-5	\$553.23	\$55.32		\$16.00

Upon recordation of this certificate of lien, the total amount required to be paid constitutes a lien upon all personal property and real property now owned or subsequently acquired by the person(s) named herein before the date on which this lien expires.

This lien has the force, effect and priority of judgement lien for ten years from the recording of this instrument, unless sooner released or otherwise discharged.

Executed on 01/03/2013

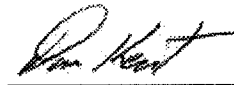

Don Kent, Tax Collector

THIS IS TO INFORM YOU THAT A TAX LIEN HAS BEEN FILED WITH RESPECT TO UNSECURED PROPERTY

When recorded, mail to:

COUNTRYWIDE HOME LOANS
1757 TAPO CANYON RD SVW88
SIMI VALLEY CA 93063

Doc # 2010-0154701
04/06/2010 08:00A Fee: NC
Page 1 of 1

Recorded in Official Records

County of Riverside
== Larry W Ward ==
Assessor, County Clerk and Recorder
This document was electronically prepared and recorded by the County of Riverside

CERTIFICATE OF LIEN

(Recorded pursuant to Revenue and Taxation Code Section 2191.3 et seq.
and without acknowledgement pursuant to Government Code Section 27282)

STATE OF CALIFORNIA | SS
COUNTY OF RIVERSIDE

No. 0380052

I, Don Kent, Tax Collector of the County of Riverside, State of California, hereby certify that there are, on record in my office, unpaid taxes which were duly assessed, computed and levied for the fiscal year shown below pursuant to Section 2151 et seq. of the Revenue and Taxation Code.

The person(s) shown below is (are) liable to said County for the unpaid amounts set forth below plus any other penalties and charges which may accrue pursuant to law.

NAME AND ADDRESS

COUNTRYWIDE HOME LOANS
1757 TAPO CANYON RD SVW88
SIMI VALLEY CA 93063

Fiscal Year	Tax Rate Area	Assessment Number	Tax	Penalty	Cost	Recording Fee
2008-2009	025-019	052748633-2	\$124.54	\$12.45		\$13.00

Upon recordation of this certificate of lien, the total amount required to be paid constitutes a lien upon all personal property and real property now owned or subsequently acquired by the person(s) named herein before the date on which this lien expires.

This lien has the force, effect and priority of judgement lien for ten years from the recording of this instrument, unless sooner released or otherwise discharged.

Executed on 03/29/2010



Don Kent, Tax Collector

THIS IS TO INFORM YOU THAT A TAX LIEN HAS BEEN FILED WITH RESPECT TO UNSECURED PROPERTY

When recorded, mail to:

COUNTRYWIDE HOME LOANS SERVICING
1800 TAPO CANYON SV2202
SIMI VALLEY CA 93063

Doc # 2010-0154815
04/06/2010 08:00A Fee: NC
Page 1 of 1

Recorded in Official Records

County of Riverside
== Larry W Ward ==
Assessor, County Clerk and Recorder
This document was electronically prepared and recorded by the County of Riverside

CERTIFICATE OF LIEN

(Recorded pursuant to Revenue and Taxation Code Section 2191.3 et seq. and without acknowledgement pursuant to Government Code Section 27282)

STATE OF CALIFORNIA | SS
COUNTY OF RIVERSIDE

No. 0380173

I, Don Kent, Tax Collector of the County of Riverside, State of California, hereby certify that there are, on record in my office, unpaid taxes which were duly assessed, computed and levied for the fiscal year shown below pursuant to Section 2151 et seq. of the Revenue and Taxation Code.

The person(s) shown below is (are) liable to said County for the unpaid amounts set forth below plus any other penalties and charges which may accrue pursuant to law.

NAME AND ADDRESS

COUNTRYWIDE HOME LOANS SERVICING
1800 TAPO CANYON SV2202
SIMI VALLEY CA 93063

Fiscal Year	Tax Rate Area	Assessment Number	Tax	Penalty	Cost	Recording Fee
2008-2010	056-004	052804165-9	\$129.65	\$12.96		\$13.00

Upon recordation of this certificate of lien, the total amount required to be paid constitutes a lien upon all personal property and real property now owned or subsequently acquired by the person(s) named herein before the date on which this lien expires.

This lien has the force, effect and priority of judgement lien for ten years from the recording of this instrument, unless sooner released or otherwise discharged.

Executed on 03/29/2010

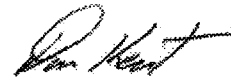

Don Kent, Tax Collector

THIS IS TO INFORM YOU THAT A TAX LIEN HAS BEEN FILED WITH RESPECT TO UNSECURED PROPERTY

When recorded, mail to:

COUNTRYWIDE HOME LOANS INC
4500 PARK GRANADA
CALABASAS CA 91302

Doc #. 2010-0500378
10/19/2010 08:00A Fee: NC
Page 1 of 1

Recorded in Official Records

County of Riverside
== Larry W Ward ==
Assessor, County Clerk and Recorder
This document was electronically prepared and recorded by the County of Riverside

CERTIFICATE OF LIEN

(Recorded pursuant to Revenue and Taxation Code Section 2191.3 et seq.
and without acknowledgement pursuant to Government Code Section 27282)

STATE OF CALIFORNIA | SS
COUNTY OF RIVERSIDE

No. 0385786

I, Don Kent, Tax Collector of the County of Riverside, State of California, hereby certify that there are, on record in my office, unpaid taxes which were duly assessed, computed and levied for the fiscal year shown below pursuant to Section 2151 et seq. of the Revenue and Taxation Code.

The person(s) shown below is (are) liable to said County for the unpaid amounts set forth below plus any other penalties and charges which may accrue pursuant to law.

NAME AND ADDRESS

COUNTRYWIDE HOME LOANS INC
4500 PARK GRANADA
CALABASAS CA 91302

Fiscal Year	Tax Rate Area	Assessment Number	Tax	Penalty	Cost	Recording Fee
2008-2010	007-007	052943822-9	\$131.23	\$13.12		\$13.00

Upon recordation of this certificate of lien, the total amount required to be paid constitutes a lien upon all personal property and real property now owned or subsequently acquired by the person(s) named herein before the date on which this lien expires.

This lien has the force, effect and priority of judgement lien for ten years from the recording of this instrument, unless sooner released or otherwise discharged.

Executed on 10/04/2010

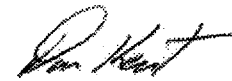

Don Kent, Tax Collector

THIS IS TO INFORM YOU THAT A TAX LIEN HAS BEEN FILED WITH RESPECT TO UNSECURED PROPERTY

When recorded, mail to:

COUNTRYWIDE HOME LOANS INC
P O BOX 4281
WOODLAND HILLS CA 91365

Doc #. 2010-0534855
11/08/2010 09:42:02 Fee: NC
Page 1 of 1

Recorded in Official Records
County of Riverside
== Larry W Ward ==
Assessor, County Clerk and Recorder
This document was electronically prepared and recorded by the County of Riverside

CERTIFICATE OF LIEN

(Recorded pursuant to Revenue and Taxation Code Section 2191.3 et seq. and without acknowledgement pursuant to Government Code Section 27282)

STATE OF CALIFORNIA | SS
COUNTY OF RIVERSIDE

No. 0387893

I, Don Kent, Tax Collector of the County of Riverside, State of California, hereby certify that there are, on record in my office, unpaid taxes which were duly assessed, computed and levied for the fiscal year shown below pursuant to Section 2151 et seq. of the Revenue and Taxation Code.

The person(s) shown below is (are) liable to said County for the unpaid amounts set forth below plus any other penalties and charges which may accrue pursuant to law.

NAME AND ADDRESS

COUNTRYWIDE HOME LOANS INC
P O BOX 4281
WOODLAND HILLS CA 91365

Fiscal Year	Tax Rate Area	Assessment Number	Tax	Penalty	Cost	Recording Fee
2010-2011	004-018	000224385-0	\$586.38	\$58.63		\$13.00

Upon recordation of this certificate of lien, the total amount required to be paid constitutes a lien upon all personal property and real property now owned or subsequently acquired by the person(s) named herein before the date on which this lien expires.

This lien has the force, effect and priority of judgement lien for ten years from the recording of this instrument, unless sooner released or otherwise discharged.

Executed on 10/31/2010

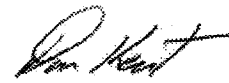

Don Kent, Tax Collector

THIS IS TO INFORM YOU THAT A TAX LIEN HAS BEEN FILED WITH RESPECT TO UNSECURED PROPERTY

When recorded, mail to:

COUNTRYWIDE HOME LOANS INC
P O BOX 4281
WOODLAND HILLS CA 91365

Doc # 2010-0535226
11/08/2010 09:43:26 Fee: NC
Page 1 of 1

Recorded in Official Records

County of Riverside
== Larry W Ward ==

Assessor, County Clerk and Recorder

This document was electronically prepared and recorded by the County of Riverside

CERTIFICATE OF LIEN

(Recorded pursuant to Revenue and Taxation Code Section 2191.3 et seq.
and without acknowledgement pursuant to Government Code Section 27282)

STATE OF CALIFORNIA | SS
COUNTY OF RIVERSIDE

No. 0388410

I, Don Kent, Tax Collector of the County of Riverside, State of California, hereby certify that there are, on record in my office, unpaid taxes which were duly assessed, computed and levied for the fiscal year shown below pursuant to Section 2151 et seq. of the Revenue and Taxation Code.

The person(s) shown below is (are) liable to said County for the unpaid amounts set forth below plus any other penalties and charges which may accrue pursuant to law.

NAME AND ADDRESS

COUNTRYWIDE HOME LOANS INC
P O BOX 4281
WOODLAND HILLS CA 91365

<u>Fiscal Year</u>	<u>Tax Rate Area</u>	<u>Assessment Number</u>	<u>Tax</u>	<u>Penalty</u>	<u>Cost</u>	<u>Recording Fee</u>
2010-2011	013-004	000232327-3	\$492.57	\$49.25		\$13.00

Upon recordation of this certificate of lien, the total amount required to be paid constitutes a lien upon all personal property and real property now owned or subsequently acquired by the person(s) named herein before the date on which this lien expires.

This lien has the force, effect and priority of judgement lien for ten years from the recording of this instrument, unless sooner released or otherwise discharged.

Executed on 10/31/2010

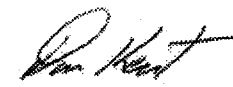

Don Kent, Tax Collector

Public Record

THIS IS TO INFORM YOU THAT A TAX LIEN HAS BEEN FILED WITH RESPECT TO UNSECURED PROPERTY

When recorded, mail to:

COUNTRYWIDE HOME LOANS INC
P O BOX 4281
WOODLAND HILLS CA 91365

Doc # 2010-0541445
11/10/2010 08:38:20 Fee: NC
Page 1 of 1

Recorded in Official Records

County of Riverside
== Larry W Ward ==
Assessor, County Clerk and Recorder
This document was electronically prepared and recorded by the County of Riverside

CERTIFICATE OF LIEN

(Recorded pursuant to Revenue and Taxation Code Section 2191.3 et seq.
and without acknowledgement pursuant to Government Code Section 27282)

STATE OF CALIFORNIA | SS
COUNTY OF RIVERSIDE

No. 0387517

I, Don Kent, Tax Collector of the County of Riverside, State of California, hereby certify that there are, on record in my office, unpaid taxes which were duly assessed, computed and levied for the fiscal year shown below pursuant to Section 2151 et seq. of the Revenue and Taxation Code.

The person(s) shown below is (are) liable to said County for the unpaid amounts set forth below plus any other penalties and charges which may accrue pursuant to law.

NAME AND ADDRESS

COUNTRYWIDE HOME LOANS INC
P O BOX 4281
WOODLAND HILLS CA 91365

Fiscal Year	Tax Rate Area	Assessment Number	Tax	Penalty	Cost	Recording Fee
2010-2011	009-159	000215482-6	\$389.66	\$38.96		\$13.00

Upon recordation of this certificate of lien, the total amount required to be paid constitutes a lien upon all personal property and real property now owned or subsequently acquired by the person(s) named herein before the date on which this lien expires.

This lien has the force, effect and priority of judgement lien for ten years from the recording of this instrument, unless sooner released or otherwise discharged.

Executed on 10/31/2010

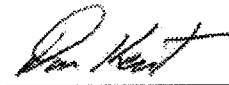

Don Kent, Tax Collector

THIS IS TO INFORM YOU THAT A TAX LIEN HAS BEEN FILED WITH RESPECT TO UNSECURED PROPERTY

When recorded, mail to:

COUNTRYWIDE HOME LOANS INC
400 COUNTRYWIDE WAY SV35
SIMI VALLEY CA 93065

Doc #. 2010-0594072
12/10/2010 03:23 PM Fee: NC
Page 1 of 1

Recorded in Official Records

County of Riverside
= Larry W Ward =
Assessor, County Clerk and Recorder
This document was electronically prepared and recorded by the County of Riverside

CERTIFICATE OF LIEN

(Recorded pursuant to Revenue and Taxation Code Section 2191.3 et seq. and without acknowledgement pursuant to Government Code Section 27282)

STATE OF CALIFORNIA | SS
COUNTY OF RIVERSIDE

No. 0392138

I, Don Kent, Tax Collector of the County of Riverside, State of California, hereby certify that there are, on record in my office, unpaid taxes which were duly assessed, computed and levied for the fiscal year shown below pursuant to Section 2151 et seq. of the Revenue and Taxation Code.

The person(s) shown below is (are) liable to said County for the unpaid amounts set forth below plus any other penalties and charges which may accrue pursuant to law.

NAME AND ADDRESS

COUNTRYWIDE HOME LOANS INC
400 COUNTRYWIDE WAY SV35
SIMI VALLEY CA 93065

Fiscal Year	Tax Rate Area	Assessment Number	Tax	Penalty	Cost	Recording Fee
2001-2002	021-219	051888340-3	\$160.12	\$16.01		\$13.00

Upon recordation of this certificate of lien, the total amount required to be paid constitutes a lien upon all personal property and real property now owned or subsequently acquired by the person(s) named herein before the date on which this lien expires.

This lien has the force, effect and priority of judgement lien for ten years from the recording of this instrument, unless sooner released or otherwise discharged.

Executed on 11/18/2010



Don Kent, Tax Collector

DON KENT
TAX COLLECTOR
County Administrative Center
4080 Lemon St. - 4th Floor
Riverside, California

Mailing Address
P.O. Box 12005
Riverside, CA 92502-2205

DOC # 2011-0025766

01/19/2011 08:00A Fee:NC

Page 1 of 1

Recorded in Official Records

County of Riverside

Larry W. Ward

Assessor, County Clerk & Recorder



M
012

(Space above this line for Recorder's use)

CERTIFICATE OF LIEN

(Filed for Record Pursuant to Section 2191.3 et seq., Revenue and Taxation Code)

STATE OF CALIFORNIA)
COUNTY OF RIVERSIDE) §§

NO. 0206907

I, Don Kent, Tax Collector of the County of Riverside, State of California, do hereby certify that there is on record in my office unpaid delinquent unsecured property taxes, which were duly assessed, computed and levied for the fiscal year 2000, in compliance with the provisions of Division 1, Part 5, of the Revenue and Taxation Code, in the amounts stated herein, together with penalties levied pursuant to sections 2921.5 and 2922 of the Revenue and Taxation Code.

The person(s) shown below is (are) liable to said County for the unpaid amounts set forth below plus any other penalties and charges which may accrue pursuant to law.

NAME AND ADDRESS	TAX RATE AREA	ASSESSMENT NUMBER	TAX	PENALTY
COUNTRYWIDE HOME LOANS INC 400 COUNTRYWIDE WAY SV35 SIMI VALLEY CA 93065	021-321	001162627-5	\$934.02	\$93.40

From and after the time of filing this certificate of lien for record, the total amount required to be paid by the person or persons named constitutes a lien upon all personal property and real property now owned by said person or persons, or that may subsequently be acquired by them before the date on which this lien expires.

This lien has the force, effect and priority of a judgement lien for ten (10) years from the time of the recording of this instrument, unless sooner released or otherwise discharged.

This "CERTIFICATE OF LIEN" is herewith filed for record for the express purpose of extending that certain lien obtained under the original certificate recorded on 03/14/2001, Document #00000000104505 of Official Records of Riverside County, California.

Dated January 12, 2011.

DON KENT, Tax Collector

By Lainie Smith, Deputy

Recorded without acknowledgement pursuant to the provisions of Section 27282 of the Government Code.

TC 119 (11/98)

Public Record

THIS IS TO INFORM YOU THAT A TAX LIEN HAS BEEN FILED WITH RESPECT TO UNSECURED PROPERTY

When recorded, mail to:

COUNTRYWIDE HOME LOANS INC
123 N PALM CANYON DR
PALM SPRINGS CA 92262

Doc # 2011-0485414
11/02/2011 09:41 AM Fee: NC
Page 1 of 1

Recorded in Official Records

County of Riverside
== Larry W Ward ==
Assessor, County Clerk and Recorder
This document was electronically prepared and recorded by the County of Riverside

CERTIFICATE OF LIEN

(Recorded pursuant to Revenue and Taxation Code Section 2191.3 et seq.
and without acknowledgement pursuant to Government Code Section 27282)

STATE OF CALIFORNIA |
COUNTY OF RIVERSIDE |SS

No. 0399900

I, Don Kent, Tax Collector of the County of Riverside, State of California, hereby certify that there are, on record in my office, unpaid taxes which were duly assessed, computed and levied for the fiscal year shown below pursuant to Section 2151 et seq. of the Revenue and Taxation Code.

The person(s) shown below is (are) liable to said County for the unpaid amounts set forth below plus any other penalties and charges which may accrue pursuant to law.

NAME AND ADDRESS

COUNTRYWIDE HOME LOANS INC
123 N PALM CANYON DR
PALM SPRINGS CA 92262

Fiscal Year	Tax Rate Area	Assessment Number	Tax	Penalty	Cost	Recording Fee
2011-2012	011-008	000224373-9	\$3,049.67	\$304.96		\$13.00

Upon recordation of this certificate of lien, the total amount required to be paid constitutes a lien upon all personal property and real property now owned or subsequently acquired by the person(s) named herein before the date on which this lien expires.

This lien has the force, effect and priority of judgement lien for ten years from the recording of this instrument, unless sooner released or otherwise discharged.

Executed on 10/31/2011

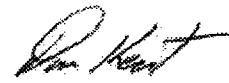

Don Kent, Tax Collector

THIS IS TO INFORM YOU THAT A TAX LIEN HAS BEEN FILED WITH RESPECT TO UNSECURED PROPERTY

When recorded, mail to:

COUNTRYWIDE HOME LOANS INC
P O BOX 4281
WOODLAND HILLS CA 91365

Doc # 2011-0495194
11/07/2011 09:08 AM Fee: NC
Page 1 of 1

Recorded in Official Records

County of Riverside
== Larry W Ward ==
Assessor, County Clerk and Recorder
This document was electronically prepared and recorded by the County of Riverside

CERTIFICATE OF LIEN

(Recorded pursuant to Revenue and Taxation Code Section 2191.3 et seq. and without acknowledgement pursuant to Government Code Section 27282)

STATE OF CALIFORNIA | SS
COUNTY OF RIVERSIDE

No. 0399901

I, Don Kent, Tax Collector of the County of Riverside, State of California, hereby certify that there are, on record in my office, unpaid taxes which were duly assessed, computed and levied for the fiscal year shown below pursuant to Section 2151 et seq. of the Revenue and Taxation Code.

The person(s) shown below is (are) liable to said County for the unpaid amounts set forth below plus any other penalties and charges which may accrue pursuant to law.

NAME AND ADDRESS

COUNTRYWIDE HOME LOANS INC
P O BOX 4281
WOODLAND HILLS CA 91365

Fiscal Year	Tax Rate Area	Assessment Number	Tax	Penalty	Cost	Recording Fee
2011-2012	004-018	000224385-0	\$589.85	\$58.98		\$13.00

Upon recordation of this certificate of lien, the total amount required to be paid constitutes a lien upon all personal property and real property now owned or subsequently acquired by the person(s) named herein before the date on which this lien expires.

This lien has the force, effect and priority of judgement lien for ten years from the recording of this instrument, unless sooner released or otherwise discharged.

Executed on 10/31/2011



Don Kent, Tax Collector

DON KENT
TAX COLLECTOR
County Administrative Center
4080 Lemon St. - 4th Floor
Riverside, California

Mailing Address
P.O. Box 12005
Riverside, CA 92502-2205

DOC # 2012-0030157

01/24/2012 11:40A Fee:NC

Page 1 of 1

Recorded in Official Records
County of Riverside

Larry W. Ward
Assessor, County Clerk & Recorder



(Space above this line for Recorder's use)

CERTIFICATE OF LIEN

(Filed for Record Pursuant to Section 2191.3 et seq., Revenue and Taxation Code)



STATE OF CALIFORNIA)
COUNTY OF RIVERSIDE) **§§**

NO. **0227272**

I, Don Kent, Tax Collector of the County of Riverside, State of California, do hereby certify that there is on record in my office unpaid delinquent unsecured property taxes, which were duly assessed, computed and levied for the fiscal year 2000, in compliance with the provisions of Division 1, Part 5, of the Revenue and Taxation Code, in the amounts stated herein, together with penalties levied pursuant to sections 2921.5 and 2922 of the Revenue and Taxation Code.

The person(s) shown below is (are) liable to said County for the unpaid amounts set forth below plus any other penalties and charges which may accrue pursuant to law.

NAME AND ADDRESS	TAX RATE AREA	ASSESSMENT NUMBER	TAX	PENALTY
COUNTRYWIDE HOME LOANS 400 COUNTRYWIDE WAY SV35 SIMI VALLEY CA 93065	021-235	051643468-9	\$105.99	\$10.59

From and after the time of filing this certificate of lien for record, the total amount required to be paid by the person or persons named constitutes a lien upon all personal property and real property now owned by said person or persons, or that may subsequently be acquired by them before the date on which this lien expires.

This lien has the force, effect and priority of a judgement lien for ten (10) years from the time of the recording of this instrument, unless sooner released or otherwise discharged.

This "CERTIFICATE OF LIEN" is herewith filed for record for the express purpose of extending that certain lien obtained under the original certificate recorded on 03/26/2002, Document #000000000151904 of Official Records of Riverside County, California.

Dated January 9, 2012.

DON KENT, Tax Collector

By Denise Gonzalez, Deputy

Recorded without acknowledgement pursuant to the provisions of Section 27282 of the Government Code.

TC 119 (11/98)

Public Record

DON KENT
TAX COLLECTOR
County Administrative Center
4080 Lemon St. - 4th Floor
Riverside, California

Mailing Address
P.O. Box 12005
Riverside, CA 92502-2205

DOC # 2012-0030165
01/24/2012 11:40A Fee:NC
Page 1 of 1
Recorded in Official Records
County of Riverside
Larry W. Ward
Assessor, County Clerk & Recorder



(Space above this line for Recorder's use)

CERTIFICATE OF LIEN

(Filed for Record Pursuant to Section 2191.3 et seq., Revenue and Taxation Code)



STATE OF CALIFORNIA)
COUNTY OF RIVERSIDE) §§

NO. **0227308**

I, Don Kent, Tax Collector of the County of Riverside, State of California, do hereby certify that there is on record in my office unpaid delinquent unsecured property taxes, which were duly assessed, computed and levied for the fiscal year 2000, in compliance with the provisions of Division 1, Part 5, of the Revenue and Taxation Code, in the amounts stated herein, together with penalties levied pursuant to sections 2921.5 and 2922 of the Revenue and Taxation Code.

The person(s) shown below is (are) liable to said County for the unpaid amounts set forth below plus any other penalties and charges which may accrue pursuant to law.

NAME AND ADDRESS	TAX RATE AREA	ASSESSMENT NUMBER	TAX	PENALTY
COUNTRYWIDE HOME LOANS INC 400 COUNTRYWIDE WAY SV35 SIMI VALLEY CA 93065	021-174	051659086-6	\$102.20	\$10.22

From and after the time of filing this certificate of lien for record, the total amount required to be paid by the person or persons named constitutes a lien upon all personal property and real property now owned by said person or persons, or that may subsequently be acquired by them before the date on which this lien expires.

This lien has the force, effect and priority of a judgement lien for ten (10) years from the time of the recording of this instrument, unless sooner released or otherwise discharged.

This "CERTIFICATE OF LIEN" is herewith filed for record for the express purpose of extending that certain lien obtained under the original certificate recorded on 03/26/2002, Document #000000000151940 of Official Records of Riverside County, California.

Dated January 9, 2012.

DON KENT, Tax Collector

By Denise Gonzalez, Deputy

Recorded without acknowledgement pursuant to the provisions of Section 27282 of the Government Code.

TC 119 (11/98)

THIS IS TO INFORM YOU THAT A TAX LIEN HAS BEEN FILED WITH RESPECT TO UNSECURED PROPERTY

When recorded, mail to:

COUNTRYWIDE HOME LOANS INC
P O BOX 4281
WOODLAND HILLS CA 91365

Doc #. 2012-0540054
11/08/2012 11:37 AM Fee: NC
Page 1 of 1

Recorded in Official Records

County of Riverside
== Larry W Ward ==

Assessor, County Clerk and Recorder

This document was electronically prepared and recorded by the County of Riverside

CERTIFICATE OF LIEN

(Recorded pursuant to Revenue and Taxation Code Section 2191.3 et seq. and without acknowledgement pursuant to Government Code Section 27282)

STATE OF CALIFORNIA | SS
COUNTY OF RIVERSIDE

No. 0409872

I, Don Kent, Tax Collector of the County of Riverside, State of California, hereby certify that there are, on record in my office, unpaid taxes which were duly assessed, computed and levied for the fiscal year shown below pursuant to Section 2151 et seq. of the Revenue and Taxation Code.

The person(s) shown below is (are) liable to said County for the unpaid amounts set forth below plus any other penalties and charges which may accrue pursuant to law.

NAME AND ADDRESS

COUNTRYWIDE HOME LOANS INC
P O BOX 4281
WOODLAND HILLS CA 91365

Fiscal Year	Tax Rate Area	Assessment Number	Tax	Penalty	Cost	Recording Fee
2012-2013	004-018	000224385-0	\$602.55	\$60.25		\$13.00

Upon recordation of this certificate of lien, the total amount required to be paid constitutes a lien upon all personal property and real property now owned or subsequently acquired by the person(s) named herein before the date on which this lien expires.

This lien has the force, effect and priority of judgement lien for ten years from the recording of this instrument, unless sooner released or otherwise discharged.

Executed on 10/31/2012



Don Kent, Tax Collector

THIS IS TO INFORM YOU THAT A TAX LIEN HAS BEEN FILED WITH RESPECT TO UNSECURED PROPERTY

When recorded, mail to:

COUNTRYWIDE HOME LOANS INC
401 N TRYON ST
CHARLOTTE NC 28255

Doc #. 2012-0540199
11/08/2012 11:37 AM Fee: NC
Page 1 of 1

Recorded in Official Records

County of Riverside
== Larry W Ward ==
Assessor, County Clerk and Recorder
This document was electronically prepared and recorded by the County of Riverside

CERTIFICATE OF LIEN

(Recorded pursuant to Revenue and Taxation Code Section 2191.3 et seq.
and without acknowledgement pursuant to Government Code Section 27282)

STATE OF CALIFORNIA | SS
COUNTY OF RIVERSIDE

No. 0410065

I, Don Kent, Tax Collector of the County of Riverside, State of California, hereby certify that there are, on record in my office, unpaid taxes which were duly assessed, computed and levied for the fiscal year shown below pursuant to Section 2151 et seq. of the Revenue and Taxation Code.

The person(s) shown below is (are) liable to said County for the unpaid amounts set forth below plus any other penalties and charges which may accrue pursuant to law.

NAME AND ADDRESS
COUNTRYWIDE HOME LOANS INC
401 N TRYON ST
CHARLOTTE NC 28255

Fiscal Year	Tax Rate Area	Assessment Number	Tax	Penalty	Cost	Recording Fee
2012-2013	013-004	000232327-3	\$493.91	\$49.39		\$13.00

Upon recordation of this certificate of lien, the total amount required to be paid constitutes a lien upon all personal property and real property now owned or subsequently acquired by the person(s) named herein before the date on which this lien expires.

This lien has the force, effect and priority of judgement lien for ten years from the recording of this instrument, unless sooner released or otherwise discharged.

Executed on 10/31/2012



Don Kent, Tax Collector

DON KENT
TAX COLLECTOR
County Administrative Center
4080 Lemon St. - 4th Floor
Riverside, California

Mailing Address
P.O. Box 12005
Riverside, CA 92502-2205

DOC # 2013-0042039

01/28/2013 11:50A Fee:NC

Page 1 of 1

Recorded in Official Records
County of Riverside

Larry M. Ward
Assessor, County Clerk & Recorder



(Space above this line for Recorder's use)

CERTIFICATE OF LIEN

(Filed for Record Pursuant to Section 2191.3 et seq., Revenue and Taxation Code)



STATE OF CALIFORNIA)
COUNTY OF RIVERSIDE) \$\$

NO. **0243389**

I, Don Kent, Tax Collector of the County of Riverside, State of California, do hereby certify that there is on record in my office unpaid delinquent unsecured property taxes, which were duly assessed, computed and levied for the fiscal year 2000, in compliance with the provisions of Division 1, Part 5, of the Revenue and Taxation Code, in the amounts stated herein, together with penalties levied pursuant to sections 2921.5 and 2922 of the Revenue and Taxation Code.

The person(s) shown below is (are) liable to said County for the unpaid amounts set forth below plus any other penalties and charges which may accrue pursuant to law.

NAME AND ADDRESS	TAX RATE AREA	ASSESSMENT NUMBER	TAX	PENALTY
COUNTRYWIDE HOME LOANS INC 400 COUNTRYWIDE WAY SV35 SIMI VALLEY CA 93065	025-073	051759955-0	\$108.20	\$10.82

From and after the time of filing this certificate of lien for record, the total amount required to be paid by the person or persons named constitutes a lien upon all personal property and real property now owned by said person or persons, or that may subsequently be acquired by them before the date on which this lien expires.

This lien has the force, effect and priority of a judgement lien for ten (10) years from the time of the recording of this instrument, unless sooner released or otherwise discharged.

This "CERTIFICATE OF LIEN" is herewith filed for record for the express purpose of extending that certain lien obtained under the original certificate recorded on 01/22/2003, Document #000002003049564 of Official Records of Riverside County, California.

Dated January 15, 2013.

DON KENT, Tax Collector

By Denise Gonzalez, Deputy

Recorded without acknowledgement pursuant to the provisions of Section 27282 of the Government Code.

TC 119 (11/98)

Public Record

DON KENT
TAX COLLECTOR
County Administrative Center
4080 Lemon St. - 4th Floor
Riverside, California

Mailing Address
P.O. Box 12005
Riverside, CA 92502-2205

DOC # 2013-0043251
01/28/2013 02:53P Fee:NC
Page 1 of 1
Recorded in Official Records
County of Riverside
Larry W. Ward
Assessor, County Clerk & Recorder



(Space above this line for Recorder's use)

C
059

CERTIFICATE OF LIEN

(Filed for Record Pursuant to Section 2191.3 et seq., Revenue and Taxation Code)

STATE OF CALIFORNIA)
COUNTY OF RIVERSIDE) §§

NO. **0252895**

I, Don Kent, Tax Collector of the County of Riverside, State of California, do hereby certify that there is on record in my office unpaid delinquent unsecured property taxes, which were duly assessed, computed and levied for the fiscal year 2001, in compliance with the provisions of Division 1, Part 5, of the Revenue and Taxation Code, in the amounts stated herein, together with penalties levied pursuant to sections 2921.5 and 2922 of the Revenue and Taxation Code.

The person(s) shown below is (are) liable to said County for the unpaid amounts set forth below plus any other penalties and charges which may accrue pursuant to law.

NAME AND ADDRESS	TAX RATE AREA	ASSESSMENT NUMBER	TAX	PENALTY
COUNTRYWIDE HOME LOANS INC 400 COUNTRYWIDE WAY SV 35 SIMI VALLEY CA 93065	019-142	051839920-5	\$117.28	\$11.72

From and after the time of filing this certificate of lien for record, the total amount required to be paid by the person or persons named constitutes a lien upon all personal property and real property now owned by said person or persons, or that may subsequently be acquired by them before the date on which this lien expires.

This lien has the force, effect and priority of a judgement lien for ten (10) years from the time of the recording of this instrument, unless sooner released or otherwise discharged.

This "CERTIFICATE OF LIEN" is herewith filed for record for the express purpose of extending that certain lien obtained under the original certificate recorded on 08/07/2003, Document #000002003602977 of Official Records of Riverside County, California.

Dated January 15, 2013.

DON KENT, Tax Collector

By Denise Gonzalez, Deputy

Recorded without acknowledgement pursuant to the provisions of Section 27282 of the Government Code.

TC 119 (11/98)

Public Record

DON KENT
TAX COLLECTOR
County Administrative Center
4080 Lemon St. - 4th Floor
Riverside, California

Mailing Address
P.O. Box 12005
Riverside, CA 92502-2205

DOC # 2013-0047603

01/29/2013 02:25P Fee:NC

Page 1 of 1

Recorded in Official Records
County of Riverside
Larry M. Ward
Assessor, County Clerk & Recorder



(Space above this line for Recorder's use)

CERTIFICATE OF LIEN

(Filed for Record Pursuant to Section 2191.3 et seq., Revenue and Taxation Code)

STATE OF CALIFORNIA)
COUNTY OF RIVERSIDE) \$5

NO. 0252709

I, Don Kent, Tax Collector of the County of Riverside, State of California, do hereby certify that there is on record in my office unpaid delinquent unsecured property taxes, which were duly assessed, computed and levied for the fiscal year 2000, in compliance with the provisions of Division 1, Part 5, of the Revenue and Taxation Code, in the amounts stated herein, together with penalties levied pursuant to sections 2921.5 and 2922 of the Revenue and Taxation Code.

The person(s) shown below is (are) liable to said County for the unpaid amounts set forth below plus any other penalties and charges which may accrue pursuant to law.

NAME AND ADDRESS	TAX RATE AREA	ASSESSMENT NUMBER	TAX	PENALTY
COUNTRYWIDE HOME LOANS INC 400 COUNTRYWIDE WAY SV35 SIMI VALLEY CA 93065	088-080	051832892-2	\$131.27	\$13.12

From and after the time of filing this certificate of lien for record, the total amount required to be paid by the person or persons named constitutes a lien upon all personal property and real property now owned by said person or persons, or that may subsequently be acquired by them before the date on which this lien expires.

This lien has the force, effect and priority of a judgement lien for ten (10) years from the time of the recording of this instrument, unless sooner released or otherwise discharged.

This "CERTIFICATE OF LIEN" is herewith filed for record for the express purpose of extending that certain lien obtained under the original certificate recorded on 08/07/2003, Document #000002003602805 of Official Records of Riverside County, California.

Dated January 15, 2013.

DON KENT, Tax Collector

By Denise Gonzalez, Deputy

Recorded without acknowledgement pursuant to the provisions of Section 27282 of the Government Code.

TC 119 (11/98)

Public Record

DON KENT
TAX COLLECTOR
County Administrative Center
4080 Lemon St. - 4th Floor
Riverside, California

Mailing Address
P.O. Box 12005
Riverside, CA 92502-2205

DOC # 2013-0047609
01/29/2013 02:25P Fee:NC
Page 1 of 1
Recorded in Official Records
County of Riverside
Larry U. Ward
Assessor, County Clerk & Recorder



(Space above this line for Recorder's use)

CERTIFICATE OF LIEN

(Filed for Record Pursuant to Section 2191.3 et seq., Revenue and Taxation Code)

STATE OF CALIFORNIA)
COUNTY OF RIVERSIDE) §§

NO. **0252730**

I, Don Kent, Tax Collector of the County of Riverside, State of California, do hereby certify that there is on record in my office unpaid delinquent unsecured property taxes, which were duly assessed, computed and levied for the fiscal year 2001, in compliance with the provisions of Division 1, Part 5, of the Revenue and Taxation Code, in the amounts stated herein, together with penalties levied pursuant to sections 2921.5 and 2922 of the Revenue and Taxation Code.

The person(s) shown below is (are) liable to said County for the unpaid amounts set forth below plus any other penalties and charges which may accrue pursuant to law.

NAME AND ADDRESS	TAX RATE AREA	ASSESSMENT NUMBER	TAX	PENALTY
COUNTRYWIDE HOME LOANS INC 400 COUNTRYWIDE WAY SV35 SIMI VALLEY CA 93065	008-103	051833227-5	\$143.67	\$14.36

From and after the time of filing this certificate of lien for record, the total amount required to be paid by the person or persons named constitutes a lien upon all personal property and real property now owned by said person or persons, or that may subsequently be acquired by them before the date on which this lien expires.

This lien has the force, effect and priority of a judgement lien for ten (10) years from the time of the recording of this instrument, unless sooner released or otherwise discharged.

This "CERTIFICATE OF LIEN" is herewith filed for record for the express purpose of extending that certain lien obtained under the original certificate recorded on 08/07/2003, Document #000002003602825 of Official Records of Riverside County, California.

Dated January 15, 2013.

DON KENT, Tax Collector

By Denise Gonzalez, Deputy

Recorded without acknowledgement pursuant to the provisions of Section 27282 of the Government Code.

TC 119 (11/98)

Public Record

DON KENT
TAX COLLECTOR
County Administrative Center
4080 Lemon St. - 4th Floor
Riverside, California

Mailing Address
P.O. Box 12005
Riverside, CA 92502-2205

DOC # 2013-0047634

01/29/2013 02:25P Fee:NC

Page 1 of 1

Recorded in Official Records

County of Riverside

Larry W. Ward

Assessor, County Clerk & Recorder



(Space above this line for Recorder's use)

CERTIFICATE OF LIEN

(Filed for Record Pursuant to Section 2191.3 et seq., Revenue and Taxation Code)

STATE OF CALIFORNIA)
COUNTY OF RIVERSIDE) §§

NO. **0252800**

I, Don Kent, Tax Collector of the County of Riverside, State of California, do hereby certify that there is on record in my office unpaid delinquent unsecured property taxes, which were duly assessed, computed and levied for the fiscal year 2001, in compliance with the provisions of Division 1, Part 5, of the Revenue and Taxation Code, in the amounts stated herein, together with penalties levied pursuant to sections 2921.5 and 2922 of the Revenue and Taxation Code.

The person(s) shown below is (are) liable to said County for the unpaid amounts set forth below plus any other penalties and charges which may accrue pursuant to law.

NAME AND ADDRESS	TAX RATE AREA	ASSESSMENT NUMBER	TAX	PENALTY
COUNTRYWIDE HOME LOANS 400 COUNTRYWIDE WAY SV35 SIMI VALLEY CA 93065	021-164	051834112-7	\$108.16	\$10.81

From and after the time of filing this certificate of lien for record, the total amount required to be paid by the person or persons named constitutes a lien upon all personal property and real property now owned by said person or persons, or that may subsequently be acquired by them before the date on which this lien expires.

This lien has the force, effect and priority of a judgement lien for ten (10) years from the time of the recording of this instrument, unless sooner released or otherwise discharged.

This "CERTIFICATE OF LIEN" is herewith filed for record for the express purpose of extending that certain lien obtained under the original certificate recorded on 08/07/2003, Document #000002003602885 of Official Records of Riverside County, California.

Dated January 15, 2013.

DON KENT, Tax Collector

By Denise Gonzalez, Deputy

Recorded without acknowledgement pursuant to the provisions of Section 27282 of the Government Code.

TC 119 (11/98)

Public Record

EXHIBIT “D”

CODE ENFORCEMENT DEPARTMENT
COUNTY OF RIVERSIDE

Juan Perez
DIRECTOR

37600 SKY CANYON ROAD
MURRIETA, CALIFORNIA 92563
(951) 696-1606

CASES#: CV12-05595

PROPERTY SITUS: 33649 El Centro Ave, Hemet

A.P.N.: 458-225-005

DRAWN ON: 04/30/2013

DRAWN BY: M. Jones #65

Provide North Arrow

REAR PROPERTY LINE

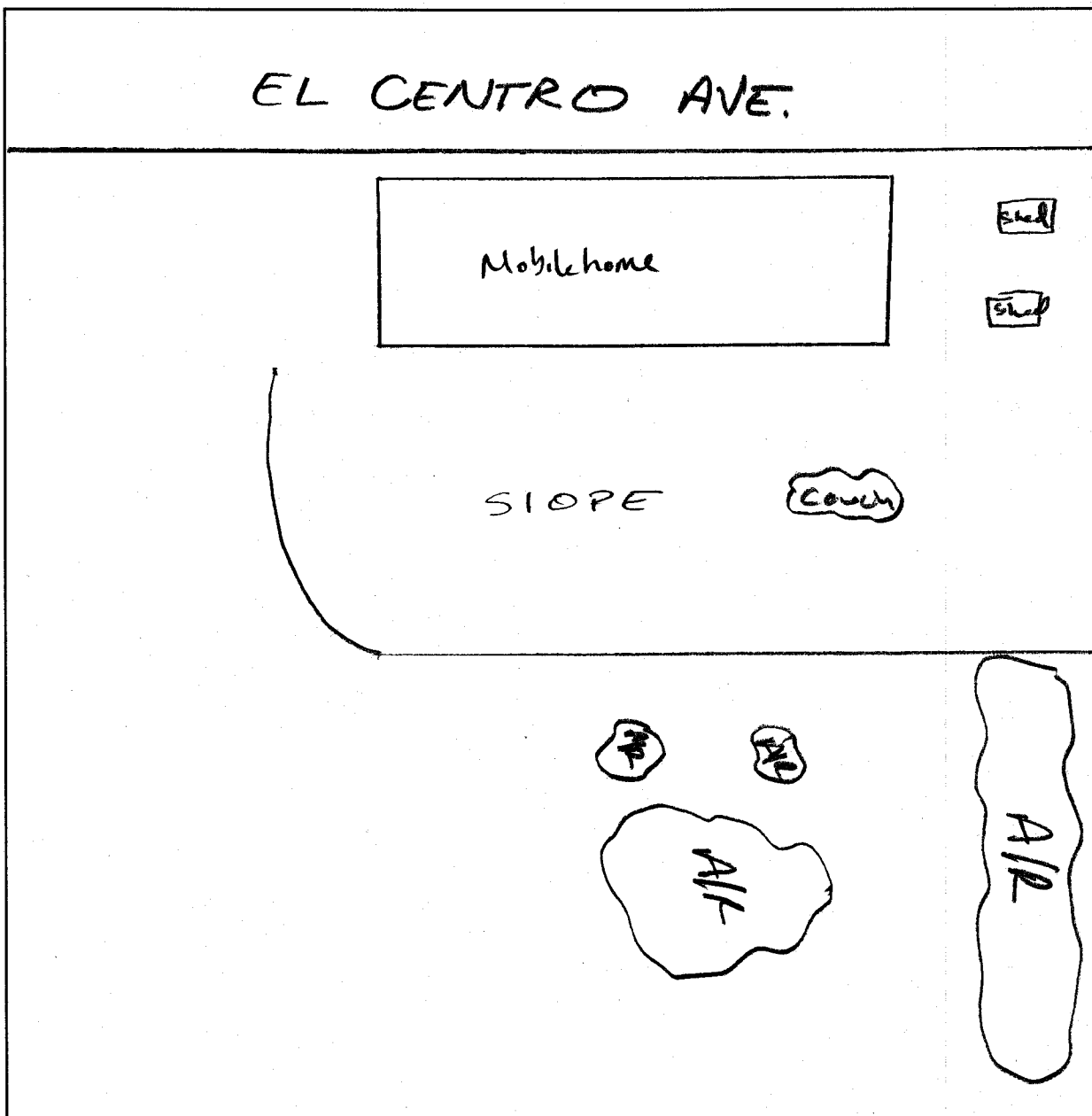

S
I
D
E

P
R
O
P
E
R
T
Y

L
I
N
E

S
I
D
E

P
R
O
P
E
R
T
Y

L
I
N
E

NOT TO SCALE

FRONT PROPERTY LINE



Large AR pile, center of the lower property



Large pile of rubbish next to the SSMH



Scattered AR



IMG 5904.JPG



Large pile of AR



Pile of AR under tree

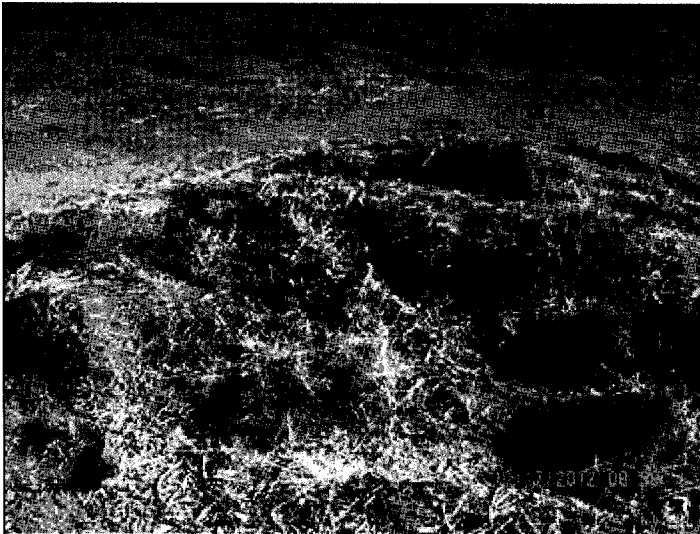

AR pile of hay



AR couch on hill to the north of the main mobi

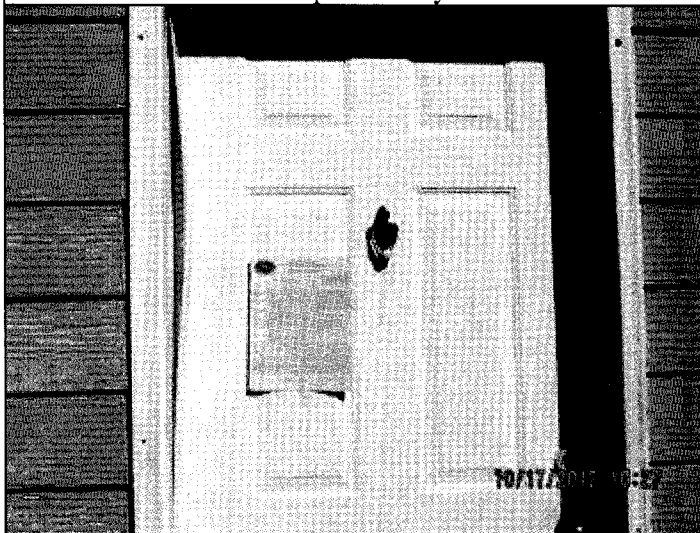

Posted NOV

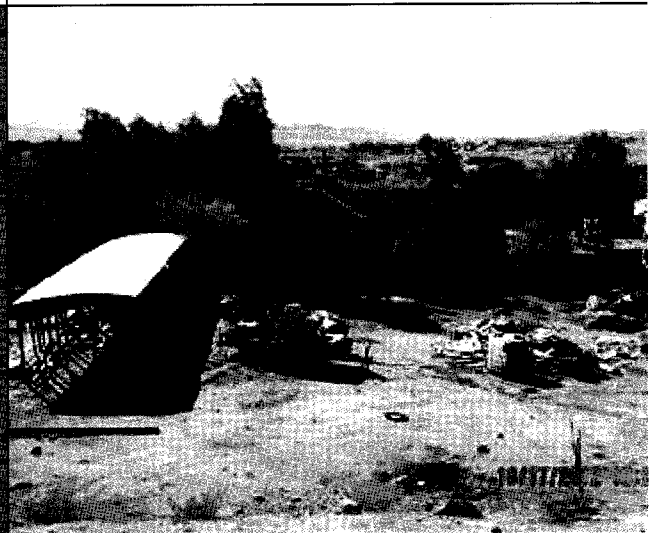

View from the top of the hill

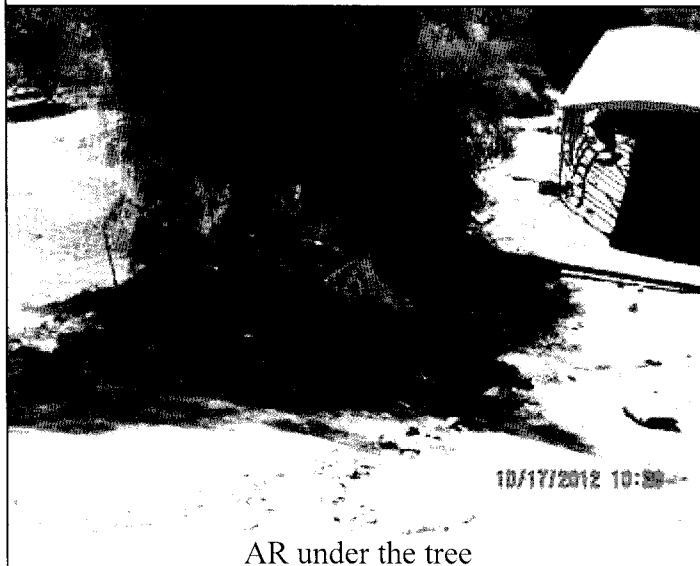

AR under the tree

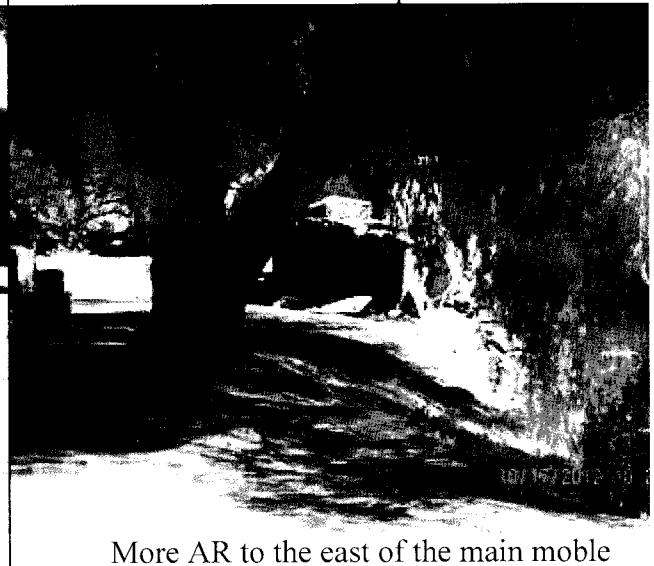

More AR to the east of the main mobile

September 5, 2013

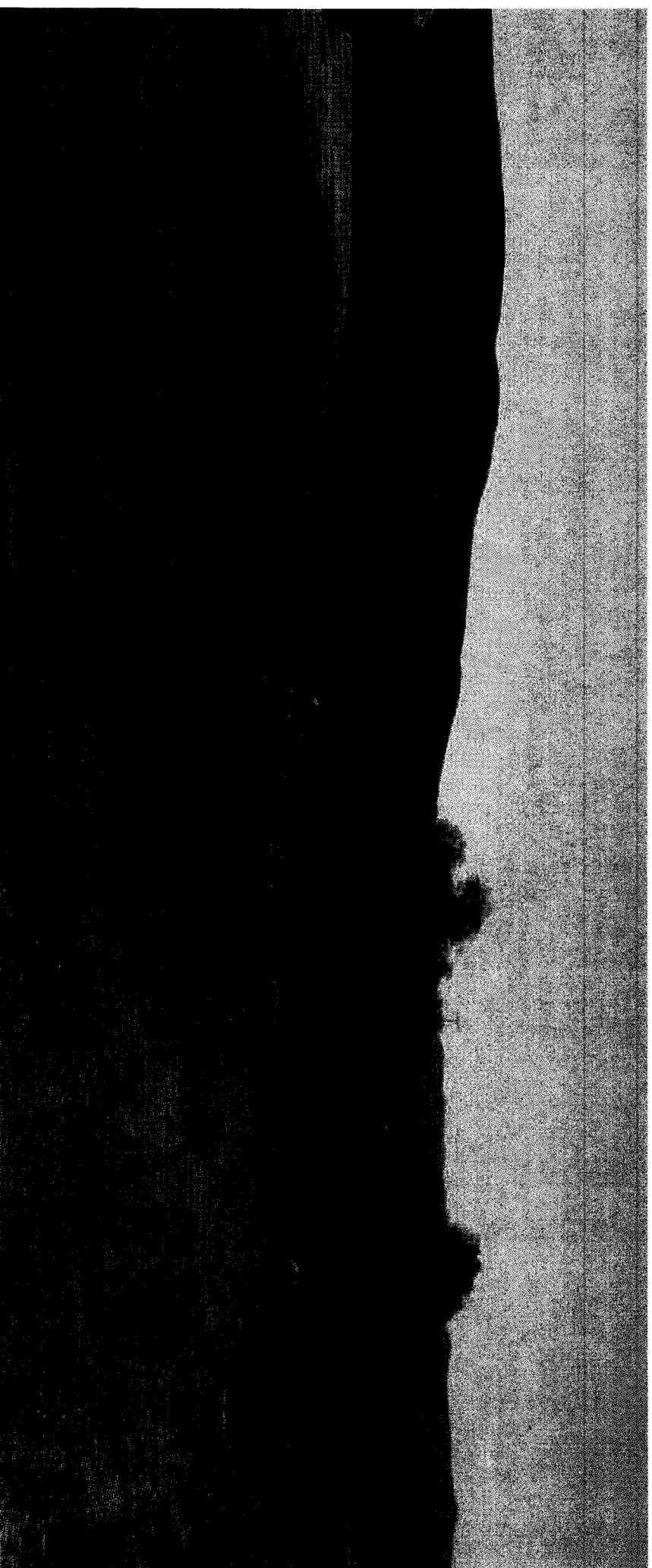



2/11/03, 2013



EXHIBIT “E”



COUNTY OF RIVERSIDE CODE ENFORCEMENT DEPARTMENT

NOTICE OF VIOLATION

CASE No.: CV 12-05595

THE PROPERTY AT: 33649 EL CENTRO AVE, HEMET APN#: 458-225-005

WAS INSPECTED BY OFFICER: M. Jones 951 722-8718 ID#: 65 ON 10/17/12 AT 0900 am/pm

AND FOUND TO BE IN VIOLATION OF RIVERSIDE COUNTY CODE(S) AS FOLLOWS:

<input type="checkbox"/>	5.28.040 (RCO 593)	Excessive Yard Sales - Cease yard sale. Limit of 3 yard sale events, not over 3 consecutive days, per year.	<input type="checkbox"/>	17.252.030 (RCO 348)	Unpermitted Outdoor Advertising Display - Obtain a permit from the Planning Dept. or remove display.
<input type="checkbox"/>	8.28.030 (RCO 821)	Unfenced Pool - Install or provide adequate fencing to secure the pool.	<input type="checkbox"/>	17.172.205 (RCO 348)	Prohibited Fencing - Remove fence. Fences shall not be constructed of garage doors, tires, pallets or other materials not typically used for the construction of fences.
<input checked="" type="checkbox"/>	8.120.010 (RCO 541)	Accumulated Rubbish - Remove all rubbish & dispose of in an approved legal landfill.	<input type="checkbox"/>	17. _____ (RCO 348)	Excessive Outside Storage: Storage of Unpermitted Mobile Home(s) Not Allowed - Remove unpermitted mobile home(s) from the property.
<input type="checkbox"/>	15.08.010 (RCO 457)	Unpermitted Construction - Cease construction. Obtain the appropriate permits from the Bldg. & Safety and Planning Departments or demolish the _____.	<input type="checkbox"/>	17. _____ (RCO 348)	Occupied RV/Trailer - Cease occupancy & disconnect all utilities to RV/Trailer.
<input type="checkbox"/>	15.12.020(J)(2) (RCO 457)	Unapproved Grading/Clearing - Cease grading/clearing/stockpiling/importing fill. Obtain a Restoration Assessment from the Dept. of Building & Safety. Perform complete restoration and remediation of the property affected by the unapproved grading in accordance with the Restoration Assessment.	<input type="checkbox"/>	17. _____ (RCO 348)	Excessive Animals - Remove or reduce the number of _____ to less than _____.
<input type="checkbox"/>	15.16.020 (RCO 457)	Substandard Structure - Obtain a permit from the Bldg. & Safety Dept. to rehabilitate per Notice of Defects or demolish the structure.	<input type="checkbox"/>	17. _____ (RCO 348)	Unpermitted Land Use: _____ Cease all business activities. Obtain Planning Dept. approval prior to resuming business operations.
<input type="checkbox"/>	15.48.010 (RCO 457)	Unpermitted Mobile Home —Vacate mobile home. Obtain the appropriate permits from the Planning Dept. & Dept. of Bldg. & Safety prior to occupancy or remove Mobile Home.	<input type="checkbox"/>	17. _____ (RCO 348)	Excessive Outside Storage - Remove or reduce all outside storage to less than _____ square feet at the rear of the property.
<input type="checkbox"/>	15.48.040 (RCO 457)	Substandard Mobile Home/Trailer/RV - Obtain a permit from the Bldg. & Safety Dept. to rehabilitate per Notice of Defects and Title 25 or demolish the Mobile Home/Trailer/RV.	<input type="checkbox"/>		

COMMENTS: Haz Mat spill (Red Dye spill) Must obtain licensed HAZ Waste contractor to remove dirt & contaminated waste & A/R

IMPORTANT! CORRECTION(S) MUST BE COMPLETED BY: 11-1-12 . FAILURE TO COMPLY BY THIS DATE, MAY RESULT IN THE ISSUANCE OF AN ADMINISTRATIVE CITATION WITH FINES UP TO \$500.00 PER DAY, FOR EACH VIOLATION. YOU MAY BE CITED EACH DAY THAT THE VIOLATION(S) EXIST BEYOND THE CORRECTION DATE. IN ADDITION, OTHER ENFORCEMENT ACTION, PENALTIES AND THE IMPOSITION OF A LIEN ON THE PROPERTY FOR THE ABATEMENT AND ENFORCEMENT COSTS MAY RESULT IF COMPLIANCE IS NOT ACHIEVED BY THE CORRECTION DATE.

NOTICE IS HEREBY GIVEN THAT AT THE CONCLUSION OF THIS CASE YOU WILL RECEIVE A SUMMARY OF ADMINISTRATIVE COSTS ASSOCIATED WITH THE PROCESSING OF SUCH VIOLATION(S), AT AN HOURLY RATE OF \$ 109.00 AS DETERMINED BY THE BOARD OF SUPERVISORS. YOU WILL HAVE THE RIGHT TO OBJECT TO THESE CHARGES BY FILING A REQUEST FOR HEARING WITH THE DEPARTMENT OF CODE ENFORCEMENT WITHIN TEN (10) DAYS OF SERVICE OF THE SUMMARY OF CHARGES, PURSUANT TO RIVERSIDE COUNTY ORDINANCE 725 AND RIVERSIDE COUNTY CODE 1.16.

SIGNATURE

PRINT NAME

DATE

PROPERTY OWNER TENANT

CDL/CID#

D.O.B.

TEL. NO.

POSTED



**CODE ENFORCEMENT DEPARTMENT
COUNTY OF RIVERSIDE**

AFFIDAVIT OF POSTING OF NOTICES

October 18, 2012

RE CASE NO: CV1205595

I, Matt Jones, hereby declare:

I am employed by the Riverside County Code Enforcement Department; that my business address is 37600 Sky Canyon Drive, Suite G, French Valley, California 92563 .

That on 10/17/2012 at 0900 AM, I securely and conspicuously posted Notice of Violation at the property described as:

Property Address: 33649 EL CENTRO AVE, HEMET

Assessor's Parcel Number: 458-225-005

I declare under the penalty of perjury that the foregoing is true and correct.

Executed on October 18, 2012 in the County of Riverside, California.

CODE ENFORCEMENT DEPARTMENT

By: Matt Jones, Code Enforcement Officer

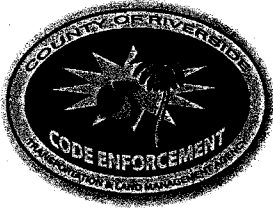

**CODE ENFORCEMENT DEPARTMENT
COUNTY OF RIVERSIDE**

NOTICE OF VIOLATION

October 18, 2012

BAC HOME LOANS SERVICING
7105 CORPORATE
PLANO, TX 75024

RE CASE NO: CV1205595 at 33649 EL CENTRO AVE, in the community of HEMET, California, Assessor's Parcel Number 458-225-005

NOTICE IS HEREBY GIVEN that property owned or controlled by you at 33649 EL CENTRO AVE, in the community of HEMET California, Assessor's Parcel Number 458-225-005, is in violation of Section(s) RCC Section No. 8.120.010 (Ord. 541), of the Riverside County Code.

Said violation is described as:

- 1) 8.120.010 (Ord. 541) - No person or entity shall permit the accumulation of rubbish or other material, dangerous or injurious to the health and welfare of persons or the environment, on any real property in the unincorporated area of Riverside County owned by them or under their control.

YOU ARE HEREBY REQUIRED TO COMPLY with the provisions of the ordinance by:

- 1) All contaminated Haz Waste must be removed by an approved Haz Waste contractor. Contact Riverside County Environmental Health Hazardous Materials Management Division for guidance. Remove all non contaminated rubbish and dispose of it in an approved, legal landfill.

COMPLIANCE MUST BE COMPLETED BY November 1, 2012. FAILURE TO COMPLY WILL RESULT IN LEGAL ACTION BEING BROUGHT AGAINST YOU.

NOTICE IS HEREBY GIVEN THAT AT THE CONCLUSION OF THIS CASE YOU WILL RECEIVE A SUMMARY OF ADMINISTRATIVE COSTS ASSOCIATED WITH THE PROCESSING OF SUCH VIOLATION(S), AT AN HOURLY RATE OF \$109.00 AS DETERMINED BY THE BOARD OF SUPERVISORS.

YOU WILL HAVE THE RIGHT TO OBJECT TO THESE CHARGES BY FILING A REQUEST FOR HEARING WITH THE DEPARTMENT OF CODE ENFORCEMENT WITHIN TEN (10) DAYS OF SERVICE OF THE SUMMARY OF CHARGES, PURSUANT TO SECTION 1.16.080 OF RIVERSIDE COUNTY CODE.

CODE ENFORCEMENT DEPARTMENT

By: Matt Jones, Code Enforcement Officer



**CODE ENFORCEMENT DEPARTMENT
COUNTY OF RIVERSIDE**

NOTICE OF VIOLATION

October 18, 2012

Occupant
33649 EL CENTRO AVE
HEMET, CA 92545

RE CASE NO: CV1205595 at 33649 EL CENTRO AVE, in the community of HEMET, California, Assessor's Parcel Number 458-225-005

NOTICE IS HEREBY GIVEN that property owned or controlled by you at 33649 EL CENTRO AVE, in the community of HEMET California, Assessor's Parcel Number 458-225-005, is in violation of Section(s) RCC Section No. 8.120.010 (Ord. 541), of the Riverside County Code.

Said violation is described as:

- 1) 8.120.010 (Ord. 541) - No person or entity shall permit the accumulation of rubbish or other material, dangerous or injurious to the health and welfare of persons or the environment, on any real property in the unincorporated area of Riverside County owned by them or under their control.

YOU ARE HEREBY REQUIRED TO COMPLY with the provisions of the ordinance by:

- 1) All contaminated Haz Waste must be removed by an approved Haz Waste contractor. Contact Riverside County Environmental Health Hazardous Materials Management Division for guidance. Remove all non contaminated rubbish and dispose of it in an approved, legal landfill.

COMPLIANCE MUST BE COMPLETED BY November 1, 2012. FAILURE TO COMPLY WILL RESULT IN LEGAL ACTION BEING BROUGHT AGAINST YOU.

NOTICE IS HEREBY GIVEN THAT AT THE CONCLUSION OF THIS CASE YOU WILL RECEIVE A SUMMARY OF ADMINISTRATIVE COSTS ASSOCIATED WITH THE PROCESSING OF SUCH VIOLATION(S), AT AN HOURLY RATE OF \$109.00 AS DETERMINED BY THE BOARD OF SUPERVISORS.

YOU WILL HAVE THE RIGHT TO OBJECT TO THESE CHARGES BY FILING A REQUEST FOR HEARING WITH THE DEPARTMENT OF CODE ENFORCEMENT WITHIN TEN (10) DAYS OF SERVICE OF THE SUMMARY OF CHARGES, PURSUANT TO SECTION 1.16.080 OF RIVERSIDE COUNTY CODE.

CODE ENFORCEMENT DEPARTMENT

By: Matt Jones, Code Enforcement Officer



**CODE ENFORCEMENT DEPARTMENT
COUNTY OF RIVERSIDE**

PROOF OF SERVICE

Case No. CV1205595

STATE OF CALIFORNIA, COUNTY OF RIVERSIDE

I, Elizabeth Ross, declare that I am a citizen of the United States and am employed in the County of Riverside, over the age of 18 years and not a party to the within action or proceeding; that my business address is at the footer of this notice.

That on October 18, 2012, I served the following documents(s):

NOTICE RE: Notice of Violation

by placing a true copy thereof enclosed in a sealed envelope(s) by **REGULAR MAIL** addressed as follows:

BAC HOME LOANS SERVICING 7105 CORPORATE, PLANO, TX 75024
OCCUPANT 33649 EL CENTRO AVE, HEMET, CA 92545

XX **By First Class Mail.** I am readily familiar with the office's practice of collection and processing correspondence for mailing. Under that practice it would be deposited with the U.S. Postal Service with postage thereon fully prepaid in the County of Riverside, California, in the ordinary course of business.

XX **STATE.** I declare under the penalty of perjury under the laws of the State of California that the above is true and correct.

EXECUTED ON October 18, 2012, in the County of Riverside, California.

CODE ENFORCEMENT DEPARTMENT

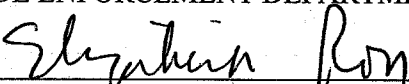
By: Elizabeth Ross, Code Enforcement Aide

**CODE ENFORCEMENT DEPARTMENT
COUNTY OF RIVERSIDE**

NOTICE OF VIOLATION

May 1, 2013

BAC HOME LOANS SERVICING
7105 CORPORATE
PLANO, TX 75024

RE CASE NO: CV1205595 at 33649 EL CENTRO AVE, in the community of HEMET, California, Assessor's Parcel Number 458-225-005

NOTICE IS HEREBY GIVEN that property owned or controlled by you at 33649 EL CENTRO AVE, in the community of HEMET California, Assessor's Parcel Number 458-225-005, is in violation of Section(s) RCC Section No. 8.120.010 (Ord. 541), of the Riverside County Code.

Said violation is described as:

- 1) 8.120.010 (Ord. 541) - No person or entity shall permit the accumulation of rubbish or other material, dangerous or injurious to the health and welfare of persons or the environment, on any real property in the unincorporated area of Riverside County owned by them or under their control.

YOU ARE HEREBY REQUIRED TO COMPLY with the provisions of the ordinance by:

- 1) All contaminated Haz Waste must be removed by an approved Haz Waste contractor. Contact Riverside County Environmental Health Hazardous Materials Management Division for guidance. Remove all non contaminated rubbish and dispose of it in an approved, legal landfill.

COMPLIANCE MUST BE COMPLETED BY May 15, 2013. FAILURE TO COMPLY WILL RESULT IN LEGAL ACTION BEING BROUGHT AGAINST YOU.

NOTICE IS HEREBY GIVEN THAT AT THE CONCLUSION OF THIS CASE YOU WILL RECEIVE A SUMMARY OF ADMINISTRATIVE COSTS ASSOCIATED WITH THE PROCESSING OF SUCH VIOLATION(S), AT AN HOURLY RATE OF \$109.00 AS DETERMINED BY THE BOARD OF SUPERVISORS.

YOU WILL HAVE THE RIGHT TO OBJECT TO THESE CHARGES BY FILING A REQUEST FOR HEARING WITH THE DEPARTMENT OF CODE ENFORCEMENT WITHIN TEN (10) DAYS OF SERVICE OF THE SUMMARY OF CHARGES, PURSUANT TO SECTION 1.16.080 OF RIVERSIDE COUNTY CODE.

CODE ENFORCEMENT DEPARTMENT

By: Matt Jones, Code Enforcement Officer



**CODE ENFORCEMENT DEPARTMENT
COUNTY OF RIVERSIDE**

PROOF OF SERVICE

Case No. CV1205595

STATE OF CALIFORNIA, COUNTY OF RIVERSIDE

I, Elizabeth Ross, declare that I am a citizen of the United States and am employed in the County of Riverside, over the age of 18 years and not a party to the within action or proceeding; that my business address is at the footer of this notice.

That on May 1, 2013, I served the following document(s):

NOTICE RE: Notice of Violation

by placing a true copy thereof enclosed in a sealed envelope(s) by **CERTIFIED MAIL, RETURN RECEIPT REQUESTED** addressed as follows:

BAC HOME LOANS SERVICING 7105 CORPORATE, PLANO, TX 75024

XX **By First Class Mail.** I am readily familiar with the office's practice of collection and processing correspondence for mailing. Under that practice it would be deposited with the U.S. Postal Service with postage thereon fully prepaid in the County of Riverside, California, in the ordinary course of business.

XX **STATE.** I declare under the penalty of perjury under the laws of the State of California that the above is true and correct.

EXECUTED ON May 1, 2013, in the County of Riverside, California.

CODE ENFORCEMENT DEPARTMENT

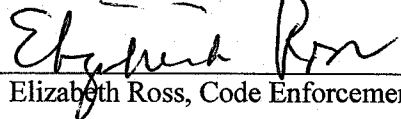
By: Elizabeth Ross, Code Enforcement Aide

U.S. Postal Service™
CERTIFIED MAIL™ RECEIPT
(Domestic Mail Only; No Insurance Coverage Provided)

For delivery information visit our website at www.usps.com®

OFFICIAL USE

Postage	\$
Certified Fee	
Return Receipt Fee (Endorsement Required)	
Restricted Delivery Fee	

Postmark
Here

7009 2250 0001 9041 6824

BAC HOME LOANS SERVICING
7105 CORPORATE
PLANO, TX 75024
CV12-05595 / 458-225

PS Form 3800, August 2006

See Reverse for Instructions

SENDER: COMPLETE THIS SECTION	COMPLETE THIS SECTION ON DELIVERY	
<ul style="list-style-type: none"> ■ Complete items 1, 2, and 3. Also complete item 4 if Restricted Delivery is desired. ■ Print your name and address on the reverse so that we can return the card to you. ■ Attach this card to the back of the mailpiece, or on the front if space permits. 	<p>A. Signature Bank of America Home Loans <input type="checkbox"/> Agent X Plano Mail Center <input type="checkbox"/> Addressee</p>	
1. Article Addressed to:	B. Received by (Printed Name) Plano, TX 75024	C. Date of Delivery
	<p><input type="checkbox"/> Is delivery address different from item 1? <input type="checkbox"/> Yes If YES, enter delivery address below: <input type="checkbox"/> No</p>	
<p>BAC HOME LOANS SERVICING 7105 CORPORATE PLANO, TX 75024 CV12-05595 / 458-225</p>	<p><input type="checkbox"/> Registered Mail <input type="checkbox"/> Express Mail <input type="checkbox"/> Return Receipt for Merchandise <input type="checkbox"/> C.O.D.</p>	
2. Article Number (Transfer from service label)	4. Restricted Delivery? (Extra Fee) <input type="checkbox"/> Yes	
	7009 2250 0001 9041 6824	

PS Form 3811, February 2004

Domestic Return Receipt

102595-02-M-1540



**CODE ENFORCEMENT DEPARTMENT
COUNTY OF RIVERSIDE**

NOTICE OF VIOLATION

September 5, 2013

BAC Homes Loans Servicing L.P
7105 Corporate
Plano, TX 75024

RE CASE NO: CV1205595 at 33649 EL CENTRO AVE, in the community of HEMET, California, Assessor's Parcel Number 458-225-005

NOTICE IS HEREBY GIVEN that property owned or controlled by you at 33649 EL CENTRO AVE, in the community of HEMET California, Assessor's Parcel Number 458-225-005, is in violation of Section(s) RCC Section No. 8.120.010 (Ord. 541), of the Riverside County Code.

Said violation is described as:

- 1) 8.120.010 (Ord. 541) - No person or entity shall permit the accumulation of rubbish or other material, dangerous or injurious to the health and welfare of persons or the environment, on any real property in the unincorporated area of Riverside County owned by them or under their control.

YOU ARE HEREBY REQUIRED TO COMPLY with the provisions of the ordinance by:

- 1) All contaminated Haz Waste must be removed by an approved Haz Waste contractor. Contact Riverside County Environmental Health Hazardous Materials Management Division for guidance. Remove all non contaminated rubbish and dispose of it in an approved, legal landfill.

COMPLIANCE MUST BE COMPLETED BY September 20, 2013. FAILURE TO COMPLY WILL RESULT IN LEGAL ACTION BEING BROUGHT AGAINST YOU.

NOTICE IS HEREBY GIVEN THAT AT THE CONCLUSION OF THIS CASE YOU WILL RECEIVE A SUMMARY OF ADMINISTRATIVE COSTS ASSOCIATED WITH THE PROCESSING OF SUCH VIOLATION(S), AT AN HOURLY RATE OF \$109.00 AS DETERMINED BY THE BOARD OF SUPERVISORS.

YOU WILL HAVE THE RIGHT TO OBJECT TO THESE CHARGES BY FILING A REQUEST FOR HEARING WITH THE DEPARTMENT OF CODE ENFORCEMENT WITHIN TEN (10) DAYS OF SERVICE OF THE SUMMARY OF CHARGES, PURSUANT TO SECTION 1.16.080 OF RIVERSIDE COUNTY CODE.

CODE ENFORCEMENT DEPARTMENT

By: Samantha Phillips, Code Enforcement Officer



**CODE ENFORCEMENT DEPARTMENT
COUNTY OF RIVERSIDE**

NOTICE OF VIOLATION

September 5, 2013

Eastern Municipal Water District Attn: Debra Deremiah
P.O. Box 8300
Perris, CA 92572-8300

RE CASE NO: CV1205595 at 33649 EL CENTRO AVE, in the community of HEMET, California, Assessor's Parcel Number 458-225-005

NOTICE IS HEREBY GIVEN that property owned or controlled by you at 33649 EL CENTRO AVE, in the community of HEMET California, Assessor's Parcel Number 458-225-005, is in violation of Section(s) RCC Section No. 8.120.010 (Ord. 541), of the Riverside County Code.

Said violation is described as:

- 1) 8.120.010 (Ord. 541) - No person or entity shall permit the accumulation of rubbish or other material, dangerous or injurious to the health and welfare of persons or the environment, on any real property in the unincorporated area of Riverside County owned by them or under their control.

YOU ARE HEREBY REQUIRED TO COMPLY with the provisions of the ordinance by:

- 1) All contaminated Haz Waste must be removed by an approved Haz Waste contractor. Contact Riverside County Environmental Health Hazardous Materials Management Division for guidance. Remove all non contaminated rubbish and dispose of it in an approved, legal landfill.

COMPLIANCE MUST BE COMPLETED BY September 20, 2013. FAILURE TO COMPLY WILL RESULT IN LEGAL ACTION BEING BROUGHT AGAINST YOU.

NOTICE IS HEREBY GIVEN THAT AT THE CONCLUSION OF THIS CASE YOU WILL RECEIVE A SUMMARY OF ADMINISTRATIVE COSTS ASSOCIATED WITH THE PROCESSING OF SUCH VIOLATION(S), AT AN HOURLY RATE OF \$109.00 AS DETERMINED BY THE BOARD OF SUPERVISORS.

YOU WILL HAVE THE RIGHT TO OBJECT TO THESE CHARGES BY FILING A REQUEST FOR HEARING WITH THE DEPARTMENT OF CODE ENFORCEMENT WITHIN TEN (10) DAYS OF SERVICE OF THE SUMMARY OF CHARGES, PURSUANT TO SECTION 1.16.080 OF RIVERSIDE COUNTY CODE.

CODE ENFORCEMENT DEPARTMENT

By: Samantha Phillips, Code Enforcement Officer



**CODE ENFORCEMENT DEPARTMENT
COUNTY OF RIVERSIDE**

NOTICE OF VIOLATION

September 5, 2013

Warren W. Markel, Sr. and Martha L. Markel
33649 El Centro Ave
Hemet, CA 92545

RE CASE NO: CV1205595 at 33649 EL CENTRO AVE, in the community of HEMET, California, Assessor's Parcel Number 458-225-005

NOTICE IS HEREBY GIVEN that property owned or controlled by you at 33649 EL CENTRO AVE, in the community of HEMET California, Assessor's Parcel Number 458-225-005, is in violation of Section(s) RCC Section No. 8.120.010 (Ord. 541), of the Riverside County Code.

Said violation is described as:

- 1) 8.120.010 (Ord. 541) - No person or entity shall permit the accumulation of rubbish or other material, dangerous or injurious to the health and welfare of persons or the environment, on any real property in the unincorporated area of Riverside County owned by them or under their control.

YOU ARE HEREBY REQUIRED TO COMPLY with the provisions of the ordinance by:

- 1) All contaminated Haz Waste must be removed by an approved Haz Waste contractor. Contact Riverside County Environmental Health Hazardous Materials Management Division for guidance. Remove all non contaminated rubbish and dispose of it in an approved, legal landfill.

COMPLIANCE MUST BE COMPLETED BY September 20, 2013. FAILURE TO COMPLY WILL RESULT IN LEGAL ACTION BEING BROUGHT AGAINST YOU.

NOTICE IS HEREBY GIVEN THAT AT THE CONCLUSION OF THIS CASE YOU WILL RECEIVE A SUMMARY OF ADMINISTRATIVE COSTS ASSOCIATED WITH THE PROCESSING OF SUCH VIOLATION(S), AT AN HOURLY RATE OF \$109.00 AS DETERMINED BY THE BOARD OF SUPERVISORS.

YOU WILL HAVE THE RIGHT TO OBJECT TO THESE CHARGES BY FILING A REQUEST FOR HEARING WITH THE DEPARTMENT OF CODE ENFORCEMENT WITHIN TEN (10) DAYS OF SERVICE OF THE SUMMARY OF CHARGES, PURSUANT TO SECTION 1.16.080 OF RIVERSIDE COUNTY CODE.

CODE ENFORCEMENT DEPARTMENT

By: Samantha Phillips, Code Enforcement Officer

**CODE ENFORCEMENT DEPARTMENT
COUNTY OF RIVERSIDE**

PROOF OF SERVICE

Case No. CV1205595

STATE OF CALIFORNIA, COUNTY OF RIVERSIDE

I, Elizabeth Ross, declare that I am a citizen of the United States and am employed in the County of Riverside, over the age of 18 years and not a party to the within action or proceeding; that my business address is at the footer of this notice.

That on September 5, 2013, I served the following documents(s):

NOTICE RE: Notice of Violation

by placing a true copy thereof enclosed in a sealed envelope(s) by **CERTIFIED MAIL, RETURN RECEIPT REQUESTED AND REGULAR MAIL** addressed as follows:

Warren W. Markel, Sr. and Martha L. Markel 33649 El Centro Ave, Hemet, CA 92545
Eastern Municipal Water District Attn: Debra Deremiah P.O. Box 8300, Perris, CA 92572-8300
BAC Homes Loans Servicing L.P 7105 Corporate, Plano, TX 75024

XX By First Class Mail. I am readily familiar with the office's practice of collection and processing correspondence for mailing. Under that practice it would be deposited with the U.S. Postal Service with postage thereon fully prepaid in the County of Riverside, California, in the ordinary course of business.

XX STATE. I declare under the penalty of perjury under the laws of the State of California that the above is true and correct.

EXECUTED ON September 5, 2013, in the County of Riverside, California.

CODE ENFORCEMENT DEPARTMENT



By: Elizabeth Ross, Code Enforcement Aide

U.S. POSTAL SERVICE
DEPARTMENT OF COMMERCE

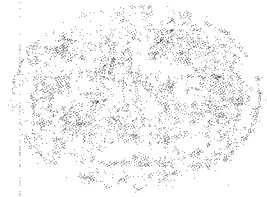

U.S. Postal Service
CERTIFIED MAIL RECEIPT
(Domestic Mail Only. No Insurance Coverage Provided)

For delivery information visit our website at www.usps.com

OFFICIAL USE

Postage \$		Postmark Here
Certified Fee		
Return Receipt Fee (Endorsement Required)		
Restricted Delivery Fee (Endorsement Required)		

BAC Homes Loans Servicing L.P.
7105 Corporate
Plano, TX 75024
Cv12-05595 /458-225

7010 2780 0001 1460 8399

PS Form 3811, August 2004

SENDER: COMPLETE THIS SECTION

- Complete Items 1, 2, and 3. Also complete Item 4 if Restricted Delivery is desired.
- Print your name and address on the reverse so that we can return the card to you.
- Attach this card to the back of the mailpiece, or on the front if space permits.

1. Article Addressed to:

BAC Homes Loans Servicing L.P.
7105 Corporate
Plano, TX 75024
Cv12-05595 /458-225

2. Article Number
(Transfer from service label)

7010 2780 0001 1460 8399

PS Form 3811, February 2004

Domestic Return Receipt

102595-02-M-1540

COMPLETE THIS SECTION ON DELIVERY

A. Signature Agent Addressee
X

B. Received by (Printed Name) C. Date of Delivery

D. Is delivery address different from item 1? Yes No
If YES, enter delivery address below:

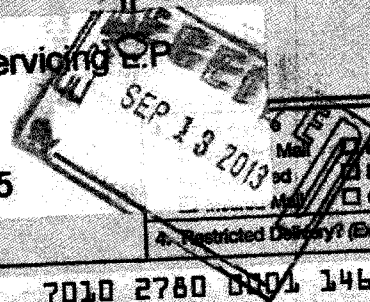

Expenses Mail
Return Receipt for Merchandise
C.O.D.
Restricted Delivery? (Extra Fee) Yes

COUNTY OF RIVERSIDE
Code Enforcement Dept.
District 3 French Valley Office
37600 Sky Canyon Dr. Ste G #507
Murrieta, CA 92563

PRESORTED
FIRST CLASS

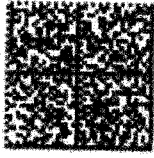

02 1R
0002004339 SEP 10 2013
\$ 00.40⁶
MAILED FROM ZIP CODE 92504

DON KENT
TAX COLLECTOR
P.O. Box 12005
RIVERSIDE, CA 92502-2205

TREASURER-TAX COLLECTOR
DATA / MAILROOM

SEP 11 2013

RECEIVED

HY1-LMB 92502



U.S. Postal Service
CERTIFIED MAIL RECEIPT
 (Domestic Mail Only. No Insurance Coverage Provided)

For delivery information visit our website at www.usps.com
OFFICIAL USE

Postage	\$	Postmark Here
Certified Fee		
Return Receipt Fee (Endorsement Required)		
Restricted Delivery Fee		

BAC HOME LOANS SERVICING
7105 CORPORATE
PLANO, TX 75024
CV12-05595 / 458-225

7009 2250 0001 9041 6824

PS Form 3800, August 2004 See Reverse for Instructions

SENDER, COMPLETE THIS SECTION	COMPLETE THIS SECTION ON DELIVERY
<ul style="list-style-type: none"> Complete items 1, 2, and 3. Also complete item 4 if Restricted Delivery is desired. Print your name and address on the reverse so that we can return the card to you. Attach this card to the back of the mailpiece, or on the front if space permits. 	<p>A. Signature <input type="checkbox"/> Agent <input checked="" type="checkbox"/> Bank of America Home Loans <input checked="" type="checkbox"/> Plano Mail Center <input type="checkbox"/> Addressed</p> <p>B. Received by (Printed Name) <input type="checkbox"/> C. Date of Delivery</p> <p><input type="checkbox"/> No delivery address different from item 17 <input type="checkbox"/> Yes <input checked="" type="checkbox"/> Yes <input type="checkbox"/> No Enter delivery address below:</p>
<p>1. Article Addressed to:</p> <p>BAC HOME LOANS SERVICING 7105 CORPORATE PLANO, TX 75024 CV12-05595 / 458-225</p>	<p><input type="checkbox"/> Mail <input type="checkbox"/> Express Mail <input type="checkbox"/> Registered Mail <input type="checkbox"/> Return Receipt for Merchandise <input type="checkbox"/> Insured Mail <input type="checkbox"/> C.O.D.</p>
<p>2. Article Number (Transfer from service label)</p>	<p>4. Restricted Delivery? (Extra Fee) <input type="checkbox"/> Yes</p>
<p>7009 2250 0001 9041 6824</p>	
<p>PS Form 3811, February 2004 Domestic Return Receipt 102595-02-M-1540</p>	

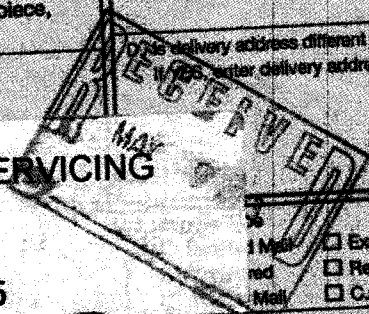

U.S. POSTAL SERVICE
CERTIFIED MAIL

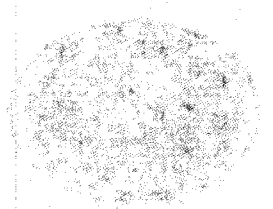

7010 2780 0001 1460 8405

U.S. Postal Service
CERTIFIED MAIL RECEIPT
(Domestic Mail Only; No Insurance Coverage Provided)

For delivery information visit our website at www.usps.com

OFFICIAL USE

Postage	\$	Postmark Here
Certified Fee		
Return Receipt Fee (Endorsement Required)		
Restricted Delivery Fee (Endorsement Required)		

Eastern Municipal Water District Attn: Debra Deremiah
P.O. Box 8300
Perris, CA 92572-8300
CV12-05595 / 458-225

PS Form 3811, February 2004

SENDER: COMPLETE THIS SECTION		COMPLETE THIS SECTION	
<ul style="list-style-type: none"> Complete items 1, 2, and 3. Also complete item 4 if Restricted Delivery is desired. Print your name and address on the reverse so that we can return the card to you. Attach this card to the back of the mailpiece, or on the front if space permits. 		<p>A. Signature <i>Debra Deremiah</i> <input type="checkbox"/> Agent <input type="checkbox"/> Addressee</p> <p>B. Received by (Printed Name) <i>Sandra B...</i></p> <p>C. Date of Delivery <i>9/9</i></p> <p>D. Is delivery address different from item 1? <input type="checkbox"/> Yes <input type="checkbox"/> No If YES, enter delivery address below:</p>	
<p>1. Article Addressed to:</p> <p>Eastern Municipal Water District Attn: Debra Deremiah P.O. Box 8300 Perris, CA 92572-8300 CV12-05595 / 458-225</p>		<p>3. <input type="checkbox"/> Express Mail <input type="checkbox"/> Return Receipt for Merchandise <input type="checkbox"/> C.O.D.</p>	
<p>2. Article Number (Transfer from service label)</p> <p>7010 2780 0001 1460 8405</p>		<p>4. Restricted Delivery? (Extra Fee) <input type="checkbox"/> Yes</p>	
PS Form 3811, February 2004		Domestic Return Receipt	



U.S. Postal Service
CERTIFIED MAIL RECEIPT

(Domestic Mail Only. No Insurance Coverage Provided)

For delivery information visit our website at www.usps.com.

7010 2780 0001 1460 8436

OFFICIAL USE

Postage \$		Postmark Here
Certified Fee		
Return Receipt Fee (Endorsement Required)		
Restricted Delivery Fee (Endorsement Required)		

**DON KENT
 TAX COLLECTOR
 P.O. Box 12005
 RIVERSIDE, CA 92502-2205
 CV12-05595 / 458-225**

PS Form 3811, August 2002

SENDER: COMPLETE THIS SECTION

- Complete items 1, 2, and 3. Also complete item 4 if Restricted Delivery is desired.
- Print your name and address on the reverse so that we can return the card to you.
- Attach this card to the back of the mailpiece, or on the front if space permits.

1. Article Addressed to:

**DON KENT
 TAX COLLECTOR
 P.O. Box 12005
 RIVERSIDE, CA 92502-2205
 CV12-05595 / 458-225**

COMPLETE THIS SECTION ON DELIVERY

A. Signature *D. Johnson* Agent Addressed

B. Received by (Printed Name) **D. Johnson** C. Date of Delivery **SEP 13 2013**

D. Is delivery address different from item 1? Yes No
 If YES, enter delivery address below:

BY **SEP 20 2013**

Mail Registered Mail Signature Required Return Receipt for Merchandise C.O.D.

4. Restricted Delivery (Extra Fee) Yes

2. Article Number (Transfer from service label) **7010 2780 0001 1460 8436**

EXHIBIT “F”

When recorded please mail to:
Riverside County Code Enforcement Department
(District 3 French Valley Office)
37600 Sky Canyon Dr. Ste G #507, Murrieta, CA 92563
Mail Stop No. 5155

DOC # 2012-0586882

12/04/2012 09:38A Fee:NC

Page 1 of 1

Recorded in Official Records

County of Riverside

Larry W. Ward

Assessor, County Clerk & Recorder



NOTICE OF PENDENCY OF ADMINISTRATIVE PROCEEDINGS

In the matter of the public nuisance or other code violation(s) on Property of)

Case No.: CV12-05595

BAC HOME LOANS SERVICING)

And DOES I through X, owners

NOTICE IS HEREBY GIVEN to all persons, pursuant to Section 14 of Ordinance Number 725 of the County of Riverside, State of California, that administrative proceedings have been commenced with respect to the structure or land located upon the following described real property in the County of Riverside:

ADDRESS: 33649 EL CENTRO AVENUE,HEMET, CA 92545

PARCEL #: 458-225-005

LEGAL DESCRIPTION: 0.37 Acres, LOT 11 BLK C MB 014/001 VALLEY VISTA AC

VIOLATIONS: RCO 541-RCC Title 8.120.010- Accumulated Rubbish

that such proceedings are based upon the noncompliance of such structure or land with the requirements of Ordinances /(Riverside County Codes) listed above that every owner of said real property waives his right to hearing on such proceedings unless he makes a proper request in the form and within the time prescribed by the Code cited; and that failure to comply with the lawful orders of the Code Enforcement Director and/or authorized agents of the County of Riverside heretofore and hereafter issued relative to the above matter may result in demolition of the offending structure, abatement of the public nuisance or other available legal remedies and assessment of the costs, expenses, and administrative costs thereof to the property heretofore described as a tax and special assessment lien on such property; that any purchaser, his heirs, or assigns acquiring said property subsequent to the recording of the Notice with the County Recorder shall have such interest subject and subordinate to said tax and assessment lien.

Notice is Further Given in accordance with §17274 and §24436.5 of the California Revenue and Taxation Code, that a tax deduction may not be allowed for interest, taxes, depreciation or amortization paid or incurred in the taxable year affected by these proceedings.

COUNTY OF RIVERSIDE
DEPARTMENT OF CODE ENFORCEMENT

Date: November 20, 2012

By: 
Brian Black, Code Enforcement Department

ACKNOWLEDGEMENT

State of California)
County of Riverside)

On 11/21/2012 before me, Elizabeth B. Ross, Notary Public, personally appeared Brian Black who proved to me on the basis of satisfactory evidence to be the person(s) whose name(s) is/are subscribed to the within instrument and acknowledged to me that he/she/they executed the same in his/her/their authorized capacity(ies), and that by his/her/their signature(s) on the instrument the person(s), or the entity upon behalf of which the person(s) acted, executed the instrument.

I certify under PENALTY OF PERJURY under the laws of the State of California that the foregoing paragraph is true and correct.

WITNESS my hand and official seal.

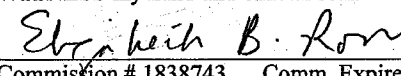
Commission # 1838743 Comm. Expires March 12, 2013

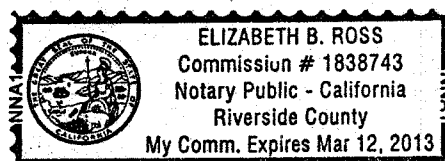

EXHIBIT “G”



**CODE ENFORCEMENT DEPARTMENT
COUNTY OF RIVERSIDE**

Greg Flannery
Interim Code
Enforcement Official

November 1, 2013

**NOTICE TO CORRECT COUNTY ORDINANCE VIOLATIONS AND ABATE
PUBLIC NUISANCE**

TO: Owners and Interested Parties
(See Attached Proof of Service
and Responsible Parties List)

Case Nos.: CV12-05595
APN: 458-225-005
Property: 33649 EL CENTRO, HEMET

NOTICE IS HEREBY GIVEN that a hearing will be held before the Riverside County Board of Supervisors pursuant to Riverside County Ordinance Nos. 541 and 725 to consider the abatement of the accumulated rubbish located on the SUBJECT PROPERTY described as 33649 E L CENTRO, HEMET, Riverside County, California, and more particularly described as Assessor's Parcel Number 458-225-005.

YOU ARE HEREBY DIRECTED as owner of the SUBJECT PROPERTY, to appear at this hearing to show cause why the SUBJECT PROPERTY should not be condemned as a public nuisance and be abated by removing the violation from the real property.

SAID HEARING will be held on **Tuesday, December 3, 2013, at 9:30 a.m.** in the Board of Supervisors Room, County Administrative Center, 4080 Lemon Street, 1st Floor Annex, Riverside, California at which time and place pertinent evidence will be received and/or testimony from all concerned parties will be heard. Failure to appear on your behalf will result in the exclusion of your testimony, and facts as known to the Code Enforcement Department ("Department") will be presented to the Board of Supervisors for consideration and deliberation in this matter.

Please be advised that the costs already accrued in this case, including but not limited to, enforcement and investigation costs, are recoverable by the Department, as allowed under Riverside County Ordinance No. 725. The Department may seek recovery of such costs from the property owner(s) which may result in a special assessment lien against the SUBJECT PROPERTY. Additionally, should the Department abate the property, the costs associated therewith, as well as all abatement costs allowed under Riverside County Ordinance No. 725, will be sought from the property owner(s) and/or may result in a special assessment lien against the property.

We encourage you to contact Code Enforcement at (951) 955-2004 upon receipt of this Notice to discuss the case and attempt to reach a resolution prior to the hearing. If you plan to attend the hearing, please check-in with Code Enforcement staff at 8:30 a.m. on the day of the hearing in the lobby of the first floor annex in front of the Clerk of the Board's Office.

GREG FLANNERY
INTERIM CODE ENFORCEMENT OFFICIAL



MARY OVERHOLT
Supervising Code Enforcement Officer

NOTICE LIST

Subject Property: 33649 El Centro, Hemet; Case No.: CV12-05595
APN: 458-225-005; District 3/3 BAC

BAC HOME LOANS SERVICING, L.P.
7105 CORPORATE
PLANO, TX 75024

WARREN W AND MARTHA L MARKEL
33649 EI CENTRO AVE.
HEMET, CA 92545

NDEX WEST, LLC
15000 SURVEYOR BLVD, SUITE 500
ADDISON, TEXAS 75001-9013

PROOF OF SERVICE

Case No. CV12-05595

1
2
3
4
5
6
7
8
9
10
11
12
13
14
15
16
17
18
19
20
21
22
23
24
25
26
27
28

STATE OF CALIFORNIA, COUNTY OF RIVERSIDE

I, Stacy Baumgartner, the undersigned, declare that I am a citizen of the United States and am employed in the County of Riverside, over the age of 18 years and not a party to the within action or proceeding; that my business address is 4080 Lemon Street, 12th Floor, Riverside, California 92501.

That on November 1, 2013, I served the following document(s):

- **NOTICE TO CORRECT COUNTY ORDINANCE VIOLATIONS AND ABATE PUBLIC NUISANCE**
- **NOTICE LIST**

by placing a true copy thereof enclosed in a sealed envelope(s) addressed as follows:

**OWNERS OR INTERESTED PARTIES
(SEE ATTACHED NOTICE LIST)**

XX **BY FIRST CLASS MAIL.** I am "readily familiar" with the office's practice of collection and processing correspondence for mailing. Under that practice it would be deposited with the U.S. Postal Service on that same day with postage thereon fully prepaid at Riverside, California, in the ordinary course of business.

— **BY PERSONAL SERVICE:** I caused to be delivered such envelope(s) by hand to the offices of the addressee(s).

XX **STATE - I declare under penalty of perjury under the laws of the State of California that the above is true and correct.**

— **FEDERAL - I declare that I am employed in the office of a member of the bar of this court at whose direction the service was made.**

EXECUTED ON November 01, 2013, at Riverside, California.

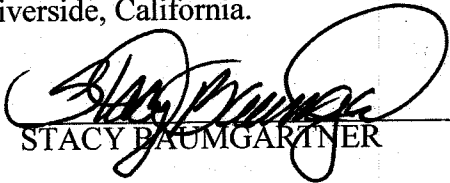
STACY BAUMGARTNER



**CODE ENFORCEMENT DEPARTMENT
COUNTY OF RIVERSIDE**

AFFIDAVIT OF POSTING OF NOTICES

November 5, 2013

RE CASE NO: CV1205595

I, Samantha Phillips, hereby declare:

I am employed by the Riverside County Code Enforcement Department; that my business address is:
37600 Sky Canyon Drive, Suite G
Murrieta, California 92563
Mail Stop #5155.

That on 11/05/2013 at 9:44AM, I securely and conspicuously posted NOTICE TO CORRECT COUNTY ORDINANCE VIOLATIONS AND ABATE PUBLIC NUISANCE at the property described as:

Property Address: 33649 EL CENTRO AVE, HEMET

Assessor's Parcel Number: 458-225-005

I declare under the penalty of perjury that the foregoing is true and correct.

Executed on November 5, 2013 in the County of Riverside, California.

CODE ENFORCEMENT DEPARTMENT

By: Samantha Phillips, Code Enforcement Officer