

726 A

**SUBMITTAL TO THE BOARD OF SUPERVISORS
COUNTY OF RIVERSIDE, STATE OF CALIFORNIA**



FROM: TLMA – Transportation Department

SUBMITTAL DATE:
December 5, 2013

SUBJECT: Notice of Completion – Pedestrian Sidewalk Construction and Associated Improvements, Krameria Avenue in the Woodcrest Area and Jurupa Road in the City of Jurupa Valley, 1st/1st & 2nd/2nd District [\$544,783]; State Funds 43%, Local Funds 57%

RECOMMENDED MOTION: That the Board of Supervisors execute and file the attached "Notice of Completion."

BACKGROUND:

Summary

By Minute Order 3-67 of June 5, 2012, the Board of Supervisors (Board) entered into a contract with Mamco, Inc. of Riverside, CA for the construction of a pedestrian sidewalk and associated improvements on Krameria Avenue in the Woodcrest area and Jurupa Road in the City of Jurupa Valley.

Patricia Romo
Assistant Director of Transportation

Juan C. Perez
Director of Transportation and Land Management

Departmental Concurrence

FINANCIAL DATA	Current Fiscal Year:	Next Fiscal Year:	Total Cost:	Ongoing Cost:	POLICY/CONSENT (Per Exec. Office)
COST	\$ 0.00	\$ 0.00	\$ 544,783	\$ 0.00	Consent <input type="checkbox"/> Policy <input type="checkbox"/>
NET COUNTY COST	\$ 0.00	\$ 0.00	\$ 0.00	\$ 0.00	
SOURCE OF FUNDS: SRTS-Sate Route to School (43%), SB 821 Bicycle and Pedestrian Facilities Program (28%), Measure A/Western (27%), Western Municipal Water District (2%). There were no General Funds used in this project.				Budget Adjustment: No	
				For Fiscal Year: 2013/2014	

C.E.O. RECOMMENDATION:

APPROVE

BY:
Tina Granda

County Executive Office Signature

MINUTES OF THE BOARD OF SUPERVISORS

On motion of Supervisor Jeffries, seconded by Supervisor Ashley and duly carried, IT WAS ORDERED that the above matter is approved as recommended.

Ayes: Jeffries, Stone, Benoit and Ashley
Nays: None
Absent: Tavaglione
Date: December 17, 2013
xc: Transp., Recorder

Kecia Harper-Ihem
Clerk of the Board

By:
Deputy

- A-30
- Positions Added
- 4/5 Vote
- Change Order

Prev. Agn. Ref.: 6/5/12, Item 3-67

District: 1/1, 2/2

Agenda Number:

3-58

SUBMITTAL TO THE BOARD OF SUPERVISORS, COUNTY OF RIVERSIDE, STATE OF CALIFORNIA
FORM 11: Notice of Completion – Pedestrian Sidewalk Construction and Associated Improvements, Krameria Avenue in the Woodcrest Area and Jurupa Road in the City of Jurupa Valley, 1st/1st & 2nd/2nd District [\$544,783]; State Funds 43%, Local Funds 57%

DATE: December 5, 2013

PAGE: 2 of 3

BACKGROUND:

Summary (continued)

The originally authorized amount of the contract was \$472,710. There were a total of four contract change orders on the project, totaling \$94,494.48. The total amended contract is \$544,783, which is 15.2% more than the originally authorized amount. The following four items account for approximately sixty percent (60%) of the total increase in cost to the project.

- Removal and replacement of an existing failing retaining wall at 9737 Jurupa Road was required for public safety. The existing wall retaining the fill under the proposed sidewalk failed after the placement and compaction of additional fill dirt material. An additional 175 linear feet of new retaining wall was required to be constructed at one location along the northerly side of Krameria Avenue. This wall was necessary in order to place the proposed sidewalk per plan, since the bottom of the slope would extend beyond the County's right-of-way limits. Finally, a block wall was extended at the northwest corner of Krameria Avenue and Porter Avenue in accordance with the right-of-way agreement.
- Construction of additional concrete and asphalt driveway adjustments throughout the project site were required for a smooth transition to accommodate the new sidewalk and tie into the new roadway grades. Although the planned driveways were designed below maximum grades, modification to the design was necessary, as there was a multiple of vehicle types utilizing the drive approaches and there was a requirement to keep roadway storm run-off within the public right-of-way.
- Relocation of several additional water meters on Krameria Avenue, which were encountered during construction. This change to the contract was fully funded by Western Municipal Water District.
- Regrade aggregate base surfacing and remobilization costs for paving operations caused by a project suspension that accommodated a utility relocation work

This work was completed at the direction of the Transportation Department on August 28, 2012, Work Orders C0-0535 and C1-0432.

Impact on Residents and Businesses

This project provided for new pedestrian accessibility and access along the roadways near two different existing school sites.

SUBMITTAL TO THE BOARD OF SUPERVISORS, COUNTY OF RIVERSIDE, STATE OF CALIFORNIA
FORM 11: Notice of Completion – Pedestrian Sidewalk Construction and Associated Improvements, Krameria Avenue in the Woodcrest Area and Jurupa Road in the City of Jurupa Valley, 1st/1st & 2nd/2nd District [\$544,783]; State Funds 43%, Local Funds 57%

DATE: December 5, 2013

PAGE: 3 of 3

Budget

Original Contract Amount		\$472,710.00
Total Change Orders Authorized	20.0%	\$94,494.48
Estimated Pending Change Orders	0.0%	\$0.00
Amended Contract Amount		\$567,204.48
* Quantity Adjustments	-4.7%	(\$22,421.50)
+ CCO FA Adjustments	0.0%	\$0.00
Total Amended Contract Amount	115.2%	<u>\$544,782.98</u>

Expenditures

Total Progress Payments	\$544,782.98
Estimated Pending Payments	<u>\$0.00</u>
Total Expenditures	<u>\$544,782.98</u>

(Over)/Under Contract Amount \$0.00

+ Change Orders using the Force Account method of payment issued prior to the work being completed generally do not use the total authorized amount.

* CAL-Trans Standard Specifications 4-1.03B. Increases or decreases in the quantity of a contract item of work will be determined by comparing the total pay quantity of such item of work with the Engineer's Estimate. If the total pay quantity of any item of work required under the contract varies from the Engineer's Estimate by 25 percent or less, payment will be made for the quantity of work of said item performed at the contract unit price, unless eligible for adjustment pursuant to Section 4-1.03C, "Changes in Character of Work."

Contract History and Price Reasonableness

N/A

ATTACHMENTS:

A. Change Order Report

CHANGE ORDER REPORT
(Construction of Krameria Avenue and Jurupa Road Sidewalk Project)

CCO	CCO	Percent	Description
	Original Contract Amount \$ 472,710.00		
1	\$ 34,605.29	7.3%	Concrete encasement of existing 36" culverts, catch basin modifications, construction of retaining walls at two locations, pedestrian safety for school traffic, and construction of concrete driveways
2	\$ 28,142.25	6.0%	Reconstruct brick planter, additional asphalt paving, asphalt and concrete driveway modifications, and tree removal
3	\$ 9,000.00	1.9%*	Remove and reconstruct sidewalk, relocate existing water meters
4	\$ 22,746.94	4.8%	Compensate contractor for extra work performed due to the delayed completion of utility relocations and other miscellaneous extra work
Change Order Total	\$ 94,494.48	20.0%	
Quantity Adjustments	\$ (22,421.50)	-4.7%	
New Contract Total	\$ 544,782.98		

* Funded by Western Municipal Water District

COUNTY OF RIVERSIDE
DEPARTMENT OF TRANSPORTATION

KRAMERIA AVENUE SIDEWALK PROJECT

GARDNER AVENUE TO GAMBLE AVENUE
FEDERAL AID PROJECT No. (IF APPLICABLE)

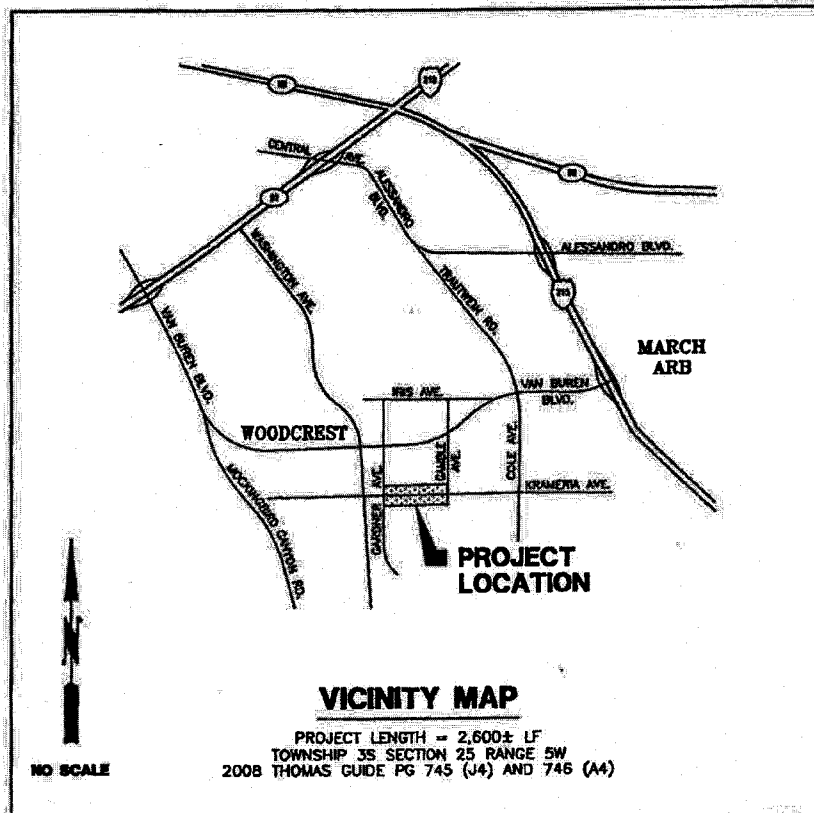
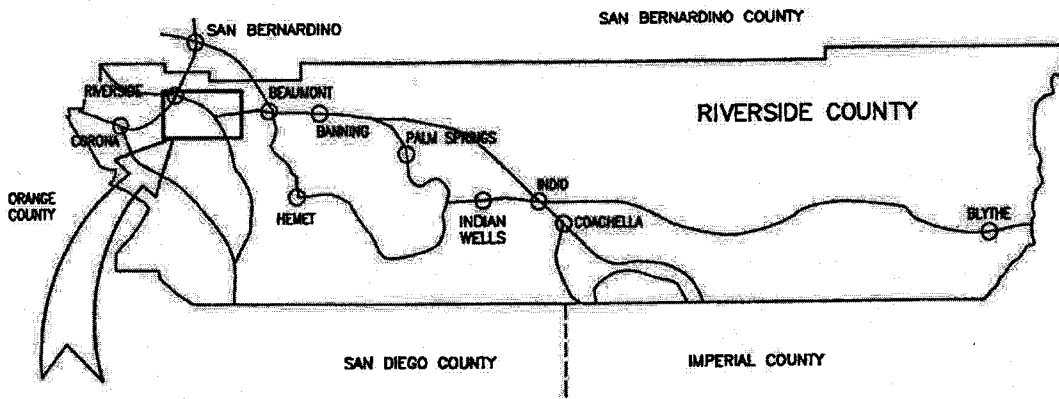

JURUPA RD SIDEWALK PROJECT

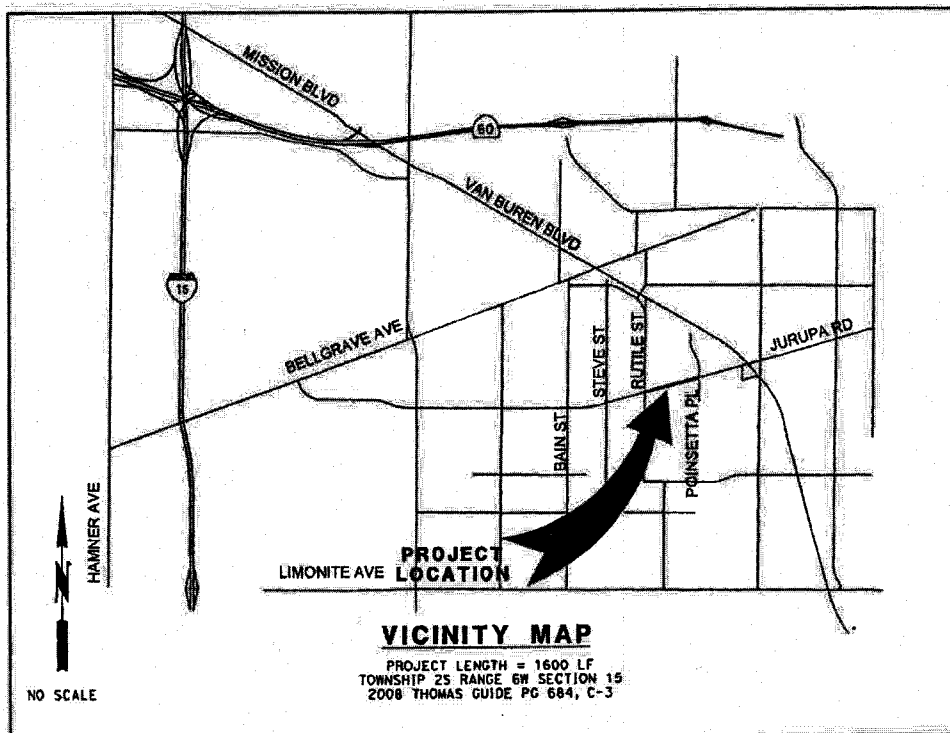
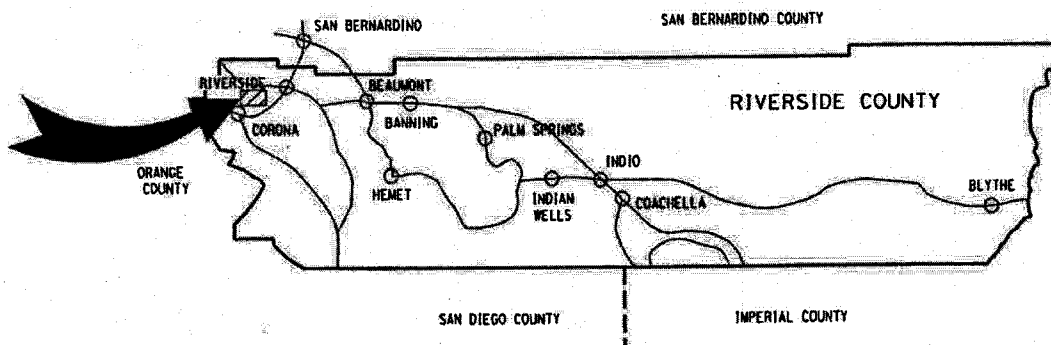

VICINITY MAP
SCALE NONE
EXHIBIT "A"

**JURUPA RD
SIDEWALK PROJECT**

PROJECT: Krameria Avenue Sidewalk & Jurupa Road Sidewalk Project, Woodcrest and Jurupa Valley area
County Project No.: C0-0535 & C1-0432
Contract No.: 12-05-004

Contractor: Mamco, Inc.
Address: 18810 Van Buren Blvd. #200
City, State, Zip: Riverside, 92504

Estimate No. 6 Final
From: April 26, 2013
To: August 26, 2013



Krameria Avenue Sidewalk - C0-0535

ESTIMATE TO DATE: \$378,168.20
LESS RETENTION: 5% 18,908.41
LESS PREVIOUSLY INVOICED: 310,401.85
LESS LABOR NON COMPLIANCE: 0.00
TOTAL DUE THIS PAYMENT: \$48,857.94

Jurupa Road Sidewalk - C1-0432

ESTIMATE TO DATE: \$166,614.78
LESS RETENTION: 5% 8,330.74
LESS PREVIOUSLY INVOICED: 150,221.12
TOTAL DUE THIS PAYMENT: \$8,062.92

TOTAL DUE THIS PAYMENT: \$56,920.86

PROJECT: Krameria Avenue Sidewalk & Jurupa Road Sidewalk Project, Woodcrest and Jurupa Valley area
 County Project No.: C0-0535 & C1-042
 Contract No.: 12-05-004

Contractor: Mamco, Inc.
 Address: 16810 Van Buren Blvd. #200
 City, State, Zip: Riverside, 92504

Estimate No. 6 Final
 From: April 26, 2013
 To: August 25, 2013



Item No.	Item Description	Units	Quantity	Unit Price	Original Contract Amount	Change Authorized Quantity	Change Authorized Amount	Total Authorized Quantity	Total Authorized Amount	This Estimate Quantity	This Estimate Amount	Previous Quantity	Total Estimate To Date Quantity	Total Estimate To Date Amount	% Auth.
1	Krameria Avenue Sidewalk - C0-0535														
1	RELOCATE MAILBOX	EA	11	325.00	3,575.00			11.00	3,575.00			13.00	13.00	4,225.00	118%
2	RELOCATE ROADSIDE SIGN	EA	9	100.00	900.00			9.00	900.00			9.00	9.00	900.00	100%
3	RELOCATE CHAIN LINK FENCE	LF	1,000	12.00	12,000.00			1,000.00	12,000.00			750.00	750.00	9,000.00	75%
4	ROADWAY EXCAVATION	CY	1,400	20.00	28,000.00			1,400.00	28,000.00			1,050.00	1,050.00	21,000.00	75%
5	IMPROVED BORROW & CCO 4	CY	600	10.00	6,000.00	-600.00	-6,000.00								N/A
6	CLASS 2 AGGREGATE BASE	CY	480	35.00	16,800.00			480.00	16,800.00			385.00	385.00	13,475.00	80%
7	HOT MIX ASPHALT & CCO 2	TON	360	89.00	32,040.00	119.00	10,591.00	479.00	42,631.00	29.00	2,581.00	450.00	479.00	42,631.00	100%
8	PLACE ASPHALT CONCRETE (MISC. AREA) & CCO 2	SQYD	50	20.00	1,000.00	93.00	1,860.00	143.00	2,860.00	80.50	1,610.00	62.50	143.00	2,860.00	100%
9	MINOR CONCRETE (CURB & GUTTER)(CRS 200)	LF	1,300	14.00	18,200.00			1,300.00	18,200.00			1,370.00	1,370.00	19,180.00	105%
10	MINOR CONCRETE (DRIVEWAY APPROACH)(CRS 207)	SOFT	4,480	4.00	17,920.00			4,480.00	17,920.00			4,482.50	4,482.50	17,930.00	100%
11	MINOR CONCRETE (CURB RAMP)(CRS 403)	EA	6	1,500.00	9,000.00			6.00	9,000.00			6.00	6.00	9,000.00	100%
12	MINOR CONCRETE (DRIVEWAY) & CCO 2	SOFT	1,300	3.50	4,550.00	2,817.50	9,861.25	4,117.50	14,411.25	2,492.50	8,723.75	1,625.00	4,117.50	14,411.25	100%
13	MINOR CONCRETE SIDEWALK	SOFT	10,000	3.00	30,000.00			10,000.00	30,000.00			10,000.00	10,000.00	30,000.00	100%
14	RETAINING WALL (MASONRY WALL)	LF	100	105.00	10,500.00			100.00	10,500.00			119.00	119.00	12,495.00	119%
15	CHAIN LINK FENCE (TYPE CL-4)	LF	50	30.00	1,500.00			50.00	1,500.00			46.00	46.00	1,380.00	92%
16	THERMOPLASTIC CROSSWALK & PAVEMENT MARKING	SOFT	1,000	4.00	4,000.00			1,000.00	4,000.00			750.00	750.00	3,000.00	75%
17	PAINT TRAFFIC STRIPE (2 COAT)	LF	3,000	0.60	1,800.00			3,000.00	1,800.00			2,250.00	2,250.00	1,350.00	75%
18	PAVEMENT MARKER (REFLECTIVE)	EA	20	10.00	200.00			20.00	200.00			15.00	15.00	150.00	75%
19	DUST ABATEMENT	LS	1	500.00	500.00			1.00	500.00			1.00	1.00	500.00	100%
20	WATER POLLUTION CONTROL	LS	1	2,500.00	2,500.00			1.00	2,500.00			1.00	1.00	2,500.00	100%
21	DEVELOP WATER SUPPLY	LS	1	1,000.00	1,000.00			1.00	1,000.00			1.00	1.00	1,000.00	100%
22	TRAFFIC CONTROL SYSTEM	LS	1	5,000.00	5,000.00			1.00	5,000.00			1.00	1.00	5,000.00	100%

PROJECT: Krameria Avenue Sidewalk & Jurupa Road Sidewalk Project, Woodcrest and Jurupa Valley area
 County Project No.: CO-0655 & C1-0482
 Contract No.: 12-05-004

Contractor: Mamco, Inc.
 Address: 16810 Van Buren Blvd. #200
 City, State, Zip: Riverside, 92504

Estimate No. 6 Final
 From: April 26, 2013
 To: August 26, 2013



Item No.	Item Description	Units	Quantity	Unit Price	Original Contract Amount	Change Authorized Quantity	Change Authorized Amount	Total Authorized		This Estimate Quantity	This Estimate Amount	Previous Quantity	Total Estimate To Date		% Auth.
								Quantity	Amount				Quantity	Amount	
23	CLEARING AND GRUBBING	LS	1	20,000.00	20,000.00			1.00	20,000.00	1.00	20,000.00	1.00	20,000.00	100%	
24	RECONSTRUCT IRRIGATION SYSTEM	LS	1	5,000.00	5,000.00			1.00	5,000.00	1.00	5,000.00	1.00	5,000.00	100%	
25	REMOVE TREE & CCO 2	EA	10	750.00	7,500.00	3.00	2,250.00	13.00	9,750.00	0.50	375.00	12.50	9,750.00	100%	
26	RELOCATE SLIDING/ROLLING GATE	EA	2	750.00	1,500.00			2.00	1,500.00			2.00	1,500.00	100%	
27	RELOCATE GATE	EA	6	500.00	3,000.00			6.00	3,000.00			6.00	3,000.00	100%	
28	RECONSTRUCT WOOD FENCE	LF	90	45.00	4,050.00			90.00	4,050.00			78.00	3,510.00	87%	
29	REMOVE AND RECONSTRUCT EXISTING BLOCK WALL FENCE	LS	70	125.00	8,750.00			70.00	8,750.00			81.00	10,125.00	116%	
30	PLACE ASPHALT CONCRETE (MISC. AREA)	LF	340	5.00	1,700.00			340.00	1,700.00			255.00	1,275.00	75%	
31	PLACE ASPHALT CONCRETE (MISC. AREA)	LF	440	5.00	2,200.00			440.00	2,200.00			330.00	1,650.00	75%	
32	MINOR CONCRETE (CRUB AND GUTTER)(CRS 201)	LF	1,400	15.00	21,000.00			1,400.00	21,000.00			1,415.00	21,225.00	101%	
33	CLASS 2 AGGREGATE RETAINING WALL	CY	25	450.00	11,250.00			25.00	11,250.00			25.00	11,250.00	100%	
34	MASONRY BLOCK WALL	SQFT	50	100.00	5,000.00			50.00	5,000.00			62.50	6,250.00	125%	
35	CABLE RAILING	LF	125	70.00	8,750.00			125.00	8,750.00			134.00	9,380.00	107%	
36	UNDER SIDEWALK DRAIN CAST IN PLACE (CRS 309)	EA	1	1,500.00	1,500.00			1.00	1,500.00			1.00	1,500.00	100%	
37	CATCH BASIN (CURB INLET)(CRS 300)	EA	1	4,500.00	4,500.00			1.00	4,500.00			1.00	4,500.00	100%	
38	36" CORRUGATED STEEL PIPE INLET (0.079" THICK) & CCO 4	LF	30	150.00	4,500.00	-30.00	-4,500.00	12.00	1,200.00			9.00	900.00	75%	
39	OBJECT MARKER (TYPE L-1)	EA	12	100.00	1,200.00			11.00	2,200.00			6.00	1,200.00	55%	
40	ADJUST WATER METER BOX TO GRADE	EA	11	200.00	2,200.00			8.00	12,000.00	4.25	6,375.00	3.75	12,000.00	100%	
41	RELOCATE WATER METER & CCO 3	EA	3	1,500.00	4,500.00	5.00	7,500.00	2.00	6,000.00			2.00	6,000.00	100%	
42	RELOCATE HYDRANT	EA	2	3,000.00	6,000.00			1.00	4,401.29			1.00	4,401.29	100%	
CCO 1	VARIOUS EXTRA WORK	AP	0	4,401.29	0.00			1.00	1,300.00	1.00	1,300.00	1.00	1,300.00	100%	
CCO 2	RECONSTRUCT EXISTING BRICK PLANTER	AP	0	1,300.00	0.00			1.00	1,500.00	1.00	1,500.00	1.00	1,500.00	100%	
CCO 3	REMOVE AND RECONSTRUCT SIDEWALK	AP	0	1,500.00	0.00			1.00	28,964.66	1.00	28,964.66	1.00	28,964.66	100%	
CCO 4	POLE RELOCATIONS & PROPERTY OWNER RESOLUTIONS	AP	0	28,964.66	0.00			1.00	28,964.66	1.00	28,964.66	1.00	28,964.66	100%	

PROJECT: Kramenia Avenue Sidewalk & Jurupa Road Sidewalk Project, Woodcrest and Jurupa Valley area
 County Project No.: C0-0635 & C1-4432
 Contract No.: 12-05-004

Contractor: Mamco, Inc.
 Address: 16810 Van Buren Blvd. #200
 City, State, Zip: Riverside, 92504



Estimate No. 6 Final
 From: April 26, 2013
 To: August 26, 2013

Item No.	Item Description	Units	Quantity	Unit Price	Original Contract Amount	Change Authorized		Total Authorized		This Estimate		Previous		Total Estimate To Date		% Auth.
						Quantity	Amount	Quantity	Amount	Quantity	Amount	Quantity	Amount	Quantity	Amount	
Jurupa Road Sidewalk - C1-4432																
43	RELOCATE MAILBOX	EA	18	350.00	6,300.00		18.00	6,300.00	18.00	18.00	18.00	18.00	6,300.00	100%		
44	RELOCATE ROADSIDE SIGN	EA	9	125.00	1,125.00		9.00	1,125.00	9.00	7.00	7.00	7.00	875.00	78%		
45	RELOCATE CHAIN LINK FENCE	LF	250	15.00	3,750.00		250.00	3,750.00	216.00	216.00	216.00	216.00	3,240.00	86%		
46	ROADWAY EXCAVATION	CY	300	30.00	9,000.00		300.00	9,000.00	225.00	225.00	225.00	225.00	6,750.00	75%		
47	IMPROVED BORROW	CY	200	10.00	2,000.00		200.00	2,000.00	150.00	150.00	150.00	150.00	1,500.00	75%		
48	CLASS 2 AGGREGATE BASE	CY	150	40.00	6,000.00		150.00	6,000.00	45.00	45.00	45.00	45.00	1,800.00	30%		
49	HOT MIX ASPHALT & CCO 2	TON	20	95.00	1,900.00	2,280.00	24.00	4,180.00	44.00	19.00	25.00	44.00	4,180.00	100%		
50	PLACE ASPHALT CONCRETE (MISC. AREA)	SQYD	200	35.00	7,000.00		200.00	7,000.00	150.00	150.00	150.00	150.00	5,250.00	75%		
51	MINOR CONCRETE (CRUB AND GUTTER)(CRS 200)	EA	700	16.00	11,200.00		700.00	11,200.00	783.00	783.00	783.00	783.00	12,528.00	112%		
52	MINOR CONCRETE (DRIVEWAY APPROACH)(CRS 207)	SQFT	4,400	4.00	17,600.00		4,400.00	17,600.00	4,130.00	4,130.00	4,130.00	4,130.00	16,520.00	94%		
53	MINOR CONCRETE (CURB RAMP)(CRS 403)	SQFT	3	1,500.00	4,500.00		3.00	4,500.00	3.00	3.00	3.00	3.00	4,500.00	100%		
54	MINOR CONCRETE (DRIVEWAY)	LF	2,700	3.50	9,450.00		2,700.00	9,450.00	2,613.00	2,613.00	2,613.00	2,613.00	9,145.50	97%		
55	MINOR CONCRETE SIDEWALK	LF	5,900	3.00	17,700.00		5,900.00	17,700.00	5,910.00	5,910.00	5,910.00	5,910.00	17,730.00	100%		
56	RETAINING WALL (MASONRY WALL) & CCO 1	SQFT	70	110.00	7,700.00	10,890.00	99.00	18,590.00	169.00	169.00	169.00	169.00	18,590.00	100%		
57	CHAIN LINK FENCE (TYPE CL-4) & CCO 4	LF	90	20.00	1,800.00	2,660.00	133.00	4,460.00	223.00	112.50	112.50	223.00	4,460.00	100%		
58	THERMOPLASTIC CROSSWALK & PAVEMENT MARKING	LF	500	1.20	600.00		500.00	600.00	375.00	375.00	375.00	375.00	450.00	75%		
59	PAINT TRAFFIC STRIPE (2 COAT) & CCO 4	SQFT	1,500	0.50	750.00	-750.00	-1,500.00								N/A	
60	PAVEMENT MARKER (REFLECTIVE) & CCO 4	LF	10	10.00	100.00	-100.00	-10.00								N/A	
61	DUST ABATEMENT	EA	1	500.00	500.00		1.00	500.00	1.00	1.00	1.00	1.00	500.00	100%		
62	WATER POLLUTION CONTROL	LS	1	2,000.00	2,000.00		1.00	2,000.00	1.00	1.00	1.00	1.00	2,000.00	100%		
63	DEVELOP WATER SUPPLY	LS	1	1,000.00	1,000.00		1.00	1,000.00	1.00	1.00	1.00	1.00	1,000.00	100%		
64	TRAFFIC CONTROL SYSTEM	LS	1	3,500.00	3,500.00		1.00	3,500.00	1.00	1.00	1.00	1.00	3,500.00	100%		
65	CLEARING AND GRUBBING	LS	1	7,000.00	7,000.00		1.00	7,000.00	1.00	1.00	1.00	1.00	7,000.00	100%		

PROJECT: Krameria Avenue Sidewalk & Jurupa Road Sidewalk Project, Woodcrest and Jurupa Valley area
 County Project No.: CD-0636 & C1-0432
 Contract No.: 12-05-004

Contractor: Mamco, Inc.
 Address: 16610 Van Buren Blvd. #200
 City, State, Zip: Riverside, 92504

Estimate No. 6 Final
 From: April 26, 2013
 To: August 26, 2013



Item No.	Item Description	Units	Quantity	Unit Price	Original Contract Amount	Change Authorized		Total Authorized		This Estimate		Total Estimate To Date		% Auth.
						Quantity	Amount	Quantity	Amount	Quantity	Amount	Quantity	Amount	
66	RECONSTRUCT IRRIGATION SYSTEM	LS	1	3,500.00	3,500.00			1.00	3,500.00	1.00	1.00	3,500.00	100%	
67	REMOVE TREE	EA	1	1,000.00	1,000.00			1.00	1,000.00	1.00	1.00	1,000.00	100%	
68	RELOCATE SLIDING/ROLLING GATE	EA	11	750.00	8,250.00			11.00	8,250.00	11.00	11.00	8,250.00	100%	
69	MINOR CONCRETE (TYPE D CURB)(CRS 204)	LF	60	20.00	1,200.00			60.00	1,200.00	45.00	45.00	900.00	75%	
70	MINOR CONCRETE (DRIVEWAY & SIDEWALK FOOTING)	LF	400	8.00	3,200.00			400.00	3,200.00	170.00	170.00	1,360.00	43%	
71	MINOR CONCRETE (CONCRETE STEPS) & CCC 4	LS	1	2,000.00	2,000.00	-2,000.00		1.00	0.00	1.00	1.00	19,314.00	N/A	
CCC 1	VARIOUS EXTRA WORK	AP	0	19,314.00	0.00			1.00	19,314.00	1.00	1.00	19,314.00	100%	
CCC 4	VARIOUS EXTRA WORK	AP	0	4,472.28	0.00			1.00	4,472.28	1.00	1.00	4,472.28	100%	

PROJECT: Krameria Avenue Sidewalk & Jurupa Road Sidewalk Project, Woodcrest and Jurupa Valley area
 County Project No.: CO-0535 & C1-0432
 Contract No.: 12-05-004
 Contractor: Mamco, Inc.
 Address: 16810 Van Buren Blvd. #200 Riverside, 92504
 City, State, Zip: Riverside, 92504
 SEP 16 2013
 TLARC Voucher No. 3273423
 Jose Gutierrez (5-3254)
 Estimate No. 6 Final
 From: April 26, 2013
 To: August 25, 2013

Item No.	Item Description	Units	Quantity	Unit Price	Original Contract		Change Authorized		This Estimate		Previous		Total Estimate To Date	% Auth.
					Amount	Quantity	Amount	Quantity	Amount	Quantity	Amount	Quantity		
Project Subtotals														
	Krameria Avenue Sidewalk - CO-0535				331,085.00			57,728.20	388,813.20	51,429.41			378,168.20	
	Jurupa Road Sidewalk - C1-0432				141,625.00		36,766.28	178,391.28	178,391.28	8,487.28			166,614.78	
PROJECT TOTAL					472,710.00		94,494.48	567,204.48	567,204.48	59,916.69			544,782.98	

Made by: Alfredo Martinez
 Checked by: WJ 8-13-13
 OK Const. Supv. [Signature]
 Working Days: 40
 Days Added: 9
 Subtotal: 49
 Days Used: 49
 % Time Elapsed: 100%
 Start Date: 7-2-12
 End Date: 8-28-12
 % \$ Complete: 96%
 Original Contract: \$472,710.00
 Amended Contract: \$567,204.48
 TOTAL VALUE OF WORK TO DATE: 294583 RET.
 LESS RETENTION: 5% 27,239.14
 TOTAL DUE TO DATE: \$517,543.84
 LESS PREVIOUSLY INVOICED: 460,622.98
 LESS LABOR NON COMPLIANCE: 0.00
 TOTAL DUE THIS PAYMENT: \$56,920.86

This Estimate Approved [Signature] Date: 9/12/13 for: Juan C. Perez Director of Transportation and Land Management
 Quantities on This Estimate Approved [Signature] Date: 8/19/13
 J-SETH LINDER P.M.
 Mamco, Inc.

Received by Accounts Payable: _____
 By: _____
 TRANSFISCAL APPROVED
 By: Crystal Potter 5-3461
 SEP 16 2013
 PAYMENT APPROVAL
 Fund 20000
 Dept ID 31305
 Account 527980
 Project ZCO-0535
ZC1-0432 E
 Activity ID Z3500
 Resource Type CNT
 Signature [Signature]
 Date 8/27/13

TLMA
 Approved
 Robert Brooks (5-3243)
 SEP 16 2013

LINE DESC: 04/24-08/25/13 EST 4 FINAL

RECEIVED
 SEP 16 2013
 COUNTY OF RIVERSIDE
 TRANSPORTATION DEPT.
 ACCOUNTING



2013-0584941
12/18/2013 10:27A
2 of 2



LARRY W. WARD
COUNTY OF RIVERSIDE
ASSESSOR-COUNTY CLERK-RECORDER

Recorder
P.O. Box 751
Riverside, CA 92502-0751
(951) 486-7000

<http://riverside.asrcrkrec.com>

CERTIFICATION

Pursuant to the provisions of Government Code 27361.7, I certify under the penalty of perjury that the following is a true copy of illegible wording found in the attached document:

(Print or type the page number(s) and wording below):

CLARIFICATION OF THE SEAL for the Riverside County Board of Supervisors
(embossed on document)

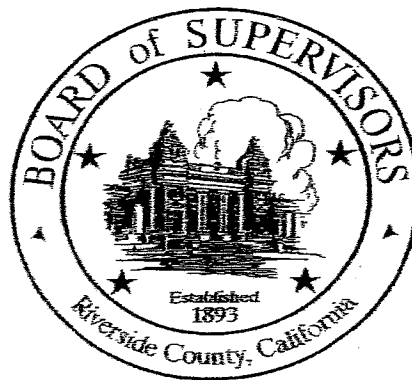

Date:

12/17/13

Signature:

Raquel Rosete

Print Name:

Raquel Rosete, Board Assistant, Riverside County Clerk of the Board