

MINUTES OF THE BOARD OF SUPERVISORS
COUNTY OF RIVERSIDE, STATE OF CALIFORNIA



9-1

9:30 a.m. being the time set for public hearing on the recommendation from Transportation & Land Management Agency/Transportation regarding Public Hearing on the Adoption of Resolution 2014-029, Authorization to Terminate the Maintenance of Skyline Dive from the Corona City limits westerly to the Orange/Riverside Counties boundary line, in the Corona area, 2nd/2nd District, the chairman called the matter for hearing

Patricia Romo, Assistant Director of Transportation, presented the matter.

The following people spoke on the matter:

Mike Harrison	Fred Daniel
Bill Wagner	Scott Crisle
Dane Lesch	Amanda McKitterick
Karalee Watson	Larry Boothe
Chris Alexander	Mark Devoss
Roger Pierce	Steven Christensen
Jennifer Batongbacal	Steve Eastwood
John Simmons	Darrell Vance
Amy Kinne	Allen Beck
Wendy Villegas	Mike Bigelor
Dwight Woodward	Garry Grant
Dana Pierce	

The chairman closed the public hearing.

On motion of Supervisor Tavaglione, seconded by Supervisor Benoit and duly carried, IT WAS ORDERED that the above matter is taken off calendar.

Roll Call:

Ayes: Jeffries, Tavaglione, Benoit and Ashley
Nays: None
Absent: Stone

I hereby certify that the foregoing is a full true, and correct copy of an order made and entered on January 14, 2014 of Supervisors Minutes.

WITNESS my hand and the seal of the Board of Supervisors
Dated: January 14, 2014
Kecia Harper-Ihem, Clerk of the Board of Supervisors, in
and for the County of Riverside, State of California.

(seal)

By:  Deputy

AGENDA NO.

9-1

xc: Transp.

922

**SUBMITTAL TO THE BOARD OF SUPERVISORS
COUNTY OF RIVERSIDE, STATE OF CALIFORNIA**



FROM: TLMA - Transportation Department

SUBMITTAL DATE:
January 2, 2014

SUBJECT: Resolution No. 2014-029, Authorization to Terminate the Maintenance of Skyline Drive from the Corona City Limits Westerly to the Orange-Riverside Counties Boundary Line in the Corona Area; California Environmental Quality Act Exempt. 2nd/2nd District; [-\$10,000, Gas Tax]

RECOMMENDED MOTION: That the Board of Supervisors:

1. Find that this action is categorically exempt from the California Environmental Quality Act (CEQA) pursuant to CEQA Guidelines Section 15301; and
2. Adopt Resolution No. 2014-029, authorization to terminate the maintenance of Skyline Drive from the Corona city limits westerly to the Orange-Riverside Counties boundary line; and
3. Direct the Clerk of the Board to submit the Notice of Exemption to the County Clerk-Recorder for posting upon approval of this action.

Patricia Romo
Assistant Director of Transportation and Land Management

Juan C. Perez
Director of Transportation and Land Management

FORM-APPROVED COUNTY COUNSEL
BY: *Synthia M. Gunzel*
DATE: 1-13-14
Departmental Concurrence
DATE: _____
SYNTHIA M. GUNZEL

FINANCIAL DATA	Current Fiscal Year:	Next Fiscal Year:	Total Cost:	Ongoing Cost:	POLICY/CONSENT (Per Exec. Office)
COST	\$ -5,000	\$ -10,000	\$ N/A	\$ [10,000]	Consent <input type="checkbox"/> Policy
NET COUNTY COST	\$ 0	\$ 0	\$ 0	\$ 0	<input checked="" type="checkbox"/>
SOURCE OF FUNDS: N/A				Budget Adjustment: No	
				For Fiscal Year: N/A	

C.E.O. RECOMMENDATION:

APPROVE

BY:

Tina Grande

County Executive Office Signature

MINUTES OF THE BOARD OF SUPERVISORS

- A-30
- 4/5 Vote
- Positions Added
- Change Order

Prev. Agn. Ref: 11/26/13, Item 3-48

District: 2/2

Agenda Number

9-1

SUBMITTAL TO THE BOARD OF SUPERVISORS, COUNTY OF RIVERSIDE, STATE OF CALIFORNIA

FORM 11: Resolution No. 2014-029, Authorization to Terminate the Maintenance of Skyline Drive from the Corona City Limits Westerly to the Orange-Riverside Counties Boundary Line in the Corona Area; California Environmental Quality Act Exempt. 2nd/2nd District; [-\$10,000, Gas Tax]

DATE: January 2, 2014

PAGE: 2 of 3

BACKGROUND:

Summary

The Transportation Department is recommending that maintenance be terminated on Skyline Drive from the Orange-Riverside Counties boundary line to the city limits of the City of Corona, approximately 24,710 feet, or 4.68 miles in length. Skyline Drive is an isolated road that is not contiguous to any county maintained road, and is not a commuter thoroughfare. Skyline Drive is a narrow, circuitous dirt road with many blind curves and steep up and down segments that are difficult to navigate by conventional motor vehicles. The road does not provide primary access to any occupied properties, and traffic on the road is intermittent and of low volume and is controlled by a gate. The Transportation Department finds Skyline Drive unnecessary for the public convenience as a transportation route and requests that maintenance be terminated.

There is a trailhead approximately one mile from the gate. Past that point, the road essentially functions as roughly a four-mile-long cul-de-sac, providing access to cell tower installations in Orange County and as a trail for hikers and bicyclists on U.S. Forest Service land. It is the Transportation Department's opinion that the responsibility of future maintenance of Skyline Drive should fall to the U.S. Forest Service to operate the road as they deem appropriate.

An unsigned copy of an agreement dated December 13, 1926, by and between the Board of Supervisors (Board) of Riverside County (County), California, and the District Forester, Forest Service, (District 5), United States Department of Agriculture, under and pursuant to the provisions of Section 23 of the Act of November 9, 1921 (Public No. 87), known as the Federal Highway Act, purportedly covered the construction of a road, referenced as Corona-Black Star Canyon Road, from the east forest boundary to the County's west boundary line, and the County agreed to assume maintenance of the constructed road commencing January 1, 1928. This 1926 Agreement did not contain a term period.

On February 24, 1948, the Board approved a resolution that adopted a primary system of County Roads of the County of Riverside and a map that established the Maintained County Road System (the "1948 Road Book"). Skyline Drive was included within the 1948 Road Book under the designation of "other county maintained roads."

On December 12, 1978, the County and the U.S. Forest Service entered into that certain Forest Development Road Cooperative Agreement, whereby the parties agreed to work cooperatively to develop and maintain forest roads, subject to the availability of funds, and identified Skyline Drive as Forest Road No. 4S01. The U.S. Forest Service has communicated to the Transportation Department a desire for a forest road to provide access to the Cleveland National Forest and to serve a federal interest. This 1978 Agreement could be terminated by either party upon 90 days advance notice. Notwithstanding these agreements with the U.S. Forest Service, the County had always maintained its discretionary powers to supervise, manage, and control any of its rights-of-way under the law.

In 1982, Orange County closed the portion of Skyline Drive within its jurisdiction, named "Black Star Canyon Road," with a locked gate and barricade after repeated concerns for public safety, high fire hazards, and road failures due to storm damage. On May 27, 1987, the Orange County Board of Supervisors terminated maintenance of Black Star Canyon Road by Resolution No. 87-732.

On February 25, 1986, the Board adopted Resolution No. 86-04, which restricted the use of Skyline Drive from the Orange-Riverside Counties boundary line to the city limits of the City of Corona. The Board determined that it was necessary for the safety of the traveling public to close and restrict the use of Skyline Drive. According to the Resolution, tragic accidents resulting in fatal and seriously disabling injuries were occurring on a regular and chronic basis to vehicle users of Skyline Drive prior to that time. Attempts to post Skyline Drive

SUBMITTAL TO THE BOARD OF SUPERVISORS, COUNTY OF RIVERSIDE, STATE OF CALIFORNIA

FORM 11: Resolution No. 2014-029, Authorization to Terminate the Maintenance of Skyline Drive from the Corona City Limits Westerly to the Orange-Riverside Counties Boundary Line in the Corona Area; California Environmental Quality Act Exempt. 2nd/2nd District; [-\$10,000, Gas Tax]

DATE: January 2, 2014

PAGE: 3 of 3

with signs and devices warning of the dangers were unsuccessful, as they were being vandalized due to destruction and theft, and funding was not available to substantially improve the road. A gate with a locking mechanism was placed at the southwest boundary of the City of Corona city limits to restrict use of the road to those with a pass key. Pass keys were issued to police, fire, emergency, public utilities, governmental agencies, persons owning or leasing property between the gate and the Orange-Riverside Counties boundary line, and those deemed to have an appropriate need as determined by the Road Commissioner (now the Director of Transportation and Land Management).

It has been the Transportation Department's position that the road is not safe for unrestricted public access, and opening it for unrestricted access would create a liability for the County and a situation where vehicles compete with hikers and bicyclists for limited space on a very narrow winding road. Since this road functions as an access road for the U. S. Forest Service's land, it is the Transportation Department's position that the U.S. Forest Service should be responsible for the operations, maintenance, and liability associated with the road, in concert with other users that own parcels accessed by the road.

The Transportation Department staff conducted a review of the above-referenced project and has determined that the termination of maintenance of Skyline Drive is categorically exempt from CEQA pursuant to CEQA Guidelines Section 15301. The proposed project is termination of maintenance of an existing road by the County and such maintenance and management would be conducted by the U.S. Forest Service. Also, there is no expansion of use or alterations, which will occur beyond that existing at the time of this determination.

Impact on Residents and Businesses

The termination of maintenance of Skyline Drive would not impact the ability of citizens or businesses to access the area. Access would be managed by the U.S. Forest Service.

SUPPLEMENTAL:

Additional Fiscal Information

A review of the maintenance cost for the last five years shows that the Transportation Department will see a realized maintenance cost savings for the road and gate of approximately \$10,000 annually.

Contract History and Price Reasonableness

N/A

Attachments

Resolution No. 2014-029

Exhibit A

2
3 **RESOLUTION NO. 2014-029**

4 **AUTHORIZATION TO TERMINATE THE MAINTENANCE OF SKYLINE DRIVE FROM THE**
5 **CITY LIMIT OF CORONA TO THE RIVERSIDE COUNTY LINE**
6 **(Second Supervisorial District)**
7

8 **WHEREAS**, a public hearing after due notice has been held upon a resolution of intention
9 to terminate maintenance of a County road known as Skyline Drive, and all persons having had
10 the opportunity to be heard, and the Board having determined, pursuant to Section 954.5 of the
11 Streets and Highways Code, that continued maintenance of this road is unnecessary to public
12 convenience; now, therefore,

13 **BE IT RESOLVED, DETERMINED, AND ORDERED** that this Board finds:

- 14 1. Skyline Drive is deemed unnecessary for the public convenience because said road
15 does not provide primary access to occupied properties and that traffic on said road is
16 intermittent and of low volume; and
- 17 2. Skyline Drive is a narrow, circuitous dirt road, with numerous blind curves, steep up
18 and down segments, and is difficult to navigate by conventional motor vehicles; and
- 19 3. Skyline Drive is isolated and not contiguous to any county maintained road, and is
20 only accessible through the City of Corona; and
- 21 4. Skyline Drive is not currently a commuter thoroughfare, nor is it projected to be one in
22 the near future; and
- 23 5. That this action is categorically exempt from the California Environmental Quality Act
24 (CEQA) pursuant to CEQA Guidelines Section 15301.

25 **BE IT FURTHER RESOLVED, FOUND, DETERMINED, AND ORDERED** by the Board
26 of Supervisors of the County of Riverside, State of California, in regular session assembled, in
27 the meeting room of this Board at the Administrative Center, 4080 Lemon Street, Riverside,
28 California, at the close of the January 14, 2014, public hearing, that this Board authorizes the

FORM APPROVED COUNTY COUNSEL
BY: *Synthia M. Gunzel* 1-13-14
DATE
SYNTHIA M. GUNZEL

1 termination of the maintenance of Skyline Drive in the County of Riverside, State of California,
2 more particularly described as follows, and said road is hereby deleted from the County's
3 maintained road system:

4 That portion of Skyline Drive in Sections 8, 9 and 10, Township 4 South, Range 7 West,
5 San Bernardino Meridian, and approximately 24,710 feet or 4.68 miles in length.

6 **BE IT FURTHER RESOLVED, DETERMINED, AND ORDERED** that the Director of
7 Transportation for the County of Riverside shall cause all notices required by the Streets and
8 Highways Code Section 954.5 to be posted and maintained for a period of one year.

9 **BE IT FURTHER RESOLVED, DETERMINED, AND ORDERED** that the Clerk of this
10 Board cause a certified copy of this resolution, attested by the Clerk under seal, to be recorded
11 without acknowledgement or further proof, in the Office of the Recorder of Riverside County,
12 California as provided in Section 8325 of the Streets and Highways Code.



N.T.S.
T.4S, R.7W
SECTIONS 8, 9, 10
S.B.M.

EXHIBIT "A"

Termination of Maintenance of Skyline Drive

CITY OF CORONA

SKYLINE DRIVE
See sheet 2 of 2

Section 8

Gate

Section 9

Section 10

Gates

RIVERSIDE COUNTY

BLACK STAR CANYON ROAD

MAIN DIVIDE TRUCK TRAIL

ORANGE COUNTY

Gate

E. SANTIAGO CANYON ROAD

SILVERADO CANYON ROAD



EXHIBIT "A"

Termination of Maintenance of Skyline Drive

N.T.S.
T. 4S, R. 7W
SECTIONS 8, 9 & 10
S.B.M.

CITY OF CORONA

CAPE DR
T. 4S, R. 7W.
3
STONEWALL DR
CHASE DR

Limits of Termination of Maintenance
Approx. 24,710 feet or 4.68 miles

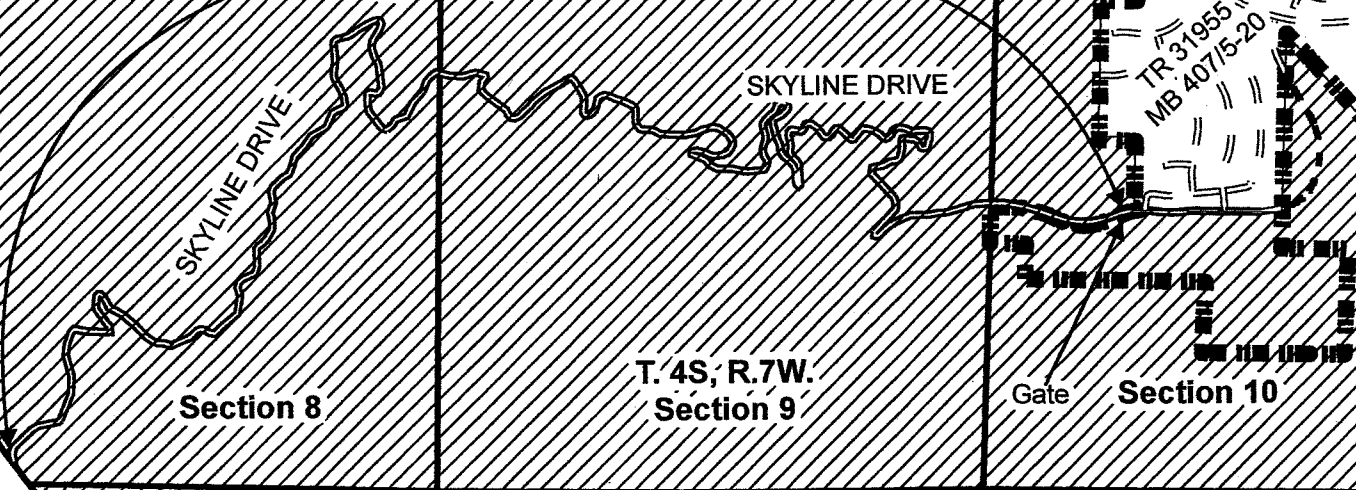

Section 8

T. 4S, R. 7W.
Section 9

Gate

Section 10

CLEVELAND NATIONAL FOREST



Crown Castle
Jonathan Dohm, AICP
510 Castillo Street, Suite 302
Santa Barbara, CA 93101

Tel: 805-957-1629
Fax: 724-416-4739
www.crowncastle.com

January 7, 2014

Mr. John J. Benoit, Chairman
Riverside County Board of Supervisors
County Administration Center
4080 Lemon Street
Riverside, CA 92501

Sent via Overnight Delivery

Re: Resolution No. 2013-250
Authorization to Terminate
Corona City Limits to the
Board of Supervisor's Meeting

9-1 1-14-14
Reso #
2014-029

Dear Chairman Benoit and Members

Recommendation

That the Board of Supervisors, prior to authorizing the termination of the county's maintenance of this portion of Skyline Drive, confirm that the United States Forest Service ("Forest Service") will indeed maintain the subject roadway in a manner that continues to facilitate critically needed vehicular access to users of the wireless communications facilities located on Santiago Peak and the surrounding areas accessed via Skyline Drive.

Skyline Drive provides access to critically needed wireless infrastructure

The 4.68 miles of Skyline Drive, from the city limits of Corona westerly to the area of the county boundary where termination of maintenance is being considered, is the first link in the critically needed vehicular road access to numerous wireless telecommunication tower sites located on Santiago Peak and the surrounding area.

Crown Castle ("Crown") owns and manages two of these telecommunications sites—the "Santiago Peak" site and the "Santa Ana" site. These two telecommunication towers, located in close proximity to one another, provide the wireless infrastructure upon which several dozen wireless tenants are located and broadcast their signals.

Crown's tenants include but are not limited to: one (1) city; three (3) school districts; two (2) major, local television stations; one (1) major cable operator; and, three (3) federal, law enforcement agencies. It is imperative that adequate and reliable vehicular access to these sites, for maintenance and operations, be maintained.

Simply by viewing aerial mapping of the Santiago Peak area, it is apparent that Crown is not the only provider of wireless infrastructure in the surrounding area. There are numerous, other telecommunication

1-14-2014
9-1

2014-1-120936

tower sites scattered all over this area of Santiago Peak and they all rely on the use of Skyline Drive for vehicle access for both routine and emergency service and repairs.

The Board's proposed action does not guarantee ongoing maintenance

The Board report dated December 24, 2013, prepared by the county's Transportation Department, finds "...Skyline Drive unnecessary for the public convenience as a transportation route and requests that maintenance be terminated." Crown disagrees. On the contrary, Crown would argue that ongoing maintenance of Skyline Drive is critical to the public's convenience for the simple reason that vehicular access to the numerous telecommunication towers and the operators they serve cannot be comprised. Failure to assure ongoing safe and reliable vehicular access over and across Skyline Drive to Santiago Peak could potentially threaten public safety due to wireless operator's access to their equipment being compromised.

While the Board report states that the Forest Service has a "desire for a forest road to provide access to the Cleveland National Forest", this desire does not necessarily imply that the Forest Service will adequately maintain this roadway for vehicular use. Further, the Board report states that "the Forest Service should be responsible for the operations, maintenance, and liability associated with the road" and that "...access will be maintained" by the Forest Service, nowhere in the Board report does the Transportation Department confirm that the Forest Service has agreed to this new arrangement and if so, what level of service and maintenance by the Forest Service should be expected.

Summary

Transportation's report to the Board indicates that the county will save \$10,000 annually if the maintenance of Skyline Drive is terminated. This minimal savings, in the context of the potential to threaten vehicular access to critically needed wireless telecommunications infrastructure and equipment, should be an unacceptable risk. This risk can only be mitigated should the Forest Service commit to maintaining this portion of Skyline Drive in a manner that facilitates safe, vehicular access.

The Board should not terminate this roadway's maintenance unless and until the Forest Service makes this commitment in a manner acceptable to the Board.

Should you have any questions or would like further information you may reach me at (805) 957-1629 or at jon.dohm@crowncastle.com. Thank you for the opportunity to comment.

Sincerely,

CROWN CASTLE

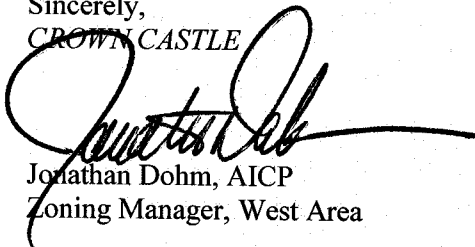

Jonathan Dohm, AICP
Zoning Manager, West Area

Cc: William Heapy, Los Angeles District Manager, Crown Castle
Scott Crisler, Tower Operations Manager, Crown Castle



United States
Department of
Agriculture

Forest
Service

Cleveland National Forest
SO

10845 Rancho Bernardo Rd.
Suite 200
San Diego, CA 92127-2107
(858) 673-6180
(858) 673-6192 FAX
(800) 735-2922 CRS

File Code: 1560/7700

Date: January 8, 2014

Juan Perez
Director of Transportation
County of Riverside
4080 Lemon Street, 8th floor
Riverside, CA 92501

Dear Mr. Perez:

We have received the County's letter dated November 27, 2013 identifying the County's desire to terminate maintenance on Skyline Drive, in Corona, CA. The Cleveland National Forest objects to this proposal.

We clearly stated our objections to this idea in our meeting with the County on June 17, 2013. Additionally, we had previously objected to this idea on August 17, 2009 in our letter to Alejandro Martinez, Senior Engineering Technician. At that time, you sent an e-mail to the Forest Service stating "We certainly are not interested in pursuing an action that would diminish your agency's ability to use the road for access". Terminating maintenance will most certainly diminish our ability to use the road for access and will significantly impair our ability to fulfill our obligations and mission in this geographic area.

The Forest Service and the County of Riverside entered into a Cooperative Agreement in 1926 in order to secure rights-of-way and construct Skyline Road under the Federal Highway Act. Based on the conditions of that agreement, and a subsequent Cooperative Agreement signed in 1979, the County has maintained this road for 85-years, since January 1, 1928. This route crosses parcels of private land as well as National Forest System lands. Skyline Drive provides access for the public to their National Forest. The Forest Service uses Skyline Drive for access to conduct forest health projects, ecosystem protection, recreation management, and hazardous vegetation management activities adjacent to Riverside County's ever growing communities. Critical access for emergency services such as fire suppression and emergency medical response (Riverside County Fire Department) and law enforcement (Riverside County Sheriff) is provided. The road serves utility companies and numerous commercial communications site users, in addition to many governmental and public safety organizations that serve as emergency responders, or provide 911 emergency support. Skyline Drive has also been used by the Riverside County Transportation Commission's Irvine-Corona Expressway geotechnical exploratory drilling consultants.

Skyline Drive's role was critical in the suppression and post fire burned area rehabilitation and resource protection for the Sierra (2006) and Santiago Fires (2007). As further development occurs adjacent to the National Forest wildlands, its role will not diminish, rather it will be of greater importance to facilitate rapid suppression of fires near the wildland urban interface.



Caring for the Land and Serving People

Submitted by

Darrell Vance

Printed on Recycled Paper

1/14/14
(date)

Item 9-1

Rights-of-way

Based on the 1926 Cooperative Agreement, the County is responsible "To secure necessary rights-of-way without expense directly or indirectly to the United States". Additionally the County holds the historic rights-of-way through the private parcels and possibly through the federal parcels. The Forest Service does not have the budget or capacity to take on the maintenance responsibility for Skyline Drive, nor do we have the authority or rights-of-way to take this on.

It is our concern that if the County terminates maintenance, then neither party will be able to spend funds on the road maintenance needs, even to repair watershed and habitat damage. If terminated, Emergency Relief for Federally Owned Roads (ERFO) funding from the Federal Highway Administration will not be available to either party. In the 1979 Cooperative Agreement, the County agreed to clause 1.f. which states "Provide for appropriate jurisdictional status of roads through transfer of easements and acquisition of easements by the appropriate party". This has not occurred. Currently, the County is the only entity with full authority and responsibility to maintain the entire length of this road.

According to the data available, the 2013/2014 County of Riverside budget is \$4.7 billion. Public Ways are funded for \$209.0 million and Transportation for \$171.0 million. The County has estimated their annual maintenance cost of Skyline Drive at approximately \$10,000 per year. This equals 0.00006% of the County's Transportation budget, or 6 thousandths of a percent.

Access and Use

In 1986, through County Board resolution No. 86-04, the County restricted motorized access to Skyline Drive. In 1987, through a recommended motion made by LeRoy Smoot (Road Commissioner and County Surveyor), the Board of Supervisors approved the issuance of both short and long term public use of the road. In particular the County stated in their March 2, 1987 letter that "Road Department keys are also available to the general public by completing a similar form and posting a refundable deposit of \$50.00 for short term use or \$100.00 for long term use".

The letter that we received from the County, dated November 27, 2013 states that "Skyline Drive has limited use due to the installation of a locked gate in 1986 that limits access at the Corona City limits". We believe this to be an inaccurate statement. One of the primary reasons that the County gave for replacing the historic lock on the Skyline gate was that too many people had been issued keys over the past 25-years, and that too many people had access; the number was estimated in the 5,000 - 10,000 key range. This is not commensurate with limited road use. Since the County replaced the old lock on January 2, 2013, and is no longer issuing keys to the general public, use has become limited because of the County's action, which stood directly in opposition to the position and recommendation of the Forest Service.

We urge the County to allow public access for a long enough duration of time so that accurate traffic count data can be gathered to empirically measure road use. Through the Cooperative Agreement of 1979, the County acknowledged that traffic carried by Skyline Drive is County responsibility. This is identified in clause 1.a. which states "Agree that certain roads under the

jurisdiction of the cooperator [County of Riverside] or the Forest Service which serve the National Forest and also carry traffic which is properly the responsibility of the cooperator [County of Riverside] should be maintained and, if necessary, improved, to a standard adequate to accommodate safely and economically all traffic which uses such roads".

Agreement Language

Finally, based on the 1979 cooperative agreement, the County cannot terminate that agreement without making full settlement to the Forest Service. The agreement states in clause 7.b. "This agreement may be terminated by either party upon at least 90-days prior written notice, except that such termination shall in no way affect or change any commitment made authorizing the use of roads or rights-of-way for purposes for which Federal funds were expended, or any operation in progress at time of notice and provided, that such termination shall in no way affect the agreement of the parties hereto with respect to any obligations incurred under the agreement until a full settlement has been made." Clearly if the County abandons this agreement and terminates road maintenance, there will be an effect and a change to the commitment made authorizing the use of roads and rights-of-way for which Federal funds were expended.

Considering that the County was an initiating agency in the original construction of Skyline Road and agreed to the maintenance responsibility; acknowledging that the motorized public has had access to Skyline Drive for 85-years; the fact that a multitude of tax paying businesses and private property owners, government and quasi-government agencies, and emergency communications and response providers depend on this road; and recognizing that Skyline Road provides critical administrative access to the U.S. Forest Service, it is our opinion that it would not be prudent, responsible, or justifiable for the County of Riverside to simply terminate maintenance of this road without having a solid plan for transitioning maintenance to another willing party. We see no benefit to any private property owner, business, government agency, or the public from the County's proposed action.

At this point, it has not been made clear why the County desires to terminate maintenance of this road. We have been given various explanations ranging from liability, to budgetary constraints, to lack of need. The Forest Service would benefit from clearly understanding the reason(s) that the County proposes termination of Skyline Drive's road maintenance responsibilities.

We formally request that the County of Riverside Board of Supervisors rejects the proposal to terminate maintenance of Skyline Drive in order to provide for continued public protection, access and safety of Riverside County communities.

If you have any questions or concerns regarding this letter, please contact Darrell Vance, Trabuco District Ranger at (951) 736-1811, ext. 3236, or Jake Rodriguez, District Recreation and Lands Officer, at (951) 736-1811, ext. 3275.

Sincerely,

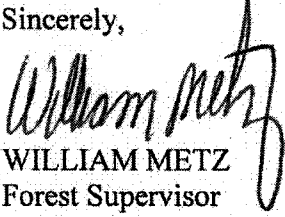
A handwritten signature in black ink that reads "William Metz". The signature is written in a cursive style with a large, sweeping initial "W".

WILLIAM METZ
Forest Supervisor

cc: Darrell W Vance, Jacob F Rodriguez, Noelle Graham, Debra S Hobbs

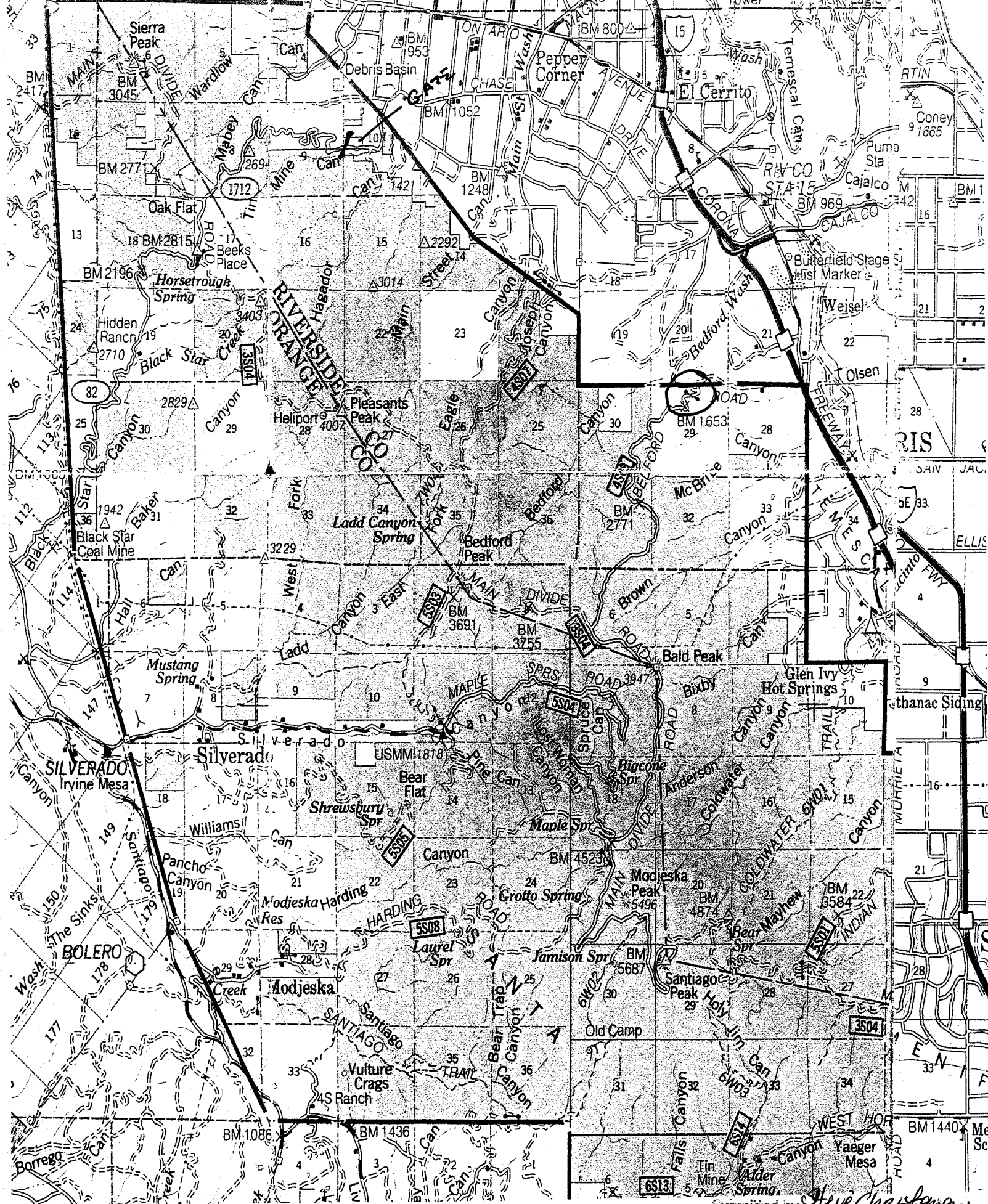

Submitted by Steve Christensen

1/14/14 (date) Item 9-1

January 14, 2014



Chairman Jeff Stone
Riverside County Board of Supervisors
4080 Lemon Street
Riverside, CA 92501

Verizon Wireless
15505 Sand Canyon Ave
Irvine, CA 92618-3114

Phone 949 286-7000

Re: Public Hearing on the Adoption of Resolution 2014-029, Authorization to Terminate the Maintenance of Skyline Drive from the Corona City limits westerly to the Orange-Riverside Counties boundary line

Dear Honorable Chairman and Members of the Board,

Verizon Wireless would like to formally state for the record its position regarding proposed Resolution 2014-029, Authorization to Terminate the Maintenance of Skyline Drive from the Corona City limits westerly to the Orange-Riverside Counties boundary line. As you may know, Verizon Wireless currently holds a twenty year lease with the U.S. Forest Service at our Sierra Peak site in the Cleveland National Forest. Verizon Wireless accesses this site via Skyline Drive and therefore has concerns over proposed termination of maintenance and is hereby requesting that this item be tabled.

After review of the 1997 Lease Agreement between Verizon Wireless and the U.S. Forest Service, the 1978 Cooperative Agreement between the U.S. Forest Service and the County of Riverside, and the 1926 Cooperative Agreement between the U.S. Forest Service and the County of Riverside, Verizon would respectfully request that any immediate termination of maintenance be postponed until a settlement can be reached between the U.S. Forest Service and the County of Riverside. This position was reached based on the following:

- The 1978 Cooperative Agreement between the U.S. Forest Service and the County of Riverside states that "This agreement may be terminated by either party upon at least 90 days prior written notice, except that such termination shall in no way affect or change any commitment made authorizing the use of the roads or rights-of-way for purposes for which federal funds were expended, or any operation in progress at time of notice and provided, that such termination shall in no way affect the agreement of the parties hereto with respect to any obligations incurred under the agreement until a full settlement has been made." The allocation of federal funds for Skyline Drive is documented in both the 1926 and the 1978 agreements.
- Verizon Wireless entered into a Lease Agreement with the U.S. Forest Service in 1997 for the Sierra Peak Site, this agreement was entered into with the understanding that a maintenance agreement was in place for Skyline Drive and access to the site would be granted without additional cost.
- Therefore, it is the position of Verizon Wireless that if termination of maintenance is to occur it must be done via a settlement between the U.S. Forest Service and the County of Riverside and unilateral abandonment maintenance is not acceptable under the current agreement. Verizon Wireless is further of the opinion that input from stakeholders, including telecommunication carriers, should be taken should a settlement discussion take place.

Submitted by Karalee Watson
1/14/14 Item 9-1
(date)

Based on the information provided above, as documented in the 1926 and 1978 Cooperative Agreements, Verizon Wireless would like to encourage the County Board of Supervisors to further investigate this issue and engage the U.S. Forest Service to determine the future maintenance responsibilities for Skyline Drive.

Sincerely,

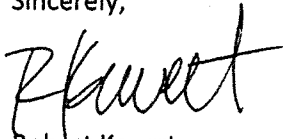
A handwritten signature in black ink, appearing to read "R Kavert". The signature is written in a cursive style with a large initial "R" and a long horizontal stroke extending to the right.

Robert Kavert
Real Estate Manager
Verizon Wireless

To: Riverside Board of Supervisors

From: Larry Boothe
17682 Kennon Drive
Yorba Linda, CA 92886
(714) 996-4104

RE: Resolution 2013-249, Terminating Maintenance of Skyline Drive

My name is Larry D. Boothe. I own 80 acres of which 14.5 acres are in Riverside County at the top of Skyline Drive. I have been going to this area since 1960, some 54 years. As you know there is one way in and one way out because of Orange County reluctance to maintain Black Star Canyon Road. I pay taxes on both gas and property to your County. The maintenance of this road is the only benefit I receive from my taxes and is crucial in getting to my property. As a matter of fact, it is the only way to my property. It is the shortest and best way to access this area of the Santa Ana Mountains. Your road department has done a superb job in grading this road after all, this is a County road. Depending on the rainfall, the County usually blades the road once a year. What is the actual cost of blading Skyline Drive? I believe the person that determined the cost to be \$10,000 a year, is mistaken and that figure is very misleading. I believe a blade and operator costs about \$1,000.00 a day, times 2 days is \$2,000.00, not \$10,000.

The Counties description of the road is very misleading also. I have owned several conventional vehicles that I have used over the years on Skyline Drive. I currently drive a Ford pickup and I pull a 20' Fifth Wheel Flat Bed trailer so to say conventional vehicles couldn't handle this road is totally false.

I understand what the county is trying to do, get rid of liability. Because of a very foolish 16 year old in the 1980s' driving off the road and becoming a paraplegic. Latter his parents sued the county for millions. Since that lawsuit, I haven't heard nor was I ever told of another lawsuit levied against the County regarding Skyline Drive.

It seems the County wants the U. S. Forestry Department to take over the maintenance of Skyline, God forbid. The Main Divide Road is perfect example of the Forestry Road maintenance. It has not been maintained for several years and is in deplorable condition. I don't want this to happen to Skyline.

As far as the Skyline Gate goes leaving it under Forestry control, will result in the gate being left open all the time which same as saying to the vandals, "Welcome back, and do as you wish!" I am sure the homeowners will be just tickled pink when they find out the gate will be opened all the time. I understand the gate has become a real nuisance to the adjacent homeowners. This road was there before this housing track was even a thought. I think their main complaint was about the drunken young people at the gate in the middle of the night, the parking in front of their houses and leaving the gate open which created a vandal fest. All of these issues have been addressed and resolved! The traffic has decreased significantly when you changed the lock on the Gate which in turn has decreased the vandalism.

I was at the first "Town Hall Meeting in the Road" in the 1980's were Mr. Smoot talked about County putting up a gate on Skyline. I am the person that distributes the keys for the Land Owner Lock on the gate. The County of Riverside made us go to the expense of hiring an attorney to draw up a "Key Agreement". Why did you make us go to this expense of making a now worthless agreement, if you always knew you were going to Terminate Maintenance? The key agreement was supposed to protect the County, as well as the landowners. This has become a slap in our faces!

There are some 40 Electronic users on Sierra and Pleasant Peak. I believe your County is one of them and so is The BNSF Railroad, The FAA, The FBI, The Metro Water Dept., LA County Sheriff, Orange County Sheriff, Verizon, A.T.T. and The US Government (Doppler radar) are just a few other users; they all use Skyline Drive. I don't think they will be very happy when they find out about your Resolution!

You're kidding me, after some 87 years, you are wanting to Terminating Maintenance. The County, accepted maintenance of the road in 1926 and it has been on the County Maps since 1948. **I do have one question for you, does this mean you are getting rid of Maintenance on all your County Roads or are we just the lucky ones? What you are doing is just wrong!**

I had a 2100 sq. foot home that I owned up on Skyline. I had to remove the house because of the vandals removing the interior walls allowing the roof to fall in on itself. I ended up taking it off the mountain because it became a safety hazard. **So will Skyline Drive become a safety hazard if you Terminate Maintenance!** I have spent approx. \$35,000.00 repairing the damage done to my property by four wheelers and vandals destroying the house.

Submitted by Larry Boothe
1-14-14 Item 9-1
(date)

**Riverside County Board of Supervisors
Request to Speak**

Submit request to Clerk of Board (right of podium),
Speakers are entitled to three (3) minutes, subject
to Board Rules listed on the reverse side of this form.

SPEAKER'S NAME: AMANDA McKitterick

Address: _____
(only if follow-up mail response requested)

City: _____ **Zip:** _____

Phone #: _____

Date: _____ **Agenda #** 9-1

PLEASE STATE YOUR POSITION BELOW:

Position on "Regular" (non-appealed) Agenda Item:

_____ **Support** **Oppose** _____ **Neutral**

Note: If you are here for an agenda item that is filed
for "Appeal", please state separately your position on
the appeal below:

_____ **Support** **Oppose** _____ **Neutral**

I give my 3 minutes to: _____

BOARD RULES

Requests to Address Board on "Agenda" Items:

You may request to be heard on a published agenda item. Requests to be heard must be submitted to the Clerk of the Board before the scheduled meeting time.

Requests to Address Board on items that are "NOT" on the Agenda:

Notwithstanding any other provisions of these rules, member of the public shall have the right to address the Board during the mid-morning "Oral Communications" segment of the published agenda. Said purpose for address must pertain to issues which are under the direct jurisdiction of the Board of Supervisors. YOUR TIME WILL BE LIMITED TO THREE (3) MINUTES.

Power Point Presentations/Printed Material:

Speakers who intend to conduct a formalized Power Point presentation or provide printed material must notify the Clerk of the Board's Office by 12 noon on the Monday preceding the Tuesday Board meeting, insuring that the Clerk's Office has sufficient copies of all printed materials and at least one (1) copy of the Power Point CD. Copies of printed material given to the Clerk (by Monday noon deadline) will be provided to each Supervisor. If you have the need to use the overhead "Elmo" projector at the Board meeting, please insure your material is clear and with proper contrast, notifying the Clerk well ahead of the meeting, of your intent to use the Elmo.

Individual Speaker Limits:

Individual speakers are limited to a maximum of three (3) minutes. Please step up to the podium when the Chairman calls your name and begin speaking immediately. Pull the microphone to your mouth so that the Board, audience, and audio recording system hear you clearly. Once you start speaking, the "green" podium light will light. The "yellow" light will come on when you have one (1) minute remaining. When you have 30 seconds remaining, the "yellow" light will begin flash, indicating you must quickly wrap up your comments. Your time is up when the "red" light flashes. The Chairman adheres to a strict three (3) minutes per speaker. **Note: If you intend to give your time to a "Group/Organized Presentation", please state so clearly at the very bottom of the reverse side of this form.**

Group/Organized Presentations:

Group/organized presentations with more than one (1) speaker will be limited to nine (9) minutes at the Chairman's discretion. The organizer of the presentation will automatically receive the first three (3) minutes, with the remaining six (6) minutes relinquished by other speakers, as requested by them on a completed "Request to Speak" form, and clearly indicated at the front bottom of the form.

Addressing the Board & Acknowledgement by Chairman:

The Chairman will determine what order the speakers will address the Board, and will call on all speakers in pairs. The first speaker should immediately step to the podium and begin addressing the Board. The second speaker should take up a position in one of the chamber aisles in order to quickly step up to the podium after the preceding speaker. This is to afford an efficient and timely Board meeting, giving all attendees the opportunity to make their case. Speakers are prohibited from making personal attacks, and/or using coarse, crude, profane or vulgar language while speaking to the Board members, staff, the general public and/or meeting participants. Such behavior, at the discretion of the Board Chairman may result in removal from the Board Chambers by Sheriff Deputies.

**Riverside County Board of Supervisors
Request to Speak**

Submit request to Clerk of Board (right of podium),
Speakers are entitled to three (3) minutes, subject
to Board Rules listed on the reverse side of this form.

SPEAKER'S NAME: Scott Crisler

Address: 3262 Vandermolen, Norco, CA 92879
(only if follow-up mail response requested)

City: Norco **Zip:** 92879

Phone #: 909.730.7378

Date: 1.14.13 **Agenda #** 9-1

PLEASE STATE YOUR POSITION BELOW:

Position on "Regular" (non-appealed) Agenda Item:

Support **Oppose** **Neutral**
with assurances

Note: If you are here for an agenda item that is filed
for "Appeal", please state separately your position on
the appeal below:

Support **Oppose** **Neutral**

I give my 3 minutes to: _____

BOARD RULES

Requests to Address Board on "Agenda" Items:

You may request to be heard on a published agenda item. Requests to be heard must be submitted to the Clerk of the Board before the scheduled meeting time.

Requests to Address Board on items that are "NOT" on the Agenda:

Notwithstanding any other provisions of these rules, member of the public shall have the right to address the Board during the mid-morning "Oral Communications" segment of the published agenda. Said purpose for address must pertain to issues which are under the direct jurisdiction of the Board of Supervisors. YOUR TIME WILL BE LIMITED TO THREE (3) MINUTES.

Power Point Presentations/Printed Material:

Speakers who intend to conduct a formalized Power Point presentation or provide printed material must notify the Clerk of the Board's Office by 12 noon on the Monday preceding the Tuesday Board meeting, insuring that the Clerk's Office has sufficient copies of all printed materials and at least one (1) copy of the Power Point CD. Copies of printed material given to the Clerk (by Monday noon deadline) will be provided to each Supervisor. If you have the need to use the overhead "Elmo" projector at the Board meeting, please insure your material is clear and with proper contrast, notifying the Clerk well ahead of the meeting, of your intent to use the Elmo.

Individual Speaker Limits:

Individual speakers are limited to a maximum of three (3) minutes. Please step up to the podium when the Chairman calls your name and begin speaking immediately. Pull the microphone to your mouth so that the Board, audience, and audio recording system hear you clearly. Once you start speaking, the "green" podium light will light. The "yellow" light will come on when you have one (1) minute remaining. When you have 30 seconds remaining, the "yellow" light will begin flash, indicating you must quickly wrap up your comments. Your time is up when the "red" light flashes. The Chairman adheres to a strict three (3) minutes per speaker. **Note: If you intend to give your time to a "Group/Organized Presentation", please state so clearly at the very bottom of the reverse side of this form.**

Group/Organized Presentations:

Group/organized presentations with more than one (1) speaker will be limited to nine (9) minutes at the Chairman's discretion. The organizer of the presentation will automatically receive the first three (3) minutes, with the remaining six (6) minutes relinquished by other speakers, as requested by them on a completed "Request to Speak" form, and clearly indicated at the front bottom of the form.

Addressing the Board & Acknowledgement by Chairman:

The Chairman will determine what order the speakers will address the Board, and will call on all speakers in pairs. The first speaker should immediately step to the podium and begin addressing the Board. The second speaker should take up a position in one of the chamber aisles in order to quickly step up to the podium after the preceding speaker. This is to afford an efficient and timely Board meeting, giving all attendees the opportunity to make their case. Speakers are prohibited from making personal attacks, and/or using coarse, crude, profane or vulgar language while speaking to the Board members, staff, the general public and/or meeting participants. Such behavior, at the discretion of the Board Chairman may result in removal from the Board Chambers by Sheriff Deputies.

**Riverside County Board of Supervisors
Request to Speak**

Submit request to Clerk of Board (right of podium),
Speakers are entitled to three (3) minutes, subject
to Board Rules listed on the reverse side of this form.

SPEAKER'S NAME: FRED DANIEL

Address: _____
(only if follow-up mail response requested)

City: _____ **Zip:** _____

Phone #: _____

Date: 1-14-14 **Agenda #** 9-1

PLEASE STATE YOUR POSITION BELOW:

Position on "Regular" (non-appealed) Agenda Item:

_____ **Support** **Oppose** _____ **Neutral**

Note: If you are here for an agenda item that is filed
for "Appeal", please state separately your position on
the appeal below:

_____ **Support** _____ **Oppose** _____ **Neutral**

I give my 3 minutes to: _____

BOARD RULES

Requests to Address Board on "Agenda" Items:

You may request to be heard on a published agenda item. Requests to be heard must be submitted to the Clerk of the Board before the scheduled meeting time.

Requests to Address Board on items that are "NOT" on the Agenda:

Notwithstanding any other provisions of these rules, member of the public shall have the right to address the Board during the mid-morning "Oral Communications" segment of the published agenda. Said purpose for address must pertain to issues which are under the direct jurisdiction of the Board of Supervisors. YOUR TIME WILL BE LIMITED TO THREE (3) MINUTES.

Power Point Presentations/Printed Material:

Speakers who intend to conduct a formalized Power Point presentation or provide printed material must notify the Clerk of the Board's Office by 12 noon on the Monday preceding the Tuesday Board meeting, insuring that the Clerk's Office has sufficient copies of all printed materials and at least one (1) copy of the Power Point CD. Copies of printed material given to the Clerk (by Monday noon deadline) will be provided to each Supervisor. If you have the need to use the overhead "Elmo" projector at the Board meeting, please insure your material is clear and with proper contrast, notifying the Clerk well ahead of the meeting, of your intent to use the Elmo.

Individual Speaker Limits:

Individual speakers are limited to a maximum of three (3) minutes. Please step up to the podium when the Chairman calls your name and begin speaking immediately. Pull the microphone to your mouth so that the Board, audience, and audio recording system hear you clearly. Once you start speaking, the "green" podium light will light. The "yellow" light will come on when you have one (1) minute remaining. When you have 30 seconds remaining, the "yellow" light will begin flash, indicating you must quickly wrap up your comments. Your time is up when the "red" light flashes. The Chairman adheres to a strict three (3) minutes per speaker. **Note: If you intend to give your time to a "Group/Organized Presentation", please state so clearly at the very bottom of the reverse side of this form.**

Group/Organized Presentations:

Group/organized presentations with more than one (1) speaker will be limited to nine (9) minutes at the Chairman's discretion. The organizer of the presentation will automatically receive the first three (3) minutes, with the remaining six (6) minutes relinquished by other speakers, as requested by them on a completed "Request to Speak" form, and clearly indicated at the front bottom of the form.

Addressing the Board & Acknowledgement by Chairman:

The Chairman will determine what order the speakers will address the Board, and will call on all speakers in pairs. The first speaker should immediately step to the podium and begin addressing the Board. The second speaker should take up a position in one of the chamber aisles in order to quickly step up to the podium after the preceding speaker. This is to afford an efficient and timely Board meeting, giving all attendees the opportunity to make their case. Speakers are prohibited from making personal attacks, and/or using coarse, crude, profane or vulgar language while speaking to the Board members, staff, the general public and/or meeting participants. Such behavior, at the discretion of the Board Chairman may result in removal from the Board Chambers by Sheriff Deputies.

**Riverside County Board of Supervisors
Request to Speak**

Submit request to Clerk of Board (right of podium),
Speakers are entitled to three (3) minutes, subject
to Board Rules listed on the reverse side of this form.

SPEAKER'S NAME: DANA Pierce

Address: 2400 McMAckin Dr
(only if follow-up mail response requested)

City: Corona **Zip:** 92881

Phone #: 951-808-9323

Date: JAN 14, 2014 **Agenda #** 9-1 Adoption of Resolution 2014-029

PLEASE STATE YOUR POSITION BELOW:

Position on "Regular" (non-appealed) Agenda Item:

Support Oppose Neutral

Note: If you are here for an agenda item that is filed
for "Appeal", please state separately your position on
the appeal below:

Support Oppose Neutral

I give my 3 minutes to: _____

BOARD RULES

Requests to Address Board on "Agenda" Items:

You may request to be heard on a published agenda item. Requests to be heard must be submitted to the Clerk of the Board before the scheduled meeting time.

Requests to Address Board on items that are "NOT" on the Agenda:

Notwithstanding any other provisions of these rules, member of the public shall have the right to address the Board during the mid-morning "Oral Communications" segment of the published agenda. Said purpose for address must pertain to issues which are under the direct jurisdiction of the Board of Supervisors. YOUR TIME WILL BE LIMITED TO THREE (3) MINUTES.

Power Point Presentations/Printed Material:

Speakers who intend to conduct a formalized Power Point presentation or provide printed material must notify the Clerk of the Board's Office by 12 noon on the Monday preceding the Tuesday Board meeting, insuring that the Clerk's Office has sufficient copies of all printed materials and at least one (1) copy of the Power Point CD. Copies of printed material given to the Clerk (by Monday noon deadline) will be provided to each Supervisor. If you have the need to use the overhead "Elmo" projector at the Board meeting, please insure your material is clear and with proper contrast, notifying the Clerk well ahead of the meeting, of your intent to use the Elmo.

Individual Speaker Limits:

Individual speakers are limited to a maximum of three (3) minutes. Please step up to the podium when the Chairman calls your name and begin speaking immediately. Pull the microphone to your mouth so that the Board, audience, and audio recording system hear you clearly. Once you start speaking, the "green" podium light will light. The "yellow" light will come on when you have one (1) minute remaining. When you have 30 seconds remaining, the "yellow" light will begin flash, indicating you must quickly wrap up your comments. Your time is up when the "red" light flashes. The Chairman adheres to a strict three (3) minutes per speaker. **Note: If you intend to give your time to a "Group/Organized Presentation", please state so clearly at the very bottom of the reverse side of this form.**

Group/Organized Presentations:

Group/organized presentations with more than one (1) speaker will be limited to nine (9) minutes at the Chairman's discretion. The organizer of the presentation will automatically receive the first three (3) minutes, with the remaining six (6) minutes relinquished by other speakers, as requested by them on a completed "Request to Speak" form, and clearly indicated at the front bottom of the form.

Addressing the Board & Acknowledgement by Chairman:

The Chairman will determine what order the speakers will address the Board, and will call on all speakers in pairs. The first speaker should immediately step to the podium and begin addressing the Board. The second speaker should take up a position in one of the chamber aisles in order to quickly step up to the podium after the preceding speaker. This is to afford an efficient and timely Board meeting, giving all attendees the opportunity to make their case. Speakers are prohibited from making personal attacks, and/or using coarse, crude, profane or vulgar language while speaking to the Board members, staff, the general public and/or meeting participants. Such behavior, at the discretion of the Board Chairman may result in removal from the Board Chambers by Sheriff Deputies.

**Riverside County Board of Supervisors
Request to Speak**

Submit request to Clerk of Board (right of podium),
Speakers are entitled to three (3) minutes, subject
to Board Rules listed on the reverse side of this form.

SPEAKER'S NAME: Dwight Woodward

Address: 2272 address Dr. Corona 92882
(only if follow-up mail response requested)

City: Corona **Zip:** 92882

Phone #: 562-242-4151

Date: 6-14-14 **Agenda #** 9-1

PLEASE STATE YOUR POSITION BELOW:

Position on "Regular" (non-appealed) Agenda Item:

Support **Oppose** **Neutral**

Note: If you are here for an agenda item that is filed
for "Appeal", please state separately your position on
the appeal below:

Support **Oppose** **Neutral**

I give my 3 minutes to: _____

BOARD RULES

Requests to Address Board on "Agenda" Items:

You may request to be heard on a published agenda item. Requests to be heard must be submitted to the Clerk of the Board before the scheduled meeting time.

Requests to Address Board on items that are "NOT" on the Agenda:

Notwithstanding any other provisions of these rules, member of the public shall have the right to address the Board during the mid-morning "Oral Communications" segment of the published agenda. Said purpose for address must pertain to issues which are under the direct jurisdiction of the Board of Supervisors. YOUR TIME WILL BE LIMITED TO THREE (3) MINUTES.

Power Point Presentations/Printed Material:

Speakers who intend to conduct a formalized Power Point presentation or provide printed material must notify the Clerk of the Board's Office by 12 noon on the Monday preceding the Tuesday Board meeting, insuring that the Clerk's Office has sufficient copies of all printed materials and at least one (1) copy of the Power Point CD. Copies of printed material given to the Clerk (by Monday noon deadline) will be provided to each Supervisor. If you have the need to use the overhead "Elmo" projector at the Board meeting, please insure your material is clear and with proper contrast, notifying the Clerk well ahead of the meeting, of your intent to use the Elmo.

Individual Speaker Limits:

Individual speakers are limited to a maximum of three (3) minutes. Please step up to the podium when the Chairman calls your name and begin speaking immediately. Pull the microphone to your mouth so that the Board, audience, and audio recording system hear you clearly. Once you start speaking, the "green" podium light will light. The "yellow" light will come on when you have one (1) minute remaining. When you have 30 seconds remaining, the "yellow" light will begin flash, indicating you must quickly wrap up your comments. Your time is up when the "red" light flashes. The Chairman adheres to a strict three (3) minutes per speaker. **Note: If you intend to give your time to a "Group/Organized Presentation", please state so clearly at the very bottom of the reverse side of this form.**

Group/Organized Presentations:

Group/organized presentations with more than one (1) speaker will be limited to nine (9) minutes at the Chairman's discretion. The organizer of the presentation will automatically receive the first three (3) minutes, with the remaining six (6) minutes relinquished by other speakers, as requested by them on a completed "Request to Speak" form, and clearly indicated at the front bottom of the form.

Addressing the Board & Acknowledgement by Chairman:

The Chairman will determine what order the speakers will address the Board, and will call on all speakers in pairs. The first speaker should immediately step to the podium and begin addressing the Board. The second speaker should take up a position in one of the chamber aisles in order to quickly step up to the podium after the preceding speaker. This is to afford an efficient and timely Board meeting, giving all attendees the opportunity to make their case. Speakers are prohibited from making personal attacks, and/or using coarse, crude, profane or vulgar language while speaking to the Board members, staff, the general public and/or meeting participants. Such behavior, at the discretion of the Board Chairman may result in removal from the Board Chambers by Sheriff Deputies.

**Riverside County Board of Supervisors
Request to Speak**

Submit request to Clerk of Board (right of podium),
Speakers are entitled to three (3) minutes, subject
to Board Rules listed on the reverse side of this form.

SPEAKER'S NAME: JON DUSTON

Address: 205 Savona Walk
(only if follow-up mail response requested)

City: Long Beach **Zip:** 90803

Phone #: (562) 439-0281

Date: 1-14-14 **Agenda #** 9-1

PLEASE STATE YOUR POSITION BELOW:

Position on "Regular" (non-appealed) Agenda Item:
 Support Oppose Neutral

Note: If you are here for an agenda item that is filed
for "Appeal", please state separately your position on
the appeal below:

 Support Oppose Neutral

I give my 3 minutes to: _____

BOARD RULES

Requests to Address Board on "Agenda" Items:

You may request to be heard on a published agenda item. Requests to be heard must be submitted to the Clerk of the Board before the scheduled meeting time.

Requests to Address Board on items that are "NOT" on the Agenda:

Notwithstanding any other provisions of these rules, member of the public shall have the right to address the Board during the mid-morning "Oral Communications" segment of the published agenda. Said purpose for address must pertain to issues which are under the direct jurisdiction of the Board of Supervisors. YOUR TIME WILL BE LIMITED TO THREE (3) MINUTES.

Power Point Presentations/Printed Material:

Speakers who intend to conduct a formalized Power Point presentation or provide printed material must notify the Clerk of the Board's Office by 12 noon on the Monday preceding the Tuesday Board meeting, insuring that the Clerk's Office has sufficient copies of all printed materials and at least one (1) copy of the Power Point CD. Copies of printed material given to the Clerk (by Monday noon deadline) will be provided to each Supervisor. If you have the need to use the overhead "Elmo" projector at the Board meeting, please insure your material is clear and with proper contrast, notifying the Clerk well ahead of the meeting, of your intent to use the Elmo.

Individual Speaker Limits:

Individual speakers are limited to a maximum of three (3) minutes. Please step up to the podium when the Chairman calls your name and begin speaking immediately. Pull the microphone to your mouth so that the Board, audience, and audio recording system hear you clearly. Once you start speaking, the "green" podium light will light. The "yellow" light will come on when you have one (1) minute remaining. When you have 30 seconds remaining, the "yellow" light will begin flash, indicating you must quickly wrap up your comments. Your time is up when the "red" light flashes. The Chairman adheres to a strict three (3) minutes per speaker. **Note: If you intend to give your time to a "Group/Organized Presentation", please state so clearly at the very bottom of the reverse side of this form.**

Group/Organized Presentations:

Group/organized presentations with more than one (1) speaker will be limited to nine (9) minutes at the Chairman's discretion. The organizer of the presentation will automatically receive the first three (3) minutes, with the remaining six (6) minutes relinquished by other speakers, as requested by them on a completed "Request to Speak" form, and clearly indicated at the front bottom of the form.

Addressing the Board & Acknowledgement by Chairman:

The Chairman will determine what order the speakers will address the Board, and will call on all speakers in pairs. The first speaker should immediately step to the podium and begin addressing the Board. The second speaker should take up a position in one of the chamber aisles in order to quickly step up to the podium after the preceding speaker. This is to afford an efficient and timely Board meeting, giving all attendees the opportunity to make their case. Speakers are prohibited from making personal attacks, and/or using coarse, crude, profane or vulgar language while speaking to the Board members, staff, the general public and/or meeting participants. Such behavior, at the discretion of the Board Chairman may result in removal from the Board Chambers by Sheriff Deputies.

**Riverside County Board of Supervisors
Request to Speak**

Submit request to Clerk of Board (right of podium),
Speakers are entitled to three (3) minutes, subject
to Board Rules listed on the reverse side of this form.

SPEAKER'S NAME: Wendy Villegas

Address: 1128 Old Hickory Rd
(only if follow-up mail response requested)

City: Corona **Zip:** 92882

Phone #: 909-702-7200

Date: 1/14/2014 **Agenda #** SKYME

PLEASE STATE YOUR POSITION BELOW:

Position on "Regular" (non-appealed) Agenda Item:

Support Oppose Neutral

Note: If you are here for an agenda item that is filed
for "Appeal", please state separately your position on
the appeal below:

Support Oppose Neutral

I give my 3 minutes to: _____

BOARD RULES

Requests to Address Board on "Agenda" Items:

You may request to be heard on a published agenda item. Requests to be heard must be submitted to the Clerk of the Board before the scheduled meeting time.

Requests to Address Board on items that are "NOT" on the Agenda:

Notwithstanding any other provisions of these rules, member of the public shall have the right to address the Board during the mid-morning "Oral Communications" segment of the published agenda. Said purpose for address must pertain to issues which are under the direct jurisdiction of the Board of Supervisors. YOUR TIME WILL BE LIMITED TO THREE (3) MINUTES.

Power Point Presentations/Printed Material:

Speakers who intend to conduct a formalized Power Point presentation or provide printed material must notify the Clerk of the Board's Office by 12 noon on the Monday preceding the Tuesday Board meeting, insuring that the Clerk's Office has sufficient copies of all printed materials and at least one (1) copy of the Power Point CD. Copies of printed material given to the Clerk (by Monday noon deadline) will be provided to each Supervisor. If you have the need to use the overhead "Elmo" projector at the Board meeting, please insure your material is clear and with proper contrast, notifying the Clerk well ahead of the meeting, of your intent to use the Elmo.

Individual Speaker Limits:

Individual speakers are limited to a maximum of three (3) minutes. Please step up to the podium when the Chairman calls your name and begin speaking immediately. Pull the microphone to your mouth so that the Board, audience, and audio recording system hear you clearly. Once you start speaking, the "green" podium light will light. The "yellow" light will come on when you have one (1) minute remaining. When you have 30 seconds remaining, the "yellow" light will begin flash, indicating you must quickly wrap up your comments. Your time is up when the "red" light flashes. The Chairman adheres to a strict three (3) minutes per speaker. **Note: If you intend to give your time to a "Group/Organized Presentation", please state so clearly at the very bottom of the reverse side of this form.**

Group/Organized Presentations:

Group/organized presentations with more than one (1) speaker will be limited to nine (9) minutes at the Chairman's discretion. The organizer of the presentation will automatically receive the first three (3) minutes, with the remaining six (6) minutes relinquished by other speakers, as requested by them on a completed "Request to Speak" form, and clearly indicated at the front bottom of the form.

Addressing the Board & Acknowledgement by Chairman:

The Chairman will determine what order the speakers will address the Board, and will call on all speakers in pairs. The first speaker should immediately step to the podium and begin addressing the Board. The second speaker should take up a position in one of the chamber aisles in order to quickly step up to the podium after the preceding speaker. This is to afford an efficient and timely Board meeting, giving all attendees the opportunity to make their case. Speakers are prohibited from making personal attacks, and/or using coarse, crude, profane or vulgar language while speaking to the Board members, staff, the general public and/or meeting participants. Such behavior, at the discretion of the Board Chairman may result in removal from the Board Chambers by Sheriff Deputies.

**Riverside County Board of Supervisors
Request to Speak**

Submit request to Clerk of Board (right of podium),
Speakers are entitled to three (3) minutes, subject
to Board Rules listed on the reverse side of this form.

SPEAKER'S NAME: Amy Kivine (Amie)

Address: 11775 Dawson Cyn Rd
(only if follow-up mail response requested)

City: Corona **Zip:** 92883

Phone #: _____

Date: 1-14-14 **Agenda #** Skyline

PLEASE STATE YOUR POSITION BELOW:

Position on "Regular" (non-appealed) Agenda Item:

_____ **Support** **Oppose** _____ **Neutral**

Note: If you are here for an agenda item that is filed
for "Appeal", please state separately your position on
the appeal below:

_____ **Support** _____ **Oppose** _____ **Neutral**

I give my 3 minutes to: _____

BOARD RULES

Requests to Address Board on "Agenda" Items:

You may request to be heard on a published agenda item. Requests to be heard must be submitted to the Clerk of the Board before the scheduled meeting time.

Requests to Address Board on items that are "NOT" on the Agenda:

Notwithstanding any other provisions of these rules, member of the public shall have the right to address the Board during the mid-morning "Oral Communications" segment of the published agenda. Said purpose for address must pertain to issues which are under the direct jurisdiction of the Board of Supervisors. YOUR TIME WILL BE LIMITED TO THREE (3) MINUTES.

Power Point Presentations/Printed Material:

Speakers who intend to conduct a formalized Power Point presentation or provide printed material must notify the Clerk of the Board's Office by 12 noon on the Monday preceding the Tuesday Board meeting, insuring that the Clerk's Office has sufficient copies of all printed materials and at least one (1) copy of the Power Point CD. Copies of printed material given to the Clerk (by Monday noon deadline) will be provided to each Supervisor. If you have the need to use the overhead "Elmo" projector at the Board meeting, please insure your material is clear and with proper contrast, notifying the Clerk well ahead of the meeting, of your intent to use the Elmo.

Individual Speaker Limits:

Individual speakers are limited to a maximum of three (3) minutes. Please step up to the podium when the Chairman calls your name and begin speaking immediately. Pull the microphone to your mouth so that the Board, audience, and audio recording system hear you clearly. Once you start speaking, the "green" podium light will light. The "yellow" light will come on when you have one (1) minute remaining. When you have 30 seconds remaining, the "yellow" light will begin flash, indicating you must quickly wrap up your comments. Your time is up when the "red" light flashes. The Chairman adheres to a strict three (3) minutes per speaker. **Note: If you intend to give your time to a "Group/Organized Presentation", please state so clearly at the very bottom of the reverse side of this form.**

Group/Organized Presentations:

Group/organized presentations with more than one (1) speaker will be limited to nine (9) minutes at the Chairman's discretion. The organizer of the presentation will automatically receive the first three (3) minutes, with the remaining six (6) minutes relinquished by other speakers, as requested by them on a completed "Request to Speak" form, and clearly indicated at the front bottom of the form.

Addressing the Board & Acknowledgement by Chairman:

The Chairman will determine what order the speakers will address the Board, and will call on all speakers in pairs. The first speaker should immediately step to the podium and begin addressing the Board. The second speaker should take up a position in one of the chamber aisles in order to quickly step up to the podium after the preceding speaker. This is to afford an efficient and timely Board meeting, giving all attendees the opportunity to make their case. Speakers are prohibited from making personal attacks, and/or using coarse, crude, profane or vulgar language while speaking to the Board members, staff, the general public and/or meeting participants. Such behavior, at the discretion of the Board Chairman may result in removal from the Board Chambers by Sheriff Deputies.

**Riverside County Board of Supervisors
Request to Speak**

Submit request to Clerk of Board (right of podium),
Speakers are entitled to three (3) minutes, subject
to Board Rules listed on the reverse side of this form.

SPEAKER'S NAME: JOHN SUMMONS

Address: 2321 MESQUITE LN
(only if follow-up mail response requested)

City: CORONA **Zip:** 92882

Phone #: 562 253 9290

Date: 1/14/2014 **Agenda #** SKYLINE DRIVE
9-1

PLEASE STATE YOUR POSITION BELOW:

Position on "Regular" (non-appealed) Agenda Item:

 Support **Oppose** X **Neutral**

Note: If you are here for an agenda item that is filed
for "Appeal", please state separately your position on
the appeal below:

 Support **Oppose** **Neutral**

I give my 3 minutes to: _____

BOARD RULES

Requests to Address Board on "Agenda" Items:

You may request to be heard on a published agenda item. Requests to be heard must be submitted to the Clerk of the Board before the scheduled meeting time.

Requests to Address Board on items that are "NOT" on the Agenda:

Notwithstanding any other provisions of these rules, member of the public shall have the right to address the Board during the mid-morning "Oral Communications" segment of the published agenda. Said purpose for address must pertain to issues which are under the direct jurisdiction of the Board of Supervisors. YOUR TIME WILL BE LIMITED TO THREE (3) MINUTES.

Power Point Presentations/Printed Material:

Speakers who intend to conduct a formalized Power Point presentation or provide printed material must notify the Clerk of the Board's Office by 12 noon on the Monday preceding the Tuesday Board meeting, insuring that the Clerk's Office has sufficient copies of all printed materials and at least one (1) copy of the Power Point CD. Copies of printed material given to the Clerk (by Monday noon deadline) will be provided to each Supervisor. If you have the need to use the overhead "Elmo" projector at the Board meeting, please insure your material is clear and with proper contrast, notifying the Clerk well ahead of the meeting, of your intent to use the Elmo.

Individual Speaker Limits:

Individual speakers are limited to a maximum of three (3) minutes. Please step up to the podium when the Chairman calls your name and begin speaking immediately. Pull the microphone to your mouth so that the Board, audience, and audio recording system hear you clearly. Once you start speaking, the "green" podium light will light. The "yellow" light will come on when you have one (1) minute remaining. When you have 30 seconds remaining, the "yellow" light will begin flash, indicating you must quickly wrap up your comments. Your time is up when the "red" light flashes. The Chairman adheres to a strict three (3) minutes per speaker. **Note: If you intend to give your time to a "Group/Organized Presentation", please state so clearly at the very bottom of the reverse side of this form.**

Group/Organized Presentations:

Group/organized presentations with more than one (1) speaker will be limited to nine (9) minutes at the Chairman's discretion. The organizer of the presentation will automatically receive the first three (3) minutes, with the remaining six (6) minutes relinquished by other speakers, as requested by them on a completed "Request to Speak" form, and clearly indicated at the front bottom of the form.

Addressing the Board & Acknowledgement by Chairman:

The Chairman will determine what order the speakers will address the Board, and will call on all speakers in pairs. The first speaker should immediately step to the podium and begin addressing the Board. The second speaker should take up a position in one of the chamber aisles in order to quickly step up to the podium after the preceding speaker. This is to afford an efficient and timely Board meeting, giving all attendees the opportunity to make their case. Speakers are prohibited from making personal attacks, and/or using coarse, crude, profane or vulgar language while speaking to the Board members, staff, the general public and/or meeting participants. Such behavior, at the discretion of the Board Chairman may result in removal from the Board Chambers by Sheriff Deputies.

**Riverside County Board of Supervisors
Request to Speak**

Submit request to Clerk of Board (right of podium),
Speakers are entitled to three (3) minutes, subject
to Board Rules listed on the reverse side of this form.

SPEAKER'S NAME: Jennifer Batongbacal

Address: 3640 Elkur Rd
(only if follow-up mail response requested)

City: Corona **Zip:** 92882

Phone #: (951) 427-5659

Date: 1/14/14 **Agenda #** 9-1

PLEASE STATE YOUR POSITION BELOW:

Position on "Regular" (non-appealed) Agenda Item:

Support **Oppose** **Neutral**

Note: If you are here for an agenda item that is filed
for "Appeal", please state separately your position on
the appeal below:

Support **Oppose** **Neutral**

I give my 3 minutes to: _____

BOARD RULES

Requests to Address Board on "Agenda" Items:

You may request to be heard on a published agenda item. Requests to be heard must be submitted to the Clerk of the Board before the scheduled meeting time.

Requests to Address Board on items that are "NOT" on the Agenda:

Notwithstanding any other provisions of these rules, member of the public shall have the right to address the Board during the mid-morning "Oral Communications" segment of the published agenda. Said purpose for address must pertain to issues which are under the direct jurisdiction of the Board of Supervisors. YOUR TIME WILL BE LIMITED TO THREE (3) MINUTES.

Power Point Presentations/Printed Material:

Speakers who intend to conduct a formalized Power Point presentation or provide printed material must notify the Clerk of the Board's Office by 12 noon on the Monday preceding the Tuesday Board meeting, insuring that the Clerk's Office has sufficient copies of all printed materials and at least one (1) copy of the Power Point CD. Copies of printed material given to the Clerk (by Monday noon deadline) will be provided to each Supervisor. If you have the need to use the overhead "Elmo" projector at the Board meeting, please insure your material is clear and with proper contrast, notifying the Clerk well ahead of the meeting, of your intent to use the Elmo.

Individual Speaker Limits:

Individual speakers are limited to a maximum of three (3) minutes. Please step up to the podium when the Chairman calls your name and begin speaking immediately. Pull the microphone to your mouth so that the Board, audience, and audio recording system hear you clearly. Once you start speaking, the "green" podium light will light. The "yellow" light will come on when you have one (1) minute remaining. When you have 30 seconds remaining, the "yellow" light will begin flash, indicating you must quickly wrap up your comments. Your time is up when the "red" light flashes. The Chairman adheres to a strict three (3) minutes per speaker. **Note: If you intend to give your time to a "Group/Organized Presentation", please state so clearly at the very bottom of the reverse side of this form.**

Group/Organized Presentations:

Group/organized presentations with more than one (1) speaker will be limited to nine (9) minutes at the Chairman's discretion. The organizer of the presentation will automatically receive the first three (3) minutes, with the remaining six (6) minutes relinquished by other speakers, as requested by them on a completed "Request to Speak" form, and clearly indicated at the front bottom of the form.

Addressing the Board & Acknowledgement by Chairman:

The Chairman will determine what order the speakers will address the Board, and will call on all speakers in pairs. The first speaker should immediately step to the podium and begin addressing the Board. The second speaker should take up a position in one of the chamber aisles in order to quickly step up to the podium after the preceding speaker. This is to afford an efficient and timely Board meeting, giving all attendees the opportunity to make their case. Speakers are prohibited from making personal attacks, and/or using coarse, crude, profane or vulgar language while speaking to the Board members, staff, the general public and/or meeting participants. Such behavior, at the discretion of the Board Chairman may result in removal from the Board Chambers by Sheriff Deputies.

Riverside County Board of Supervisors
Request to Speak

10 Min

Submit request to Clerk of Board (right of podium),
Speakers are entitled to three (3) minutes, subject
to Board Rules listed on the reverse side of this form.

SPEAKER'S NAME: ROGER PIERCE

Address: 11440 W. Bernardo Court #230
(only if follow-up mail response requested)

City: SAN DIEGO CA **Zip:** 92127

Phone #: 858-675-8716

Date: 1/14/14 **Agenda #** 9-1

PLEASE STATE YOUR POSITION BELOW:

Position on "Regular" (non-appealed) Agenda Item:

Support Oppose Neutral

Note: If you are here for an agenda item that is filed
for "Appeal", please state separately your position on
the appeal below:

Support Oppose Neutral

I give my 3 minutes to: SPEAKER

BOARD RULES

Requests to Address Board on "Agenda" Items:

You may request to be heard on a published agenda item. Requests to be heard must be submitted to the Clerk of the Board before the scheduled meeting time.

Requests to Address Board on items that are "NOT" on the Agenda:

Notwithstanding any other provisions of these rules, member of the public shall have the right to address the Board during the mid-morning "Oral Communications" segment of the published agenda. Said purpose for address must pertain to issues which are under the direct jurisdiction of the Board of Supervisors. YOUR TIME WILL BE LIMITED TO THREE (3) MINUTES.

Power Point Presentations/Printed Material:

Speakers who intend to conduct a formalized Power Point presentation or provide printed material must notify the Clerk of the Board's Office by 12 noon on the Monday preceding the Tuesday Board meeting, insuring that the Clerk's Office has sufficient copies of all printed materials and at least one (1) copy of the Power Point CD. Copies of printed material given to the Clerk (by Monday noon deadline) will be provided to each Supervisor. If you have the need to use the overhead "Elmo" projector at the Board meeting, please insure your material is clear and with proper contrast, notifying the Clerk well ahead of the meeting, of your intent to use the Elmo.

Individual Speaker Limits:

Individual speakers are limited to a maximum of three (3) minutes. Please step up to the podium when the Chairman calls your name and begin speaking immediately. Pull the microphone to your mouth so that the Board, audience, and audio recording system hear you clearly. Once you start speaking, the "green" podium light will light. The "yellow" light will come on when you have one (1) minute remaining. When you have 30 seconds remaining, the "yellow" light will begin flash, indicating you must quickly wrap up your comments. Your time is up when the "red" light flashes. The Chairman adheres to a strict three (3) minutes per speaker. **Note: If you intend to give your time to a "Group/Organized Presentation", please state so clearly at the very bottom of the reverse side of this form.**

Group/Organized Presentations:

Group/organized presentations with more than one (1) speaker will be limited to nine (9) minutes at the Chairman's discretion. The organizer of the presentation will automatically receive the first three (3) minutes, with the remaining six (6) minutes relinquished by other speakers, as requested by them on a completed "Request to Speak" form, and clearly indicated at the front bottom of the form.

Addressing the Board & Acknowledgement by Chairman:

The Chairman will determine what order the speakers will address the Board, and will call on all speakers in pairs. The first speaker should immediately step to the podium and begin addressing the Board. The second speaker should take up a position in one of the chamber aisles in order to quickly step up to the podium after the preceding speaker. This is to afford an efficient and timely Board meeting, giving all attendees the opportunity to make their case. Speakers are prohibited from making personal attacks, and/or using coarse, crude, profane or vulgar language while speaking to the Board members, staff, the general public and/or meeting participants. Such behavior, at the discretion of the Board Chairman may result in removal from the Board Chambers by Sheriff Deputies.

**Riverside County Board of Supervisors
Request to Speak**

Submit request to Clerk of Board (right of podium),
Speakers are entitled to three (3) minutes, subject
to Board Rules listed on the reverse side of this form.

SPEAKER'S NAME: MICHAEL LAUDERDALE

Address: 11440 W. BERNARDO CT #230
(only if follow-up mail response requested)

City: SAN DIEGO **Zip:** CA 92127

Phone #: 858-675-8704

Date: 1/14/14 **Agenda #** 9-1

PLEASE STATE YOUR POSITION BELOW:

Position on "Regular" (non-appealed) Agenda Item:

 Support X Oppose Neutral

Note: If you are here for an agenda item that is filed
for "Appeal", please state separately your position on
the appeal below:

 Support Oppose Neutral

I give my 3 minutes to: ROGER PIERCE

BOARD RULES

Requests to Address Board on "Agenda" Items:

You may request to be heard on a published agenda item. Requests to be heard must be submitted to the Clerk of the Board before the scheduled meeting time.

Requests to Address Board on items that are "NOT" on the Agenda:

Notwithstanding any other provisions of these rules, member of the public shall have the right to address the Board during the mid-morning "Oral Communications" segment of the published agenda. Said purpose for address must pertain to issues which are under the direct jurisdiction of the Board of Supervisors. YOUR TIME WILL BE LIMITED TO THREE (3) MINUTES.

Power Point Presentations/Printed Material:

Speakers who intend to conduct a formalized Power Point presentation or provide printed material must notify the Clerk of the Board's Office by 12 noon on the Monday preceding the Tuesday Board meeting, insuring that the Clerk's Office has sufficient copies of all printed materials and at least one (1) copy of the Power Point CD. Copies of printed material given to the Clerk (by Monday noon deadline) will be provided to each Supervisor. If you have the need to use the overhead "Elmo" projector at the Board meeting, please insure your material is clear and with proper contrast, notifying the Clerk well ahead of the meeting, of your intent to use the Elmo.

Individual Speaker Limits:

Individual speakers are limited to a maximum of three (3) minutes. Please step up to the podium when the Chairman calls your name and begin speaking immediately. Pull the microphone to your mouth so that the Board, audience, and audio recording system hear you clearly. Once you start speaking, the "green" podium light will light. The "yellow" light will come on when you have one (1) minute remaining. When you have 30 seconds remaining, the "yellow" light will begin flash, indicating you must quickly wrap up your comments. Your time is up when the "red" light flashes. The Chairman adheres to a strict three (3) minutes per speaker. **Note: If you intend to give your time to a "Group/Organized Presentation", please state so clearly at the very bottom of the reverse side of this form.**

Group/Organized Presentations:

Group/organized presentations with more than one (1) speaker will be limited to nine (9) minutes at the Chairman's discretion. The organizer of the presentation will automatically receive the first three (3) minutes, with the remaining six (6) minutes relinquished by other speakers, as requested by them on a completed "Request to Speak" form, and clearly indicated at the front bottom of the form.

Addressing the Board & Acknowledgement by Chairman:

The Chairman will determine what order the speakers will address the Board, and will call on all speakers in pairs. The first speaker should immediately step to the podium and begin addressing the Board. The second speaker should take up a position in one of the chamber aisles in order to quickly step up to the podium after the preceding speaker. This is to afford an efficient and timely Board meeting, giving all attendees the opportunity to make their case. Speakers are prohibited from making personal attacks, and/or using coarse, crude, profane or vulgar language while speaking to the Board members, staff, the general public and/or meeting participants. Such behavior, at the discretion of the Board Chairman may result in removal from the Board Chambers by Sheriff Deputies.

**Riverside County Board of Supervisors
Request to Speak**

Submit request to Clerk of Board (right of podium),
Speakers are entitled to three (3) minutes, subject
to Board Rules listed on the reverse side of this form.

SPEAKER'S NAME: CRIS ALEXANDER

Address: _____
(only if follow-up mail response requested)

City: _____ **Zip:** _____

Phone #: _____

Date: 1/14/2013 **Agenda #** 9-1

PLEASE STATE YOUR POSITION BELOW:

Position on "Regular" (non-appealed) Agenda Item:

_____ **Support** **Oppose** _____ **Neutral**

Note: If you are here for an agenda item that is filed
for "Appeal", please state separately your position on
the appeal below:

_____ **Support** _____ **Oppose** _____ **Neutral**

I give my 3 minutes to: _____

BOARD RULES

Requests to Address Board on "Agenda" Items:

You may request to be heard on a published agenda item. Requests to be heard must be submitted to the Clerk of the Board before the scheduled meeting time.

Requests to Address Board on items that are "NOT" on the Agenda:

Notwithstanding any other provisions of these rules, member of the public shall have the right to address the Board during the mid-morning "Oral Communications" segment of the published agenda. Said purpose for address must pertain to issues which are under the direct jurisdiction of the Board of Supervisors. YOUR TIME WILL BE LIMITED TO THREE (3) MINUTES.

Power Point Presentations/Printed Material:

Speakers who intend to conduct a formalized Power Point presentation or provide printed material must notify the Clerk of the Board's Office by 12 noon on the Monday preceding the Tuesday Board meeting, insuring that the Clerk's Office has sufficient copies of all printed materials and at least one (1) copy of the Power Point CD. Copies of printed material given to the Clerk (by Monday noon deadline) will be provided to each Supervisor. If you have the need to use the overhead "Elmo" projector at the Board meeting, please insure your material is clear and with proper contrast, notifying the Clerk well ahead of the meeting, of your intent to use the Elmo.

Individual Speaker Limits:

Individual speakers are limited to a maximum of three (3) minutes. Please step up to the podium when the Chairman calls your name and begin speaking immediately. Pull the microphone to your mouth so that the Board, audience, and audio recording system hear you clearly. Once you start speaking, the "green" podium light will light. The "yellow" light will come on when you have one (1) minute remaining. When you have 30 seconds remaining, the "yellow" light will begin flash, indicating you must quickly wrap up your comments. Your time is up when the "red" light flashes. The Chairman adheres to a strict three (3) minutes per speaker. **Note: If you intend to give your time to a "Group/Organized Presentation", please state so clearly at the very bottom of the reverse side of this form.**

Group/Organized Presentations:

Group/organized presentations with more than one (1) speaker will be limited to nine (9) minutes at the Chairman's discretion. The organizer of the presentation will automatically receive the first three (3) minutes, with the remaining six (6) minutes relinquished by other speakers, as requested by them on a completed "Request to Speak" form, and clearly indicated at the front bottom of the form.

Addressing the Board & Acknowledgement by Chairman:

The Chairman will determine what order the speakers will address the Board, and will call on all speakers in pairs. The first speaker should immediately step to the podium and begin addressing the Board. The second speaker should take up a position in one of the chamber aisles in order to quickly step up to the podium after the preceding speaker. This is to afford an efficient and timely Board meeting, giving all attendees the opportunity to make their case. Speakers are prohibited from making personal attacks, and/or using coarse, crude, profane or vulgar language while speaking to the Board members, staff, the general public and/or meeting participants. Such behavior, at the discretion of the Board Chairman may result in removal from the Board Chambers by Sheriff Deputies.

**Riverside County Board of Supervisors
Request to Speak**

Submit request to Clerk of Board (right of podium),
Speakers are entitled to three (3) minutes, subject
to Board Rules listed on the reverse side of this form.

SPEAKER'S NAME: Karalee Watson

Address: 210 W. Birch St #208
(only if follow-up mail response requested)

City: Brea **Zip:** 92821

Phone #: 714-552-2000

Date: 1/14/14 **Agenda #** 9-1

PLEASE STATE YOUR POSITION BELOW:

Position on "Regular" (non-appealed) Agenda Item:

Support Oppose Neutral

Note: If you are here for an agenda item that is filed
for "Appeal", please state separately your position on
the appeal below:

Support Oppose Neutral

I give my 3 minutes to: _____

BOARD RULES

Requests to Address Board on "Agenda" Items:

You may request to be heard on a published agenda item. Requests to be heard must be submitted to the Clerk of the Board before the scheduled meeting time.

Requests to Address Board on items that are "NOT" on the Agenda:

Notwithstanding any other provisions of these rules, member of the public shall have the right to address the Board during the mid-morning "Oral Communications" segment of the published agenda. Said purpose for address must pertain to issues which are under the direct jurisdiction of the Board of Supervisors. YOUR TIME WILL BE LIMITED TO THREE (3) MINUTES.

Power Point Presentations/Printed Material:

Speakers who intend to conduct a formalized Power Point presentation or provide printed material must notify the Clerk of the Board's Office by 12 noon on the Monday preceding the Tuesday Board meeting, insuring that the Clerk's Office has sufficient copies of all printed materials and at least one (1) copy of the Power Point CD. Copies of printed material given to the Clerk (by Monday noon deadline) will be provided to each Supervisor. If you have the need to use the overhead "Elmo" projector at the Board meeting, please insure your material is clear and with proper contrast, notifying the Clerk well ahead of the meeting, of your intent to use the Elmo.

Individual Speaker Limits:

Individual speakers are limited to a maximum of three (3) minutes. Please step up to the podium when the Chairman calls your name and begin speaking immediately. Pull the microphone to your mouth so that the Board, audience, and audio recording system hear you clearly. Once you start speaking, the "green" podium light will light. The "yellow" light will come on when you have one (1) minute remaining. When you have 30 seconds remaining, the "yellow" light will begin flash, indicating you must quickly wrap up your comments. Your time is up when the "red" light flashes. The Chairman adheres to a strict three (3) minutes per speaker. **Note: If you intend to give your time to a "Group/Organized Presentation", please state so clearly at the very bottom of the reverse side of this form.**

Group/Organized Presentations:

Group/organized presentations with more than one (1) speaker will be limited to nine (9) minutes at the Chairman's discretion. The organizer of the presentation will automatically receive the first three (3) minutes, with the remaining six (6) minutes relinquished by other speakers, as requested by them on a completed "Request to Speak" form, and clearly indicated at the front bottom of the form.

Addressing the Board & Acknowledgement by Chairman:

The Chairman will determine what order the speakers will address the Board, and will call on all speakers in pairs. The first speaker should immediately step to the podium and begin addressing the Board. The second speaker should take up a position in one of the chamber aisles in order to quickly step up to the podium after the preceding speaker. This is to afford an efficient and timely Board meeting, giving all attendees the opportunity to make their case. Speakers are prohibited from making personal attacks, and/or using coarse, crude, profane or vulgar language while speaking to the Board members, staff, the general public and/or meeting participants. Such behavior, at the discretion of the Board Chairman may result in removal from the Board Chambers by Sheriff Deputies.

**Riverside County Board of Supervisors
Request to Speak**

Submit request to Clerk of Board (right of podium),
Speakers are entitled to three (3) minutes, subject
to Board Rules listed on the reverse side of this form.

SPEAKER'S NAME: Dane Lesch

Address: 44450 Cayenne Trail
(only if follow-up mail response requested)

City: Temecula **Zip:** 92592

Phone #: 760-586-9592

Date: 1/14/14 **Agenda #** 9-1

PLEASE STATE YOUR POSITION BELOW:

Position on "Regular" (non-appealed) Agenda Item:

Support Oppose Neutral

Note: If you are here for an agenda item that is filed
for "Appeal", please state separately your position on
the appeal below:

Support Oppose Neutral

I give my 3 minutes to: _____

BOARD RULES

Requests to Address Board on "Agenda" Items:

You may request to be heard on a published agenda item. Requests to be heard must be submitted to the Clerk of the Board before the scheduled meeting time.

Requests to Address Board on items that are "NOT" on the Agenda:

Notwithstanding any other provisions of these rules, member of the public shall have the right to address the Board during the mid-morning "Oral Communications" segment of the published agenda. Said purpose for address must pertain to issues which are under the direct jurisdiction of the Board of Supervisors. YOUR TIME WILL BE LIMITED TO THREE (3) MINUTES.

Power Point Presentations/Printed Material:

Speakers who intend to conduct a formalized Power Point presentation or provide printed material must notify the Clerk of the Board's Office by 12 noon on the Monday preceding the Tuesday Board meeting, insuring that the Clerk's Office has sufficient copies of all printed materials and at least one (1) copy of the Power Point CD. Copies of printed material given to the Clerk (by Monday noon deadline) will be provided to each Supervisor. If you have the need to use the overhead "Elmo" projector at the Board meeting, please insure your material is clear and with proper contrast, notifying the Clerk well ahead of the meeting, of your intent to use the Elmo.

Individual Speaker Limits:

Individual speakers are limited to a maximum of three (3) minutes. Please step up to the podium when the Chairman calls your name and begin speaking immediately. Pull the microphone to your mouth so that the Board, audience, and audio recording system hear you clearly. Once you start speaking, the "green" podium light will light. The "yellow" light will come on when you have one (1) minute remaining. When you have 30 seconds remaining, the "yellow" light will begin flash, indicating you must quickly wrap up your comments. Your time is up when the "red" light flashes. The Chairman adheres to a strict three (3) minutes per speaker. **Note: If you intend to give your time to a "Group/Organized Presentation", please state so clearly at the very bottom of the reverse side of this form.**

Group/Organized Presentations:

Group/organized presentations with more than one (1) speaker will be limited to nine (9) minutes at the Chairman's discretion. The organizer of the presentation will automatically receive the first three (3) minutes, with the remaining six (6) minutes relinquished by other speakers, as requested by them on a completed "Request to Speak" form, and clearly indicated at the front bottom of the form.

Addressing the Board & Acknowledgement by Chairman:

The Chairman will determine what order the speakers will address the Board, and will call on all speakers in pairs. The first speaker should immediately step to the podium and begin addressing the Board. The second speaker should take up a position in one of the chamber aisles in order to quickly step up to the podium after the preceding speaker. This is to afford an efficient and timely Board meeting, giving all attendees the opportunity to make their case. Speakers are prohibited from making personal attacks, and/or using coarse, crude, profane or vulgar language while speaking to the Board members, staff, the general public and/or meeting participants. Such behavior, at the discretion of the Board Chairman may result in removal from the Board Chambers by Sheriff Deputies.

**Riverside County Board of Supervisors
Request to Speak**

Submit request to Clerk of Board (right of podium),
Speakers are entitled to three (3) minutes, subject
to Board Rules listed on the reverse side of this form.

SPEAKER'S NAME: BILL WAGNER

Address: _____
(only if follow-up mail response requested)

City: _____ **Zip:** _____

Phone #: _____

Date: _____ **Agenda #** 9-1

PLEASE STATE YOUR POSITION BELOW:

Position on "Regular" (non-appealed) Agenda Item:

_____ **Support** **Oppose** _____ **Neutral**

Note: If you are here for an agenda item that is filed
for "Appeal", please state separately your position on
the appeal below:

_____ **Support** _____ **Oppose** _____ **Neutral**

I give my 3 minutes to: _____

BOARD RULES

Requests to Address Board on "Agenda" Items:

You may request to be heard on a published agenda item. Requests to be heard must be submitted to the Clerk of the Board before the scheduled meeting time.

Requests to Address Board on items that are "NOT" on the Agenda:

Notwithstanding any other provisions of these rules, member of the public shall have the right to address the Board during the mid-morning "Oral Communications" segment of the published agenda. Said purpose for address must pertain to issues which are under the direct jurisdiction of the Board of Supervisors. YOUR TIME WILL BE LIMITED TO THREE (3) MINUTES.

Power Point Presentations/Printed Material:

Speakers who intend to conduct a formalized Power Point presentation or provide printed material must notify the Clerk of the Board's Office by 12 noon on the Monday preceding the Tuesday Board meeting, insuring that the Clerk's Office has sufficient copies of all printed materials and at least one (1) copy of the Power Point CD. Copies of printed material given to the Clerk (by Monday noon deadline) will be provided to each Supervisor. If you have the need to use the overhead "Elmo" projector at the Board meeting, please insure your material is clear and with proper contrast, notifying the Clerk well ahead of the meeting, of your intent to use the Elmo.

Individual Speaker Limits:

Individual speakers are limited to a maximum of three (3) minutes. Please step up to the podium when the Chairman calls your name and begin speaking immediately. Pull the microphone to your mouth so that the Board, audience, and audio recording system hear you clearly. Once you start speaking, the "green" podium light will light. The "yellow" light will come on when you have one (1) minute remaining. When you have 30 seconds remaining, the "yellow" light will begin flash, indicating you must quickly wrap up your comments. Your time is up when the "red" light flashes. The Chairman adheres to a strict three (3) minutes per speaker. **Note: If you intend to give your time to a "Group/Organized Presentation", please state so clearly at the very bottom of the reverse side of this form.**

Group/Organized Presentations:

Group/organized presentations with more than one (1) speaker will be limited to nine (9) minutes at the Chairman's discretion. The organizer of the presentation will automatically receive the first three (3) minutes, with the remaining six (6) minutes relinquished by other speakers, as requested by them on a completed "Request to Speak" form, and clearly indicated at the front bottom of the form.

Addressing the Board & Acknowledgement by Chairman:

The Chairman will determine what order the speakers will address the Board, and will call on all speakers in pairs. The first speaker should immediately step to the podium and begin addressing the Board. The second speaker should take up a position in one of the chamber aisles in order to quickly step up to the podium after the preceding speaker. This is to afford an efficient and timely Board meeting, giving all attendees the opportunity to make their case. Speakers are prohibited from making personal attacks, and/or using coarse, crude, profane or vulgar language while speaking to the Board members, staff, the general public and/or meeting participants. Such behavior, at the discretion of the Board Chairman may result in removal from the Board Chambers by Sheriff Deputies.

**Riverside County Board of Supervisors
Request to Speak**

Submit request to Clerk of Board (right of podium),
Speakers are entitled to three (3) minutes, subject
to Board Rules listed on the reverse side of this form.

SPEAKER'S NAME: GARRY GRANT

Address: _____
(only if follow-up mail response requested)

City: _____ **Zip:** _____

Phone #: _____

Date: JAN 15TH **Agenda #** 9-1

PLEASE STATE YOUR POSITION BELOW:

Position on "Regular" (non-appealed) Agenda Item:

_____ **Support** _____ **Oppose** _____ **Neutral**

Note: If you are here for an agenda item that is filed
for "Appeal", please state separately your position on
the appeal below:

_____ **Support** _____ **Oppose** _____ **Neutral**

I give my 3 minutes to: _____

BOARD RULES

Requests to Address Board on "Agenda" Items:

You may request to be heard on a published agenda item. Requests to be heard must be submitted to the Clerk of the Board before the scheduled meeting time.

Requests to Address Board on items that are "NOT" on the Agenda:

Notwithstanding any other provisions of these rules, member of the public shall have the right to address the Board during the mid-morning "Oral Communications" segment of the published agenda. Said purpose for address must pertain to issues which are under the direct jurisdiction of the Board of Supervisors. YOUR TIME WILL BE LIMITED TO THREE (3) MINUTES.

Power Point Presentations/Printed Material:

Speakers who intend to conduct a formalized Power Point presentation or provide printed material must notify the Clerk of the Board's Office by 12 noon on the Monday preceding the Tuesday Board meeting, insuring that the Clerk's Office has sufficient copies of all printed materials and at least one (1) copy of the Power Point CD. Copies of printed material given to the Clerk (by Monday noon deadline) will be provided to each Supervisor. If you have the need to use the overhead "Elmo" projector at the Board meeting, please insure your material is clear and with proper contrast, notifying the Clerk well ahead of the meeting, of your intent to use the Elmo.

Individual Speaker Limits:

Individual speakers are limited to a maximum of three (3) minutes. Please step up to the podium when the Chairman calls your name and begin speaking immediately. Pull the microphone to your mouth so that the Board, audience, and audio recording system hear you clearly. Once you start speaking, the "green" podium light will light. The "yellow" light will come on when you have one (1) minute remaining. When you have 30 seconds remaining, the "yellow" light will begin flash, indicating you must quickly wrap up your comments. Your time is up when the "red" light flashes. The Chairman adheres to a strict three (3) minutes per speaker. **Note: If you intend to give your time to a "Group/Organized Presentation", please state so clearly at the very bottom of the reverse side of this form.**

Group/Organized Presentations:

Group/organized presentations with more than one (1) speaker will be limited to nine (9) minutes at the Chairman's discretion. The organizer of the presentation will automatically receive the first three (3) minutes, with the remaining six (6) minutes relinquished by other speakers, as requested by them on a completed "Request to Speak" form, and clearly indicated at the front bottom of the form.

Addressing the Board & Acknowledgement by Chairman:

The Chairman will determine what order the speakers will address the Board, and will call on all speakers in pairs. The first speaker should immediately step to the podium and begin addressing the Board. The second speaker should take up a position in one of the chamber aisles in order to quickly step up to the podium after the preceding speaker. This is to afford an efficient and timely Board meeting, giving all attendees the opportunity to make their case. Speakers are prohibited from making personal attacks, and/or using coarse, crude, profane or vulgar language while speaking to the Board members, staff, the general public and/or meeting participants. Such behavior, at the discretion of the Board Chairman may result in removal from the Board Chambers by Sheriff Deputies.

**Riverside County Board of Supervisors
Request to Speak**

Submit request to Clerk of Board (right of podium),
Speakers are entitled to three (3) minutes, subject
to Board Rules listed on the reverse side of this form.

SPEAKER'S NAME: Mike Bigelow

Address: 4985 Rose Ave
(only if follow-up mail response requested)

City: Riverside **Zip:** 92505

Phone #: 562 665 6522

Date: 1/14/14 **Agenda #** 9-1

PLEASE STATE YOUR POSITION BELOW:

Position on "Regular" (non-appealed) Agenda Item:

Support **Oppose** **Neutral**

Note: If you are here for an agenda item that is filed
for "Appeal", please state separately your position on
the appeal below:

Support **Oppose** **Neutral**

I give my 3 minutes to: ~~Adam Beck~~

BOARD RULES

Requests to Address Board on "Agenda" Items:

You may request to be heard on a published agenda item. Requests to be heard must be submitted to the Clerk of the Board before the scheduled meeting time.

Requests to Address Board on items that are "NOT" on the Agenda:

Notwithstanding any other provisions of these rules, member of the public shall have the right to address the Board during the mid-morning "Oral Communications" segment of the published agenda. Said purpose for address must pertain to issues which are under the direct jurisdiction of the Board of Supervisors. YOUR TIME WILL BE LIMITED TO THREE (3) MINUTES.

Power Point Presentations/Printed Material:

Speakers who intend to conduct a formalized Power Point presentation or provide printed material must notify the Clerk of the Board's Office by 12 noon on the Monday preceding the Tuesday Board meeting, insuring that the Clerk's Office has sufficient copies of all printed materials and at least one (1) copy of the Power Point CD. Copies of printed material given to the Clerk (by Monday noon deadline) will be provided to each Supervisor. If you have the need to use the overhead "Elmo" projector at the Board meeting, please insure your material is clear and with proper contrast, notifying the Clerk well ahead of the meeting, of your intent to use the Elmo.

Individual Speaker Limits:

Individual speakers are limited to a maximum of three (3) minutes. Please step up to the podium when the Chairman calls your name and begin speaking immediately. Pull the microphone to your mouth so that the Board, audience, and audio recording system hear you clearly. Once you start speaking, the "green" podium light will light. The "yellow" light will come on when you have one (1) minute remaining. When you have 30 seconds remaining, the "yellow" light will begin flash, indicating you must quickly wrap up your comments. Your time is up when the "red" light flashes. The Chairman adheres to a strict three (3) minutes per speaker. **Note: If you intend to give your time to a "Group/Organized Presentation", please state so clearly at the very bottom of the reverse side of this form.**

Group/Organized Presentations:

Group/organized presentations with more than one (1) speaker will be limited to nine (9) minutes at the Chairman's discretion. The organizer of the presentation will automatically receive the first three (3) minutes, with the remaining six (6) minutes relinquished by other speakers, as requested by them on a completed "Request to Speak" form, and clearly indicated at the front bottom of the form.

Addressing the Board & Acknowledgement by Chairman:

The Chairman will determine what order the speakers will address the Board, and will call on all speakers in pairs. The first speaker should immediately step to the podium and begin addressing the Board. The second speaker should take up a position in one of the chamber aisles in order to quickly step up to the podium after the preceding speaker. This is to afford an efficient and timely Board meeting, giving all attendees the opportunity to make their case. Speakers are prohibited from making personal attacks, and/or using coarse, crude, profane or vulgar language while speaking to the Board members, staff, the general public and/or meeting participants. Such behavior, at the discretion of the Board Chairman may result in removal from the Board Chambers by Sheriff Deputies.

**Riverside County Board of Supervisors
Request to Speak**

Submit request to Clerk of Board (right of podium),
Speakers are entitled to three (3) minutes, subject
to Board Rules listed on the reverse side of this form.

SPEAKER'S NAME: ALLAN BEEK

Address: _____
(only if follow-up mail response requested)

City: NEWPORT BEACH **Zip:** 92660

Phone #: 949-645-1419
RESOLUTION 2013-249

Date: JAN 14, 2014 **Agenda #** 9-1

PLEASE STATE YOUR POSITION BELOW:

Position on "Regular" (non-appealed) Agenda Item:

Support **Oppose** **Neutral**

Note: If you are here for an agenda item that is filed
for "Appeal", please state separately your position on
the appeal below:

Support **Oppose** **Neutral**

I give my 3 minutes to: _____

BOARD RULES

Requests to Address Board on "Agenda" Items:

You may request to be heard on a published agenda item. Requests to be heard must be submitted to the Clerk of the Board before the scheduled meeting time.

Requests to Address Board on items that are "NOT" on the Agenda:

Notwithstanding any other provisions of these rules, member of the public shall have the right to address the Board during the mid-morning "Oral Communications" segment of the published agenda. Said purpose for address must pertain to issues which are under the direct jurisdiction of the Board of Supervisors. YOUR TIME WILL BE LIMITED TO THREE (3) MINUTES.

Power Point Presentations/Printed Material:

Speakers who intend to conduct a formalized Power Point presentation or provide printed material must notify the Clerk of the Board's Office by 12 noon on the Monday preceding the Tuesday Board meeting, insuring that the Clerk's Office has sufficient copies of all printed materials and at least one (1) copy of the Power Point CD. Copies of printed material given to the Clerk (by Monday noon deadline) will be provided to each Supervisor. If you have the need to use the overhead "Elmo" projector at the Board meeting, please insure your material is clear and with proper contrast, notifying the Clerk well ahead of the meeting, of your intent to use the Elmo.

Individual Speaker Limits:

Individual speakers are limited to a maximum of three (3) minutes. Please step up to the podium when the Chairman calls your name and begin speaking immediately. Pull the microphone to your mouth so that the Board, audience, and audio recording system hear you clearly. Once you start speaking, the "green" podium light will light. The "yellow" light will come on when you have one (1) minute remaining. When you have 30 seconds remaining, the "yellow" light will begin flash, indicating you must quickly wrap up your comments. Your time is up when the "red" light flashes. The Chairman adheres to a strict three (3) minutes per speaker. **Note: If you intend to give your time to a "Group/Organized Presentation", please state so clearly at the very bottom of the reverse side of this form.**

Group/Organized Presentations:

Group/organized presentations with more than one (1) speaker will be limited to nine (9) minutes at the Chairman's discretion. The organizer of the presentation will automatically receive the first three (3) minutes, with the remaining six (6) minutes relinquished by other speakers, as requested by them on a completed "Request to Speak" form, and clearly indicated at the front bottom of the form.

Addressing the Board & Acknowledgement by Chairman:

The Chairman will determine what order the speakers will address the Board, and will call on all speakers in pairs. The first speaker should immediately step to the podium and begin addressing the Board. The second speaker should take up a position in one of the chamber aisles in order to quickly step up to the podium after the preceding speaker. This is to afford an efficient and timely Board meeting, giving all attendees the opportunity to make their case. Speakers are prohibited from making personal attacks, and/or using coarse, crude, profane or vulgar language while speaking to the Board members, staff, the general public and/or meeting participants. Such behavior, at the discretion of the Board Chairman may result in removal from the Board Chambers by Sheriff Deputies.

**Riverside County Board of Supervisors
Request to Speak**

Submit request to Clerk of Board (right of podium),
Speakers are entitled to three (3) minutes, subject
to Board Rules listed on the reverse side of this form.

SPEAKER'S NAME: DARRELL VANCE, USFS

Address: 1147 E. 6TH ST.
(only if follow-up mail response requested)

City: CORONA **Zip:** 92879-1616

Phone #: 951-736-1811 x3236

Date: 7/14/14 **Agenda #** 9-1

PLEASE STATE YOUR POSITION BELOW:

Position on "Regular" (non-appealed) Agenda Item:

Support Oppose Neutral

~~(APPEAL TO BOARD OF SUPERVISORS)~~

Note: If you are here for an agenda item that is filed
for "Appeal", please state separately your position on
the appeal below:

Support Oppose Neutral

I give my 3 minutes to: _____

BOARD RULES

Requests to Address Board on "Agenda" Items:

You may request to be heard on a published agenda item. Requests to be heard must be submitted to the Clerk of the Board before the scheduled meeting time.

Requests to Address Board on items that are "NOT" on the Agenda:

Notwithstanding any other provisions of these rules, member of the public shall have the right to address the Board during the mid-morning "Oral Communications" segment of the published agenda. Said purpose for address must pertain to issues which are under the direct jurisdiction of the Board of Supervisors. YOUR TIME WILL BE LIMITED TO THREE (3) MINUTES.

Power Point Presentations/Printed Material:

Speakers who intend to conduct a formalized Power Point presentation or provide printed material must notify the Clerk of the Board's Office by 12 noon on the Monday preceding the Tuesday Board meeting, insuring that the Clerk's Office has sufficient copies of all printed materials and at least one (1) copy of the Power Point CD. Copies of printed material given to the Clerk (by Monday noon deadline) will be provided to each Supervisor. If you have the need to use the overhead "Elmo" projector at the Board meeting, please insure your material is clear and with proper contrast, notifying the Clerk well ahead of the meeting, of your intent to use the Elmo.

Individual Speaker Limits:

Individual speakers are limited to a maximum of three (3) minutes. Please step up to the podium when the Chairman calls your name and begin speaking immediately. Pull the microphone to your mouth so that the Board, audience, and audio recording system hear you clearly. Once you start speaking, the "green" podium light will light. The "yellow" light will come on when you have one (1) minute remaining. When you have 30 seconds remaining, the "yellow" light will begin flash, indicating you must quickly wrap up your comments. Your time is up when the "red" light flashes. The Chairman adheres to a strict three (3) minutes per speaker. **Note: If you intend to give your time to a "Group/Organized Presentation", please state so clearly at the very bottom of the reverse side of this form.**

Group/Organized Presentations:

Group/organized presentations with more than one (1) speaker will be limited to nine (9) minutes at the Chairman's discretion. The organizer of the presentation will automatically receive the first three (3) minutes, with the remaining six (6) minutes relinquished by other speakers, as requested by them on a completed "Request to Speak" form, and clearly indicated at the front bottom of the form.

Addressing the Board & Acknowledgement by Chairman:

The Chairman will determine what order the speakers will address the Board, and will call on all speakers in pairs. The first speaker should immediately step to the podium and begin addressing the Board. The second speaker should take up a position in one of the chamber aisles in order to quickly step up to the podium after the preceding speaker. This is to afford an efficient and timely Board meeting, giving all attendees the opportunity to make their case. Speakers are prohibited from making personal attacks, and/or using coarse, crude, profane or vulgar language while speaking to the Board members, staff, the general public and/or meeting participants. Such behavior, at the discretion of the Board Chairman may result in removal from the Board Chambers by Sheriff Deputies.

**Riverside County Board of Supervisors
Request to Speak**

Submit request to Clerk of Board (right of podium),
Speakers are entitled to three (3) minutes, subject
to Board Rules listed on the reverse side of this form.

SPEAKER'S NAME: STEVE EASTWOOD

Address: _____
(only if follow-up mail response requested)

City: _____ **Zip:** _____

Phone #: 760-310-2663

Date: JAN 14, 2014 **Agenda #** 9-1 ^{PUBLIC HEARING} RES 2014029

PLEASE STATE YOUR POSITION BELOW:

Position on "Regular" (non-appealed) Agenda Item:

Support Oppose Neutral

Note: If you are here for an agenda item that is filed
for "Appeal", please state separately your position on
the appeal below:

Support Oppose Neutral

I give my 3 minutes to: _____

BOARD RULES

Requests to Address Board on "Agenda" Items:

You may request to be heard on a published agenda item. Requests to be heard must be submitted to the Clerk of the Board before the scheduled meeting time.

Requests to Address Board on items that are "NOT" on the Agenda:

Notwithstanding any other provisions of these rules, member of the public shall have the right to address the Board during the mid-morning "Oral Communications" segment of the published agenda. Said purpose for address must pertain to issues which are under the direct jurisdiction of the Board of Supervisors. YOUR TIME WILL BE LIMITED TO THREE (3) MINUTES.

Power Point Presentations/Printed Material:

Speakers who intend to conduct a formalized Power Point presentation or provide printed material must notify the Clerk of the Board's Office by 12 noon on the Monday preceding the Tuesday Board meeting, insuring that the Clerk's Office has sufficient copies of all printed materials and at least one (1) copy of the Power Point CD. Copies of printed material given to the Clerk (by Monday noon deadline) will be provided to each Supervisor. If you have the need to use the overhead "Elmo" projector at the Board meeting, please insure your material is clear and with proper contrast, notifying the Clerk well ahead of the meeting, of your intent to use the Elmo.

Individual Speaker Limits:

Individual speakers are limited to a maximum of three (3) minutes. Please step up to the podium when the Chairman calls your name and begin speaking immediately. Pull the microphone to your mouth so that the Board, audience, and audio recording system hear you clearly. Once you start speaking, the "green" podium light will light. The "yellow" light will come on when you have one (1) minute remaining. When you have 30 seconds remaining, the "yellow" light will begin flash, indicating you must quickly wrap up your comments. Your time is up when the "red" light flashes. The Chairman adheres to a strict three (3) minutes per speaker. **Note: If you intend to give your time to a "Group/Organized Presentation", please state so clearly at the very bottom of the reverse side of this form.**

Group/Organized Presentations:

Group/organized presentations with more than one (1) speaker will be limited to nine (9) minutes at the Chairman's discretion. The organizer of the presentation will automatically receive the first three (3) minutes, with the remaining six (6) minutes relinquished by other speakers, as requested by them on a completed "Request to Speak" form, and clearly indicated at the front bottom of the form.

Addressing the Board & Acknowledgement by Chairman:

The Chairman will determine what order the speakers will address the Board, and will call on all speakers in pairs. The first speaker should immediately step to the podium and begin addressing the Board. The second speaker should take up a position in one of the chamber aisles in order to quickly step up to the podium after the preceding speaker. This is to afford an efficient and timely Board meeting, giving all attendees the opportunity to make their case. Speakers are prohibited from making personal attacks, and/or using coarse, crude, profane or vulgar language while speaking to the Board members, staff, the general public and/or meeting participants. Such behavior, at the discretion of the Board Chairman may result in removal from the Board Chambers by Sheriff Deputies.

**Riverside County Board of Supervisors
Request to Speak**

Submit request to Clerk of Board (right of podium),
Speakers are entitled to three (3) minutes, subject
to Board Rules listed on the reverse side of this form.

SPEAKER'S NAME: STEVEN CHRISTENSEN

Address: 10601 GEMINI DR.
(only if follow-up mail response requested)

City: REVERSIDE **Zip:** 92503

Phone #: (951) 785-1670

Date: 1-14-14 **Agenda #** 2013-249 ^{A-1}

PLEASE STATE YOUR POSITION BELOW:

Position on "Regular" (non-appealed) Agenda Item:

 Support Oppose Neutral

Note: If you are here for an agenda item that is filed
for "Appeal", please state separately your position on
the appeal below:

 Support Oppose Neutral

I give my 3 minutes to: _____

BOARD RULES

Requests to Address Board on "Agenda" Items:

You may request to be heard on a published agenda item. Requests to be heard must be submitted to the Clerk of the Board before the scheduled meeting time.

Requests to Address Board on items that are "NOT" on the Agenda:

Notwithstanding any other provisions of these rules, member of the public shall have the right to address the Board during the mid-morning "Oral Communications" segment of the published agenda. Said purpose for address must pertain to issues which are under the direct jurisdiction of the Board of Supervisors. YOUR TIME WILL BE LIMITED TO THREE (3) MINUTES.

Power Point Presentations/Printed Material:

Speakers who intend to conduct a formalized Power Point presentation or provide printed material must notify the Clerk of the Board's Office by 12 noon on the Monday preceding the Tuesday Board meeting, insuring that the Clerk's Office has sufficient copies of all printed materials and at least one (1) copy of the Power Point CD. Copies of printed material given to the Clerk (by Monday noon deadline) will be provided to each Supervisor. If you have the need to use the overhead "Elmo" projector at the Board meeting, please insure your material is clear and with proper contrast, notifying the Clerk well ahead of the meeting, of your intent to use the Elmo.

Individual Speaker Limits:

Individual speakers are limited to a maximum of three (3) minutes. Please step up to the podium when the Chairman calls your name and begin speaking immediately. Pull the microphone to your mouth so that the Board, audience, and audio recording system hear you clearly. Once you start speaking, the "green" podium light will light. The "yellow" light will come on when you have one (1) minute remaining. When you have 30 seconds remaining, the "yellow" light will begin flash, indicating you must quickly wrap up your comments. Your time is up when the "red" light flashes. The Chairman adheres to a strict three (3) minutes per speaker. **Note: If you intend to give your time to a "Group/Organized Presentation", please state so clearly at the very bottom of the reverse side of this form.**

Group/Organized Presentations:

Group/organized presentations with more than one (1) speaker will be limited to nine (9) minutes at the Chairman's discretion. The organizer of the presentation will automatically receive the first three (3) minutes, with the remaining six (6) minutes relinquished by other speakers, as requested by them on a completed "Request to Speak" form, and clearly indicated at the front bottom of the form.

Addressing the Board & Acknowledgement by Chairman:

The Chairman will determine what order the speakers will address the Board, and will call on all speakers in pairs. The first speaker should immediately step to the podium and begin addressing the Board. The second speaker should take up a position in one of the chamber aisles in order to quickly step up to the podium after the preceding speaker. This is to afford an efficient and timely Board meeting, giving all attendees the opportunity to make their case. Speakers are prohibited from making personal attacks, and/or using coarse, crude, profane or vulgar language while speaking to the Board members, staff, the general public and/or meeting participants. Such behavior, at the discretion of the Board Chairman may result in removal from the Board Chambers by Sheriff Deputies.

**Riverside County Board of Supervisors
Request to Speak**

Submit request to Clerk of Board (right of podium),
Speakers are entitled to three (3) minutes, subject
to Board Rules listed on the reverse side of this form.

SPEAKER'S NAME: MARK DEVOSS

Address: 3525 Rawley St.
(only if follow-up mail response requested)

City: Corona **Zip:** 92882

Phone #: 714-305-4220 91
Date: 1/14/14 **Agenda #** TRAIL ANDGATE
SKYLINE TRAIL

PLEASE STATE YOUR POSITION BELOW:

Position on "Regular" (non-appealed) Agenda Item:

Support Oppose Neutral

Note: If you are here for an agenda item that is filed
for "Appeal", please state separately your position on
the appeal below:

Support Oppose Neutral

I give my 3 minutes to: _____

BOARD RULES

Requests to Address Board on "Agenda" Items:

You may request to be heard on a published agenda item. Requests to be heard must be submitted to the Clerk of the Board before the scheduled meeting time.

Requests to Address Board on items that are "NOT" on the Agenda:

Notwithstanding any other provisions of these rules, member of the public shall have the right to address the Board during the mid-morning "Oral Communications" segment of the published agenda. Said purpose for address must pertain to issues which are under the direct jurisdiction of the Board of Supervisors. YOUR TIME WILL BE LIMITED TO THREE (3) MINUTES.

Power Point Presentations/Printed Material:

Speakers who intend to conduct a formalized Power Point presentation or provide printed material must notify the Clerk of the Board's Office by 12 noon on the Monday preceding the Tuesday Board meeting, insuring that the Clerk's Office has sufficient copies of all printed materials and at least one (1) copy of the Power Point CD. Copies of printed material given to the Clerk (by Monday noon deadline) will be provided to each Supervisor. If you have the need to use the overhead "Elmo" projector at the Board meeting, please insure your material is clear and with proper contrast, notifying the Clerk well ahead of the meeting, of your intent to use the Elmo.

Individual Speaker Limits:

Individual speakers are limited to a maximum of three (3) minutes. Please step up to the podium when the Chairman calls your name and begin speaking immediately. Pull the microphone to your mouth so that the Board, audience, and audio recording system hear you clearly. Once you start speaking, the "green" podium light will light. The "yellow" light will come on when you have one (1) minute remaining. When you have 30 seconds remaining, the "yellow" light will begin flash, indicating you must quickly wrap up your comments. Your time is up when the "red" light flashes. The Chairman adheres to a strict three (3) minutes per speaker. **Note: If you intend to give your time to a "Group/Organized Presentation", please state so clearly at the very bottom of the reverse side of this form.**

Group/Organized Presentations:

Group/organized presentations with more than one (1) speaker will be limited to nine (9) minutes at the Chairman's discretion. The organizer of the presentation will automatically receive the first three (3) minutes, with the remaining six (6) minutes relinquished by other speakers, as requested by them on a completed "Request to Speak" form, and clearly indicated at the front bottom of the form.

Addressing the Board & Acknowledgement by Chairman:

The Chairman will determine what order the speakers will address the Board, and will call on all speakers in pairs. The first speaker should immediately step to the podium and begin addressing the Board. The second speaker should take up a position in one of the chamber aisles in order to quickly step up to the podium after the preceding speaker. This is to afford an efficient and timely Board meeting, giving all attendees the opportunity to make their case. Speakers are prohibited from making personal attacks, and/or using coarse, crude, profane or vulgar language while speaking to the Board members, staff, the general public and/or meeting participants. Such behavior, at the discretion of the Board Chairman may result in removal from the Board Chambers by Sheriff Deputies.

Riverside County Board of Supervisors
Request to Speak

6min.

Submit request to Clerk of Board (right of podium),
Speakers are entitled to three (3) minutes, subject
to Board Rules listed on the reverse side of this form.

SPEAKER'S NAME: Larry D Boathe

Address: 17682 Kennon Drive
(only if follow-up mail response requested)

City: Yerba Linda **Zip:** CA

Phone #: (714) 927-745-3790

Date: 1-14-14 **Agenda #:** Resolution 2013-249
9-1

PLEASE STATE YOUR POSITION BELOW:

Position on "Regular" (non-appealed) Agenda Item:
 Support Oppose Neutral

Note: If you are here for an agenda item that is filed
for "Appeal", please state separately your position on
the appeal below:

 Support Oppose Neutral

I give my 3 minutes to: _____

BOARD RULES

Requests to Address Board on "Agenda" Items:

You may request to be heard on a published agenda item. Requests to be heard must be submitted to the Clerk of the Board before the scheduled meeting time.

Requests to Address Board on items that are "NOT" on the Agenda:

Notwithstanding any other provisions of these rules, member of the public shall have the right to address the Board during the mid-morning "Oral Communications" segment of the published agenda. Said purpose for address must pertain to issues which are under the direct jurisdiction of the Board of Supervisors. YOUR TIME WILL BE LIMITED TO THREE (3) MINUTES.

Power Point Presentations/Printed Material:

Speakers who intend to conduct a formalized Power Point presentation or provide printed material must notify the Clerk of the Board's Office by 12 noon on the Monday preceding the Tuesday Board meeting, insuring that the Clerk's Office has sufficient copies of all printed materials and at least one (1) copy of the Power Point CD. Copies of printed material given to the Clerk (by Monday noon deadline) will be provided to each Supervisor. If you have the need to use the overhead "Elmo" projector at the Board meeting, please insure your material is clear and with proper contrast, notifying the Clerk well ahead of the meeting, of your intent to use the Elmo.

Individual Speaker Limits:

Individual speakers are limited to a maximum of three (3) minutes. Please step up to the podium when the Chairman calls your name and begin speaking immediately. Pull the microphone to your mouth so that the Board, audience, and audio recording system hear you clearly. Once you start speaking, the "green" podium light will light. The "yellow" light will come on when you have one (1) minute remaining. When you have 30 seconds remaining, the "yellow" light will begin flash, indicating you must quickly wrap up your comments. Your time is up when the "red" light flashes. The Chairman adheres to a strict three (3) minutes per speaker. **Note: If you intend to give your time to a "Group/Organized Presentation", please state so clearly at the very bottom of the reverse side of this form.**

Group/Organized Presentations:

Group/organized presentations with more than one (1) speaker will be limited to nine (9) minutes at the Chairman's discretion. The organizer of the presentation will automatically receive the first three (3) minutes, with the remaining six (6) minutes relinquished by other speakers, as requested by them on a completed "Request to Speak" form, and clearly indicated at the front bottom of the form.

Addressing the Board & Acknowledgement by Chairman:

The Chairman will determine what order the speakers will address the Board, and will call on all speakers in pairs. The first speaker should immediately step to the podium and begin addressing the Board. The second speaker should take up a position in one of the chamber aisles in order to quickly step up to the podium after the preceding speaker. This is to afford an efficient and timely Board meeting, giving all attendees the opportunity to make their case. Speakers are prohibited from making personal attacks, and/or using coarse, crude, profane or vulgar language while speaking to the Board members, staff, the general public and/or meeting participants. Such behavior, at the discretion of the Board Chairman may result in removal from the Board Chambers by Sheriff Deputies.

**Riverside County Board of Supervisors
Request to Speak**

Submit request to Clerk of Board (right of podium),
Speakers are entitled to three (3) minutes, subject
to Board Rules listed on the reverse side of this form.

SPEAKER'S NAME: Larry Best Johnson

Address: 8519 Oakwood Ave
(only if follow-up mail response requested)

City: Highland **Zip:** 92345

Phone #: 760 403-2704

Date: 1-14-14 **Agenda #** 9-1

PLEASE STATE YOUR POSITION BELOW:

Position on "Regular" (non-appealed) Agenda Item:

Support Oppose Neutral

Note: If you are here for an agenda item that is filed
for "Appeal", please state separately your position on
the appeal below:

Support Oppose Neutral

I give my 3 minutes to: Larry Best

BOARD RULES

Requests to Address Board on "Agenda" Items:

You may request to be heard on a published agenda item. Requests to be heard must be submitted to the Clerk of the Board before the scheduled meeting time.

Requests to Address Board on items that are "NOT" on the Agenda:

Notwithstanding any other provisions of these rules, member of the public shall have the right to address the Board during the mid-morning "Oral Communications" segment of the published agenda. Said purpose for address must pertain to issues which are under the direct jurisdiction of the Board of Supervisors. YOUR TIME WILL BE LIMITED TO THREE (3) MINUTES.

Power Point Presentations/Printed Material:

Speakers who intend to conduct a formalized Power Point presentation or provide printed material must notify the Clerk of the Board's Office by 12 noon on the Monday preceding the Tuesday Board meeting, insuring that the Clerk's Office has sufficient copies of all printed materials and at least one (1) copy of the Power Point CD. Copies of printed material given to the Clerk (by Monday noon deadline) will be provided to each Supervisor. If you have the need to use the overhead "Elmo" projector at the Board meeting, please insure your material is clear and with proper contrast, notifying the Clerk well ahead of the meeting, of your intent to use the Elmo.

Individual Speaker Limits:

Individual speakers are limited to a maximum of three (3) minutes. Please step up to the podium when the Chairman calls your name and begin speaking immediately. Pull the microphone to your mouth so that the Board, audience, and audio recording system hear you clearly. Once you start speaking, the "green" podium light will light. The "yellow" light will come on when you have one (1) minute remaining. When you have 30 seconds remaining, the "yellow" light will begin flash, indicating you must quickly wrap up your comments. Your time is up when the "red" light flashes. The Chairman adheres to a strict three (3) minutes per speaker. **Note: If you intend to give your time to a "Group/Organized Presentation", please state so clearly at the very bottom of the reverse side of this form.**

Group/Organized Presentations:

Group/organized presentations with more than one (1) speaker will be limited to nine (9) minutes at the Chairman's discretion. The organizer of the presentation will automatically receive the first three (3) minutes, with the remaining six (6) minutes relinquished by other speakers, as requested by them on a completed "Request to Speak" form, and clearly indicated at the front bottom of the form.

Addressing the Board & Acknowledgement by Chairman:

The Chairman will determine what order the speakers will address the Board, and will call on all speakers in pairs. The first speaker should immediately step to the podium and begin addressing the Board. The second speaker should take up a position in one of the chamber aisles in order to quickly step up to the podium after the preceding speaker. This is to afford an efficient and timely Board meeting, giving all attendees the opportunity to make their case. Speakers are prohibited from making personal attacks, and/or using coarse, crude, profane or vulgar language while speaking to the Board members, staff, the general public and/or meeting participants. Such behavior, at the discretion of the Board Chairman may result in removal from the Board Chambers by Sheriff Deputies.

**Riverside County Board of Supervisors
Request to Speak**

Submit request to Clerk of Board (right of podium),
Speakers are entitled to three (3) minutes, subject
to Board Rules listed on the reverse side of this form.

SPEAKER'S NAME: Todd Stickle

Address: 7977 7079 Beechwood Way
(only if follow-up mail response requested)

City: Stanton **Zip:** 90680

Phone #: 714-754-4450

Date: 1-14-14 **Agenda #** 9-1

PLEASE STATE YOUR POSITION BELOW:

Position on "Regular" (non-appealed) Agenda Item:

Support Oppose Neutral

Note: If you are here for an agenda item that is filed
for "Appeal", please state separately your position on
the appeal below:

Support Oppose Neutral

I give my 3 minutes to: Larry Boothe
already has been given
max time.

BOARD RULES

Requests to Address Board on "Agenda" Items:

You may request to be heard on a published agenda item. Requests to be heard must be submitted to the Clerk of the Board before the scheduled meeting time.

Requests to Address Board on items that are "NOT" on the Agenda:

Notwithstanding any other provisions of these rules, member of the public shall have the right to address the Board during the mid-morning "Oral Communications" segment of the published agenda. Said purpose for address must pertain to issues which are under the direct jurisdiction of the Board of Supervisors. YOUR TIME WILL BE LIMITED TO THREE (3) MINUTES.

Power Point Presentations/Printed Material:

Speakers who intend to conduct a formalized Power Point presentation or provide printed material must notify the Clerk of the Board's Office by 12 noon on the Monday preceding the Tuesday Board meeting, insuring that the Clerk's Office has sufficient copies of all printed materials and at least one (1) copy of the Power Point CD. Copies of printed material given to the Clerk (by Monday noon deadline) will be provided to each Supervisor. If you have the need to use the overhead "Elmo" projector at the Board meeting, please insure your material is clear and with proper contrast, notifying the Clerk well ahead of the meeting, of your intent to use the Elmo.

Individual Speaker Limits:

Individual speakers are limited to a maximum of three (3) minutes. Please step up to the podium when the Chairman calls your name and begin speaking immediately. Pull the microphone to your mouth so that the Board, audience, and audio recording system hear you clearly. Once you start speaking, the "green" podium light will light. The "yellow" light will come on when you have one (1) minute remaining. When you have 30 seconds remaining, the "yellow" light will begin flash, indicating you must quickly wrap up your comments. Your time is up when the "red" light flashes. The Chairman adheres to a strict three (3) minutes per speaker. **Note: If you intend to give your time to a "Group/Organized Presentation", please state so clearly at the very bottom of the reverse side of this form.**

Group/Organized Presentations:

Group/organized presentations with more than one (1) speaker will be limited to nine (9) minutes at the Chairman's discretion. The organizer of the presentation will automatically receive the first three (3) minutes, with the remaining six (6) minutes relinquished by other speakers, as requested by them on a completed "Request to Speak" form, and clearly indicated at the front bottom of the form.

Addressing the Board & Acknowledgement by Chairman:

The Chairman will determine what order the speakers will address the Board, and will call on all speakers in pairs. The first speaker should immediately step to the podium and begin addressing the Board. The second speaker should take up a position in one of the chamber aisles in order to quickly step up to the podium after the preceding speaker. This is to afford an efficient and timely Board meeting, giving all attendees the opportunity to make their case. Speakers are prohibited from making personal attacks, and/or using coarse, crude, profane or vulgar language while speaking to the Board members, staff, the general public and/or meeting participants. Such behavior, at the discretion of the Board Chairman may result in removal from the Board Chambers by Sheriff Deputies.

**Riverside County Board of Supervisors
Request to Speak**

Submit request to Clerk of Board (right of podium),
Speakers are entitled to three (3) minutes, subject
to Board Rules listed on the reverse side of this form.

SPEAKER'S NAME: MIKE HARRISON

Address: _____
(only if follow-up mail response requested)

City: _____ **Zip:** _____

Phone #: 714-751-4420

Date: 1/14/14 **Agenda #** 9-1

PLEASE STATE YOUR POSITION BELOW:

Position on "Regular" (non-appealed) Agenda Item:
 Support **Oppose** **Neutral**

Note: If you are here for an agenda item that is filed
for "Appeal", please state separately your position on
the appeal below:

Support **Oppose** **Neutral**

I give my 3 minutes to: _____

BOARD RULES

Requests to Address Board on "Agenda" Items:

You may request to be heard on a published agenda item. Requests to be heard must be submitted to the Clerk of the Board before the scheduled meeting time.

Requests to Address Board on items that are "NOT" on the Agenda:

Notwithstanding any other provisions of these rules, member of the public shall have the right to address the Board during the mid-morning "Oral Communications" segment of the published agenda. Said purpose for address must pertain to issues which are under the direct jurisdiction of the Board of Supervisors. YOUR TIME WILL BE LIMITED TO THREE (3) MINUTES.

Power Point Presentations/Printed Material:

Speakers who intend to conduct a formalized Power Point presentation or provide printed material must notify the Clerk of the Board's Office by 12 noon on the Monday preceding the Tuesday Board meeting, insuring that the Clerk's Office has sufficient copies of all printed materials and at least one (1) copy of the Power Point CD. Copies of printed material given to the Clerk (by Monday noon deadline) will be provided to each Supervisor. If you have the need to use the overhead "Elmo" projector at the Board meeting, please insure your material is clear and with proper contrast, notifying the Clerk well ahead of the meeting, of your intent to use the Elmo.

Individual Speaker Limits:

Individual speakers are limited to a maximum of three (3) minutes. Please step up to the podium when the Chairman calls your name and begin speaking immediately. Pull the microphone to your mouth so that the Board, audience, and audio recording system hear you clearly. Once you start speaking, the "green" podium light will light. The "yellow" light will come on when you have one (1) minute remaining. When you have 30 seconds remaining, the "yellow" light will begin flash, indicating you must quickly wrap up your comments. Your time is up when the "red" light flashes. The Chairman adheres to a strict three (3) minutes per speaker. **Note: If you intend to give your time to a "Group/Organized Presentation", please state so clearly at the very bottom of the reverse side of this form.**

Group/Organized Presentations:

Group/organized presentations with more than one (1) speaker will be limited to nine (9) minutes at the Chairman's discretion. The organizer of the presentation will automatically receive the first three (3) minutes, with the remaining six (6) minutes relinquished by other speakers, as requested by them on a completed "Request to Speak" form, and clearly indicated at the front bottom of the form.

Addressing the Board & Acknowledgement by Chairman:

The Chairman will determine what order the speakers will address the Board, and will call on all speakers in pairs. The first speaker should immediately step to the podium and begin addressing the Board. The second speaker should take up a position in one of the chamber aisles in order to quickly step up to the podium after the preceding speaker. This is to afford an efficient and timely Board meeting, giving all attendees the opportunity to make their case. Speakers are prohibited from making personal attacks, and/or using coarse, crude, profane or vulgar language while speaking to the Board members, staff, the general public and/or meeting participants. Such behavior, at the discretion of the Board Chairman may result in removal from the Board Chambers by Sheriff Deputies.

MINUTES OF THE BOARD OF SUPERVISORS
COUNTY OF RIVERSIDE, STATE OF CALIFORNIA



9-2

9:30 a.m. being the time set for public hearing on the recommendation from Transportation & Land Management Agency/Transportation regarding Public Hearing on the Adoption of Resolution 2013-250, Authorization to Terminate the Maintenance of Skyline Drive from the Corona City limits westerly to the Orange-Riverside Counties boundary line, in the Corona area, 2nd/2nd District, the chairman called the matter for hearing.

On motion of Supervisor Benoit, seconded by Supervisor Jeffries and duly carried, IT WAS ORDERED that the above matter is continued to Tuesday, January 14, 2014 at 9:30 a.m.

Roll Call:

Ayes: Jeffries, Benoit and Ashley
Nays: None
Absent: Tavaglione and Stone

I hereby certify that the foregoing is a full true, and correct copy of an order made and entered on December 17, 2013 of Supervisors Minutes.

(seal)

WITNESS my hand and the seal of the Board of Supervisors
Dated: December 17, 2013
Kecia Harper-Ihem, Clerk of the Board of Supervisors, in
and for the County of Riverside, State of California.

By: [Signature] Deputy

AGENDA NO.

xc: Transp., COB

01.14.2014

9-1

**SUBMITTAL TO THE BOARD OF SUPERVISORS
COUNTY OF RIVERSIDE, STATE OF CALIFORNIA**



FROM: TLMA - Transportation Department

SUBMITTAL DATE:
December 24, 2013

SUBJECT: Resolution No. 2013-250, Authorization to Terminate the Maintenance of Skyline Drive from the Corona City Limits Westerly to the Orange-Riverside Counties Boundary Line in the Corona Area; California Environmental Quality Act Exempt. 2nd/2nd District. [-\$10,000 Gas Tax 100%]

RECOMMENDED MOTION: That the Board of Supervisors:

1. Find that this action is categorically exempt from the California Environmental Quality Act (CEQA) pursuant to CEQA Guidelines Section 15301; and
2. Adopt Resolution No. 2013-250, Authorization to Terminate the Maintenance of Skyline Drive from the Corona city limits westerly to the Orange-Riverside Counties boundary line; and
3. Direct the Clerk of the Board to submit the Notice of Exemption to the County Clerk-Recorder for posting upon approval of this action.

Patricia Romo
Assistant Director of Transportation

Juan C. Perez
Director of Transportation and
Land Management

FORM APPROVED COUNTY COUNSEL
BY: Synthia M. Gunzel 12-16-13
SYNTHIA M. GUNZEL
DATE: 12-16-13
Departmental Concurrence

FINANCIAL DATA	Current Fiscal Year:	Next Fiscal Year:	Total Cost:	Ongoing Cost:	POLICY/CONSENT (Per Exec. Office)
COST	\$ -5,000	\$ -10,000	\$ N/A	\$ [10,000]	Consent <input type="checkbox"/> Policy <input checked="" type="checkbox"/>
NET COUNTY COST	\$ 0	\$ 0	\$ 0	\$ 0	

SOURCE OF FUNDS: N/A

Budget Adjustment: No

For Fiscal Year: N/A

C.E.O. RECOMMENDATION:

APPROVE

BY:
Tina Grande

County Executive Office Signature

MINUTES OF THE BOARD OF SUPERVISORS

- A-30
- 4/5 Vote
- Positions Added
- Change Order

Prev. Agn. Ref: 11/26/13, Item 3-48

District: 2/2

Agenda Number:

**SUBMITTAL TO THE BOARD OF SUPERVISORS
COUNTY OF RIVERSIDE, STATE OF CALIFORNIA**

410A



FROM: TLMA - Transportation Department

SUBMITTAL DATE:
November 14, 2013

SUBJECT: Resolution No. 2013-249, Notice of Intention to Terminate the Maintenance of Skyline Drive from the Corona City limits westerly to the Orange-Riverside Counties boundary line, in the Corona area, Setting Public Hearing, 2nd/2nd District. [-\$10,000.00, Local Funds 100%]

RECOMMENDED MOTION: That the Board of Supervisors:

1. Adopt Resolution No. 2013-249, Notice of Intention to Terminate the Maintenance of Skyline Drive from the Corona City limits westerly to the Riverside County boundary line; and
2. Schedule a public hearing in regular session assembled on December 17, 2013, pursuant to Section 954.5 of the Streets and Highways Code, that it is this Board's Intention to Terminate the Maintenance of Skyline Drive from the Corona City limits westerly to the Orange-Riverside Counties boundary line.

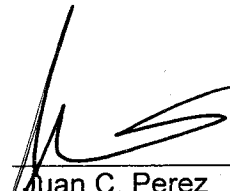
Juan C. Perez
Director of Transportation and Land Management

FINANCIAL DATA	Current Fiscal Year:	Next Fiscal Year:	Total Cost:	Ongoing Cost:	POLICY/CONSENT (per Exec. Office)
COST	\$ 5,000	\$ N/A	\$ N/A	\$ [10,000.00]	Consent <input type="checkbox"/> Policy <input checked="" type="checkbox"/>
NET COUNTY COST	\$ 0	\$ 0	\$ 0	\$ 0	
SOURCE OF FUNDS: Gas Tax (100%) There are no General Funds used in this project.				Budget Adjustment: No	
				For Fiscal Year: 2013/14	

C.E.O. RECOMMENDATION:

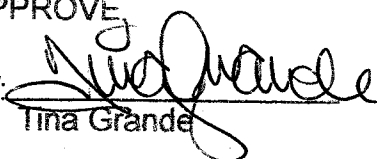
APPROVE
BY: 
Tina Grande

County Executive Office Signature

MINUTES OF THE BOARD OF SUPERVISORS

On motion of Supervisor Benoit, seconded by Supervisor Ashley and duly carried by unanimous vote, IT WAS ORDERED that the above matter is approved as recommended and is set for hearing on December 17, 2013 at 9:30 a.m.

Ayes: Jeffries, Tavaglione, Stone, Benoit and Ashley
Nays: None
Absent: None
Date: November 26, 2013

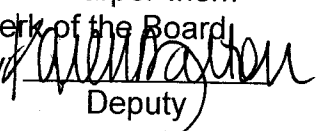
Kecia Harper-Ihem
Clerk of the Board
By: 
Deputy

Prev. Agn. Ref.: | District: 2/2 | Agenda Number:

FORM APPROVED COUNTY COUNSEL
BY: 
DATE: 11-5-13
CYNTHIA M. GUNZEL

Departmental Concurrence

- A-30
- Positions Added
- 4/5 Vote
- Change Order

SUBMITTAL TO THE BOARD OF SUPERVISORS, COUNTY OF RIVERSIDE, STATE OF CALIFORNIA
FORM 11: Resolution No. 2013-249, Notice of Intention to Terminate the Maintenance of Skyline Drive
from the Corona City limits westerly to the Orange-Riverside Counties boundary line, in the Corona area,
Setting Public Hearing, 2nd/2nd District, [-\$10,000.00, Local Funds 100%]

DATE: November 14, 2013

Page 2 of 3

BACKGROUND:

Summary

The Transportation Department is recommending that maintenance be terminated on Skyline Drive from the Orange-Riverside Counties Boundary line to the City limits of the City of Corona, approximately 24,710 feet, or 4.68 miles in length. Skyline Drive is an isolated road that is not contiguous to any county maintained road, and is not a commuter thoroughfare. Skyline Drive is a narrow, circuitous dirt road, with many blind curves and steep up and down segments, that is difficult to navigate by conventional motor vehicles. The road does not provide primary access to any occupied properties, and traffic on the road is intermittent and of low volume, and is controlled by a gate. The Transportation Department finds Skyline Drive unnecessary for the public convenience as a transportation route and requests that maintenance be terminated.

There is a trail head approximately one mile from the gate. Past that point, the road essentially functions as about a four mile long cul-de-sac providing access to cell tower installations in Orange County, and as a trail for hikers and bicyclists on U.S. Forest Service land. It is the Transportation Department's opinion that the responsibility of future maintenance of Skyline Drive should fall to the U. S. Forest Service and/or the owners of the cell tower property, for them to operate the road as they deem appropriate.

An unsigned copy of an agreement dated December 13, 1926 by and between the Board of Supervisors of Riverside County, California, and the District Forester, Forest Service, (District 5), United States Department of Agriculture, under and pursuant to the provisions of Section 23 of the Act of November 9, 1921 (Public No. 87), known as the Federal Highway Act, purportedly covered the construction of a road, referenced as Corona-Black Star Canyon Road, from the east forest boundary to Riverside County's west boundary line, and the County agreed to assume maintenance of the constructed road commencing January 1, 1928. This 1926 Agreement did not contain a term period.

On February 24, 1948, the Board of Supervisors for the County of Riverside adopted a Resolution that adopted a primary system of County Roads of the County of Riverside and a map that established the Maintained County Road System (the "1948 Road Book"). Skyline Drive was included within the 1948 Road Book under the designation of "other county maintained roads".

On December 12, 1978, the County and the Forest Service entered into that certain Forest Development Road Cooperative Agreement whereby the parties agreed to work cooperatively to develop and maintain forest roads, subject to the availability of funds, and identified Skyline Drive as Forest Road No. 4S01. The Forest Service has communicated to the Transportation Department a desire for a forest road to provide access to the Cleveland National Forest and to serve a federal interest. This 1978 Agreement could be terminated by either party upon a 90 days advance notice. Notwithstanding these agreements with the Forest Service, the County had always maintained its discretionary powers to supervise, manage and control any of its rights-of-way under the law.

In 1982, Orange County closed the portion of Skyline Drive within its jurisdiction, named "Black Star Canyon Road", with a massive gate and barricade after repeated concerns for public safety, high fire hazards, and road failures due to storm damage. On May 27, 1987, the Orange County Board of Supervisors terminated maintenance of Black Star Canyon Road by Resolution No. 87-732.

SUBMITTAL TO THE BOARD OF SUPERVISORS, COUNTY OF RIVERSIDE, STATE OF CALIFORNIA
FORM 11: Resolution No. 2013-249, Notice of Intention to Terminate the Maintenance of Skyline Drive
from the Corona City limits westerly to the Orange-Riverside Counties boundary line, in the Corona area,
Setting Public Hearing, 2nd/2nd District, [-\$10,000.00, Local Funds 100%]

DATE: November 14, 2013

Page 3 of 3

On February 25, 1986, the Riverside County Board of Supervisors adopted Resolution No. 86-04 which restricted the use of Skyline Drive from the Orange-Riverside Counties Boundary line to the City Limits of the City of Corona. The Board determined that it was necessary for the safety of the traveling public to close and restrict the use of Skyline Drive. According to the Resolution, tragic accidents resulting in fatal and seriously disabling injuries were occurring on a regular and chronic basis to vehicle users of Skyline Drive prior to that time. Attempts to post Skyline Drive with signs and devices warning of the dangers were unsuccessful as they were being vandalized due to destruction and theft, and funding was not available to substantially improve the road. A gate with a locking mechanism was placed at the southwest boundary of the City of Corona City limits to restrict use of the road to those with a pass key. Pass keys were issued to police, fire, emergency, public utilities, governmental agencies, persons owning or leasing property between the gate and the Orange-Riverside Counties Boundary line and those deemed to have an appropriate need as determined by the Road Commissioner (now the Director of Transportation and Land Management).

About a year ago the Transportation Department was contacted by representatives from the Homeowner's Association adjacent to the gate, in the City of Corona, requesting that the County more closely manage the issuance of keys. The gate was being left open frequently and traffic was increasing, particularly at night. The Department conducted an assessment of our key issuance and found that over 1,000 keys had been issued over the years, essentially upon request. We then changed the locks on the gate and restricted key issuance to property owners, Forest Service, and emergency service providers. We have been approached by members of the public that would like for the County to continue to issue keys upon request. However, it is the Department's position that the road is not safe for unrestricted public access, and opening it for unrestricted access would create a liability for the County, and a situation where vehicles compete with hikers and bicyclists for limited space on a very narrow winding road. Since this road really functions as an access road to U. S. Forest Service land, it is the Department's position that the Forest Service should be responsible for the operations, maintenance, and liability associated with road, in concert with other users that own parcels accessed by the road.

Impact on Citizens and Businesses

The termination of maintenance of Skyline Drive would not impact the ability of citizens or businesses to access the area. Access would be managed by the U.S. Forest Service.

SUPPLEMENTAL:

Additional Fiscal Information

A review of the maintenance cost for the last five years shows that the Transportation Department will see a realized maintenance cost savings for the road and gate of approximately \$10,000.00 annually.

Contract History and Price Reasonableness

N/A

Attachments

Resolution No. 2013-249
Exhibit A – 2 pages

1 **RESOLUTION NO. 2013-249**

2
3 **BE IT RESOLVED, FOUND, DETERMINED AND ORDERED** by the Board of
4 Supervisors of the County of Riverside, State of California, in regular session assembled on
5 November 26, 2013, pursuant to Section 954.5 of the Streets and Highways
6 Code, that it is the intention of this Board to terminate, as unnecessary for the public
7 convenience, the maintenance of Skyline Drive in Sections 8, 9, and 10, T4S, R7W, S.B.M., in
8 the County of Riverside, State of California;

9 **BE IT FURTHER RESOLVED** that a public hearing on this Resolution will be held on
10 December 17, 2013 in the meeting room of the Board of Supervisors of the County of
11 Riverside at the Administrative Center, 4080 Lemon Street, Riverside, California, at which time
12 and place the Board will hear and consider the evidence that Skyline Drive in Sections 8, 9 and
13 10, T4S, R7W, S.B.M., approximately 24,710 feet or 4.68 miles in length, is unnecessary to the
14 public convenience, and any additional evidence offered by persons interested therein,
15 permitting the Riverside County Transportation Department to terminate the maintenance of it;

16 **BE IT FURTHER RESOLVED** that a notice of the hearing shall be posted and mailed as
17 required by the Streets and Highways Code Section 954.5;

18 **BE IT FURTHER RESOLVED, DETERMINED AND ORDERED** that the Clerk of the
19 Board is directed to cause this Resolution to be published pursuant to Section 8322(a) and the
20 Transportation Director shall cause notice of hearing to be posted pursuant to Section 8323 of
21 the Streets and Highway Code.

22 ROLL CALL:

23 Ayes: Jeffries, Tavaglione, Stone, Benoit and Ashley
24 Nays: None
25 Absent: None

26 The foregoing is certified to be a true copy of a resolution duly
27 adopted by said Board of Supervisors on the date therein set forth.

28 KECLIA HARPER-IHEM, Clerk of said Board
By  Deputy



N.T.S.
T.4S, R.7W
SECTIONS 8, 9, 10
S.B.M.

EXHIBIT "A"

Termination of Maintenance of Skyline Drive

CITY OF CORONA

SKYLINE DRIVE
See sheet 2 of 2

Section 8

Section 9

Section 10

Gates

Gate

RIVERSIDE COUNTY

BLACK STAR CANYON ROAD

MAIN DIVIDE

TRUCK TRAIL

ORANGE COUNTY

Gate

E. SANTIAGO CANYON ROAD

SILVERADO CANYON ROAD



EXHIBIT "A"

N.T.S.
T. 4S, R. 7W
SECTIONS 8, 9 & 10
S.B.M.

Termination of Maintenance of Skyline Drive

CITY OF CORONA

CAPE DR
T. 4S, R. 7W
3
STONEWALL DR
CHASE DR

Limits of Termination of Maintenance
Approx. 24,710 feet or 4.68 miles

SKYLINE DRIVE

SKYLINE DRIVE

Section 8

T. 4S, R. 7W.
Section 9

Gate

Section 10

CLEVELAND NATIONAL FOREST



OFFICE OF
CLERK OF THE BOARD OF SUPERVISORS
1st FLOOR, COUNTY ADMINISTRATIVE CENTER
P.O. BOX 1147, 4080 LEMON STREET
RIVERSIDE, CA 92502-1147
PHONE: (951) 955-1060
FAX: (951) 955-1071

KECIA HARPER-IHEM
Clerk of the Board of Supervisors

KIMBERLY A. RECTOR
Assistant Clerk of the Board

December 3, 2013

RIVERSIDE COUNTY RECORD
ATTN: LEGALS
P.O. BOX 3187
RIVERSIDE, CA 92519

FAX: (951) 685-2961
E-MAIL: recordmde@aol.com

**RE: NOTICE OF PUBLIC HEARING: RESOLUTION 2013-249 INTENT TO TERMINATE
MAINTENANCE OF SKYLINE DRIVE**

To Whom It May Concern:

Attached is a copy for publication in your newspaper for **TWO (2) TIMES** on two Thursdays:
December 5 and 12, 2013.

We require your affidavit of publication immediately upon completion of the last publication.

Your invoice must be submitted to this office in duplicate, WITH TWO CLIPPINGS OF THE
PUBLICATION.

NOTE: PLEASE COMPOSE THIS PUBLICATION INTO A SINGLE COLUMN
FORMAT.

Thank you in advance for your assistance and expertise.

Sincerely,

Cecilia Gil

Board Assistant to:
KECIA HARPER-IHEM, CLERK OF THE BOARD

Gil, Cecilia

From: Michael Evans <recordmde@aol.com>
Sent: Tuesday, December 03, 2013 11:04 AM
To: Gil, Cecilia
Subject: Re: FOR PUBLICATION: RES. 2013-249

Good Morning to You!

I have received the notice for publication.

Thanks much, Mike

-----Original Message-----

From: Gil, Cecilia <CCGIL@rcbos.org>

To: recordmde <recordmde@aol.com>

Sent: Tue, Dec 3, 2013 8:08 am

Subject: FOR PUBLICATION: RES. 2013-249

Good morning! Attached is a Notice of Public Hearing, for publication on Dec. 5 and Dec. 12, 2013. Please confirm.
THANK YOU!

Cecilia Gil
Board Assistant
Clerk of the Board
951-955-8464
MS# 1010

NOTICE OF PUBLIC HEARING BEFORE THE BOARD OF SUPERVISORS OF THE COUNTY OF RIVERSIDE

NOTICE IS HEREBY GIVEN that a public hearing at which all interested persons will be heard, will be held before the Board of Supervisors of Riverside County, California, on the 1st Floor, County Administrative Center, Board of Supervisors Chambers, 4080 Lemon Street, Riverside, on **Tuesday, December 17, 2013 at 9:30 a.m.** to consider the following:

RESOLUTION NO. 2013-249

**NOTICE OF INTENTION TO TERMINATE THE MAINTENANCE OF SKYLINE DRIVE FROM THE CITY LIMIT OF CORONA TO THE RIVERSIDE COUNTY LINE;
SETTING PUBLIC HEARING
(Second Supervisorial District)**

WHEREAS, the Board of Supervisors of the County of Riverside has the general supervision, management and control of County highways within the County of Riverside; and,
WHEREAS, the Board of Supervisors may terminate the maintenance of any County highway that it is in the public's interest to do so and upon the finding that the highway is unnecessary for the public convenience; and,

WHEREAS, pursuant to Section 954.5 of the Streets and Highways Code, a road may be deemed unnecessary for the public convenience when said road does not provide primary access to occupied properties and that traffic on said road is intermittent and of low volume; and,

WHEREAS, Skyline Drive is a narrow circuitous dirt road, with numerous blind curves, steep up and down segments, and is difficult to navigate by conventional motor vehicles; and,

WHEREAS, Skyline Drive is isolated and not contiguous to any county maintained road, and is only accessible through the City of Corona; and,

WHEREAS, Skyline Drive is not currently a commuter thoroughfare, nor is it projected to be one in the near future; and,

WHEREAS, there is no planned improvements for Skyline Drive or any planned funding arrangements for such improvements in the foreseeable future; and,

WHEREAS, it is the judgment of the Transportation Department that Skyline Drive that the maintenance of it should be terminated, now, therefore,

BE IT RESOLVED, FOUND, DETERMINED AND ORDERED by the Board of Supervisors of the County of Riverside, State of California, in regular session assembled on November 26, 2013, pursuant to Section 954.5 of the Streets and Highways Code, that it is the intention of this Board to terminate, as unnecessary for the public convenience, the maintenance of Skyline Drive in Sections 8, 9, and 10, T4S, R?W, S.B.M., in the County of Riverside, State of California;

BE IT FURTHER RESOLVED that a public hearing on this Resolution will be held on December 17, 2013, in the meeting room of the Board of Supervisors of the County of Riverside at the Administrative Center, 4080 Lemon Street, Riverside, California, at which time and place the Board will hear and consider the evidence that Skyline Drive in Sections 8, 9 and 10, T4S, R?W, S.B.M., approximately 24,710 feet or 4.68 miles in length; is unnecessary to the public convenience, and any additional evidence offered by persons interested therein, permitting the Riverside County Transportation Department to terminate the maintenance of it;

BE IT FURTHER RESOLVED that a notice of the hearing shall be posted and mailed as required by the Streets and Highways Code Section 954.5;

BE IT FURTHER RESOLVED, DETERMINED AND ORDERED that the Clerk of the Board is directed to cause this Resolution to be published pursuant to Section 8322(a) and the Transportation Director shall cause notice of hearing to be posted pursuant to Section 8323 of the Streets and Highway Code.

ROLL CALL:

AYES: Jeffries, Tavaglione, Stone, Benoit, and Ashley
NAYS: None
ABSENT: None

The foregoing is certified to be a true copy of a resolution duly adopted by said Board of Supervisors on November 26, 2013.

Kecia Harper-Ihem, Clerk of said Board
By: Cecilia Gil, Board Assistant

Any person affected by the above matter(s) may submit written comments to the Clerk of the Board before the public hearing or may appear and be heard in support of or opposition to the project at the time of the hearing. If you challenge the above item(s) in court, you may be limited to raising only those issues you or someone else raised at the public hearing described in this notice, or in written correspondence, to the Board of Supervisors at, or prior to, the public hearing.

Please send all written correspondence to: Clerk of the Board, 4080 Lemon Street, 1st Floor, Post Office Box 1147, Riverside, CA 92502-1147

Dated: December 3, 2013

Kecia Harper-Ihem, Clerk of the Board
By: Cecilia Gil, Board Assistant



The Riverside County Record Newspaper

Western Riverside County's Only Hometown Newspaper

Since 1955

Post Office Box 3187 • Riverside, California 92519

951 685-6191 • FAX 951 685-2961

e-mail: recorddhh@aol.com

INVOICE

December 5, 2013

Riverside County
Clerk of the Board
4080 Lemon Street, 1st Floor
P.O. Box 1147
Riverside, CA 92502- 1147

Legal Advertising

Notice of Public Hearing

Your: Resolution No. 2013-249
Our 0929

19.00 column inches x \$8.94 = \$169.86 x 2 = \$339.72

Publish two (2) week: December 5, 12, 2013

Amount Due: \$339.72

Thank You,

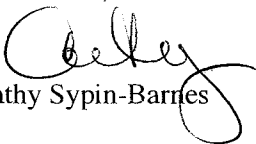
Cathy Sypin-Barries

Transp.
3-48 of 11/26/13

RECEIVED RIVERSIDE COUNTY
CLERK / BOARD OF SUPERVISORS
2013 DEC 16 PM 11:42

Affidavit of Publication

(2015.5 C.C.P.)

County of Riverside

State of California

Catherine Sy-pin-Barnes, being first duly sworn, deposes and says: The all times hereinafter, mentioned that she was a citizen of the United States over the age of eighteen years, and a resident of said County, and was and during all said times the principal clerk of the printer and publisher of The Riverside County Record-News, a newspaper of general circulation adjudicated by court decree, printed and published weekly in said County of Riverside, State of California, that said Riverside County Record-News and was at all times herein mentioned, a newspaper of general circulation that term is defined in section 4460 of the Political Code, and, as provided that section, is published for the dissemination of local and telegraphic news and intelligence of a general character, having a bona fide subscription of paying subscribers, and is not devoted to nor published for the inter-entertainment or instruction of a particular class, profession, trade, call or race of denominations; that at all said time said newspaper has been established, printed and published in said County and State at regular intervals more than one year preceding the date of publication of the notice herein mentioned; that said notice was set in type not smaller than nonpareil and preceded with words printed in black face type not smaller than nonpareil describing and expressing in general terms the purport and character of notice intended to be given; that the

RIVERSIDE COUNTY RECORD NEWSPAPER

of which the annexed is a printed copy, published and printed in said newspaper in at least 2 weekly issue, as follows:

December 5, 12, 2013

I certify (or declare) under penalty of perjury that the foregoing is true and correct.



Signature

Dated: December 12, 2013
at Riverside, California

NOTICE OF PUBLIC HEARING BEFORE THE BOARD OF SUPERVISORS OF THE COUNTY OF RIVERSIDE

NOTICE IS HEREBY GIVEN that a public hearing at which all interested persons will be heard, will be held before the Board of Supervisors of Riverside County, California, on the 1st Floor, County Administrative Center, Board of Supervisors Chambers, 4080 Lemon Street, Riverside, on **Tuesday, December 17, 2013** at 9:30 a.m. to consider the following:

RESOLUTION NO. 2013-249

NOTICE OF INTENTION TO TERMINATE THE MAINTENANCE OF SKYLINE DRIVE FROM THE CITY LIMIT OF CORONA TO THE RIVERSIDE COUNTY LINE; SETTING PUBLIC HEARING (Second Supervisorial District)

WHEREAS, the Board of Supervisors of the County of Riverside has the general supervision, management and control of County highways within the County of Riverside; and,

WHEREAS, the Board of Supervisors may terminate the maintenance of any County highway that it is in the public's interest to do so and upon the finding that the highway is unnecessary for the public convenience; and,

WHEREAS, pursuant to Section 954.5 of the Streets and Highways Code, a road may be deemed unnecessary for the public convenience when said road does not provide primary access to occupied properties and that traffic on said road is intermittent and of low volume; and,

WHEREAS, Skyline Drive is a narrow circuitous dirt road, with numerous blind curves, steep up and down segments, and is difficult to navigate by conventional motor vehicles; and,

WHEREAS, Skyline Drive is isolated and not contiguous to any county maintained road, and is only accessible through the City of Corona; and,

WHEREAS, Skyline Drive is not currently a commuter thoroughfare, nor is it projected to be one in the near future; and,

WHEREAS, there is no planned improvements for Skyline Drive or any planned funding arrangements for such improvements in the foreseeable future; and,

WHEREAS, it is the judgment of the Transportation Department that Skyline Drive that the maintenance of it should be terminated, now, therefore,

BE IT RESOLVED, FOUND, DETERMINED AND ORDERED by the Board of Supervisors of the County of Riverside, State of California, in regular session assembled on **November 26, 2013**, pursuant to Section 954.5 of the Streets and Highways Code, that it is the intention of this Board to terminate, as unnecessary for the public convenience, the maintenance of Skyline Drive in Sections 8, 9, and 10, T4S, R7W, S.B.M., in the County of Riverside, State of California;

BE IT FURTHER RESOLVED that a public hearing on this Resolution will be held on **December 17, 2013**, in the meeting room of the Board of Supervisors of the County of Riverside at the Administrative Center, 4080 Lemon Street, Riverside, California, at which time and place the Board will hear and consider the evidence that Skyline Drive in Sections 8, 9 and 10, T4S, R7W, S.B.M., approximately 24,710 feet or 4.68 miles in length; is unnecessary to the public convenience, and any additional evidence offered by persons interested therein, permitting the Riverside County Transportation Department to terminate the maintenance of it;

BE IT FURTHER RESOLVED that a notice of the hearing shall be posted and mailed as required by the Streets and Highways Code Section 954.5;

BE IT FURTHER RESOLVED, DETERMINED AND ORDERED that the Clerk of the Board is directed to cause this Resolution to be published pursuant to Section 8322(a) and the Transportation Director shall cause notice of hearing to be posted pursuant to Section 8323 of the Streets and Highway Code.

ROLL CALL:

AYES: Jeffries, Tavaglione, Stone, Benoit, and Ashley
NAYS: None
ABSENT: None

The foregoing is certified to be a true copy of a resolution duly adopted by said Board of Supervisors on November 26, 2013.

Kecia Harper-Ihem, Clerk of said Board

By: Cecilia Gil, Board Assistant

Any person affected by the above matter(s) may submit written comments to the Clerk of the Board before the public hearing or may appear and be heard in support of or opposition to the project at the time of the hearing. If you challenge the above item(s) in court, you may be limited to raising only those issues you or someone else raised at the public hearing described in this notice, or in written correspondence, to the Board of Supervisors at, or prior to, the public hearing.

Please send all written correspondence to: Clerk of the Board, 4080 Lemon Street, 1st Floor, Post Office Box 1147, Riverside, CA 92502-1147

Dated: December 3, 2013
Kecia Harper-Ihem, Clerk of the Board
By: Cecilia Gil, Board Assistant

Published: December 5, 12, 2013 RCR0929

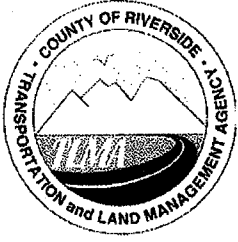

COUNTY OF RIVERSIDE

TRANSPORTATION AND LAND MANAGEMENT AGENCY

Transportation Department



*Juan C. Perez, P.E., T.E.
Director*

*Patricia Romo, P.E.
Assistant Director*

December 2, 2013

TO: Cecilia Gil

FROM: Wesley Hohenberger, Transportation Department / Survey Division

RE: Certificate of Posting- Resolution No. 2013-249

Attached please find the Certificate of Posting for Resolution No. 2013-249: Notice of Intention to Terminate Maintenance of Skyline Drive, in the Corona area, Second Supervisorial District

Attachment: Certificate of Posting



COUNTY OF RIVERSIDE

TRANSPORTATION AND LAND MANAGEMENT AGENCY

Transportation Department

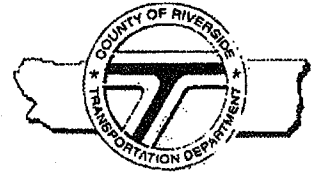

Juan C. Perez, P.E., T.E.
Director

Patricia Romo, P.E.
Assistant Director

CERTIFICATE OF POSTING

I, BUD Y MARTINEZ, Transportation Dept. Staff / Survey Division, for the County of Riverside, do hereby certify that I am not a party to the within action or proceeding; that on NOV. 27, 2013, I posted, a minimum of three (3), copies of the following document, as required by Streets and Highways Code, Section 970.5.

RESOLUTION NO. 2013-249 NOTICE OF INTENTION TO TERMINATE MAINTENANCE OF SKYLINE DRIVE IN THE CORONA AREA

Posted near each end and the middle of the Skyline Drive as being affected by the Termination of Maintenance, Corona area, Second Supervisorial District.

Board Agenda date for Notice of Intention: **November 26, 2013, Agenda Item 3-48**

Board Agenda date for Public Hearing: **December 17, 2013**

Rudy Martinez
Signature

SUBMITTAL TO THE BOARD OF SUPERVISORS
COUNTY OF RIVERSIDE, STATE OF CALIFORNIA



FROM: Walter P. Abraham SUBMITTAL DATE: 2/11/86
Supervisor, First District
SUBJECT: Skyline Drive
(First Supervisorial District)

RECOMMENDED MOTION:

That the Board adopt Resolution No. 86-04 -- "Restricting the Use of Skyline Drive From the Orange County Boundary to the City Limits of the City of Corona"

JUSTIFICATION:

This matter was heard at a public hearing before the Board on January 14, 1986. The hearing was closed and continued to February 18, 1986 for decision.

After considering the testimony and the public concerns and evaluating the matter, it appears necessary to restrict the use of Skyline Drive in order to protect the public.

Resolution No. 86-04 makes the finding necessary to restrict the use of Skyline Drive by placing a gate, with locking mechanism, southwest of the City of Corona and makes provision of restricted use of the road.

Approved as to form:
Gerald J. Geerlings
County Counsel

Walter P. Abraham
Walter P. Abraham
Supervisor, First District

By *[Signature]*

Approved by
Leroy D. Smoot
Road Commissioner

[Signature]

MINUTES OF THE BOARD OF SUPERVISORS

On motion of Supervisor Abraham, seconded by Supervisor Cenicerros and duly carried by unanimous vote, IT WAS ORDERED that the above matter is approved as recommended.

Ayes: Abraham, Cenicerros, Larson, Younglove and Dunlap

Noes: None

Absent: None

Date: February 25, 1986

xc: Supervisor Abraham, Road, Sheriff

Gerald A. Maloney
Clerk of the Board

[Signature]
Deputy

Prev. Agn. ref.

Depts. Comments

Dist.

AGENDA NO.

RESOLUTION NO. 86-04

RESTRICTING THE USE OF SKYLINE DRIVE FROM
THE ORANGE COUNTY BOUNDARY TO
THE CITY LIMITS OF CORONA
(First Supervisorial District)

WHEREAS, the Board of Supervisors of the County of Riverside may close or restrict the use of a county highway to protect the public pursuant to Section 942.5 of the Streets and Highways Code; and,

WHEREAS, a public hearing on a Resolution of Intention to Permanently Restrict Access and to Terminate Maintenance of Skyline Drive was held by the Board at its regular session on January 14, 1986, at 1:30 P.M., at which time oral and written testimony from interested persons on the proposal to restrict access and terminate maintenance was received, evaluated and considered; now, therefore,

BE IT RESOLVED, FOUND AND DETERMINED by the Board of Supervisors of the County of Riverside, State of California, in regular session assembled on February 25, 1986, as follows:

1. Skyline Drive is a narrow, circuitous, mountain dirt road with numerous blind curves and many steep up and downhill segments.
2. Motor vehicle operators traversing Skyline Drive must exert maximum attention and alertness, and must have a driving skill not found with typical drivers.
3. Tragic accidents resulting in fatal and seriously disabling injuries occur on a regular and chronic basis to motor vehicle users of Skyline Drive.

1 4. The majority of the serious accidents occurring on
2 Skyline Drive are the result of errors in judgment by motor
3 vehicle drivers which occur because they are unable to apply the
4 skill necessary to negotiate Skyline Drive.

5 5. There is no funding currently available to the
6 County to substantially improve Skyline Drive.

7 6. Attempts to post Skyline Drive with signs and
8 devices warning of the dangers are constantly frustrated by
9 vandalism including, but not limited to, destruction and theft of
10 the warning signs and devices.

11 BE IT FURTHER RESOLVED, FOUND, DETERMINED AND ORDERED by
12 the Board of Supervisors of the County of Riverside, pursuant to
13 Section 942.5 of the Streets and Highways Code, that it is
14 necessary, for the safety of the traveling public, to close and
15 restrict the use of Skyline Drive from the city limits of the
16 City of Corona to the Orange County Boundary in order to provide
17 for the protection of the public.

18 BE IT FURTHER RESOLVED, FOUND, DETERMINED AND ORDERED by
19 the Board of Supervisors of the County of Riverside, pursuant to
20 Section 942.6 of the Streets and Highways Code, that the Road
21 Commissioner of the County of Riverside shall cause a gate, with
22 locking mechanism, to be installed approximately 200 feet
23 southwest of the city limits of the City of Corona.

24 BE IT FURTHER RESOLVED, FOUND, DETERMINED AND ORDERED
25 that the motor vehicle use of Skyline Drive shall be restricted
26 to those persons who have secured a pass key from the Road
27 Commissioner of the County of Riverside and that pass keys shall
28

1 only be issued to police, fire, emergency, public utilities and
2 governmental agencies, persons owning or leasing property between
3 the gate and the Orange County Boundary and those persons the
4 Road Commissioner deems have an appropriate need to use Skyline
5 Drive.

6 Roll Call resulted as follows:

7 Ayes: Abraham, Cenicerros, Larson, Younglove and Dunlap

8 Noes: None

9 Absent: None

10

11

12

13

14

15

16

17

18

19

20

21

22

23

24

25

26

27

28